

3315 Almaden Expressway, Suite 34
 San Jose, CA 95118
 Phone: (408) 264-7723
 Fax: (408) 264-2345

COPIES TO TRANSMIT

T R A N S M I T T A L

TO: Mr. E. Nacor
 State of California
 Department of Transportation
 Box 7310
 San Francisco, California 94120

DATE: February 2, 1993
 PROJECT NUMBER: 62026.02
 SUBJECT: Street Encroachment Permit
 to Install One Monitoring Well & Conduct
 Offsite Subsurface Environmental
 Investigation at ARCO Station 2185, 9800
 E. 14th Street, Oakland, California.

FROM: Erin McLucas
 TITLE: Staff Geologist

WE ARE SENDING YOU:

COPIES	DATED	NO.	DESCRIPTION
1	1/22/93	62026.02	Street Encroachment Permit for the above subject site.

THESE ARE TRANSMITTED as checked below:

- For review and comment Approved as submitted Resubmit ___ copies for approval
 As requested Approved as noted Submit ___ copies for distribution
 For approval Return for corrections Return ___ corrected prints
 For your files

REMARKS: cc: Mr. Joel Coffman, RESNA Industries Inc.
 Mr. Barney Chan, Alameda County Health Care Services Agency
 Mr. Richard Hiett, RWOCB, San Francisco Bay Region

Copies: 1 to RESNA project file no. 62026.02

ARCO Products Company
2000 Alameda de las Pulgas
Mailing Address: Box 5811
San Mateo, California 94402
Telephone 415 571 2400



January 22, 1993
1215ENAC
62026.02

Mr. E. Nacor
State of California
Department of Transportation
Box 7310
San Francisco, California 94120

Subject: Street Encroachment Permit to Install One Monitoring Well and Conduct Offsite Subsurface Environmental Investigation at ARCO Station 2185, located at 9800 East 14th Street, Oakland, California.

Dear Mr. Nacor:

ARCO Products Company (ARCO) is requesting a street encroachment permit to install and monitor one groundwater monitoring well (MW-7) on the street adjacent to the property located at 9800 East 14th Street in Oakland California (Plate 1) as part of an ongoing offsite subsurface environmental investigation. The proposed groundwater monitoring well will be installed in the sidewalk area on East 14th Street as shown on Plate 2. After initial installation of the well, it will be monitored on a quarterly basis to evaluate changes in groundwater levels, and sampling to evaluate groundwater quality.

Description of Work

One soil boring (B-15) will be drilled using 10-inch-diameter hollow-stem augers approximately 30 feet below ground surface. Monitoring well (MW-7) will be constructed in the boring using a clean 2-inch diameter, thread-jointed, Schedule 40 polyvinyl chloride (PVC) casing. No chemical cements, glues, or solvents will be used in well construction. The casing bottom will be sealed with a threaded end-plug, and the casing top with a locking plug. The screened portion of the well will be constructed of machine-slotted PVC casing with 0.020-inch-wide (typical) slots. The screened section in the groundwater monitoring well will be placed to allow monitoring during seasonal fluctuations of groundwater levels. The annular space of the well will be backfilled with No. 3 sand, to approximately two feet above the top of the screened casing. A 1 to 2-foot-thick bentonite plug will be placed above the sand as a seal against cement entering the filter pack. The remaining annulus will



Street Encroachment Permit
ARCO Station 2185

January 22, 1993
62026.02

be then backfilled with a slurry of water, neat cement, and bentonite to approximately one foot below the ground surface. An aluminum traffic-rated utility box with a PVC apron will be placed over the wellhead and set in concrete, flush with the surrounding ground surface. The wellhead cover will have a seal to protect the monitoring well against surface water infiltration and requires a special wrench to open. The design discourages vandalism and reduces the possibility of accidental disturbance of the well. A typical monitoring well construction is shown on Plate 3.

The proposed monitoring well will be an important source of information concerning soils and groundwater in the immediate area of ARCO Station 2185 located at 9800 East 14th Street in Oakland California. The installation and maintenance of the well will remain the responsibility of ARCO. A well construction permit will be acquired from Alameda County Flood Control and Water Conservation District, Zone 7 (ACFCWCD) prior to drilling, and an underground utility line locating company will be contracted to locate underground utilities.

ARCO Products Company
2000 Alameda de las Pulgas
Mailing Address: Box 5811
San Mateo, California 94402
Telephone 415 571 2400



Street Encroachment Permit
ARCO Station 2185

January 22, 1993
62026.02

If you have any questions regarding this request, please call us at (415) 571-7435.

Sincerely,
ARCO Products Company

Michael Whelan
Environmental Engineer

Enclosures: Plate 1, Site Vicinity Map (five copies)
 Plate 2, Proposed Boring/Monitoring Well Locations (five copies)
 Plate 3, Typical Monitoring Well Construction (five copies)
 Standard Encroachment Permit Application
 Performance Bond for \$2000
 Check No. 938, dated January 7, 1993 for \$260.00 (Permit Fee)

cc: Joel Coffman, RESNA Industries Inc.
 Barney Chan, Alameda County Health Care Services Agency
 Richard Hiett, Regional Water Quality Control Board

STANDARD ENCROACHMENT PERMIT APPLICATION

DM-M-P-201A (REV 1/90) PART A

Permit No.
Dist/Co/Rte/PM

Permission is requested to encroach on the State Highway right of way as follows: (Complete all items: NA if not applicable.) Application is not complete until all required attachments are included.

Location: City OAKLAND	1	County ALAMEDA	2	Route	3	Post Mile	4	Date	5
Address or Street Name 9800 EAST 14TH STREET		6		Cross Street (distance and direction from site) 99TH AVENUE		7		FOR CALTRANS USE	
Portion of Right of Way WEST SIDEWALK (SEE PLATE 2)		8		Work to be Performed By		9			
				<input type="checkbox"/> Own Forces		<input checked="" type="checkbox"/> Contractor			
Est. Starting Date JANUARY 1993		10		Est. Completion Date FEBRUARY 1993		11		Estimated Cost in State R/W \$ 2000	
12									
EXCAVATION		Max. Depth 30		13		Average Depth NA		14	
		FL		FL		Average Width 1		15	
						Length NA		16	
						Surface Type CONCRETE		17	
PIPES		Type NA		18		Diameter NA		19	
						Voltage/PSIG NA		20	
						Product NA		21	

FULLY DESCRIBE WORK WITHIN STATE R/W: Attach complete plans (5 sets folded 8 1/2 x 11), specs, calcs, maps, etc., if applicable.

ONE 10-INCH-DIAMETER SOIL BORING WILL BE DRILLED TO THE DEPTH OF APPROXIMATELY 30 FEET BELOW THE GROUND SURFACE, AND A TWO-INCH-DIAMETER GROUNDWATER MONITORING WELL (MW-7) WILL BE INSTALLED IN THE BORING. MONITORING WELL CONSTRUCTION DETAILS ARE SHOWN ON ATTACHED PLATE 3. AFTER INITIAL INSTALLATION OF THE WELL IT WILL BE MONITORED ON A QUARTERLY BASIS TO DETERMINE CHANGES IN GROUNDWATER LEVELS AND FOR SAMPLING TO EVALUATE THE PRESENCE OF HYDROCARBONS IN GROUNDWATER. THE MONITORING WELL WILL BE AN IMPORTANT SOURCE OF INFORMATION CONCERNING SOILS AND GROUNDWATER IN THE IMMEDIATE VICINITY OF ARCO STATION 2185.

IS ANY WORK BEING DONE ON APPLICANT'S PROPERTY? If "Yes" briefly describe and attach site and grading plans. **SEE PLATE 2** 22

Yes No **DRILLING AND INSTALLING 2 1/2-INCH DIAMETER GROUNDWATER MONITORING WELLS (MW-5 AND MW-6)**

IS A CITY, COUNTY OR OTHER AGENCY INVOLVED IN ENVIRONMENTAL APPROVAL? 23

Yes (Check Documentation type and attach approved copy) **WELL CONSTRUCTION PERMIT WILL BE OBTAINED FROM ALAMEDA COUNTY FLOOD CONTROL AND WATER CONSERVATION DISTRICT, ZONE 7, PRIOR TO DRILLING**

Exempt N.D. EIR

No (Check the category below which describes the project.)

- | | | | |
|--|--|---|--|
| <input type="checkbox"/> SURVEY | <input type="checkbox"/> FENCE | <input type="checkbox"/> PARADES, CELEBRATIONS | <input type="checkbox"/> MAINTENANCE OF EXISTING LANDSCAPING |
| <input type="checkbox"/> FLAGS, SIGNS, BANNERS, DECORATIONS | <input type="checkbox"/> SINGLE FAMILY DWELLING DRIVEWAY | <input type="checkbox"/> COMMUNITY ANTENNA TV SYSTEM | <input type="checkbox"/> REGULATORY WARNING INFORMATION SIGNS |
| <input type="checkbox"/> TEMPORARY SIGNALS | <input type="checkbox"/> REMOVAL-REPLACEMENT OF DISTINCTIVE ROADWAY MARKINGS | <input type="checkbox"/> EROSION CONTROL | <input type="checkbox"/> DITCH PAVING |
| <input type="checkbox"/> PUBLIC UTILITY MODIFICATIONS, EXTENSIONS, HOOKUPS | <input type="checkbox"/> DITCH PAVING | <input type="checkbox"/> AGRICULTURAL APPROACH | <input type="checkbox"/> MODIFICATION OF TRAFFIC CONTROL SYSTEMS |
| <input type="checkbox"/> SIDEWALK/GUTTERS | <input type="checkbox"/> MAILBOX | <input type="checkbox"/> MOVIE, TV FILMING | |
| | | <input type="checkbox"/> MAINTENANCE, RECONSTRUCTION, OR RESURFACING OF A DRIVEWAY OF ROAD APPROACH | |

NONE OF THE ABOVE. IF PROJECT CANNOT BE DESCRIBED IN ABOVE CATEGORIES, REQUEST APPLICATION PART B FROM THE PERMIT OFFICE.

THE UNDERSIGNED AGREES THAT THE WORK WILL BE DONE IN ACCORDANCE WITH CALTRANS RULES AND REGULATIONS AND SUBJECT TO INSPECTION AND APPROVAL

Organization or Applicant ARCO PRODUCTS COMPANY	Phone (415) 571-7435	Architect, Engineer or Project Mgr. MIKE WHELAN	Phone (415) 571-7435
Address (include city and zip code) P.O. Box 5811 SAN MATEO CA 94402			
Authorized Signature 		Title ENVIRONMENTAL ENGINEER	

FEE CALCULATIONS (For Caltrans Use Only)

Cash Charge Exempt
 Set Fee AS (Estimated) AX (Actual Cost)
 Major Project EA _____

Calculated By: -----			
Fee/Deposit	(1) Initial Deposit Due	(2) Addi Deposit	(3) Total Fee
a. Bridge Toll (if Applicable)	\$ _____	\$ _____	\$ _____
b. Review <input type="checkbox"/> Set Fee			\$ _____
<input type="checkbox"/> Calc Fee	\$ _____		\$ _____
Estimated _____ Hrs @ \$60 per hr			
Additional Rev & _____		\$ _____	\$ _____
P.E.E.R. Hours			
EA _____	\$ _____	\$ _____	\$ _____
c. Inspection <input type="checkbox"/> Set Fee			\$ _____
<input type="checkbox"/> Calc Fee	\$ _____		\$ _____
Estimated _____ Hrs @ \$60 per hr			
EA _____	\$ _____	\$ _____	\$ _____
d. Field Work			
<input type="checkbox"/> Cal Fee		\$ _____	\$ _____
TOTAL FEE/DEPOSIT			
	Collected by:	Collected by:	Collected by:
	Initial Deposit Paid	Addi Deposit	Total Fee
	\$ _____	\$ _____	\$ _____

	NO	Yes	Amount \$
Surety Bond Required?	<input type="checkbox"/>	<input type="checkbox"/>	_____
Liability Insurance Required?	<input type="checkbox"/>	<input type="checkbox"/>	_____

- 7. This bond to become effective on DECEMBER 22, 1992
- 8. This bond is executed to comply with the provisions of Chapter 3 of Division 1 of the Streets and Highways Code and of Chapter 2, Title 14, Part 2 of the Code of Civil Procedure, and said bond shall be subject to all of the terms and provisions thereof.

NAME OF PRINCIPAL ARCO PRODUCTS COMPANY		DATE 12/22/92
BUSINESS ADDRESS OF PRINCIPAL 515 SOUTH FLOWER STREET		
CITY LOS ANGELES	STATE CALIFORNIA	ZIP CODE 90071
PRINT OR TYPE NAME OF AUTHORIZED SIGNATURE AND TITLE Edgar H. Gerner, Asst. Treasurer		AUTHORIZED SIGNATURE AND TITLE <i>Edgar H. Gerner</i> , Asst. Treasurer

NAME OF SURETY: UNITED PACIFIC INSURANCE COMPANY		DATE: 12/22/92
BUSINESS ADDRESS OF SURETY: 505 NORTH BRAND BLVD., SUITE 770		
CITY GLENDALE	STATE: CALIFORNIA	ZIP CODE: 91203

**CALIFORNIA
CERTIFICATE OF ACKNOWLEDGMENT**

State of California)
County of Los Angeles)

On DECEMBER 22, 1992 before me, Cora V. Rodriguez, Notary Public,
personally appeared C.K. NAKAMURA, ATTORNEY-IN-FACT OF UNITED PACIFIC INSURANCE COMPANY

personally known to me (or proved to me on the basis of satisfactory evidence) to be the person(s) whose name(s) is/are subscribed to the within instrument and acknowledged to me that he/she/they executed the same in his/her/their authorized capacity(ies), and that by his/her/their signature(s) on the instrument the person(s), or the entity upon behalf of which the person(s) acted, executed the instrument.

WITNESS my hand and official seal.

Signature *Cora V. Rodriguez*

(Seal)



STATE OF CALIFORNIA - DEPARTMENT OF TRANSPORTATION
PERFORMANCE BOND OF STATE HIGHWAY ENCROACHMENT PERMITTEE
TR-0001A (REV. 10/90)

[To Accompany the Permit]
Streets and Highways Code Section 677

BOND NO.: U-8003444		PERMIT NO.:		PRINCIPAL: ARCO PRODUCTS COMPANY	
LOCATION	DIST.	CO.	RT.	P.M.	EFFECTIVE DATE: 12/22/92
BOND NUMBER U-8003444			PREMIUM AMOUNT \$50.00		

Know All Persons by These Presents:

That ARCO PRODUCTS COMPANY, as **PRINCIPAL**, having an address for service of 515 SOUTH FLOWER STREET LOS ANGELES, CA 90071, and UNITED PACIFIC INSURANCE COMPANY, a Surety

Company qualified and duly licensed to do business in the State of California, as **SURETY**, are held and firmly bound to the **STATE OF CALIFORNIA**, as **OBLIGEE**, in the sum of

TWO THOUSAND AND NO/100----- Dollars (\$ 2,000 00)

lawful money of the United States of America, to be paid to the **OBLIGEE**, for which payment, we bind ourselves, our heirs, executors, administrators, successors, and assigns, jointly and severally,

THAT THE CONDITION OF THIS OBLIGATION IS SUCH,

1. That whereas **PRINCIPAL** has made, or is about to make, application to the State of California for a permit under Article 2 of Chapter 3 of Division 1 of the Streets and Highways Code to place, change or renew an encroachment in, under or over any portion of a state highway, and Streets and Highways Code Section 677 requires a bond payable to the State of California as a condition therefore, this performance bond is executed and tendered in accordance therewith.
2. That this bond shall be subject to all of the terms and provisions of the afore-mentioned provisions of the Streets and Highways Code.
3. That if the **PRINCIPAL** shall fail to faithfully perform the work for which the encroachment permit was issued, then the **SURETY** herein shall pay for the same, otherwise this obligation is null and void.
4. No right of action shall accrue under this bond to or for the use of any person or entity other than the State of California.
5. That this bond shall be deemed continuous in form, remain in full force and effect, and run concurrently with the permit period and any and all renewals, or until cancellation or withdrawal of the **SURETY** from the bond. If no work has commenced under the encroachment permit, the **SURETY** may cancel this bond upon thirty (30) days written notice to the **OBLIGEE**.
6. That the **SURETY** shall bear no liability on this bond in the event the encroachment permit issued to the **PRINCIPAL** is cancelled or withdrawn prior to commencement of work on State property by the **PRINCIPAL**.

UNITED PACIFIC INSURANCE COMPANY

HEAD OFFICE, FEDERAL WAY, WASHINGTON

POWER OF ATTORNEY

KNOW ALL MEN BY THESE PRESENTS, That the UNITED PACIFIC INSURANCE COMPANY, a corporation duly organized under the laws of the State of Washington, does hereby make, constitute and appoint

C.K. NAKAMURA of LOS ANGELES, CALIFORNIA -----

its true and lawful Attorney-in-Fact, to make, execute, seal and deliver for and on its behalf, and as its act and deed

ANY AND ALL BONDS AND UNDERTAKINGS OF SURETYSHIP -----

and to bind the UNITED PACIFIC INSURANCE COMPANY thereby as fully and to the same extent as if such bonds and undertakings and other writings obligatory in the nature thereof were signed by an Executive Officer of the UNITED PACIFIC INSURANCE COMPANY and sealed and attested by one other of such officers, and hereby ratifies and confirms all that its said Attorney(s)-in-Fact may do in pursuance hereof.

This Power of Attorney is granted under and by authority of Article VII of the By-Laws of UNITED PACIFIC INSURANCE COMPANY which became effective September 7, 1978, which provisions are now in full force and effect, reading as follows:

ARTICLE VII — EXECUTION OF BONDS AND UNDERTAKINGS

1. The Board of Directors, the President, the Chairman of the Board, any Senior Vice President, any Vice President or Assistant Vice President or other officer designated by the Board of Directors shall have power and authority to (a) appoint Attorneys-in-Fact and to authorize them to execute on behalf of the Company, bonds and undertakings, recognizances, contracts of indemnity and other writings obligatory in the nature thereof, and (b) to remove any such Attorney-in-Fact at any time and revoke the power and authority given to him.

2. Attorneys-in-Fact shall have power and authority, subject to the terms and limitations of the power of attorney issued to them, to execute and deliver on behalf of the Company, bonds and undertakings, recognizances, contracts of indemnity and other writings obligatory in the nature thereof. The corporate seal is not necessary for the validity of any bonds and undertakings, recognizances, contracts of indemnity and other writings obligatory in the nature thereof.

3. Attorneys-in-Fact shall have power and authority to execute affidavits required to be attached to bonds, recognizances, contracts of indemnity or other conditional or obligatory undertakings and they shall also have power and authority to certify the financial statement of the Company and to copies of the By-Laws of the Company or any article or section thereof.

This power of attorney is signed and sealed by facsimile under and by authority of the following Resolution adopted by the Board of Directors of UNITED PACIFIC INSURANCE COMPANY at a meeting held on the 5th day of June, 1979, at which a quorum was present, and said Resolution has not been amended or repealed:

"Resolved, that the signatures of such directors and officers and the seal of the Company may be affixed to any such power of attorney or any certificate relating thereto by facsimile, and any such power of attorney or certificate bearing such facsimile signatures or facsimile seal shall be valid and binding upon the Company and any such power so executed and certified by facsimile signatures and facsimile seal shall be valid and binding upon the Company in the future with respect to any bond or undertaking to which it is attached."

IN WITNESS WHEREOF, the UNITED PACIFIC INSURANCE COMPANY has caused these presents to be signed by its Vice President, and its corporate seal to be hereto affixed, this 7th day of May 19 90

UNITED PACIFIC INSURANCE COMPANY



Lawrence W. Carlstrom
Vice President

STATE OF Washington } ss.
COUNTY OF King

On this 7th day of May, 1990, personally appeared Lawrence W. Carlstrom

to me known to be the Vice-President of the UNITED PACIFIC INSURANCE COMPANY, and acknowledged that he executed and attested the foregoing instrument and affixed the seal of said corporation thereto, and that Article VII, Section 1, 2, and 3 of the By-Laws of said Company and the Resolution, set forth therein, are still in full force.

My Commission Expires:
May 15, 19 90



Pamela Young
Notary Public in and for State of Washington
Residing at Tacoma

I, Robert D. Ritzhaupt, Assistant Secretary of the UNITED PACIFIC INSURANCE COMPANY, do hereby certify that the above and foregoing is a true and correct copy of a Power of Attorney executed by said UNITED PACIFIC INSURANCE COMPANY, which is still in full force and effect.

IN WITNESS WHEREOF, I have hereunto set my hand and affixed the seal of said Company this 22ND day of DECEMBER 19 92



Assistant Secretary *Robert D. Ritzhaupt*
Robert D. Ritzhaupt

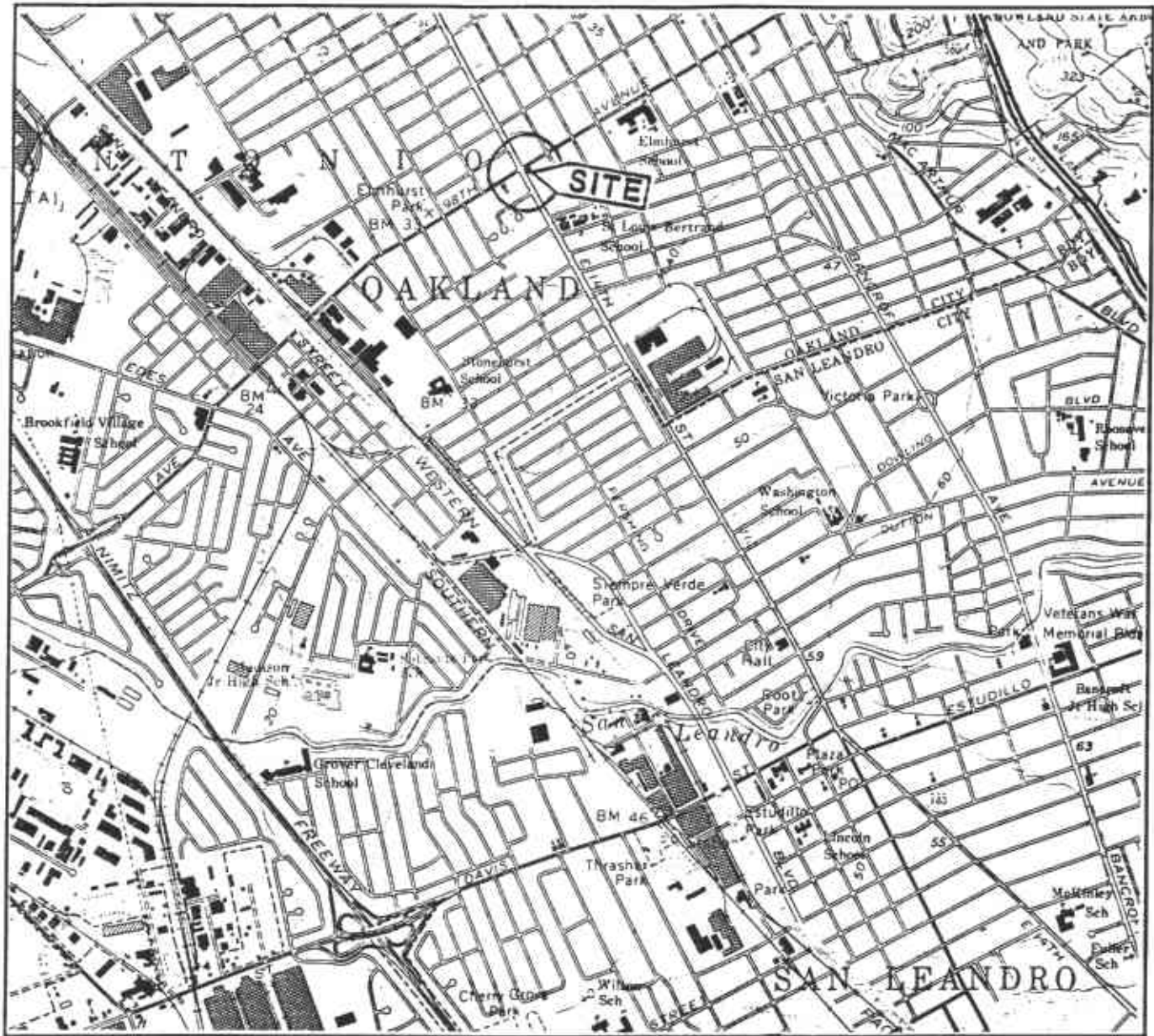

Base: U.S. Geological Survey
 7.5-Minute Quadrangles
 San Leandro, California.
 Photorevised 1980

LEGEND

● = Site Location



Approximate Scale



RESNA
Working to Restore Nature







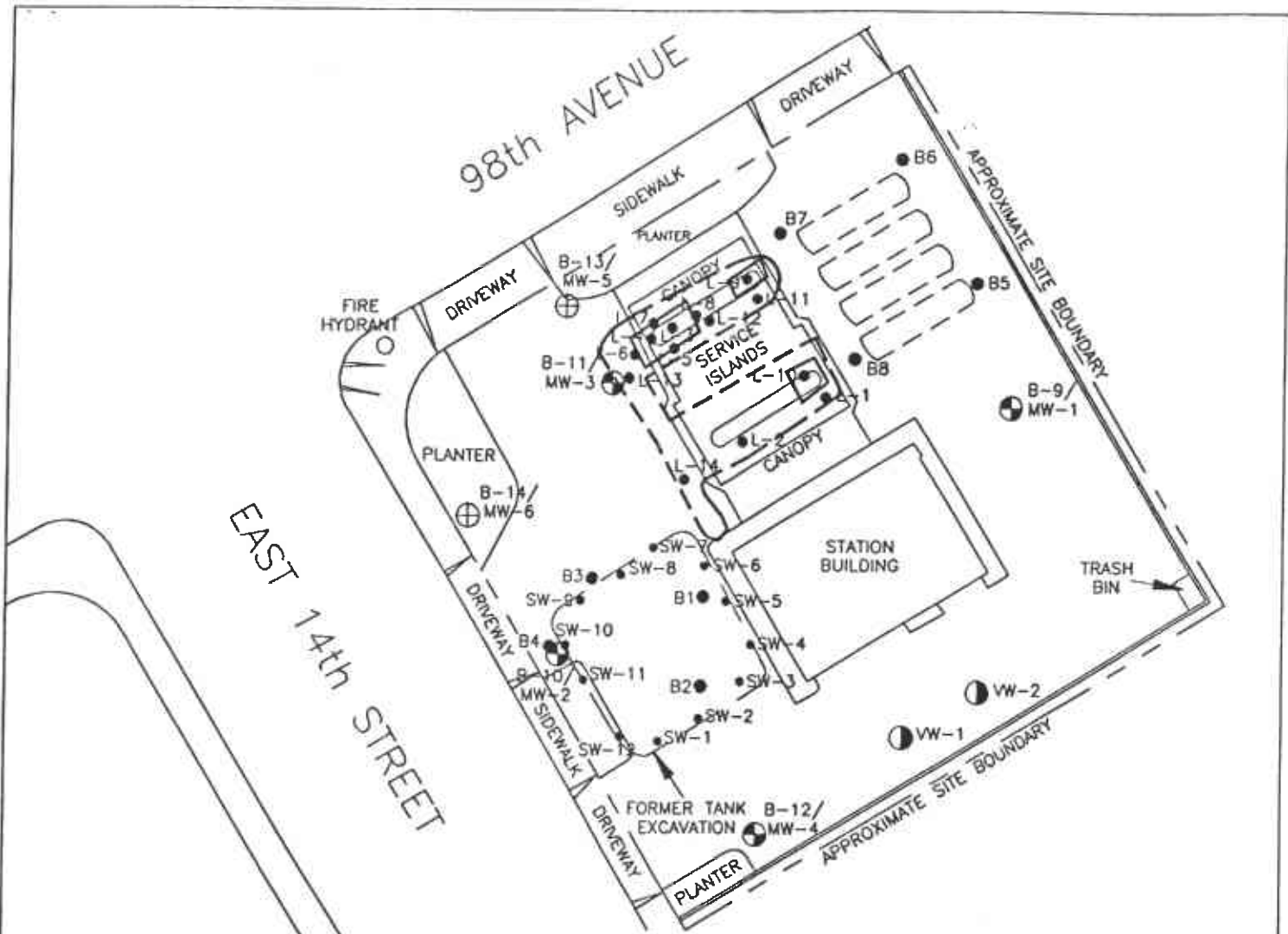

PROJECT 62026.02

**SITE VICINITY MAP
 ARCO Station 2185
 9800 East 14th Street
 San Leandro, California**

**PLATE
 1**



EXPLANATION

- B-12/
MW-4  = Monitoring well
(RESNA, July 1992)
- VW-2  = Vapor extraction well
(Roux Associates, May 1991)
- B8 or
L-13  = Soil boring
(Roux Associates, May, September, and November 1991)
- SW-12  = Tank cavity soil sample
(Roux Associates, November 1991)
-  = Existing underground storage tanks
-  = Former product line excavation
-  = Extended excavated areas
- B-15/
MW-5  = Proposed boring/well

Approximate Scale



Source: Modified from a site plan provided by Roux Associates dated December 1991. Also surveyed by John Koch, Licensed Land Surveyor, July 1992.

RESNA
Working to Restore Nature

PROPOSED BORING/WELL LOCATIONS
ARCO Station 2185
9800 East 14th Street
Oakland, California

PLATE
2

PROJECT 62026.02

GROUNDWATER MONITORING WELL

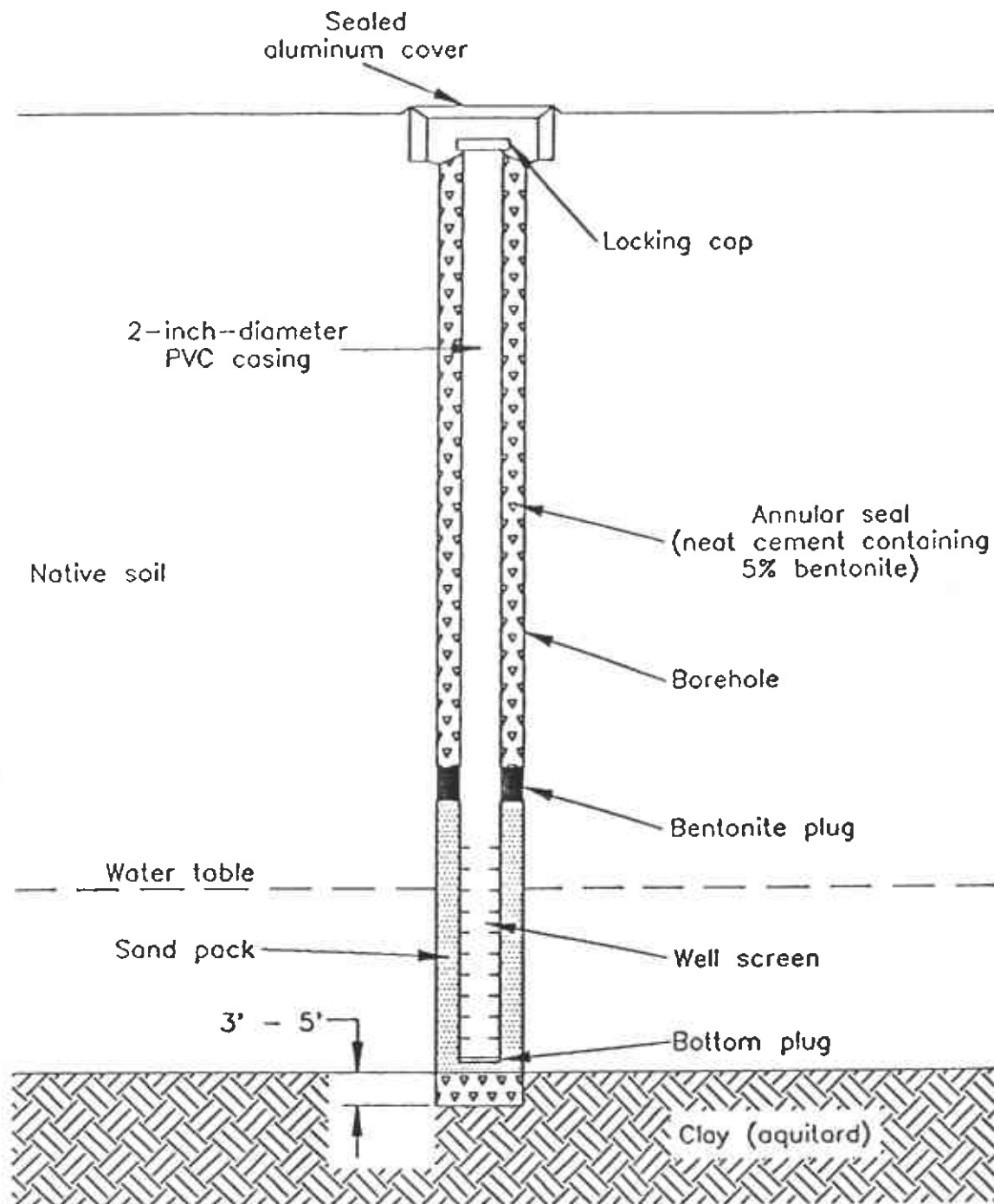

Not to scale

RESNA
Working to Restore Nature

PROJECT 62026.02

**TYPICAL
MONITORING WELL CONSTRUCTION**
ARCO Station 2185
9800 East 14th Street
Oakland, California

PLATE

3