

Atlantic Richfield Company

Chuck Carmel
Environmental Business Manager

RECEIVED

10:28 am, Oct 19, 2009

**Alameda County
Environmental Health**

PO Box 1257
San Ramon, CA 94583
Phone: (925) 275-3803
Fax: (925) 275-3815
E-Mail: charles.carmel@bp.com

16 October 2009

Re: Third Quarter 2009 Status Report
Atlantic Richfield Company Station #2185
9800 International Boulevard, Oakland, California
ACEH Case #RO0000392

"I declare, that to the best of my knowledge at the present time, that the information and/or recommendations contained in the attached document are true and correct.

Submitted by,



Chuck Carmel
Environmental Business Manager

Attachment

16 October 2009

Project No. 06-88-622

Atlantic Richfield Company
P.O. Box 1257
San Ramon, California 94583
Submitted via ENFOS

Attn.: Mr. Chuck Carmel

Re: Third Quarter 2009 Status Report, Atlantic Richfield Company Service Station #2185
9800 International Boulevard, Oakland, California; ACEH Case #RO0000392

Dear Mr. Carmel:

Provided herein is the *Third Quarter 2009 Status Report* for Atlantic Richfield Company (a BP affiliated company) Station #2185, located at 9800 International Boulevard (formerly known as East 14th Street), Oakland, California (Site). This report presents a summary of current developments regarding the Site through the Third Quarter of 2009. As a reminder, Atlantic Richfield Company is still awaiting the results of case closure evaluation anticipated from ACEH as put forth in the 17 September 2008 letter from Mr. Paresh Khatri.

Should you have questions regarding this submission, please do not hesitate to contact me at (530) 566-1400.

Sincerely,

BROADBENT & ASSOCIATES, INC.



Thomas A. Venus, P.E.
Senior Engineer



Enclosures

cc: Mr. Paresh Khatri, ACEH (Submitted via ACEH ftp site)
Electronic copy uploaded to GeoTracker

STATION #2185 QUARTERLY STATUS REPORT

Facility: #2185	Address: 9800 International Boulevard, Oakland, California
Environmental Business Manager:	Mr. Chuck Carmel
Consulting Company/Contact Person:	Broadbent & Associates, Inc.(BAI)/Mr. Tom Venus, PE (530)566-1400
Consultant Project No.:	06-08-622
Primary Agency/Regulatory ID No.:	Alameda County Environmental Health (ACEH) ACEH Case #RO0000392

WORK PERFORMED THIS QUARTER (Third Quarter 2009):

1. Prepared and submitted the *Second Quarter 2009 Status Report* (BAI, 7/7/2009).
2. No environmental work was conducted at the Site during the Third Quarter of 2009.

WORK PROPOSED FOR NEXT QUARTER (Fourth Quarter 2009):

1. Prepared and submitted this *Third Quarter 2009 Status Report* (contained herein).
2. No environmental work is scheduled for the Site during the Fourth Quarter 2009.

DISCUSSION:

Case closure was requested by Atlantic Richfield Company on 9 September 2003 from ACEH. In a letter dated 25 April 2008, ACEH requested redevelopment and sampling of onsite monitoring wells and drilling of an exploratory boring to test for residual hydrocarbons in soil. Ground-water samples were collected on 4 June 2008 from wells MW-2 through MW-10. A sample could not be collected from well MW-1 as it has reportedly been paved over. Atlantic Richfield Company submitted these results within the *Second Quarter 2008 Ground-Water Monitoring Report* (BAI, 6/30/2008). For reference, a Site Location Map is provided as Drawing 1. Ground-water elevation contours and analytical results from the most recent Second Quarter 2008 monitoring/sampling event are presented in Drawing 2.

On 26 August 2008, Atlantic Richfield Company submitted the requested *Soil Investigation Report* (BAI, 8/26/2008) containing results obtained from drilling a soil boring to the north of the dispenser islands at the Site. No petroleum hydrocarbons were detected in soil samples from 6.0 ft below ground surface (bgs), 7.5 ft bgs, and 9.5 ft bgs from boring B-1, collected in the vicinity of previous soil sample L-9 (6 November 1991) which had contained TPH-G at 5,400 milligrams per kilogram (mg/kg) and Benzene at 22 mg/kg at 9.5 ft bgs. The location of Boring B-1 is provided within Drawing 3.

In a letter dated 17 September 2008 from ACEH, Mr. Paresh Khatri stated that as concentrations of contaminants in ground water appeared low and concentrations of contaminants in the confirmation soil samples collected from boring B-1 were not detected above the laboratory detection limits, the Site appears to qualify for case closure evaluation. The letter continued that the Site would be further reviewed for case closure and that Atlantic Richfield Company would be notified of the results of the closure evaluation within 90 days from the date of the letter (by approximately 17 December 2008). Atlantic Richfield Company is still awaiting the results of this evaluation.

ATTACHMENTS:

- Drawing 1. Site Location Map, Station #2185, 9800 International Blvd., Oakland, California
- Drawing 2. Ground-Water Elevation Contour Map, 4 June 2008, Station #2185, 9800 International Blvd., Oakland, California
- Drawing 3. Site Layout Plan with Soil Boring Location, Station #2185, 9800 International Blvd., Oakland, California

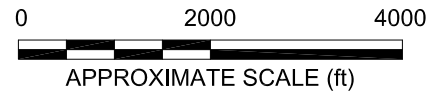
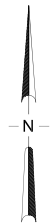
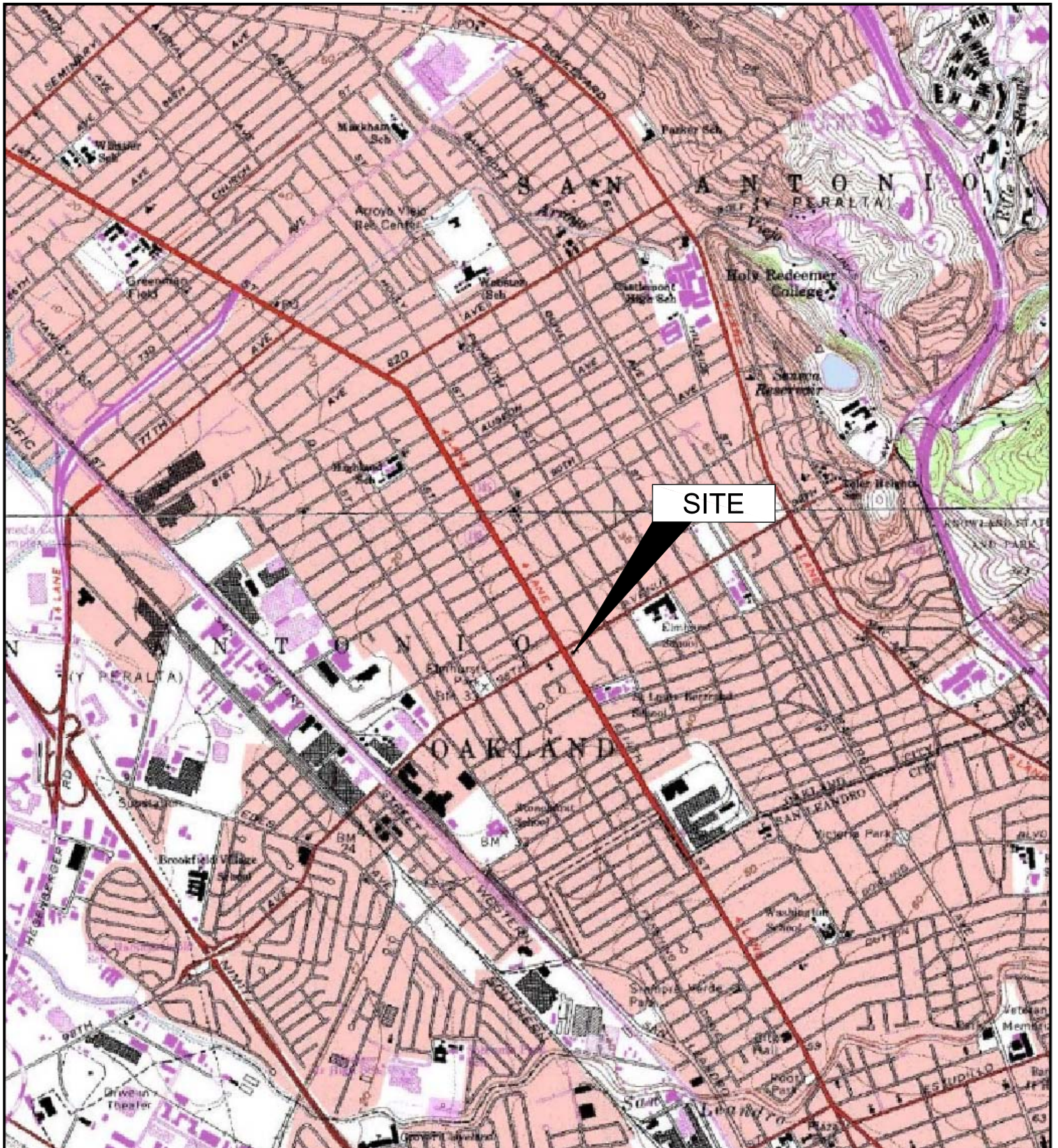
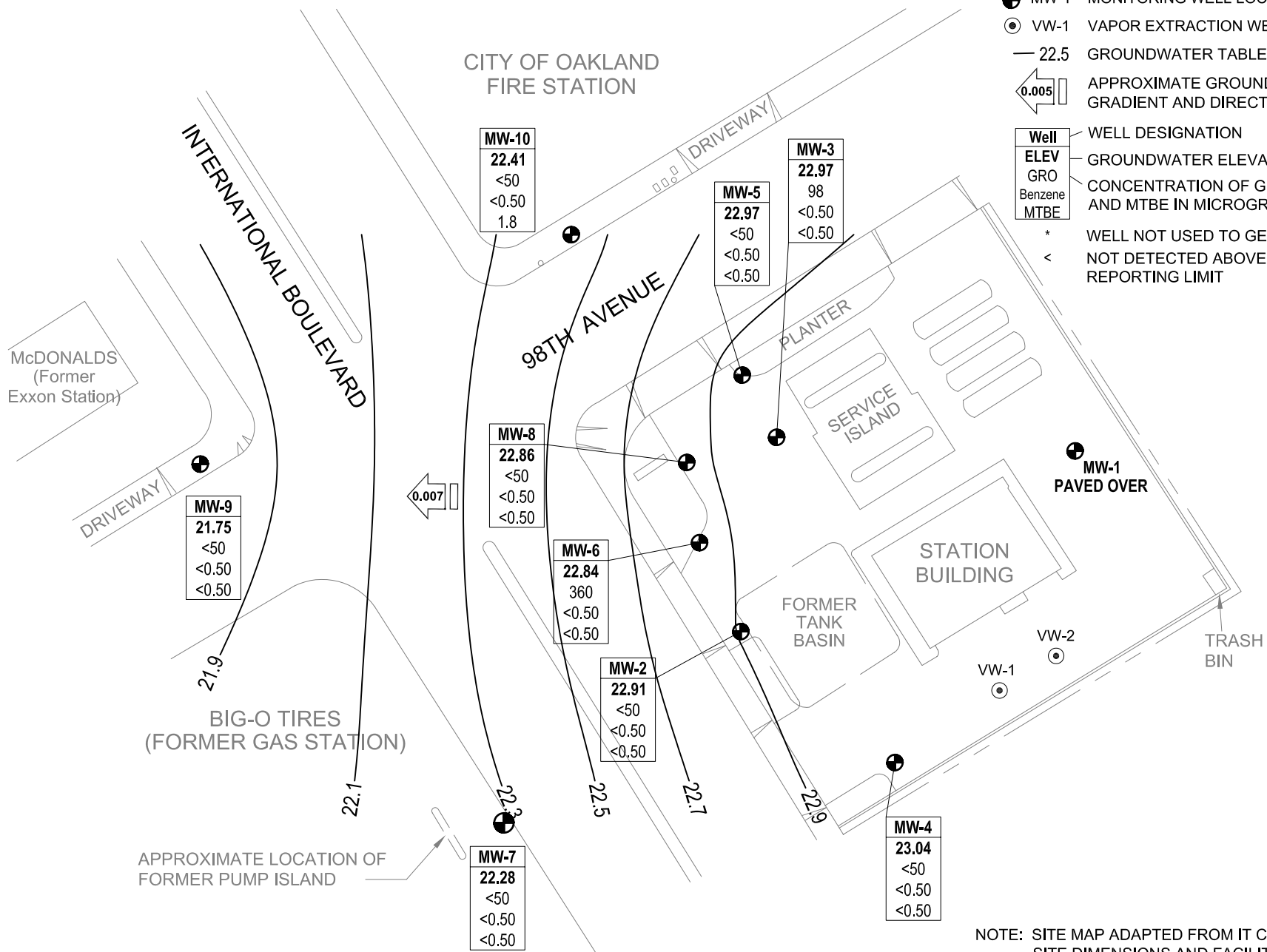

IMAGE SOURCE: USGS

LEGEND:

- ⊕ MW-1 MONITORING WELL LOCATION
 - ⊙ VW-1 VAPOR EXTRACTION WELL LOCATION
 - 22.5 GROUNDWATER TABLE CONTOUR (FT ABOVE MSL)
 - ← 0.005 APPROXIMATE GROUNDWATER FLOW GRADIENT AND DIRECTION (FT/FT)
- | Well | WELL DESIGNATION |
|---------|--|
| ELEV | GROUNDWATER ELEVATION (FT ABOVE MSL) |
| GRO | CONCENTRATION OF GRO, BENZENE AND MTBE IN MICROGRAMS PER LITER |
| Benzene | |
| MTBE | |
| * | WELL NOT USED TO GENERATE CONTOUR MAP |
| < | NOT DETECTED ABOVE LABORATORY REPORTING LIMIT |



NOTE: SITE MAP ADAPTED FROM IT CORPORATION FIGURES. SITE DIMENSIONS AND FACILITY LOCATIONS NOT VERIFIED

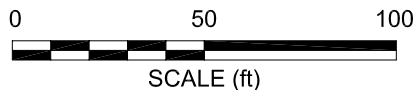

BROADBENT & ASSOCIATES, INC.
ENGINEERING, WATER RESOURCES & ENVIRONMENTAL
1324 Mangrove Ave. Suite 212, Chico, California
Project No.: 06-08-622 Date: 6/19/08

Station #2185
9800 International Blvd.
Oakland, California

Ground-Water Elevation Contour
and Analytical Summary Map
4 June 2008

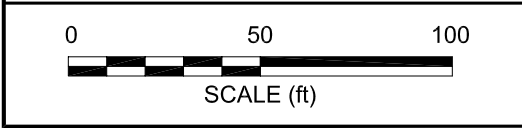
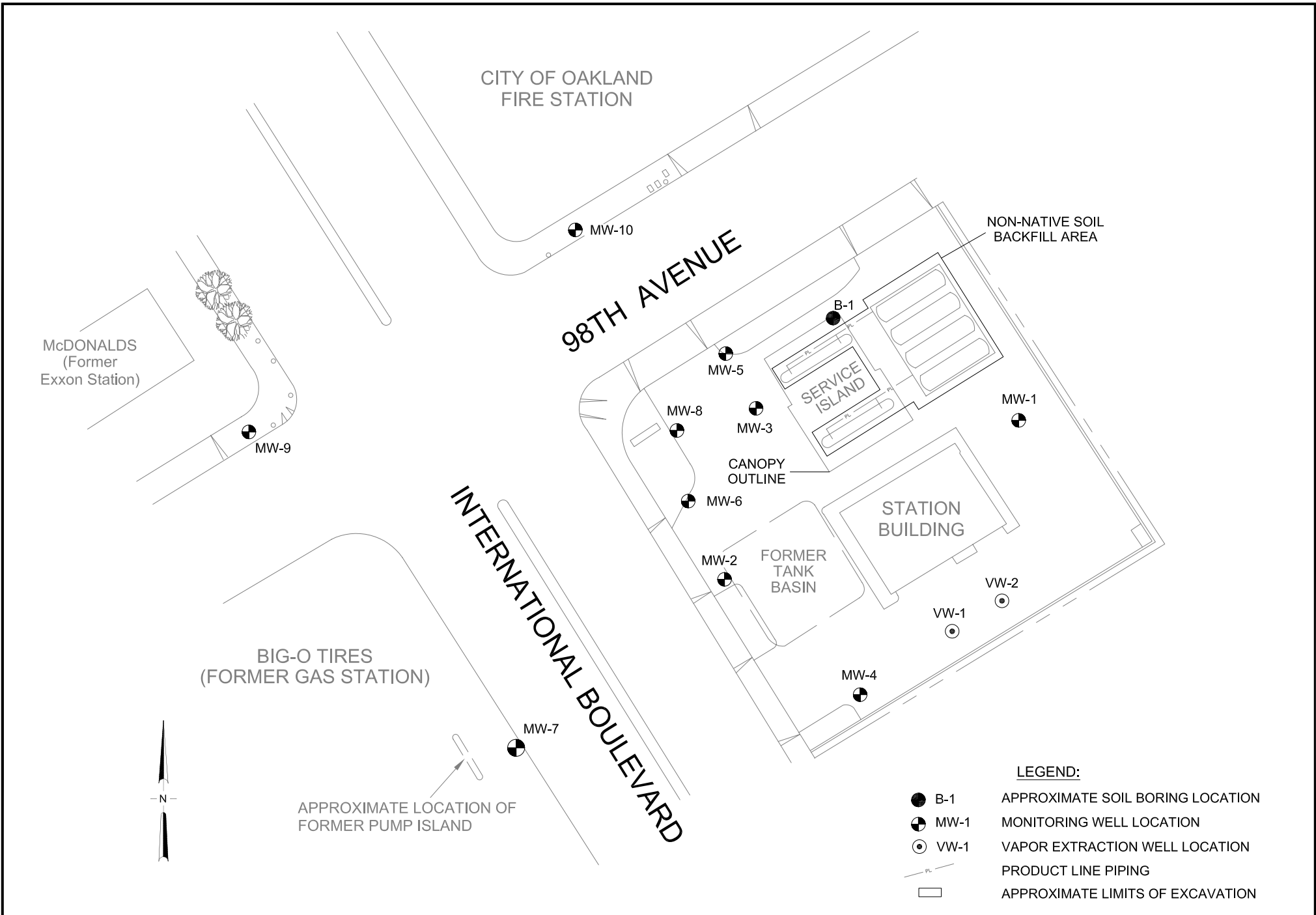

BROADBENT & ASSOCIATES, INC.
ENGINEERING, WATER RESOURCES & ENVIRONMENTAL
1324 Mangrove Ave. Suite 212, Chico, California
Project No.: 06-08-622 Date: 8/12/08

Station #2185
9800 International Blvd.
Oakland, California

Site Layout Plan with
Soil Boring Location