



Atlantic Richfield Company  
(a BP affiliated company)

P.O. Box 1257  
San Ramon, California 94583  
Phone: (925) 275-3801  
Fax: (925) 275-3815

**RECEIVED**

9:25 am, May 01, 2008

Alameda County  
Environmental Health



8 April 2008

Re: First Quarter 2008 Status Report  
Atlantic Richfield Company Service Station #2185  
9800 International Boulevard  
Oakland, California  
ACEH Case #RO0000392

"I declare, that to the best of my knowledge at the present time, that the information and/or recommendations contained in the attached document are true and correct."

Submitted by:

Paul Supple  
Environmental Business Manager

8 April 2008

Project No. 06-08-622

Atlantic Richfield Company  
P.O. Box 1257  
San Ramon, California 94583  
Submitted via ENFOS

Attn.: Mr. Paul Supple

Re: First Quarter 2008 Status Report, Atlantic Richfield Company (a BP affiliated company)  
Service Station #2185, 9800 International Boulevard, Oakland, California;  
ACEH Case #RO0000392

Dear Mr. Supple:

Provided herein is the *First Quarter 2008 Status Report* for Atlantic Richfield Company Station #2185, located at 9800 International Boulevard (formerly known as East 14<sup>th</sup> Street), Oakland, California (Site). Case closure was requested by BP from Alameda County Environmental Health (ACEH) on 9 September 2003. BP is currently awaiting a response from ACEH.

Should you have questions regarding this submission, please do not hesitate to contact us at (530) 566-1400.

Sincerely,

BROADBENT & ASSOCIATES, INC.

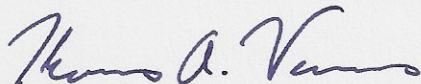

Thomas A. Venus, P.E.  
Senior Engineer



Robert H. Miller, P.G., C.HG.  
Principal Hydrogeologist

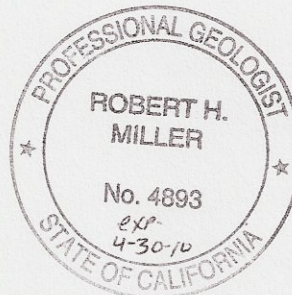

Enclosures

cc: Mr. Paresh Khatri, ACEH (Submitted via ACEH ftp site)  
Electronic copy uploaded to GeoTracker

## STATION #2185 QUARTERLY GROUND-WATER STATUS REPORT

Facility: #2185	Address: 9800 International Boulevard, Oakland, California
Environmental Business Manager:	Mr. Paul Supple
Consulting Company/Contact Person:	Broadbent & Associates, Inc.(BAI)/Rob Miller & Tom Venus (530)566-1400
Consultant Project No.:	06-08-622
Primary Agency/Regulatory ID No.:	Alameda County Environmental Health (ACEH) ACEH Case #RO0000392

### WORK PERFORMED THIS QUARTER (First Quarter 2008):

1. Prepared and submitted the Fourth Quarter 2007 Status Report.
2. No environmental work was conducted at the site during the First Quarter of 2008.

### WORK PROPOSED FOR NEXT QUARTER (Second Quarter 2008):

1. Prepared and submitted the First Quarter 2008 Status Report (contained herein).
2. No environmental work is scheduled for the site during the Second Quarter 2008.

### DISCUSSION:

Case closure was requested by BP on 9 September 2003 from ACEH. BP is currently awaiting a response from the ACEH. A Site Map is provided as Drawing 1.

### ATTACHMENTS:

Drawing 1. Site Map, Station #2185, 9800 International Blvd., Oakland, California

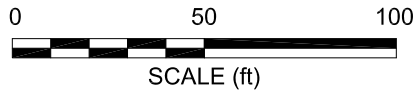
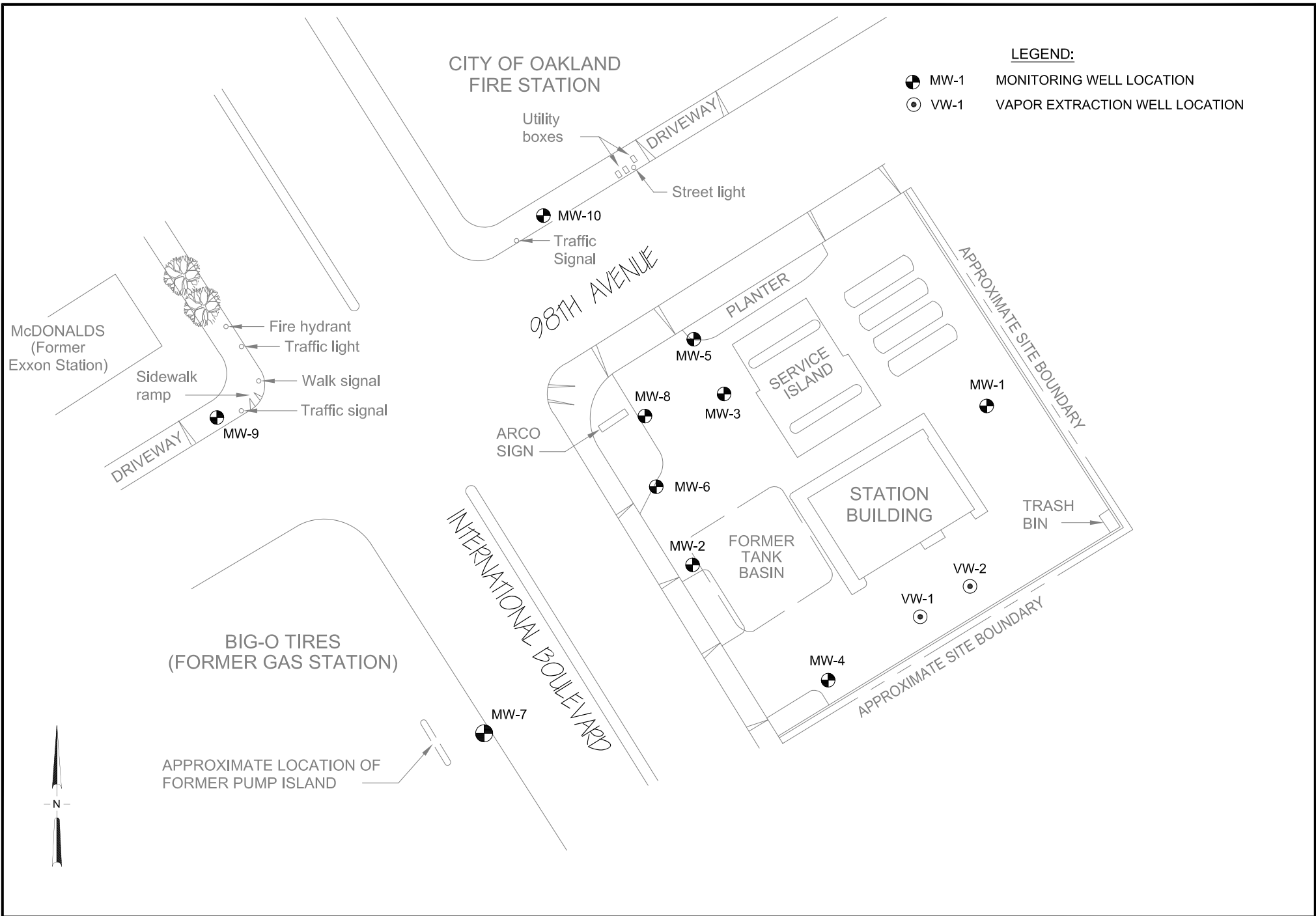

**BROADBENT & ASSOCIATES, INC.**  
 ENGINEERING, WATER RESOURCES & ENVIRONMENTAL  
 1324 Mangrove Ave. Suite 212, Chico, California  
 Project No.: 06-08-622 Date: 10/03/06

Station #2185  
 9800 International Blvd.  
 Oakland, California

Site Map

Drawing

1