



3164 Gold Camp Drive  
Suite 200  
Fancho Cordova, CA 95670-6021  
U.S.A.  
916.638-2085  
FAX: 916.638-8385

JUN 18 2002

Date: June 3, 2002

Mr. Paul Supple  
Atlantic Richfield Company  
P.O. Box 6549  
Moraga, CA 94570

Ro 392

**ARCO FIRST QUARTER 2002 STATUS REPORT**

Station No.:	<u>2185</u>	Address:	<u>9800 East 14<sup>th</sup> Street, Oakland, CA</u>
	Atlantic Richfield Company Environmental		<u>Paul Supple 925-299-8891</u>
	Engineer/Phone No.:		
	Consulting Co./Contact Person		<u>Delta Environmental Consultants, Inc.</u>
			<u>Steven W. Meeks, P.E.</u>
	Consultant Project No.:		<u>D000-312</u>
	Primary Agency/Regulatory ID No.		<u>Alameda County Health Care Services Agency</u>

**WORK PERFORMED THIS QUARTER**

1. Prepared and submitted quarterly status report for fourth quarter 2001.
2. No environmental work was conducted at the site during the first quarter 2002.

**WORK PROPOSED FOR NEXT QUARTER**

1. Prepare and submit quarterly status report for second quarter 2002.
2. No environmental work is scheduled at the site during the second quarter 2002.
3. Site will be transferred to new consultant (URS) during second quarter 2002.

If you have any questions concerning this project, please contact Steven W. Meeks at (916) 536-2613.

Sincerely,

**DELTA ENVIRONMENTAL CONSULTANTS, INC.**

Steven W. Meeks, P.E.  
Project Manager  
California Registered Civil Engineer No. C057461

SWM (QSR007.312.doc)  
Enclosures: Figure 1 (Site Map)

cc: Mr. Barney M. Chan – Alameda County Health Care Services Agency

I:\Sacramento\CAD Files\Sacramento\ARCO\2185\2185-1.dwg

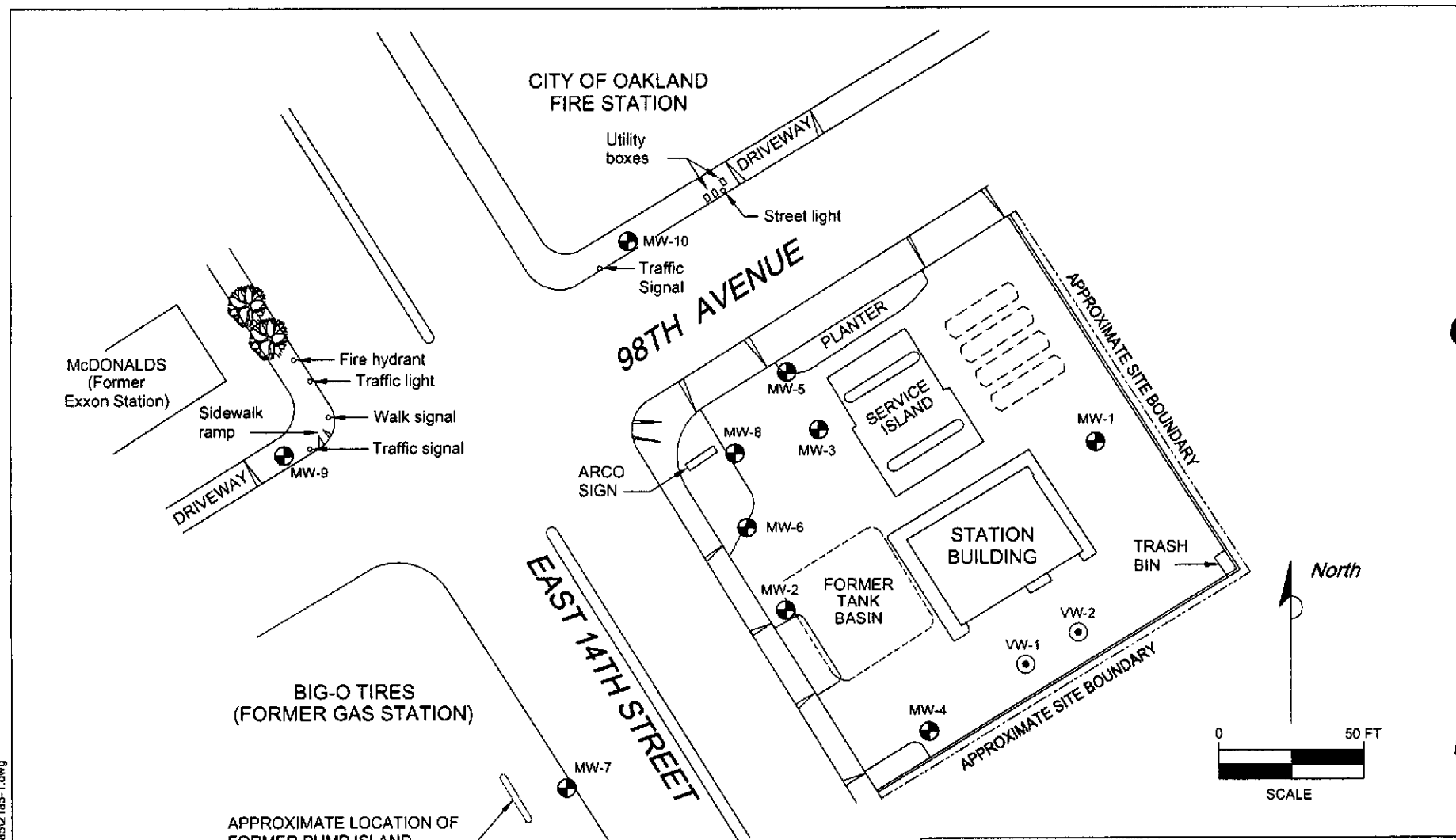

**LEGEND:**

⊕ MW-1 MONITORING WELL LOCATION

⊙ VW-1 VAPOR EXTRACTION WELL LOCATION

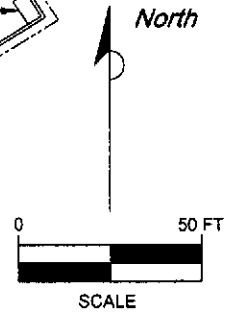

**FIGURE 1**  
**SITE MAP**

ARCO SERVICE STATION NO. 2185  
9800 EAST 14TH STREET  
OAKLAND, CALIFORNIA

PROJECT NO. D000-312	DRAWN BY TLA 11/29/00
FILE NO. 2185-1	PREPARED BY TLA
REVISION NO. 1	REVIEWED BY

**Delta**  
Environmental  
Consultants, Inc.