

ExxonMobil
Refining and Supply Company
Downstream - Safety, Health & Environment
Environmental Remediation
2300 Clayton Road, Suite 1250
P.O. Box 4032
Concord, CA 94524-4032
(925) 246-8768 Telephone
(925) 246-8798 Facsimile
darin.l.rouse@exxon.com

Darin L. Rouse
Senior Engineer
Environmental Remediation

ExxonMobil
Refining & Supply

September 1, 2000

245

Mr. Barney Chan
Alameda County Health Care Services Agency
Department of Environmental Health
1131 Harbor Bay Parkway, Room 250
Alameda, California 94502-6577

00 AUG 29 PM 4:10
ENVIRONMENTAL
PROTECTION

RE: Former Exxon RAS #7-0238/2200 East 12th Street, Oakland, California.

Dear Mr. Chan:

Attached for your review and comment is a letter report entitled *Quarterly Groundwater Monitoring Report, Third Quarter 2000*, dated August 18, 2000, for the above referenced site. The report was prepared by Environmental Resolutions, Inc. (ERI) of Novato, California, and details the results of quarterly groundwater monitoring and sampling activities at the subject site.

A site conceptual model is being developed for the site. An approved National Pollutant Discharge Elimination System (NPDES) discharge permit has been received and a dual-phase pilot test is scheduled for October 2000.

If you have any questions or comments, please contact me at (925) 246-8768.

Sincerely,

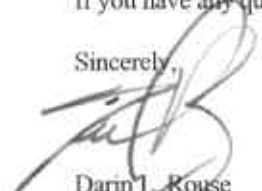

Darin L. Rouse
Senior Engineer

Attachment: ERI's Quarterly Groundwater Monitoring Report, Third Quarter 2000, dated August 18, 2000.

cc: w/attachment
Mr. Stephen Hill, California Regional Water Quality Control Board-San Francisco Bay Region

w/o attachment
Mr. James F. Chappell, Environmental Resolutions, Inc.

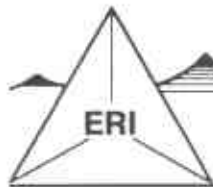

August 18, 2000
ERI 229313.R10

Mr. Darin L. Rouse
ExxonMobil Refining and Supply
P.O. Box 4032
Concord, California 94524-4032

Subject: Quarterly Groundwater Monitoring Report, Third Quarter 2000, Former Exxon Service Station 7-0238, 2200 East 12th Street, Oakland, California.

Mr. Rouse:

At the request of ExxonMobil Refining and Supply (formerly known as Exxon Company, U.S.A.) (ExxonMobil), Environmental Resolutions, Inc. (ERI) is reporting the results of the third quarter 2000 groundwater monitoring and sampling event. The location of the site is shown on the Site Vicinity Map (Plate 1). The purpose of quarterly monitoring and sampling is to evaluate concentrations of dissolved hydrocarbons in groundwater and groundwater flow direction and gradient.

GROUNDWATER MONITORING AND SAMPLING

On July 24, 2000, ERI measured depth to water (DTW) and collected groundwater samples from select monitoring wells for laboratory analysis. Groundwater monitoring and sampling were performed in accordance with ERI's groundwater sampling protocol (Attachment A).

Calculated groundwater gradient and flow direction are presented on Plate 2. Historical and recent monitoring data are summarized in Table 1.

LABORATORY ANALYSES AND RESULTS

Groundwater samples were submitted to Southern Petroleum Laboratories, Inc. (SPL), a California state-certified laboratory, under Chain of Custody protocol. The samples were analyzed for benzene, toluene, ethylbenzene, and total xylenes (BTEX), methyl tertiary butyl ether (MTBE), and total purgeable petroleum hydrocarbons as gasoline (TPPHg), using the methods listed in the notes in Table 1. The laboratory analysis report and Chain of Custody record are attached (Attachment B). Cumulative results of laboratory analyses of groundwater samples are summarized in Table 1. The results of analyses of groundwater samples collected during the recent sampling event are shown on Plate 2.

LIMITATIONS

This report was prepared in accordance with generally accepted standards of environmental practice in California at the time this investigation was performed. This report has been prepared for ExxonMobil, and any reliance on this report by third parties shall be at such party's sole risk.

ERI recommends forwarding copies of this report to:

Mr. Barney Chan
Alameda County Health Care Services Agency
Department of Environmental Health
1131 Harbor Bay Parkway, Room 250
Alameda, California 94502-6577

Mr. Stephen Hill
California Regional Water Quality Control Board
San Francisco Bay Region
1515 Clay Street, Suite 1400
Oakland, California 94612

Please call Mr. James Chappell, ERI's project manager for this site, at (415) 382-4323, with any questions regarding this project.

Sincerely,
Environmental Resolutions, Inc.



James F. Chappell
Assistant Project Manager

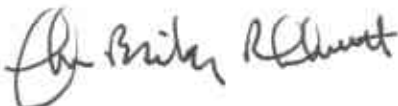

John B. Bobbitt
R.G. 4313

Attachments: Table 1: Cumulative Groundwater Monitoring and Sampling Data

Plate 1: Site Vicinity Map

Plate 2: Generalized Site Plan

Attachment A: Groundwater Sampling Protocol

Attachment B: Laboratory Analysis Report and Chain of Custody Record

TABLE 1
 CUMULATIVE GROUNDWATER MONITORING AND SAMPLING DATA
 Former Exxon Service Station 7-0238
 2200 East 12th Street
 Oakland, California
 (Page 1 of 5)

Well ID # (TOC)	Sampling Date	SUBJ <.....>	DTW .feet.....>	Elev.	TPPHg <.....>	MTBE	B ug/L	T	E	X
MW9A (11.46)	11/02/95	NLPH	7.16	4.30	<50	<10	<0.5	<0.5	<0.5	<0.5
	04/26/96	NLPH	6.33	5.13	---	---	---	---	---	---
	08/22/96	NLPH	7.02	4.44	---	---	---	---	---	---
	02/24/97	---	---	---	---	---	---	---	---	---
	03/16/98	NLPH	6.14	5.32	<200	40,000	7.9	<2.0	<2.0	<2.0
	04/21/98	NLPH	6.29	5.17	<50	53,000	3.8	<0.5	<0.5	<0.5
(14.53)	07/22/98	NLPH	6.58	7.95	<250	18,000	<2.5	<2.5	<2.5	<2.5
	12/22/98	NLPH	6.47	8.06	<50	5,200	<0.5	<0.5	<0.5	<0.5
	02/26/99	NLPH	6.38	8.15	<100	10,000	<1.0	<1.0	<1.0	<1.0
	5/27/99**	NLPH	6.56	7.97	<5,000	15,300	<50	<50	<50	<50
	08/03/99	NLPH	9.39	5.14	<50	<2.5	<0.5	<0.5	<0.5	<0.5
	12/03/99	NLPH	6.52	8.01	<50	1,400	<0.5	<0.5	<0.5	0.67 ^A
	02/29/00	NLPH	5.31	9.22	<50	20,000	1.2	<0.5	<0.5	<0.5
	05/18/00	NLPH	6.31	8.22	<50	14,000/11,000*	<0.5	<0.5	<0.5	<0.5
	07/24/00	NLPH	6.54	7.99	<50	7,400 [‡]	<0.5	<0.5	<0.5	<0.5
MW9B (9.80)	11/02/95	NLPH	6.14	3.66	130	<10	3.3	<0.5	<0.5	<0.5
	04/26/96	NLPH	5.66	4.14	270	70	130	2.8	6.7	<3
	08/22/96	NLPH	6.16	3.64	210	31	5.7	6.8	1.1	9.2
	02/24/97	NLPH	5.58	4.22	1,400	1,300	76	1.4	4.1	1.2
	03/16/98	NLPH	5.32	4.48	860	1,500	140	2.0	11	<2.0
	04/21/98	NLPH	5.49	4.31	1,800	18,000	300	<5.0	7.9	<5.0
(12.83)	07/22/98	NLPH	5.79	7.04	<500	26,000	13	<5.0	<5.0	<5.0
	12/22/98	NLPH	5.69	7.14	700	21,000	110	3.1	9.1	14
	02/26/99	NLPH	5.10	7.73	8,800	8,000	2,000	<25	52	38
	05/18/99	NLPH	5.65	7.18	<10,000	42,100	158	<100	<100	<100
	08/03/99	NLPH	6.24	6.59	960	24,900	<5.0	<5.0	<5.0	<5.0
	12/03/99	NLPH	5.66	7.17	<50	1,000	<0.5	<0.5	<0.5	<0.5
	02/29/00	NLPH	4.61	8.22	3,100	25,000	900	7	23	7.1
	05/18/00	NLPH	5.54	7.29	780	34,000/26,000*	150	<2.5	4.5	<2.5
	07/24/00	NLPH	8.75	4.08	<250	39,000 [‡]	8	<2.5	<2.5	<2.5

TABLE 1
 CUMULATIVE GROUNDWATER MONITORING AND SAMPLING DATA
 Former Exxon Service Station 7-0238
 2200 East 12th Street
 Oakland, California
 (Page 2 of 5)

Well ID # (TOC)	Sampling Date	SUBJ <----->	DTW feet	Elev.	TPPHg <----->	MTBE	B ug/L	T	E	X
MW9C	11/02/95	---	---	---	---	---	---	---	---	---
(11.14)	04/26/96	---	---	---	---	---	---	---	---	---
	08/22/96	---	---	---	---	---	---	---	---	---
	02/24/97	---	---	---	---	---	---	---	---	---
	03/16/98	NLPH	5.51	5.63	< 500	150,000	24	<5.0	<5.0	<5.0
	04/21/98	NLPH	5.83	5.31	150	130,000/150,000*	<0.5	<0.5	<0.5	<0.5
(14.19)	07/22/98	NLPH	6.43	7.76	<500	95,000	<5.0	<5.0	<5.0	<5.0
	12/22/98	NLPH	6.16	8.03	<500	84,000	<5.0	<5.0	<5.0	<5.0
	02/26/99	NLPH	5.46	8.73	<250	55,000	<2.5	<2.5	<2.5	<2.5
	05/18/99	NLPH	6.27	7.92	<25,000	68,900	<250	<250	<250	<250
	08/03/99	NLPH	7.13	7.06	210	69,200	<1.0	1.3	<1.0	<1.0
	12/03/99	NLPH	6.17	8.02	290	50,000	<2.5	<2.5	<2.5	<2.5
	02/29/00	NLPH	4.49	9.70	<250	40,000	<2.5	<2.5	<2.5	<2.5
	05/18/00	NLPH	5.96	8.23	<250	46,000/33,000	<2.5	<2.5	<2.5	<2.5
	07/24/00	NLPH	6.47	7.72	<250	44,000	<2.5	<2.5	<2.5	<2.5
MW9D	11/02/95	---	---	---	---	---	---	---	---	---
(12.90)	04/26/96	---	---	---	---	---	---	---	---	---
	08/22/96	---	---	---	---	---	---	---	---	---
	02/24/97	---	---	---	---	---	---	---	---	---
	03/16/98	NLPH	6.94	5.96	<50	10	<0.5	<0.5	<0.5	<0.5
	04/21/98	NLPH	7.22	5.68	<50	12	<0.5	<0.5	<0.5	<0.5
(15.98)	07/22/98	NLPH	7.85	8.13	<50	13	<0.5	<0.5	<0.5	<0.5
	12/22/98	NLPH	7.58	8.40	<50	12	<0.5	<0.5	<0.5	<0.5
	02/26/99	NLPH	6.42	9.56	<50	310	<0.5	<0.5	<0.5	<0.5
	05/18/99	NLPH	6.55	9.43	<2,500	13,500	<25	<25	<25	<25
	08/03/99	NLPH	8.34	7.64	<50	<2.5	<0.5	<0.5	<0.5	<0.5
	12/03/99	NLPH	7.56	8.42	<50	<2	<0.5	<0.5	<0.5	<0.5
	02/29/00	NLPH	4.82	11.16	<50	2.5	<0.5	<0.5	<0.5	<0.5
	05/18/00	NLPH	7.40	8.58	<50	6.2	<0.5	<0.5	<0.5	<0.5
	07/24/00	NLPH	7.91	8.07	<50	14	<0.5	<0.5	0.85	0.74

TABLE 1
 CUMULATIVE GROUNDWATER MONITORING AND SAMPLING DATA
 Former Exxon Service Station 7-0238
 2200 East 12th Street
 Oakland, California
 (Page 3 of 5)

Well ID # (TOC)	Sampling Date	SUBJ <.....>	DTW feet.....>	Elev. <.....>	TPPHg <.....>	MTBE <.....>	B ug/L	T <.....>	E <.....>	X <.....>
MW9F	11/02/95	---	---	---	---	---	---	---	---	---
(8.37)	04/26/96	NLPH	---	---	<50	57	<0.5	<0.5	<0.5	<0.5
	08/22/96	NLPH	---	---	<50	5.8	<0.5	<0.5	<0.5	<0.5
	02/24/97	NLPH	---	---	<50	<30	<0.5	<0.5	<0.5	<0.5
	03/16/98	NLPH	---	---	---	---	---	---	---	---
	04/21/98	---	---	---	---	---	---	---	---	---
(11.38)	07/22/98	---	---	---	---	---	---	---	---	---
	12/22/98	NLPH	5.47	5.91	<50	81	<0.5	<0.5	<0.5	<0.5
	02/26/99	NLPH	5.35	6.03	<50	<2.5	<0.5	<0.5	<0.5	<0.5
	05/18/99	NLPH	5.62	5.76	<50	61.6	<0.5	<0.5	<0.5	<0.5
	08/03/99	NLPH	6.32	5.06	<50	3.10	<0.5	<0.5	<0.5	<0.5
	12/03/99	NLPH	5.59	5.79	<50	<2	<0.5	<0.5	0.71	<0.5
	02/29/00	NLPH	4.70	6.68	<50	52	<0.5	<0.5	<0.5	<0.5
	05/18/00	NLPH	5.37	6.01	<50	65	<0.5	<0.5	<0.5	<0.5
	07/24/00	NLPH	5.65	5.73	<50	170	<0.5	<0.5	<0.5	<0.5
MW9G	11/02/95	NLPH	5.92	4.03	<50	<10	<0.5	<0.5	<0.5	<0.5
(9.95)	04/26/96	NLPH	5.28	4.67	<50	18	<0.5	<0.5	<0.5	<0.5
	08/22/96	NLPH	5.57	4.38	<50	18	<0.5	<0.5	<0.5	<0.5
	02/24/97	NLPH	5.30	4.65	<50	240	<0.5	0.57	<0.5	0.62
	03/16/98	---	---	---	---	---	---	---	---	---
	04/21/98	---	---	---	---	---	---	---	---	---
(12.99)	07/22/98	---	---	---	---	---	---	---	---	---
	12/22/98	NLPH	5.28	7.71	<50	1,100	<0.5	<0.5	<0.5	<0.5
	02/26/99	NLPH	5.31	7.68	<50	50	<0.5	<0.5	<0.5	<0.5
	05/18/99	NLPH	5.18	7.81	<1,000	3,990	<10	<10	<10	<10
	08/03/99	NLPH	6.00	6.99	<50	1,340	<0.5	<0.5	<0.5	<0.5
	12/03/99	NLPH	5.27	7.72	<50	<2	<0.5	<0.5	<0.5	0.55 ^A
	02/29/00	NLPH	4.60	8.39	<50	7,900	<0.5	<0.5	<0.5	<0.5
	05/18/00	NLPH	5.16	7.83	<50	2,400	<0.5	<0.5	<0.5	<0.5
	07/24/00	NLPH	5.20	7.79	<50	1,000	<0.5	<0.5	<0.5	<0.5

TABLE I
CUMULATIVE GROUNDWATER MONITORING AND SAMPLING DATA
 Former Exxon Service Station 7-0238
 2200 East 12th Street
 Oakland, California
 (Page 4 of 5)

Well ID # (TOC)	Sampling Date	SUBJ <.....>	DTW feet.....>	Elev.	TPPHg <.....>	MTBE	B ug/L.....>	T	E	X	
MW9H (8.58)	11/02/95	NLPH	8.40	0.18	<50	<10	<0.5	<0.5	<0.5	<0.5	
	04/26/96	NLPH	8.05	0.53	---	---	---	---	---	---	
	08/22/96	NLPH	8.17	0.41	---	---	---	---	---	---	
	02/24/97	---	---	---	---	---	---	---	---	---	
	03/16/98	---	---	---	---	---	---	---	---	---	
	04/21/98	---	---	---	---	---	---	---	---	---	
	(11.61)	07/22/98	---	---	---	---	---	---	---	---	---
		12/22/98	NLPH	7.81	3.80	<50	<2.5	<0.5	<0.5	<0.5	<0.5
		02/26/99	NLPH	7.61	4.00	<50	<2.5	<0.5	<0.5	<0.5	<0.5
		05/18/99	NLPH	8.00	3.61	<50	3.98	<0.5	<0.5	<0.5	<0.5
		08/03/99	NLPH	6.05	5.56	<50	<2.5	<0.5	<0.5	<0.5	<0.5
		12/03/99	NLPH	5.32	6.29	<50	<2	<0.5	<0.5	<0.5	0.57 ^A
		02/29/00	NLPH	7.10	4.51	<50	<2	<0.5	<0.5	<0.5	<0.5
	05/18/00	NLPH	7.84	3.77	<50	9.7	<0.5	<0.5	<0.5	<0.5	
07/24/00	NLPH	7.94	3.67	<50	17	<0.5	<0.5	<0.5	<0.5		
MW9I (10.11)	11/02/95	NLPH	6.04	4.07	<50	<10	<0.5	<0.5	<0.5	<0.5	
	04/26/96	NLPH	5.27	4.84	<50	99	<0.5	<0.5	<0.5	<0.5	
	08/22/96	NLPH	5.66	4.45	<50	170	<0.5	<0.5	<0.5	<0.5	
	02/24/97	NLPH	5.24	4.87	120	9,100	<0.5	<0.5	<0.5	<0.5	
	03/16/98	NLPH	4.91	5.20	<200	59,000	13	<2.0	<2.0	<2.0	
	04/21/98	NLPH	5.08	5.03	<500	59,000	<5.0	<5.0	<5.0	<5.0	
	(13.14)	07/22/98	NLPH	5.44	7.70	<500	62,000	<5.0	<5.0	<5.0	<5.0
		12/22/98	NLPH	5.32	7.82	200	51,000	1.7	<0.5	<0.5	<0.5
		02/26/99	NLPH	4.71	8.43	<500	9,700	<5.0	<5.0	<5.0	<5.0
		05/18/99	NLPH	5.30	7.84	<1,000	3,730	<10	<10	<10	<10
		08/03/99	NLPH	5.98	7.16	<50	21,900	<0.5	0.650	<0.5	<0.5
		12/03/99	NLPH	5.31	7.83	<250	2,000	3.9	2.9	<2.5	14
		02/29/00	NLPH	4.20	8.94	50	16,000	0.74	<0.5	<0.5	<0.5
	05/18/00	NLPH	5.12	8.02	<50	2,900	<0.5	<0.5	<0.5	<0.5	
07/24/00	NLPH	5.41	7.73	<250	43,000	<2.5	<2.5	<2.5	<2.5		

TABLE 1
CUMULATIVE GROUNDWATER MONITORING AND SAMPLING DATA

Former Exxon Service Station 7-0238

2200 East 12th Street

Oakland, California

(Page 5 of 5)

Notes:

SUBJ	=	Results of subjective evaluation.
NLPH	=	No liquid-phase hydrocarbons present in well.
TOC	=	Elevation of top of well casing; relative to mean sea level.
DTW	=	Depth to water.
Elev.	=	Elevation of groundwater surface; relative to mean sea level.
TPPHg	=	Total purgeable petroleum hydrocarbons as gasoline analyzed using EPA method 5030/8015 (modified).
MTBE	=	Methyl tertiary butyl ether analyzed using EPA method 8021B.
BTEX	=	Benzene, toluene, ethylbenzene, and total xylenes analyzed using EPA method 8021B.
<	=	Less than the indicated detection limit shown by the laboratory.
---	=	Not measured or sampled.
*	=	MTBE confirmed using EPA method 8260.
**	=	Miscalculation in field. Field technician may have inadvertently monitored and sampled the wrong well. Resampled 5/27/99.
^	=	Analyte detected in the associated Trip Blank at 0.52 ug/L.



3-D TopoQuads Copyright © 1999 DeLorme Kennebunk, ME 04046 Source Data: USGS 1:19,200 Scale: 1 : 19,200 Detail: 1:4 Datum: WGS84

FN 2293TOPO

EXPLANATION

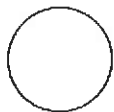

1/2-mile radius circle

APPROXIMATE SCALE



SOURCE:
Modified from a map
provided by
DeLorme 3-D TopoQuads

SITE VICINITY MAP

FORMER EXXON SERVICE STATION 7-0238
2200 East 12th Street
Oakland, California

PROJECT NO.

2293

PLATE

1



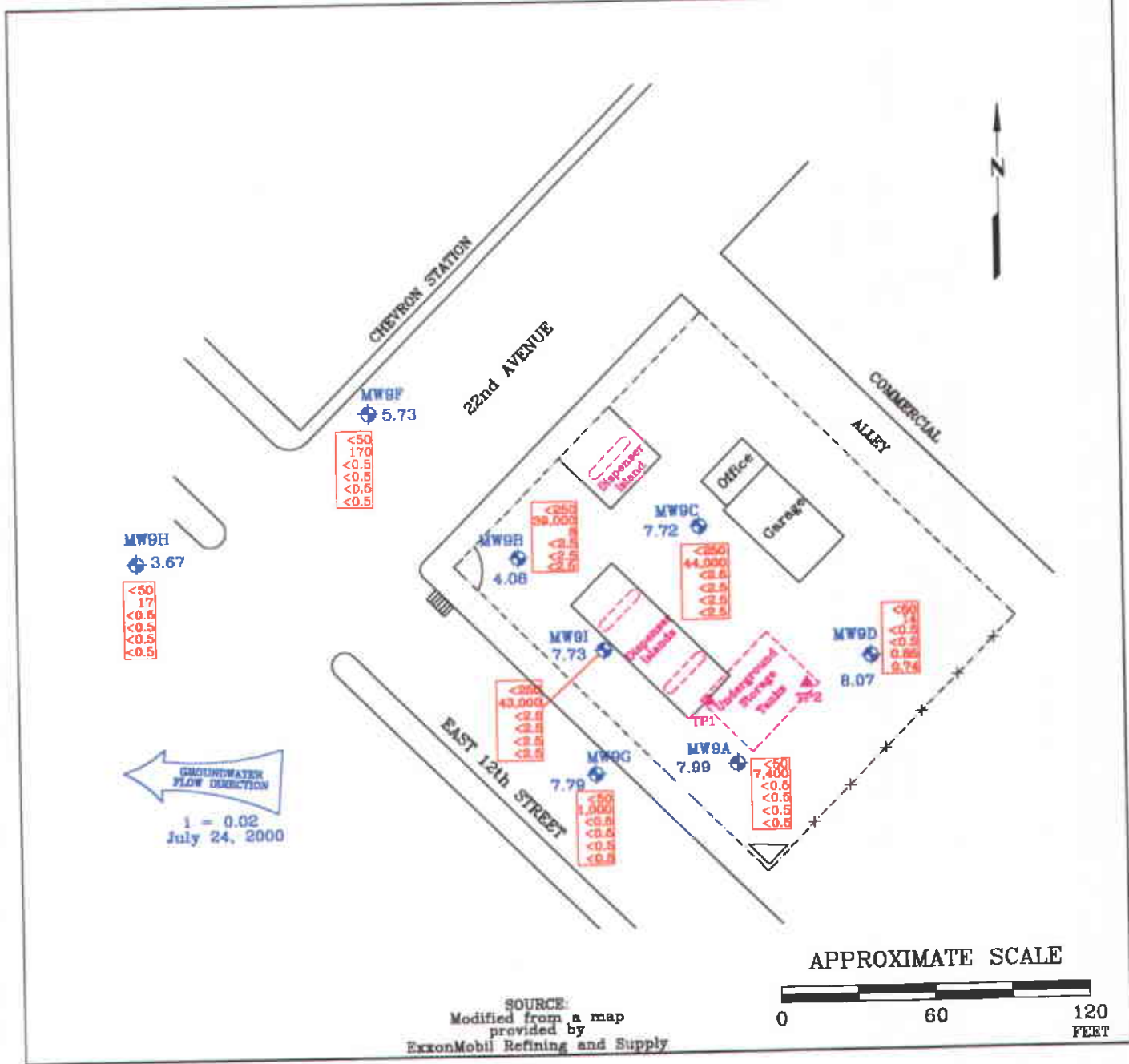

FN 22930002

EXPLANATION

- MW9I
 Groundwater Monitoring Well
- 7.73
 Groundwater elevation in feet above mean sea level
- i =
 Interpreted Groundwater Gradient
- TP2
 UST Observation Well
- Discharge Sewer Location

- <250 Total Purgeable Petroleum Hydrocarbons as gasoline
- 44,000 Methyl Tertiary Butyl Ether
- <2.5 Benzene
- <2.5 Toluene
- <2.5 Ethylbenzene
- <2.5 Total Xylenes
- ug/L Micrograms per Liter (ug/L)
- < Less Than the Stated Laboratory Detection Level



GENERALIZED SITE PLAN

FORMER EXXON SERVICE STATION 7-0238
 2200 East 12th Street
 Oakland, California

PROJECT NO.
 2293

PLATE
 2

August 3, 2000

ATTACHMENT A
GROUNDWATER SAMPLING PROTOCOL

GROUNDWATER SAMPLING PROTOCOL

The static water level and separate-phase product level, if present, in each well that contained water and/or separate-phase product are measured with a ORS Interface Probe, which is accurate to the nearest 0.01 foot. To calculate groundwater elevations and evaluate groundwater gradient, depth to water (DTW) levels are subtracted from wellhead elevations.

Groundwater samples collected for subjective evaluation are collected by gently lowering approximately half the length of a clean Teflon® bailer past the air-water interface (if possible) and collecting a sample from near the surface of the water in the well. The samples are checked for measurable free-phase hydrocarbons or sheen. Any free-phase hydrocarbons are removed from the well.

Before water samples are collected from the groundwater monitoring wells, the wells are purged until stabilization of the temperature, pH, and conductivity is obtained, or until a minimum of three well casing volumes are purged. Water samples from the wells that do not obtain stability of the temperature, pH, and conductivity are considered to be "grab samples". The quantity of water purged from each well is calculated as follows:

1 well casing volume = $\pi r^2 h (7.48)$ where:

r	=	radius of the well casing in feet.
h	=	column of water in the well in feet (depth to bottom - depth to water)
7.48	=	conversion constant from cubic feet to gallons
π	=	ratio of the circumference of a circle to its diameter

Gallons of water purged/gallons in 1 well casing volume = well casing volumes removed.

After purging, each well is allowed to recharge to at least 80% of the initial water level. Water samples from wells that do not recover at least 80% (due to slow recharging of the well) between purging and sampling are considered to be "grab samples". Water samples are collected with a new, disposable Teflon® bailer. The groundwater is carefully poured into 40-milliliter (ml) glass vials, which are filled so as to produce a positive meniscus. Each vial is preserved with hydrochloric acid, sealed with a cap containing a Teflon® septum, and subsequently examined for air bubbles to avoid headspace, which would allow volatilization to occur. The samples are promptly transported in iced storage in a thermally-insulated ice chest, accompanied by a Chain of Custody Record, to a California-certified laboratory.

ATTACHMENT B

**LABORATORY ANALYSIS REPORT
AND CHAIN OF CUSTODY RECORD**



HOUSTON LABORATORY
 8880 INTERCHANGE DRIVE
 HOUSTON, TEXAS 77054
 (713) 660-0901

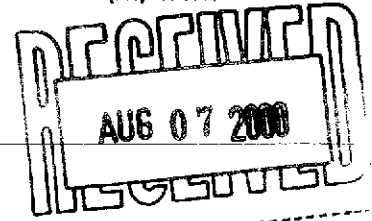

Case Narrative for:
EXXON Company U.S.A.

Certificate of Analysis Number:
00070643

<p>Report To: Environmental Resolution, Inc. Jim Chappell 73 Digital Drive Suite 100</p> <p>Novato California 94949- ph: (415) 382-9105 fax: (415) 382-1856</p>	<p>Project Name: 229313X Site: 7-0238,19802889 Site Address:</p> <p>PO Number: EWR#20900300 State: California State Cert. No.: Date Reported: 8/2/00</p>
---	--

Any data flags or quality control exceptions associated with this report will be footnoted in the analytical result page(s) or the quality control summary page(s).

Please do not hesitate to contact us if you have any questions or comments pertaining to this data report. Please reference the above Certificate of Analysis Number.

SPL, Inc. is pleased to be of service to you. We anticipate working with you in fulfilling all your current and future analytical needs.

This report shall not be reproduced except in full, without the written approval of the laboratory. The reported results are only representative of the samples submitted for testing.

Sonia West
 West, Sonia
 Senior Project Manager

8/2/00

Date



HOUSTON LABORATORY
 8880 INTERCHANGE DRIVE
 HOUSTON, TEXAS 77054
 (713) 660-0901

EXXON Company U.S.A.

Certificate of Analysis Number:
00070643

Report To: Environmental Resolution, Inc. Jim Chappell 73 Digital Drive Suite 100 Novato California 94949- ph: (415) 382-9105 fax: (415) 382-1856	Project Name: 229313X Site: 7-0238,19802889 Site Address: PO Number: EWR#20900300 State: California State Cert. No.: Date Reported: 8/2/00
File To: Environmental Resolution, Inc. Jim Chappell fax: (415) 382-1856	

Client Sample ID	Lab Sample ID	Matrix	Date Collected	Date Received	COC ID	HOLD
TB 7/18/00	00070643-01	Water	7/24/00	7/26/00 10:00:00 AM		<input type="checkbox"/>
W-3-MW9D	00070643-02	Water	7/24/00 2:50:00 PM	7/26/00 10:00:00 AM		<input type="checkbox"/>
W-4-MW9D	00070643-03	Water	7/24/00 2:55:00 PM	7/26/00 10:00:00 AM		<input type="checkbox"/>
W-8-MW9H	00070643-04	Water	7/24/00 3:08:00 PM	7/26/00 10:00:00 AM		<input type="checkbox"/>
W-9-MW9F	00070643-05	Water	7/24/00 3:19:00 PM	7/26/00 10:00:00 AM		<input type="checkbox"/>
W-1-MW9G	00070643-06	Water	7/24/00 3:33:00 PM	7/26/00 10:00:00 AM		<input type="checkbox"/>
W-5-MW9I	00070643-07	Water	7/24/00 3:45:00 PM	7/26/00 10:00:00 AM		<input type="checkbox"/>
W-6-MW9A	00070643-08	Water	7/24/00 3:55:00 PM	7/26/00 10:00:00 AM		<input type="checkbox"/>
W-7-MW9C	00070643-09	Water	7/24/00 4:05:00 PM	7/26/00 10:00:00 AM		<input type="checkbox"/>
W-8-MW9B	00070643-10	Water	7/24/00 4:18:00 PM	7/26/00 10:00:00 AM		<input type="checkbox"/>

Sonia West

8/2/00

West, Sonia
 Senior Project Manager

Date

Joel Grice
 Laboratory Director

Ted Yen
 Quality Assurance Officer



Client Sample ID TB 7/18/00

Collected: 7/24/00

SPL Sample ID: 00070643-01

Site: 7-0238,19802889

Analyses/Method	Result	Rep.Limit	Dil. Factor	QUAL	Date Analyzed	Analyst	Seq. #
GASOLINE RANGE ORGANICS			MCL	CA_GRO	Units: ug/L		
Gasoline Range Organics	ND	50	1		07/27/00 15:09	DL	350729
Surr: 1,4-Difluorobenzene	107	% 62-144	1		07/27/00 15:09	DL	350729
Surr: 4-Bromofluorobenzene	92.0	% 44-153	1		07/27/00 15:09	DL	350729
PURGEABLE AROMATICS			MCL	SW8021B	Units: ug/L		
Benzene	ND	0.5	1		07/27/00 15:09	DL	350575
Ethylbenzene	ND	0.5	1		07/27/00 15:09	DL	350575
Methyl tert-butyl ether	ND	2	1		07/27/00 15:09	DL	350575
Toluene	ND	0.5	1		07/27/00 15:09	DL	350575
m,p-Xylene	ND	0.5	1		07/27/00 15:09	DL	350575
o-Xylene	ND	0.5	1		07/27/00 15:09	DL	350575
Xylenes, Total	ND	0.5	1		07/27/00 15:09	DL	350575
Surr: 1,4-Difluorobenzene	99.1	% 72-137	1		07/27/00 15:09	DL	350575
Surr: 4-Bromofluorobenzene	103	% 48-156	1		07/27/00 15:09	DL	350575

Sonia West

West, Sonia
 Project Manager

Qualifiers: ND/U - Not Detected at the Reporting Limit >MCL - Result Over Maximum Contamination Limit(MCL)
 B - Analyte detected in the associated Method Blank D - Surrogate Recovery Unreportable due to Dilution
 * - Surrogate Recovery Outside Advisable QC Limits MI - Matrix Interference
 J - Estimated Value between MDL and PQL



Client Sample ID W-BB-MW9D Collected: 7/24/00 2:50:00 SPL Sample ID: 00070643-02

Site: 7-0238,19802889

Analyses/Method	Result	Rep.Limit	Dil. Factor	QUAL	Date Analyzed	Analyst	Seq. #
GASOLINE RANGE ORGANICS			MCL	CA_GRO	Units: ug/L		
Gasoline Range Organics	ND	50	1		07/27/00 15:32	DL	350733
Surr: 1,4-Difluorobenzene	112	% 62-144	1		07/27/00 15:32	DL	350733
Surr: 4-Bromofluorobenzene	94.3	% 44-153	1		07/27/00 15:32	DL	350733
PURGEABLE AROMATICS			MCL	SW8021B	Units: ug/L		
Benzene	ND	0.5	1		07/27/00 15:32	DL	350576
Ethylbenzene	ND	0.5	1		07/27/00 15:32	DL	350576
Methyl tert-butyl ether	ND	2	1		07/27/00 15:32	DL	350576
Toluene	ND	0.5	1		07/27/00 15:32	DL	350576
m,p-Xylene	ND	0.5	1		07/27/00 15:32	DL	350576
o-Xylene	ND	0.5	1		07/27/00 15:32	DL	350576
Xylenes, Total	ND	0.5	1		07/27/00 15:32	DL	350576
Surr: 1,4-Difluorobenzene	100	% 72-137	1		07/27/00 15:32	DL	350576
Surr: 4-Bromofluorobenzene	103	% 48-156	1		07/27/00 15:32	DL	350576

Sonia West

West, Sonia
 Project Manager

Qualifiers: ND/U - Not Detected at the Reporting Limit >MCL - Result Over Maximum Contamination Limit(MCL)
 B - Analyte detected in the associated Method Blank D - Surrogate Recovery Unreportable due to Dilution
 * - Surrogate Recovery Outside Advisable QC Limits MI - Matrix Interference
 J - Estimated Value between MDL and PQL



Client Sample ID W-7-MW9D Collected: 7/24/00 2:55:00 SPL Sample ID: 00070643-03

Site: 7-0238,19802889

Analyses/Method	Result	Rep.Limit	Dil. Factor	QUAL	Date Analyzed	Analyst	Seq. #
GASOLINE RANGE ORGANICS			MCL	CA_GRO	Units: ug/L		
Gasoline Range Organics	ND	50	1		07/27/00 15:57	DL	350738
Surr: 1,4-Difluorobenzene	104	% 62-144	1		07/27/00 15:57	DL	350738
Surr: 4-Bromofluorobenzene	97.3	% 44-153	1		07/27/00 15:57	DL	350738
PURGEABLE AROMATICS			MCL	SW8021B	Units: ug/L		
Benzene	ND	0.5	1		07/27/00 15:57	DL	350577
Ethylbenzene	0.85	0.5	1		07/27/00 15:57	DL	350577
Methyl tert-butyl ether	14	2	1		07/27/00 15:57	DL	350577
Toluene	ND	0.5	1		07/27/00 15:57	DL	350577
m,p-Xylene	0.74	0.5	1		07/27/00 15:57	DL	350577
o-Xylene	ND	0.5	1		07/27/00 15:57	DL	350577
Xylenes, Total	0.74	0.5	1		07/27/00 15:57	DL	350577
Surr: 1,4-Difluorobenzene	99.9	% 72-137	1		07/27/00 15:57	DL	350577
Surr: 4-Bromofluorobenzene	107	% 48-156	1		07/27/00 15:57	DL	350577

Sonia West

West, Sonia
 Project Manager

Qualifiers: ND/U - Not Detected at the Reporting Limit >MCL - Result Over Maximum Contamination Limit(MCL)
 B - Analyte detected in the associated Method Blank D - Surrogate Recovery Unreportable due to Dilution
 * - Surrogate Recovery Outside Advisable QC Limits MI - Matrix Interference
 J - Estimated Value between MDL and PQL



Client Sample ID W-8-MW9H Collected: 7/24/00 3:08:00 SPL Sample ID: 00070643-04

Site: 7-0238,19802889

Analyses/Method	Result	Rep.Limit	Dil. Factor	QUAL	Date Analyzed	Analyst	Seq. #
GASOLINE RANGE ORGANICS			MCL	CA_GRO	Units: ug/L		
Gasoline Range Organics	ND	50	1		07/27/00 16:21	DL	350741
Surr: 1,4-Difluorobenzene	110	% 62-144	1		07/27/00 16:21	DL	350741
Surr: 4-Bromofluorobenzene	96.0	% 44-153	1		07/27/00 16:21	DL	350741
PURGEABLE AROMATICS			MCL	SW8021B	Units: ug/L		
Benzene	ND	0.5	1		07/27/00 16:21	DL	350578
Ethylbenzene	ND	0.5	1		07/27/00 16:21	DL	350578
Methyl tert-butyl ether	17	2	1		07/27/00 16:21	DL	350578
Toluene	ND	0.5	1		07/27/00 16:21	DL	350578
m,p-Xylene	ND	0.5	1		07/27/00 16:21	DL	350578
o-Xylene	ND	0.5	1		07/27/00 16:21	DL	350578
Xylenes,Total	ND	0.5	1		07/27/00 16:21	DL	350578
Surr: 1,4-Difluorobenzene	102	% 72-137	1		07/27/00 16:21	DL	350578
Surr: 4-Bromofluorobenzene	108	% 48-156	1		07/27/00 16:21	DL	350578

Sonia West

West, Sonia
 Project Manager

Qualifiers: ND/U - Not Detected at the Reporting Limit >MCL - Result Over Maximum Contamination Limit(MCL)
 B - Analyte detected in the associated Method Blank D - Surrogate Recovery Unreportable due to Dilution
 * - Surrogate Recovery Outside Advisable QC Limits MI - Matrix Interference
 J - Estimated Value between MDL and PQL



Client Sample ID W-5-MW9F Collected: 7/24/00 3:19:00 SPL Sample ID: 00070643-05

Site: 7-0238,19802889

Analyses/Method	Result	Rep.Limit	Dil. Factor	QUAL	Date Analyzed	Analyst	Seq. #
GASOLINE RANGE ORGANICS			MCL	CA_GRO	Units: ug/L		
Gasoline Range Organics	ND	50	1		07/27/00 16:45	DL	350748
Surr: 1,4-Difluorobenzene	109	% 62-144	1		07/27/00 16:45	DL	350748
Surr: 4-Bromofluorobenzene	94.7	% 44-153	1		07/27/00 16:45	DL	350748
PURGEABLE AROMATICS			MCL	SW8021B	Units: ug/L		
Benzene	ND	0.5	1		07/27/00 16:45	DL	350580
Ethylbenzene	ND	0.5	1		07/27/00 16:45	DL	350580
Methyl tert-butyl ether	170	2	1		07/27/00 16:45	DL	350580
Toluene	ND	0.5	1		07/27/00 16:45	DL	350580
m,p-Xylene	ND	0.5	1		07/27/00 16:45	DL	350580
o-Xylene	ND	0.5	1		07/27/00 16:45	DL	350580
Xylenes, Total	ND	0.5	1		07/27/00 16:45	DL	350580
Surr: 1,4-Difluorobenzene	103	% 72-137	1		07/27/00 16:45	DL	350580
Surr: 4-Bromofluorobenzene	107	% 48-156	1		07/27/00 16:45	DL	350580

Sonia West

West, Sonia
 Project Manager

Qualifiers: ND/U - Not Detected at the Reporting Limit >MCL - Result Over Maximum Contamination Limit(MCL)
 B - Analyte detected in the associated Method Blank D - Surrogate Recovery Unreportable due to Dilution
 * - Surrogate Recovery Outside Advisable QC Limits MI - Matrix Interference
 J - Estimated Value between MDL and PQL



Client Sample ID W-5-MW9G Collected: 7/24/00 3:33:00 SPL Sample ID: 00070643-06

Site: 7-0238,19802889

Analyses/Method	Result	Rep.Limit	Dil. Factor	QUAL	Date Analyzed	Analyst	Seq. #
GASOLINE RANGE ORGANICS			MCL	CA_GRO	Units: ug/L		
Gasoline Range Organics	ND	50	1		07/27/00 17:10	DL	351021
Surr: 1,4-Difluorobenzene	112	% 62-144	1		07/27/00 17:10	DL	351021
Surr: 4-Bromofluorobenzene	96.3	% 44-153	1		07/27/00 17:10	DL	351021
PURGEABLE AROMATICS			MCL	SW8021B	Units: ug/L		
Benzene	ND	0.5	1		07/27/00 17:10	DL	350581
Ethylbenzene	ND	0.5	1		07/27/00 17:10	DL	350581
Methyl tert-butyl ether	1000	20	10		08/01/00 13:42	DL	356066
Toluene	ND	0.5	1		07/27/00 17:10	DL	350581
m,p-Xylene	ND	0.5	1		07/27/00 17:10	DL	350581
o-Xylene	ND	0.5	1		07/27/00 17:10	DL	350581
Xylenes, Total	ND	0.5	1		07/27/00 17:10	DL	350581
Surr: 1,4-Difluorobenzene	99.2	% 72-137	10		08/01/00 13:42	DL	356066
Surr: 1,4-Difluorobenzene	104	% 72-137	1		07/27/00 17:10	DL	350581
Surr: 4-Bromofluorobenzene	99.5	% 48-156	10		08/01/00 13:42	DL	356066
Surr: 4-Bromofluorobenzene	106	% 48-156	1		07/27/00 17:10	DL	350581

Sonia West

West, Sonia
 Project Manager

Qualifiers: ND/U - Not Detected at the Reporting Limit >MCL - Result Over Maximum Contamination Limit(MCL)
 B - Analyte detected in the associated Method Blank D - Surrogate Recovery Unreportable due to Dilution
 * - Surrogate Recovery Outside Advisable QC Limits MI - Matrix Interference
 J - Estimated Value between MDL and PQL



Client Sample ID W-5-MW9I

Collected: 7/24/00 3:45:00

SPL Sample ID: 00070643-07

Site: 7-0238,19802889

Analyses/Method	Result	Rep.Limit	Dil. Factor	QUAL	Date Analyzed	Analyst	Seq. #
GASOLINE RANGE ORGANICS			MCL	CA_GRO	Units: ug/L		
Gasoline Range Organics	ND	250	5		07/28/00 21:00	DL	353196
Surr: 1,4-Difluorobenzene	116	% 62-144	5		07/28/00 21:00	DL	353196
Surr: 4-Bromofluorobenzene	90.9	% 44-153	5		07/28/00 21:00	DL	353196
PURGEABLE AROMATICS			MCL	SW8021B	Units: ug/L		
Benzene	ND	2.5	5		07/28/00 21:00	DL	353102
Ethylbenzene	ND	2.5	5		07/28/00 21:00	DL	353102
Methyl tert-butyl ether	43000	200	100		08/01/00 13:17	DL	355941
Toluene	ND	2.5	5		07/28/00 21:00	DL	353102
m,p-Xylene	ND	2.5	5		07/28/00 21:00	DL	353102
o-Xylene	ND	2.5	5		07/28/00 21:00	DL	353102
Xylenes, Total	ND	2.5	5		07/28/00 21:00	DL	353102
Surr: 1,4-Difluorobenzene	103	% 72-137	100		08/01/00 13:17	DL	355941
Surr: 1,4-Difluorobenzene	108	% 72-137	5		07/28/00 21:00	DL	353102
Surr: 4-Bromofluorobenzene	99.8	% 48-156	100		08/01/00 13:17	DL	355941
Surr: 4-Bromofluorobenzene	94.6	% 48-156	5		07/28/00 21:00	DL	353102

Sonia West

West, Sonia
 Project Manager

Qualifiers: ND/U - Not Detected at the Reporting Limit
 B - Analyte detected in the associated Method Blank
 * - Surrogate Recovery Outside Advisable QC Limits
 J - Estimated Value between MDL and PQL

>MCL - Result Over Maximum Contamination Limit(MCL)
 D - Surrogate Recovery Unreportable due to Dilution
 MI - Matrix Interference



Client Sample ID W-6-MW9A

Collected: 7/24/00 3:55:00

SPL Sample ID: 00070643-08

Site: 7-0238,19802889

Analyses/Method	Result	Rep.Limit	Dil. Factor	QUAL	Date Analyzed	Analyst	Seq. #
GASOLINE RANGE ORGANICS			MCL	CA_GRO	Units: ug/L		
Gasoline Range Organics	ND	50	1		07/27/00 17:34	DL	350755
Surr: 1,4-Difluorobenzene	116	% 62-144	1		07/27/00 17:34	DL	350755
Surr: 4-Bromofluorobenzene	96.0	% 44-153	1		07/27/00 17:34	DL	350755
PURGEABLE AROMATICS			MCL	SW8021B	Units: ug/L		
Benzene	ND	0.5	1		07/27/00 17:34	DL	350582
Ethylbenzene	ND	0.5	1		07/27/00 17:34	DL	350582
Methyl tert-butyl ether	7400	50	25		08/01/00 14:08	DL	355942
Toluene	ND	0.5	1		07/27/00 17:34	DL	350582
m,p-Xylene	ND	0.5	1		07/27/00 17:34	DL	350582
o-Xylene	ND	0.5	1		07/27/00 17:34	DL	350582
Xylenes, Total	ND	0.5	1		07/27/00 17:34	DL	350582
Surr: 1,4-Difluorobenzene	103	% 72-137	25		08/01/00 14:08	DL	355942
Surr: 1,4-Difluorobenzene	106	% 72-137	1		07/27/00 17:34	DL	350582
Surr: 4-Bromofluorobenzene	98.8	% 48-156	25		08/01/00 14:08	DL	355942
Surr: 4-Bromofluorobenzene	106	% 48-156	1		07/27/00 17:34	DL	350582

Sonia West

West, Sonia
 Project Manager

Qualifiers: ND/U - Not Detected at the Reporting Limit >MCL - Result Over Maximum Contamination Limit(MCL)
 B - Analyte detected in the associated Method Blank D - Surrogate Recovery Unreportable due to Dilution
 * - Surrogate Recovery Outside Advisable QC Limits MI - Matrix Interference
 J - Estimated Value between MDL and PQL



Client Sample ID W-6-MW9C Collected: 7/24/00 4:05:00 SPL Sample ID: 00070643-09

Site: 7-0238,19802889

Analyses/Method	Result	Rep.Limit	Dil. Factor	QUAL	Date Analyzed	Analyst	Seq. #
GASOLINE RANGE ORGANICS			MCL	CA_GRO	Units: ug/L		
Gasoline Range Organics	ND	250	5		07/27/00 18:47	DL	350757
Surr: 1,4-Difluorobenzene	114	% 62-144	5		07/27/00 18:47	DL	350757
Surr: 4-Bromofluorobenzene	94.3	% 44-153	5		07/27/00 18:47	DL	350757
PURGEABLE AROMATICS			MCL	SW8021B	Units: ug/L		
Benzene	ND	2.5	5		07/27/00 18:47	DL	350587
Ethylbenzene	ND	2.5	5		07/27/00 18:47	DL	350587
Methyl tert-butyl ether	44000	500	250		08/01/00 14:33	DL	355943
Toluene	ND	2.5	5		07/27/00 18:47	DL	350587
m,p-Xylene	ND	2.5	5		07/27/00 18:47	DL	350587
o-Xylene	ND	2.5	5		07/27/00 18:47	DL	350587
Xylenes, Total	ND	2.5	5		07/27/00 18:47	DL	350587
Surr: 1,4-Difluorobenzene	103	% 72-137	250		08/01/00 14:33	DL	355943
Surr: 1,4-Difluorobenzene	108	% 72-137	5		07/27/00 18:47	DL	350587
Surr: 4-Bromofluorobenzene	99.1	% 48-156	250		08/01/00 14:33	DL	355943
Surr: 4-Bromofluorobenzene	104	% 48-156	5		07/27/00 18:47	DL	350587

Sonia West

West, Sonia
 Project Manager

Qualifiers: ND/U - Not Detected at the Reporting Limit >MCL - Result Over Maximum Contamination Limit(MCL)
 B - Analyte detected in the associated Method Blank D - Surrogate Recovery Unreportable due to Dilution
 * - Surrogate Recovery Outside Advisable QC Limits MI - Matrix Interference
 J - Estimated Value between MDL and PQL



Client Sample ID W-5-MW9B Collected: 7/24/00 4:18:00 SPL Sample ID: 00070643-10

Site: 7-0238,19802889

Analyses/Method	Result	Rep.Limit	Dil. Factor	QUAL	Date Analyzed	Analyst	Seq. #
GASOLINE RANGE ORGANICS			MCL	CA_GRO	Units: ug/L		
Gasoline Range Organics	ND	250	5		07/27/00 19:12	DL	350766
Surr: 1,4-Difluorobenzene	116	% 62-144	5		07/27/00 19:12	DL	350766
Surr: 4-Bromofluorobenzene	97.5	% 44-153	5		07/27/00 19:12	DL	350766
PURGEABLE AROMATICS			MCL	SW8021B	Units: ug/L		
Benzene	8	2.5	5		07/27/00 19:12	DL	350594
Ethylbenzene	ND	2.5	5		07/27/00 19:12	DL	350594
Methyl tert-butyl ether	39000	500	250		08/01/00 14:58	DL	355944
Toluene	ND	2.5	5		07/27/00 19:12	DL	350594
m,p-Xylene	ND	2.5	5		07/27/00 19:12	DL	350594
o-Xylene	ND	2.5	5		07/27/00 19:12	DL	350594
Xylenes, Total	ND	2.5	5		07/27/00 19:12	DL	350594
Surr: 1,4-Difluorobenzene	103	% 72-137	250		08/01/00 14:58	DL	355944
Surr: 1,4-Difluorobenzene	112	% 72-137	5		07/27/00 19:12	DL	350594
Surr: 4-Bromofluorobenzene	99.5	% 48-156	250		08/01/00 14:58	DL	355944
Surr: 4-Bromofluorobenzene	106	% 48-156	5		07/27/00 19:12	DL	350594

Sonia West

West, Sonia
 Project Manager

Qualifiers: ND/U - Not Detected at the Reporting Limit >MCL - Result Over Maximum Contamination Limit(MCL)
 B - Analyte detected in the associated Method Blank D - Surrogate Recovery Unreportable due to Dilution
 * - Surrogate Recovery Outside Advisable QC Limits MI - Matrix Interference
 J - Estimated Value between MDL and PQL



Quality Control Documentation



Quality Control Report

EXXON Company U.S.A.

229313X

Analysis: Purgeable Aromatics
Method: SW8021B

WorkOrder: 00070643
Lab Batch ID: R18041

Method Blank

Samples in Analytical Batch:

RunID: HP_U_000727A-350573 Units: ug/L
Analysis Date: 07/27/2000 12:43 Analyst: DL

Lab Sample ID	Client Sample ID
00070643-01A	TB 7/18/00
00070643-02A	W-BB-MW9D
00070643-03A	W-7-MW9D
00070643-04A	W-8-MW9H
00070643-05A	W-5-MW9F
00070643-06A	W-5-MW9G
00070643-08A	W-6-MW9A
00070643-09A	W-6-MW9C
00070643-10A	W-5-MW9B

Analyte	Result	Rep Limit
Benzene	ND	0.50
Ethylbenzene	ND	0.50
Methyl tert-butyl ether	ND	2.0
Toluene	ND	0.50
m,p-Xylene	ND	0.50
o-Xylene	ND	0.50
Xylenes, Total	ND	0.50
Surr: 1,4-Difluorobenzene	100.0	72-137
Surr: 4-Bromofluorobenzene	103.2	48-156

Laboratory Control Sample (LCS)

RunID: HP_U_000727A-350572 Units: ug/L
Analysis Date: 07/27/2000 11:52 Analyst: DL

Analyte	Spike Added	Result	Percent Recovery	Lower Limit	Upper Limit
Benzene	50	53	106	70	130
Ethylbenzene	50	54	108	70	130
Methyl tert-butyl ether	50	54	108	70	130
Toluene	50	53	107	70	130
m,p-Xylene	100	110	109	70	130
o-Xylene	50	54	108	70	130
Xylenes, Total	150	164	109	70	130

Matrix Spike (MS) / Matrix Spike Duplicate (MSD)

Sample Spiked: 00070643-02
RunID: HP_U_000727A-351022 Units: ug/L
Analysis Date: 07/27/2000 13:07 Analyst: DL

Analyte	Sample Result	MS Spike Added	MS Result	MS % Recovery	MSD Spike Added	MSD Result	MSD % Recovery	RPD	RPD Limit	Low Limit	High Limit
Benzene	ND	20	22	110	20	22	110	0.515	21	32	164
Ethylbenzene	ND	20	23	113	20	23	112	0.801	19	52	142
Methyl tert-butyl ether	ND	20	22	112	20	22	108	4.03	20	39	150

Qualifiers: ND/U - Not Detected at the Reporting Limit * - Recovery Outside Advisable QC Limits
B - Analyte detected in the associated Method Blank D - Recovery Unreportable due to Dilution
J - Estimated value between MDL and PQL MI - Matrix Interference



Quality Control Report

EXXON Company U.S.A.

229313X

Analysis: Purgeable Aromatics
 Method: SW8021B

WorkOrder: 00070643
 Lab Batch ID: R18041

Matrix Spike (MS) / Matrix Spike Duplicate (MSD)

Sample Spiked: 00070643-02
 RunID: HP_U_000727A-351022 Units: ug/L
 Analysis Date: 07/27/2000 13:07 Analyst: DL

Analyte	Sample Result	MS Spike Added	MS Result	MS % Recovery	MSD Spike Added	MSD Result	MSD % Recovery	RPD	RPD Limit	Low Limit	High Limit
Benzene	ND	20	22	110	20	22	111	0.703	20	38	159
m-Xylene	ND	40	45	112	40	45	112	0.360	17	53	144
o-Xylene	ND	20	22	110	20	22	110	0.170	18	53	143
Xylenes, Total	ND	60	67	112	60	67	112	0	18	53	144

Qualifiers: ND/U - Not Detected at the Reporting Limit * - Recovery Outside Advisable QC Limits
 B - Analyte detected in the associated Method Blank D - Recovery Unreportable due to Dilution
 J - Estimated value between MDL and PQL MI - Matrix Interference



Quality Control Report
EXXON Company U.S.A.
229313X

Analysis: Gasoline Range Organics
Method: CA_GRO

WorkOrder: 00070643
Lab Batch ID: R18046

Method Blank

RunID: HP_U_000727B-351020 Units: mg/L
Analysis Date: 07/27/2000 12:43 Analyst: DL

Samples in Analytical Batch:

Lab Sample ID	Client Sample ID
00070643-01A	TB 7/18/00
00070643-02A	W-BB-MW9D
00070643-03A	W-7-MW9D
00070643-04A	W-8-MW9H
00070643-05A	W-5-MW9F
00070643-06A	W-5-MW9G
00070643-08A	W-6-MW9A
00070643-09A	W-6-MW9C
00070643-10A	W-5-MW9B

Analyte	Result	Rep Limit
Gasoline Range Organics	ND	0.050
Surr: 1,4-Difluorobenzene	102.0	62-144
Surr: 4-Bromofluorobenzene	93.7	44-153

Laboratory Control Sample (LCS)

RunID: HP_U_000727B-351019 Units: mg/L
Analysis Date: 07/27/2000 11:27 Analyst: DL

Analyte	Spike Added	Result	Percent Recovery	Lower Limit	Upper Limit
Gasoline Range Organics	1	0.89	89	75	125

Matrix Spike (MS) / Matrix Spike Duplicate (MSD)

Sample Spiked: 00070643-03
RunID: HP_U_000727B-350726 Units: mg/L
Analysis Date: 07/27/2000 13:56 Analyst: DL

Analyte	Sample Result	MS Spike Added	MS Result	MS % Recovery	MSD Spike Added	MSD Result	MSD % Recovery	RPD	RPD Limit	Low Limit	High Limit
Gasoline Range Organics	ND	0.9	0.93	103	0.9	0.94	104	0.931	36	36	160

Qualifiers: ND/U - Not Detected at the Reporting Limit * - Recovery Outside Advisable QC Limits
B - Analyte detected in the associated Method Blank D - Recovery Unreportable due to Dilution
J - Estimated value between MDL and PQL MI - Matrix Interference



Quality Control Report

EXXON Company U.S.A.

229313X

Analysis: Purgeable Aromatics
Method: SW8021B

WorkOrder: 00070643
Lab Batch ID: R18155

Method Blank

Samples in Analytical Batch:

RunID: HP_W_000728A-352983 Units: ug/L
Analysis Date: 07/28/2000 10:45 Analyst: DL

Lab Sample ID: 00070643-07A
Client Sample ID: W-5-MW9I

Analyte	Result	Rep Limit
Benzene	ND	0.50
Ethylbenzene	ND	0.50
Toluene	ND	0.50
m,p-Xylene	ND	0.50
o-Xylene	ND	0.50
Xylenes, Total	ND	0.50
Surr: 1,4-Difluorobenzene	99.9	72-137
Surr: 4-Bromofluorobenzene	99.1	48-156

Laboratory Control Sample (LCS)

RunID: HP_W_000728A-352982 Units: ug/L
Analysis Date: 07/28/2000 9:55 Analyst: DL

Analyte	Spike Added	Result	Percent Recovery	Lower Limit	Upper Limit
Benzene	50	51	103	70	130
Ethylbenzene	50	51	102	70	130
Toluene	50	52	103	70	130
m,p-Xylene	100	100	101	70	130
o-Xylene	50	51	102	70	130
Xylenes, Total	150	151	101	70	130

Matrix Spike (MS) / Matrix Spike Duplicate (MSD)

Sample Spiked: 00070682-02
RunID: HP_W_000728A-352989 Units: ug/L
Analysis Date: 07/28/2000 11:19 Analyst: DL

Analyte	Sample Result	MS Spike Added	MS Result	MS % Recovery	MSD Spike Added	MSD Result	MSD % Recovery	RPD	RPD Limit	Low Limit	High Limit
Benzene	ND	20	20	101	20	21	104	3.24	21	32	164
Ethylbenzene	ND	20	20	101	20	21	103	1.49	19	52	142
Toluene	ND	20	21	103	20	21	105	1.76	20	38	159
m,p-Xylene	ND	40	40	100	40	41	102	1.61	17	53	144
o-Xylene	ND	20	20	101	20	21	103	1.52	18	53	143

Qualifiers: ND/U - Not Detected at the Reporting Limit * - Recovery Outside Advisable QC Limits
B - Analyte detected in the associated Method Blank D - Recovery Unreportable due to Dilution
J - Estimated value between MDL and PQL MI - Matrix Interference



Quality Control Report

EXXON Company U.S.A.

229313X

Analysis: Purgeable Aromatics
 Method: SW8021B

WorkOrder: 00070643
 Lab Batch ID: R18155

Matrix Spike (MS) / Matrix Spike Duplicate (MSD)

Sample Spiked: 00070682-02
 RunID: HP_W_000728A-352989 Units: ug/L
 Analysis Date: 07/28/2000 11:19 Analyst: DL

Analyte	Sample Result	MS Spike Added	MS Result	MS % Recovery	MSD Spike Added	MSD Result	MSD % Recovery	RPD	RPD Limit	Low Limit	High Limit
Xylenes, Total	ND	60	60	100	60	62	103	3.28	18	53	144

Qualifiers:
 ND/U - Not Detected at the Reporting Limit
 B - Analyte detected in the associated Method Blank
 J - Estimated value between MDL and PQL

* - Recovery Outside Advisable QC Limits
 D - Recovery Unreportable due to Dilution
 Mi - Matrix Interference



Quality Control Report

EXXON Company U.S.A.
 229313X

Analysis: Gasoline Range Organics
 Method: CA_GRO

WorkOrder: 00070643
 Lab Batch ID: R18167

Method Blank

Samples in Analytical Batch:

RunID: HP_W_000728B-353149 Units: mg/L
 Analysis Date: 07/28/2000 10:45 Analyst: DL

Lab Sample ID: 00070643-07A
 Client Sample ID: W-5-MW9I

Analyte	Result	Rep Limit
Gasoline Range Organics	ND	0.050
Surr: 1,4-Difluorobenzene	106.0	62-144
Surr: 4-Bromofluorobenzene	88.7	44-153

Laboratory Control Sample (LCS)

RunID: HP_W_000728B-353140 Units: mg/L
 Analysis Date: 07/28/2000 9:29 Analyst: DL

Analyte	Spike Added	Result	Percent Recovery	Lower Limit	Upper Limit
Gasoline Range Organics	1	0.98	98	75	125

Matrix Spike (MS) / Matrix Spike Duplicate (MSD)

Sample Spiked: 00070682-03
 RunID: HP_W_000728B-353159 Units: mg/L
 Analysis Date: 07/28/2000 12:10 Analyst: DL

Analyte	Sample Result	MS Spike Added	MS Result	MS % Recovery	MSD Spike Added	MSD Result	MSD % Recovery	RPD	RPD Limit	Low Limit	High Limit
Gasoline Range Organics	ND	0.9	0.95	105	0.9	0.93	103	1.63	36	36	160

Qualifiers: ND/U - Not Detected at the Reporting Limit * - Recovery Outside Advisable QC Limits
 B - Analyte detected in the associated Method Blank D - Recovery Unreportable due to Dilution
 J - Estimated value between MDL and PQL MI - Matrix Interference



Quality Control Report
EXXON Company U.S.A.
229313X

Analysis: Purgeable Aromatics
Method: SW8021B

WorkOrder: 00070643
Lab Batch ID: R18271

Method Blank

Samples in Analytical Batch:

RunID: HP_W_000801A-355938 Units: ug/L
Analysis Date: 08/01/2000 11:16 Analyst: DL

Lab Sample ID	Client Sample ID
00070643-06A	W-5-MW9G
00070643-07A	W-5-MW9I
00070643-08A	W-6-MW9A
00070643-09A	W-6-MW9C
00070643-10A	W-5-MW9B

Analyte	Result	Rep Limit
Methyl tert-butyl ether	ND	2.0
Surr: 1,4-Difluorobenzene	99.2	72-137
Surr: 4-Bromofluorobenzene	103.8	48-156

Laboratory Control Sample (LCS)

RunID: HP_W_000801A-355933 Units: ug/L
Analysis Date: 08/01/2000 10:25 Analyst: DL

Analyte	Spike Added	Result	Percent Recovery	Lower Limit	Upper Limit
Methyl tert-butyl ether	50	46	92	70	130

Matrix Spike (MS) / Matrix Spike Duplicate (MSD)

Sample Spiked: 00080005-04
RunID: HP_W_000801A-355970 Units: ug/L
Analysis Date: 08/01/2000 18:52 Analyst: DL

Analyte	Sample Result	MS Spike Added	MS Result	MS % Recovery	MSD Spike Added	MSD Result	MSD % Recovery	RPD	RPD Limit	Low Limit	High Limit
Methyl tert-butyl ether	ND	20	16	79.4	20	16	80.9	1.77	20	39	150

Qualifiers: ND/U - Not Detected at the Reporting Limit

B - Analyte detected in the associated Method Blank

J - Estimated value between MDL and PQL

* - Recovery Outside Advisable QC Limits

D - Recovery Unreportable due to Dilution

MI - Matrix Interference

*Chain of Custody
And
Sample Receipt Checklist*



HOUSTON LABORATORY
8880 INTERCHANGE DRIVE
HOUSTON, TEXAS 77054
(713) 660-0901

Sample Receipt Checklist

Workorder: 00070643
Date and Time Received: 7/26/00 10:00:00 AM
Temperature: 4

Received by: Barrera, Nancy
Carrier name: FedEx

-
- | | | | |
|---|---|-----------------------------|---|
| Shipping container/cooler in good condition? | Yes <input checked="" type="checkbox"/> | No <input type="checkbox"/> | Not Present <input type="checkbox"/> |
| Custody seals intact on shipping container/cooler? | Yes <input type="checkbox"/> | No <input type="checkbox"/> | Not Present <input checked="" type="checkbox"/> |
| Custody seals intact on sample bottles? | Yes <input type="checkbox"/> | No <input type="checkbox"/> | Not Present <input checked="" type="checkbox"/> |
| Chain of custody present? | Yes <input checked="" type="checkbox"/> | No <input type="checkbox"/> | |
| Chain of custody signed when relinquished and received? | Yes <input checked="" type="checkbox"/> | No <input type="checkbox"/> | |
| Chain of custody agrees with sample labels? | Yes <input checked="" type="checkbox"/> | No <input type="checkbox"/> | |
| Samples in proper container/bottle? | Yes <input checked="" type="checkbox"/> | No <input type="checkbox"/> | |
| Sample containers intact? | Yes <input checked="" type="checkbox"/> | No <input type="checkbox"/> | |
| Sufficient sample volume for indicated test? | Yes <input checked="" type="checkbox"/> | No <input type="checkbox"/> | |
| All samples received within holding time? | Yes <input checked="" type="checkbox"/> | No <input type="checkbox"/> | |
| Container/Temp Blank temperature in compliance? | Yes <input checked="" type="checkbox"/> | No <input type="checkbox"/> | |
| Water - VOA vials have zero headspace? | Yes <input checked="" type="checkbox"/> | No <input type="checkbox"/> | Not Present <input type="checkbox"/> |
| Water - pH acceptable upon receipt? | Yes <input checked="" type="checkbox"/> | No <input type="checkbox"/> | |
-