

# Alameda County Public Works Agency - Water Resources Well Permit



399 Elmhurst Street  
Hayward, CA 94544-1395  
Telephone: (510)670-6633 Fax:(510)782-1939

**Application Approved on: 06/12/2006 By jamesy**

**Permit Numbers: W2006-0569 to W2006-0571  
Permits Valid from 06/27/2006 to 06/27/2006**

**Application Id:** 1149697575978  
**Site Location:** 744 E. 12th St, Oakland, CA 94612  
**Project Start Date:** 06/27/2006

**City of Project Site:** Oakland

**Completion Date:** 06/27/2006

**Requested Inspection:**

**Applicant:** Tetra Tech Inc. - Debra De Leon  
135 Main St. #1800, San Francisco, CA 94105  
**Property Owner:** J W Silveira Co.  
499 Embarcadero St., Oakland, CA 94606  
**Client:** \*\* same as Property Owner \*\*

**Phone:** 415-222-8220

**Phone:** 510-834-9810

<b>Receipt Number: WR2006-0282</b>	<b>Total Due:</b>	\$900.00
<b>Payer Name : Tetra Tech Inc.</b>	<b>Total Amount Paid:</b>	\$900.00
	Paid By: CHECK	<b>PAID IN FULL</b>

**Works Requesting Permits:**

Well Destruction-Monitoring - 3 Wells

Driller: Resonant Sonic International - Lic #: 334802 - Method: auger

**Work Total: \$900.00**

**Specifications**

Permit #	Issued Date	Expire Date	Owner Well Id	Hole Diam.	Casing Diam.	Seal Depth	Max. Depth	State Well #	Orig. Permit #	DWR #
W2006-0569	06/12/2006	09/25/2006	MW1	8.25 in.	2.00 in.	0.00 ft	17.13 ft	0	0	0
W2006-0570	06/12/2006	09/25/2006	MW2	8.25 in.	2.00 in.	0.00 ft	17.95 ft	0	0	0
W2006-0571	06/12/2006	09/25/2006	MW3	8.25 in.	2.00 in.	0.00 ft	17.20 ft	0	0	0

**Specific Work Permit Conditions**

1. Drilling Permit(s) can be voided/ cancelled only in writing. It is the applicant's responsibility to notify Alameda County Public Works Agency, Water Resources Section in writing for an extension or to cancel the drilling permit application. No drilling permit application(s) shall be extended beyond ninety (90) days from the original start date. Applicants may not cancel a drilling permit application after the completion date of the permit issued has passed.

2. Sound the well to measure depth and to ensure no obstructions exist.

Excavate and remove existing casing 3 to 5 foot below ground surface (bgs), including vent cap and well or vault cover.

Grout neat cement with a tremie to the bottom of the well and by filling with neat cement to three (3-5) feet below surface grade.

After the seal has set, backfill the remaining hole with concrete or compacted material to match existing conditions

3. Prior to any drilling activities, it shall be the applicant's responsibility to contact and coordinate an Underground Service Alert (USA), obtain encroachment permit(s), excavation permit(s) or any other permits or agreements required for that Federal, State, County or City, and follow all City or County Ordinances. No work shall begin until all the permits and requirements have been approved or obtained. It shall also be the applicants responsibilities to provide to the Cities

## Alameda County Public Works Agency - Water Resources Well Permit

or to Alameda County an Traffic Safety Plan for any lane closures or detours planned. No work shall begin until all the permits and requirements have been approved or obtained.

4. Compliance with the well-sealing specifications shall not exempt the well-sealing contractor from complying with appropriate State reporting-requirements related to well construction or destruction (Sections 13750 through 13755 (Division 7, Chapter 10, Article 3) of the California Water Code). Contractor must complete State DWR Form 188 and mail original to the Alameda County Public Works Agency, Water Resources Section, within 60 days. Including permit number and site map.

5. Applicant shall submit the copies of the approved encroachment permit to this office within 60 days.

6. Permittee shall assume entire responsibility for all activities and uses under this permit and shall indemnify, defend and save the Alameda County Public Works Agency, its officers, agents, and employees free and harmless from any and all expense, cost and liability in connection with or resulting from the exercise of this Permit including, but not limited to, property damage, personal injury and wrongful death.

7. Permitte, permittee's contractors, consultants or agents shall be responsible to assure that all material or waters generated during drilling, boring destruction, and/or other activities associated with this Permit will be safely handled, properly managed, and disposed of according to all applicable federal, state, and local statutes regulating such. In no case shall these materials and/or waters be allowed to enter, or potentially enter, on or off-site storm sewers, dry wells, or waterways or be allowed to move off the property where work is being completed.

8. Copy of approved drilling permit must be on site at all times. Failure to present or show proof of the approved permit application on site shall result in a fine of \$500.00.

9. Prior to any drilling activities onto any public right-of-ways, it shall be the applicants responsibilities to contact and coordinate a Underground Service Alert (USA), obtain encroachment permit(s), excavation permit(s) or any other permits required for that City or to the County and follow all City or County Ordinances. It shall also be the applicants responsibilities to provide to the Cities or to Alameda County a Traffic Safety Plan for any lane closures or detours planned. No work shall begin until all the permits and requirements have been approved or obtained.

10. Destroy MW-2 & MW-3 by overdrilling & Tremie Grouting with Cement. After the seal has set, backfill the remaining hole with concrete or compacted material to match existing.

Destroy MW-1 by condition #2.

11. Call 510-670-6633 for assigned Inspector at least 5 working days prior to starting.

---

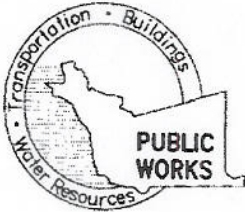

ALAMEDA COUNTY PUBLIC WORKS AGENCY  
 Water Resources Section, Attn: James Yoo  
 399 Elmhurst Street, Hayward, CA 94544-1395  
 Phone: (510) 670-6633 Fax: (510) 782-1939  
 General Info: [www.acgov.org/pwa/wells](http://www.acgov.org/pwa/wells) or email at [wells@acpwa.org](mailto:wells@acpwa.org)

**ID #1149697575978**

**DRILLING PERMIT APPLICATION**

*Applicants: Please attach a site map for all drilling permit applications.*

Location of Project: 744 EAST 12TH STREET

City: OAKLAND, CA 94612

Project start date: 6/27/06 Project completion date: 6/27/06

**APPLICANT:**

**PROPERTY OWNER**  
 Name: J.W. Silva Company  
 Address: 499 Embarcadero St.  
 City, State, Zip: Oakland, CA 94604  
 Phone: (510) 834-9810  
 E-mail Address: N/A

**CLIENT** (Required if different from Property Owner)  
 Name: Tetra Tech EM Inc.  
 Address: 135 Main St Suite 1800  
 City, State, Zip: San Francisco, CA 94105  
 Phone: (415) 222-8250  
 E-mail Address: debbie.telcon@ttemi.com  
 cc E-mail Address: \_\_\_\_\_

**WORK CATEGORIES**

**Type of Project**

<b>Well Construction</b>	<b>Geotechnical Investigation</b>
Cathodic Protection <input type="checkbox"/>	General <input type="checkbox"/>
Water Supply <input type="checkbox"/>	Contamination <input type="checkbox"/>
Monitoring <input type="checkbox"/>	Well Destruction <input checked="" type="checkbox"/>

**Proposed Water Supply Well Use** N/A

New Domestic <input type="checkbox"/>	Industrial <input type="checkbox"/>	Replacement Domestic <input type="checkbox"/>
Municipal <input type="checkbox"/>	Irrigation <input type="checkbox"/>	Other <input type="checkbox"/>

**Drilling Method**

Mud Rotary <input type="checkbox"/>	Air Rotary <input type="checkbox"/>	Auger <input checked="" type="checkbox"/>
Cable <input type="checkbox"/>	Other <input type="checkbox"/>	

Driller's Name: Resonant Sonic International Driller's License No.: 334802

**WELL PROJECTS**

Owner Well ID	Drill Hole Diameter (in.)	Casing Diameter (in.)	Surface Seal Depth (ft.)	Max. Depth (ft.)	Latitude	Longitude
1 MW 1	8.25	2	NA	17.13	NA	See
2 MW 2	8.25	2	NA	17.95	Attached Map for location	
3 MW 3	8.25	2	NA	17.20		
4						
5						
6						

**GEOTECHNICAL/ENVIRONMENTAL/CONTAMINATION PROJECTS**

Number of Boreholes	Hole Diameter (in.)	Max. Depth (ft.)
1		
2		

Applicant's Signature [Signature]

Approved by: \_\_\_\_\_

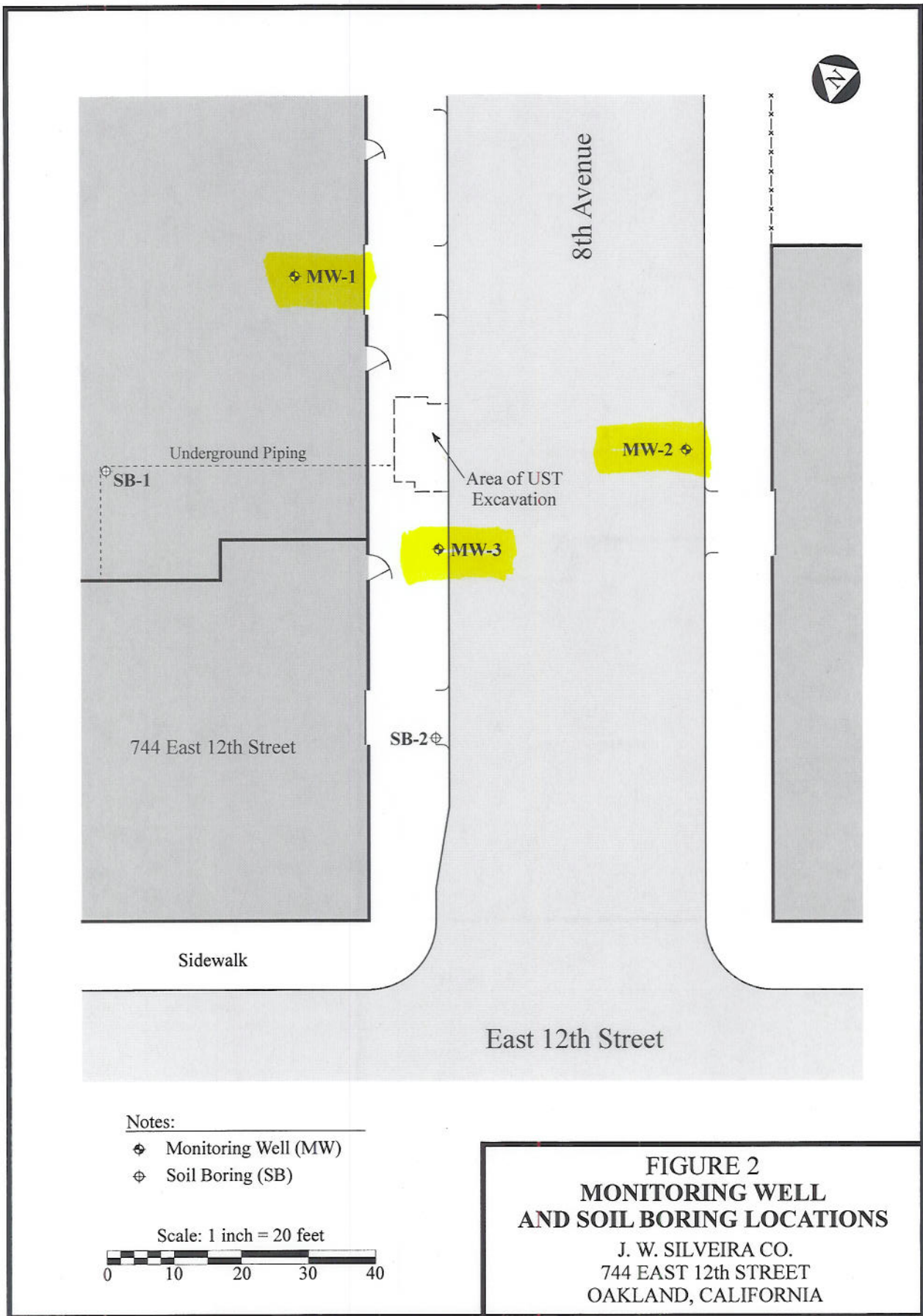

**Notes:**

- ◆ Monitoring Well (MW)
- ⊕ Soil Boring (SB)

Scale: 1 inch = 20 feet



**FIGURE 2  
MONITORING WELL  
AND SOIL BORING LOCATIONS**

J. W. SILVEIRA CO.  
744 EAST 12th STREET  
OAKLAND, CALIFORNIA





TETRA TECH EM INC.

June 6, 2006

James Yoo  
Alameda County Public Works Agency  
Water Resource Section  
399 Elmhurst Street  
Hayward, CA 94544-1395

**Subject: Application for Permit to Deconstruct Three Monitoring Wells at 744 East 12<sup>th</sup> Street, Oakland, California on June 27, 2006**

Dear Mr. Yoo,

Tetra Tech EM Inc. is hereby requesting a permit to deconstruct three monitoring wells located at 744 East 12<sup>th</sup> Street, Oakland, California on June 27, 2006.

The subject property is owned by J.W. Silveira Company. Tetra Tech EM Inc. has been contracted by J.W. Silveira Company to conduct field activities at 744 East 12<sup>th</sup> Street in Oakland CA. As part of these field activities, J.W. Silveira Company requested that three monitoring wells be destroyed according to the California Well Standards Bulletin 74-90, Section 19 (Requirements for Destroying Monitoring Wells and Exploration Holes [DWR 1991]).

As requested, a brief history of the site follows. One 500-gallon underground storage tank (UST) was removed from the site in April 1996. The UST, which had been used to store gasoline, had not been in use since the mid-1980s and was reportedly empty at the time of removal. During UST removal, corrosion of the tank was observed. As a result, three monitoring wells were installed at the site in 1999 (permit number X9900416, issued on 6/2/1999) and four quarters of groundwater monitoring were conducted in 2000. On December 7, 2005, the Alameda County Health Care Services Agency provided a closure letter for the site. The closure letter specified that the three monitoring wells must be destroyed before a remedial action completion certificate can be issued.

The following documents are attached for your review:

- Permit application
- Site map illustrating existing monitoring well locations
- Closure letter from Alameda County Health Care Services Agency.

Please do not hesitate to contact me if you need any additional information.

Thank You,

Debra de León  
Tetra Tech EM Inc.  
135 Main Street, Suite 1800  
San Francisco, CA 94105  
(415) 222-8220 direct line  
(415) 543-5458 fax  
debbie.deleon@ttemi.com

135 Main Street, Suite 1800, San Francisco, CA 94105  
Tel 415.543.4880 Fax 415.543.5480  
www.ttemi.com

ALAMEDA COUNTY  
HEALTH CARE SERVICES

AGENCY

DAVID J. KEARS, Agency Director



ENVIRONMENTAL HEALTH SERVICES  
ENVIRONMENTAL PROTECTION  
1131 Harbor Bay Parkway, Suite 250  
Alameda, CA 94502-6577  
(510) 567-6700  
FAX (510) 337-9335

December 7, 2005

J.W. Silveira  
C/o Virginia Tracy  
J.W. Silveira Realty  
499 Embarcadero  
Oakland, CA 94606

Subject: Fuel Leak Case No. RO0000388, Harley Davidson, 744 East 12<sup>th</sup> Street, Oakland, CA

Dear Mr. Silveira:

Alameda County Environmental Health (ACEH) and California Regional Water Quality Control Board staff have reviewed the fuel leak case file and case closure summary for the above-referenced site and concur that no further action related to the underground storage tank fuel release is required at this time. This fuel leak case will be closed with the following site management requirement:

*"Case closure for the fuel leak site is granted for commercial land use. If a change in land use to residential or other conservative scenario occurs at this property, Alameda County Environmental Health must be notified and the case needs to be re-evaluated. This site is to be entered into the City of Oakland Permit Tracking System due to the residual contamination posing a nuisance for subsurface utility work."*

Prior to issuance of a remedial action completion certificate, the monitoring wells at the site are to be properly destroyed, should the monitoring wells have no further use at the site. Please decommission the monitoring wells and provide documentation of the well decommissioning to this office. A remedial action completion certificate will be issued following receipt of the documentation.

Well destruction permits may be obtained from the Alameda County Public Works Agency (<http://www.acgov.org/pwa/wells/index.shtml>). If you have any questions, please call me at (510) 567-6791.

Sincerely,

^ ^ ^ ^