

ExxonMobil Environmental Services Company
4096 Piedmont Avenue #194
Oakland, California 94611
510 547 8196 Telephone
510 547 8706 Facsimile

Jennifer C. Sedlachek
Project Manager

RECEIVED

8:30 am, Feb 09, 2011
Alameda County
Environmental Health

ExxonMobil

February 8, 2011

Ms. Barbara Jakub
Alameda County Health Care Services Agency
1131 Harbor Bay Parkway, Suite 250
Alameda, California 94502

Subject: Former Mobil Station 04334, 2492 Castro Valley Boulevard, Castro Valley, California

Dear Ms. Jakub:

Attached for your review and comment is a copy of the *Well Destruction Report* for the above-referenced site. The document, prepared by ETIC Engineering, Inc. of Pleasant Hill, California, is being submitted in response to a letter from the Alameda County Health Care Services Agency dated October 4, 2010.

Upon information and belief, I declare, under penalty of perjury, that the information contained in the attached report is true and correct.

If you have any questions or comments, please contact me at 510.547.8196.

Sincerely,



Jennifer C. Sedlachek
Project Manager

Attachment: Well Destruction Report

- c: w/ attachment:
Ms. Paula Floeck – Jiffy Lube International
Mr. Joseph D. Phillips – Jiffy Lube Remediation Coordinator
Mr. William Slautterback – Cal Lube Real Estate Limited Partnership
Mr. William Peterson – Owner of Castro Valley Lumber Company
- c: w/o attachment:
Mr. Bryan Campbell – ETIC Engineering, Inc.

8 February 2011

Ms. Jennifer C. Sedlachek
ExxonMobil Environmental Services Company
4096 Piedmont Avenue, #194
Oakland, California 94611

Subject: Well Destruction
Former Mobil Station 04334
2492 Castro Valley Boulevard, Castro Valley, California

Dear Ms. Sedlachek:

On behalf of ExxonMobil Environmental Services Company, ETIC Engineering Inc. (ETIC) observed the destruction of five existing wells at the above-referenced site. The destruction of the wells was approved by the Alameda County Health Care Services Agency (ACHCSA) in a letter dated 4 October 2010 (attached).

On 20 January 2011, a total of five existing wells (MW1 through MW5) were destroyed by Woodward Drilling of Rio Vista, California (C-57 license #710079). All wells were destroyed in accordance with the Alameda County Public Works Agency (ACPWA) Water Resources Well Permit.

Well MW1 was destroyed by tremie grouting the well casing with neat cement grout. Wells MW2 through MW5 were destroyed by pressure grouting the well casings with neat cement grout. The well casings were then removed to the original ground surface, and a cap of neat cement grout was placed at depths where the casings were removed. The surface was restored to match the surrounding surface conditions. Well destruction activities were observed and inspected by an inspector from the ACPWA.

Waste (construction debris) generated during the well destruction activities was contained in a 55-gallon drum and stored at the site. The waste was removed from the site on 28 January 2011 by Dillard Environmental Services and transported for disposal to Republic Landfill Services, Inc. in Livermore, California. Waste documentation is attached.

The former locations of the wells are shown on the attached site map (Figure 1). Well construction details for the destroyed wells are summarized in the attached well completion reports. Department of Water Resources Forms 188 are completed and attached to this letter. In addition to the Forms 188, a copy of the ACPWA well destruction permit is attached.

This concludes the work to be conducted on this project. Per the letter dated 4 October 2010 from the ACHCSA (attached), a final closure letter will be issued for the site after this well destruction report is submitted.

If you have any questions or comments, please contact Bryan Campbell at ext. 24.

Sincerely,



Yuko Mamiya
Project Geologist



Bryan Campbell, P.G. #7724
Senior Geologist

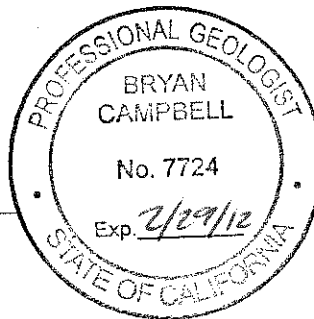

Figures

LEGEND	
	Former Thrifty Oil Station groundwater monitoring well
	Destroyed groundwater monitoring well
	Soil boring

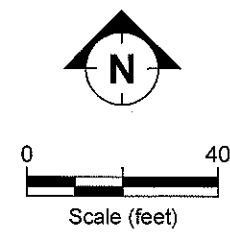
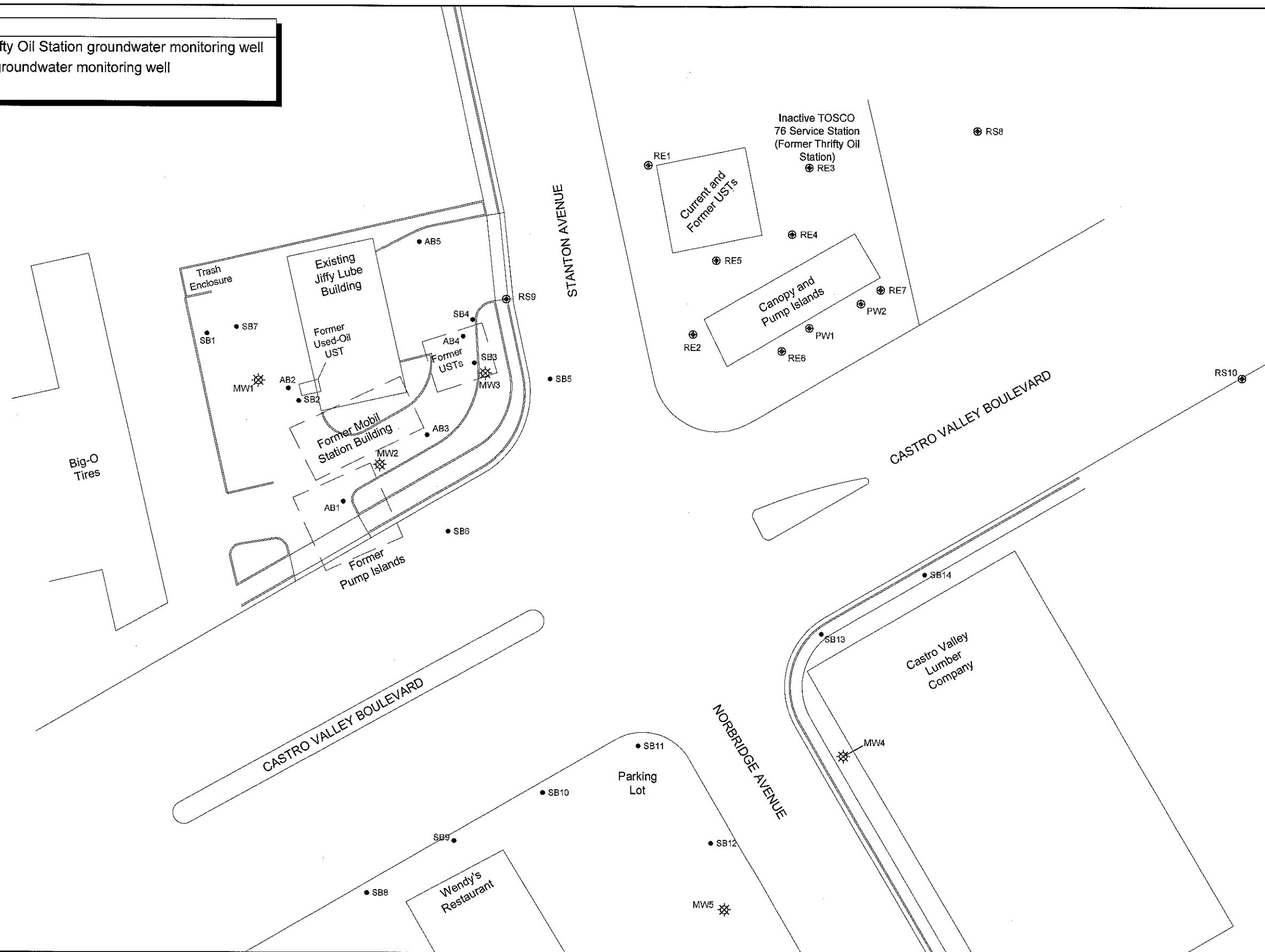

SITE MAP
 FORMER MOBIL STATION 04334
 2492 CASTRO VALLEY BOULEVARD
 CASTRO VALLEY, CALIFORNIA

FIGURE:
1

FILENAME: basemap0806.DWG 10/15/2007



Regulatory Correspondence

ALAMEDA COUNTY
HEALTH CARE SERVICES
AGENCY
ALEX BRISCOE, Agency Director



ENVIRONMENTAL HEALTH SERVICES
ENVIRONMENTAL PROTECTION
1131 Harbor Bay Parkway, Suite 250
Alameda, CA 94502-6577
(510) 567-6700
FAX (510) 337-9335

October 4, 2010

Ms. Jennifer Sedlachek (sent via e-mail: jennifer.c.sedlachek@exxonmobil.com)
Exxon Mobil Refining & Supply Company
4096 Piedmont Avenue #194
Oakland, CA 94611

Mr. William Slautterback
Cal Lube Real Estate Limited Partnership
PO Box 4369
Houston, TX 77210-4369

Subject: Monitoring Well Decommissioning for Case Closure of Fuel Leak Case No. RO0000386 and Geotracker Global ID T0600101278, Mobil #04-334/Jiffy Lube #606, 2492 Castro Valley Boulevard, Castro Valley, CA 94546

Dear Ms. Sedlachek and Mr. Slautterback

Alameda County Environmental Health (ACEH) and California Regional Water Quality Control Board staff have reviewed the fuel leak case file and case closure summary for the above-referenced site and concur that no further action related to the underground storage tank fuel release is required at this time. Prior to issuance of a remedial action completion certificate, all wells at the site must be properly destroyed, per California Water Code and all current record owners of fee title to the site must be notified by the primary or active responsible party of the proposed closure action.

ACEH requests that you address the following technical comments, perform the proposed work, and send us the technical reports requested below. Upon receipt of the requested documents a remedial action completion certificate will be sent to the responsible party.

TECHNICAL COMMENTS

1. **Well Destruction** – ACEH is requesting that you contact Alameda County Public Works Agency at (510) 567-6791, obtain the necessary permits, decommission the wells, and electronically upload the well destruction report to ACEH's ftp server and the State Water Resources Control Board's GeoTracker website within ninety (90) days from the date of this letter. Electronic reporting is described in detail below.
2. **Landowner Notification Form** – We have yet to receive the Landowner Notification Form requested by October 4, 2010. Pursuant to Section 25297.15 (a), Alameda County Environmental Health (ACEH), the local agency, shall not consider cleanup or site closure proposals from the primary or active responsible party, issue a closure letter, or make a

Ms. Sedlachek and Mr. Slautterback
RO0000386
October 4, 2010, Page 2

determination that no further action is required with respect to a site upon which there was an unauthorized release of hazardous substances from an underground storage tank subject to this chapter unless all current record owners of fee title to the site of the proposed action have been notified of the proposed action by the primary or active responsible party. ACEH is required to notify the primary or active responsible party of their requirement to certify in writing to the local agency that the notification requirement in the above-mentioned regulation has been satisfied and to provide the local agency with a complete mailing list of all record fee title owners.

Upon our receipt of the completed Landowner Notification Form and report of well decommissioning, (which includes confirmation of investigation derived waste disposal) this office will issue you the remedial action completion certificate.

NOTIFICATION OF FIELDWORK ACTIVITIES

Please schedule and perform the proposed work. Please provide ACEH with at least three (3) business days notification prior to conducting the fieldwork (e-mail preferred to barbara.jakub@acgov.org).

TECHNICAL REPORT REQUEST

Please submit technical reports to ACEH (Attention: Barbara Jakub), according to the following schedule:

- **December 5, 2010** – Well Decommissioning Report

Thank you for your cooperation. Should you have any questions or concerns regarding this correspondence or your case, please call me at (510) 639-1287 or send me an electronic mail message at barbara.jakub@acgov.org.

Sincerely,

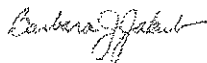

Digitally signed by Barbara J.
Jakub
DN: cn=Barbara J. Jakub, o, ou,
email=barbara.jakub@acgov.org,
c=US
Date: 2010.10.04 16:29:58 -07'00'

Barbara J. Jakub, P.G.
Hazardous Materials Specialist

Enclosures: Responsible Party(ies) Legal Requirements/Obligations
ACEH Electronic Report Upload (ftp) Instructions

cc: Bryan Campbell, ETIC Engineering, Inc., 2285 Morello Avenue, Pleasant Hill, CA 94523 (Sent via E-mail to: bcampbell@eticeng.com)
Donna Drogos, ACEH (Sent via E-mail to: donna.drogos@acgov.org)
Barbara Jakub, ACEH (Sent via E-mail to: barbara.jakub@acgov.org)
GeoTracker, file

Responsible Party(ies) Legal Requirements/Obligations

REPORT REQUESTS

These reports are being requested pursuant to California Health and Safety Code Section 25296.10. 23 CCR Sections 2652 through 2654, and 2721 through 2728 outline the responsibilities of a responsible party in response to an unauthorized release from a petroleum UST system, and require your compliance with this request.

ELECTRONIC SUBMITTAL OF REPORTS

ACEH's Environmental Cleanup Oversight Programs (LOP and SLIC) require submission of reports in electronic form. The electronic copy replaces paper copies and is expected to be used for all public information requests, regulatory review, and compliance/enforcement activities. Instructions for submission of electronic documents to the Alameda County Environmental Cleanup Oversight Program FTP site are provided on the attached "Electronic Report Upload Instructions." Submission of reports to the Alameda County FTP site is an addition to existing requirements for electronic submittal of information to the State Water Resources Control Board (SWRCB) GeoTracker website. In September 2004, the SWRCB adopted regulations that require electronic submittal of information for all groundwater cleanup programs. For several years, responsible parties for cleanup of leaks from underground storage tanks (USTs) have been required to submit groundwater analytical data, surveyed locations of monitoring wells, and other data to the GeoTracker database over the Internet. Beginning July 1, 2005, these same reporting requirements were added to Spills, Leaks, Investigations, and Cleanup (SLIC) sites. Beginning July 1, 2005, electronic submittal of a complete copy of all reports for all sites is required in GeoTracker (in PDF format). Please visit the SWRCB website for more information on these requirements (http://www.swrcb.ca.gov/ust/electronic_submittal/report_rqmts.shtml).

PERJURY STATEMENT

All work plans, technical reports, or technical documents submitted to ACEH must be accompanied by a cover letter from the responsible party that states, at a minimum, the following: "I declare, under penalty of perjury, that the information and/or recommendations contained in the attached document or report is true and correct to the best of my knowledge." This letter must be signed by an officer or legally authorized representative of your company. Please include a cover letter satisfying these requirements with all future reports and technical documents submitted for this fuel leak case.

PROFESSIONAL CERTIFICATION & CONCLUSIONS/RECOMMENDATIONS

The California Business and Professions Code (Sections 6735, 6835, and 7835.1) requires that work plans and technical or implementation reports containing geologic or engineering evaluations and/or judgments be performed under the direction of an appropriately registered or certified professional. For your submittal to be considered a valid technical report, you are to present site specific data, data interpretations, and recommendations prepared by an appropriately licensed professional and include the professional registration stamp, signature, and statement of professional certification. Please ensure all that all technical reports submitted for this fuel leak case meet this requirement.

UNDERGROUND STORAGE TANK CLEANUP FUND

Please note that delays in investigation, later reports, or enforcement actions may result in your becoming ineligible to receive grant money from the state's Underground Storage Tank Cleanup Fund (Senate Bill 2004) to reimburse you for the cost of cleanup.

AGENCY OVERSIGHT

If it appears as though significant delays are occurring or reports are not submitted as requested, we will consider referring your case to the Regional Board or other appropriate agency, including the County District Attorney, for possible enforcement actions. California Health and Safety Code, Section 25299.76 authorizes enforcement including administrative action or monetary penalties of up to \$10,000 per day for each day of violation.

Alameda County Environmental Cleanup Oversight Programs (LOP and SLIC)	REVISION DATE: July 20, 2010
	ISSUE DATE: July 5, 2005
	PREVIOUS REVISIONS: December 16, 2005; October 31, 2005; March 27, 2009; July 8, 2010
SECTION: Miscellaneous Administrative Topics & Procedures	SUBJECT: Electronic Report Upload (ftp) Instructions

The Alameda County Environmental Cleanup Oversight Programs (LOP and SLIC) require submission of all reports in electronic form to the county's ftp site. Paper copies of reports will no longer be accepted. The electronic copy replaces the paper copy and will be used for all public information requests, regulatory review, and compliance/enforcement activities.

REQUIREMENTS

- **Please do not submit reports as attachments to electronic mail.**
- Entire report including cover letter must be submitted to the ftp site as a **single portable document format (PDF) with no password protection.**
- It is **preferable** that reports be converted to PDF format from their original format, (e.g., Microsoft Word) rather than scanned.
- **Signature pages and perjury statements must be included and have either original or electronic signature.**
- **Do not password protect the document.** Once indexed and inserted into the correct electronic case file, the document will be secured in compliance with the County's current security standards and a password. **Documents with password protection will not be accepted.**
- Each page in the PDF document should be rotated in the direction that will make it easiest to read on a computer monitor.
- Reports must be named and saved using the following naming convention:

RO#_Report Name_Year-Month-Date (e.g., RO#5555_WorkPlan_2005-06-14)

Submission Instructions

- 1) Obtain User Name and Password
 - a) Contact the Alameda County Environmental Health Department to obtain a User Name and Password to upload files to the ftp site.
 - i) Send an e-mail to dehloptoxic@acgov.org
 - b) In the subject line of your request, be sure to include **"ftp PASSWORD REQUEST"** and in the body of your request, include the **Contact Information, Site Addresses, and the Case Numbers (RO# available in Geotracker) you will be posting for.**
- 2) Upload Files to the ftp Site
 - a) Using Internet Explorer (IE4+), go to <ftp://alcoftp1.acgov.org>
 - (i) Note: Netscape, Safari, and Firefox browsers will not open the FTP site as they are NOT being supported at this time.
 - b) Click on Page located on the Command bar on upper right side of window, and then scroll down to Open FTP Site in Windows Explorer.
 - c) Enter your User Name and Password. (Note: Both are Case Sensitive.)
 - d) Open "My Computer" on your computer and navigate to the file(s) you wish to upload to the ftp site.
 - e) With both "My Computer" and the ftp site open in separate windows, drag and drop the file(s) from "My Computer" to the ftp window.
- 3) Send E-mail Notifications to the Environmental Cleanup Oversight Programs
 - a) Send email to dehloptoxic@acgov.org notify us that you have placed a report on our ftp site.
 - b) Copy your Caseworker on the e-mail. Your Caseworker's e-mail address is the entire first name then a period and entire last name [@acgov.org](mailto:firstname.lastname@acgov.org). (e.g., firstname.lastname@acgov.org)

- c) The subject line of the e-mail must start with the RO# followed by **Report Upload**. (e.g., Subject: RO1234 Report Upload) If site is a new case without an RO#, use the street address instead.
- d) If your document meets the above requirements and you follow the submission instructions, you will receive a notification by email indicating that your document was successfully uploaded to the ftp site.

**Well Completion Reports
(DWR 188 Forms)**

CONFIDENTIAL

STATE OF CALIFORNIA DWR
WELL COMPLETION REPORT
(WELL LOGS)

REMOVED

- LEGEND**
- ⊙ Former Thrifty Oil Station groundwater monitoring well
 - ⊗ Destroyed groundwater monitoring well
 - Soil boring

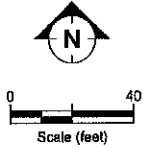
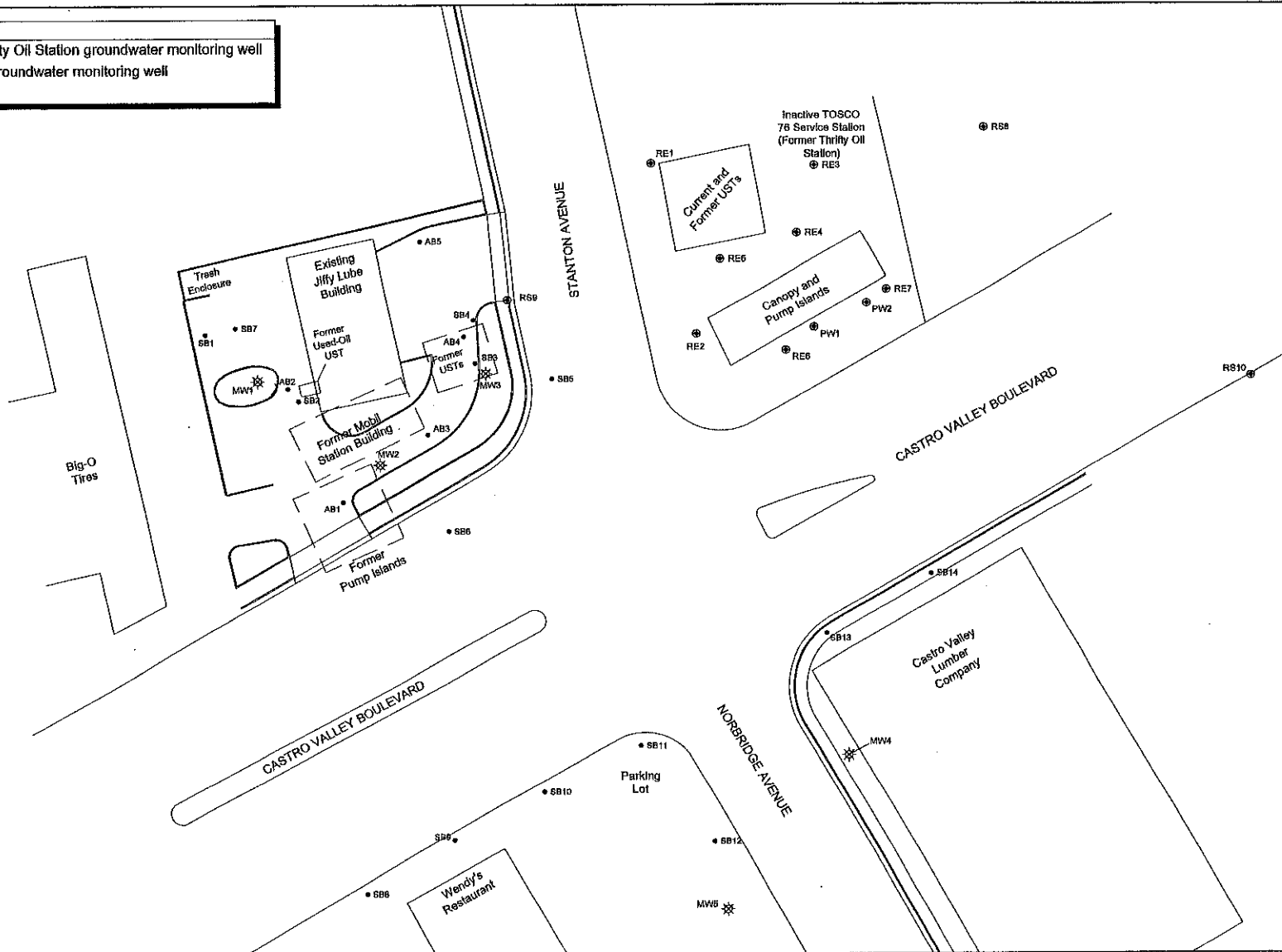

SITE MAP
 FORMER MOBIL STATION 04334
 2492 CASTRO VALLEY BOULEVARD
 CASTRO VALLEY, CALIFORNIA

FIGURE:
1

REVISION: 10/15/2007



CONFIDENTIAL

STATE OF CALIFORNIA DWR
WELL COMPLETION REPORT
(WELL LOGS)

REMOVED

LEGEND	
⊕	Former Thrifty Oil Station groundwater monitoring well
⊗	Destroyed groundwater monitoring well
•	Soil boring

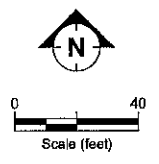
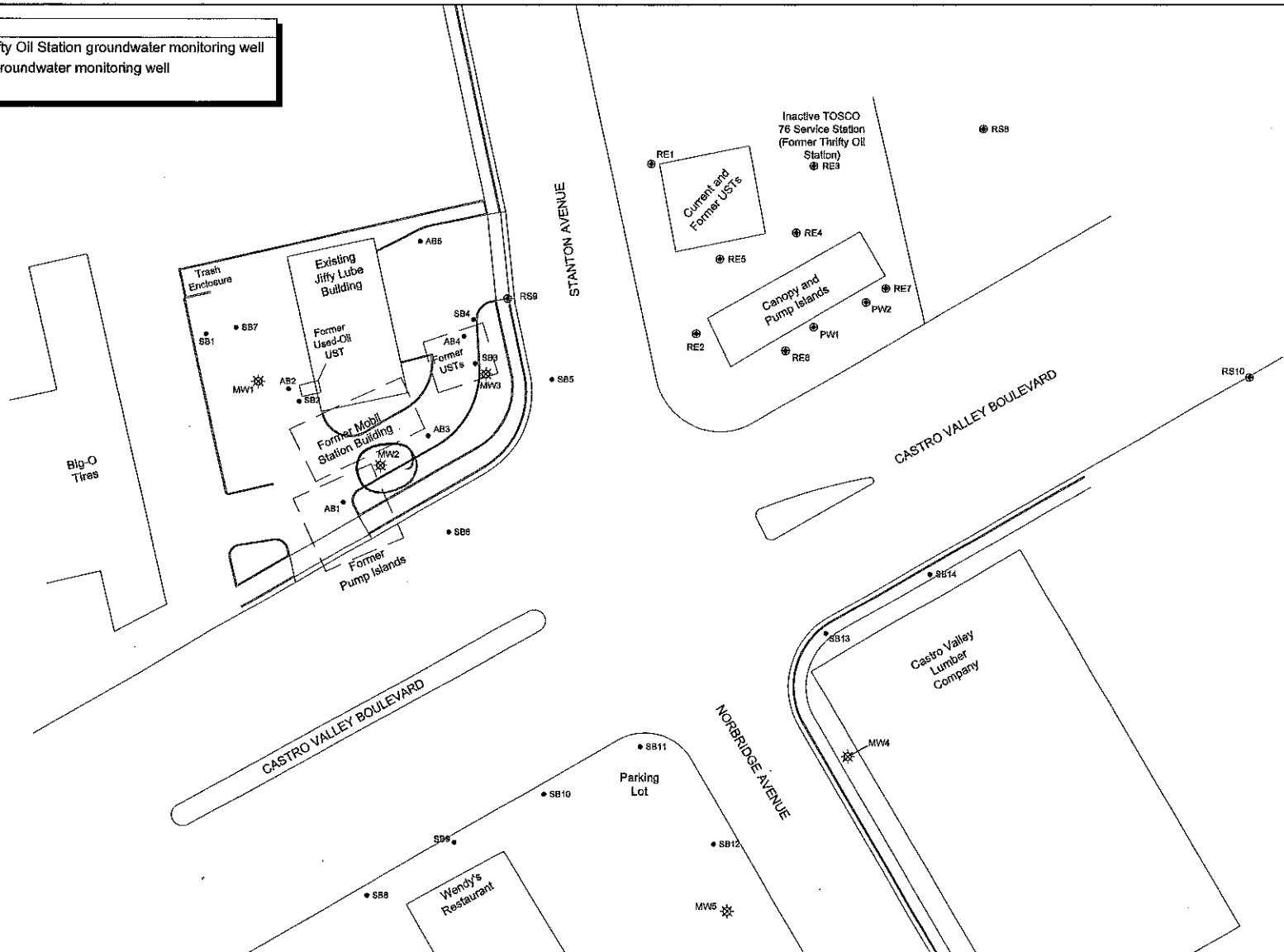

SITE MAP
 FORMER MOBIL STATION 04334
 2492 CASTRO VALLEY BOULEVARD
 CASTRO VALLEY, CALIFORNIA

FIGURE:
1

FILENAME: basemap04334.dwg 10/15/2007





CLIENT ExxonMobil	SITE NUMBER 04-334	LOCATION 2492 Castro Valley Blvd, Castro Valley, CA
----------------------	-----------------------	-----------------------------------------------------------

LOG OF SOIL BORING: **MW2**

DRILLING AND SAMPLING METHODS Vacuum cleared to 5 feet bgs. Drilled with CME 75 limited access drill rig with 8.25" O.D. hollow stem augers. Sampled with a 18" California Modified Split Spoon Sampler.

COORDINATES:
ELEVATION TOP OF CASING:
CASING BELOW SURFACE:

WATER LEVEL	▽ 16.5	▽ 11.75		
TIME	0820	1030	START TIME	FINISH TIME
DATE	6/25/4	6/25/4	1445	0905
REFERENCE	GS	GS	DATE	DATE
			6/23/04	6/25/04

DRILLING COMPANY: Cascade Drilling, Inc.
LICENSE NUMBER: C57-717510

INCHES				DEPTH (feet)	AIR SAMPLE	WATER SAMPLE	SOIL SAMPLE RECOVERED	GRAPHIC LOG	SURFACE CONDITIONS	
DRIVEN	RECOVER	BLOWS / 6" SAMPLER	OVA READING						DESCRIPTION BY:	DETAILS
				0				Asphalt	Tracy Job	Asphalt
				1				Soil fill with asphalt fragments		Water-tight traffic box
				2				SILTY CLAY, black (2.5/N), firm, medium plasticity, minor fine sand, dry.		Neat cement grout from 0.5 to 4.0 feet
				3				Change to dark greenish gray (5GY 4/1) and soft.		2 in. I.D. Schedule 40 PVC Riser Casing from 0.5 to 5.0 ft.
				4				CL		Bentonite chips from 3.5 to 4.5 feet
				5				Change to dry.		# 2/12 Sand Filter Pack from 4.5 to 20 ft.
			0.7	6				ML		
				7				CLAYEY SILT, light olive brown (10YR 4/2), firm, medium plasticity, minor strongly cemented silt and fine to medium sand, dry.		
24	18			8				ML		
				9				SILTY CLAY, brownish yellow (10YR 7/8), hard, medium plasticity, minor fine sand, frequent small caliche nodules, dry.		
				10				CLAYEY SILT, light olive brown (2.5Y 5/6), soft, low plasticity, minor strongly cemented silt and fine to medium sand, dry.		
18	18	18		11				ML		
				12				CL		
				13				SILTY CLAY, light olive brown (2.5Y 5/4), soft, medium plasticity, minor fine to medium sand, dry.		
18	12	36		14				ML		
				15				SILT, light olive brown (2.5Y 5/6), firm, low plasticity, some strongly cemented silt and fine to medium sand, dry.		
				16				CL		
18	6	42		17				SILT, light olive brown (2.5Y 5/6), firm, low plasticity, some strongly cemented silt and fine to medium sand, dry.		
				18				ML		
				19				Change to soft and wet.		
24	18	23		20				Change to hard and dry.		
								Boring terminated at 20 feet bgs.		

LOG OF SOIL BORING 334_2004.GPJ ETIC.GDT 10/5/04

CONFIDENTIAL

STATE OF CALIFORNIA DWR
WELL COMPLETION REPORT
(WELL LOGS)

REMOVED

LEGEND

- ⊕ Former Thrifty Oil Station groundwater monitoring well
- ⊗ Destroyed groundwater monitoring well
- Soil boring

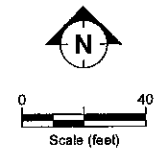
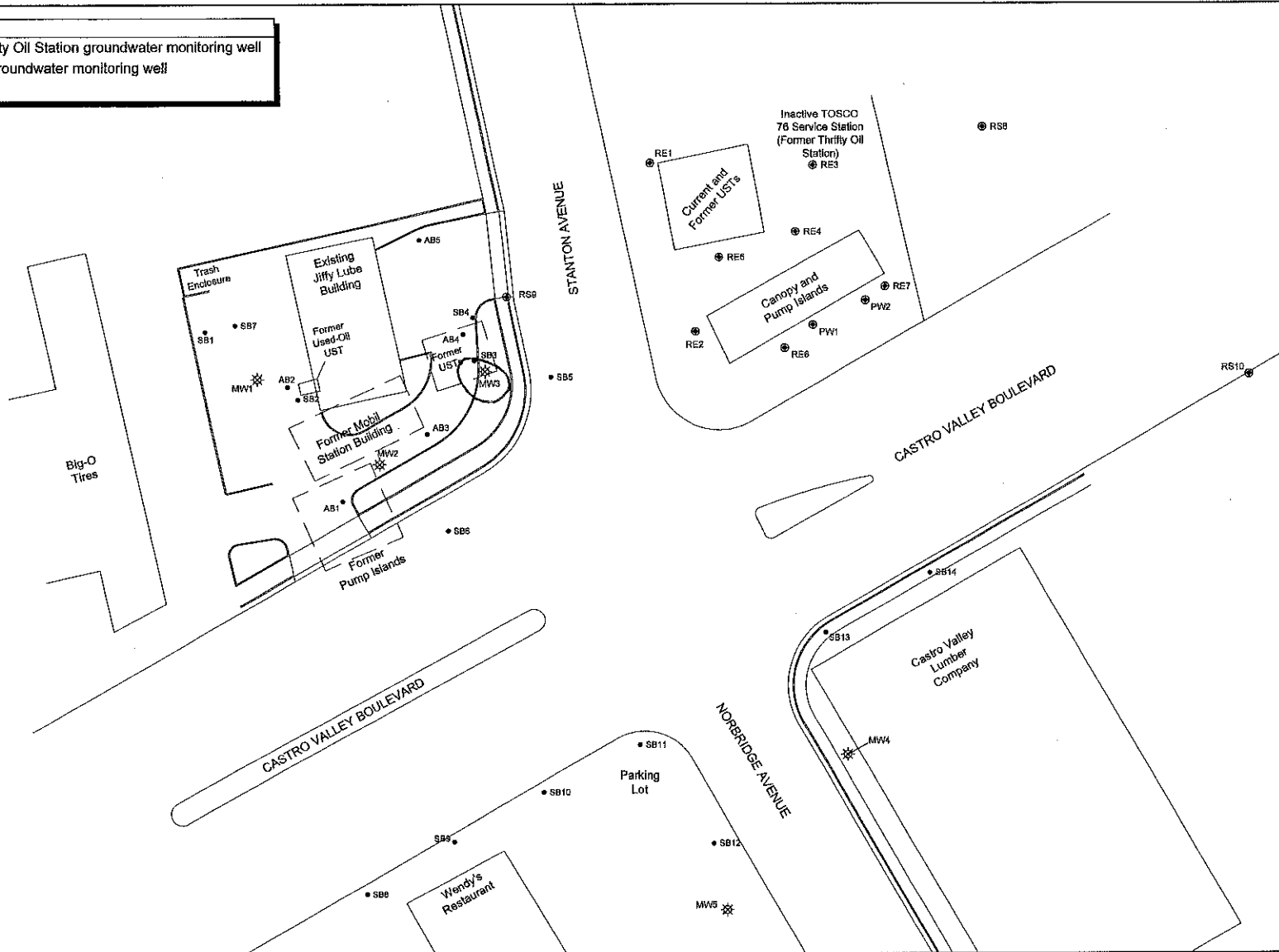

SITE MAP
FORMER MOBIL STATION 04334
2492 CASTRO VALLEY BOULEVARD
CASTRO VALLEY, CALIFORNIA

FIGURE:
1

FILENAME: bennet04334.dwg 10/15/2007



CONFIDENTIAL

STATE OF CALIFORNIA DWR
WELL COMPLETION REPORT
(WELL LOGS)

REMOVED

LEGEND

- ⊕ Former Thrifty Oil Station groundwater monitoring well
- ☒ Destroyed groundwater monitoring well
- Soil boring

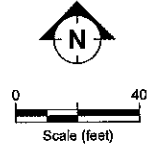
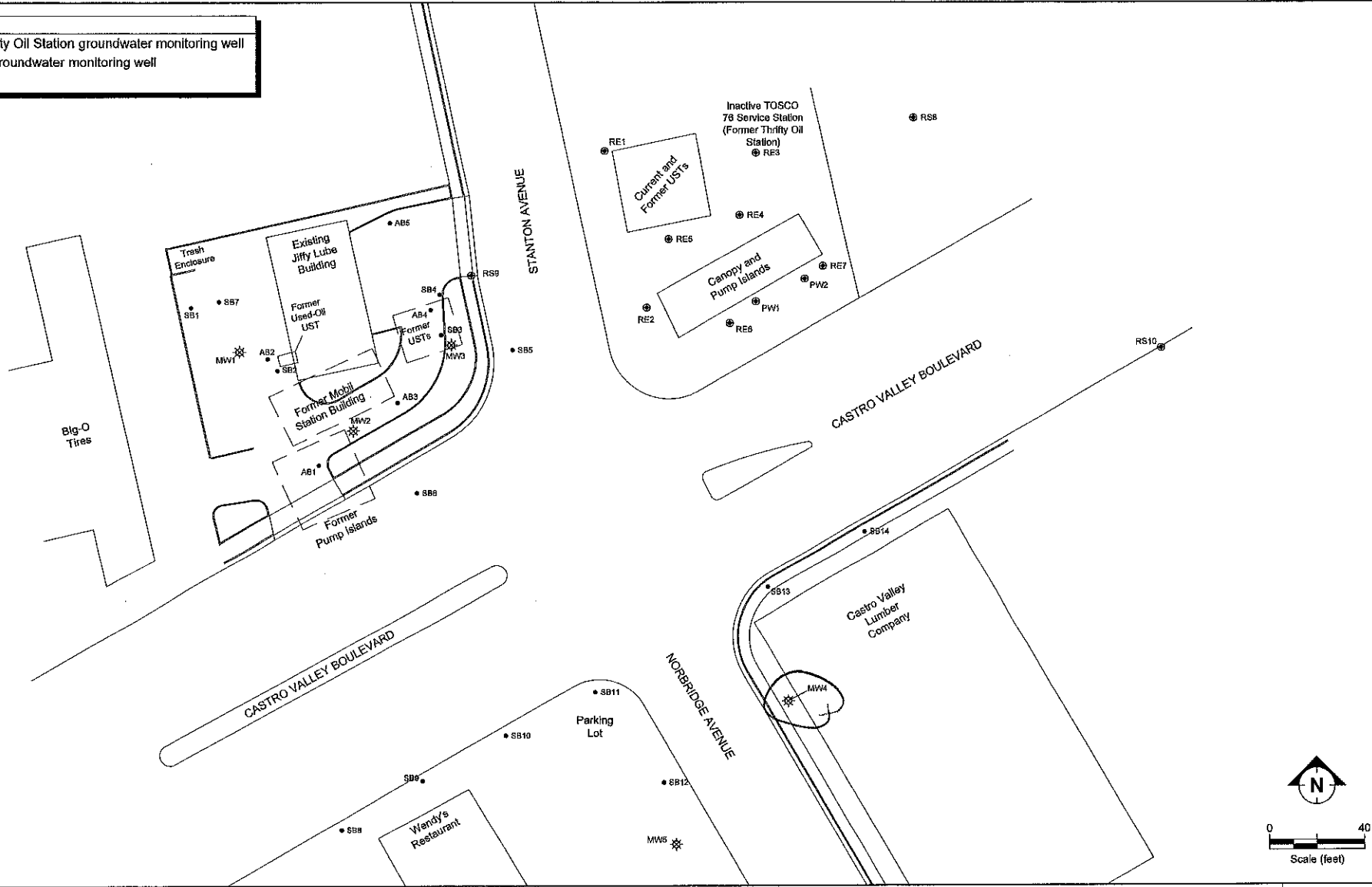

SITE MAP
 FORMER MOBIL STATION 04334
 2492 CASTRO VALLEY BOULEVARD
 CASTRO VALLEY, CALIFORNIA

FIGURE:
1

FILENAME: barmap0306.dwg 10/15/2007





CLIENT ExxonMobil	SITE NUMBER 04-334	LOCATION 2492 Castro Valley Blvd, Castro Valley, CA
----------------------	-----------------------	-----------------------------------------------------------

LOG OF SOIL BORING: **MW4**

DRILLING AND SAMPLING METHODS Vacuum cleared to 8 feet bgs. Drilled with CME 75 limited access drill rig with 8.25" O.D. hollow stem augers. Sampled with a 18" California Modified Split Spoon Sampler.

COORDINATES:
ELEVATION TOP OF CASING:
CASING BELOW SURFACE:

WATER LEVEL	▽ 7.2	▽ 6.5		
TIME	1151	1046	START TIME	FINISH TIME
DATE	6/23/4	6/24/4	1151	1046
REFERENCE	GS	GS	DATE	DATE
			6/23/04	6/24/04

DRILLING COMPANY: Cascade Drilling, Inc.
LICENSE NUMBER: C57-717510

INCHES				DEPTH (feet)	SURFACE CONDITIONS	GRAPHIC LOG	DESCRIPTION BY: Tracy Job	DETAILS
DRIVEN	RECOVER	BLOWS / 6" SAMPLER	OVA READING					
				0		OL	Top soil.	
				1		GP	Base rock with angular gravels from 0.75" to 1.5" diameter.	
				2			SILTY CLAY, very dark brown (10YR 2/2), soft, medium plasticity, moist.	
				3				
				4			SILTY CLAY, olive gray (5Y 4/2), firm, medium plasticity, minor fine to medium poorly sorted sand, moist.	
				5		CL	Color change to light olive brown (2.5Y 5/3).	
				6			SANDY CLAY, olive brown (2.5Y 4/4), firm, medium plasticity, minor strongly cemented silt, some coarse poorly sorted sand, moist.	
				7			Change to olive yellow (2.5Y 6/6) and soft.	
				8			SILT, gray (5Y 5/1), fractured strongly cemented silt, some medium poorly sorted sand, wet.	
				9				
				10		ML		
18	0	9		11				
		9						
		10						
		50/6"	0.1	12			SANDY SILT, olive brown (2.5Y 4/4), firm, low plasticity, some siltstone, some fine sand, dry.	
6	6							
		50/4"	0.1	13		ML		
6	6							
		50/6"	0.5	14				
6	6			15			Boring terminated 15 feet bgs.	
				16				
				17				
				18				
				19				
				20				

LOG OF SOIL BORING 334_2004.GPJ ETIC.GDT 10/5/04

CONFIDENTIAL

STATE OF CALIFORNIA DWR
WELL COMPLETION REPORT
(WELL LOGS)

REMOVED

LEGEND

- ⊙ Former Thrifty Oil Station groundwater monitoring well
- ⊗ Destroyed groundwater monitoring well
- Soil boring

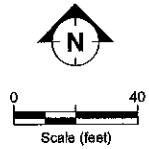
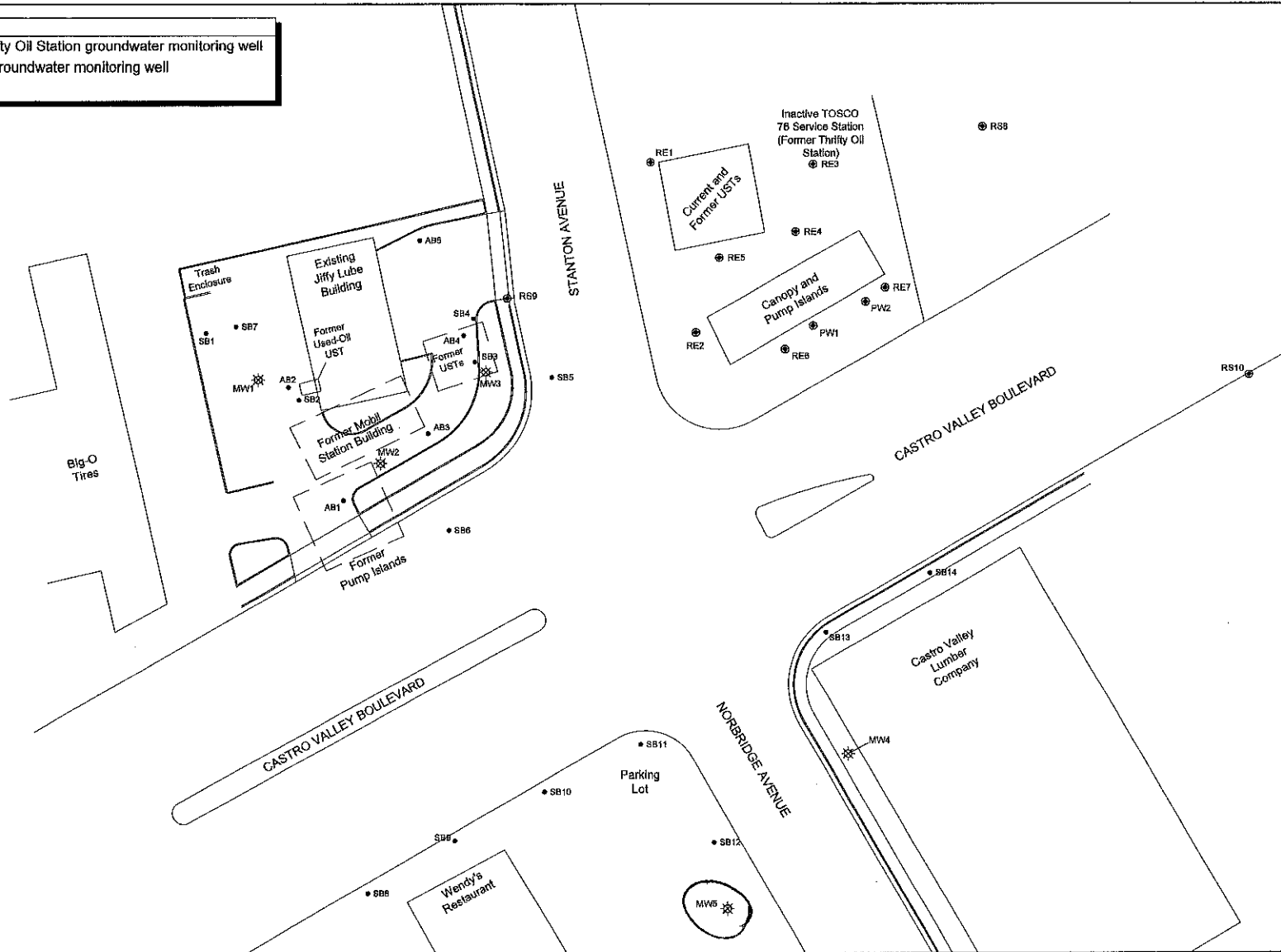

SITE MAP
FORMER MOBIL STATION 04334
2492 CASTRO VALLEY BOULEVARD
CASTRO VALLEY, CALIFORNIA

FILENAME: boramap04334.dwg 10/15/2007





CLIENT ExxonMobil	SITE NUMBER 04334	LOCATION 2492 Castro Valley Blvd Castro Valley, CA
----------------------	----------------------	----------------------------------------------------------

LOG OF SOIL BORING: **MW5**

DRILLING AND SAMPLING METHODS: Vacuum cleared to 8 feet bgs. Hand sampled at 5 and 7.5 feet bgs. Drilled using a hollow stem auger rig with 8-inch augers. Sampled with a split spoon sampler.

COORDINATES: N2077744.5 :E6100668.6
ELEVATION TOP OF CASING: 173.80
CASING BELOW SURFACE: 0.44

WATER LEVEL	▽ 15.2	▽ 14.36		
TIME	0726	0840	START TIME 0630	FINISH TIME 0915
DATE	1/30/09	1/30/09	DATE 1/29/09	DATE 1/30/09
REFERENCE	GS	TOC		

DRILLING COMPANY: Woodward Drilling
LICENSE NUMBER: C57-710079

INCHES				DEPTH (feet)	AIR SAMPLE	WATER SAMPLE	SOIL SAMPLE RECOVERED	GRAPHIC LOG	SURFACE CONDITIONS	
DRIVEN	RECOVER	BLOWS/6" SAMPLER	OVA READING						Asphalt	
				0				AC/AB	ASPHALT - from 0 to 0.33 feet below ground surface.	
				1				GC	AGGREGATE BASE - from 0.33 to 1 foot below ground surface.	
				2				CL	CLAY AND GRAVEL - mixture of gravels up to 1-inch in diameter, native clay and aggregate base. CLAY WITH SILT - black (10YR 2/1), medium stiff, low plasticity, moist.	
				3				CL	- pervasive caliche.	
				4				CL		
		6		5				CL	SILTY CLAY - dark greenish gray (GLE Y 4/10GY), stiff, low plasticity, pervasive caliche, moist.	
				6				CL	- increasing sand content, becoming very moist.	
		6		7				ML	SANDY SILT WITH CLAY - dark greenish gray (GLE Y 4/10GY), stiff, low plasticity, fine to medium grained sand, wet.	
				8				ML		
				9				ML		
12	10	11 50/5"		10				ML	SANDY SILT WITH GRAVEL - dark yellowish brown (10YR 3/6), stiff, low plasticity, fine to coarse grained sand, gravels up to 0.5 inches in diameter, slightly moist.	
			0.5	11				ML		
				12				ML		
18		17 20 26		13				ML	CLAYSTONE - olive brown (2.5Y 4/4), highly weathered, friable, low plasticity.	
	14		0.6	14				MUDSTONE		
				15					Boring terminated at 15 feet bgs.	
12	12	28 50/5"	0.6	16						

LOG OF SOIL BORING 04-334 BORING LOGS.GPJ ETIC.GDT 3/26/09

Well Destruction Permits

Alameda County Public Works Agency - Water Resources Well Permit



399 Elmhurst Street
Hayward, CA 94544-1395
Telephone: (510)670-6633 Fax:(510)782-1939

Application Approved on: 12/08/2010 By jamesy

Permit Numbers: W2010-0992 to W2010-0996
Permits Valid from 01/20/2011 to 01/21/2011

Application Id: 1291079516809
Site Location: Former Mobil Station 04334,
2492 Castro Valley Boulevard, Castro Valley, CA
Project Start Date: 12/20/2010
Assigned Inspector: Contact Steve Miller at (510) 670-5517 or stevem@acpwa.org
Extension Start Date: 01/20/2011
Extension Count: 1

City of Project Site:Castro Valley

Completion Date:12/21/2010

Extension End Date: 01/21/2011
Extended By: priest

Applicant: ETIC Engineering, Inc. - Bryan Campbell
2285 Morello Avenue, Pleasant Hill, CA 94523
Property Owner: Calube Real Estate
P.O. Box 4369, Houston, TX 77210
Client: ExxonMobil Environmental Services Company
4096 Piedmont Avenue, #194, Oakland, CA 94611
Contact: Erik Appel

Phone: 925-602-4710 x24

Phone: --

Phone: 510-547-8196

Phone: 925-602-4710 x21
Cell: 925-642-2545

	Total Due:	\$1985.00
Receipt Number: WR2010-0420	Total Amount Paid:	\$1985.00
Payer Name : ETIC Engineering, Inc.	Paid By: CHECK	PAID IN FULL

Works Requesting Permits:

Well Destruction-Monitoring - 5 Wells
Driller: Woodard Drilling - Lic #: 710079 - Method: press

Work Total: \$1985.00

Specifications

Permit #	Issued Date	Expire Date	Owner Well Id	Hole Diam.	Casing Diam.	Seal Depth	Max. Depth	State Well #	Orig. Permit #	DWR #
W2010-0992	12/08/2010	03/20/2011	MW1	8.25 in.	2.00 in.	4.50 ft	20.00 ft	3S/2W9	W04-0454	e0015025
W2010-0993	12/08/2010	03/20/2011	MW2	8.25 in.	2.00 in.	4.50 ft	20.00 ft	3S/2W9	W04-0455	e0015149
W2010-0994	12/08/2010	03/20/2011	MW3	8.25 in.	2.00 in.	4.50 ft	20.00 ft	3S/2W9	W04-0456	e0015149
W2010-0995	12/08/2010	03/20/2011	MW4	8.25 in.	2.00 in.	3.50 ft	15.00 ft	3S/2W9	W04-0457	e0015149
W2010-0996	12/08/2010	03/20/2011	MW5	8.25 in.	2.00 in.	4.00 ft	15.00 ft	3S/2W9	W2009-0037	e0087394

Specific Work Permit Conditions

1. Drilling Permit(s) can be voided/ cancelled only in writing. It is the applicant's responsibility to notify Alameda County Public Works Agency, Water Resources Section in writing for an extension or to cancel the drilling permit application. No drilling permit application(s) shall be extended beyond ninety (90) days from the original start date. Applicants may not cancel a drilling permit application after the completion date of the permit issued has passed.

2. Prior to any drilling activities, it shall be the applicant's responsibility to contact and coordinate an Underground Service Alert (USA), obtain encroachment permit(s), excavation permit(s) or any other permits or agreements required for that Federal, State, County or City, and follow all City or County Ordinances. No work shall begin until all the permits and requirements have been approved or obtained. It shall also be the applicants responsibilities to provide to the Cities or to Alameda County an Traffic Safety Plan for any lane closures or detours planned. No work shall begin until all the permits and requirements have been approved or obtained.

Alameda County Public Works Agency - Water Resources Well Permit

3. Compliance with the well-sealing specifications shall not exempt the well-sealing contractor from complying with appropriate State reporting-requirements related to well construction or destruction (Sections 13750 through 13755 (Division 7, Chapter 10, Article 3) of the California Water Code). Contractor must complete State DWR Form 188 and mail original to the Alameda County Public Works Agency, Water Resources Section, within 60 days. Including permit number and site map.
 4. Applicant shall submit the copies of the approved encroachment permit to this office within 60 days.
 5. Permittee shall assume entire responsibility for all activities and uses under this permit and shall indemnify, defend and save the Alameda County Public Works Agency, its officers, agents, and employees free and harmless from any and all expense, cost and liability in connection with or resulting from the exercise of this Permit including, but not limited to, property damage, personal injury and wrongful death.
 6. Applicant shall contact assigned inspector listed on the top of the permit at least five (5) working days prior to starting, once the permit has been approved. Confirm the scheduled date(s) at least 24 hours prior to drilling.
 7. Permittee, permittee's contractors, consultants or agents shall be responsible to assure that all material or waters generated during drilling, boring destruction, and/or other activities associated with this Permit will be safely handled, properly managed, and disposed of according to all applicable federal, state, and local statutes regulating such. In no case shall these materials and/or waters be allowed to enter, or potentially enter, on or off-site storm sewers, dry wells, or waterways or be allowed to move off the property where work is being completed.
 8. Remove the Christy box or similar structure.

Destroy well by grouting neat cement with a tremie pipe or pressure grouting (25 psi for 5min.) to the bottom of the well and by filling with neat cement to three (3-5) feet below surface grade. Allow the sealing material to spill over the top of the casing to fill any annular space between casing and soil.

After the seal has set, backfill the remaining hole with concrete or compacted material to match existing conditions.
 9. Copy of approved drilling permit must be on site at all times. Failure to present or show proof of the approved permit application on site shall result in a fine of \$500.00.
-

Waste Documentation

NON-HAZARDOUS WASTE MANIFEST

1. Generator's Name: **ExxonMobil Oil Corp** 2. Page 1 of 1 3. Emergency Response Phone: **800-575-1065** 4. Waste Tracking Number: **911025-012611**

5. Generator's Name and Mailing Address: **ExxonMobil Oil Corp (04354) 2555 W 120th Street, #105 Dept. 5M629 Torrance, CA 90505 USA** Generator's Site Address (if different than mailing address): **04354, 2482 Castro Valley Boulevard Castro Valley, CA USA**

Generator's Phone: **800-575-1065** U.S. EPA ID Number: **CA01982525433**

6. Transporter 1 Company Name: **DILLARD ENVIRONMENTAL SERVICES** U.S. EPA ID Number:

7. Transporter 2 Company Name: U.S. EPA ID Number:

8. Designated Facility Name and Address: **(MUNICIPAL ROAD LANDFILL) 4001 N VAUGHN ROAD LIVERMORE, CA 94550 UNL 925-447-0491** U.S. EPA ID Number:

9. Waste Shipping Name and Description	10. Containers		11. Total Quantity	12. Unit Wt./Vol
	No.	Type		
1. NON-HAZARDOUS SOLIDS (EXHAUSTION RESIDUE)	1	DRM	225	15
2.				
3.				
4.				

13. Special Handling Instructions and Associated Information: **USE RESTRICTIONS**

14. GENERATOR'S/OFFEROR'S CERTIFICATION: I hereby declare that the contents of this consignment are fully and accurately described above by the proper shipping name, and are classified, packaged, marked and labeled/placarded, and are in proper condition for transport according to applicable international and national governmental regulations.
 Generator's/Offeror's Printed/Typed Name: **Bryan Campbell** Signature: *[Signature]* Month Day Year: **01/28/11**

15. International Shipments: Import from U.S. Export from U.S. Port of entry/exit: Date leaving U.S.:

16. Transporter Acknowledgment of Receipt of Materials
 Transporter Signature (for exports only): Date leaving U.S.:
 Transporter 1 Printed/Typed Name: **David Burke** Signature: *[Signature]* Month Day Year: **01/28/11**
 Transporter 2 Printed/Typed Name: Signature: Month Day Year:

17. Discrepancy
 17a. Discrepancy indication Space: Type Residue Partial Rejection Full Rejection

17b. Alternate Facility (or Generator): Manifest Reference Number: U.S. EPA ID Number:

Facility's Phone: 17c. Signature of Alternate Facility (or Generator): Month Day Year:

18. Designated Facility Owner or Operator: Description of receipt of materials covered by the manifest except as noted in item 17a: Signature: Month Day Year:

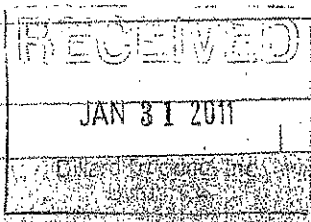

[Signature]
 DESIGNATED FACILITY TO GENERATOR

OK CID DR 1/28/11