

ACC - SITE SAFETY PLAN

A. GENERAL INFORMATION

Project Title: Peralta Community College - Maintenance Yard
Project No.: 6045-14
Project Manager: Misty Kaltreider
Location: 501 5th Avenue
Prepared by/date: Misty Kaltreider/ 5/31/95

Approved by/date: _____

Scope of Work/Objective(s): Tank removal onsite

Proposed Date of Field Activities: June 2, 1995

Documentation/Summary:

Overall Chemical Hazard: Serious [] Moderate [X]
Low [] Unknown []

Overall Physical Hazard: Serious [] Moderate [X]
Low [] Unknown []

B. SITE/WASTE CHARACTERISTICS

Waste Type(s):
Liquid [X] Solid [X] Sludge [] Gas/Vapor [X]

Characteristics:
Flammable/Ignitable [X] Volatile [X] Corrosive [] Acutely Toxic []
Explosive [] Reactive [] Carcinogen [X] Radioactive []

Other: _____

Physical Hazards:
Overhead [] Confined Space [] Below Grade [] Trip/Fall [X]
Puncture [] Burn [] Cut [] Splash [X]
Noise [X]

Other: _____

Site History/Description and Unusual Features:
UST discovered during excavation; back end of tank damaged

Locations of Chemicals/Waste: **In soil and water**

Estimated Volume of Chemicals/Waste: **Unknown**

Site Currently in Operation: Yes No

C. HAZARD EVALUATION

List and Evaluate Hazards By Task (ie. sampling/drilling)

Task	Physical Hazard	Level of Protection
1	Tank Removal	D
2	Sampling	D
3	Groundwater Collection	D

Chemical Hazard Evaluation:

Compound	PEL/TWA	Route of Exposure	Acute Symptoms	Odor Threshold/Desc.
Benzene	300 ppm	inhalation, dermal, ingestion	Skin Blisters, Nausea, Central Nervous System Disorder	Characteristic Odor

D. SITE SAFETY AND WORK PLAN

Site Control: Attach map of the site.

Perimeter identified? Site secured? Work areas identified?
Zone(s) of contamination identified?

Air Monitoring:

Contaminant of Interest: **Diesel/BTEX**

Type of Monitoring: **Air**

Frequency: **Continuous - As needed**

Equipment: **HNu**

Decontamination procedures and solutions:

Tri-sodium phosphate and water, triple rinsed

Special Site Equipment: (Sanitary facilities, lighting, etc)
None anticipated

Site Entry Procedures and Special Considerations
Underground Services Alert (USA) notified to avoid underground utilities

Work Limitations (time of day, weather conditions, etc.)
None.

General Spill Control, if applicable: **N/A**

Investigation-Derived Material Disposal (expendables, cuttings, etc.)
No cuttings will be generated during drilling and sampling process.

Sample Handling Procedures:

**Soil samples collected in steel tubes, teflon tape and plastic end caps taped to each end.
Water samples collected in one-liter jars and 40 ml VOA vials, without headspace. All samples will be placed in ice-filled coolers until pick-up by laboratory.**

E. EMERGENCY INFORMATION

Ambulance 911

Hospital Emergency Room (510) 534-0855

Directions to Hospital (attach map), Highland General Hospital, Oakland, CA

Poison Control Center 911

Police 911

Fire Department 911

Laboratory Sparger Technology (916) 362-8947

UPS/Fed. Express N/A

Client Contact Mr. Robert Mibach (510) 466-7200

SITE RESOURCES

Water Supply Source On-site

Telephone On-site

Cellular Phone, if available ---

Other ---

EQUIPMENT CHECKLIST

Protective Gear	Quantity	Equipment	Quantity	Equipment	Quantity
Respirator	1	PID (HNu)	1	Baggies	1 box
Organic Cartridges	2	Liter bottles	10	Chain of Custody Forms	1 set
Tyvek	1	VOA Vials	20	Labels	1 set
Gloves, Nitrile	1 pair	Surveyors Tape	1	Paper Towels	1 roll
Steel Toed Boots	1 pair	Rope	100 feet	Trash Bags	1
First Aid Kit	1	Camera/Film	1	Buckets	3
Safety Glasses	1 pair	Bailers	5	Brushes	2
Portable eye wash	1	Cooler	1	TSP	1 box
Ear Plugs	1 pair	Teflon Tape	1 roll	Boring Logs	1 set

SITE SAFETY REVIEW

General Information

Date _____ 1995 Time _____ Project No. 6045-14

Site: Peralta Community College - Maintenance Yard

Client Contact Mr. Robert Mibach ((510) 466-7200

Objectives Tank removal

Types of Chemicals Anticipated - Diesel / BTEX

Topics Discussed: Traffic management issues

Physical Hazards Typical Hazards associated with drilling adjacent to an open excavation

Personal Protection Level D, modified as required

Decontamination Equipment to be decontaminated after each boring. Rinsate water will be drummed

Special Site Considerations Note: Working period perimeters (time of day), depending on traffic onsite).

ATTENDEES

Name Printed	Signature

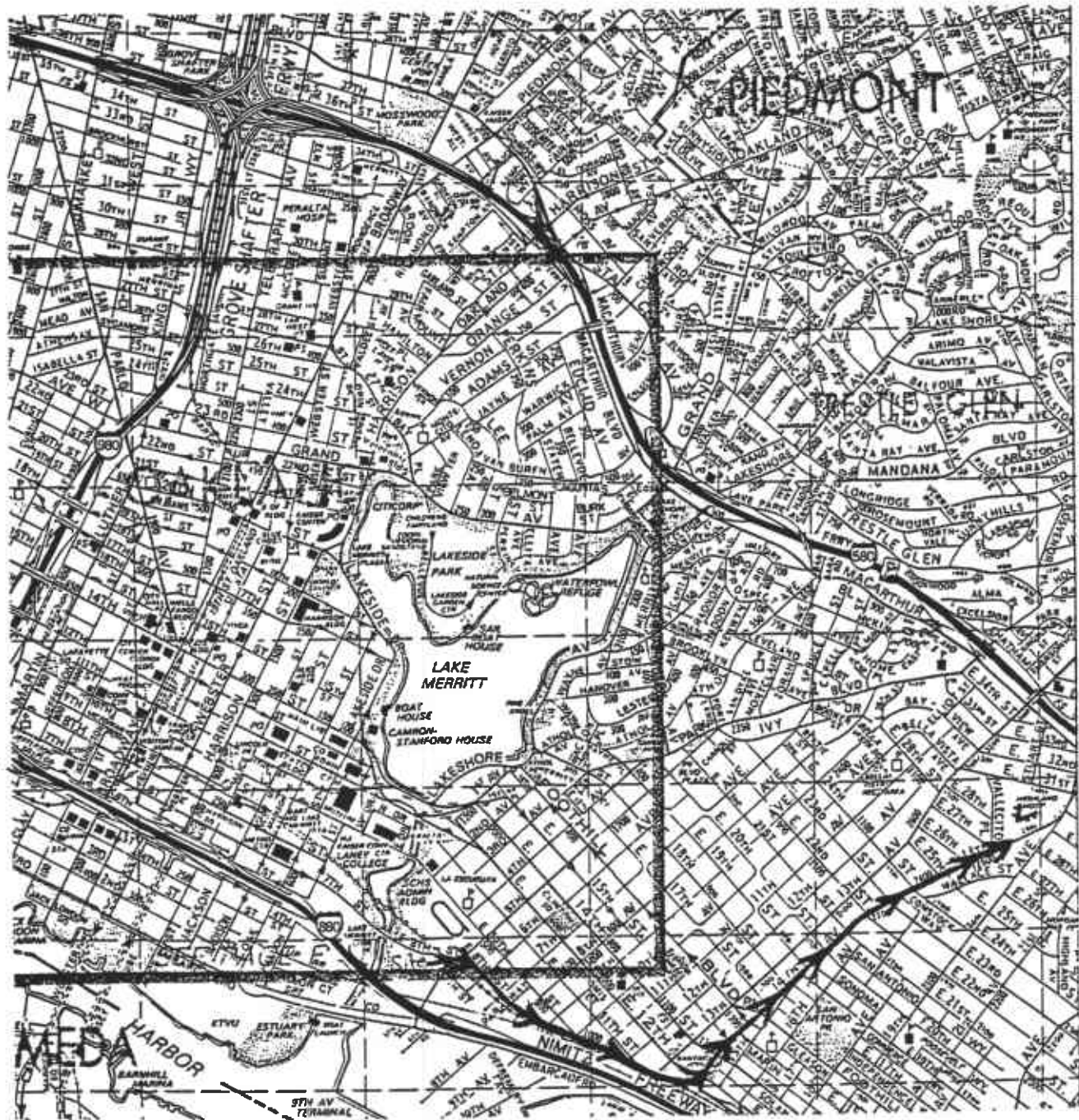

HOSPITAL LOCATION MAP

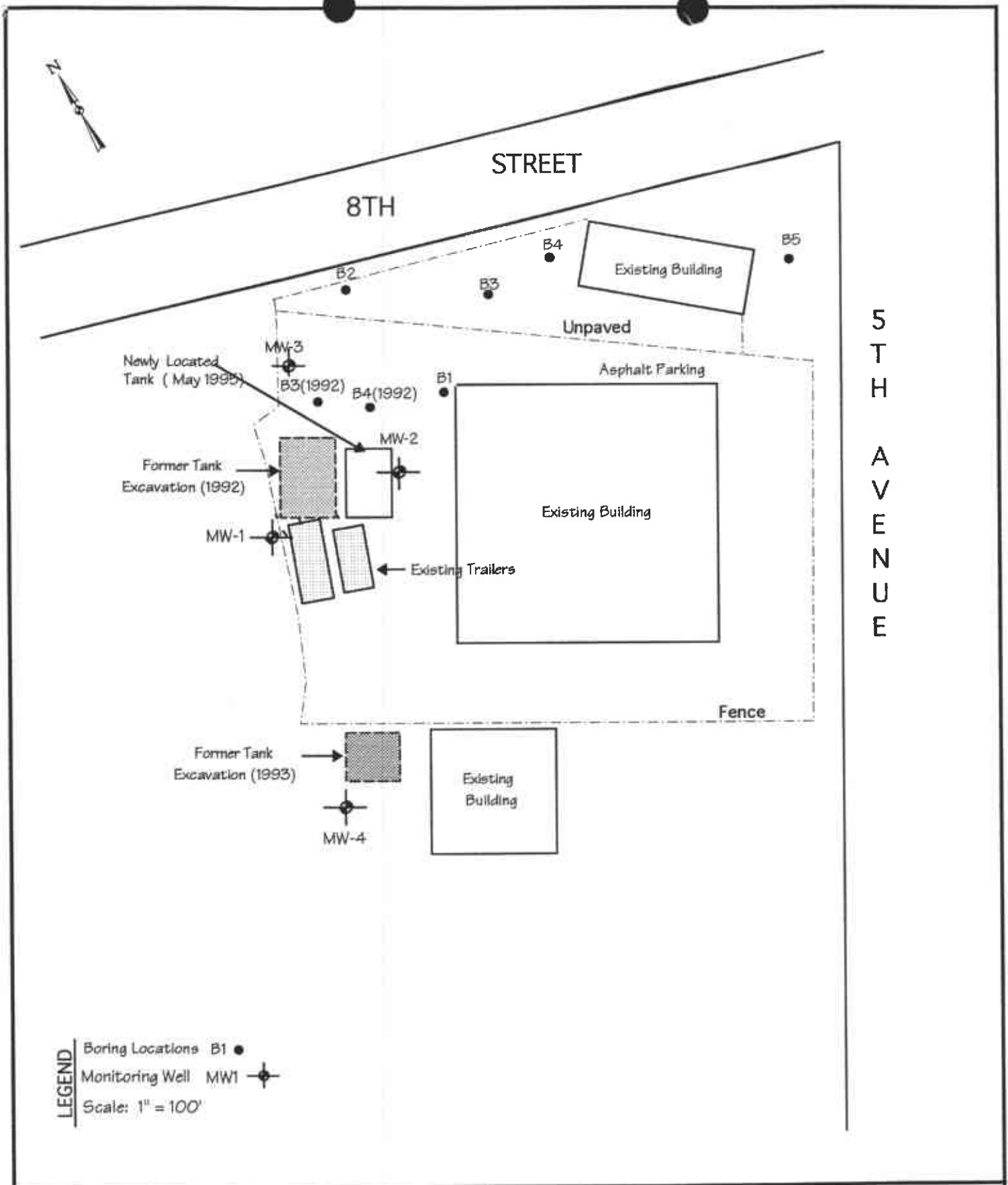

LEGEND
 Boring Locations B1 ●
 Monitoring Well MW1 ⊕
 Scale: 1" = 100'

05/31/95	Drawn By: MCK	Project: 6045-11	Figure 2: Site Plan Peralta Maintenance Yard, Oakland, CA
----------	---------------	------------------	---