

1/7/93

Post-It™ brand fax transmittal memo 7671		# of pages ▶ 7
To GARRET SMITH	From SCOTT SEERY	
Co. MOBIL OIL	Co. ACDEH	
Dept. ENV.	Phone # 510/271-4320	
Fax # 818-953-2648	Fax #	

Here are copies of several maps of both the Jiffy Lube / former Mobil Oil station site, and the down gradient Thrifty Oil station. Note well RS-9, located on the NW corner of Stanton Ave. and Castro Valley Blvd., is within approximately 30 feet from the apparent former UST pit at the Jiffy Lube site.

Attached also please find a copy of the Oct. 22, 1992 correspondence from this office to your predecessor, Mr. Hill.

Please call me at 510/271-4320 with any Questions.

Overview

Based on geotechnical engineering reports regarding backfilling the former UST pit at this site, it appears the USTs at this site were removed sometime prior to November 1983. In 1986 a soil investigation was completed by the installation of six soil borings. Petroleum odors were noted from 3-8.5 ft bgs in some of the soil samples obtained from boring no. 3 installed in the former tank. Petroleum odors were not identified in any of the other five borings.

In October 1992, this office requested Mobil to submit specific info regarding the tank closure (samples, tightness testing, etc.). In response to the County's letter, Mobil submitted a PSA workplan in Feb. 1994. This workplan was approved 2/94 but has not been implemented as of 6/97. California Lubricants (current property owner) gave access to the property in 12/94. Phone conversation with Brady Nagle w/Alisto Engineering who represents Mobile, indicated that they were planning to revise and resubmit a new workplan based on current regulatory guidelines.

*on 6/17/97*  
Per telephone conversation with Brady Nagle w/Alisto, they just sent a letter to us requesting closure w/no further investigations. I told him I would review the letter; however, at minimum a rapid site assessment would most likely be in order. Told him I would need to know landuse of adjacent properties.

USTs @ this site  
 removed prior to  
 15 Nov 1983

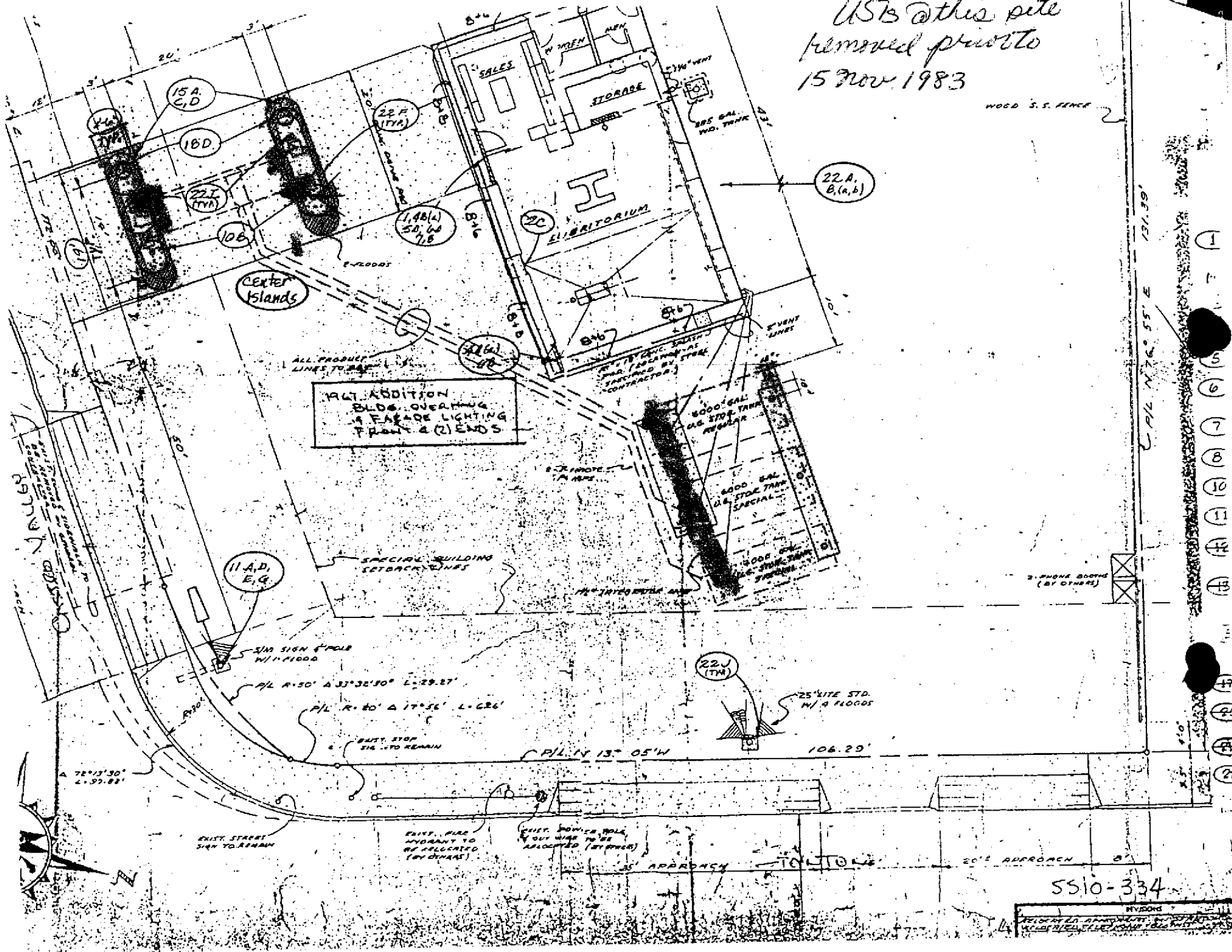

- 1
- 2
- 3
- 4
- 5
- 6
- 7
- 8
- 9
- 10
- 11
- 12
- 13
- 14
- 15
- 16
- 17
- 18
- 19
- 20
- 21
- 22
- 23
- 24
- 25
- 26
- 27
- 28
- 29
- 30
- 31
- 32
- 33
- 34
- 35
- 36
- 37
- 38
- 39
- 40
- 41
- 42
- 43
- 44
- 45
- 46
- 47
- 48
- 49
- 50
- 51
- 52
- 53
- 54
- 55
- 56
- 57
- 58
- 59
- 60
- 61
- 62
- 63
- 64
- 65
- 66
- 67
- 68
- 69
- 70
- 71
- 72
- 73
- 74
- 75
- 76
- 77
- 78
- 79
- 80
- 81
- 82
- 83
- 84
- 85
- 86
- 87
- 88
- 89
- 90
- 91
- 92
- 93
- 94
- 95
- 96
- 97
- 98
- 99
- 100

5510-334

INVSCHD  
 PROJECTED TO APPROXIMATELY 1983  
 WASHINGTON STATE DEPARTMENT OF TRANSPORTATION