

ALAMEDA COUNTY  
**HEALTH CARE SERVICES  
AGENCY**

ALEX BRISCOE, Agency Director

DEPARTMENT OF ENVIRONMENTAL HEALTH  
OFFICE OF THE DIRECTOR  
1131 HARBOR BAY PARKWAY  
ALAMEDA, CA 94502  
(510) 567-6777  
FAX (510) 337-9135

---

February 17, 2011

Ms. Jennifer Sedlachek (sent via e-mail: jennifer.c.sedlachek@exxonmobil.com)  
Exxon Mobil Refining & Supply Company  
4096 Piedmont Avenue #194  
Oakland, CA 94611

Mr. William Slautterback  
Cal Lube Real Estate Limited Partnership  
916 Stagi Ct.  
Los Altos, CA 94024

Subject: Subject: Fuel Leak Case, RO0000386 and Geotracker Global ID T0600101278, Mobil #04-334/Jiffy Lube #606, 2492 Castro Valley Boulevard, Castro Valley, CA 94546

Dear Ms. Sedlachek and Mr. Slautterback:

This letter transmits the enclosed underground storage tank (UST) case closure letter in accordance with Chapter 6.75 (Article 4, Section 25299.37[h]). The State Water Resources Control Board adopted this letter on February 20, 1997. As of March 1, 1997, the Alameda County Environmental Health (ACEH) is required to use this case closure letter for all UST leak sites. We are also transmitting to you the enclosed case closure summary. These documents confirm the completion of the investigation and cleanup of the reported release at the subject site. The subject fuel leak case is closed.

**SITE INVESTIGATION AND CLEANUP SUMMARY**

Please be advised that the following conditions exist at the site:

- Residual pollution remaining in soil beneath the site includes TPH as gas and benzene at concentrations of 2,600 ppm and 3.4 ppm, respectively.
- Maximum concentrations of up to 300 ppb TPH as gas and 15 ppb benzene remain in groundwater beneath the site.

If you have any questions, please call Barbara Jakub at (510) 639-1287. Thank you.

Sincerely,

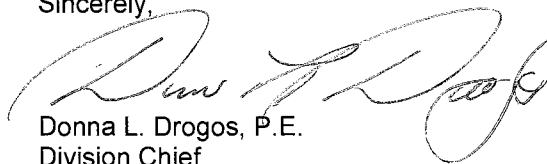

Donna L. Drogos, P.E.  
Division Chief

Enclosures:

1. Remedial Action Completion Certificate

Ms. Sedlachek and Mr. Slautterback  
February 17, 2011  
Page 2

2. Case Closure Summary

cc:

Ms. Cherie McCaulou (w/enc) (via electronic  
mail: [cmccaulou@waterboards.ca.gov](mailto:cmccaulou@waterboards.ca.gov))  
SF- Regional Water Quality Control Board

Leroy Griffin (w/enc via electronic mail:  
[lgriffin@oaklandnet.com](mailto:lgriffin@oaklandnet.com))  
Oakland, Fire Department

Barbara Jakub (w/ enc via e-mail), D. Drogos (w/ enc via e-mail), T. LeKhan (via e-mail and w/orig enc)  
Geotracker

ALAMEDA COUNTY  
**HEALTH CARE SERVICES**  
**AGENCY**  
ALEX BRISCOE, Agency Director

DEPARTMENT OF ENVIRONMENTAL HEALTH  
OFFICE OF THE DIRECTOR  
1131 HARBOR BAY PARKWAY  
ALAMEDA, CA 94502  
(510) 567-6777  
FAX (510) 337-9135

---

February 10, 2011

Ms. Jennifer Sedlachek (sent via e-mail: jennifer.c.sedlachek@exxonmobil.com)  
Exxon Mobil Refining & Supply Company  
4096 Piedmont Avenue #194  
Oakland, CA 94611

Mr. William Slutterback  
Cal Lube Real Estate Limited Partnership  
916 Stagi Ct.  
Los Altos, CA 94024

**REMEDIAL ACTION COMPLETION CERTIFICATE**

Subject: Fuel Leak Case, RO0000386 and Geotracker Global ID T0600101278, Mobil #04-334/Jiffy Lube #606,  
2492 Castro Valley Boulevard, Castro Valley, CA 94546

Dear Ms. Sedlachek and Mr Slutterback:

This letter confirms the completion of a site investigation and remedial action for the underground storage tanks formerly located at the above-described location. Thank you for your cooperation throughout this investigation. Your willingness and promptness in responding to our inquiries concerning the former underground storage tank(s) are greatly appreciated.

Based on information in the above-referenced file and with the provision that the information provided to this agency was accurate and representative of site conditions, this agency finds that the site investigation and corrective action carried out at your underground storage tank(s) site is in compliance with the requirements of subdivisions (a) and (b) of Section 25299.37 of the Health and Safety Code and with corrective action regulations adopted pursuant to Section 25299.77 of the Health and Safety Code and that no further action related to the petroleum release(s) at the site is required.

This notice is issued pursuant to subdivision (h) of Section 25299.37 of the Health and Safety Code.

Please contact our office if you have any questions regarding this matter.

Sincerely,

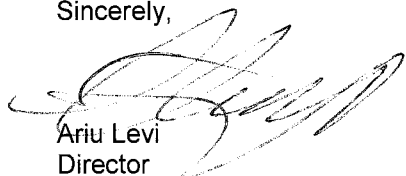

Ariu Levi  
Director  
Alameda County Environmental Health

**CASE CLOSURE SUMMARY  
LEAKING UNDERGROUND FUEL STORAGE TANK - LOCAL OVERSIGHT PROGRAM**

**I. AGENCY INFORMATION**

Date: August 27, 2010

Agency Name: Alameda County Environmental Health	Address: 1131 Harbor Bay Parkway
City/State/Zip: Alameda, CA 94502-6577	Phone: (510) 639-1287
Responsible Staff Person: Barbara Jakub	Title: Hazardous Materials Specialist

**II. CASE INFORMATION**

Site Facility Name: Mobil #04-334/ Jiffy Lube #606		
Site Facility Address: 2492 Castro Valley Blvd., Castro Valley, CA 94546		
RB Case No.: 01-1384	StID No.: 1549	LOP Case No.: RO0000386
URF Filing Date: ---	Geotracker ID: T0600101278	APN: 084A-0224-002-05
<b>Responsible Parties</b>	<b>Addresses</b>	<b>Phone Numbers</b>
Jennifer Sedlachek ExxonMobil Environmental Services Company	4096 Piedmont Avenue, #194 Oakland, CA 94611	(510) 547-8196
Will Slautterback, Cal Lube Real Estate Limited Partnership	916 Stagi Ct. Los Altos, CA 94024	----

Tank I.D. No	Size in Gallons	Contents	Closed In Place/Removed?	Date
1	6,000	Gasoline	Removed	1983
2	6,000	Gasoline	Removed	1983
3	8,000	Gasoline	Removed	1983
4	Unknown	Waste-oil	Removed	1983
Piping			Assumed removed w/ USTs	1983

### III. RELEASE AND SITE CHARACTERIZATION INFORMATION

Cause and Type of Release: Unknown, no reports submitted for UST removal.		
Site characterization complete? Yes	Date Approved By Oversight Agency: ----	
Monitoring wells installed? Yes	Number: 5	Proper screened interval? Yes
Highest GW Depth Below Ground Surface: 3.1 ft bgs	Lowest Depth: 8.3 ft bgs	Flow Direction: Southwest to northeast. Predominantly to the southeast.
Most Sensitive Current Use: Potential drinking water source.		

Summary of Production Wells in Vicinity:	
One domestic well is located approximately 1,400 feet from the site to the southeast. The total depth of the well is 52 feet with no specified screen interval. Due to the distance from the site and the relatively low concentrations observed in the offsite wells, this well does not appear to be a receptor for the site.	
Are drinking water wells affected? No	Aquifer Name: East Bay Plain
Is surface water affected? Yes No	Nearest SW Name: South Reservoir is located approximately 2,300 feet to the S/SW
Off-Site Beneficial Use Impacts (Addresses/Locations): None	
Reports on file? Yes	Where are reports filed? Alameda County Environmental Health

TREATMENT AND DISPOSAL OF AFFECTED MATERIAL			
Material	Amount (Include Units)	Action (Treatment or Disposal w/Destination)	Date
Tank	2- 6,000 gallon gas	Disposed- destination not reported	1983
	1- 8,000 gallon gas	Disposed- destination not reported	1983
	1- unknown size WO	Disposed- destination not reported	1983
Piping	Unknown quantity	Not reported, assumed removed with USTS	1983
Free Product	None reported	----	----
Soil	None reported	----	----
Groundwater	None reported	----	----

**MAXIMUM DOCUMENTED CONTAMINANT CONCENTRATIONS BEFORE AND AFTER CLEANUP**  
 (Please see Attachments 1 through 6 for additional information on contaminant locations and concentrations)

Contaminant	Soil (ppm)		Water (ppb)	
	Before	After	Before	After
TPH (Gas)	2,600	2,600	46,700 (SB-3)	300
TPH (Diesel)	876	876	13,400	<50
TPH (Motor Oil)	NA	NA	NA	NA
TRPH	47.4	47.4	NA	NA
Benzene	3.4	3.4	1,170 (SB-3)	15
Toluene	18	18	65	0.44
Ethylbenzene	38	38	1,780	85
Xylenes	170	170	2,240	1.4
Heavy Metals (Cd, Cr, Pb, Ni, Zn)	122 <sup>^</sup>	122 <sup>^</sup>	NA	NA
MTBE	0.0024 <sup>*</sup>	0.0024 <sup>*</sup>	11 <sup>**</sup>	11 <sup>**</sup>
Other (8270)	NA	NA	<2.0	<2.0

NA = not analyzed

<sup>^</sup> 1.63 ppm Cd; 31.1 ppm Cr; 9.4 ppm Pb; 43.1 ppm Ni; 122 ppm Zn

<sup>\*</sup> 0.0024 ppm MTBE by EPA Method 8260; <20 ppm TBA,; <5.0 ppb TAME; <5.0 ppm ETBE; <5.0 ppm DIPE; <0.25 ppm EtOH ; <5.0 ppm EDB; and <0.005 ppm EDC

<sup>\*\*</sup> 11 ppb MTBE; 19 ppb TBA,; <0.50 ppb TAME,; <0.50 ppb ETBE; <0.50 ppb DIPE; 22 ppb EtOH ; <0.50 ppb EDB; and 0.11 ppb EDC

Site History and Description of Corrective Actions:

The site is occupied by Jiffy Lube-branded oil change service business located at 2492 Castro Valley Boulevard, on the northwest corner of the intersection of Castro Valley Boulevard and Stanton. The site was previously operated as a service station by GP Petroleum from 1956 to 1969. In 1956, two 6,000-gallon underground storage tanks (USTs) and one used-oil UST were installed. The service station was operated by Mobil Oil from 1969 to 1983. An 8,000-gallon UST was installed in 1971. In 1983, the three fuel USTs and one used-oil UST were removed from the site. No sampling was performed for chemical analysis. The property is currently owned by Cal Lube Real Estate Limited Partnership. The surrounding area is primarily commercial with some residential property located to the north.

In March 1999, a soil and groundwater investigation was performed. Maximum concentrations in soil were 2,600 mg/kg TPHg and 3.4 mg/kg benzene. Maximum concentrations in groundwater were 4,300 ppb TPHg and 210 ppb benzene.

In November 2003, SB-1 through SB-7 were advanced on-site. Maximum concentrations in soil were 1,960 mg/kg TPHg and 2.67 mg/kg benzene. Maximum concentrations in groundwater were 46,700 ppb TPHg and 1,170 ppb benzene.

Four groundwater monitoring wells were installed in June 2004. Maximum concentrations in soil were 1,400 mg/kg TPHg and 2.21 mg/kg benzene from 8 to 8.5 ft bgs. The maximum MTBE concentrations were detected in off-site well at a concentration of 0.0024 mg/kg.

Borings SB-8 to SB-14 were installed in October 2007 to define the extent of off-site contamination. Maximum concentrations in soil were 25mg/kg TPHg. No benzene or MTBE was detected in soil.

Off-site groundwater well MW-5 was installed in January 2009. MTBE was detected in water at a maximum concentration of 11 ppb.

**IV. CLOSURE**

Does completed corrective action protect existing beneficial uses per the Regional Board Basin Plan? Yes		
Does completed corrective action protect potential beneficial uses per the Regional Board Basin Plan? Yes		
Does corrective action protect public health for current land use? Alameda County Environmental Health staff does not make specific determinations concerning public health risk. However, based upon the information available in our files to date, it does not appear that the release would present a risk to human health based upon current land use and conditions.		
<p>Site Management Requirements:</p> <p>Case closure for this fuel leak site is granted for the current commercial land use only. If a change in land use to any residential or other conservative land use scenario occurs at this site, Alameda County Environmental Health (ACEH) must be notified as required by Government Code Section 65850.2.2. ACEH will re-evaluate the case upon receipt of approved development/construction plans.</p> <p>Excavation or construction activities in areas of residual contamination require planning and implementation of appropriate health and safety procedures by the responsible party prior to and during excavation and construction activities.</p>		
Should corrective action be reviewed if land use changes? Yes		
Was a deed restriction or deed notification filed? No		Date Recorded: N/A
Monitoring Wells Decommissioned: No	Number Decommissioned: 0	Number Retained: 5
List Enforcement Actions Taken: None		
List Enforcement Actions Rescinded: ---		

**V. ADDITIONAL COMMENTS, DATA, ETC.**

<p>Considerations and/or Variances: Residual petroleum hydrocarbon contamination in soil and groundwater remains in place at this site.</p> <p>Conclusion:</p> <p>Alameda County Environmental Health staff believe that the levels of residual contamination do not pose a significant threat to water resources, public health and safety, and the environment under the current commercial land use based upon the information available in our files to date. No further investigation or cleanup for the fuel leak case is necessary at this time. However, as specified in the Site Management Requirements, re-evaluation of this case may be required if land uses changes to any residential or other conservative land use scenario; or construction or excavation activities take place. ACEH staff recommend closure for this site.</p>
---



**VI. LOCAL AGENCY REPRESENTATIVE DATA**

Prepared by: Barbara Jakub, P.G.	Title: Hazardous Materials Specialist
Signature: <i>Barbara J Jakub</i>	Date: 8/27/10
Approved by: Donna L. Drogos, P.E.	Title: Division Chief
Signature: <i>Donna L Drogos</i>	Date: 09/02/10

This closure approval is based upon the available information and with the provision that the information provided to this agency was accurate and representative of site conditions.

**VII. REGIONAL BOARD NOTIFICATION**

Regional Board Staff Name: Cherie McCaulou	Title: Engineering Geologist
Notification Date: 9/3/2010	

**VIII. MONITORING WELL DECOMMISSIONING**

Date Requested by ACEH: 10/4/10	Date of Well Decommissioning Report: 2/8/11	
All Monitoring Wells Decommissioned: <input checked="" type="radio"/> Yes <input type="radio"/> No	Number Decommissioned: 5	Number Retained: 0
Reason Wells Retained: - - -		
Additional requirements for submittal of groundwater data from retained wells: - - -		
ACEH Concurrence - Signature: <i>Barbara J Jakub</i>	Date: 2/9/11	

**Attachments:**

1. Site Vicinity Map (1 pp)
2. Site Plans (2 pp)
3. Soil Analytical Data (13 pp)
4. Groundwater Analytical Data (13 pp)
5. Boring Logs (6 pp)
6. Cross Sections (2 pp)

This document and the related CASE CLOSURE LETTER & REMEDIAL ACTION COMPLETION CERTIFICATE shall be retained by the lead agency as part of the official site file.

## Jakub, Barbara, Env. Health

---

**From:** Cherie McCaulou [CMccaulou@waterboards.ca.gov]  
**Sent:** Friday, September 03, 2010 1:14 PM  
**To:** Jakub, Barbara, Env. Health  
**Subject:** Re: RO386 Closure Summary

Barbara - The Regional Water Board has no objection to ACEH recommendation for closing the case located at 2492 Castro Valley Blvd., Castro Valley. Thank you.

Sincerely,

Cherie McCaulou  
Engineering Geologist  
San Francisco Bay Regional Water Quality Control Board  
[cmccaulou@waterboards.ca.gov](mailto:cmccaulou@waterboards.ca.gov)  
510-622-2342

>>> "Jakub, Barbara, Env. Health" <[barbara.jakub@acgov.org](mailto:barbara.jakub@acgov.org)> 9/3/2010 9:58 AM >>>

Hello Cherie,

Attached is a closure summary for RO0000386 Mobil #04-334/ Jiffy Lube #606 located at to comply with the RWQCB's 30-day review period. If no comments from the RWQCB are received within the 30-day review period, ACEH's will proceed with case closure.

Please contact me if you have any comments or questions regarding the subject site.

Regards,

Barbara Jakub, P.G.  
Hazardous Materials Specialist  
Alameda County Environmental Health  
1131 Harbor Bay Pky.  
Alameda, CA 94502  
Direct: 510-639-1287  
Fax: 510-337-9335

PDF copies of case files can be downloaded at:

<http://www.acgov.org/aceh/lop/ust.htm>

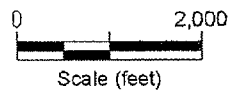
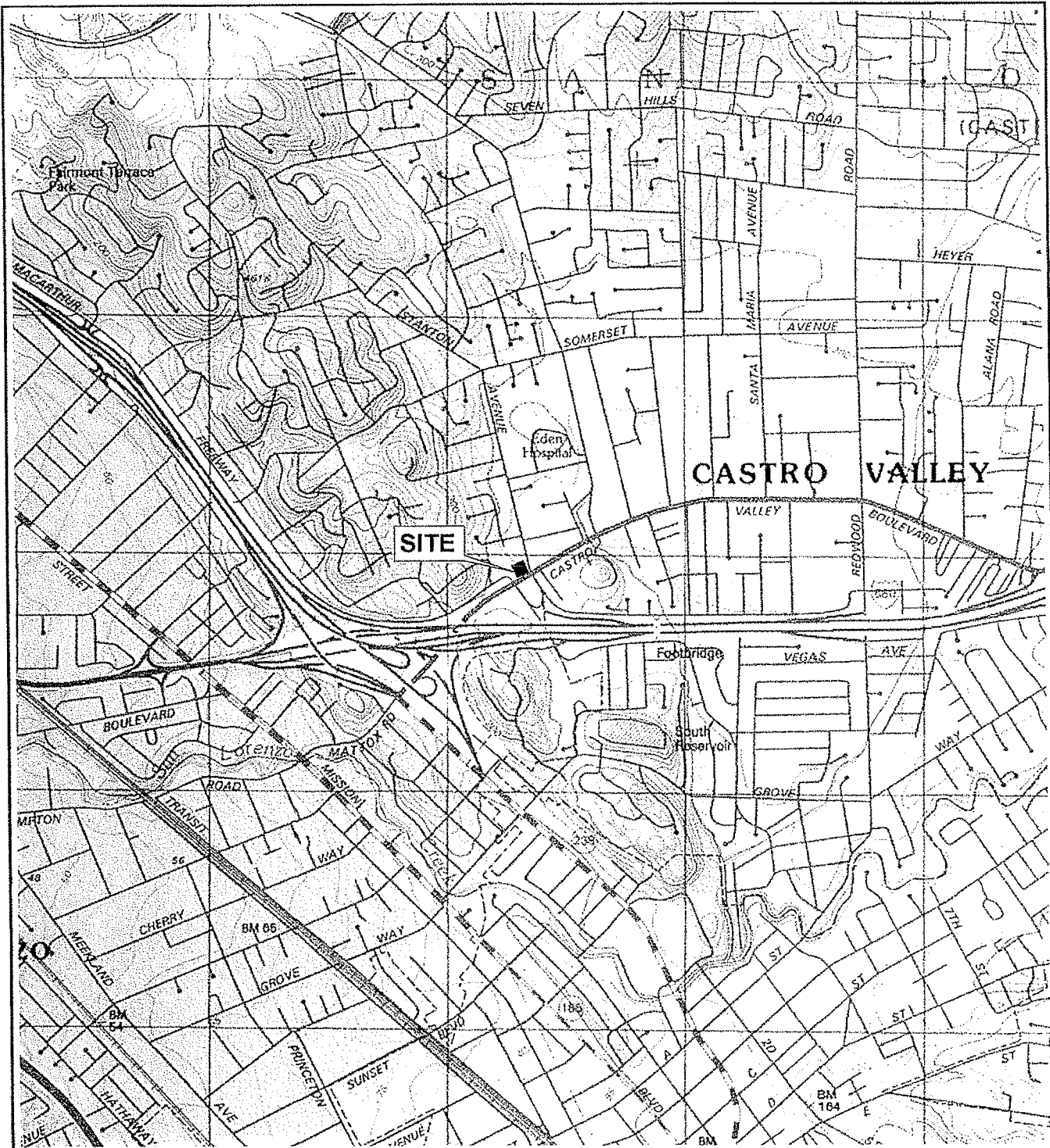

FILENAME: TOP.DWG 12/24/07

(Map Source: USGS Topographic Map)



**SITE LOCATION AND TOPOGRAPHIC MAP**  
 FORMER MOBIL STATION 04334  
 2492 CASTRO VALLEY BOULEVARD  
 CASTRO VALLEY, CALIFORNIA

FIGURE:  
**1**

# ATTACHMENT 1

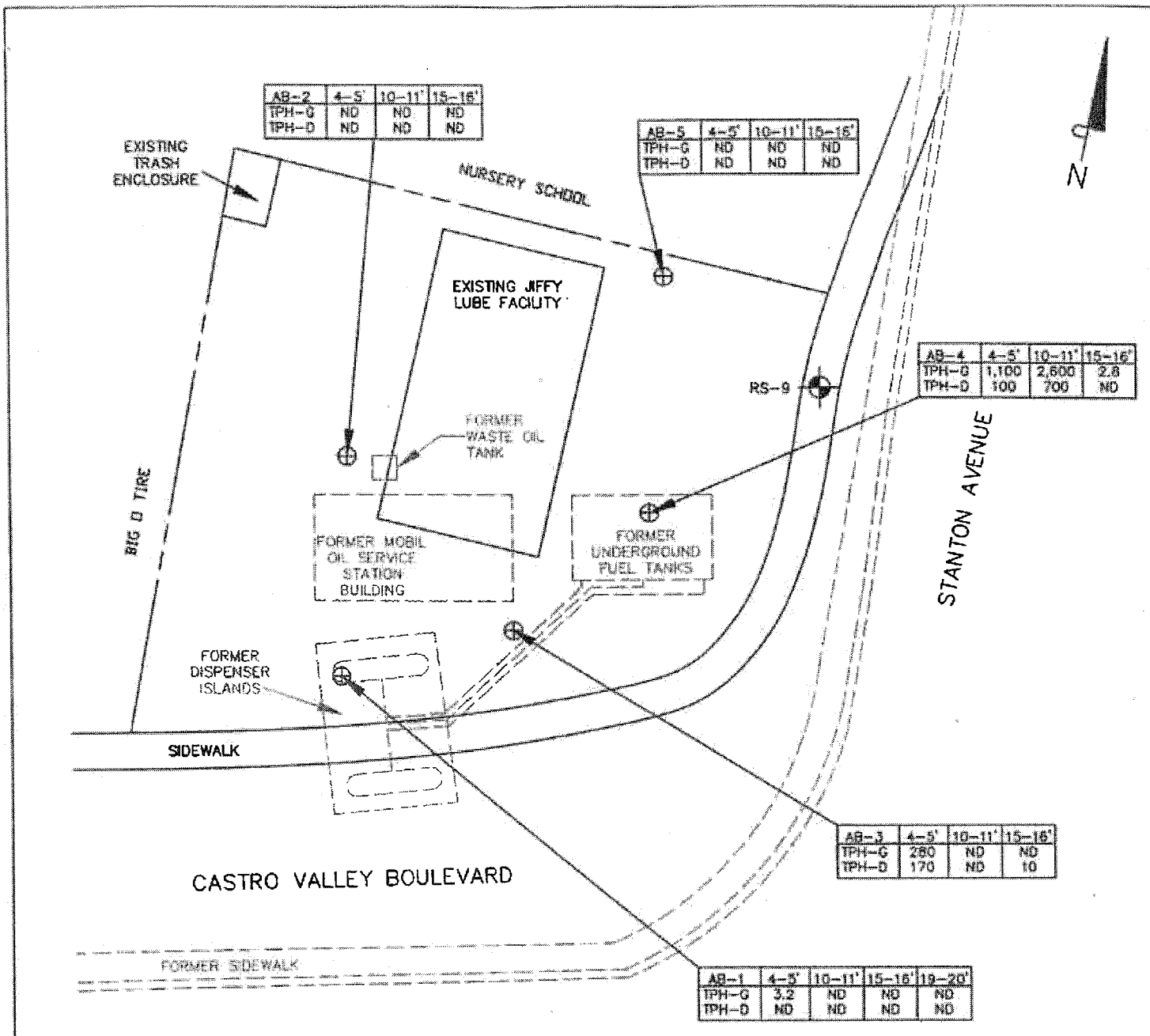

AB-2	4-5'	10-11'	15-16'
TPH-G	ND	ND	ND
TPH-D	ND	ND	ND

AB-5	4-5'	10-11'	15-16'
TPH-G	ND	ND	ND
TPH-D	ND	ND	ND

AB-4	4-5'	10-11'	15-16'
TPH-G	1,100	2,600	2.8
TPH-D	100	700	ND

AB-3	4-5'	10-11'	15-16'
TPH-G	280	ND	ND
TPH-D	170	ND	10

AB-1	4-5'	10-11'	15-16'	19-20'
TPH-G	3.2	ND	ND	ND
TPH-D	ND	ND	ND	ND

**LEGEND**

- Monitoring Well (Thrifty Oil Co.)
- Soil Boring
- Property Line

AB-1	Depth
TPH-G	
TPH-D	

Hydrocarbon Concentrations in Soil (mg/kg)

**NOTES:**  
 Results are based on laboratory analysis of soil samples collected on March 4, 1999. Depths are in feet below grade. mg/kg = milligrams per kilogram; TPH-G = total petroleum hydrocarbons as gasoline; TPH-D = total petroleum hydrocarbons as diesel; ND = not detected at or above method detection limit.

**HYDROCARBON CONCENTRATIONS IN SOIL**  
 March 4, 1999

Former Mobil Station 04-334  
 2492 Castro Valley Boulevard  
 Castro Valley, California

**ATTACHMENT 2**

SCALE (FEET)

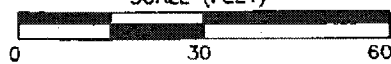
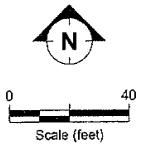
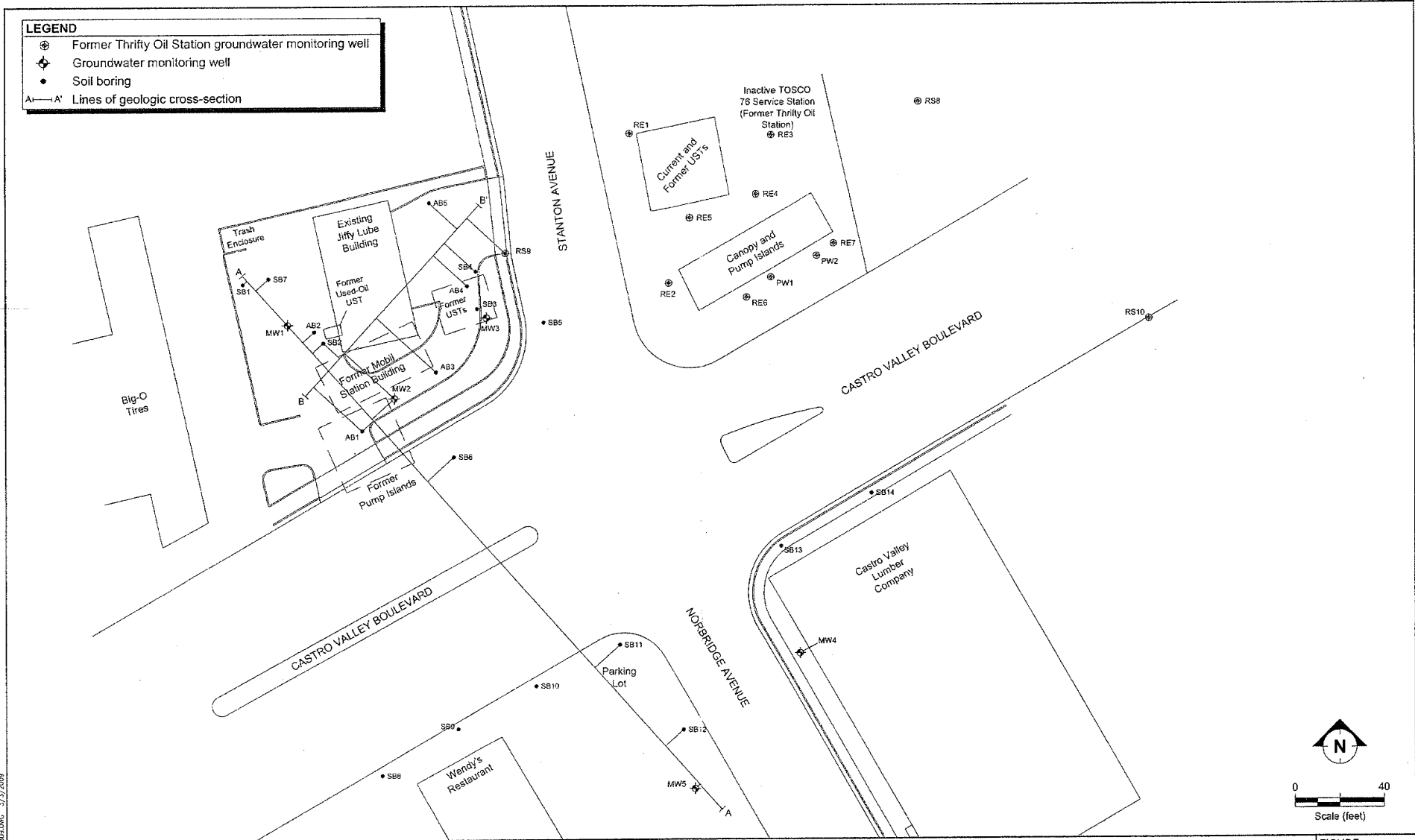

**FIGURE 5**

m:\p\p\04-334\04-334-934\04334-911.dwg

**LEGEND**

- ⊕ Former Thrifty Oil Station groundwater monitoring well
- ⊕ Groundwater monitoring well
- Soil boring
- A—A' Lines of geologic cross-section



SITE MAP SHOWING LINES OF GEOLOGIC CROSS-SECTION  
 FORMER MOBIL STATION 04334  
 2492 CASTRO VALLEY BOULEVARD  
 CASTRO VALLEY, CALIFORNIA

FIGURE:  
**2**

FILENAME: scd040003.DWG 1/1/2009



TABLE 2 SOIL SAMPLE ANALYTICAL RESULTS, FORMER MOBIL STATION 04334, 2492 CASTRO VALLEY BOULEVARD, CASTRO VALLEY, CALIFORNIA

Boring Number	Date	Sample Depth (feet bgs)	Concentration (mg/kg)							MTBE (8021B)	MTBE (8260B)
			Benzene	Toluene	Ethyl-benzene	Xylenes	TPH-g	TPH-d	TRPH		
AB1	03/04/99	4-5	ND	ND	0.010	ND	3.2	ND	--	ND	--
AB1	03/04/99	10-11	ND	ND	ND	ND	ND	ND	--	ND	--
AB1	03/04/99	15-16	ND	ND	ND	ND	ND	ND	--	ND	--
AB1	03/04/99	19-20	ND	ND	ND	ND	ND	ND	--	ND	--
AB2	03/04/99	4-5	ND	ND	ND	ND	ND	ND	ND	ND	--
AB2	03/04/99	10-11	ND	ND	ND	ND	ND	ND	13	ND	--
AB2	03/04/99	15-16	ND	ND	ND	ND	ND	ND	ND	ND	--
AB3	03/04/99	4-5	ND	0.09	1.9	ND	280	170	--	0.4	--
AB3	03/04/99	10-11	ND	ND	ND	ND	ND	ND	--	ND	--
AB3	03/04/99	15-16	ND	ND	ND	ND	ND	10	--	ND	--
AB4	03/04/99	4-5	0.2	ND	18	62	1,100	100	--	ND	--
AB4	03/04/99	10-11	3.4	18	38	170	2,600	700	--	8	ND
AB4	03/04/99	15-16	0.005	0.011	0.038	0.12	2.8	ND	--	ND	--
AB5	03/04/99	4-5	ND	ND	ND	ND	ND	ND	--	ND	--
AB5	03/04/99	10-11	ND	ND	ND	ND	ND	ND	--	ND	--
AB5	03/04/99	15-16	ND	ND	ND	ND	ND	ND	--	ND	--
SB1	11/12/03	5.5-6	<0.001	<0.001	<0.001	<0.001	<5.05	<9.88	--	--	<0.002
SB1	11/12/03	11-11.5	0.002	0.0022	<0.001	<0.001	<4.88	<10.1	--	--	<0.002
SB1	11/12/03	14.5-15	0.0027	0.0061	<0.001	0.0029	<4.98	<10.1	--	--	<0.002
SB1	11/12/03	17.5-18	0.0051	0.0112	0.0011	0.0039	<5.06	<10	--	--	<0.002
SB2	11/12/03	5.5-6	<0.001	<0.001	<0.001	<0.001	<4.93	<10	47.4	--	<0.002
SB2	11/12/03	10-10.5	0.0013	0.0023	<0.001	0.0018	<5.07	<9.96	30.3	--	<0.002
SB3	11/12/03	5-5.5	0.131	0.0027	0.0456	0.0153	6.19	<9.92	--	--	<0.002
SB3	11/12/03	10.5-11	2.67	0.782	19.6	32	1,960	876	--	--	<0.0502
SB3	11/12/03	15.5-16	0.0315	0.0043	0.0593	0.09	5.49	12	--	--	<0.002
SB3	11/12/03	16.5-17	1.83	0.529	8.13	14.8	932	178	--	--	<0.002
SB3	11/12/03	19.5-20	0.004	0.0042	0.0017	0.0037	<4.97	13.9	--	--	<0.002
SB4	11/12/03	Boring terminated at 2 feet bgs. No soil samples collected.									

ATTACHMENT 3

TABLE 2 SOIL SAMPLE ANALYTICAL RESULTS, FORMER MOBIL STATION 04334, 2492 CASTRO VALLEY BOULEVARD, CASTRO VALLEY, CALIFORNIA

Boring Number	Date	Sample Depth (feet bgs)	Concentration (mg/kg)							TRPH	MTBE (8021B)	MTBE (8260B)
			Benzene	Toluene	Ethyl-benzene	Xylenes	TPH-g	TPH-d	TPH			
SB5	11/13/03	8.5-9	<0.001	<0.001	<0.001	<0.001	<4.95	<9.84	--	--	<0.002	
SB5	11/13/03	11.5-12	0.0039	0.0174	0.0098	0.018	14.2	<10.1	--	--	<0.002	
SB5	11/13/03	15.5-16	<0.001	<0.001	<0.001	<0.001	<5.02	<10.1	--	--	<0.002	
SB5	11/13/03	16.5-17	0.0014	<0.001	<0.001	<0.001	<5.03	<10.2	--	--	<0.002	
SB6	11/13/03	8.5-9	0.0015	<0.001	0.0011	0.0014	<5.01	<10	--	--	<0.002	
SB6	11/13/03	11-11.5	0.0028	0.0016	<0.001	<0.001	<5.02	<9.84	--	--	<0.002	
SB6	11/13/03	14.5-15	0.0019	0.0012	<0.001	<0.001	<4.96	<10	--	--	<0.002	
SB7	11/13/03	6.5-7	<0.001	<0.001	<0.001	<0.001	<4.98	<10.1	--	--	<0.002	
SB7	11/13/03	9-9.5	<0.001	<0.001	<0.001	<0.001	<5.07	<10	--	--	<0.002	
SB7	11/13/03	16-16.5	<0.001	0.0011	<0.001	<0.001	<4.97	<9.65	--	--	<0.002	
SB8	10/03/07	5-5.5	<1.0	<1.0	<1.0	<1.0	<100	13b	--	--	<5.0	
SB8	10/04/07	9.5-10	<1.0	<1.0	<1.0	<1.0	<100	1.0b	--	--	<5.0	
SB8	10/04/07	14.5-15	<1.0	<1.0	<1.0	<1.0	<100	4.6b	--	--	<5.0	
SB9	10/03/07	5-5.5	<1.0	<1.0	<1.0	<1.0	<100	1.6 <sup>b</sup>	--	--	<5.0	
SB9	10/03/07	9.5-10	<1.0	<1.0	<1.0	<1.0	<100	3.5 <sup>b</sup>	--	--	<5.0	
SB10	10/02/07	5-5.5	<0.000984	<0.000984	0.00119	<0.00295	<0.0984	<4.00	--	--	<0.00190	
SB10	10/04/07	9.5-10	<0.10	<0.10	<0.10	<0.10	25	5.6 <sup>b</sup>	--	--	<5.0	
SB10	10/04/07	14.5-15	<1.0	<1.0	<1.0	<1.0	<100	2.9 <sup>b</sup>	--	--	<5.0	
SB11	10/03/07	5-5.5	<1.0	<1.0	<1.0	<1.0	<100	<1.0	--	--	<5.0	
SB11	10/04/07	9.5-10	<1.0	<1.0	<1.0	1.8	<100	1.1 <sup>b</sup>	--	--	<5.0	
SB12	10/02/07	5-5.5	<0.000958	<0.000958	<0.000958	<0.00287	0.103	<4.00	--	--	<0.00197	
SB12	10/03/07	9.5-10	<1.0	<1.0	<1.0	<1.0	<100	<1.0	--	<5.0	<5.0	
SB13	10/02/07	5-5.5	<0.000982	<0.000982	<0.000982	<0.00295	<0.0982	<3.90	--	--	<0.00195	
SB13	10/03/07	14.5-15	<1.0	<1.0	<1.0	<1.0	<100	1.3 <sup>b</sup>	--	--	<5.0	
SB14	10/02/07	5-5.5	<0.000996	<0.000996	<0.000996	<0.00299	<0.0996	<3.90	--	--	<0.00193	
SB14	10/04/07	9.5-10	--	--	--	--	--	--	--	--	--	

TABLE 2 SOIL SAMPLE ANALYTICAL RESULTS, FORMER MOBIL STATION 04334, 2492 CASTRO VALLEY BOULEVARD, CASTRO VALLEY, CALIFORNIA

Boring Number	Date	Sample Depth (feet bgs)	Concentration (mg/kg)							MTBE (8021B)	MTBE (8260B)
			Benzene	Toluene	Ethyl-benzene	Xylenes	TPH-g	TPH-d	TRPH		
MW1	06/23/04	5-5.5	<0.001	<0.001	<0.001	<0.001	<4.97	<10	--	--	<0.002
MW1	06/24/04	8.5-9	<0.001	<0.001	<0.001	<0.001	<4.98	<10.2	--	--	<0.002
MW1	06/24/04	16.5-17	<0.001	<0.001	<0.001	<0.001	<4.96	<10.1	--	--	<0.002
MW1	06/24/04	19.5-20	<0.001	<0.001	<0.001	<0.001	<5.04	<10.1	--	--	<0.002
MW2	06/23/04	5-5.5	<0.001	0.0018	<0.001	0.0039	<4.96	<9.84	--	--	<0.002
MW2	06/25/04	9-9.5	<0.001	<0.001	<0.001	<0.001	<5.01	<10.2	--	--	<0.002
MW2	06/25/04	13-13.5	<0.001	<0.001	<0.001	<0.001	<5.05	<10	--	--	<0.002
MW2	06/25/04	16.5-17	<0.001	<0.001	<0.001	<0.001	<4.97	<9.8	--	--	<0.002
MW2	06/25/04	19.5-20	<0.001	<0.001	<0.001	<0.001	<5.04	<10	--	--	<0.002
MW3	06/23/04	5-5.5	0.0324	0.0184	3.11	2.22	12.7	18.1	--	--	<0.0996
MW3	06/25/04	8-8.5	2.21	1.48	27.4	5.49	1,400	<10	--	--	<0.002
MW3	06/25/04	10.5-11	0.003	0.0014	0.001	<0.001	<4.95	<9.88	--	--	<0.002
MW3	06/25/04	12-12.5	0.0061	0.0059	0.0122	0.0111	<4.96	<10.1	--	--	<0.002
MW3	06/25/04	17-17.5	0.0012	<0.001	<0.001	<0.001	<5	<10.1	--	--	<0.002
MW3	06/25/04	19-19.5	<0.001	<0.001	<0.001	<0.001	<5.03	<9.92	--	--	<0.002
MW4	06/24/04	11.5-12	<0.001	<0.001	<0.001	<0.001	<4.97	<9.88	--	--	0.0024
MW4	06/24/04	13-13.5	<0.001	<0.001	<0.001	<0.001	<4.99	<10	--	--	<0.002
MW4	06/24/04	14.5-15	<0.001	<0.001	<0.001	<0.001	<4.99	<10.1	--	--	0.0024
MW5	01/29/09	5-5.5	<0.00050	0.0020 <sup>c</sup>	<0.00050	0.0024 <sup>c,d</sup>	<0.50	--	--	--	<0.0050
MW5	01/29/09	7.5-8	<0.00050	<0.00050	<0.00050	<0.010	<0.50	--	--	--	<0.0050
MW5	01/30/09	10.5-11	<0.00050	<0.00050	<0.00050	<0.010	<0.50	--	--	--	<0.0050
MW5	01/30/09	13.5-14	<0.00050	<0.00050	<0.00050	<0.010	<0.50	--	--	--	0.00028 <sup>c</sup>
MW5	01/30/09	15.5-16	<0.00050	0.0012 <sup>c</sup>	<0.00050	<0.010	<0.50	--	--	--	0.00038 <sup>c</sup>

Notes:

- a TRC's Initial Site Assessment report, dated 3 September 1999, states "Results were below preliminary remediation goals for residential soils as required by the USEPA Region 9."
- b Does not match typical pattern.
- c Analyte was detected at a concentration below the reportig limit and above the laboratory method detection limit. Reported value is estimated.
- d Analyte presence was not confirmed by second column or GC/MS analysis.



TABLE 2 SOIL SAMPLE ANALYTICAL RESULTS, FORMER MOBIL STATION 04334, 2492 CASTRO VALLEY BOULEVARD, CASTRO VALLEY, CALIFORNIA

Boring Number	Date	Sample Depth (feet bgs)	Concentration (mg/kg)							
			Benzene	Toluene	Ethyl- benzene	Xylenes	TPH-g	TPH-d	TRPH	MTBE (8021B)

bgs Below ground surface.  
mg/kg Milligrams per kilogram.  
MTBE Methyl tertiary butyl ether.  
ND Not detected.  
TPH-d Total Petroleum Hydrocarbons as diesel.  
TPH-g Total Petroleum Hydrocarbons as gasoline.  
TRPH Total Recoverable Petroleum Hydrocarbons.  
-- Not analyzed.

TABLE 3 SOIL SAMPLE ANALYTICAL RESULTS FOR OXYGENATES AND ADDITIVES, FORMER MOBIL STATION 04334,  
2492 CASTRO VALLEY BOULEVARD, CASTRO VALLEY, CALIFORNIA

Boring Number	Date	Sample Depth (feet bgs)	Concentration (mg/kg)									CAM-17 (200.7)	HVOC (8010)
			MTBE (8021B)	MTBE (8260B)	TBA	DIPE	ETBE	1,2-DCA	TAME	EDB	Ethanol		
AB1	03/04/99	4-5	ND	--	--	--	--	--	--	--	--	--	--
AB1	03/04/99	10-11	ND	--	--	--	--	--	--	--	--	--	--
AB1	03/04/99	15-16	ND	--	--	--	--	--	--	--	--	--	--
AB1	03/04/99	19-20	ND	--	--	--	--	--	--	--	--	--	--
AB2	03/04/99	4-5	ND	--	--	--	--	--	--	--	--	a	ND
AB2	03/04/99	10-11	ND	--	--	--	--	--	--	--	--	a	ND
AB2	03/04/99	15-16	ND	--	--	--	--	--	--	--	--	a	ND
AB3	03/04/99	4-5	0.4	--	--	--	--	--	--	--	--	--	--
AB3	03/04/99	10-11	ND	--	--	--	--	--	--	--	--	--	--
AB3	03/04/99	15-16	ND	--	--	--	--	--	--	--	--	--	--
AB4	03/04/99	4-5	ND	--	--	--	--	--	--	--	--	--	--
AB4	03/04/99	10-11	8	ND	--	--	--	--	--	--	--	--	--
AB4	03/04/99	15-16	ND	--	--	--	--	--	--	--	--	--	--
AB5	03/04/99	4-5	ND	--	--	--	--	--	--	--	--	--	--
AB5	03/04/99	10-11	ND	--	--	--	--	--	--	--	--	--	--
AB5	03/04/99	15-16	ND	--	--	--	--	--	--	--	--	--	--
SB1	11/12/03	5.5-6	--	<0.002	--	--	--	--	--	--	--	--	--
SB1	11/12/03	11-11.5	--	<0.002	--	--	--	--	--	--	--	--	--
SB1	11/12/03	14.5-15	--	<0.002	--	--	--	--	--	--	--	--	--
SB1	11/12/03	17.5-18	--	<0.002	--	--	--	--	--	--	--	--	--
SB2	11/12/03	5.5-6	--	<0.002	--	--	--	--	--	--	--	--	--
SB2	11/12/03	10-10.5	--	<0.002	--	--	--	--	--	--	--	--	--
SB3	11/12/03	5-5.5	--	<0.002	--	--	--	--	--	--	--	--	--
SB3	11/12/03	10.5-11	--	<0.0502	--	--	--	--	--	--	--	--	--
SB3	11/12/03	15.5-16	--	<0.002	--	--	--	--	--	--	--	--	--
SB3	11/12/03	16.5-17	--	<0.002	--	--	--	--	--	--	--	--	--
SB3	11/12/03	19.5-20	--	<0.002	--	--	--	--	--	--	--	--	--

SB4 11/12/03 Boring terminated at 2 feet bgs. No soil samples collected.

TABLE 3 SOIL SAMPLE ANALYTICAL RESULTS FOR OXYGENATES AND ADDITIVES, FORMER MOBIL STATION 04334,  
2492 CASTRO VALLEY BOULEVARD, CASTRO VALLEY, CALIFORNIA

Boring Number	Date	Sample Depth (feet bgs)	Concentration (mg/kg)									CAM-17 (200.7)	HVOC (8010)
			MTBE (8021B)	MTBE (8260B)	TBA	DIPE	ETBE	1,2-DCA	TAME	EDB	Ethanol		
SB5	11/13/03	8.5-9	--	<0.002	--	--	--	--	--	--	--	--	--
SB5	11/13/03	11.5-12	--	<0.002	--	--	--	--	--	--	--	--	--
SB5	11/13/03	15.5-16	--	<0.002	--	--	--	--	--	--	--	--	--
SB5	11/13/03	16.5-17	--	<0.002	--	--	--	--	--	--	--	--	--
SB6	11/13/03	8.5-9	--	<0.002	--	--	--	--	--	--	--	--	--
SB6	11/13/03	11-11.5	--	<0.002	--	--	--	--	--	--	--	--	--
SB6	11/13/03	14.5-15	--	<0.002	--	--	--	--	--	--	--	--	--
SB7	11/13/03	6.5-7	--	<0.002	--	--	--	--	--	--	--	--	--
SB7	11/13/03	9-9.5	--	<0.002	--	--	--	--	--	--	--	--	--
SB7	11/13/03	16-16.5	--	<0.002	--	--	--	--	--	--	--	--	--
MW1	06/23/04	5-5.5	--	<0.002	--	--	--	--	--	--	--	--	--
MW1	06/24/04	8.5-9	--	<0.002	--	--	--	--	--	--	--	--	--
MW1	06/24/04	16.5-17	--	<0.002	--	--	--	--	--	--	--	--	--
MW1	06/24/04	19.5-20	--	<0.002	--	--	--	--	--	--	--	--	--
MW2	06/23/04	5-5.5	--	<0.002	--	--	--	--	--	--	--	--	--
MW2	06/25/04	9-9.5	--	<0.002	--	--	--	--	--	--	--	--	--
MW2	06/25/04	13-13.5	--	<0.002	--	--	--	--	--	--	--	--	--
MW2	06/25/04	16.5-17	--	<0.002	--	--	--	--	--	--	--	--	--
MW2	06/25/04	19.5-20	--	<0.002	--	--	--	--	--	--	--	--	--
MW3	06/23/04	5-5.5	--	<0.0996	--	--	--	--	--	--	--	--	--
MW3	06/25/04	8-8.5	--	<0.002	--	--	--	--	--	--	--	--	--
MW3	06/25/04	10.5-11	--	<0.002	--	--	--	--	--	--	--	--	--
MW3	06/25/04	12-12.5	--	<0.002	--	--	--	--	--	--	--	--	--
MW3	06/25/04	17-17.5	--	<0.002	--	--	--	--	--	--	--	--	--
MW3	06/25/04	19-19.5	--	<0.002	--	--	--	--	--	--	--	--	--
MW4	06/24/04	11.5-12	--	0.0024	--	--	--	--	--	--	--	--	--
MW4	06/24/04	13-13.5	--	<0.002	--	--	--	--	--	--	--	--	--
MW4	06/24/04	14.5-15	--	0.0024	--	--	--	--	--	--	--	--	--

TABLE 3 SOIL SAMPLE ANALYTICAL RESULTS FOR OXYGENATES AND ADDITIVES, FORMER MOBIL STATION 04334,  
2492 CASTRO VALLEY BOULEVARD, CASTRO VALLEY, CALIFORNIA

Boring Number	Date	Sample Depth (feet bgs)	Concentration (mg/kg)									CAM-17 (200.7)	HVOC (8010)	
			MTBE (8021B)	MTBE (8260B)	TBA	DIPE	ETBE	1,2-DCA	TAME	EDB	Ethanol			
MW5	01/29/09	5-5.5	--	<0.0050	<0.050	<0.010	<0.010	<0.010	<0.0050	<0.010	<0.0050	<0.25	--	--
MW5	01/29/09	7.5-8	--	<0.0050	<0.050	<0.010	<0.010	<0.010	<0.0050	<0.010	<0.0050	<0.25	--	--
MW5	01/30/09	10.5-11	--	<0.0050	<0.050	<0.010	<0.010	<0.010	<0.0050	<0.010	<0.0050	<0.25	--	--
MW5	01/30/09	13.5-14	--	0.00028 <sup>b</sup>	<0.050	<0.010	<0.010	<0.010	<0.0050	<0.010	<0.0050	<0.25	--	--
MW5	01/30/09	15.5-16	--	0.00038 <sup>b</sup>	<0.050	<0.010	<0.010	<0.010	<0.0050	<0.010	<0.0050	<0.25	--	--
SB8	10/03/07	5-5.5	--	<5.0	<20	<5.0	<5.0	<5.0	<5.0	<5.0	<5.0	--	--	--
SB8	10/04/07	9.5-10	--	<5.0	<20	<5.0	<5.0	<5.0	<5.0	<5.0	<5.0	--	--	--
SB8	10/04/07	14.5-15	--	<5.0	<20	<5.0	<5.0	<5.0	<5.0	<5.0	<5.0	--	--	--
SB9	10/03/07	5-5.5	--	<5.0	<20	<5.0	<5.0	<5.0	<5.0	<5.0	<5.0	--	--	--
SB9	10/03/07	9.5-10	--	<5.0	<20	<5.0	<5.0	<5.0	<5.0	<5.0	<5.0	--	--	--
SB10	10/02/07	5-5.5	--	<0.00190	<0.0476	<0.00190	<0.00476	<0.00190	<0.00190	<0.00190	<0.00190	--	--	--
SB10	10/04/07	9.5-10	--	<5.0	<20	<5.0	<5.0	<5.0	<5.0	<5.0	<5.0	--	--	--
SB10	10/04/07	14.5-15	--	<5.0	<20	<5.0	<5.0	<5.0	<5.0	<5.0	<5.0	--	--	--
SB11	10/03/07	5-5.5	--	<5.0	<20	<5.0	<5.0	<5.0	<5.0	<5.0	<5.0	--	--	--
SB11	10/04/07	9.5-10	--	<5.0	<20	<5.0	<5.0	<5.0	<5.0	<5.0	<5.0	--	--	--
SB12	10/02/07	5-5.5	--	<0.00197	<0.0492	<0.0197	<0.00492	<0.00197	<0.00197	<0.00197	<0.00197	--	--	--
SB12	10/03/07	9.5-10	<5.0	<5.0	<20	<5.0	<5.0	<5.0	<5.0	<5.0	<5.0	--	--	--
SB13	10/02/07	5-5.5	--	<0.00195	<0.0487	<0.00195	<0.00487	<0.00195	<0.00195	<0.00195	<0.00195	--	--	--
SB13	10/03/07	14.5-15	--	<5.0	<20	<5.0	<5.0	<5.0	<5.0	<5.0	<5.0	--	--	--
SB14	10/02/07	5-5.5	--	<0.00193	<0.0484	<0.00193	<0.00484	<0.00193	<0.00193	<0.00193	<0.00193	--	--	--
SB14	10/04/07	9.5-10	--	--	--	--	--	--	--	--	--	--	--	--

Notes:

- a TRC's Initial Site Assessment report, dated 3 September 1999, states "Results were below preliminary remediation goals for residential soils as required by the USEPA Region 9."
- b Analyte was detected at a concentration below the reportig limit and above the laboratory method detection limit. Reported value is estimated.

1,2-DCA 1,2-Dichloroethane.

TABLE 3 SOIL SAMPLE ANALYTICAL RESULTS FOR OXYGENATES AND ADDITIVES, FORMER MOBIL STATION 04334,  
2492 CASTRO VALLEY BOULEVARD, CASTRO VALLEY, CALIFORNIA

Boring Number	Date	Sample Depth (feet bgs)	Concentration (mg/kg)									
			MTBE (8021B)	MTBE (8260B)	TBA	DIPE	ETBE	1,2-DCA	TAME	EDB	Ethanol	CAM-17 (200.7)

bgs Below ground surface.  
 DIPE Diisopropyl ether.  
 EDB 1,2-Dibromomethane.  
 ETBE Ethyl tertiary butyl ether.  
 HVOC Halogenated volatile organic compounds.  
 mg/kg Milligrams per kilogram.  
 MTBE Methyl tertiary butyl ether.  
 ND Not detected.  
 TAME Tertiary amyl methyl ether.  
 TBA Tertiary butyl alcohol.  
 -- Not analyzed.



LLI Sample No. SW 3105253  
 Collected: 3/ 4/99 at 10:50 by CS

Submitted: 3/ 6/99 Reported: 3/24/99  
 Discard: 4/24/99

AB-2 (4-5) Grab Soil Sample  
 LOC# 04-334 PRC# 980044 PHC# 2L  
 Mobil:2492 Castro Valley Blvd. - Castro Valley, CA

Account No: 09728  
 Mobil Business Resources Corp.  
 2063 Main Street  
 Suite 501  
 Oakley CA 94561

P.O. 04-334  
 Rel.

AS RECEIVED

CAT NO.	ANALYSIS NAME	RESULTS	REPORTING LIMIT	UNITS
1644	Antimony	N.D.	2.7	mg/kg
1646	Barium	318.	0.20	mg/kg
1647	Beryllium	0.39	0.15	mg/kg
1649	Cadmium	1.03	0.16	mg/kg
1651	Chromium	24.9	0.74	mg/kg
1652	Cobalt	6.8	1.0	mg/kg
1653	Copper	24.8	0.25	mg/kg
1661	Nickel	25.5	1.0	mg/kg
1666	Silver	N.D.	0.77	mg/kg
1671	Vanadium	28.9	0.56	mg/kg
6925	Thallium TR	N.D.	0.67	mg/kg
6935	Arsenic TR	3.0	0.39	mg/kg
6936	Selenium TR	N.D.	0.41	mg/kg
6956	Lead TR	3.5	0.40	mg/kg
6960	Molybdenum TR	N.D.	0.22	mg/kg
6972	Zinc TR	31.0	0.64	mg/kg
0159	Mercury	0.0314	0.0047	mg/kg

8430 Purgeable Halocarbons (8010)

8563	Chloromethane	N.D.	10.	ug/kg
8564	Vinyl Chloride	N.D.	4.0	ug/kg
8565	Bromomethane	N.D.	10.	ug/kg
8566	Chloroethane	N.D.	4.0	ug/kg
8567	Trichlorofluoromethane	N.D.	4.0	ug/kg
8568	1,1-Dichloroethene	N.D.	4.0	ug/kg
8569	Methylene Chloride	N.D.	4.0	ug/kg
8571	trans-1,2-Dichloroethene	N.D.	4.0	ug/kg
8572	1,1-Dichloroethane	N.D.	4.0	ug/kg
8573	cis-1,2-Dichloroethene	N.D.	4.0	ug/kg
8576	Chloroform	N.D.	4.0	ug/kg
8578	1,2-Dichloroethane	N.D.	5.0	ug/kg
8579	1,1,1-Trichloroethane	N.D.	4.0	ug/kg
8581	Carbon Tetrachloride	N.D.	4.0	ug/kg

#-Laboratory Method Detection Limit exceeded State Regulatory Limit  
 N.D.=Not detected at or above the Reporting Limit

1 COPY TO Alton Geoscience

ATTN: Tom Seeliger

Questions? Contact your Client Services Representative  
 Jedidiah E. Turzi at (717) 656-2300  
 21:05:00 D 0001 22 REP 134751 656006  
 288 145.00 00062800 ASR000

*Donald L. Shady Jr.*  
for

Respectfully Submitted  
 Michele Turner, B.A.  
 Manager, Volatiles



Lancaster Laboratories  
 2425 New Holland Pike  
 PO Box 12425  
 Lancaster, PA 17605-2425



LLI Sample No. SW 3105253

Collected: 3/ 4/99 at 10:50 by CS

Submitted: 3/ 6/99 Reported: 3/24/99

Discard: 4/24/99

AB-2 (4-5) Grab Soil Sample  
 LOC# 04-334 PRCA# 980044 PHC# 2L  
 Mobil:2492 Castro Valley Blvd. - Castro Valley, CA

Account No: 09728  
 Mobil Business Resources Corp.  
 2063 Main Street  
 Suite 501  
 Oakley CA 94561

P.O. 04-334  
 Rel.

AS RECEIVED

CAT NO.	ANALYSIS NAME	RESULTS	REPORTING LIMIT	UNITS
8583	1,2-Dichloropropane	N.D.	4.0	ug/kg
8584	Trichloroethene	N.D.	4.0	ug/kg
8585	Bromodichloromethane	N.D.	4.0	ug/kg
8587	cis-1,3-Dichloropropene	N.D.	4.0	ug/kg
8588	trans-1,3-Dichloropropene	N.D.	4.0	ug/kg
8589	1,1,2-Trichloroethane	N.D.	4.0	ug/kg
8591	Dibromochloromethane	N.D.	4.0	ug/kg
8593	Tetrachloroethene	N.D.	4.0	ug/kg
8595	Chlorobenzene	N.D.	4.0	ug/kg
8596	Bromoform	N.D.	4.0	ug/kg
8597	1,1,2,2-Tetrachloroethane	N.D.	4.0	ug/kg
<hr/>				
8442	2-Chloroethyl Vinyl Ether			
8586	2-Chloroethyl Vinyl Ether	N.D.	20.	ug/kg
<hr/>				
0425	Hexavalent Chromium (SOLIDS)	N.D.	0.13	mg/kg
1562	Petroleum Hydrocarbons (418.1)	N.D.	11.	mg/kg
5547	8015 Mod. for Diesel	N.D.	10.	mg/kg
According to the California LUFT Protocol, the quantitation for Diesel Range Organics was performed by peak area comparison of the sample pattern to that of our #2 fuel oil reference standard (between C10 and C28 normal hydrocarbons).				
2464	Methyl tertiary butyl ether	N.D.	0.1	mg/kg
<hr/>				
5550	8015 Mod. for Gasoline & BTEX			
<hr/>				
2603	Benzene	N.D.	0.005	mg/kg
2604	Toluene	N.D.	0.005	mg/kg
2606	Ethylbenzene	N.D.	0.005	mg/kg
5327	Total Xylenes	N.D.	0.015	mg/kg
5555	TPH - GRO CA LUFT (Soils)	N.D.	1.	mg/kg
According to the California LUFT Protocol, the quantitation for Gasoline Range Organics was performed by peak area comparison of the sample pattern				

#-Laboratory Method Detection Limit exceeded State Regulatory Limit  
 N.D.=Not detected at or above the Reporting Limit

Questions? Contact your Client Services Representative  
 Jedidiah E. Turzi at (717) 656-2300

*Donald J. Shady Jr.*  
for

Respectfully Submitted  
 Michele Turner, B.A.  
 Manager, Volatiles



Lancaster Laboratories  
 2425 New Holland Pike  
 PO Box 12425  
 Lancaster, PA 17605-2425



LLI Sample No. SW 3105254  
 Collected: 3/ 4/99 at 11:05 by CS

Submitted: 3/ 6/99 Reported: 3/24/99  
 Discard: 4/24/99

AB-2 (10-11) Grab Soil Sample  
 LOC# 04-334 PRCA# 980044 PHC# 2L  
 Mobil:2492 Castro Valley Blvd. - Castro Valley, CA

Account No: 09728  
 Mobil Business Resources Corp.  
 2063 Main Street  
 Suite 501  
 Oakley CA 94561

P.O. 04-334  
 Rel.

CAT NO.	ANALYSIS NAME	AS RECEIVED		
		RESULTS	REPORTING LIMIT	UNITS
1644	Antimony	N.D.	2.7	mg/kg
1646	Barium	208.	0.20	mg/kg
1647	Beryllium	0.36	0.15	mg/kg
1649	Cadmium	1.62	0.16	mg/kg
1651	Chromium	31.1	0.74	mg/kg
1652	Cobalt	11.4	1.0	mg/kg
1653	Copper	51.3	0.25	mg/kg
1661	Nickel	34.7	1.0	mg/kg
1666	Silver	N.D.	0.77	mg/kg
1671	Vanadium	41.5	0.56	mg/kg
6925	Thallium TR	N.D.	0.67	mg/kg
6935	Arsenic TR	2.7	0.39	mg/kg
6936	Selenium TR	0.45	0.41	mg/kg
6955	Lead TR	6.3	0.40	mg/kg
6960	Molybdenum TR	N.D.	0.22	mg/kg
6972	Zinc TR	73.7	0.64	mg/kg
0159	Mercury	0.0927	0.0046	mg/kg
-----				
8430	Purgeable Halocarbons (8010)			
-----				
8563	Chloromethane	N.D.	10.	ug/kg
8564	Vinyl Chloride	N.D.	4.0	ug/kg
8565	Bromomethane	N.D.	10.	ug/kg
8566	Chloroethane	N.D.	4.0	ug/kg
8567	Trichlorofluoromethane	N.D.	4.0	ug/kg
8568	1,1-Dichloroethene	N.D.	4.0	ug/kg
8569	Methylene Chloride	N.D.	4.0	ug/kg
8571	trans-1,2-Dichloroethene	N.D.	4.0	ug/kg
8572	1,1-Dichloroethane	N.D.	4.0	ug/kg
8573	cis-1,2-Dichloroethene	N.D.	4.0	ug/kg
8576	Chloroform	N.D.	4.0	ug/kg
8578	1,2-Dichloroethane	N.D.	5.0	ug/kg
8579	1,1,1-Trichloroethane	N.D.	4.0	ug/kg
8581	Carbon Tetrachloride	N.D.	4.0	ug/kg

#Laboratory Method Detection Limit exceeded State Regulatory Limit  
 N.D.=Not detected at or above the Reporting Limit

1 COPY TO Alton Geoscience

ATTN: Tom Seeliger

Questions? Contact your Client Services Representative  
 Jedidiah E. Turzi at (717) 656-2300  
 21:07:54 D 0001 22 REP 134751 656006  
 288 145.00 00062800 ASR000

*Donald J. Shady Jr.*  
 for

Respectfully Submitted  
 Michele Turner, B.A.  
 Manager, Volatiles



Lancaster Laboratories  
 2425 New Holland Pike  
 PO Box 12425  
 Lancaster, PA 17605-2425





LLI Sample No. SW 3105254  
 Collected: 3/ 4/99 at 11:05 by CS

Submitted: 3/ 6/99 Reported: 3/24/99  
 Discard: 4/24/99

AB-2 (10-11) Grab Soil Sample  
 LOC# 04-334 PRCA# 980044 PHC# 2L  
 Mobil:2492 Castro Valley Blvd. - Castro Valley, CA

Account No: 09728  
 Mobil Business Resources Corp.  
 2063 Main Street  
 Suite 501  
 Oakley CA 94561

P.O. 04-334  
 Rel.

CAT NO.	ANALYSIS NAME	AS RECEIVED		
		RESULTS	REPORTING LIMIT	UNITS
8583	1,2-Dichloropropane	N.D.	4.0	ug/kg
8584	Trichloroethene	N.D.	4.0	ug/kg
8585	Bromodichloromethane	N.D.	4.0	ug/kg
8587	cis-1,3-Dichloropropene	N.D.	4.0	ug/kg
8588	trans-1,3-Dichloropropene	N.D.	4.0	ug/kg
8589	1,1,2-Trichloroethane	N.D.	4.0	ug/kg
8591	Dibromochloromethane	N.D.	4.0	ug/kg
8593	Tetrachloroethene	N.D.	4.0	ug/kg
8595	Chlorobenzene	N.D.	4.0	ug/kg
8596	Bromoform	N.D.	4.0	ug/kg
8597	1,1,2,2-Tetrachloroethane	N.D.	4.0	ug/kg
-----				
8442	2-Chloroethyl Vinyl Ether			
-----				
8586	2-Chloroethyl Vinyl Ether	N.D.	20.	ug/kg
-----				
0425	Hexavalent Chromium (SOLIDS)	N.D.	0.13	mg/kg
1562	Petroleum Hydrocarbons (418.1)	13.	11.	mg/kg
5547	8015 Mod. for Diesel	N.D.	10.	mg/kg
According to the California LUFT Protocol, the quantitation for Diesel Range Organics was performed by peak area comparison of the sample pattern to that of our #2 fuel oil reference standard (between C10 and C28 normal hydrocarbons).				
2464	Methyl tertiary butyl ether	N.D.	0.1	mg/kg
-----				
5550	8015 Mod. for Gasoline & BTEX			
-----				
2603	Benzene	N.D.	0.005	mg/kg
2604	Toluene	N.D.	0.005	mg/kg
2606	Ethylbenzene	N.D.	0.005	mg/kg
5327	Total Xylenes	N.D.	0.015	mg/kg
5555	TPH - GRO CA LUFT (Soils)	N.D.	1.	mg/kg
According to the California LUFT Protocol, the quantitation for Gasoline Range Organics was performed by peak area comparison of the sample pattern				

#-Laboratory Method Detection Limit exceeded State Regulatory Limit  
 N.D.=Not detected at or above the Reporting Limit

Questions? Contact your Client Services Representative  
 Jedidiah E. Turzi at (717) 656-2300

*Donald J. Shultz*  
 for

Respectfully Submitted  
 Michele Turner, B.A.  
 Manager, Volatiles



Lancaster Laboratories  
 2425 New Holland Pike  
 PO Box 12425  
 Lancaster, PA 17605-2425



LLI Sample No. SW 3105255  
 Collected: 3/ 4/99 at 11:30 by CS

Submitted: 3/ 6/99 Reported: 3/24/99  
 Discard: 4/24/99

AB-2 (15-16) Grab Soil Sample  
 LOC# 04-334 PRCA# 980044 PHC# 2L  
 Mobil:2492 Castro Valley Blvd. - Castro Valley, CA

Account No: 09728  
 Mobil Business Resources Corp.  
 2063 Main Street  
 Suite 501  
 Oakley CA 94561

P.O. 04-334  
 Rel.

AS RECEIVED

CAT NO.	ANALYSIS NAME	RESULTS	REPORTING LIMIT	UNITS
1644	Antimony	N.D.	2.7	mg/kg
1646	Barium	194.	0.20	mg/kg
1647	Beryllium	0.63	0.15	mg/kg
1649	Cadmium	1.63	0.16	mg/kg
1651	Chromium	29.7	0.74	mg/kg
1652	Cobalt	14.2	1.0	mg/kg
1653	Copper	75.7	0.25	mg/kg
1661	Nickel	43.1	1.0	mg/kg
1666	Silver	N.D.	0.77	mg/kg
1671	Vanadium	55.5	0.56	mg/kg
6925	Thallium TR	N.D.	0.67	mg/kg
6935	Arsenic TR	13.8	0.39	mg/kg
6936	Selenium TR	0.89	0.41	mg/kg
6955	Lead TR	9.4	0.40	mg/kg
6960	Molybdenum TR	0.55	0.22	mg/kg
6972	Zinc TR	122.	0.64	mg/kg
0159	Mercury	0.149	0.0047	mg/kg

8430 Purgeable Halocarbons (8010)

8563	Chloromethane	N.D.	10.	ug/kg
8564	Vinyl Chloride	N.D.	4.0	ug/kg
8565	Bromomethane	N.D.	10.	ug/kg
8566	Chloroethane	N.D.	4.0	ug/kg
8567	Trichlorofluoromethane	N.D.	4.0	ug/kg
8568	1,1-Dichloroethene	N.D.	4.0	ug/kg
8569	Methylene Chloride	N.D.	4.0	ug/kg
8571	trans-1,2-Dichloroethene	N.D.	4.0	ug/kg
8572	1,1-Dichloroethane	N.D.	4.0	ug/kg
8573	cis-1,2-Dichloroethene	N.D.	4.0	ug/kg
8576	Chloroform	N.D.	4.0	ug/kg
8578	1,2-Dichloroethane	N.D.	5.0	ug/kg
8579	1,1,1-Trichloroethane	N.D.	4.0	ug/kg
8581	Carbon Tetrachloride	N.D.	4.0	ug/kg

#-Laboratory Method Detection Limit exceeded State Regulatory Limit  
 N.D.=Not detected at or above the Reporting Limit

1 COPY TO Alton Geoscience

ATTN: Tom Seeliger

Questions? Contact your Client Services Representative  
 Jedidiah E. Turzi at (717) 656-2300  
 21:11:03 D 0001 22 REP 134751 656006  
 288 145.00 00062800 ASR000

*Donald J. Shelly Jr.*

Respectfully Submitted  
 Michele Turner, B.A.  
 Manager, Volatiles



Lancaster Laboratories  
 2425 New Holland Pike  
 PO Box 12425  
 Lancaster, PA 17605-2425  
 717.656.2300 Fax 717.656.2681



LLI Sample No. SW 3105255

Collected: 3/ 4/99 at 11:30 by CS

Submitted: 3/ 6/99 Reported: 3/24/99

Discard: 4/24/99

AB-2 (15-16) Grab Soil Sample

LOC# 04-334 PRCA# 980044 PHC# 2L

Mobil:2492 Castro Valley Blvd. - Castro Valley, CA

Account No: 09728  
 Mobil Business Resources Corp.  
 2063 Main Street  
 Suite 501  
 Oakley CA 94561

P.O. 04-334

Rel.

AS RECEIVED

CAT NO.	ANALYSIS NAME	RESULTS	REPORTING LIMIT	UNITS
8583	1,2-Dichloropropane	N.D.	4.0	ug/kg
8584	Trichloroethene	N.D.	4.0	ug/kg
8585	Bromodichloromethane	N.D.	4.0	ug/kg
8587	cis-1,3-Dichloropropene	N.D.	4.0	ug/kg
8588	trans-1,3-Dichloropropene	N.D.	4.0	ug/kg
8589	1,1,2-Trichloroethane	N.D.	4.0	ug/kg
8591	Dibromochloromethane	N.D.	4.0	ug/kg
8593	Tetrachloroethene	N.D.	4.0	ug/kg
8595	Chlorobenzene	N.D.	4.0	ug/kg
8596	Bromoform	N.D.	4.0	ug/kg
8597	1,1,1,2-Tetrachloroethane	N.D.	4.0	ug/kg
-----				
8442	2-Chloroethyl Vinyl Ether			
-----				
8586	2-Chloroethyl Vinyl Ether	N.D.	20.	ug/kg
-----				
0425	Hexavalent Chromium (SOLIDS)	N.D.	0.13	mg/kg
1562	Petroleum Hydrocarbons (418.1)	N.D.	11.	mg/kg
5547	8015 Mod. for Diesel	N.D.	10.	mg/kg
According to the California LUFT Protocol, the quantitation for Diesel Range Organics was performed by peak area comparison of the sample pattern to that of our #2 fuel oil reference standard (between C10 and C28 normal hydrocarbons).				
2464	Methyl tertiary butyl ether	N.D.	0.1	mg/kg
-----				
5550	8015 Mod. for Gasoline & BTEX			
-----				
2603	Benzene	N.D.	0.005	mg/kg
2604	Toluene	N.D.	0.005	mg/kg
2606	Ethylbenzene	N.D.	0.005	mg/kg
5327	Total Xylenes	N.D.	0.015	mg/kg
5555	TPH - GRO CA LUFT (Soils)	N.D.	1.	mg/kg
According to the California LUFT Protocol, the quantitation for Gasoline Range Organics was performed by peak area comparison of the sample pattern				

#=Laboratory Method Detection Limit exceeded State Regulatory Limit  
 N.D.=Not detected at or above the Reporting Limit

Questions? Contact your Client Services Representative  
 Jedidiah E. Turzi at (717) 656-2300

*Donald J. Shelby*  
for

Respectfully Submitted  
 Michele Turner, B.A.  
 Manager, Volatiles



Lancaster Laboratories  
 2425 New Holland Pike  
 PO Box 12425  
 Lancaster, PA 17605-2425  
 717.656.2300 Fax 717.656.2681

TABLE 4 GROUNDWATER SAMPLE ANALYTICAL RESULTS FOR TEMPORARY BORINGS, FORMER MOBIL STATION 04334,  
2492 CASTRO VALLEY BOULEVARD, CASTRO VALLEY, CALIFORNIA

Boring Number	Date	Depth (feet)	Concentration (µg/L)														HVOC (8010)	
			Benzene	Toluene	Ethyl-benzene	Xylenes	TPH-g	TPH-d	MTBE (8021B)	MTBE (8260B)	TBA	DIPE	ETBE	1,2-DCA	TAME	EDB		TRPH
AB1	03/05/99	8.7 <sup>a</sup>	ND	ND	ND	ND	ND	450	ND	--	--	--	--	--	--	--	--	--
AB2	03/05/99	4.2 <sup>a</sup>	ND	ND	0.8	ND	ND	730	ND	--	--	--	--	--	--	--	1.0	ND
AB3	03/05/99	8.3 <sup>a</sup>	210	7.5	660	34	4,300	2,100	ND	--	--	--	--	--	--	--	--	--
AB4	03/05/99	3.2 <sup>a</sup>	100	43	170	260	2,900	5,500	ND	--	--	--	--	--	--	--	--	--
AB5	03/05/99	9.65 <sup>a</sup>	ND	ND	1.9	ND	ND	1,600	ND	--	--	--	--	--	--	--	--	--
SB1	11/12/03	Boring dry. No groundwater samples were collected.																
SB2	11/13/03	2-17 <sup>b</sup>	<0.5	<0.5	<0.5	<0.5	<50	127	--	2.1	--	--	--	--	--	--	<100	--
SB3	11/12/03	0-12 <sup>b</sup>	1,170	65.0	1,780	2,240	46,700	13,400	--	<0.5	--	--	--	--	--	--	--	--
SB4	11/12/03	Boring terminated at 2 feet bgs. No groundwater samples were collected.																
SB5	11/13/03	0-12 <sup>b</sup>	6.30	2.6	2.8	1.4	760	173	--	<0.5	--	--	--	--	--	--	--	--
SB6	11/13/03	0-12 <sup>b</sup>	1.90	6.3	3.6	4.3	1,650	816	--	<0.5	--	--	--	--	--	--	--	--
SB7	11/13/03	Boring dry. No groundwater samples were collected.																
SB8	10/04/07	0-12 <sup>b</sup>	<0.50	<0.50	<0.50	<0.50	<50	<51	--	0.71	<20	<0.50	<0.50	<0.50	<0.50	<0.50	<0.50	--
SB9	10/03/07	0-10 <sup>b</sup>	Boring dry. No groundwater samples were collected.															
SB10	10/02/07	0-15 <sup>b</sup>	Boring dry. No groundwater samples were collected.															
SB11	10/04/07	0-12 <sup>b</sup>	<0.50	3.5	<0.50	4.9	1,100	--	--	0.52	<20	<0.50	<0.50	<0.50	<0.50	<0.50	--	--
SB12	10/04/07	0-12 <sup>b</sup>	<1.0	<1.0	260	2.9	2,500	1,800	--	1.6	<40	<1.0	<1.0	<1.0	<1.0	<1.0	--	--
SB13	10/03/07	0-15 <sup>b</sup>	<0.50	<0.50	<0.50	<0.50	<50	51	--	<0.50	<20	<0.50	<0.50	<0.50	<0.50	<0.50	--	--
SB14	10/03/07	0-10 <sup>b</sup>	Sample collected but not analyzed (analysis contingent on the results of other samples).															

ATTACHMENT 4

TABLE 4 GROUNDWATER SAMPLE ANALYTICAL RESULTS FOR TEMPORARY BORINGS, FORMER MOBIL STATION 04334,  
2492 CASTRO VALLEY BOULEVARD, CASTRO VALLEY, CALIFORNIA

Boring Number	Date	Depth (feet)	Concentration (µg/L)													
			Benzene	Toluene	Ethyl- benzene	Xylenes	TPH-g	TPH-d	MTBE (8021B)	MTBE (8260B)	TBA	DIPE	ETBE	1,2-DCA	TAME	EDB

Notes:

- a Depth to water.
- b Interval of screen placed in boring.
- µg/L Micrograms per liter.
- 1,2-DCA 1,2-Dichloroethane.
- bgs Below ground surface.
- DIPE Diisopropyl ether.
- EDB 1,2-Dibromomethane.
- ETBE Ethyl tertiary butyl ether.
- HVOC Halogenated volatile organic compounds.
- MTBE Methyl tertiary butyl ether.
- ND Not detected.
- TAME Tertiary amyl methyl ether.
- TBA Tertiary butyl alcohol.
- TPH-d Total Petroleum Hydrocarbons as diesel.
- TPH-g Total Petroleum Hydrocarbons as gasoline.
- TRPH Total Recoverable Petroleum Hydrocarbons.
- Not analyzed.

TABLE 2 GROUNDWATER MONITORING DATA, FORMER MOBIL STATION 04334, 2492 CASTRO VALLEY BOULEVARD, CASTRO VALLEY, CALIFORNIA

Well ID	Date	Top of Casing Elevation (feet)	Depth to Water (feet)	Groundwater Elevation (feet)	Concentration (µg/L)							Other Oxygenates and Additives
					Benzene	Toluene	Ethyl-benzene	Total Xylenes	TPH-g	TPH-d	MTBE	
MW1	a 08/13/04	173.23	7.32	165.91	<0.5	0.7	<0.5	1.0	<50	71	1.20 <sup>b</sup>	--
MW1	11/09/04	173.23	6.96	166.27	<0.5	0.9	<0.5	0.9	<50	63	1.50 <sup>b</sup>	--
MW1	02/16/05	173.23	6.10	167.13	<0.5	1.0	<0.5	1.5	<50	78	1.30 <sup>b</sup>	--
MW1	05/16/05	173.23	5.81	167.42	<0.5	<0.5	<0.5	<0.5	<50	<50	1.40 <sup>b</sup>	--
MW1	08/17/05	173.23	6.70	166.53	<0.5	<0.5	<0.5	<0.5	<50	<50	1.19 <sup>b</sup>	--
MW1	11/15/05	173.23	7.55	165.68	<0.5	<0.5	<0.5	<0.5	<50	<50	1.13 <sup>b</sup>	--
MW1	02/06/06	173.23	6.40	166.83	<0.5	<0.5	<0.5	<0.5	<50	160	<0.5 <sup>b</sup>	--
MW1	05/03/06	173.23	6.95	166.28	<1.00	<1.00	<1.00	<3.00	<50.0	78	<0.50 <sup>b</sup>	--
MW1	08/04/06	173.23	7.71	165.52	<0.50	<0.50	<0.50	<0.50	<50.0	167	<0.500 <sup>b</sup>	--
MW1	11/06/06	173.23	7.57	165.66	<0.50	<0.50	<0.50	<0.50	<50.0	<47.2	0.880 <sup>b</sup>	--
MW1	02/21/07	173.23	7.19	166.04	<0.50	<0.50	<0.50	<0.50	<50.0	<46.9	2.42 <sup>b</sup>	--
MW1	08/01/07	173.23	8.00	165.23	3.02	4.18	0.89	3.96	90.8	<47	1.54 <sup>b</sup>	--
MW1	10/25/07	173.23	7.90	165.33	<0.50	<0.50	<0.50	<0.50	<50.0	<47.2	1.63 <sup>b</sup>	--
MW1	01/31/08	173.23	6.60	166.63	<0.50	<0.50	<0.50	<0.50	<50	<50	1.8 <sup>b</sup>	--
MW1	05/01/08	173.23	7.80	165.43	<1.00	<1.00	<1.00	<3.00	<50.0	<47.2	1.67 <sup>b</sup>	--
MW1	07/31/08	173.23	8.15	165.08	<0.50	<0.50	<0.50	<0.50	<50	<47	1.7 <sup>b</sup>	--
MW1	11/07/08	173.23	8.11	165.12	<0.50	<0.50	<0.50	<0.50	<50	<47	1.4 <sup>b</sup>	--
MW1	01/29/09	173.23	7.75	165.48	<0.50	0.21 <sup>e,f</sup>	<0.50	0.30 <sup>e,f</sup>	<50	<50	1.6 <sup>b</sup>	--
MW1	04/15/09	173.23	7.55	165.68	<0.50	<0.50	<0.50	<1.0	<50	<50	1.6 <sup>b</sup>	19 <sup>g</sup> , 22 <sup>h,c</sup>
MW1	07/21/09	173.23	8.14	165.09	<0.50	<0.50	<0.50	<1.0	<50	<50	1.2 <sup>b</sup>	ND
MW1	10/05/09	173.23	8.32	164.91	<0.50	<0.50	<0.50	<1.0	<50	<50	1.1 <sup>b</sup>	ND
MW1	04/06/10	173.23	6.81	166.42	<0.50	<0.50	<0.50	<1.0	<50	<50	1.1 <sup>b</sup>	ND
MW2	a 08/13/04	173.63	6.96	166.67	<0.5	0.8	<0.5	1.0	<50	57	<0.5 <sup>b</sup>	--
MW2	11/09/04	173.63	6.44	167.19	<0.5	1.1	<0.5	1.2	<50	<50	<0.5 <sup>b</sup>	--
MW2	02/16/05	173.63	5.21	168.42	<0.5	0.9	<0.5	1.4	<50	55	<0.5 <sup>b</sup>	--
MW2	05/16/05	173.63	5.86	167.77	<0.5	<0.5	<0.5	<0.5	<50	<50	<0.5 <sup>b</sup>	--
MW2	08/17/05	173.63	5.72	167.91	<0.5	<0.5	<0.5	<0.5	<50	<50	<0.5 <sup>b</sup>	--
MW2	11/15/05	173.63	7.65	165.98	<0.5	<0.5	<0.5	<0.5	<50	<50	<0.5 <sup>b</sup>	--

TABLE 2 GROUNDWATER MONITORING DATA, FORMER MOBIL STATION 04334, 2492 CASTRO VALLEY BOULEVARD, CASTRO VALLEY, CALIFORNIA

Well ID	Date	Top of Casing Elevation (feet)	Depth to Water (feet)	Groundwater Elevation (feet)	Concentration (µg/L)							Other Oxygenates and Additives
					Benzene	Toluene	Ethyl-benzene	Total Xylenes	TPH-g	TPH-d	MTBE	
MW2	02/06/06	173.63	6.24	167.39	<0.5	<0.5	<0.5	<0.5	<50	<50	<0.5 <sup>b</sup>	--
MW2	05/03/06	173.63	6.53	167.10	<1.00	<1.00	<1.00	<3.00	<50.0	<50	<0.50 <sup>b</sup>	--
MW2	08/04/06	173.63	7.65	165.98	<0.50	<0.50	<0.50	<0.50	<50.0	<47.2	<0.500 <sup>b</sup>	--
MW2	11/06/06	173.63	6.98	166.65	<0.50	<0.50	<0.50	<0.50	<50.0	<46.9	<0.500 <sup>b</sup>	--
MW2	02/21/07	173.63	6.36	167.27	<0.50	<0.50	<0.50	<0.50	<50.0	<46.9	1.70 <sup>b</sup>	--
MW2	05/01/07	173.63	7.51	166.12	<0.50	<0.50	<0.50	<0.50	<50.0	<46.9	<0.50 <sup>b</sup>	--
MW2	08/01/07	173.63	8.12	165.51	<0.50	<0.50	<0.50	<0.50	<50.0	<47	<0.500 <sup>b</sup>	--
MW2	10/25/07	173.63	7.79	165.84	<0.50	<0.50	<0.50	<0.50	<50.0	<47.2	<0.500 <sup>b</sup>	--
MW2	01/31/08	173.63	5.89	167.74	<0.50	<0.50	<0.50	<0.50	<50	<50	0.82 <sup>b</sup>	--
MW2	05/01/08	173.63	7.81	165.82	<1.00	<1.00	<1.00	<3.00	<50.0	<47.2	<0.500 <sup>b</sup>	--
MW2	07/31/08	173.63	8.30	165.33	<0.50	<0.50	<0.50	<0.50	<50	<47	<0.50 <sup>b</sup>	--
MW2	11/07/08	173.63	8.09	165.54	<0.50	<0.50	<0.50	<0.50	<50	<47	<0.50 <sup>b</sup>	--
MW2	01/29/09	173.63	7.65	165.98	<0.50	<0.50	<0.50	<1.0	<50	<50	<0.50 <sup>b</sup>	--
MW2	04/15/09	173.63	7.51	166.12	<0.50	<0.50	<0.50	<1.0	<50	<50	0.50 <sup>b,c</sup>	6.5 <sup>b,c</sup>
MW2	07/21/09	173.63	8.27	165.36	<0.50	<0.50	<0.50	<1.0	<50	<50	0.12 <sup>b,c</sup>	ND
MW2	10/05/09	173.63	8.54	165.09	<0.50	<0.50	<0.50	<1.0	<50	<50	0.14 <sup>b,c</sup>	ND
<b>MW2</b>	<b>04/06/10</b>	<b>173.63</b>	<b>6.30</b>	<b>167.33</b>	<b>&lt;0.50</b>	<b>&lt;0.50</b>	<b>&lt;0.50</b>	<b>&lt;1.0</b>	<b>&lt;50</b>	<b>&lt;50</b>	<b>0.53<sup>b</sup></b>	<b>ND</b>
MW3	a 08/13/04	171.91	5.36	166.55	100	2.0	187	59.6	1,440	352	<0.5 <sup>b</sup>	--
MW3	11/09/04	171.91	4.80	167.11	188	3.6	242	20.0	1,690	461	<0.5 <sup>b</sup>	--
MW3	02/16/05	171.91	3.10	168.81	66.2	1.4	61.1	12.6	575	269	<0.5 <sup>b</sup>	--
MW3	05/16/05	171.91	3.86	168.05	74.2	1.4	61.0	9.0	592	92	<0.5 <sup>b</sup>	--
MW3	08/17/05	171.91	4.75	167.16	231 <sup>c</sup>	2.35	102	11.4	1,130	416	<0.5 <sup>b</sup>	--
MW3	11/15/05	171.91	6.56	165.35	57.4	0.95	62.4	10.5	452	193	<0.5 <sup>b</sup>	--
MW3	02/06/06	171.91	4.00	167.91	69	<5.0	64	10	830	165	<0.5 <sup>b</sup>	--
MW3	05/03/06	171.91	5.44	166.47	52.1	<1.00	37.0	4.81	605	140	<0.50 <sup>b</sup>	--
MW3	08/04/06	171.91	5.25	166.66	15.2	<0.50	5.34	1.25	262	108	<0.500 <sup>b</sup>	--
MW3	11/06/06	171.91	4.11	167.80	60.0	1.04	47.3	3.09	561	106	<0.500 <sup>b</sup>	--
MW3	02/21/07	171.91	4.94	166.97	35.1	<0.50	45.4	1.09	483	125	<0.500 <sup>b</sup>	--

TABLE 2 GROUNDWATER MONITORING DATA, FORMER MOBIL STATION 04334, 2492 CASTRO VALLEY BOULEVARD, CASTRO VALLEY, CALIFORNIA

Well ID	Date	Top of Casing Elevation (feet)	Depth to Water (feet)	Groundwater Elevation (feet)	Concentration (µg/L)							Other Oxygenates and Additives
					Benzene	Toluene	Ethyl-benzene	Total Xylenes	TPH-g	TPH-d	MTBE	
MW3	05/01/07	171.91	5.86	166.05	32.5	1.63	28.7	1.53	539	120	<0.50 <sup>b</sup>	--
MW3	08/01/07	171.91	7.54	164.37	1.26	0.60	<0.50	<0.50	89.2	<47	<0.500 <sup>b</sup>	--
MW3	10/25/07	171.91	6.30	165.61	2.94	<0.50	<0.50	<0.50	50.4	<47.2	<0.500 <sup>b</sup>	--
MW3	01/31/08	171.91	3.75	168.16	10	<0.50	11	<0.50	120	51 <sup>d</sup>	<0.50 <sup>b</sup>	--
MW3	05/01/08	171.91	6.60	165.31	2.38	<1.00	<1.00	<3.00	<50.0	<47.2	<0.500 <sup>b</sup>	--
MW3	07/31/08	171.91	7.77	164.14	<0.50	<0.50	<0.50	<0.50	<50	<47	<0.50 <sup>b</sup>	--
MW3	11/07/08	171.91	6.34	165.57	3.6	<0.50	1.4	<0.50	<50	<47	<0.50 <sup>b</sup>	--
MW3	01/29/09	171.91	5.86	166.05	13	0.33 <sup>c</sup>	13	0.52 <sup>e,f</sup>	92	<50	<0.50 <sup>b</sup>	--
MW3	04/15/09	171.91	6.14	165.77	2.2	<0.50	3.2	<1.0	51	<50	<0.50 <sup>b</sup>	3.7 <sup>g,c</sup>
MW3	07/21/09	171.91	7.74	164.17	0.24 <sup>c</sup>	<0.50	<0.50	<1.0	<50	<50	<0.50 <sup>b</sup>	0.11 <sup>j,e</sup>
MW3	10/05/09	171.91	8.15	163.76	<0.50	<0.50	<0.50	<1.0	<50	<50	<0.50 <sup>b</sup>	0.084 <sup>j,e</sup>
<b>MW3</b>	<b>04/06/10</b>	<b>171.91</b>	<b>4.27</b>	<b>167.64</b>	<b>15</b>	<b>0.44<sup>e</sup></b>	<b>85</b>	<b>1.4</b>	<b>300<sup>k</sup></b>	<b>&lt;50</b>	<b>&lt;0.50<sup>b</sup></b>	<b>ND</b>
MW4	a 08/13/04	170.48	6.10	164.38	<0.5	0.8	<0.5	1.1	<50	72	2.80 <sup>b</sup>	--
MW4	11/09/04	170.48	5.54	164.94	<0.5	2.3	0.7	1.5	<50	<50	2.10 <sup>b</sup>	--
MW4	02/16/05	170.48	5.11	165.37	<0.5	1.1	<0.5	1.7	<50	<50	<0.5 <sup>b</sup>	--
MW4	05/16/05	170.48	5.44	165.04	<0.5	<0.5	<0.5	<0.5	<50	<50	<0.5 <sup>b</sup>	--
MW4	08/17/05	170.48	5.71	164.77	<0.5	<0.5	<0.5	<0.5	<50	<50	1.03 <sup>b</sup>	--
MW4	11/15/05	170.48	5.80	164.68	<0.5	<0.5	<0.5	<0.5	<50	<50	0.730 <sup>b</sup>	--
MW4	02/06/06	170.48	5.10	165.38	<0.5	<0.5	<0.5	<0.5	<50	85.2	<0.5 <sup>b</sup>	--
MW4	05/03/06	170.48	5.54	164.94	<1.00	<1.00	<1.00	<3.00	<50.0	<47	<0.50 <sup>b</sup>	--
MW4	08/04/06	170.48	5.75	164.73	<0.50	<0.50	<0.50	<0.50	<50.0	52.7	<0.500 <sup>b</sup>	--
MW4	11/06/06	170.48	5.95	164.53	<0.50	<0.50	<0.50	<0.50	<50.0	<47.2	<0.500 <sup>b</sup>	--
MW4	02/21/07	170.48	5.56	164.92	<0.50	<0.50	<0.50	<0.50	<50.0	<46.9	<0.500 <sup>b</sup>	--
MW4	05/01/07	170.48	5.66	164.82	<0.50	<0.50	<0.50	<0.50	<50.0	<46.9	<0.50 <sup>b</sup>	--
MW4	08/01/07	170.48	6.06	164.42	0.85	<0.50	<0.50	0.97	<50.0	<47	<0.870 <sup>b</sup>	--
MW4	10/25/07	170.48	5.34	165.14	<0.50	<0.50	<0.50	<0.50	<50.0	<47.2	<0.500 <sup>b</sup>	--
MW4	01/31/08	170.48	5.05	165.43	<0.50	<0.50	<0.50	<0.50	<50	<47	<0.50 <sup>b</sup>	--
MW4	05/01/08	170.48	5.86	164.62	<1.00	<1.00	<1.00	<3.00	<50.0	<47.2	<0.500 <sup>b</sup>	--
MW4	07/31/08	170.48	6.10	164.38	<0.50	<0.50	<0.50	<0.50	<50	<47	<0.50 <sup>b</sup>	--



TABLE 2 GROUNDWATER MONITORING DATA, FORMER MOBIL STATION 04334, 2492 CASTRO VALLEY BOULEVARD, CASTRO VALLEY, CALIFORNIA

Well ID	Date	Top of Casing Elevation (feet)	Depth to Water (feet)	Groundwater Elevation (feet)	Concentration (µg/L)							Other Oxygenates and Additives
					Benzene	Toluene	Ethyl-benzene	Total Xylenes	TPH-g	TPH-d	MTBE	
MW4	11/07/08	170.48	5.65	164.83	<0.50	<0.50	<0.50	<0.50	<50	<47	<0.50 <sup>d</sup>	--
MW4	01/29/09	170.48	5.80	164.68	<0.50	0.19 <sup>e,f</sup>	<0.50	<1.0	<50	<50	<0.50 <sup>b</sup>	--
MW4	04/15/09	170.48	5.90	164.58	<0.50	<0.50	<0.50	<1.0	<50	<50	0.15 <sup>b,c</sup>	ND
MW4	07/21/09	170.48	6.00	164.48	<0.50	<0.50	<0.50	<1.0	<50	<50	0.16 <sup>b,c</sup>	ND
MW4	10/05/09	170.48	6.01	164.47	<0.50	<0.50	<0.50	<1.0	<50	<50	0.18 <sup>b,c</sup>	ND
<b>MW4</b>	<b>04/06/10</b>	<b>170.48</b>	<b>4.65</b>	<b>165.83</b>	<b>&lt;0.50</b>	<b>&lt;0.50</b>	<b>&lt;0.50</b>	<b>&lt;1.0</b>	<b>&lt;50</b>	<b>&lt;50</b>	<b>&lt;0.50<sup>b</sup></b>	<b>ND</b>
MW5	i 03/04/09	173.80	4.70	169.10	<0.50	<0.50	<0.50	<1.0	150	--	10 <sup>b</sup>	ND
MW5	04/15/09	173.80	5.17	168.63	<0.50	<0.50	<0.50	<1.0	<50	<50	9.3 <sup>b</sup>	24 <sup>h,e</sup>
MW5	07/21/09	173.80	5.05	168.75	<0.50	<0.50	<0.50	<1.0	<50	<50	7.0 <sup>b</sup>	ND
MW5	10/05/09	173.80	4.41	169.39	<0.50	<0.50	<0.50	<1.0	<50	<50	8.2 <sup>b</sup>	ND
<b>MW5</b>	<b>04/06/10</b>	<b>173.80</b>	<b>6.24</b>	<b>167.56</b>	<b>&lt;0.50</b>	<b>0.23<sup>e,f</sup></b>	<b>&lt;0.50</b>	<b>&lt;1.0</b>	<b>&lt;50</b>	<b>&lt;50</b>	<b>11<sup>b</sup></b>	<b>ND</b>

Notes: Depth-to-water-level measurements in feet from top-of-casing.  
 Other Oxygenates and Additives include ethyl tertiary butyl ether, tertiary amyl methyl ether, tertiary butyl alcohol, 1,2-dibromoethane, 1,2-dichloroethane, diisopropyl ether, and ethanol which are individually identified only if detected above the laboratory reporting limit. Analyzed by EPA Method 8260B.

- a Top-of-casing elevation surveyed by Morrow Surveying on 12 July 2004.
- b Analyzed by EPA Method 8260 or 8260B.
- c Concentration estimated. Analyte exceeded calibration range. Reanalysis not performed due to holding time requirements.
- d Does not match typical pattern.
- e Analyte was detected at a concentration below the reporting limit and above the laboratory method detection limit. Reported value is estimated.
- f Analyte presence was not confirmed by second column or GC/MS analysis.
- g Tertiary butyl alcohol.
- h Ethanol.
- i Top-of-casing elevation surveyed by Morrow Surveying on 10 February 2009.
- j 1,2-Dichloroethane.
- k The sample chromatographic pattern for TPH does not match the chromatographic pattern of the specified standard. Quantitation of the unknown hydrocarbon(s) in the sample was based upon the specified standard.

MTBE Methyl tertiary butyl ether.  
 TPH-d Total Petroleum Hydrocarbons as diesel.  
 TPH-g Total Petroleum Hydrocarbons as gasoline.

TABLE 2 GROUNDWATER MONITORING DATA, FORMER MOBIL STATION 04334, 2492 CASTRO VALLEY BOULEVARD, CASTRO VALLEY, CALIFORNIA

Well ID	Date	Top of Casing Elevation (feet)	Depth to Water (feet)	Groundwater Elevation (feet)	Concentration (µg/L)						
					Benzene	Toluene	Ethyl- benzene	Total Xylenes	TPH-g	TPH-d	MTBE

ND Not detected at or above laboratory reporting limits.

µg/L Micrograms per liter.

-- Not sampled or not analyzed.

TABLE 4 GROUNDWATER SAMPLE ANALYTICAL RESULTS FOR TEMPORARY BORINGS, FORMER MOBIL STATION 04334,  
2492 CASTRO VALLEY BOULEVARD, CASTRO VALLEY, CALIFORNIA

Boring Number	Date	Depth (feet)	Concentration (µg/L)															
			Benzene	Toluene	Ethyl-benzene	Xylenes	TPH-g	TPH-d	MTBE (8021B)	MTBE (8260B)	TBA	DIPE	ETBE	1,2-DCA	TAME	EDB	TRPH	HVOC (8010)
AB1	03/05/99	8.7 <sup>a</sup>	ND	ND	ND	ND	ND	450	ND	--	--	--	--	--	--	--	--	--
AB2	03/05/99	4.2 <sup>a</sup>	ND	ND	0.8	ND	ND	730	ND	--	--	--	--	--	--	--	1.0	ND
AB3	03/05/99	8.3 <sup>a</sup>	210	7.5	660	34	4,300	2,100	ND	--	--	--	--	--	--	--	--	--
AB4	03/05/99	3.2 <sup>a</sup>	100	43	170	260	2,900	5,500	ND	--	--	--	--	--	--	--	--	--
AB5	03/05/99	9.65 <sup>a</sup>	ND	ND	1.9	ND	ND	1,600	ND	--	--	--	--	--	--	--	--	--
SB1	11/12/03	Boring dry. No groundwater samples were collected.																
SB2	11/13/03	2-17 <sup>b</sup>	<0.5	<0.5	<0.5	<0.5	<50	127	--	2.1	--	--	--	--	--	--	<100	--
SB3	11/12/03	0-12 <sup>b</sup>	1,170	65.0	1,780	2,240	46,700	13,400	--	<0.5	--	--	--	--	--	--	--	--
SB4	11/12/03	Boring terminated at 2 feet bgs. No groundwater samples were collected.																
SB5	11/13/03	0-12 <sup>b</sup>	6.30	2.6	2.8	1.4	760	173	--	<0.5	--	--	--	--	--	--	--	--
SB6	11/13/03	0-12 <sup>b</sup>	1.90	6.3	3.6	4.3	1,650	816	--	<0.5	--	--	--	--	--	--	--	--
SB7	11/13/03	Boring dry. No groundwater samples were collected.																
SB8	10/04/07	0-12 <sup>b</sup>	<0.50	<0.50	<0.50	<0.50	<50	<51	--	0.71	<20	<0.50	<0.50	<0.50	<0.50	<0.50	--	--
SB9	10/03/07	0-10 <sup>b</sup>	Boring dry. No groundwater samples were collected.															
SB10	10/02/07	0-15 <sup>b</sup>	Boring dry. No groundwater samples were collected.															
SB11	10/04/07	0-12 <sup>b</sup>	<0.50	3.5	<0.50	4.9	1,100	--	--	0.52	<20	<0.50	<0.50	<0.50	<0.50	<0.50	--	--
SB12	10/04/07	0-12 <sup>b</sup>	<1.0	<1.0	260	2.9	2,500	1,800	--	1.6	<40	<1.0	<1.0	<1.0	<1.0	<1.0	--	--
SB13	10/03/07	0-15 <sup>b</sup>	<0.50	<0.50	<0.50	<0.50	<50	51	--	<0.50	<20	<0.50	<0.50	<0.50	<0.50	<0.50	--	--
SB14	10/03/07	0-10 <sup>b</sup>	Sample collected but not analyzed (analysis contingent on the results of other samples).															

TABLE 4 GROUNDWATER SAMPLE ANALYTICAL RESULTS FOR TEMPORARY BORINGS, FORMER MOBIL STATION 04334,  
2492 CASTRO VALLEY BOULEVARD, CASTRO VALLEY, CALIFORNIA

Boring Number	Date	Depth (feet)	Concentration (µg/L)											HVOC (8010)
			Benzene	Toluene	Ethyl- benzene	Xylenes	TPH-g	TPH-d	MTBE (8021B)	MTBE (8260B)	TBA	DIPE	ETBE	

Notes:

- a Depth to water.
- b Interval of screen placed in boring.
  
- µg/L Micrograms per liter.
- 1,2-DCA 1,2-Dichloroethane.
- bgs Below ground surface.
- DIPE Diisopropyl ether.
- EDB 1,2-Dibromomethane.
- ETBE Ethyl tertiary butyl ether.
- HVOC Halogenated volatile organic compounds.
- MTBE Methyl tertiary butyl ether.
- ND Not detected.
- TAME Tertiary amyl methyl ether.
- TBA Tertiary butyl alcohol.
- TPH-d Total Petroleum Hydrocarbons as diesel.
- TPH-g Total Petroleum Hydrocarbons as gasoline.
- TRPH Total Recoverable Petroleum Hydrocarbons.
  
- Not analyzed.

TABLE 5 GROUNDWATER MONITORING DATA, FORMER MOBIL STATION 04334, 2492 CASTRO VALLEY BOULEVARD, CASTRO VALLEY, CALIFORNIA

Well ID	Date	Top of Casing Elevation (feet)	Depth to Water (feet)	Groundwater Elevation (feet)	Concentration (µg/L)							Other Oxygenates and Additives
					Benzene	Toluene	Ethylbenzene	Total Xylenes	TPH-g	TPH-d	MTBE	
MW1	a 08/13/04	173.23	7.32	165.91	<0.5	0.7	<0.5	1.0	<50	71	1.20 <sup>b</sup>	--
MW1	11/09/04	173.23	6.96	166.27	<0.5	0.9	<0.5	0.9	<50	63	1.50 <sup>b</sup>	--
MW1	02/16/05	173.23	6.10	167.13	<0.5	1.0	<0.5	1.5	<50	78	1.30 <sup>b</sup>	--
MW1	05/16/05	173.23	5.81	167.42	<0.5	<0.5	<0.5	<0.5	<50	<50	1.40 <sup>b</sup>	--
MW1	08/17/05	173.23	6.70	166.53	<0.5	<0.5	<0.5	<0.5	<50	<50	1.19 <sup>b</sup>	--
MW1	11/15/05	173.23	7.55	165.68	<0.5	<0.5	<0.5	<0.5	<50	<50	1.13 <sup>b</sup>	--
MW1	02/06/06	173.23	6.40	166.83	<0.5	<0.5	<0.5	<0.5	<50	160	<0.5 <sup>b</sup>	--
MW1	05/03/06	173.23	6.95	166.28	<1.00	<1.00	<1.00	<3.00	<50.0	78	<0.50 <sup>b</sup>	--
MW1	08/04/06	173.23	7.71	165.52	<0.50	<0.50	<0.50	<0.50	<50.0	167	<0.500 <sup>b</sup>	--
MW1	11/06/06	173.23	7.57	165.66	<0.50	<0.50	<0.50	<0.50	<50.0	<47.2	0.880 <sup>b</sup>	--
MW1	02/21/07	173.23	7.19	166.04	<0.50	<0.50	<0.50	<0.50	<50.0	<46.9	2.42 <sup>b</sup>	--
MW1	08/01/07	173.23	8.00	165.23	3.02	4.18	0.89	3.96	90.8	<47	1.54 <sup>b</sup>	--
MW1	10/25/07	173.23	7.90	165.33	<0.50	<0.50	<0.50	<0.50	<50.0	<47.2	1.63 <sup>b</sup>	--
MW1	01/31/08	173.23	6.60	166.63	<0.50	<0.50	<0.50	<0.50	<50	<50	1.8 <sup>b</sup>	--
MW1	05/01/08	173.23	7.80	165.43	<1.00	<1.00	<1.00	<3.00	<50.0	<47.2	1.67 <sup>b</sup>	--
MW1	07/31/08	173.23	8.15	165.08	<0.50	<0.50	<0.50	<0.50	<50	<47	1.7 <sup>b</sup>	--
MW1	11/07/08	173.23	8.11	165.12	<0.50	<0.50	<0.50	<0.50	<50	<47	1.4 <sup>b</sup>	--
MW1	01/29/09	173.23	7.75	165.48	<0.50	0.21 <sup>e,f</sup>	<0.50	0.30 <sup>e,f</sup>	<50	<50	1.6 <sup>b</sup>	--
MW1	04/15/09	173.23	7.55	165.68	<0.50	<0.50	<0.50	<1.0	<50	<50	1.6 <sup>b</sup>	19 <sup>g</sup> , 22 <sup>h,e</sup>
MW1	07/21/09	173.23	8.14	165.09	<0.50	<0.50	<0.50	<1.0	<50	<50	1.2 <sup>b</sup>	ND
MW1	10/05/09	173.23	8.32	164.91	<0.50	<0.50	<0.50	<1.0	<50	<50	1.1 <sup>b</sup>	ND
MW2	a 08/13/04	173.63	6.96	166.67	<0.5	0.8	<0.5	1.0	<50	57	<0.5 <sup>b</sup>	--
MW2	11/09/04	173.63	6.44	167.19	<0.5	1.1	<0.5	1.2	<50	<50	<0.5 <sup>b</sup>	--
MW2	02/16/05	173.63	5.21	168.42	<0.5	0.9	<0.5	1.4	<50	55	<0.5 <sup>b</sup>	--
MW2	05/16/05	173.63	5.86	167.77	<0.5	<0.5	<0.5	<0.5	<50	<50	<0.5 <sup>b</sup>	--
MW2	08/17/05	173.63	5.72	167.91	<0.5	<0.5	<0.5	<0.5	<50	<50	<0.5 <sup>b</sup>	--
MW2	11/15/05	173.63	7.65	165.98	<0.5	<0.5	<0.5	<0.5	<50	<50	<0.5 <sup>b</sup>	--
MW2	02/06/06	173.63	6.24	167.39	<0.5	<0.5	<0.5	<0.5	<50	<50	<0.5 <sup>b</sup>	--
MW2	05/03/06	173.63	6.53	167.10	<1.00	<1.00	<1.00	<3.00	<50.0	<50	<0.50 <sup>b</sup>	--
MW2	08/04/06	173.63	7.65	165.98	<0.50	<0.50	<0.50	<0.50	<50.0	<47.2	<0.500 <sup>b</sup>	--

TABLE 5 GROUNDWATER MONITORING DATA, FORMER MOBIL STATION 04334, 2492 CASTRO VALLEY BOULEVARD, CASTRO VALLEY, CALIFORNIA

Well ID	Date	Top of Casing Elevation (feet)	Depth to Water (feet)	Groundwater Elevation (feet)	Concentration (µg/L)							Other Oxygenates and Additives
					Benzene	Toluene	Ethyl-benzene	Total Xylenes	TPH-g	TPH-d	MTBE	
MW2	11/06/06	173.63	6.98	166.65	<0.50	<0.50	<0.50	<0.50	<50.0	<46.9	<0.500 <sup>b</sup>	--
MW2	02/21/07	173.63	6.36	167.27	<0.50	<0.50	<0.50	<0.50	<50.0	<46.9	1.70 <sup>b</sup>	--
MW2	05/01/07	173.63	7.51	166.12	<0.50	<0.50	<0.50	<0.50	<50.0	<46.9	<0.50 <sup>b</sup>	--
MW2	08/01/07	173.63	8.12	165.51	<0.50	<0.50	<0.50	<0.50	<50.0	<47	<0.500 <sup>b</sup>	--
MW2	10/25/07	173.63	7.79	165.84	<0.50	<0.50	<0.50	<0.50	<50.0	<47.2	<0.500 <sup>b</sup>	--
MW2	01/31/08	173.63	5.89	167.74	<0.50	<0.50	<0.50	<0.50	<50	<50	0.82 <sup>b</sup>	--
MW2	05/01/08	173.63	7.81	165.82	<1.00	<1.00	<1.00	<3.00	<50.0	<47.2	<0.500 <sup>b</sup>	--
MW2	07/31/08	173.63	8.30	165.33	<0.50	<0.50	<0.50	<0.50	<50	<47	<0.50 <sup>b</sup>	--
MW2	11/07/08	173.63	8.09	165.54	<0.50	<0.50	<0.50	<0.50	<50	<47	<0.50 <sup>b</sup>	--
MW2	01/29/09	173.63	7.65	165.98	<0.50	<0.50	<0.50	<1.0	<50	<50	<0.50 <sup>b</sup>	--
MW2	04/15/09	173.63	7.51	166.12	<0.50	<0.50	<0.50	<1.0	<50	<50	0.50 <sup>b,e</sup>	6.5 <sup>g,e</sup>
MW2	07/21/09	173.63	8.27	165.36	<0.50	<0.50	<0.50	<1.0	<50	<50	0.12 <sup>b,e</sup>	ND
MW2	10/05/09	173.63	8.54	165.09	<0.50	<0.50	<0.50	<1.0	<50	<50	0.14 <sup>b,e</sup>	ND
MW3	a 08/13/04	171.91	5.36	166.55	100	2.0	187	59.6	1,440	352	<0.5 <sup>b</sup>	--
MW3	11/09/04	171.91	4.80	167.11	188	3.6	242	20.0	1,690	461	<0.5 <sup>b</sup>	--
MW3	02/16/05	171.91	3.10	168.81	66.2	1.4	61.1	12.6	575	269	<0.5 <sup>b</sup>	--
MW3	05/16/05	171.91	3.86	168.05	74.2	1.4	61.0	9.0	592	92	<0.5 <sup>b</sup>	--
MW3	08/17/05	171.91	4.75	167.16	231 <sup>c</sup>	2.35	102	11.4	1,130	416	<0.5 <sup>b</sup>	--
MW3	11/15/05	171.91	6.56	165.35	57.4	0.95	62.4	10.5	452	193	<0.5 <sup>b</sup>	--
MW3	02/06/06	171.91	4.00	167.91	69	<5.0	64	10	830	165	<0.5 <sup>b</sup>	--
MW3	05/03/06	171.91	5.44	166.47	52.1	<1.00	37.0	4.81	605	140	<0.50 <sup>b</sup>	--
MW3	08/04/06	171.91	5.25	166.66	15.2	<0.50	5.34	1.25	262	108	<0.500 <sup>b</sup>	--
MW3	11/06/06	171.91	4.11	167.80	60.0	1.04	47.3	3.09	561	106	<0.500 <sup>b</sup>	--
MW3	02/21/07	171.91	4.94	166.97	35.1	<0.50	45.4	1.09	483	125	<0.500 <sup>b</sup>	--
MW3	05/01/07	171.91	5.86	166.05	32.5	1.63	28.7	1.53	539	120	<0.50 <sup>b</sup>	--
MW3	08/01/07	171.91	7.54	164.37	1.26	0.60	<0.50	<0.50	89.2	<47	<0.500 <sup>b</sup>	--
MW3	10/25/07	171.91	6.30	165.61	2.94	<0.50	<0.50	<0.50	50.4	<47.2	<0.500 <sup>b</sup>	--
MW3	01/31/08	171.91	3.75	168.16	10	<0.50	11	<0.50	120	51 <sup>d</sup>	<0.50 <sup>b</sup>	--
MW3	05/01/08	171.91	6.60	165.31	2.38	<1.00	<1.00	<3.00	<50.0	<47.2	<0.500 <sup>b</sup>	--
MW3	07/31/08	171.91	7.77	164.14	<0.50	<0.50	<0.50	<0.50	<50	<47	<0.50 <sup>b</sup>	--

TABLE 5 GROUNDWATER MONITORING DATA, FORMER MOBIL STATION 04334, 2492 CASTRO VALLEY BOULEVARD, CASTRO VALLEY, CALIFORNIA

Well ID	Date	Top of Casing Elevation (feet)	Depth to Water (feet)	Groundwater Elevation (feet)	Concentration (µg/L)							Other Oxygenates and Additives
					Benzene	Toluene	Ethyl-benzene	Total Xylenes	TPH-g	TPH-d	MTBE	
MW3	11/07/08	171.91	6.34	165.57	3.6	<0.50	1.4	<0.50	<50	<47	<0.50 <sup>b</sup>	--
MW3	01/29/09	171.91	5.86	166.05	13	0.33 <sup>e</sup>	13	0.52 <sup>e,f</sup>	92	<50	<0.50 <sup>b</sup>	--
MW3	04/15/09	171.91	6.14	165.77	2.2	<0.50	3.2	<1.0	51	<50	<0.50 <sup>b</sup>	3.7 <sup>g,e</sup>
MW3	07/21/09	171.91	7.74	164.17	0.24 <sup>e</sup>	<0.50	<0.50	<1.0	<50	<50	<0.50 <sup>b</sup>	0.11 <sup>h,e</sup>
MW3	10/05/09	171.91	8.15	163.76	<0.50	<0.50	<0.50	<1.0	<50	<50	<0.50 <sup>b</sup>	0.084 <sup>h,e</sup>
MW4	a 08/13/04	170.48	6.10	164.38	<0.5	0.8	<0.5	1.1	<50	72	2.80 <sup>b</sup>	--
MW4	11/09/04	170.48	5.54	164.94	<0.5	2.3	0.7	1.5	<50	<50	2.10 <sup>b</sup>	--
MW4	02/16/05	170.48	5.11	165.37	<0.5	1.1	<0.5	1.7	<50	<50	<0.5 <sup>b</sup>	--
MW4	05/16/05	170.48	5.44	165.04	<0.5	<0.5	<0.5	<0.5	<50	<50	<0.5 <sup>b</sup>	--
MW4	08/17/05	170.48	5.71	164.77	<0.5	<0.5	<0.5	<0.5	<50	<50	1.03 <sup>b</sup>	--
MW4	11/15/05	170.48	5.80	164.68	<0.5	<0.5	<0.5	<0.5	<50	<50	0.730 <sup>b</sup>	--
MW4	02/06/06	170.48	5.10	165.38	<0.5	<0.5	<0.5	<0.5	<50	85.2	<0.5 <sup>b</sup>	--
MW4	05/03/06	170.48	5.54	164.94	<1.00	<1.00	<1.00	<3.00	<50.0	<47	<0.50 <sup>b</sup>	--
MW4	08/04/06	170.48	5.75	164.73	<0.50	<0.50	<0.50	<0.50	<50.0	52.7	<0.500 <sup>b</sup>	--
MW4	11/06/06	170.48	5.95	164.53	<0.50	<0.50	<0.50	<0.50	<50.0	<47.2	<0.500 <sup>b</sup>	--
MW4	02/21/07	170.48	5.56	164.92	<0.50	<0.50	<0.50	<0.50	<50.0	<46.9	<0.500 <sup>b</sup>	--
MW4	05/01/07	170.48	5.66	164.82	<0.50	<0.50	<0.50	<0.50	<50.0	<46.9	<0.50 <sup>b</sup>	--
MW4	08/01/07	170.48	6.06	164.42	0.85	<0.50	<0.50	0.97	<50.0	<47	<0.870 <sup>b</sup>	--
MW4	10/25/07	170.48	5.34	165.14	<0.50	<0.50	<0.50	<0.50	<50.0	<47.2	<0.500 <sup>b</sup>	--
MW4	01/31/08	170.48	5.05	165.43	<0.50	<0.50	<0.50	<0.50	<50	<47	<0.50 <sup>b</sup>	--
MW4	05/01/08	170.48	5.86	164.62	<1.00	<1.00	<1.00	<3.00	<50.0	<47.2	<0.500 <sup>b</sup>	--
MW4	07/31/08	170.48	6.10	164.38	<0.50	<0.50	<0.50	<0.50	<50	<47	<0.50 <sup>b</sup>	--
MW4	11/07/08	170.48	5.65	164.83	<0.50	<0.50	<0.50	<0.50	<50	<47	<0.50 <sup>b</sup>	--
MW4	01/29/09	170.48	5.80	164.68	<0.50	0.19 <sup>g,f</sup>	<0.50	<1.0	<50	<50	<0.50 <sup>b</sup>	--
MW4	04/15/09	170.48	5.90	164.58	<0.50	<0.50	<0.50	<1.0	<50	<50	0.15 <sup>b,e</sup>	ND
MW4	07/21/09	170.48	6.00	164.48	<0.50	<0.50	<0.50	<1.0	<50	<50	0.16 <sup>b,e</sup>	ND
MW4	10/05/09	170.48	6.01	164.47	<0.50	<0.50	<0.50	<1.0	<50	<50	0.18 <sup>b,e</sup>	ND
MW5	i 03/04/09	173.80	4.70	169.10	<0.50	<0.50	<0.50	<1.0	150	--	10 <sup>b</sup>	ND
MW5	04/15/09	173.80	5.17	168.63	<0.50	<0.50	<0.50	<1.0	<50	<50	9.3 <sup>b</sup>	24 <sup>h,e</sup>

TABLE 5 GROUNDWATER MONITORING DATA, FORMER MOBIL STATION 04334, 2492 CASTRO VALLEY BOULEVARD, CASTRO VALLEY, CALIFORNIA

Well ID	Date	Top of Casing Elevation (feet)	Depth to Water (feet)	Groundwater Elevation (feet)	Concentration (µg/L)							Other Oxygenates and Additives
					Benzene	Toluene	Ethyl-benzene	Total Xylenes	TPH-g	TPH-d	MTBE	
MW5	07/21/09	173.80	5.05	168.75	<0.50	<0.50	<0.50	<1.0	<50	<50	7.0 <sup>b</sup>	ND
MW5	10/05/09	173.80	4.41	169.39	<0.50	<0.50	<0.50	<1.0	<50	<50	8.2 <sup>b</sup>	ND

Notes: Depth-to-water-level measurements in feet from top-of-casing.  
 Other Oxygenates and Additives include ethyl tertiary butyl ether, tertiary amyl methyl ether, tertiary butyl alcohol, 1,2-dibromoethane, 1,2-dichloroethane, diisopropyl ether, and ethanol which are individually identified only if detected above the laboratory reporting limit. Analyzed by EPA Method 8260B.

- a Top-of-casing elevation surveyed by Morrow Surveying on 12 July 2004.
- b Analyzed by EPA Method 8260 or 8260B.
- c Concentration estimated. Analyte exceeded calibration range. Reanalysis not performed due to holding time requirements.
- d Does not match typical pattern.
- e Analyte was detected at a concentration below the reporting limit and above the laboratory method detection limit. Reported value is estimated.
- f Analyte presence was not confirmed by second column or GC/MS analysis
- g Tertiary butyl alcohol.
- h Ethanol.
- i Top-of-casing elevation surveyed by Morrow Surveying on 10 February 2009.
- j 1,2-Dichloroethane.

MTBE Methyl tertiary butyl ether.  
 TPH-d Total Petroleum Hydrocarbons as diesel.  
 TPH-g Total Petroleum Hydrocarbons as gasoline.  
 ND Not detected at or above laboratory reporting limits.

µg/L Micrograms per liter.  
 -- Not sampled or not analyzed.



TABLE 1 WELL CONSTRUCTION DETAILS, FORMER MOBIL STATION 04334, 2492 CASTRO VALLEY BOULEVARD, CASTRO VALLEY, CALIFORNIA

Well Number	Well Installation Date	Elevation TOC (feet)	Casing Material	Total Depth (feet)	Well Depth (feet)	Borehole Diameter (inches)	Casing Diameter (inches)	Screened Interval (feet)	Slot Size (inches)	Filter Pack Interval (feet)	Filter Pack Material
MW1	a 06/24/04	173.23	PVC	20	20	8.25	2	5 - 20	0.010	4.5 - 20	#2/12 Sand
MW2	a 06/25/04	173.63	PVC	20	20	8.25	2	5 - 20	0.010	4.5 - 20	#2/12 Sand
MW3	a 06/25/04	171.91	PVC	20	20	8.25	2	5 - 20	0.010	4.5 - 20	#2/12 Sand
MW4	a 06/24/04	170.48	PVC	15	14	8.25	2	4 - 14	0.010	3.5 - 15	#2/12 Sand
MW5	b 01/30/09	173.80	PVC	15	15	8.25	2	5 - 15	0.010	4.0 - 15	#2/12 Sand

Notes:

- a Well surveyed on 12 July 2004 by Morrow Surveying.
- b Well surveyed on 10 February 2009 by Morrow Surveying.
- PVC Polyvinyl chloride.
- TOC Top of casing.

ATTACHMENT 5



CLIENT ExxonMobil	SITE NUMBER 04-334	LOCATION 2492 Castro Valley Blvd, Castro Valley, CA
----------------------	-----------------------	---

LOG OF SOIL BORING: **MW1**

DRILLING AND SAMPLING METHODS Vacuum cleared to 5.5 feet bgs. Drilled with CME 75 limited access drill rig with 8.25" O.D. hollow stem augers. Sampled with a 18" California Modified Split Spoon Sampler.

COORDINATES:  
ELEVATION TOP OF CASING:  
CASING BELOW SURFACE:

WATER LEVEL	▽ 20	▽ 7.6		
TIME	1541	0715	START TIME	FINISH TIME
DATE	6/24/4	6/25/4	1315	1620
REFERENCE	GS	GS	DATE	DATE
			6/23/04	6/24/04

DRILLING COMPANY: Cascade Drilling, Inc.  
LICENSE NUMBER: C57-717510

INCHES				DEPTH (feet)	AIR SAMPLE	WATER SAMPLE	SOIL SAMPLE RECOVERED	GRAPHIC LOG	SURFACE CONDITIONS	
DRIVEN	RECOVER	BLOWS / 6" SAMPLER	OVA READING						Asphalt	
DESCRIPTION BY: Tracy Job									DETAILS	
				0					Asphalt	Water-tight traffic box
				1					Soil fill with .75" gravels.	Neat cement grout from 0.5 to 3.5 feet
				2					SILTY CLAY, black (2.5/N), hard, medium plasticity, minor poorly sorted sand, dry.	2 in. I.D. Schedule 40 PVC Riser Casing from 0.5 to 5.0 ft.
				3					SILTY CLAY, black (2.5/N), firm, medium plasticity, minor poorly sorted sand, dry.	Bentonite chips from 3.5 to 4.5 feet
				4					Color change to light green gray (10Y 7/1).	
				5				CL		# 2/12 Sand Filter Pack from 4.5 to 20 ft.
			1.3	6						
				7						
				8					SILTY CLAY, very dark gray (2.5Y 3,1), firm, medium plasticity, minor strongly cemented silt and poorly sorted sand, dry.	
24	18	17		9						
		31	0.8	10				ML	CLAYEY SILT, light olive brown (2.5Y 5/4), firm, medium plasticity, minor strongly cemented silt and poorly sorted sand, dry.	
		50/2"		11						
18	18	21		12				ML	SILT, dark olive brown (2.5Y 3/3), fractured strongly cemented silt, moist to wet.	2 in. I.D. 0.010 in. Slot, Schedule 40 PVC Screen from 5.0 to 20.0 ft.
		31		13					CLAYEY SILT, light olive brown (2.5Y 5/4), hard, medium plasticity, minor strongly cemented silt and poorly sorted sand, dry.	
		50/6"		14						
15	18	17		15						
		30	1.1	16						
		50		17						
18	18	37		18						
		44		19						
		50/3"		20						
16	12	31								
		45								
		50								
18	12	36	1.4							
		50								
18	5	29	1.7							
		43								
		50								
12	8	50/6"	6.6						Same as above, moist.	
				20					Boring terminated at 20 feet bgs.	

LOG OF SOIL BORING: 334\_2004\_CPI\_ETIC.GDT 10/5/04



CLIENT ExxonMobil	SITE NUMBER 04-334	LOCATION 2492 Castro Valley Blvd, Castro Valley, CA
----------------------	-----------------------	---

LOG OF SOIL BORING: **MW2**

DRILLING AND SAMPLING METHODS: Vacuum cleared to 5 feet bgs. Drilled with CME 75 limited access drill rig with 8.25" O.D. hollow stem augers. Sampled with a 18" California Modified Split Spoon Sampler.

COORDINATES:  
ELEVATION TOP OF CASING:  
CASING BELOW SURFACE:

WATER LEVEL	± 16.5	± 11.75		
TIME	0820	1030	START TIME	FINISH TIME
DATE	6/25/4	6/25/4	1445	0905
REFERENCE	GS	GS	DATE	DATE
			6/23/04	6/25/04

DRILLING COMPANY: Cascade Drilling, Inc.  
LICENSE NUMBER: C57-717510

INCHES				DEPTH (feet)	SURFACE CONDITIONS	GRAPHIC LOG	DESCRIPTION BY: Tracy Job	DETAILS
DRIVEN	RECOVER	BLOWS / 6" SAMPLER	QVA READING					
				0	Asphalt	OL	Asphalt	Water-tight traffic box
				1	Soil fill with asphalt fragments	OL	Soil fill with asphalt fragments	Neat cement grout from 0.5 to 4.0 feet
				2	SILTY CLAY, black (2.5/N), firm, medium plasticity, minor fine sand, dry.		SILTY CLAY, black (2.5/N), firm, medium plasticity, minor fine sand, dry.	2 in. I.D. Schedule 40 PVC Riser Casing from 0.5 to 5.0 ft.
				3	Change to dark greenish gray (5GY 4/1) and soft.		Change to dark greenish gray (5GY 4/1) and soft.	
				4		CL		Bentonite chips from 3.5 to 4.5 feet
			0.7	5	Change to dry.		Change to dry.	
				6	CLAYEY SILT, light olive brown (10YR 4/2), firm, medium plasticity, minor strongly cemented silt and fine to medium sand, dry.	ML	CLAYEY SILT, light olive brown (10YR 4/2), firm, medium plasticity, minor strongly cemented silt and fine to medium sand, dry.	# 2/12 Sand Filter Pack from 4.5 to 20 ft.
24	18			8		ML		
			1.9	9	SILTY CLAY, brownish yellow (10YR 7/8), hard, medium plasticity, minor fine sand, frequent small caliche nodules, dry.	CL	SILTY CLAY, brownish yellow (10YR 7/8), hard, medium plasticity, minor fine sand, frequent small caliche nodules, dry.	
18	18	18		10	CLAYEY SILT, light olive brown (2.5Y 5/6), soft, low plasticity, minor strongly cemented silt and fine to medium sand, dry.		CLAYEY SILT, light olive brown (2.5Y 5/6), soft, low plasticity, minor strongly cemented silt and fine to medium sand, dry.	
		24		11		ML		
		36		12		ML		2 in. I.D. 0.010 in. Slot, Schedule 40 PVC Screen from 5.0 to 20.0 ft.
16	12	28		12		ML		
		32	1.4	13		ML		
		50		14	SILTY CLAY, light olive brown (2.5Y 5/4), soft, medium plasticity, minor fine to medium sand, dry.	CL	SILTY CLAY, light olive brown (2.5Y 5/4), soft, medium plasticity, minor fine to medium sand, dry.	
24	6	36	2.1	14		CL		
		50/4"		15		CL		
				16	SILT, light olive brown (2.5Y 5/6), firm, low plasticity, some strongly cemented silt and fine to medium sand, dry.		SILT, light olive brown (2.5Y 5/6), firm, low plasticity, some strongly cemented silt and fine to medium sand, dry.	
18	12	36		16		ML		
		50		17	Change to soft and wet.		Change to soft and wet.	
		42	1.8	17		ML		
		50		18		ML		
24				18		ML		
	18	23	1.9	19	Change to hard and dry.		Change to hard and dry.	
		31		19		ML		
		38		20	Boring terminated at 20 feet bgs.		Boring terminated at 20 feet bgs.	

LOG OF SOIL BORING: 334 2004-CP-1 ETIC.GDT 10/24/04



CLIENT ExxonMobil	SITE NUMBER 04-334	LOCATION 2492 Castro Valley Blvd, Castro Valley, CA
----------------------	-----------------------	---

LOG OF SOIL BORING: **MW3**

DRILLING AND SAMPLING METHODS Vacuum cleared to 5 feet bgs. Drilled with CME 75 limited access drill rig with 8.25" O.D. hollow stem augers. Sampled with a 18" California Modified Split Spoon Sampler.

COORDINATES:  
ELEVATION TOP OF CASING:  
CASING BELOW SURFACE:

WATER LEVEL	± 15	± 19.2		
TIME	1000	1125	START TIME 1610	FINISH TIME 1036
DATE	6/25/4	6/25/4	DATE 6/23/04	DATE 6/25/04
REFERENCE	GS	GS		

DRILLING COMPANY: Cascade Drilling, Inc.  
LICENSE NUMBER: C57-717510

INCHES				DEPTH (feet)	SOIL SAMPLE	WATER SAMPLE	SOIL SAMPLE RECORDED	GRAPHIC LOG	SURFACE CONDITIONS	
DRIVEN	RECOVER	BLOWS / B' SAMPLER	QVA READING						DESCRIPTION BY:	DETAILS
				0				OL	Open soil	
				1				OL	Tracy Job	Water-tight traffic box
				2				OL	Soil fill with asphalt fragments.	Neat cement grout from 0.5 to 4.0 feet
				3				CL	SILTY CLAY, very dark brown (10YR 2/2), firm, medium plasticity, minor fine to medium poorly sorted sand, dry.	2 in. I.D. Schedule 40 PVC Riser
				4				CL	Change to greenish gray (10YR 6/1).	Casing from 0.5 to 5.0 ft.
			149.0	5				CL		Bentonite chips from 3.5 to 4.5 feet
				6				CL		# 2/12 Sand Filter Pack from 4.5 to 20 ft.
				7				CL		
24	18	17	19.5	8				CL	Change to moist.	
		21		9				CL		
		23		10				ML	SANDY SILT, grayish brown (2.5Y 5/2), firm, medium plasticity, minor clay, some strongly cemented silt and fine to coarse sand, moist.	
18	12	19	10.6	11				ML		
		26		12				CL	SILTY CLAY, greenish gray (10YR 6/1), firm, medium plasticity, minor fine to medium poorly sorted sand, dry.	2 in. I.D. 0.010 in. Slot, Schedule 40 PVC Screen from 5.0 to 20.0 ft.
		28		13				CL		
		22	0.6	14				CL		
		31		15				ML	SANDY SILT, olive brown (2.5Y 4/4), hard, medium plasticity, some fine sand, dry.	
		50		16				ML	Change to moist, minor clay.	
24	12	23	1.2	17				ML		
		39		18				ML	CLAYEY SILT, dark yellowish brown (10YR 4/6), firm, low plasticity, minor fine sand, moist.	
		50		19				ML	SILT, black (2.5Y /1), soft, low plasticity, moist.	
		33		20				ML	Change to hard and dry.	
		45						ML		
		50						ML		
24	12	39	1.4					ML		
		50						ML		
		27						ML		
		50	1.5					ML		

LOG OF SOIL BORING 334 2004/EP1 ETIC GET 10/04

Boring terminated at 20 feet bgs.

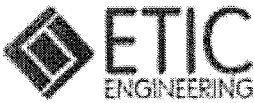

CLIENT ExxonMobil	SITE NUMBER 04-334	LOCATION 2492 Castro Valley Blvd, Castro Valley, CA
----------------------	-----------------------	---

LOG OF SOIL BORING: **MW4**

DRILLING AND SAMPLING METHODS: Vacuum cleared to 8 feet bgs. Drilled with CME 75 limited access drill rig with 8.25" O.D. hollow stem augers. Sampled with a 18" California Modified Split Spoon Sampler.

COORDINATES:  
ELEVATION TOP OF CASING:  
CASING BELOW SURFACE:

WATER LEVEL	± 7.2	± 6.5		
TIME	1151	1046	START TIME	FINISH TIME
DATE	6/23/4	6/24/4	1151	1046
REFERENCE	GS	GS	DATE	DATE
			6/23/04	6/24/04

DRILLING COMPANY: Cascade Drilling, Inc.  
LICENSE NUMBER: C57-717510

INCHES				DEPTH (feet)	SURFACE CONDITIONS	GRAPHIC LOG	DESCRIPTION BY: Tracy Iob	DETAILS
DRIVEN	RECOVER	BLOWS / 6" SAMPLER	OVA READING					
				0	Open soil	OL	Top soil. Base rock with angular gravels from 0.75" to 1.5" diameter.	Water-tight traffic box
				1		GP		Neat cement grout from 0.5 to 3.0 feet
				2			SILTY CLAY, very dark brown (10YR 2/2), soft, medium plasticity, moist.	2 in. I.D. Schedule 40 PVC Riser Casing from 0.5 to 4.0 ft.
				3				Bentonite chips from 3.0 to 3.5 feet
				4			SILTY CLAY, olive gray (5Y 4/2), firm, medium plasticity, minor fine to medium poorly sorted sand, moist.	
				5		CL	Color change to light olive brown (2.5Y 5/3). SANDY CLAY, olive brown (2.5Y 4/4), firm, medium plasticity, minor strongly cemented silt, some coarse poorly sorted sand, moist.	
				6			Change to olive yellow (2.5Y 6/6) and soft.	
				7				# 2/12 Sand Filter Pack from 3.5 to 15 ft.
				8			SILT, gray (5Y 5/1), fractured strongly cemented silt, some medium poorly sorted sand, wet.	
				9				2 in. I.D. 0.010 in. Slot, Schedule 40 PVC Screen from 4.0 to 14.0 ft.
				10		ML		
18	0	9		11				
		9		12			SANDY SILT, olive brown (2.5Y 4/4), firm, low plasticity, some siltstone, some fine sand, dry.	
		10	0.1	13				
6	6	50/6"		14		ML		
		50/4"	0.1	15			Boring terminated 15 feet bgs.	
		50/6"	0.5	16				
				17				
				18				
				19				
				20				

LOG OF SOIL BORING 034\_2004.GPJ ETIC.GDT 10/26/04



CLIENT ExxonMobil	SITE NUMBER 04334	LOCATION 2492 Castro Valley Blvd Castro Valley, CA
----------------------	----------------------	--

LOG OF SOIL BORING:

**MW5**

DRILLING AND SAMPLING METHODS: Vacuum cleared to 8 feet bgs. Hand sampled at 5 and 7.5 feet bgs. Drilled using a hollow stem auger rig with 8-inch augers. Sampled with a split spoon sampler.

COORDINATES: N2077744.5 :E6100688.6  
 ELEVATION TOP OF CASING: 173.80  
 CASING BELOW SURFACE: 0.44

WATER LEVEL	▽ 15.2	▽ 14.36		
TIME	0726	0840	START TIME 0630	FINISH TIME 0915
DATE	1/30/09	1/30/09	DATE 1/29/09	DATE 1/30/09
REFERENCE	GS	TOC		

DRILLING COMPANY: Woodward Drilling  
 LICENSE NUMBER: C57-710079

INCHES				DEPTH (feet)	AIR SAMPLE	WATER SAMPLE	SOIL SAMPLE RECOVERED	GRAPHIC LOG	SURFACE CONDITIONS	
DRIVEN	RECOVER	BLOWS / 6" SAMPLER	OVA READING						Asphalt	
				0				AC/AB	DESCRIPTION BY: Yuko Mamiya	DETAILS Single bolt, watertight, Morrison well box 2-inch diameter Schedule 40 PVC riser casing from original grade to 5 feet below ground surface Cement grout from surface to 2 feet below ground surface Bentonite chips from 2 to 4 feet below ground surface #2/12 sand filter pack from 4 to 15 feet below ground surface 2-inch diameter 0.010-inch slot Schedule 40 PVC screen from 5 to 15 feet below ground surface Threaded PVC cap at 15 feet below ground surface
				1				GC	ASPHALT - from 0 to 0.33 feet below ground surface. AGGREGATE BASE - from 0.33 to 1 foot below ground surface.	
				2				CL	CLAY AND GRAVEL - mixture of gravels up to 1-inch in diameter, native clay and aggregate base. CLAY WITH SILT - black (10YR 2/1), medium stiff, low plasticity, moist.	
				3				CL	- pervasive caliche.	
	6			5				CL	SILTY CLAY - dark greenish gray (GLE Y1 4/10GY), stiff, low plasticity, pervasive caliche, moist.	
				6				CL	- increasing sand content, becoming very moist.	
	6			8				ML	SANDY SILT WITH CLAY - dark greenish gray (GLE Y1 4/10GY), stiff, low plasticity, fine to medium grained sand, wet.	
				9				ML		
12	10	11 50/5"		10				ML	SANDY SILT WITH GRAVEL - dark yellowish brown (10YR 3/6), stiff, low plasticity, fine to coarse grained sand, gravels up to 0.5 inches in diameter, slightly moist.	
			0.5	11				ML		
18	14	17 20 26		13				ML	CLAYSTONE - olive brown (2.5Y 4/4), highly weathered, friable, low plasticity.	
			0.6	14				MUDSTONE		
12	12	28 50/5"	0.6	15					Boring terminated at 15 feet bgs.	

LOG OF SOIL BORING 04-334 BORING LOGS.GPJ ETIC.GDT 3/26/09

# ATTACHMENT 6

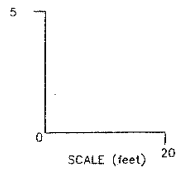
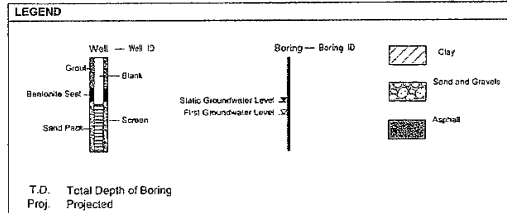
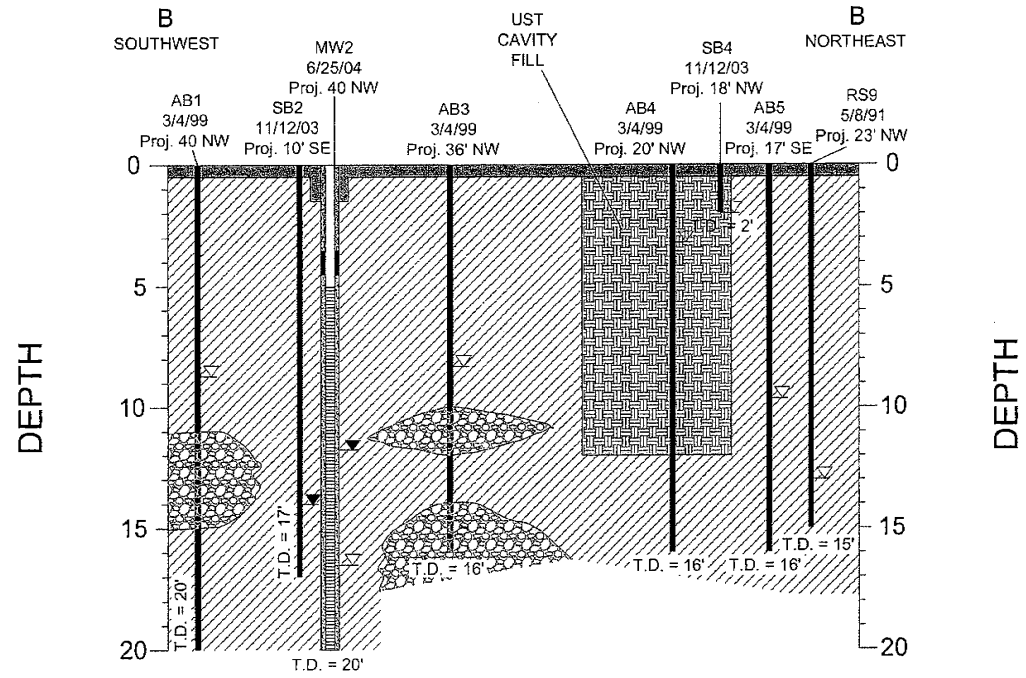

GEOLOGIC CROSS-SECTION B-B'  
FORMER MOBIL STATION 04334  
2492 CASTRO VALLEY BOULEVARD  
CASTRO VALLEY, CALIFORNIA

FIGURE:  
**6**

FILENAME: etic\ca0308.dwg 7/29/2008



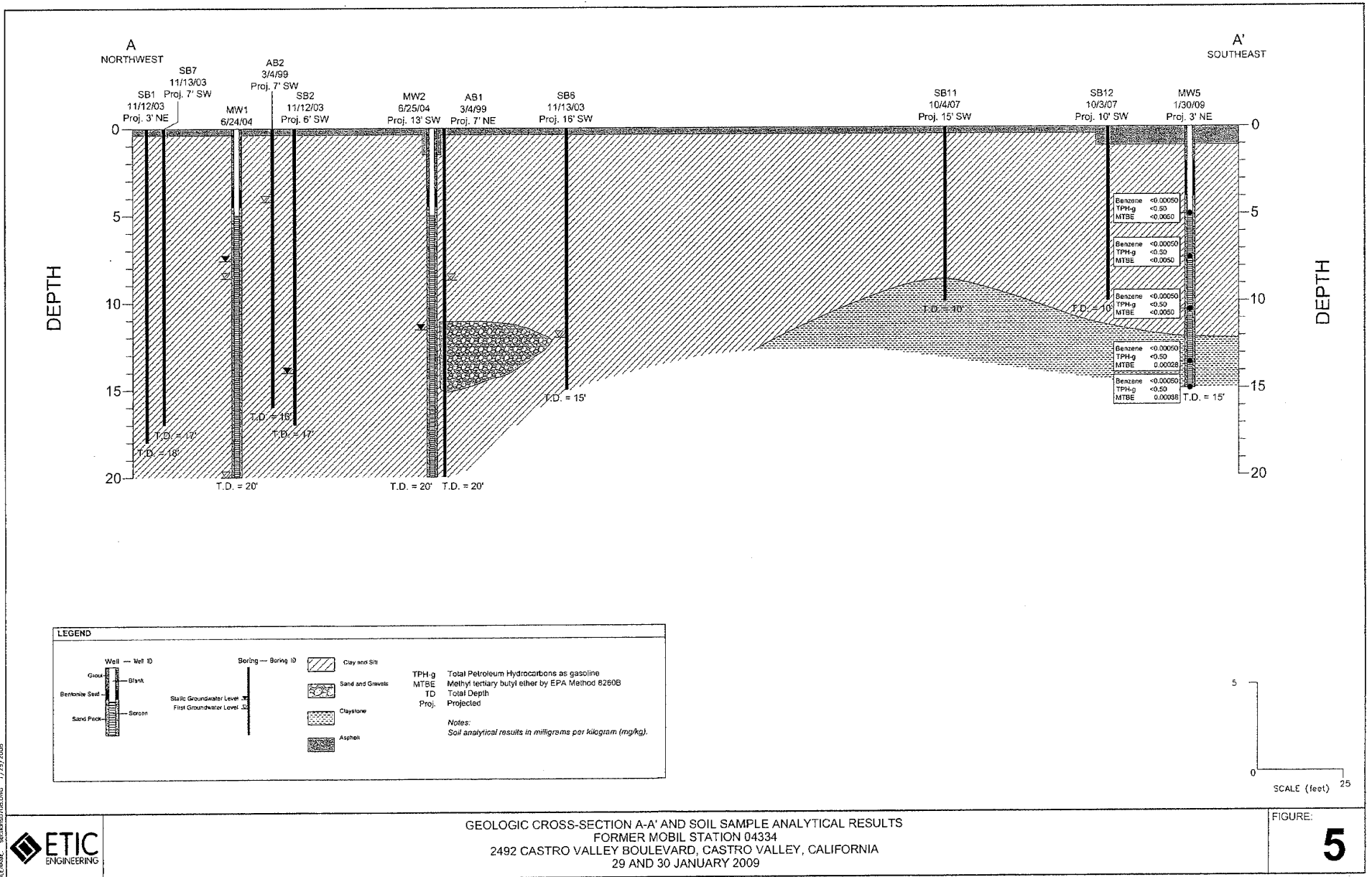

FILENAME: esdscand008.DWG 1/29/2009

