



Industrial Compliance

9719 Lincoln Village Drive, Suite 310 Sacramento, CA 95827 916/369-8971 FAX 916/369-8370

October 26, 1992

3748

0200700

Mr. Barney Chan
Alameda County Health Care Services Agency
80 Swan Way, Room 200
Oakland, California 94621

**SUBJECT: Workplan Addendum
Southern Pacific Transportation Company
5th Avenue and 7th Street Property
Oakland, California
IC Project No. 05269**

94606

Dear Mr. Chan:

Industrial Compliance (IC), on behalf of Southern Pacific Transportation Company (SPTCo), prepared a workplan dated June 18, 1992 (workplan entitled: *Preliminary Site Investigation Workplan, Southern Pacific Transportation Company, 5th Avenue and 7th Street, Oakland, California*). The workplan outlined a work scope to assess the impact, if any, that 2 former underground storage tanks (USTs) may have had on the above referenced SPTCo property. The workplan proposes sampling the stockpile of soil that originated from the overexcavation of the former tank pits, installing a groundwater monitoring well in the assumed downgradient direction of the tank pits, and sampling the proposed monitoring well quarterly for a period of 1 year. The Alameda County Health Care Services Agency (Alameda County) responded to the workplan in a letter dated August 7, 1992, which required that the monitoring well be installed in a verified downgradient direction, instead of an assumed downgradient direction.

IC has reviewed the files available at the San Francisco Bay Regional Water Quality Control Board (Regional Board) to assess the regional hydraulic gradient direction in the vicinity of the site. The closest measured gradient direction was at the former Davlin Paint Company property at 1401 East 14th Street, approximately 1,500 feet southeast of the site. The gradient direction at this site was measured to be north-northwest, approximately parallel to the Inner Harbor.

IC found only 1 other site which had a measured groundwater flow direction and was located in close proximity to the Inner Harbor; the SPTCo 5th and Kirkham Street property at 301 Cypress Street. This site also had a hydraulic gradient direction parallel to the Inner Harbor.

IC proposes to use the gradient direction measured at the Davlin Paint Company property to position the proposed monitoring well at the SPTCo 5th Avenue and 7th Street site since Davlin Paint Company is located in close proximity to the site and the gradient direction there appears consistent with regional hydraulic data

This is pretty far away

The proposed monitoring well location, shown on Figure 1 (attached) will be northwest of the former tank pits.



October 26, 1992
Alameda County Health Care Services Agency (05269)
Mr. Barney Chan
Page 2

IC will proceed with installation of the proposed monitoring well within 3 weeks upon receipt of Alameda County's approval to install the monitoring well at the location shown on Figure 1.

If there are any questions, please do not hesitate to contact Mr. Walter Floyd at (916) 369-8971.

Sincerely,



Walter Floyd
Project Geologist

*no longer
w/company*



Mark S. Dockum, C.E.G.
Project Manager

Attachment

cc: Mr. Mike Grant

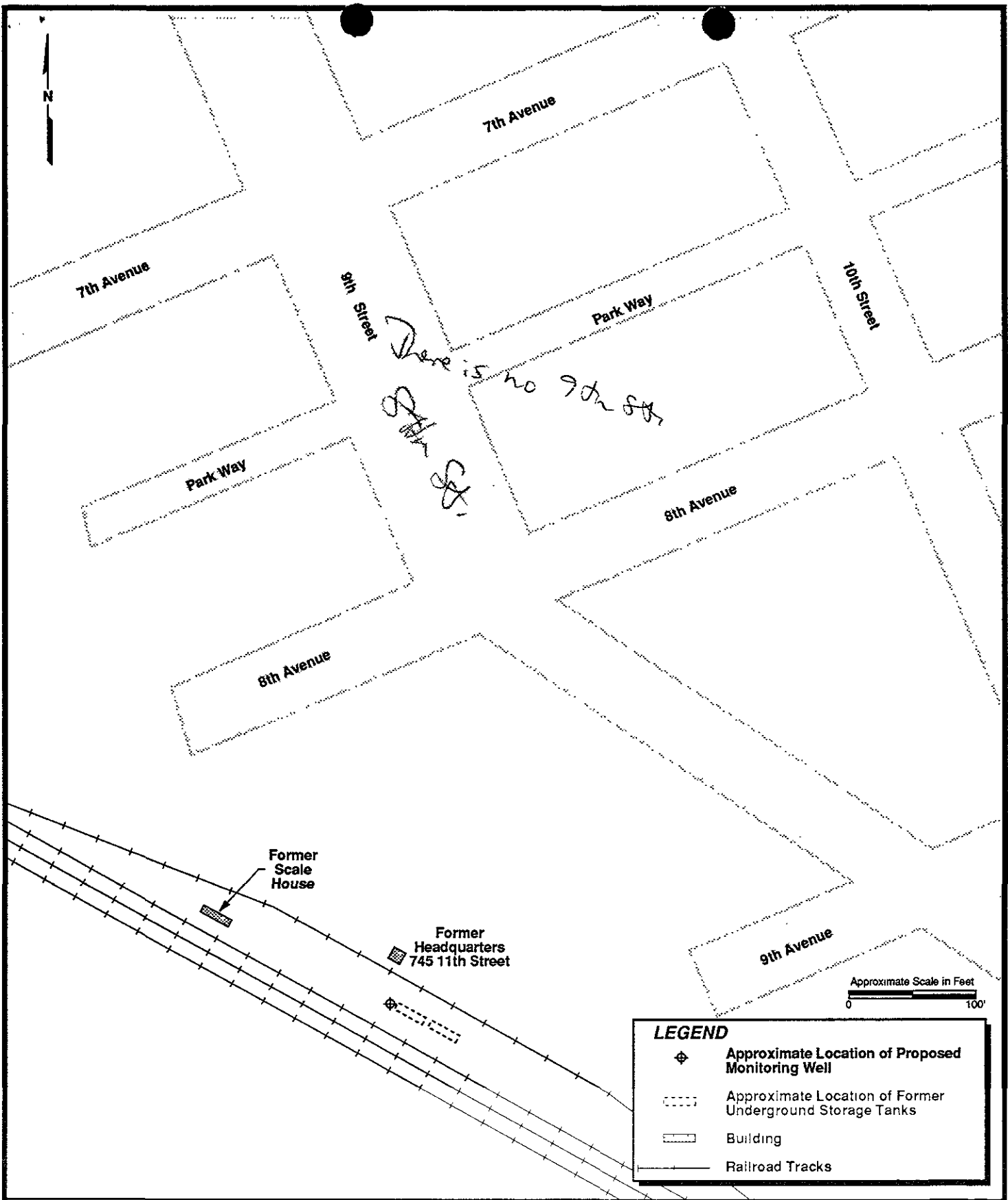

Industrial Compliance
A Subsidiary of SP Environmental Systems, Inc.

PROJECT NO: 05269	DATE: 10/28/92
DRAWN BY: PD	CHECKED BY: WF

SITE MAP
SOUTHERN PACIFIC TRANSPORTATION CO.
5TH AVENUE AND 7TH STREET PROPERTY
OAKLAND, CALIFORNIA

FIGURE:
1

SCALE:
as shown