

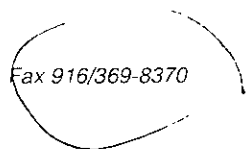

# Industrial Compliance

9719 Lincoln Village Drive, Suite 310 Sacramento, CA 95827 916/369-8971 Fax 916/369-8370

Alameda County  
HAZMAT



March 2, 1994

94 MAR -4 PM 2:30

IC Project No. 05100269

Ms. Jennifer Eberle  
Alameda County Health Care Services Agency  
Department of Environmental Health  
Division of Hazardous Materials  
80 Swan Way, Room 350  
Oakland, California 94621

VIA FACSIMILE

3748

**Re: Status Report - Preliminary Site Assessment at  
5th Avenue and 7th Street Property  
Southern Pacific Transportation Company  
Oakland, California**

Dear Ms. Eberle:

Industrial Compliance (IC), on behalf of Southern Pacific Transportation Company (SPTCo), will be conducting a preliminary site assessment at the SPTCo property located in the East Oakland Yard at 5th Avenue and 7th Street, Oakland, California. The purpose of this letter is to confirm the discussion between Alameda County Health Care Services Agency (Alameda County) and IC on November 3, 1993 and to present a status report on site activities.

The field work was originally scheduled to commence in ~~November~~<sup>Oct.</sup>, 1993. In a conversation with SPTCo's I-880 realignment program project engineer on October 28, 1993, IC learned that Santa Fe Pacific Pipeline (SFPP) would be relocating a petroleum product pipeline in the approximate area where monitoring wells are proposed to be installed. In a conversation with Ms. Jennifer Eberle of Alameda County, Mr. James Jensen of IC discussed postponing the field work until after the pipeline had been relocated. The SFPP construction activity was originally scheduled for December, 1993 but the construction work may not begin until February or March, 1994. Due to the potential for destruction of monitoring wells during the SFPP construction activities, IC recommends postponement of the site assessment until after SFPP completes its pipeline relocation. Figure 1 shows the site layout, including proposed locations of monitoring wells and the location of SFPP pipeline activities.

In October, 1993 IC submitted to Alameda County a schedule for activities at this site. Due to the pipeline issues, the schedule has been adjusted. The new schedule is presented below:

- × Week of March 14, 1994 - Drill soil borings/install monitoring wells.
- × Week of March 21, 1994 - First round quarterly ground water monitoring and sampling.



Ms. Jennifer Eberle  
March 2, 1994  
Page 3

cc: Mr. Greg Shepherd, Southern Pacific Transportation Company (with attachment)  
Mr. Darrell J. Maxey, Oakland Program Office, Southern Pacific Transportation  
Company (with attachment)  
Mr. Larry Phipps, Southern Pacific Transportation Company (with attachment)  
Mr. R. Webb Garey, Industrial Compliance (without attachment)

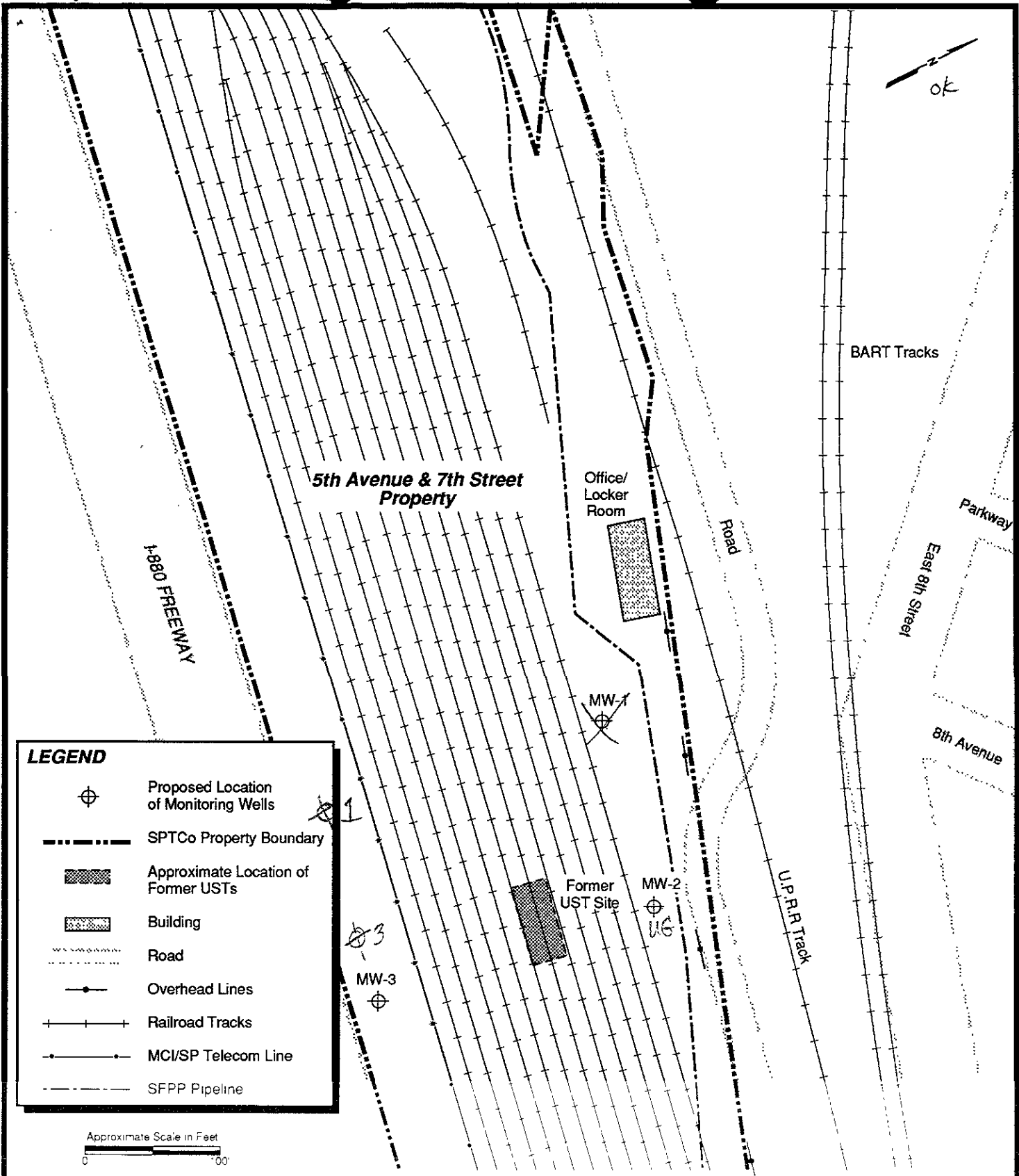

**Industrial Compliance**  
A Subsidiary of SP Environmental Systems, Inc.

Project No: 05100269      Date: 2/07/94

Drawn By: Lynn Fischbeck      Checked By: James G. Jensen

**SITE LAYOUT MAP**  
**SOUTHERN PACIFIC TRANSPORTATION COMPANY**  
**5TH AVENUE AND 7TH STREET PROPERTY**  
**OAKLAND, CALIFORNIA**

Figure	1
Page No	—
Scale	as shown