

RECEIVED

10:33 am, Jan 12, 2012

**Alameda County
Environmental Health**

Mr. Mark Detterman
Alameda County Environmental Health Care Services
Department of Environmental Health
1131 Harbor Bay Parkway, Suite 250
Alameda, California 94502

Re: Former Olympic Service Station
1436 Grant Avenue
San Lorenzo, California
ACEHD Case No. RO0000373, GeoTacker No. T0600102256

Dear Mr. Detterman:

I declare, under penalty of perjury, that the information and or recommendations contained in the attached document are true and correct to the best of my knowledge.

Sincerely,
George and Frida Jaber 1989 Family Trust

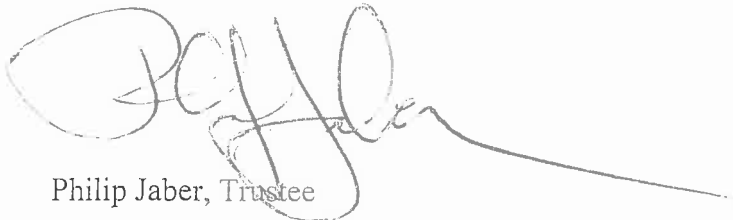
A handwritten signature in black ink, appearing to read 'Philip Jaber', with a long horizontal line extending to the right.

Philip Jaber, Trustee



3330 Cameron Park Drive, Ste 550
Cameron Park, California 95682
(530) 676-6004 ~ Fax: (530) 676-6005

January 9, 2012
Project No. 2115-1436-01

Mr. Mark Detterman
Alameda County Health Care Services Agency
Environmental Health Department
1131 Harbor Bay Parkway, Suite 250
Alameda, California 94502-6577

Re: Verification of Subsurface Utilities at former Olympic Service Station
1436 Grant Avenue, San Leandro, California
ACEHD Case No. RO0000373, GeoTracker No. T0600102256

Dear Mr. Detterman:

Stratus Environmental, Inc. (Stratus) has prepared this letter on behalf of Mr. Philip Jaber and the George and Frida Jaber 1989 Family Trust. Your correspondence of May 13, 2011, approving the proposed dual-phase extraction (DPE) and ozone injection pilot tests, also requested a utility lateral preferential pathway survey.

On September 20, 2011, OHJ Subsurface Utility Locator (OHJ) surveyed the area south and west of the former station building to identify if sewer laterals were present in the vicinity of the Arroyo Center building. OHJ identified the sewer lateral at the back (southwest side) of the Arroyo Center building (in the vicinity of borings B-6 and B-7). The sewer lateral appears to run along the backside of the building toward the southeast (toward Via Lacqua). This sewer lateral does not appear to continue from the station building toward the northwest (toward Grant Avenue). OHJ was not able to estimate the burial depth of the sewer lateral.

OHJ identified electrical lines that connect yard lights in the parking lot adjacent to Grant Avenue. The yard lights appeared to connect to the former Olympic Station building, and to the other lights located in the Arroyo Center parking lot. OHJ confirmed the natural gas and water lines servicing the Arroyo Center building. OHJ estimated the burial depths of these utilities between 32 and 40 inches below ground surface. Storm drains were not observed in the Arroyo Center or former Olympic Station parking lots.

Other than the electrical line discussed above, OHJ did not identify subsurface utilities in the vicinity of borings BH-A, BH-B, BH-C or SV-1.

A revised site plan that includes the sewer and electrical lines identified by OHJ is attached.

Mr. Mark Detterman, ACEHD
Verification of Subsurface Utilities
Former Olympic Service Station, San Leandro, CA
Page 2

January 9, 2012

If you have any questions or comments concerning this letter, please contact Steve Carter at scarter@stratusinc.net or (530) 676-6008.

Sincerely,

STRATUS ENVIRONMENTAL, INC.

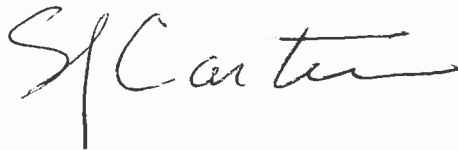
A handwritten signature in black ink that reads "S J Carter". The signature is written in a cursive, flowing style.

Stephen J. Carter, P.G.
Project Manager

Attachment: Site Plan

cc: Mr. Philip Jaber
Ms. Cherie McCaulou, RWQCB

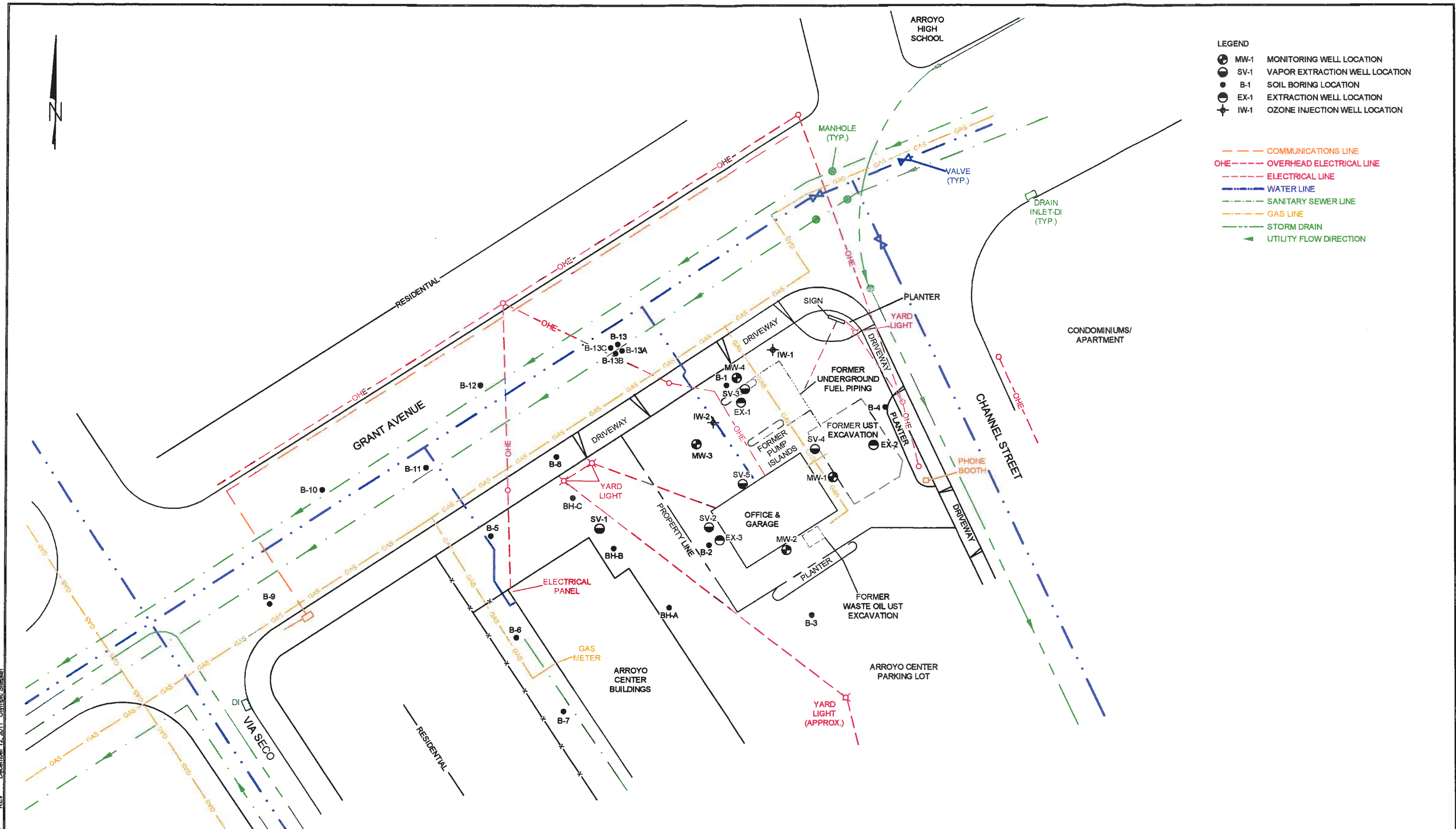

- LEGEND**
- MW-1 MONITORING WELL LOCATION
 - SV-1 VAPOR EXTRACTION WELL LOCATION
 - B-1 SOIL BORING LOCATION
 - EX-1 EXTRACTION WELL LOCATION
 - ⊕ IW-1 OZONE INJECTION WELL LOCATION
-
- COMMUNICATIONS LINE
 - OHE--- OVERHEAD ELECTRICAL LINE
 - ELECTRICAL LINE
 - WATER LINE
 - SANITARY SEWER LINE
 - GAS LINE
 - STORM DRAIN
 - UTILITY FLOW DIRECTION

REV December 12, 2011 Olympic Station JHP

STRATUS
ENVIRONMENTAL, INC.

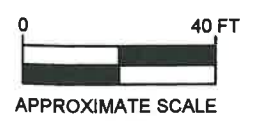

FORMER OLYMPIC SERVICE STATION
1436 GRANT AVENUE
SAN LORENZO, CALIFORNIA

SITE PLAN

FIGURE
2

PROJECT NO.
2115-1436-01