

100 - 372



Shell Oil Products US

July 11, 2003

Scott Seery
Alameda County Health Care Services Agency
1131 Harbor Bay Parkway, Suite 250
Alameda, California 94502-6577

Alameda County
JUL 13 2003
Environmental Health

Subject: Former Shell Service Station
15275 Washington Avenue
San Leandro, California

Dear Mr. Seery:

Attached for your review and comment is a copy of the *Second Quarter 2003 Monitoring and Remediation Report* for the above referenced site. Upon information and belief, I declare, under penalty of perjury, that the information contained in the attached document is true and correct.

As always, please feel free to contact me directly at (559) 645-9306 with any questions or concerns.

Sincerely,

Shell Oil Products US

Karen Petryna

Karen Petryna
Sr. Environmental Engineer

July 11, 2003

Scott Seery
Alameda County Health Care Services Agency
1131 Harbor Bay Parkway, Suite 250
Alameda, California 94502-6577

Re: **Second Quarter 2003 Monitoring and Remediation Report**
Former Shell Service Station
15275 Washington Avenue
San Leandro, California
Incident #97088270
Cambria Project #245-0933-002



Dear Mr. Seery:

On behalf of Equilon Enterprises LLC dba Shell Oil Products US, Cambria Environmental Technology, Inc. (Cambria) is submitting this groundwater monitoring report in accordance with the reporting requirements of 23 CCR 2652d.

HYDROCARBON REMOVAL SUMMARY

A soil-vapor extraction (SVE) system was operated at the site from May 1998 to August 1999, when it was turned off due to low, asymptotic influent concentrations. Approximately 1,410 pounds of vapor-phase hydrocarbons were removed by the system. Asymptotic influent concentrations were confirmed during October 2000. A February 9, 2001 letter from the Alameda County Health Care Services Agency stated that SVE system operation was no longer required at that time. The aboveground remediation equipment was removed from the site during May 2002.

SECOND QUARTER 2003 ACTIVITIES

Groundwater Monitoring: Blaine Tech Services, Inc. (Blaine) of San Jose, California gauged, sampled, and measured dissolved oxygen (D.O.) in selected wells, calculated groundwater elevations, and compiled the analytical data. Cambria prepared a groundwater elevation contour map (Figure 1). Blaine's report, presenting the laboratory report and supporting field documents, is included as Attachment A.

**Cambria
Environmental
Technology, Inc.**

5900 Hollis Street
Suite A
Emeryville, CA 94608
Tel (510) 420-0700
Fax (510) 420-9170

ANTICIPATED THIRD QUARTER 2003 ACTIVITIES

Groundwater Monitoring: Blaine will gauge and sample selected site wells and tabulate the data. Cambria will prepare a monitoring report.

Oxygen Releasing Compound (ORC) Maintenance: Blaine will replace the ORCs in wells S-3 and S-9.



CLOSING

We appreciate the opportunity to work with you on this project. Please call Matt Derby at (510) 420-3332 if you have any questions or comments.

Sincerely,
Cambria Environmental Technology, Inc

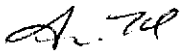
Anni Kreml
Senior Staff Scientist

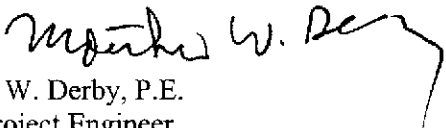
Matthew W. Derby, P.E.
Senior Project Engineer

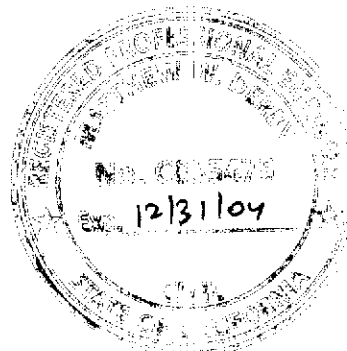

Figure: 1 - Groundwater Elevation Contour Map

Attachment: A - Blaine Groundwater Monitoring Report and Field Notes

- cc: Karen Petryna, Shell Oil Products US, P.O. Box 7869, Burbank, CA 91510-7869
- Mike Bakaldin, San Leandro Fire Department, Civic Center, 835 E. 14th Street, San Leandro, CA 94577
- Jonathan Redding, Wendell, Rosen, Black & Dean, P. O. Box 2047, Oakland, CA 94604-2047
- Richard Waxman, Wendell, Rosen, Black & Dean, P. O. Box 2047, Oakland, CA 94604-2047
- Salel Enterprises c/o Foothill Hardware, 6733 Foothill Blvd, Oakland, CA 94605

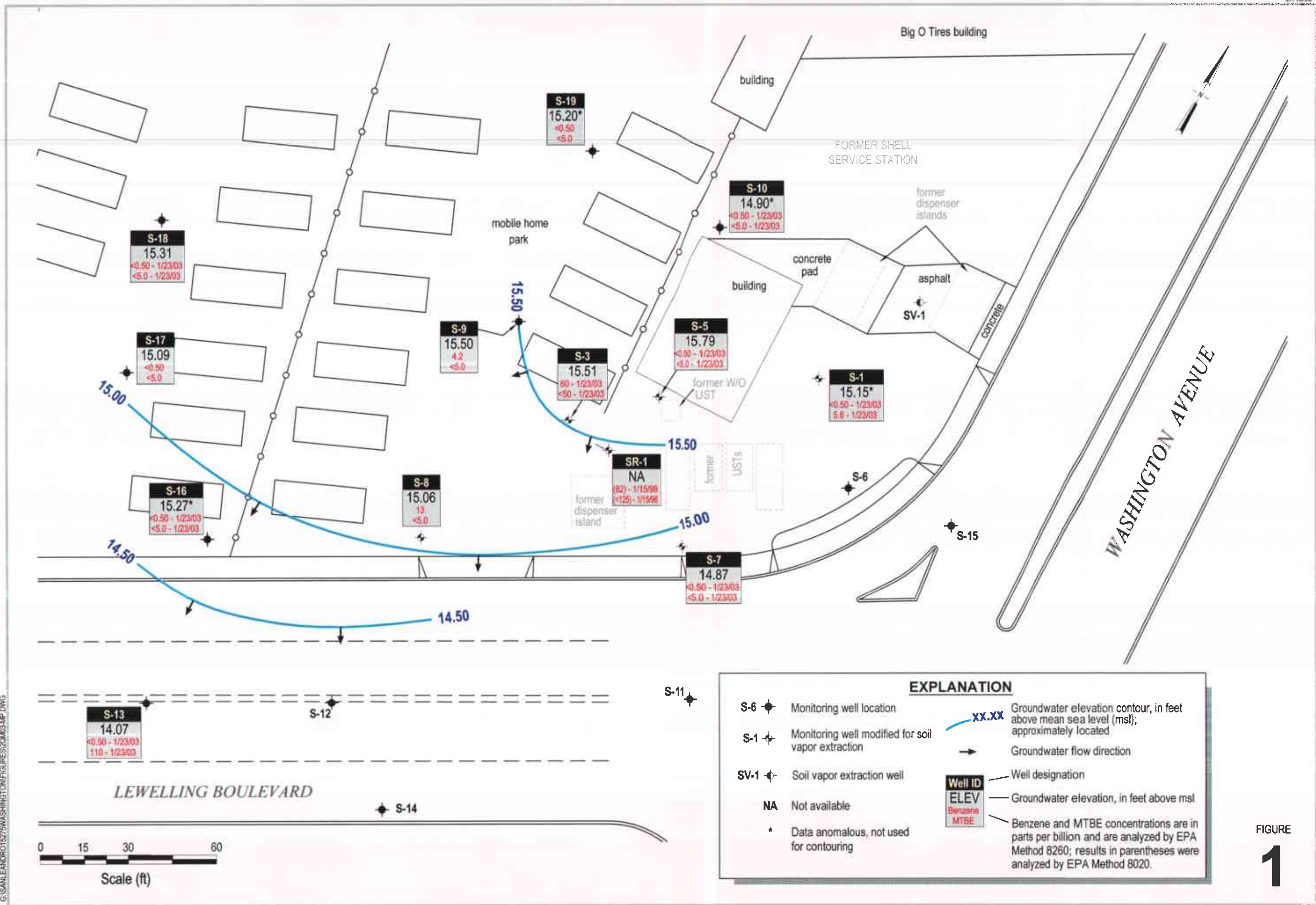
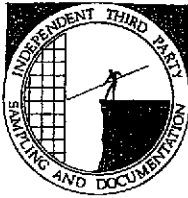

FIGURE 1

ATTACHMENT A
Blaine Groundwater Monitoring Report
and Field Notes

BLAINE
TECH SERVICES, INC.



1680 ROGERS AVENUE
SAN JOSE, CA 95112-1105
(408) 573-7771 FAX
(408) 573-0555 PHONE
CONTRACTOR'S LICENSE #746684
www.blainetech.com

June 6, 2003

Karen Petryna
Shell Oil Products US
P.O. Box 7869
Burbank, CA 91510-7869

Second Quarter 2003 Groundwater Monitoring at
Former Shell Service Station
15275 Washington Boulevard
San Leandro, CA

Monitoring performed on April 30, 2003

Groundwater Monitoring Report **030430-DA-1**

This report covers the routine monitoring of groundwater wells at this Former Shell facility. In accordance with standard procedures that conform to Regional Water Quality Control Board requirements, routine field data collection includes depth to water, total well depth, thickness of any separate immiscible layer, water column volume, calculated purge volume (if applicable), elapsed evacuation time (if applicable), total volume of water removed (if applicable), and standard water parameter instrument readings. Sample material is collected, contained, stored, and transported to the laboratory in conformance with EPA standards. Purgewater (if applicable) is, likewise, collected and transported to the Martinez Refining Company.

Basic field information is presented alongside analytical values excerpted from the laboratory report in the cumulative table of **WELL CONCENTRATIONS**. The full analytical report for the most recent samples and the field data sheets are attached to this report.

At a minimum, Blaine Tech Services, Inc. field personnel are certified on completion of a forty-hour Hazardous Materials and Emergency Response training course per 29 CFR 1910.120. Field personnel are also enrolled in annual eight-hour refresher courses.

Blaine Tech Services, Inc. conducts sampling and documentation assignments of this type as an independent third party. Our activities at this site consisted of objective data and sample collection only. No interpretation of analytical results, defining of hydrological conditions or formulation of recommendations was performed.

Please call if you have any questions.

Yours truly,

Leon Gearhart
Project Coordinator

LG/jt

attachments: Cumulative Table of WELL CONCENTRATIONS
Certified Analytical Report
Field Data Sheets

cc: Anni Kreml
Cambria Environmental Technology, Inc.
5900 Hollis Street, Suite A
Oakland, CA 94608

WELL CONCENTRATIONS
Former Shell Service Station
15275 Washington
San Leandro, CA

Well ID	Date	TPPH (ug/L)	B (ug/L)	T (ug/L)	E (ug/L)	X (ug/L)	MTBE 8020 (ug/L)	MTBE 8260 (ug/L)	TOC (MSL)	Depth to Water (ft.)	GW Elevation (MSL)	SPH Thickness (ft.)	DO Reading (ppm)
S-1	07/08/1985	520	NA	NA	NA	NA	NA	NA	21.55	NA	NA	NA	NA
S-1	09/06/1988	<50	<0.5	<1	<1	<0.3	NA	NA	21.55	NA	NA	NA	NA
S-1	11/16/1988	<50	<0.5	<1	<1	<0.3	NA	NA	21.55	8.01	13.54	NA	NA
S-1	02/27/1989	<50	0.5	<1	<1	<0.3	NA	NA	21.55	NA	NA	NA	NA
S-1	05/04/1989	<50	1.0	<1	<1	<0.3	NA	NA	21.55	NA	NA	NA	NA
S-1	08/10/1989	<50	0.7	<1	<1	<0.3	NA	NA	21.55	7.93	13.62	NA	NA
S-1	10/10/1989	<50	<0.5	<1	<1	<0.3	NA	NA	21.55	8.09	13.46	NA	NA
S-1	01/25/1990	<50	<0.5	<0.5	<0.5	<1	NA	NA	21.55	7.73	13.82	NA	NA
S-1	04/18/1990	<50	<0.5	<0.5	<0.5	<1	NA	NA	21.55	7.91	13.64	NA	NA
S-1	07/23/1990	<50	<0.5	<0.5	<0.5	<0.5	NA	NA	21.55	7.72	13.83	NA	NA
S-1	10/18/1990	80	5	<0.5	<0.5	3.0	NA	NA	21.55	8.55	13.00	NA	NA
S-1	01/28/1991	<50	4.5	<0.5	<0.5	2.0	NA	NA	21.55	8.52	13.03	NA	NA
S-1	04/25/1991	80a	3.7	<0.5	0.7	2.0	NA	NA	21.55	7.18	14.37	NA	NA
S-1	07/09/1991	200	16	<0.5	1.3	5.8	NA	NA	21.55	8.22	13.33	NA	NA
S-1	10/08/1991	<50	2.3	<0.5	<0.5	<0.5	NA	NA	21.55	8.70	12.85	NA	NA
S-1	02/05/1992	160	8.9	<0.5	2.1	6.0	NA	NA	21.55	8.14	13.41	NA	NA
S-1	04/28/1992	<50	2.4	<0.5	<0.5	0.9	NA	NA	21.55	7.52	14.03	NA	NA
S-1	07/27/1992	<50	<0.5	<0.5	<0.5	<0.5	NA	NA	21.55	8.28	13.27	NA	NA
S-1	10/26/1992	57	3.0	1.6	1.4	1.7	NA	NA	21.55	8.74	12.81	NA	NA
S-1	01/14/1993	490	53	1.2	20	33	NA	NA	21.55	5.91	15.64	NA	NA
S-1	04/16/1993	240	20	<0.5	15	240	NA	NA	21.55	6.66	14.89	NA	NA
S-1	07/23/1993	<50	0.5	<0.5	<0.5	<0.5	NA	NA	21.55	7.53	14.02	NA	NA
S-1	10/27/1993	60	5.9	<0.5	2.5	1.7	NA	NA	21.55	8.20	13.35	NA	NA
S-1	01/27/1994	<50	2.1	<0.5	<0.5	0.63	NA	NA	21.55	7.26	14.29	NA	NA
S-1	05/05/1994	57	3.9	<0.5	1.9	1.9	NA	NA	21.27	7.38	13.89	NA	NA
S-1	07/26/1994	<50	2.2	<0.3	<0.3	<0.6	NA	NA	21.27	7.86	13.41	NA	NA
S-1	10/28/1994	<50	0.8	<0.3	<0.3	0.8	NA	NA	21.27	7.86	13.41	NA	NA
S-1	01/02/1995	<50	<0.5	<0.5	<0.5	<0.5	NA	NA	21.27	6.85	14.42	NA	NA

WELL CONCENTRATIONS
Former Shell Service Station
15275 Washington
San Leandro, CA

Well ID	Date	TPPH (ug/L)	B (ug/L)	T (ug/L)	E (ug/L)	X (ug/L)	MTBE 8020 (ug/L)	MTBE 8260 (ug/L)	TOC (MSL)	Depth to Water (ft)	GW Elevation (MSL)	SPH Thickness (ft)	DO Reading (ppm)
S-1	04/14/1995	NA	NA	NA	NA	NA	NA	NA	21.27	6.08	15.19	NA	NA
S-1	07/28/1995	60	2.2	<0.5	1.3	1.2	NA	NA	21.27	6.79	14.48	NA	NA
S-1	10/17/1995	60	2.6	<0.5	1.2	1.3	NA	NA	21.27	7.04	14.23	NA	NA
S-1	01/11/1996	<50	2.0	<0.5	<0.5	<0.5	<2	NA	21.27	6.40	14.87	NA	NA
S-1	04/02/1996	NA	NA	NA	NA	NA	NA	NA	21.27	5.84	15.43	NA	NA
S-1	07/09/1996	NA	NA	NA	NA	NA	NA	NA	21.27	6.50	14.77	NA	NA
S-1	10/10/1996	NA	NA	NA	NA	NA	NA	NA	21.27	7.31	13.96	NA	NA
S-1	01/09/1997	<50	<0.50	<0.50	<0.50	<0.50	6.7	NA	21.27	5.50	15.77	NA	NA
S-1	04/08/1997	NA	NA	NA	NA	NA	NA	NA	21.27	7.03	14.24	NA	NA
S-1	07/21/1997	NA	NA	NA	NA	NA	NA	NA	21.27	7.00	14.27	NA	NA
S-1	10/08/1997	NA	NA	NA	NA	NA	NA	NA	21.27	7.51	13.76	NA	NA
S-1	01/15/1998	420	16	<0.50	4.6	3.9	26	NA	21.27	5.43	15.84	NA	NA
S-1	04/14/1998	NA	NA	NA	NA	NA	NA	NA	21.27	5.55	15.72	NA	NA
S-1	07/14/1998	NA	NA	NA	NA	NA	NA	NA	21.33	6.38	14.95	NA	NA
S-1	10/20/1998	NA	NA	NA	NA	NA	NA	NA	21.33	7.48	13.85	NA	NA
S-1	01/22/1999	<50.0	<0.500	<0.500	<0.500	<0.500	2.53	NA	21.33	6.37	14.96	NA	NA
S-1	04/08/1999	NA	NA	NA	NA	NA	NA	NA	21.33	5.93	15.40	NA	NA
S-1	07/23/1999	NA	NA	NA	NA	NA	NA	NA	21.33	7.20	14.13	NA	NA
S-1	10/26/1999	NA	NA	NA	NA	NA	NA	NA	21.33	7.61	13.72	NA	NA
S-1	01/03/2000	<50.0	<0.500	<0.500	<0.500	<0.500	4.73	NA	21.33	7.76	13.57	NA	NA
S-1	04/14/2000	NA	NA	NA	NA	NA	NA	NA	21.33	6.35	14.98	NA	NA
S-1	07/12/2000	NA	NA	NA	NA	NA	NA	NA	21.33	7.05	14.28	NA	NA
S-1	11/01/2000	NA	NA	NA	NA	NA	NA	NA	21.33	6.51	14.82	NA	NA
S-1	01/03/2001	<50.0	<0.500	<0.500	<0.500	<0.500	<2.50	NA	21.33	7.49	13.84	NA	NA
S-1	04/24/2001	NA	NA	NA	NA	NA	NA	NA	21.33	6.85	14.48	NA	NA
S-1	07/02/2001	NA	NA	NA	NA	NA	NA	NA	21.33	7.65	13.68	NA	NA
S-1	11/02/2001	NA	NA	NA	NA	NA	NA	NA	21.33	7.84	13.49	NA	NA
S-1	01/16/2002	<50	<0.50	<0.50	<0.50	<0.50	NA	<5.0	21.33	6.16	15.17	NA	NA

WELL CONCENTRATIONS
Former Shell Service Station
15275 Washington
San Leandro, CA

Well ID	Date	TPPH (ug/L)	B (ug/L)	T (ug/L)	E (ug/L)	X (ug/L)	MTBE 8020 (ug/L)	MTBE 8260 (ug/L)	TOC (MSL)	Depth to Water (ft.)	GW Elevation (MSL)	SPH Thickness (ft.)	DO Reading (ppm)
S-1	04/01/2002	NA	NA	NA	NA	NA	NA	NA	21.33	6.57	14.76	NA	NA
S-1	07/11/2002	NA	NA	NA	NA	NA	NA	NA	21.33	7.52	13.81	NA	NA
S-1	10/28/2002	NA	NA	NA	NA	NA	NA	NA	21.33	7.99	13.34	NA	NA
S-1	01/23/2003	<50	<0.50	<0.50	<0.50	<0.50	NA	5.6	21.33	6.46	14.87	NA	NA
S-1	04/30/2003	NA	NA	NA	NA	NA	NA	NA	21.33	6.18	15.15	NA	NA
S-3	09/06/1988	96000	3400	9500	2700	17000	NA	NA	21.14	NA	NA	NA	NA
S-3	11/16/1988	70000	4600	8400	2500	13000	NA	NA	21.14	7.76	13.38	NA	NA
S-3	02/27/1989	32000	2400	3100	1500	6400	NA	NA	21.14	NA	NA	NA	NA
S-3	05/04/1989	47000	4400	300	2400	15000	NA	NA	21.14	NA	NA	NA	NA
S-3	08/10/1989	110000	5700	5700	3200	19000	NA	NA	21.14	7.92	13.22	NA	NA
S-3	10/10/1989	52000	4600	3300	2600	15000	NA	NA	21.14	8.00	13.14	NA	NA
S-3	01/25/1990	420000	5200	4100	6700	34000	NA	NA	21.14	7.54	13.60	NA	NA
S-3	04/18/1990	58000	3800	1400	2400	12000	NA	NA	21.14	7.74	13.40	NA	NA
S-3	07/23/1990	49000	3400	1800	2300	12000	NA	NA	21.14	7.55	13.59	NA	NA
S-3	10/18/1990	44000	3500	650	2400	11000	NA	NA	21.14	8.47	12.67	NA	NA
S-3	01/28/1991	64000	40900	570	1940	8090	NA	NA	21.14	8.38	12.76	NA	NA
S-3	04/25/1991	120000	3900	3600	2400	8900	NA	NA	21.14	6.91	14.23	NA	NA
S-3	07/09/1991	50000	3600	2300	1800	10000	NA	NA	21.14	8.07	13.07	NA	NA
S-3	10/08/1991	130000	3600	1000	2800	8400	NA	NA	21.14	8.61	12.53	NA	NA
S-3	02/05/1992	150000	2500	670	2700	10000	NA	NA	21.14	7.80	13.34	NA	NA
S-3	04/28/1992	120000	2200	1200	2000	5800	NA	NA	21.14	7.27	13.87	NA	NA
S-3	07/27/1992	190000	1400	<1250	<1250	3400	NA	NA	21.14	8.10	13.04	NA	NA
S-3	10/26/1992	950000	2000	8400	16000	36000	NA	NA	21.14	8.62	12.52	NA	NA
S-3	01/14/1993	41000	2700	2500	1800	6900	NA	NA	21.14	5.16	15.98	NA	NA
S-3	04/16/1993	40000	930	2800	1900	14000	NA	NA	21.14	7.18	13.96	NA	NA
S-3	07/23/1993	87000	1600	<5	1300	4000	NA	NA	21.14	7.34	13.80	NA	NA
S-3	10/27/1993	36000	2200	<500	1500	3200	NA	NA	21.14	8.03	13.11	NA	NA

WELL CONCENTRATIONS
Former Shell Service Station
15275 Washington
San Leandro, CA

Well ID	Date	TPPH (ug/L)	B (ug/L)	T (ug/L)	E (ug/L)	X (ug/L)	MTBE 8020 (ug/L)	MTBE 8260 (ug/L)	TOC (MSL)	Depth to Water (ft)	GW Elevation (MSL)	SPH Thickness (ft)	DO Reading (ppm)
S-3	01/27/1994	190000	3200	3100	4100	15000	NA	NA	21.14	6.79	14.35	NA	NA
S-3	05/05/1994	36000	1100	490	1600	4700	NA	NA	20.48	6.75	13.73	NA	NA
S-3	07/26/1994	18000	1039	170.5	845.4	967.5	NA	NA	20.48	7.30	13.18	NA	NA
S-3	10/28/1994	25869	467.9	294	546.2	343.3	NA	NA	20.48	8.36	12.12	NA	NA
S-3	01/02/1995	23000	850	260	900	2100	NA	NA	20.48	6.36	14.12	NA	NA
S-3	04/14/1995	33000	720	670	1600	6600	NA	NA	20.48	5.87	14.61	NA	NA
S-3	07/28/1995	12000	540	<10	580	780	NA	NA	20.48	6.33	14.15	NA	NA
S-3	10/17/1995	Well inaccessible		NA	NA	NA	NA	NA	20.48	6.48	14.00	NA	NA
S-3	01/11/1996	16000	520	290	740	2600	<200	NA	20.48	5.80	14.68	NA	NA
S-3	04/02/1996	NA	NA	NA	NA	NA	NA	NA	20.48	5.00	15.48	NA	NA
S-3	07/09/1996	NA	NA	NA	NA	NA	NA	NA	20.48	5.93	14.55	NA	NA
S-3	10/10/1996	NA	NA	NA	NA	NA	NA	NA	20.48	6.73	13.75	NA	NA
S-3	01/09/1997	30000	420	330	1500	6300	<500	NA	20.48	4.72	15.76	NA	NA
S-3	04/08/1997	NA	NA	NA	NA	NA	NA	NA	20.48	6.63	13.85	NA	NA
S-3	07/21/1997	NA	NA	NA	NA	NA	NA	NA	20.48	6.18	14.30	NA	NA
S-3	10/08/1997	NA	NA	NA	NA	NA	NA	NA	20.48	6.83	13.65	NA	NA
S-3	01/15/1998	21000	300	51	770	2800	<100	NA	20.48	4.30	16.18	NA	NA
S-3 (D)	01/15/1998	14000	330	63	920	3400	<250	NA	20.48	NA	NA	NA	NA
S-3	04/14/1998	NA	NA	NA	NA	NA	NA	NA	20.48	4.37	16.11	NA	NA
S-3	07/14/1998	NA	NA	NA	NA	NA	NA	NA	20.48	5.47	15.01	NA	NA
S-3	10/20/1998	Well inaccessible		NA	NA	NA	NA	NA	20.48	NA	NA	NA	NA
S-3	01/22/1999	40000	313	194	2200	8800	<40.0	NA	20.48	5.71	14.77	NA	NA
S-3	04/08/1999	NA	NA	NA	NA	NA	NA	NA	20.48	4.95	15.53	NA	NA
S-3	07/23/1999	NA	NA	NA	NA	NA	NA	NA	20.48	6.78	13.70	NA	NA
S-3	10/26/1999	NA	NA	NA	NA	NA	NA	NA	20.48	7.25	13.23	NA	NA
S-3	01/03/2000	39700	150	61.8	1690	7720	445	NA	20.48	7.46	13.02	NA	NA
S-3	04/14/2000	NA	NA	NA	NA	NA	NA	NA	20.48	5.64	14.84	NA	NA
S-3	07/12/2000	Well inaccessible		NA	NA	NA	NA	NA	20.48	NA	NA	NA	NA

WELL CONCENTRATIONS
Former Shell Service Station
15275 Washington
San Leandro, CA

Well ID	Date	TPPH (ug/L)	B (ug/L)	T (ug/L)	E (ug/L)	X (ug/L)	MTBE 8020 (ug/L)	MTBE 8260 (ug/L)	TOC (MSL)	Depth to Water (ft.)	GW Elevation (MSL)	SPH Thickness (ft.)	DO Reading (ppm)
---------	------	----------------	-------------	-------------	-------------	-------------	------------------------	------------------------	--------------	----------------------------	--------------------------	---------------------------	------------------------

S-3	11/01/2000	NA	NA	NA	NA	NA	NA	NA	20.48	6.72	13.76	NA	NA
S-3	01/03/2001	25000	89.0	<50.0	1270	5180	<250	NA	20.48	7.14	13.34	NA	NA
S-3	04/24/2001	Well inaccessible		NA	NA	NA	NA	NA	20.48	NA	NA	NA	NA
S-3	07/02/2001	NA	NA	NA	NA	NA	NA	NA	20.48	7.28	13.20	NA	3.2
S-3	11/02/2001	NA	NA	NA	NA	NA	NA	NA	20.48	7.64	12.84	NA	3.5
S-3	01/16/2002	Well inaccessible		NA	NA	NA	NA	NA	20.48	NA	NA	NA	NA
S-3	04/01/2002	NA	NA	NA	NA	NA	NA	NA	20.48	5.99	14.49	NA	3.8
S-3	07/11/2002	NA	NA	NA	NA	NA	NA	NA	20.48	7.21	13.27	NA	0.7
S-3	10/28/2002	NA	NA	NA	NA	NA	NA	NA	20.85	7.90	12.95	NA	e
S-3	01/23/2003	28000	60	13	970	3700	NA	<50	20.85	6.00	14.85	NA	0.3
S-3	04/30/2003	NA	NA	NA	NA	NA	NA	NA	20.85	5.34	15.51	NA	1.0

S-5	01/08/1987	7800	380	510	NA	1000	NA	NA	21.41	NA	NA	NA	NA
S-5	09/06/1988	7000	2600	60	400	700	NA	NA	21.41	NA	NA	NA	NA
S-5	11/16/1988	3000	660	60	120	220	NA	NA	21.41	NA	NA	NA	NA
S-5	02/27/1989	5700	2000	220	260	320	NA	NA	21.41	NA	NA	NA	NA
S-5	05/04/1989	9000	3000	600	630	1700	NA	NA	21.41	NA	NA	NA	NA
S-5	08/10/1989	5100	1100	<50	270	400	NA	NA	21.41	8.28	13.13	NA	NA
S-5	10/10/1989	15000	3300	160	830	2200	NA	NA	21.41	8.32	13.09	NA	NA
S-5	01/25/1990	12000	2400	360	570	1400	NA	NA	21.41	8.20	13.21	NA	NA
S-5	04/18/1990	5200	1100	40	300	460	NA	NA	21.41	8.32	13.09	NA	NA
S-5	07/23/1990	5500	1300	140	320	730	NA	NA	21.41	8.03	13.38	NA	NA
S-5	10/18/1990	12000	3200	40	720	900	NA	NA	21.41	9.03	12.38	NA	NA
S-5	01/28/1991	2550	410	15	110	60	NA	NA	21.41	8.80	12.61	NA	NA
S-5	04/25/1991	67000	5100	3100	2800	11000	NA	NA	21.41	7.40	14.01	NA	NA
S-5	07/09/1991	4900	480	36	360	1000	NA	NA	21.41	8.52	12.89	NA	NA
S-5	10/08/1991	6600	370	7.0	190	380	NA	NA	21.41	9.00	12.41	NA	NA
S-5	02/05/1992	44000	4800	850	2700	8400	NA	NA	21.41	8.11	13.30	NA	NA

WELL CONCENTRATIONS
Former Shell Service Station
15275 Washington
San Leandro, CA

Well ID	Date	TPPH (ug/L)	B (ug/L)	T (ug/L)	E (ug/L)	X (ug/L)	MTBE 8020 (ug/L)	MTBE 8260 (ug/L)	TOC (MSL)	Depth to Water (ft.)	GW Elevation (MSL)	SPH Thickness (ft.)	DO Reading (ppm)
S-5	04/28/1992	33000	1400	320	1600	5200	NA	NA	21.41	7.70	13.71	NA	NA
S-5	07/27/1992	20000	2400	<25	1800	2300	NA	NA	21.41	8.52	12.89	NA	NA
S-5	10/26/1992	21000	1600	140	1500	2800	NA	NA	21.41	9.02	12.39	NA	NA
S-5	01/14/1993	54000	1900	1000	2700	16000	NA	NA	21.41	5.22	16.19	NA	NA
S-5	04/16/1993	42000	2000	1300	4300	18000	NA	NA	21.41	7.04	14.37	NA	NA
S-5	07/23/1993	46000	2500	2200	3400	11000	NA	NA	21.41	7.75	13.66	NA	NA
S-5	10/27/1993	6500	990	31	1100	1000	NA	NA	21.41	8.49	12.92	NA	NA
S-5	01/27/1994	34000	1800	580	2900	9700	NA	NA	21.41	7.04	14.37	NA	NA
S-5	05/05/1994	24000	670	70	1400	2700	NA	NA	21.03	7.20	13.83	NA	NA
S-5	07/27/1994	4700	193.6	33.1	332.3	281.2	NA	NA	21.03	7.72	13.31	NA	NA
S-5	10/28/1994	3200	167.3	18	238.7	104.5	NA	NA	21.03	7.82	13.21	NA	NA
S-5	01/02/1995	18000	1300	220	3400	10000	NA	NA	21.03	6.65	14.38	NA	NA
S-5	04/14/1995	NA	NA	NA	NA	NA	NA	NA	21.03	5.99	15.04	NA	NA
S-5	07/28/1995	25000	440	74	1700	4500	NA	NA	21.03	6.77	14.26	NA	NA
S-5 (D)	07/28/1995	25000	450	<50	1700	4600	NA	NA	21.03	NA	NA	NA	NA
S-5	10/17/1995	18000	360	24	1300	2200	NA	NA	21.03	7.00	14.03	NA	NA
S-5	01/11/1996	41000	420	180	1600	9500	<200	NA	21.03	6.22	14.81	NA	NA
S-5	04/02/1996	NA	NA	NA	NA	NA	NA	NA	21.03	5.44	15.59	NA	NA
S-5	07/09/1996	NA	NA	NA	NA	NA	NA	NA	21.03	6.41	14.62	NA	NA
S-5	10/10/1996	NA	NA	NA	NA	NA	NA	NA	21.03	7.19	13.84	NA	NA
S-5	01/09/1997	38000	130	43	160	6200	<125	NA	21.03	5.03	16.00	NA	NA
S-5 (D)	01/09/1997	36000	130	<50	160	5600	<250	NA	21.03	NA	NA	NA	NA
S-5	04/08/1997	NA	NA	NA	NA	NA	NA	NA	21.03	7.20	13.83	NA	NA
S-5	07/21/1997	NA	NA	NA	NA	NA	NA	NA	21.03	6.82	14.21	NA	NA
S-5	10/08/1997	NA	NA	NA	NA	NA	NA	NA	21.03	7.31	13.72	NA	NA
S-5	01/15/1998	49000	62	<50	93	4100	<250	NA	21.03	4.58	16.45	NA	NA
S-5	04/14/1998	NA	NA	NA	NA	NA	NA	NA	21.03	4.94	16.09	NA	NA
S-5	07/14/1998	NA	NA	NA	NA	NA	NA	NA	21.27	5.36	15.91	NA	NA

WELL CONCENTRATIONS
Former Shell Service Station
15275 Washington
San Leandro, CA

Well ID	Date	TPPH (ug/L)	B (ug/L)	T (ug/L)	E (ug/L)	X (ug/L)	MTBE 8020 (ug/L)	MTBE 8260 (ug/L)	TOC (MSL)	Depth to Water (ft.)	GW Elevation (MSL)	SPH Thickness (ft.)	DO Reading (ppm)
---------	------	----------------	-------------	-------------	-------------	-------------	------------------------	------------------------	--------------	----------------------------	--------------------------	---------------------------	------------------------

S-5	10/20/1998	NA	NA	NA	NA	NA	NA	NA	21.27	7.53	13.74	NA	NA
S-5	01/22/1999	2550	9.09	<0.500	1.93	112	4.40	NA	21.27	6.35	14.92	NA	NA
S-5	04/08/1999	NA	NA	NA	NA	NA	NA	NA	21.27	5.37	15.90	NA	NA
S-5	07/23/1999	NA	NA	NA	NA	NA	NA	NA	21.27	6.43	14.84	NA	NA
S-5	10/26/1999	NA	NA	NA	NA	NA	NA	NA	21.27	7.51	13.76	NA	NA
S-5	01/03/2000	3310	39.0	<10.0	293	21.7	<50.0	NA	21.27	7.78	13.49	NA	NA
S-5	04/14/2000	NA	NA	NA	NA	NA	NA	NA	21.27	6.15	15.12	NA	NA
S-5	07/12/2000	NA	NA	NA	NA	NA	NA	NA	21.27	7.05	14.22	NA	NA
S-5	11/01/2000	NA	NA	NA	NA	NA	NA	NA	21.27	6.00	15.27	NA	NA
S-5	01/03/2001	516	3.65	0.968	18.0	4.02	18.4	NA	21.27	7.48	13.79	NA	NA
S-5	04/24/2001	NA	NA	NA	NA	NA	NA	NA	21.27	6.58	14.69	NA	NA
S-5	07/02/2001	NA	NA	NA	NA	NA	NA	NA	21.27	7.60	13.67	NA	NA
S-5	11/02/2001	NA	NA	NA	NA	NA	NA	NA	21.27	7.94	13.33	NA	NA
S-5	01/16/2002	<50	<0.50	<0.50	<0.50	<0.50	NA	<5.0	21.27	5.88	15.39	NA	NA
S-5	04/01/2002	NA	NA	NA	NA	NA	NA	NA	21.27	6.27	15.00	NA	NA
S-5	07/11/2002	NA	NA	NA	NA	NA	NA	NA	21.27	7.53	13.74	NA	NA
S-5	10/28/2002	NA	NA	NA	NA	NA	NA	NA	21.27	8.11	13.16	NA	NA
S-5	01/23/2003	<50	<0.50	<0.50	<0.50	<0.50	NA	<5.0	21.27	6.22	15.05	NA	NA
S-5	04/30/2003	NA	NA	NA	NA	NA	NA	NA	21.27	5.48	15.79	NA	NA

S-6	11/16/1988	50	0.7	<1	<1	<3	NA	NA	22.02	8.58	13.44	NA	NA
S-6	02/27/1989	<50	<0.5	<1	<1	<3	NA	NA	22.02	NA	NA	NA	NA
S-6	05/04/1989	<50	<0.5	<1	<1	<3	NA	NA	22.02	NA	NA	NA	NA
S-6	08/10/1989	<50	<0.5	<1	<1	<3	NA	NA	22.02	8.54	13.48	NA	NA
S-6	10/10/1989	<50	<0.5	<1	<1	<3	NA	NA	22.02	8.58	13.44	NA	NA
S-6	01/25/1990	<50	<0.5	<0.5	<0.5	<1	NA	NA	22.02	8.31	13.71	NA	NA
S-6	04/18/1990	<50	<0.5	0.6	<0.5	1.0	NA	NA	22.02	8.43	13.59	NA	NA
S-6	07/23/1990	<50	<0.5	0.9	<0.5	1.8	NA	NA	22.02	8.24	13.78	NA	NA

WELL CONCENTRATIONS
Former Shell Service Station
15275 Washington
San Leandro, CA

Well ID	Date	TPPH (ug/L)	B (ug/L)	T (ug/L)	E (ug/L)	X (ug/L)	MTBE 8020 (ug/L)	MTBE 8260 (ug/L)	TOC (MSL)	Depth to Water (ft.)	GW Elevation (MSL)	SPH Thickness (ft.)	DO Reading (ppm)
S-6	10/18/1990	<50	<0.5	0.7	<0.5	0.8	NA	NA	22.02	9.20	12.82	NA	NA
S-6	01/28/1991	<50	<0.5	<0.5	<0.5	<0.5	NA	NA	22.02	9.10	12.92	NA	NA
S-6	04/25/1991	<50	<0.5	<0.5	<0.5	0.7	NA	NA	22.02	7.74	14.28	NA	NA
S-6	07/09/1991	<50	<0.5	<0.5	<0.5	<0.5	NA	NA	22.02	8.81	13.21	NA	NA
S-6	10/08/1991	<50	0.7	<0.5	<0.5	<0.5	NA	NA	22.02	9.26	12.76	NA	NA
S-6	02/02/1992	NA	NA	NA	NA	NA	NA	NA	22.02	8.47	13.55	NA	NA
S-6	04/28/1992	<50	<0.5	<0.5	<0.5	<0.5	NA	NA	22.02	7.91	14.11	NA	NA
S-6	07/27/1992	NA	NA	NA	NA	NA	NA	NA	22.02	8.83	13.19	NA	NA
S-6	10/26/1992	<50	<0.5	<0.5	<0.5	<0.5	NA	NA	22.02	9.29	12.73	NA	NA
S-6	01/13/1994	NA	NA	NA	NA	NA	NA	NA	22.02	9.43	12.59	NA	NA
S-6	04/16/1993	<50	<0.5	<0.5	<0.5	<0.5	NA	NA	22.02	7.12	14.90	NA	NA
S-6	07/23/1993	NA	NA	NA	NA	NA	NA	NA	22.02	8.14	13.88	NA	NA
S-6	10/27/1993	<50	<0.5	<0.5	<0.5	<0.5	NA	NA	22.02	8.75	13.27	NA	NA
S-6	01/27/1994	NA	NA	NA	NA	NA	NA	NA	22.02	7.87	14.15	NA	NA
S-6	05/05/1994	<50	<0.5	<0.5	<0.5	<0.5	NA	NA	21.40	7.71	13.69	NA	NA
S-6	07/26/1994	NA	NA	NA	NA	NA	NA	NA	21.40	8.10	13.30	NA	NA
S-6	10/28/1994	<50	<0.3	<0.3	<0.3	<0.6	NA	NA	21.40	8.04	13.36	NA	NA
S-6	01/02/1995	NA	NA	NA	NA	NA	NA	NA	21.40	7.07	14.33	NA	NA
S-6	04/14/1995	<50	<0.5	1.3	<0.5	<0.5	NA	NA	21.40	6.29	15.11	NA	NA
S-6	07/28/1995	NA	NA	NA	NA	NA	NA	NA	21.40	6.91	14.49	NA	NA
S-6	10/17/1995	<50	<0.5	<0.5	<0.5	<0.5	NA	NA	21.40	7.20	14.20	NA	NA
S-6	01/11/1996	NA	NA	NA	NA	NA	NA	NA	21.40	6.60	14.80	NA	NA
S-7	11/16/1988	100	5.1	15	2.0	13	NA	NA	21.47	8.24	13.23	NA	NA
S-7	02/27/1989	50	0.5	3.0	1.0	11	NA	NA	21.47	NA	NA	NA	NA
S-7	05/04/1989	<50	<0.5	<1	<1	<3	NA	NA	21.47	NA	NA	NA	NA
S-7	08/10/1989	<50	<0.5	<1	<1	<3	NA	NA	21.47	8.18	13.29	NA	NA
S-7	10/10/1989	<50	<0.5	<1	<1	<3	NA	NA	21.47	8.35	13.12	NA	NA

WELL CONCENTRATIONS
Former Shell Service Station
15275 Washington
San Leandro, CA

Well ID	Date	TPPH (ug/L)	B (ug/L)	T (ug/L)	E (ug/L)	X (ug/L)	MTBE 8020 (ug/L)	MTBE 8260 (ug/L)	TOC (MSL)	Depth to Water (ft)	GW Elevation (MSL)	SPH Thickness (ft)	DO Reading (ppm)
S-7	01/25/1990	<50	<0.5	<0.5	<0.5	<1	NA	NA	21.47	7.95	13.52	NA	NA
S-7	04/18/1990	<50	<0.5	<0.5	<0.5	<1	NA	NA	21.47	8.06	13.41	NA	NA
S-7	07/23/1990	<50	<0.5	<0.5	<0.5	<0.5	NA	NA	21.47	7.89	13.58	NA	NA
S-7	10/18/1990	<50	<0.5	0.5	0.5	4.1	NA	NA	21.47	8.83	12.64	NA	NA
S-7	01/28/1991	<50	<0.5	<0.5	<0.5	<0.5	NA	NA	21.47	8.77	12.70	NA	NA
S-7	04/25/1991	60	<0.5	<0.5	<0.5	<0.5	NA	NA	21.47	7.25	14.22	NA	NA
S-7	07/09/1991	<50	<0.5	<0.5	<0.5	<0.5	NA	NA	21.47	8.41	13.06	NA	NA
S-7	10/08/1991	NA	NA	NA	NA	NA	NA	NA	21.47	8.95	12.52	NA	NA
S-7	02/05/1992	<50	<0.5	<0.5	<0.5	<0.5	NA	NA	21.47	8.04	13.43	NA	NA
S-7	10/08/1991	<50	<0.5	<0.5	<0.5	<0.5	NA	NA	21.47	8.95	12.52	NA	NA
S-7	04/28/1992	<50	<0.5	<0.5	<0.5	<0.5	NA	NA	21.47	7.45	14.02	NA	NA
S-7	07/27/1992	<50	<0.5	<0.5	<0.5	<0.5	NA	NA	21.47	8.48	12.99	NA	NA
S-7	10/26/1992	570	<0.5	<0.5	<0.5	<0.5	NA	NA	21.47	9.95	11.52	NA	NA
S-7	01/14/1993	56	<0.5	<0.5	<0.5	<0.5	NA	NA	21.47	5.84	15.63	NA	NA
S-7	04/16/1993	110	28	<0.5	<0.5	1.8	NA	NA	21.47	6.38	15.09	NA	NA
S-7	07/23/1993	80	0.48	<0.5	<0.5	0.8	NA	NA	21.47	7.72	13.75	NA	NA
S-7	10/27/1993	<50	<0.5	<0.5	<0.5	<0.5	NA	NA	21.47	7.79	13.68	NA	NA
S-7	01/27/1994	70a	<0.5	<0.5	<0.5	<0.5	NA	NA	21.47	7.85	13.62	NA	NA
S-7	05/05/1994	92	2.1	<0.5	<0.5	<0.5	NA	NA	20.85	9.45	11.40	NA	NA
S-7	07/26/1994	88	<0.3	<0.3	<0.3	<0.6	NA	NA	20.85	7.64	13.21	NA	NA
S-7	10/28/1994	60	<0.3	0.5	<0.3	<0.6	NA	NA	20.85	7.68	13.17	NA	NA
S-7	01/02/1995	<50	<0.5	<0.5	<0.5	<0.5	NA	NA	20.85	6.95	13.90	NA	NA
S-7	04/14/1995	NA	NA	NA	NA	NA	NA	NA	20.85	5.82	15.03	NA	NA
S-7	07/28/1995	170	1.7	<0.5	<0.5	2.2	NA	NA	20.85	6.32	14.53	NA	NA
S-7	10/17/1995	100	<0.5	0.6	<0.5	<0.5	NA	NA	20.85	7.07	13.78	NA	NA
S-7	01/11/1996	80	0.6	<0.5	<0.5	<0.5	54	NA	20.85	6.10	14.75	NA	NA
S-7	04/02/1996	NA	NA	NA	NA	NA	NA	NA	20.85	6.14	14.71	NA	NA
S-7	07/09/1996	NA	NA	NA	NA	NA	NA	NA	20.85	6.40	14.45	NA	NA

WELL CONCENTRATIONS
Former Shell Service Station
15275 Washington
San Leandro, CA

Well ID	Date	TPPH (ug/L)	B (ug/L)	T (ug/L)	E (ug/L)	X (ug/L)	MTBE 8020 (ug/L)	MTBE 8260 (ug/L)	TOC (MSL)	Depth to Water (ft)	GW Elevation (MSL)	SPH Thickness (ft)	DO Reading (ppm)
S-7	10/10/1996	NA	NA	NA	NA	NA	NA	NA	20.85	6.70	14.15	NA	NA
S-7	01/09/1997	130	1.4	<0.50	<0.50	0.56	70	NA	20.85	5.25	15.60	NA	NA
S-7	04/08/1997	NA	NA	NA	NA	NA	NA	NA	20.85	7.15	13.70	NA	NA
S-7	07/21/1997	NA	NA	NA	NA	NA	NA	NA	20.85	6.67	14.18	NA	NA
S-7	10/08/1997	NA	NA	NA	NA	NA	NA	NA	20.85	7.26	13.59	NA	NA
S-7	01/15/1998	<50	<0.50	<0.50	<0.50	<0.50	39	NA	20.85	5.51	15.34	NA	NA
S-7	04/14/1998	NA	NA	NA	NA	NA	NA	NA	20.85	5.45	15.40	NA	NA
S-7	07/14/1998	NA	NA	NA	NA	NA	NA	NA	21.03	6.48	14.55	NA	NA
S-7	10/20/1998	NA	NA	NA	NA	NA	NA	NA	21.03	7.37	13.66	NA	NA
S-7	01/22/1999	<50.0	<0.500	<0.500	<0.500	<0.500	97.8	NA	21.03	6.21	14.82	NA	NA
S-7	04/08/1999	NA	NA	NA	NA	NA	NA	NA	21.03	5.30	15.73	NA	NA
S-7	07/23/1999	NA	NA	NA	NA	NA	NA	NA	21.03	7.12	13.91	NA	NA
S-7	10/26/1999	NA	NA	NA	NA	NA	NA	NA	21.03	7.54	13.49	NA	NA
S-7	01/03/2000	615	8.73	2.90	4.00	7.17	17.0	NA	21.03	7.73	13.30	NA	NA
S-7	04/14/2000	NA	NA	NA	NA	NA	NA	NA	21.03	6.27	14.76	NA	NA
S-7	07/12/2000	NA	NA	NA	NA	NA	NA	NA	21.03	6.97	14.06	NA	NA
S-7	11/01/2000	NA	NA	NA	NA	NA	NA	NA	21.03	6.43	14.60	NA	NA
S-7	01/03/2001	460	6.68	<0.500	0.712	0.596	10.2	NA	21.03	7.27	13.76	NA	NA
S-7	04/24/2001	NA	NA	NA	NA	NA	NA	NA	21.03	6.75	14.28	NA	NA
S-7	07/02/2001	NA	NA	NA	NA	NA	NA	NA	21.03	7.55	13.48	NA	NA
S-7	11/02/2001	NA	NA	NA	NA	NA	NA	NA	21.03	7.80	13.23	NA	NA
S-7	01/16/2002	360	<0.50	<0.50	<0.50	<0.50	NA	<5.0	21.03	6.11	14.92	NA	NA
S-7	04/01/2002	NA	NA	NA	NA	NA	NA	NA	21.03	6.54	14.49	NA	NA
S-7	07/11/2002	NA	NA	NA	NA	NA	NA	NA	21.03	7.37	13.66	NA	NA
S-7	10/28/2002	NA	NA	NA	NA	NA	NA	NA	21.01	7.97	13.04	NA	NA
S-7	01/23/2003	160	<0.50	<0.50	<0.50	<0.50	NA	<5.0	21.01	6.45	14.56	NA	NA
S-7	04/30/2003	NA	NA	NA	NA	NA	NA	NA	21.01	6.14	14.87	NA	NA

WELL CONCENTRATIONS
Former Shell Service Station
15275 Washington
San Leandro, CA

Well ID	Date	TPPH (ug/L)	B (ug/L)	T (ug/L)	E (ug/L)	X (ug/L)	MTBE 8020 (ug/L)	MTBE 8260 (ug/L)	TOC (MSL)	Depth to Water (ft.)	GW Elevation (MSL)	SPH Thickness (ft.)	DO Reading (ppm)
S-8	11/16/1988	210	5.0	<1	1.0	5.0	NA	NA	20.72	7.76	12.96	NA	NA
S-8	02/27/1989	<50	2.4	<1	<1	<3	NA	NA	20.72	NA	NA	NA	NA
S-8	05/04/1989	<50	7.5	<1	2.0	<3	NA	NA	20.72	NA	NA	NA	NA
S-8	08/10/1989	<50	0.6	<1	<1	<3	NA	NA	20.72	7.79	12.93	NA	NA
S-8	10/10/1989	<50	<0.5	<1	<1	<3	NA	NA	20.72	7.84	12.88	NA	NA
S-8	01/25/1990	<50	<0.5	<0.5	<0.5	<1	NA	NA	20.72	7.47	13.25	NA	NA
S-8	04/18/1990	<50	<0.5	<0.5	<0.5	<1	NA	NA	20.72	7.59	13.13	NA	NA
S-8	07/23/1990	<50	<0.5	<0.5	<0.5	<0.5	NA	NA	20.72	7.49	13.23	NA	NA
S-8	10/18/1990	<50	<0.5	<0.5	<0.5	<0.5	NA	NA	20.72	8.44	12.28	NA	NA
S-8	01/28/1991	<50	55	0.5	<0.5	1.4	NA	NA	20.72	8.28	12.44	NA	NA
S-8	04/25/1991	130a	19	<0.5	1.3	1.1	NA	NA	20.72	6.72	14.00	NA	NA
S-8	07/09/1991	200	33	<0.5	1.8	2.8	NA	NA	20.72	7.98	12.74	NA	NA
S-8	10/08/1991	580	95	2.2	4.9	6.5	NA	NA	20.72	8.55	12.17	NA	NA
S-8	02/05/1992	90a	18	<0.5	6.2	1.8	NA	NA	20.72	7.50	13.22	NA	NA
S-8	04/28/1992	<50	5.9	<0.5	2.5	<0.5	NA	NA	20.72	7.14	13.58	NA	NA
S-8	07/27/1992	<50	<0.5	<0.5	<0.5	<0.5	NA	NA	20.72	8.06	12.66	NA	NA
S-8	10/26/1992	<50	<0.5	<0.5	<0.5	<0.5	NA	NA	20.72	8.58	12.14	NA	NA
S-8	01/14/1993	270	74	0.9	25	5.5	NA	NA	20.72	5.32	15.40	NA	NA
S-8	04/16/1993	1100	420	<0.5	200	20	NA	NA	20.72	5.76	14.96	NA	NA
S-8	07/23/1993	160	23	<0.5	1.2	1.5	NA	NA	20.72	7.29	13.43	NA	NA
S-8	10/27/1993	420	650	0.7	11	1.7	NA	NA	20.72	7.93	12.79	NA	NA
S-8	01/27/1994	290	65	<1	6.9	2.4	NA	NA	20.72	6.31	14.41	NA	NA
S-8	05/05/1994	120	13	<0.5	<0.5	<0.5	NA	NA	20.32	6.84	13.48	NA	NA
S-8	07/26/1994	115	12.2	1.3	<0.3	2.7	NA	NA	20.32	7.42	12.90	NA	NA
S-8	10/28/1994	733	75.9	3.2	4.9	4.2	NA	NA	20.32	7.56	12.76	NA	NA
S-8	01/02/1995	290	54	<0.5	10	<0.5	NA	NA	20.32	6.19	14.13	NA	NA
S-8	04/14/1995	230	68	<0.5	10	2.4	NA	NA	20.32	5.54	14.78	NA	NA
S-8	07/28/1995	290	44	<0.5	8.0	<0.5	NA	NA	20.32	6.28	14.04	NA	NA

WELL CONCENTRATIONS
Former Shell Service Station
15275 Washington
San Leandro, CA

Well ID	Date	TPPH (ug/L)	B (ug/L)	T (ug/L)	E (ug/L)	X (ug/L)	MTBE 8020 (ug/L)	MTBE 8260 (ug/L)	TOC (MSL)	Depth to Water (ft)	GW Elevation (MSL)	SPH Thickness (ft)	DO Reading (ppm)
S-8	10/17/1995	190	24	<0.5	1.0	0.9	NA	NA	20.32	6.64	13.68	NA	NA
S-8	01/11/1996	400	85	1.1	13	3.4	2.3	NA	20.32	5.96	14.36	NA	NA
S-8	04/02/1996	300	110	0.7	4.9	0.9	<2	NA	20.32	5.21	15.11	NA	NA
S-8	07/09/1996	<50	5.4	<0.50	0.63	<0.50	<2.5	NA	20.32	6.05	14.27	NA	NA
S-8	10/10/1996	150	0.53	0.66	2.3	1.0	8.9	NA	20.32	6.83	13.49	NA	NA
S-8	01/09/1997	240	27	<0.50	2.4	<0.50	5.8	NA	20.32	4.51	15.81	NA	NA
S-8	04/08/1997	220	27	0.62	1.9	0.71	5.7	NA	20.32	6.50	13.82	NA	NA
S-8	07/21/1997	1200	140	2.8	21	5.0	27	NA	20.32	6.36	13.96	NA	NA
S-8 (D)	07/21/1997	1200	120	<2.0	19	3.9	25	NA	20.32	NA	NA	NA	NA
S-8	10/08/1997	690	92	1.4	25	2.0	<2.5	NA	20.32	6.83	13.49	NA	NA
S-8 (D)	10/08/1997	700	95	1.3	26	1.9	<2.5	NA	20.32	NA	NA	NA	NA
S-8	01/15/1998	460	110	1.0	3.4	1.7	<5.0	NA	20.32	4.30	16.02	NA	NA
S-8	04/14/1998	780	190	2.9	15	3.4	<2.5	NA	20.32	4.68	15.64	NA	NA
S-8	07/14/1998	1600	240	<5.0	36	<5.0	<25	NA	20.36	6.36	14.00	NA	NA
S-8	10/20/1998	700	55	<5.0	<5.0	<5.0	49	NA	20.36	6.91	13.45	NA	NA
S-8	01/22/1999	<50.0	5.83	<0.500	0.919	<0.500	<2.00	NA	20.36	5.97	14.39	NA	NA
S-8	04/08/1999	684	10.6	1.3	9.75	1.0	10.5	NA	20.36	5.01	15.35	NA	NA
S-8	07/23/1999	1540	86.5	5.20	5.30	6.35	<25.0	NA	20.36	6.61	13.75	NA	NA
S-8	10/26/1999	1680	116	<2.50	22.4	5.58	<12.5	NA	20.36	6.95	13.41	NA	NA
S-8	01/03/2000	Well inaccessible		NA	NA	NA	NA	NA	20.36	NA	NA	NA	NA
S-8	04/14/2000	Well inaccessible		NA	NA	NA	NA	NA	20.36	NA	NA	NA	NA
S-8	07/12/2000	Well inaccessible		NA	NA	NA	NA	NA	20.36	NA	NA	NA	NA
S-8	11/01/2000	2300	118	12.4	51.7	<2.50	<12.5	NA	20.36	5.68	14.68	NA	NA
S-8	01/03/2001	263	4.34	0.620	<0.500	0.643	5.40	NA	20.36	6.95	13.41	NA	NA
S-8	04/24/2001	680	12	<0.50	0.86	<0.50	NA	<0.50	20.36	6.25	14.11	NA	NA
S-8	07/02/2001	330	2.5	<0.50	0.86	<0.50	NA	<5.0	20.36	7.00	13.36	NA	NA
S-8	11/02/2001	1300	71	0.84	14	1.7	NA	<5.0	20.36	7.44	12.92	NA	NA
S-8	01/16/2002	<50	<0.50	<0.50	<0.50	<0.50	NA	<5.0	20.36	5.67	14.69	NA	NA

WELL CONCENTRATIONS
Former Shell Service Station
15275 Washington
San Leandro, CA

Well ID	Date	TPPH (ug/L)	B (ug/L)	T (ug/L)	E (ug/L)	X (ug/L)	MTBE 8020 (ug/L)	MTBE 8260 (ug/L)	TOC (MSL)	Depth to Water (ft.)	GW Elevation (MSL)	SPH Thickness (ft.)	DO Reading (ppm)
S-8	04/01/2002	330	2.2	<0.50	<0.50	<0.50	NA	<5.0	20.36	5.99	14.37	NA	NA
S-8	07/11/2002	1400	55	0.83	5.3	0.71	NA	<5.0	20.36	6.94	13.42	NA	NA
S-8	10/28/2002	660	6.2	0.63	0.76	<0.50	NA	<0.50	20.36	7.50	12.86	NA	1.1
S-8	01/23/2003	1600	30	0.56	6.7	<0.50	NA	<5.0	20.36	5.99	14.37	NA	NA
S-8	04/30/2003	890	13	<0.50	0.59	<1.0	NA	<5.0	20.36	5.30	15.06	NA	NA
S-9	11/16/1988	1400	69	3.0	52	180	NA	NA	20.96	7.78	13.18	NA	NA
S-9	02/27/1989	1600	240	4.0	130	180	NA	NA	20.96	NA	NA	NA	NA
S-9	05/04/1989	2600	470	10	240	480	NA	NA	20.96	NA	NA	NA	NA
S-9	08/10/1989	520	73	<10	40	<30	NA	NA	20.96	7.82	13.14	NA	NA
S-9	10/10/1989	380	82	<1	46	13	NA	NA	20.96	7.87	13.09	NA	NA
S-9	01/25/1990	750	140	1.2	69	75	NA	NA	20.96	7.41	13.55	NA	NA
S-9	04/18/1990	680	150	1.7	50	37	NA	NA	20.96	7.65	13.31	NA	NA
S-9	07/23/1990	490	94	1.2	32	24	NA	NA	20.96	7.58	13.38	NA	NA
S-9	10/18/1990	390	140	0.7	3.3	24	NA	NA	20.96	8.46	12.50	NA	NA
S-9	01/28/1991	1040	450	4.6	85	97	NA	NA	20.96	8.29	12.67	NA	NA
S-9	04/25/1991	5800	880	9.0	360	500	NA	NA	20.96	6.09	14.87	NA	NA
S-9	07/09/1991	1400	220	2.8	82	100	NA	NA	20.96	7.82	13.14	NA	NA
S-9	10/08/1991	890	960	<2.5	16	29	NA	NA	20.96	8.55	12.41	NA	NA
S-9	02/05/1992	950	240	<2.5	28	55	NA	NA	20.96	6.96	14.00	NA	NA
S-9	04/28/1992	1400a	290	3.0	100	81	NA	NA	20.96	6.76	14.20	NA	NA
S-9	07/27/1992	890	190	<2.5	66	68	NA	NA	20.96	8.10	12.86	NA	NA
S-9	10/26/1992	650	160	<2.5	63	89	NA	NA	20.96	8.53	12.43	NA	NA
S-9	01/13/1993	19000	2400	38	1700	2200	NA	NA	20.96	6.80	14.16	NA	NA
S-9	04/16/1993	10000	1500	<5	1100	990	NA	NA	20.96	6.28	14.68	NA	NA
S-9	07/23/1993	1100	400	<5	260	160	NA	NA	20.96	7.26	13.70	NA	NA
S-9	10/27/1993	2500	400	<5	190	110	NA	NA	20.96	8.00	12.96	NA	NA
S-9	01/27/1994	4800	990	16	630	490	NA	NA	20.96	5.96	15.00	NA	NA

WELL CONCENTRATIONS
Former Shell Service Station
15275 Washington
San Leandro, CA

Well ID	Date	TPPH (ug/L)	B (ug/L)	T (ug/L)	E (ug/L)	X (ug/L)	MTBE 8020 (ug/L)	MTBE 8260 (ug/L)	TOC (MSL)	Depth to Water (ft)	GW Elevation (MSL)	SPH Thickness (ft)	DO Reading (ppm)
S-9	05/05/1994	3700	480	<5	21	120	NA	NA	20.68	6.99	13.69	NA	NA
S-9	07/26/1994	1000	124.6	<0.3	35.8	28.6	NA	NA	20.68	7.56	13.12	NA	NA
S-9	10/28/1994	979	80.3	7.0	21.7	29.2	NA	NA	20.68	7.78	12.90	NA	NA
S-9	01/02/1995	3900	540	2.4	350	150	NA	NA	20.68	6.29	14.39	NA	NA
S-9	04/14/1995	5100	1000	<10	380	230	NA	NA	20.68	5.69	14.99	NA	NA
S-9	07/28/1995	4600	680	<10	120	47	NA	NA	20.68	6.61	14.07	NA	NA
S-9	10/17/1995	1600	150	<0.5	42	15	NA	NA	20.68	7.00	13.68	NA	NA
S-9	01/11/1996	6800	1100	12	720	95	24	NA	20.68	6.20	14.48	NA	NA
S-9	04/02/1996	6000	1300	8.3	430	99	49	NA	20.68	5.19	15.49	NA	NA
S-9 (D)	04/02/1996	6500	1200	8.3	410	90	<20	NA	20.68	NA	NA	NA	NA
S-9	07/09/1996	3400	680	6.7	54	31	<25	NA	20.68	6.43	14.25	NA	NA
S-9 (D)	07/09/1996	3300	730	<5.0	58	28	<25	NA	20.68	NA	NA	NA	NA
S-9	10/10/1996	6600	1200	<10	160	<10	70	NA	20.68	7.08	13.60	NA	NA
S-9 (D)	10/10/1996	6100	1000	<10	200	15	65	NA	20.68	NA	NA	NA	NA
S-9	01/09/1997	12000	1400	<25	1000	39	<125	NA	20.68	5.03	15.65	NA	NA
S-9	04/08/1997	6600	920	10	230	26	150	NA	20.68	6.78	13.90	NA	NA
S-9	07/21/1997	7800	860	13	260	14	87	NA	20.68	6.77	13.91	NA	NA
S-9	10/08/1997	4600	320	<10	61	<10	28	NA	20.68	6.92	13.76	NA	NA
S-9	01/15/1998	9300	1000	<10	730	24	<50	NA	20.68	4.50	16.18	NA	NA
S-9	04/14/1998	12000	1200	<2.5	960	<2.5	<12	NA	20.68	4.35	16.33	NA	NA
S-9 (D)	04/14/1998	12000	1200	<2.5	930	<2.5	<12	NA	20.68	NA	NA	NA	NA
S-9	07/14/1998	12000	1700	<25	990	39	<125	NA	20.68	5.95	14.73	NA	NA
S-9 (D)	07/14/1998	11000	1800	<25	650	<25	<125	NA	20.68	NA	NA	NA	NA
S-9	10/20/1998	14000	1600	<25	560	<25	340	NA	20.68	7.03	13.65	NA	NA
S-9 (D)	10/20/1998	11000	1100	<10	230	<10	100	NA	20.68	NA	NA	NA	NA
S-9	01/22/1999	9900	1030	26.7	819	27.5	46.8	NA	20.68	6.01	14.67	NA	NA
S-9	04/08/1999	17900	1450	<50.0	1610	73.8	<500	NA	20.68	5.25	15.43	NA	NA
S-9	07/23/1999	12200	1020	<20.0	536	<20.0	<200	NA	20.68	6.71	13.97	NA	NA

WELL CONCENTRATIONS
Former Shell Service Station
15275 Washington
San Leandro, CA

Well ID	Date	TPPH (ug/L)	B (ug/L)	T (ug/L)	E (ug/L)	X (ug/L)	MTBE 8020 (ug/L)	MTBE 8260 (ug/L)	TOC (MSL)	Depth to Water (ft)	GW Elevation (MSL)	SPH Thickness (ft)	DO Reading (ppm)
---------	------	----------------	-------------	-------------	-------------	-------------	------------------------	------------------------	--------------	---------------------------	--------------------------	--------------------------	------------------------

S-9	10/26/1999	9580	1170	11.9	566	23.1	<50.0	NA	20.68	7.27	13.41	NA	NA
S-9	10/26/1999	9580	1170	11.9	566	23.1	<50.0	NA	20.68	7.27	13.41	NA	NA
S-9	01/03/2000	9660	689	<50.0	640	<50.0	<250	NA	20.68	7.47	13.21	NA	NA
S-9	04/14/2000	14000	1040	<50.0	1210	<50.0	<250	NA	20.68	5.75	14.93	NA	NA
S-9	07/12/2000	13200	1360	33.9	552	26.8	<100	NA	20.68	6.63	14.05	NA	NA
S-9	11/01/2000	9120	928	13.5	468	<10.0	<50.0	NA	20.68	5.50	15.18	NA	NA
S-9	01/03/2001	355	19.8	0.732	2.23	0.630	5.09	NA	20.68	7.11	13.57	NA	NA
S-9	04/24/2001	3500	300	1.7	150	1.7	NA	<1.0	20.68	6.30	14.38	NA	NA
S-9	07/02/2001	88	3.8	<0.50	<0.50	<0.50	NA	<5.0	20.68	8.18	12.50	NA	2.6
S-9	11/02/2001	210	9.5	<0.50	<0.50	<0.50	NA	<5.0	20.68	8.40	12.28	NA	16.4
S-9	01/16/2002	15000	520	4.9	580	7.1	NA	<20	20.68	5.71	14.97	NA	0.5
S-9	04/01/2002	15000	530	5.1	920	7.8	NA	<25	20.68	5.99	14.69	NA	3.0
S-9	07/11/2002	10000	520	5.3	97	5.8	NA	<25	20.68	6.99	13.69	NA	0.5
S-9	10/28/2002	11000	580	6.2	65	5.3	NA	<2.5	20.70	7.63	13.07	NA	1.0
S-9	01/23/2003	9300	400	5.6	320	6.5	NA	<5.0	20.70	5.96	14.74	NA	0.5
S-9	04/30/2003	180	4.2	<0.50	3.7	<1.0	NA	<5.0	20.70	5.20	15.50	NA	7.0

S-10	11/16/1988	330	0.5	<1	1.0	11	NA	NA	20.86	7.91	12.95	NA	NA
S-10	02/27/1989	140	<0.5	<3	2.0	6.0	NA	NA	20.86	NA	NA	NA	NA
S-10	05/03/1989	220	<0.5	1.0	2.0	7.0	NA	NA	20.86	NA	NA	NA	NA
S-10	08/10/1989	<50	<0.5	<1	<1	<3	NA	NA	20.86	7.94	12.92	NA	NA
S-10	10/09/1989	170	<0.5	<1	<1	<3	NA	NA	20.86	7.99	12.87	NA	NA
S-10	01/25/1990	<50	<0.5	<0.5	1.1	4.0	NA	NA	20.86	7.56	13.30	NA	NA
S-10	04/18/1990	<50	<0.5	0.9	<0.5	2.0	NA	NA	20.86	7.71	13.15	NA	NA
S-10	07/23/1990	590	<0.5	<0.5	1.9	19	NA	NA	20.86	7.64	13.22	NA	NA
S-10	10/18/1990	140	<0.5	0.7	<0.5	7.0	NA	NA	20.86	8.58	12.28	NA	NA
S-10	01/28/1991	<50	<0.5	<0.5	<0.5	0.5	NA	NA	20.86	8.35	12.51	NA	NA
S-10	04/25/1991	<50	<0.5	<0.5	1.1	0.8	NA	NA	20.69	6.91	13.78	NA	NA

WELL CONCENTRATIONS
Former Shell Service Station
15275 Washington
San Leandro, CA

Well ID	Date	TPPH (ug/L)	B (ug/L)	T (ug/L)	E (ug/L)	X (ug/L)	MTBE 8020 (ug/L)	MTBE 8260 (ug/L)	TOC (MSL)	Depth to Water (ft.)	GW Elevation (MSL)	SPH Thickness (ft.)	DO Reading (ppm)
S-10	07/09/1991	<50	<0.5	<0.5	<0.5	<0.5	NA	NA	20.69	8.14	12.55	NA	NA
S-10	10/08/1991	140	<0.5	<0.5	<0.5	<0.5	NA	NA	20.69	8.70	11.99	NA	NA
S-10	02/05/1992	<50	<0.5	<0.5	<0.5	<0.5	NA	NA	20.69	7.57	13.12	NA	NA
S-10	04/28/1992	<50	<0.5	<0.5	<0.5	<0.5	NA	NA	20.69	7.20	13.49	NA	NA
S-10	07/27/1992	<50	<0.5	<0.5	<0.5	<0.5	NA	NA	20.69	8.17	12.52	NA	NA
S-10	10/26/1992	<50	<0.5	<0.5	<0.5	<0.5	NA	NA	20.69	8.68	12.01	NA	NA
S-10	01/13/1993	88	<0.5	0.6	0.6	<0.5	NA	NA	20.69	3.78	16.91	NA	NA
S-10	04/16/1993	80	<0.5	<0.5	<0.5	<0.5	NA	NA	20.69	6.46	14.23	NA	NA
S-10	07/23/1993	<50	1.5	<0.5	0.7	2.7	NA	NA	20.69	7.38	13.31	NA	NA
S-10	10/27/1993	<50	<0.5	<0.5	<0.5	<0.5	NA	NA	20.69	8.09	12.60	NA	NA
S-10	01/27/1994	270	1.1	1.3	2.0	7.4	NA	NA	20.69	5.81	14.88	NA	NA
S-10	05/05/1994	<50	<0.5	<0.5	<0.5	<0.5	NA	NA	20.15	6.82	13.33	NA	NA
S-10	07/26/1994	<50	<0.3	<0.3	<0.3	<0.6	NA	NA	20.15	7.40	12.75	NA	NA
S-10	10/28/1994	<50	2.4	<0.3	0.5	0.8	NA	NA	20.15	7.62	12.53	NA	NA
S-10	01/02/1995	<50	<0.5	<0.5	<0.5	<0.5	NA	NA	20.15	6.13	14.02	NA	NA
S-10	04/14/1995	<50	<0.5	<0.5	<0.5	<0.5	NA	NA	20.15	5.60	14.55	NA	NA
S-10	07/28/1995	<50	<0.5	<0.5	<0.5	<0.5	NA	NA	20.15	6.44	13.71	NA	NA
S-10	10/17/1995	<50	<0.5	<0.5	<0.5	<0.5	NA	NA	20.15	6.85	13.30	NA	NA
S-10	01/11/1996	<50	<0.5	<0.5	<0.5	<0.5	<2	NA	20.15	6.08	14.07	NA	NA
S-10	04/02/1996	NA	NA	NA	NA	NA	NA	NA	20.15	5.21	14.94	NA	NA
S-10	07/09/1996	NA	NA	NA	NA	NA	NA	NA	20.15	6.20	13.95	NA	NA
S-10	10/10/1996	NA	NA	NA	NA	NA	NA	NA	20.15	6.92	13.23	NA	NA
S-10	01/09/1997	<50	<0.50	<0.50	<0.50	<0.50	<2.5	NA	20.15	4.64	15.51	NA	NA
S-10	04/08/1997	NA	NA	NA	NA	NA	NA	NA	20.15	5.82	14.33	NA	NA
S-10	07/21/1997	NA	NA	NA	NA	NA	NA	NA	20.15	6.48	13.67	NA	NA
S-10	10/08/1997	NA	NA	NA	NA	NA	NA	NA	20.15	5.48	14.67	NA	NA
S-10	01/15/1998	<50	<0.50	<0.50	<0.50	<0.50	<2.5	NA	20.15	3.01	17.14	NA	NA
S-10	04/14/1998	NA	NA	NA	NA	NA	NA	NA	20.15	4.30	15.85	NA	NA

WELL CONCENTRATIONS
Former Shell Service Station
15275 Washington
San Leandro, CA

Well ID	Date	TPPH (ug/L)	B (ug/L)	T (ug/L)	E (ug/L)	X (ug/L)	MTBE 8020 (ug/L)	MTBE 8260 (ug/L)	TOC (MSL)	Depth to Water (ft)	GW Elevation (MSL)	SPH Thickness (ft)	DO Reading (ppm)
---------	------	----------------	-------------	-------------	-------------	-------------	------------------------	------------------------	--------------	---------------------------	--------------------------	--------------------------	------------------------

S-10	07/14/1998	NA	NA	NA	NA	NA	NA	NA	20.15	5.84	14.31	NA	NA
S-10	10/20/1998	NA	NA	NA	NA	NA	NA	NA	20.15	6.89	13.26	NA	NA
S-10	01/22/1999	<50.0	<0.500	<0.500	<0.500	<0.500	<2.00	NA	20.15	6.00	14.15	NA	NA
S-10	04/08/1999	NA	NA	NA	NA	NA	NA	NA	20.15	4.41	15.74	NA	NA
S-10	07/23/1999	NA	NA	NA	NA	NA	NA	NA	20.15	6.48	13.67	NA	NA
S-10	10/26/1999	NA	NA	NA	NA	NA	NA	NA	20.15	7.07	13.08	NA	NA
S-10	01/03/2000	<50.0	<0.500	<0.500	<0.500	<0.500	<2.50	NA	20.15	7.27	12.88	NA	NA
S-10	04/14/2000	NA	NA	NA	NA	NA	NA	NA	20.15	5.75	14.40	NA	NA
S-10	07/12/2000	NA	NA	NA	NA	NA	NA	NA	20.15	6.17	13.98	NA	NA
S-10	11/01/2000	NA	NA	NA	NA	NA	NA	NA	20.15	5.63	14.52	NA	NA
S-10	01/03/2001	<50.0	<0.500	<0.500	<0.500	<0.500	<2.50	NA	20.15	6.89	13.26	NA	NA
S-10	04/24/2001	NA	NA	NA	NA	NA	NA	NA	20.15	6.20	13.95	NA	NA
S-10	07/02/2001	NA	NA	NA	NA	NA	NA	NA	20.15	6.80	13.35	NA	NA
S-10	11/02/2001	NA	NA	NA	NA	NA	NA	NA	20.15	7.40	12.75	NA	NA
S-10	01/16/2002	<50	<0.50	<0.50	<0.50	<0.50	NA	<5.0	20.15	5.66	14.49	NA	NA
S-10	04/01/2002	NA	NA	NA	NA	NA	NA	NA	20.15	5.63	14.52	NA	NA
S-10	07/11/2002	NA	NA	NA	NA	NA	NA	NA	20.15	6.72	13.43	NA	NA
S-10	10/28/2002	NA	NA	NA	NA	NA	NA	NA	20.14	7.50	12.64	NA	NA
S-10	01/23/2003	<50	<0.50	<0.50	<0.50	<0.50	NA	<5.0	20.14	5.97	14.17	NA	NA
S-10	04/30/2003	NA	NA	NA	NA	NA	NA	NA	20.14	5.24	14.90	NA	NA

S-11	11/16/1988	<50	<0.5	<1	<1	<3	NA	NA	21.26	8.62	12.64	NA	NA
S-11	02/27/1989	<50	<0.5	<1	<1	<3	NA	NA	21.26	NA	NA	NA	NA
S-11	05/03/1989	<50	<0.5	<1	<1	<3	NA	NA	21.26	NA	NA	NA	NA
S-11	08/10/1989	<50	<0.5	<1	<1	<3	NA	NA	21.26	8.65	12.61	NA	NA
S-11	10/09/1989	<50	<0.5	<1	<1	<3	NA	NA	21.26	8.64	12.62	NA	NA
S-11	01/25/1990	<50	<0.5	<0.5	<0.5	<1	NA	NA	21.26	8.43	12.83	NA	NA
S-11	04/18/1990	<50	<0.5	<0.5	<0.5	<1	NA	NA	21.26	8.42	12.84	NA	NA

WELL CONCENTRATIONS
Former Shell Service Station
15275 Washington
San Leandro, CA

Well ID	Date	TPPH (ug/L)	B (ug/L)	T (ug/L)	E (ug/L)	X (ug/L)	MTBE 8020 (ug/L)	MTBE 8260 (ug/L)	TOC (MSL)	Depth to Water (ft)	GW Elevation (MSL)	SPH Thickness (ft)	DO Reading (ppm)
S-11	07/23/1990	<50	<0.5	0.6	<0.5	1.1	NA	NA	21.26	8.23	13.03	NA	NA
S-11	10/18/1990	<50	<0.5	<0.5	<0.5	0.5	NA	NA	21.26	9.20	12.06	NA	NA
S-11	01/28/1991	63	<0.5	3.3	0.9	7.0	NA	NA	21.26	9.13	12.13	NA	NA
S-11	04/25/1991	<50	<0.5	<0.5	0.8	<0.5	NA	NA	21.26	7.53	13.73	NA	NA
S-11	07/09/1991	<50	<0.5	<0.5	<0.5	<0.5	NA	NA	21.26	8.85	12.41	NA	NA
S-11	10/08/1991	<50	<0.5	<0.5	<0.5	<0.5	NA	NA	21.26	9.34	11.92	NA	NA
S-11	02/05/1991	NA	NA	NA	NA	NA	NA	NA	21.26	8.50	12.76	NA	NA
S-11	04/28/1992	<50	<0.5	<0.5	<0.5	<0.5	NA	NA	21.26	7.80	13.46	NA	NA
S-11	07/27/1992	<50	<0.5	<0.5	<0.5	<0.5	NA	NA	21.26	8.80	12.46	NA	NA
S-11	10/26/1992	<50	<0.5	<0.5	<0.5	<0.5	NA	NA	21.26	9.42	11.84	NA	NA
S-11	01/13/1993	NA	NA	NA	NA	NA	NA	NA	21.26	6.52	14.74	NA	NA
S-11	04/16/1993	<50	<0.5	<0.5	<0.5	<0.5	NA	NA	21.26	6.86	14.40	NA	NA
S-11	07/23/1993	NA	NA	NA	NA	NA	NA	NA	21.26	8.07	13.19	NA	NA
S-11	10/27/1993	Well inaccessible		NA	NA	NA	NA	NA	21.26	NA	NA	NA	NA
S-11	01/27/1994	NA	NA	NA	NA	NA	NA	NA	21.26	NA	NA	NA	NA
S-11	05/05/1994	<50	<0.5	<0.5	<0.5	<0.5	NA	NA	21.24	7.73	13.51	NA	NA
S-11	07/26/1994	NA	NA	NA	NA	NA	NA	NA	21.24	8.30	12.94	NA	NA
S-11	10/28/1994	<50	<0.3	<0.3	<0.3	<0.6	NA	NA	21.24	8.30	12.94	NA	NA
S-11	01/02/1995	NA	NA	NA	NA	NA	NA	NA	21.24	7.25	13.99	NA	NA
S-11	04/14/1995	<50	<0.5	<0.5	<0.5	<0.5	NA	NA	21.24	6.99	14.25	NA	NA
S-11	07/28/1995	NA	NA	NA	NA	NA	NA	NA	21.24	7.21	14.03	NA	NA
S-11	10/17/1995	<50	<0.5	<0.5	<0.5	<0.5	NA	NA	21.24	7.41	13.83	NA	NA
S-11	01/11/1996	NA	NA	NA	NA	NA	NA	NA	21.24	6.80	14.44	NA	NA
S-11	07/21/1997	<50	<0.50	<0.50	<0.50	<0.50	<2.5	NA	21.24	7.28	13.96	NA	NA
S-11	03/18/2002 d	NA	NA	NA	NA	NA	NA	NA	21.27	NA	NA	NA	NA
S-12	11/16/1988	50	3.5	<1	<1	<3	NA	NA	21.05	NA	NA	NA	NA
S-12	02/27/1989	<50	0.8	<1	<1	<3	NA	NA	21.05	NA	NA	NA	NA

WELL CONCENTRATIONS
Former Shell Service Station
15275 Washington
San Leandro, CA

Well ID	Date	TPPH (ug/L)	B (ug/L)	T (ug/L)	E (ug/L)	X (ug/L)	MTBE 8020 (ug/L)	MTBE 8260 (ug/L)	TOC (MSL)	Depth to Water (ft)	GW Elevation (MSL)	SPH Thickness (ft)	DO Reading (ppm)
S-12	05/03/1989	<50	<0.5	<1	<1	<3	NA	NA	21.05	NA	NA	NA	NA
S-12	08/10/1989	<50	<0.5	<1	<1	<3	NA	NA	21.05	8.32	12.73	NA	NA
S-12	10/09/1989	<50	<0.5	<1	<1	<1	NA	NA	21.05	8.32	12.73	NA	NA
S-12	01/25/1990	<50	<0.5	<0.5	<0.5	<1	NA	NA	21.05	8.18	12.87	NA	NA
S-12	04/18/1990	<50	<0.5	<0.5	<0.5	<0.5	NA	NA	21.05	8.05	13.00	NA	NA
S-12	07/23/1990	<50	<0.5	<0.5	<0.5	<0.5	NA	NA	21.05	7.92	13.13	NA	NA
S-12	10/18/1990	<50	<0.5	<0.5	<0.5	<0.5	NA	NA	21.05	8.90	12.15	NA	NA
S-12	01/28/1991	<50	<0.5	<0.5	<0.5	<0.5	NA	NA	21.05	8.54	12.51	NA	NA
S-12	04/25/1991	90	5.4	<0.5	1.1	0.7	NA	NA	21.05	7.08	13.97	NA	NA
S-12	07/09/1991	<50	2.9	<0.5	<0.5	<0.5	NA	NA	21.05	8.42	12.63	NA	NA
S-12	10/08/1991	50	<0.5	<0.5	<0.5	<0.5	NA	NA	21.05	8.80	12.25	NA	NA
S-12	02/05/1992	50a	<0.5	<0.5	<0.5	<0.5	NA	NA	21.05	8.07	12.98	NA	NA
S-12	04/28/1992	<50	<0.5	<0.5	<0.5	<0.5	NA	NA	21.05	8.33	12.72	NA	NA
S-12	07/27/1992	94	<0.5	<0.5	<0.5	<0.5	NA	NA	21.05	8.55	12.50	NA	NA
S-12	10/26/1992	86	<0.5	<0.5	<0.5	<0.5	NA	NA	21.05	9.03	12.02	NA	NA
S-12	01/14/1993	120	2.0	<0.5	<0.5	<0.5	NA	NA	21.05	6.38	14.67	NA	NA
S-12	04/16/1993	60	<0.5	<0.5	<0.5	<0.5	NA	NA	21.05	6.56	14.49	NA	NA
S-12	07/23/1993	90	<0.5	<0.5	<0.5	<0.5	NA	NA	21.05	7.76	13.29	NA	NA
S-12	10/27/1993	Well inaccessible		NA	NA	NA	NA	NA	21.05	NA	NA	NA	NA
S-12	01/27/1994	Well inaccessible		NA	NA	NA	NA	NA	21.05	NA	NA	NA	NA
S-12	05/05/1994	<50	2.0	<0.5	<0.5	<0.5	NA	NA	20.71	7.49	13.22	NA	NA
S-12	07/26/1994	128	<0.3	<0.3	<0.3	<0.6	NA	NA	20.71	7.92	12.79	NA	NA
S-12	10/28/1994	167	<0.3	<0.3	<0.3	<0.6	NA	NA	20.71	7.78	12.93	NA	NA
S-12	01/02/1995	50	<0.5	<0.5	<0.5	<0.5	NA	NA	20.71	7.33	13.38	NA	NA
S-12	04/14/1995	<50	<0.5	<0.5	<0.5	<0.5	NA	NA	20.71	6.47	14.24	NA	NA
S-12	07/28/1995	<50	<0.5	<0.5	<0.5	<0.5	NA	NA	20.71	6.90	13.81	NA	NA
S-12	10/17/1995	<50	<0.5	<0.5	<0.5	<0.5	NA	NA	20.71	7.16	13.55	NA	NA
S-12	01/11/1996	<50	<0.5	<0.5	<0.5	<0.5	82	NA	20.71	6.65	14.06	NA	NA

WELL CONCENTRATIONS
Former Shell Service Station
15275 Washington
San Leandro, CA

Well ID	Date	TPPH (ug/L)	B (ug/L)	T (ug/L)	E (ug/L)	X (ug/L)	MTBE 8020 (ug/L)	MTBE 8260 (ug/L)	TOC (MSL)	Depth to Water (ft)	GW Elevation (MSL)	SPH Thickness (ft)	DO Reading (ppm)
S-12	07/21/1997	<50	<0.50	<0.50	<0.50	<0.50	45	NA	20.71	6.95	13.76	NA	NA
S-12	03/18/2002 d	NA	NA	NA	NA	NA	NA	NA	20.73	NA	NA	NA	NA
S-13	05/03/1989	150	4.9	4.0	2.0	14	NA	NA	20.57	NA	NA	NA	NA
S-13	08/10/1989	110	2.9	<1	<1	<3	NA	NA	20.57	8.00	12.57	NA	NA
S-13	10/09/1989	77	1.4	<1	<1	<3	NA	NA	20.57	7.95	12.62	NA	NA
S-13	01/25/1990	51	0.5	<0.5	<0.5	<1	NA	NA	20.57	7.79	12.78	NA	NA
S-13	04/18/1990	85	8.7	<0.5	<0.5	<1	NA	NA	20.57	7.73	12.84	NA	NA
S-13	07/23/1990	80	0.8	<0.5	<0.5	<0.5	NA	NA	20.57	7.63	12.94	NA	NA
S-13	10/18/1990	130	<0.5	<0.5	<0.5	<5	NA	NA	20.57	8.58	11.99	NA	NA
S-13	01/28/1991	<50	<0.5	0.9	1.2	1.0	NA	NA	20.57	8.39	12.18	NA	NA
S-13	04/25/1991	440a	3.8	<0.5	<0.5	0.6	NA	NA	20.57	7.00	13.57	NA	NA
S-13	07/09/1991	320a	0.6	<0.5	<0.5	<0.5	NA	NA	20.57	8.12	12.45	NA	NA
S-13	10/08/1991	310	<0.5	<0.5	<0.5	<0.5	NA	NA	20.57	8.69	11.88	NA	NA
S-13	02/05/1992	NA	NA	NA	NA	NA	NA	NA	20.57	7.62	12.95	NA	NA
S-13	04/28/1992	<50	<0.5	<0.5	<0.5	<0.5	NA	NA	20.57	7.15	13.42	NA	NA
S-13	07/27/1992	NA	NA	NA	NA	NA	NA	NA	20.57	8.20	12.37	NA	NA
S-13	10/26/1992	180	<0.5	<0.5	<0.5	<0.5	NA	NA	20.57	8.73	11.84	NA	NA
S-13	01/13/1993	NA	NA	NA	NA	NA	NA	NA	20.57	5.06	15.51	NA	NA
S-13	04/16/1993	240	4.8	<0.5	1.3	<0.5	NA	NA	20.57	6.38	14.19	NA	NA
S-13	07/23/1993	NA	NA	NA	NA	NA	NA	NA	20.57	7.45	13.12	NA	NA
S-13	10/27/1993	Well inaccessible		NA	NA	NA	NA	NA	20.57	NA	NA	NA	NA
S-13	01/27/1994	NA	NA	NA	NA	NA	NA	NA	20.57	NA	NA	NA	NA
S-13	05/05/1994	<50	<0.5	<0.5	<0.5	<0.5	NA	NA	20.16	6.91	13.25	NA	NA
S-13	07/26/1994	NA	NA	NA	NA	NA	NA	NA	20.16	7.52	12.64	NA	NA
S-13	10/28/1994	368	<0.3	<0.3	<0.3	<0.6	NA	NA	20.16	7.68	12.48	NA	NA
S-13	01/02/1995	NA	NA	NA	NA	NA	NA	NA	20.16	6.37	13.79	NA	NA
S-13	04/14/1995	NA	NA	NA	NA	NA	NA	NA	20.16	5.81	14.35	NA	NA

WELL CONCENTRATIONS
Former Shell Service Station
15275 Washington
San Leandro, CA

Well ID	Date	TPPH (ug/L)	B (ug/L)	T (ug/L)	E (ug/L)	X (ug/L)	MTBE 8020 (ug/L)	MTBE 8260 (ug/L)	TOC (MSL)	Depth to Water (ft.)	GW Elevation (MSL)	SPH Thickness (ft.)	DO Reading (ppm)
S-13	07/28/1995	NA	NA	NA	NA	NA	NA	NA	20.16	6.73	13.43	NA	NA
S-13	10/17/1995	<50	1.0	<0.5	<0.5	<0.5	NA	NA	20.16	6.94	13.22	NA	NA
S-13	01/11/1996	NA	NA	NA	NA	NA	NA	NA	20.16	6.20	13.96	NA	NA
S-13	04/02/1996	<50	<0.5	<0.5	<0.5	<0.5	<2	NA	20.16	5.28	14.88	NA	NA
S-13	07/09/1996	NA	NA	NA	NA	NA	NA	NA	20.16	6.35	13.81	NA	NA
S-13	10/10/1996	<50	<0.50	<0.50	<0.50	<0.50	210	160	20.16	7.04	13.12	NA	NA
S-13	01/09/1997	NA	NA	NA	NA	NA	NA	NA	20.16	5.19	14.97	NA	NA
S-13	04/08/1997	<50	<0.50	<0.50	<0.50	<0.50	81	NA	20.16	6.62	13.54	NA	NA
S-13	07/21/1997	NA	NA	NA	NA	NA	NA	NA	20.16	6.76	13.40	NA	NA
S-13	10/08/1997	<50	<0.50	<0.50	<0.50	<0.50	110	NA	20.16	7.05	13.11	NA	NA
S-13	01/15/1998	NA	NA	NA	NA	NA	NA	NA	20.16	5.27	14.89	NA	NA
S-13	04/14/1998	<50	<0.50	<0.50	<0.50	<0.50	3.2	NA	20.16	5.24	14.92	NA	NA
S-13	07/14/1998	NA	NA	NA	NA	NA	NA	NA	20.16	5.48	14.68	NA	NA
S-13	10/20/1998	NA	NA	NA	NA	NA	NA	NA	20.16	7.08	13.08	NA	NA
S-13	01/22/1999	<50.0	<0.500	<0.500	<0.500	<0.500	92.2	NA	20.16	6.65	13.51	NA	NA
S-13	04/08/1999	NA	NA	NA	NA	NA	NA	NA	20.16	5.61	14.55	NA	NA
S-13	07/23/1999	<50.0	<0.500	<0.500	<0.500	<0.500	<5.00	NA	20.16	6.78	13.38	NA	NA
S-13	10/26/1999	NA	NA	NA	NA	NA	NA	NA	20.16	7.33	12.83	NA	NA
S-13	01/03/2000	<50.0	<0.500	<0.500	<0.500	<0.500	<2.50	NA	20.16	7.51	12.65	NA	NA
S-13	04/14/2000	NA	NA	NA	NA	NA	NA	NA	20.16	6.08	14.08	NA	NA
S-13	07/12/2000	<50.0	<0.500	<0.500	<0.500	<0.500	<2.50	NA	20.16	6.50	13.66	NA	NA
S-13	11/01/2000	NA	NA	NA	NA	NA	NA	NA	20.16	6.10	14.06	NA	NA
S-13	01/03/2001	<50.0	<0.500	<0.500	<0.500	<0.500	21.2	23.9	20.16	7.09	13.07	NA	NA
S-13	04/24/2001	Well inaccessible		NA	NA	NA	NA	NA	20.16	NA	NA	NA	NA
S-13	07/02/2001	<50	<0.50	<0.50	<0.50	<0.50	NA	<5.0	20.16	7.13	13.03	NA	NA
S-13	11/02/2001	NA	NA	NA	NA	NA	NA	NA	20.16	7.38	12.78	NA	NA
S-13	01/16/2002	<50	<0.50	<0.50	<0.50	<0.50	NA	5.9	20.16	6.02	14.14	NA	NA
S-13	04/01/2002	NA	NA	NA	NA	NA	NA	NA	20.16	6.26	13.90	NA	NA

WELL CONCENTRATIONS
Former Shell Service Station
15275 Washington
San Leandro, CA

Well ID	Date	TPPH (ug/L)	B (ug/L)	T (ug/L)	E (ug/L)	X (ug/L)	MTBE 8020 (ug/L)	MTBE 8260 (ug/L)	TOC (MSL)	Depth to Water (ft)	GW Elevation (MSL)	SPH Thickness (ft)	DO Reading (ppm)
S-13	07/11/2002	<50	<0.50	<0.50	<0.50	<0.50	NA	<5.0	20.16	7.00	13.16	NA	NA
S-13	10/28/2002	NA	NA	NA	NA	NA	NA	NA	20.19	7.70	12.49	NA	NA
S-13	01/23/2003	<50	<0.50	<0.50	<0.50	<0.50	NA	110	20.19	6.41	13.78	NA	NA
S-13	04/30/2003	NA	NA	NA	NA	NA	NA	NA	20.19	6.12	14.07	NA	NA
S-14	05/03/1989	5300	750	400	200	800	NA	NA	20.44	NA	NA	NA	NA
S-14	08/10/1989	1800	540	140	42	50	NA	NA	20.44	7.58	12.86	NA	NA
S-14	10/09/1989	1000	360	60	20	30	NA	NA	20.44	7.62	12.82	NA	NA
S-14	01/25/1990	640	160	77	17	39	NA	NA	20.44	7.82	12.62	NA	NA
S-14	04/18/1990	1200	200	110	30	96	NA	NA	20.44	7.37	13.07	NA	NA
S-14	07/23/1990	5000	430	340	140	660	NA	NA	20.44	7.28	13.16	NA	NA
S-14	10/18/1990	1800	770	13	17	120	NA	NA	20.44	8.10	12.34	NA	NA
S-14	01/28/1991	720	200	36	21	78	NA	NA	20.44	8.04	12.40	NA	NA
S-14	04/25/1991	14000	930	430	250	970	NA	NA	20.44	6.40	14.04	NA	NA
S-14	07/09/1991	160	30	5.3	5	16	NA	NA	20.44	7.69	12.75	NA	NA
S-14	10/08/1991	5400	81	57	95	380	NA	NA	20.44	8.24	12.20	NA	NA
S-14	02/02/1992	NA	NA	NA	NA	NA	NA	NA	20.44	7.20	13.24	NA	NA
S-14	04/28/1992	2000	270	140	48	170	NA	NA	20.44	9.75	10.69	NA	NA
S-14	10/26/1992	920	33	12	25	88	NA	NA	20.44	8.32	12.12	NA	NA
S-14	01/13/1993	NA	NA	NA	NA	NA	NA	NA	20.44	5.07	15.37	NA	NA
S-14	04/16/1993	4500	1100	29	91	170	NA	NA	20.44	5.86	14.58	NA	NA
S-14	07/23/1993	NA	NA	NA	NA	NA	NA	NA	20.44	7.06	13.38	NA	NA
S-14	10/27/1993	Well inaccessible		NA	NA	NA	NA	NA	20.44	NA	NA	NA	NA
S-14	01/27/1994	NA	NA	NA	NA	NA	NA	NA	20.44	NA	NA	NA	NA
S-14	05/05/1994	810	250	<2.5	9.4	19	NA	NA	19.99	6.48	13.51	NA	NA
S-14	07/26/1994	NA	NA	NA	NA	NA	NA	NA	19.99	7.04	12.95	NA	NA
S-14	10/28/1994	5385	290.6	85.8	49.7	186.2	NA	NA	19.99	7.07	12.92	NA	NA
S-14	01/02/1995	NA	NA	NA	NA	NA	NA	NA	19.99	5.95	14.04	NA	NA

WELL CONCENTRATIONS
Former Shell Service Station
15275 Washington
San Leandro, CA

Well ID	Date	TPPH (ug/L)	B (ug/L)	T (ug/L)	E (ug/L)	X (ug/L)	MTBE 8020 (ug/L)	MTBE 8260 (ug/L)	TOC (MSL)	Depth to Water (ft.)	GW Elevation (MSL)	SPH Thickness (ft.)	DO Reading (ppm)
S-14	04/14/1995	1600	40	4.7	11	20	NA	NA	19.99	5.22	14.77	NA	NA
S-14	07/28/1995	NA	NA	NA	NA	NA	NA	NA	19.99	6.21	13.78	NA	NA
S-14	10/17/1995	1200	37	<0.5	7.8	11	NA	NA	19.99	6.30	13.69	NA	NA
S-14	01/11/1996	NA	NA	NA	NA	NA	NA	NA	19.99	5.70	14.29	NA	NA
S-14	07/21/1997	220	71	0.71	1.3	1.3	100	NA	19.99	6.14	13.85	NA	NA
S-14	03/18/2002 d	NA	NA	NA	NA	NA	NA	NA	20.01	NA	NA	NA	NA
S-15	05/03/1989	<50	<0.5	<1	<1	<3	NA	NA	22.22	NA	NA	NA	NA
S-15	08/10/1989	<50	<0.5	<1	<1	<3	NA	NA	22.22	8.48	13.74	NA	NA
S-15	10/09/1989	<50	<0.5	<1	<1	<3	NA	NA	22.22	8.46	13.76	NA	NA
S-15	01/25/1990	<50	<0.5	<1	<1	<1	NA	NA	22.22	8.34	13.88	NA	NA
S-15	04/18/1990	<50	<0.5	<0.5	<0.5	<1	NA	NA	22.22	8.45	13.77	NA	NA
S-15	07/23/1990	<50	<0.5	<0.5	<0.5	<0.5	NA	NA	22.22	8.22	14.00	NA	NA
S-15	10/18/1990	<50	<0.5	<0.5	<0.5	<0.5	NA	NA	22.22	9.11	13.11	NA	NA
S-15	01/28/1991	<50	<0.5	0.6	<0.5	0.8	NA	NA	22.22	9.13	13.09	NA	NA
S-15	04/25/1991	<50	<0.5	<0.5	<0.5	<0.5	NA	NA	22.22	7.83	14.39	NA	NA
S-15	07/09/1991	<50	<0.5	<0.5	<0.5	<0.5	NA	NA	22.22	8.93	13.29	NA	NA
S-15	10/08/1991	<50	<0.5	<0.5	<0.5	<0.5	NA	NA	22.22	9.26	12.96	NA	NA
S-15	02/05/1992	<50	<0.5	<0.5	<0.5	<0.5	NA	NA	22.22	8.60	13.62	NA	NA
S-15	04/28/1992	50	0.8	0.9	<0.5	1.4	NA	NA	22.22	8.09	14.13	NA	NA
S-15	07/27/1992	<50	<0.5	<0.5	<0.5	<0.5	NA	NA	22.22	8.83	13.39	NA	NA
S-15	10/26/1992	<50	<0.5	<0.5	<0.5	<0.5	NA	NA	22.22	9.31	12.91	NA	NA
S-15	01/14/1993	<50	<0.5	<0.5	<0.5	<0.5	NA	NA	22.22	6.64	15.58	NA	NA
S-15	04/16/1993	<50	0.6	1.0	<0.5	0.7	NA	NA	22.22	7.14	15.08	NA	NA
S-15	07/23/1993	<50	1.2	<0.5	<0.5	1.6	NA	NA	22.22	8.23	13.99	NA	NA
S-15	10/27/1993	Well inaccessible		NA	NA	NA	NA	NA	22.22	NA	NA	NA	NA
S-15	01/27/1994	Well inaccessible		NA	NA	NA	NA	NA	22.22	NA	NA	NA	NA
S-15	05/05/1994	<50	<0.5	<0.5	<0.5	<0.5	NA	NA	21.42	7.57	13.85	NA	NA

WELL CONCENTRATIONS
Former Shell Service Station
15275 Washington
San Leandro, CA

Well ID	Date	TPPH (ug/L)	B (ug/L)	T (ug/L)	E (ug/L)	X (ug/L)	MTBE 8020 (ug/L)	MTBE 8260 (ug/L)	TOC (MSL)	Depth to Water (ft)	GW Elevation (MSL)	SPH Thickness (ft)	DO Reading (ppm)
---------	------	----------------	-------------	-------------	-------------	-------------	------------------------	------------------------	--------------	---------------------------	--------------------------	--------------------------	------------------------

S-15	07/26/1994	<50	<0.3	<0.3	<0.3	<0.6	NA	NA	21.42	8.16	13.26	NA	NA
S-15	10/28/1994	<50	0.3	<0.3	<0.3	<0.6	NA	NA	21.42	7.87	13.55	NA	NA
S-15	01/02/1995	<50	<0.5	<0.5	<0.5	<0.5	NA	NA	21.42	7.02	14.40	NA	NA
S-15	04/14/1995	NA	NA	NA	NA	NA	NA	NA	21.42	6.19	15.23	NA	NA
S-15	07/28/1995	<50	<0.5	<0.5	<0.5	<0.5	NA	NA	21.42	6.72	14.70	NA	NA
S-15	10/17/1995	<50	<0.5	<0.5	<0.5	<0.5	NA	NA	21.42	7.04	14.38	NA	NA
S-15	01/11/1996	<50	<0.5	<0.5	<0.5	<0.5	<2	NA	21.42	6.40	15.02	NA	NA
S-15	03/18/2002 d	NA	NA	NA	NA	NA	NA	NA	21.47	NA	NA	NA	NA

S-16	05/04/1994	380	44	3.0	2.0	<3	NA	NA	21.82	NA	NA	NA	NA
S-16	08/10/1989	<50	0.6	<1	<1	<3	NA	NA	21.82	8.36	13.46	NA	NA
S-16	10/10/1989	<5	<0.5	<1	<1	<3	NA	NA	21.82	8.23	13.59	NA	NA
S-16	01/25/1990	240	160	3.3	0.8	11	NA	NA	21.82	7.88	13.94	NA	NA
S-16	04/18/1990	<50	1.0	<0.5	<0.5	<1	NA	NA	21.82	8.19	13.63	NA	NA
S-16	07/23/1990	<50	1.1	<0.5	<0.5	<0.5	NA	NA	21.82	8.09	13.73	NA	NA
S-16	10/18/1990	<50	<0.5	<0.5	<0.5	<0.5	NA	NA	21.82	8.90	12.92	NA	NA
S-16	01/28/1991	<50	<0.5	0.6	<0.5	0.9	NA	NA	21.82	8.55	13.27	NA	NA
S-16	04/25/1991	60	21	0.5	3.2	4.8	NA	NA	21.82	7.48	14.34	NA	NA
S-16	07/09/1991	<50	1.0	<0.5	<0.5	<0.5	NA	NA	21.82	8.48	13.34	NA	NA
S-16	10/08/1991	50	17	1.4	1.2	5.5	NA	NA	21.82	8.95	12.87	NA	NA
S-16	02/05/1992	150	65	0.7	<0.5	8.4	NA	NA	21.82	8.20	13.62	NA	NA
S-16	04/28/1992	<50	13	<0.5	<0.5	<0.5	NA	NA	21.82	7.80	14.02	NA	NA
S-16	07/27/1992	510	130	<2.5	<0.5	21	NA	NA	21.82	8.29	13.53	NA	NA
S-16	10/26/1992	<50	<0.5	<0.5	<2.5	<0.5	NA	NA	21.82	9.02	12.80	NA	NA
S-16	01/13/1993	100	25	1.9	<0.5	8.4	NA	NA	21.82	5.78	16.04	NA	NA
S-16	04/16/1993	150	56	1.8	4.6	12	NA	NA	21.82	6.80	15.02	NA	NA
S-16	07/23/1993	<50	0.9	<0.5	<0.5	<0.5	NA	NA	21.82	7.67	14.15	NA	NA
S-16	10/27/1993	<50	1.5	<0.5	<0.5	<0.5	NA	NA	21.82	8.52	13.30	NA	NA

WELL CONCENTRATIONS
Former Shell Service Station
15275 Washington
San Leandro, CA

Well ID	Date	TPPH (ug/L)	B (ug/L)	T (ug/L)	E (ug/L)	X (ug/L)	MTBE 8020 (ug/L)	MTBE 8260 (ug/L)	TOC (MSL)	Depth to Water (ft)	GW Elevation (MSL)	SPH Thickness (ft)	DO Reading (ppm)
S-16	01/27/1994	140	85	<1	<1	13	NA	NA	21.82	7.20	14.62	NA	NA
S-16	05/05/1994	71	25	<0.5	<0.5	4.2	NA	NA	21.24	7.76	13.48	NA	NA
S-16	07/26/1994	<50	<0.3	<0.3	<0.3	<0.6	NA	NA	21.24	7.84	13.40	NA	NA
S-16	10/28/1994	<50	11.5	<0.3	<0.3	1.8	NA	NA	21.24	7.97	13.27	NA	NA
S-16	01/02/1995	70	64	<0.5	<0.5	4.0	NA	NA	21.24	6.49	14.75	NA	NA
S-16	04/14/1995	NA	NA	NA	NA	NA	NA	NA	21.24	6.08	15.16	NA	NA
S-16	07/28/1995	<50	1.7	<0.5	<0.5	<0.5	NA	NA	21.24	7.00	14.24	NA	NA
S-16	10/17/1995	<50	4.6	<0.5	<0.5	<0.5	NA	NA	21.24	7.15	14.09	NA	NA
S-16	01/11/1996	80	17	0.7	<0.5	2.9	<2	NA	21.24	6.30	14.94	NA	NA
S-16	04/02/1996	NA	NA	NA	NA	NA	NA	NA	21.24	5.84	15.40	NA	NA
S-16	07/09/1996	NA	NA	NA	NA	NA	NA	NA	21.24	6.72	14.52	NA	NA
S-16	10/10/1996	NA	NA	NA	NA	NA	NA	NA	21.24	7.41	13.83	NA	NA
S-16	01/09/1997	80	18	<0.50	1.7	4.8	<2.5	NA	21.24	5.60	15.64	NA	NA
S-16	04/08/1997	NA	NA	NA	NA	NA	NA	NA	21.24	7.34	13.90	NA	NA
S-16	07/21/1997	NA	NA	NA	NA	NA	NA	NA	21.24	7.20	14.04	NA	NA
S-16	10/08/1997	NA	NA	NA	NA	NA	NA	NA	21.24	7.34	13.90	NA	NA
S-16	01/15/1998	650	160	2.7	8.7	62	<12	NA	21.24	4.79	16.45	NA	NA
S-16	04/14/1998	NA	NA	NA	NA	NA	NA	NA	21.24	5.27	15.97	NA	NA
S-16	07/14/1998	NA	NA	NA	NA	NA	NA	NA	21.24	6.32	14.92	NA	NA
S-16	10/20/1998	NA	NA	NA	NA	NA	NA	NA	21.24	6.94	14.30	NA	NA
S-16	01/22/1999	Well inaccessible		NA	NA	NA	NA	NA	21.24	NA	NA	NA	NA
S-16	04/08/1999	NA	NA	NA	NA	NA	NA	NA	21.24	5.80	15.44	NA	NA
S-16	07/23/1999	NA	NA	NA	NA	NA	NA	NA	21.24	6.62	14.62	NA	NA
S-16	10/26/1999	NA	NA	NA	NA	NA	NA	NA	21.24	7.42	13.82	NA	NA
S-16	01/03/2000	<50.0	<0.500	<0.500	<0.500	<0.500	<2.50	NA	21.24	7.34	13.90	NA	NA
S-16	04/14/2000	NA	NA	NA	NA	NA	NA	NA	21.24	6.27	14.97	NA	NA
S-16	07/12/2000	NA	NA	NA	NA	NA	NA	NA	21.24	7.02	14.22	NA	NA
S-16	11/01/2000	NA	NA	NA	NA	NA	NA	NA	21.24	6.79	14.45	NA	NA

WELL CONCENTRATIONS
Former Shell Service Station
15275 Washington
San Leandro, CA

Well ID	Date	TPPH (ug/L)	B (ug/L)	T (ug/L)	E (ug/L)	X (ug/L)	MTBE 8020 (ug/L)	MTBE 8260 (ug/L)	TOC (MSL)	Depth to Water (ft)	GW Elevation (MSL)	SPH Thickness (ft)	DO Reading (ppm)
S-16	01/03/2001	<50.0	<0.500	<0.500	<0.500	<0.500	3.05	NA	21.24	7.18	14.06	NA	NA
S-16	04/24/2001	NA	NA	NA	NA	NA	NA	NA	21.24	6.85	14.39	NA	NA
S-16	07/02/2001	NA	NA	NA	NA	NA	NA	NA	21.24	7.51	13.73	NA	NA
S-16	11/02/2001	NA	NA	NA	NA	NA	NA	NA	21.24	7.68	13.56	NA	NA
S-16	01/16/2002	<50	<0.50	<0.50	<0.50	<0.50	NA	<5.0	21.24	6.40	14.84	NA	NA
S-16	04/01/2002	NA	NA	NA	NA	NA	NA	NA	21.24	6.33	14.91	NA	NA
S-16	07/11/2002	NA	NA	NA	NA	NA	NA	NA	21.24	7.39	13.85	NA	NA
S-16	10/28/2002	NA	NA	NA	NA	NA	NA	NA	21.30	8.00	13.30	NA	NA
S-16	01/23/2003	<50	<0.50	<0.50	<0.50	<0.50	NA	<5.0	21.30	6.36	14.94	NA	NA
S-16	04/30/2003	NA	NA	NA	NA	NA	NA	NA	21.30	6.03	15.27	NA	NA

S-17	05/03/1989	<50	<0.5	<1	<1	<3	NA	NA	20.95	NA	NA	NA	NA
S-17	08/10/1989	<50	<0.5	<1	<1	<3	NA	NA	20.95	8.13	12.82	NA	NA
S-17	10/09/1989	<50	<0.5	<1	<1	<3	NA	NA	20.95	8.18	12.77	NA	NA
S-17	01/25/1990	<50	<0.5	<0.5	<0.5	<1	NA	NA	20.95	7.60	13.35	NA	NA
S-17	04/18/1990	<50	<0.5	<0.5	<0.5	<1	NA	NA	20.95	7.95	13.00	NA	NA
S-17	07/23/1990	<50	<0.5	<0.5	<0.5	<0.5	NA	NA	20.95	7.87	13.08	NA	NA
S-17	10/18/1990	390	10	62	22	110	NA	NA	20.95	8.71	12.24	NA	NA
S-17	01/28/1991	<50	<0.5	<0.5	<0.5	<0.5	NA	NA	20.95	8.54	12.41	NA	NA
S-17	04/25/1991	<50	<0.5	<0.5	<0.5	<0.5	NA	NA	20.95	7.15	13.80	NA	NA
S-17	07/09/1991	<50	<0.5	<0.5	<0.5	<0.5	NA	NA	20.95	8.24	12.71	NA	NA
S-17	10/08/1991	<50	<0.5	<0.5	<0.5	<0.5	NA	NA	20.95	8.86	12.09	NA	NA
S-17	02/05/1992	NA	NA	NA	NA	NA	NA	NA	20.95	7.74	13.21	NA	NA
S-17	04/28/1992	<50	<0.5	<0.5	<0.5	<0.5	NA	NA	20.95	7.41	13.54	NA	NA
S-17	07/27/1992	NA	NA	NA	NA	NA	NA	NA	20.95	8.34	12.61	NA	NA
S-17	10/26/1992	<50	<0.5	<0.5	<0.5	<0.5	NA	NA	20.95	8.87	12.08	NA	NA
S-17	01/13/1993	NA	NA	NA	NA	NA	NA	NA	20.95	3.43	17.52	NA	NA
S-17	04/16/1993	130	<0.5	<0.5	<0.5	<0.5	NA	NA	20.95	6.70	14.25	NA	NA

WELL CONCENTRATIONS
Former Shell Service Station
15275 Washington
San Leandro, CA

Well ID	Date	TPPH (ug/L)	B (ug/L)	T (ug/L)	E (ug/L)	X (ug/L)	MTBE 8020 (ug/L)	MTBE 8260 (ug/L)	TOC (MSL)	Depth to Water (ft.)	GW Elevation (MSL)	SPH Thickness (ft.)	DO Reading (ppm)
S-17	07/23/1993	NA	NA	NA	NA	NA	NA	NA	20.95	7.53	13.42	NA	NA
S-17	10/27/1993	<50	<0.5	<0.5	<0.5	<0.5	NA	NA	20.95	8.29	12.66	NA	NA
S-17	01/27/1994	NA	NA	NA	NA	NA	NA	NA	20.95	5.78	15.17	NA	NA
S-17	05/05/1994	<50	<0.5	<0.5	<0.5	<0.5	NA	NA	20.45	6.99	13.46	NA	NA
S-17	07/26/1994	NA	NA	NA	NA	NA	NA	NA	20.45	7.62	12.83	NA	NA
S-17	10/28/1994	<50	<0.3	<0.3	<0.3	<0.6	NA	NA	20.45	7.91	12.54	NA	NA
S-17	01/02/1995	NA	NA	NA	NA	NA	NA	NA	20.45	6.33	14.12	NA	NA
S-17	04/14/1995	NA	NA	NA	NA	NA	NA	NA	20.45	5.53	14.92	NA	NA
S-17	07/28/1995	NA	NA	NA	NA	NA	NA	NA	20.45	6.75	13.70	NA	NA
S-17	10/17/1995	<50	<0.5	<0.5	<0.5	<0.5	NA	NA	20.45	7.15	13.30	NA	NA
S-17	01/11/1996	NA	NA	NA	NA	NA	NA	NA	20.45	6.37	14.08	NA	NA
S-17	04/02/1996	<50	<0.5	<0.5	<0.5	<0.5	<2	NA	20.45	5.31	15.14	NA	NA
S-17	07/09/1996	<50	<0.50	<0.50	<0.50	<0.50	<2.5	NA	20.45	6.30	14.15	NA	NA
S-17	10/10/1996	<50	<0.50	<0.50	<0.50	<0.50	<2.5	NA	20.45	7.80	12.65	NA	NA
S-17	01/09/1997	<50	<0.50	<0.50	<0.50	<0.50	<2.5	NA	20.45	4.80	15.65	NA	NA
S-17	04/08/1997	<50	<0.50	<0.50	<0.50	<0.50	<2.5	NA	20.45	6.83	13.62	NA	NA
S-17 (D)	04/08/1997	<50	<0.50	<0.50	<0.50	<0.50	<2.5	NA	20.45	NA	NA	NA	NA
S-17	07/21/1997	<50	<0.50	<0.50	<0.50	<0.50	<2.5	NA	20.45	6.78	13.67	NA	NA
S-17	10/08/1997	<50	<0.50	<0.50	<0.50	<0.50	<2.5	NA	20.45	6.80	13.65	NA	NA
S-17	01/15/1998	380	<0.50	<0.50	<0.50	0.94	<2.5	NA	20.45	2.91	17.54	NA	NA
S-17	04/14/1998	160	<0.50	<0.50	<0.50	<0.50	<2.5	NA	20.45	4.47	15.98	NA	NA
S-17	07/14/1998	<50	<0.50	<0.50	<0.50	<0.50	<2.5	NA	20.45	6.45	14.00	NA	NA
S-17	10/20/1998	<50	<0.50	<0.50	<0.50	<0.50	<2.5	NA	20.45	7.11	13.34	NA	NA
S-17	01/22/1999	<50.0	<0.500	<0.500	<0.500	<0.500	<2.00	NA	20.45	6.01	14.44	NA	NA
S-17	04/08/1999	145	<0.500	<0.500	<0.500	<0.500	<5.00	NA	20.45	4.69	15.76	NA	NA
S-17	07/23/1999	<50.0	<0.500	<0.500	<0.500	<0.500	<5.00	NA	20.45	6.60	13.85	NA	NA
S-17	10/26/1999	<50.0	<0.500	<0.500	<0.500	<0.500	<2.50	NA	20.45	6.68	13.77	NA	NA
S-17	01/03/2000	<50.0	<0.500	<0.500	<0.500	<0.500	<2.50	NA	20.45	7.20	13.25	NA	NA

WELL CONCENTRATIONS
Former Shell Service Station
15275 Washington
San Leandro, CA

Well ID	Date	TPPH (ug/L)	B (ug/L)	T (ug/L)	E (ug/L)	X (ug/L)	MTBE 8020 (ug/L)	MTBE 8260 (ug/L)	TOC (MSL)	Depth to Water (ft.)	GW Elevation (MSL)	SPH Thickness (ft.)	DO Reading (ppm)
S-17	04/14/2000	<50.0	<0.500	<0.500	<0.500	<0.500	<2.50	NA	20.45	5.88	14.57	NA	NA
S-17	07/12/2000	<50.0	<0.500	<0.500	<0.500	<0.500	<2.50	NA	20.45	6.45	14.00	NA	NA
S-17	11/01/2000	<50.0	<0.500	<0.500	<0.500	<0.500	<2.50	NA	20.45	5.45	15.00	NA	NA
S-17	01/03/2001	<50.0	<0.500	<0.500	<0.500	<0.500	<2.50	NA	20.45	7.22	13.23	NA	NA
S-17	04/24/2001	<50	<0.50	<0.50	<0.50	<0.50	NA	<0.50	20.45	6.10	14.35	NA	NA
S-17	07/02/2001	<50	<0.50	<0.50	<0.50	<0.50	NA	<5.0	20.45	6.95	13.50	NA	NA
S-17	11/02/2001	<50	<0.50	<0.50	<0.50	<0.50	NA	<5.0	20.45	7.50	12.95	NA	NA
S-17	01/16/2002	<50	<0.50	<0.50	<0.50	<0.50	NA	<5.0	20.45	5.76	14.69	NA	NA
S-17	04/01/2002	<50	<0.50	<0.50	<0.50	<0.50	NA	<5.0	20.45	6.02	14.43	NA	NA
S-17	07/11/2002	<50	<0.50	<0.50	<0.50	<0.50	NA	<5.0	20.45	6.97	13.48	NA	NA
S-17	10/28/2002	<50	<0.50	<0.50	<0.50	<0.50	NA	<0.50	20.44	7.60	12.84	NA	0.9
S-17	01/23/2003	<50	<0.50	<0.50	<0.50	<0.50	NA	<5.0	20.44	5.77	14.67	NA	NA
S-17	04/30/2003	<50	<0.50	<0.50	<0.50	<1.0	NA	<5.0	20.44	5.35	15.09	NA	NA

S-18	05/31/1991	<50	<0.5	<0.5	<0.5	<0.5	NA	NA	21.03	NA	NA	NA	NA
S-18	07/09/1991	<50	<0.5	<0.5	<0.5	<0.5	NA	NA	21.03	8.23	12.80	NA	NA
S-18	10/08/1991	<50	<0.5	<0.5	<0.5	<0.5	NA	NA	21.03	8.84	12.19	NA	NA
S-18	02/05/1992	<50	<0.5	<0.5	<0.5	<0.5	NA	NA	21.03	7.67	13.36	NA	NA
S-18	04/28/1992	<50	<0.5	<0.5	<0.5	<0.5	NA	NA	21.03	7.40	13.63	NA	NA
S-18	07/27/1992	<50	<0.5	<0.5	<0.5	<0.5	NA	NA	21.03	8.38	12.65	NA	NA
S-18	10/26/1992	<50	<0.5	<0.5	<0.5	<0.5	NA	NA	21.03	8.83	12.20	NA	NA
S-18	01/13/1993	<50	<0.5	<0.5	<0.5	<0.5	NA	NA	21.03	5.86	15.17	NA	NA
S-18	04/16/1993	<50	<0.5	<0.5	<0.5	<0.5	NA	NA	21.03	4.88	16.15	NA	NA
S-18	07/23/1993	<50	<0.5	<0.5	<0.5	<0.5	NA	NA	21.03	7.56	13.47	NA	NA
S-18	10/27/1993	<50	<0.5	<0.5	<0.5	<0.5	NA	NA	21.03	8.30	12.73	NA	NA
S-18	01/27/1994	<50	1.9	<0.5	<0.5	<0.5	NA	NA	21.03	6.84	14.19	NA	NA
S-18	05/05/1994	<50	<0.5	<0.5	<0.5	<0.5	NA	NA	20.57	7.05	13.52	NA	NA
S-18	07/26/1994	<500	<3	1.1	<0.3	1.8	NA	NA	20.57	7.62	12.95	NA	NA

WELL CONCENTRATIONS
Former Shell Service Station
15275 Washington
San Leandro, CA

Well ID	Date	TPPH (ug/L)	B (ug/L)	T (ug/L)	E (ug/L)	X (ug/L)	MTBE 8020 (ug/L)	MTBE 8260 (ug/L)	TOC (MSL)	Depth to Water (ft)	GW Elevation (MSL)	SPH Thickness (ft)	DO Reading (ppm)
S-18	10/28/1994	<50	<0.3	<0.3	<0.3	<0.6	NA	NA	20.57	8.01	12.56	NA	NA
S-18	01/02/1995	<50	<0.5	<0.5	<0.5	<0.5	NA	NA	20.57	6.26	14.31	NA	NA
S-18	04/14/1995	NA	NA	NA	NA	NA	NA	NA	20.57	4.85	15.72	NA	NA
S-18	07/28/1995	<50	<0.5	<0.5	<0.5	<0.5	NA	NA	20.57	5.80	14.77	NA	NA
S-18	10/17/1995	<50	<0.5	<0.5	<0.5	<0.5	NA	NA	20.57	7.22	13.35	NA	NA
S-18	01/11/1996	<50	<0.5	<0.5	<0.5	<0.5	<2	NA	20.57	6.40	14.17	NA	NA
S-18	04/02/1996	NA	NA	NA	NA	NA	NA	NA	20.57	4.80	15.77	NA	NA
S-18	07/09/1996	NA	NA	NA	NA	NA	NA	NA	20.57	5.74	14.83	NA	NA
S-18	10/10/1996	NA	NA	NA	NA	NA	NA	NA	20.57	6.06	14.51	NA	NA
S-18	01/09/1997	<50	<0.50	<0.50	<0.50	<0.50	<2.5	NA	20.57	4.70	15.87	NA	NA
S-18	04/08/1997	NA	NA	NA	NA	NA	NA	NA	20.57	6.62	13.95	NA	NA
S-18	07/21/1997	NA	NA	NA	NA	NA	NA	NA	20.57	6.94	13.63	NA	NA
S-18	10/08/1997	NA	NA	NA	NA	NA	NA	NA	20.57	6.88	13.69	NA	NA
S-18	01/15/1998	<50	<0.50	<0.50	<0.50	<0.50	<2.5	NA	20.57	3.60	16.97	NA	NA
S-18	04/14/1998	NA	NA	NA	NA	NA	NA	NA	20.57	4.28	16.29	NA	NA
S-18	07/14/1998	NA	NA	NA	NA	NA	NA	NA	20.57	6.13	14.44	NA	NA
S-18	10/20/1998	NA	NA	NA	NA	NA	NA	NA	20.57	7.20	13.37	NA	NA
S-18	01/22/1999	<50.0	<0.500	<0.500	<0.500	<0.500	<2.00	NA	20.57	6.00	14.57	NA	NA
S-18	04/08/1999	NA	NA	NA	NA	NA	NA	NA	20.57	4.95	15.62	NA	NA
S-18	07/23/1999	NA	NA	NA	NA	NA	NA	NA	20.57	6.03	14.54	NA	NA
S-18	10/26/1999	NA	NA	NA	NA	NA	NA	NA	20.57	7.39	13.18	NA	NA
S-18	01/03/2000	<50.0	<0.500	<0.500	<0.500	<0.500	<2.50	NA	20.57	7.54	13.03	NA	NA
S-18	04/14/2000	NA	NA	NA	NA	NA	NA	NA	20.57	4.41	16.16	NA	NA
S-18	07/12/2000	NA	NA	NA	NA	NA	NA	NA	20.57	5.31	15.26	NA	NA
S-18	11/01/2000	NA	NA	NA	NA	NA	NA	NA	20.57	6.42	14.15	NA	NA
S-18	01/03/2001	<50.0	<0.500	<0.500	<0.500	<0.500	3.67	NA	20.57	7.30	13.27	NA	NA
S-18	04/24/2001	NA	NA	NA	NA	NA	NA	NA	20.57	6.83	13.74	NA	NA
S-18	07/02/2001	NA	NA	NA	NA	NA	NA	NA	20.57	7.23	13.34	NA	NA

WELL CONCENTRATIONS
Former Shell Service Station
15275 Washington
San Leandro, CA

Well ID	Date	TPPH (ug/L)	B (ug/L)	T (ug/L)	E (ug/L)	X (ug/L)	MTBE 8020 (ug/L)	MTBE 8260 (ug/L)	TOC (MSL)	Depth to Water (ft)	GW Elevation (MSL)	SPH Thickness (ft)	DO Reading (ppm)
---------	------	----------------	-------------	-------------	-------------	-------------	------------------------	------------------------	--------------	---------------------------	--------------------------	--------------------------	------------------------

S-18	11/02/2001	Unable to locate		NA	NA	NA	NA	NA	20.57	NA	NA	NA	NA
S-18	01/16/2002	<50	<0.50	<0.50	<0.50	<0.50	NA	<5.0	20.57	6.15	14.42	NA	NA
S-18	04/01/2002	NA	NA	NA	NA	NA	NA	NA	20.57	6.06	14.51	NA	NA
S-18	07/11/2002	NA	NA	NA	NA	NA	NA	NA	20.57	6.98	13.59	NA	NA
S-18	10/28/2002	NA	NA	NA	NA	NA	NA	NA	20.63	7.66	12.97	NA	NA
S-18	01/23/2003	<50	<0.50	<0.50	<0.50	<0.50	NA	<5.0	20.63	6.18	14.45	NA	NA
S-18	04/30/2003	NA	NA	NA	NA	NA	NA	NA	20.63	5.32	15.31	NA	NA

S-19	10/20/1998	<50	<0.50	<0.50	<0.50	<0.50	<2.5	NA	20.11	6.41	13.70	NA	NA
S-19	01/22/1999	<50.0	<0.500	<0.500	<0.500	<0.500	90.6	NA	20.11	5.42	14.69	NA	NA
S-19	04/08/1999	<50.0	<0.500	<0.500	<0.500	<0.500	<5.00	NA	20.11	4.61	15.50	NA	NA
S-19	07/23/1999	<50.0	<0.500	<0.500	<0.500	<0.500	<5.00	NA	20.11	5.86	14.25	NA	NA
S-19	10/26/1999	<50.0	<0.500	<0.500	<0.500	<0.500	<2.50	NA	20.11	6.28	13.83	NA	NA
S-19	01/03/2000	<50.0	<0.500	<0.500	<0.500	<0.500	<2.50	NA	20.11	6.62	13.49	NA	NA
S-19	04/14/2000	<50.0	<0.500	<0.500	<0.500	<0.500	<2.50	NA	20.11	4.31	15.80	NA	NA
S-19	07/12/2000	<50.0	<0.500	<0.500	<0.500	<0.500	<2.50	NA	20.11	5.46	14.65	NA	NA
S-19	11/01/2000	<50.0	<0.500	<0.500	<0.500	<0.500	<2.50	NA	20.11	5.05	15.06	NA	NA
S-19	01/03/2001	<50.0	<0.500	<0.500	<0.500	<0.500	9.61	NA	20.11	6.00	14.11	NA	NA
S-19	04/24/2001	<50	<0.50	<0.50	<0.50	<0.50	NA	<0.50	20.11	5.58	14.53	NA	NA
S-19	07/02/2001	<50	<0.50	<0.50	<0.50	<0.50	NA	<5.0	20.11	6.34	13.77	NA	3.4
S-19	11/02/2001	<50	<0.50	<0.50	<0.50	<0.50	NA	<5.0	20.11	6.57	13.54	NA	3.4
S-19	01/16/2002	<50	<0.50	<0.50	<0.50	<0.50	NA	<5.0	20.11	5.05	15.06	NA	0.5
S-19	04/01/2002	<50	<0.50	<0.50	<0.50	<0.50	NA	<5.0	20.11	5.13	14.98	NA	3.3
S-19	07/11/2002	<50	<0.50	<0.50	<0.50	<0.50	NA	<5.0	20.11	5.50	14.61	NA	0.5
S-19	10/28/2002	<50	<0.50	<0.50	<0.50	<0.50	NA	<0.50	20.10	6.35	13.75	NA	0.6
S-19	01/23/2003	<50	<0.50	<0.50	<0.50	<0.50	NA	<5.0	20.10	5.15	14.95	NA	0.3
S-19	04/30/2003	<50	<0.50	<0.50	<0.50	<1.0	NA	<5.0	20.10	4.90	15.20	NA	0.5

WELL CONCENTRATIONS
Former Shell Service Station
15275 Washington
San Leandro, CA

Well ID	Date	TPPH (ug/L)	B (ug/L)	T (ug/L)	E (ug/L)	X (ug/L)	MTBE 8020 (ug/L)	MTBE 8260 (ug/L)	TOC (MSL)	Depth to Water (ft)	GW Elevation (MSL)	SPH Thickness (ft)	DO Reading (ppm)
SR-1	03/22/1989	5400	1100	230	350	1300	NA	NA	21.45	NA	NA	NA	NA
SR-1	01/25/1990	2200	470	120	110	510	NA	NA	21.45	7.53	13.92	NA	NA
SR-1	04/18/1990	1000	130	47	47	220	NA	NA	21.45	8.17	13.28	NA	NA
SR-1	07/23/1990	3200	470	320	170	870	NA	NA	21.45	7.58	13.87	NA	NA
SR-1	10/18/1990	1300	280	6.6	110	130	NA	NA	21.45	8.81	12.64	NA	NA
SR-1	01/28/1991	110	120	12	51	110	NA	NA	21.45	8.37	13.08	NA	NA
SR-1	04/25/1991	NA	NA	NA	NA	NA	NA	NA	21.45	6.91	14.54	NA	NA
SR-1	07/09/1991	1400	200	27	130	340	NA	NA	21.45	8.11	13.34	NA	NA
SR-1	10/08/1991	980	79	1.5	44	52	NA	NA	21.45	8.63	12.82	NA	NA
SR-1	02/05/1991	3800	580	36	320	400	NA	NA	21.45	7.68	13.77	NA	NA
SR-1	04/28/1992	38000	1800	460	1900	750	NA	NA	21.45	7.27	14.18	NA	NA
SR-1	07/27/1992	NA	NA	NA	NA	NA	NA	NA	21.45	8.11	13.34	0.01	NA
SR-1	10/26/1992	1800	370	10	130	130	NA	NA	21.45	8.63	12.82	NA	NA
SR-1	01/13/1993	47000	1000	1100	1700	13000	NA	NA	21.45	5.46	15.99	NA	NA
SR-1	04/16/1993	25000	1700	430	2400	8300	NA	NA	21.45	6.28	15.17	NA	NA
SR-1	07/23/1993	33000	2400	2000	3800	14000	NA	NA	21.45	7.34	14.11	NA	NA
SR-1	10/27/1993	2300	340	<12.5	270	440	NA	NA	21.45	8.04	13.41	NA	NA
SR-1	01/27/1994	36000	2000	1700	3000	11000	NA	NA	21.45	6.68	14.77	NA	NA
SR-1	05/05/1994	43000	1500	130	2900	12000	NA	NA	20.57	6.81	13.76	NA	NA
SR-1	07/26/1994	13600	682.7	39.2	996.6	2516	NA	NA	20.57	7.38	13.19	NA	NA
SR-1	10/28/1994	8462	301.5	29.3	384.7	2019	NA	NA	20.57	7.48	13.09	NA	NA
SR-1	01/02/1995	13000	400	120	2500	10000	NA	NA	20.57	6.34	14.23	NA	NA
SR-1	04/14/1995	43000	690	370	2500	12000	NA	NA	20.57	5.29	15.28	NA	NA
SR-1	07/28/1995	35000	760	120	2300	8100	NA	NA	20.57	6.36	14.21	NA	NA
SR-1	10/17/1995	9700	310	12	610	1200	NA	NA	20.57	6.62	13.95	NA	NA
SR-1 (D)	10/17/1995	8300	230	9.6	680	840	NA	NA	20.57	NA	NA	NA	NA
SR-1	01/11/1996	18000	410	170	1200	4400	42	NA	20.57	5.66	14.91	NA	NA
SR-1 (D)	01/11/1996	17000	420	180	1100	4000	42	NA	20.57	NA	NA	NA	NA

WELL CONCENTRATIONS
Former Shell Service Station
15275 Washington
San Leandro, CA

Well ID	Date	TPPH (ug/L)	B (ug/L)	T (ug/L)	E (ug/L)	X (ug/L)	MTBE 8020 (ug/L)	MTBE 8260 (ug/L)	TOC (MSL)	Depth to Water (ft)	GW Elevation (MSL)	SPH Thickness (ft)	DO Reading (ppm)
SR-1	04/02/1996	NA	NA	NA	NA	NA	NA	NA	20.57	5.14	15.43	NA	NA
SR-1	07/09/1996	Well inaccessible		NA	NA	NA	NA	NA	20.57	NA	NA	NA	NA
SR-1	10/10/1996	Well inaccessible		NA	NA	NA	NA	NA	20.57	NA	NA	NA	NA
SR-1	01/09/1997	Well inaccessible		NA	NA	NA	NA	NA	20.57	NA	NA	NA	NA
SR-1	04/08/1997	Well inaccessible		NA	NA	NA	NA	NA	20.57	NA	NA	NA	NA
SR-1	07/21/1997	Well inaccessible		NA	NA	NA	NA	NA	20.57	NA	NA	NA	NA
SR-1	10/08/1997	NA	NA	NA	NA	NA	NA	NA	20.57	6.94	13.63	NA	NA
SR-1	01/15/1998	8100	82	<25	36	2300	<125	NA	20.57	4.30	16.27	NA	NA
SR-1	04/14/1998	Well inaccessible		NA	NA	NA	NA	NA	20.57	NA	NA	NA	NA
SR-1	07/14/1998	NA	NA	NA	NA	NA	NA	NA	20.28	6.48	13.80	NA	NA
SR-1	10/20/1998	NA	NA	NA	NA	NA	NA	NA	20.28	6.61	13.67	NA	NA
SR-1	01/22/1999	Well inaccessible		NA	NA	NA	NA	NA	20.28	NA	NA	NA	NA
SR-1	04/08/1999	NA	NA	NA	NA	NA	NA	NA	20.28	0.97	19.31	NA	NA
SR-1	07/23/1999	Well dry		NA	NA	NA	NA	NA	20.28	NA	NA	NA	NA
SR-1	10/26/1999	Well dry		NA	NA	NA	NA	NA	20.28	NA	NA	NA	NA
SR-1	04/14/2000	Obstruction in well		NA	NA	NA	NA	NA	20.28	NA	NA	NA	NA
SR-1	07/12/2000	Obstruction in well		NA	NA	NA	NA	NA	20.28	NA	NA	NA	NA
SR-1	11/01/2000	Obstruction in well		NA	NA	NA	NA	NA	20.28	NA	NA	NA	NA
SR-1	01/03/2001	Obstruction in well		NA	NA	NA	NA	NA	20.28	NA	NA	NA	NA
SR-1	04/24/2001	Obstruction in well		NA	NA	NA	NA	NA	20.28	NA	NA	NA	NA
SR-1	07/02/2001	Obstruction in well		NA	NA	NA	NA	NA	20.28	NA	NA	NA	NA
SR-1	11/02/2001	Well dry	NA	NA	NA	NA	NA	NA	20.28	NA	NA	NA	NA
SR-1	01/16/2002	Well dry	NA	NA	NA	NA	NA	NA	20.28	NA	NA	NA	NA
SR-1	04/01/2002	Obstruction in well		NA	NA	NA	NA	NA	20.28	NA	NA	NA	NA
SR-1	07/11/2002	Obstruction in well		NA	NA	NA	NA	NA	20.28	NA	NA	NA	NA
SR-1	10/28/2002	Obstruction in well		NA	NA	NA	NA	NA	20.27	NA	NA	NA	NA
SR-1	01/23/2003	Obstruction in well		NA	NA	NA	NA	NA	20.27	NA	NA	NA	NA
SR-1	04/30/2003	Obstruction in well		NA	NA	NA	NA	NA	20.27	NA	NA	NA	NA

WELL CONCENTRATIONS
Former Shell Service Station
15275 Washington
San Leandro, CA

Well ID	Date	TPPH (ug/L)	B (ug/L)	T (ug/L)	E (ug/L)	X (ug/L)	MTBE 8020 (ug/L)	MTBE 8260 (ug/L)	TOC (MSL)	Depth to Water (ft)	GW Elevation (MSL)	SPH Thickness (ft)	DO Reading (ppm)
---------	------	----------------	-------------	-------------	-------------	-------------	------------------------	------------------------	--------------	---------------------------	--------------------------	--------------------------	------------------------

SV-1	04/15/1998 b	NA	NA	NA	NA	NA	NA	NA	NA	6.02	NA	NA	NA
SV-1	04/15/1998 c	NA	NA	NA	NA	NA	NA	NA	NA	7.15	NA	NA	NA
SV-1	03/18/2002 d	NA	NA	NA	NA	NA	NA	NA	21.31	NA	NA	NA	NA

Abbreviations:

TPPH = Total petroleum hydrocarbons as gasoline by EPA Method 8260B; prior to April 24, 2001, analyzed by EPA Method 8015.

BTEX = Benzene, toluene, ethylbenzene, xylenes by EPA Method 8260B; prior to April 24, 2001, analyzed by EPA Method 8020.

MTBE = Methyl-tertiary-butyl ether

TOC = Top of Casing Elevation

SPH = Separate-Phase Hydrocarbons

GW = Groundwater

DO = Dissolved Oxygen

ug/L = Parts per billion

MSL = Mean sea level

ppm = Parts per million

ft = Feet

<n = Below detection limit

D = Duplicate sample

NA = Not applicable

Notes:

a = Chromatogram pattern indicated an unidentified hydrocarbon.

b = Pre-development sample

c = Post-development sample

d = Survey date only.

e = DO reading not taken.

Site surveyed March 18, 2002, by Virgil Chavez Land Surveying of Vallejo, California.

Blaine Tech Services, Inc.

May 15, 2003

1680 Rogers Avenue
San Jose, CA 95112-1105

Attn.: Leon Gearhart

Project#: 030430-DA1

Project: 97093412

Site: 15275 Washington Ave., San Leandro

Dear Mr. Gearhart,

Attached is our report for your samples received on 05/01/2003 15:20

This report has been reviewed and approved for release. Reproduction of this report is permitted only in its entirety.

Please note that any unused portion of the samples will be discarded after 06/15/2003 unless you have requested otherwise.

We appreciate the opportunity to be of service to you. If you have any questions, please call me at (925) 484-1919.

You can also contact me via email. My email address is: tgranicher@stl-inc.com

Sincerely,

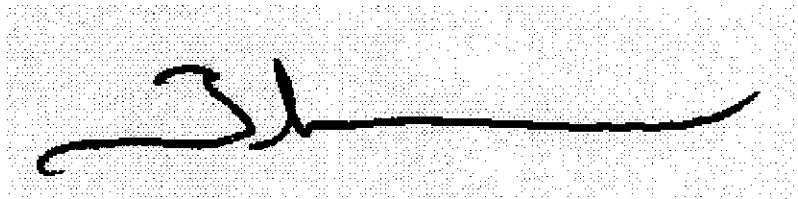

Tod Granicher
Project Manager

Severn Trent Laboratories, Inc.

STL San Francisco * 1220 Quarry Lane, Pleasanton, CA 94566

Tel 925 484 1919 Fax 925 484 1096 * www.stl-inc.com * CA DHS ELAP# 2496

Gas/BTEX/MTBE by 8260B (C6-C12)

Blaine Tech Services, Inc.

Attn.: Leon Gearhart

1680 Rogers Avenue

San Jose, CA 95112-1105

Phone: (408) 573-0555 Fax: (408) 573-7771

Project: 030430-DA1
97093412

Received: 05/01/2003 15:20

Site: 15275 Washington Ave., San Leandro

Samples Reported

Sample Name	Date Sampled	Matrix	Lab #
S-8	04/30/2003 08:10	Water	1
S-9	04/30/2003 08:20	Water	2
S-17	04/30/2003 09:00	Water	3
S-19	04/30/2003 08:40	Water	4

Gas/BTEX/MTBE by 8260B (C6-C12)

Blaine Tech Services, Inc.

Attn.: Leon Gearhart

1680 Rogers Avenue

San Jose, CA 95112-1105

Phone: (408) 573-0555 Fax: (408) 573-7771

Project: 030430-DA1

97093412

Received: 05/01/2003 15:20

Site: 15275 Washington Ave., San Leandro

Prep(s): 5030B	Test(s): 8260FAB
Sample ID: S-8	Lab ID: 2003-05-0045 - 1
Sampled: 04/30/2003 08:10	Extracted: 5/12/2003 20:01
Matrix: Water	QC Batch#: 2003/05/12-1c.65

Compound	Conc.	RL	Unit	Dilution	Analyzed	Flag
Gasoline	890	50	ug/L	1.00	05/12/2003 20:01	g
Benzene	13	0.50	ug/L	1.00	05/12/2003 20:01	
Toluene	ND	0.50	ug/L	1.00	05/12/2003 20:01	
Ethylbenzene	0.59	0.50	ug/L	1.00	05/12/2003 20:01	
Total xylenes	ND	1.0	ug/L	1.00	05/12/2003 20:01	
Methyl tert-butyl ether (MTBE)	ND	5.0	ug/L	1.00	05/12/2003 20:01	
Surrogates(s)						
1,2-Dichloroethane-d4	107.9	76-114	%	1.00	05/12/2003 20:01	
Toluene-d8	98.9	88-110	%	1.00	05/12/2003 20:01	

Gas/BTEX/MTBE by 8260B (C6-C12)

Blaine Tech Services, Inc.

Attn.: Leon Gearhart

1680 Rogers Avenue

San Jose, CA 95112-1105

Phone: (408) 573-0555 Fax: (408) 573-7771

Project: 030430-DA1

97093412

Received: 05/01/2003 15:20

Site: 15275 Washington Ave., San Leandro

Prep(s):	5030B	Test(s):	8260FAB
Sample ID:	S-9	Lab ID:	2003-05-0045 - 2
Sampled:	04/30/2003 08:20	Extracted:	5/12/2003 19:39
Matrix:	Water	QC Batch#:	2003/05/12-1c.65

Compound	Conc.	RL	Unit	Dilution	Analyzed	Flag
Gasoline	180	50	ug/L	1.00	05/12/2003 19:39	g
Benzene	4.2	0.50	ug/L	1.00	05/12/2003 19:39	
Toluene	ND	0.50	ug/L	1.00	05/12/2003 19:39	
Ethylbenzene	3.7	0.50	ug/L	1.00	05/12/2003 19:39	
Total xylenes	ND	1.0	ug/L	1.00	05/12/2003 19:39	
Methyl tert-butyl ether (MTBE)	ND	5.0	ug/L	1.00	05/12/2003 19:39	
Surrogates(s)						
1,2-Dichloroethane-d4	106.4	76-114	%	1.00	05/12/2003 19:39	
Toluene-d8	98.7	88-110	%	1.00	05/12/2003 19:39	

Gas/BTEX/MTBE by 8260B (C6-C12)

Blaine Tech Services, Inc.

Attn.: Leon Gearhart

1680 Rogers Avenue

San Jose, CA 95112-1105

Phone: (408) 573-0555 Fax: (408) 573-7771

Project: 030430-DA1

97093412

Received: 05/01/2003 15:20

Site: 15275 Washington Ave., San Leandro

Prep(s):	5030B	Test(s):	8260FAB
Sample ID:	S-17	Lab ID:	2003-05-0045 - 3
Sampled:	04/30/2003 09:00	Extracted:	5/12/2003 19:17
Matrix:	Water	QC Batch#:	2003/05/12-1c.65

Compound	Conc.	RL	Unit	Dilution	Analyzed	Flag
Gasoline	ND	50	ug/L	1.00	05/12/2003 19:17	
Benzene	ND	0.50	ug/L	1.00	05/12/2003 19:17	
Toluene	ND	0.50	ug/L	1.00	05/12/2003 19:17	
Ethylbenzene	ND	0.50	ug/L	1.00	05/12/2003 19:17	
Total xylenes	ND	1.0	ug/L	1.00	05/12/2003 19:17	
Methyl tert-butyl ether (MTBE)	ND	5.0	ug/L	1.00	05/12/2003 19:17	
Surrogates(s)						
1,2-Dichloroethane-d4	104.1	76-114	%	1.00	05/12/2003 19:17	
Toluene-d8	99.7	88-110	%	1.00	05/12/2003 19:17	

Severn Trent Laboratories, Inc.

STL San Francisco * 1220 Quarry Lane, Pleasanton, CA 94566

Tel 925 484 1919 Fax 925 484 1096 * www.stl-inc.com * CA DHS ELAP# 2496

05/13/2003 13:18

Gas/BTEX/MTBE by 8260B (C6-C12)

Blaine Tech Services, Inc.

Attn.: Leon Gearhart

1680 Rogers Avenue

San Jose, CA 95112-1105

Phone: (408) 573-0555 Fax: (408) 573-7771

Project: 030430-DA1

97093412

Received: 05/01/2003 15:20

Site: 15275 Washington Ave., San Leandro

Prep(s):	5030B	Test(s):	8260FAB
Sample ID:	S-19	Lab ID:	2003-05-0045 - 4
Sampled:	04/30/2003 08:40	Extracted:	5/12/2003 18:55
Matrix:	Water	QC Batch#:	2003/05/12-1c.65

Compound	Conc.	RL	Unit	Dilution	Analyzed	Flag
Gasoline	ND	50	ug/L	1.00	05/12/2003 18:55	
Benzene	ND	0.50	ug/L	1.00	05/12/2003 18:55	
Toluene	ND	0.50	ug/L	1.00	05/12/2003 18:55	
Ethylbenzene	ND	0.50	ug/L	1.00	05/12/2003 18:55	
Total xylenes	ND	1.0	ug/L	1.00	05/12/2003 18:55	
Methyl tert-butyl ether (MTBE)	ND	5.0	ug/L	1.00	05/12/2003 18:55	
Surrogates(s)						
1,2-Dichloroethane-d4	108.8	76-114	%	1.00	05/12/2003 18:55	
Toluene-d8	97.5	88-110	%	1.00	05/12/2003 18:55	

Gas/BTEX/MTBE by 8260B (C6-C12)

Blaine Tech Services, Inc.

Attn.: Leon Gearhart

1680 Rogers Avenue
San Jose, CA 95112-1105
Phone: (408) 573-0555 Fax: (408) 573-7771

Project: 030430-DA1
97093412

Received: 05/01/2003 15:20

Site: 15275 Washington Ave., San Leandro

Batch QC Report					
Prep(s): 5030B				Test(s): 8260FAB	
Method Blank		Water		QC Batch # 2003/05/12-1c.65	
MB: 2003/05/12-1c.65-003				Date Extracted: 05/12/2003 11:00	

Compound	Conc.	RL	Unit	Analyzed	Flag
Gasoline	ND	50	ug/L	05/12/2003 11:00	
Benzene	ND	0.5	ug/L	05/12/2003 11:00	
Toluene	ND	0.5	ug/L	05/12/2003 11:00	
Ethylbenzene	ND	0.5	ug/L	05/12/2003 11:00	
Total xylenes	ND	1.0	ug/L	05/12/2003 11:00	
Methyl tert-butyl ether (MTBE)	ND	5.0	ug/L	05/12/2003 11:00	
Surrogates(s)					
1,2-Dichloroethane-d4	99.2	76-130	%	05/12/2003 11:00	
Toluene-d8	98.4	78-115	%	05/12/2003 11:00	

Sewern Trent Laboratories, Inc.

STL San Francisco * 1220 Quarry Lane, Pleasanton, CA 94566

Tel 925 484 1919 Fax 925 484 1096 * www.stl-inc.com * CA DHS ELAP# 2496

05/13/2003 13:18

Gas/BTEX/MTBE by 8260B (C6-C12)

Blaine Tech Services, Inc.

Attn.: Leon Gearhart

1680 Rogers Avenue

San Jose, CA 95112-1105

Phone: (408) 573-0555 Fax: (408) 573-7771

Project: 030430-DA1

97093412

Received: 05/01/2003 15:20

Site: 15275 Washington Ave., San Leandro

Batch QC Report										
Prep(s): 5030B					Test(s): 8260FAB					
Laboratory Control Spike			Water			QC Batch # 2003/05/12-1c.65				
LCS	2003/05/12-1c.65-002		Extracted: 05/12/2003			Analyzed: 05/12/2003 10:16				
LCSD	2003/05/12-1c.65-001		Extracted: 05/12/2003			Analyzed: 05/12/2003 10:38				
Compound	Conc. ug/L		Exp. Conc.	Recovery		RPD %	Ctrl.Limits %		Flags	
	LCS	LCSD		LCS	LCSD		Rec.	RPD	LCS	LCSD
Benzene	25.4	24.6	25	101.6	98.4	3.2	69-129	20		
Toluene	24.5	23.9	25	98.0	95.6	2.5	70-130	20		
Methyl tert-butyl ether (MTBE)	31.8	33.7	25	127.2	134.8	5.8	65-165	20		
Surrogates(s)										
1,2-Dichloroethane-d4	480	518	500	96.0	103.6		76-130			
Toluene-d8	495	502	500	99.0	100.4		78-115			

Gas/BTEX/MTBE by 8260B (C6-C12)

Blaine Tech Services, Inc.

Attn.: Leon Gearhart

1680 Rogers Avenue

San Jose, CA 95112-1105

Phone: (408) 573-0555 Fax: (408) 573-7771

Project: 030430-DA1

97093412

Received: 05/01/2003 15:20

Site: 15275 Washington Ave., San Leandro

Batch QC Report			
Prep(s):	5030B	Test(s):	8260FAB
Matrix Spike (MS / MSD)		Water	QC Batch # 2003/05/12-1c.65
S-19 >> MS		Lab ID:	2003-05-0045 - 004
MS: 2003/05/12-1c.65-004	Extracted: 05/12/2003	Analyzed:	05/12/2003 18:10
		Dilution:	1.00
MSD: 2003/05/12-1c.65-005	Extracted: 05/12/2003	Analyzed:	05/12/2003 18:33
		Dilution:	1.00

Compound	Conc. ug/L			Spk.Level	Recovery			Limits %		Flags	
	MS	MSD	Sample		ug/L	MS	MSD	RPD	Rec.	RPD	MS
Benzene	25.3	26.2	ND	25.0	101.2	104.8	3.5	69-129	20		
Toluene	25.6	25.2	ND	25.0	102.4	100.8	1.6	70-130	20		
Methyl tert-butyl ether	32.1	34.5	ND	25.0	128.4	138.0	7.2	65-165	20		
Surrogate(s)											
1,2-Dichloroethane-d4	497	514		500	99.4	102.8		76-130	0		
Toluene-d8	520	503		500	104.0	100.6		78-115	0		

Severn Trent Laboratories, Inc.

STL San Francisco * 1220 Quarry Lane, Pleasanton, CA 94566

Tel 925 484 1919 Fax 925 484 1096 * www.stl-inc.com * CA DHS ELAP# 2496

05/13/2003 13:18

Gas/BTEX/MTBE by 8260B (C6-C12)

Blaine Tech Services, Inc.

Attn.: Leon Gearhart

1680 Rogers Avenue

San Jose, CA 95112-1105

Phone: (408) 573-0555 Fax: (408) 573-7771

Project: 030430-DA1
97093412

Received: 05/01/2003 15:20

Site: 15275 Washington Ave., San Leandro

Legend and Notes

Result Flag

g

Hydrocarbon reported in the gasoline range does not match our gasoline standard.

SMELL CHAIN OF CUSTODY RECORD

10070

Lab Identification (if necessary):

Address:

City, State, Zip:

Shell Project Manager to be invoiced:

SCIENCE & ENGINEERING
 TECHNICAL SERVICES
 CRMT HOUSTON

Karen Petryna

2003-05-0045

INCIDENT NUMBER (S&E ONLY)

9 7 0 9 3 4 1 2

SAP or CRMT NUMBER (TS/CRMT)

DATE: 4/30/03

PAGE: 1 of 1

OPERATING COMPANY: Blaine Tech Services	LAB CODE: BTSS	SITE ADDRESS (Street and City): 15275 Washington Avenue, San Leandro	SCHEM ID NO.: T0600101226
ADDRESS: 1680 Rogers Avenue, San Jose, CA 95112	SHIP DELIVERABLE TO (Recipient's Party Name): Ann Kreml	PHONE NO.: 510-420-3335	EMAIL: ShellOaklandEDF@cambrin-env.com
PROJECT CONTACT (Project No. / CF Report No.): Leon Gearhart	CALLER BY NAME (Print): David Allbut		CONSULTANT PROJECT NO.: 030430-DA1
TELEPHONE: 408-573-0555	FAX: 408-573-7771	EMAIL: lgearhart@blainetech.com	

TURNAROUND TIME (BUSINESS DAYS):
 10 DAYS 5 DAYS 72 HOURS 48 HOURS 24 HOURS LESS THAN 24 HOURS

LA - RWQCB REPORT FORMAT LIST AGENCY: _____

COMS/MTBE CONFIRMATION: HIGHEST _____ HIGHEST per BORING _____ ALL _____

SPECIAL INSTRUCTIONS OR NOTES: _____ CHECK BOX IF BGD IS NOT NEEDED

REQUESTED ANALYSIS

LAB USE ONLY	Field Sample Identification	SAMPLING		MATRIX	NO. OF CCNT.	TPH - Gas, Purgeable	BTEX	MTBE (6021B - 5ppb RL)	MTBE (6260B - 0.3ppb RL)	Oxygenates (P) by (6260B)	Ethanol (6260B)	Methanol	1,2-DCA (6260B)	SDS (6260B)	TPH - Diesel, Extractable (6045m)
		DATE	TIME												
	S-8	4/30/03	0810	W	3	X	X	X							
	S-9		0820			X	X	X							
	S-17		0900			X	X	X							
	S-19		0840			X	X	X							

FIELD NOTES:
 Container/Preservative
 or PID Readings
 or Laboratory Notes

2.0°C

TEMPERATURE ON RECEIPT C°

Submitted by (Signature): <i>David Allbut</i>	Received by (Signature): <i>[Signature]</i>	Date: 5/1/03	Time: 1520
Submitted by (Signature): <i>[Signature]</i>	Received by (Signature): <i>[Signature]</i>	Date: 5-1-03	Time: 1650

WELL GAUGING DATA

Project # 030430-DA1 Date 4/30/03 Client Shell

Site 15275 Washington Ave. San Leandro, CA

Well ID	Well Size (in.)	Sheen / Odor	Depth to Immiscible Liquid (ft.)	Thickness of Immiscible Liquid (ft.)	Volume of Immiscibles Removed (ml)	Depth to water (ft.)	Depth to well bottom (ft.)	Survey Point: TOB or TOC	Pre-Purge DO
S-1	3					6.18	19.73	TOC	
S-3	3					5.34	20.92		1.0
S-5	4					5.48	18.08		
S-7	3					6.14	23.93		
S-8	3					5.30	23.97		
S-9	3					5.20	17.40		7.0 ✓
S-10	3					5.24	17.81		
S-13	3					6.12	23.18		
S-16	3					6.03	23.41		
S-17	3					5.35	24.03		
S-18	3					5.32	17.68		
S-19	2					4.90	20.28		0.5
SR-1	3	Obstruction in well				—	—		
* Gauged w/ ORC's in well									

SHELL WELL MONITORING DATA SHEET

BTS #: 030430-PA4	Site: 15275 Washington San Leandro, CA
Sampler: OA	Date: 4/30/03
Well I.D.: 5-9	Well Diameter: 2 <input checked="" type="radio"/> 4 6 8
Total Well Depth (TD): 17.40	Depth to Water (DTW): 5.20
Depth to Free Product:	Thickness of Free Product (feet):
Referenced to: <u>PTO</u> Grade	D.O. Meter (if req'd): YSI HACH
DTW with 80% Recharge [(Height of Water Column x 0.20) + DTW]: -	

Purge Method: Bailer Disposable Bailer Middleburg Electric Submersible	Water: Peristaltic Extraction Pump Other: _____	Sampling Method: Bailer Disposable Bailer Extraction Port Dedicated Tubing Other: _____
-----------------------------------------------------------------------------------------------------------------------------	-----------------------------------------------------------------------------	-------------------------------------------------------------------------------------------------------------------------------------------------

(Gals.) X <u>No Purge</u> = _____ Gals. Case Volume Specified Volumes Calculated Volume	<table border="1" style="width:100%; border-collapse: collapse;"> <thead> <tr> <th>Well Diameter</th> <th>Multiplier</th> <th>Well Diameter</th> <th>Multiplier</th> </tr> </thead> <tbody> <tr> <td>1"</td> <td>0.04</td> <td>4"</td> <td>0.65</td> </tr> <tr> <td>2"</td> <td>0.16</td> <td>6"</td> <td>1.47</td> </tr> <tr> <td><input checked="" type="radio"/> 3"</td> <td>0.37</td> <td>Other</td> <td>radius² * 0.163</td> </tr> </tbody> </table>	Well Diameter	Multiplier	Well Diameter	Multiplier	1"	0.04	4"	0.65	2"	0.16	6"	1.47	<input checked="" type="radio"/> 3"	0.37	Other	radius ² * 0.163
Well Diameter	Multiplier	Well Diameter	Multiplier														
1"	0.04	4"	0.65														
2"	0.16	6"	1.47														
<input checked="" type="radio"/> 3"	0.37	Other	radius ² * 0.163														

Time	Temp (°F)	pH	Cond. (mS or <input checked="" type="radio"/> μS)	Turbidity (NTUs)	Gals. Removed	Observations
8:15	65.0	6.9	868	20	-	clear

Did well dewater? Yes No Gallons actually evacuated: -

Sampling Date: 4/30/03 Sampling Time: 8:20 Depth to Water: -

Sample I.D.: 5-9 Laboratory: Kiff SPL Other: STL

Analyzed for: TPH-D BTEX MTBE TPH-D Other: _____

Well I.D. (if applicable): _____ Duplicate I.D. (if applicable): _____

Analyzed for: TPH-D BTEX MTBE TPH-D Other: _____

D.O. (if req'd):	Pre-purge:	7.0 ✓ mg/L	Post-purge:	mg/L
R.P. (if req'd):	Pre-purge:	mV	Post-purge:	mV

SHELL WELL MONITORING DATA SHEET

BTS #: 030430-DA4	Site: 15275 Washington San Leandro, CA
Sampler: DA	Date: 4/30/03
Well I.D.: S-17	Well Diameter: 2 <input checked="" type="radio"/> 4 <input type="radio"/> 6 <input type="radio"/> 8 <input type="radio"/>
Total Well Depth (TD): 24.03	Depth to Water (DTW): 5.35
Depth to Free Product:	Thickness of Free Product (feet):
Referenced to: <input checked="" type="radio"/> PVC <input type="radio"/> Galv	D.O. Meter (if req'd): YSI HACH
DTW with 80% Recharge [(Height of Water Column x 0.20) + DTW]: —	

Purge Method: Bailer Disposable Bailer Middleburg Electric Submersible	Water Peristaltic Extraction Pump Other: _____	Sampling Method: Bailer <input checked="" type="checkbox"/> Disposable Bailer Extraction Port Dedicated Tubing Other: _____
-----------------------------------------------------------------------------------------------------------------------------	---------------------------------------------------------	----------------------------------------------------------------------------------------------------------------------------------------------------

(Gals.) X <u>No Purge</u> = _____ Gals. Case Volume Specified Volumes Calculated Volume	<table border="1" style="width: 100%; border-collapse: collapse; text-align: center;"> <thead> <tr> <th>Well Diameter</th> <th>Multiplier</th> <th>Well Diameter</th> <th>Multiplier</th> </tr> </thead> <tbody> <tr> <td>1"</td> <td>0.04</td> <td>4"</td> <td>0.65</td> </tr> <tr> <td>2"</td> <td>0.16</td> <td>6"</td> <td>1.47</td> </tr> <tr> <td>3"</td> <td>0.37</td> <td>Other</td> <td>radius² * 0.163</td> </tr> </tbody> </table>	Well Diameter	Multiplier	Well Diameter	Multiplier	1"	0.04	4"	0.65	2"	0.16	6"	1.47	3"	0.37	Other	radius ² * 0.163
Well Diameter	Multiplier	Well Diameter	Multiplier														
1"	0.04	4"	0.65														
2"	0.16	6"	1.47														
3"	0.37	Other	radius ² * 0.163														

Time	Temp (°F)	pH	Cond. (mS or <input checked="" type="radio"/> µS)	Turbidity (NTUs)	Gals. Removed	Observations
855	64.0	7.5	455	7200	—	brown, turbid

Did well dewater? Yes No Gallons actually evacuated: —

Sampling Date: 4/30/03 Sampling Time: 0900 Depth to Water: —

Sample I.D.: S-17 Laboratory: KIF SPL Other: STL

Analyzed for: TPH-G BTEX MTBE TPH-D Other: _____

IB I.D. (if applicable): _____ @ _____ Time Duplicate I.D. (if applicable): _____

Analyzed for: TPH-G BTEX MTBE TPH-D Other: _____

D.O. (if req'd):	Pre-purge:	mg/L	Post-purge:	mg/L
D.R.P. (if req'd):	Pre-purge:	mV	Post-purge:	mV

SHELL WELL MONITORING DATA SHEET

WTS #: 030430-PA4	Site: 15275 Washington San Leandro, CA
Sampler: NA	Date: 4/30/03
Well I.D.: S-19	Well Diameter: 2 <input checked="" type="radio"/> 4 6 8
Total Well Depth (TD): 20.28	Depth to Water (DTW): 4.90
Depth to Free Product:	Thickness of Free Product (feet):
Referenced to: <input checked="" type="radio"/> PVC <input type="radio"/> Grnde	D.O. Meter (if req'd): <input checked="" type="radio"/> YSI <input type="radio"/> HACH
DTW with 80% Recharge [(Height of Water Column x 0.20) + DTW]: -	

Purge Method: Bailer Disposable Bailer Middleburg Electric Submersible	Water: Peristaltic Extraction Pump Other:	Sampling Method: Bailer <input checked="" type="checkbox"/> Disposable Bailer Extraction Port Dedicated Tubing Other:
---------------------------------------------------------------------------------	-------------------------------------------------	-----------------------------------------------------------------------------------------------------------------------------------

(Gals.) X No Purge = _____ Gals.
 Case Volume Specified Volumes Calculated Volume

Well Diameter	Multiplier	Well Diameter	Multiplier
1"	0.04	4"	0.65
2"	0.16	6"	1.47
<input checked="" type="radio"/> 3"	0.37	Other	radius ² * 0.163

Time	Temp (°F)	pH	Cond. (mS or <input checked="" type="radio"/> µS)	Turbidity (NTUs)	Gals. Removed	Observations
835	63.9	7.2	994	153	-	cloudy

Did well dewater? Yes No Gallons actually evacuated: -

Sampling Date: 4/30/03 Sampling Time: 0840 Depth to Water: -

Sample I.D.: S-19 Laboratory: KITT SPL Other: STL

Analyzed for: TPH-G BTEX MTBE TPH-D Other:

IB I.D. (if applicable): @ _____ Time Duplicate I.D. (if applicable):

Analyzed for: TPH-G BTEX MTBE TPH-D Other:

D.O. (if req'd):	Pre-purge:	0.5 ^{mE/l}	Post-purge:	_____ ^{mE/l}
D.R.P. (if req'd):	Pre-purge:	mV	Post-purge:	mV