



Olivia Skance
Team Lead
Marketing Business Unit

**Chevron Environmental
Management Company**
6101 Bollinger Canyon Road
San Ramon, CA 94583
Tel (925) 790-6521

February 22, 2012

Alameda County Environmental Health
1131 Harbor Bay Parkway, Suite 250
Alameda, CA 94502-6577

RECEIVED

5:13 pm, Feb 27, 2012

Alameda County
Environmental Health

Re: Chevron Facility # 9-8139

Address: 16304 Foothill Boulevard, San Leandro, California

I have reviewed the attached report titled Results of Door-to-Door Well Survey and Sampling and dated February 22, 2012.

I agree with the conclusions and recommendations presented in the referenced report. The information in this report is accurate to the best of my knowledge and all local Agency/Regional Board guidelines have been followed. This report was prepared by Conestoga-Rovers & Associates, upon whose assistance and advice I have relied.

This letter is submitted pursuant to the requirements of California Water Code Section 13267(b)(1) and the regulating implementation entitled Appendix A pertaining thereto.

I declare under penalty of perjury that the foregoing is true and correct.

Sincerely,

Olivia Skance
Project Manager

Enclosure: Report



**CONESTOGA-ROVERS
& ASSOCIATES**

10969 Trade Center Drive
Rancho Cordova, California 95670
Telephone: (916) 889-8900 Fax: (916) 889-8999
www.CRAworld.com

February 22, 2012

Reference No. 611971

Mr. Mark Detterman, P.G., C.E.G.
Alameda County Environmental Health
1131 Harbor Bay Parkway, Suite 250
Alameda, California 94502-6577

Re: Results of Door-to-Door Well Survey and Sampling
Chevron Service Station 98139
16304 Foothill Boulevard
San Leandro, California
Case No. RO0000368

Dear Mr. Detterman:

Conestoga-Rovers & Associates (CRA) has prepared this report documenting the recent door-to-door well survey and sampling at the site referenced above on behalf of Chevron Environmental Management Company (Chevron). In a letter dated December 23, 2011 (Attachment A), Alameda County Environmental Health (ACEH) requested a focused neighborhood door-to-door well survey in an attempt to locate known registered wells and any potential unregistered wells downgradient of the site, and sampling of any identified wells. Specifically, ACEH requested the survey area be bound by Maubert Court on the south, Bevil Way on the west (extending to 162nd Avenue), 162nd Avenue on the north, and Liberty Street on the east (Figure 1). The details and results of the door-to-door survey and sampling, and our conclusions and recommendations, are presented below.

DOOR-TO-DOOR WELL SURVEY

CRA previously submitted the *2011 Annual Groundwater Monitoring Report and Requested Additional Information* on October 11, 2011, which presented additional information requested by ACEH, including an updated well survey within 2,000 feet of the site. The survey, which consisted of a review of California Department of Water Resources (DWR) and Alameda County Public Works Agency (ACPWA) records, only identified four irrigation wells within the search radius. Two were located in the downgradient (southwest and south-southwest) direction, approximately 750 feet and 1,200 feet from the site at 1700 163rd Avenue and 1595 164th Avenue, respectively. These wells reportedly were installed in 1915 and 1934, and based on the fact that the local water supply is provided by East Bay Municipal Utility District (EBMUD), it was concluded they likely were no longer in use. However, in the December 23, 2011 letter, ACEH noted that many older areas of San Leandro were known to have an

Equal
Employment Opportunity
Employer



above-average number of “backyard” residential or irrigation wells (registered and unregistered). Thus, the door-to-door survey was requested.

On January 12, 2012, CRA performed the door-to-door survey of the 108 residential properties located within the specified area (Figure 1 and Table 1). A questionnaire form was prepared on which the tenants/property owners were asked if they have knowledge of a well or sump pump on the property, and if so, to specify the construction and use of each well identified. A copy of the questionnaire is included as Attachment B. A questionnaire form was provided to tenants/property owners that were present during the survey. If no one was present or answered the door, the form was left at the residence along with a CRA return-addressed, stamped envelope. For those multi-family residential properties where no one was present, a questionnaire was also mailed to the recorded property owner.

On the day of the survey, we were able to speak directly with people at 28 of the properties and have them fill out the form. Of these 28 property owners/tenants, none identified a well as present on the property; two identified a sump pump as present. Of the remaining properties where a questionnaire was left, we received 17 returned questionnaires as of the date of this report. Of these 17, two properties were identified as having a well (16308 and 16322 Bevil Way). For 16308 Bevil Way, it was indicated that the well on the property was only used for backyard irrigation purposes approximately once a month. For 16322 Bevil Way, it was indicated that the well was covered up and not in use. Both properties are single-family residences. Several follow-up attempts by CRA to contact the parties at the two residences with identified wells by phone were unsuccessful. The properties surveyed and the results are presented in Table 1. Copies of the returned questionnaires are maintained in CRA and Chevron files, and are not included herein.

Regarding the two above-mentioned properties (1700 163rd Avenue and 1595 164th Avenue) where old irrigation wells were identified during the 2011 well survey, Alameda County Assessor’s Office records indicate those addresses no longer exist. The reported 1700 163rd Avenue address was theoretically within the door-to-door survey area, but the first property on the 1700 block of 163rd Avenue was a four-plex building at 1706 163rd Avenue, at which questionnaires were left and mailed to the property owner (no response). The reported 1595 164th Avenue address was theoretically outside the survey area, but also no longer exists. On 164th Avenue, there are adjacent single-family residences at 1593 and 1597, but no 1595.

FOLLOW-UP VISIT AND WELL SAMPLING

As attempts to contact the two parties by phone were unsuccessful, on February 13, 2012 CRA again visited the 16308 and 16322 Bevil Way residences. No one at the 16308 Bevil Way



residence answered the door. Prior to leaving the area, CRA again attempted to contact someone at the residence by phone, but no one answered. We have not heard back as of the date of this report.

The resident/owner at 16322 Bevil Way was home and allowed CRA to collect a grab-groundwater sample from the well. The groundwater sample was collected in the appropriate laboratory-supplied containers using a disposable bailer, placed in an ice-chilled cooler, and transported under chain-of-custody to California Laboratory Services in Rancho Cordova, California (a California-certified analytical laboratory) for analysis. The sample was analyzed for the following site-specific constituents of concern:

- Total petroleum hydrocarbons as gasoline (TPHg) by EPA Method 8260M.
- Benzene, toluene, ethylbenzene, xylenes (BTEX) and fuel oxygenates (methyl tertiary butyl ether [MTBE], ethyl tertiary butyl ether [ETBE], tertiary amyl methyl ether [TAME], diisopropyl ether [DIPE], and tertiary butyl alcohol [TBA]) by EPA Method 8260B.

ANALYTICAL RESULTS

The only analyte detected in the sample was MTBE at 2.3 micrograms per liter ($\mu\text{g/L}$). This concentration does not exceed either the primary (13 $\mu\text{g/L}$) or secondary (5 $\mu\text{g/L}$) drinking water Maximum Contaminant Levels (MCLs) established by the California Department of Public Health (CDPH). The analytical results are presented in Table 2. A copy of the laboratory analytical report is included as Attachment C.

CONCLUSIONS AND RECOMMENDATIONS

As requested by ACEH, CRA performed a door-to-door well survey in the specified area downgradient of the site. Two single-family residential properties were identified as having wells, 16308 and 16322 Bevil Way. The well at 16308 Bevil Way was identified as used for irrigation purposes only (water backyard once a month), and the well at 16322 Bevil Way reportedly was not in use. A grab-groundwater sample collected from the well at 16322 Bevil Way only contained a low concentration of MTBE (2.3 $\mu\text{g/L}$). Although the well is not used for drinking water purposes, the detected concentration does not exceed the primary or secondary drinking water MCLs, and thus does not appear to be a significant concern. Although we were unable to collect a sample from the reported well at 16308 Bevil Way, only one parcel is present between the two properties (a distance of 50 feet).



**CONESTOGA-ROVERS
& ASSOCIATES**

February 22, 2012

4

Reference No. 611971

Based on the survey and sampling results, no further work appears warranted at this time. If we receive any questionnaires following issuance of this report with significant results, we will promptly notify ACEH.

We appreciate your assistance on this project. Please contact Mr. James Kiernan at (916) 889-8917 if you have any questions or require additional information.

Sincerely,

CONESTOGA-ROVERS & ASSOCIATES

A handwritten signature in blue ink, appearing to read 'BS' followed by a flourish.

Benjamin R. Summersett

A handwritten signature in blue ink, appearing to read 'JK' followed by a flourish.

James P. Kiernan, P.E.



BS/de/14
Encl.

Figure 1	Door-to-Door Well Survey Area
Table 1	Door-to-Door Well Survey Results
Table 2	Grab-Groundwater Sample Analytical Results
Attachment A	ACEH Letter Dated December 23, 2011
Attachment B	Example Questionnaire
Attachment C	Laboratory Report

cc: Ms. Olivia Skance, Chevron (*electronic copy*)
Mr. Harv Dhaliwal, G&S Associates, Inc.
Ms. Cun Wang, property owner, 16322 Bevil Way

FIGURE

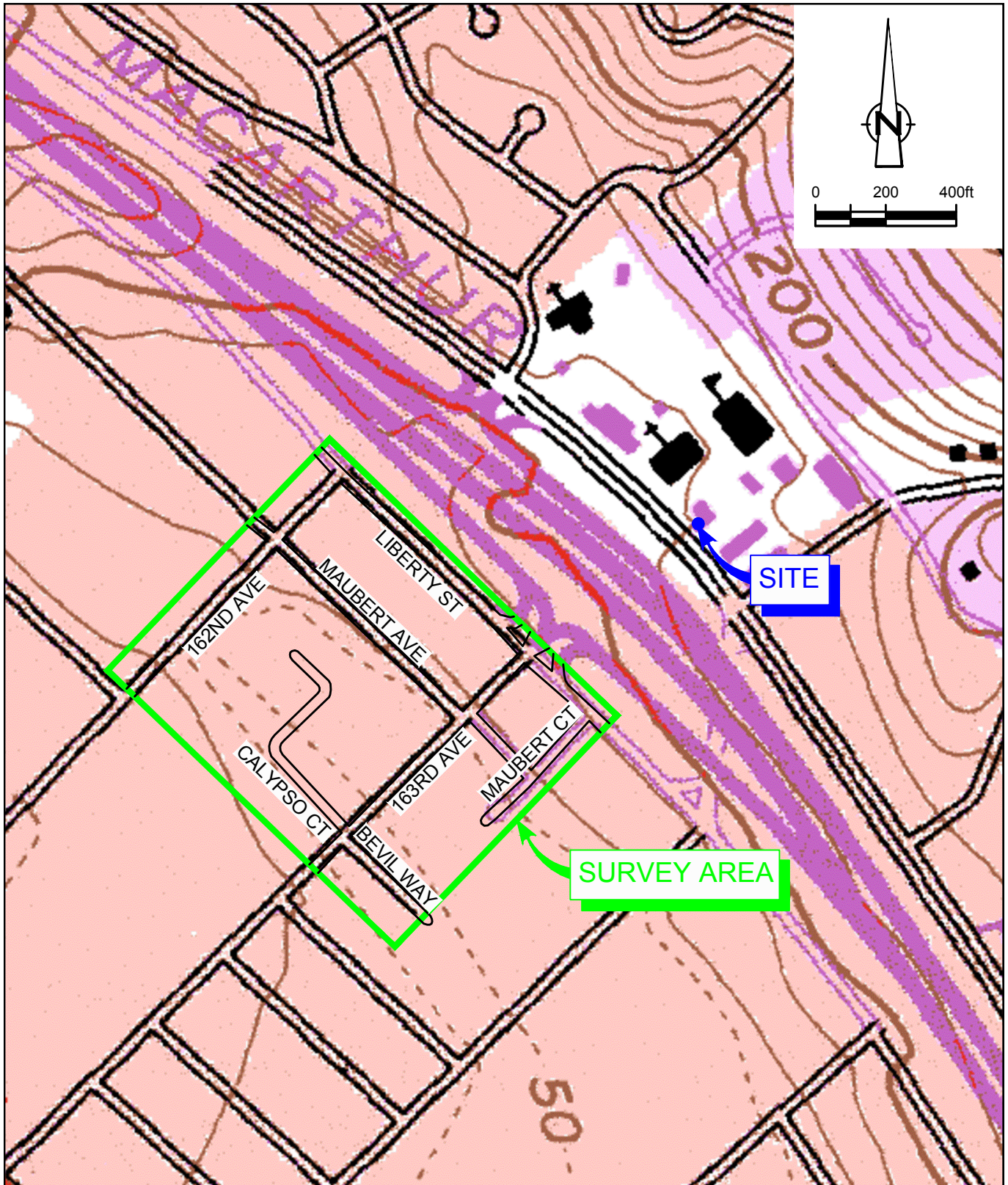

SOURCE: USGS QUADRANGLE MAP: HAYWARD, CA.

figure 1

DOOR-TO-DOOR WELL SURVEY AREA
 CHEVRON SERVICE STATION 98139
 16304 FOOTHILL BOULEVARD
San Leandro, California



TABLES

**DOOR-TO-DOOR WELL SURVEY RESULTS
CHEVRON SERVICE STATION 98139
16304 FOOTHILL BOULEVARD
SAN LEANDRO, CALIFORNIA**

<i>Property Type - Address</i>	<i>Survey/Questionnaire Status</i>	<i>Wells/Sump Pumps?</i>	<i>Single Family or Apartment</i>
Residence - 16210 Calypso Ct	Spoke in person with owner/resident	No	Single Family
Residence - 16214 Calypso Ct	Spoke in person with owner/resident	No	Single Family
Residence - 16218 Calypso Ct	Not returned		Single Family
Residence - 16219 Calypso Ct	Not returned		Single Family
Residence - 16222 Calypso Ct	Spoke in person with owner/resident	No	Single Family
Residence - 16225 Calypso Ct	Not returned		Single Family
Residence - 16226 Calypso Ct	Spoke in person with owner/resident	No	Single Family
Residence - 16230 Calypso Ct	Spoke in person with owner/resident	Unknown	Single Family
Residence - 16231 Calypso Ct	Not returned		Single Family
Residence - 16236 Calypso Ct	Returned	No	Single Family
Residence - 16237 Calypso Ct	Spoke in person with owner/resident	No	Single Family
Residence - 16242 Calypso Ct	Spoke in person with owner/resident	Unknown	Single Family
Residence - 16243 Calypso Ct	Not returned		Single Family
Residence - 16249 Calypso Ct	Not returned		Single Family
Residence - 16255 Calypso Ct	Not returned		Single Family
Residence - 16261 Calypso Ct	Spoke in person with owner/resident	No	Single Family
Residence - 16267 Calypso Ct	Not returned		Single Family
Residence - 16272 Calypso Ct	Not returned		Single Family
Residence - 16273 Calypso Ct	Returned	No	Single Family
Residence - 16279 Calypso Ct	Not returned		Single Family
Residence - 16280 Calypso Ct	Not returned		Single Family
Residence - 16285 Calypso Ct	Not returned		Single Family
Residence - 16288 Calypso Ct	Returned	No	Single Family
Residence - 16291 Calypso Ct	Spoke in person with owner/resident	No	Single Family
Residence - 16297 Calypso Ct	Not returned		Single Family
Residence - 16301 Bevil Way	Not returned		Single Family
Residence - 16302 Bevil Way	Not returned		Single Family
Residence - 16308 Bevil Way	Returned	Well (irrigation)	Single Family
Residence - 16315 Bevil Way	Spoke in person with owner/resident	No	Single Family
Residence - 16321 Bevil Way	Not returned		Single Family
Residence - 16322 Bevil Way	Returned	Well (not in use)	Single Family
Residence - 16327 Bevil Way	Not returned		Single Family
Residence - 16330 Bevil Way	Not returned		Single Family
Residence - 16333 Bevil Way	Not returned		Single Family
Residence - 16334 Bevil Way	Not returned		Single Family
Residence - 1615 163rd Ave	Not returned		Single Family
Residence - 1620 163rd Ave	Not returned		Single Family
Residence - 1621 163rd Ave	Returned	No	Apartment
Residence - 1634 163rd Ave	Not returned		Single Family
Residence - 1639 163rd Ave	Returned	Unknown	Single Family
Residence - 1650 163rd Ave	Not returned		Single Family
Residence - 1663 163rd Ave	Spoke in person with owner/resident	Unknown	Single Family
Residence - 1664 163rd Ave	Not returned		Single Family
Residence - 1666 163rd Ave	Not returned		Single Family

**DOOR-TO-DOOR WELL SURVEY RESULTS
CHEVRON SERVICE STATION 98139
16304 FOOTHILL BOULEVARD
SAN LEANDRO, CALIFORNIA**

<i>Property Type - Address</i>	<i>Survey/Questionnaire Status</i>	<i>Wells/Sump Pumps?</i>	<i>Single Family or Apartment</i>
Residence - 1672 163rd Ave	Spoke in person with owner/resident	No	Single Family
Residence - 1675 163rd Ave	Spoke in person with owner/resident	Yes/sump	Single Family
Residence - 1680 163rd Ave	Not returned		Single Family
Residence - 1705 163rd Ave	Not returned		Single Family
Residence - 1706 163rd Ave	Not returned		Apartment
Residence - 1722 163rd Ave	Returned	No	Apartment
Residence - 1734 163rd Ave	Returned	No	Apartment
Residence - 1749 163rd Ave	Not returned		Single Family
Residence - 1664 Maubert Ct	Returned	No	Apartment
Residence - 1676 Maubert Ct	Returned	No	Apartment
Residence - 1685 Maubert Ct	Not returned		Apartment
Residence - 1688 Maubert Ct	Not returned		Apartment
Residence - 1710 Maubert Ct	Not returned		Apartment
Residence - 1723 Maubert Ct	Returned	Unknown	Apartment
Residence - 1728 Maubert Ct	Returned	Unknown	Apartment
Residence - 1739 Maubert Ct	Not returned		Apartment
Residence - 16211 Maubert Ave	Spoke in person with owner/resident	No	Single Family
Residence - 16221 Maubert Ave	Spoke in person with owner/resident	No	Single Family
Residence - 16226 Maubert Ave	Spoke in person with owner/resident	Unknown	Single Family
Residence - 16230 Maubert Ave	Not returned		Single Family
Residence - 16233 Maubert Ave	Not returned		Single Family
Residence - 16238 Maubert Ave	Not returned		Single Family
Residence - 16240 Maubert Ave	Not returned		Single Family
Residence - 16245 Maubert Ave	Not returned		Single Family
Residence - 16249 Maubert Ave	Returned	Unknown	Single Family
Residence - 16253 Maubert Ave	Spoke in person with owner/resident	No	Single Family
Residence - 16256 Maubert Ave	Not returned		Single Family
Residence - 16262 Maubert Ave	Not returned		Single Family
Residence - 16263 Maubert Ave	Spoke in person with owner/resident	No	Single Family
Residence - 16267 Maubert Ave	Not returned		Single Family
Residence - 16268 Maubert Ave	Spoke in person with owner/resident	No	Single Family
Residence - 16275 Maubert Ave	Not returned		Single Family
Residence - 16276 Maubert Ave	Spoke in person with owner/resident	No	Single Family
Residence - 16283 Maubert Ave	Not returned		Single Family
Residence - 16305 Maubert Ave	Not returned		Apartment
Residence - 16318 Maubert Ave	Not returned		Apartment
Residence - 1625 162nd Ave	Spoke in person with owner/resident	No	Single Family
Residence - 1629 162nd Ave	Returned	No	Single Family
Residence - 1630 162nd Ave	Not returned		Single Family
Residence - 1636 162nd Ave	Spoke in person with owner/resident	No	Single Family
Residence - 1645 162nd Ave	Spoke in person with owner/resident	Unknown	Single Family
Residence - 1649 162nd Ave	Not returned		Single Family
Residence - 1653 162nd Ave	Returned	No	Single Family
Residence - 1654 162nd Ave	Not returned		Apartment

**DOOR-TO-DOOR WELL SURVEY RESULTS
CHEVRON SERVICE STATION 98139
16304 FOOTHILL BOULEVARD
SAN LEANDRO, CALIFORNIA**

<i>Property Type - Address</i>	<i>Survey/Questionnaire Status</i>	<i>Wells/Sump Pumps?</i>	<i>Single Family or Apartment</i>
Residence - 1656 162nd Ave	Not returned		Apartment
Residence - 1657 162nd Ave	Not returned		Single Family
Residence - 1660 162nd Ave	Not returned		Single Family
Residence - 1671 162nd Ave	Not returned		Single Family
Residence - 1672 162nd Ave	Not returned		Single Family
Residence - 1675 162nd Ave	Not returned		Single Family
Residence - 1694 162nd Ave	Not returned		Single Family
Residence - 1706 162nd Ave	Spoke in person with owner/resident	No	Single Family
Residence - 1707 162nd Ave	Spoke in person with owner/resident	Yes/sump	Single Family
Residence - 1714 162nd Ave	Spoke in person with owner/resident	Unknown	Apartment
Residence - 1716 162nd Ave	Spoke in person with owner/resident	No	Single Family
Residence - 16205 Liberty St	Not returned		Single Family
Residence - 16217 Liberty St	Not returned		Single Family
Residence - 16229 Liberty St	Not returned		Single Family
Residence - 16235 Liberty St	Not returned		Single Family
Residence - 16241 Liberty St	Not returned		Single Family
Residence - 16247 Liberty St	Spoke in person with owner/resident	No	Single Family
Residence - 16255 Liberty St	Returned	No	Single Family
Residence - 16263 Liberty St	Not returned		Single Family
Residence - 16269 Liberty St	Not returned		Single Family
Residence - 16277 Liberty St	Not returned		Single Family
Residence - 16281 Liberty St	Returned	Unknown	Single Family

**GRAB-GROUNDWATER SAMPLE ANALYTICAL RESULTS
CHEVRON SERVICE STATION 98139
16304 FOOTHILL BOULEVARD
SAN LEANDRO, CALIFORNIA**

<i>Sample ID</i>	<i>Sample Date</i>	<i>TPHg</i>	<i>Benzene</i>	<i>Toluene</i>	<i>Ethylbenzene</i>	<i>Xylenes</i>	<i>MTBE</i>	<i>ETBE</i>	<i>DIPE</i>	<i>TAME</i>	<i>TBA</i>
		←————— Concentrations reported in micrograms per liter (µg/L) —————→									
16322 Bevil	2/13/12	<50	<0.5	<0.5	<0.5	<1.0	2.3	<0.5	<0.5	<0.5	<5.0

Abbreviations/Notes:

TPHg = Total petroleum hydrocarbons as gasoline

MTBE = Methyl tertiary butyl ether

ETBE = Ethyl tertiary butyl ether

DIPE = Di-isopropyl ether

TAME = Tertiary amyl methyl ether

TBA = Tertiary butyl alcohol

<x = Not detected at or above stated laboratory reporting limit

ATTACHMENT A

ACEH LETTER DATED DECEMBER 23, 2011



ENVIRONMENTAL HEALTH DEPARTMENT
ENVIRONMENTAL PROTECTION
1131 Harbor Bay Parkway, Suite 250
Alameda, CA 94502-6577
(510) 567-6700
FAX (510) 337-9335

December 23, 2011

Ms. Olivia Skance
Chevron Environmental Management
6001 Bollinger Canyon Rd.
PO Box 6012
San Ramon, CA 94583
(sent via electronic mail to Olivia.Skance@chevron.com)

Mr. Bhushan Bansal
Bansal Inc.
1784 150th Street
San Leandro, CA 94578-1826

Anabi Real Estate Development LLC
Mr. Rene Anabi
1041 North Benson Avenue
Upland, CA 91786

Subject: Request for Neighborhood Well Canvas and Sampling; Fuel Leak Case No. RO0000368
(Global ID # T0600100303), Chevron #9-8139, 16304 Foothill Blvd, San Leandro, CA 94587

Dear Ms. Skance, Messrs. Bansal and Anabi:

Alameda County Environmental Health (ACEH) has reviewed the case file, including the October 11, 2011, *2011 Annual Groundwater Monitoring Report and Requested Additional Information*, generated and submitted on your behalf by Conestoga-Rovers & Associates (CRA). Thank you for submitting the report and information. The well survey located four irrigation wells within the radius, and concluded that two wells were cross-gradient of the site (north-northwest) and two were located downgradient (southwest) at approximately 750 and 1,200 feet from the site. ACEH notes that the requested trend graphs generally show declining trends at the site, except for MTBE in the furthest downgradient well MW-13, which was not graphed. The concentration of MTBE in well downgradient MW-13 has risen from the previous time it was sampled (August 2005) from 470 µg/l to 1,700 µg/l (August 2011).

Based on ACEH staff review of the case file, we request that you address the following technical comments and send us the reports described below.

TECHNICAL COMMENTS

- 1. Neighborhood Well Survey and Sampling** – ACEH appreciates the added information the well survey has provided and notes that the data moves the site forward. ACEH also notes, based on direct experience, that many older areas of San Lorenzo are known to contain an above average number of “backyard” residential or irrigation wells that are both registered and unregistered (and are thus unknown if unregistered). An assumption has been made that because domestic water is available in the area, the wells are unused. ACEH has continued, and very recent, experience that this is an erroneous assumption. A quick review of the downgradient vicinity of the site (west of I-580) on Google Maps located several older larger residential (and non-residential) parcels, which have been found to typically predate urbanization of this region of the East Bay Plan, and typically have a higher probability of containing an older well (registered or unregistered). Because this site has previously had elevated detected MTBE concentrations and because the MTBE concentration in downgradient well MW-13 has risen since the previous sampling event, ACEH requests a focused neighborhood door to door well survey in an attempt to locate known registered wells and to locate

potential unregistered wells, and to sample those wells for site specific contaminants. Specifically ACEH requests the door to door survey to be bound by Maubert Court on the south, Bevil Way on the west (extending to 162nd Avenue), 162 Avenue on the north, and Liberty Street on the east. ACEH requests the submittal of a technical report, including a door to door tabulation of the results, by the date identified below.

TECHNICAL REPORT REQUEST

Please submit the following deliverable to ACEH (Attention: Mark Detterman), according to the following schedule:

- **February 24, 2012** – Soil and Groundwater Investigation (Door to Door Well Survey)
- **April 13, 2012** – First Semi-Annual 2011 Groundwater Monitoring Report

These reports are being requested pursuant to California Health and Safety Code Section 25296.10. 23 CCR Sections 2652 through 2654, and 2721 through 2728 outline the responsibilities of a responsible party in response to an unauthorized release from a petroleum UST system, and require your compliance with this request.

Should you have any questions, please contact me at (510) 567--6876 or send me an electronic mail message at mark.detterman@acgov.org.

Sincerely,

Mark Detterman, PG, CEG
Senior Hazardous Materials Specialist

Enclosures: Attachment 1 – Responsible Party (ies) Legal Requirements / Obligations
Electronic Report Upload (ftp) Instructions

cc: James Kiernan, 10969 Trade Center Drive, Suite 106, Rancho Cordova, CA 95670
(sent via electronic mail to jkiernan@croworld.com)

Donna Drogos, ACEH, (sent via electronic mail to donna.drogos@acgov.org)
Mark Detterman, ACEH, (sent via electronic mail to mark.detterman@acgov.org)
Geotracker, Case Electronic File

Responsible Party(ies) Legal Requirements / Obligations

REPORT REQUESTS

These reports are being requested pursuant to California Health and Safety Code Section 25296.10. 23 CCR Sections 2652 through 2654, and 2721 through 2728 outline the responsibilities of a responsible party in response to an unauthorized release from a petroleum UST system, and require your compliance with this request.

ELECTRONIC SUBMITTAL OF REPORTS

ACEH's Environmental Cleanup Oversight Programs (LOP and SLIC) require submission of reports in electronic form. The electronic copy replaces paper copies and is expected to be used for all public information requests, regulatory review, and compliance/enforcement activities. Instructions for submission of electronic documents to the Alameda County Environmental Cleanup Oversight Program FTP site are provided on the attached "Electronic Report Upload Instructions." Submission of reports to the Alameda County FTP site is an addition to existing requirements for electronic submittal of information to the State Water Resources Control Board (SWRCB) GeoTracker website. In September 2004, the SWRCB adopted regulations that require electronic submittal of information for all groundwater cleanup programs. For several years, responsible parties for cleanup of leaks from underground storage tanks (USTs) have been required to submit groundwater analytical data, surveyed locations of monitoring wells, and other data to the GeoTracker database over the Internet. Beginning July 1, 2005, these same reporting requirements were added to Spills, Leaks, Investigations, and Cleanup (SLIC) sites. Beginning July 1, 2005, electronic submittal of a complete copy of all reports for all sites is required in GeoTracker (in PDF format). Please visit the SWRCB website for more information on these requirements (http://www.waterboards.ca.gov/water_issues/programs/ust/electronic_submittal/).

PERJURY STATEMENT

All work plans, technical reports, or technical documents submitted to ACEH must be accompanied by a cover letter from the responsible party that states, at a minimum, the following: "I declare, under penalty of perjury, that the information and/or recommendations contained in the attached document or report is true and correct to the best of my knowledge." This letter must be signed by an officer or legally authorized representative of your company. Please include a cover letter satisfying these requirements with all future reports and technical documents submitted for this fuel leak case.

PROFESSIONAL CERTIFICATION & CONCLUSIONS/RECOMMENDATIONS

The California Business and Professions Code (Sections 6735, 6835, and 7835.1) requires that work plans and technical or implementation reports containing geologic or engineering evaluations and/or judgments be performed under the direction of an appropriately registered or certified professional. For your submittal to be considered a valid technical report, you are to present site specific data, data interpretations, and recommendations prepared by an appropriately licensed professional and include the professional registration stamp, signature, and statement of professional certification. Please ensure all that all technical reports submitted for this fuel leak case meet this requirement.

UNDERGROUND STORAGE TANK CLEANUP FUND

Please note that delays in investigation, later reports, or enforcement actions may result in your becoming ineligible to receive grant money from the state's Underground Storage Tank Cleanup Fund (Senate Bill 2004) to reimburse you for the cost of cleanup.

AGENCY OVERSIGHT

If it appears as though significant delays are occurring or reports are not submitted as requested, we will consider referring your case to the Regional Board or other appropriate agency, including the County District Attorney, for possible enforcement actions. California Health and Safety Code, Section 25299.76 authorizes enforcement including administrative action or monetary penalties of up to \$10,000 per day for each day of violation.

Alameda County Environmental Cleanup Oversight Programs (LOP and SLIC)	REVISION DATE: July 20, 2010
	ISSUE DATE: July 5, 2005
	PREVIOUS REVISIONS: October 31, 2005; December 16, 2005; March 27, 2009; July 8, 2010
SECTION: Miscellaneous Administrative Topics & Procedures	SUBJECT: Electronic Report Upload (ftp) Instructions

The Alameda County Environmental Cleanup Oversight Programs (LOP and SLIC) require submission of all reports in electronic form to the county's ftp site. Paper copies of reports will no longer be accepted. The electronic copy replaces the paper copy and will be used for all public information requests, regulatory review, and compliance/enforcement activities.

REQUIREMENTS

- **Please do not submit reports as attachments to electronic mail.**
- Entire report including cover letter must be submitted to the ftp site as **a single portable document format (PDF) with no password protection.**
- It is **preferable** that reports be converted to PDF format from their original format, (e.g., Microsoft Word) rather than scanned.
- **Signature pages and perjury statements must be included and have either original or electronic signature.**
- **Do not password protect the document.** Once indexed and inserted into the correct electronic case file, the document will be secured in compliance with the County's current security standards and a password. **Documents with password protection will not be accepted.**
- Each page in the PDF document should be rotated in the direction that will make it easiest to read on a computer monitor.
- Reports must be named and saved using the following naming convention:

RO#_Report Name_Year-Month-Date (e.g., RO#5555_WorkPlan_2005-06-14)

Submission Instructions

- 1) Obtain User Name and Password
 - a) Contact the Alameda County Environmental Health Department to obtain a User Name and Password to upload files to the ftp site.
 - i) Send an e-mail to deh.loptoxic@acgov.org
 - b) In the subject line of your request, be sure to include "**ftp PASSWORD REQUEST**" and in the body of your request, include the **Contact Information, Site Addresses,** and the **Case Numbers (RO# available in Geotracker) you will be posting for.**
- 2) Upload Files to the ftp Site
 - a) Using Internet Explorer (IE4+), go to <ftp://alcoftp1.acgov.org>
 - (i) Note: Netscape, Safari, and Firefox browsers will not open the FTP site as they are NOT being supported at this time.
 - b) Click on Page located on the Command bar on upper right side of window, and then scroll down to Open FTP Site in Windows Explorer.
 - c) Enter your User Name and Password. (Note: Both are Case Sensitive.)
 - d) Open "My Computer" on your computer and navigate to the file(s) you wish to upload to the ftp site.
 - e) With both "My Computer" and the ftp site open in separate windows, drag and drop the file(s) from "My Computer" to the ftp window.
- 3) Send E-mail Notifications to the Environmental Cleanup Oversight Programs
 - a) Send email to deh.loptoxic@acgov.org notify us that you have placed a report on our ftp site.
 - b) Copy your Caseworker on the e-mail. Your Caseworker's e-mail address is the entire first name then a period and entire last name @acgov.org. (e.g., firstname.lastname@acgov.org)
 - c) The subject line of the e-mail must start with the RO# followed by **Report Upload.** (e.g., Subject: RO1234 Report Upload) If site is a new case without an RO#, use the street address instead.
 - d) If your document meets the above requirements and you follow the submission instructions, you will receive a notification by email indicating that your document was successfully uploaded to the ftp site.

ATTACHMENT B
EXAMPLE QUESTIONNAIRE



**CONESTOGA-ROVERS
& ASSOCIATES**

10969 Trade Center Drive
Rancho Cordova, California 95670
Telephone: (916) 889-8900 Fax: (916) 889-8999
www.CRAworld.com

Reference No. 611971

January 12, 2012

Re: Groundwater Well Survey
Chevron Service Station 9-8139
16304 Foothill Boulevard
San Leandro, California
ACEH Case No. RO0000368

Dear Property Owner:

Conestoga-Rovers & Associates (CRA), on behalf of Chevron Environmental Management Company (Chevron), is attempting to identify all water wells in the vicinity of the site referenced above. This task is being done at the request of Alameda County Environmental Health (ACEH) as part of an ongoing Leaking Underground Storage Tank (LUST) investigation. To accomplish this task, we are requesting property owners within our designated search area to complete this questionnaire and mail it back to us in the enclosed self-addressed, stamped envelope. We would appreciate if you could please complete and return the questionnaire as soon as possible.

Please fill out the following information to the best of your knowledge. If you do not know an item, mark "Unknown." Even if you do not have a well on your property, please answer Questions #1 through #3.

Property Address: _____

Assessor Parcel Number: _____

#1 Is there a well on the property listed above? yes no don't know (please circle)

#2 Is there a sump pump on this property? yes no don't know (please circle)
(Sump pumps are often used in basements)

#3 Is this property occupied by a tenant? yes no (please circle)

Print name and address of tenant _____

Your Signature: _____ Date: _____

- - CONTINUE ON OTHER SIDE - -

Equal
Employment Opportunity
Employer



**CONESTOGA-ROVERS
& ASSOCIATES**

January 12, 2012

2

Reference No. 611971

Please complete the following if you answered "yes" to Question #1 above:

Number of wells on the property: _____

Date well(s) were installed: _____

Diameter of each well in inches: _____

Depth of each well in feet: _____

Depth to the top of the filter pack in each well in feet: _____

Depth to the top of the screened well casing in each well in feet: _____

Use of each well: _____

Frequency of use: _____

Your telephone number: _____

Thank you for your assistance. Please call James Kiernan at (916) 889-8917 if you have any questions.

ATTACHMENT C
LABORATORY REPORT

CALIFORNIA LABORATORY SERVICES

3249 Fitzgerald Road Rancho Cordova, CA 95742

February 16, 2012

CLS Work Order #: CVB0493

COC #: 124061

James Kiernan
Conestoga-Rovers & Associates - Rancho Cordova
10969 Trade Center Dr., Suite 107
Rancho Cordova, CA 95670

Project Name: Chevron 9-8139

Enclosed are the results of analyses for samples received by the laboratory on 02/14/12 09:50. Samples were analyzed pursuant to client request utilizing EPA or other ELAP approved methodologies. I certify that the results are in compliance both technically and for completeness.

Analytical results are attached to this letter. Please call if we can provide additional assistance.

Sincerely,

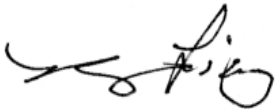

James Liang, Ph.D.
Laboratory Director

CA DOHS ELAP Accreditation/Registration number 1233

CALIFORNIA LABORATORY SERVICES

Conestoga-Rovers & Associates - Rancho Cordova 10969 Trade Center Dr., Suite 107 Rancho Cordova, CA 95670	Project: Chevron 9-8139 Project Number: 611971 Project Manager: James Kiernan	CLS Work Order #: CVB0493 COC #: 124061
---	---	--

CLS - Labs		CHAIN OF CUSTODY				CLS ID No.: CVB0493			LOG NO.: 124061	
REPORT TO:		CLIENT JOB NUMBER		ANALYSIS REQUESTED			GEOTRACKER:			
NAME AND ADDRESS CRA 10969 Trade Center Dr. #107 Rancho Cordova, CA 95670		611971		PRESERVATIVES TPHg by 8015 BTEX by 8260 ETBE, DEPE, MTBE, TBA, TAME by 8260			EDF REPORT <input type="checkbox"/> YES <input checked="" type="checkbox"/> NO			
PROJECT MANAGER James Kiernan PHONE# 916-889-8917		DESTINATION LABORATORY <input checked="" type="checkbox"/> CLS (916) 638-7301 3249 FITZGERALD RD. RANCHO CORDOVA, CA 95742					GLOBAL ID: _____			
PROJECT NAME Chevron 9-8139		<input type="checkbox"/> OTHER					COMPOSITE:			
SAMPLED BY Ben Sumnerett							FIELD CONDITIONS:			
JOB DESCRIPTION E6H							TURN AROUND TIME		SPECIAL INSTRUCTIONS	
SITE LOCATION 16304 Foothill Blvd, San Leandro, CA							1 DAY		OR	
DATE	TIME	SAMPLE IDENTIFICATION		MATRIX	CONTAINER NO.	TYPE	2 DAY	ALT. ID:		
2-13-12	1330	16322 Bev.1		W	6 HU	VOAS	5 DAY			
							10 DAY			
SUSPECTED CONSTITUENTS				PRESERVATIVES:						
							(1) HCL (2) HNO ₃ (3) = COLD (4) = NaOH (5) = H ₂ SO ₄ (6) = Na ₂ S ₂ O ₈ (7) =			
RELINQUISHED BY (SIGN)		PRINT NAME / COMPANY		DATE / TIME		RECEIVED BY (SIGN)		PRINT NAME / COMPANY		
		Ben Sumnerett/CRA		2-14-12 9:50						
REC'D AT LAB BY:		DATE / TIME		CONDITIONS / COMMENTS:						
ShoR		2-14-12 9:50		7.2°C						
SHIPPED BY:		<input type="checkbox"/> FED X <input type="checkbox"/> UPS <input checked="" type="checkbox"/> OTHER		drop off			AIR BILL #			

CALIFORNIA LABORATORY SERVICES

Page 2 of 6

02/16/12 12:06

Conestoga-Rovers & Associates - Rancho Cordova 10969 Trade Center Dr., Suite 107 Rancho Cordova, CA 95670	Project: Chevron 9-8139 Project Number: 611971 Project Manager: James Kiernan	CLS Work Order #: CVB0493 COC #: 124061
---	---	---

TPH-Gasoline by GC/MS

Analyte	Result	Reporting Limit	Units	Dilution	Batch	Prepared	Analyzed	Method	Notes
16322 Bevil (CVB0493-01) Water Sampled: 02/13/12 13:30 Received: 02/14/12 09:50									
Gasoline	ND	50	µg/L	1	CV01006	02/14/12	02/15/12	EPA 8260M	
<i>Surrogate: Toluene-d8</i>		92 %		65-135	"	"	"	"	

CA DOHS ELAP Accreditation/Registration Number 1233

3249 Fitzgerald Road Rancho Cordova, CA 95742

www.californialab.com

916-638-7301

Fax: 916-638-4510

CALIFORNIA LABORATORY SERVICES

Conestoga-Rovers & Associates - Rancho Cordova 10969 Trade Center Dr., Suite 107 Rancho Cordova, CA 95670	Project: Chevron 9-8139 Project Number: 611971 Project Manager: James Kiernan	CLS Work Order #: CVB0493 COC #: 124061
---	---	---

Volatile Organic Compounds by EPA Method 8260B

Analyte	Result	Reporting Limit	Units	Dilution	Batch	Prepared	Analyzed	Method	Notes
---------	--------	-----------------	-------	----------	-------	----------	----------	--------	-------

16322 Bevil (CVB0493-01) Water Sampled: 02/13/12 13:30 Received: 02/14/12 09:50

Di-isopropyl ether	ND	0.50	µg/L	1	CV01006	"	02/15/12	EPA 8260B	
Ethyl tert-butyl ether	ND	0.50	"	"	"	"	"	"	
Methyl tert-butyl ether	2.3	0.50	"	"	"	"	"	"	
tert-Amyl methyl ether	ND	0.50	"	"	"	"	"	"	
tert-Butyl alcohol	ND	5.0	"	"	"	"	"	"	
Benzene	ND	0.50	"	"	"	"	"	"	
Toluene	ND	0.50	"	"	"	"	"	"	
Ethylbenzene	ND	0.50	"	"	"	"	"	"	
Xylenes (total)	ND	1.0	"	"	"	"	"	"	

<i>Surrogate: Toluene-d8</i>		92 %		72-125	"	"	"	"	
------------------------------	--	------	--	--------	---	---	---	---	--

CALIFORNIA LABORATORY SERVICES

Page 4 of 6

02/16/12 12:06

Conestoga-Rovers & Associates - Rancho Cordova 10969 Trade Center Dr., Suite 107 Rancho Cordova, CA 95670	Project: Chevron 9-8139 Project Number: 611971 Project Manager: James Kiernan	CLS Work Order #: CVB0493 COC #: 124061
---	---	---

TPH-Gasoline by GC/MS - Quality Control

Analyte	Result	Reporting Limit	Units	Spike Level	Source Result	%REC	%REC Limits	RPD	RPD Limit	Notes
---------	--------	-----------------	-------	-------------	---------------	------	-------------	-----	-----------	-------

Batch CV01006 - EPA 5030 Water MS

Blank (CV01006-BLK1)

Prepared: 02/14/12 Analyzed: 02/15/12

Gasoline	ND	50	µg/L							
<i>Surrogate: Toluene-d8</i>	<i>7.64</i>		<i>"</i>	<i>10.0</i>		<i>76</i>	<i>65-135</i>			

LCS (CV01006-BS1)

Prepared: 02/14/12 Analyzed: 02/15/12

Gasoline	361	50	µg/L	500		72	70-130			
<i>Surrogate: Toluene-d8</i>	<i>9.68</i>		<i>"</i>	<i>10.0</i>		<i>97</i>	<i>65-135</i>			

LCS Dup (CV01006-BSD1)

Prepared: 02/14/12 Analyzed: 02/15/12

Gasoline	424	50	µg/L	500		85	70-130	16	30	
<i>Surrogate: Toluene-d8</i>	<i>9.38</i>		<i>"</i>	<i>10.0</i>		<i>94</i>	<i>65-135</i>			

CALIFORNIA LABORATORY SERVICES

Conestoga-Rovers & Associates - Rancho Cordova 10969 Trade Center Dr., Suite 107 Rancho Cordova, CA 95670	Project: Chevron 9-8139 Project Number: 611971 Project Manager: James Kiernan	CLS Work Order #: CVB0493 COC #: 124061
---	---	--

Volatile Organic Compounds by EPA Method 8260B - Quality Control

Analyte	Result	Reporting Limit	Units	Spike Level	Source Result	%REC	%REC Limits	RPD	RPD Limit	Notes
---------	--------	-----------------	-------	-------------	---------------	------	-------------	-----	-----------	-------

Batch CV01006 - EPA 5030 Water MS

Blank (CV01006-BLK1)

Prepared & Analyzed: 02/14/12

Di-isopropyl ether	ND	0.50	µg/L							
Ethyl tert-butyl ether	ND	0.50	"							
Methyl tert-butyl ether	ND	0.50	"							
tert-Amyl methyl ether	ND	0.50	"							
tert-Butyl alcohol	ND	5.0	"							
<i>Surrogate: Toluene-d8</i>	7.64		"	10.0		76	72-125			

LCS (CV01006-BS1)

Prepared & Analyzed: 02/14/12

Methyl tert-butyl ether	24.6	0.50	µg/L	20.0		123	52-130			
<i>Surrogate: Toluene-d8</i>	9.68		"	10.0		97	72-125			

LCS Dup (CV01006-BSD1)

Prepared & Analyzed: 02/14/12

Methyl tert-butyl ether	29.3	0.50	µg/L	20.0		147	52-130	18	30	QC-4H
<i>Surrogate: Toluene-d8</i>	9.38		"	10.0		94	72-125			

CALIFORNIA LABORATORY SERVICES

Page 6 of 6

02/16/12 12:06

Conestoga-Rovers & Associates - Rancho Cordova
10969 Trade Center Dr., Suite 107
Rancho Cordova, CA 95670

Project: Chevron 9-8139
Project Number: 611971
Project Manager: James Kiernan

CLS Work Order #: CVB0493
COC #: 124061

Notes and Definitions

- QC-4H The percent recovery of LCS or LCSD was above the upper control limit; however, all analytes in the associated sample were ND; therefore, a reanalysis was not performed.
- DET Analyte DETECTED
- ND Analyte NOT DETECTED at or above the reporting limit
- NR Not Reported
- dry Sample results reported on a dry weight basis
- RPD Relative Percent Difference

CA DOHS ELAP Accreditation/Registration Number 1233

3249 Fitzgerald Road Rancho Cordova, CA 95742

www.californialab.com

916-638-7301

Fax: 916-638-4510