



**CONESTOGA-ROVERS
& ASSOCIATES**

RECEIVED

By Alameda County Environmental Health at 2:54 pm, Aug 23, 2013

5900 Hollis Street, Suite A
Emeryville, California 94608
Telephone: (510) 420-0700 Fax: (510) 420-9170
www.CRAworld.com

TRANSMITTAL

DATE: August 23, 2013 REFERENCE NO.: 240612

PROJECT NAME: 1784 150th Avenue, San Leandro

TO: Jerry Wickham
Alameda County Environmental Health
1131 Harbor Bay Parkway, Suite 250
Alameda, California 94502-6577

Please find enclosed: Draft Final
 Originals Other
 Prints

Sent via: Mail Same Day Courier
 Overnight Courier Other GeoTracker and Alameda County FTP

QUANTITY	DESCRIPTION
1	Well Destruction Report

As Requested For Review and Comment
 For Your Use _____

COMMENTS:
If you have any questions regarding the contents of this document, please call the CRA project manager Peter Schaefer at (510) 420-3319 or the Shell program manager Marvin Katz at (310) 550-5846.

Copy to: Marvin Katz, Shell Oil Products US (electronic copy)
Bansal, Inc. (property owner), 1784 150th Avenue, San Leandro, CA 94578-1826

Completed by: Peter Schaefer Signed: *Peter Schaefer*

Filing: Correspondence File



Mr. Jerry Wickham
Alameda County Environmental Health
1131 Harbor Bay Parkway, Suite 250
Alameda, California 94502-6577

Shell Oil Products US
Soil and Groundwater Focus Delivery Group
20945 S. Wilmington Avenue
Carson, CA 90810
Tel (310) 550 5846
Fax (281) 582 4172
Email marvin.katz@shell.com
Internet <http://www.shell.com>

Re: 1784 150th Street
San Leandro, California
SAP Code 136019
Incident No. 98996068
ACEH Case No. RO0000367

Dear Mr. Wickham:

The attached document is provided for your review and comment. Upon information and belief, I declare, under penalty of perjury, that the information contained in the attached document is true and correct.

As always, please feel free to contact me directly at (310) 550-5846 with any questions or concerns.

Sincerely,
Shell Oil Products US

A handwritten signature in cursive script that reads "Marvin Katz".

Marvin Katz
Senior Program Manager



WELL DESTRUCTION REPORT

**SHELL-BRANDED SERVICE STATION
1784 150TH AVENUE
SAN LEANDRO, CALIFORNIA**

**SAP CODE 136019
INCIDENT NO. 98996068
AGENCY NO. RO0000367**

**AUGUST 23, 2013
REF. NO. 240612 (31)**

This report is printed on recycled paper.

**Prepared by:
Conestoga-Rovers
& Associates**

5900 Hollis Street, Suite A
Emeryville, California
U.S.A. 94608

Office: (510) 420-0700
Fax: (510) 420-9170

web: <http://www.CRAworld.com>

TABLE OF CONTENTS

	<u>Page</u>
1.0 INTRODUCTION.....	1
2.0 WELL DESTRUCTION.....	1
2.1 FIELD DATES.....	1
2.2 PERSONNEL PRESENT	1
2.3 DESTRUCTION METHOD	1
2.4 WASTE DISPOSAL.....	1

LIST OF FIGURES
(Following Text)

- FIGURE 1 VICINITY MAP
FIGURE 2 SITE PLAN

LIST OF APPENDICES

- APPENDIX A PERMITS
APPENDIX B TESTAMERICA LABORATORIES, INC. - ANALYTICAL REPORT
APPENDIX C DISPOSAL DOCUMENTATION

1.0 INTRODUCTION

Conestoga-Rovers & Associates (CRA) prepared this report on behalf of Equilon Enterprises LLC dba Shell Oil Products US (Shell) to document the recent well destructions at the referenced site.

The wells were properly destroyed as required for case closure per Alameda County Environmental Health's (ACEH's) February 6, 2013 letter. CRA followed the scope of work and procedures presented in our April 8, 2013 *Well Destruction Work Plan*, which was approved in ACEH's April 17, 2013 letter. ACEH's June 18, 2013 electronic correspondence extended the due date for a well destruction report to August 26, 2013.

2.0 WELL DESTRUCTION

2.1 FIELD DATES

June 17 to 28, 2013.

2.2 PERSONNEL PRESENT

CRA field staff member Chris Benedict directed the well destructions under the supervision of California Professional Geologist Peter Schaefer.

2.3 DESTRUCTION METHOD

Twenty-six wells (MW-1A, MW-1B, MW-2A, MW-3 through MW-13, P-1A, P-1B, P-2A, P-2B, P-3A, P-3B, P-4A, P-4B, EW-1, EW-2, SVE-1, and AS-1) were destroyed by pressure grouting, and 10 soil vapor probes (SVP-1 through SVP-8, SVP-4A, and SVP-5A) were destroyed by over-drilling using an air- or water-knife drill rig. Copies of the Alameda County Public Works Agency well destruction permit and City of San Leandro encroachment and excavation permits are included in Appendix A.

2.4 WASTE DISPOSAL

Soil and construction debris generated during the well destructions were stored on site in 55-gallon drums, tested, and profiled for disposal. CRA includes the laboratory report in Appendix B. On July 26, 2013, the soil and construction debris were

transported to American Integrated Services, Inc.'s Keller Canyon Landfill in Pittsburg, California for disposal as non-hazardous waste. Disposal documentation is presented in Appendix C.

All of Which is Respectfully Submitted,
CONESTOGA-ROVERS & ASSOCIATES



Peter Schaefer, CEG, CHG



Aubrey K. Cool, PG

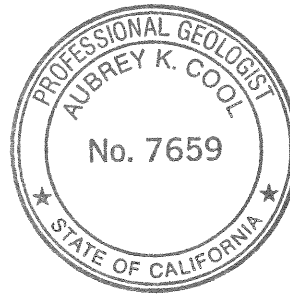

FIGURES

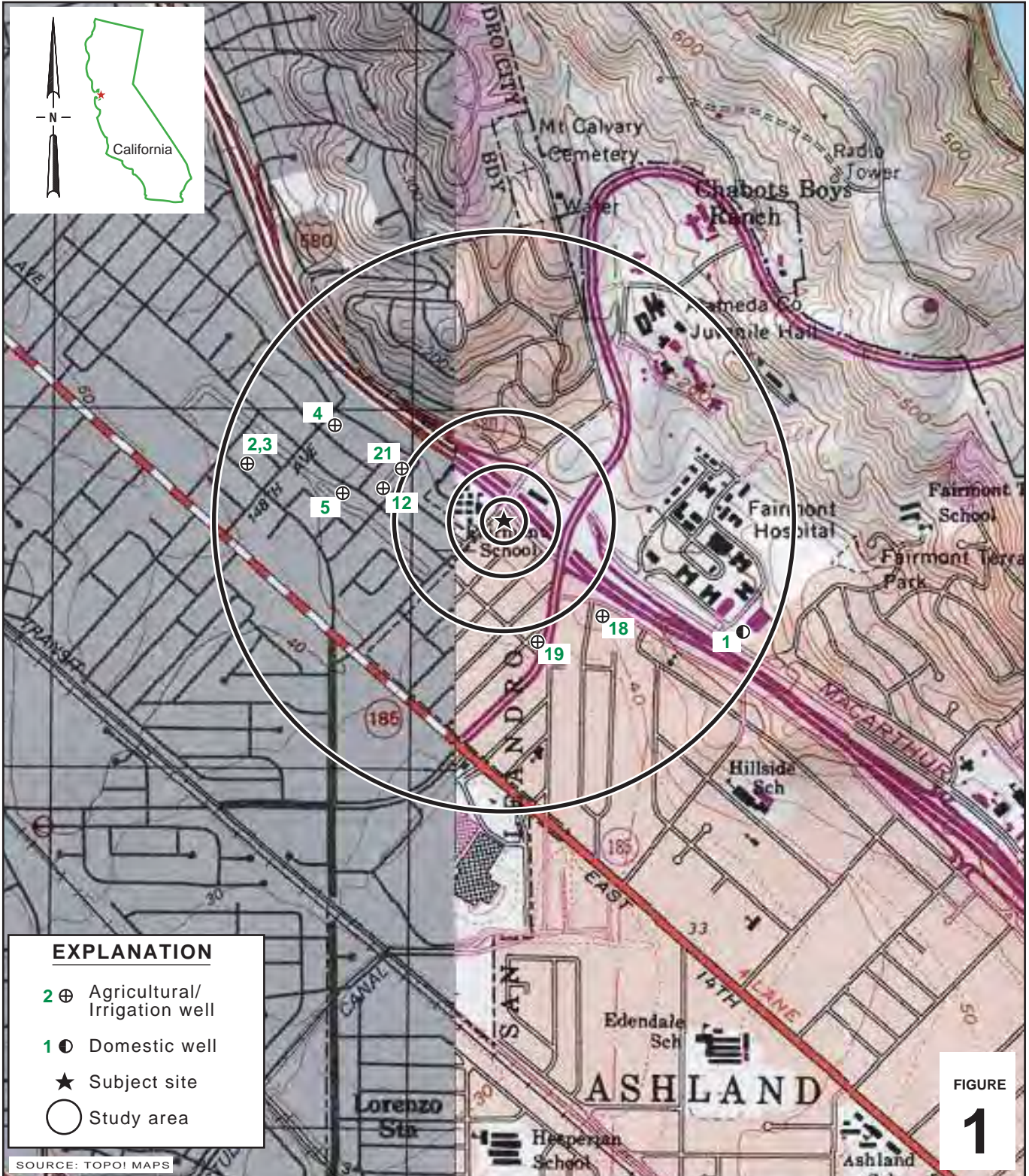

I:\Shell\6-charts\2406--\240612--San Leandro 1784 150th\240612-FIGURES\240612 VICINITY.AI

FIGURE 1

Shell-branded Service Station
 1784 150th Avenue
 San Leandro, California



CONESTOGA-ROVERS & ASSOCIATES

Vicinity Map

EXPLANATION	
SVE-1	Destroyed soil vapor extraction well location
SVP-1	Destroyed soil vapor probe location
AS-1	Destroyed air sparge well location
P-1A	Destroyed piezometer location
P-1B	Destroyed deeper piezometer location
EW-1	Destroyed extraction well location
MW-1B	Destroyed deeper monitoring well location
MW-1	Destroyed monitoring well location
WO-1-6.5	Soil sample location (Cambria, 2006)
S-19	Soil boring location (Cambria, 2006)
D-1-5.0	Soil sample location (Cambria, 2005)
S-23	Soil boring location (Cambria, 2006)
D-1-3.5	Soil sample location (Cambria, 2005)
SB-17	Soil boring location (Cambria, 2004)
SB-11	Soil boring location (Cambria, 2002)
BH-7	Soil boring location (Weiss, 1995)
A	Dispenser soil sample location (Weiss, 1995)
BH-1	Soil boring location (Weiss, 1994)

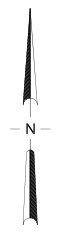
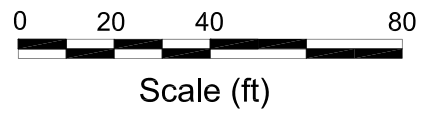
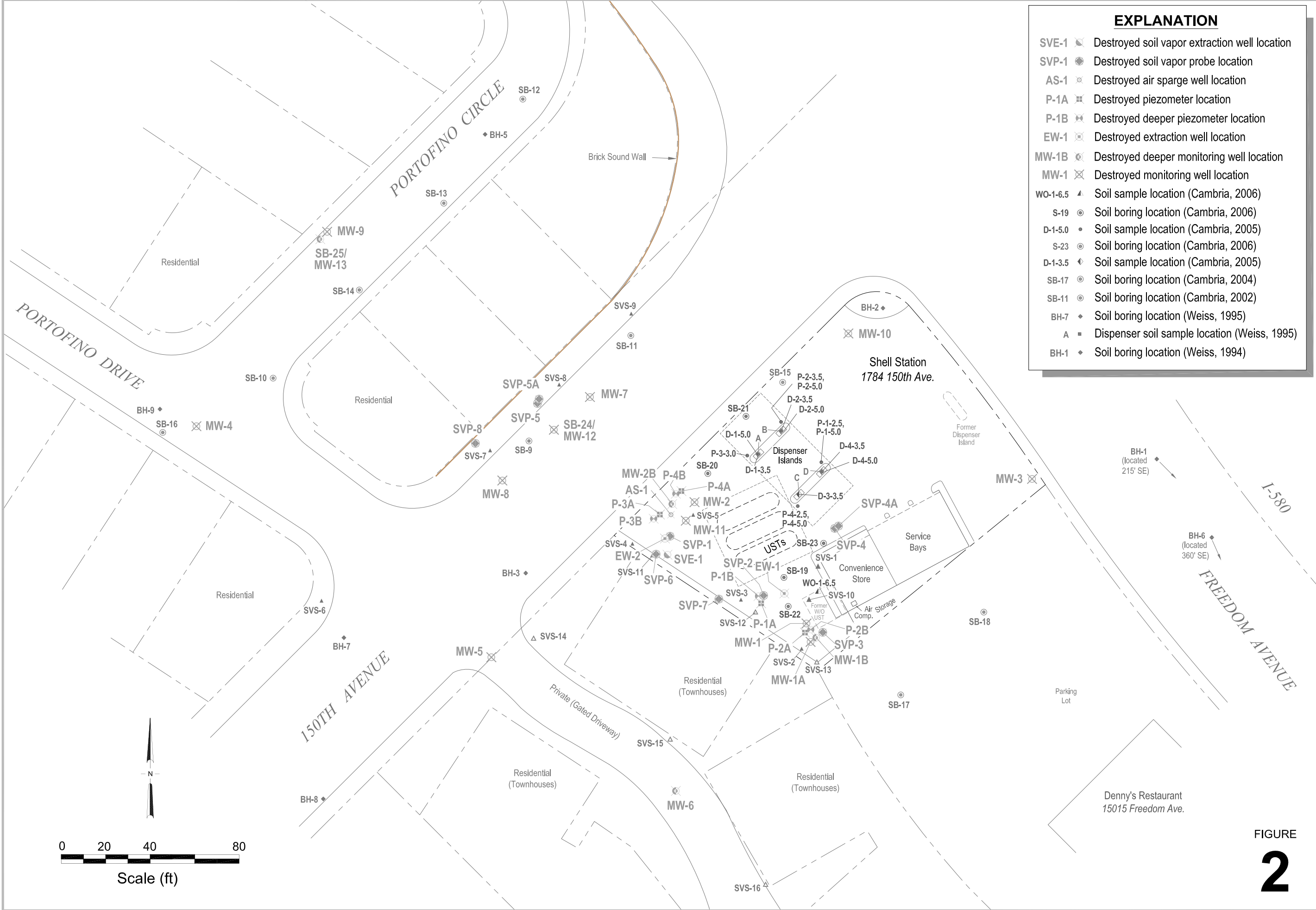

FIGURE
2



Shell-branded Service Station

1784 150th Avenue
San Leandro, California

I:\Shell\6-chars\2406--240612-San Leandro 1784 150th\240612-FIGURES\240612 SITE PLAN.DWG

APPENDIX A

PERMITS

Alameda County Public Works Agency - Water Resources Well Permit



399 Elmhurst Street
Hayward, CA 94544-1395
Telephone: (510)670-6633 Fax:(510)782-1939

Application Approved on: 04/04/2013 By jamesy

Permit Numbers: W2013-0260 to W2013-0286
Permits Valid from 04/22/2013 to 04/28/2013

Application Id: 1364331123545
Site Location: Shell-branded service station
1784 150th Avenue

City of Project Site:San Leandro

Project Start Date: 04/22/2013
Assigned Inspector: Contact Steve Miller at (510) 670-5517 or stevem@acpwa.org

Completion Date:04/28/2013

Applicant: Conestoga-Rovers & Associates - Chris Benedict
10969 Trade Center Drive # 107, Rancho Cordova, CA 95670
Property Owner: Bansal Inc.
1784 150th Avenue, San Leandro, CA 94577
Client: Denis Brown
20945 S. Wilmington Avenue, Carson, CA 90810

Phone: 916-919-5808

Phone: --

Phone: --

	Total Due:	\$10587.00
Receipt Number: WR2013-0120	Total Amount Paid:	\$10587.00
Payer Name : Conestoga-Rovers & Associates	Paid By: CHECK	PAID IN FULL

Works Requesting Permits:

Well Destruction-Monitoring - 26 Wells
Driller: PeneCore Drilling - Lic #: 906899 - Method: press

Work Total: \$10322.00

Specifications

Permit #	Issued Date	Expire Date	Owner Well Id	Hole Diam.	Casing Diam.	Seal Depth	Max. Depth	State Well #	Orig. Permit #	DWR #
W2013-0260	04/04/2013	07/21/2013	AS-1	6.00 in.	2.00 in.	26.00 ft	31.00 ft	2S/3W31Q	NO RECORDS	NO RECORDS
W2013-0261	04/04/2013	07/21/2013	EW-1	10.00 in.	4.00 in.	17.00 ft	36.00 ft	2S/3W31Q	NO RECORDS	NO RECORDS
W2013-0262	04/04/2013	07/21/2013	EW-2	10.00 in.	4.00 in.	14.00 ft	33.00 ft	2S/3W31Q	NO RECORDS	NO RECORDS
W2013-0263	04/04/2013	07/21/2013	MW-10	10.00 in.	4.00 in.	24.00 ft	32.00 ft	2S/3W31Q	NO RECORDS	NO RECORDS
W2013-0264	04/04/2013	07/21/2013	MW-11	10.00 in.	4.00 in.	11.00 ft	25.00 ft	2S/3W31Q	NO RECORDS	NO RECORDS
W2013-0265	04/04/2013	07/21/2013	MW-12	8.00 in.	2.00 in.	14.00 ft	28.00 ft	2S/3W31Q	W2006-0191	e040055
W2013-0266	04/04/2013	07/21/2013	MW-13	8.00 in.	2.00 in.	10.00 ft	24.00 ft	2S/3W31Q	W2006-0192	e040491
W2013-0267	04/04/2013	07/21/2013	MW-1A	10.00 in.	4.00 in.	13.00 ft	27.00 ft	2S/3W31Q	NO RECORDS	NO RECORDS
W2013-0268	04/04/2013	07/21/2013	MW-1B	10.00 in.	4.00 in.	41.00 ft	50.00 ft	2S/3W31Q	NO RECORDS	NO RECORDS
W2013-0269	04/04/2013	07/21/2013	MW-2B	10.00 in.	4.00 in.	41.00 ft	50.00 ft	2S/3W31Q	NO RECORDS	NO RECORDS
W2013-0270	04/04/2013	07/21/2013	MW-3	10.00 in.	4.00 in.	18.00 ft	42.00 ft	2S/3W31Q	NO RECORDS	NO RECORDS
W2013-0271	04/04/2013	07/21/2013	MW-4	8.00 in.	2.00 in.	2.00 ft	27.00 ft	2S/3W31Q	94811	398642

Alameda County Public Works Agency - Water Resources Well Permit

W2013-0272	04/04/2013	07/21/2013	MW-5	8.00 in.	2.00 in.	6.00 ft	25.00 ft	2S/3W31Q	NO RECORDS	NO RECORDS
W2013-0273	04/04/2013	07/21/2013	MW-6	8.00 in.	2.00 in.	2.00 ft	20.00 ft	2S/3W31Q	NO RECORDS	NO RECORDS
W2013-0274	04/04/2013	07/21/2013	MW-7	8.00 in.	2.00 in.	18.00 ft	27.00 ft	2S/3W31Q	NO RECORDS	NO RECORDS
W2013-0275	04/04/2013	07/21/2013	MW-8	8.00 in.	2.00 in.	15.00 ft	24.00 ft	2S/3W31Q	NO RECORDS	NO RECORDS
W2013-0276	04/04/2013	07/21/2013	MW-9	8.00 in.	2.00 in.	26.00 ft	35.00 ft	2S/3W31Q	NO RECORDS	NO RECORDS
W2013-0277	04/04/2013	07/21/2013	P-1A	10.00 in.	4.00 in.	8.00 ft	27.00 ft	2S/3W31Q	NO RECORDS	NO RECORDS
W2013-0278	04/04/2013	07/21/2013	P-1B	10.00 in.	4.00 in.	22.00 ft	36.00 ft	2S/3W31Q	NO RECORDS	NO RECORDS
W2013-0279	04/04/2013	07/21/2013	P-2A	10.00 in.	4.00 in.	8.00 ft	27.00 ft	2S/3W31Q	NO RECORDS	NO RECORDS
W2013-0280	04/04/2013	07/21/2013	P-2B	10.00 in.	4.00 in.	22.00 ft	36.00 ft	2S/3W31Q	NO RECORDS	NO RECORDS
W2013-0281	04/04/2013	07/21/2013	P-3A	10.00 in.	4.00 in.	4.00 ft	23.00 ft	2S/3W31Q	NO RECORDS	NO RECORDS
W2013-0282	04/04/2013	07/21/2013	P-3B	10.00 in.	4.00 in.	17.00 ft	32.00 ft	2S/3W31Q	NO RECORDS	NO RECORDS
W2013-0283	04/04/2013	07/21/2013	P-4A	10.00 in.	4.00 in.	4.00 ft	23.00 ft	2S/3W31Q	NO RECORDS	NO RECORDS
W2013-0284	04/04/2013	07/21/2013	P-4B	10.00 in.	4.00 in.	19.00 ft	33.00 ft	2S/3W31Q	NO RECORDS	NO RECORDS
W2013-0285	04/04/2013	07/21/2013	SVE-1	10.00 in.	4.00 in.	4.00 ft	23.00 ft	2S/3W31Q	NO RECORDS	NO RECORDS

Specific Work Permit Conditions

1. Drilling Permit(s) can be voided/ cancelled only in writing. It is the applicant's responsibility to notify Alameda County Public Works Agency, Water Resources Section in writing for an extension or to cancel the drilling permit application. No drilling permit application(s) shall be extended beyond ninety (90) days from the original start date. Applicants may not cancel a drilling permit application after the completion date of the permit issued has passed.

2. Prior to any drilling activities, it shall be the applicant's responsibility to contact and coordinate an Underground Service Alert (USA), obtain encroachment permit(s), excavation permit(s) or any other permits or agreements required for that Federal, State, County or City, and follow all City or County Ordinances. No work shall begin until all the permits and requirements have been approved or obtained. It shall also be the applicants responsibilities to provide to the Cities or to Alameda County an Traffic Safety Plan for any lane closures or detours planned. No work shall begin until all the permits and requirements have been approved or obtained.

3. Compliance with the well-sealing specifications shall not exempt the well-sealing contractor from complying with appropriate State reporting-requirements related to well construction or destruction (Sections 13750 through 13755 (Division 7, Chapter 10, Article 3) of the California Water Code). Contractor must complete State DWR Form 188 and mail original to the Alameda County Public Works Agency, Water Resources Section, within 60 days. Include permit number and site map.

4. Applicant shall submit the copies of the approved encroachment permit to this office within 60 days.

5. Permittee shall assume entire responsibility for all activities and uses under this permit and shall indemnify, defend and save the Alameda County Public Works Agency, its officers, agents, and employees free and harmless from any and all expense, cost and liability in connection with or resulting from the exercise of this Permit including, but not limited to, property damage, personal injury and wrongful death.

Alameda County Public Works Agency - Water Resources Well Permit

6. Applicant shall contact Steve Miller for an inspection time at (510) 670-5517 or email to stevem@acpwa.org at least five (5) working days prior to starting, once the permit has been approved. Confirm the scheduled date(s) at least 24 hours prior to drilling.

7. Permittee, permittee's contractors, consultants or agents shall be responsible to assure that all material or waters generated during drilling, boring destruction, and/or other activities associated with this Permit will be safely handled, properly managed, and disposed of according to all applicable federal, state, and local statutes regulating such. In no case shall these materials and/or waters be allowed to enter, or potentially enter, on or off-site storm sewers, dry wells, or waterways or be allowed to move off the property where work is being completed.

8. Remove the Christy box or similar structure.

Destroy well by grouting neat cement with a tremie pipe or pressure grouting (25 psi for 5min.) to the bottom of the well and by filling with neat cement to three (3-5) feet below surface grade. Allow the sealing material to spill over the top of the casing to fill any annular space between casing and soil.

After the seal has set, backfill the remaining hole with concrete or compacted material to match existing conditions.

9. Copy of approved drilling permit must be on site at all times. Failure to present or show proof of the approved permit application on site shall result in a fine of \$500.00.

Well Destruction-Vapor monitoring well - 10 Wells

Driller: PeneCore Drilling - Lic #: 906899 - Method: other

Work Total: \$265.00

Specifications

Permit #	Issued Date	Expire Date	Owner Well Id	Hole Diam.	Casing Diam.	Seal Depth	Max. Depth	State Well #	Orig. Permit #	DWR #
W2013-0286	04/04/2013	07/21/2013	SVP-1	3.50 in.	0.25 in.	4.50 ft	5.00 ft	2S/3W31Q	W2007-0840	e065273
W2013-0286	04/04/2013	07/21/2013	SVP-2	3.50 in.	0.25 in.	4.50 ft	5.20 ft	2S/3W31Q	W2007-0840	e065274
W2013-0286	04/04/2013	07/21/2013	SVP-3	3.50 in.	0.25 in.	4.50 ft	5.20 ft	2S/3W31Q	W2007-0840	e065275
W2013-0286	04/04/2013	07/21/2013	SVP-4	3.50 in.	0.25 in.	4.50 ft	5.20 ft	2S/3W31Q	W2007-0840	e065276
W2013-0286	04/04/2013	07/21/2013	SVP-4A	3.50 in.	0.25 in.	2.00 ft	2.50 ft	2S/3W31Q	No Records	No Records
W2013-0286	04/04/2013	07/21/2013	SVP-5	3.50 in.	0.25 in.	4.50 ft	5.20 ft	2S/3W31Q	W2007-0840	e065277
W2013-0286	04/04/2013	07/21/2013	SVP-5A	3.50 in.	0.25 in.	2.00 ft	2.50 ft	2S/3W31Q	No Records	No Records
W2013-0286	04/04/2013	07/21/2013	SVP-6	4.00 in.	0.25 in.	4.50 ft	5.30 ft	2S/3W31Q	No Records	No Records
W2013-0286	04/04/2013	07/21/2013	SVP-7	4.00 in.	0.25 in.	2.75 ft	3.60 ft	2S/3W31Q	No Records	No Records
W2013-0286	04/04/2013	07/21/2013	SVP-8	3.50 in.	0.25 in.	4.50 ft	5.00 ft	2S/3W31Q	No Records	No Records

Specific Work Permit Conditions

1. Compliance with the above well-sealing specifications shall not exempt the well-sealing contractor from complying with appropriate state reporting-requirements related to well destruction (Sections 13750 through 13755 (Division 7, Chapter 10, Article 3) of the California Water Code). Contractor must complete State DWR Form 188 and mail original to the Alameda County Public Works Agency, Water Resources Section, within 60 days, including permit number and site map.

Alameda County Public Works Agency - Water Resources Well Permit

2. Permittee shall assume entire responsibility for all activities and uses under this permit and shall indemnify, defend and save the Alameda County Public Works Agency, its officers, agents, and employees free and harmless from any and all expense, cost, liability in connection with or resulting from the exercise of this Permit including, but not limited to, property damage, personal injury and wrongful death.
 3. Permittee, permittee's contractors, consultants or agents shall be responsible to assure that all material or waters generated during drilling, boring destruction, and/or other activities associated with this Permit will be safely handled, properly managed, and disposed of according to all applicable federal, state, and local statutes regulating such. In no case shall these materials and/or waters be allowed to enter, or potentially enter, on or off-site storm sewers, dry wells, or waterways or be allowed to move off the property where work is being completed.
 4. Prior to any drilling activities, it shall be the applicant's responsibility to contact and coordinate an Underground Service Alert (USA), obtain encroachment permit(s), excavation permit(s) or any other permits or agreements required for that Federal, State, County or City, and follow all City or County Ordinances. No work shall begin until all the permits and requirements have been approved or obtained. It shall also be the applicants responsibilities to provide to the Cities or to Alameda County an Traffic Safety Plan for any lane closures or detours planned. No work shall begin until all the permits and requirements have been approved or obtained.
 5. No changes in construction procedures or well type shall change, as described on this permit application. This permit may be voided if it contains incorrect information.
 6. Applicant shall submit the copies of the approved encroachment permit to this office within 60 days.
 7. Applicant shall contact Steve Miller for an inspection time at (510) 670-5517 or email to stevem@acpwa.org at least five (5) working days prior to starting, once the permit has been approved. Confirm the scheduled date(s) at least 24 hours prior to drilling.
 8. Remove the Christy box or similar structure. Overdrill or clean out to original depth. After the seal has set, backfill the remaining hole with concrete or compacted material to match existing.
 9. Copy of approved drilling permit must be on site at all times. Failure to present or show proof of the approved permit application on site shall result in a fine of \$500.00.
 10. Vapor monitoring wells constructed with tubing shall be decommissioned by complete removal of tubing, grout seal, and fill material of sand or bentonite. Fill material may be removed by hand auger if material can be removed completely.
- Vapor monitoring wells constructed with pvc pipe less than 2" shall be overdrilled to total depth.
- Vapor monitoring wells constructed with 2" pvc pipe or larger may be grouted by tremie pipe (any depth) or pressure grouted (less than 30', 25 psi for 5 min).
-

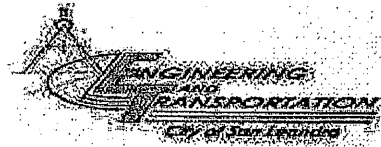

TIVE
 City of San Leandro
 Engineering and Transportation Department
 835 East 14th Street
 San Leandro, California 94577
 (510) 577-3428



ENCROACHMENT PERMIT

Permit Type **Environmental**

AMS

Permit Number: **ENC2013-00204** Job Address: **14940 Portofino Ci**

Issued: **5/21/2013**

Project Name: **CONESTOGA-ROVERS & ASSOC.**

Description of Work:

Remove & restor monitoring wells 4 located at 150th PCI=73, 3 located at Portofino Ct. PCI=46 Destruction per State and Alameda Co permit. Restoration of top 36" per 120A&B, 122AB&C, 126, 128, 608AB&C

Customer # 24918

Planned Start Date : May 21, 2013

Planned Completion Date : June 21, 2013

USA Tag No. 0185958

Emergency Contact

Chris Benedict

Contact Phone Number

510-385-0212

Applicant:

100,10A

Owner:

CONESTOGA-ROVERS & ASSOCIATES
 5900 HOLLIS STREET SUITE A
 EMERIVILLE CA 94706

Stanley C Lo
 14940 Portofino Cir
 San Leandro CA 94578-1816

SUB-Contractor:

REVISED
6-21-13

Agent:

Calvac Paving
 2645 Pacer Lane
 San Jose, CA 95111
 Jim Adam (408) 225-7700

CHRIS BENEDICT
 2000 OPPORTUNITY DRIVESUITE 110
 ROSEVILLE CA 95678

Associated Permits:

- Building Permit No.
- Oro Loma Permit No.
- Cal State Permit No.
- Ala County Permit No. W2013-0260.286
- Grading Permit No.

PERMIT FEE: \$65.00 To Acct #3306
 PLAN CHECKER _____ Hrs _____
 RESTORE/INSPECT DEPOSIT \$4,200.00
 To CN# 24918
 STREET CUT FEE _____ To Acct #3304
 TOTAL: \$4,265.00

Utility /Job Number

Method of Repair

Backfill Required Class 2 AB or CDF

Pavement Section Require

- Section 1 12 inches
- Section 2 6 inches
- Section 3

Min Depth of Cover.

* 36 inches

All work shall be per City Standard Curb, Gutter, Sidewalk, Driveway, Trench, Backfill & Resurface plans and specifications. Two way traffic and pedestrian safety and access shall be maintained at all times.

Consent Form

Pre Video

Post Video

* See Traffic Control plan for additional information. Must restore 36" from lip of gutter.

* Police and Fire Notification: Police (510) 577-3208 Fire (925) 447-4257

Traffic Control Required

PLEASE CALL (510) 577-3308 FOR INSPECTIONS 24 HOURS PRIOR TO WORK

By the application and acceptance of this permit, the undersigned intending to be legally bound does hereby agree that all work performed will be in accordance with all applicable provisions of this permit and all regulations, provisions, and specifications as adopted by the City. Further, the undersigned agrees that this permit is to serve as a guaranty for payment for all permit and/or inspection charges as billed by the City. Any misrepresentation of information requested from the applicant on this form shall make this permit null and void.

Signature: _____

ON FILE

Print Name: **CHRIS BENEDICT**

Date: **5/21/2013 10:02:43A**

Sanchez, Alfonso

From: Sanchez, Alfonso
Sent: Monday, June 17, 2013 4:55 PM
To: 'Benedict, Chris'
Subject: RE: ENC2013-00204; Well Destruction and restoration.

Chris,

These were my questions to Calvac.

Please provide the following information.

1. Will you be using the TCP approved for Conestoga?
2. Will the inspection fees be charged to the permit from Conestoga, or are you going to pull your own permit?
3. Make sure you are familiar with restoration standards and procedures.

Jim stated the following,

"CRA will handle all permit fees and all traffic control. I will restore as directed by CRA, as I haven't had any meetings with the inspectors and they have." is this not correct?

Thanks.

From: Sanchez, Alfonso
Sent: Monday, June 17, 2013 11:07 AM
To: 'jim@calvacpaving.com'; victoria@calvacpaving.com
Cc: 'Benedict, Chris'
Subject: RE: ENC2013-00204; Well Destruction and restoration.

Jim,

You will be required to submit a permit application to include the following.

1. Restoration deposit of \$4,265.00
2. City Of San Leandro Business License.
3. Proof that you have renewed your State of California state License as it is inactive (see attached)
4. Traffic Control Plan
5. Restoration must be per Alameda County permit with the exception of the first 36" inches which must be per City Of San Leandro Standards.
 - a. Once you get your permit you will need to call for a pre-inspection.

Thanks.

From: Jim Adam [<mailto:jim@calvacpaving.com>]
Sent: Friday, June 14, 2013 2:53 PM
To: victoria@calvacpaving.com
Cc: Sanchez, Alfonso
Subject: RE: ENC2013-00204; Well Destruction and restoration.

CRA will handle all permit fees and all traffic control. I will restore as directed by CRA, as I haven't had any meetings with the inspectors and they have.

Thank you for your time,

Jim Adam

President



2645 Pacer Lane / San Jose, CA 95111
Ph: 408-225-7700 / Fx: 408-225-7733

From: Victoria Wilson [<mailto:victoria@calvacpaving.com>]
Sent: Friday, June 14, 2013 11:21 AM
To: Jim Adam
Subject: FW: ENC2013-00204; Well Destruction and restoration.

I have no idea what he's asking about? This is the contact at the City of San Leandro...

Thank You,

Victoria Wilson

Office Manager



2645 Pacer Lane / San Jose, CA 95111
Ph: 408-225-7700 / Fx: 408-225-7733

From: ASanchez@sanleandro.org [<mailto:ASanchez@sanleandro.org>]
Sent: Friday, June 14, 2013 11:18 AM
To: mmelendez@thoitsinsurance.com
Cc: victoria@calvacpaving.com
Subject: RE: ENC2013-00204; Well Destruction and restoration.

Victoria,

The insurance has been accepted by the Risk Management Department.

Please provide the following information.

1. Will you be using the TCP approved for Conestoga?
2. Will the inspection fees be charged to the permit from Conestoga, or are you going to pull your own permit?
3. Make sure you are familiar with restoration standards and procedures.

Thanks.

From: Melendez, Minelly [<mailto:mmelendez@thoitsinsurance.com>]
Sent: Thursday, June 13, 2013 2:41 PM
To: Sanchez, Alfonso
Cc: victoria@calvacpaving.com
Subject: FW: ENC2013-00204; Well Destruction and restoration.

Hello,

Attached is the revised certificate of insurance for Calvac Inc.

Please contact me if you have any questions.

MINELLY MELENDEZ
Account Coordinator
mmelendez@thoitsinsurance.com
Office: 408.792.5487 Fax: 408.792.3670

From: Victoria Wilson [<mailto:victoria@calvacpaving.com>]
Sent: Thursday, June 13, 2013 1:29 PM
To: Melendez, Minelly
Subject: FW: ENC2013-00204; Well Destruction and restoration.

FYI

Thank You,

Victoria Wilson
Office Manager



Asphalt / Concrete

2645 Pacer Lane / San Jose, CA 95111
Ph: 408-225-7700 / Fx: 408-225-7733

From: ASanchez@sanleandro.org [<mailto:ASanchez@sanleandro.org>]
Sent: Thursday, June 13, 2013 12:58 PM
To: victoria@calvacpaving.com; cbenedict@craworld.com
Subject: RE: ENC2013-00204; Well Destruction and restoration.

Victoria,

The certificate wording must read exactly like this. "CITY OF SAN LEANDRO, ITS OFFICERS, OFFICIALS, EMPLOYEES AND VOLUNTEERS ARE NAMED AS ADDITIONAL INSURED. WAIVER OF SUBROGATION APPLIES IN FAVOR OF CERTIFICATE HOLDER AS PER RESPECTS ALL POLICIES PROVIDED UNDER THIS CERTIFICATE PER ENDORSEMENTS ATTACHED. COVERAGE IS PRIMARY AND NON-CONTRIBUTORY PER THE ATTACHED FORMS(S)."

You are missing the following Endorsements.

General Liability

- Waiver of subrogation

Automobile Liability

- Additional Insured Endorsement.
- Primary Insurance Endorsement.
- Waiver of Subrogation

Workers' Comp

- Waiver of Subrogation

Are you going to use the same traffic control plan that was submitted by Conestoga?

Thanks.

From: Victoria Wilson [<mailto:victoria@calvacpaving.com>]
Sent: Thursday, June 13, 2013 11:43 AM
To: 'Benedict, Chris'
Cc: Sanchez, Alfonso
Subject: RE: ENC2013-00204; Well Destruction and restoration.

Good Morning Alfonso,

Please see the attached requested certificate of insurance. Our business license renewal was fedexed to the City yesterday and was scheduled for delivery this morning, the tracking number is 799985258801. Our Contractors license is 706145 and holds an A C12 and C32 Classifications.

If I can be of further assistance please do not hesitate to let me know.

Thank You,

Victoria Wilson
Office Manager



Asphalt / Concrete

2645 Pacer Lane / San Jose, CA 95111
Ph: 408-225-7700 / Fx: 408-225-7733

From: ASanchez@sanleandro.org [<mailto:ASanchez@sanleandro.org>]
Sent: Wednesday, June 12, 2013 9:31 AM
To: jim@calvacpaving.com
Subject: ENC2013-00204; Well Destruction and restoration.

Jim,

Conestoga did not include your company on the permit. You will not be allowed to do any work on the public right of way until the City Of San Leandro has the following information on file.

1. Insurance as per the attached.
 - a. General Liability
 - b. Automobile Liability
 - c. Workers' Comp
2. City Of San Leandro Business license.
3. Your State of CA License # and Classification.
4. Restoration. (see attached)
 - a. You will be required to restore 3'-0" deep from the gutter lip with native dirt, A/B, and A/C
 - b. A compaction test will also be required. (see standard plans 120B)
 - c. Or you may do CDF & AC, but the remainder of the well must be closed per Alameda County and State requirements.

Sincerely,

Alfonso Sanchez, Senior Engineering Aide
Engineering and Transportation Department
City of San Leandro Civic Center
835 East 14th Street
San Leandro, CA 94577
Phone (510) 577-3414
Fax (510) 577-3294
asanchez@sanleandro.org
www.sanleandro.org

Notice: This e-mail message and any attachment to this e-mail message may contain information that is confidential, proprietary, privileged, legally privileged and/or exempt from disclosure under applicable law. If you are not the intended recipient, please accept this as notice that any disclosure, copying, distribution or use of the information contained in this transmission is strictly prohibited. NFP reserves the right, to the extent and under circumstances permitted by applicable law, to retain, monitor and intercept e-mail messages to and from its systems.

Any views or opinions expressed in this e-mail are those of the sender and do not necessarily express those of NFP. Although this transmission and any attachment are believed to be free of any virus or other defect that might affect any computer system into which it is received and opened, it is the responsibility of the recipient to ensure that it is virus free and no responsibility is accepted by NFP, its subsidiaries and affiliates, as applicable, for any loss or damage arising in any way from its use.

If you have received this e-mail in error, please immediately contact the sender by return e-mail or by telephone at 212-301-4000 and destroy the material in its entirety, whether electronic or hard copy format.

APPENDIX B

TESTAMERICA LABORATORIES, INC. -
ANALYTICAL REPORT

TestAmerica

THE LEADER IN ENVIRONMENTAL TESTING

ANALYTICAL REPORT

TestAmerica Laboratories, Inc.

TestAmerica Irvine

17461 Derian Ave

Suite 100

Irvine, CA 92614-5817

Tel: (949)261-1022

TestAmerica Job ID: 440-50442-1

Client Project/Site: 1748 150th Ave., San Leandro

For:

Conestoga-Rovers & Associates, Inc.

5900 Hollis Street

Suite A

Emeryville, California 94608

Attn: Peter Schaefer



Authorized for release by:

7/16/2013 7:58:59 AM

Jorge Ramirez, Project Manager I

(949)261-1022

jorge.ramirez@testamericainc.com

Designee for

Philip Sanelle, Project Manager I

philip.sanelle@testamericainc.com

LINKS

Review your project
results through

Total Access

Have a Question?

**Ask
The
Expert**

Visit us at:

www.testamericainc.com

The test results in this report meet all 2003 NELAC and 2009 TNI requirements for accredited parameters, exceptions are noted in this report. This report may not be reproduced except in full, and with written approval from the laboratory. For questions please contact the Project Manager at the e-mail address or telephone number listed on this page.

This report has been electronically signed and authorized by the signatory. Electronic signature is intended to be the legally binding equivalent of a traditionally handwritten signature.

Results relate only to the items tested and the sample(s) as received by the laboratory.

Table of Contents

Cover Page	1
Table of Contents	2
Sample Summary	3
Case Narrative	4
Client Sample Results	5
Method Summary	6
Chronicle	7
QC Sample Results	8
QC Association	14
Definitions	16
Certification Summary	17
Chain of Custody	18
Receipt Checklists	19

Sample Summary

Client: Conestoga-Rovers & Associates, Inc.
Project/Site: 1748 150th Ave., San Leandro

TestAmerica Job ID: 440-50442-1

Lab Sample ID	Client Sample ID	Matrix	Collected	Received
440-50442-1	CRA-1A	Solid	06/28/13 10:00	06/29/13 09:50

Case Narrative

Client: Conestoga-Rovers & Associates, Inc.
Project/Site: 1748 150th Ave., San Leandro

TestAmerica Job ID: 440-50442-1

Job ID: 440-50442-1

Laboratory: TestAmerica Irvine

Narrative

**Job Narrative
440-50442-1**

Comments

No additional comments.

Receipt

The sample was received on 6/29/2013 9:50 AM; the sample arrived in good condition, properly preserved and, where required, on ice. The temperature of the cooler at receipt was 3.3° C.

GC/MS VOA

Method(s) 8260B/CA_LUFTMS: Surrogate recovery for the following sample(s) was outside control limits: CRA-1A (440-50442-1). Evidence of matrix interference is present; therefore, re-extraction and/or re-analysis was not performed.

Method(s) 8260B: Surrogate recovery for the following sample(s) was outside control limits: CRA-1A (440-50442-1). Evidence of matrix interference is present; therefore, re-extraction and/or re-analysis was not performed.

No other analytical or quality issues were noted.

GC Semi VOA

Method(s) 8015B: Surrogate recovery for the following sample(s) was outside control limits: (440-50359-1 MS), (440-50359-1 MSD). Evidence of matrix interference is present; therefore, re-extraction and/or re-analysis was not performed.

Method(s) 8015B: The matrix spike (MS) recoveries associated with batch 115552 were outside control limits: (440-50359-1 MS), (440-50359-1 MSD). Matrix interference is suspected. The associated laboratory control sample (LCS) recovery met acceptance criteria.

Method(s) 8015B: The matrix spike / matrix spike duplicate (MS/MSD) precision for batch 115552 was outside control limits. Non-homogeneity of the sample matrix is suspected.

No other analytical or quality issues were noted.

Metals

Method(s) 6010B: The matrix spike recoveries for Barium & Antimony in batch 116030 were outside control limits. The associated laboratory control sample (LCS) recovery met acceptance criteria. (440-50442-1 MS)

Method(s) 6010B: The matrix spike duplicate recoveries for Antimony in batch 116030 were outside control limits. The associated laboratory control sample (LCS) recovery met acceptance criteria. (440-50442-1 MSD)

No other analytical or quality issues were noted.

Organic Prep

No analytical or quality issues were noted.

VOA Prep

No analytical or quality issues were noted.

Client Sample Results

Client: Conestoga-Rovers & Associates, Inc.
 Project/Site: 1748 150th Ave., San Leandro

TestAmerica Job ID: 440-50442-1

Client Sample ID: CRA-1A

Lab Sample ID: 440-50442-1

Date Collected: 06/28/13 10:00

Matrix: Solid

Date Received: 06/29/13 09:50

Method: 8260B/CA_LUFTMS - Volatile Organic Compounds by GC/MS

Analyte	Result	Qualifier	RL	MDL	Unit	D	Prepared	Analyzed	Dil Fac
Volatile Fuel Hydrocarbons (C4-C12)	ND		0.099		mg/Kg			07/06/13 18:01	1
Surrogate	%Recovery	Qualifier	Limits				Prepared	Analyzed	Dil Fac
Dibromofluoromethane (Surr)	20	X	80 - 125					07/06/13 18:01	1
4-Bromofluorobenzene (Surr)	93		80 - 120					07/06/13 18:01	1
Toluene-d8 (Surr)	113		80 - 120					07/06/13 18:01	1

Method: 8260B - Volatile Organic Compounds (GC/MS)

Analyte	Result	Qualifier	RL	MDL	Unit	D	Prepared	Analyzed	Dil Fac
Benzene	ND		0.00099		mg/Kg			07/06/13 18:01	1
Ethylbenzene	ND		0.00099		mg/Kg			07/06/13 18:01	1
Toluene	ND		0.00099		mg/Kg			07/06/13 18:01	1
Xylenes, Total	ND		0.0020		mg/Kg			07/06/13 18:01	1
Surrogate	%Recovery	Qualifier	Limits				Prepared	Analyzed	Dil Fac
4-Bromofluorobenzene (Surr)	93		80 - 120					07/06/13 18:01	1
Dibromofluoromethane (Surr)	20	X	80 - 125					07/06/13 18:01	1
Toluene-d8 (Surr)	113		80 - 120					07/06/13 18:01	1

Method: 8015B - Diesel Range Organics (DRO) (GC)

Analyte	Result	Qualifier	RL	MDL	Unit	D	Prepared	Analyzed	Dil Fac
DRO (C10-C28)	ND		5.0		mg/Kg		07/03/13 15:15	07/04/13 00:42	1
ORO (C29-C40)	ND		5.0		mg/Kg		07/03/13 15:15	07/04/13 00:42	1
Surrogate	%Recovery	Qualifier	Limits				Prepared	Analyzed	Dil Fac
n-Octacosane	73		40 - 140				07/03/13 15:15	07/04/13 00:42	1

Method: 6010B - Metals (ICP)

Analyte	Result	Qualifier	RL	MDL	Unit	D	Prepared	Analyzed	Dil Fac
Antimony	ND		10		mg/Kg		07/08/13 11:16	07/09/13 14:40	5
Arsenic	3.3		2.0		mg/Kg		07/08/13 11:16	07/09/13 14:40	5
Barium	34		1.0		mg/Kg		07/08/13 11:16	07/09/13 14:40	5
Beryllium	ND		0.50		mg/Kg		07/08/13 11:16	07/09/13 14:40	5
Cadmium	ND		0.50		mg/Kg		07/08/13 11:16	07/09/13 14:40	5
Chromium	2.6		1.0		mg/Kg		07/08/13 11:16	07/09/13 14:40	5
Cobalt	1.0		1.0		mg/Kg		07/08/13 11:16	07/09/13 14:40	5
Copper	3.2		2.0		mg/Kg		07/08/13 11:16	07/09/13 14:40	5
Lead	9.6		2.0		mg/Kg		07/08/13 11:16	07/09/13 14:40	5
Molybdenum	ND		2.0		mg/Kg		07/08/13 11:16	07/09/13 14:40	5
Nickel	3.8		2.0		mg/Kg		07/08/13 11:16	07/09/13 14:40	5
Selenium	ND		2.0		mg/Kg		07/08/13 11:16	07/09/13 14:40	5
Thallium	ND		10		mg/Kg		07/08/13 11:16	07/09/13 14:40	5
Vanadium	1.9		1.0		mg/Kg		07/08/13 11:16	07/09/13 14:40	5
Zinc	660		5.0		mg/Kg		07/08/13 11:16	07/09/13 14:40	5
Silver	ND		1.0		mg/Kg		07/08/13 11:16	07/09/13 14:40	5

Method: 7471A - Mercury (CVAA)

Analyte	Result	Qualifier	RL	MDL	Unit	D	Prepared	Analyzed	Dil Fac
Mercury	ND		0.020		mg/Kg		07/07/13 12:05	07/08/13 17:47	1

TestAmerica Irvine

Method Summary

Client: Conestoga-Rovers & Associates, Inc.
Project/Site: 1748 150th Ave., San Leandro

TestAmerica Job ID: 440-50442-1

Method	Method Description	Protocol	Laboratory
8260B	Volatile Organic Compounds (GC/MS)	SW846	TAL IRV
8260B/CA_LUFTM S	Volatile Organic Compounds by GC/MS	SW846	TAL IRV
8015B	Diesel Range Organics (DRO) (GC)	SW846	TAL IRV
6010B	Metals (ICP)	SW846	TAL IRV
7471A	Mercury (CVAA)	SW846	TAL IRV

Protocol References:

SW846 = "Test Methods For Evaluating Solid Waste, Physical/Chemical Methods", Third Edition, November 1986 And Its Updates.

Laboratory References:

TAL IRV = TestAmerica Irvine, 17461 Derian Ave, Suite 100, Irvine, CA 92614-5817, TEL (949)261-1022

Lab Chronicle

Client: Conestoga-Rovers & Associates, Inc.
 Project/Site: 1748 150th Ave., San Leandro

TestAmerica Job ID: 440-50442-1

Client Sample ID: CRA-1A

Lab Sample ID: 440-50442-1

Date Collected: 06/28/13 10:00

Matrix: Solid

Date Received: 06/29/13 09:50

Prep Type	Batch Type	Batch Method	Run	Dil Factor	Initial Amount	Final Amount	Batch Number	Prepared or Analyzed	Analyst	Lab
Total/NA	Analysis	8260B		1	5.07 g	10 mL	115864	07/06/13 18:01	BD	TAL IRV
Total/NA	Analysis	8260B/CA_LUFTMS		1	5.07 g	10 mL	115865	07/06/13 18:01	BD	TAL IRV
Total/NA	Prep	CA LUFT			30.01 g	1 mL	115552	07/03/13 15:15	SJ	TAL IRV
Total/NA	Analysis	8015B		1			115437	07/04/13 00:42	KW	TAL IRV
Total/NA	Prep	7471A			0.49 g	50 mL	115919	07/07/13 12:05	MM	TAL IRV
Total/NA	Analysis	7471A		1			116215	07/08/13 17:47	DB	TAL IRV
Total/NA	Prep	3050B			2.01 g	50 mL	116030	07/08/13 11:16	MP	TAL IRV
Total/NA	Analysis	6010B		5			116454	07/09/13 14:40	EN	TAL IRV

Laboratory References:

TAL IRV = TestAmerica Irvine, 17461 Derian Ave, Suite 100, Irvine, CA 92614-5817, TEL (949)261-1022

QC Sample Results

Client: Conestoga-Rovers & Associates, Inc.
 Project/Site: 1748 150th Ave., San Leandro

TestAmerica Job ID: 440-50442-1

Method: 8260B - Volatile Organic Compounds (GC/MS)

Lab Sample ID: MB 440-115864/4

Matrix: Solid

Analysis Batch: 115864

Client Sample ID: Method Blank

Prep Type: Total/NA

Analyte	MB MB		RL	MDL	Unit	D	Prepared	Analyzed	Dil Fac
	Result	Qualifier							
Benzene	ND		0.0010		mg/Kg			07/06/13 11:44	1
Ethylbenzene	ND		0.0010		mg/Kg			07/06/13 11:44	1
Toluene	ND		0.0010		mg/Kg			07/06/13 11:44	1
Xylenes, Total	ND		0.0020		mg/Kg			07/06/13 11:44	1

Surrogate	MB MB		Limits	Prepared	Analyzed	Dil Fac
	%Recovery	Qualifier				
4-Bromofluorobenzene (Surr)	103		80 - 120		07/06/13 11:44	1
Dibromofluoromethane (Surr)	121		80 - 125		07/06/13 11:44	1
Toluene-d8 (Surr)	110		80 - 120		07/06/13 11:44	1

Lab Sample ID: LCS 440-115864/5

Matrix: Solid

Analysis Batch: 115864

Client Sample ID: Lab Control Sample

Prep Type: Total/NA

Analyte	Spike Added	LCS LCS		Unit	D	%Rec	%Rec. Limits
		Result	Qualifier				
Benzene	0.0500	0.0405		mg/Kg		81	65 - 120
Ethylbenzene	0.0500	0.0471		mg/Kg		94	70 - 125
m,p-Xylene	0.100	0.102		mg/Kg		102	70 - 125
o-Xylene	0.0500	0.0507		mg/Kg		101	70 - 125
Toluene	0.0500	0.0443		mg/Kg		89	70 - 125

Surrogate	LCS LCS		Limits
	%Recovery	Qualifier	
4-Bromofluorobenzene (Surr)	103		80 - 120
Dibromofluoromethane (Surr)	116		80 - 125
Toluene-d8 (Surr)	109		80 - 120

Lab Sample ID: 440-50586-B-1 MS

Matrix: Solid

Analysis Batch: 115864

Client Sample ID: Matrix Spike

Prep Type: Total/NA

Analyte	Sample Sample		Spike Added	MS MS		Unit	D	%Rec	%Rec. Limits
	Result	Qualifier		Result	Qualifier				
Benzene	ND		0.0493	0.0411		mg/Kg		83	65 - 130
Ethylbenzene	ND		0.0493	0.0464		mg/Kg		94	70 - 135
m,p-Xylene	ND		0.0986	0.101		mg/Kg		103	70 - 130
o-Xylene	ND		0.0493	0.0527		mg/Kg		107	65 - 130
Toluene	ND		0.0493	0.0450		mg/Kg		91	70 - 130

Surrogate	MS MS		Limits
	%Recovery	Qualifier	
4-Bromofluorobenzene (Surr)	109		80 - 120
Dibromofluoromethane (Surr)	106		80 - 125
Toluene-d8 (Surr)	113		80 - 120

TestAmerica Irvine

QC Sample Results

Client: Conestoga-Rovers & Associates, Inc.
 Project/Site: 1748 150th Ave., San Leandro

TestAmerica Job ID: 440-50442-1

Method: 8260B - Volatile Organic Compounds (GC/MS) (Continued)

Lab Sample ID: 440-50586-B-1 MSD

Matrix: Solid

Analysis Batch: 115864

Client Sample ID: Matrix Spike Duplicate

Prep Type: Total/NA

Analyte	Sample	Sample	Spike	MSD	MSD	Unit	D	%Rec	%Rec.	Limits	RPD	Limit
	Result	Qualifier	Added	Result	Qualifier							
Benzene	ND		0.0497	0.0402		mg/Kg		81	65 - 130	2	20	
Ethylbenzene	ND		0.0497	0.0450		mg/Kg		91	70 - 135	3	25	
m,p-Xylene	ND		0.0994	0.0962		mg/Kg		97	70 - 130	5	25	
o-Xylene	ND		0.0497	0.0502		mg/Kg		101	65 - 130	5	25	
Toluene	ND		0.0497	0.0436		mg/Kg		88	70 - 130	3	20	

Surrogate	MSD	MSD	Limits
	%Recovery	Qualifier	
4-Bromofluorobenzene (Surr)	97		80 - 120
Dibromofluoromethane (Surr)	85		80 - 125
Toluene-d8 (Surr)	108		80 - 120

Method: 8260B/CA_LUFTMS - Volatile Organic Compounds by GC/MS

Lab Sample ID: MB 440-115865/4

Matrix: Solid

Analysis Batch: 115865

Client Sample ID: Method Blank

Prep Type: Total/NA

Analyte	MB	MB	RL	MDL	Unit	D	Prepared	Analyzed	Dil Fac
	Result	Qualifier							
Volatile Fuel Hydrocarbons (C4-C12)	ND		0.10		mg/Kg			07/06/13 11:44	1

Surrogate	MB	MB	Limits	Prepared	Analyzed	Dil Fac
	%Recovery	Qualifier				
Dibromofluoromethane (Surr)	121		80 - 125		07/06/13 11:44	1
4-Bromofluorobenzene (Surr)	103		80 - 120		07/06/13 11:44	1
Toluene-d8 (Surr)	110		80 - 120		07/06/13 11:44	1

Lab Sample ID: LCS 440-115865/6

Matrix: Solid

Analysis Batch: 115865

Client Sample ID: Lab Control Sample

Prep Type: Total/NA

Analyte	Spike	LCS	LCS	Unit	D	%Rec	%Rec.
		Added	Result				
Volatile Fuel Hydrocarbons (C4-C12)	1.00	0.889		mg/Kg		89	60 - 135

Surrogate	LCS	LCS	Limits
	%Recovery	Qualifier	
Dibromofluoromethane (Surr)	116		80 - 125
4-Bromofluorobenzene (Surr)	106		80 - 120
Toluene-d8 (Surr)	111		80 - 120

Lab Sample ID: 440-50586-B-1 MS

Matrix: Solid

Analysis Batch: 115865

Client Sample ID: Matrix Spike

Prep Type: Total/NA

Analyte	Sample	Sample	Spike	MS	MS	Unit	D	%Rec	%Rec.	Limits
	Result	Qualifier	Added	Result	Qualifier					
Volatile Fuel Hydrocarbons (C4-C12)	ND		3.40	2.82		mg/Kg		83	55 - 140	

TestAmerica Irvine

QC Sample Results

Client: Conestoga-Rovers & Associates, Inc.
 Project/Site: 1748 150th Ave., San Leandro

TestAmerica Job ID: 440-50442-1

Method: 8260B/CA_LUFTMS - Volatile Organic Compounds by GC/MS (Continued)

Lab Sample ID: 440-50586-B-1 MS
 Matrix: Solid
 Analysis Batch: 115865

Client Sample ID: Matrix Spike
 Prep Type: Total/NA

Surrogate	MS %Recovery	MS Qualifier	Limits
Dibromofluoromethane (Surr)	106		80 - 125
4-Bromofluorobenzene (Surr)	109		80 - 120
Toluene-d8 (Surr)	113		80 - 120

Lab Sample ID: 440-50586-B-1 MSD
 Matrix: Solid
 Analysis Batch: 115865

Client Sample ID: Matrix Spike Duplicate
 Prep Type: Total/NA

Analyte	Sample Result	Sample Qualifier	Spike Added	MSD Result	MSD Qualifier	Unit	D	%Rec	%Rec. Limits	RPD	RPD Limit
Volatile Fuel Hydrocarbons (C4-C12)	ND		3.43	2.48		mg/Kg		72	55 - 140	13	25

Surrogate	MSD %Recovery	MSD Qualifier	Limits
Dibromofluoromethane (Surr)	85		80 - 125
4-Bromofluorobenzene (Surr)	97		80 - 120
Toluene-d8 (Surr)	108		80 - 120

Method: 8015B - Diesel Range Organics (DRO) (GC)

Lab Sample ID: MB 440-115552/1-A
 Matrix: Solid
 Analysis Batch: 115437

Client Sample ID: Method Blank
 Prep Type: Total/NA
 Prep Batch: 115552

Analyte	MB Result	MB Qualifier	RL	MDL	Unit	D	Prepared	Analyzed	Dil Fac
DRO (C10-C28)	ND		5.0		mg/Kg		07/03/13 15:15	07/03/13 22:48	1
ORO (C29-C40)	ND		5.0		mg/Kg		07/03/13 15:15	07/03/13 22:48	1

Surrogate	MB %Recovery	MB Qualifier	Limits	Prepared	Analyzed	Dil Fac
n-Octacosane	68		40 - 140	07/03/13 15:15	07/03/13 22:48	1

Lab Sample ID: LCS 440-115552/2-A
 Matrix: Solid
 Analysis Batch: 115437

Client Sample ID: Lab Control Sample
 Prep Type: Total/NA
 Prep Batch: 115552

Analyte	Spike Added	LCS Result	LCS Qualifier	Unit	D	%Rec	%Rec. Limits
DRO (C10-C28)	33.3	21.4		mg/Kg		64	45 - 115

Surrogate	LCS %Recovery	LCS Qualifier	Limits
n-Octacosane	69		40 - 140

Lab Sample ID: 440-50359-B-1-F MS
 Matrix: Solid
 Analysis Batch: 115443

Client Sample ID: Matrix Spike
 Prep Type: Total/NA
 Prep Batch: 115552

Analyte	Sample Result	Sample Qualifier	Spike Added	MS Result	MS Qualifier	Unit	D	%Rec	%Rec. Limits
DRO (C10-C28)	87		33.3	36.3	F	mg/Kg		-151	40 - 120

TestAmerica Irvine

QC Sample Results

Client: Conestoga-Rovers & Associates, Inc.
 Project/Site: 1748 150th Ave., San Leandro

TestAmerica Job ID: 440-50442-1

Method: 8015B - Diesel Range Organics (DRO) (GC) (Continued)

Lab Sample ID: 440-50359-B-1-F MS
 Matrix: Solid
 Analysis Batch: 115443

Client Sample ID: Matrix Spike
 Prep Type: Total/NA
 Prep Batch: 115552

Surrogate	MS MS		Limits
	%Recovery	Qualifier	
n-Octacosane	19	X	40 - 140

Lab Sample ID: 440-50359-B-1-G MSD
 Matrix: Solid
 Analysis Batch: 115443

Client Sample ID: Matrix Spike Duplicate
 Prep Type: Total/NA
 Prep Batch: 115552

Analyte	Sample	Sample	Spike	MSD MSD		Unit	D	%Rec	%Rec.	Limits	RPD	Limit
	Result	Qualifier	Added	Result	Qualifier							
DRO (C10-C28)	87		33.3	71.3	F	mg/Kg		-46		40 - 120	65	30

Surrogate	MSD MSD		Limits
	%Recovery	Qualifier	
n-Octacosane	28	X	40 - 140

Method: 6010B - Metals (ICP)

Lab Sample ID: MB 440-116030/1-A ^5
 Matrix: Solid
 Analysis Batch: 116454

Client Sample ID: Method Blank
 Prep Type: Total/NA
 Prep Batch: 116030

Analyte	MB MB		RL	MDL	Unit	D	Prepared	Analyzed	Dil Fac
	Result	Qualifier							
Antimony	ND		9.9		mg/Kg		07/08/13 11:16	07/09/13 14:35	5
Arsenic	ND		2.0		mg/Kg		07/08/13 11:16	07/09/13 14:35	5
Barium	ND		0.99		mg/Kg		07/08/13 11:16	07/09/13 14:35	5
Beryllium	ND		0.49		mg/Kg		07/08/13 11:16	07/09/13 14:35	5
Cadmium	ND		0.49		mg/Kg		07/08/13 11:16	07/09/13 14:35	5
Chromium	ND		0.99		mg/Kg		07/08/13 11:16	07/09/13 14:35	5
Cobalt	ND		0.99		mg/Kg		07/08/13 11:16	07/09/13 14:35	5
Copper	ND		2.0		mg/Kg		07/08/13 11:16	07/09/13 14:35	5
Lead	ND		2.0		mg/Kg		07/08/13 11:16	07/09/13 14:35	5
Molybdenum	ND		2.0		mg/Kg		07/08/13 11:16	07/09/13 14:35	5
Nickel	ND		2.0		mg/Kg		07/08/13 11:16	07/09/13 14:35	5
Selenium	ND		2.0		mg/Kg		07/08/13 11:16	07/09/13 14:35	5
Thallium	ND		9.9		mg/Kg		07/08/13 11:16	07/09/13 14:35	5
Vanadium	ND		0.99		mg/Kg		07/08/13 11:16	07/09/13 14:35	5
Zinc	ND		4.9		mg/Kg		07/08/13 11:16	07/09/13 14:35	5
Silver	ND		0.99		mg/Kg		07/08/13 11:16	07/09/13 14:35	5

Lab Sample ID: LCS 440-116030/2-A ^5
 Matrix: Solid
 Analysis Batch: 116454

Client Sample ID: Lab Control Sample
 Prep Type: Total/NA
 Prep Batch: 116030

Analyte	Spike Added	LCS LCS		Unit	D	%Rec	%Rec.	Limits
		Result	Qualifier					
Antimony	49.3	46.2		mg/Kg		94		80 - 120
Arsenic	49.3	46.4		mg/Kg		94		80 - 120
Barium	49.3	47.0		mg/Kg		96		80 - 120
Beryllium	49.3	46.8		mg/Kg		95		80 - 120
Cadmium	49.3	46.5		mg/Kg		94		80 - 120
Chromium	49.3	46.0		mg/Kg		93		80 - 120
Cobalt	49.3	47.1		mg/Kg		96		80 - 120

TestAmerica Irvine

QC Sample Results

Client: Conestoga-Rovers & Associates, Inc.
 Project/Site: 1748 150th Ave., San Leandro

TestAmerica Job ID: 440-50442-1

Method: 6010B - Metals (ICP) (Continued)

Lab Sample ID: LCS 440-116030/2-A ^5
 Matrix: Solid
 Analysis Batch: 116454

Client Sample ID: Lab Control Sample
 Prep Type: Total/NA
 Prep Batch: 116030

Analyte	Spike Added	LCS Result	LCS Qualifier	Unit	D	%Rec	%Rec.
							Limits
Copper	49.3	46.2		mg/Kg		94	80 - 120
Lead	49.3	46.7		mg/Kg		95	80 - 120
Molybdenum	49.3	45.7		mg/Kg		93	80 - 120
Nickel	49.3	48.0		mg/Kg		97	80 - 120
Selenium	49.3	44.3		mg/Kg		90	80 - 120
Thallium	49.3	46.6		mg/Kg		95	80 - 120
Vanadium	49.3	45.8		mg/Kg		93	80 - 120
Zinc	49.3	44.3		mg/Kg		90	80 - 120
Silver	24.6	22.7		mg/Kg		92	80 - 120

Lab Sample ID: 440-50442-1 MS
 Matrix: Solid
 Analysis Batch: 116454

Client Sample ID: CRA-1A
 Prep Type: Total/NA
 Prep Batch: 116030

Analyte	Sample Result	Sample Qualifier	Spike Added	MS Result	MS Qualifier	Unit	D	%Rec	%Rec.
									Limits
Antimony	ND		50.8	19.1	F	mg/Kg		38	75 - 125
Arsenic	3.3		50.8	58.9		mg/Kg		110	75 - 125
Barium	34		50.8	101	F	mg/Kg		130	75 - 125
Beryllium	ND		50.8	56.9		mg/Kg		111	75 - 125
Cadmium	ND		50.8	53.2		mg/Kg		105	75 - 125
Chromium	2.6		50.8	53.9		mg/Kg		101	75 - 125
Cobalt	1.0		50.8	52.3		mg/Kg		101	75 - 125
Copper	3.2		50.8	61.6		mg/Kg		115	75 - 125
Lead	9.6		50.8	72.9		mg/Kg		125	75 - 125
Molybdenum	ND		50.8	51.0		mg/Kg		100	75 - 125
Nickel	3.8		50.8	54.4		mg/Kg		100	75 - 125
Selenium	ND		50.8	51.2		mg/Kg		101	75 - 125
Thallium	ND		50.8	50.2		mg/Kg		99	75 - 125
Vanadium	1.9		50.8	55.2		mg/Kg		105	75 - 125
Zinc	660		50.8	161	4	mg/Kg		-978	75 - 125
Silver	ND		25.4	27.2		mg/Kg		107	75 - 125

Lab Sample ID: 440-50442-1 MSD
 Matrix: Solid
 Analysis Batch: 116454

Client Sample ID: CRA-1A
 Prep Type: Total/NA
 Prep Batch: 116030

Analyte	Sample Result	Sample Qualifier	Spike Added	MSD Result	MSD Qualifier	Unit	D	%Rec	%Rec.	RPD	
									Limits		RPD
Antimony	ND		50.5	16.5	F	mg/Kg		33	75 - 125	14	20
Arsenic	3.3		50.5	55.8		mg/Kg		104	75 - 125	5	20
Barium	34		50.5	93.9		mg/Kg		118	75 - 125	7	20
Beryllium	ND		50.5	52.2		mg/Kg		102	75 - 125	9	20
Cadmium	ND		50.5	49.0		mg/Kg		97	75 - 125	8	20
Chromium	2.6		50.5	50.8		mg/Kg		96	75 - 125	6	20
Cobalt	1.0		50.5	49.4		mg/Kg		96	75 - 125	6	20
Copper	3.2		50.5	53.5		mg/Kg		100	75 - 125	14	20
Lead	9.6		50.5	70.7		mg/Kg		121	75 - 125	3	20
Molybdenum	ND		50.5	47.1		mg/Kg		93	75 - 125	8	20
Nickel	3.8		50.5	51.3		mg/Kg		94	75 - 125	6	20
Selenium	ND		50.5	48.6		mg/Kg		96	75 - 125	5	20

TestAmerica Irvine

QC Sample Results

Client: Conestoga-Rovers & Associates, Inc.
 Project/Site: 1748 150th Ave., San Leandro

TestAmerica Job ID: 440-50442-1

Method: 6010B - Metals (ICP) (Continued)

Lab Sample ID: 440-50442-1 MSD
 Matrix: Solid
 Analysis Batch: 116454

Client Sample ID: CRA-1A
 Prep Type: Total/NA
 Prep Batch: 116030

Analyte	Sample	Sample	Spike	MSD	MSD	Unit	D	%Rec	%Rec.	RPD	Limit
	Result	Qualifier	Added	Result	Qualifier				Limits		
Thallium	ND		50.5	47.5		mg/Kg		94	75 - 125	6	20
Vanadium	1.9		50.5	50.8		mg/Kg		97	75 - 125	8	20
Zinc	660		50.5	145	4	mg/Kg		-1015	75 - 125	10	20
Silver	ND		25.3	25.1		mg/Kg		99	75 - 125	8	20

Method: 7471A - Mercury (CVAA)

Lab Sample ID: MB 440-115919/1-A
 Matrix: Solid
 Analysis Batch: 116215

Client Sample ID: Method Blank
 Prep Type: Total/NA
 Prep Batch: 115919

Analyte	MB	MB	RL	MDL	Unit	D	Prepared	Analyzed	Dil Fac
	Result	Qualifier							
Mercury	ND		0.020		mg/Kg		07/07/13 12:05	07/08/13 17:18	1

Lab Sample ID: LCS 440-115919/2-A
 Matrix: Solid
 Analysis Batch: 116215

Client Sample ID: Lab Control Sample
 Prep Type: Total/NA
 Prep Batch: 115919

Analyte	Spike Added	LCS Result	LCS Qualifier	Unit	D	%Rec	%Rec.
							Limits
Mercury	0.800	0.797		mg/Kg		100	80 - 120

Lab Sample ID: 440-50897-A-1-C MS
 Matrix: Solid
 Analysis Batch: 116215

Client Sample ID: Matrix Spike
 Prep Type: Total/NA
 Prep Batch: 115919

Analyte	Sample	Sample	Spike	MS	MS	Unit	D	%Rec	%Rec.
	Result	Qualifier	Added	Result	Qualifier				Limits
Mercury	0.78		0.784	1.46		mg/Kg		86	70 - 130

Lab Sample ID: 440-50897-A-1-D MSD
 Matrix: Solid
 Analysis Batch: 116215

Client Sample ID: Matrix Spike Duplicate
 Prep Type: Total/NA
 Prep Batch: 115919

Analyte	Sample	Sample	Spike	MSD	MSD	Unit	D	%Rec	%Rec.	RPD	Limit
	Result	Qualifier	Added	Result	Qualifier				Limits		
Mercury	0.78		0.784	1.45		mg/Kg		85	70 - 130	1	20

QC Association Summary

Client: Conestoga-Rovers & Associates, Inc.
 Project/Site: 1748 150th Ave., San Leandro

TestAmerica Job ID: 440-50442-1

GC/MS VOA

Analysis Batch: 115864

Lab Sample ID	Client Sample ID	Prep Type	Matrix	Method	Prep Batch
440-50442-1	CRA-1A	Total/NA	Solid	8260B	
440-50586-B-1 MS	Matrix Spike	Total/NA	Solid	8260B	
440-50586-B-1 MSD	Matrix Spike Duplicate	Total/NA	Solid	8260B	
LCS 440-115864/5	Lab Control Sample	Total/NA	Solid	8260B	
MB 440-115864/4	Method Blank	Total/NA	Solid	8260B	

Analysis Batch: 115865

Lab Sample ID	Client Sample ID	Prep Type	Matrix	Method	Prep Batch
440-50442-1	CRA-1A	Total/NA	Solid	8260B/CA_LUFT MS	
440-50586-B-1 MS	Matrix Spike	Total/NA	Solid	8260B/CA_LUFT MS	
440-50586-B-1 MSD	Matrix Spike Duplicate	Total/NA	Solid	8260B/CA_LUFT MS	
LCS 440-115865/6	Lab Control Sample	Total/NA	Solid	8260B/CA_LUFT MS	
MB 440-115865/4	Method Blank	Total/NA	Solid	8260B/CA_LUFT MS	

GC Semi VOA

Analysis Batch: 115437

Lab Sample ID	Client Sample ID	Prep Type	Matrix	Method	Prep Batch
440-50442-1	CRA-1A	Total/NA	Solid	8015B	115552
LCS 440-115552/2-A	Lab Control Sample	Total/NA	Solid	8015B	115552
MB 440-115552/1-A	Method Blank	Total/NA	Solid	8015B	115552

Analysis Batch: 115443

Lab Sample ID	Client Sample ID	Prep Type	Matrix	Method	Prep Batch
440-50359-B-1-F MS	Matrix Spike	Total/NA	Solid	8015B	115552
440-50359-B-1-G MSD	Matrix Spike Duplicate	Total/NA	Solid	8015B	115552

Prep Batch: 115552

Lab Sample ID	Client Sample ID	Prep Type	Matrix	Method	Prep Batch
440-50359-B-1-F MS	Matrix Spike	Total/NA	Solid	CA LUFT	
440-50359-B-1-G MSD	Matrix Spike Duplicate	Total/NA	Solid	CA LUFT	
440-50442-1	CRA-1A	Total/NA	Solid	CA LUFT	
LCS 440-115552/2-A	Lab Control Sample	Total/NA	Solid	CA LUFT	
MB 440-115552/1-A	Method Blank	Total/NA	Solid	CA LUFT	

Metals

Prep Batch: 115919

Lab Sample ID	Client Sample ID	Prep Type	Matrix	Method	Prep Batch
440-50442-1	CRA-1A	Total/NA	Solid	7471A	
440-50897-A-1-C MS	Matrix Spike	Total/NA	Solid	7471A	
440-50897-A-1-D MSD	Matrix Spike Duplicate	Total/NA	Solid	7471A	
LCS 440-115919/2-A	Lab Control Sample	Total/NA	Solid	7471A	
MB 440-115919/1-A	Method Blank	Total/NA	Solid	7471A	

QC Association Summary

Client: Conestoga-Rovers & Associates, Inc.
 Project/Site: 1748 150th Ave., San Leandro

TestAmerica Job ID: 440-50442-1

Metals (Continued)

Prep Batch: 116030

Lab Sample ID	Client Sample ID	Prep Type	Matrix	Method	Prep Batch
440-50442-1	CRA-1A	Total/NA	Solid	3050B	
440-50442-1 MS	CRA-1A	Total/NA	Solid	3050B	
440-50442-1 MSD	CRA-1A	Total/NA	Solid	3050B	
LCS 440-116030/2-A ^5	Lab Control Sample	Total/NA	Solid	3050B	
MB 440-116030/1-A ^5	Method Blank	Total/NA	Solid	3050B	

Analysis Batch: 116215

Lab Sample ID	Client Sample ID	Prep Type	Matrix	Method	Prep Batch
440-50442-1	CRA-1A	Total/NA	Solid	7471A	115919
440-50897-A-1-C MS	Matrix Spike	Total/NA	Solid	7471A	115919
440-50897-A-1-D MSD	Matrix Spike Duplicate	Total/NA	Solid	7471A	115919
LCS 440-115919/2-A	Lab Control Sample	Total/NA	Solid	7471A	115919
MB 440-115919/1-A	Method Blank	Total/NA	Solid	7471A	115919

Analysis Batch: 116454

Lab Sample ID	Client Sample ID	Prep Type	Matrix	Method	Prep Batch
440-50442-1	CRA-1A	Total/NA	Solid	6010B	116030
440-50442-1 MS	CRA-1A	Total/NA	Solid	6010B	116030
440-50442-1 MSD	CRA-1A	Total/NA	Solid	6010B	116030
LCS 440-116030/2-A ^5	Lab Control Sample	Total/NA	Solid	6010B	116030
MB 440-116030/1-A ^5	Method Blank	Total/NA	Solid	6010B	116030

Definitions/Glossary

Client: Conestoga-Rovers & Associates, Inc.
Project/Site: 1748 150th Ave., San Leandro

TestAmerica Job ID: 440-50442-1

Qualifiers

GC/MS VOA

Qualifier	Qualifier Description
X	Surrogate is outside control limits

GC Semi VOA

Qualifier	Qualifier Description
F	MS or MSD exceeds the control limits
X	Surrogate is outside control limits
F	RPD of the MS and MSD exceeds the control limits

Metals

Qualifier	Qualifier Description
F	MS or MSD exceeds the control limits
4	MS, MSD: The analyte present in the original sample is 4 times greater than the matrix spike concentration; therefore, control limits are not applicable.

Glossary

Abbreviation	These commonly used abbreviations may or may not be present in this report.
α	Listed under the "D" column to designate that the result is reported on a dry weight basis
%R	Percent Recovery
CNF	Contains no Free Liquid
DER	Duplicate error ratio (normalized absolute difference)
DL, RA, RE, IN	Indicates a Dilution, Re-analysis, Re-extraction, or additional Initial metals/anion analysis of the sample
DLC	Decision level concentration
MDA	Minimum detectable activity
EDL	Estimated Detection Limit
MDC	Minimum detectable concentration
MDL	Method Detection Limit
ML	Minimum Level (Dioxin)
NC	Not Calculated
ND	Not detected at the reporting limit (or MDL or EDL if shown)
PQL	Practical Quantitation Limit
QC	Quality Control
RER	Relative error ratio
RL	Reporting Limit or Requested Limit (Radiochemistry)
RPD	Relative Percent Difference, a measure of the relative difference between two points
TEF	Toxicity Equivalent Factor (Dioxin)
TEQ	Toxicity Equivalent Quotient (Dioxin)

Certification Summary

Client: Conestoga-Rovers & Associates, Inc.
Project/Site: 1748 150th Ave., San Leandro

TestAmerica Job ID: 440-50442-1

Laboratory: TestAmerica Irvine

All certifications held by this laboratory are listed. Not all certifications are applicable to this report.

Authority	Program	EPA Region	Certification ID	Expiration Date
Alaska	State Program	10	CA01531	06-30-14
Arizona	State Program	9	AZ0671	10-13-13
California	LA Cty Sanitation Districts	9	10256	01-31-14
California	NELAP	9	1108CA	01-31-14
California	State Program	9	2706	06-30-14
Guam	State Program	9	Cert. No. 12.002r	01-28-14 *
Hawaii	State Program	9	N/A	01-31-14
Nevada	State Program	9	CA015312007A	07-31-13
New Mexico	State Program	6	N/A	01-31-14
Northern Mariana Islands	State Program	9	MP0002	01-31-14
Oregon	NELAP	10	4005	09-12-13
USDA	Federal		P330-09-00080	06-06-14
USEPA UCMR	Federal	1	CA01531	01-31-15

* Expired certification is currently pending renewal and is considered valid.

TestAmerica Irvine

LAB (LOCATION)

- CALSCIENCE ()
- SPL ()
- XENCO ()
- TEST AMERICA ()
- OTHER ()



Shell Oil Products Chain Of Custody Record 440-50442

Please Check Appropriate Box:

<input type="checkbox"/> ENV SERVICES	<input type="checkbox"/> MOTIVA RETAIL	<input type="checkbox"/> SHELL RETAIL
<input type="checkbox"/> MOTIVA SD&CM	<input checked="" type="checkbox"/> CONSULTANT	<input type="checkbox"/> LUBES
<input type="checkbox"/> SHELL PIPELINE	<input type="checkbox"/> OTHER	

Print Bill To Contact Name: Peter Schaefer - 240612

INCIDENT # (ENV SERVICES) 9 8 9 9 8 0 6 8

PO # _____ SAP # _____

DATE 6/28/13

PAGE 1 of 1

SAMPLING COMPANY: Conestoga-Rovers & Associates

LOG CODE: CRAW

SITE ADDRESS: 1748 150th Ave., San Leandro, CA

GLOBAL ID NO: T0600101230

ADDRESS: 5900 Hollis St, Suite A, Emeryville, CA 94608

EDF DELIVERABLE TO (Name Company Office Location): Brenda Carter, CRA, Emeryville

PHONE NO: 510-420-3343

E-MAIL: shelledf@croworld.com

CONSULTANT PROJECT NO: 240612

PROJECT CONTACT (Hardcopy or PDF Report to): Peter Schaefer

TELEPHONE: 510-420-3319

FAX: 510-420-9170

E-MAIL: pschaefer@croworld.com

TURNAROUND TIME (CALENDAR DAYS):

STANDARD (1-4 DAY) 5 DAYS 3 DAYS 2 DAYS 24 HOURS

RESULTS NEEDED ON WEEKEND

LA - RWQCB REPORT FORMAT UST AGENCY

SPECIAL INSTRUCTIONS OR NOTES:

Call composite sample ID and field point name CRA-A

Marked TAT except for those contingent tests needed for Aquatic Bioassay

cc: Derek Eisman, Deisman@croworld.com and Shell.Lab.Billing@croworld.com

SHELL CONTRACT RATE APPLIES

STATE REIMBURSEMENT RATE APPLIES

EDD NOT NEEDED

RECEIPT VERIFICATION REQUESTED

REQUESTED ANALYSIS

TPH - Purgeable (8260B)	TPH - Extractable (8015M)	BTEX (8260B)	5 Oxygenates (8260B)	MTBE (8260B)	TBA (8260B)	DIPE (8260B)	TAME (8260B)	ETBE (8260B)	1,2 DCA (8260B)	EDB (8260B)	Ethanol (8260B)	Methanol (8015M)	TPH - MO (8015M)	CAM 17 Metals - Total (8010)	SVOCs (8270C)	VOCs (8260)	PCBs (8082)	TEMPERATURE ON RECEIPT C°
X	X	X											X	X				3.6/3.3 3.1/2.8 2.7/2.4 Container PID Readings or Laboratory Notes

LAB USE ONLY	Field Sample Identification	SAMPLING		MATRIX	PRESERVATIVE					NO OF CONT.								
		DATE	TIME		HCL	HNO3	H2SO4	NONE	OTHER									
	CRA-1A	6/24/13	1000	SOIL						1	X	X	X					



Relinquished by (Signature): <i>[Signature]</i>	Received by (Signature): <i>[Signature]</i>	Date: 6/28/13	Time: 1500
Relinquished by (Signature): <i>[Signature]</i>	Received by (Signature): <i>[Signature]</i>	Date: 6-28-13	Time: 16:00
Relinquished by (Signature): <i>[Signature]</i>	Received by (Signature): <i>[Signature]</i>	Date: 6/29/13	Time: 9:50

Login Sample Receipt Checklist

Client: Conestoga-Rovers & Associates, Inc.

Job Number: 440-50442-1

Login Number: 50442

List Source: TestAmerica Irvine

List Number: 1

Creator: Chy, Jonathan

Question	Answer	Comment
Radioactivity wasn't checked or is \leq background as measured by a survey meter.	N/A	
The cooler's custody seal, if present, is intact.	True	
Sample custody seals, if present, are intact.	N/A	
The cooler or samples do not appear to have been compromised or tampered with.	True	
Samples were received on ice.	True	
Cooler Temperature is acceptable.	True	
Cooler Temperature is recorded.	True	
COC is present.	True	
COC is filled out in ink and legible.	True	
COC is filled out with all pertinent information.	True	
Is the Field Sampler's name present on COC?	True	Chris Benedict
There are no discrepancies between the containers received and the COC.	True	
Samples are received within Holding Time.	True	
Sample containers have legible labels.	True	
Containers are not broken or leaking.	True	
Sample collection date/times are provided.	True	
Appropriate sample containers are used.	True	
Sample bottles are completely filled.	True	
Sample Preservation Verified.	N/A	
There is sufficient vol. for all requested analyses, incl. any requested MS/MSDs	True	
Containers requiring zero headspace have no headspace or bubble is $<6\text{mm}$ ($1/4"$).	N/A	
Multiphasic samples are not present.	True	
Samples do not require splitting or compositing.	True	
Residual Chlorine Checked.	N/A	

APPENDIX C

DISPOSAL DOCUMENTATION

NON-HAZARDOUS
WASTE MANIFEST

1. Generator ID Number
NOT REQUIRED

2. Page 1 of 1
3. Emergency Response Phone
800-424-9300

4. Waste Tracking Number
0702083

5. Generator's Name and Mailing Address
**Shell Oil Products US care of CRA Attn: Derek Eisman
6520 Corporate Drive, Indianapolis, IN 46278**

Generator's Site Address (if different than mailing address)
**1784 150th
San Leandro, CA 94578**

Generator's Phone:

6. Transporter 1 Company Name
American Integrated Services, Inc.

U.S. EPA ID Number
CAR000148338

7. Transporter 2 Company Name

U.S. EPA ID Number

8. Designated Facility Name and Site Address
**Keller Canyon Landfill
901 Bailey Road**

U.S. EPA ID Number
Not Required

Facility's Phone: **Pittsburg, CA 94565 925-458-9800**

9. Waste Shipping Name and Description

10. Containers
No. Type

11. Total
Quantity

12. Unit
Wt./Vol.

1. **Non-Hazardous Waste Solid. (Construction Debris)**

011 DM 5500 P

2.

3.

4.

13. Special Handling Instructions and Additional Information

Wear protective equipment while handling. Weights or volumes are approximate.

LIXSS

Project #: 73006-2-61

14. GENERATOR'S/OFFEROR'S CERTIFICATION: I hereby declare that the contents of this consignment are fully and accurately described above by the proper shipping name, and are classified, packaged, marked and labeled/placarded, and are in all respects in proper condition for transport according to applicable international and national governmental regulations.

Generator's/Offereor's Printed/Typed Name
ATS on behalf of SOPS - K Dupler

Signature
Kari D...e

Month Day Year
7 26 13

15. International Shipments Import to U.S. Export from U.S.

Port of entry/exit:

Transporter Signature (for exports only):

Date leaving U.S.:

16. Transporter Acknowledgment of Receipt of Materials

Transporter 1 Printed/Typed Name
MARCO MARTINEZ

Signature
Marco Martinez

Month Day Year
7 26 13

Transporter 2 Printed/Typed Name

Signature

Month Day Year

17. Discrepancy

17a. Discrepancy Indication Space Quantity Type Residue Partial Rejection Full Rejection

Manifest Reference Number:

17b. Alternate Facility (or Generator)

U.S. EPA ID Number

Facility's Phone:

17c. Signature of Alternate Facility (or Generator)

Month Day Year

18. Designated Facility Owner or Operator: Certification of receipt of materials covered by the manifest except as noted in Item 17a

Printed/Typed Name

Signature

Month Day Year

GENERATOR

INT'L

TRANSPORTER

DESIGNATED FACILITY

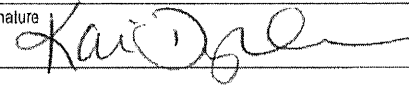
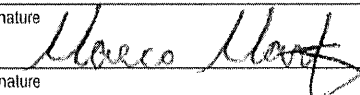
NON-HAZARDOUS WASTE MANIFEST	1. Generator ID Number NOT REQUIRED	2. Page 1 of 1	3. Emergency Response Phone 800-424-9300	4. Waste Tracking Number 0702084
5. Generator's Name and Mailing Address Shell Oil Products US c/o CRA, Attn: Derek Eisman 6520 Corporate Drive, Indianapolis, IN 46278		Generator's Site Address (if different than mailing address) 1784 150th San Leandro, CA 94578		
6. Transporter 1 Company Name American Integrated Services, Inc.		U.S. EPA ID Number CAR000148338		
7. Transporter 2 Company Name		U.S. EPA ID Number		
8. Designated Facility Name and Site Address Keller Canyon Landfill 901 Bailey Road Pittsburg, CA 94565 925-458-9800		U.S. EPA ID Number Not Required		
9. Waste Shipping Name and Description		10. Containers		11. Total Quantity
		No.	Type	12. Unit Wt./Vol.
1. Non-Hazardous Waste Solid (Soil)		400	DM	5000 P
2.				
3.				
4.				
13. Special Handling Instructions and Additional Information Wear protective equipment while handling. Weights or volumes are approximate. 24 hour emergency number (800) 424-9300 Chemtrec.		RIPR#: 98932 SAP#: 136019 Incident#: 98996068 Profile#: 4212107702 Project #: 73006-2-61 CRA# 240612 IXSS		
14. GENERATOR'S/OFFEROR'S CERTIFICATION: I hereby declare that the contents of this consignment are fully and accurately described above by the proper shipping name, and are classified, packaged, marked and labeled/placarded, and are in all respects in proper condition for transport according to applicable international and national governmental regulations.				
Generator's/Offoror's Printed/Typed Name AIS on behalf of SOPUS - K Dupler		Signature 		Month Day Year 7 26 03
15. International Shipments <input type="checkbox"/> Import to U.S. <input type="checkbox"/> Export from U.S. Port of entry/exit: _____ Date leaving U.S.: _____				
16. Transporter Acknowledgment of Receipt of Materials				
Transporter 1 Printed/Typed Name MARCO MARTINEZ		Signature 		Month Day Year 7 25 03
Transporter 2 Printed/Typed Name		Signature		Month Day Year
17. Discrepancy				
17a. Discrepancy Indication Space <input type="checkbox"/> Quantity <input type="checkbox"/> Type <input type="checkbox"/> Residue <input type="checkbox"/> Partial Rejection <input type="checkbox"/> Full Rejection				
17b. Alternate Facility (or Generator) Manifest Reference Number: _____ U.S. EPA ID Number _____				
17c. Signature of Alternate Facility (or Generator) _____ Month Day Year _____				
18. Designated Facility Owner or Operator: Certification of receipt of materials covered by the manifest except as noted in Item 17a				
Printed/Typed Name		Signature		Month Day Year

GENERATOR

INT'L

TRANSPORTER

DESIGNATED FACILITY