

# C A M B R I A

April 30, 2001

Scott Seery  
Alameda County Health Care Services Agency  
1131 Harbor Bay Parkway, Suite 250  
Alameda, California 94502-6577

Re: **First Quarter 2001 Monitoring Report**  
Shell-branded Service Station  
1784 150th Avenue  
San Leandro, California  
Incident #98996068  
Cambria Project #243-0612-002



Dear Mr. Seery:

On behalf of Equiva Services LLC, Cambria Environmental Technology, Inc. (Cambria) is submitting this groundwater monitoring report in accordance with the reporting requirements of 23 CCR 2652d.

## FIRST QUARTER 2001 ACTIVITIES

**Groundwater Monitoring:** Blaine Tech Services, Inc. (Blaine) of San Jose, gauged all site wells, sampled selected site wells, calculated groundwater elevations, and compiled the analytical data. Cambria prepared a groundwater elevation contour map (Figure 1). Blaine's report, presenting the laboratory report and supporting field documents, is included as Attachment A.

In addition to the usual gasoline constituents, all sampled wells were analyzed for volatile organic compounds (VOCs) by EPA Method 8021B. VOCs were reported for the quarter, except for benzene at 6.76 parts per billion (ppb) in MW-1, 0.891 ppb in MW-2, and 31.8 ppb in MW-3.

Oakland, CA  
San Ramon, CA  
Sonoma, CA

## ANTICIPATED SECOND QUARTER 2001 ACTIVITIES

**Cambria  
Environmental  
Technology, Inc.**

**Groundwater Monitoring:** Blaine will gauge and sample all wells, and tabulate the data. Cambria will prepare a monitoring report.

1144 65th Street  
Suite B  
Oakland, CA 94608  
Tel (510) 420-0700  
Fax (510) 420-9170

C A M B R I A

Scott Seery  
April 30, 2001

**CLOSING**

We appreciate the opportunity to work with you on this project. Please call Stephan Bork at (510) 420-3344 if you have any questions or comments.

Sincerely,  
**Cambria Environmental Technology, Inc**



  
Anni Kreml  
Senior Staff Scientist

  
Stephan A. Bork, C.E.G., C.HG.  
Associate Hydrogeologist

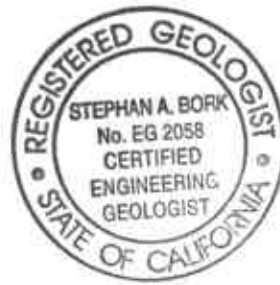

Figure: 1 - Groundwater Elevation Contour Map

Attachment: A - Blaine Groundwater Monitoring Report and Field Notes

cc: Karen Petryna, Equiva Services LLC, P.O. Box 7869, Burbank, California 91510-7869

g:\sanleandro\1784-150th\qm\Iq01qm.doc

D:\SANLEANDRO-1784-150TH\FIGURES\10M01.MP.A

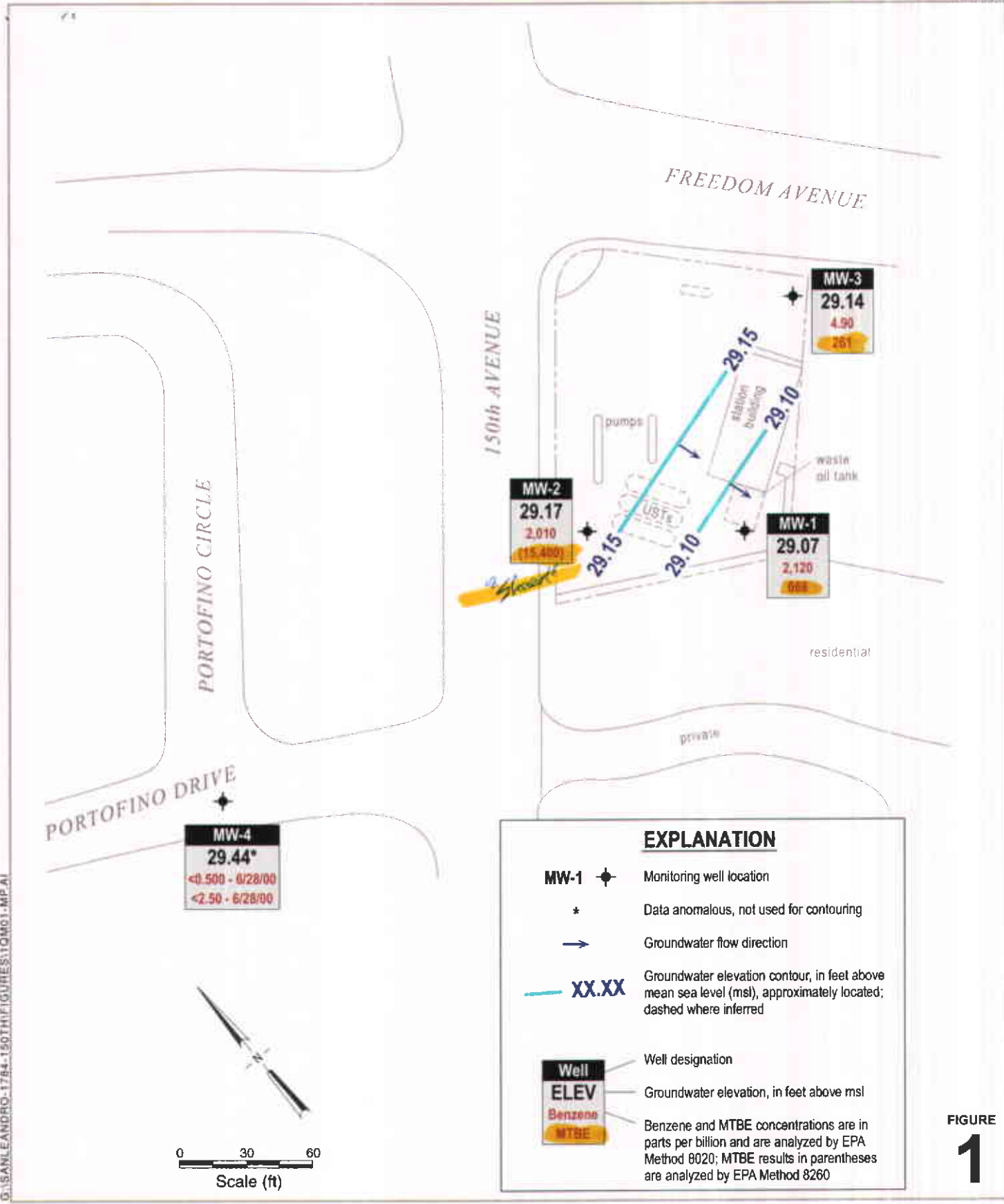

**EXPLANATION**

- MW-1 + Monitoring well location
- \* Data anomalous, not used for contouring
- Groundwater flow direction
- XX.XX Groundwater elevation contour, in feet above mean sea level (msl), approximately located; dashed where inferred
- Well Well designation
- ELEV Groundwater elevation, in feet above msl
- Benzene MTBE Benzene and MTBE concentrations are in parts per billion and are analyzed by EPA Method 8020; MTBE results in parentheses are analyzed by EPA Method 8260

**FIGURE 1**

**Shell-branded Service Station**  
 1784 150th Avenue  
 San Leandro, California  
 Incident #98996068



**Groundwater Elevation Contour Map**

March 5, 2001

**ATTACHMENT A**  
**Blaine Groundwater Monitoring Report**  
**and Field Notes**

**BLAINE**  
TECH SERVICES, INC.



1680 ROGERS AVENUE  
SAN JOSE, CA 95112-1105  
(408) 573-7771 FAX  
(408) 573-0555 PHONE  
CONTRACTOR'S LICENSE #746684  
[www.blainetech.com](http://www.blainetech.com)

March 26, 2001

Karen Petryna  
Equiva Services LLC  
P.O. Box 7869  
Burbank, CA 91510-7869

First Quarter 2001 Groundwater Monitoring at  
Shell-branded Service Station  
1784 150<sup>th</sup> Avenue  
San Leandro, CA

Monitoring performed on March 5, 2001

---

Groundwater Monitoring Report **010305-G-1**

This report covers the routine monitoring of groundwater wells at this Shell-branded facility. In accordance with standard procedures that conform to Regional Water Quality Control Board requirements, routine field data collection includes depth to water, total well depth, thickness of any separate immiscible layer, water column volume, calculated purge volume (if applicable), elapsed evacuation time (if applicable), total volume of water removed (if applicable), and standard water parameter instrument readings. Sample material is collected, contained, stored, and transported to the laboratory in conformance with EPA standards. Purgewater (if applicable) is, likewise, collected and transported to the Shell Martinez Manufacturing Complex.

Basic field information is presented alongside analytical values excerpted from the laboratory report in the cumulative table of **WELL CONCENTRATIONS**. The full analytical report for the most recent samples and the field data sheets are attached to this report.

At a minimum, Blaine Tech Services, Inc. field personnel are certified on completion of a forty hour Hazardous Materials and Emergency Response training course per 29 CFR 1910.120. Field personnel are also enrolled in annual eight hour refresher courses.

Blaine Tech Services, Inc. conducts sampling and documentation assignments of this type as an independent third party. In order to avoid compromising the objectivity necessary for the proper and disinterested performance of this work, Blaine Tech Services, Inc. concentrates on objective data collection and does not participate in the interpretation of analytical results, the definition of geological or hydrological conditions, the formulation of recommendations, or the marketing of remedial systems.

Please call if you have any questions.

Yours truly,

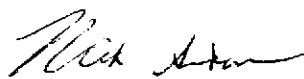

for

Deidre Kerwin  
Operations Manager

DK/jt

attachments: Cumulative Table of WELL CONCENTRATIONS  
Certified Analytical Report  
Field Data Sheet

cc: Anni Kreml  
Cambria Environmental Technology, Inc.  
1144 65<sup>th</sup> Street, Ste. C  
Oakland, CA 94608

**WELL CONCENTRATIONS**  
**Shell-branded Service Station**  
**1784 150th Avenue**  
**San Leandro, CA**  
**Wic #204-6852-1404**

Well ID	Date	TPPH (ug/L)	TEPH (ug/L)	B (ug/L)	T (ug/L)	E (ug/L)	X (ug/L)	MTBE 8020 (ug/L)	MTBE 8260 (ug/L)	TOC (MSL)	Depth to Water (ft.)	GW Elevation (MSL)	SPH Thickness (ft.)	DO Reading (ppm)
---------	------	----------------	----------------	-------------	-------------	-------------	-------------	------------------------	------------------------	--------------	----------------------------	--------------------------	---------------------------	------------------------

MW-1	03/08/1990	510	120	1.5	0.8	<0.5	5.4	NA	NA	49.13	25.29	23.84	NA	NA
MW-1	06/12/1990	390	100	86	1.3	0.7	6.2	NA	NA	49.13	25.85	23.28	NA	NA
MW-1	09/13/1990	100	130	56	0.75	2.4	2.8	NA	NA	49.13	27.49	21.64	NA	NA
MW-1	12/18/1990	480	<50	54	1.7	3.3	3.7	NA	NA	49.13	27.41	21.72	NA	NA
MW-1	03/07/1991	80	<50	266	<0.5	1.2	<1.5	NA	NA	49.13	25.79	23.34	NA	NA
MW-1	06/07/1991	510	<50	130	3.8	6.1	11	NA	NA	49.13	25.64	23.49	NA	NA
MW-1	09/17/1991	330	120a	67	<0.5	3.0	2.2	NA	NA	49.13	27.54	21.59	NA	NA
MW-1	12/09/1991	140a	80	<0.5	<0.5	1.7	4.7	NA	NA	49.13	27.81	21.32	NA	NA
MW-1	02/13/1992	NA	NA	NA	NA	NA	NA	NA	NA	49.13	25.57	23.56	NA	NA
MW-1	02/24/1992	NA	NA	NA	NA	NA	NA	NA	NA	49.13	22.83	26.30	NA	NA
MW-1	02/27/1992	NA	NA	NA	NA	NA	NA	NA	NA	49.13	23.09	26.04	NA	NA
MW-1	03/01/1992	<50	<50	<0.5	<0.5	<0.5	<0.5	NA	NA	49.13	23.26	25.87	NA	NA
MW-1	06/03/1992	1,500	NA	520	180	72	230	NA	NA	49.13	24.64	24.49	NA	NA
MW-1	09/01/1992	130	NA	16	1.4	1.8	3.4	NA	NA	49.13	26.74	22.39	NA	NA
MW-1	10/06/1992	NA	NA	NA	NA	NA	NA	NA	NA	49.13	27.18	21.95	NA	NA
MW-1	11/11/1992	NA	NA	NA	NA	NA	NA	NA	NA	49.13	27.99	21.14	NA	NA
MW-1	12/04/1992	150	NA	360	0.7	1.8	2.1	NA	NA	49.13	27.14	21.99	NA	NA
MW-1	01/22/1993	NA	NA	NA	NA	NA	NA	NA	NA	49.13	20.09	29.04	NA	NA
MW-1	02/10/1993	NA	NA	NA	NA	NA	NA	NA	NA	49.13	24.26	24.87	NA	NA
MW-1	03/03/1993	<50	NA	1.5	<0.5	<0.5	<0.5	NA	NA	49.13	20.50	28.63	NA	NA
MW-1	05/11/1993	NA	NA	NA	NA	NA	NA	NA	NA	49.13	21.70	27.43	NA	NA
MW-1	06/17/1993	1,600	NA	340	120	120	440	NA	NA	49.13	22.42	26.71	NA	NA
MW-1	09/10/1993	2,600	NA	670	340	310	730	NA	NA	49.13	24.11	25.02	NA	NA
MW-1	12/13/1993	11,000	NA	470	320	380	2,300	NA	NA	49.13	23.73	25.40	NA	NA
MW-1	03/03/1994	16,000	NA	700	690	480	3,200	NA	NA	49.13	22.08	27.05	NA	NA

**WELL CONCENTRATIONS**  
**Shell-branded Service Station**  
**1784 150th Avenue**  
**San Leandro, CA**  
**Wic #204-6852-1404**

Well ID	Date	TPPH (ug/L)	TEPH (ug/L)	B (ug/L)	T (ug/L)	E (ug/L)	X (ug/L)	MTBE 8020 (ug/L)	MTBE 8260 (ug/L)	TOC (MSL)	Depth to Water (ft.)	GW Elevation (MSL)	SPH Thickness (ft.)	DO Reading (ppm)
MW-1	06/06/1994	7,500	NA	420	280	200	1,000	NA	NA	49.13	23.10	26.03	NA	NA
MW-1	09/12/1994	1,200	NA	110	21	3.3	420	NA	NA	49.13	25.19	23.94	NA	NA
MW-1	12/19/1994	4,600	NA	470	330	230	1,300	NA	NA	49.13	23.06	26.07	NA	NA
MW-1	02/28/1995	500	NA	59	32	6.8	68	NA	NA	49.13	20.90	28.23	NA	NA
MW-1	03/24/1995	NA	NA	NA	NA	NA	NA	NA	NA	49.13	18.28	30.85	NA	NA
MW-1	06/26/1995	5,500	NA	740	420	300	1,800	NA	NA	49.13	20.40	28.73	NA	NA
MW-1	09/13/1995	84,000	NA	1,900	2,600	3,000	14,000	NA	NA	49.13	22.62	26.51	NA	NA
MW-1	12/19/1995	80,000	NA	660	350	170	18,000	NA	NA	49.13	22.10	27.03	NA	NA
MW-1	03/07/1996	NA	NA	NA	NA	NA	NA	NA	NA	49.13	18.83	30.34	0.05	NA
MW-1	06/28/1996	270,000	NA	2,800	820	1,000	16,000	<0.5	NA	49.13	21.46	27.67	NA	NA
MW-1 (D)	06/28/1996	790,000	NA	2,200	780	1,000	13,000	15,000	NA	49.13	21.46	27.67	NA	NA
MW-1	09/26/1996	29,000	NA	1,100	260	270	1,900	<1,000	NA	49.13	23.57	25.57	0.01	NA
MW-1	09/26/1996	25,000	NA	1,200	320	240	1,900	<1,000	NA	49.13	NA	NA	NA	NA
MW-1	12/10/1996	13,000	NA	510	240	230	1,200	100	NA	49.13	21.43	27.70	NA	1.0
MW-1 (D)	12/10/1996	8,400	NA	420	130	140	680	81	NA	49.13	21.43	27.70	NA	1.0
MW-1	03/10/1997	4,200	NA	13	8.8	16	74	<12	NA	49.13	20.08	29.05	NA	2.0
MW-1 (D)	03/10/1997	5,100	NA	12	8.9	17	79	<25	NA	49.13	20.08	29.05	NA	2.0
MW-1	06/30/1997	5,700	NA	320	120	140	700	47	NA	49.13	21.68	27.45	NA	1.6
MW-1 (D)	06/30/1997	5,300	NA	300	95	120	580	45	NA	49.13	21.68	27.45	NA	1.6
MW-1	09/12/1997	6,300	NA	120	26	82	260	30	NA	49.13	21.78	27.35	NA	2.1
MW-1 b	12/18/1997	NA	NA	NA	NA	NA	NA	NA	NA	49.13	20.78	28.35	NA	1.3
MW-1	02/02/1998	84	NA	5.1	<0.50	<0.50	2.1	2.5	NA	49.13	19.65	29.48	NA	2.0
MW-1	06/24/1998	13,000	NA	3,000	260	410	1,400	<250	NA	49.13	19.65	29.48	NA	2.5
MW-1 (D)	06/24/1998	12,000	NA	3,800	250	47	1,400	710	NA	49.13	19.65	29.48	NA	2.5
MW-1	08/26/1998	3,100	NA	1,200	27	170	50	88	NA	49.13	20.49	28.64	NA	2.1



**WELL CONCENTRATIONS**  
**Shell-branded Service Station**  
**1784 150th Avenue**  
**San Leandro, CA**  
**Wic #204-6852-1404**

Well ID	Date	TPPH (ug/L)	TEPH (ug/L)	B (ug/L)	T (ug/L)	E (ug/L)	X (ug/L)	MTBE 8020 (ug/L)	MTBE 8260 (ug/L)	TOC (MSL)	Depth to Water (ft.)	GW Elevation (MSL)	SPH Thickness (ft.)	DO Reading (ppm)
---------	------	----------------	----------------	-------------	-------------	-------------	-------------	------------------------	------------------------	--------------	----------------------------	--------------------------	---------------------------	------------------------

MW-1	12/23/1998	45,000	NA	5,300	220	1,000	3,600	970	NA	49.13	21.22	27.91	NA	3.8
MW-1	03/01/1999	22,300	NA	2,540	436	753	3,370	<400	NA	49.13	19.27	29.86	NA	1.8
MW-1	06/14/1999	18,800	NA	6,820	210	436	958	1,360	NA	49.13	20.80	28.33	NA	2.2
MW-1	09/28/1999	21,500	NA	7,470	281	467	927	1,800	NA	49.13	22.55	26.58	NA	2.0
MW-1	12/08/1999	22,300	NA	6,140	135	256	367	232	NA	49.13	23.12	26.01	NA	2.1
MW-1	03/14/2000	6,690	NA	1,880	63.5	134	307	460	NA	49.13	18.87	30.26	NA	2.3
MW-1	06/28/2000	8,080	NA	2,690	85.1	149	514	701	NA	49.13	21.12	28.01	NA	2.4
MW-1	09/06/2000	17,800	NA	7,390	212	329	1,270	<1,000	NA	49.13	21.90	27.23	NA	3.0
MW-1	12/14/2000	8,900	NA	4,870	79.2	106	370	1,840	673*	49.13	22.60	26.53	NA	2.0
<b>MW-1</b>	<b>03/05/2001</b>	<b>7,520</b>	<b>NA</b>	<b>2,120</b>	<b>66.0</b>	<b>107</b>	<b>129</b>	<b>668</b>	<b>NA</b>	<b>49.13</b>	<b>20.06</b>	<b>29.07</b>	<b>NA</b>	<b>0.4</b>

MW-2	02/13/1992	NA	NA	NA	NA	NA	NA	NA	NA	45.83	22.22	23.61	NA	NA
MW-2	02/24/1992	17,000	2,700a	6,200	1,600	550	1,900	NA	NA	45.83	19.61	26.22	NA	NA
MW-2	02/27/1992	NA	NA	NA	NA	NA	NA	NA	NA	45.83	19.92	25.91	NA	NA
MW-2	03/01/1992	86,000	1,000a	30,000	34,000	2,300	16,000	NA	NA	45.83	21.11	24.72	NA	NA
MW-2	06/03/1992	87,000	NA	28,000	18,000	2,000	10,000	NA	NA	45.83	21.58	24.25	NA	NA
MW-2	09/01/1992	110,000	NA	21,000	13,000	1,900	7,800	NA	NA	45.83	23.46	22.37	NA	NA
MW-2	10/06/1992	NA	NA	NA	NA	NA	NA	NA	NA	45.83	23.99	21.84	NA	NA
MW-2	11/11/1992	NA	NA	NA	NA	NA	NA	NA	NA	45.83	24.25	21.58	NA	NA
MW-2	12/04/1992	42,000	NA	15,000	2,400	960	2,900	NA	NA	45.83	23.89	21.94	NA	NA
MW-2	01/22/1993	NA	NA	NA	NA	NA	NA	NA	NA	45.83	17.03	28.80	NA	NA
MW-2	02/10/1993	NA	NA	NA	NA	NA	NA	NA	NA	45.83	18.08	27.75	NA	NA
MW-2	03/03/1993	160,000	NA	36,000	3,800	32,000	21,000	NA	NA	45.83	17.28	28.55	NA	NA
MW-2 (D)	03/03/1993	150,000	NA	31,000	3,100	20,000	14,000	NA	NA	45.83	17.28	28.55	NA	NA
MW-2	05/11/1993	NA	NA	NA	NA	NA	NA	NA	NA	45.83	18.41	27.42	NA	NA

**WELL CONCENTRATIONS**  
**Shell-branded Service Station**  
**1784 150th Avenue**  
**San Leandro, CA**  
**Wic #204-6852-1404**

Well ID	Date	TPPH (ug/L)	TEPH (ug/L)	B (ug/L)	T (ug/L)	E (ug/L)	X (ug/L)	MTBE 8020 (ug/L)	MTBE 8260 (ug/L)	TOC (MSL)	Depth to Water (ft.)	GW Elevation (MSL)	SPH Thickness (ft.)	DO Reading (ppm)
MW-2	06/17/1993	65,000	NA	34,000	15,000	3,200	11,000	NA	NA	45.83	19.06	26.77	NA	NA
MW-2 (D)	06/17/1993	62,000	NA	28,000	14,000	2,700	10,000	NA	NA	45.83	19.06	26.77	NA	NA
MW-2	09/10/1993	72,000	NA	24,000	16,000	2,300	11,000	NA	NA	45.83	20.88	24.95	NA	NA
MW-2 (D)	09/10/1993	71,000	NA	23,000	15,000	2,300	10,000	NA	NA	45.83	20.88	24.95	NA	NA
MW-2	12/13/1993	19,000	NA	5,400	4,900	680	3,100	NA	NA	45.83	20.42	25.41	NA	NA
MW-2 (D)	12/13/1993	17,000	NA	6,200	5,500	720	3,500	NA	NA	45.83	20.42	25.41	NA	NA
MW-2	03/03/1994	110,000	NA	21,000	24,000	2,000	13,000	NA	NA	45.83	18.48	27.35	NA	NA
MW-2 (D)	03/03/1994	93,000	NA	19,000	22,000	1,800	12,000	NA	NA	45.83	18.48	27.35	NA	NA
MW-2	06/06/1994	10,000	NA	1,900	3,300	2,500	13,000	NA	NA	45.83	20.26	25.57	NA	NA
MW-2 (D)	06/06/1994	99,000	NA	9,900	12,000	2,400	12,000	NA	NA	45.83	20.26	25.57	NA	NA
MW-2	09/12/1994	160,000	NA	22,000	33,000	3,400	23,000	NA	NA	45.83	21.80	24.03	NA	NA
MW-2 (D)	09/12/1994	150,000	NA	23,000	34,000	3,500	23,000	NA	NA	45.83	21.80	24.03	NA	NA
MW-2	12/19/1994	80,000	NA	17,000	16,000	2,300	14,000	NA	NA	45.83	19.66	26.17	NA	NA
MW-2 (D)	12/19/1994	100,000	NA	28,000	26,000	3,400	20,000	NA	NA	45.83	19.66	26.17	NA	NA
MW-2	02/28/1995	100,000	NA	24,000	18,000	2,300	17,000	NA	NA	45.83	17.51	28.32	NA	NA
MW-2 (D)	02/28/1995	100,000	NA	31,000	21,000	3,200	18,000	NA	NA	45.83	17.51	28.32	NA	NA
MW-2	03/24/1995	NA	NA	NA	NA	NA	NA	NA	NA	45.83	14.88	30.95	NA	NA
MW-2	06/26/1995	45,000	NA	14,000	12,000	1,500	7,500	NA	NA	45.83	17.58	28.25	NA	NA
MW-2 (D)	06/26/1995	68,000	NA	13,000	11,000	1,800	7,700	NA	NA	45.83	17.58	28.25	NA	NA
MW-2	09/13/1995	110,000	NA	19,000	19,000	2,800	15,000	NA	NA	45.83	19.28	26.55	NA	NA
MW-2 (D)	09/13/1995	120,000	NA	20,000	20,000	2,900	15,000	NA	NA	45.83	19.28	26.55	NA	NA
MW-2	12/19/1995	180,000	NA	18,000	29,000	4,100	24,000	NA	NA	45.83	18.61	27.22	NA	NA
MW-2 (D)	12/19/1995	160,000	NA	18,000	28,000	3,800	24,000	NA	NA	45.83	18.61	27.22	NA	NA
MW-2	03/06/1996	120,000	NA	28,000	15,000	3,900	17,000	NA	NA	45.83	15.41	30.42	NA	NA
MW-2	06/28/1996	96,000	NA	20,000	20,000	4,100	22,000	2,400	NA	45.83	17.84	27.99	NA	NA

**WELL CONCENTRATIONS**  
**Shell-branded Service Station**  
**1784 150th Avenue**  
**San Leandro, CA**  
**Wic #204-6852-1404**

Well ID	Date	TPPH (ug/L)	TEPH (ug/L)	B (ug/L)	T (ug/L)	E (ug/L)	X (ug/L)	MTBE 8020 (ug/L)	MTBE 8260 (ug/L)	TOC (MSL)	Depth to Water (ft.)	GW Elevation (MSL)	SPH Thickness (ft.)	DO Reading (ppm)
MW-2	09/26/1996	87,000	NA	7,600	11,000	2,500	15,000	990	840	45.83	19.60	26.23	NA	NA
MW-2	12/10/1996	NA	NA	NA	NA	NA	NA	NA	NA	45.83	18.15	27.88	0.25	NA
MW-2	03/10/1997	NA	NA	NA	NA	NA	NA	NA	NA	45.83	17.02	28.97	0.20	NA
MW-2	06/30/1997	57,000	NA	3,600	4,600	1,300	9,700	2,300	NA	45.83	19.42	26.41	NA	2.4
MW-2	09/12/1997	88,000	NA	7,800	8,800	2,600	16,000	3,200	NA	45.83	19.40	26.43	NA	1.7
MW-2 (D)	09/12/1997	90,000	NA	8,300	9,400	2,700	17,000	3,400	NA	45.83	19.40	26.43	NA	1.7
MW-2 b	12/18/1997	NA	NA	NA	NA	NA	NA	NA	NA	45.83	17.56	28.27	NA	1.3
MW-2	02/02/1998	<50	NA	0.6	1.9	0.93	6.0	9.3	NA	45.83	18.14	27.69	NA	2
MW-2 (D)	02/02/1998	56	NA	1.0	2.8	1.4	9.3	13	NA	45.83	18.14	27.69	NA	2
MW-2	06/24/1998	20,000	NA	<200	620	560	4,500	<1,000	NA	45.83	16.08	29.75	NA	2.4
MW-2	08/26/1998	22,000	NA	380	1,100	560	4,400	330	NA	45.83	19.25	26.58	NA	NA
MW-2 (D)	08/26/1998	11,000	NA	180	130	290	500	1,400	NA	45.83	19.25	26.58	NA	NA
MW-2	12/23/1998	100,000	NA	4,100	6,500	2,400	16,000	<500	NA	45.83	18.29	27.54	NA	3.8
MW-2	03/01/1999	50,800	NA	3,910	7,480	1,890	13,100	9,620	NA	45.83	22.81	23.02	NA	2.0
MW-2	06/14/1999	4,930	NA	128	270	139	1,040	2,200	2,540*	45.83	18.86	26.97	NA	1.6
MW-2	09/28/1999	16,200	NA	647	1,070	542	4,130	5,320	4,790	45.83	21.41	24.42	NA	1.8
MW-2	12/08/1999	25,700	NA	1,670	2,110	977	6,600	6,190	5,970	45.83	21.89	23.94	NA	1.8
MW-2	03/14/2000	45,100	NA	2,070	4,710	1,920	12,800	16,700	18,300*	45.83	15.57	30.26	NA	2.0
MW-2	06/28/2000	52,100	NA	5,150	4,200	1,880	13,300	15,500	13,500*	45.83	17.79	28.04	NA	1.9
MW-2	09/06/2000	39,500	NA	4,490	3,290	2,100	14,000	18,500	9,060*	45.83	18.65	27.18	NA	3.5
MW-2	12/14/2000	209	NA	3.51	1.11	1.00	64.4	79.4	NA	45.83	19.00	26.83	NA	1.5
MW-2	03/05/2001	38,200	NA	2,010	927	1,250	8,300	13,100	15,400	45.83	16.66	29.17	NA	1.0
MW-3	02/13/1992	NA	NA	NA	NA	NA	NA	NA	NA	51.97	27.97	24.00	NA	NA
MW-3	02/24/1992	4,500	1,300a	97	<5	78	18	NA	NA	51.97	25.60	26.37	NA	NA

**WELL CONCENTRATIONS**  
**Shell-branded Service Station**  
**1784 150th Avenue**  
**San Leandro, CA**  
**Wic #204-6852-1404**

Well ID	Date	TPPH (ug/L)	TEPH (ug/L)	B (ug/L)	T (ug/L)	E (ug/L)	X (ug/L)	MTBE 8020 (ug/L)	MTBE 8260 (ug/L)	TOC (MSL)	Depth to Water (ft.)	GW Elevation (MSL)	SPH Thickness (ft.)	DO Reading (ppm)
MW-3	02/27/1992	NA	NA	NA	NA	NA	NA	NA	NA	51.97	25.88	26.09	NA	NA
MW-3	03/01/1992	2,200	440	69	<0.5	<0.5	<0.5	NA	NA	51.97	26.00	25.97	NA	NA
MW-3	06/03/1992	4,100	NA	13	72	44	65	NA	NA	51.97	27.70	24.27	NA	NA
MW-3	09/01/1992	1,900	NA	20	6.8	5.5	<5	NA	NA	51.97	29.46	22.51	NA	NA
MW-3 (D)	09/01/1992	1,900	NA	21	6.6	3.4	<5	NA	NA	51.97	29.46	22.51	NA	NA
MW-3	10/06/1992	NA	NA	NA	NA	NA	NA	NA	NA	51.97	30.01	21.96	NA	NA
MW-3	11/11/1992	NA	NA	NA	NA	NA	NA	NA	NA	51.97	30.26	21.71	NA	NA
MW-3	12/04/1992	2,400	NA	8.2	<5	<5	<5	NA	NA	51.97	29.93	22.04	NA	NA
MW-3 (D)	12/04/1992	2,100	NA	11	<0.5	5.7	<0.5	NA	NA	51.97	29.93	22.04	NA	NA
MW-3	01/22/1993	NA	NA	NA	NA	NA	NA	NA	NA	51.97	22.76	29.21	NA	NA
MW-3	02/10/1993	NA	NA	NA	NA	NA	NA	NA	NA	51.97	21.40	30.57	NA	NA
MW-3	03/03/1993	5,100	NA	63	61	75	150	NA	NA	51.97	23.08	28.89	NA	NA
MW-3	05/11/1993	NA	NA	NA	NA	NA	NA	NA	NA	51.97	24.51	27.46	NA	NA
MW-3	06/17/1993	4,000	NA	94	140	82	150	NA	NA	51.97	25.21	26.76	NA	NA
MW-3	09/10/1993	3,200	NA	140	12.5	12.5	12.5	NA	NA	51.97	26.95	25.02	NA	NA
MW-3	12/13/1993	6,200	NA	<12.5	<12.5	<12.5	<12.5	NA	NA	51.97	26.52	25.45	NA	NA
MW-3	03/03/1994	4,500	NA	73	<5	<5	<5	NA	NA	51.97	24.50	27.47	NA	NA
MW-3	06/06/1994	3,200	NA	<0.5	<0.5	3.1	<0.5	NA	NA	51.97	26.33	25.64	NA	NA
MW-3	09/12/1994	3,900	NA	<0.5	<0.5	9.6	4.1	NA	NA	51.97	27.98	23.99	NA	NA
MW-3	12/19/1994	2,400	NA	21	22	4.2	2.6	NA	NA	51.97	25.63	26.34	NA	NA
MW-3	02/28/1995	4,000	NA	58	<0.5	7.1	3.5	NA	NA	51.97	23.45	28.52	NA	NA
MW-3	03/24/1995	NA	NA	NA	NA	NA	NA	NA	NA	51.97	21.07	30.90	NA	NA
MW-3	06/26/1995	3,900	NA	8.1	<0.5	12	2.4	NA	NA	51.97	23.64	28.33	NA	NA
MW-3	09/13/1995	4,100	NA	58	5.5	5.5	<0.5	NA	NA	51.97	25.40	26.57	NA	NA
MW-3	12/19/1995	3,600	NA	<0.5	4.3	2.1	1.1	NA	NA	51.97	24.53	27.44	NA	NA

**WELL CONCENTRATIONS**  
**Shell-branded Service Station**  
**1784 150th Avenue**  
**San Leandro, CA**  
**Wic #204-6852-1404**

Well ID	Date	TPPH (ug/L)	TEPH (ug/L)	B (ug/L)	T (ug/L)	E (ug/L)	X (ug/L)	MTBE 8020 (ug/L)	MTBE 8260 (ug/L)	TOC (MSL)	Depth to Water (ft.)	GW Elevation (MSL)	SPH Thickness (ft.)	DO Reading (ppm)
---------	------	----------------	----------------	-------------	-------------	-------------	-------------	------------------------	------------------------	--------------	----------------------------	--------------------------	---------------------------	------------------------

MW-3	03/07/1996	NA	NA	NA	NA	NA	NA	NA	NA	51.97	21.59	30.41	0.04	NA
MW-3	06/28/1996	2,400	NA	55	<0.5	<0.5	11	120	NA	51.97	23.95	28.02	NA	NA
MW-3	09/26/1996	2,500	NA	<5.0	<5.0	<5.0	<5.0	160	NA	51.97	25.89	26.08	NA	NA
MW-3	12/10/1996	1,600	NA	28	4.2	<2.0	3.9	110	NA	51.97	24.22	27.75	NA	0.8
MW-3	03/10/1997	130	NA	<0.50	<0.50	<0.50	1.4	4.2	NA	51.97	23.05	28.92	NA	2.8
MW-3	06/30/1997	1,200	NA	21	2.3	<2.0	<2.0	69	NA	51.97	24.34	27.63	NA	2.3
MW-3	09/12/1997	440	NA	8.3	0.82	<0.50	1.9	3.4	NA	51.97	24.47	27.50	NA	1.9
MW-3 b	12/18/1997	NA	NA	NA	NA	NA	NA	NA	NA	51.97	23.54	28.43	NA	0.8
MW-3	02/02/1998	400	NA	9.3	0.68	<0.50	<0.50	9	NA	51.97	21.92	30.05	NA	1.5
MW-3	06/24/1998	<50	NA	<0.50	<0.50	<0.50	<0.50	<2.5	NA	51.97	22.35	29.62	NA	1.9
MW-3	08/26/1998	140	NA	7.4	<0.50	<0.50	2.5	13	NA	51.97	23.45	28.52	NA	1.3
MW-3	12/23/1998	1,200	NA	50	<2.0	<2.0	<2.0	69	NA	51.97	24.01	27.96	NA	4.2
MW-3	03/01/1999	2,550	NA	<0.500	<0.500	<0.500	0.658	32.4	NA	51.97	22.08	29.89	NA	2.0
MW-3	06/14/1999	514	NA	18.1	0.728	<0.500	<0.500	15.9	NA	51.97	23.15	28.82	NA	1.7
MW-3	09/28/1999	1,180	NA	<1.00	<1.00	<1.00	<1.00	<10.0	NA	51.97	25.36	26.61	NA	1.2
MW-3	12/08/1999	1,740	NA	71.5	23.0	24.2	61.3	103	NA	51.97	25.75	26.22	NA	2.0
MW-3	03/14/2000	1,410	NA	5.63	35.6	<5.00	8.41	38.7	NA	51.97	21.64	30.33	NA	2.1
MW-3	06/28/2000	2,460	NA	<5.00	9.48	<5.00	28.4	64.0	NA	51.97	23.84	28.13	NA	2.87
MW-3	09/06/2000	887	NA	<1.00	<1.00	<1.00	<1.00	<10.0	NA	51.97	24.73	27.24	NA	2.0
MW-3	12/14/2000	955	NA	25.4	1.96	<0.500	1.13	10.2	NA	51.97	25.45	26.52	NA	2.1
<b>MW-3</b>	<b>03/05/2001</b>	<b>2,100</b>	<b>NA</b>	<b>4.90</b>	<b>56.5</b>	<b>&lt;2.00</b>	<b>3.62</b>	<b>261</b>	<b>NA</b>	<b>51.97</b>	<b>22.83</b>	<b>29.14</b>	<b>NA</b>	<b>0.8</b>

MW-4	03/24/1995	<50	NA	<0.5	<0.5	<0.5	<0.5	NA	NA	40.51	9.16	31.35	NA	NA
MW-4	06/26/1995	<50	NA	<0.5	<0.5	<0.5	<0.5	NA	NA	40.51	12.06	28.45	NA	NA
MW-4	09/13/1995	<50	NA	<0.5	<0.5	<0.5	<0.5	NA	NA	40.51	13.90	26.61	NA	NA

**WELL CONCENTRATIONS**  
**Shell-branded Service Station**  
**1784 150th Avenue**  
**San Leandro, CA**  
**Wic #204-6852-1404**

Well ID	Date	TPPH (ug/L)	TEPH (ug/L)	B (ug/L)	T (ug/L)	E (ug/L)	X (ug/L)	MTBE 8020 (ug/L)	MTBE 8260 (ug/L)	TOC (MSL)	Depth to Water (ft.)	GW Elevation (MSL)	SPH Thickness (ft.)	DO Reading (ppm)
MW-4	12/19/1995	<50	NA	<0.5	<0.5	<0.5	<0.5	NA	NA	40.51	12.90	27.61	NA	NA
MW-4	03/06/1996	<50	NA	<0.5	<0.5	<0.5	<0.5	NA	NA	40.51	9.63	30.88	NA	NA
MW-4	06/28/1996	40	NA	<0.5	0.59	0.97	3.8	26	NA	40.51	12.30	28.21	NA	NA
MW-4	09/26/1996	<50	NA	<0.5	<0.5	<0.5	<0.5	<2.5	NA	40.51	14.12	26.39	NA	NA
MW-4	12/10/1996	<50	NA	<0.5	<0.5	<0.5	<0.5	<2.5	NA	40.51	12.31	28.20	NA	1.2
MW-4	03/10/1997	<50	NA	<0.50	<0.50	<0.50	<0.50	<2.5	NA	40.51	11.34	29.17	NA	NA
MW-4	06/30/1997	<50	NA	<0.50	<0.50	<0.50	<0.50	<2.5	NA	40.51	13.80	26.71	NA	1.9
MW-4	09/12/1997	<50	NA	<0.50	<0.50	<0.50	<0.50	<2.5	NA	40.51	13.99	26.52	NA	1.7
MW-4 b	12/18/1997	NA	NA	NA	NA	NA	NA	NA	NA	40.51	12.02	28.49	NA	1.8
MW-4	02/02/1998	<50	NA	<0.50	<0.50	<0.50	<0.50	<2.5	NA	40.51	11.23	29.28	NA	1
MW-4	06/24/1998	<50	NA	<0.50	<0.50	<0.50	<0.50	<2.5	NA	40.51	10.58	29.93	NA	1.9
MW-4	08/26/1998	<50	NA	<0.50	<0.50	<0.50	<0.50	<2.5	NA	40.51	11.75	28.76	NA	1.2
MW-4	12/23/1998	<50	NA	0.60	<0.50	<0.50	<0.50	<2.5	NA	40.51	12.41	28.10	NA	4.2
MW-4	03/01/1999	<50.0	NA	<0.500	<0.500	<0.500	<0.500	<2.00	NA	40.51	10.38	30.13	NA	2.1
MW-4	06/14/1999	<50.0	NA	<0.500	<0.500	<0.500	<0.500	<2.50	NA	40.51	11.91	28.60	NA	2.4
MW-4	09/28/1999	<50.0	NA	<0.500	<0.500	<0.500	<0.500	<5.00	NA	40.51	10.19	30.32	NA	2.2
MW-4	12/08/1999	<50.0	NA	<0.500	<0.500	<0.500	<0.500	<2.50	NA	40.51	10.67	29.84	NA	1.8
MW-4	03/14/2000	<50.0	NA	<0.500	<0.500	<0.500	<0.500	<2.50	NA	40.51	9.95	30.56	NA	2.5
MW-4	06/28/2000	<50.0	NA	<0.500	<0.500	<0.500	<0.500	<2.50	NA	40.51	12.22	28.29	NA	0.9
MW-4	09/06/2000	NA	NA	NA	NA	NA	NA	NA	NA	40.51	13.17	27.34	NA	3.0
MW-4	12/14/2000	NA	NA	NA	NA	NA	NA	NA	NA	40.51	8.65	31.86	NA	NA
MW-4	03/05/2001	NA	NA	NA	NA	NA	NA	NA	NA	40.51	11.07	29.44	NA	NA

**WELL CONCENTRATIONS**  
**Shell-branded Service Station**  
**1784 150th Avenue**  
**San Leandro, CA**  
**Wic #204-6852-1404**

Well ID	Date	TPPH (ug/L)	TEPH (ug/L)	B (ug/L)	T (ug/L)	E (ug/L)	X (ug/L)	MTBE 8020 (ug/L)	MTBE 8260 (ug/L)	TOC (MSL)	Depth to Water (ft.)	GW Elevation (MSL)	SPH Thickness (ft.)	DO Reading (ppm)
---------	------	----------------	----------------	-------------	-------------	-------------	-------------	------------------------	------------------------	--------------	----------------------------	--------------------------	---------------------------	------------------------

**Abbreviations:**

TPPH = Total petroleum hydrocarbons as gasoline by modified EPA Method 8015

TEPH = Total petroleum hydrocarbons as diesel by modified EPA Method 8015

BTEX = benzene, toluene, ethylbenzene, xylenes by EPA Method 8020

MTBE = methyl-tertiary-butyl ether

TOC = Top of Casing Elevation

SPH = Separate-Phase Hydrocarbons

GW = Groundwater

DO = Dissolved Oxygen

ug/L = parts per billion

ppm = parts per million

msl = Mean sea level

ft = Feet

<n = Below detection limit

D = Duplicate sample

NA = Not applicable

**Notes:**

a = Chromatogram pattern indicates an unidentified hydrocarbon.

b = Samples not analyzed due to laboratory oversight.

\* = Sample analyzed out of EPA recommended hold time.



# Sequoia Analytical

885 Jarvis Drive  
Morgan Hill, CA 95037  
(408) 776-9600  
FAX (408) 782-6308  
www.sequoialabs.com

20 March, 2001

Nick Sudano  
Blaine Tech Services (Shell)  
1680 Rogers Avenue  
San Jose, CA 95112

RE: 1784 150th Ave.  
Sequoia Report: MKC0142

Enclosed are the results of analyses for samples received by the laboratory on 03/06/01 16:01. If you have any questions concerning this report, please feel free to contact me.

Sincerely,

Jeff Smyly  
Project Manager

CA ELAP Certificate #1210







Blaine Tech Services (Shell)  
1680 Rogers Avenue  
San Jose CA, 95112

Project: 1784 150th Ave.  
Project Number: 1784 150th Avenue/ San Leandro  
Project Manager: Nick Sudano

**Reported:**  
03/20/01 09:01

## ANALYTICAL REPORT FOR SAMPLES

Sample ID	Laboratory ID	Matrix	Date Sampled	Date Received
MW-1	MKC0142-01	Water	03/05/01 13:30	03/06/01 16:01
MW-2	MKC0142-02	Water	03/05/01 12:34	03/06/01 16:01
MW-3	MKC0142-03	Water	03/05/01 13:04	03/06/01 16:01

Sequoia Analytical - Morgan Hill

*The results in this report apply to the samples analyzed in accordance with the chain of custody document. This analytical report must be reproduced in its entirety.*

Jeff Smyly, Project Manager





Blaine Tech Services (Shell)  
1680 Rogers Avenue  
San Jose CA, 95112

Project: 1784 150th Ave.  
Project Number: 1784 150th Avenue/ San Leandro  
Project Manager: Nick Sudano

**Reported:**  
03/20/01 09:01

**Total Purgeable Hydrocarbons (C6-C12), BTEX and MTBE by DHS LUFT**  
**Sequoia Analytical - Morgan Hill**

Analyte	Result	Reporting Limit	Units	Dilution	Batch	Prepared	Analyzed	Method	Notes
<b>MW-1 (MKC0142-01) Water</b> Sampled: 03/05/01 13:30 Received: 03/06/01 16:01									
Purgeable Hydrocarbons	7520	5000	ug/l	100	1C08003	03/08/01	03/08/01	DHS LUFT	P-01
Benzene	2120	50.0	"	"	"	"	"	"	
Toluene	66.0	50.0	"	"	"	"	"	"	
Ethylbenzene	107	50.0	"	"	"	"	"	"	
Xylenes (total)	129	50.0	"	"	"	"	"	"	
Methyl tert-butyl ether	668	250	"	"	"	"	"	"	
Surrogate: a,a,a-Trifluorotoluene		104 %	70-130		"	"	"	"	
<b>MW-2 (MKC0142-02) Water</b> Sampled: 03/05/01 12:34 Received: 03/06/01 16:01									
Purgeable Hydrocarbons	38200	5000	ug/l	100	1C08003	03/08/01	03/08/01	DHS LUFT	P-01
Benzene	2010	50.0	"	"	"	"	"	"	
Toluene	927	50.0	"	"	"	"	"	"	
Ethylbenzene	1250	50.0	"	"	"	"	"	"	
Xylenes (total)	8300	50.0	"	"	"	"	"	"	
Methyl tert-butyl ether	13100	250	"	"	"	"	"	"	
Surrogate: a,a,a-Trifluorotoluene		104 %	70-130		"	"	"	"	
<b>MW-3 (MKC0142-03) Water</b> Sampled: 03/05/01 13:04 Received: 03/06/01 16:01									
Purgeable Hydrocarbons	2100	200	ug/l	4	1C12004	03/12/01	03/12/01	DHS LUFT	P-03
Benzene	4.90	2.00	"	"	"	"	"	"	
Toluene	56.5	2.00	"	"	"	"	"	"	
Ethylbenzene	ND	2.00	"	"	"	"	"	"	
Xylenes (total)	3.62	2.00	"	"	"	"	"	"	
Methyl tert-butyl ether	261	10.0	"	"	"	"	"	"	
Surrogate: a,a,a-Trifluorotoluene		395 %	70-130		"	"	"	"	S-02





Blaine Tech Services (Shell)  
1680 Rogers Avenue  
San Jose CA, 95112

Project: 1784 150th Ave.  
Project Number: 1784 150th Avenue/ San Leandro  
Project Manager: Nick Sudano

**Reported:**  
03/20/01 09:01

**MTBE Confirmation by EPA Method 8260A  
Sequoia Analytical - Morgan Hill**

Analyte	Result	Reporting Limit	Units	Dilution	Batch	Prepared	Analyzed	Method	Notes
<b>MW-2 (MKC0142-02) Water</b> Sampled: 03/05/01 12:34 Received: 03/06/01 16:01									
Methyl tert-butyl ether	15400	500	ug/l	500	1C13001	03/12/01	03/12/01	EPA 8260A	
Surrogate: 1,2-Dichloroethane-d4		83.9 %	70-130		"	"	"	"	



Blaine Tech Services (Shell)  
1680 Rogers Avenue  
San Jose CA, 95112

Project: 1784 150th Ave.  
Project Number: 1784 150th Avenue/ San Leandro  
Project Manager: Nick Sudano

**Reported:**  
03/20/01 09:01

## Volatile Organic Compounds by EPA Method 8021B Sequoia Analytical - Morgan Hill

Analyte	Result	Reporting Limit	Units	Dilution	Batch	Prepared	Analyzed	Method	Notes
<b>MW-1 (MKC0142-01) Water Sampled: 03/05/01 13:30 Received: 03/06/01 16:01</b>									
Bromodichloromethane	ND	0.500	ug/l	1	1C13010	03/13/01	03/13/01	EPA 8021B	
Bromoform	ND	0.500	"	"	"	"	"	"	
Bromomethane	ND	1.00	"	"	"	"	"	"	
Carbon tetrachloride	ND	0.500	"	"	"	"	"	"	
Chlorobenzene	ND	0.500	"	"	"	"	"	"	
Chloroethane	ND	1.00	"	"	"	"	"	"	
Chloroform	ND	0.500	"	"	"	"	"	"	
Chloromethane	ND	1.00	"	"	"	"	"	"	
Dibromochloromethane	ND	0.500	"	"	"	"	"	"	
1,3-Dichlorobenzene	ND	0.500	"	"	"	"	"	"	
1,4-Dichlorobenzene	ND	0.500	"	"	"	"	"	"	
1,2-Dichlorobenzene	ND	0.500	"	"	"	"	"	"	
1,1-Dichloroethane	ND	0.500	"	"	"	"	"	"	
<b>1,2-Dichloroethane</b>	<b>6.76</b>	0.500	"	"	"	"	"	"	
1,1-Dichloroethene	ND	0.500	"	"	"	"	"	"	
cis-1,2-Dichloroethene	ND	0.500	"	"	"	"	"	"	
trans-1,2-Dichloroethene	ND	0.500	"	"	"	"	"	"	
1,2-Dichloropropane	ND	0.500	"	"	"	"	"	"	
cis-1,3-Dichloropropene	ND	0.500	"	"	"	"	"	"	
trans-1,3-Dichloropropene	ND	0.500	"	"	"	"	"	"	
Methylene chloride	ND	5.00	"	"	"	"	"	"	
1,1,2,2-Tetrachloroethane	ND	0.500	"	"	"	"	"	"	
Tetrachloroethene	ND	0.500	"	"	"	"	"	"	
1,1,1-Trichloroethane	ND	0.500	"	"	"	"	"	"	
1,1,2-Trichloroethane	ND	0.500	"	"	"	"	"	"	
1,1,2-Trichlorotrifluoroethane	ND	1.00	"	"	"	"	"	"	
Trichloroethene	ND	0.500	"	"	"	"	"	"	
Trichlorofluoromethane	ND	0.500	"	"	"	"	"	"	
Vinyl chloride	ND	1.00	"	"	"	"	"	"	
1,2-Dibromoethane	ND	1.00	"	"	"	"	"	"	
<i>Surrogate: 1-Chloro-3-fluorobenzene</i>		93.3 %		70-130	"	"	"	"	





Blaine Tech Services (Shell)  
1680 Rogers Avenue  
San Jose CA, 95112

Project: 1784 150th Ave.  
Project Number: 1784 150th Avenue/ San Leandro  
Project Manager: Nick Sudano

**Reported:**  
03/20/01 09:01

**Volatile Organic Compounds by EPA Method 8021B  
Sequoia Analytical - Morgan Hill**

Analyte	Result	Reporting Limit	Units	Dilution	Batch	Prepared	Analyzed	Method	Notes
<b>MW-2 (MKC0142-02) Water Sampled: 03/05/01 12:34 Received: 03/06/01 16:01</b>									
Bromodichloromethane	ND	0.500	ug/l	1	1C13010	03/13/01	03/13/01	EPA 8021B	
Bromoform	ND	0.500	"	"	"	"	"	"	
Bromomethane	ND	1.00	"	"	"	"	"	"	
Carbon tetrachloride	ND	0.500	"	"	"	"	"	"	
Chlorobenzene	ND	0.500	"	"	"	"	"	"	
Chloroethane	ND	1.00	"	"	"	"	"	"	
Chloroform	ND	0.500	"	"	"	"	"	"	
Chloromethane	ND	1.00	"	"	"	"	"	"	
Dibromochloromethane	ND	0.500	"	"	"	"	"	"	
1,3-Dichlorobenzene	ND	0.500	"	"	"	"	"	"	
1,4-Dichlorobenzene	ND	0.500	"	"	"	"	"	"	
1,2-Dichlorobenzene	ND	0.500	"	"	"	"	"	"	
1,1-Dichloroethane	ND	0.500	"	"	"	"	"	"	
<b>1,2-Dichloroethane</b>	<b>0.891</b>	0.500	"	"	"	"	"	"	
1,1-Dichloroethene	ND	0.500	"	"	"	"	"	"	
cis-1,2-Dichloroethene	ND	0.500	"	"	"	"	"	"	
trans-1,2-Dichloroethene	ND	0.500	"	"	"	"	"	"	
1,2-Dichloropropane	ND	0.500	"	"	"	"	"	"	
cis-1,3-Dichloropropene	ND	0.500	"	"	"	"	"	"	
trans-1,3-Dichloropropene	ND	0.500	"	"	"	"	"	"	
Methylene chloride	ND	5.00	"	"	"	"	"	"	
1,1,2,2-Tetrachloroethane	ND	0.500	"	"	"	"	"	"	
Tetrachloroethene	ND	0.500	"	"	"	"	"	"	
1,1,1-Trichloroethane	ND	0.500	"	"	"	"	"	"	
1,1,2-Trichloroethane	ND	0.500	"	"	"	"	"	"	
1,1,2-Trichlorotrifluoroethane	ND	1.00	"	"	"	"	"	"	
Trichloroethene	ND	0.500	"	"	"	"	"	"	
Trichlorofluoromethane	ND	0.500	"	"	"	"	"	"	
Vinyl chloride	ND	1.00	"	"	"	"	"	"	
1,2-Dibromoethane	ND	1.00	"	"	"	"	"	"	
<i>Surrogate: 1-Chloro-3-fluorobenzene</i>		89.7 %		70-130	"	"	"	"	





Blaine Tech Services (Shell)  
1680 Rogers Avenue  
San Jose CA, 95112

Project: 1784 150th Ave.  
Project Number: 1784 150th Avenue/ San Leandro  
Project Manager: Nick Sudano

Reported:  
03/20/01 09:01

## Volatile Organic Compounds by EPA Method 8021B Sequoia Analytical - Morgan Hill

Analyte	Result	Reporting Limit	Units	Dilution	Batch	Prepared	Analyzed	Method	Notes
<b>MW-3 (MKC0142-03) Water Sampled: 03/05/01 13:04 Received: 03/06/01 16:01</b>									
Bromodichloromethane	ND	1.00	ug/l	2	1C13010	03/13/01	03/13/01	EPA 8021B	
Bromoform	ND	1.00	"	"	"	"	"	"	
Bromomethane	ND	2.00	"	"	"	"	"	"	
Carbon tetrachloride	ND	1.00	"	"	"	"	"	"	
Chlorobenzene	ND	1.00	"	"	"	"	"	"	
Chloroethane	ND	2.00	"	"	"	"	"	"	
Chloroform	ND	1.00	"	"	"	"	"	"	
Chloromethane	ND	2.00	"	"	"	"	"	"	
Dibromochloromethane	ND	1.00	"	"	"	"	"	"	
1,3-Dichlorobenzene	ND	1.00	"	"	"	"	"	"	
1,4-Dichlorobenzene	ND	1.00	"	"	"	"	"	"	
1,2-Dichlorobenzene	ND	1.00	"	"	"	"	"	"	
1,1-Dichloroethane	ND	1.00	"	"	"	"	"	"	
<b>1,2-Dichloroethane</b>	<b>31.8</b>	1.00	"	"	"	"	"	"	
1,1-Dichloroethene	ND	1.00	"	"	"	"	"	"	
cis-1,2-Dichloroethene	ND	1.00	"	"	"	"	"	"	
trans-1,2-Dichloroethene	ND	1.00	"	"	"	"	"	"	
1,2-Dichloropropane	ND	1.00	"	"	"	"	"	"	
cis-1,3-Dichloropropene	ND	1.00	"	"	"	"	"	"	
trans-1,3-Dichloropropene	ND	1.00	"	"	"	"	"	"	
Methylene chloride	ND	10.0	"	"	"	"	"	"	
1,1,2,2-Tetrachloroethane	ND	1.00	"	"	"	"	"	"	
Tetrachloroethene	ND	1.00	"	"	"	"	"	"	
1,1,1-Trichloroethane	ND	1.00	"	"	"	"	"	"	
1,1,2-Trichloroethane	ND	1.00	"	"	"	"	"	"	
1,1,2-Trichlorotrifluoroethane	ND	2.00	"	"	"	"	"	"	
Trichloroethene	ND	1.00	"	"	"	"	"	"	
Trichlorofluoromethane	ND	1.00	"	"	"	"	"	"	
Vinyl chloride	ND	2.00	"	"	"	"	"	"	
1,2-Dibromoethane	ND	2.00	"	"	"	"	"	"	
<i>Surrogate: 1-Chloro-3-fluorobenzene</i>		104 %		70-130	"	"	"	"	



Blaine Tech Services (Shell)  
1680 Rogers Avenue  
San Jose CA, 95112

Project: 1784 150th Ave.  
Project Number: 1784 150th Avenue/ San Leandro  
Project Manager: Nick Sudano

**Reported:**  
03/20/01 09:01

**Total Purgeable Hydrocarbons (C6-C12), BTEX and MTBE by DHS LUFT - Quality Control**  
**Sequoia Analytical - Morgan Hill**

Analyte	Result	Reporting Limit	Units	Spike Level	Source Result	%REC	%REC Limits	RPD	RPD Limit	Notes
---------	--------	-----------------	-------	-------------	---------------	------	-------------	-----	-----------	-------

**Batch 1C08003 - EPA 5030B [P/T]**

**Blank (1C08003-BLK1)**

Prepared & Analyzed: 03/08/01

Purgeable Hydrocarbons	ND	50.0	ug/l							
Benzene	ND	0.500	"							
Toluene	ND	0.500	"							
Ethylbenzene	ND	0.500	"							
Xylenes (total)	ND	0.500	"							
Methyl tert-butyl ether	ND	2.50	"							
Surrogate: a,a,a-Trifluorotoluene	9.08		"	10.0		90.8	70-130			

**LCS (1C08003-BS1)**

Prepared & Analyzed: 03/08/01

Benzene	7.99	0.500	ug/l	10.0		79.9	70-130			
Toluene	8.74	0.500	"	10.0		87.4	70-130			
Ethylbenzene	9.54	0.500	"	10.0		95.4	70-130			
Xylenes (total)	28.2	0.500	"	30.0		94.0	70-130			
Surrogate: a,a,a-Trifluorotoluene	9.42		"	10.0		94.2	70-130			

**Matrix Spike (1C08003-MS1)**

Source: MKC0139-02

Prepared & Analyzed: 03/08/01

Benzene	7.68	0.500	ug/l	10.0	ND	74.6	60-140			
Toluene	8.22	0.500	"	10.0	ND	82.2	60-140			
Ethylbenzene	8.44	0.500	"	10.0	ND	84.4	60-140			
Xylenes (total)	26.8	0.500	"	30.0	ND	89.3	60-140			
Surrogate: a,a,a-Trifluorotoluene	9.03		"	10.0		90.3	70-130			

**Matrix Spike Dup (1C08003-MSD1)**

Source: MKC0139-02

Prepared & Analyzed: 03/08/01

Benzene	7.56	0.500	ug/l	10.0	ND	73.4	60-140	1.57	25	
Toluene	8.27	0.500	"	10.0	ND	82.7	60-140	0.606	25	
Ethylbenzene	8.90	0.500	"	10.0	ND	89.0	60-140	5.31	25	
Xylenes (total)	26.5	0.500	"	30.0	ND	88.3	60-140	1.13	25	
Surrogate: a,a,a-Trifluorotoluene	8.85		"	10.0		88.5	70-130			





Blaine Tech Services (Shell) 1680 Rogers Avenue San Jose CA, 95112	Project: 1784 150th Ave. Project Number: 1784 150th Avenue/ San Leandro Project Manager: Nick Sudano	<b>Reported:</b> 03/20/01 09:01
--------------------------------------------------------------------------	------------------------------------------------------------------------------------------------------------	------------------------------------

**Total Purgeable Hydrocarbons (C6-C12), BTEX and MTBE by DHS LUFT - Quality Control  
Sequoia Analytical - Morgan Hill**

Analyte	Result	Reporting Limit	Units	Spike Level	Source Result	%REC	%REC Limits	RPD	RPD Limit	Notes
<b>Batch 1C12004 - EPA 5030B [P/T]</b>										
<b>Blank (1C12004-BLK1)</b> Prepared & Analyzed: 03/12/01										
Purgeable Hydrocarbons	ND	50.0	ug/l							
Benzene	ND	0.500	"							
Toluene	ND	0.500	"							
Ethylbenzene	ND	0.500	"							
Xylenes (total)	ND	0.500	"							
Methyl tert-butyl ether	ND	2.50	"							
<i>Surrogate: a,a,a-Trifluorotoluene</i>	9.76		"	10.0		97.6	70-130			
<b>LCS (1C12004-BS1)</b> Prepared & Analyzed: 03/12/01										
Purgeable Hydrocarbons	218	50.0	ug/l	250		87.2	70-130			
<i>Surrogate: a,a,a-Trifluorotoluene</i>	14.5		"	10.0		145	70-130			S-03
<b>Matrix Spike (1C12004-MS1)</b> Source: MKC0239-01 Prepared & Analyzed: 03/12/01										
Purgeable Hydrocarbons	228	50.0	ug/l	250	ND	91.2	60-140			
<i>Surrogate: a,a,a-Trifluorotoluene</i>	15.1		"	10.0		151	70-130			S-03
<b>Matrix Spike Dup (1C12004-MSD1)</b> Source: MKC0239-01 Prepared & Analyzed: 03/12/01										
Purgeable Hydrocarbons	206	50.0	ug/l	250	ND	82.4	60-140	10.1	25	
<i>Surrogate: a,a,a-Trifluorotoluene</i>	14.7		"	10.0		147	70-130			S-03







Blaine Tech Services (Shell)  
1680 Rogers Avenue  
San Jose CA, 95112

Project: 1784 150th Ave.  
Project Number: 1784 150th Avenue/ San Leandro  
Project Manager: Nick Sudano

**Reported:**  
03/20/01 09:01

**MTBE Confirmation by EPA Method 8260A - Quality Control  
Sequoia Analytical - Morgan Hill**

Analyte	Result	Reporting Limit	Units	Spike Level	Source Result	%REC	%REC Limits	RPD	RPD Limit	Notes
<b>Batch 1C13001 - EPA 5030B P/T</b>										
<b>Blank (1C13001-BLK1)</b>										
				Prepared & Analyzed: 03/12/01						
Methyl tert-butyl ether	ND	1.00	ug/l							
Surrogate: 1,2-Dichloroethane-d4	9.28		"	10.0		92.8	70-130			
<b>LCS (1C13001-BS1)</b>										
				Prepared & Analyzed: 03/12/01						
Methyl tert-butyl ether	10.5	1.00	ug/l	10.0		105	70-130			
Surrogate: 1,2-Dichloroethane-d4	9.88		"	10.0		98.8	70-130			
<b>LCS Dup (1C13001-BSD1)</b>										
				Prepared & Analyzed: 03/12/01						
Methyl tert-butyl ether	10.9	1.00	ug/l	10.0		109	70-130	3.74	25	
Surrogate: 1,2-Dichloroethane-d4	10.4		"	10.0		104	70-130			
<b>Matrix Spike (1C13001-MS1)</b>										
		<b>Source: MKC0155-06</b>		Prepared & Analyzed: 03/12/01						
Methyl tert-butyl ether	12.7	1.00	ug/l	10.0	ND	127	70-130			
Surrogate: 1,2-Dichloroethane-d4	10.1		"	10.0		101	70-130			
<b>Matrix Spike Dup (1C13001-MSD1)</b>										
		<b>Source: MKC0155-06</b>		Prepared & Analyzed: 03/12/01						
Methyl tert-butyl ether	13.6	1.00	ug/l	10.0	ND	136	70-130	6.84	25	Q-01
Surrogate: 1,2-Dichloroethane-d4	9.73		"	10.0		97.3	70-130			



Blaine Tech Services (Shell)  
1680 Rogers Avenue  
San Jose CA, 95112

Project: 1784 150th Ave.  
Project Number: 1784 150th Avenue/ San Leandro  
Project Manager: Nick Sudano

**Reported:**  
03/20/01 09:01

**Volatile Organic Compounds by EPA Method 8021B - Quality Control**  
**Sequoia Analytical - Morgan Hill**

Analyte	Result	Reporting Limit	Units	Spike Level	Source Result	%REC	%REC Limits	RPD	RPD Limit	Notes
---------	--------	-----------------	-------	-------------	---------------	------	-------------	-----	-----------	-------

**Batch 1C13010 - EPA 5030B [P/T]**

**Blank (1C13010-BLK1)**

Prepared & Analyzed: 03/13/01

Bromodichloromethane	ND	0.500	ug/l							
Bromoform	ND	0.500	"							
Bromomethane	ND	1.00	"							
Carbon tetrachloride	ND	0.500	"							
Chlorobenzene	ND	0.500	"							
Chloroethane	ND	1.00	"							
Chloroform	ND	0.500	"							
Chloromethane	ND	1.00	"							
Dibromochloromethane	ND	0.500	"							
1,3-Dichlorobenzene	ND	0.500	"							
1,4-Dichlorobenzene	ND	0.500	"							
1,2-Dichlorobenzene	ND	0.500	"							
1,1-Dichloroethane	ND	0.500	"							
1,2-Dichloroethane	ND	0.500	"							
1,1-Dichloroethene	ND	0.500	"							
cis-1,2-Dichloroethene	ND	0.500	"							
trans-1,2-Dichloroethene	ND	0.500	"							
1,2-Dichloropropane	ND	0.500	"							
cis-1,3-Dichloropropene	ND	0.500	"							
trans-1,3-Dichloropropene	ND	0.500	"							
Methylene chloride	ND	5.00	"							
1,1,1,2-Tetrachloroethane	ND	0.500	"							
Tetrachloroethene	ND	0.500	"							
1,1,1-Trichloroethane	ND	0.500	"							
1,1,2-Trichloroethane	ND	0.500	"							
1,1,2-Trichlorotrifluoroethane	ND	1.00	"							
Trichloroethene	ND	0.500	"							
Trichlorofluoromethane	ND	0.500	"							
Vinyl chloride	ND	1.00	"							
1,2-Dibromoethane	ND	1.00	"							
<i>Surrogate: 1-Chloro-3-fluorobenzene</i>	<i>10.3</i>		<i>"</i>	<i>10.0</i>		<i>103</i>	<i>70-130</i>			



Blaine Tech Services (Shell)  
1680 Rogers Avenue  
San Jose CA, 95112

Project: 1784 150th Ave.  
Project Number: 1784 150th Avenue/ San Leandro  
Project Manager: Nick Sudano

**Reported:**  
03/20/01 09:01

**Volatile Organic Compounds by EPA Method 8021B - Quality Control  
Sequoia Analytical - Morgan Hill**

Analyte	Result	Reporting Limit	Units	Spike Level	Source Result	%REC	%REC Limits	RPD	RPD Limit	Notes
---------	--------	-----------------	-------	-------------	---------------	------	-------------	-----	-----------	-------

**Batch 1C13010 - EPA 5030B [P/T]**

**LCS (1C13010-BS1)**

Prepared & Analyzed: 03/13/01

Chlorobenzene	13.4	0.500	ug/l	12.5		107	70-130			
1,1-Dichloroethene	10.3	0.500	"	12.5		82.4	65-135			
Trichloroethene	10.6	0.500	"	12.5		84.8	70-130			
<i>Surrogate: 1-Chloro-3-fluorobenzene</i>	<i>9.93</i>		"	<i>10.0</i>		<i>99.3</i>	<i>70-130</i>			

**Matrix Spike (1C13010-MS1)**

Source: MKC0142-01

Prepared & Analyzed: 03/13/01

Chlorobenzene	9.02	0.500	ug/l	12.5	ND	72.2	60-140			
1,1-Dichloroethene	5.66	0.500	"	12.5	ND	45.3	60-140			Q-02
Trichloroethene	10.0	0.500	"	12.5	ND	80.0	60-140			
<i>Surrogate: 1-Chloro-3-fluorobenzene</i>	<i>10.4</i>		"	<i>10.0</i>		<i>104</i>	<i>70-130</i>			

**Matrix Spike Dup (1C13010-MSD1)**

Source: MKC0142-01

Prepared & Analyzed: 03/13/01

Chlorobenzene	8.61	0.500	ug/l	12.5	ND	68.9	60-140	4.65	25	
1,1-Dichloroethene	5.39	0.500	"	12.5	ND	43.1	60-140	4.89	25	Q-02
Trichloroethene	9.65	0.500	"	12.5	ND	77.2	60-140	3.56	25	Q-02
<i>Surrogate: 1-Chloro-3-fluorobenzene</i>	<i>10.2</i>		"	<i>10.0</i>		<i>102</i>	<i>70-130</i>			



Blaine Tech Services (Shell)  
1680 Rogers Avenue  
San Jose CA, 95112

Project: 1784 150th Ave.  
Project Number: 1784 150th Avenue/ San Leandro  
Project Manager: Nick Sudano

**Reported:**  
03/20/01 09:01

### Notes and Definitions

- P-01 Chromatogram Pattern: Gasoline C6-C12
- P-03 Chromatogram Pattern: Unidentified Hydrocarbons C6-C12
- Q-01 The spike recovery for this QC sample is outside of established control limits. Review of associated batch QC indicates the recovery for this analyte does not represent an out-of-control condition for the batch.
- Q-02 The spike recovery for this quality control sample is outside of the established control limits due to interference from the sample matrix. However, the accuracy of the data was validated by a laboratory control sample which was within acceptance limits.
- S-02 The surrogate recovery for this sample cannot be accurately quantified due to interference from coeluting organic compounds present in the sample.
- S-03 The surrogate recovery for this sample is outside of established control limits. Review of associated QC indicates the recovery for this surrogate does not represent an out-of-control condition.
- DET Analyte DETECTED
- ND Analyte NOT DETECTED at or above the reporting limit
- NR Not Reported
- dry Sample results reported on a dry weight basis
- RPD Relative Percent Difference



LAB: Sequoia

# EQUIVA Services LLC Chain Of Custody Record

Lab Identification (if necessary):

Address:

City, State, Zip:

**Equiva Project Manager to be invoiced:**

Karen Petryna

- SCIENCE & ENGINEERING
- TECHNICAL SERVICES
- CRMT HOUSTON

INCIDENT NUMBER (S&E ONLY)

9 8 9 9 6 0 6 8

SAP or CRMT NUMBER (TS/CRMT)

DATE: 3/5/01

PAGE: 1 of 1

CONSULTANT COMPANY:  
**Blaine Tech Services**  
 ADDRESS:  
**1680 Rogers Avenue**  
 CITY:  
**San Jose, CA 95112**  
 TELEPHONE: **408-573-0555** FAX: **408-573-7771** E-MAIL: **nsudano@blainetech.com**

SITE ADDRESS (Street and City):  
**1784 150th Avenue, San Leandro**

PROJECT CONTACT (Report to):  
**Nick Sudano**  
 SAMPLER NAME(S) (Print):

CONSULTANT PROJECT NO.:  
**BTS # 010305-G1**

*Morgan Gillies*

LAB USE ONLY

TURNAROUND TIME (BUSINESS DAYS):  
 10 DAYS  5 DAYS  72 HOURS  48 HOURS  24 HOURS  LESS THAN 24 HOURS

LA - RWQCB REPORT FORMAT  UST AGENCY:

GC/MS MTBE CONFIRMATION: HIGHEST  HIGHEST per BORING  ALL

SPECIAL INSTRUCTIONS OR NOTES: TEMPERATURE ON RECEIPT C'

**REQUESTED ANALYSIS**

LAB USE ONLY	Field Sample Identification	SAMPLING		MATRIX	NO. OF CONT.	TPH - Gas, Purgeable (8015m)	BTX (8021B)	MTBE (8021B)	MTBE (8260B)	TPH - Diesel, Extractable (8015m)	Oxygenates (5) by (8260B)	Ethanol, Methanol (8015B)	VOC'S by 8010B	MTBE (8260B) Confirmation, See Note	FIELD NOTES: Container/Preservative or PID Readings or Laboratory Notes
		DATE	TIME												
	MW-1	3/5/01	1330	GW	6	X	X	X					X	X	MK00142  01 02 03
	MW-2	↓	1234	↓	↓	X	X	X					X	X	
	MW-3	↓	1304	↓	↓	X	X	X					X	X	

Relinquished by: (Signature) *[Signature]*

Received by: (Signature) *[Signature]*

Date: 3-6-01 Time: 1220

Relinquished by: (Signature) *[Signature]*

Received by: (Signature) *[Signature]*

Date: 3/6/01 Time: 1601

Relinquished by: (Signature) *[Signature]*

Received by: (Signature) *[Signature]*

Date: 3/6/01 Time: 1601

WELL GAUGING DATA

Project # 010305-G1 Date 3/5/01 Client Equiva 204-6852-14c

Site 1784 150th Ave., San Leandro, CA

Well ID	Well Size (in.)	Sheen / Odor	Depth to Immiscible Liquid (ft.)	Thickness of Immiscible Liquid (ft.)	Volume of Immiscibles Removed (ml)	Depth to water (ft.)	Depth to well bottom (ft.)	Survey Point: TOB or TOC
MW-1	4					20.06	44.40	↓
MW-2	4					16.66	44.68	
MW-3	4					22.83	41.30	
MW-4	2					11.07	24.90	

## EQUIVA WELL MONITORING DATA SHEET

BTS #: <u>010305-G1</u>	Site: <u>204-6852-1404</u>
Sampler: <u>M/G</u>	Date: <u>3/5/01</u>
Well I.D.: <del>44.40</del> <u>MW-1</u>	Well Diameter: 2 3 <u>(4)</u> 6 8
Total Well Depth: <u>44.40</u>	Depth to Water: <u>20.06</u>
Depth to Free Product:	Thickness of Free Product (feet):
Referenced to: <u>(PVC)</u> Grade	D.O. Meter (if req'd): <del>VSI</del> <u>(HACH)</u>

Purge Method:

- |                                                                                                                                                                                  |                                                                                                                                                              |
|----------------------------------------------------------------------------------------------------------------------------------------------------------------------------------|--------------------------------------------------------------------------------------------------------------------------------------------------------------|
| <input type="checkbox"/> Bailer<br><input type="checkbox"/> Disposable Bailer<br><input type="checkbox"/> Middleburg<br><input checked="" type="checkbox"/> Electric Submersible | <input type="checkbox"/> Waterra<br><input type="checkbox"/> Peristaltic<br><input type="checkbox"/> Extraction Pump<br><input type="checkbox"/> Other _____ |
|----------------------------------------------------------------------------------------------------------------------------------------------------------------------------------|--------------------------------------------------------------------------------------------------------------------------------------------------------------|

Sampling Method:

- Bailer  
 Disposable Bailer  
 Extraction Port  
 Dedicated Tubing

Other: \_\_\_\_\_

$15.8 \text{ (Gals.)} \times 3 = 47.4 \text{ Gals.}$   
 I Case Volume      Specified Volumes      Calculated Volume

Well Diameter	Multiplier	Well Diameter	Multiplier
1"	0.04	4"	0.65
2"	0.16	6"	1.47
3"	0.37	Other	radius <sup>2</sup> * 0.163

Time	Temp (°F)	pH	Cond.	Turbidity	Gals. Removed	Observations
1320	68.3	6.6	1800	3	16	<u>Odor, Clear</u>
1323	68.2	6.6	1805	2	32	
1326	68.3	6.6	1806	2	48	

Did well dewater? Yes  No  Gallons actually evacuated: 48

Sampling Time: 1330 Sampling Date: 3/5/01

Sample I.D.: MW-1 Laboratory: (Sequoia) Columbia Other \_\_\_\_\_

Analyzed for: (TPH-G BTEX MTBE TPH-D) Other: VOC's by 8010B

EB I.D. (if applicable): \_\_\_\_\_ @ \_\_\_\_\_ Time Duplicate I.D. (if applicable): \_\_\_\_\_

Analyzed for: TPH-G BTEX MTBE TPH-D Other: \_\_\_\_\_

D.O. (if req'd): Pre-purge: \_\_\_\_\_ mg/L Post-purge: (0.4) mg/L

O.R.P. (if req'd): Pre-purge: \_\_\_\_\_ mV Post-purge: \_\_\_\_\_ mV

## EQUIVA WELL MONITORING DATA SHEET

BTS #: <u>010305-61</u>	Site: <u>204-6852-1404</u>
Sampler: <u>MG</u>	Date: <u>3/5/01</u>
Well I.D.: <u>MW-2</u>	Well Diameter: 2 3 <u>4</u> 6 8
Total Well Depth: <u>44.68</u>	Depth to Water: <u>16.66</u>
Depth to Free Product:	Thickness of Free Product (feet):
Referenced to: <u>PVC</u> Grade	D.O. Meter (if req'd): <u>YSI</u> <u>HACH</u>

Purge Method:

- Bailer
- Disposable Bailer
- Middleburg
- Electric Submersible
- Waterra
- Peristaltic
- Extraction Pump
- Other \_\_\_\_\_

Sampling Method:

- Bailer
- Disposable Bailer
- Extraction Port
- Dedicated Tubing
- Other: \_\_\_\_\_

$$\begin{array}{l}
 \underline{18.2} \text{ (Gals.)} \times \underline{3} = \underline{54.6} \text{ Gals.} \\
 \text{1 Case Volume} \quad \text{Specified Volumes} \quad \text{Calculated Volume}
 \end{array}$$

Well Diameter	Multiplier	Well Diameter	Multiplier
1"	0.04	4"	0.65
2"	0.16	6"	1.47
3"	0.37	Other	radius <sup>2</sup> * 0.163

Time	Temp (°F)	pH	Cond.	Turbidity	Gals. Removed	Observations
1219	69.0	8.2	480	>200	19	Sheen, Odor
1222	69.1	7.6	547	65	38	✓ pH calibration
1225	69.2	7.4	647	34	55	
1228	69.2	7.1	777	20	74	
1231	69.0	7.0	872	12	93	

Did well dewater? Yes  No  Gallons actually evacuated: ~~58~~ 74

Sampling Time: 1234 Sampling Date: 3/5/01

Sample I.D.: MW-2 Laboratory: Sequoia Columbia Other \_\_\_\_\_

Analyzed for: TPH-G BTEX MTBE TPH-D Other: VOC's by 8010B

EB I.D. (if applicable): \_\_\_\_\_ @ \_\_\_\_\_ Time Duplicate I.D. (if applicable): \_\_\_\_\_

Analyzed for: TPH-G BTEX MTBE TPH-D Other: \_\_\_\_\_

D.O. (if req'd):	Pre-purge:	mg/L	Post-purge:	<u>1.0</u> mg/L
	O.R.P. (if req'd):	Pre-purge:	mV	Post-purge:



## EQUIVA WELL MONITORING DATA SHEET

BTS #: <u>010305-G1</u>	Site: <u>204-6852-1404</u>
Sampler: <u>M/S</u>	Date: <u>3/5/01</u>
Well I.D.: <u>MW-3</u>	Well Diameter: 2 3 <u>4</u> 6 8
Total Well Depth: <u>41.30</u>	Depth to Water: <u>22.83</u>
Depth to Free Product:	Thickness of Free Product (feet):
Referenced to: <u>PVC</u> Grade	D.O. Meter (if req'd): <del>VSI</del> <u>HACH</u>

Purge Method:  Bailer       Waterra  
 Disposable Bailer       Peristaltic  
 Middleburg       Extraction Pump  
 Electric Submersible       Other \_\_\_\_\_

Sampling Method:  Bailer       Disposable Bailer  
 Extraction Port  
 Dedicated Tubing  
 Other: \_\_\_\_\_

$12.0 \text{ (Gals.)} \times 3 = 36.0 \text{ Gals.}$   
 I Case Volume      Specified Volumes      Calculated Volume

Well Diameter	Multiplier	Well Diameter	Multiplier
1"	0.04	4"	0.65
2"	0.16	6"	1.47
3"	0.37	Other	radius <sup>2</sup> * 0.163

Time	Temp (°F)	pH	Cond.	Turbidity	Gals. Removed	Observations
1255	68.8	6.6	1317	16	13	Clear
1257	68.7	6.6	1362	10	25	
1259	68.6	6.5	1386	13	37	

Did well dewater? Yes  No  Gallons actually evacuated: 37

Sampling Time: 1304      Sampling Date: 3/5/01

Sample I.D.: MW-3      Laboratory: Sequoia Columbia Other \_\_\_\_\_

Analyzed for: TPH-G BTEX MTBE TPH-D Other: VOCs by 8010B

EB I.D. (if applicable): \_\_\_\_\_ @ \_\_\_\_\_ Time Duplicate I.D. (if applicable): \_\_\_\_\_

Analyzed for: TPH-G BTEX MTBE TPH-D Other: \_\_\_\_\_

D.O. (if req'd):	Pre-purge:	mg/L	Post-purge:	<u>0.8</u> mg/L
	O.R.P. (if req'd):	mV	Post-purge:	mV