



Shell Oil Products US

July 9, 2003

Alameda County  
JUL 15 2003  
Environmental Health

Mr. Scott Seery  
Alameda County Health Care Services Agency  
1131 Harbor Bay Parkway, Suite 250  
Alameda, California 94502-6577

**Subject: Shell-branded Service Station**  
3790 Hopyard Road  
Pleasanton, California

Dear Mr. Seery:

Attached for your review and comment is a copy of the *Second Quarter 2003 Groundwater Monitoring Report* for the above referenced site. Upon information and belief, I declare, under penalty of perjury, that the information contained in the attached document is true and correct.

As always, please feel free to contact me directly at (559) 645-9306 with any questions or concerns.

Sincerely,

Shell Oil Products US

*Karen Petryna*

Karen Petryna  
Sr. Environmental Engineer

# C A M B R I A

July 9, 2003

Scott Seery  
Alameda County Health Care Services Agency  
1131 Harbor Bay Parkway, Suite 250  
Alameda, California 94502-6577

Re: **Groundwater Monitoring Report – Second Quarter 2003**  
Shell-branded Service Station  
3790 Hopyard Road  
Pleasanton, California  
SAP Code 135784  
Incident #98995842



Dear Mr. Seery:

Cambria Environmental Technology, Inc. prepared this report on behalf of Equilon Enterprises LLC dba Shell Oil Products US (Shell). This report was prepared in accordance with the quarterly reporting requirements of 23 CCR 2652d.

## **SECOND QUARTER 2003 ACTIVITIES**

**Groundwater Monitoring:** Blaine Tech Services, Inc. (Blaine) of San Jose, California gauged and sampled selected site wells and prepared a summary table of field gauging data and petroleum hydrocarbon and methyl tertiary butyl ether concentrations. Cambria prepared a summary table of additional groundwater analytical data (Table 1), a site vicinity map (Figure 1) and a groundwater contour/chemical concentration map (Figure 2). Blaine's report, presenting the laboratory report, is included as Appendix A.

**Oxygenates Analyses:** As recommended in previous submittals dated March 28, 2003 and May 12, 2003, the analyses of fuel oxygenates has been reduced to include only MTBE and TBA, as no other direction was received from the ACHCSA.

**Interim Remediation:** On August 28, 2002, Cambria submitted an *Interim Remediation Work Plan* proposing installation of a fixed GWE system at the site. The Alameda County Health Care Services Agency (ACHCSA) approved this work plan in a September 9, 2003 letter. Cambria began system installation during the fourth quarter 2002. System completion and startup had been held up by PG&E permitting and scheduling requirements. The final PG&E inspection and connection occurred on June 18, 2003 and Cambria performed a final system inspection on June 24, 2003. Figure 3 shows the layout of the remediation system piping.

Oakland, CA  
Sonoma, CA  
Portland, OR  
Seattle, WA

**Cambria  
Environmental  
Technology, Inc.**

270 Perkins Street  
P.O. Box 259  
Sonoma, CA 95476  
Tel (707)935-4850  
Fax (707)935-6649

# C A M B R I A

**Other Activities:** In an April 9, 2003 *Agency Response and Extension Request*, Cambria addressed several items that were discussed in the ACHCSA letter dated February 27, 2003, and requested an extension for submittal of a Site Conceptual Model (SCM) and work plan from April 14, 2003 to May 30, 2003. The ACHCSA approved an extension to May 1, 2003 in electronic correspondence dated April 15, 2003. Thus, Cambria submitted the *Subsurface Investigation Work Plan* on April 30, 2003, which included additional responses to the agency letter dated February 27, 2003, the preferential pathway study, the SCM, and plume definition information.



## **ANTICIPATED THIRD QUARTER 2003 ACTIVITIES**

**Groundwater Monitoring:** Blaine will gauge and sample the site wells and tabulate the data. Cambria will prepare a monitoring report. As specified in the February 27, 2002 ACHCSA letter, the next quarterly monitoring report will be submitted by October 15, 2003.

**Interim Remediation:** As mentioned above, the final connection by PG&E occurred on June 18, and Cambria has completed the final system inspection. The system is scheduled for startup and full-time operation beginning on July 1, 2003. A system installation and start-up report will be submitted under separate cover, and ongoing updates will be included with the quarterly groundwater monitoring reports.

**Implementation of Work Plan:** Cambria will move forward with the proposed work following written work plan approval from the ACHCSA.

## **HISTORICAL REMEDIATION SUMMARY**

**Mobile Groundwater Extraction (GWE):** Beginning the week of May 14, 2001, Advanced Cleanup Technologies Inc. of Benicia, California conducted three weekly 8-hour mobile GWE events using wells S-2, S-4 and T-2. Three additional GWE events were performed in August 2001. At Shell's direction, Onyx Industrial Service initiated twice-monthly events extracting from tank backfill well T-2 beginning in April 2002. Groundwater was also extracted from well S-4 between June 2002 and September 2002; extraction from well S-4 was discontinued due to low extraction volumes. Tank backfill well T-4 was added to the twice-monthly extraction events in October 2002.

Through the mobile GWE efforts, MTBE concentrations have decreased by approximately one order of magnitude in well S-4. MTBE concentrations detected in well T-2 in March 2003 are

# C A M B R I A

three orders of magnitude lower than those detected in June 2002. And, MTBE concentrations detected in well T-4 in March 2003 are also three orders of magnitude lower than those detected in June 2002.

GWE was discontinued in March 2003 pending fixed GWE system installation and start-up. To date, approximately 9.32 pounds of methyl tertiary butyl ether (MTBE) have been removed by mobile GWE at the site.

## CLOSING



We appreciate the opportunity to work with you on this project. **Please note that there is a new Cambria Project Manager for this site. Please call Ana Friel at (707) 442-2700 if you have any questions or comments and direct future correspondence for Cambria to 270 Perkins Street, Sonoma, CA 95476.**

Sincerely,  
**Cambria Environmental Technology, Inc**

  
Ana Friel, RG *for*  
Senior Project Geologist  
RG 6452

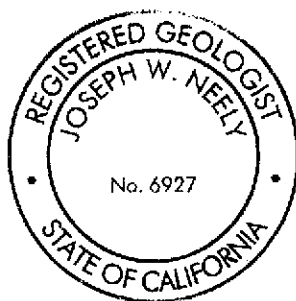

### Attachments:

- Table 1. Additional Groundwater Analytical Data
- Figure 1. Vicinity/Area Well Survey Map
- Figure 2. Groundwater Elevation Contour Map
  
- Appendix A. Blaine Tech Services, Inc. - Groundwater Monitoring Report

cc: Karen Petryna, Shell Oil Products US  
Chuck Headlee, RWQCB  
Danielle Stefani, Livermore-Pleasanton Fire Department  
Matthew W. Katen, Zone 7 Water Agency  
Tri-Valley Management

**Table 1. Additional Groundwater Analytical Data, Shell-branded Service Station, 3790 Hopyard Road, Pleasanton, California**

| Sample | Date<br>Sampled | MTBE<br>( $\mu\text{g/l}$ ) | DIPE<br>( $\mu\text{g/l}$ ) | ETBE<br>( $\mu\text{g/l}$ ) | TAME<br>( $\mu\text{g/l}$ ) | TBA<br>( $\mu\text{g/l}$ ) | Ethanol | 1,2-DCA<br>( $\mu\text{g/l}$ ) | EDB<br>( $\mu\text{g/l}$ ) |
|--------|-----------------|-----------------------------|-----------------------------|-----------------------------|-----------------------------|----------------------------|---------|--------------------------------|----------------------------|
| S-2    | 09/17/01        | 7,500                       | <10                         | <10                         | <10                         | 680                        | <500    | NA                             | NA                         |
| S-2    | 12/27/02        | 4,300                       | <10                         | <10                         | <10                         | 5,600                      | NA      | <10                            | <10                        |
| S-2    | 05/09/03        | 4,000                       | NA                          | NA                          | NA                          | 6,200                      | NA      | NA                             | NA                         |
| S-3    | 12/27/02        | <5.0                        | <2.0                        | <2.0                        | <2.0                        | <50                        | NA      | <2.0                           | <2.0                       |
| S-3    | 05/09/03        | <0.50                       | NA                          | NA                          | NA                          | <5.0                       | NA      | NA                             | NA                         |
| S-4    | 12/27/02        | 390                         | <2.5                        | <2.5                        | <5.0                        | 9,000                      | NA      | <2.5                           | <2.5                       |
| S-4    | 05/09/03        | 1,200                       | NA                          | NA                          | NA                          | 18,000                     | NA      | NA                             | NA                         |
| S-5    | 12/27/02        | 87                          | <2.0                        | <2.0                        | <2.0                        | <50                        | NA      | <2.0                           | <2.0                       |
| S-5    | 05/09/03        | 110                         | NA                          | NA                          | NA                          | 17                         | NA      | NA                             | NA                         |
| S-6    | 09/17/01        | 5.7                         | <2.0                        | <2.0                        | <2.0                        | <50                        | <500    | NA                             | NA                         |
| S-6    | 12/27/02        | 230                         | <5.0                        | <5.0                        | <5.0                        | 10,000                     | NA      | <5.0                           | <5.0                       |
| S-6    | 05/09/03        | 140                         | NA                          | NA                          | NA                          | 12,000                     | NA      | NA                             | NA                         |
| S-7    | 12/27/02        | 22                          | <2.0                        | <2.0                        | <2.0                        | <50                        | NA      | 4.1                            | <2.0                       |
| S-7    | 05/09/03        | 31                          | NA                          | NA                          | NA                          | 7.3                        | NA      | NA                             | NA                         |
| S-8    | 05/09/03        | 24                          | NA                          | NA                          | NA                          | <5.0                       | NA      | NA                             | NA                         |
| S-9    | 12/27/02        | 180                         | <2.0                        | <2.0                        | <2.0                        | <50                        | NA      | 2.8                            | <2.0                       |
| S-9    | 05/09/03        | 240                         | NA                          | NA                          | NA                          | <25                        | NA      | NA                             | NA                         |

Table 1. Additional Groundwater Analytical Data, Shell-branded Service Station, 3790 Hopyard Road, Pleasanton, California

| Sample | Date<br>Sampled | MTBE<br>( $\mu\text{g/l}$ ) | DIPE<br>( $\mu\text{g/l}$ ) | ETBE<br>( $\mu\text{g/l}$ ) | TAME<br>( $\mu\text{g/l}$ ) | TBA<br>( $\mu\text{g/l}$ ) | Ethanol | 1,2-DCA<br>( $\mu\text{g/l}$ ) | EDB<br>( $\mu\text{g/l}$ ) |
|--------|-----------------|-----------------------------|-----------------------------|-----------------------------|-----------------------------|----------------------------|---------|--------------------------------|----------------------------|
| S-10   | 12/27/02        | <5.0                        | <2.0                        | <2.0                        | <2.0                        | <50                        | NA      | <2.0                           | <2.0                       |
| S-10   | 05/09/03        | 1.7                         | NA                          | NA                          | NA                          | <5.0                       | NA      | NA                             | NA                         |
| S-11   | 12/27/02        | <5.0                        | <2.0                        | <2.0                        | <2.0                        | <50                        | NA      | <2.0                           | <2.0                       |
| S-11   | 05/09/03        | 0.54                        | NA                          | NA                          | NA                          | <5.0                       | NA      | NA                             | NA                         |
| S-12   | 12/27/02        | <5.0                        | <2.0                        | <2.0                        | <2.0                        | <50                        | NA      | <2.0                           | <2.0                       |
| S-12   | 05/09/03        | 1.5                         | NA                          | NA                          | NA                          | <5.0                       | NA      | NA                             | NA                         |
| SR-2   | 12/27/02        | 4,800                       | <10                         | <10                         | <10                         | 1,600                      | NA      | <10                            | <10                        |
| SR-2   | 05/09/03        | 13,000                      | NA                          | NA                          | NA                          | 6,100                      | NA      | NA                             | NA                         |
| SR-3   | 12/27/02        | 5,100                       | <20                         | <20                         | <20                         | 4,600                      | NA      | <20                            | <20                        |
| SR-3   | 05/09/03        | 3,700                       | NA                          | NA                          | NA                          | 8,400                      | NA      | NA                             | NA                         |
| T-2    | 12/27/02        | 790                         | <2.0                        | <2.0                        | 2.7                         | 1,200                      | NA      | <2.0                           | <2.0                       |
| T-2    | 05/09/03        | 100                         | NA                          | NA                          | NA                          | 92                         | NA      | NA                             | NA                         |
| T-4    | 12/27/02        | 140                         | <2.0                        | <2.0                        | <2.0                        | 120                        | NA      | <2.0                           | <2.0                       |
| T-4    | 05/09/03        | 14                          | NA                          | NA                          | NA                          | 5.2                        | NA      | NA                             | NA                         |

---

**Table 1. Additional Groundwater Analytical Data, Shell-branded Service Station, 3790 Hopyard Road, Pleasanton, California**

---

Abbreviations and Notes:

$\mu\text{g/L}$  = Micrograms per liter (parts per billion)

<x = Not detected at reporting limit x

NA = Not analyzed for this constituent

All constituents by EPA Method 8260B

MTBE = Methyl tertiary butyl ether

DIPE = Di-isopropyl ether

ETBE = Ethyl tertiary butyl ether

TAME = Tertiary amyl methyl ether

TBA = Tertiary butyl alcohol

1,2-DCA = 1,2-Dichloroethane

EDB = 1,2-Dibromoethane

---

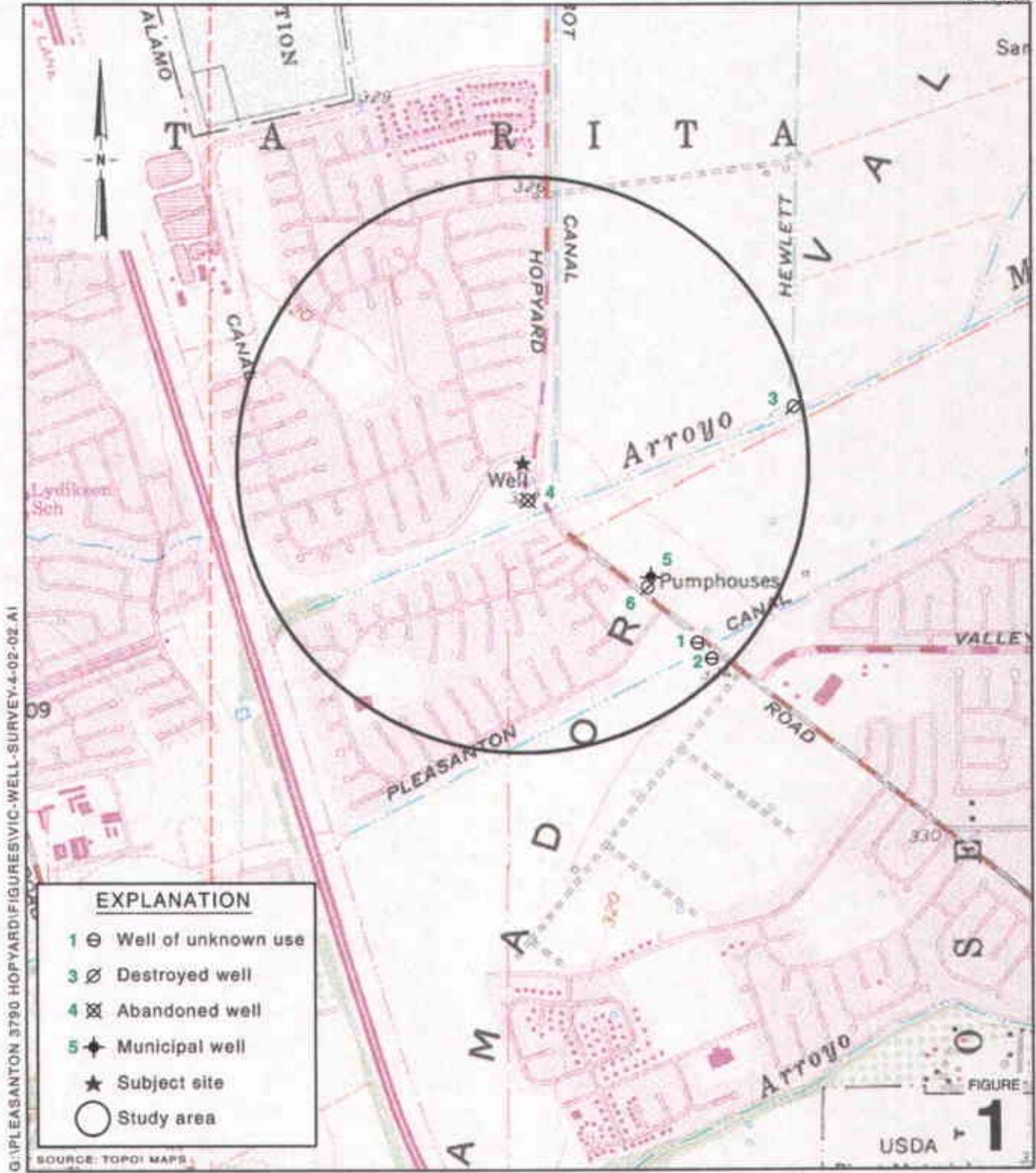

**Shell-branded Service Station**  
 3790 Hopyard Road  
 Pleasanton, California  
 Incident #98995842



**Vicinity/Area Well  
 Survey Map**  
 1/2 Mile Radius



06/20/03

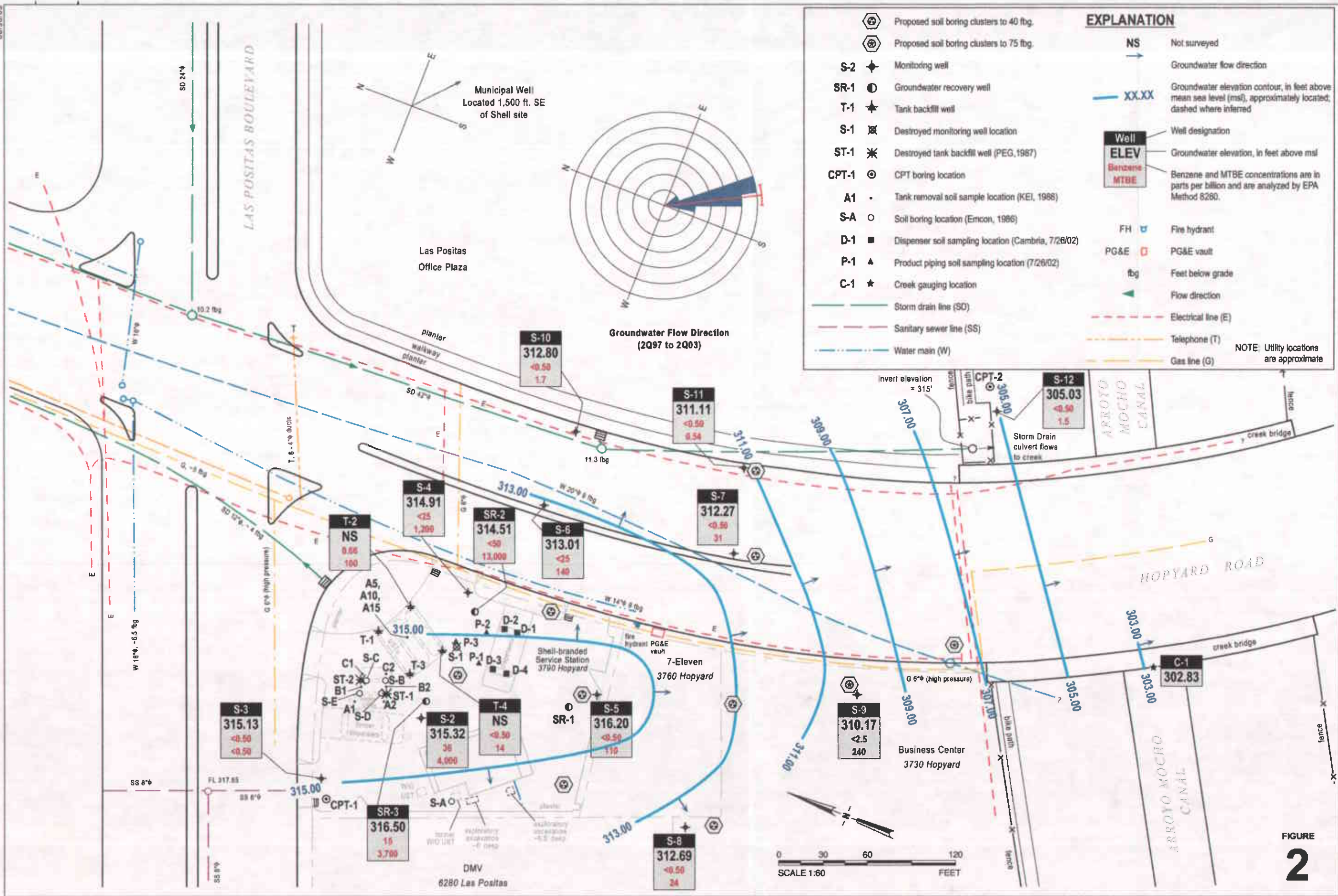

**Groundwater Elevation Contour Map**

May 9, 2003



C A M B R I A

G:\PLEASANTON\3790HOPYARD\FIGURES\2QM03-MP.A

**Appendix A**  
**Blaine Tech Services, Inc.**  
**Groundwater Monitoring Report**

**BLAINE**  
TECH SERVICES, INC.

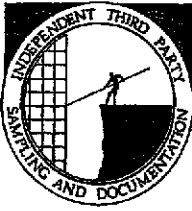

1680 ROGERS AVENUE  
SAN JOSE, CA 95112-1105  
(408) 573-7771 FAX  
(408) 573-0555 PHONE  
CONTRACTOR'S LICENSE #746684  
www.blainetech.com

June 17, 2003

Karen Petryna  
Shell Oil Products US  
P.O. Box 7869  
Burbank, CA 91510-7869

Second Quarter 2003 Groundwater Monitoring at  
Shell-branded Service Station  
3790 Hopyard Road  
Pleasanton, CA

Monitoring performed on May 9, 2003

---

Groundwater Monitoring Report **030509-RH-1**

This report covers the routine monitoring of groundwater wells at this Shell-branded facility. In accordance with standard procedures that conform to Regional Water Quality Control Board requirements, routine field data collection includes depth to water, total well depth, thickness of any separate immiscible layer, water column volume, calculated purge volume (if applicable), elapsed evacuation time (if applicable), total volume of water removed (if applicable), and standard water parameter instrument readings. Sample material is collected, contained, stored, and transported to the laboratory in conformance with EPA standards. Purgewater (if applicable) is, likewise, collected and transported to the Martinez Refining Company.

Basic field information is presented alongside analytical values excerpted from the laboratory report in the cumulative table of **WELL CONCENTRATIONS**. The full analytical report for the most recent samples and the field data sheets are attached to this report.

At a minimum, Blaine Tech Services, Inc. field personnel are certified on completion of a forty-hour Hazardous Materials and Emergency Response training course per 29 CFR 1910.120. Field personnel are also enrolled in annual eight-hour refresher courses.

Blaine Tech Services, Inc. conducts sampling and documentation assignments of this type as an independent third party. Our activities at this site consisted of objective data and sample collection only. No interpretation of analytical results, defining of hydrological conditions or formulation of recommendations was performed.

Please call if you have any questions.

Yours truly,

Leon Gearhart  
Project Coordinator

LG/jt

attachments: Cumulative Table of WELL CONCENTRATIONS  
Certified Analytical Report  
Field Data Sheets

cc: Ana Friel  
Cambria Environmental Technology, Inc.  
P.O. Box 259  
Sonoma, CA 95476-0259

**WELL CONCENTRATIONS**  
**Shell-branded Service Station**  
**3790 Hopyard Road**  
**Pleasanton, CA**

| Well ID | Date       | TPPH<br>(ug/L) | TEPH<br>(ug/L) | B<br>(ug/L) | T<br>(ug/L) | E<br>(ug/L) | X<br>(ug/L) | MTBE<br>8020<br>(ug/L) | MTBE<br>8260<br>(ug/L) | TOC<br>(MSL) | Depth to<br>Water<br>(ft.) | GW<br>Elevation<br>(MSL) | DO<br>Reading<br>(ppm) |
|---------|------------|----------------|----------------|-------------|-------------|-------------|-------------|------------------------|------------------------|--------------|----------------------------|--------------------------|------------------------|
| S-2     | 03/20/1991 | 110            | NA             | 30          | 2.2         | 10          | 7           | NA                     | NA                     | 329.21       | NA                         | NA                       | NA                     |
| S-2     | 06/26/1991 | 50a            | NA             | 6.3         | <0.5        | 3.3         | 1.3         | NA                     | NA                     | 329.21       | NA                         | NA                       | NA                     |
| S-2     | 09/05/1991 | 90             | NA             | 12          | 3.2         | 2.5         | 2.3         | NA                     | NA                     | 329.21       | NA                         | NA                       | NA                     |
| S-2     | 12/13/1991 | <50            | NA             | 12          | <0.5        | <0.5        | <0.5        | NA                     | NA                     | 329.21       | 15.85                      | 313.36                   | NA                     |
| S-2     | 03/11/1992 | <30            | NA             | <0.3        | <0.3        | <0.3        | <0.3        | NA                     | NA                     | 329.21       | 14.94                      | 314.27                   | NA                     |
| S-2     | 06/24/1992 | <50            | NA             | 0.9         | <0.5        | <0.5        | <0.5        | NA                     | NA                     | 329.21       | 15.78                      | 313.43                   | NA                     |
| S-2     | 09/17/1992 | 78             | NA             | 2.6         | 1.3         | 1.3         | 0.9         | NA                     | NA                     | 329.21       | 15.03                      | 314.18                   | NA                     |
| S-2     | 12/11/1992 | <50            | NA             | 0.8         | <0.5        | <0.5        | <0.5        | NA                     | NA                     | 329.21       | 14.81                      | 314.40                   | NA                     |
| S-2     | 02/04/1993 | 55             | NA             | 1.3         | 0.7         | 0.7         | <0.5        | NA                     | NA                     | 329.21       | NA                         | NA                       | NA                     |
| S-2     | 06/03/1993 | <50            | NA             | 0.7         | <0.5        | <0.5        | <0.5        | NA                     | NA                     | 329.21       | NA                         | NA                       | NA                     |
| S-2     | 09/15/1993 | <50            | NA             | <0.5        | <0.5        | <0.5        | <0.5        | NA                     | NA                     | 329.21       | 14.63                      | 314.58                   | NA                     |
| S-2     | 12/09/1993 | <50            | NA             | <0.5        | <0.5        | <0.5        | <0.5        | NA                     | NA                     | 329.21       | 14.70                      | 314.51                   | NA                     |
| S-2     | 06/16/1994 | <50            | NA             | 0.8         | <0.5        | 0.7         | <0.5        | NA                     | NA                     | 329.21       | 14.94                      | 314.27                   | NA                     |
| S-2     | 09/13/1994 | <50            | NA             | <0.5        | <0.5        | <0.5        | <0.5        | NA                     | NA                     | 329.21       | 15.17                      | 314.04                   | NA                     |
| S-2     | 06/21/1995 | <50            | NA             | <0.5        | <0.5        | <0.5        | <0.5        | NA                     | NA                     | 329.21       | 14.25                      | 314.96                   | NA                     |
| S-2     | 06/12/1996 | <50            | NA             | 6.1         | <0.5        | <0.5        | <0.5        | 48                     | NA                     | 329.21       | 14.31                      | 314.90                   | NA                     |
| S-2     | 06/25/1997 | 120            | NA             | 25          | 0.59        | 2.4         | 8.7         | 130                    | NA                     | 329.21       | 14.40                      | 314.81                   | 4.4                    |
| S-2     | 06/19/1998 | 450            | NA             | 96          | <2.5        | 4           | 19          | 180                    | NA                     | 329.21       | 13.72                      | 315.49                   | 2.8                    |
| S-2     | 06/17/1999 | 312            | NA             | 74.4        | 2.04        | 1.02        | <1.00       | 147                    | NA                     | 329.21       | 13.97                      | 315.24                   | 3.7                    |
| S-2     | 06/15/2000 | 1,050          | NA             | 261         | <5.00       | 7.54        | 11.4        | 13,500                 | 9,850b                 | 329.21       | 14.25                      | 314.96                   | 3.3                    |
| S-2     | 11/29/2000 | <250           | NA             | 3.75        | <2.50       | <2.50       | <2.50       | 12,400                 | 10,700b                | 329.21       | 14.82                      | 314.39                   | 2.2                    |
| S-2     | 03/07/2001 | <500           | NA             | 14.7        | <5.00       | <5.00       | <5.00       | 8,610                  | NA                     | 329.21       | 13.70                      | 315.51                   | 2.3                    |
| S-2     | 06/18/2001 | <2,000         | NA             | <20         | <20         | <20         | <20         | NA                     | 7,100                  | 329.21       | 14.56                      | 314.65                   | NA                     |
| S-2     | 09/17/2001 | <2,000         | NA             | <10         | <10         | <10         | <10         | NA                     | 7,500                  | 329.21       | 15.18                      | 314.03                   | NA                     |
| S-2     | 12/31/2001 | <1,000         | NA             | <10         | <10         | <10         | <10         | NA                     | 3,800                  | 329.21       | 13.19                      | 316.02                   | NA                     |
| S-2     | 03/13/2002 | <1,000         | NA             | 65          | <10         | 13          | <10         | NA                     | 6,500                  | 329.21       | 15.03                      | 314.18                   | NA                     |
| S-2     | 06/18/2002 | 520            | NA             | 28          | <5.0        | <5.0        | <5.0        | NA                     | 2,800                  | 329.21       | 15.60                      | 313.61                   | NA                     |

**WELL CONCENTRATIONS**  
**Shell-branded Service Station**  
**3790 Hopyard Road**  
**Pleasanton, CA**

| Well ID | Date       | TPPH<br>(ug/L) | TEPH<br>(ug/L) | B<br>(ug/L) | T<br>(ug/L) | E<br>(ug/L) | X<br>(ug/L) | MTBE<br>8020<br>(ug/L) | MTBE<br>8260<br>(ug/L) | TOC<br>(MSL) | Depth to<br>Water<br>(ft.) | GW<br>Elevation<br>(MSL) | DO<br>Reading<br>(ppm) |
|---------|------------|----------------|----------------|-------------|-------------|-------------|-------------|------------------------|------------------------|--------------|----------------------------|--------------------------|------------------------|
| S-2     | 09/27/2002 | <1,000         | NA             | <10         | <10         | <10         | <10         | NA                     | 4,200                  | 328.77       | 14.90                      | 313.87                   | NA                     |
| S-2     | 12/27/2002 | <1,000         | NA             | <10         | <10         | <10         | <10         | NA                     | 4,300                  | 328.77       | 14.40                      | 314.37                   | NA                     |
| S-2     | 03/24/2003 | <2,500         | NA             | 28          | <25         | <25         | <50         | NA                     | 1,300                  | 328.77       | 14.86                      | 313.91                   | NA                     |
| S-2     | 05/09/2003 | <2,500         | NA             | 36          | <25         | 35          | <50         | NA                     | 4,000                  | 328.77       | 13.45                      | 315.32                   | NA                     |
| S-3     | 03/20/1991 | 70             | NA             | 2.3         | 8.9         | 4           | 23          | NA                     | NA                     | 327.67       | NA                         | NA                       | NA                     |
| S-3     | 06/26/1991 | <50            | NA             | <0.5        | <0.5        | <0.5        | <0.5        | NA                     | NA                     | 327.67       | NA                         | NA                       | NA                     |
| S-3     | 09/05/1991 | <50            | NA             | <0.5        | <0.5        | <0.5        | <0.5        | NA                     | NA                     | 327.67       | NA                         | NA                       | NA                     |
| S-3     | 12/13/1991 | <50            | NA             | <0.5        | <0.5        | <0.5        | <0.5        | NA                     | NA                     | 327.67       | 13.87                      | 313.80                   | NA                     |
| S-3     | 03/11/1992 | <30            | NA             | <0.5        | <0.5        | <0.5        | <0.5        | NA                     | NA                     | 327.67       | 13.05                      | 314.62                   | NA                     |
| S-3     | 06/24/1992 | <50            | NA             | <0.5        | <0.5        | <0.5        | <0.5        | NA                     | NA                     | 327.67       | 13.86                      | 313.81                   | NA                     |
| S-3     | 09/17/1992 | <50            | NA             | <0.5        | <0.5        | <0.5        | <0.5        | NA                     | NA                     | 327.67       | 13.01                      | 314.66                   | NA                     |
| S-3     | 12/11/1992 | <50            | NA             | <0.5        | <0.5        | <0.5        | <0.5        | NA                     | NA                     | 327.67       | 13.00                      | 314.67                   | NA                     |
| S-3     | 02/04/1993 | <50            | NA             | <0.5        | <0.5        | <0.5        | <0.5        | NA                     | NA                     | 327.67       | NA                         | NA                       | NA                     |
| S-3     | 06/03/1993 | <50            | NA             | <0.5        | <0.5        | <0.5        | <0.5        | NA                     | NA                     | 327.67       | NA                         | NA                       | NA                     |
| S-3     | 09/15/1993 | NA             | NA             | NA          | NA          | NA          | NA          | NA                     | NA                     | 327.67       | 13.02                      | 314.65                   | NA                     |
| S-3     | 12/09/1993 | NA             | NA             | NA          | NA          | NA          | NA          | NA                     | NA                     | 327.67       | NA                         | NA                       | NA                     |
| S-3     | 09/13/1994 | NA             | NA             | NA          | NA          | NA          | NA          | NA                     | NA                     | 327.67       | 15.17                      | 312.50                   | NA                     |
| S-3     | 06/21/1995 | 50             | NA             | 4.1         | <0.5        | 20          | 1.2         | NA                     | NA                     | 327.67       | 12.49                      | 315.18                   | NA                     |
| S-3     | 06/12/1996 | <50            | NA             | <0.5        | <0.5        | <0.5        | <0.5        | <2.5                   | NA                     | 327.67       | 12.53                      | 315.14                   | NA                     |
| S-3     | 06/25/1997 | <50            | NA             | <0.50       | <0.50       | <0.50       | <0.50       | <2.5                   | NA                     | 327.67       | 12.64                      | 315.03                   | 1.8                    |
| S-3     | 06/19/1998 | <50            | NA             | <0.50       | <0.50       | <0.50       | <0.50       | <2.5                   | NA                     | 327.67       | 11.74                      | 315.93                   | 4.1                    |
| S-3     | 06/17/1999 | <50.0          | NA             | <0.500      | <0.500      | <0.500      | <0.500      | <5.00                  | NA                     | 327.67       | 12.35                      | 315.32                   | 2.8                    |
| S-3     | 06/15/2000 | <50.0          | NA             | <0.500      | <0.500      | <0.500      | <0.500      | <2.50                  | NA                     | 327.67       | 12.51                      | 315.16                   | 3.2                    |
| S-3     | 11/29/2000 | <50.0          | NA             | <0.500      | <0.500      | <0.500      | <0.500      | <2.50                  | NA                     | 327.67       | 12.84                      | 314.83                   | 1.0                    |
| S-3     | 03/07/2001 | <50.0          | NA             | <0.500      | <0.500      | <0.500      | <0.500      | <2.50                  | NA                     | 327.67       | 12.42                      | 315.25                   | 2.8                    |
| S-3     | 06/18/2001 | <50            | NA             | 0.66        | 1.1         | <0.50       | 0.51        | NA                     | 0.66                   | 327.67       | 13.74                      | 313.93                   | NA                     |

**WELL CONCENTRATIONS**  
**Shell-branded Service Station**  
**3790 Hopyard Road**  
**Pleasanton, CA**

| Well ID | Date       | TPPH<br>(ug/L) | TEPH<br>(ug/L) | B<br>(ug/L) | T<br>(ug/L) | E<br>(ug/L) | X<br>(ug/L) | MTBE<br>8020<br>(ug/L) | MTBE<br>8260<br>(ug/L) | TOC<br>(MSL) | Depth to<br>Water<br>(ft.) | GW<br>Elevation<br>(MSL) | DO<br>Reading<br>(ppm) |
|---------|------------|----------------|----------------|-------------|-------------|-------------|-------------|------------------------|------------------------|--------------|----------------------------|--------------------------|------------------------|
| S-3     | 09/17/2001 | <50            | NA             | 0.73        | 0.96        | <0.50       | 0.61        | NA                     | <5.0                   | 327.67       | 13.25                      | 314.42                   | NA                     |
| S-3     | 12/31/2001 | <50            | NA             | <0.50       | <0.50       | <0.50       | <0.50       | NA                     | <5.0                   | 327.67       | 12.38                      | 315.29                   | NA                     |
| S-3     | 03/13/2002 | <50            | NA             | <0.50       | <0.50       | <0.50       | <0.50       | NA                     | <5.0                   | 327.67       | 13.16                      | 314.51                   | NA                     |
| S-3     | 06/18/2002 | <50            | NA             | <0.50       | <0.50       | <0.50       | <0.50       | NA                     | <5.0                   | 327.67       | 13.55                      | 314.12                   | NA                     |
| S-3     | 09/27/2002 | <50            | NA             | <0.50       | <0.50       | <0.50       | <0.50       | NA                     | <5.0                   | 327.40       | 13.32                      | 314.08                   | NA                     |
| S-3     | 12/27/2002 | <50            | NA             | <0.50       | <0.50       | <0.50       | <0.50       | NA                     | <5.0                   | 327.40       | 12.55                      | 314.85                   | NA                     |
| S-3     | 03/24/2003 | <50            | NA             | <0.50       | <0.50       | <0.50       | <1.0        | NA                     | <5.0                   | 327.40       | 12.71                      | 314.69                   | NA                     |
| S-3     | 05/09/2003 | <50            | NA             | <0.50       | <0.50       | <0.50       | <1.0        | NA                     | <0.50                  | 327.40       | 12.27                      | 315.13                   | NA                     |
| S-4     | 03/20/1991 | 1,200          | NA             | 100         | <2.0        | 210         | 130         | NA                     | NA                     | 328.53       | NA                         | NA                       | NA                     |
| S-4     | 06/26/1991 | 220            | NA             | 14          | <0.5        | 34          | 17          | NA                     | NA                     | 328.53       | NA                         | NA                       | NA                     |
| S-4     | 09/05/1991 | 580            | NA             | 31          | 0.8         | 53          | 26          | NA                     | NA                     | 328.53       | NA                         | NA                       | NA                     |
| S-4     | 12/13/1991 | 370            | NA             | 24          | 0.9         | 1.3         | 46          | NA                     | NA                     | 328.53       | 15.20                      | 313.33                   | NA                     |
| S-4     | 03/11/1992 | 1,600          | NA             | 23          | 1.2         | 12          | 20          | NA                     | NA                     | 328.53       | 14.37                      | 314.16                   | NA                     |
| S-4     | 06/24/1992 | 480            | NA             | 48          | <1.0        | 95          | 22          | NA                     | NA                     | 328.53       | 15.30                      | 313.23                   | NA                     |
| S-4     | 09/17/1992 | 260            | NA             | 35          | 1.2         | 51          | 7.8         | NA                     | NA                     | 328.53       | 14.17                      | 314.36                   | NA                     |
| S-4     | 12/11/1992 | 270            | NA             | 34          | 0.8         | 28          | 4.5         | NA                     | NA                     | 328.53       | 14.18                      | 314.35                   | NA                     |
| S-4     | 02/04/1993 | 1,100          | NA             | 12          | <5.0        | 89          | 100         | NA                     | NA                     | 328.53       | NA                         | NA                       | NA                     |
| S-4     | 06/03/1993 | 210            | NA             | 48          | 1.1         | 42          | 4           | NA                     | NA                     | 328.53       | NA                         | NA                       | NA                     |
| S-4     | 09/15/1993 | 700            | NA             | 21          | <1.0        | 110         | 91          | NA                     | NA                     | 328.53       | 13.86                      | 314.67                   | NA                     |
| S-4     | 12/09/1993 | 250            | NA             | 39          | <0.5        | 3.8         | 2.6         | NA                     | NA                     | 328.53       | 14.16                      | 314.37                   | NA                     |
| S-4     | 03/04/1994 | 150            | NA             | 25          | 1.4         | 6.8         | 2.8         | NA                     | NA                     | 328.53       | 14.17                      | 314.36                   | NA                     |
| S-4 (D) | 03/04/1994 | 140            | NA             | 28          | 0.8         | 7.9         | 3.2         | NA                     | NA                     | 328.53       | 14.17                      | 314.36                   | NA                     |
| S-4     | 06/16/1994 | 90             | NA             | 12          | <0.5        | 1.8         | 2.4         | NA                     | NA                     | 328.53       | 14.14                      | 314.39                   | NA                     |
| S-4 (D) | 06/16/1994 | 80             | NA             | 5.9         | <0.5        | 1.5         | 0.9         | NA                     | NA                     | 328.53       | 14.14                      | 314.39                   | NA                     |
| S-4     | 09/13/1994 | <50            | NA             | 23          | <0.5        | 4.9         | 2.4         | NA                     | NA                     | 328.53       | 14.42                      | 314.11                   | NA                     |
| S-4 (D) | 09/13/1994 | <50            | NA             | 23          | <0.5        | 4           | 2.3         | NA                     | NA                     | 328.53       | 14.42                      | 314.11                   | NA                     |

**WELL CONCENTRATIONS**  
**Shell-branded Service Station**  
**3790 Hopyard Road**  
**Pleasanton, CA**

| Well ID | Date       | TPPH<br>(ug/L) | TEPH<br>(ug/L) | B<br>(ug/L) | T<br>(ug/L) | E<br>(ug/L) | X<br>(ug/L) | MTBE<br>8020<br>(ug/L) | MTBE<br>8260<br>(ug/L) | TOC<br>(MSL) | Depth to<br>Water<br>(ft.) | GW<br>Elevation<br>(MSL) | DO<br>Reading<br>(ppm) |
|---------|------------|----------------|----------------|-------------|-------------|-------------|-------------|------------------------|------------------------|--------------|----------------------------|--------------------------|------------------------|
| S-4     | 06/21/1995 | 270            | NA             | 34          | 1.4         | 25          | 7.6         | NA                     | NA                     | 328.53       | 13.82                      | 314.71                   | NA                     |
| S-4 (D) | 06/21/1995 | 280            | NA             | 35          | 2.1         | 26          | 8.4         | NA                     | NA                     | 328.53       | 13.82                      | 314.71                   | NA                     |
| S-4     | 06/12/1996 | 360            | NA             | 52          | <0.5        | <0.5        | <0.5        | 92                     | NA                     | 328.53       | 13.64                      | 314.89                   | NA                     |
| S-4 (D) | 06/12/1996 | 430            | NA             | 54          | <1.2        | 72          | 21          | 96                     | NA                     | 328.53       | 13.64                      | 314.89                   | NA                     |
| S-4     | 06/25/1997 | 6,700          | NA             | 93          | 1,200       | 240         | 1,300       | 6,900                  | 6,800                  | 328.53       | 13.74                      | 314.79                   | 0.6                    |
| S-4     | 06/19/1998 | 3,500          | NA             | 56          | 15          | 140         | 670         | 2,100                  | NA                     | 328.53       | 12.55                      | 315.98                   | 0.8                    |
| S-4 (D) | 06/19/1998 | 3,000          | NA             | 51          | 14          | 110         | 530         | 2,000                  | NA                     | 328.53       | 12.55                      | 315.98                   | 0.8                    |
| S-4     | 06/17/1999 | 1,510          | NA             | 28.4        | 9.84        | 176         | 132         | 1,780                  | NA                     | 328.53       | 13.24                      | 315.29                   | 4.8                    |
| S-4     | 06/15/2000 | <500           | NA             | 12.0        | <5.00       | 31.0        | 22.8        | 12,200                 | NA                     | 328.53       | 13.65                      | 314.88                   | 2.1                    |
| S-4     | 11/29/2000 | <500           | NA             | <5.00       | <5.00       | <5.00       | <5.00       | 12,100                 | NA                     | 328.53       | 14.23                      | 314.30                   | 1.8                    |
| S-4     | 03/07/2001 | <500           | NA             | 5.44        | <5.00       | 6.49        | <5.00       | 11,400                 | 14,500                 | 328.53       | 13.15                      | 315.38                   | 2.4                    |
| S-4     | 06/18/2001 | <1,000         | NA             | <10         | <10         | <10         | <10         | NA                     | 3,500                  | 328.53       | 13.81                      | 314.72                   | NA                     |
| S-4     | 09/17/2001 | <500           | NA             | <5.0        | <5.0        | <5.0        | <5.0        | NA                     | 7,700                  | 328.53       | 14.29                      | 314.24                   | NA                     |
| S-4     | 12/31/2001 | <1,000         | NA             | <10         | <10         | <10         | <10         | NA                     | 3,800                  | 328.53       | 13.44                      | 315.09                   | NA                     |
| S-4     | 03/13/2002 | <2,500         | NA             | <25         | <25         | <25         | <25         | NA                     | 18,000                 | 328.53       | 14.42                      | 314.11                   | NA                     |
| S-4     | 06/18/2002 | <100           | NA             | 1.1         | <1.0        | <1.0        | <1.0        | NA                     | 530                    | 328.53       | 15.19                      | 313.34                   | NA                     |
| S-4     | 09/27/2002 | <200           | NA             | <2.0        | <2.0        | <2.0        | <2.0        | NA                     | 1,100                  | 328.11       | 14.32                      | 313.79                   | NA                     |
| S-4     | 12/27/2002 | 280            | NA             | 3.5         | <2.5        | 17          | 4.7         | NA                     | 390                    | 328.11       | 13.50                      | 314.61                   | NA                     |
| S-4     | 03/24/2003 | <2,500         | NA             | <25         | <25         | <25         | <50         | NA                     | 780                    | 328.11       | 14.56                      | 313.55                   | NA                     |
| S-4     | 05/09/2003 | <2,500         | NA             | <25         | <25         | <25         | <50         | NA                     | 1,200                  | 328.11       | 13.20                      | 314.91                   | NA                     |
| S-5     | 03/20/1991 | 310            | NA             | 39          | 12          | 18          | 30          | NA                     | NA                     | 329.66       | NA                         | NA                       | NA                     |
| S-5     | 06/26/1991 | 1,300          | NA             | 250         | 62          | 120         | 180         | NA                     | NA                     | 329.66       | NA                         | NA                       | NA                     |
| S-5     | 09/05/1991 | 4,700          | NA             | 660         | 150         | 170         | 280         | NA                     | NA                     | 329.66       | NA                         | NA                       | NA                     |
| S-5     | 12/13/1991 | 1,400          | NA             | 580         | 19          | 110         | 80          | NA                     | NA                     | 329.66       | 17.48                      | 312.18                   | NA                     |
| S-5     | 03/11/1992 | <30            | NA             | <0.3        | <0.3        | <0.3        | <0.3        | NA                     | NA                     | 329.66       | 16.22                      | 313.44                   | NA                     |
| S-5     | 06/24/1992 | 1,800          | NA             | 380         | 52          | 120         | 180         | NA                     | NA                     | 329.66       | 17.47                      | 312.19                   | NA                     |



**WELL CONCENTRATIONS**  
**Shell-branded Service Station**  
**3790 Hopyard Road**  
**Pleasanton, CA**

| Well ID | Date       | TPPH<br>(ug/L) | TEPH<br>(ug/L) | B<br>(ug/L) | T<br>(ug/L) | E<br>(ug/L) | X<br>(ug/L) | MTBE<br>8020<br>(ug/L) | MTBE<br>8260<br>(ug/L) | TOC<br>(MSL) | Depth to<br>Water<br>(ft.) | GW<br>Elevation<br>(MSL) | DO<br>Reading<br>(ppm) |
|---------|------------|----------------|----------------|-------------|-------------|-------------|-------------|------------------------|------------------------|--------------|----------------------------|--------------------------|------------------------|
| S-5     | 09/17/1992 | 2,200          | NA             | 750         | 91          | 170         | 170         | NA                     | NA                     | 329.66       | 16.84                      | 312.82                   | NA                     |
| S-5     | 12/11/1992 | 8,700          | NA             | 1,600       | 66          | 48          | 340         | NA                     | NA                     | 329.66       | 16.37                      | 313.29                   | NA                     |
| S-5     | 02/04/1993 | 150            | NA             | 156         | 0.7         | 4.7         | 4           | NA                     | NA                     | 329.66       | NA                         | NA                       | NA                     |
| S-5     | 06/03/1993 | 480            | NA             | 140         | 3.4         | 17          | 14          | NA                     | NA                     | 329.66       | NA                         | NA                       | NA                     |
| S-5     | 09/15/1993 | 80             | NA             | 2.4         | 0.5         | 1.4         | 2.9         | NA                     | NA                     | 329.66       | 16.20                      | 313.46                   | NA                     |
| S-5     | 12/09/1993 | 120            | NA             | 0.56        | <0.5        | 2.2         | 1.2         | NA                     | NA                     | 329.66       | 16.26                      | 313.40                   | NA                     |
| S-5     | 03/04/1994 | 70             | NA             | <0.5        | <0.5        | <0.5        | <0.5        | NA                     | NA                     | 329.66       | 16.25                      | 313.41                   | NA                     |
| S-5     | 06/16/1994 | <50            | NA             | <0.5        | <0.5        | <0.5        | <0.5        | NA                     | NA                     | 329.66       | 16.04                      | 313.62                   | NA                     |
| S-5     | 09/13/1994 | <50            | NA             | <0.5        | <0.5        | <0.5        | <0.5        | NA                     | NA                     | 329.66       | 11.52                      | 318.14                   | NA                     |
| S-5     | 06/21/1995 | <50            | NA             | <0.5        | <0.5        | <0.5        | <0.5        | NA                     | NA                     | 329.66       | 14.50                      | 315.16                   | NA                     |
| S-5     | 06/12/1996 | <500           | NA             | 6           | <5.0        | <5.0        | <5.0        | 1,400                  | NA                     | 329.66       | 12.53                      | 317.13                   | NA                     |
| S-5     | 06/25/1997 | <250           | NA             | <2.5        | <2.5        | <2.5        | <2.5        | 1,100                  | NA                     | 329.66       | 15.34                      | 314.32                   | 1.1                    |
| S-5     | 06/19/1998 | <50            | NA             | 1           | <0.50       | <0.50       | <0.50       | 61                     | NA                     | 329.66       | 13.71                      | 315.95                   | 3.6                    |
| S-5     | 06/17/1999 | <50.0          | NA             | 1.44        | <0.500      | <0.500      | <0.500      | 336                    | NA                     | 329.66       | 13.56                      | 316.10                   | 1.4                    |
| S-5     | 06/15/2000 | <50.0          | NA             | 0.820       | <0.500      | <0.500      | <0.500      | 221                    | NA                     | 329.66       | 15.00                      | 314.66                   | 2.7                    |
| S-5     | 11/29/2000 | <50.0          | NA             | <0.500      | <0.500      | <0.500      | <0.500      | 183                    | NA                     | 329.66       | 16.29                      | 313.37                   | 0.7                    |
| S-5     | 03/07/2001 | <50.0          | NA             | <0.500      | <0.500      | <0.500      | <0.500      | 7.55                   | NA                     | 329.66       | 15.49                      | 314.17                   | 2.5                    |
| S-5     | 06/18/2001 | <50            | NA             | <0.50       | <0.50       | <0.50       | <0.50       | NA                     | 11                     | 329.66       | 15.50                      | 314.16                   | NA                     |
| S-5     | 09/17/2001 | <50            | NA             | <0.50       | <0.50       | <0.50       | <0.50       | NA                     | 17                     | 329.66       | 16.35                      | 313.31                   | NA                     |
| S-5     | 12/31/2001 | <50            | NA             | <0.50       | <0.50       | <0.50       | <0.50       | NA                     | <5.0                   | 329.66       | 12.80                      | 316.86                   | NA                     |
| S-5     | 03/13/2002 | <50            | NA             | <0.50       | <0.50       | <0.50       | <0.50       | NA                     | 93                     | 329.66       | 16.32                      | 313.34                   | NA                     |
| S-5     | 06/18/2002 | <50            | NA             | <0.50       | <0.50       | <0.50       | <0.50       | NA                     | 130                    | 329.66       | 17.00                      | 312.66                   | NA                     |
| S-5     | 09/27/2002 | <50            | NA             | 0.88        | <0.50       | <0.50       | <0.50       | NA                     | 280                    | 329.36       | 16.34                      | 313.02                   | NA                     |
| S-5     | 12/27/2002 | <50            | NA             | 1.9         | <0.50       | <0.50       | <0.50       | NA                     | 87                     | 329.36       | 15.45                      | 313.91                   | NA                     |
| S-5     | 03/24/2003 | <250           | NA             | 2.5         | <2.5        | <2.5        | <5.0        | NA                     | 220                    | 329.36       | 16.70                      | 312.66                   | NA                     |
| S-5     | 05/09/2003 | <50            | NA             | <0.50       | <0.50       | <0.50       | <1.0        | NA                     | 110                    | 329.36       | 13.16                      | 316.20                   | NA                     |

**WELL CONCENTRATIONS**  
**Shell-branded Service Station**  
**3790 Hopyard Road**  
**Pleasanton, CA**

| Well ID | Date         | TPPH<br>(ug/L) | TEPH<br>(ug/L) | B<br>(ug/L) | T<br>(ug/L) | E<br>(ug/L) | X<br>(ug/L) | MTBE<br>8020<br>(ug/L) | MTBE<br>8260<br>(ug/L) | TOC<br>(MSL) | Depth to<br>Water<br>(ft.) | GW<br>Elevation<br>(MSL) | DO<br>Reading<br>(ppm) |
|---------|--------------|----------------|----------------|-------------|-------------|-------------|-------------|------------------------|------------------------|--------------|----------------------------|--------------------------|------------------------|
| S-6     | 03/20/1991   | 130a           | NA             | 606         | 0.6         | 0.7         | 3           | NA                     | NA                     | 327.62       | NA                         | NA                       | NA                     |
| S-6     | 06/26/1991   | 120a           | NA             | 3.8         | 0.8         | <0.5        | 1.7         | NA                     | NA                     | 327.62       | NA                         | NA                       | NA                     |
| S-6     | 09/05/1991   | 60             | NA             | <0.5        | 0.8         | <0.5        | 0.5         | NA                     | NA                     | 327.62       | NA                         | NA                       | NA                     |
| S-6     | 12/13/1991   | 150            | NA             | 2.3         | <0.5        | <0.5        | 150         | NA                     | NA                     | 327.62       | 15.11                      | 312.51                   | NA                     |
| S-6     | 03/11/1992   | <30            | NA             | <0.3        | <0.3        | <0.5        | <0.3        | NA                     | NA                     | 327.62       | 16.35                      | 311.27                   | NA                     |
| S-6     | 06/24/1992   | 170            | NA             | <0.5        | <0.5        | <0.5        | <0.5        | NA                     | NA                     | 327.62       | 16.51                      | 311.11                   | NA                     |
| S-6     | 09/17/1992   | 190            | NA             | <0.5        | 1.6         | <0.5        | 1.2         | NA                     | NA                     | 327.62       | 14.33                      | 313.29                   | NA                     |
| S-6     | 12/11/1992   | 180            | NA             | <0.5        | 0.8         | <0.5        | 0.7         | NA                     | NA                     | 327.62       | 14.48                      | 313.14                   | NA                     |
| S-6     | 02/04/1993   | 290            | NA             | <0.5        | <0.5        | <0.5        | 0.7         | NA                     | NA                     | 327.62       | NA                         | NA                       | NA                     |
| S-6     | 06/03/1993   | 100            | NA             | 1.2         | <0.5        | <0.5        | <0.5        | NA                     | NA                     | 327.62       | NA                         | NA                       | NA                     |
| S-6     | 09/15/1993   | 160            | NA             | 1.4         | <0.5        | 0.9         | 2           | NA                     | NA                     | 327.62       | 14.16                      | 313.46                   | NA                     |
| S-6     | 12/09/1993   | 130            | NA             | 2.3         | 2.6         | 5.1         | 6.2         | NA                     | NA                     | 327.62       | 14.68                      | 312.94                   | NA                     |
| S-6     | 03/04/1994   | 220            | NA             | <0.5        | <0.5        | <0.5        | <0.5        | NA                     | NA                     | 327.62       | 14.42                      | 313.20                   | NA                     |
| S-6     | 06/16/1994   | 60             | NA             | <0.5        | <0.5        | <0.5        | <0.5        | NA                     | NA                     | 327.62       | 14.92                      | 312.70                   | NA                     |
| S-6     | 09/13/1994   | <50            | NA             | <0.5        | 6           | <0.5        | <0.5        | NA                     | NA                     | 327.62       | 14.72                      | 312.90                   | NA                     |
| S-6     | 06/21/1995   | 270            | NA             | <0.5        | <0.5        | <0.5        | <0.5        | NA                     | NA                     | 327.62       | 13.86                      | 313.76                   | NA                     |
| S-6     | 06/12/1996   | 200            | NA             | 2           | <0.5        | <0.5        | <0.5        | 12                     | NA                     | 327.62       | 13.90                      | 313.72                   | NA                     |
| S-6     | 06/25/1997   | 180            | NA             | <0.50       | 0.61        | <0.50       | 0.77        | 28                     | NA                     | 327.62       | 13.64                      | 313.98                   | 1.8                    |
| S-6 (D) | 06/25/1997   | 130            | NA             | <0.50       | <0.50       | <0.50       | <0.50       | 21                     | NA                     | 327.62       | 13.64                      | 313.98                   | 1.8                    |
| S-6     | 06/19/1998   | 100            | NA             | 7.6         | <0.50       | <0.50       | <0.50       | 27                     | NA                     | 327.62       | 13.81                      | 313.81                   | 1.7                    |
| S-6     | 06/17/1999   | 114            | NA             | 4.14        | <0.500      | <0.500      | <0.500      | 19.9                   | NA                     | 327.62       | 14.21                      | 313.41                   | 1.6                    |
| S-6     | 06/15/2000   | 367            | NA             | 17.5        | <0.500      | <0.500      | <0.500      | 1,050                  | NA                     | 327.62       | 14.51                      | 313.11                   | 1.8                    |
| S-6     | 11/29/2000   | 154            | NA             | 0.754       | 16.4        | <0.500      | 1.05        | 5,470                  | NA                     | 327.62       | 14.32                      | 313.30                   | 2.1                    |
| S-6     | 03/07/2001   | 183            | NA             | 0.971       | 25.1        | 0.636       | 0.996       | 6,830                  | NA                     | 327.62       | 15.39                      | 312.23                   | 1.7                    |
| S-6     | 06/18/2001   | <2,000         | NA             | <20         | <20         | <20         | <20         | NA                     | 8,200                  | 327.62       | 14.72                      | 312.90                   | NA                     |
| S-6     | 09/17/2001 c | <50            | NA             | <0.50       | <0.50       | <0.50       | <0.50       | NA                     | 5.7                    | 327.62       | 16.69                      | 310.93                   | NA                     |
| S-6     | 12/31/2001   | 260            | NA             | <0.50       | <0.50       | <0.50       | <0.50       | NA                     | 11,000                 | 327.62       | 13.99                      | 313.63                   | NA                     |

**WELL CONCENTRATIONS**  
**Shell-branded Service Station**  
**3790 Hopyard Road**  
**Pleasanton, CA**

| Well ID | Date       | TPPH<br>(ug/L) | TEPH<br>(ug/L) | B<br>(ug/L) | T<br>(ug/L) | E<br>(ug/L) | X<br>(ug/L) | MTBE<br>8020<br>(ug/L) | MTBE<br>8260<br>(ug/L) | TOC<br>(MSL) | Depth to<br>Water<br>(ft.) | GW<br>Elevation<br>(MSL) | DO<br>Reading<br>(ppm) |
|---------|------------|----------------|----------------|-------------|-------------|-------------|-------------|------------------------|------------------------|--------------|----------------------------|--------------------------|------------------------|
| S-6     | 03/13/2002 | 440            | NA             | <2.5        | <2.5        | <2.5        | <2.5        | NA                     | 930                    | 327.62       | 15.10                      | 312.52                   | NA                     |
| S-6     | 06/18/2002 | 340            | NA             | <1.0        | <1.0        | <1.0        | <1.0        | NA                     | 560                    | 327.62       | 15.24                      | 312.38                   | NA                     |
| S-6     | 09/27/2002 | <250           | NA             | <2.5        | <2.5        | <2.5        | <2.5        | NA                     | 580                    | 327.26       | 14.34                      | 312.92                   | NA                     |
| S-6     | 12/27/2002 | <500           | NA             | <5.0        | <5.0        | <5.0        | <5.0        | NA                     | 230                    | 327.26       | 14.30                      | 312.96                   | NA                     |
| S-6     | 03/24/2003 | <5,000         | NA             | <50         | <50         | <50         | <100        | NA                     | <500                   | 327.26       | 14.37                      | 312.89                   | NA                     |
| S-6     | 05/09/2003 | <2,500         | NA             | <25         | <25         | <25         | <50         | NA                     | 140                    | 327.26       | 14.25                      | 313.01                   | NA                     |
| S-7     | 03/20/1991 | <50            | NA             | <0.5        | <0.5        | <0.5        | <0.5        | NA                     | NA                     | 328.67       | NA                         | NA                       | NA                     |
| S-7     | 06/26/1991 | <50            | NA             | <0.5        | <0.5        | <0.5        | <0.5        | NA                     | NA                     | 328.67       | NA                         | NA                       | NA                     |
| S-7     | 09/05/1991 | <50            | NA             | <0.5        | 0.6         | <0.5        | <0.5        | NA                     | NA                     | 328.67       | NA                         | NA                       | NA                     |
| S-7     | 12/13/1991 | <50            | NA             | <0.6        | <0.5        | <0.5        | <0.5        | NA                     | NA                     | 328.67       | 17.70                      | 310.97                   | NA                     |
| S-7     | 03/11/1992 | <50            | NA             | <0.3        | <0.3        | <0.3        | <0.3        | NA                     | NA                     | 328.67       | 17.06                      | 311.61                   | NA                     |
| S-7     | 06/24/1992 | <50            | NA             | <0.5        | <0.5        | <0.5        | <0.5        | NA                     | NA                     | 328.67       | 17.80                      | 310.87                   | NA                     |
| S-7     | 09/17/1992 | <50            | NA             | 0.6         | 0.6         | <0.5        | <0.5        | NA                     | NA                     | 328.67       | 17.00                      | 311.67                   | NA                     |
| S-7     | 12/11/1992 | <50            | NA             | <0.5        | <0.5        | <0.5        | <0.5        | NA                     | NA                     | 328.67       | 17.35                      | 311.32                   | NA                     |
| S-7     | 02/04/1993 | <50            | NA             | <0.5        | <0.5        | <0.5        | <0.5        | NA                     | NA                     | 328.67       | NA                         | NA                       | NA                     |
| S-7     | 06/03/1993 | <50            | NA             | <0.5        | <0.5        | <0.5        | <0.5        | NA                     | NA                     | 328.67       | NA                         | NA                       | NA                     |
| S-7     | 09/15/1993 | NA             | NA             | NA          | NA          | NA          | NA          | NA                     | NA                     | 328.67       | 16.65                      | 312.02                   | NA                     |
| S-7     | 12/09/1993 | NA             | NA             | NA          | NA          | NA          | NA          | NA                     | NA                     | 328.67       | NA                         | NA                       | NA                     |
| S-7     | 09/13/1994 | NA             | NA             | NA          | NA          | NA          | NA          | NA                     | NA                     | 328.67       | 16.83                      | 311.84                   | NA                     |
| S-7     | 06/21/1995 | <50            | NA             | <0.5        | <0.5        | <0.5        | <0.5        | NA                     | NA                     | 328.67       | 15.88                      | 312.79                   | NA                     |
| S-7     | 06/12/1996 | <50            | NA             | <0.5        | <0.5        | <0.5        | <0.5        | <2.5                   | NA                     | 328.67       | 16.22                      | 312.45                   | NA                     |
| S-7     | 06/25/1997 | <50            | NA             | <0.50       | <0.50       | <0.50       | <0.50       | <2.5                   | NA                     | 328.67       | 16.12                      | 312.55                   | 3                      |
| S-7     | 06/19/1998 | <50            | NA             | <0.50       | <.050       | <0.50       | <0.50       | <2.5                   | NA                     | 328.67       | 14.81                      | 313.86                   | 2.6                    |
| S-7     | 06/17/1999 | <50.0          | NA             | <0.500      | <0.500      | <0.500      | <0.500      | <5.00                  | NA                     | 328.67       | 15.91                      | 312.76                   | 5.1                    |
| S-7     | 06/15/2000 | <50.0          | NA             | <0.500      | <0.500      | <0.500      | <0.500      | 7.32                   | NA                     | 328.67       | 16.14                      | 312.53                   | 2.0                    |
| S-7     | 11/29/2000 | <50.0          | NA             | <0.500      | <0.500      | <0.500      | <0.500      | <2.50                  | NA                     | 328.67       | 16.89                      | 311.78                   | 3.6                    |

**WELL CONCENTRATIONS**  
**Shell-branded Service Station**  
**3790 Hopyard Road**  
**Pleasanton, CA**

| Well ID | Date | TPPH<br>(ug/L) | TEPH<br>(ug/L) | B<br>(ug/L) | T<br>(ug/L) | E<br>(ug/L) | X<br>(ug/L) | MTBE<br>8020<br>(ug/L) | MTBE<br>8260<br>(ug/L) | TOC<br>(MSL) | Depth to<br>Water<br>(ft.) | GW<br>Elevation<br>(MSL) | DO<br>Reading<br>(ppm) |
|---------|------|----------------|----------------|-------------|-------------|-------------|-------------|------------------------|------------------------|--------------|----------------------------|--------------------------|------------------------|
|---------|------|----------------|----------------|-------------|-------------|-------------|-------------|------------------------|------------------------|--------------|----------------------------|--------------------------|------------------------|

|     |              |       |    |        |        |        |        |       |       |        |       |        |     |
|-----|--------------|-------|----|--------|--------|--------|--------|-------|-------|--------|-------|--------|-----|
| S-7 | 03/07/2001   | <50.0 | NA | <0.500 | <0.500 | <0.500 | <0.500 | <2.50 | NA    | 328.67 | 16.55 | 312.12 | 2.1 |
| S-7 | 06/18/2001   | <50   | NA | <0.50  | <0.50  | <0.50  | <0.50  | NA    | 2.5   | 328.67 | 16.30 | 312.37 | NA  |
| S-7 | 09/17/2001 c | 150   | NA | <0.50  | 55     | <0.50  | <0.50  | NA    | 8,300 | 328.67 | 14.23 | 314.44 | NA  |
| S-7 | 12/31/2001   | <50   | NA | <0.50  | <0.50  | <0.50  | <0.50  | NA    | <5.0  | 328.67 | 16.28 | 312.39 | NA  |
| S-7 | 03/13/2002   | <50   | NA | <0.50  | <0.50  | <0.50  | <0.50  | NA    | 5.9   | 328.67 | 17.41 | 311.26 | NA  |
| S-7 | 06/18/2002   | <50   | NA | <0.50  | <0.50  | <0.50  | <0.50  | NA    | 12    | 328.67 | 17.63 | 311.04 | NA  |
| S-7 | 09/27/2002   | <50   | NA | <0.50  | <0.50  | <0.50  | <0.50  | NA    | 10    | 328.41 | 16.96 | 311.45 | NA  |
| S-7 | 12/27/2002   | <50   | NA | <0.50  | <0.50  | <0.50  | <0.50  | NA    | 22    | 328.41 | 16.00 | 312.41 | NA  |
| S-7 | 03/24/2003   | <50   | NA | <0.50  | <0.50  | <0.50  | <1.0   | NA    | 21    | 328.41 | 17.12 | 311.29 | NA  |
| S-7 | 05/09/2003   | <50   | NA | <0.50  | <0.50  | <0.50  | <1.0   | NA    | 31    | 328.41 | 16.14 | 312.27 | NA  |

|     |            |      |    |       |       |       |       |      |    |        |       |        |     |
|-----|------------|------|----|-------|-------|-------|-------|------|----|--------|-------|--------|-----|
| S-8 | 03/20/1991 | <50a | NA | 0.8   | 1.8   | 2.6   | 5.2   | NA   | NA | 327.00 | NA    | NA     | NA  |
| S-8 | 06/26/1991 | <50  | NA | <0.5  | <0.5  | <0.5  | <0.5  | NA   | NA | 327.00 | NA    | NA     | NA  |
| S-8 | 09/05/1991 | <50  | NA | <0.5  | <0.5  | <0.5  | <0.5  | NA   | NA | 327.00 | NA    | NA     | NA  |
| S-8 | 12/13/1991 | <50  | NA | <0.5  | <0.5  | <0.5  | <0.5  | NA   | NA | 327.00 | 15.73 | 311.27 | NA  |
| S-8 | 03/11/1992 | <30  | NA | <0.3  | <0.3  | <0.3  | <0.3  | NA   | NA | 327.00 | 14.64 | 312.36 | NA  |
| S-8 | 06/24/1992 | <50  | NA | 1.4   | 1.9   | <0.5  | <0.5  | NA   | NA | 327.00 | 15.77 | 311.23 | NA  |
| S-8 | 09/17/1992 | <50  | NA | <0.5  | <0.5  | <0.5  | <0.5  | NA   | NA | 327.00 | 15.37 | 311.63 | NA  |
| S-8 | 12/11/1992 | <50  | NA | <0.5  | <0.5  | <0.5  | <0.5  | NA   | NA | 327.00 | 14.94 | 312.06 | NA  |
| S-8 | 02/04/1993 | <50  | NA | <0.5  | <0.5  | <0.5  | <0.5  | NA   | NA | 327.00 | NA    | NA     | NA  |
| S-8 | 06/03/1993 | <50  | NA | <0.5  | <0.5  | <0.5  | <0.5  | NA   | NA | 327.00 | NA    | NA     | NA  |
| S-8 | 09/15/1993 | NA   | NA | NA    | NA    | NA    | NA    | NA   | NA | 327.00 | 14.91 | 312.09 | NA  |
| S-8 | 12/09/1993 | NA   | NA | NA    | NA    | NA    | NA    | NA   | NA | 327.00 | NA    | NA     | NA  |
| S-8 | 09/13/1994 | NA   | NA | NA    | NA    | NA    | NA    | NA   | NA | 327.00 | 15.16 | 313.08 | NA  |
| S-8 | 06/21/1995 | <50  | NA | <0.5  | <0.5  | <0.5  | <0.5  | NA   | NA | 327.00 | 14.11 | 312.89 | NA  |
| S-8 | 06/12/1996 | <50  | NA | <0.5  | <0.5  | <0.5  | <0.5  | <2.5 | NA | 327.00 | 14.20 | 312.80 | NA  |
| S-8 | 06/25/1997 | 170  | NA | <0.50 | <0.50 | <0.50 | <0.50 | <2.5 | NA | 327.00 | 14.42 | 312.58 | 0.5 |

**WELL CONCENTRATIONS**  
**Shell-branded Service Station**  
**3790 Hopyard Road**  
**Pleasanton, CA**

| Well ID | Date | TPPH<br>(ug/L) | TEPH<br>(ug/L) | B<br>(ug/L) | T<br>(ug/L) | E<br>(ug/L) | X<br>(ug/L) | MTBE<br>8020<br>(ug/L) | MTBE<br>8260<br>(ug/L) | TOC<br>(MSL) | Depth to<br>Water<br>(ft.) | GW<br>Elevation<br>(MSL) | DO<br>Reading<br>(ppm) |
|---------|------|----------------|----------------|-------------|-------------|-------------|-------------|------------------------|------------------------|--------------|----------------------------|--------------------------|------------------------|
|---------|------|----------------|----------------|-------------|-------------|-------------|-------------|------------------------|------------------------|--------------|----------------------------|--------------------------|------------------------|

|     |            |                   |    |        |        |        |        |       |     |        |       |        |     |
|-----|------------|-------------------|----|--------|--------|--------|--------|-------|-----|--------|-------|--------|-----|
| S-8 | 06/19/1998 | <50               | NA | <0.50  | <0.50  | <0.50  | <0.50  | <2.5  | NA  | 327.00 | 13.49 | 313.51 | 2.2 |
| S-8 | 06/17/1999 | <50.0             | NA | <0.500 | <0.500 | <0.500 | <0.500 | <5.00 | NA  | 327.00 | 14.07 | 312.93 | 0.9 |
| S-8 | 06/15/2000 | Well inaccessible |    | NA     | NA     | NA     | NA     | NA    | NA  | 327.00 | NA    | NA     | NA  |
| S-8 | 06/21/2000 | <50.0             | NA | <0.500 | <0.500 | <0.500 | <0.500 | 21.0  | NA  | 327.00 | 14.43 | 312.57 | NA  |
| S-8 | 11/29/2000 | <50.0             | NA | <0.500 | <0.500 | <0.500 | <0.500 | 9.46  | NA  | 327.00 | 14.44 | 312.56 | 2.2 |
| S-8 | 03/07/2001 | <50.0             | NA | <0.500 | <0.500 | <0.500 | <0.500 | 4.21  | NA  | 327.00 | 13.69 | 313.31 | 2.1 |
| S-8 | 06/18/2001 | <50               | NA | 0.55   | 0.92   | <0.50  | 0.51   | NA    | 13  | 327.00 | 14.60 | 312.40 | NA  |
| S-8 | 09/17/2001 | Unable to sample  |    | NA     | NA     | NA     | NA     | NA    | NA  | 327.00 | 15.07 | 311.93 | NA  |
| S-8 | 09/18/2001 | Unable to sample  |    | NA     | NA     | NA     | NA     | NA    | NA  | 327.00 | NA    | NA     | NA  |
| S-8 | 12/31/2001 | <50               | NA | 1.1    | 1.4    | <0.50  | <0.50  | NA    | 8.4 | 327.00 | 14.02 | 312.98 | NA  |
| S-8 | 03/13/2002 | Unable to sample  |    | NA     | NA     | NA     | NA     | NA    | NA  | 327.00 | 14.92 | 312.08 | NA  |
| S-8 | 06/18/2002 | <50               | NA | <0.50  | <0.50  | <0.50  | <0.50  | NA    | 19  | 327.00 | 15.37 | 311.63 | NA  |
| S-8 | 09/27/2002 | <50               | NA | <0.50  | <0.50  | <0.50  | <0.50  | NA    | 19  | 326.14 | 14.60 | 311.54 | NA  |
| S-8 | 12/27/2002 | Well inaccessible |    | NA     | NA     | NA     | NA     | NA    | NA  | 326.14 | NA    | NA     | NA  |
| S-8 | 01/07/2003 | Well inaccessible |    | NA     | NA     | NA     | NA     | NA    | NA  | 326.14 | NA    | NA     | NA  |
| S-8 | 03/24/2003 | <50               | NA | <0.50  | <0.50  | <0.50  | <1.0   | NA    | 25  | 326.14 | 14.58 | 311.56 | NA  |
| S-8 | 05/09/2003 | <50               | NA | <0.50  | <0.50  | <0.50  | <1.0   | NA    | 24  | 326.14 | 13.45 | 312.69 | NA  |

|     |            |     |    |      |      |      |      |    |    |        |       |        |    |
|-----|------------|-----|----|------|------|------|------|----|----|--------|-------|--------|----|
| S-9 | 03/20/1991 | 70a | NA | 0.7  | 0.7  | <0.5 | 1    | NA | NA | 328.24 | NA    | NA     | NA |
| S-9 | 06/26/1991 | <50 | NA | <0.5 | <0.5 | <0.5 | <0.5 | NA | NA | 328.24 | NA    | NA     | NA |
| S-9 | 09/05/1991 | <50 | NA | <0.5 | 0.8  | <0.5 | <0.5 | NA | NA | 328.24 | NA    | NA     | NA |
| S-9 | 12/13/1991 | <50 | NA | <0.5 | <0.5 | <0.5 | <0.5 | NA | NA | 328.24 | 18.18 | 310.06 | NA |
| S-9 | 03/11/1992 | <30 | NA | <0.3 | <0.3 | <0.3 | <0.3 | NA | NA | 328.24 | 17.37 | 310.87 | NA |
| S-9 | 06/24/1992 | <50 | NA | <0.5 | <0.5 | <0.5 | <0.5 | NA | NA | 328.24 | 18.45 | 309.79 | NA |
| S-9 | 09/17/1992 | <50 | NA | <0.5 | <0.5 | <0.5 | <0.5 | NA | NA | 328.24 | 17.88 | 310.36 | NA |
| S-9 | 12/11/1992 | <50 | NA | <0.5 | <0.5 | <0.5 | <0.5 | NA | NA | 328.24 | 17.34 | 310.90 | NA |
| S-9 | 02/04/1993 | <50 | NA | <0.5 | <0.5 | <0.5 | <0.5 | NA | NA | 328.24 | NA    | NA     | NA |

**WELL CONCENTRATIONS**  
**Shell-branded Service Station**  
**3790 Hopyard Road**  
**Pleasanton, CA**

| Well ID | Date       | TPPH<br>(ug/L) | TEPH<br>(ug/L) | B<br>(ug/L) | T<br>(ug/L) | E<br>(ug/L) | X<br>(ug/L) | MTBE<br>8020<br>(ug/L) | MTBE<br>8260<br>(ug/L) | TOC<br>(MSL) | Depth to<br>Water<br>(ft.) | GW<br>Elevation<br>(MSL) | DO<br>Reading<br>(ppm) |
|---------|------------|----------------|----------------|-------------|-------------|-------------|-------------|------------------------|------------------------|--------------|----------------------------|--------------------------|------------------------|
| S-9     | 06/03/1993 | <50            | NA             | <0.5        | <0.5        | <0.5        | <0.5        | NA                     | NA                     | 328.24       | NA                         | NA                       | NA                     |
| S-9     | 09/15/1993 | NA             | NA             | NA          | NA          | NA          | NA          | NA                     | NA                     | 328.24       | 17.42                      | 310.82                   | NA                     |
| S-9     | 12/09/1993 | <50            | NA             | <0.5        | <0.5        | <0.5        | <0.5        | NA                     | NA                     | 328.24       | 16.89                      | 311.35                   | NA                     |
| S-9     | 03/04/1994 | <50            | NA             | <0.5        | <0.5        | <0.5        | <0.5        | NA                     | NA                     | 328.24       | 17.22                      | 311.02                   | NA                     |
| S-9     | 06/16/1994 | <50            | NA             | <0.5        | <0.5        | <0.5        | <0.5        | NA                     | NA                     | 328.24       | 17.46                      | 310.78                   | NA                     |
| S-9     | 09/13/1994 | <50            | NA             | <0.5        | <0.5        | <0.5        | <0.5        | NA                     | NA                     | 328.24       | 17.59                      | 310.65                   | NA                     |
| S-9     | 06/21/1995 | <50            | NA             | <0.5        | <0.5        | <0.5        | <0.5        | NA                     | NA                     | 328.24       | 17.03                      | 311.21                   | NA                     |
| S-9     | 06/12/1996 | <50            | NA             | <0.5        | <0.5        | <0.5        | <0.5        | <2.5                   | NA                     | 328.24       | 16.76                      | 311.48                   | NA                     |
| S-9     | 06/25/1997 | <50            | NA             | <0.50       | <0.50       | <0.50       | <0.50       | 2.8                    | NA                     | 328.24       | 16.89                      | 311.35                   | 1                      |
| S-9     | 06/19/1998 | <50            | NA             | <0.50       | <0.50       | <0.50       | <0.50       | 7.1                    | NA                     | 328.24       | 15.59                      | 312.65                   | 3.8                    |
| S-9     | 06/17/1999 | <50.0          | NA             | <0.500      | <0.500      | <0.500      | <0.500      | 15.3                   | NA                     | 328.24       | 16.47                      | 311.77                   | 1.9                    |
| S-9     | 06/15/2000 | <50.0          | NA             | <0.500      | <0.500      | <0.500      | <0.500      | 57.2                   | NA                     | 328.24       | 16.11                      | 312.13                   | 1.1                    |
| S-9     | 11/29/2000 | <50.0          | NA             | <0.500      | <0.500      | <0.500      | <0.500      | 76.5                   | NA                     | 328.24       | 17.30                      | 310.94                   | 1.1                    |
| S-9     | 03/07/2001 | <50.0          | NA             | <0.500      | <0.500      | <0.500      | <0.500      | 84.9                   | NA                     | 328.24       | 19.42                      | 308.82                   | 1.1                    |
| S-9     | 06/18/2001 | <50            | NA             | <0.50       | <0.50       | <0.50       | <0.50       | NA                     | 86                     | 328.24       | 17.22                      | 311.02                   | NA                     |
| S-9     | 09/17/2001 | <50            | NA             | <0.50       | <0.50       | <0.50       | <0.50       | NA                     | 130                    | 328.24       | 17.66                      | 310.58                   | NA                     |
| S-9     | 12/31/2001 | <50            | NA             | <0.50       | <0.50       | <0.50       | <0.50       | NA                     | 120                    | 328.24       | 17.65                      | 310.59                   | NA                     |
| S-9     | 03/13/2002 | <50            | NA             | <0.50       | <0.50       | <0.50       | <0.50       | NA                     | 130                    | 328.24       | 17.75                      | 310.49                   | NA                     |
| S-9     | 06/18/2002 | <50            | NA             | <0.50       | <0.50       | <0.50       | <0.50       | NA                     | 160                    | 328.24       | 19.59                      | 308.65                   | NA                     |
| S-9     | 09/27/2002 | <50            | NA             | <0.50       | <0.50       | <0.50       | <0.50       | NA                     | 180                    | 327.85       | 17.65                      | 310.20                   | NA                     |
| S-9     | 12/27/2002 | <50            | NA             | <0.50       | <0.50       | <0.50       | <0.50       | NA                     | 180                    | 327.85       | 18.45                      | 309.40                   | NA                     |
| S-9     | 03/24/2003 | <250           | NA             | <2.5        | <2.5        | <2.5        | <5.0        | NA                     | 230                    | 327.85       | 17.97                      | 309.88                   | NA                     |
| S-9     | 05/09/2003 | <250           | NA             | <2.5        | <2.5        | <2.5        | <5.0        | NA                     | 240                    | 327.85       | 17.68                      | 310.17                   | NA                     |
| S-10    | 03/20/1991 | <50            | NA             | <0.5        | <0.5        | <0.5        | <0.5        | NA                     | NA                     | 326.55       | NA                         | NA                       | NA                     |
| S-10    | 06/26/1991 | 50             | NA             | 1.8         | 5.8         | 1.9         | 13          | NA                     | NA                     | 326.55       | NA                         | NA                       | NA                     |
| S-10    | 09/05/1991 | <50            | NA             | <0.5        | <0.5        | <0.5        | <0.5        | NA                     | NA                     | 326.55       | NA                         | NA                       | NA                     |

**WELL CONCENTRATIONS**  
**Shell-branded Service Station**  
**3790 Hopyard Road**  
**Pleasanton, CA**

| Well ID | Date       | TPPH<br>(ug/L) | TEPH<br>(ug/L) | B<br>(ug/L) | T<br>(ug/L) | E<br>(ug/L) | X<br>(ug/L) | MTBE<br>8020<br>(ug/L) | MTBE<br>8260<br>(ug/L) | TOC<br>(MSL) | Depth to<br>Water<br>(ft.) | GW<br>Elevation<br>(MSL) | DO<br>Reading<br>(ppm) |
|---------|------------|----------------|----------------|-------------|-------------|-------------|-------------|------------------------|------------------------|--------------|----------------------------|--------------------------|------------------------|
| S-10    | 12/13/1991 | <50            | NA             | <0.5        | <0.5        | <0.5        | <0.5        | NA                     | NA                     | 326.55       | 14.77                      | 311.78                   | NA                     |
| S-10    | 03/11/1992 | <30            | NA             | <0.3        | <0.3        | <0.3        | <0.3        | NA                     | NA                     | 326.55       | 14.16                      | 312.39                   | NA                     |
| S-10    | 06/24/1992 | <50            | NA             | <0.5        | <0.5        | <0.5        | <0.5        | NA                     | NA                     | 326.55       | 14.83                      | 311.72                   | NA                     |
| S-10    | 09/17/1992 | <50            | NA             | <0.5        | <0.5        | <0.5        | <0.5        | NA                     | NA                     | 326.55       | 13.85                      | 312.70                   | NA                     |
| S-10    | 12/11/1992 | <50            | NA             | <0.5        | <0.5        | <0.5        | <0.5        | NA                     | NA                     | 326.55       | 13.90                      | 312.65                   | NA                     |
| S-10    | 02/04/1993 | <50            | NA             | <0.5        | <0.5        | <0.5        | <0.5        | NA                     | NA                     | 326.55       | NA                         | NA                       | NA                     |
| S-10    | 06/03/1993 | <50            | NA             | <0.5        | <0.5        | <0.5        | <0.5        | NA                     | NA                     | 326.55       | NA                         | NA                       | NA                     |
| S-10    | 09/15/1993 | NA             | NA             | NA          | NA          | NA          | NA          | NA                     | NA                     | 326.55       | 13.66                      | 312.89                   | NA                     |
| S-10    | 12/09/1993 | NA             | NA             | NA          | NA          | NA          | NA          | NA                     | NA                     | 326.55       | NA                         | NA                       | NA                     |
| S-10    | 09/13/1994 | NA             | NA             | NA          | NA          | NA          | NA          | NA                     | NA                     | 326.55       | 13.84                      | 312.71                   | NA                     |
| S-10    | 06/21/1995 | NA             | NA             | NA          | NA          | NA          | NA          | NA                     | NA                     | 326.55       | 13.08                      | 313.47                   | NA                     |
| S-10    | 06/12/1996 | <50            | NA             | <0.5        | <0.5        | <0.5        | <0.5        | <2.5                   | NA                     | 326.55       | 13.34                      | 313.21                   | NA                     |
| S-10    | 06/25/1997 | <50            | NA             | <0.50       | <0.50       | <0.50       | <0.50       | 2.8                    | NA                     | 326.55       | 13.28                      | 313.27                   | 2.4                    |
| S-10    | 06/19/1998 | <50            | NA             | <0.50       | <0.50       | <0.50       | <0.50       | <2.5                   | NA                     | 326.55       | 12.41                      | 314.14                   | 1.8                    |
| S-10    | 06/17/1999 | <50.0          | NA             | <0.500      | <0.500      | <0.500      | <0.500      | <5.00                  | NA                     | 326.55       | 12.81                      | 313.74                   | 2.0                    |
| S-10    | 06/15/2000 | <50.0          | NA             | <0.500      | <0.500      | <0.500      | <0.500      | <2.50                  | NA                     | 326.55       | 13.27                      | 313.28                   | 2.1                    |
| S-10    | 11/29/2000 | <50.0          | NA             | <0.500      | <0.500      | <0.500      | <0.500      | <2.50                  | NA                     | 326.55       | 13.98                      | 312.57                   | 2.4                    |
| S-10    | 03/07/2001 | <50.0          | NA             | <0.500      | <0.500      | <0.500      | <0.500      | <2.50                  | NA                     | 326.55       | 13.40                      | 313.15                   | 2.5                    |
| S-10    | 06/18/2001 | <50            | NA             | <0.50       | <0.50       | <0.50       | <0.50       | NA                     | 3.7                    | 326.55       | 13.29                      | 313.26                   | NA                     |
| S-10    | 09/17/2001 | <50            | NA             | <0.50       | <0.50       | <0.50       | <0.50       | NA                     | <5.0                   | 326.55       | 13.61                      | 312.94                   | NA                     |
| S-10    | 12/31/2001 | <50            | NA             | <0.50       | <0.50       | <0.50       | <0.50       | NA                     | <5.0                   | 326.55       | 13.48                      | 313.07                   | NA                     |
| S-10    | 03/13/2002 | <50            | NA             | <0.50       | <0.50       | <0.50       | <0.50       | NA                     | <5.0                   | 326.55       | 14.66                      | 311.89                   | NA                     |
| S-10    | 06/18/2002 | <50            | NA             | <0.50       | <0.50       | <0.50       | <0.50       | NA                     | <5.0                   | 326.55       | 14.59                      | 311.96                   | NA                     |
| S-10    | 09/27/2002 | <50            | NA             | <0.50       | <0.50       | <0.50       | <0.50       | NA                     | <5.0                   | 325.87       | 13.21                      | 312.66                   | NA                     |
| S-10    | 12/27/2002 | <50            | NA             | <0.50       | <0.50       | <0.50       | <0.50       | NA                     | <5.0                   | 325.87       | 13.50                      | 312.37                   | NA                     |
| S-10    | 03/24/2003 | <50            | NA             | <0.50       | <0.50       | <0.50       | <1.0        | NA                     | <5.0                   | 325.87       | 16.60                      | 309.27                   | NA                     |
| S-10    | 05/09/2003 | <50            | NA             | <0.50       | <0.50       | <0.50       | <1.0        | NA                     | 1.7                    | 325.87       | 13.07                      | 312.80                   | NA                     |

**WELL CONCENTRATIONS**  
**Shell-branded Service Station**  
**3790 Hopyard Road**  
**Pleasanton, CA**

| Well ID | Date | TPPH<br>(ug/L) | TEPH<br>(ug/L) | B<br>(ug/L) | T<br>(ug/L) | E<br>(ug/L) | X<br>(ug/L) | MTBE<br>8020<br>(ug/L) | MTBE<br>8260<br>(ug/L) | TOC<br>(MSL) | Depth to<br>Water<br>(ft.) | GW<br>Elevation<br>(MSL) | DO<br>Reading<br>(ppm) |
|---------|------|----------------|----------------|-------------|-------------|-------------|-------------|------------------------|------------------------|--------------|----------------------------|--------------------------|------------------------|
|---------|------|----------------|----------------|-------------|-------------|-------------|-------------|------------------------|------------------------|--------------|----------------------------|--------------------------|------------------------|

|      |            |     |    |       |       |       |       |    |      |        |       |        |    |
|------|------------|-----|----|-------|-------|-------|-------|----|------|--------|-------|--------|----|
| S-11 | 09/23/2002 | NA  | NA | NA    | NA    | NA    | NA    | NA | NA   | NA     | 16.93 | NA     | NA |
| S-11 | 09/27/2002 | <50 | NA | <0.50 | <0.50 | <0.50 | <0.50 | NA | <5.0 | NA     | 16.95 | NA     | NA |
| S-11 | 12/27/2002 | <50 | NA | <0.50 | <0.50 | <0.50 | <0.50 | NA | <5.0 | 327.48 | 16.40 | 311.08 | NA |
| S-11 | 03/24/2003 | <50 | NA | <0.50 | <0.50 | <0.50 | <1.0  | NA | <5.0 | 327.48 | 17.25 | 310.23 | NA |
| S-11 | 05/09/2003 | <50 | NA | <0.50 | <0.50 | <0.50 | <1.0  | NA | 0.54 | 327.48 | 16.37 | 311.11 | NA |

|      |            |     |    |       |       |       |       |    |      |        |       |        |    |
|------|------------|-----|----|-------|-------|-------|-------|----|------|--------|-------|--------|----|
| S-12 | 09/23/2002 | NA  | NA | NA    | NA    | NA    | NA    | NA | NA   | NA     | 14.74 | NA     | NA |
| S-12 | 09/27/2002 | <50 | NA | <0.50 | <0.50 | <0.50 | <0.50 | NA | <5.0 | NA     | 17.95 | NA     | NA |
| S-12 | 12/27/2002 | <50 | NA | <0.50 | <0.50 | <0.50 | <0.50 | NA | <5.0 | 322.76 | 16.92 | 305.84 | NA |
| S-12 | 03/24/2003 | <50 | NA | <0.50 | <0.50 | <0.50 | <1.0  | NA | <5.0 | 322.76 | 16.53 | 306.23 | NA |
| S-12 | 05/09/2003 | <50 | NA | <0.50 | <0.50 | <0.50 | <1.0  | NA | 1.5  | 322.76 | 17.73 | 305.03 | NA |

|      |              |    |    |    |    |    |    |    |    |        |       |        |    |
|------|--------------|----|----|----|----|----|----|----|----|--------|-------|--------|----|
| SR-1 | 03/04/1994   | NA | NA | NA | NA | NA | NA | NA | NA | 329.78 | 16.34 | 313.44 | NA |
| SR-1 | 06/16/1994   | NA | NA | NA | NA | NA | NA | NA | NA | 329.78 | 16.72 | 313.06 | NA |
| SR-1 | 12/31/2001   | NA | NA | NA | NA | NA | NA | NA | NA | 329.78 | 15.31 | 314.47 | NA |
| SR-1 | 03/11/2002 d | NA | NA | NA | NA | NA | NA | NA | NA | 329.13 | NA    | NA     | NA |

|      |            |        |    |     |     |     |      |    |        |        |       |        |    |
|------|------------|--------|----|-----|-----|-----|------|----|--------|--------|-------|--------|----|
| SR-2 | 03/04/1994 | NA     | NA | NA  | NA  | NA  | NA   | NA | NA     | 328.35 | 14.39 | 313.96 | NA |
| SR-2 | 06/16/1994 | NA     | NA | NA  | NA  | NA  | NA   | NA | NA     | 328.35 | 14.48 | 313.87 | NA |
| SR-2 | 12/31/2001 | NA     | NA | NA  | NA  | NA  | NA   | NA | NA     | 328.35 | 13.62 | 314.73 | NA |
| SR-2 | 09/27/2002 | <1,000 | NA | <10 | <10 | <10 | <10  | NA | 5,000  | 327.91 | 14.20 | 313.71 | NA |
| SR-2 | 12/27/2002 | <1,000 | NA | <10 | <10 | <10 | <10  | NA | 4,800  | 327.91 | 13.33 | 314.58 | NA |
| SR-2 | 03/24/2003 | <5,000 | NA | <50 | <50 | <50 | <100 | NA | 10,000 | 327.91 | 13.75 | 314.16 | NA |
| SR-2 | 05/09/2003 | <5,000 | NA | <50 | <50 | 80  | 290  | NA | 13,000 | 327.91 | 13.40 | 314.51 | NA |

|      |            |    |    |    |    |    |    |    |    |        |       |        |    |
|------|------------|----|----|----|----|----|----|----|----|--------|-------|--------|----|
| SR-3 | 03/04/1994 | NA | NA | NA | NA | NA | NA | NA | NA | 329.11 | 14.66 | 314.45 | NA |
|------|------------|----|----|----|----|----|----|----|----|--------|-------|--------|----|



**WELL CONCENTRATIONS**  
**Shell-branded Service Station**  
**3790 Hopyard Road**  
**Pleasanton, CA**

| Well ID | Date       | TPPH<br>(ug/L) | TEPH<br>(ug/L) | B<br>(ug/L) | T<br>(ug/L) | E<br>(ug/L) | X<br>(ug/L) | MTBE<br>8020<br>(ug/L) | MTBE<br>8260<br>(ug/L) | TOC<br>(MSL) | Depth to<br>Water<br>(ft.) | GW<br>Elevation<br>(MSL) | DO<br>Reading<br>(ppm) |
|---------|------------|----------------|----------------|-------------|-------------|-------------|-------------|------------------------|------------------------|--------------|----------------------------|--------------------------|------------------------|
| SR-3    | 06/16/1994 | NA             | NA             | NA          | NA          | NA          | NA          | NA                     | NA                     | 329.11       | 14.96                      | 314.15                   | NA                     |
| SR-3    | 12/31/2001 | NA             | NA             | NA          | NA          | NA          | NA          | NA                     | NA                     | 329.11       | 13.60                      | 315.51                   | NA                     |
| SR-3    | 09/27/2002 | <2,500         | NA             | <25         | <25         | <25         | <25         | NA                     | 11,000                 | 328.65       | 14.75                      | 313.90                   | NA                     |
| SR-3    | 12/27/2002 | <2,000         | NA             | <20         | <20         | <20         | <20         | NA                     | 5,100                  | 328.65       | 13.65                      | 315.00                   | NA                     |
| SR-3    | 03/24/2003 | <2,500         | NA             | <25         | <25         | <25         | <50         | NA                     | 3,700                  | 328.65       | 13.52                      | 315.13                   | NA                     |
| SR-3    | 05/09/2003 | <1,000         | NA             | 15          | <10         | 19          | 48          | NA                     | 3,700                  | 328.65       | 12.15                      | 316.50                   | NA                     |
|         |            |                |                |             |             |             |             |                        |                        |              |                            |                          |                        |
| T-1     | 06/18/2002 | <5,000         | NA             | <50         | <50         | <50         | <50         | NA                     | 20,000                 | NA           | 12.31                      | NA                       | NA                     |
|         |            |                |                |             |             |             |             |                        |                        |              |                            |                          |                        |
| T-2     | 09/17/2001 | <5,000         | NA             | <25         | <25         | <25         | <25         | NA                     | 29,000                 | NA           | 11.48                      | NA                       | NA                     |
| T-2     | 12/31/2001 | <5,000         | NA             | <50         | <50         | <50         | <50         | NA                     | 31,000                 | NA           | 4.96                       | NA                       | NA                     |
| T-2     | 03/13/2002 | <5,000         | NA             | <50         | <50         | <50         | <50         | NA                     | 48,000                 | NA           | 9.76                       | NA                       | NA                     |
| T-2     | 06/18/2002 | <20,000        | NA             | <200        | <200        | <200        | <200        | NA                     | 100,000                | NA           | 12.58                      | NA                       | NA                     |
| T-2     | 09/27/2002 | 240            | NA             | 0.55        | 2.8         | 1.8         | 2.6         | NA                     | 39                     | NA           | 8.15                       | NA                       | NA                     |
| T-2     | 12/27/2002 | 2,100          | NA             | 7.8         | 17          | <0.50       | 11          | NA                     | 790                    | NA           | 6.75                       | NA                       | NA                     |
| T-2     | 03/24/2003 | 550            | NA             | <2.5        | <2.5        | <2.5        | <5.0        | NA                     | 310                    | NA           | 11.68                      | NA                       | NA                     |
| T-2     | 05/09/2003 | 220            | NA             | 0.66        | 0.55        | <0.50       | 1.8         | NA                     | 100                    | NA           | 6.40                       | NA                       | NA                     |
|         |            |                |                |             |             |             |             |                        |                        |              |                            |                          |                        |
| T-3     | 06/18/2002 | NA             | NA             | NA          | NA          | NA          | NA          | NA                     | NA                     | NA           | Dry                        | NA                       | NA                     |
|         |            |                |                |             |             |             |             |                        |                        |              |                            |                          |                        |
| T-4     | 06/18/2002 | <10,000        | NA             | <100        | <100        | <100        | <200        | NA                     | 97,000                 | NA           | 13.50                      | NA                       | NA                     |
| T-4     | 12/27/2002 | 550            | NA             | 5.3         | 16          | 0.60        | 39          | NA                     | 140                    | NA           | 7.65                       | NA                       | NA                     |
| T-4     | 03/24/2003 | 1,400          | NA             | <0.50       | 1.0         | 1.2         | 3.6         | NA                     | 15                     | NA           | 12.88                      | NA                       | NA                     |
| T-4     | 05/09/2003 | <50            | NA             | <0.50       | <0.50       | <0.50       | 1.6         | NA                     | 14                     | NA           | 7.59                       | NA                       | NA                     |
|         |            |                |                |             |             |             |             |                        |                        |              |                            |                          |                        |
| C-1     | 05/09/2003 | NA             | NA             | NA          | NA          | NA          | NA          | NA                     | NA                     | 331.33       | 28.50                      | 302.83                   | NA                     |

**WELL CONCENTRATIONS**  
**Shell-branded Service Station**  
**3790 Hopyard Road**  
**Pleasanton, CA**

| Well ID | Date | TPPH<br>(ug/L) | TEPH<br>(ug/L) | B<br>(ug/L) | T<br>(ug/L) | E<br>(ug/L) | X<br>(ug/L) | MTBE<br>8020<br>(ug/L) | MTBE<br>8260<br>(ug/L) | TOC<br>(MSL) | Depth to<br>Water<br>(ft.) | GW<br>Elevation<br>(MSL) | DO<br>Reading<br>(ppm) |
|---------|------|----------------|----------------|-------------|-------------|-------------|-------------|------------------------|------------------------|--------------|----------------------------|--------------------------|------------------------|
|---------|------|----------------|----------------|-------------|-------------|-------------|-------------|------------------------|------------------------|--------------|----------------------------|--------------------------|------------------------|

**Abbreviations:**

TPPH = Total petroleum hydrocarbons as gasoline by EPA Method 8260B; prior to June 18, 2001, analyzed by EPA Method 8015.

BTEX = benzene, toluene, ethylbenzene, xylenes by EPA Method 8260B; prior to June 18, 2001, analyzed by EPA Method 8020.

MTBE = Methyl-tertiary-butyl ether

TOB = Top of Wellbox Elevation

TOC = Top of Casing Elevation

SPH = Separate-Phase Hydrocarbons

GW = Groundwater

DO = Dissolved Oxygen

ppm = Parts per million

ug/L = Parts per billion

MSL = Mean sea level

ft = Feet

<n = Below detection limit

D = Duplicate sample

**Notes:**

a = Compounds detected within the chromatographic range of gasoline but not characteristic of the standard gasoline pattern

b = This sample was analyzed outside of the EPA recommended holding time.

c = Samples for wells S-6 and S-7 may have been switched.

d = Survey date only.

Well T-2 is a backfill well.

Beginning September 23, 2002, depth to water referenced to Top of Casing.

All wells except S-11, S-12, and T-1 through T-4 surveyed March 11, 2002, by Virgil Chavez Land Surveying of Vallejo, California.

Survey data for wells S-11 and S-12 provided by Cambria Environmental Technology, Inc.

C-1 surveyed March 18, 2003, by Virgil Chavez Land Surveying of Vallejo, California.

**Blaine Tech Services, Inc.**

May 23, 2003

1680 Rogers Avenue  
San Jose, CA 95112-1105  
Attn.: Leon Gearhart  
Project#: BTS# 030509-RH1  
Project: 98995842  
Site: 3790 Hopyard Rd., Pleasanton

Dear Mr. Gearhart,

Attached is our report for your samples received on 05/09/2003 16:20  
This report has been reviewed and approved for release. Reproduction of this report  
is permitted only in its entirety.

Please note that any unused portion of the samples will be discarded after  
06/23/2003 unless you have requested otherwise.

We appreciate the opportunity to be of service to you. If you have any questions,  
please call me at (925) 484-1919.

You can also contact me via email. My email address is: [tgranicher@stl-inc.com](mailto:tgranicher@stl-inc.com)

Sincerely,

A handwritten signature in black ink on a light-colored background. The signature is stylized, starting with a large 'T' and ending with a long horizontal stroke that curves slightly upwards at the end.

Tod Granicher  
Project Manager

**Gas/BTEX Fuel Oxygenates by 8260B (C6-C12)**

Blaine Tech Services, Inc.

Attn.: Leon Gearhart

1680 Rogers Avenue

San Jose, CA 95112-1105

Phone: (408) 573-0555 Fax: (408) 573-7771

Project: BTS# 030509-RH1  
98995842

Received: 05/09/2003 16:20

Site: 3790 Hopyard Rd., Pleasanton

**Samples Reported**

| Sample Name | Date Sampled     | Matrix | Lab # |
|-------------|------------------|--------|-------|
| S-2         | 05/09/2003 12:40 | Water  | 1     |
| S-3         | 05/09/2003 08:13 | Water  | 2     |
| S-4         | 05/09/2003 12:50 | Water  | 3     |
| S-5         | 05/09/2003 08:44 | Water  | 4     |
| S-6         | 05/09/2003 10:22 | Water  | 5     |
| S-7         | 05/09/2003 10:04 | Water  | 6     |
| S-8         | 05/09/2003 07:45 | Water  | 7     |
| S-9         | 05/09/2003 07:55 | Water  | 8     |
| S-10        | 05/09/2003 09:44 | Water  | 9     |
| S-11        | 05/09/2003 09:23 | Water  | 10    |
| S-12        | 05/09/2003 10:49 | Water  | 11    |
| T-2         | 05/09/2003 11:07 | Water  | 12    |
| T-4         | 05/09/2003 11:18 | Water  | 13    |
| SR-2        | 05/09/2003 12:30 | Water  | 14    |
| SR-3        | 05/09/2003 11:46 | Water  | 15    |

**Gas/BTEX Fuel Oxygenates by 8260B (C6-C12)**

Blaine Tech Services, Inc.

Attn.: Leon Gearhart

1680 Rogers Avenue

San Jose, CA 95112-1105

Phone: (408) 573-0555 Fax: (408) 573-7771

Project: BTS# 030509-RH1  
98995842

Received: 05/09/2003 16:20

Site: 3790 Hopyard Rd., Pleasanton

|  |                             |
|--|-----------------------------|
| Prep(s): 5030B                                   | Test(s): 8260FAB            |
| Sample ID: S-2                                   | Lab ID: 2003-05-0305 - 1    |
| Sampled: 05/09/2003 12:40                        | Extracted: 5/19/2003 17:12  |
| Matrix: Water                                    | QC Batch#: 2003/05/19-1a.64 |
| Analysis Flag: 0 ( See Legend and Note Section ) |                             |

| Compound                       | Conc. | RL     | Unit | Dilution | Analyzed         | Flag |
|--------------------------------|-------|--------|------|----------|------------------|------|
| Gasoline                       | ND    | 2500   | ug/L | 50.00    | 05/19/2003 17:12 |      |
| Benzene                        | 36    | 25     | ug/L | 50.00    | 05/19/2003 17:12 |      |
| Toluene                        | ND    | 25     | ug/L | 50.00    | 05/19/2003 17:12 |      |
| Ethylbenzene                   | 35    | 25     | ug/L | 50.00    | 05/19/2003 17:12 |      |
| Total xylenes                  | ND    | 50     | ug/L | 50.00    | 05/19/2003 17:12 |      |
| tert-Butyl alcohol (TBA)       | 6200  | 250    | ug/L | 50.00    | 05/19/2003 17:12 |      |
| Methyl tert-butyl ether (MTBE) | 4000  | 25     | ug/L | 50.00    | 05/19/2003 17:12 |      |
| <b>Surrogates(s)</b>           |       |        |      |          |                  |      |
| 1,2-Dichloroethane-d4          | 112.5 | 76-130 | %    | 50.00    | 05/19/2003 17:12 |      |
| Toluene-d8                     | 101.5 | 78-115 | %    | 50.00    | 05/19/2003 17:12 |      |

**Gas/BTEX Fuel Oxygenates by 8260B (C6-C12)**

Blaine Tech Services, Inc.

Attn.: Leon Gearhart

1680 Rogers Avenue

San Jose, CA 95112-1105

Phone: (408) 573-0555 Fax: (408) 573-7771

Project: BTS# 030509-RH1  
98995842

Received: 05/09/2003 16:20

Site: 3790 Hopyard Rd., Pleasanton

|            |                  |            |                  |
|------------|------------------|------------|------------------|
| Prep(s):   | 5030B            | Test(s):   | 8260FAB          |
| Sample ID: | S-3              | Lab ID:    | 2003-05-0305 - 2 |
| Sampled:   | 05/09/2003 08:13 | Extracted: | 5/21/2003 14:16  |
| Matrix:    | Water            | QC Batch#: | 2003/05/21-1d.65 |

| Compound                       | Conc. | RL     | Unit | Dilution | Analyzed         | Flag |
|--------------------------------|-------|--------|------|----------|------------------|------|
| Gasoline                       | ND    | 50     | ug/L | 1.00     | 05/21/2003 14:16 |      |
| Benzene                        | ND    | 0.50   | ug/L | 1.00     | 05/21/2003 14:16 |      |
| Toluene                        | ND    | 0.50   | ug/L | 1.00     | 05/21/2003 14:16 |      |
| Ethylbenzene                   | ND    | 0.50   | ug/L | 1.00     | 05/21/2003 14:16 |      |
| Total xylenes                  | ND    | 1.0    | ug/L | 1.00     | 05/21/2003 14:16 |      |
| tert-Butyl alcohol (TBA)       | ND    | 5.0    | ug/L | 1.00     | 05/21/2003 14:16 |      |
| Methyl tert-butyl ether (MTBE) | ND    | 0.50   | ug/L | 1.00     | 05/21/2003 14:16 |      |
| <b>Surrogates(s)</b>           |       |        |      |          |                  |      |
| 1,2-Dichloroethane-d4          | 108.3 | 76-130 | %    | 1.00     | 05/21/2003 14:16 |      |
| Toluene-d8                     | 97.8  | 78-115 | %    | 1.00     | 05/21/2003 14:16 |      |

**Gas/BTEX Fuel Oxygenates by 8260B (C6-C12)**

Blaine Tech Services, Inc.

Attn.: Leon Gearhart

1680 Rogers Avenue

San Jose, CA 95112-1105

Phone: (408) 573-0555 Fax: (408) 573-7771

Project: BTS# 030509-RH1  
98995842

Received: 05/09/2003 16:20

Site: 3790 Hopyard Rd., Pleasanton

|  |                             |
|--|-----------------------------|
| Prep(s): 5030B                                   | Test(s): 8260FAB            |
| Sample ID: S-4                                   | Lab ID: 2003-05-0305-3      |
| Sampled: 05/09/2003 12:50                        | Extracted: 5/19/2003 17:56  |
| Matrix: Water                                    | QC Batch#: 2003/05/19-1a 64 |
| Analysis Flag: 0 ( See Legend and Note Section ) |                             |

| Compound                       | Conc. | RL     | Unit | Dilution | Analyzed         | Flag |
|--------------------------------|-------|--------|------|----------|------------------|------|
| Gasoline                       | ND    | 2500   | ug/L | 50.00    | 05/19/2003 17:56 |      |
| Benzene                        | ND    | 25     | ug/L | 50.00    | 05/19/2003 17:56 |      |
| Toluene                        | ND    | 25     | ug/L | 50.00    | 05/19/2003 17:56 |      |
| Ethylbenzene                   | ND    | 25     | ug/L | 50.00    | 05/19/2003 17:56 |      |
| Total xylenes                  | ND    | 50     | ug/L | 50.00    | 05/19/2003 17:56 |      |
| tert-Butyl alcohol (TBA)       | 18000 | 250    | ug/L | 50.00    | 05/19/2003 17:56 |      |
| Methyl tert-butyl ether (MTBE) | 1200  | 25     | ug/L | 50.00    | 05/19/2003 17:56 |      |
| <b>Surrogates(s)</b>           |       |        |      |          |                  |      |
| 1,2-Dichloroethane-d4          | 111.2 | 76-130 | %    | 50.00    | 05/19/2003 17:56 |      |
| Toluene-d8                     | 101.8 | 78-115 | %    | 50.00    | 05/19/2003 17:56 |      |

**Gas/BTEX Fuel Oxygenates by 8260B (C6-C12)**

Blaine Tech Services, Inc.

Attn.: Leon Gearhart

1680 Rogers Avenue

San Jose, CA 95112-1105

Phone: (408) 573-0555 Fax: (408) 573-7771

Project: BTS# 030509-RH1

98995842

Received: 05/09/2003 16:20

Site: 3790 Hopyard Rd., Pleasanton

|            |                  |            |                  |
|------------|------------------|------------|------------------|
| Prep(s):   | 5030B            | Test(s):   | 8260FAB          |
| Sample ID: | S-5              | Lab ID:    | 2003-05-0305 - 4 |
| Sampled:   | 05/09/2003 08:44 | Extracted: | 5/19/2003 18:18  |
| Matrix:    | Water            | QC Batch#: | 2003/05/19-1a.64 |

| Compound                       | Conc. | RL     | Unit | Dilution | Analyzed         | Flag |
|--------------------------------|-------|--------|------|----------|------------------|------|
| Gasoline                       | ND    | 50     | ug/L | 1.00     | 05/19/2003 18:18 |      |
| Benzene                        | ND    | 0.50   | ug/L | 1.00     | 05/19/2003 18:18 |      |
| Toluene                        | ND    | 0.50   | ug/L | 1.00     | 05/19/2003 18:18 |      |
| Ethylbenzene                   | ND    | 0.50   | ug/L | 1.00     | 05/19/2003 18:18 |      |
| Total xylenes                  | ND    | 1.0    | ug/L | 1.00     | 05/19/2003 18:18 |      |
| tert-Butyl alcohol (TBA)       | 17    | 5.0    | ug/L | 1.00     | 05/19/2003 18:18 |      |
| Methyl tert-butyl ether (MTBE) | 110   | 0.50   | ug/L | 1.00     | 05/19/2003 18:18 |      |
| <b>Surrogates(s)</b>           |       |        |      |          |                  |      |
| 1,2-Dichloroethane-d4          | 102.0 | 76-130 | %    | 1.00     | 05/19/2003 18:18 |      |
| Toluene-d8                     | 100.8 | 78-115 | %    | 1.00     | 05/19/2003 18:18 |      |



**Gas/BTEX Fuel Oxygenates by 8260B (C6-C12)**

Blaine Tech Services, Inc.

Attn.: Leon Gearhart

1680 Rogers Avenue

San Jose, CA 95112-1105

Phone: (408) 573-0555 Fax: (408) 573-7771

Project: BTS# 030509-RH1  
98995842

Received: 05/09/2003 16:20

Site: 3790 Hopyard Rd., Pleasanton

|  |                  |            |                  |
|--|------------------|------------|------------------|
| Prep(s):   | 5030B            | Test(s):   | 8260FAB          |
| Sample ID:                                       | S-6              | Lab ID:    | 2003-05-0305- 5  |
| Sampled:   | 05/09/2003 10:22 | Extracted: | 5/21/2003 00:15  |
| Matrix:  | Water            | QC Batch#: | 2003/05/20-2b 65 |
| Analysis Flag: 0 ( See Legend and Note Section ) |                  |            |                  |

| Compound                       | Conc. | RL     | Unit | Dilution | Analyzed         | Flag |
|--------------------------------|-------|--------|------|----------|------------------|------|
| Gasoline                       | ND    | 2500   | ug/L | 50.00    | 05/21/2003 00:15 |      |
| Benzene                        | ND    | 25     | ug/L | 50.00    | 05/21/2003 00:15 |      |
| Toluene                        | ND    | 25     | ug/L | 50.00    | 05/21/2003 00:15 |      |
| Ethylbenzene                   | ND    | 25     | ug/L | 50.00    | 05/21/2003 00:15 |      |
| Total xylenes                  | ND    | 50     | ug/L | 50.00    | 05/21/2003 00:15 |      |
| tert-Butyl alcohol (TBA)       | 12000 | 250    | ug/L | 50.00    | 05/21/2003 00:15 |      |
| Methyl tert-butyl ether (MTBE) | 140   | 25     | ug/L | 50.00    | 05/21/2003 00:15 |      |
| <b>Surrogates(s)</b>           |       |        |      |          |                  |      |
| 1,2-Dichloroethane-d4          | 121.0 | 76-130 | %    | 50.00    | 05/21/2003 00:15 |      |
| Toluene-d8                     | 98.2  | 78-115 | %    | 50.00    | 05/21/2003 00:15 |      |

**Gas/BTEX Fuel Oxygenates by 8260B (C6-C12)**

Blaine Tech Services, Inc.

Attn.: Leon Gearhart

1680 Rogers Avenue

San Jose, CA 95112-1105

Phone: (408) 573-0555 Fax: (408) 573-7771

Project: BTS# 030509-RH1  
98995842

Received: 05/09/2003 16:20

Site: 3790 Hopyard Rd., Pleasanton

|            |                  |            |                  |
|------------|------------------|------------|------------------|
| Prep(s):   | 5030B            | Test(s):   | 8260FAB          |
| Sample ID: | S-7              | Lab ID:    | 2003-05-0305 - 6 |
| Sampled:   | 05/09/2003 10:04 | Extracted: | 5/19/2003 19:46  |
| Matrix:    | Water            | QC Batch#: | 2003/05/19-1a,64 |

| Compound                       | Conc. | RL     | Unit | Dilution | Analyzed         | Flag |
|--------------------------------|-------|--------|------|----------|------------------|------|
| Gasoline                       | ND    | 50     | ug/L | 1.00     | 05/19/2003 19:46 |      |
| Benzene                        | ND    | 0.50   | ug/L | 1.00     | 05/19/2003 19:46 |      |
| Toluene                        | ND    | 0.50   | ug/L | 1.00     | 05/19/2003 19:46 |      |
| Ethylbenzene                   | ND    | 0.50   | ug/L | 1.00     | 05/19/2003 19:46 |      |
| Total xylenes                  | ND    | 1.0    | ug/L | 1.00     | 05/19/2003 19:46 |      |
| tert-Butyl alcohol (TBA)       | 7.3   | 5.0    | ug/L | 1.00     | 05/19/2003 19:46 |      |
| Methyl tert-butyl ether (MTBE) | 31    | 0.50   | ug/L | 1.00     | 05/19/2003 19:46 |      |
| <b>Surrogates(s)</b>           |       |        |      |          |                  |      |
| 1,2-Dichloroethane-d4          | 115.6 | 76-130 | %    | 1.00     | 05/19/2003 19:46 |      |
| Toluene-d8                     | 101.5 | 78-115 | %    | 1.00     | 05/19/2003 19:46 |      |

**Gas/BTEX Fuel Oxygenates by 8260B (C6-C12)**

Blaine Tech Services, Inc.

Attn.: Leon Gearhart

1680 Rogers Avenue

San Jose, CA 95112-1105

Phone: (408) 573-0555 Fax: (408) 573-7771

Project: BTS# 030509-RH1  
98995842

Received: 05/09/2003 16:20

Site: 3790 Hopyard Rd., Pleasanton

|                           |                             |
|---------------------------|-----------------------------|
| Prep(s): 5030B            | Test(s): 8260FAB            |
| Sample ID: S-8            | Lab ID: 2003-05-0305-7      |
| Sampled: 05/09/2003 07:45 | Extracted: 5/19/2003 20:08  |
| Matrix: Water             | QC Batch#: 2003/05/19-1a.64 |

| Compound                       | Conc. | RL     | Unit | Dilution | Analyzed         | Flag |
|--------------------------------|-------|--------|------|----------|------------------|------|
| Gasoline                       | ND    | 50     | ug/L | 1.00     | 05/19/2003 20:08 |      |
| Benzene                        | ND    | 0.50   | ug/L | 1.00     | 05/19/2003 20:08 |      |
| Toluene                        | ND    | 0.50   | ug/L | 1.00     | 05/19/2003 20:08 |      |
| Ethylbenzene                   | ND    | 0.50   | ug/L | 1.00     | 05/19/2003 20:08 |      |
| Total xylenes                  | ND    | 1.0    | ug/L | 1.00     | 05/19/2003 20:08 |      |
| tert-Butyl alcohol (TBA)       | ND    | 5.0    | ug/L | 1.00     | 05/19/2003 20:08 |      |
| Methyl tert-butyl ether (MTBE) | 24    | 0.50   | ug/L | 1.00     | 05/19/2003 20:08 |      |
| <b>Surrogates(s)</b>           |       |        |      |          |                  |      |
| 1,2-Dichloroethane-d4          | 114.6 | 76-130 | %    | 1.00     | 05/19/2003 20:08 |      |
| Toluene-d8                     | 98.6  | 78-115 | %    | 1.00     | 05/19/2003 20:08 |      |

**Gas/BTEX Fuel Oxygenates by 8260B (C6-C12)**

Blaine Tech Services, Inc.

Attn.: Leon Gearhart

1680 Rogers Avenue

San Jose, CA 95112-1105

Phone: (408) 573-0555 Fax: (408) 573-7771

Project: BTS# 030509-RH1  
98995842

Received: 05/09/2003 16:20

Site: 3790 Hopyard Rd., Pleasanton

|  |                             |
|--|-----------------------------|
| Prep(s): 5030B                                   | Test(s): 8260FAB            |
| Sample ID: S-9                                   | Lab ID: 2003-05-0305 - 8    |
| Sampled: 05/09/2003 07:55                        | Extracted: 5/19/2003 20:30  |
| Matrix: Water                                    | QC Batch#: 2003/05/19-1a.64 |
| Analysis Flag: o ( See Legend and Note Section ) |                             |

| Compound                       | Conc. | RL     | Unit | Dilution | Analyzed         | Flag |
|--------------------------------|-------|--------|------|----------|------------------|------|
| Gasoline                       | ND    | 250    | ug/L | 5.00     | 05/19/2003 20:30 |      |
| Benzene                        | ND    | 2.5    | ug/L | 5.00     | 05/19/2003 20:30 |      |
| Toluene                        | ND    | 2.5    | ug/L | 5.00     | 05/19/2003 20:30 |      |
| Ethylbenzene                   | ND    | 2.5    | ug/L | 5.00     | 05/19/2003 20:30 |      |
| Total xylenes                  | ND    | 5.0    | ug/L | 5.00     | 05/19/2003 20:30 |      |
| tert-Butyl alcohol (TBA)       | ND    | 25     | ug/L | 5.00     | 05/19/2003 20:30 |      |
| Methyl tert-butyl ether (MTBE) | 240   | 2.5    | ug/L | 5.00     | 05/19/2003 20:30 |      |
| <b>Surrogates(s)</b>           |       |        |      |          |                  |      |
| 1,2-Dichloroethane-d4          | 109.3 | 76-130 | %    | 5.00     | 05/19/2003 20:30 |      |
| Toluene-d8                     | 98.7  | 78-115 | %    | 5.00     | 05/19/2003 20:30 |      |

**Gas/BTEX Fuel Oxygenates by 8260B (C6-C12)**

Blaine Tech Services, Inc.

Attn.: Leon Gearhart

1680 Rogers Avenue

San Jose, CA 95112-1105

Phone: (408) 573-0555 Fax: (408) 573-7771

Project: BTS# 030509-RH1  
98995842

Received: 05/09/2003 16:20

Site: 3790 Hopyard Rd., Pleasanton

|            |                  |            |                  |
|------------|------------------|------------|------------------|
| Prep(s):   | 5030B            | Test(s):   | 8260FAB          |
| Sample ID: | S-10             | Lab ID:    | 2003-05-0305 - 9 |
| Sampled:   | 05/09/2003 09:44 | Extracted: | 5/19/2003 20:52  |
| Matrix:    | Water            | QC Batch#: | 2003/05/19-1a 64 |

| Compound                       | Conc. | RL     | Unit | Dilution | Analyzed         | Flag |
|--------------------------------|-------|--------|------|----------|------------------|------|
| Gasoline                       | ND    | 50     | ug/L | 1.00     | 05/19/2003 20:52 |      |
| Benzene                        | ND    | 0.50   | ug/L | 1.00     | 05/19/2003 20:52 |      |
| Toluene                        | ND    | 0.50   | ug/L | 1.00     | 05/19/2003 20:52 |      |
| Ethylbenzene                   | ND    | 0.50   | ug/L | 1.00     | 05/19/2003 20:52 |      |
| Total xylenes                  | ND    | 1.0    | ug/L | 1.00     | 05/19/2003 20:52 |      |
| tert-Butyl alcohol (TBA)       | ND    | 5.0    | ug/L | 1.00     | 05/19/2003 20:52 |      |
| Methyl tert-butyl ether (MTBE) | 1.7   | 0.50   | ug/L | 1.00     | 05/19/2003 20:52 |      |
| <b>Surrogates(s)</b>           |       |        |      |          |                  |      |
| 1,2-Dichloroethane-d4          | 108.0 | 76-130 | %    | 1.00     | 05/19/2003 20:52 |      |
| Toluene-d8                     | 98.3  | 78-115 | %    | 1.00     | 05/19/2003 20:52 |      |

Severn Trent Laboratories, Inc.

STL San Francisco \* 1220 Quarry Lane, Pleasanton, CA 94566

Tel 925 484 1919 Fax 925 484 1096 \* www.stl-inc.com \* CA DHS ELAP# 2496

05/22/2003 16:22

Page 10 of 23

**Gas/BTEX Fuel Oxygenates by 8260B (C6-C12)**

Blaine Tech Services, Inc.

Attn.: Leon Gearhart

1680 Rogers Avenue

San Jose, CA 95112-1105

Phone: (408) 573-0555 Fax: (408) 573-7771

Project: BTS# 030509-RH1  
98995842

Received: 05/09/2003 16:20

Site: 3790 Hopyard Rd., Pleasanton

|            |                  |            |                   |
|------------|------------------|------------|-------------------|
| Prep(s):   | 5030B            | Test(s):   | 8260FAB           |
| Sample ID: | S-11             | Lab ID:    | 2003-05-0305 - 10 |
| Sampled:   | 05/09/2003 09:23 | Extracted: | 5/21/2003 00:37   |
| Matrix:    | Water            | QC Batch#: | 2003/05/20-2b 65  |

| Compound                       | Conc. | RL     | Unit | Dilution | Analyzed         | Flag |
|--------------------------------|-------|--------|------|----------|------------------|------|
| Gasoline                       | ND    | 50     | ug/L | 1.00     | 05/21/2003 00:37 |      |
| Benzene                        | ND    | 0.50   | ug/L | 1.00     | 05/21/2003 00:37 |      |
| Toluene                        | ND    | 0.50   | ug/L | 1.00     | 05/21/2003 00:37 |      |
| Ethylbenzene                   | ND    | 0.50   | ug/L | 1.00     | 05/21/2003 00:37 |      |
| Total xylenes                  | ND    | 1.0    | ug/L | 1.00     | 05/21/2003 00:37 |      |
| tert-Butyl alcohol (TBA)       | ND    | 5.0    | ug/L | 1.00     | 05/21/2003 00:37 |      |
| Methyl tert-butyl ether (MTBE) | 0.54  | 0.50   | ug/L | 1.00     | 05/21/2003 00:37 |      |
| <b>Surrogates(s)</b>           |       |        |      |          |                  |      |
| 1,2-Dichloroethane-d4          | 110.9 | 76-130 | %    | 1.00     | 05/21/2003 00:37 |      |
| Toluene-d8                     | 97.9  | 78-115 | %    | 1.00     | 05/21/2003 00:37 |      |

**Gas/BTEX Fuel Oxygenates by 8260B (C6-C12)**

Blaine Tech Services, Inc.

Attn.: Leon Gearhart

1680 Rogers Avenue

San Jose, CA 95112-1105

Phone: (408) 573-0555 Fax: (408) 573-7771

Project: BTS# 030509-RH1

98995842

Received: 05/09/2003 16:20

Site: 3790 Hopyard Rd., Pleasanton

|                           |                             |
|---------------------------|-----------------------------|
| Prep(s): 5030B            | Test(s): 8260FAB            |
| Sample ID: S-12           | Lab ID: 2003-05-0305-11     |
| Sampled: 05/09/2003 10:49 | Extracted: 5/21/2003 00:59  |
| Matrix: Water             | QC Batch#: 2003/05/20-2b 65 |

| Compound                       | Conc. | RL     | Unit | Dilution | Analyzed         | Flag |
|--------------------------------|-------|--------|------|----------|------------------|------|
| Gasoline                       | ND    | 50     | ug/L | 1.00     | 05/21/2003 00:59 |      |
| Benzene                        | ND    | 0.50   | ug/L | 1.00     | 05/21/2003 00:59 |      |
| Toluene                        | ND    | 0.50   | ug/L | 1.00     | 05/21/2003 00:59 |      |
| Ethylbenzene                   | ND    | 0.50   | ug/L | 1.00     | 05/21/2003 00:59 |      |
| Total xylenes                  | ND    | 1.0    | ug/L | 1.00     | 05/21/2003 00:59 |      |
| tert-Butyl alcohol (TBA)       | ND    | 5.0    | ug/L | 1.00     | 05/21/2003 00:59 |      |
| Methyl tert-butyl ether (MTBE) | 1.5   | 0.50   | ug/L | 1.00     | 05/21/2003 00:59 |      |
| <b>Surrogates(s)</b>           |       |        |      |          |                  |      |
| 1,2-Dichloroethane-d4          | 108.8 | 76-130 | %    | 1.00     | 05/21/2003 00:59 |      |
| Toluene-d8                     | 98.3  | 78-115 | %    | 1.00     | 05/21/2003 00:59 |      |

**Gas/BTEX Fuel Oxygenates by 8260B (C6-C12)**

Blaine Tech Services, Inc.

Attn.: Leon Gearhart

1680 Rogers Avenue

San Jose, CA 95112-1105

Phone: (408) 573-0555 Fax: (408) 573-7771

Project: BTS# 030509-RH1  
98995842

Received: 05/09/2003 16:20

Site: 3790 Hopyard Rd., Pleasanton

|                           |                             |
|---------------------------|-----------------------------|
| Prep(s): 5030B            | Test(s): 8260FAB            |
| Sample ID: T-2            | Lab ID: 2003-05-0305 - 12   |
| Sampled: 05/09/2003 11:07 | Extracted: 5/21/2003 01:21  |
| Matrix: Water             | QC Batch#: 2003/05/20-2b.65 |

| Compound                       | Conc. | RL     | Unit | Dilution | Analyzed         | Flag |
|--------------------------------|-------|--------|------|----------|------------------|------|
| Gasoline                       | 220   | 50     | ug/L | 1.00     | 05/21/2003 01:21 |      |
| Benzene                        | 0.66  | 0.50   | ug/L | 1.00     | 05/21/2003 01:21 |      |
| Toluene                        | 0.55  | 0.50   | ug/L | 1.00     | 05/21/2003 01:21 |      |
| Ethylbenzene                   | ND    | 0.50   | ug/L | 1.00     | 05/21/2003 01:21 |      |
| Total xylenes                  | 1.8   | 1.0    | ug/L | 1.00     | 05/21/2003 01:21 |      |
| tert-Butyl alcohol (TBA)       | 92    | 5.0    | ug/L | 1.00     | 05/21/2003 01:21 |      |
| Methyl tert-butyl ether (MTBE) | 100   | 0.50   | ug/L | 1.00     | 05/21/2003 01:21 |      |
| <b>Surrogates(s)</b>           |       |        |      |          |                  |      |
| 1,2-Dichloroethane-d4          | 110.3 | 76-130 | %    | 1.00     | 05/21/2003 01:21 |      |
| Toluene-d8                     | 97.4  | 78-115 | %    | 1.00     | 05/21/2003 01:21 |      |



**Gas/BTEX Fuel Oxygenates by 8260B (C6-C12)**

Blaine Tech Services, Inc.

Attn.: Leon Gearhart

1680 Rogers Avenue

San Jose, CA 95112-1105

Phone: (408) 573-0555 Fax: (408) 573-7771

Project: BTS# 030509-RH1  
98995842

Received: 05/09/2003 16:20

Site: 3790 Hopyard Rd., Pleasanton

|            |                  |            |                  |
|------------|------------------|------------|------------------|
| Prep(s):   | 5030B            | Test(s):   | 8260FAB          |
| Sample ID: | T-4              | Lab ID:    | 2003-05-0305-13  |
| Sampled:   | 05/09/2003 11:18 | Extracted: | 5/21/2003 01:44  |
| Matrix:    | Water            | QC Batch#: | 2003/05/20-26 65 |

| Compound                       | Conc. | RL     | Unit | Dilution | Analyzed         | Flag |
|--------------------------------|-------|--------|------|----------|------------------|------|
| Gasoline                       | ND    | 50     | ug/L | 1.00     | 05/21/2003 01:44 |      |
| Benzene                        | ND    | 0.50   | ug/L | 1.00     | 05/21/2003 01:44 |      |
| Toluene                        | ND    | 0.50   | ug/L | 1.00     | 05/21/2003 01:44 |      |
| Ethylbenzene                   | ND    | 0.50   | ug/L | 1.00     | 05/21/2003 01:44 |      |
| Total xylenes                  | 1.6   | 1.0    | ug/L | 1.00     | 05/21/2003 01:44 |      |
| tert-Butyl alcohol (TBA)       | 5.2   | 5.0    | ug/L | 1.00     | 05/21/2003 01:44 |      |
| Methyl tert-butyl ether (MTBE) | 14    | 0.50   | ug/L | 1.00     | 05/21/2003 01:44 |      |
| <b>Surrogates(s)</b>           |       |        |      |          |                  |      |
| 1,2-Dichloroethane-d4          | 106.5 | 76-130 | %    | 1.00     | 05/21/2003 01:44 |      |
| Toluene-d8                     | 98.1  | 78-115 | %    | 1.00     | 05/21/2003 01:44 |      |

**Gas/BTEX Fuel Oxygenates by 8260B (C6-C12)**

Blaine Tech Services, Inc.

Attn.: Leon Gearhart

1680 Rogers Avenue  
San Jose, CA 95112-1105  
Phone: (408) 573-0555 Fax: (408) 573-7771

Project: BTS# 030509-RH1  
98995842

Received: 05/09/2003 16:20

Site: 3790 Hopyard Rd., Pleasanton

|  |   |
|--|---|
| Prep(s): 5030B                                   | Test(s): 8260FAB                                |
| Sample ID: SR-2                                  | Lab ID: 2003-05-0305 - 14                       |
| Sampled: 05/09/2003 12:30                        | Extracted: 5/21/2003 02:06<br>5/21/2003 14:38   |
| Matrix: Water                                    | QC Batch#: 2003/05/20-2b 65<br>2003/05/21-1d 65 |
| Analysis Flag: 0 ( See Legend and Note Section ) |   |

| Compound                       | Conc. | RL     | Unit | Dilution | Analyzed         | Flag |
|--------------------------------|-------|--------|------|----------|------------------|------|
| Gasoline                       | ND    | 5000   | ug/L | 100.00   | 05/21/2003 14:38 |      |
| Benzene                        | ND    | 50     | ug/L | 100.00   | 05/21/2003 14:38 |      |
| Toluene                        | ND    | 50     | ug/L | 100.00   | 05/21/2003 14:38 |      |
| Ethylbenzene                   | 80    | 50     | ug/L | 100.00   | 05/21/2003 14:38 |      |
| Total xylenes                  | 290   | 100    | ug/L | 100.00   | 05/21/2003 14:38 |      |
| tert-Butyl alcohol (TBA)       | 6100  | 500    | ug/L | 100.00   | 05/21/2003 14:38 |      |
| Methyl tert-butyl ether (MTBE) | 13000 | 50     | ug/L | 100.00   | 05/21/2003 14:38 |      |
| <b>Surrogates(s)</b>           |       |        |      |          |                  |      |
| 1,2-Dichloroethane-d4          | 110.2 | 76-130 | %    | 100.00   | 05/21/2003 14:38 |      |
| 1,2-Dichloroethane-d4          | 107.6 | 76-130 | %    | 1.00     | 05/21/2003 02:06 |      |
| Toluene-d8                     | 97.8  | 78-115 | %    | 100.00   | 05/21/2003 14:38 |      |
| Toluene-d8                     | 100.2 | 78-115 | %    | 1.00     | 05/21/2003 02:06 |      |

Gas/BTEX Fuel Oxygenates by 8260B (C6-C12)

Blaine Tech Services, Inc.

Attn.: Leon Gearhart

1680 Rogers Avenue

San Jose, CA 95112-1105

Phone: (408) 573-0555 Fax: (408) 573-7771

Project: BTS# 030509-RH1  
98995842

Received: 05/09/2003 16:20

Site: 3790 Hopyard Rd., Pleasanton

|  |                             |
|--|-----------------------------|
| Prep(s): 5030B                                   | Test(s): 8260FAB            |
| Sample ID: SR-3                                  | Lab ID: 2003-05-0305 - 15   |
| Sampled: 05/09/2003 11:46                        | Extracted: 5/21/2003 15:00  |
| Matrix: Water                                    | QC Batch#: 2003/05/21-1d 65 |
| Analysis Flag: o ( See Legend and Note Section ) |                             |

| Compound                       | Conc. | RL     | Unit | Dilution | Analyzed         | Flag |
|--------------------------------|-------|--------|------|----------|------------------|------|
| Gasoline                       | ND    | 1000   | ug/L | 20.00    | 05/21/2003 15:00 |      |
| Benzene                        | 15    | 10     | ug/L | 20.00    | 05/21/2003 15:00 |      |
| Toluene                        | ND    | 10     | ug/L | 20.00    | 05/21/2003 15:00 |      |
| Ethylbenzene                   | 19    | 10     | ug/L | 20.00    | 05/21/2003 15:00 |      |
| Total xylenes                  | 48    | 20     | ug/L | 20.00    | 05/21/2003 15:00 |      |
| tert-Butyl alcohol (TBA)       | 8400  | 100    | ug/L | 20.00    | 05/21/2003 15:00 |      |
| Methyl tert-butyl ether (MTBE) | 3700  | 10     | ug/L | 20.00    | 05/21/2003 15:00 |      |
| <b>Surrogates(s)</b>           |       |        |      |          |                  |      |
| 1,2-Dichloroethane-d4          | 98.8  | 76-130 | %    | 20.00    | 05/21/2003 15:00 |      |
| Toluene-d8                     | 99.0  | 78-115 | %    | 20.00    | 05/21/2003 15:00 |      |

**Gas/BTEX Fuel Oxygenates by 8260B (C6-C12)**

Blaine Tech Services, Inc.

Attn.: Leon Gearhart

1680 Rogers Avenue  
San Jose, CA 95112-1105  
Phone: (408) 573-0555 Fax: (408) 573-7771

Project: BTS# 030509-RH1  
98995842

Received: 05/09/2003 16:20

Site: 3790 Hopyard Rd., Pleasanton

| Batch QC Report                |       |        |      |                                  |      |
|--------------------------------|-------|--------|------|----------------------------------|------|
| Prep(s): 5030B                 |       | Water  |      | Test(s): 8260FAB                 |      |
| Method Blank                   |       |        |      | QC Batch # 2003/05/19-1a.64      |      |
| MB: 2003/05/19-1a.64-003       |       |        |      | Date Extracted: 05/19/2003 11:25 |      |
| Compound                       | Conc. | RL     | Unit | Analyzed                         | Flag |
| Gasoline                       | ND    | 50     | ug/L | 05/19/2003 11:25                 |      |
| Benzene                        | ND    | 0.5    | ug/L | 05/19/2003 11:25                 |      |
| Toluene                        | ND    | 0.5    | ug/L | 05/19/2003 11:25                 |      |
| Ethylbenzene                   | ND    | 0.5    | ug/L | 05/19/2003 11:25                 |      |
| Total xylenes                  | ND    | 1.0    | ug/L | 05/19/2003 11:25                 |      |
| tert-Butyl alcohol (TBA)       | ND    | 5.0    | ug/L | 05/19/2003 11:25                 |      |
| Methyl tert-butyl ether (MTBE) | ND    | 0.5    | ug/L | 05/19/2003 11:25                 |      |
| <b>Surrogates(s)</b>           |       |        |      |                                  |      |
| 1,2-Dichloroethane-d4          | 100.6 | 76-130 | %    | 05/19/2003 11:25                 |      |
| Toluene-d8                     | 96.4  | 78-115 | %    | 05/19/2003 11:25                 |      |

**Gas/BTEX Fuel Oxygenates by 8260B (C6-C12)**

Blaine Tech Services, Inc.

Attn.: Leon Gearhart

1680 Rogers Avenue

San Jose, CA 95112-1105

Phone: (408) 573-0555 Fax: (408) 573-7771

Project: BTS# 030509-RH1  
98995842

Received: 05/09/2003 16:20

Site: 3790 Hopyard Rd., Pleasanton

| Batch QC Report                |       |        |      |                                  |      |
|--------------------------------|-------|--------|------|----------------------------------|------|
| Prep(s): 5030B                 |       | Water  |      | Test(s): 8260FAB                 |      |
| Method Blank                   |       |        |      | QC Batch # 2003/05/20-2b.65      |      |
| MB: 2003/05/20-2b.65-041       |       |        |      | Date Extracted: 05/21/2003 20:11 |      |
| Compound                       | Conc. | RL     | Unit | Analyzed                         | Flag |
| Gasoline                       | ND    | 50     | ug/L | 05/21/2003 20:11                 |      |
| Benzene                        | ND    | 0.5    | ug/L | 05/21/2003 20:11                 |      |
| Toluene                        | ND    | 0.5    | ug/L | 05/21/2003 20:11                 |      |
| Ethylbenzene                   | ND    | 0.5    | ug/L | 05/21/2003 20:11                 |      |
| Total xylenes                  | ND    | 1.0    | ug/L | 05/21/2003 20:11                 |      |
| tert-Butyl alcohol (TBA)       | ND    | 5.0    | ug/L | 05/21/2003 20:11                 |      |
| Methyl tert-butyl ether (MTBE) | ND    | 0.5    | ug/L | 05/21/2003 20:11                 |      |
| <b>Surrogates(s)</b>           |       |        |      |                                  |      |
| 1,2-Dichloroethane-d4          | 99.4  | 76-130 | %    | 05/21/2003 20:11                 |      |
| Toluene-d8                     | 96.6  | 78-115 | %    | 05/21/2003 20:11                 |      |

**Gas/BTEX Fuel Oxygenates by 8260B (C6-C12)**

Blaine Tech Services, Inc.

Attn.: Leon Gearhart

1680 Rogers Avenue

San Jose, CA 95112-1105

Phone: (408) 573-0555 Fax: (408) 573-7771

Project: BTS# 030509-RH1  
98995842

Received: 05/09/2003 16:20

Site: 3790 Hopyard Rd., Pleasanton

| Batch QC Report          |  |       |  |                                  |  |
|--------------------------|--|-------|--|----------------------------------|--|
| Prep(s): 5030B           |  |       |  | Test(s): 8260FAB                 |  |
| Method Blank             |  | Water |  | QC Batch # 2003/05/21-1d.65      |  |
| MB: 2003/05/21-1d.65-002 |  |       |  | Date Extracted: 05/21/2003 10:11 |  |

| Compound                       | Conc. | RL     | Unit | Analyzed         | Flag |
|--------------------------------|-------|--------|------|------------------|------|
| Gasoline                       | ND    | 50     | ug/L | 05/21/2003 10:11 |      |
| tert-Butyl alcohol (TBA)       | ND    | 5.0    | ug/L | 05/21/2003 10:11 |      |
| Methyl tert-butyl ether (MTBE) | ND    | 0.5    | ug/L | 05/21/2003 10:11 |      |
| Benzene                        | ND    | 0.5    | ug/L | 05/21/2003 10:11 |      |
| Toluene                        | ND    | 0.5    | ug/L | 05/21/2003 10:11 |      |
| Ethylbenzene                   | ND    | 0.5    | ug/L | 05/21/2003 10:11 |      |
| Total xylenes                  | ND    | 1.0    | ug/L | 05/21/2003 10:11 |      |
| <b>Surrogates(s)</b>           |       |        |      |                  |      |
| 1,2-Dichloroethane-d4          | 101.6 | 76-130 | %    | 05/21/2003 10:11 |      |
| Toluene-d8                     | 97.0  | 78-115 | %    | 05/21/2003 10:11 |      |

Gas/BTEX Fuel Oxygenates by 8260B (C6-C12)

Blaine Tech Services, Inc.

Attn.: Leon Gearhart

1680 Rogers Avenue  
San Jose, CA 95112-1105  
Phone: (408) 573-0555 Fax: (408) 573-7771

Project: BTS# 030509-RH1  
98995842

Received: 05/09/2003 16:20

Site: 3790 Hopyard Rd., Pleasanton

| Batch QC Report          |                      |  |                       |  |                  |                             |  |  |  |
|--------------------------|----------------------|--|-----------------------|--|------------------|-----------------------------|--|--|--|
| Prep(s): 5030B           |                      |  |                       |  | Test(s): 8260FAB |                             |  |  |  |
| Laboratory Control Spike |                      |  | Water                 |  |                  | QC Batch # 2003/05/19-1a.64 |  |  |  |
| LCS                      | 2003/05/19-1a.64-002 |  | Extracted: 05/19/2003 |  |                  | Analyzed: 05/19/2003 10:41  |  |  |  |
| LCSD                     | 2003/05/19-1a.64-001 |  | Extracted: 05/19/2003 |  |                  | Analyzed: 05/19/2003 11:03  |  |  |  |

| Compound                       | Conc. ug/L |      | Exp.Conc. | Recovery |       | RPD | Ctrl.Limits % |      | Flags |     |
|--------------------------------|------------|------|-----------|----------|-------|-----|---------------|------|-------|-----|
|                                | LCS        | LCSD |           | LCS      | LCSD  |     | %             | Rec. | RPD   | LCS |
| Benzene                        | 22.0       | 22.7 | 25        | 88.0     | 90.8  | 3.1 | 69-129        | 20   |       |     |
| Toluene                        | 21.9       | 22.7 | 25        | 87.6     | 90.8  | 3.6 | 70-130        | 20   |       |     |
| Methyl tert-butyl ether (MTBE) | 23.3       | 23.7 | 25        | 93.2     | 94.8  | 1.7 | 65-165        | 20   |       |     |
| <b>Surrogates(s)</b>           |            |      |           |          |       |     |               |      |       |     |
| 1,2-Dichloroethane-d4          | 504        | 510  | 500       | 100.8    | 102.0 |     | 76-130        |      |       |     |
| Toluene-d8                     | 477        | 478  | 500       | 95.4     | 95.6  |     | 78-115        |      |       |     |

Severn Trent Laboratories, Inc.

STL San Francisco \* 1220 Quarry Lane, Pleasanton, CA 94566

Tel 925 484 1919 Fax 925 484 1096 \* www.stl-inc.com \* CA DHS ELAP# 2496

05/22/2003 16:22

**Gas/BTEX Fuel Oxygenates by 8260B (C6-C12)**

Blaine Tech Services, Inc.

Attn.: Leon Gearhart

1680 Rogers Avenue

San Jose, CA 95112-1105

Phone: (408) 573-0555 Fax: (408) 573-7771

Project: BTS# 030509-RH1  
98995842

Received: 05/09/2003 16:20

Site: 3790 Hopyard Rd., Pleasanton

| Batch QC Report          |                      |            |                  |                             |                  |
|--------------------------|----------------------|------------|------------------|-----------------------------|------------------|
| Prep(s): 5030B           |                      |            | Test(s): 8260FAB |                             |                  |
| Laboratory Control Spike |                      | Water      |                  | QC Batch # 2003/05/20-2b.65 |                  |
| LCS                      | 2003/05/20-2b.65-040 | Extracted: | 05/20/2003       | Analyzed:                   | 05/20/2003 19:27 |
| LCSD                     | 2003/05/20-2b.65-002 | Extracted: | 05/20/2003       | Analyzed:                   | 05/20/2003 19:49 |

| Compound                       | Conc. ug/L |      | Exp.Conc. | Recovery |       | RPD | Ctrl.Limits % |      | Flags |     |
|--------------------------------|------------|------|-----------|----------|-------|-----|---------------|------|-------|-----|
|                                | LCS        | LCSD |           | LCS      | LCSD  |     | %             | Rec. | RPD   | LCS |
| Benzene                        | 28.7       | 28.1 | 25        | 114.8    | 112.4 | 2.1 | 69-129        | 20   |       |     |
| Toluene                        | 27.2       | 26.8 | 25        | 108.8    | 107.2 | 1.5 | 70-130        | 20   |       |     |
| Methyl tert-butyl ether (MTBE) | 37.5       | 38.2 | 25        | 150.0    | 152.8 | 1.8 | 65-165        | 20   |       |     |
| <b>Surrogates(s)</b>           |            |      |           |          |       |     |               |      |       |     |
| 1,2-Dichloroethane-d4          | 501        | 498  | 500       | 100.2    | 99.6  |     | 76-130        |      |       |     |
| Toluene-d8                     | 472        | 487  | 500       | 94.4     | 97.4  |     | 78-115        |      |       |     |



**Gas/BTEX Fuel Oxygenates by 8260B (C6-C12)**

Blaine Tech Services, Inc.

Attn.: Leon Gearhart

1680 Rogers Avenue

San Jose, CA 95112-1105

Phone: (408) 573-0555 Fax: (408) 573-7771

Project: BTS# 030509-RH1  
98995842

Received: 05/09/2003 16:20

Site: 3790 Hopyard Rd., Pleasanton

| Batch QC Report          |                      |  |                       |  |                  |                             |  |  |  |
|--------------------------|----------------------|--|-----------------------|--|------------------|-----------------------------|--|--|--|
| Prep(s): 5030B           |                      |  |                       |  | Test(s): 8260FAB |                             |  |  |  |
| Laboratory Control Spike |                      |  | Water                 |  |                  | QC Batch # 2003/05/21-1d.65 |  |  |  |
| LCS                      | 2003/05/21-1d.65-003 |  | Extracted: 05/21/2003 |  |                  | Analyzed: 05/21/2003 09:26  |  |  |  |
| LCSD                     | 2003/05/21-1d.65-001 |  | Extracted: 05/21/2003 |  |                  | Analyzed: 05/21/2003 09:48  |  |  |  |

| Compound                       | Conc. ug/L |      | Exp. Conc. | Recovery |       | RPD | Ctrl.Limits % |      | Flags |     |
|--------------------------------|------------|------|------------|----------|-------|-----|---------------|------|-------|-----|
|                                | LCS        | LCSD |            | LCS      | LCSD  |     | %             | Rec. | RPD   | LCS |
| Methyl tert-butyl ether (MTBE) | 36.3       | 35.8 | 25         | 145.2    | 143.2 | 1.4 | 65-165        | 20   |       |     |
| Benzene                        | 27.7       | 27.5 | 25         | 110.8    | 110.0 | 0.7 | 69-129        | 20   |       |     |
| Toluene                        | 26.3       | 26.8 | 25         | 105.2    | 107.2 | 1.9 | 70-130        | 20   |       |     |
| <b>Surrogates(s)</b>           |            |      |            |          |       |     |               |      |       |     |
| 1,2-Dichloroethane-d4          | 525        | 508  | 500        | 105.0    | 101.6 |     | 76-130        |      |       |     |
| Toluene-d8                     | 488        | 517  | 500        | 97.6     | 103.4 |     | 78-115        |      |       |     |

Severn Trent Laboratories, Inc.

STL San Francisco \* 1220 Quarry Lane, Pleasanton, CA 94566

Tel 925 484 1919 Fax 925 484 1096 \* www.stl-inc.com \* CA DHS ELAP# 2496

05/22/2003 16:22

Page 22 of 23

**Gas/BTEX Fuel Oxygenates by 8260B (C6-C12)**

Blaine Tech Services, Inc.

Attn.: Leon Gearhart

1680 Rogers Avenue

San Jose, CA 95112-1105

Phone: (408) 573-0555 Fax: (408) 573-7771

Project: BTS# 030509-RH1

98995842

Received: 05/09/2003 16:20

Site: 3790 Hopyard Rd., Pleasanton

Legend and Notes

**Analysis Flag**

o

Reporting limits were raised due to high level of analyte present in the sample.

# SHELL Chain Of Custody Record

74128

Lab Identification (if necessary):

Address:

City, State, Zip:

Shell Project Manager to be involved:

- SCIENCE & ENGINEERING
- TECHNICAL SERVICES
- CRUISE DIVISION

Karen Petryna

2003.05.0305

INCIDENT NUMBER (SEE ONLY)

9 8 9 9 5 8 4 2

SAMPLE NUMBER (SIGINT)

DATE: 5/9/03

PAGE: 1 of 2

|  |                             |   |  |
|--|-----------------------------|---|--|
| SAMPLE COMPANY:<br><b>Blaine Tech Services</b>                         | LAB CODE:<br><b>BTSS</b>    | SITE ADDRESS (Street and City):<br><b>3790 Hopyard Rd., Pleasanton</b>  | GLOBAL ID NO.:<br><b>T0800401257</b>             |
| ADDRESS:<br><b>1880 Rogers Avenue, San Jose, CA 95132</b>              |                             | EDGE DELIVERABLE TO (Responsible Party or Designer):<br><b>Ana Friel</b>                                      | PHONE NO.:<br><b>(707) 442-2700</b>              |
| PROJECT CONTACT (personality or PDF Report to):<br><b>Leon Garmatz</b> |                             | SAMPLE NUMBER (P/N):<br><p style="font-size: 1.5em; font-weight: bold; text-align: center;">Ryan Homstedt</p> | CONSULTANT PROJECT NO.:<br><b>BTS#030509-241</b> |
| TELEPHONE:<br><b>408-573-0555</b>                                      | FAX:<br><b>408-573-7771</b> | EMAIL:<br><b>kgarmatz@blainetech.com</b>  |  |

TURNAROUND TIME (BUSINESS DAYS):  
 10 DAYS  5 DAYS  72 HOURS  48 HOURS  24 HOURS  LESS THAN 24 HOURS

LA - ENVOI REPORT FORMAT  LIST AGENCY

GCMS MTBE CONFIRMATION: HIGHEST: \_\_\_\_\_ HIGHEST per BORING: \_\_\_\_\_ ALL \_\_\_\_\_

SPECIAL INSTRUCTIONS OR NOTES: CHECK BOX IF EDO IS NOT NEEDED:

**REQUESTED ANALYSIS:**

| LAB USE ONLY | Field Sample Identification | SAMPLING |      | MATRIX | NO. OF CONT. | TPT - One: Purgeable (absorb) | BTX (absorb) | MTBE (absorb - 30ppb RL) | MTHB (absorb - 0.3ppb RL) | Oxyaromatics (5 by (23008) | Elisabert (absorb) | Methanol | EDB & 1,2-DCA (23009) | TBA (absorb) | FIELD NOTES:<br>Container/Preservative or PID Readings or Laboratory Notes |
|--------------|-----------------------------|----------|------|--------|--------------|-------------------------------|--------------|--------------------------|---------------------------|----------------------------|--------------------|----------|-----------------------|--------------|--|
|              |                             | DATE     | TIME |        |              |                               |              |                          |                           |                            |                    |          |                       |              |  |
|              | S-2                         | 5/9/03   | 1240 | GW     | 3            | X                             | X            | X                        |                           |                            |                    |          |                       |              | 2.2°C<br>TEMPERATURE ON RECEIPT C°   |
|              | S-3                         |          | 915  |        |              | X                             | X            | X                        |                           |                            |                    |          |                       |              |  |
|              | S-4                         |          | 1250 |        |              | X                             | X            | X                        |                           |                            |                    |          |                       |              |  |
|              | S-5                         |          | 844  |        |              | X                             | X            | X                        |                           |                            |                    |          |                       |              |  |
|              | S-6                         |          | 1022 |        |              | X                             | X            | X                        |                           |                            |                    |          |                       |              |  |
|              | S-7                         |          | 1004 |        |              | X                             | X            | X                        |                           |                            |                    |          |                       |              |  |
|              | S-8                         |          | 745  |        |              | X                             | X            | X                        |                           |                            |                    |          |                       |              |  |
|              | S-9                         |          | 755  |        |              | X                             | X            | X                        |                           |                            |                    |          |                       |              |  |
|              | S-10                        |          | 944  |        |              | X                             | X            | X                        |                           |                            |                    |          |                       |              |  |
|              | S-11                        |          | 923  |        |              | X                             | X            | X                        |                           |                            |                    |          |                       |              |  |

|                              |                              |                 |               |
|------------------------------|------------------------------|-----------------|---------------|
| Released by (Signature):<br> | Received by (Signature):<br> | Date:<br>5/9/03 | Time:<br>1620 |
| Released by (Signature):<br> | Received by (Signature):<br> | Date:<br>5/9/03 | Time:<br>1830 |

# SHELL Chain Of Custody Record

Lab Identification (if necessary):

Address:

City, State, Zip:

Shell Project Manager to be Invoiced:

SCIENCE & ENGINEERING  
 TECHNICAL SERVICES  
 CHEMISTRY

Karen Petryna  
**2003-05-0305**

INCIDENT NUMBER (S&E ONLY)

9 8 9 8 5 8 4 2

S&E COST NUMBER (IF COST)

DATE: 5/9/03

PAGE: 2 of 2

|  |                          |  |  |
|--|--------------------------|--|--|
| ANALYZING COMPANY:<br><b>Blaine Tech Services</b><br>ADDRESS:<br>1680 Rogers Avenue, San Jose, CA 95112<br>PROJECT CONTACT (Name, Title or Dept. Name):<br>Leon Gearhart<br>TELEPHONE:<br>408-573-0555<br>FAX:<br>408-573-7771<br>EMAIL:<br>lgearhart@blainetech.com | LAB CODE:<br><b>BTSS</b> | SITE ADDRESS (Street and City):<br><b>3790 Hopyard Rd., Pleasanton</b><br>DELIVERABLE TO (Name, Title, Firm or Department):<br>Ana Friel<br>PHONE NO.:<br>(707) 442-2700 | GLOBAL ID NO.:<br><b>T0600101257</b><br>CONSULTANT PROJECT NO.:<br>STS #030503-241 |
| TURNAROUND TIME (BUSINESS DAYS):<br><input checked="" type="checkbox"/> 10 DAYS <input type="checkbox"/> 5 DAYS <input type="checkbox"/> 72 HOURS <input type="checkbox"/> 48 HOURS <input type="checkbox"/> 24 HOURS <input type="checkbox"/> LESS THAN 24 HOURS    |                          | REQUESTED ANALYSIS   |  |

LA - EWQCS REPORT FORMAT  UST AGENCY:  
 GC/MS MTBE CONFIRMATION: HIGHEST \_\_\_\_\_ HIGHEST per BORING \_\_\_\_\_ ALL \_\_\_\_\_  
 SPECIAL INSTRUCTIONS OR NOTES: CHECK BOX IF EDO IS NOT NEEDED:

| LAB USE ONLY | Field Sample Identification | SAMPLING |      | MATRIX | NO. OF CONT. | TPH - Gas, purgeable (2000) | BTEX (2000) | MTBE (2001) - Spill RL | MTBE (2000) - 0.000 RL | Oxygenation (S) by (2001) | Ethanol (2000) | Methanol | EDG & 1,3-DCA (2000) | TBA (2000) | FIELD NOTES:<br>Container/Preservative or PID Readings or Laboratory Notes:<br><br>2.2<br>TEMPERATURE ON RECEIPT C |
|--------------|-----------------------------|----------|------|--------|--------------|-----------------------------|-------------|------------------------|------------------------|---------------------------|----------------|----------|----------------------|------------|--|
|              |                             | DATE     | TIME |        |              |                             |             |                        |                        |                           |                |          |                      |            |  |
|              | S-12                        | 5/9/03   | 1049 | GW     | 7            | X                           | X           | X                      |                        |                           |                |          |                      |            |  |
|              | T-2                         |          | 1107 |        | 7            | X                           | X           | X                      |                        |                           |                |          |                      |            |  |
|              | T-4                         |          | 1118 |        |              | X                           | X           | X                      |                        |                           |                |          |                      |            |  |
|              | SR-2                        |          | 1230 |        |              | X                           | X           | X                      |                        |                           |                |          |                      |            |  |
|              | SR-3                        |          | 1146 |        |              | X                           | X           | X                      |                        |                           |                |          |                      |            |  |

|                                  |                              |                  |               |
|----------------------------------|------------------------------|------------------|---------------|
| Relinquished by (Signature):<br> | Received by (Signature):<br> | Date:<br>5/9/03  | Time:<br>1600 |
| Relinquished by (Signature):<br> | Received by (Signature):<br> | Date:<br>5/14/03 | Time:<br>1830 |
| Relinquished by (Signature):<br> | Received by (Signature):<br> | Date:<br>5/19/03 | Time:<br>1830 |