

# EXXON COMPANY, U.S.A.

P.O. BOX 4032 • CONCORD, CA 94524-4032

MARKETING DEPARTMENT • ENVIRONMENTAL ENGINEERING

MARLA D. GUENSLER  
SENIOR ENGINEER  
(510) 246-8776  
(510) 246-8798 FAX

July 22, 1997

Mr. Scott Seery  
Alameda County Environmental Health Department  
1131 Harbor Bay Parkway  
Alameda, California 94501-6577

**RE: EXXON RAS #7-3399/2991 HOPYARD ROAD, PLEASANTON, CA**

Dear Mr. Seery:

This letter confirms the submittal of the report entitled *Quarterly Groundwater Monitoring Report, Second Quarter 1997* for the above referenced site. This report was prepared by Delta Environmental Consultants, Inc., of Rancho Cordova, California, and summarizes sampling activities conducted on May 23, 1997.

If you have any questions or comments, please contact me at (510) 246-8776.

Sincerely,



Marla D. Guensler  
Senior Engineer

MDG/tjm

Attachment: Delta Second Quarter Report dated July 3, 1997

cc: w/attachment:

Mr. Dennis Mishek - San Francisco Bay RWQCB  
Mr. David Lunn - Alameda Co. Flood Control (Zone-7)  
Mr. Steve Cusenza - City of Pleasanton Public Works Dept.

w/o attachment:

Mr. Keoni Almeida - Delta Environmental Consultants

ENVIRONMENTAL  
PROTECTION  
97 JUL 23 PM 2:15



3164 Gold Camp Drive  
Suite 200  
Rancho Cordova, CA 95670  
916/638-2085  
FAX: 916/638-8385

July 3, 1997

Ms. Marla D. Guensler  
Exxon Company, U.S.A.  
2300 Clayton Road, Suite 640  
Concord, California 94520

Subject: *Quarterly Ground Water Monitoring Report, Second Quarter 1997*  
Exxon Retail Station No. 7-3399  
2991 Hopyard Road  
Pleasanton, California  
Delta Project No. D094-836

Dear Ms. Guensler:

Delta Environmental Consultants, Inc. (Delta), has been authorized by Exxon Company, U.S.A. (Exxon), to conduct quarterly ground water monitoring at Exxon Service Station No. 7-3399, located at 2991 Hopyard Road, Pleasanton, California. This document presents the results of quarterly ground water monitoring and sampling conducted for the second quarter 1997. The location of the site is shown in Figure 1 and site features are illustrated in Figure 2. Work conducted at the site by Delta was performed in accordance with the field methods and procedures described in Enclosure A.

#### **Ground Water Elevations, Flow Direction, and Hydraulic Gradient**

On May 23, 1997, ground water elevations were measured in on-site monitoring wells MW-1, MW-4, MW-7, MW-8, MW-9, MW-10 and off-site monitoring wells MW-5D, MW-5S, and MW-11. Depth to ground water in the monitoring wells ranged from 33.63 (MW-1) to 36.41 (MW-8) feet below the top of the well casings. Ground water elevation levels decreased an average of 0.40 feet in the monitoring wells since the February 1997 event. Cumulative ground water elevation measurements recorded are presented in Table 1.

A water table contour map constructed from the ground water elevations recorded on May 23, 1997, is included as Figure 3. The water table contours illustrated in Figure 3 indicate that ground water in the upper water bearing zone flowed generally toward the northeast. Based on the water table contour map, the estimated hydraulic gradient is less than 0.01. The ground water elevation measurements from monitoring wells MW-5D and MW-8 were not included in the contour map, because these wells are screened in a lower zone.

#### **Subjective Analysis**

No liquid-phase petroleum hydrocarbons or hydrocarbon sheens were present in the wells during the May 1997, sampling visit.

### Ground Water Analytical Results

Ground water samples were collected from monitoring wells MW-1, MW-5S, MW-5D, MW-8 and MW-9 on May 23, 1997. As requested by Alameda County Health Agency, duplicate samples labeled MW5DD and MW-8D were collected from MW-5D and MW-8, respectively. Samples labeled MW-5DR and MW-8R were rinsate samples collected following decontamination procedures of field equipment. All ground water samples were submitted to Sequoia Analytical (a California-certified laboratory) for analysis of benzene, toluene, ethylbenzene, total xylenes and methyl tertiary butyl ether (MTBE) by EPA Method 8020, and total purgeable petroleum hydrocarbons (TPPH) as gasoline by EPA Method 8015 Modified. Ground water samples are collected annually from monitoring wells MW-4 and MW-7. Monitoring wells MW-10 and MW-11 will continue to be excluded from quarterly sampling, as these wells have continuously shown nondetectable concentrations.

The analytical results reported that all analytes were below the laboratory's limits of detection, with the exception of the samples obtained from monitoring well MW-9. The analytical results reported the ground water sample collected from monitoring well MW-9 contained 5,300 micrograms per liter ( $\mu\text{g/L}$ ) of benzene, which is an increase in concentration from 2,900  $\mu\text{g/L}$  reported during the previous sampling event in February 1997. MTBE was reported in the sample collected from MW-9 at a concentration of 1,600  $\mu\text{g/L}$  and TPPH as gasoline at 32,000  $\mu\text{g/L}$ . Cumulative ground water analytical results are presented in Table 1, and a copy of the laboratory analytical report for the May 23, 1997, sampling event is included in Enclosure B.

### Discussion

Concentrations of hydrocarbons in samples collected from monitoring wells MW-8 and MW-5D, which are screened across a lower water bearing zone were below the laboratory's limits of detection for all analytes. Analytical results from duplicate and rinsate samples also collected from these wells were below the laboratory's limit of detection for all analytes. Monitoring of residual dissolved hydrocarbons in the deep monitoring well will continue, due to the proximity of the City of Pleasanton municipal wells northeast of the site.

### Future Work

Preparations are being made to proceed with the proposed *Remedial Action Plan* dated May 30, 1996, to address petroleum hydrocarbon concentrations in soil and ground water in the vicinity of monitoring well MW-9.

The next quarterly monitoring event for this site is scheduled for August 1997.

### Remarks/Signatures

The interpretations contained in this document represent our professional opinions, and are based in part, on information supplied by the client. These opinions are based on currently available information and are arrived at in accordance with currently accepted hydrogeologic and engineering practices at this time and location. Other than this, no warranty is implied or intended.

Ms. Marla Guensler  
Exxon Company, U.S.A.  
July 3, 1997  
Page 3

Delta recommends that copies of this document be forwarded to:

Mr. Scott Seery  
Alameda County Health Care Services  
1131 Harbor Bay Parkway  
Alameda, California 94502-5577

Mr. Steve Cusenza  
City of Pleasanton Public Works Dept.  
Post Office Box 520  
Pleasanton, California 94566

Mr. Dennis Mishek  
California Regional Water Quality  
Control Board  
San Francisco Bay Region  
2101 Street, Suite 500  
Oakland, California 94612

Mr. David Lum  
Alameda County Flood Control and Water  
Conservation District (Zone 7)  
5997 Parkside Drive  
Pleasanton, California 94566

If you have any questions, please contact Keoni Almeida at (916) 638-2085.

Sincerely,

**DELTA ENVIRONMENTAL CONSULTANTS, INC.**

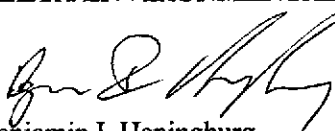
  
Benjamin I. Heningburg  
Staff Geologist

  
Charles Keoni Almeida  
Project Manager

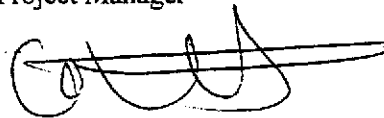
  
Owen M. Kittredge, R.G.  
California Registered Geologist No. 5853



BIH (LRP009.836)  
Enclosures

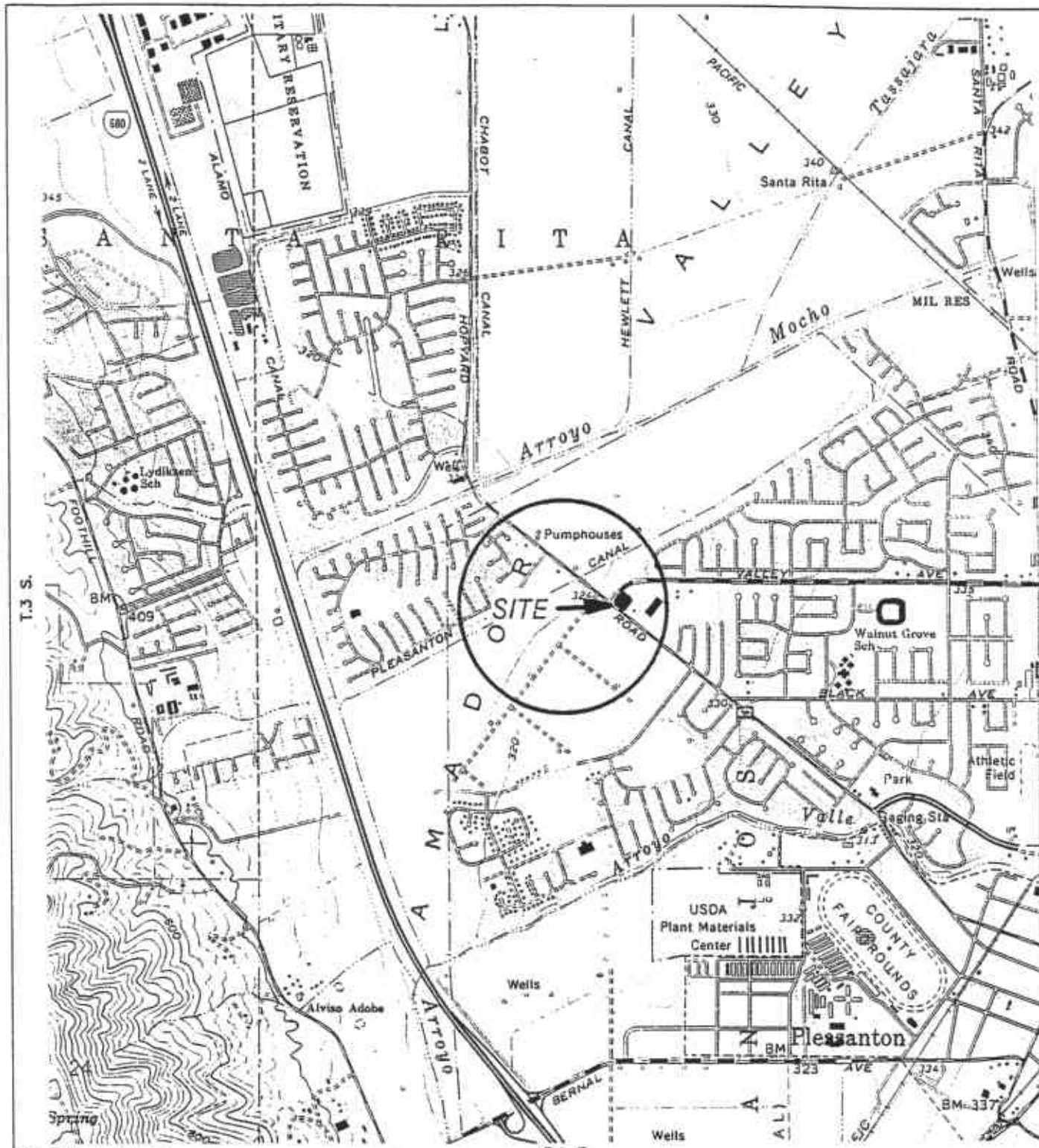

GENERAL NOTES:  
 BASE MAP FROM U.S.G.S.  
 DUBLIN, CA  
 7.5 MINUTE TOPOGRAPHIC  
 PHOTOREVISED 1980



QUADRANGLE LOCATION

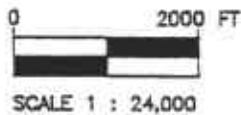
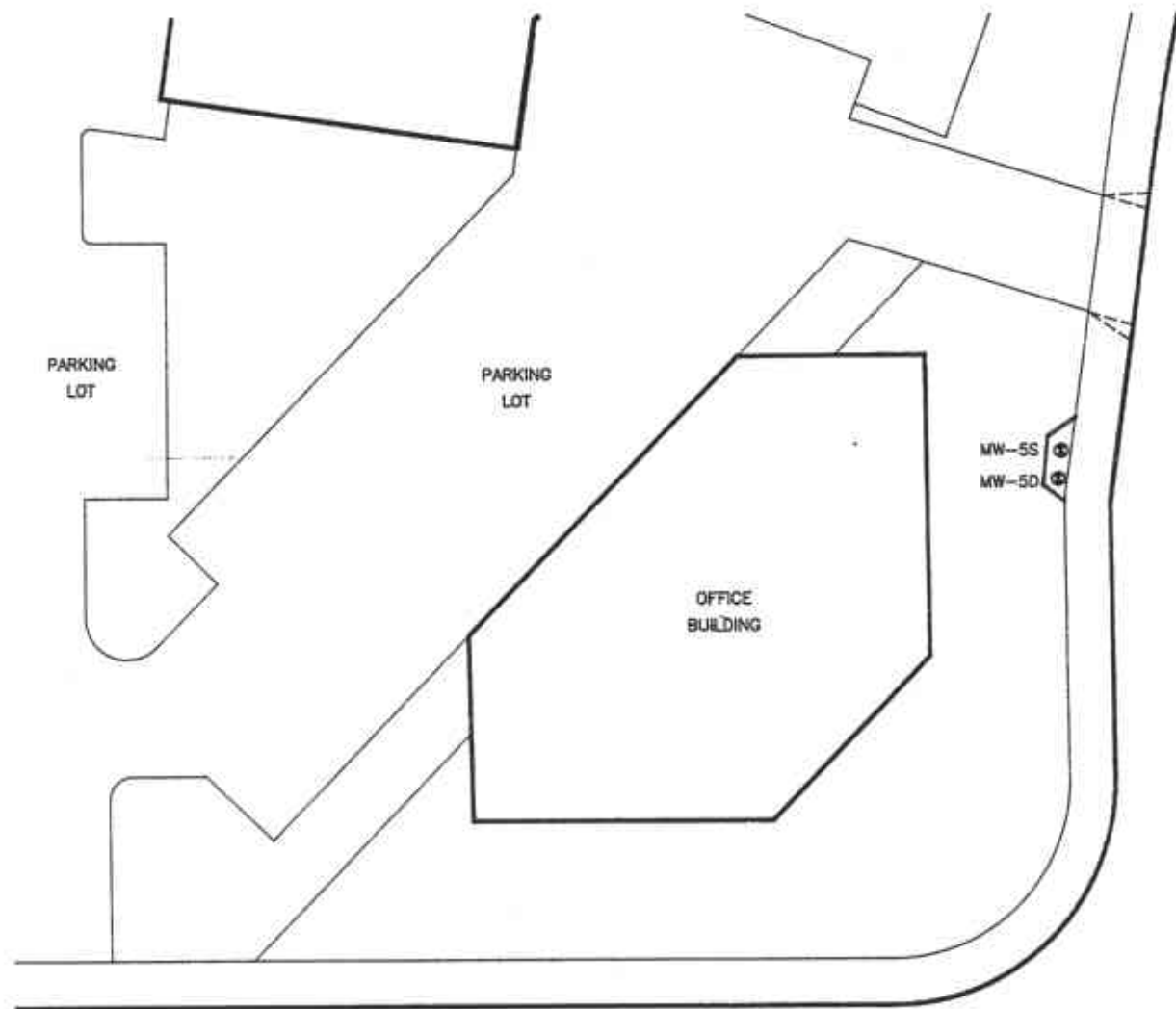

FIGURE 1  
 SITE LOCATION MAP  
 EXXON STATION NO 7-3399  
 2991 HOPYARD ROAD  
 PLEASANTON, CA.

PROJECT NO. D094-838	DRAWN BY LH, 9/22/94
FILE NO. ---	PREPARED BY TMG
REVISION NO. 1	REVIEWED BY <i>[Signature]</i>





VALLEY AVENUE

HOPYARD ROAD

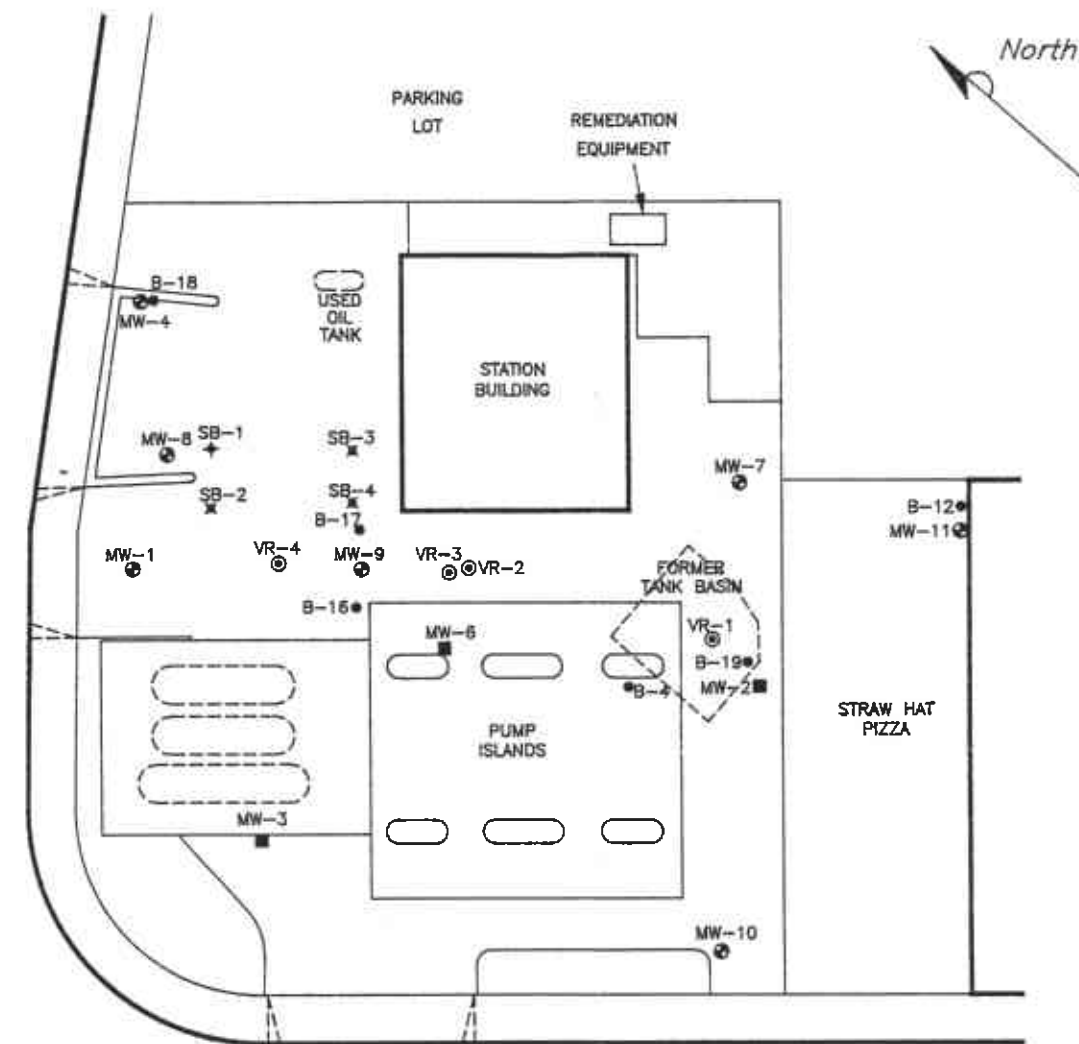

LEGEND:

- B-12 SOIL BORING LOCATION
- ⊙ VR-1 VAPOR EXTRACTION WELL LOCATION
- MW-2 DESTROYED MONITORING WELL
- ⊙ MW-1 MONITORING WELL LOCATION
- × SB-1 SOIL BORING LOCATION

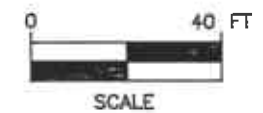

FIGURE 2  
SITE VICINITY MAP  
EXXON STATION NO 7-3399  
2991 HOPYARD ROAD  
PLEASANTON, CA.

PROJECT NO. 0094-836	DRAWN BY M.L. 4/24/97
FILE NO. 94-836-5	PREPARED BY CKA
REVISION NO. 2	REVIEWED BY CKA

**Delta**  
Environmental  
Consultants, Inc.

NOTE:

BASE MAP ADAPTED FROM RESNA FIGURE.SITE  
DIMENSIONS AND FACILITY LOCATIONS NOT VERIFIED.

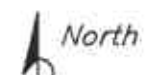
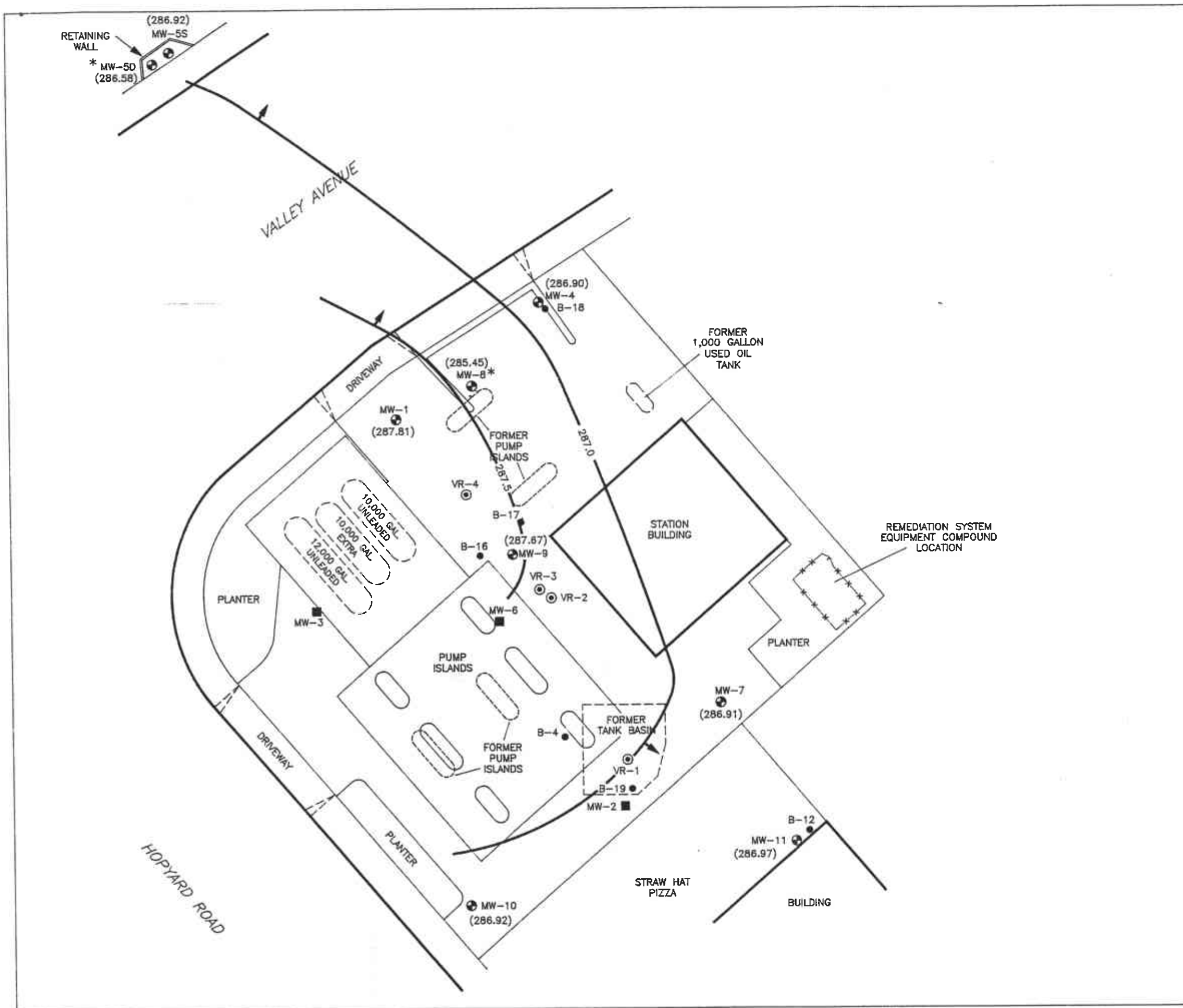

**LEGEND:**

- ⊕ MW-1 MONITORING WELL LOCATION
- ⊙ VR-1 VAPOR EXTRACTION WELL LOCATION
- MW-2 DESTROYED MONITORING WELL
- B-12 SOIL BORING LOCATION
- (286.91) GROUND WATER ELEVATION IN FEET ABOVE MEAN SEA LEVEL
- 282.5 — WATER TABLE CONTOUR IN FEET ABOVE MEAN SEA LEVEL
- ➔ GROUND WATER FLOW DIRECTION

**NOTE:**

\* MONITORING WELLS MW-5D AND MW-8 WERE NOT USED IN THE CALCULATION OF THE WATER TABLE CONTOURS BECAUSE THEY ARE SCREENED IN LOWER WATER BEARING ZONES.

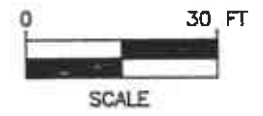

**NOTE:**

BASE MAP ADAPTED FROM RESNA FIGURE.SITE DIMENSIONS AND FACILITY LOCATIONS NOT VERIFIED.

**FIGURE 3**  
**WATER TABLE CONTOUR MAP - 5/23/97**  
**EXXON STATION NO 7-3399**  
**2991 HOPYARD ROAD**  
**PLEASANTON, CA.**

PROJECT NO. D094-836	DRAWN BY M.L. 5/30/97
FILE NO. 94-836-1	PREPARED BY BIH
REVISION NO. 2	REVIEWED BY CKA



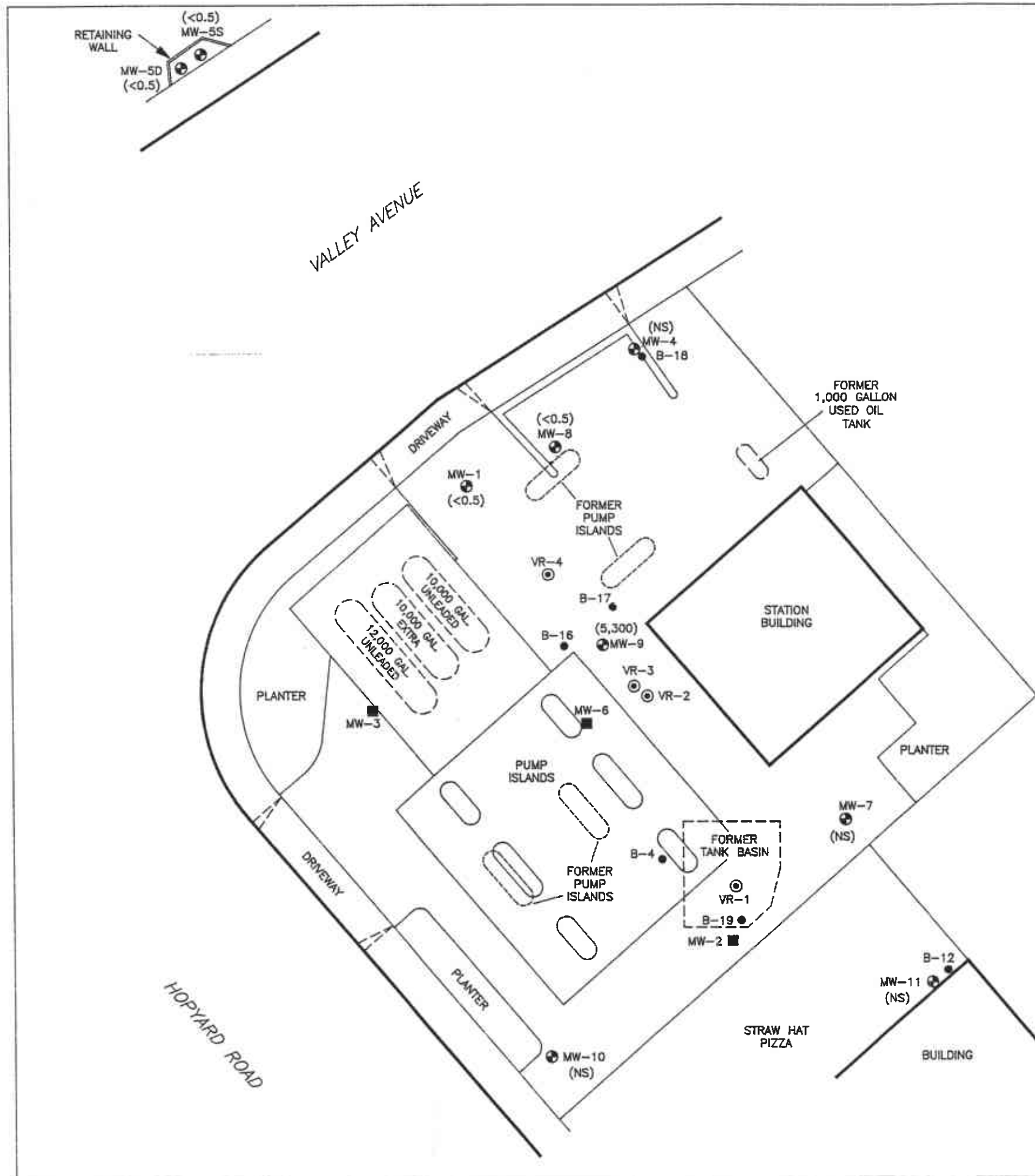

- LEGEND:
- ⊕ MW-1 MONITORING WELL LOCATION
  - ⊙ VR-1 VAPOR EXTRACTION WELL LOCATION
  - MW-2 DESTROYED MONITORING WELL
  - B-12 SOIL BORING LOCATION
  - <math><0.5</math> DISSOLVED BENZENE CONCENTRATION IN GROUND WATER IN MICROGRAMS PER LITER
  - (NS) NOT SAMPLED

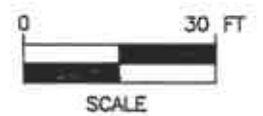

NOTE:  
 BASE MAP ADAPTED FROM RESNA FIGURE.SITE  
 DIMENSIONS AND FACILITY LOCATIONS NOT VERIFIED.

FIGURE 4  
 DISSOLVED BENZENE CONCENTRATIONS  
 5/23/97  
 EXXON STATION NO 7-3399  
 2991 HOPYARD ROAD  
 PLEASANTON, CA.

PROJECT NO. D094-836	DRAWN BY M.L. 8/10/97	
FILE NO. 94-836-1	PREPARED BY BIH	
REVISION NO. 1	REVIEWED BY CKA	



TABLE 1

## GROUND WATER MONITORING DATA

Exxon Service Station No. 7-3399

2991 Hopyard Road

Pleasanton, California

Monitoring Well	Date	Reference Elevation (ft)	Depth to Water (ft)	Ground Water Elevation (ft)	Benzene (µg/L)	Toluene (µg/L)	Ethyl-benzene (µg/L)	Total Xylenes (µg/L)	TPPH as gasoline (µg/L)	MTBE (µg/L)	Comments
MW-1	04/02/88	321.44	NM	NC	<0.5	1.7	<0.5	<0.5	<20	NA	Not measured
	04/06/88		36.34	285.10	NS	NS	NS	NS	NS	NS	No LPH
	04/08/88		36.29	285.15	NS	NS	NS	NS	NS	NS	No LPH
	04/19/88		36.36	285.08	NS	NS	NS	NS	NS	NS	No LPH
	06/06/88		38.16	283.28	NS	NS	NS	NS	NS	NS	No LPH
	06/23/88		38.71	282.73	NS	NS	NS	NS	NS	NS	No LPH
	06/28/88		39.16	282.28	NS	NS	NS	NS	NS	NS	No LPH
	07/06/88		39.73	281.71	<0.5	<0.5	<0.5	<0.5	<20	NA	No LPH
	07/13/88		40.22	281.22	<0.5	<0.5	<0.5	<0.5	<20	NA	No LPH
	08/12/88		NM	NC	NS	NS	NS	NS	NS	NS	Not measured
	08/26/88		41.90	279.54	NS	NS	NS	NS	NS	NS	No LPH
	09/07/88		42.27	279.17	<0.5	<0.5	<0.5	<0.5	<20	NA	No LPH
	12/07/88		43.94	277.50	NS	NS	NS	NS	NS	NS	No LPH
	12/19/88		43.70	277.74	NS	NS	NS	NS	NS	NS	No LPH
	02/09/89		42.53	278.91	NS	NS	NS	NS	NS	NS	No LPH
	03/03/89		NM	NC	1.6	<0.5	<0.5	<0.5	<20	NA	Not measured
	03/08/89		41.96	279.48	NS	NS	NS	NS	NS	NS	No LPH
	04/03/89		41.59	279.85	NS	NS	NS	NS	NS	NS	No LPH
	04/26/89		41.67	279.77	NS	NS	NS	NS	NS	NS	No LPH
	06/30/89		43.79	277.65	<0.5	<0.5	<0.5	<0.5	<20	NA	No LPH
	07/17/89		44.74	276.70	<0.5	<0.5	<0.5	<0.5	23	NA	No LPH
	07/18/89		44.76	276.68	NS	NS	NS	NS	NS	NS	No LPH
	07/19/89		44.82	276.62	NS	NS	NS	NS	NS	NS	No LPH
	07/20/89		44.85	276.59	<0.5	<0.5	<0.5	<0.5	<20	NA	No LPH
	07/21/89		44.95	276.49	NS	NS	NS	NS	NS	NS	No LPH
	07/26/89		45.42	276.02	<0.5	<0.5	<0.5	<0.5	<20	NA	No LPH
	08/02/89		NM	NC	<0.5	<0.5	<0.5	<0.5	<20	NA	Not measured
	08/03/89		46.18	275.26	NS	NS	NS	NS	NS	NS	No LPH
	08/17/89		47.12	274.32	NS	NS	NS	NS	NS	NS	No LPH
	09/13/89		49.08	272.36	39	0.6	<0.5	5.1	220	NA	No LPH
	11/28/89		50.21	271.23	NS	NS	NS	NS	NS	NS	No LPH
	12/20/89		NM	NC	56	0.72	<0.5	0.71	220	NA	Not measured

TABLE 1

## GROUND WATER MONITORING DATA

Exxon Service Station No. 7-3399

2991 Hopyard Road

Pleasanton, California

Monitoring Well	Date	Reference Elevation (ft)	Depth to Water (ft)	Ground Water Elevation (ft)	Benzene (µg/L)	Toluene (µg/L)	Ethyl-benzene (µg/L)	Total Xylenes (µg/L)	TPPH as gasoline (µg/L)	MTBE (µg/L)	Comments
MW-1	01/09/90	321.44	49.31	272.13	NS	NS	NS	NS	NS	NS	No LPH
(Cont.)	01/25/90		NM	NC	18	1.6	<0.5	1.8	57	NA	Not measured
	01/26/90		49.29	272.15	NS	NS	NS	NS	NS	NS	No LPH
	02/23/90		49.02 <sup>a</sup>	272.42	NS	NS	NS	NS	NS	NS	No LPH
	02/23/90		49.02	272.42	NS	NS	NS	NS	NS	NS	No LPH
	02/27/90		NM	NC	3.2	2.3	<0.5	3.2	55	NA	Not measured
	03/26/90		48.71 <sup>a</sup>	272.73	<0.5	<0.5	<0.5	<0.5	<20	NA	No LPH
	03/26/90		48.70	272.74	NS	NS	NS	NS	NS	NS	No LPH
	04/18/90		48.79	272.65	1.1	1.6	<0.5	3.1	25	NA	No LPH
	05/17/90		49.40	272.04	<0.5	<0.5	<0.5	<0.5	<20	NA	No LPH
	06/11/90		50.83	270.61	<0.5	<0.5	<0.5	<0.5	<20	NA	No LPH
	07/30/90		52.17	269.27	<0.5	<0.5	<0.5	<0.5	<20	NA	No LPH
	08/27/90		53.44	268.00	<0.5	<0.5	<0.5	<0.5	<20	NA	No LPH
	09/28/90		53.40	268.04	<0.5	<0.5	<0.5	<0.5	<50	NA	No LPH
	12/27/90		NM	NC	NS	NS	NS	NS	NS	NS	Not measured
	03/20/91		53.35	268.09	NS	NS	NS	NS	NS	NS	No LPH
	06/20/91		53.55	267.89	NS	NS	NS	NS	NS	NS	No LPH
	09/12/91		NM	NC	NS	NS	NS	NS	NS	NS	Not measured
	12/30/91		NM	NC	NS	NS	NS	NS	NS	NS	Not measured
	12/10/92		NM	NC	NS	NS	NS	NS	NS	NS	Not measured
	01/30/92		NM	NC	NS	NS	NS	NS	NS	NS	Not measured
	02/16/93		NM	NC	NS	NS	NS	NS	NS	NS	Not measured
	03/02/92		NM	NC	NS	NS	NS	NS	NS	NS	Not measured
	03/24/92		NM	NC	NS	NS	NS	NS	NS	NS	Not measured
	04/14/92		NM	NC	NS	NS	NS	NS	NS	NS	Not measured
	05/21/92		NM	NC	NS	NS	NS	NS	NS	NS	Not measured
	06/08/92		NM	NC	NS	NS	NS	NS	NS	NS	Not measured
	07/14/92		NM	NC	NS	NS	NS	NS	NS	NS	Not measured
	08/10/92		NM	NC	NS	NS	NS	NS	NS	NS	Not measured
	09/16/92		NM	NC	NS	NS	NS	NS	NS	NS	Not measured
	10/07/92		NM	NC	NS	NS	NS	NS	NS	NS	Not measured
	11/09/92		NM	NC	NS	NS	NS	NS	NS	NS	Dry
	12/10/92		NM	NC	NS	NS	NS	NS	NS	NS	Not measured

TABLE 1

## GROUND WATER MONITORING DATA

Exxon Service Station No. 7-3399  
2991 Hopyard Road  
Pleasanton, California

Monitoring Well	Date	Reference Elevation (ft)	Depth to Water (ft)	Ground Water							Comments
				Elevation (ft)	Benzene (µg/L)	Toluene (µg/L)	Ethyl-benzene (µg/L)	Total Xylenes (µg/L)	TPPH as gasoline (µg/L)	MTBE (µg/L)	
MW-1 (Cont.)	01/26/93	321.44	NM	NC	NS	NS	NS	NS	NS	NS	Not measured
	02/16/93		NM	NC	NS	NS	NS	NS	NS	NS	Not measured
	03/11/93		53.09	268.35	NS	NS	NS	NS	NS	NS	No LPH
	04/12/93		53.32	268.12	NS	NS	NS	NS	NS	NS	No LPH
	06/01/93		53.40	268.04	NS	NS	NS	NS	NS	NS	No LPH
	07/15/93		59.80	261.64	NS	NS	NS	NS	NS	NS	No LPH
	08/15/93		53.45	267.99	NS	NS	NS	NS	NS	NS	No LPH
	09/29/93		53.43	268.01	NS	NS	NS	NS	NS	NS	No LPH
	09/30/93		NM	NC	<0.5	<0.5	<0.5	<0.5	<50	NA	Not measured
	10/28/93		53.38	268.06	NS	NS	NS	NS	NS	NS	No LPH
	11/23/93		53.46	267.98	NS	NS	NS	NS	NS	NS	No LPH
	11/24/93		NM	NC	<0.5	<0.5	<0.5	<0.5	<50	NA	Not measured
	03/10-11/94		53.46	267.98	<0.5	<0.5	<0.5	<0.5	<50	NA	No LPH
	05/04-05/94		53.34	268.10	<0.5	<0.5	<0.5	<0.5	<50	NA	No LPH
	09/01/94 <sup>a</sup>		NM	NC	<0.5	<0.5	<0.5	<0.5	<50	NA	No LPH
	11/16/94		52.09	269.35	<0.5	<0.5	<0.5	<0.5	<50	NA	No LPH
	02/15/95		49.41	272.03	<0.5	<0.5	<0.5	<0.5	<50	NA	No LPH
	05/09/95		39.97	281.47	<0.5	<0.5	<0.5	<0.5	<50	NA	No LPH
	08/21/95		40.68	280.76	<0.5	0.83	<0.5	<0.5	<50	<2.5	No LPH
	11/30/95		38.99	282.45	<0.5	<0.5	<0.5	<0.5	<50	<5.0	No LPH
	03/28/96		35.70	285.74	<0.5	<0.5	<0.5	<0.5	<50	<5.0	No LPH
	05/31/96		34.17	287.27	<0.5	<0.5	<0.5	<0.5	52	<5.0	No LPH
	08/28/96		38.37	283.07	<0.5	<0.5	<0.5	<0.5	<50	<5.0	No LPH
	11/18/96		38.40	283.04	<0.5	<0.5	<0.5	<0.5	<50	<5.0	No LPH
	02/28/97		33.29	288.15	<0.5	<0.5	<0.5	<0.5	<50	<2.5	No LPH
	05/23/97		33.63	287.91	<0.5	<0.5	<0.5	<0.5	<50	<2.5	No LPH

TABLE 1

## GROUND WATER MONITORING DATA

Exxon Service Station No. 7-3399  
2991 Hopyard Road  
Pleasanton, California

Monitoring Well	Date	Reference Elevation (ft)	Depth to Water (ft)	Ground Water		Benzene (µg/L)	Toluene (µg/L)	Ethyl-benzene (µg/L)	Total Xylenes (µg/L)	TPPH as gasoline (µg/L)	MTBE (µg/L)	Comments
				Elevation (ft)	(ft)							
MW-2	04/02/88	NM	NM	NC	NS	NS	NS	NS	NS	NS	NS	0.25
	04/04/88		NM	NC	NS	NS	NS	NS	NS	NS	NS	1.5
	04/05/88		NM	NC	NS	NS	NS	NS	NS	NS	NS	1.5
	04/06/88		39.31	NC	NS	NS	NS	NS	NS	NS	NS	3.2
	04/08/88		NM	NC	NS	NS	NS	NS	NS	NS	NS	Not measured
	04/19/88		38.90	NC	NS	NS	NS	NS	NS	NS	NS	2.48
	06/06/88		38.78	NC	NS	NS	NS	NS	NS	NS	NS	0.26
	06/23/88		39.23	NC	NS	NS	NS	NS	NS	NS	NS	0.13
	06/28/88		39.72	NC	NS	NS	NS	NS	NS	NS	NS	Not measured
	07/06/88		40.31	NC	25,700	18,500	2,900	21,400	62,000	NA	NA	Slight sheen
07/12/88			Well destroyed									
MW-3	04/06/88	NM	37.19	NC	<0.5	<0.5	<0.5	<0.5	20	NA	NA	No LPH
	04/08/88		37.14	NC	NS	NS	NS	NS	NS	NS	NS	No LPH
	04/19/88		37.22	NC	NS	NS	NS	NS	NS	NS	NS	No LPH
	06/06/88		39.02	NC	NS	NS	NS	NS	NS	NS	NS	No LPH
	06/23/88		39.58	NC	NS	NS	NS	NS	NS	NS	NS	No LPH
	06/28/88		40.04	NC	NS	NS	NS	NS	NS	NS	NS	No LPH
	07/06/88		40.60	NC	<0.5	<0.5	<0.5	<0.5	<20	NA	NA	No LPH
	07/13/88		41.09	NC	<0.5	<0.5	<0.5	<0.5	<20	NA	NA	No LPH
	08/12/88		NM	NC	NS	NS	NS	NS	NS	NS	NS	No LPH
	08/26/88		42.77	NC	<0.5	<0.5	<0.5	<0.5	<20	NA	NA	Not measured
08/29/88			Well destroyed									

TABLE 1

## GROUND WATER MONITORING DATA

Exxon Service Station No. 7-3399  
2991 Hopyard Road  
Pleasanton, California

Monitoring Well	Date	Reference Elevation (ft)	Depth to Water (ft)	Ground Water Elevation (ft)	Benzene (µg/L)	Toluene (µg/L)	Ethyl-benzene (µg/L)	Total Xylenes (µg/L)	TPPH as gasoline (µg/L)	MTBE (µg/L)	Comments
MW-4	04/08/88	321.56	36.41	285.15	NS	NS	NS	NS	NS	NS	No LPH
	04/11/88		NM	NC	1.8	16.3	0.6	7.1	80	NA	Not measured
	04/19/88		36.51	285.05	NS	NS	NS	NS	NS	NS	No LPH
	06/06/88		38.26	283.30	NS	NS	NS	NS	NS	NS	No LPH
	06/23/88		38.83	282.73	NS	NS	NS	NS	NS	NS	No LPH
	06/28/88		39.28	282.28	NS	NS	NS	NS	NS	NS	No LPH
	07/06/88		39.85	281.71	<0.5	<0.5	<0.5	<0.5	<20	NA	No LPH
	07/13/88		40.31	281.25	<0.5	0.9	<0.5	<0.5	<20	NA	No LPH
	08/12/88		NM	NC	NS	NS	NS	NS	NS	NS	Not measured
	08/26/88		42.01	279.55	NS	NS	NS	NS	NS	NS	No LPH
	09/07/88		NM	NC	NS	NS	NS	NS	NS	NS	Not measured
	12/07/88		NM	NC	NS	NS	NS	NS	NS	NS	Not measured
	12/19/88		43.83	277.73	NS	NS	NS	NS	NS	NS	No LPH
	02/09/89		42.67	278.89	NS	NS	NS	NS	NS	NS	No LPH
	03/08/89		42.11	279.45	3.8	1.0	<0.5	<0.5	440	NA	No LPH
	04/03/89		41.73	279.83	NS	NS	NS	NS	NS	NS	No LPH
	04/26/89		41.79	279.77	NS	NS	NS	NS	NS	NS	No LPH
	06/30/89		43.88	277.68	<0.5	<0.5	<0.5	<0.5	100	NA	No LPH
	07/17/89		44.85	276.71	<0.5	<0.5	<0.5	<0.5	390	NA	No LPH
	07/18/89		44.88	276.68	NS	NS	NS	NS	NS	NS	No LPH
	07/19/89		44.92	276.64	NS	NS	NS	NS	NS	NS	No LPH
	07/20/89		44.98	276.58	<0.5	<0.5	<0.5	<0.5	200	NA	No LPH
	07/21/89		45.04	276.52	NS	NS	NS	NS	NS	NS	No LPH
	07/26/89		45.50	276.06	<0.5	<0.5	<0.5	<0.5	66	NA	No LPH
	08/02/89		NM	NC	NS	NS	NS	NS	NS	NS	Not measured
	08/03/89		46.28	275.28	NS	NS	NS	NS	NS	NS	No LPH
	08/17/89		47.22	274.34	NS	NS	NS	NS	NS	NS	No LPH
	09/13/89		49.19	272.37	<0.5	<0.5	<0.5	<0.5	<20	NA	No LPH
	11/28/89		50.34	271.22	NS	NS	NS	NS	NS	NS	No LPH
	12/20/89		NM	NC	<0.5	<0.5	<0.5	<0.5	<20	NA	Not measured
	01/09/90		49.47	272.09	NS	NS	NS	NS	NS	NS	No LPH
	01/26/90		49.36	272.20	NS	NS	NS	NS	NS	NS	No LPH
	02/23/90		49.18 <sup>a</sup>	272.38	NS	NS	NS	NS	NS	NS	No LPH

TABLE 1

## GROUND WATER MONITORING DATA

Exxon Service Station No. 7-3399  
2991 Hopyard Road  
Pleasanton, California

Monitoring Well	Date	Reference Elevation (ft)	Depth to Water (ft)	Ground Water Elevation (ft)	Benzene (µg/L)	Toluene (µg/L)	Ethyl-benzene (µg/L)	Total Xylenes (µg/L)	TPPH as gasoline (µg/L)	MTBE (µg/L)	Comments
MW-4	02/23/90	321.56	49.15	272.41	NS	NS	NS	NS	NS	NS	No LPH
(Cont.)	03/26/90		48.84 <sup>a</sup>	272.72	<0.5	<0.5	<0.5	<0.5	<20	NA	No LPH
	03/26/90		48.83	272.73	NS	NS	NS	NS	NS	NS	No LPH
	04/18/90		48.90	272.66	NS	NS	NS	NS	NS	NS	No LPH
	05/17/90		50.03	271.53	NS	NS	NS	NS	NS	NS	No LPH
	06/11/90		50.98	270.58	NS	NS	NS	NS	NS	NS	No LPH
	07/30/90		53.57	267.99	NS	NS	NS	NS	NS	NS	No LPH
	08/01/90		NM	NC	<0.5	<0.5	<0.5	<0.5	<20	NA	Not measured
	08/27/90		53.61	267.95	NS	NS	NS	NS	NS	NS	No LPH
	09/28/90		53.57	267.99	NS	NS	NS	NS	NS	NS	No LPH
	12/27/90		53.68	267.88	<0.5	<0.5	<0.5	<0.5	<50	NA	No LPH
	03/20/91		53.56	268.00	<0.5	<0.5	<0.5	<0.5	<50	NA	No LPH
	06/20/91		53.75	267.81	NS	NS	NS	NS	NS	NS	No LPH
	09/12/91		53.70	267.86	NS	NS	NS	NS	NS	NS	No LPH
	12/30/91		NM	NC	NS	NS	NS	NS	NS	NS	Dry
	01/30/92		NM	NC	NS	NS	NS	NS	NS	NS	Dry
	03/02/92		53.83	267.73	NS	NS	NS	NS	NS	NS	No LPH
	03/24/92		53.73	267.83	<0.5	<0.5	<0.5	<0.5	<50	NA	No LPH
	12/10/92		NM	NC	NS	NS	NS	NS	NS	NS	Not measured
	04/14/92		53.76	267.80	NS	NS	NS	NS	NS	NS	No LPH
	05/21/92		54.73	266.83	NS	NS	NS	NS	NS	NS	No LPH
	06/08/92		53.80	267.76	NS	NS	NS	NS	NS	NS	No LPH
	07/14/92		53.60	267.96	NS	NS	NS	NS	NS	NS	No LPH
	08/10/92		53.71	267.85	NS	NS	NS	NS	NS	NS	No LPH
	09/16/92		53.89	267.67	NS	NS	NS	NS	NS	NS	No LPH
	10/07/92		NM	NC	NS	NS	NS	NS	NS	NS	Dry
	11/09/92		NM	NC	NS	NS	NS	NS	NS	NS	Dry
	12/10/92		53.83	267.73	57	34	11	200	600	NA	No LPH
	01/26/93		NM	NC	NS	NS	NS	NS	NS	NS	Dry
	02/16/93		53.64	267.92	NS	NS	NS	NS	NS	NS	No LPH
	03/11/93		53.54	268.02	NS	NS	NS	NS	NS	NS	No LPH
	04/12/93		53.62	267.94	20	10	22	80	360	NA	No LPH
	06/01/93		53.52	268.04	NS	NS	NS	NS	NS	NS	No LPH

TABLE 1

## GROUND WATER MONITORING DATA

Exxon Service Station No. 7-3399

2991 Hopyard Road

Pleasanton, California

Monitoring Well	Date	Reference Elevation (ft)	Depth to Water (ft)	Ground Water		Benzene (µg/L)	Toluene (µg/L)	Ethyl-benzene (µg/L)	Total Xylenes (µg/L)	TPPH as gasoline (µg/L)	MTBE (µg/L)	Comments
				Elevation (ft)								
MW-4	07/15/93	321.56	53.80	267.76	NS	NS	NS	NS	NS	NS	NS	No LPH
(Cont.)	08/15/93		53.65	267.91	NS	NS	NS	NS	NS	NS	NS	No LPH
	09/29/93		54.23	267.33	NS	NS	NS	NS	NS	NS	NS	No LPH
	09/30/93		NM	NC	<0.5	<0.5	<0.5	<0.5	<50	NA	NA	Not measured
	10/28/93		53.54	268.25	NS	NS	NS	NS	NS	NS	NS	No LPH
	11/23/93		53.57	267.99	NS	NS	NS	NS	NS	NS	NS	No LPH
	11/24/93		NM	NC	<0.5	<0.5	<0.5	<0.5	<50	NA	NA	Not measured
	03/10-11/94		53.64	267.92	<0.5	<0.5	<0.5	<0.5	<50	NA	NA	No LPH
	05/04-05/94		53.54	268.02	<0.5	<0.5	<0.5	<0.5	<50	NA	NA	No LPH
	09/01/94 <sup>e</sup>		NM	NM	<0.5	<0.5	<0.5	<0.5	<50	NA	NA	No LPH
	11/16/94		52.96	268.60	<0.5	<0.5	<0.5	<0.5	<50	NA	NA	No LPH
	02/15/95		50.37	271.19	<0.5	<0.5	<0.5	<0.5	<50	NA	NA	No LPH
	05/09/95		44.86	276.70	<0.5	<0.5	<0.5	<0.5	<50	NA	NA	No LPH
	08/21/95		41.71	279.85	<0.5	<0.5	<0.5	<0.5	<50	2.6	2.6	No LPH
	11/30/95		39.95	281.61	<0.5	<0.5	<0.5	<0.5	<50	<5.0	<5.0	No LPH
	03/28/96		36.76	284.80	<0.5	<0.5	<0.5	<0.5	<50	<5.0	<5.0	No LPH
	05/31/96		35.19	286.37	<0.5	<0.5	<0.5	<0.5	<50	<5.0	<5.0	No LPH
	08/28/96		39.39	282.17	NS	NS	NS	NS	NS	NS	NS	No LPH
	11/18/96		39.42	282.14	NS	NS	NS	NS	NS	NS	NS	No LPH
	02/28/97		34.38	287.18	NS	NS	NS	NS	NS	NS	NS	No LPH
	05/23/97		34.66	286.90	NS	NS	NS	NS	NS	NS	NS	No LPH

TABLE 1

## GROUND WATER MONITORING DATA

Exxon Service Station No. 7-3399  
2991 Hopyard Road  
Pleasanton, California

Monitoring Well	Date	Reference Elevation (ft)	Depth to Water (ft)	Ground Water Elevation (ft)	Benzene (µg/L)	Toluene (µg/L)	Ethyl-benzene (µg/L)	Total Xylenes (µg/L)	TPPH as gasoline (µg/L)	MTBE (µg/L)	Comments
MW-5S	05/25/88	321.64	38.46	283.18	<0.5	0.9	<0.5	<0.5	<20	NA	No LPH
	06/06/88		38.86	282.78	NS	NS	NS	NS	NS	NS	No LPH
	06/23/88		39.52	282.12	NS	NS	NS	NS	NS	NS	No LPH
	06/28/88		39.84	281.80	NS	NS	NS	NS	NS	NS	No LPH
	07/06/88		40.45	281.19	<0.5	<0.5	<0.5	<0.5	<20	NA	No LPH
	07/13/88		40.90	280.74	<0.5	<0.5	<0.5	<0.5	<20	NA	No LPH
	07/22/88		41.30	280.34	0.9	4.1	1.3	8.7	50	NA	No LPH
	08/05/88		23.84 <sup>b</sup>	297.80	<0.5	<0.5	<0.5	<0.5	<20	NA	No LPH
	08/12/88		42.21	279.43	NS	NS	NS	NS	NS	NS	No LPH
	08/26/88		42.55	279.09	NS	NS	NS	NS	NS	NS	No LPH
	09/07/88		42.94	278.70	<0.5	<0.5	<0.5	<0.5	<20	NA	No LPH
	12/07/88		44.67	276.97	NS	NS	NS	NS	NS	NS	No LPH
	02/09/89		43.19	278.45	NS	NS	NS	NS	NS	NS	No LPH
	03/08/89		42.11	279.53	<0.5	<0.5	<0.5	<1.0	<20	NA	No LPH
	04/26/89		41.84	279.80	NS	NS	NS	NS	NS	NS	No LPH
	06/30/89		43.95	277.69	<0.5	<0.5	<0.5	<0.5	<20	NA	No LPH
	07/17/89		44.91	276.73	<0.5	<0.5	<0.5	<0.5	<20	NA	No LPH
	07/18/89		44.93	276.71	NS	NS	NS	NS	NS	NS	No LPH
	07/19/89		44.98	276.66	NS	NS	NS	NS	NS	NS	No LPH
	07/20/89		45.02	276.62	<0.5	<0.5	<0.5	<0.5	<20	NA	No LPH
	07/21/89		45.10	276.54	NS	NS	NS	NS	NS	NS	No LPH
	07/26/89		45.57	276.07	<0.5	<0.5	<0.5	<0.5	<20	NA	No LPH
	08/02/89		NM	NC	<0.5	<0.5	<0.5	<0.5	<20	NA	Not measured
	08/03/89		46.31	275.33	NS	NS	NS	NS	NS	NS	No LPH
	08/17/89		47.25	274.39	NS	NS	NS	NS	NS	NS	No LPH
	09/13/89		49.22	272.42	<0.5	<0.5	<0.5	<0.5	<20	NA	No LPH
	11/28/89		50.39	271.25	NS	NS	NS	NS	NS	NS	No LPH
	12/20/89		NM	NC	<0.5	<0.5	<0.5	<0.5	<20	NA	Not measured
	01/09/90		49.51	272.13	NS	NS	NS	NS	NS	NS	No LPH
	01/26/90		49.40	272.24	NS	NS	NS	NS	NS	NS	No LPH
	02/23/90		49.20 <sup>a</sup>	272.44	NS	NS	NS	NS	NS	NS	No LPH
	02/23/90		49.20	272.44	NS	NS	NS	NS	NS	NS	No LPH
	03/26/90		48.89 <sup>a</sup>	272.75	<0.5	<0.5	<0.5	<0.5	<20	NA	No LPH



TABLE 1

## GROUND WATER MONITORING DATA

Exxon Service Station No. 7-3399  
2991 Hopyard Road  
Pleasanton, California

Monitoring Well	Date	Reference Elevation (ft)	Depth to Water (ft)	Ground Water Elevation (ft)	Benzene (µg/L)	Toluene (µg/L)	Ethyl-benzene (µg/L)	Total Xylenes (µg/L)	TPPH as gasoline (µg/L)	MTBE (µg/L)	Comments
MW-5S	03/26/90	321.64	48.88	272.76	NS	NS	NS	NS	NS	NS	No LPH
(Cont.)	04/18/90		48.95	272.69	NS	NS	NS	NS	NS	NS	No LPH
	05/17/90		50.06	271.58	NS	NS	NS	NS	NS	NS	No LPH
	06/11/90		50.98	270.66	NS	NS	NS	NS	NS	NS	No LPH
	07/30/90		53.40	268.24	NS	NS	NS	NS	NS	NS	No LPH
	08/01/90		NM	NC	<0.5	<0.5	<0.5	<0.5	<50	NA	Not measured
	08/27/90		53.60	268.04	NS	NS	NS	NS	NS	NS	No LPH
	09/28/90		53.55	268.09	NS	NS	NS	NS	NS	NS	No LPH
	12/27/90		53.61	268.03	<0.5	<0.5	<0.5	<0.5	<50	NA	No LPH
	03/20/91		53.56	268.08	NS	NS	NS	NS	NS	NS	No LPH
	06/20/91		53.73	267.91	NS	NS	NS	NS	NS	NS	No LPH
	09/12/91		53.78	267.86	NS	NS	NS	NS	NS	NS	No LPH
	12/30/91		53.80	267.84	NS	NS	NS	NS	NS	NS	No LPH
	01/30/92		53.82	267.82	NS	NS	NS	NS	NS	NS	No LPH
	03/02/92		53.82	267.82	NS	NS	NS	NS	NS	NS	No LPH
	04/14/92		53.74	267.90	NS	NS	NS	NS	NS	NS	No LPH
	05/21/92		53.77	267.87	NS	NS	NS	NS	NS	NS	No LPH
	06/08/92		53.81	267.83	NS	NS	NS	NS	NS	NS	No LPH
	07/14/92		53.74	267.90	NS	NS	NS	NS	NS	NS	No LPH
	08/10/92		53.78	267.86	NS	NS	NS	NS	NS	NS	No LPH
	09/16/92		53.90	267.74	NS	NS	NS	NS	NS	NS	No LPH
	10/07/92		NM	NC	NS	NS	NS	NS	NS	NS	Dry
	11/09/92		53.87	267.77	NS	NS	NS	NS	NS	NS	No LPH
	12/10/92		53.78	267.86	NS	NS	NS	NS	NS	NS	No LPH
	01/26/93		53.38	268.26	NS	NS	NS	NS	NS	NS	No LPH
	02/16/93		53.44	268.20	NS	NS	NS	NS	NS	NS	No LPH
	03/11/93		53.28	268.36	NS	NS	NS	NS	NS	NS	No LPH
	04/12/93		53.42	268.22	11	5.9	13	48	220	NA	No LPH
	06/01/93		53.56	268.08	NS	NS	NS	NS	NS	NS	No LPH
	07/15/93		53.00	268.64	NS	NS	NS	NS	NS	NS	No LPH
	08/15/93		53.60	268.04	NS	NS	NS	NS	NS	NS	No LPH
	09/29/93		53.62	268.02	NS	NS	NS	NS	NS	NS	No LPH
	09/30/93		NM	NC	<0.5	<0.5	<0.5	<0.5	<50	NA	Not measured

TABLE 1

## GROUND WATER MONITORING DATA

Exxon Service Station No. 7-3399

2991 Hopyard Road

Pleasanton, California

Monitoring Well	Date	Reference Elevation (ft)	Depth to Water (ft)	Ground Water Elevation (ft)	Benzene (µg/L)	Toluene (µg/L)	Ethyl-benzene (µg/L)	Total Xylenes (µg/L)	TPPH as gasoline (µg/L)	MTBE (µg/L)	Comments
MW-5S	10/28/93	321.64	54.62	267.02	NS	NS	NS	NS	NS	NS	No LPH
(Cont.)	11/23/93		53.62	268.02	NS	NS	NS	NS	NS	NS	No LPH
	03/10-11/94		53.61	268.03	<0.5	<0.5	<0.5	<0.5	<50	NA	No LPH
	05/04-05/94		53.52	268.12	<0.5	<0.5	<0.5	<0.5	<50	NA	No LPH
	09/01/94 <sup>e</sup>		NM	NC	<0.5	<0.5	<0.5	<0.5	<50	NA	No LPH
	11/16/94		53.05	268.59	<0.5	<0.5	<0.5	<0.5	<50	NA	No LPH
	09/01/94		NM	NC	<0.5	<0.5	<0.5	<0.5	<50	NA	Not measured
	11/16/94		NM	NC	<0.5	<0.5	<0.5	<0.5	<50	NA	Not measured
	02/15/95		50.55	271.09	<0.5	<0.5	<0.5	<0.5	<50	NA	No LPH
	05/09/95		44.96	276.68	<0.5	<0.5	<0.5	<0.5	<50	NA	No LPH
	08/21/95		41.77	279.87	<0.5	<0.5	<0.5	<0.5	<50	<2.5	No LPH
	11/30/95		39.95	281.69	<0.5	<0.5	<0.5	<0.5	<50	<5.0	No LPH
	03/28/96		36.80	284.84	<0.5	<0.5	<0.5	<0.5	<50	<5.0	No LPH
	05/31/96		35.28	286.36	<0.5	<0.5	<0.5	<0.5	<50	<5.0	No LPH
	08/28/96		39.46	282.18	<0.5	<0.5	<0.5	<0.5	<50	<5.0	No LPH
	11/18/96		39.47	282.17	<0.5	<0.5	<0.5	<0.5	<50	<5.0	No LPH
	02/28/97		34.44	287.20	<0.5	<0.5	<0.5	<0.5	<50	<2.5	No LPH
	05/23/97		34.72	286.92	<0.5	<0.5	<0.5	<0.5	<50	<2.5	No LPH

TABLE 1

## GROUND WATER MONITORING DATA

Exxon Service Station No. 7-3399  
2991 Hopyard Road  
Pleasanton, California

Monitoring Well	Date	Reference Elevation (ft)	Depth to Water (ft)	Ground Water Elevation (ft)	Benzene (µg/L)	Toluene (µg/L)	Ethyl-benzene (µg/L)	Total Xylenes (µg/L)	TPPH as gasoline (µg/L)	MTBE (µg/L)	Comments
MW-5D	05/25/88	321.79	38.55	283.24	<0.5	3.1	<0.5	<0.5	<20	NA	No LPH
	06/06/88		38.90	282.89	NS	NS	NS	NS	NS	NS	No LPH
	06/23/88		39.56	282.23	NS	NS	NS	NS	NS	NS	No LPH
	06/28/88		40.23	281.56	NS	NS	NS	NS	NS	NS	No LPH
	07/06/88		40.69	281.10	<0.5	<0.5	<0.5	<0.5	<20	NA	No LPH
	07/13/88		41.22	280.57	<0.5	<0.5	<0.5	<0.5	40	NA	No LPH
	08/12/88		42.34	279.45	NS	NS	NS	NS	NS	NS	No LPH
	08/26/88		42.60	279.19	NS	NS	NS	NS	NS	NS	No LPH
	09/07/88		42.99	278.80	NS	NS	NS	NS	NS	NS	No LPH
	12/07/88		44.58	277.21	NS	NS	NS	NS	NS	NS	No LPH
	02/09/89 <sup>c</sup>		NM	NC	NS	NS	NS	NS	NS	NS	Not measured
	03/08/89 <sup>d</sup>		NM	NC	<0.5	<0.5	<0.5	<0.5	<20	NA	Not measured
	03/08/89		42.49	279.30	NS	NS	NS	NS	NS	NS	No LPH
	04/03/89		42.21	279.58	NS	NS	NS	NS	NS	NS	No LPH
	04/26/89		42.36	279.43	NS	NS	NS	NS	NS	NS	No LPH
	06/30/89		44.79	277.00	<0.5	<0.5	<0.5	<0.5	<20	NA	No LPH
	07/17/89		45.73	276.06	<0.5	<0.5	<0.5	<0.5	<20	NA	No LPH
	07/18/89		45.75	276.04	NS	NS	NS	NS	NS	NS	No LPH
	07/19/89		44.89	276.90	NS	NS	NS	NS	NS	NS	No LPH
	07/20/89		46.02	275.77	<0.5	<0.5	<0.5	<0.5	<20	NA	No LPH
	07/21/89		46.18	275.61	NS	NS	NS	NS	NS	NS	No LPH
	07/26/89		46.83	274.96	<0.5	<0.5	<0.5	<0.5	<20	NA	No LPH
	08/02/89		NM	NC	<0.5	<0.5	<0.5	<0.5	<20	NA	Not measured
	08/03/89		47.67	274.12	NS	NS	NS	NS	NS	NS	No LPH
	08/17/89		48.27	273.52	NS	NS	NS	NS	NS	NS	No LPH
	09/13/89		50.60	271.19	<0.5	<0.5	<0.5	<0.5	<20	NA	No LPH
	11/28/89		51.16	270.63	NS	NS	NS	NS	NS	NS	No LPH
	12/20/89		NM	NC	<0.5	<0.5	<0.5	<0.5	<20	NA	Not measured
	01/09/90		50.42	271.37	NS	NS	NS	NS	NS	NS	No LPH
	01/26/90		50.10	271.69	NS	NS	NS	NS	NS	NS	No LPH
	02/23/90		50.08	271.71	NS	NS	NS	NS	NS	NS	No LPH
	03/26/90		49.80 <sup>f</sup>	271.99	NS	NS	NS	NS	NS	NS	No LPH
	03/26/90		49.77	272.02	<0.5	<0.5	<0.5	<0.5	<20	NA	No LPH

TABLE 1

## GROUND WATER MONITORING DATA

Exxon Service Station No. 7-3399

2991 Hopyard Road

Pleasanton, California

Monitoring Well	Date	Reference Elevation (ft)	Depth to Water (ft)	Ground Water		Benzene (µg/L)	Toluene (µg/L)	Ethyl-benzene (µg/L)	Total Xylenes (µg/L)	TPPH as gasoline (µg/L)	MTBE (µg/L)	Comments
				Elevation (ft)								
MW-5D	04/18/90	321.79	49.80	271.99	NS	NS	NS	NS	NS	NS	NS	No LPH
(Cont.)	05/17/90		51.32	270.47	NS	NS	NS	NS	NS	NS	NS	No LPH
	06/11/90		52.10	269.69	NS	NS	NS	NS	NS	NS	NS	No LPH
	07/30/90		53.47	268.32	NS	NS	NS	NS	NS	NS	NS	No LPH
	08/01/90		NM	NM	<0.5	<0.5	<0.5	<0.5	<20	NA	NS	Not measured
	08/27/90		58.24	263.55	NS	NS	NS	NS	NS	NS	NS	No LPH
	09/29/90		60.70	261.09	NS	NS	NS	NS	NS	NS	NS	No LPH
	12/27/90		62.52	259.27	<0.5	<0.5	<0.5	<0.5	<50	NA	NS	No LPH
	03/20/91		59.18	262.61	<0.5	<0.5	<0.5	<0.5	<50	NA	NS	No LPH
	06/20/91		65.02	256.77	<0.5	<0.5	<0.5	<0.5	<50	NA	NS	No LPH
	09/12/91		DRY	DRY	NS	NS	NS	NS	NS	NS	NS	Not measured
	12/30/91		DRY	DRY	NS	NS	NS	NS	NS	NS	NS	Not measured
	01/30/92		DRY	DRY	NS	NS	NS	NS	NS	NS	NS	Not measured
	03/02/92		DRY	DRY	NS	NS	NS	NS	NS	NS	NS	Not measured
	03/24/92		74.98	246.81	NS	NS	NS	NS	NS	NS	NS	No LPH
	04/14/92		74.42	247.37	NS	NS	NS	NS	NS	NS	NS	No LPH
	05/21/92		75.67	246.12	NS	NS	NS	NS	NS	NS	NS	No LPH
	06/08/92		NM	NC	NS	NS	NS	NS	NS	NS	NS	Dry
	07/14/92		NM	NC	NS	NS	NS	NS	NS	NS	NS	Dry
	08/10/92		NM	NC	NS	NS	NS	NS	NS	NS	NS	Dry
	09/16/92		NM	NC	NS	NS	NS	NS	NS	NS	NS	Dry
	10/07/92		NM	NC	NS	NS	NS	NS	NS	NS	NS	Dry
	11/09/92		NM	NC	NS	NS	NS	NS	NS	NS	NS	Dry
	12/10/92		NM	NC	NS	NS	NS	NS	NS	NS	NS	Dry
	01/26/93		NM	NC	NS	NS	NS	NS	NS	NS	NS	Dry
	02/16/93		76.47	245.32	NS	NS	NS	NS	NS	NS	NS	No LPH
	03/11/93		74.03	247.76	NS	NS	NS	NS	NS	NS	NS	No LPH
	04/12/93		70.96	250.83	1.0	1.0	2.5	7.4	<50	NA	NS	No LPH
	06/01/93		67.64	254.15	NS	NS	NS	NS	NS	NS	NS	No LPH
	07/15/93		54.40	267.39	<0.5	<0.5	<0.5	<0.5	<50	NA	NS	No LPH
	08/15/93		67.85	253.94	<0.5	<0.5	<0.5	<0.5	<50	NA	NS	No LPH
	09/29/93		67.62	254.17	NS	NS	NS	NS	NS	NS	NS	No LPH
	09/30/93		NM	NC	<0.5	<0.5	<0.5	<0.5	<50	NA	NS	Not measured

TABLE 1

## GROUND WATER MONITORING DATA

Exxon Service Station No. 7-3399  
2991 Hopyard Road  
Pleasanton, California

Monitoring Well	Date	Reference Elevation (ft)	Depth to Water (ft)	Ground Water Elevation (ft)	Benzene (µg/L)	Toluene (µg/L)	Ethyl-benzene (µg/L)	Total Xylenes (µg/L)	TPPH as gasoline (µg/L)	MTBE (µg/L)	Comments
MW-5D	10/28/93	321.79	66.15	255.49	NS	NS	NS	NS	NS	NS	No LPH
(Cont.)	11/23/93		64.80	256.84	<0.5	<0.5	<0.5	<0.5	<50	NA	No LPH
	03/10-11/94		59.10	262.69	<0.5	<0.5	<0.5	<0.5	<50	NA	No LPH
	05/04-05/94		55.66	265.13	<0.5	<0.5	<0.5	<0.5	<50	NA	No LPH
	09/01/94 <sup>e</sup>		NM	NC	<0.5	<0.5	<0.5	<0.5	<50	NA	No LPH
	11/16/94		54.36	268.74	<0.5	<0.5	<0.5	<0.5	<50	NA	No LPH
	02/15/95		51.20	270.59	NS	NS	NS	NS	NS	NS	No LPH
	05/09/95		45.49	276.30	NS	NS	NS	NS	NS	NS	No LPH
	05/12/95		NM	NC	<0.5	<0.5	<0.5	<0.5	<50	NA	Not measured
	08/21/95		42.35	279.44	<0.5	<0.5	<0.5	<0.5	<50	<2.5	No LPH
	11/30/95		43.60	278.19	5.4	10	1.4	12	77	<5.0	No LPH
	03/28/96		37.12	284.67	<0.5	<0.5	<0.5	<0.5	<50	<5.0	No LPH
	05/31/96		35.67	286.12	<0.5	<0.5	<0.5	<0.5	<50	<5.0	No LPH
	08/28/96		40.22	281.57	<0.5	<0.5	<0.5	<0.5	<50	<5.0	No LPH
	11/18/96		39.89	281.90	<0.5	<0.5	<0.5	<0.5	<50	<5.0	No LPH
	02/28/97		34.75	287.04	<0.5	<0.5	<0.5	<0.5	<50	<2.5	No LPH
Duplicate	02/28/97		NM	NC	<0.5	<0.5	<0.5	<0.5	<50	<2.5	Not measured
Rinsate	02/28/97		NM	NC	<0.5	<0.5	<0.5	<0.5	<50	<2.5	Not measured
	05/23/97		35.21	286.58	<0.5	<0.5	<0.5	<0.5	<50	<2.5	No LPH
Duplicate	05/23/97		NM	NC	<0.5	<0.5	<0.5	<0.5	<50	<2.5	Not measured
Rinsate	05/23/97		NM	NC	<0.5	<0.5	<0.5	<0.5	<50	<2.5	Not measured

TABLE 1

## GROUND WATER MONITORING DATA

Exxon Service Station No. 7-3399

2991 Hopyard Road

Pleasanton, California

Monitoring Well	Date	Reference Elevation (ft)	Depth to Water (ft)	Ground	Benzene (µg/L)	Toluene (µg/L)	Ethyl-benzene (µg/L)	Total Xylenes (µg/L)	TPPH as gasoline (µg/L)	MTBE (µg/L)	Comments
				Water Elevation (ft)							
MW-6	05/11/88	NM	37.31	NC	NS	NS	NS	NS	NS	NS	No LPH
	05/17/88		NM	NM	<0.5	<0.5	<0.5	<0.5	<20	NA	Not measured
	06/06/88		38.70	NC	NS	NS	NS	NS	NS	NS	No LPH
	06/23/88		39.23	NC	NS	NS	NS	NS	NS	NS	No LPH
	06/28/88		39.74	NC	31.8	7.5	5.4	6.7	440	NA	No LPH
	07/13/88		40.78	NC	162.3	7.7	22.5	14.1	290	NA	No LPH
	08/05/88		41.72	NC	245	5.2	47.1	23.7	1,180	NA	No LPH
	08/12/88		42.14	NC	NS	NS	NS	NS	NS	NS	No LPH
	08/17/88		NM	NC	NS	NS	NS	NS	NS	NS	Not measured
	08/26/88		42.51	NC	NS	NS	NS	NS	NS	NS	No LPH
	09/07/88		42.85	NC	474	16	262	136	2,920	NA	No LPH
	10/24/88		Well destroyed								

TABLE 1

## GROUND WATER MONITORING DATA

Exxon Service Station No. 7-3399  
2991 Hopyard Road  
Pleasanton, California

Monitoring Well	Date	Reference Elevation (ft)	Depth to Water (ft)	Ground Water Elevation (ft)	Benzene (µg/L)	Toluene (µg/L)	Ethyl-benzene (µg/L)	Total Xylenes (µg/L)	TPPH as gasoline (µg/L)	MTBE (µg/L)	Comments
MW-7	07/13/88	321.27	40.50	280.77	860	1,910	710	4,420	16,700	NA	No LPH
	07/22/88		41.85 <sup>a</sup>	279.42	136	85	5	58	460	NA	No LPH
	08/05/88		41.45 <sup>a</sup>	279.82	73.3	52.8	2.3	28.1	270	NA	No LPH
	08/12/88		42.69	278.58	NS	NS	NS	NS	NS	NS	Not measured
	09/07/88		42.60	278.67	NS	NS	NS	NS	NS	NS	Not measured
	12/07/88		NM	NC	NS	NS	NS	NS	NS	NS	Not measured
	01/17/89		43.20	278.07	NS	NS	NS	NS	NS	NS	Not measured
	02/09/89		NM	NC	600	688	10	448	6,700	NA	Not measured
	06/30/89		NM	NC	180	50	13	40	1,100	NA	Not measured
	08/02/89		NM	NC	1.6	<0.5	<0.5	0.6	31	NA	Not measured
	09/13/89		NM	NC	<0.5	2.6	<0.5	12	87	NA	Not measured
	10/12/89		49.93	271.34	NS	NS	NS	NS	NS	NS	No LPH
	11/28/89		57.61 <sup>a</sup>	263.66	NS	NS	NS	NS	NS	NS	No LPH
	12/20/89		NM	NC	<0.5	<0.5	<0.5	<0.5	<20	NA	Not measured
	01/09/90		57.57 <sup>a</sup>	263.70	NS	NS	NS	NS	NS	NS	No LPH
	01/26/90		57.54 <sup>a</sup>	263.73	NS	NS	NS	NS	NS	NS	No LPH
	01/26/90		49.08	272.19	NS	NS	NS	NS	NS	NS	No LPH
	02/23/90		55.26 <sup>a</sup>	266.01	NS	NS	NS	NS	NS	NS	No LPH
	02/23/90		48.93	272.34	NS	NS	NS	NS	NS	NS	No LPH
	03/26/90		57.52 <sup>a</sup>	263.75	NS	NS	NS	NS	NS	NS	No LPH
	03/26/90		48.60	272.67	NS	NS	NS	NS	NS	NS	No LPH
	04/18/90		57.55 <sup>a</sup>	263.72	NS	NS	NS	NS	NS	NS	No LPH
	05/17/90		57.40 <sup>a</sup>	263.87	NS	NS	NS	NS	NS	NS	No LPH
	06/11/90		50.68	270.59	NS	NS	NS	NS	NS	NS	No LPH
	07/30/90		NM	NC	NS	NS	NS	NS	NS	NS	Not measured
	08/27/90		53.05	268.22	NS	NS	NS	NS	NS	NS	No LPH
	09/28/90		NM	NC	NS	NS	NS	NS	NS	NS	Not measured
	12/27/90		NM	NC	NS	NS	NS	NS	NS	NS	Not measured
	03/20/91		54.11	267.16	NS	NS	NS	NS	NS	NS	No LPH
	06/20/91		55.14	266.13	<0.5	1.8	0.6	4.1	74	NA	No LPH
	09/12/91		55.84	265.43	3.5	<0.5	1.7	6.8	<50	NA	No LPH
	12/30/91		55.21	266.06	<0.5	<0.5	<0.5	<0.5	<50	NA	No LPH
	01/30/92		54.88	266.39	NS	NS	NS	NS	NS	NS	No LPH

TABLE 1

## GROUND WATER MONITORING DATA

Exxon Service Station No. 7-3399  
2991 Hopyard Road  
Pleasanton, California

Monitoring Well	Date	Reference Elevation (ft)	Depth to Water (ft)	Ground Water Elevation (ft)	Benzene (µg/L)	Toluene (µg/L)	Ethyl-benzene (µg/L)	Total Xylenes (µg/L)	TPPH as gasoline (µg/L)	MTBE (µg/L)	Comments
MW-7	03/02/92	321.27	NM	NC	NS	NS	NS	NS	NS	NS	Not measured
(Cont.)	03/24/92		NM	NC	NS	NS	NS	NS	NS	NS	Not measured
	04/14/92		NM	NC	NS	NS	NS	NS	NS	NS	Not measured
	05/21/92		53.36	267.91	NS	NS	NS	NS	NS	NS	No LPH
	06/08/92		54.20	267.07	<0.5	<0.5	<0.5	<0.5	<50	NA	No LPH
	07/14/92		53.31	267.96	NS	NS	NS	NS	NS	NS	No LPH
	08/10/92		54.01	267.26	NS	NS	NS	NS	NS	NS	No LPH
	09/16/92		55.97	265.30	NS	NS	NS	NS	NS	NS	No LPH
	10/07/92		56.09	265.18	NS	NS	NS	NS	NS	NS	No LPH
	11/09/92		54.16	267.11	NS	NS	NS	NS	NS	NS	No LPH
	12/10/92		56.02	265.25	NS	NS	NS	NS	NS	NS	No LPH
	01/26/93		56.15	265.12	NS	NS	NS	NS	NS	NS	No LPH
	02/16/93		56.23	265.04	28	30	17	200	600	NA	No LPH
	03/11/93		55.82	265.45	NS	NS	NS	NS	NS	NS	No LPH
	04/12/93		55.45	265.82	NS	NS	NS	NS	NS	NS	No LPH
	06/01/93		54.90	266.37	NS	NS	NS	NS	NS	NS	No LPH
	07/15/93		54.50	266.77	NS	NS	NS	NS	NS	NS	No LPH
	08/15/93		54.25	267.02	NS	NS	NS	NS	NS	NS	No LPH
	09/29/93		54.55	266.72	NS	NS	NS	NS	NS	NS	No LPH
	09/30/93		NM	NC	NS	NS	NS	NS	NS	NS	Not measured
	10/28/93		54.94	266.92	NS	NS	NS	NS	NS	NS	No LPH
	11/23/93		54.73	266.54	NS	NS	NS	NS	NS	NS	No LPH
	11/24/93		NM	NC	<0.5	<0.5	<0.5	<0.5	<50	NA	Not measured
	03/10-11-94		52.83	268.44	<0.5	<0.5	<0.5	<0.5	<50	NA	No LPH
	05/04-05/94		52.77	268.50	<0.5	<0.5	<0.5	<0.5	<50	NA	No LPH
	09/01/94 <sup>e</sup>		NM	NC	<0.5	<0.5	<0.5	<0.5	<50	NA	No LPH
	11/16/94		52.74	268.53	<0.5	<0.5	<0.5	<0.5	<50	NA	No LPH
	02/15/95		50.05	271.22	<0.5	<0.5	<0.5	<0.5	<50	NA	No LPH
	05/09/95		44.61	276.66	<0.5	<0.5	<0.5	<0.5	<50	NA	No LPH
	08/21/95		41.40	279.87	<0.5	<0.5	<0.5	<0.5	<50	4.1	No LPH
	11/30/95		39.64	281.63	<0.5	<0.5	<0.5	<0.5	<50	<5.0	No LPH
	03/28/96		36.42	284.85	<0.5	<0.5	<0.5	<0.5	<50	<5.0	No LPH
	05/31/96		34.87	286.40	<0.5	<0.5	<0.5	<0.5	<50	<5.0	No LPH



TABLE 1

GROUND WATER MONITORING DATA

Exxon Service Station No. 7-3399  
 2991 Hopyard Road  
 Pleasanton, California

Monitoring Well	Date	Reference Elevation (ft)	Depth to Water (ft)	Ground Water Elevation (ft)	Benzene (µg/L)	Toluene (µg/L)	Ethyl-benzene (µg/L)	Total Xylenes (µg/L)	TPPH as gasoline (µg/L)	MTBE (µg/L)	Comments
MW-7	08/28/96	321.27	39.11	282.16	NS	NS	NS	NS	NS	NS	No LPH
(Cont.)	11/18/96		39.10	282.17	NS	NS	NS	NS	NS	NS	No LPH
	02/28/97		34.03	287.24	NS	NS	NS	NS	NS	NS	No LPH
	05/23/97		34.36	286.91	NS	NS	NS	NS	NS	NS	No LPH

TABLE 1

## GROUND WATER MONITORING DATA

Exxon Service Station No. 7-3399

2991 Hopyard Road

Pleasanton, California

Monitoring Well	Date	Reference Elevation (ft)	Depth to Water (ft)	Ground Water Elevation (ft)	Benzene (µg/L)	Toluene (µg/L)	Ethyl-benzene (µg/L)	Total Xylenes (µg/L)	TPPH as gasoline (µg/L)	MTBE (µg/L)	Comments
MW-8	10/01/89	321.86	53.88	267.98	NS	NS	NS	NS	NS	NS	No LPH
	10/03/89		NM	NC	<0.5	<0.5	<0.5	<0.5	<20	NA	Not measured
	11/28/89		53.74	268.12	NS	NS	NS	NS	NS	NS	No LPH
	12/20/89		NM	NC	<0.5	<0.5	<0.5	0.61	<20	NA	Not measured
	01/09/90		57.90	263.96	NS	NS	NS	NS	NS	NS	No LPH
	01/26/90		53.57	268.29	NS	NS	NS	NS	NS	NS	No LPH
	01/31/90		NM	NC	<0.5	<0.5	<0.5	0.87	<20	NA	Not measured
	02/09/90		NM	NC	<0.5	<0.5	<0.5	1.1	<20	NA	Not measured
	(Blank)		NM	NC	<0.5	<0.5	<0.5	<0.5	<20	NA	Not measured
	02/23/90		52.16	269.70	NS	NS	NS	NS	NS	NS	No LPH
	03/26/90		52.80 <sup>a</sup>	269.06	<0.5	<0.5	<0.5	<0.5	<20	NA	No LPH
	(Blank)		NM	NC	<0.5	<0.5	<0.5	<0.5	<20	NA	Not measured
	04/18/90		51.60	270.26	<0.5	0.58	<0.5	1.1	<20	NA	No LPH
	05/17/90		58.21	263.65	<0.5	<0.5	<0.5	<0.5	<20	NA	No LPH
	06/11/90		58.65	263.21	<0.5	<0.5	<0.5	<0.5	<20	NA	No LPH
	07/30/90		64.33	257.53	NS	NS	NS	NS	NS	NS	No LPH
	08/01/90		NM	NC	<0.5	<0.5	<0.5	<0.5	<20	NA	Not measured
	08/27/90		70.41	251.45	<0.5	<0.5	<0.5	0.5	<20	NA	No LPH
	09/28/90		71.93	249.93	<0.5	<0.5	<0.5	0.5	<50	NA	No LPH
	12/27/90		66.60	255.26	<0.5	<0.5	<0.5	0.6	<50	NA	No LPH
	03/20/91		60.75	261.11	<0.5	<0.5	<0.5	<0.5	<50	NA	No LPH
	06/20/91		88.77	233.09	<0.5	<0.5	<0.5	0.6	<50	NA	No LPH
	09/12/91		103.17	218.69	NS	NS	NS	NS	NS	NS	No LPH
	10/14/91		NM	NC	<0.5	<0.5	<0.5	<0.5	<50	NA	Not measured
	12/30/91		81.15	240.71	<0.5	<0.5	<0.5	<0.5	<50	NA	No LPH
	01/30/92		81.69	240.17	NS	NS	NS	NS	NS	NS	No LPH
	03/02/92		78.45	243.41	NS	NS	NS	NS	NS	NS	No LPH
	03/24/92		76.55	245.31	<0.5	<0.5	<0.5	<0.5	<50	NA	No LPH
	04/14/92		75.56	246.30	NS	NS	NS	NS	NS	NS	No LPH
	05/21/92		86.99	234.87	NS	NS	NS	NS	NS	NS	No LPH
	06/08/92		91.69	230.17	<0.5	<0.5	<0.5	<0.5	<50	NA	No LPH
	07/14/92		94.65	227.21	NS	NS	NS	NS	NS	NS	No LPH
	08/10/92		95.02	226.84	NS	NS	NS	NS	NS	NS	No LPH

TABLE 1

## GROUND WATER MONITORING DATA

Exxon Service Station No. 7-3399

2991 Hopyard Road

Pleasanton, California

Monitoring Well	Date	Reference Elevation (ft)	Depth to Water (ft)	Ground Water Elevation (ft)	Benzene (µg/L)	Toluene (µg/L)	Ethyl-benzene (µg/L)	Total Xylenes (µg/L)	TPPH as gasoline (µg/L)	MTBE (µg/L)	Comments
MW-8	09/16/92	321.86	91.90	229.96	<0.5	0.9	<0.5	<0.5	<50	NA	No LPH
(Cont.)	10/07/92		NM	NC	NS	NS	NS	NS	NS	NS	Dry
	11/09/92		84.35	237.51	NS	NS	NS	NS	NS	NS	No LPH
	12/10/92		82.20	239.66	<0.5	0.6	<0.5	<0.5	<50	NA	No LPH
	01/26/93		78.63	243.23	NS	NS	NS	NS	NS	NS	No LPH
	02/16/93		76.90	244.96	0.7	0.6	<0.5	2.3	<50	NA	No LPH
	03/11/93		74.39	247.47	NS	NS	NS	NS	NS	NS	No LPH
	04/12/93		71.20	250.66	26	7.3	11	38	230	NA	No LPH
	06/01/93		68.04	253.82	NS	NS	NS	NS	NS	NS	No LPH
	07/15/93		78.05	243.81	NS	NS	NS	NS	NS	NS	No LPH
	08/15/93		78.45	243.41	NS	NS	NS	NS	NS	NS	No LPH
	09/29/93		73.64	248.22	NS	NS	NS	NS	NS	NS	No LPH
	09/30/93		NM	NC	<0.5	<0.5	<0.5	<0.5	<50	NA	Not measured
	10/28/93		67.53	253.91	NS	NS	NS	NS	NS	NS	No LPH
	11/23/93		64.68	256.76	NS	NS	NS	NS	NS	NS	No LPH
	11/24/93		NM	NC	<0.5	<0.5	<0.5	<0.5	<50	NA	Not measured
	03/10-11/94		59.26	262.60	<0.5	<0.5	<0.5	<0.5	<50	NA	No LPH
	05/04-05/94		56.84	265.02	<0.5	<0.5	<0.5	<0.5	<50	NA	No LPH
	09/01/94 <sup>c</sup>		NM	NC	<0.5	<0.5	<0.5	<0.5	<50	NA	No LPH
	11/16/94		55.47	266.39	<0.5	<0.5	<0.5	<0.5	<50	NA	No LPH
	02/15/95		52.00	269.86	NS	NS	NS	NS	NS	NS	No LPH
	05/09/95		46.60	275.26	NS	NS	NS	NS	NS	NS	No LPH
	05/12/95		NM	NC	2.3	1.2	2.0	7.4	<50	NA	No LPH
	08/21/95		43.86	278.00	<0.5	<0.5	<0.5	<0.5	<50	<2.5	No LPH
	11/30/95		41.25	280.61	<0.5	<0.5	0.69	2.7	<50	<5.0	No LPH
	03/28/96		37.71	284.15	<0.5	<0.5	<0.5	<0.5	<50	<5.0	No LPH
	05/31/96		36.71	285.15	<0.5	<0.5	<0.5	<0.5	<50	<5.0	No LPH
	08/28/96		42.80	279.06	<0.5	<0.5	<0.5	<0.5	<50	<5.0	No LPH
	11/18/96		40.78	281.08	<0.5	<0.5	<0.5	<0.5	<50	<5.0	No LPH
	02/28/97		35.14	286.72	<0.5	<0.5	<0.5	<0.5	<50	<2.5	No LPH
Duplicate	02/28/97		NM	NC	<0.5	<0.5	<0.5	<0.5	<50	<2.5	Not measured
Rinsate	02/28/97		NM	NC	<0.5	<0.5	<0.5	<0.5	<50	<2.5	Not measured
	05/23/97		36.41	285.45	<0.5	<0.5	<0.5	<0.5	<50	<2.5	No LPH

TABLE 1

GROUND WATER MONITORING DATA

Exxon Service Station No. 7-3399  
 2991 Hopyard Road  
 Pleasanton, California

Monitoring Well	Date	Reference Elevation (ft)	Depth to Water (ft)	Ground Water		Benzene (µg/L)	Toluene (µg/L)	Ethyl-benzene (µg/L)	Total Xylenes (µg/L)	TPPH as gasoline (µg/L)	MTBE (µg/L)	Comments
				Elevation (ft)								
Duplicate	05/23/97		NM	NC	<0.5	<0.5	<0.5	<0.5	<0.5	<50	<2.5	Not measured
Rinsate	05/23/97		NM	NC	<0.5	<0.5	<0.5	<0.5	<0.5	<50	<2.5	Not measured

TABLE 1

## GROUND WATER MONITORING DATA

Exxon Service Station No. 7-3399  
2991 Hopyard Road  
Pleasanton, California

Monitoring Well	Date	Reference Elevation (ft)	Depth to Water (ft)	Ground Water Elevation (ft)	Benzene (µg/L)	Toluene (µg/L)	Ethyl-benzene (µg/L)	Total Xylenes (µg/L)	TPPH as gasoline (µg/L)	MTBE (µg/L)	Comments
MW-9	10/03/89	321.44	NM	NC	1,000	9,200	3,000	13,000	89,000	NA	No LPH
	10/12/89		50.24	271.20	NS	NS	NS	NS	NS	NS	No LPH
	11/28/89		50.59	270.85	NS	NS	NS	NS	NS	NS	0.10
	12/01/89		50.32	271.12	NS	NS	NS	NS	NS	NS	0.02
	12/07/89		50.13	271.31	NS	NS	NS	NS	NS	NS	0.16
	12/13/89		49.91	271.53	NS	NS	NS	NS	NS	NS	Slight Sheen
	12/20/89		49.78	271.66	6,300	31,000	9,500	55,000	190,000	NA	Slight Sheen
	01/02/90		NM	NC	NS	NS	NS	NS	NS	NS	Not measured
	01/09/90		49.39	272.05	NS	NS	NS	NS	NS	NS	Slight Sheen
	01/25/90		NM	NC	2,400	9,400	2,700	15,000	77,000	NA	Not measured
	01/26/90		49.30	272.14	NS	NS	NS	NS	NS	NS	No LPH
	02/23/90		49.06 <sup>a</sup>	272.38	1,200	7,100	2,300	14,000	97,000	NA	No LPH
	02/23/90		49.05	272.39	NS	NS	NS	NS	NS	NS	No LPH
	03/26/90		48.75 <sup>a</sup>	272.69	1,800	7,700	2,000	11,000	89,000	NA	No LPH
	03/26/90		48.73	272.71	NS	NS	NS	NS	NS	NS	Slight sheen
	04/18/90		48.81	272.63	2,000	7,500	2,500	16,000	110,000	NA	No LPH
	05/17/90		49.96	271.48	1,500	5,700	2,300	14,000	81,000	NA	No LPH
	06/11/90		51.58	269.86	NS	NS	NS	NS	NS	NS	No LPH
	06/20/90		NM	NC	<0.5	<0.5	<0.5	<0.5	430	NA	No LPH
	07/30/90		NM	NC	NS	NS	NS	NS	NS	NS	Dry
	08/27/90		NM	NC	NS	NS	NS	NS	NS	NS	Dry
	09/28/90		NM	NC	NS	NS	NS	NS	NS	NS	Dry
	12/27/90		NM	NC	NS	NS	NS	NS	NS	NS	Not measured
	03/20/91		NM	NC	NS	NS	NS	NS	NS	NS	Dry
	06/20/91		49.63	271.81	NS	NS	NS	NS	NS	NS	Not measured
	09/12/91		NM	NC	NS	NS	NS	NS	NS	NS	No LPH
	12/30/91		NM	NC	NS	NS	NS	NS	NS	NS	Not measured
	12/10/92		NM	NC	NS	NS	NS	NS	NS	NS	Not measured
	01/30/92		NM	NC	NS	NS	NS	NS	NS	NS	Not measured
	03/02/92		NM	NC	NS	NS	NS	NS	NS	NS	Not measured
	03/24/92		NM	NC	NS	NS	NS	NS	NS	NS	Not measured
	04/14/92		NM	NC	NS	NS	NS	NS	NS	NS	Not measured
	05/21/92		NM	NC	NS	NS	NS	NS	NS	NS	Not measured

TABLE 1

## GROUND WATER MONITORING DATA

Exxon Service Station No. 7-3399

2991 Hopyard Road

Pleasanton, California

Monitoring Well	Date	Reference Elevation (ft)	Depth to Water (ft)	Ground Water Elevation (ft)	Benzene (µg/L)	Toluene (µg/L)	Ethyl-benzene (µg/L)	Total Xylenes (µg/L)	TPPH as gasoline (µg/L)	MTBE (µg/L)	Comments
MW-9	06/08/92	321.44	NM	NC	NS	NS	NS	NS	NS	NS	Not measured
(Cont.)	07/14/92		NM	NC	NS	NS	NS	NS	NS	NS	Not measured
	08/10/92		NM	NC	NS	NS	NS	NS	NS	NS	Not measured
	09/16/92		NM	NC	NS	NS	NS	NS	NS	NS	Not measured
	10/07/92		NM	NC	NS	NS	NS	NS	NS	NS	Dry
	11/09/92		NM	NC	NS	NS	NS	NS	NS	NS	Dry
	12/10/92		NM	NC	NS	NS	NS	NS	NS	NS	Not measured
	01/26/93		NM	NC	NS	NS	NS	NS	NS	NS	Dry
	02/16/93		NM	NC	NS	NS	NS	NS	NS	NS	Dry
	03/11/93		NM	NC	NS	NS	NS	NS	NS	NS	Dry
	04/12/93		NM	NC	NS	NS	NS	NS	NS	NS	Dry
	06/01/93		NM	NC	NS	NS	NS	NS	NS	NS	Dry
	07/15/93		NM	NC	NS	NS	NS	NS	NS	NS	Dry
	08/15/93		NM	NC	NS	NS	NS	NS	NS	NS	Dry
	09/29/93		NM	NC	NS	NS	NS	NS	NS	NS	Dry
	10/28/93		NM	NC	NS	NS	NS	NS	NS	NS	Dry
	11/23/93		NM	NC	NS	NS	NS	NS	NS	NS	Dry
	03/10-11/94		NM	NC	NS	NS	NS	NS	NS	NS	Dry
	05/04-05/94		NM	NC	NS	NS	NS	NS	NS	NS	Dry
	11/16/94		52.62	268.82	NS	NS	NS	NS	NS	NS	No LPH
	02/15/95		49.76	271.68	<0.5	<0.5	<0.5	<0.5	<50	NA	No LPH
	05/09/95		44.30	277.14	<0.5	<0.5	<0.5	<0.5	<50	NA	No LPH
	08/21/95		41.11	280.33	270	51	5.2	140	1,100	<25	No LPH
	11/30/95		39.40	282.04	920	680	120	870	6,600	<100	No LPH
	03/28/96		36.13	285.31	72	28	1.8	49	360	<10	No LPH
	05/31/96		34.56	286.88	2,800	510	<50	400	8,200	<5.0	No LPH
	08/28/96		38.80	282.64	1.6	<0.5	<0.5	9.6	160	28	No LPH
	11/18/96		38.74	282.70	2,000	610	130	790	7,100	<200	No LPH
	02/28/97		33.74	287.70	2,900	2,600	280	2,400	22,000	4,200	No LPH
	05/23/97		33.77	287.67	5,300	5,200	800	3,900	32,000	1,600	No LPH

TABLE 1

## GROUND WATER MONITORING DATA

Exxon Service Station No. 7-3399  
2991 Hopyard Road  
Pleasanton, California

Monitoring Well	Date	Reference Elevation (ft)	Depth to Water (ft)	Ground Water Elevation (ft)	Benzene (µg/L)	Toluene (µg/L)	Ethyl-benzene (µg/L)	Total Xylenes (µg/L)	TPPH as gasoline (µg/L)	MTBE (µg/L)	Comments
MW-10	10/12/89	322.99	51.93	271.06	<0.5	<0.5	<0.5	<0.5	20	NA	No LPH
	11/28/89		51.88	271.11	NS	NS	NS	NS	NS	NS	No LPH
	12/20/89		51.47	271.52	<0.5	<0.5	<0.5	<0.5	<20	NA	No LPH
	01/09/90		50.98	272.01	NS	NS	NS	NS	NS	NS	No LPH
	01/26/90		50.87	272.12	NS	NS	NS	NS	NS	NS	No LPH
	02/23/90		50.67 <sup>a</sup>	272.32	NS	NS	NS	NS	NS	NS	No LPH
	02/23/90		50.65	272.34	NS	NS	NS	NS	NS	NS	No LPH
	03/26/90		50.36 <sup>a</sup>	272.63	<0.5	<0.5	<0.5	<0.5	<20	NA	No LPH
	03/26/90		50.35	272.64	NS	NS	NS	NS	NS	NS	No LPH
	04/18/90		50.45	272.54	NS	NS	NS	NS	NS	NS	No LPH
	06/11/90		51.16	271.83	NS	NS	NS	NS	NS	NS	No LPH
	07/30/90		55.72	267.27	NS	NS	NS	NS	NS	NS	No LPH
	08/27/90		57.75	265.24	<0.5	<0.5	<0.5	<0.5	<20	NA	No LPH
	09/28/90		NM	NC	NS	NS	NS	NS	NS	NS	Not measured
	12/27/90		58.08	264.91	NS	NS	NS	NS	NS	NS	No LPH
	03/20/91		57.80	265.19	NS	NS	NS	NS	NS	NS	No LPH
	06/20/91		58.00	264.99	NS	NS	NS	NS	NS	NS	No LPH
	09/12/91		NM	NC	NS	NS	NS	NS	NS	NS	Dry
	12/30/91		NM	NC	NS	NS	NS	NS	NS	NS	Not measured
	01/30/92		NM	NC	NS	NS	NS	NS	NS	NS	Dry
	03/02/92		NM	NC	NS	NS	NS	NS	NS	NS	Dry
	03/24/92		58.53	264.46	NS	NS	NS	NS	NS	NS	No LPH
	04/14/92		NM	NC	NS	NS	NS	NS	NS	NS	Dry
	05/21/92		NM	NC	NS	NS	NS	NS	NS	NS	Dry
	06/08/92		NM	NC	NS	NS	NS	NS	NS	NS	Dry
	07/14/92		NM	NC	NS	NS	NS	NS	NS	NS	Dry
	08/10/92		NM	NC	NS	NS	NS	NS	NS	NS	Dry
	09/16/92		NM	NC	NS	NS	NS	NS	NS	NS	Dry
	10/07/92		NM	NC	NS	NS	NS	NS	NS	NS	Dry
	11/09/92		NM	NC	NS	NS	NS	NS	NS	NS	Dry
	12/10/92		NM	NC	NS	NS	NS	NS	NS	NS	Dry
	01/26/93		NM	NC	NS	NS	NS	NS	NS	NS	Dry
	02/16/93		58.23	264.76	NS	NS	NS	NS	NS	NS	No LPH

TABLE 1

## GROUND WATER MONITORING DATA

Exxon Service Station No. 7-3399  
2991 Hopyard Road  
Pleasanton, California

Monitoring Well	Date	Reference Elevation (ft)	Depth to Water (ft)	Ground	Benzene (µg/L)	Toluene (µg/L)	Ethyl-benzene (µg/L)	Total Xylenes (µg/L)	TPPH as gasoline (µg/L)	MTBE (µg/L)	Comments
				Water Elevation (ft)							
MW-10	03/11/93	322.99	57.81	265.18	NS	NS	NS	NS	NS	NS	No LPH
(Cont.)	04/12/93		57.84	265.15	21	11	21	75	350	NA	No LPH
	06/01/93		57.88	265.11	NS	NS	NS	NS	NS	NS	Not measured
	07/15/93		NM	NC	NS	NS	NS	NS	NS	NS	Dry
	08/15/93		NM	NC	NS	NS	NS	NS	NS	NS	Dry
	09/29/93		NM	NC	NS	NS	NS	NS	NS	NS	Dry
	10/28/93		NM	NC	NS	NS	NS	NS	NS	NS	Dry
	11/23/93		NM	NC	NS	NS	NS	NS	NS	NS	Dry
	03/10-11/94		NM	NC	NS	NS	NS	NS	NS	NS	Dry
	05/04-05/94		57.21	265.78	NS	NS	NS	NS	NS	NS	Dry
	09/01/94 <sup>c</sup>		NM	NC	<0.5	<0.5	<0.5	<0.5	<50	NA	No LPH
	11/16/94		54.82	268.17	<0.5	<0.5	<0.5	<0.5	<50	NA	No LPH
	02/15/95		51.90	271.09	<0.5	<0.5	<0.5	<0.5	<50	NA	No LPH
	05/09/95		46.32	276.67	<0.5	<0.5	<0.5	<0.5	<50	NA	No LPH
	08/21/95		43.06	279.93	<0.5	<0.5	<0.5	<0.5	<50	<2.5	No LPH
	11/30/95		41.34	281.65	<0.5	<0.5	<0.5	<0.5	<50	<5.0	No LPH
	03/28/96		38.15	284.84	<0.5	<0.5	<0.5	<0.5	<50	<5.0	No LPH
	05/31/96		36.61	286.38	<0.5	<0.5	<0.5	<0.5	<50	<5.0	No LPH
	08/28/96		40.86	282.13	NS	NS	NS	NS	NS	NS	No LPH
	11/18/96		40.90	282.09	NS	NS	NS	NS	NS	NS	No LPH
	02/28/97		35.75	287.24	NS	NS	NS	NS	NS	NS	No LPH
	05/23/97		36.07	286.92	NS	NS	NS	NS	NS	NS	No LPH



TABLE 1

## GROUND WATER MONITORING DATA

Exxon Service Station No. 7-3399  
2991 Hopyard Road  
Pleasanton, California

Monitoring Well	Date	Reference Elevation (ft)	Depth to Water (ft)	Ground Water		Benzene (µg/L)	Toluene (µg/L)	Ethyl-benzene (µg/L)	Total Xylenes (µg/L)	TPPH as gasoline (µg/L)	MTBE (µg/L)	Comments
				Elevation (ft)								
MW-11	11/10/89	321.77	50.64	272.13	NS	NS	NS	NS	NS	NS	NS	No LPH
	11/16/89		NM	NC	4.1	9.4	0.74	20	150	NA		Not measured
	11/28/89		50.51	272.26	NS	NS	NS	NS	NS	NS	NS	No LPH
	12/20/89		51.47	271.30	7.2	7.5	2.9	13	150	NA		No LPH
	01/09/90		49.68	273.09	NS	NS	NS	NS	NS	NS	NS	No LPH
	01/26/90		49.55	273.22	NS	NS	NS	NS	NS	NS	NS	No LPH
	02/23/90		49.37 <sup>a</sup>	273.40	NS	NS	NS	NS	NS	NS	NS	No LPH
	02/23/90		49.35	273.42	NS	NS	NS	NS	NS	NS	NS	No LPH
	03/26/90		49.03 <sup>a</sup>	273.74	<0.5	<0.5	<0.5	2.7	32	NA		No LPH
	04/18/90		49.12	273.65	NS	NS	NS	NS	NS	NS	NS	No LPH
	05/17/90		50.30	272.47	NS	NS	NS	NS	NS	NS	NS	No LPH
	06/11/90		51.16	271.61	NS	NS	NS	NS	NS	NS	NS	No LPH
	07/30/90		53.50	269.27	<0.5	<0.5	<0.5	3.8	26	NA		No LPH
	08/27/90		53.65	269.12	NS	NS	NS	NS	NS	NS	NS	No LPH
	09/28/90		53.62	269.15	NS	NS	NS	NS	NS	NS	NS	No LPH
	12/27/90		53.63	269.14	NS	NS	NS	NS	NS	NS	NS	No LPH
	03/20/91		53.26	269.51	NS	NS	NS	NS	NS	NS	NS	No LPH
	06/20/91		53.60	269.17	NS	NS	NS	NS	NS	NS	NS	No LPH
	09/12/91		53.60	269.17	NS	NS	NS	NS	NS	NS	NS	No LPH
	12/30/91		53.95	268.82	NS	NS	NS	NS	NS	NS	NS	No LPH
	01/30/92		53.65	269.12	NS	NS	NS	NS	NS	NS	NS	No LPH
	03/02/92		53.68	269.09	NS	NS	NS	NS	NS	NS	NS	No LPH
	03/24/92		53.70	269.07	NS	NS	NS	NS	NS	NS	NS	No LPH
	04/14/92		53.66	269.11	NS	NS	NS	NS	NS	NS	NS	No LPH
	05/21/92		53.62	269.15	NS	NS	NS	NS	NS	NS	NS	No LPH
	06/08/92		53.61	269.16	NS	NS	NS	NS	NS	NS	NS	No LPH
	07/14/92		53.53	269.24	NS	NS	NS	NS	NS	NS	NS	No LPH
	08/10/92		53.58	269.19	NS	NS	NS	NS	NS	NS	NS	No LPH
	09/16/92		53.60	269.17	NS	NS	NS	NS	NS	NS	NS	No LPH
	10/07/92		DRY	DRY	NS	NS	NS	NS	NS	NS	NS	Not measured
	11/09/92		DRY	DRY	NS	NS	NS	NS	NS	NS	NS	Not measured
	12/10/92		53.59	269.18	NS	NS	NS	NS	NS	NS	NS	No LPH
	01/26/93		53.67	269.10	NS	NS	NS	NS	NS	NS	NS	No LPH

TABLE 1

## GROUND WATER MONITORING DATA

Exxon Service Station No. 7-3399  
2991 Hopyard Road  
Pleasanton, California

Monitoring Well	Date	Reference Elevation (ft)	Depth to Water (ft)	Ground Water Elevation (ft)	Benzene (µg/L)	Toluene (µg/L)	Ethyl-benzene (µg/L)	Total Xylenes (µg/L)	TPPH as gasoline (µg/L)	MTBE (µg/L)	Comments
MW-11	02/16/93	321.77	53.60	269.17	NS	NS	NS	NS	NS	NS	No LPH
(Cont.)	03/11/93		53.58	269.19	NS	NS	NS	NS	NS	NS	No LPH
	04/12/93		53.54	269.23	<0.5	<0.5	<0.5	<0.5	<50	NA	No LPH
	06/01/93		53.52	269.25	NS	NS	NS	NS	NS	NS	No LPH
	07/15/93		53.60	269.17	NS	NS	NS	NS	NS	NS	No LPH
	08/15/93		53.55	269.22	NS	NS	NS	NS	NS	NS	No LPH
	09/29/93		53.62	269.15	NS	NS	NS	NS	NS	NS	No LPH
	09/30/93		NM	NC	NS	NS	NS	NS	NS	NS	Not measured
	10/28/93		53.63	269.14	NS	NS	NS	NS	NS	NS	No LPH
	11/23/93		53.58	268.19	NS	NS	NS	NS	NS	NS	No LPH
	11/24/93		NM	NC	<0.5	<0.5	<0.5	<0.5	<50	NA	Not measured
	03/10-11/94		53.61	268.16	NS	NS	NS	NS	NS	NS	No LPH
	05/04-05/94		53.51	268.26	NS	NS	NS	NS	NS	NS	No LPH
	11/16/94		53.46	268.31	NS	NS	NS	NS	NS	NS	No LPH
	02/15/95		50.57	271.20	<0.5	<0.5	<0.5	<0.5	<50	NA	No LPH
	05/09/95		45.05	276.72	<0.5	<0.5	<0.5	<0.5	<50	NA	No LPH
	08/21/95		41.88	279.89	<0.5	<0.5	<0.5	<0.5	<50	2.8	No LPH
	11/30/95		40.04	281.73	<0.5	<0.5	<0.5	<0.5	<50	<5.0	No LPH
	03/28/96		36.90	284.87	<0.5	<0.5	<0.5	<0.5	<50	<5.0	No LPH
	05/31/96		35.34	286.43	<0.5	<0.5	<0.5	<0.5	<50	<5.0	No LPH
	08/28/96		39.56	282.21	NS	NS	NS	NS	NS	NS	No LPH
	11/18/96		39.56	282.21	NS	NS	NS	NS	NS	NS	No LPH
	02/28/97		34.50	287.27	NS	NS	NS	NS	NS	NS	No LPH
	05/23/97		34.80	286.97	NS	NS	NS	NS	NS	NS	No LPH

TABLE 1

GROUND WATER MONITORING DATA

Exxon Service Station No. 7-3399  
2991 Hopyard Road  
Pleasanton, California

Monitoring Well	Date	Reference Elevation (ft)	Depth to Water (ft)	Ground Water		Benzene (µg/L)	Toluene (µg/L)	Ethyl-benzene (µg/L)	Total Xylenes (µg/L)	TPPH as gasoline (µg/L)	MTBE (µg/L)	Comments
				Elevation (ft)								
VR-1	03/24/92		NM	NC		1.7	<0.5	<0.5	<0.5	<50	NA	Not measured

- <sup>a</sup> Water level recorded during pumping of MW-7.
- <sup>b</sup> Anomalous water level possibly due to recharge from a perched water zone.
- <sup>c</sup> Casing head cut to lower elevation.
- <sup>d</sup> Casing head damaged by construction.
- <sup>e</sup> Results obtained past the technical holding time.

Reference elevation = Elevation relative to mean sea level.  
 Depth to ground water = Measured from notch/mark or north edge of well casing.  
 µg/L = Micrograms per liter.  
 TPPH = Total purageble petroleum hydrocarbons.  
 MTBE = Methyl tertiary butyl ether.  
 LPH = Liquid-phase petroleum hydrocarbons.  
 NS = Not sampled.  
 NM = Not measured.  
 NC = Not calculated.  
 NA = Not analyzed.

NOTE: Elevation detection limit quantified by multiplying laboratory limits by Report Limit Multiplication Factor.

**ENCLOSURE A**

Field Methods and Procedures

## FIELD METHODS AND PROCEDURES

### 1.0 GROUND WATER AND LIQUID-PHASE PETROLEUM HYDROCARBON DEPTH ASSESSMENT

A water/petroleum interface probe was used to assess the liquid-phase petroleum hydrocarbons (LPH) thickness if present, and a water level indicator was used to assess ground water depth in monitoring wells that do not contain LPH. Depth to ground water was measured from the top of each monitoring well casing. The tip of the water level indicator was subjectively analyzed for hydrocarbon sheen. All measurements and physical observations were recorded in the field.

### 2.0 SUBJECTIVE ANALYSIS OF GROUND WATER

Prior to purging, a water sample was collected from the monitoring well for subjective assessment. The sample was retrieved by gently lowering a clean, disposable bailer to approximately one-half the bailer length past the air/liquid interface. The bailer was then retrieved and the sample contained within the bailer was examined for floating LPH and the appearance of an LPH sheen.

### 3.0 MONITORING WELL PURGING AND SAMPLING

Monitoring wells were purged using a centrifugal pump until pH, temperature, and conductivity of the purge water had stabilized and a minimum of three well volumes of water had been removed. Ground water removed from the wells was stored in 55-gallon barrels at the site. The barrels were labeled with corresponding monitoring well numbers and the date of purging. After purging, ground water levels were allowed to stabilize. A ground water sample was then removed from each of the wells using a disposable bailer. If the well was purged dry, it was allowed to sufficiently recharge and a sample was collected. Samples were collected in air-tight vials, appropriately labeled, and stored on ice from the time of collection through the time of delivery to the laboratory. A chain-of-custody form was completed to document possession of the samples. Ground water samples were transported to the laboratory and analyzed within the EPA-specified holding times for the requested analyses. Purge water will be collected from the storage barrels in a vacuum truck and transported to an appropriate facility for treatment and/or disposal.



Delta Environmental Consults 3164 Gold Camp Drive, #200 Rancho Cordova, CA 95670	Client Proj. ID: Exxon 7-3399, D094-836 Sample Descript: MW-5S Matrix: LIQUID Analysis Method: 8015Mod/8020 Lab Number: 9705E45-01	Sampled: 05/23/97 Received: 05/28/97  Analyzed: 06/03/97 Reported: 06/05/97
Attention: Keoni Almeida		

QC Batch Number: GC060397BTEX03A  
Instrument ID: GCHP03

**Total Purgeable Petroleum Hydrocarbons (TPPH) with BTEX and MTBE**

Analyte	Detection Limit ug/L	Sample Results ug/L
TPPH as Gas	50	N.D.
Methyl t-Butyl Ether	2.5	N.D.
Benzene	0.50	N.D.
Toluene	0.50	N.D.
Ethyl Benzene	0.50	N.D.
Xylenes (Total)	0.50	N.D.
Chromatogram Pattern		N.D.
<b>Surrogates</b>	<b>Control Limits %</b>	<b>% Recovery</b>
Trifluorotoluene	70                      130	93

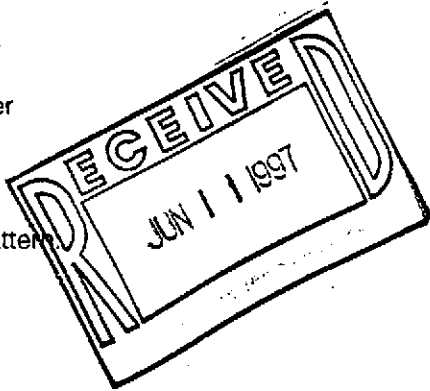

Analytes reported as N.D. were not present above the stated limit of detection.

**SEQUOIA ANALYTICAL - ELAP #1210**

  
Mike Gregory  
Project Manager





Delta Environmental Consults 3164 Gold Camp Drive, #200 Rancho Cordova, CA 95670	Client Proj. ID: Exxon 7-3399, D094-836 Sample Descript: MW-8 Matrix: LIQUID Analysis Method: 8015Mod/8020 Lab Number: 9705E45-02	Sampled: 05/23/97 Received: 05/28/97 Analyzed: 06/03/97 Reported: 06/05/97
Attention: Keoni Almeida		

QC Batch Number: GC060397BTEX02A  
Instrument ID: GCHP02

**Total Purgeable Petroleum Hydrocarbons (TPPH) with BTEX and MTBE**

Analyte	Detection Limit ug/L	Sample Results ug/L
TPPH as Gas	50	N.D.
Methyl t-Butyl Ether	2.5	N.D.
Benzene	0.50	N.D.
Toluene	0.50	N.D.
Ethyl Benzene	0.50	N.D.
Xylenes (Total)	0.50	N.D.
Chromatogram Pattern:		
<b>Surrogates</b>	<b>Control Limits %</b>	<b>% Recovery</b>
Trifluorotoluene	70 130	76

Analytes reported as N.D. were not present above the stated limit of detection.

**SEQUOIA ANALYTICAL - ELAP #1210**

  
\_\_\_\_\_  
Mike Gregory  
Project Manager





Delta Environmental Consults 3164 Gold Camp Drive, #200 Rancho Cordova, CA 95670	Client Proj. ID: Exxon 7-3399, D094-836 Sample Descript: MW-8R Matrix: LIQUID Analysis Method: 8015Mod/8020 Lab Number: 9705E45-03	Sampled: 05/23/97 Received: 05/28/97 Analyzed: 06/03/97 Reported: 06/05/97
Attention: Keoni Almeida		

QC Batch Number: GC060397BTEX17A  
Instrument ID: GCHP17

**Total Purgeable Petroleum Hydrocarbons (TPPH) with BTEX and MTBE**

Analyte	Detection Limit ug/L	Sample Results ug/L
TPPH as Gas	50	N.D.
Methyl t-Butyl Ether	2.5	N.D.
Benzene	0.50	N.D.
Toluene	0.50	N.D.
Ethyl Benzene	0.50	N.D.
Xylenes (Total)	0.50	N.D.
Chromatogram Pattern:		
<b>Surrogates</b>	<b>Control Limits %</b>	<b>% Recovery</b>
Trifluorotoluene	70 130	85

Analytes reported as N.D. were not present above the stated limit of detection.

SEQUOIA ANALYTICAL - ELAP #1210

  
Mike Gregory  
Project Manager







Delta Environmental Consults 3164 Gold Camp Drive, #200 Rancho Cordova, CA 95670	Client Proj. ID: Exxon 7-3399, D094-836 Sample Descript: MW-8D Matrix: LIQUID Analysis Method: 8015Mod/8020 Lab Number: 9705E45-04	Sampled: 05/23/97 Received: 05/28/97 Analyzed: 06/03/97 Reported: 06/05/97
--	--	---

QC Batch Number: GC060397BTEX17A  
Instrument ID: GCHP17

**Total Purgeable Petroleum Hydrocarbons (TPPH) with BTEX and MTBE**

Analyte	Detection Limit ug/L	Sample Results ug/L
TPPH as Gas	50	N.D.
Methyl t-Butyl Ether	2.5	N.D.
Benzene	0.50	N.D.
Toluene	0.50	N.D.
Ethyl Benzene	0.50	N.D.
Xylenes (Total)	0.50	N.D.
Chromatogram Pattern:		
<b>Surrogates</b>	<b>Control Limits %</b>	<b>% Recovery</b>
Trifluorotoluene	70 130	78

Analytes reported as N.D. were not present above the stated limit of detection.

SEQUOIA ANALYTICAL - ELAP #1210

  
Mike Gregory  
Project Manager





Delta Environmental Consults 3164 Gold Camp Drive, #200 Rancho Cordova, CA 95670	Client Proj. ID: Exxon 7-3399, D094-836 Sample Descript: MW-1 Matrix: LIQUID Analysis Method: 8015Mod/8020 Lab Number: 9705E45-05	Sampled: 05/23/97 Received: 05/28/97 Analyzed: 06/03/97 Reported: 06/05/97
--	---	---

QC Batch Number: GC060397BTEX17A  
Instrument ID: GCHP17

**Total Purgeable Petroleum Hydrocarbons (TPPH) with BTEX and MTBE**

Analyte	Detection Limit ug/L	Sample Results ug/L
TPPH as Gas	50	N.D.
Methyl t-Butyl Ether	2.5	N.D.
Benzene	0.50	N.D.
Toluene	0.50	N.D.
Ethyl Benzene	0.50	N.D.
Xylenes (Total)	0.50	N.D.
Chromatogram Pattern:		
<b>Surrogates</b>	<b>Control Limits %</b>	<b>% Recovery</b>
Trifluorotoluene	70 130	85

Analytes reported as N.D. were not present above the stated limit of detection.

**SEQUOIA ANALYTICAL - ELAP #1210**

  
\_\_\_\_\_  
Mike Gregory  
Project Manager





Delta Environmental Consults 3164 Gold Camp Drive, #200 Rancho Cordova, CA 95670	Client Proj. ID: Exxon 7-3399, D094-836 Sample Descript: MW-5D Matrix: LIQUID Analysis Method: 8015Mod/8020 Lab Number: 9705E45-06	Sampled: 05/23/97 Received: 05/28/97 Analyzed: 06/03/97 Reported: 06/05/97
--	--	---

QC Batch Number: GC060397BTEX03A  
Instrument ID: GCHP03

**Total Purgeable Petroleum Hydrocarbons (TPPH) with BTEX and MTBE**

Analyte	Detection Limit ug/L	Sample Results ug/L
TPPH as Gas	50	N.D.
Methyl t-Butyl Ether	2.5	N.D.
Benzene	0.50	N.D.
Toluene	0.50	N.D.
Ethyl Benzene	0.50	N.D.
Xylenes (Total)	0.50	N.D.
Chromatogram Pattern:		

Surrogates	Control Limits %	% Recovery
Trifluorotoluene	70 130	82

Analytes reported as N.D. were not present above the stated limit of detection.

SEQUOIA ANALYTICAL - ELAP #1210

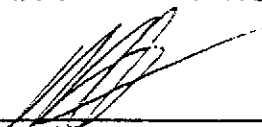
  
Mike Gregory  
Project Manager





Delta Environmental Consults 3164 Gold Camp Drive, #200 Rancho Cordova, CA 95670	Client Proj. ID: Exxon 7-3399, D094-836 Sample Descript: MW-5DR Matrix: LIQUID Analysis Method: 8015Mod/8020 Lab Number: 9705E45-07	Sampled: 05/23/97 Received: 05/28/97 Analyzed: 06/03/97 Reported: 06/05/97
--	---	---

QC Batch Number: GC060397BTEX03A  
Instrument ID: GCHP03

**Total Purgeable Petroleum Hydrocarbons (TPPH) with BTEX and MTBE**

Analyte	Detection Limit ug/L	Sample Results ug/L
TPPH as Gas	50	N.D.
Methyl t-Butyl Ether	2.5	N.D.
Benzene	0.50	N.D.
Toluene	0.50	N.D.
Ethyl Benzene	0.50	N.D.
Xylenes (Total)	0.50	N.D.
Chromatogram Pattern:		
<b>Surrogates</b>	<b>Control Limits %</b>	<b>% Recovery</b>
Trifluorotoluene	70                      130	85

Analytes reported as N.D. were not present above the stated limit of detection.

**SEQUOIA ANALYTICAL - ELAP #1210**

  
\_\_\_\_\_  
Mike Gregory  
Project Manager





Delta Environmental Consults	Client Proj. ID: Exxon 7-3399, D094-836	Sampled: 05/23/97
3164 Gold Camp Drive, #200	Sample Descript: MW-5DD	Received: 05/28/97
Rancho Cordova, CA 95670	Matrix: LIQUID	
Attention: Keoni Almeida	Analysis Method: 8015Mod/8020	Analyzed: 06/03/97
	Lab Number: 9705E45-08	Reported: 06/05/97

QC Batch Number: GC060397BTEX02A  
Instrument ID: GCHP02

**Total Purgeable Petroleum Hydrocarbons (TPPH) with BTEX and MTBE**

Analyte	Detection Limit ug/L	Sample Results ug/L
TPPH as Gas	50	N.D.
Methyl t-Butyl Ether	2.5	N.D.
Benzene	0.50	N.D.
Toluene	0.50	N.D.
Ethyl Benzene	0.50	N.D.
Xylenes (Total)	0.50	N.D.
Chromatogram Pattern:		
<b>Surrogates</b>	<b>Control Limits %</b>	<b>% Recovery</b>
Trifluorotoluene	70                      130	74

Analytes reported as N.D. were not present above the stated limit of detection.

**SEQUOIA ANALYTICAL - ELAP #1210**

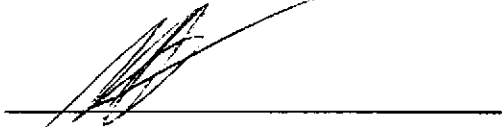

Mike Gregory  
Project Manager





Delta Environmental Consults 3164 Gold Camp Drive, #200 Rancho Cordova, CA 95670	Client Proj. ID: Exxon 7-3399, D094-836 Sample Descript: MW-9 Matrix: LIQUID Analysis Method: 8015Mod/8020 Lab Number: 9705E45-09	Sampled: 05/23/97 Received: 05/28/97 Analyzed: 06/03/97 Reported: 06/05/97
--	---	---

QC Batch Number: GC060397BTEX02A  
Instrument ID: GCHP02

**Total Purgeable Petroleum Hydrocarbons (TPPH) with BTEX and MTBE**

Analyte	Detection Limit ug/L	Sample Results ug/L
TPPH as Gas	5000	32000
Methyl t-Butyl Ether	250	1600
Benzene	50	5300
Toluene	50	5200
Ethyl Benzene	50	800
Xylenes (Total)	50	3900
Chromatogram Pattern:		Gas

Surrogates	Control Limits %	% Recovery
Trifluorotoluene	70 130	78

Analytes reported as N.D. were not present above the stated limit of detection.

SEQUOIA ANALYTICAL - ELAP #1210

  
\_\_\_\_\_  
Mike Gregory  
Project Manager

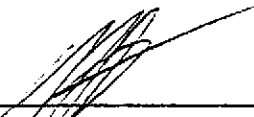



Delta Environmental Consults  
3164 Gold Camp Drive, #200  
Rancho Cordova, CA 95670  
Attention: Keoni Almeida

Client Proj. ID: Exxon 7-3399, D094-836

Received: 05/28/97

Lab Proj. ID: 9705E45

Reported: 06/05/97

### LABORATORY NARRATIVE

In order to properly interpret this report, it must be reproduced in its entirety. This report contains a total of 14 pages including the laboratory narrative, sample results, quality control, and related documents as required (cover page, COC, raw data, etc.).

SEQUOIA ANALYTICAL

Mike Gregory  
Project Manager





Delta Environmental Consultants Client Project ID: Exxon 7-3399, D094-836  
 3164 Gold Camp Drive, #200 Matrix: Liquid  
 Rancho Cordova, CA 95670  
 Attention: Keoni Almeida Work Order #: 9705E45 -01, 06, 07 Reported: Jun 9, 1997

**QUALITY CONTROL DATA REPORT**

Analyte:	Benzene	Toluene	Ethyl Benzene	Xylenes	Gas
QC Batch#:	GC060397BTEX03A	GC060397BTEX03A	GC060397BTEX03A	GC060397BTEX03A	GC060397BTEX03A
Analy. Method:	EPA 8020	EPA 8020	EPA 8020	EPA 8020	EPA 8015M
Prep. Method:	EPA 5030	EPA 5030	EPA 5030	EPA 5030	EPA 5030
Analyst:	A. Miraftab	A. Miraftab	A. Miraftab	A. Miraftab	A. Miraftab
MS/MSD #:	9705E79-30	9705E79-30	9705E79-30	9705E79-30	9705E79-30
Sample Conc.:	N.D.	N.D.	N.D.	N.D.	N.D.
Prepared Date:	6/3/97	6/3/97	6/3/97	6/3/97	6/3/97
Analyzed Date:	6/3/97	6/3/97	6/3/97	6/3/97	6/3/97
Instrument I.D.#:	GCHP-3	GCHP-3	GCHP-3	GCHP-3	GCHP-3
Conc. Spiked:	10 µg/L	10 µg/L	10 µg/L	30 µg/L	60 µg/L
Result:	10	10	11	32	72
MS % Recovery:	100	100	110	107	120
Dup. Result:	10	10	10	32	73
MSD % Recov.:	100	100	100	107	122
RPD:	0.0	0.0	9.5	0.0	1.4
RPD Limit:	0-25	0-25	0-25	0-25	0-25

LCS #:	BLK060397	BLK060397	BLK060397	BLK060397	BLK060397
Prepared Date:	6/3/97	6/3/97	6/3/97	6/3/97	6/3/97
Analyzed Date:	6/3/97	6/3/97	6/3/97	6/3/97	6/3/97
Instrument I.D.#:	GCHP-3	GCHP-3	GCHP-3	GCHP-3	GCHP-3
Conc. Spiked:	10 µg/L	10 µg/L	10 µg/L	30 µg/L	60 µg/L
LCS Result:	11	11	11	33	73
LCS % Recov.:	110	110	110	110	122

MS/MSD	60-140	60-140	60-140	60-140	60-140
LCS	70-130	70-130	70-130	70-130	70-130
Control Limits					

SEQUOIA ANALYTICAL

*Mike Gregory*  
 Mike Gregory  
 Project Manager

**Please Note:**

The LCS is a control sample of known, interferent-free matrix that is analyzed using the same reagents, preparation, and analytical methods employed for the samples. The matrix spike is an aliquot of sample fortified with known quantities of specific compounds and subjected to the entire analytical procedure. If the recovery of analytes from the matrix spike does not fall within specified control limits due to matrix interference, the LCS recovery is to be used to validate the batch.

\*\* MS=Matrix Spike, MSD=MS Duplicate, RPD=Relative % Difference

9705E45.DLT <1>







Delta Environmental Consultants 3164 Gold Camp Drive, #200 Rancho Cordova, CA 95670 Attention: Keoni Almeida	Client Project ID: Exxon 7-3399, D094-836 Matrix: Liquid Work Order #: 9705E45-02, 08, 09	Reported: Jun 9, 1997
---	---	-----------------------

**QUALITY CONTROL DATA REPORT**

Analyte:	Benzene	Toluene	Ethyl Benzene	Xylenes	Gas
QC Batch#:	GC060397BTEX02A	GC060397BTEX02A	GC060397BTEX02A	GC060397BTEX02A	GC060397BTEX02A
Analy. Method:	EPA 8020	EPA 8020	EPA 8020	EPA 8020	EPA 8015M
Prep. Method:	EPA 5030	EPA 5030	EPA 5030	EPA 5030	EPA 5030
Analyst:	A. Miraftab	A. Miraftab	A. Miraftab	A. Miraftab	A. Miraftab
MS/MSD #:	9705E79-30	9705E79-30	9705E79-30	9705E79-30	9705E79-30
Sample Conc.:	N.D.	N.D.	N.D.	N.D.	N.D.
Prepared Date:	6/3/97	6/3/97	6/3/97	6/3/97	6/3/97
Analyzed Date:	6/3/97	6/3/97	6/3/97	6/3/97	6/3/97
Instrument I.D.#:	GCHP-2	GCHP-2	GCHP-2	GCHP-2	GCHP-2
Conc. Spiked:	10 µg/L	10 µg/L	10 µg/L	30 µg/L	60 µg/L
Result:	8.8	8.6	8.8	28	62
MS % Recovery:	88	86	88	93	103
Dup. Result:	8.3	8.2	8.4	26	59
MSD % Recov.:	83	82	84	87	98
RPD:	5.8	4.8	4.7	7.4	5.0
RPD Limit:	0-25	0-25	0-25	0-25	0-25

LCS #:	BLK060397	BLK060397	BLK060397	BLK060397	BLK060397
Prepared Date:	6/3/97	6/3/97	6/3/97	6/3/97	6/3/97
Analyzed Date:	6/3/97	6/3/97	6/3/97	6/3/97	6/3/97
Instrument I.D.#:	GCHP-2	GCHP-2	GCHP-2	GCHP-2	GCHP-2
Conc. Spiked:	10 µg/L	10 µg/L	10 µg/L	30 µg/L	60 µg/L
LCS Result:	8.4	8.3	8.3	26	66
LCS % Recov.:	84	83	83	87	110

MS/MSD	60-140	60-140	60-140	60-140	60-140
LCS	70-130	70-130	70-130	70-130	70-130
Control Limits					

SEQUOIA ANALYTICAL

*[Signature]*  
Mike Gregory  
Project Manager

**Please Note:**

The LCS is a control sample of known, interferent-free matrix that is analyzed using the same reagents, preparation, and analytical methods employed for the samples. The matrix spike is an aliquot of sample fortified with known quantities of specific compounds and subjected to the entire analytical procedure. If the recovery of analytes from the matrix spike does not fall within specified control limits due to matrix interference, the LCS recovery is to be used to validate the batch.

\*\* MS = Matrix Spike, MSD = MS Duplicate, RPD = Relative % Difference

9705E45.DLT <2>





Delta Environmental Consultants Client Project ID: Exxon 7-3399, D094-836  
 3164 Gold Camp Drive, #200 Matrix: Liquid  
 Rancho Cordova, CA 95670  
 Attention: Keoni Almeida Work Order #: 9705E45-03, 04, 05 Reported: Jun 9, 1997

**QUALITY CONTROL DATA REPORT**

Analyte:	Benzene	Toluene	Ethyl Benzene	Xylenes	Gas
QC Batch#:	GC060397BTEX17A	GC060397BTEX17A	GC060397BTEX17A	GC060397BTEX17A	GC060397BTEX17A
Analy. Method:	EPA 8020	EPA 8020	EPA 8020	EPA 8020	EPA 8015M
Prep. Method:	EPA 5030	EPA 5030	EPA 5030	EPA 5030	EPA 5030

Analyst:	A. Mirafitab	A. Mirafitab	A. Mirafitab	A. Mirafitab	A. Mirafitab
MS/MSD #:	9705E79-30	9705E79-30	9705E79-30	9705E79-30	9705E79-30
Sample Conc.:	N.D.	N.D.	N.D.	N.D.	N.D.
Prepared Date:	6/3/97	6/3/97	6/3/97	6/3/97	6/3/97
Analyzed Date:	6/3/97	6/3/97	6/3/97	6/3/97	6/3/97
Instrument I.D.#:	GCHP-17	GCHP-17	GCHP-17	GCHP-17	GCHP-17
Conc. Spiked:	10 µg/L	10 µg/L	10 µg/L	30 µg/L	60 µg/L
Result:	10	10	10	31	64
MS % Recovery:	100	100	100	103	107
Dup. Result:	10	10	10	31	64
MSD % Recov.:	100	100	100	103	107
RPD:	0.0	0.0	0.0	0.0	0.0
RPD Limit:	0-25	0-25	0-25	0-25	0-25

LCS #:	BLK060397	BLK060397	BLK060397	BLK060397	BLK060397
Prepared Date:	6/3/97	6/3/97	6/3/97	6/3/97	6/3/97
Analyzed Date:	6/3/97	6/3/97	6/3/97	6/3/97	6/3/97
Instrument I.D.#:	GCHP-17	GCHP-17	GCHP-17	GCHP-17	GCHP-17
Conc. Spiked:	10 µg/L	10 µg/L	10 µg/L	30 µg/L	60 µg/L
LCS Result:	9.7	9.7	9.7	29	60
LCS % Recov.:	97	97	97	97	100

MS/MSD	60-140	60-140	60-140	60-140	60-140
LCS	70-130	70-130	70-130	70-130	70-130
Control Limits					

**Please Note:**  
 The LCS is a control sample of known, interferent-free matrix that is analyzed using the same reagents, preparation, and analytical methods employed for the samples. The matrix spike is an aliquot of sample fortified with known quantities of specific compounds and subjected to the entire analytical procedure. If the recovery of analytes from the matrix spike does not fall within specified control limits due to matrix interference, the LCS recovery is to be used to validate the batch.

**SEQUOIA ANALYTICAL**

*[Signature]*  
 Mike Gregory  
 Project Manager

\*\* MS=Matrix Spike, MSD=MS Duplicate, RPD=Relative % Difference

9705E45.DLT <3>





Sequoia Analytical  
680 Chesapeake Dr.  
Redwood City, CA 94063  
(415) 364-9600 • FAX (415) 364-9233

# EXXON COMPANY, U.S.A.

P.O. Box 2180, Houston, TX 77002-7426

## CHAIN OF CUSTODY

Consultant's Name: <u>Delta Environmental Consultants</u>		Page <u>1</u> of <u>1</u>
Address: <u>3164 Gold Camp Dr. Rancho</u>		Site Location: <u>Pleasanton</u>
Project #: _____	Consultant Project #: <u>D094-886</u>	Consultant Work Release #: <u>19432566</u>
Project Contact: <u>Keoni Almeida</u>	Phone #: <u>688-2085</u>	Laboratory Work Release #: _____
EXXON Contact: <u>Marla Guendler</u>	Phone #: _____	EXXON RAS #: <u>7-3399</u>
Sampled by (print): <u>Jay Star</u>	Sampler's Signature: <u>[Signature]</u>	_____
Shipment Method: <u>Sequoia</u>	Air Bill #: _____	_____

TAT:  24 hr  48 hr  72 hr  96 hr  Standard (10 day)      ANALYSIS REQUIRED 1705E45

Sample Description	Collection Date	Collection Time	Matrix Soil/Water/Air	Prsv	# of Cont.	Sequoia's Sample #	TPH/Gas BTEX/8015/8020	TPH/Diesel EPA 8015	TPH S.M. 5520	MTBE	Temperature: _____
MW-55	5-23-97	0745	H2O	✓	3	1	X			X	
MW-8	↓	1135	↓	↓	↓	2	↓			↓	
MW-8R	↓	1057	↓	↓	↓	3	↓			↓	
MW-8D	↓	1140	↓	↓	↓	4	↓			↓	
MW-1	↓	1140	↓	↓	↓	5	↓			↓	
MW-5D	↓	1010	↓	↓	↓	6	↓			↓	
MW-5R	↓	0955	↓	↓	↓	7	↓			↓	
MW-5DD	↓	1040	↓	↓	↓	8	↓			↓	
MW-9	↓	1100	↓	↓	↓	9	↓			↓	

RELINQUISHED BY / AFFILIATION	Date	Time	ACCEPTED / AFFILIATION	Date	Time	Additional Comments
<u>[Signature]</u> / Sequoia	5/20/97	0955	<u>[Signature]</u> / Sequoia	5/20/97		
<u>[Signature]</u> / Sequoia			<u>[Signature]</u> / Sequoia	5/20/97	0955	
<u>[Signature]</u> / Sequoia	5-28	1000	<u>[Signature]</u> / CSC	5-28	1000	

Pink - Client  
Yellow - Sequoia  
White - Sequoia