

EXXON COMPANY, U.S.A.

P.O. BOX 4032 • CONCORD, CA 94524-2032

MARKETING DEPARTMENT • ENVIRONMENTAL ENGINEERING

MARLA D. GUENSLER
SENIOR ENGINEER

(510) 246-8776
(510) 246-8798 FAX

RECEIVED

FEB - 2 1995

PLEASANTON FIRE DEPARTMENT

January 27, 1995

Mr. Rich Mueller
Pleasanton Fire Department
4444 Railroad Street
Pleasanton, CA 94566

RE: EXXON RAS #7-3399/2991 HOPYARD ROAD, PLEASANTON, CA

Dear Mr. Mueller:

Attached for your review and comment is a report entitled *Quarterly Ground Water Monitoring Report, Fourth Quarter 1994* for the above referenced site. This report, prepared by Delta Environmental Consultants, Inc., of Rancho Cordova, California, details the results of the November 1994 groundwater monitoring and sampling event.

If you have any questions or comments, please contact me at the above listed phone number.

Sincerely,



Marla D. Guensler
Senior Engineer

MDG/mdg

attachment: Delta Quarterly Report dated January 24, 1995

cc: w/attachment:

Mr. Sum Arigalia - San Francisco Bay Region CRWQCB
Mr. Jerry Killingstad - Alameda Co. Flood Control (Zone-7)
Mr. Steve Cusenza - City of Pleasanton Public Works Dept.

w/o attachment:

Mr. Todd Galati - Delta





3330 Data Drive
Suite 100
Rancho Cordova, CA 95670
916/638-2085
FAX: 916/638-8385

January 24, 1995

Ms. Marla Guensler
Exxon Company, U.S.A.
Post Office Box 4032
Concord, California 94524-2032

Subject: *Quarterly Ground Water Monitoring Report, Fourth Quarter 1994*
Exxon Retail Station No. 7-3399
2991 Hopyard Road
Pleasanton, California
Delta Project No. D094-836

Dear Ms. Guensler:

Delta Environmental Consultants, Inc. (Delta), has been authorized by Exxon Company, U.S.A. (Exxon), to conduct quarterly ground water monitoring at Exxon Retail Station No. 7-3399, located at 2991 Hopyard Road, Pleasanton, California. This letter report presents the results of quarterly ground water monitoring and sampling conducted on November 16, 1994. The location of the site is shown in Figure 1 and site features are illustrated in Figure 2. All work conducted at the site by Delta was performed in accordance with the field methods and procedures described in Enclosure A.

Ground Water Table Elevations, Flow Direction, and Hydraulic Gradient

Ground water table elevations were measured in six on-site monitoring wells (MW-1, MW-4, MW-7, MW-8, MW-9, MW-10) and three off-site monitoring wells (MW-5D, MW-5S, and MW-11) on November 16, 1994. Depths to ground water in the monitoring wells ranged from 52.09 to 55.47 feet below the tops of the well casings. Ground water table measurements are presented in Table 1. Prior ground water table measurements collected by RESNA Industries Inc. are included in Enclosure B. A water table contour map constructed from the ground water table elevations recorded on November 16, 1994, is included as Figure 3. The water table contours illustrated in Figure 3 indicate that ground water flowed toward the northeast with a hydraulic gradient of approximately 0.05.

Subjective Analysis

No liquid-phase petroleum hydrocarbons or hydrocarbon sheens were present in the wells during the November 1994 sampling visit.

Analytical Results

Ground water samples collected from monitoring wells MW-1, MW-4, MW-5D, MW-5S, MW-7, MW-8, and MW-10 on November 16, 1994, were submitted to a California-certified laboratory for analysis of benzene, toluene, ethylbenzene, total xylenes, and total volatile hydrocarbons as gasoline.

Ms. Marla Guensler
Exxon Company, U.S.A.
January 24, 1995
Page 2

Analytical test results are summarized in Table 2. Analytical test results prior to July, 1994 are included in Enclosure C. Ground water samples were not collected from monitoring wells MW-9 and MW-11 due to insufficient water in these wells. None of the ground water samples collected from any of the monitoring wells contained detectable concentrations of volatile hydrocarbons. Copies of the laboratory analytical reports are presented in Enclosure D.

Future Work

The next quarterly monitoring event for this site is scheduled for February 1995.

Remarks/Signatures

The interpretations contained in this report represent our professional opinions, and are based in part, on information supplied by the client. These opinions are based on currently available information and are arrived at in accordance with currently accepted hydrogeologic and engineering practices at this time and location. Other than this, no warranty is implied or intended.

Delta recommends that copies of this report be forwarded to:

Mr. Sum Arigalia
California Regional Water Quality
Control Board
San Francisco Bay Region
2101 Webster Street, Suite 500
Oakland, California 94612

Mr. Steve Cusenza
City of Pleasanton Public Works Dept.
Post Office Box 520
Pleasanton, California 94566

Mr. Jerry Killingstad
Alameda County Flood Control and Water
Conservation District (Zone 7)
5997 Parkside Drive
Pleasanton, California 94566

Mr. Rich Mueller
Pleasanton Fire Department
4444 Railroad Street
Pleasanton, California 94566

Ms. Marla Guensler
Exxon Company, U.S.A.
January 24, 1995
Page 3

If you have any questions, please contact Todd Galati at (916) 638-2085.

Sincerely,

DELTA ENVIRONMENTAL CONSULTANTS, INC.



William L. Brattain
Staff Engineer



Todd M. Galati
Project Manager/Senior Engineer



Eric J. Holm, R.G.
California Registered Geologist No. 5880

WLB (LRP412.SJS)
Enclosure

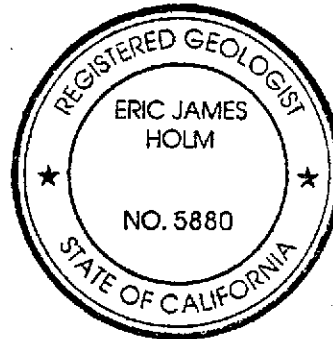

TABLE 1

GROUND WATER LEVEL DATA

Exxon Retail Station No. 7-3399
2991 Hopyard Road
Pleasanton, California

<u>Monitoring Well</u>	<u>Date</u>	<u>Top of Riser Elevation (ft)^a</u>	<u>Depth to Water (ft)</u>	<u>Ground Water Elevation (ft)</u>
MW-1	11/16/94	321.44	52.09	269.35
MW-4	11/16/94	321.56	52.96	268.60
MW-5S	11/16/94	321.64	53.05	268.59
MW-5D	11/16/94	321.79	54.36	268.74
MW-7	11/16/94	321.27	52.74	268.53
MW-8	11/16/94	321.86	55.47	266.39
MW-9	11/16/94	321.44	52.62	268.82
MW-10	11/16/94	322.99	54.82	268.17
MW-11	11/16/94	321.77	53.46	268.31

- Reference works at the tops of the well risers have been surveyed relative to mean sea level.

TABLE 2

GROUND WATER ANALYTICAL RESULTS

Concentrations in parts per billion (ppb)

Exxon Retail Station No. 7-3399

2991 Hopyard Road

Pleasanton, California

<u>Monitoring Well</u>	<u>Date</u>	<u>Benzene</u>	<u>Toluene</u>	<u>Ethyl-benzene</u>	<u>Xylenes</u>	<u>TPH^a as gasoline</u>
MW-1	11/16/94	<0.5	<0.5	<0.5	<0.5	<50
MW-4	11/16/94	<0.5	<0.5	<0.5	<0.5	<50
MW-5S	11/16/94	<0.5	<0.5	<0.5	<0.5	<50
MW-5D	11/16/94	<0.5	<0.5	<0.5	<0.5	<50
MW-7	11/16/94	<0.5	<0.5	<0.5	<0.5	<50
MW-8	11/16/94	<0.5	<0.5	<0.5	<0.5	<50
MW-9	11/16/94	NS ^b	NS	NS	NS	NS
MW-10	11/16/94	<0.5	<0.5	<0.5	<0.5	<50
MW-11	11/16/94	NS	NS	NS	NS	NS

^a Total petroleum hydrocarbons.^b Not sampled, well dry.

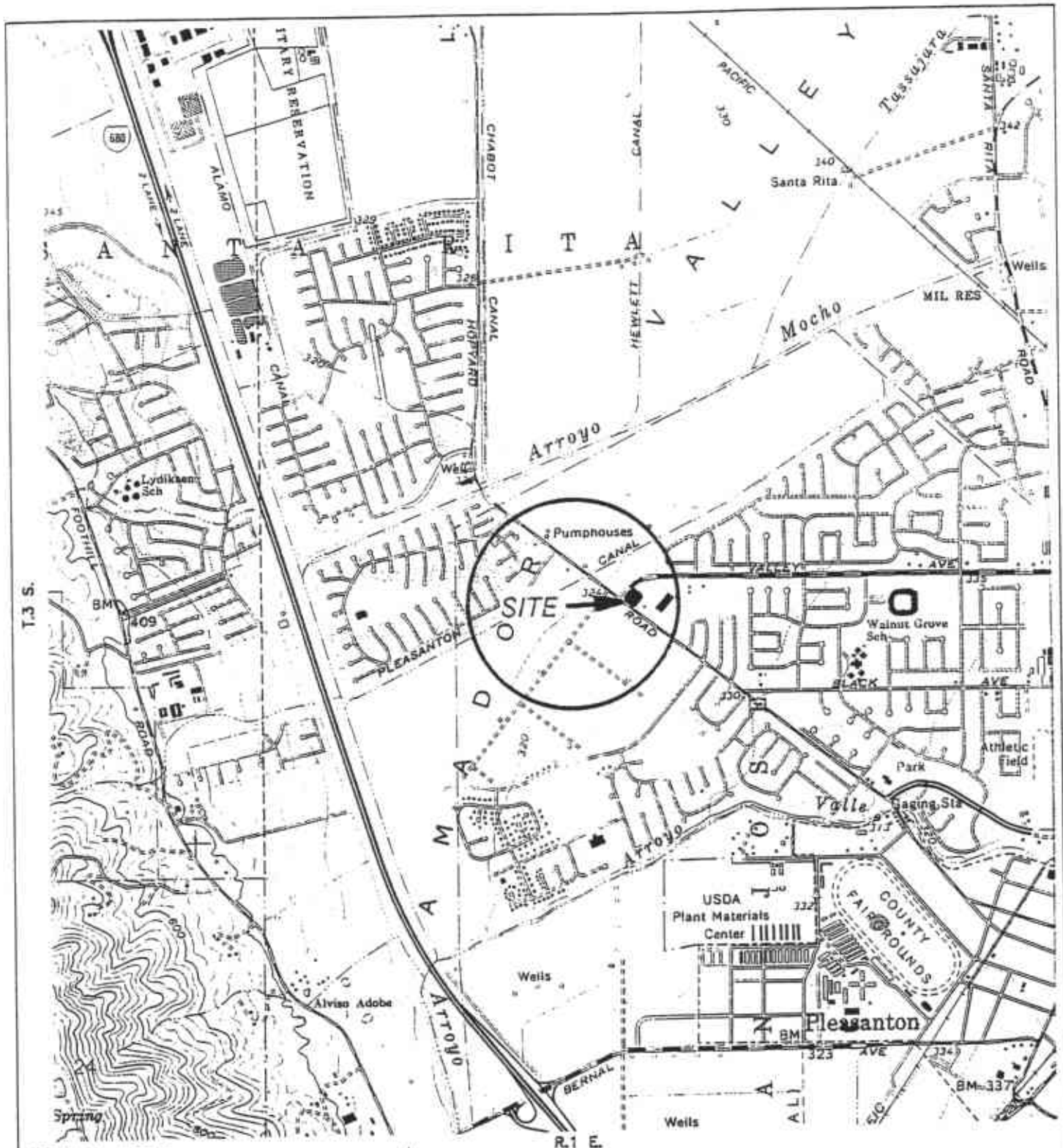

GENERAL NOTES:
 BASE MAP FROM U.S.G.S.
 DUBLIN, CA.
 7.5 MINUTE TOPOGRAPHIC
 PHOTOREVISED 1980

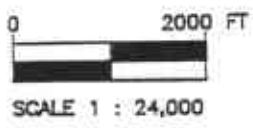
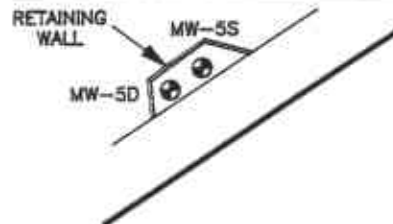

FIGURE 1
 SITE LOCATION MAP
 EXXON STATION NO 7-3399
 2991 HOPYARD ROAD
 PLEASANTON, CA.

PROJECT NO. D094-836	DRAWN BY L.H. 3/22/94
FILE NO. —	PREPARED BY TMG
REVISION NO. 1	REVIEWED BY <i>[Signature]</i>





LEGEND:

- B-12 SOIL BORING LOCATION
- ⊙ VR-1 VAPOR EXTRACTION WELL LOCATION
- MW-2 DESTROYED MONITORING WELL
- ⊕ MW-1 MONITORING WELL LOCATION

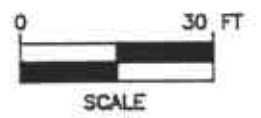

NOTE:
 BASE MAP ADAPTED FROM RESNA FIGURE. SITE DIMENSIONS AND FACILITY LOCATIONS NOT VERIFIED.

FIGURE 2
SITE MAP
EXXON STATION NO 7-3399
2991 HOPYARD ROAD
PLEASANTON, CA.

PROJECT NO. D094-836	DRAWN BY I.H. 9/22/94
FILE NO. 94-836-1	PREPARED BY TMG
REVISION NO. 1	REVIEWED BY <i>[Signature]</i>

Delta
Environmental
Consultants, Inc.

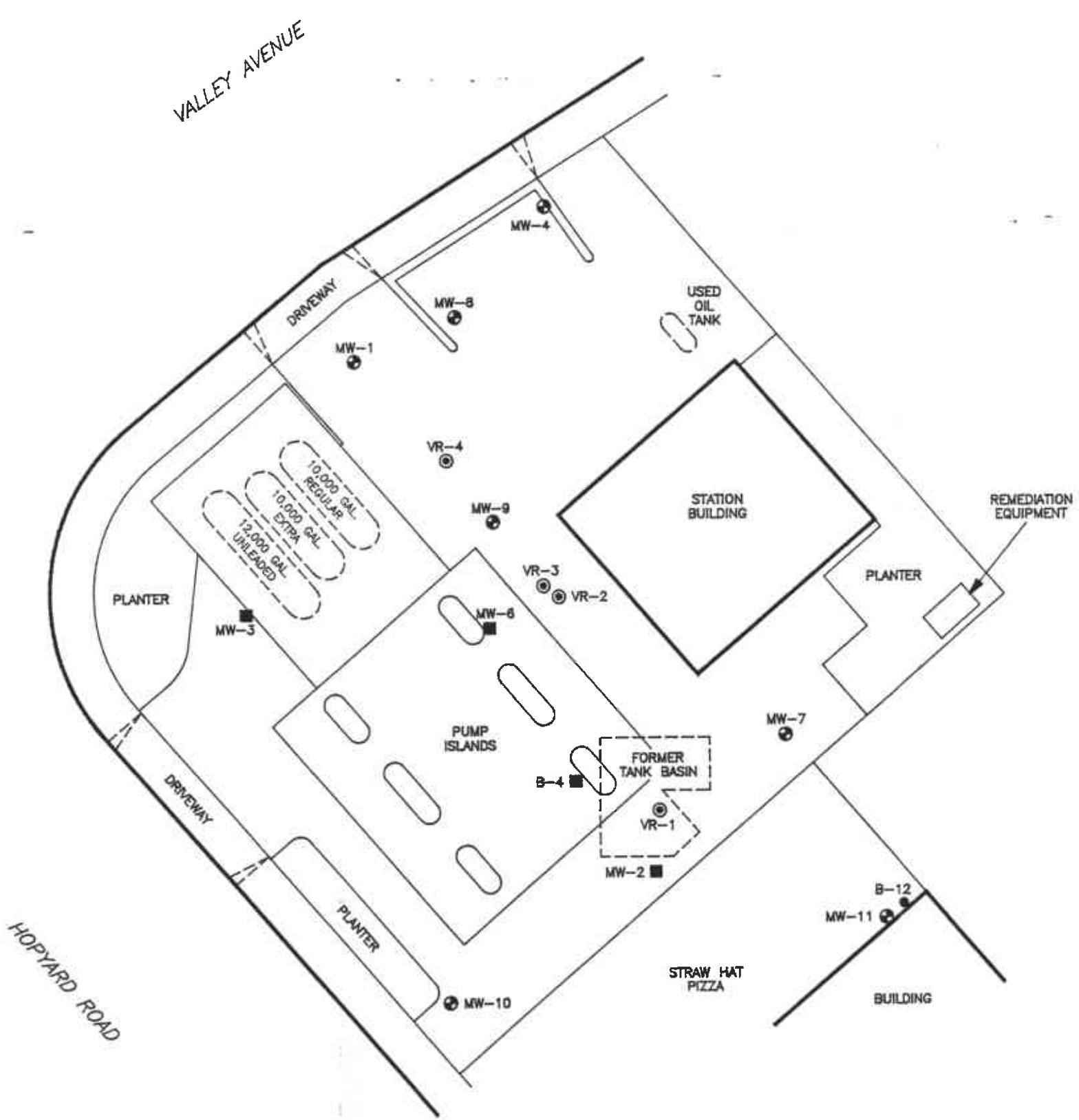

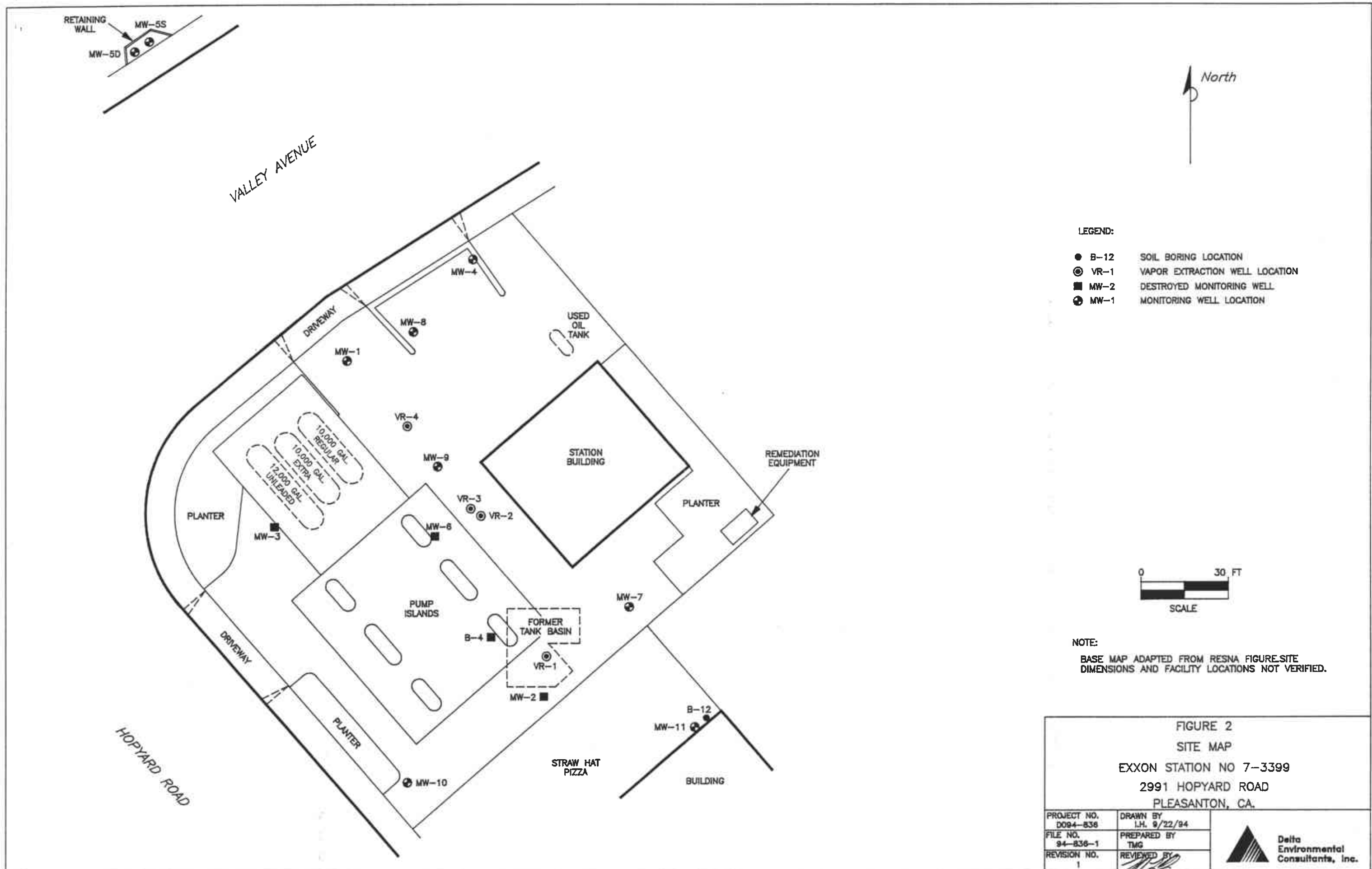

- LEGEND:**
- B-12 SOIL BORING LOCATION
 - ⊙ VR-1 VAPOR EXTRACTION WELL LOCATION
 - MW-2 DESTROYED MONITORING WELL
 - ⊕ MW-1 MONITORING WELL LOCATION

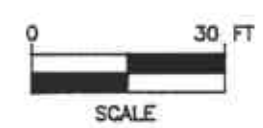

NOTE:
BASE MAP ADAPTED FROM RESNA FIGURE.SITE
DIMENSIONS AND FACILITY LOCATIONS NOT VERIFIED.

FIGURE 2
SITE MAP
EXXON STATION NO 7-3399
2991 HOPYARD ROAD
PLEASANTON, CA.

PROJECT NO. D094-836	DRAWN BY L.H. 9/22/94	Delta Environmental Consultants, Inc.
FILE NO. 94-836-1	PREPARED BY TMG	
REVISION NO. 1	REVIEWED BY <i>[Signature]</i>	

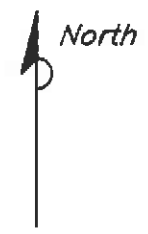
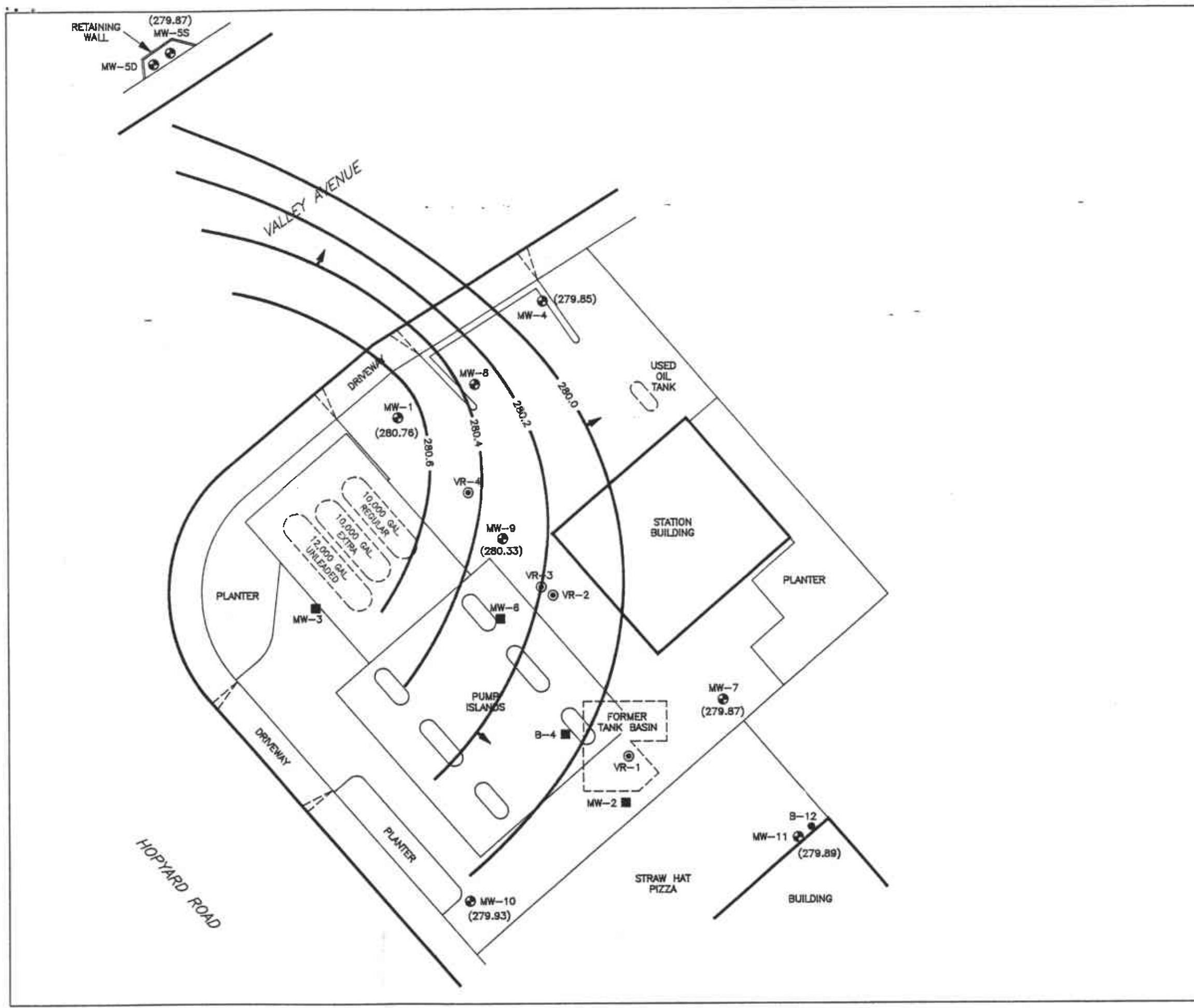

LEGEND:

- B-12 SOIL BORING LOCATION
- ⊙ VR-1 VAPOR EXTRACTION WELL LOCATION
- MW-2 DESTROYED MONITORING WELL
- ⊕ MW-1 MONITORING WELL LOCATION
- (280.76) GROUND WATER ELEVATION IN FEET ABOVE MEAN SEA LEVEL
- 280.4 — WATER TABLE CONTOUR IN FEET ABOVE MEAN SEA LEVEL
- ➔ GROUND WATER FLOW DIRECTION

NOTE:

MONITORING WELLS MW-5D AND MW-8 WERE NOT USED IN THE CALCULATION OF THE WATER TABLE CONTOURS BECAUSE THEY ARE SCREENED IN A DEEPER AQUIFER.

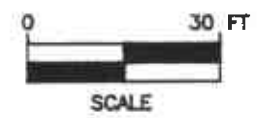

NOTE:

BASE MAP ADAPTED FROM RESNA FIGURE. SITE DIMENSIONS AND FACILITY LOCATIONS NOT VERIFIED.

FIGURE 3
WATER TABLE CONTOUR MAP - 8/21/95
EXXON STATION NO 7-3399
2991 HOPYARD ROAD
PLEASANTON, CA.

PROJECT NO. 0084-838	DRAWN BY L.H. 8/19/95
FILE NO. 94-838-1	PREPARED BY LJM
REVISION NO. 2	REVIEWED BY <i>[Signature]</i>

Delta
Environmental
Consultants, Inc.

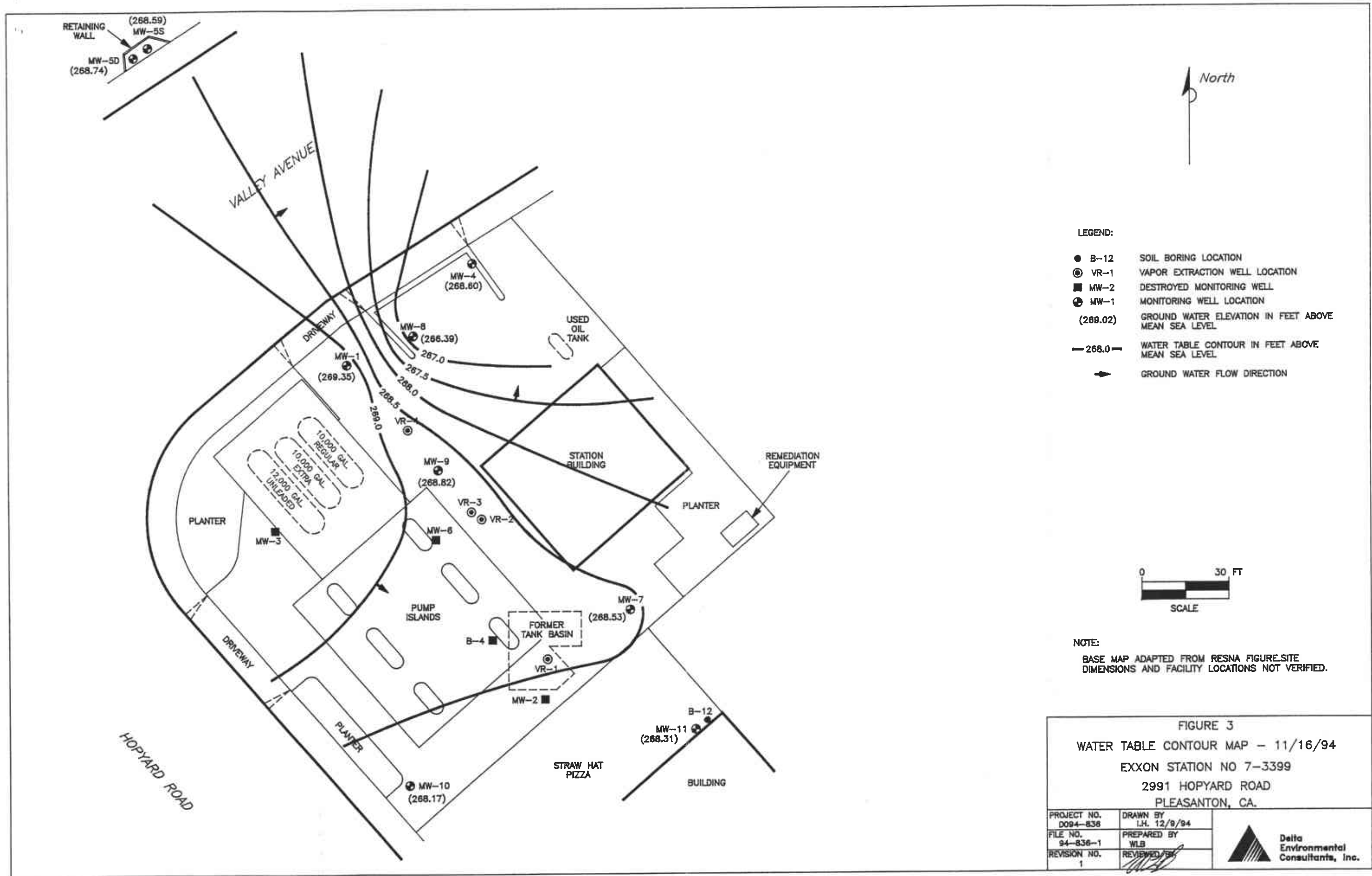

FIELD METHODS AND PROCEDURES

1.0 GROUND WATER AND LIQUID-PHASE HYDROCARBON DEPTH DETERMINATION

A water/petroleum interface probe was used to determine the thickness of liquid-phase hydrocarbon (LPH) if present, and a water level indicator was used to determine ground water depth in monitoring wells that do not contain LPH. Depth to ground water was measured from the top of each monitoring well casing. The tip of the water level indicator was subjectively analyzed for hydrocarbon sheen. All measurements and physical observations were recorded in the field.

2.0 SUBJECTIVE ANALYSIS OF GROUND WATER

Prior to purging, a water sample was collected from the monitoring well for subjective analysis. The sample was retrieved by gently lowering a clean, disposal bailer to approximately one-half the bailer length past the air/liquid interface. The bailer was then retrieved and the sample contained within the bailer was examined for floating LPH and the appearance of an LPH sheen.

3.0 MONITORING WELL PURGING AND SAMPLING

Monitoring wells were purged using a centrifugal pump or bailer until pH, temperature, and conductivity of the purge water had stabilized and a minimum of three to four well volumes of water had been removed. Ground water removed from the wells was stored in 55-gallon barrels at the site. The barrels were labeled with corresponding monitoring well numbers and the date of purging. After purging, ground water levels were allowed to stabilize. A ground water sample was then removed from each of the wells using a disposal bailer. If the well was purged dry, it was allowed to sufficiently recharge and a sample was collected. Samples were collected in air-tight vials, appropriately labeled, and stored on ice from the time of collection through the time of delivery to the laboratory. A chain-of-custody form was completed to ensure sample integrity. Ground water samples were transported to the laboratory and analyzed within the EPA-specified holding times for the requested analyses. Purge water will be collected from the storage barrels in a vacuum truck and transported to an appropriate facility for treatment and/or disposal.

ENCLOSURE B

Ground Water Table Measurements by RESNA Industries Inc.

TABLE 1
 CUMULATIVE GROUNDWATER MONITORING DATA
 Exxon Station 7-3399
 Pleasanton, California
 Page 1 of 18
 See notes on page 18

WELL	DATE	WELL ELEVATION	DEPTH TO WATER	GROUNDWATER ELEVATION	FLOATING PRODUCT
MW-1	04/06/88	321.44	36.34	285.10	None
	04/08/88		36.29	285.15	None
	04/19/88		36.36	285.08	None
	06/06/88		38.16	283.28	None
	06/23/88		38.71	282.73	None
	06/28/88		39.16	282.28	None
	07/06/88		39.73	281.71	None
	07/13/88		40.22	281.22	None
	08/12/88		NA		
	08/26/88		41.90	279.54	None
	09/07/88		42.27	279.17	None
	12/07/88		43.94	277.50	None
	12/19/88		43.70	277.74	None
	02/09/89		42.53	278.91	None
	03/08/89		41.96	279.48	None
	04/03/89		41.59	279.85	None
	04/26/89		41.67	279.77	None
	06/30/89		43.79	277.65	None
	07/17/89		44.74	276.70	None
	07/18/89		44.76	276.68	None
	07/19/89		44.82	276.62	None
	07/20/89		44.85	276.59	None
	07/21/89		44.95	276.49	None
	07/26/89		45.42	276.02	None
	08/02/89		NA		
	08/03/89		46.18	275.26	None
	08/17/89		47.12	274.32	None
	09/13/89		49.08	272.36	None
	11/28/89		50.21	271.23	None
	01/09/90		49.31	272.13	None

TABLE 1
 CUMULATIVE GROUNDWATER MONITORING DATA
 Exxon Station 7-3399
 Pleasanton, California
 Page 2 of 18
 See notes on page 18

WELL	DATE	WELL ELEVATION	DEPTH TO WATER	GROUNDWATER ELEVATION	FLOATING PRODUCT
MW-1	01/26/90		49.29	272.15	None
cont.	02/23/90		#49.02	272.42	None
	02/23/90		49.02	272.42	None
	03/26/90		#48.71	272.73	None
	03/26/90		48.70	272.74	None
	04/18/90		48.79	272.65	None
	05/17/90		49.40	272.04	None
	06/11/90		50.83	270.61	None
	07/30/90		52.17	269.27	None
	08/27/90		53.44	268.00	None
	09/28/90		53.40	268.04	None
	12/27/90		NA		
	03/20/91		53.35	268.09	None
	06/20/91		53.55	267.89	None
	09/12/91		NA		
	12/30/91		NA		
	01/30/92		NA		
	03/02/92		NA		
	03/24/92		NA		
	04/14/92		NA		
	05/21/92		NA		
	06/08/92		NA		
	07/14/92		NA		
	08/10/92		NA		
	09/16/92		NA		
	10/07/92		NA		
	11/09/92		DRY		
	12/10/92		NA		
	01/26/93		NA		
	02/16/93		NA		

TABLE 1
 CUMULATIVE GROUNDWATER MONITORING DATA
 Exxon Station 7-3399
 Pleasanton, California
 Page 3 of 18
 See notes on page 18

WELL	DATE	WELL ELEVATION	DEPTH TO WATER	GROUNDWATER ELEVATION	FLOATING PRODUCT
MW-1 cont.	03/11/93		53.09	268.35	None
	04/12/93		53.32	268.12	None
	06/01/93		53.40	268.04	None
	07/15/93		59.80	261.64	None
	08/15/93		53.45	267.99	None
	09/29/93		53.43	268.01	None
	10/28/93		53.38	268.06	None
	11/23/93		53.46	267.98	None
MW-2	04/02/88	NA	NA		3"
	04/04/88		NA		18.0"
	04/05/88		NA		18.0"
	04/06/88		39.31	NA	38.4"
	04/08/88		*	NA	*
	04/19/88		38.90	NA	29.76**
	06/06/88		38.78	NA	3.12"
	06/23/88		39.23	NA	1.50"
	06/28/88		39.72	NA	NA
	07/06/88		40.31	NA	Slight
			Well Destroyed		
MW-3	04/06/88		37.19	NA	None
	04/08/88		37.14	NA	None
	04/19/88		37.22	NA	None
	06/06/88		39.02	NA	None
	06/23/88		39.58	NA	None
	06/28/88		40.04	NA	None
	07/06/88		40.60	NA	None
	07/13/88		41.09	NA	None
	08/12/88		NA		
	08/26/88		42.77	NA	None
			Well Destroyed		

TABLE 1
 CUMULATIVE GROUNDWATER MONITORING DATA
 Exxon Station 7-3399
 Pleasanton, California
 Page 4 of 18
 See notes on page 18

WELL	DATE	WELL ELEVATION	DEPTH TO WATER	GROUNDWATER ELEVATION	FLOATING PRODUCT
MW-4	04/08/88	321.56	36.41	285.15	None
	04/19/88		36.51	285.05	None
	06/06/88		38.26	283.30	None
	06/23/88		38.83	282.73	None
	06/28/88		39.28	282.28	None
	07/06/88		39.85	281.71	None
	07/13/88		40.31	281.25	None
	08/12/88		NA		
	08/26/88		42.01	279.55	None
	09/07/88		NA		
	12/07/88		NA		
	12/19/88		43.83	277.73	None
	02/09/89		42.67	278.89	None
	03/08/89		42.11	279.45	None
	04/03/89		41.73	279.83	None
	04/26/89		41.79	279.77	None
	06/30/89		43.88	277.68	None
	07/17/89		44.85	276.71	None
	07/18/89		44.88	276.68	None
	07/19/89		44.92	276.64	None
	07/20/89		44.98	276.58	None
	07/21/89		45.04	276.52	None
	07/26/89		45.50	276.06	None
	08/02/89		NA		
	08/03/89		46.28	275.28	None
	08/17/89		47.22	274.34	None
	09/13/89		49.19	272.37	None
	11/28/89		50.34	271.22	None
	01/09/90		49.47	272.09	None
	01/26/90		49.36	272.20	None

TABLE 1
 CUMULATIVE GROUNDWATER MONITORING DATA
 Exxon Station 7-3399
 Pleasanton, California
 Page 5 of 18
 See notes on page 18

WELL	DATE	WELL ELEVATION	DEPTH TO WATER	GROUNDWATER ELEVATION	FLOATING PRODUCT
MW-4	02/23/90		#49.18	272.38	None
cont.	02/23/90		49.15	272.41	None
	03/26/90		#48.84	272.72	None
	03/26/90		48.83	272.73	None
	04/18/90		48.90	272.66	None
	05/17/90		50.03	271.53	None
	06/11/90		50.98	270.58	None
	07/30/90		53.57	267.99	None
	08/27/90		53.61	267.95	None
	09/28/90		53.57	267.99	None
	12/27/90		53.68	267.88	None
	03/20/91		53.56	268.00	None
	06/20/91		53.75	267.81	None
	09/12/91		53.70	267.86	None
	12/30/91		DRY		
	01/30/92		DRY		
	03/02/92		53.83	267.73	None
	03/24/92		53.73	267.83	None
	04/14/92		53.76	267.80	None
	05/21/92		54.73	266.83	None
	06/08/92		53.80	267.76	None
	07/14/92		53.60	267.96	None
	08/10/92		53.71	267.85	None
	09/16/92		53.89	267.67	None
	10/07/92		DRY		
	11/09/92		DRY		
	12/10/92		53.83	267.73	None
	01/26/93		DRY		
	02/16/93		53.64	267.92	None

TABLE 1
 CUMULATIVE GROUNDWATER MONITORING DATA
 Exxon Station 7-3399
 Pleasanton, California
 Page 6 of 18
 See notes on page 18

WELL	DATE	WELL ELEVATION	DEPTH TO WATER	GROUNDWATER ELEVATION	FLOATING PRODUCT	
MW-4 cont.	03/11/93		53.54	268.02	None	
	04/12/93		53.62	267.94	None	
	06/01/93		53.52	268.04	None	
	07/15/93		53.80	267.76	None	
	08/15/93		53.65	267.91	None	
	09/29/93		54.23	267.33	None	
	10/28/93		53.54	268.25	None	
	11/23/93		53.57	268.22	None	
MW-5d	05/25/88	321.79	38.55	283.24	None	
	06/06/88		38.90	282.89	None	
	06/23/88		39.56	282.23	None	
	06/28/88		40.23	281.56	None	
	07/06/88		40.69	281.10	None	
	07/13/88		41.22	280.57	None	
	08/12/88		42.34	279.45	None	
	08/26/88		42.60	279.19	None	
	09/07/88		42.99	278.80	None	
	12/07/88		44.58	277.21	None	
	02/09/89		Casing head damaged by construction			
	03/08/89		Casing head cut to lower elevation			
	03/08/93		42.49	279.30	None	
	04/03/89		42.21	279.58	None	
	04/26/89		42.36	279.43	None	
	06/30/89		44.79	277.00	None	
	07/17/89		45.73	276.06	None	
	07/18/89		45.75	276.04	None	
	07/19/89		44.89	276.90	None	
	07/20/89		46.02	275.77	None	
07/21/89		46.18	275.61	None		
07/26/89		46.83	274.96	None		

TABLE 1
 CUMULATIVE GROUNDWATER MONITORING DATA
 Exxon Station 7-3399
 Pleasanton, California
 Page 7 of 18
 See notes on page 18

WELL	DATE	WELL ELEVATION	DEPTH TO WATER	GROUNDWATER ELEVATION	FLOATING PRODUCT
MW-5d	08/02/89		NA		
cont.	08/03/89		47.67	274.12	None
	08/17/89		48.27	273.52	None
	09/13/89		50.60	271.19	None
	11/28/89		51.16	270.63	None
	01/09/90		50.42	271.37	None
	01/26/90		50.10	271.69	None
	02/23/90		50.08	271.71	None
	03/26/90		*49.80	271.99	None
	03/26/90		49.77	272.02	None
	04/18/90		49.80	271.99	None
	05/17/90		51.32	270.47	None
	06/11/90		52.10	269.69	None
	07/30/90		53.47	268.32	None
	08/27/90		58.24	263.55	None
	09/28/90		60.70	261.09	None
	12/27/90		62.52	259.27	None
	03/20/91		59.18	262.61	None
	06/20/91		65.02	256.77	None
	09/12/91		DRY		
	12/30/91		DRY		
	01/30/92		DRY		
	03/02/92		DRY		
	03/24/92		74.98	246.81	None
	04/14/92		74.42	247.37	None
	05/21/92		75.67	246.12	None
	06/08/92		DRY		
	07/14/92		DRY		
	08/10/92		DRY		
	09/16/92		DRY		

TABLE 1
 CUMULATIVE GROUNDWATER MONITORING DATA

Exxon Station 7-3399
 Pleasanton, California
 Page 8 of 18
 See notes on page 18

WELL	DATE	WELL ELEVATION	DEPTH TO WATER	GROUNDWATER ELEVATION	FLOATING PRODUCT
MW-5d cont.	10/07/92		DRY		
	11/09/92		DRY		
	12/10/92		DRY		
	01/26/93		DRY		
	02/16/93		76.47	245.32	None
	03/11/93		74.03	247.76	None
	04/12/93		70.96	250.83	None
	06/01/93		67.64	254.15	None
	07/15/93		54.40	267.39	None
	08/15/93		67.85	253.94	None
	09/29/93		67.62	254.17	None
	10/28/93		66.15	255.49	None
11/23/93		64.80	256.84	None	
MW-5s	05/25/88	321.64	38.46	283.18	None
	06/06/88		38.86	282.78	None
	06/23/88		39.52	282.12	None
	06/28/88		39.84	281.80	None
	07/06/88		40.45	281.19	None
	07/13/88		40.90	280.74	None
	07/22/88		41.30	280.34	None
	08/05/88		▼23.84	297.80	None
	08/12/88		42.21	279.43	None
	08/26/88		42.55	279.09	None
	09/07/88		42.94	278.70	None
	12/07/88		44.67	276.97	None
	02/09/89		43.19	278.45	None
	03/08/89		Casing head cut to lower elevation		
			42.11	279.53	None
04/26/89		41.84	279.80	None	
06/30/89		43.95	277.69	None	

TABLE 1
 CUMULATIVE GROUNDWATER MONITORING DATA
 Exxon Station 7-3399
 Pleasanton, California
 Page 9 of 18
 See notes on page 18

WELL	DATE	WELL ELEVATION	DEPTH TO WATER	GROUNDWATER ELEVATION	FLOATING PRODUCT
MW-5s	07/17/89		44.91	276.73	None
cont.	07/18/89		44.93	276.71	None
	07/19/89		44.98	276.66	None
	07/20/89		45.02	276.62	None
	07/21/89		45.10	276.54	None
	07/26/89		45.57	276.07	None
	08/02/89		NA		
	08/03/89		46.31	275.33	None
	08/17/89		47.25	274.39	None
	09/13/89		49.22	272.42	None
	11/28/89		50.39	271.25	None
	01/09/90		49.51	272.13	None
	01/26/90		49.40	272.24	None
	02/23/90		#49.20	272.44	None
	02/23/90		49.20	272.44	None
	03/26/90		#48.89	272.75	None
	03/26/90		48.88	272.76	None
	04/18/90		48.95	272.69	None
	05/17/90		50.06	271.58	None
	06/11/90		50.98	270.66	None
	07/30/90		53.40	268.24	None
	08/27/90		53.60	268.04	None
	09/28/90		53.55	268.09	None
	12/27/90		53.61	268.03	None
	03/20/91		53.56	268.08	None
	06/20/91		53.73	267.91	None
	09/12/91		53.78	267.86	None
	12/30/91		53.80	267.84	None
	01/30/92		53.82	267.82	None
	03/02/92		53.82	267.82	None

TABLE 1
 CUMULATIVE GROUNDWATER MONITORING DATA
 Exxon Station 7-3399
 Pleasanton, California
 Page 10 of 18
 See notes on page 18

WELL	DATE	WELL ELEVATION	DEPTH TO WATER	GROUNDWATER ELEVATION	FLOATING PRODUCT
MW-5s cont.	04/14/92		53.74	267.90	None
	05/21/92		53.77	267.87	None
	06/08/92		53.81	267.83	None
	07/14/92		53.74	267.90	None
	08/10/92		53.78	267.86	None
	09/16/92		53.90	267.74	None
	10/07/92		DRY		
	11/09/92		53.87	267.77	None
	12/10/92		53.78	267.86	None
	01/26/93		53.38	268.26	None
	02/16/93		53.44	268.20	None
	03/11/93		53.28	268.36	None
	04/12/93		53.42	268.22	None
	06/01/93		53.56	268.08	None
	07/15/93		53.00	268.64	None
	08/15/93		53.60	268.04	None
	09/29/93		53.62	268.02	None
	10/28/93		54.62	267.02	None
11/23/93		53.62	268.02	None	
MW-6	05/11/88	NA	37.31	NA	None
	06/06/88		38.70	NA	None
	06/23/88		39.23	NA	None
	06/28/88		39.74	NA	None
	07/13/88		40.78	NA	None
	08/05/88		41.72	NA	None
	08/12/88		42.14	NA	None
	08/17/88		NA		
	08/26/88		42.51	NA	None
	09/07/88		42.85	NA	None
	10/24/88			Well Destroyed	

TABLE 1
 CUMULATIVE GROUNDWATER MONITORING DATA
 Exxon Station 7-3399
 Pleasanton, California
 Page 11 of 18
 See notes on page 18

WELL	DATE	WELL ELEVATION	DEPTH TO WATER	GROUNDWATER ELEVATION	FLOATING PRODUCT
MW-7	07/13/88	321.27	40.50	280.77	None
	07/22/88		#41.85	279.42	##None
	08/05/88		#41.45	279.82	##None
	08/12/88		42.69	278.58	NM
	09/07/88		42.60	278.67	NM
	12/07/88		NA		
	01/17/89		43.20	278.07	NM
	02/09/89		NA		
	10/12/89		49.93	271.34	None
	11/28/89		#57.61	263.66	NM
	01/09/90		#57.57	263.70	NM
	01/26/90		#57.54	263.73	None
	01/26/90		49.08	272.19	None
	02/23/90		#55.26	266.01	None
	02/23/90		48.93	272.34	None
	03/26/90		#57.52	263.75	None
	03/26/90		48.60	272.67	None
	04/18/90		#57.55	263.72	None
	05/17/90		#57.40	263.87	None
	06/11/90		50.68	270.59	None
	07/30/90		NA		
	08/27/90		53.05	268.22	None
	09/28/90		NA		
	12/27/90		NA		
	03/20/91		54.11	267.16	None
	06/20/91		55.14	266.13	None
	09/12/91		55.84	265.43	None
	12/30/91		55.21	266.06	None
	01/30/92		54.88	266.39	None
	03/02/92		NA		

TABLE 1
 CUMULATIVE GROUNDWATER MONITORING DATA
 Exxon Station 7-3399
 Pleasanton, California
 Page 12 of 18
 See notes on page 18

WELL	DATE	WELL ELEVATION	DEPTH TO WATER	GROUNDWATER ELEVATION	FLOATING PRODUCT
MW-7 cont.	03/24/92		NA		
	04/14/92		NA		
	05/21/92		53.36	267.91	None
	06/08/92		54.20	267.07	None
	07/14/92		53.31	267.96	None
	08/10/92		54.01	267.26	None
	09/16/92		55.97	265.30	None
	10/07/92		56.09	265.18	None
	11/09/92		54.16	267.11	None
	12/10/92		56.02	265.25	None
	01/26/93		56.15	265.12	None
	02/16/93		56.23	265.04	None
	03/11/93		55.82	265.45	None
	04/12/93		55.45	265.82	None
	06/01/93		54.90	266.37	None
	07/15/93		54.50	266.77	None
	08/15/93		54.25	267.02	None
09/29/93		54.55	266.72	None	
10/28/93		54.94	266.92	None	
11/23/93		54.73	267.13	None	
MW-8	10/01/89	321.86	53.88	267.98	None
	11/28/89		53.74	268.12	None
	01/09/90		57.90	263.96	None
	01/26/90		53.57	268.29	None
	02/23/90		52.16	269.70	None
	03/26/90		#52.80	269.06	None
	04/18/90		51.60	270.26	None
	05/17/90		58.21	263.65	None
	06/11/90		58.65	263.21	None

TABLE 1
 CUMULATIVE GROUNDWATER MONITORING DATA
 Exxon Station 7-3399
 Pleasanton, California
 Page 13 of 18
 See notes on page 18

WELL	DATE	WELL ELEVATION	DEPTH TO WATER	GROUNDWATER ELEVATION	FLOATING PRODUCT
MW-8	07/30/90		64.33	257.53	None
cont.	08/27/90		70.41	251.45	None
	09/28/90		71.93	249.93	None
	12/27/90		66.60	255.26	None
	03/20/91		60.75	261.11	None
	06/20/91		88.77	233.09	None
	09/12/91		103.17	218.69	None
	12/30/91		81.15	240.71	None
	01/30/92		81.69	240.17	None
	03/02/92		78.45	243.41	None
	03/24/92		76.55	245.31	None
	04/14/92		75.56	246.30	None
	05/21/92		86.99	234.87	None
	06/08/92		91.69	230.17	None
	07/14/92		94.65	227.21	None
	08/10/92		95.02	226.84	None
	09/16/92		91.90	229.96	None
	10/07/92		DRY		
	11/09/92		84.35	237.51	None
	12/10/92		82.20	239.66	None
	01/26/93		78.63	243.23	None
	02/16/93		76.90	244.96	None
	03/11/93		74.39	247.47	None
	04/12/93		71.20	250.66	None
	06/01/93		68.04	253.82	None
	07/15/93		78.05	243.81	None
	08/15/93		78.45	243.41	None
	09/29/93		73.64	248.22	None
	10/28/93		67.53	253.91	None
	11/23/93		64.68	256.76	None

TABLE 1
 CUMULATIVE GROUNDWATER MONITORING DATA
 Exxon Station 7-3399
 Pleasanton, California
 Page 14 of 18
 See notes on page 18

WELL	DATE	WELL ELEVATION	DEPTH TO WATER	GROUNDWATER ELEVATION	FLOATING PRODUCT	
MW-9	10/12/89	321.44	50.24	271.20	None	
	11/28/89		50.59	270.85	Heavy	
	12/01/89		50.32	271.12	Heavy	
	12/07/89		50.13	271.31	Heavy	
	12/13/89		49.91	271.53	Slight	
	12/20/89		49.78	271.66	Slight	
	01/02/89		NA			
	01/09/90		49.39	272.05	Slight	
	01/26/90		49.30	272.14	None	
	02/23/90		#49.06	272.38	None	
	02/23/90		49.05	272.39	None	
	03/26/90		#48.75	272.69	None	
	03/26/90		48.73	272.71	Very Slight	
	04/18/90		48.81	272.63	Slight	
	05/17/90		49.96	271.48	Slight	
	06/11/90		51.58	269.86	NA	
	07/30/90		DRY			
	08/27/90		DRY			
	09/28/90		DRY			
	12/27/90		NA			
	03/20/91		DRY			
	06/20/91		49.63	271.81	None	
	09/12/91		NA			
	12/30/91		NA			
	01/30/92		NA			
	03/02/92		NA			
	03/24/92		NA			
	04/14/92		NA			
	05/21/92		NA			
	06/08/92		NA			
	07/14/92		NA			

TABLE 1
 CUMULATIVE GROUNDWATER MONITORING DATA
 Exxon Station 7-3399
 Pleasanton, California
 Page 15 of 18
 See notes on page 18

WELL	DATE	WELL ELEVATION	DEPTH TO WATER	GROUNDWATER ELEVATION	FLOATING PRODUCT
MW-9 cont.	08/10/92		NA		
	09/16/92		NA		
	10/07/92		DRY		
	11/09/92		DRY		
	12/10/92		NA		
	01/26/93		DRY		
	02/16/93		DRY		
	03/11/93		DRY		
	04/12/93		DRY		
	06/01/93		DRY		
	07/15/93		DRY		
	08/15/93		DRY		
	09/29/93		DRY		
10/28/93		DRY			
11/23/93		DRY			
MW-10	10/12/89	322.99	51.93	271.06	None
	11/28/89		51.88	271.11	None
	12/20/89		51.47	271.52	None
	01/09/90		50.98	272.01	None
	01/26/90		50.87	272.12	None
	02/23/90		#50.67	272.32	None
	02/23/90		50.65	272.34	None
	03/26/90		#50.36	272.63	None
	03/26/90		50.35	272.64	None
	04/18/90		50.45	272.54	None
	06/11/90		51.16	271.83	None
	07/30/90		55.72	267.27	None
	08/27/90		57.75	265.24	None
	09/28/90		NA		
	12/27/90		58.08	264.91	None
03/20/91		57.80	265.19	None	

TABLE 1
 CUMULATIVE GROUNDWATER MONITORING DATA
 Exxon Station 7-3399
 Pleasanton, California
 Page 16 of 18
 See notes on page 18

WELL	DATE	WELL ELEVATION	DEPTH TO WATER	GROUNDWATER ELEVATION	FLOATING PRODUCT
MW-10	06/20/91		58.00	264.99	None
cont.	09/12/91		DRY		
	12/30/91		NA		
	01/30/92		DRY		
	03/02/92		DRY		
	03/24/92		58.53	264.46	None
	04/14/92		DRY		
	05/21/92		DRY		
	06/08/92		DRY		
	07/14/92		DRY		
	08/10/92		DRY		
	09/16/92		DRY		
	10/07/92		DRY		
	11/09/92		DRY		
	12/10/92		DRY		
	01/26/93		DRY		
	02/16/93		58.23	264.76	None
	03/11/93		57.81	265.18	None
	04/12/93		57.84	265.15	None
	06/01/93		57.88	265.11	None
	07/15/93		DRY		
	08/15/93		DRY		
	09/29/93		DRY		
	10/28/93		DRY		
	11/23/93		DRY		
MW-11	11/10/89	321.77	50.64	272.13	None
	11/28/89		50.51	272.26	None
	12/20/89		51.47	271.30	None
	01/09/90		49.68	273.09	None
	01/26/90		49.55	273.22	None
	02/23/90		#49.37	273.40	None

TABLE 1
 CUMULATIVE GROUNDWATER MONITORING DATA
 Exxon Station 7-3399
 Pleasanton, California
 Page 17 of 18
 See notes on page 18

WELL	DATE	WELL ELEVATION	DEPTH TO WATER	GROUNDWATER ELEVATION	FLOATING PRODUCT
MW-11	02/23/90		49.35	273.42	None
cont.	03/26/90		#49.03	273.74	None
	04/18/90		49.12	273.65	None
	05/17/90		50.30	272.47	None
	06/11/90		51.16	271.61	None
	07/30/90		53.50	269.27	None
	08/27/90		53.65	269.12	None
	09/28/90		53.62	269.15	None
	12/27/90		53.63	269.14	None
	03/20/91		53.26	269.51	None
	06/20/91		53.60	269.17	None
	09/12/91		53.60	269.17	None
	12/30/91		53.95	268.82	None
	01/30/92		53.65	269.12	None
	03/02/92		53.68	269.09	None
	03/24/92		53.70	269.07	None
	04/14/92		53.66	269.11	None
	05/21/92		53.62	269.15	None
	06/08/92		53.61	269.16	None
	07/14/92		53.53	269.24	None
	08/10/92		53.58	269.19	None
	09/16/92		53.60	269.17	None
	10/07/92		DRY		
	11/09/92		DRY		
	12/10/92		53.59	269.18	None
	01/26/93		53.67	269.10	None
	02/16/93		53.60	269.17	None
	03/11/93		53.58	269.19	None
	04/12/93		53.54	269.23	None
	06/01/93		53.52	269.25	None
	07/15/93		53.60	269.17	None

TABLE 1
 CUMULATIVE GROUNDWATER MONITORING DATA
 Exxon Station 7-3399
 Pleasanton, California
 Page 18 of 18

WELL	DATE	WELL ELEVATION	DEPTH TO WATER	GROUNDWATER ELEVATION	FLOATING PRODUCT
MW-11	08/15/93		53.55	269.22	None
cont.	09/29/93		53.62	269.15	None
	10/28/93		53.63	269.14	None
	11/23/93		53.58	269.19	None

Well elevation relative to Mean Sea Level (MSL).
 Measurements in feet

NA : Not accessible

• : Not measured because of installed product-skimmer pump.

** : Thickness of floating product after the well was allowed to recharge for approximately 3 hours.

▼ : Anomalous water level possibly due to recharge from a perched water zone.

: Water level during pumping of MW-7.

: Water inspected in oil-water separator tank.

ENCLOSURE C

Ground Water Analytical Results Prior to July 1994

TABLE 2
 CUMULATIVE RESULTS OF LABORATORY ANALYSES
 OF GROUNDWATER SAMPLES

Exxon Station 7-3399
 Pleasanton, California
 Page 1 of 11
 See notes on page 11

WELL	DATE	TPHg	BENZENE	TOLUENE	ETHYL-BENZENE	TOTAL XYLENES	VOCs
MW-1	04/02/88	<20	<0.5	1.7	<0.5	<0.5	NA
	07/06/88	<20	<0.5	<0.5	<0.5	<0.5	NA
	07/13/88	<20	<0.5	<0.5	<0.5	<0.5	NA
	09/07/88	<20	<0.5	<0.5	<0.5	<0.5	NA
	03/03/89	<20	1.6	<0.5	<0.5	<0.5	NA
	06/30/89	<20	<0.5	<0.5	<0.5	<0.5	NA
	07/17/89	23	<0.5	<0.5	<0.5	<0.5	NA
	07/20/89	<20	<0.5	<0.5	<0.5	<0.5	NA
	07/26/89	<20	<0.5	<0.5	<0.5	<0.5	NA
	08/02/89	<20	<0.5	<0.5	<0.5	<0.5	NA
	09/13/89	220	39	0.60	<0.50	5.1	NA
	12/20/89	220	56	0.72	<0.50	0.71	NA
	01/25/90	57	18	1.6	<0.50	1.8	NA
	02/27/90	55	3.2	2.3	<0.50	3.2	NA
	03/26/90	<20	<0.5	<0.5	<0.5	<0.5	NA
	04/18/90	25	1.1	1.6	<0.50	3.1	NA
	05/17/90	<20	<0.5	<0.5	<0.5	<0.5	NA

TABLE 2
 CUMULATIVE RESULTS OF LABORATORY ANALYSES
 OF GROUNDWATER SAMPLES
 Exxon Station 7-3399
 Pleasanton, California
 Page 2 of 11
 See notes on page 11

WELL	DATE	TPHg	BENZENE	TOLUENE	ETHYL BENZENE	TOTAL XYLENES	VOCs
MW-1 cont.	06/11/90	<20	<0.5	<0.5	<0.5	<0.5	NA
	07/30/90	<20	<0.5	<0.5	<0.5	<0.5	NA
	08/27/90	<20	<0.5	<0.5	<0.5	<0.5	NA
	09/28/90	<50	<0.5	<0.5	<0.5	<0.5	NA
	12/10/92			Not Accessible			
	02/16/93			Not Accessible			
	04/12/93			Not Accessible			
	09/30/93	<50	<0.5	<0.5	<0.5	<0.5	NA
	11/24/93	<50	<0.5	<0.5	<0.5	<0.5	NA
MW-2	07/06/88	62,000	25,700	18,500	2,900	21,400	NA
	07/12/88			Well Destroyed			
MW-3	04/06/88	20	<0.5	<0.5	<0.5	<0.5	NA
	07/06/88	<20	<0.5	<0.5	<0.5	<0.5	NA
	07/13/88	<20	<0.5	<0.5	<0.5	<0.5	NA
	08/26/88	<20	<0.5	<0.5	<0.5	<0.5	NA
	08/29/88			Well Destroyed			

TABLE 2
CUMULATIVE RESULTS OF LABORATORY ANALYSES
OF GROUNDWATER SAMPLES

Exxon Station 7-3399
Pleasanton, California
Page 4 of 11
See notes on page 11

WELL	DATE	TPHg	BENZENE	TOLUENE	ETHYL- BENZENE	TOTAL XYLENES	VOCs
MW-4 cont.	02/16/93	600	57	34	11	200	NA
	04/12/93	360	20	10	22	80	NA
	09/30/93	<50	<0.5	<0.5	<0.5	<0.5	NA
	11/24/93	<50	<0.5	<0.5	<0.5	<0.5	NA
MW-5d	05/25/88	<20	<0.5	3.1	<0.5	<0.5	NA
	07/06/88	<20	<0.5	<0.5	<0.5	<0.5	NA
	07/13/88	40	<0.5	<0.5	<0.5	<0.5	NA
	03/08/89	<20	<0.5	<0.5	<0.5	<0.5	NA
	06/30/89	<20	<0.5	<0.5	<0.5	<0.5	NA
	07/17/89	<20	<0.5	<0.5	<0.5	<0.5	NA
	07/20/89	<20	<0.5	<0.5	<0.5	<0.5	NA
	07/26/89	<20	<0.5	<0.5	<0.5	<0.5	NA
	08/02/89	<20	<0.5	<0.5	<0.5	<0.5	NA
	09/13/89	<20	<0.5	<0.5	<0.5	<0.5	NA
	12/20/89	<20	<0.5	<0.5	<0.5	<0.5	NA
	03/26/90	<20	<0.5	<0.5	<0.5	<0.5	NA
	08/01/90	<20	<0.5	<0.5	<0.5	<0.5	NA
12/27/90	<50	<0.5	<0.5	<0.5	<0.5	NA	

TABLE 2
 CUMULATIVE RESULTS OF LABORATORY ANALYSES
 OF GROUNDWATER SAMPLES

Exxon Station 7-3399
 Pleasanton, California
 Page 5 of 11
 See notes on page 11

WELL	DATE	TPHg	BENZENE	TOLUENE	ETHYL-BENZENE	TOTAL XYLENES	VOCs
MW-5d	03/20/91	<50	<0.5	<0.5	<0.5	<0.5	NA
cont.	06/20/91	<50	<0.5	<0.5	<0.5	<0.5	NA
	12/10/92			Not Sampled			
	02/16/93			Not Sampled			
	04/12/93	<50	1.0	1.0	2.5	7.4	NA
	09/30/93	<50	<0.5	<0.5	<0.5	<0.5	NA
	11/24/93	<50	<0.5	<0.5	<0.5	<0.5	NA
MW-5s	05/25/88	<20	<0.5	0.9	<0.5	<0.5	NA
	07/06/88	<20	<0.5	<0.5	<0.5	<0.5	NA
	07/13/88	<20	<0.5	<0.5	<0.5	<0.5	NA
	07/22/88	50	0.9	4.1	1.3	8.7	NA
	08/05/88	<20	<0.5	<0.5	<0.5	<0.5	NA
	09/07/88	<20	<0.5	<0.5	<0.5	<0.5	NA
	03/08/89	<20	<0.5	<0.5	<0.5	<1.0	NA
	06/30/89	<20	<0.5	<0.5	<0.5	<0.5	NA
	07/17/89	<20	<0.5	<0.5	<0.5	<0.5	NA
	07/20/89	<20	<0.5	<0.5	<0.5	<0.5	NA

TABLE 2
CUMULATIVE RESULTS OF LABORATORY ANALYSES
OF GROUNDWATER SAMPLES
Exxon Station 7-3399
Pleasanton, California
Page 6 of 11
See notes on page 11

WELL	DATE	TPHg	BENZENE	TOLUENE	ETHYL-BENZENE	TOTAL XYLENES	VOCs
MW-5s	07/26/89	<20	<0.5	<0.5	<0.5	<0.5	NA
cont.	08/02/89	<20	<0.5	<0.5	<0.5	<0.5	NA
	09/13/89	<20	<0.5	<0.5	<0.5	<0.5	NA
	12/20/89	<50	<0.5	<0.5	<0.5	<0.5	NA
	03/26/90	<20	<0.5	<0.5	<0.5	<0.5	NA
	08/01/90	<50	<0.5	<0.5	<0.5	<0.5	NA
	12/27/90	<50	<0.5	<0.5	<0.5	<0.5	NA
	12/10/92			Not Sampled			
	02/16/93			Not Sampled			
	04/12/93	220	11	5.9	13	48	NA
	09/30/93	<50	<0.5	<0.5	<0.5	<0.5	NA
	11/24/93	<50	<0.5	<0.5	<0.5	<0.5	NA
MW-6	05/17/88	<20	<0.5	<0.5	<0.5	<0.5	NA
	06/28/88	440	31.8	7.5	5.4	6.7	NA
	07/13/88	290	162.3	7.7	22.5	14.1	NA
	08/05/88	1180	245	5.2	47.1	23.7	NA
	09/07/88	2920	474	16	262	136	NA
	10/24/88			Well Destroyed			

TABLE 2
 CUMULATIVE RESULTS OF LABORATORY ANALYSES
 OF GROUNDWATER SAMPLES
 Exxon Station 7-3399
 Pleasanton, California
 Page 7 of 11
 See notes on page 11

WELL	DATE	TPHg	BENZENE	TOLUENE	ETHYL- BENZENE	TOTAL XYLENES	VOCs
MW-7	07/13/88	16700	860	1910	710	4420	NA
	07/22/88	460	136	85	5	58	NA
	08/05/88	270	73.3	52.8	2.3	28.1	NA
	02/09/89	6700	600	688	10	448	NA
	06/30/89	1100	180	50	13	40	NA
	08/02/89	31	1.6	<0.5	<0.5	0.60	NA
	09/13/89	87	<0.5	2.6	<0.5	12	NA
	12/20/89	<20	<0.5	<0.5	<0.5	<0.5	NA
	06/20/91	74	<0.5	1.8	0.6	4.1	NA
	09/12/91	<50	3.5	<0.5	1.7	6.8	NA
	12/30/91	<50	<0.5	<0.5	<0.5	<0.5	NA
	06/08/92	<50	<0.5	<0.5	<0.5	<0.5	NA
	12/10/92			Not Sampled			
	02/16/93	600	28	30	17	200	NA
	04/12/93			Not Sampled			
	09/30/93			Not Sampled			
	11/24/93	<50	<0.5	<0.5	<0.5	<0.5	NA

TABLE 2
 CUMULATIVE RESULTS OF LABORATORY ANALYSES
 OF GROUNDWATER SAMPLES
 Exxon Station 7-3399
 Pleasanton, California
 Page 8 of 11
 See notes on page 11

WELL	DATE	TPHg	BENZENE	TOLUENE	ETHYL-BENZENE	TOTAL XYLENES	VOCs
Well #7 (City of Pleasanton)	07/20/89	NA	NA	NA	NA	NA	ND*
	08/02/89	NA	NA	NA	NA	NA	ND**
	03/26/90	<50	<0.50	<0.50	<0.50	<0.50	NA
MW-8	10/03/89	<20	<0.5	<0.5	<0.5	<0.5	NA
	12/20/89	<20	<0.50	<0.50	<0.50	0.61	NA
	01/31/90	<20	<0.50	<0.50	<0.50	0.87	NA
	02/09/90	<20	<0.5	<0.5	<0.5	1.1	NA
	(Blank)	<20	<0.5	<0.5	<0.5	<0.5	NA
	03/26/90	<20	<0.5	<0.5	<0.5	<0.5	NA
	(Blank)	<20	<0.5	<0.50	<0.5	<0.5	NA
	04/18/90	<20	<0.50	0.58	<0.50	1.1	NA
	05/17/90	<20	<0.5	<0.5	<0.5	<0.5	NA
	06/11/90	<20	<0.5	<0.5	<0.5	<0.5	NA
	08/01/90	<20	<0.5	<0.5	<0.5	<0.5	NA
	08/27/90	<20	<0.5	<0.5	<0.5	0.5	NA
09/28/90	<50	<0.5	<0.5	<0.5	0.5	NA	

TABLE 2
 CUMULATIVE RESULTS OF LABORATORY ANALYSES
 OF GROUNDWATER SAMPLES
 Exxon Station 7-3399
 Pleasanton, California
 Page 9 of 11
 See notes on page 11

WELL	DATE	TPHg	BENZENE	TOLUENE	ETHYL-BENZENE	TOTAL XYLENES	VOCs
MW-8	12/27/90	<50	<0.5	<0.5	<0.5	0.6	NA
cont.	03/20/91	<50	<0.5	<0.5	<0.5	<0.5	NA
	06/20/91	<50	<0.5	<0.5	<0.5	0.6	NA
	10/14/91	<50	<0.5	<0.5	<0.5	<0.5	NA
	12/30/91	<50	<0.5	<0.5	<0.5	<0.5	NA
	03/24/92	<50	<0.5	<0.5	<0.5	<0.5	NA
	06/08/92	<50	<0.5	<0.5	<0.5	<0.5	NA
	09/16/92	<50	<0.5	0.9	<0.5	<0.5	NA
	12/10/92	<50	<0.5	0.6	<0.5	<0.5	NA
	02/16/93	<50	0.7	0.6	<0.5	2.3	NA
	04/12/93	230	26	7.3	11	38	NA
	09/30/93	<50	<0.5	<0.5	<0.5	<0.5	NA
	11/24/93	<50	<0.5	<0.5	<0.5	<0.5	NA
MW-9	10/03/89	89000	1000	9200	3000	13000	NA
	12/20/89	190000	6300	31000	9500	55000	NA
	01/25/90	77000	2400	9400	2700	15000	NA
	02/27/90	97000	1200	7100	2300	14000	NA

TABLE 2
CUMULATIVE RESULTS OF LABORATORY ANALYSES
OF GROUNDWATER SAMPLES

Exxon Station 7-3399
Pleasanton, California
Page 10 of 11
See notes on page 11

WELL	DATE	TPHg	BENZENE	TOLUENE	ETHYL- BENZENE	TOTAL XYLENES	VOCs
MW-9 cont.	03/26/90	89000	1800	7700	2000	11000	NA
	04/18/90	110000	2000	7500	2500	16000	NA
	05/17/90	81000	1500	5700	2300	14000	NA
	06/20/90	430	<0.5	<0.5	<0.5	<0.5	NA
	12/10/92	Not Accessible					
MW-10	10/12/89	20	<0.5	<0.5	<0.5	1.5	NA
	12/20/89	<20	<0.5	<0.5	<0.5	1.8	NA
	03/26/90	<20	<0.5	<0.5	<0.5	<0.5	NA
	08/01/90	<20	<0.5	<0.5	<0.5	<0.5	NA
	02/16/93	Not Sampled					
	04/12/93	350	21	11	21	75	NA
MW-11	11/16/89	150	4.1	9.4	0.74	20	NA
	12/20/89	150	7.2	7.5	2.9	13	NA
	03/26/90	32	<0.5	<0.5	<0.5	2.7	NA
	07/30/90	26	<0.5	<0.5	<0.5	3.8	NA
	12/10/92	Not Sampled					
	02/16/93	Not Sampled					

TABLE 2
 CUMULATIVE RESULTS OF LABORATORY ANALYSES
 OF GROUNDWATER SAMPLES
 Exxon Station 7-3399
 Pleasanton, California
 Page 11 of 11

WELL	DATE	TPHg	BENZENE	TOLUENE	ETHYL-BENZENE	TOTAL XYLENES	VOCs
MW-11	04/12/93	<50	<0.5	<0.5	<0.5	<0.5	NA
cont.	09/30/93			Not Sampled			
	11/24/93	<50	<0.5	<0.5	<0.5	<0.5	NA
VR-1	03/24/92	<50	1.7	<0.5	<0.5	<0.5	NA
	MCLs	---	1.0	---	680	1,750	---
	DWAL	---	---	100	---	---	---

Results in parts per billion (ppb).

<	:	Less than the laboratory detection limit.
NA	:	Not Analyzed
ND	:	Not detected at or above method detection limit
---	:	Not Applicable
TPHg	:	Total petroleum hydrocarbons as gasoline analyzed using modified EPA method 5030/8015.
BTEX	:	Analyzed using modified EPA method 5030/8020.
VOCs	:	Volatile organic compounds
•	:	VOCs analyzed using EPA method 502.2.
••	:	VOCs analyzed using EPA method 524.2.
MCLs	:	Maximum Contaminant Levels, DHS (October 1990).
DWAL	:	Drinking Water Action Level, DHS (October 1990).

ENCLOSURE D

Copies of Laboratory Analytical Reports



Curtis & Tompkins, Ltd., Analytical Laboratories, Since 1878

2323 Fifth Street, Berkeley, CA 94710. Phone (510) 486-0900

ANALYTICAL REPORT

Prepared for:

Delta Environmental Consultants, Inc.
2350 Data Drive
Rancho Cordova, CA 95670

Date: 30-NOV-94
Lab Job Number: 118573
Project ID: 7-3399
Location: Pleasanton

Reviewed by: Tracy Babier

Reviewed by: Cynthia C. Kelley

This package may be reproduced only in its entirety.



LABORATORY NUMBER: 118573
 CLIENT: DELTA ENVIRONMENTAL CONSULTANTS
 PROJECT ID: 7-3399
 LOCATION: PLEASANTON

DATE SAMPLED: 11/16/94
 DATE RECEIVED: 11/17/94
 DATE ANALYZED: 11/27/94
 DATE REPORTED: 11/30/94

Total Volatile Hydrocarbons with BTXE in Aqueous Solutions
 TVH by California DOHS Method/LUFT Manual October 1989
 BTXE by EPA 5030/8020

LAB ID	SAMPLE ID	TVH AS GASOLINE (ug/L)	BENZENE (ug/L)	TOLUENE (ug/L)	ETHYL BENZENE (ug/L)	TOTAL XYLENES (ug/L)
118573-1	MW-1	ND(50)	ND(0.5)	ND(0.5)	ND(0.5)	ND(0.5)
118573-2	MW-4	ND(50)	ND(0.5)	ND(0.5)	ND(0.5)	ND(0.5)
118573-3	MW-5S	ND(50)	ND(0.5)	ND(0.5)	ND(0.5)	ND(0.5)
118573-4	MW-5D	ND(50)	ND(0.5)	ND(0.5)	ND(0.5)	ND(0.5)
118573-5	MW-7	ND(50)	ND(0.5)	ND(0.5)	ND(0.5)	ND(0.5)
118573-6	MW-8	ND(50)	ND(0.5)	ND(0.5)	ND(0.5)	ND(0.5)
118573-7	MW-10	ND(50)	ND(0.5)	ND(0.5)	ND(0.5)	ND(0.5)
	METHOD BLANK	ND(50)	ND(0.5)	ND(0.5)	ND(0.5)	ND(0.5)

ND = Not detected at or above reporting limit; Reporting limit indicated in parentheses.

QA/QC SUMMARY

RPD, ‰	4
RECOVERY, ‰	96



118572

EXXON COMPANY, U.S.A

P.O. Box 2180, Houston, TX 77002-7426

CHAIN OF CUSTODY

Berkeley, CA, 2323 Blk St., 94710
(610) 488-0900

Irvine, CA 2495 De Vinci Rd, 92714
(714) 262-9700

Curtis & Tompkins, Ltd.

P. 4
OV 30 '34 17:48 CURTIS & TOMPKINS BERKELEY

Page 1 of 1

Consultant's Name: Delta Environmental Consultants, Inc.

Address: 3330 Dana Dr. ste. 100, Rancho Cordova

Project #: D094-836

Project Contact: Todd Galati

EXXON Contact: Marla Guenoler

Sampled by (print): Paul Zicarro

Shipment Method: Arrow Courier

Site Location: Pleasanton

Consultant Project #: D094-836

Phone #: (916) 638-2085

Phone #: (510) 246-8776

Sampler's Signature: Paul Zicarro

Consultant Work Release #: 1943252.6

Laboratory Work Release #: _____

EXXON RAS #: 7-3399

Air Bill #: _____

TAT: 24 hr 48 hr 72 hr 96 hr Standard (10 day)

Sample Description	Collection Date	Collection Time	Matrix Soil/Water/Air	Presv	# of Cont.	C & T Sample #	ANALYSIS REQUIRED			Temperature: _____
							TPH/GAS/BTEX/8015/8020	TPH/Diesel EPA 8015	TRPH EPA 418.1	
MW-1 -1	11/16/94	11:50	Water	HCl	3		X			Inbound Seal: Yes No
MW-4 -2		10:10								Outbound Seal: Yes No
MW-5S -3		11:05								
MW-5D -4		11:15								
MW-7 -5		12:45								
MW-8 -6		10:25								
MW-10 -7		13:40								

Relinquished by/Affiliation	Date	Time	Accepted/Affiliation	Date	Time	Additional comments:
<u>Paul Zicarro</u>	<u>11/17/94</u>	<u>0903</u>	<u>Stephanie Senas</u>	<u>11/17/94</u>	<u>0903</u>	
<u>Stephanie Senas</u>	<u>11/17/94</u>	<u>1200</u>	<u>M. W. Smith</u>	<u>11/17/94</u>	<u>1200</u>	
	<u>11/17/94</u>	<u>1435</u>	<u>T. W. Scott</u>			