

*Maz Mattie*

**EXXON COMPANY, U.S.A.**

P.O. BOX 4032 . CONCORD, CA 94524-2032

ENVIRONMENTAL ENGINEERING

MARLA D. GUENSLER  
SENIOR ENVIRONMENTAL ENGINEER

(510) 246-8776  
(510) 246-8798 FAX

July 26, 1994

Mr. Rick Mueller  
Pleasanton Fire Department  
4444 Railroad Street  
Pleasanton, CA 94566

RE: Exxon RAS #7-3399; 2991 Hopyard Road, Pleasanton, CA

Dear Mr. Mueller:

Attached for your review and comment is a report entitled Letter Report Quarterly Groundwater Monitoring for the above referenced site. This report, prepared by RESNA Industries, Inc., of San Jose, California, details the results of the groundwater monitoring and sampling events which occurred Second Quarter 1994

Exxon will continue quarterly groundwater monitoring and sampling wells MW-1, MW-4, MW-5D, MW-5S, and MW-7 through MW-11 to evaluate the distribution of gasoline hydrocarbons in groundwater, and direction and gradient of groundwater flow. For third quarter 1994, groundwater samples collected during monitoring will be submitted for laboratory analyses for benzene, toluene, ethylbenzene, total xylenes, and total petroleum hydrocarbons as gasoline using modified Environmental Protection Agency methods 5030/8015/8020. Routine well maintenance and quality control will be performed as necessary during site visits.

If you have any questions or comments, please contact me at the above listed phone number.

Sincerely,

*Andrea J. Perez*

Andrea J. Perez  
Environmental Engineering Intern

*Marla D. Guensler*

Marla D. Guensler  
Senior Environmental Engineer

MDG/mdg

attachment: RESNA Letter Report Dated June 16, 1994

cc: w/attachment:  
Mr. Sum Arigalia - San Francisco Bay Region CRWQCB  
Mr. Jerry Killingstad - Alameda Co. Flood Control (Zone-7)  
Mr. Steve Cusenza - City of Pleasanton Public Works Dept.





3164 Gold Camp Drive  
Suite 200  
Rancho Cordova, CA 95670  
916/638-2085  
FAX: 916/638-8385

**EXXON COMPANY, U.S.A.**  
**QUARTERLY SUMMARY REPORT**

April through June 1995  
Date: June 22, 1995

RAS No. 7-3399  
2991 Hopyard  
Pleasanton, California  
Delta Project No. D094-836

**WORK PERFORMED THIS QUARTER**

Quarterly sampling report.

**DATE COMPLETED**

June 15, 1995

**QUARTERLY GROUND WATER SAMPLING (May 9 and 12, 1995) RESULTS: (ug/L)**

| Well No. | B    | T    | E    | X    | TPH <sup>a</sup> as gasoline | Historical Trend |
|----------|------|------|------|------|------------------------------|------------------|
| MW-1     | <0.5 | <0.5 | <0.5 | <0.5 | <50                          | Unchanged        |
| MW-4     | <0.5 | <0.5 | <0.5 | <0.5 | <50                          | Unchanged        |
| MW-5D    | <0.5 | <0.5 | <0.5 | <0.5 | <50                          | Unchanged        |
| MW-5S    | <0.5 | <0.5 | <0.5 | <0.5 | <50                          | Unchanged        |
| MW-7     | <0.5 | <0.5 | <0.5 | <0.5 | <50                          | Unchanged        |
| MW-8     | 2.3  | 1.2  | 2.0  | 7.4  | <50                          | Unchanged        |
| MW-9     | <0.5 | <0.5 | <0.5 | <0.5 | <50                          | Unchanged        |
| MW-10    | <0.5 | <0.5 | <0.5 | <0.5 | <50                          | Unchanged        |
| MW-11    | <0.5 | <0.5 | <0.5 | <0.5 | <50                          | Unchanged        |

<sup>a</sup> Total petroleum hydrocarbons.

<sup>b</sup> Not sampled.

**LIQUID PHASE HYDROCARBON RECOVERY SUMMARY:**

Not applicable.

Exxon Company, U.S.A.  
June 22, 1995  
Page 2

**WORK TO BE PERFORMED NEXT QUARTER:**

| <u>Activity</u>       | <u>Estimated<br/>Completion Date</u> |
|-----------------------|--------------------------------------|
| Quarterly monitoring. | August 1995                          |

**WORK TO BE PERFORMED NEXT 12 MONTHS:**

| <u>Activity</u>                     | <u>Estimated<br/>Completion Date</u>        |
|-------------------------------------|---|
| Quarterly monitoring and reporting. | August and November 1995, and February 1996 |

If you have any questions, please contact Linda J. McGahan at (916) 638-2085.

Sincerely,

**DELTA ENVIRONMENTAL CONSULTANTS, INC.**

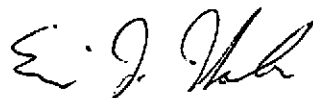

Eric J. Holm, R.G.  
California Registered Geologist No. 5880

LJM (MS228.SJS)

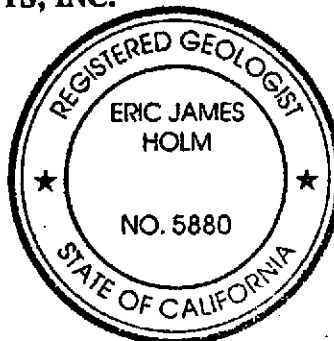

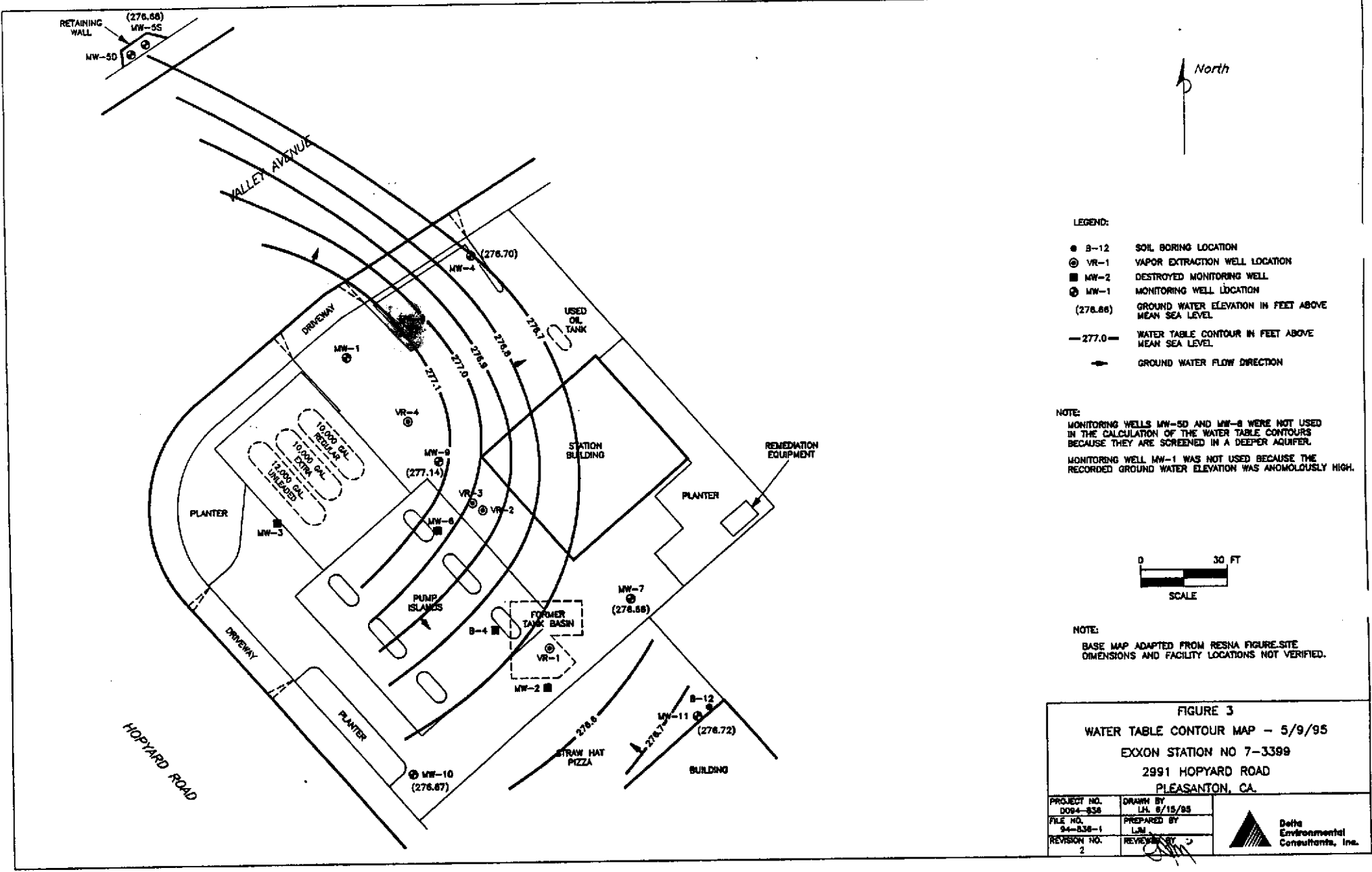

LEGEND:

- B-12 SOIL BORING LOCATION
- ⊙ VR-1 VAPOR EXTRACTION WELL LOCATION
- MW-2 DESTROYED MONITORING WELL
- ⊕ MW-1 MONITORING WELL LOCATION
- (278.88) GROUND WATER ELEVATION IN FEET ABOVE MEAN SEA LEVEL
- 277.0 — WATER TABLE CONTOUR IN FEET ABOVE MEAN SEA LEVEL
- GROUND WATER FLOW DIRECTION

NOTE:

MONITORING WELLS MW-5D AND MW-8 WERE NOT USED IN THE CALCULATION OF THE WATER TABLE CONTOURS BECAUSE THEY ARE SCREENED IN A DEEPER AQUIFER. MONITORING WELL MW-1 WAS NOT USED BECAUSE THE RECORDED GROUND WATER ELEVATION WAS ANOMALOUSLY HIGH.



NOTE:

BASE MAP ADAPTED FROM RESNA FIGURE. SITE DIMENSIONS AND FACILITY LOCATIONS NOT VERIFIED.

**FIGURE 3**  
**WATER TABLE CONTOUR MAP - 5/9/95**  
**EXXON STATION NO 7-3399**  
**2991 HOPYARD ROAD**  
**PLEASANTON, CA.**

|  |   |
|--|---|
| PROJECT NO.<br>D094-838<br>FILE NO.<br>94-838-1<br>REVISION NO.<br>2 | DRAWN BY<br>LH 8/15/95<br>PREPARED BY<br>LJM<br>REVIEWED BY<br> |
|--|---|

**Delta Environmental Consultants, Inc.**

# EXXON COMPANY, U.S.A.

POST OFFICE BOX 4032 • CONCORD, CA 94524-2032

ENVIRONMENTAL ENGINEERING

G. D. GIBSON  
SENIOR ENVIRONMENTAL ENGINEER

November 20, 1990

Exxon RAS 7-3399  
2991 Hopyard Road  
Pleasanton, California

Mr. Lester Feldman  
San Francisco Bay Regional Water Quality Control Board  
1800 Harrison Street, Suite 700  
Oakland, California 94612

Dear Mr. Feldman:

The attached letter, forwarded from Applied GeoSystems of Fremont, California, requests a change to the reporting frequency of the progress reports for the ongoing subsurface investigation at the above referenced Exxon Company, U.S.A. facility in the City of Pleasanton. Currently reports are being submitted every two months while the groundwater wells are being monitored and sampled quarterly. We feel that the reports will be more consistant and less confusing if the reporting was also done on a quarterly basis.

Please reply to me in writing if you concur or contact me at (415) 246-8768 to discuss this request. Thank you.

Sincerely,

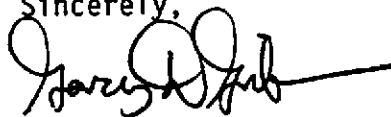

Gary D. Gibson

GDG:rh  
1929E  
Attachment

c - w/attachment:

Mr. S. Cusenza - City of Pleasanton Public Works Department  
Mr. R. Hiatt - San Francisco Bay Region Water Quality Control Board  
Mr. J. Killingstad - Alameda County Flood Control District Zone 7  
Mr. R. Mueller - City of Pleasanton Fire Department

w/o attachment:

Ms. M. D. Baca  
Mr. D. J. Bertoch  
Mr. P. J. Brininstool  
Mr. J. R. Hastings  
Mr. R. C. Witham - Applied GeoSystems

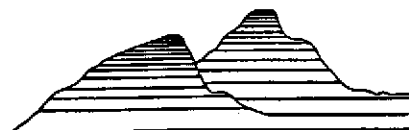

**Applied GeoSystems**

43255 Mission Boulevard, Fremont, CA 94539 (415) 651-1906

• FREMONT • IRVINE • HOUSTON • BOSTON • SACRAMENTO • CULVER CITY • SAN JOSE

November 16, 1990

1116lfel

AGS 18034-8

Mr. Lester Feldman  
California Regional Water Quality Control Board  
San Francisco Bay Region  
1800 Harrison Street, Suite 700  
Oakland, California 94612

Subject: Request for Quarterly Reporting Frequency at Exxon Station No. 7-3399,  
2991 Hopyard Road, Pleasanton, California.

Mr. Feldman:

On behalf of Exxon Company U.S.A. (Exxon), Applied GeoSystems (AGS) is performing periodic monitoring and ground-water sampling at Exxon Station No. 7-3399. In Administrative Order No. 89-132 (dated August 11, 1989), the California Regional Water Quality Control Board directed Exxon to provide status reports on a bimonthly basis. At the request of Exxon, AGS has reported the results of monitoring and sampling on a bimonthly basis for a period of 1 year. We hereby request authorization to begin quarterly reporting for this site. We will continue to monitor and sample on a quarterly basis.

We believe that reporting frequency has become less critical because (1) dissolved hydrocarbon concentrations are nondetectable in ground-water samples from seven of nine monitoring wells and (2) lowering of the shallow water table over the past 2 years has significantly reduced the rate of ground-water recovery (AGS Report No. 18034-8, dated September 28, 1990). The ground-water recovery system is currently shut down until water levels increase sufficiently for pumping. Exxon has installed a vapor-recovery and treatment system at the site and will recover hydrocarbon vapors from the sand and gravel unit that was formerly the shallow aquifer. Operation of that system will commence in November 1990.

**Request for Quarterly Reporting Frequency  
Exxon Station No. 7-3399, Pleasanton, California**

**November 16, 1990  
AGS 18034-8**

**We ask that you respond to this request at your earliest convenience. Please call if you have any questions.**

**Sincerely,  
Applied GeoSystems**

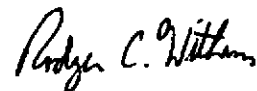

**Rodger C. Witham  
Project Manager**

**cc: Mr. Gary Gibson, Exxon Company U.S.A.**



3330 Data Drive  
 Suite 100  
 Rancho Cordova, CA 95670  
 916/638-2085  
 FAX: 916/638-8385

EXXON COMPANY, U.S.A.

QUARTERLY SUMMARY REPORT

July 1, 1994 through September 30, 1994  
 Date: October 11, 1994

RAS No. 7-3399  
 2991 Hopyard  
 Pleasanton, California

Delta Project No. D094-836

WORK PERFORMED THIS QUARTER

DATE COMPLETED

Quarterly sampling.

September 1, 1994

Prepared third quarter monitoring report.

October 10, 1994

QUARTERLY GROUND WATER SAMPLING (September 1, 1994) RESULTS: ( $\mu\text{g/L}$ )<sup>a</sup>

| Well No. | B               | T    | E    | X    | TPH <sup>b</sup> as gasoline | Historical Trend |
|----------|-----------------|------|------|------|------------------------------|------------------|
| MW-1     | <0.5            | <0.5 | <0.5 | <0.5 | <50                          | Increased        |
| MW-4     | <0.5            | <0.5 | <0.5 | <0.5 | <50                          | Decreased        |
| MW-5D    | <0.5            | <0.5 | <0.5 | <0.5 | <50                          | Unchanged        |
| MW-5S    | <0.5            | <0.5 | <0.5 | <0.5 | <50                          | Decreased        |
| MW-7     | <0.5            | <0.5 | <0.5 | <0.5 | <50                          | Decreased        |
| MW-8     | <0.5            | 0.5  | <0.5 | 1.0  | <50                          | Decreased        |
| MW-9     | NS <sup>c</sup> | NS   | NS   | NS   | NS                           |                  |
| MW-10    | <0.5            | <0.5 | <0.5 | <0.5 | <50                          | Unchanged        |
| MW-11    | NS              | NS   | NS   | NS   | NS                           |                  |

<sup>a</sup> Sample hold time was exceeded. The wells are scheduled for resampling in October 1994.

<sup>b</sup> Total petroleum hydrocarbons.

<sup>c</sup> Not sampled (well dry).



Exxon Company, U.S.A.  
October 11, 1994  
Page 2

**LIQUID PHASE HYDROCARBON RECOVERY SUMMARY:**

Not applicable.

**WORK TO BE PERFORMED NEXT QUARTER:**

| <u>Activity</u>                    | <u>Estimated<br/>Completion Date</u> |
|------------------------------------|--------------------------------------|
| Conduct fourth quarter monitoring. | November 1994                        |

**WORK TO BE PERFORMED NEXT 12 MONTHS:**

| <u>Activity</u>                     | <u>Estimated<br/>Completion Date</u>             |
|-------------------------------------|--|
| Quarterly monitoring and reporting. | November 1994, February, May, and<br>August 1995 |

If you have any questions, please contact me at (916) 638-2085.

Sincerely,

DELTA ENVIRONMENTAL CONSULTANTS, INC.

  
James R. Brownell, R.G.  
California Registered Geologist No. 5078

RDM (MS172.TA)

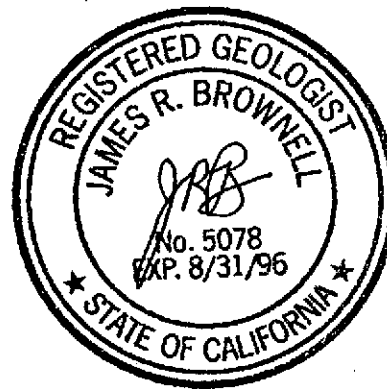

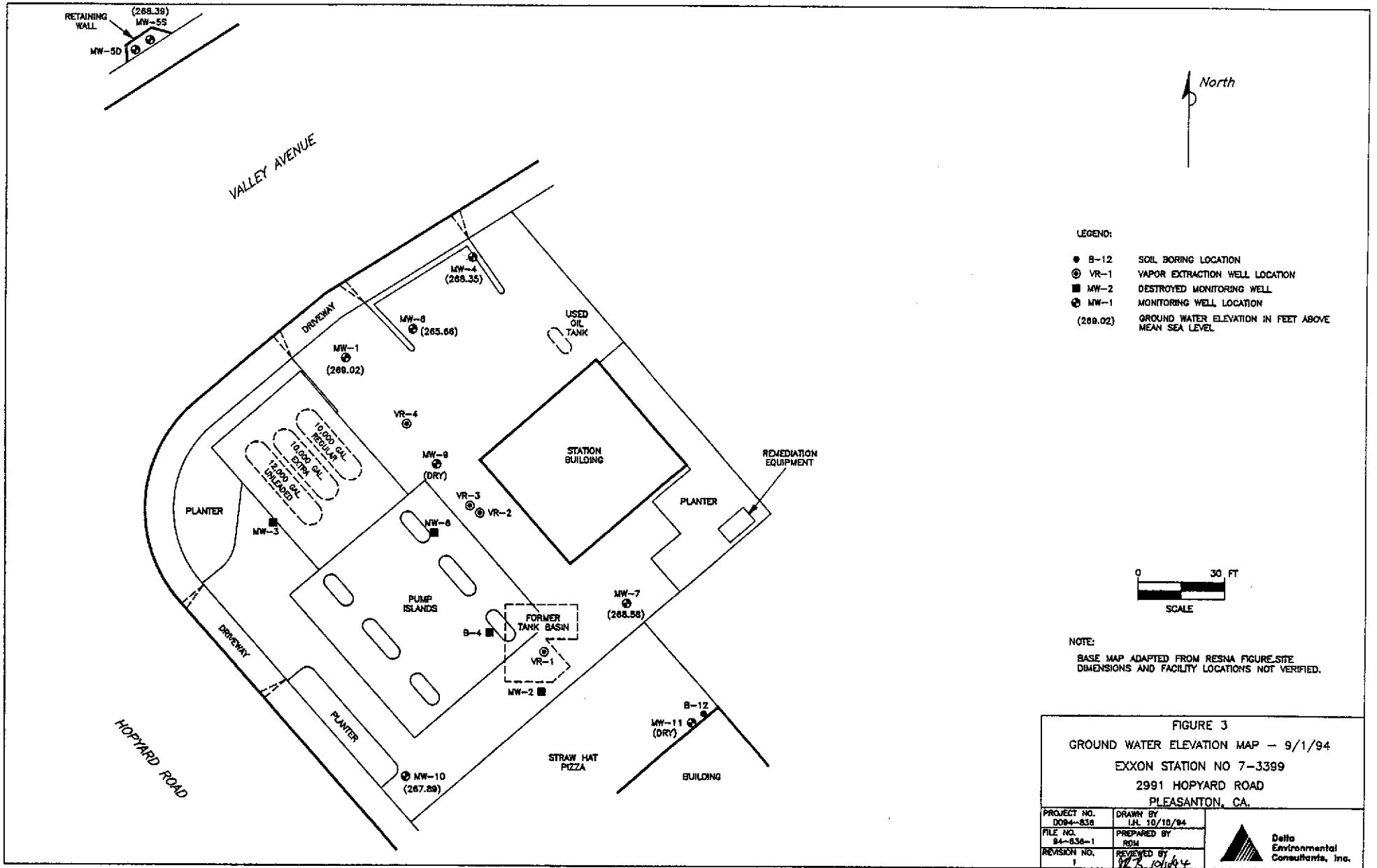

LEGEND:

- B-12 SOIL BORING LOCATION
- ⊙ VR-1 VAPOR EXTRACTION WELL LOCATION
- MW-2 DESTROYED MONITORING WELL
- ⊕ MW-1 MONITORING WELL LOCATION
- (288.02) GROUND WATER ELEVATION IN FEET ABOVE MEAN SEA LEVEL



NOTE:  
BASE MAP ADAPTED FROM RESNA FIGURE SITE.  
DIMENSIONS AND FACILITY LOCATIONS NOT VERIFIED.

FIGURE 3  
GROUND WATER ELEVATION MAP - 9/1/94  
EXXON STATION NO 7-3399  
2991 HOPYARD ROAD  
PLEASANTON, CA.

|                         |  |
|-------------------------|--|
| PROJECT NO.<br>D084-836 | DRAWN BY<br>LKL 10/18/84                   |
| FILE NO.<br>84-836-1    | PREPARED BY<br>RDM                         |
| REVISION NO.<br>1       | REVIEWED BY<br><i>[Signature]</i> 10/18/84 |

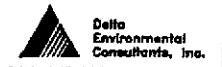

Haz Mat File



42501 Albrae Street, Suite 100  
Fremont, California 94538  
Phone: (510) 440-3300  
FAX: (510) 651-2233

LETTER REPORT  
QUARTERLY GROUNDWATER MONITORING  
Second Quarter 1994  
Exxon Station 7-3399  
2991 Hopyard Road  
Pleasanton, California

130009.20

6-16-94

42501 Albrae Street, Suite 100  
Fremont, California 94538  
Phone: (510) 440-3300  
FAX: (510) 651-2233

June 16, 1994

Ms. Marla Guensler  
Exxon Company, U.S.A.  
P.O. Box 4032  
2300 Clayton Road  
Concord, California 94520

Subject: Quarterly Groundwater Monitoring, Second Quarter 1994  
Exxon Station 7-3399  
2991 Hopyard Road, Pleasanton, California.

Ms. Guensler:

At the request of Exxon Company U.S.A. (Exxon), RESNA Industries Inc. (RESNA) performed the second quarter 1994 groundwater monitoring at the subject site (Plate 1, Site Vicinity Map). The objectives of groundwater monitoring are to evaluate: groundwater elevations, gradient and flow direction; the presence and thickness of any liquid-phase hydrocarbons; and the distribution of dissolved gasoline hydrocarbons in groundwater.

#### **GROUNDWATER MONITORING AND SAMPLING**

On May 4 and 5, 1994, RESNA measured the depth to water and performed subjective analysis on wells MW-1, MW-4, MW-5D, MW-5S, and MW-7 through MW-11. Groundwater samples were collected from wells MW-1, MW-4, MW-5D, MW-5S, MW-7, and MW-8 for laboratory analyses. Well MW-9 was not sampled because it was dry. Wells MW-10 and MW-11 were not sampled because the amount of water in each well was insufficient to purge, or take a water sample. RESNA's groundwater sampling protocol and well purge data sheets are in Appendix A, Groundwater Sampling Protocol and Well Purge Data Sheets.

Neither liquid phase hydrocarbons nor sheen were observed in groundwater samples collected from the wells. Depth to water measurements from May 4, 1994, indicate that groundwater elevations at the site have increased an average of approximately 0.8 foot in wells MW-1, MW-4, MW-5D, MW-5S, MW-7, MW-8, MW-10, and MW-11 since last

quarter. Based on the groundwater elevations for the first water bearing zone, the groundwater surface appears to flow north-northwest with a hydraulic gradient of approximately 0.004. Wells MW-10 and MW-11 were excluded from the interpreted groundwater gradient because they are believed to contain residual water. Groundwater elevations from wells MW-5D and MW-8 were excluded because they are installed in the second and third water-bearing zones respectively. Results are shown on plate 2, Groundwater Elevations and Chemical Concentrations. Historical and recent monitoring data are summarized in Table 1, Cumulative Groundwater Monitoring and Sampling Data.

## **LABORATORY ANALYSES AND RESULTS**

Groundwater samples were submitted to Pace Incorporated Laboratories (California State Certification Number 1282) in Novato, California, under chain of custody protocol. The samples were analyzed for total petroleum hydrocarbons as gasoline (TPHg), benzene, toluene, ethylbenzene, and total xylenes, using the methods listed in the notes in Table 1. The laboratory analysis reports and chain of custody records are in Appendix B, Laboratory Analysis Reports and Chain of Custody Records.

Results of laboratory analysis of groundwater samples are shown on Plate 2, and are summarized in Table 1.

- Concentrations of TPHg, benzene, toluene, ethylbenzene, and total xylenes were not detected at their method detection limits in all wells sampled.

## **LIMITATIONS**

This report was prepared in accordance with generally accepted standards of environmental geological practice in California at the time this investigation was performed. This report has been prepared for Exxon Company U.S.A. and any reliance on this report by third parties shall be at such party's sole risk.

If you have any questions or comments regarding this report, please call (510) 440-3300.

Sincerely,  
RESNA Industries Inc.

*Christian O. Allen* (MS)

Christian O. Allen  
Geologic Technician

*Michael L. Siembieda*

Michael L. Siembieda, R.G. 4007  
Geoscience Manager

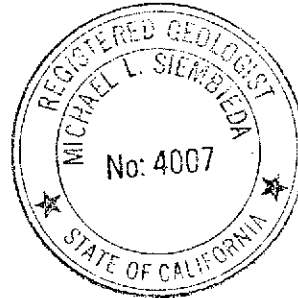

Enclosures: Plate 1: Site Vicinity Map  
Plate 2: Groundwater Elevation and Chemical Concentrations

Table 1: Cumulative Groundwater Monitoring and Sampling Data

Appendix A: Groundwater Sampling Protocol and Well Purge Data Sheets  
Appendix B: Laboratory Analysis Reports and Chain of Custody Records



Note: MW-2 Destroyed July 12, 1988  
 MW-3 Destroyed August 28, 1988  
 MW-6 Destroyed October 24, 1988

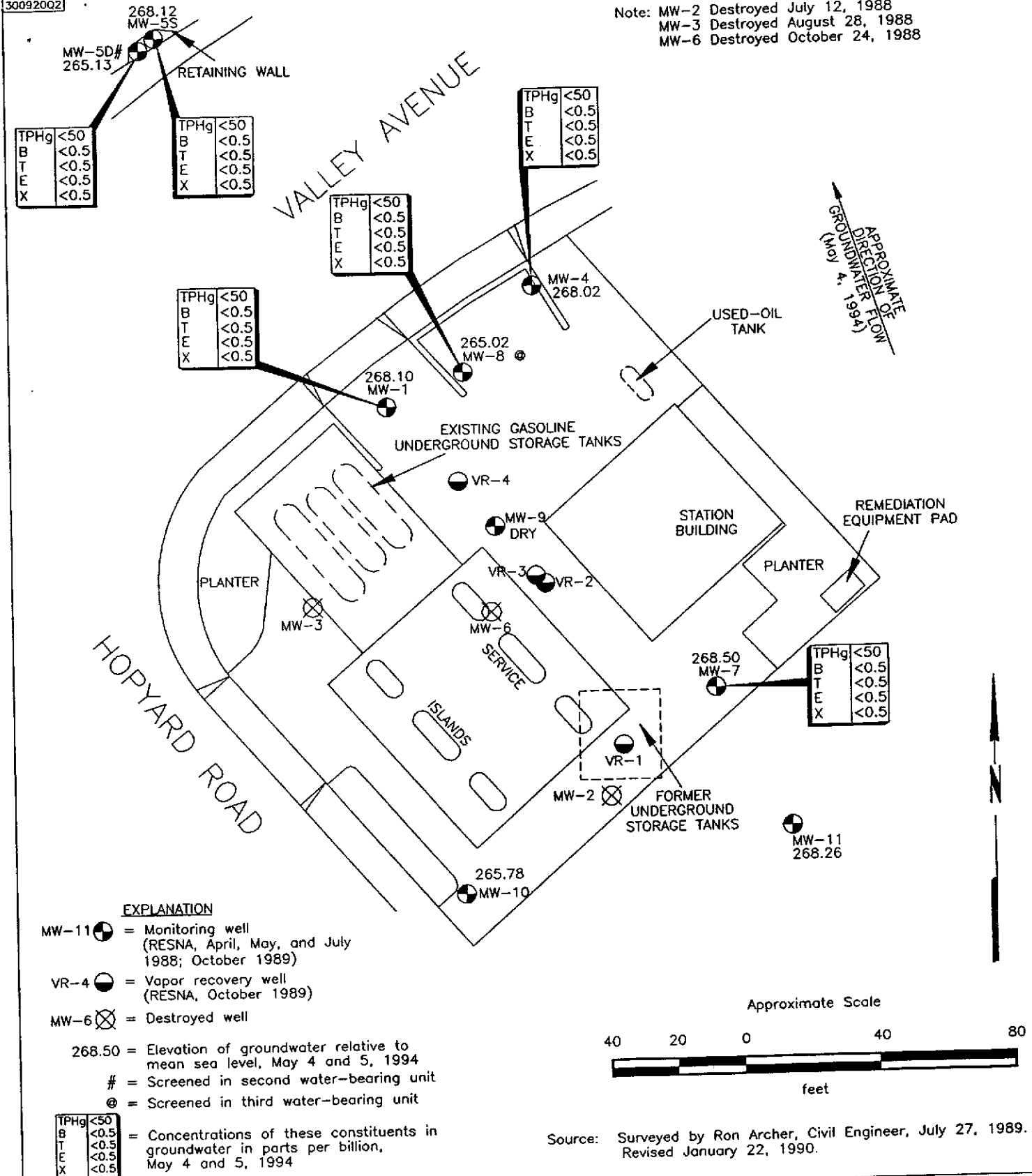

**EXPLANATION**

- MW-11 = Monitoring well (RESNA, April, May, and July 1988; October 1989)
- VR-4 = Vapor recovery well (RESNA, October 1989)
- MW-6 = Destroyed well
- 268.50 = Elevation of groundwater relative to mean sea level, May 4 and 5, 1994
- # = Screened in second water-bearing unit
- @ = Screened in third water-bearing unit

|      |      |
|------|------|
| TPHg | <0.5 |
| B    | <0.5 |
| T    | <0.5 |
| E    | <0.5 |
| X    | <0.5 |

= Concentrations of these constituents in groundwater in parts per billion, May 4 and 5, 1994

Source: Surveyed by Ron Archer, Civil Engineer, July 27, 1989.  
 Revised January 22, 1990.

**GROUNDWATER ELEVATION AND  
 CHEMICAL CONCENTRATIONS**  
 Exxon Station 7-3399  
 2991 Hopyard Road  
 Pleasanton, California

**PLATE  
 2**





**TABLE 1  
CUMULATIVE GROUNDWATER MONITORING AND SAMPLING DATA**

Exxon Service Station 7-3399  
2991 Hopyard Road  
Pleasanton, California  
(Page 1 of 16)

| Well ID #<br>(TOC) | Sampling<br>Date | SUBJ<br>< . . . . . | DTW<br>feet | Elev.<br>> . . . . . | TPHg<br>< . . . . . | B<br>< . . . . . | T<br>parts per billion | E<br>< . . . . . | X<br>< . . . . . | VOCs<br>> . . . . . |
|--------------------|------------------|---------------------|-------------|----------------------|---------------------|------------------|------------------------|------------------|------------------|---------------------|
| MW-1<br>(321.44)   | 04/02/88         | NM                  | NM          | —                    | <20                 | <0.5             | 1.7                    | <0.5             | <0.5             | NA                  |
|                    | 04/06/88         | NLPH                | 36.34       | 285.10#              |                     |                  |                        |                  |                  |                     |
|                    | 04/08/88         | NLPH                | 36.29       | 285.15#              |                     |                  |                        |                  |                  |                     |
|                    | 04/19/88         | NLPH                | 36.36       | 285.08#              |                     |                  |                        |                  |                  |                     |
|                    | 06/06/88         | NLPH                | 38.16       | 283.28#              |                     |                  |                        |                  |                  |                     |
|                    | 06/23/88         | NLPH                | 38.71       | 282.73#              |                     |                  |                        |                  |                  |                     |
|                    | 06/28/88         | NLPH                | 39.16       | 282.28#              |                     |                  |                        |                  |                  |                     |
|                    | 07/06/88         | NLPH                | 39.73       | 281.71               | <20                 | <0.5             | <0.5                   | <0.5             | <0.5             | NA                  |
|                    | 07/13/88         | NLPH                | 40.22       | 281.22               | <20                 | <0.5             | <0.5                   | <0.5             | <0.5             | NA                  |
|                    | 08/12/88         |                     |             |                      |                     | Not Accessible   |                        |                  |                  |                     |
|                    | 08/26/88         | NLPH                | 41.90       | 279.54#              |                     |                  |                        |                  |                  |                     |
|                    | 09/07/88         | NLPH                | 42.27       | 279.17               | <20                 | <0.5             | <0.5                   | <0.5             | <0.5             | NA                  |
|                    | 12/07/88         | NLPH                | 43.94       | 277.50#              |                     |                  |                        |                  |                  |                     |
|                    | 12/19/88         | NLPH                | 43.70       | 277.74#              |                     |                  |                        |                  |                  |                     |
|                    | 02/09/89         | NLPH                | 42.53       | 278.91#              |                     |                  |                        |                  |                  |                     |
|                    | 03/03/89         | NM                  | NM          | —                    | <20                 | 1.6              | <0.5                   | <0.5             | <0.5             | NA                  |
|                    | 03/08/89         | NLPH                | 41.96       | 279.48#              |                     |                  |                        |                  |                  |                     |
|                    | 04/03/89         | NLPH                | 41.59       | 279.85#              |                     |                  |                        |                  |                  |                     |
|                    | 04/26/89         | NLPH                | 41.67       | 279.77#              |                     |                  |                        |                  |                  |                     |
|                    | 06/30/89         | NLPH                | 43.79       | 277.65               | <20                 | <0.5             | <0.5                   | <0.5             | <0.5             | NA                  |
|                    | 07/17/89         | NLPH                | 44.74       | 276.70               | 23                  | <0.5             | <0.5                   | <0.5             | <0.5             | NA                  |
|                    | 07/18/89         | NLPH                | 44.76       | 276.68#              |                     |                  |                        |                  |                  |                     |
|                    | 07/19/89         | NLPH                | 44.82       | 276.62#              |                     |                  |                        |                  |                  |                     |
|                    | 07/20/89         | NLPH                | 44.85       | 276.59               | <20                 | <0.5             | <0.5                   | <0.5             | <0.5             | NA                  |
|                    | 07/21/89         | NLPH                | 44.95       | 276.49#              |                     |                  |                        |                  |                  |                     |
|                    | 07/26/89         | NLPH                | 45.42       | 276.02               | <20                 | <0.5             | <0.5                   | <0.5             | <0.5             | NA                  |
|                    | 08/02/89         |                     |             | Not Accessible       |                     |                  |                        |                  |                  |                     |
|                    | 08/03/89         | NLPH                | 46.18       | 275.26               | <20                 | <0.5             | <0.5                   | <0.5             | <0.5             | NA                  |
|                    | 08/17/89         | NLPH                | 47.12       | 274.32#              |                     |                  |                        |                  |                  |                     |
|                    | 09/13/89         | NLPH                | 49.08       | 272.36               | 220                 | 39               | 0.60                   | <0.50            | 5.1              | NA                  |
|                    | 11/28/89         | NLPH                | 50.21       | 271.23#              |                     |                  |                        |                  |                  |                     |
|                    | 12/20/89         | NM                  | NM          | —                    | 220                 | 56               | 0.72                   | <0.50            | 0.71             | NA                  |
|                    | 01/09/90         | NLPH                | 49.31       | 272.13#              |                     |                  |                        |                  |                  |                     |
|                    | 01/25-26/90      | NLPH                | 49.29       | 272.15               | 57                  | 18               | 1.6                    | <0.50            | 1.8              | NA                  |
|                    | 02/23/90         | NLPH                | 49.02       | 272.42#              |                     |                  |                        |                  |                  |                     |
|                    | 02/23/90         | NLPH                | 49.02       | 272.42#              |                     |                  |                        |                  |                  |                     |
|                    | 02/27/90         | NM                  | NM          | —                    | 55                  | 3.2              | 2.3                    | <0.50            | 3.2              | NA                  |
|                    | 03/26/90         | NLPH                | 48.70       | 272.74               | <20                 | <0.5             | <0.5                   | <0.5             | <0.5             | NA                  |
|                    | 04/18/90         | NLPH                | 48.79       | 272.65               | 25                  | 1.1              | 1.6                    | <0.50            | 3.1              | NA                  |
|                    | 05/17/90         | NLPH                | 49.40       | 272.04               | <20                 | <0.5             | <0.5                   | <0.5             | <0.5             | NA                  |
|                    | 06/11/90         | NLPH                | 50.83       | 270.61               | <20                 | <0.5             | <0.5                   | <0.5             | <0.5             | NA                  |

See notes on page 16 of 16.

**TABLE 1  
CUMULATIVE GROUNDWATER MONITORING AND SAMPLING DATA**

Exxon Service Station 7-3399  
2991 Hopyard Road  
Pleasanton, California  
(Page 2 of 16)

| Well ID #<br>(TOC)       | Sampling<br>Date | SUBJ<br>< . . . . . > | DTW<br>feet | Elev.<br>> . . . . . < | TPHg<br>< . . . . . > | B    | T    | E    | X    | VOCs<br>> . . . . . < |
|--------------------------|------------------|-----------------------|-------------|------------------------|-----------------------|------|------|------|------|-----------------------|
| MW-1 (cont.)<br>(321.44) |                  |                       |             |                        |                       |      |      |      |      |                       |
|                          | 07/30/90         | NLPH                  | 52.17       | 269.27                 | <20                   | <0.5 | <0.5 | <0.5 | <0.5 | NA                    |
|                          | 08/27/90         | NLPH                  | 53.44       | 268.00                 | <20                   | <0.5 | <0.5 | <0.5 | <0.5 | NA                    |
|                          | 09/28/90         | NLPH                  | 53.40       | 268.04                 | <50                   | <0.5 | <0.5 | <0.5 | <0.5 | NA                    |
|                          | 12/27/90         |                       |             |                        |                       |      |      |      |      |                       |
|                          | 03/20/91         | NLPH                  | 53.35       | 268.09#                |                       |      |      |      |      |                       |
|                          | 06/20/91         | NLPH                  | 53.55       | 267.89#                |                       |      |      |      |      |                       |
|                          | 09/12/91         |                       |             |                        |                       |      |      |      |      |                       |
|                          | 12/30/91         |                       |             |                        |                       |      |      |      |      |                       |
|                          | 01/30/92         |                       |             |                        |                       |      |      |      |      |                       |
|                          | 03/02/92         |                       |             |                        |                       |      |      |      |      |                       |
|                          | 03/24/92         |                       |             |                        |                       |      |      |      |      |                       |
|                          | 04/14/92         |                       |             |                        |                       |      |      |      |      |                       |
|                          | 05/21/92         |                       |             |                        |                       |      |      |      |      |                       |
|                          | 06/08/92         |                       |             |                        |                       |      |      |      |      |                       |
|                          | 07/14/92         |                       |             |                        |                       |      |      |      |      |                       |
|                          | 08/10/92         |                       |             |                        |                       |      |      |      |      |                       |
|                          | 09/16/92         |                       |             |                        |                       |      |      |      |      |                       |
|                          | 10/07/92         |                       |             |                        |                       |      |      |      |      |                       |
|                          | 11/09/92         |                       |             |                        |                       |      |      |      |      |                       |
|                          | 12/10/92         |                       |             |                        |                       |      |      |      |      |                       |
|                          | 01/26/93         |                       |             |                        |                       |      |      |      |      |                       |
|                          | 02/16/93         |                       |             |                        |                       |      |      |      |      |                       |
|                          | 03/11/93         | NLPH                  | 53.09       | 268.35#                |                       |      |      |      |      |                       |
|                          | 04/12/93         | NLPH                  | 53.32       | 268.12#                |                       |      |      |      |      |                       |
|                          | 06/01/93         | NLPH                  | 53.40       | 268.04#                |                       |      |      |      |      |                       |
|                          | 07/15/93         | NLPH                  | 59.80       | 261.64#                |                       |      |      |      |      |                       |
|                          | 08/15/93         | NLPH                  | 53.45       | 267.99#                |                       |      |      |      |      |                       |
|                          | 09/29-30/93      | NLPH                  | 53.43       | 268.01#                |                       |      |      |      |      |                       |
|                          | 10/28/93         | NLPH                  | 53.38       | 268.06#                |                       |      |      |      |      |                       |
|                          | 11/23-24/93      | NLPH                  | 53.46       | 267.98                 | <50                   | <0.5 | <0.5 | <0.5 | <0.5 | NA                    |
|                          | 03/10-11/94      | NLPH                  | 53.46       | 267.98                 | <50                   | <0.5 | <0.5 | <0.5 | <0.5 | NA                    |
|                          | 05/04-05/94      | NLPH                  | 53.34       | 268.10                 | <50                   | <0.5 | <0.5 | <0.5 | <0.5 | NA                    |
| MW-2<br>(NM)             |                  |                       |             |                        |                       |      |      |      |      |                       |
|                          | 04/02/88         | .25                   | NM          | ---                    |                       |      |      |      |      |                       |
|                          | 04/04/88         | 1.5                   | NM          | ---                    |                       |      |      |      |      |                       |
|                          | 04/05/88         | 1.5                   | NM          | ---                    |                       |      |      |      |      |                       |
|                          | 04/06/88         | 3.2                   | 39.31       | ---#                   |                       |      |      |      |      |                       |
|                          | 04/08/88         | *                     | *           | ---                    |                       |      |      |      |      |                       |

See notes on page 16 of 16.

**TABLE 1  
CUMULATIVE GROUNDWATER MONITORING AND SAMPLING DATA**

Exxon Service Station 7-3399  
2991 Hopyard Road  
Pleasanton, California

(Page 3 of 16)

| Well ID #<br>(TOC) | Sampling<br>Date | SUBJ<br>< . . . . . | DTW<br>feet | Elev.<br>> . . . . . | TPHg<br>< . . . . . | B      | T      | E     | X      | VOCs<br>> . . . . . |
|--------------------|------------------|---------------------|-------------|----------------------|---------------------|--------|--------|-------|--------|---------------------|
|                    |                  |                     |             |                      | parts per billion   |        |        |       |        |                     |
| MW-2 cont.<br>(NM) | 04/19/88         | 2.48**              | 38.90       | ---#                 |                     |        |        |       |        |                     |
|                    | 06/06/88         | 0.26                | 38.78       | ---#                 |                     |        |        |       |        |                     |
|                    | 06/23/88         | 0.125               | 39.23       | ---#                 |                     |        |        |       |        |                     |
|                    | 06/28/88         | NM                  | 39.72       | ---#                 |                     |        |        |       |        |                     |
|                    | 07/06/88         | Slight              | 40.31       | ---                  | 62,000              | 25,700 | 18,500 | 2,900 | 21,400 | NA                  |
|                    | 07/12/88         |                     |             |                      | Well Destroyed      |        |        |       |        |                     |
| MW-3<br>(NM)       | 04/06/88         | NLPH                | 37.19       | ---                  | 20                  | <0.5   | <0.5   | <0.5  | <0.5   | NA                  |
|                    | 04/08/88         | NLPH                | 37.14       | ---#                 |                     |        |        |       |        |                     |
|                    | 04/19/88         | NLPH                | 37.22       | ---#                 |                     |        |        |       |        |                     |
|                    | 06/06/88         | NLPH                | 39.02       | ---#                 |                     |        |        |       |        |                     |
|                    | 06/23/88         | NLPH                | 39.58       | ---#                 |                     |        |        |       |        |                     |
|                    | 06/28/88         | NLPH                | 40.04       | ---#                 |                     |        |        |       |        |                     |
|                    | 07/06/88         | NLPH                | 40.60       | ---                  | <20                 | <0.5   | <0.5   | <0.5  | <0.5   | NA                  |
|                    | 07/13/88         | NLPH                | 41.09       | ---                  | <20                 | <0.5   | <0.5   | <0.5  | <0.5   | NA                  |
|                    | 08/12/88         | NLPH                | NM          | ---#                 |                     |        |        |       |        |                     |
|                    | 08/26/88         | NLPH                | 42.77       | ---                  | <20                 | <0.5   | <0.5   | <0.5  | <0.5   | NA                  |
|                    | 08/29/88         |                     |             |                      | Well Destroyed      |        |        |       |        |                     |
| MW-4<br>(321.56)   | 04/08/88         | NLPH                | 36.41       | 285.15#              |                     |        |        |       |        |                     |
|                    | 04/11/88         | NM                  | NM          | ---                  | 80                  | 1.8    | 16.3   | 0.6   | 7.1    | NA                  |
|                    | 04/19/88         | NLPH                | 36.51       | 285.05#              |                     |        |        |       |        |                     |
|                    | 06/06/88         | NLPH                | 38.26       | 283.30#              |                     |        |        |       |        |                     |
|                    | 06/23/88         | NLPH                | 38.83       | 282.73#              |                     |        |        |       |        |                     |
|                    | 06/28/88         | NLPH                | 39.28       | 282.28#              |                     |        |        |       |        |                     |
|                    | 07/06/88         | NLPH                | 39.85       | 281.71               | <20                 | <0.5   | <0.5   | <0.5  | <0.5   | NA                  |
|                    | 07/13/88         | NLPH                | 40.31       | 281.25               | <20                 | <0.5   | 0.9    | <0.5  | <0.5   | NA                  |
|                    | 08/12/88         |                     |             |                      | Not Accessible      |        |        |       |        |                     |
|                    | 08/26/88         | NLPH                | 42.01       | 279.55#              |                     |        |        |       |        |                     |
|                    | 09/07/88         |                     |             |                      | Not Accessible      |        |        |       |        |                     |
|                    | 12/07/88         |                     |             |                      | Not Accessible      |        |        |       |        |                     |
|                    | 12/19/88         | NLPH                | 43.83       | 277.73#              |                     |        |        |       |        |                     |
|                    | 02/09/89         | NLPH                | 42.67       | 278.89#              |                     |        |        |       |        |                     |
|                    | 03/08/89         | NLPH                | 42.11       | 279.45               | 440                 | 3.8    | 1.0    | <0.5  | <0.5   | NA                  |
|                    | 04/03/89         | NLPH                | 41.73       | 279.83#              |                     |        |        |       |        |                     |
|                    | 04/26/89         | NLPH                | 41.79       | 279.77#              |                     |        |        |       |        |                     |
|                    | 06/30/89         | NLPH                | 43.88       | 277.68               | 100                 | <0.5   | <0.5   | <0.5  | <0.5   | NA                  |
|                    | 07/17/89         | NLPH                | 44.85       | 276.71               | 390                 | <0.5   | <0.5   | <0.5  | <0.5   | NA                  |
|                    | 07/18/89         | NLPH                | 44.88       | 276.68#              |                     |        |        |       |        |                     |

See notes on page 16 of 16.

**TABLE 1  
CUMULATIVE GROUNDWATER MONITORING AND SAMPLING DATA**

Exxon Service Station 7-3399  
2991 Hopyard Road  
Pleasanton, California  
(Page 4 of 16)

| Well ID #<br>(TOC)     | Sampling<br>Date | SUBJ<br>< . . . . . | DTW<br>feet | Elev.<br>> . . . . . | TPHg<br>< . . . . . | B<br>parts per billion | T    | E    | X    | VOCs<br>> . . . . . |
|------------------------|------------------|---------------------|-------------|----------------------|---------------------|------------------------|------|------|------|---------------------|
| MW-4 cont.<br>(321.56) | 07/19/89         | NLPH                | 44.92       | 276.64#              |                     |                        |      |      |      |                     |
|                        | 07/20/89         | NLPH                | 44.98       | 276.58               | 200                 | <0.5                   | <0.5 | <0.5 | <0.5 | ND†                 |
|                        | 07/21/89         | NLPH                | 45.04       | 276.52#              |                     |                        |      |      |      |                     |
|                        | 07/26/89         | NLPH                | 45.50       | 276.06               | 66                  | <0.5                   | <0.5 | <0.5 | <0.5 | NA                  |
|                        | 08/02/89         | NM                  | NM          | NM                   | NA                  | NA                     | NA   | NA   | NA   | ND††                |
|                        | 08/03/89         | NLPH                | 46.28       | 275.28#              |                     |                        |      |      |      |                     |
|                        | 08/17/89         | NLPH                | 47.22       | 274.34#              |                     |                        |      |      |      |                     |
|                        | 09/13/89         | NLPH                | 49.19       | 272.37               | <20                 | <0.5                   | <0.5 | <0.5 | <0.5 | NA                  |
|                        | 11/28/89         | NLPH                | 50.34       | 271.22#              |                     |                        |      |      |      |                     |
|                        | 12/20/89         | NM                  | NM          | —                    | <20                 | <0.5                   | <0.5 | <0.5 | <0.5 | NA                  |
|                        | 01/09/90         | NLPH                | 49.47       | 272.09#              |                     |                        |      |      |      |                     |
|                        | 01/26/90         | NLPH                | 49.36       | 272.20#              |                     |                        |      |      |      |                     |
|                        | 02/23/90         | NLPH                | ‡49.18##    | 272.38#              |                     |                        |      |      |      |                     |
|                        | 02/23/90         | NLPH                | 49.15       | 272.41#              |                     |                        |      |      |      |                     |
|                        | 03/26/90         | NLPH                | ‡48.84      | 272.72               | <20                 | <0.5                   | <0.5 | <0.5 | <0.5 | NA                  |
|                        | 04/18/90         | NLPH                | 48.90       | 272.66#              |                     |                        |      |      |      |                     |
|                        | 05/17/90         | NLPH                | 50.03       | 271.53#              |                     |                        |      |      |      |                     |
|                        | 06/11/90         | NLPH                | 50.98       | 270.58#              |                     |                        |      |      |      |                     |
|                        | 07/30/90         | NLPH                | 53.57       | 267.99#              |                     |                        |      |      |      |                     |
|                        | 08/01/90         | NM                  | NM          | —                    | <20                 | <0.5                   | <0.5 | <0.5 | <0.5 | NA                  |
|                        | 08/27/90         | NLPH                | 53.61       | 267.95#              |                     |                        |      |      |      |                     |
|                        | 09/28/90         | NLPH                | 53.57       | 267.99#              |                     |                        |      |      |      |                     |
|                        | 12/27/90         | NLPH                | 53.68       | 267.88               | <50                 | <0.5                   | <0.5 | <0.5 | <0.5 | NA                  |
|                        | 03/20/91         | NLPH                | 53.56       | 268.00               | <50                 | <0.5                   | <0.5 | <0.5 | <0.5 | NA                  |
|                        | 06/20/91         | NLPH                | 53.75       | 267.81#              |                     |                        |      |      |      |                     |
|                        | 09/12/91         | NLPH                | 53.70       | 267.86#              |                     |                        |      |      |      |                     |
|                        | 12/30/91         |                     |             | DRY                  |                     |                        |      |      |      |                     |
|                        | 01/30/92         |                     |             | DRY                  |                     |                        |      |      |      |                     |
|                        | 03/02/92         | NLPH                | 53.83       | 267.73#              |                     |                        |      |      |      |                     |
|                        | 03/24/92         | NLPH                | 53.73       | 267.83               | <50                 | <0.5                   | <0.5 | <0.5 | <0.5 | NA                  |
|                        | 04/14/92         | NLPH                | 53.76       | 267.80#              |                     |                        |      |      |      |                     |
|                        | 05/21/92         | NLPH                | 54.73       | 266.83#              |                     |                        |      |      |      |                     |
|                        | 06/08/92         | NLPH                | 53.80       | 267.76#              |                     |                        |      |      |      |                     |
|                        | 07/14/92         | NLPH                | 53.60       | 267.96#              |                     |                        |      |      |      |                     |
|                        | 08/10/92         | NLPH                | 53.71       | 267.85#              |                     |                        |      |      |      |                     |
|                        | 09/16/92         | NLPH                | 53.89       | 267.67#              |                     |                        |      |      |      |                     |
|                        | 10/07/92         |                     |             | DRY                  |                     |                        |      |      |      |                     |
|                        | 11/09/92         |                     |             | DRY                  |                     |                        |      |      |      |                     |
|                        | 12/10/92         | NLPH                | 53.83       | 267.73#              |                     |                        |      |      |      |                     |
|                        | 01/26/93         |                     |             | DRY                  |                     |                        |      |      |      |                     |
|                        | 02/18/93         | NLPH                | 53.64       | 267.92               | 600                 | 57                     | 34   | 11   | 200  | NA                  |

See notes on page 16 of 16.

**TABLE 1  
CUMULATIVE GROUNDWATER MONITORING AND SAMPLING DATA**

Exxon Service Station 7-3399  
2991 Hopyard Road  
Pleasanton, California  
(Page 5 of 16)

| Well ID #<br>(TOC)     | Sampling<br>Date | SUBJ<br>< . . . . .                 | DTW<br>feet | Elev.<br>> . . . . . | TPHg<br>< . . . . . | B    | T    | E    | X    | VOCs<br>> . . . . . |
|------------------------|------------------|-------------------------------------|-------------|----------------------|---------------------|------|------|------|------|---------------------|
|                        |                  |                                     |             |                      | parts per billion   |      |      |      |      |                     |
| MW-4 cont.<br>(321.56) | 03/11/93         | NLPH                                | 53.54       | 268.02#              |                     |      |      |      |      |                     |
|                        | 04/12/93         | NLPH                                | 53.62       | 267.94               | 360                 | 20   | 10   | 22   | 80   | NA                  |
|                        | 06/01/93         | NLPH                                | 53.52       | 268.04#              |                     |      |      |      |      |                     |
|                        | 07/15/93         | NLPH                                | 53.80       | 267.76#              |                     |      |      |      |      |                     |
|                        | 08/15/93         | NLPH                                | 53.65       | 267.91#              |                     |      |      |      |      |                     |
|                        | 09/29/93         | NLPH                                | 54.23       | 267.33#              |                     |      |      |      |      |                     |
|                        | 09/30/92         | NM                                  | NM          | ---                  | <50                 | <0.5 | <0.5 | <0.5 | <0.5 | NA                  |
|                        | 10/28/93         | NLPH                                | 53.54       | 268.25#              |                     |      |      |      |      |                     |
|                        | 11/23/93         | NLPH                                | 53.57       | 267.99#              |                     |      |      |      |      |                     |
|                        | 11/24/93         | NM                                  | NM          | ---                  | <50                 | <0.5 | <0.5 | <0.5 | <0.5 | NA                  |
|                        | 03/10-11/94      | NLPH                                | 53.64       | 267.92               | <50                 | <0.5 | <0.5 | <0.5 | <0.5 | NA                  |
|                        | 05/04-05/94      | NLPH                                | 53.54       | 268.02               | <50                 | <0.5 | <0.5 | <0.5 | <0.5 | NA                  |
| MW-5d<br>(321.79)      | 05/25/88         | NLPH                                | 38.55       | 283.24               | <20                 | <0.5 | 3.1  | <0.5 | <0.5 | NA                  |
|                        | 06/06/88         | NLPH                                | 38.90       | 282.89#              |                     |      |      |      |      |                     |
|                        | 06/23/88         | NLPH                                | 39.56       | 282.23#              |                     |      |      |      |      |                     |
|                        | 06/28/88         | NLPH                                | 40.23       | 281.56#              |                     |      |      |      |      |                     |
|                        | 07/06/88         | NLPH                                | 40.69       | 281.10               | <20                 | <0.5 | <0.5 | <0.5 | <0.5 | NA                  |
|                        | 07/13/88         | NLPH                                | 41.22       | 280.57               | 40                  | <0.5 | <0.5 | <0.5 | <0.5 | NA                  |
|                        | 08/12/88         | NLPH                                | 42.34       | 279.45#              |                     |      |      |      |      |                     |
|                        | 08/26/88         | NLPH                                | 42.60       | 279.19#              |                     |      |      |      |      |                     |
|                        | 09/07/88         | NLPH                                | 42.99       | 278.80#              |                     |      |      |      |      |                     |
|                        | 12/07/88         | NLPH                                | 44.58       | 277.21#              |                     |      |      |      |      |                     |
|                        | 02/09/89         | Casing head damaged by construction |             |                      |                     |      |      |      |      |                     |
|                        | 03/08/89         | Casing head cut to lower elevation  |             |                      | <20                 | <0.5 | <0.5 | <0.5 | <0.5 | NA                  |
|                        | 04/03/89         | NLPH                                | 42.21       | 279.58#              |                     |      |      |      |      |                     |
|                        | 04/26/89         | NLPH                                | 42.36       | 279.43#              |                     |      |      |      |      |                     |
|                        | 06/30/89         | NLPH                                | 44.79       | 277.00               | <20                 | <0.5 | <0.5 | <0.5 | <0.5 | NA                  |
|                        | 07/17/89         | NLPH                                | 45.73       | 276.06               | <20                 | <0.5 | <0.5 | <0.5 | <0.5 | NA                  |
|                        | 07/18/89         | NLPH                                | 45.75       | 276.04#              |                     |      |      |      |      |                     |
|                        | 07/19/89         | NLPH                                | 44.89       | 276.90#              |                     |      |      |      |      |                     |
|                        | 07/20/89         | NLPH                                | 46.02       | 275.77               | <20                 | <0.5 | <0.5 | <0.5 | <0.5 | NA                  |
|                        | 07/21/89         | NLPH                                | 46.18       | 275.61#              |                     |      |      |      |      |                     |
|                        | 07/26/89         | NLPH                                | 46.83       | 274.96               | <20                 | <0.5 | <0.5 | <0.5 | <0.5 | NA                  |
|                        | 08/02/89         | NM                                  | NM          | ---                  | <20                 | <0.5 | <0.5 | <0.5 | <0.5 | NA                  |
|                        | 08/03/89         | NLPH                                | 47.67       | 274.12#              |                     |      |      |      |      |                     |
|                        | 08/17/89         | NLPH                                | 48.27       | 273.52#              |                     |      |      |      |      |                     |
|                        | 09/13/89         | NLPH                                | 50.60       | 271.19               | <20                 | <0.5 | <0.5 | <0.5 | <0.5 | NA                  |
|                        | 11/28/89         | NLPH                                | 51.16       | 270.63#              |                     |      |      |      |      |                     |
|                        | 12/20/89         | NM                                  | NM          | ---                  | <20                 | <0.5 | <0.5 | <0.5 | <0.5 | NA                  |

See notes on page 16 of 16.

**TABLE 1  
CUMULATIVE GROUNDWATER MONITORING AND SAMPLING DATA**

Exxon Service Station 7-3399  
2991 Hopyard Road  
Pleasanton, California  
(Page 6 of 16)

| Well ID #<br>(TOC)     | Sampling<br>Date | SUBJ<br>< . . . . . | DTW<br>feet | Elev.<br>> . . . . . | TPHg<br>< . . . . . | B<br>parts per billion | T<br>parts per billion | E<br>parts per billion | X<br>parts per billion | VOCs<br>> . . . . . |
|------------------------|------------------|---------------------|-------------|----------------------|---------------------|------------------------|------------------------|------------------------|------------------------|---------------------|
| MW-5 cont.<br>(321.79) | 01/09/90         | NLPH                | 50.42       | 271.37#              |                     |                        |                        |                        |                        |                     |
|                        | 01/26/90         | NLPH                | 50.10       | 271.69#              |                     |                        |                        |                        |                        |                     |
|                        | 02/23/90         | NLPH                | 50.08       | 271.71#              |                     |                        |                        |                        |                        |                     |
|                        | 03/26/90         | NLPH                | *49.80      | 271.99               | <20                 | <0.5                   | <0.5                   | <0.5                   | <0.5                   | NA                  |
|                        | 04/18/90         | NLPH                | 49.80       | 271.99#              |                     |                        |                        |                        |                        |                     |
|                        | 05/17/90         | NLPH                | 51.32       | 270.47#              |                     |                        |                        |                        |                        |                     |
|                        | 06/11/90         | NLPH                | 52.10       | 269.69#              |                     |                        |                        |                        |                        |                     |
|                        | 07/30/90         | NLPH                | 53.47       | 268.32#              |                     |                        |                        |                        |                        |                     |
|                        | 08/01/90         | NM                  | NM          | ---                  | <20                 | <0.5                   | <0.5                   | <0.5                   | <0.5                   | NA                  |
|                        | 08/27/90         | NLPH                | 58.24       | 263.55#              |                     |                        |                        |                        |                        |                     |
|                        | 09/28/90         | NLPH                | 60.70       | 261.09#              |                     |                        |                        |                        |                        |                     |
|                        | 12/27/90         | NLPH                | 62.52       | 259.27               | <50                 | <0.5                   | <0.5                   | <0.5                   | <0.5                   | NA                  |
|                        | 03/20/91         | NLPH                | 59.18       | 262.61               | <50                 | <0.5                   | <0.5                   | <0.5                   | <0.5                   | NA                  |
|                        | 06/20/91         | NLPH                | 65.02       | 256.77               | <50                 | <0.5                   | <0.5                   | <0.5                   | <0.5                   | NA                  |
|                        | 09/12/91         |                     |             | DRY                  |                     |                        |                        |                        |                        |                     |
|                        | 12/30/91         |                     |             | DRY                  |                     |                        |                        |                        |                        |                     |
|                        | 01/30/92         |                     |             | DRY                  |                     |                        |                        |                        |                        |                     |
|                        | 03/02/92         |                     |             | DRY                  |                     |                        |                        |                        |                        |                     |
|                        | 03/24/92         | NLPH                | 74.98       | 246.81#              |                     |                        |                        |                        |                        |                     |
|                        | 04/14/92         | NLPH                | 74.42       | 247.37#              |                     |                        |                        |                        |                        |                     |
|                        | 05/21/92         | NLPH                | 75.67       | 246.12#              |                     |                        |                        |                        |                        |                     |
|                        | 06/08/92         |                     |             | DRY                  |                     |                        |                        |                        |                        |                     |
|                        | 07/14/92         |                     |             | DRY                  |                     |                        |                        |                        |                        |                     |
|                        | 08/10/92         |                     |             | DRY                  |                     |                        |                        |                        |                        |                     |
|                        | 09/16/92         |                     |             | DRY                  |                     |                        |                        |                        |                        |                     |
|                        | 10/07/92         |                     |             | DRY                  |                     |                        |                        |                        |                        |                     |
|                        | 11/09/92         |                     |             | DRY                  |                     |                        |                        |                        |                        |                     |
|                        | 12/10/92         |                     |             | DRY                  |                     |                        |                        |                        |                        |                     |
|                        | 01/26/93         |                     |             | DRY                  |                     |                        |                        |                        |                        |                     |
|                        | 02/16/93         | NLPH                | 76.47       | 245.32#              |                     |                        |                        |                        |                        |                     |
|                        | 03/08/93         | NLPH                | 42.49       | 279.30#              |                     |                        |                        |                        |                        |                     |
|                        | 03/11/93         | NLPH                | 74.03       | 247.76#              |                     |                        |                        |                        |                        |                     |
|                        | 04/12/93         | NLPH                | 70.96       | 250.83               | <50                 | 1.0                    | 1.0                    | 2.5                    | 7.4                    | NA                  |
|                        | 06/01/93         | NLPH                | 67.64       | 254.15#              |                     |                        |                        |                        |                        |                     |
|                        | 07/15/93         | NLPH                | 54.40       | 267.39#              |                     |                        |                        |                        |                        |                     |
|                        | 08/15/93         | NLPH                | 67.85       | 253.94#              |                     |                        |                        |                        |                        |                     |
|                        | 09/29-30/93      | NLPH                | 67.62       | 254.17               | <50                 | <0.5                   | <0.5                   | <0.5                   | <0.5                   | NA                  |
|                        | 10/28/93         | NLPH                | 66.15       | 255.49#              |                     |                        |                        |                        |                        |                     |
|                        | 11/23-24/93      | NLPH                | 64.80       | 256.99               | <50                 | <0.5                   | <0.5                   | <0.5                   | <0.5                   | NA                  |
|                        | 03/10-11/94      | NLPH                | 59.10       | 262.69               | <50                 | <0.5                   | <0.5                   | <0.5                   | <0.5                   | NA                  |
|                        | 05/04-05/94      | NLPH                | 56.66       | 265.13               | <50                 | <0.5                   | <0.5                   | <0.5                   | <0.5                   | NA                  |

See notes on page 16 of 16.

**TABLE 1  
CUMULATIVE GROUNDWATER MONITORING AND SAMPLING DATA**

Exxon Service Station 7-3399  
2991 Hopyard Road  
Pleasanton, California  
(Page 7 of 16)

| Well ID #<br>(TOC) | Sampling<br>Date | SUBJ<br>< . . . . .                | DTW<br>feet | Elev.<br>> . . . . . | TPHg<br>< . . . . . | B<br>parts per billion | T    | E    | X    | VOCs<br>> . . . . . |
|--------------------|------------------|------------------------------------|-------------|----------------------|---------------------|------------------------|------|------|------|---------------------|
| MW-5s<br>(321.64)  | 05/25/88         | NLPH                               | 38.46       | 283.18               | <20                 | <0.5                   | 0.9  | <0.5 | <0.5 | NA                  |
|                    | 06/06/88         | NLPH                               | 38.86       | 282.78#              |                     |                        |      |      |      |                     |
|                    | 06/23/88         | NLPH                               | 39.52       | 282.12#              |                     |                        |      |      |      |                     |
|                    | 06/28/88         | NLPH                               | 39.84       | 281.80#              |                     |                        |      |      |      |                     |
|                    | 07/06/88         | NLPH                               | 40.45       | 281.19               | <20                 | <0.5                   | <0.5 | <0.5 | <0.5 | NA                  |
|                    | 07/13/88         | NLPH                               | 40.90       | 280.74               | <20                 | <0.5                   | <0.5 | <0.5 | <0.5 | NA                  |
|                    | 07/22/88         | NLPH                               | 41.30       | 280.34               | 50                  | 0.9                    | 4.1  | 1.3  | 8.7  | NA                  |
|                    | 08/05/88         | NLPH                               | ▼23.84      | 297.80               | <20                 | <0.5                   | <0.5 | <0.5 | <0.5 | NA                  |
|                    | 08/12/88         | NLPH                               | 42.21       | 279.43#              |                     |                        |      |      |      |                     |
|                    | 08/26/88         | NLPH                               | 42.55       | 279.09#              |                     |                        |      |      |      |                     |
|                    | 09/07/88         | NLPH                               | 42.94       | 278.70               | <20                 | <0.5                   | <0.5 | <0.5 | <0.5 | NA                  |
|                    | 12/07/88         | NLPH                               | 44.67       | 276.97#              |                     |                        |      |      |      |                     |
|                    | 02/09/89         | NLPH                               | 43.19       | 278.45#              |                     |                        |      |      |      |                     |
| (321.64)           | 03/08/89         | Casing head out to lower elevation |             |                      |                     |                        |      |      |      |                     |
|                    | (Blank)          | NLPH                               | 42.11       | 279.53               | <20                 | <0.5                   | <0.5 | <0.5 | <1.0 | NA                  |
|                    | 04/26/89         | NLPH                               | 41.84       | 279.80#              |                     |                        |      |      |      |                     |
|                    | 06/30/89         | NLPH                               | 43.95       | 277.69               | <20                 | <0.5                   | <0.5 | <0.5 | <0.5 | NA                  |
|                    | 07/17/89         | NLPH                               | 44.91       | 276.73               | <20                 | <0.5                   | <0.5 | <0.5 | <0.5 | NA                  |
|                    | 07/18/89         | NLPH                               | 44.93       | 276.71#              |                     |                        |      |      |      |                     |
|                    | 07/19/89         | NLPH                               | 44.98       | 276.66#              |                     |                        |      |      |      |                     |
|                    | 07/20/89         | NLPH                               | 45.02       | 276.62               | <20                 | <0.5                   | <0.5 | <0.5 | <0.5 | NA                  |
|                    | 07/21/89         | NLPH                               | 45.10       | 276.54#              |                     |                        |      |      |      |                     |
|                    | 07/26/89         | NLPH                               | 45.57       | 276.07               | <20                 | <0.5                   | <0.5 | <0.5 | <0.5 | NA                  |
|                    | 08/02/89         | Not Accessible                     |             |                      | <20                 | <0.5                   | <0.5 | <0.5 | <0.5 | NA                  |
|                    | 08/03/89         | NLPH                               | 46.31       | 275.33#              |                     |                        |      |      |      |                     |
|                    | 08/17/89         | NLPH                               | 47.25       | 274.39#              |                     |                        |      |      |      |                     |
|                    | 09/13/89         | NLPH                               | 49.22       | 272.42               | <20                 | <0.5                   | <0.5 | <0.5 | <0.5 | NA                  |
|                    | 11/28/89         | NLPH                               | 50.39       | 271.25#              |                     |                        |      |      |      |                     |
|                    | 12/20/89         | NM                                 | NM          | ---                  | <50                 | <0.5                   | <0.5 | <0.5 | <0.5 | NA                  |
|                    | 01/09/90         | NLPH                               | 49.51       | 272.13#              |                     |                        |      |      |      |                     |
|                    | 01/26/90         | NLPH                               | 49.40       | 272.24#              |                     |                        |      |      |      |                     |
|                    | 02/23/90         | NLPH                               | ±49.20**    | 272.44#              |                     |                        |      |      |      |                     |
|                    | 02/23/90         | NLPH                               | 49.20       | 272.44#              |                     |                        |      |      |      |                     |
|                    | 03/26/90         | NLPH                               | 48.88       | 272.76               | <20                 | <0.5                   | <0.5 | <0.5 | <0.5 | NA                  |
|                    | 04/18/90         | NLPH                               | 48.95       | 272.69#              |                     |                        |      |      |      |                     |
|                    | 05/17/90         | NLPH                               | 50.06       | 271.58#              |                     |                        |      |      |      |                     |
|                    | 06/11/90         | NLPH                               | 50.98       | 270.66#              |                     |                        |      |      |      |                     |
|                    | 07/30/90         | NLPH                               | 53.40       | 268.24#              |                     |                        |      |      |      |                     |
|                    | 08/01/90         | NM                                 | NM          | ---                  | <50                 | <0.5                   | <0.5 | <0.5 | <0.5 | NA                  |
|                    | 08/27/90         | NLPH                               | 53.60       | 268.04#              |                     |                        |      |      |      |                     |
|                    | 09/28/90         | NLPH                               | 53.55       | 268.09#              |                     |                        |      |      |      |                     |

See notes on page 16 of 16.

**TABLE 1  
CUMULATIVE GROUNDWATER MONITORING AND SAMPLING DATA**

Exxon Service Station 7-3399  
2991 Hopyard Road  
Pleasanton, California  
(Page 8 of 16)

| Well ID #<br>(TOC)      | Sampling<br>Date | SUBJ<br>< . . . . . | DTW<br>feet | Elev.<br>> . . . . . | TPHg<br>< . . . . . | B     | T    | E    | X    | VOCs<br>> . . . . . |
|-------------------------|------------------|---------------------|-------------|----------------------|---------------------|-------|------|------|------|---------------------|
| parts per billion       |                  |                     |             |                      |                     |       |      |      |      |                     |
| MW-5s cont.<br>(321.64) | 12/27/90         | NLPH                | 53.61       | 268.03               | <50                 | <0.5  | <0.5 | <0.5 | <0.5 | NA                  |
|                         | 03/20/91         | NLPH                | 53.56       | 268.08#              |                     |       |      |      |      |                     |
|                         | 06/20/91         | NLPH                | 53.73       | 267.91#              |                     |       |      |      |      |                     |
|                         | 09/12/91         | NLPH                | 53.78       | 267.86#              |                     |       |      |      |      |                     |
|                         | 12/30/91         | NLPH                | 53.80       | 267.84#              |                     |       |      |      |      |                     |
|                         | 01/30/92         | NLPH                | 53.82       | 267.82#              |                     |       |      |      |      |                     |
|                         | 03/02/92         | NLPH                | 53.82       | 267.82#              |                     |       |      |      |      |                     |
|                         | 04/14/92         | NLPH                | 53.74       | 267.90#              |                     |       |      |      |      |                     |
|                         | 05/21/92         | NLPH                | 53.77       | 267.87#              |                     |       |      |      |      |                     |
|                         | 06/08/92         | NLPH                | 53.81       | 267.83#              |                     |       |      |      |      |                     |
|                         | 07/14/92         | NLPH                | 53.74       | 267.90#              |                     |       |      |      |      |                     |
|                         | 08/10/92         | NLPH                | 53.78       | 267.86#              |                     |       |      |      |      |                     |
|                         | 09/16/92         | NLPH                | 53.90       | 267.74#              |                     |       |      |      |      |                     |
|                         | 10/07/92         |                     |             | DRY                  |                     |       |      |      |      |                     |
|                         | 11/09/92         | NLPH                | 53.87       | 267.77#              |                     |       |      |      |      |                     |
|                         | 12/10/92         | NLPH                | 53.78       | 267.86               |                     |       |      |      |      |                     |
|                         | 01/26/93         | NLPH                | 53.38       | 268.26#              |                     |       |      |      |      |                     |
|                         | 02/16/93         | NLPH                | 53.44       | 268.20               |                     |       |      |      |      |                     |
|                         | 03/11/93         | NLPH                | 53.28       | 268.36#              |                     |       |      |      |      |                     |
|                         | 04/12/93         | NLPH                | 53.42       | 268.22               | 220                 | 11    | 5.9  | 13   | 48   | NA                  |
|                         | 06/01/93         | NLPH                | 53.56       | 268.08#              |                     |       |      |      |      |                     |
|                         | 07/15/93         | NLPH                | 53.00       | 268.64#              |                     |       |      |      |      |                     |
|                         | 08/15/93         | NLPH                | 53.60       | 268.04#              |                     |       |      |      |      |                     |
|                         | 09/29-30/93      | NLPH                | 53.62       | 268.02               | <50                 | <0.5  | <0.5 | <0.5 | <0.5 | NA                  |
|                         | 10/28/93         | NLPH                | 54.62       | 267.02#              |                     |       |      |      |      |                     |
|                         | 11/23-24/93      | NLPH                | 53.62       | 268.02               | <50                 | <0.5  | <0.5 | <0.5 | <0.5 | NA                  |
|                         | 03/10-11/94      | NLPH                | 53.61       | 268.03               | <50                 | <0.5  | <0.5 | <0.5 | <0.5 | NA                  |
|                         | 05/04-05/94      | NLPH                | 53.52       | 268.12               | <50                 | <0.5  | <0.5 | <0.5 | <0.5 | NA                  |
| MW-6<br>(NM)            | 05/11/88         | NLPH                | 37.31       | ---#                 |                     |       |      |      |      |                     |
|                         | 05/17/88         | NM                  | NM          | ---                  | <20                 | <0.5  | <0.5 | <0.5 | <0.5 | NA                  |
|                         | 06/06/88         | NLPH                | 38.70       | ---#                 |                     |       |      |      |      |                     |
|                         | 06/23/88         | NLPH                | 39.23       | ---#                 |                     |       |      |      |      |                     |
|                         | 06/28/88         | NLPH                | 39.74       | ---                  | 440                 | 31.8  | 7.5  | 5.4  | 6.7  | NA                  |
|                         | 07/13/88         | NLPH                | 40.78       | ---                  | 290                 | 162.3 | 7.7  | 22.5 | 14.1 | NA                  |
|                         | 08/05/88         | NLPH                | 41.72       | ---                  | 1180                | 245   | 5.2  | 47.1 | 23.7 | NA                  |
|                         | 08/12/88         | NLPH                | 42.14       | ---#                 |                     |       |      |      |      |                     |
|                         | 08/17/88         |                     |             | Not Accessible       |                     |       |      |      |      |                     |
|                         | 08/26/88         | NLPH                | 42.51       | ---#                 |                     |       |      |      |      |                     |

See notes on page 16 of 16.



**TABLE 1  
CUMULATIVE GROUNDWATER MONITORING AND SAMPLING DATA**

Exxon Service Station 7-3399  
2991 Hopyard Road  
Pleasanton, California

(Page 9 of 16)

| Well ID #<br>(TOC) | Sampling<br>Date     | SUBJ<br>< . . . . . | DTW<br>feet | Elev.<br>> . . . . . | TPHg<br>< . . . . . | B<br>parts per billion | T<br>parts per billion | E<br>parts per billion | X<br>parts per billion | VOCs<br>> . . . . . |  |
|--------------------|----------------------|---------------------|-------------|----------------------|---------------------|------------------------|------------------------|------------------------|------------------------|---------------------|--|
| MW-6 cont.<br>(NM) | 09/07/88<br>10/24/88 | NLPH                | 42.85       | ---                  | 2920                | 474                    | 16                     | 262                    | 136                    | NA                  |  |
|                    |                      |                     |             | Well Destroyed       |                     |                        |                        |                        |                        |                     |  |
| MW-7<br>(321.27)   | 07/13/88             | NLPH                | 40.50       | 280.77               | 16700               | 860                    | 1910                   | 710                    | 4420                   | NA                  |  |
|                    | 07/22/88             | NLPH                | ‡41.85      | 279.42               | 460                 | 136                    | 85                     | 5                      | 58                     | NA                  |  |
|                    | 08/05/88             | NLPH                | ‡41.45      | 279.82               | 270                 | 73.3                   | 52.8                   | 2.3                    | 28.1                   | NA                  |  |
|                    | 08/12/88             | NLPH                | 42.69       | 278.58#              |                     |                        |                        |                        |                        |                     |  |
|                    | 09/07/88             | NLPH                | 42.60       | 278.67#              |                     |                        |                        |                        |                        |                     |  |
|                    | 12/07/88             |                     |             | Not Accessible       |                     |                        |                        |                        |                        |                     |  |
|                    | 01/17/89             | NLPH                | 43.20       | 278.07#              |                     |                        |                        |                        |                        |                     |  |
|                    | 02/09/89             |                     |             | Not Accessible       |                     |                        |                        |                        |                        |                     |  |
|                    | 06/30/89             | NM                  | NM          | ---                  | 1100                | 180                    | 50                     | 13                     | 40                     | NA                  |  |
|                    | 08/02/89             | NM                  | NM          | ---                  | 31                  | 1.6                    | <0.5                   | <0.5                   | 0.60                   | NA                  |  |
|                    | 09/13/89             | NM                  | NM          | ---                  | 87                  | <0.5                   | 2.6                    | <0.5                   | 12                     | NA                  |  |
|                    | 10/12/89             | NLPH                | 49.93       | 271.34#              |                     |                        |                        |                        |                        |                     |  |
|                    | 11/28/89             | NLPH                | ‡57.61      | 263.66#              |                     |                        |                        |                        |                        |                     |  |
|                    | 12/20/89             | NM                  | NM          | ---                  | <20                 | <0.5                   | <0.5                   | <0.5                   | <0.5                   | NA                  |  |
|                    | 01/09/90             | NLPH                | ‡57.57      | 263.70#              |                     |                        |                        |                        |                        |                     |  |
|                    | 01/26/90             | NLPH                | ‡57.54      | 263.73#              |                     |                        |                        |                        |                        |                     |  |
|                    | 01/26/90             | NLPH                | 49.08       | 272.19#              |                     |                        |                        |                        |                        |                     |  |
|                    | 02/23/90             | NLPH                | ‡55.26      | 266.01#              |                     |                        |                        |                        |                        |                     |  |
|                    | 02/23/90             | NLPH                | 48.93       | 272.34#              |                     |                        |                        |                        |                        |                     |  |
|                    | 03/26/90             | NLPH                | ‡57.52      | 263.75#              |                     |                        |                        |                        |                        |                     |  |
|                    | 03/26/90             | NLPH                | 48.60       | 272.67#              |                     |                        |                        |                        |                        |                     |  |
|                    | 04/18/90             | NLPH                | ‡57.55      | 263.72#              |                     |                        |                        |                        |                        |                     |  |
|                    | 05/17/90             | NLPH                | ‡57.40      | 263.87#              |                     |                        |                        |                        |                        |                     |  |
|                    | 06/11/90             | NLPH                | 50.68       | 270.59#              |                     |                        |                        |                        |                        |                     |  |
|                    | 07/30/90             |                     |             | Not Accessible       |                     |                        |                        |                        |                        |                     |  |
|                    | 08/27/90             | NLPH                | 53.05       | 268.22#              |                     |                        |                        |                        |                        |                     |  |
|                    | 09/28/90             |                     |             | Not Accessible       |                     |                        |                        |                        |                        |                     |  |
|                    | 12/27/90             |                     |             | Not Accessible       |                     |                        |                        |                        |                        |                     |  |
|                    | 03/20/91             | NLPH                | 54.11       | 267.16#              |                     |                        |                        |                        |                        |                     |  |
|                    | 06/20/91             | NLPH                | 55.14       | 266.13               | 74                  | <0.5                   | 1.8                    | 0.6                    | 4.1                    | NA                  |  |
|                    | 09/12/91             | NLPH                | 55.84       | 265.43               | <50                 | 3.5                    | <0.5                   | 1.7                    | 6.8                    | NA                  |  |
|                    | 12/30/91             | NLPH                | 55.21       | 266.06               | <50                 | <0.5                   | <0.5                   | <0.5                   | <0.5                   | NA                  |  |
|                    | 01/30/92             | NLPH                | 54.88       | 266.39#              |                     |                        |                        |                        |                        |                     |  |
|                    | 03/02/92             |                     |             | Not Accessible       |                     |                        |                        |                        |                        |                     |  |
|                    | 03/24/92             |                     |             | Not Accessible       |                     |                        |                        |                        |                        |                     |  |
|                    | 04/14/92             |                     |             | Not Accessible       |                     |                        |                        |                        |                        |                     |  |
|                    | 05/21/92             | NLPH                | 53.36       | 267.91#              |                     |                        |                        |                        |                        |                     |  |
|                    | 06/08/92             | NLPH                | 54.20       | 267.07               | <50                 | <0.5                   | <0.5                   | <0.5                   | <0.5                   | NA                  |  |

See notes on page 16 of 16.

**TABLE 1**  
**CUMULATIVE GROUNDWATER MONITORING AND SAMPLING DATA**

Exxon Service Station 7-3399  
2991 Hopyard Road  
Pleasanton, California  
(Page 10 of 16)

| Well ID #<br>(TOC)   | Sampling<br>Date | SUBJ<br>< . . . . . | DTW<br>feet | Elev.<br>> . . . . . | TPHg<br>< . . . . . | B<br>parts per billion | T<br>> | E     | X     | VOCs<br>> |
|----------------------|------------------|---------------------|-------------|----------------------|---------------------|------------------------|--------|-------|-------|-----------|
| MW-7 cont.           |                  |                     |             |                      |                     |                        |        |       |       |           |
| (321.27)             | 07/14/92         | NLPH                | 53.31       | 267.96#              |                     |                        |        |       |       |           |
|                      | 08/10/92         | NLPH                | 54.01       | 267.26#              |                     |                        |        |       |       |           |
|                      | 09/16/92         | NLPH                | 55.97       | 265.30#              |                     |                        |        |       |       |           |
|                      | 10/07/92         | NLPH                | 56.09       | 265.18#              |                     |                        |        |       |       |           |
|                      | 11/09/92         | NLPH                | 54.16       | 267.11#              |                     |                        |        |       |       |           |
|                      | 12/10/92         | NLPH                | 56.02       | 265.25#              |                     |                        |        |       |       |           |
|                      | 01/26/93         | NLPH                | 56.16       | 265.12#              |                     |                        |        |       |       |           |
|                      | 02/16/93         | NLPH                | 56.23       | 265.04               | 600                 | 28                     | 30     | 17    | 200   | NA        |
|                      | 03/11/93         | NLPH                | 55.82       | 265.45#              |                     |                        |        |       |       |           |
|                      | 04/12/93         | NLPH                | 55.45       | 265.82#              |                     |                        |        |       |       |           |
|                      | 06/01/93         | NLPH                | 54.90       | 266.37#              |                     |                        |        |       |       |           |
|                      | 07/15/93         | NLPH                | 54.50       | 266.77#              |                     |                        |        |       |       |           |
|                      | 08/15/93         | NLPH                | 54.25       | 267.02#              |                     |                        |        |       |       |           |
|                      | 09/29-30/93      | NLPH                | 54.55       | 266.72#              |                     |                        |        |       |       |           |
|                      | 10/28/93         | NLPH                | 54.94       | 266.92#              |                     |                        |        |       |       |           |
|                      | 11/23-24/93      | NLPH                | 54.73       | 266.54               | <50                 | <0.5                   | <0.5   | <0.5  | <0.5  | NA        |
|                      | 03/10-11/94      | NLPH                | 52.83       | 268.44               | <50                 | <0.5                   | <0.5   | <0.5  | <0.5  | NA        |
|                      | 05/04-05/94      | NLPH                | 52.77       | 268.50               | <50                 | <0.5                   | <0.5   | <0.5  | <0.5  | NA        |
| Well #7              |                  |                     |             |                      |                     |                        |        |       |       |           |
| (City of Pleasanton) | 07/20/89         | NM                  | NM          | ---                  | NA                  | NA                     | NA     | NA    | NA    | ND†       |
|                      | 08/02/89         | NM                  | NM          | ---                  | NA                  | NA                     | NA     | NA    | NA    | ND††      |
|                      | 03/26/90         | NM                  | NM          | ---                  | <50                 | <0.50                  | <0.50  | <0.50 | <0.50 | NA        |
| MW-8                 |                  |                     |             |                      |                     |                        |        |       |       |           |
| (321.86)             | 10/01/89         | NLPH                | 53.88       | 267.98#              |                     |                        |        |       |       |           |
|                      | 10/03/89         | NM                  | NM          | ---                  | <20                 | <0.5                   | <0.5   | <0.5  | <0.5  | NA        |
|                      | 11/28/89         | NLPH                | 53.74       | 268.12#              |                     |                        |        |       |       |           |
|                      | 12/20/89         | NM                  | NM          | ---                  | <20                 | <0.50                  | <0.50  | <0.50 | 0.61  | NA        |
|                      | 01/09/90         | NLPH                | 57.90       | 263.96#              |                     |                        |        |       |       |           |
|                      | 01/26/90         | NLPH                | 53.57       | 268.29#              |                     |                        |        |       |       |           |
|                      | 01/31/90         | NM                  | NM          | ---                  | <20                 | <0.50                  | <0.50  | <0.50 | 0.87  | NA        |
|                      | 02/09/90         | NM                  | NM          | ---                  | <20                 | <0.5                   | <0.5   | <0.5  | 1.1   | NA        |
|                      | 02/23/90         | NLPH                | 52.16       | 269.70#              |                     |                        |        |       |       |           |
|                      | (Blank)          | NM                  | NM          | ---                  | <20                 | <0.5                   | <0.5   | <0.5  | <0.5  | NA        |
|                      | 03/26/90         | NLPH                | 52.80       | 269.06               | <20                 | <0.5                   | <0.5   | <0.5  | <0.5  | NA        |
|                      | (Blank)          | NM                  | NM          | ---                  | <20                 | <0.5                   | <0.50  | <0.5  | <0.5  | NA        |
|                      | 04/18/90         | NLPH                | 51.60       | 270.26               | <20                 | <0.50                  | 0.58   | <0.50 | 1.1   | NA        |
|                      | 05/17/90         | NLPH                | 58.21       | 263.65               | <20                 | <0.5                   | <0.5   | <0.5  | <0.5  | NA        |
|                      | 06/11/90         | NLPH                | 58.65       | 263.21               | <20                 | <0.5                   | <0.5   | <0.5  | <0.5  | NA        |
|                      | 07/30/90         | NLPH                | 64.33       | 257.53#              |                     |                        |        |       |       |           |

See notes on page 16 of 16.

**TABLE 1  
CUMULATIVE GROUNDWATER MONITORING AND SAMPLING DATA**

Exxon Service Station 7-3399  
2991 Hopyard Road  
Pleasanton, California  
(Page 11 of 16)

| Well ID #<br>(TOC)     | Sampling<br>Date | SUBJ<br>< . . . . . | DTW<br>feet | Elev.<br>> . . . . . | TPHg<br>< . . . . . | B<br>parts per billion | T    | E    | X     | VOCs<br>> . . . . . |
|------------------------|------------------|---------------------|-------------|----------------------|---------------------|------------------------|------|------|-------|---------------------|
| MW-8 cont.<br>(321.86) | 08/01/90         | NM                  | NM          | ---                  | <20                 | <0.5                   | <0.5 | <0.5 | <0.5  | NA                  |
|                        | 08/27/90         | NLPH                | 70.41       | 251.45               | <20                 | <0.5                   | <0.5 | <0.5 | 0.5   | NA                  |
|                        | 09/28/90         | NLPH                | 71.93       | 249.93               | <50                 | <0.5                   | <0.5 | <0.5 | 0.5   | NA                  |
|                        | 12/27/90         | NLPH                | 66.60       | 255.26               | <50                 | <0.5                   | <0.5 | <0.5 | 0.6   | NA                  |
|                        | 03/20/91         | NLPH                | 60.75       | 261.11               | <50                 | <0.5                   | <0.5 | <0.5 | <0.5  | NA                  |
|                        | 06/20/91         | NLPH                | 88.77       | 233.09               | <50                 | <0.5                   | <0.5 | <0.5 | 0.6   | NA                  |
|                        | 09/12/91         | NLPH                | 103.17      | 218.69#              |                     |                        |      |      |       |                     |
|                        | 10/14/91         | NM                  | NM          | ---                  | <50                 | <0.5                   | <0.5 | <0.5 | <0.5  | NA                  |
|                        | 12/30/91         | NLPH                | 81.15       | 240.71               | <50                 | <0.5                   | <0.5 | <0.5 | <0.5  | NA                  |
|                        | 01/30/92         | NLPH                | 81.69       | 240.17#              |                     |                        |      |      |       |                     |
|                        | 03/02/92         | NLPH                | 78.45       | 243.41#              |                     |                        |      |      |       |                     |
|                        | 03/24/92         | NLPH                | 76.55       | 245.31               | <50                 | <0.5                   | <0.5 | <0.5 | <0.5  | NA                  |
|                        | 04/14/92         | NLPH                | 75.56       | 246.30#              |                     |                        |      |      |       |                     |
|                        | 05/21/92         | NLPH                | 86.99       | 234.87#              |                     |                        |      |      |       |                     |
|                        | 06/08/92         | NLPH                | 91.69       | 230.17               | <50                 | <0.5                   | <0.5 | <0.5 | <0.5  | NA                  |
|                        | 07/14/92         | NLPH                | 94.65       | 227.21#              |                     |                        |      |      |       |                     |
|                        | 08/10/92         | NLPH                | 95.02       | 226.84#              |                     |                        |      |      |       |                     |
|                        | 09/16/92         | NLPH                | 91.90       | 229.96               | <50                 | <0.5                   | 0.9  | <0.5 | <0.5  | NA                  |
|                        | 10/07/92         |                     |             | DRY                  |                     |                        |      |      |       |                     |
|                        | 11/09/92         | NLPH                | 84.35       | 237.51#              |                     |                        |      |      |       |                     |
|                        | 12/10/92         | NLPH                | 82.20       | 239.66               | <50                 | <0.5                   | 0.6  | <0.5 | <0.5  | NA                  |
|                        | 01/26/93         | NLPH                | 78.63       | 243.23#              |                     |                        |      |      |       |                     |
|                        | 02/16/93         | NLPH                | 76.90       | 244.96               | <50                 | 0.7                    | 0.6  | <0.5 | 2.3   | NA                  |
|                        | 03/11/93         | NLPH                | 74.39       | 247.47#              |                     |                        |      |      |       |                     |
|                        | 04/12/93         | NLPH                | 71.20       | 250.66               | 230                 | 26                     | 7.3  | 11   | 38    | NA                  |
|                        | 06/01/93         | NLPH                | 68.04       | 253.82#              |                     |                        |      |      |       |                     |
|                        | 07/15/93         | NLPH                | 78.05       | 243.81#              |                     |                        |      |      |       |                     |
|                        | 08/15/93         | NLPH                | 78.45       | 243.41#              |                     |                        |      |      |       |                     |
|                        | 09/29-30/93      | NLPH                | 73.64       | 248.22               | <50                 | <0.5                   | <0.5 | <0.5 | <0.5  | NA                  |
|                        | 10/28/93         | NLPH                | 67.53       | 253.91#              |                     |                        |      |      |       |                     |
|                        | 11/23-24/93      | NLPH                | 64.68       | 257.18               | <50                 | <0.5                   | <0.5 | <0.5 | <0.5  | NA                  |
|                        | 03/10-11/94      | NLPH                | 59.26       | 262.60               | <50                 | <0.5                   | <0.5 | <0.5 | <0.5  | NA                  |
|                        | 05/04-05/94      | NLPH                | 56.84       | 265.02               | <50                 | <0.5                   | <0.5 | <0.5 | <0.5  | NA                  |
| MW-9<br>(321.44)       | 10/03/89         | NM                  | NM          | ---                  | 89000               | 1000                   | 9200 | 3000 | 13000 | NA                  |
|                        | 10/12/89         | NLPH                | 50.24       | 271.20#              |                     |                        |      |      |       |                     |
|                        | 11/28/89         | sheen               | 50.59       | 270.85#              |                     |                        |      |      |       |                     |
|                        | 12/01/89         | sheen               | 50.32       | 271.12#              |                     |                        |      |      |       |                     |
|                        | 12/07/89         | sheen               | 50.13       | 271.31#              |                     |                        |      |      |       |                     |
|                        | 12/13/89         | sheen               | 49.91       | 271.53#              |                     |                        |      |      |       |                     |

See notes on page 16 of 16.

**TABLE 1  
CUMULATIVE GROUNDWATER MONITORING AND SAMPLING DATA**

Exxon Service Station 7-3399  
2991 Hopyard Road  
Pleasanton, California  
(Page 12 of 16)

| Well ID #<br>(TOC)     | Sampling<br>Date | SUBJ<br>< . . . . . | DTW<br>feet | Elev.<br>> . . . . . | TPHg<br>< . . . . . | B                 | T     | E    | X     | VOCs<br>> . . . . . |
|------------------------|------------------|---------------------|-------------|----------------------|---------------------|-------------------|-------|------|-------|---------------------|
|                        |                  |                     |             |                      |                     | parts per billion |       |      |       |                     |
| MW-9 cont.<br>(321.44) | 12/20/89         | sheen               | 49.78       | 271.66               | 190000              | 6300              | 31000 | 9500 | 55000 | NA                  |
|                        | 01/02/89         |                     |             | Not Accessible       |                     |                   |       |      |       |                     |
|                        | 01/09/90         | sheen               | 49.39       | 272.05#              |                     |                   |       |      |       |                     |
|                        | 01/25-26/90      | NLPH                | 49.30       | 272.14               | 77000               | 2400              | 9400  | 2700 | 15000 | NA                  |
|                        | 02/23/90         | NLPH                | 49.06       | 272.38#              |                     |                   |       |      |       |                     |
|                        | 02/23/90         | NLPH                | 49.05       | 272.39#              |                     |                   |       |      |       |                     |
|                        | 02/27/90         | NM                  | NM          | ---                  | 97000               | 1200              | 7100  | 2300 | 14000 | NA                  |
|                        | 03/26/90         | sheen               | 48.73       | 272.71               | 89000               | 1800              | 7700  | 2000 | 11000 | NA                  |
|                        | 04/18/90         | sheen               | 48.81       | 272.63               | 110000              | 2000              | 7500  | 2500 | 16000 | NA                  |
|                        | 05/17/90         | sheen               | 49.96       | 271.48               | 81000               | 1500              | 5700  | 2300 | 14000 | NA                  |
|                        | 06/11/90         | NM                  | 51.58       | 269.86#              | 430                 | <0.5              | <0.5  | <0.5 | <0.5  | NA                  |
|                        | 07/30/90         |                     |             | DRY                  |                     |                   |       |      |       |                     |
|                        | 08/27/90         |                     |             | DRY                  |                     |                   |       |      |       |                     |
|                        | 09/28/90         |                     |             | DRY                  |                     |                   |       |      |       |                     |
|                        | 12/27/90         |                     |             | Not Accessible       |                     |                   |       |      |       |                     |
|                        | 03/20/91         |                     |             | DRY                  |                     |                   |       |      |       |                     |
|                        | 06/20/91         | NM                  | 49.63       | 271.81#              |                     |                   |       |      |       |                     |
|                        | 09/12/91         | NM                  | NM          | ---                  |                     |                   |       |      |       |                     |
|                        | 12/30/91         | NM                  | NM          | ---                  |                     |                   |       |      |       |                     |
|                        | 01/30/92         | NM                  | NM          | ---                  |                     |                   |       |      |       |                     |
|                        | 03/02/92         | NM                  | NM          | ---                  |                     |                   |       |      |       |                     |
|                        | 03/24/92         | NM                  | NM          | ---                  |                     |                   |       |      |       |                     |
|                        | 04/14/92         | NM                  | NM          | ---                  |                     |                   |       |      |       |                     |
|                        | 05/21/92         | NM                  | NM          | ---                  |                     |                   |       |      |       |                     |
|                        | 06/08/92         | NM                  | NM          | ---                  |                     |                   |       |      |       |                     |
|                        | 07/14/92         | NM                  | NM          | ---                  |                     |                   |       |      |       |                     |
|                        | 08/10/92         | NM                  | NM          | ---                  |                     |                   |       |      |       |                     |
|                        | 09/16/92         | NM                  | NM          | ---                  |                     |                   |       |      |       |                     |
|                        | 10/07/92         |                     |             | DRY                  |                     |                   |       |      |       |                     |
|                        | 11/09/92         |                     |             | DRY                  |                     |                   |       |      |       |                     |
|                        | 12/10/92         |                     |             | Not Accessible       |                     |                   |       |      |       |                     |
|                        | 01/26/93         |                     |             | DRY                  |                     |                   |       |      |       |                     |
|                        | 02/16/93         |                     |             | DRY                  |                     |                   |       |      |       |                     |
|                        | 03/11/93         |                     |             | DRY                  |                     |                   |       |      |       |                     |
|                        | 04/12/93         |                     |             | DRY                  |                     |                   |       |      |       |                     |
|                        | 06/01/93         |                     |             | DRY                  |                     |                   |       |      |       |                     |
|                        | 07/15/93         |                     |             | DRY                  |                     |                   |       |      |       |                     |
|                        | 08/15/93         |                     |             | DRY                  |                     |                   |       |      |       |                     |
|                        | 09/29/93         |                     |             | DRY                  |                     |                   |       |      |       |                     |
|                        | 10/28/93         |                     |             | DRY                  |                     |                   |       |      |       |                     |
|                        | 11/23/93         |                     |             | DRY                  |                     |                   |       |      |       |                     |

See notes on page 16 of 16.

**TABLE 1  
CUMULATIVE GROUNDWATER MONITORING AND SAMPLING DATA**

Exxon Service Station 7-3399  
2991 Hopyard Road  
Pleasanton, California  
(Page 13 of 16)

| Well ID #<br>(TOC)     | Sampling<br>Date | SUBJ<br>< . . . . . > | DTW<br>feet | Elev.<br>> . . . . . < | TPHg<br>< . . . . . > | B    | T    | E    | X    | VOCs<br>parts per billion . . . . . > |
|------------------------|------------------|-----------------------|-------------|------------------------|-----------------------|------|------|------|------|---------------------------------------|
| MW-9 cont.<br>(321.44) | 03/10-11/94      |                       |             | DRY                    |                       |      |      |      |      |                                       |
|                        | 05/04-05/94      |                       |             | DRY                    |                       |      |      |      |      |                                       |
| MW-10<br>(322.99)      | 10/12/89         | NLPH                  | 51.93       | 271.06                 | 20                    | <0.5 | <0.5 | <0.5 | 1.5  | NA                                    |
|                        | 11/28/89         | NLPH                  | 51.88       | 271.11#                |                       |      |      |      |      |                                       |
|                        | 12/20/89         | NLPH                  | 51.47       | 271.52                 | <20                   | <0.5 | <0.5 | <0.5 | 1.8  | NA                                    |
|                        | 01/09/90         | NLPH                  | 50.98       | 272.01#                |                       |      |      |      |      |                                       |
|                        | 01/26/90         | NLPH                  | 50.87       | 272.12#                |                       |      |      |      |      |                                       |
|                        | 02/23/90         | NLPH                  | ±50.67      | 272.32#                |                       |      |      |      |      |                                       |
|                        | 02/23/90         | NLPH                  | 50.65       | 272.34#                |                       |      |      |      |      |                                       |
|                        | 03/26/90         | NLPH                  | 50.35       | 272.64                 | <20                   | <0.5 | <0.5 | <0.5 | <0.5 | NA                                    |
|                        | 04/18/90         | NLPH                  | 50.45       | 272.54#                |                       |      |      |      |      |                                       |
|                        | 06/11/90         | NLPH                  | 51.16       | 271.83#                |                       |      |      |      |      |                                       |
|                        | 07/30/90         | NLPH                  | 55.72       | 267.27#                |                       |      |      |      |      |                                       |
|                        | 08/01/90         | NM                    | NM          | ---                    | <20                   | <0.5 | <0.5 | <0.5 | <0.5 | NA                                    |
|                        | 08/27/90         | NLPH                  | 57.75       | 265.24#                |                       |      |      |      |      |                                       |
|                        | 09/28/90         |                       |             | Not Accessible         |                       |      |      |      |      |                                       |
|                        | 12/27/90         | NLPH                  | 58.08       | 264.91#                |                       |      |      |      |      |                                       |
|                        | 03/20/91         | NLPH                  | 57.80       | 265.19#                |                       |      |      |      |      |                                       |
|                        | 06/20/91         | NLPH                  | 58.00       | 264.99#                |                       |      |      |      |      |                                       |
|                        | 09/12/91         |                       |             | DRY                    |                       |      |      |      |      |                                       |
|                        | 12/30/91         | NM                    | NM          | ---                    |                       |      |      |      |      |                                       |
|                        | 01/30/92         |                       |             | DRY                    |                       |      |      |      |      |                                       |
|                        | 03/02/92         |                       |             | DRY                    |                       |      |      |      |      |                                       |
|                        | 03/24/92         | NLPH                  | 58.53       | 264.46#                |                       |      |      |      |      |                                       |
|                        | 04/14/92         |                       |             | DRY                    |                       |      |      |      |      |                                       |
|                        | 05/21/92         |                       |             | DRY                    |                       |      |      |      |      |                                       |
|                        | 06/08/92         |                       |             | DRY                    |                       |      |      |      |      |                                       |
|                        | 07/14/92         |                       |             | DRY                    |                       |      |      |      |      |                                       |
|                        | 08/10/92         |                       |             | DRY                    |                       |      |      |      |      |                                       |
|                        | 09/16/92         |                       |             | DRY                    |                       |      |      |      |      |                                       |
|                        | 10/07/92         |                       |             | DRY                    |                       |      |      |      |      |                                       |
|                        | 11/09/92         |                       |             | DRY                    |                       |      |      |      |      |                                       |
|                        | 12/10/92         |                       |             | DRY                    |                       |      |      |      |      |                                       |
|                        | 01/26/93         |                       |             | DRY                    |                       |      |      |      |      |                                       |
|                        | 02/16/93         | NLPH                  | 58.23       | 264.76#                |                       |      |      |      |      |                                       |
|                        | 03/11/93         | NLPH                  | 57.81       | 265.18#                |                       |      |      |      |      |                                       |
|                        | 04/12/93         | NLPH                  | 57.84       | 265.15                 | 350                   | 21   | 11   | 21   | 75   | NA                                    |
|                        | 06/01/93         | NLPH                  | 57.88       | 265.11#                |                       |      |      |      |      |                                       |
|                        | 07/16/93         |                       |             | DRY                    |                       |      |      |      |      |                                       |

See notes on page 16 of 16.

**TABLE 1**  
**CUMULATIVE GROUNDWATER MONITORING AND SAMPLING DATA**

Exxon Service Station 7-3399  
2991 Hopyard Road  
Pleasanton, California  
(Page 14 of 16)

| Well ID #<br>(TOC) | Sampling<br>Date | SUBJ<br>< . . . . . | DTW<br>feet | Elev.<br>> . . . . . | TPHg<br>< . . . . . | B    | T    | E    | X   | VOCs<br>> |
|--------------------|------------------|---------------------|-------------|----------------------|---------------------|------|------|------|-----|-----------|
| parts per billion  |                  |                     |             |                      |                     |      |      |      |     |           |
| MW-10 cont.        |                  |                     |             |                      |                     |      |      |      |     |           |
| (322.99)           | 08/15/93         |                     |             |                      |                     |      |      |      |     | DRY       |
|                    | 09/29/93         |                     |             |                      |                     |      |      |      |     | DRY       |
|                    | 10/28/93         |                     |             |                      |                     |      |      |      |     | DRY       |
|                    | 11/23/93         |                     |             |                      |                     |      |      |      |     | DRY       |
|                    | 03/10-11/94      |                     |             |                      |                     |      |      |      |     | DRY       |
|                    | 05/04-05/94      | NLPH                | 57.21       | 265.78#              |                     |      |      |      |     |           |
| MW-11              |                  |                     |             |                      |                     |      |      |      |     |           |
| (321.77)           | 11/10/89         | NLPH                | 50.64       | 272.13#              |                     |      |      |      |     |           |
|                    | 11/16/89         | NM                  | NM          | ---                  | 150                 | 4.1  | 9.4  | 0.74 | 20  | NA        |
|                    | 11/28/89         | NLPH                | 50.51       | 272.26#              |                     |      |      |      |     |           |
|                    | 12/20/89         | NLPH                | 51.47       | 271.30               | 150                 | 7.2  | 7.5  | 2.9  | 13  | NA        |
|                    | 01/09/90         | NLPH                | 49.68       | 273.09#              |                     |      |      |      |     |           |
|                    | 01/26/90         | NLPH                | 49.55       | 273.22#              |                     |      |      |      |     |           |
|                    | 02/23/90         | NLPH                | 49.37       | 273.40#              |                     |      |      |      |     |           |
|                    | 02/23/90         | NLPH                | 49.35       | 273.42#              |                     |      |      |      |     |           |
|                    | 03/26/90         | NLPH                | 49.03       | 273.74               | 32                  | <0.5 | <0.5 | <0.5 | 2.7 | NA        |
|                    | 04/18/90         | NLPH                | 49.12       | 273.65#              |                     |      |      |      |     |           |
|                    | 05/17/90         | NLPH                | 50.30       | 272.47#              |                     |      |      |      |     |           |
|                    | 06/11/90         | NLPH                | 51.16       | 271.61#              |                     |      |      |      |     |           |
|                    | 07/30/90         | NLPH                | 53.50       | 269.27               | 26                  | <0.5 | <0.5 | <0.5 | 3.8 | NA        |
|                    | 08/27/90         | NLPH                | 53.65       | 269.12#              |                     |      |      |      |     |           |
|                    | 09/28/90         | NLPH                | 53.62       | 269.15#              |                     |      |      |      |     |           |
|                    | 12/27/90         | NLPH                | 53.63       | 269.14#              |                     |      |      |      |     |           |
|                    | 03/20/91         | NLPH                | 53.26       | 269.51#              |                     |      |      |      |     |           |
|                    | 06/20/91         | NLPH                | 53.60       | 269.17#              |                     |      |      |      |     |           |
|                    | 09/12/91         | NLPH                | 53.60       | 269.17#              |                     |      |      |      |     |           |
|                    | 12/30/91         | NLPH                | 53.95       | 268.82#              |                     |      |      |      |     |           |
|                    | 01/30/92         | NLPH                | 53.65       | 269.12#              |                     |      |      |      |     |           |
|                    | 03/02/92         | NLPH                | 53.68       | 269.09#              |                     |      |      |      |     |           |
|                    | 03/24/92         | NLPH                | 53.70       | 269.07#              |                     |      |      |      |     |           |
|                    | 04/14/92         | NLPH                | 53.66       | 269.11               |                     |      |      |      |     |           |
|                    | 05/21/92         | NLPH                | 53.62       | 269.15               |                     |      |      |      |     |           |
|                    | 06/08/92         | NLPH                | 53.61       | 269.16               |                     |      |      |      |     |           |
|                    | 07/14/92         | NLPH                | 53.53       | 269.24               |                     |      |      |      |     |           |
|                    | 08/10/92         | NLPH                | 53.58       | 269.19               |                     |      |      |      |     |           |
|                    | 09/16/92         | NLPH                | 53.60       | 269.17               |                     |      |      |      |     |           |
|                    | 10/07/92         |                     |             |                      |                     |      |      |      |     | DRY       |
|                    | 11/09/92         |                     |             |                      |                     |      |      |      |     | DRY       |
|                    | 12/10/92         | NLPH                | 53.59       | 269.18#              |                     |      |      |      |     |           |
|                    | 01/26/93         | NLPH                | 53.67       | 269.10#              |                     |      |      |      |     |           |

See notes on page 16 of 16.

**TABLE 1**  
**CUMULATIVE GROUNDWATER MONITORING AND SAMPLING DATA**

Exxon Service Station 7-3399  
2991 Hopyard Road  
Pleasanton, California  
(Page 15 of 16)

| Well ID #<br>(TOC)      | Sampling<br>Date | SUBJ<br>< . . . . . > | DTW<br>feet | Elev.<br>> . . . . . < | TPHg<br>< . . . . . > | B    | T    | E    | X    | VOCs<br>parts per billion . . . . . > |
|-------------------------|------------------|-----------------------|-------------|------------------------|-----------------------|------|------|------|------|---------------------------------------|
| MW-11 cont.<br>(321.77) | 02/16/93         | NLPH                  | 53.60       | 269.17#                |                       |      |      |      |      |                                       |
|                         | 03/11/93         | NLPH                  | 53.58       | 269.19#                |                       |      |      |      |      |                                       |
|                         | 04/12/93         | NLPH                  | 53.54       | 269.23                 | <50                   | <0.5 | <0.5 | <0.5 | <0.5 | NA                                    |
|                         | 06/01/93         | NLPH                  | 53.52       | 269.25#                |                       |      |      |      |      |                                       |
|                         | 07/15/93         | NLPH                  | 53.60       | 269.17#                |                       |      |      |      |      |                                       |
|                         | 08/15/93         | NLPH                  | 53.55       | 269.22#                |                       |      |      |      |      |                                       |
|                         | 09/29-30/93      | NLPH                  | 53.62       | 269.15#                |                       |      |      |      |      |                                       |
|                         | 10/28/93         | NLPH                  | 53.63       | 269.14#                |                       |      |      |      |      |                                       |
|                         | 11/23-24/93      | NLPH                  | 53.58       | 268.19#                |                       |      |      |      |      |                                       |
|                         | 03/10-11/94      | NLPH                  | 53.61       | 268.16#                |                       |      |      |      |      |                                       |
|                         | 05/04-05/94      | NLPH                  | 53.51       | 268.26#                |                       |      |      |      |      |                                       |

See notes on page 16 of 16.

**TABLE 1  
CUMULATIVE GROUNDWATER MONITORING AND SAMPLING DATA**

Exxon Service Station 7-3399  
2991 Hopyard Road  
Pleasanton, California

(Page 16 of 16)

| Well ID #<br>(TOC) | Sampling<br>Date | SUBJ<br>< . . . . . > | DTW<br>feet | Elev.<br>> . . . . . < | TPHg<br>< . . . . . > | B   | T    | E    | X     | VOCs<br>> . . . . . < |
|--------------------|------------------|-----------------------|-------------|------------------------|-----------------------|-----|------|------|-------|-----------------------|
| VR-1               | 03/24/92         | NM                    | NM          | ---                    | <50                   | 1.7 | <0.5 | <0.5 | <0.5  | NA                    |
|                    | MCLs             | ---                   | ---         | ---                    | ---                   | 1.0 | ---  | 680  | 1,750 | ---                   |
|                    | DWAL             | ---                   | ---         | ---                    | ---                   | --- | 100  | ---  | ---   | ---                   |

Notes:

- SUBJ = Results of subjective evaluation, liquid-phase product thickness (PT) in feet
- NLPH = Liquid-phase hydrocarbons not present in well
- TOC = Elevation of top of well casing relative to mean sea level
- DTW = Depth to water
- Elev. = Elevation of groundwater
  
- TPHg = Total petroleum hydrocarbons as gasoline analyzed using modified EPA method 5030/8015.
- BTEX = Benzene, Toluene, Ethylbenzene, and total Xylenes analyzed using modified EPA method 5030/8020.
- VOCs = Volatile organic compounds analyzed using EPA method 624.
- < = Less than the indicated detection limit shown by the laboratory
- NM = Not Measured
- NA = Not Analyzed
- ND = Not detected at or above method detection limit
- † = VOCs analyzed using EPA Method 502.2
- †† = VOCs analyzed using EPA Method 524.2
- \* = Not measured because of installed product-skimmer pump
- \*\* = Thickness of liquid-phase product after the well was allowed to recharge for approximately 3 hours
- ∇ = Anomalous water level possibly due to recharge from a perched water zone
- ‡ = Water Level during pumping of MW-7
- ## = Water inspected in oil-water separator tank
- MCLs = Maximum Contaminant Levels (DHS, October 1990)
- DWAL = Drinking Water Action Level (DHS, October 1990)
- = Not applicable
- # = Well monitored, not sampled



**APPENDIX A**

**GROUNDWATER SAMPLING PROTOCOL AND  
WELL PURGE DATA SHEETS**

## GROUNDWATER SAMPLING PROTOCOL

The static water level and liquid phase hydrocarbon level, if present, in each well that contained water and/or liquid phase hydrocarbons are measured with an ORS Interphase Probe Model No. 106801, which is accurate to the nearest 0.01 foot. To calculate groundwater elevations and evaluate groundwater gradient, depth to water (DTW) levels are subtracted from wellhead elevations and corrected for liquid phase hydrocarbon thickness (HT), when necessary, by multiplying (HT) by a correction factor 0.8 and subtracting from the DTW level (Adjusted DTW = DTW - [HT x 0.8]).

Groundwater samples collected for subjective evaluation are collected by gently lowering approximately half the length of a clean disposable or Teflon® bailer past the air-water interface (if possible) and collecting a sample from near the surface of the water in the well. The samples are checked for measurable liquid phase hydrocarbons or sheen. Any liquid phase hydrocarbons are removed from the well.

Before water samples are collected from the groundwater monitoring wells, the wells are purged until stabilization of the temperature, pH, and conductivity is obtained, or until a maximum of four well casing volumes are purged. Turbidity measurements are also collected from the purged well water. Water samples from the wells that do not obtain stability of the temperature, pH, and conductivity are considered to be "grab samples". Wells having demonstrated stabilization within purging of four well volumes for at least three consecutive quarters are not monitored for the above parameters. Instead, four well volumes are purged. The quantity of water purged from each well is calculated as follows:

1 well casing volume =  $\pi r^2 h(7.48)$  where:

r = radius of the well casing in feet.

h = column of water in the well in feet  
(depth to bottom - depth to water).

7.48 = conversion constant from cubic feet to gallons

Gallons of water purged/gallons in 1 well casing volume = well casing volumes removed.

After purging, each well is allowed to recharge to at least 80% of the initial water level. Water samples from wells that do not recover at least 80% (due to slow recharging of the well) between purging and sampling are considered to be "grab samples". Water samples were collected with an Environmental Protection Agency (EPA) approved disposable or Teflon® sampler which has been cleaned with Alconox® and deionized water. The groundwater was carefully poured into 40-milliliter (ml) glass vials, which are filled so as to produce a positive meniscus. Each vial is preserved with hydrochloric acid, sealed with a cap containing a Teflon® septum, and subsequently examined for air bubbles to avoid headspace which would allow volatilization to occur. The samples are promptly transported in iced storage in a thermally-insulated ice chest, accompanied by a Chain of Custody form, to a California-certified laboratory.

**WELL PURGE DATA SHEET**

Project Name: Exxon 7-3399

Job No. 13009.20

Date: 5/4/94

Page 1 of 1

Well No. MW-1

Time Started 12:35

| TIME (hr) | GALLONS (cum.)     | TEMP. (F) | pH   | CONDUCT. (micromho) | TURBIDITY (NTU) |
|-----------|--------------------|-----------|------|---------------------|-----------------|
| 12:35     | Start purging MW-1 |           |      |                     |                 |
| 12:35     | 0                  | 72.6      | 6.85 | 2.94                | 75.3            |
| 12:40     | 1.5                | 70.5      | 6.82 | 2.91                | >200            |
| 12:46     | 3.0                | 69.5      | 6.82 | 2.86                | 149.8           |
| 12:56     | 4.5                | 68.5      | 6.81 | 2.85                | 123.7           |
| 13:03     | 6.0                | 68.2      | 6.82 | 2.84                | 114.3           |
|           |                    |           |      |                     |                 |
|           |                    |           |      |                     |                 |
|           |                    |           |      |                     |                 |
| 13:03     | Stop purging MW-1  |           |      |                     |                 |

Notes:

- Hand bailed
- Conductivity at (x1,000)

Well Diameter (inches) : 4

Depth to Bottom (feet) : 55.05

Depth to Water - initial (feet) : 53.34

Depth to Water - final (feet) : 53.33

% recovery : 100

Time Sampled : 13:30

Gallons per Well Casing Volume : 1.3

Gallons Purged : 6.0

Well Casing Volume Purged : 4.6

Approximate Pumping Rate (gpm) : 0.2

**WELL PURGE DATA SHEET**

Project Name: Exxon 7-3399

Job No. 13009.20

Date: 5/5/94

Page 1 of 1

Well No. MW-4

Time Started 11:07

| TIME (hr) | GALLONS (cum.)     | TEMP. (F)        | pH   | CONDUCT. (micromho) | TURBIDITY (NTU) |
|-----------|--------------------|------------------|------|---------------------|-----------------|
| 11:07     | Start purging MW-4 |                  |      |                     |                 |
| 11:07     | 0                  | 66.6             | 6.74 | 2.59                | >200            |
| 11:16     | 2                  | 63.8             | 6.79 | 2.57                | >200            |
| 11:30     | 4                  | 63.7             | 6.78 | 2.57                | >200            |
|           |                    | Dry at 4 gallons |      |                     |                 |
|           |                    |                  |      |                     |                 |
|           |                    |                  |      |                     |                 |
|           |                    |                  |      |                     |                 |
|           |                    |                  |      |                     |                 |
| 11:30     | Stop purging MW-4  |                  |      |                     |                 |

**Notes:**

- Hand bailed  
 - Conductivity at (x1,000)

Well Diameter (inches) : 4  
 Depth to Bottom (feet) : 56.67  
 Depth to Water - initial (feet) : 53.54  
 Depth to Water - final (feet) : 54.66  
 % recovery : 64  
 Time Sampled : 13:15  
 Gallons per Well Casing Volume : 2.0  
 Gallons Purged : 4.0  
 Well Casing Volume Purged : 2.0  
 Approximate Pumping Rate (gpm) : 0.2

WELL PURGE DATA SHEET

Project Name: EXXON 7-3399

Job No. 130009.20

Date: 5/4/94

Page 1 of 1

Well No. MW-50

Time Started 14:05

| TIME (hr) | GALLONS (cum.)      | TEMP. (F) | pH   | CONDUCT. (micromho) | TURBIDITY (NTU) |
|-----------|---------------------|-----------|------|---------------------|-----------------|
| 14:05     | Start purging MW-50 |           |      |                     | 7               |
| 14:05     | 0                   | 77.7      | 7.35 | 2.76                | 7200            |
| 14:14     | 14                  | 72.2      | 7.13 | 2.57                | 48.7            |
| 14:23     | 28                  | 70.4      | 7.11 | 2.52                | 29.3            |
| 14:28     | 35                  | 69.8      | 7.10 | 2.50                | 19.4            |
| 14:33     | 42                  | 69.4      | 7.09 | 2.49                | 16.1            |
|           |                     |           |      |                     |                 |
|           |                     |           |      |                     |                 |
|           |                     |           |      |                     |                 |

14:33 Stop purging MW-50

Notes:

- Brunellos
- conductivity at (x1,000)

Well Diameter (inches) : 4

Depth to Bottom (feet) : 77.48

Depth to Water - initial (feet) : 56.66

Depth to Water - final (feet) : 56.60

% recovery : 100

Time Sampled : 15:00

Gallons per Well Casing Volume : 13.6

Gallons Purged : 42

Well Casing Volume Purged : 3.1

Approximate Pumping Rate (gpm) : 1.5

**WELL PURGE DATA SHEET**

Project Name: EXXON 7-3399

Job No. 130009.20

Date: 5/4/94

Page 1 of 1

Well No. MW-55

Time Started 14:12

| TIME (hr) | GALLONS (cum.)      | TEMP. (F) | pH   | CONDUCT. (micromho) | TURBIDITY (NTU) |
|-----------|---------------------|-----------|------|---------------------|-----------------|
| 14:12     | start purging MW-55 |           |      |                     |                 |
| 14:12     | 0                   | 73.8      | 6.83 | 3.74                | 7200            |
| 14:21     | 0.7                 | 70.6      | 6.85 | 3.61                | 1570            |
| 14:31     | 1.5                 | 68.6      | 6.85 | 3.57                | 87.3            |
| 14:42     | 2.1                 | 68.3      | 6.87 | 3.56                | 90.1            |
|           |                     |           |      |                     |                 |
|           |                     |           |      |                     |                 |
|           |                     |           |      |                     |                 |
|           |                     |           |      |                     |                 |

14:42 Stop purging MW-55

Notes:  
 - Hand bailed  
 - Conductivity at (X1,000)

Well Diameter (inches) : 4  
 Depth to Bottom (feet) : 54.57  
 Depth to Water - initial (feet) : 53.52  
 Depth to Water - final (feet) : 53.50  
 % recovery : 101  
 Time Sampled : 15:15  
 Gallons per Well Casing Volume : 0.7  
 Gallons Purged : 2.1  
 Well Casing Volume Purged : 3.0  
 Approximate Pumping Rate (gpm) : 0.07

**WELL PURGE DATA SHEET**

Project Name: Exxon 7-3399

Job No. 130009.20

Date: 5/4/94

Page 1 of 1

Well No. MW-7

Time Started 12:10

| TIME (hr) | GALLONS (cum.)     | TEMP. (F) | pH   | CONDUCT. (micromho) | TURBIDITY (NTU) |
|-----------|--------------------|-----------|------|---------------------|-----------------|
| 12:10     | Start purging MW-7 |           |      |                     |                 |
| 12:10     | 0                  | 72.3      | 6.74 | 5.40                | 7.7             |
| 12:18     | 4.5                | 70.1      | 6.79 | 5.34                | >200            |
| 12:25     | Dry at 5 gallons   |           |      |                     |                 |
|           |                    |           |      |                     |                 |
|           |                    |           |      |                     |                 |
|           |                    |           |      |                     |                 |
|           |                    |           |      |                     |                 |
|           |                    |           |      |                     |                 |
| 12:25     | Stop purging MW-7  |           |      |                     |                 |

**Notes:**

- Hand banded  
- conductivity at (x1,000)

Well Diameter (inches) : 4  
 Depth to Bottom (feet) : 59.29  
 Depth to Water - initial (feet) : 52.77  
 Depth to Water - final (feet) : 54.33  
 % recovery : 76  
 Time Sampled : 12:30  
 Gallons per Well Casing Volume : >4.3  
 Gallons Purged : 5.0  
 Well Casing Volume Purged : 1.0  
 Approximate Pumping Rate (gpm) : 0.3

5/5/94

WELL PURGE DATA SHEET

Project Name: Exxon 7-3399

Job No. 130009.20

Date: 5/6/94

Page 1 of 1

Well No. MW-8

Time started 10:53

| TIME (hr) | GALLONS (cum.)     | TEMP. (F) | pH   | CONDUCT. (micromho) | TURBIDITY (NTU) |
|-----------|--------------------|-----------|------|---------------------|-----------------|
| 10:53     | Start purging MW-8 |           |      |                     |                 |
| 10:53     | 0                  | 67.6      | 7.01 | 2.44                | 5.7             |
| 11:11     | 50                 | 64.7      | 7.09 | 1.43                | 1.44            |
| 11:31     | 100                | 63.1      | 7.07 | 1.42                | 1.0             |
| 11:33     | 125                | 61.9      | 7.11 | 1.40                | 0.6             |
| 11:50     | 150                | 62.4      | 7.22 | 1.40                | 0.1             |
| 11:58     | 175                | 62.4      | 7.25 | 1.40                | 0.0             |
| 12:00     | 180                |           |      |                     |                 |
| 12:00     | Stop purging MW-8  |           |      |                     |                 |

Notes:

- Conductivity at  
(x1,000)

Well Diameter (inches) : 4

Depth to Bottom (feet) : 135.00

Depth to Water - initial (feet) : 56.84

Depth to Water - final (feet) : 56.76

% recovery : 100

Time Sampled : 13:00

Gallons per Well Casing Volume : 51

Gallons Purged : 180

Well Casing Volume Purged : 3.5

Approximate Pumping Rate (gpm) : 1.7



**APPENDIX B**

**LABORATORY ANALYSIS REPORTS AND  
CHAIN OF CUSTODY RECORDS**

May 16, 1994

MAY 31 1994

RESNA  
SAN JOSE

Mr. Marc Briggs  
RESNA  
3315 Almaden Expressway Suite 34  
San Jose, CA 95118

RE: PACE Project No. 440509.504  
Client Reference: Exxon 7-3399 (EE)

Dear Mr. Briggs:

Enclosed is the report of laboratory analyses for samples received  
May 09, 1994.

Footnotes are given at the end of the report.

If you have any questions concerning this report, please feel free  
to contact us.

Sincerely,

  
for Stephanie Matzo  
Project Manager

Enclosures

RESNA  
 3315 Almaden Expressway Suite 34  
 San Jose, CA 95118

May 16, 1994  
 PACE Project Number: 440509504

Attn: Mr. Marc Briggs

Client Reference: Exxon 7-3399 (EE)

PACE Sample Number: 70 0317509  
 Date Collected: 05/04/94  
 Date Received: 05/09/94  
 Client Sample ID: Rinsate

| <u>Parameter</u> | <u>Units</u> | <u>MDL</u> | <u>DATE ANALYZED</u> |
|------------------|--------------|------------|----------------------|
|------------------|--------------|------------|----------------------|

ORGANIC ANALYSIS

|  |      |     |          |
|--|------|-----|----------|
| <u>PURGEABLE FUELS AND AROMATICS</u>     |      |     |          |
| TOTAL FUEL HYDROCARBONS, (LIGHT):        |      |     |          |
| Purgeable Fuels, as Gasoline (EPA 8015M) | ug/L | 50  | 05/13/94 |
| PURGEABLE AROMATICS (BTXE BY EPA 8020M): |      |     |          |
| Benzene                                  | ug/L | 0.5 | 05/13/94 |
| Toluene                                  | ug/L | 0.5 | 05/13/94 |
| Ethylbenzene                             | ug/L | 0.5 | 05/13/94 |
| Xylenes, Total                           | ug/L | 0.5 | 05/13/94 |

Mr. Marc Briggs  
 Page 2

May 16, 1994  
 PACE Project Number: 440509504

Client Reference: Exxon 7-3399 (EE)

PACE Sample Number: 70 0317517  
 Date Collected: 05/04/94  
 Date Received: 05/09/94  
 Client Sample ID: R 1

| <u>Parameter</u> | <u>Units</u> | <u>MDL</u> | <u>DATE ANALYZED</u> |
|------------------|--------------|------------|----------------------|
|------------------|--------------|------------|----------------------|

ORGANIC ANALYSIS

|  |      |     |             |
|--|------|-----|-------------|
| PURGEABLE FUELS AND AROMATICS            |      |     |             |
| TOTAL FUEL HYDROCARBONS, (LIGHT):        |      |     | 05/11/94    |
| Purgeable Fuels, as Gasoline (EPA 8015M) | ug/L | 50  | ND 05/11/94 |
| PURGEABLE AROMATICS (BTXE BY EPA 8020M): |      |     |             |
| Benzene                                  | ug/L | 0.5 | ND 05/11/94 |
| Toluene                                  | ug/L | 0.5 | ND 05/11/94 |
| Ethylbenzene                             | ug/L | 0.5 | ND 05/11/94 |
| Xylenes, Total                           | ug/L | 0.5 | ND 05/11/94 |

Mr. Marc Briggs  
 Page 3

May 16, 1994  
 PACE Project Number: 440509504

Client Reference: Exxon 7-3399 (EE)

PACE Sample Number: 70 0317525  
 Date Collected: 05/04/94  
 Date Received: 05/09/94  
 Client Sample ID: W-53-MW 1

| <u>Parameter</u> | <u>Units</u> | <u>MDL</u> | <u>DATE ANALYZED</u> |
|------------------|--------------|------------|----------------------|
|------------------|--------------|------------|----------------------|

ORGANIC ANALYSIS

|  |      |     |             |
|--|------|-----|-------------|
| PURGEABLE FUELS AND AROMATICS            |      |     |             |
| TOTAL FUEL HYDROCARBONS, (LIGHT):        |      |     | 05/11/94    |
| Purgeable Fuels, as Gasoline (EPA 8015M) | ug/L | 50  | ND 05/11/94 |
| PURGEABLE AROMATICS (BTXE BY EPA 8020M): |      |     |             |
| Benzene                                  | ug/L | 0.5 | ND 05/11/94 |
| Toluene                                  | ug/L | 0.5 | ND 05/11/94 |
| Ethylbenzene                             | ug/L | 0.5 | ND 05/11/94 |
| Xylenes, Total                           | ug/L | 0.5 | ND 05/11/94 |

Mr. Marc Briggs  
 Page 4

May 16, 1994  
 PACE Project Number: 440509504

Client Reference: Exxon 7-3399 (EE)

PACE Sample Number: 70 0317533  
 Date Collected: 05/04/94  
 Date Received: 05/09/94  
 Client Sample ID: W-56-MW 50

| <u>Parameter</u> | <u>Units</u> | <u>MDL</u> | <u>DATE ANALYZED</u> |
|------------------|--------------|------------|----------------------|
|------------------|--------------|------------|----------------------|

ORGANIC ANALYSIS

PURGEABLE FUELS AND AROMATICS

|  |      |     |    |          |
|--|------|-----|----|----------|
| TOTAL FUEL HYDROCARBONS, (LIGHT):        |      |     | -  | 05/11/94 |
| Purgeable Fuels, as Gasoline (EPA 8015M) | ug/L | 50  | ND | 05/11/94 |
| PURGEABLE AROMATICS (BTXE BY EPA 8020M): |      |     | -  | 05/11/94 |
| Benzene                                  | ug/L | 0.5 | ND | 05/11/94 |
| Toluene                                  | ug/L | 0.5 | ND | 05/11/94 |
| Ethylbenzene                             | ug/L | 0.5 | ND | 05/11/94 |
| Xylenes, Total                           | ug/L | 0.5 | ND | 05/11/94 |

Mr. Marc Briggs  
 Page 5

May 16, 1994  
 PACE Project Number: 440509504

Client Reference: Exxon 7-3399 (EE)

PACE Sample Number: 70 0317541  
 Date Collected: 05/04/94  
 Date Received: 05/09/94  
 Client Sample ID: W-53-MW 5S

| <u>Parameter</u> | <u>Units</u> | <u>MDL</u> | <u>DATE ANALYZED</u> |
|------------------|--------------|------------|----------------------|
|------------------|--------------|------------|----------------------|

ORGANIC ANALYSIS

|  |      |     |             |
|--|------|-----|-------------|
| PURGEABLE FUELS AND AROMATICS            |      |     |             |
| TOTAL FUEL HYDROCARBONS, (LIGHT):        |      |     | 05/11/94    |
| Purgeable Fuels, as Gasoline (EPA 8015M) | ug/L | 50  | ND 05/11/94 |
| PURGEABLE AROMATICS (BTXE BY EPA 8020M): |      |     |             |
| Benzene                                  | ug/L | 0.5 | ND 05/11/94 |
| Toluene                                  | ug/L | 0.5 | ND 05/11/94 |
| Ethylbenzene                             | ug/L | 0.5 | ND 05/11/94 |
| Xylenes, Total                           | ug/L | 0.5 | ND 05/11/94 |

Mr. Marc Briggs  
 Page 6

May 16, 1994  
 PACE Project Number: 440509504

Client Reference: Exxon 7-3399 (EE)

PACE Sample Number: 70 0317550  
 Date Collected: 05/05/94  
 Date Received: 05/09/94  
 Client Sample ID: W-56-MW 8

| <u>Parameter</u> | <u>Units</u> | <u>MDL</u> |  | <u>DATE ANALYZED</u> |
|------------------|--------------|------------|--|----------------------|
|------------------|--------------|------------|--|----------------------|

ORGANIC ANALYSIS

|   |      |     |    |          |
|---|------|-----|----|----------|
| <b>PURGEABLE FUELS AND AROMATICS</b>            |      |     |    |          |
| <b>TOTAL FUEL HYDROCARBONS, (LIGHT):</b>        |      |     |    |          |
| Purgeable Fuels, as Gasoline (EPA 8015M)        | ug/L | 50  | -  | 05/11/94 |
| <b>PURGEABLE AROMATICS (BTXE BY EPA 8020M):</b> |      |     |    |          |
| Benzene   | ug/L | 0.5 | ND | 05/11/94 |
| Toluene   | ug/L | 0.5 | ND | 05/11/94 |
| Ethylbenzene                                    | ug/L | 0.5 | ND | 05/11/94 |
| Xylenes, Total                                  | ug/L | 0.5 | ND | 05/11/94 |



Mr. Marc Briggs  
 Page 7

May 16, 1994  
 PACE Project Number: 440509504

Client Reference: Exxon 7-3399 (EE)

PACE Sample Number: 70 0317568  
 Date Collected: 05/05/44  
 Date Received: 05/09/94  
 Client Sample ID: W-54-MW 4

| <u>Parameter</u> | <u>Units</u> | <u>MDL</u> | <u>DATE ANALYZED</u> |
|------------------|--------------|------------|----------------------|
|------------------|--------------|------------|----------------------|

ORGANIC ANALYSIS

PURGEABLE FUELS AND AROMATICS

|  |      |     |    |          |
|--|------|-----|----|----------|
| TOTAL FUEL HYDROCARBONS, (LIGHT):        |      |     | -  | 05/11/94 |
| Purgeable Fuels, as Gasoline (EPA 8015M) | ug/L | 50  | ND | 05/11/94 |
| PURGEABLE AROMATICS (BTXE BY EPA 8020M): |      |     | -  | 05/11/94 |
| Benzene                                  | ug/L | 0.5 | ND | 05/11/94 |
| Toluene                                  | ug/L | 0.5 | ND | 05/11/94 |
| Ethylbenzene                             | ug/L | 0.5 | ND | 05/11/94 |
| Xylenes, Total                           | ug/L | 0.5 | ND | 05/11/94 |

Mr. Marc Briggs  
 Page 8

May 16, 1994  
 PACE Project Number: 440509504

Client Reference: Exxon 7-3399 (EE)

PACE Sample Number: 70 0317576  
 Date Collected: 05/05/94  
 Date Received: 05/09/94  
 Client Sample ID: W-54-MW 7

| <u>Parameter</u> | <u>Units</u> | <u>MDL</u> | <u>DATE ANALYZED</u> |
|------------------|--------------|------------|----------------------|
|------------------|--------------|------------|----------------------|

ORGANIC ANALYSIS

|  |      |     |             |
|--|------|-----|-------------|
| PURGEABLE FUELS AND AROMATICS            |      |     |             |
| TOTAL FUEL HYDROCARBONS, (LIGHT):        |      |     | 05/11/94    |
| Purgeable Fuels, as Gasoline (EPA 8015M) | ug/L | 50  | ND 05/11/94 |
| PURGEABLE AROMATICS (BTXE BY EPA 8020M): |      |     | 05/11/94    |
| Benzene                                  | ug/L | 0.5 | ND 05/11/94 |
| Toluene                                  | ug/L | 0.5 | ND 05/11/94 |
| Ethylbenzene                             | ug/L | 0.5 | ND 05/11/94 |
| Xylenes, Total                           | ug/L | 0.5 | ND 05/11/94 |

These data have been reviewed and are approved for release.

  
 Darrell C. Cain  
 Regional Director

Mr. Marc Briggs  
Page 9

FOOTNOTES  
for pages 1 through 8

May 16, 1994  
PACE Project Number: 440509504

Client Reference: Exxon 7-3399 (EE)

MDL Method Detection Limit  
ND Not detected at or above the MDL.

Mr. Marc Briggs  
 Page 10

QUALITY CONTROL DATA

May 16, 1994  
 PACE Project Number: 440509504

Client Reference: Exxon 7-3399 (EE)

PURGEABLE FUELS AND AROMATICS

Batch: 70 30345

Samples: 70 0317517, 70 0317525, 70 0317533, 70 0317541, 70 0317550  
 70 0317568, 70 0317576

METHOD BLANK:

| <u>Parameter</u>                         | <u>Units</u> | <u>MDL</u> | <u>Method Blank</u> |
|--|--------------|------------|---------------------|
| INDIVIDUAL PARAMETERS                    |              |            |                     |
| Methyl tert-butyl ether                  | ug/L         | 5.0        | ND                  |
| PURGEABLE FUELS AND AROMATICS            |              |            |                     |
| TOTAL FUEL HYDROCARBONS, (LIGHT):        |              |            |                     |
| Purgeable Fuels, as Gasoline (EPA 8015M) | ug/L         | 50         | ND                  |
| PURGEABLE AROMATICS (BTXE BY EPA 8020M)  |              |            |                     |
| Benzene                                  | ug/L         | 0.5        | ND                  |
| Toluene                                  | ug/L         | 0.5        | ND                  |
| Ethylbenzene                             | ug/L         | 0.5        | ND                  |
| Xylenes, Total                           | ug/L         | 0.5        | ND                  |

SPIKE AND SPIKE DUPLICATE:

| <u>Parameter</u>              | <u>Units</u> | <u>MDL</u> | <u>700317592</u> | <u>Spike</u> | <u>Spike Recv</u> | <u>Dupl Recv</u> | <u>RPD</u> |
|-------------------------------|--------------|------------|------------------|--------------|-------------------|------------------|------------|
| PURGEABLE FUELS AND AROMATICS |              |            |                  |              |                   |                  |            |
| Benzene                       | ug/L         | 0.5        | ND               | 100          | 104%              | 102%             | 2%         |
| Toluene                       | ug/L         | 0.5        | ND               | 100          | 103%              | 101%             | 2%         |
| Ethylbenzene                  | ug/L         | 0.5        | ND               | 100          | 102%              | 100%             | 2%         |
| Xylenes, Total                | ug/L         | 0.5        | ND               | 300          | 103%              | 101%             | 2%         |

Mr. Marc Briggs  
 Page 11

QUALITY CONTROL DATA

May 16, 1994  
 PACE Project Number: 440509504

Client Reference: Exxon 7-3399 (EE)

**PURGEABLE FUELS AND AROMATICS**

Batch: 70 30345

Samples: 70 0317517, 70 0317525, 70 0317533, 70 0317541, 70 0317550  
 70 0317568, 70 0317576

**LABORATORY CONTROL SAMPLE AND CONTROL SAMPLE DUPLICATE:**

| <u>Parameter</u>                     | <u>Units</u> | <u>MDL</u> | <u>Reference Value</u> | <u>Recv</u> | <u>Dupl Recv</u> | <u>RPD</u> |
|--------------------------------------|--------------|------------|------------------------|-------------|------------------|------------|
| <b>INDIVIDUAL PARAMETERS</b>         |              |            |                        |             |                  |            |
| Methyl tert-butyl ether              | ug/L         | 5.0        | 100                    | 97%         | 93%              | 4%         |
| <b>PURGEABLE FUELS AND AROMATICS</b> |              |            |                        |             |                  |            |
| Benzene                              | ug/L         | 0.5        | 100                    | 99%         | 96%              | 3%         |
| Toluene                              | ug/L         | 0.5        | 100                    | 99%         | 96%              | 3%         |
| Ethylbenzene                         | ug/L         | 0.5        | 100                    | 100%        | 96%              | 4%         |
| Xylenes, Total                       | ug/L         | 0.5        | 300                    | 100%        | 97%              | 3%         |

Mr. Marc Briggs  
Page 12

QUALITY CONTROL DATA

May 16, 1994  
PACE Project Number: 440509504

Client Reference: Exxon 7-3399 (EE)

**PURGEABLE FUELS AND AROMATICS**

Batch: 70 30395  
Samples: 70 0317509

**METHOD BLANK:**

| Parameter                                | Units | MDL | Method Blank |
|--|-------|-----|--------------|
| TOTAL FUEL HYDROCARBONS, (LIGHT):        |       |     | -            |
| Purgeable Fuels, as Gasoline (EPA 8015M) | ug/L  | 50  | ND           |
| PURGEABLE AROMATICS (BTXE BY EPA 8020M)  |       |     | -            |
| Benzene                                  | ug/L  | 0.5 | ND           |
| Toluene                                  | ug/L  | 0.5 | ND           |
| Ethylbenzene                             | ug/L  | 0.5 | ND           |
| Xylenes, Total                           | ug/L  | 0.5 | ND           |

**SPIKE AND SPIKE DUPLICATE:**

| Parameter      | Units | MDL | 700318238 | Spike | Spike Recv | Spike Dupl Recv | RPD |
|----------------|-------|-----|-----------|-------|------------|-----------------|-----|
| Benzene        | ug/L  | 0.5 | ND        | 100   | 97%        | 95%             | 2%  |
| Toluene        | ug/L  | 0.5 | ND        | 100   | 100%       | 98%             | 2%  |
| Ethylbenzene   | ug/L  | 0.5 | ND        | 100   | 101%       | 100%            | 1%  |
| Xylenes, Total | ug/L  | 0.5 | ND        | 300   | 99%        | 98%             | 1%  |

**LABORATORY CONTROL SAMPLE AND CONTROL SAMPLE DUPLICATE:**

| Parameter      | Units | MDL | Reference Value | Recv | Dupl Recv | RPD |
|----------------|-------|-----|-----------------|------|-----------|-----|
| Benzene        | ug/L  | 0.5 | 100             | 102% | 102%      | 0%  |
| Toluene        | ug/L  | 0.5 | 100             | 106% | 105%      | 1%  |
| Ethylbenzene   | ug/L  | 0.5 | 100             | 112% | 112%      | 0%  |
| Xylenes, Total | ug/L  | 0.5 | 300             | 107% | 108%      | 1%  |

Mr. Marc Briggs  
Page 13

FOOTNOTES  
for pages 10 through 12

May 16, 1994  
PACE Project Number: 440509504

Client Reference: Exxon 7-3399 (EE)

MDL Method Detection Limit  
ND Not detected at or above the MDL.  
RPD Relative Percent Difference



**EXXON COMPANY, U.S.A.**

P.O. Box 4415, Houston, TX 77210-4415

**CHAIN OF CUSTODY**

440508.504

Novato, CA, 11 Digital Drive, 94949  
(415) 883-6100

Huntington Beach, CA, 5702 Bolsa Avenue, 92649  
(714) 892-2565

Consultant's Name: RESNA Industries Page 2 of 2  
 Address: 3315 Almaden Express #34 San Jose CA 95118 Site Location: 2991 Hayward Rd  
 Project #: \_\_\_\_\_ Consultant Project #: 130009.20 Consultant Work Release #: 8735040/00 #3  
 Project Contact: Jane Burkhardt Briggs Phone: (408) 264-3778 Fax: 264-2435 Laboratory Work Release #: \_\_\_\_\_  
 EXXON Contact: Marta Guenster  EE  C&M Phone: (510) 246-8776 Fax #: \_\_\_\_\_ EXXON RAS #: 7-3399  
 Sampled by (print): Chris Allen Sampler's Signature: Chris Allen  
 Shipment Method: Curier Air Bill #: \_\_\_\_\_ Shipment Date: \_\_\_\_\_

| TAT: <input type="checkbox"/> 24 hr <input type="checkbox"/> 48 hr <input type="checkbox"/> 72 hr <input checked="" type="checkbox"/> Standard (5 day) |                      |                       |            |           |                | ANALYSIS REQUIRED                   |                         |                   |                                     |  |  |  |  |  |  | Sample Condition as Received<br>Temperature °C: _____<br>Cooler #: _____<br>Inbound Seal Yes No<br>Outbound Seal Yes No |  |  |          |  |
|--|----------------------|-----------------------|------------|-----------|----------------|-------------------------------------|-------------------------|-------------------|-------------------------------------|--|--|--|--|--|--|---|--|--|----------|--|
| Sample Description   | Collection Date/Time | Matrix Soil/Water     | Prsv       | # of Cont | PACE Sample #  | TPH/GAS/BTEX<br>EPA 801.5/8020      | TPH/Diesel<br>EPA 801.5 | TPRH<br>EPA 418.1 | Hold                                |  |  |  |  |  |  |   |  |  | COMMENTS |  |
| <u>10-54-UW4</u>   | <u>5/5/94</u>        | <u>H<sub>2</sub>O</u> | <u>HPL</u> | <u>3</u>  | <u>31756.8</u> | <input checked="" type="checkbox"/> |                         |                   |                                     |  |  |  |  |  |  |   |  |  |          |  |
| <u>R7</u>  | <u>"</u>             | <u>"</u>              | <u>"</u>   | <u>2</u>  | <u>31749.5</u> |                                     |                         |                   | <input checked="" type="checkbox"/> |  |  |  |  |  |  |   |  |  |          |  |
| <u>10-54-UW7</u>   | <u>"</u>             | <u>"</u>              | <u>"</u>   | <u>3</u>  | <u>31757.6</u> | <input checked="" type="checkbox"/> |                         |                   |                                     |  |  |  |  |  |  |   |  |  |          |  |

| Relinquished by/Affiliation | Date          | Time        | Accepted by/Affiliation    | Date          | Time        | Additional Comments: |
|-----------------------------|---------------|-------------|----------------------------|---------------|-------------|----------------------|
| <u>Chris Allen</u>          | <u>5/6/94</u> | <u>3:00</u> | <u>Donald Jankshi Pace</u> | <u>5/9/94</u> | <u>1240</u> |                      |
| <u>Donald Jankshi Pace</u>  | <u>5/9/94</u> | <u>1543</u> | <u>Wrex Hoover Pace</u>    | <u>5/9/94</u> | <u>1543</u> |                      |



