

ExxonMobil
Environmental Services Company
4096 Piedmont Avenue #194
Oakland, California 94611
510.547.8196
510.547.8706 Fax
jennifer.c.sedlachek@exxonmobil.com

RECEIVED

10:02 am, Sep 08, 2008

Alameda County
Environmental Health

Jennifer C. Sedlachek
Project Manager

ExxonMobil

August 22, 2008

Ms. Barbara Jakub, P.G.
Alameda County Health Care Services Agency
Department of Environmental Health
1131 Harbor Bay Parkway, Room 250
Alameda, California 94502-6577

RE: Former Exxon RAS #70235/2225 Telegraph Avenue, Oakland California.

Dear Ms. Jakub:

Attached for your review and comment is a copy of the letter report entitled *Work Plan for Groundwater Assessment*, dated August 22, 2008, for the above-referenced site. The report was prepared by Environmental Resolutions, Inc. (ERI) of Petaluma, California, and details proposed activities pertaining to the subject site.

I declare, under penalty of perjury, that the information and/or recommendations contained in the attached document or report is true and correct to the best of my knowledge.

If you have any questions or comments, please contact me at 510.547.8196.

Sincerely,



Jennifer C. Sedlachek
Project Manager

Attachment: ERI's Work Plan for Groundwater Assessment, dated August 22, 2008

cc: w/ attachment
Mr. Robert C. Elhers, M.S., P.E., The Valero Companies, Environmental Liability Management

w/o attachment
Ms. Paula Sime, Environmental Resolutions, Inc.



*Southern California
Northern California
Pacific Northwest
Southwest
Texas
Montana*

August 22, 2008
ERI 222903.W05

Ms. Jennifer C. Sedlachek
ExxonMobil Environmental Services Company
4096 Piedmont Avenue #194
Oakland, California 94611

SUBJECT Work Plan for Groundwater Assessment
Former Exxon Service Station 70235
2225 Telegraph Avenue, Oakland, California

Ms. Sedlachek:

At the request of ExxonMobil Environmental Services Company, on behalf of ExxonMobil Oil Corporation (ExxonMobil), Environmental Resolutions, Inc. (ERI) prepared this work plan for the subject site. The purpose of the work is to assess the lateral and vertical extent of residual adsorbed-phase and dissolved-phase fuel constituents beneath the site in preparation for completion and submittal of a corrective action plan to the Alameda County Health Care Services Agency Department of Environmental Health (the ACEH). The proposed work consists of the advancement of three paired CPT and Hydropunch® (HP)-type borings (CPT1 through CPT3 and HP1 through HP3) and two dual-wall direct-push (DP) borings (DP1 and DP2).

SITE DESCRIPTION

Former Exxon Service Station 70235 is located at 2225 Telegraph Avenue, on the eastern corner of Telegraph Avenue and West Grand Avenue, Oakland, California, as depicted on the Site Vicinity Map (Plate 1). The site is at an elevation of approximately 20 feet above msl and the surrounding area is a mix of industrial and residential properties.

The site is an active retail service station. Texaco Refining and Marketing, Incorporated operated the station from 1963 until 1988 when the site property was transferred to ExxonMobil. ExxonMobil sold the site to Valero Refining Company in 2000. In 2001, Valero sold the site to Mr. Lam Truong who currently owns and operates the station.

Environmental Resolutions, Inc.

601 North McDowell Blvd., Petaluma, CA 94954-2312 | Tel: 707.766.2000 | Fax: 707.789.0414 | Contractor # A/C10-611383

GEOLOGY AND HYDROGEOLOGY

The site is located along the eastern margin of the San Francisco Bay within the East Bay Plain (Hickenbottom and Muir, 1988). The surficial deposits in the site vicinity are mapped as Merritt Sand consisting of fine-grained, very well sorted, well-drained eolian deposits of the Pleistocene and Holocene age (Graymer, 2000). The active northwest trending Hayward fault is located approximately 3½ miles east of the site.

The East Bay Plain is regionally divided into two major groundwater basins: the San Pablo and the San Francisco Basin. These basins are tectonic depressions that are filled primarily with a sequence of coalescing alluvial fans. The San Francisco Basin is further divided into seven sub-areas. The site is located in the Oakland Sub-Area, which is filled primarily by alluvial deposits that range from 300 to 700 feet thick without well-defined aquitards (CRWQCB, 1999). Under natural conditions, the direction of groundwater flow in the East Bay Plain is east to west and correlates with topography.

The site is located approximately 2,200 feet west of the Lake Merritt. Lake Merritt is connected to the Oakland Inner Harbor to the west, which connects to the San Francisco Bay. The San Francisco Bay is located approximately 2.7 miles west and 3.5 miles south of the site. Groundwater flow direction is predominantly to the southwest towards the San Francisco Bay, consistent with site data and the local topography. Groundwater recharge of the East Bay Plain occurs by infiltration from precipitation, irrigation, pipe leakage, and stream flow.

PREVIOUS WORK

Fueling System Activities

The site currently dispenses Regular, Plus, and Premium Unleaded gasoline and diesel. The locations of the USTs, dispenser islands, and other select site features are shown on the Generalized Site Plan (Plate 2).

In November of 1991 three single-walled USTs and their associated piping were removed and replaced with double-walled fiberglass tanks and piping. The existing UST cavity was enlarged to accommodate the new USTs (EA, 1992).

Site Assessment Activities

Multiple phases of assessment have been conducted from 1988 to the present, including the advancement of seven soil-gas probes and 22 soil borings and the installation of two vapor extraction wells, four recovery wells (RW1 through RW3 and RW3A), and 10 groundwater monitoring wells (MW6A through MW6J) (Alton, 1991; ERI, 2000, 2001a, 2002, 2007; HLA, 1988, 1989, 1990, 1992). Wells MW6A and RW3 were destroyed in conjunction with assessment activities (ERI, 2002; HLA, 1992). Results of the assessment indicated maximum residual adsorbed-phase TPHg, benzene, and MTBE concentrations of 11,000 mg/kg, 130 mg/kg, and 0.016 mg/kg, respectively. Residual adsorbed-phase TPHg and benzene are primarily present in the soils from surface to 13.5 feet bgs around the northern dispenser islands and the northeastern portion of the site (borings B1A, B3A, B1, B2, MW6H, TG2, and TG3). Residual MTBE was reported in soil samples collected from boring B9 along the eastern edge of the site. A detailed description of site conditions is presented in ERI's *Site Conceptual Model*, dated May 29, 2007 (ERI, 2007b). Cumulative soil data is presented in Tables 1A through 1C.

Remediation Activities

In November and December 1991, the product USTs were removed and the former tank pit was enlarged to accommodate the new product USTs; an area approximately 45 by 33 feet to 13.5 feet bgs was excavated. Concentrations of TPHg up to 10,000 mg/kg (TG2, 13 feet bgs) and benzene up to 130 mg/kg (TG2, 13 feet bgs) were reported in soil samples collected from the base of the excavation. Concentrations of TPHg up to 660 mg/kg (TG12, 12 feet bgs) and benzene up to 4.3 mg/kg (TG12, 12 feet bgs) were reported in the sidewall soil samples of the enlarged cavity (EA, 1992).

A groundwater remediation system extracted, treated, and discharged approximately 307,000 gallons of groundwater between fourth quarter 1990 and the end of first quarter 1992 (HLA, 1992). As of November 15, 1993, approximately 583,679 gallons of groundwater was discharged (Texaco, 1994).

On September 11, 2001, ERI conducted a DPE test. A total of 9,000 gallons of groundwater was extracted and treated during the nine day DPE test. The average extraction rate for the test was 1.06 gpm. Approximately 187.5 pounds of TPHg and 2.36 pounds of MTBE were removed during the DPE feasibility test. A total of 0.329 pound of TPHg and 0.0374 pound of MTBE were removed by groundwater extraction during the DPE test (ERI, 2001b). The results of the DPE test indicated that DPE is a feasible remedial alternative for the site.

Groundwater Monitoring Activities

Quarterly groundwater monitoring was implemented at the site in 1988. NAPL has not been encountered. Dissolved-phase TPHg, benzene, and MTBE extend from the east-northeastern portion of the site off site into the public right-of-way, with the maximum concentrations reported in samples collected from wells RW1 and MW6H and boring B9. During the monitoring program, fuel constituent concentrations detected in samples collected from wells MW6E, MW6F, and MW6I have declined to concentrations at or below the laboratory reporting limit. Cumulative grab groundwater analytical data is summarized in Tables 2A through 2C. Cumulative groundwater monitoring and sampling data are summarized in Tables 3A and 3B. The second quarter 2008 groundwater monitoring figures are included as Plates 3 and 4. Well details are summarized in Table 4.

PROPOSED WORK

In preparation for submittal of a corrective action plan, additional assessment is needed to evaluate the vertical extent of residual adsorbed-phase and dissolved-phase fuel constituents along the eastern edge of the site.

The proposed work consists of the advancement of three paired CPT and HP borings (CPT1 through CPT3 and HP1 through HP3) and one dual-wall DP boring (DP1). The proposed boring locations are depicted on Plate 5.

Pre-Field Activities

Prior to the onset of drilling activities, a well installation permit will be obtained from the Alameda County Public Works Agency (ACWPA). ERI personnel will visit the site to check for obstructions and to mark the proposed locations. Underground Service Alert, the ACPWA, and the ACEH will be notified at least 48 hours prior to the beginning of field activities. Prior to drilling, the locations will be excavated using a hand auger or vacuum excavation equipment to 8 feet bgs to ensure that there are not subsurface obstructions near the potential path of the rods.

Drilling and Sampling Activities

The proposed CPT and HP borings will be drilled using direct-push technology. Borings CPT1 through CPT3 will be advanced to depths of 50 feet bgs to identify subsurface sediments and potential water-bearing intervals. Pore pressure testing will be conducted at selected intervals to evaluate vertical gradient between water-bearing zones. ERI personnel will evaluate the CPT logs prior to advancing the

HP borings (HP1 through HP3) adjacent to each CPT boring and collecting water samples from within identified water-bearing zones for laboratory analysis.

The DP borings (DP1 and DP2) will be advanced to a depth of approximately 30 feet bgs to collect continuous soil samples from the borings to correlate soil stratigraphy with the CPT logs and screen for VOCs using a PID. ERI personnel will classify soil samples using visual and manual methods according to the USCS and construct boring logs. Select soil samples will be submitted for laboratory analysis at approximately 5-foot intervals and at locations where PID screening indicates the possible presence of residual hydrocarbons.

Field procedures are described in the field protocol presented in Appendix A. The fieldwork will be conducted under the advisement of a State of California professional geologist and in accordance with applicable regulatory guidelines.

Laboratory Analyses

Select soil and grab groundwater samples will be submitted for analysis to an ExxonMobil-approved, state-certified analytical laboratory. The samples will be analyzed for TPHg, TPHd, and TPHmo by EPA Method 8015B and BTEX, MTBE, oxygenated compounds (ETBE, TAME, TBA, and DIPE), lead scavengers (EDB and 1,2-DCA), and ethanol by EPA Method 8260B.

Waste Management Plan

The soil and decontamination water generated during drilling activities will be temporarily stored on site in DOT-approved, 55-gallon drums. Soil cuttings and decontamination water will be transported to ExxonMobil-approved facilities following laboratory analysis and characterization. Copies of the waste manifests for disposal of soil and water will be included in the report.

Site Safety Plan

Fieldwork will be performed in accordance with the site-specific safety plan.

Report

After completion of the field activities and receipt of analytical results, a report summarizing field and laboratory procedures, boring logs, and laboratory results will be submitted to ExxonMobil and the ACEH.

CONTACT INFORMATION

The responsible party contact is Ms. Jennifer C. Sedlachek ExxonMobil Environmental Services Company, 4096 Piedmont Avenue #194, Oakland, California 94611. The consultant contact is Ms. Paula Sime, Environmental Resolutions, Inc., 601 N. McDowell Boulevard, Petaluma, California 94954. The agency contact is Ms. Barbara Jakub, P.G., Alameda County Health Care Services Agency, Department of Environmental Health, 1131 Harbor Bay Parkway, Suite 250, Alameda, California 94502-6577.

LIMITATIONS

For any reports cited that were not generated by ERI, the data taken from those reports is used "as is" and is assumed to be accurate. ERI does not guarantee the accuracy of this data and makes no warranties for the referenced work performed nor the inferences or conclusions stated in these reports.

This report was prepared in accordance with generally accepted standards of environmental, geological and engineering practices in California at the time of investigation. No soil engineering or geotechnical references are implied or should be inferred. The evaluation of the geologic conditions at the site for this investigation is made from a limited number of data points. Subsurface conditions may vary away from these data points.

For any questions concerning the content of this work plan, please contact Ms. Paula Sime at (707) 766-2000.



Sincerely,

Environmental Resolutions, Inc.

Rebekah A. Westrup

Senior Staff Geologist

Heidi L. Dieffenbach-Carle

P.G. 6793

cc: Ms. Barbara Jakub, P.G., Alameda County Health Care Services Agency, Department of Environmental Health, 1131 Harbor Bay Parkway, Suite 250, Alameda, California 94502-6577

Mr. Robert C. Ehlers, M.S., P.E., The Valero Companies, Environmental Liability Management, 685 West Third Street, Hanford, California 93230

Enclosures:

References

Acronym List

Plate 1	Site Vicinity Map
Plate 2	Generalized Site Plan
Plate 3	Proposed Boring Locations
Plate 4	Groundwater Elevation Map – June 26, 2008
Plate 5	Select Analytical Results – June 26, 2008
Table 1A	Cumulative Laboratory Analytical Results of Soil Samples
Table 1B	Additional Cumulative Laboratory Analytical Results of Soil Samples – VOCs
Table 1C	Additional Cumulative Laboratory Analytical Results of Soil Samples – Metals
Table 2A	Cumulative Laboratory Analytical Results of Grab Groundwater Samples
Table 2B	Additional Cumulative Laboratory Analytical Results of Grab Groundwater Samples -VOCs
Table 2C	Additional Cumulative Laboratory Analytical Results of Grab Groundwater Samples – Metals
Table 3A	Cumulative Groundwater Monitoring and Sampling Data
Table 3B	Additional Cumulative Groundwater Monitoring and Sampling Data
Table 4	Well Construction Details
Appendix A	Field Protocol

REFERENCES

Alton Geoscience Inc. (Alton). April 25, 1991. *Preliminary Soil Assessment Report, Exxon Company U.S.A., Exxon Station No 7-0235, 2225 Telegraph Ave., Oakland, California.*

California Regional Water Quality Control Board San Francisco Bay Region Groundwater Committee (CRWQCB). June 1999. *East Bay Plain Groundwater Basin Beneficial Use Evaluation Report, Alameda and Contra Costa Counties, CA.*

EA Engineering (EA). January 1992. *Report of Tank Replacement and Closure Sampling Exxon Retail Site 7-0235, 225 Telegraph Avenue, Oakland, California.*

Environmental Resolutions, Inc (ERI). May 11, 2000. *Soil and Groundwater Investigation Report for Exxon Service Station 7-0235, 2225 Telegraph Avenue, Oakland, California.* ERI 222903.R01.

Environmental Resolutions, Inc (ERI). September 7, 2001a. *Well Installation Report for Former Exxon Service Station 7-0235, 2225 Telegraph Avenue, Oakland, California.* ERI 222903.R02.

Environmental Resolutions, Inc (ERI). October 19, 2001b. *Dual-Phase Extraction Pilot Test, Former Exxon Service Station 7-0235, 2225 Telegraph Avenue, Oakland, California.* ERI 222905.R01.

Environmental Resolutions, Inc (ERI). November 25, 2002. *Preferential Pathway Study and Work Plan for Off-Site Delineation at Former Exxon Service Station 7-0235, 2225 Telegraph Avenue, Oakland, California.*

Environmental Resolutions, Inc (ERI). April 27, 2007a. *Off-Site Delineation Investigation Report, Former Exxon Service Station 7-0235, 2225 Telegraph Avenue, Oakland, California.* ERI 229212.R22.

Environmental Resolutions, Inc. (ERI). May 29, 2007b. *Site Conceptual Model, Former Exxon Service Station 7-0235, 2225 Telegraph Avenue, Oakland, California.* ERI 222903.R23.

Graymer, R.W. 2000. Geologic map and map database of the Oakland metropolitan area, Alameda, Contra Costa, and San Francisco Counties, California. USGS, Miscellaneous Field Studies MF-2342.

Harding Lawson Associates (HLA). July 20, 1988. *Subsurface Investigation Texaco Station No. 62488000195, 2225 Telegraph Avenue, Oakland, California.* HLA Job No. 2251,052.04.

Harding Lawson Associates (HLA). June 22, 1989. *Environmental Assessment Former Texaco Station No. 62488000195, 2225 Telegraph Avenue, Oakland, California.*

Harding Lawson Associates (HLA). September 7, 1990. *Quarterly Technical Report, Second Quarter of 1990, Former Texaco Station, 2225 Telegraph Avenue, Oakland, California.*

Harding Lawson Associates (HLA). September 10, 1992. *Quarterly Technical Report, Second Quarter 1992, Exxon Station, 2225 Telegraph Avenue, Oakland, California.*

Hickenbottom, Kelvin and Muir, Kenneth S. June 1988. *Geohydrogeology and Groundwater Quality Overview of the East Bay Plain Area, Alameda County, CA.* Alameda County Flood Control and Water Conservation District. 83p.

Texaco Refining and Marketing Inc. (Texaco). April 28, 1994. Letter from Bob Robles, Environmental Protection Coordinator – Texaco to Tom Peacock, Alameda County Environmental Health Department re: ENV-Service Stations, Quarterly Groundwater Monitoring Report, 2225 Telegraph Avenue, Oakland, California.

ACRONYM LIST

µg/L	Micrograms per liter	NEPA	National Environmental Policy Act
µs	Microsiemens	NGVD	National Geodetic Vertical Datum
1,2-DCA	1,2-dichloroethane	NPDES	National Pollutant Discharge Elimination System
acfm	Actual cubic feet per minute	O&M	Operations and Maintenance
AS	Air sparge	ORP	Oxidation-reduction potential
bgs	Below ground surface	OSHA	Occupational Safety and Health Administration
BTEX	Benzene, toluene, ethylbenzene, and total xylenes	OVA	Organic vapor analyzer
CEQA	California Environmental Quality Act	P&ID	Process & Instrumentation Diagram
cfm	Cubic feet per minute	PAH	Polynuclear aromatic hydrocarbon
COC	Chain of Custody	PCB	Polychlorinated biphenyl
CPT	Cone Penetration (Penetrometer) Test	PCE	Tetrachloroethene or perchloroethylene
DIPE	Di-isopropyl ether	PID	Photo-ionization detector
DO	Dissolved oxygen	PLC	Programmable logic control
DOT	Department of Transportation	POTW	Publicly owned treatment works
DPE	Dual-phase extraction	ppmv	Parts per million by volume
DTW	Depth to water	PQL	Practical quantitation limit
EDB	1,2-dibromoethane	psi	Pounds per square inch
EPA	Environmental Protection Agency	PVC	Polyvinyl chloride
ESL	Environmental screening level	QA/QC	Quality assurance/quality control
ETBE	Ethyl tertiary butyl ether	RBSL	Risk-based screening levels
FID	Flame-ionization detector	RCRA	Resource Conservation and Recovery Act
fpm	Feet per minute	RL	Reporting limit
GAC	Granular activated carbon	scfm	Standard cubic feet per minute
gpd	Gallons per day	SSTL	Site-specific target level
gpm	Gallons per minute	STLC	Soluble threshold limit concentration
GWPTS	Groundwater pump and treat system	SVE	Soil vapor extraction
HVOC	Halogenated volatile organic compound	SVOC	Semivolatile organic compound
J	Estimated value between MDL and PQL	TAME	Tertiary amyl methyl ether
LEL	Lower explosive limit	TBA	Tertiary butyl alcohol
LPC	Liquid-phase carbon	TCE	Trichloroethene
LRP	Liquid-ring pump	TOC	Top of well casing elevation; datum is msl
LUFT	Leaking underground fuel tank	TOG	Total oil and grease
LUST	Leaking underground storage tank	TPHd	Total petroleum hydrocarbons as diesel
MCL	Maximum contaminant level	TPHg	Total petroleum hydrocarbons as gasoline
MDL	Method detection limit	TPHmo	Total petroleum hydrocarbons as motor oil
mg/kg	Milligrams per kilogram	TPHs	Total petroleum hydrocarbons as stoddard solvent
mg/L	Milligrams per liter	TRPH	Total recoverable petroleum hydrocarbons
mg/m ³	Milligrams per cubic meter	UCL	Upper confidence level
MPE	Multi-phase extraction	USCS	Unified Soil Classification System
MRL	Method reporting limit	USGS	United States Geologic Survey
msl	Mean sea level	UST	Underground storage tank
MTBE	Methyl tertiary butyl ether	VCP	Voluntary Cleanup Program
MTCA	Model Toxics Control Act	VOC	Volatile organic compound
NAI	Natural attenuation indicators	VPC	Vapor-phase carbon
NAPL	Non-aqueous phase liquid		

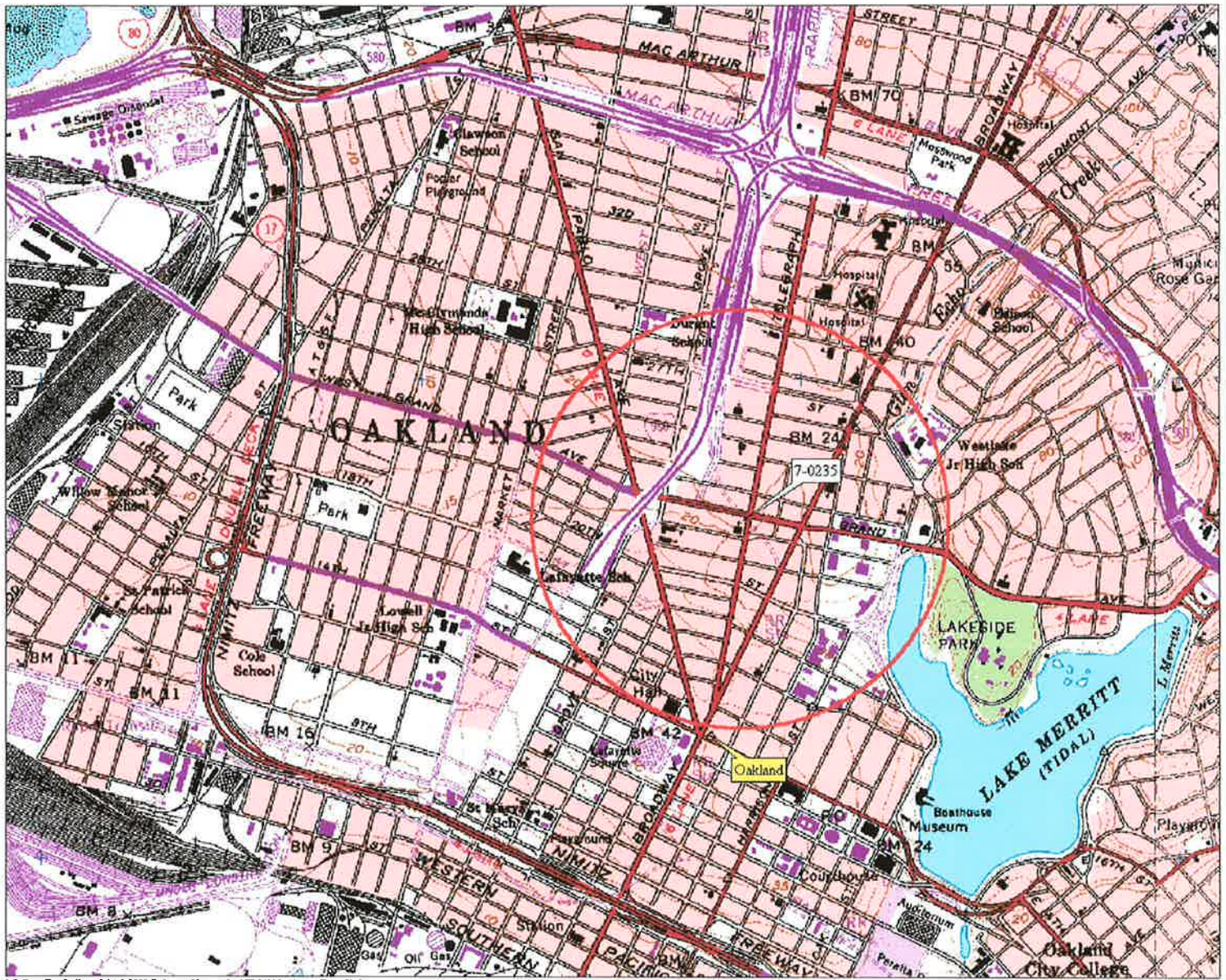

3-D TopoQuads Copyright © 1999 DeLorme Yarmouth, ME 04096 Source Data: USGS 1:500 ft Scale: 1:19,200 Detail: 13.0 Datum: WGS84

FN 2229Topo

J:\2229\2229 Topo.Dwg, mkjones

EXPLANATION



1/2-mile radius circle



APPROXIMATE SCALE



1 mile

SOURCE:
Modified from a map
provided by
DeLorme 3-D TopoQuads



SITE VICINITY MAP

FORMER EXXON SERVICE STATION 70235
2225 Telegraph Avenue
Oakland, California

PROJECT NO.

2229

PLATE

1



APPROXIMATE SCALE

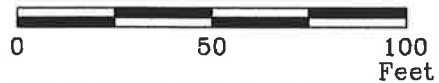

J:\2229\SPECIALITY MAPS\08 W05\08 W05 GSP_SP.dwg, mkjones

FN 2229 08 W05 GSP_SP



GENERALIZED SITE PLAN

FORMER EXXON SERVICE STATION 70235
 2225 Telegraph Avenue
 Oakland, California

EXPLANATION

- MW6J Groundwater Monitoring Well
- RW3A Recovery Well
- SB10 Soil Boring
- GP2 Geoprobe

PROJECT NO.
2229

PLATE
2

Analyte Concentrations in ug/L
 Sampled June 26, 2008

3,700 Total Petroleum Hydrocarbons
 as gasoline
 930 Benzene
 40 Methyl Tertiary Butyl Ether
 (EPA Method 8260B)

< Less Than the Stated Laboratory
 Reporting Limit

ug/L Micrograms per Liter

b Well sampled semi-annually.

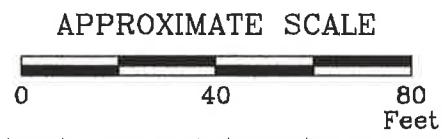

J:\2229\SPECIALTY MAPS\06 W05\08 W05 2QTR QM_SP.dwg, mkjones
 FN 2229 08 W05 2QTR QM_SP



SELECT ANALYTICAL RESULTS
June 26, 2008
 FORMER
 EXXON SERVICE STATION 70235
 2225 Telegraph Avenue
 Oakland, California

EXPLANATION	
	Groundwater Monitoring Well
	Recovery Groundwater Monitoring Well

PROJECT NO. 2229
PLATE 3



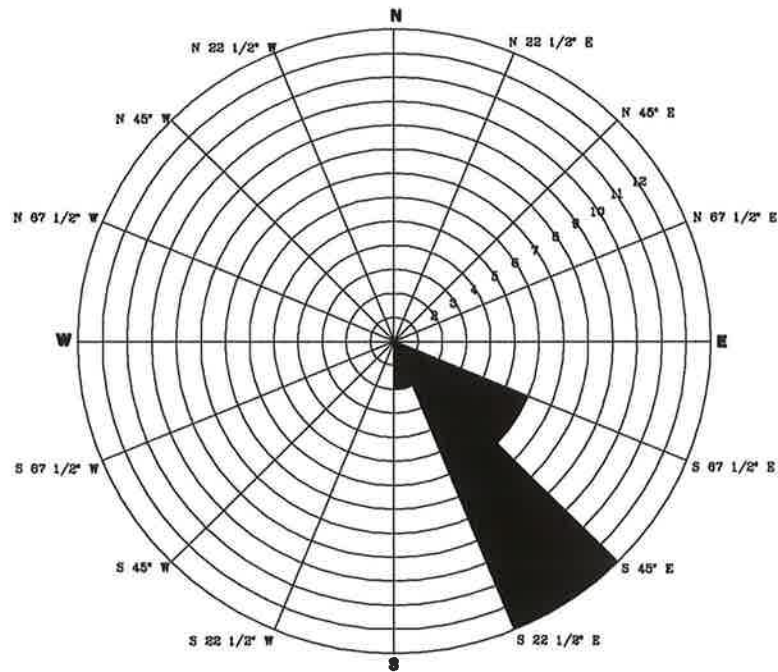

GROUNDWATER FLOW DIRECTION ROSE DIAGRAM
 Second Quarter 2003–Second Quarter 2008.

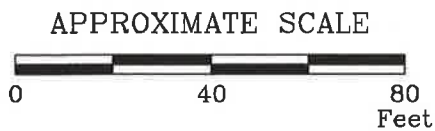
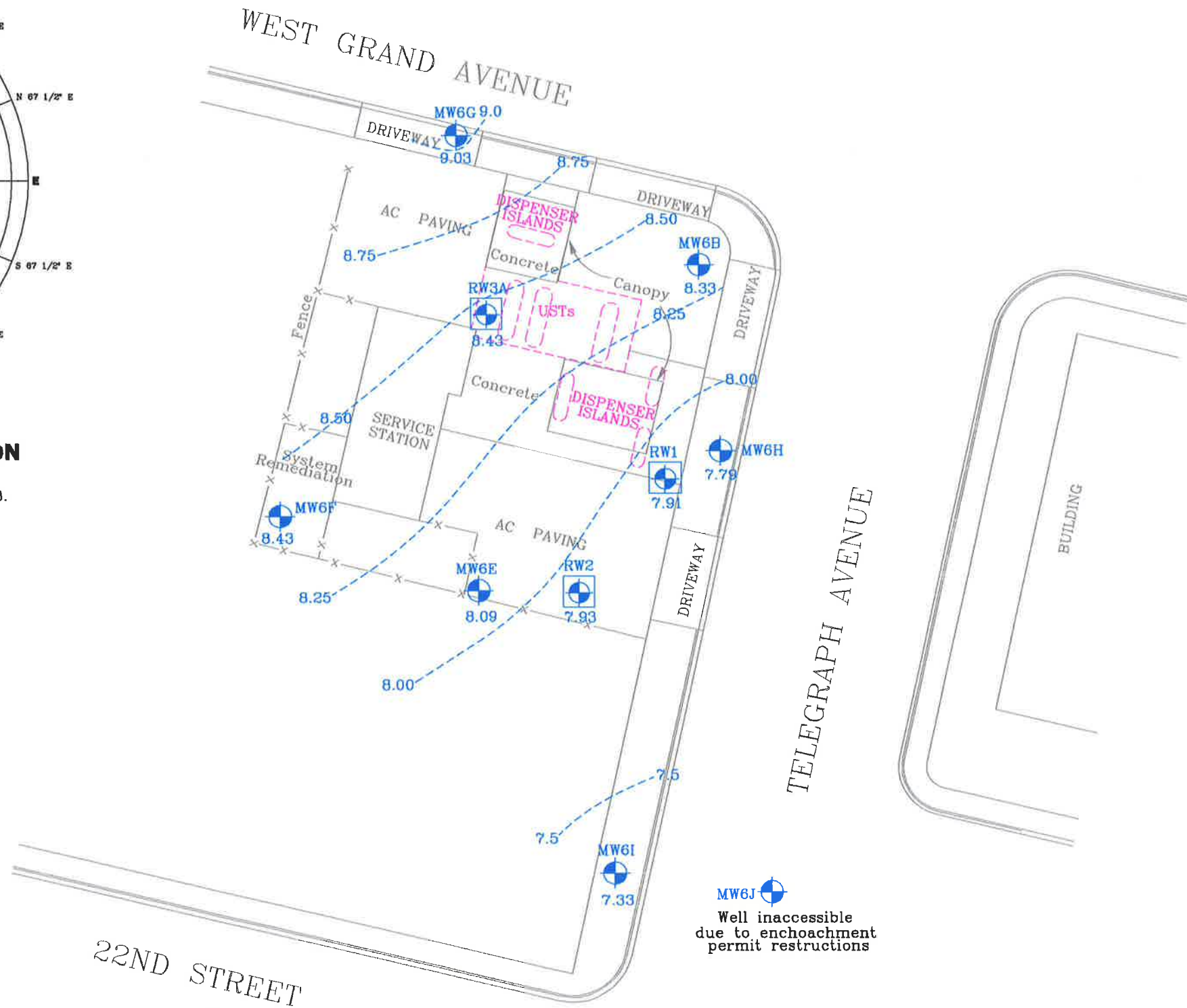

J:\2229\SPECIALITY MAPS\08 W05\08 W05 2QTR QM_SP.dwg, mkjones
 FN 2229 08 W05 2QTR QM_SP

9.0 ---- Line of Equal Groundwater Elevation;
 datum is mean sea level



GROUNDWATER ELEVATION MAP
June 26, 2008
 FORMER
 EXXON SERVICE STATION 70235
 2225 Telegraph Avenue
 Oakland, California

EXPLANATION

- MW6I Groundwater Monitoring Well
- 7.33 Groundwater elevation in feet; datum is mean sea level
- RW3A Recovery Groundwater Monitoring Well

PROJECT NO.
 2229
PLATE
 4



APPROXIMATE SCALE



J:\2229\SPECIALITY MAPS\08 W05\08 W05 PROP BORINGS_SP.dwg, mkjones
 FN 2229 08 W05 PROP BORINGS_SP



PROPOSED BORING LOCATIONS
 FORMER EXXON SERVICE STATION 70235
 2225 Telegraph Avenue
 Oakland, California

EXPLANATION

- MW6J Groundwater Monitoring Well
- RW3A Recovery Well
- GP2 Geoprobe
- CPT3 Proposed Cone Penetration Test Boring
- HP3 Proposed Hydropunch
- DP2 Proposed Direct Push Boring

PROJECT NO.
2229

PLATE
5

TABLE 1A
CUMULATIVE LABORATORY ANALYTICAL RESULTS OF SOIL SAMPLES
Former Exxon Service Station 70235
2225 Telegraph Avenue
Oakland, California
(Page 1 of 5)

Sample ID	Sample Date	Depth (feet bgs)	TPHd (mg/kg)	TPHg (mg/kg)	MTBE (mg/kg)	B (mg/kg)	T (mg/kg)	E (mg/kg)	X (mg/kg)	Total Lead (mg/kg)	HVOCs (mg/kg)	TPHmo (mg/kg)	TOG (mg/kg)
Soil Boring Samples													
B-1 (HLA)	10/04/88	8.0	---	<10	---	0.05	<0.1	<0.2	<0.1	---	---	---	---
B-1 (HLA)	10/04/88	13.0	---	2,000	---	<5	16	10	41	---	---	---	---
B-2 (HLA)	10/04/88	7.0	---	<10	---	<0.05	<0.1	<0.2	<0.1	---	---	---	---
B-2 (HLA)	10/04/88	13.5	---	<10	---	<0.05	<0.1	<0.2	<0.1	---	---	---	---
B-3 (HLA)	10/04/88	7.0	---	<10	---	0.06	<0.1	<0.2	<0.1	---	---	---	---
B-3 (HLA)	10/04/88	13.5	---	11,000	---	40	390	84	370	---	---	---	---
B-4 (HLA)	11/17/88	13.5	---	<10	---	<0.05	<0.1	<0.2	<0.1	---	---	---	---
B-5 (HLA)	1989-1992e	5.5	---	ND	---	ND	ND	ND	ND	---	---	---	---
B-5 (HLA)	1989-1992e	9.5	---	ND	---	ND	ND	ND	ND	---	---	---	---
B-5 (HLA)	1989-1992e	12.5	---	ND	---	ND	ND	ND	ND	---	---	---	---
B-6 (HLA)	1989-1992e	6.0	---	ND	---	ND	ND	ND	ND	---	---	---	---
B-6 (HLA)	1989-1992e	9.5	---	ND	---	ND	ND	ND	ND	---	---	---	---
B-6 (HLA)	1989-1992e	12.0	---	3,000	---	40	40	110	450	---	---	---	---
B-7 (HLA)	1989-1992e	6.0	---	24	---	0.64	0.4	0.9	3.4	---	---	---	---
B-7 (HLA)	1989-1992e	9.5	---	ND	---	0.5	ND	0.7	1.0	---	---	---	---
B-7 (HLA)	1989-1992e	12.0	---	1,400	---	20	20	72	190	---	---	---	---
B-1 (Alton)	03/19/91	5.5	---	240	---	1.2	0.87	11	7.7	---	---	---	---
B-1 (Alton)	03/19/91	10.5	---	10,000	---	81	660	310	1,600	---	---	---	---
B-1 (Alton)	03/19/91	15.5	---	4,400	---	8.4	77	56	310	---	---	---	---
B-2 (Alton)	03/19/91	5.5	---	880	---	1.0	7.2	11	47	---	---	---	---
B-2 (Alton)	03/19/91	10.5	---	2,400	---	3.5	38	26	150	---	---	---	---
B-2 (Alton)	03/19/91	14.5	---	9,900	---	33	170	150	980	---	---	---	---
B-3 (Alton)	03/19/91	5.5	---	<1.0	---	<0.003	<0.003	<0.003	<0.003	---	---	---	---
B-3 (Alton)	03/19/91	10.5	---	11	---	0.022	0.14	0.18	3.2	---	---	---	---
B-4 (Alton)	03/19/91	5.5	---	<1.0	---	0.036	<0.003	<0.003	<0.003	---	---	---	---
B-4 (Alton)	03/19/91	10.5	---	7	---	0.370	0.15	0.18	0.93	---	---	---	---
B-5 (Alton)	03/19/91	5.5	---	310	---	0.82	3.6	4.2	22	---	---	---	---
B-5 (Alton)	03/19/91	10.5	---	40	---	0.69	1.4	0.58	3.2	---	---	---	---

**TABLE 1A
CUMULATIVE LABORATORY ANALYTICAL RESULTS OF SOIL SAMPLES**

Former Exxon Service Station 70235
2225 Telegraph Avenue
Oakland, California
(Page 2 of 5)

Sample ID	Sample Date	Depth (feet bgs)	TPHd (mg/kg)	TPHg (mg/kg)	MTBE (mg/kg)	B (mg/kg)	T (mg/kg)	E (mg/kg)	X (mg/kg)	Total Lead (mg/kg)	HVOCs (mg/kg)	TPHmo (mg/kg)	TOG (mg/kg)
B-6 (Alton)	03/19/91	5.5	---	<1.0	---	0.054	0.003	0.005	0.011	---	---	---	---
B-6 (Alton)	03/19/91	10.5	---	2	---	0.15	0.067	0.019	0.09	---	---	---	---
B-7 (Alton)	03/19/91	5.5	---	<1.0	---	<0.003	<0.003	<0.003	<0.003	---	---	---	---
B-7 (Alton)	03/19/91	10.5	---	<1.0	---	<0.003	<0.003	<0.003	<0.003	---	---	---	---
B-8 (Alton)	03/19/91	5.5	---	<1.0	---	<0.003	<0.003	<0.003	<0.003	---	---	---	---
B-8 (Alton)	03/19/91	10.5	---	<1.0	---	0.048	0.013	<0.003	0.025	---	---	---	---
B-9 (Alton)	03/19/91	5.5	---	---	---	---	---	---	---	---	---	---	<50
B-9 (Alton)	03/19/91	10.5	---	---	---	---	---	---	---	---	---	---	<50
B-9 (Alton)	03/19/91	14.5	---	---	---	---	---	---	---	---	---	---	<50
B-10 (Alton)	03/19/91	5.5	---	<1.0	---	0.085	<0.003	0.006	<0.003	---	---	---	---
B-10 (Alton)	03/19/91	10.5	---	2	---	0.27	0.075	0.026	0.1	---	---	---	---
S-9-GP1	03/29/00	9.0	---	<1	<0.001a	<0.001	<0.001	<0.001	<0.001	---	---	---	---
S-11-GP1	03/29/00	11.0	---	<1	<0.001a	<0.001	<0.001	<0.001	<0.001	---	---	---	---
S-9-GP2	03/29/00	9.0	---	<1	<0.001a	<0.001	<0.001	<0.001	<0.001	---	---	---	---
S-11-GP2	03/29/00	11.0	---	<1	<0.001a	<0.001	<0.001	<0.001	<0.001	---	---	---	---
MW-6E	10/05/88	13.0	---	<10	---	<0.05	<0.1	<0.2	<0.1	---	---	---	---
MW-6F	10/05/88	13.0	---	<10	---	<0.05	<0.1	<0.2	<0.1	---	---	---	---
MW-6G	11/16/88	13.5	---	5.2	---	<0.05	<0.1	<0.2	<0.1	---	---	---	---
MW-6H	11/16/88	13.5	---	1,000	---	<0.5	3.2	3.2	19	---	---	---	---
MW-6I	11/17/88	13.5	---	<10	---	<0.05	<0.1	<0.2	<0.1	---	---	---	---
S-5-MW6J	04/06/01	5.0	<2	<1	<0.01	<0.001	<0.001	<0.001	<0.001	---	---	<10	---
S-10-MW6J	04/06/01	10.0	<2	<5	<0.01	<0.005	<0.005	<0.005	<0.005	---	---	<10	---
S-15-MW6J	04/06/01	15.0	<2	<1	<0.01	<0.001	<0.001	<0.001	<0.001	---	---	<10	---
S-20-MW6J	04/06/01	20.0	<2	<1	<0.01	<0.001	<0.001	0.013	0.037	---	---	<10	---
S-5-B5	03/01/07	5.0	1.6c,d	<0.10	<0.0050	<0.0010	<0.0010	<0.0010	<0.0010	---	---	<10	---
S-5-B7	03/05/07	5.0	<1.0	<0.10	<0.0050	<0.0010	<0.0010	<0.0010	<0.0010	---	---	<10	---
S-10-B7	03/05/07	10.0	<1.0	<0.10	<0.0050	<0.0010	<0.0010	<0.0010	<0.0010	---	---	<10	---
S-15-B7	03/05/07	15.0	<1.0	<0.10	<0.0050	<0.0010	<0.0010	<0.0010	<0.0010	---	---	<10	---
S-16.5-B7	03/05/07	16.5	<1.0	<0.10	<0.0050	<0.0010	<0.0010	<0.0010	<0.0010	---	---	<10	---
S-19-B7	03/05/07	19.0	1.0c	<0.10	<0.0050	<0.0010	<0.0010	<0.0010	<0.0010	---	---	<10	---
S-21-B7	03/05/07	21.0	<1.0	<0.10	<0.0050	<0.0010	<0.0010	<0.0010	<0.0010	---	---	<10	---

TABLE 1A
CUMULATIVE LABORATORY ANALYTICAL RESULTS OF SOIL SAMPLES

Former Exxon Service Station 70235
2225 Telegraph Avenue
Oakland, California
(Page 3 of 5)

Sample ID	Sample Date	Depth (feet bgs)	TPHd (mg/kg)	TPHg (mg/kg)	MTBE (mg/kg)	B (mg/kg)	T (mg/kg)	E (mg/kg)	X (mg/kg)	Total Lead (mg/kg)	HVOCs (mg/kg)	TPHmo (mg/kg)	TOG (mg/kg)
S-5-B8	03/01/07	5.0	1.2c,d	<0.10	<0.0050	<0.0010	<0.0010	<0.0010	<0.0010	---	---	<10	---
S-10-B8	03/01/07	10.0	<1.0	<0.10	<0.0050	<0.0010	<0.0010	<0.0010	<0.0010	---	---	<10	---
S-5-B9	03/02/07	5.0	1.3c,d	<0.10	<0.0050	<0.0010	<0.0010	<0.0010	<0.0010	---	---	<10	---
S-10-B9	03/02/07	10.0	1.8c,d	1.3	0.016	0.13	0.11	0.042	0.17	---	---	<10	---
S-11-B9	03/02/07	11.0	1.8c,d	12	<0.0050	0.18	0.36	0.22	0.92	---	---	<10	---
S-15-B9	03/06/07	15.0	<1.0	1.9	0.0067	0.48	0.032	0.042	0.12	---	---	<10	---
S-19.5-B9	03/06/07	19.5	<1.0	<0.10	0.0050	0.0068	<0.0010	<0.0010	<0.0010	---	---	<10	---
S-23.5-B9	03/06/07	23.5	<1.0	<0.10	<0.0050	<0.0010	<0.0010	<0.0010	<0.0010	---	---	<10	---
S-29.5-B9	03/06/07	29.5	<1.0	<0.10	<0.0050	<0.0010	<0.0010	<0.0010	<0.0010	---	---	<10	---
Fuel Dispenser Samples													
AB-1	1988-1992e	8.0	---	65	---	1.9	3.4	1.0	4.2	---	---	---	---
AB-2	1988-1992e	Surface	---	7,200	---	<0.0025	43	14	140	---	---	---	---
AB-2	1988-1992e	2.0	---	78	---	0.83	2.1	0.76	4.0	---	---	---	---
AB-3	1988-1992e	2.0	---	540	---	<0.0025	<0.005	<0.0025	18	---	---	---	---
AB-4	1988-1992e	6.0	---	<1	---	<0.0025	<0.005	<0.0025	<0.0025	---	---	---	---
AB-5	1988-1992e	6.0	---	5.0	---	<0.0025	<0.005	0.021	0.016	---	---	---	---
AB-6	1988-1992e	5.0	---	<1	---	<0.0025	<0.005	<0.0025	<0.0025	---	---	---	---
Tank Pit Samples													
Tank Pit Bottom													
TG1	11/27/91	13.0	---	130	---	0.3700	2	3	82	---	---	---	---
TG2	11/27/91	13.0	---	10,000	---	130	950	280	1,100	---	---	---	---
TG3	11/27/91	13.0	---	6,300	---	76	540	200	900	---	---	---	---
TG4	11/27/91	13.0	---	130	---	0.770	7.3	3.3	18	---	---	---	---
TG5	11/27/91	13.0	---	10	---	0.65	0.0084	0.140	0.160	---	---	---	---
TG6	11/27/91	13.0	---	12	---	<0.050	0.200	0.230	1	---	---	---	---
Tank Pit Sidewall													
TG7	12/03/91	12.0	---	430	---	1.7	15	7.2	34	<10	---	---	---
TG8	12/03/91	12.0	---	240	---	1.7	7.9	4.4	19	<10	---	---	---
TG9	12/03/91	12.0	---	<1.0	---	0.052	0.033	0.021	0.067	13	---	---	---
TG10	12/03/91	12.0	---	1.7	---	0.051	<0.005	0.044	<0.005	13	---	---	---
TG11	12/03/91	12.0	---	420	---	1.5	10	6.2	29	13	---	---	---
TG12	12/03/91	12.0	---	660	---	4.3	24	11	49	<10	---	---	---
Used-Oil Tank Pit Sample													
WO1	11/27/91	7.0	22	1.1	---	0.0057/200a	<0.005/1,200a	0.015/380a	<0.005/2,100a	<10	NDb	---	580

TABLE 1A
CUMULATIVE LABORATORY ANALYTICAL RESULTS OF SOIL SAMPLES

Former Exxon Service Station 70235
 2225 Telegraph Avenue
 Oakland, California
 (Page 4 of 5)

Sample ID	Sample Date	Depth (feet bgs)	TPHd (mg/kg)	TPHg (mg/kg)	MTBE (mg/kg)	B (mg/kg)	T (mg/kg)	E (mg/kg)	X (mg/kg)	Total Lead (mg/kg)	HVOCs (mg/kg)	TPHmo (mg/kg)	TOG (mg/kg)
Product Line Trench Samples													
PL1	12/06/91	2.0	---	<4.0	---	<0.020	0.077	0.035	0.140	---	---	---	---
PL2	12/06/91	2.0	---	<1.0	---	<0.005	<0.005	<0.005	<0.005	---	---	---	---
PL3	12/06/91	2.0	---	150	---	0.690	0.450	2.3	7.3	---	---	---	---
PL4	12/06/91	2.0	---	330	---	2.7	17	5.7	29	---	---	---	---
PL5	12/06/91	2.0	---	<1.0	---	0.0053	<0.005	0.0088	0.0086	---	---	---	---
PL6	12/06/91	2.0	---	4.9	---	<0.020	0.048	0.052	0.033	---	---	---	---
PL7	12/06/91	2.0	---	38	---	<0.020	0.095	0.180	0.250	---	---	---	---
PL8	12/06/91	2.0	---	5.8	---	0.330	0.590	0.080	0.720	---	---	---	---
PL9	12/06/91	2.0	---	1.9	---	<0.005	<0.005	<0.005	<0.005	---	---	---	---
PL10	12/06/91	2.0	---	<1.0	---	<0.005	<0.005	<0.005	<0.005	---	---	---	---
Soil Stockpile Samples													
SS1-4	Nov-Dec 1991	---	---	120	---	<0.020	0.370	0.910	1.7	<1.0	---	---	---
SS5-8	Nov-Dec 1991	---	---	180	---	<0.050	1.9	1.7	7.8	---	---	---	---
SS9-12	Nov-Dec 1991	---	---	270	---	0.170	8.9	5.4	26	---	---	---	---
SS13-16	Nov-Dec 1991	---	---	30	---	0.022	0.480	0.300	1.5	---	---	---	---
SS17-20	Nov-Dec 1991	---	---	130	---	<0.020	1.8	1.9	7.8	---	---	---	---
SS21-24	Nov-Dec 1991	---	---	<1.0	---	<0.005	<0.005	<0.005	0.011	---	---	---	---
SS25-28	Nov-Dec 1991	---	35	1.2	---	<0.005	<0.005	0.025	0.0083	---	NDb	---	---
EA1-4	Nov-Dec 1991	---	---	46	---	<0.250	0.110	0.130	1.5	---	---	---	---
EA5-8	Nov-Dec 1991	---	---	94	---	<0.500	0.610	0.400	5.8	---	---	---	---
EA9-12	Nov-Dec 1991	---	---	390	---	<1.0	2.3	3.2	24	---	---	---	---
EA13-16	Nov-Dec 1991	---	---	80	---	0.150	0.830	0.700	4.3	---	---	---	---
EA17-20	Nov-Dec 1991	---	---	1,200	---	<1.0	16	18	100	---	---	---	---
EA21-24	Nov-Dec 1991	---	---	980	---	1.1	20	16	90	---	---	---	---
EA25-28	Nov-Dec 1991	---	---	1,900	---	12	88	37	190	19	---	---	---
EA29-32	Nov-Dec 1991	---	---	4,200	---	17	190	94	480	---	---	---	---
SP-1-1	03/29/00	---	---	<1	<0.001a	<0.001	<0.001	<0.001	<0.001	4.35	ND	---	---
SP-1-1(1-4)	04/06/01	---	<2	<1	<0.01	---	---	---	---	4.68	ND	<10	---
SP-1 (1-4)	03/07/07	---	<1.0	<0.10	<0.0050	<0.0010	<0.0010	<0.0010	<0.0010	14	---	<10	---

TABLE 1A
CUMULATIVE LABORATORY ANALYTICAL RESULTS OF SOIL SAMPLES
Former Exxon Service Station 70235
2225 Telegraph Avenue
Oakland, California
(Page 5 of 5)

Notes:	=	Alton wells B-5 through B-9 were advanced into monitoring wells MW6E through MW6I.
TPHg	=	Total petroleum hydrocarbons as gasoline analyzed using modified EPA Method 8015M/8015B.
TPHd	=	Total petroleum hydrocarbons as diesel analyzed using modified EPA Method 8015M/8015B.
MTBE	=	Methyl tertiary butyl ether analyzed using EPA Method 8260B.
BTEX	=	Benzene, toluene, ethylbenzene, and total xylenes analyzed using EPA Method 8020 or 8021B.
Total Lead	=	Total lead analyzed using EPA Method 6010B.
HVOCs	=	Halogenated volatiles organic compounds using EPA Method 8260B.
TPHmo	=	Total petroleum hydrocarbons as motor oil analyzed using Modified EPA Method 8015M/8015B.
TOG	=	Total oil and grease analyzed using EPA Method 5520.
TAME	=	Tertiary amyl methyl ether analyzed using EPA Method 8260B.
TBA	=	Tertiary butyl alcohol analyzed using EPA Method 8260B.
DIPE	=	Di-isopropyl ether analyzed using EPA Method 8260B.
EDB	=	1,2-dibromoethane analyzed using EPA Method 8260B.
1,2-DCA	=	1,2-dichloroethane analyzed using EPA Method 8260B.
ETBE	=	Ethyl tertiary butyl ether analyzed using EPA Method 8260B.
Ethanol	=	Ethanol analyzed using EPA Method 8260B.
Cadmium	=	Cadmium analyzed using EPA Method 6010.
Chromium	=	Chromium analyzed using EPA Method 6010.
Nickel	=	Nickel analyzed using EPA Method 6010.
Zinc	=	Zinc analyzed using EPA Method 6010.
ND	=	Analytes not detected at or above the laboratory method reporting limit.
feet bgs	=	Feet below ground surface.
mg/kg	=	Milligrams per kilogram.
--	=	Not Analyzed/Not Applicable/Not sampled.
a	=	Analyzed using EPA Method 8021B.
b	=	Analyzed using EPA Method 8240.
c	=	Hydrocarbon pattern does not resemble the requested fuel.
d	=	Analyte detected in associated method blank.
e	=	Exact sampling date unclear from previous consultant reports.

TABLE 1B
ADDITIONAL CUMULATIVE LABORATORY ANALYTICAL RESULTS OF SOIL SAMPLES-VOCs

Former Exxon Service Station 70235
 2225 Telegraph Avenue
 Oakland, California
 (Page 1 of 2)

Sample ID	Sample Date	Depth (feet bgs)	TAME (mg/kg)	TBA (mg/kg)	DIPE (mg/kg)	EDB (mg/kg)	1,2-DCA (mg/kg)	ETBE (mg/kg)	Ethanol (mg/kg)
<u>Soil Boring Samples</u>									
Prior to March 2007, soil boring samples were not analyzed for these analytes.									
S-5-B5	03/01/07	5.0	<0.0050	<0.0050	<0.0050	<0.0050	<0.0050	<0.0050	---
S-5-B7	03/05/07	5.0	<0.0050	<0.020	<0.0050	<0.0050	<0.0050	<0.0050	<0.10
S-10-B7	03/05/07	10.0	<0.0050	<0.020	<0.0050	<0.0050	<0.0050	<0.0050	<0.10
S-15-B7	03/05/07	15.0	<0.0050	<0.0050	<0.0050	<0.0050	<0.0050	<0.0050	<0.10
S-16.5-B7	03/05/07	16.5	<0.0050	<0.020	<0.0050	<0.0050	<0.0050	<0.0050	<0.10
S-19-B7	03/05/07	19.0	<0.0050	<0.0050	<0.0050	<0.0050	<0.0050	<0.0050	<0.10
S-21-B7	03/05/07	21.0	<0.0050	<0.0050	<0.0050	<0.0050	<0.0050	<0.0050	<0.10
S-5-B8	03/01/07	5.0	<0.0050	<0.0050	<0.0050	<0.0050	<0.0050	<0.0050	---
S-10-B8	03/01/07	10.0	<0.0050	<0.0050	<0.0050	<0.0050	<0.0050	<0.0050	---
S-5-B9	03/02/07	5.0	<0.0050	<0.0050	<0.0050	<0.0050	<0.0050	<0.0050	---
S-10-B9	03/02/07	10.0	<0.0050	0.045	<0.0050	<0.0050	<0.0050	<0.0050	---
S-11-B9	03/02/07	11.0	<0.025	0.067	<0.025	<0.025	<0.025	<0.025	---
S-15-B9	03/06/07	15.0	<0.0050	0.034	<0.0050	<0.0050	<0.0050	<0.0050	---
S-19.5-B9	03/06/07	19.5	<0.0050	<0.0050	<0.0050	<0.0050	<0.0050	<0.0050	---
S-23.5-B9	03/06/07	23.5	<0.0050	<0.0050	<0.0050	<0.0050	<0.0050	<0.0050	---
S-29.5-B9	03/06/07	29.5	<0.0050	<0.0050	<0.0050	<0.0050	<0.0050	<0.0050	---
<u>Fuel Dispenser Samples</u>									
Not analyzed for these analytes.									
<u>Tank Pit Samples</u>									
Not analyzed for these analytes.									
<u>Used-Oil Tank Pit Sample</u>									
Not analyzed for these analytes.									
<u>Product Line Trench Samples</u>									
Not analyzed for these analytes.									
<u>Soil Stockpile Samples</u>									
Prior to March 2007, soil stockpile samples were not analyzed for these analytes.									
SP-1 (1-4)	03/07/07	---	<0.0050	<0.020	<0.0050	<0.0050	<0.0050	<0.0050	<0.10

TABLE 1B
ADDITIONAL CUMULATIVE LABORATORY ANALYTICAL RESULTS OF SOIL SAMPLES-VOCs

Former Exxon Service Station 70235
 2225 Telegraph Avenue
 Oakland, California
 (Page 2 of 2)

Notes:	=	Alton wells B-5 through B-9 were advanced into monitoring wells MW6E through MW6I.
TPHg	=	Total petroleum hydrocarbons as gasoline analyzed using modified EPA Method 8015M/8015B.
TPHd	=	Total petroleum hydrocarbons as diesel analyzed using modified EPA Method 8015M/8015B.
MTBE	=	Methyl tertiary butyl ether analyzed using EPA Method 8260B.
BTEX	=	Benzene, toluene, ethylbenzene, and total xylenes analyzed using EPA Method 8020 or 8021B.
Total Lead	=	Total lead analyzed using EPA Method 6010B.
HVOCs	=	Halogenated volatiles organic compounds using EPA Method 8260B.
TPHmo	=	Total petroleum hydrocarbons as motor oil analyzed using Modified EPA Method 8015M/8015B.
TOG	=	Total oil and grease analyzed using EPA Method 5520.
TAME	=	Tertiary amyl methyl ether analyzed using EPA Method 8260B.
TBA	=	Tertiary butyl alcohol analyzed using EPA Method 8260B.
DIPE	=	Di-isopropyl ether analyzed using EPA Method 8260B.
EDB	=	1,2-dibromoethane analyzed using EPA Method 8260B.
1,2-DCA	=	1,2-dichloroethane analyzed using EPA Method 8260B.
ETBE	=	Ethyl tertiary butyl ether analyzed using EPA Method 8260B.
Ethanol	=	Ethanol analyzed using EPA Method 8260B.
Cadmium	=	Cadmium analyzed using EPA Method 6010.
Chromium	=	Chromium analyzed using EPA Method 6010.
Nickel	=	Nickel analyzed using EPA Method 6010.
Zinc	=	Zinc analyzed using EPA Method 6010.
ND	=	Analytes not detected at or above the laboratory method detection limit.
feet bgs	=	Feet below ground surface.
mg/kg	=	Milligrams per kilogram.
---	=	Not Analyzed/Not Applicable/Not sampled.
a	=	Analyzed using EPA Method 8021B.
b	=	Analyzed using EPA Method 8240.
c	=	Hydrocarbon pattern does not resemble the requested fuel.
d	=	Analyte detected in associated method blank.

TABLE 1C
ADDITIONAL CUMULATIVE LABORATORY ANALYTICAL RESULTS OF SOIL SAMPLES-METALS

Former Exxon Service Station 70235
 2225 Telegraph Avenue
 Oakland, California
 (Page 2 of 2)

Notes:	Alton wells B-5 through B-9 were advanced into monitoring wells MW6E through MW6I.	
TPHg	=	Total petroleum hydrocarbons as gasoline analyzed using modified EPA Method 8015M/8015B.
TPHd	=	Total petroleum hydrocarbons as diesel analyzed using modified EPA Method 8015M/8015B.
MTBE	=	Methyl tertiary butyl ether analyzed using EPA Method 8260B.
BTEX	=	Benzene, toluene, ethylbenzene, and total xylenes analyzed using EPA Method 8020 or 8021B.
Total Lead	=	Total lead analyzed using EPA Method 6010B.
HVOCs	=	Halogenated volatiles organic compounds using EPA Method 8260B.
TPHmo	=	Total petroleum hydrocarbons as motor oil analyzed using Modified EPA Method 8015M/8015B.
TOG	=	Total oil and grease analyzed using EPA Method 5520.
TAME	=	Tertiary amyl methyl ether analyzed using EPA Method 8260B.
TBA	=	Tertiary butyl alcohol analyzed using EPA Method 8260B.
DIPE	=	Di-isopropyl ether analyzed using EPA Method 8260B.
EDB	=	1,2-dibromoethane analyzed using EPA Method 8260B.
1,2-DCA	=	1,2-dichloroethane analyzed using EPA Method 8260B.
ETBE	=	Ethyl tertiary butyl ether analyzed using EPA Method 8260B.
Ethanol	=	Ethanol analyzed using EPA Method 8260B.
Cadmium	=	Cadmium analyzed using EPA Method 6010.
Chromium	=	Chromium analyzed using EPA Method 6010.
Nickel	=	Nickel analyzed using EPA Method 6010.
Zinc	=	Zinc analyzed using EPA Method 6010.
ND	=	Analytes not detected at or above the laboratory method detection limit.
feet bgs	=	Feet below ground surface.
mg/kg	=	Milligrams per kilogram.
---	=	Not Analyzed/Not Applicable/Not sampled.
a	=	Analyzed using EPA Method 8021B.
b	=	Analyzed using EPA Method 8240.
c	=	Hydrocarbon pattern does not resemble the requested fuel.
d	=	Analyte detected in associated method blank.

TABLE 2A
CUMULATIVE LABORATORY ANALYTICAL RESULTS OF GRAB GROUNDWATER SAMPLES

Former Exxon Service Station 70235
2225 Telegraph Avenue
Oakland, California
(Page 2 of 2)

Notes:	
TPHd	= Total petroleum hydrocarbons as diesel analyzed using EPA Method 8015M or 8015B.
TPHg	= Total petroleum hydrocarbons as gasoline analyzed using modified EPA Method 8015M.
TPHmo	= Total petroleum hydrocarbons as motor oil analyzed using EPA Method 8015B
MTBE	= Methyl tertiary butyl ether analyzed using EPA Method 8021B or 8260B.
BTEX	= Benzene, toluene, ethylbenzene, and total xylenes analyzed using EPA Method 8021B.
TOG	= Total oil and grease analyzed using EPA Method 5520.
HVOCs	= Halogenated volatile organic compounds analyzed using EPA Method 8240 or 624.
TAME	= Tertiary amyl methyl ether analyzed using EPA Method 8260B.
TBA	= Tertiary butyl alcohol analyzed using EPA Method 8260B.
DIPE	= Di-isopropyl ether analyzed using EPA Method 8260B.
EDB	= 1,2-dibromoethane analyzed using EPA Method 8260B.
1,2-DCA	= 1,2-dichloroethane analyzed using EPA Method 8260B.
ETBE	= Ethyl tertiary butyl ether analyzed using EPA Method 8260B.
Ethanol	= Ethanol analyzed using EPA Method 8260B.
Arsenic	= Arsenic analyzed using EPA Method 200.7
Lead	= Lead analyzed using EPA Method 200.7
Cadmium	= Cadmium analyzed using EPA Method 200.7
Chromium	= Chromium analyzed using EPA Method 200.7
Copper	= Copper analyzed using EPA Method 200.7
Iron	= Iron analyzed using EPA Method 200.7
Nickel	= Nickel analyzed using EPA Method 200.7
Silver	= Silver analyzed using EPA Method 200.7
Zinc	= Zinc analyzed using EPA Method 200.7
µg/L	= Micrograms per liter.
---	= Not sampled/Not analyzed.
a	= Analyzed using EPA Method 624.
b	= Hydrocarbon pattern does not resemble the requested fuel.
c	= Bromoform.

TABLE 2B
ADDITIONAL CUMULATIVE LABORATORY ANALYTICAL RESULTS OF GRAB GROUNDWATER SAMPLES-VOCs

Former Exxon Service Station 70235
 2225 Telegraph Avenue
 Oakland, California
 (Page 2 of 2)

Notes:		
TPHd	=	Total petroleum hydrocarbons as diesel analyzed using EPA Method 8015M or 8015B.
TPHg	=	Total petroleum hydrocarbons as gasoline analyzed using modified EPA Method 8015M.
TPHmo	=	Total petroleum hydrocarbons as motor oil analyzed using EPA Method 8015B
MTBE	=	Methyl tertiary butyl ether analyzed using EPA Method 8021B or 8260B.
BTEX	=	Benzene, toluene, ethylbenzene, and total xylenes analyzed using EPA Method 8021B.
TOG	=	Total oil and grease analyzed using EPA Method 5520.
HVOCs	=	Halogenated volatile organic compounds analyzed using EPA Method 8240 or 624.
TAME	=	Tertiary amyl methyl ether analyzed using EPA Method 8260B.
TBA	=	Tertiary butyl alcohol analyzed using EPA Method 8260B.
DIPE	=	Di-isopropyl ether analyzed using EPA Method 8260B.
EDB	=	1,2-dibromoethane analyzed using EPA Method 8260B.
1,2-DCA	=	1,2-dichloroethane analyzed using EPA Method 8260B.
ETBE	=	Ethyl tertiary butyl ether analyzed using EPA Method 8260B.
Ethanol	=	Ethanol analyzed using EPA Method 8260B.
Arsenic	=	Arsenic analyzed using EPA Method 200.7
Lead	=	Lead analyzed using EPA Method 200.7
Cadmium	=	Cadmium analyzed using EPA Method 200.7
Chromium	=	Chromium analyzed using EPA Method 200.7
Copper	=	Copper analyzed using EPA Method 200.7
Iron	=	Iron analyzed using EPA Method 200.7
Nickel	=	Nickel analyzed using EPA Method 200.7
Silver	=	Silver analyzed using EPA Method 200.7
Zinc	=	Zinc analyzed using EPA Method 200.7
µg/L	=	Micrograms per liter.
---	=	Not sampled/Not analyzed.
a	=	Analyzed using EPA Method 624.
b	=	Hydrocarbon pattern does not resemble the requested fuel.
c	=	Bromoform.

TABLE 2C
 ADDITIONAL CUMULATIVE LABORATORY ANALYTICAL RESULTS OF GRAB GROUNDWATER SAMPLES-METALS
 Former Exxon Service Station 70235
 2225 Telegraph Avenue
 Oakland, California
 (Page 1 of 1)

Sample ID	Sample Date	Arsenic (µg/L)	Lead (µg/L)	Cadmium (µg/L)	Chromium (µg/L)	Copper (µg/L)	Iron (µg/L)	Nickel (µg/L)	Silver (µg/L)	Zinc (µg/L)
GeoProbe Samples										
Not analyzed for these analytes.										
Boring Samples										
Not analyzed for these analytes.										
Used-Oil Tank Pit Sample										
UOW	11/27/91	—	<100	<5	<10	—	—	30	—	10
W-Comp	10/26/00	11.5	<5	<5	<10	<10	825	27.5	<10	28.5

Notes:

- TPHd = Total petroleum hydrocarbons as diesel analyzed using EPA Method 8015M or 8015B.
- TPHg = Total petroleum hydrocarbons as gasoline analyzed using modified EPA Method 8015M.
- TPHmo = Total petroleum hydrocarbons as motor oil analyzed using EPA Method 8015B
- MTBE = Methyl tertiary butyl ether analyzed using EPA Method 8021B or 8260B.
- BTEX = Benzene, toluene, ethylbenzene, and total xylenes analyzed using EPA Method 8021B.
- TOG = Total oil and grease analyzed using EPA Method 5520.
- HVOCs = Halogenated volatile organic compounds analyzed using EPA Method 8240 or 624.
- TAME = Tertiary amyl methyl ether analyzed using EPA Method 8260B.
- TBA = Tertiary butyl alcohol analyzed using EPA Method 8260B.
- DIPE = Di-isopropyl ether analyzed using EPA Method 8260B.
- EDB = 1,2-dibromoethane analyzed using EPA Method 8260B.
- 1,2-DCA = 1,2-dichloroethane analyzed using EPA Method 8260B.
- ETBE = Ethyl tertiary butyl ether analyzed using EPA Method 8260B.
- Ethanol = Ethanol analyzed using EPA Method 8260B.
- Arsenic = Arsenic analyzed using EPA Method 200.7
- Lead = Lead analyzed using EPA Method 200.7
- Cadmium = Cadmium analyzed using EPA Method 200.7
- Chromium = Chromium analyzed using EPA Method 200.7
- Copper = Copper analyzed using EPA Method 200.7
- Iron = Iron analyzed using EPA Method 200.7
- Nickel = Nickel analyzed using EPA Method 200.7
- Silver = Silver analyzed using EPA Method 200.7
- Zinc = Zinc analyzed using EPA Method 200.7
- µg/L = Micrograms per liter.
- = Not sampled/Not analyzed.
- a = Analyzed using EPA Method 624.
- b = Hydrocarbon pattern does not resemble the requested fuel.
- c = Bromoform.

TABLE 3A
CUMULATIVE GROUNDWATER MONITORING AND SAMPLING DATA
Former Exxon Service Station 70235
2225 Telegraph Avenue
Oakland, California
(Page 1 of 19)

Well ID	Sampling Date	TOC (feet)	DTW (feet)	GW Elev. (feet)	NAPL (feet)	TPHd (µg/L)	TPHg (µg/L)	TPHmo (µg/L)	MTBE 8021B (µg/L)	MTBE 8260B (µg/L)	B (µg/L)	T (µg/L)	E (µg/L)	X (µg/L)
MW6A	June 1988	---	Well installed.											
MW6A	06/24/88	98.99i	---	---	---	---	---	---	---	---	<0.5	<1	<2	<1
MW6A	07/11/88	98.99i	13.25	85.74	---	---	---	---	---	---	---	---	---	---
MW6A	10/20/88	98.99i	---	---	---	---	---	---	---	---	0.6	<1	<2	<1
MW6A	12/15/88	98.99i	13.40	85.59i	---	---	---	---	---	---	---	---	---	---
MW6A	09/07/89	98.99i	---	---	---	---	ND	---	---	---	---	---	---	ND
MW6A	05/11/90	98.99i	12.87	86.12i	---	---	<500	---	---	---	150	6.2	<0.25	13
MW6A	10/16/90	98.99i	13.27	85.72i	---	---	---	---	---	---	---	---	---	---
MW6A	12/06/90	98.99i	13.28	85.71i	---	---	---	---	---	---	---	---	---	---
MW6A	02/08/91	98.99i	12.49	86.50i	---	---	---	---	---	---	---	---	---	---
MW6A	05/07/91	98.99i	11.94	87.05i	---	---	2,700	---	---	---	700	64	67	74
MW6A	06/26/91	98.99i	12.87	86.12i	---	---	---	---	---	---	---	---	---	---
MW6A	08/05/91	98.99i	13.44	85.55i	---	---	---	---	---	---	---	---	---	---
MW6A	08/14/91	98.99i	13.47	85.52i	---	---	ND	---	---	---	3.6	<0.5	<0.5	<0.5
MW6A	09/11/91	98.99i	13.48	85.51i	---	---	---	---	---	---	---	---	---	---
MW6A	10/16/91	98.99i	13.64	85.35i	---	---	---	---	---	---	---	---	---	---
MW6A	12/30/91	---	Well damaged.											
MW6A	05/02/92	---	Well destroyed.											
MW6B	June 1988	---	Well installed.											
MW6B	06/24/88	98.81i	---	---	---	---	---	---	---	---	<0.5	<1	<2	5.0
MW6B	07/11/88	98.81i	12.86	85.95i	---	---	---	---	---	---	---	---	---	---
MW6B	10/20/88	98.81i	---	---	---	---	---	---	---	---	4.1	<1	<2	<1
MW6B	12/15/88	98.81i	12.94	85.87i	---	---	---	---	---	---	---	---	---	---
MW6B	09/07/89	98.81i	---	---	---	---	2,700	---	---	---	70	3.0	ND	160
MW6B	04/30/90	98.81i	12.53	86.28i	---	---	168	---	---	---	45	8.0	60	22
MW6B	10/16/90	98.81i	12.73	86.08i	---	---	---	---	---	---	---	---	---	---
MW6B	12/06/90	98.81i	12.74	86.07i	---	---	---	---	---	---	---	---	---	---
MW6B	01/14/91	98.81i	12.57	86.24i	---	---	---	---	---	---	---	---	---	---
MW6B	02/08/91	98.81i	12.16	86.65i	---	---	---	---	---	---	---	---	---	---
MW6B	04/02/91	98.81i	11.50	87.31i	---	---	---	---	---	---	---	---	---	---
MW6B	05/07/91	98.81i	12.02	86.79i	---	---	3,300	---	---	---	240	6.0	20	660
MW6B	05/31/91	98.81i	12.40	86.41i	---	---	---	---	---	---	---	---	---	---
MW6B	06/26/91	98.81i	12.69	86.12i	---	---	---	---	---	---	---	---	---	---
MW6B	08/05/91	98.81i	12.95	85.86i	---	---	---	---	---	---	---	---	---	---
MW6B	08/14/91	98.81i	12.93	85.88i	---	---	980	---	---	---	9.1	42	310	150
MW6B	09/11/91	98.81i	13.01	85.80i	---	---	---	---	---	---	---	---	---	---
MW6B	10/16/91	98.81i	13.09	85.72i	---	---	---	---	---	---	---	---	---	---
MW6B	12/30/91	98.81i	12.62	86.19i	---	---	---	---	---	---	---	---	---	---
MW6B	12/31/91	98.81i	---	---	---	---	1,200	---	---	---	46	<5.0	85	220
MW6B	02/25/92	98.81i	11.81	87.00i	---	---	---	---	---	---	---	---	---	---
MW6B	03/25/92	98.81i	11.58	87.23i	---	---	190	---	---	---	31	8.6	84	8.6
MW6B	06/16/92	15.34	12.54	2.80	---	---	1,700	---	---	---	44	1.7	7.2	230
MW6B	09/08/92	15.34	12.87	2.47	No	---	2,900	---	---	---	35	8.3	110	330
MW6B	11/05/92	15.34	12.70	2.64	No	---	1,400	---	---	---	29	<0.5	75	190

TABLE 3A
CUMULATIVE GROUNDWATER MONITORING AND SAMPLING DATA
Former Exxon Service Station 70235
2225 Telegraph Avenue
Oakland, California
(Page 2 of 19)

Well ID	Sampling Date	TOC (feet)	DTW (feet)	GW Elev. (feet)	NAPL (feet)	TPHd (µg/L)	TPHg (µg/L)	TPHmo (µg/L)	MTBE 8021B (µg/L)	MTBE 8260B (µg/L)	B (µg/L)	T (µg/L)	E (µg/L)	X (µg/L)
MW6B	12/14/92	15.34	12.19	3.15	No	---	---	---	---	---	---	---	---	---
MW6B	01/28/93	15.34	11.39	3.95	No	---	---	---	---	---	---	---	---	---
MW6B	02/11/93	15.34	11.70	3.64	No	---	210	---	---	---	1.2	<0.5	2.8	4.3
MW6B	03/09/93	15.34	11.70	3.64	No	---	---	---	---	---	---	---	---	---
MW6B	04/14/93	15.34	11.87	3.47	No	---	---	---	---	---	---	---	---	---
MW6B	05/11/93	15.34	12.22	3.12	No	---	570	---	---	---	54	2.4	37	36
MW6B	06/17/93	15.34	12.46	2.88	No	---	---	---	---	---	---	---	---	---
MW6B	07/26/93	15.34	12.72	2.58	No	---	---	---	---	---	---	---	---	---
MW6B	08/10/93	15.34	12.82	2.52	No	---	1,300	---	---	---	48	2.4	28	44
MW6B	09/21/93	15.34	13.08	2.26	No	---	---	---	---	---	---	---	---	---
MW6B	10/27/93	15.34	13.18	2.16	No	---	1,300	---	---	---	23	1.7	25	250
MW6B	11/23/93	15.34	13.07	2.27	No	---	---	---	---	---	---	---	---	---
MW6B	12/17/93	15.34	---	---	---	---	---	---	---	---	---	---	---	---
MW6B	02/16/94	15.34	12.07	3.27	---	---	300	---	---	---	16	<0.5	3.5	2.4
MW6B	05/31/94	15.34	12.42	2.92	No	---	690	---	---	---	21	3.9	11	36
MW6B	08/30/94	17.48j	13.02	4.46	No	---	260	---	---	---	4	0.62	0.82	4
MW6B	11/11/94	17.48j	11.72	5.76	No	---	300	---	---	---	60	2	1.2	2.4
MW6B	02/27/95	17.48j	11.84	5.64	No	---	180	---	---	---	28	2.6	0.65	1.6
MW6B	05/30/95	17.48j	12.09	5.39	No	---	200	---	---	---	23	3.6	0.88	2.3
MW6B	08/30/95	17.48j	12.76	4.72	No	---	120	---	42	---	3.8	3.6	0.61	0.69
MW6B	11/26/96	17.48j	12.26	5.22	No	---	<50	---	<30	---	<0.5	<0.5	<0.5	<0.5
MW6B	02/27/97	17.48j	11.73	5.75	No	---	<50	---	<30	---	<0.5	<0.5	<0.5	0.80
MW6B	05/21/97	17.48j	12.70	4.78	No	---	<50	---	<30	---	<0.5	<0.5	<0.5	<0.5
MW6B	08/18/97	17.48j	12.89	4.59	No	---	380	---	<30	---	4.3	<0.5	1.2	1.5
MW6B	03/13/98	17.48j	11.15	6.33	No	---	360	---	<6.2	---	93	4.9	4.1	12
MW6B	04/20/98	17.48j	11.49	5.99	No	---	110	---	5.5	---	19	1.3	1.5	3.9
MW6B	07/21/98	21.37	12.18	9.19	No	---	<50	---	8.7	---	0.84	0.59	<0.5	<0.5
MW6B	10/06/98	21.37	12.70	8.67	No	---	190	---	6.0	---	2.4	0.56	0.51	1.2
MW6B	01/11/99	21.37	12.48	8.89	No	---	50	---	3.9	---	1.2	<0.5	<0.5	0.95
MW6B	04/08/99	21.37	11.52	9.85	No	---	85	---	14.0	---	4.4	<0.5	<0.5	<0.5
MW6B	07/19/99	21.37	11.39	9.98	No	---	<50	---	<2.50	---	<0.5	<0.5	<0.5	<0.5
MW6B	07/27/99	21.37	12.71	8.66	No	---	---	---	---	---	---	---	---	---
MW6B	10/25/99	21.37	12.49	8.88	No	---	260	---	<2	---	2.3	<0.5	<0.5	<0.5
MW6B	01/27/00	21.37	11.80	9.57	No	---	770	---	13	---	210	4.8	4.9	13
MW6B	04/03/00	21.37	11.61	9.76	No	---	670	---	3.4	---	110	6.6	3.8	9.45
MW6B	07/05/00	21.37	12.27	9.10	No	---	<50	---	2.1	---	0.89	<0.5	<0.5	<0.5
MW6B	10/04/00	21.37	12.67	8.70	No	---	<50	---	54	---	<0.5	<0.5	<0.5	2
MW6B	10/05/00	21.37	---	---	---	---	---	<1,000	---	---	---	---	---	---
MW6B	01/04/01	21.37	12.47	8.90	No	---	<50	---	35	---	<0.5	<0.5	<0.5	<0.5
MW6B	04/03/01	21.37	11.81	9.56	No	---	<50	---	7.8	---	<0.5	<0.5	<0.5	<0.5
MW6B	07/05/01	21.37	12.44	8.93	No	---	<50	---	3	---	<0.5	<0.5	<0.5	<0.5
MW6B	10/03/01	21.37	12.52	8.85	No	---	310	---	10	---	2.1	<0.5	6.5	11.6
MW6B	Oct-01	21.09	Well surveyed in compliance with AB 2886 requirements.					---	---	---	---	---	---	---
MW6B	01/02/02	21.09	11.25	9.84	No	---	710	---	21.8	---	99.5	4.40	3.30	7.40
MW6B	04/02/02	21.09	11.72	9.37	No	---	<50.0	<100	12.2	---	0.60	<0.50	<0.50	<0.50

TABLE 3A
CUMULATIVE GROUNDWATER MONITORING AND SAMPLING DATA
Former Exxon Service Station 70235
2225 Telegraph Avenue
Oakland, California
(Page 3 of 19)

Well ID	Sampling Date	TOC (feet)	DTW (feet)	GW Elev. (feet)	NAPL (feet)	TPHd (µg/L)	TPHg (µg/L)	TPHmo (µg/L)	MTBE 8021B (µg/L)	MTBE 8260B (µg/L)	B (µg/L)	T (µg/L)	E (µg/L)	X (µg/L)
MW6B	07/01/02	21.09	12.34	8.75	No	---	<50	<100a	10.7	---	<0.5	<0.5	<0.5	<0.5
MW6B	10/02/02	21.09	12.71	8.38	No	---	<50.0	<100	10.9	---	<0.5	<0.5	<0.5	<0.5
MW6B	01/07/03	21.09	11.65	9.44	No	---	82.5	<50	20.8	27.8	3.7	0.5	<0.5	0.8
MW6B	06/17/03	21.09	12.09	9.00	No	---	<50.0	<100	7.3	6.10a	0.50	<0.5	<0.5	<0.5
MW6B	07/16/03	21.09	12.29	8.80	No	---	<50.0	<100	11.0	8.5	<0.50	<0.5	<0.5	<0.5
MW6B	10/07/03	21.09	12.63	8.46	No	<50	<50.0	<100	4.1	3.10	<0.50	<0.5	<0.5	<0.5
MW6B	01/14/04	21.09	11.50	9.59	No	54	62.0	<100	9.0	11.0	2.10	<0.5	<0.5	<0.5
MW6B	06/03/04	21.09	12.12	8.97	No	---	56.0	<100	6.2	5.90	0.60	<0.5	<0.5	<0.5
MW6B	08/12/04	21.09	c	c	c	<50c	94.0c	<100c	---	3.40c	0.70c	<0.5c	<0.5c	0.9c
MW6B	11/04/04	21.09	12.27	8.82	No	<50	<50.0	143	---	2.60	<0.50	<0.5	<0.5	0.7
MW6B	02/01/05	21.09	11.48	9.61	No	<100	55.9	<100	---	7.50	1.30	<0.5	<0.5	<0.5
MW6B	05/03/05	21.09	11.48	9.61	No	<50	<50.0	<100	---	4.90	0.50	<0.5	<0.5	0.8
MW6B	08/04/05	21.09	12.23	8.86	No	<50.0	<50.0	<100	---	5.99	<0.500	<0.500	<0.500	0.692
MW6B	10/27/05	21.09	12.60	8.49	No	<50.0	<50.0	<50.0	---	1.65	<0.50	0.94f	<0.50	1.29
MW6B	01/26/06	21.09	11.39	9.70	No	83d	510	<500	---	12	130	12	14	39
MW6B	04/28/06	21.09	10.99	10.10	No	240d	3,100	<470	---	43	920h	110	130	290
MW6B	07/05/06	21.09	12.05	9.04	No	<47.6	79.4	<95.2	---	11.4	2.95	<1.00	<1.00	<3.00
MW6B	10/27/06	21.09	12.53	8.56	No	<47	<50.0	<470	---	2.25	0.63	<0.50	<0.50	<0.50
MW6B	01/19/07	21.09	12.05	9.04	No	<47	<50.0	<470	---	3.75	<0.50	<0.50	<0.50	<0.50
MW6B	04/24/07	21.09	11.71	9.38	No	60.9d	<50.0	<46.9	---	4.19	0.51	<0.50	<0.50	<0.50
MW6B	07/24/07	21.09	12.24	8.85	No	<47	<50	<470	---	3.2	0.80	<0.50	<0.50	<0.50
MW6B	12/03/07	21.09	12.71	8.38	No	<47	64	<470	---	2.8	2.5	<0.50	<0.50	<0.50
MW6B	03/06/08	21.09	11.50	9.59	No	52d	330	<470	---	6.2	60	2.5	4.1	5.4
MW6C	06/15/88	99.89i	Well installed.											
MW6C	05/10/90	---	Well over-drilled into recovery well RW3.											
MW6D	07/06/88	98.78i	Well installed.											
MW6D	05/10/90	---	Well over-drilled into recovery well RW2.											
MW6E	10/04/88	98.99i	Well installed.											
MW6E	10/20/88	98.99i	---	---	---	---	---	---	---	---	1.1	<2	<1	3.4
MW6E	12/15/88	98.99i	13.70	85.29i	---	---	---	---	---	---	---	---	---	---
MW6E	09/07/89	98.99i	---	---	---	---	220	---	---	---	3.0	ND	ND	ND
MW6E	04/30/90	98.99i	13.43	85.56i	---	---	250	---	---	---	57	<5.0	<5.0	53
MW6E	10/16/90	98.99i	13.77	85.22i	---	---	---	---	---	---	---	---	---	---
MW6E	12/06/90	98.99i	13.95	85.04i	---	---	---	---	---	---	---	---	---	---
MW6E	01/14/91	98.99i	13.95	85.04i	---	---	---	---	---	---	---	---	---	---
MW6E	02/08/91	98.99i	13.20	85.79i	---	---	---	---	---	---	---	---	---	---
MW6E	04/02/91	98.99i	12.28	86.71i	---	---	---	---	---	---	---	---	---	---
MW6E	05/07/91	98.99i	13.48	85.51i	---	---	160	---	---	---	32	1.0	2.2	1.4
MW6E	05/31/91	98.99i	14.09	84.90i	---	---	---	---	---	---	---	---	---	---
MW6E	06/26/91	98.99i	12.54	86.45i	---	---	---	---	---	---	---	---	---	---
MW6E	08/05/91	98.99i	14.39	84.60i	---	---	---	---	---	---	---	---	---	---
MW6E	08/14/91	98.99i	14.18	84.81i	---	---	ND	---	---	---	0.9	<0.5	<0.5	<0.5

TABLE 3A
CUMULATIVE GROUNDWATER MONITORING AND SAMPLING DATA
Former Exxon Service Station 70235
2225 Telegraph Avenue
Oakland, California
(Page 4 of 19)

Well ID	Sampling Date	TOC (feet)	DTW (feet)	GW Elev. (feet)	NAPL (feet)	TPHd (µg/L)	TPHg (µg/L)	TPHmo (µg/L)	MTBE 8021B (µg/L)	MTBE 8260B (µg/L)	B (µg/L)	T (µg/L)	E (µg/L)	X (µg/L)
MW6E	09/11/91	98.99i	14.73	84.26i	---	---	---	---	---	---	---	---	---	---
MW6E	10/16/91	98.99i	14.40	84.59i	---	---	---	---	---	---	---	---	---	---
MW6E	12/30/91	98.99i	13.39	85.60i	---	---	---	---	---	---	---	---	---	---
MW6E	12/31/91	98.99i	---	---	---	---	90	---	---	---	3.1	<0.5	<0.5	<0.5
MW6E	02/25/92	98.99i	13.16	85.83i	---	---	---	---	---	---	---	---	---	---
MW6E	03/25/92	98.99i	12.15	86.84i	---	---	830	---	---	---	41	1.0	3.8	16
MW6E	06/16/92	15.23	13.54	1.69	---	---	3,400	---	---	---	300	23	68	510
MW6E	09/08/92	15.23	14.78	0.45	No	---	480	---	---	---	27	<0.5	3.6	21
MW6E	11/05/92	15.23	---	---	---	---	---	---	---	---	---	---	---	---
MW6E	12/14/92	15.23	---	---	---	---	---	---	---	---	---	---	---	---
MW6E	01/28/93	15.23	11.62	3.61	No	---	---	---	---	---	---	---	---	---
MW6E	02/11/93	15.23	12.85	2.38	No	---	270	---	---	---	15	<0.5	<0.5	8.7
MW6E	03/09/93	15.23	12.83	2.40	No	---	---	---	---	---	---	---	---	---
MW6E	04/14/93	15.23	---	---	No	---	---	---	---	---	---	---	---	---
MW6E	05/11/93	15.23	13.59	1.64	No	---	<50	---	---	---	2.3	<0.5	1.4	3.2
MW6E	06/17/93	15.23	13.74	1.49	No	---	---	---	---	---	---	---	---	---
MW6E	07/26/93	15.23	14.01	1.22	No	---	---	---	---	---	---	---	---	---
MW6E	08/10/93	15.23	14.13	1.10	No	---	1,700	---	---	---	130	2.7	23	140
MW6E	09/21/93	15.23	14.20	1.03	No	---	---	---	---	---	---	---	---	---
MW6E	10/27/93	15.23	14.34	0.89	No	---	100	---	---	---	6.0	<0.5	<0.5	<0.5
MW6E	11/23/93	15.23	13.97	1.26	No	---	---	---	---	---	---	---	---	---
MW6E	12/17/93	15.23	13.08	2.15	No	---	---	---	---	---	---	---	---	---
MW6E	02/16/94	15.23	13.34	1.89	No	---	640	---	---	---	45	<0.5	12	15
MW6E	05/31/94	15.23	13.82	1.41	No	---	52	---	---	---	1.5	0.97	<0.5	<0.5
MW6E	08/30/94	17.63j	14.32	3.31	No	---	920	---	---	---	22	0.98	5.2	33
MW6E	11/11/94	17.63j	13.92	3.71	No	---	910	---	---	---	13	2.4	13	2.5
MW6E	02/27/95	17.63j	12.96	4.67	No	---	<50	---	---	---	1.9	1.3	<0.5	0.83
MW6E	05/30/95	17.63j	13.20	4.43	No	---	<50	---	---	---	<0.5	<0.5	<0.5	<0.5
MW6E	08/30/95	17.63j	13.85	3.78	No	---	1,500	---	11	---	91	2.3	56	59
MW6E	11/26/96	17.63j	12.94	4.69	No	---	<50	---	<30	---	1.1	<0.5	<0.5	<0.5
MW6E	02/27/97	17.63j	12.28	5.35	No	---	<50	---	<30	---	<0.5	<0.5	<0.5	<0.5
MW6E	05/21/97	17.63j	13.60	4.03	No	---	160	---	<5	---	10	1.4	5.5	4.8
MW6E	08/18/97	17.63j	13.75	3.88	No	---	66	---	<30	---	<0.5	<0.5	<0.5	<0.5
MW6E	03/13/98	17.63j	11.36	6.27	No	---	<50	---	<2.5	---	<0.5	<0.5	<0.5	<0.5
MW6E	04/20/98	17.63j	11.88	5.75	No	---	<50	---	<2.5	---	<0.5	<0.5	<0.5	<0.5
MW6E	07/21/98	21.58	13.10	8.48	No	---	1,200	---	<10	---	81	3.1	28	77
MW6E	10/06/98	21.58	13.55	8.03	No	---	<50	---	6.6	---	1.4	0.51	<0.5	0.97
MW6E	01/11/99	21.58	13.40	8.18	No	---	<50	---	5.1	---	<0.5	<0.5	<0.5	<0.5
MW6E	04/08/99	21.58	12.04	9.54	No	---	<50	---	4.7	---	<0.5	<0.5	<0.5	<0.5
MW6E	07/19/99	21.58	11.59	9.99	No	---	---	---	---	---	---	---	---	---
MW6E	07/27/99	21.58	13.65	7.93	No	---	---	---	---	---	---	---	---	---
MW6E	10/25/99	21.58	13.52	8.06	No	---	<50	---	2.5	---	<0.5	<0.5	<0.5	<0.5
MW6E	01/27/00	21.58	11.71	9.87	No	---	<50	---	2.3	---	<0.5	<0.5	<0.5	<0.5
MW6E	04/03/00	21.58	12.11	9.47	No	---	<50	---	<2	---	0.51	<0.5	<0.5	<0.5
MW6E	07/05/00	21.58	12.91	8.67	No	---	<50	---	<2	---	3.7	<0.5	<0.5	<0.5
MW6E	10/04/00	21.58	13.35	8.23	No	---	<50	---	<2	---	4.1	<0.5	<0.5	<0.5

TABLE 3A
CUMULATIVE GROUNDWATER MONITORING AND SAMPLING DATA
Former Exxon Service Station 70235
2225 Telegraph Avenue
Oakland, California
(Page 10 of 19)

Well ID	Sampling Date	TOC (feet)	DTW (feet)	GW Elev. (feet)	NAPL (feet)	TPHd (µg/L)	TPHg (µg/L)	TPHmo (µg/L)	MTBE 8021B (µg/L)	MTBE 8260B (µg/L)	B (µg/L)	T (µg/L)	E (µg/L)	X (µg/L)
MW6H	04/02/91	97.93i	11.59	86.34i	---	---	---	---	---	---	---	---	---	---
MW6H	05/07/91	97.93i	12.24	85.69i	---	---	570	---	---	---	95	14	15	21
MW6H	05/31/91	97.93i	12.22	85.71i	---	---	---	---	---	---	---	---	---	---
MW6H	06/26/91	97.93i	14.34	83.59i	---	---	---	---	---	---	---	---	---	---
MW6H	08/05/91	97.93i	12.62	85.31i	---	---	---	---	---	---	---	---	---	---
MW6H	08/14/91	97.93i	12.43	85.50i	---	---	540	---	---	---	52	9.9	11	18
MW6H	09/11/91	97.93i	12.83	85.10i	---	---	---	---	---	---	---	---	---	---
MW6H	10/16/91	97.93i	12.71	85.22i	---	---	---	---	---	---	---	---	---	---
MW6H	12/30/91	97.93i	12.16	85.77i	---	---	---	---	---	---	---	---	---	---
MW6H	12/31/91	97.93i	---	---	---	---	790	---	---	---	52	28	22	42
MW6H	02/25/92	97.93i	12.17	85.76i	---	---	---	---	---	---	---	---	---	---
MW6H	03/25/92	97.93i	11.65	86.28i	---	---	920	---	---	---	170	52	25	54
MW6H	06/16/92	14.47	12.12	2.35	---	---	460	---	---	---	31	11	6.8	16
MW6H	09/08/92	14.47	12.30	2.17	No	---	780	---	---	---	69	23	17	18
MW6H	11/05/92	14.47	12.05	2.42	No	---	3,400	---	---	---	500	260	85	160
MW6H	12/14/92	14.47	11.65	2.82	No	---	---	---	---	---	---	---	---	---
MW6H	01/28/93	14.47	11.57	2.90	No	---	---	---	---	---	---	---	---	---
MW6H	02/11/93	14.47	12.22	2.25	No	---	2,500	---	---	---	410	170	28	130
MW6H	03/09/93	14.47	12.02	2.45	No	---	---	---	---	---	---	---	---	---
MW6H	04/14/93	14.47	12.02	2.45	No	---	---	---	---	---	---	---	---	---
MW6H	05/11/93	14.47	12.35	2.12	No	---	4,200	---	---	---	490	270	80	210
MW6H	06/17/93	14.47	12.22	2.25	No	---	---	---	---	---	---	---	---	---
MW6H	07/26/93	14.47	12.32	2.15	No	---	---	---	---	---	---	---	---	---
MW6H	08/10/93	14.47	12.30	2.17	No	---	650	---	---	---	83	22	14	29
MW6H	09/21/93	14.47	12.79	1.68	No	---	---	---	---	---	---	---	---	---
MW6H	10/27/93	14.47	13.93	0.54	No	---	1,600	---	---	---	130	90	29	130
MW6H	11/23/93	14.47	12.46	2.01	No	---	---	---	---	---	---	---	---	---
MW6H	12/17/93	14.47	12.08	2.39	No	---	---	---	---	---	---	---	---	---
MW6H	02/16/94	14.47	12.31	2.16	No	---	<50	---	---	---	<0.5	<0.5	<0.5	2.9
MW6H	05/31/94	14.47	12.46	2.01	No	---	1,800	---	---	---	370	220	65	210
MW6H	08/30/94	16.58j	12.72	3.86	No	---	1,900	---	---	---	130	90	19	86
MW6H	11/11/94	16.58j	11.98	4.60	No	---	13,000	---	---	---	1,700	1,400	260	1,800
MW6H	02/27/95	16.58j	11.89	4.69	No	---	320	---	---	---	450	120	28	79
MW6H	05/30/95	16.58j	12.05	4.53	No	---	2,300	---	---	---	960	260	64	200
MW6H	08/30/95	16.58j	12.34	4.24	No	---	2,100	---	50	---	590	35	24	74
MW6H	11/26/96	16.58j	11.87	4.71	No	---	1,200	---	<30	---	320	110	22	85
MW6H	02/27/97	16.58j	11.58	5.00	No	---	1,800	---	<200	---	760	31	8.4	44
MW6H	05/21/97	16.58j	12.23	4.35	No	---	1,100	---	81	---	640	18	5.4	45
MW6H	08/18/97	16.58j	12.29	4.29	No	---	870	---	26	---	200	3.6	2.4	7.4
MW6H	03/13/98	20.47	11.44	9.03	No	---	5,300	---	<125	---	1,900	720	100	470
MW6H	04/20/98	20.47	11.58	8.89	No	---	6,000	---	2,700	---	1,500	600	91	440
MW6H	07/21/98	20.47	11.97	8.50	No	---	2,200	---	1,600	---	740	44	15	63
MW6H	10/06/98	20.47	12.23	8.24	No	---	5,400	---	3,000	---	1,900	<25	<25	76
MW6H	01/11/99	20.47	12.17	8.30	No	---	2,600	---	4,300	---	1,200	<12	<12	20
MW6H	04/08/99	20.47	11.56	8.91	No	---	13,000	---	13,000	---	3,400	1,300	260	1,200
MW6H	07/19/99	20.47	11.71	8.76	No	---	<2,000	---	6,920	8,520	732	<20	<20	<20

TABLE 3A
CUMULATIVE GROUNDWATER MONITORING AND SAMPLING DATA
Former Exxon Service Station 70235
2225 Telegraph Avenue
Oakland, California
(Page 12 of 19)

Well ID	Sampling Date	TOC (feet)	DTW (feet)	GW Elev. (feet)	NAPL (feet)	TPHd (µg/L)	TPHg (µg/L)	TPHmo (µg/L)	MTBE 8021B (µg/L)	MTBE 8260B (µg/L)	B (µg/L)	T (µg/L)	E (µg/L)	X (µg/L)
MW6I	01/14/91	97.60i	12.55	85.05i	---	---	---	---	---	---	---	---	---	---
MW6I	02/08/91	97.60i	12.32	85.28i	---	---	---	---	---	---	---	---	---	---
MW6I	04/02/91	97.60i	12.22	85.38i	---	---	---	---	---	---	---	---	---	---
MW6I	05/07/91	97.60i	12.61	84.99i	---	---	ND	---	---	---	ND	<0.5	<0.5	<0.5
MW6I	05/31/91	97.60i	12.82	84.78i	---	---	---	---	---	---	---	---	---	---
MW6I	06/26/91	97.60i	12.93	84.67i	---	---	---	---	---	---	---	---	---	---
MW6I	08/05/91	97.60i	13.01	84.59i	---	---	---	---	---	---	---	---	---	---
MW6I	08/14/91	97.60i	12.98	84.62i	---	---	ND	---	---	---	ND	<0.5	<0.5	<0.5
MW6I	09/11/91	97.60i	13.11	84.49i	---	---	---	---	---	---	---	---	---	---
MW6I	10/16/91	97.60i	13.04	84.56i	---	---	---	---	---	---	---	---	---	---
MW6I	12/30/91	97.60i	12.72	84.88i	---	---	---	---	---	---	---	---	---	---
MW6I	12/31/91	97.60i	---	---	---	---	ND	---	---	---	ND	<0.5	<0.5	<0.5
MW6I	02/25/92	97.60i	12.45	85.15i	---	---	---	---	---	---	---	---	---	---
MW6I	03/25/92	97.60i	12.12	85.48i	---	---	ND	---	---	---	ND	<0.5	<0.5	<0.5
MW6I	06/16/92	14.14	12.75	1.39	---	---	ND	---	---	---	ND	<0.5	<0.5	<0.5
MW6I	09/08/92	14.14	12.84	1.30	No	---	<50	---	---	---	<0.5	<0.5	<0.5	<0.5
MW6I	11/05/92	14.14	12.75	1.39	No	---	<50	---	---	---	<0.5	<0.5	<0.5	<0.5
MW6I	12/14/92	14.14	12.40	1.74	No	---	---	---	---	---	---	---	---	---
MW6I	01/28/93	14.14	12.20	1.94	No	---	---	---	---	---	---	---	---	---
MW6I	02/11/93	14.14	12.40	1.74	No	---	<50	---	---	---	<0.5	<0.5	<0.5	<0.5
MW6I	03/09/93	14.14	12.45	1.69	No	---	---	---	---	---	---	---	---	---
MW6I	04/14/93	14.14	12.43	1.71	No	---	---	---	---	---	---	---	---	---
MW6I	05/11/93	14.14	12.73	1.41	No	---	<50	---	---	---	<0.5	<0.5	<0.5	<0.5
MW6I	06/17/93	14.14	12.78	1.36	No	---	---	---	---	---	---	---	---	---
MW6I	07/26/93	14.14	12.92	1.22	No	---	---	---	---	---	---	---	---	---
MW6I	08/10/93	14.14	12.97	1.17	No	---	<50	---	---	---	<0.5	<0.5	<0.5	<0.5
MW6I	09/21/93	14.14	13.02	1.12	No	---	---	---	---	---	---	---	---	---
MW6I	10/27/93	14.14	13.10	1.04	No	---	<50	---	---	---	<0.5	<0.5	<0.5	1.1
MW6I	11/23/93	14.14	13.02	1.12	No	---	---	---	---	---	---	---	---	---
MW6I	12/17/93	14.14	12.65	1.49	No	---	---	---	---	---	---	---	---	---
MW6I	02/16/94	14.14	12.66	1.48	No	---	<50	---	---	---	<0.5	<0.5	<0.5	<0.5
MW6I	05/31/94	14.14	12.90	1.24	No	---	<50	---	---	---	<0.5	<0.5	<0.5	<0.5
MW6I	08/30/94	16.26j	13.06	3.20	No	---	<50	---	---	---	<0.5	<0.5	<0.5	<0.5
MW6I	11/11/94	16.26j	15.20	1.06	No	---	53	---	---	---	0.62	1.8	<0.5	2.0
MW6I	02/27/95	16.26j	12.51	3.75	No	---	<50	---	---	---	<0.5	<0.5	<0.5	<0.5
MW6I	05/30/95	16.26j	12.57	3.69	No	---	69	---	---	---	2.8	0.96	1.1	4.3
MW6I	08/30/95	16.26j	12.86	3.4	No	---	<50	---	<10	---	<0.5	<0.5	<0.5	<0.5
MW6I	11/26/96	16.26j	12.45	3.81	No	---	<50	---	<30	---	<0.5	<0.5	<0.5	<0.5
MW6I	02/27/97	16.26j	12.24	4.02	No	---	<50	---	<30	---	<0.5	<0.5	<0.5	<0.5
MW6I	05/21/97	16.26j	12.82	3.44	No	---	<50	---	<30	---	<0.5	<0.5	<0.5	<0.5
MW6I	08/18/97	16.26j	12.81	3.45	No	---	<50	---	<30	---	<0.5	<0.5	<0.5	<0.5
MW6I	03/13/98	16.26j	---	---	---	---	---	---	---	---	---	---	---	---
MW6I	04/20/98	16.26j	12.14	4.12	No	---	<50	---	<2.5	---	<0.5	<0.5	<0.5	<0.5
MW6I	07/21/98	20.24	12.59	7.65	No	---	<50	---	<2.5	---	<0.5	<0.5	<0.5	<0.5
MW6I	10/06/98	20.24	12.81	7.43	No	---	---	---	---	---	---	---	---	---
MW6I	01/11/99	20.24	12.74	7.50	No	---	<50	---	<2.5	---	<0.5	<0.5	<0.5	<0.5

**TABLE 3A
CUMULATIVE GROUNDWATER MONITORING AND SAMPLING DATA**

Former Exxon Service Station 70235

2225 Telegraph Avenue

Oakland, California

(Page 13 of 19)

Well ID	Sampling Date	TOC (feet)	DTW (feet)	GW Elev. (feet)	NAPL (feet)	TPHd (µg/L)	TPHg (µg/L)	TPHmo (µg/L)	MTBE 8021B (µg/L)	MTBE 8260B (µg/L)	B (µg/L)	T (µg/L)	E (µg/L)	X (µg/L)
MW6I	04/08/99	20.24	11.93	8.31	No	---	---	---	---	---	---	---	---	---
MW6I	07/19/99	20.24	11.75	8.49	No	---	281	---	17.6	---	35.4	9.1	7.4	30.7
MW6I	07/27/99	20.24	12.95	7.29	No	---	---	---	---	---	---	---	---	---
MW6I	10/25/99	20.24	12.79	7.45	No	---	---	---	---	---	---	---	---	---
MW6I	01/27/00	20.24	12.06	8.18	No	---	<50	---	<2	---	<0.5	<0.5	<0.5	<0.5
MW6I	04/03/00	20.24	12.24	8.00	No	---	---	---	---	---	---	---	---	---
MW6I	07/05/00	20.24	12.48	7.76	No	---	<50	---	<2	---	<0.5	<0.5	<0.5	<0.5
MW6I	10/04/00	20.24	---	---	---	---	---	---	---	---	---	---	---	---
MW6I	10/05/00	20.24	---	---	---	---	---	<1,000	---	---	---	---	---	---
MW6I	01/04/01	20.24	12.54	7.70	No	---	<50	---	<2	---	<0.5	<0.5	<0.5	<0.5
MW6I	04/03/01	20.24	12.32	7.92	No	---	<50	---	<2	---	<0.5	<0.5	<0.5	<0.5
MW6I	07/05/01	20.24	12.55	7.69	No	---	<50	---	<2	---	<0.5	<0.5	<0.5	<0.5
MW6I	10/03/01	20.24	12.67	7.57	No	---	<50	---	<2	---	<0.5	<0.5	<0.5	<0.5
MW6I	Oct-01	19.87	Well surveyed in compliance with AB 2886 requirements.											
MW6I	01/02/02	19.87	10.98	8.89	No	---	<100	---	<0.5	---	<0.50	<0.50	<0.50	<0.50
MW6I	04/02/02 b	19.87	12.24	7.63	No	---	---	---	---	---	---	---	---	---
MW6I	07/01/02	19.87	12.51	7.36	No	---	<50	<100a	<0.5	---	<0.5	<0.5	<0.5	<0.5
MW6I	10/02/02 b	19.87	12.72	7.15	No	---	---	---	---	---	---	---	---	---
MW6I	01/07/03	19.87	12.09	7.78	No	---	<50.0	<50	<0.5	1.10	<0.5	<0.5	<0.5	<0.5
MW6I	06/17/03 b	19.87	---	---	---	---	---	---	---	---	---	---	---	---
MW6I	07/16/03	19.87	12.49	7.38	No	---	<50.0	<100	<0.5	<0.50	<0.50	<0.5	<0.5	<0.5
MW6I	10/07/03 b	19.87	12.64	7.23	No	---	---	---	---	---	---	---	---	---
MW6I	01/14/04	19.87	12.13	7.74	No	---	<50.0	<100	<0.5	<0.50	<0.50	<0.5	<0.5	<0.5
MW6I	06/03/04 b	19.87	12.56	7.31	No	---	---	---	---	---	---	---	---	---
MW6I	08/12/04	19.87	c	c	c	99c	<50.0c	155c	---	<0.50c	<0.50c	<0.5c	<0.5c	0.8c
MW6I	11/04/04 b	19.87	12.33	7.54	No	---	---	---	---	---	---	---	---	---
MW6I	02/01/05	19.87	12.09	7.78	No	<100	<50.0	<100	---	<0.50	<0.50	<0.5	<0.5	<0.5
MW6I	05/03/05 b	19.87	12.16	7.71	No	---	---	---	---	---	---	---	---	---
MW6I	08/04/05	19.87	12.46	7.41	No	54.2d	<50.0	<100	---	<0.500	<0.500	<0.500	<0.500	<0.500
MW6I	10/27/05 b	19.87	12.58	7.29	No	---	---	---	---	---	---	---	---	---
MW6I	01/26/06	19.87	12.04	7.83	No	<50	<50	<500	---	<0.50	<0.50	<0.50	<0.50	<0.50
MW6I	04/28/06 b	19.87	11.94	7.93	No	---	---	---	---	---	---	---	---	---
MW6I	07/05/06	19.87	13.06	6.81	No	<47.6	<50.0	<95.2	---	<0.500	<1.00	<1.00	<1.00	<3.00
MW6I	10/27/06 b	19.87	12.64	7.23	No	---	---	---	---	---	---	---	---	---
MW6I	01/19/07	19.87	12.41	7.46	No	<47	<50.0	<470	---	<0.500	<0.50	<0.50	<0.50	0.62
MW6I	04/24/07 b	19.87	12.11	7.76	No	---	---	---	---	---	---	---	---	---
MW6I	07/24/07	19.87	12.51	7.36	No	<47	<50	<470	---	<0.50	<0.50	<0.50	<0.50	<0.50
MW6I	12/03/07	19.87	12.64	7.23	No	<47	<50	<470	---	<0.50	<0.50	<0.50	<0.50	<0.50
MW6I	03/06/08	19.87	11.97	7.90	No	<47	<50	<470	---	<0.50	<0.50	<0.50	<0.50	<0.50
MW6J	04/06/01	---	Well installed.											
MW6J	07/05/01	20.72	13.47	7.25	No	---	<50	---	<2	---	<0.5	<0.5	<0.5	<0.5
MW6J	10/03/01	20.72	13.57	7.15	No	---	<50	---	<2	---	<0.5	<0.5	<0.5	<0.5
MW6J	Oct-01	20.75	Well surveyed in compliance with AB 2886 requirements.											
MW6J	01/02/02	20.75	13.19	7.56	No	---	<100	---	<0.5	---	<0.50	<0.50	<0.50	<0.50

TABLE 3A
CUMULATIVE GROUNDWATER MONITORING AND SAMPLING DATA
Former Exxon Service Station 70235
2225 Telegraph Avenue
Oakland, California
(Page 16 of 19)

Well ID	Sampling Date	TOC (feet)	DTW (feet)	GW Elev. (feet)	NAPL (feet)	TPHd (µg/L)	TPHg (µg/L)	TPHmo (µg/L)	MTBE 8021B (µg/L)	MTBE 8260B (µg/L)	B (µg/L)	T (µg/L)	E (µg/L)	X (µg/L)
RW2	04/02/91	98.11i	11.70	86.41i	---	---	---	---	---	---	---	---	---	---
RW2	05/07/91	98.11i	14.09	84.02i	---	---	11,000	---	---	---	3,200	480	150	780
RW2	05/31/91	98.11i	16.01	82.10i	---	---	---	---	---	---	---	---	---	---
RW2	06/26/91	98.11i	14.60	83.51i	---	---	---	---	---	---	---	---	---	---
RW2	08/05/91	98.11i	14.00	84.11i	---	---	---	---	---	---	---	---	---	---
RW2	08/13/91	98.11i	21.30	76.81i	---	---	---	---	---	---	---	---	---	---
RW2	09/11/91	98.11i	19.97	78.14i	---	---	---	---	---	---	---	---	---	---
RW2	10/16/91	98.11i	15.19	82.92i	---	---	---	---	---	---	---	---	---	---
RW2	12/30/91	98.11i	13.19	84.92i	---	---	---	---	---	---	---	---	---	---
RW2	02/25/92	98.11i	16.27	81.84i	---	---	---	---	---	---	---	---	---	---
RW2	03/25/92	98.11i	---	---	---	---	---	---	---	---	---	---	---	---
RW2	06/16/92	14.61	12.86	1.75	---	---	28,000	---	---	---	2,900	1,000	120	2,700
RW2	09/08/92 through 05/31/94 Not monitored or sampled.													
RW2	08/30/94	17.02j	Well resurveyed.											
RW2	08/30/94 through 04/20/98 Not monitored or sampled.													
RW2	07/21/98	20.44	12.65	7.79	No	---	3,500	---	170	---	240	100	41	96
RW2	10/06/98	20.44	13.06	7.38	No	---	3,200	---	200	---	120	48	56	120
RW2	01/11/99	20.44	12.88	7.56	No	---	3,300	---	350	---	150	17	35	40
RW2	04/08/99	20.44	11.76	8.68	sheen	---	---	---	---	---	---	---	---	---
RW2	07/19/99	20.44	11.61	8.83	No	---	1,980	---	160	499	44	4.16	22.3	11.6
RW2	07/27/99	20.44	13.26	7.18	No	---	---	---	---	---	---	---	---	---
RW2	10/25/99	20.44	12.96	7.48	No	---	1,800	---	440	---	51	<0.5	4.7	9.5
RW2	01/27/00	20.44	12.70	7.74	No	---	1,900	---	750	---	38	<2.5	4.8	10.4
RW2	04/03/00	20.44	11.97	8.47	No	---	2,100	---	300	---	28	2.4	1.4	0.73
RW2	07/05/00	20.44	12.50	7.94	No	---	2,300	---	230	---	20	<2.5	5.3	8
RW2	10/04/00	20.44	12.97	7.47	No	---	1,300	---	570	---	42	<2.5	15	17.7
RW2	10/05/00	20.44	---	---	---	---	---	<1,000	---	---	---	---	---	---
RW2	01/04/01	20.44	13.71	6.73	No	---	1,000	---	380	---	33	<2.5	13	17.7
RW2	04/03/01	20.44	12.10	8.34	No	---	1,300	---	99	---	18	2.1	16	19.4
RW2	07/05/01	20.44	Well inaccessible.											
RW2	10/03/01	20.44	12.8	7.64	No	---	1,900	---	240	---	35	4.4	34	105
RW2	Oct-01	20.64	Well surveyed in compliance with AB 2886 requirements.											
RW2	01/02/02	20.64	10.22	10.42	No	---	2,440	---	76.0	---	24.4	6.20	26.2	83.0
RW2	04/02/02	20.64	12.02	8.62	No	---	1,460	260	47.5	---	8.60	3.30	5.30	29.1
RW2	07/01/02	20.64	12.51	8.13	No	---	1,380	<100a	39.9	---	11.0	1.8	17.9	45.0
RW2	10/02/02	20.64	12.91	7.73	No	---	720	<100	46.9	---	5.5	1.7	3.7	11.9
RW2	01/07/03	20.64	11.61	9.03	No	---	1,180	197	48.0	56.0	12.3	3.6	12.2	25.6
RW2	06/17/03	20.64	12.32	8.32	No	---	1,070	<100	29.7	26.4	13.9	4.4	11.8	16.9
RW2	07/16/03	20.64	12.51	8.13	No	---	1,200	295	32.9	19.3	6.60	4.1	10.9	12.3
RW2	10/07/03	20.64	12.81	7.83	No	332	1,170	<100	55.0	50.2	8.70	1.1	9.3	12.2
RW2	01/14/04	20.64	11.70	8.94	No	167	1,250	<100	8.4	128	18.0	4.4	8.6	10.7
RW2	06/03/04	20.64	12.93	7.71	No	---	1,100	1,310	17.0	10.9	6.70	1.3	4.0	11.5
RW2	08/12/04	20.64	c	c	c	438c	1,110c	521c	---	32.8c	7.00c	1.5c	3.1c	10.2c
RW2	11/04/04	20.64	12.30	8.34	No	503	506	419	---	r	4.30	5.9	6.2	16.0
RW2	02/01/05	20.64	11.61	9.03	No	725	640	1,400	---	13.7	5.30	1.5	4.0	3.8
RW2	05/03/05	20.64	11.72	8.92	No	493d,e	1,130	801	---	8.20	10.3	1.1	5.8	6.3

TABLE 3A
CUMULATIVE GROUNDWATER MONITORING AND SAMPLING DATA
Former Exxon Service Station 70235
2225 Telegraph Avenue
Oakland, California
(Page 17 of 19)

Well ID	Sampling Date	TOC (feet)	DTW (feet)	GW Elev. (feet)	NAPL (feet)	TPHd (µg/L)	TPHg (µg/L)	TPHmo (µg/L)	MTBE 8021B (µg/L)	MTBE 8260B (µg/L)	B (µg/L)	T (µg/L)	E (µg/L)	X (µg/L)
RW2	08/04/05	20.64	12.46	8.18	No	3,020d	1,060	3,810	---	9.02	6.36	0.848	1.90	2.47
RW2	10/27/05	20.64	12.71	7.93	No	716	163	703	---	8.74	<0.50	<0.50	<0.50	0.95
RW2	01/26/06	20.64	11.65	8.99	No	410d	620a	<500	---	5.1	6.1a	1.2a	4.3a	2.1a
RW2	04/28/06	20.64	11.24	9.40	No	300d	680	<470	---	2.6	9.7	1.2	5.3	2.9
RW2	07/05/06	20.64	12.33	8.31	No	284	946	221	---	<0.500	8.87	1.05	1.81	3.10
RW2	10/27/06	20.64	12.78	7.86	No	240d	920	<470	---	4.59	<0.50	<0.50	3.65	3.09
RW2	01/19/07	20.64	12.29	8.35	No	230d	794	<470	---	3.72	6.32	2.27	<0.50	3.09
RW2	04/24/07	20.64	11.81	8.83	No	652d	1,170	332	---	3.01	7.21	<0.50	6.74	6.15
RW2	07/24/07	20.64	12.51	8.13	No	250d	970	<470	---	2.5	9.1	<0.50	2.8	1.9
RW2	12/03/07	20.64	12.71	7.93	No	660d,l	460	660d	---	6.8	7.5	<2.5	<2.5	<2.5
RW2	03/06/08	20.64	11.61	9.03	No	610d	750	620d	---	2.2	8.5	<2.5	2.7	<2.5
MW6C	06/15/88	99.89i	Well installed.											
MW6C	06/24/88	99.89i	---	---	---	---	---	---	---	---	7,400	7.1	170	2,300
MW6C	07/11/88	99.89i	14.21	85.68i	---	---	---	---	---	---	---	---	---	---
MW6C	10/20/88	99.89i	---	---	---	---	---	---	---	---	9,500	65	170	850
MW6C	12/15/88	99.89i	14.10	85.79i	---	---	---	---	---	---	---	---	---	---
MW6C	09/07/89	99.89i	---	---	---	---	18,000	---	---	---	7,900	430	350	1,100
MW6C	04/30/90	99.89i	13.81	86.68i	---	---	30,000	---	---	---	6,100	1,500	1,000	2,700
MW6C	05/10/90	---	Well over-drilled into recovery well RW3											
RW3	10/16/90	98.97i	13.29	85.68i	---	---	---	---	---	---	---	---	---	---
RW3	01/14/91	98.97i	14.50	84.47i	---	---	---	---	---	---	---	---	---	---
RW3	02/08/91	98.97i	12.54	86.43i	---	---	---	---	---	---	---	---	---	---
RW3	04/02/91	98.97i	11.39	87.58i	---	---	---	---	---	---	---	---	---	---
RW3	05/07/91	98.97i	12.47	86.50i	---	---	5,800	---	---	---	4,200	640	220	670
RW3	05/31/91	98.97i	16.31	82.66i	---	---	---	---	---	---	---	---	---	---
RW3	06/26/91	98.97i	15.50	83.47i	---	---	---	---	---	---	---	---	---	---
RW3	08/05/91	98.97i	13.69	85.28i	---	---	---	---	---	---	---	---	---	---
RW3	08/13/91	98.97i	13.67	85.30i	---	---	---	---	---	---	---	---	---	---
RW3	08/14/91	98.97i	---	---	---	---	3,800	---	---	---	2,300	300	49	360
RW3	09/11/91	98.97i	13.77	85.20i	---	---	---	---	---	---	---	---	---	---
RW3	10/16/91	98.97i	16.66	82.31i	---	---	---	---	---	---	---	---	---	---
RW3	11/05/91	---	Well destroyed.											
RW3A	08/24/92	---	Well installed in place of RW3.											
RW3A	08/24/92 through 04/20/98	---	Not monitored or sampled.											
RW3A	07/21/98	21.75	13.08	8.67	No	---	280	---	16	---	97	<1.2	<1.2	<1.2
RW3A	10/06/98	21.89	13.72	8.17	No	---	78	---	26	---	26	0.89	<0.5	<0.5
RW3A	01/11/99	21.75	12.00	9.75	No	---	1,000	---	230	---	490	5.0	<5.0	7.4
RW3A	04/08/99	21.75	11.90	9.85	No	---	130	---	11	---	70	<1.0	<1.0	<1.0
RW3A	07/19/99	21.75	11.75	10.00	No	---	989	---	16.4	---	393	6.40	5.70	15.0
RW3A	07/27/99	21.75	13.68	8.07	No	---	---	---	---	---	---	---	---	---
RW3A	10/25/99	21.75	13.61	8.14	No	---	150	---	19	---	53	<0.5	<0.5	<0.5
RW3A	01/27/00	21.75	12.22	9.53	No	---	500	---	12	---	210	0.59	1.40	2.29
RW3A	04/03/00	21.75	12.00	9.75	No	---	1,100	---	16	---	420	1.6	1.8	1.4

TABLE 3A
CUMULATIVE GROUNDWATER MONITORING AND SAMPLING DATA
Former Exxon Service Station 70235
2225 Telegraph Avenue
Oakland, California
(Page 18 of 19)

Well ID	Sampling Date	TOC (feet)	DTW (feet)	GW Elev. (feet)	NAPL (feet)	TPHd (µg/L)	TPHg (µg/L)	TPHmo (µg/L)	MTBE 8021B (µg/L)	MTBE 8260B (µg/L)	B (µg/L)	T (µg/L)	E (µg/L)	X (µg/L)
RW3A	07/05/00	21.75	13.01	8.74	No	---	1,200	---	16	---	440	1.4	2.5	1.9
RW3A	10/04/00	21.75	13.60	8.15	No	---	390	---	8.3	---	160	1.1	1.5	2.6
RW3A	10/05/00	21.75	---	---	---	---	---	<1,000	---	---	---	---	---	---
RW3A	01/04/01	21.75	13.65	8.10	No	---	500	---	12	---	230	0.97	1.1	1.4
RW3A	04/03/01	21.75	12.30	9.45	No	---	710	---	7.5	---	290	<0.5	<0.5	<0.5
RW3A	07/05/01	21.75	13.28	8.47	No	---	640	---	9	---	280	1.4	1.6	2.7
RW3A	10/03/01	21.75	13.58	8.17	No	---	<50	---	12	---	21	<0.5	<0.5	<0.5
RW3A	Oct-01	21.89	Well surveyed in compliance with AB 2886 requirements.											
RW3A	01/02/02	21.89	10.80	11.09	No	---	<100	---	11.2	---	<0.50	<0.50	<0.50	<0.50
RW3A	04/02/02	21.89	12.03	9.86	No	---	55.7	<100	11.0	---	1.30	<0.50	<0.50	<0.50
RW3A	07/01/02	21.89	13.13	8.76	No	---	275	<100a	21.7	---	60.4	<0.5	2.4	4.2
RW3A	10/02/02	21.89	13.70	8.19	No	---	138	114	11.1	---	53.4	<0.5	<0.5	0.7
RW3A	01/07/03	21.89	11.77	10.12	No	---	<50.0	<50	22.4	30.9	1.5	<0.5	<0.5	<0.5
RW3A	06/17/03	21.89	12.82	9.07	No	---	54.5	<100	12.8	16.0	7.40	<0.5	<0.5	<0.5
RW3A	07/16/03	21.89	13.40	8.49	No	---	112	<100	18.0	13.6	26.0	<0.5	<0.5	<0.5
RW3A	10/07/03	21.89	13.93	7.96	No	124	62.6	<100	10.4	11.3	7.30	<0.5	<0.5	<0.5
RW3A	01/14/04	21.89	11.55	10.34	No	401	<50.0	<100	11.7	16.2	3.10	<0.5	<0.5	<0.5
RW3A	06/03/04	21.89	13.43	8.46	No	---	79.0	<100	19.4	22.4	6.30	<0.5	<0.5	<0.5
RW3A	08/12/04	21.89	c	c	c	1,190c	<50.0c	296c	---	16.2c	<0.50c	<0.5c	<0.5c	<0.5c
RW3A	11/04/04	21.89	12.91	8.98	No	178	<50.0	122	---	5.40	<0.50	1.7	0.7	3.6
RW3A	02/01/05	21.89	11.63	10.26	No	<100	<50.0	<100	---	11.8	<0.50	<0.5	<0.5	<0.5
RW3A	05/03/05	21.89	11.79	10.10	No	158d	<50.0	<100	---	8.50	<0.50	<0.5	<0.5	<0.5
RW3A	08/04/05	21.89	12.99	8.90	No	687d	89.9	107	---	16.7	26.0	0.645	<0.500	0.835
RW3A	10/27/05	21.89	13.49	8.40	No	140	<50.0	79.1	---	4.00	9.63	<0.50	<0.50	0.65
RW3A	01/26/06	21.89	11.76	10.13	No	210d	100a	<500	---	17	5.6a	<0.50a	<0.50a	<0.50a
RW3A	04/28/06	21.89	10.96	10.93	No	140g	82	<470	---	19	2.6	<0.50	<0.50	<0.50
RW3A	07/05/06	21.89	13.12	8.77	No	340	50.0	<95.2	---	8.11	1.37	<1.00	<1.00	<3.00
RW3A	10/27/06	21.89	13.48	8.41	No	63d	789	<470	---	10.6	287	1.29	<0.50	2.03
RW3A	01/19/07	21.89	12.69	9.20	No	49d	<50.0	<470	---	6.25	2.08	<0.50	<0.50	<0.50
RW3A	04/24/07	21.89	12.12	9.77	No	<47.6	107	<47.6	---	4.95	17.9	<0.50	<0.50	0.57
RW3A	07/24/07	21.89	13.11	8.78	No	<47	<500	<470	---	8.5	240	<5.0	<5.0	<5.0
RW3A	12/03/07	21.89	13.35	8.54	No	61d,l	1,200g	<470	---	12	700	<10	<10	13
RW3A	03/06/08	21.89	11.69	10.20	No	<47	52	<470	---	4.4	1.5	<0.50	<0.50	<0.50

TABLE 3A
CUMULATIVE GROUNDWATER MONITORING AND SAMPLING DATA
Former Exxon Service Station 70235
2225 Telegraph Avenue
Oakland, California
(Page 19 of 19)

Notes:	=	
TOC	=	Top of casing elevation; datum is mean sea level.
NAPL	=	Non-aqueous phase liquid.
sheen	=	Liquid-phase hydrocarbon present as sheen.
in.	=	Inches of floating product.
DTW	=	Depth to water.
GW Elev.	=	Groundwater elevation; datum is mean sea level.
TPHd	=	Total petroleum hydrocarbons as diesel analyzed using EPA Method 5030/8015B (modified).
TPHg	=	Total petroleum hydrocarbons as gasoline analyzed using EPA Method 5030/8015B (modified).
TPHmo	=	Total petroleum hydrocarbons as motor oil using EPA Method 8015B.
MTBE 8260B	=	Methyl tertiary butyl ether analyzed using EPA Method 8260B.
MTBE 8021B	=	Methyl tertiary butyl ether analyzed using EPA Method 8021B.
BTEX	=	Benzene, toluene, ethylbenzene, and total xylenes analyzed using EPA Method 602 or 8021B.
ETBE	=	Ethyl tertiary butyl ether analyzed using EPA Method 8260B.
TAME	=	Tertiary amyl methyl ether analyzed using EPA Method 8260B.
TBA	=	Tertiary butyl alcohol analyzed using EPA Method 8260B.
EDB	=	1,2-dibromoethane analyzed using EPA Method 8260B.
1,2-DCA	=	1,2-dichloroethane analyzed using EPA Method 8260B.
DIPE	=	Di-isopropyl ether analyzed using EPA Method 8260B.
Ethanol	=	Ethanol analyzed using EPA Method 8260B.
µg/L	=	Micrograms per liter.
<	=	Less than the indicated reporting limit shown by the laboratory.
---	=	Not measured/Not sampled/Not analyzed.
a	=	Analyses performed past EPA recommended holding time.
b	=	Well sampled semi-annually.
c	=	Groundwater elevation data invalidated; analytical results suspect.
d	=	Hydrocarbon pattern is present in the requested fuel quantitation range but does not resemble the pattern of the requested fuel.
e	=	TRPH-diesel surrogate was diluted out due to sample matrix
f	=	Analyte detected in Matrix Spike and Matrix Spike Duplicate.
g	=	Elevated result due to single analyte peak in quantitation range.
h	=	Initial analysis within EPA recommended hold time. Re-analysis for dilution performed past hold time.
i	=	Based on assigned benchmark with elevation arbitrarily set at 100 feet.
j	=	Benchmark is City of Oakland #37J.
k	=	Sample container broken in shipment. Analyses not performed.
l	=	Analyte detected in associated method blank.

TABLE 3B
ADDITIONAL CUMULATIVE GROUNDWATER MONITORING AND SAMPLING DATA
Former Exxon Service Station 70235
2225 Telegraph Avenue
Oakland, California
(Page 1 of 8)

Well ID	Sampling Date	ETBE (µg/L)	TAME (µg/L)	TBA (µg/L)	EDB (µg/L)	1,2-DCA (µg/L)	DIPE (µg/L)	Ethanol (µg/L)
MW6A	June 1988 - Well installed.							
MW6A	06/24/88 - 12/31/91 Not analyzed for these analytes.							
MW6A	05/02/92 - Well destroyed.							
MW6B	June 1988 - Well installed.							
MW6B	06/24/88 - 10/02/02 Not analyzed for these analytes.							
MW6B	01/07/03	<0.50	<0.50	<10.0	<0.50	<0.50	<0.50	---
MW6B	06/17/03	<0.50	<0.50	<10.0	<0.50	<0.50	<0.50	<100
MW6B	07/16/03	<0.50	<0.50	<10.0	<0.50	<0.50	<0.50	<100
MW6B	10/07/03	<0.50	<0.50	<10.0	<0.50	<0.50	<0.50	<100
MW6B	01/14/04	<0.50	<0.50	<10.0	<0.50	<0.50	<0.50	<50.0
MW6B	06/03/04	<0.50	<0.50	<10.0	<0.50	<0.50	<0.50	<50.0
MW6B	08/12/04	<0.50c	<0.50c	<10.0c	<0.50c	<0.50c	<0.50c	<50.0c
MW6B	11/04/04	<0.50	<0.50	<10.0	<0.50	<0.50	<0.50	<50.0
MW6B	02/01/05	<0.50	<0.50	<10.0	<0.50	<0.50	<0.50	<50.0
MW6B	05/03/05	<0.50	<0.50	<10.0	<0.50	<0.50	<0.50	<50.0
MW6B	08/04/05	<0.500	<0.500	<10.0	<0.500	<0.500	<0.500	<50.0
MW6B	10/27/05	<0.500	<0.500	<20.0	<0.500	<0.500	<0.500	<100
MW6B	01/26/06	<0.50	0.56	<20	<0.50	<0.50	<0.50	<100
MW6B	04/28/06	<0.50	<0.50	27	<0.50	15	3.6	---
MW6B	07/05/06	<0.500	<0.500	<10.0	<0.500	<0.500	<0.500	<50.0
MW6B	10/27/06	<0.500	<0.500	<10.0	<0.500	<0.500	<0.500	---
MW6B	01/19/07	<0.500	<0.500	<10.0	<0.500	<0.500	<0.500	<50.0
MW6B	04/24/07	<0.500	<0.500	<10.0	<0.500	<0.500	<0.500	---
MW6B	07/24/07	<0.50	<0.50	<20	<0.50	<0.50	<0.50	---
MW6B	12/03/07	<0.50	<0.50	<10	<0.50	<0.50	<0.50	---
MW6B	03/06/08	<0.50	<0.50	<5.0	<0.50	<0.50	<0.50	---
MW6C	06/15/88 - Well installed.							
MW6C	06/24/88 - 04/30/90 Not analyzed for these analytes.							
MW6C	05/10/90 - Well over-drilled into recovery well RW3.							
MW6D	07/06/88 - Well installed.							
MW6D	07/11/88 - 04/30/90 Not analyzed for these analytes.							
MW6D	05/10/90 - Well over-drilled into recovery well RW2.							
MW6E	10/04/88 - Well installed.							
MW6E	10/20/88 - 10/02/02 Not analyzed for these analytes.							
MW6E	01/07/03	<0.50	<0.50	<10.0	<0.50	<0.50	<0.50	---
MW6E	06/17/03	<0.50	<0.50	<10.0	<0.50	<0.50	<0.50	<100

TABLE 3B
ADDITIONAL CUMULATIVE GROUNDWATER MONITORING AND SAMPLING DATA
Former Exxon Service Station 70235
2225 Telegraph Avenue
Oakland, California
(Page 2 of 8)

Well ID	Sampling Date	ETBE (µg/L)	TAME (µg/L)	TBA (µg/L)	EDB (µg/L)	1,2-DCA (µg/L)	DIPE (µg/L)	Ethanol (µg/L)
MW6E	07/16/03	<0.50	<0.50	<10.0	<0.50	<0.50	<0.50	<100
MW6E	10/07/03	<0.50	<0.50	<10.0	<0.50	<0.50	<0.50	<100
MW6E	01/14/04	<0.50	<0.50	<10.0	<0.50	<0.50	<0.50	<50.0
MW6E	06/03/04	<0.50	<0.50	<10.0	<0.50	<0.50	<0.50	<50.0
MW6E	08/12/04	<0.50c	<0.50c	<10.0c	<0.50c	<0.50c	<0.50c	<50.0c
MW6E	11/04/04	<0.50	<0.50	<10.0	<0.50	<0.50	<0.50	<50.0
MW6E	02/01/05	<0.50	<0.50	<10.0	<0.50	<0.50	<0.50	<50.0
MW6E	05/03/05	<0.50	<0.50	<10.0	<0.50	<0.50	<0.50	<50.0
MW6E	08/04/05	<0.500	<0.500	<10.0	<0.500	<0.500	<0.500	<50.0
MW6E	10/27/05	<0.500	<0.500	<20.0	<0.500	<0.500	<0.500	<100
MW6E	01/26/06	<0.50	<0.50	<20	<0.50	<0.50	<0.50	<100
MW6E	04/28/06	<0.50	<0.50	<20	<0.50	<0.50	<0.50	---
MW6E	07/05/06	<0.500	<0.500	<10.0	<0.500	<0.500	<0.500	<50.0
MW6E	10/27/06	<0.500	<0.500	<10.0	<0.500	<0.500	<0.500	---
MW6E	01/19/07	<0.500	<0.500	<10.0	<0.500	<0.500	<0.500	<50.0
MW6E	04/24/07	<0.500	<0.500	<10.0	<0.500	<0.500	<0.500	---
MW6E	07/24/07	<0.50	<0.50	<5.0	<0.50	<0.50	<0.50	---
MW6E	12/03/07	<0.50	<0.50	<10	<0.50	<0.50	<0.50	---
MW6E	03/06/08	<0.50	<0.50	<5.0	<0.50	<0.50	<0.50	---
MW6F	10/05/88 - Well installed.							
MW6F	10/20/88 - 10/02/02 Not analyzed for these analytes.							
MW6F	01/07/03	<0.50	<0.50	<10.0	<0.50	<0.50	<0.50	---
MW6F	06/17/03	<0.50	<0.50	<10.0	<0.50	<0.50	<0.50	<100
MW6F	07/16/03	<0.50	<0.50	<10.0	<0.50	<0.50	<0.50	<100
MW6F	10/07/03	<0.50	<0.50	<10.0	<0.50	<0.50	<0.50	<100
MW6F	01/14/04	<0.50	<0.50	<10.0	<0.50	<0.50	<0.50	<50.0
MW6F	06/03/04	<0.50	<0.50	<10.0	<0.50	<0.50	<0.50	<50.0
MW6F	08/12/04	<0.50c	<0.50c	<10.0c	<0.50c	<0.50c	<0.50c	<50.0c
MW6F	11/04/04	<0.50	<0.50	<10.0	<0.50	<0.50	<0.50	<50.0
MW6F	02/01/05	<0.50	<0.50	<10.0	<0.50	<0.50	<0.50	<50.0
MW6F	05/03/05	<0.50	0.90	<10.0	<0.50	1.70	<0.50	<50.0
MW6F	08/04/05	<0.500	<0.500	<10.0	<0.500	<0.500	<0.500	<50.0
MW6F	10/27/05	<0.500	<0.500	<20.0	<0.500	<0.500	<0.500	<100
MW6F	01/26/06	<0.50	<0.50	<20	<0.50	<0.50	<0.50	<100
MW6F	04/28/06	<0.50	<0.50	<20	<0.50	<0.50	<0.50	---
MW6F	07/05/06	<0.500	<0.500	<10.0	<0.500	<0.500	<0.500	<50.0
MW6F	10/27/06	<0.500	<0.500	<10.0	<0.500	<0.500	<0.500	---
MW6F	01/19/07	<0.500	<0.500	<10.0	<0.500	<0.500	<0.500	<50.0
MW6F	04/24/07	<0.500	<0.500	<10.0	<0.500	<0.500	<0.500	---
MW6F	07/24/07	<0.50	<0.50	<5.0	<0.50	<0.50	<0.50	---

TABLE 3B
ADDITIONAL CUMULATIVE GROUNDWATER MONITORING AND SAMPLING DATA
Former Exxon Service Station 70235
2225 Telegraph Avenue
Oakland, California
(Page 3 of 8)

Well ID	Sampling Date	ETBE (µg/L)	TAME (µg/L)	TBA (µg/L)	EDB (µg/L)	1,2-DCA (µg/L)	DIPE (µg/L)	Ethanol (µg/L)
MW6F	12/03/07	---	---	---	---	---	---	---
MW6F	03/06/08	<0.50	<0.50	<5.0	<0.50	<0.50	<0.50	---
MW6G	11/16/88 - Well installed.							
MW6G	12/07/88 - 10/02/02 Not analyzed for these analytes.							
MW6G	01/07/03	<0.50	<0.50	<10.0	<0.50	<0.50	<0.50	---
MW6G	06/17/03	<0.50	<0.50	<10.0	<0.50	<0.50	<0.50	<100
MW6G	07/16/03	<0.50	<0.50	<10.0	<0.50	<0.50	<0.50	<100
MW6G	10/07/03	<0.50	<0.50	<10.0	<0.50	<0.50	<0.50	<100
MW6G	01/14/04	<0.50	<0.50	<10.0	<0.50	<0.50	<0.50	<50.0
MW6G	06/03/04	<0.50	<0.50	<10.0	<0.50	<0.50	<0.50	<50.0
MW6G	08/12/04	<0.50c	<0.50c	<10.0c	<0.50c	<0.50c	<0.50c	<50.0c
MW6G	11/04/04	<0.50	<0.50	<10.0	<0.50	<0.50	<0.50	<50.0
MW6G	02/01/05	<0.50	<0.50	<10.0	<0.50	<0.50	<0.50	<50.0
MW6G	05/03/05	<0.50	<0.50	<10.0	<0.50	<0.50	<0.50	<50.0
MW6G	08/04/05	<0.500	<0.500	<10.0	<0.500	<0.500	<0.500	<50.0
MW6G	10/27/05	<0.500	<0.500	<20.0	<0.500	<0.500	<0.500	<100
MW6G	01/26/06	<0.50	<0.50	<20	<0.50	<0.50	<0.50	<100
MW6G	04/28/06	<0.50	<0.50	<20	<0.50	<0.50	<0.50	<100
MW6G	07/05/06	<0.500	<0.500	<10.0	<0.500	<0.500	<0.500	<50.0
MW6G	10/27/06	<0.500	<0.500	<10.0	<0.500	<0.500	<0.500	<100
MW6G	01/19/07	<0.500	<0.500	<10.0	<0.500	<0.500	<0.500	<50.0
MW6G	04/24/07	<0.500	<0.500	<10.0	<0.500	<0.500	<0.500	<50.0
MW6G	07/24/07	<0.50	<0.50	<5.0	<0.50	<0.50	<0.50	<100
MW6G	12/03/07	<0.50	<0.50	<10	<0.50	<0.50	<0.50	<100
MW6G	03/06/08	<0.50	<0.50	<5.0	<0.50	<0.50	<0.50	<100
MW6H	December 1988 - Well installed.							
MW6H	12/07/88 - 10/02/02 Not analyzed for these analytes.							
MW6H	01/07/03	<0.50	<0.50	952	<0.50	<0.50	7.50	---
MW6H	06/17/03	<0.50	<0.50	678	<0.50	<0.50	7.10	<100
MW6H	07/16/03	<0.50	0.70	307	<0.50	14.6	6.20	<100
MW6H	10/07/03	<0.50	<0.50	294	<0.50	<0.50	7.40	<100
MW6H	01/14/04	<0.50	<0.50	883	<0.50	<0.50	6.80	<50.0
MW6H	06/03/04	<0.50	<0.50	541	<0.50	<0.50	5.80	<50.0
MW6H	08/12/04	<0.50c	<0.50c	754c	<0.50c	<0.50c	5.40c	<50.0c
MW6H	11/04/04	<0.50	<0.50	<10.0	<0.50	<0.50	<0.50	<50.0
MW6H	02/01/05	<0.50	<0.50	625	<0.50	<0.50	4.20	<50.0
MW6H	05/03/05	<0.50	<0.50	436	<0.50	<0.50	3.10	<50.0
MW6H	08/04/05	<0.500	<0.500	530	<0.500	<0.500	3.73	<50.0
MW6H	10/27/05	<0.500	<0.500	422	<0.500	<0.500	4.62	<100

TABLE 3B
ADDITIONAL CUMULATIVE GROUNDWATER MONITORING AND SAMPLING DATA
Former Exxon Service Station 70235
2225 Telegraph Avenue
Oakland, California
(Page 4 of 8)

Well ID	Sampling Date	ETBE (µg/L)	TAME (µg/L)	TBA (µg/L)	EDB (µg/L)	1,2-DCA (µg/L)	DIPE (µg/L)	Ethanol (µg/L)
MW6H	01/26/06	<25	<25	<1,000	<25	<25	<25	<5,000
MW6H	04/28/06	<25	<25	<1,000	<25	<25	<25	<5,000
MW6H	07/05/06	<0.500	<0.500	137	<0.500	<0.500	2.41	<50.0
MW6H	10/27/06	<0.500	<0.500	131	<0.500	<0.500	3.61	<100
MW6H	01/19/07	<0.500	28.1	161	<0.500	25.7	2.96	<50.0
MW6H	04/24/07	<0.500	<0.500	173	<0.500	<0.500	1.97	<50.0
MW6H	07/24/07	<0.50	<0.50	140	<0.50	<0.50	3.8	<100
MW6H	12/03/07	<0.50	<0.50	150	<0.50	<0.50	7.0	<100
MW6H	03/06/08	<0.50	<0.50	92	<0.50	<0.50	1.8	<100
MW6I	December 1988 - Well installed.							
MW6I	12/07/88 - 10/02/02 Not analyzed for these analytes.							
MW6I	01/07/03	<0.50	<0.50	<10.0	<0.50	<0.50	<0.50	---
MW6I	06/17/03 b	---	---	---	---	---	---	---
MW6I	07/16/03	<0.50	<0.50	16.4	<0.50	<0.50	<0.50	<100
MW6I	10/07/03 b	---	---	---	---	---	---	---
MW6I	01/14/04	<0.50	<0.50	<10.0	<0.50	<0.50	<0.50	<50.0
MW6I	06/03/04 b	---	---	---	---	---	---	---
MW6I	08/12/04	<0.50c	<0.50c	<10.0c	<0.50c	<0.50c	<0.50c	<50.0c
MW6I	11/04/04 b	---	---	---	---	---	---	---
MW6I	02/01/05	<0.50	<0.50	<10.0	<0.50	<0.50	<0.50	<50.0
MW6I	05/03/04 b	---	---	---	---	---	---	---
MW6I	08/04/05	<0.500	<0.500	<10.0	<0.500	<0.500	<0.500	<50.0
MW6I	10/27/05 b	---	---	---	---	---	---	---
MW6I	01/26/06	<0.50	<0.50	<20	<0.50	<0.50	<0.50	<100
MW6I	04/28/06 b	---	---	---	---	---	---	---
MW6I	07/05/06	<0.500	<0.500	<10.0	<0.500	<0.500	<0.500	<50.0
MW6I	10/27/06 b	---	---	---	---	---	---	---
MW6I	01/19/07	<0.500	<0.500	<10.0	<0.500	<0.500	<0.500	<50.0
MW6I	04/24/07 b	---	---	---	---	---	---	---
MW6I	07/24/07	<0.50	<0.50	<5.0	<0.50	<0.50	<0.50	---
MW6I	12/03/07	<0.50	<0.50	<10	<0.50	<0.50	<0.50	<100
MW6I	03/06/08	<0.50	<0.50	<5.0	<0.50	<0.50	<0.50	---
MW6J	04/06/01 - Well installed.							
MW6J	07/05/01 - 10/02/02 Not analyzed for these analytes.							
MW6J	01/07/03	<0.50	<0.50	<10.0	<0.50	<0.50	<0.50	---
MW6J	06/17/03	<0.50	<0.50	<10.0	<0.50	0.90	<0.50	<100
MW6J	07/16/03	<0.50	<0.50	<10.0	<0.50	1.00	<0.50	<100
MW6J	10/07/03	<0.50	<0.50	<10.0	<0.50	<0.5	<0.50	<100
MW6J	01/14/04	<0.50	<0.50	<10.0	<0.50	<0.50	<0.50	<50.0

TABLE 3B
ADDITIONAL CUMULATIVE GROUNDWATER MONITORING AND SAMPLING DATA
Former Exxon Service Station 70235
2225 Telegraph Avenue
Oakland, California
(Page 5 of 8)

Well ID	Sampling Date	ETBE (µg/L)	TAME (µg/L)	TBA (µg/L)	EDB (µg/L)	1,2-DCA (µg/L)	DIPE (µg/L)	Ethanol (µg/L)
MW6J	06/03/04	<0.50	<0.50	<10.0	<0.50	2.00	<0.50	<50.0
MW6J	08/12/04	<0.50c	<0.50c	<10.0c	<0.50c	1.20c	<0.50c	<50.0c
MW6J	11/04/04	<0.50	<0.50	<10.0	<0.50	<0.50	<0.50	<50.0
MW6J	02/01/05	<0.50	<0.50	<10.0	<0.50	1.20	<0.50	<50.0
MW6J	05/03/05	<0.50	<0.50	<10.0	<0.50	1.20	<0.50	<50.0
MW6J	08/04/05	<0.500	<0.500	<10.0	<0.500	<0.500	<0.500	<50.0
MW6J	10/27/05	<0.500	<0.500	<20.0	<0.500	<0.500	<0.500	<100
MW6J	01/26/06	<0.50	<0.50	<20	<0.50	1.1	<0.50	<100
MW6J	04/28/06	<0.50	<0.50	<20	<0.50	1.3	<0.50	---
MW6J	07/05/06	<0.500	<0.500	<10.0	<0.500	<0.500	<0.500	<50.0
MW6J	10/27/06	<0.500	<0.500	<10.0	<0.500	1.04	<0.500	---
MW6J	01/19/07	<0.500	<0.500	<10.0	<0.500	1.15	<0.500	<50.0
MW6J	04/24/07	<0.500	<0.500	<10.0	<0.500	<0.500	<0.500	---
MW6J	07/24/07	<0.50	<0.50	<20	<0.50	1.1	<0.50	---
MW6J	12/03/07	<0.50	<0.50	<10	<0.50	1.8	<0.50	---
MW6J	03/06/08 m	---	---	---	---	---	---	---
RW1	05/10/90 - Well installed.							
RW1	10/16/90 - 10/02/02 Not analyzed for these analytes.							
RW1	01/07/03	<10.0	<10.0	<200	<10.0	<10.0	<10.0	---
RW1	06/17/03	<0.50	<0.50	324	<0.50	<0.50	<0.50	<100
RW1	07/16/03	<0.50	<0.50	110	<10.0	1.70	1.10	<100
RW1	10/07/03	<0.50	<0.50	<10.0	<0.50	<0.50	<0.50	<100
RW1	01/14/04	<0.50	<0.50	234	<0.50	<0.50	0.90	<50.0
RW1	06/03/04	<0.50	<0.50	338	<0.50	<0.50	1.30	<50.0
RW1	08/12/04	<0.50c	<0.50c	437c	1.30c	<0.50c	1.20c	<50.0c
RW1	11/04/04	<0.50	<0.50	541	<0.50	<0.50	<0.50	<50.0
RW1	02/01/05	<0.50	<0.50	261	<0.50	<0.50	1.80	<50.0
RW1	05/03/05	<0.50	<0.50	200	<0.50	<0.50	<0.50	<50.0
RW1	08/04/05	<0.500	<0.500	169	<0.500	<0.500	<0.500	<50.0
RW1	10/27/05	<0.500	<0.500	152	<0.500	<0.500	0.660	<100
RW1	01/26/06	<2.5	<2.5	280	<2.5	<2.5	<2.5	<500
RW1	04/28/06	<0.50	<0.50	86	<0.50	<0.50	<0.50	<100
RW1	07/05/06	<0.500	<0.500	80.5	1.02	<0.500	<0.500	<50.0
RW1	10/27/06	<0.500	<0.500	104	<0.500	<0.500	<0.500	<100
RW1	01/19/07	<0.500	<0.500	64.6	<0.500	<0.500	<0.500	<50.0
RW1	04/24/07	<0.500	<0.500	70.8	<0.500	<0.500	<0.500	<50.0
RW1	07/24/07	<0.50	<0.50	17	<0.50	<0.50	<0.50	<100
RW1	12/03/07	<0.50	<0.50	<10	<0.50	<0.50	<0.50	<100
RW1	03/06/08	<0.50	<0.50	37	<0.50	<0.50	<0.50	<100

TABLE 3B
ADDITIONAL CUMULATIVE GROUNDWATER MONITORING AND SAMPLING DATA
Former Exxon Service Station 70235
2225 Telegraph Avenue
Oakland, California
(Page 6 of 8)

Well ID	Sampling Date	ETBE (µg/L)	TAME (µg/L)	TBA (µg/L)	EDB (µg/L)	1,2-DCA (µg/L)	DIPE (µg/L)	Ethanol (µg/L)
MW6D	07/06/88 - Well installed.							
MW6D	07/11/88 - 04/30/90 Not analyzed for these analytes.							
MW6D	05/10/90 - Well over-drilled into recovery well RW2							
RW2	10/16/90 - 10/02/02 Not analyzed for these analytes.							
RW2	01/07/03	<0.50	<0.50	<10.0	<0.50	<0.50	<0.50	---
RW2	06/17/03	<0.50	<0.50	<10.0	<0.50	<0.50	<0.50	<100
RW2	07/16/03	<0.50	<0.50	<10.0	<0.50	<0.50	<0.50	<100
RW2	10/07/03	<0.50	<0.50	<10.0	<0.50	<0.50	<0.50	<100
RW2	01/14/04	<0.50	<0.50	370	<0.50	<0.50	<0.50	<50.0
RW2	06/03/04	<0.50	<0.50	370	<0.50	<0.50	<0.50	<50.0
RW2	08/12/04	<0.50c	<0.50c	<10.0c	1.30c	<0.50c	<0.50c	<50.0c
RW2	11/04/04	<0.50	<0.50	<10.0	<0.50	<0.50	<0.50	<50.0
RW2	02/01/05	<0.50	<0.50	<10.0	<0.50	<0.50	<0.50	<50.0
RW2	05/03/05	<0.50	<0.50	<10.0	<0.50	<0.50	<0.50	<50.0
RW2	08/04/05	<0.500	<0.500	<10.0	<0.500	<0.500	<0.500	<50.0
RW2	10/27/05	<0.500	<0.500	<20.0	<0.500	<0.500	<0.500	<100
RW2	01/26/06	<0.50	<0.50	<20	<0.50	<0.50	<0.50	<100
RW2	04/28/06	<0.50	<0.50	<20	<0.50	<0.50	<0.50	---
RW2	07/05/06	<0.500	<0.500	<10.0	<0.500	<0.500	<0.500	<50.0
RW2	10/27/06	<0.500	<0.500	<10.0	<0.500	<0.500	<0.500	---
RW2	01/19/07	<0.500	<0.500	<10.0	<0.500	<0.500	<0.500	<50.0
RW2	04/24/07	<0.500	<0.500	<10.0	<0.500	<0.500	<0.500	---
RW2	07/24/07	<0.50	<0.50	<5.0	<0.50	<0.50	<0.50	---
RW2	12/03/07	<0.50	<0.50	<10	<0.50	<0.50	<0.50	---
RW2	03/06/08	<0.50	<0.50	<5.0	<0.50	<0.50	<0.50	---
MW6C	06/15/88 - Well installed.							
MW6C	06/24/88 - 04/30/90 Not analyzed for these analytes.							
MW6C	05/10/90 - Well over-drilled into recovery well RW3							
RW3	10/16/90 - 10/16/91 Not analyzed for these analytes.							
RW3	11/05/91 - Well destroyed.							
RW3A	08/24/92 - Well installed in place of RW3.							
RW3A	08/24/98 - 10/02/02 Not analyzed for these analytes.							
RW3A	01/07/03	<0.50	<0.50	<10.0	<0.50	<0.50	<0.50	---
RW3A	06/17/03	<0.50	<0.50	<10.0	<0.50	<0.50	1.20	<100
RW3A	07/16/03	<0.50	<0.50	<10.0	<0.50	<0.50	1.40	<100
RW3A	10/07/03	<0.50	<0.50	<10.0	<0.50	<0.50	1.40	<100
RW3A	01/14/04	<0.50	<0.50	<10.0	<0.50	<0.50	2.20	<50.0
RW3A	06/03/04	<0.50	<0.50	<10.0	<0.50	<0.50	1.20	<50.0
RW3A	08/12/04	<0.50c	<0.50c	<10.0c	<0.50c	<0.50c	1.10c	<50.0c

TABLE 3B
ADDITIONAL CUMULATIVE GROUNDWATER MONITORING AND SAMPLING DATA
Former Exxon Service Station 70235
2225 Telegraph Avenue
Oakland, California
(Page 7 of 8)

Well ID	Sampling Date	ETBE (µg/L)	TAME (µg/L)	TBA (µg/L)	EDB (µg/L)	1,2-DCA (µg/L)	DIPE (µg/L)	Ethanol (µg/L)
RW3A	11/04/04	<0.50	<0.50	<10.0	<0.50	<0.50	<0.50	<50.0
RW3A	02/01/05	<0.50	<0.50	<10.0	<0.50	<0.50	2.10	<50.0
RW3A	05/03/05	<0.50	<0.50	<10.0	<0.50	<0.50	0.60	<50.0
RW3A	08/04/05	<0.500	<0.500	<10.0	<0.500	<0.500	<0.500	<50.0
RW3A	10/27/05	<0.500	<0.500	<20.0	<0.500	<0.500	0.980	<100
RW3A	01/26/06	<0.50	<0.50	<20	<0.50	<0.50	3.2	<100
RW3A	04/28/06	<0.50	<0.50	<20	<0.50	<0.50	1.5	<100
RW3A	07/05/06	<0.500	<0.500	<10.0	<0.500	<0.500	1.20	<50.0
RW3A	10/27/06	<0.500	<0.500	17.3	<0.500	<0.500	3.90	<100
RW3A	01/19/07	<0.500	<0.500	<10.0	<0.500	1.30	1.55	<50.0
RW3A	04/24/07	<0.500	<0.500	<10.0	<0.500	<0.500	1.61	<50.0
RW3A	07/24/07	<0.50	<0.50	<5.0	<0.50	<0.50	3.1	<100
RW3A	12/03/07	<0.50	<0.50	30	<0.50	<0.50	7.5	<100
RW3A	03/06/08	<0.50	<0.50	<5.0	<0.50	<0.50	0.88	<100

TABLE 3B
ADDITIONAL CUMULATIVE GROUNDWATER MONITORING AND SAMPLING DATA

Former Exxon Service Station 70235
 2225 Telegraph Avenue
 Oakland, California
 (Page 8 of 8)

Notes:		
TOC	=	Top of casing elevation; datum is mean sea level.
NAPL	=	Non-aqueous phase liquid.
sheen	=	Liquid-phase hydrocarbon present as sheen.
in.	=	Inches of floating product.
DTW	=	Depth to water.
GW Elev.	=	Groundwater elevation; datum is mean sea level.
TPHd	=	Total petroleum hydrocarbons as diesel analyzed using EPA Method 5030/8015B (modified).
TPHg	=	Total petroleum hydrocarbons as gasoline analyzed using EPA Method 5030/8015B (modified).
TPHmo	=	Total petroleum hydrocarbons as motor oil using EPA Method 8015B.
MTBE 8260B	=	Methyl tertiary butyl ether analyzed using EPA Method 8260B.
MTBE 8021B	=	Methyl tertiary butyl ether analyzed using EPA Method 8021B.
BTEX	=	Benzene, toluene, ethylbenzene, and total xylenes analyzed using EPA Method 602 or 8021B.
ETBE	=	Ethyl tertiary butyl ether analyzed using EPA Method 8260B.
TAME	=	Tertiary amyl methyl ether analyzed using EPA Method 8260B.
TBA	=	Tertiary butyl alcohol analyzed using EPA Method 8260B.
EDB	=	1,2-dibromoethane analyzed using EPA Method 8260B.
1,2-DCA	=	1,2-dichloroethane analyzed using EPA Method 8260B.
DIPE	=	Di-isopropyl ether analyzed using EPA Method 8260B.
Ethanol	=	Ethanol analyzed using EPA Method 8260B.
µg/L	=	Micrograms per liter.
<	=	Less than the indicated reporting limit shown by the laboratory.
---	=	Not measured/Not sampled/Not analyzed.
a	=	Analyses performed past EPA recommended holding time.
b	=	Well sampled semi-annually.
c	=	Groundwater elevation data invalidated; analytical results suspect.
d	=	Hydrocarbon pattern is present in the requested fuel quantitation range but does not resemble the pattern of the requested fuel.
e	=	TRPH-diesel surrogate was diluted out due to sample matrix
f	=	Analyte detected in Matrix Spike and Matrix Spike Duplicate.
g	=	Elevated result due to single analyte peak in quantitation range.
h	=	Initial analysis within EPA recommended hold time. Re-analysis for dilution performed past hold time.
i	=	Based on assigned benchmark with elevation arbitrarily set at 100 feet.
j	=	Benchmark is City of Oakland #37J.
k	=	Sample container broken in shipment. Analyses not performed.
l	=	Analyte detected in associated method blank.

TABLE 4
WELL CONSTRUCTION DETAILS
Former Exxon Service Station 70235
2225 Telegraph Avenue
Oakland, California
(Page 1 of 1)

Well ID	Date Well Installed	TOC Elevation (feet)	Borehole Diameter (inches)	Total Depth of Boring (feet bgs)	Well Depth (feet bgs)	Well Casing Diameter (inches)	Well Casing Material	Screened Interval (feet bgs)	Slot Size (inches)	Filter Pack Interval (feet bgs)	Filter Pack Material
MW6A	Well destroyed in 1992.										
MW6B	June 1988	21.09	8	20	19	2	PVC	9-19	0.020	7-20	#3 Sand
MW6C	Well converted to groundwater recovery well RW3 in 1990.										
MW6D	Well converted to groundwater recovery well RW2 in 1990.										
MW6E	10/04/88	21.24	10.5	21.5	20.5	4	PVC	10-19.5	0.020	8-21.5	#3 Sand
MW6F	10/05/88	22.17	10.5	22	20	4	PVC	10-19.5	0.020	8-22	#3 Sand
MW6G	11/16/88	20.46	8	20	20	4	PVC	10-19.5	0.020	8-20	#3 Sand
MW6H	11/16/88	20.20	8	21	20	4	PVC	10-19.5	0.020	8-21	#3 Sand
MW6I	11/17/88	19.87	8	21	20	4	PVC	10-19.5	0.020	8-21	#3 Sand
MW6J	04/06/01	20.75	8	23	23	2	PVC	6-23	0.020	6-23	#2/12 Sand
RW1	05/10/90	20.43	12	25	25	4	PVC	9.5-24.5	0.020	8.5-25	#3 Sand
RW2	07/06/88	20.64	12	25	25	4	PVC	9.5-24.5	0.020	9.5-25	#3 Sand
RW3	Well destroyed in 1991 and replaced with well RW3A in 1992.										
RW3A	08/24/92	21.89	12	21.5	21.5	4	PVC	9-21	0.020	8-21.5	#3 Sand
VW1	06/05/92	NS	NS	11	11	4	PVC	6-11	0.020	NS	NS
VW2	06/05/92	NS	NS	11	11	4	PVC	6-11	0.020	NS	NS
VW3	08/24/92	NS	12	13.5	13.5	4	PVC	4-13.5	0.050	4-13.5	Aquarium Sand

Notes:
TOC = Top of well casing elevation; datum is mean sea level.
feet bgs = Feet below ground surface.
PVC = Polyvinyl chloride.
NS = Not specified.

APPENDIX A

FIELD PROTOCOL

FIELD PROTOCOL

Site Safety Plan

Field work will be performed by ERI personnel in accordance with a Site Safety Plan developed for the site. This plan describes the basic safety requirements for the subsurface investigation at the site. The Site Safety Plan is applicable to personnel and subcontractors of ERI. Personnel at the site are informed of the contents of the Site Safety Plan before work begins. A copy of the Site Safety Plan is kept at the work site and is available for reference during the work. The ERI geologist will act as the Site Safety Officer.

Drilling of Soil Borings

Prior to the drilling of soil borings, ERI will acquire necessary permits from the appropriate agency(ies). ERI will also contact Underground Service Alert (USA) and a private underground utility locator (per ExxonMobil protocol) before drilling to help locate utility lines at the site. ERI will clear the proposed locations to a depth of approximately 4 or 8 feet (depending on the location), before drilling to reduce the risk of damaging underground structures.

The Cone Penetration Test (CPT) and Hydropunch® (HP) borings will be drilled with a direct-push drill rig. Soil borings will be drilled with a direct-push drill rig. Core samples will be continuously collected from the soil borings. Drill rods and sampling equipment will be steam-cleaned before use and between borings to minimize the possibility of crosshole contamination. The rinsate will be containerized and stored on site. ERI will coordinate with ExxonMobil for appropriate disposal of the rinsate.

Drilling will be performed under the observation of a field geologist, and the earth materials in the boring will be identified using visual and manual methods, and classified as drilling progresses using the Unified Soil Classification System.

Soil samples will be monitored with a photo-ionization detector (PID), which measures hydrocarbon concentrations in the ambient air or headspace above the soil sample. Field instruments such as the PID are useful for indicating relative levels of hydrocarbon vapors, but do not detect concentrations of hydrocarbons with the same precision as laboratory analyses. Soil samples selected for possible chemical analysis will be sealed promptly with Teflon® tape and plastic caps. The samples will be labeled and placed in iced storage for transport to the laboratory. Chain of Custody records will be initiated by the geologist in the field, updated throughout handling of the samples, and sent with the samples to the laboratory. Copies of these records will be in the final report. Cuttings generated during drilling will be placed on plastic sheeting and covered and left at the site. ERI will coordinate with ExxonMobil for the soil to be removed to an appropriate disposal facility.

Groundwater Sample Collection

Water samples are collected with a new, disposable Teflon® or polypropylene bailer. The groundwater is carefully poured into selected sample containers (40-milliliter [ml] glass vials, 1,000-ml glass amber bottles, etc.), which are filled so as to produce a positive meniscus. Depending on the required analysis, each sample container is preserved with hydrochloric acid, nitric acid, etc., or it is preservative free. The type of preservation used for each sample is specified on the Chain of Custody record. Each vial and glass amber bottle is sealed with a cap containing a Teflon® septum, and subsequently examined for air bubble to avoid headspace, which would allow volatilization to occur. The samples are promptly transported in iced storage in a thermally insulated ice chest, accompanied by a Chain of Custody record, to a California state-certified laboratory.