

RECEIVED

By dehloptoxic at 9:02 am, Aug 17, 2006

ExxonMobil
Refining & Supply Company
Global Remediation

Jennifer C. Sedlachek
Project Manager

4096 Piedmont Avenue #194
Oakland, California 94611
510.547.8196
510.547.8706 Fax
jennifer.c.sedlachek@exxonmobil.com

ExxonMobil
Refining & Supply

August 4, 2006

Mr. Steven Plunkett
Alameda County Health Care Services Agency
Department of Environmental Health
1131 Harbor Bay Parkway, Room 250
Alameda, California 94502-6577

RE: Former Exxon RAS #7-0235/2225 Telegraph Avenue, Oakland California.

Dear Mr. Plunkett:

Attached for your review and comment is a copy of the letter report entitled *Groundwater Monitoring Report, Third Quarter 2006*, dated August 4, 2006, for the above-referenced site. The report was prepared by Environmental Resolutions, Inc. (ERI) of Petaluma, California, and details groundwater monitoring and sampling activities at the subject site.

I declare, under penalty of perjury, that the information and/or recommendations contained in the attached document or report is true and correct to the best of my knowledge.

If you have any questions or comments, please contact me at 510.547.8196.

Sincerely,



Jennifer C. Sedlachek
Project Manager

Attachment: ERI's Groundwater Monitoring Report, Third Quarter 2006, dated August 4, 2006.

cc: w/ attachment
Mr. Chuck Headlee, California Regional Water Quality Control Board, San Francisco Bay Region
Mr. Robert C. Elhers, M.S., P.E., The Valero Companies, Environmental Liability Management

w/o attachment
Ms. Paula Sime, Environmental Resolutions, Inc.

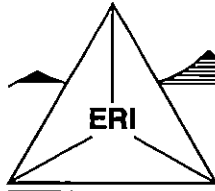

ENVIRONMENTAL RESOLUTIONS, INC.

August 4, 2006
ERI 222913.Q063

Ms. Jennifer C. Sedlachek
ExxonMobil Refining & Supply – Global Remediation
4096 Piedmont Avenue #194
Oakland, California 94611

SUBJECT Groundwater Monitoring Report, Third Quarter 2006
Former Exxon Service Station 7-0235
2225 Telegraph Avenue, Oakland, California

INTRODUCTION

At the request of Exxon Mobil Corporation (Exxon Mobil), Environmental Resolutions, Inc. (ERI) performed third quarter 2006 groundwater monitoring and sampling activities at the subject site. Relevant tables, plates, and attachments are included at the end of this report. Currently, the site is an active Valero Service Station.

GROUNDWATER MONITORING AND SAMPLING SUMMARY

Gauging and sampling date: 07/05/06

Wells gauged and sampled: MW6B, MW6E through MW6J, RW1, RW2, RW3A

Presence of NAPL: Not observed

Laboratory: TestAmerica Analytical Testing Corporation
Nashville, Tennessee

Analyses performed: EPA Method 8015B TPHd, TPHg, TPHmo
EPA Method 8021B BTEX
EPA Method 8260B MTBE, ETBE, TAME, TBA, EDB, 1,2-DCA, DIPE,
Ethanol

Waste disposal: 147 gallons purge and decon water delivered to
Romic Environmental Technologies Corporation
on 07/14/06

REMEDIATION SYSTEM SUMMARY

Prior to 1990, a groundwater extraction and treatment (GET) system operated at the site under the ownership of Texaco. The GET system was shut down in 1990 and replaced with a soil vapor extraction (SVE) system, which operated from approximately 1991 until 1996. The SVE system was shut down when ownership of the site transferred from Texaco to Exxon Mobil in 1996 and has been non-operational since that time. Additional information on the remediation systems is not available in Exxon Mobil or ERI's files.

DOCUMENT DISTRIBUTION

ERI recommends forwarding copies of this report to:

Mr. Steven Plunkett
Alameda County Health Care Services Agency
Department of Environmental Health
1131 Harbor Bay Parkway, Suite 250
Alameda, California 94502-6577

Mr. Chuck Headlee
California Regional Water Quality Control Board
San Francisco Bay Region
1515 Clay Street, Suite 1400
Oakland, California 94612

Mr. Robert C. Ehlers, M.S., P.E.
The Valero Companies
Environmental Liability Management
685 West Third Street
Hanford, California 93230

LIMITATIONS

This report was prepared in accordance with generally accepted standards of environmental practice in California at the time this investigation was performed. This report has been prepared for Exxon Mobil, and any reliance on this report by third parties shall be at such party's sole risk.

Please call Ms. Paula Sime, ERI's project manager for this site, at (707) 766-2000 with any questions regarding this report.

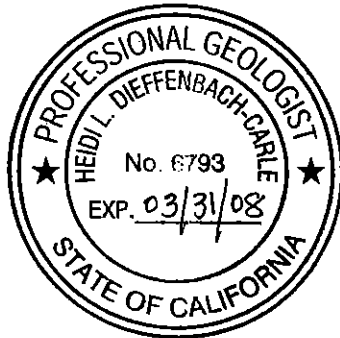

Sincerely,
Environmental Resolutions, Inc.

Karen L. Valero
Karen L. Valero
Technical Writer

Heidi Dieffenbach-Carle
Heidi Dieffenbach-Carle
P.G. 6793

SCANNED
IMAGE

- Attachments: Table 1A: Cumulative Groundwater Monitoring and Sampling Data
- Table 1B: Additional Cumulative Groundwater Monitoring and Sampling Data
- Table 2: Well Construction Details

- Plate 1: Site Vicinity Map
- Plate 2: Select Analytical Results
- Plate 3: Groundwater Elevation Map

- Attachment A: Groundwater Sampling Protocol
- Attachment B: Laboratory Analytical Report and Chain-of-Custody Record
- Attachment C: Waste Disposal Documentation

TABLE 1A
CUMULATIVE GROUNDWATER MONITORING AND SAMPLING DATA
Former Exxon Service Station 7-0235
2225 Telegraph Avenue
Oakland, California
(Page 1 of 10)

Well ID	Sampling Date	TOC (feet)	DTW (feet)	GW Elev. (feet)	SUBJ	TPHd (µg/L)	TPHg (µg/L)	TPHmo (µg/L)	MTBE 8260B (µg/L)	MTBE 8021B (µg/L)	B (µg/L)	T (µg/L)	E (µg/L)	X (µg/L)
MW6B	11/26/96	17.48	12.26	5.22	NLPH	---	<50	---	---	<30	<0.5	<0.5	<0.5	<0.5
MW6B	02/27/97	17.48	11.73	5.75	NLPH	---	<50	---	---	<30	<0.5	<0.5	<0.5	0.80
MW6B	05/21/97	17.48	12.70	4.78	NLPH	---	<50	---	---	<30	<0.5	<0.5	<0.5	<0.5
MW6B	08/18/97	17.48	12.89	4.59	NLPH	---	380	---	---	<30	4.3	<0.5	1.2	1.5
MW6B	03/13/98	17.48	11.15	6.33	NLPH	---	360	---	---	<6.2	93	4.9	4.1	12
MW6B	04/20/98	17.48	11.49	5.99	NLPH	---	110	---	---	5.5	19	1.3	1.5	3.9
MW6B	07/21/98	21.37	12.18	9.19	NLPH	---	<50	---	---	8.7	0.84	0.59	<0.5	<0.5
MW6B	10/06/98	21.37	12.70	8.67	NLPH	---	190	---	---	6.0	2.4	0.56	0.51	1.2
MW6B	01/11/99	21.37	12.48	8.89	NLPH	---	50	---	---	3.9	1.2	<0.5	<0.5	0.95
MW6B	04/08/99	21.37	11.52	9.85	NLPH	---	85	---	---	14.0	4.4	<0.5	<0.5	<0.5
MW6B	07/19/99	21.37	11.39	9.98	NLPH	---	<50	---	---	<2.50	<0.5	<0.5	<0.5	<0.5
MW6B	07/27/99	21.37	12.71	8.66	NLPH	---	---	---	---	---	---	---	---	---
MW6B	10/25/99	21.37	12.49	8.88	NLPH	---	260	---	---	<2	2.3	<0.5	<0.5	<0.5
MW6B	01/27/00	21.37	11.80	9.57	NLPH	---	770	---	---	13	210	4.8	4.9	13
MW6B	04/03/00	21.37	11.61	9.76	NLPH	---	670	---	---	3.4	110	6.6	3.8	9.45
MW6B	07/05/00	21.37	12.27	9.10	NLPH	---	<50	---	---	2.1	0.89	<0.5	<0.5	<0.5
MW6B	10/04/00	21.37	12.67	8.70	NLPH	---	<50	---	---	54	<0.5	<0.5	<0.5	2
MW6B	10/05/00	21.37	---	---	---	---	---	<1,000	---	---	---	---	---	---
MW6B	01/04/01	21.37	12.47	8.90	NLPH	---	<50	---	---	35	<0.5	<0.5	<0.5	<0.5
MW6B	04/03/01	21.37	11.81	9.56	NLPH	---	<50	---	---	7.8	<0.5	<0.5	<0.5	<0.5
MW6B	07/05/01	21.37	12.44	8.93	NLPH	---	<50	---	---	3	<0.5	<0.5	<0.5	<0.5
MW6B	10/03/01	21.37	12.52	8.85	NLPH	---	310	---	---	10	2.1	<0.5	6.5	11.6
MW6B	Nov-01	21.09	Well surveyed in compliance with AB 2886 requirements.											
MW6B	01/02/02	21.09	11.25	9.84	NLPH	---	710	---	---	21.8	99.5	4.40	3.30	7.40
MW6B	04/02/02	21.09	11.72	9.37	NLPH	---	<50.0	<100	---	12.2	0.60	<0.50	<0.50	<0.50
MW6B	07/01/02	21.09	12.34	8.75	NLPH	---	<50	<100a	---	10.7	<0.5	<0.5	<0.5	<0.5
MW6B	10/02/02	21.09	12.71	8.38	NLPH	---	<50.0	<100	---	10.9	<0.5	<0.5	<0.5	<0.5
MW6B	01/07/03	21.09	11.65	9.44	NLPH	---	82.5	<50	27.8	20.8	3.7	0.5	<0.5	0.8
MW6B	06/17/03	21.09	12.09	9.00	NLPH	---	<50.0	<100	6.10a	7.3	0.50	<0.5	<0.5	<0.5
MW6B	07/16/03	21.09	12.29	8.80	NLPH	---	<50.0	<100	8.5	11.0	<0.50	<0.5	<0.5	<0.5
MW6B	10/07/03	21.09	12.63	8.46	NLPH	<50	<50.0	<100	3.10	4.1	<0.50	<0.5	<0.5	<0.5
MW6B	01/14/04	21.09	11.50	9.59	NLPH	54	62.0	<100	11.0	9.0	2.10	<0.5	<0.5	<0.5
MW6B	06/03/04	21.09	12.12	8.97	NLPH	---	56.0	<100	5.90	6.2	0.60	<0.5	<0.5	<0.5
MW6B	08/12/04	21.09	c	c	c	<50c	94.0c	<100c	3.40c	---	0.70c	<0.5c	<0.5c	0.9c
MW6B	11/04/04	21.09	12.27	8.82	NLPH	<50	<50.0	143	2.60	---	<0.50	<0.5	<0.5	0.7
MW6B	02/01/05	21.09	11.48	9.61	NLPH	<100	55.9	<100	7.50	---	1.30	<0.5	<0.5	<0.5
MW6B	05/03/05	21.09	11.48	9.61	NLPH	<50	<50.0	<100	4.90	---	0.50	<0.5	<0.5	0.8
MW6B	08/04/05	21.09	12.23	8.86	NLPH	<50.0	<50.0	<100	5.99	---	<0.500	<0.500	<0.500	0.692
MW6B	10/27/05	21.09	12.60	8.49	NLPH	<50.0	<50.0	<50.0	1.65	---	<0.50	0.94f	<0.50	1.29
MW6B	01/26/06	21.09	11.39	9.70	NLPH	83d	510	<500	12	---	130	11	14	39
MW6B	04/28/06	21.09	10.99	10.10	NLPH	240d	3,100	<470	43	---	920h	110	130	290
MW6B	07/05/06	21.09	12.05	9.04	NLPH	<47.6	79.4	<95.2	11.4	---	2.95	<1.00	<1.00	<3.00
MW6E	11/26/96	17.63	12.94	4.69	NLPH	---	<50	---	---	<30	1.1	<0.5	<0.5	<0.5
MW6E	02/27/97	17.63	12.28	5.35	NLPH	---	<50	---	---	<30	<0.5	<0.5	<0.5	<0.5
MW6E	05/21/97	17.63	13.60	4.03	NLPH	---	160	---	---	<5	10	1.4	5.5	4.8
MW6E	08/18/97	17.63	13.75	3.88	NLPH	---	66	---	---	<30	<0.5	<0.5	<0.5	<0.5

TABLE 1A
CUMULATIVE GROUNDWATER MONITORING AND SAMPLING DATA
Former Exxon Service Station 7-0235
2225 Telegraph Avenue
Oakland, California
(Page 4 of 10)

Well ID	Sampling Date	TOC (feet)	DTW (feet)	GW Elev. (feet)	SUBJ	TPHd (µg/L)	TPHg (µg/L)	TPHmo (µg/L)	MTBE 8260B (µg/L)	MTBE 8021B (µg/L)	B (µg/L)	T (µg/L)	E (µg/L)	X (µg/L)
MW6G	10/25/99	20.72	11.76	8.96	NLPH	---	---	---	---	---	---	---	---	---
MW6G	01/27/00	20.72	11.46	9.26	NLPH	---	---	---	---	---	---	---	---	---
MW6G	04/03/00	20.72	10.00	10.72	NLPH	---	---	---	---	---	---	---	---	---
MW6G	07/05/00	20.72	11.24	9.48	NLPH	---	<50	---	---	<2	<0.5	<0.5	<0.5	<0.5
MW6G	10/04/00	20.72	11.88	8.84	NLPH	---	<50	---	---	<2	<0.5	<0.5	<0.5	<0.5
MW6G	10/05/00	20.72	---	---	---	---	---	<1,000	---	---	---	---	---	---
MW6G	01/04/01	20.72	11.56	9.16	NLPH	---	<50	---	---	<2	<0.5	<0.5	<0.5	<0.5
MW6G	04/03/01	20.72	10.45	10.27	NLPH	---	<50	---	---	<2	<0.5	<0.5	<0.5	<0.5
MW6G	07/05/01	20.72	11.51	9.21	NLPH	---	<50	---	---	<2	0.75	<0.5	<0.5	<0.5
MW6G	10/03/01	20.72	11.63	9.09	NLPH	---	<50	---	---	<2	<0.5	<0.5	<0.5	<0.5
MW6G	Nov-01	20.46	Well surveyed in compliance with AB 2886 requirements.											
MW6G	01/02/02	20.46	9.15	11.31	NLPH	---	<100	---	---	1.8	<0.50	<0.50	<0.50	<0.50
MW6G	04/02/02	20.46	10.19	10.27	NLPH	---	<50.0	<100	---	1.10	<0.50	<0.50	<0.50	<0.50
MW6G	07/01/02	20.46	11.35	9.11	NLPH	---	<50	<100a	---	1.3	<0.5	<0.5	<0.5	<0.5
MW6G	10/02/02	20.46	11.99	8.47	NLPH	---	<50.0	<100	---	0.7	<0.5	<0.5	<0.5	<0.5
MW6G	01/07/03	20.46	9.97	10.49	NLPH	---	<50.0	<50	2.0	1.3	<0.5	<0.5	<0.5	<0.5
MW6G	06/17/03	20.46	10.98	9.48	NLPH	---	<50.0	<100	1.6	1.5	<0.50	<0.5	<0.5	<0.5
MW6G	07/16/03	20.46	11.37	9.09	NLPH	---	<50.0	<100	0.9	1.2	<0.50	<0.5	<0.5	<0.5
MW6G	10/07/03	20.46	11.90	8.56	NLPH	<50	<50.0	<100	0.80	0.8	<0.50	<0.5	<0.5	<0.5
MW6G	01/14/04	20.46	10.10	10.36	NLPH	<50	<50.0	<100	1.40	1.0	<0.50	<0.5	<0.5	<0.5
MW6G	06/03/04	20.46	11.10	9.36	NLPH	<50	<50.0	<100	1.4	1.40	<0.50	<0.5	<0.5	<0.5
MW6G	08/12/04	20.46	c	c	c	99c	<50.0c	101c	1.10c	---	<0.50c	<0.5c	<0.5c	<0.5c
MW6G	11/04/04	20.46	11.18	9.28	NLPH	<50	<50.0	<100	<0.50	---	<0.50	<0.5	<0.5	<0.5
MW6G	02/01/05	20.46	9.79	10.67	NLPH	<100	<50.0	<100	3.40	---	<0.50	<0.5	<0.5	<0.5
MW6G	05/03/05	20.46	9.95	10.51	NLPH	<50	<50.0	<100	1.40	---	<0.50	<0.5	<0.5	<0.5
MW6G	08/04/05	20.46	11.22	9.24	NLPH	<50.0	<50.0	<100	1.42	---	<0.500	<0.500	<0.500	<0.500
MW6G	10/27/05	20.46	11.76	8.70	NLPH	<50.0	<50.0	61.3	0.810	---	<0.50	0.93f	<0.50	<0.50
MW6G	01/26/06	20.46	11.07	9.39	NLPH	<50	<50	<500	1.8	---	<0.50	<0.50	<0.50	<0.50
MW6G	04/28/06	20.46	9.11	11.35	NLPH	<47	<50	<470	2.8	---	<0.50	<0.50	<0.50	<0.50
MW6G	07/05/06	20.46	10.70	9.76	NLPH	88.6	<50.0	277	2.49	---	<1.00	<1.00	<1.00	<3.00
MW6H	11/26/96	16.58	11.87	4.71	NLPH	---	1,200	---	---	<30	320	110	22	85
MW6H	02/27/97	16.58	11.58	5.00	NLPH	---	1,800	---	---	<200	760	31	8.4	44
MW6H	05/21/97	16.58	12.23	4.35	NLPH	---	1,100	---	---	81	640	18	5.4	45
MW6H	08/18/97	16.58	12.29	4.29	NLPH	---	870	---	---	26	200	3.6	2.4	7.4
MW6H	03/13/98	20.47	11.44	9.03	NLPH	---	5,300	---	---	<125	1,900	720	100	470
MW6H	04/20/98	20.47	11.58	8.89	NLPH	---	6,000	---	---	2,700	1,500	600	91	440
MW6H	07/21/98	20.47	11.97	8.50	NLPH	---	2,200	---	---	1,600	740	44	15	63
MW6H	10/06/98	20.47	12.23	8.24	NLPH	---	5,400	---	---	3,000	1,900	<25	<25	76
MW6H	01/11/99	20.47	12.17	8.30	NLPH	---	2,600	---	---	4,300	1,200	<12	<12	20
MW6H	04/08/99	20.47	11.56	8.91	NLPH	---	13,000	---	---	13,000	3,400	1,300	260	1,200
MW6H	07/19/99	20.47	11.71	8.76	NLPH	---	<2,000	---	8,520	6,920	732	<20	<20	<20
MW6H	07/27/99	20.47	12.39	8.08	NLPH	---	---	---	---	---	---	---	---	---
MW6H	10/25/99	20.47	12.16	8.31	NLPH	---	700	---	---	4,000	360	1.1	0.68	2
MW6H	01/27/00	20.47	11.60	8.87	NLPH	---	9,100	---	---	7,600	2,400	840	150	670
MW6H	04/03/00	20.47	11.62	8.85	NLPH	---	12,000	---	---	8,800	2,800	1,100	230	1,020

TABLE 1A
CUMULATIVE GROUNDWATER MONITORING AND SAMPLING DATA
Former Exxon Service Station 7-0235
2225 Telegraph Avenue
Oakland, California
(Page 5 of 10)

Well ID	Sampling Date	TOC (feet)	DTW (feet)	GW Elev. (feet)	SUBJ	TPHd (µg/L)	TPHg (µg/L)	TPHmo (µg/L)	MTBE 8260B (µg/L)	MTBE 8021B (µg/L)	B (µg/L)	T (µg/L)	E (µg/L)	X (µg/L)
MW6H	07/05/00	20.47	11.93	8.54	NLPH	---	12,000	---	---	8,000	1,200	56	13	92
MW6H	10/04/00	20.47	12.16	8.31	NLPH	---	4,400	---	---	8,400	1,500	23	12	80.6
MW6H	10/05/00	20.47	---	---	---	---	---	<1,000	---	---	---	---	---	---
MW6H	01/04/01	20.47	12.03	8.44	NLPH	---	2,300	---	---	3,800	880	15	6.4	33.9
MW6H	04/03/01	20.47	11.73	8.74	NLPH	---	7,800	---	---	5,100	2,000	730	140	590
MW6H	07/05/01	20.47	11.98	8.49	NLPH	---	2,300	---	---	3,200	630	25	10	40.8
MW6H	10/03/01	20.47	12.1	8.37	NLPH	---	1,400	---	---	550	270	5.6	4.2	11.6
MW6H	Nov-01	20.20	Well surveyed in compliance with AB 2886 requirements.											
MW6H	01/02/02	20.20	11.14	9.06	NLPH	---	47,100	---	---	4,260	7,880	5,220	1,060	4,460
MW6H	04/02/02	20.20	11.68	8.52	NLPH	---	17,500	<500	---	1,590	2,280	1,290	282	1,090
MW6H	07/01/02	20.20	11.97	8.23	NLPH	---	5,370	<100a	---	1,910	1,170	200	44.0	158
MW6H	10/02/02	20.20	12.20	8.00	NLPH	---	2,570	<100	---	899	655	13.0	8.0	25.0
MW6H	01/07/03	20.20	11.58	8.62	NLPH	---	12,500	<50	2,500	1,700	2,480	1,340	250	1,120
MW6H	06/17/03	20.20	11.82	8.38	NLPH	---	6,330	<100	1,660	1,490	604	104	44.0	152
MW6H	07/16/03	20.20	12.89	7.31	NLPH	---	3,170	<100	1,170	1,270	614	20.0	9.5	31.8
MW6H	10/07/03	20.20	12.10	8.10	NLPH	---	2,090	<100	640	612	433	11.6	6.7	22.5
MW6H	01/14/04	20.20	11.55	8.65	NLPH	390	6,320	<100	1,250	59.0	1,340	517	117	515
MW6H	06/03/04	20.20	11.92	8.28	NLPH	---	3,330	<100	632	604	546	128	38.4	140
MW6H	08/12/04	20.20	c	c	c	174c	1,920c	<100c	426c	---	330c	17.9c	9.3c	35.3c
MW6H	11/04/04	20.20	11.86	8.34	NLPH	578	8,090	552	442	---	1,280	620	185	822
MW6H	02/01/05	20.20	11.55	8.65	NLPH	616	9,500	193	335	---	1,360	764	214	844
MW6H	05/03/05	20.20	11.54	8.66	NLPH	560d	9,120	168	323	---	1,320	886	245	928
MW6H	08/04/05	20.20	11.89	8.31	NLPH	269d	1,810	143	268	---	349	57.0	20.1	70.0
MW6H	10/27/05	20.20	12.10	8.10	NLPH	228	942	98.5	164	---	154	23.1f	6.09	23.2
MW6H	01/26/06	20.20	11.54	8.66	NLPH	910d	20,000	<500	270	---	3,200	3,400	660	3,100
MW6H	04/28/06	20.20	11.29	8.91	NLPH	550d	11,000	<470	160	---	2,000	1,500	380	1,600
MW6H	07/05/06	20.20	11.90	8.30	NLPH	273	2,360	114	62.9	---	389	111	39.5	125
MW6I	11/26/96	16.26	12.45	3.81	NLPH	---	<50	---	---	<30	<0.5	<0.5	<0.5	<0.5
MW6I	02/27/97	16.26	12.24	4.02	NLPH	---	<50	---	---	<30	<0.5	<0.5	<0.5	<0.5
MW6I	05/21/97	16.26	12.82	3.44	NLPH	---	<50	---	---	<30	<0.5	<0.5	<0.5	<0.5
MW6I	08/18/97	16.26	12.81	3.45	NLPH	---	<50	---	---	<30	<0.5	<0.5	<0.5	<0.5
MW6I	03/13/98	16.26	---	---	---	---	---	---	---	---	---	---	---	---
MW6I	04/20/98	16.26	12.14	4.12	NLPH	---	<50	---	---	<2.5	<0.5	<0.5	<0.5	<0.5
MW6I	07/21/98	20.24	12.59	7.65	NLPH	---	<50	---	---	<2.5	<0.5	<0.5	<0.5	<0.5
MW6I	10/06/98	20.24	12.81	7.43	NLPH	---	---	---	---	---	---	---	---	---
MW6I	01/11/99	20.24	12.74	7.50	NLPH	---	<50	---	---	<2.5	<0.5	<0.5	<0.5	<0.5
MW6I	04/08/99	20.24	11.93	8.31	NLPH	---	---	---	---	---	---	---	---	---
MW6I	07/19/99	20.24	11.75	8.49	NLPH	---	281	---	---	17.6	35.4	9.1	7.4	30.7
MW6I	07/27/99	20.24	12.95	7.29	NLPH	---	---	---	---	---	---	---	---	---
MW6I	10/25/99	20.24	12.79	7.45	NLPH	---	---	---	---	---	---	---	---	---
MW6I	01/27/00	20.24	12.06	8.18	NLPH	---	<50	---	---	<2	<0.5	<0.5	<0.5	<0.5
MW6I	04/03/00	20.24	12.24	8.00	NLPH	---	---	---	---	---	---	---	---	---
MW6I	07/05/00	20.24	12.48	7.76	NLPH	---	<50	---	---	<2	<0.5	<0.5	<0.5	<0.5
MW6I	10/04/00	20.24	---	---	---	---	---	---	---	---	---	---	---	---
MW6I	10/05/00	20.24	---	---	---	---	---	<1,000	---	---	---	---	---	---

TABLE 1A
CUMULATIVE GROUNDWATER MONITORING AND SAMPLING DATA
Former Exxon Service Station 7-0235
2225 Telegraph Avenue
Oakland, California
(Page 6 of 10)

Well ID	Sampling Date	TOC (feet)	DTW (feet)	GW Elev. (feet)	SUBJ	TPHd (µg/L)	TPHg (µg/L)	TPHmo (µg/L)	MTBE 8260B (µg/L)	MTBE 8021B (µg/L)	B (µg/L)	T (µg/L)	E (µg/L)	X (µg/L)
MW6I	01/04/01	20.24	12.54	7.70	NLPH	---	<50	---	---	<2	<0.5	<0.5	<0.5	<0.5
MW6I	04/03/01	20.24	12.32	7.92	NLPH	---	<50	---	---	<2	<0.5	<0.5	<0.5	<0.5
MW6I	07/05/01	20.24	12.55	7.69	NLPH	---	<50	---	---	<2	<0.5	<0.5	<0.5	<0.5
MW6I	10/03/01	20.24	12.67	7.57	NLPH	---	<50	---	---	<2	<0.5	<0.5	<0.5	<0.5
MW6I	Nov-01	19.87	Well surveyed in compliance with AB 2886 requirements.											
MW6I	01/02/02	19.87	10.98	8.89	NLPH	---	<100	---	---	<0.5	<0.50	<0.50	<0.50	<0.50
MW6I	04/02/02 b	19.87	12.24	7.63	NLPH	---	---	---	---	---	---	---	---	---
MW6I	07/01/02	19.87	12.51	7.36	NLPH	---	<50	<100a	---	<0.5	<0.5	<0.5	<0.5	<0.5
MW6I	10/02/02 b	19.87	12.72	7.15	NLPH	---	---	---	---	---	---	---	---	---
MW6I	01/07/03	19.87	12.09	7.78	NLPH	---	<50.0	<50	1.10	<0.5	<0.5	<0.5	<0.5	<0.5
MW6I	06/17/03 b	19.87	---	---	---	---	---	---	---	---	---	---	---	---
MW6I	07/16/03	19.87	12.49	7.38	NLPH	---	<50.0	<100	<0.50	<0.5	<0.50	<0.5	<0.5	<0.5
MW6I	10/07/03 b	19.87	12.64	7.23	NLPH	---	---	---	---	---	---	---	---	---
MW6I	01/14/04	19.87	12.13	7.74	NLPH	---	<50.0	<100	<0.50	<0.5	<0.50	<0.5	<0.5	<0.5
MW6I	06/03/04 b	19.87	12.56	7.31	NLPH	---	---	---	---	---	---	---	---	---
MW6I	08/12/04	19.87	c	c	c	99c	<50.0c	155c	<0.50c	---	<0.50c	<0.5c	<0.5c	0.8c
MW6I	11/04/04 b	19.87	12.33	7.54	NLPH	---	---	---	---	---	---	---	---	---
MW6I	02/01/05	19.87	12.09	7.78	NLPH	<100	<50.0	<100	<0.50	---	<0.50	<0.5	<0.5	<0.5
MW6I	05/03/05 b	19.87	12.16	7.71	NLPH	---	---	---	---	---	---	---	---	---
MW6I	08/04/05	19.87	12.46	7.41	NLPH	54.2d	<50.0	<100	<0.500	---	<0.500	<0.500	<0.500	<0.500
MW6I	10/27/05 b	19.87	12.58	7.29	NLPH	---	---	---	---	---	---	---	---	---
MW6I	01/26/06	19.87	12.04	7.83	NLPH	<50	<50	<500	<0.50	---	<0.50	<0.50	<0.50	<0.50
MW6I	04/28/06 b	19.87	11.94	7.93	NLPH	---	---	---	---	---	---	---	---	---
MW6I	07/05/06	19.87	13.06	6.81	NLPH	<47.6	<50.0	<95.2	<0.500	---	<1.00	<1.00	<1.00	<3.00
MW6J	07/05/01	20.72	13.47	7.25	NLPH	---	<50	---	---	<2	<0.5	<0.5	<0.5	<0.5
MW6J	10/03/01	20.72	13.57	7.15	NLPH	---	<50	---	---	<2	<0.5	<0.5	<0.5	<0.5
MW6J	Nov-01	20.75	Well surveyed in compliance with AB 2886 requirements.											
MW6J	01/02/02	20.75	13.19	7.56	NLPH	---	<100	---	---	<0.5	<0.50	<0.50	<0.50	<0.50
MW6J	04/02/02	20.75	13.74	7.01	NLPH	---	<50.0	<100	---	1.00	0.80	<0.50	<0.50	0.80
MW6J	07/01/02	20.75	13.58	7.17	NLPH	---	<50	<100a	---	<0.5	<0.5	<0.5	<0.5	<0.5
MW6J	10/02/02	20.75	13.79	6.96	NLPH	---	<50.0	<100	---	<0.5	<0.5	<0.5	<0.5	<0.5
MW6J	01/07/03	20.75	13.49	7.26	NLPH	---	<50.0	<50	1.30	0.60	<0.5	<0.5	<0.5	<0.5
MW6J	06/17/03	20.75	13.76	6.99	NLPH	---	<50.0	<100	0.70	3.00	<0.50	<0.5	<0.5	<0.5
MW6J	07/16/03	20.75	13.57	7.18	NLPH	---	<50.0	<100	0.60	0.70	<0.50	<0.5	<0.5	<0.5
MW6J	10/07/03	20.75	13.74	7.01	NLPH	---	<50.0	<100	1.20	1.1	<0.50	<0.5	<0.5	<0.5
MW6J	01/14/04	20.75	13.46	7.29	NLPH	<50	<50.0	<100	1.80	1.8	<0.50	<0.5	<0.5	<0.5
MW6J	06/03/04	20.75	13.72	7.03	NLPH	<50	<50.0	<100	10.3	5.1	0.50	<0.5	<0.5	<0.5
MW6J	08/12/04	20.75	c	c	c	<50c	<50.0c	<100c	3.30c	---	1.40c	2.1c	1.3c	4.6c
MW6J	11/04/04	20.75	13.68	7.07	NLPH	<50	<50.0	116	3.50	---	0.50	0.5	<0.5	<0.5
MW6J	02/01/05	20.75	13.47	7.28	NLPH	<100	<50.0	<100	5.50	---	<0.50	<0.5	<0.5	0.6
MW6J	05/03/05	20.75	13.66	7.09	NLPH	<50	<50.0	<100	3.00	---	0.70	0.9	0.6	0.8
MW6J	08/04/05	20.75	13.75	7.00	NLPH	55.8d	<50.0	130	<0.500	---	<0.500	<0.500	<0.500	<0.500
MW6J	10/27/05	20.75	13.71	7.04	NLPH	<50.0	<50.0	<50.0	2.48	---	<0.50	0.94f	<0.50	<0.50
MW6J	01/26/06	20.75	13.49	7.26	NLPH	<50	<50	<500	6.2	---	<0.50	<0.50	<0.50	<0.50
MW6J	04/28/06	20.75	13.56	7.19	NLPH	<47	<50	<470	7.2	---	<0.50	<0.50	<0.50	<0.50
MW6J	07/05/06	20.75	13.75	7.00	NLPH	<47.6	<50.0	<95.2	7.73	---	<1.00	<1.00	<1.00	<3.00

TABLE 1A
CUMULATIVE GROUNDWATER MONITORING AND SAMPLING DATA
Former Exxon Service Station 7-0235
2225 Telegraph Avenue
Oakland, California
(Page 7 of 10)

Well ID	Sampling Date	TOC (feet)	DTW (feet)	GW Elev. (feet)	SUBJ	TPHd (µg/L)	TPHg (µg/L)	TPHmo (µg/L)	MTBE 8260B (µg/L)	MTBE 8021B (µg/L)	B (µg/L)	T (µg/L)	E (µg/L)	X (µg/L)
RW1	Not Monitored 06/16/92 through 10/06/98.													
RW1	01/11/99	20.24	12.37	7.87	NLPH	---	---	---	---	---	---	---	---	---
RW1	04/08/99	20.24	10.41	9.83	NLPH	---	---	---	---	---	---	---	---	---
RW1	07/19/99	20.24	---	---	---	---	---	---	---	---	---	---	---	---
RW1	07/27/99	20.24	12.76	7.48	NLPH	---	---	---	---	---	---	---	---	---
RW1	10/25/99	20.24	12.50	7.74	NLPH	---	---	---	---	---	---	---	---	---
RW1	01/27/00	20.24	12.11	8.13	NLPH	---	---	---	---	---	---	---	---	---
RW1	04/03/00	20.24	12.07	8.17	NLPH	---	---	---	---	---	---	---	---	---
RW1	07/05/00	20.24	---	---	---	---	---	---	---	---	---	---	---	---
RW1	10/04/00	20.24	---	---	---	---	---	---	---	---	---	---	---	---
RW1	10/05/00	20.24	---	---	---	---	---	---	---	---	---	---	---	---
RW1	01/04/01	20.24	13.90	6.34	NLPH	---	8,000	---	---	2,500	1,200	65	250	258
RW1	04/03/01	20.24	11.92	8.32	NLPH	---	4,100	---	---	610	62	<2.5	18	61
RW1	07/05/01	20.24	Well inaccessible.											
RW1	10/03/01	20.24	12.32	8.32	NLPH	---	11,000	---	---	4,100	1,900	780	150	700
RW1	Nov-01	20.43	Well surveyed in compliance with AB 2886 requirements.											
RW1	01/02/02	20.43	10.85	9.58	NLPH	---	32,000	---	---	7,760	358	2,270	894	4,820
RW1	04/02/02	20.43	11.72	8.71	NLPH	---	4,220	<500	---	922	172	22.5	106	340
RW1	07/01/02	20.43	12.17	8.26	NLPH	---	2,500	<100a	---	986	176	8.0	71.0	75.0
RW1	10/02/02	20.43	12.44	7.99	NLPH	---	2,970	1,720	---	1,310	197	11.0	70.0	69.0
RW1	01/07/03	20.43	11.64	8.79	NLPH	---	2,210	1,340	1,010	747	134	12.0	33.0	53.0
RW1	06/17/03	20.43	11.98	8.45	NLPH	---	3,850	316	847	645	48.9	38.7	46.1	197
RW1	07/16/03	20.43	12.11	8.32	NLPH	---	2,640	2,080	615	730	78.5	20.0	47.5	166
RW1	10/07/03	20.43	12.35	8.08	NLPH	1,340	2,310	1,040	578	744	118	7.6	25.1	52.1
RW1	01/14/04	20.43	11.61	8.82	NLPH	4,240	4,230	5,640	328	7.8	52.7	65.8	42.7	543
RW1	06/03/04	20.43	12.12	8.31	NLPH	---	2,910	1,840	250	234	79.9	6.0	28.6	67.2
RW1	08/12/04	20.43	c	c	c	---	1,980c	164c	107c	---	146c	5.7c	18.1c	10.9c
RW1	11/04/04	20.43	12.06	8.37	NLPH	2,570	127,000	1,790	386	---	130	5,150	4,020	24,300
RW1	02/01/05	20.43	11.55	8.88	NLPH	3,530	2,880	4,680	78.7	---	25.3	13.3	49.3	258
RW1	05/03/05	20.43	11.58	8.85	NLPH	6,830d,e	2,490	14,600	91.3	---	33.8	18.4	17.3	97.7
RW1	08/04/05	20.43	12.10	8.33	NLPH	2,430d	3,080	3,410	49.6	---	193	20.4	48.2	117
RW1	10/27/05	20.43	12.32	8.11	NLPH	1,970	348	2,960	36.3	---	9.40	1.99f	2.22	5.36
RW1	01/26/06	20.43	11.55	8.88	NLPH	5,000d	640	<10,000	72	---	13	7.5	1.8	5.2
RW1	04/28/06	20.43	11.23	9.20	NLPH	950d	810	1,500	30	---	18	12	4.9	19
RW1	07/05/06	20.43	11.96	8.47	NLPH	687	1,020	886	40.0	---	25.0	4.77	4.67	11.4
RW2	Not Monitored 06/16/92 through 04/20/98.													
RW2	07/21/98	20.44	12.65	7.79	NLPH	---	3,500	---	---	170	240	100	41	96
RW2	10/06/98	20.44	13.06	7.38	NLPH	---	3,200	---	---	200	120	48	56	120
RW2	01/11/99	20.44	12.88	7.56	NLPH	---	3,300	---	---	350	150	17	35	40
RW2	04/08/99	20.44	11.76	8.68	sheen	---	---	---	---	---	---	---	---	---
RW2	07/19/99	20.44	11.61	8.83	NLPH	---	1,980	---	499	160	44	4.16	22.3	11.6
RW2	07/27/99	20.44	13.26	7.18	NLPH	---	---	---	---	---	---	---	---	---
RW2	10/25/99	20.44	12.96	7.48	NLPH	---	1,800	---	---	440	51	<0.5	4.7	9.5
RW2	01/27/00	20.44	12.70	7.74	NLPH	---	1,900	---	---	750	38	<2.5	4.8	10.4

TABLE 1A
CUMULATIVE GROUNDWATER MONITORING AND SAMPLING DATA
Former Exxon Service Station 7-0235
2225 Telegraph Avenue
Oakland, California
(Page 8 of 10)

Well ID	Sampling Date	TOC (feet)	DTW (feet)	GW Elev. (feet)	SUBJ	TPHd (µg/L)	TPHg (µg/L)	TPHmo (µg/L)	MTBE 8260B (µg/L)	MTBE 8021B (µg/L)	B (µg/L)	T (µg/L)	E (µg/L)	X (µg/L)
RW2	04/03/00	20.44	11.97	8.47	NLPH	---	2,100	---	---	300	28	2.4	1.4	0.73
RW2	07/05/00	20.44	12.50	7.94	NLPH	---	2,300	---	---	230	20	<2.5	5.3	8
RW2	10/04/00	20.44	12.97	7.47	NLPH	---	1,300	---	---	570	42	<2.5	15	17.7
RW2	10/05/00	20.44	---	---	---	---	---	<1,000	---	---	---	---	---	---
RW2	01/04/01	20.44	13.71	6.73	NLPH	---	1,000	---	---	380	33	<2.5	13	17.7
RW2	04/03/01	20.44	12.10	8.34	NLPH	---	1,300	---	---	99	18	2.1	16	19.4
RW2	07/05/01	20.44	Not sampled: inaccessible.			---	---	---	---	---	---	---	---	---
RW2	10/03/01	20.44	12.8	7.64	NLPH	---	1,900	---	---	240	35	4.4	34	105
RW2	Nov-01	20.64	Well surveyed in compliance with AB 2886 requirements.			---	---	---	---	---	---	---	---	---
RW2	01/02/02	20.64	10.22	10.42	NLPH	---	2,440	---	---	76.0	24.4	6.20	26.2	83.0
RW2	04/02/02	20.64	12.02	8.62	NLPH	---	1,460	260	---	47.5	8.60	3.30	5.30	29.1
RW2	07/01/02	20.64	12.51	8.13	NLPH	---	1,380	<100a	---	39.9	11.0	1.8	17.9	45.0
RW2	10/02/02	20.64	12.91	7.73	NLPH	---	720	<100	---	46.9	5.5	1.7	3.7	11.9
RW2	01/07/03	20.64	11.61	9.03	NLPH	---	1,180	197	56.0	48.0	12.3	3.6	12.2	25.6
RW2	06/17/03	20.64	12.32	8.32	NLPH	---	1,070	<100	26.4	29.7	13.9	4.4	11.8	16.9
RW2	07/16/03	20.64	12.51	8.13	NLPH	---	1,200	295	19.3	32.9	6.60	4.1	10.9	12.3
RW2	10/07/03	20.64	12.81	7.83	NLPH	332	1,170	<100	50.2	55.0	8.70	1.1	9.3	12.2
RW2	01/14/04	20.64	11.70	8.94	NLPH	167	1,250	<100	128	8.4	18.0	4.4	8.6	10.7
RW2	06/03/04	20.64	12.93	7.71	NLPH	---	1,100	1,310	10.9	17.0	6.70	1.3	4.0	11.5
RW2	08/12/04	20.64	c	c	c	438c	1,110c	521c	32.8c	---	7.00c	1.5c	3.1c	10.2c
RW2	11/04/04	20.64	12.30	8.34	NLPH	503	506	419	r	---	4.30	5.9	6.2	16.0
RW2	02/01/05	20.64	11.61	9.03	NLPH	725	640	1,400	13.7	---	5.30	1.5	4.0	3.8
RW2	05/03/05	20.64	11.72	8.92	NLPH	493d,e	1,130	801	8.20	---	10.3	1.1	5.8	6.3
RW2	08/04/05	20.64	12.46	8.18	NLPH	3,020d	1,060	3,810	9.02	---	6.36	0.848	1.90	2.47
RW2	10/27/05	20.64	12.71	7.93	NLPH	716	163	703	8.74	---	<0.50	<0.50	<0.50	0.95
RW2	01/26/06	20.64	11.65	8.99	NLPH	410d	620a	<500	5.1	---	6.1a	1.2a	4.3a	2.1a
RW2	04/28/06	20.64	11.24	9.40	NLPH	300d	680	<470	2.6	---	9.7	1.2	5.3	2.9
RW2	07/05/06	20.64	12.33	8.31	NLPH	284	946	221	<0.500	---	8.87	1.05	1.81	3.10
RW3A	Not monitored 06/16/92 through 04/20/98.													
RW3A	07/21/98	21.75	13.08	8.67	NLPH	---	280	---	---	16	97	<1.2	<1.2	<1.2
RW3A	10/06/98	21.89	13.72	8.17	NLPH	---	78	---	---	26	26	0.89	<0.5	<0.5
RW3A	01/11/99	21.75	12.00	9.75	NLPH	---	1,000	---	---	230	490	5.0	<5.0	7.4
RW3A	04/08/99	21.75	11.90	9.85	NLPH	---	130	---	---	11	70	<1.0	<1.0	<1.0
RW3A	07/19/99	21.75	11.75	10.00	NLPH	---	989	---	---	16.4	393	6.40	5.70	15.0
RW3A	07/27/99	21.75	13.68	8.07	NLPH	---	---	---	---	---	---	---	---	---
RW3A	10/25/99	21.75	13.61	8.14	NLPH	---	150	---	---	19	53	<0.5	<0.5	<0.5
RW3A	01/27/00	21.75	12.22	9.53	NLPH	---	500	---	---	12	210	0.59	1.40	2.29
RW3A	04/03/00	21.75	12.00	9.75	NLPH	---	1,100	---	---	16	420	1.6	1.8	1.4
RW3A	07/05/00	21.75	13.01	8.74	NLPH	---	1,200	---	---	16	440	1.4	2.5	1.9
RW3A	10/04/00	21.75	13.60	8.15	NLPH	---	390	---	---	8.3	160	1.1	1.5	2.6
RW3A	10/05/00	21.75	---	---	---	---	---	<1,000	---	---	---	---	---	---
RW3A	01/04/01	21.75	13.65	8.10	NLPH	---	500	---	---	12	230	0.97	1.1	1.4
RW3A	04/03/01	21.75	12.30	9.45	NLPH	---	710	---	---	7.5	290	<0.5	<0.5	<0.5
RW3A	07/05/01	21.75	13.28	8.47	NLPH	---	640	---	---	9	280	1.4	1.6	2.7
RW3A	10/03/01	21.75	13.58	8.17	NLPH	---	<50	---	---	12	21	<0.5	<0.5	<0.5

TABLE 1A
CUMULATIVE GROUNDWATER MONITORING AND SAMPLING DATA
Former Exxon Service Station 7-0235
2225 Telegraph Avenue
Oakland, California
(Page 9 of 10)

Well ID	Sampling Date	TOC (feet)	DTW (feet)	GW Elev. (feet)	SUBJ	TPHd (µg/L)	TPHg (µg/L)	TPHmo (µg/L)	MTBE 8260B (µg/L)	MTBE 8021B (µg/L)	B (µg/L)	T (µg/L)	E (µg/L)	X (µg/L)	
RW3A	Nov-01	21.89	Well surveyed in compliance with AB 2886 requirements.												
RW3A	01/02/02	21.89	10.80	11.09	NLPH	---	<100	---	---	11.2	<0.50	<0.50	<0.50	<0.50	
RW3A	04/02/02	21.89	12.03	9.86	NLPH	---	55.7	<100	---	11.0	1.30	<0.50	<0.50	<0.50	
RW3A	07/01/02	21.89	13.13	8.76	NLPH	---	275	<100a	---	21.7	60.4	<0.5	2.4	4.2	
RW3A	10/02/02	21.89	13.70	8.19	NLPH	---	138	114	---	11.1	53.4	<0.5	<0.5	0.7	
RW3A	01/07/03	21.89	11.77	10.12	NLPH	---	<50.0	<50	30.9	22.4	1.5	<0.5	<0.5	<0.5	
RW3A	06/17/03	21.89	12.82	9.07	NLPH	---	54.5	<100	16.0	12.8	7.40	<0.5	<0.5	<0.5	
RW3A	07/16/03	21.89	13.40	8.49	NLPH	---	112	<100	13.6	18.0	26.0	<0.5	<0.5	<0.5	
RW3A	10/07/03	21.89	13.93	7.96	NLPH	124	62.6	<100	11.3	10.4	7.30	<0.5	<0.5	<0.5	
RW3A	01/14/04	21.89	11.55	10.34	NLPH	401	<50.0	<100	16.2	11.7	3.10	<0.5	<0.5	<0.5	
RW3A	06/03/04	21.89	13.43	8.46	NLPH	---	79.0	<100	22.4	19.4	6.30	<0.5	<0.5	<0.5	
RW3A	08/12/04	21.89	c	c	c	1,190c	<50.0c	296c	16.2c	---	<0.50c	<0.5c	<0.5c	<0.5c	
RW3A	11/04/04	21.89	12.91	8.98	NLPH	178	<50.0	122	5.40	---	<0.50	1.7	0.7	3.6	
RW3A	02/01/05	21.89	11.63	10.26	NLPH	<100	<50.0	<100	11.8	---	<0.50	<0.5	<0.5	<0.5	
RW3A	05/03/05	21.89	11.79	10.10	NLPH	158d	<50.0	<100	8.50	---	<0.50	<0.5	<0.5	<0.5	
RW3A	08/04/05	21.89	12.99	8.90	NLPH	667d	89.9	107	16.7	---	26.0	0.645	<0.500	0.835	
RW3A	10/27/05	21.89	13.49	8.40	NLPH	140	<50.0	79.1	4.00	---	9.63	<0.50	<0.50	0.65	
RW3A	01/26/06	21.89	11.76	10.13	NLPH	210d	100a	<500	17	---	5.6a	<0.50a	<0.50a	<0.50a	
RW3A	04/28/06	21.89	10.96	10.93	NLPH	140g	82	<470	19	---	2.6	<0.50	<0.50	<0.50	
RW3A	07/05/06	21.89	13.12	8.77	NLPH	340	50.0	<95.2	8.11	---	1.37	<1.00	<1.00	<3.00	

TABLE 1A
CUMULATIVE GROUNDWATER MONITORING AND SAMPLING DATA
Former Exxon Service Station 7-0235
2225 Telegraph Avenue
Oakland, California
(Page 10 of 10)

Notes:

TOC	=	Top of casing elevation; datum is mean sea level.
SUBJ	=	Results of subjective evaluation.
NLPH	=	No liquid-phase hydrocarbons present in well.
sheen	=	Liquid-phase hydrocarbon present as sheen.
DTW	=	Depth to water.
GW Elev.	=	Groundwater elevation; datum is mean sea level.
TPHd	=	Total petroleum hydrocarbons as diesel analyzed using EPA Method 5030/8015 (modified).
TPHg	=	Total petroleum hydrocarbons as gasoline analyzed using EPA Method 5030/8015 (modified).
MTBE 8260B	=	Methyl tertiary butyl ether analyzed using EPA Method 8260B.
MTBE 8021B	=	Methyl tertiary butyl ether analyzed using EPA Method 8021B.
BTEX	=	Benzene, toluene, ethylbenzene, and total xylenes analyzed using EPA Method 8021B.
TPHmo	=	Total petroleum hydrocarbons as motor oil using EPA Method 8015B.
ETBE	=	Ethyl tertiary butyl ether analyzed using EPA Method 8260B.
TAME	=	Tertiary amyl methyl ether analyzed using EPA Method 8260B.
TBA	=	Tertiary butyl alcohol analyzed using EPA Method 8260B.
EDB	=	1,2-dibromoethane analyzed using EPA Method 8260B.
1,2-DCA	=	1,2-dichloroethane analyzed using EPA Method 8260B.
DIPE	=	Di-isopropyl ether analyzed using EPA Method 8260B.
Ethanol	=	Ethanol analyzed using EPA Method 8260B.
µg/L	=	Micrograms per liter.
<	=	Less than the indicated reporting limit shown by the laboratory.
---	=	Not measured/Not sampled.
a	=	Analyses performed past EPA recommended holding time.
b	=	Well sampled semi-annually.
c	=	Groundwater elevation data invalidated; analytical results suspect.
d	=	TPH-diesel result was not consistent with diesel.
e	=	TRPH-diesel surrogate was diluted out due to sample matrix
f	=	Analyte detected in Matrix Spike and Matrix Spike Duplicate.
g	=	Elevated result due to single analyte peak in quantitation range.
h	=	Initial analysis within EPA recommended hold time. Re-analysis for dilution performed past hold time.

TABLE 1B
ADDITIONAL CUMMULATIVE GROUNDWATER MONITORING AND SAMPLING DATA
Former Exxon Service Station 7-0235
2225 Telegraph Avenue
Oakland, California
(Page 1 of 5)

Well ID	Sampling Date	ETBE (µg/L)	TAME (µg/L)	TBA (µg/L)	EDB (µg/L)	1,2-DCA (µg/L)	DIPE (µg/L)	Ethanol (µg/L)
MW6B	01/07/03	<0.50	<0.50	<10.0	<0.50	<0.50	<0.50	---
MW6B	06/17/03	<0.50	<0.50	<10.0	<0.50	<0.50	<0.50	<100
MW6B	07/16/03	<0.50	<0.50	<10.0	<0.50	<0.50	<0.50	<100
MW6B	10/07/03	<0.50	<0.50	<10.0	<0.50	<0.50	<0.50	<100
MW6B	01/14/04	<0.50	<0.50	<10.0	<0.50	<0.50	<0.50	<50.0
MW6B	06/03/04	<0.50	<0.50	<10.0	<0.50	<0.50	<0.50	<50.0
MW6B	08/12/04	<0.50c	<0.50c	<10.0c	<0.50c	<0.50c	<0.50c	<50.0c
MW6B	11/04/04	<0.50	<0.50	<10.0	<0.50	<0.50	<0.50	<50.0
MW6B	02/01/05	<0.50	<0.50	<10.0	<0.50	<0.50	<0.50	<50.0
MW6B	05/03/05	<0.50	<0.50	<10.0	<0.50	<0.50	<0.50	<50.0
MW6B	08/04/05	<0.500	<0.500	<10.0	<0.500	<0.500	<0.500	<50.0
MW6B	10/27/05	<0.500	<0.500	<20.0	<0.500	<0.500	<0.500	<100
MW6B	01/26/06	<0.50	0.56	<20	<0.50	<0.50	<0.50	<100
MW6B	04/28/06	<0.50	<0.50	27	<0.50	15	3.6	---
MW6B	07/05/06	<0.500	<0.500	<10.0	<0.500	<0.500	<0.500	<50.0
MW6E	01/07/03	<0.50	<0.50	<10.0	<0.50	<0.50	<0.50	--
MW6E	06/17/03	<0.50	<0.50	<10.0	<0.50	<0.50	<0.50	<100
MW6E	07/16/03	<0.50	<0.50	<10.0	<0.50	<0.50	<0.50	<100
MW6E	10/07/03	<0.50	<0.50	<10.0	<0.50	<0.50	<0.50	<100
MW6E	01/14/04	<0.50	<0.50	<10.0	<0.50	<0.50	<0.50	<50.0
MW6E	06/03/04	<0.50	<0.50	<10.0	<0.50	<0.50	<0.50	<50.0
MW6E	08/12/04	<0.50c	<0.50c	<10.0c	<0.50c	<0.50c	<0.50c	<50.0c
MW6E	11/04/04	<0.50	<0.50	<10.0	<0.50	<0.50	<0.50	<50.0
MW6E	02/01/05	<0.50	<0.50	<10.0	<0.50	<0.50	<0.50	<50.0
MW6E	05/03/05	<0.50	<0.50	<10.0	<0.50	<0.50	<0.50	<50.0
MW6E	08/04/05	<0.500	<0.500	<10.0	<0.500	<0.500	<0.500	<50.0
MW6E	10/27/05	<0.500	<0.500	<20.0	<0.500	<0.500	<0.500	<100
MW6E	01/26/06	<0.50	<0.50	<20	<0.50	<0.50	<0.50	<100
MW6E	04/28/06	<0.50	<0.50	<20	<0.50	<0.50	<0.50	---
MW6E	07/05/06	<0.500	<0.500	<10.0	<0.500	<0.500	<0.500	<50.0
MW6F	01/07/03	<0.50	<0.50	<10.0	<0.50	<0.50	<0.50	---
MW6F	06/17/03	<0.50	<0.50	<10.0	<0.50	<0.50	<0.50	<100
MW6F	07/16/03	<0.50	<0.50	<10.0	<0.50	<0.50	<0.50	<100
MW6F	10/07/03	<0.50	<0.50	<10.0	<0.50	<0.50	<0.50	<100
MW6F	01/14/04	<0.50	<0.50	<10.0	<0.50	<0.50	<0.50	<50.0
MW6F	06/03/04	<0.50	<0.50	<10.0	<0.50	<0.50	<0.50	<50.0
MW6F	08/12/04	<0.50c	<0.50c	<10.0c	<0.50c	<0.50c	<0.50c	<50.0c
MW6F	11/04/04	<0.50	<0.50	<10.0	<0.50	<0.50	<0.50	<50.0
MW6F	02/01/05	<0.50	<0.50	<10.0	<0.50	<0.50	<0.50	<50.0
MW6F	05/03/05	<0.50	0.90	<10.0	<0.50	1.70	<0.50	<50.0
MW6F	08/04/05	<0.500	<0.500	<10.0	<0.500	<0.500	<0.500	<50.0
MW6F	10/27/05	<0.500	<0.500	<20.0	<0.500	<0.500	<0.500	<100
MW6F	01/26/06	<0.50	<0.50	<20	<0.50	<0.50	<0.50	<100

TABLE 1B
ADDITIONAL CUMMULATIVE GROUNDWATER MONITORING AND SAMPLING DATA
Former Exxon Service Station 7-0235
2225 Telegraph Avenue
Oakland, California
(Page 3 of 5)

Well ID	Sampling Date	ETBE (µg/L)	TAME (µg/L)	TBA (µg/L)	EDB (µg/L)	1,2-DCA (µg/L)	DIPE (µg/L)	Ethanol (µg/L)
MW6I	08/04/05	<0.500	<0.500	<10.0	<0.500	<0.500	<0.500	<50.0
MW6I	10/27/05 b	---	---	---	---	---	---	---
MW6I	01/26/06	<0.50	<0.50	<20	<0.50	<0.50	<0.50	<100
MW6I	04/28/06 b	---	---	---	---	---	---	---
MW6I	07/05/06	<0.500	<0.500	<10.0	<0.500	<0.500	<0.500	<50.0
MW6J	01/07/03	<0.50	<0.50	<10.0	<0.50	<0.50	<0.50	---
MW6J	06/17/03	<0.50	<0.50	<10.0	<0.50	0.90	<0.50	<100
MW6J	07/16/03	<0.50	<0.50	<10.0	<0.50	1.00	<0.50	<100
MW6J	10/07/03	<0.50	<0.50	<10.0	<0.50	<0.5	<0.50	<100
MW6J	01/14/04	<0.50	<0.50	<10.0	<0.50	<0.50	<0.50	<50.0
MW6J	06/03/04	<0.50	<0.50	<10.0	<0.50	2.00	<0.50	<50.0
MW6J	08/12/04	<0.50c	<0.50c	<10.0c	<0.50c	1.20c	<0.50c	<50.0c
MW6J	11/04/04	<0.50	<0.50	<10.0	<0.50	<0.50	<0.50	<50.0
MW6J	02/01/05	<0.50	<0.50	<10.0	<0.50	1.20	<0.50	<50.0
MW6J	05/03/05	<0.50	<0.50	<10.0	<0.50	1.20	<0.50	<50.0
MW6J	08/04/05	<0.500	<0.500	<10.0	<0.500	<0.500	<0.500	<50.0
MW6J	10/27/05	<0.500	<0.500	<20.0	<0.500	<0.500	<0.500	<100
MW6J	01/26/06	<0.50	<0.50	<20	<0.50	1.1	<0.50	<100
MW6J	04/28/06	<0.50	<0.50	<20	<0.50	1.3	<0.50	---
MW6J	07/05/06	<0.500	<0.500	<10.0	<0.500	<0.500	<0.500	<50.0
RW1	01/07/03	<10.0	<10.0	<200	<10.0	<10.0	<10.0	---
RW1	06/17/03	<0.50	<0.50	324	<0.50	<0.50	<0.50	<100
RW1	07/16/03	<0.50	<0.50	110	<10.0	1.70	1.10	<100
RW1	10/07/03	<0.50	<0.50	<10.0	<0.50	<0.50	<0.50	<100
RW1	01/14/04	<0.50	<0.50	234	<0.50	<0.50	0.90	<50.0
RW1	06/03/04	<0.50	<0.50	338	<0.50	<0.50	1.30	<50.0
RW1	08/12/04	<0.50c	<0.50c	437c	1.30c	<0.50c	1.20c	<50.0c
RW1	11/04/04	<0.50	<0.50	541	<0.50	<0.50	<0.50	<50.0
RW1	02/01/05	<0.50	<0.50	261	<0.50	<0.50	1.80	<50.0
RW1	05/03/05	<0.50	<0.50	200	<0.50	<0.50	<0.50	<50.0
RW1	08/04/05	<0.500	<0.500	169	<0.500	<0.500	<0.500	<50.0
RW1	10/27/05	<0.500	<0.500	152	<0.500	<0.500	0.660	<100
RW1	01/26/06	<2.5	<2.5	280	<2.5	<2.5	<2.5	<500
RW1	04/28/06	<0.50	<0.50	86	<0.50	<0.50	<0.50	<100
RW1	07/05/06	<0.500	<0.500	80.5	1.02	<0.500	<0.500	<50.0
RW2	01/07/03	<0.50	<0.50	<10.0	<0.50	<0.50	<0.50	---
RW2	06/17/03	<0.50	<0.50	<10.0	<0.50	<0.50	<0.50	<100
RW2	07/16/03	<0.50	<0.50	<10.0	<0.50	<0.50	<0.50	<100
RW2	10/07/03	<0.50	<0.50	<10.0	<0.50	<0.50	<0.50	<100
RW2	01/14/04	<0.50	<0.50	370	<0.50	<0.50	<0.50	<50.0
RW2	06/03/04	<0.50	<0.50	370	<0.50	<0.50	<0.50	<50.0

TABLE 1B
ADDITIONAL CUMMULATIVE GROUNDWATER MONITORING AND SAMPLING DATA
Former Exxon Service Station 7-0235
2225 Telegraph Avenue
Oakland, California
(Page 4 of 5)

Well ID	Sampling Date	ETBE (µg/L)	TAME (µg/L)	TBA (µg/L)	EDB (µg/L)	1,2-DCA (µg/L)	DIPE (µg/L)	Ethanol (µg/L)
RW2	08/12/04	<0.50c	<0.50c	<10.0c	1.30c	<0.50c	<0.50c	<50.0c
RW2	11/04/04	<0.50	<0.50	<10.0	<0.50	<0.50	<0.50	<50.0
RW2	02/01/05	<0.50	<0.50	<10.0	<0.50	<0.50	<0.50	<50.0
RW2	05/03/05	<0.50	<0.50	<10.0	<0.50	<0.50	<0.50	<50.0
RW2	08/04/05	<0.500	<0.500	<10.0	<0.500	<0.500	<0.500	<50.0
RW2	10/27/05	<0.500	<0.500	<20.0	<0.500	<0.500	<0.500	<100
RW2	01/26/06	<0.50	<0.50	<20	<0.50	<0.50	<0.50	<100
RW2	04/28/06	<0.50	<0.50	<20	<0.50	<0.50	<0.50	---
RW2	07/05/06	<0.500	<0.500	<10.0	<0.500	<0.500	<0.500	<50.0
RW3A	01/07/03	<0.50	<0.50	<10.0	<0.50	<0.50	<0.50	---
RW3A	06/17/03	<0.50	<0.50	<10.0	<0.50	<0.50	1.20	<100
RW3A	07/16/03	<0.50	<0.50	<10.0	<0.50	<0.50	1.40	<100
RW3A	10/07/03	<0.50	<0.50	<10.0	<0.50	<0.50	1.40	<100
RW3A	01/14/04	<0.50	<0.50	<10.0	<0.50	<0.50	2.20	<50.0
RW3A	06/03/04	<0.50	<0.50	<10.0	<0.50	<0.50	1.20	<50.0
RW3A	08/12/04	<0.50c	<0.50c	<10.0c	<0.50c	<0.50c	1.10c	<50.0c
RW3A	11/04/04	<0.50	<0.50	<10.0	<0.50	<0.50	<0.50	<50.0
RW3A	02/01/05	<0.50	<0.50	<10.0	<0.50	<0.50	2.10	<50.0
RW3A	05/03/05	<0.50	<0.50	<10.0	<0.50	<0.50	0.60	<50.0
RW3A	08/04/05	<0.500	<0.500	<10.0	<0.500	<0.500	<0.500	<50.0
RW3A	10/27/05	<0.500	<0.500	<20.0	<0.500	<0.500	0.980	<100
RW3A	01/26/06	<0.50	<0.50	<20	<0.50	<0.50	3.2	<100
RW3A	04/28/06	<0.50	<0.50	<20	<0.50	<0.50	1.5	<100
RW3A	07/05/06	<0.500	<0.500	<10.0	<0.500	<0.500	1.20	<50.0

TABLE 1B
ADDITIONAL CUMMULATIVE GROUNDWATER MONITORING AND SAMPLING DATA
Former Exxon Service Station 7-0235
2225 Telegraph Avenue
Oakland, California
(Page 5 of 5)

Notes:	=	
TOC	=	Top of casing elevation; datum is mean sea level.
SUBJ	=	Results of subjective evaluation.
NLPH	=	No liquid-phase hydrocarbons present in well.
sheen	=	Liquid-phase hydrocarbon present as sheen.
DTW	=	Depth to water.
GW Elev.	=	Groundwater elevation; datum is mean sea level.
TPHd	=	Total petroleum hydrocarbons as diesel analyzed using EPA Method 5030/8015 (modified).
TPHg	=	Total petroleum hydrocarbons as gasoline analyzed using EPA Method 5030/8015 (modified).
MTBE 8260B	=	Methyl tertiary butyl ether analyzed using EPA Method 8260B.
MTBE 8021B	=	Methyl tertiary butyl ether analyzed using EPA Method 8021B.
BTEX	=	Benzene, toluene, ethylbenzene, and total xylenes analyzed using EPA Method 8021B.
TPHmo	=	Total petroleum hydrocarbons as motor oil using EPA Method 8015B.
ETBE	=	Ethyl tertiary butyl ether analyzed using EPA Method 8260B.
TAME	=	Tertiary amyl methyl ether analyzed using EPA Method 8260B.
TBA	=	Tertiary butyl alcohol analyzed using EPA Method 8260B.
EDB	=	1,2-dibromoethane analyzed using EPA Method 8260B.
1,2-DCA	=	1,2-dichloroethane analyzed using EPA Method 8260B.
DIPE	=	Di-isopropyl ether analyzed using EPA Method 8260B.
Ethanol	=	Ethanol analyzed using EPA Method 8260B.
µg/L	=	Micrograms per liter.
<	=	Less than the indicated reporting limit shown by the laboratory.
---	=	Not measured/Not sampled.
a	=	Analyses performed past EPA recommended holding time.
b	=	Well sampled semi-annually.
c	=	Groundwater elevation data invalidated; analytical results suspect.
d	=	TPH-diesel result was not consistent with diesel.
e	=	TRPH-diesel surrogate was diluted out due to sample matrix
f	=	Analyte detected in Matrix Spike and Matrix Spike Duplicate.
g	=	Elevated result due to single analyte peak in quantitation range.
h	=	Initial analysis within EPA recommended hold time. Re-analysis for dilution performed past hold time.

TABLE 2
WELL CONSTRUCTION DETAILS
Former Exxon Service Station 7-0235
2225 Telegraph Avenue
Oakland, California
(Page 1 of 1)

Well ID	Date Well Installed	TOC Elevation (feet)	Borehole Diameter (Inches)	Total Depth of Boring (feet)	Well Depth (feet)	Well Casing Diameter (Inches)	Well Casing Material	Screened Interval (feet)	Slot Size (Inches)	Filter Pack Interval (feet)	Filter Pack Material
MW6A	July 1988	NS	8	20	19.5	2	PVC	9.5-19.5	0.020	7.5-20	#3 Sand
MW6B	July 1988	21.09	8	20	19	2	PVC	9-19	0.020	7-20	#3 Sand
MW6C	July 1988	NS	8	20	19.5	2	PVC	9.5-19.5	0.020	7.5-20	#3 Sand
MW6D	July 1988	NS	8	20	19.5	2	PVC	9.5-19.5	0.020	7.5-20	#3 Sand
MW6E	Dec. 1988	21.24	10.5	21.5	20.5	4	PVC	10-19.5	0.020	8-21.5	#3 Sand
MW6F	Dec. 1988	22.17	10.5	22	20	4	PVC	10-19.5	0.020	8-22	#3 Sand
MW6G	Dec. 1988	20.46	8	20	20	4	PVC	10-19.5	0.020	8-20	#3 Sand
MW6H	Dec. 1988	20.20	8	21	20	4	PVC	10-19.5	0.020	8-21	#3 Sand
MW6I	Dec. 1988	19.87	8	21	20	4	PVC	10-19.5	0.020	8-21	#3 Sand
MW6J	04/06/01	20.75	8	23	23	2	PVC	6-23	0.020	6-23	#2/12 Sand
RW1	06/05/92	20.43	12	25	25	4	PVC	9.5-24.5	0.020	8.5-25	#3 Sand
RW2	06/05/92	20.64	12	25	25	4	PVC	9.5-24.5	0.020	9.5-25	#3 Sand
RW3A	08/24/92	21.89	12	21.5	21.5	4	PVC	9-21	0.020	8-21.5	#3 Sand
VW1	06/05/92	NS	NS	11	11	4	PVC	6-11	0.020	NS	NS
VW2	06/05/92	NS	NS	11	11	4	PVC	6-11	0.020	NS	NS
VW3	08/24/92	NS	12	13.5	13.5	4	PVC	4-13.5	0.050	4-13.5	Aquarium Sand

Notes:

- TOC = Top of well casing elevation; datum is mean sea level.
- NS = Not specified.
- PVC = Polyvinyl chloride.



3-D TopoQuads Copyright © 1999 DeLorme, Yarmouth, ME 04096 Source Data: UFG1 500 ft. Scale: 1 : 11,280 Detail: 1:30 Datum: WGS84

FN 2229Topo

EXPLANATION

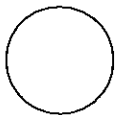

1/2-mile radius circle

APPROXIMATE SCALE

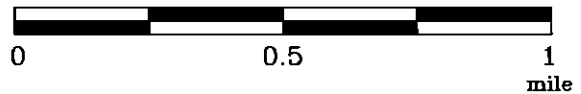

SOURCE:
Modified from a map
provided by
DeLorme 3-D TopoQuads

SITE VICINITY MAP

FORMER EXXON SERVICE STATION 7-0235
2225 Telegraph Avenue
Oakland, California

PROJECT NO.

2229

PLATE

1



Analyte Concentrations in ug/L
 Sampled July 5, 2006

2,360 Total Petroleum Hydrocarbons
 as gasoline
 389 Benzene
 82.9 Methyl Tertiary Butyl Ether
 (EPA Method 8260B)

< Less Than the Stated Laboratory
 Reporting Limit
 ug/L Micrograms per Liter

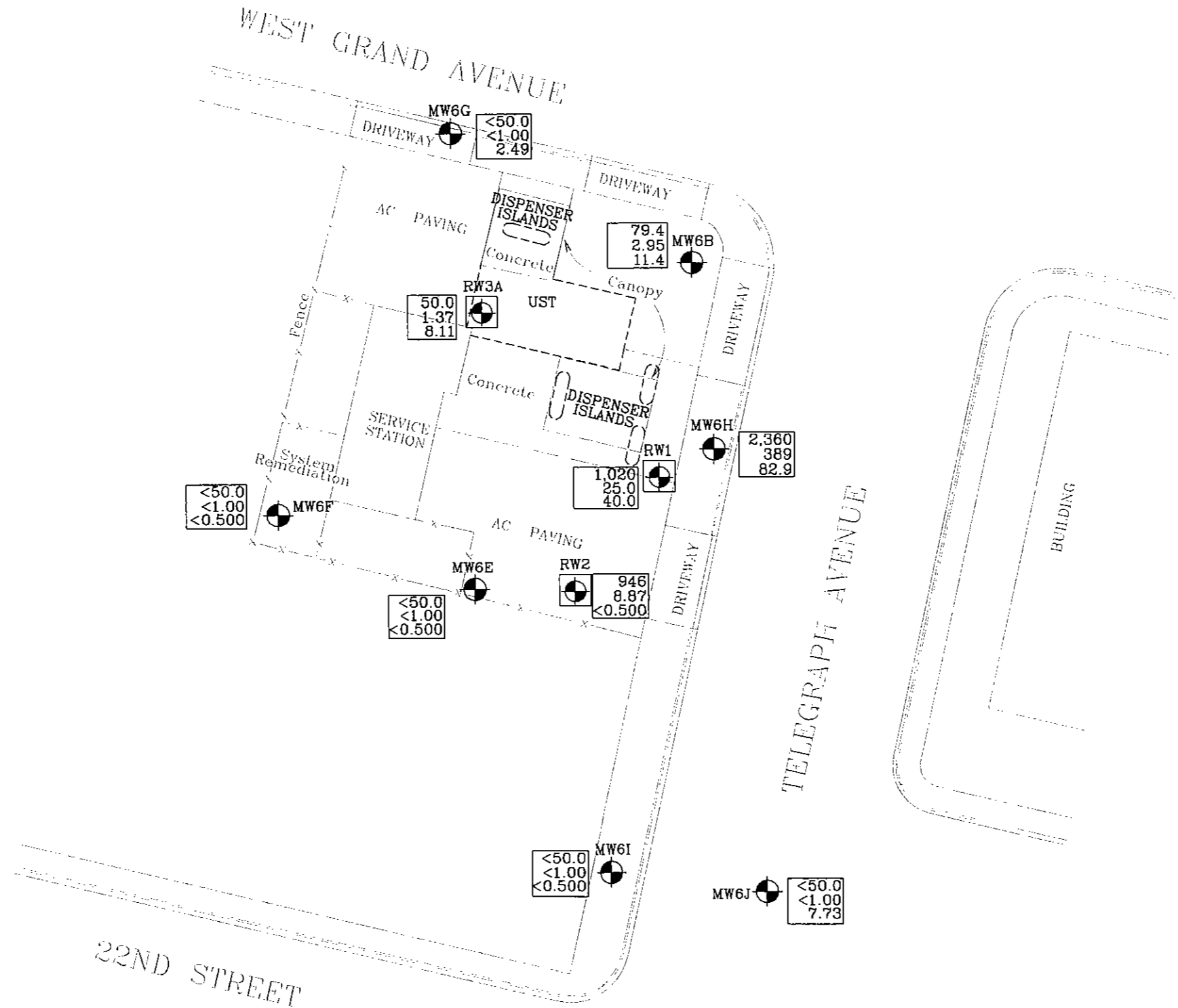

APPROXIMATE SCALE

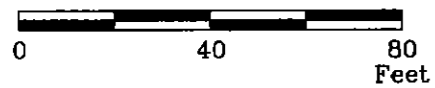

FN 2229004a_QM



SELECT ANALYTICAL RESULTS
July 5, 2006
 FORMER
 EXXON SERVICE STATION 7-0235
 2225 Telegraph Avenue
 Oakland, California

EXPLANATION

- MW6J Groundwater Monitoring Well
- RW3A Recovery Groundwater Monitoring Well

PROJECT NO.

2229

PLATE

2

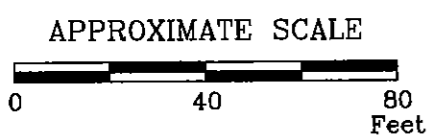
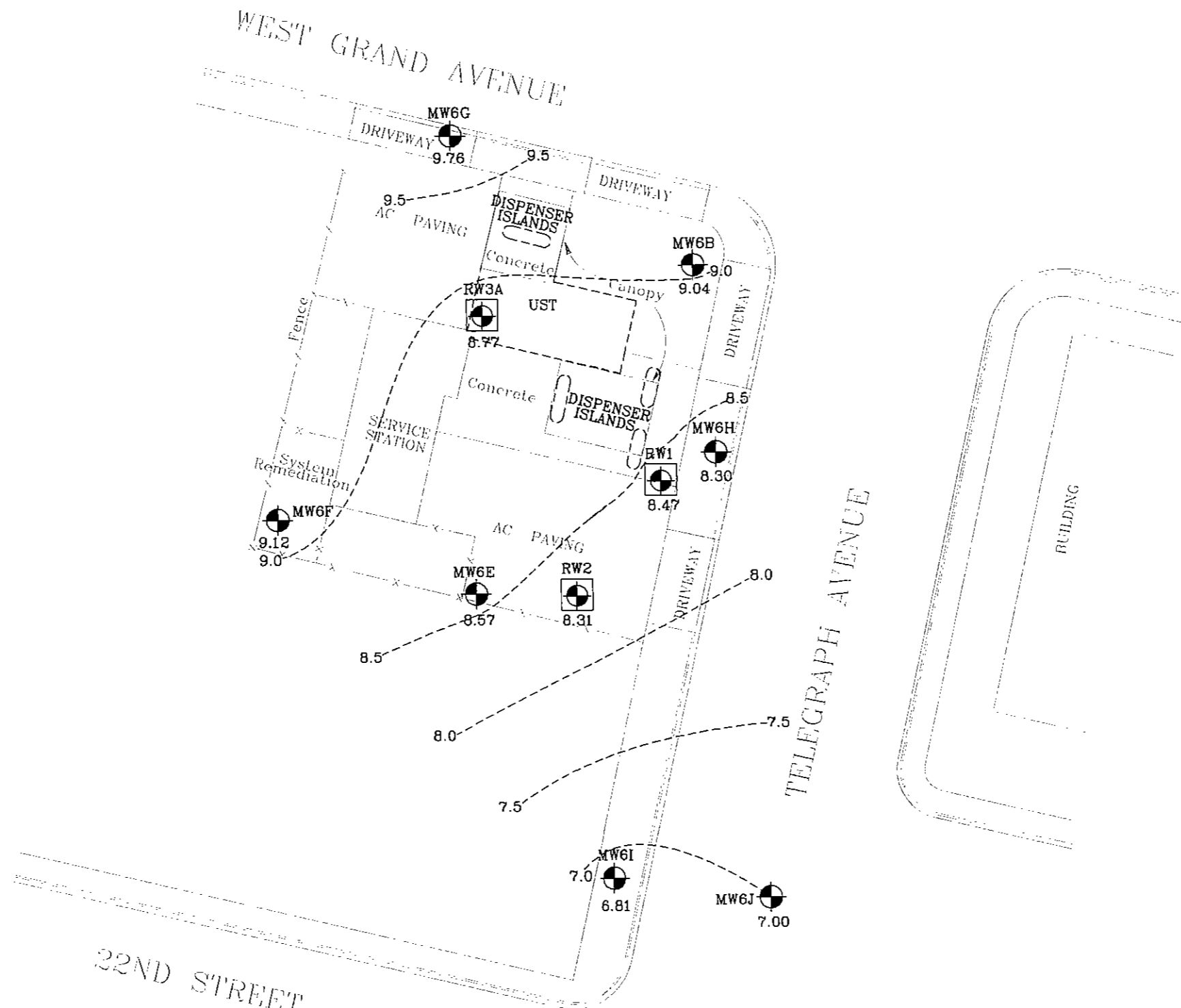

9.5---- Line of Equal Groundwater Elevation;
datum is mean sea level

FN 2229004a_QM

GROUNDWATER ELEVATION MAP
July 5, 2006
 FORMER
 EXXON SERVICE STATION 7-0235
 2225 Telegraph Avenue
 Oakland, California

EXPLANATION

	MW6J	Groundwater Monitoring Well
	7.00	Groundwater elevation in feet; datum is mean sea level
	RW3A	Recovery Groundwater Monitoring Well

PROJECT NO.	2229
PLATE	3



ATTACHMENT A
GROUNDWATER SAMPLING PROTOCOL

GROUNDWATER SAMPLING PROTOCOL

The static water level and separate-phase product level, if present, in each well that contained water and/or separate-phase product are measured with a ORS Interface Probe, which is accurate to the nearest 0.01 foot. To calculate groundwater elevations and evaluate groundwater gradient, depth to water (DTW) levels are subtracted from top of casing elevations.

Groundwater samples collected for subjective evaluation are collected by gently lowering approximately half the length of a clean Teflon® or polypropylene bailer past the air-water interface (if possible) and collecting a sample from near the surface of the water in the well. The samples are checked for measurable free-phase hydrocarbons or sheen. If appropriate, free-phase hydrocarbons are removed from the well.

Before water samples are collected from the groundwater monitoring wells, the wells are purged until a minimum of three well casing volumes is purged and stabilization of the temperature, pH, and conductivity is obtained. Water samples from the wells that do not obtain stability of the temperature, pH, and conductivity are considered to be "grab samples." The quantity of water purged from each well is calculated as follows:

1 well casing volume = $\pi r^2 h(7.48)$ where:

r	=	radius of the well casing in feet.
h	=	column of water in the well in feet (depth to bottom - depth to water)
7.48	=	conversion constant from cubic feet to gallons
π	=	ratio of the circumference of a circle to its diameter

Gallons of water purged/gallons in 1 well casing volume = well casing volumes removed.

After purging, each well is allowed to recharge to at least 80% of the initial water level. Water samples from wells that do not recover at least 80% (due to slow recharging of the well) between purging and sampling are considered to be "grab samples." Water samples are collected with a new, disposable Teflon® or polypropylene bailer. The groundwater is carefully poured into selected sample containers (40-milliliter [ml] glass vials, 1,000-ml glass amber bottles, etc.), which are filled so as to produce a positive meniscus.

Depending on the required analysis, each sample container is preserved with hydrochloric acid, nitric acid, etc., or it is preservative free. The type of preservative used for each sample is specified on the Chain-of-Custody form.

Each vial and glass amber bottle is sealed with a cap containing a Teflon® septum, and subsequently examined for air bubbles to avoid headspace, which would allow volatilization to occur. The samples are promptly transported in iced storage in a thermally-insulated ice chest, accompanied by a Chain-of-Custody record, to a California state-certified laboratory.

ATTACHMENT B

**LABORATORY ANALYTICAL REPORT
AND CHAIN-OF-CUSTODY RECORD**

July 21, 2006

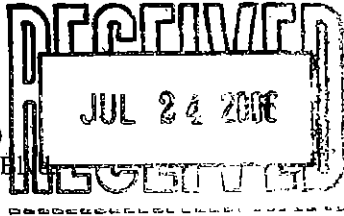

Client: ERI Petaluma (10228)
601 North McDowell Blvd
Petaluma, CA 94954
Attn: Paula Sime

Work Order: NPG0854
Project Name: Exxon(06) 7-0235 PO:4507203575
Project Nbr: 222913X
P/O Nbr: 4507203575
Date Received: 07/08/06

SAMPLE IDENTIFICATION	LAB NUMBER	COLLECTION DATE AND TIME
MW6B	NPG0854-02	07/05/06 16:30
MW6E	NPG0854-03	07/05/06 14:30
MW6F	NPG0854-04	07/05/06 14:55
MW6G	NPG0854-05	07/05/06 15:15
MW6H	NPG0854-06	07/05/06 16:45
MW6I	NPG0854-07	07/05/06 14:10
MW6J	NPG0854-08	07/05/06 11:45
RW1	NPG0854-09	07/05/06 16:15
RW2	NPG0854-10	07/05/06 15:35
RW3A	NPG0854-11	07/05/06 15:55

An executed copy of the chain of custody, the project quality control data, and the sample receipt form are also included as an addendum to this report. If you have any questions relating to this analytical report, please contact your Laboratory Project Manager at 1-800-765-0980. Any opinions, if expressed, are outside the scope of the Laboratory's accreditation.

This material is intended only for the use of the individual(s) or entity to whom it is addressed, and may contain information that is privileged and confidential. If you are not the intended recipient, or the employee or agent responsible for delivering this material to the intended recipient, you are hereby notified that any dissemination, distribution, or copying of this material is strictly prohibited. If you have received this material in error, please notify us immediately at 615-726-0177.

California Certification Number: 01168CA

The Chain(s) of Custody, 2 pages, are included and are an integral part of this report.

These results relate only to the items tested. This report shall not be reproduced except in full and with permission of the laboratory.

Report Approved By:

A handwritten signature in black ink, appearing to read "Jim Hatfield".

Jim Hatfield

Project Management

Client ERI Petaluma (10228)
601 North McDowell Blvd.
Petaluma, CA 94954
Attn Paula Sims

Work Order: NPG0854
Project Name: Exxon(06) 7-0235 PO:4507203575
Project Number: 222913X
Received: 07/08/06 08:00

ANALYTICAL REPORT

Analyte	Result	Flag	Units	MRL	Dilution Factor	Analysis Date/Time	Method	Batch
Sample ID: NPG0854-02 (MW6B - Water) Sampled: 07/05/06 16:30								
Volatile Organic Compounds by EPA Method 8021B								
Benzene	2.95		ug/L	1.00	1	07/16/06 15:33	SW846 8021B	6072740
Ethylbenzene	ND		ug/L	1.00	1	07/16/06 15:33	SW846 8021B	6072740
Toluene	ND		ug/L	1.00	1	07/16/06 15:33	SW846 8021B	6072740
Xylenes, total	ND		ug/L	3.00	1	07/16/06 15:33	SW846 8021B	6072740
<i>Surr: a,a,a-Trifluorotoluene (63-134%)</i>	106 %					07/16/06 15:33	SW846 8021B	6072740
Volatile Organic Compounds by EPA Method 8260B								
Tert-Amyl Methyl Ether	ND		ug/L	0.500	1	07/15/06 15:15	SW846 8260B	6072505
1,2-Dibromoethane (EDB)	ND		ug/L	0.500	1	07/15/06 15:15	SW846 8260B	6072505
Ethanol	ND		ug/L	50.0	1	07/15/06 15:15	SW846 8260B	6072505
1,2-Dichloroethane	ND		ug/L	0.500	1	07/15/06 15:15	SW846 8260B	6072505
Ethyl tert-Butyl Ether	ND		ug/L	0.500	1	07/15/06 15:15	SW846 8260B	6072505
Diisopropyl Ether	ND		ug/L	0.500	1	07/15/06 15:15	SW846 8260B	6072505
Methyl tert-Butyl Ether	11.4		ug/L	0.500	1	07/15/06 15:15	SW846 8260B	6072505
Tertiary Butyl Alcohol	ND		ug/L	10.0	1	07/15/06 15:15	SW846 8260B	6072505
Extractable Petroleum Hydrocarbons								
TPH - Oil Range	ND		ug/L	95.2	1	07/15/06 22:34	SW846 8015B	6071353
<i>Surr: o-Terphenyl (55-150%)</i>	89 %					07/15/06 22:34	SW846 8015B	6071353
Purgeable Petroleum Hydrocarbons								
GRO as Gasoline	79.4		ug/L	50.0	1	07/16/06 15:33	SW846 8015B	6072740
<i>Surr: a,a,a-Trifluorotoluene (63-134%)</i>	106 %					07/16/06 15:33	SW846 8015B	6072740
Extractable Petroleum Hydrocarbons with Silica Gel Treatment								
Diesel	ND		ug/L	47.6	1	07/15/06 22:34	SW846 8015B	6071353
<i>Surr: o-Terphenyl (55-150%)</i>	89 %					07/15/06 22:34	SW846 8015B	6071353
Sample ID: NPG0854-03 (MW6E - Water) Sampled: 07/05/06 14:30								
Volatile Organic Compounds by EPA Method 8021B								
Benzene	ND		ug/L	1.00	1	07/16/06 15:53	SW846 8021B	6072740
Ethylbenzene	ND		ug/L	1.00	1	07/16/06 15:53	SW846 8021B	6072740
Toluene	ND		ug/L	1.00	1	07/16/06 15:53	SW846 8021B	6072740
Xylenes, total	ND		ug/L	3.00	1	07/16/06 15:53	SW846 8021B	6072740
<i>Surr: a,a,a-Trifluorotoluene (63-134%)</i>	95 %					07/16/06 15:53	SW846 8021B	6072740
Volatile Organic Compounds by EPA Method 8260B								
Tert-Amyl Methyl Ether	ND		ug/L	0.500	1	07/15/06 15:42	SW846 8260B	6072505
1,2-Dibromoethane (EDB)	ND		ug/L	0.500	1	07/15/06 15:42	SW846 8260B	6072505
Ethanol	ND		ug/L	50.0	1	07/15/06 15:42	SW846 8260B	6072505
1,2-Dichloroethane	ND		ug/L	0.500	1	07/15/06 15:42	SW846 8260B	6072505
Ethyl tert-Butyl Ether	ND		ug/L	0.500	1	07/15/06 15:42	SW846 8260B	6072505
Diisopropyl Ether	ND		ug/L	0.500	1	07/15/06 15:42	SW846 8260B	6072505
Methyl tert-Butyl Ether	ND		ug/L	0.500	1	07/15/06 15:42	SW846 8260B	6072505
Tertiary Butyl Alcohol	ND		ug/L	10.0	1	07/15/06 15:42	SW846 8260B	6072505
Extractable Petroleum Hydrocarbons								

Client ERI Petaluma (10228)
601 North McDowell Blvd.
Petaluma, CA 94954
Attn Paula Sime

Work Order: NPG0854
Project Name: Exxon(06) 7-0235 PO:4507203575
Project Number: 222913X
Received: 07/08/06 08:00

ANALYTICAL REPORT

Analyte	Result	Flag	Units	MRL	Dilution Factor	Analysis Date/Time	Method	Batch
Sample ID: NPG0854-03 (MW6E - Water) - cont. Sampled: 07/05/06 14:30								
Extractable Petroleum Hydrocarbons - cont.								
TPH - Oil Range	316		ug/L	95.2	1	07/15/06 22:53	SW846 8015B	6071353
Surr: <i>o</i> -Terphenyl (55-150%)	106 %					07/15/06 22:53	SW846 8015B	6071353
Purgeable Petroleum Hydrocarbons								
GRO as Gasoline	ND		ug/L	50.0	1	07/16/06 15:53	SW846 8015B	6072740
Surr: <i>a,a,a</i> -Trifluorotoluene (63-134%)	95 %					07/16/06 15:53	SW846 8015B	6072740
Extractable Petroleum Hydrocarbons with Silica Gel Treatment								
Diesel	149		ug/L	47.6	1	07/15/06 22:53	SW846 8015B	6071353
Surr: <i>o</i> -Terphenyl (55-150%)	106 %					07/15/06 22:53	SW846 8015B	6071353
Sample ID: NPG0854-04 (MW6F - Water) Sampled: 07/05/06 14:55								
Volatile Organic Compounds by EPA Method 8021B								
Benzene	ND		ug/L	1.00	1	07/16/06 16:12	SW846 8021B	6072740
Ethylbenzene	ND		ug/L	1.00	1	07/16/06 16:12	SW846 8021B	6072740
Toluene	ND		ug/L	1.00	1	07/16/06 16:12	SW846 8021B	6072740
Xylenes, total	ND		ug/L	3.00	1	07/16/06 16:12	SW846 8021B	6072740
Surr: <i>a,a,a</i> -Trifluorotoluene (63-134%)	108 %					07/16/06 16:12	SW846 8021B	6072740
Volatile Organic Compounds by EPA Method 8260B								
Tert-Amyl Methyl Ether	ND		ug/L	0.500	1	07/15/06 16:10	SW846 8260B	6072505
1,2-Dibromoethane (EDB)	ND		ug/L	0.500	1	07/15/06 16:10	SW846 8260B	6072505
Ethanol	ND		ug/L	50.0	1	07/15/06 16:10	SW846 8260B	6072505
1,2-Dichloroethane	ND		ug/L	0.500	1	07/15/06 16:10	SW846 8260B	6072505
Ethyl tert-Butyl Ether	ND		ug/L	0.500	1	07/15/06 16:10	SW846 8260B	6072505
Diisopropyl Ether	ND		ug/L	0.500	1	07/15/06 16:10	SW846 8260B	6072505
Methyl tert-Butyl Ether	ND		ug/L	0.500	1	07/15/06 16:10	SW846 8260B	6072505
Tertiary Butyl Alcohol	ND		ug/L	10.0	1	07/15/06 16:10	SW846 8260B	6072505
Extractable Petroleum Hydrocarbons								
TPH - Oil Range	ND		ug/L	95.2	1	07/15/06 23:11	SW846 8015B	6071353
Surr: <i>o</i> -Terphenyl (55-150%)	82 %					07/15/06 23:11	SW846 8015B	6071353
Purgeable Petroleum Hydrocarbons								
GRO as Gasoline	ND		ug/L	50.0	1	07/16/06 16:12	SW846 8015B	6072740
Surr: <i>a,a,a</i> -Trifluorotoluene (63-134%)	108 %					07/16/06 16:12	SW846 8015B	6072740
Extractable Petroleum Hydrocarbons with Silica Gel Treatment								
Diesel	ND		ug/L	47.6	1	07/15/06 23:11	SW846 8015B	6071353
Surr: <i>o</i> -Terphenyl (55-150%)	82 %					07/15/06 23:11	SW846 8015B	6071353

Client ERI Petaluma (10228)
601 North McDowell Blvd.
Petaluma, CA 94954
Attn Paula Sime

Work Order: NPG0854
Project Name: Exxon(06) 7-0235 PO:4507203575
Project Number: 222913X
Received: 07/08/06 08:00

ANALYTICAL REPORT

Analyte	Result	Flag	Units	MRL	Dilution Factor	Analysis Date/Time	Method	Batch
---------	--------	------	-------	-----	-----------------	--------------------	--------	-------

Sample ID: NPG0854-05 (MW6G - Water) Sampled: 07/05/06 15:15

Volatile Organic Compounds by EPA Method 8021B

Benzene	ND		ug/L	1.00	1	07/16/06 16:32	SW846 8021B	6072740
Ethylbenzene	ND		ug/L	1.00	1	07/16/06 16:32	SW846 8021B	6072740
Toluene	ND		ug/L	1.00	1	07/16/06 16:32	SW846 8021B	6072740
Xylenes, total	ND		ug/L	3.00	1	07/16/06 16:32	SW846 8021B	6072740
<i>Surr: a,a,a-Trifluorotoluene (63-134%)</i>	88 %					07/16/06 16:32	SW846 8021B	6072740

Volatile Organic Compounds by EPA Method 8260B

Tert-Amyl Methyl Ether	ND		ug/L	0.500	1	07/15/06 16:38	SW846 8260B	6072505
1,2-Dibromoethane (EDB)	ND		ug/L	0.500	1	07/15/06 16:38	SW846 8260B	6072505
Ethanol	ND		ug/L	50.0	1	07/15/06 16:38	SW846 8260B	6072505
1,2-Dichloroethane	ND		ug/L	0.500	1	07/15/06 16:38	SW846 8260B	6072505
Ethyl tert-Butyl Ether	ND		ug/L	0.500	1	07/15/06 16:38	SW846 8260B	6072505
Diisopropyl Ether	ND		ug/L	0.500	1	07/15/06 16:38	SW846 8260B	6072505
Methyl tert-Butyl Ether	2.49		ug/L	0.500	1	07/15/06 16:38	SW846 8260B	6072505
Tertiary Butyl Alcohol	ND		ug/L	10.0	1	07/15/06 16:38	SW846 8260B	6072505

Extractable Petroleum Hydrocarbons

TPH - Oil Range	277		ug/L	95.2	1	07/15/06 23:30	SW846 8015B	6071353
<i>Surr: o-Terphenyl (55-150%)</i>	94 %					07/15/06 23:30	SW846 8015B	6071353

Purgeable Petroleum Hydrocarbons

GRO as Gasoline	ND		ug/L	50.0	1	07/16/06 16:32	SW846 8015B	6072740
<i>Surr: a,a,a-Trifluorotoluene (63-134%)</i>	88 %					07/16/06 16:32	SW846 8015B	6072740

Extractable Petroleum Hydrocarbons with Silica Gel Treatment

Diesel	88.6		ug/L	47.6	1	07/15/06 23:30	SW846 8015B	6071353
<i>Surr: o-Terphenyl (55-150%)</i>	94 %					07/15/06 23:30	SW846 8015B	6071353

Sample ID: NPG0854-06RE2 (MW6H - Water) Sampled: 07/05/06 16:45

Volatile Organic Compounds by EPA Method 8021B

Benzene	389		ug/L	5.00	5	07/17/06 17:12	SW846 8021B	6072779
Ethylbenzene	39.5		ug/L	1.00	1	07/16/06 16:52	SW846 8021B	6072740
Toluene	111		ug/L	1.00	1	07/16/06 16:52	SW846 8021B	6072740
Xylenes, total	125		ug/L	3.00	1	07/17/06 15:53	SW846 8021B	6072779
<i>Surr: a,a,a-Trifluorotoluene (63-134%)</i>	112 %					07/16/06 16:52	SW846 8021B	6072740
<i>Surr: a,a,a-Trifluorotoluene (63-134%)</i>	118 %					07/17/06 15:53	SW846 8021B	6072779
<i>Surr: a,a,a-Trifluorotoluene (63-134%)</i>	112 %					07/17/06 17:12	SW846 8021B	6072779

Volatile Organic Compounds by EPA Method 8260B

Tert-Amyl Methyl Ether	ND		ug/L	0.500	1	07/15/06 17:06	SW846 8260B	6072505
1,2-Dibromoethane (EDB)	ND		ug/L	0.500	1	07/15/06 17:06	SW846 8260B	6072505
Ethanol	ND		ug/L	50.0	1	07/15/06 17:06	SW846 8260B	6072505
1,2-Dichloroethane	ND		ug/L	0.500	1	07/15/06 17:06	SW846 8260B	6072505
Ethyl tert-Butyl Ether	ND		ug/L	0.500	1	07/15/06 17:06	SW846 8260B	6072505
Diisopropyl Ether	2.41		ug/L	0.500	1	07/15/06 17:06	SW846 8260B	6072505
Methyl tert-Butyl Ether	82.9		ug/L	0.500	1	07/15/06 17:06	SW846 8260B	6072505

Client ERI Petaluma (10228)
601 North McDowell Blvd.
Petaluma, CA 94954
Attn Paula Sime

Work Order: NPG0854
Project Name: Exxon(06) 7-0235 PO:4507203575
Project Number: 222913X
Received: 07/08/06 08:00

ANALYTICAL REPORT

Analyte	Result	Flag	Units	MRL	Dilution Factor	Analysis Date/Time	Method	Batch
Sample ID: NPG0854-06 (MW6H - Water) - cont. Sampled: 07/05/06 16:45								
Volatile Organic Compounds by EPA Method 8260B - cont.								
Tertiary Butyl Alcohol	137		ug/L	10.0	1	07/15/06 17:06	SW846 8260B	6072505
Extractable Petroleum Hydrocarbons								
TPH - Oil Range	114		ug/L	95.2	1	07/15/06 23:48	SW846 8015B	6071353
Surr: o-Terphenyl (55-150%)	88 %					07/15/06 23:48	SW846 8015B	6071353
Purgeable Petroleum Hydrocarbons								
GRO as Gasoline	2360		ug/L	50.0	1	07/16/06 16:52	SW846 8015B	6072740
Surr: a,a,a-Trifluorotoluene (63-134%)	112 %					07/16/06 16:52	SW846 8015B	6072740
Extractable Petroleum Hydrocarbons with Silica Gel Treatment								
Diesel	273		ug/L	47.6	1	07/15/06 23:48	SW846 8015B	6071353
Surr: o-Terphenyl (55-150%)	88 %					07/15/06 23:48	SW846 8015B	6071353
Sample ID: NPG0854-07 (MW6I - Water) Sampled: 07/05/06 14:10								
Volatile Organic Compounds by EPA Method 8021B								
Benzene	ND		ug/L	1.00	1	07/16/06 17:11	SW846 8021B	6072740
Ethylbenzene	ND		ug/L	1.00	1	07/16/06 17:11	SW846 8021B	6072740
Toluene	ND		ug/L	1.00	1	07/16/06 17:11	SW846 8021B	6072740
Xylenes, total	ND		ug/L	3.00	1	07/16/06 17:11	SW846 8021B	6072740
Surr: a,a,a-Trifluorotoluene (63-134%)	101 %					07/16/06 17:11	SW846 8021B	6072740
Volatile Organic Compounds by EPA Method 8260B								
Tert-Amyl Methyl Ether	ND		ug/L	0.500	1	07/15/06 17:33	SW846 8260B	6072505
1,2-Dibromoethane (EDB)	ND		ug/L	0.500	1	07/15/06 17:33	SW846 8260B	6072505
Ethanol	ND		ug/L	50.0	1	07/15/06 17:33	SW846 8260B	6072505
1,2-Dichloroethane	ND		ug/L	0.500	1	07/15/06 17:33	SW846 8260B	6072505
Ethyl tert-Butyl Ether	ND		ug/L	0.500	1	07/15/06 17:33	SW846 8260B	6072505
Diisopropyl Ether	ND		ug/L	0.500	1	07/15/06 17:33	SW846 8260B	6072505
Methyl tert-Butyl Ether	ND		ug/L	0.500	1	07/15/06 17:33	SW846 8260B	6072505
Tertiary Butyl Alcohol	ND		ug/L	10.0	1	07/15/06 17:33	SW846 8260B	6072505
Extractable Petroleum Hydrocarbons								
TPH - Oil Range	ND		ug/L	95.2	1	07/16/06 00:07	SW846 8015B	6071353
Surr: o-Terphenyl (55-150%)	83 %					07/16/06 00:07	SW846 8015B	6071353
Purgeable Petroleum Hydrocarbons								
GRO as Gasoline	ND		ug/L	50.0	1	07/16/06 17:11	SW846 8015B	6072740
Surr: a,a,a-Trifluorotoluene (63-134%)	101 %					07/16/06 17:11	SW846 8015B	6072740
Extractable Petroleum Hydrocarbons with Silica Gel Treatment								
Diesel	ND		ug/L	47.6	1	07/16/06 00:07	SW846 8015B	6071353
Surr: o-Terphenyl (55-150%)	83 %					07/16/06 00:07	SW846 8015B	6071353

Client ERI Petaluma (10228)
601 North McDowell Blvd.
Petaluma, CA 94954
Attn Paula Sime

Work Order: NPG0854
Project Name: Exxon(06) 7-0235 PO:4507203575
Project Number: 222913X
Received: 07/08/06 08:00

ANALYTICAL REPORT

Analyte	Result	Flag	Units	MRL	Dilution Factor	Analysis Date/Time	Method	Batch
Sample ID: NPG0854-08 (MW6J - Water) Sampled: 07/05/06 11:45								
Volatile Organic Compounds by EPA Method 8021B								
Benzene	ND		ug/L	1.00	1	07/16/06 17:31	SW846 8021B	6072740
Ethylbenzene	ND		ug/L	1.00	1	07/16/06 17:31	SW846 8021B	6072740
Toluene	ND		ug/L	1.00	1	07/16/06 17:31	SW846 8021B	6072740
Xylenes, total	ND		ug/L	3.00	1	07/16/06 17:31	SW846 8021B	6072740
<i>Surr: a,a,a-Trifluorotoluene (63-134%)</i>	102 %					07/16/06 17:31	SW846 8021B	6072740
Volatile Organic Compounds by EPA Method 8260B								
Tert-Amyl Methyl Ether	ND		ug/L	0.500	1	07/15/06 18:01	SW846 8260B	6072505
1,2-Dibromoethane (EDB)	ND		ug/L	0.500	1	07/15/06 18:01	SW846 8260B	6072505
Ethanol	ND		ug/L	50.0	1	07/15/06 18:01	SW846 8260B	6072505
1,2-Dichloroethane	ND		ug/L	0.500	1	07/15/06 18:01	SW846 8260B	6072505
Ethyl tert-Butyl Ether	ND		ug/L	0.500	1	07/15/06 18:01	SW846 8260B	6072505
Diisopropyl Ether	ND		ug/L	0.500	1	07/15/06 18:01	SW846 8260B	6072505
Methyl tert-Butyl Ether	7.73		ug/L	0.500	1	07/15/06 18:01	SW846 8260B	6072505
Tertiary Butyl Alcohol	ND		ug/L	10.0	1	07/15/06 18:01	SW846 8260B	6072505
Extractable Petroleum Hydrocarbons								
TPH - Oil Range	ND		ug/L	95.2	1	07/16/06 00:25	SW846 8015B	6071353
<i>Surr: o-Terphenyl (55-150%)</i>	85 %					07/16/06 00:25	SW846 8015B	6071353
Purgeable Petroleum Hydrocarbons								
GRO as Gasoline	ND		ug/L	50.0	1	07/16/06 17:31	SW846 8015B	6072740
<i>Surr: a,a,a-Trifluorotoluene (63-134%)</i>	102 %					07/16/06 17:31	SW846 8015B	6072740
Extractable Petroleum Hydrocarbons with Silica Gel Treatment								
Diesel	ND		ug/L	47.6	1	07/16/06 00:25	SW846 8015B	6071353
<i>Surr: o-Terphenyl (55-150%)</i>	85 %					07/16/06 00:25	SW846 8015B	6071353
Sample ID: NPG0854-09 (RW1 - Water) Sampled: 07/05/06 16:15								
Volatile Organic Compounds by EPA Method 8021B								
Benzene	25.0		ug/L	1.00	1	07/16/06 17:50	SW846 8021B	6072740
Ethylbenzene	4.67		ug/L	1.00	1	07/16/06 17:50	SW846 8021B	6072740
Toluene	4.77		ug/L	1.00	1	07/16/06 17:50	SW846 8021B	6072740
Xylenes, total	11.4		ug/L	3.00	1	07/16/06 17:50	SW846 8021B	6072740
<i>Surr: a,a,a-Trifluorotoluene (63-134%)</i>	104 %					07/16/06 17:50	SW846 8021B	6072740
Volatile Organic Compounds by EPA Method 8260B								
Tert-Amyl Methyl Ether	ND		ug/L	0.500	1	07/15/06 18:29	SW846 8260B	6072505
1,2-Dibromoethane (EDB)	1.02		ug/L	0.500	1	07/15/06 18:29	SW846 8260B	6072505
Ethanol	ND		ug/L	50.0	1	07/15/06 18:29	SW846 8260B	6072505
1,2-Dichloroethane	ND		ug/L	0.500	1	07/15/06 18:29	SW846 8260B	6072505
Ethyl tert-Butyl Ether	ND		ug/L	0.500	1	07/15/06 18:29	SW846 8260B	6072505
Diisopropyl Ether	ND		ug/L	0.500	1	07/15/06 18:29	SW846 8260B	6072505
Methyl tert-Butyl Ether	40.0	ID2	ug/L	0.500	1	07/15/06 18:29	SW846 8260B	6072505
Tertiary Butyl Alcohol	80.5	ID2	ug/L	10.0	1	07/15/06 18:29	SW846 8260B	6072505
Extractable Petroleum Hydrocarbons								

Client ERI Petaluma (10228)
601 North McDowell Blvd.
Petaluma, CA 94954
Attn Paula Sime

Work Order: NPG0854
Project Name: Exxon(06) 7-0235 PO:4507203575
Project Number: 222913X
Received: 07/08/06 08:00

ANALYTICAL REPORT

Analyte	Result	Flag	Units	MRL	Dilution Factor	Analysis Date/Time	Method	Batch
Sample ID: NPG0854-09 (RW1 - Water) - cont. Sampled: 07/05/06 16:15								
Extractable Petroleum Hydrocarbons - cont.								
TPH - Oil Range	886		ug/L	95.2	1	07/16/06 01:21	SW846 8015B	6071353
Surr: o-Terphenyl (55-150%)	87 %					07/16/06 01:21	SW846 8015B	6071353
Purgeable Petroleum Hydrocarbons								
GRO as Gasoline	1020		ug/L	50.0	1	07/16/06 17:50	SW846 8015B	6072740
Surr: a,a,a-Trifluorotoluene (63-134%)	104 %					07/16/06 17:50	SW846 8015B	6072740
Extractable Petroleum Hydrocarbons with Silica Gel Treatment								
Diesel	687		ug/L	47.6	1	07/16/06 01:21	SW846 8015B	6071353
Surr: o-Terphenyl (55-150%)	87 %					07/16/06 01:21	SW846 8015B	6071353
Sample ID: NPG0854-10 (RW2 - Water) Sampled: 07/05/06 15:35								
Volatile Organic Compounds by EPA Method 8021B								
Benzene	8.87		ug/L	1.00	1	07/16/06 18:10	SW846 8021B	6072740
Ethylbenzene	1.81		ug/L	1.00	1	07/16/06 18:10	SW846 8021B	6072740
Toluene	1.05		ug/L	1.00	1	07/16/06 18:10	SW846 8021B	6072740
Xylenes, total	3.10		ug/L	3.00	1	07/17/06 16:13	SW846 8021B	6072779
Surr: a,a,a-Trifluorotoluene (63-134%)	106 %					07/16/06 18:10	SW846 8021B	6072740
Surr: a,a,a-Trifluorotoluene (63-134%)	95 %					07/17/06 16:13	SW846 8021B	6072779
Volatile Organic Compounds by EPA Method 8260B								
Tert-Amyl Methyl Ether	ND		ug/L	0.500	1	07/15/06 18:57	SW846 8260B	6072505
1,2-Dibromoethane (EDB)	ND		ug/L	0.500	1	07/15/06 18:57	SW846 8260B	6072505
Ethanol	ND		ug/L	50.0	1	07/15/06 18:57	SW846 8260B	6072505
1,2-Dichloroethane	ND		ug/L	0.500	1	07/15/06 18:57	SW846 8260B	6072505
Ethyl tert-Butyl Ether	ND		ug/L	0.500	1	07/15/06 18:57	SW846 8260B	6072505
Diisopropyl Ether	ND		ug/L	0.500	1	07/15/06 18:57	SW846 8260B	6072505
Methyl tert-Butyl Ether	ND		ug/L	0.500	1	07/15/06 18:57	SW846 8260B	6072505
Tertiary Butyl Alcohol	ND		ug/L	10.0	1	07/15/06 18:57	SW846 8260B	6072505
Extractable Petroleum Hydrocarbons								
TPH - Oil Range	221		ug/L	95.2	1	07/16/06 01:39	SW846 8015B	6071353
Surr: o-Terphenyl (55-150%)	91 %					07/16/06 01:39	SW846 8015B	6071353
Purgeable Petroleum Hydrocarbons								
GRO as Gasoline	946		ug/L	50.0	1	07/16/06 18:10	SW846 8015B	6072740
Surr: a,a,a-Trifluorotoluene (63-134%)	106 %					07/16/06 18:10	SW846 8015B	6072740
Extractable Petroleum Hydrocarbons with Silica Gel Treatment								
Diesel	284		ug/L	47.6	1	07/16/06 01:39	SW846 8015B	6071353
Surr: o-Terphenyl (55-150%)	91 %					07/16/06 01:39	SW846 8015B	6071353

Client ERI Petaluma (10228)
601 North McDowell Blvd.
Petaluma, CA 94954
Attn Paula Sime

Work Order: NPG0854
Project Name: Exxon(06) 7-0235 PO:4507203575
Project Number: 222913X
Received: 07/08/06 08:00

ANALYTICAL REPORT

Analyte	Result	Flag	Units	MRL	Dilution Factor	Analysis Date/Time	Method	Batch
Sample ID: NPG0854-11 (RW3A - Water) Sampled: 07/05/06 15:55								
Volatile Organic Compounds by EPA Method 8021B								
Benzene	1.37		ug/L	1.00	1	07/16/06 18:29	SW846 8021B	6072740
Ethylbenzene	ND		ug/L	1.00	1	07/16/06 18:29	SW846 8021B	6072740
Toluene	ND		ug/L	1.00	1	07/16/06 18:29	SW846 8021B	6072740
Xylenes, total	ND		ug/L	3.00	1	07/16/06 18:29	SW846 8021B	6072740
Surr: <i>a,a,a</i> -Trifluorotoluene (63-134%)	97 %					07/16/06 18:29	SW846 8021B	6072740
Volatile Organic Compounds by EPA Method 8260B								
Tert-Amyl Methyl Ether	ND		ug/L	0.500	1	07/15/06 19:24	SW846 8260B	6072505
1,2-Dibromoethane (EDB)	ND		ug/L	0.500	1	07/15/06 19:24	SW846 8260B	6072505
Ethanol	ND		ug/L	50.0	1	07/15/06 19:24	SW846 8260B	6072505
1,2-Dichloroethane	ND		ug/L	0.500	1	07/15/06 19:24	SW846 8260B	6072505
Ethyl tert-Butyl Ether	ND		ug/L	0.500	1	07/15/06 19:24	SW846 8260B	6072505
Diisopropyl Ether	1.20		ug/L	0.500	1	07/15/06 19:24	SW846 8260B	6072505
Methyl tert-Butyl Ether	8.11		ug/L	0.500	1	07/15/06 19:24	SW846 8260B	6072505
Tertiary Butyl Alcohol	ND		ug/L	10.0	1	07/15/06 19:24	SW846 8260B	6072505
Extractable Petroleum Hydrocarbons								
TPH - Oil Range	ND		ug/L	95.2	1	07/16/06 01:57	SW846 8015B	6071353
Surr: <i>o</i> -Terphenyl (55-150%)	103 %					07/16/06 01:57	SW846 8015B	6071353
Purgeable Petroleum Hydrocarbons								
GRO as Gasoline	50.0		ug/L	50.0	1	07/16/06 18:29	SW846 8015B	6072740
Surr: <i>a,a,a</i> -Trifluorotoluene (63-134%)	97 %					07/16/06 18:29	SW846 8015B	6072740
Extractable Petroleum Hydrocarbons with Silica Gel Treatment								
Diesel	340		ug/L	47.6	1	07/16/06 01:57	SW846 8015B	6071353
Surr: <i>o</i> -Terphenyl (55-150%)	103 %					07/16/06 01:57	SW846 8015B	6071353

Client ERI Petaluma (10228)
 601 North McDowell Blvd.
 Petaluma, CA 94954
 Attn Paula Sime

Work Order: NPG0854
 Project Name: Exxon(06) 7-0235 PO:4507203575
 Project Number: 222913X
 Received: 07/08/06 08:00

SAMPLE EXTRACTION DATA

Parameter	Batch	Lab Number	Wt/Vol Extracted	Extracted Vol	Date	Analyst	Extraction Method
Extractable Petroleum Hydrocarbons							
SW846 8015B	6071353	NPG0854-02	1050.00	1.00	07/10/06 15:05	KLG	EPA 3510C
SW846 8015B	6071353	NPG0854-03	1050.00	1.00	07/10/06 15:05	KLG	EPA 3510C
SW846 8015B	6071353	NPG0854-04	1050.00	1.00	07/10/06 15:05	KLG	EPA 3510C
SW846 8015B	6071353	NPG0854-05	1050.00	1.00	07/10/06 15:05	KLG	EPA 3510C
SW846 8015B	6071353	NPG0854-06	1050.00	1.00	07/10/06 15:05	KLG	EPA 3510C
SW846 8015B	6071353	NPG0854-07	1050.00	1.00	07/10/06 15:05	KLG	EPA 3510C
SW846 8015B	6071353	NPG0854-08	1050.00	1.00	07/10/06 15:05	KLG	EPA 3510C
SW846 8015B	6071353	NPG0854-09	1050.00	1.00	07/10/06 15:05	KLG	EPA 3510C
SW846 8015B	6071353	NPG0854-10	1050.00	1.00	07/10/06 15:05	KLG	EPA 3510C
SW846 8015B	6071353	NPG0854-11	1050.00	1.00	07/10/06 15:05	KLG	EPA 3510C
Extractable Petroleum Hydrocarbons with Silica Gel Treatment							
SW846 8015B	6071353	NPG0854-02	1050.00	1.00	07/10/06 15:05	KLG	EPA 3510C
SW846 8015B	6071353	NPG0854-03	1050.00	1.00	07/10/06 15:05	KLG	EPA 3510C
SW846 8015B	6071353	NPG0854-04	1050.00	1.00	07/10/06 15:05	KLG	EPA 3510C
SW846 8015B	6071353	NPG0854-05	1050.00	1.00	07/10/06 15:05	KLG	EPA 3510C
SW846 8015B	6071353	NPG0854-06	1050.00	1.00	07/10/06 15:05	KLG	EPA 3510C
SW846 8015B	6071353	NPG0854-07	1050.00	1.00	07/10/06 15:05	KLG	EPA 3510C
SW846 8015B	6071353	NPG0854-08	1050.00	1.00	07/10/06 15:05	KLG	EPA 3510C
SW846 8015B	6071353	NPG0854-09	1050.00	1.00	07/10/06 15:05	KLG	EPA 3510C
SW846 8015B	6071353	NPG0854-10	1050.00	1.00	07/10/06 15:05	KLG	EPA 3510C
SW846 8015B	6071353	NPG0854-11	1050.00	1.00	07/10/06 15:05	KLG	EPA 3510C

Client ERI Petaluma (10228)
601 North McDowell Blvd.
Petaluma, CA 94954
Attn Paula Sime

Work Order: NPG0854
Project Name: Exxon(06) 7-0235 PO:4507203575
Project Number: 222913X
Received: 07/08/06 08:00

PROJECT QUALITY CONTROL DATA

Blank

Analyte	Blank Value	Q	Units	Q.C. Batch	Lab Number	Analyzed Date/Time
Volatile Organic Compounds by EPA Method 8021B						
6072740-BLK1						
Benzene	<0.440		ug/L	6072740	6072740-BLK1	07/16/06 06:06
Ethylbenzene	<0.410		ug/L	6072740	6072740-BLK1	07/16/06 06:06
Toluene	<0.540		ug/L	6072740	6072740-BLK1	07/16/06 06:06
Xylenes, total	<1.23		ug/L	6072740	6072740-BLK1	07/16/06 06:06
Surrogate: <i>a,a,a-Trifluorotoluene</i>	101%			6072740	6072740-BLK1	07/16/06 06:06
6072740-BLK2						
Benzene	<0.440		ug/L	6072740	6072740-BLK2	07/16/06 06:25
Ethylbenzene	<0.410		ug/L	6072740	6072740-BLK2	07/16/06 06:25
Toluene	<0.540		ug/L	6072740	6072740-BLK2	07/16/06 06:25
Xylenes, total	<1.23		ug/L	6072740	6072740-BLK2	07/16/06 06:25
Surrogate: <i>a,a,a-Trifluorotoluene</i>	104%			6072740	6072740-BLK2	07/16/06 06:25
6072779-BLK1						
Benzene	<0.440		ug/L	6072779	6072779-BLK1	07/17/06 14:35
Ethylbenzene	<0.410		ug/L	6072779	6072779-BLK1	07/17/06 14:35
Toluene	0.889		ug/L	6072779	6072779-BLK1	07/17/06 14:35
Xylenes, total	<1.23		ug/L	6072779	6072779-BLK1	07/17/06 14:35
Surrogate: <i>a,a,a-Trifluorotoluene</i>	108%			6072779	6072779-BLK1	07/17/06 14:35
6072779-BLK2						
Benzene	<0.440		ug/L	6072779	6072779-BLK2	07/17/06 14:54
Ethylbenzene	<0.410		ug/L	6072779	6072779-BLK2	07/17/06 14:54
Toluene	<0.540		ug/L	6072779	6072779-BLK2	07/17/06 14:54
Xylenes, total	<1.23		ug/L	6072779	6072779-BLK2	07/17/06 14:54
Surrogate: <i>a,a,a-Trifluorotoluene</i>	110%			6072779	6072779-BLK2	07/17/06 14:54
Volatile Organic Compounds by EPA Method 8260B						
6072505-BLK1						
Tert-Amyl Methyl Ether	<0.200		ug/L	6072505	6072505-BLK1	07/15/06 14:43
1,2-Dibromoethane (EDB)	<0.250		ug/L	6072505	6072505-BLK1	07/15/06 14:43
Ethanol	<30.7		ug/L	6072505	6072505-BLK1	07/15/06 14:43
1,2-Dichloroethane	<0.390		ug/L	6072505	6072505-BLK1	07/15/06 14:43
Ethyl tert-Butyl Ether	<0.200		ug/L	6072505	6072505-BLK1	07/15/06 14:43
Diisopropyl Ether	<0.200		ug/L	6072505	6072505-BLK1	07/15/06 14:43
Methyl tert-Butyl Ether	<0.200		ug/L	6072505	6072505-BLK1	07/15/06 14:43
Tertiary Butyl Alcohol	<5.06		ug/L	6072505	6072505-BLK1	07/15/06 14:43
Surrogate: <i>1,2-Dichloroethane-d4</i>	98%			6072505	6072505-BLK1	07/15/06 14:43
Surrogate: <i>Dibromofluoromethane</i>	102%			6072505	6072505-BLK1	07/15/06 14:43
Surrogate: <i>Toluene-d8</i>	93%			6072505	6072505-BLK1	07/15/06 14:43
Surrogate: <i>4-Bromofluorobenzene</i>	99%			6072505	6072505-BLK1	07/15/06 14:43

Client ERI Petaluma (10228)
 601 North McDowell Blvd.
 Petaluma, CA 94954
 Attn Paula Sime

Work Order: NPG0854
 Project Name: Exxon(06) 7-0235 PO:4507203575
 Project Number: 222913X
 Received: 07/08/06 08:00

PROJECT QUALITY CONTROL DATA
Blank - Cont.

Analyte	Blank Value	Q	Units	Q.C. Batch	Lab Number	Analyzed Date/Time
Extractable Petroleum Hydrocarbons						
6071353-BLK1						
TPH - Oil Range	58.4		ug/L	6071353	6071353-BLK1	07/15/06 19:26
Surrogate: <i>o</i> -Terphenyl	78%			6071353	6071353-BLK1	07/15/06 19:26
Purgeable Petroleum Hydrocarbons						
6072740-BLK1						
GRO as Gasoline	<39.0		ug/L	6072740	6072740-BLK1	07/16/06 06:06
Surrogate: <i>a,a,a</i> -Trifluorotoluene	101%			6072740	6072740-BLK1	07/16/06 06:06
6072740-BLK2						
GRO as Gasoline	<39.0		ug/L	6072740	6072740-BLK2	07/16/06 06:25
Surrogate: <i>a,a,a</i> -Trifluorotoluene	104%			6072740	6072740-BLK2	07/16/06 06:25
Extractable Petroleum Hydrocarbons with Silica Gel Treatment						
6071353-BLK1						
Diesel	<33.0		ug/L	6071353	6071353-BLK1	07/15/06 19:26
Surrogate: <i>o</i> -Terphenyl	78%			6071353	6071353-BLK1	07/15/06 19:26

Client ERI Petaluma (10228)
601 North McDowell Blvd.
Petaluma, CA 94954

Attn Paula Sime

Work Order: NPG0854
Project Name: Exxon(06) 7-0235 PO:4507203575
Project Number: 222913X
Received: 07/08/06 08:00

Extractable Petroleum Hydrocarbons

6G17011-ICB1

Client ERI Petaluma (10228)
 601 North McDowell Blvd.
 Petaluma, CA 94954
 Attn Paula Sime

Work Order: NPG0854
 Project Name: Exxon(06) 7-0235 PO:4507203575
 Project Number: 222913X
 Received: 07/08/06 08:00

PROJECT QUALITY CONTROL DATA
LCS

Analyte	Known Val.	Analyzed Val	Q	Units	% Rec.	Target Range	Batch	Analyzed Date/Time
Volatile Organic Compounds by EPA Method 8021B								
6072740-BS1								
Benzene	100	103		ug/L	103%	90 - 117	6072740	07/17/06 04:00
Ethylbenzene	100	95.2		ug/L	95%	89 - 119	6072740	07/17/06 04:00
Toluene	100	99.5		ug/L	100%	87 - 119	6072740	07/17/06 04:00
Xylenes, total	200	210		ug/L	105%	83 - 117	6072740	07/17/06 04:00
Surrogate: a,a,a-Trifluorotoluene	30.0	30.5			102%	63 - 134	6072740	07/17/06 04:00
6072740-BS2								
Surrogate: a,a,a-Trifluorotoluene	30.0	32.9			110%	63 - 134	6072740	07/17/06 04:38
6072779-BS1								
Benzene	100	106	MNR1	ug/L	106%	90 - 117	6072779	07/18/06 06:01
Ethylbenzene	100	100	MNR1	ug/L	100%	89 - 119	6072779	07/18/06 06:01
Toluene	100	104	MNR1	ug/L	104%	87 - 121	6072779	07/18/06 06:01
Xylenes, total	200	223	MNR1	ug/L	112%	83 - 121	6072779	07/18/06 06:01
Surrogate: a,a,a-Trifluorotoluene	30.0	32.8			109%	63 - 134	6072779	07/18/06 06:01
6072779-BS2								
Benzene	100	104	MNR1	ug/L	104%	90 - 117	6072779	07/18/06 06:19
Ethylbenzene	100	93.4	MNR1	ug/L	93%	89 - 119	6072779	07/18/06 06:19
Toluene	100	99.6	MNR1	ug/L	100%	87 - 121	6072779	07/18/06 06:19
Xylenes, total	200	208	MNR1	ug/L	104%	83 - 121	6072779	07/18/06 06:19
Surrogate: a,a,a-Trifluorotoluene	30.0	30.0			100%	63 - 134	6072779	07/18/06 06:19
Volatile Organic Compounds by EPA Method 8260B								
6072505-BS1								
Tert-Amyl Methyl Ether	50.0	49.7		ug/L	99%	56 - 145	6072505	07/15/06 13:46
1,2-Dibromoethane (EDB)	50.0	46.9		ug/L	94%	75 - 128	6072505	07/15/06 13:46
Ethanol	5000	4450		ug/L	89%	48 - 164	6072505	07/15/06 13:46
1,2-Dichloroethane	50.0	51.8		ug/L	104%	74 - 131	6072505	07/15/06 13:46
Ethyl tert-Butyl Ether	50.0	51.2		ug/L	102%	64 - 141	6072505	07/15/06 13:46
Diisopropyl Ether	50.0	52.2		ug/L	104%	73 - 135	6072505	07/15/06 13:46
Methyl tert-Butyl Ether	50.0	51.2		ug/L	102%	66 - 142	6072505	07/15/06 13:46
Tertiary Butyl Alcohol	500	467		ug/L	93%	42 - 154	6072505	07/15/06 13:46
Surrogate: 1,2-Dichloroethane-d4	50.0	47.8			96%	70 - 130	6072505	07/15/06 13:46
Surrogate: Dibromofluoromethane	50.0	50.2			100%	79 - 122	6072505	07/15/06 13:46
Surrogate: Toluene-d8	50.0	48.8			98%	78 - 121	6072505	07/15/06 13:46
Surrogate: 4-Bromofluorobenzene	50.0	48.8			98%	78 - 126	6072505	07/15/06 13:46
Extractable Petroleum Hydrocarbons								
6071353-BS1								
Diesel	1000	870		ug/L	87%	49 - 118	6071353	07/15/06 20:23
Surrogate: o-Terphenyl	20.0	16.7			84%	55 - 150	6071353	07/15/06 20:23

Client ERI Petaluma (10228)
 601 North McDowell Blvd.
 Petaluma, CA 94954
 Attn Paula Sime

Work Order: NPG0854
 Project Name: Exxon(06) 7-0235 PO:4507203575
 Project Number: 222913X
 Received: 07/08/06 08:00

PROJECT QUALITY CONTROL DATA
LCS - Cont.

Analyte	Known Val.	Analyzed Val	Q	Units	% Rec.	Target Range	Batch	Analyzed Date/Time
Extractable Petroleum Hydrocarbons								
Purgeable Petroleum Hydrocarbons								
6072740-BS1								
GRO as Gasoline	1100	1790		ug/L	163%	68 - 128	6072740	07/17/06 04:00
<i>Surrogate: a,a,a-Trifluorotoluene</i>	30.0	30.5			102%	63 - 134	6072740	07/17/06 04:00
8072740-BS2								
GRO as Gasoline	1000	1000		ug/L	100%	68 - 128	6072740	07/17/06 04:38
<i>Surrogate: a,a,a-Trifluorotoluene</i>	30.0	32.9			110%	63 - 134	6072740	07/17/06 04:38
Extractable Petroleum Hydrocarbons with Silica Gel Treatment								
6071353-BS1								
Diesel	1000	870		ug/L	87%	49 - 118	6071353	07/15/06 20:23
<i>Surrogate: o-Terphenyl</i>	20.0	16.7			84%	55 - 150	6071353	07/15/06 20:23

Client ERI Petaluma (10228)
 601 North McDowell Blvd.
 Petaluma, CA 94954
 Attn Paula Sime

Work Order: NPG0854
 Project Name: Exxon(06) 7-0235 PO:4507203575
 Project Number: 222913X
 Received: 07/08/06 08:00

PROJECT QUALITY CONTROL DATA

LCS Dup

Analyte	Orig. Val.	Duplicate	Q	Units	Spike Conc	% Rec.	Target Range	RPD	Limit	Batch	Sample Duplicated	Analyzed Date/Time
Volatile Organic Compounds by EPA Method 8021B												
6072740-BSD1												
Benzene		111		ug/L	100	111%	90 - 117	7	30	6072740		07/17/06 04:19
Ethylbenzene		105		ug/L	100	105%	89 - 119	10	35	6072740		07/17/06 04:19
Toluene		108		ug/L	100	108%	87 - 119	8	33	6072740		07/17/06 04:19
Xylenes, total		233		ug/L	200	116%	83 - 117	10	33	6072740		07/17/06 04:19
Surrogate: <i>a,a,a</i> -Trifluorotoluene		33.4		ug/L	30.0	111%	63 - 134			6072740		07/17/06 04:19
6072740-BSD2												
Benzene		16.6		ug/L			90 - 117		30	6072740		07/17/06 04:57
Ethylbenzene		17.8		ug/L			89 - 119	8	35	6072740		07/17/06 04:57
Toluene		87.8		ug/L			87 - 119	5	33	6072740		07/17/06 04:57
Xylenes, total		105		ug/L			83 - 117	8	33	6072740		07/17/06 04:57
Surrogate: <i>a,a,a</i> -Trifluorotoluene		34.4		ug/L	30.0	115%	63 - 134			6072740		07/17/06 04:57
Purgeable Petroleum Hydrocarbons												
6072740-BSD1												
GRO as Gasoline		1980		ug/L	1100	180%	68 - 128	10	27	6072740		07/17/06 04:19
Surrogate: <i>a,a,a</i> -Trifluorotoluene		33.4		ug/L	30.0	111%	63 - 134			6072740		07/17/06 04:19
6072740-BSD2												
GRO as Gasoline		1110		ug/L	1000	111%	68 - 128	10	27	6072740		07/17/06 04:57
Surrogate: <i>a,a,a</i> -Trifluorotoluene		34.4		ug/L	30.0	115%	63 - 134			6072740		07/17/06 04:57

Client ERI Petaluma (10228)
601 North McDowell Blvd.
Petaluma, CA 94954
Attn Paula Sime

Work Order: NPG0854
Project Name: Exxon(06) 7-0235 PO:4507203575
Project Number: 222913X
Received: 07/08/06 08:00

PROJECT QUALITY CONTROL DATA
Matrix Spike

Analyte	Orig. Val.	MS Val	Q	Units	Spike Conc	% Rec.	Target Range	Batch	Sample Spiked	Analyzed Date/Time
Volatile Organic Compounds by EPA Method 8021B										
6072740-MS1										
Benzene	ND	58.5		ug/L	50.0	117%	54 - 147	6072740	NPG0854-05	07/17/06 02:45
Ethylbenzene	ND	54.1		ug/L	50.0	108%	50 - 155	6072740	NPG0854-05	07/17/06 02:45
Toluene	0.153	56.5		ug/L	50.0	113%	57 - 149	6072740	NPG0854-05	07/17/06 02:45
Xylenes, total	ND	117		ug/L	100	117%	51 - 151	6072740	NPG0854-05	07/17/06 02:45
<i>Surrogate: a,a,a-Trifluorotoluene</i>		30.8		ug/L	30.0	103%	63 - 134	6072740	NPG0854-05	07/17/06 02:45
6072740-MS2										
Benzene	48.9	2.71	M1	ug/L	50.0	-92%	50 - 159	6072740	NPG0892-05	07/17/06 03:23
Ethylbenzene	669	607	M1	ug/L	50.0	-124%	50 - 155	6072740	NPG0892-05	07/17/06 03:23
Toluene	7.11	62.4	M1	ug/L	50.0	111%	57 - 150	6072740	NPG0892-05	07/17/06 03:23
Xylenes, total	1180	1140	M1	ug/L	100	-40%	48 - 151	6072740	NPG0892-05	07/17/06 03:23
<i>Surrogate: a,a,a-Trifluorotoluene</i>		32.7		ug/L	30.0	109%	63 - 134	6072740	NPG0892-05	07/17/06 03:23
Volatile Organic Compounds by EPA Method 8260B										
6072505-MS1										
Tert-Amyl Methyl Ether	ND	46.7		ug/L	50.0	93%	45 - 155	6072505	NPG0866-03	07/16/06 00:29
1,2-Dibromoethane (EDB)	ND	49.8		ug/L	50.0	100%	71 - 138	6072505	NPG0866-03	07/16/06 00:29
Ethanol	46.4	4140		ug/L	5000	82%	36 - 177	6072505	NPG0866-03	07/16/06 00:29
1,2-Dichloroethane	ND	50.8		ug/L	50.0	102%	70 - 140	6072505	NPG0866-03	07/16/06 00:29
Ethyl tert-Butyl Ether	ND	47.1		ug/L	50.0	94%	57 - 148	6072505	NPG0866-03	07/16/06 00:29
Diisopropyl Ether	ND	49.7		ug/L	50.0	99%	67 - 143	6072505	NPG0866-03	07/16/06 00:29
Methyl tert-Butyl Ether	ND	46.7		ug/L	50.0	93%	55 - 152	6072505	NPG0866-03	07/16/06 00:29
Tertiary Butyl Alcohol	ND	477		ug/L	500	95%	19 - 183	6072505	NPG0866-03	07/16/06 00:29
<i>Surrogate: 1,2-Dichloroethane-d4</i>		43.1		ug/L	50.0	86%	70 - 130	6072505	NPG0866-03	07/16/06 00:29
<i>Surrogate: Dibromofluoromethane</i>		45.2		ug/L	50.0	90%	79 - 122	6072505	NPG0866-03	07/16/06 00:29
<i>Surrogate: Toluene-d8</i>		48.9		ug/L	50.0	98%	78 - 121	6072505	NPG0866-03	07/16/06 00:29
<i>Surrogate: 4-Bromofluorobenzene</i>		47.2		ug/L	50.0	94%	78 - 126	6072505	NPG0866-03	07/16/06 00:29
Purgeable Petroleum Hydrocarbons										
6072740-MS1										
GRO as Gasoline	4.60	1030		ug/L	550	186%	43 - 146	6072740	NPG0854-05	07/17/06 02:45
<i>Surrogate: a,a,a-Trifluorotoluene</i>		30.8		ug/L	30.0	103%	63 - 134	6072740	NPG0854-05	07/17/06 02:45
6072740-MS2										
GRO as Gasoline	23200	18700		ug/L	550	-818%	41 - 146	6072740	NPG0892-05	07/17/06 03:23
<i>Surrogate: a,a,a-Trifluorotoluene</i>		32.7		ug/L	30.0	109%	63 - 134	6072740	NPG0892-05	07/17/06 03:23

Client ERI Petaluma (10228)
601 North McDowell Blvd.
Petaluma, CA 94954
Attn Paula Sime

Work Order: NPG0854
Project Name: Exxon(06) 7-0235 PO:4507203575
Project Number: 222913X
Received: 07/08/06 08:00

PROJECT QUALITY CONTROL DATA
Matrix Spike Dup

Analyte	Orig. Val.	Duplicate	Q	Units	Spike Conc	% Rec.	Target Range	RPD	Limit	Batch	Sample Duplicated	Analyzed Date/Time
Volatile Organic Compounds by EPA Method 8021B												
6072740-MSD1												
Benzene	ND	58.0		ug/L	50.0	116%	54 - 147	0.9	30	6072740	NPG0854-05	07/17/06 03:04
Ethylbenzene	ND	53.5		ug/L	50.0	107%	50 - 155	1	35	6072740	NPG0854-05	07/17/06 03:04
Toluene	0.153	55.6		ug/L	50.0	111%	57 - 149	2	33	6072740	NPG0854-05	07/17/06 03:04
Xylenes, total	ND	118		ug/L	100	118%	51 - 151	0.9	33	6072740	NPG0854-05	07/17/06 03:04
Surrogate: <i>a,a,a</i> -Trifluorotoluene		32.5		ug/L	30.0	108%	63 - 134			6072740	NPG0854-05	07/17/06 03:04
6072740-MSD2												
Benzene	48.9	3.25	M1	ug/L	50.0	-91%	50 - 159	18	33	6072740	NPG0892-05	07/18/06 05:42
Ethylbenzene	669	660	M1	ug/L	50.0	-18%	50 - 155	8	35	6072740	NPG0892-05	07/18/06 05:42
Toluene	7.11	68.6	M1	ug/L	50.0	123%	57 - 150	9	33	6072740	NPG0892-05	07/18/06 05:42
Xylenes, total	1180	1200	M1	ug/L	100	20%	48 - 151	5	35	6072740	NPG0892-05	07/18/06 05:42
Surrogate: <i>a,a,a</i> -Trifluorotoluene		31.4		ug/L	30.0	105%	63 - 134			6072740	NPG0892-05	07/18/06 05:42
Volatile Organic Compounds by EPA Method 8260B												
6072505-MSD1												
Tert-Amyl Methyl Ether	ND	51.2		ug/L	50.0	102%	45 - 155	9	24	6072505	NPG0866-03	07/16/06 00:57
1,2-Dibromoethane (EDB)	ND	49.0		ug/L	50.0	98%	71 - 138	2	27	6072505	NPG0866-03	07/16/06 00:57
Ethanol	46.4	4520		ug/L	5000	89%	36 - 177	9	45	6072505	NPG0866-03	07/16/06 00:57
1,2-Dichloroethane	ND	53.7		ug/L	50.0	107%	70 - 140	6	21	6072505	NPG0866-03	07/16/06 00:57
Ethyl tert-Butyl Ether	ND	51.9		ug/L	50.0	104%	57 - 148	10	22	6072505	NPG0866-03	07/16/06 00:57
Diisopropyl Ether	ND	54.4		ug/L	50.0	109%	67 - 143	9	22	6072505	NPG0866-03	07/16/06 00:57
Methyl tert-Butyl Ether	ND	51.6		ug/L	50.0	103%	55 - 152	10	27	6072505	NPG0866-03	07/16/06 00:57
Tertiary Butyl Alcohol	ND	526		ug/L	500	105%	19 - 183	10	39	6072505	NPG0866-03	07/16/06 00:57
Surrogate: <i>1,2</i> -Dichloroethane- <i>d4</i>		45.9		ug/L	50.0	92%	70 - 130			6072505	NPG0866-03	07/16/06 00:57
Surrogate: <i>Dibromofluoromethane</i>		49.0		ug/L	50.0	98%	79 - 122			6072505	NPG0866-03	07/16/06 00:57
Surrogate: <i>Toluene-d8</i>		48.4		ug/L	50.0	97%	78 - 121			6072505	NPG0866-03	07/16/06 00:57
Surrogate: <i>4-Bromofluorobenzene</i>		48.0		ug/L	50.0	96%	78 - 126			6072505	NPG0866-03	07/16/06 00:57
Purgeable Petroleum Hydrocarbons												
6072740-MSD1												
GRO as Gasoline	4.60	1030		ug/L	550	186%	43 - 146	0	27	6072740	NPG0854-05	07/17/06 03:04
Surrogate: <i>a,a,a</i> -Trifluorotoluene		32.5		ug/L	30.0	108%	63 - 134			6072740	NPG0854-05	07/17/06 03:04
6072740-MSD2												
GRO as Gasoline	23200	20800		ug/L	550	-436%	41 - 146	11	30	6072740	NPG0892-05	07/18/06 05:42
Surrogate: <i>a,a,a</i> -Trifluorotoluene		31.4		ug/L	30.0	105%	63 - 134			6072740	NPG0892-05	07/18/06 05:42

Client ERI Petaluma (10228)
601 North McDowell Blvd.
Petaluma, CA 94954
Attn Paula Sime

Work Order: NPG0854
Project Name: Exxon(06) 7-0235 PO:4507203575
Project Number: 222913X
Received: 07/08/06 08:00

CERTIFICATION SUMMARY

TestAmerica - Nashville, TN

Method	Matrix	AIHA	Nelac	California
SW846 8015B	Water			
SW846 8015B	Water	N/A	X	X
SW846 8021B	Water	N/A	X	X
SW846 8260B	Water	N/A	X	X

Client ERI Petaluma (10228)
601 North McDowell Blvd.
Petaluma, CA 94954

Attn Paula Sime

Work Order: NPG0854
Project Name: Exxon(06) 7-0235 PO:4507203575
Project Number: 222913X
Received: 07/08/06 08:00

NELAC CERTIFICATION SUMMARY

TestAmerica Analytical - Nashville does not hold NELAC certifications for the following analytes included in this report

<u>Method</u>	<u>Matrix</u>	<u>Analyte</u>
SW846 8015B	Water	Diesel

Client ERI Petaluma (10228)
601 North McDowell Blvd.
Petaluma, CA 94954

Attn Paula Sime

Work Order: NPG0854
Project Name: Exxon(06) 7-0235 PO:4507203575
Project Number: 222913X
Received: 07/08/06 08:00

DATA QUALIFIERS AND DEFINITIONS

ID2 Secondary ion abundances were outside method requirements. Identification based on analytical judgement.
M1 The MS and/or MSD were above the acceptance limits due to sample matrix interference. See Blank Spike (LCS).
MNR1 There was no MS/MSD analyzed with this batch due to insufficient sample volume. See Blank Spike.

METHOD MODIFICATION NOTES



Nashville Division
COOLER RECEIPT FORM

BC#

NPG0854

Cooler Received/Opened On 7/8/06 8:00

1. Indicate the Airbill Tracking Number (last 4 digits for Fedex only) and Name of Courier below: 3487

Fed-Ex UPS Velocity DHL Route Off-street Misc.

2. Temperature of representative sample or temperature blank when opened: 3.2 Degrees Celsius (indicate IR Gun ID#)

NA A00466 A00750 A01124 100190 101282 102594

3. Were custody seals on outside of cooler?..... YES...NO...NA

a. If yes, how many and where: 2 Front

4. Were the seals intact, signed, and dated correctly?..... YES...NO...NA

5. Were custody papers inside cooler?..... YES...NO...NA

I certify that I opened the cooler and answered questions 1-5 (initial)..... JR

6. Were custody seals on containers: YES NO and Intact YES NO NA
were these signed, and dated correctly?..... YES...NO...NA

7. What kind of packing material used? Bubblewrap Peanuts Vermiculite Foam Insert
Plastic bag Paper Other _____ None

8. Cooling process: Ice Ice-pack Ice (direct contact) Dry ice Other None

9. Did all containers arrive in good condition (unbroken)?..... YES...NO...NA

10. Were all container labels complete (#, date, signed, pres., etc)?..... YES...NO...NA

11. Did all container labels and tags agree with custody papers?..... YES...NO...NA

12. a. Were VOA vials received?..... YES...NO...NA

b. Was there any observable head space present in any VOA vial?..... YES...NO...NA

I certify that I unloaded the cooler and answered questions 6-12 (initial).....

13. a. On preserved bottles did the pH test strips suggest that preservation reached the correct pH level? YES...NO...NA

b. Did the bottle labels indicate that the correct preservatives were used..... YES...NO...NA

If preservation in-house was needed, record standard ID of preservative used here _____

14. Was residual chlorine present?..... YES...NO...NA

I certify that I checked for chlorine and pH as per SOP and answered questions 13-14 (initial).....

15. Were custody papers properly filled out (ink, signed, etc)?..... YES...NO...NA

16. Did you sign the custody papers in the appropriate place?..... YES...NO...NA

17. Were correct containers used for the analysis requested?..... YES...NO...NA

18. Was sufficient amount of sample sent in each container?..... YES...NO...NA

I certify that I entered this project into LIMS and answered questions 15-18 (initial).....

I certify that I attached a label with the unique LIMS number to each container (initial).....

19. Were there Non-Conformance issues at login YES NO Was a PIPE generated YES NO # _____

BIS = Broken in shipment
Cooler Receipt Form



408-776-9600

Morgan Hill Division

885 Jarvis Drive

Morgan Hill, CA 95037



Consultant Name: Environmental Resolutions, Inc.

Address: 601 North McDowell Blvd.

City/State/Zip: Petaluma, California 94954

Project Manager: Paula Sime

Telephone Number: (707) 766-2000

ERI Job Number: 222913X

Sampler Name: (Print) Shawn Baker

Sampler Signature: [Signature]

ExxonMobil Engineer Jennifer Sedlachek

Telephone Number (510) 547-8196

Account #: 3876

PO #: 4507203575

Facility ID # 70235

Global ID# T0600101354

Site Address 2225 Telegraph Avenue

City, State Zip Oakland, California

Shipping Method: Lab Courier Hand Deliver Commercial Express Other: _____

TAT
 24 hour 72 hour
 48 hour 96 hour
 8 day

PROVIDE:
 EDF Report

Special Instructions:
 7 CA Oxys = MTBE, TBA, TAME, ETBE, DIPE, 1,2-DCA, EDB.
 Use silica gel cleanup for all TPHd analyses.
 Use 8260B SIM for TBA analyses TBA detection limit 5ug/L

Matrix: Water, Soil, Vapor
 Analyze For: TPHd 8015B, TPHg 8015B, TPH motor oil 8015B, BTEX 8021B, 7 CA Oxys 8260B, Ethanol 8260B

Sample ID / Description	DATE	TIME	COMP	GRAB	PRESERV (VOA/liter)	NUMBER	Water	Soil	Vapor	TPHd 8015B	TPHg 8015B	TPH motor oil 8015B	BTEX 8021B	7 CA Oxys 8260B	Ethanol 8260B			
QCBB	7-5-06	1140			HCL/none	2 VOAs	X				H	O	L	D			NPG0854-01	
MW6B		1630			HCL/none	8 VOAs/ 2 AMBs	X			X	X	X	X	X	X			2
MW6E		1430			HCL/none	8 VOAs/ 2 AMBs	X			X	X	X	X	X	X			3
MW6F		1455			HCL/none	8 VOAs/ 2 AMBs	X			X	X	X	X	X	X			4
MW6G		1515			HCL/none	8 VOAs/ 2 AMBs	X			X	X	X	X	X	X			5
MW6H		1645			HCL/none	8 VOAs/ 2 AMBs	X			X	X	X	X	X	X			6
MW6I		1410			HCL/none	8 VOAs/ 2 AMBs	X			X	X	X	X	X	X			7
MW6J		1145			HCL/none	8 VOAs/ 2 AMBs	X			X	X	X	X	X	X			8
RW1		1615			HCL/none	8 VOAs/ 2 AMBs	X			X	X	X	X	X	X			9
RW2		1535			HCL/none	8 VOAs/ 2 AMBs	X			X	X	X	X	X	X			10
RW3A		1555			HCL/none	8 VOAs/ 2 AMBs	X			X	X	X	X	X	X			11

Relinquished by: Shawn Baker Date 7-5-06 Time 1835 Received by: Apple Fring P Time 1835

Relinquished by: Alonzy Date 7-6-06 Time 1210 Received by TestAmerica: [Signature] Time 1408

Laboratory Comments: 3-2
 Temperature Upon Receipt:
 Sample Containers Intact?
 VOAs Free of Headspace?

(Rec) [Signature] 1900
[Signature] 7/7/06 12pm
[Signature] 7/8/06 8:00

ATTACHMENT C
WASTE DISPOSAL DOCUMENTATION

2229 13X

SHIPPER NO. B 021491

CARRIER NO. _____

DATE: 7-5-06

STRAIGHT BILL OF LADING—SHORT FORM—Original—Not Negotiable

ENVIRONMENTAL RESOLUTIONS

NAME OF CARRIER)

(SCAC)

TO

CONSIGNEE ROMIC ENVIRONMENTAL TECHN. CORP.
2081 BAY ROAD
 STREET EAST PALO ALTO, CA. 94303

DESTINATION _____ STATE _____ ZIP _____

FROM

SHIPPER EXXON MOBIL CORPORATION
C/O ERI
 STREET 501 N. MCDOWELL BOULEVARD
PETALUMA, CA 94954

ORIGIN _____ STATE _____ ZIP _____

ROUTE: _____ U.S. DOT Hazmat Reg. No. _____ VEHICLE NUMBER _____

CAD 981 411 085

NO. SHIPPING UNIT	HM	Description of articles, special marks, and exceptions	*WEIGHT (Subject to correction)	Class or Rate	CHARGES (For carrier use only)	Check column
		GROUNDWATER MONITORING WELL PURGE WATER PROFILE: 301560 HANDLING CODE: <u>01</u> RECEIVED BY: <u>Quyen Ly 7/14/06</u> PLACARDS TENDERED: YES _____ NO <u>X</u> PO# _____ EWR# <u>7-0235</u> STORE NAME: <u>2225 Telegraph Ave</u> STORE ADDRESS: <u>Oakland Ca</u>				<div style="border: 1px solid black; border-radius: 50%; width: 100px; height: 100px; display: flex; align-items: center; justify-content: center; margin: 0 auto;"> 147 gal </div>

EMIT C.O.D. TO: _____ ADDRESS: _____ CITY: _____ STATE _____ ZIP _____

COD AMT: \$

C.O.D. Fee: PREPAID COLLECT \$

If the shipment moves between two ports by a carrier by water, the law requires that the bill of lading shall state whether it is "carrier's or shipper's weight".

Note - where the rate is dependent on value, shippers are required to state specifically in writing the agreed or declared value of the property.

The agreed or declared value of the property is hereby specifically stated by the shipper to be not exceeding _____ per _____

Subject to Section 7 of conditions of applicable bill of lading, if this shipment is to be delivered to the consignee without recourse on the consignor, the consignor shall sign the following statement:
 The carrier shall not make delivery of this shipment without payment of freight and all other lawful charges.

(Signature of Consignor)

TOTAL CHARGES: \$

FREIGHT CHARGES

Freight Prepaid except when box at right is checked Check box if charges to be collect

RECEIVED, subject to the classifications and tariffs in effect on the date of this Bill of Lading, the property described above in apparent good order, except as noted (contents and condition of contents of packages unknown marked, consigned, and destined as indicated above, which said company (the word company being understood throughout this contract as meaning any person or corporation in possession of the property under the contract) agrees to carry to its usual place of delivery at said destination, if on its own road or its own water line, otherwise to deliver to another carrier on the route to said destination. It is mutually agreed as to each carrier, l or any of said property over all or any portion of said route to destination, and as to each party at any time interested in all or any of said property, that every service to be performed hereunder shall be subject to all the conditions not prohibited by law, whether printed or written, herein contained (as specified in Appendix B to Part 1035) which are hereby agreed to by the shipper and accepted for himself and his assigns.

This is to certify that the above-named materials are properly classified, described, packaged, marked, and labeled, and are in proper condition for transportation according to the applicable regulations of the Department of Transportation PER:

SHIPPER: EXXON MOBIL REFINING & SUPPLIES CARRIER: ENVIRONMENTAL RESOLUTIONS

PER: Request Exxon Mobil PER: Exxon Mobil

DATE: 7-14-06

EMERGENCY RESPONSE
TELEPHONE NUMBER: 800-766-4248

MONITORED AT ALL TIMES THE HAZARDOUS MATERIAL IS IN TRANSPORTATION INCLUDING STORAGE INCIDENTAL TO TRANSPORTATION. (172.604)

Mark with "X" to designate Hazardous Material as defined in The Department of Transportation Regulations Governing Transportation of Hazardous Materials. The use of this column is an optional method of designating hazardous materials on Bills of Lading per Section 172.201 and 172.202(b) of the regulations governing the transportation of such materials.