



Texaco Refining
and Marketing Inc

138 Cutting Boulevard
Richmond, CA 94601

ENVIRONMENTAL
PROTECTION

97 JAN 10 AM 11:23

January 7, 1997

ENV - STUDIES, SURVEYS & REPORTS

Former Texaco/Current Exxon Service Station
2225 Telegraph Ave., Oakland, California
Quarterly Monitoring Report

STD
1039

Mr. Dale Klettke, CHMM
Hazardous Materials Specialist
Alameda County
Environmental Health Services
1131 Harbor Bay Parkway, #250
Alameda, CA 94502-6577

Dear Mr. Klettke:

This letter presents the results of groundwater monitoring and sampling conducted by Blaine Tech Services, Inc. on November 26, 1996, at the site referenced above (see Plate 1, Site Vicinity Map). Based on groundwater level measurements, the areal hydraulic gradient was estimated to be south (see Plate 2, Groundwater Gradient Map). TPHg and benzene concentrations are shown on Plate 3. Tables 1 and 2 list historical groundwater monitoring data and analytical results, respectively.

The certified analytical report, chain-of-custody, field data sheets, bill of lading, and quarterly summary report are in the Appendix. Texaco's Standard Operating Procedures may be found in the first quarter, 1995 monitoring report.

If you have any questions or comments regarding this site, please call the Texaco Project Coordinator, Ms. Karen Petryna at (510) 236-9139.

Best Regards,

Rebecca Digerness
Environmental Assistant

Karen E. Petryna, P. E.
Project Manager
Texaco Refining and Marketing, Inc.



RBD:hs
C:\QMR\2225T\QMR.LET

Enclosure

cc: Mr. Richard Hiett
CRWQCB - San Francisco Bay Region
2101 Webster Street, Suite 500
Oakland, CA 94612

Mr. Michael Faber
Exxon Company, USA
2300 Clayton Road, Suite 1250
Concord, CA 94524-2032

Mr. Timothy Ross
Kaprealian Engineering, Inc.
2401 Stanwell Dr., Suite 400
Concord, CA 94520

RRZielinski (w/o enclosure) RAOfFile-UCPFile (w/enclosure)

pr: EG

**Groundwater Monitoring and Sampling
Fourth Quarter, 1996
at the
Former Texaco / Current Exxon Service Station
2225 Telegraph Avenue
Oakland, CA**

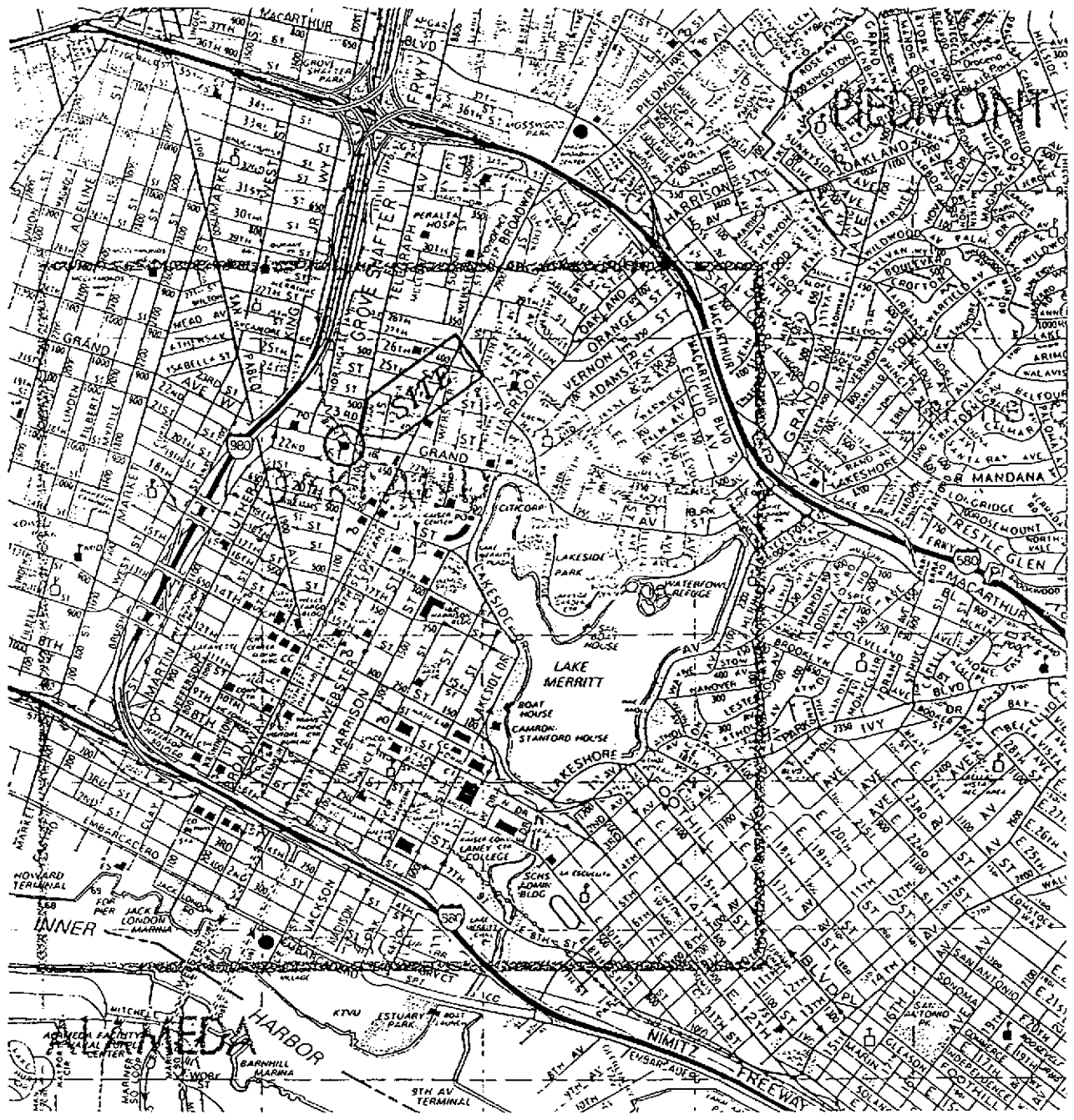

SOURCE:

1993 THE THOMAS GUIDE
ALAMEDA COUNTY, PAGE 9 (B5)

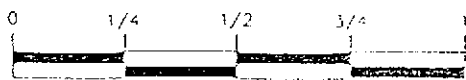

1" = 2200'



TEXACO

REFINING AND MARKETING, INC.
TEXACO ENVIRONMENTAL SERVICES

PLATE 1

SITE VICINITY MAP





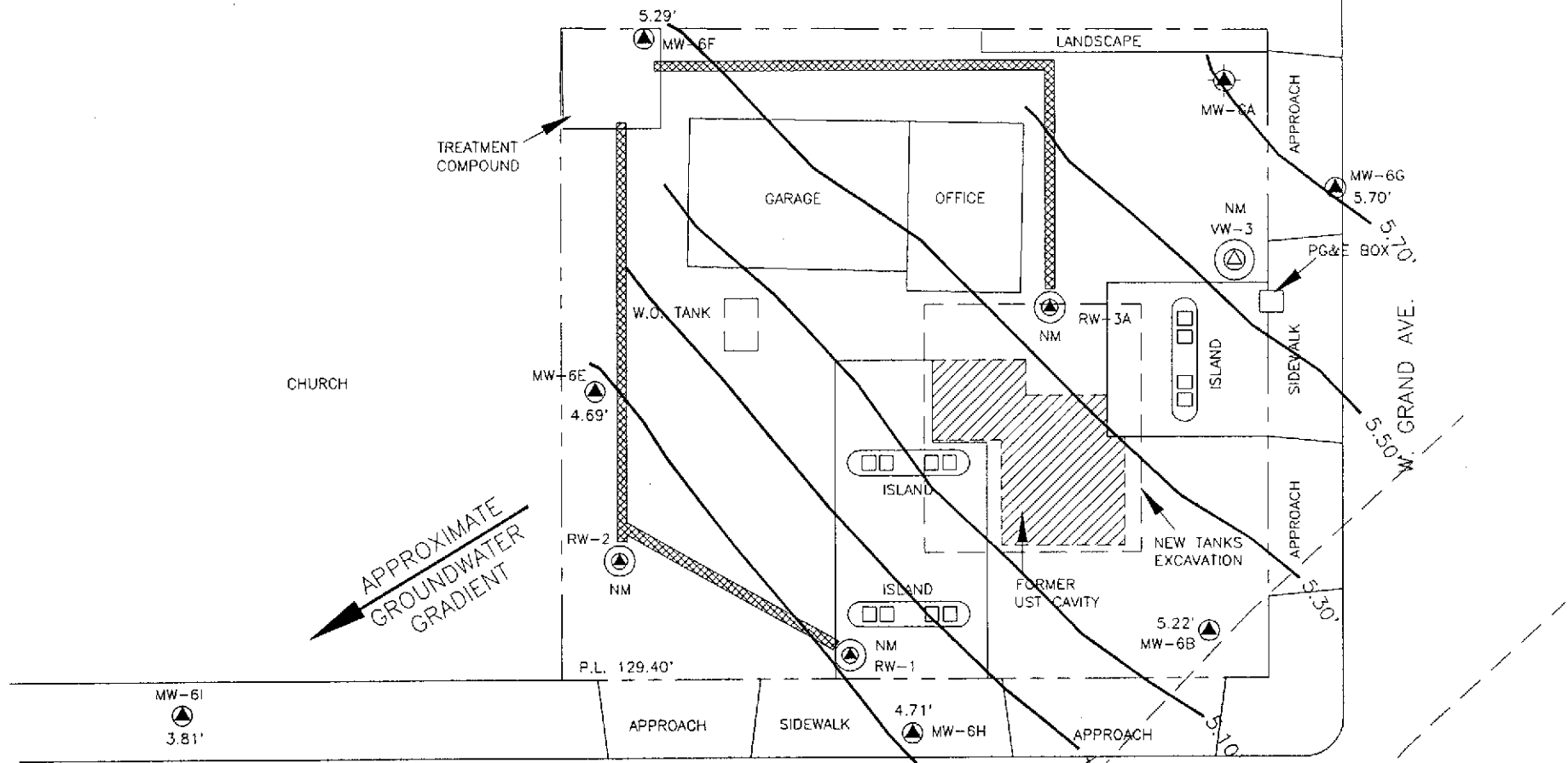

FORMER TEXACO SERVICE STATION

2225 TELEGRAPH AVE. / GRAND AVE.,

OAKLAND, CALIFORNIA



LEGEND :



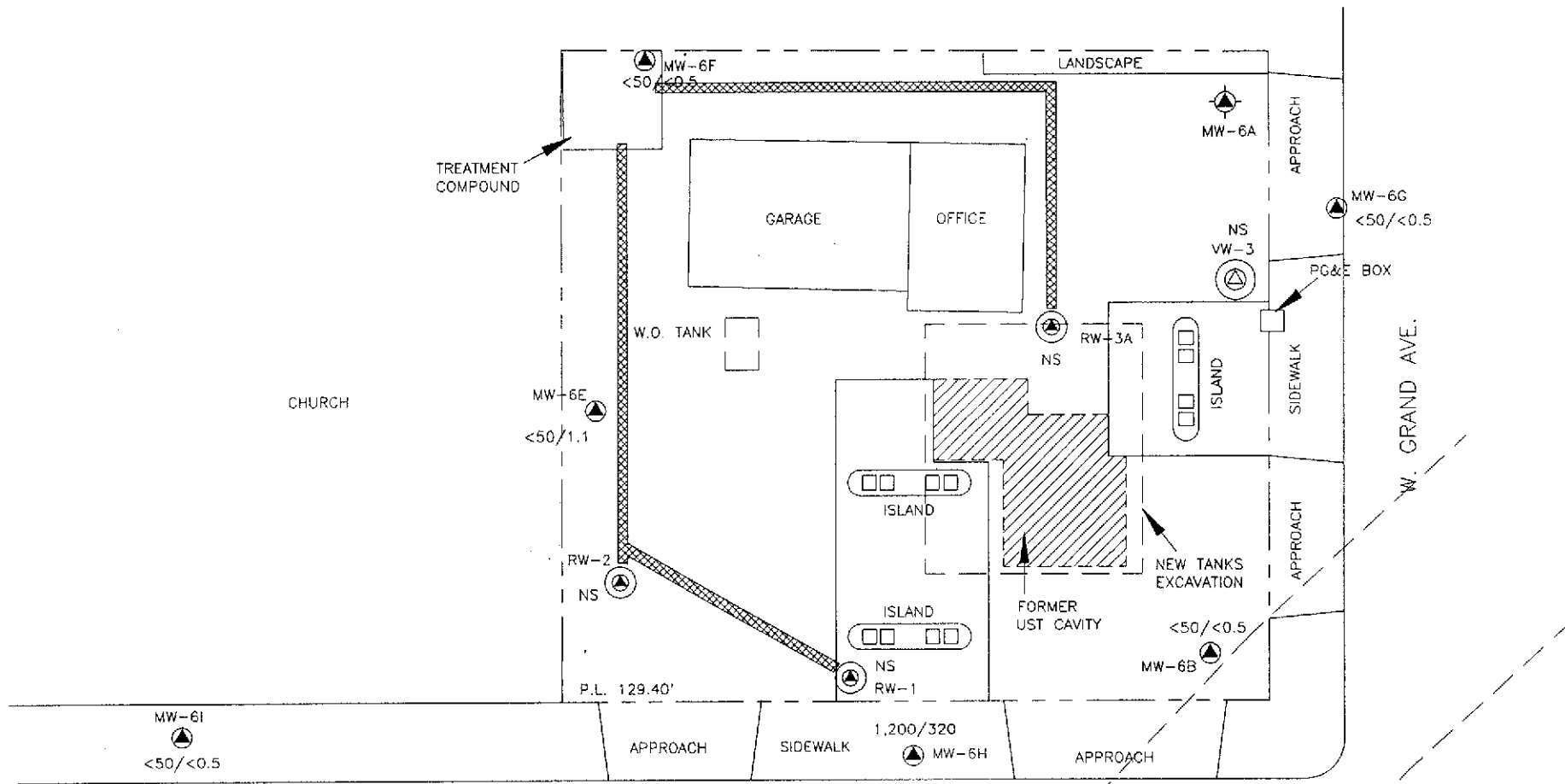

-  VAPOR EXTRACTION WELL LOCATION AND WELL NUMBER
-  PROPERLY ABANDONED WELL LOCATION AND WELL NUMBER
-  GROUNDWATER MONITORING WELL LOCATION AND WELL NUMBER
-  GROUNDWATER RECOVERY/VAPOR EXTRACTION WELL LOCATION AND WELL NUMBER
-  TEXACO REMEDIATION SYSTEM TRENCH WITH 2" PVC VAPOR EXTRACTION LINE
-  GROUNDWATER CONTOUR LINE
- 4.71' GROUNDWATER ELEVATION (ABOVE MSL)
- NM WELL NOT MEASURED

SOURCE : MATTESON ENGINEERING CONDUCTED SURVEY ON 08/04/1994

	
TEXACO REFINING AND MARKETING INC. ENVIRONMENT, HEALTH AND SAFETY	
PLATE 2 : GROUNDWATER GRADIENT MAP (11/26/1996)	
FORMER TEXACO SERVICE STATION 2225 TELEGRAPH AVE. / GRAND AVE., OAKLAND, CALIFORNIA	
SCALE 1" = 30'-0"	LOCATION # 62-488-0195
DRAWN BY <i>RBD</i>	DATE
CHECKED BY <i>KED</i>	DATE 1-8-97
DRAWING NO. (OAKLAND) TE-CR-OK-DWG	



LEGEND :

-  VAPOR EXTRACTION WELL LOCATION AND WELL NUMBER
VW-3
-  PROPERLY ABANDONED WELL LOCATION AND WELL NUMBER
MW-6A
-  GROUNDWATER MONITORING WELL LOCATION AND WELL NUMBER
MW-1
-  GROUNDWATER RECOVERY/VAPOR EXTRACTION WELL LOCATION AND WELL NUMBER
RW-1
-  TEXACO REMEDIATION SYSTEM TRENCH WITH 1/2" PVC VAPOR EXTRACTION LINE
- <50/<0.5 TPHq/BENZENE CONCENTRATION IN GROUNDWATER (ppb)
- NS WELL NOT SAMPLED

TELEGRAPH AVE.

APPROXIMATE LOCATION OF BART TUNNEL

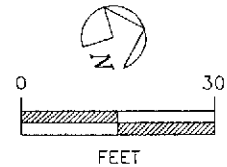

SOURCE : MATTESON ENGINEERING CONDUCTED SURVEY ON 08/04/1994

 TEXACO	
REFINING AND MARKETING INC. ENVIRONMENT, HEALTH AND SAFETY	
PLATE 3 : TPHq/BENZENE CONCENTRATION IN GROUNDWATER (11/26/1996) FORMER TEXACO SERVICE STATION 2225 TELEGRAPH AVE. / GRAND AVE., OAKLAND, CALIFORNIA	
SCALE 1"=30'-0"	LOCATION # 62-488-0195
DRAWN BY RBD	DATE
CHECKED BY KKP	DATE 1-8-97
DRAWING NO. (OAKLAND) TE-GR-OK.DWG	

Table 1
Groundwater Elevation Data
2225 Telegraph Avenue, Oakland, CA

Well Number	Date Gauged	Top of Casing Elevation (feet)	Depth to Water (feet, TOC)	Elevation of Groundwater (feet)
MW-6A	12/30/91			Well Destroyed
MW-6B	2/25/92	17.48	11.81	5.67
MW-6B	3/25/92	17.48	11.58	5.90
MW-6B	6/16/92	17.48	12.54	4.94
MW-6B	9/8/92	17.48	12.87	4.61
MW-6B	11/5/92	17.48	12.70	4.78
MW-6B	12/14/92	17.48	12.19	5.29
MW-6B	1/28/93	17.48	11.39	6.09
MW-6B	2/11/93	17.48	11.70	5.78
MW-6B	3/9/93	17.48	11.70	5.78
MW-6B	4/14/93	17.48	11.87	5.61
MW-6B	5/11/93	17.48	12.22	5.26
MW-6B	6/17/93	17.48	12.46	5.02
MW-6B	7/26/93	17.48	12.72	4.76
MW-6B	8/10/93	17.48	12.82	4.66
MW-6B	9/21/93	17.48	13.08	4.40
MW-6B	10/27/93	17.48	13.18	4.30
MW-6B	11/23/93	17.48	13.07	4.41
MW-6B	12/17/93	17.48	NA	NA
MW-6B	2/16/94	17.48	12.07	5.41
MW-6B	5/31/94	17.48	12.42	5.06
MW-6B	8/30/94	17.48	13.02	4.46
MW-6B	11/11/94	17.48	11.72	5.76
MW-6B	2/27/95	17.48	11.84	5.64
MW-6B	5/30/95	17.48	12.09	5.39
MW-6B	8/30/95	17.48	12.76	4.72
MW-6B	10/25/95	17.48	13.03	4.45
MW-6B	2/24/96	17.48	11.48	6.00
MW-6B	4/22/96	17.48	12.91	4.57
MW-6B	11/26/96	17.48	12.26	5.22
MW-6E	2/25/92	17.63	13.16	4.47
MW-6E	3/25/92	17.63	12.15	5.48
MW-6E	6/16/92	17.63	13.54	4.09
MW-6E	9/8/92	17.63	14.78	2.85
MW-6E	11/5/92	17.63		Not Monitored
MW-6E	12/14/92	17.63		Not Monitored
MW-6E	1/28/93	17.63	11.62	6.01
MW-6E	2/11/93	17.63	12.85	4.78
MW-6E	3/9/93	17.63	12.83	4.80
MW-6E	4/14/93	17.63		Not Monitored
MW-6E	5/11/93	17.63	13.59	4.04
MW-6E	6/17/93	17.63	13.74	3.89
MW-6E	7/26/93	17.63	14.01	3.62
MW-6E	8/10/93	17.63	14.13	3.50

Table 1
Groundwater Elevation Data
2225 Telegraph Avenue, Oakland, CA

Well Number	Date Gauged	Top of Casing Elevation (feet)	Depth to Water (feet, TOC)	Elevation of Groundwater (feet)
MW-6E	9/21/93	17.63	14.20	3.43
MW-6E	10/27/93	17.63	14.34	3.29
MW-6E	11/23/93	17.63	13.97	3.66
MW-6E	12/17/93	17.63	13.08	4.55
MW-6E	2/16/94	17.63	13.34	4.29
MW-6E	5/31/94	17.63	13.82	3.81
MW-6E	8/30/94	17.63	14.32	3.31
MW-6E	11/11/94	17.63	13.92	3.71
MW-6E	2/27/95	17.63	12.96	4.67
MW-6E	5/30/95	17.63	13.20	4.43
MW-6E	8/30/95	17.63	13.85	3.78
MW-6E	10/25/95	17.63	13.96	3.67
MW-6E	2/24/96	17.63	11.80	5.83
MW-6E	4/22/96	17.63	12.45	5.18
MW-6E	11/26/96	17.63	12.94	4.69
MW-6F	2/25/92	18.58	12.68	5.90
MW-6F	3/25/92	18.58	11.93	6.65
MW-6F	6/16/92	18.58	14.34	4.24
MW-6F	9/8/92	18.58	14.75	3.83
MW-6F	11/5/92	18.58	14.35	4.23
MW-6F	12/14/92	18.58	12.90	5.68
MW-6F	1/28/93	18.58	11.60	6.98
MW-6F	2/11/93	18.58	12.25	6.33
MW-6F	3/9/93	18.58	12.50	6.08
MW-6F	4/14/93	18.58	12.71	5.87
MW-6F	5/11/93	18.58	13.63	4.95
MW-6F	6/17/93	18.58	14.02	4.56
MW-6F	7/26/93	18.58		Not Monitored
MW-6F	8/10/93	18.58		Not Monitored
MW-6F	9/21/93	18.58	14.80	3.78
MW-6F	10/27/93	18.58	14.85	3.73
MW-6F	11/23/93	18.58	Not Monitored - Inaccessible	
MW-6F	12/17/93	18.58	13.86	4.72
MW-6F	2/16/94	18.58	13.08	5.50
MW-6F	5/31/94	18.58	14.06	4.52
MW-6F	8/30/94	18.58	14.84	3.74
MW-6F	11/11/94	18.58	12.60	5.98
MW-6F	2/27/95	18.58	12.75	5.83
MW-6F	5/30/95	18.58	13.16	5.42
MW-6F	8/30/95	18.58	14.31	4.27
MW-6F	10/25/95	18.58	14.40	4.18
MW-6F	2/24/96	18.58	10.88	7.70
MW-6F	4/22/96	18.58	12.56	6.02
MW-6F	11/26/96	18.58	13.29	5.29

Table 1
Groundwater Elevation Data
2225 Telegraph Avenue, Oakland, CA

Well Number	Date Gauged	Top of Casing Elevation (feet)	Depth to Water (feet, TOC)	Elevation of Groundwater (feet)
MW-6G	2/25/92	16.82	10.32	6.50
MW-6G	3/25/92	16.82	9.93	6.89
MW-6G	6/16/92	16.82	11.88	4.94
MW-6G	9/8/92	16.82	12.20	4.62
MW-6G	11/5/92	16.82	12.02	4.80
MW-6G	12/14/92	16.82	10.95	5.87
MW-6G	1/28/93	16.82	9.56	7.26
MW-6G	2/11/93	16.82	10.04	6.78
MW-6G	3/9/93	16.82	10.10	6.72
MW-6G	4/14/93	16.82	10.43	6.39
MW-6G	5/11/93	16.82	11.05	5.77
MW-6G	6/17/93	16.82	11.49	5.33
MW-6G	7/26/93	16.82	11.98	4.84
MW-6G	8/10/93	16.82	12.17	4.65
MW-6G	9/21/93	16.82	12.42	4.40
MW-6G	10/27/93	16.82	13.47	3.35
MW-6G	11/23/93	16.82	12.48	4.34
MW-6G	12/17/93	16.82	11.19	5.63
MW-6G	2/16/94	16.82	10.62	6.20
MW-6G	5/31/94	16.82	11.40	5.42
MW-6G	8/30/94	16.82	12.32	4.50
MW-6G	11/11/94	16.82	11.06	5.76
MW-6G	2/27/95	16.82	10.32	6.50
MW-6G	5/30/95	16.82	10.77	6.05
MW-6G	8/30/95	16.82	11.92	4.90
MW-6G	10/25/95	16.82	12.11	4.71
MW-6G	2/24/96	16.82	9.47	7.35
MW-6G	4/22/96	16.82	10.43	6.39
MW-6G	11/26/96	16.82	11.12	5.70
MW-6H	2/25/92	16.58	12.17	4.41
MW-6H	3/25/92	16.58	11.65	4.93
MW-6H	6/16/92	16.58	12.12	4.46
MW-6H	9/8/92	16.58	12.30	4.28
MW-6H	11/5/92	16.58	12.05	4.53
MW-6H	12/14/92	16.58	11.65	4.93
MW-6H	1/28/93	16.58	11.57	5.01
MW-6H	2/11/93	16.58	12.22	4.36
MW-6H	3/9/93	16.58	12.02	4.56
MW-6H	4/14/93	16.58	12.02	4.56
MW-6H	5/11/93	16.58	12.35	4.23
MW-6H	6/17/93	16.58	12.22	4.36
MW-6H	7/26/93	16.58	12.32	4.26
MW-6H	8/10/93	16.58	12.30	4.28
MW-6H	9/21/93	16.58	12.79	3.79
MW-6H	10/27/93	16.58	13.93	2.65

Table 1
Groundwater Elevation Data
2225 Telegraph Avenue, Oakland, CA

Well Number	Date Gauged	Top of Casing Elevation (feet)	Depth to Water (feet, TOC)	Elevation of Groundwater (feet)
MW-6H	11/23/93	16.58	12.46	4.12
MW-6H	12/17/93	16.58	12.08	4.50
MW-6H	5/31/94	16.58	12.46	4.12
MW-6H	8/30/94	16.58	12.72	3.86
MW-6H	11/11/94	16.58	11.98	4.60
MW-6H	2/27/95	16.58	11.89	4.69
MW-6H	5/30/95	16.58	12.05	4.53
MW-6H	8/30/95	16.58	12.34	4.24
MW-6H	10/25/95	16.58	12.52	4.06
MW-6H	2/24/96	16.58	11.58	5.00
MW-6H	4/22/96	16.58	11.68	4.90
MW-6H	11/26/96	16.58	11.87	4.71
MW-6I	2/25/92	16.26	12.45	3.81
MW-6I	3/25/92	16.26	12.12	4.14
MW-6I	6/16/92	16.26	12.75	3.51
MW-6I	9/8/92	16.26	12.84	3.42
MW-6I	11/5/92	16.26	12.75	3.51
MW-6I	12/14/92	16.26	12.40	3.86
MW-6I	1/28/93	16.26	12.20	4.06
MW-6I	2/11/93	16.26	12.40	3.86
MW-6I	3/9/93	16.26	12.45	3.81
MW-6I	4/14/93	16.26	12.43	3.83
MW-6I	5/11/93	16.26	12.73	3.53
MW-6I	6/17/93	16.26	12.78	3.48
MW-6I	7/26/93	16.26	12.92	3.34
MW-6I	8/10/93	16.26	12.97	3.29
MW-6I	9/21/93	16.26	13.02	3.24
MW-6I	10/27/93	16.26	13.10	3.16
MW-6I	11/23/93	16.26	13.02	3.24
MW-6I	12/17/93	16.26	12.65	3.61
MW-6I	2/16/94	16.26	12.66	3.60
MW-6I	5/31/94	16.26	12.90	3.36
MW-6I	8/30/94	16.26	13.06	3.20
MW-6I	11/11/94	16.26	15.20	1.06
MW-6I	2/27/95	16.26	12.51	3.75
MW-6I	5/30/95	16.26	12.57	3.69
MW-6I	8/30/95	16.26	12.86	3.40
MW-6I	10/25/95	16.26	12.92	3.34
MW-6I	2/24/96	16.26	11.97	4.29
MW-6I	4/22/96	16.26	12.35	3.91
MW-6I	11/26/96	16.26	12.45	3.81
RW-1	2/25/92	16.79	14.40	2.39
RW-1	3/25/92	16.79	NA	NA
RW-1	6/16/92	16.79	12.37	4.42

Table 1
Groundwater Elevation Data
2225 Telegraph Avenue, Oakland, CA

Well Number	Date Gauged	Top of Casing Elevation (feet)	Depth to Water (feet, TOC)	Elevation of Groundwater (feet)
RW-1	9/8/92 - 5/31/94	16.79		Not Monitored
RW-1	8/30/94 - 4/22/96	16.79		Not Monitored
RW-1	11/26/96	16.79		Not Monitored
RW-2 (formerly MW-6D)	2/25/92	17.02	16.27	0.75
RW-2 (formerly MW-6D)	3/25/92	17.02		Not Monitored
RW-2 (formerly MW-6D)	6/16/92	17.02	12.86	4.16
RW-2 (formerly MW-6D)	9/8/92 - 5/31/94	17.02		Not Monitored
RW-2 (formerly MW-6D)	8/30/94	17.02		Not Monitored
RW-2 (formerly MW-6D)	11/11/94 - 4/22/96	17.02		Not Monitored
RW-2 (formerly MW-6D)	11/26/96	17.02		Not Monitored
RW-3 (formerly MW-6C)	8/30/94	18.04		Not Monitored
RW-3 (formerly MW-6C)	11/11/94 - 4/22/96	18.04		Not Monitored
RW-3 (formerly MW-6C)	11/26/96	18.04		Not Monitored
Elevation 17.68 @ intersection of Telegraph & 23rd St. jobsite				
NA = Not Available				

Table 2
Groundwater Analytical Data
2225 Telegraph Avenue, Oakland, CA

Well	Date	TPH as	Benzene	Toluene	Ethyl-	Xylenes	MTBE	
Number	Sampled	gasoline	(ppb)	(ppb)	benzene	(ppb)	(ppb)	
		(ppb)	(ppb)	(ppb)	(ppb)	(ppb)	(ppb)	
MW-6A		Well Destroyed						
MW-6B	3/25/92	190	31	8.6	84	8.6	NA	
MW-6B	6/16/92	1,700	44	1.7	7.2	230	NA	
MW-6B	9/8/92	2,900	35	8.3	110	330	NA	
MW-6B	11/5/92	1,400	29	<0.5	75	190	NA	
MW-6B	2/11/93	210	1.2	<0.5	2.8	4.3	NA	
MW-6B	5/11/93	570	54	2.4	37	36	NA	
MW-6B	8/10/93	1,300	48	2.4	28	44	NA	
MW-6B	10/27/93	1,300	23	1.7	25	250	NA	
MW-6B	2/16/94	300	16	<0.5	3.5	2.4	NA	
MW-6B	5/31/94	690	21	3.9	11	36	NA	
MW-6B	8/30/94	260	4	0.62	0.82	4	NA	
MW-6B	11/11/94	300	60	2	1.2	2.4	NA	
MW-6B	2/27/95	180	28	2.6	0.65	1.6	NA	
MW-6B	5/30/95	200	23	3.6	0.88	2.3	NA	
MW-6B	8/30/95	120	3.8	3.6	0.61	0.69	42	
MW-6B	10/25/95	91	1.7	<0.5	<0.5	0.84	NA	
MW-6B	2/24/96	110	27	0.86	0.98	1.8	NA	
MW-6B	4/22/96	<50	2.3	<0.5	<0.5	<0.5	<30	
MW-6B	8/13/96	210	4.3	0.70	<0.5	1.1	<30	
MW-6B	11/26/96	<50	<0.5	<0.5	<0.5	<0.5	<30	
MW-6E	3/25/92	830	41	1	3.8	16	NA	
MW-6E	6/16/92	3,400	300	23	68	510	NA	
MW-6E	9/8/92	480	27	<0.5	3.6	21	NA	
MW-6E	11/5/92	Not Sampled						
MW-6E	2/11/93	270	15	<0.5	<0.5	8.7	NA	
MW-6E	5/11/93	<50	2.3	<0.5	1.4	3.2	NA	
MW-6E	8/10/93	1,700	130	2.7	23	140	NA	
MW-6E	10/27/93	100	6	<0.5	<0.5	<0.5	NA	
MW-6E	2/16/94	640	45	<0.5	12	15	NA	
MW-6E	5/31/94	52	1.5	0.97	<0.5	<0.5	NA	
MW-6E	8/30/94	920	22	0.98	5.2	33	NA	
MW-6E	11/11/94	910	13	2.4	13	2.5	NA	
MW-6E	2/27/95	<50	1.9	1.3	<0.5	0.83	NA	
MW-6E	5/30/95	<50	<0.5	<0.5	<0.5	<0.5	NA	
MW-6E	8/30/95	1,500	91	2.3	56	59	11	
MW-6E	10/25/95	290	7.7	<0.5	5.7	1.7	NA	
MW-6E	2/24/96	<50	2.2	0.77	<0.5	0.83	NA	
MW-6E	4/22/96	<50	<0.5	<0.5	<0.5	<0.5	<30	
MW-6E	8/13/96	420	47	1.9	8.1	26	<30	
MW-6E	11/26/96	<50	1.1	<0.5	<0.5	<0.5	<30	
MW-6F	3/25/92	ND	ND	<0.5	<0.5	<0.5	NA	
MW-6F	6/16/92	ND	ND	<0.5	<0.5	<0.5	NA	

Table 2
Groundwater Analytical Data
2225 Telegraph Avenue, Oakland, CA

Well Number	Date Sampled	TPH as gasoline (ppb)	Benzene (ppb)	Toluene (ppb)	Ethyl-benzene (ppb)	Xylenes (ppb)	MTBE (ppb)
MW-6F	9/8/92	<50	<0.5	<0.5	<0.5	<0.5	NA
MW-6F	11/5/92	<50	<0.5	<0.5	<0.5	<0.5	NA
MW-6F	2/11/93	<50	<0.5	<0.5	<0.5	<0.5	NA
MW-6F	5/11/93	<50	<0.5	<0.5	<0.5	<0.5	NA
MW-6F	8/10/93	Not Sampled					NA
MW-6F	10/27/93	<50	<0.5	<0.5	<0.5	<0.5	NA
MW-6F	2/16/94	<50	<0.5	<0.5	<0.5	<0.5	NA
MW-6F	5/31/94	<50	<0.5	<0.5	<0.5	<0.5	NA
MW-6F	8/30/94	<50	<0.5	<0.5	<0.5	<0.5	NA
MW-6F	11/11/94	<50	<0.5	0.54	<0.5	<0.5	NA
MW-6F	2/27/95	<50	6.2	3.0	0.82	3.5	NA
MW-6F	5/30/95	<50	<0.5	<0.5	<0.5	<0.5	NA
MW-6F	8/30/95	<50	<0.5	<0.5	<0.5	<0.5	<10
MW-6F	10/25/95	<50	<0.5	<0.5	<0.5	<0.5	NA
MW-6F	2/24/96	Not Sampled					
MW-6F	4/22/96	<50	<0.5	<0.5	<0.5	<0.5	<30
MW-6F	8/13/96	Not Sampled					
MW-6F	11/26/96	<50	<0.5	<0.5	<0.5	<0.5	<30
MW-6G	3/25/92	ND	ND	<0.5	<0.5	<0.5	NA
MW-6G	6/16/92	ND	ND	<0.5	<0.5	<0.5	NA
MW-6G	9/8/92	<50	<0.5	<0.5	<0.5	<0.5	NA
MW-6G	11/5/92	<50	<0.5	<0.5	<0.5	<0.5	NA
MW-6G	2/11/93	<50	<0.5	<0.5	<0.5	<0.5	NA
MW-6G	5/11/93	<50	<0.5	<0.5	<0.5	<0.5	NA
MW-6G	8/10/93	<50	<0.5	<0.5	<0.5	<0.5	NA
MW-6G	10/27/93	<50	<0.5	<0.5	<0.5	<0.5	NA
MW-6G	2/16/94	<50	<0.5	<0.5	<0.5	<0.5	NA
MW-6G	5/31/94	<50	<0.5	<0.5	<0.5	<0.5	NA
MW-6G	8/30/94	<50	<0.5	<0.5	<0.5	<0.5	NA
MW-6G	11/11/94	58	0.58	1.6	<0.5	1.6	NA
MW-6G	2/27/95	<50	0.86	0.99	<0.5	0.51	NA
MW-6G	5/30/95	<50	<0.5	<0.5	<0.5	<0.5	NA
MW-6G	8/30/95	<50	<0.5	<0.5	<0.5	<0.5	<10
MW-6G	10/25/95	<50	<0.5	<0.5	<0.5	<0.5	NA
MW-6G	2/24/96	Not Sampled					
MW-6G	4/22/96	<50	<0.5	<0.5	<0.5	<0.5	<30
MW-6G	8/13/96	Not Sampled					
MW-6G	11/26/96	<50	<0.5	<0.5	<0.5	<0.5	<30
MW-6H	3/25/92	920	170	52	25	54	NA
MW-6H	6/16/92	460	31	11	6.8	16	NA
MW-6H	9/8/92	780	69	23	17	18	NA
MW-6H	11/5/92	3,400	500	260	85	160	NA
MW-6H	2/11/93	2,500	410	170	28	130	NA
MW-6H	5/11/93	4,200	490	270	80	210	NA

Table 2
Groundwater Analytical Data
2225 Telegraph Avenue, Oakland, CA

Well	Date	TPH as	Benzene	Toluene	Ethyl-	Xylenes	MTBE
Number	Sampled	gasoline (ppb)	(ppb)	(ppb)	benzene (ppb)	(ppb)	(ppb)
MW-6H	8/10/93	650	83	22	14	29	NA
MW-6H	10/27/93	1,600	130	90	29	130	NA
MW-6H	2/16/94	<50	<0.5	<0.5	<0.5	2.9	NA
MW-6H	5/31/94	1,800	370	220	65	210	NA
MW-6H	8/30/94	1,900	130	90	19	86	NA
MW-6H	11/11/94	13,000	1,700	1,400	260	1,800	NA
MW-6H	2/27/95	320	450	120	28	79	NA
MW-6H	5/30/95	2,300	960	260	64	200	NA
MW-6H	8/30/95	2,100	590	35	24	74	50
MW-6H	10/25/95	1,400	93	23	11	80	NA
MW-6H	2/24/96	2,000	810	92	25	78	NA
MW-6H	4/22/96	3,200	1,200	160	38	200	<30
MW-6H	8/13/96	930	110	21	4.2	81	77
MW-6H	11/26/96	1,200	320	110	22	85	<30
MW-6I	3/25/92	ND	ND	<0.5	<0.5	<0.5	NA
MW-6I	6/16/92	ND	ND	<0.5	<0.5	<0.5	NA
MW-6I	9/8/92	<50	<0.5	<0.5	<0.5	<0.5	NA
MW-6I	11/5/92	<50	<0.5	<0.5	<0.5	<0.5	NA
MW-6I	2/11/93	<50	<0.5	<0.5	<0.5	<0.5	NA
MW-6I	5/11/93	<50	<0.5	<0.5	<0.5	<0.5	NA
MW-6I	8/10/93	<50	<0.5	<0.5	<0.5	<0.5	NA
MW-6I	10/27/93	<50	<0.5	<0.5	<0.5	1.1	NA
MW-6I	2/16/94	<50	<0.5	<0.5	<0.5	<0.5	NA
MW-6I	5/31/94	<50	<0.5	<0.5	<0.5	<0.5	NA
MW-6I	8/30/94	<50	<0.5	<0.5	<0.5	<0.5	NA
MW-6I	11/11/94	53	0.62	1.8	<0.5	2.0	NA
MW-6I	2/27/95	<50	<0.5	<0.5	<0.5	<0.5	NA
MW-6I	5/30/95	69	2.8	0.96	1.1	4.3	NA
MW-6I	8/30/95	<50	<0.5	<0.5	<0.5	<0.5	<10
MW-6I	10/25/95	<50	<0.5	<0.5	<0.5	<0.5	NA
MW-6I	2/24/96	<50	<0.5	<0.5	<0.5	<0.5	NA
MW-6I	4/22/96	<50	<0.5	<0.5	<0.5	<0.5	<30
MW-6I	8/13/96	<50	<0.5	<0.5	<0.5	<0.5	<30
MW-6I	11/26/96	<50	<0.5	<0.5	<0.5	<0.5	<30
RW-1	6/16/92	6,200	620	1,400	240	1,400	NA
RW-1	9/8/92 - 11/26/96	Not Sampled					

Table 2
Groundwater Analytical Data
2225 Telegraph Avenue, Oakland, CA

Well Number	Date Sampled	TPH as gasoline (ppb)	Benzene (ppb)	Toluene (ppb)	Ethyl-benzene (ppb)	Xylenes (ppb)	MTBE (ppb)
RW-2	3/25/92	NA	NA	NA	NA	NA	NA
RW-2	6/16/92	28,000	2,900	1,000	120	2,700	NA
RW-2	9/8/92 - 11/26/96	Not Sampled					
RW-3	8/30/94 - 11/26/96	Not Sampled					
ppb = parts per billion							
TPHg = Total Petroleum Hydrocarbons as gasoline							
< = Less than the detection limit for the specified method of analysis							
NA = Not Analyzed							
ND = Not detectable at or above method detection limit							
MTBE = Methyl-tert-butylether							

801 Western Avenue
 Glendale, CA 91201
 818/247-5737
 Fax: 818/247-9797

LOG NO: G96-11-705
 Received: 27 NOV 96
 Mailed: **DEC 12 1996**

Ms. Rebecca Digerness
 Texaco Environmental Services
 108 Cutting Boulevard
 Richmond, CA 94804

Purchase Order: 94-1446346+4370
 Requisition: 624880195
 Project: FKEP9036L

REPORT OF ANALYTICAL RESULTS

AQUEOUS

SAMPLE DESCRIPTION	DATE SAMPLED	TPH/BTEX (CADHS/8020)	Date Analyzed	Dilution Factor Times	TPH-g	Benzene	Toluene	Ethyl-Benzene	Methyl-tert-butylether	Total Xylenes Isomers	Carbon Range
					ug/L	ug/L	ug/L	ug/L	ug/L	ug/L	
RDL				1	50	0.5	0.5	0.5	30	0.5	
1*MW-6B	11/26/96	12/04/96		1	<50	<0.5	<0.5	<0.5	<30	<0.5	C6-C12
2*MW-6E	11/26/96	12/04/96		1	<50	1.1	<0.5	<0.5	<30	<0.5	C6-C12
3*MW-6F	11/26/96	12/04/96		1	<50	<0.5	<0.5	<0.5	<30	<0.5	C6-C12
4*MW-6G	11/26/96	12/04/96		1	<50	<0.5	<0.5	<0.5	<30	<0.5	C6-C12
5*MW-6H	11/26/96	12/04/96		1	1200	320	110	22	<30	85	C6-C12
6*MW-6I	11/26/96	12/04/96		1	<50	<0.5	<0.5	<0.5	<30	<0.5	C6-C12

Karen Petryna
 2225 Telegraph Ave., Oakland
 Alameda County

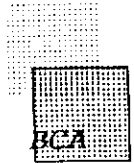

801 Western Avenue
 Glendale, CA 91201
 818/247-5737
 Fax: 818/247-9797

LOG NO: G96-11-705

Received: 27 NOV 96

Ms. Rebecca Digerness
 Texaco Environmental Services
 108 Cutting Boulevard
 Richmond, CA 94804

Purchase Order: 94-1446346+4370

Requisition: 624880195
 Project: FKEP9036L

REPORT OF ANALYTICAL RESULTS

Page 2

AQUEOUS

SAMPLE DESCRIPTION	DATE SAMPLED	TPH/BTEX (CADHS/8020)	ANALYTICAL DATA								
			Date Analyzed Date	Dilution Factor Times	TPH-g ug/L	Benzene ug/L	Toluene ug/L	Ethyl-Benzene ug/L	Methyl-tert-butylether ug/L	Total Xylenes Isomers ug/L	Carbon Range
RDL				1	50	0.5	0.5	0.5	30	0.5	
7*EB	11/26/96	12/11/96		1	<50	<0.5	<0.5	<0.5	<30	<0.5	C6-C12

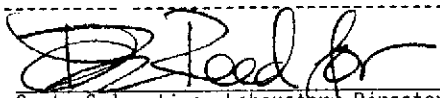
 Greta Galoustian, Laboratory Director

The analytical results within this report relate only to the specific compounds and samples investigated and may not necessarily reflect other apparently similar material from the same or a similar location.

This report shall not be reproduced, except in full, without the written approval of BCA. No use of this report for promotional or advertising purposes is permitted without prior written BCA approval.



SAMPLES...	SAMPLE DESCRIPTION..	DETERM.....	DATE..... ANALYZED	METHOD.....	EQUIP. BATCH..	ID.NO
9611705*1	MW-6B	GAS.MTBE.TESNC DATA.REVIEW	12.04.96 12.10.96	8015M.TX	536-23 965163	8171 7524
9611705*2	MW-6E	GAS.MTBE.TESNC DATA.REVIEW	12.04.96 12.10.96	8015M.TX	536-23 965163	8171 7524
9611705*3	MW-6F	GAS.MTBE.TESNC DATA.REVIEW	12.04.96 12.10.96	8015M.TX	536-23 965163	8171 7524
9611705*4	MW-6G	GAS.MTBE.TESNC DATA.REVIEW	12.04.96 12.10.96	8015M.TX	536-23 965163	8171 7524
9611705*5	MW-6H	GAS.MTBE.TESNC DATA.REVIEW	12.04.96 12.10.96	8015M.TX	536-23 965163	8171 7524
9611705*6	MW-6I	GAS.MTBE.TESNC DATA.REVIEW	12.04.96 12.10.96	8015M.TX	536-23 965163	8171 7524
9611705*7	EB	GAS.MTBE.TESNC	12.11.96	8015M.TX	536-21 96304	1012

Notes: Equipment = BC Analytical identification number for a particular piece of analytical equipment.
 ID.NO = BC Analytical employee identification number of analyst.

AQUEOUS SAMPLES	----- METHOD BLANK -----			----- LAB CONTROL -----							----- MATRIX QC -----											
	UNITS	RESULT	RDL FLG	LCS		LCSD		RPD		RPD	MS		MSD		RPD		RPD					
				%REC	FLG	%REC	FLG	LCL	UCL		RPD	UCL	FLG	%REC	FLG	%REC		FLG	LCL	UCL	RPD	UCL
Batch: GAS*965163 Method: 8015M.TX - Modified 8015																						
Benzene	ug/L	0	0.5	-	91	-	-	-	76	155	-	-	-	82	-	86	-	70	153	5	25	-
Toluene	ug/L	0	0.5	-	93	-	-	-	72	121	-	-	-	87	-	90	-	69	119	3	25	-
Ethylbenzene	ug/L	0	0.5	-	91	-	-	-	72	115	-	-	-	84	-	88	-	68	116	5	25	-
Methyl-tert-butylether	ug/L	0	30	+	69	-	-	-	62	159	-	-	-	85	-	70	Q	80	176	20	25	-
Total Xylene Isomers	ug/L	0	0.5	-	95	-	-	-	68	115	-	-	-	89	-	92	-	61	118	3	25	-
TPH (Gasoline Range)	ug/L	0	50	-	100	-	-	-	85	120	-	-	-	86	-	101	-	78	124	16	25	-
[a,a,a-Trifluorotoluene]	Percent	98	-	-	96	-	-	-	85	118	-	-	-	95	-	99	-	85	118	-	-	-

METHOD	ANALYTE	BATCH	ANALYZED	REPORTED	TRUE	%REC	FLAG
9611705*1							
8015M.TXa	a,a-Trifluorotoluene	Re965163	12/04/96	45.3	50.0	91	
9611705*2							
8015M.TXa	a,a-Trifluorotoluene	Re965163	12/04/96	44.7	50.0	89	
9611705*3							
8015M.TXa	a,a-Trifluorotoluene	Re965163	12/04/96	43.6	50.0	87	
9611705*4							
8015M.TXa	a,a-Trifluorotoluene	Re965163	12/04/96	46.3	50.0	93	
9611705*5							
8015M.TXa	a,a-Trifluorotoluene	Re965163	12/04/96	44.8	50.0	90	
9611705*6							
8015M.TXa	a,a-Trifluorotoluene	Re965163	12/04/96	48.5	50.0	97	
9611705*7							
8015M.TXa	a,a-Trifluorotoluene	Re96304	12/11/96	53.4	50.0	107	

976-11-10

Chain-of-Custody

Page ___ of ___

Texaco Environmental Services
 108 Cutting Boulevard
 Richmond, California 94804
 Phone: (510) 236-3541
 FAX: (510) 237-7021
 Forward Results to the Attention of Rebecca Digerness
 Texaco Project Coordinator Karen Petryna

Site Name: Texaco Loc# 624880195
 Site Address: 2225 Telegraph Ave., Oakland, CA
 Contractor Project Number: 961126-CZ
 Contractor Name: Blaine Tech Services, Inc.
 Address: 985 Timothy Dr., San Jose, CA 95133
 Project Contact: Jim Keller
 Phone/FAX: (408) 995-5535 / (408) 293-8773

Laboratory: B C Analytical
 Turn Around Time: normal (10 day)
 Samplers (PRINT NAME): DOUG SANDERS
 Sampler Signature: [Signature]
 Date Samples Collected: 11-26-96

ANALYSIS

1 week TAT
 KEP
 624880195
 FKEP90364
 Alameda

Sample Number	Lab Sample Number	Date/Time Collected	No. of Containers	Type of Containers	Sample Matrix	Preservative	TPH gas/BTEX / MTBE	TPH Diesel	O&G/TRPH (4 LB. 1)	TPH Ex. (CB-C36+)	VOCs B240/624	P. Halocarbons 8010/60	P. Aromatics 8020/602	Organic Lead
MW-6B		11-26-96/1430	3	VOAS	water	HCl	XXX							
MW-6E		11-26-96/1330	3				XXX							
MW-6F		11-26-96/1310	3				XXX							
MW-6G		11-26-96/1350	3				XXX							
MW-6H		11-26-96/1450	3				XXX							
MW-6I		11-26-96/1415	3				XXX							
EB		11-26-96/1315	3	↓	↓	↓	XXX							

Relinquished by: [Signature] Date: 11/27/96 Time: 3:10
 Relinquished by: Bill Reynolds Date: 11-27-96 Time: 5:35
 Relinquished by: _____ Date: _____ Time: _____
 Method of Shipment: _____

Received by: [Signature] Date: 11/27/96 Time: 3:10
 Received by: Monica Mathu Date: 11/27/96 Time: 5:35
 Received by: _____ Date: _____ Time: _____
 Lab Comments: _____

TEXACO WELL MONITORING DATA SHEET

Project #: 961126-CZ	Texaco ID#: 624880195
Sampler: DOUG	Date: 11-26-96
Well I.D.: MW-6B	Well Diameter: (2) 3 4 6 8 ____
Total Well Depth: 18.21	Depth to Water: 12.26
Depth to Free Product:	Thickness of Free Product:
All Measurements are referenced to TOC. Meter used is Myron LpDS pH/EC Meter. All temperatures taken in degrees Fahrenheit.	

Well Diameter	Multiplier	Well Diameter	Multiplier
2"	0.17	5"	1.02
3"	0.38	6"	1.50
4"	0.66	8"	2.60
4.5"	0.83	Other	radius ² * 0.164

Purge Method: <u>S.S. Bailer</u> Teflon Bailer Middleburg Electric Submersible Extraction Pump Other: _____	Sampling Method: <u>S.S. Bailer</u> Teflon Bailer Extraction Port Other: _____
--	---

<u>1.0</u>	x	<u>3</u>	=	<u>3.0</u>	Gals.
1 Case Volume (Gals.)		Specified Volumes		Calculated Volume	

Time	Temp (°F)	pH	Cond.	Turbidity	Gals. Removed	Color/Odor
14:21	71.6	6.6	820	>200	1.0	
14:23	70.8	6.6	830	>200	2.0	
14:24	71.0	6.6	830	>200	3.0	

Did well dewater? Yes <input type="checkbox"/> No <input checked="" type="checkbox"/>	Gallons actually evacuated: 3.0
Sampling Time: 14:30	Sampling Date: 11-26-96
Sample I.D.: MW-6B	Laboratory: BC Analytical
Analyzed for: <u>Tph-G</u> <u>BTEX</u> Tph-D	Other: <u>MTBE</u>
Equipment Blank I.D.:	Analyzed for same as primary sample

TEXACO WELL MONITORING DATA SHEET

Project #: 961126-CZ	Texaco ID#: 624880195
Sampler: DOUG	Date: 11-26-96
Well I.D.: MW-6E	Well Diameter: 2 3 <u>4</u> 6 8
Total Well Depth: 19.43	Depth to Water: 12.94
Depth to Free Product:	Thickness of Free Product:

All Measurements are referenced to TOC. Meter used is Myron LpDS pH/EC Meter. All temperatures taken in degrees Fahrenheit.

Well Diameter	Multiplier	Well Diameter	Multiplier
2"	0.17	5"	1.02
3"	0.38	6"	1.50
4"	0.66	8"	2.60
4.5"	0.83	Other	radius ² * 0.164

Purge Method: S.S. Bailer Sampling Method: S.S. Bailer
 Teflon Bailer Teflon Bailer
 Middleburg Extraction Port
Electric Submersible Other: _____
 Extraction Pump
 Other: _____

<u>4.3</u>	x	<u>3</u>	=	<u>12.9</u>	Gals.
1 Case Volume (Gals.)		Specified Volumes		Calculated Volume	

Time	Temp (°F)	pH	Cond.	Turbidity	Gals. Removed	Color/Odor
13:23	65.2	6.8	650	101	4.5	
13:24	65.4	6.9	580	76	9.0	
13:25	65.2	6.9	560	34	13.0	

Did well dewater? Yes <input type="radio"/> <u>No</u> <input checked="" type="radio"/>	Gallons actually evacuated: <u>13.0</u>
Sampling Time: <u>13:30</u>	Sampling Date: <u>11-26-96</u>
Sample I.D.: <u>MW-6E</u>	Laboratory: <u>BC Analytical</u>
Analyzed for: <u>Tph-G</u> <u>BTEX</u> Tph-D	Other: <u>MTBE</u>
Equipment Blank I.D.:	Analyzed for same as primary sample

TEXACO WELL MONITORING DATA SHEET

Project #: 961126-CZ	Texaco ID#: 624880195
Sampler: DOUG	Date: 11-26-96
Well I.D.: MW-66	Well Diameter: 2 3 (4) 6 8
Total Well Depth: 19.69	Depth to Water: 11.12
Depth to Free Product:	Thickness of Free Product:
All Measurements are referenced to TOC. Meter used is Myron LpDS pH/EC Meter. All temperatures taken in degrees Fahrenheit.	

Well Diameter	Multiplier	Well Diameter	Multiplier
2"	0.17	5"	1.02
3"	0.38	6"	1.50
4"	0.66	8"	2.60
4.5"	0.83	Other	radius ² * 0.164

Purge Method: S.S. Bailer Teflon Bailer Middleburg <u>Electric Submersible</u> Extraction Pump Other: _____	Sampling Method: <u>S.S. Bailer</u> Teflon Bailer Extraction Port Other: _____
--	---

<u>5.7</u>	x	<u>3</u>	=	<u>17.0</u> Gals.
1 Case Volume (Gals.)		Specified Volumes		Calculated Volume

Time	Temp (°F)	pH	Cond.	Turbidity	Gals. Removed	Color/Odor
13:40	68.0	6.5	620	121	6	
13:41	68.2	6.4	680	103	12	
13:42	68.2	6.5	700	110	17	

Did well dewater? Yes <input type="checkbox"/> <u>No</u>	Gallons actually evacuated: <u>17.0</u>
Sampling Time: <u>13:50</u>	Sampling Date: <u>11-26-96</u>
Sample I.D.: <u>MW-66</u>	Laboratory: <u>BC Analytical</u>
Analyzed for: <u>Tph-G</u> <u>BTEX</u> Tph-D	Other: <u>MTBE</u>
Equipment Blank I.D.:	Analyzed for same as primary sample

TEXACO WELL MONITORING DATA SHEET

Project #: 961126-CZ	Texaco ID#: 624880195
Sampler: DOUG	Date: 11-26-96
Well I.D.: MW-6H	Well Diameter: 2 3 (4) 6 8
Total Well Depth: 19.50	Depth to Water: 11.87
Depth to Free Product:	Thickness of Free Product:
All Measurements are referenced to TOC. Meter used is Myron LpDS pH/EC Meter. All temperatures taken in degrees Fahrenheit.	

Well Diameter	Multiplier	Well Diameter	Multiplier
2"	0.17	5"	1.02
3"	0.38	6"	1.50
4"	0.66	8"	2.60
4.5"	0.83	Other	radius ² * 0.164

Purge Method: S.S. Bailer Sampling Method: S.S. Bailer
 Teflon Bailer Teflon Bailer
 Middleburg Extraction Port
Electric Submersible Other: _____
 Extraction Pump
 Other: _____

<u>5.0</u>	x	<u>3</u>	=	<u>15.5</u>	Gals.
1 Case Volume (Gals.)		Specified Volumes		Calculated Volume	

Time	Temp (°F)	pH	Cond.	Turbidity	Gals. Removed	Color/Odor
14:42	69.8	6.8	620	7200	5.0	
14:43	70.0	6.8	640	172	10.0	
14:44	70.0	6.7	650	108	15.5	

Did well dewater? Yes <input type="checkbox"/> No <input checked="" type="checkbox"/>	Gallons actually evacuated: 15.5
Sampling Time: 14:50	Sampling Date: 11-26-96
Sample I.D.: MW-6H	Laboratory: BC Analytical
Analyzed for: <u>Tph-G</u> <u>BTEX</u> Tph-D	Other: <u>MTBE</u>
Equipment Blank I.D.:	Analyzed for same as primary sample

TEXACO WELL MONITORING DATA SHEET

Project #: 961126-C2	Texaco ID#: 624880195
Sampler: Doug	Date: 11-26-96
Well I.D.: MW-6I	Well Diameter: 2 3 (4) 6 8
Total Well Depth: 19.31	Depth to Water: 12.45
Depth to Free Product:	Thickness of Free Product:
All Measurements are referenced to TOC. Meter used is Myron LpDS pH/EC Meter. All temperatures taken in degrees Fahrenheit.	

Well Diameter	Multiplier	Well Diameter	Multiplier
2"	0.17	5"	1.02
3"	0.38	6"	1.50
4"	0.65	8"	2.60
4.5"	0.83	Other	radius ² * 0.164

Purge Method: S.S. Bailer Sampling Method: S.S. Bailer
 Teflon Bailer Teflon Bailer
 Middleburg Extraction Port
Electric Submersible Other: _____
 Extraction Pump
 Other: _____

<u>4.5</u>	x	<u>3</u>	=	<u>13.6</u> Gals.
1 Case Volume (Gals.)		Specified Volumes		Calculated Volume

Time	Temp (°F)	pH	Cond.	Turbidity	Gals. Removed	Color/Odor
14:08	71.2	6.7	850	184	5	
14:09	70.8	6.7	840	110	10	
14:10	70.8	6.6	840	65	14	

Did well dewater? Yes <input type="radio"/> No <input checked="" type="radio"/>	Gallons actually evacuated: 14.0
Sampling Time: 14:15	Sampling Date: 11-26-96
Sample I.D.: MW-6I	Laboratory: BC Analytical
Analyzed for: <u>Tph-G</u> <u>BTEX</u> Tph-D	Other: MTBE
Equipment Blank I.D.:	Analyzed for same as primary sample

SOURCE RECORD BILL OF LADING
 FOR NON-HAZARDOUS PURGEWATER RECOVERED FROM
 GROUNDWATER WELLS AT TEXACO FACILITIES IN THE
 STATE OF CALIFORNIA. THE NON-HAZARDOUS PURGE-
 WATER WHICH HAS BEEN RECOVERED FROM GROUND-
 WATER WELLS IS COLLECTED BY THE CONTRACTOR,
 MADE UP INTO LOADS OF APPROPRIATE SIZE AND
 HAULED TO THE DESTINATION DESIGNATED BY TEXACO
 ENVIRONMENTAL SERVICES (TES).

Contractor: Blaine Tech Services, Inc.
 Address: 985 Timothy Drive
 City, State, ZIP: San Jose, CA 95133
 Phone: (408) 995-5535

is authorized by Texaco Environmental Services to recover, collect, apportion into loads, and haul the NON-HAZARDOUS WELL PURGEWATER that is drawn from wells at the Texaco facility listed below and to deliver that purgewater to an appropriate destination designated by TEXACO ENVIRONMENTAL SERVICES in either Redwood City, California or in Richmond, California. Transport routing of the Non-Hazardous Well Purgewater may be directed from one Texaco facility to the designated destination point; from one Texaco facility to the designated destination point via another Texaco facility; from a Texaco facility via the contractor's facility, or any combination thereof. The Non-Hazardous Well Purgewater is and remains the property of Texaco Environmental Services (TES).

This SOURCE RECORD BILL OF LADING was initiated to cover the recovery of Non-Hazardous Well Purgewater from wells at the Texaco facility described below:

TEXACO #: 624880195
 Address: 2225 Telegraph Rd.
 City, State, ZIP: Oakland, CA

Well I.D.	Gals.	Well I.D.	Gals.
MW-6B1	3.0		
MW-6E1	13.0		
MW-6F1	13.0		
MW-6G1	17.0		
MW-6H1	15.5		
MW-6I1	14.0		

Total gals. 75.5 added rinse water 5.0
 Total Gals. Recovered 75.5

Job #: 961126-CR
 Date: 11-26-96
 Time: 15:00
 Signature: [Signature]

REC'D AT: BTS
 Date: 11-26-96
 Time: 16:30
 Signature: [Signature]

QUARTERLY SUMMARY REPORT
Former Texaco/Current Exxon Service Station
2225 Telegraph Avenue, Oakland, California
Alameda County
Third Quarter 1996

HISTORY OF INVESTIGATIVE AND REMEDIAL ACTIONS

A preliminary subsurface investigation and a sensitive receptor survey were conducted in May, 1988. Nine shallow monitoring wells (MW-6A through MW-6I) were installed on site and seven soil borings were drilled near the pump islands and underground fuel storage tanks. Two vapor extraction wells were installed in the tank pit backfill, and an additional vapor extraction well (VE-3) was installed on site. Soil boring B-3 was converted to recovery well RW-1. Two of the on-site monitoring wells (MW-6C and MW-6D) were also converted to groundwater recovery wells (RW-3 and RW-2, respectively) when the groundwater treatment system was installed in 1990. The underground fuel storage tanks, lines, and dispensers were replaced in late 1991. RW-3 was destroyed in 1991 and replaced in 1992 with RW-3A. MW-6A was destroyed in 1992 because it was damaged. A soil vapor extraction system was installed in November 1995 and is currently operating.

WORK PERFORMED DURING THIS QUARTER

Ground water monitoring and sampling. Operation of the vapor extraction system. With concurrence from the ACDEH, ground water pumping was terminated.

CHARACTERIZATION STATUS

SOIL: The extent of petroleum hydrocarbons in soil has been delineated.

GROUND WATER: The extent of dissolved hydrocarbons in ground water is partially delineated.

REMEDIATION STATUS

A vapor extraction system is currently operating at the site. The ground water recovery wells will also be connected to the vapor extraction system.

WORK TO BE PERFORMED NEXT QUARTER

Continuation of the quarterly ground water monitoring and sampling program. Continued operation of the vapor extraction system.

SITE CONTACTS

Texaco:	Karen Petryna (510) 236-9139
Exxon:	Michael Faber, Exxon Company U.S.A.
Site Contact:	Lam Truong, station dealer (510) 832-4000
Lead Agency:	Dale Klettke (510) 567-6880 (ACDEH)