



Atlantic Richfield Company
(a BP affiliated company)

P.O. Box 1257
San Ramon, CA 94583
Phone: (925) 275-3801
Fax: (925) 275-3815

30 October 2007

Re: Third Quarter 2007 Ground-Water Monitoring Report
Former BP Station # 11117
7210 Bancroft Avenue
Oakland, California
ACEH Case # RO0000356

“I declare, that to the best of my knowledge at the present time, that the information and/or recommendations contained in the attached document are true and correct.”

Submitted by:

Paul Supple
Environmental Business Manger

RECEIVED

9:59 am, Nov 02, 2007

Alameda County
Environmental Health



Third Quarter 2007 Ground-Water Monitoring Report

Former BP Station #11117

7210 Bancroft Avenue

Oakland, California

Prepared for

Mr. Paul Supple
Environmental Business Manager
Atlantic Richfield Company
P.O. Box 1257
San Ramon, California 94583

Prepared by



1324 Mangrove Avenue, Suite 212
Chico, California 95926
(530) 566-1400
www.broadbentinc.com

30 October 2007

Project No. 06-08-649

Broadbent & Associates, Inc.
1324 Mangrove Ave., Suite 212
Chico, CA 95926
Voice (530) 566-1400
Fax (530) 566-1401



30 October 2007

Project No. 06-08-649

Atlantic Richfield Company
P.O. Box 1257
San Ramon, CA 94583
Submitted via ENFOS

Attn.: Mr. Paul Supple

Re: Third Quarter 2007 Ground-Water Monitoring Report
Former BP Station #11117, 7210 Bancroft Avenue, Oakland, California
ACEH Case # RO0000356

Dear Mr. Supple:

Attached is the *Third Quarter 2007 Ground-Water Monitoring Report* for Former BP Station #11117 (herein referred to as Station #11117) located at 7210 Bancroft Avenue, Oakland, Alameda County, California (Site). This report presents a summary of the Third Quarter 2007 ground-water monitoring results and recent developments concerning the Site.

Should you have questions regarding the work performed or results obtained, please do not hesitate to contact us at (530) 566-1400.

Sincerely,

BROADBENT & ASSOCIATES, INC.

A handwritten signature in cursive script, appearing to read 'Thomas A. Venus'.

Thomas A. Venus, P.E.
Senior Engineer

A handwritten signature in cursive script, appearing to read 'Robert H. Miller'.

Robert H. Miller, P.G., C.HG.
Principal Hydrogeologist

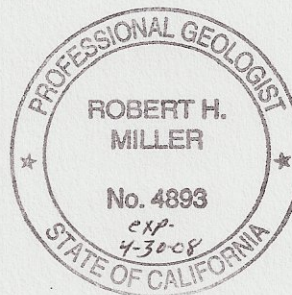

Enclosures

cc: Mr. Steven Plunkett, Alameda County Environmental Health (Submitted via ACEH ftp site)
Ms. Shelby Lathrop, ConocoPhillips, 76 Broadway, Sacramento, CA 95818
Mr. Paul Bernard, One Eastmont Town Center, 7200 Bancroft Avenue, Oakland, CA 94605
Electronic copy uploaded to GeoTracker

STATION #11117 QUARTERLY GROUND-WATER MONITORING REPORT

Facility: #11117	Address:	7210 Bancroft Avenue, Oakland, California
Environmental Business Manager:		Mr. Paul Supple
Consulting Co./Contact Persons:		Broadbent & Associates, Inc.(BAI)/Rob Miller & Tom Venus (530) 566-1400
Consultant Project No.:		06-08-649
Primary Agency/Regulatory ID No.:		Alameda County Environmental Health (ACEH) ACEH Case #RO0000356
Facility Permits/Permitting Agency:		NA

WORK PERFORMED THIS QUARTER (Third Quarter 2007):

1. Prepared and submitted Second Quarter 2007 Ground-Water Monitoring Report.
2. Conducted ground-water monitoring/sampling for Third Quarter 2007. Work performed by Stratus Environmental, Inc. (Stratus) on 9 August 2007.

WORK PROPOSED FOR NEXT QUARTER (Fourth Quarter 2007):

1. Prepared and submitted Third Quarter 2007 Ground-Water Monitoring Report (contained herein).
2. Conduct Fourth Quarter 2007 ground-water monitoring/sampling.
3. Install ground-water monitoring and dual-phase extraction wells as approved in ACEH letter dated 11 October 2007. Drilling tentatively scheduled for 19 November 2007.
4. Prepare and submit Monitoring Well Installation Report.
5. Begin DPE remediation system permitting and construction. Continue to provide monthly email updates of progress.

QUARTERLY RESULTS SUMMARY:

Current phase of project:	Ground-Water Monitoring/Sampling
Frequency of ground-water monitoring:	Quarterly: MW-1, MW-2, MW-3, MW-4, MW-6, MW-7, MW-8, MW-9, MW-10, EX-1, EX-2
Frequency of ground-water sampling:	Quarterly: EX-1, EX-2, MW-2, MW-4, MW-7, MW-10 Semi-annually (1Q and 3Q): MW-9 Annually (1Q): MW-1, MW-3, MW-6, MW-8
Is free product (FP) present on-site:	No
FP recovered this quarter:	None
Depth to ground water (below TOC):	18.38 ft (MW-1) to 20.83 ft (MW-10)
General ground-water flow direction:	Northwest
Approximate hydraulic gradient:	0.002 ft/ft

DISCUSSION:

Third Quarter 2007 ground-water monitoring and sampling was conducted at Station #11117 on 9 August 2007 by Stratus. Water levels were gauged in the 11 wells at the Site. Sheen was observed in well MW-2. No other irregularities were noted during water level gauging. Depth to water measurements ranged from 18.38 ft at MW-1 to 20.83 ft at MW-10. Resulting ground-water surface elevations ranged from 31.63 feet above mean sea level in well MW-8 to 31.17 feet at well MW-6. Water level elevations were between historic minimum and maximum ranges for each well, as summarized in Table 1. Water level elevations yielded a potentiometric ground-water flow direction and gradient to the

northwest at approximately 0.002 ft/ft, contrary to more recent gradient directions (see Table 3). Ground-water monitoring field data sheets are provided within Appendix A. Measured depths to ground-water and respective ground-water elevations are summarized in Table 1. Potentiometric ground-water elevation contours are presented in Drawing 1.

Consistent with the current ground-water sampling schedule, water samples were collected from wells MW-2, MW-4, MW-7, MW-9, MW-10, EX-1, and EX-2. Well EX-1 ran dry prior to purging three wetted casing volumes of water. No other irregularities were reported during sampling. Samples were submitted under chain-of-custody protocol to Test America Analytical Testing Corporation (Morgan Hill, California), for analysis of Gasoline Range Organics (GRO, C4-C12) by the LUFT GCMS method; Benzene, Toluene, Ethylbenzene, and Total Xylenes (BTEX) by EPA Method 8260B; and Methyl tert-butyl ether (MTBE), Ethyl tert-butyl ether (ETBE), Ethanol, 1,2-Dichloroethane (1,2-DCA), 1,2-Dibromomethane (EDB), Di-isopropyl ether (DIPE), tert-Butyl alcohol (TBA), and tert-Amyl methyl ether (TAME) by EPA Method 8260B. No significant analytical irregularities were encountered during laboratory analysis of the samples. Ground-water sampling field data sheets and the laboratory analytical report, including chain-of-custody documentation, are provided in Appendix A.

Concentrations of GRO were detected above the laboratory reporting limit in five of the seven wells sampled at concentrations up to 180,000 micrograms per liter ($\mu\text{g/L}$) in well MW-4. Benzene was detected above the laboratory reporting limit in four of the seven wells sampled at concentrations up to 7,400 $\mu\text{g/L}$ in well MW-2. Toluene was detected above the laboratory reporting limit in three of the seven wells sampled at concentrations up to 7,700 $\mu\text{g/L}$ in well MW-4. Ethylbenzene was detected above the laboratory reporting limit in three of the seven wells sampled at concentrations up to 5,700 $\mu\text{g/L}$ in well MW-4. Total Xylenes were detected above the laboratory reporting limit in four of the seven wells sampled at concentrations up to 21,000 $\mu\text{g/L}$ in well MW-4. TAME was detected above the laboratory reporting limit in one of the seven wells sampled at a concentration of 15 $\mu\text{g/L}$ in well EX-1. TBA was detected above the laboratory reporting limit in three of the seven wells sampled at concentrations up to 4,100 $\mu\text{g/L}$ in well MW-4. MTBE was detected above the laboratory reporting limit in each of the seven wells sampled at concentrations up to 4,100 $\mu\text{g/L}$ in well MW-2. The remaining fuel additives and oxygenates were not detected above their laboratory reporting limits in the seven wells sampled this quarter.

Detected analyte concentrations were within the historic minimum and maximum ranges recorded for each well with the following exceptions: Detected MTBE concentrations in samples collected from wells EX-1 and MW-9 reached historic minimum values of 530 $\mu\text{g/L}$ and 1.4 $\mu\text{g/L}$, respectively; and detected TBA concentrations in samples collected from wells EX-1 and MW-4 were detected for the first time (possibly due to lowered reporting limits) at 530 $\mu\text{g/L}$ and 4,100 $\mu\text{g/L}$ respectively. Historic laboratory analytical results are summarized in Table 1 and Table 2. A copy of the Laboratory Analytical Report, including chain-of-custody documentation is provided in Appendix A. The most recent GRO, Benzene, and MTBE concentrations are also presented in Drawing 1. Drawing 2 presents a map showing approximate GRO iso-concentration contours. Drawing 3 presents a map showing approximate Benzene iso-concentration contours. Drawing 4 presents a map showing approximate MTBE iso-concentration contours. Third Quarter 2007 ground-water monitoring data (GEO_WELL) and laboratory analytical results (EDF) were uploaded to the GeoTracker AB2886 Database. Upload confirmation pages have been provided in Appendix B.

CLOSURE:

The findings presented in this report are based upon: observations of Stratus field personnel (see Appendix A), the points investigated, and results of laboratory tests performed by Test America (Morgan

Hill, California). Our services were performed in accordance with the generally accepted standard of practice at the time this report was written. No other warranty, expressed or implied was made. This report has been prepared for the exclusive use of Atlantic Richfield Company. It is possible that variations in soil or ground-water conditions could exist beyond points explored in this investigation. Also, changes in site conditions could occur in the future due to variations in rainfall, temperature, regional water usage, or other factors.

ATTACHMENTS:

- Drawing 1. Ground-Water Elevation Contours and Analytical Summary Map, 9 August 2007, Station #11117, 7210 Bancroft Avenue, Oakland, California
- Drawing 2. Gasoline Range Organics Iso-Concentration Contours Map, 9 August 2007, Station #11117, 7210 Bancroft Avenue, Oakland, California
- Drawing 3. Benzene Iso-Concentration Contours Map, 9 August 2007, Station #11117, 7210 Bancroft Avenue, Oakland, California
- Drawing 4. MTBE Iso-Concentration Contours Map, 9 August 2007, Station #11117, 7210 Bancroft Avenue, Oakland, California
- Table 1. Summary of Ground-Water Monitoring Data: Relative Water Elevations and Laboratory Analyses, Station #11117, 7210 Bancroft Ave., Oakland, CA
- Table 2. Summary of Fuel Additives Analytical Data, Station #11117, 7210 Bancroft Ave., Oakland, CA
- Table 3. Historical Ground-Water Flow Direction and Gradient, Station #11117, 7210 Bancroft Ave., Oakland, CA
- Appendix A. Stratus Ground-Water Sampling Data Package (Includes Field Data Sheets and Laboratory Analytical Report with Chain-of-Custody Documentation)
- Appendix B. GeoTracker Upload Confirmation

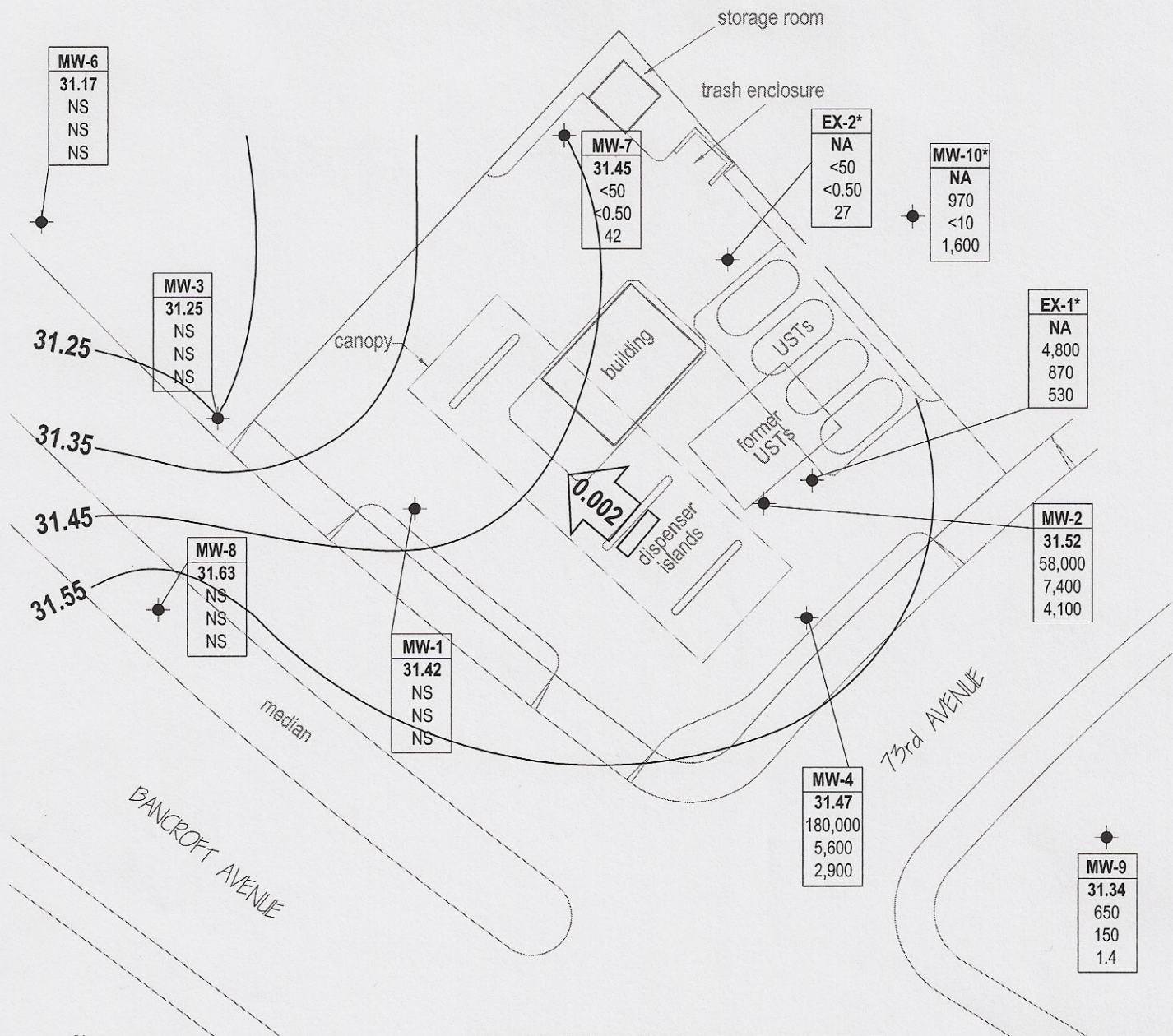

MW-6
31.17
NS
NS
NS

MW-3
31.25
NS
NS
NS

MW-8
31.63
NS
NS
NS

MW-1
31.42
NS
NS
NS

MW-7
31.45
<50
<0.50
42

EX-2*
NA
<50
<0.50
27

MW-10*
NA
970
<10
1,600

EX-1*
NA
4,800
870
530

MW-2
31.52
58,000
7,400
4,100

MW-4
31.47
180,000
5,600
2,900

MW-9
31.34
650
150
1.4

LEGEND

- Monitoring well location
- | |
|----------------|
| Well |
| ELEV |
| GRO |
| Benzene |
| MTBE |

 Well designation
- | |
|-------------|
| ELEV |
|-------------|

 Ground-water elevation (ft/MSL)
- | |
|----------------|
| GRO |
| Benzene |
| MTBE |

 GRO, Benzene and MTBE concentrations in micrograms per liter (µg/L)
- Ground-water flow gradient and direction (ft/ft)
- Ground-water elevation contour (ft/MSL)
- Not detected at or above laboratory reporting limit
- NM Not measured
- NS Not sampled
- NA Not available, well elevation not surveyed
- * Elevation not used for contours

Chevron-branded site

0 40 80

SCALE (ft)

NOTE: SITE MAP ADAPTED FROM CAMBRIA ENVIRONMENTAL FIGURES. SITE DIMENSIONS AND FACILITY LOCATIONS NOT VERIFIED.

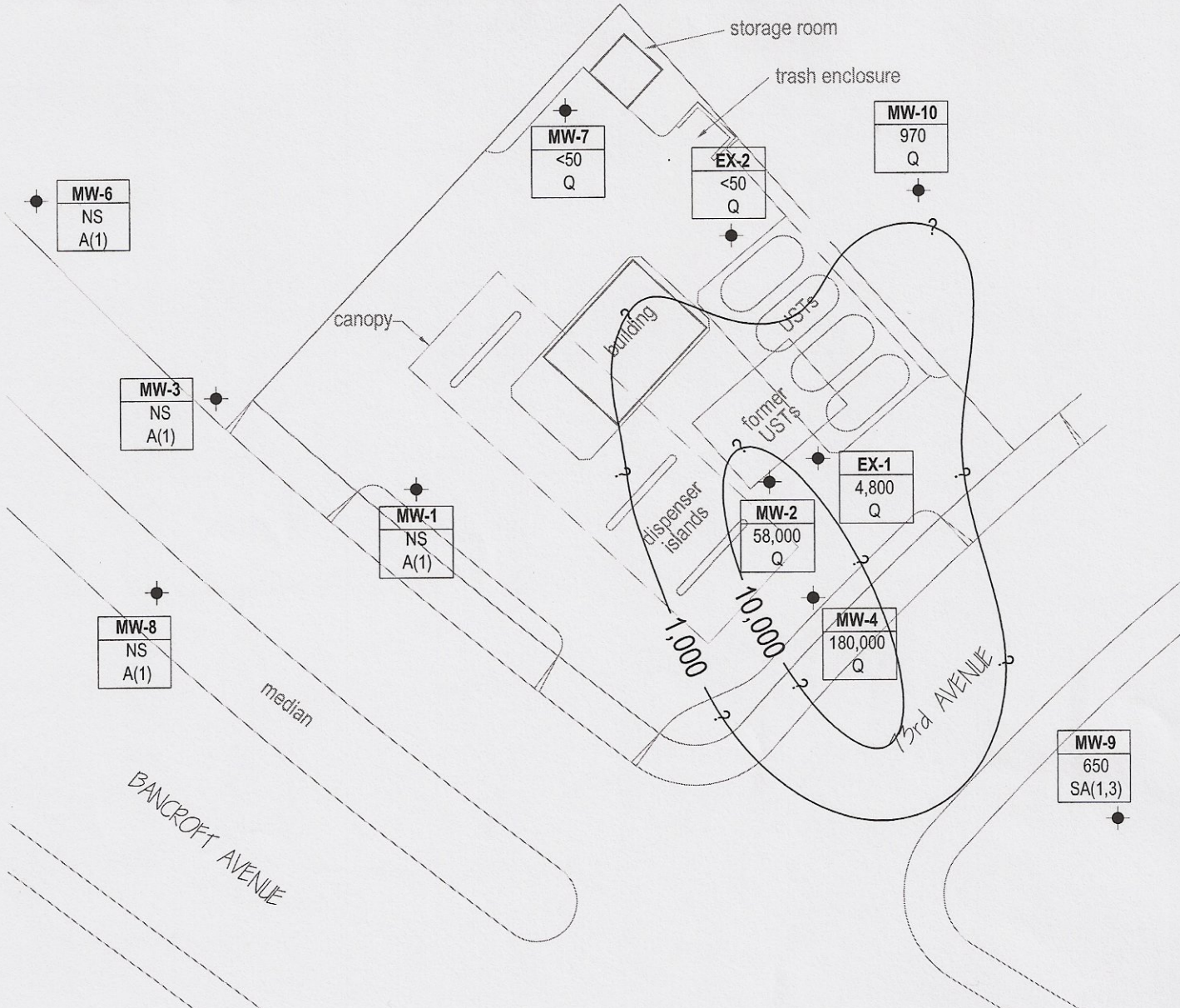

Chevron-branded site

LEGEND

- Monitoring well location
- | |
|-------------|
| Well |
| GRO |
| A/Q/SA |

 Well designation
- | |
|--------|
| GRO |
| A/Q/SA |

 GRO concentrations in micrograms per liter (µg/L)
- | |
|--------|
| A/Q/SA |
|--------|

 Sampling frequency
- 1,000 Approximate GRO iso-concentration contour in micrograms per liter (µg/L). Contour interval = logarithmic.
- | |
|---|
| Q |
|---|

 Sampled quarterly
- | |
|---------|
| SA(1,3) |
|---------|

 Sampled semi-annually, 1st and 3rd quarter
- | |
|------|
| A(1) |
|------|

 Sampled annually, 1st quarter
- | |
|---|
| < |
|---|

 Not detected at or above laboratory reporting limit
- | |
|----|
| NS |
|----|

 Not sampled
- | |
|---|
| ? |
|---|

 Contours within regions not bounded by monitoring points. All contours depicted are approximate.

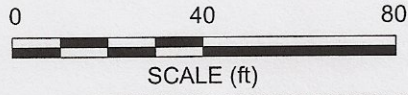

NOTE: SITE MAP ADAPTED FROM CAMBRIA ENVIRONMENTAL FIGURES. SITE DIMENSIONS AND FACILITY LOCATIONS NOT VERIFIED.

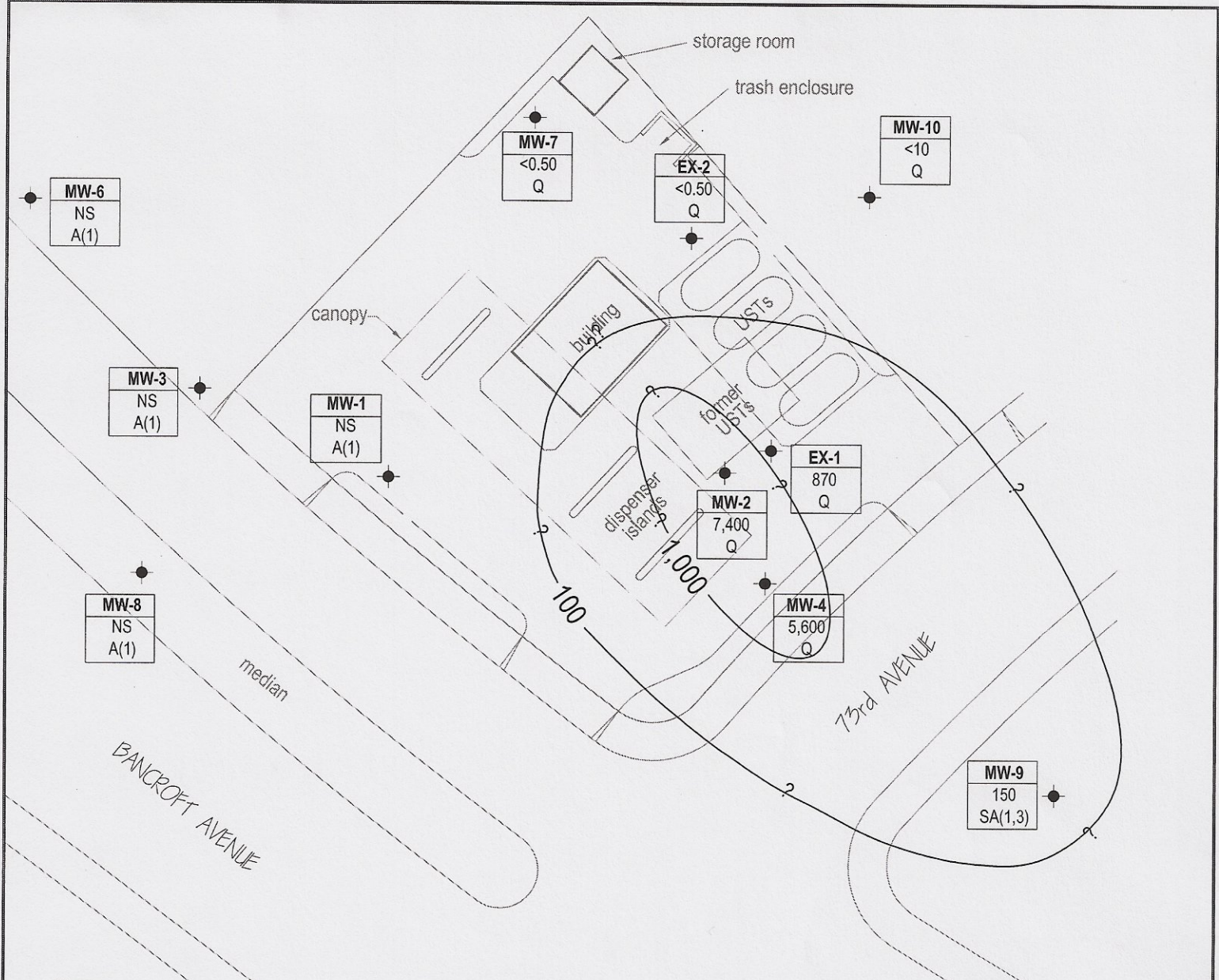

Chevron-branded site

LEGEND

- Monitoring well location
- Well** — Well designation
- Benzene** — Benzene concentrations in micrograms per liter (µg/L)
- A/Q/SA** — Sampling frequency
- Approximate Benzene iso-concentration contour in micrograms per liter (µg/L). Contour interval = logarithmic.
- Q** — Sampled quarterly
- SA(1,3)** — Sampled semi-annually, 1st and 3rd quarter
- A(1)** — Sampled annually, 1st quarter
- <** — Not detected at or above laboratory reporting limit
- NS** — Not sampled
- ?** — Contours within regions not bounded by monitoring points. All contours depicted are approximate.

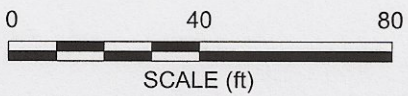

NOTE: SITE MAP ADAPTED FROM CAMBRIA ENVIRONMENTAL FIGURES. SITE DIMENSIONS AND FACILITY LOCATIONS NOT VERIFIED.

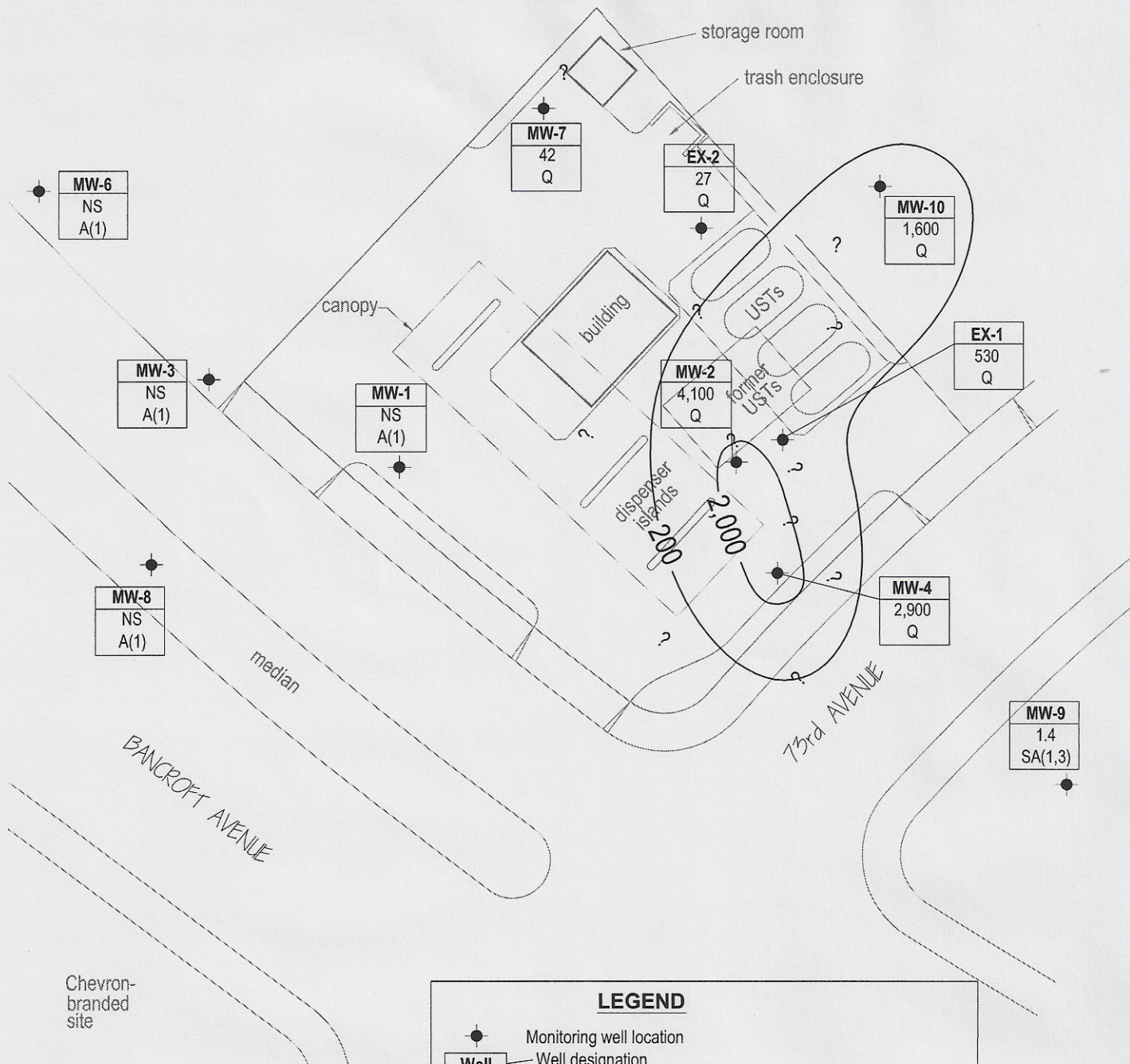

Chevron-branded site

LEGEND

- Monitoring well location
- Well** Well designation
- MTBE** MTBE concentrations in micrograms per liter (µg/L)
- A/Q/SA** Sampling frequency
- Approximate MTBE iso-concentration contour in micrograms per liter (µg/L). Contour interval = logarithmic.
- Q** Sampled quarterly
- SA(1,3)** Sampled semi-annually, 1st and 3rd quarter
- A(1)** Sampled annually, 1st quarter
- <** Not detected at or above laboratory reporting limit
- NS** Not sampled
- ?** Contours within regions not bounded by monitoring points. All contours depicted are approximate.

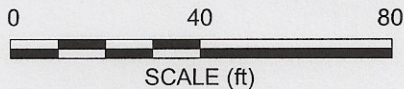
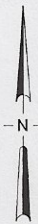

NOTE: SITE MAP ADAPTED FROM CAMBRIA ENVIRONMENTAL FIGURES. SITE DIMENSIONS AND FACILITY LOCATIONS NOT VERIFIED.

Table 1. Summary of Ground-Water Monitoring Data: Relative Water Elevations and Laboratory Analyses
Station #11117, 7210 Bancroft Ave., Oakland, CA

Well and Sample Date	P/NP	TOC Elevation (feet msl)	Depth to Water (feet bgs)	Product Thickness (feet)	Water Level Elevation (feet msl)	Concentrations in (µg/L)						DO (mg/L)	Lab	pH	Comments
						GRO/TPHg	Benzene	Toluene	Ethyl-Benzene	Total Xylenes	MTBE				
EX-1															
05/04/2004	P	--	16.29	--	--	12,000	2,300	430	740	1,100	2,500	--	SEQM	6.8	h
08/31/2004	P	--	19.39	--	--	13,000	2,500	95	650	1,500	2,100	--	SEQM	6.7	h
11/23/2004	P	--	17.90	--	--	13,000	2,700	94	460	1,700	3,000	--	SEQM	6.9	
01/18/2005	P	--	14.20	--	--	16,000	2,100	390	570	2,500	2,200	--	SEQM	6.6	
06/29/2005	P	--	14.22	--	--	6,400	1,100	52	280	790	1,400	--	SEQM	7.2	
09/01/2005	P	--	17.22	--	--	7,900	2,000	94	400	870	2,000	--	SEQM	6.7	
11/03/2005	P	--	19.92	--	--	22,000	3,200	640	550	3,300	3,000	0.88	SEQM	6.8	
02/14/2006	P	--	15.40	--	--	3,500	<25	<25	<25	74	1,100	--	SEQM	6.8	
5/30/2006	P	--	13.43	--	--	8,600	1,400	120	490	1,300	1,400	--	SEQM	6.8	
8/29/2006	--	--	17.74	--	--	22,000	2,900	210	1,400	3,600	2,500	--	TAMC	6.9	
11/29/2006	P	--	20.25	--	--	15,000	4,000	110	770	2,700	2,700	0.61	TAMC	6.86	
2/20/2007	P	--	16.75	--	--	10,000	2,500	<50	550	1,300	920	1.15	TAMC	7.14	
5/25/2007	P	--	17.04	--	--	8,600	2,100	88	700	1,400	890	2.96	TAMC	6.95	
8/9/2007	NP	--	19.76	--	--	4,800	870	40	230	460	530	0.26	TAMC	7.01	
EX-2															
05/04/2004	P	--	16.65	--	--	<50	0.63	<0.50	<0.50	0.66	46	--	SEQM	6.7	h
08/31/2004	P	--	19.90	--	--	<250	<2.5	<2.5	<2.5	<2.5	130	--	SEQM	6.9	h
11/23/2004	P	--	18.36	--	--	<50	0.74	<0.50	0.83	3.0	5.8	--	SEQM	6.6	
01/18/2005	P	--	14.67	--	--	<50	<0.50	<0.50	<0.50	0.69	6.5	--	SEQM	6.5	
06/29/2005	P	--	14.60	--	--	<50	<0.50	<0.50	<0.50	0.50	24	--	SEQM	6.8	s
09/01/2005	P	--	17.28	--	--	<50	<0.50	1.4	<0.50	1.4	55	--	SEQM	7.0	
11/03/2005	P	--	20.42	--	--	<50	0.50	<0.50	<0.50	1.4	39	0.77	SEQM	6.9	
02/14/2006	P	--	14.54	--	--	220	<0.50	3.2	7.5	33	0.72	--	SEQM	7.0	
5/30/2006	P	--	13.35	--	--	<50	<0.50	<0.50	<0.50	0.70	7.8	--	SEQM	6.9	
8/29/2006	--	--	17.92	--	--	66	0.67	<0.50	0.79	1.9	94	--	TAMC	6.9	
11/29/2006	P	--	20.63	--	--	<50	<0.50	<0.50	<0.50	<0.50	4.4	--	TAMC	7.73	
2/20/2007	P	--	17.58	--	--	<50	<0.50	<0.50	<0.50	2.0	12	1.41	TAMC	7.77	
5/25/2007	P	--	17.23	0.01	--	<50	<0.50	<0.50	<0.50	<0.50	10	2.99	TAMC	7.30	
8/9/2007	P	--	20.40	--	--	<50	<0.50	<0.50	<0.50	<0.50	27	1.14	TAMC	7.19	

Table 1. Summary of Ground-Water Monitoring Data: Relative Water Elevations and Laboratory Analyses
Station #11117, 7210 Bancroft Ave., Oakland, CA

Well and Sample Date	P/NP	TOC Elevation (feet msl)	Depth to Water (feet bgs)	Product Thickness (feet)	Water Level Elevation (feet msl)	Concentrations in (µg/L)						DO (mg/L)	Lab	pH	Comments
						GRO/TPHg	Benzene	Toluene	Ethyl-Benzene	Total Xylenes	MTBE				
MW-1															
1/5/1992	--	49.80	33.16	--	16.64	57,000	2,400	1,000	1,100	3,100	--	--	--	--	
1/10/1992	--	49.80	33.16	--	16.64	--	--	--	--	--	--	--	--	--	
6/5/1992	--	49.80	29.01	--	20.79	31,000	2,800	2,100	800	2,300	--	--	--	--	
7/24/1992	--	49.80	29.45	--	20.35	--	--	--	--	--	--	--	--	--	
7/27/1992	--	49.80	29.45	--	20.35	--	--	--	--	--	--	--	--	--	
9/15/1992	--	--	--	--	--	36,000	3,800	3,400	1,400	3,800	--	--	ANA	--	d
9/15/1992	--	49.80	30.53	--	19.27	40,000	3,400	3,000	1,300	3,400	--	--	ANA	--	c
12/15/1992	--	49.80	31.26	--	18.54	27,000	1,700	580	700	1,900	--	--	ANA	--	c
12/15/1992	--	--	--	--	--	22,000	1,500	440	510	1,300	--	--	ANA	--	d
3/15/1993	--	49.80	24.80	--	25.00	17,000	1,700	1,200	590	1,800	--	--	PACE	--	l
3/15/1993	--	--	--	--	--	15,000	1,100	860	440	1,400	--	--	PACE	--	d, l
6/7/1993	--	49.80	25.01	--	24.79	750	0.8	0.8	<0.5	<0.5	--	--	PACE	--	l
6/7/1993	--	--	--	--	--	720	0.7	0.7	<0.5	<0.5	--	--	PACE	--	d, l
9/23/1993	--	49.80	28.70	--	21.10	40,000	4,000	500	920	3,000	6,619	--	PACE	--	e, l
12/27/1993	--	--	--	--	--	21,000	1,700	380	830	2,400	9,219	--	PACE	--	e, l, d
12/27/1993	--	49.80	28.66	--	21.14	27,000	2,000	400	940	2,600	13,558	--	PACE	--	e, l
4/5/1994	--	--	--	--	--	29,000	3,700	1,000	1,000	3,100	9,672	1.3	PACE	--	e, l, d
4/5/1994	--	49.80	26.37	--	23.43	27,000	3,400	930	950	2,900	8,595	--	PACE	--	e, l,
7/22/1994	--	49.80	26.54	--	23.26	1,700	220	2.3	2	3.4	262	2.0	PACE	--	e, l,
10/13/1994	--	49.80	27.46	--	22.34	1,200	250	21	<0.5	3.2	321	2.6	PACE	--	e, l
1/25/1995	--	49.80	20.96	--	28.84	1,000	420	8	13	4	--	--	ATI	--	
4/19/1995	--	49.80	19.59	--	30.21	5,200	420	51	230	340	--	6.0	ATI	--	
7/5/1995	--	49.80	19.61	--	30.19	320	4.2	<0.50	<0.50	<1.0	--	4.6	ATI	--	
10/5/1995	--	49.80	24.40	--	25.40	5,800	1,000	40	31	180	7,800	2.3	ATI	--	
1/12/1996	--	49.80	25.44	--	24.36	370	<0.50	<0.50	<0.50	<1.0	<5.0	3.7	ATI	--	
4/22/1996	--	49.80	18.02	--	31.78	<50	<0.5	<1	<1	<1	<10	3.9	SPL	--	
7/2/1996	--	49.80	19.72	--	30.08	--	--	--	--	--	--	--	--	--	
7/3/1996	--	49.80	--	--	--	<250	<2.5	<5	<5	<5	<50	3.6	SPL	--	
11/8/1996	--	49.80	19.98	--	29.82	<50	<0.5	<1.0	<1.0	<1.0	<10	4.3	SPL	--	
1/3/1997	--	49.80	19.49	--	30.31	<50	<0.5	14	<1.0	<1.0	<10	4.6	SPL	--	
4/28/1997	--	49.80	20.20	--	29.60	<50	<0.5	<1.0	<1.0	<1.0	<10	3.9	SPL	--	

**Table 1. Summary of Ground-Water Monitoring Data: Relative Water Elevations and Laboratory Analyses
Station #11117, 7210 Bancroft Ave., Oakland, CA**

Well and Sample Date	P/NP	TOC Elevation (feet msl)	Depth to Water (feet bgs)	Product Thickness (feet)	Water Level Elevation (feet msl)	Concentrations in (µg/L)						DO (mg/L)	Lab	pH	Comments
						GRO/TPHg	Benzene	Toluene	Ethyl-Benzene	Total Xylenes	MTBE				
MW-1 Cont.															
7/1/1997	--	49.80	22.53	--	27.27	<50	<0.5	<1.0	<1.0	<1.0	<10	3.9	SPL	--	
10/2/1997	--	49.80	24.27	--	25.53	<50	<0.5	<1.0	<1.0	<1.0	<10	4.6	SPL	--	
1/9/1998	--	49.80	21.07	--	28.73	<50	<0.5	<1.0	<1.0	<1.0	<10	4.2	SPL	--	
5/6/1998	--	49.80	14.94	--	34.86	60	<0.5	<1.0	<1.0	<1.0	<10	3.8	SPL	--	
7/21/1998	--	49.80	15.11	--	34.69	70	<0.5	<1.0	<1.0	<1.0	<10	3.8	SPL	--	
12/30/1998	--	49.80	19.95	--	29.85	--	--	--	--	--	--	--	--	--	
2/2/1999	--	49.80	19.12	--	30.68	420	<1.0	<1.0	<1.0	<1.0	390	--	SPL	--	
5/10/1999	--	49.80	15.51	--	34.29	--	--	--	--	--	--	--	--	--	
9/23/1999	--	49.80	21.65	--	28.15	440	49	<1.0	<1.0	<1.0	910	--	SPL	--	
12/23/1999	--	49.80	22.32	--	27.48	--	--	--	--	--	--	--	--	--	
3/27/2000	--	49.80	15.72	--	34.08	2,500	230	3	83	36	4,400	--	PACE	--	
5/22/2000	--	49.80	16.92	--	32.88	--	--	--	--	--	--	--	--	--	
8/31/2000	--	49.80	20.12	--	29.68	1,700	18	5.5	7.9	5	510	--	PACE	--	
12/11/2000	--	49.80	20.72	--	29.08	--	--	--	--	--	--	--	--	--	
3/20/2001	--	49.80	15.91	--	33.89	880	38.2	<0.5	24.1	<1.5	391	--	PACE	--	
6/19/2001	--	49.80	18.38	--	31.42	--	--	--	--	--	--	--	--	--	
9/20/2001	--	49.80	21.23	--	28.57	3,200	400	19.8	42	32.5	2,510	--	PACE	--	
12/27/2001	--	49.80	16.72	--	33.08	750	70.1	0.536	4.74	3.76	649	--	PACE	--	
2/28/2002	--	49.80	15.25	--	34.55	<50	<0.5	<0.5	<0.5	<1.0	8.7	--	PACE	--	
6/28/2002	--	49.80	16.57	--	33.23	110	0.977	<0.5	0.818	<1.0	8.35	--	PACE	--	
9/12/2002	--	49.80	18.41	--	31.39	98	2.7	1.5	1.5	5.4	48	--	SEQ	6.9	
12/12/2002	--	49.80	20.26	--	29.54	210	1.9	<0.50	<0.50	<0.50	32	--	SEQ	6.8	
3/10/2003	--	49.80	16.22	--	33.58	<50	<0.50	<0.50	<0.50	<0.50	3.2	--	SEQ	6.9	
5/12/2003	--	49.80	14.30	--	35.50	<50	<0.50	<0.50	<0.50	<0.50	<2.5	--	SEQ	7.1	
8/27/2003	--	49.80	18.15	--	31.65	<50	<0.50	<0.50	<0.50	<0.50	4.2	--	SEQ	7.1	n
11/10/2003	P	49.80	19.24	--	30.56	<50	<0.50	<0.50	<0.50	<0.50	0.51	--	SEQM	6.8	
02/03/2004	P	49.80	14.84	--	34.96	<50	<0.50	<0.50	<0.50	<0.50	<0.50	--	SEQM	7.0	
05/04/2004	P	49.80	14.67	--	35.13	<50	<0.50	<0.50	<0.50	<0.50	<0.50	--	SEQM	7.1	
08/31/2004	P	49.80	17.75	--	32.05	<50	<0.50	<0.50	<0.50	<0.50	0.50	--	SEQM	7.1	
11/23/2004	--	49.80	16.03	--	33.77	--	--	--	--	--	--	--	--	--	
01/18/2005	P	49.80	12.47	--	37.33	<50	<0.50	<0.50	<0.50	<0.50	<0.50	--	SEQM	6.9	

Table 1. Summary of Ground-Water Monitoring Data: Relative Water Elevations and Laboratory Analyses
Station #11117, 7210 Bancroft Ave., Oakland, CA

Well and Sample Date	P/NP	TOC Elevation (feet msl)	Depth to Water (feet bgs)	Product Thickness (feet)	Water Level Elevation (feet msl)	Concentrations in (µg/L)						DO (mg/L)	Lab	pH	Comments
						GRO/TPHg	Benzene	Toluene	Ethyl-Benzene	Total Xylenes	MTBE				
MW-1 Cont.															
06/29/2005	--	49.80	12.65	--	37.15	--	--	--	--	--	--	--	--	--	--
09/01/2005	--	49.80	15.79	--	34.01	--	--	--	--	--	--	--	--	--	--
11/03/2005	--	49.80	18.55	--	31.25	--	--	--	--	--	--	--	--	--	--
02/14/2006	P	49.80	12.29	--	37.51	51	<0.50	<0.50	<0.50	<0.50	<0.50	--	SEQM	7.0	w
5/30/2006	--	49.80	12.15	--	37.65	--	--	--	--	--	--	--	--	--	--
8/29/2006	--	49.80	16.37	--	33.43	--	--	--	--	--	--	--	--	--	--
11/29/2006	--	49.80	18.73	--	31.07	--	--	--	--	--	--	--	--	--	--
2/20/2007	P	49.80	14.71	--	35.09	110	<0.50	<0.50	0.58	<0.50	<0.50	3.52	TAMC	7.51	
5/25/2007	--	49.80	15.59	--	34.21	--	--	--	--	--	--	--	--	--	--
8/9/2007	--	49.80	18.38	--	31.42	--	--	--	--	--	--	--	--	--	--
MW-2															
1/5/1992	--	51.07	--	--	--	--	--	--	--	--	--	--	--	--	r
1/10/1992	--	51.07	--	--	--	--	--	--	--	--	--	--	--	--	r
6/5/1992	--	51.07	30.05	--	21.02	11,000	2,000	180	490	1,900	--	--	--	--	
7/24/1992	--	51.07	30.72	--	20.35	--	--	--	--	--	--	--	--	--	
7/27/1992	--	51.07	30.52	--	20.55	--	--	--	--	--	--	--	--	--	
9/15/1992	--	51.07	31.56	--	19.51	75,000	2,000	6,500	2,300	13,000	--	--	ANA	--	c
12/15/1992	--	51.07	32.40	--	18.67	34,000	6,200	8,900	2,000	7,900	--	--	ANA	--	c
3/15/1993	--	51.07	26.14	--	24.93	150,000	12,000	18,000	3,200	22,000	82,000	--	PACE	--	e
6/7/1993	--	51.07	26.38	--	24.69	--	--	--	--	--	--	--	--	--	f
9/23/1993	--	51.07	31.43	1.92	17.72	--	--	--	--	--	--	--	--	--	f
12/27/1993	--	51.07	34.07	1.07	15.93	--	--	--	--	--	--	--	--	--	f
4/5/1994	--	51.07	30.44	3.30	17.33	--	--	--	--	--	--	--	--	--	f
7/22/1994	--	51.07	28.51	0.80	21.76	--	--	--	--	--	--	--	--	--	f
10/13/1994	--	51.07	29.33	0.70	21.04	--	--	--	--	--	--	--	--	--	f
1/25/1995	--	51.07	25.55	4.25	21.27	--	--	--	--	--	--	--	--	--	f
4/19/1995	--	51.07	19.78	0.12	31.17	--	--	--	--	--	--	--	--	--	f
7/5/1995	--	51.07	20.88	0.09	30.10	140,000	14,000	30,000	3,500	26,000	--	--	ATI	--	
10/5/1995	--	51.07	24.68	0.10	26.29	--	--	--	--	--	--	--	--	--	f
1/12/1996	--	51.07	25.72	0.06	25.29	--	--	--	--	--	--	--	--	--	f

Table 1. Summary of Ground-Water Monitoring Data: Relative Water Elevations and Laboratory Analyses

Station #11117, 7210 Bancroft Ave., Oakland, CA

Well and Sample Date	P/NP	TOC Elevation (feet msl)	Depth to Water (feet bgs)	Product Thickness (feet)	Water Level Elevation (feet msl)	Concentrations in (µg/L)						DO (mg/L)	Lab	pH	Comments
						GRO/TPHg	Benzene	Toluene	Ethyl-Benzene	Total Xylenes	MTBE				
MW-2 Cont.															
4/22/1996	--	51.07	19.33	0.08	31.66	--	--	--	--	--	--	--	--	--	f
7/2/1996	--	51.07	20.01	0.04	31.02	--	--	--	--	--	--	--	--	--	f
11/8/1996	--	51.07	20.28	0.01	30.78	--	--	--	--	--	--	--	--	--	f
1/3/1997	--	51.07	19.87	0.02	31.18	--	--	--	--	--	--	--	--	--	f
4/28/1997	--	51.07	20.59	0.01	30.47	560,000	1,200	1,300	290	2,310	6,100	3.9	SPL	--	
7/1/1997	--	--	--	--	--	150,000	14,000	13,000	1,800	14,200	57,000	--	SPL	--	d
7/1/1997	--	51.07	22.90	0.01	28.16	24,000	15,000	16,000	4,900	24,400	63,000	3.7	SPL	--	
10/2/1997	--	51.07	24.65	0.02	26.40	--	--	--	--	--	--	--	--	--	
10/3/1997	--	51.07	--	--	--	250,000	32,000	39,000	6,000	42,000	160,000	4.5	SPL	--	
1/9/1998	--	--	--	--	--	300,000	20,000	25,000	5,200	37,000	84,000	--	SPL	--	d
1/9/1998	--	51.07	21.22	0.01	29.84	420,000	23,000	29,000	5,800	43,000	75,000	4.0	SPL	--	
2/2/1998	--	51.07	20.11	--	30.96	410,000	27,000	43,000	6,700	50,000	20,000	--	SPL	--	
5/6/1998	--	51.07	15.10	0.01	35.96	180,000	25,000	26,000	3,400	22,900	35,000	3.7	SPL	--	
7/21/1998	--	51.07	15.31	0.01	35.75	270,000	21,000	20,000	2,700	18,800	34,000	3.8	SPL	--	
12/30/1998	--	51.07	21.10	0.10	29.87	300,000	22,000	24,000	4,200	26,000	89000/95000	--	SPL	--	j
5/10/1999	--	51.07	16.68	--	34.39	220,000	20,000	20,000	2,800	20,000	100,000	--	SPL	--	
9/23/1999	--	51.07	22.50	--	28.57	160,000	21,000	24,000	2,900	20,000	44,000	--	SPL	--	
12/23/1999	--	51.07	22.64	--	28.43	170,000	25,000	41,000	3,100	24,000	40,000	--	PACE	--	k
3/27/2000	--	51.07	16.88	--	34.19	140,000	15,000	25,000	3,400	21,000	19,000	--	PACE	--	
5/22/2000	--	51.07	17.75	--	33.32	150,000	18,000	31,000	3,500	22,000	26,000	--	PACE	--	
8/31/2000	--	51.07	21.97	--	29.10	200,000	16,000	26,000	2,500	16,000	38,000	--	PACE	--	
12/11/2000	--	51.07	22.05	--	29.02	130,000	18,600	30,000	3,250	20,600	21,700	--	PACE	--	
3/20/2001	--	51.07	17.75	--	33.32	140,000	15,900	24,800	3,700	22,100	12,900	--	PACE	--	
6/19/2001	--	51.07	20.15	--	30.92	130,000	15,100	19,500	3,300	21,400	20,300	--	PACE	--	
9/20/2001	--	51.07	22.14	--	28.93	110,000	12,400	12,600	2,230	13,000	39,500	--	PACE	--	
12/27/2001	--	51.07	18.17	--	32.90	150,000	17,500	26,000	3,050	19,500	27,500	--	PACE	--	
2/28/2002	--	51.07	17.42	--	33.65	120,000	13,900	18,800	3,030	19,600	17,300	--	PACE	--	
6/28/2002	--	51.07	17.04	--	34.03	3,700	190	23.3	139	287	826	--	PACE	--	u
9/12/2002	--	51.07	19.52	--	31.55	100,000	13,000	22,000	3,600	20,000	18,000	--	SEQ	6.6	
12/12/2002	--	51.07	21.08	--	29.99	120,000	13,000	21,000	4,400	25,000	16,000	--	SEQ	6.6	
3/10/2003	--	51.07	17.84	--	33.23	100,000	17,000	21,000	3,400	20,000	4,400	--	SEQ	6.8	

Table 1. Summary of Ground-Water Monitoring Data: Relative Water Elevations and Laboratory Analyses

Station #11117, 7210 Bancroft Ave., Oakland, CA

Well and Sample Date	P/NP	TOC Elevation (feet msl)	Depth to Water (feet bgs)	Product Thickness (feet)	Water Level Elevation (feet msl)	Concentrations in (µg/L)						DO (mg/L)	Lab	pH	Comments
						GRO/TPHg	Benzene	Toluene	Ethyl-Benzene	Total Xylenes	MTBE				
MW-2 Cont.															
5/12/2003	--	51.07	16.66	--	34.41	150,000	16,000	24,000	3,500	22,000	3,600	--	SEQ	7.1	
8/27/2003	--	51.07	19.65	--	31.42	120,000	14,000	12,000	3,900	20,000	5,100	--	SEQ	6.9	n
11/10/2003	P	51.07	20.80	--	30.27	97,000	12,000	9,500	3,600	15,000	4,200	--	SEQM	6.7	
02/03/2004	P	51.07	16.82	--	34.25	130,000	14,000	19,000	3,400	20,000	1,900	--	SEQM	6.8	
05/04/2004	P	51.07	16.19	--	34.88	120,000	12,000	16,000	3,700	22,000	2,500	--	SEQM	6.7	
08/31/2004	P	51.07	19.50	--	31.57	99,000	10,000	13,000	3,700	18,000	3,400	--	SEQM	6.8	
11/23/2004	P	51.07	18.20	--	32.87	110,000	8,200	17,000	4,000	23,000	2,400	--	SEQM	6.7	s
01/18/2005	P	51.07	14.91	--	36.16	96,000	6,500	14,000	3,500	21,000	3,700	--	SEQM	6.6	
06/29/2005	P	51.07	13.98	--	37.09	54,000	6,200	4,900	3,300	12,000	3,600	--	SEQM	7.3	
09/01/2005	P	51.07	17.00	--	34.07	58,000	6,300	6,000	3,300	15,000	5,100	--	SEQM	7.0	
11/03/2005	P	51.07	20.25	--	30.82	63,000	7,400	3,700	3,300	10,000	3,700	0.66	SEQM	6.7	
02/14/2006	P	51.07	13.72	--	37.35	97,000	7,500	11,000	4,300	16,000	3,400	--	SEQM	6.9	
5/30/2006	P	51.07	13.50	--	37.57	28,000	5,200	2,500	1,500	3,300	2,300	--	SEQM	6.7	
8/29/2006	--	51.07	18.16	--	32.91	65,000	7,200	4,500	3,200	11,000	13,000	--	TAMC	6.7	
11/29/2006	P	51.07	20.06	--	31.01	46,000	8,500	4,600	3,300	10,000	11,000	0.56	TAMC	6.91	
2/20/2007	P	51.07	16.43	--	34.64	78,000	9,700	12,000	4,100	16,000	10,000	1.08	TAMC	7.11	
5/25/2007	P	51.07	16.80	SHEEN	34.27	62,000	7,400	9,500	4,100	15,000	3,400	0.10	TAMC	6.83	
8/9/2007	P	51.07	19.55	SHEEN	31.52	58,000	7,400	5,000	3,800	12,000	4,100	0.72	TAMC	7.01	
MW-3															
1/5/1992	--	49.95	33.69	--	16.26	7,400	790	23	210	40	--	--	--	--	
1/10/1992	--	49.95	33.74	--	16.21	--	--	--	--	--	--	--	--	--	
6/5/1992	--	49.95	29.65	--	20.30	2,000	130	5.3	93	20	--	--	--	--	
7/24/1992	--	49.95	30.14	--	19.81	--	--	--	--	--	--	--	--	--	
7/27/1992	--	49.95	30.14	--	19.81	--	--	--	--	--	--	--	--	--	
9/15/1992	--	49.95	31.07	--	18.88	450	55	3.1	34	7.1	--	--	ANA	--	
12/15/1992	--	49.95	31.93	--	18.02	12,000	940	<50	310	120	--	--	ANA	--	c
3/15/1993	--	49.95	25.71	--	24.24	<50	<0.5	<0.5	<0.5	<0.5	--	--	PACE	--	l
6/7/1993	--	49.95	25.80	--	24.15	150	3.6	<0.5	0.9	1.3	--	--	PACE	--	l
9/23/1993	--	49.95	29.18	--	20.77	--	--	--	--	--	--	--	--	--	
9/24/1993	--	49.95	--	--	--	160	8.4	<0.5	3.7	1.3	15.3	--	PACE	--	l

Table 1. Summary of Ground-Water Monitoring Data: Relative Water Elevations and Laboratory Analyses

Station #11117, 7210 Bancroft Ave., Oakland, CA

Well and Sample Date	P/NP	TOC Elevation (feet msl)	Depth to Water (feet bgs)	Product Thickness (feet)	Water Level Elevation (feet msl)	Concentrations in (µg/L)						DO (mg/L)	Lab	pH	Comments
						GRO/TPHg	Benzene	Toluene	Ethyl-Benzene	Total Xylenes	MTBE				
MW-3 Cont.															
12/27/1993	--	49.95	29.25	--	20.70	9,400	1,100	48	530	120	2,871	--	PACE	--	e,l
4/5/1994	--	49.95	26.84	--	23.11	7,000	860	19	330	52	10,414	2.0	PACE	--	l
7/22/1994	--	49.95	26.90	--	23.05	<50	<0.5	<0.5	<0.5	<0.5	<5.0	2.1	PACE	--	l
10/13/1994	--	49.95	27.83	--	22.12	<50	<0.5	<0.5	<0.5	<0.5	<5.0	2.6	PACE	--	l
1/25/1995	--	49.95	21.65	--	28.30	<50	<0.5	<0.5	<0.5	<1	--	--	ATI	--	
4/19/1995	--	49.95	19.33	--	30.62	2,400	170	8	130	27	--	5.0	ATI	--	
7/5/1995	--	49.95	20.27	--	29.68	<50	<0.50	<0.50	<0.50	<1.0	--	4.4	ATI	--	
10/5/1995	--	49.95	23.73	--	26.22	2,300	210	3.1	10	5.1	2,400	4.2	ATI	--	
1/12/1996	--	49.95	24.84	--	25.11	<50	<0.50	<0.50	<0.50	<1.0	<5.0	4.1	ATI	--	
4/22/1996	--	49.95	18.60	--	31.35	<50	<0.5	<1	<1	<1	<10	4.4	SPL	--	
7/2/1996	--	49.95	18.88	--	31.07	<50	<0.5	<1	<1	<1	<10	4.2	SPL	--	
11/8/1996	--	49.95	19.14	--	30.81	<50	<0.5	<1.0	<1.0	<1.0	<10	4.4	SPL	--	
1/3/1997	--	49.95	18.72	--	31.23	<50	<0.5	<1.0	<1.0	<1.0	<10	4.6	SPL	--	
4/28/1997	--	49.95	19.38	--	30.57	<50	<0.5	<1.0	<1.0	<1.0	<10	4.2	SPL	--	
7/1/1997	--	49.95	21.65	--	28.30	<50	<0.5	<1.0	<1.0	<1.0	<10	3.8	SPL	--	
10/2/1997	--	49.95	23.45	--	26.50	<50	<0.5	<1.0	<1.0	<1.0	<10	4.5	SPL	--	
1/9/1998	--	49.95	20.10	--	29.85	<50	<0.5	<1.0	<1.0	<1.0	<10	4.1	SPL	--	
5/6/1998	--	49.95	15.57	--	34.38	<50	<0.5	<1.0	<1.0	<1.0	<10	3.8	SPL	--	
7/21/1998	--	--	--	--	--	60	<0.5	<1.0	<1.0	<1.0	<10	--	SPL	--	d
7/21/1998	--	49.95	15.88	--	34.07	51	<0.5	<1.0	<1.0	<1.0	<10	3.8	SPL	--	
12/30/1998	--	49.95	20.30	--	29.65	--	--	--	--	--	--	--	SPL	--	
2/2/1999	--	49.95	19.75	--	30.20	<50	<1.0	<1.0	<1.0	<1.0	<10	--	SPL	--	
5/10/1999	--	49.95	16.17	--	33.78	--	--	--	--	--	--	--	--	--	
9/23/1999	--	49.95	22.05	--	27.90	--	--	--	--	--	--	--	--	--	
12/23/1999	--	49.95	22.55	--	27.40	--	--	--	--	--	--	--	--	--	
3/27/2000	--	49.95	16.40	--	33.55	350	22	<0.5	<0.5	<0.5	580	--	PACE	--	
5/22/2000	--	49.95	9.49	--	40.46	--	--	--	--	--	--	--	--	--	t
8/31/2000	--	49.95	13.02	--	36.93	--	--	--	--	--	--	--	--	--	t
12/11/2000	--	49.95	13.30	--	36.65	--	--	--	--	--	--	--	--	--	t
3/20/2001	--	49.95	16.49	--	33.46	1,000	66.4	0.597	6.96	<1.5	398	--	PACE	--	
6/19/2001	--	49.95	18.82	--	31.13	--	--	--	--	--	--	--	--	--	

Table 1. Summary of Ground-Water Monitoring Data: Relative Water Elevations and Laboratory Analyses

Station #11117, 7210 Bancroft Ave., Oakland, CA

Well and Sample Date	P/NP	TOC Elevation (feet msl)	Depth to Water (feet bgs)	Product Thickness (feet)	Water Level Elevation (feet msl)	Concentrations in (µg/L)						DO (mg/L)	Lab	pH	Comments
						GRO/TPHg	Benzene	Toluene	Ethyl-Benzene	Total Xylenes	MTBE				
MW-3 Cont.															
9/20/2001	--	49.95	21.59	--	28.36	230	<0.5	0.593	<0.5	<1.5	289	--	PACE	--	
12/27/2001	--	49.95	17.37	--	32.58	--	--	--	--	--	--	--	--	--	
2/28/2002	--	49.95	15.81	--	34.14	<50	<0.5	<0.5	<0.5	<1.0	0.58	--	PACE	--	
6/28/2002	--	49.95	17.09	--	32.86	--	--	--	--	--	--	--	--	--	
9/12/2002	--	49.95	18.80	--	31.15	52	3.3	8.6	1.7	12	11	--	SEQ	7.0	
12/12/2002	--	49.95	20.57	--	29.38	--	--	--	--	--	--	--	--	--	
3/10/2003	--	49.95	16.68	--	33.27	<50	<0.50	<0.50	<0.50	<0.50	<2.5	--	SEQ	7.0	
5/12/2003	--	49.95	14.72	--	35.23	--	--	--	--	--	--	--	--	--	
8/27/2003	--	49.95	18.50	--	31.45	<50	<0.50	<0.50	<0.50	0.5	<0.50	--	--	7.1	n
11/10/2003	--	49.95	19.66	--	30.29	--	--	--	--	--	--	--	--	--	
02/03/2004	P	49.95	15.33	--	34.62	<50	<0.50	<0.50	<0.50	<0.50	<0.50	--	SEQM	7.0	
08/31/2004	P	49.95	18.13	--	31.82	<50	<0.50	<0.50	<0.50	<0.50	<0.50	--	SEQM	7.1	
11/23/2004	--	49.95	16.48	--	33.47	--	--	--	--	--	--	--	--	--	
01/18/2005	P	49.95	13.06	--	36.89	<50	<0.50	<0.50	<0.50	<0.50	<0.50	--	SEQM	6.9	
06/29/2005	--	49.95	13.00	--	36.95	--	--	--	--	--	--	--	--	--	
09/01/2005	--	49.95	16.00	--	33.95	--	--	--	--	--	--	--	--	--	
11/03/2005	--	49.95	18.91	--	31.04	--	--	--	--	--	--	--	--	--	
02/14/2006	P	49.95	12.90	--	37.05	86	<0.50	<0.50	<0.50	0.55	<0.50	--	SEQM	7.3	
5/30/2006	--	49.95	12.55	--	37.40	--	--	--	--	--	--	--	--	--	
8/29/2006	--	49.95	16.68	--	33.27	--	--	--	--	--	--	--	--	--	
11/29/2006	--	49.95	19.10	--	30.85	--	--	--	--	--	--	--	--	--	
2/20/2007	P	49.95	15.29	--	34.66	56	<0.50	<0.50	<0.50	<0.50	0.89	2.27	TAMC	7.59	
5/25/2007	--	49.95	15.94	--	34.01	--	--	--	--	--	--	--	--	--	
8/9/2007	--	49.95	18.70	--	31.25	--	--	--	--	--	--	--	--	--	
MW-4															
7/24/1992	--	50.76	30.02	--	20.74	42,000	3,200	3,600	1,400	4,100	--	--	--	--	
7/27/1992	--	50.76	30.02	--	20.74	--	--	--	--	--	--	--	--	--	
9/15/1992	--	50.76	31.14	--	19.62	55,000	7,600	13,000	2,800	9,500	--	--	ANA	--	c
12/15/1992	--	50.76	31.98	--	18.78	36,000	3,700	4,700	1,200	4,000	--	--	ANA	--	c
3/15/1993	--	50.76	25.34	--	25.42	69,000	7,600	15,000	2,500	11,000	--	--	PACE	--	l

Table 1. Summary of Ground-Water Monitoring Data: Relative Water Elevations and Laboratory Analyses

Station #11117, 7210 Bancroft Ave., Oakland, CA

Well and Sample Date	P/NP	TOC Elevation (feet msl)	Depth to Water (feet bgs)	Product Thickness (feet)	Water Level Elevation (feet msl)	Concentrations in (µg/L)						DO (mg/L)	Lab	pH	Comments
						GRO/TPHg	Benzene	Toluene	Ethyl-Benzene	Total Xylenes	MTBE				
MW-4 Cont.															
6/7/1993	--	50.76	25.67	--	25.09	73,000	10,000	19,000	3,400	14,000	--	--	PACE	--	l
9/23/1993	--	50.76	29.37	--	21.39	--	--	--	--	--	--	--	--	--	
9/24/1993	--	50.76	--	--	--	68,000	11,000	2,100	8,600	990	390	--	PACE	--	l
9/24/1993	--	--	--	--	--	59,000	5,300	10,000	2,200	8,400	309	--	PACE	--	d
12/27/1993	--	50.76	29.40	--	21.36	32,000	2,500	4,400	1,300	4,400	387	--	PACE	--	l
4/5/1994	--	50.76	27.09	--	23.67	64,000	6,500	14,000	1,900	9,600	413	1.4	PACE	--	l
7/22/1994	--	--	--	--	--	85,000	11,000	21,000	3,300	14,000	435	--	PACE	--	d, l
7/22/1994	--	50.76	27.33	--	23.43	85,000	10,000	20,000	3,200	13,000	796	0.8	PACE	--	l
10/13/1994	--	--	--	--	--	51,000	7,400	13,000	2,100	9,100	773	--	PACE	--	d, l
10/13/1994	--	50.76	28.25	--	22.51	51,000	7,100	13,000	2,100	8,900	506	2.9	PACE	--	e, l
1/25/1995	--	--	--	--	--	28,000	4,200	12,000	1,500	7,800	--	--	ATI	--	d, l
1/25/1995	--	50.76	21.85	--	28.91	26,000	3,600	9,600	1,200	6,400	--	--	ATI	--	
4/19/1995	--	50.76	19.44	--	31.32	89,000	12,000	24,000	3,500	18,000	--	5.1	ATI	--	
4/19/1995	--	--	--	--	--	100,000	12,000	26,000	3,800	21,000	--	--	ATI	--	d
7/5/1995	--	50.76	20.52	--	30.24	130,000	13,000	29,000	3,300	25,000	--	4.3	ATI	--	
10/5/1995	--	50.76	24.23	--	26.53	110,000	10,000	23,000	3,600	17,000	34,000	2.1	ATI	--	
1/12/1996	--	--	--	--	--	40,000	3,500	9,000	1,200	8,700	4,300	--	ATI	--	d
1/12/1996	--	50.76	25.34	--	25.42	46,000	3,500	8,300	1,100	8,000	3,000	3.3	ATI	--	
4/22/1996	--	50.76	19.13	--	31.63	40,000	5,100	9,600	980	11,800	29,000	3.2	SPL	--	
4/22/1996	--	--	--	--	--	61,000	8,300	16,000	1,600	15,200	36,000	--	SPL	--	d
7/2/1996	--	--	--	--	--	78,000	9,800	21,000	1,900	15,300	42,000	--	SPL	--	d
7/2/1996	--	50.76	20.67	--	30.09	74,000	9,800	21,000	2,100	16,600	41,000	3.4	SPL	--	
11/8/1996	--	--	--	--	--	110,000	9,100	20,000	3,000	15,400	39,000	--	SPL	--	d
11/8/1996	--	50.76	20.95	--	29.81	100,000	7,900	16,000	2,500	13,700	37,000	3.7	SPL	--	
1/3/1997	--	--	--	--	--	66,000	12,000	19,000	2,900	15,000	69,000	--	SPL	--	d
1/3/1997	--	50.76	20.54	--	30.22	99,000	17,000	30,000	4,300	22,700	79,000	4.2	SPL	--	
4/28/1997	--	--	--	--	--	110,000	11,000	26,000	3,200	18,200	34,000	--	SPL	--	d
4/28/1997	--	50.76	21.28	--	29.48	130,000	12,000	28,000	3,800	21,000	37,000	3.9	SPL	--	
7/1/1997	--	50.76	23.61	--	27.15	110,000	16,000	25,000	4,900	24,400	37,000	3.6	SPL	--	
10/2/1997	--	50.76	25.39	--	25.37	--	--	--	--	--	--	--	--	--	
10/3/1997	--	--	--	--	--	71,000	8,600	8,700	2,900	13,500	84,000	--	SPL	--	d

Table 1. Summary of Ground-Water Monitoring Data: Relative Water Elevations and Laboratory Analyses

Station #11117, 7210 Bancroft Ave., Oakland, CA

Well and Sample Date	P/NP	TOC Elevation (feet msl)	Depth to Water (feet bgs)	Product Thickness (feet)	Water Level Elevation (feet msl)	Concentrations in (µg/L)						DO (mg/L)	Lab	pH	Comments
						GRO/TPHg	Benzene	Toluene	Ethyl-Benzene	Total Xylenes	MTBE				
MW-4 Cont.															
10/3/1997	--	50.76	--	--	--	66,000	8,200	8,600	2,700	13,400	80,000	4.4	SPL	--	
1/9/1998	--	50.76	21.25	--	29.51	100,000	9,700	3,200	1,500	4,700	92,000	3.8	SPL	--	
5/6/1998	--	--	--	--	--	440,000	8,000	39,000	14,000	70,000	<5000	--	SPL	--	d
5/6/1998	--	50.76	15.96	--	34.80	430,000	6,900	31,000	11,000	56,000	<5000	3.9	SPL	--	
7/21/1998	--	--	--	--	--	210,000	11,000	27,000	5,600	26,800	29,000	--	SPL	--	d
7/21/1998	--	50.76	16.10	--	34.66	250,000	11,000	26,000	5,500	26,900	29,000	3.7	SPL	--	
12/30/1998	--	50.76	20.91	--	29.85	370,000	11,000	22,000	8,500	40,000	90000/92000	--	SPL	--	j
2/2/1999	--	50.76	20.13	--	30.63	190,000	4,100	19,000	4,800	32,000	28,000	--	SPL	--	
5/10/1999	--	50.76	16.63	--	34.13	2,700	23	7.1	8.1	25	120	--	SPL	--	
9/23/1999	--	50.76	22.48	--	28.28	180,000	11,000	29,000	7,000	38,000	12,000	--	SPL	--	
12/23/1999	--	50.76	22.94	--	27.82	66,000	6,300	5,200	2,200	7,800	35,000	--	PACE	--	k
3/27/2000	--	50.76	16.84	--	33.92	120,000	8,700	12,000	3,800	16,000	27,000	--	PACE	--	
5/22/2000	--	50.76	17.85	--	32.91	110,000	7,600	16,000	4,400	20,000	25,000	--	PACE	--	
8/31/2000	--	50.76	21.71	--	29.05	110,000	8,800	7,600	3,400	14,000	18,000	--	PACE	--	
12/11/2000	--	50.76	22.05	--	28.71	70,000	4,580	3,480	2,550	9,220	24,400	--	PACE	--	
3/20/2001	--	50.76	17.68	--	33.08	100,000	7,100	4,530	2,540	9,370	63,100	--	PACE	--	
6/19/2001	--	50.76	19.40	--	31.36	180,000	7,430	14,600	5,400	25,300	36,100	--	PACE	--	
9/20/2001	--	50.76	22.01	0.03	28.75	--	--	--	--	--	--	--	--	--	f, m
12/27/2001	--	50.76	17.96	--	32.80	120,000	6,880	9,030	2,840	14,600	32,300	--	PACE	--	
2/28/2002	--	50.76	17.06	--	33.70	80,000	4,920	5,450	2,220	12,300	35,900	--	PACE	--	
6/28/2002	--	50.76	17.76	--	33.00	48,000	2,780	2,770	1,530	6,790	25,100	--	PACE	--	
9/12/2002	--	50.76	19.45	--	31.31	46,000	4,500	6,800	2,600	10,000	9,100	--	SEQ	6.8	
12/12/2002	--	50.76	21.29	--	29.47	36,000	5,200	3,400	2,000	6,500	12,000	--	SEQ	6.7	
3/10/2003	--	50.76	17.16	--	33.60	70,000	7,000	4,800	3,300	13,000	29,000	--	SEQ	6.7	
5/12/2003	--	50.76	14.51	--	36.25	75,000	7,600	3,700	3,400	13,000	26,000	--	SEQ	6.8	
8/27/2003	--	50.76	19.32	--	31.44	77,000	7,500	1,300	2,100	4,000	32,000	--	SEQ	6.8	n, s
11/10/2003	P	50.76	20.36	--	30.40	110,000	7,100	3,100	2,100	5,800	25,000	--	SEQM	6.6	
02/03/2004	P	50.76	16.51	--	34.25	160,000	8,400	9,700	5,000	23,000	26,000	--	SEQM	6.7	
05/04/2004	P	50.76	16.47	--	34.29	110,000	8,100	7,500	4,300	17,000	<250	--	SEQM	6.7	
08/31/2004	P	50.76	19.16	--	31.60	91,000	6,600	8,400	3,700	14,000	14,000	--	SEQM	6.7	
11/23/2004	P	50.76	18.02	--	32.74	7,400,000	20,000	150,000	320,000	1,400,000	23,000	--	SEQM	6.6	s

Table 1. Summary of Ground-Water Monitoring Data: Relative Water Elevations and Laboratory Analyses

Station #11117, 7210 Bancroft Ave., Oakland, CA

Well and Sample Date	P/NP	TOC Elevation (feet msl)	Depth to Water (feet bgs)	Product Thickness (feet)	Water Level Elevation (feet msl)	Concentrations in (µg/L)						DO (mg/L)	Lab	pH	Comments
						GRO/TPHg	Benzene	Toluene	Ethyl-Benzene	Total Xylenes	MTBE				
MW-4 Cont.															
01/18/2005	P	50.76	14.21	--	36.55	170,000	5,400	14,000	6,900	33,000	8,800	--	SEQM	6.5	s
06/29/2005	P	50.76	13.86	--	36.90	640,000	3,500	25,000	24,000	110,000	1,700	--	SEQM	7.2	
09/01/2005	P	50.76	16.89	--	33.87	100,000	3,800	11,000	4,900	33,000	1,100	--	SEQM	6.7	
11/03/2005	P	50.76	19.33	--	31.43	490,000	4,700	11,000	10,000	49,000	1,500	0.5	SEQM	6.6	
02/14/2006	P	50.76	13.55	--	37.21	970,000	60,000	7,000	36,000	140,000	38,000	--	SEQM	6.8	s
5/30/2006	P	50.76	13.52	--	37.24	140,000	3,000	6,600	6,200	29,000	560	--	SEQM	6.6	
8/29/2006	--	50.76	17.52	--	33.24	52,000	4,700	2,500	3,500	12,000	1,800	--	TAMC	6.7	
11/29/2006	--	50.76	19.93	0.11	30.91	--	--	--	--	--	--	--	--	--	f
2/20/2007	P	50.76	16.14	SHEEN	34.62	68,000	8,400	2,600	4,100	13,000	15,000	1.03	TAMC	6.95	
5/25/2007	P	50.76	16.65	SHEEN	34.11	37,000	5,100	1,200	2,800	6,900	3,500	1.13	TAMC	6.82	
8/9/2007	P	50.76	19.29	--	31.47	180,000	5,600	7,700	5,700	21,000	2,900	0.72	TAMC	7.02	y (XYLENES)
MW-6															
7/24/1992	--	50.32	30.63	--	19.69	--	1.6	--	--	--	--	--	--	--	
7/27/1992	--	50.32	30.63	--	19.69	--	--	--	--	--	--	--	--	--	
9/15/1992	--	50.32	31.52	--	18.80	<50	<0.5	<0.5	<0.5	<0.5	--	--	ANA	--	
12/15/1992	--	50.32	32.42	--	17.90	58	1.3	<0.5	<0.5	<0.5	--	--	ANA	--	
3/15/1993	--	50.32	26.29	--	24.03	<50	<0.5	0.6	<0.5	0.7	--	--	PACE	--	l
6/7/1993	--	50.32	26.33	--	23.99	<50	<0.5	<0.5	<0.5	1.5	--	--	PACE	--	l
9/23/1993	--	50.32	29.64	--	20.68	--	--	--	--	--	--	--	--	--	
9/24/1993	--	50.32	--	--	--	<50	<0.5	<0.5	<0.5	<0.5	28.5	--	PACE	--	l
12/27/1993	--	50.32	29.75	--	20.57	<50	<0.5	<0.5	<0.5	<0.5	55.4	--	PACE	--	e,l
4/5/1994	--	50.32	27.26	--	23.06	<50	<0.5	<0.5	<0.5	<0.5	295	1.7	PACE	--	e,l
7/22/1994	--	50.32	27.34	--	22.98	350	<0.5	<0.5	<0.5	<0.5	419	4.5	PACE	--	e,l
10/13/1994	--	50.32	--	--	--	--	--	--	--	--	--	--	--	--	g
1/25/1995	--	50.32	22.16	--	28.16	240	6	<0.5	<0.5	<1	--	--	ATI	--	
4/19/1995	--	50.32	--	--	--	--	--	--	--	--	--	--	--	--	g
7/5/1995	--	50.32	20.80	--	29.52	180	<0.50	<0.50	<0.50	<1.0	--	4.9	ATI	--	
10/5/1995	--	50.32	24.20	--	26.12	860	<5.0	<5.0	<5.0	<10	3,600	2.8	ATI	--	
1/12/1996	--	50.32	25.30	--	25.02	860	<5.0	<5.0	<5.0	<10	2,800	4.2	ATI	--	
4/22/1996	--	50.32	19.13	--	31.19	<50	<0.5	<1	<1	<1	470	4.3	SPL	--	

Table 1. Summary of Ground-Water Monitoring Data: Relative Water Elevations and Laboratory Analyses

Station #11117, 7210 Bancroft Ave., Oakland, CA

Well and Sample Date	P/NP	TOC Elevation (feet msl)	Depth to Water (feet bgs)	Product Thickness (feet)	Water Level Elevation (feet msl)	Concentrations in (µg/L)						DO (mg/L)	Lab	pH	Comments
						GRO/TPHg	Benzene	Toluene	Ethyl-Benzene	Total Xylenes	MTBE				
MW-6 Cont.															
7/2/1996	--	50.32	20.66	--	29.66	100	<0.5	<1	<1	<1	1,100	4.2	SPL	--	
11/8/1996	--	50.32	20.98	--	29.34	1,100	<5	<10	<10	<10	1,500	4.3	SPL	--	
1/3/1997	--	50.32	20.53	--	29.79	<50	<0.5	<1.0	<1.0	<1.0	450	4.5	SPL	--	
4/28/1997	--	50.32	21.25	--	29.07	1,400	<0.5	<1.0	<1.0	<1.0	3,500	4.4	SPL	--	
7/1/1997	--	50.32	23.40	--	26.92	6,100	<0.5	<1.0	<1.0	<1.0	9,100	3.9	SPL	--	
10/2/1997	--	50.32	25.16	--	25.16	--	--	--	--	--	--	--	--	--	
10/3/1997	--	50.32	--	--	--	330	<0.5	<1.0	<1.0	<1.0	2,600	4.4	SPL	--	
1/9/1998	--	50.32	21.13	--	29.19	<50	<0.5	<1.0	<1.0	<1.0	<10	4.3	SPL	--	
5/6/1998	--	50.32	16.11	--	34.21	410	<0.5	<1.0	<1.0	<1.0	500	3.6	SPL	--	
7/21/1998	--	50.32	16.33	--	33.99	4,300	<5	<10	<10	<10	3,800	4.0	SPL	--	
12/30/1998	--	50.32	20.89	--	29.43	--	--	--	--	--	--	--	--	--	
2/2/1999	--	50.32	20.20	--	30.12	--	--	--	--	--	--	--	--	--	
5/10/1999	--	50.32	16.75	--	33.57	--	--	--	--	--	--	--	--	--	
9/23/1999	--	50.32	22.55	--	27.77	<50	<1.0	<1.0	<1.0	<1.0	1,600	--	SPL	--	
12/23/1999	--	50.32	23.00	--	27.32	--	--	--	--	--	--	--	--	--	
3/27/2000	--	50.32	16.89	--	33.43	1,700	4.4	0.54	<0.5	1	14,000	--	PACE	--	
5/22/2000	--	50.32	18.02	--	32.30	--	--	--	--	--	--	--	--	--	
8/31/2000	--	50.32	21.62	--	28.70	1,200	<0.5	<0.5	<0.5	<0.5	3,900	--	PACE	--	
12/11/2000	--	50.32	21.81	--	28.51	--	--	--	--	--	--	--	--	--	
3/20/2001	--	50.32	16.97	--	33.35	3,300	<0.5	<0.5	<0.5	<1.5	3,760	--	PACE	--	
6/19/2001	--	50.32	19.30	--	31.02	--	--	--	--	--	--	--	--	--	
9/20/2001	--	50.32	22.00	--	28.32	2,200	2.04	8.1	3.62	13.7	2,460	--	PACE	--	
12/27/2001	--	50.32	17.85	--	32.47	830	0.59	<0.5	<0.5	<1.0	1,040	--	PACE	--	
2/28/2002	--	50.32	16.31	--	34.01	1,100	<0.5	<0.5	<0.5	<1.0	1,450	--	PACE	--	
6/28/2002	--	50.32	17.57	--	32.75	<50	<0.5	<0.5	<0.5	<1.0	1,020	--	PACE	--	
9/12/2002	--	50.32	19.27	--	31.05	190	1.9	4.6	1	7.3	480	--	SEQ	7.1	
12/12/2002	--	50.32	20.94	--	29.38	270	<2.5	<2.5	<2.5	<2.5	500	--	SEQ	6.9	
3/10/2003	--	50.32	17.11	--	33.21	110	<0.50	<0.50	<0.50	<0.50	190	--	SEQ	7.0	
5/12/2003	--	50.32	15.18	--	35.14	<50	<0.50	<0.50	<0.50	<0.50	36	--	SEQ	7.0	
8/27/2003	--	50.32	18.90	--	31.42	<50	<0.50	<0.50	<0.50	<0.50	8.9	--	SEQ	7.0	n
11/10/2003	P	50.32	20.13	--	30.19	<50	<0.50	<0.50	<0.50	<0.50	4.5	--	SEQM	6.8	

Table 1. Summary of Ground-Water Monitoring Data: Relative Water Elevations and Laboratory Analyses
Station #11117, 7210 Bancroft Ave., Oakland, CA

Well and Sample Date	P/NP	TOC Elevation (feet msl)	Depth to Water (feet bgs)	Product Thickness (feet)	Water Level Elevation (feet msl)	Concentrations in (µg/L)						DO (mg/L)	Lab	pH	Comments
						GRO/TPHg	Benzene	Toluene	Ethyl-Benzene	Total Xylenes	MTBE				
MW-6 Cont.															
02/03/2004	NP	50.32	15.83	--	34.49	<50	<0.50	<0.50	<0.50	<0.50	<0.50	--	SEQM	6.9	
05/04/2004	P	50.32	15.62	--	34.70	<50	<0.50	<0.50	<0.50	<0.50	24	--	SEQM	6.9	
08/31/2004	P	50.32	18.56	--	31.76	<50	<0.50	<0.50	<0.50	<0.50	27	--	SEQM	7.0	
11/23/2004	--	50.32	16.95	--	33.37	--	--	--	--	--	--	--	--	--	
01/18/2005	P	50.32	13.61	--	36.71	<50	<0.50	<0.50	<0.50	<0.50	1.3	--	SEQM	6.8	
06/29/2005	--	50.32	13.55	--	36.77	--	--	--	--	--	--	--	--	--	
09/01/2005	--	50.32	16.52	--	33.80	--	--	--	--	--	--	--	--	--	
11/03/2005	--	50.32	19.28	--	31.04	--	--	--	--	--	--	--	--	--	
02/14/2006	--	50.32	--	--	--	--	--	--	--	--	--	--	--	--	g
5/30/2006	--	50.32	--	--	--	--	--	--	--	--	--	--	--	--	g
8/29/2006	--	50.32	17.15	--	33.17	--	--	--	--	--	--	--	--	--	
11/29/2006	--	50.32	19.50	--	30.82	--	--	--	--	--	--	--	--	--	
2/20/2007	P	50.32	15.81	--	34.51	<50	<0.50	<0.50	<0.50	<0.50	24	1.59	TAMC	7.60	
5/25/2007	--	50.32	16.38	--	33.94	--	--	--	--	--	--	--	--	--	
8/9/2007	--	50.32	19.15	--	31.17	--	--	--	--	--	--	--	--	--	
MW-7															
1/25/1995	--	51.40	21.67	--	29.73	<50	<0.5	<0.5	<0.5	<1	--	7.0	ATI	--	
4/19/1995	--	51.40	25.27	--	26.13	<50	<0.5	<0.5	<0.5	<1	--	5.0	ATI	--	
7/5/1995	--	51.40	24.63	--	26.77	<50	<0.50	<0.50	<0.50	<1.0	--	4.2	ATI	--	
10/5/1995	--	51.40	28.21	--	23.19	83	<0.50	<0.50	<0.50	<1.0	77	4.5	ATI	--	
1/12/1996	--	51.40	29.29	--	22.11	63	<0.50	<0.50	<0.50	<1.0	120	4.8	ATI	--	
4/22/1996	--	51.40	23.11	--	28.29	<50	<0.5	<1	<1	<1	13	4.8	SPL	--	
7/2/1996	--	51.40	23.56	--	27.84	<50	<0.5	<1	<1	<1	<10	4.8	SPL	--	
11/8/1996	--	51.40	20.06	--	31.34	<50	<0.5	<1.0	<1.0	<1.0	<10	5.1	SPL	--	
1/3/1997	--	51.40	23.42	--	27.98	<50	<0.5	<1.0	<1.0	<1.0	<10	4.7	SPL	--	
4/28/1997	--	51.40	24.12	--	27.28	<50	<0.5	<1.0	<1.0	<1.0	<10	3.9	SPL	--	
7/1/1997	--	51.40	26.40	--	25.00	<50	<0.5	<1.0	<1.0	<1.0	<10	4.2	SPL	--	
10/2/1997	--	51.40	28.14	--	23.26	<50	<0.5	<1.0	<1.0	<1.0	<10	4.7	SPL	--	
1/9/1998	--	51.40	24.02	--	27.38	<50	<0.5	<1.0	<1.0	<1.0	<10	4.1	SPL	--	
5/6/1998	--	51.40	21.00	--	30.40	1,900	<0.5	<1.0	<1.0	<1.0	1,800	3.5	SPL	--	

Table 1. Summary of Ground-Water Monitoring Data: Relative Water Elevations and Laboratory Analyses

Station #11117, 7210 Bancroft Ave., Oakland, CA

Well and Sample Date	P/NP	TOC Elevation (feet msl)	Depth to Water (feet bgs)	Product Thickness (feet)	Water Level Elevation (feet msl)	Concentrations in (µg/L)						DO (mg/L)	Lab	pH	Comments
						GRO/TPHg	Benzene	Toluene	Ethyl-Benzene	Total Xylenes	MTBE				
MW-7 Cont.															
7/21/1998	--	51.40	21.17	--	30.23	50	<0.5	<1.0	<1.0	<1.0	<10	3.7	SPL	--	
12/30/1998	--	51.40	22.13	--	29.27	--	--	--	--	--	--	--	--	--	
2/2/1999	--	51.40	22.08	--	29.32	--	--	--	--	--	--	--	--	--	
5/10/1999	--	51.40	18.58	--	32.82	--	--	--	--	--	--	--	--	--	
9/23/1999	--	51.40	24.29	--	27.11	70	<1.0	<1.0	<1.0	<1.0	4,700	--	SPL	--	
12/23/1999	--	51.40	24.53	--	26.87	--	--	--	--	--	--	--	--	--	
3/27/2000	--	51.40	18.58	--	32.82	910	<0.5	<0.5	<0.5	<0.5	2,600	--	PACE	--	
5/22/2000	--	51.40	19.49	--	31.91	--	--	--	--	--	--	--	--	--	
8/31/2000	--	51.40	22.53	--	28.87	440	<0.5	<0.5	<0.5	<0.5	900	--	PACE	--	
12/11/2000	--	51.40	22.75	--	28.65	--	--	--	--	--	--	--	--	--	
3/20/2001	--	51.40	18.79	--	32.61	1,100	<0.5	<0.5	<0.5	<1.5	1,210	--	PACE	--	
6/19/2001	--	51.40	19.82	--	31.58	--	--	--	--	--	--	--	--	--	
9/20/2001	--	51.40	21.35	--	30.05	1,300	1.21	<0.5	<0.5	<1.5	1,550	--	PACE	--	
12/27/2001	--	51.40	20.36	--	31.04	510	<0.5	<0.5	<0.5	<1.0	643	--	PACE	--	
2/28/2002	--	51.40	21.86	--	29.54	250	<0.5	<0.5	<0.5	<1.0	317	--	PACE	--	
6/28/2002	--	51.40	22.64	--	28.76	<50	<0.5	<0.5	<0.5	<1.0	102	--	PACE	--	
9/12/2002	--	51.40	23.51	--	27.89	<50	<0.5	<0.5	<0.5	1	14	--	SEQ	7.5	
12/12/2002	--	51.40	23.75	--	27.65	<50	<0.5	<0.5	<0.5	<0.5	<2.5	--	SEQ	7.5	
3/10/2003	--	51.40	21.25	--	30.15	61	<0.50	<0.50	<0.50	<0.50	99	--	SEQ	7.6	
5/12/2003	--	51.40	21.44	--	29.96	<100	<1.0	<1.0	<1.0	<1.0	120	--	SEQ	7.6	
8/27/2003	--	51.40	23.30	--	28.10	120	<0.50	<0.50	<0.50	<0.50	84	--	SEQ	7.6	n
11/10/2003	P	51.40	20.24	--	31.16	230	<1.0	<1.0	<1.0	<1.0	92	--	SEQM	6.7	o
02/03/2004	P	51.40	20.63	--	30.77	<250	<2.5	<2.5	<2.5	<2.5	91	--	SEQM	7.5	
05/04/2004	P	51.40	21.89	--	29.51	<250	<2.5	<2.5	<2.5	<2.5	190	--	SEQM	7.6	k
08/31/2004	P	51.40	23.16	--	28.24	<500	<5.0	<5.0	<5.0	<5.0	220	--	SEQM	7.3	
11/23/2004	P	51.40	21.65	--	29.75	590	<2.5	5.0	11	51	290	--	SEQM	7.1	
01/18/2005	P	51.40	16.28	--	35.12	<250	<2.5	<2.5	<2.5	2.5	92	--	SEQM	7.3	
06/29/2005	P	51.40	14.50	--	36.90	2,200	43	97	92	390	250	--	SEQM	8.0	
09/01/2005	P	51.40	20.41	--	30.99	<500	<5.0	<5.0	<5.0	<5.0	60	--	SEQM	7.5	
11/03/2005	P	51.40	21.00	--	30.40	130	<1.0	<1.0	<1.0	1.0	130	0.63	SEQM	7.2	w
02/14/2006	P	51.40	16.31	--	35.09	100	<0.50	<0.50	<0.50	0.87	62	--	SEQM	7.4	

**Table 1. Summary of Ground-Water Monitoring Data: Relative Water Elevations and Laboratory Analyses
Station #11117, 7210 Bancroft Ave., Oakland, CA**

Well and Sample Date	P/NP	TOC Elevation (feet msl)	Depth to Water (feet bgs)	Product Thickness (feet)	Water Level Elevation (feet msl)	Concentrations in (µg/L)						DO (mg/L)	Lab	pH	Comments
						GRO/TPHg	Benzene	Toluene	Ethyl-Benzene	Total Xylenes	MTBE				
MW-7 Cont.															
5/30/2006	P	51.40	17.58	--	33.82	<50	<0.50	<0.50	<0.50	<0.50	9.1	--	SEQM	7.2	
8/29/2006	--	51.40	18.64	--	32.76	100	<2.5	<2.5	<2.5	<2.5	140	--	TAMC	7.0	
11/29/2006	P	51.40	20.35	--	31.05	84	<2.5	<2.5	<2.5	<2.5	190	3.06	TAMC	7.65	
2/20/2007	P	51.40	17.09	--	34.31	160	<2.5	<2.5	<2.5	<2.5	170	1.77	TAMC	7.66	w
5/25/2007	P	51.40	17.20	--	34.20	70	<1.0	<1.0	<1.0	<1.0	93	1.13	TAMC	7.41	w
8/9/2007	P	51.40	19.95	--	31.45	<50	<0.50	<0.50	<0.50	<0.50	42	1.94	TAMC	7.55	
MW-8															
1/25/1995	--	50.88	31.59	--	19.29	54	<0.5	<0.5	<0.5	<1	--	7.1	ATI	--	
4/19/1995	--	50.88	19.18	--	31.70	<50	<0.5	<0.5	<0.5	<1	--	5.1	ATI	--	
7/5/1995	--	50.88	19.03	--	31.85	<50	<0.50	<0.50	<0.50	<1.0	--	4.5	ATI	--	
10/5/1995	--	50.88	24.40	--	26.48	<50	<0.50	<0.50	<0.50	<1.0	<5.0	4.1	ATI	--	
1/12/1996	--	50.88	25.51	--	25.37	<50	<0.50	<0.50	<0.50	<1.0	<5.0	4.6	ATI	--	
4/22/1996	--	50.88	18.00	--	32.88	<50	<0.5	<1	<1	<1	<10	4.8	SPL	--	
7/2/1996	--	50.88	19.83	--	31.05	<50	<0.5	<1	<1	<1	<10	4.5	SPL	--	
11/8/1996	--	50.88	20.09	--	30.79	<50	<0.5	<1.0	<1.0	<1.0	<10	4.7	SPL	--	
1/3/1997	--	50.88	19.72	--	31.16	<50	<0.5	<1.0	<1.0	<1.0	<10	4.4	SPL	--	
4/28/1997	--	50.88	20.44	--	30.44	<50	<0.5	<1.0	<1.0	<1.0	<10	4.1	SPL	--	
7/1/1997	--	50.88	22.72	--	28.16	<50	<0.5	<1.0	<1.0	<1.0	<10	3.8	SPL	--	
10/2/1997	--	50.88	24.51	--	26.37	<50	<0.5	<1.0	<1.0	<1.0	<10	4.2	SPL	--	
1/9/1998	--	50.88	21.17	--	29.71	<50	<0.5	<1.0	<1.0	<1.0	<10	3.5	SPL	--	
5/6/1998	--	50.88	18.34	--	32.54	<50	<0.5	<1.0	<1.0	<1.0	<10	3.6	SPL	--	
7/21/1998	--	50.88	18.55	--	32.33	90	<0.5	<1.0	<1.0	<1.0	<10	3.3	SPL	--	
12/30/1998	--	50.88	20.40	--	30.48	--	--	--	--	--	--	--	--	--	
2/2/1999	--	50.88	19.28	--	31.60	--	--	--	--	--	--	--	--	--	
5/10/1999	--	50.88	15.62	--	35.26	--	--	--	--	--	--	--	--	--	
9/23/1999	--	50.88	21.74	--	29.14	--	--	--	--	--	--	--	--	--	
12/23/1999	--	50.88	22.83	--	28.05	--	--	--	--	--	--	--	--	--	
3/27/2000	--	50.88	16.25	--	34.63	<50	<0.5	<0.5	<0.5	<0.5	<0.5	--	PACE	--	
5/22/2000	--	50.88	17.06	--	33.82	--	--	--	--	--	--	--	--	--	
8/31/2000	--	50.88	21.72	--	29.16	--	--	--	--	--	--	--	--	--	

Table 1. Summary of Ground-Water Monitoring Data: Relative Water Elevations and Laboratory Analyses

Station #11117, 7210 Bancroft Ave., Oakland, CA

Well and Sample Date	P/NP	TOC Elevation (feet msl)	Depth to Water (feet bgs)	Product Thickness (feet)	Water Level Elevation (feet msl)	Concentrations in (µg/L)						DO (mg/L)	Lab	pH	Comments
						GRO/TPHg	Benzene	Toluene	Ethyl-Benzene	Total Xylenes	MTBE				
MW-8 Cont.															
12/11/2000	--	50.88	22.03	--	28.85	--	--	--	--	--	--	--	--	--	
3/20/2001	--	50.88	16.23	--	34.65	<50	<0.5	<0.5	<0.5	<1.5	0.991	--	PACE	--	
6/19/2001	--	50.88	19.35	--	31.53	--	--	--	--	--	--	--	--	--	
9/20/2001	--	50.88	21.95	--	28.93	--	--	--	--	--	--	--	--	--	
12/27/2001	--	50.88	16.98	--	33.90	--	--	--	--	--	--	--	--	--	
2/28/2002	--	50.88	15.38	--	35.50	<50	<0.5	<0.5	<0.5	<1.0	<0.5	--	PACE	--	
6/28/2002	--	50.88	16.97	--	33.91	--	--	--	--	--	--	--	--	--	
9/12/2002	--	50.88	19.47	--	31.41	--	--	--	--	--	--	--	--	--	
12/12/2002	--	50.88	20.84	--	30.04	--	--	--	--	--	--	--	--	--	
3/10/2003	--	50.88	16.56	--	34.32	<50	<0.50	<0.50	<0.50	<0.50	3	--	SEQ	7.1	
5/12/2003	--	50.88	13.63	--	37.25	--	--	--	--	--	--	--	--	--	
8/27/2003	--	50.88	18.90	--	31.98	--	--	--	--	--	--	--	--	--	n
11/10/2003	--	50.88	19.68	--	31.20	--	--	--	--	--	--	--	--	--	
02/03/2004	P	50.88	14.76	--	36.12	<50	<0.50	<0.50	<0.50	<0.50	<0.50	--	SEQM	7.5	
05/04/2004	--	50.88	14.69	--	36.19	--	--	--	--	--	--	--	--	--	
08/31/2004	--	50.88	18.08	--	32.80	--	--	--	--	--	--	--	--	--	
11/23/2004	NP	50.88	15.77	--	35.11	--	--	--	--	--	--	--	--	--	
01/18/2005	P	50.88	12.04	--	38.84	<50	<0.50	<0.50	<0.50	<0.50	<0.50	--	SEQM	7.0	
06/29/2005	--	50.88	--	--	--	--	--	--	--	--	--	--	--	--	v
09/01/2005	--	50.88	16.12	--	34.76	--	--	--	--	--	--	--	--	--	
11/03/2005	--	50.88	19.42	--	31.46	--	--	--	--	--	--	--	--	--	
02/14/2006	P	50.88	12.43	--	38.45	<50	<0.50	<0.50	<0.50	<0.50	<0.50	--	SEQM	7.0	
5/30/2006	--	50.88	12.40	--	38.48	--	--	--	--	--	--	--	--	--	
8/29/2006	--	50.88	17.16	--	33.72	--	--	--	--	--	--	--	--	--	
11/29/2006	--	50.88	19.35	--	31.53	--	--	--	--	--	--	--	--	--	
2/20/2007	P	50.88	14.57	--	36.31	<50	<0.50	<0.50	<0.50	<0.50	<0.50	4.28	TAMC	7.65	
5/25/2007	--	50.88	16.11	--	34.77	--	--	--	--	--	--	--	--	--	
8/9/2007	--	50.88	19.25	--	31.63	--	--	--	--	--	--	--	--	--	
MW-9															
1/25/1995	--	51.05	22.32	--	28.73	<50	<0.5	<0.5	<0.5	<1	--	7.4	ATI	--	

Table 1. Summary of Ground-Water Monitoring Data: Relative Water Elevations and Laboratory Analyses

Station #11117, 7210 Bancroft Ave., Oakland, CA

Well and Sample Date	P/NP	TOC Elevation (feet msl)	Depth to Water (feet bgs)	Product Thickness (feet)	Water Level Elevation (feet msl)	Concentrations in (µg/L)						DO (mg/L)	Lab	pH	Comments
						GRO/TPHg	Benzene	Toluene	Ethyl-Benzene	Total Xylenes	MTBE				
MW-9 Cont.															
4/19/1995	--	51.05	19.86	--	31.19	<50	<0.5	<0.5	<0.5	<1	--	5.2	ATI	--	
7/5/1995	--	51.05	20.78	--	30.27	<50	<0.50	<0.50	<0.50	<1.0	--	4.4	ATI	--	
10/5/1995	--	--	--	--	--	52	<0.50	<0.50	<0.50	<1.0	160	--	ATI	--	d
10/5/1995	--	51.05	24.33	--	26.72	<50	<0.50	<0.50	<0.50	<1.0	--	2.3	ATI	--	
1/12/1996	--	51.05	25.44	--	25.61	<50	<0.50	<0.50	<0.50	<1.0	<5.0	3.2	ATI	--	
4/22/1996	--	51.05	18.01	--	33.04	<50	<0.5	<1	<1	<1	11	3.5	SPL	--	
7/2/1996	--	51.05	19.70	--	31.35	<50	<0.5	<1	<1	<1	<10	3.3	SPL	--	
11/8/1996	--	51.05	19.96	--	31.09	<50	<0.5	<1.0	<1.0	<1.0	<10	3.7	SPL	--	
1/3/1997	--	51.05	19.52	--	31.53	<250	<2.5	<5.0	<5.0	<5.0	<50	4.4	SPL	--	
4/28/1997	--	51.05	20.22	--	30.83	<50	<0.5	<1.0	<1.0	<1.0	<10	4.0	SPL	--	
7/1/1997	--	51.05	22.59	--	28.46	<50	<0.5	<1.0	<1.0	<1.0	<10	3.9	SPL	--	
10/2/1997	--	51.05	24.33	--	26.72	--	--	--	--	--	--	--	--	--	
10/3/1997	--	51.05	--	--	--	<50	<0.5	<1.0	<1.0	<1.0	<10	4.4	SPL	--	
1/9/1998	--	51.05	21.11	--	29.94	<50	<0.5	<1.0	<1.0	<1.0	<10	3.9	SPL	--	
5/6/1998	--	51.05	18.26	--	32.79	<50	<0.5	<1.0	<1.0	<1.0	<10	4.0	SPL	--	
7/21/1998	--	51.05	18.46	--	32.59	70	<0.5	<1.0	<1.0	<1.0	<10	3.7	SPL	--	
12/30/1998	--	51.05	--	--	--	--	--	--	--	--	--	--	--	--	g
2/2/1999	--	51.05	--	--	--	--	--	--	--	--	--	--	--	--	g
5/10/1999	--	51.05	--	--	--	--	--	--	--	--	--	--	--	--	g
9/23/1999	--	51.05	--	--	--	--	--	--	--	--	--	--	--	--	g
12/23/1999	--	51.05	--	--	--	--	--	--	--	--	--	--	--	--	g
3/27/2000	--	51.05	--	--	--	--	--	--	--	--	--	--	--	--	g
5/22/2000	--	51.05	--	--	--	--	--	--	--	--	--	--	--	--	g
8/31/2000	--	51.05	--	--	--	--	--	--	--	--	--	--	--	--	g
12/11/2000	--	51.05	--	--	--	--	--	--	--	--	--	--	--	--	g
3/20/2001	--	51.05	--	--	--	--	--	--	--	--	--	--	--	--	g
6/19/2001	--	51.05	--	--	--	--	--	--	--	--	--	--	--	--	g
9/20/2001	--	51.05	22.20	--	28.85	6,300	2.87	<0.5	<0.5	<1.5	8,640	--	PACE	--	
12/27/2001	--	51.05	18.92	--	32.13	--	--	--	--	--	--	--	--	--	
2/28/2002	--	51.05	17.22	--	33.83	19,000	1,560	61.3	84	111	20,200	--	PACE	--	
6/28/2002	--	51.05	18.20	--	32.85	--	--	--	--	--	--	--	--	--	

Table 1. Summary of Ground-Water Monitoring Data: Relative Water Elevations and Laboratory Analyses

Station #11117, 7210 Bancroft Ave., Oakland, CA

Well and Sample Date	P/NP	TOC Elevation (feet msl)	Depth to Water (feet bgs)	Product Thickness (feet)	Water Level Elevation (feet msl)	Concentrations in (µg/L)						DO (mg/L)	Lab	pH	Comments
						GRO/TPHg	Benzene	Toluene	Ethyl-Benzene	Total Xylenes	MTBE				
MW-9 Cont.															
9/12/2002	--	51.05	19.92	--	31.13	5,100	570	180	<25	220	6,400	--	SEQ	6.8	
12/12/2002	--	51.05	21.78	--	29.27	--	--	--	--	--	--	--	--	--	
3/10/2003	--	51.05	18.25	--	32.80	26,000	2,500	<100	<100	<100	33,000	--	SEQ	6.9	
5/12/2003	--	51.05	16.29	--	34.76	--	--	--	--	--	--	--	SEQ	--	
8/27/2003	--	51.05	19.69	--	31.36	11,000	830	<50	<50	<50	6,300	--	SEQ	7.1	n
11/10/2003	--	51.05	19.97	--	31.08	--	--	--	--	--	--	--	--	--	
02/03/2004	P	51.05	17.23	--	33.82	6,200	180	<50	<50	<50	2,100	--	SEQM	7.2	
05/04/2004	--	51.05	17.17	--	33.88	--	--	--	--	--	--	--	--	--	
08/31/2004	P	51.05	19.71	--	31.34	<2,500	210	<25	<25	<25	1,500	--	SEQM	7.0	
11/23/2004	--	51.05	18.58	--	32.47	--	--	--	--	--	--	--	--	--	
01/18/2005	P	51.05	14.98	--	36.07	490	32	<2.5	<2.5	8.9	130	--	SEQM	6.9	
06/29/2005	--	51.05	14.74	--	36.31	--	--	--	--	--	--	--	--	--	
09/01/2005	P	51.05	17.42	--	33.63	3,500	1,300	<25	<25	28	240	--	SEQM	6.9	
11/03/2005	--	51.05	19.90	--	31.15	--	--	--	--	--	--	--	--	--	
02/14/2006	P	51.05	12.95	--	38.10	2,700	<25	<25	<25	<25	2,200	--	SEQM	7.0	w
5/30/2006	--	51.05	13.76	--	37.29	--	--	--	--	--	--	--	--	--	
8/29/2006	--	51.05	17.86	--	33.19	1,200	580	<25	<25	<25	<25	--	TAMC	6.9	
11/29/2006	--	51.05	20.25	--	30.80	--	--	--	--	--	--	--	--	--	
2/20/2007	P	51.05	16.91	--	34.14	780	66	1.5	2.0	1.4	3.2	2.66	TAMC	7.93	
5/25/2007	--	51.05	17.28	--	33.77	--	--	--	--	--	--	--	--	--	
8/9/2007	P	51.05	19.71	--	31.34	650	150	<0.50	<0.50	2.0	1.4	1.07	TAMC	7.58	
MW-10															
1/9/1998	--	--	20.97	--	--	<50	<0.5	<1.0	<1.0	<1.0	<10	4.3	SPL	--	h
5/6/1998	--	--	18.07	--	--	800	<0.5	<1.0	<1.0	<1.0	980	3.9	SPL	--	h
7/21/1998	--	--	18.28	--	--	80	<0.5	<1.0	<1.0	<1.0	<10	4.0	SPL	--	h
12/30/1998	--	--	22.22	--	--	--	--	--	--	--	--	--	--	--	h
2/2/1999	--	--	21.83	--	--	940	<10	<10	<10	<10	690	--	SPL	--	h
5/10/1999	--	--	17.99	--	--	--	--	--	--	--	--	--	--	--	h
9/23/1999	--	--	22.61	--	--	<50	<1.0	<1.0	<1.0	1.4	1,000	--	SPL	--	h
12/23/1999	--	--	23.75	--	--	--	--	--	--	--	--	--	--	--	h

Table 1. Summary of Ground-Water Monitoring Data: Relative Water Elevations and Laboratory Analyses

Station #11117, 7210 Bancroft Ave., Oakland, CA

Well and Sample Date	P/NP	TOC Elevation (feet msl)	Depth to Water (feet bgs)	Product Thickness (feet)	Water Level Elevation (feet msl)	Concentrations in (µg/L)						DO (mg/L)	Lab	pH	Comments
						GRO/TPHg	Benzene	Toluene	Ethyl-Benzene	Total Xylenes	MTBE				
MW-10 Cont.															
3/27/2000	--	--	18.83	--	--	1,900	<0.5	<0.5	<0.5	<0.5	28,000	--	PACE	--	h
5/22/2000	--	--	19.47	--	--	--	--	--	--	--	--	--	--	--	h
8/31/2000	--	--	22.64	--	--	1,700	<0.5	<0.5	<0.5	<0.5	13,000	--	PACE	--	h
12/11/2000	--	--	22.84	--	--	--	--	--	--	--	--	--	--	--	h
3/20/2001	--	--	19.57	--	--	16,000	<0.5	<0.5	<0.5	<1.5	11,900	--	PACE	--	h
6/19/2001	--	--	20.63	--	--	--	--	--	--	--	--	--	--	--	h
9/20/2001	--	--	23.07	--	--	5,800	<0.5	<0.5	<0.5	<1.5	8,160	--	PACE	--	h
12/27/2001	--	--	20.92	--	--	6,600	17.3	14.5	<12.5	<25	7,750	--	PACE	--	h
2/28/2002	--	--	18.52	--	--	3,600	10.8	<0.5	<0.5	<1.0	5,380	--	PACE	--	h
6/28/2002	--	--	18.41	--	--	<50	<0.5	<0.5	<0.5	<1.0	2,570	--	PACE	--	h
9/12/2002	--	--	20.57	--	--	660	<5.0	<5.0	<5.0	<5.0	3,300	--	SEQ	7.2	h
12/12/2002	--	--	22.80	--	--	1,400	<5.0	<5.0	<5.0	<5.0	3,300	--	SEQ	6.9	h
3/10/2003	--	--	19.26	--	--	1,700	<5.0	<5.0	5.3	15	2,800	--	SEQ	6.9	h
5/12/2003	--	--	17.90	--	--	1,500	<12	<12	<12	<12	2,200	--	SEQ	6.9	h
8/27/2003	--	--	20.82	--	--	4,100	<25	<25	<25	<25	2,800	--	SEQ	7.0	n, h
11/10/2003	P	--	21.92	--	--	<5,000	<50	<50	<50	<50	3,300	--	SEQM	6.8	
02/03/2004	P	--	18.52	--	--	5,100	<50	<50	<50	<50	2,300	--	SEQM	7.0	q
05/04/2004	P	--	17.63	--	--	<2,500	<25	<25	<25	<25	1,600	--	SEQM	6.8	
08/31/2004	P	--	20.67	--	--	<5,000	<50	<50	<50	<50	1,900	--	SEQM	7.0	
11/23/2004	P	--	19.79	--	--	2,600	<25	<25	<25	<25	2,300	--	SEQM	6.8	
01/18/2005	P	--	16.13	--	--	560	<5.0	<5.0	<5.0	<5.0	530	--	SEQM	6.9	
06/29/2005	P	--	15.56	--	--	110	1.9	4.6	4.2	17	71	--	SEQM	6.8	
09/01/2005	P	--	18.10	--	--	<250	<2.5	<2.5	<2.5	<2.5	280	--	SEQM	6.9	
11/03/2005	P	--	20.90	--	--	800	<5.0	<5.0	<5.0	7.0	770	0.71	SEQM	6.8	w
02/14/2006	P	--	15.58	--	--	600	<0.50	<0.50	<0.50	<0.50	400	--	SEQM	7.1	x
5/30/2006	P	--	14.70	--	--	95	<0.50	<0.50	<0.50	<0.50	<0.50	--	SEQM	6.7	
8/29/2006	--	--	18.69	--	--	250	<5.0	<5.0	<5.0	<5.0	490	--	TAMC	6.8	
11/29/2006	P	--	21.35	--	--	650	<5.0	<5.0	<5.0	<5.0	1,400	0.89	TAMC	7.19	w
2/20/2007	P	--	18.65	--	--	720	<5.0	<5.0	<5.0	<5.0	850	1.19	TAMC	7.32	
5/25/2007	P	--	18.15	--	--	130	<0.50	<0.50	<0.50	<0.50	170	0.51	TAMC	7.00	w
8/9/2007	P	--	20.83	--	--	970	<10	<10	<10	<10	1,600	0.74	TAMC	7.24	

Table 1. Summary of Ground-Water Monitoring Data: Relative Water Elevations and Laboratory Analyses
Station #11117, 7210 Bancroft Ave., Oakland, CA

Well and Sample Date	P/NP	TOC Elevation (feet msl)	Depth to Water (feet bgs)	Product Thickness (feet)	Water Level Elevation (feet msl)	Concentrations in (µg/L)						DO (mg/L)	Lab	pH	Comments
						GRO/TPHg	Benzene	Toluene	Ethyl-Benzene	Total Xylenes	MTBE				
MW-10															
QC-2															
9/15/1992	--	--	--	--	--	<50	<0.5	<0.5	<0.5	<0.5	--	--	ANA	--	i
12/15/1992	--	--	--	--	--	<50	<0.5	<0.5	<0.5	<0.5	--	--	ANA	--	i
3/15/1993	--	--	--	--	--	<50	<0.5	<0.5	<0.5	<0.5	--	--	PACE	--	i, l
6/7/1993	--	--	--	--	--	<50	<0.5	<0.5	<0.5	<0.5	--	--	PACE	--	i, l
9/24/1993	--	--	--	--	--	<50	<0.5	<0.5	<0.5	<0.5	<5.0	--	PACE	--	i, l
12/27/1993	--	--	--	--	--	<50	<0.5	<0.5	<0.5	<0.5	<5.0	--	PACE	--	i, l
4/5/1994	--	--	--	--	--	<50	<0.5	<0.5	<0.5	<0.5	<5.0	--	PACE	--	i, l
7/22/1994	--	--	--	--	--	<50	<0.5	<0.5	<0.5	<0.5	<5.0	--	PACE	--	i, l
10/13/1994	--	--	--	--	--	<50	<0.5	<0.5	<0.5	<0.5	<5.0	--	PACE	--	i, l
1/25/1995	--	--	--	--	--	<50	<0.5	2	0.6	1	--	--	ATI	--	i
4/19/1995	--	--	--	--	--	<50	<0.5	<0.5	<0.5	<0.5	--	--	ATI	--	i
7/5/1995	--	--	--	--	--	<50	<0.50	<0.50	<0.50	<1.0	--	--	ATI	--	i
10/5/1995	--	--	--	--	--	<50	<0.50	<0.50	<0.50	<1.0	<5.0	--	ATI	--	i
1/12/1996	--	--	--	--	--	<50	<0.50	<0.50	<0.50	<1.0	<5.0	--	ATI	--	i
4/22/1996	--	--	--	--	--	<50	<0.5	<1	<1	<1	<10	--	SPL	--	i
7/2/1996	--	--	--	--	--	<50	<0.5	<1	<1	<1	<10	--	SPL	--	i

ABBREVIATIONS AND SYMBOLS:

< = Not detected at or laboratory reporting limit
--- = Not analyzed/applicable/measurable
µg/L = Micrograms per liter
ANA = Anamatrix, Inc.
ATI = Analytical Technologies, Inc.
DO = Dissolved oxygen
DTW = Depth to water in ft bgs
ft bgs = Feet below ground surface
ft MSL = Feet above mean sea level
GRO = Gasoline range organics
GWE = Groundwater elevation in ft MSL
mg/L = Milligrams per liter
MTBE = Methyl tert butyl ether
NP = Well not purged prior to sampling
P = Well purged prior to sampling
PACE = Pace, Inc.
SEQ/SEQM = Sequoia/Sequoia Morgan Hill Analytical
SPL = Southern Petroleum Laboratories
TOC = Top of casing in ft MSL
TPH-g = Total petroleum hydrocarbons as gasoline

FOOTNOTES:

c = Concentrations reported as diesel from MW-1, MW-2 and MW-4 are primarily due to the presence of a lighter petroleum product, possibly gasoline or kerosene.
d = Blind duplicate.
e = A copy of the documentation for this data is included in Appendix C of Alisto report 10-018-05-004.
f = Well not sampled due to presence of free product (FP).
g = Well inaccessible.
h = TOC not surveyed.
i = Travel blank.
j = EPA method by 8020\8260.
k = Samples ran outside of EPA recommended hold time.
l = A copy of the documentation for this data can be found in Blaine Tech Services report 010619-C-2. The MTBE data for the March 15, 1993 and June 7, 1993 events have been destroyed.
m = Thickness of SPH is only an estimate. The resulting GWE will not be used in contouring.
n = Samples analyzed by EPA Method 8260B for TPH-g, benzene, toluene, ethylbenzene, total xylenes, and fuel oxygenates.
o = Discrete peak @ C6-C7.
q = Discrete peak @ C5-C6.
r = Well was dry.
s = Sheen in well.
t = DTW and resulting GWE were anomalous and not used in groundwater contouring.
u = Anomalously low concentrations reported from Cambria. Do not appear to support historic trends.
v = Unable to locate well.
w = The hydrocarbon result for GRO was partly due to individual peaks in the quantitation range.
x = Initial analysis for MTBE within holding time but required dilution.
y = Sample > 4x spike concentration.

NOTES:

Casing elevations surveyed to the nearest 0.01 ft MSL.

GWE adjusted assuming a specific gravity of 0.75 for FP.

During the third quarter of 2002, URS Corporation assumed groundwater monitoring activities for BP.

Beginning in the fourth quarter 2003, the laboratory modified the reported analyte list. TPH-g was changed to GRO. The resulting data may be impacted by the potential of non-TPH-g analytes within the requested fuel range resulting in a higher concentration being reported.

Beginning in second quarter 2004, the carbon range for GRO was changed from C6-C10 to C4-C12.

Values for pH and DO are field measurements.

Note: The data within this table collected prior to April 2006 was provided to Broadbent & Associates, Inc. by Atlantic Richfield Company and their previous consultants. Broadbent & Associates, Inc. has not verified the accuracy of this information.

**Table 2. Summary of Fuel Additives Analytical Data
Station #11117, 7210 Bancroft Ave., Oakland, CA**

Well and Sample Date	Concentrations in (µg/L)								Comments
	Ethanol	TBA	MTBE	DIPE	ETBE	TAME	1,2-DCA	EDB	
EX-1									
05/04/2004	<5,000	<1,000	2,500	<25	<25	38	<25	<25	
08/31/2004	<10,000	<2,000	2,100	<50	<50	<50	<50	<50	
11/23/2004	<5,000	<1,000	3,000	<25	<25	74	<25	<25	
01/18/2005	<5,000	<1,000	2,200	<25	<25	54	<25	<25	a
06/29/2005	<5,000	<1,000	1,400	<25	<25	30	<25	<25	
09/01/2005	<5,000	<1,000	2,000	<25	<25	46	<25	<25	
11/03/2005	<5,000	<1,000	3,000	<25	<25	87	<25	<25	
02/14/2006	<15,000	<1,000	1,100	<25	<25	<25	<25	<25	a
5/30/2006	<15,000	<1,000	1,400	<25	<25	37	<25	<25	a
8/29/2006	<15,000	<1,000	2,500	<25	<25	56	<25	<25	
11/29/2006	<30,000	<2,000	2,700	<50	<50	75	<50	<50	
2/20/2007	<30,000	<2,000	920	<50	<50	<50	<50	<50	
5/25/2007	<30,000	<2,000	890	<50	<50	<50	<50	<50	
8/9/2007	<6,000	440	530	<10	<10	15	<10	<10	
EX-2									
05/04/2004	<100	<20	46	<0.50	<0.50	<0.50	<0.50	<0.50	
08/31/2004	<500	<100	130	<2.5	<2.5	3.4	<2.5	<2.5	
11/23/2004	<100	<20	5.8	<0.50	<0.50	<0.50	<0.50	<0.50	
01/18/2005	<100	<20	6.5	<0.50	<0.50	<0.50	<0.50	<0.50	a
06/29/2005	<100	<20	24	<0.50	<0.50	<0.50	<0.50	<0.50	
09/01/2005	<100	<20	55	<0.50	<0.50	0.56	<0.50	<0.50	
11/03/2005	<100	<20	39	<0.50	<0.50	0.80	<0.50	<0.50	
02/14/2006	<300	<20	0.72	<0.50	<0.50	<0.50	<0.50	<0.50	a
5/30/2006	<300	<20	7.8	<0.50	<0.50	<0.50	<0.50	<0.50	
8/29/2006	<300	<20	94	<0.50	<0.50	0.98	<0.50	<0.50	
11/29/2006	<300	<20	4.4	<0.50	<0.50	<0.50	<0.50	<0.50	
2/20/2007	<300	<20	12	<0.50	<0.50	<0.50	<0.50	<0.50	
5/25/2007	<300	<20	10	<0.50	<0.50	<0.50	<0.50	<0.50	
8/9/2007	<300	<20	27	<0.50	<0.50	<0.50	<0.50	<0.50	
MW-1									

**Table 2. Summary of Fuel Additives Analytical Data
Station #11117, 7210 Bancroft Ave., Oakland, CA**

Well and Sample Date	Concentrations in (µg/L)								Comments
	Ethanol	TBA	MTBE	DIPE	ETBE	TAME	1,2-DCA	EDB	
MW-1 Cont.									
8/27/2003	<100	<20	4.2	<0.50	<0.50	<0.50	--	--	
11/10/2003	<100	<20	0.51	<0.50	<0.50	<0.50	--	--	
02/03/2004	<100	<20	<0.50	<0.50	<0.50	<0.50	<0.50	<0.50	
05/04/2004	<100	<20	<0.50	<0.50	<0.50	<0.50	<0.50	<0.50	
08/31/2004	<100	<20	0.50	<0.50	<0.50	<0.50	<0.50	<0.50	
01/18/2005	<100	<20	<0.50	<0.50	<0.50	<0.50	<0.50	<0.50	a
02/14/2006	<300	<20	<0.50	<0.50	<0.50	<0.50	<0.50	<0.50	a
2/20/2007	<300	<20	<0.50	<0.50	<0.50	<0.50	<0.50	<0.50	
MW-2									
8/27/2003	<25,000	<5,000	5,100	<120	<120	140	--	--	
11/10/2003	<50,000	<10,000	4,200	<250	<250	<250	--	--	
02/03/2004	<100,000	<20,000	1,900	<500	<500	<500	<500	<500	
05/04/2004	<50,000	<10,000	2,500	<250	<250	<250	<250	<250	
08/31/2004	<50,000	<10,000	3,400	<250	<250	<250	<250	<250	
11/23/2004	<50,000	<10,000	2,400	<250	<250	<250	<250	<250	
01/18/2005	<20,000	<4,000	3,700	<100	<100	<100	<100	<100	a
06/29/2005	<10,000	<2,000	3,600	<50	<50	72	<50	<50	
09/01/2005	<20,000	<4,000	5,100	<100	<100	100	<100	<100	
11/03/2005	<20,000	<4,000	3,700	<100	<100	100	<100	<100	
02/14/2006	<60,000	<4,000	3,400	<100	<100	<100	<100	<100	a
5/30/2006	<60,000	<4,000	2,300	<100	<100	<100	<100	<100	
8/29/2006	<60,000	<4,000	13,000	<100	<100	100	<100	<100	
11/29/2006	<75,000	<5,000	11,000	<120	<120	120	<120	<120	
2/20/2007	<60,000	<4,000	10,000	<100	<100	<100	<100	<100	
5/25/2007	<120,000	<8,000	3,400	<200	<200	<200	<200	<200	
8/9/2007	<60,000	<4,000	4,100	<100	<100	<100	<100	<100	
MW-3									
8/27/2003	<100	<20	<0.50	<0.50	<0.50	<0.50	--	--	
02/03/2004	<100	<20	<0.50	<0.50	<0.50	<0.50	<0.50	<0.50	
08/31/2004	<100	<20	<0.50	<0.50	<0.50	<0.50	<0.50	<0.50	

**Table 2. Summary of Fuel Additives Analytical Data
Station #11117, 7210 Bancroft Ave., Oakland, CA**

Well and Sample Date	Concentrations in (µg/L)								Comments
	Ethanol	TBA	MTBE	DIPE	ETBE	TAME	1,2-DCA	EDB	
MW-3 Cont.									
01/18/2005	<100	<20	<0.50	<0.50	<0.50	<0.50	<0.50	<0.50	a
02/14/2006	<300	<20	<0.50	<0.50	<0.50	<0.50	<0.50	<0.50	a
2/20/2007	<300	<20	0.89	<0.50	<0.50	<0.50	<0.50	<0.50	
MW-4									
8/27/2003	<50,000	<10,000	32,000	<250	<250	250	--	--	
11/10/2003	<100,000	<20,000	25,000	<500	<500	<500	--	--	
02/03/2004	<100,000	<20,000	26,000	<500	<500	<500	<500	<500	
05/04/2004	<50,000	<10,000	<250	<250	<250	<250	<250	<250	
08/31/2004	<50,000	<10,000	14,000	<250	<250	<250	<250	<250	
11/23/2004	<500,000	<100,000	23,000	<2,500	<2,500	<2,500	<2,500	<2,500	
01/18/2005	<50,000	<10,000	8,800	<250	<250	<250	<250	<250	a
06/29/2005	<50,000	<10,000	1,700	<250	<250	<250	<250	<250	
09/01/2005	<100,000	<20,000	1,100	<500	<500	<500	<500	<500	
11/03/2005	<100,000	<20,000	1,500	<500	<500	<500	<500	<500	
02/14/2006	<300,000	<20,000	38,000	<500	<500	1,000	<500	<500	a
5/30/2006	<300,000	<20,000	560	<500	<500	<500	<500	<500	
8/29/2006	<300,000	<20,000	1,800	<500	<500	<500	<500	<500	
2/20/2007	<150,000	<10,000	15,000	<250	<250	<250	<250	<250	
5/25/2007	<120,000	<8,000	3,500	<200	<200	<200	<200	<200	
8/9/2007	<60,000	4,100	2,900	<100	<100	<100	<100	<100	
MW-6									
8/27/2003	<100	<20	8.9	<0.50	<0.50	<0.50	--	--	
11/10/2003	<100	<20	4.5	<0.50	<0.50	<0.50	--	--	
02/03/2004	<100	<20	<0.50	<0.50	<0.50	<0.50	<0.50	<0.50	a
05/04/2004	<100	<20	24	<0.50	<0.50	<0.50	<0.50	<0.50	
08/31/2004	<100	<20	27	<0.50	<0.50	<0.50	<0.50	<0.50	
01/18/2005	<100	<20	1.3	<0.50	<0.50	<0.50	<0.50	<0.50	a
2/20/2007	<300	<20	24	<0.50	<0.50	<0.50	<0.50	<0.50	
MW-7									
8/27/2003	<100	<20	84	<0.50	<0.50	<0.50	--	--	

**Table 2. Summary of Fuel Additives Analytical Data
Station #11117, 7210 Bancroft Ave., Oakland, CA**

Well and Sample Date	Concentrations in (µg/L)								Comments
	Ethanol	TBA	MTBE	DIPE	ETBE	TAME	1,2-DCA	EDB	
MW-7 Cont.									
11/10/2003	<200	<40	92	<1.0	<1.0	<1.0	--	--	
02/03/2004	<500	<100	91	<2.5	<2.5	<2.5	<2.5	<2.5	
05/04/2004	<500	<100	190	<2.5	<2.5	<2.5	<2.5	<2.5	
08/31/2004	<1,000	<200	220	<5.0	<5.0	<5.0	<5.0	<5.0	
11/23/2004	<500	<100	290	<2.5	<2.5	<2.5	<2.5	<2.5	
01/18/2005	<500	<100	92	<2.5	<2.5	<2.5	<2.5	<2.5	a
06/29/2005	<500	<100	250	<2.5	<2.5	<2.5	<2.5	<2.5	
09/01/2005	<1,000	<200	60	<5.0	<5.0	<5.0	<5.0	<5.0	
11/03/2005	<200	<40	130	<1.0	<1.0	<1.0	<1.0	<1.0	
02/14/2006	<300	<20	62	<0.50	<0.50	<0.50	<0.50	<0.50	a
5/30/2006	<300	<20	9.1	<0.50	<0.50	<0.50	<0.50	<0.50	
8/29/2006	<1,500	<100	140	<2.5	<2.5	<2.5	<2.5	<2.5	
11/29/2006	<1,500	<100	190	<2.5	<2.5	<2.5	<2.5	<2.5	
2/20/2007	<1,500	<100	170	<2.5	<2.5	<2.5	<2.5	<2.5	
5/25/2007	<600	<40	93	<1.0	<1.0	<1.0	<1.0	<1.0	
8/9/2007	<300	<20	42	<0.50	<0.50	<0.50	<0.50	<0.50	
MW-8									
02/03/2004	<100	<20	<0.50	<0.50	<0.50	<0.50	<0.50	<0.50	
01/18/2005	<100	<20	<0.50	<0.50	<0.50	<0.50	<0.50	<0.50	a
02/14/2006	<300	<20	<0.50	<0.50	<0.50	<0.50	<0.50	<0.50	a
2/20/2007	<300	<20	<0.50	<0.50	<0.50	<0.50	<0.50	<0.50	
MW-9									
8/27/2003	<10,000	<2,000	6,300	<50	<50	<50	--	--	
02/03/2004	<10,000	<2,000	2,100	<50	<50	<50	<50	<50	a
08/31/2004	<5,000	<1,000	1,500	<25	<25	<25	<25	<25	
01/18/2005	<500	150	130	<2.5	<2.5	<2.5	<2.5	<2.5	a
09/01/2005	<5,000	2,700	240	<25	<25	<25	<25	<25	
02/14/2006	<15,000	<1,000	2,200	<25	<25	<25	<25	<25	a
8/29/2006	<15,000	2,100	<25	<25	<25	<25	<25	<25	
2/20/2007	<600	380	3.2	<1.0	<1.0	<1.0	<1.0	<1.0	

**Table 2. Summary of Fuel Additives Analytical Data
Station #11117, 7210 Bancroft Ave., Oakland, CA**

Well and Sample Date	Concentrations in (µg/L)								Comments
	Ethanol	TBA	MTBE	DIPE	ETBE	TAME	1,2-DCA	EDB	
MW-9 Cont.									
8/9/2007	<300	790	1.4	<0.50	<0.50	<0.50	<0.50	<0.50	
MW-10									
8/27/2003	<5,000	<1,000	2,800	<25	<25	<25	--	--	
11/10/2003	<10,000	<2,000	3,300	<50	<50	<50	--	--	
02/03/2004	<10,000	<2,000	2,300	<50	<50	<50	<50	<50	a
05/04/2004	<5,000	<1,000	1,600	<25	<25	<25	<25	<25	
08/31/2004	<10,000	<2,000	1,900	<50	<50	<50	<50	<50	
11/23/2004	<5,000	<1,000	2,300	<25	<25	<25	<25	<25	
01/18/2005	<1,000	<200	530	<5.0	<5.0	<5.0	<5.0	<5.0	a
06/29/2005	<100	<20	71	<0.50	<0.50	<0.50	<0.50	<0.50	
09/01/2005	<500	<100	280	<2.5	<2.5	<2.5	<2.5	<2.5	
11/03/2005	<1,000	<200	770	<5.0	<5.0	<5.0	<5.0	<5.0	
02/14/2006	<300	34	400	<0.50	<0.50	1.2	<0.50	<0.50	a, b
5/30/2006	<300	<20	<0.50	<0.50	<0.50	<0.50	<0.50	<0.50	
8/29/2006	<3,000	<200	490	<5.0	<5.0	<5.0	<5.0	<5.0	
11/29/2006	<3,000	<200	1,400	<5.0	<5.0	5.8	<5.0	<5.0	
2/20/2007	<3,000	<200	850	<5.0	<5.0	<5.0	<5.0	<5.0	
5/25/2007	<300	<20	170	<0.50	<0.50	0.69	<0.50	<0.50	
8/9/2007	<6,000	<400	1,600	<10	<10	<10	<10	<10	

ABBREVIATIONS AND SYMBOLS:

-- = Not analyzed/applicable/measurable
< = Not detected above reported detection limit
1,2-DCA = 1,2-Dichloroethane
µg/L = Micrograms per Liter
DIPE = Di-isopropyl ether
EDB = 1, 2-Dibromoethane
ETBE = Ethyl tert-butyl ether
MTBE = Methyl tert-butyl ether
TAME = tert-Amyl methyl ether
TBA = tert-Butyl alcohol

FOOTNOTES:

a = The continuing calibration verification for ethanol was outside of client contractual acceptance limits. However, it was within method acceptance limits. The data should still be useful for its intended purpose.
b = Initial analysis for MTBE within holding time but required dilution.

NOTES:

All volatile organic compounds analyzed using EPA Method 8260B.

Note: The data within this table collected prior to April 2006 was provided to Broadbent & Associates, Inc. by Atlantic Richfield Company and their previous consultants. Broadbent & Associates, Inc. has not verified the accuracy of this information.

**Table 3. Historical Ground-Water Flow Direction and Gradient
Station #11117, 7210 Bancroft Ave., Oakland, CA**

Date Sampled	Approximate Flow Direction	Approximate Hydraulic Gradient
9/12/2002	Northeast	0.03
12/12/2002	Northeast	0.02
3/10/2003	Northeast	0.03
5/12/2003	North-Northeast	0.055
8/27/2003	North-Northeast	0.036
11/10/2003	North-Northeast	0.012
2/3/2004	Northeast	0.013
5/4/2004	Northeast	0.015
8/31/2004	Northeast	0.010
11/23/2004	North-Northeast	0.04
1/18/2005	Northeast	0.02
6/29/2005	Variable	0.003, 0.006
9/1/2005	North	0.03
11/3/2005	North	0.008
2/14/2006	North-Northeast	0.02
5/30/2006	North	0.03
8/29/2006	Northeast	0.006
11/29/2006	West, Southeast	0.002, 0.001
2/20/2007	Northeast	0.004
5/25/2007	North	0.005
8/9/2007	Northwest	0.002

Note: The data within this table collected prior to April 2006 was provided to Broadbent & Associates, Inc. by Atlantic Richfield Company and their previous consultants. Broadbent & Associates, Inc. has not verified the accuracy of this information.

APPENDIX A

**STRATUS GROUND-WATER SAMPLING DATA PACKAGE
(INCLUDES FIELD DATA SHEETS AND LABORATORY REPORT AND
CHAIN-OF-CUSTODY DOCUMENTATION)**



3330 Cameron Park Drive, Ste 550
Cameron Park, California 95682
(530) 676-6004 ~ Fax: (530) 676-6005

September 6, 2007

Mr. Rob Miller
Broadbent & Associates, Inc.
2000 Kirman Avenue
Reno, NV 89502

Re: Groundwater Sampling Data Package, BP Service Station No. 11117, located at
7210 Bancroft, Oakland, California

General Information

Data Submittal Prepared / Reviewed by: Sandy Hayes / Jay Johnson

Phone Number: (530) 676-6000

On-Site Supplier Representative: David DeMello

Sampling Date: August 9, 2007

Arrival: 08:30 *Departure:* 15:30

Weather Conditions: Clear

Unusual Field Conditions: None

Scope of Work Performed: Quarterly monitoring and sampling

Variations from Work Scope: A sheen was noted in Well MW-2. Well EX-1 ran dry before three casing volumes were removed.

This submittal presents the tabulation of data collected in association with routine groundwater monitoring. The attachments include field data sheets, non-hazardous waste data form, chain of custody documentation, and certified analytical results. The information is being provided to BP-ARCO's Scoping Supplier for use in preparing a report for regulatory submittal. This submittal is limited to presentation of collected data and does not include data interpretation or conclusions or recommendations. Any questions concerning this submittal should be addressed to the Preparer/Reviewer identified above.

Sincerely,

STRATUS ENVIRONMENTAL, INC.

Jay R. Johnson, P.G.
Project Manager



Attachments:

- Field Data Sheets
- Non-Hazardous Waste Data Form
- Chain of Custody Documentation
- Certified Analytical Results

cc: Mr. Paul Supple, BP/ARCO



Global ID: T0600100201
 Site Address 7210 Bancroft
 City Oakland, CA
 Sampled By: D. Demello

ORIGINAL

Site Number 11117
 Project No -
 Project PM JAY JOHNSON
 Date 08-09-07

Signature D. Demello Date: 8/9/07

Water Level Data					Purge Volume Calculations					Well Purge Method				Sample Record			Field Data
Well ID	Time	Depth to water feet	Top of Screen feet	Qtr. Meas. Depth of Well (feet)	Casing Water Column (A)	Well Diameter (Inches)	Multiplier Value (B)	Three Casing Volumes (Gallons)	Actual Water Purged (Gallons)	No Purge	Bailer	Pump	Other	DTW At Sample Time	Sample I.D.	Sample time	Dissolved Oxygen (ppm)
MW-1	0953	19.38	20	36.28		2									MW-1		
MW-2	0930	19.55	20	39.25	19.70	2	.5	10	10		X			20.35	MW-2	1426	.72
MW-3	0915	18.70	30	40.44		2									MW-3		
* MW-4	0927	19.29	20	39.42	20.13	2	.5	10	10		X			19.52	* MW-4	1451	.72
MW-5	—	—	—	—	—	2	—	—	—					—	MW-5	—	—
MW-6	0918	19.15	20	39.24		2									MW-6		
MW-7	0947	19.95	25	44.45	24.50	2	.5	12	12		X			33.81	MW-7	1308	1.94
MW-8	1005	19.25	25	39.33		2									MW-8		
MW-9	1012	19.71	25	38.85	19.14	2	.5	9.5	9.5		X			19.73	MW-9	1206	1.07
MW-10	0923	20.83	15	35.45	14.62	2	.5	7	7		X			24.15	MW-10	1232	.74
EX-1	0935	19.76	18	37.87	—	4	—	—	—	X	Sample only			—	EX-1	1404	.76
EX-2	0942	20.40	15	35.08	14.68	4	2	29	29		X			24.92	EX-2	1352	1.14
TB 11117 08092007														TB 11117 08092007			0845
									Total 77.5 gals								

Collect 3 extra HCl voas from MW-4 and also look for and bail if needed any FP
 MW-4, EX-1 & EX-2 use Interface probe

Multiplier Values
 2" = 0.5 3" = 1.0 4" = 2.0 6" = 4.4



Site Address 7210 Bancroft
 City Oakland, CA
 Sampled By D. DeMello

Site Number 11117
 Project No -
 Project PM JAY JOHNSON
 Date 08-09-07

ORIGINAL

Well ID MW <u>9 1206</u>					Well ID <u>Sheen</u> MW-2 <u>1426</u>				
purge start time <u>Bailer No odor</u>					purge start time <u>Bailer No odor</u>				
	Temp C	pH	cond	gallons		Temp C	pH	cond	gallons
time	<u>21.1</u>	<u>7.52</u>	<u>661</u>	<u>0</u>	time	<u>22.7</u>	<u>6.99</u>	<u>992</u>	<u>0</u>
time	<u>20.6</u>	<u>7.55</u>	<u>596</u>	<u>4.5</u>	time	<u>22.6</u>	<u>7.08</u>	<u>919</u>	<u>5</u>
time	<u>21.6</u>	<u>7.52</u>	<u>580</u>	<u>9.5</u>	time	<u>23.3</u>	<u>7.01</u>	<u>913</u>	<u>10</u>
time					time				
purge stop time <u>ORP (77)</u>					purge stop time <u>ORP (70)</u>				
Well ID MW <u>10 1232</u>					Well ID MW-4 <u>1451</u>				
purge start time <u>Bailer No odor</u>					purge start time <u>Bailer No odor</u>				
	Temp C	pH	cond	gallons		Temp C	pH	cond	gallons
time	<u>24.0</u>	<u>7.15</u>	<u>977</u>	<u>0</u>	time	<u>23.0</u>	<u>6.96</u>	<u>921</u>	<u>0</u>
time	<u>24.1</u>	<u>7.23</u>	<u>963</u>	<u>3.5</u>	time	<u>22.6</u>	<u>6.89</u>	<u>960</u>	<u>5</u>
time	<u>24.4</u>	<u>7.24</u>	<u>943</u>	<u>7</u>	time	<u>23.6</u>	<u>7.02</u>	<u>957</u>	<u>10</u>
time					time				
purge stop time <u>ORP (115)</u>					purge stop time <u>ORP (118)</u>				
Well ID <u>1404</u> EX-1					Well ID <u>1352</u> EX-2				
Purge start time <u>Bailer No odor</u>					Purge start time <u>Bailer No odor</u>				
	Temp C	pH	cond	gallons		Temp C	pH	cond	gallons
time	<u>23.5</u>	<u>7.01</u>	<u>836</u>	<u>0</u>	time	<u>22.8</u>	<u>7.20</u>	<u>453</u>	<u>0</u>
time					time	<u>22.7</u>	<u>7.37</u>	<u>482</u>	<u>14</u>
time					time	<u>23.1</u>	<u>7.19</u>	<u>473</u>	<u>29</u>
time					time				
purge stop time <u>ORP (96)</u>					purge stop time <u>ORP (178)</u>				
Well ID MW-7 <u>1308</u>					Well ID				
purge start time <u>Bailer No odor</u>					purge start time				
	Temp C	pH	cond	gallons		Temp C	pH	cond	gallons
time	<u>23.8</u>	<u>7.58</u>	<u>808</u>	<u>0</u>	time				
time	<u>24.1</u>	<u>7.52</u>	<u>819</u>	<u>6</u>	time				
time	<u>24.2</u>	<u>7.55</u>	<u>855</u>	<u>12</u>	time				
time					time				
purge stop time <u>ORP (117)</u>					purge stop time				

ORIGINAL

NO. 662215

NON-HAZARDOUS WASTE DATA FORM

TO BE COMPLETED BY GENERATOR

SITE: 1117
7210 CAMERON

NAME BP WEST COAST PRODUCTS LLC ARCO # 7210 CAMERON, CA EPA I.D. NO. NOT REQUIRED

ADDRESS P.O. BOX 80249 PROFILE NO.
RANCHO SANTA MARGARITA

CITY, STATE, ZIP CA 92688 PHONE NO. ()

CONTAINERS: No. _____ VOLUME -77.5 WEIGHT _____

TYPE: TANK TRUCK DUMP TRUCK DRUMS CARTONS OTHER _____

WASTE DESCRIPTION NON-HAZARDOUS WATER GENERATING PROCESS WELL PURGING/DECON WATER

COMPONENTS OF WASTE		PPM	%	COMPONENTS OF WASTE		PPM	%
1. <u>WATER</u>	<u>59-100%</u>			5. _____			
2. <u>TPH</u>	<u><1%</u>			6. _____			
3. _____				7. <u>DESI*</u>			
4. _____				8. _____			

PROPERTIES: 7-10 pH SOLID LIQUID SLUDGE SLURRY OTHER _____

HANDLING INSTRUCTIONS: WEAR ALL APPROPRIATE PROTECTIVE CLOTHING

THE GENERATOR CERTIFIES THAT THE WASTE AS DESCRIBED IS 100% NON-HAZARDOUS.

Larry Moothart
TYPED OR PRINTED FULL NAME & SIGNATURE Larry Moothart DESI for BP DATE 08-10-17

TRANSPORTER

NAME Transporter #1 STRATUS ENVIRONMENTAL EPA I.D. NO.
Transporter #2

ADDRESS 3330 CAMERON PARK DRIVE STE 530 SERVICE ORDER NO. _____

CITY, STATE, ZIP CAMERON PARK CA 95682 PICK UP DATE _____

PHONE NO. 530-676-6004

TRUCK, UNIT, I.D. NO. _____ TYPED OR PRINTED FULL NAME & SIGNATURE Larry Moothart DATE 08-10-17

TSD FACILITY

NAME SEAPORT REFINING & ENVIRONMENTAL, LLC EPA I.D. NO.

ADDRESS 700 SEAPORT BLVD. DISPOSAL METHOD LANDFILL OTHER _____

CITY, STATE, ZIP REDWOOD CITY, CA 94063

PHONE NO. 650-364-1024

TYPED OR PRINTED FULL NAME & SIGNATURE _____ DATE _____

GEN	OLD/NEW	L	A	TONS
TRANS		S	B	
C/Q		RT/CD	H/WDF	NONE

DISCREPANCY



bp
A BP affiliated company

Chain of Custody Record

Project Name: ARCO 11117
 BP BU/AR Region/Enfos Segment: BP > Americas > West > Retail > Alameda > 11117
 State or Lead Regulatory Agency: _____
 Requested Due Date (mm/dd/yy): STD-TAY

ORIGINAL

On-site Time: <u>0830</u>	Temp: <u>low 70's</u>
Off-site Time: <u>1530</u>	Temp: <u>70's</u>
Sky Conditions: <u>Clear</u>	
Meteorological Events:	
Wind Speed: <u>—</u>	Direction: <u>—</u>

Lab Name: <u>TestAmerica</u>	BP/AR Facility No.: <u>11117</u>	Consultant/Contractor: <u>Stratus Environmental, Inc.</u>
Address: <u>885 Jarvis Drive</u>	BP/AR Facility Address: <u>7210 Bancroft, Oakland</u>	Address: <u>3330 Cameron Park Drive, Suite 550</u>
<u>Morgan Hill, CA 95937</u>	Site Lat/Long:	<u>Cameron Park, CA 95682</u>
Lab PM: <u>Lisa Race</u>	California Global ID No.: <u>T0600100201</u>	Consultant/Contractor Project No.:
Tele/Fax: <u>408-782-8156 408-782-6308 (fax)</u>	Enfos Project No.: <u>G07TK-0029</u>	Consultant/Contractor PM: <u>Jay Johnson</u>
BP/AR PM Contact: <u>Paul Supple</u>	Provision or OOC (circle one) <u>Provision</u>	Tele/Fax: <u>(530) 676-6000 / (530) 676-6005</u>
Address: <u>2010 Crow Canyon Place, Suite 150</u>	Phase/WBS: <u>04-Monitoring</u>	Report Type & QC Level: <u>Level 1 with EDF</u>
<u>San Ramon, CA</u>	Sub Phase/Task: <u>03-Analytical</u>	E-mail EDD To: <u>shayes@stratusinc.net</u>
Tele/Fax: <u>925-275-3506</u>	Cost Element: <u>01-Contractor labor</u>	Invoice to: <u>Atlantic Richfield Co.</u>

Item No.	Sample Description	Time	Date	Matrix			Laboratory No.	No. of Containers	Preservative					Requested Analysis					Sample Point Lat/Long and Comments *Oxy = MTBE, TAME, ETBE, DIPE, TBA					
				Soil/Solid	Water/Liquid	Air			Unpreserved	H ₂ SO ₄	HNO ₃	HCl	Methanol	GRO/BTEX/Oxy*	1,2-DCA	Ethanol	EDB	DRO						
1	MW-2	1426	08/09		X			3						X	X	X	X							
2	MW-4	1451						6																
3	MW-7	1308						3																
4	MW-9	1206						3																
5	MW-10	1232						3																
6	EX-1	1404						3																
7	EX-2	1352						3																
8																								
9	TB-11117 08092007	0845	08/09		X			2																Hold
10																								

Sampler's Name: <u>David DeMello</u>	Relinquished By / Affiliation: <u>David DeMello / STRATUS</u>	Date: <u>2007 08-10</u>	Time: <u>1435</u>	Accepted By / Affiliation: <u>Clayton TAYLOR</u>	Date: <u>8-10-07</u>	Time: <u>1435</u>
Sampler's Company: <u>STRATUS ENVIRONMENTAL</u>						
Shipment Date: <u>08/09/07</u>						
Shipment Method:						
Shipment Tracking No:						

Special Instructions: Please cc results to rmler@broadbentinc.com

Custody Seals In Place: Yes / No | Temp Blank: Yes / No | Cooler Temp on Receipt: °F/C | Trip Blank: Yes / No | MS/MSD Sample Submitted: Yes / No

28 August, 2007

Jay Johnson
Stratus Environmental Inc. [Arco]
3330 Cameron Park Dr., Suite 550
Cameron Park, CA 95682

RE: BP Heritage #11117, Oakland, CA
Work Order: MQH0368

Enclosed are the results of analyses for samples received by the laboratory on 08/10/07 19:40. If you have any questions concerning this report, please feel free to contact me.

Sincerely,



Lisa Race
Senior Project Manager

CA ELAP Certificate # 1210

The results in this laboratory report pertain only to the samples tested in the laboratory. The analyses contained in this report were performed in accordance with the BPGCLN Technical Specifications, applicable Federal, State, local regulations and certification requirements as well as the methodologies as described in laboratory SOPs reviewed by the BPGCLN. This entire report was reviewed and approved for release.

Stratus Environmental Inc. [Arco] 3330 Cameron Park Dr., Suite 550 Cameron Park CA, 95682	Project: BP Heritage #11117, Oakland, CA Project Number: G07TK-0029 Project Manager: Jay Johnson	MQH0368 Reported: 08/28/07 12:17
---	--	--

ANALYTICAL REPORT FOR SAMPLES

Sample ID	Laboratory ID	Matrix	Date Sampled	Date Received
MW-2	MQH0368-01	Water	08/09/07 14:26	08/10/07 19:40
MW-4	MQH0368-02	Water	08/09/07 14:51	08/10/07 19:40
MW-7	MQH0368-03	Water	08/09/07 13:08	08/10/07 19:40
MW-9	MQH0368-04	Water	08/09/07 12:06	08/10/07 19:40
MW-10	MQH0368-05	Water	08/09/07 12:32	08/10/07 19:40
EX-1	MQH0368-06	Water	08/09/07 14:04	08/10/07 19:40
EX-2	MQH0368-07	Water	08/09/07 13:52	08/10/07 19:40
TB-11117-08092007	MQH0368-08	Water	08/09/07 08:45	08/10/07 19:40

The carbon range for the TPH-GRO has been changed from C6-C10 to C4-C12. The carbon range for TPH-DRO has been changed from C10-C28 to C10-C36. EPA 8015B has been modified to better meet the requirements of California regulatory agencies.

These samples were received with no custody seals.

Stratus Environmental Inc. [Arco]
3330 Cameron Park Dr., Suite 550
Cameron Park CA, 95682

Project: BP Heritage #11117, Oakland, CA
Project Number: G07TK-0029
Project Manager: Jay Johnson

MQH0368
Reported:
08/28/07 12:17

Total Purgeable Hydrocarbons by GC/MS (CA LUFT)
TestAmerica - Morgan Hill, CA

Analyte	Result	Reporting Limit	Units	Dilution	Batch	Prepared	Analyzed	Method	Notes
MW-2 (MQH0368-01) Water Sampled: 08/09/07 14:26 Received: 08/10/07 19:40									
Gasoline Range Organics (C4-C12)	58000	10000	ug/l	200	7H16018	08/16/07	08/16/07	LUFT GCMS	
<i>Surrogate: 1,2-Dichloroethane-d4</i>		109 %	60-125		"	"	"	"	
<i>Surrogate: Dibromofluoromethane</i>		100 %	75-120		"	"	"	"	
<i>Surrogate: Toluene-d8</i>		98 %	80-120		"	"	"	"	
<i>Surrogate: 4-Bromofluorobenzene</i>		98 %	60-135		"	"	"	"	
MW-4 (MQH0368-02) Water Sampled: 08/09/07 14:51 Received: 08/10/07 19:40									
Gasoline Range Organics (C4-C12)	180000	10000	ug/l	200	7H16018	08/16/07	08/16/07	LUFT GCMS	
<i>Surrogate: 1,2-Dichloroethane-d4</i>		106 %	60-125		"	"	"	"	
<i>Surrogate: Dibromofluoromethane</i>		100 %	75-120		"	"	"	"	
<i>Surrogate: Toluene-d8</i>		101 %	80-120		"	"	"	"	
<i>Surrogate: 4-Bromofluorobenzene</i>		106 %	60-135		"	"	"	"	
MW-7 (MQH0368-03) Water Sampled: 08/09/07 13:08 Received: 08/10/07 19:40									
Gasoline Range Organics (C4-C12)	ND	50	ug/l	1	7H16018	08/16/07	08/17/07	LUFT GCMS	
<i>Surrogate: 1,2-Dichloroethane-d4</i>		103 %	60-125		"	"	"	"	
<i>Surrogate: Dibromofluoromethane</i>		101 %	75-120		"	"	"	"	
<i>Surrogate: Toluene-d8</i>		96 %	80-120		"	"	"	"	
<i>Surrogate: 4-Bromofluorobenzene</i>		96 %	60-135		"	"	"	"	
MW-9 (MQH0368-04) Water Sampled: 08/09/07 12:06 Received: 08/10/07 19:40									
Gasoline Range Organics (C4-C12)	650	50	ug/l	1	7H16018	08/16/07	08/17/07	LUFT GCMS	
<i>Surrogate: 1,2-Dichloroethane-d4</i>		110 %	60-125		"	"	"	"	
<i>Surrogate: Dibromofluoromethane</i>		100 %	75-120		"	"	"	"	
<i>Surrogate: Toluene-d8</i>		98 %	80-120		"	"	"	"	
<i>Surrogate: 4-Bromofluorobenzene</i>		96 %	60-135		"	"	"	"	

Stratus Environmental Inc. [Arco]
3330 Cameron Park Dr., Suite 550
Cameron Park CA, 95682

Project: BP Heritage #11117, Oakland, CA
Project Number: G07TK-0029
Project Manager: Jay Johnson

MQH0368
Reported:
08/28/07 12:17

Total Purgeable Hydrocarbons by GC/MS (CA LUFT)
TestAmerica - Morgan Hill, CA

Analyte	Result	Reporting Limit	Units	Dilution	Batch	Prepared	Analyzed	Method	Notes
MW-10 (MQH0368-05) Water Sampled: 08/09/07 12:32 Received: 08/10/07 19:40									
Gasoline Range Organics (C4-C12)	970	250	ug/l	5	7H16009	08/16/07	08/16/07	LUFT GCMS	
<i>Surrogate: 1,2-Dichloroethane-d4</i>		104 %	60-125		"	"	"	"	
<i>Surrogate: Dibromofluoromethane</i>		101 %	75-120		"	"	"	"	
<i>Surrogate: Toluene-d8</i>		96 %	80-120		"	"	"	"	
<i>Surrogate: 4-Bromofluorobenzene</i>		96 %	60-135		"	"	"	"	
EX-1 (MQH0368-06) Water Sampled: 08/09/07 14:04 Received: 08/10/07 19:40									
Gasoline Range Organics (C4-C12)	4800	1000	ug/l	20	7H17010	08/17/07	08/18/07	LUFT GCMS	
<i>Surrogate: 1,2-Dichloroethane-d4</i>		111 %	60-125		"	"	"	"	
<i>Surrogate: Dibromofluoromethane</i>		106 %	75-120		"	"	"	"	
<i>Surrogate: Toluene-d8</i>		97 %	80-120		"	"	"	"	
<i>Surrogate: 4-Bromofluorobenzene</i>		96 %	60-135		"	"	"	"	
EX-2 (MQH0368-07) Water Sampled: 08/09/07 13:52 Received: 08/10/07 19:40									
Gasoline Range Organics (C4-C12)	ND	50	ug/l	1	7H16009	08/16/07	08/16/07	LUFT GCMS	
<i>Surrogate: 1,2-Dichloroethane-d4</i>		108 %	60-125		"	"	"	"	
<i>Surrogate: Dibromofluoromethane</i>		103 %	75-120		"	"	"	"	
<i>Surrogate: Toluene-d8</i>		96 %	80-120		"	"	"	"	
<i>Surrogate: 4-Bromofluorobenzene</i>		95 %	60-135		"	"	"	"	

Stratus Environmental Inc. [Arco] 3330 Cameron Park Dr., Suite 550 Cameron Park CA, 95682	Project: BP Heritage #11117, Oakland, CA Project Number: G07TK-0029 Project Manager: Jay Johnson	MQH0368 Reported: 08/28/07 12:17
---	--	--

Volatile Organic Compounds by EPA Method 8260B
TestAmerica - Morgan Hill, CA

Analyte	Result	Reporting Limit	Units	Dilution	Batch	Prepared	Analyzed	Method	Notes
---------	--------	-----------------	-------	----------	-------	----------	----------	--------	-------

MW-2 (MQH0368-01) Water Sampled: 08/09/07 14:26 Received: 08/10/07 19:40

tert-Amyl methyl ether	ND	100	ug/l	200	7H16018	08/16/07	08/16/07	EPA 8260B	
Benzene	7400	100	"	"	"	"	"	"	
tert-Butyl alcohol	ND	4000	"	"	"	"	"	"	
Di-isopropyl ether	ND	100	"	"	"	"	"	"	
1,2-Dibromoethane (EDB)	ND	100	"	"	"	"	"	"	
1,2-Dichloroethane	ND	100	"	"	"	"	"	"	
Ethanol	ND	60000	"	"	"	"	"	"	
Ethyl tert-butyl ether	ND	100	"	"	"	"	"	"	
Ethylbenzene	3800	100	"	"	"	"	"	"	
Methyl tert-butyl ether	4100	100	"	"	"	"	"	"	
Toluene	5000	100	"	"	"	"	"	"	
Xylenes (total)	12000	100	"	"	"	"	"	"	
<i>Surrogate: Dibromofluoromethane</i>		100 %		75-120	"	"	"	"	
<i>Surrogate: 1,2-Dichloroethane-d4</i>		109 %		60-125	"	"	"	"	
<i>Surrogate: Toluene-d8</i>		98 %		80-120	"	"	"	"	
<i>Surrogate: 4-Bromofluorobenzene</i>		98 %		60-135	"	"	"	"	

MW-4 (MQH0368-02) Water Sampled: 08/09/07 14:51 Received: 08/10/07 19:40

tert-Amyl methyl ether	ND	100	ug/l	200	7H16018	08/16/07	08/16/07	EPA 8260B	
Benzene	5600	100	"	"	"	"	"	"	
tert-Butyl alcohol	4100	4000	"	"	"	"	"	"	
Di-isopropyl ether	ND	100	"	"	"	"	"	"	
1,2-Dibromoethane (EDB)	ND	100	"	"	"	"	"	"	
1,2-Dichloroethane	ND	100	"	"	"	"	"	"	
Ethanol	ND	60000	"	"	"	"	"	"	
Ethyl tert-butyl ether	ND	100	"	"	"	"	"	"	
Ethylbenzene	5700	100	"	"	"	"	"	"	
Methyl tert-butyl ether	2900	100	"	"	"	"	"	"	
Toluene	7700	100	"	"	"	"	"	"	
Xylenes (total)	21000	100	"	"	"	"	"	"	BB
<i>Surrogate: Dibromofluoromethane</i>		100 %		75-120	"	"	"	"	
<i>Surrogate: 1,2-Dichloroethane-d4</i>		106 %		60-125	"	"	"	"	
<i>Surrogate: Toluene-d8</i>		101 %		80-120	"	"	"	"	
<i>Surrogate: 4-Bromofluorobenzene</i>		106 %		60-135	"	"	"	"	

Stratus Environmental Inc. [Arco]
3330 Cameron Park Dr., Suite 550
Cameron Park CA, 95682

Project: BP Heritage #11117, Oakland, CA
Project Number: G07TK-0029
Project Manager: Jay Johnson

MQH0368
Reported:
08/28/07 12:17

Volatile Organic Compounds by EPA Method 8260B
TestAmerica - Morgan Hill, CA

Analyte	Result	Reporting Limit	Units	Dilution	Batch	Prepared	Analyzed	Method	Notes
---------	--------	-----------------	-------	----------	-------	----------	----------	--------	-------

MW-7 (MQH0368-03) Water Sampled: 08/09/07 13:08 Received: 08/10/07 19:40

tert-Amyl methyl ether	ND	0.50	ug/l	1	7H16018	08/16/07	08/17/07	EPA 8260B	
Benzene	ND	0.50	"	"	"	"	"	"	
tert-Butyl alcohol	ND	20	"	"	"	"	"	"	
Di-isopropyl ether	ND	0.50	"	"	"	"	"	"	
1,2-Dibromoethane (EDB)	ND	0.50	"	"	"	"	"	"	
1,2-Dichloroethane	ND	0.50	"	"	"	"	"	"	
Ethanol	ND	300	"	"	"	"	"	"	
Ethyl tert-butyl ether	ND	0.50	"	"	"	"	"	"	
Ethylbenzene	ND	0.50	"	"	"	"	"	"	
Methyl tert-butyl ether	42	0.50	"	"	"	"	"	"	
Toluene	ND	0.50	"	"	"	"	"	"	
Xylenes (total)	ND	0.50	"	"	"	"	"	"	
<i>Surrogate: Dibromofluoromethane</i>		101 %	75-120		"	"	"	"	
<i>Surrogate: 1,2-Dichloroethane-d4</i>		103 %	60-125		"	"	"	"	
<i>Surrogate: Toluene-d8</i>		96 %	80-120		"	"	"	"	
<i>Surrogate: 4-Bromofluorobenzene</i>		96 %	60-135		"	"	"	"	

MW-9 (MQH0368-04) Water Sampled: 08/09/07 12:06 Received: 08/10/07 19:40

tert-Amyl methyl ether	ND	0.50	ug/l	1	7H16018	08/16/07	08/17/07	EPA 8260B	
tert-Butyl alcohol	790	20	"	"	"	"	"	"	
Di-isopropyl ether	ND	0.50	"	"	"	"	"	"	
1,2-Dibromoethane (EDB)	ND	0.50	"	"	"	"	"	"	
1,2-Dichloroethane	ND	0.50	"	"	"	"	"	"	
Ethanol	ND	300	"	"	"	"	"	"	
Ethyl tert-butyl ether	ND	0.50	"	"	"	"	"	"	
Ethylbenzene	ND	0.50	"	"	"	"	"	"	
Methyl tert-butyl ether	1.4	0.50	"	"	"	"	"	"	
Toluene	ND	0.50	"	"	"	"	"	"	
Xylenes (total)	2.0	0.50	"	"	"	"	"	"	
<i>Surrogate: Dibromofluoromethane</i>		100 %	75-120		"	"	"	"	
<i>Surrogate: 1,2-Dichloroethane-d4</i>		110 %	60-125		"	"	"	"	
<i>Surrogate: Toluene-d8</i>		98 %	80-120		"	"	"	"	
<i>Surrogate: 4-Bromofluorobenzene</i>		96 %	60-135		"	"	"	"	

Stratus Environmental Inc. [Arco]
3330 Cameron Park Dr., Suite 550
Cameron Park CA, 95682

Project: BP Heritage #11117, Oakland, CA
Project Number: G07TK-0029
Project Manager: Jay Johnson

MQH0368
Reported:
08/28/07 12:17

Volatile Organic Compounds by EPA Method 8260B
TestAmerica - Morgan Hill, CA

Analyte	Result	Reporting Limit	Units	Dilution	Batch	Prepared	Analyzed	Method	Notes
---------	--------	-----------------	-------	----------	-------	----------	----------	--------	-------

MW-9 (MQH0368-04RE1) Water Sampled: 08/09/07 12:06 Received: 08/10/07 19:40

Benzene	150	2.5	ug/l	5	7H23006	08/23/07	08/23/07	EPA 8260B	
<i>Surrogate: Dibromofluoromethane</i>		95 %	75-120		"	"	"	"	
<i>Surrogate: 1,2-Dichloroethane-d4</i>		84 %	60-125		"	"	"	"	
<i>Surrogate: Toluene-d8</i>		102 %	80-120		"	"	"	"	
<i>Surrogate: 4-Bromofluorobenzene</i>		89 %	60-135		"	"	"	"	

MW-10 (MQH0368-05) Water Sampled: 08/09/07 12:32 Received: 08/10/07 19:40

tert-Amyl methyl ether	ND	10	ug/l	20	7H17010	08/17/07	08/18/07	EPA 8260B	
Benzene	ND	10	"	"	"	"	"	"	
tert-Butyl alcohol	ND	400	"	"	"	"	"	"	
Di-isopropyl ether	ND	10	"	"	"	"	"	"	
1,2-Dibromoethane (EDB)	ND	10	"	"	"	"	"	"	
1,2-Dichloroethane	ND	10	"	"	"	"	"	"	
Ethanol	ND	6000	"	"	"	"	"	"	
Ethyl tert-butyl ether	ND	10	"	"	"	"	"	"	
Ethylbenzene	ND	10	"	"	"	"	"	"	
Methyl tert-butyl ether	1600	10	"	"	"	"	"	"	
Toluene	ND	10	"	"	"	"	"	"	
Xylenes (total)	ND	10	"	"	"	"	"	"	
<i>Surrogate: Dibromofluoromethane</i>		101 %	75-120		"	"	"	"	
<i>Surrogate: 1,2-Dichloroethane-d4</i>		109 %	60-125		"	"	"	"	
<i>Surrogate: Toluene-d8</i>		95 %	80-120		"	"	"	"	
<i>Surrogate: 4-Bromofluorobenzene</i>		90 %	60-135		"	"	"	"	

EX-1 (MQH0368-06) Water Sampled: 08/09/07 14:04 Received: 08/10/07 19:40

tert-Amyl methyl ether	15	10	ug/l	20	7H17010	08/17/07	08/18/07	EPA 8260B	
Benzene	870	10	"	"	"	"	"	"	
tert-Butyl alcohol	440	400	"	"	"	"	"	"	
Di-isopropyl ether	ND	10	"	"	"	"	"	"	
1,2-Dibromoethane (EDB)	ND	10	"	"	"	"	"	"	
1,2-Dichloroethane	ND	10	"	"	"	"	"	"	
Ethanol	ND	6000	"	"	"	"	"	"	
Ethyl tert-butyl ether	ND	10	"	"	"	"	"	"	
Ethylbenzene	230	10	"	"	"	"	"	"	
Methyl tert-butyl ether	530	10	"	"	"	"	"	"	
Toluene	40	10	"	"	"	"	"	"	
Xylenes (total)	460	10	"	"	"	"	"	"	
<i>Surrogate: Dibromofluoromethane</i>		106 %	75-120		"	"	"	"	

TestAmerica - Morgan Hill, CA

The results in this report apply to the samples analyzed in accordance with the chain of custody document. Unless otherwise stated, results are reported on a wet weight basis. This analytical report must be reproduced in its entirety.

Stratus Environmental Inc. [Arco]
3330 Cameron Park Dr., Suite 550
Cameron Park CA, 95682

Project: BP Heritage #11117, Oakland, CA
Project Number: G07TK-0029
Project Manager: Jay Johnson

MQH0368
Reported:
08/28/07 12:17

Volatile Organic Compounds by EPA Method 8260B
TestAmerica - Morgan Hill, CA

Analyte	Result	Reporting Limit	Units	Dilution	Batch	Prepared	Analyzed	Method	Notes
EX-1 (MQH0368-06) Water Sampled: 08/09/07 14:04 Received: 08/10/07 19:40									
Surrogate: 1,2-Dichloroethane-d4		111 %	60-125		7H17010	08/17/07	08/18/07	EPA 8260B	
Surrogate: Toluene-d8		97 %	80-120		"	"	"	"	
Surrogate: 4-Bromofluorobenzene		96 %	60-135		"	"	"	"	
EX-2 (MQH0368-07) Water Sampled: 08/09/07 13:52 Received: 08/10/07 19:40									
tert-Amyl methyl ether	ND	0.50	ug/l	1	7H16009	08/16/07	08/16/07	EPA 8260B	
Benzene	ND	0.50	"	"	"	"	"	"	
tert-Butyl alcohol	ND	20	"	"	"	"	"	"	
Di-isopropyl ether	ND	0.50	"	"	"	"	"	"	
1,2-Dibromoethane (EDB)	ND	0.50	"	"	"	"	"	"	
1,2-Dichloroethane	ND	0.50	"	"	"	"	"	"	
Ethanol	ND	300	"	"	"	"	"	"	
Ethyl tert-butyl ether	ND	0.50	"	"	"	"	"	"	
Ethylbenzene	ND	0.50	"	"	"	"	"	"	
Methyl tert-butyl ether	27	0.50	"	"	"	"	"	"	
Toluene	ND	0.50	"	"	"	"	"	"	
Xylenes (total)	ND	0.50	"	"	"	"	"	"	
Surrogate: Dibromofluoromethane		103 %	75-120		"	"	"	"	
Surrogate: 1,2-Dichloroethane-d4		108 %	60-125		"	"	"	"	
Surrogate: Toluene-d8		96 %	80-120		"	"	"	"	
Surrogate: 4-Bromofluorobenzene		95 %	60-135		"	"	"	"	

Stratus Environmental Inc. [Arco]
3330 Cameron Park Dr., Suite 550
Cameron Park CA, 95682

Project: BP Heritage #11117, Oakland, CA
Project Number: G07TK-0029
Project Manager: Jay Johnson

MQH0368
Reported:
08/28/07 12:17

Total Purgeable Hydrocarbons by GC/MS (CA LUFT) - Quality Control
TestAmerica - Morgan Hill, CA

Analyte	Result	Reporting Limit	Units	Spike Level	Source Result	%REC	%REC Limits	RPD	RPD Limit	Notes
---------	--------	-----------------	-------	-------------	---------------	------	-------------	-----	-----------	-------

Batch 7H16009 - EPA 5030B P/T / LUFT GCMS

Blank (7H16009-BLK1)

Prepared & Analyzed: 08/16/07

Gasoline Range Organics (C4-C12)	ND	50	ug/l							
Surrogate: 1,2-Dichloroethane-d4	2.75		"	2.50		110	60-125			
Surrogate: Dibromofluoromethane	2.42		"	2.50		97	75-120			
Surrogate: Toluene-d8	2.37		"	2.50		95	80-120			
Surrogate: 4-Bromofluorobenzene	2.35		"	2.50		94	60-135			

Laboratory Control Sample (7H16009-BS2)

Prepared & Analyzed: 08/16/07

Gasoline Range Organics (C4-C12)	554	50	ug/l	500		111	65-120			
Surrogate: 1,2-Dichloroethane-d4	2.74		"	2.50		110	60-125			
Surrogate: Dibromofluoromethane	2.39		"	2.50		96	75-120			
Surrogate: Toluene-d8	2.54		"	2.50		102	80-120			
Surrogate: 4-Bromofluorobenzene	2.65		"	2.50		106	60-135			

Laboratory Control Sample Dup (7H16009-BSD2)

Prepared & Analyzed: 08/16/07

Gasoline Range Organics (C4-C12)	530	50	ug/l	500		106	65-120	4	20	
Surrogate: 1,2-Dichloroethane-d4	2.61		"	2.50		104	60-125			
Surrogate: Dibromofluoromethane	2.34		"	2.50		94	75-120			
Surrogate: Toluene-d8	2.53		"	2.50		101	80-120			
Surrogate: 4-Bromofluorobenzene	2.57		"	2.50		103	60-135			

Batch 7H16018 - EPA 5030B P/T / LUFT GCMS

Blank (7H16018-BLK1)

Prepared & Analyzed: 08/16/07

Gasoline Range Organics (C4-C12)	ND	50	ug/l							
Surrogate: 1,2-Dichloroethane-d4	2.64		"	2.50		106	60-125			
Surrogate: Dibromofluoromethane	2.41		"	2.50		96	75-120			
Surrogate: Toluene-d8	2.41		"	2.50		96	80-120			
Surrogate: 4-Bromofluorobenzene	2.42		"	2.50		97	60-135			

Stratus Environmental Inc. [Arco]
3330 Cameron Park Dr., Suite 550
Cameron Park CA, 95682

Project: BP Heritage #11117, Oakland, CA
Project Number: G07TK-0029
Project Manager: Jay Johnson

MQH0368
Reported:
08/28/07 12:17

Total Purgeable Hydrocarbons by GC/MS (CA LUFT) - Quality Control
TestAmerica - Morgan Hill, CA

Analyte	Result	Reporting Limit	Units	Spike Level	Source Result	%REC	%REC Limits	RPD	RPD Limit	Notes
---------	--------	-----------------	-------	-------------	---------------	------	-------------	-----	-----------	-------

Batch 7H16018 - EPA 5030B P/T / LUFT GCMS

Laboratory Control Sample (7H16018-BS2)

Prepared & Analyzed: 08/16/07

Gasoline Range Organics (C4-C12)	481	50	ug/l	500		96	65-120			
Surrogate: 1,2-Dichloroethane-d4	2.73		"	2.50		109	60-125			
Surrogate: Dibromofluoromethane	2.48		"	2.50		99	75-120			
Surrogate: Toluene-d8	2.54		"	2.50		102	80-120			
Surrogate: 4-Bromofluorobenzene	2.56		"	2.50		102	60-135			

Laboratory Control Sample Dup (7H16018-BSD2)

Prepared & Analyzed: 08/16/07

Gasoline Range Organics (C4-C12)	474	50	ug/l	500		95	65-120	1	20	
Surrogate: 1,2-Dichloroethane-d4	2.70		"	2.50		108	60-125			
Surrogate: Dibromofluoromethane	2.51		"	2.50		100	75-120			
Surrogate: Toluene-d8	2.51		"	2.50		100	80-120			
Surrogate: 4-Bromofluorobenzene	2.65		"	2.50		106	60-135			

Batch 7H17010 - EPA 5030B P/T / LUFT GCMS

Blank (7H17010-BLK1)

Prepared & Analyzed: 08/17/07

Gasoline Range Organics (C4-C12)	ND	50	ug/l							
Surrogate: 1,2-Dichloroethane-d4	2.98		"	2.50		119	60-125			
Surrogate: Dibromofluoromethane	2.54		"	2.50		102	75-120			
Surrogate: Toluene-d8	2.39		"	2.50		96	80-120			
Surrogate: 4-Bromofluorobenzene	2.34		"	2.50		94	60-135			

Laboratory Control Sample (7H17010-BS2)

Prepared & Analyzed: 08/17/07

Gasoline Range Organics (C4-C12)	460	50	ug/l	500		92	65-120			
Surrogate: 1,2-Dichloroethane-d4	2.84		"	2.50		114	60-125			
Surrogate: Dibromofluoromethane	2.53		"	2.50		101	75-120			
Surrogate: Toluene-d8	2.52		"	2.50		101	80-120			
Surrogate: 4-Bromofluorobenzene	2.67		"	2.50		107	60-135			

Stratus Environmental Inc. [Arco]
3330 Cameron Park Dr., Suite 550
Cameron Park CA, 95682

Project: BP Heritage #11117, Oakland, CA
Project Number: G07TK-0029
Project Manager: Jay Johnson

MQH0368
Reported:
08/28/07 12:17

Total Purgeable Hydrocarbons by GC/MS (CA LUFT) - Quality Control
TestAmerica - Morgan Hill, CA

Analyte	Result	Reporting Limit	Units	Spike Level	Source Result	%REC	%REC Limits	RPD	RPD Limit	Notes
---------	--------	-----------------	-------	-------------	---------------	------	-------------	-----	-----------	-------

Batch 7H17010 - EPA 5030B P/T / LUFT GCMS

Laboratory Control Sample Dup (7H17010-BSD2)

Prepared & Analyzed: 08/17/07

Gasoline Range Organics (C4-C12)	452	50	ug/l	500		90	65-120	2	20	
Surrogate: 1,2-Dichloroethane-d4	2.82		"	2.50		113	60-125			
Surrogate: Dibromofluoromethane	2.51		"	2.50		100	75-120			
Surrogate: Toluene-d8	2.46		"	2.50		98	80-120			
Surrogate: 4-Bromofluorobenzene	2.60		"	2.50		104	60-135			

Stratus Environmental Inc. [Arco]
3330 Cameron Park Dr., Suite 550
Cameron Park CA, 95682

Project: BP Heritage #11117, Oakland, CA
Project Number: G07TK-0029
Project Manager: Jay Johnson

MQH0368
Reported:
08/28/07 12:17

Volatile Organic Compounds by EPA Method 8260B - Quality Control
TestAmerica - Morgan Hill, CA

Analyte	Result	Reporting Limit	Units	Spike Level	Source Result	%REC	%REC Limits	RPD	RPD Limit	Notes
---------	--------	-----------------	-------	-------------	---------------	------	-------------	-----	-----------	-------

Batch 7H16009 - EPA 5030B P/T / EPA 8260B

Blank (7H16009-BLK1)

Prepared & Analyzed: 08/16/07

tert-Amyl methyl ether	ND	0.50	ug/l							
Benzene	ND	0.50	"							
tert-Butyl alcohol	ND	20	"							
Di-isopropyl ether	ND	0.50	"							
1,2-Dibromoethane (EDB)	ND	0.50	"							
1,2-Dichloroethane	ND	0.50	"							
Ethanol	ND	300	"							
Ethyl tert-butyl ether	ND	0.50	"							
Ethylbenzene	ND	0.50	"							
Methyl tert-butyl ether	ND	0.50	"							
Toluene	ND	0.50	"							
Xylenes (total)	ND	0.50	"							
<i>Surrogate: Dibromofluoromethane</i>	2.42		"	2.50		97	75-120			
<i>Surrogate: 1,2-Dichloroethane-d4</i>	2.75		"	2.50		110	60-125			
<i>Surrogate: Toluene-d8</i>	2.37		"	2.50		95	80-120			
<i>Surrogate: 4-Bromofluorobenzene</i>	2.35		"	2.50		94	60-135			

Laboratory Control Sample (7H16009-BS1)

Prepared & Analyzed: 08/16/07

tert-Amyl methyl ether	11.2	0.50	ug/l	10.0		112	65-135			
Benzene	10.5	0.50	"	10.0		105	75-120			
tert-Butyl alcohol	200	20	"	200		100	60-135			
Di-isopropyl ether	11.2	0.50	"	10.0		112	70-130			
1,2-Dibromoethane (EDB)	11.6	0.50	"	10.0		116	70-135			
1,2-Dichloroethane	11.4	0.50	"	10.0		114	70-125			
Ethanol	185	300	"	200		93	15-150			
Ethyl tert-butyl ether	11.4	0.50	"	10.0		114	65-130			
Ethylbenzene	10.3	0.50	"	10.0		103	75-120			
Methyl tert-butyl ether	11.5	0.50	"	10.0		115	50-140			
Toluene	10.5	0.50	"	10.0		105	75-120			
Xylenes (total)	31.2	0.50	"	30.0		104	75-130			
<i>Surrogate: Dibromofluoromethane</i>	2.60		"	2.50		104	75-120			
<i>Surrogate: 1,2-Dichloroethane-d4</i>	2.78		"	2.50		111	60-125			
<i>Surrogate: Toluene-d8</i>	2.50		"	2.50		100	80-120			
<i>Surrogate: 4-Bromofluorobenzene</i>	2.24		"	2.50		90	60-135			

Stratus Environmental Inc. [Arco]
3330 Cameron Park Dr., Suite 550
Cameron Park CA, 95682

Project: BP Heritage #11117, Oakland, CA
Project Number: G07TK-0029
Project Manager: Jay Johnson

MQH0368
Reported:
08/28/07 12:17

Volatile Organic Compounds by EPA Method 8260B - Quality Control
TestAmerica - Morgan Hill, CA

Analyte	Result	Reporting Limit	Units	Spike Level	Source Result	%REC	%REC Limits	RPD	RPD Limit	Notes
---------	--------	-----------------	-------	-------------	---------------	------	-------------	-----	-----------	-------

Batch 7H16009 - EPA 5030B P/T / EPA 8260B

Matrix Spike (7H16009-MS1)	Source: MQH0228-04	Prepared & Analyzed: 08/16/07								
tert-Amyl methyl ether	12.4	0.50	ug/l	10.0	ND	124	65-135			
Benzene	11.1	0.50	"	10.0	ND	111	75-120			
tert-Butyl alcohol	213	20	"	200	ND	106	60-135			
Di-isopropyl ether	11.6	0.50	"	10.0	ND	116	70-130			
1,2-Dibromoethane (EDB)	11.6	0.50	"	10.0	ND	116	70-135			
1,2-Dichloroethane	11.1	0.50	"	10.0	ND	111	70-125			
Ethanol	220	300	"	200	ND	110	15-150			
Ethyl tert-butyl ether	11.7	0.50	"	10.0	ND	117	65-130			
Ethylbenzene	10.9	0.50	"	10.0	ND	109	75-120			
Methyl tert-butyl ether	11.6	0.50	"	10.0	ND	116	50-140			
Toluene	11.0	0.50	"	10.0	ND	110	75-120			
Xylenes (total)	33.0	0.50	"	30.0	ND	110	75-130			
Surrogate: Dibromofluoromethane	2.55		"	2.50		102	75-120			
Surrogate: 1,2-Dichloroethane-d4	2.59		"	2.50		104	60-125			
Surrogate: Toluene-d8	2.51		"	2.50		100	80-120			
Surrogate: 4-Bromofluorobenzene	2.62		"	2.50		105	60-135			

Matrix Spike Dup (7H16009-MSD1)	Source: MQH0228-04	Prepared & Analyzed: 08/16/07								
tert-Amyl methyl ether	12.5	0.50	ug/l	10.0	ND	125	65-135	1	25	
Benzene	11.0	0.50	"	10.0	ND	110	75-120	0.6	20	
tert-Butyl alcohol	218	20	"	200	ND	109	60-135	3	25	
Di-isopropyl ether	11.4	0.50	"	10.0	ND	114	70-130	2	25	
1,2-Dibromoethane (EDB)	12.0	0.50	"	10.0	ND	120	70-135	3	30	
1,2-Dichloroethane	11.0	0.50	"	10.0	ND	110	70-125	1	25	
Ethanol	214	300	"	200	ND	107	15-150	3	25	
Ethyl tert-butyl ether	11.7	0.50	"	10.0	ND	117	65-130	0.3	25	
Ethylbenzene	10.7	0.50	"	10.0	ND	107	75-120	2	20	
Methyl tert-butyl ether	11.8	0.50	"	10.0	ND	118	50-140	2	25	
Toluene	11.0	0.50	"	10.0	ND	110	75-120	0.3	25	
Xylenes (total)	32.6	0.50	"	30.0	ND	109	75-130	1	20	
Surrogate: Dibromofluoromethane	2.51		"	2.50		100	75-120			
Surrogate: 1,2-Dichloroethane-d4	2.55		"	2.50		102	60-125			
Surrogate: Toluene-d8	2.50		"	2.50		100	80-120			
Surrogate: 4-Bromofluorobenzene	2.53		"	2.50		101	60-135			

TestAmerica - Morgan Hill, CA

The results in this report apply to the samples analyzed in accordance with the chain of custody document. Unless otherwise stated, results are reported on a wet weight basis. This analytical report must be reproduced in its entirety.

Stratus Environmental Inc. [Arco]
3330 Cameron Park Dr., Suite 550
Cameron Park CA, 95682

Project: BP Heritage #11117, Oakland, CA
Project Number: G07TK-0029
Project Manager: Jay Johnson

MQH0368
Reported:
08/28/07 12:17

Volatile Organic Compounds by EPA Method 8260B - Quality Control
TestAmerica - Morgan Hill, CA

Analyte	Result	Reporting Limit	Units	Spike Level	Source Result	%REC	%REC Limits	RPD	RPD Limit	Notes
---------	--------	-----------------	-------	-------------	---------------	------	-------------	-----	-----------	-------

Batch 7H16018 - EPA 5030B P/T / EPA 8260B

Blank (7H16018-BLK1)

Prepared & Analyzed: 08/16/07

tert-Amyl methyl ether	ND	0.50	ug/l							
Benzene	ND	0.50	"							
tert-Butyl alcohol	ND	20	"							
Di-isopropyl ether	ND	0.50	"							
1,2-Dibromoethane (EDB)	ND	0.50	"							
1,2-Dichloroethane	ND	0.50	"							
Ethanol	ND	300	"							
Ethyl tert-butyl ether	ND	0.50	"							
Ethylbenzene	ND	0.50	"							
Methyl tert-butyl ether	ND	0.50	"							
Toluene	ND	0.50	"							
Xylenes (total)	ND	0.50	"							
<i>Surrogate: Dibromofluoromethane</i>	2.41		"	2.50		96	75-120			
<i>Surrogate: 1,2-Dichloroethane-d4</i>	2.64		"	2.50		106	60-125			
<i>Surrogate: Toluene-d8</i>	2.41		"	2.50		96	80-120			
<i>Surrogate: 4-Bromofluorobenzene</i>	2.42		"	2.50		97	60-135			

Laboratory Control Sample (7H16018-BS1)

Prepared & Analyzed: 08/16/07

tert-Amyl methyl ether	11.4	0.50	ug/l	10.0		114	65-135			
Benzene	10.1	0.50	"	10.0		101	75-120			
tert-Butyl alcohol	194	20	"	200		97	60-135			
Di-isopropyl ether	10.2	0.50	"	10.0		102	70-130			
1,2-Dibromoethane (EDB)	10.9	0.50	"	10.0		109	70-135			
1,2-Dichloroethane	10.2	0.50	"	10.0		102	70-125			
Ethanol	187	300	"	200		94	15-150			
Ethyl tert-butyl ether	10.6	0.50	"	10.0		106	65-130			
Ethylbenzene	9.90	0.50	"	10.0		99	75-120			
Methyl tert-butyl ether	10.6	0.50	"	10.0		106	50-140			
Toluene	10.2	0.50	"	10.0		102	75-120			
Xylenes (total)	30.5	0.50	"	30.0		102	75-130			
<i>Surrogate: Dibromofluoromethane</i>	2.55		"	2.50		102	75-120			
<i>Surrogate: 1,2-Dichloroethane-d4</i>	2.53		"	2.50		101	60-125			
<i>Surrogate: Toluene-d8</i>	2.47		"	2.50		99	80-120			
<i>Surrogate: 4-Bromofluorobenzene</i>	2.26		"	2.50		90	60-135			

TestAmerica - Morgan Hill, CA

The results in this report apply to the samples analyzed in accordance with the chain of custody document. Unless otherwise stated, results are reported on a wet weight basis. This analytical report must be reproduced in its entirety.

Stratus Environmental Inc. [Arco]
3330 Cameron Park Dr., Suite 550
Cameron Park CA, 95682

Project: BP Heritage #11117, Oakland, CA
Project Number: G07TK-0029
Project Manager: Jay Johnson

MQH0368
Reported:
08/28/07 12:17

Volatile Organic Compounds by EPA Method 8260B - Quality Control
TestAmerica - Morgan Hill, CA

Analyte	Result	Reporting Limit	Units	Spike Level	Source Result	%REC	%REC Limits	RPD	RPD Limit	Notes
---------	--------	-----------------	-------	-------------	---------------	------	-------------	-----	-----------	-------

Batch 7H16018 - EPA 5030B P/T / EPA 8260B

Matrix Spike (7H16018-MS1)	Source: MQH0368-02			Prepared & Analyzed: 08/16/07						
tert-Amyl methyl ether	2670	100	ug/l	2000	ND	133	65-135			
Benzene	7840	100	"	2000	5650	109	75-120			
tert-Butyl alcohol	45900	4000	"	40000	4120	104	60-135			
Di-isopropyl ether	2350	100	"	2000	ND	118	70-130			
1,2-Dibromoethane (EDB)	2520	100	"	2000	ND	126	70-135			
1,2-Dichloroethane	2350	100	"	2000	ND	117	70-125			
Ethanol	40200	60000	"	40000	ND	100	15-150			
Ethyl tert-butyl ether	2460	100	"	2000	ND	123	65-130			
Ethylbenzene	6730	100	"	2000	5700	52	75-120			LN,AY
Methyl tert-butyl ether	5590	100	"	2000	2940	133	50-140			
Toluene	9990	100	"	2000	7730	113	75-120			
Xylenes (total)	23600	100	"	6000	20700	48	75-130			BB
<i>Surrogate: Dibromofluoromethane</i>	2.62		"	2.50		105	75-120			
<i>Surrogate: 1,2-Dichloroethane-d4</i>	2.72		"	2.50		109	60-125			
<i>Surrogate: Toluene-d8</i>	2.52		"	2.50		101	80-120			
<i>Surrogate: 4-Bromofluorobenzene</i>	2.27		"	2.50		91	60-135			

Matrix Spike Dup (7H16018-MSD1)	Source: MQH0368-02			Prepared: 08/16/07 Analyzed: 08/17/07						
tert-Amyl methyl ether	2480	100	ug/l	2000	ND	124	65-135	7	25	
Benzene	7630	100	"	2000	5650	99	75-120	3	20	LN,AY
tert-Butyl alcohol	42500	4000	"	40000	4120	96	60-135	8	25	
Di-isopropyl ether	2320	100	"	2000	ND	116	70-130	1	25	
1,2-Dibromoethane (EDB)	2210	100	"	2000	ND	110	70-135	13	30	
1,2-Dichloroethane	2180	100	"	2000	ND	109	70-125	7	25	
Ethanol	40900	60000	"	40000	ND	102	15-150	2	25	
Ethyl tert-butyl ether	2320	100	"	2000	ND	116	65-130	6	25	
Ethylbenzene	6710	100	"	2000	5700	50	75-120	0.4	20	LN,AY
Methyl tert-butyl ether	5140	100	"	2000	2940	110	50-140	9	25	
Toluene	9560	100	"	2000	7730	91	75-120	4	25	
Xylenes (total)	23000	100	"	6000	20700	37	75-130	3	20	BB
<i>Surrogate: Dibromofluoromethane</i>	2.59		"	2.50		104	75-120			
<i>Surrogate: 1,2-Dichloroethane-d4</i>	2.56		"	2.50		102	60-125			
<i>Surrogate: Toluene-d8</i>	2.51		"	2.50		100	80-120			
<i>Surrogate: 4-Bromofluorobenzene</i>	2.27		"	2.50		91	60-135			

TestAmerica - Morgan Hill, CA

The results in this report apply to the samples analyzed in accordance with the chain of custody document. Unless otherwise stated, results are reported on a wet weight basis. This analytical report must be reproduced in its entirety.

Stratus Environmental Inc. [Arco]
3330 Cameron Park Dr., Suite 550
Cameron Park CA, 95682

Project: BP Heritage #11117, Oakland, CA
Project Number: G07TK-0029
Project Manager: Jay Johnson

MQH0368
Reported:
08/28/07 12:17

Volatile Organic Compounds by EPA Method 8260B - Quality Control
TestAmerica - Morgan Hill, CA

Analyte	Result	Reporting Limit	Units	Spike Level	Source Result	%REC	%REC Limits	RPD	RPD Limit	Notes
---------	--------	-----------------	-------	-------------	---------------	------	-------------	-----	-----------	-------

Batch 7H17010 - EPA 5030B P/T / EPA 8260B

Blank (7H17010-BLK1)

Prepared & Analyzed: 08/17/07

tert-Amyl methyl ether	ND	0.50	ug/l							
Benzene	ND	0.50	"							
tert-Butyl alcohol	ND	20	"							
Di-isopropyl ether	ND	0.50	"							
1,2-Dibromoethane (EDB)	ND	0.50	"							
1,2-Dichloroethane	ND	0.50	"							
Ethanol	ND	300	"							
Ethyl tert-butyl ether	ND	0.50	"							
Ethylbenzene	ND	0.50	"							
Methyl tert-butyl ether	ND	0.50	"							
Toluene	ND	0.50	"							
Xylenes (total)	ND	0.50	"							
<i>Surrogate: Dibromofluoromethane</i>	2.54		"	2.50		102	75-120			
<i>Surrogate: 1,2-Dichloroethane-d4</i>	2.98		"	2.50		119	60-125			
<i>Surrogate: Toluene-d8</i>	2.39		"	2.50		96	80-120			
<i>Surrogate: 4-Bromofluorobenzene</i>	2.34		"	2.50		94	60-135			

Laboratory Control Sample (7H17010-BS1)

Prepared & Analyzed: 08/17/07

tert-Amyl methyl ether	12.1	0.50	ug/l	10.0		121	65-135			
Benzene	10.2	0.50	"	10.0		102	75-120			
tert-Butyl alcohol	201	20	"	200		100	60-135			
Di-isopropyl ether	11.0	0.50	"	10.0		110	70-130			
1,2-Dibromoethane (EDB)	11.4	0.50	"	10.0		114	70-135			
1,2-Dichloroethane	11.2	0.50	"	10.0		112	70-125			
Ethanol	198	300	"	200		99	15-150			
Ethyl tert-butyl ether	11.2	0.50	"	10.0		112	65-130			
Ethylbenzene	9.86	0.50	"	10.0		99	75-120			
Methyl tert-butyl ether	11.3	0.50	"	10.0		113	50-140			
Toluene	10.3	0.50	"	10.0		103	75-120			
Xylenes (total)	30.5	0.50	"	30.0		102	75-130			
<i>Surrogate: Dibromofluoromethane</i>	2.55		"	2.50		102	75-120			
<i>Surrogate: 1,2-Dichloroethane-d4</i>	2.75		"	2.50		110	60-125			
<i>Surrogate: Toluene-d8</i>	2.48		"	2.50		99	80-120			
<i>Surrogate: 4-Bromofluorobenzene</i>	2.29		"	2.50		92	60-135			

TestAmerica - Morgan Hill, CA

The results in this report apply to the samples analyzed in accordance with the chain of custody document. Unless otherwise stated, results are reported on a wet weight basis. This analytical report must be reproduced in its entirety.

Stratus Environmental Inc. [Arco]
3330 Cameron Park Dr., Suite 550
Cameron Park CA, 95682

Project: BP Heritage #11117, Oakland, CA
Project Number: G07TK-0029
Project Manager: Jay Johnson

MQH0368
Reported:
08/28/07 12:17

Volatile Organic Compounds by EPA Method 8260B - Quality Control
TestAmerica - Morgan Hill, CA

Analyte	Result	Reporting Limit	Units	Spike Level	Source Result	%REC	%REC Limits	RPD	RPD Limit	Notes
---------	--------	-----------------	-------	-------------	---------------	------	-------------	-----	-----------	-------

Batch 7H17010 - EPA 5030B P/T / EPA 8260B

Matrix Spike (7H17010-MS1)	Source: MQH0400-13			Prepared & Analyzed: 08/17/07						
tert-Amyl methyl ether	12.9	0.50	ug/l	10.0	ND	129	65-135			
Benzene	10.6	0.50	"	10.0	ND	106	75-120			
tert-Butyl alcohol	200	20	"	200	ND	100	60-135			
Di-isopropyl ether	11.5	0.50	"	10.0	ND	115	70-130			
1,2-Dibromoethane (EDB)	12.4	0.50	"	10.0	ND	124	70-135			
1,2-Dichloroethane	12.0	0.50	"	10.0	ND	120	70-125			
Ethanol	204	300	"	200	ND	102	15-150			
Ethyl tert-butyl ether	11.9	0.50	"	10.0	ND	119	65-130			
Ethylbenzene	9.94	0.50	"	10.0	ND	99	75-120			
Methyl tert-butyl ether	12.4	0.50	"	10.0	ND	124	50-140			
Toluene	10.3	0.50	"	10.0	ND	103	75-120			
Xylenes (total)	30.0	0.50	"	30.0	ND	100	75-130			
Surrogate: Dibromofluoromethane	2.71		"	2.50		108	75-120			
Surrogate: 1,2-Dichloroethane-d4	2.88		"	2.50		115	60-125			
Surrogate: Toluene-d8	2.53		"	2.50		101	80-120			
Surrogate: 4-Bromofluorobenzene	2.29		"	2.50		92	60-135			

Matrix Spike Dup (7H17010-MSD1)	Source: MQH0400-13			Prepared: 08/17/07 Analyzed: 08/18/07						
tert-Amyl methyl ether	13.4	0.50	ug/l	10.0	ND	134	65-135	4	25	
Benzene	10.8	0.50	"	10.0	ND	108	75-120	2	20	
tert-Butyl alcohol	203	20	"	200	ND	101	60-135	1	25	
Di-isopropyl ether	12.1	0.50	"	10.0	ND	121	70-130	5	25	
1,2-Dibromoethane (EDB)	12.6	0.50	"	10.0	ND	126	70-135	2	30	
1,2-Dichloroethane	12.3	0.50	"	10.0	ND	123	70-125	2	25	
Ethanol	208	300	"	200	ND	104	15-150	2	25	
Ethyl tert-butyl ether	12.4	0.50	"	10.0	ND	124	65-130	4	25	
Ethylbenzene	9.96	0.50	"	10.0	ND	100	75-120	0.2	20	
Methyl tert-butyl ether	13.0	0.50	"	10.0	ND	130	50-140	5	25	
Toluene	10.5	0.50	"	10.0	ND	105	75-120	2	25	
Xylenes (total)	30.1	0.50	"	30.0	ND	100	75-130	0.4	20	
Surrogate: Dibromofluoromethane	2.65		"	2.50		106	75-120			
Surrogate: 1,2-Dichloroethane-d4	3.03		"	2.50		121	60-125			
Surrogate: Toluene-d8	2.54		"	2.50		102	80-120			
Surrogate: 4-Bromofluorobenzene	2.33		"	2.50		93	60-135			

Stratus Environmental Inc. [Arco]
3330 Cameron Park Dr., Suite 550
Cameron Park CA, 95682

Project: BP Heritage #11117, Oakland, CA
Project Number: G07TK-0029
Project Manager: Jay Johnson

MQH0368
Reported:
08/28/07 12:17

Volatile Organic Compounds by EPA Method 8260B - Quality Control
TestAmerica - Morgan Hill, CA

Analyte	Result	Reporting Limit	Units	Spike Level	Source Result	%REC	%REC Limits	RPD	RPD Limit	Notes
---------	--------	-----------------	-------	-------------	---------------	------	-------------	-----	-----------	-------

Batch 7H23006 - EPA 5030B P/T / EPA 8260B

Blank (7H23006-BLK1)										
										Prepared & Analyzed: 08/23/07
tert-Amyl methyl ether	ND	0.50	ug/l							
Benzene	ND	0.50	"							
tert-Butyl alcohol	ND	20	"							
Di-isopropyl ether	ND	0.50	"							
1,2-Dibromoethane (EDB)	ND	0.50	"							
1,2-Dichloroethane	ND	0.50	"							
Ethanol	ND	300	"							
Ethyl tert-butyl ether	ND	0.50	"							
Ethylbenzene	ND	0.50	"							
Methyl tert-butyl ether	ND	0.50	"							
Toluene	ND	0.50	"							
Xylenes (total)	ND	0.50	"							
<i>Surrogate: Dibromofluoromethane</i>	2.61		"	2.50		104	75-120			
<i>Surrogate: 1,2-Dichloroethane-d4</i>	2.57		"	2.50		103	60-125			
<i>Surrogate: Toluene-d8</i>	2.36		"	2.50		94	80-120			
<i>Surrogate: 4-Bromofluorobenzene</i>	2.27		"	2.50		91	60-135			

Laboratory Control Sample (7H23006-BS1)										
										Prepared & Analyzed: 08/23/07
tert-Amyl methyl ether	7.97	0.50	ug/l	10.0		80	65-135			
Benzene	8.54	0.50	"	10.0		85	75-120			
tert-Butyl alcohol	219	20	"	200		110	60-135			
Di-isopropyl ether	9.20	0.50	"	10.0		92	70-130			
1,2-Dibromoethane (EDB)	8.38	0.50	"	10.0		84	70-135			
1,2-Dichloroethane	9.12	0.50	"	10.0		91	70-125			
Ethanol	180	300	"	200		90	15-150			
Ethyl tert-butyl ether	9.11	0.50	"	10.0		91	65-130			
Ethylbenzene	9.88	0.50	"	10.0		99	75-120			
Methyl tert-butyl ether	8.20	0.50	"	10.0		82	50-140			
Toluene	8.82	0.50	"	10.0		88	75-120			
Xylenes (total)	30.4	0.50	"	30.0		101	75-130			
<i>Surrogate: Dibromofluoromethane</i>	2.14		"	2.50		86	75-120			
<i>Surrogate: 1,2-Dichloroethane-d4</i>	1.96		"	2.50		78	60-125			
<i>Surrogate: Toluene-d8</i>	2.44		"	2.50		98	80-120			
<i>Surrogate: 4-Bromofluorobenzene</i>	2.49		"	2.50		100	60-135			

TestAmerica - Morgan Hill, CA

The results in this report apply to the samples analyzed in accordance with the chain of custody document. Unless otherwise stated, results are reported on a wet weight basis. This analytical report must be reproduced in its entirety.

Stratus Environmental Inc. [Arco]
3330 Cameron Park Dr., Suite 550
Cameron Park CA, 95682

Project: BP Heritage #11117, Oakland, CA
Project Number: G07TK-0029
Project Manager: Jay Johnson

MQH0368
Reported:
08/28/07 12:17

Volatile Organic Compounds by EPA Method 8260B - Quality Control
TestAmerica - Morgan Hill, CA

Analyte	Result	Reporting Limit	Units	Spike Level	Source Result	%REC	%REC Limits	RPD	RPD Limit	Notes
---------	--------	-----------------	-------	-------------	---------------	------	-------------	-----	-----------	-------

Batch 7H23006 - EPA 5030B P/T / EPA 8260B

Laboratory Control Sample Dup (7H23006-BSD1)

Prepared & Analyzed: 08/23/07

tert-Amyl methyl ether	8.13	0.50	ug/l	10.0		81	65-135	2	25	
Benzene	8.52	0.50	"	10.0		85	75-120	0.2	20	
tert-Butyl alcohol	192	20	"	200		96	60-135	13	25	
Di-isopropyl ether	8.23	0.50	"	10.0		82	70-130	11	25	
1,2-Dibromoethane (EDB)	8.52	0.50	"	10.0		85	70-135	2	30	
1,2-Dichloroethane	8.53	0.50	"	10.0		85	70-125	7	25	
Ethanol	201	300	"	200		100	15-150	11	25	
Ethyl tert-butyl ether	8.01	0.50	"	10.0		80	65-130	13	25	
Ethylbenzene	8.65	0.50	"	10.0		86	75-120	13	20	
Methyl tert-butyl ether	8.50	0.50	"	10.0		85	50-140	4	25	
Toluene	9.05	0.50	"	10.0		90	75-120	3	25	
Xylenes (total)	25.6	0.50	"	30.0		85	75-130	17	20	
<i>Surrogate: Dibromofluoromethane</i>	2.24		"	2.50		90	75-120			
<i>Surrogate: 1,2-Dichloroethane-d4</i>	2.07		"	2.50		83	60-125			
<i>Surrogate: Toluene-d8</i>	2.46		"	2.50		98	80-120			
<i>Surrogate: 4-Bromofluorobenzene</i>	2.27		"	2.50		91	60-135			

Matrix Spike (7H23006-MS1)

Source: MQH0556-03

Prepared & Analyzed: 08/23/07

tert-Amyl methyl ether	10.3	0.50	ug/l	10.0	ND	103	65-135			
Benzene	9.93	0.50	"	10.0	ND	99	75-120			
tert-Butyl alcohol	224	20	"	200	30.3	97	60-135			
Di-isopropyl ether	10.4	0.50	"	10.0	ND	104	70-130			
1,2-Dibromoethane (EDB)	10.2	0.50	"	10.0	ND	102	70-135			
1,2-Dichloroethane	9.95	0.50	"	10.0	ND	100	70-125			
Ethanol	178	300	"	200	ND	89	15-150			
Ethyl tert-butyl ether	10.6	0.50	"	10.0	ND	106	65-130			
Ethylbenzene	8.96	0.50	"	10.0	ND	90	75-120			
Methyl tert-butyl ether	10.2	0.50	"	10.0	ND	102	50-140			
Toluene	9.96	0.50	"	10.0	ND	100	75-120			
Xylenes (total)	27.6	0.50	"	30.0	ND	92	75-130			
<i>Surrogate: Dibromofluoromethane</i>	2.44		"	2.50		98	75-120			
<i>Surrogate: 1,2-Dichloroethane-d4</i>	2.39		"	2.50		96	60-125			
<i>Surrogate: Toluene-d8</i>	2.65		"	2.50		106	80-120			
<i>Surrogate: 4-Bromofluorobenzene</i>	2.39		"	2.50		96	60-135			

TestAmerica - Morgan Hill, CA

The results in this report apply to the samples analyzed in accordance with the chain of custody document. Unless otherwise stated, results are reported on a wet weight basis. This analytical report must be reproduced in its entirety.

Stratus Environmental Inc. [Arco]
3330 Cameron Park Dr., Suite 550
Cameron Park CA, 95682

Project: BP Heritage #11117, Oakland, CA
Project Number: G07TK-0029
Project Manager: Jay Johnson

MQH0368
Reported:
08/28/07 12:17

Volatile Organic Compounds by EPA Method 8260B - Quality Control
TestAmerica - Morgan Hill, CA

Analyte	Result	Reporting Limit	Units	Spike Level	Source Result	%REC	%REC Limits	RPD	RPD Limit	Notes
---------	--------	-----------------	-------	-------------	---------------	------	-------------	-----	-----------	-------

Batch 7H23006 - EPA 5030B P/T / EPA 8260B

Matrix Spike Dup (7H23006-MSD1)	Source: MQH0556-03	Prepared & Analyzed: 08/23/07								
tert-Amyl methyl ether	9.74	0.50	ug/l	10.0	ND	97	65-135	6	25	
Benzene	9.10	0.50	"	10.0	ND	91	75-120	9	20	
tert-Butyl alcohol	248	20	"	200	30.3	109	60-135	10	25	
Di-isopropyl ether	9.87	0.50	"	10.0	ND	99	70-130	6	25	
1,2-Dibromoethane (EDB)	10.2	0.50	"	10.0	ND	102	70-135	0.5	30	
1,2-Dichloroethane	9.00	0.50	"	10.0	ND	90	70-125	10	25	
Ethanol	194	300	"	200	ND	97	15-150	9	25	
Ethyl tert-butyl ether	10.8	0.50	"	10.0	ND	108	65-130	2	25	
Ethylbenzene	9.23	0.50	"	10.0	ND	92	75-120	3	20	
Methyl tert-butyl ether	9.21	0.50	"	10.0	ND	92	50-140	11	25	
Toluene	8.19	0.50	"	10.0	ND	82	75-120	20	25	
Xylenes (total)	26.0	0.50	"	30.0	ND	86	75-130	6	20	
Surrogate: Dibromofluoromethane	2.33		"	2.50		93	75-120			
Surrogate: 1,2-Dichloroethane-d4	2.47		"	2.50		99	60-125			
Surrogate: Toluene-d8	2.11		"	2.50		84	80-120			
Surrogate: 4-Bromofluorobenzene	2.34		"	2.50		94	60-135			

Stratus Environmental Inc. [Arco]
3330 Cameron Park Dr., Suite 550
Cameron Park CA, 95682

Project: BP Heritage #11117, Oakland, CA
Project Number: G07TK-0029
Project Manager: Jay Johnson

MQH0368
Reported:
08/28/07 12:17

Notes and Definitions

LN,AY MS and/or MSD below acceptance limits. See Blank Spike(LCS). Matrix interference suspected.
BB Sample > 4x spike concentration
DET Analyte DETECTED
ND Analyte NOT DETECTED at or above the reporting limit or MDL, if MDL is specified
NR Not Reported
dry Sample results reported on a dry weight basis
RPD Relative Percent Difference



bp
A BP affiliated company

Chain of Custody Record

Project Name: ARCO 11117
 BP BU/AR Region/Enfos Segment: BP > Americas > West > Retail > Alameda > 11117
 State or Lead Regulatory Agency:
 Requested Due Date (mm/dd/yy): STD - TAY

On-site Time: <u>0830</u>	Temp: <u>low 70's</u>
Off-site Time: <u>1530</u>	Temp: <u>70's</u>
Sky Conditions: <u>clear</u>	
Meteorological Events:	
Wind Speed: <u>—</u>	Direction: <u>—</u>

Lab Name: TestAmerica	BP/AR Facility No.: 11117	Consultant/Contractor: Stratus Environmental, Inc.
Address: 885 Jarvis Drive	BP/AR Facility Address: 7210 Bancroft, Oakland	Address: 3330 Cameron Park Drive, Suite 550
Morgan Hill, CA 95937	Site Lat/Long:	Cameron Park, CA 95682
Lab PM: Lisa Race	California Global ID No.: T0600100201	Consultant/Contractor Project No.:
Tele/Fax: 408-782-8156 408-782-6308 (fax)	Enfos Project No.: G07TK-0029	Consultant/Contractor PM: Jay Johnson
BP/AR PM Contact: Paul Supple	Provision or OOC (circle one) Provision	Tele/Fax: (530) 676-6000 / (530) 676-6005
Address: 2010 Crow Canyon Place, Suite 150	Phase/WBS: 04-Monitoring	Report Type & QC Level: Level I with EDF
San Ramon, CA	Sub Phase/Task: 03-Analytical	E-mail EDD To: shayes@stratusinc.net
Tele/Fax: 925-275-3506	Cost Element: 01-Contractor labor	Invoice to: Atlantic Richfield Co.

Item No.	Sample Description	Time	Date	Matrix			Laboratory No.	No. of Containers	Preservative					Requested Analysis					Sample Point Lat/Long and Comments *Oxy = MTBE, TAME, ETBE, DIPE, TBA	
				Soil/Solid	Water/Liquid	Air			Unpreserved	H ₂ SO ₄	HNO ₃	HCl	Methanol	GRO/BTEX/Oxy*	1,2-DCA	Ethanol	EDB	DRO		
1	MW-2	1426	08/09	X			MQ40368	3						X	X	X	X			
2	MW-4	1451					02	6												
3	MW-7	1308					03	3												
4	MW-9	1206					04	3												
5	MW-10	1232					05	3												
6	EX-1	1404					06	3												
7	EX-2	1352					07	3												
8																				
9	TB-11117 08092007	0845	08/09	X			08	2												-Hold
10																				

Sampler's Name: <u>David DeMello</u>	Relinquished By / Affiliation: <u>David DeMello / STRATUS</u>	Date: <u>08-10</u>	Time: <u>1435</u>	Accepted By / Affiliation: <u>Cliff Taylor / TAYLOR</u>	Date: <u>8/10/07</u>	Time: <u>1435</u>
Shipment Date: <u>08/09/07</u>	Shipment Method: <u>Reg. Truck</u>	Date: <u>8-10-07</u>	Time: <u>1650</u>	Accepted By / Affiliation: <u>Cliff Taylor</u>	Date: <u>8/10</u>	Time: <u>1650</u>
Shipment Tracking No:		Date: <u>8/10</u>	Time: <u>1940</u>			

Special Instructions: Please cc results to miller@broadbentinc.com

Custody Seals In Place: Yes / No	Temp Blank: Yes / No	Cooler Temp on Receipt: °F/C	Trip Blank: <u>Yes</u> / No	MS/MSD Sample Submitted: Yes / No
----------------------------------	----------------------	------------------------------	-----------------------------	-----------------------------------

TEST AMERICA SAMPLE RECEIPT LOG

CLIENT NAME: Arco 11117
 REC. BY (PRINT) D.V.
 WORKORDER: MO40368

DATE REC'D AT LAB: 8/10/07
 TIME REC'D AT LAB: 1940
 DATE LOGGED IN: 8/11/07

For Regulatory Purposes?
 DRINKING WATER YES / NO
 WASTE WATER YES / NO

CIRCLE THE APPROPRIATE RESPONSE	LAB SAMPLE #	CLIENT ID	CONTAINER DESCRIPTION	PRESERVATIVE	pH	SAMPLE MATRIX	DATE SAMPLED	REMARKS: CONDITION (ETC.)
1. Custody Seal(s) Present / <u>Absent</u> Intact / Broken*								/
2. Chain-of-Custody <u>Present</u> / Absent*								
3. Traffic Reports or Packing List: Present / <u>Absent</u>								
4. Airbill: Airbill / Sticker Present / <u>Absent</u>								
5. Airbill #:								
6. Sample Labels: <u>Present</u> / Absent								
7. Sample IDs: <u>Listed</u> / Not Listed on Chain-of-Custody			see C.O.C					
8. Sample Condition: <u>Intact</u> / Broken* / Leaking*			8/10/07					
			D.V.					
9. Does information on chain-of-custody, traffic reports and sample labels agree? <u>Yes</u> / No*								
10. Sample received within hold time? <u>Yes</u> / No*								
11. Adequate sample volume received? <u>Yes</u> / No*								
12. Proper preservatives used? <u>Yes</u> / No*								
13. Trip Blank / Temp Blank Received? (circle which, if yes) <u>Yes</u> / No*								
14. Read Temp: <u>2-3°</u> Corrected Temp: <u>✓</u> Is corrected temp 4 +/-2°C? <u>Yes</u> / No**								

(Acceptance range for samples requiring thermal pres.)
 **Exception (if any): METALS / DFF ON ICE
 or Problem COC

*IF CIRCLED, CONTACT PROJECT MANAGER AND ATTACH RECORD OF RESOLUTION.

APPENDIX B

GEOTRACKER UPLOAD CONFIRMATION

Electronic Submittal Information

[Main Menu](#) | [View/Add Facilities](#) | [Upload EDD](#) | [Check EDD](#)

UPLOADING A GEO_WELL FILE

Processing is complete. No errors were found!
Your file has been successfully submitted!

Submittal Title:	3Q07 GEO_WELL 11117
Facility Global ID:	T0600100201
Facility Name:	BP #11117
Submittal Date/Time:	10/8/2007 10:46:00 AM
Confirmation Number:	3173708856

[Back to Main Menu](#)

Logged in as BROADBENT-C
(CONTRACTOR)

CONTACT SITE [ADMINISTRATOR](#).

Electronic Submittal Information

[Main Menu](#) | [View/Add Facilities](#) | [Upload EDD](#) | [Check EDD](#)

Your EDF file has been successfully uploaded!

Confirmation Number: 8448518037

Date/Time of Submittal: 10/8/2007 10:42:12 AM

Facility Global ID: T0600100201

Facility Name: BP #11117

Submittal Title: 3Q07 GW Monitoring

Submittal Type: GW Monitoring Report

[Click here](#) to view the detections report for this upload.

BP #11117 7210 BANCROFT OAKLAND, CA 94605	Regional Board - Case #: 01-0215 SAN FRANCISCO BAY RWQCB (REGION 2) Local Agency (lead agency) - Case #: RO0000356 ALAMEDA COUNTY LOP - (SP)
--	---

<u>CONF #</u>	<u>TITLE</u>	<u>QUARTER</u>
8448518037	3Q07 GW Monitoring	Q3 2007
<u>SUBMITTED BY</u>	<u>SUBMIT DATE</u>	<u>STATUS</u>
Broadbent & Associates, Inc.	10/8/2007	PENDING REVIEW

SAMPLE DETECTIONS REPORT

# FIELD POINTS SAMPLED	7
# FIELD POINTS WITH DETECTIONS	7
# FIELD POINTS WITH WATER SAMPLE DETECTIONS ABOVE MCL	5
SAMPLE MATRIX TYPES	WATER

METHOD QA/QC REPORT

METHODS USED	8260FA,8260TPH
TESTED FOR REQUIRED ANALYTES?	Y
LAB NOTE DATA QUALIFIERS	Y

QA/QC FOR 8021/8260 SERIES SAMPLES

TECHNICAL HOLDING TIME VIOLATIONS	0
METHOD HOLDING TIME VIOLATIONS	0
LAB BLANK DETECTIONS ABOVE REPORTING DETECTION LIMIT	0
LAB BLANK DETECTIONS	0
DO ALL BATCHES WITH THE 8021/8260 SERIES INCLUDE THE FOLLOWING?	
- LAB METHOD BLANK	Y
- MATRIX SPIKE	N
- MATRIX SPIKE DUPLICATE	N
- BLANK SPIKE	Y
- SURROGATE SPIKE	Y

WATER SAMPLES FOR 8021/8260 SERIES

MATRIX SPIKE / MATRIX SPIKE DUPLICATE(S) % RECOVERY BETWEEN 65-135%	Y
MATRIX SPIKE / MATRIX SPIKE DUPLICATE(S) RPD LESS THAN 30%	Y
SURROGATE SPIKES % RECOVERY BETWEEN 85-115%	N
BLANK SPIKE / BLANK SPIKE DUPLICATES % RECOVERY BETWEEN 70-130%	Y

SOIL SAMPLES FOR 8021/8260 SERIES

MATRIX SPIKE / MATRIX SPIKE DUPLICATE(S) % RECOVERY BETWEEN 65-135% n/a
MATRIX SPIKE / MATRIX SPIKE DUPLICATE(S) RPD LESS THAN 30% n/a
SURROGATE SPIKES % RECOVERY BETWEEN 70-125% n/a
BLANK SPIKE / BLANK SPIKE DUPLICATES % RECOVERY BETWEEN 70-130% n/a

FIELD QC SAMPLES

<u>SAMPLE</u>	<u>COLLECTED</u>	<u>DETECTIONS > REPD</u>
QCTB SAMPLES	N	0
QCEB SAMPLES	N	0
QCAB SAMPLES	N	0