



1704 Via Riata, Roseville, CA 95747
April 27, 2004

Tel: (916) 771-7098, FAX : (916) 771-4584

Mr. Richard Hiett
California Regional Water Quality Control Board
San Francisco Bay Region
1515 Clay Street, Suite 1400
Oakland, CA 94612

Subject: Quarterly Ground Water Monitoring Report, First Half 2004
Former Beacon Station No. 12574
22315 Redwood Road
Castro Valley, California
RDM Project No. 00-12574

10/213/04
Munoz
(BC)

Alameda County
MAY 13 2004
Environmental Health

Dear Mr. Hiett:

RDM Environmental (RDM) has been authorized by Ultramar Inc. to perform ground water monitoring oversight for the subject site. This report describes ground water monitoring activities conducted during the **First Half 2004**.

Work Performed During the First Half 2004:

- Doulos Environmental, Inc. conducted quarterly monitoring activities on **March 23, 2004**.

STATUS OF GROUND WATER MONITORING

Cumulative ground water sampling information is tabulated in Table 1. A site topographic map, site map, ground water elevation contour map and a concentration map are shown as Figures 1 through 4, respectively. The site history is included in Enclosure A, the monitoring data sheets are included in Enclosure B, the analytical results are included in Enclosure C and the historical ground water monitoring data is included in Enclosure D.

- Historical ground water flow direction is to the southwest.

CONCLUSIONS/RECOMMENDATIONS

Based on the March 2004 sampling results and historical ground water data, RDM recommends the ground water monitoring events continue on a semi-annual basis.

The interpretations contained in this report represent our professional opinions and are based, in part, on information supplied by the client. These opinions are based on currently available information and are

Mr. Richard Hiatt
California Regional Water Quality Control Board
San Francisco Bay Region
April 27, 2004
Page 2

arrived at in accordance with currently accepted hydrogeologic and engineering practices at this time and location. Other than this, no warranty is implied or intended.

If you have any questions concerning this project, please contact Richard Munsch at (916) 771-7098.

RDM ENVIRONMENTAL



Richard D. Munsch
Project Manager



Michael G. Lee, P.E.
California Registered Civil Engineer No. C055795

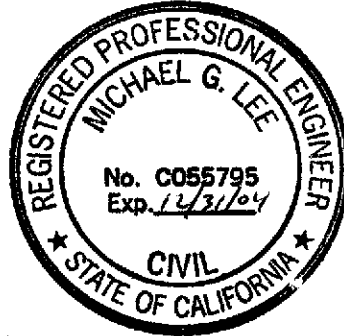

RDM (12574 1Q GWM 3-23-04.doc)

cc: Mr. Steve Coodey - Ultramar, Inc.
Mr. Amir K. Gholami - Alameda County Department of Environmental Health
Mr. Bill Courtney - Property Manager

Enclosures:

- Enclosure A: Site Background Information
- Enclosure B: Ground Water Sampling Information
- Enclosure C: Ground Water Monitoring Analytical Results
- Enclosure D: Historical Ground Water Monitoring Data

TABLE 1

GROUND WATER MONITORING DATA

Former Beacon Station
 No. 12574
 22315 Redwood Road
 Castro Valley, California

Monitoring Well	Date	Reference Elevation (ft)	Depth to Ground Water (ft)	Ground Water Elevation (ft)	Benzene (µg/L)	Toluene (µg/L)	Ethyl-benzene (µg/L)	Total Xylenes (µg/L)	TPH as gasoline (µg/L)	MTBE (µg/L)	Comments
MW-1	02/11/02	158.70	22.58	136.12	7,600	160	1,600	4,200	41,000	640	
	08/21/02		23.18	135.52	2,000	31	220	510	7,400	270	
	03/04/03		22.43	136.27	6,000	130	1,300	2,900	30,000	490	
	09/09/03		23.02	135.68	3,900	69	760	1,700	18,000	390	
	03/23/04		21.97	136.73	4,500	89	1,000	2,000	24,000	410	
MW-2	02/11/02	157.33	21.03	136.30	3,100	270	690	1,600	17,000	660	
	08/21/02		21.60	135.73	1,600	44	290	260	6,800	440	
	03/04/03		20.86	136.47	3,400	200	590	1,100	20,000	670	
	09/09/03		21.45	135.88	3,200	120	630	940	19,000	630	
	03/23/04		20.41	136.92	3,200	110	640	740	18,000	580	
MW-3	02/11/02	159.23	21.55	137.68	NS	NS	NS	NS	NS	NS	
	08/21/02		22.00	137.23	NS	NS	NS	NS	NS	NS	
	03/04/03		21.48	137.75	NS	NS	NS	NS	NS	NS	
	09/09/03		21.84	137.39	NS	NS	NS	NS	NS	NS	
	03/23/04		20.82	138.41	NS	NS	NS	NS	NS	NS	
MW-4	02/11/02	154.13	16.81	137.32	NS	NS	NS	NS	NS	NS	
	08/21/02		17.58	136.55	NS	NS	NS	NS	NS	NS	
	03/04/03		16.70	137.43	NS	NS	NS	NS	NS	NS	
	09/09/03		17.48	136.65	NS	NS	NS	NS	NS	NS	
	03/23/04		16.35	137.78	NS	NS	NS	NS	NS	NS	
MW-5	02/11/02	150.73	15.70	135.03	NS	NS	NS	NS	NS	NS	
	08/21/02		16.17	134.56	NS	NS	NS	NS	NS	NS	
	03/04/03		15.46	135.27	NS	NS	NS	NS	NS	NS	
	09/09/03		16.05	134.68	NS	NS	NS	NS	NS	NS	
	03/23/04		14.88	135.85	NS	NS	NS	NS	NS	NS	

Environmental Health Services
 MAY 13 2004
 Alameda County

TABLE 1

GROUND WATER MONITORING DATA

Former Beacon Station
 No. 12574
 22315 Redwood Road
 Castro Valley, California

Monitoring Well	Date	Reference Elevation (ft)	Depth to Ground Water (ft)	Ground Water Elevation (ft)	Benzene (µg/L)	Toluene (µg/L)	Ethyl-benzene (µg/L)	Total Xylenes (µg/L)	TPH as gasoline (µg/L)	MTBE (µg/L)	Comments
MW-6	02/11/02	156.11	20.78	135.33	NS	NS	NS	NS	NS	NS	
	08/21/02		21.41	134.70	NS	NS	NS	NS	NS	NS	
	03/04/03		20.64	135.47	NS	NS	NS	NS	NS	NS	
	09/09/03		21.23	134.88	NS	NS	NS	NS	NS	NS	
	03/23/04		20.21	135.90	NS	NS	NS	NS	NS	NS	

TPH = Total petroleum hydrocarbons.

MTBE = Methyl tertiary butyl ether.

NA = Not analyzed

ND = Not detected at or above the laboratory reporting limit.

NS = Not sampled

µg/L = Micrograms per liter.

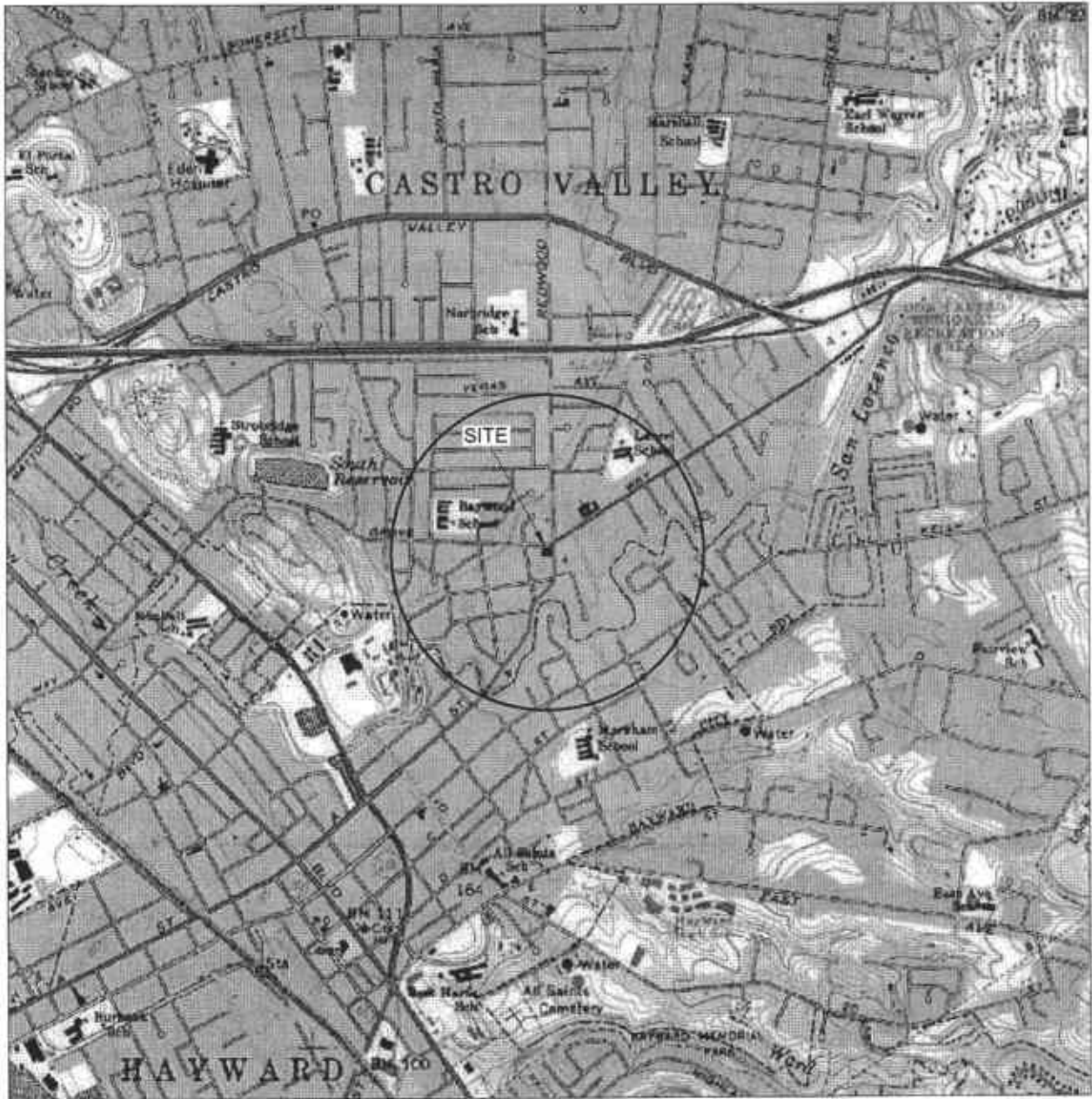

T.3 S.

R.2 W.

GENERAL NOTES:
 BASE MAP FROM U.S.G.S.
 HAYWARD, CA.
 7.5 MINUTE TOPOGRAPHIC
 PHOTOREVISED 1980



QUADRANGLE LOCATION

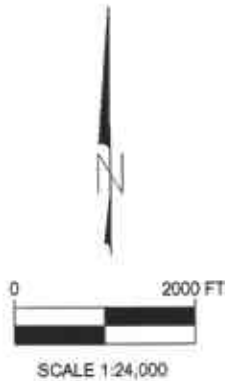

FIGURE 1
 SITE LOCATION MAP

FORMER BEACON STATION NO. 12574
 22315 REDWOOD ROAD
 CASTRO VALLEY, CA.

PROJECT NO. 00-12574	DRAWN BY M.L. 4/12/02
FILE NO. 12574 Topo	PREPARED BY RDM
REVISION NO. 1	REVIEWED BY



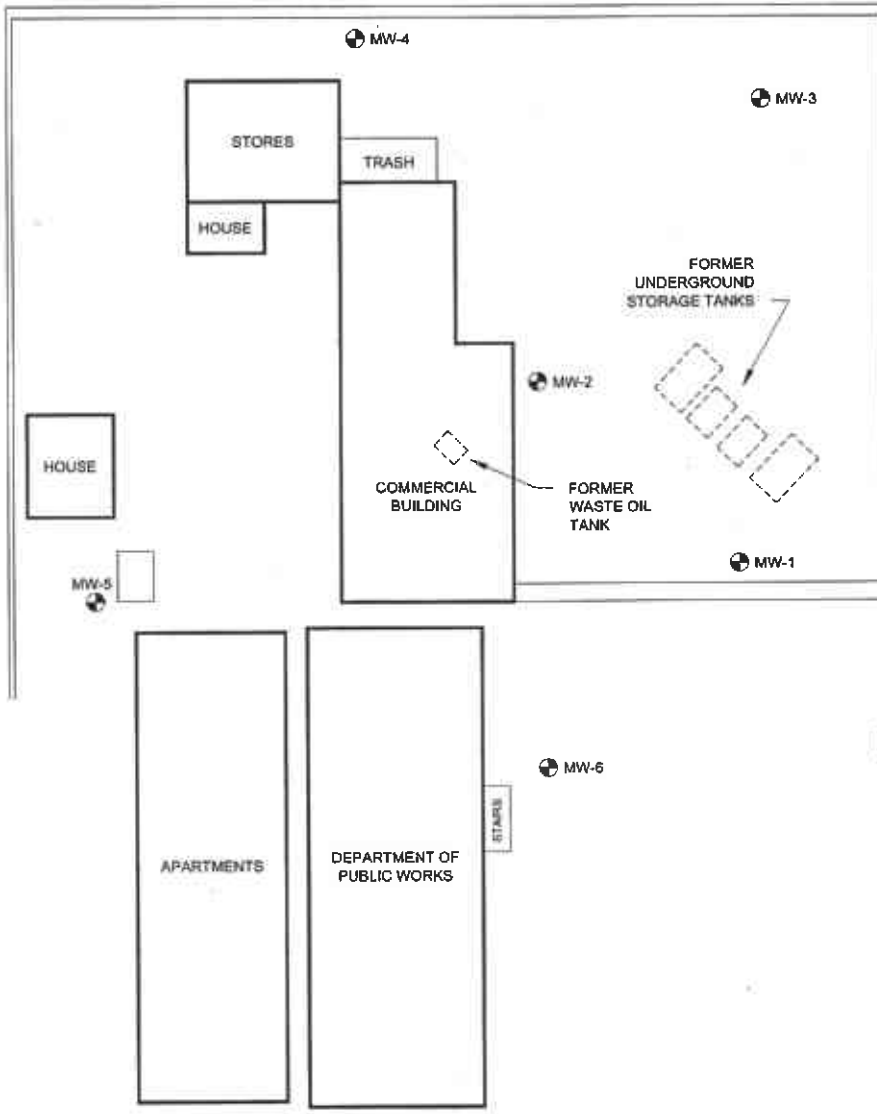

GROVE WAY

MW-8



LEGEND:

-  MW-1 MONITORING WELL LOCATION
-  MW-8 ABANDONED MONITORING WELL LOCATION



APPROX SCALE

FIGURE 2
SITE MAP

FORMER BEACON STATION NO. 12574
22315 REDWOOD ROAD
CASTRO VALLEY, CA.

PROJECT NO. 00-12574	DRAWN BY M.L. 4/12/02
FILE NO. 12574 Site	PREPARED BY RDM
REVISION NO. 1	REVIEWED BY



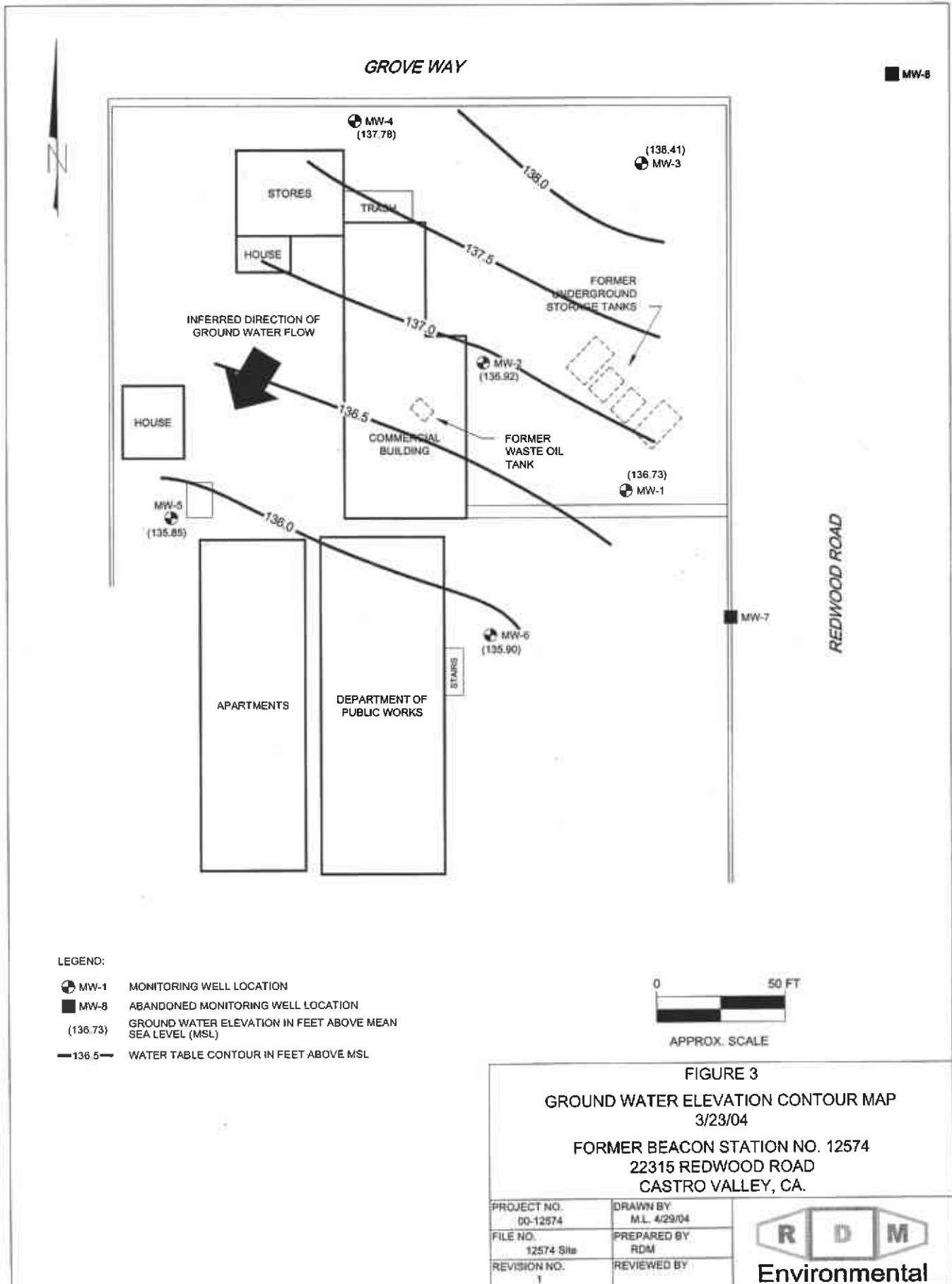

GROVE WAY

MW-8

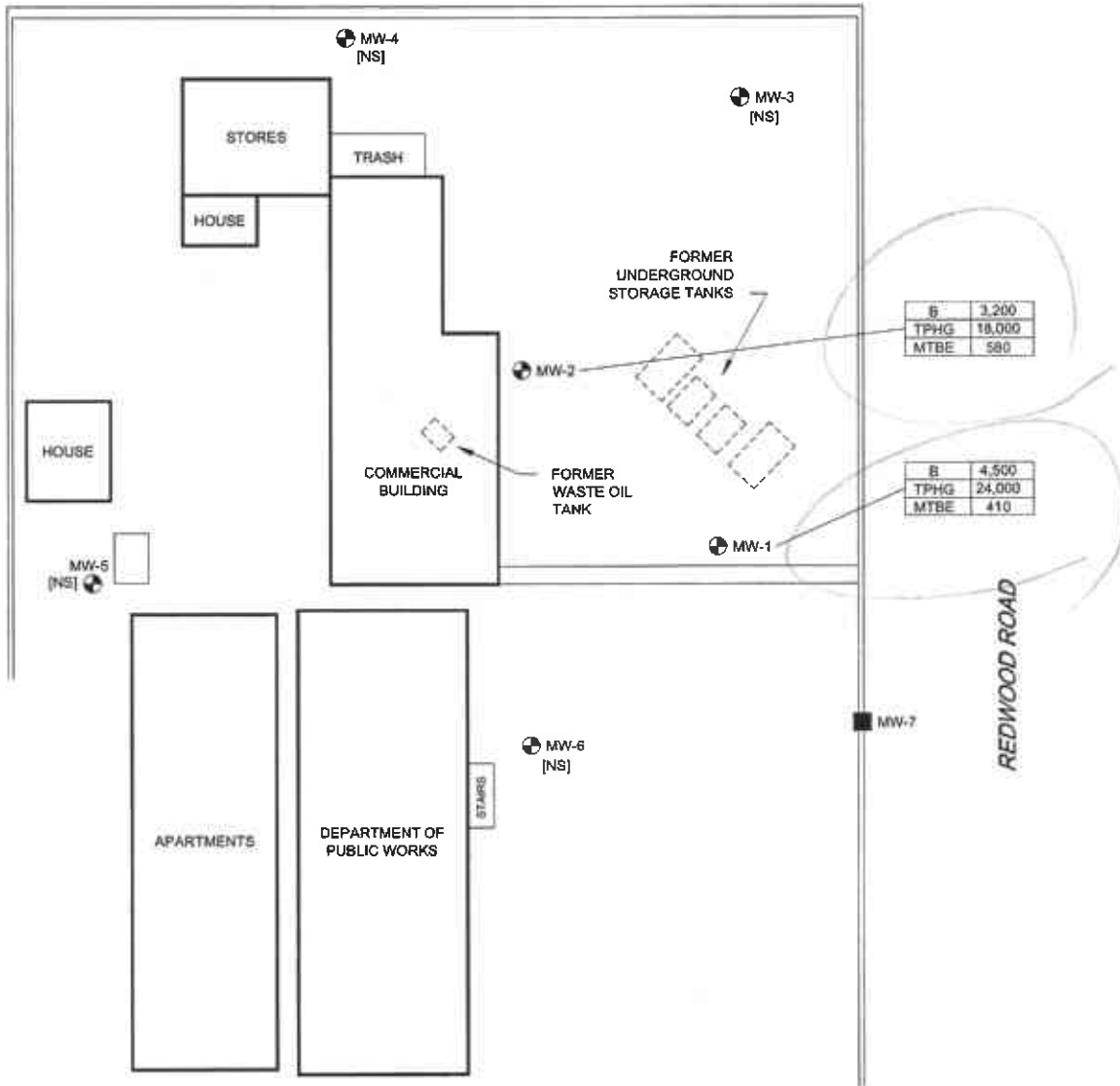

LEGEND:

- MW-1 MONITORING WELL LOCATION
- MW-8 ABANDONED MONITORING WELL LOCATION

B	4,500	BENZENE CONCENTRATION IN MICROGRAMS PER LITER (ug/L)
TPHG	24,000	TOTAL PETROLEUM HYDROCARBONS AS GASOLINE IN ug/L
MTBE	410	METHYL TERTIARY BUTYL ETHER IN ug/L
NS		NOT SAMPLED

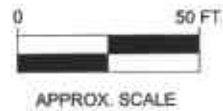

FIGURE 4
GROUNDWATER ANALYTICAL SUMMARY
3/23/04
FORMER BEACON STATION NO. 12574
22315 REDWOOD ROAD
CASTRO VALLEY, CA.

PROJECT NO. 00-12574	DRAWN BY M.L. 4/29/04
FILE NO. 12574-Site	PREPARED BY RDM
REVISION NO. 1	REVIEWED BY



Historical Background Information

Former Beacon No. 12574
22315 Redwood Road
Castro Valley, California

Ultramar Inc.

- On May 5, 1987, five underground storage tanks (two gasoline, two diesel and one waste oil) were excavated and removed from the site. Soil samples were collected from beneath the tanks and analyzed for hydrocarbon constituents. It was determined that gasoline and diesel were present in the soil beneath the former fuel tanks. Soil was over-excavated to the depth of groundwater. Most soil samples collected after the over-excavation confirmed removal of impacted soil. A sample collected from the over-excavation northeast of the former tanks contained petroleum hydrocarbons at a concentration of 1989 parts per million. No further excavation was conducted.
- During March 1991, three groundwater monitoring wells were installed on-site. Laboratory analysis of soil samples obtained from monitoring well borings indicated that soil had been impacted in the vicinity of former USTs (these USTs were no longer present when Beacon operated the station) to the depth of groundwater, where it then apparently spread across the site and impacted soil immediately above groundwater.
- In May 1993, five ground water monitoring wells were installed. With the installation of these new wells the extent of impacted groundwater was defined.
- During the first quarter 1994, a soil gas survey/performance test, aquifer pump test, and air sparging was conducted.
- During the fourth quarter 1994, a PAR/RAP was submitted. The consultant concluded that further assessment and remediation were not necessary. It was recommended that groundwater monitoring continue.
- In December 1996, a Risk-Based Corrective Action (RBCA) assessment was prepared and submitted to the County. Correspondence prepared by the County in May 1997, and July 1998, requested further RBCA analyses. A *Supplement to Risk-Based Corrective Action Tier 1 and Tier 2 Analyses* was completed in March 1999.
- In September 1998, monitoring wells MW-7 and MW-8 were abandoned, as required by the Alameda County Department of Public Works.
- In July 1999, the property owner had a geophysical survey completed, which concluded that additional USTs were not present at the site.
- In January 2002, RDM Environmental was contracted by Ultramar Inc. to continue environmental oversight of the site.

ENCLOSURE B

Ground Water Sampling Information

DOULOS ENVIRONMENTAL, INC.
 GROUNDWATER/LIQUID LEVEL DATA
 (measurements in feet)

Project Address: Beacon # 12574 22315 Redwood Rd.
Castro Valley, Ca.

Date: 3-23-04

Project No.: 12574-25

Recorded by: _____

Well No.	Time	Well Elev. TOC	Depth to Groundwater	Measured Total Depth	Groundwater Elevation	Depth to Product	Product Thickness	Comments
MW-1	10:46		21.97	29.73				
MW-2	10:40		20.41	29.50				
MW-3	10:35		20.82	29.46				
MW-4	10:50		16.35	24.71				
MW-5	10:57		14.88	29.60				
MW-6	10:30		20.21	27.99				

Notes:

DOULOS ENVIRONMENTALS, INC.

SAMPLING INFORMATION SHEET

Client: Ultramar

Sampling Date: 3-23-04

Site: Beacon #12574

Project No.: _____

22315 Redwood Rd.

Well Designation: MW-2

Castro Valley, Ca.

Is setup of traffic control devices required? YES NO

Is there standing water in the well box? YES NO

Is top of casing cut level? YES NO

Is well cap sealed and locked? YES NO

time: _____ hours

Above TOC _____ Below TOC _____

If no, see remarks

If no, see remarks

Height of well casing riser (in inches): 3

Well cover type: 8" or 12" UV 12" EMCO _____ 8" or 12" BK _____ 8" Christy _____

12" Christy _____ 8" M&D _____ 12" M&D _____ 12" DWP _____

12" CNI _____ 36" CNI _____ 12" Pomoco _____ Other: _____

General condition of wellhead assembly: Excellent _____ Good Fair _____ Poor _____

Purging Equipment: _____ 2" disposable bailer _____ Submersible pump

_____ 2" PVC bailer _____ Dedicated bailer

_____ 4" PVC bailer Centrifugal pump

Sampled with: Disposable bailer Teflon bailer _____ Disposable Tubing _____

Well Diameter: 2" _____ 4" 6" _____ 8" _____

Purge Vol. Multiplier: 0.16 _____ 0.65 _____ 1.47 _____ 2.61 gal/ft.

Initial Measurement

Recharge Measurement

Time: 10:40

Time: 12:20 Calculated purge: 23.6

Depth of well: 29.50

Depth to water: 21.60 Actual purge: 23.6

Depth to water: 20.41

Start purge: 11:22

Sampling time: 12:26

Time	Temperature	E.C.	pH	Turbidity	Volume
11:25	67.8	609	7.45		1
11:30	69.0	590	7.35		2
11:34	69.3	517	7.22		3
11:41	69.5	510	7.19		4

Sample appearance: Clear

Lock: Dolphin

Equipment replaced: (check all that apply)

Note condition of replaced item(s)

2" Locking Cap: _____

Lock: _____ 7/32 Allenhead: _____

4" Locking Cap: _____

Lock-Dolphin: _____ 9/16 Bolt: _____

6" Locking Cap: _____

Pinned Allenhead (DWP): _____

Remarks: _____

Signature: _____

DOULOS ENVIRONMENTALS, INC.

SAMPLING INFORMATION SHEET

Client: Ultramar
 Site: Beacon #12574
22315 Redwood Rd.
Castro Valley, Ca.

Sampling Date: 3-23-04
 Project No.: _____
 Well Designation: MW-1

Is setup of traffic control devices required? NO YES
 Is there standing water in the well box? NO YES
 Is top of casing cut level? NO YES
 Is well cap sealed and locked? NO YES
 Height of well casing riser (in inches): 3
 Well cover type: 8" or 12" UV 12" EMCO _____ 8" or 12" BK _____ 8" Christy _____
 12" Christy _____ 8" M&D _____ 12" M&D _____ 12" DWP _____
 12" CNI _____ 36" CNI _____ 12" Pomeco _____ Other: _____
 General condition of wellhead assembly: Excellent _____ Good Fair _____ Poor _____

time: _____ hours
 Above TOC _____ Below TOC
 If no, see remarks
 If no, see remarks

Purging Equipment: _____ 2" disposable bailer _____ Submersible pump
 _____ 2" PVC bailer _____ Dedicated bailer
 _____ 4" PVC bailer _____ Centrifugal pump
 Sampled with: Disposable bailer Teflon bailer _____ Disposable Tubing _____

Well Diameter: 2" _____ 4" 6" _____ 8" _____
 Purge Vol. Multiplier: _____ 0.16 _____ 0.65 _____ 1.47 _____ 2.61 gal/ft.
Initial Measurement Recharge Measurement
 Time: 10:46 Time: 12:10 Calculated purge: 20.1
 Depth of well: 29.73 Depth to water: 23.06 Actual purge: 20.1
 Depth to water: 21.97

Start purge: 10:50 Sampling time: 12:13

Time	Temperature	E.C.	pH	Turbidity	Volume
10:54	68.1	590	7.21		1
10:59	68.5	517	7.16		2
11:02	67.1	510	7.04		3
11:10	67.3	505	7.03		4

Sample appearance: Clear Lock: Dolphin

Equipment replaced: (check all that apply) Note condition of replaced item(s)
 2" Locking Cap: _____ Lock: _____ 7/32 Allenhead: _____
 4" Locking Cap: _____ Lock-Dolphin: _____ 9/16 Bolt: _____
 6" Locking Cap: _____ Pinned Allenhead (DWP): _____

Remarks: _____

Signature: _____

ENCLOSURE C

Ground Water Monitoring
Analytical Results



Report Number : 37614

Date : 3/31/2004

Richard Munsch
RDM Environmental
1704 Via Riata
Roseville, CA 95747

Subject : 2 Water Samples
Project Name : Beacon
Project Number : 12574 Castro Valley
P.O. Number : 12574-27

Dear Mr. Munsch,

Chemical analysis of the samples referenced above has been completed. Summaries of the data are contained on the following pages. Sample(s) were received under documented chain-of-custody. US EPA protocols for sample storage and preservation were followed.

Kiff Analytical is certified by the State of California (# 2236). If you have any questions regarding procedures or results, please call me at 530-297-4800.

Sincerely,

A handwritten signature in black ink, appearing to read "Jeff Dahl", is written over a printed name.

Jeff Dahl



Report Number : 37614

Date : 3/31/2004

Project Name : **Beacon**

Project Number : **12574 Castro Valley**

Sample : **MW-1**

Matrix : Water

Lab Number : 37614-01

Sample Date :3/23/2004

Parameter	Measured Value	Method Reporting Limit	Units	Analysis Method	Date Analyzed
Benzene	4500	10	ug/L	EPA 8260B	3/26/2004
Toluene	89	10	ug/L	EPA 8260B	3/26/2004
Ethylbenzene	1000	10	ug/L	EPA 8260B	3/26/2004
Total Xylenes	2000	10	ug/L	EPA 8260B	3/26/2004
Methyl-t-butyl ether (MTBE)	410	10	ug/L	EPA 8260B	3/26/2004
TPH as Gasoline	24000	1000	ug/L	EPA 8260B	3/26/2004
Toluene - d8 (Surr)	99.2		% Recovery	EPA 8260B	3/26/2004
4-Bromofluorobenzene (Surr)	98.6		% Recovery	EPA 8260B	3/26/2004

Sample : **MW-2**

Matrix : Water

Lab Number : 37614-02

Sample Date :3/23/2004

Parameter	Measured Value	Method Reporting Limit	Units	Analysis Method	Date Analyzed
Benzene	3200	10	ug/L	EPA 8260B	3/26/2004
Toluene	110	10	ug/L	EPA 8260B	3/26/2004
Ethylbenzene	640	10	ug/L	EPA 8260B	3/26/2004
Total Xylenes	740	10	ug/L	EPA 8260B	3/26/2004
Methyl-t-butyl ether (MTBE)	580	10	ug/L	EPA 8260B	3/26/2004
TPH as Gasoline	18000	1000	ug/L	EPA 8260B	3/26/2004
Toluene - d8 (Surr)	99.5		% Recovery	EPA 8260B	3/26/2004
4-Bromofluorobenzene (Surr)	98.0		% Recovery	EPA 8260B	3/26/2004

Approved By:  Jeff Dahl

Report Number : 37614

Date : 3/31/2004

QC Report : Method Blank Data

Project Name : **Beacon**

Project Number : **12574 Castro Valley**

<u>Parameter</u>	<u>Measured Value</u>	<u>Method Reporting Limit</u>	<u>Units</u>	<u>Analysis Method</u>	<u>Date Analyzed</u>
Benzene	< 0.50	0.50	ug/L	EPA 8260B	3/25/2004
Toluene	< 0.50	0.50	ug/L	EPA 8260B	3/25/2004
Ethylbenzene	< 0.50	0.50	ug/L	EPA 8260B	3/25/2004
Total Xylenes	< 0.50	0.50	ug/L	EPA 8260B	3/25/2004
Methyl-t-butyl ether (MTBE)	< 5.0	5.0	ug/L	EPA 8260B	3/25/2004
TPH as Gasoline	< 50	50	ug/L	EPA 8260B	3/25/2004
Toluene - dB (Surr)	98.0		%	EPA 8260B	3/25/2004
4-Bromofluorobenzene (Surr)	104		%	EPA 8260B	3/25/2004

<u>Parameter</u>	<u>Measured Value</u>	<u>Method Reporting Limit</u>	<u>Units</u>	<u>Analysis Method</u>	<u>Date Analyzed</u>
------------------	-----------------------	-------------------------------	--------------	------------------------	----------------------

KIFF ANALYTICAL, LLC

2795 2nd St, Suite 300 Davis, CA 95616 530-297-4800

Approved By: Jeff Dahl



Report Number : 37614

Date : 3/31/2004

QC Report : Matrix Spike/ Matrix Spike Duplicate

Project Name : **Beacon**

Project Number : **12574 Castro Valley**

Parameter	Spiked Sample	Sample Value	Spike Level	Spike Dup. Level	Spiked Sample Value	Duplicate Spiked Sample Value	Units	Analysis Method	Date Analyzed	Spiked Sample Percent Recov.	Duplicate Spiked Sample Percent Recov.	Relative Percent Diff.	Spiked Sample Percent Recov. Limit	Relative Percent Diff. Limit
Benzene	37623-03	<0.50	39.8	40.0	39.5	39.9	ug/L	EPA 8260B	3/25/04	99.3	99.7	0.409	70-130	25
Toluene	37623-03	<0.50	39.8	40.0	40.8	40.7	ug/L	EPA 8260B	3/25/04	103	102	0.940	70-130	25
Tert-Butanol	37623-03	<5.0	199	200	206	204	ug/L	EPA 8260B	3/25/04	104	102	1.43	70-130	25
Methyl-t-Butyl Ether	37623-03	0.81	39.8	40.0	41.2	41.3	ug/L	EPA 8260B	3/25/04	102	101	0.580	70-130	25

KIFF ANALYTICAL, LLC

2795 2nd St, Suite 300 Davis, CA 95616 530-297-4800

Approved By:  Jeff Dahl

Report Number : 37614

Date : 3/31/2004

QC Report : Laboratory Control Sample (LCS)

Project Name : **Beacon**

Project Number : **12574 Castro Valley**

Parameter	Spike Level	Units	Analysis Method	Date Analyzed	LCS Percent Recov.	LCS Percent Recov. Limit
Benzene	40.0	ug/L	EPA 8260B	3/25/04	99.4	70-130
Toluene	40.0	ug/L	EPA 8260B	3/25/04	101	70-130
Tert-Butanol	200	ug/L	EPA 8260B	3/25/04	101	70-130
Methyl-t-Butyl Ether	40.0	ug/L	EPA 8260B	3/25/04	102	70-130

KIFF ANALYTICAL, LLC

Approved By:  Jeff Dahl

2795 2nd St, Suite 300 Davis, CA 95616 530-297-4800



Analysis Summary

Report Number : 37614

Date : 3/31/2004

Attention : Richard Munsch
RDM Environmental
1704 Via Riata
Roseville, CA 95747

Project Name : Beacon
Project Number : 12574 Castro Valley

Sample Name		MW-1			MW-2	
Sample Date		3/23/2004			3/23/2004	
Analyte	Method	Units	MRL	Results	MRL	Results
Benzene	EPA 8260B	ug/L	10	4500	10	3200
Toluene	EPA 8260B	ug/L	10	89	10	110
Ethylbenzene	EPA 8260B	ug/L	10	1000	10	640
Total Xylenes	EPA 8260B	ug/L	10	2000	10	740
Methyl-t-butyl ether (MTBE)	EPA 8260B	ug/L	10	410	10	580
TPH as Gasoline	EPA 8260B	ug/L	1000	24000	1000	18000
Toluene - d8 (Surr)	EPA 8260B	%		99.2		99.5
4-Bromofluorobenzene (Surr)	EPA 8260B	%		98.6		98.0

MRL = Method Reporting Limit

ND = Not Detected

Approved By,

Jeff Dahl

2795 2nd St., Suite 300 Davis, CA 95616 530-297-4800

ELAP # 2236



2795 2nd Street, Suite 300
 Davis, CA 95616
 Lab: 530.297.4800
 Fax: 530.297.4808

Lab No. 37614 Page 1 of 1

Project Contact (Hardcopy or PDF to): Richard Munsch		EDF Report? <input checked="" type="checkbox"/> Yes <input type="checkbox"/> No
Company/Address: RDM		Recommended but not mandatory to complete this section: Sampling Company Log Code: DEIO
Phone No.: 771-7096	FAX No.: 771-4584	Global ID: T0600100155
Project Number: 12574 Castro Valley	P.O. No.: 12574-27	EDF Deliverable to (Email Address): rmunsch@rcsis.com
Project Name: Beacon		Project Address: Castro Valley

Chain-of-Custody Record and Analysis Request

Analysis Request

Sampler Signature (below): Edgar Quintanilla	Sampling		40 ml VOA	SLEEVE	Container				Preservative				Matrix		BTEX (8021B)	BTEX/TPH Gas/MTBE (8021B/M8015)	TPH as Diesel (M8015)	TPH as Motor Oil (M8015)	TPH Gas/BTEX/MTBE (8260B)	5 Oxygenates/TPH Gas/BTEX (8260B)	7 Oxygenates/TPH Gas/BTEX (8260B)	5 Oxygenates (8260B)	7 Oxygenates (8260B)	Lead Scav. (1,2 DCA & 1,2 EDB - 8280B)	EPA 8280B (Full List)	Volatile Halocarbons (EPA 8260B)	Lead (7421/239.2) TOTAL (X) W.E.T. (X)	TAT
	Date	Time					HCl	HNO ₃	ICE	NONE	WATER	SOIL																

Sample Designation	Date	Time	40 ml VOA	SLEEVE	Container	HCl	HNO ₃	ICE	NONE	WATER	SOIL	BTEX (8021B)	BTEX/TPH Gas/MTBE (8021B/M8015)	TPH as Diesel (M8015)	TPH as Motor Oil (M8015)	TPH Gas/BTEX/MTBE (8260B)	5 Oxygenates/TPH Gas/BTEX (8260B)	7 Oxygenates/TPH Gas/BTEX (8260B)	5 Oxygenates (8260B)	7 Oxygenates (8260B)	Lead Scav. (1,2 DCA & 1,2 EDB - 8280B)	EPA 8280B (Full List)	Volatile Halocarbons (EPA 8260B)	Lead (7421/239.2) TOTAL (X) W.E.T. (X)	TAT	
MW-1	3-23-04	12:13	3			X		X		X			X													START
MW-2	✓	12:26	3			✓		✓		X			X													6 02

Relinquished by: <i>[Signature]</i>	Date	Time	Received by: _____	Remarks:
Relinquished by: _____	Date	Time	Received by: _____	
Relinquished by: _____	Date	Time	Received by Laboratory: <i>N. [Signature] / KIFF ANALYTICAL</i>	
			Bill to: JOE ALDRIDGE	

Distribution: White - Lab, Pink - Originator

ENCLOSURE D

Historical Ground Water Monitoring
Data

Table 2
Cumulative Groundwater Elevation Data
Former Beacon Station # 12574 - Castro Valley, California

Well ID	Top of Casing Elevation (Feet) ¹	Date Sounded	Depth to Groundwater (Feet) ¹	Groundwater Elevation (Feet) ²	Well Depth (Feet)
MW-1	156.55	03/27/92	22.43	134.12	-
		06/04/92	23.40	133.15	-
		09/23/92	24.07	132.48	-
		11/12/92	24.16	132.39	29.33
		02/02/93	21.87	134.68	29.80
		05/07/93	22.58	133.97	29.84
		05/18/93	22.66	133.89	-
		08/11/93	23.41	133.14	29.81
		11/05/93	24.09	132.46	29.81
		03/01/94	22.76	133.79	29.85
		06/02/94	23.24	133.31	29.85
		09/09/94	23.93	132.62	29.86
		12/20/94	22.94	133.61	29.85
		03/08/95	22.20	134.35	29.71
		06/14/95	22.65	133.90	29.70
		09/26/95	23.44	133.11	29.71
		12/27/95	23.04	133.51	29.72
		03/26/96	21.39	135.16	29.71
		06/05/96	22.43	134.12	29.73
		09/16/96	24.42	132.13	29.74
		12/02/96	23.14	133.41	29.75
		03/10/97	22.30	134.25	29.76
		06/12/97	22.97	133.58	29.76
		09/29/97	23.35	133.20	29.78
		12/01/97	22.73	133.82	29.79
		03/19/98	20.56	135.99	29.78
		05/28/98	21.78	134.77	29.76
		08/31/98	22.64	133.91	29.78
		12/08/98	22.87	133.68	29.76
		02/17/99	21.53	135.02	29.75
		06/10/99	22.74	133.81	29.74
09/07/99	23.06	133.49	29.73		
12/13/00	23.06	133.46	29.74		
3/16/00	20.66	135.89	29.75		
6/12/00	22.53	134.02	29.76		
9/5/00	22.73	133.82	29.74		
11/13/00	23.20	133.35	29.74		
2/26/01	21.75	134.80	29.73		
6/12/01	22.70	133.85	29.73		
9/21/01	23.40	133.15	29.73		
MW-2	155.17	03/27/92	20.82	134.35	-
		06/04/92	21.81	133.36	-
		09/23/92	22.45	132.72	-
		11/12/92	22.60	132.57	29.71

Table 2
Cumulative Groundwater Elevation Data
Former Beacon Station # 12574 - Castro Valley, California

Well ID	Top of Casing Elevation (Feet) ¹	Date Sounded	Depth to Groundwater (Feet) ¹	Groundwater Elevation (Feet) ²	Well Depth (Feet)
		02/02/93	20.28	134.89	29.73
		05/07/93	20.97	134.20	29.73
		05/18/93	21.06	134.11	-
		08/11/93	21.85	133.32	29.70
		11/05/93	22.32	132.85	29.70
		03/01/94	21.19	133.98	29.68
		06/02/94	21.59	133.58	29.69
		09/09/94	22.33	132.84	29.66
		12/20/94	21.37	133.80	29.65
		03/08/95	20.60	134.57	29.52
		06/14/95	21.04	134.13	29.54
		09/26/95	21.84	133.33	29.53
		12/27/95	21.44	133.73	29.56
		03/26/96	19.81	135.36	29.56
		06/05/96	20.83	134.34	29.59
		09/16/96	21.93	133.24	29.58
		12/02/96	21.54	133.63	29.58
		03/10/97	20.71	134.46	29.58
		06/12/97	21.41	133.76	29.52
		09/29/97	21.26	133.91	29.51
		12/01/97	20.97	134.20	29.50
		03/19/98	18.98	136.19	29.51
		05/28/98	20.22	134.95	29.50
		08/31/98	21.09	134.08	29.51
		12/08/98	21.31	133.86	29.50
		02/17/99	20.02	135.15	29.51
		06/10/99	21.30	133.87	29.50
		09/07/99	21.49	133.68	29.50
		12/13/99	21.52	133.65	29.50
		3/16/00	19.13	136.04	29.50
		6/12/00	20.93	134.24	29.50
		9/5/00	21.15	134.02	29.50
		11/13/00	21.66	133.51	29.50
		2/26/01	20.17	135.00	29.50
		6/12/01	21.15	134.02	29.50
		9/21/01	21.63	133.54	29.50
MW-3	157.13	03/27/92	21.46	135.67	-
		06/04/92	22.34	134.79	-
		09/23/92	22.84	134.29	-
		11/12/92	23.04	134.09	29.55
		02/02/93	21.03	136.10	29.45
		05/07/93	21.59	135.54	29.53
		05/18/93	21.73	135.40	-
		08/11/93	22.31	134.82	29.41
		11/05/93	22.85	134.28	29.41

Table 2
Cumulative Groundwater Elevation Data
Former Beacon Station # 12574 - Castro Valley, California

Well ID	Top of Casing Elevation (Feet) ¹	Date Sounded	Depth to Groundwater (Feet) ¹	Groundwater Elevation (Feet) ²	Well Depth (Feet)
		03/01/94	21.97	135.16	29.55
		06/02/94	22.29	134.84	29.56
		09/09/94	22.91	134.22	29.56
		12/20/94	22.11	135.02	29.54
		03/08/95	21.40	135.73	29.38
		06/14/95	21.80	135.33	29.36
		09/26/95	22.38	134.75	29.37
		12/27/95	22.07	135.06	29.37
		03/26/96	20.73	136.40	29.38
		06/05/96	21.54	135.59	29.40
		09/16/96	22.37	134.76	29.43
		12/02/96	22.35	134.78	29.45
		03/10/97	21.44	135.69	29.47
		06/12/97	21.97	135.16	29.45
		09/29/97	22.30	134.83	29.45
		12/01/97	21.78	135.35	29.46
		03/19/98	19.88	137.25	29.46
		05/28/98	20.91	136.22	29.47
		08/31/98	21.61	135.52	29.47
		12/08/98	21.83	135.30	29.47
		02/17/99	20.81	130.32	29.45
		06/10/99	21.61	135.52	29.45
		09/07/99	21.91	135.22	29.45
		12/13/99	21.93	135.20	29.44
		3/16/00	19.86	137.27	29.46
		6/12/00	21.61	135.52	29.46
		9/5/00	21.54	135.59	29.47
		11/13/00	21.98	135.15	29.46
		2/26/01	20.65	136.48	29.46
		6/12/01	21.70	135.43	29.46
		9/21/01	22.05	135.07	29.46
MW-4	151.96	05/18/93	17.55	134.41	-
		08/11/93	17.50	134.46	28.43
		11/05/93	15.84	136.12	28.43
		03/01/94	17.35	134.61	28.11
		06/02/94	17.68	134.28	28.12
		09/09/94	18.19	133.77	28.13
		12/20/94	17.52	134.44	28.10
		03/08/95	16.82	135.14	27.97
		06/14/95	17.22	134.74	27.97
		09/26/95	17.79	134.17	27.91
		12/27/95	17.47	134.49	27.89
		03/26/96	16.32	135.64	27.89
		06/05/96	17.10	134.86	27.88
		09/16/96	17.85	134.11	27.89

Table 2
Cumulative Groundwater Elevation Data
Former Beacon Station # 12574 - Castro Valley, California

Well ID	Top of Casing Elevation (Feet) ¹	Date Sounded	Depth to Groundwater (Feet) ¹	Groundwater Elevation (Feet) ²	Well Depth (Feet)
		12/02/96	17.59	134.37	27.88
		03/10/97	16.79	135.17	27.89
		06/12/97	17.49	134.47	27.90
		09/29/97	18.33	133.63	27.91
		12/01/97	17.36	134.60	27.90
		03/19/98	15.90	136.06	27.91
		05/28/98	16.34	135.62	27.90
		08/31/98	16.83	135.13	27.90
		12/08/98	17.37	134.59	27.91
		02/17/99	16.49	135.47	27.98
		06/10/99	17.63	134.33	24.76
		09/07/99	17.80	134.16	24.75
		12/13/99	17.82	134.14	24.73
		3/16/00	15.81	136.15	24.71
		6/12/00	16.64	135.32	24.70
		9/5/00	16.71	135.25	24.70
		11/13/00	17.24	134.72	24.70
		2/26/01	15.83	136.13	24.70
		6/12/01	16.80	135.16	24.70
		9/21/01	17.30	134.66	24.71
MW-5	148.68	05/18/93	15.72	132.96	-
		08/11/93	16.42	132.26	28.43
		11/05/93	16.92	131.76	28.43
		03/01/94	15.54	133.14	28.11
		06/02/94	16.19	132.49	28.12
		09/09/94	16.87	131.81	28.13
		12/20/94	15.87	132.84	28.10
		03/08/95	15.11	133.57	27.97
		06/14/95	15.69	132.99	27.97
		09/26/95	16.46	132.22	27.91
		12/27/95	15.91	132.77	27.89
		03/26/96	14.31	134.37	27.89
		06/05/96	15.43	133.25	27.88
		09/16/96	16.52	132.16	27.89
		12/02/96	16.05	132.63	27.88
		03/10/97	14.80	133.88	27.89
		06/12/97	15.95	132.78	27.90
		09/29/97	16.33	132.35	27.91
		12/01/97	15.48	133.20	27.90
		03/19/98	13.16	135.52	27.91
		05/28/98	14.04	134.64	27.90
		08/31/98	14.81	133.87	27.90
		12/08/98	15.75	132.93	27.91
		02/17/99	14.80	133.88	27.98
		06/10/99	15.54	133.14	24.76

Table 2
Cumulative Groundwater Elevation Data
Former Beacon Station # 12574 - Castro Valley, California

Well ID	Top of Casing Elevation (Feet) ¹	Date Sounded	Depth to Groundwater (Feet) ¹	Groundwater Elevation (Feet) ²	Well Depth (Feet)
		09/07/99	16.01	132.67	24.75
		12/13/99	16.21	132.47	24.73
		3/16/00	14.35	134.33	29.60
		6/12/00	15.21	133.47	29.61
		9/5/00	15.80	132.88	29.60
		11/13/00	16.21	132.47	29.60
		2/26/01	14.71	133.97	29.61
		6/12/01	15.72	132.96	29.60
		9/21/01	16.21	132.47	29.60
MW-6	153.96	05/18/93	20.80	133.16	-
		08/11/93	21.64	132.32	31.15
		11/05/93	22.11	131.85	31.15
		03/01/94	20.80	133.16	29.96
		06/02/94	21.37	132.59	29.98
		09/09/94	22.05	131.91	29.96
		12/20/94	21.06	132.90	29.89
		03/08/95	20.29	133.67	29.67
		06/14/95	20.81	133.15	29.65
		09/26/95	21.62	132.34	29.66
		12/27/95	21.12	132.84	29.63
		03/26/96	19.50	134.46	29.60
		06/05/96	20.56	133.40	29.63
		09/16/96	21.70	132.26	29.65
		12/02/96	21.25	132.71	29.66
		03/10/97	20.16	133.80	29.64
		06/12/97	21.16	132.80	29.62
		09/29/97	21.51	132.45	29.62
		12/01/97	20.89	133.07	29.61
		03/19/98	18.71	135.25	29.60
		05/28/98	19.99	133.97	29.62
		08/31/98	20.81	133.15	29.63
		12/08/98	21.00	132.96	29.64
		02/17/99	19.54	134.42	29.63
		06/10/99	20.74	133.22	27.98
		09/07/99	21.23	132.73	27.98
		12/13/99	21.22	132.74	27.98
		3/16/00	18.79	135.17	27.99
		6/12/00	20.49	133.47	27.99
		9/5/00	20.95	133.01	27.98
		11/13/00	21.44	132.52	27.98
		2/26/01	19.86	134.10	27.99
		6/12/01	20.91	133.05	27.98
		9/21/01	21.22	132.74	27.99
MW-7	156.09	05/18/93	22.64	133.45	-

Table 2
Cumulative Groundwater Elevation Data
Former Beacon Station # 12574 - Castro Valley, California

Well ID	Top of Casing Elevation (Feet) ¹	Date Sounded	Depth to Groundwater (Feet) ¹	Groundwater Elevation (Feet) ²	Well Depth (Feet)
		08/11/93	23.25	132.84	30.75
		11/05/93	23.93	132.16	30.75
		03/01/94	22.72	133.37	30.11
		06/02/94	23.22	132.87	30.12
		09/09/94	23.90	132.19	30.12
		12/20/94	22.98	133.11	30.10
		03/08/95	22.14	133.95	29.91
		06/14/95	22.61	133.48	29.91
		09/26/95	23.43	132.66	29.90
		12/27/95	23.01	133.08	29.90
		03/26/96	21.32	134.77	29.87
		06/05/96	22.37	133.72	29.91
		09/16/96	23.51	132.58	29.90
		12/02/96	23.08	133.01	29.91
		03/10/97	21.94	134.15	29.90
		06/12/97	22.96	133.13	29.88
		09/29/97	23.35	132.74	29.87
		12/01/97	22.68	133.41	29.88
		03/19/98	20.52	135.57	29.88
		05/28/98	21.76	134.33	29.88
		08/31/98	22.66	133.43	29.86
		12/08/98 ³			
MW-8	158.04	05/18/93	21.55	136.49	-
		08/11/93	22.43	135.61	34.82
		11/05/93	23.00	135.04	34.82
		03/01/94	22.05	135.99	34.04
		06/02/94	22.29	135.75	34.04
		09/09/94	22.99	135.05	34.04
		12/20/94	22.14	135.90	33.98
		03/08/95	21.25	136.79	34.48
		06/14/95	21.70	136.34	34.49
		09/26/95	22.29	135.75	34.40
		12/27/95	21.96	136.08	34.43
		03/26/96	20.48	137.56	34.42
		06/05/96	21.50	136.54	34.41
		09/16/96	22.38	135.66	34.43
		12/02/96	22.39	135.65	34.42
		03/10/97	20.89	137.16	34.43
		06/12/97	21.80	136.24	34.42
		09/29/97	22.81	135.23	34.40
		12/01/97	21.70	136.34	34.41
		03/19/98	19.35	138.69	34.42
		05/28/98	20.52	137.52	34.41
		08/31/98	21.40	136.64	34.40
		12/08/98 ³			

Table 2
Cumulative Groundwater Elevation Data
Former Beacon Station # 12574 - Castro Valley, California

Well ID	Top of Casing Elevation (Feet)¹	Date Sounded	Depth to Groundwater (Feet)¹	Groundwater Elevation (Feet)²	Well Depth (Feet)
----------------	---	---------------------	--	---	--------------------------

NOTES:

- 1 : Measurement and reference elevation taken from notch/mark on top north side of well casing.
- 2 : Elevation reference to mean sea level.
- Well Depth : Measured from top of casing to bottom of well.
- 3 : Well abandoned.

Table 3
Summary of Groundwater Analytical Results
Former Beacon Station # 12574 - Castro Valley, California

Well ID	Sample Date	TPHg (µg/L)	TPHd (µg/L)	TPHmo (µg/L)	Benzene (µg/L)	Toluene (µg/L)	Ethylbenzene (µg/L)	Xylenes (µg/L)	MTBE (µg/L)
MW-2	9/21/01	23,000	NA	NA	4,600	75	1,200	2,300	450
	03/27/92	18,000	<50	<50	2,400	2,300	870	3,300	-
	06/04/92	14,000	<5,000	NA	1,900	1,700	580	2,300	-
	09/23/92	22,000	NA	NA	2,100	1,500	760	2,900	-
	11/12/92	29,000	NA	NA	2,400	860	540	3,500	-
	02/02/93	24,000	NA	NA	2,700	1,900	590	2,600	-
	05/07/93	19,000	NA	NA	1,800	1,300	460	2,600	-
	08/11/93	23,000	NA	NA	2,300	1,500	550	2,300	-
	11/05/93	30,000	NA	NA	3,100	2,900	860	3,700	-
	03/01/94	13,000	NA	NA	1,500	490	350	1,100	-
	06/02/94	12,000	NA	NA	2,000	790	460	1,300	-
	09/09/94	13,000	NA	NA	1,800	660	440	1,000	-
	12/20/94	16,000	NA	NA	2,300	1,000	650	1,900	-
	03/08/95	16,000	NA	NA	2,200	1,000	550	2,100	-
	06/14/95	NS	NS	NS	NS	NS	NS	NS	-
	09/26/95	18,000	NA	NA	2,500	1,000	770	2,700	-
	12/27/95	NS	NS	NS	NS	NS	NS	NS	-
	03/26/96	33,000	NA	NA	4,200	2,600	1,000	5,000	-
	06/05/96	NS	NS	NS	NS	NS	NS	NS	-
	09/16/96	19,000	NA	NA	2,600	490	560	2,000	940
	12/02/96	NS	NS	NS	NS	NS	NS	NS	NS
	03/10/97	23,000	NA	NA	3,700	870	650	3,000	1,400
	06/12/97	NS	NS	NS	NS	NS	NS	NS	NS
	09/29/97	30,000	NA	NA	4,900	880	990	3,800	1,400
	12/01/97	NS	NS	NS	NS	NS	NS	NS	NS
	03/19/98	72,000	NA	NA	14,000	9,500	2,300	11,000	<1,500
	05/28/98	NS	NS	NS	NS	NS	NS	NS	NS
	08/31/98	29,000	NA	NA	4,900	1,600	960	3,900	890
	12/08/98	NS	NS	NS	NS	NS	NS	NS	NS
	02/17/99	26,000	NA	NA	5,200	930	1,200	4,400	640
	06/10/99	NS	NS	NS	NS	NS	NS	NS	NS
	09/07/99	32,000	NA	NA	5,700	600	1200	3,500	1,100
	12/13/99	NS	NS	NS	NS	NS	NS	NS	NS
3/16/00	38,000	NA	NA	4,900	780	1,100	3,700	870	
6/12/00	NS	NS	NS	NS	NS	NS	NS	NS	
9/5/00	21,000	NA	NA	3,400	490	730	2,200	1,000	
11/13/00	NS	NS	NS	NS	NS	NS	NS	NS	
2/26/01	33,000	NA	NA	5,200	260	1,400	3,200	740	

Table 3
Summary of Groundwater Analytical Results
Former Beacon Station # 12574 - Castro Valley, California

Well ID	Sample Date	TPHg (µg/L)	TPHd (µg/L)	TPHmo (µg/L)	Benzene (µg/L)	Toluene (µg/L)	Ethylbenzene (µg/L)	Xylenes (µg/L)	MTBE (µg/L)
MW-3	6/12/01	NS	NS	NS	NS	NS	NS	NS	NS
	9/21/01	63,000	NA	NA	4,400	180	1,000	2,000	730
	03/27/92	160	<50	<50	9.2	4.8	10	23	-
	06/04/92	120	<50	NA	7.5	2.7	0.5	15	-
	09/23/92	220	NA	NA	8.3	4.3	62	19	-
	11/12/92	230	NA	NA	12	5.5	77	19	-
	02/02/93	86	NA	NA	2.4	0.71	27	6.2	-
	05/07/93	140	NA	NA	2.6	1.2	39	8.4	-
	08/11/93	490	NA	NA	15	8.1	14	37	-
	11/05/93	820	NA	NA	45	24	34	93	-
	03/01/94	410	NA	NA	7.4	2.7	56	10	-
	06/02/94	440	NA	NA	13	4.9	14	31	-
	09/09/94	620	NA	NA	12	4.8	97	20	-
	12/20/94	770	NA	NA	24	11	16	36	-
	03/08/95	300	NA	NA	6.1	0.97	4.8	7.5	-
	06/14/95	NS	NS	NS	NS	NS	NS	NS	-
	09/26/95	130	NA	NA	4.8	1.6	4.8	9.4	-
	12/27/95	NS	NS	NS	NS	NS	NS	NS	-
	03/26/96	<50	NA	NA	<0.50	<0.50	<0.50	<0.50	-
	06/05/96	NS	NS	NS	NS	NS	NS	NS	-
	09/16/96	170	NA	NA	10	2.9	44	15	<5.0
	12/02/96	NS	NS	NS	NS	NS	NS	NS	NS
	03/10/97	84	NA	NA	2.3	<0.50	14	2.6	<5.0
	06/12/97	NS	NS	NS	NS	NS	NS	NS	NS
	09/29/97	740	NA	NA	61	9.8	42	61	<5.0
	12/01/97	NS	NS	NS	NS	NS	NS	NS	NS
	03/19/98	<50	NA	NA	<0.50	<0.50	<0.50	<0.50	<5.0
	05/28/98	NS	NS	NS	NS	NS	NS	NS	NS
	08/31/98	320	NA	NA	6.7	1.0	10	9.3	3.4
	12/08/98	NS	NS	NS	NS	NS	NS	NS	NS
	02/17/99	310	NA	NA	<5.0	8.6	1.8	13	14
	06/10/99	NS	NS	NS	NS	NS	NS	NS	NS
09/07/99	99	NA	NA	4.2	0.51	4.0	3.0	<5.0	
12/13/99	NS	NS	NS	NS	NS	NS	NS	NS	
3/16/00	<50	NA	NA	<0.50	<0.50	<0.50	<0.50	<5.0	
6/12/00	NS	NA	NA	NS	NS	NS	NS	NS	
9/5/00	240	NA	NA	3.0	0.53	9.6	4.0	<5.0	
11/13/00	NS	NA	NA	NS	NS	NS	NS	NS	

Table 3
Summary of Groundwater Analytical Results
Former Beacon Station # 12574 - Castro Valley, California

Well ID	Sample Date	TPHg (µg/L)	TPHd (µg/L)	TPHmo (µg/L)	Benzene (µg/L)	Toluene (µg/L)	Ethyl-benzene (µg/L)	Xylenes (µg/L)	MTBE (µg/L)
MW-4	2/26/01	100	NA	NA	0.84	<0.50	3.5	1.7	0.84
	6/12/01	NS	NS	NS	NS	NS	NS	NS	NS
	8/27/01 ³	-	-	-	-	-	-	-	-
	05/18/93	<50	NA	NA	<0.5	<0.5	<0.5	<0.5	-
	08/11/93	<50	NA	NA	<0.5	<0.5	<0.5	<0.5	-
	11/05/93	<50	NA	NA	<0.5	<0.5	<0.5	<0.5	-
	03/01/94	<50	NA	NA	<0.5	<0.5	<0.5	<0.5	-
	06/02/94	<50	NA	NA	<0.5	<0.5	<0.5	<0.5	-
	09/09/94	<50	NA	NA	<0.5	<0.5	<0.5	<0.5	-
	12/20/94	<50	NA	NA	<0.5	<0.5	<0.5	<0.5	-
	03/08/95	NS	NS	NS	NS	NS	NS	NS	-
	06/14/95	NS	NS	NS	NS	NS	NS	NS	-
	09/26/95	NS	NS	NS	NS	NS	NS	NS	-
	12/27/95	NS	NS	NS	NS	NS	NS	NS	-
	03/26/96	NS	NS	NS	NS	NS	NS	NS	-
	06/05/96	NS	NS	NS	NS	NS	NS	NS	-
	09/16/96	<50	NA	NA	<0.50	<0.50	<0.50	<0.50	<5.0
	12/02/96	NS	NS	NS	NS	NS	NS	NS	NS
	03/10/97	NS	NS	NS	NS	NS	NS	NS	NS
	06/12/97	NS	NS	NS	NS	NS	NS	NS	NS
	09/29/97	NS	NS	NS	NS	NS	NS	NS	NS
	12/01/97	NS	NS	NS	NS	NS	NS	NS	NS
	03/19/98	NS	NS	NS	NS	NS	NS	NS	NS
	05/28/98	NS	NS	NS	NS	NS	NS	NS	NS
	08/31/98	NS	NS	NS	NS	NS	NS	NS	NS
	12/08/98	NS	NS	NS	NS	NS	NS	NS	NS
	02/17/99	NS	NS	NS	NS	NS	NS	NS	NS
	06/10/99	NS	NS	NS	NS	NS	NS	NS	NS
	09/07/99	NS	NS	NS	NS	NS	NS	NS	NS
	12/13/99	NS	NS	NS	NS	NS	NS	NS	NS
	3/16/00	NS	NS	NS	NS	NS	NS	NS	NS
	6/12/00	NS	NS	NS	NS	NS	NS	NS	NS
9/5/00	NS	NS	NS	NS	NS	NS	NS	NS	
11/13/00	NS	NS	NS	NS	NS	NS	NS	NS	
2/26/01	NS	NS	NS	NS	NS	NS	NS	NS	
6/12/01	NS	NS	NS	NS	NS	NS	NS	NS	
8/27/01 ³	-	-	-	-	-	-	-	-	-
MW-5	05/18/93	<50	NA	NA	<0.5	<0.5	<0.5	<0.5	-
	08/11/93	<50	NA	NA	<0.5	<0.5	<0.5	<0.5	-

Table 3
Summary of Groundwater Analytical Results
Former Beacon Station # 12574 - Castro Valley, California

Well ID	Sample Date	TPHg (µg/L)	TPHd (µg/L)	TPHmo (µg/L)	Benzene (µg/L)	Toluene (µg/L)	Ethylbenzene (µg/L)	Xylenes (µg/L)	MTBE (µg/L)
	11/05/93	<50	NA	NA	<0.5	<0.5	<0.5	<0.5	-
	03/01/94	<50	NA	NA	<0.5	<0.5	<0.5	<0.5	-
	06/02/94	<50	NA	NA	<0.5	<0.5	<0.5	<0.5	-
	09/09/94	<50	NA	NA	<0.5	<0.5	<0.5	<0.5	-
MW-5	12/20/94	<50	NA	NA	<0.5	<0.5	<0.5	<0.5	-
(cont.)	03/08/95	<50	NA	NA	<0.5	<0.5	<0.5	<0.5	-
	06/14/95	<50	NA	NA	<0.5	<0.5	<0.5	<0.5	-
	09/26/95	<50	NA	NA	<0.50	<0.50	<0.50	<0.50	-
	12/27/95	<50	NA	NA	<0.50	<0.50	<0.50	<0.50	-
	03/26/96	<50	NA	NA	<0.50	<0.50	<0.50	<0.50	-
	06/05/96	<50	NA	NA	<0.50	<0.50	<0.50	<0.50	15
	09/16/96	<50	NA	NA	<0.50	<0.50	<0.50	<0.50	20
	12/02/96	<50	NA	NA	<0.50	<0.50	<0.50	<0.50	12
	03/10/97	<50	NA	NA	<0.50	<0.50	<0.50	<0.50	7.0
	06/12/97	<50	NA	NA	<0.50	<0.50	<0.50	<0.50	7.2
	09/29/97	<50	NA	NA	<0.50	<0.50	<0.50	<0.50	<5.0
	12/01/97	<50	NA	NA	<0.50	<0.50	<0.50	<0.50	<5.0
	03/19/98	<50	NA	NA	<0.50	<0.50	<0.50	<0.50	<5.0
	05/28/98	<50	NA	NA	<0.50	<0.50	<0.50	<0.50	<5.0
	08/31/98	<50	NA	NA	<0.50	<0.50	<0.50	<0.50	<0.50
	12/08/98	<50	NA	NA	<0.50	<0.50	<0.50	<0.50	<5.0
	02/17/99	<50	NA	NA	<0.50	<0.50	<0.50	<0.50	<5.0
	06/10/99	<50	NA	NA	<0.50	<0.50	<0.50	<0.50	<5.0
	09/07/99	<50	NA	NA	<0.50	<0.50	<0.50	<0.50	<5.0
	12/13/99	<50	NA	NA	<0.50	<0.50	<0.50	<0.50	<5.0
	3/16/00	<50	NA	NA	<0.50	<0.50	<0.50	<0.50	<5.0
	6/12/00	<50	NA	NA	<0.50	<0.50	<0.50	<0.50	<5.0
	9/5/00	<50	NA	NA	<0.50	<0.50	<0.50	<0.50	<5.0
	11/13/00	<50	NA	NA	<0.50	<0.50	<0.50	<0.50	<0.50
	2/26/01	<50	NA	NA	<0.50	<0.50	<0.50	<0.50	<0.50
	6/12/01	<50	NA	NA	<0.50	<0.50	<0.50	<0.50	<0.50
	8/27/01 ³	-	-	-	-	-	-	-	-
MW-6	05/18/93	170	NA	NA	<0.5	<0.5	<0.5	<0.5	
	08/11/93	78	NA	NA	<0.5	<0.5	<0.5	<0.5	
	11/05/93	170	NA	NA	<0.5	<0.5	<0.5	<0.5	
	03/01/94	210	NA	NA	<0.5	<0.5	<0.5	<0.5	
	06/02/94	190	NA	NA	<0.5	<0.5	<0.5	<0.5	
	09/09/94	140	NA	NA	<0.5	<0.5	<0.5	<0.5	
	12/20/94	210	NA	NA	<0.5	<0.5	<0.5	<0.5	

Table 3
Summary of Groundwater Analytical Results
Former Beacon Station # 12574 - Castro Valley, California

Well ID	Sample Date	TPHg (µg/L)	TPHd (µg/L)	TPHmo (µg/L)	Benzene (µg/L)	Toluene (µg/L)	Ethyl-benzene (µg/L)	Xylenes (µg/L)	MTBE (µg/L)
	03/08/95	180 ¹	NA	NA	<0.5	<0.5	<0.5	<0.5	
	06/14/95	220 ¹	NA	NA	<0.5	<0.5	<0.5	<0.5	
	09/26/95	110 ¹	NA	NA	<0.50	<0.50	<0.50	<0.50	
	12/27/95	130 ¹	NA	NA	<0.50	<0.50	<0.50	<0.50	
	03/08/95	100 ¹	NA	NA	<0.50	<0.50	<0.50	<0.50	
MW-6 (cont.)	06/05/96	100 ¹	NA	NA	<0.50	<0.50	<0.50	<0.50	430
	09/16/96	170	NA	NA	<0.50	<0.50	<0.50	<0.50	430
	12/02/96	160	NA	NA	<0.50	<0.50	<0.50	<0.50	160
	03/10/97	140	NA	NA	<0.50	<0.50	<0.50	<0.50	390
	06/12/97	<50	NA	NA	<0.50	<0.50	<0.50	<0.50	330
	09/29/97	<50	NA	NA	<0.50	<0.50	<0.50	<0.50	130
	12/01/97	<50	NA	NA	<0.50	<0.50	<0.50	<0.50	200
	03/19/98	<50	NA	NA	<0.50	<0.50	<0.50	<0.50	240
	05/28/98	<50	NA	NA	<0.50	<0.50	<0.50	<0.50	290
	08/31/98	<50	NA	NA	<0.50	<0.50	<0.50	<0.50	290
	12/08/98	<50	NA	NA	<0.50	<0.50	<0.50	<0.50	230
	02/17/99	<50	NA	NA	<0.50	<0.50	<0.50	<0.50	200
	06/10/99	<50	NA	NA	<0.50	<0.50	<0.50	<0.50	290
	09/07/99	<50	NA	NA	<0.50	<0.50	<0.50	<0.50	230
	12/13/99	<50	NA	NA	<0.50	<0.50	<0.50	<0.50	180
	3/16/00	<50	NA	NA	<0.50	<0.50	<0.50	<0.50	260
	6/12/00	<50	NA	NA	<0.50	<0.50	<0.50	<0.50	160
	9/5/00	<50	NA	NA	<0.50	0.50	<0.50	0.81	170
	11/13/00	<50	NA	NA	<0.50	<0.50	<0.50	<0.50	190
	2/26/01	<50	NA	NA	<0.50	<0.50	<0.50	<0.50	130
6/12/01	<50	NA	NA	<0.50	<0.50	<0.50	<0.50	96	
8/27/01 ³	-	-	-	-	-	-	-	-	
MW-7	05/18/93	<50	NA	NA	<0.5	<0.5	<0.5	<0.5	
	08/11/93	<50	NA	NA	<0.5	<0.5	<0.5	<0.5	
	11/05/93	<50	NA	NA	<0.5	<0.5	<0.5	<0.5	
	03/01/94	60	NA	NA	<0.5	<0.5	<0.5	<0.5	
	06/02/94	<50	NA	NA	<0.5	<0.5	<0.5	<0.5	
	09/09/94	<50	NA	NA	<0.5	<0.5	<0.5	<0.5	
	12/20/94	<50	NA	NA	<0.5	<0.5	<0.5	<0.5	
	03/08/95	<50	NA	NA	<0.5	<0.5	<0.5	<0.5	
	06/14/95	<50	NA	NA	<0.5	<0.5	<0.5	<0.5	
	09/26/95	<50	NA	NA	<0.50	<0.50	<0.50	<0.50	
12/27/95	<50	NA	NA	<0.50	<0.50	<0.50	<0.50		

Table 3
Summary of Groundwater Analytical Results
Former Beacon Station # 12574 - Castro Valley, California

Well ID	Sample Date	TPHg (µg/L)	TPHd (µg/L)	TPHmo (µg/L)	Benzene (µg/L)	Toluene (µg/L)	Ethyl-benzene (µg/L)	Xylenes (µg/L)	MTBE (µg/L)
	03/08/95	<50	NA	NA	<0.50	<0.50	<0.50	<0.50	
	06/05/96	<50	NA	NA	<0.50	<0.50	<0.50	<0.50	20
	09/16/96	<50	NA	NA	<0.50	<0.50	<0.50	<0.50	26
	12/02/96	140	NA	NA	<0.50	<0.50	<0.50	<0.50	140
	03/10/97	<50	NA	NA	<0.50	<0.50	<0.50	<0.50	29
	06/12/97	<50	NA	NA	<0.50	<0.50	<0.50	<0.50	28
	09/29/97	<50	NA	NA	<0.50	<0.50	<0.50	<0.50	27
MW-7	12/01/97	<50	NA	NA	<0.50	<0.50	<0.50	<0.50	29
(cont.)	03/19/98	<50	NA	NA	<0.50	<0.50	<0.50	<0.50	6.0
	05/28/98	<50	NA	NA	<0.50	<0.50	<0.50	<0.50	25
	08/31/98	<50	NA	NA	<0.50	<0.50	<0.50	<0.50	20
	12/08/98 ²								
MW-8	05/18/93	<50	NA	NA	<0.5	<0.5	<0.5	<0.5	-
	08/11/93	<50	NA	NA	<0.5	<0.5	<0.5	<0.5	-
	11/05/93	<50	NA	NA	<0.5	<0.5	<0.5	<0.5	-
	03/01/94	<50	NA	NA	<0.5	<0.5	<0.5	<0.5	-
	06/02/94	<50	NA	NA	<0.5	<0.5	<0.5	<0.5	-
	09/09/94	<50	NA	NA	<0.5	<0.5	<0.5	<0.5	-
	12/20/94	<50	NA	NA	<0.5	<0.5	<0.5	<0.5	-
	03/08/95	NS	NS	NS	NS	NS	NS	NS	-
	06/14/95	NS	NS	NS	NS	NS	NS	NS	-
	09/26/95	NS	NS	NS	NS	NS	NS	NS	-
	12/27/95	NS	NS	NS	NS	NS	NS	NS	-
	03/08/95	NS	NS	NS	NS	NS	NS	NS	-
	06/05/96	NS	NS	NS	NS	NS	NS	NS	-
	09/16/96	<50	NA	NA	<0.50	<0.50	<0.50	<0.50	<5.0
	12/02/96	NS	NS	NS	NS	NS	NS	NS	NS
	03/10/97	NS	NS	NS	NS	NS	NS	NS	NS
	06/12/97	NS	NS	NS	NS	NS	NS	NS	NS
	09/29/97	NS	NS	NS	NS	NS	NS	NS	NS
	12/01/97	NS	NS	NS	NS	NS	NS	NS	NS
	03/19/98	NS	NS	NS	NS	NS	NS	NS	NS
	05/28/98	NS	NS	NS	NS	NS	NS	NS	NS
	08/31/98	NS	NS	NS	NS	NS	NS	NS	NS
	12/08/98 ²								

Notes:

<: Below indicated detection limit.

NS : Not sampled.

NA: Not Analyzed.

Table 3
Summary of Groundwater Analytical Results
Former Beacon Station # 12574 - Castro Valley, California

Well ID	Sample Date	TPHg (µg/L)	TPHd (µg/L)	TPHmo (µg/L)	Benzene (µg/L)	Toluene (µg/L)	Ethyl-benzene (µg/L)	Xylenes (µg/L)	MTBE (µg/L)
¹ : Product not typical gasoline. ² : Well abandoned ³ : As directed by Alameda County, Monitoring wells not sampled.									