

Environmental

1704 Via Riata, Roseville, CA 95747
May 30, 2002

Tel: (916) 771-7098, FAX : (916) 771-4584

Mr. Richard Hiatt
California Regional Water Quality Control Board
San Francisco Bay Region
1515 Clay Street, Suite 1400
Oakland, CA 94612

Subject: Quarterly *Ground Water Monitoring Report, First Quarter 2002*
Former Beacon Station No. 12574
22315 Redwood Road
Castro Valley, California
RDM Project No. 00-12574

Dear Mr. Hiatt:

RDM Environmental (RDM) has been authorized by Ultramar Inc. to perform ground water monitoring oversight for the subject site. This report describes ground water monitoring activities conducted during the **First Quarter 2002**.

Work Performed During the First Quarter 2002:

- Doulos Environmental, Inc. conducted quarterly monitoring activities on **February 11, 2002**.

STATUS OF GROUND WATER MONITORING

Cumulative ground water sampling information is tabulated in Table 1. A site topographic map, site map, ground water elevation contour map and a concentration map are shown as Figures 1 through 4, respectively. The site history is included in Enclosure A, the monitoring data sheets are included in Enclosure B, the analytical results are included in Enclosure C and the historical ground water monitoring data is included in Enclosure D.

- Historical ground water flow direction is to the southwest.

CONCLUSIONS/RECOMMENDATIONS

Based on the February 2002 sampling results and historical ground water data, RDM recommends the ground water monitoring events continue on a quarterly basis.

The interpretations contained in this report represent our professional opinions and are based, in part, on information supplied by the client. These opinions are based on currently available information and are

20355

JUN 07 2002

ST70
3579 ✓

Mr. Richard Hiatt
California Regional Water Quality Control Board
San Francisco Bay Region
May 30, 2002
Page 2

arrived at in accordance with currently accepted hydrogeologic and engineering practices at this time and location. Other than this, no warranty is implied or intended.

If you have any questions concerning this project, please contact Richard Munsch at (916) 771-7098.

RDM ENVIRONMENTAL

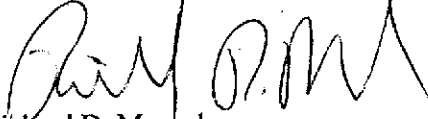
Richard D. Munsch
Project Manager

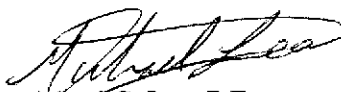

Michael G. Lee, P.E.
California Registered Civil Engineer No. C055795

RDM (12574 1Q GWM 2-11-02)

cc: Mr. Joe Aldridge - Ultramar, Inc.
Mr. Amir K. Gholami – Alameda County Department of Environmental Health
Mr. Bill Courtney – Property Manager

Enclosures:

- Enclosure A: Site Background Information
- Enclosure B: Ground Water Sampling Information
- Enclosure C: Ground Water Monitoring Analytical Results
- Enclosure D: Historical Ground Water Monitoring Data

TABLE 1

GROUND WATER MONITORING DATA

Former Beacon Station
 No. 12574
 22315 Redwood Road
 Castro Valley, California

| Monitoring Well | Date | Reference Elevation (ft) | Depth to Ground Water (ft) | Ground Water Elevation (ft) | Benzene (µg/L) | Toluene (µg/L) | Ethylbenzene (µg/L) | Total Xylenes (µg/L) | TPH as gasoline (µg/L) | MTBE (µg/L) | Comments |
|-----------------|----------|--------------------------|----------------------------|-----------------------------|----------------|----------------|---------------------|----------------------|------------------------|-------------|----------|
| MW-1 | 02/11/02 | 158.70 | 22.58 | 136.12 | 7,600 | 160 | 1,600 | 4,200 | 41,000 | 640 | |
| MW-2 | 02/11/02 | 157.33 | 21.03 | 136.30 | 3,100 | 270 | 690 | 1,600 | 17,000 | 660 | |
| MW-3 | 02/11/02 | 159.23 | 21.55 | 137.68 | NS | NS | NS | NS | NS | NS | |
| MW-4 | 02/11/02 | 154.13 | 16.81 | 137.32 | NS | NS | NS | NS | NS | NS | |
| MW-5 | 02/11/02 | 150.73 | 15.70 | 135.03 | NS | NS | NS | NS | NS | NS | |
| MW-6 | 02/11/02 | 156.11 | 20.78 | 135.33 | NS | NS | NS | NS | NS | NS | |

TPH = Total petroleum hydrocarbons.

MTBE = Methyl tertiary butyl ether.

NA = Not analyzed

ND = Not detected at or above the laboratory reporting limit.

NS = Not sampled

µg/L = Micrograms per liter.

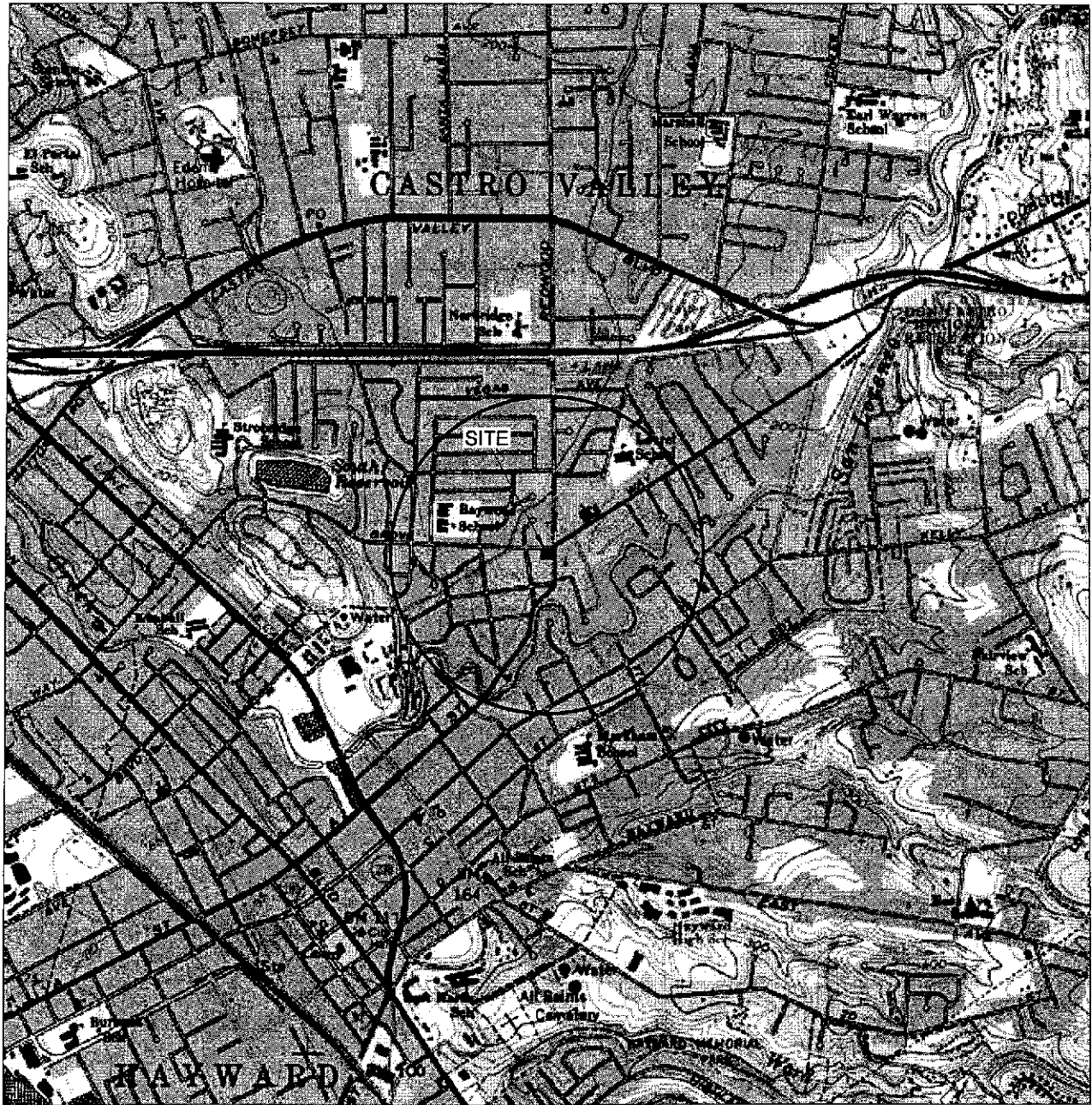

T.3 S.

R.2 W.

GENERAL NOTES:
 BASE MAP FROM U.S.G.S.
 HAYWARD, CA.
 7.5 MINUTE TOPOGRAPHIC
 PHOTOREVISED 1980



QUADRANGLE LOCATION

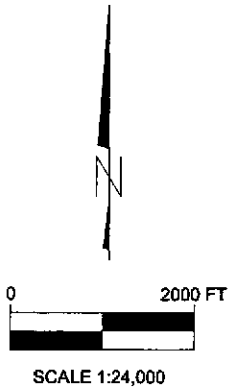

FIGURE 1
 SITE LOCATION MAP

FORMER BEACON STATION NO. 12574
 22315 REDWOOD ROAD
 CASTRO VALLEY, CA.

| | |
|-------------------------|--------------------------|
| PROJECT NO. 00-12574 | DRAWN BY M.L. 4/12/02 |
| FILE NO. 12574 Topo | PREPARED BY RDM |
| REVISION NO. 1 | REVIEWED BY |



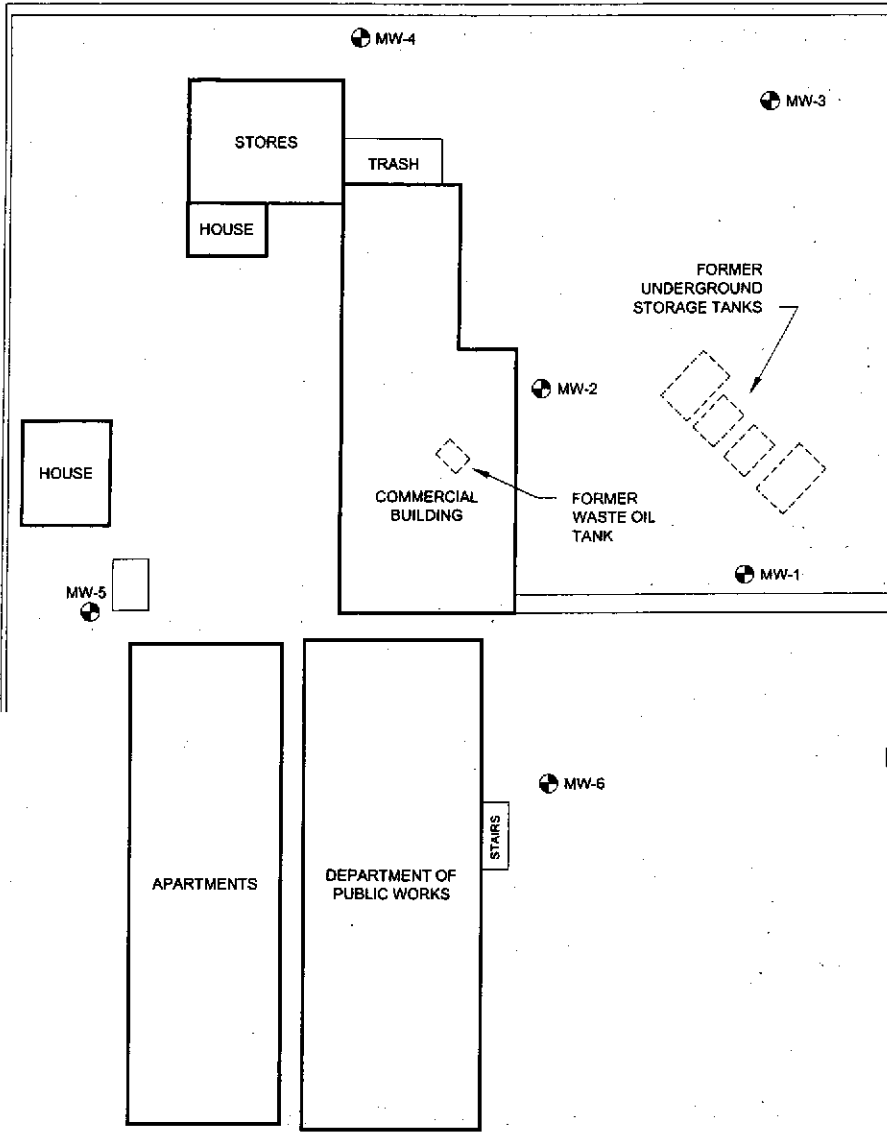

GROVE WAY

MW-8



LEGEND:

-  MW-1 MONITORING WELL LOCATION
-  MW-8 ABANDONED MONITORING WELL LOCATION



APPROX. SCALE

FIGURE 2
SITE MAP

FORMER BEACON STATION NO. 12574
22315 REDWOOD ROAD
CASTRO VALLEY, CA.

| | |
|-------------------------|--------------------------|
| PROJECT NO. 00-12574 | DRAWN BY M.L. 4/12/02 |
| FILE NO. 12574 Site | PREPARED BY RDM |
| REVISION NO. 1 | REVIEWED BY |



GROVE WAY

■ MW-8

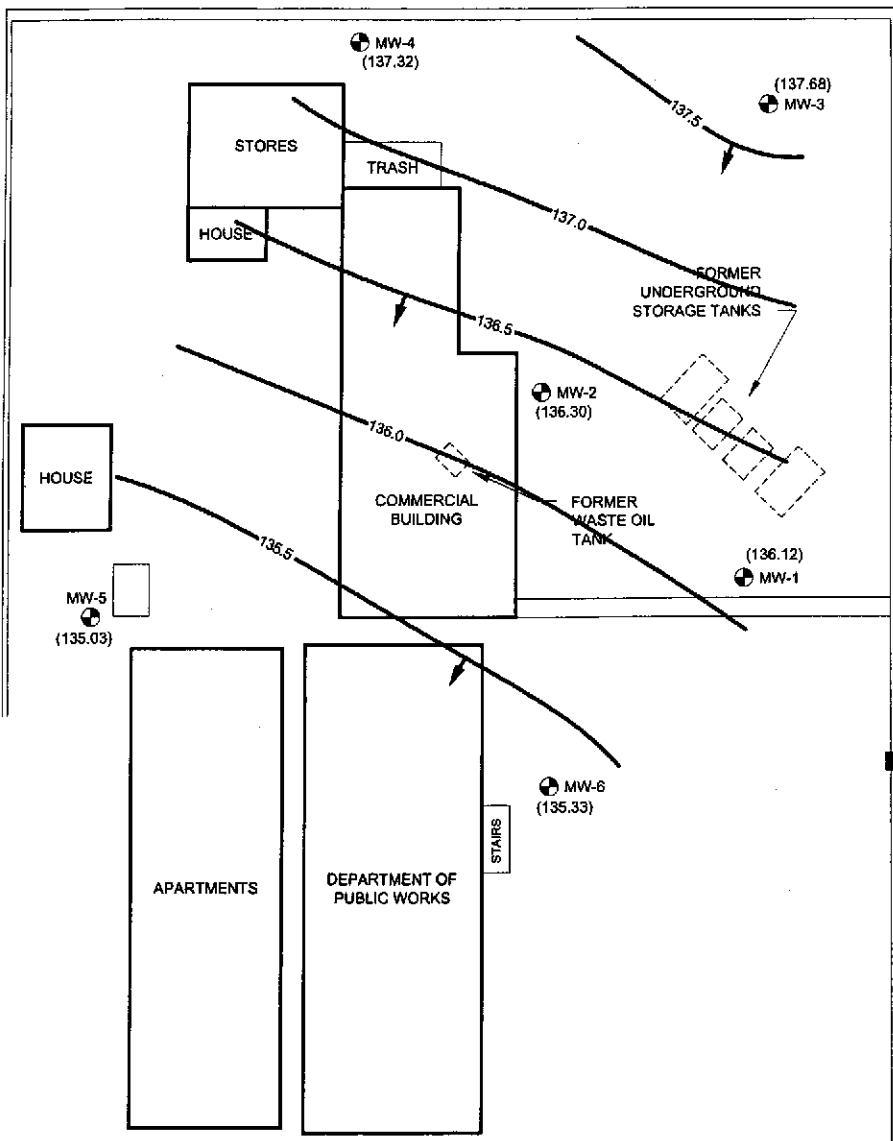

REDWOOD ROAD

LEGEND:

- MW-1 MONITORING WELL LOCATION
- MW-8 ABANDONED MONITORING WELL LOCATION
- (136.12) GROUND WATER ELEVATION IN FEET ABOVE MEAN SEA LEVEL (MSL)
- 136.5— WATER TABLE CONTOUR IN FEET ABOVE MSL
- ➔ GROUND WATER FLOW DIRECTION

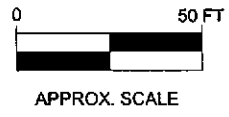

FIGURE 3
GROUND WATER ELEVATION CONTOUR MAP
 2/11/02
 FORMER BEACON STATION NO. 12574
 22315 REDWOOD ROAD
 CASTRO VALLEY, CA.

| | |
|-------------------------|--------------------------|
| PROJECT NO. 00-12574 | DRAWN BY M.L. 4/30/02 |
| FILE NO. 12574 Site | PREPARED BY RDM |
| REVISION NO. 2 | REVIEWED BY |

RDM
Environmental

GROVE WAY

MW-8

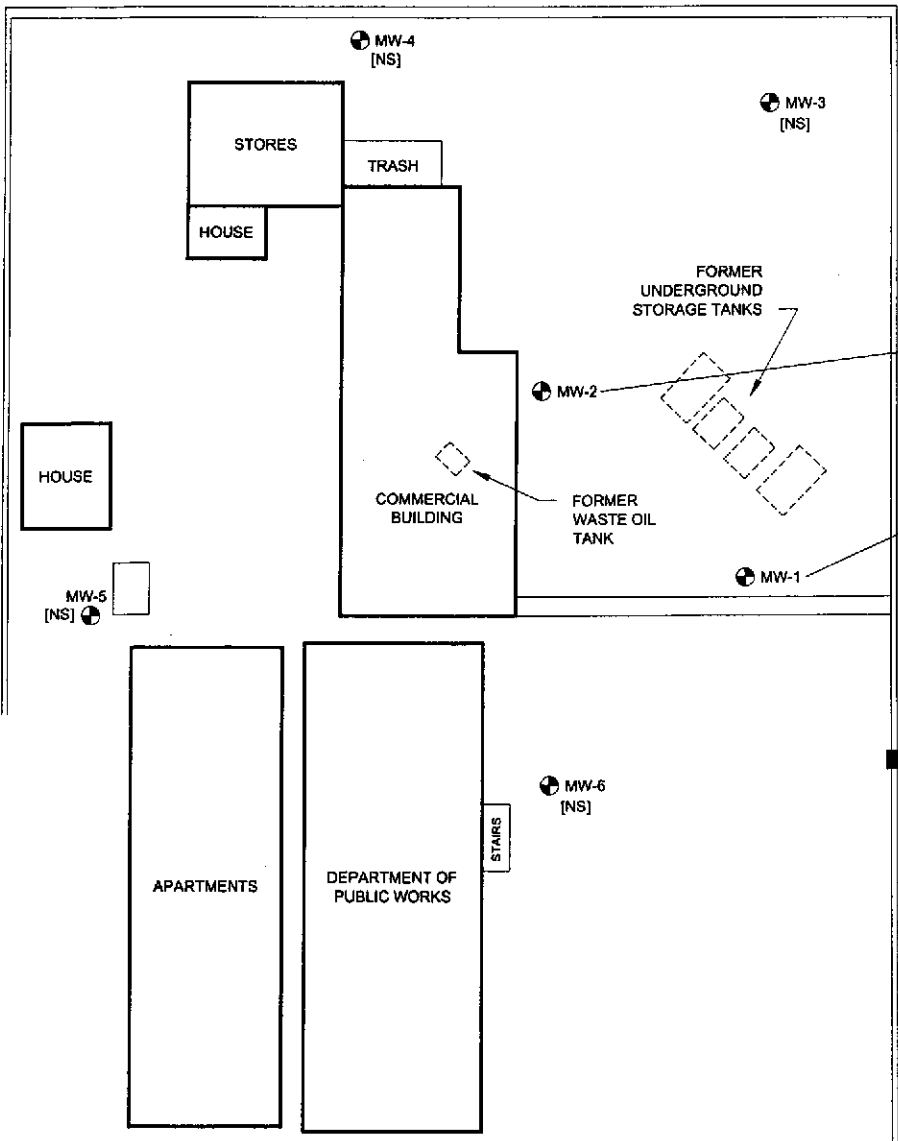

| | |
|------|--------|
| B | 3,100 |
| TPHG | 17,000 |
| MTBE | 660 |

| | |
|------|--------|
| B | 7,600 |
| TPHG | 41,000 |
| MTBE | 640 |

LEGEND:

- ⊕ MW-1 MONITORING WELL LOCATION
- MW-8 ABANDONED MONITORING WELL LOCATION

| | | |
|------|--------|--|
| B | 7,600 | BENZENE CONCENTRATION IN MICROGRAMS PER LITER (ug/L) |
| TPHG | 41,000 | TOTAL PETROLEUM HYDROCARBONS AS GASOLINE IN ug/L |
| MTBE | 640 | METHYL TERTIARY BUTYL ETHER IN ug/L |
| NS | | NOT SAMPLED |



APPROX. SCALE

FIGURE 4
GROUNDWATER ANALYTICAL SUMMARY
 2/11/02

FORMER BEACON STATION NO. 12574
 22315 REDWOOD ROAD
 CASTRO VALLEY, CA.

| | |
|-------------------------|--------------------------|
| PROJECT NO. 00-12574 | DRAWN BY M.L. 4/12/02 |
| FILE NO. 12574 Site | PREPARED BY RDM |
| REVISION NO. 1 | REVIEWED BY |

RDM
Environmental

ENCLOSURE A

Site Background Information

Historical Background Information

Former Beacon No. 12574
22315 Redwood Road
Castro Valley, California

Ultramar Inc.

- On May 5, 1987, five underground storage tanks (two gasoline, two diesel and one waste oil) were excavated and removed from the site. Soil samples were collected from beneath the tanks and analyzed for hydrocarbon constituents. It was determined that gasoline and diesel were present in the soil beneath the former fuel tanks. Soil was over-excavated to the depth of groundwater. Most soil samples collected after the over-excavation confirmed removal of impacted soil. A sample collected from the over-excavation northeast of the former tanks contained petroleum hydrocarbons at a concentration of 1989 parts per million. No further excavation was conducted.
- During March 1991, three groundwater monitoring wells were installed on-site. Laboratory analysis of soil samples obtained from monitoring well borings indicated that soil had been impacted in the vicinity of former USTs (these USTs were no longer present when Beacon operated the station) to the depth of groundwater, where it then apparently spread across the site and impacted soil immediately above groundwater.
- In May 1993, five ground water monitoring wells were installed. With the installation of these new wells the extent of impacted groundwater was defined.
- During the first quarter 1994, a soil gas survey/performance test, aquifer pump test, and air sparging was conducted.
- During the fourth quarter 1994, a PAR/RAP was submitted. The consultant concluded that further assessment and remediation were not necessary. It was recommended that groundwater monitoring continue.
- In December 1996, a Risk-Based Corrective Action (RBCA) assessment was prepared and submitted to the County. Correspondence prepared by the County in May 1997, and July 1998, requested further RBCA analyses. A *Supplement to Risk-Based Corrective Action Tier 1 and Tier 2 Analyses* was completed in March 1999.
- In September 1998, monitoring wells MW-7 and MW-8 were abandoned, as required by the Alameda County Department of Public Works.
- In July 1999, the property owner had a geophysical survey completed, which concluded that additional USTs were not present at the site.
- In January 2002, RDM Environmental was contracted by Ultramar Inc. to continue environmental oversight of the site.

ENCLOSURE B

Ground Water Sampling Information

DOULOS ENVIRONMENTAL, INC.
GROUNDWATER/LIQUID LEVEL DATA
(measurements in feet)

Project Address: Beacon # 12574 22315 Redwood Rd.
Castro Valley, Ca.

Date: 2-11-02

Project No.: 12574-24

Recorded by: _____

| Well No. | Time | Well Elev. TOC | Depth to Groundwater | Measured Total Depth | Groundwater Elevation | Depth to Product | Product Thickness | Comments |
|----------|-------|-------------------|-------------------------|-------------------------|--------------------------|---------------------|----------------------|----------|
| MW-1 | 10:37 | | 22.58 | 29.73 | | | | |
| MW-2 | 10:35 | | 21.03 | 29.50 | | | | |
| MW-3 | 10:30 | | 21.55 | 29.46 | | | | |
| MW-4 | 10:24 | | 16.81 | 24.71 | | | | |
| MW-5 | 10:15 | | 15.70 | 29.60 | | | | |
| MW-6 | 10:20 | | 20.78 | 27.99 | | | | |
| | | | | | | | | |
| | | | | | | | | |
| | | | | | | | | |
| | | | | | | | | |
| | | | | | | | | |
| | | | | | | | | |
| | | | | | | | | |
| | | | | | | | | |
| | | | | | | | | |
| | | | | | | | | |

Notes:

Client: Ultramar
 Site: Beacon #12574
22315 Redwood Rd.
Castro Valley, Ca.

Sampling Date: 2-11-02
 Project No.: _____
 Well Designation: MW-1

Is setup of traffic control devices required? NO YES
 Is there standing water in the well box? NO YES
 Is top of casing cut level? NO YES
 Is well cap sealed and locked? NO YES
 Height of well casing riser (in inches): 3
 Well cover type: 8" or 12" UV 12" EMCO _____ 8" or 12" BK _____ 8" Christy _____
 12" Christy _____ 8" M&D _____ 12" M&D _____ 12" DWP _____
 12" CNI _____ 36" CNI _____ 12" Pomeco _____ Other: _____
 General condition of wellhead assembly: Excellent _____ Good Fair _____ Poor _____

Purging Equipment: _____ 2" disposable bailer _____ Submersible pump
 _____ 2" PVC bailer _____ Dedicated bailer
 _____ 4" PVC bailer Centrifugal pump
 Sampled with: Disposable bailer Teflon bailer _____ Disposable Tubing _____

Well Diameter: 2" _____ 4" 6" _____ 8" _____
 Purge Vol. Multiplier: 0.16 0.65 1.47 2.61 gal/ft.
 Initial Measurement Recharge Measurement
 Time: 10:37 Time: 11:50 Calculated purge: 18.5
 Depth of well: 29.73 Depth to water: 23.10 Actual purge: 18.5
 Depth to water: 22.58

Start purge: 10:42 Sampling time: 11:51

| Time | Temperature | E.C. | pH | Turbidity | Volume |
|-------|-------------|------|------|-----------|--------|
| 10:44 | 66.2 | 1142 | 7.36 | | 1 |
| 10:46 | 67.1 | 1110 | 7.32 | | 2 |
| 10:50 | 67.2 | 1100 | 7.31 | | 3 |
| 10:53 | 67.4 | 1086 | 7.30 | | 4 |
| | | | | | |

DRY

Sample appearance: Clear Lock: Dolphin

Equipment replaced: (check all that apply) Note condition of replaced item(s)
 2" Locking Cap: _____ Lock: _____ 7/32 Allenhead: _____
 4" Locking Cap: _____ Lock-Dolphin: _____ 9/16 Bolt: _____
 6" Locking Cap: _____ Pinned Allenhead (DWP): _____

Remarks: _____

Signature: _____

Client: Ultramar
 Site: Beacon #12574
22315 Redwood Rd.
Castro Valley, Ca.

Sampling Date: 2-11-02
 Project No.: _____
 Well Designation: MW-2

Is setup of traffic control devices required? NO YES
 Is there standing water in the well box? NO YES
 Is top of casing cut level? NO YES
 Is well cap sealed and locked? NO YES
 Height of well casing riser (in inches): 3
 Well cover type: 8" or 12" UV 12" EMCO _____ 8" or 12" BK _____ 8" Christy _____
 12" Christy _____ 8" M&D _____ 12" M&D _____ 12" DWP _____
 12" CNI _____ 36" CNI _____ 12" Pomeco _____ Other: _____
 General condition of wellhead assembly: Excellent _____ Good Fair _____ Poor _____

time: _____ hours
 Above TOC _____ Below TOC
 If no, see remarks
 If no, see remarks

Purging Equipment: _____ 2" disposable bailer _____ Submersible pump
 _____ 2" PVC bailer _____ Dedicated bailer
 _____ 4" PVC bailer _____ Centrifugal pump
 Sampled with: Disposable bailer Teflon bailer _____ Disposable Tubing

Well Diameter: 2" _____ 4" 6" _____ 8" _____
 Purge Vol. Multiplier: 0.16 _____ 0.65 _____ 1.47 _____ 2.61 gal/ft.

Initial Measurement Recharge Measurement
 Time: 10:35 Time: 12:06 Calculated purge: 22.0
 Depth of well: 29.50 Depth to water: 22.90 Actual purge: 22.0
 Depth to water: 21.03

Start purge: 11:00 Sampling time: 12:10

| Time | Temperature | E.C. | pH | Turbidity | Volume |
|-------|-------------|------|------|-----------|--------|
| 11:02 | 66.8 | 1150 | 7.42 | | 1 |
| 11:06 | 67.0 | 1141 | 7.36 | | 2 |
| 11:10 | 67.2 | 1020 | 7.31 | | 3 |
| 11:13 | 67.3 | 1081 | 7.30 | | 4 |
| | | | | | |

DRY

Sample appearance: Clear Lock: J. Johnson

Equipment replaced: (check all that apply)
 2" Locking Cap: _____ Lock: _____ Note condition of replaced item(s)
 4" Locking Cap: _____ Lock-Dolphin: _____ 7/32 Allenhead: _____
 6" Locking Cap: _____ Pinned Allenhead (DWP): _____ 9/16 Bolt: _____

Remarks: _____

Signature: _____

ENCLOSURE D

Historical Ground Water Monitoring
Data

Table 2
Cumulative Groundwater Elevation Data
Former Beacon Station # 12574 - Castro Valley, California

| Well ID | Top of Casing Elevation (Feet) ¹ | Date Sounded | Depth-to Groundwater (Feet) ¹ | Groundwater Elevation (Feet) ² | Well Depth (Feet) |
|----------|---|--------------|--|---|-------------------|
| MW-1 | 156.55 | 03/27/92 | 22.43 | 134.12 | - |
| | | 06/04/92 | 23.40 | 133.15 | - |
| | | 09/23/92 | 24.07 | 132.48 | - |
| | | 11/12/92 | 24.16 | 132.39 | 29.33 |
| | | 02/02/93 | 21.87 | 134.68 | 29.80 |
| | | 05/07/93 | 22.58 | 133.97 | 29.84 |
| | | 05/18/93 | 22.66 | 133.89 | - |
| | | 08/11/93 | 23.41 | 133.14 | 29.81 |
| | | 11/05/93 | 24.09 | 132.46 | 29.81 |
| | | 03/01/94 | 22.76 | 133.79 | 29.85 |
| | | 06/02/94 | 23.24 | 133.31 | 29.85 |
| | | 09/09/94 | 23.93 | 132.62 | 29.86 |
| | | 12/20/94 | 22.94 | 133.61 | 29.85 |
| | | 03/08/95 | 22.20 | 134.35 | 29.71 |
| | | 06/14/95 | 22.65 | 133.90 | 29.70 |
| | | 09/26/95 | 23.44 | 133.11 | 29.71 |
| | | 12/27/95 | 23.04 | 133.51 | 29.72 |
| | | 03/26/96 | 21.39 | 135.16 | 29.71 |
| | | 06/05/96 | 22.43 | 134.12 | 29.73 |
| | | 09/16/96 | 24.42 | 132.13 | 29.74 |
| | | 12/02/96 | 23.14 | 133.41 | 29.75 |
| | | 03/10/97 | 22.30 | 134.25 | 29.76 |
| | | 06/12/97 | 22.97 | 133.58 | 29.76 |
| | | 09/29/97 | 23.35 | 133.20 | 29.78 |
| | | 12/01/97 | 22.73 | 133.82 | 29.79 |
| | | 03/19/98 | 20.56 | 135.99 | 29.78 |
| | | 05/28/98 | 21.78 | 134.77 | 29.76 |
| | | 08/31/98 | 22.64 | 133.91 | 29.78 |
| | | 12/08/98 | 22.87 | 133.68 | 29.76 |
| | | 02/17/99 | 21.53 | 135.02 | 29.75 |
| | | 06/10/99 | 22.74 | 133.81 | 29.74 |
| 09/07/99 | 23.06 | 133.49 | 29.73 | | |
| 12/13/00 | 23.06 | 133.46 | 29.74 | | |
| 3/16/00 | 20.66 | 135.89 | 29.75 | | |
| 6/12/00 | 22.53 | 134.02 | 29.76 | | |
| 9/5/00 | 22.73 | 133.82 | 29.74 | | |
| 11/13/00 | 23.20 | 133.35 | 29.74 | | |
| 2/26/01 | 21.75 | 134.80 | 29.73 | | |
| 6/12/01 | 22.70 | 133.85 | 29.73 | | |
| 9/21/01 | 23.40 | 133.15 | 29.73 | | |
| MW-2 | 155.17 | 03/27/92 | 20.82 | 134.35 | - |
| | | 06/04/92 | 21.81 | 133.36 | - |
| | | 09/23/92 | 22.45 | 132.72 | - |

Table 2
Cumulative Groundwater Elevation Data
Former Beacon Station # 12574 - Castro Valley, California

| Well ID | Top of Casing Elevation (Feet) ¹ | Date Sounded | Depth to Groundwater (Feet) ¹ | Groundwater Elevation (Feet) ² | Well Depth (Feet) |
|-------------|---|--------------|--|---|-------------------|
| | | 11/12/92 | 22.60 | 132.57 | 29.71 |
| | | 02/02/93 | 20.28 | 134.89 | 29.73 |
| | | 05/07/93 | 20.97 | 134.20 | 29.73 |
| | | 05/18/93 | 21.06 | 134.11 | - |
| | | 08/11/93 | 21.85 | 133.32 | 29.70 |
| | | 11/05/93 | 22.32 | 132.85 | 29.70 |
| | | 03/01/94 | 21.19 | 133.98 | 29.68 |
| | | 06/02/94 | 21.59 | 133.58 | 29.69 |
| | | 09/09/94 | 22.33 | 132.84 | 29.66 |
| | | 12/20/94 | 21.37 | 133.80 | 29.65 |
| | | 03/08/95 | 20.60 | 134.57 | 29.52 |
| | | 06/14/95 | 21.04 | 134.13 | 29.54 |
| | | 09/26/95 | 21.84 | 133.33 | 29.53 |
| | | 12/27/95 | 21.44 | 133.73 | 29.56 |
| | | 03/26/96 | 19.81 | 135.36 | 29.56 |
| | | 06/05/96 | 20.83 | 134.34 | 29.59 |
| | | 09/16/96 | 21.93 | 133.24 | 29.58 |
| | | 12/02/96 | 21.54 | 133.63 | 29.58 |
| | | 03/10/97 | 20.71 | 134.46 | 29.58 |
| | | 06/12/97 | 21.41 | 133.76 | 29.52 |
| | | 09/29/97 | 21.26 | 133.91 | 29.51 |
| | | 12/01/97 | 20.97 | 134.20 | 29.50 |
| | | 03/19/98 | 18.98 | 136.19 | 29.51 |
| | | 05/28/98 | 20.22 | 134.95 | 29.50 |
| | | 08/31/98 | 21.09 | 134.08 | 29.51 |
| | | 12/08/98 | 21.31 | 133.86 | 29.50 |
| | | 02/17/99 | 20.02 | 135.15 | 29.51 |
| | | 06/10/99 | 21.30 | 133.87 | 29.50 |
| | | 09/07/99 | 21.49 | 133.68 | 29.50 |
| | | 12/13/99 | 21.52 | 133.65 | 29.50 |
| | | 3/16/00 | 19.13 | 136.04 | 29.50 |
| | | 6/12/00 | 20.93 | 134.24 | 29.50 |
| | | 9/5/00 | 21.15 | 134.02 | 29.50 |
| | | 11/13/00 | 21.66 | 133.51 | 29.50 |
| | | 2/26/01 | 20.17 | 135.00 | 29.50 |
| | | 6/12/01 | 21.15 | 134.02 | 29.50 |
| | | 9/21/01 | 21.63 | 133.54 | 29.50 |
| MW-3 | 157.13 | 03/27/92 | 21.46 | 135.67 | - |
| | | 06/04/92 | 22.34 | 134.79 | - |
| | | 09/23/92 | 22.84 | 134.29 | - |
| | | 11/12/92 | 23.04 | 134.09 | 29.55 |
| | | 02/02/93 | 21.03 | 136.10 | 29.45 |
| | | 05/07/93 | 21.59 | 135.54 | 29.53 |
| | | 05/18/93 | 21.73 | 135.40 | - |
| | | 08/11/93 | 22.31 | 134.82 | 29.41 |

Table 2
Cumulative Groundwater Elevation Data
Former Beacon Station # 12574 - Castro Valley, California

| Well ID | Top of Casing Elevation (Feet) ¹ | Date Sounded | Depth to Groundwater (Feet) ¹ | Groundwater Elevation (Feet) ² | Well Depth (Feet) |
|-------------|---|--------------|--|---|-------------------|
| | | 11/05/93 | 22.85 | 134.28 | 29.41 |
| | | 03/01/94 | 21.97 | 135.16 | 29.55 |
| | | 06/02/94 | 22.29 | 134.84 | 29.56 |
| | | 09/09/94 | 22.91 | 134.22 | 29.56 |
| | | 12/20/94 | 22.11 | 135.02 | 29.54 |
| | | 03/08/95 | 21.40 | 135.73 | 29.38 |
| | | 06/14/95 | 21.80 | 135.33 | 29.36 |
| | | 09/26/95 | 22.38 | 134.75 | 29.37 |
| | | 12/27/95 | 22.07 | 135.06 | 29.37 |
| | | 03/26/96 | 20.73 | 136.40 | 29.38 |
| | | 06/05/96 | 21.54 | 135.59 | 29.40 |
| | | 09/16/96 | 22.37 | 134.76 | 29.43 |
| | | 12/02/96 | 22.35 | 134.78 | 29.45 |
| | | 03/10/97 | 21.44 | 135.69 | 29.47 |
| | | 06/12/97 | 21.97 | 135.16 | 29.45 |
| | | 09/29/97 | 22.30 | 134.83 | 29.45 |
| | | 12/01/97 | 21.78 | 135.35 | 29.46 |
| | | 03/19/98 | 19.88 | 137.25 | 29.46 |
| | | 05/28/98 | 20.91 | 136.22 | 29.47 |
| | | 08/31/98 | 21.61 | 135.52 | 29.47 |
| | | 12/08/98 | 21.83 | 135.30 | 29.47 |
| | | 02/17/99 | 20.81 | 130.32 | 29.45 |
| | | 06/10/99 | 21.61 | 135.52 | 29.45 |
| | | 09/07/99 | 21.91 | 135.22 | 29.45 |
| | | 12/13/99 | 21.93 | 135.20 | 29.44 |
| | | 3/16/00 | 19.86 | 137.27 | 29.46 |
| | | 6/12/00 | 21.61 | 135.52 | 29.46 |
| | | 9/5/00 | 21.54 | 135.59 | 29.47 |
| | | 11/13/00 | 21.98 | 135.15 | 29.46 |
| | | 2/26/01 | 20.65 | 136.48 | 29.46 |
| | | 6/12/01 | 21.70 | 135.43 | 29.46 |
| | | 9/21/01 | 22.05 | 135.07 | 29.46 |
| MW-4 | 151.96 | 05/18/93 | 17.55 | 134.41 | - |
| | | 08/11/93 | 17.50 | 134.46 | 28.43 |
| | | 11/05/93 | 15.84 | 136.12 | 28.43 |
| | | 03/01/94 | 17.35 | 134.61 | 28.11 |
| | | 06/02/94 | 17.68 | 134.28 | 28.12 |
| | | 09/09/94 | 18.19 | 133.77 | 28.13 |
| | | 12/20/94 | 17.52 | 134.44 | 28.10 |
| | | 03/08/95 | 16.82 | 135.14 | 27.97 |
| | | 06/14/95 | 17.22 | 134.74 | 27.97 |
| | | 09/26/95 | 17.79 | 134.17 | 27.91 |
| | | 12/27/95 | 17.47 | 134.49 | 27.89 |
| | | 03/26/96 | 16.32 | 135.64 | 27.89 |
| | | 06/05/96 | 17.10 | 134.86 | 27.88 |

Table 2
Cumulative Groundwater Elevation Data
Former Beacon Station # 12574 - Castro Valley, California

| Well ID | Top of Casing Elevation (Feet) ¹ | Date Sounded | Depth to Groundwater (Feet) ¹ | Groundwater Elevation (Feet) ² | Well Depth (Feet) |
|-------------|---|--------------|--|---|-------------------|
| | | 09/16/96 | 17.85 | 134.11 | 27.89 |
| | | 12/02/96 | 17.59 | 134.37 | 27.88 |
| | | 03/10/97 | 16.79 | 135.17 | 27.89 |
| | | 06/12/97 | 17.49 | 134.47 | 27.90 |
| | | 09/29/97 | 18.33 | 133.63 | 27.91 |
| | | 12/01/97 | 17.36 | 134.60 | 27.90 |
| | | 03/19/98 | 15.90 | 136.06 | 27.91 |
| | | 05/28/98 | 16.34 | 135.62 | 27.90 |
| | | 08/31/98 | 16.83 | 135.13 | 27.90 |
| | | 12/08/98 | 17.37 | 134.59 | 27.91 |
| | | 02/17/99 | 16.49 | 135.47 | 27.98 |
| | | 06/10/99 | 17.63 | 134.33 | 24.76 |
| | | 09/07/99 | 17.80 | 134.16 | 24.75 |
| | | 12/13/99 | 17.82 | 134.14 | 24.73 |
| | | 3/16/00 | 15.81 | 136.15 | 24.71 |
| | | 6/12/00 | 16.64 | 135.32 | 24.70 |
| | | 9/5/00 | 16.71 | 135.25 | 24.70 |
| | | 11/13/00 | 17.24 | 134.72 | 24.70 |
| | | 2/26/01 | 15.83 | 136.13 | 24.70 |
| | | 6/12/01 | 16.80 | 135.16 | 24.70 |
| | | 9/21/01 | 17.30 | 134.66 | 24.71 |
| MW-5 | 148.68 | 05/18/93 | 15.72 | 132.96 | - |
| | | 08/11/93 | 16.42 | 132.26 | 28.43 |
| | | 11/05/93 | 16.92 | 131.76 | 28.43 |
| | | 03/01/94 | 15.54 | 133.14 | 28.11 |
| | | 06/02/94 | 16.19 | 132.49 | 28.12 |
| | | 09/09/94 | 16.87 | 131.81 | 28.13 |
| | | 12/20/94 | 15.87 | 132.84 | 28.10 |
| | | 03/08/95 | 15.11 | 133.57 | 27.97 |
| | | 06/14/95 | 15.69 | 132.99 | 27.97 |
| | | 09/26/95 | 16.46 | 132.22 | 27.91 |
| | | 12/27/95 | 15.91 | 132.77 | 27.89 |
| | | 03/26/96 | 14.31 | 134.37 | 27.89 |
| | | 06/05/96 | 15.43 | 133.25 | 27.88 |
| | | 09/16/96 | 16.52 | 132.16 | 27.89 |
| | | 12/02/96 | 16.05 | 132.63 | 27.88 |
| | | 03/10/97 | 14.80 | 133.88 | 27.89 |
| | | 06/12/97 | 15.95 | 132.78 | 27.90 |
| | | 09/29/97 | 16.33 | 132.35 | 27.91 |
| | | 12/01/97 | 15.48 | 133.20 | 27.90 |
| | | 03/19/98 | 13.16 | 135.52 | 27.91 |
| | | 05/28/98 | 14.04 | 134.64 | 27.90 |
| | | 08/31/98 | 14.81 | 133.87 | 27.90 |
| | | 12/08/98 | 15.75 | 132.93 | 27.91 |
| | | 02/17/99 | 14.80 | 133.88 | 27.98 |

Table 2
Cumulative Groundwater Elevation Data
Former Beacon Station # 12574 - Castro Valley, California

| Well ID | Top of Casing Elevation (Feet) ¹ | Date Sounded | Depth to Groundwater (Feet) ¹ | Groundwater Elevation (Feet) ² | Well Depth (Feet) |
|---------|---|--------------|--|---|-------------------|
| | | 06/10/99 | 15.54 | 133.14 | 24.76 |
| | | 09/07/99 | 16.01 | 132.67 | 24.75 |
| | | 12/13/99 | 16.21 | 132.47 | 24.73 |
| | | 3/16/00 | 14.35 | 134.33 | 29.60 |
| | | 6/12/00 | 15.21 | 133.47 | 29.61 |
| | | 9/5/00 | 15.80 | 132.88 | 29.60 |
| | | 11/13/00 | 16.21 | 132.47 | 29.60 |
| | | 2/26/01 | 14.71 | 133.97 | 29.61 |
| | | 6/12/01 | 15.72 | 132.96 | 29.60 |
| | | 9/21/01 | 16.21 | 132.47 | 29.60 |
| MW-6 | 153.96 | 05/18/93 | 20.80 | 133.16 | - |
| | | 08/11/93 | 21.64 | 132.32 | 31.15 |
| | | 11/05/93 | 22.11 | 131.85 | 31.15 |
| | | 03/01/94 | 20.80 | 133.16 | 29.96 |
| | | 06/02/94 | 21.37 | 132.59 | 29.98 |
| | | 09/09/94 | 22.05 | 131.91 | 29.96 |
| | | 12/20/94 | 21.06 | 132.90 | 29.89 |
| | | 03/08/95 | 20.29 | 133.67 | 29.67 |
| | | 06/14/95 | 20.81 | 133.15 | 29.65 |
| | | 09/26/95 | 21.62 | 132.34 | 29.66 |
| | | 12/27/95 | 21.12 | 132.84 | 29.63 |
| | | 03/26/96 | 19.50 | 134.46 | 29.60 |
| | | 06/05/96 | 20.56 | 133.40 | 29.63 |
| | | 09/16/96 | 21.70 | 132.26 | 29.65 |
| | | 12/02/96 | 21.25 | 132.71 | 29.66 |
| | | 03/10/97 | 20.16 | 133.80 | 29.64 |
| | | 06/12/97 | 21.16 | 132.80 | 29.62 |
| | | 09/29/97 | 21.51 | 132.45 | 29.62 |
| | | 12/01/97 | 20.89 | 133.07 | 29.61 |
| | | 03/19/98 | 18.71 | 135.25 | 29.60 |
| | | 05/28/98 | 19.99 | 133.97 | 29.62 |
| | | 08/31/98 | 20.81 | 133.15 | 29.63 |
| | | 12/08/98 | 21.00 | 132.96 | 29.64 |
| | | 02/17/99 | 19.54 | 134.42 | 29.63 |
| | | 06/10/99 | 20.74 | 133.22 | 27.98 |
| | | 09/07/99 | 21.23 | 132.73 | 27.98 |
| | | 12/13/99 | 21.22 | 132.74 | 27.98 |
| | | 3/16/00 | 18.79 | 135.17 | 27.99 |
| | | 6/12/00 | 20.49 | 133.47 | 27.99 |
| | | 9/5/00 | 20.95 | 133.01 | 27.98 |
| | | 11/13/00 | 21.44 | 132.52 | 27.98 |
| | | 2/26/01 | 19.86 | 134.10 | 27.99 |
| | | 6/12/01 | 20.91 | 133.05 | 27.98 |
| | | 9/21/01 | 21.22 | 132.74 | 27.99 |

Table 2
Cumulative Groundwater Elevation Data
Former Beacon Station # 12574 - Castro Valley, California

| Well ID | Top of Casing Elevation (Feet) ¹ | Date Sounded | Depth to Groundwater (Feet) ¹ | Groundwater Elevation (Feet) ² | Well Depth (Feet) |
|-----------------------|---|--------------|--|---|-------------------|
| MW-7 | 156.09 | 05/18/93 | 22.64 | 133.45 | - |
| | | 08/11/93 | 23.25 | 132.84 | 30.75 |
| | | 11/05/93 | 23.93 | 132.16 | 30.75 |
| | | 03/01/94 | 22.72 | 133.37 | 30.11 |
| | | 06/02/94 | 23.22 | 132.87 | 30.12 |
| | | 09/09/94 | 23.90 | 132.19 | 30.12 |
| | | 12/20/94 | 22.98 | 133.11 | 30.10 |
| | | 03/08/95 | 22.14 | 133.95 | 29.91 |
| | | 06/14/95 | 22.61 | 133.48 | 29.91 |
| | | 09/26/95 | 23.43 | 132.66 | 29.90 |
| | | 12/27/95 | 23.01 | 133.08 | 29.90 |
| | | 03/26/96 | 21.32 | 134.77 | 29.87 |
| | | 06/05/96 | 22.37 | 133.72 | 29.91 |
| | | 09/16/96 | 23.51 | 132.58 | 29.90 |
| | | 12/02/96 | 23.08 | 133.01 | 29.91 |
| | | 03/10/97 | 21.94 | 134.15 | 29.90 |
| | | 06/12/97 | 22.96 | 133.13 | 29.88 |
| | | 09/29/97 | 23.35 | 132.74 | 29.87 |
| | | 12/01/97 | 22.68 | 133.41 | 29.88 |
| | | 03/19/98 | 20.52 | 135.57 | 29.88 |
| 05/28/98 | 21.76 | 134.33 | 29.88 | | |
| 08/31/98 | 22.66 | 133.43 | 29.86 | | |
| 12/08/98 ³ | | | | | |
| MW-8 | 158.04 | 05/18/93 | 21.55 | 136.49 | - |
| | | 08/11/93 | 22.43 | 135.61 | 34.82 |
| | | 11/05/93 | 23.00 | 135.04 | 34.82 |
| | | 03/01/94 | 22.05 | 135.99 | 34.04 |
| | | 06/02/94 | 22.29 | 135.75 | 34.04 |
| | | 09/09/94 | 22.99 | 135.05 | 34.04 |
| | | 12/20/94 | 22.14 | 135.90 | 33.98 |
| | | 03/08/95 | 21.25 | 136.79 | 34.48 |
| | | 06/14/95 | 21.70 | 136.34 | 34.49 |
| | | 09/26/95 | 22.29 | 135.75 | 34.40 |
| | | 12/27/95 | 21.96 | 136.08 | 34.43 |
| | | 03/26/96 | 20.48 | 137.56 | 34.42 |
| | | 06/05/96 | 21.50 | 136.54 | 34.41 |
| | | 09/16/96 | 22.38 | 135.66 | 34.43 |
| | | 12/02/96 | 22.39 | 135.65 | 34.42 |
| | | 03/10/97 | 20.89 | 137.16 | 34.43 |
| | | 06/12/97 | 21.80 | 136.24 | 34.42 |
| | | 09/29/97 | 22.81 | 135.23 | 34.40 |
| | | 12/01/97 | 21.70 | 136.34 | 34.41 |
| | | 03/19/98 | 19.35 | 138.69 | 34.42 |
| 05/28/98 | 20.52 | 137.52 | 34.41 | | |
| 08/31/98 | 21.40 | 136.64 | 34.40 | | |

Table 2
Cumulative Groundwater Elevation Data
Former Beacon Station # 12574 - Castro Valley, California

| Well ID | Top of Casing Elevation (Feet) ¹ | Date Sounded | Depth to Groundwater (Feet) ¹ | Groundwater Elevation (Feet) ² | Well Depth (Feet) |
|---------|---|-----------------------|--|---|-------------------|
| | | 12/08/98 ³ | | | |

NOTES:

- 1 : Measurement and reference elevation taken from notch/mark on top north side of well casing.
- 2 : Elevation reference to mean sea level.
- Well Depth : Measured from top of casing to bottom of well.
- 3 : Well abandoned.

Table 3
Summary of Groundwater Analytical Results
Former Beacon Station # 12574 - Castro Valley, California

| Well ID | Sample Date | TPHg (µg/L) | TPHd (µg/L) | TPHmo (µg/L) | Benzene (µg/L) | Toluene (µg/L) | Ethylbenzene (µg/L) | Xylenes (µg/L) | MTBE (µg/L) |
|----------|-------------|-------------|-------------|--------------|----------------|----------------|---------------------|----------------|-------------|
| MW-2 | 9/21/01 | 23,000 | NA | NA | 4,600 | 75 | 1,200 | 2,300 | 450 |
| | 03/27/92 | 18,000 | <50 | <50 | 2,400 | 2,300 | 870 | 3,300 | - |
| | 06/04/92 | 14,000 | <5,000 | NA | 1,900 | 1,700 | 580 | 2,300 | - |
| | 09/23/92 | 22,000 | NA | NA | 2,100 | 1,500 | 760 | 2,900 | - |
| | 11/12/92 | 29,000 | NA | NA | 2,400 | 860 | 540 | 3,500 | - |
| | 02/02/93 | 24,000 | NA | NA | 2,700 | 1,900 | 590 | 2,600 | - |
| | 05/07/93 | 19,000 | NA | NA | 1,800 | 1,300 | 460 | 2,600 | - |
| | 08/11/93 | 23,000 | NA | NA | 2,300 | 1,500 | 550 | 2,300 | - |
| | 11/05/93 | 30,000 | NA | NA | 3,100 | 2,900 | 860 | 3,700 | - |
| | 03/01/94 | 13,000 | NA | NA | 1,500 | 490 | 350 | 1,100 | - |
| | 06/02/94 | 12,000 | NA | NA | 2,000 | 790 | 460 | 1,300 | - |
| | 09/09/94 | 13,000 | NA | NA | 1,800 | 660 | 440 | 1,000 | - |
| | 12/20/94 | 16,000 | NA | NA | 2,300 | 1,000 | 650 | 1,900 | - |
| | 03/08/95 | 16,000 | NA | NA | 2,200 | 1,000 | 550 | 2,100 | - |
| | 06/14/95 | NS | NS | NS | NS | NS | NS | NS | - |
| | 09/26/95 | 18,000 | NA | NA | 2,500 | 1,000 | 770 | 2,700 | - |
| | 12/27/95 | NS | NS | NS | NS | NS | NS | NS | - |
| | 03/26/96 | 33,000 | NA | NA | 4,200 | 2,600 | 1,000 | 5,000 | - |
| | 06/05/96 | NS | NS | NS | NS | NS | NS | NS | - |
| | 09/16/96 | 19,000 | NA | NA | 2,600 | 490 | 560 | 2,000 | 940 |
| | 12/02/96 | NS | NS | NS | NS | NS | NS | NS | NS |
| | 03/10/97 | 23,000 | NA | NA | 3,700 | 870 | 650 | 3,000 | 1,400 |
| | 06/12/97 | NS | NS | NS | NS | NS | NS | NS | NS |
| | 09/29/97 | 30,000 | NA | NA | 4,900 | 880 | 990 | 3,800 | 1,400 |
| | 12/01/97 | NS | NS | NS | NS | NS | NS | NS | NS |
| | 03/19/98 | 72,000 | NA | NA | 14,000 | 9,500 | 2,300 | 11,000 | <1,500 |
| | 05/28/98 | NS | NS | NS | NS | NS | NS | NS | NS |
| | 08/31/98 | 29,000 | NA | NA | 4,900 | 1,600 | 960 | 3,900 | 890 |
| | 12/08/98 | NS | NS | NS | NS | NS | NS | NS | NS |
| | 02/17/99 | 26,000 | NA | NA | 5,200 | 930 | 1,200 | 4,400 | 640 |
| | 06/10/99 | NS | NS | NS | NS | NS | NS | NS | NS |
| | 09/07/99 | 32,000 | NA | NA | 5,700 | 600 | 1200 | 3,500 | 1,100 |
| | 12/13/99 | NS | NS | NS | NS | NS | NS | NS | NS |
| 3/16/00 | 38,000 | NA | NA | 4,900 | 780 | 1,100 | 3,700 | 870 | |
| 6/12/00 | NS | NS | NS | NS | NS | NS | NS | NS | |
| 9/5/00 | 21,000 | NA | NA | 3,400 | 490 | 730 | 2,200 | 1,000 | |
| 11/13/00 | NS | NS | NS | NS | NS | NS | NS | NS | |
| 2/26/01 | 33,000 | NA | NA | 5,200 | 260 | 1,400 | 3,200 | 740 | |

Table 3
Summary of Groundwater Analytical Results
Former Beacon Station # 12574 - Castro Valley, California

| Well ID | Sample Date | TPHg (µg/L) | TPHd (µg/L) | TPHmo (µg/L) | Benzene (µg/L) | Toluene (µg/L) | Ethylbenzene (µg/L) | Xylenes (µg/L) | MTBE (µg/L) |
|----------|-------------|-------------|-------------|--------------|----------------|----------------|---------------------|----------------|-------------|
| MW-3 | 6/12/01 | NS | NS | NS | NS | NS | NS | NS | NS |
| | 9/21/01 | 63,000 | NA | NA | 4,400 | 180 | 1,000 | 2,000 | 730 |
| | 03/27/92 | 160 | <50 | <50 | 9.2 | 4.8 | 10 | 23 | - |
| | 06/04/92 | 120 | <50 | NA | 7.5 | 2.7 | 0.5 | 15 | - |
| | 09/23/92 | 220 | NA | NA | 8.3 | 4.3 | 62 | 19 | - |
| | 11/12/92 | 230 | NA | NA | 12 | 5.5 | 77 | 19 | - |
| | 02/02/93 | 86 | NA | NA | 2.4 | 0.71 | 27 | 6.2 | - |
| | 05/07/93 | 140 | NA | NA | 2.6 | 1.2 | 39 | 8.4 | - |
| | 08/11/93 | 490 | NA | NA | 15 | 8.1 | 14 | 37 | - |
| | 11/05/93 | 820 | NA | NA | 45 | 24 | 34 | 93 | - |
| | 03/01/94 | 410 | NA | NA | 7.4 | 2.7 | 56 | 10 | - |
| | 06/02/94 | 440 | NA | NA | 13 | 4.9 | 14 | 31 | - |
| | 09/09/94 | 620 | NA | NA | 12 | 4.8 | 97 | 20 | - |
| | 12/20/94 | 770 | NA | NA | 24 | 11 | 16 | 36 | - |
| | 03/08/95 | 300 | NA | NA | 6.1 | 0.97 | 4.8 | 7.5 | - |
| | 06/14/95 | NS | NS | NS | NS | NS | NS | NS | - |
| | 09/26/95 | 130 | NA | NA | 4.8 | 1.6 | 4.8 | 9.4 | - |
| | 12/27/95 | NS | NS | NS | NS | NS | NS | NS | - |
| | 03/26/96 | <50 | NA | NA | <0.50 | <0.50 | <0.50 | <0.50 | - |
| | 06/05/96 | NS | NS | NS | NS | NS | NS | NS | - |
| | 09/16/96 | 170 | NA | NA | 10 | 2.9 | 44 | 15 | <5.0 |
| | 12/02/96 | NS | NS | NS | NS | NS | NS | NS | NS |
| | 03/10/97 | 84 | NA | NA | 2.3 | <0.50 | 14 | 2.6 | <5.0 |
| | 06/12/97 | NS | NS | NS | NS | NS | NS | NS | NS |
| | 09/29/97 | 740 | NA | NA | 61 | 9.8 | 42 | 61 | <5.0 |
| | 12/01/97 | NS | NS | NS | NS | NS | NS | NS | NS |
| | 03/19/98 | <50 | NA | NA | <0.50 | <0.50 | <0.50 | <0.50 | <5.0 |
| | 05/28/98 | NS | NS | NS | NS | NS | NS | NS | NS |
| | 08/31/98 | 320 | NA | NA | 6.7 | 1.0 | 10 | 9.3 | 3.4 |
| | 12/08/98 | NS | NS | NS | NS | NS | NS | NS | NS |
| | 02/17/99 | 310 | NA | NA | <5.0 | 8.6 | 1.8 | 13 | 14 |
| | 06/10/99 | NS | NS | NS | NS | NS | NS | NS | NS |
| 09/07/99 | 99 | NA | NA | 4.2 | 0.51 | 4.0 | 3.0 | <5.0 | |
| 12/13/99 | NS | NS | NS | NS | NS | NS | NS | NS | |
| 3/16/00 | <50 | NA | NA | <0.50 | <0.50 | <0.50 | <0.50 | <5.0 | |
| 6/12/00 | NS | NA | NA | NS | NS | NS | NS | NS | |
| 9/5/00 | 240 | NA | NA | 3.0 | 0.53 | 9.6 | 4.0 | <5.0 | |
| 11/13/00 | NS | NA | NA | NS | NS | NS | NS | NS | |

Table 3
Summary of Groundwater Analytical Results
Former Beacon Station # 12574 - Castro Valley, California

| Well ID | Sample Date | TPHg (µg/L) | TPHd (µg/L) | TPHmo (µg/L) | Benzene (µg/L) | Toluene (µg/L) | Ethylbenzene (µg/L) | Xylenes (µg/L) | MTBE (µg/L) |
|----------------------|----------------------|-------------|-------------|--------------|----------------|----------------|---------------------|----------------|-------------|
| MW-4 | 2/26/01 | 100 | NA | NA | 0.84 | <0.50 | 3.5 | 1.7 | 0.84 |
| | 6/12/01 | NS | NS | NS | NS | NS | NS | NS | NS |
| | 8/27/01 ³ | - | - | - | - | - | - | - | - |
| | 05/18/93 | <50 | NA | NA | <0.5 | <0.5 | <0.5 | <0.5 | - |
| | 08/11/93 | <50 | NA | NA | <0.5 | <0.5 | <0.5 | <0.5 | - |
| | 11/05/93 | <50 | NA | NA | <0.5 | <0.5 | <0.5 | <0.5 | - |
| | 03/01/94 | <50 | NA | NA | <0.5 | <0.5 | <0.5 | <0.5 | - |
| | 06/02/94 | <50 | NA | NA | <0.5 | <0.5 | <0.5 | <0.5 | - |
| | 09/09/94 | <50 | NA | NA | <0.5 | <0.5 | <0.5 | <0.5 | - |
| | 12/20/94 | <50 | NA | NA | <0.5 | <0.5 | <0.5 | <0.5 | - |
| | 03/08/95 | NS | NS | NS | NS | NS | NS | NS | - |
| | 06/14/95 | NS | NS | NS | NS | NS | NS | NS | - |
| | 09/26/95 | NS | NS | NS | NS | NS | NS | NS | - |
| | 12/27/95 | NS | NS | NS | NS | NS | NS | NS | - |
| | 03/26/96 | NS | NS | NS | NS | NS | NS | NS | - |
| | 06/05/96 | NS | NS | NS | NS | NS | NS | NS | - |
| | 09/16/96 | <50 | NA | NA | <0.50 | <0.50 | <0.50 | <0.50 | <5.0 |
| | 12/02/96 | NS | NS | NS | NS | NS | NS | NS | NS |
| | 03/10/97 | NS | NS | NS | NS | NS | NS | NS | NS |
| | 06/12/97 | NS | NS | NS | NS | NS | NS | NS | NS |
| | 09/29/97 | NS | NS | NS | NS | NS | NS | NS | NS |
| | 12/01/97 | NS | NS | NS | NS | NS | NS | NS | NS |
| | 03/19/98 | NS | NS | NS | NS | NS | NS | NS | NS |
| | 05/28/98 | NS | NS | NS | NS | NS | NS | NS | NS |
| | 08/31/98 | NS | NS | NS | NS | NS | NS | NS | NS |
| | 12/08/98 | NS | NS | NS | NS | NS | NS | NS | NS |
| | 02/17/99 | NS | NS | NS | NS | NS | NS | NS | NS |
| | 06/10/99 | NS | NS | NS | NS | NS | NS | NS | NS |
| | 09/07/99 | NS | NS | NS | NS | NS | NS | NS | NS |
| | 12/13/99 | NS | NS | NS | NS | NS | NS | NS | NS |
| | 3/16/00 | NS | NS | NS | NS | NS | NS | NS | NS |
| | 6/12/00 | NS | NS | NS | NS | NS | NS | NS | NS |
| 9/5/00 | NS | NS | NS | NS | NS | NS | NS | NS | |
| 11/13/00 | NS | NS | NS | NS | NS | NS | NS | NS | |
| 2/26/01 | NS | NS | NS | NS | NS | NS | NS | NS | |
| 6/12/01 | NS | NS | NS | NS | NS | NS | NS | NS | |
| 8/27/01 ³ | - | - | - | - | - | - | - | - | - |
| MW-5 | 05/18/93 | <50 | NA | NA | <0.5 | <0.5 | <0.5 | <0.5 | - |
| | 08/11/93 | <50 | NA | NA | <0.5 | <0.5 | <0.5 | <0.5 | - |

Table 3
Summary of Groundwater Analytical Results
Former Beacon Station # 12574 - Castro Valley, California

| Well ID | Sample Date | TPHg (µg/L) | TPHd (µg/L) | TPHmo (µg/L) | Benzene (µg/L) | Toluene (µg/L) | Ethyl-benzene (µg/L) | Xylenes (µg/L) | MTBE (µg/L) |
|----------------------|-------------|-------------|-------------|--------------|----------------|----------------|----------------------|----------------|-------------|
| | 11/05/93 | <50 | NA | NA | <0.5 | <0.5 | <0.5 | <0.5 | - |
| | 03/01/94 | <50 | NA | NA | <0.5 | <0.5 | <0.5 | <0.5 | - |
| | 06/02/94 | <50 | NA | NA | <0.5 | <0.5 | <0.5 | <0.5 | - |
| | 09/09/94 | <50 | NA | NA | <0.5 | <0.5 | <0.5 | <0.5 | - |
| MW-5 (cont.) | 12/20/94 | <50 | NA | NA | <0.5 | <0.5 | <0.5 | <0.5 | - |
| | 03/08/95 | <50 | NA | NA | <0.5 | <0.5 | <0.5 | <0.5 | - |
| | 06/14/95 | <50 | NA | NA | <0.5 | <0.5 | <0.5 | <0.5 | - |
| | 09/26/95 | <50 | NA | NA | <0.50 | <0.50 | <0.50 | <0.50 | - |
| | 12/27/95 | <50 | NA | NA | <0.50 | <0.50 | <0.50 | <0.50 | - |
| | 03/26/96 | <50 | NA | NA | <0.50 | <0.50 | <0.50 | <0.50 | - |
| | 06/05/96 | <50 | NA | NA | <0.50 | <0.50 | <0.50 | <0.50 | 15 |
| | 09/16/96 | <50 | NA | NA | <0.50 | <0.50 | <0.50 | <0.50 | 20 |
| | 12/02/96 | <50 | NA | NA | <0.50 | <0.50 | <0.50 | <0.50 | 12 |
| | 03/10/97 | <50 | NA | NA | <0.50 | <0.50 | <0.50 | <0.50 | 7.0 |
| | 06/12/97 | <50 | NA | NA | <0.50 | <0.50 | <0.50 | <0.50 | 7.2 |
| | 09/29/97 | <50 | NA | NA | <0.50 | <0.50 | <0.50 | <0.50 | <5.0 |
| | 12/01/97 | <50 | NA | NA | <0.50 | <0.50 | <0.50 | <0.50 | <5.0 |
| | 03/19/98 | <50 | NA | NA | <0.50 | <0.50 | <0.50 | <0.50 | <5.0 |
| | 05/28/98 | <50 | NA | NA | <0.50 | <0.50 | <0.50 | <0.50 | <5.0 |
| | 08/31/98 | <50 | NA | NA | <0.50 | <0.50 | <0.50 | <0.50 | <0.50 |
| | 12/08/98 | <50 | NA | NA | <0.50 | <0.50 | <0.50 | <0.50 | <5.0 |
| | 02/17/99 | <50 | NA | NA | <0.50 | <0.50 | <0.50 | <0.50 | <5.0 |
| | 06/10/99 | <50 | NA | NA | <0.50 | <0.50 | <0.50 | <0.50 | <5.0 |
| | 09/07/99 | <50 | NA | NA | <0.50 | <0.50 | <0.50 | <0.50 | <5.0 |
| | 12/13/99 | <50 | NA | NA | <0.50 | <0.50 | <0.50 | <0.50 | <5.0 |
| | 3/16/00 | <50 | NA | NA | <0.50 | <0.50 | <0.50 | <0.50 | <5.0 |
| | 6/12/00 | <50 | NA | NA | <0.50 | <0.50 | <0.50 | <0.50 | <5.0 |
| | 9/5/00 | <50 | NA | NA | <0.50 | <0.50 | <0.50 | <0.50 | <5.0 |
| | 11/13/00 | <50 | NA | NA | <0.50 | <0.50 | <0.50 | <0.50 | <0.50 |
| | 2/26/01 | <50 | NA | NA | <0.50 | <0.50 | <0.50 | <0.50 | <0.50 |
| 6/12/01 | <50 | NA | NA | <0.50 | <0.50 | <0.50 | <0.50 | <0.50 | |
| 8/27/01 ³ | - | - | - | - | - | - | - | - | - |
| MW-6 | 05/18/93 | 170 | NA | NA | <0.5 | <0.5 | <0.5 | <0.5 | |
| | 08/11/93 | 78 | NA | NA | <0.5 | <0.5 | <0.5 | <0.5 | |
| | 11/05/93 | 170 | NA | NA | <0.5 | <0.5 | <0.5 | <0.5 | |
| | 03/01/94 | 210 | NA | NA | <0.5 | <0.5 | <0.5 | <0.5 | |
| | 06/02/94 | 190 | NA | NA | <0.5 | <0.5 | <0.5 | <0.5 | |
| | 09/09/94 | 140 | NA | NA | <0.5 | <0.5 | <0.5 | <0.5 | |
| | 12/20/94 | 210 | NA | NA | <0.5 | <0.5 | <0.5 | <0.5 | |

Table 3
Summary of Groundwater Analytical Results
Former Beacon Station # 12574 - Castro Valley, California

| Well ID | Sample Date | TPHg (µg/L) | TPHd (µg/L) | TPHmo (µg/L) | Benzene (µg/L) | Toluene (µg/L) | Ethyl-benzene (µg/L) | Xylenes (µg/L) | MTBE (µg/L) |
|-----------------|----------------------|------------------|-------------|--------------|----------------|----------------|----------------------|----------------|-------------|
| | 03/08/95 | 180 ¹ | NA | NA | <0.5 | <0.5 | <0.5 | <0.5 | |
| | 06/14/95 | 220 ¹ | NA | NA | <0.5 | <0.5 | <0.5 | <0.5 | |
| | 09/26/95 | 110 ¹ | NA | NA | <0.50 | <0.50 | <0.50 | <0.50 | |
| | 12/27/95 | 130 ¹ | NA | NA | <0.50 | <0.50 | <0.50 | <0.50 | |
| | 03/08/95 | 100 ¹ | NA | NA | <0.50 | <0.50 | <0.50 | <0.50 | |
| MW-6 (cont.) | 06/05/96 | 100 ¹ | NA | NA | <0.50 | <0.50 | <0.50 | <0.50 | 430 |
| | 09/16/96 | 170 | NA | NA | <0.50 | <0.50 | <0.50 | <0.50 | 430 |
| | 12/02/96 | 160 | NA | NA | <0.50 | <0.50 | <0.50 | <0.50 | 160 |
| | 03/10/97 | 140 | NA | NA | <0.50 | <0.50 | <0.50 | <0.50 | 390 |
| | 06/12/97 | <50 | NA | NA | <0.50 | <0.50 | <0.50 | <0.50 | 330 |
| | 09/29/97 | <50 | NA | NA | <0.50 | <0.50 | <0.50 | <0.50 | 130 |
| | 12/01/97 | <50 | NA | NA | <0.50 | <0.50 | <0.50 | <0.50 | 200 |
| | 03/19/98 | <50 | NA | NA | <0.50 | <0.50 | <0.50 | <0.50 | 240 |
| | 05/28/98 | <50 | NA | NA | <0.50 | <0.50 | <0.50 | <0.50 | 290 |
| | 08/31/98 | <50 | NA | NA | <0.50 | <0.50 | <0.50 | <0.50 | 290 |
| | 12/08/98 | <50 | NA | NA | <0.50 | <0.50 | <0.50 | <0.50 | 230 |
| | 02/17/99 | <50 | NA | NA | <0.50 | <0.50 | <0.50 | <0.50 | 200 |
| | 06/10/99 | <50 | NA | NA | <0.50 | <0.50 | <0.50 | <0.50 | 290 |
| | 09/07/99 | <50 | NA | NA | <0.50 | <0.50 | <0.50 | <0.50 | 230 |
| | 12/13/99 | <50 | NA | NA | <0.50 | <0.50 | <0.50 | <0.50 | 180 |
| | 3/16/00 | <50 | NA | NA | <0.50 | <0.50 | <0.50 | <0.50 | 260 |
| | 6/12/00 | <50 | NA | NA | <0.50 | <0.50 | <0.50 | <0.50 | 160 |
| | 9/5/00 | <50 | NA | NA | <0.50 | 0.50 | <0.50 | 0.81 | 170 |
| | 11/13/00 | <50 | NA | NA | <0.50 | <0.50 | <0.50 | <0.50 | 190 |
| | 2/26/01 | <50 | NA | NA | <0.50 | <0.50 | <0.50 | <0.50 | 130 |
| 6/12/01 | <50 | NA | NA | <0.50 | <0.50 | <0.50 | <0.50 | 96 | |
| | 8/27/01 ³ | - | - | - | - | - | - | - | - |
| MW-7 | 05/18/93 | <50 | NA | NA | <0.5 | <0.5 | <0.5 | <0.5 | |
| | 08/11/93 | <50 | NA | NA | <0.5 | <0.5 | <0.5 | <0.5 | |
| | 11/05/93 | <50 | NA | NA | <0.5 | <0.5 | <0.5 | <0.5 | |
| | 03/01/94 | 60 | NA | NA | <0.5 | <0.5 | <0.5 | <0.5 | |
| | 06/02/94 | <50 | NA | NA | <0.5 | <0.5 | <0.5 | <0.5 | |
| | 09/09/94 | <50 | NA | NA | <0.5 | <0.5 | <0.5 | <0.5 | |
| | 12/20/94 | <50 | NA | NA | <0.5 | <0.5 | <0.5 | <0.5 | |
| | 03/08/95 | <50 | NA | NA | <0.5 | <0.5 | <0.5 | <0.5 | |
| | 06/14/95 | <50 | NA | NA | <0.5 | <0.5 | <0.5 | <0.5 | |
| | 09/26/95 | <50 | NA | NA | <0.50 | <0.50 | <0.50 | <0.50 | |
| 12/27/95 | <50 | NA | NA | <0.50 | <0.50 | <0.50 | <0.50 | | |

Table 3
Summary of Groundwater Analytical Results
Former Beacon Station # 12574 - Castro Valley, California

| Well ID | Sample Date | TPHg (µg/L) | TPHd (µg/L) | TPHmo (µg/L) | Benzene (µg/L) | Toluene (µg/L) | Ethylbenzene (µg/L) | Xylenes (µg/L) | MTBE (µg/L) |
|-------------|-----------------------|-------------|-------------|--------------|----------------|----------------|---------------------|----------------|-------------|
| | 03/08/95 | <50 | NA | NA | <0.50 | <0.50 | <0.50 | <0.50 | |
| | 06/05/96 | <50 | NA | NA | <0.50 | <0.50 | <0.50 | <0.50 | 20 |
| | 09/16/96 | <50 | NA | NA | <0.50 | <0.50 | <0.50 | <0.50 | 26 |
| | 12/02/96 | 140 | NA | NA | <0.50 | <0.50 | <0.50 | <0.50 | 140 |
| | 03/10/97 | <50 | NA | NA | <0.50 | <0.50 | <0.50 | <0.50 | 29 |
| | 06/12/97 | <50 | NA | NA | <0.50 | <0.50 | <0.50 | <0.50 | 28 |
| | 09/29/97 | <50 | NA | NA | <0.50 | <0.50 | <0.50 | <0.50 | 27 |
| MW-7 | 12/01/97 | <50 | NA | NA | <0.50 | <0.50 | <0.50 | <0.50 | 29 |
| (cont.) | 03/19/98 | <50 | NA | NA | <0.50 | <0.50 | <0.50 | <0.50 | 6.0 |
| | 05/28/98 | <50 | NA | NA | <0.50 | <0.50 | <0.50 | <0.50 | 25 |
| | 08/31/98 | <50 | NA | NA | <0.50 | <0.50 | <0.50 | <0.50 | 20 |
| | 12/08/98 ² | | | | | | | | |
| MW-8 | 05/18/93 | <50 | NA | NA | <0.5 | <0.5 | <0.5 | <0.5 | - |
| | 08/11/93 | <50 | NA | NA | <0.5 | <0.5 | <0.5 | <0.5 | - |
| | 11/05/93 | <50 | NA | NA | <0.5 | <0.5 | <0.5 | <0.5 | - |
| | 03/01/94 | <50 | NA | NA | <0.5 | <0.5 | <0.5 | <0.5 | - |
| | 06/02/94 | <50 | NA | NA | <0.5 | <0.5 | <0.5 | <0.5 | - |
| | 09/09/94 | <50 | NA | NA | <0.5 | <0.5 | <0.5 | <0.5 | - |
| | 12/20/94 | <50 | NA | NA | <0.5 | <0.5 | <0.5 | <0.5 | - |
| | 03/08/95 | NS | NS | NS | NS | NS | NS | NS | - |
| | 06/14/95 | NS | NS | NS | NS | NS | NS | NS | - |
| | 09/26/95 | NS | NS | NS | NS | NS | NS | NS | - |
| | 12/27/95 | NS | NS | NS | NS | NS | NS | NS | - |
| | 03/08/95 | NS | NS | NS | NS | NS | NS | NS | - |
| | 06/05/96 | NS | NS | NS | NS | NS | NS | NS | - |
| | 09/16/96 | <50 | NA | NA | <0.50 | <0.50 | <0.50 | <0.50 | <5.0 |
| | 12/02/96 | NS | NS | NS | NS | NS | NS | NS | NS |
| | 03/10/97 | NS | NS | NS | NS | NS | NS | NS | NS |
| | 06/12/97 | NS | NS | NS | NS | NS | NS | NS | NS |
| | 09/29/97 | NS | NS | NS | NS | NS | NS | NS | NS |
| | 12/01/97 | NS | NS | NS | NS | NS | NS | NS | NS |
| | 03/19/98 | NS | NS | NS | NS | NS | NS | NS | NS |
| | 05/28/98 | NS | NS | NS | NS | NS | NS | NS | NS |
| | 08/31/98 | NS | NS | NS | NS | NS | NS | NS | NS |
| | 12/08/98 ² | | | | | | | | |

Notes:

<: Below indicated detection limit.

NS : Not sampled.

NA: Not Analyzed.

Table 3
Summary of Groundwater Analytical Results
Former Beacon Station # 12574 - Castro Valley, California

| Well ID | Sample Date | TPHg (µg/L) | TPHd (µg/L) | TPHmo (µg/L) | Benzene (µg/L) | Toluene (µg/L) | Ethyl-benzene (µg/L) | Xylenes (µg/L) | MTBE (µg/L) |
|--|-------------|-------------|-------------|--------------|----------------|----------------|----------------------|----------------|-------------|
| ¹ : Product not typical gasoline. ² : Well abandoned ³ : As directed by Alameda County, Monitoring wells not sampled. | | | | | | | | | |