

ENVIRONMENTAL  
PROTECTION



**Chevron**

96 DEC 17 PM 4: 01

December 13, 1996

*STIP 402*

Ms. Susan Hugo  
Alameda County Health Care Services  
Department of Environmental Health  
1131 Harbor Bay Parkway, Suite 250  
Alameda, CA 94502-6577

*PO 351*

**Chevron Products Company**  
6001 Bollinger Canyon Road  
Building L  
San Ramon, CA 94583  
P.O. Box 5004  
San Ramon, CA 94583-0804

**Marketing - Northwest Region**  
Phone 510 842 9500

**Re: Former Chevron Service Station #9-3864  
5101 Telegraph Avenue, Oakland, CA**

Dear Ms. Hugo:

I appreciate the time you spent at the meeting held at the Regional Water Quality Control Board (RWQCB) offices on December 11, 1996, and also the time given by Mr. Kevin Graves of the RWQCB, to discuss the proposed development of this site, by Mr. Howard Schindler of Schindler Associates, with his contractor Mr. Norbert Doran of Kilkenny Inc.

As discussed in the meeting, you and Mr. Kevin Graves of the RWQCB, agreed that the site is acceptable for development by Schindler Associates. It was also noted that two of Chevron's monitoring wells would be located under the proposed buildings to be constructed on the site. After some discussion, you gave verbal authority to remove these wells ( C-1 and C-4 ), but you requested that this be followed up with a letter from Chevron requesting abandonment of these wells. This letter is that request, and I have already contracted with Gettler-Ryan to remove these wells. They have advised me that they are expecting to abandon the wells on December 20, 1996.

We also discussed the abandonment of the other two remaining monitoring wells on the site, C-2 and C-3. The concentrations of BTEX constituents have been historical minimal in these wells and there are offsite monitoring wells that will continued to be sampled, to give us the same information. Also in the course of any construction activities, there is the possibility of damage to these wells, even though all care is taken to prevent this. Therefore, Chevron requests that monitoring wells C-2 and C-3 also be abandoned. Please review this request as soon as possible, since Gettler-Ryan will be on the site December 20. Copy of ground water monitoring site plan and developers sketch of proposed development is enclosed for reference.

For your information, I have contracted with Touchstone Developments, to be available at the site, if any petroleum hydrocarbon impacted soil is encountered during the course of the development. Touchstone, with my approval, will submit a Soil Excavation Management Plan as you requested.

If you have any questions or comments, call me at (510) 842-9136.

Sincerely,  
CHEVRON PRODUCTS COMPANY

*Philip R. Briggs*  
Philip R. Briggs

Site Assessment and Remediation Project Manger

December 13, 1996  
Ms. Susan Hugo  
Former Chevron Service Station # 9-3864  
Page 2

Enclosure

cc. Mr. Bette Owen, Chevron

Dr. Ravi Arulanantham  
RWQCB-San Francisco Bay Region  
2101 Webster Street, Suite 500  
Oakland, CA 94612



Mr. Kevin Graves  
RWQCB-San Francisco Bay Region  
2101 Webster Street, Suite 500  
Oakland, CA 94612

Mr. Howard Schindler  
Schindler Associates  
4179 Piedmont Avenue  
Oakland, CA 94611

Mr. Greg Gurss  
Gettler-Ryan  
3164 Gold Camp Drive, Suite 240  
Rancho Cordova, CA 95670

Mr. Jeff Monroe  
Touchstone Developoments  
P.O. Box 2554  
Santa Rosa, CA 95405

**EXPLANATION**

- MW-2  GROUND-WATER MONITORING WELL
- 99.81 GROUND-WATER ELEVATION IN FEET ABOVE MEAN SEA LEVEL
- 102 GROUND-WATER ELEVATION CONTOUR IN FEET ABOVE MEAN SEA LEVEL
- 0.02  APPROXIMATE DIRECTION OF GROUND-WATER FLOW. GRADIENT INDICATED IN FEET / FEET

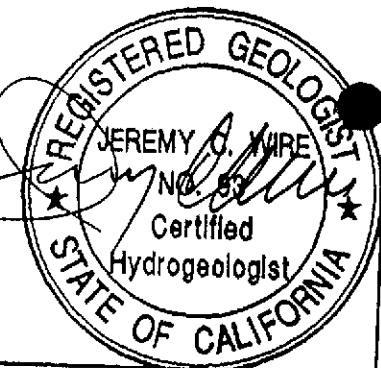
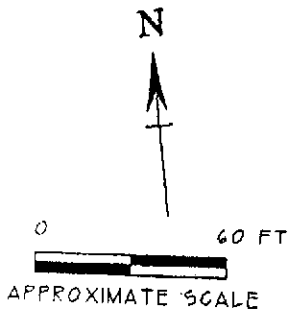
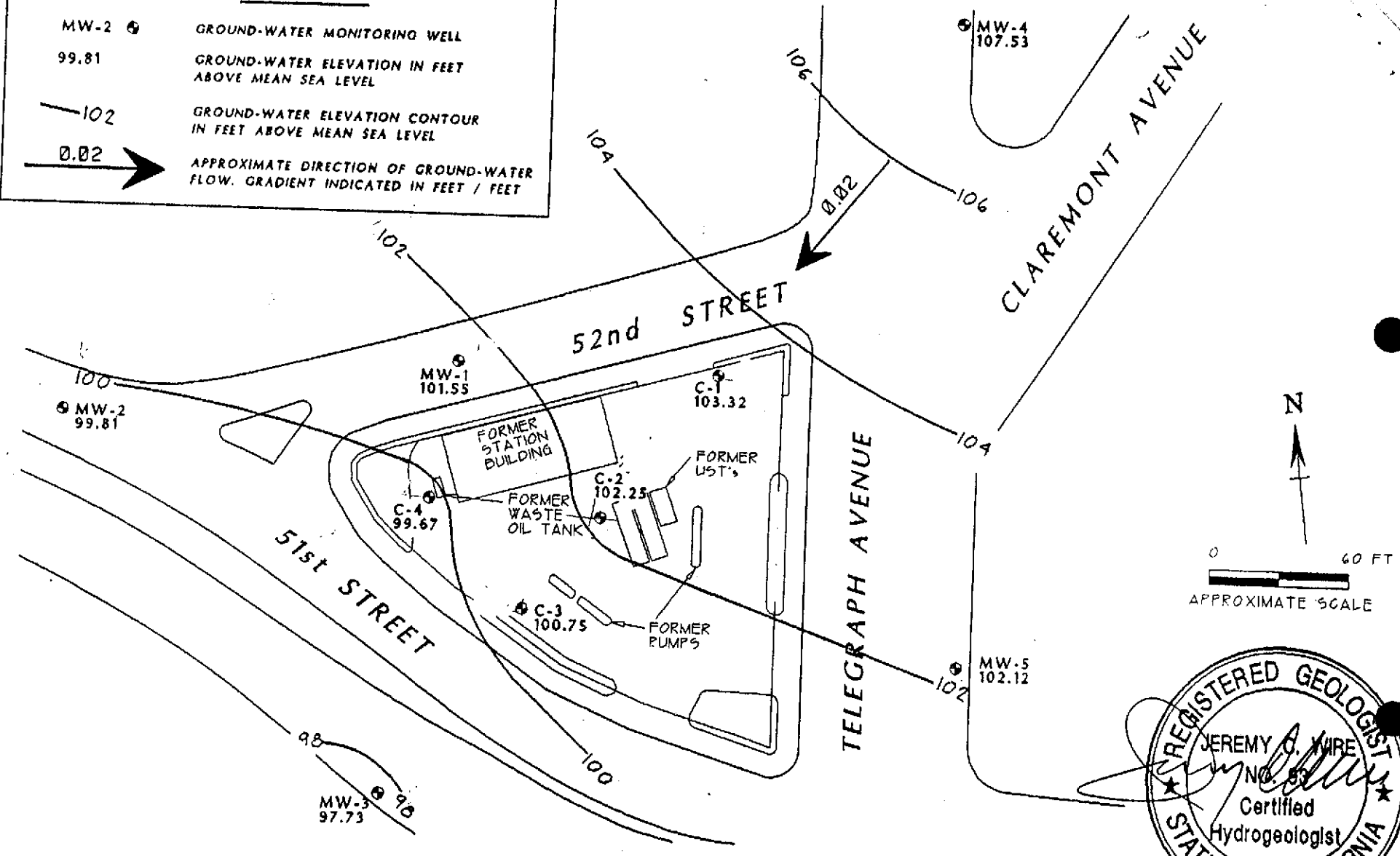

NOTES:

TITLE : GROUND-WATER ELEVATION CONTOUR MAP - SEPTEMBER 12, 1996  
 LOCATION : FORMER CHEVRON SERVICE STATION 9-3864 5101 TELEGRAPH AVENUE, OAKLAND, CALIFORNIA  
 SOURCE : CAMBRIA ENVIRONMENTAL TECHNOLOGY, INC.



GEOCONSULTANTS, INC  
 SAN JOSE, CALIFORNIA  
 Project No. Q758-09  
 DRWG NO: W091296 REV:

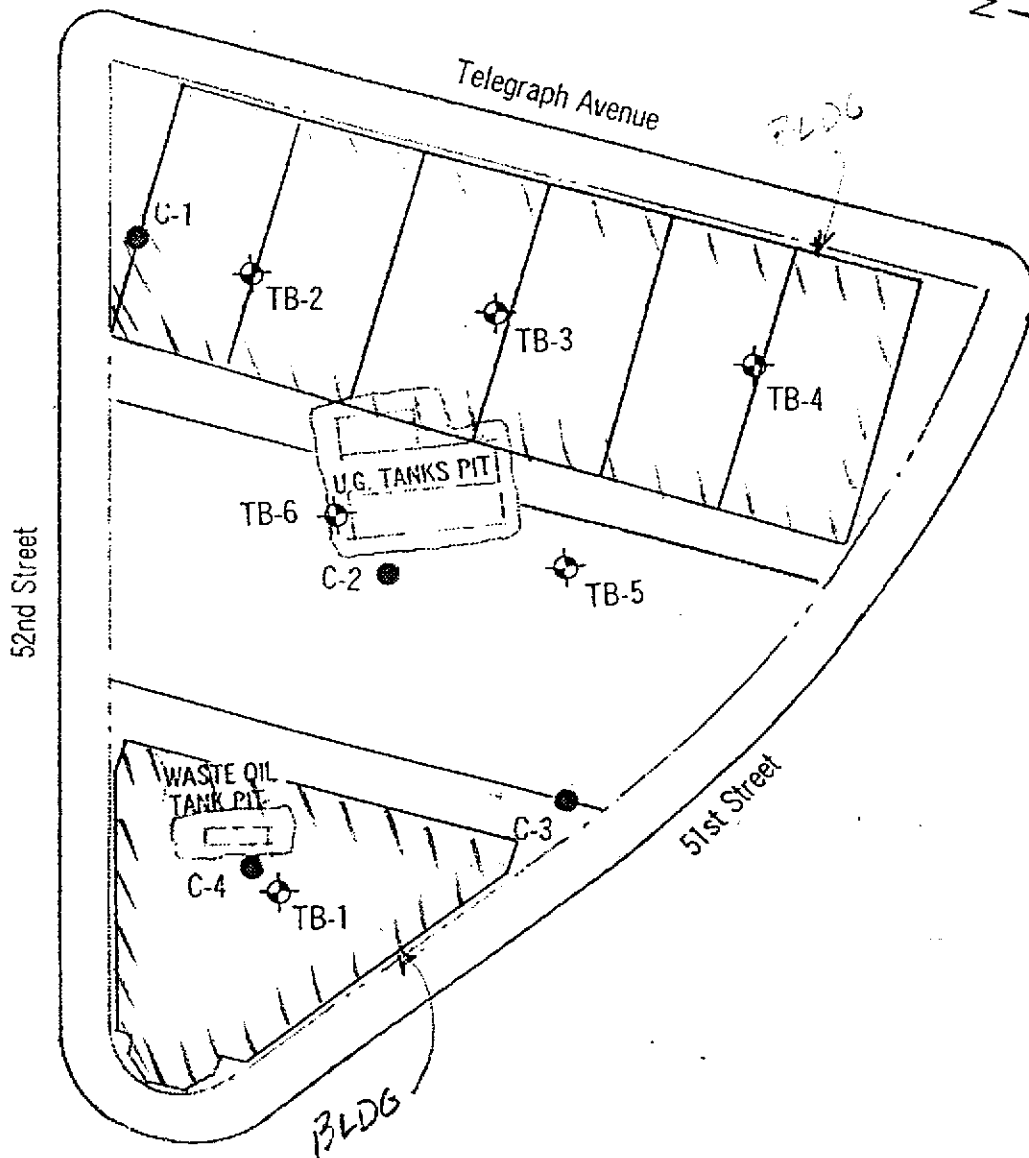
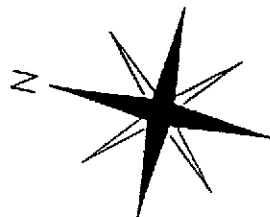

**LEGEND**

- TB-1 TEST BORING
- C-1 MONITORING WELL (by GeoStrategies, Inc.)

SOURCES: MONITORING WELLS AND TANK PIT LOCATIONS  
GEOSTRATEGIES, INC. 1/17/1991 REPORT.

BUILDING LOCATIONS  
KIRK E. PETERSON & ASSOCIATES, 1/6/96

SCALE: 1" = 20'

5101 TELEGRAPH AVENUE  
OAKLAND, CALIFORNIA

**SITE MAP / BORING LOCATION MAP**

**TONG & CHANG CONSULTANTS, INC.**

PROJECT NO. TCC-037

DATE: 7/2/96

PREPARED BY: PLC

PLATE: 2