



GETTLER-RYAN INC. JUN 28 2002

TRANSMITTAL

June 3, 2002
G-R #386539

TO: Mr. James Brownell
Delta Environmental Consultants, Inc.
3164 Gold Camp Drive, Suite 200
Rancho Cordova, California 95670

CC: Ms. Karen Streich
Chevron Products Company
P.O. Box 6004
San Ramon, California 94583

FROM: Deanna L. Harding
Project Coordinator
Gettler-Ryan Inc.
6747 Sierra Court, Suite J
Dublin, California 94568

RE: **Chevron Service Station
#9-5607
5269 Crow Canyon Road
Castro Valley, California**

WE HAVE ENCLOSED THE FOLLOWING:

COPIES	DATED	DESCRIPTION
1	May 24, 2002	Groundwater Monitoring and Sampling Report Second Quarter - Event of April 11, 2002

COMMENTS:

Please provide any comments/changes and propose any groundwater monitoring modifications for the next event prior to **June 17, 2002**, at which time the final report will be distributed to the following:

- cc: ~~Mr. Scott Seery, Alameda County Health Care Services, Dept. of Environmental Health, 1131 Harbor Bay Parkway, Suite 250, Alameda, CA 94502-6577~~
- Mr. Greg Gurss, Gettler-Ryan Inc., 3140 Gold Camp Drive, Suite 170, Rancho Cordova, CA 95670
- Mr. Chuck Headlee, RWQCB - San Francisco Bay Region, 1515 Clay Street, Suite 1400, Oakland, CA 94612
- Mr. Kevin Hinckley, 5269 Crow Canyon Road, Castro Valley, CA 94546
- Ms. Diane Riggs, Forest Creek Townhomes Assoc., c/o Walsh Property Management, P.O. Box 2657, Castro Valley, CA, 94541
- Mr. Tim Utterback, Weiss Associates, 5801 Christy Avenue, Suite 600, Emeryville, CA 94608

Enclosures



GETTLER-RYAN INC.

May 24, 2002
G-R Job #386539

Ms. Karen Streich
Chevron Products Company
P.O. Box 6004
San Ramon, CA 94583

RE: Second Quarter Event of April 11, 2002
Groundwater Monitoring & Sampling Report
Chevron Service Station #9-5607
5269 Crow Canyon Road
Castro Valley, California

Dear Ms. Streich:

This report documents the most recent groundwater monitoring and sampling event performed by Gettler-Ryan Inc. (G-R) at the referenced site. All field work was conducted in accordance with G-R Standard Operating Procedure - Groundwater Sampling (attached).

Static groundwater levels were measured and the wells were checked for the presence of separate-phase hydrocarbons. Static water level data, groundwater elevations, and separate-phase hydrocarbon thickness (if any) are presented in the attached Table 1. A Potentiometric Map is included as Figure 1.

Groundwater samples were collected from the monitoring wells and submitted to a state certified laboratory for analyses. The field data sheets for this event are attached. Analytical results are presented in the table(s) listed below. Isoconcentration Maps are included as Figures 2 and 3. The chain of custody document and laboratory analytical report are also attached.

Please call if you have any questions or comments regarding this report. Thank you.

Sincerely,

Deanna L. Harding
Project Coordinator

Douglas J. Lee
Senior Geologist, R.G. No. 6882

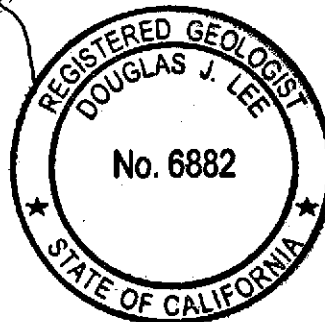

- Figure 1: Potentiometric Map
- Figure 2: TPH-G Isoconcentration Map
- Figure 3: Benzene Isoconcentration Map
- Table 1: Groundwater Monitoring Data and Analytical Results
- Table 2: Groundwater Analytical Results - Oxygenate Compounds
- Attachments: Standard Operating Procedure - Groundwater Sampling
Field Data Sheets
Chain of Custody Document and Laboratory Analytical Reports

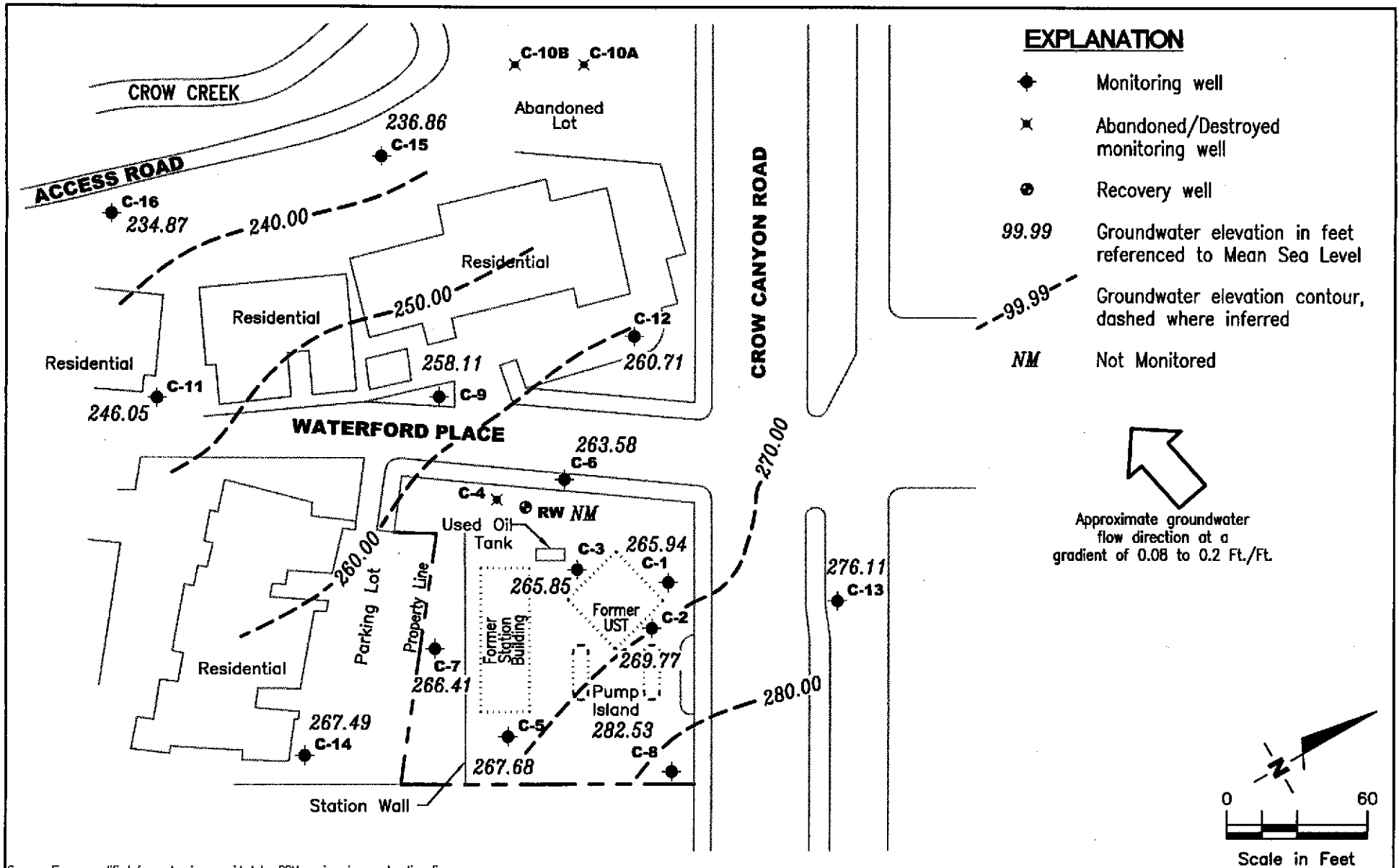

Source: Figure modified from drawing provided by RRM engineering contracting firm.

GETTLER - RYAN INC.
 6747 Sierra Ct., Suite J
 Dublin, CA 94568 (925) 551-7555

POTENTIOMETRIC MAP
 Chevron Service Station #9-5607
 5269 Crow Canyon Road
 Castro Valley, California

FIGURE

1

PROJECT NUMBER
 386539

REVIEWED BY

DATE
 April 11, 2002

REVISED DATE

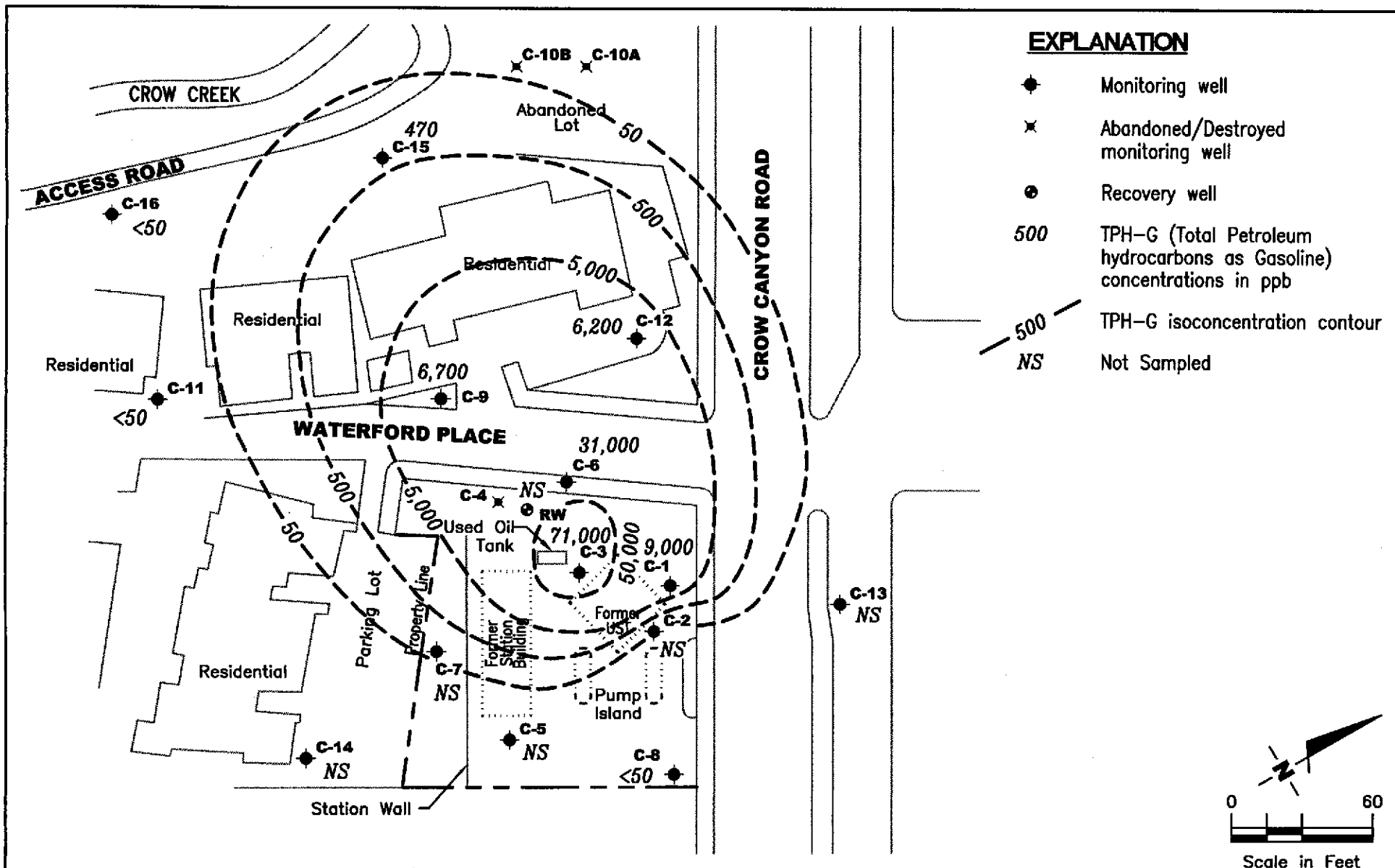

GETTLER - RYAN INC.
 6747 Sierra Ct., Suite J
 Dublin, CA 94568 (925) 551-7555

TPH-G ISOCONCENTRATION MAP
 Chevron Service Station #9-5607
 5269 Crow Canyon Road
 Castro Valley, California

FIGURE
2

PROJECT NUMBER
386539

REVIEWED BY

DATE
 April 11, 2002

REVISED DATE

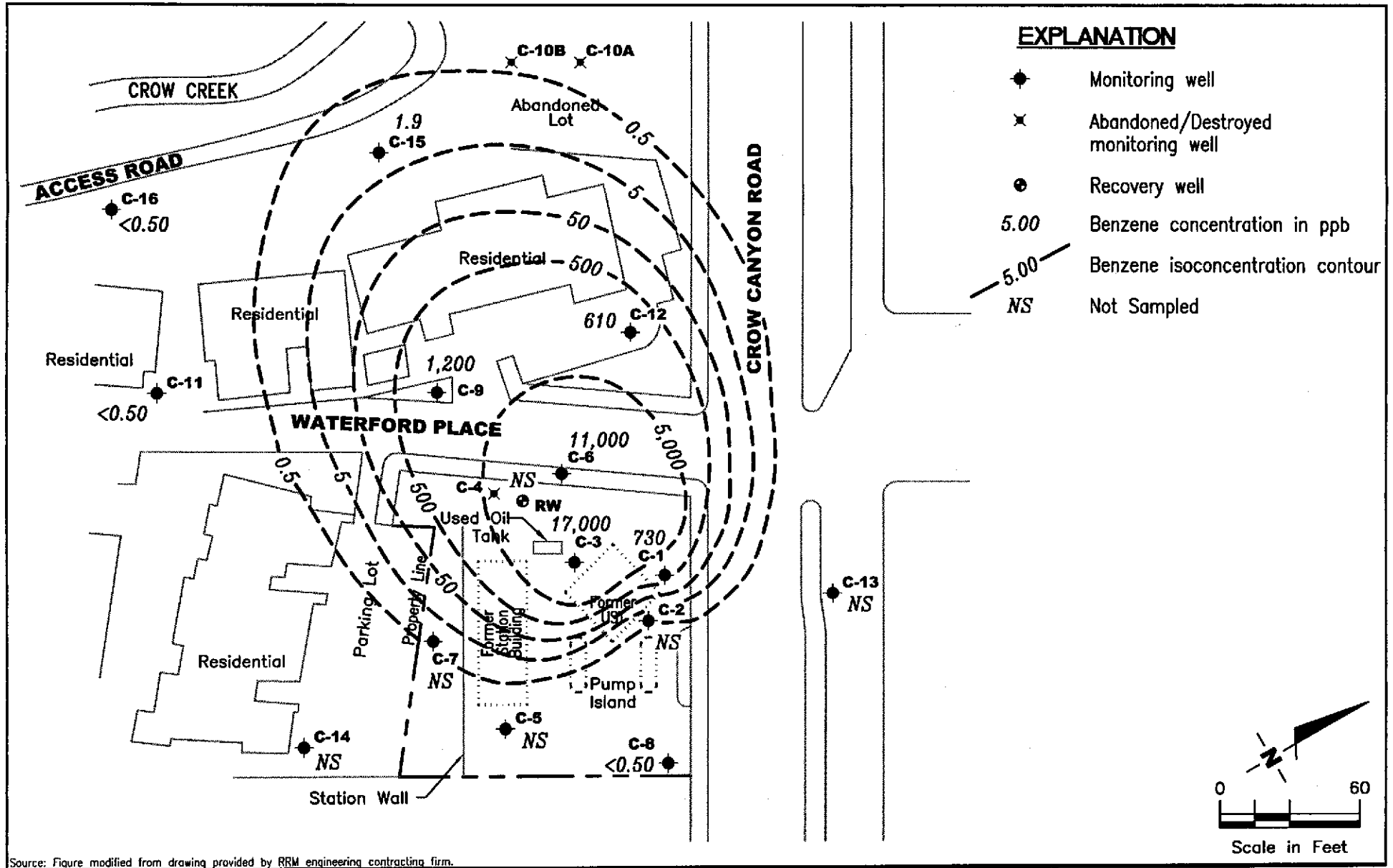

Source: Figure modified from drawing provided by RRM engineering contracting firm.

GETTLER - RYAN INC.
 6747 Sierra Ct., Suite J
 Dublin, CA 94568 (925) 551-7555

BENZENE ISOCONCENTRATION
 Chevron Service Station #9-5607
 5269 Crow Canyon Road
 Castro Valley, California

FIGURE
3

PROJECT NUMBER
386539

REVIEWED BY

DATE
 April 11, 2002

REVISED DATE

Table 1
Groundwater Monitoring Data and Analytical Results
Chevron Service Station #9-5607
5269 Crow Canyon Road
Castro Valley, California

WELL ID/ DATE	TOC (ft.)	GWE (msl)	DTW (ft.)	SPHT (ft.)	TPH-G (ppb)	B (ppb)	T (ppb)	E (ppb)	X (ppb)	MTBE (ppb)
C-1										
03/26/85	283.46	260.63	22.83	--	--	--	--	--	--	--
07/03/86	283.46	259.88	23.58	--	--	--	--	--	--	--
03/26/87	283.46	262.96	20.50	--	--	--	--	--	--	--
03/28/88	283.46	257.46	26.00	--	--	--	--	--	--	--
03/10/89	283.46	267.60	15.86	--	--	--	--	--	--	--
04/03/89	283.46	266.61	16.85	--	--	--	--	--	--	--
05/08/89	283.46	260.78	22.68	--	--	--	--	--	--	--
06/05/89	283.46	258.80	24.66	--	--	--	--	--	--	--
07/12/90	283.46	257.90	25.56	--	--	--	--	--	--	--
08/10/90	283.46	257.57	25.89	--	--	--	--	--	--	--
09/13/89	283.46	256.91	26.55	--	22,000	3,600	1,100	1,000	3,500	--
10/04/89	283.46	258.22	25.24	--	--	--	--	--	--	--
11/03/89	283.46	258.43	25.03	--	--	--	--	--	--	--
12/04/89	283.46	257.09	26.37	--	13,000	2,000	550	610	1,600	--
03/07/90	283.46	260.98	22.48	--	--	--	--	--	--	--
03/09/90	283.46	--	--	--	--	--	--	--	--	--
06/12/90	283.46	259.11	24.35	--	21,000	3,500	1,400	840	4,000	--
09/20/90	283.46	257.19	26.27	--	23,000	2,100	1,200	860	5,000	--
12/20/90	283.46	260.87	22.59	--	8,200	760	410	260	1,100	--
03/27/91	283.46	264.38	19.08	--	--	--	--	--	--	--
06/18/91	283.46	256.35	27.11	--	--	--	--	--	--	--
09/12/91	283.46	255.24	28.22	--	--	--	--	--	--	--
01/23/92	283.46	256.81	26.65	--	--	--	--	--	--	--
04/13/92	283.46	261.30	22.16	--	38,000	3,100	1,300	850	3,100	--
08/03/92	283.46	257.31	26.15	--	13,000	3,100	1,300	850	3,100	--
10/22/92	283.46	256.67	26.79	--	24,000	3,500	1,400	1,500	4,300	--
01/18/93	283.46	264.86	18.60	--	370,000	6,900	8,900	3,100	23,000	--
04/19/93	283.46	262.34	21.12	--	51,000	8,000	7,000	1,400	10,000	--
07/21-22/93	283.46	260.18	23.28	--	22,000	3,400	1,000	990	3,100	--
10/25/93	283.46	258.80	24.66	--	14,000	2,000	550	790	2,300	--
01/21/94	283.46	262.99	20.47	--	1,100	350	6.0	3.0	15	--
04/18/94	283.46	260.36	23.10	--	24,000	3,200	1,000	1,000	3,100	--

Table 1
Groundwater Monitoring Data and Analytical Results
Chevron Service Station #9-5607
5269 Crow Canyon Road
Castro Valley, California

WELL ID/ DATE	TOC (ft.)	GWE (msl)	DTW (ft.)	SPHT (ft.)	TPH-G (ppb)	B (ppb)	T (ppb)	E (ppb)	X (ppb)	MTBE (ppb)
C-1 (cont)										
07/06-07/94	283.46	260.56	22.90	--	65,000	6,500	4,200	1,600	9,300	--
10/07/94	283.46	258.75	24.71	--	27,000	5,100	1,200	1,400	4,300	--
01/11/95	283.46	265.16	18.30	--	29,000	1,300	1,200	930	4,000	--
04/24/95	283.46	266.52	16.94	--	75,000	8,900	5,000	1,700	8,400	--
07/31/95	283.46	262.90	20.56	--	56,000	11,000	2,600	2,500	11,000	--
10/02/95	283.46	272.88	10.58	--	44,000	7,900	1,100	2,100	6,500	--
01/16/96	283.46	261.71	21.75	--	29,000	5,300	460	1,000	2,800	<500
04/18/96	283.46	264.51	18.95	--	59,000	7,100	3,000	2,000	7,600	<250
07/22/96	283.46	262.46	21.00	--	26,000	6,100	610	1,800	4,700	<250
10/10/96	283.46	261.46	22.00	--	24,000	7,100	600	1,700	3,200	<250
01/09/97	283.46	268.05	15.41	--	32,000	4,600	820	1,500	4,000	670
04/15/97	283.46	264.12	19.34	--	100,000	11,000	4,500	3,200	13,000	1,700/<200 ¹
07/08/97	283.46	263.68	19.78	--	42,000	5,500	880	2,000	4,800	920
10/22/97	283.46	265.13	18.33	--	29,000	5,200	970	1,800	4,200	740
01/12/98	283.46	271.81	11.65	--	31,000	2,700	960	2,100	5,700	<1000
04/21/98	283.46	271.17	12.29	--	60,000	3,300	2,100	3,100	10,000	1,400
07/08/98	283.46	264.89	18.57	--	33,000	4,400	1,500	2,800	8,200	<250
10/13/98	283.46	262.11	21.35	--	27,000	3,900	580	2,000	4,200	210
01/27/99	283.46	262.91	20.55	--	1,220	126	21.9	1.6	163	10.3
04/27/99	283.46	265.81	17.65	--	21,300	1,720	226	1,230	2,060	<500
07/23/99	283.46	264.00	19.46	--	17,200	1,440	257	1,070	1,960	<500
11/01/99	283.46	264.53	18.93	--	45,700	4,020	1,280	2,690	8,140	1,250
01/20/00	283.46	262.62	20.84	--	18,000	2,110	354	1,340	2,330	<500
04/28-29/00	283.46	265.61	17.85	0.00	8,300 ³	1,300	470	370	1,300	<130
07/21/00	283.46	264.57	18.89	0.00	18,000 ³	3,100	1,200	1,600	5,700	1,100
10/09-10/00	283.46	263.38	20.08	0.00	31,800 ⁵	3,280	<50.0	2,230	6,800	<250
01/08-09/01	283.46	262.95	20.51	0.00	43,700 ⁵	3,160	1,250	2,580	7,140	1,100
04/30/01	283.46	265.37	18.09	0.00	41,600 ³	3,060	791	2,380	6,260	<1,000
07/09-10/01	283.46	263.78	19.68	0.00	27,000 ³	2,500	480	1,900	5,100	1,900

Table 1
Groundwater Monitoring Data and Analytical Results
Chevron Service Station #9-5607
5269 Crow Canyon Road
Castro Valley, California

WELL ID/ DATE	TOC (ft.)	GWE (msf)	DTW (ft.)	SPHT (ft.)	TPH-G (ppb)	B (ppb)	T (ppb)	E (ppb)	X (ppb)	MTBE (ppb)
C-1 (cont)										
10/10/01	283.46	263.49	19.97	0.00	28,000	1,900	320	1,500	4,000	170
01/07/02	283.46	266.91	16.55	0.00	7,100	640	47	570	430	64
04/11/02	283.46	265.94	17.52	0.00	9,000	730	80	720	740	<50
C-2										
03/26/85	284.37	--	--	--	--	--	--	--	--	--
07/03/86	284.37	264.68	19.69	--	--	--	--	--	--	--
03/26/87	284.37	268.92	15.45	--	--	--	--	--	--	--
03/28/88	284.37	263.45	20.92	--	--	--	--	--	--	--
03/10/89	284.37	271.57	12.80	--	--	--	--	--	--	--
04/03/89	284.37	270.11	14.26	--	--	--	--	--	--	--
05/08/89	284.37	265.95	18.42	--	--	--	--	--	--	--
06/05/89	284.37	264.28	20.09	--	--	--	--	--	--	--
07/12/90	284.37	263.58	20.79	--	--	--	--	--	--	--
08/10/90	284.37	262.97	21.40	--	--	--	--	--	--	--
09/13/89	284.37	262.51	21.86	--	320	62	4.0	10	14	--
10/04/89	284.37	264.48	19.89	--	--	--	--	--	--	--
11/03/89	284.37	263.61	20.76	--	--	--	--	--	--	--
12/04/89	284.37	263.55	20.82	--	1,000	240	37	66	130	--
03/07/90	284.37	266.54	17.83	--	--	--	--	--	--	--
03/09/90	284.37	266.54	17.83	--	390	280	35	27	50	--
06/12/90	284.37	264.48	19.89	--	700	260	34	28	55	--
09/20/90	284.37	262.40	21.97	--	--	--	--	--	--	--
12/20/90	284.37	266.64	17.73	--	--	--	--	--	--	--
03/27/91	284.37	269.27	15.10	--	--	--	--	--	--	--
06/18/91	284.37	261.69	22.68	--	--	--	--	--	--	--
09/12/91	284.37	260.45	23.92	--	--	--	--	--	--	--
01/23/92	284.37	263.13	21.24	--	--	--	--	--	--	--
04/13/92	284.37	266.83	17.54	--	1,100	120	76	17	72	--
08/03/92	284.37	262.32	22.05	--	--	--	--	--	--	--
10/22/92	284.37	261.34	23.03	--	--	--	--	--	--	--

Table 1
Groundwater Monitoring Data and Analytical Results
Chevron Service Station #9-5607
5269 Crow Canyon Road
Castro Valley, California

WELL ID/ DATE	TOC (ft.)	GWE (msl)	DTW (ft.)	SPHT (ft.)	TPH-G (ppb)	B (ppb)	T (ppb)	E (ppb)	X (ppb)	MTBE (ppb)
C-2 (cont)										
01/18/93	284.37	269.51	14.86	--	70	6.4	ND	ND	ND	--
04/19/93	284.37	267.57	16.80	--	--	--	--	--	--	--
07/21-22/93	284.37	265.12	19.25	--	--	--	--	--	--	--
10/25/93	284.37	264.72	19.65	--	--	--	--	--	--	--
07/06-07/94	284.37	265.61	18.76	--	--	--	--	--	--	--
10/07/94	284.37	264.20	20.17	--	--	--	--	--	--	--
01/11/95	284.37	270.33	14.04	--	780	290	9.1	19	58	--
04/24/95	284.37	272.03	12.34	--	SAMPLED ANNUALLY		--	--	--	--
07/31/95	287.37	266.82	17.55	--	--	--	--	--	--	--
10/02/95	284.37	265.39	18.98	--	--	--	--	--	--	--
01/16/96	284.37	268.37	16.00	--	260	29	2.9	5.7	21	6.1
04/18/96	284.37	270.47	13.90	--	--	--	--	--	--	--
07/22/96	284.37	266.63	17.74	--	--	--	--	--	--	--
10/10/96	284.37	265.46	18.91	--	--	--	--	--	--	--
01/09/97	284.37	271.62	12.75	--	460	25	15	72	24	6.3
04/15/97	284.37	268.32	16.05	--	--	--	--	--	--	--
07/08/97	284.37	267.95	16.42	--	--	--	--	--	--	--
10/22/97	284.37	268.95	15.42	--	--	--	--	--	--	--
01/12/98	284.37	272.85	11.52	--	280	22	1.4	5.3	1.2	13
04/21/98	284.37	274.22	10.15	--	--	--	--	--	--	--
07/08/98	284.37	268.29	16.08	--	--	--	--	--	--	--
10/13/98	284.37	265.40	18.97	--	--	--	--	--	--	--
01/27/99	284.37	268.52	15.85	--	153	4.83	0.628	<0.5	<0.5	4.73
04/27/99	284.37	270.11	14.26	--	--	--	--	--	--	--
07/23/99	284.37	268.99	15.38	--	--	--	--	--	--	--
11/01/99	284.37	266.74	17.63	--	--	--	--	--	--	--
01/20/00	284.37	266.92	17.45	--	201	9.68	<0.5	7.32	4.78	<5.0
04/28-29/00	284.37	269.86	14.51	0.00	SAMPLED ANNUALLY		--	--	--	--
07/21/00	284.37	269.30	15.07	0.00	--	--	--	--	--	--
10/09-10/00	284.37	266.54	17.83	0.00	--	--	--	--	--	--
01/08-09/01	284.37	INACCESSIBLE	--	--	--	--	--	--	--	--
04/30/01	284.37	269.86	14.51	0.00	--	--	--	--	--	--

Table 1
Groundwater Monitoring Data and Analytical Results
Chevron Service Station #9-5607
5269 Crow Canyon Road
Castro Valley, California

WELL ID/ DATE	TOC (ft.)	GWE (msl)	DTW (ft.)	SPHT (ft.)	TPH-G (ppb)	B (ppb)	T (ppb)	E (ppb)	X (ppb)	MTBE (ppb)
C-2 (cont)										
07/09-10/01	284.37	268.82	15.55	0.00	--	--	--	--	--	--
10/10/01	284.37	268.81	15.56	0.00	SAMPLED ANNUALLY		--	--	--	--
01/07/02	284.37	271.30	13.07	0.00	<50	<0.50	<0.50	<0.50	<1.5	<2.5
04/11/02	284.37	269.77	14.60	0.00	--	--	--	--	--	--
C-3										
03/26/85	285.98	--	--	--	--	--	--	--	--	--
07/03/86	285.98	259.94	26.04	--	--	--	--	--	--	--
03/26/87	285.98	260.34	25.64	--	--	--	--	--	--	--
03/28/88	285.98	257.16	28.82	--	--	--	--	--	--	--
03/10/89	285.98	263.20	22.78	--	--	--	--	--	--	--
04/03/89	285.98	263.27	22.71	--	--	--	--	--	--	--
05/08/89	285.98	260.03	25.95	--	--	--	--	--	--	--
06/05/89	285.98	258.36	27.62	--	--	--	--	--	--	--
07/12/90	285.98	257.69	28.29	--	--	--	--	--	--	--
08/10/90	285.98	257.52	28.46	--	--	--	--	--	--	--
09/13/89	285.98	256.65	29.33	--	60,000	1,400	6,800	2,300	10,000	--
10/04/89	285.98	257.01	28.97	--	--	--	--	--	--	--
11/03/89	285.98	257.26	28.72	--	--	--	--	--	--	--
12/04/89	285.98	256.97	29.01	--	56,000	1,300	3,300	1,400	2,700	--
03/07/90	285.98	258.29	27.69	--	--	--	--	--	--	--
03/09/90	285.98	258.29	27.69	--	42,000	1,100	5,700	1,600	7,900	--
06/12/90	285.98	257.89	28.09	--	160,000	1,400	7,100	3,400	16,000	--
09/24/90	285.98	256.80	29.18	--	53,000	850	7,700	2,000	10,000	--
12/20/90	285.98	257.71	28.27	--	520	1,200	5,400	5,400	33,000	--
03/27/91	285.98	261.18	24.80	--	92,000	1,300	3,100	1,200	11,000	--
06/18/91	285.98	255.14	30.84	--	--	--	--	--	--	--
09/12/91	285.98	254.34	31.64	0.03	--	--	--	--	--	--
01/23/92	285.98	255.46	30.52	Sheen	--	--	--	--	--	--
04/13/92	285.98	259.04	26.94	0.01	--	--	--	--	--	--
08/03/92	285.98	255.98	30.00	--	220,000	1,300	2,800	3,100	17,000	--

Table 1
Groundwater Monitoring Data and Analytical Results
Chevron Service Station #9-5607
5269 Crow Canyon Road
Castro Valley, California

WELL ID/ DATE	TOC (ft.)	GWE (msl)	DTW (ft.)	SPHT (ft.)	TPH-G (ppb)	B (ppb)	T (ppb)	E (ppb)	X (ppb)	MTBE (ppb)
C-3 (cont)										
10/22/92	285.98	255.38	30.62	0.03	--	--	--	--	--	--
01/18/93	285.98	262.07	23.91	--	1,000,000	2,400	5,300	10,000	61,000	--
04/19/93	285.98	260.98	25.00	--	94,000	33,000	22,000	1,600	9,200	--
07/21-22/93	285.98	259.43	26.55	--	44,000	2,600	5,500	1,300	6,900	--
10/25/93	285.98	257.26	28.72	--	35,000	3,900	2,400	1,100	6,600	--
01/21/94	285.98	256.32	29.66	--	120,000	4,200	2,200	2,000	11,000	--
04/18/94	285.98	259.24	26.74	--	29,000	1,200	310	520	2,000	--
07/06-07/94	285.98	259.62	26.36	--	84,000	2,700	1,400	1,400	9,700	--
10/07/94	285.98	257.49	28.49	--	40,000	1,600	390	1,200	6,100	--
01/11/95	285.98	262.84	23.14	--	34,000	4,200	910	720	3,800	--
04/24/95	285.98	266.10	19.88	--	210,000	43,000	28,000	2,400	13,000	--
07/31/95	285.98	261.30	24.68	--	110,000	33,000	17,000	2,300	12,000	--
10/02/95	285.98	258.84	27.14	--	69,000	6,700	4,000	2,000	11,000	--
01/16/96	285.98	261.60	24.38	--	40,000	2,400	440	1,200	5,500	<500
04/18/96	285.98	265.28	20.70	--	66,000	26,000	17,000	2,200	12,000	1,250
07/22/96	285.98	261.32	24.66	--	69,000	21,000	8,800	1,800	9,900	<1000
10/10/96	285.98	260.75	25.23	--	53,000	12,000	2,600	1,900	9,300	<500
01/09/97	285.98	267.74	18.24	--	73,000	17,000	6,000	1,700	7,800	<1250
04/15/97	285.98	263.96	22.02	--	160,000	28,000	17,000	2,600	12,000	<2500
07/08/97	285.98	263.04	22.96	0.03	--	--	--	--	--	--
10/22/97	285.98	264.08	21.90	--	59,000	13,000	5,200	2,100	11,000	1,500
01/12/98	285.98	277.93	8.05	--	62,000	10,000	4,100	1,700	8,000	1,000
04/21/98	285.98	270.70	15.28	--	70,000	13,000	5,800	1,600	7,100	<1000
07/08/98	285.98	264.83	21.15	--	22,000	7,300	2,100	560	2,900	<25
10/13/98	285.98	268.38	17.60	--	390	32	4.8	26	42	2.9
01/27/99	285.98	262.31	23.67	--	57,100	18,400	2,440	1,660	8,690	<200
04/27/99	285.98	265.98	20.00	--	121,000	22,500	11,500	2,970	14,500	<2000
07/23/99	285.98	255.45	31.09	0.70	--	--	--	--	--	--
11/01/99	285.98	255.45	21.03	--	138,000	23,900	14,700	3,970	18,400	1,180
01/20/00	285.98	262.72	23.26	--	135,000	20,700	9,870	2,840	13,600	<5000
04/28-29/00	285.98	265.63	20.35	0.00	120,000 ³	24,000	11,000	2,700	14,000	2,100
07/21/00	285.98	265.34	20.64	0.00	93,000 ³	24,000	11,000	3,100	15,000	2,000

Table 1
Groundwater Monitoring Data and Analytical Results
Chevron Service Station #9-5607
5269 Crow Canyon Road
Castro Valley, California

WELL ID/ DATE	TOC (ft.)	GWE (msl)	DTW (ft.)	SPHT (ft.)	TPH-G (ppb)	B (ppb)	T (ppb)	E (ppb)	X (ppb)	MTBE (ppb)
C-3 (cont)										
10/09-10/00	285.98	264.35	21.63	0.00	83,400 ⁵	21,400	7,130	2,160	12,000	<2,500
01/08-09/01	285.98	INACCESSIBLE	--	--	--	--	--	--	--	--
04/30/01	285.98	265.65	20.33	0.00	104,000 ³	20,800	6,170	2,370	12,800	<2,500
07/09-10/01	285.98	264.53	21.45	0.00	81,000 ³	19,000	6,200	2,800	14,000	2,600
10/10/01	285.98	264.70	21.28	0.00	90,000	18,000	4,200	1,900	13,000	<50
01/07/02	285.98	267.25	18.73	0.00	70,000	15,000	1,300	2,400	15,000	200
04/11/02	285.98	265.85	20.13	0.00	71,000	17,000	660	1,600	10,000	<50
C-4										
03/26/85	273.01	257.87	15.14	--	--	--	--	--	--	--
07/03/86	273.01	257.64	15.37	--	--	--	--	--	--	--
03/26/87	273.01	--	--	--	--	--	--	--	--	--
03/28/88	273.01	254.97	18.04	--	--	--	--	--	--	--
03/10/89	273.01	--	--	--	--	--	--	--	--	--
04/03/89	273.01	259.67	13.34	--	--	--	--	--	--	--
05/08/89	273.01	257.41	15.60	--	--	--	--	--	--	--
06/05/89	273.01	256.50	16.51	--	--	--	--	--	--	--
09/13/89	273.01	254.85	18.16	--	57,000	21,000	3,100	3,200	11,000	--
10/04/89	273.01	254.77	18.24	--	--	--	--	--	--	--
11/03/89	273.01	254.84	18.17	--	--	--	--	--	--	--
12/04/89	273.01	254.56	18.45	--	48,000	17,000	2,200	2,800	9,800	--
03/07/90	273.01	255.81	17.20	--	--	--	--	--	--	--
03/09/90	273.01	255.81	17.20	--	43,000	20,000	2,300	2,800	11,000	--
06/12/90	273.01	256.35	16.66	--	82,000	21,000	2,400	4,000	16,000	--
07/12/90	273.01	256.02	16.99	--	--	--	--	--	--	--
08/10/90	273.01	255.74	17.27	--	--	--	--	--	--	--
09/24/90	273.01	254.90	18.11	--	--	--	--	--	--	--
ABANDONED										

Table 1
Groundwater Monitoring Data and Analytical Results
Chevron Service Station #9-5607
5269 Crow Canyon Road
Castro Valley, California

WELL ID/ DATE	TOC (ft.)	GWE (msl)	DTW (ft.)	SPHT (ft.)	TPH-G (ppb)	B (ppb)	T (ppb)	E (ppb)	X (ppb)	MTBE (ppb)
C-5										
03/26/85	287.95	262.62	25.33	--	--	--	--	--	--	--
07/03/86	287.95	261.54	26.41	--	--	--	--	--	--	--
03/26/87	287.95	262.99	24.96	--	--	--	--	--	--	--
03/28/88	287.95	258.15	29.80	--	--	--	--	--	--	--
03/10/89	287.95	262.06	25.89	--	--	--	--	--	--	--
04/03/89	287.95	263.57	24.38	--	--	--	--	--	--	--
05/08/89	287.95	260.15	27.80	--	--	--	--	--	--	--
06/05/89	287.95	258.53	29.42	--	--	--	--	--	--	--
07/12/90	287.95	258.09	29.86	--	--	--	--	--	--	--
08/10/90	287.95	258.18	29.77	--	--	--	--	--	--	--
09/13/89	287.95	257.00	30.95	--	310	ND	ND	ND	ND	--
10/04/89	287.95	256.47	31.48	--	--	--	--	--	--	--
11/03/89	287.95	256.63	31.32	--	--	--	--	--	--	--
12/04/89	287.95	256.25	31.70	--	ND	ND	ND	ND	ND	--
03/07/90	287.95	257.67	30.28	--	--	--	--	--	--	--
03/09/90	287.95	257.67	30.28	--	ND	ND	ND	ND	ND	--
06/12/90	287.95	257.47	30.48	--	90	ND	ND	ND	ND	--
09/24/90	287.95	256.17	31.78	--	ND	ND	ND	ND	ND	--
12/20/90	287.95	254.66	33.29	--	170	ND	ND	1.0	0.7	--
03/27/91	287.95	259.97	27.98	--	--	--	--	--	--	--
06/18/91	287.95	255.43	32.52	--	--	--	--	--	--	--
09/12/91	287.95	254.58	33.37	--	--	--	--	--	--	--
01/23/92	287.95	255.28	32.67	--	--	--	--	--	--	--
04/13/92	287.95	259.47	28.48	--	140	ND	ND	0.7	ND	--
08/03/92	287.95	255.45	32.50	--	ND	ND	ND	ND	ND	--
10/22/92	287.95	253.97	33.98	--	--	--	--	--	--	--
01/18/93	287.95	260.93	27.02	--	230	6.6	2.2	3.4	2.2	--
04/19/93	287.95	263.14	24.81	--	--	--	--	--	--	--
07/21-22/93	287.95	258.89	29.06	--	130	ND	0.6	ND	ND	--
10/25/93	287.95	257.00	30.95	--	--	--	--	--	--	--
01/21/94	287.95	256.04	31.91	--	ND	ND	ND	ND	ND	--
04/18/94	287.95	257.80	30.15	--	--	--	--	--	--	--

Table 1
Groundwater Monitoring Data and Analytical Results
Chevron Service Station #9-5607
5269 Crow Canyon Road
Castro Valley, California

WELL ID/ DATE	TOC (ft.)	GWE (msl)	DTW (ft.)	SPHT (ft.)	TPH-G (ppb)	B (ppb)	T (ppb)	E (ppb)	X (ppb)	MTBE (ppb)
C-5 (cont)										
07/06-07/94	287.95	258.91	29.04	--	ND	ND	ND	ND	ND	--
10/07/94	287.95	256.11	31.84	--	--	--	--	--	--	--
01/11/95	287.95	262.97	24.98	--	700	1.1	6.0	1.5	2.1	--
04/24/95	287.95	266.17	21.78	--	SAMPLED SEMI-ANNUALLY		--	--	--	--
07/31/95	287.95	INACCESSIBLE	--	--	--	--	--	--	--	--
10/02/95	287.95	257.77	30.18	--	--	--	--	--	--	--
01/16/96	287.95	261.23	26.72	--	200	<0.5	<0.5	<0.5	1.3	<2.5
04/18/96	287.95	266.15	21.80	--	--	--	--	--	--	--
07/22/96	287.95	INACCESSIBLE	--	--	--	--	--	--	--	--
10/10/96	287.95	261.17	26.78	--	--	--	--	--	--	--
01/09/97	287.95	268.93	19.02	--	190	0.630	<0.5	<0.5	<0.5	<2.5
04/15/97	287.95	264.64	23.31	--	--	--	--	--	--	--
07/08/97	287.95	INACCESSIBLE	--	--	--	--	--	--	--	--
10/22/97	287.95	INACCESSIBLE	--	--	--	--	--	--	--	--
01/12/98	287.95	269.37	18.58	--	200	1.10	0.570	1.30	2.5	<2.5
04/21/98	287.95	272.75	15.20	--	--	--	--	--	--	--
07/08/98	287.95	264.76	23.19	--	52 ²	<0.5	<0.5	<0.5	<0.5	<2.5
10/13/98	287.95	261.95	26.00	--	--	--	--	--	--	--
01/27/99	287.95	263.97	23.98	--	<50	<0.5	<0.5	<0.5	<0.5	<2.0
04/27/99	287.95	267.29	20.66	--	--	--	--	--	--	--
07/23/99	287.95	266.73	21.22	--	80.7	<0.5	<0.5	<0.5	<0.5	<5.0
11/01/99	287.95	268.22	19.73	--	--	--	--	--	--	--
01/20/00	287.95	263.93	24.02	--	82.5	<0.5	<0.5	<0.5	<0.5	<5.0
04/28-29/00	287.95	267.84	20.11	0.00	SAMPLED SEMI-ANNUALLY		--	--	--	--
07/21/00	287.95	267.95	20.00	0.00	--	--	--	--	--	--
07/26/00	287.95	267.86	20.09	0.00	66 ³	<0.50	<0.50	<0.50	<0.50	3.1
10/09-10/00	287.95	266.19	21.76	0.00	--	--	--	--	--	--
01/08-09/01	287.95	INACCESSIBLE	--	--	--	--	--	--	--	--
04/30/01	287.95	267.79	20.16	0.00	--	--	--	--	--	--
07/09-10/01	287.95	267.13	20.82	0.00	<50	<0.50	<0.50	<0.50	<0.50	<2.5

Table 1
Groundwater Monitoring Data and Analytical Results
Chevron Service Station #9-5607
5269 Crow Canyon Road
Castro Valley, California

WELL ID/ DATE	TOC (ft.)	GWE (mst)	DTW (ft.)	SPHT (ft.)	TPH-G (ppb)	B (ppb)	T (ppb)	E (ppb)	X (ppb)	MTBE (ppb)
C-5 (cont)										
10/10/01	287.95	268.05	19.90	0.00	SAMPLED SEMI-ANNUALLY		--	--	--	--
01/07/02	287.95	270.55	17.40	0.00	<50	<0.50	<0.50	<0.50	<1.5	<2.5
04/11/02	287.95	267.68	20.27	0.00	--	--	--	--	--	--
C-6										
03/26/85	--	--	16.74	--	--	--	--	--	--	--
07/03/86	275.28	257.82	17.46	--	--	--	--	--	--	--
03/26/87	275.28	256.91	18.37	--	--	--	--	--	--	--
03/28/88	275.28	245.44	29.84	--	--	--	--	--	--	--
03/10/89	275.28	260.84	14.44	--	--	--	--	--	--	--
04/03/89	275.28	260.84	14.44	--	--	--	--	--	--	--
05/08/89	275.28	258.12	17.16	--	--	--	--	--	--	--
06/05/89	275.28	256.77	18.51	--	--	--	--	--	--	--
07/12/90	275.28	256.57	18.71	--	--	--	--	--	--	--
08/10/90	275.28	255.96	19.32	--	--	--	--	--	--	--
09/13/89	275.28	255.33	19.95	--	47	5,600	3,000	2,400	10,000	--
10/04/89	275.28	255.41	19.87	--	--	--	--	--	--	--
11/03/89	275.28	255.93	19.35	--	--	--	--	--	--	--
12/04/89	275.28	255.69	19.59	--	40,000	8,100	1,800	1,700	7,500	--
03/07/90	275.28	256.89	18.39	--	--	--	--	--	--	--
03/09/90	275.28	256.89	18.39	--	73,000	23,000	5,900	3,400	17,000	--
06/12/90	275.28	256.41	18.87	--	85,000	19,000	6,500	3,400	16,000	--
09/24/90	275.28	255.29	19.99	--	72,000	15,000	3,200	2,600	11,000	--
12/20/90	275.28	253.71	21.57	--	100,000	11,000	4,200	3,400	16,000	--
03/27/91	275.28	258.96	16.32	--	100,000	11,000	4,400	2,300	11,000	--
06/18/91	275.28	251.95	23.33	--	--	--	--	--	--	--
09/12/91	275.28	251.32	23.96	--	--	--	--	--	--	--
01/23/92	275.28	263.20	12.08	--	--	--	--	--	--	--
04/13/92	275.28	255.43	19.85	Sheen	--	--	--	--	--	--
08/03/92	275.28	260.56	14.72	--	120,000	16,000	1,100	2,300	15,000	--
10/22/92	275.28	260.37	14.91	--	63,000	7,400	920	1,800	14,000	--

Table 1
Groundwater Monitoring Data and Analytical Results
Chevron Service Station #9-5607
5269 Crow Canyon Road
Castro Valley, California

WELL ID/ DATE	TOC (ft.)	GWE (msl)	DTW (ft.)	SPHT (ft.)	TPH-G (ppb)	B (ppb)	T (ppb)	E (ppb)	X (ppb)	MTBE (ppb)
C-6 (cont)										
01/18/93	275.28	259.84	15.44	--	77,000	13,000	1,600	2,700	12,000	--
04/19/93	275.28	266.03	9.25	--	56,000	14,000	1,100	2,400	9,100	--
07/21-22/93	275.28	257.93	17.35	--	38,000	6,600	610	1,500	5,800	--
10/25/93	275.28	254.25	21.03	--	42,000	11,000	800	2,200	8,200	--
01/21/94	275.28	253.71	21.57	--	57,000	11,000	940	2,300	9,800	--
04/18/94	275.28	257.17	18.11	--	48,000	9,800	830	1,900	7,500	--
07/06-07/94	275.28	258.28	17.00	--	46,000	6,800	610	900	6,200	--
10/07/94	275.28	256.09	19.19	--	35,000	5,900	410	1,400	3,800	--
01/11/95	275.28	256.64	18.64	--	54,000	1,200	1,100	2,100	9,500	--
04/24/95	275.28	262.72	12.56	--	81,000	12,000	1,500	2,400	9,900	--
07/31/95	275.28	259.54	15.74	--	75,000	12,000	1,200	2,800	11,000	--
10/02/95	275.28	257.56	17.72	--	59,000	13,000	990	2,800	10,000	--
01/16/96	275.28	259.81	15.47	--	63,000	10,000	650	2,200	7,500	<500
04/18/96	275.28	259.33	15.95	--	56,000	9,800	590	1,500	5,800	660
07/22/96	275.28	INACCESSIBLE	--	--	--	--	--	--	--	--
10/10/96	275.28	INACCESSIBLE	--	--	--	--	--	--	--	--
01/09/97	275.28	INACCESSIBLE	--	--	--	--	--	--	--	--
04/15/97	275.28	INACCESSIBLE	--	--	--	--	--	--	--	--
07/08/97	275.28	INACCESSIBLE	--	--	--	--	--	--	--	--
07/15/97	275.28	260.95	14.33	--	64,000	12,000	400	1,500	4,400	<1000
10/22/97	275.28	261.80	13.48	--	49,000	15,000	570	1,900	5,600	1,500
01/12/98	275.28	265.14	10.14	--	60,000	16,000	540	1,800	5,400	<1000
04/21/98	275.28	267.73	7.55	--	51,000	16,000	310	1,400	3,400	<1000
07/08/98	275.28	262.80	12.48	--	19,000	8,200	150	720	1,100	<250
10/13/98	275.28	259.82	15.46	--	46,000	12,000	490	1600	3,600	<250
01/27/99	275.28	263.32	11.96	--	16,000	4,440	132	688	1,290	190
04/27/99	275.28	263.15	12.13	--	38,800	13,100	403	1,540	3,430	<1250
07/23/99	275.28	261.82	13.46	--	33,400	9,460	182	1,030	2,040	<1000
11/01/99	275.28	262.01	13.27	--	23,700	7,250	335	775	882	161
01/20/00	275.28	260.64	14.64	--	32,300	8,970	181	1,020	1,450	<1000
04/28-29/00	275.28	263.21	12.07	0.00	1,900 ³	3,100	40	51	130	120
07/21/00	275.28	262.88	12.40	0.00	5,000 ³	4,400	43	50	88	130

Table 1
Groundwater Monitoring Data and Analytical Results
Chevron Service Station #9-5607
5269 Crow Canyon Road
Castro Valley, California

WELL ID/ DATE	TOC (ft.)	GWE (msl)	DTW (ft.)	SPHT (ft.)	TPH-G (ppb)	B (ppb)	T (ppb)	E (ppb)	X (ppb)	MTBE (ppb)
C-6 (cont)										
10/09-10/00	275.28	261.89	13.39	0.00	4,810 ⁵	2,570	<25.0	<25.0	<25.0	<125
01/08-09/01	275.28	261.51	13.77	0.00	110 ⁵	16.8	0.827	<0.500	1.88	<2.50
04/30/01	275.28	265.16	10.12	0.00	19,400 ³	5,290	74.0	171	648	<500
07/09-10/01	275.28	261.77	13.51	0.00	7,000 ³	5,300	65	200	360	680
10/10/01	275.28	261.54	13.74	0.00	18,000	5,600	51	140	340	<50
01/07/02	275.28	264.67	10.61	0.00	34,000	12,000	270	960	1,700	160
04/11/02	275.28	263.58	11.70	0.00	31,000	11,000	230	790	2,000	<50
C-7										
03/26/85	--	--	9.61	--	--	--	--	--	--	--
07/03/86	270.70	259.96	10.74	--	--	--	--	--	--	--
03/26/87	270.70	260.62	10.08	--	--	--	--	--	--	--
03/28/88	270.70	256.91	13.79	--	--	--	--	--	--	--
03/10/89	270.70	260.28	10.42	--	--	--	--	--	--	--
04/03/89	270.70	261.56	9.14	--	--	--	--	--	--	--
05/08/89	270.70	258.79	11.91	--	--	--	--	--	--	--
06/05/89	270.70	259.16	11.54	--	--	--	--	--	--	--
07/12/90	270.70	257.25	13.45	--	--	--	--	--	--	--
08/10/90	270.70	257.33	13.37	--	--	--	--	--	--	--
09/13/89	270.70	256.10	14.60	--	410	1.3	ND	10	ND	--
10/04/89	270.70	255.53	15.17	--	--	--	--	--	--	--
11/03/89	270.70	255.42	15.28	--	--	--	--	--	--	--
12/04/89	270.70	255.00	15.70	--	1,000	1.0	ND	5.0	ND	--
03/07/90	270.70	256.48	14.22	--	--	--	--	--	--	--
03/09/90	270.70	256.48	14.22	--	590	2.8	2.4	3.5	2.0	--
06/12/90	270.70	256.52	14.18	--	1,200	ND	5.0	8.2	3.2	--
09/24/90	270.70	255.26	15.44	Sheen	400	1.4	1.9	1.4	2.2	--
09/24/90 (D)	270.70	255.26	15.44	--	580	ND	2.4	1.4	1.5	--
12/20/90	270.70	253.62	17.08	--	2,300	ND	6.5	4.7	9.3	--
03/27/91	270.70	258.05	12.65	--	980	ND	2.4	9.1	3.0	--
06/18/91	270.70	254.26	16.44	--	--	--	--	--	--	--

Table 1
Groundwater Monitoring Data and Analytical Results
Chevron Service Station #9-5607
5269 Crow Canyon Road
Castro Valley, California

WELL ID/ DATE	TOC (ft.)	GWE (msl)	DTW (ft.)	SPHT (ft.)	TPH-G (ppb)	B (ppb)	T (ppb)	E (ppb)	X (ppb)	MTBE (ppb)
C-7 (cont)										
09/12/91	270.70	253.65	17.05	--	1,200	ND	3.1	6.5	2.7	--
01/23/92	270.70	253.78	16.92	--	--	--	--	--	--	--
04/13/92	270.70	257.70	13.00	--	830	ND	1.0	7.8	1.2	--
08/03/92	270.70	--	--	--	--	--	--	--	--	--
10/22/92	270.70	UNABLE TO LOCATE		--	--	--	--	--	--	--
01/18/93	270.70	UNABLE TO LOCATE		--	--	--	--	--	--	--
04/19/93	270.70	UNABLE TO LOCATE		--	--	--	--	--	--	--
07/21-22/93	270.70	257.76	12.94	--	890	0.9	3.0	4.0	4.0	--
10/25/93	270.70	255.87	14.83	--	--	--	--	--	--	--
01/21/94	270.70	254.76	15.94	--	660	ND	6.0	1.0	3.0	--
04/18/94	270.70	255.72	14.98	--	--	--	--	--	--	--
07/06-07/94	270.70	257.76	12.94	--	960	ND	5.8	4.2	8.2	--
10/07/94	270.70	254.87	15.83	--	--	--	--	--	--	--
01/11/95	270.70	261.45	9.25	--	900	<0.5	<0.5	2.3	1.3	--
04/24/95	270.70	264.00	6.70	--	SAMPLED SEMI-ANNUALLY		--	--	--	--
07/31/95	270.70	259.46	11.24	--	690	<1.2	<1.2	<1.2	<1.2	--
10/02/95	270.70	256.68	14.02	--	--	--	--	--	--	--
01/16/96	270.70	259.48	11.22	--	<50	<0.5	<0.5	<0.5	<0.5	<2.5
04/18/96	270.70	264.05	6.65	--	--	--	--	--	--	--
07/22/96	270.70	259.60	11.10	--	360	4.4	2.0	<0.5	<0.5	17
10/10/96	270.70	259.35	11.35	--	--	--	--	--	--	--
01/09/97	270.70	266.82	3.88	--	69	<0.5	<0.5	<0.5	<0.5	<2.5
04/15/97	270.70	262.82	7.88	--	--	--	--	--	--	--
07/08/97	270.70	261.70	9.00	--	710	8.0	1.20	<0.5	<0.5	22
10/22/97	270.70	262.09	8.61	--	--	--	--	--	--	--
01/12/98	270.70	267.03	3.67	--	400	7.20	<1.0	1.60	1.30	16
04/21/98	270.70	270.19	0.51	--	--	--	--	--	--	--
07/08/98	270.70	263.72	6.98	--	<50	<0.5	<0.5	<0.5	<0.5	<2.5
10/13/98	270.70	261.58	9.12	--	--	--	--	--	--	--
01/27/99	270.70	262.15	8.55	--	<50	<0.5	<0.5	<0.5	<0.5	<2.0
04/27/99	270.70	265.75	4.95	--	--	--	--	--	--	--
07/23/99	270.70	265.60	5.10	--	500	7.84	0.983	1.71	0.658	<5.0

Table 1
Groundwater Monitoring Data and Analytical Results
Chevron Service Station #9-5607
5269 Crow Canyon Road
Castro Valley, California

WELL ID/ DATE	TOC (ft.)	GWE (msl)	DTW (ft.)	SPHT (ft.)	TPH-G (ppb)	B (ppb)	T (ppb)	E (ppb)	X (ppb)	MTBE (ppb)
C-7 (cont)										
11/01/99	270.70	263.41	7.29	--	--	--	--	--	--	--
01/20/00	270.70	262.94	7.76	--	503	6.82	0.56	<0.5	1.35	<5.0
04/28-29/00	270.70	266.33	4.37	0.00	SAMPLED SEMI-ANNUALLY		--	--	--	--
07/21/00	270.70	266.51	4.19	0.00	--	--	--	--	--	--
07/26/00	270.70	266.41	4.29	0.00	110 ⁴	1.8	1.1	<0.50	<0.50	<2.5
10/09-10/00	270.70	265.47	5.23	0.00	--	--	--	--	--	--
01/08-09/01	270.70	264.00	6.70	0.00	<50.0	<0.500	<0.500	<0.500	<0.500	<2.50
04/30/01	270.70	266.39	4.31	0.00	--	--	--	--	--	--
07/09-10/01	270.70	265.87	4.83	0.00	150 ³	1.9	0.83	<0.50	0.95	4.8
10/10/01	270.70	266.43	4.27	0.00	SAMPLED SEMI-ANNUALLY		--	--	--	--
01/07/02	270.70	268.78	1.92	0.00	<50	<0.50	<0.50	<0.50	<1.5	<2.5
04/11/02	270.70	266.41	4.29	0.00	--	--	--	--	--	--
C-8										
03/26/85	--	--	8.68	--	--	--	--	--	--	--
07/03/86	288.40	274.51	13.89	--	--	--	--	--	--	--
03/26/87	288.40	282.39	6.01	--	--	--	--	--	--	--
03/28/88	288.40	277.74	10.66	--	--	--	--	--	--	--
03/10/89	288.40	281.79	6.61	--	--	--	--	--	--	--
04/03/89	288.40	281.94	6.46	--	--	--	--	--	--	--
05/08/89	288.40	279.43	8.97	--	--	--	--	--	--	--
06/05/89	288.40	277.52	10.88	--	--	--	--	--	--	--
07/12/90	288.40	276.25	12.15	--	--	--	--	--	--	--
08/10/90	288.40	275.94	12.46	--	--	--	--	--	--	--
09/13/89	288.40	275.62	12.78	--	ND	ND	ND	ND	ND	--
10/04/89	288.40	275.89	12.51	--	--	--	--	--	--	--
11/03/89	288.40	273.77	14.63	--	--	--	--	--	--	--
12/04/89	288.40	278.81	9.59	--	64	0.6	0.6	ND	1.0	--
03/07/90	288.40	279.60	8.80	--	--	--	--	--	--	--
03/09/90	288.40	279.60	8.80	--	ND	ND	ND	ND	ND	--
06/12/90	288.40	279.46	8.94	--	120	2.5	1.2	1.0	1.4	--

Table 1
Groundwater Monitoring Data and Analytical Results
Chevron Service Station #9-5607
5269 Crow Canyon Road
Castro Valley, California

WELL ID/ DATE	TOC (ft.)	GWE (msl)	DTW (ft.)	SPHT (ft.)	TPH-G (ppb)	B (ppb)	T (ppb)	E (ppb)	X (ppb)	MTBE (ppb)
C-8 (cont)										
09/24/90	288.40	274.86	13.54	--	--	--	--	--	--	--
12/20/90	288.40	279.07	9.33	--	--	--	--	--	--	--
03/27/91	288.40	282.30	6.10	--	54	0.7	ND	0.7	1.9	--
06/18/91	288.40	276.44	11.96	--	--	--	--	--	--	--
09/12/91	288.40	274.80	13.60	--	ND	ND	ND	ND	ND	--
09/12/91 (D)	288.40	274.80	13.60	--	ND	ND	ND	ND	ND	--
01/23/92	288.40	264.20	24.20	--	--	--	--	--	--	--
04/13/92	288.40	280.05	8.35	--	ND	ND	ND	ND	ND	--
08/03/92	288.40	275.82	12.58	--	ND	ND	ND	ND	ND	--
10/22/92	288.40	275.30	13.10	--	ND	ND	ND	ND	ND	--
01/18/93	288.40	282.28	6.12	--	ND	ND	ND	ND	ND	--
04/19/93	288.40	281.35	7.05	--	ND	ND	ND	ND	ND	--
07/21-22/93	288.40	277.05	11.35	--	ND	ND	ND	ND	ND	--
10/25/93	288.40	275.55	12.85	--	ND	ND	ND	ND	ND	--
01/21/94	288.40	277.85	10.55	--	ND	ND	ND	ND	ND	--
04/18/94	288.40	278.89	9.51	--	ND	1.2	0.9	ND	1.6	--
07/06-07/94	288.40	277.02	11.38	--	ND	ND	ND	ND	ND	--
10/07/94	288.40	275.48	12.92	--	ND	ND	ND	ND	ND	--
01/11/95	288.40	283.04	5.36	--	<50	<0.5	<0.5	<0.5	<0.5	--
04/24/95	288.40	281.82	6.58	--	<50	<0.5	0.61	<0.5	0.51	--
07/31/95	288.40	278.94	9.46	--	<50	<0.5	<0.5	<0.5	<0.5	--
10/02/95	288.40	276.56	11.84	--	<50	<0.5	<0.5	<0.5	<0.5	--
01/16/96	288.40	281.40	7.00	--	<50	<0.5	<0.5	<0.5	<0.5	5.4
04/18/96	288.40	281.77	6.63	--	<50	<0.5	<0.5	<0.5	<0.5	<2.5
07/22/96	288.40	280.49	7.91	--	<50	<0.5	<0.5	<0.5	<0.5	<2.5
10/10/96	288.40	279.71	8.69	--	<50	<0.5	<0.5	<0.5	<0.5	<2.5
01/09/97	288.40	283.11	5.29	--	<50	<0.5	<0.5	<0.5	<0.5	<2.5
04/15/97	288.40	281.90	6.50	--	<50	<0.5	<0.5	<0.5	<0.5	<2.5
07/08/97	288.40	281.90	6.50	--	<50	<0.5	<0.5	<0.5	<0.5	<2.5
10/22/97	288.40	283.00	5.40	--	<50	<0.5	<0.5	<0.5	<0.5	<2.5
01/12/98	288.40	284.27	4.13	--	<50	<0.5	<0.5	<0.5	<0.5	<2.5
04/21/98	288.40	283.84	4.56	--	<50	<0.5	<0.5	<0.5	<0.5	<2.5

Table 1
Groundwater Monitoring Data and Analytical Results
Chevron Service Station #9-5607
5269 Crow Canyon Road
Castro Valley, California

WELL ID/ DATE	TOC (ft.)	GWE (msl)	DTW (ft.)	SPHT (ft.)	TPH-G (ppb)	B (ppb)	T (ppb)	E (ppb)	X (ppb)	MTBE (ppb)
C-8 (cont)										
07/08/98	288.40	277.81	10.59	--	<50	<0.5	0.57	<0.5	<0.5	<2.5
10/13/98	288.40	276.32	12.08	--	<50	<0.5	<0.5	<0.5	<0.5	<2.5
01/27/99	288.40	276.89	11.51	--	<50	<0.5	<0.5	<0.5	<0.5	<2.0
04/27/99	288.40	282.40	6.00	--	<50	<0.5	<0.5	<0.5	<0.5	<5.0
07/23/99	288.40	282.13	6.27	--	<50	<0.5	<0.5	<0.5	<0.5	<5.0
11/01/99	288.40	282.30	6.10	--	<50	<0.5	<0.5	<0.5	<0.5	<2.5
01/20/00	288.40	281.92	6.48	--	<50	<0.5	<0.5	<0.5	<0.5	<5.0
04/28-29/00	288.40	282.82	5.58	0.00	<50	<0.50	<0.50	<0.50	<0.50	<2.5
07/21/00	288.40	282.45	5.95	0.00	<50	<0.50	<0.50	<0.50	<0.50	<2.5
10/09-10/00	288.40	281.82	6.58	0.00	<50.0	<0.500	<0.500	<0.500	<0.500	<2.50
01/08-09/01	288.40	INACCESSIBLE	--	--	--	--	--	--	--	--
04/30/01	288.40	282.44	5.96	0.00	<50.0	<0.500	<0.500	<0.500	<0.500	<5.00
07/09-10/01	288.40	282.81	5.59	0.00	<50	<0.50	<0.50	<0.50	<0.50	<2.5
10/10/01	288.40	282.88	5.52	0.00	<50	<0.50	<0.50	<0.50	<1.5	<2.5
01/07/02	288.40	282.90	5.50	0.00	<50	<0.50	<0.50	<0.50	<1.5	<2.5
04/11/02	288.40	282.53	5.87	0.00	<50	<0.50	<0.50	<0.50	<1.5	<2.5
C-9										
07/03/86	268.46	254.57	13.89	--	--	--	--	--	--	--
03/26/87	268.46	254.72	13.74	--	--	--	--	--	--	--
03/28/88	268.46	253.47	14.99	--	--	--	--	--	--	--
03/10/89	268.46	255.07	13.39	--	--	--	--	--	--	--
04/03/89	268.46	255.62	12.84	--	--	--	--	--	--	--
05/08/89	268.46	254.08	14.38	--	--	--	--	--	--	--
06/05/89	268.46	253.10	15.36	--	--	--	--	--	--	--
07/12/90	268.46	252.81	15.65	--	--	--	--	--	--	--
08/10/90	268.46	252.66	15.80	--	--	--	--	--	--	--
09/13/89	268.46	251.93	16.53	--	42,000	14,000	1,100	2,800	4,200	--
10/04/89	268.46	251.94	16.52	--	--	--	--	--	--	--
11/03/89	268.46	251.95	16.51	--	--	--	--	--	--	--
12/04/89	268.46	251.67	16.79	--	36,000	11,000	670	2,500	3,800	--

Table 1
Groundwater Monitoring Data and Analytical Results
Chevron Service Station #9-5607
5269 Crow Canyon Road
Castro Valley, California

WELL ID/ DATE	TOC (ft.)	GWE (msl)	DTW (ft.)	SPHT (ft.)	TPH-G (ppb)	B (ppb)	T (ppb)	E (ppb)	X (ppb)	MTBE (ppb)
C-9 (cont)										
03/07/90	268.46	252.24	16.22	--	--	--	--	--	--	--
03/09/90	268.46	252.24	16.22	--	28,000	12,000	940	3,000	4,700	--
06/12/90	268.46	253.58	14.88	--	39,000	11,000	1,600	2,300	4,800	--
09/24/90	268.46	252.16	16.30	--	120,000	13,000	1,600	3,700	6,800	--
12/20/90	268.46	251.23	17.23	--	51,000	9,300	560	2,800	3,300	--
12/20/90 (D)	268.46	251.23	17.23	--	44,000	12,000	580	2,800	3,500	--
03/27/91	268.46	254.68	13.78	--	56,000	3,400	5,000	1,600	5,600	--
06/18/91	268.46	249.82	18.64	--	--	--	--	--	--	--
09/12/91	268.46	INACCESSIBLE	--	--	--	--	--	--	--	--
10/24/95	268.46	250.39	18.07	--	30,000	7,200	440	2,500	1,600	--
01/16/96	268.46	252.18	16.28	--	36,000	8,200	700	2,500	2,100	<500
01/16/96	268.46	252.18	16.28	--	36,000	8,200	700	2,500	2,100	<500
07/08/98	268.46	256.46	12.00	--	20,000	4,900	880	1,100	2,500	<250
10/13/98	268.46	254.19	14.27	--	28,000	7,100	1,100	1,300	2,700	<125
01/27/99	268.46	256.92	11.54	--	12,100	3,490	249	654	1,260	131
04/27/99	268.46	257.46	11.00	--	42,400	12,500	732	3,060	2,760	1000
07/23/99	268.46	257.16	11.30	--	28,800	7,420	418	1,900	1,720	<1000
11/01/99	268.46	257.02	11.44	--	10,100	2,050	227	628	830	933
01/20/00	268.46	255.38	13.08	--	33,100	7,990	239	1,990	1,030	<1000
04/28-29/00	268.46	257.61	10.85	0.00	7,400 ³	1,100	<50	440	280	<250
07/21/00	268.46	256.93	11.53	0.00	3,900 ³	770	33	270	200	210
10/09-10/00	268.46	254.76	13.70	0.00	4,190 ⁵	732	32.3	340	200	<50.0
01/08-09/01	268.46	254.68	13.78	0.00	7,430 ⁵	1,740	<50.0	554	317	297
04/30/01 ⁹	268.46	255.07	13.39	0.00	5,040 ³	509	12.2	248	119	<100
07/09-10/01 ⁹	268.46	255.46	13.00	0.00	2,800 ³	430	<25	200	91	200
10/10/01 ⁹	268.46	255.96	12.50	0.00	5,900	920	33	300	240	<20
01/07/02	268.46	258.75	9.71	0.00	2,800	120	6.3	33	82	62
04/11/02 ⁹	268.46	258.11	10.35	0.00	6,700	1,200	24	360	140	<50

Table 1
Groundwater Monitoring Data and Analytical Results
 Chevron Service Station #9-5607
 5269 Crow Canyon Road
 Castro Valley, California

WELL ID/ DATE	TOC (ft.)	GWE (msl)	DTW (ft.)	SPHT (ft.)	TPH-G (ppb)	B (ppb)	T (ppb)	E (ppb)	X (ppb)	MTBE (ppb)
C-10A										
03/07/90	264.84	244.63	20.21	--	--	--	--	--	--	--
03/09/90	264.84	--	--	--	ND	1.6	0.7	0.8	3.5	--
06/12/90	264.84	245.14	19.70	--	ND	ND	ND	ND	ND	--
09/24/90	264.84	245.30	19.54	--	ND	ND	ND	ND	ND	--
12/20/90	264.84	245.00	19.84	--	ND	ND	ND	ND	ND	--
03/27/91	264.84	246.83	18.01	--	--	--	--	--	--	--
06/18/91	264.84	244.68	20.16	--	ND	ND	ND	ND	ND	--
09/12/91	264.84	244.27	20.57	--	ND	ND	ND	ND	ND	--
01/23/92	264.84	244.17	20.67	--	ND	ND	ND	ND	ND	--
04/13/92	264.84	245.44	19.40	--	53	0.9	1.3	ND	1.0	--
08/03/92	264.84	245.03	19.81	--	ND	ND	ND	ND	ND	--
10/22/92	264.84	245.01	19.83	--	ND	ND	ND	ND	0.5	--
01/18/93	264.84	247.80	17.04	--	ND	ND	ND	ND	ND	--
04/19/93	264.84	247.07	17.77	--	ND	ND	ND	ND	ND	--
04/19/93	264.84	247.28	17.56	--	ND	ND	ND	ND	ND	--
10/25/93	264.84	247.07	17.77	--	ND	ND	ND	ND	ND	--
01/21/94	264.84	246.93	17.91	--	ND	ND	ND	ND	ND	--
04/18/94	264.84	247.81	17.03	--	ND	3.0	3.0	1.4	5.5	--
07/06-07/94	264.84	248.06	16.78	--	ND	ND	ND	ND	ND	--
10/07/94	264.84	247.63	17.21	--	ND	ND	ND	ND	ND	--
01/11/95	264.84	248.78	16.06	--	<50	<0.5	<0.5	<0.5	<0.5	--
04/24/95	264.84	248.32	16.52	--	<50	<0.5	<0.5	<0.5	<0.5	--
07/31/95	264.84	245.82	19.02	--	<50	<0.5	<0.5	<0.5	<0.5	--
10/02/95	264.84	245.14	19.70	--	<50	<0.5	<0.5	<0.5	<0.5	--
01/16/96	264.84	246.21	18.63	--	<50	<0.5	<0.5	<0.5	<0.5	<2.5
04/18/96	264.84	247.19	17.65	--	<50	<0.5	<0.5	<0.5	<0.5	<2.5
07/22/96	264.84	245.99	18.85	--	<50	<0.5	<0.5	<0.5	<0.5	<2.5
10/10/96	264.84	245.40	19.44	--	<50	<0.5	<0.5	<0.5	<0.5	<2.5
01/09/97	264.84	248.00	16.84	--	<50	<0.5	<0.5	<0.5	<0.5	<2.5
04/15/97	264.84	246.47	18.37	--	<50	<0.5	<0.5	<0.5	<0.5	<2.5
07/08/97	264.84	246.33	18.51	--	<50	<0.5	<0.5	<0.5	<0.5	<2.5
10/22/97	264.84	246.64	18.20	--	<50	<0.5	<0.5	<0.5	<0.5	<2.5

Table 1
Groundwater Monitoring Data and Analytical Results
Chevron Service Station #9-5607
5269 Crow Canyon Road
Castro Valley, California

WELL ID/ DATE	TOC (ft.)	GWE (msl)	DTW (ft.)	SPHT (ft.)	TPH-G (ppb)	B (ppb)	T (ppb)	E (ppb)	X (ppb)	MTBE (ppb)
C-10A (cont)										
01/12/98	264.84	248.00	16.84	--	<50	<0.5	<0.5	<0.5	<0.5	<2.5
04/21/98	264.84	248.04	16.80	--	<50	<0.5	<0.5	<0.5	<0.5	<2.5
07/08/98	264.84	246.89	17.95	--	<50	<0.5	0.57	<0.5	<0.5	<2.5
10/13/98	264.84	246.16	18.68	--	<50	1.3	<0.5	0.67	1.5	<2.5
01/27/99	264.84	246.96	17.88	--	79.2	<0.5	<0.5	<0.5	<0.5	<2.0
04/27/99	264.84	247.53	17.31	--	<50	<0.5	<0.5	<0.5	<0.5	<5.0
07/23/99	264.84	246.27	18.57	--	<50	<0.5	<0.5	<0.5	<0.5	<5.0
11/01/99	264.84	246.75	18.09	--	<50	<0.5	<0.5	<0.5	<0.5	<2.5
01/20/00	264.84	246.85	17.99	--	<50	<0.5	<0.5	<0.5	<0.5	<5.0
04/28-29/00	264.84	247.53	17.31	0.00	<50	<0.50	<0.50	<0.50	<0.50	<2.5
07/21/00	264.84	247.26	17.58	0.00	<50	<0.50	<0.50	<0.50	<0.50	<2.5
10/09-10/00	264.84	246.80	18.04	0.00	<50.0	<0.500	<0.500	<0.500	<0.500	<2.50
01/08-09/01	264.84	246.94	17.90	0.00	<50.0	<0.500	<0.500	<0.500	<0.500	<2.50
04/30/01	264.84	247.53	17.31	0.00	<50.0	<0.500	<0.500	<0.500	<0.500	<5.00
07/09-10/01	264.84	247.02	17.82	0.00	<50	<0.50	<0.50	<0.50	<0.50	<2.5
DESTROYED										
C-10B										
03/07/90	264.85	243.41	21.44	--	--	--	--	--	--	--
06/12/90	264.85	244.91	19.94	--	ND	ND	ND	ND	ND	--
09/24/90	264.85	245.08	19.77	--	ND	ND	ND	ND	ND	--
12/20/90	264.85	244.85	20.00	--	ND	ND	ND	ND	ND	--
03/27/91	264.85	246.62	18.23	--	--	--	--	--	--	--
06/18/91	264.85	244.41	20.44	--	--	--	--	--	--	--
09/12/91	264.85	244.03	20.82	--	ND	ND	ND	ND	ND	--
01/23/92	264.85	243.93	20.92	--	ND	ND	ND	ND	ND	--
04/13/92	264.85	245.17	19.68	--	ND	ND	ND	ND	ND	--
08/03/92	264.85	244.78	20.07	--	ND	ND	ND	ND	ND	--
10/22/92	264.85	244.73	20.12	--	ND	ND	ND	ND	ND	--
01/18/93	264.85	247.49	17.36	--	60	3.3	11	2.1	8.9	--
04/19/93	264.85	246.95	17.90	--	ND	ND	ND	ND	ND	--

Table 1
Groundwater Monitoring Data and Analytical Results
Chevron Service Station #9-5607
5269 Crow Canyon Road
Castro Valley, California

WELL ID/ DATE	TOC (ft.)	GWE (msl)	DTW (ft.)	SPHT (ft.)	TPH-G (ppb)	B (ppb)	T (ppb)	E (ppb)	X (ppb)	MTBE (ppb)
C-10B (cont)										
07/21-22/93	264.85	246.99	17.86	--	ND	ND	ND	ND	ND	--
10/25/93	264.85	246.75	18.10	--	ND	ND	ND	ND	ND	--
01/21/94	264.85	246.62	18.23	--	ND	ND	ND	ND	ND	--
04/18/94	264.85	247.49	17.36	--	ND	ND	ND	ND	0.5	--
07/06-07/94	264.85	247.80	17.05	--	ND	ND	ND	ND	ND	--
10/07/94	264.85	247.31	17.54	--	ND	ND	ND	ND	ND	--
01/11/95	264.85	248.61	16.24	--	<50	<0.5	<0.5	<0.5	<0.5	--
04/24/95	264.85	247.95	16.90	--	<50	<0.5	<0.5	<0.5	<0.5	--
07/31/95	264.85	245.57	19.28	--	<50	<0.5	<0.5	<0.5	<0.5	--
10/02/95	264.85	244.91	19.94	--	<50	<0.5	<0.5	<0.5	<0.5	--
01/16/96	264.85	246.25	18.60	--	<50	<0.5	<0.5	<0.5	<0.5	<2.5
04/18/96	264.85	246.87	17.98	--	<50	<0.5	<0.5	<0.5	<0.5	<2.5
07/22/96	264.85	245.75	19.10	--	<50	<0.5	<0.5	<0.5	<0.5	<2.5
10/10/96	264.85	245.14	19.71	--	<50	<0.5	<0.5	<0.5	<0.5	<2.5
01/09/97	264.85	247.65	17.20	--	<50	<0.5	<0.5	<0.5	<0.5	<2.5
04/15/97	264.85	246.11	18.74	--	<50	<0.5	<0.5	<0.5	<0.5	<2.5
07/08/97	264.85	246.10	18.75	--	<50	<0.5	<0.5	<0.5	<0.5	<2.5
10/22/97	264.85	246.35	18.50	--	<50	<0.5	<0.5	<0.5	<0.5	<2.5
01/12/98	264.85	247.71	17.14	--	<50	<0.5	<0.5	<0.5	<0.5	<2.5
04/21/98	264.85	247.69	17.16	--	<50	<0.5	<0.5	<0.5	<0.5	<2.5
07/08/98	264.85	246.61	18.24	--	<50	<0.5	0.62	<0.5	<0.5	<2.5
10/13/98	264.85	245.93	18.92	--	<50	<0.5	<0.5	<0.5	<0.5	<2.5
01/27/99	264.85	246.74	18.11	--	<50	<0.5	<0.5	<0.5	<0.5	<2.0
04/27/99	264.85	247.26	17.59	--	<50	<0.5	<0.5	<0.5	<0.5	<5.0
07/23/99	264.85	246.70	18.15	--	<50	<0.5	<0.5	<0.5	<0.5	<5.0
11/01/99	264.85	247.16	17.69	--	<50	<0.5	<0.5	<0.5	<0.5	<2.5
01/20/00	264.85	246.62	18.23	--	<50	<0.5	<0.5	<0.5	<0.5	<5.0
04/28-29/00	264.85	247.34	17.51	0.00	<50	<0.50	<0.50	<0.50	<0.50	<2.5
07/21/00	264.85	247.03	17.82	0.00	<50	<0.50	<0.50	<0.50	<0.50	<2.5
10/09-10/00	264.85	246.62	18.23	0.00	<50.0	<0.500	<0.500	<0.500	<0.500	<2.50
01/08-09/01	264.85	246.72	18.13	0.00	<50.0	<0.500	<0.500	<0.500	<0.500	<2.50

Table 1
Groundwater Monitoring Data and Analytical Results
Chevron Service Station #9-5607
5269 Crow Canyon Road
Castro Valley, California

WELL ID/ DATE	TOC (ft.)	GWE (msl)	DTW (ft.)	SPHT (ft.)	TPH-G (ppb)	B (ppb)	T (ppb)	E (ppb)	X (ppb)	MTBE (ppb)
C-10B (cont)										
04/30/01	264.85	247.31	17.54	0.00	<50.0	<0.500	<0.500	<0.500	<0.500	<5.00
07/09-10/01	264.85	246.80	18.05	0.00	<50	<0.50	<0.50	<0.50	<0.50	<2.5
DESTROYED										
C-11										
03/07/90	265.30	242.56	22.74	--	--	--	--	--	--	--
03/09/90	265.30	--	--	--	ND	1.2	0.7	ND	1.4	--
06/12/90	265.30	243.32	21.98	--	ND	ND	ND	ND	ND	--
09/24/90	265.30	243.42	21.88	--	ND	ND	ND	ND	ND	--
12/20/90	265.30	242.12	23.18	--	ND	ND	ND	ND	ND	--
03/27/91	265.30	243.78	21.52	--	ND	ND	ND	ND	1.5	--
06/18/91	265.30	243.40	21.90	--	--	--	--	--	--	--
09/12/91	265.30	242.60	22.70	--	ND	ND	ND	ND	ND	--
01/23/92	265.30	241.84	23.46	--	ND	ND	ND	ND	ND	--
04/13/92	265.30	243.73	21.57	--	ND	ND	ND	ND	ND	--
08/03/92	265.30	242.63	22.67	--	ND	ND	ND	ND	ND	--
10/22/92	265.30	242.01	23.29	--	ND	ND	ND	ND	ND	--
01/18/93	265.30	243.94	21.36	--	ND	ND	1.2	ND	2.2	--
04/19/93	265.30	245.33	19.97	--	ND	ND	ND	ND	ND	--
07/21-22/93	265.30	244.65	20.65	--	ND	ND	ND	ND	ND	--
10/25/93	265.30	244.55	20.75	--	ND	ND	ND	ND	ND	--
01/21/94	265.30	243.69	21.61	--	ND	ND	ND	ND	ND	--
04/18/94	265.30	244.52	20.78	--	ND	ND	ND	ND	ND	--
07/06-07/94	265.30	244.88	20.42	--	ND	ND	ND	ND	ND	--
10/07/94	265.30	243.70	21.60	--	ND	ND	ND	ND	ND	--
01/11/95	265.30	245.28	20.02	--	<50	<0.5	<0.5	<0.5	<0.5	--
04/24/95	265.30	247.58	17.72	--	<50	<0.5	<0.5	<0.5	<0.5	--
07/31/95	265.30	246.12	19.18	--	<50	<0.5	<0.5	<0.5	<0.5	--
10/02/95	265.30	244.88	20.42	--	<50	<0.5	<0.5	<0.5	<0.5	--
01/16/96	265.30	245.48	19.82	--	<50	<0.5	<0.5	<0.5	<0.5	<2.5
04/18/96	265.30	248.30	17.00	--	260	7.9	6.9	5.3	23	11

Table 1
Groundwater Monitoring Data and Analytical Results
Chevron Service Station #9-5607
5269 Crow Canyon Road
Castro Valley, California

WELL ID/ DATE	TOC (ft.)	GWE (msl)	DTW (ft.)	SPHT (ft.)	TPH-G (ppb)	B (ppb)	T (ppb)	E (ppb)	X (ppb)	MTBE (ppb)
C-11 (cont)										
07/22/96	265.30	248.40	16.90	--	<50	<0.5	<0.5	<0.5	<0.5	<2.5
10/10/96	265.30	245.74	19.56	--	130	32	2.70	4.30	14	3.40
01/09/97	265.30	249.28	16.02	--	75	5.30	6.40	2.0	9.0	<2.5
04/15/97	265.30	247.35	17.95	--	<50	<0.5	<0.5	<0.5	<0.5	<2.5
07/08/97	265.30	245.55	19.75	--	<50	<0.5	<0.5	<0.5	<0.5	<2.5
10/22/97	265.30	245.74	19.56	--	<50	<0.5	<0.5	<0.5	<0.5	<2.5
01/12/98	265.30	246.97	18.33	--	<50	<0.5	<0.5	<0.5	<0.5	<2.5
04/21/98	265.30	248.62	16.68	--	<50	<0.5	<0.5	<0.5	<0.5	<2.5
07/08/98	265.30	246.76	18.54	--	<50	<0.5	0.58	<0.5	<0.5	<2.5
10/13/98	265.30	245.02	20.28	--	<50	<0.5	<0.5	<0.5	<0.5	<2.5
01/27/99	265.30	245.85	19.45	--	<50	<0.5	<0.5	<0.5	<0.5	<2.0
04/27/99	265.30	246.90	18.40	--	<50	<0.5	<0.5	<0.5	<0.5	<5.0
07/23/99	265.30	246.05	19.25	--	<50	<0.5	<0.5	<0.5	<0.5	<5.0
11/01/99	265.30	247.47	17.83	--	<50	<0.5	<0.5	<0.5	<0.5	<2.5
01/20/00	265.30	245.06	20.24	--	<50	<0.5	<0.5	<0.5	<0.5	<5.0
04/28-29/00	265.30	246.35	18.95	0.00	<50	<0.50	<0.50	<0.50	<0.50	<2.5
07/21/00	265.30	246.07	19.23	0.00	<50	<0.50	<0.50	<0.50	<0.50	<2.5
10/09-10/00	265.30	245.57	19.73	0.00	<50.0	<0.500	<0.500	<0.500	<0.500	<2.50
01/08-09/01	265.30	244.99	20.31	0.00	<50.0	<0.500	<0.500	<0.500	<0.500	<2.50
04/30/01	265.30	246.01	19.29	0.00	<50.0	<0.500	<0.500	<0.500	<0.500	<5.00
07/09-10/01	265.30	245.51	19.79	0.00	<50	<0.50	<0.50	<0.50	<0.50	<2.5
10/10/01	265.30	245.23	20.07	0.00	<50	<0.50	<0.50	<0.50	<1.5	<2.5
01/07/02	265.30	246.85	18.45	0.00	<50	<0.50	<0.50	<0.50	<1.5	<2.5
04/11/02	265.30	246.05	19.25	0.00	<50	<0.50	<0.50	<0.50	<1.5	<2.5
C-12										
03/07/90	269.66	254.74	14.92	--	--	--	--	--	--	--
03/09/90	269.66	--	--	--	1,400	230	140	33	180	--
06/12/90	269.66	254.87	14.79	--	720	190	71	18	73	--
09/24/90	269.66	253.94	15.72	--	ND	1.1	ND	ND	0.6	--
12/20/90	269.66	254.40	15.26	--	810	210	26	8.2	23	--

Table 1
Groundwater Monitoring Data and Analytical Results
Chevron Service Station #9-5607
5269 Crow Canyon Road
Castro Valley, California

WELL ID/ DATE	TOC (ft.)	GWE (msl)	DTW (ft.)	SPHT (ft.)	TPH-G (ppb)	B (ppb)	T (ppb)	E (ppb)	X (ppb)	MTBE (ppb)
C-12 (cont)										
03/27/91	269.66	257.55	12.11	--	2,900	350	220	52	210	--
06/18/91	269.66	253.28	16.38	--	--	--	--	--	--	--
09/12/91	269.66	252.11	17.55	--	350	59	12	4.5	8.5	--
01/23/92	269.66	252.55	17.11	--	450	110	31	7.9	22	--
04/13/92	269.66	255.26	14.40	--	5,000	1,100	76	100	200	--
08/03/92	269.66	253.83	15.83	--	520	200	21	13	25	--
10/22/92	269.66	253.52	16.14	--	1,300	310	66	35	56	--
01/18/93	269.66	257.96	11.70	--	5,600	1,200	430	220	610	--
04/19/93	269.66	256.61	13.05	--	2,000	600	99	96	170	--
07/21-22/93	269.66	256.82	12.84	--	540	95	36	18	56	--
10/25/93	269.66	255.63	14.03	--	350	90	29	20	50	--
01/21/94	269.66	255.51	14.15	--	450	73	18	14	37	--
04/18/94	269.66	256.71	12.95	--	370	70	21	12	39	--
07/06-07/94	269.66	257.35	12.31	--	840	200	35	28	66	--
10/07/94	269.66	256.31	13.35	--	830	85	29	17	63	--
01/11/95	269.66	258.43	11.23	--	2,100	570	190	98	390	--
04/24/95	269.66	259.34	10.32	--	820	120	28	23	61	--
07/31/95	269.66	256.92	12.74	--	520	79	13	16	42	--
10/02/95	269.66	255.26	14.40	--	400	50	5.3	11	29	--
01/16/96	269.66	256.94	12.72	--	1,900	490	32	60	120	<25
04/18/96	269.66	258.91	10.75	--	2,900	640	54	100	190	68
07/22/96	269.66	256.46	13.20	--	730	150	13	26	75	10
10/10/96	269.66	255.95	13.71	--	270	58	4.40	7.70	31	<2.5
01/09/97	269.66	260.60	9.06	--	2,900	550	67	94	300	63
04/15/97	269.66	258.13	11.53	--	2,500	350	29	92	200	43
07/08/97	269.66	257.92	11.74	--	1,400	190	17	54	120	21
10/22/97	269.66	258.78	10.88	--	2,300	490	45	110	340	42
01/12/98	269.66	260.76	8.90	--	5,000	840	89	220	610	<50
04/21/98	269.66	262.41	7.25	--	2,400	410	39	79	270	130
07/08/98	269.66	258.95	10.71	--	<50	7.6	<0.5	2.0	2.9	<2.5
10/13/98	269.66	257.01	12.65	--	2,600	460	34	120	240	11
01/27/99	269.66	257.41	12.25	--	96.9	6.88	<0.5	<0.5	<0.5	<2.0

Table 1
Groundwater Monitoring Data and Analytical Results
 Chevron Service Station #9-5607
 5269 Crow Canyon Road
 Castro Valley, California

WELL ID/ DATE	TOC (ft.)	GWE (msl)	DTW (ft.)	SPHT (ft.)	TPH-G (ppb)	B (ppb)	T (ppb)	F (ppb)	X (ppb)	MTBE (ppb)
C-12 (cont)										
04/27/99	269.66	259.46	10.20	--	2,720	614	32	128	300	<50
07/23/99	269.66	258.27	11.39	--	1,230	220	10	45	93.6	<20
11/01/99	269.66	257.13	12.53	--	70.7	10.7	1.02	<0.5	1.61	5.55
01/20/00	269.66	257.85	11.81	--	1,390	301	10.7	29.9	90.8	<50
04/28-29/00	269.66	259.37	10.29	0.00	310 ³	57	<0.50	11	6.8	15
07/21/00	269.66	258.67	10.99	0.00	260 ³	74	1.5	<0.50	12	5.55
10/09-10/00	269.66	257.63	12.03	0.00	3,510 ⁵	903	24.0	53.9	200	<100
01/08-09/01	269.66	257.70	11.96	0.00	1,600 ⁷	319	<5.00	60.7	55.1	84.8
04/30/01	269.66	259.08	10.58	0.00	985 ³	114	<2.50	26.4	14.6	<25.0
07/09-10/01	269.66	258.04	11.62	0.00	<50	6.5	<0.50	<0.50	<0.50	<2.5
10/10/01	269.66	257.60	12.06	0.00	8,700	720	15	430	250	<50
01/07/02	269.66	261.28	8.38	0.00	2,200	460	8.5	60	73	31
04/11/02	269.66	260.71	8.95	0.00	6,200	610	8.4	420	230	<25
C-13										
03/07/90	284.32	273.14	11.18	--	--	--	--	--	--	--
03/09/90	284.32	--	--	--	ND	15	3.7	1.0	6.2	--
06/12/90	284.32	273.62	10.70	--	ND	2.6	ND	ND	ND	--
09/24/90	284.32	272.72	11.60	--	ND	2.4	ND	ND	ND	--
12/20/90	284.32	274.16	10.16	--	ND	1.6	ND	ND	ND	--
03/27/91	284.32	276.68	7.64	--	--	--	--	--	--	--
06/18/91	284.32	273.00	11.32	--	--	--	--	--	--	--
09/12/91	284.32	272.48	11.84	--	ND	ND	ND	ND	ND	--
01/23/92	284.32	273.77	10.55	--	--	--	--	--	--	--
04/13/92	284.32	273.36	10.96	--	ND	1.0	ND	ND	ND	--
08/03/92	284.32	273.42	10.90	--	ND	ND	ND	ND	ND	--
10/22/92	284.32	273.14	11.18	--	--	--	--	--	--	--
01/18/93	284.32	276.92	7.40	--	290	54	10	5.4	12	--
04/19/93	284.32	275.39	8.93	--	--	--	--	--	--	--
07/21-22/93	284.32	273.57	10.75	--	ND	ND	ND	ND	ND	--
10/25/93	284.32	273.47	10.85	--	--	--	--	--	--	--

Table 1
Groundwater Monitoring Data and Analytical Results
Chevron Service Station #9-5607
5269 Crow Canyon Road
Castro Valley, California

WELL ID/ DATE	TOC (ft.)	GWE (msl)	DTW (ft.)	SPHT (ft.)	TPH-G (ppb)	B (ppb)	T (ppb)	E (ppb)	X (ppb)	MTBE (ppb)
C-13 (cont)										
01/21/94	284.32	273.27	11.05	--	ND	ND	ND	ND	ND	--
04/18/94	284.32	273.61	10.71	--	--	--	--	--	--	--
07/06-07/94	284.32	273.67	10.65	--	ND	0.5	ND	ND	ND	--
10/07/94	284.32	273.24	11.08	--	--	--	--	--	--	--
01/11/95	284.32	278.94	5.38	--	120	15	<0.5	3.1	2.7	--
04/24/95	284.32	276.54	7.78	--	SAMPLED SEMI-ANNUALLY					--
07/31/95	284.32	274.38	9.94	--	<50	<0.5	<0.5	<0.5	<0.5	--
10/02/95	284.32	273.74	10.58	--	--	--	--	--	--	--
01/16/96	284.32	274.52	9.80	--	<50	<0.5	<0.5	<0.5	<0.5	<2.5
04/18/96	284.32	276.57	7.75	--	--	--	--	--	--	--
07/22/96	284.32	274.82	9.50	--	59	18	<0.5	1.0	<0.5	<2.5
10/10/96	284.32	273.63	10.69	--	--	--	--	--	--	--
01/09/97	284.32	276.95	7.37	--	<50	0.60	<0.5	<0.5	<0.5	<2.5
04/15/97	284.32	275.63	8.69	--	--	--	--	--	--	--
07/08/97	284.32	276.12	8.20	--	SAMPLES LOST					--
07/15/97	284.32	276.02	8.30	--	<50	2.6	<0.5	<0.5	1.6	<2.5
10/22/97	284.32	276.79	7.53	--	--	--	--	--	--	--
01/12/98	284.32	278.38	5.94	--	<50	<0.5	<0.5	<0.5	<0.5	<2.5
04/21/98	284.32	277.35	6.97	--	--	--	--	--	--	--
07/08/98	284.32	274.45	9.87	--	<50	<0.5	<0.5	<0.5	<0.5	<2.5
10/13/98	284.32	273.51	10.81	--	--	--	--	--	--	--
01/27/99	284.32	273.06	11.26	--	<50	<0.5	<0.5	<0.5	<0.5	<2.0
04/27/99	284.32	275.42	8.90	--	--	--	--	--	--	--
07/23/99	284.32	275.00	9.32	--	158	14.9	<0.5	0.69	0.928	<5.0
11/01/99	284.32	272.83	11.49	--	--	--	--	--	--	--
01/20/00	284.32	274.23	10.09	--	<50	<0.5	<0.5	<0.5	<0.5	<5.0
04/28-29/00	284.32	275.43	8.89	0.00	SAMPLED SEMI-ANNUALLY					--
07/21/00	284.32	274.87	9.45	0.00	--	--	--	--	--	--
07/26/00	284.32	INACCESSIBLE	--	--	--	--	--	--	--	--
10/09-10/00	284.32	274.07	10.25	0.00	--	--	--	--	--	--
01/08-09/01	284.32	INACCESSIBLE	--	--	--	--	--	--	--	--
04/30/01	284.32	275.17	9.15	0.00	<50.0	0.925	<0.500	<0.500	<0.500	<5.00

Table 1
Groundwater Monitoring Data and Analytical Results
Chevron Service Station #9-5607
5269 Crow Canyon Road
Castro Valley, California

WELL ID/ DATE	TOC (ft.)	GWE (msl)	DTW (ft.)	SPHT (ft.)	TPH-G (ppb)	B (ppb)	T (ppb)	E (ppb)	X (ppb)	MTBE (ppb)
C-13 (cont)										
07/09-10/01	284.32	274.72	9.60	0.00	<50	0.66	<0.50	<0.50	<0.50	<2.5
10/10/01	284.32	274.52	9.80	0.00	SAMPLED SEMI-ANNUALLY		--	--	--	--
01/07/02	284.32	276.47	7.85	0.00	<50	<0.50	<0.50	<0.50	<1.5	<2.5
04/11/02	284.32	276.11	8.21	0.00	--	--	--	--	--	--
C-14										
03/07/90	270.74	255.56	15.18	--	--	--	--	--	--	--
03/09/90	270.74	--	--	--	ND	ND	ND	ND	ND	--
06/12/90	270.74	257.32	13.42	--	ND	ND	ND	ND	ND	--
09/24/90	270.74	257.90	12.84	--	ND	ND	ND	ND	ND	--
12/20/90	270.74	254.02	16.72	--	ND	1.7	0.7	ND	0.7	--
03/27/91	270.74	262.74	8.00	--	ND	ND	ND	ND	1.3	--
06/18/91	270.74	255.53	15.21	--	--	--	--	--	--	--
09/12/91	270.74	255.13	15.61	--	ND	ND	ND	ND	ND	--
01/23/92	270.74	246.10	24.64	--	--	--	--	--	--	--
04/13/92	270.74	258.53	12.21	--	ND	ND	ND	ND	ND	--
08/03/92	270.74	256.10	14.64	--	ND	ND	ND	ND	ND	--
10/22/92	270.74	253.80	16.94	--	--	--	--	--	--	--
01/18/93	270.74	265.64	5.10	--	ND	ND	ND	ND	ND	--
04/19/93	270.74	263.86	6.88	--	--	--	--	--	--	--
07/21-22/93	270.74	259.58	11.16	--	ND	ND	ND	ND	ND	--
10/25/93	270.74	256.87	13.87	--	--	--	--	--	--	--
01/21/94	270.74	255.42	15.32	--	ND	ND	ND	ND	ND	--
04/18/94	270.74	254.85	15.89	--	--	--	--	--	--	--
07/06-07/94	270.74	258.66	12.08	--	ND	ND	ND	ND	ND	--
10/07/94	270.74	255.45	15.29	--	--	--	--	--	--	--
01/11/95	270.74	266.94	3.80	--	<50	<0.5	<0.5	<0.5	<0.5	--
04/24/95	270.74	265.68	5.06	--	SAMPLED SEMI-ANNUALLY		--	--	--	--
07/31/95	270.74	260.34	10.40	--	<50	<0.5	<0.5	<0.5	<0.5	--
10/02/95	270.74	257.20	13.54	--	--	--	--	--	--	--
01/16/96	270.74	259.62	11.12	--	<50	<0.5	<0.5	<0.5	<0.5	<2.5

Table 1
Groundwater Monitoring Data and Analytical Results
Chevron Service Station #9-5607
5269 Crow Canyon Road
Castro Valley, California

WELL ID/ DATE	TOC (ft.)	GWE (msl)	DTW (ft.)	SPHT (ft.)	TPH-G (ppb)	B (ppb)	T (ppb)	E (ppb)	X (ppb)	MTBE (ppb)
C-14 (cont)										
04/18/96	270.74	265.78	4.96	--	--	--	--	--	--	--
07/22/96	270.74	259.89	10.85	--	<50	<0.5	<0.5	<0.5	<0.5	<2.5
10/10/96	270.74	261.44	9.30	--	--	--	--	--	--	--
01/09/97	270.74	269.80	0.94	--	56	3.80	4.20	1.10	5.0	<2.5
04/15/97	270.74	263.59	7.15	--	--	--	--	--	--	--
07/08/97	270.74	261.44	9.30	--	<50	<0.5	<0.5	<0.5	<0.5	<2.5
10/22/97	270.74	261.17	9.57	--	--	--	--	--	--	--
01/12/98	270.74	268.45	2.29	--	<50	<0.5	<0.5	<0.5	<0.5	<2.5
04/21/98	270.74	270.70	0.04	--	--	--	--	--	--	--
07/08/98	270.74	264.85	5.89	--	<50	<0.5	<0.5	<0.5	<0.5	<2.5
10/13/98	270.74	260.38	10.36	--	--	--	--	--	--	--
01/27/99	270.74	263.42	7.32	--	<50	<0.5	<0.5	<0.5	<0.5	<2.0
04/27/99	270.74	267.98	2.76	--	--	--	--	--	--	--
07/23/99	270.74	269.59	1.15	--	<50	<0.5	<0.5	<0.5	<0.5	<5.0
11/01/99	270.74	267.11	3.63	--	--	--	--	--	--	--
01/20/00	270.74	266.77	3.97	--	<50	<0.5	<0.5	<0.5	<0.5	<5.0
04/28-29/00	270.74	269.13	1.61	0.00	SAMPLED SEMI-ANNUALLY		--	--	--	--
07/21/00	270.74	268.72	2.02	0.00	--	--	--	--	--	--
07/26/00	270.74	268.45	2.29	0.00	<50	<0.50	<0.50	<0.50	<0.50	<2.5
10/09-10/00	270.74	267.39	3.35	0.00	--	--	--	--	--	--
01/08-09/01	270.74	266.72	4.02	0.00	<50.0	<0.500	<0.500	<0.500	<0.500	<2.50
04/30/01	270.74	268.19	2.55	0.00	--	--	--	--	--	--
07/09-10/01	270.74	267.56	3.18	0.00	<50	<0.50	<0.50	<0.50	<0.50	<2.5
10/10/01	270.74	267.69	3.05	0.00	SAMPLED SEMI-ANNUALLY		--	--	--	--
01/07/02	270.74	270.71	0.03	0.00	<50	<0.50	<0.50	<0.50	<1.5	<2.5
04/11/02	270.74	267.49	3.25	0.00	--	--	--	--	--	--
C-15										
03/07/90	246.15	235.05	11.10	--	--	--	--	--	--	--
03/09/90	246.15	--	--	--	410	ND	1.4	0.5	0.6	--
06/12/90	246.15	235.37	10.78	--	420	11	ND	ND	ND	--

Table 1
Groundwater Monitoring Data and Analytical Results
Chevron Service Station #9-5607
5269 Crow Canyon Road
Castro Valley, California

WELL ID/ DATE	TOC (ft.)	GWE (msl)	DTW (ft.)	SPHT (ft.)	TPH-G (ppb)	B (ppb)	T (ppb)	E (ppb)	X (ppb)	MTBE (ppb)
C-15 (cont)										
09/24/90	246.15	235.22	10.93	--	430	ND	1.5	ND	ND	--
12/20/90	246.15	235.07	11.08	--	300	1.3	1.1	0.6	1.5	--
03/27/91	246.15	237.65	8.50	--	520	4.6	1.1	ND	1.0	--
06/18/91	246.15	235.32	10.83	--	290	ND	1.1	ND	ND	--
06/18/91 (D)	246.15	235.32	10.83	--	320	ND	1.3	ND	ND	--
09/12/91	246.15	235.10	11.05	--	330	ND	0.9	ND	ND	--
01/23/92	246.15	235.35	10.80	--	210	ND	0.6	ND	ND	--
01/23/92 (D)	246.15	235.35	10.80	--	190	1.2	0.8	ND	ND	--
04/13/92	246.15	236.57	9.58	--	430	1.8	ND	ND	ND	--
08/03/92	246.15	234.94	11.21	--	640	ND	2.1	0.7	1.3	--
10/22/92	246.15	234.50	11.65	--	420	ND	ND	ND	0.8	--
01/18/93	246.15	239.03	7.12	--	640	7.0	3.0	2.9	6.7	--
04/19/93	246.15	237.22	8.93	--	260	6.0	2.0	0.7	ND	--
07/21-22/93	246.15	236.37	9.78	--	580	ND	8.0	ND	0.6	--
10/25/93	246.15	236.41	9.74	--	240	ND	12	ND	0.6	--
01/21/94	246.15	235.78	10.37	--	420	0.6	ND	0.6	ND	--
04/18/94	246.15	236.19	9.96	--	550	1.0	4.6	0.6	ND	--
07/06-07/94	246.15	235.92	10.23	--	660	0.7	ND	ND	0.7	--
10/07/94	246.15	235.47	10.68	--	440	13	0.8	ND	1.2	--
01/11/95	246.15	238.84	7.31	--	750	2.5	<0.5	<0.5	0.6	--
04/24/95	246.15	237.41	8.74	--	850	<0.5	<0.5	<0.5	<0.5	--
07/31/95	246.15	235.41	10.74	--	640	<0.5	1.6	<0.5	<0.5	--
10/02/95	246.15	234.83	11.32	--	560	<0.5	<0.5	<0.5	<0.5	--
01/16/96	246.15	235.58	10.57	--	740	<0.5	<0.5	<0.5	<0.5	<2.5
04/18/96	246.15	237.55	8.60	--	760	<0.5	<0.5	<0.5	<0.5	<2.5
07/22/96	246.15	235.57	10.58	--	690	<0.5	1.60	<0.5	<0.5	7.90
10/10/96	246.15	234.97	11.18	--	870	7.0	2.10	<0.5	<0.5	11
01/09/97	246.15	238.83	7.32	--	370	2.60	1.10	<0.5	<0.5	4.60
04/15/97	246.15	235.76	10.39	--	510	22	<0.5	<0.5	<0.5	<2.5
07/08/97	246.15	235.68	10.47	--	490	71	6.80	22	48	7.0
10/22/97	246.15	235.01	11.14	--	790	2.30	1.80	<0.5	<0.5	5.10
01/12/98	246.15	238.17	7.98	--	400	13	<1.0	<1.0	<1.0	<5.0

Table 1
Groundwater Monitoring Data and Analytical Results
 Chevron Service Station #9-5607
 5269 Crow Canyon Road
 Castro Valley, California

WELL ID/ DATE	TOC (ft.)	GWE (msl)	DTW (ft.)	SPHT (ft.)	TPH-G (ppb)	B (ppb)	T (ppb)	E (ppb)	X (ppb)	MTBE (ppb)
C-15 (cont)										
04/21/98	246.15	238.05	8.10	--	770	<0.5	0.6	0.82	0.51	<2.5
07/08/98	246.15	235.65	10.50	--	540	13	<0.5	<0.5	<0.5	<2.5
10/13/98	246.15	234.95	11.20	--	<50	<0.5	<0.5	<0.5	0.54	<2.5
01/27/99	246.15	235.53	10.62	--	769	<0.5	1.88	0.675	<0.5	4.35
04/27/99	246.15	236.91	9.24	--	612	2.57	1.79	<0.5	<0.5	<5.0
07/23/99	246.15	235.11	11.04	--	626	13.6	<0.5	<0.5	<0.5	<5.0
11/01/99	246.15	235.25	10.90	--	739	21.9	4.54	1.45	1.28	17.3
01/20/00 ⁶	246.15	235.06	11.09	--	465	1.43	0.815	<0.5	<0.5	<5.0
04/28-29/00	246.15	235.85	10.30	0.00	470 ³	2.9	3.2	<0.50	<0.50	8.0
07/21/00	246.15	235.19	10.96	0.00	610 ³	2.1	3.5	<0.50	1.7	7.9
10/09-10/00	246.15	235.01	11.14	0.00	527 ⁵	<0.500	<0.500	<0.500	<0.500	10.3
01/08-09/01	246.15	235.07	11.08	0.00	677 ⁷	3.86	0.862	<0.500	<0.500	12.1
04/30/01	246.15	235.38	10.77	0.00	690 ⁸	<1.00	<1.00	<1.00	<1.00	11.0
07/09-10/01	246.15	234.93	11.22	0.00	510 ³	30	1.6	<0.50	1.2	11
10/10/01	246.15	234.83	11.32	0.00	780	1.7	<1.0	<0.50	<1.5	7.0
01/07/02	246.15	238.04	8.11	0.00	260	2.0	<0.50	<0.50	<1.5	4.4
04/11/02	246.15	236.86	9.29	0.00	470	1.9	<1.0	<0.50	<1.5	4.9
C-16										
03/07/90	246.69	228.19	18.50	--	--	--	--	--	--	--
03/09/90	246.69	--	--	--	ND	ND	ND	ND	ND	--
06/12/90	246.69	235.27	11.42	--	ND	ND	ND	ND	ND	--
09/24/90	246.69	235.30	11.39	--	ND	ND	ND	ND	ND	--
12/20/90	246.69	235.12	11.57	--	ND	ND	ND	ND	0.7	--
03/27/91	246.69	237.93	8.76	--	ND	ND	ND	ND	1.3	--
03/27/91 (D)	246.69	237.93	8.76	--	ND	ND	ND	ND	1.2	--
06/18/91	246.69	235.51	11.18	--	ND	ND	ND	ND	ND	--
09/12/91	246.69	234.74	11.95	--	ND	ND	ND	ND	ND	--
01/23/92	246.69	234.28	12.41	--	ND	ND	ND	ND	ND	--
04/13/92	246.69	236.00	10.69	--	ND	ND	ND	ND	ND	--
08/03/92	246.69	234.49	12.20	--	ND	ND	ND	ND	ND	--

Table 1
Groundwater Monitoring Data and Analytical Results
Chevron Service Station #9-5607
5269 Crow Canyon Road
Castro Valley, California

WELL ID/ DATE	TOC (ft.)	GWE (msl)	DTW (ft.)	SPHT (ft.)	TPH-G (ppb)	B (ppb)	T (ppb)	E (ppb)	X (ppb)	MTBE (ppb)
C-16 (cont)										
10/22/92	246.69	234.09	12.60	--	ND	ND	ND	ND	ND	--
01/18/93	246.69	237.69	9.00	--	ND	ND	ND	ND	ND	--
04/19/93	246.69	236.80	9.89	--	ND	ND	ND	ND	ND	--
07/21-22/93	246.69	236.44	10.25	--	ND	ND	ND	ND	ND	--
10/25/93	246.69	235.73	10.96	--	ND	ND	ND	ND	ND	--
01/21/94	246.69	234.93	11.76	--	ND	ND	0.7	ND	1.0	--
04/18/94	246.69	235.47	11.22	--	ND	ND	ND	ND	ND	--
07/06-07/94	246.69	235.32	11.37	--	ND	ND	ND	ND	ND	--
10/07/94	246.69	234.30	12.39	--	ND	ND	ND	ND	ND	--
01/11/95	246.69	237.73	8.96	--	<50	<0.5	<0.5	<0.5	<0.5	--
04/24/95	246.69	236.31	10.38	--	<50	<0.5	<0.5	<0.5	<0.5	--
07/31/95	246.69	235.37	11.32	--	<50	<0.5	<0.5	<0.5	<0.5	--
10/02/95	246.69	234.29	12.40	--	<50	<0.5	<0.5	<0.5	<0.5	--
01/16/96	246.69	235.15	11.54	--	<50	<0.5	<0.5	<0.5	<0.5	<2.5
04/18/96	246.69	236.09	10.60	--	<50	<0.5	<0.5	<0.5	<0.5	<2.5
07/22/96	246.69	235.12	11.57	--	<50	<0.5	<0.5	<0.5	<0.5	<2.5
10/10/96	246.69	234.25	12.44	--	<50	<0.5	<0.5	<0.5	<0.5	<2.5
01/09/97	246.69	237.16	9.53	--	<50	<0.5	<0.5	<0.5	<0.5	<2.5
04/15/97	246.69	234.66	12.03	--	<50	<0.5	<0.5	<0.5	<0.5	<2.5
07/08/97	246.69	234.51	12.18	--	<50	<0.5	<0.5	<0.5	<0.5	<2.5
10/22/97	246.69	233.94	12.75	--	<50	<0.5	<0.5	<0.5	<0.5	<2.5
01/12/98	246.69	236.34	10.35	--	<50	<0.5	<0.5	<0.5	<0.5	<2.5
04/21/98	246.69	236.06	10.63	--	<50	<0.5	<0.5	<0.5	<0.5	<2.5
07/08/98	246.69	234.62	12.07	--	<50	<0.5	0.51	<0.5	<0.5	<2.5
10/13/98	246.69	233.94	12.75	--	<50	<0.5	<0.5	<0.5	<0.5	<2.5
01/27/99	246.69	234.58	12.11	--	<50	<0.5	<0.5	<0.5	<0.5	<2.0
04/27/99	246.69	235.56	11.13	--	<50	<0.5	<0.5	<0.5	<0.5	<5.0
07/23/99	246.69	234.35	12.34	--	<50	<0.5	<0.5	<0.5	<0.5	<5.0
11/01/99	246.69	233.57	13.12	--	<50	<0.5	<0.5	<0.5	<0.5	<2.5
01/20/00	246.69	233.84	12.85	--	<50	<0.5	<0.5	<0.5	<0.5	<5.0
04/28-29/00	246.69	234.49	12.20	0.00	<50	<0.50	<0.50	<0.50	<0.50	<2.5
07/21/00	246.69	234.03	12.66	0.00	<50	<0.50	<0.50	<0.50	<0.50	<2.5

Table 1
Groundwater Monitoring Data and Analytical Results
Chevron Service Station #9-5607
5269 Crow Canyon Road
Castro Valley, California

WELL ID/ DATE	TOC (ft.)	GWE (msl)	DFW (ft.)	SPHT (ft.)	TPH-G (ppb)	B (ppb)	T (ppb)	E (ppb)	X (ppb)	MTBE (ppb)
C-16 (cont)										
10/09-10/00	246.69	233.80	12.89	0.00	<50.0	<0.500	<0.500	<0.500	<0.500	<2.50
01/08-09/01	246.69	233.73	12.96	0.00	<50.0	<0.500	<0.500	<0.500	<0.500	<2.50
04/30/01	246.69	235.95	10.74	0.00	724 ⁸	<1.00	<1.00	<1.00	<1.00	<10.0
07/09-10/01	246.69	233.90	12.79	0.00	<50	<0.50	<0.50	<0.50	<0.50	<2.5
10/10/01	246.69	233.62	13.07	0.00	<50	<0.50	<0.50	<0.50	<1.5	<2.5
01/07/02	246.69	235.73	10.96	0.00	<50	<0.50	<0.50	<0.50	<1.5	<2.5
04/11/02	246.69	234.87	11.82	0.00	<50	<0.50	<0.50	<0.50	<1.5	<2.5
RW										
12/04/89	--	--	--	--	62,000	29,000	1,700	1,800	8,800	--
03/07/90	274.52	256.02	18.50	--	--	--	--	--	--	--
06/12/90	274.52	256.03	18.49	--	31,000	15,000	2,000	560	3,100	--
09/24/90	274.52	--	--	--	--	--	--	--	--	--
12/20/90	274.52	--	--	--	ND	0.5	ND	ND	1.2	--
03/27/91	274.52	--	--	--	--	--	--	--	--	--
06/18/91	274.52	--	--	--	--	--	--	--	--	--
09/12/91	274.52	INSUFFICIENT WATER	--	--	--	--	--	--	--	--
01/23/92	274.52	INSUFFICIENT WATER	--	--	--	--	--	--	--	--
04/13/92	274.52	INSUFFICIENT WATER	--	--	--	--	--	--	--	--
08/03/92	274.52	INSUFFICIENT WATER	--	--	--	--	--	--	--	--
10/22/92	274.52	INSUFFICIENT WATER	--	--	--	--	--	--	--	--
01/18/93	274.52	INSUFFICIENT WATER	--	--	--	--	--	--	--	--
04/19/93	274.52	INSUFFICIENT WATER	--	--	--	--	--	--	--	--
07/21-22/93	274.52	INSUFFICIENT WATER	--	--	--	--	--	--	--	--
10/25/93	274.52	--	--	--	--	--	--	--	--	--
01/21/94	274.52	--	--	--	--	--	--	--	--	--
04/18/94	274.52	--	--	--	--	--	--	--	--	--
07/06-07/94	274.52	--	--	--	--	--	--	--	--	--
10/07/94	274.52	--	--	--	--	--	--	--	--	--

Table 1
Groundwater Monitoring Data and Analytical Results
 Chevron Service Station #9-5607
 5269 Crow Canyon Road
 Castro Valley, California

WELL ID/ DATE	TOC (ft.)	GWE (msl)	DTW (ft.)	SPHT (ft.)	TPH-G (ppb)	B (ppb)	T (ppb)	E (ppb)	X (ppb)	MTBE (ppb)
RW (cont)										
10/24/95	274.52	256.63	17.89	--	37,000	11,000	380	1,100	3,000	--
01/16/96	274.52	259.09	15.43	--	59,000	17,000	660	1,600	5,400	<1000
NOT MONITORED/SAMPLED										
TRIP BLANK										
01/11/95	--	--	--	--	<50	<0.5	<0.5	<0.5	<0.5	--
04/24/95	--	--	--	--	<50	<0.5	<0.5	<0.5	<0.5	--
07/31/95	--	--	--	--	<50	<0.5	<0.5	<0.5	<0.5	--
10/02/95	--	--	--	--	<50	<0.5	<0.5	<0.5	<0.5	--
01/16/96	--	--	--	--	<50	<0.5	<0.5	<0.5	<0.5	--
04/18/96	--	--	--	--	<50	<0.5	<0.5	<0.5	<0.5	--
07/22/96	--	--	--	--	<50	<0.5	<0.5	<0.5	<0.5	--
10/10/96	--	--	--	--	<50	<0.5	<0.5	<0.5	<0.5	--
01/09/97	--	--	--	--	<50	<0.5	<0.5	<0.5	<0.5	--
04/15/97	--	--	--	--	<50	<0.5	<0.5	<0.5	<0.5	<2.5
07/08/97	--	--	--	--	<50	<0.5	<0.5	<0.5	<0.5	<2.5
07/15/97	--	--	--	--	<50	<0.5	<0.5	<0.5	<0.5	<2.5
10/22/97	--	--	--	--	<50	<0.5	<0.5	<0.5	<0.5	<2.5
01/12/98	--	--	--	--	<50	<0.5	<0.5	<0.5	<0.5	<2.5
04/21/98	--	--	--	--	<50	<0.5	<0.5	<0.5	<0.5	<2.5
07/08/98	--	--	--	--	<50	<0.5	<0.5	<0.5	<0.5	<2.5
10/13/98	--	--	--	--	<50	<0.5	<0.5	<0.5	<0.5	<2.5
01/27/99	--	--	--	--	<50	<0.5	<0.5	<0.5	<0.5	<2.0
04/27/99	--	--	--	--	<50	<0.5	<0.5	<0.5	<0.5	<5.0
07/23/99	--	--	--	--	<50	<0.5	<0.5	<0.5	<0.5	<5.0
11/01/99	--	--	--	--	<50	<0.5	<0.5	<0.5	<0.5	<2.5
01/20/00	--	--	--	--	<50	<0.5	<0.5	<0.5	<0.5	<5.0
04/28-29/00	--	--	--	--	<50	<0.50	<0.50	<0.50	<0.50	<2.5
07/21/00	--	--	--	--	<50	<0.50	<0.50	<0.50	<0.50	<2.5
07/26/00	--	--	--	--	<50	<0.50	<0.50	<0.50	<0.50	<2.5
10/09-10/00	--	--	--	--	<50.0	<0.500	<0.500	<0.500	<0.500	<2.50

Table 1
Groundwater Monitoring Data and Analytical Results
Chevron Service Station #9-5607
5269 Crow Canyon Road
Castro Valley, California

WELL ID/ DATE	TOC (ft.)	GWE (msl)	DTW (ft.)	SPHT (ft.)	TPH-G (ppb)	B (ppb)	T (ppb)	E (ppb)	X (ppb)	MTBE (ppb)
TRIP BLANK (cont)										
01/08-09/01	--	--	--	--	<50.0	<0.500	<0.500	<0.500	<0.500	<2.50
04/30/01	--	--	--	--	<50.0	<0.500	<0.500	<0.500	<0.500	<5.00
07/09-10/01	--	--	--	--	<50	<0.50	<0.50	<0.50	<0.50	<2.5
QA										
10/10/01	--	--	--	--	<50	<0.50	<0.50	<0.50	<1.5	<2.5
01/07/02	--	--	--	--	<50	<0.50	<0.50	<0.50	<1.5	<2.5
04/11/02	--	--	--	--	<50	<0.50	<0.50	<0.50	<1.5	<2.5

Table 1
Groundwater Monitoring Data and Analytical Results
Chevron Service Station #9-5607
5269 Crow Canyon Road
Castro Valley, California

EXPLANATIONS:

Groundwater monitoring data and laboratory analytical results prior to April 28, 2000, were compiled from reports prepared by Blaine Tech Services, Inc.

TOC = Top of Casing

(ft.) = Feet

GWE = Groundwater Elevation

(msl) = Mean sea level

DTW = Depth to Water

SPHT = Separate Phase Hydrocarbon Thickness

TPH-G = Total Petroleum Hydrocarbons as Gasoline

B = Benzene

T = Toluene

E = Ethylbenzene

X = Xylenes

MTBE = Methyl tertiary butyl ether

(ppb) = Parts per billion

(D) = Duplicate

-- = Not Measured/Not Analyzed

ND = Not Detected

QA = Quality Assurance

- 1 Confirmation run.
- 2 Chromatogram pattern indicates an unidentified hydrocarbon.
- 3 Laboratory report indicates gasoline C6-C12.
- 4 Laboratory report indicates gasoline C6-C12 + unidentified hydrocarbons C6-C12.
- 5 Laboratory report indicates weathered gasoline C6-C12.
- 6 Insufficient Preservative to reduce sample pH to less than 2. Sample was analyzed within 14 days, but beyond the seventh day recommended for Benzene, Toluene, Xylene and Ethylbenzene.
- 7 Laboratory report indicates weathered gasoline C6-C12 + unidentified hydrocarbons C6-C12.
- 8 Laboratory report indicates unidentified hydrocarbons C6-C12.
- 9 Pump in well.

Table 2
Groundwater Analytical Results - Oxygenate Compounds
 Chevron Service Station #9-5607
 5269 Crow Canyon Road
 Castro Valley, California

WELL ID/ DATE	ETHANOL (ppb)	TBA (ppb)	MTBE (ppb)	DIPE (ppb)	ETBE (ppb)	TAME (ppb)
C-1 10/13/98	<10,000	<2,000	<40	<40	<40	<40

EXPLANATIONS:

Groundwater laboratory analytical results were compiled from reports prepared by Blaine Tech Services, Inc.

TBA = Tertiary butyl alcohol

MTBE = Methyl tertiary butyl ether

DIPE = Di-isopropyl ether

ETBE = Ethyl tertiary butyl ether

TAME = Tertiary amyl methyl ether

(ppb) = Parts per billion

ANALYTICAL METHOD:

EPA Method 8260 for Oxygenate Compounds

STANDARD OPERATING PROCEDURE - GROUNDWATER SAMPLING

Gettler-Ryan Inc. field personnel adhere to the following procedures for the collection and handling of groundwater samples prior to analysis by the analytical laboratory. Prior to sample collection, the type of analysis to be performed is determined. Loss prevention of volatile compounds is controlled and sample preservation for subsequent analysis is maintained.

Prior to sampling, the presence or absence of free-phase hydrocarbons is determined using an interface probe. Product thickness, if present, is measured to the nearest 0.01 foot and is noted in the field notes. In addition, static water level measurements are collected with the interface probe and are also recorded in the field notes.

After water levels are collected and prior to sampling, each well is purged a minimum of three well casing volumes of water using pre-cleaned pumps (stack, suction, Grundfos), or polyvinyl chloride bailers. Temperature, pH and electrical conductivity are measured a minimum of three times during the purging. Purging continues until these parameters stabilize.

Groundwater samples are collected using Chevron-designated disposable bailers. The water samples are transferred from the bailer into appropriate containers. Pre-preserved containers, supplied by analytical laboratories, are used when possible. When pre-preserved containers are not available, the laboratory is instructed to preserve the sample as appropriate. Duplicate samples are collected for the laboratory to use in maintaining quality assurance/quality control standards. The samples are labeled to include the job number, sample identification, collection date and time, analysis, preservation (if any), and the sample collector's initials. The water samples are placed in a cooler, maintained at 4°C for transport to the laboratory. Once collected in the field, all samples are maintained under chain of custody until delivered to the laboratory.

The chain of custody document includes the job number, type of preservation, if any, analysis requested, sample identification, date and time collected, and the sample collector's name. The chain of custody is signed and dated (including time of transfer) by each person who receives or surrenders the samples, beginning with the field personnel and ending with the laboratory personnel.

A laboratory supplied trip blank accompanies each sampling set. For sampling sets greater than 20 samples, 5% trip blanks are included. The trip blank is analyzed for some or all of the same compounds as the groundwater samples.

As requested by Chevron Products Company, the purge water and decontamination water generated during sampling activities is transported by IWM to McKittrick Waste Management located in McKittrick, California.

**WELL MONITORING/SAMPLING
FIELD DATA SHEET.**

Client/CHEVRON

Facility # 9-5607

Job#: 386539

Address: 5269 Crow Canyon Rd.

Date: 4-11-02

City: Castro Valley, CA

Sampler: FB

Well ID C-1

Well Condition: OK

Well Diameter 213/16 in.

Hydrocarbon Thickness: ∅ (feet) Amount Bailed ∅ (Gallons)
(product/water):

Total Depth 43.20 ft.

Depth to Water 17.52 ft.

Volume Factor (VF)	2" = 0.17	3" = 0.38	4" = 0.66
	6" = 1.50	12" = 5.80	

25.68 x VF .666 = 16.94 x 3 (case volume) = Estimated Purge Volume: 51 (gal.)

Purge Equipment: Disposable Bailer
Stack
Suction
Grundfos
Other: _____

Sampling Equipment: Disposable Bailer
Bailer
Pressure Bailer
Grab Sample
Other: _____

Starting Time: 1354

Weather Conditions: clear

Sampling Time: 1430

Water Color: clear Odor: yes

Purging Flow Rate: 2 gpm.

Sediment Description: _____

Did well de-water? NO

If yes; Time: _____ Volume: _____ (gal.)

Time	Volume (gal.)	pH	Conductivity μ mhos/cm	Temperature $^{\circ}$ C	D.O. (mg/L)	ORP (mV)	Alkalinity (ppm)
<u>1404</u>	<u>17</u>	<u>7.76</u>	<u>557</u>	<u>20.9</u>			
<u>1412</u>	<u>34</u>	<u>7.54</u>	<u>421</u>	<u>20.7</u>			
<u>1420</u>	<u>51</u>	<u>7.21</u>	<u>388</u>	<u>20.5</u>			

LABORATORY INFORMATION

SAMPLE ID	(#) - CONTAINER	REFRIG.	PRESERV. TYPE	LABORATORY	ANALYSES
<u>C-1</u>	<u>3 VOCAS</u>	<u>Y</u>	<u>HCL</u>	<u>LANCASTER</u>	<u>TPHIG)/btex/mtbe</u>

COMMENTS: _____

**WELL MONITORING/SAMPLING
FIELD DATA SHEET.**

Client/CHEVRON

Facility # 9-5607

Job#: 386539

Address: 5269 Crow Canyon Rd.

Date: 4-11-02

City: Castro Valley, CA

Sampler: FB

Well ID

C-2

Well Condition:

OK

Well Diameter

213 (4) in.

Hydrocarbon

∅

Amount Bailed

∅

Thickness: _____ (feet) (product/water): _____ (Gallons)

Total Depth

44.48 ft.

Volume	2" = 0.17	3" = 0.38	4" = 0.66
Factor (VF)	6" = 1.50	12" = 5.80	

Depth to Water

14.60 ft.

_____ X VF _____ = _____ X 3 (case volume) = Estimated Purge Volume: _____ (gal.)

Purge Equipment:

- Disposable Bailer
- Bailer
- Stack
- Suction
- Grundfos
- Other: _____

Sampling Equipment:

- Disposable Bailer
- Bailer
- Pressure Bailer
- Grab Sample
- Other: _____

Starting Time: _____

Weather Conditions: _____

Sampling Time: _____

Water Color: _____ Odor: _____

Purging Flow Rate: _____ gpm.

Sediment Description: _____

Did well de-water? _____

If yes; Time: _____ Volume: _____ (gal.)

Time	Volume (gal.)	pH	Conductivity μ mhos/cm	Temperature °F	D.O. (mg/L)	ORP (mV)	Alkalinity (ppm)

LABORATORY INFORMATION

SAMPLE ID	(#) - CONTAINER	REFRIG.	PRESERV. TYPE	LABORATORY	ANALYSES
				LANCASTER	TPH(G)/btex/mtbe

COMMENTS: monitor only

**WELL MONITORING/SAMPLING
FIELD DATA SHEET.**

Client/CHEVRON

Facility # 9-5607

Job#: 386539

Address: 5269 Crow Canyon Rd.

Date: 4-11-02

City: Castro Valley, CA

Sampler: FB

Well ID: C-3

Well Condition: OK

Well Diameter: 21.314 in.

Hydrocarbon Thickness: ∅ (feet) Amount Bailed ∅ (Gallons)

Total Depth: 31.78 ft.

Volume Factor (VF)	2" = 0.17	3" = 0.38	4" = 0.66
	6" = 1.50	12" = 5.80	

Depth to Water: 20.13 ft.

11.65 x VF 0.66 = 7.68 x 3 (case volume) = Estimated Purge Volume: 23 (gal.)

Purge Equipment: Disposable Bailer
Bailer
Stack
Suction
Grundfos
Other:

Sampling Equipment: Disposable Bailer
Bailer
Pressure Bailer
Grab Sample
Other:

Starting Time: 1446

Weather Conditions: clear

Sampling Time: 1507

Water Color: cloudy Odor: YES

Purging Flow Rate: 2 gpm.

Sediment Description: _____

Did well de-water? NO

If yes; Time: _____ Volume: _____ (gal.)

Time	Volume (gal.)	pH	Conductivity μ mhos/cm	Temperature $^{\circ}$ C	D.O. (mg/L)	ORP (mV)	Alkalinity (ppm)
<u>1450</u>	<u>7.5</u>	<u>7.50</u>	<u>597</u>	<u>20.5</u>			
<u>1454</u>	<u>15.0</u>	<u>7.31</u>	<u>694</u>	<u>20.7</u>			
<u>1458</u>	<u>23.0</u>	<u>7.60</u>	<u>708</u>	<u>20.7</u>			

LABORATORY INFORMATION

SAMPLE ID	(#) - CONTAINER	REFRIG.	PRESERV. TYPE	LABORATORY	ANALYSES
<u>C-3</u>	<u>3 VOAS</u>	<u>Y</u>	<u>HCL</u>	<u>LANCASTER</u>	<u>TPHIGI/btex/mtbe</u>

COMMENTS: _____

**WELL MONITORING/SAMPLING
FIELD DATA SHEET.**

Client/CHEVRON

Facility # 9-5607

Job#: 386539

Address: 5269 Crow Canyon Rd.

Date: 4-11-02

City: Castro Valley, CA

Sampler: FB

Well ID: C-5
 Well Diameter: 213 (4)
 Total Depth: 40.19 ft.
 Depth to Water: 20.27 ft.

Well Condition: OK
 Hydrocarbon Thickness: ∅ (feet) Amount Bailed: ∅ (Gallons)
 Volume Factor (VF) 2" = 0.17 3" = 0.38 4" = 0.66
 6" = 1.50 12" = 5.80

_____ X VF _____ = _____ X 3 (case volume) = Estimated Purge Volume: _____ (gal.)

Purge Equipment: Disposable Bailer
 Bailer
 Stack
 Suction
 Grundfos
 Other: _____

Sampling Equipment: Disposable Bailer
 Bailer
 Pressure Bailer
 Grab Sample
 Other: _____

Starting Time: _____
 Sampling Time: _____
 Purging Flow Rate: _____ gpm.
 Did well de-water? _____

Weather Conditions: _____
 Water Color: _____ Odor: _____
 Sediment Description: _____
 If yes; Time: _____ Volume: _____ (gal.)

Time	Volume (gal.)	pH	Conductivity μ hos/cm	Temperature °F	D.O. (mg/L)	ORP (mV)	Alkalinity (ppm)

LABORATORY INFORMATION

SAMPLE ID	(#) - CONTAINER	REFRIG.	PRESERV. TYPE	LABORATORY	ANALYSES
		Y		LANCASTER	TPH(G)/btex/mtbe

COMMENTS: monitor only

**WELL MONITORING/SAMPLING
FIELD DATA SHEET.**

Client/CHEVRON
 Facility # 9-5607 Job#: 386539
 Address: 5269 Crow Canyon Rd. Date: 4-11-02
 City: Castro Valley, CA Sampler: FB

Well ID: C-6 Well Condition: OK
 Well Diameter: 21.3 (H) in Hydrocarbon Thickness: Ø Amount Bailed: Ø (Gallons)
 Total Depth: 29.91 ft. Volume Factor (VF) 2" = 0.17 3" = 0.38 4" = 0.66
 Depth to Water: 11.70 ft. 6" = 1.50 12" = 5.80

18.21 X VF 1.66 = 12.01 X 3 (case volume) = Estimated Purge Volume: 36 (gal.)

Purge Equipment: Disposable Bailer Stack Sampling Equipment: Disposable Bailer
 Suction Bailer
 Grundfos Pressure Bailer
 Other: _____ Grab Sample
 Other: _____

Starting Time: 1447 Weather Conditions: clean
 Sampling Time: 1511 Water Color: clean Odor: YES
 Purging Flow Rate: 2 gpm. Sediment Description: _____
 Did well de-water? NO If yes; Time: _____ Volume: _____ (gal.)

Time	Volume (gal.)	pH	Conductivity μ mhos/cm	Temperature $^{\circ}$ C	D.O. (mg/L)	ORP (mV)	Alkalinity (ppm)
<u>1453</u>	<u>12</u>	<u>7.45</u>	<u>607</u>	<u>20.5</u>			
<u>1459</u>	<u>24</u>	<u>7.62</u>	<u>546</u>	<u>20.1</u>			
<u>1505</u>	<u>36</u>	<u>7.70</u>	<u>421</u>	<u>19.9</u>			

LABORATORY INFORMATION

SAMPLE ID	(#) - CONTAINER	REFRIG.	PRESERV. TYPE	LABORATORY	ANALYSES
<u>C-6</u>	<u>3 VOAS</u>	<u>Y</u>	<u>HCL</u>	<u>LANCASTER</u>	<u>TPH(G)/btex/mtbe</u>

COMMENTS: _____

**WELL MONITORING/SAMPLING
FIELD DATA SHEET.**

Client/ **CHEVRON**

Facility # 9-5607

Job#: 386539

Address: 5269 Crow Canyon Rd.

Date: 4-11-02

City: Castro Valley, CA

Sampler: FB

Well ID: S-7

Well Condition: OK

Well Diameter: 213/4 in.

Hydrocarbon Thickness: ∅ (feet) Amount Bailed (product/water): ∅ (Gallons)

Total Depth: 26.69 ft.

Depth to Water: 4.29 ft.

Volume Factor (VF)	2" = 0.17	3" = 0.38	4" = 0.66
	6" = 1.50	12" = 5.80	

_____ X VF _____ = _____ X 3 (case volume) = Estimated Purge Volume: _____ (gal.)

Purge Equipment: Disposable Bailer
Bailer
Stack
Suction
Grundfos
Other: _____

Sampling Equipment: Disposable Bailer
Bailer
Pressure Bailer
Grab Sample
Other: _____

Starting Time: _____

Weather Conditions: _____

Sampling Time: _____

Water Color: _____ Odor: _____

Purging Flow Rate: _____ gpm.

Sediment Description: _____

Did well de-water? _____

If yes; Time: _____ Volume: _____ (gal.)

Time	Volume (gal.)	pH	Conductivity μ mhos/cm	Temperature $^{\circ}$ F	D.O. (mg/L)	ORP (mV)	Alkalinity (ppm)
/	/	/	/	/	/	/	/
/	/	/	/	/	/	/	/
/	/	/	/	/	/	/	/
/	/	/	/	/	/	/	/
/	/	/	/	/	/	/	/
/	/	/	/	/	/	/	/

LABORATORY INFORMATION

SAMPLE ID	(#) - CONTAINER	REFRIG.	PRESERV. TYPE	LABORATORY	ANALYSES
		Y		LANGASTER	TPH(G)/bTEX/mtbe

COMMENTS: monitor only

**WELL MONITORING/SAMPLING
FIELD DATA SHEET.**

Client/CHEVRON
 Facility # 9-5607 Job#: 386539
 Address: 5269 Crow Canyon Rd. Date: 4-11-02
 City: Castro Valley, CA Sampler: FB

Well ID: 5-8 Well Condition: OK
 Well Diameter: 2 3/4 in. Hydrocarbon Thickness: ∅ (feet) Amount Bailed: ∅ (Gallons)
 Total Depth: 25.05 ft. Volume 2" = 0.17 3" = 0.38 4" = 0.66
 Depth to Water: 5.87 ft. Factor (VF) 6" = 1.50 12" = 5.80

19.18 x VF 1.7 = 3.26 x 3 (case volume) = Estimated Purge Volume: 10 (gal.)

Purge Equipment: Disposable Bailer
 Bailer
 Stack
 Suction
 Grundfos
 Other: _____

Sampling Equipment: Disposable Bailer
 Bailer
 Pressure Bailer
 Grab Sample
 Other: _____

Starting Time: 0850 Weather Conditions: Clear
 Sampling Time: 0920 Water Color: Clear Odor: NO
 Purging Flow Rate: _____ gpm. Sediment Description: _____
 Did well de-water? NO If yes; Time: _____ Volume: _____ (gal.)

Time	Volume (gal.)	pH	Conductivity μ mhos/cm	Temperature $^{\circ}$ C	D.O. (mg/L)	ORP (mV)	Alkalinity (ppm)
<u>0857</u>	<u>3.5</u>	<u>7.93</u>	<u>427</u>	<u>17.4</u>			
<u>0907</u>	<u>7.0</u>	<u>7.80</u>	<u>403</u>	<u>17.4</u>			
<u>0910</u>	<u>10.0</u>	<u>7.78</u>	<u>420</u>	<u>17.6</u>			

LABORATORY INFORMATION

SAMPLE ID	(#) - CONTAINER	REFRIG.	PRESERV. TYPE	LABORATORY	ANALYSES
<u>C-8</u>	<u>3 UOAS</u>	<u>Y</u>	<u>HCL</u>	<u>LANCASTER</u>	<u>TPH(G)/btex/mtbe</u>

COMMENTS: _____

**WELL MONITORING/SAMPLING
FIELD DATA SHEET.**

Client/CHEVRON

Facility # 9-5607

Job#: 386539

Address: 5269 Crow Canyon Rd.

Date: 4-11-02

City: Castro Valley, CA

Sampler: FB

Well ID C-9

Well Condition: ~~OK~~ CASING BROKEN * See BELOW

Well Diameter 21.37 in.

Hydrocarbon Thickness: ∅ (feet) Amount Bailed (product/water): ∅ (Gallons)

Total Depth 27.84 ft.

Volume Factor (VF)	2" = 0.17	3" = 0.38	4" = 0.66
	6" = 1.50	12" = 5.80	

Depth to Water 10.35 ft.

17.49 x VF 0.66 = 11.54 x 3 (case volume) = Estimated Purge Volume: 34.5 (gal.)

Purge Equipment: Stack Suction
 Disposable Bailer
 Bailer
 Grundfos
 Other: _____

Sampling Equipment: Disposable Bailer
 Bailer
 Pressure Bailer
 Grab Sample
 Other: _____

Starting Time: 1312

Weather Conditions: clear

Sampling Time: 1338

Water Color: GRAY Odor: YES

Purging Flow Rate: 2 gpm.

Sediment Description: _____

Did well de-water? NO

If yes; Time: _____ Volume: _____ (gal.)

Time	Volume (gal.)	pH	Conductivity μ mhos/cm	Temperature $^{\circ}$ C	D.O. (mg/L)	ORP (mV)	Alkalinity (ppm)
<u>1318</u>	<u>11.6</u>	<u>7.53</u>	<u>550</u>	<u>19.1</u>			
<u>1324</u>	<u>23.0</u>	<u>7.64</u>	<u>471</u>	<u>19.3</u>			
<u>1330</u>	<u>34.5</u>	<u>7.41</u>	<u>426</u>	<u>19.4</u>			

LABORATORY INFORMATION

SAMPLE ID	(#) - CONTAINER	REFRIG.	PRESERV. TYPE	LABORATORY	ANALYSES
		Y		LANCASTER	TPHIG)/btex/mtbe

COMMENTS: Has submersible pump in it. can it be removed permanently? See photo

**WELL MONITORING/SAMPLING
FIELD DATA SHEET.**

Client/CHEVRON
 Facility # 9-5607 Job#: 386539
 Address: 5269 Crow Canyon Rd. Date: 4-11-02
 City: Castro Valley, CA Sampler: FB

Well ID: C-11 Well Condition: OK
 Well Diameter: 21(3)4 in. Hydrocarbon Thickness: ∅ Amount Bailed: ∅ (Gallons)
 Total Depth: 33.53 ft.
 Depth to Water: 19.25 ft.

Volume Factor (VF)	2" = 0.17	3" = 0.38	4" = 0.66
	6" = 1.50	12" = 5.80	

14.28 x VF .38 = 5.42 x 3 (case volume) = Estimated Purge Volume: 16 (gal.)

Purge Equipment: Disposable Bailer
 Bailer
Stack
 Suction
 Grundfos
 Other: _____

Sampling Equipment: Disposable Bailer
 Bailer
 Pressure Bailer
 Grab Sample
 Other: _____

Starting Time: 0939 Weather Conditions: clear
 Sampling Time: 0959 Water Color: clear Odor: no
 Purging Flow Rate: 2 gpm. Sediment Description: _____
 Did well de-water? NO If yes; Time: _____ Volume: _____ (gal.)

Time	Volume (gal.)	pH	Conductivity μ mhos/cm	Temperature $^{\circ}$ C	D.O. (mg/L)	ORP (mV)	Alkalinity (ppm)
<u>0942</u>	<u>5.5</u>	<u>7.30</u>	<u>560</u>	<u>18.7</u>			
<u>0945</u>	<u>11.0</u>	<u>7.16</u>	<u>548</u>	<u>19.0</u>			
<u>0948</u>	<u>16.0</u>	<u>7.02</u>	<u>540</u>	<u>19.1</u>			

LABORATORY INFORMATION

SAMPLE ID	(#) - CONTAINER	REFRIG.	PRESERV. TYPE	LABORATORY	ANALYSES
<u>C-11</u>	<u>3 VOAS</u>	<u>Y</u>	<u>HCL</u>	<u>LANCASTER</u>	<u>TPH(G)/btex/mtbe</u>

COMMENTS: _____

**WELL MONITORING/SAMPLING
FIELD DATA SHEET**

Client/CHEVRON
 Facility # 9-5607
 Address: 5269 Crow Canyon Rd.
 City: Castro Valley, CA

Job#: 386539
 Date: 4-11-02
 Sampler: FB

Well ID: C-12
 Well Diameter: 2 1/8 in.
 Total Depth: 29.30 ft.
 Depth to Water: 8.95 ft.

Well Condition: OK
 Hydrocarbon Thickness: ∅ (feet)
 Amount Bailed (product/water): ∅ (Gallons)
 Volume Factor (VF):
 2" = 0.17 3" = 0.38 4" = 0.66
 6" = 1.50 12" = 5.80

20.35 x VF 38 = 773 x 3 (case volume) = Estimated Purge Volume: 23 (gal.)

Purge Equipment: Disposable Bailer
 Bailer
 Stack
 Suction
 Grundfos
 Other: _____

Sampling Equipment: Disposable Bailer
 Bailer
 Pressure Bailer
 Grab Sample
 Other: _____

Starting Time: 1236
 Sampling Time: 1257
 Purging Flow Rate: 2 gpm.
 Did well de-water? NO

Weather Conditions: clear
 Water Color: clear Odor: YES
 Sediment Description: _____
 If yes: Time: _____ Volume: _____ (gal.)

Time	Volume (gal.)	pH	Conductivity μ mhos/cm	Temperature $^{\circ}$ C	D.O. (mg/L)	ORP (mV)	Alkalinity (ppm)
<u>1240</u>	<u>7.5</u>	<u>7.94</u>	<u>505</u>	<u>17.8</u>			
<u>1244</u>	<u>15.0</u>	<u>7.90</u>	<u>526</u>	<u>17.9</u>			
<u>1248</u>	<u>23.0</u>	<u>7.81</u>	<u>500</u>	<u>17.8</u>			

LABORATORY INFORMATION

SAMPLE ID	(#) - CONTAINER	REFRIG.	PRESERV. TYPE	LABORATORY	ANALYSES
<u>C-12</u>	<u>3 VOA'S</u>	<u>Y</u>	<u>ACL</u>	<u>LANCASTER</u>	<u>TPH(G)/btex/mtbe</u>

COMMENTS: _____

**WELL MONITORING/SAMPLING
FIELD DATA SHEET.**

Client/CHEVRON
 Facility # 9-5607 Job#: 386539
 Address: 5269 Crow Canyon Rd. Date: 4-11-02
 City: Castro Valley, CA Sampler: FB

Well ID C-13 Well Condition: OK
 Well Diameter 2 1/4 in. Hydrocarbon Thickness: ∅ (feet) Amount Bailed: ∅ (Gallons)
 Total Depth 28.22 ft. Volume 2" = 0.17 3" = 0.38 4" = 0.66
 Depth to Water 8.21 ft. Factor (VF) 6" = 1.50 12" = 5.80

_____ X VF _____ = _____ X 3 (case volume) = Estimated Purge Volume: _____ (gal.)

Purge Equipment: Disposable Bailer
 Bailer
 Stack
 Suction
 Grundfos
 Other: _____

Sampling Equipment: Disposable Bailer
 Bailer
 Pressure Bailer
 Grab Sample
 Other: _____

Starting Time: _____ Weather Conditions: _____
 Sampling Time: _____ Water Color: _____ Odor: _____
 Purging Flow Rate: _____ gpm. Sediment Description: _____
 Did well de-water? _____ If yes; Time: _____ Volume: _____ (gal.)

Time	Volume (gal.)	pH	Conductivity μ mhos/cm	Temperature °F	D.O. (mg/L)	ORP (mV)	Alkalinity (ppm)
/	/	/	/	/	/	/	/
/	/	/	/	/	/	/	/
/	/	/	/	/	/	/	/
/	/	/	/	/	/	/	/
/	/	/	/	/	/	/	/
/	/	/	/	/	/	/	/

LABORATORY INFORMATION

SAMPLE ID	(#) - CONTAINER	REFRIG.	PRESERV. TYPE	LABORATORY	ANALYSES
/	/	Y	/	LANCASTER	TPH(G)/btox/mtbe

COMMENTS: monitor only

**WELL MONITORING/SAMPLING
FIELD DATA SHEET.**

Client/CHEVRON

Facility # 9-5607

Job#: 386539

Address: 5269 Crow Canyon Rd.

Date: 4-11-02

City: Castro Valley, CA

Sampler: FB

Well ID C-14

Well Condition: OK

Well Diameter 2 1/4 in.

Hydrocarbon Thickness: Ø (feet) Amount Bailed: Ø (Gallons)

Total Depth 27.62 ft.

Volume Factor (VF)	2" = 0.17	3" = 0.38	4" = 0.66
	6" = 1.50	12" = 5.80	

Depth to Water 3.25 ft.

_____ X VF _____ = _____ X 3 (case volume) = Estimated Purge Volume: _____ (gal.)

Purge Equipment: Disposable Bailer
Bailer
Stack
Suction
Grundfos
Other: _____

Sampling Equipment: Disposable Bailer
Bailer
Pressure Bailer
Grab Sample
Other: _____

Starting Time: _____
Sampling Time: _____
Purging Flow Rate: _____ gpm.
Did well de-water? _____

Weather Conditions: _____
Water Color: _____ Odor: _____
Sediment Description: _____
If yes; Time: _____ Volume: _____ (gal.)

Time	Volume (gal)	pH	Conductivity μ mhos/cm	Temperature $^{\circ}$ F	D.O. (mg/L)	ORP (mV)	Alkalinity (ppm)
	/	/	/	/	/	/	/
	/	/	/	/	/	/	/
	/	/	/	/	/	/	/
	/	/	/	/	/	/	/
	/	/	/	/	/	/	/
	/	/	/	/	/	/	/

LABORATORY INFORMATION

SAMPLE ID	(#) - CONTAINER	REFRIG.	PRESERV. TYPE	LABORATORY	ANALYSES
		Y		LANCASTER	TPH(G)/btox/mtbe

COMMENTS: monitor ONLY

**WELL MONITORING/SAMPLING
FIELD DATA SHEET.**

Client/CHEVRON
 Facility # 9-5607 Job#: 386539
 Address: 5269 Crow Canyon Rd. Date: 4-11-02
 City: Castro Valley, CA Sampler: FB

Well ID: C-15 Well Condition: OK
 Well Diameter: 2 1/3 1/4 in. Hydrocarbon Thickness: φ Amount Bailed (Gallons): φ
 Total Depth: 19.40 ft.
 Depth to Water: 9.29 ft.

Volume Factor (VF)	2" = 0.17	3" = 0.38	4" = 0.66
	6" = 1.50	12" = 5.80	

10.11 x VF 38 = 384 x 3 (case volume) = Estimated Purge Volume: 11.5 (gal.)

Purge Equipment: Disposable Bailer
 Bailer
 Stack
 Suction
 Grundfos
 Other: _____

Sampling Equipment: Disposable Bailer
 Bailer
 Pressure Bailer
 Grab Sample
 Other: _____

Starting Time: 1139 Weather Conditions: clear
 Sampling Time: 1222 Water Color: clear Odor: NO
 Purging Flow Rate: _____ gpm. Sediment Description: _____
 Did well de-water? NO If yes; Time: _____ Volume: _____ (gal.)

Time	Volume (gal.)	pH	Conductivity (μmhos/cm)	Temperature (°C)	D.O. (mg/L)	ORP (mV)	Alkalinity (ppm)
<u>1149</u>	<u>4</u>	<u>7.39</u>	<u>585</u>	<u>16.6</u>			
<u>1200</u>	<u>8</u>	<u>7.30</u>	<u>570</u>	<u>16.8</u>			
<u>1214</u>	<u>11.5</u>	<u>7.27</u>	<u>561</u>	<u>17.0</u>			

LABORATORY INFORMATION

SAMPLE ID	(#) - CONTAINER	REFRIG.	PRESERV. TYPE	LABORATORY	ANALYSES
<u>C-15</u>	<u>3 60x5</u>	<u>Y</u>	<u>HCL</u>	<u>LANCASTER</u>	<u>TPH(G)/btex/mtbe</u>

COMMENTS: _____

**WELL MONITORING/SAMPLING
FIELD DATA SHEET**

Client/CHEVRON
Facility # 9-5607
Address: 5269 Crow Canyon Rd.
City: Castro Valley, CA

Job#: 386539
Date: 4-11-02
Sampler: FB

Well ID: C-16
Well Diameter: 21(3)4 in.
Total Depth: 30.70 ft.
Depth to Water: 11.82 ft.

Well Condition: OK
Hydrocarbon Thickness: ∅ (feet) Amount Bailed ∅ (Gallons)
Volume Factor (VF) 2" = 0.17 3" = 0.38 4" = 0.66
6" = 1.50 12" = 5.80

18.88 X VF 38 = 7.17 X 3 (case volume) = Estimated Purge Volume: 21 (gal.)

Purge Equipment: Disposable Bailer
Bailer
Stack
Suction
Grundfos
Other: _____

Sampling Equipment: Disposable Bailer
Bailer
Pressure Bailer
Grab Sample
Other: _____

Starting Time: 1019
Sampling Time: 1128
Purging Flow Rate: _____ gpm.
Did well de-water? NO

Weather Conditions: clear
Water Color: clear Odor: NO
Sediment Description: _____
If yes; Time: _____ Volume: _____ (gal.)

Time	Volume (gal.)	pH	Conductivity μ mhos/cm	Temperature $^{\circ}$ F	D.O. (mg/L)	ORP (mV)	Alkalinity (ppm)
<u>1034</u>	<u>7</u>	<u>7.09</u>	<u>647</u>	<u>17.6</u>	_____	_____	_____
<u>1050</u>	<u>14</u>	<u>7.03</u>	<u>641</u>	<u>17.5</u>	_____	_____	_____
<u>1120</u>	<u>21</u>	<u>7.50</u>	<u>618</u>	<u>17.5</u>	_____	_____	_____

LABORATORY INFORMATION

SAMPLE ID	(#) - CONTAINER	REFRIG.	PRESERV. TYPE	LABORATORY	ANALYSES
<u>C-16</u>	<u>3 VOA's</u>	<u>Y</u>	<u>HCL</u>	<u>LANCASTER</u>	<u>TPH(G)/btex/mtbe</u>

COMMENTS: _____

Chevron California Region Analysis Request/Chain of Custody



041202-005

Acct. #: 10905 For Lancaster Laboratories use only Sample #: 3805189-98 SCR#:

Facility #: 9-5607 Job #386539 Global ID#T0600100344 Site Address: 5269 CROW CANYON ROAD, CASTRO VALLEY, CA Chevron PM: Tom Bauhs Lead Consultant: Delta/G-R Consultant/Office: G-R, Inc., 6747 Sierra Court, Dublin, Ca 94568 Consultant Prj. Mgr.: Deanna L. Harding (Deanna@grinc.com) Consultant Phone #: 925-551-7555 Fax #: 925-551-7899 Sampler: <u>F BOHNET</u> Service Order #: _____ <input type="checkbox"/> Non SAR: _____				Analyses Requested		Preservative Codes H = HCl T = Thiosulfate N = HNO ₃ B = NaOH S = H ₂ SO ₄ O = Other <input type="checkbox"/> J value reporting needed <input type="checkbox"/> Must meet lowest detection limits possible for 8260 compounds 8021 MTBE Confirmation <input type="checkbox"/> Confirm highest hit by 8260 <input type="checkbox"/> Confirm all hits by 8260 <input type="checkbox"/> Run ___ oxy s on highest hit <input type="checkbox"/> Run ___ oxy s on all hits			
Matrix <input type="checkbox"/> Potable Water <input type="checkbox"/> NPDES <input type="checkbox"/> Oil <input type="checkbox"/> Air				Preservation Codes					
Sample Identification				Total Number of Containers					
		Date Collected	Time Collected	Grab	Composite	Soil	Water	Oil	Air
		4/11/02				X	X	2	X
			1430	X		X	X	3	X
			1507	X		X	X	3	X
			1511	X		X	X	3	X
			0920	X		X	X	3	X
			1338	X		X	X	3	X
			0959	X		X	X	3	X
			1257	X		X	X	3	X
			1222	X		X	X	3	X
			1128	X		X	X	3	X
				Comments / Remarks					
Turnaround Time Requested (TAT) (please circle) STD. TAT 72 hour 48 hour 24 hour 4 day 5 day				Relinquished by: <u>Frank H Bohm</u> Date: <u>4/11/02</u> Time: <u>1545</u>		Received by: <u>[Signature]</u> Date: <u>4/11/02</u> Time: <u>1430</u>			
Data Package Options (please circle if required) QC Summary Type I — Full Type VI (Raw Data) <input type="checkbox"/> Coelt Deliverable not needed WIP (RWQCB) Disk				Relinquished by: <u>[Signature]</u> Date: <u>4/11/02</u> Time: <u>1430</u>		Received by: <u>[Signature]</u> Date: <u>4/11/02</u> Time: <u>1440</u>			
				Relinquished by Commercial Carrier: <u>Airborne</u> Date: <u>4-12-02</u> Time: <u>1530</u>		Received by: <u>[Signature]</u> Date: <u>4-12-02</u> Time: <u>1530</u>			
				UPS FedEx Other: <u>Airborne</u>		Received by: <u>[Signature]</u> Date: <u>4/12/02</u> Time: <u>1530</u>			
				Temperature Upon Receipt: <u>15-50</u> °C		Custody Seals Intact? <input checked="" type="radio"/> Yes <input type="radio"/> No			



ANALYTICAL RESULTS

Prepared for:

Chevron Products Company
6001 Bollinger Canyon Road
Building L PO Box 6004
San Ramon CA 94583-0904
925-842-8582

RECEIVED

APR 24 2002

Prepared by:

Lancaster Laboratories
2425 New Holland Pike
Lancaster, PA 17605-2425

GETTLER-RYAN INC.
GENERAL CONTRACTORS

SAMPLE GROUP

The sample group for this submittal is 803939. Samples arrived at the laboratory on Saturday, April 13, 2002. The PO# for this group is 99011184 and the release number is BAUHS.

<u>Client Description</u>			<u>Lancaster Labs Number</u>
QA-T-020411	NA	Water	3805189
C-1-W-020411	Grab	Water	3805190
C-3-W-020411	Grab	Water	3805191
C-6-W-020411	Grab	Water	3805192
C-8-W-020411	Grab	Water	3805193
C-9-W-020411	Grab	Water	3805194
C-11-W-020411	Grab	Water	3805195
C-12-W-020411	Grab	Water	3805196
C-15-W-020411	Grab	Water	3805197
C-16-W-020411	Grab	Water	3805198

METHODOLOGY

The specific methodologies used in obtaining the enclosed analytical results are indicated on the laboratory chronicles.

1 COPY TO

Delta C/O Gettler-Ryan

Attn: Deanna L. Harding



Lancaster Laboratories, Inc.
2425 New Holland Pike
PO Box 12425
Lancaster, PA 17605-2425
717-656-2300 Fax: 717-656-2681



Lancaster Laboratories

Where quality is a science

Questions? Contact your Client Services Representative
Teresa M Lis at (717) 656-2300.

Respectfully Submitted,

Steven A. Skiles
Steven A. Skiles
Sr. Chemist



Lancaster Laboratories, Inc.
2425 New Holland Pike
PO Box 12425
Lancaster, PA 17605-2425
717-656-2300 Fax: 717-656-2681



Lancaster Laboratories Sample No. WW 3805189

Collected: 04/11/2002 00:00

Account Number: 10905

Submitted: 04/13/2002 12:00

Chevron Products Company

Reported: 04/23/2002 at 11:59

6001 Bollinger Canyon Road

Discard: 05/24/2002

Building L PO Box 6004

QA-T-020411

NA

Water

San Ramon CA 94583-0904

Facility# 95607 Job# 386539 GRD
5269 CROW CANYON-CASTRO V T0600100344 QA

CAT No.	Analysis Name	CAS Number	As Received Result	As Received Method Detection Limit	Units	Dilution Factor
01729	TPH-GRO - Waters					
01730	TPH-GRO - Waters	n.a.	N.D.	50.	ug/l	1
The reported concentration of TPH-GRO does not include MTBE or other gasoline constituents eluting prior to the C6 (n-hexane) TPH-GRO range start time.						
A site-specific MSD sample was not submitted for the project. A LCS/LCSD was performed to demonstrate precision and accuracy at a batch level.						
08214	BTEX, MTBE (8021)					
00776	Benzene	71-43-2	N.D.	0.50	ug/l	1
00777	Toluene	108-88-3	N.D.	0.50	ug/l	1
00778	Ethylbenzene	100-41-4	N.D.	0.50	ug/l	1
00779	Total Xylenes	1330-20-7	N.D.	1.5	ug/l	1
00780	Methyl tert-Butyl Ether	1634-04-4	N.D.	2.5	ug/l	1
Site-specific MS/MSD samples were not submitted for the project. A LCS/LCSD was performed to demonstrate precision and accuracy at a batch level.						

State of California Lab Certification No. 2116

Laboratory Chronicle

CAT No.	Analysis Name	Method	Trial#	Analysis Date and Time	Analyst	Dilution Factor
01729	TPH-GRO - Waters	N. CA LUFT Gasoline Method	1	04/16/2002 21:38	Melissa D Mann	1
08214	BTEX, MTBE (8021)	SW-846 8021B	1	04/16/2002 21:38	Melissa D Mann	1
01146	GC VOA Water Prep	SW-846 5030B	1	04/16/2002 21:38	Melissa D Mann	n.a.

#=Laboratory Method Detection Limit exceeded target detection limit

N.D.=Not detected at or above the Reporting Limit



Lancaster Laboratories, Inc.
2425 New Holland Pike
PO Box 12425
Lancaster, PA 17605-2425
717-656-2300 Fax: 717-656-2681



Lancaster Laboratories Sample No. WW 3805190

Collected: 04/11/2002 14:30 by FB

Account Number: 10905

Submitted: 04/13/2002 12:00

Chevron Products Company

Reported: 04/23/2002 at 11:59

6001 Bollinger Canyon Road

Discard: 05/24/2002

Building L PO Box 6004

C-1-W-020411 Grab Water

San Ramon CA 94583-0904

Facility# 95607 Job# 386539 GRD

5269 CROW CANYON-CASTRO V T0600100344 C-1

CAT No.	Analysis Name	CAS Number	As Received Result	As Received Method Detection Limit	Units	Dilution Factor
01729	TPH-GRO - Waters					
01730	TPH-GRO - Waters	n.a.	9,000.	250.	ug/l	5
	The reported concentration of TPH-GRO does not include MTBE or other gasoline constituents eluting prior to the C6 (n-hexane) TPH-GRO range start time.					
	A site-specific MSD sample was not submitted for the project. A LCS/LCSD was performed to demonstrate precision and accuracy at a batch level.					
08214	BTEX, MTBE (8021)					
00776	Benzene	71-43-2	730.	1.0	ug/l	5
00777	Toluene	108-88-3	80.	1.0	ug/l	5
00778	Ethylbenzene	100-41-4	720.	1.0	ug/l	5
00779	Total Xylenes	1330-20-7	740.	3.0	ug/l	5
00780	Methyl tert-Butyl Ether	1634-04-4	N.D. #	50.	ug/l	5

Site-specific MS/MSD samples were not submitted for the project. A LCS/LCSD was performed to demonstrate precision and accuracy at a batch level.

Due to the presence of an interferent near its retention time, the normal reporting limit was not attained for MTBE. The presence or concentration of this compound cannot be determined due to the presence of this interferent.

Due to the nature of the sample matrix, the surrogate standard recovery is above the range of specifications.

State of California Lab Certification No. 2116

Laboratory Chronicle

#=Laboratory Method Detection Limit exceeded target detection limit

N.D.=Not detected at or above the Reporting Limit



MEMBER
 Lancaster Laboratories, Inc.
 2425 New Holland Pike
 PO Box 12425
 Lancaster, PA 17605-2425
 717-656-2300 Fax: 717-656-2681



Lancaster Laboratories Sample No. WW 3805190

Collected: 04/11/2002 14:30 by FB

Account Number: 10905

Submitted: 04/13/2002 12:00

Chevron Products Company

Reported: 04/23/2002 at 11:59

6001 Bollinger Canyon Road

Discard: 05/24/2002

Building L PO Box 6004

C-1-W-020411

Grab Water

San Ramon CA 94583-0904

Facility# 95607 Job# 386539 GRD

5269 CROW CANYON-CASTRO V T0600100344 C-1

CAT No.	Analysis Name	Method	Trial#	Analysis Date and Time	Analyst	Dilution Factor
01729	TPH-GRO - Waters	N. CA LUFT Gasoline Method	1	04/16/2002 16:11	Melissa D Mann	5
08214	BTEX, MTBE (8021)	SW-846 8021B	1	04/16/2002 16:11	Melissa D Mann	5
01146	GC VOA Water Prep	SW-846 5030B	1	04/16/2002 16:11	Melissa D Mann	n.a.

#=Laboratory Method Detection Limit exceeded target detection limit

N.D.=Not detected at or above the Reporting Limit



Lancaster Laboratories Inc.
2425 New Holland Pike
PO Box 12425
Lancaster, PA 17605-2425
717-656-2300 Fax: 717-656-2681



Lancaster Laboratories Sample No. WW 3805191

Collected: 04/11/2002 15:07 by FB

Account Number: 10905

Submitted: 04/13/2002 12:00

Reported: 04/23/2002 at 11:59

Discard: 05/24/2002

C-3-W-020411

Grab

Water

Chevron Products Company
6001 Bollinger Canyon Road
Building L PO Box 6004
San Ramon CA 94583-0904

Facility# 95607 Job# 386539 GRD

5269 CROW CANYON-CASTRO V T0600100344 C-3

CAT No.	Analysis Name	CAS Number	As Received Result	As Received Method Detection Limit	Units	Dilution Factor
01729	TPH-GRO - Waters					
01730	TPH-GRO - Waters	n.a.	71,000.	1,300.	ug/l	25
<p>The reported concentration of TPH-GRO does not include MTBE or other gasoline constituents eluting prior to the C6 (n-hexane) TPH-GRO range start time.</p> <p>A site-specific MSD sample was not submitted for the project. A LCS/LCSD was performed to demonstrate precision and accuracy at a batch level.</p>						
08214	BTEX, MTBE (8021)					
00776	Benzene	71-43-2	17,000.	20.	ug/l	100
00777	Toluene	108-88-3	660.	5.0	ug/l	25
00778	Ethylbenzene	100-41-4	1,600.	5.0	ug/l	25
00779	Total Xylenes	1330-20-7	10,000.	15.	ug/l	25
00780	Methyl tert-Butyl Ether	1634-04-4	N.D. #	50.	ug/l	25
<p>Site-specific MS/MSD samples were not submitted for the project. A LCS/LCSD was performed to demonstrate precision and accuracy at a batch level.</p>						

Due to the presence of an interferent near its retention time, the normal reporting limit was not attained for MTBE. The presence or concentration of this compound cannot be determined due to the presence of this interferent.

State of California Lab Certification No. 2116

Laboratory Chronicle

CAT No.	Analysis Name	Method	Trial#	Analysis Date and Time	Analyst	Dilution Factor
---------	---------------	--------	--------	------------------------	---------	-----------------

#=Laboratory Method Detection Limit exceeded target detection limit

N.D.=Not detected at or above the Reporting Limit.



2425 New Holland Pike
PO Box 12425
Lancaster, PA 17605-2425
717-656-2300 Fax: 717-656-2681



Lancaster Laboratories Sample No. WW 3805191

Collected: 04/11/2002 15:07 by FB

Account Number: 10905

Submitted: 04/13/2002 12:00

Chevron Products Company

Reported: 04/23/2002 at 11:59

6001 Bollinger Canyon Road

Discard: 05/24/2002

Building L PO Box 6004

C-3-W-020411

Grab

Water

San Ramon CA 94583-0904

Facility# 95607 Job# 386539

GRD

5269 CROW CANYON-CASTRO V T0600100344 C-3

01729	TPH-GRO - Waters	N. CA LUFT Gasoline Method	1	04/16/2002 16:47	Melissa D Mann	25
08214	BTEX, MTBE (8021)	SW-846 8021B	1	04/16/2002 16:47	Melissa D Mann	25
08214	BTEX, MTBE (8021)	SW-846 8021B	1	04/17/2002 08:50	Melissa D Mann	100
01146	GC VOA Water Prep	SW-846 5030B	1	04/16/2002 16:47	Melissa D Mann	n.a.

#=Laboratory Method Detection Limit exceeded target detection limit

N.D.=Not detected at or above the Reporting Limit.

MEMBER



2425 New Holland Pike
PO Box 12425
Lancaster, PA 17605-2425
717-656-2300 Fax: 717-656-2681



Lancaster Laboratories Sample No. WW 3805192

Collected: 04/11/2002 15:11 by FB

Account Number: 10905

Submitted: 04/13/2002 12:00

Chevron Products Company

Reported: 04/23/2002 at 11:59

6001 Bollinger Canyon Road

Discard: 05/24/2002

Building L PO Box 6004

C-6-W-020411

Grab Water

San Ramon CA 94583-0904

Facility# 95607 Job# 386539 GRD
5269 CROW CANYON-CASTRO V T0600100344 C-6

CAT No.	Analysis Name	CAS Number	As Received Result	As Received Method Detection Limit	Units	Dilution Factor
01729	TPH-GRO - Waters					
01730	TPH-GRO - Waters	n.a.	31,000.	2,500.	ug/l	50
	The reported concentration of TPH-GRO does not include MTBE or other gasoline constituents eluting prior to the C6 (n-hexane) TPH-GRO range start time.					
	A site-specific MSD sample was not submitted for the project. A LCS/LCSD was performed to demonstrate precision and accuracy at a batch level.					
08214	BTEX, MTBE (8021)					
00776	Benzene	71-43-2	11,000.	10.	ug/l	50
00777	Toluene	108-88-3	230.	1.0	ug/l	5
00778	Ethylbenzene	100-41-4	790.	1.0	ug/l	5
00779	Total Xylenes	1330-20-7	2,000.	3.0	ug/l	5
00780	Methyl tert-Butyl Ether	1634-04-4	N.D. #	50.	ug/l	5

Site-specific MS/MSD samples were not submitted for the project. A LCS/LCSD was performed to demonstrate precision and accuracy at a batch level.

Due to the presence of an interferent near its retention time, the normal reporting limit was not attained for MTBE. The presence or concentration of this compound cannot be determined due to the presence of this interferent.

Due to the nature of the sample matrix, the surrogate standard recovery is above the range of specifications.

State of California Lab Certification No. 2116

Laboratory Chronicle

#=Laboratory Method Detection Limit exceeded target detection limit

N.D.=Not detected at or above the Reporting Limit



MEMBER
2425 New Holland Pike
PO Box 12425
Lancaster, PA 17605-2425
717-656-2300 Fax: 717-656-2681



Lancaster Laboratories Sample No. WW 3805192

Collected: 04/11/2002 15:11 by FB

Account Number: 10905

Submitted: 04/13/2002 12:00

Reported: 04/23/2002 at 11:59

Discard: 05/24/2002

C-6-W-020411

Grab Water

Chevron Products Company
6001 Bollinger Canyon Road
Building L PO Box 6004
San Ramon CA 94583-0904

Facility# 95607 Job# 386539 GRD
5269 CROW CANYON-CASTRO V T0600100344 C-6

CAT No.	Analysis Name	Method	Trial#	Analysis Date and Time	Analyst	Dilution Factor
01729	TPH-GRO - Waters	N. CA LUFT Gasoline Method	1	04/17/2002 09:25	Melissa D Mann	50
08214	BTEX, MTBE (8021)	SW-846 8021B	1	04/16/2002 17:23	Melissa D Mann	5
08214	BTEX, MTBE (8021)	SW-846 8021B	1	04/17/2002 09:25	Melissa D Mann	50
01146	GC VOA Water Prep	SW-846 5030B	1	04/16/2002 17:23	Melissa D Mann	n.a.

#=Laboratory Method Detection Limit exceeded target detection limit
N.D.=Not detected at or above the Reporting Limit.

MEMBER
ACIL
2425 New Holland Pike
PO Box 12425
Lancaster, PA 17605-2425
717-656-2300 Fax: 717-656-2681



Lancaster Laboratories Sample No. **WW 3805193**

Collected: 04/11/2002 09:20 by **FB**

Account Number: 10905

Submitted: 04/13/2002 12:00

Chevron Products Company
6001 Bollinger Canyon Road
Building L PO Box 6004
San Ramon CA 94583-0904

Reported: 04/23/2002 at 11:59

Discard: 05/24/2002

C-8-W-020411 **Grab Water**

Facility# 95607 Job# 386539 **GRD**

5269 CROW CANYON-CASTRO V T0600100344 C-8

CAT No.	Analysis Name	CAS Number	As Received Result	As Received Method Detection Limit	Units	Dilution Factor
01729	TPH-GRO - Waters					
01730	TPH-GRO - Waters	n.a.	N.D.	50.	ug/l	1
The reported concentration of TPH-GRO does not include MTBE or other gasoline constituents eluting prior to the C6 (n-hexane) TPH-GRO range start time.						
A site-specific MSD sample was not submitted for the project. A LCS/LCSD was performed to demonstrate precision and accuracy at a batch level.						
08214	BTEX, MTBE (8021)					
00776	Benzene	71-43-2	N.D.	0.50	ug/l	1
00777	Toluene	108-88-3	N.D.	0.50	ug/l	1
00778	Ethylbenzene	100-41-4	N.D.	0.50	ug/l	1
00779	Total Xylenes	1330-20-7	N.D.	1.5	ug/l	1
00780	Methyl tert-Butyl Ether	1634-04-4	N.D.	2.5	ug/l	1
Site-specific MS/MSD samples were not submitted for the project. A LCS/LCSD was performed to demonstrate precision and accuracy at a batch level.						

State of California Lab Certification No. 2116

Laboratory Chronicle

CAT No.	Analysis Name	Method	Trial#	Analysis Date and Time	Analyst	Dilution Factor
01729	TPH-GRO - Waters	N. CA LUFT Gasoline Method	1	04/17/2002 00:02	Melissa D Mann	1
08214	BTEX, MTBE (8021)	SW-846 8021B	1	04/17/2002 00:02	Melissa D Mann	1
01146	GC VOA Water Prep	SW-846 5030B	1	04/17/2002 00:02	Melissa D Mann	n.a.

#=Laboratory Method Detection Limit exceeded target detection limit

N.D.=Not detected at or above the Reporting Limit

MEMBER
ACIL
2425 New Holland Pike
PO Box 12425
Lancaster, PA 17605-2425
717-656-2300 Fax: 717-656-2681



Lancaster Laboratories Sample No. **WW 3805194**

Collected: 04/11/2002 13:38 by **FB**

Account Number: **10905**

Submitted: 04/13/2002 12:00

Chevron Products Company

Reported: 04/23/2002 at 11:59

6001 Bollinger Canyon Road

Discard: 05/24/2002

Building L PO Box 6004

C-9-W-020411

Grab Water

San Ramon CA 94583-0904

Facility# 95607 Job# 386539 GRD

5269 CROW CANYON-CASTRO V T0600100344 C-9

CAT No.	Analysis Name	CAS Number	As Received Result	As Received Method Detection Limit	Units	Dilution Factor
01729	TPH-GRO - Waters					
01730	TPH-GRO - Waters	n.a.	6,700.	250.	ug/l	5
The reported concentration of TPH-GRO does not include MTBE or other gasoline constituents eluting prior to the C6 (n-hexane) TPH-GRO range start time. A site-specific MSD sample was not submitted for the project. A LCS/LCSD was performed to demonstrate precision and accuracy at a batch level.						
08214	BTEX, MTBE (8021)					
00776	Benzene	71-43-2	1,200.	1.0	ug/l	5
00777	Toluene	108-88-3	24.	1.0	ug/l	5
00778	Ethylbenzene	100-41-4	360.	1.0	ug/l	5
00779	Total Xylenes	1330-20-7	140.	3.0	ug/l	5
00780	Methyl tert-Butyl Ether	1634-04-4	N.D. #	50.	ug/l	5

Site-specific MS/MSD samples were not submitted for the project. A LCS/LCSD was performed to demonstrate precision and accuracy at a batch level.

Due to the presence of an interferent near its retention time, the normal reporting limit was not attained for MTBE. The presence or concentration of this compound cannot be determined due to the presence of this interferent.

State of California Lab Certification No. 2116

Laboratory Chronicle

CAT No.	Analysis Name	Method	Trial#	Analysis Date and Time	Analyst	Dilution Factor
---------	---------------	--------	--------	------------------------	---------	-----------------

#=Laboratory Method Detection Limit exceeded target detection limit

N.D.=Not detected at or above the Reporting Limit

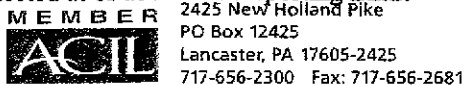



Lancaster Laboratories Sample No. WW 3805194

Collected: 04/11/2002 13:38 by FB

Account Number: 10905

Submitted: 04/13/2002 12:00

Reported: 04/23/2002 at 11:59

Discard: 05/24/2002

C-9-W-020411

Grab Water

Chevron Products Company
6001 Bollinger Canyon Road
Building L PO Box 6004
San Ramon CA 94583-0904

Facility# 95607 Job# 386539 GRD
5269 CROW CANYON-CASTRO V T0600100344 C-9

01729	TPH-GRO - Waters	N. CA LUFT Gasoline	1	04/17/2002 00:38	Melissa D Mann	5
		Method				
08214	BTEX, MTBE (8021)	SW-846 8021B	1	04/17/2002 00:38	Melissa D Mann	5
01146	GC VOA Water Prep	SW-846 5030B	1	04/17/2002 00:38	Melissa D Mann	n.a.

#=Laboratory Method Detection Limit exceeded target detection limit
N.D.=Not detected at or above the Reporting Limit.



MEMBER
2425 New Holland Pike
PO Box 12425
Lancaster, PA 17605-2425
717-656-2300 Fax: 717-656-2681



Lancaster Laboratories Sample No. WW 3805195

Collected: 04/11/2002 09:59 by FB Account Number: 10905

Submitted: 04/13/2002 12:00
 Reported: 04/23/2002 at 12:00
 Discard: 05/24/2002
 C-11-W-020411 Grab Water

Chevron Products Company
 6001 Bollinger Canyon Road
 Building L PO Box 6004
 San Ramon CA 94583-0904

Facility# 95607 Job# 386539 GRD
 5269 CROW CANYON-CASTRO V T0600100344 C-11

CAT No.	Analysis Name	CAS Number	As Received Result	As Received Method Detection Limit	Units	Dilution Factor
01729	TPH-GRO - Waters					
01730	TPH-GRO - Waters	n.a.	N.D.	50.	ug/l	1
The reported concentration of TPH-GRO does not include MTBE or other gasoline constituents eluting prior to the C6 (n-hexane) TPH-GRO range start time.						
A site-specific MSD sample was not submitted for the project. A LCS/LCSD was performed to demonstrate precision and accuracy at a batch level.						
08214	BTEX, MTBE (8021)					
00776	Benzene	71-43-2	N.D.	0.50	ug/l	1
00777	Toluene	108-88-3	N.D.	0.50	ug/l	1
00778	Ethylbenzene	100-41-4	N.D.	0.50	ug/l	1
00779	Total Xylenes	1330-20-7	N.D.	1.5	ug/l	1
00780	Methyl tert-Butyl Ether	1634-04-4	N.D.	2.5	ug/l	1
Site-specific MS/MSD samples were not submitted for the project. A LCS/LCSD was performed to demonstrate precision and accuracy at a batch level.						

State of California Lab Certification No. 2116

Laboratory Chronicle

CAT No.	Analysis Name	Method	Trial#	Analysis Date and Time	Analyst	Dilution Factor
01729	TPH-GRO - Waters	N. CA LUFT Gasoline Method	1	04/17/2002 02:58	Melissa D Mann	1
08214	BTEX, MTBE (8021)	SW-846 8021B	1	04/17/2002 02:58	Melissa D Mann	1
01146	GC VOA Water Prep	SW-846 5030B	1	04/17/2002 02:58	Melissa D Mann	n.a.

#=Laboratory Method Detection Limit exceeded target detection limit
 N.D.=Not detected at or above the Reporting Limit.

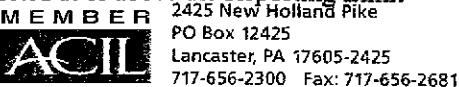



Lancaster Laboratories Sample No. WW 3805196

Collected: 04/11/2002 12:57 by FB

Account Number: 10905

Submitted: 04/13/2002 12:00
 Reported: 04/23/2002 at 12:00
 Discard: 05/24/2002

Chevron Products Company
 6001 Bollinger Canyon Road
 Building L PO Box 6004
 San Ramon CA 94583-0904

C-12-W-020411 Grab Water

Facility# 95607 Job# 386539 GRD
 5269 CROW CANYON-CASTRO V T0600100344 C-12

CAT No.	Analysis Name	CAS Number	As Received Result	As Received Method Detection Limit	Units	Dilution Factor
01729	TPH-GRO - Waters					
01730	TPH-GRO - Waters	n.a.	6,200.	250.	ug/l	5
	The reported concentration of TPH-GRO does not include MTBE or other gasoline constituents eluting prior to the C6 (n-hexane) TPH-GRO range start time.					
	A site-specific MSD sample was not submitted for the project. A LCS/LCSD was performed to demonstrate precision and accuracy at a batch level.					
08214	BTEX, MTBE (8021)					
00776	Benzene	71-43-2	610.	1.0	ug/l	5
00777	Toluene	108-88-3	8.4	0.50	ug/l	1
00778	Ethylbenzene	100-41-4	420.	1.0	ug/l	5
00779	Total Xylenes	1330-20-7	230.	1.5	ug/l	1
00780	Methyl tert-Butyl Ether	1634-04-4	N.D. #	25.	ug/l	1
	Site-specific MS/MSD samples were not submitted for the project. A LCS/LCSD was performed to demonstrate precision and accuracy at a batch level.					

Due to the presence of an interferent near its retention time, the normal reporting limit was not attained for MTBE. The presence or concentration of this compound cannot be determined due to the presence of this interferent.

Due to the nature of the sample matrix, the surrogate standard recovery is above the range of specifications.

State of California Lab Certification No. 2116

Laboratory Chronicle

#=Laboratory Method Detection Limit exceeded target detection limit
 N.D.=Not detected at or above the Reporting Limit.

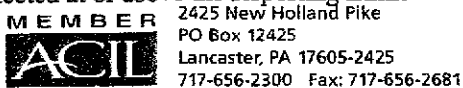



Lancaster Laboratories Sample No. WW 3805196

Collected: 04/11/2002 12:57 by FB

Account Number: 10905

Submitted: 04/13/2002 12:00

Chevron Products Company

Reported: 04/23/2002 at 12:00

6001 Bollinger Canyon Road

Discard: 05/24/2002

Building L PO Box 6004

C-12-W-020411

Grab Water

San Ramon CA 94583-0904

Facility# 95607 Job# 386539 GRD

5269 CROW CANYON-CASTRO V T0600100344 C-12

CAT No.	Analysis Name	Method	Trial#	Analysis Date and Time	Analyst	Dilution Factor
01729	TPH-GRO - Waters	N. CA LUFT Gasoline Method	1	04/17/2002 01:13	Melissa D Mann	5
08214	BTEX, MTBE (8021)	SW-846 8021B	1	04/17/2002 01:13	Melissa D Mann	5
08214	BTEX, MTBE (8021)	SW-846 8021B	1	04/17/2002 07:40	Linda C Pape	1
01146	GC VOA Water Prep	SW-846 5030B	1	04/17/2002 07:40	Linda C Pape	n.a.

#=Laboratory Method Detection Limit exceeded target detection limit

N.D.=Not detected at or above the Reporting Limit

MEMBER



2425 New Holland Pike
PO Box 12425
Lancaster, PA 17605-2425
717-656-2300 Fax: 717-656-2681



Lancaster Laboratories Sample No. WW 3805197

Collected: 04/11/2002 12:22 by FB

Account Number: 10905

Submitted: 04/13/2002 12:00

Reported: 04/23/2002 at 12:00

Discard: 05/24/2002

C-15-W-020411

Grab Water

Chevron Products Company
6001 Bollinger Canyon Road
Building L PO Box 6004
San Ramon CA 94583-0904

Facility# 95607 Job# 386539 GRD
5269 CROW CANYON-CASTRO V T0600100344 C-15

CAT No.	Analysis Name	CAS Number	As Received Result	As Received Method Detection Limit	Units	Dilution Factor
01729	TPH-GRO - Waters					
01730	TPH-GRO - Waters	n.a.	470.	50.	ug/l	1
<p>The reported concentration of TPH-GRO does not include MTBE or other gasoline constituents eluting prior to the C6 (n-hexane) TPH-GRO range start time.</p> <p>A site-specific MSD sample was not submitted for the project. A LCS/LCSD was performed to demonstrate precision and accuracy at a batch level.</p>						
08214	BTEX, MTBE (8021)					
00776	Benzene	71-43-2	1.9	0.50	ug/l	1
00777	Toluene	108-88-3	N.D. #	1.0	ug/l	1
00778	Ethylbenzene	100-41-4	N.D.	0.50	ug/l	1
00779	Total Xylenes	1330-20-7	N.D.	1.5	ug/l	1
00780	Methyl tert-Butyl Ether	1634-04-4	4.9	2.5	ug/l	1
<p>Site-specific MS/MSD samples were not submitted for the project. A LCS/LCSD was performed to demonstrate precision and accuracy at a batch level.</p>						

Due to the presence of an interferent near its retention time, the normal reporting limit was not attained for toluene. The presence or concentration of this compound cannot be determined due to the presence of this interferent.

State of California Lab Certification No. 2116

Laboratory Chronicle

CAT No.	Analysis Name	Method	Trial#	Analysis Date and Time	Analyst	Dilution Factor
---------	---------------	--------	--------	------------------------	---------	-----------------

#=Laboratory Method Detection Limit exceeded target detection limit
N.D.=Not detected at or above the Reporting Limit.

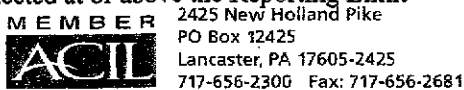



Lancaster Laboratories Sample No. WW 3805197

Collected: 04/11/2002 12:22 by FB

Account Number: 10905

Submitted: 04/13/2002 12:00

Chevron Products Company

Reported: 04/23/2002 at 12:00

6001 Bollinger Canyon Road

Discard: 05/24/2002

Building L PO Box 6004

C-15-W-020411

Grab Water

San Ramon CA 94583-0904

Facility# 95607 Job# 386539 GRD

5269 CROW CANYON-CASTRO V T0600100344 C-15

01729	TPH-GRO - Waters	N. CA LUFT Gasoline Method	1	04/17/2002 01:48	Melissa D Mann	1
08214	BTEX, MTBE (8021)	SW-846 8021B	1	04/17/2002 01:48	Melissa D Mann	1
01146	GC VOA Water Prep	SW-846 5030B	1	04/17/2002 01:48	Melissa D Mann	n.a.

#=Laboratory Method Detection Limit exceeded target detection limit

N.D.=Not detected at or above the Reporting Limit



MEMBER
2425 New Holland Pike
PO Box 12425
Lancaster, PA 17605-2425
717-656-2300 Fax: 717-656-2681



Lancaster Laboratories Sample No. WW 3805198

Collected: 04/11/2002 11:28 by FB

Account Number: 10905

Submitted: 04/13/2002 12:00

Reported: 04/23/2002 at 12:00

Discard: 05/24/2002

C-16-W-020411

Grab Water

Chevron Products Company
6001 Bollinger Canyon Road
Building L PO Box 6004
San Ramon CA 94583-0904

Facility# 95607 Job# 386539 GRD

5269 CROW CANYON-CASTRO V T0600100344 C-16

CAT No.	Analysis Name	CAS Number	As Received Result	As Received Method Detection Limit	Units	Dilution Factor
01729	TPH-GRO - Waters					
01730	TPH-GRO - Waters	n.a.	N.D.	50.	ug/l	1
The reported concentration of TPH-GRO does not include MTBE or other gasoline constituents eluting prior to the C6 (n-hexane) TPH-GRO range start time. A site-specific MSD sample was not submitted for the project. A LCS/LCSD was performed to demonstrate precision and accuracy at a batch level.						
08214	BTEX, MTBE (8021)					
00776	Benzene	71-43-2	N.D.	0.50	ug/l	1
00777	Toluene	108-88-3	N.D.	0.50	ug/l	1
00778	Ethylbenzene	100-41-4	N.D.	0.50	ug/l	1
00779	Total Xylenes	1330-20-7	N.D.	1.5	ug/l	1
00780	Methyl tert-Butyl Ether	1634-04-4	N.D.	2.5	ug/l	1
Site-specific MS/MSD samples were not submitted for the project. A LCS/LCSD was performed to demonstrate precision and accuracy at a batch level.						

State of California Lab Certification No. 2116

Laboratory Chronicle

CAT No.	Analysis Name	Method	Trial#	Analysis Date and Time	Analyst	Dilution Factor
01729	TPH-GRO - Waters	N. CA LUFT Gasoline	1	04/17/2002 02:23	Melissa D Mann	1
08214	BTEX, MTBE (8021)	SW-846 8021B	1	04/17/2002 02:23	Melissa D Mann	1
01146	GC VOA Water Prep	SW-846 5030B	1	04/17/2002 02:23	Melissa D Mann	n.a.

#=Laboratory Method Detection Limit exceeded target detection limit

N.D.=Not detected at or above the Reporting Limit.

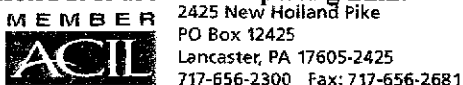



Client Name: Chevron Products Company
Reported: 04/23/02 at 12:00 PM

Group Number: 803939

Laboratory Compliance Quality Control

Analysis Name	Blank Result	Blank MDL	Report Units	LCS %REC	LCSD %REC	LCS/LCSD Limits	RPD	RPD Max
Batch number: 02106A55A Sample number(s): 3805189-3805198								
Benzene	N.D.	0.5	ug/l	106	100	80-118	6	30
Toluene	N.D.	0.5	ug/l	102	97	82-119	5	30
Ethylbenzene	N.D.	0.5	ug/l	102	97	81-119	6	30
Total Xylenes	N.D.	1.5	ug/l	101	96	82-120	5	30
Methyl tert-Butyl Ether	N.D.	2.5	ug/l	91	89	79-127	2	30
TPH-GRO - Waters	N.D.	50.	ug/l	89	92	76-126	3	30
Batch number: 02106A55B Sample number(s): 3805191-3805192,3805196								
Benzene	N.D.	0.5	ug/l	106	100	80-118	6	30
Toluene	N.D.	0.5	ug/l	102	97	82-119	5	30
Total Xylenes	N.D.	1.5	ug/l	101	96	82-120	5	30
Methyl tert-Butyl Ether	N.D.	2.5	ug/l	91	89	79-127	2	30
TPH-GRO - Waters	N.D.	50.	ug/l	89	92	76-126	3	30

Sample Matrix Quality Control

Analysis Name	MS %REC	MSD %REC	MS/MSD Limits	RPD	BKG MAX	DUP CONC	DUP RPD	Dup RPD Max
Batch number: 02106A55A Sample number(s): 3805189-3805198								
TPH-GRO - Waters	104		74-132					
Batch number: 02106A55B Sample number(s): 3805191-3805192,3805196								
TPH-GRO - Waters	104		74-132					

Surrogate Quality Control

Analysis Name: TPH-GRO - Waters
Batch number: 02106A55A

	Trifluorotoluene-F	Trifluorotoluene-P
3805189	93	99
3805190	112	137*
3805191	97	100
3805192		206*
3805193	95	99
3805194	104	120
3805195	92	100
3805196	116	
3805197	96	94
3805198	96	100

*- Outside of specification

- (1) The result for one or both determinations was less than five times the LOQ.
- (2) The background result was more than four times the spike added.



Lancaster Laboratories, Inc.
2425 New Holland Pike
PO Box 12425
Lancaster, PA 17605-2425
717-656-2300 Fax: 717-656-2681



Client Name: Chevron Products Company
Reported: 04/23/02 at 12:00 PM

Group Number: 803939

Surrogate Quality Control

Blank	99	102
LCS	106	102
LCSD	105	100
MS	105	

Limits: 67-135 71-130

Analysis Name: TPH-GRO - Waters
Batch number: 02106A55B

Trifluorotoluene-F	Trifluorotoluene-P
--------------------	--------------------

3805192	91	
3805196		168*
Blank	98	102
LCS	106	102
LCSD	105	100
MS	105	

Limits: 67-135 71-130

*- Outside of specification

- (1) The result for one or both determinations was less than five times the LOQ.
- (2) The background result was more than four times the spike added.



Lancaster Laboratories, Inc.
2425 New Holland Pike
PO Box 12425
Lancaster, PA 17605-2425
717-656-2300 Fax: 717-656-2681