

ENVIRONMENTAL
PROTECTION



Chevron

96 NOV 27 PM 1:31

November 25, 1996

Mr. Scott Seery
Alameda County Environmental Health
1131 Harbor Bay Parkway, 2nd Floor
Alameda, CA 94502

Chevron U.S.A. Products Company
6001 Bollinger Canyon Road
Building L
San Ramon, CA 94583
P.O. Box 5004
San Ramon, CA 94583-0804

Marketing - Northwest Region
Phone 510 842 9500

Re: Former Chevron Station # 9-5607, 5269 Crow Canyon Road, Castro Valley, CA
Attached groundwater monitoring reports (Blaine Tech; 3/27/96, 6/7/96, 8/21/96, 11/12/96)

Dear Mr. Seery:

Please find attached four reports dated March 27, June 7, August 21, and November 12, 1996 that were prepared by Chevron's consultant, Blaine Tech Services, Inc. (Blaine Tech), to describe the results of groundwater monitoring that was performed at the subject site on January 16, April 18, July 22, and October 10, 1996, respectively. The direction of groundwater flow remained the same during all four quarters. The levels of dissolved contaminants measured throughout all four quarters were consistent with past measurements. However, **there was a detection of 7.0 ppb benzene measured at downgradient well C-15 in October.** This detection was not consistent with the previous six measurements (all ND) and will be verified during the first quarter 1997 sampling event.

I apologize for the late transmittal of these reports. If you have any questions or comments, I can be reached at (510) 842-8695.

Sincerely,

Brett L. Hunter
Environmental Engineer
Site Assessment and Remediation

Attachments

cc: Kevin Hinckley, 5269 Crow Canyon Road, Castro Valley, CA 94546
Diane Riggs, Forest Creek Townhomes Association, c/o Walsh Property Management,
P.O. Box 2657, Castro Valley, CA 94541
Mike Cooke, Weiss Associates, 5500 Shellmound St., Emeryville, CA 94608-2411
Kevin Graves, San Francisco Bay RWQCB, Oakland, CA (w/o attachment)
Bette Owen, Chevron Products Company, San Ramon, CA (w/o attachment)



BLAINE TECH SERVICES INC.

985 TIMOTHY DRIVE
SAN JOSE, CA 95133
(408) 995-5535
FAX (408) 293-8773

November 12, 1996

Brett Hunter
Chevron U.S.A. Products Company
P.O. Box 5004
San Ramon, CA 94583-0804

4th Quarter 1996 Monitoring at 9-5607

Fourth Quarter 1996 Groundwater Monitoring at
Chevron Service Station Number 9-5607
5269 Crow Canyon Road
Castro Valley, CA

Monitoring Performed on October 10, 1996

Groundwater Sampling Report 961010-J-3

This report covers the routine quarterly monitoring of groundwater wells at this Chevron facility. Blaine Tech Services, Inc.'s work at the site includes inspection, gauging, evacuation, purgewater containment, sample collection and sample handling in accordance with standard procedures that conform to Regional Water Quality Control Board requirements.

Routine field data collection includes depth to water, total well depth, thickness of any separate immiscible layer, water column volume, calculated volume of a three-case volume purge, elapsed evacuation time, total volume of water removed, and standard water parameter instrument readings. Sample material is collected, contained, stored, and transported to the laboratory in conformance with EPA standards. Purgewater is, likewise, collected and transported to McKittrick Waste Treatment Site for disposal.

Basic field information is presented alongside analytical values excerpted from the laboratory report in the cumulative table of **WELL DATA AND ANALYTICAL RESULTS**. The full analytical report for the most recent samples is located in the **Analytical Appendix**. The table also contains new groundwater elevation calculations taken from the computer plotted gradient map which is located in the **Professional Engineering Appendix**.

At a minimum, Blaine Tech Services, Inc. field personnel are certified upon completion of a forty-hour Hazardous Materials and Emergency Response training course per 29 CFR 1910.120. Field personnel are also enrolled in annual eight hour refresher courses.

Blaine Tech Services, Inc. conducts sampling and documentation assignments of this type as an independent third party. In order to avoid compromising the objectivity necessary for the proper and disinterested performance of this work, Blaine Tech Services, Inc. concentrates on objective data collection and does not participate in the interpretation of analytical results, the definition of geological or hydrological conditions, the formulation of recommendations, or the marketing of remedial systems.

Please call if you have any questions.

Yours truly,

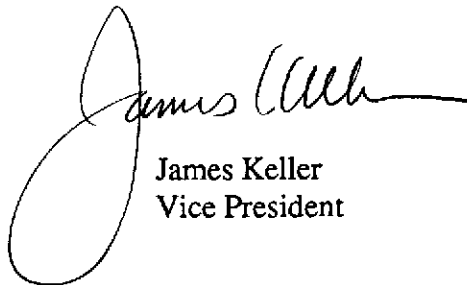
A handwritten signature in black ink, appearing to read "James Keller". The signature is fluid and cursive, with a large loop at the beginning and a horizontal line extending to the right.

James Keller
Vice President

JPK/cg

attachments: Professional Engineering Appendix
Cumulative Table of Well Data and Analytical Results
Analytical Appendix
Field Data Sheets

Professional Engineering Appendix



SCALE (ft)

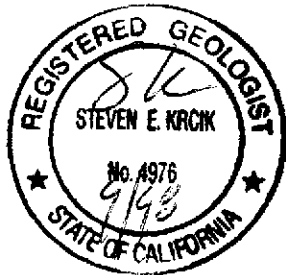
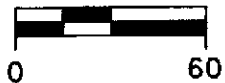

EXPLANATION

- MONITORING WELL
- ABANDONED MONITORING WELL
- RECOVERY WELL
- 261.44
 GROUNDWATER ELEVATION (FT, MSL)
- 255.00
 GROUNDWATER ELEVATION CONTOUR (FT, MSL)
- NM NOT MONITORED
- NA DATA NOT AVAILABLE
- APPROXIMATE GROUNDWATER FLOW DIRECTION;
APPROXIMATE GRADIENT = 0.10

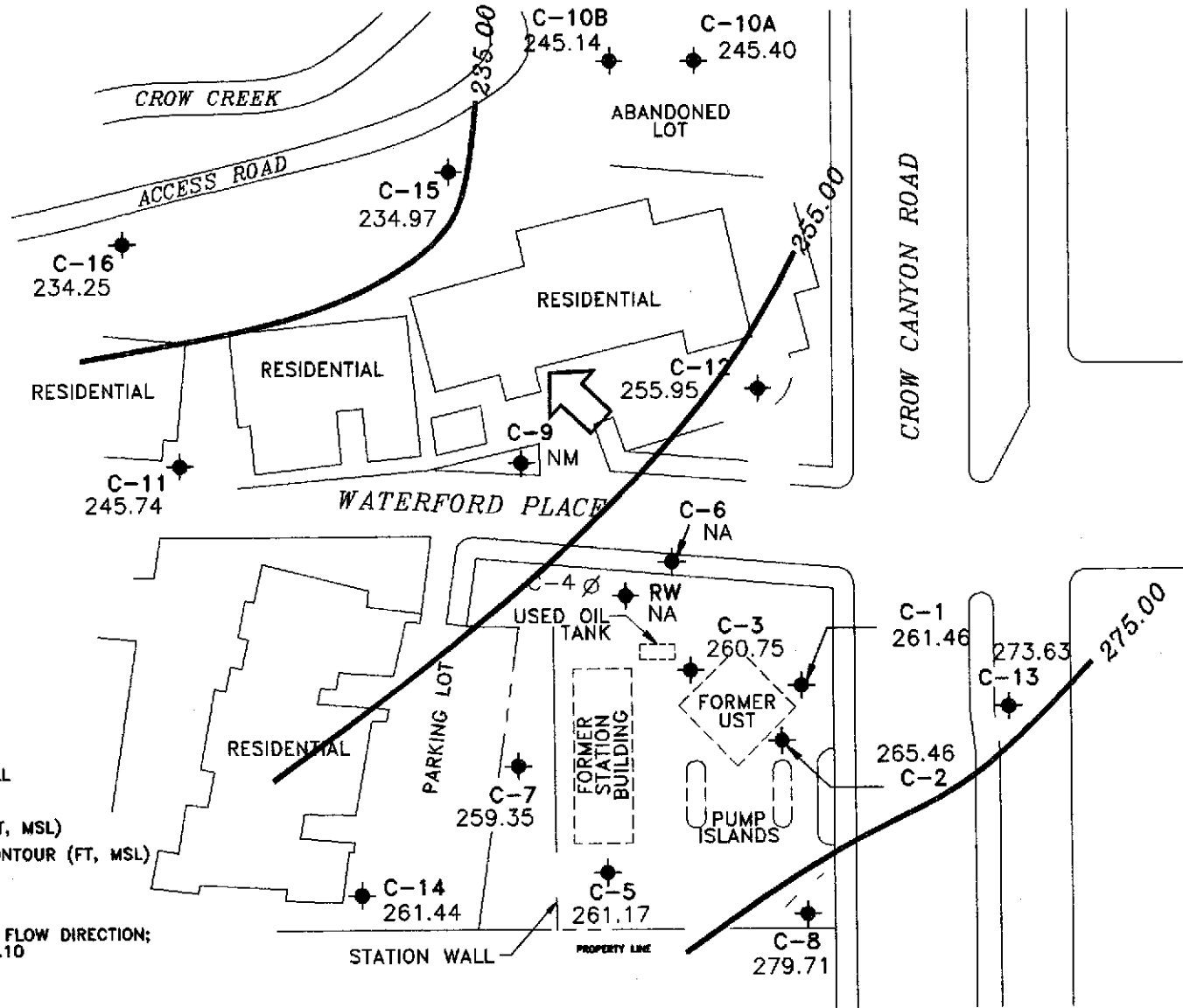

Basemap from Cambria Environmental Technology, Inc.

PREPARED BY

RRM INC.

Chevron Station 9-5607
5269 Crow Canyon Road
Castro Valley, California

**GROUNDWATER ELEVATION
CONTOUR MAP, OCTOBER 10, 1996**

**FIGURE:
1
PROJECT:
DAC04**

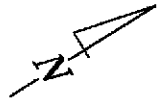

SCALE (ft)

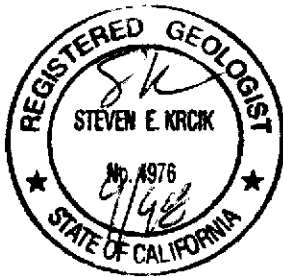
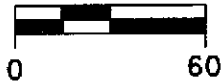

EXPLANATION

- ◆ MONITORING WELL
- ∅ ABANDONED MONITORING WELL
- ▲ RECOVERY WELL
- 58 BENZENE CONCENTRATIONS (ppb)
- 100 ——— BENZENE CONCENTRATION CONTOUR
- NA DATA NOT AVAILABLE

NOTE: CONTOURS BASED ON CURRENT AND HISTORIC DATA.

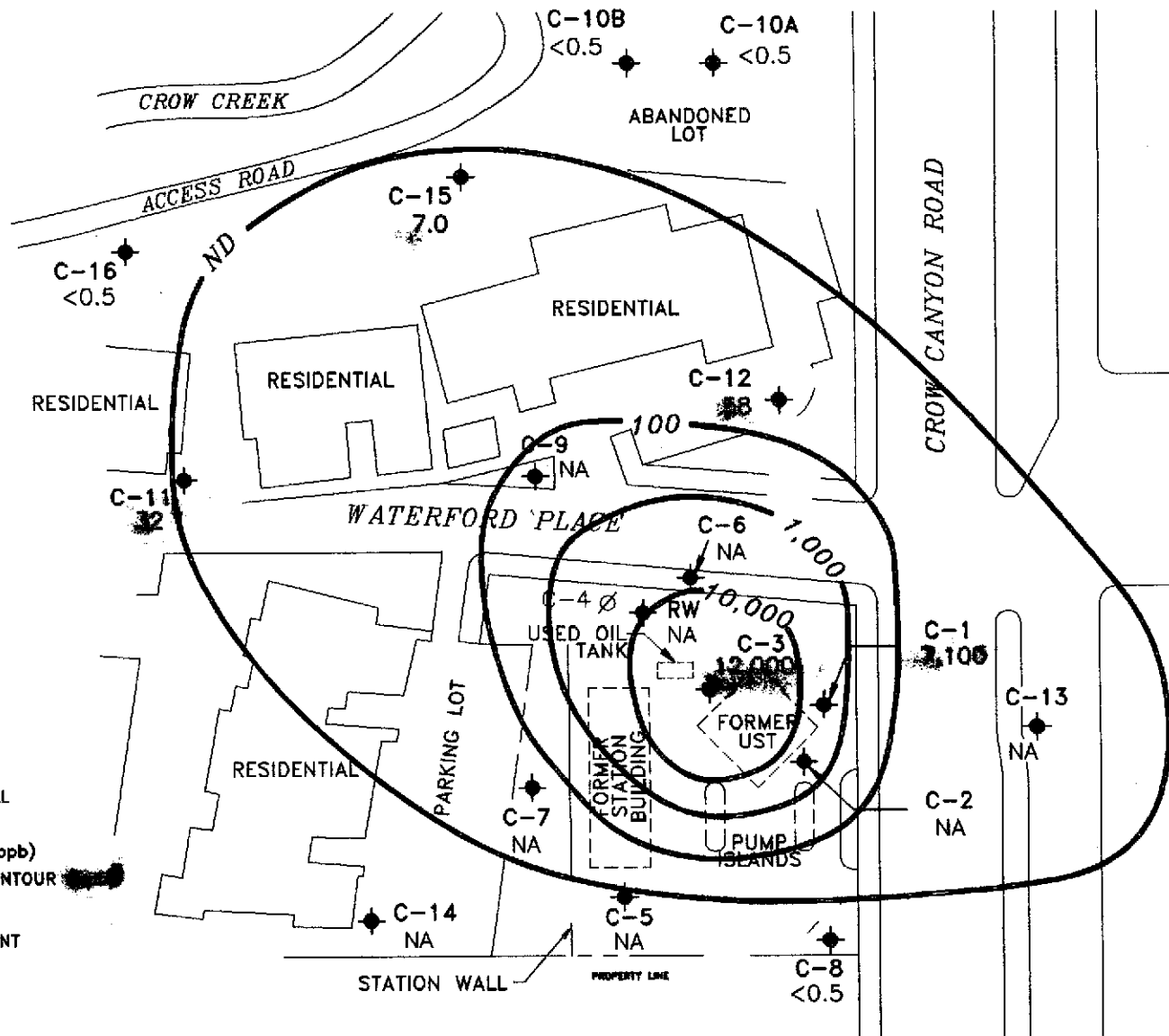

Basemap from Cambria Environmental Technology, Inc.

PREPARED BY

RRM INC.

Chevron Station 9-5607
5269 Crow Canyon Road
Castro Valley, California

**◆ BENZENE CONCENTRATION IN
GROUNDWATER, OCTOBER 10, 1996**

**FIGURE:
2
PROJECT:
DAC04**



SCALE (ft)

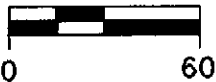

EXPLANATION

- MONITORING WELL
- ABANDONED MONITORING WELL
- RECOVERY WELL
- 130 TPH-g CONCENTRATIONS (ppb)
- 100 TPH-g CONCENTRATION CONTOUR (ppb)
- NA DATA NOT AVAILABLE

NOTE: CONTOURS BASED ON CURRENT AND HISTORIC DATA.

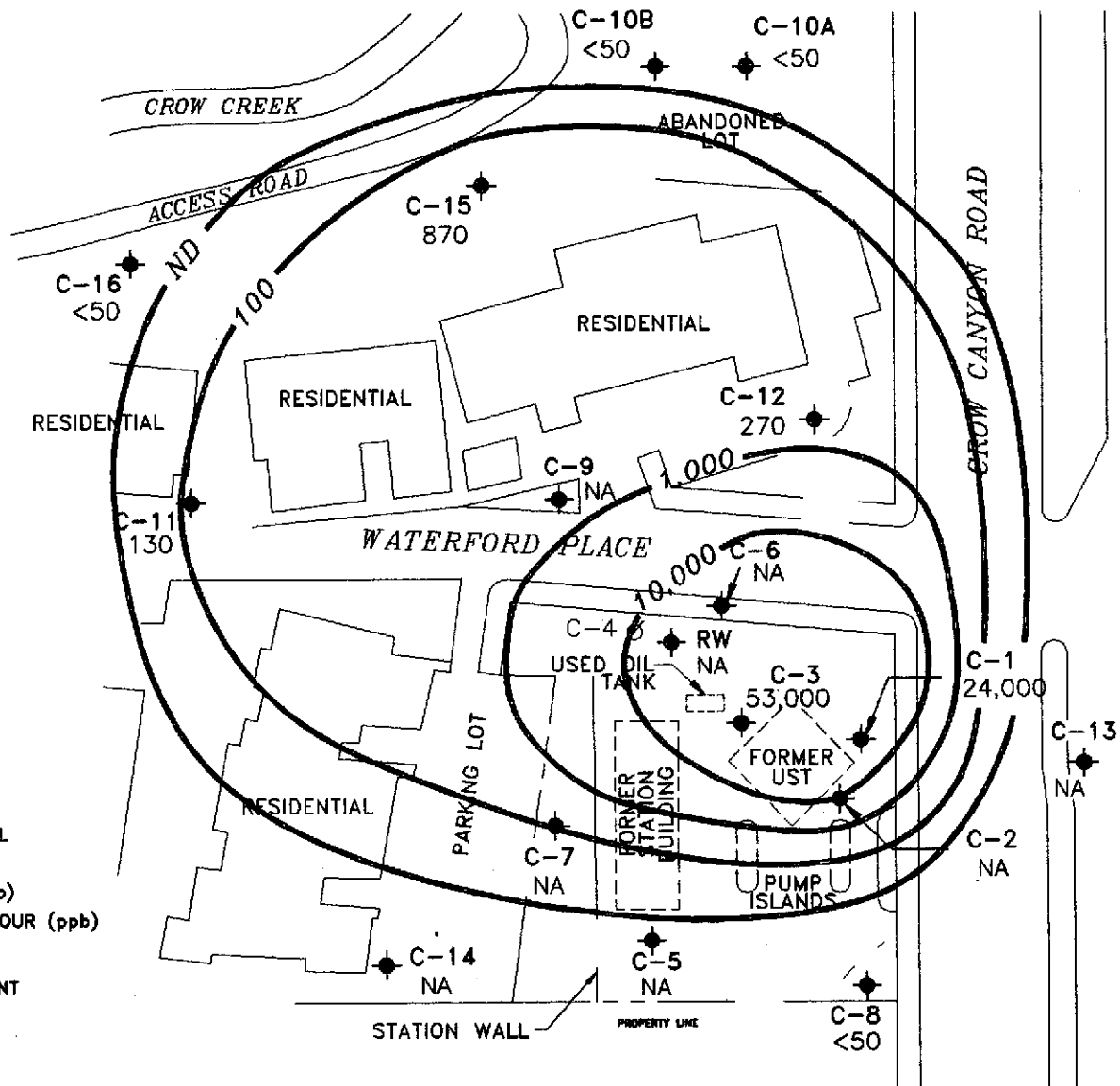

Basemap from Cambria Environmental Technology, Inc.

PREPARED BY

RRM INC.

Chevron Station 9-5607
5269 Crow Canyon Road
Castro Valley, California

**TPH-GASOLINE CONCENTRATION IN
GROUNDWATER, OCTOBER 10, 1996**

**FIGURE:
3
PROJECT:
DAC04**

Table of Well Data and Analytical Results

Cumulative Table of Well Data and Analytical Results

Vertical Measurements are in feet.

Analytical results are in parts per billion (ppb)

DATE	Well Head Elev.	Ground Water Elev.	Depth To Water	Notes	TPH-Gasoline	Benzene	Toluene	Ethyl-Benzene	Xylene	MTBE	Organic Lead
C-1											
03/26/85	283.46	260.63	22.83	--	--	--	--	--	--	--	--
07/03/86	283.46	259.88	23.58	--	--	--	--	--	--	--	--
03/26/87	283.46	262.96	20.50	--	--	--	--	--	--	--	--
03/28/88	283.46	257.46	26.00	--	--	--	--	--	--	--	--
03/10/89	283.46	267.60	15.86	--	--	--	--	--	--	--	--
04/03/89	283.46	266.61	16.85	--	--	--	--	--	--	--	--
05/08/89	283.46	260.78	22.68	--	--	--	--	--	--	--	--
06/05/89	283.46	258.80	24.66	--	--	--	--	--	--	--	--
07/12/90	283.46	257.90	25.56	--	--	--	--	--	--	--	--
08/10/90	283.46	257.57	25.89	--	--	--	--	--	--	--	--
09/13/89	283.46	256.91	26.55	--	22,000	3600	1100	1000	3500	--	--
10/04/89	283.46	258.22	25.24	--	--	--	--	--	--	--	--
11/03/89	283.46	258.43	25.03	--	--	--	--	--	--	--	--
12/04/89	283.46	257.09	26.37	--	13,000	2000	550	610	1600	--	--
03/07/90	283.46	260.98	22.48	--	--	--	--	--	--	--	--
03/09/90	283.46	--	--	--	--	--	--	--	--	--	--
06/12/90	283.46	259.11	24.35	--	21,000	3500	1400	840	4000	--	--
09/20/90	283.46	257.19	26.27	--	23,000	2100	1200	860	5000	--	--
12/20/90	283.46	260.87	22.59	--	8200	760	410	260	1100	--	--
03/27/91	283.46	264.38	19.08	--	--	--	--	--	--	--	--
06/18/91	283.46	256.35	27.11	--	--	--	--	--	--	--	--
09/12/91	283.46	255.24	28.22	--	--	--	--	--	--	--	--
01/23/92	283.46	256.81	26.65	--	--	--	--	--	--	--	--
04/13/92	283.46	261.30	22.16	--	38,000	3100	1300	850	3100	--	--
08/03/92	283.46	257.31	26.15	--	13,000	1300	470	550	1600	--	ND
10/22/92	283.46	256.67	26.79	--	24,000	3500	1400	1500	4300	--	--
01/18/93	283.46	264.86	18.60	--	370,000	6900	8900	3100	23,000	--	--
04/19/93	283.46	262.34	21.12	--	51,000	8000	7000	1400	10,000	--	--
07/21,22/93	283.46	260.18	23.28	--	22,000	3400	1000	990	3100	--	--
10/25/93	283.46	258.80	24.66	--	14,000	2000	550	790	2300	--	--
01/21/94	283.46	262.99	20.47	--	1100	350	6.0	3.0	15	--	--
04/18/94	283.46	260.36	23.10	--	24,000	3200	1000	1000	3100	--	--
07/06-07/94	283.46	260.56	22.90	--	65,000	6500	4200	1600	9300	--	--
10/07/94	283.46	258.75	24.71	--	27,000	5100	1200	1400	4300	--	--

CONTINUED ON NEXT PAGE

Cumulative Table of Well Data and Analytical Results

Vertical Measurements are in feet.

Analytical results are in parts per billion (ppb)

DATE	Well Head Elev.	Ground Water Elev.	Depth To Water	Notes	TPH-Gasoline	Benzene	Toluene	Ethyl-Benzene	Xylene	MTBE	Organic Lead
C-1(CONT'D)											
01/11/95	283.46	265.16	18.30	--	29,000	1300	1200	930	4000	--	--
04/24/95	283.46	266.52	16.94	--	75,000	8900	5000	1700	8400	--	--
07/31/95	283.46	262.90	20.56	--	56,000	11,000	2600	2500	11,000	--	--
10/02/95	283.46	272.88	10.58	--	44,000	7900	1100	2100	6500	--	--
01/16/96	283.46	261.71	21.75	--	29,000	5300	460	1000	2800	<500	--
04/18/96	283.46	264.51	18.95	--	59,000	7100	3000	2000	7600	<250	--
07/22/96	283.46	262.46	21.00	--	26,000	6100	610	1800	4700	<250	--
10/10/96	283.46	261.46	22.00	--	24,000	7100	600	1700	3200	<250	--

Cumulative Table of Well Data and Analytical Results

Vertical Measurements are in feet.

Analytical results are in parts per billion (ppb)

DATE	Well Head Elev.	Ground Water Elev.	Depth To Water	Notes	TPH-Gasoline	Benzene	Toluene	Ethyl-Benzene	Xylene	MTBE	Organic Lead
C-2											
03/26/85	284.37	--	--	--	--	--	--	--	--	--	--
07/03/86	284.37	264.68	19.69	--	--	--	--	--	--	--	--
03/26/87	284.37	268.92	15.45	--	--	--	--	--	--	--	--
03/28/88	284.37	263.45	20.92	--	--	--	--	--	--	--	--
03/10/89	284.37	271.57	12.80	--	--	--	--	--	--	--	--
04/03/89	284.37	270.11	14.26	--	--	--	--	--	--	--	--
05/08/89	284.37	265.95	18.42	--	--	--	--	--	--	--	--
06/05/89	284.37	264.28	20.09	--	--	--	--	--	--	--	--
07/12/90	284.37	263.58	20.79	--	--	--	--	--	--	--	--
08/10/90	284.37	262.97	21.40	--	--	--	--	--	--	--	--
09/13/89	284.37	262.51	21.86	--	320	62	4.0	10	14	--	--
10/04/89	284.37	264.48	19.89	--	--	--	--	--	--	--	--
11/03/89	284.37	263.61	20.76	--	--	--	--	--	--	--	--
12/04/89	284.37	263.55	20.82	--	1000	240	37	66	130	--	--
03/07/90	284.37	266.54	17.83	--	--	--	--	--	--	--	--
03/09/90	284.37	266.54	17.83	--	390	280	35	27	50	--	--
06/12/90	284.37	264.48	19.89	--	700	260	34	28	55	--	--
09/20/90	284.37	262.40	21.97	--	--	--	--	--	--	--	--
12/20/90	284.37	266.64	17.73	--	--	--	--	--	--	--	--
03/27/91	284.37	269.27	15.10	--	--	--	--	--	--	--	--
06/18/91	284.37	261.69	22.68	--	--	--	--	--	--	--	--
09/12/91	284.37	260.45	23.92	--	--	--	--	--	--	--	--
01/23/92	284.37	263.13	21.24	--	--	--	--	--	--	--	--
04/13/92	284.37	266.83	17.54	--	1100	120	76	17	72	--	--
08/03/92	284.37	262.32	22.05	--	--	--	--	--	--	--	--
10/22/92	284.37	261.34	23.03	--	--	--	--	--	--	--	--
01/18/93	284.37	269.51	14.86	--	70	6.4	ND	ND	ND	--	--
04/19/93	284.37	267.57	16.80	--	--	--	--	--	--	--	--
07/21,22/93	284.37	265.12	19.25	--	--	--	--	--	--	--	--
10/25/93	284.37	264.72	19.65	--	--	--	--	--	--	--	--
01/21/94	284.37	258.80	25.57	--	43,000	5100	1800	2000	6800	--	--
04/18/94	284.37	274.61	9.76	--	--	--	--	--	--	--	--
07/06-07/94	284.37	265.61	18.76	--	--	--	--	--	--	--	--
10/07/94	284.37	264.20	20.17	--	--	--	--	--	--	--	--

CONTINUED ON NEXT PAGE

Cumulative Table of Well Data and Analytical Results

Vertical Measurements are in feet.

Analytical results are in parts per billion (ppb)

DATE	Well Head Elev.	Ground Water Elev.	Depth To Water	Notes	TPH-Gasoline	Benzene	Toluene	Ethyl-Benzene	Xylene	MTBE	Organic Lead
C-2 (CONT'D)											
01/11/95	284.37	270.33	14.04	Sampled annually	780	290	9.1	19	58	--	--
04/24/95	284.37	272.03	12.34	--	--	--	--	--	--	--	--
07/31/95	284.37	266.82	17.55	--	--	--	--	--	--	--	--
10/02/95	284.37	265.39	18.98	--	--	--	--	--	--	--	--
01/16/96	284.37	268.37	16.00	--	260	29	2.9	5.7	21	6.1	--
04/18/96	284.37	270.47	13.90	--	--	--	--	--	--	--	--
07/22/96	284.37	266.63	17.74	--	--	--	--	--	--	--	--
10/10/96	284.37	265.46	18.91	--	--	--	--	--	--	--	--

Cumulative Table of Well Data and Analytical Results

Vertical Measurements are in feet.

Analytical results are in parts per billion (ppb)

DATE	Well Head Elev.	Ground Water Elev.	Depth To Water	Notes	TPH-Gasoline	Benzene	Toluene	Ethyl-Benzene	Xylene	MTBE	Organic Lead
C-3											
03/26/85	285.98	--	--	--	--	--	--	--	--	--	--
07/03/86	285.98	259.94	26.04	--	--	--	--	--	--	--	--
03/26/87	285.98	260.34	25.64	--	--	--	--	--	--	--	--
03/28/88	285.98	257.16	28.82	--	--	--	--	--	--	--	--
03/10/89	285.98	263.20	22.78	--	--	--	--	--	--	--	--
04/03/89	285.98	263.27	22.71	--	--	--	--	--	--	--	--
05/08/89	285.98	260.03	25.95	--	--	--	--	--	--	--	--
06/05/89	285.98	258.36	27.62	--	--	--	--	--	--	--	--
07/12/90	285.98	257.69	28.29	--	--	--	--	--	--	--	--
08/10/90	285.98	257.52	28.46	--	--	--	--	--	--	--	--
09/13/89	285.98	256.65	29.33	--	60,000	1400	6800	2300	10,000	--	--
10/04/89	285.98	257.01	28.97	--	--	--	--	--	--	--	--
11/03/89	285.98	257.26	28.72	--	--	--	--	--	--	--	--
12/04/89	285.98	256.97	29.01	--	56,000	1300	3300	1400	2700	--	--
03/07/90	285.98	258.29	27.69	--	--	--	--	--	--	--	--
03/09/90	285.98	258.29	27.69	--	42,000	1100	5700	1600	7900	--	--
06/12/90	285.98	257.89	28.09	--	160,000	1400	7100	3400	16,000	--	--
09/24/90	285.98	256.80	29.18	--	53,000	850	7700	2000	10,000	--	--
12/20/90	285.98	257.71	28.27	--	520	1200	5400	5400	33,000	--	--
03/27/91	285.98	261.18	24.80	--	92,000	1300	3100	1200	11,000	--	--
06/18/91	285.98	255.14	30.84	--	--	--	--	--	--	--	--
09/12/91	285.98	254.34	31.64	Free Product (0.03')	--	--	--	--	--	--	--
01/23/92	285.98	255.46	30.52	Sheen	--	--	--	--	--	--	--
04/13/92	285.98	259.04	26.94	Free Product (0.01')	--	--	--	--	--	--	--
08/03/92	285.98	255.98	30.00	--	220,000	1300	2800	3100	17,000	--	ND
10/22/92	285.98	255.38	30.62	Free Product (0.03')	--	--	--	--	--	--	--
01/18/93	285.98	262.07	23.91	--	1,000,000	2400	5300	10,000	61,000	--	--
04/19/93	285.98	260.98	25.00	--	94,000	33,000	22,000	1600	9200	--	--
07/21,22/93	285.98	259.43	26.55	--	44,000	2600	5500	1300	6900	--	--
10/25/93	285.98	257.26	28.72	--	35,000	3900	2400	1100	6600	--	--
01/21/94	285.98	256.32	29.66	--	120,000	4200	2200	2000	11,000	--	--
04/18/94	285.98	259.24	26.74	--	29,000	1200	310	520	2000	--	--
07/06-07/94	285.98	259.62	26.36	--	84,000	2700	1400	1400	9700	--	--
10/07/94	285.98	257.49	28.49	--	40,000	1600	390	1200	6100	--	--

CONTINUED ON NEXT PAGE

Cumulative Table of Well Data and Analytical Results

Vertical Measurements are in feet.

Analytical results are in parts per billion (ppb)

DATE	Well Head Elev.	Ground Water Elev.	Depth To Water	Notes	TPH-Gasoline	Benzene	Toluene	Ethyl-Benzene	Xylene	MTBE	Organic Lead
C-3 (CONT'D)											
01/11/95	285.98	262.84	23.14	--	34,000	4200	910	720	3800	--	--
04/24/95	285.98	266.10	19.88	--	210,000	43,000	28,000	2400	13,000	--	--
07/31/95	285.98	261.30	24.68	--	110,000	33,000	17,000	2300	12,000	--	--
10/02/95	285.98	258.84	27.14	--	69,000	6700	4000	2000	11,000	--	--
01/16/96	285.98	261.60	24.38	--	40,000	2400	440	1200	5500	<500	--
04/18/96	285.98	265.31	20.67	--	66,000	26,000	17,000	2200	12,000	<1250	--
07/22/96	285.98	261.32	24.66	--	69,000	21,000	8800	1800	9900	<1000	--
10/10/96	285.98	260.75	25.23	--	53,000	12,000	2600	1900	9300	<500	--

Cumulative Table of Well Data and Analytical Results

Vertical Measurements are in feet.

Analytical results are in parts per billion (ppb)

DATE	Well Head Elev.	Ground Water Elev.	Depth To Water	Notes	TPH-Gasoline	Benzene	Toluene	Ethyl-Benzene	Xylene	MTBE	Organic Lead
C-4											
03/26/85	273.01	257.87	15.14	--	--	--	--	--	--	--	--
07/03/86	273.01	257.64	15.37	--	--	--	--	--	--	--	--
03/26/87	273.01	--	--	--	--	--	--	--	--	--	--
03/28/88	273.01	254.97	18.04	--	--	--	--	--	--	--	--
03/10/89	273.01	--	--	--	--	--	--	--	--	--	--
04/03/89	273.01	259.67	13.34	--	--	--	--	--	--	--	--
05/08/89	273.01	257.41	15.60	--	--	--	--	--	--	--	--
06/05/89	273.01	256.50	16.51	--	--	--	--	--	--	--	--
07/12/90	273.01	256.02	16.99	--	--	--	--	--	--	--	--
08/10/90	273.01	255.74	17.27	--	--	--	--	--	--	--	--
09/13/89	273.01	254.85	18.16	--	57,000	21,000	3100	3200	11,000	--	--
10/04/89	273.01	254.77	18.24	--	--	--	--	--	--	--	--
11/03/89	273.01	254.84	18.17	--	--	--	--	--	--	--	--
12/04/89	273.01	254.56	18.45	--	48,000	17,000	2200	2800	9800	--	--
03/07/90	273.01	255.81	17.20	--	--	--	--	--	--	--	--
03/09/90	273.01	255.81	17.20	--	43,000	20,000	2300	2800	11,000	--	--
06/12/90	273.01	256.35	16.66	--	82,000	21,000	2400	4000	16,000	--	--
09/24/90	273.01	254.90	18.11	--	--	--	--	--	--	--	--
12/20/90	273.01	--	--	Abandoned	--	--	--	--	--	--	--

Cumulative Table of Well Data and Analytical Results

Vertical Measurements are in feet.

Analytical results are in parts per billion (ppb)

DATE	Well Head Elev.	Ground Water Elev.	Depth To Water	Notes	TPH-Gasoline	Benzene	Toluene	Ethyl-Benzene	Xylene	MTBE	Organic Lead
C-5											
03/26/85	287.95	262.62	25.33	--	--	--	--	--	--	--	--
07/03/86	287.95	261.54	26.41	--	--	--	--	--	--	--	--
03/26/87	287.95	262.99	24.96	--	--	--	--	--	--	--	--
03/28/88	287.95	258.15	29.80	--	--	--	--	--	--	--	--
03/10/89	287.95	262.06	25.89	--	--	--	--	--	--	--	--
04/03/89	287.95	263.57	24.38	--	--	--	--	--	--	--	--
05/08/89	287.95	260.15	27.80	--	--	--	--	--	--	--	--
06/05/89	287.95	258.53	29.42	--	--	--	--	--	--	--	--
07/12/90	287.95	258.09	29.86	--	--	--	--	--	--	--	--
08/10/90	287.95	258.18	29.77	--	--	--	--	--	--	--	--
09/13/89	287.95	257.00	30.95	--	310	ND	ND	ND	ND	--	--
10/04/89	287.95	256.47	31.48	--	--	--	--	--	--	--	--
11/03/89	287.95	256.63	31.32	--	--	--	--	--	--	--	--
12/04/89	287.95	256.25	31.70	--	ND	ND	ND	ND	ND	--	--
03/07/90	287.95	257.67	30.28	--	--	--	--	--	--	--	--
03/09/90	287.95	257.67	30.28	--	ND	ND	ND	ND	ND	--	--
06/12/90	287.95	257.47	30.48	--	90	ND	ND	ND	ND	--	--
09/24/90	287.95	256.17	31.78	--	ND	ND	ND	ND	ND	--	--
12/20/90	287.95	254.66	33.29	--	170	ND	ND	1.0	0.7	--	--
03/27/91	287.95	259.97	27.98	--	--	--	--	--	--	--	--
06/18/91	287.95	255.43	32.52	--	--	--	--	--	--	--	--
09/12/91	287.95	254.58	33.37	--	--	--	--	--	--	--	--
01/23/92	287.95	255.28	32.67	--	--	--	--	--	--	--	--
04/13/92	287.95	259.47	28.48	--	140	ND	ND	0.7	ND	--	--
08/03/92	287.95	255.45	32.50	--	ND	ND	ND	ND	ND	--	ND
10/22/92	287.95	253.97	33.98	--	--	--	--	--	--	--	--
01/18/93	287.95	260.93	27.02	--	230	6.6	2.2	3.4	2.2	--	--
04/19/93	287.95	263.14	24.81	--	--	--	--	--	--	--	--
07/21,22/93	287.95	258.89	29.06	--	130	ND	0.6	ND	ND	--	--
10/25/93	287.95	257.00	30.95	--	--	--	--	--	--	--	--
01/21/94	287.95	256.04	31.91	--	ND	ND	ND	ND	ND	--	--
04/18/94	287.95	257.80	30.15	--	--	--	--	--	--	--	--
07/06-07/94	287.95	258.91	29.04	--	ND	ND	ND	ND	ND	--	--
10/07/94	287.95	256.11	31.84	--	--	--	--	--	--	--	--

CONTINUED ON NEXT PAGE

Cumulative Table of Well Data and Analytical Results

Vertical Measurements are in feet.

Analytical results are in parts per billion (ppb)

DATE	Well Head Elev.	Ground Water Elev.	Depth To Water	Notes	TPH-Gasoline	Benzene	Toluene	Ethyl-Benzene	Xylene	MTBE	Organic Lead
C-5 (CONT'D)											
01/11/95	287.95	262.97	24.98	Sampled biannually	700	1.1	6.0	1.5	2.1	--	--
04/24/95	287.95	266.17	21.78	--	--	--	--	--	--	--	--
07/31/95	287.95	--	--	Inaccessible	--	--	--	--	--	--	--
10/02/95	287.95	257.77	30.18	--	--	--	--	--	--	--	--
01/16/96	287.95	261.23	26.72	--	200	<0.5	<0.5	<0.5	1.3	<2.5	--
04/18/96	287.95	266.15	21.80	--	--	--	--	--	--	--	--
07/22/96	287.95	--	--	Inaccessible	--	--	--	--	--	--	--
10/10/96	287.95	261.17	26.78	--	--	--	--	--	--	--	--

Cumulative Table of Well Data and Analytical Results

Vertical Measurements are in feet.

Analytical results are in parts per billion (ppb)

DATE	Well Head Elev.	Ground Water Elev.	Depth To Water	Notes	TPH-Gasoline	Benzene	Toluene	Ethyl-Benzene	Xylene	MTBE	Organic Lead
C-6											
03/26/85	--	--	16.74	--	--	--	--	--	--	--	--
07/03/86	275.28	257.82	17.46	--	--	--	--	--	--	--	--
03/26/87	275.28	256.91	18.37	--	--	--	--	--	--	--	--
03/28/88	275.28	245.44	29.84	--	--	--	--	--	--	--	--
03/10/89	275.28	260.84	14.44	--	--	--	--	--	--	--	--
04/03/89	275.28	260.84	14.44	--	--	--	--	--	--	--	--
05/08/89	275.28	258.12	17.16	--	--	--	--	--	--	--	--
06/05/89	275.28	256.77	18.51	--	--	--	--	--	--	--	--
07/12/90	275.28	256.57	18.71	--	--	--	--	--	--	--	--
08/10/90	275.28	255.96	19.32	--	--	--	--	--	--	--	--
09/13/89	275.28	255.33	19.95	--	47	5600	3000	2400	10,000	--	--
10/04/89	275.28	255.41	19.87	--	--	--	--	--	--	--	--
11/03/89	275.28	255.93	19.35	--	--	--	--	--	--	--	--
12/04/89	275.28	255.69	19.59	--	40,000	8100	1800	1700	7500	--	--
03/07/90	275.28	256.89	18.39	--	--	--	--	--	--	--	--
03/09/90	275.28	256.89	18.39	--	73,000	23,000	5900	3400	17,000	--	--
06/12/90	275.28	256.41	18.87	--	85,000	19,000	6500	3400	16,000	--	--
09/24/90	275.28	255.29	19.99	--	72,000	15,000	3200	2600	11,000	--	--
12/20/90	275.28	253.71	21.57	--	100,000	11,000	4200	3400	16,000	--	--
03/27/91	275.28	258.96	16.32	--	100,000	11,000	4400	2300	11,000	--	--
06/18/91	275.28	251.95	23.33	--	--	--	--	--	--	--	--
09/12/91	275.28	251.32	23.96	--	--	--	--	--	--	--	--
01/23/92	275.28	263.20	12.08	--	--	--	--	--	--	--	--
04/13/92	275.28	255.43	19.85	Sheen	--	--	--	--	--	--	--
08/03/92	275.28	260.56	14.72	--	120,000	16,000	1100	2300	15,000	--	ND
10/22/92	275.28	260.37	14.91	--	63,000	7400	920	1800	14,000	--	--
01/18/93	275.28	259.84	15.44	--	77,000	13,000	1600	2700	12,000	--	--
04/19/93	275.28	266.03	9.25	--	56,000	14,000	1100	2400	9100	--	--
07/21,22/93	275.28	257.93	17.35	--	38,000	6600	610	1500	5800	--	--
10/25/93	275.28	254.25	21.03	--	42,000	11,000	800	2200	8200	--	--
01/21/94	275.28	253.71	21.57	--	57,000	11,000	940	2300	9800	--	--
04/18/94	275.28	257.17	18.11	--	48,000	9800	830	1900	7500	--	--
07/06-07/94	275.28	258.28	17.00	--	46,000	6800	610	900	6200	--	--
10/07/94	275.28	256.09	19.19	--	35,000	5900	410	1400	3800	--	--

CONTINUED ON NEXT PAGE

Cumulative Table of Well Data and Analytical Results

Vertical Measurements are in feet.

Analytical results are in parts per billion (ppb)

DATE	Well Head Elev.	Ground Water Elev.	Depth To Water	Notes	TPH-Gasoline	Benzene	Toluene	Ethyl-Benzene	Xylene	MTBE	Organic Lead
C-6 (CONT'D)											
01/11/95	275.28	256.64	18.64	--	54,000	1200	1100	2100	9500	--	--
04/24/95	275.28	262.72	12.56	--	81,000	12,000	1500	2400	9900	--	--
07/31/95	275.28	259.54	15.74	--	75,000	12,000	1200	2800	11,000	--	--
10/02/95	275.28	257.56	17.72	--	59,000	13,000	990	2800	10,000	--	--
01/16/96	275.28	259.81	15.47	--	63,000	10,000	650	2200	7500	<500	--
04/18/96	275.28	259.33	15.95	--	56,000	9800	590	1500	5800	660	--
07/22/96	275.28	--	--	Inaccessible	--	--	--	--	--	--	--
10/10/96	275.28	--	--	Inaccessible	--	--	--	--	--	--	--

Cumulative Table of Well Data and Analytical Results

Vertical Measurements are in feet.

Analytical results are in parts per billion (ppb)

DATE	Well Head Elev.	Ground Water Elev.	Depth To Water	Notes	TPH-Gasoline	Benzene	Toluene	Ethyl-Benzene	Xylene	MTBE	Organic Lead
C-7											
03/26/85	--	--	9.61	--	--	--	--	--	--	--	--
07/03/86	270.70	259.96	10.74	--	--	--	--	--	--	--	--
03/26/87	270.70	260.62	10.08	--	--	--	--	--	--	--	--
03/28/88	270.70	256.91	13.79	--	--	--	--	--	--	--	--
03/10/89	270.70	260.28	10.42	--	--	--	--	--	--	--	--
04/03/89	270.70	261.56	9.14	--	--	--	--	--	--	--	--
05/08/89	270.70	258.79	11.91	--	--	--	--	--	--	--	--
06/05/89	270.70	259.16	11.54	--	--	--	--	--	--	--	--
07/12/90	270.70	257.25	13.45	--	--	--	--	--	--	--	--
08/10/90	270.70	257.33	13.37	--	--	--	--	--	--	--	--
09/13/89	270.70	256.10	14.60	--	410	1.3	ND	10	ND	--	--
10/04/89	270.70	255.53	15.17	--	--	--	--	--	--	--	--
11/03/89	270.70	255.42	15.28	--	--	--	--	--	--	--	--
12/04/89	270.70	255.00	15.70	--	1000	1.0	ND	5.0	ND	--	--
03/07/90	270.70	256.48	14.22	--	--	--	--	--	--	--	--
03/09/90	270.70	256.48	14.22	--	590	2.8	2.4	3.5	2.0	--	--
06/12/90	270.70	256.52	14.18	--	1200	ND	5	8.2	3.2	--	--
09/24/90	270.70	255.26	15.44	Sheen	400	1.4	1.9	1.4	2.2	--	--
09/24/90	270.70	255.26	15.44	Duplicate	580	ND	2.4	1.4	1.5	--	--
12/20/90	270.70	253.62	17.08	--	2300	ND	6.5	4.7	9.3	--	--
03/27/91	270.70	258.05	12.65	--	980	ND	2.4	9.1	3.0	--	--
06/18/91	270.70	254.26	16.44	--	--	--	--	--	--	--	--
09/12/91	270.70	253.65	17.05	--	1200	ND	3.1	6.5	2.7	--	--
01/23/92	270.70	253.78	16.92	--	--	--	--	--	--	--	--
04/13/92	270.70	257.70	13.00	--	830	ND	1.0	7.8	1.2	--	--
08/03/92	270.70	--	--	--	--	--	--	--	--	--	--
10/22/92	270.70	--	--	Could not locate	--	--	--	--	--	--	--
01/18/93	270.70	--	--	Could not locate	--	--	--	--	--	--	--
04/19/93	270.70	--	--	Could not locate	--	--	--	--	--	--	--
07/21,22/93	270.70	257.76	12.94	--	890	0.9	3.0	4.0	4.0	--	--
10/25/93	270.70	255.87	14.83	--	--	--	--	--	--	--	--

CONTINUED ON NEXT PAGE

Cumulative Table of Well Data and Analytical Results

Vertical Measurements are in feet.

Analytical results are in parts per billion (ppb)

DATE	Well Head Elev.	Ground Water Elev.	Depth To Water	Notes	TPH-Gasoline	Benzene	Toluene	Ethyl-Benzene	Xylene	MTBE	Organic Lead
C-7 (CONTD)											
01/21/94	270.70	254.76	15.94	--	660	ND	6.0	1.0	3.0	--	--
04/18/94	270.70	255.72	14.98	--	--	--	--	--	--	--	--
07/06-07/94	270.70	257.76	12.94	--	960	ND	5.8	4.2	8.2	--	--
10/07/94	270.70	254.87	15.83	--	--	--	--	--	--	--	--
01/11/95	270.70	261.45	9.25	Sampled biannually	900	<0.5	<0.5	2.3	1.3	--	--
04/24/95	270.70	264.00	6.70	--	--	--	--	--	--	--	--
07/31/95	270.70	259.46	11.24	--	690	<1.2	<1.2	<1.2	<1.2	--	--
10/02/95	270.70	256.68	14.02	--	--	--	--	--	--	--	--
01/16/96	270.70	259.48	11.22	--	<50	<0.5	<0.5	<0.5	<0.5	<2.5	--
04/18/96	270.70	264.05	6.65	--	--	--	--	--	--	--	--
07/22/96	270.70	259.60	11.10	--	360	4.4	2.0	<0.5	<0.5	17	--
10/10/96	270.70	259.35	11.35	--	--	--	--	--	--	--	--

Cumulative Table of Well Data and Analytical Results

Vertical Measurements are in feet.

Analytical results are in parts per billion (ppb)

DATE	Well Head Elev.	Ground Water Elev.	Depth To Water	Notes	TPH-Gasoline	Benzene	Toluene	Ethyl-Benzene	Xylene	MTBE	Organic Lead
C-8											
03/26/85	--	--	8.68	--	--	--	--	--	--	--	--
07/03/86	288.40	274.51	13.89	--	--	--	--	--	--	--	--
03/26/87	288.40	282.39	6.01	--	--	--	--	--	--	--	--
03/28/88	288.40	277.74	10.66	--	--	--	--	--	--	--	--
03/10/89	288.40	281.79	6.61	--	--	--	--	--	--	--	--
04/03/89	288.40	281.94	6.46	--	--	--	--	--	--	--	--
05/08/89	288.40	279.43	8.97	--	--	--	--	--	--	--	--
06/05/89	288.40	277.52	10.88	--	--	--	--	--	--	--	--
07/12/90	288.40	276.25	12.15	--	--	--	--	--	--	--	--
08/10/90	288.40	275.94	12.46	--	--	--	--	--	--	--	--
09/13/89	288.40	275.62	12.78	--	ND	ND	ND	ND	ND	--	--
10/04/89	288.40	275.89	12.51	--	--	--	--	--	--	--	--
11/03/89	288.40	273.77	14.63	--	--	--	--	--	--	--	--
12/04/89	288.40	278.81	9.59	--	64	0.6	0.6	ND	1.0	--	--
03/07/90	288.40	279.60	8.80	--	--	--	--	--	--	--	--
03/09/90	288.40	279.60	8.80	--	ND	ND	ND	ND	ND	--	--
06/12/90	288.40	279.46	8.94	--	120	2.5	1.2	1.0	1.4	--	--
09/24/90	288.40	274.86	13.54	--	--	--	--	--	--	--	--
12/20/90	288.40	279.07	9.33	--	--	--	--	--	--	--	--
03/27/91	288.40	282.30	6.10	--	54	0.7	ND	0.7	1.9	--	--
06/18/91	288.40	276.44	11.96	--	--	--	--	--	--	--	--
09/12/91	288.40	274.80	13.60	--	ND	ND	ND	ND	ND	--	--
09/12/91	288.40	274.80	13.60	Duplicate	ND	ND	ND	ND	ND	--	--
01/23/92	288.40	264.20	24.20	--	--	--	--	--	--	--	--
04/13/92	288.40	280.05	8.35	--	ND	ND	ND	ND	ND	--	--
08/03/92	288.40	275.82	12.58	--	ND	ND	ND	ND	ND	--	ND
10/22/92	288.40	275.30	13.10	--	ND	ND	ND	ND	ND	--	--
01/18/93	288.40	282.28	6.12	--	ND	ND	ND	ND	ND	--	--
04/19/93	288.40	281.35	7.05	--	ND	ND	ND	ND	ND	--	--
07/21,22/93	288.40	277.05	11.35	--	ND	ND	ND	ND	ND	--	--
10/25/93	288.40	275.55	12.85	--	ND	ND	ND	ND	ND	--	--

CONTINUED ON NEXT PAGE

Cumulative Table of Well Data and Analytical Results

Vertical Measurements are in feet.

Analytical results are in parts per billion (ppb)

DATE	Well Head Elev.	Ground Water Elev.	Depth To Water	Notes	TPH-Gasoline	Benzene	Toluene	Ethyl-Benzene	Xylene	MTBE	Organic Lead
C-8 (CONT'D)											
01/21/94	288.40	277.85	10.55	--	ND	ND	ND	ND	ND	--	--
04/18/94	288.40	278.89	9.51	--	ND	1.2	0.9	ND	1.6	--	--
07/06-07/94	288.40	277.02	11.38	--	ND	ND	ND	ND	ND	--	--
10/07/94	288.40	275.48	12.92	--	ND	ND	ND	ND	ND	--	--
01/11/95	288.40	283.04	5.36	--	<50	<0.5	<0.5	<0.5	<0.5	--	--
04/24/95	288.40	281.82	6.58	--	<50	<0.5	0.61	<0.5	0.51	--	--
07/31/95	288.40	278.94	9.46	--	<50	<0.5	<0.5	<0.5	<0.5	--	--
10/02/95	288.40	276.56	11.84	--	<50	<0.5	<0.5	<0.5	<0.5	--	--
01/16/96	288.40	281.40	7.00	--	<50	<0.5	<0.5	<0.5	<0.5	5.4	--
04/18/96	288.40	281.77	6.63	--	<50	<0.5	<0.5	<0.5	<0.5	<2.5	--
07/22/96	288.40	280.49	7.91	--	<50	<0.5	<0.5	<0.5	<0.5	<2.5	--
10/10/96	288.40	279.71	8.69	--	<50	<0.5	<0.5	<0.5	<0.5	<2.5	--

Cumulative Table of Well Data and Analytical Results

Vertical Measurements are in feet.

Analytical results are in parts per billion (ppb)

DATE	Well Head Elev.	Ground Water Elev.	Depth To Water	Notes	TPH-Gasoline	Benzene	Toluene	Ethyl-Benzene	Xylene	MTBE	Organic Lead
C-9											
07/03/86	268.46	254.57	13.89	--	--	--	--	--	--	--	--
03/26/87	268.46	254.72	13.74	--	--	--	--	--	--	--	--
03/28/88	268.46	253.47	14.99	--	--	--	--	--	--	--	--
03/10/89	268.46	255.07	13.39	--	--	--	--	--	--	--	--
04/03/89	268.46	255.62	12.84	--	--	--	--	--	--	--	--
05/08/89	268.46	254.08	14.38	--	--	--	--	--	--	--	--
06/05/89	268.46	253.10	15.36	--	--	--	--	--	--	--	--
07/12/90	268.46	252.81	15.65	--	--	--	--	--	--	--	--
08/10/90	268.46	252.66	15.80	--	--	--	--	--	--	--	--
09/13/89	268.46	251.93	16.53	--	42,000	14,000	1100	2800	4200	--	--
10/04/89	268.46	251.94	16.52	--	--	--	--	--	--	--	--
11/03/89	268.46	251.95	16.51	--	--	--	--	--	--	--	--
12/04/89	268.46	251.67	16.79	--	36,000	11,000	670	2500	3800	--	--
03/07/90	268.46	252.24	16.22	--	--	--	--	--	--	--	--
03/09/90	268.46	252.24	16.22	--	28,000	12,000	940	3000	4700	--	--
06/12/90	268.46	253.58	14.88	--	39,000	11,000	1600	2300	4800	--	--
09/24/90	268.46	252.16	16.30	--	120,000	13,000	1600	3700	6800	--	--
12/20/90	268.46	251.23	17.23	--	51,000	9300	560	2800	3300	--	--
12/20/90	268.46	251.23	17.23	Duplicate	44,000	12,000	580	2800	3500	--	--
03/27/91	268.46	254.68	13.78	--	56,000	3400	5000	1600	5600	--	--
06/18/91	268.46	249.82	18.64	--	--	--	--	--	--	--	--
09/12/91	268.46	--	--	Inaccessible	--	--	--	--	--	--	--
10/24/95	268.46	250.39	18.07	--	30,000	7200	440	2500	1600	--	--
01/16/96	268.46	252.18	16.28	--	36,000	8200	700	2500	2100	<500	--

Y. NO LONGER MONITORED OR SAMPLED

Cumulative Table of Well Data and Analytical Results

Vertical Measurements are in feet.

Analytical results are in parts per billion (ppb)

DATE	Well Head Elev.	Ground Water Elev.	Depth To Water	Notes	TPH-Gasoline	Benzene	Toluene	Ethyl-Benzene	Xylene	MTBE	Organic Lead
C-10A											
03/07/90	264.84	244.63	20.21	--	--	--	--	--	--	--	--
03/09/90	264.84	--	--	--	ND	1.6	0.7	0.8	3.5	--	--
06/12/90	264.84	245.14	19.70	--	ND	ND	ND	ND	ND	--	--
09/24/90	264.84	245.30	19.54	--	ND	ND	ND	ND	ND	--	--
12/20/90	264.84	245.00	19.84	--	ND	ND	ND	ND	ND	--	--
03/27/91	264.84	246.83	18.01	--	--	--	--	--	--	--	--
06/18/91	264.84	244.68	20.16	--	ND	ND	ND	ND	ND	--	--
09/12/91	264.84	244.27	20.57	--	ND	ND	ND	ND	ND	--	--
01/23/92	264.84	244.17	20.67	--	ND	ND	ND	ND	ND	--	--
04/13/92	264.84	245.44	19.40	--	53	0.9	1.3	ND	1.0	--	--
08/03/92	264.84	245.03	19.81	--	ND	ND	ND	ND	ND	--	ND
10/22/92	264.84	245.01	19.83	--	ND	ND	ND	ND	0.5	--	--
01/18/93	264.84	247.80	17.04	--	ND	ND	ND	ND	ND	--	--
04/19/93	264.84	247.07	17.77	--	ND	ND	ND	ND	ND	--	--
04/19/93	264.84	247.28	17.56	--	ND	ND	ND	ND	ND	--	--
10/25/93	264.84	247.07	17.77	--	ND	ND	ND	ND	ND	--	--
01/21/94	264.84	246.93	17.91	--	ND	ND	ND	ND	ND	--	--
04/18/94	264.84	247.81	17.03	--	ND	3.0	3.0	1.4	5.5	--	--
07/06-07/94	264.84	248.06	16.78	--	ND	ND	ND	ND	ND	--	--
10/07/94	264.84	247.63	17.21	--	ND	ND	ND	ND	ND	--	--
01/11/95	264.84	248.78	16.06	--	<50	<0.5	<0.5	<0.5	<0.5	--	--
04/24/95	264.84	248.32	16.52	--	<50	<0.5	<0.5	<0.5	<0.5	--	--
07/31/95	264.84	245.82	19.02	--	<50	<0.5	<0.5	<0.5	<0.5	--	--
10/02/95	264.84	245.14	19.70	--	<50	<0.5	<0.5	<0.5	<0.5	--	--
01/16/96	264.84	246.21	18.63	--	<50	<0.5	<0.5	<0.5	<0.5	<2.5	--
04/18/96	264.84	247.19	17.65	--	<50	<0.5	<0.5	<0.5	<0.5	<2.5	--
07/22/96	264.84	245.99	18.85	--	<50	<0.5	<0.5	<0.5	<0.5	<2.5	--
10/10/96	264.84	245.40	19.44	--	<50	<0.5	<0.5	<0.5	<0.5	<2.5	--

Cumulative Table of Well Data and Analytical Results

Vertical Measurements are in feet.

Analytical results are in parts per billion (ppb)

DATE	Well Head Elev.	Ground Water Elev.	Depth To Water	Notes	TPH-Gasoline	Benzene	Toluene	Ethyl-Benzene	Xylene	MTBE	Organic Lead
C-10B											
03/07/90	264.85	243.41	21.44	--	--	--	--	--	--	--	--
06/12/90	264.85	244.91	19.94	--	ND	ND	ND	ND	ND	--	--
09/24/90	264.85	245.08	19.77	--	ND	ND	ND	ND	ND	--	--
12/20/90	264.85	244.85	20.00	--	ND	ND	ND	ND	ND	--	--
03/27/91	264.85	246.62	18.23	--	--	--	--	--	--	--	--
06/18/91	264.85	244.41	20.44	--	--	--	--	--	--	--	--
09/12/91	264.85	244.03	20.82	--	ND	ND	ND	ND	ND	--	--
01/23/92	264.85	243.93	20.92	--	ND	ND	ND	ND	ND	--	--
04/13/92	264.85	245.17	19.68	--	ND	ND	ND	ND	ND	--	--
08/03/92	264.85	244.78	20.07	--	ND	ND	ND	ND	ND	--	ND
10/22/92	264.85	244.73	20.12	--	ND	ND	ND	ND	ND	--	--
01/18/93	264.85	247.49	17.36	--	60	3.3	11	2.1	8.9	--	--
04/19/93	264.85	246.95	17.90	--	ND	ND	ND	ND	ND	--	--
07/21,22/93	264.85	246.99	17.86	--	ND	ND	ND	ND	ND	--	--
10/25/93	264.85	246.75	18.10	--	ND	ND	ND	ND	ND	--	--
01/21/94	264.85	246.62	18.23	--	ND	ND	ND	ND	ND	--	--
04/18/94	264.85	247.49	17.36	--	ND	ND	ND	ND	0.5	--	--
07/06-07/94	264.85	247.80	17.05	--	ND	ND	ND	ND	ND	--	--
10/07/94	264.85	247.31	17.54	--	ND	ND	ND	ND	ND	--	--
01/11/95	264.85	248.61	16.24	--	<50	<0.5	<0.5	<0.5	<0.5	--	--
04/24/95	264.85	247.95	16.90	--	<50	<0.5	<0.5	<0.5	<0.5	--	--
07/31/95	264.85	245.57	19.28	--	<50	<0.5	<0.5	<0.5	<0.5	--	--
10/02/95	264.85	244.91	19.94	--	<50	<0.5	<0.5	<0.5	<0.5	--	--
01/16/96	264.85	246.25	18.60	--	<50	<0.5	<0.5	<0.5	<0.5	<2.5	--
04/18/96	264.85	246.87	17.98	--	<50	<0.5	<0.5	<0.5	<0.5	<2.5	--
07/22/96	264.85	245.75	19.10	--	<50	<0.5	<0.5	<0.5	<0.5	<2.5	--
10/10/96	264.85	245.14	19.71	--	<50	<0.5	<0.5	<0.5	<0.5	<2.5	--

Cumulative Table of Well Data and Analytical Results

Vertical Measurements are in feet.

Analytical results are in parts per billion (ppb)

DATE	Well Head Elev.	Ground Water Elev.	Depth To Water	Notes	TPH-Gasoline	Benzene	Toluene	Ethyl-Benzene	Xylene	MTBE	Organic Lead
C-11											
03/07/90	265.30	242.56	22.74	--	--	--	--	--	--	--	--
03/09/90	265.30	--	--	--	ND	1.2	0.7	ND	1.4	--	--
06/12/90	265.30	243.32	21.98	--	ND	ND	ND	ND	ND	--	--
09/24/90	265.30	243.42	21.88	--	ND	ND	ND	ND	ND	--	--
12/20/90	265.30	242.12	23.18	--	ND	ND	ND	ND	ND	--	--
03/27/91	265.30	243.78	21.52	--	ND	ND	ND	ND	1.5	--	--
06/18/91	265.30	243.40	21.90	--	--	--	--	--	--	--	--
09/12/91	265.30	242.60	22.70	--	ND	ND	ND	ND	ND	--	--
01/23/92	265.30	241.84	23.46	--	ND	ND	ND	ND	ND	--	--
04/13/92	265.30	243.73	21.57	--	ND	ND	ND	ND	ND	--	--
08/03/92	265.30	242.63	22.67	--	ND	ND	ND	ND	ND	--	ND
10/22/92	265.30	242.01	23.29	--	ND	ND	ND	ND	ND	--	--
01/18/93	265.30	243.94	21.36	--	ND	ND	1.2	ND	2.2	--	--
04/19/93	265.30	245.33	19.97	--	ND	ND	ND	ND	ND	--	--
07/21,22/93	265.30	244.65	20.65	--	ND	ND	ND	ND	ND	--	--
10/25/93	265.30	244.55	20.75	--	ND	ND	ND	ND	ND	--	--
01/21/94	265.30	243.69	21.61	--	ND	ND	ND	ND	ND	--	--
04/18/94	265.30	244.52	20.78	--	ND	ND	ND	ND	ND	--	--
07/06-07/94	265.30	244.88	20.42	--	ND	ND	ND	ND	ND	--	--
10/07/94	265.30	243.70	21.60	--	ND	ND	ND	ND	ND	--	--
01/11/95	265.30	245.28	20.02	--	<50	<0.5	<0.5	<0.5	<0.5	--	--
04/24/95	265.30	247.58	17.72	--	<50	<0.5	<0.5	<0.5	<0.5	--	--
07/31/95	265.30	246.12	19.18	--	<50	<0.5	<0.5	<0.5	<0.5	--	--
10/02/95	265.30	244.88	20.42	--	<50	<0.5	<0.5	<0.5	<0.5	--	--
01/16/96	265.30	245.48	19.82	--	<50	<0.5	<0.5	<0.5	<0.5	<2.5	--
04/18/96	265.30	248.30	17.00	--	260	7.9	6.9	5.3	23	11	--
07/22/96	265.30	248.40	16.90	--	<50	<0.5	<0.5	<0.5	<0.5	<2.5	--
10/10/96	265.30	245.74	19.56	--	130	32	2.7	4.3	14	3.4	--

Cumulative Table of Well Data and Analytical Results

Vertical Measurements are in feet.

Analytical results are in parts per billion (ppb)

DATE	Well Head Elev.	Ground Water Elev.	Depth To Water	Notes	TPH-Gasoline	Benzene	Toluene	Ethyl-Benzene	Xylene	MTBE	Organic Lead
C-12											
03/07/90	269.66	254.74	14.92	--	--	--	--	--	--	--	--
03/09/90	269.66	--	--	--	1400	230	140	33	180	--	--
06/12/90	269.66	254.87	14.79	--	720	190	71	18	73	--	--
09/24/90	269.66	253.94	15.72	--	ND	1.1	ND	ND	0.6	--	--
12/20/90	269.66	254.40	15.26	--	810	210	26	8.2	23	--	--
03/27/91	269.66	257.55	12.11	--	2900	350	220	52	210	--	--
06/18/91	269.66	253.28	16.38	--	--	--	--	--	--	--	--
09/12/91	269.66	252.11	17.55	--	350	59	12	4.5	8.5	--	--
01/23/92	269.66	252.55	17.11	--	450	110	31	7.9	22	--	--
04/13/92	269.66	255.26	14.40	--	5000	1100	76	100	200	--	--
08/03/92	269.66	253.83	15.83	--	520	200	21	13	25	--	ND
10/22/92	269.66	253.52	16.14	--	1300	310	66	35	56	--	--
01/18/93	269.66	257.96	11.70	--	5600	1200	430	220	610	--	--
04/19/93	269.66	256.61	13.05	--	2000	600	99	96	170	--	--
07/21,22/93	269.66	256.82	12.84	--	540	95	36	18	56	--	--
10/25/93	269.66	255.63	14.03	--	350	90	29	20	50	--	--
01/21/94	269.66	255.51	14.15	--	450	73	18	14	37	--	--
04/18/94	269.66	256.71	12.95	--	370	70	21	12	39	--	--
07/06-07/94	269.66	257.35	12.31	--	840	200	35	28	66	--	--
10/07/94	269.66	256.31	13.35	--	830	85	29	17	63	--	--
01/11/95	269.66	258.43	11.23	--	2100	570	190	98	390	--	--
04/24/95	269.66	259.34	10.32	--	820	120	28	23	61	--	--
07/31/95	269.66	256.92	12.74	--	520	79	13	16	42	--	--
10/02/95	269.66	255.26	14.40	--	400	50	5.3	11	29	--	--
01/16/96	269.66	256.94	12.72	--	1900	490	32	60	120	<25	--
04/18/96	269.66	258.91	10.75	--	2900	640	54	100	190	68	--
07/22/96	269.66	256.46	13.20	--	730	150	13	26	75	9.5	--
10/10/96	269.66	255.95	13.71	--	270		4.4	7.7	31	<2.5	--

Cumulative Table of Well Data and Analytical Results

Vertical Measurements are in feet.

Analytical results are in parts per billion (ppb)

DATE	Well Head Elev.	Ground Water Elev.	Depth To Water	Notes	TPH-Gasoline	Benzene	Toluene	Ethyl-Benzene	Xylene	MTBE	Organic Lead
C-13											
03/07/90	284.32	273.14	11.18	--	--	--	--	--	--	--	--
03/09/90	284.32	--	--	--	ND	15	3.7	1.0	6.2	--	--
06/12/90	284.32	273.62	10.70	--	ND	2.6	ND	ND	ND	--	--
09/24/90	284.32	272.72	11.60	--	ND	2.4	ND	ND	ND	--	--
12/20/90	284.32	274.16	10.16	--	ND	1.6	ND	ND	ND	--	--
03/27/91	284.32	276.68	7.64	--	--	--	--	--	--	--	--
06/18/91	284.32	273.00	11.32	--	--	--	--	--	--	--	--
09/12/91	284.32	272.48	11.84	--	ND	ND	ND	ND	ND	--	--
01/23/92	284.32	273.77	10.55	--	--	--	--	--	--	--	--
04/13/92	284.32	273.36	10.96	--	ND	1.0	ND	ND	ND	--	--
08/03/92	284.32	273.42	10.90	--	ND	ND	ND	ND	ND	--	ND
10/22/92	284.32	273.14	11.18	--	--	--	--	--	--	--	--
01/18/93	284.32	276.92	7.40	--	290	54	10	5.4	12	--	--
04/19/93	284.32	275.39	8.93	--	--	--	--	--	--	--	--
07/21,22/93	284.32	273.57	10.75	--	ND	ND	ND	ND	ND	--	--
10/25/93	284.32	273.47	10.85	--	--	--	--	--	--	--	--
01/21/94	284.32	273.27	11.05	--	ND	ND	ND	ND	ND	--	--
04/18/94	284.32	273.61	10.71	--	--	--	--	--	--	--	--
07/06-07/94	284.32	273.67	10.65	--	ND	0.5	ND	ND	ND	--	--
10/07/94	284.32	273.24	11.08	--	--	--	--	--	--	--	--
01/11/95	284.32	278.94	5.38	Sampled bi-annually	120	15	<0.5	3.1	2.7	--	--
04/24/95	284.32	276.54	7.78	--	--	--	--	--	--	--	--
07/31/95	284.32	274.38	9.94	--	<50	<0.5	<0.5	<0.5	<0.5	--	--
10/02/95	284.32	273.74	10.58	--	--	--	--	--	--	--	--
01/16/96	284.32	274.52	9.80	--	<50	<0.5	<0.5	<0.5	<0.5	<2.5	--
04/18/96	284.32	276.57	7.75	--	--	--	--	--	--	--	--
07/22/96	284.32	274.82	9.50	--	59	18	<0.5	1.0	<0.5	<2.5	--
10/10/96	284.32	273.63	10.69	--	--	--	--	--	--	--	--

Cumulative Table of Well Data and Analytical Results

Vertical Measurements are in feet.

Analytical results are in parts per billion (ppb)

DATE	Well Head Elev.	Ground Water Elev.	Depth To Water	Notes	TPH-Gasoline	Benzene	Toluene	Ethyl-Benzene	Xylene	MTBE	Organic Lead
C-14											
03/07/90	270.74	255.56	15.18	--	--	--	--	--	--	--	--
03/09/90	270.74	--	--	--	ND	ND	ND	ND	ND	--	--
06/12/90	270.74	257.32	13.42	--	ND	ND	ND	ND	ND	--	--
09/24/90	270.74	257.90	12.84	--	ND	ND	ND	ND	ND	--	--
12/20/90	270.74	254.02	16.72	--	ND	1.7	0.7	ND	0.7	--	--
03/27/91	270.74	262.74	8.00	--	ND	ND	ND	ND	1.3	--	--
06/18/91	270.74	255.53	15.21	--	--	--	--	--	--	--	--
09/12/91	270.74	255.13	15.61	--	ND	ND	ND	ND	ND	--	--
01/23/92	270.74	246.10	24.64	--	--	--	--	--	--	--	--
04/13/92	270.74	258.53	12.21	--	ND	ND	ND	ND	ND	--	--
08/03/92	270.74	256.10	14.64	--	ND	ND	ND	ND	ND	--	ND
10/22/92	270.74	253.80	16.94	--	--	--	--	--	--	--	--
01/18/93	270.74	265.64	5.10	--	ND	ND	ND	ND	ND	--	--
04/19/93	270.74	263.86	6.88	--	--	--	--	--	--	--	--
07/21,22/93	270.74	259.58	11.16	--	ND	ND	ND	ND	ND	--	--
10/25/93	270.74	256.87	13.87	--	--	--	--	--	--	--	--
01/21/94	270.74	255.42	15.32	--	ND	ND	ND	ND	ND	--	--
04/18/94	270.74	254.85	15.89	--	--	--	--	--	--	--	--
07/06-07/94	270.74	258.66	12.08	--	ND	ND	ND	ND	ND	--	--
10/07/94	270.74	255.45	15.29	--	--	--	--	--	--	--	--
01/11/95	270.74	266.94	3.80	Sampled bi-annually	<50	<0.5	<0.5	<0.5	<0.5	--	--
04/24/95	270.74	265.68	5.06	--	--	--	--	--	--	--	--
07/31/95	270.74	260.34	10.40	--	<50	<0.5	<0.5	<0.5	<0.5	--	--
10/02/95	270.74	257.20	13.54	--	--	--	--	--	--	--	--
01/16/96	270.74	259.62	11.12	--	<50	<0.5	<0.5	<0.5	<0.5	<2.5	--
04/18/96	270.74	265.78	4.96	--	--	--	--	--	--	--	--
07/22/96	270.74	259.89	10.85	--	<50	<0.5	<0.5	<0.5	<0.5	<2.5	--
10/10/96	270.74	261.44	9.30	--	--	--	--	--	--	--	--

Cumulative Table of Well Data and Analytical Results

Vertical Measurements are in feet.

Analytical results are in parts per billion (ppb)

DATE	Well Head Elev.	Ground Water Elev.	Depth To Water	Notes	TPH-Gasoline	Benzene	Toluene	Ethyl-Benzene	Xylene	MTBE	Organic Lead
C-15											
03/07/90	246.15	235.05	11.10	--	--	--	--	--	--	--	--
03/09/90	246.15	--	--	--	410	ND	1.4	0.5	0.6	--	--
06/12/90	246.15	235.37	10.78	--	420	11	ND	ND	ND	--	--
09/24/90	246.15	235.22	10.93	--	430	ND	1.5	ND	ND	--	--
12/20/90	246.15	235.07	11.08	--	300	1.3	1.1	0.6	1.5	--	--
03/27/91	246.15	237.65	8.50	--	520	4.6	1.1	ND	1.0	--	--
06/18/91	246.15	235.32	10.83	--	290	ND	1.1	ND	ND	--	--
06/18/91	246.15	235.32	10.83	Duplicate	320	ND	1.3	ND	ND	--	--
09/12/91	246.15	235.10	11.05	--	330	ND	0.9	ND	ND	--	--
01/23/92	246.15	235.35	10.80	--	210	ND	0.6	ND	ND	--	--
01/23/92	246.15	235.35	10.80	Duplicate	190	1.2	0.8	ND	ND	--	--
04/13/92	246.15	236.57	9.58	--	430	1.8	ND	ND	ND	--	--
08/03/92	246.15	234.94	11.21	--	640	ND	2.1	0.7	1.3	--	ND
10/22/92	246.15	234.50	11.65	--	420	ND	ND	ND	0.8	--	--
01/18/93	246.15	239.03	7.12	--	640	7.0	3.0	2.9	6.7	--	--
04/19/93	246.15	237.22	8.93	--	260	6.0	2.0	0.7	ND	--	--
07/21,22/93	246.15	236.37	9.78	--	580	ND	8.0	ND	0.6	--	--
10/25/93	246.15	236.41	9.74	--	240	ND	12.0	ND	0.6	--	--
01/21/94	246.15	235.78	10.37	--	420	0.6	ND	0.6	ND	--	--
04/18/94	246.15	236.19	9.96	--	550	1.0	4.6	0.6	ND	--	--
07/06-07/94	246.15	235.92	10.23	--	660	0.7	ND	ND	0.7	--	--
10/07/94	246.15	235.47	10.68	--	440	13	0.8	ND	1.2	--	--
01/11/95	246.15	238.84	7.31	--	750	2.5	<0.5	<0.5	0.6	--	--
04/24/95	246.15	237.41	8.74	--	850	<0.5	<0.5	<0.5	<0.5	--	--
07/31/95	246.15	235.41	10.74	--	640	<0.5	1.6	<0.5	<0.5	--	--
10/02/95	246.15	234.83	11.32	--	560	<0.5	<0.5	<0.5	<0.5	--	--
01/16/96	246.15	235.58	10.57	--	740	<0.5	<0.5	<0.5	<0.5	<2.5	--
04/18/96	246.15	237.55	8.60	--	760	<0.5	<0.5	<0.5	<0.5	2.5	--
07/22/96	246.15	235.57	10.58	--	690	<0.5	1.6	<0.5	<0.5		--
10/10/96	246.15	234.97	11.18	--				<0.5	<0.5		--

Cumulative Table of Well Data and Analytical Results

Vertical Measurements are in feet.

Analytical results are in parts per billion (ppb)

DATE	Well Head Elev.	Ground Water Elev.	Depth To Water	Notes	TPH-Gasoline	Benzene	Toluene	Ethyl-Benzene	Xylene	MTBE	Organic Lead
C-16											
03/07/90	246.69	228.19	18.50	--	--	--	--	--	--	--	--
03/09/90	246.69	--	--	--	ND	ND	ND	ND	ND	--	--
06/12/90	246.69	235.27	11.42	--	ND	ND	ND	ND	ND	--	--
09/24/90	246.69	235.30	11.39	--	ND	ND	ND	ND	ND	--	--
12/20/90	246.69	235.12	11.57	--	ND	ND	ND	ND	0.7	--	--
03/27/91	246.69	237.93	8.76	--	ND	ND	ND	ND	1.3	--	--
03/27/91	246.69	237.93	8.76	Duplicate	ND	ND	ND	ND	1.2	--	--
06/18/91	246.69	235.51	11.18	--	ND	ND	ND	ND	ND	--	--
09/12/91	246.69	234.74	11.95	--	ND	ND	ND	ND	ND	--	--
01/23/92	246.69	234.28	12.41	--	ND	ND	ND	ND	ND	--	--
04/13/92	246.69	236.00	10.69	--	ND	ND	ND	ND	ND	--	--
08/03/92	246.69	234.49	12.20	--	ND	ND	ND	ND	ND	--	ND
10/22/92	246.69	234.09	12.60	--	ND	ND	ND	ND	ND	--	--
01/18/93	246.69	237.69	9.00	--	ND	ND	ND	ND	ND	--	--
04/19/93	246.69	236.80	9.89	--	ND	ND	ND	ND	ND	--	--
07/21,22/93	246.69	236.44	10.25	--	ND	ND	ND	ND	ND	--	--
10/25/93	246.69	235.73	10.96	--	ND	ND	ND	ND	ND	--	--
01/21/94	246.69	234.93	11.76	--	ND	ND	0.7	ND	1.0	--	--
04/18/94	246.69	235.47	11.22	--	ND	ND	ND	ND	ND	--	--
07/06-07/94	246.69	235.32	11.37	--	ND	ND	ND	ND	ND	--	--
10/07/94	246.69	234.30	12.39	--	ND	ND	ND	ND	ND	--	--
01/11/95	246.69	237.73	8.96	--	<50	<0.5	<0.5	<0.5	<0.5	--	--
04/24/95	246.69	236.31	10.38	--	<50	<0.5	<0.5	<0.5	<0.5	--	--
07/31/95	246.69	235.37	11.32	--	<50	<0.5	<0.5	<0.5	<0.5	--	--
10/02/95	246.69	234.29	12.40	--	<50	<0.5	<0.5	<0.5	<0.5	--	--
01/16/96	246.69	235.15	11.54	--	<50	<0.5	<0.5	<0.5	<0.5	<2.5	--
04/18/96	246.69	236.09	10.60	--	<50	<0.5	<0.5	<0.5	<0.5	<2.5	--
07/22/96	246.69	235.12	11.57	--	<50	<0.5	<0.5	<0.5	<0.5	<2.5	--
10/10/96	246.69	234.25	12.44	--	<50	<0.5	<0.5	<0.5	<0.5	<2.5	--

Cumulative Table of Well Data and Analytical Results

Vertical Measurements are in feet.

Analytical results are in parts per billion (ppb)

DATE	Well Head Elev.	Ground Water Elev.	Depth To Water	Notes	TPH-Gasoline	Benzene	Toluene	Ethyl-Benzene	Xylene	MTBE	Organic Lead
RW											
12/04/89	--	--	--	--	62,000	29,000	1700	1800	8800	--	--
03/07/90	274.52	256.02	18.50	--	--	--	--	--	--	--	--
06/12/90	274.52	256.03	18.49	--	31,000	15,000	2000	560	3100	--	--
09/24/90	274.52	--	--	--	--	--	--	--	--	--	--
12/20/90	274.52	--	--	--	ND	0.5	ND	ND	1.2	--	--
03/27/91	274.52	--	--	--	--	--	--	--	--	--	--
06/18/91	274.52	--	--	--	--	--	--	--	--	--	--
09/12/91	274.52	--	--	Insufficient water	--	--	--	--	--	--	--
01/23/92	274.52	--	--	Insufficient water	--	--	--	--	--	--	--
04/13/92	274.52	--	--	Insufficient water	--	--	--	--	--	--	--
08/03/92	274.52	--	--	Insufficient water	--	--	--	--	--	--	--
10/22/92	274.52	--	--	Insufficient water	--	--	--	--	--	--	--
01/18/93	274.52	--	--	Insufficient water	--	--	--	--	--	--	--
04/19/93	274.52	--	--	Insufficient water	--	--	--	--	--	--	--
07/21,22/93	274.52	--	--	Insufficient water	--	--	--	--	--	--	--
10/25/93	274.52	--	--	--	--	--	--	--	--	--	--
01/21/94	274.52	--	--	--	--	--	--	--	--	--	--
04/18/94	274.52	--	--	--	--	--	--	--	--	--	--
07/06-07/94	274.52	--	--	--	--	--	--	--	--	--	--
10/07/94	274.52	--	--	--	--	--	--	--	--	--	--
10/24/95	274.52	256.63	17.89	--	37,000	11,000	380	1100	3000	--	--
01/16/96	274.52	259.09	15.43	--	59,000	17,000	660	1600	5400	<1000	--

~~NO LONGER MONITORED OR SAMPLED~~

Cumulative Table of Well Data and Analytical Results

Vertical Measurements are in feet.

Analytical results are in parts per billion (ppb)

DATE	Well Head Elev.	Ground Water Elev.	Depth To Water	Notes	TPH-Gasoline	Benzene	Toluene	Ethyl-Benzene	Xylene	MTBE	Organic Lead
TRIP BLANK											
01/11/95	--	--	--	--	<50	<0.5	<0.5	<0.5	<0.5	--	--
04/24/95	--	--	--	--	<50	<0.5	<0.5	<0.5	<0.5	--	--
07/31/95	--	--	--	--	<50	<0.5	<0.5	<0.5	<0.5	--	--
10/02/95	--	--	--	--	<50	<0.5	<0.5	<0.5	<0.5	--	--
01/16/96	--	--	--	--	<50	<0.5	<0.5	<0.5	<0.5	--	--
04/18/96	--	--	--	--	<50	<0.5	<0.5	<0.5	<0.5	--	--
07/22/96	--	--	--	--	<50	<0.5	<0.5	<0.5	<0.5	--	--
10/10/96	--	--	--	--	<50	<0.5	<0.5	<0.5	<0.5	--	--

Note: Blaine Tech Services, Inc. began routine monitoring of the groundwater wells at this site on November 1, 1994.
 Earlier field data and analytical results are drawn from the November 4, 1994 Groundwater Technology, Inc. report.

ABBREVIATIONS:

TPH = Total Petroleum Hydrocarbons

ND = Not detected at or above the minimum quantitation limit. See laboratory reports for minimum quantitation limits.

MTBE = Methyl t-butyl ether



Blaine Technical Services 985 Timothy Drive San Jose, CA 95133 Attention: Jim Keller	Client Proj. ID: Chevron,9-5607,961010-J3 Sample Descript: C-1 Matrix: LIQUID Analysis Method: 8015Mod/8020 Lab Number: 9610811-01	Sampled: 10/10/96 Received: 10/11/96 Analyzed: 10/15/96 Reported: 10/25/96
---	--	---

QC Batch Number: GC101596BTEX07A
Instrument ID: GCHP07

Total Purgeable Petroleum Hydrocarbons (TPPH) with BTEX and MTBE

Analyte	Detection Limit ug/L	Sample Results ug/L
TPPH as Gas	5000	24000
Methyl t-Butyl Ether	250	N.D.
Benzene	50	7100
Toluene	50	600
Ethyl Benzene	50	1700
Xylenes (Total)	50	3200
Chromatogram Pattern:		Gas
Surrogates	Control Limits %	% Recovery
Trifluorotoluene	70 130	111

Analytes reported as N.D. were not present above the stated limit of detection.

SEQUOIA ANALYTICAL - ELAP #1210

Peggy Penner
Peggy Penner
Project Manager





Blaine Technical Services
985 Timothy Drive
San Jose, CA 95133

Client Proj. ID: Chevron,9-5607,961010-J3
Sample Descript: C-3
Matrix: LIQUID
Analysis Method: 8015Mod/8020
Lab Number: 9610811-02

Sampled: 10/10/96
Received: 10/11/96
Analyzed: 10/15/96
Reported: 10/25/96

QC Batch Number: GC101596BTEX07A
Instrument ID: GCHP07

Total Purgeable Petroleum Hydrocarbons (TPPH) with BTEX and MTBE

Analyte	Detection Limit ug/L	Sample Results ug/L
TPPH as Gas	10000	53000
Methyl t-Butyl Ether	500	N.D.
Benzene	100	12000
Toluene	100	2600
Ethyl Benzene	100	1900
Xylenes (Total)	100	9300
Chromatogram Pattern:		Gas
Surrogates	Control Limits %	% Recovery
Trifluorotoluene	70 130	110

Analytes reported as N.D. were not present above the stated limit of detection.

SEQUOIA ANALYTICAL - ELAP #1210

Peggy Penner
Peggy Penner
Project Manager





Blaine Technical Services 985 Timothy Drive San Jose, CA 95133 Attention: Jim Keller	Client Proj. ID: Chevron,9-5607,961010-J3 Sample Descript: C-8 Matrix: LIQUID Analysis Method: 8015Mod/8020 Lab Number: 9610811-03	Sampled: 10/10/96 Received: 10/11/96 Analyzed: 10/15/96 Reported: 10/25/96
---	--	---

QC Batch Number: GC101596BTEX07A
Instrument ID: GCHP07

Total Purgeable Petroleum Hydrocarbons (TPPH) with BTEX and MTBE

Analyte	Detection Limit ug/L	Sample Results ug/L
TPPH as Gas	50	N.D.
Methyl t-Butyl Ether	2.5	N.D.
Benzene	0.50	N.D.
Toluene	0.50	N.D.
Ethyl Benzene	0.50	N.D.
Xylenes (Total)	0.50	N.D.
Chromatogram Pattern:		
Surrogates	Control Limits %	% Recovery
Trifluorotoluene	70 130	117

Analytes reported as N.D. were not present above the stated limit of detection.

SEQUOIA ANALYTICAL - ELAP #1210

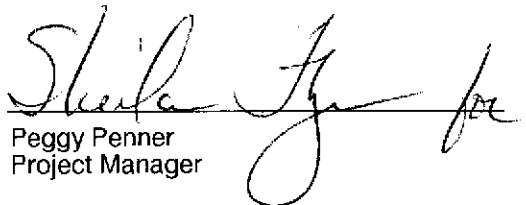
Peggy Penner
Project Manager





Blaine Technical Services	Client Proj. ID: Chevron,9-5607,961010-J3	Sampled: 10/10/96
985 Timothy Drive	Sample Descript: C-10A	Received: 10/11/96
San Jose, CA 95133	Matrix: LIQUID	
Attention: Jim Keller	Analysis Method: 8015Mod/8020	Analyzed: 10/15/96
	Lab Number: 9610811-04	Reported: 10/25/96

QC Batch Number: GC101596BTEX07A
Instrument ID: GCHP07

Total Purgeable Petroleum Hydrocarbons (TPPH) with BTEX and MTBE

Analyte	Detection Limit ug/L	Sample Results ug/L
TPPH as Gas	50	N.D.
Methyl t-Butyl Ether	2.5	N.D.
Benzene	0.50	N.D.
Toluene	0.50	N.D.
Ethyl Benzene	0.50	N.D.
Xylenes (Total)	0.50	N.D.
Chromatogram Pattern:		
Surrogates	Control Limits %	% Recovery
Trifluorotoluene	70 130	121

Analytes reported as N.D. were not present above the stated limit of detection.

SEQUOIA ANALYTICAL - ELAP #1210

Peggy Penner
Peggy Penner
Project Manager





Blaine Technical Services 985 Timothy Drive San Jose, CA 95133	Client Proj. ID: Chevron, 9-5607, 961010-J3 Sample Descript: C-10B Matrix: LIQUID Analysis Method: 8015Mod/8020 Lab Number: 9610811-05	Sampled: 10/10/96 Received: 10/11/96 Analyzed: 10/15/96 Reported: 10/25/96
Attention: Jim Keller		

QC Batch Number: GC101596BTEX07A
Instrument ID: GCHP07

Total Purgeable Petroleum Hydrocarbons (TPPH) with BTEX and MTBE

Analyte	Detection Limit ug/L	Sample Results ug/L
TPPH as Gas	50	N.D.
Methyl t-Butyl Ether	2.5	N.D.
Benzene	0.50	N.D.
Toluene	0.50	N.D.
Ethyl Benzene	0.50	N.D.
Xylenes (Total)	0.50	N.D.
Chromatogram Pattern:		
Surrogates	Control Limits %	% Recovery
Trifluorotoluene	70 130	112

Analytes reported as N.D. were not present above the stated limit of detection.

SEQUOIA ANALYTICAL - ELAP #1210

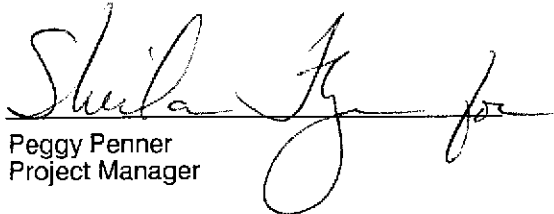

Peggy Penner
Project Manager





Blaine Technical Services	Client Proj. ID: Chevron,9-5607,961010-J3	Sampled: 10/10/96
985 Timothy Drive	Sample Descript: C-11	Received: 10/11/96
San Jose, CA 95133	Matrix: LIQUID	
Attention: Jim Keller	Analysis Method: 8015Mod/8020	Analyzed: 10/15/96
	Lab Number: 9610811-06	Reported: 10/25/96

QC Batch Number: GC101596BTEX07A
Instrument ID: GCHP07

Total Purgeable Petroleum Hydrocarbons (TPPH) with BTEX and MTBE

Analyte	Detection Limit ug/L	Sample Results ug/L
TPPH as Gas	50	130
Methyl t-Butyl Ether	2.5	3.4
Benzene	0.50	32
Toluene	0.50	2.7
Ethyl Benzene	0.50	4.3
Xylenes (Total)	0.50	14
Chromatogram Pattern:		Gas
Surrogates	Control Limits %	% Recovery
Trifluorotoluene	70 130	116

Analytes reported as N.D. were not present above the stated limit of detection.

SEQUOIA ANALYTICAL - ELAP #1210

Peggy Penner
Peggy Penner
Project Manager





Blaine Technical Services	Client Proj. ID: Chevron,9-5607,961010-J3	Sampled: 10/10/96
985 Timothy Drive	Sample Descript: C-12	Received: 10/11/96
San Jose, CA 95133	Matrix: LIQUID	
Attention: Jim Keller	Analysis Method: 8015Mod/8020	Analyzed: 10/15/96
	Lab Number: 9610811-07	Reported: 10/25/96

QC Batch Number: GC101596BTEX07A
Instrument ID: GCHP07

Total Purgeable Petroleum Hydrocarbons (TPPH) with BTEX and MTBE

Analyte	Detection Limit ug/L	Sample Results ug/L
TPPH as Gas	50	270
Methyl t-Butyl Ether	2.5	N.D.
Benzene	0.50	58
Toluene	0.50	4.4
Ethyl Benzene	0.50	7.7
Xylenes (Total)	0.50	31
Chromatogram Pattern:		Gas
Surrogates	Control Limits %	% Recovery
Trifluorotoluene	70 130	105

Analytes reported as N.D. were not present above the stated limit of detection.

SEQUOIA ANALYTICAL - ELAP #1210

Shela J. Penner
Peggy Penner
Project Manager





Blaine Technical Services 985 Timothy Drive San Jose, CA 95133	Client Proj. ID: Chevron,9-5607,961010-J3 Sample Descript: C-15 Matrix: LIQUID Analysis Method: 8015Mod/8020 Lab Number: 9610811-08	Sampled: 10/10/96 Received: 10/11/96 Analyzed: 10/15/96 Reported: 10/25/96
Attention: Jim Keller		

QC Batch Number: GC101596BTEX07A
Instrument ID: GCHP07

Total Purgeable Petroleum Hydrocarbons (TPPH) with BTEX and MTBE

Analyte	Detection Limit ug/L	Sample Results ug/L
TPPH as Gas	50	870
Methyl t-Butyl Ether	2.5	11
Benzene	0.50	7.0
Toluene	0.50	2.1
Ethyl Benzene	0.50	N.D.
Xylenes (Total)	0.50	N.D.
Chromatogram Pattern: Unidentified HC		C6-C12
Surrogates	Control Limits %	% Recovery
Trifluorotoluene	70 130	125

Analytes reported as N.D. were not present above the stated limit of detection.

SEQUOIA ANALYTICAL - ELAP #1210

Shela G. Penner
Peggy Penner
Project Manager





Blaine Technical Services 985 Timothy Drive San Jose, CA 95133 Attention: Jim Keller	Client Proj. ID: Chevron,9-5607,961010-J3 Sample Descript: C-16 Matrix: LIQUID Analysis Method: 8015Mod/8020 Lab Number: 9610811-09	Sampled: 10/10/96 Received: 10/11/96 Analyzed: 10/15/96 Reported: 10/25/96
---	---	---

QC Batch Number: GC101596BTEX07A
Instrument ID: GCHP07

Total Purgeable Petroleum Hydrocarbons (TPPH) with BTEX and MTBE

Analyte	Detection Limit ug/L	Sample Results ug/L
TPPH as Gas	50	N.D.
Methyl t-Butyl Ether	2.5	N.D.
Benzene	0.50	N.D.
Toluene	0.50	N.D.
Ethyl Benzene	0.50	N.D.
Xylenes (Total)	0.50	N.D.
Chromatogram Pattern:		
Surrogates	Control Limits %	% Recovery
Trifluorotoluene	70 130	111

Analytes reported as N.D. were not present above the stated limit of detection.

SEQUOIA ANALYTICAL - ELAP #1210

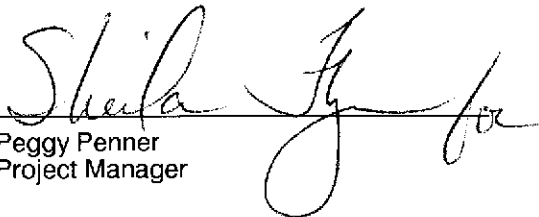
Peggy Penner
Project Manager





Blaine Technical Services
985 Timothy Drive
San Jose, CA 95133
Attention: Jim Keller

Client Proj. ID: Chevron,9-5607,961010-J3
Sample Descript: TB
Matrix: LIQUID
Analysis Method: 8015Mod/8020
Lab Number: 9610811-10

Sampled: 10/10/96
Received: 10/11/96
Analyzed: 10/15/96
Reported: 10/25/96

QC Batch Number: GC101596BTEX07A
Instrument ID: GCHP07

Total Purgeable Petroleum Hydrocarbons (TPPH) with BTEX

Analyte	Detection Limit ug/L	Sample Results ug/L
TPPH as Gas	50	N.D.
Benzene	0.50	N.D.
Toluene	0.50	N.D.
Ethyl Benzene	0.50	N.D.
Xylenes (Total)	0.50	N.D.
Chromatogram Pattern:		
Surrogates	Control Limits %	% Recovery
Trifluorotoluene	70 130	104

Analytes reported as N.D. were not present above the stated limit of detection.

SEQUOIA ANALYTICAL - ELAP #1210

Shirley J. Penner
Peggy Penner
Project Manager





Sequoia
Analytical

680 Chesapeake Drive	Redwood City, CA 94063	(415) 364-9600	FAX (415) 364-9233
404 N. Wiget Lane	Walnut Creek, CA 94598	(510) 988-9600	FAX (510) 988-9673
819 Striker Avenue, Suite 8	Sacramento, CA 95834	(916) 921-9600	FAX (916) 921-0100

Blaine Technical Services	Client Proj. ID: Chevron,9-5607,961010-J3	Received: 10/11/96
985 Timothy Drive		
San Jose, CA 95133	Lab Proj. ID: 9610811	Reported: 10/25/96
Attention: Jim Keller		

LABORATORY NARRATIVE

TPH Note: Sample 9610811-01 was diluted 100-fold.
Sample 9610811-02 was diluted 200-fold.

SEQUOIA ANALYTICAL

Peggy Penner
Project Manager





Blaine Tech Services, Inc. 985 Timothy Drive San Jose, CA 95133 Attention: Jim Keller	Client Project ID: Chevron 9-5607 / 961010-J3 Matrix: Liquid	Work Order #: 9610811 -01-10	Reported: Oct 28, 1996
---	---	-------------------------------------	-------------------------------

QUALITY CONTROL DATA REPORT

Analyte:	Benzene	Toluene	Ethyl Benzene	Xylenes
QC Batch#:	GC101596BTEX07A	GC101596BTEX07A	GC101596BTEX07A	GC101596BTEX07A
Analy. Method:	EPA 8020	EPA 8020	EPA 8020	EPA 8020
Prep. Method:	EPA 5030	EPA 5030	EPA 5030	EPA 5030

Analyst:	H. Porter	H. Porter	H. Porter	H. Porter
MS/MSD #:	961047008	961047008	961047008	961047008
Sample Conc.:	N.D.	N.D.	N.D.	N.D.
Prepared Date:	10/15/96	10/15/96	10/15/96	10/15/96
Analyzed Date:	10/15/96	10/15/96	10/15/96	10/15/96
Instrument I.D.#:	GCHP7	GCHP7	GCHP7	GCHP7
Conc. Spiked:	10 µg/L	10 µg/L	10 µg/L	30 µg/L
Result:	14	13	13	39
MS % Recovery:	140	130	130	130
Dup. Result:	13	12	12	38
MSD % Recov.:	130	120	120	127
RPD:	7.4	8.0	8.0	2.6
RPD Limit:	0-25	0-25	0-25	0-25

LCS #:	BLK101596	BLK101596	BLK101596	BLK101596
Prepared Date:	10/15/96	10/15/96	10/15/96	10/15/96
Analyzed Date:	10/15/96	10/15/96	10/15/96	10/15/96
Instrument I.D.#:	GCHP7	GCHP7	GCHP7	GCHP7
Conc. Spiked:	10 µg/L	10 µg/L	10 µg/L	30 µg/L
LCS Result:	12	11	11	34
LCS % Recov.:	120	110	110	113

MS/MSD	60-140	60-140	60-140	60-140
LCS	70-130	70-130	70-130	70-130
Control Limits				

SEQUOIA ANALYTICAL

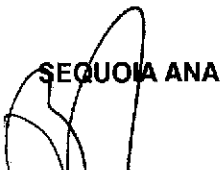

Peggy Renner
Project Manager

Please Note:
The LCS is a control sample of known, interferent-free matrix that is analyzed using the same reagents, preparation, and analytical methods employed for the samples. The matrix spike is an aliquot of sample fortified with known quantities of specific compounds and subjected to the entire analytical procedure. If the recovery of analytes from the matrix spike does not fall within specified control limits due to matrix interference, the LCS recovery is to be used to validate the batch.

** MS=Matrix Spike, MSD=MS Duplicate, RPD=Relative % Difference

9610811.BLA <1>



**Field
Data
Sheets**

WELL GAUGING DATA

Project # 961010-3 Date 10/10/90 Client Ched

Site 5269 Crow Canyon Rd., Castro Valley

Well I.D.	Well Size (in.)	Sheen/Odor	Depth to Immiscible Liquid (feet)	Thickness of Immiscible Liquid (ft.)	Volume of Immiscibles Removed (ml)	Depth to Water (feet)	Depth to Well Bottom (feet)	Survey Point: TOB or TOC
C-1	4					22.00	43.12	TOC
C-2	4					18.91	44.66	
C-3	4					25.23	31.95	
C-5	4					26.78	32.04	
C-6		Paved over						
C-7	2					11.35	26.79	
C-8	2					8.69	25.12	
C-10A	3					19.44	22.80	
C-10B	3					19.71	34.36	
C-11	3					19.56	33.76	
C-12	3					13.71	29.65	
C-13	3					10.69	28.32	
C-14	3					9.30	27.88	
C-15	3					11.18	19.52	
C-16	3					12.44	30.60	✓

CHEVRON WELL MONITORING DATA SHEET

Project #: <u>961010-53</u>	Station #: <u>9-5607</u>
Sampler: <u>MS</u>	Start Date: <u>10/10/98</u>
Well I.D.: <u>C-1</u>	Well Diameter: (circle one) 2 3 <u>4</u> 6
Total Well Depth: Before <u>43.12</u> After _____	Depth to Water: Before <u>2200</u> After _____
Depth to Free Product: _____	Thickness of Free Product (feet): _____
Measurements referenced to: <u>PVC</u> Grade Other: _____	

Well Diameter	VCF	Well Diameter	VCF
1"	0.04	6"	1.47
2"	0.16	8"	2.61
3"	0.37	10"	4.08
4"	0.65	12"	5.87
5"	1.02	16"	10.43

<u>13.7</u>	x	<u>3</u>	=	<u>41.2</u>
1 Case Volume		Specified Volumes		gallons

Purging: Bailer Disposable Bailer Middleburg Electric Submersible <input checked="" type="checkbox"/> Extraction Pump Other: _____	Sampling: Bailer Disposable Bailer <input checked="" type="checkbox"/> Extraction Port Other: _____
---	--

TIME	TEMP. (F)	pH	COND.	TURBIDITY:	VOLUME REMOVED:	OBSERVATIONS:
1523	69.4	6.8	1400	—	14	000
1525	67.6	6.6	1300	—	28	Grey/Cloudy
1527	68.0	6.5	1200	—	42	

Did Well Dewater? N If yes, gals. Gallons Actually Evacuated: 42

Sampling Time: <u>1535</u>	Sampling Date: <u>10/10</u>
Sample I.D.: <u>C-1</u>	Laboratory: <u>SEQ</u>
Analyzed for: <u>TPH-G BTEX</u> (Circle)	TPH-D OTHER: <u>MTBC</u>
Duplicate I.D.: _____	Cleaning Blank I.D.: _____
Analyzed for: <u>TPH-G BTEX</u> (Circle)	TPH-D OTHER: _____

CHEVRON WELL MONITORING DATA SHEET

Project #: <u>961010-53</u>	Station #: <u>9-5607</u>
Sampler: <u>MS</u>	Start Date: <u>10/10/96</u>
Well I.D.: <u>C-3</u>	Well Diameter: (circle one) <u>2</u> <u>3</u> <u>4</u> <u>6</u>
Total Well Depth: Before <u>31.95</u> After	Depth to Water: Before <u>25.23</u> After
Depth to Free Product:	Thickness of Free Product (feet):
Measurements referenced to: <u>VFC</u> Grade Other:	

Well Diameter	VCF	Well Diameter	VCF
1"	0.04	6"	1.47
2"	0.16	8"	2.61
3"	0.37	10"	4.08
4"	0.65	12"	5.87
5"	1.02	16"	10.43

<u>4.4</u>	<u>x</u>	<u>3</u>	<u>=</u>	<u>13.1</u>	gallons
1 Case Volume		Specified Volumes			

Purging: Bailer Disposable Bailer Middleburg Electric Submersible <input checked="" type="checkbox"/> Extraction Pump Other _____	Sampling: Bailer Disposable Bailer <input checked="" type="checkbox"/> Extraction Port Other _____
--	---

TIME	TEMP. (F)	pH	COND.	TURBIDITY:	VOLUME REMOVED:	OBSERVATIONS:
1547	68.8	6.6	1200	—	5	
1549	68.4	6.6	1200	—	9	
1551	68.4	6.6	1200	—	14	

Did Well Dewater?	If yes, gals.	Gallons Actually Evacuated: <u>14</u>
Sampling Time: <u>1555</u>	Sampling Date: <u>10/10/96</u>	
Sample I.D.: <u>C-3</u>	Laboratory: <u>SEK</u>	
Analyzed for: <u>TPH-G BTEX</u> (Circle) TPH-D OTHER: <u>MTBE</u>		
Duplicate I.D.:	Cleaning Blank I.D.:	
Analyzed for: TPH-G BTEX TPH-D OTHER: (Circle)		

CHEVRON WELL MONITORING DATA SHEET

Project #: <u>961010-53</u>		Station #: <u>9-5607</u>	
Sampler: <u>MS</u>		Start Date: <u>10/10/46</u>	
Well I.D.: <u>C-6</u>		Well Diameter: (circle one) 2 3 4 6 <u> </u>	
Total Well Depth:		Depth to Water:	
Before	After	Before	After
Depth to Free Product:		Thickness of Free Product (feet):	
Measurements referenced to:		PVC	Grade Other:

Well Diameter	VCF	Well Diameter	VCF
1"	0.04	6"	1.47
2"	0.16	8"	2.61
3"	0.37	10"	4.08
4"	0.65	12"	5.87
5"	1.02	16"	10.43

_____ X _____	=	_____ gallons
1 Case Volume	Specified Volumes	

Purging: Bailer Disposable Bailer Middleburg Electric Submersible Extraction Pump Other _____	Sampling: Bailer Disposable Bailer Extraction Port Other _____
--	---

TIME	TEMP. (F)	pH	COND.	TURBIDITY:	VOLUME REMOVED:	OBSERVATIONS:
						Unable to locate Paved over?

Did Well Dewater?	If yes, gals.	Gallons Actually Evacuated:
Sampling Time:	Sampling Date:	
Sample I.D.:	Laboratory:	
Analyzed for: (Circle) TPH-G BTEX TPH-D OTHER:		
Duplicate I.D.:	Cleaning Blank I.D.:	
Analyzed for: (Circle) TPH-G BTEX TPH-D OTHER:		

CHEVRON WELL MONITORING DATA SHEET

Project #: <u>961010-53</u>	Station #: <u>9-5607</u>
Sampler: <u>MS</u>	Start Date: <u>10/10/96</u>
Well I.D.: <u>C-8</u>	Well Diameter: (circle one) <u>(2)</u> 3 4 6
Total Well Depth: Before <u>25.12</u> After	Depth to Water: Before <u>8.69</u> After
Depth to Free Product:	Thickness of Free Product (feet):
Measurements referenced to:	PVC Grade Other:

Well Diameter	VCF	Well Diameter	VCF
1"	0.04	6"	1.47
2"	0.16	8"	2.61
3"	0.37	10"	4.08
4"	0.65	12"	5.87
5"	1.02	16"	10.43

<u>2.6</u>	x	<u>3</u>	=	<u>7.9</u>
1 Case Volume		Specified Volumes		gallons

Purging: Bailer Disposable Bailer <input checked="" type="checkbox"/> Middleburg Electric Submersible Extraction Pump Other _____	Sampling: Bailer Disposable Bailer <input checked="" type="checkbox"/> Extraction Port Other _____
--	---

TIME	TEMP. (F)	pH	COND.	TURBIDITY:	VOLUME REMOVED:	OBSERVATIONS:
1437	71.6	6.8	880	—	3	
1441	70.2	6.9	860	—	5.5	
1445	70.0	6.9	890	—	8	

Did Well Dewater? If yes, gals. Gallons Actually Evacuated: 8

Sampling Time: <u>1450</u>	Sampling Date: <u>10/10</u>
Sample I.D.: <u>C-8</u>	Laboratory: <u>SEO</u>
Analyzed for: <u>TPH-G BTEX</u> (Circle) TPH-D OTHER: <u>MTBE</u>	
Duplicate I.D.:	Cleaning Blank I.D.:
Analyzed for: TPH-G BTEX TPH-D OTHER: (Circle)	

CHEVRON WELL MONITORING DATA SHEET

Project #: <u>961010-53</u>	Station #: <u>9-5607</u>
Sampler: <u>MS</u>	Start Date: <u>10/10/94</u>
Well I.D.: <u>C-10A</u>	Well Diameter: (circle one) 2 <u>3</u> 4 6
Total Well Depth: Before <u>22.80</u> After	Depth to Water: Before <u>19.44</u> After
Depth to Free Product:	Thickness of Free Product (feet):
Measurements referenced to: <u>VFC</u>	Grade Other:

Well Diameter	VCF	Well Diameter	VCF
1"	0.04	6"	1.47
2"	0.16	8"	2.61
3"	0.37	10"	4.08
4"	0.65	12"	5.87
5"	1.02	16"	10.43

$$\underline{1.2} \times \underline{3} = \underline{3.7}$$

1 Case Volume Specified Volumes = gallons

Purging: Bailer Disposable Bailer <input checked="" type="checkbox"/> Middleburg Electric Submersible Extraction Pump Other _____	Sampling: Bailer Disposable Bailer <input checked="" type="checkbox"/> Extraction Port Other _____
--	---

TIME	TEMP. (F)	pH	COND.	TURBIDITY:	VOLUME REMOVED:	OBSERVATIONS:
<u>1328</u>	<u>68.0</u>	<u>7.3</u>	<u>1000</u>	<u>—</u>	<u>1.5</u>	
<u>1331</u>	<u>67.2</u>	<u>7.1</u>	<u>1000</u>	<u>—</u>	<u>2.5</u>	
<u>1335</u>	<u>67.0</u>	<u>7.1</u>	<u>1000</u>	<u>—</u>	<u>4</u>	

Did Well Dewater? If yes, gals. Gallons Actually Evacuated: 2

Sampling Time: 1340 Sampling Date: 10/10

Sample I.D.: C-10A Laboratory: SEQ

Analyzed for: TPH-G BTEX TPH-D OTHER: MTBE
 (Circle)

Duplicate I.D.: Cleaning Blank I.D.:

Analyzed for: TPH-G BTEX TPH-D OTHER:
 (Circle)

CHEVRON WELL MONITORING DATA SHEET

Project #: <u>96/10-53</u>	Station #: <u>9-5607</u>
Sampler: <u>MS</u>	Start Date: <u>10/10/96</u>
Well I.D.: <u>C-10B</u>	Well Diameter: (circle one) 2 <u>(3)</u> 4 6
Total Well Depth: Before <u>34.36</u> After	Depth to Water: Before <u>19.71</u> After
Depth to Free Product:	Thickness of Free Product (feet):
Measurements referenced to:	PVC Grade Other:

Well Diameter	VCF	Well Diameter	VCF
1"	0.04	6"	1.47
2"	0.16	8"	2.61
3"	0.37	10"	4.08
4"	0.65	12"	5.87
5"	1.02	16"	10.43

<u>5.4</u>	x	<u>3</u>	=	<u>16.3</u>
1 Case Volume		Specified Volumes		gallons

Purging: Bailer Disposable Bailer Middleburg Electric Submersible <input checked="" type="checkbox"/> Extraction Pump Other _____	Sampling: Bailer Disposable Bailer <input checked="" type="checkbox"/> Extraction Port Other _____
--	---

TIME	TEMP. (F)	pH	COND.	TURBIDITY:	VOLUME REMOVED:	OBSERVATIONS:
1353	67.0	7.0	960	—	6	
1355	66.8	7.1	950	—	11	
1357	66.8	7.1	950	—	17	

Did Well Dewater? If yes, gals. Gallons Actually Evacuated: 17

Sampling Time: 1400 Sampling Date: 10/10

Sample I.D.: C-10B Laboratory: SEQ

Analyzed for: TPH-G BTEX TPH-D OTHER: MTBC
(Circle)

Duplicate I.D.: Cleaning Blank I.D.:

Analyzed for: TPH-G BTEX TPH-D OTHER:
(Circle)

CHEVRON WELL MONITORING DATA SHEET

Project #: <u>961010-53</u>	Station #: <u>9-5607</u>
Sampler: <u>MS</u>	Start Date: <u>10/10/96</u>
Well I.D.: <u>C-11</u>	Well Diameter: (circle one) 2 <u>(3)</u> 4 6
Total Well Depth: Before <u>33.76</u> After	Depth to Water: Before <u>19.56</u> After
Depth to Free Product:	Thickness of Free Product (feet):
Measurements referenced to: <u>(PVC)</u>	Grade Other:

Well Diameter	VCF	Well Diameter	VCF
1"	0.04	6"	1.47
2"	0.16	8"	2.61
3"	0.37	10"	4.08
4"	0.65	12"	5.87
5"	1.02	16"	10.43

<u>5.3</u>	x	<u>3</u>	=	<u>15.8</u>
1 Case Volume		Specified Volumes		gallons

Purging: Bailer Disposable Bailer Middleburg Electric Submersible <input checked="" type="checkbox"/> Extraction Pump Other _____	Sampling: Bailer Disposable Bailer <input checked="" type="checkbox"/> Extraction Port Other _____
--	---

TIME	TEMP. (F)	pH	COND.	TURBIDITY:	VOLUME REMOVED:	OBSERVATIONS:
<u>1414</u>	<u>68.2</u>	<u>6.9</u>	<u>1100</u>	<u>—</u>	<u>6</u>	
<u>1416</u>	<u>66.8</u>	<u>6.8</u>	<u>1200</u>	<u>—</u>	<u>11</u>	
<u>1417</u>	<u>66.8</u>	<u>6.8</u>	<u>1200</u>	<u>—</u>	<u>10</u>	

Did Well Dewater? N If yes, gals. Gallons Actually Evacuated: 16

Sampling Time: 1420 Sampling Date: 10/10

Sample I.D.: C-11 Laboratory: SEA

Analyzed for: (TPH-G BTEX) TPH-D OTHER: MTBE

Duplicate I.D.: Cleaning Blank I.D.:

Analyzed for: TPH-G BTEX TPH-D OTHER:

CHEVRON WELL MONITORING DATA SHEET

Project #: <u>961010-33</u>	Station #: <u>9-5607</u>
Sampler: <u>MS</u>	Start Date: <u>10/10/96</u>
Well I.D.: <u>C-12</u>	Well Diameter: (circle one) 2 <u>3</u> 4 6
Total Well Depth: Before <u>296</u> After	Depth to Water: Before <u>13.75</u> After
Depth to Free Product:	Thickness of Free Product (feet):
Measurements referenced to: <u>PVC</u>	Grade Other:

Well Diameter	VCF	Well Diameter	VCF
1"	0.04	6"	1.47
2"	0.16	8"	2.61
3"	0.37	10"	4.08
4"	0.65	12"	5.87
5"	1.02	16"	10.43

<u>5.9</u>	x	<u>3</u>	=	<u>17.6</u>
1 Case Volume		Specified Volumes		gallons

Purging: Bailer
 Disposable Bailer
 Middleburg
 Electric Submersible
 Extraction Pump
 Other _____

Sampling: Bailer
 Disposable Bailer
 Extraction Port
 Other _____

TIME	TEMP. (F)	pH	COND.	TURBIDITY:	VOLUME REMOVED:	OBSERVATIONS:
<u>1503</u>	<u>67.4</u>	<u>7.1</u>	<u>970</u>	—	<u>276</u>	<u>odd</u>
<u>1504</u>	<u>66.4</u>	<u>7.1</u>	<u>1000</u>	—	<u>12</u>	
<u>1506</u>	<u>66.2</u>	<u>7.1</u>	<u>1000</u>	—	<u>18</u>	

Did Well Dewater? If yes, gals. Gallons Actually Evacuated: 18

Sampling Time: <u>1510</u>	Sampling Date: <u>10/10</u>
Sample I.D.: <u>C-12</u>	Laboratory: <u>SEA</u>
Analyzed for: <u>TPH-G</u> BTEX TPH-D OTHER: <u>MTBE</u> (Circle)	
Duplicate I.D.:	Cleaning Blank I.D.:
Analyzed for: TPH-G BTEX TPH-D OTHER: (Circle)	

CHEVRON WELL MONITORING DATA SHEET

Project #: <u>96/010-33</u>	Station #: <u>9-5607</u>
Sampler: <u>MS</u>	Date: <u>10/10/00</u>
Well I.D.: <u>C-15</u>	Well Diameter: 2 <u>(3)</u> 4 6 8
Total Well Depth: <u>1952</u>	Depth to Water: <u>11.18</u>
Depth to Free Product:	Thickness of Free Product (feet):
Referenced to: <u>PVC</u> Grade	D.O. Meter (if req'd): YSI HACH

Well Diameter	Multiplier	Well Diameter	Multiplier
2"	0.15	3"	1.02
3"	0.37	4"	1.47
4"	0.65	Other	radius ² * 0.163

Purge Method: Bailer Sampling Method: Bailer

Disposable Bailer Disposable Bailer

Middleburg Extraction Port

Electric Submersible Other: _____

Extraction Pump

Other: _____

<u>3.1</u>	x	<u>3</u>	=	<u>9.3</u>	Gals.
1 Case Volume (Gals.)		Specified Volumes		Calculated Volume	

Time	Temp (°F)	pH	Cond.	Gals. Removed	Observations
1307	69.2	7.5	1000	4	
1309	68.4	7.4	1000	7	
1311	68.2	7.4	1000	10	

Did well dewater? Yes No Gallons actually evacuated: 10

Sampling Time: 1315 Sampling Date: 10/10

Sample I.D.: C-15 Laboratory: Sequoia GTEL

Analyzed for: TPH-G BTEX MTBE TPH-D Other:

D.O. (if req'd):	Pre-purge:	mg/L	Post-purge:	mg/L
O.R.P. (if req'd):	Pre-purge:	mV	Post-purge:	mV

CHEVRON WELL MONITORING DATA SHEET

Project #: <u>96/010-53</u>	Station #: <u>9-5607</u>
Sampler: <u>MS</u>	Date: <u>10/10/96</u>
Well I.D.: <u>C-16</u>	Well Diameter: 2 <u>3</u> 4 6 8 <u> </u>
Total Well Depth: <u>30.60</u>	Depth to Water: <u>12.44</u>
Depth to Free Product:	Thickness of Free Product (feet):
Referenced to: <u>PVC</u> <u>Grade</u>	D.O. Meter (if req'd): <u>YSI</u> <u>HACH</u>

Well Diameter	Multiplier	Well Diameter	Multiplier
2"	0.16	5"	1.02
3"	0.37	6"	1.47
4"	0.65	Other	radius ² * 0.163

Purge Method: <u>Bailer</u>	Sampling Method: <u>Bailer</u> <input checked="" type="checkbox"/>
<u>Disposable Bailer</u>	<u>Disposable Bailer</u>
<u>Middleburg</u>	<u>Extraction Port</u>
<u>Electric Submersible</u> <input checked="" type="checkbox"/>	Other: <u> </u>
<u>Extraction Pump</u>	
Other: <u> </u>	

<u>6.7</u>	x	<u>3</u>	=	<u>20.2</u>	Gals.
1 Case Volume (Gals.)		Specified Volumes		Calculated Volume	

Time	Temp (°F)	pH	Cond.	Gals. Removed	Observations
<u>1247</u>	<u>66.6</u>	<u>7.1</u>	<u>1100</u>	<u>7</u>	
<u>1248</u>	<u>66.2</u>	<u>7.0</u>	<u>1000</u>	<u>14</u>	
<u>1250</u>	<u>66.0</u>	<u>7.0</u>	<u>1000</u>	<u>21</u>	

Did well dewater? <u>Yes</u> <input checked="" type="checkbox"/> <u>No</u> <input type="checkbox"/>	Gallons actually evacuated: <u>21</u>	
Sampling Time: <u>1250</u> <u>1255</u>	Sampling Date: <u>10/10</u>	
Sample I.D.: <u>C-16</u>	Laboratory: <u>Sequoia</u> <u>GTEL</u>	
Analyzed for: <u>TPH-G</u> <u>BTEX</u> <u>MTBE</u> <u>TPH-D</u> Other:		
D.O. (if req'd):	Pre-purge: <u> </u> <u>mg/L</u>	Post-purge: <u> </u> <u>mg/L</u>
O.R.P. (if req'd):	Pre-purge: <u> </u> <u>mV</u>	Post-purge: <u> </u> <u>mV</u>