



Chevron U.S.A. Products Company

2410 Camino Ramon, San Ramon, California • Phone (510) 842-9500
Mail Address: P.O. Box 5004, San Ramon, CA 94583-0804

April 2, 1993

Mr. Scott Seery
Alameda County Environmental Health
80 Swan Way, Room 200
Oakland, CA 94621

Re: Former Chevron Station # 9-5607, 5269 Crow Canyon Road, Castro Valley, CA
Attached groundwater monitoring report (GTI, 2/12/93)

Dear Mr. Seery:

Attached is a report dated February 12, 1993, which was prepared by Chevron's consultant, Groundwater Technology Inc. (GTI), to describe quarterly groundwater monitoring performed at the subject site on January 18, 1993.

With the increased precipitation during the past winter, water levels have risen and the concentrations of dissolved hydrocarbons in several of the wells have increased.

The groundwater extraction and treatment system continues to operate to control the migration of and to remove dissolved hydrocarbons from the shallow groundwater. Chevron is still awaiting approval of its proposal to expand the groundwater extraction system as presented in the August 31, 1992 report sent to your office.

If you have any questions or comments, I can be reached at (510) 842-8658.

Sincerely,

Clint B. Rogers
Environmental Engineer

Attachment

cc: Rich Hiatt, San Francisco Bay RWQCB, Oakland, CA
Kevin Hinckley, 5269 Crow Canyon Road, Castro Valley, CA 94546
Paul Hehn, Geraghty and Miller, Richmond, CA



GROUNDWATER TECHNOLOGY, INC.

1401 Halyard Drive, Suite 140, West Sacramento, CA 95691, (916) 372-4700

FAX (916) 372-8781

February 12, 1993

Project No. 02020 2887

Mr. Clint B. Rogers
Chevron U.S.A. Products Company
2410 Camino Ramon
San Ramon, CA 94583-0804

**RE: QUARTERLY MONITORING AND SAMPLING ACTIVITIES
FORMER CHEVRON SERVICE STATION 9-5607
5269 CROW CANYON ROAD
CASTRO VALLEY, CALIFORNIA**

Dear Mr. Rogers:

Groundwater Technology, Inc. submits this letter as a summary of quarterly groundwater monitoring and sampling data collected at the above-referenced site on January 18, 1993. Fourteen site-related groundwater monitoring wells were gauged to determine depth to groundwater (DTW) and to check for the presence of separate-phase petroleum hydrocarbons (SP). A potentiometric surface map (Figure 1) and a summary of groundwater monitoring data (Table 1) are included. After measuring DTW, the wells were purged and sampled. The groundwater samples were analyzed for dissolved benzene, toluene, ethylbenzene and xylenes (BTEX), and total petroleum hydrocarbons-as-gasoline (TPH-G). Results of the chemical analyses are summarized in Table 1. Laboratory reports and chain-of-custody manifests are included in Attachment I. All purge water generated during the sampling process was processed through the on-site groundwater treatment system.

Groundwater Technology, Inc. is pleased to assist Chevron on this project. If you have any questions or comments please call our West Sacramento office.

Sincerely,
Groundwater Technology, Inc.
Written/Submitted by

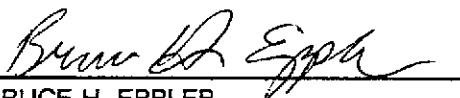

BRUCE H. EPPLER
Environmental Geologist
Project Manager

Groundwater Technology, Inc.
Reviewed/Approved by

E. K. SIMONIS, R.G.
Senior Environmental Geologist

DSB/BHE/EKS:rb

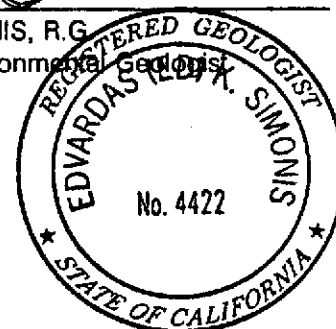
Attachments
2887QTR1.LTR



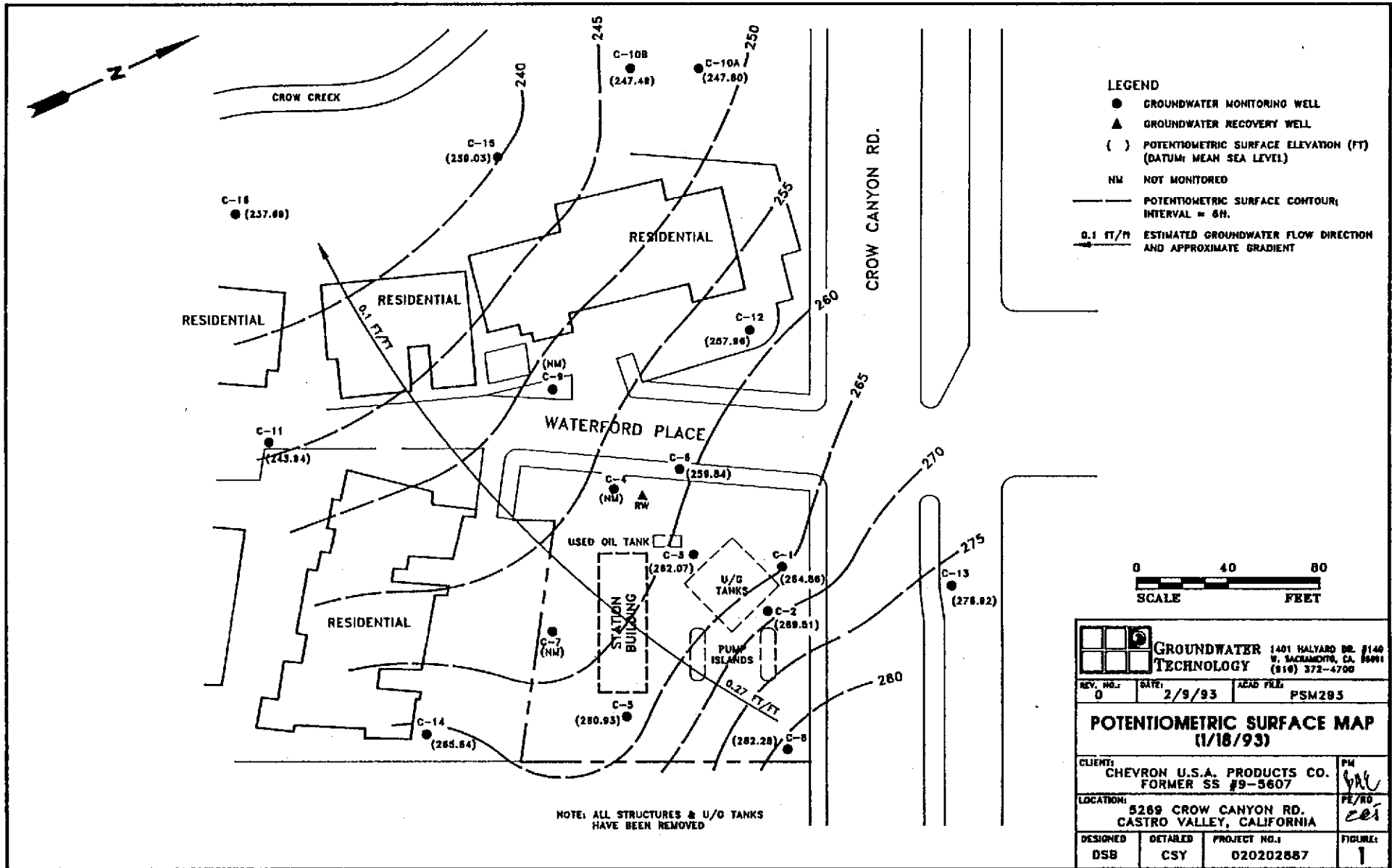

Table 1
HISTORICAL GROUNDWATER ANALYTICAL RESULTS AND MONITORING DATA
 FORMER CHEVRON SERVICE STATION NO. 9-5607
 5269 CROW CANYON ROAD, CASTRO VALLEY, CALIFORNIA

WELL ID/ ELEVATION (TOC)	DATE	BENZENE (ppb)	TOLUENE (ppb)	ETHYL- BENZENE (ppb)	XYLENES (ppb)	TPH-G (ppb)	ORGANIC LEAD (ppb)	DTW (feet)	SPT (feet)	WTE (feet)
C-1 283.46	03/26/85	--	--	--	--	--	--	22.83	0.00	260.63
	07/03/86	--	--	--	--	--	--	23.58	0.00	259.88
	03/26/87	--	--	--	--	--	--	20.50	0.00	262.96
	03/28/88	--	--	--	--	--	--	26.00	0.00	257.46
	03/10/89	--	--	--	--	--	--	15.86	0.00	267.60
	04/03/89	--	--	--	--	--	--	16.85	0.00	266.61
	05/08/89	--	--	--	--	--	--	22.68	0.00	260.78
	06/05/89	--	--	--	--	--	--	24.66	0.00	258.80
	07/12/90	--	--	--	--	--	--	25.56	0.00	257.90
	08/10/90	--	--	--	--	--	--	25.89	0.00	257.57
	09/13/89	3,600	1,100	1,000	3,500	22,000	--	26.55	0.00	256.91
	10/04/89	--	--	--	--	--	--	25.24	0.00	258.22
	11/03/89	--	--	--	--	--	--	25.03	0.00	258.43
	12/04/89	2,000	550	610	1,600	13,000	--	26.37	0.00	257.09
	03/07/90	--	--	--	--	--	--	22.48	0.00	260.98
	03/09/90	--	--	--	--	--	--	--	--	--
	06/12/90	3,500	1,400	840	4,000	21,000	--	24.35	0.00	259.11
	09/20/90	2,100	1,200	860	5,000	23,000	--	26.27	0.00	257.19
	12/20/90	760	410	260	1,100	8,200	--	22.59	0.00	260.87
	03/27/91	--	--	--	--	--	--	19.08	0.00	264.38
06/18/91	--	--	--	--	--	--	27.11	0.00	256.35	
09/12/91	--	--	--	--	--	--	28.22	0.00	255.24	
01/23/92	--	--	--	--	--	--	26.65	0.00	256.81	
04/13/92	3,100	1,300	850	3,100	38,000	--	22.16	0.00	261.30	
08/03/92	1,300	470	550	1,600	13,000	ND	26.15	0.00	257.31	
10/22/92	3,500	1,400	1,500	4,300	24,000	--	26.79	0.00	256.67	
01/18/93	6,900	8,900	3,100	23,000	370,000	--	18.60	0.00	264.86	
C-2 284.37	03/26/85	--	--	--	--	--	--	--	--	--
	07/03/86	--	--	--	--	--	--	19.69	0.00	264.68
	03/26/87	--	--	--	--	--	--	15.45	0.00	268.92
	03/28/88	--	--	--	--	--	--	20.92	0.00	263.45
	03/10/89	--	--	--	--	--	--	12.80	0.00	271.57
	04/03/89	--	--	--	--	--	--	14.26	0.00	270.11
	05/08/89	--	--	--	--	--	--	18.42	0.00	265.95
	06/05/89	--	--	--	--	--	--	20.09	0.00	264.28
	07/12/90	--	--	--	--	--	--	20.79	0.00	263.58
	08/10/90	--	--	--	--	--	--	21.40	0.00	262.97
	09/13/89	62	4	10	14	320	--	21.86	0.00	262.51
	10/04/89	--	--	--	--	--	--	19.89	0.00	264.48
	11/03/89	--	--	--	--	--	--	20.76	0.00	263.61
	12/04/89	240	37	66	130	1,000	--	20.82	0.00	263.55
	03/07/90	--	--	--	--	--	--	17.83	0.00	266.54
	03/09/90	280	35	27	50	390	--	17.83	0.00	266.54
	06/12/90	260	34	28	55	700	--	19.89	0.00	264.48
	09/20/90	--	--	--	--	--	--	21.97	0.00	262.40
	12/20/90	--	--	--	--	--	--	17.73	0.00	266.64
	03/27/91	--	--	--	--	--	--	15.10	0.00	269.27
06/18/91	--	--	--	--	--	--	22.68	0.00	261.69	
09/12/91	--	--	--	--	--	--	23.92	0.00	260.45	
01/23/92	--	--	--	--	--	--	21.24	0.00	263.13	
04/13/92	120	76	17	72	1,100	--	17.54	0.00	266.83	
08/03/92	--	--	--	--	--	--	22.05	0.00	262.32	
10/22/92	--	--	--	--	--	--	23.03	0.00	261.34	
01/18/93	6.4	ND	ND	ND	ND	70	--	14.86	0.00	269.51

Table 1 (Continued)
HISTORICAL GROUNDWATER ANALYTICAL RESULTS AND MONITORING DATA

FORMER CHEVRON SERVICE STATION NO. 9-5607
 5269 CROW CANYON ROAD, CASTRO VALLEY, CALIFORNIA

WELL ID/ ELEVATION (TOC)	DATE	BENZENE (ppb)	TOLUENE (ppb)	ETHYL- BENZENE (ppb)	XYLENES (ppb)	TPH-G (ppb)	ORGANIC LEAD (ppb)	DTW (feet)	SPT (feet)	WTE (feet)
C-3 285.98	03/26/85	--	--	--	--	--	--	--	--	--
	07/03/86	--	--	--	--	--	--	26.04	0.00	259.94
	03/26/87	--	--	--	--	--	--	25.64	0.00	260.34
	03/28/88	--	--	--	--	--	--	28.82	0.00	257.16
	03/10/89	--	--	--	--	--	--	22.78	0.00	263.20
	04/03/89	--	--	--	--	--	--	22.71	0.00	263.27
	05/08/89	--	--	--	--	--	--	25.95	0.00	260.03
	06/05/89	--	--	--	--	--	--	27.62	0.00	258.36
	07/12/90	--	--	--	--	--	--	28.29	0.00	257.69
	08/10/90	--	--	--	--	--	--	28.46	0.00	257.52
	09/13/89	1,400	6,800	2,300	10,000	60,000	--	29.33	0.00	256.65
	10/04/89	--	--	--	--	--	--	28.97	0.00	257.01
	11/03/89	--	--	--	--	--	--	28.72	0.00	257.26
	12/04/89	1,300	3,300	1,400	2,700	56,000	--	29.01	0.00	256.97
	03/07/90	--	--	--	--	--	--	27.69	0.00	258.29
	03/09/90	1,100	5,700	1,600	7,900	42,000	--	27.69	0.00	258.29
	06/12/90	1,400	7,100	3,400	16,000	160,000	--	28.09	0.00	257.89
	09/24/90	850	7,700	2,000	10,000	53,000	--	29.18	0.00	256.80
	12/20/90	1,200	5,400	5,400	33,000	520	--	28.27	0.00	257.71
	03/27/91	1,300	3,100	1,200	11,000	92,000	--	24.80	0.00	261.18
	06/18/91	--	--	--	--	--	--	30.84	0.00	255.14
	09/12/91##	--	--	--	--	--	--	31.64	0.03	254.34
	01/23/92	--	--	--	--	--	--	30.52	SHEEN	255.46
04/13/92##	--	--	--	--	--	--	26.94	0.01	259.04	
08/03/92	1,300	2,800	3,100	17,000	220,000	ND	30.00	0.00	255.98	
10/22/92##	SP	SP	SP	SP	SP	--	30.62	0.03	255.38	
01/18/93	2,400	5,300	10,000	61,000	1,000,000	--	23.91	0.00	262.07	
C-4 273.01	03/26/85	--	--	--	--	--	--	15.14	0.00	257.87
	07/03/86	--	--	--	--	--	--	15.37	0.00	257.64
	03/26/87	--	--	--	--	--	--	--	--	--
	03/28/88	--	--	--	--	--	--	18.04	0.00	254.97
	03/10/89	--	--	--	--	--	--	--	--	--
	04/03/89	--	--	--	--	--	--	13.34	0.00	259.67
	05/08/89	--	--	--	--	--	--	15.60	0.00	257.41
	06/05/89	--	--	--	--	--	--	16.51	0.00	256.50
	07/12/90	--	--	--	--	--	--	16.99	0.00	256.02
	08/10/90	--	--	--	--	--	--	17.27	0.00	255.74
	09/13/89	21,000	3,100	3,200	11,000	57,000	--	18.16	0.00	254.85
	10/04/89	--	--	--	--	--	--	18.24	0.00	254.77
	11/03/89	--	--	--	--	--	--	18.17	0.00	254.84
	12/04/89	17,000	2,200	2,800	9,800	46,000	--	18.45	0.00	254.56
	03/07/90	--	--	--	--	--	--	17.20	0.00	255.81
	03/09/90	20,000	2,300	2,800	11,000	43,000	--	17.20	0.00	255.81
	06/12/90	21,000	2,400	4,000	16,000	82,000	--	16.66	0.00	256.35
	09/24/90	--	--	--	--	--	--	18.11	0.00	254.90
	12/20/90**	--	--	--	--	--	--	--	--	--
	03/27/91**	--	--	--	--	--	--	--	--	--
	06/18/91**	--	--	--	--	--	--	--	--	--
	09/12/91**	--	--	--	--	--	--	--	--	--
	01/23/92**	--	--	--	--	--	--	--	--	--
04/13/92**	--	--	--	--	--	--	--	--	--	
08/03/92**	--	--	--	--	--	--	--	--	--	
10/22/92**	--	--	--	--	--	--	--	--	--	
01/18/93**	--	--	--	--	--	--	--	--	--	

Table 1 (continued)
HISTORICAL GROUNDWATER ANALYTICAL RESULTS AND MONITORING DATA

FORMER CHEVRON SERVICE STATION NO. 9-5607
 5269 CROW CANYON ROAD, CASTRO VALLEY, CALIFORNIA

WELL ID/ ELEVATION (TOC)	DATE	BENZENE (ppb)	TOLUENE (ppb)	ETHYL- BENZENE (ppb)	XYLENES (ppb)	TPH-G (ppb)	ORGANIC LEAD (ppb)	DTW (feet)	SPT (feet)	WTE (feet)
C-5 287.95	03/26/85	---	---	---	---	---	---	25.33	0.00	262.62
	07/03/86	---	---	---	---	---	---	26.41	0.00	261.54
	03/26/87	---	---	---	---	---	---	24.96	0.00	262.99
	03/28/88	---	---	---	---	---	---	29.80	0.00	258.15
	03/10/89	---	---	---	---	---	---	25.89	0.00	262.06
	04/03/89	---	---	---	---	---	---	24.38	0.00	263.57
	05/08/89	---	---	---	---	---	---	27.80	0.00	260.15
	06/05/89	---	---	---	---	---	---	29.42	0.00	258.53
	07/12/90	---	---	---	---	---	---	29.86	0.00	258.09
	08/10/90	---	---	---	---	---	---	29.77	0.00	258.18
	09/13/89	ND	ND	ND	ND	310	---	30.95	0.00	257.00
	10/04/89	---	---	---	---	---	---	31.48	0.00	256.47
	11/03/89	---	---	---	---	---	---	31.32	0.00	256.63
	12/04/89	ND	ND	ND	ND	ND	---	31.70	0.00	256.25
	03/07/90	---	---	---	---	---	---	30.28	0.00	257.67
	03/09/90	ND	ND	ND	ND	ND	---	30.28	0.00	257.67
	06/12/90	ND	ND	ND	ND	90	---	30.48	0.00	257.47
	09/24/90	ND	ND	ND	ND	ND	---	31.78	0.00	256.17
	12/20/90	ND	ND	1.0	0.7	170	---	33.29	0.00	254.66
	03/27/91	---	---	---	---	---	---	27.98	0.00	259.97
06/18/91	---	---	---	---	---	---	32.52	0.00	255.43	
09/12/91	---	---	---	---	---	---	33.37	0.00	254.58	
01/23/92	---	---	---	---	---	---	32.67	0.00	255.28	
04/13/92	ND	ND	0.7	ND	140	---	28.48	0.00	259.47	
08/03/92	ND	ND	ND	ND	ND	ND	32.50	0.00	255.45	
10/22/92	---	---	---	---	---	---	33.98	0.00	253.97	
01/18/93	6.6	2.2	3.4	2.2	230	---	27.02	0.00	260.93	
C-6 275.28	03/26/85	---	---	---	---	---	---	16.74	---	---
	07/03/86	---	---	---	---	---	---	17.46	0.00	257.82
	03/26/87	---	---	---	---	---	---	18.37	0.00	256.91
	03/28/88	---	---	---	---	---	---	29.64	0.00	245.44
	03/10/89	---	---	---	---	---	---	14.44	0.00	260.84
	04/03/89	---	---	---	---	---	---	14.44	0.00	260.84
	05/08/89	---	---	---	---	---	---	17.16	0.00	258.12
	06/05/89	---	---	---	---	---	---	18.51	0.00	256.77
	07/12/90	---	---	---	---	---	---	18.71	0.00	256.57
	08/10/90	---	---	---	---	---	---	19.32	0.00	255.96
	09/13/89	5,600	3,000	2,400	10,000	47	---	19.95	0.00	255.33
	10/04/89	---	---	---	---	---	---	19.87	0.00	255.41
	11/03/89	---	---	---	---	---	---	19.35	0.00	255.93
	12/04/89	8,100	1,800	1,700	7,500	40,000	---	19.59	0.00	255.69
	03/07/90	---	---	---	---	---	---	18.39	0.00	256.89
	03/09/90	23,000	5,900	3,400	17,000	73,000	---	18.39	0.00	256.89
	06/12/90	19,000	6,500	3,400	16,000	85,000	---	18.87	0.00	256.41
	09/24/90	15,000	3,200	2,600	11,000	72,000	---	19.99	0.00	255.29
	12/20/90	11,000	4,200	3,400	16,000	100,000	---	21.57	0.00	253.71
	03/27/91	11,000	4,400	2,300	11,000	100,000	---	16.32	0.00	258.96
06/18/91	---	---	---	---	---	---	23.33	0.00	251.95	
09/12/91	---	---	---	---	---	---	23.96	0.00	251.32	
01/23/92	---	---	---	---	---	---	12.08	0.00	263.20	
04/13/92	---	---	---	---	---	---	19.85	SHEEN	255.43	
08/03/92	16,000	1,100	2,300	15,000	120,000	ND	14.72	0.00	260.56	
10/22/92	7,400	920	1,800	14,000	63,000	---	14.91	0.00	260.37	
01/18/93	13,000	1,600	2,700	12,000	77,000	---	15.44	0.00	259.84	

Table 1 (continued)
HISTORICAL GROUNDWATER ANALYTICAL RESULTS AND MONITORING DATA
 FORMER CHEVRON SERVICE STATION NO. 9-5607
 5269 CROW CANYON ROAD, CASTRO VALLEY, CALIFORNIA

WELL ID/ ELEVATION (TOC)	DATE	BENZENE (ppb)	TOLUENE (ppb)	ETHYL- BENZENE (ppb)	XYLENES (ppb)	TPH-G (ppb)	ORGANIC LEAD (ppb)	DTW (feet)	SPT (feet)	WTE (feet)
C-7 270.70	03/26/85	--	--	--	--	--	--	9.61	--	--
	07/03/86	--	--	--	--	--	--	10.74	0.00	259.96
	03/26/87	--	--	--	--	--	--	10.08	0.00	260.62
	03/28/88	--	--	--	--	--	--	13.79	0.00	256.91
	03/10/89	--	--	--	--	--	--	10.42	0.00	260.28
	04/03/89	--	--	--	--	--	--	9.14	0.00	261.56
	05/08/89	--	--	--	--	--	--	11.91	0.00	258.79
	06/05/89	--	--	--	--	--	--	11.54	0.00	259.16
	07/12/90	--	--	--	--	--	--	13.45	0.00	257.25
	08/10/90	--	--	--	--	--	--	13.37	0.00	257.33
	09/13/89	1.3	ND	10	ND	410	--	14.60	0.00	256.10
	10/04/89	--	--	--	--	--	--	15.17	0.00	255.53
	11/03/89	--	--	--	--	--	--	15.28	0.00	255.42
	12/04/89	1	ND	5	ND	1,000	--	15.70	0.00	255.00
	03/07/90	--	--	--	--	--	--	14.22	0.00	256.48
	03/09/90	2.8	2.4	3.5	2	590	--	14.22	0.00	256.48
	06/12/90	ND	5	8.2	3.2	1,200	--	14.18	0.00	256.52
	09/24/90	1.4	1.9	1.4	2.2	400	--	15.44	SHEEN	255.26
	09/24/90D	ND	2.4	1.4	1.5	580	--	15.44	SHEEN	255.26
	12/20/90	ND	6.5	4.7	9.3	2,300	--	17.08	0.00	253.62
03/27/91	ND	2.4	9.1	3	980	--	12.65	0.00	258.05	
06/18/91	--	--	--	--	--	--	16.44	0.00	254.26	
09/12/91	ND	3.1	6.5	2.7	1,200***	--	17.05	0.00	253.65	
01/23/92	--	--	--	--	--	--	16.92	0.00	253.78	
04/13/92	ND	1	7.8	1.2	830	--	13.00	0.00	257.70	
08/03/92	--	--	--	--	--	--	--	--	--	
10/22/92**	--	--	--	--	--	--	--	--	--	
01/18/93**	--	--	--	--	--	--	--	--	--	
C-8 288.40	03/26/85	--	--	--	--	--	--	8.68	--	--
	07/03/86	--	--	--	--	--	--	13.89	0.00	274.51
	03/26/87	--	--	--	--	--	--	6.01	0.00	282.39
	03/28/88	--	--	--	--	--	--	10.66	0.00	277.74
	03/10/89	--	--	--	--	--	--	6.61	0.00	281.79
	04/03/89	--	--	--	--	--	--	6.46	0.00	281.94
	05/08/89	--	--	--	--	--	--	8.97	0.00	279.43
	06/05/89	--	--	--	--	--	--	10.88	0.00	277.52
	07/12/90	--	--	--	--	--	--	12.15	0.00	276.25
	08/10/90	--	--	--	--	--	--	12.46	0.00	275.94
	09/13/89	ND	ND	ND	ND	ND	--	12.78	0.00	275.62
	10/04/89	--	--	--	--	--	--	12.51	0.00	275.89
	11/03/89	--	--	--	--	--	--	14.63	0.00	273.77
	12/04/89	0.6	0.6	ND	1	64	--	9.59	0.00	278.81
	03/07/90	--	--	--	--	--	--	8.80	0.00	279.60
	03/09/90	ND	ND	ND	ND	ND	--	8.80	0.00	279.60
	06/12/90	2.5	1.2	1	1.4	120	--	8.94	0.00	279.46
	09/24/90	--	--	--	--	--	--	13.54	0.00	274.86
	12/20/90	--	--	--	--	--	--	9.33	0.00	279.07
	03/27/91	0.7	ND	0.7	1.9	54	--	6.10	0.00	282.30
06/18/91	--	--	--	--	--	--	11.96	0.00	276.44	
09/12/91	ND	ND	ND	ND	ND	--	13.60	0.00	274.80	
09/12/91D	ND	ND	ND	ND	ND	--	13.60	0.00	274.80	
01/23/92	--	--	--	--	--	--	24.20	0.00	264.20	
04/13/92	ND	ND	ND	ND	ND	--	8.35	0.00	280.05	
08/03/92	ND	ND	ND	ND	ND	--	12.58	0.00	275.82	
10/22/92	ND	ND	ND	ND	ND	--	13.10	0.00	275.30	
01/18/93	ND	ND	ND	ND	ND	--	6.12	0.00	282.28	

Table 1 (continued)

HISTORICAL GROUNDWATER ANALYTICAL RESULTS AND MONITORING DATA
FORMER CHEVRON SERVICE STATION NO. 9-5607
5269 CROW CANYON ROAD, CASTRO VALLEY, CALIFORNIA

WELL ID/ ELEVATION (TOC)	DATE	BENZENE (ppb)	TOLUENE (ppb)	ETHYL- BENZENE (ppb)	XYLENES (ppb)	TPH-G (ppb)	ORGANIC LEAD (ppb)	DTW (feet)	SPT (feet)	WTE (feet)
C-9 268.46	07/03/86	--	--	--	--	--	--	13.89	0.00	254.57
	03/26/87	--	--	--	--	--	--	13.74	0.00	254.72
	03/28/88	--	--	--	--	--	--	14.99	0.00	253.47
	03/10/89	--	--	--	--	--	--	13.99	0.00	255.07
	04/03/89	--	--	--	--	--	--	12.84	0.00	255.62
	05/08/89	--	--	--	--	--	--	14.38	0.00	254.08
	06/05/89	--	--	--	--	--	--	15.36	0.00	253.10
	07/12/90	--	--	--	--	--	--	15.65	0.00	252.81
	08/10/90	--	--	--	--	--	--	15.80	0.00	252.66
	09/13/89	14,000	1,100	2,800	4,200	42,000	--	16.53	0.00	251.83
	10/04/89	--	--	--	--	--	--	16.52	0.00	251.94
	11/03/89	--	--	--	--	--	--	16.51	0.00	251.95
	12/04/89	11,000	670	2,500	3,800	36,000	--	16.79	0.00	251.67
	03/07/90	--	--	--	--	--	--	16.22	0.00	252.24
	03/09/90	12,000	940	3,000	4,700	28,000	--	16.22	0.00	252.24
	06/12/90	11,000	1,600	2,300	4,800	39,000	--	14.88	0.00	253.58
	09/24/90	13,000	1,600	3,700	6,800	120,000	--	16.30	0.00	252.16
	12/20/90	9,300	560	2,800	3,300	51,000	--	17.23	0.00	251.23
	12/20/90D	12,000	580	2,800	3,500	44,000	--	17.23	0.00	251.23
	03/27/91	3,400	5,000	1,600	5,600	56,000	--	13.76	0.00	254.66
06/18/91	--	--	--	--	--	--	18.64	0.00	249.82	
09/12/91#	--	--	--	--	--	--	--	--	--	
01/23/92#	--	--	--	--	--	--	--	--	--	
04/13/92#	--	--	--	--	--	--	--	--	--	
08/03/92#	--	--	--	--	--	--	--	--	--	
10/22/92#	--	--	--	--	--	--	--	--	--	
01/18/93#	--	--	--	--	--	--	--	--	--	
C-10A 264.84	03/07/90	--	--	--	--	--	--	20.21	0.00	244.63
	03/09/90	1.6	0.7	0.8	3.5	ND	--	--	--	--
	06/12/90	ND	ND	ND	ND	ND	--	19.70	0.00	245.14
	09/24/90	ND	ND	ND	ND	ND	--	19.54	0.00	245.30
	12/20/90	ND	ND	ND	ND	ND	--	19.84	0.00	245.00
	03/27/91	--	--	--	--	--	--	18.01	0.00	246.83
	06/18/91	ND	ND	ND	ND	ND	--	20.16	0.00	244.68
	09/12/91	ND	ND	ND	ND	ND	--	20.57	0.00	244.27
	01/23/92	ND	ND	ND	ND	ND	--	20.67	0.00	244.17
	04/13/92	0.9	1.3	ND	1	53	--	19.40	0.00	245.44
	08/03/92	ND	ND	ND	ND	ND	ND	19.81	0.00	245.03
	10/22/92	ND	ND	ND	0.5	ND	--	19.83	0.00	245.01
01/18/93	ND	ND	ND	ND	ND	--	17.04	0.00	247.80	
C-10B 264.85	03/07/90	--	--	--	--	--	--	21.44	0.00	243.41
	06/12/90	ND	ND	ND	ND	ND	--	19.94	0.00	244.91
	09/24/90	ND	ND	ND	ND	ND	--	19.77	0.00	245.08
	12/20/90	ND	ND	ND	ND	ND	--	20.00	0.00	244.85
	03/27/91	--	--	--	--	--	--	18.23	0.00	246.62
	06/18/91	--	--	--	--	--	--	20.44	0.00	244.41
	09/12/91	ND	ND	ND	ND	ND	--	20.82	0.00	244.03
	01/23/92	ND	ND	ND	ND	ND	--	20.92	0.00	243.93
	04/13/92	ND	ND	ND	ND	ND	--	19.68	0.00	245.17
	08/03/92	ND	ND	ND	ND	ND	ND	20.07	0.00	244.78
	10/22/92	ND	ND	ND	ND	ND	--	20.12	0.00	244.73
	01/18/93	3.3	11	2.1	8.9	60	--	17.36	0.00	247.49

Table 1 (continued)
HISTORICAL GROUNDWATER ANALYTICAL RESULTS AND MONITORING DATA
 FORMER CHEVRON SERVICE STATION NO. 9-5607
 5269 CROW CANYON ROAD, CASTRO VALLEY, CALIFORNIA

WELL ID/ ELEVATION (TOC)	DATE	BENZENE (ppb)	TOLUENE (ppb)	ETHYL- BENZENE (ppb)	XYLENES (ppb)	TPH-G (ppb)	ORGANIC LEAD (ppb)	DTW (feet)	SPT (feet)	WTE (feet)
C-11 265.30	03/07/90	--	--	--	--	--	--	22.74	0.00	242.56
	03/09/90	1.2	0.7	ND	1.4	ND	--	--	--	--
	06/12/90	ND	ND	ND	ND	ND	--	21.98	0.00	243.32
	09/24/90	ND	ND	ND	ND	ND	--	21.88	0.00	243.42
	12/20/90	ND	ND	ND	ND	ND	--	23.18	0.00	242.12
	03/27/91	ND	ND	ND	1.5	ND	--	21.52	0.00	243.78
	06/18/91	--	--	--	--	--	--	21.90	0.00	243.40
	09/12/91	ND	ND	ND	ND	ND	--	22.70	0.00	242.60
	01/23/92	ND	ND	ND	ND	ND	--	23.46	0.00	241.84
	04/13/92	ND	ND	ND	ND	ND	--	21.57	0.00	243.73
	08/03/92	ND	ND	ND	ND	ND	ND	22.67	0.00	242.63
	10/22/92	ND	ND	ND	ND	ND	--	23.29	0.00	242.01
	01/18/93	ND	1.2	ND	2.2	ND	--	21.36	0.00	243.94
C-12 269.66	03/07/90	--	--	--	--	--	--	14.92	0.00	254.74
	03/09/90	230	140	33	180	1,400	--	--	--	--
	06/12/90	190	71	18	73	720	--	14.79	0.00	254.87
	09/24/90	1.1	ND	ND	0.6	ND	--	15.72	0.00	253.94
	12/20/90	210	26	8.2	23	810	--	15.26	0.00	254.40
	03/27/91	350	220	52	210	2,900	--	12.11	0.00	257.55
	06/18/91	--	--	--	--	--	--	16.38	0.00	253.28
	09/12/91	59	12	4.5	8.5	350	--	17.55	0.00	252.11
	01/23/92	110	31	7.9	22	450	--	17.11	0.00	252.55
	04/13/92	1,100	76	100	200	5,000	--	14.40	0.00	255.26
	08/03/92	200	21	13	25	520	ND	15.83	0.00	253.83
	10/22/92	310	66	35	56	1,300	--	16.14	0.00	253.52
	01/18/93	1,200	430	220	610	5,600	--	11.70	0.00	257.96
C-13 284.32	03/07/90	--	--	--	--	--	--	11.18	0.00	273.14
	03/09/90	15	3.7	1	6.2	ND	--	--	--	--
	06/12/90	2.6	ND	ND	ND	ND	--	10.70	0.00	273.62
	09/24/90	2.4	ND	ND	ND	ND	--	11.60	0.00	272.72
	12/20/90	1.6	ND	ND	ND	ND	--	10.16	0.00	274.16
	03/27/91	--	--	--	--	--	--	7.64	0.00	276.68
	06/18/91	--	--	--	--	--	--	11.32	0.00	273.00
	09/12/91	ND	ND	ND	ND	ND	--	11.84	0.00	272.48
	01/23/92	--	--	--	--	--	--	10.55	0.00	273.77
	04/13/92	1	ND	ND	ND	ND	--	10.96	0.00	273.36
	08/03/92	ND	ND	ND	ND	ND	ND	10.90	0.00	273.42
	10/22/92	--	--	--	--	--	--	11.18	0.00	273.14
	01/18/93	54	10	5.4	12	290	--	7.40	0.00	276.92
C-14 270.74	03/07/90	--	--	--	--	--	--	15.18	0.00	255.56
	03/09/90	ND	ND	ND	ND	ND	--	--	--	--
	06/12/90	ND	ND	ND	ND	ND	--	13.42	0.00	257.32
	09/24/90	ND	ND	ND	ND	ND	--	12.84	0.00	257.90
	12/20/90	1.7	0.7	ND	0.7	ND	--	16.72	0.00	254.02
	03/27/91	ND	ND	ND	1.3	ND	--	8.00	0.00	262.74
	06/18/91	--	--	--	--	--	--	15.21	0.00	255.53
	09/12/91	ND	ND	ND	ND	ND	--	15.61	0.00	255.13
	01/23/92	--	--	--	--	--	--	24.64	0.00	246.10
	04/13/92	ND	ND	ND	ND	ND	--	12.21	0.00	258.53
	08/03/92	ND	ND	ND	ND	ND	ND	14.64	0.00	256.10
	10/22/92	--	--	--	--	--	--	16.94	0.00	253.80
	01/18/93	ND	ND	ND	ND	ND	--	5.10	0.00	265.64

Table 1 (continued)
HISTORICAL GROUNDWATER ANALYTICAL RESULTS AND MONITORING DATA
 FORMER CHEVRON SERVICE STATION NO. 9-5607
 5269 CROW CANYON ROAD, CASTRO VALLEY, CALIFORNIA

WELL ID/ ELEVATION (TOC)	DATE	BENZENE (ppb)	TOLUENE (ppb)	ETHYL- BENZENE (ppb)	XYLENES (ppb)	TPH-G (ppb)	ORGANIC LEAD (ppb)	DTW (feet)	SPT (feet)	WTE (feet)
C-15 246.15	03/07/90	--	--	--	--	--	--	11.10	0.00	235.05
	03/09/90	ND	1.4	0.5	0.6	410	--	--	--	--
	06/12/90	11	ND	ND	ND	420	--	10.78	0.00	235.37
	09/24/90	ND	1.5	ND	ND	430	--	10.93	0.00	235.22
	12/20/90	1.3	1.1	0.6	1.5	300	--	11.08	0.00	235.07
	03/27/91	4.6	1.1	ND	1	520***	--	8.50	0.00	237.65
	06/18/91	ND	1.1	ND	ND	290	--	10.83	0.00	235.32
	06/18/91D	ND	1.3	ND	ND	320	--	10.83	0.00	235.32
	09/12/91	ND	0.9	ND	ND	330***	--	11.05	0.00	235.10
	01/23/92	ND	0.6	ND	ND	210	--	10.80	0.00	235.35
	01/23/92D	1.2	0.8	ND	ND	190	--	10.80	0.00	235.35
	04/13/92	1.8	ND	ND	ND	430	--	9.58	0.00	236.57
	08/03/92	ND	2.1	0.7	1.3	640	ND	11.21	0.00	234.94
	10/22/92	ND	ND	ND	0.8	420	--	11.65	0.00	234.50
01/18/93	7.0	3.0	2.9	6.7	640	--	7.12	0.00	239.03	
C-16 246.69	03/07/90	--	--	--	--	--	--	18.50	0.00	228.19
	03/09/90	ND	ND	ND	ND	ND	--	--	--	--
	06/12/90	ND	ND	ND	ND	ND	--	11.42	0.00	235.27
	09/24/90	ND	ND	ND	ND	ND	--	11.39	0.00	235.30
	12/20/90	ND	ND	ND	0.7	ND	--	11.57	0.00	235.12
	03/27/91	ND	ND	ND	1.3	ND	--	8.76	0.00	237.93
	03/27/91D	ND	ND	ND	1.2	ND	--	8.76	0.00	237.93
	06/18/91	ND	ND	ND	ND	ND	--	11.18	0.00	235.51
	09/12/91	ND	ND	ND	ND	ND	--	11.95	0.00	234.74
	01/23/92	ND	ND	ND	ND	ND	--	12.41	0.00	234.28
	04/13/92	ND	ND	ND	ND	ND	--	10.69	0.00	236.00
	08/03/92	ND	ND	ND	ND	ND	ND	12.20	0.00	234.49
	10/22/92	ND	ND	ND	ND	ND	--	12.60	0.00	234.09
	01/18/93	ND	ND	ND	ND	ND	--	9.00	0.00	237.69
RW 274.52	12/04/89	29,000	1,700	1,800	8,800	62,000	--	--	--	--
	03/07/90	--	--	--	--	--	--	18.50	0.00	256.02
	06/12/90	15,000	2,000	560	3,100	31,000	--	18.49	0.00	256.03
	09/24/90	--	--	--	--	--	--	--	--	--
	12/20/90	0.5	ND	ND	1.2	ND	--	--	--	--
	03/27/91	--	--	--	--	--	--	--	--	--
	06/18/91	--	--	--	--	--	--	--	--	--
	09/12/91#	--	--	--	--	--	--	--	--	--
	01/23/92#	--	--	--	--	--	--	--	--	--
	04/13/92#	--	--	--	--	--	--	--	--	--
	08/03/92#	--	--	--	--	--	--	--	--	--
10/22/92#	--	--	--	--	--	--	--	--	--	
01/18/93#	--	--	--	--	--	--	--	--	--	

Explanation

Top of casing and groundwater elevations are expressed as feet above mean sea level.

TPH-G = Total petroleum hydrocarbons as gasoline

SP = Separate-phase petroleum hydrocarbons

DTW = Depth to water

SPT = Separate-phase hydrocarbon thickness

WTE = Water table elevation (adjusted WTE = well elevation - (DTW - (SPT X 0.8))

TOC = Top of casing

ppb = parts per billion

ND = Not detected at or above the minimum quantitation limit

-- = Not analyzed

NOTE: See laboratory reports for minimum quantitation limits.

D = Duplicate

* = Not sampled due to insufficient water in well

** = Well could not be located

*** = Typical gasoline chromatographic pattern not present

= Not sampled: Well adapted for on-site remediation system

= Groundwater elevation corrected assuming 0.8 specific gravity for gasoline

Sampling frequency:

Quarterly: C-1, C-3, C-4, C-6, C-8, C-10A, C-10B, C-11, C-12, C-15, and C-16.

Semi-annually: C-5, C-7, C-13, and C-14.

Annually: C-2.

ATTACHMENT I

**LABORATORY REPORTS
AND
CHAIN-OF-CUSTODY MANIFESTS**



Superior Precision Analytical, Inc.

825 Arnold Drive, Suite 114 • Martinez, California 94553 • (510) 229-1512 / fax (510) 229-1526

Groundwater Technology Inc.
Attn: Bruce Eppler

Project 02020-2887
Reported 01/27/93

TOTAL PETROLEUM HYDROCARBONS

Lab #	Sample Identification	Sampled	Analyzed Matrix
87649- 1	TB-LB	01/18/93	01/22/93 Water
87649- 2	RINSATE	01/18/93	01/26/93 Water
87649- 3	C-16	01/18/93	01/26/93 Water
87649- 4	C-14	01/18/93	01/22/93 Water
87649- 5	C-13	01/18/93	01/22/93 Water
87649- 6	C-11	01/18/93	01/25/93 Water
87649- 7	C-10B	01/18/93	01/22/93 Water
87649- 8	C-8	01/18/93	01/22/93 Water
87649- 9	C-10A	01/18/93	01/23/93 Water
87649-10	C-5	01/18/93	01/23/93 Water

RESULTS OF ANALYSIS

Laboratory Number: 87649- 1 87649- 2 87649- 3 87649- 4 87649- 5

Gasoline:	ND<50	ND<50	ND<50	ND<50	290
Benzene:	ND<0.5	ND<0.5	ND<0.5	ND<0.5	54
Toluene:	ND<0.5	ND<0.5	ND<0.5	ND<0.5	10
Ethyl Benzene:	ND<0.5	ND<0.5	ND<0.5	ND<0.5	5.4
Xylenes:	ND<0.5	0.7	ND<0.5	ND<0.5	12
Concentration:	ug/L	ug/L	ug/L	ug/L	ug/L

Laboratory Number: 87649- 6 87649- 7 87649- 8 87649- 9 87649-10

Gasoline:	ND<50	60	ND<50	ND<50	230
Benzene:	ND<0.5	3.3	ND<0.5	ND<0.5	6.6
Toluene:	1.2	11	ND<0.5	ND<0.5	2.2
Ethyl Benzene:	ND<0.5	2.1	ND<0.5	ND<0.5	3.4
Xylenes:	2.2	8.9	ND<0.5	ND<0.5	2.2
Concentration:	ug/L	ug/L	ug/L	ug/L	ug/L



Superior Precision Analytical, Inc.

825 Arnold Drive, Suite 114 • Martinez, California 94553 • (510) 229-1512 / fax (510) 229-1526

Groundwater Technology Inc.
Attn: Bruce Eppler

Project 02020-2887
Reported 01/27/93

TOTAL PETROLEUM HYDROCARBONS

Lab #	Sample Identification	Sampled	Analyzed Matrix
87649-11	C-2	01/18/93	01/23/93 Water
87649-12	C-12	01/18/93	01/25/93 Water
87649-13	C-1	01/18/93	01/26/93 Water
87649-14	C-3	01/18/93	01/25/93 Water
87649-15	C-6	01/18/93	01/25/93 Water
87649-16	C-15	01/18/93	01/23/93 Water

RESULTS OF ANALYSIS

Laboratory Number: 87649-11 87649-12 87649-13 87649-14 87649-15

Gasoline:	70	5600	370000	1000000	77000
Benzene:	6.4	1200	6900	2400	13000
Toluene:	ND<0.5	430	8900	5300	1600
Ethyl Benzene:	ND<0.5	220	3100	10000	2700
Xylenes:	ND<0.5	610	23000	61000	12000
Concentration:	ug/L	ug/L	ug/L	ug/L	ug/L

Laboratory Number: 87649-16

Gasoline:	640
Benzene:	7.0
Toluene:	3.0
Ethyl Benzene:	2.9
Xylenes:	6.7
Concentration:	ug/L



Superior Precision Analytical, Inc.

825 Arnold Drive, Suite 114 • Martinez, California 94553 • (510) 229-1512 / fax (510) 229-1526

C E R T I F I C A T E O F A N A L Y S I S

ANALYSIS FOR TOTAL PETROLEUM HYDROCARBONS

Page 4 of 4
QA/QC INFORMATION
SET: 87649

NA = ANALYSIS NOT REQUESTED
ND = ANALYSIS NOT DETECTED ABOVE QUANTITATION LIMIT
ug/L = parts per billion (ppb)

OIL AND GREASE ANALYSIS By Standard Methods Method 5520F:
Minimum Detection Limit in Water: 5000ug/L

Modified EPA SW-846 Method 8015 for Extractable Hydrocarbons:
Minimum Quantitation Limit for Diesel in Water: 50ug/L

EPA SW-846 Method 8015/5030 Total Purgable Petroleum Hydrocarbons:
Minimum Quantitation Limit for Gasoline in Water: 50ug/L

EPA SW-846 Method 8020/BTXE
Minimum Quantitation Limit in Water: 0.5ug/L

ANALYTE	MS/MSD RECOVERY	RPD	CONTROL LIMIT
Gasoline:	94/98	5	70-130
Benzene:	89/90	1	70-130
Toluene:	93/95	2	70-130
Ethyl Benzene:	100/101	1	70-130
Xylenes:	98/99	1	70-130

Richard Srna, Ph.D.
Nancy A. Nelson for
Laboratory Director

Fax copy of Lab Report and COC to Chevron Contact: Yes No

87649

Chain-of-Custody-Record

Chevron U.S.A. Inc. P.O. BOX 5004 San Ramon, CA 94583 FAX (415)842-9591	Chevron Facility Number <u>9-5607</u>	Chevron Contact (Name) <u>Clint Rogers</u>
	Facility Address <u>5269 Crow Canyon Rd, Castro Valley</u>	(Phone) <u>(510) 842-8658</u>
	Consultant Project Number <u>02020 2887</u>	Laboratory Name <u>SUPERIOR GTL</u>
Consultant Name <u>Groundwater Technology, Inc.</u>	Laboratory Release Number <u>8683910</u>	Sample Collected by (Name) <u>John McIntosh</u>
Address <u>1401 Halyard Dr, #140 West Sacramento CA</u>	Project Contact (Name) <u>Bruce Eppler</u>	Collection Date <u>1-18-93</u>
	(Phone) <u>(916) 372-4700</u> (Fax Number) <u>(916) 372-8781</u>	Signature <u>Danae Bequard for J. McIntosh</u>

Sample Number	Lab Sample Number	Number of Containers	Matrix S - Soil W - Water A - Air C - Charcoal	Type G - Grab C - Composite D - Discrete	Time	Sample Preservation	Iced (Yes or No)	Analysis To Be Performed											NOTE: Do NOT BILL TB-LB SAMPLES				
								BTEX + TPH GAS (8020 + 8015)	TPH Diesel (8015)	Oil and Grease (5520)	Purgeable Halocarbons (8010)	Purgeable Aromatics (8020)	Purgeable Organics (8240)	Extractable Organics (8270)	Metals Cd, Cr, Pb, Zn, Ni (ICAP or AA)							Remarks	
TB-LB	1	2	W	G	1400	HCL	Yes	X															
Rinseate	2	2	W	G	1410			X															
C-16	3	3	W	G	1420			X															
C-14	4	3	W	G	1430			X															
C-13	5	3	W	G	1440			X															
C-11	6	3	W	G	1450			X															
C-10b	7	3	W	G	1500			X															
C-8	8	3	W	G	1510			X															
C-10A	9	3	W	C	1520			X															
C-5	10	3	W	G	1530			X															
C-2	11	3	W	G	1550			X															
C-12	12	3	W	G	1600			X															
C-1	13	3	W	G	1610			X															
C-3	14	3	W	C	1630			X															

Please Initial
Samples Stored in ice
Appropriate container
Samples prepared
VOA's
Com...

Relinquished By (Signature) <u>Danae Bequard</u>	Organization <u>GTL</u>	Date/Time <u>1/19/93 9:00</u>	Received By (Signature) <u>[Signature]</u>	Organization <u>Aero</u>	Date/Time <u>1-19-93 12:40 pm</u>	Turn Around Time (Circle Choice) 24 hrs. 48 hrs. 5 Days 10 Days As Contracted
Relinquished By (Signature) <u>[Signature]</u>	Organization <u>Aero</u>	Date/Time <u>1-19-93 2:30</u>	Received For Laboratory By (Signature) <u>R. Vargas</u>	Organization <u>Aero</u>	Date/Time <u>1-19-93 2:30 pm</u>	

Fax copy of Lab Report and COC to Chevron Contact: Yes No

87649 Chain-of-Custody-Record

Chevron U.S.A. Inc.
P.O. BOX 5004
San Ramon, CA 94583
FAX (415)842-9591

Chevron Facility Number: 9-5607
Facility Address: 5269 Cross Canyon Rd, Castro Valley
Chevron Contact (Name): Clint Rogers
(Phone): (510) 842-8658

Consultant Project Number: 62020 2887
Laboratory Name: GTEL
Laboratory Release Number: 8683910
Consultant Name: Groundwater Technology, Inc.
Address: 1401 Halcyon Dr #140, West Sacramento, CA
Project Contact (Name): Bruce Eppler 95891
(Phone) (916) 372-4700 (Fax Number) (916) 372-8381
Sample Collected by (Name): John McIntosh
Collection Date: 1-18-93
Signature: Danielle Beaudou for J McIntosh

Sample Number	Lab Sample Number	Number of Containers	Matrix S = Soil W = Water A = Air C = Charcoal	Type C = Grab C = Composite D = Discrete	Time	Sample Preservation	Iced (Yes or No)	Analysis To Be Performed										Remarks			
								BTEX + TPH GAS (8020 + 8015)	TPH Diesel (8015)	Oil and Grease (5520)	Purgeable Halocarbons (8010)	Purgeable Aromatics (8020)	Purgeable Organics (8240)	Extractable Organics (8270)	Metals Cd, Cr, Pb, Zn, Ni (ICAP or AA)						
C-6	15	3	W	G	1640	HCL	Yes	X													
C-15	16	3	W	G	1650	HCL	Yes	X													

Please Initial: DW

Samples Stored in ice. _____

Appropriate containers _____

Samples preserved _____

VOA's without headspace _____

Comments: _____

NOTE:
Do NOT BILL
TB-LB SAMPLES

Relinquished By (Signature) <u>Danielle Beaudou</u>	Organization <u>GTEL</u>	Date/Time <u>1/19/93/9:00</u>	Received By (Signature) <u>[Signature]</u>	Organization <u>Aero</u>	Date/Time <u>1-19-93 12:40 PM</u>	Turn Around Time (Circle Choice) 24 Hrs. 48 Hrs. 5 Days 10 Days As Contracted
Relinquished By (Signature) <u>[Signature]</u>	Organization <u>Aero</u>	Date/Time <u>1-19-93 PM</u>	Received By (Signature) <u>[Signature]</u>	Organization <u>Aero</u>	Date/Time <u>1-19-93 2:30 PM</u>	
Relinquished By (Signature) <u>[Signature]</u>	Organization <u>Aero</u>	Date/Time <u>1-19-93 2:30 PM</u>	Received For Laboratory By (Signature) <u>[Signature]</u>	Organization <u>Aero</u>	Date/Time <u>1-19-93 2:30 PM</u>	

Fax copy of Lab Report and COC to Chevron Contact: Yes No

Chain-of-Custody-Record

Chevron U.S.A. Inc.
P.O. BOX 5004
San Ramon, CA 94583
FAX (415)842-9591

Chevron Facility Number SS*9-5607
 Facility Address 5269 Crow Canyon Rd
 Consultant Project Number 02020-2887
 Consultant Name Groundwater Technology
 Address 1401 Halyard w. Sacramento 95691
 Project Contact (Name) Bruce Eppler
 (Phone) 916-372-4700 (Fax Number) 916-372-8781

Chevron Contact (Name) Clint Rogers
 (Phone) 510-847-8658
 Laboratory Name Superior Analytical
 Laboratory Release Number 10489350 8683810
 Samples Collected by (Name) John McIntosh
 Collection Date 1-25-93
 Signature John McIntosh

Sample Number	Lab Sample Number	Number of Containers	Matrix S = Soil W = Water A = Air C = Charcoal	Type C = Grab C = Composite D = Discrete	Time	Sample Preservation	Iced (Yes or No)	Analyses To Be Performed											NOTE: Do NOT BILL TB-LB SAMPLES * Remarks
								STEX + TPH GAS (8020 + 8015)	TPH Diesel (8015)	Oil and Grease (5520)	Purgeable Halocarbons (8010)	Purgeable Aromatics (8020)	Purgeable Organics (8240)	Extractable Organics (8270)	Metals Cd, Cr, Pb, Zn, Ni (ICAP or AA)				
7840B		1	W	W														*	
7840C		1	W	W															
7840D		1	W	W															
C-1		3	W	G	1030	HCL	Y	✓											
<div style="border: 2px solid black; padding: 10px; width: fit-content; margin: auto;"> <p>Please Initial: <u>ET</u></p> <p>Samples Stored in ice <u>✓</u></p> <p>Appropriate containers <u>✓</u></p> <p>Samples preserved <u>✓</u></p> <p>VOA's without headspace <u>✓</u></p> <p>Comments: <u>None</u></p> </div>																			

Influenced By (Signature) <u>John McIntosh</u>	Organization <u>02320</u>	Date/Time	Received By (Signature)	Organization	Date/Time	Turn Around Time (Circle Choice) 24 Hrs. 48 Hrs. 5 Days 10 Days <u>As Contracted</u>
Influenced By (Signature)	Organization	Date/Time	Received By (Signature)	Organization	Date/Time	
Influenced By (Signature)	Organization	Date/Time	Received For Laboratory By (Signature)		Date/Time	

F Tanquili 1-25-93 12:20 PM