



Chevron U.S.A. Products Company

2410 Camino Ramon, San Ramon, California • Phone (510) 842-9500
Mail Address: P.O. Box 5004, San Ramon, CA 94583-0804

December 31, 1992

Mr. Scott Seery
Alameda County Environmental Health
80 Swan Way, Room 200
Oakland, CA 94621

Re: Former Chevron Station # 9-5607, 5269 Crow Canyon Road, Castro Valley, CA
Enclosed groundwater monitoring report (GTI, 10/12/92)

Dear Mr. Seery:

Attached is a report dated October 12, 1992, which was prepared by Chevron's consultant, Groundwater Technology Inc. (GTI), to describe quarterly groundwater monitoring performed at the subject site on August 3, 1992.

I apologize for the delay in submitting this report. The report was mistakenly sent to another person at Chevron by GTI, and I only recently received it.

GTI has completed the fourth quarter monitoring, and their report is forthcoming.

If you have any questions or comments, I can be reached at (510) 842-8658.

Sincerely,

Clint B. Rogers
Environmental Engineer

Attachment

cc: Rich Hiatt, San Francisco Bay RWQCB, Oakland, CA
Kevin Hinckley, 5269 Crow Canyon Road, Castro Valley, CA 94546
Paul Hehn, Geraghty and Miller, Richmond, CA

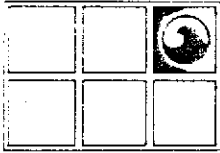

GROUNDWATER TECHNOLOGY, INC.

1401 Halyard Drive, Suite 140, West Sacramento, CA 95691, (916) 372-4700

FAX (916) 372-8781

October 12, 1992

Project No. 02020 2887

Mr. Brett L. Hunter
Chevron U.S.A. Products Company
2410 Camino Ramon
San Ramon, CA 94583-0804

**RE: QUARTERLY MONITORING AND SAMPLING ACTIVITIES
FORMER CHEVRON SERVICE STATION 9-5607
5269 CROW CANYON ROAD
CASTRO VALLEY, CALIFORNIA**

Dear Mr. Hunter:

Groundwater Technology, Inc. submits this letter as a summary of quarterly groundwater monitoring and sampling data collected on August 3, 1992 at the above-referenced site. Fourteen site-related groundwater monitoring wells were gauged to determine depth to groundwater (DTW) and to check for the presence of separate-phase petroleum hydrocarbons. A potentiometric surface map (Figure 1) and a summary of groundwater monitoring data (Table 1) are included. After measuring DTW, each monitoring well was purged and sampled. The groundwater samples were analyzed for dissolved benzene, toluene, ethylbenzene and xylenes (BTEX), and total petroleum hydrocarbons-as-gasoline (TPH-G). Results of the chemical analyses are summarized in Table 1. Laboratory reports and chain-of-custody manifests are included in Attachment A. All purge water generated during the sampling process was processed through the onsite groundwater treatment system.

Groundwater Technology, Inc. is pleased to assist Chevron on this project. If you have any questions or comments please call our West Sacramento office.

Sincerely,
Groundwater Technology, Inc.
Written/Submitted by

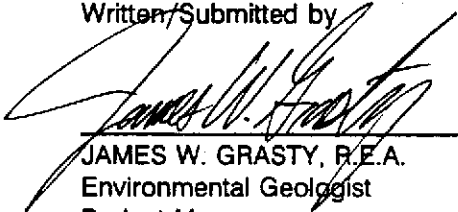

JAMES W. GRASTY, R.E.A.
Environmental Geologist
Project Manager

Groundwater Technology, Inc.
Reviewed/Approved by



E. K. SIMONIS, R.G.
Senior Environmental Geologist

JWG/EKS:rc

Attachments
2887QTR4.LTR

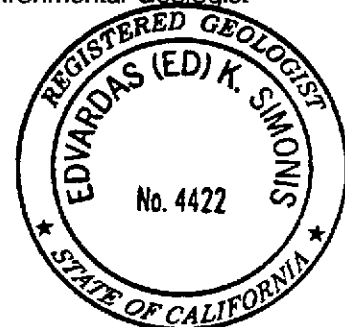

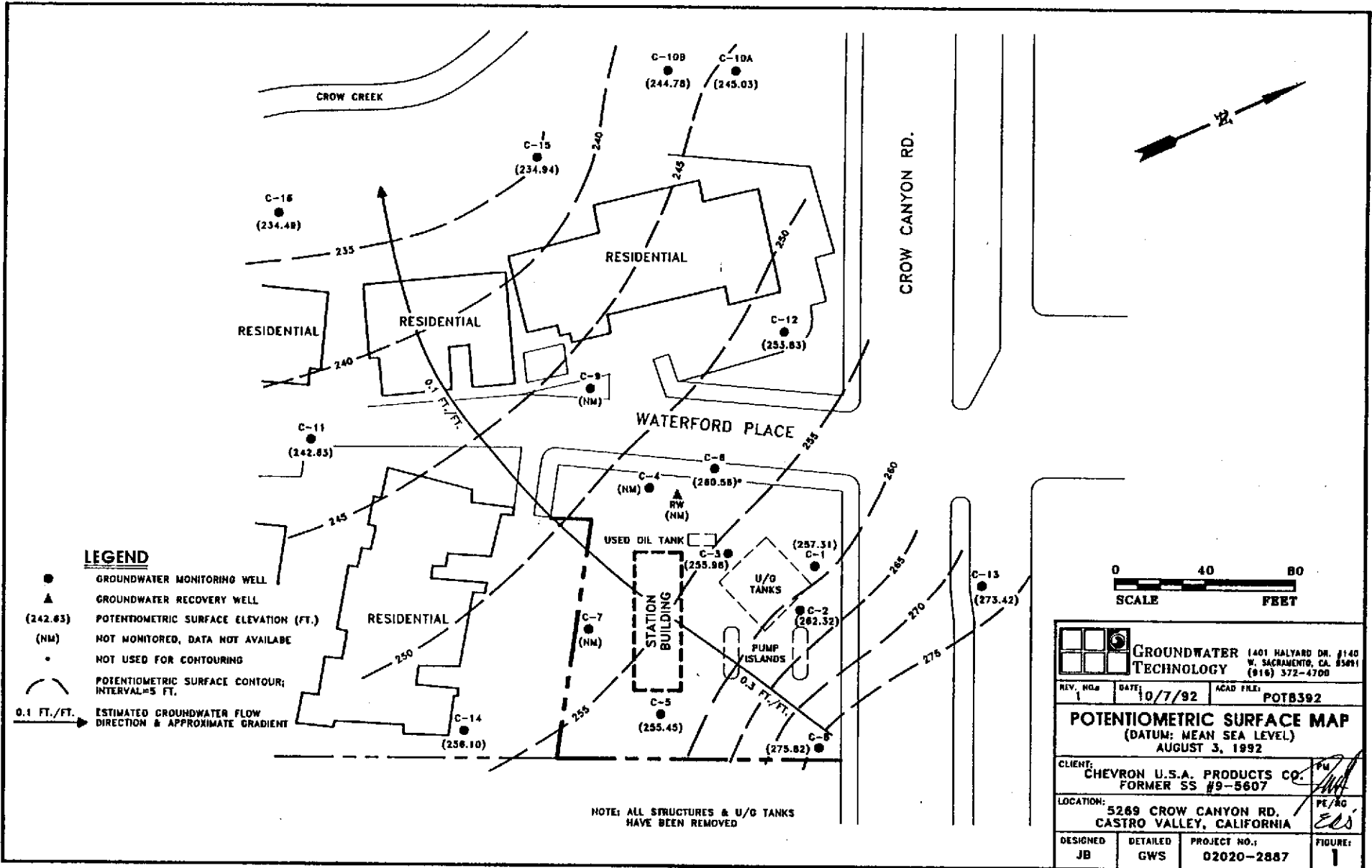

Table 1
HISTORICAL GROUNDWATER ANALYTICAL RESULTS AND MONITORING DATA
 FORMER CHEVRON SERVICE STATION NO. 9-5607
 5269 CROW CANYON ROAD, CASTRO VALLEY, CALIFORNIA

WELL ID/ ELEVATION (TOC)	DATE	BENZENE (ppb)	TOLUENE (ppb)	ETHYL- BENZENE (ppb)	XYLENES (ppb)	TPH-G (ppb)	ORGANIC LEAD (ppb)	DTW (feet)	SPT (feet)	WTE (feet)
C-1 283.46	03/26/85	--	--	--	--	--	--	22.83	0.00	260.63
	07/03/86	--	--	--	--	--	--	23.58	0.00	259.88
	03/26/87	--	--	--	--	--	--	20.50	0.00	262.96
	03/28/88	--	--	--	--	--	--	26.00	0.00	257.46
	03/10/89	--	--	--	--	--	--	15.86	0.00	267.60
	04/03/89	--	--	--	--	--	--	16.85	0.00	266.61
	05/08/89	--	--	--	--	--	--	22.68	0.00	260.78
	06/05/89	--	--	--	--	--	--	24.66	0.00	258.80
	07/12/90	--	--	--	--	--	--	25.56	0.00	257.90
	08/10/90	--	--	--	--	--	--	25.89	0.00	257.57
	09/13/89	3,600	1,100	1,000	3,500	22,000	--	26.55	0.00	256.91
	10/04/89	--	--	--	--	--	--	25.24	0.00	258.22
	11/03/89	--	--	--	--	--	--	25.03	0.00	258.43
	12/04/89	2,000	550	610	1,600	13,000	--	26.37	0.00	257.09
	03/07/90	--	--	--	--	--	--	22.48	0.00	260.98
	03/09/90	--	--	--	--	--	--	--	--	--
	06/12/90	3,500	1,400	840	4,000	21,000	--	24.35	0.00	259.11
	09/20/90	2,100	1,200	860	5,000	23,000	--	26.27	0.00	257.19
	12/20/90	760	410	260	1,100	8,200	--	22.59	0.00	260.87
	03/27/91	--	--	--	--	--	--	19.08	0.00	264.38
06/18/91	--	--	--	--	--	--	27.11	0.00	256.35	
09/12/91	--	--	--	--	--	--	26.22	0.00	255.24	
01/23/92	--	--	--	--	--	--	26.65	0.00	256.81	
04/13/92	3,100	1,300	850	3,100	38,000	--	22.16	0.00	261.30	
08/03/92	1,300	470	550	1,600	13,000	ND	26.15	0.00	257.31	
C-2 284.37	03/26/85	--	--	--	--	--	--	--	--	--
	07/03/86	--	--	--	--	--	--	19.69	0.00	264.68
	03/26/87	--	--	--	--	--	--	15.45	0.00	268.92
	03/28/88	--	--	--	--	--	--	20.92	0.00	263.45
	03/10/89	--	--	--	--	--	--	12.80	0.00	271.57
	04/03/89	--	--	--	--	--	--	14.26	0.00	270.11
	05/08/89	--	--	--	--	--	--	18.42	0.00	265.95
	06/05/89	--	--	--	--	--	--	20.09	0.00	264.28
	07/12/90	--	--	--	--	--	--	20.79	0.00	263.58
	08/10/90	--	--	--	--	--	--	21.40	0.00	262.97
	09/13/89	62	4	10	14	320	--	21.86	0.00	262.51
	10/04/89	--	--	--	--	--	--	19.89	0.00	264.48
	11/03/89	--	--	--	--	--	--	20.76	0.00	263.61
	12/04/89	240	37	66	130	1,000	--	20.82	0.00	263.55
	03/07/90	--	--	--	--	--	--	17.83	0.00	266.54
	03/09/90	280	35	27	50	390	--	17.83	0.00	266.54
	06/12/90	260	34	28	55	700	--	19.89	0.00	264.48
	09/20/90	--	--	--	--	--	--	21.97	0.00	262.40
	12/20/90	--	--	--	--	--	--	17.73	0.00	266.64
	03/27/91	--	--	--	--	--	--	15.10	0.00	269.27
06/18/91	--	--	--	--	--	--	22.68	0.00	261.69	
09/12/91	--	--	--	--	--	--	23.92	0.00	260.45	
01/23/92	--	--	--	--	--	--	21.24	0.00	263.13	
04/13/92	120	76	17	72	1,100	--	17.54	0.00	266.83	
08/03/92	--	--	--	--	--	--	22.05	0.00	262.32	

Table 1 (Continued)
HISTORICAL GROUNDWATER ANALYTICAL RESULTS AND MONITORING DATA

FORMER CHEVRON SERVICE STATION NO. 9-5607
 5269 CROW CANYON ROAD, CASTRO VALLEY, CALIFORNIA

WELL ID/ ELEVATION (TOC)	DATE	BENZENE (ppb)	TOLUENE (ppb)	ETHYL- BENZENE (ppb)	XYLENES (ppb)	TPH-G (ppb)	ORGANIC LEAD (ppb)	DTW (feet)	SPT (feet)	WTE (feet)
C-3 285.98	03/26/85	--	--	--	--	--	--	--	--	--
	07/03/86	--	--	--	--	--	--	26.04	0.00	259.94
	03/26/87	--	--	--	--	--	--	25.64	0.00	260.34
	03/28/88	--	--	--	--	--	--	28.82	0.00	257.16
	03/10/89	--	--	--	--	--	--	22.78	0.00	263.20
	04/03/89	--	--	--	--	--	--	22.71	0.00	263.27
	05/08/89	--	--	--	--	--	--	25.95	0.00	260.03
	06/05/89	--	--	--	--	--	--	27.62	0.00	258.36
	07/12/90	--	--	--	--	--	--	28.29	0.00	257.69
	08/10/90	--	--	--	--	--	--	28.46	0.00	257.52
	09/13/89	1,400	6,800	2,300	10,000	60,000	--	29.33	0.00	256.65
	10/04/89	--	--	--	--	--	--	28.97	0.00	257.01
	11/03/89	--	--	--	--	--	--	28.72	0.00	257.26
	12/04/89	1,300	3,300	1,400	2,700	58,000	--	29.01	0.00	256.97
	03/07/90	--	--	--	--	--	--	27.69	0.00	258.29
	03/09/90	1,100	5,700	1,600	7,900	42,000	--	27.69	0.00	258.29
	06/12/90	1,400	7,100	3,400	16,000	160,000	--	28.09	0.00	257.89
	09/24/90	850	7,700	2,000	10,000	53,000	--	29.18	0.00	256.80
	12/20/90	1,200	5,400	5,400	33,000	520	--	28.27	0.00	257.71
	03/27/91	1,300	3,100	1,200	11,000	92,000	--	24.80	0.00	261.18
06/18/91	--	--	--	--	--	--	30.84	0.00	255.14	
09/12/91##	--	--	--	--	--	--	31.64	0.03	254.34	
01/23/92	--	--	--	--	--	--	30.52	SHEEN	255.46	
04/13/92##	--	--	--	--	--	--	26.94	0.01	259.04	
08/03/92	1,300	2,800	3,100	17,000	220,000	ND	30.00	0.00	255.98	
C-4 273.01	03/26/85	--	--	--	--	--	--	15.14	0.00	257.87
	07/03/86	--	--	--	--	--	--	15.37	0.00	257.64
	03/26/87	--	--	--	--	--	--	--	--	--
	03/28/88	--	--	--	--	--	--	18.04	0.00	254.97
	03/10/89	--	--	--	--	--	--	--	--	--
	04/03/89	--	--	--	--	--	--	13.34	0.00	259.67
	05/08/89	--	--	--	--	--	--	15.60	0.00	257.41
	06/05/89	--	--	--	--	--	--	16.51	0.00	256.50
	07/12/90	--	--	--	--	--	--	16.99	0.00	256.02
	08/10/90	--	--	--	--	--	--	17.27	0.00	255.74
	09/13/89	21,000	3,100	3,200	11,000	57,000	--	18.16	0.00	254.85
	10/04/89	--	--	--	--	--	--	18.24	0.00	254.77
	11/03/89	--	--	--	--	--	--	18.17	0.00	254.84
	12/04/89	17,000	2,200	2,800	9,800	48,000	--	18.45	0.00	254.56
	03/07/90	--	--	--	--	--	--	17.20	0.00	255.81
	03/09/90	20,000	2,300	2,800	11,000	49,000	--	17.20	0.00	255.81
	06/12/90	21,000	2,400	4,000	16,000	82,000	--	16.66	0.00	256.35
	09/24/90	--	--	--	--	--	--	18.11	0.00	254.90
	12/20/90**	--	--	--	--	--	--	--	--	--
	03/27/91**	--	--	--	--	--	--	--	--	--
06/18/91**	--	--	--	--	--	--	--	--	--	
09/12/91**	--	--	--	--	--	--	--	--	--	
01/23/92**	--	--	--	--	--	--	--	--	--	
04/13/92**	--	--	--	--	--	--	--	--	--	
08/03/92**	--	--	--	--	--	--	--	--	--	

Table 1 (continued)
HISTORICAL GROUNDWATER ANALYTICAL RESULTS AND MONITORING DATA

FORMER CHEVRON SERVICE STATION NO. 9-5607
 5269 CROW CANYON ROAD, CASTRO VALLEY, CALIFORNIA

WELL ID/ ELEVATION (TOC)	DATE	BENZENE (ppb)	TOLUENE (ppb)	ETHYL- BENZENE (ppb)	XYLENES (ppb)	TPH-G (ppb)	ORGANIC LEAD (ppb)	DTW (feet)	SPT (feet)	WTE (feet)
C-5 287.95	03/26/85	--	--	--	--	--	--	25.33	0.00	262.62
	07/03/86	--	--	--	--	--	--	26.41	0.00	261.54
	03/26/87	--	--	--	--	--	--	24.96	0.00	262.99
	03/28/88	--	--	--	--	--	--	29.80	0.00	258.15
	03/10/89	--	--	--	--	--	--	25.89	0.00	262.06
	04/03/89	--	--	--	--	--	--	24.38	0.00	263.57
	05/08/89	--	--	--	--	--	--	27.80	0.00	260.15
	06/05/89	--	--	--	--	--	--	29.42	0.00	258.53
	07/12/90	--	--	--	--	--	--	29.86	0.00	258.09
	08/10/90	--	--	--	--	--	--	29.77	0.00	258.18
	09/13/89	ND	ND	ND	ND	310	--	30.95	0.00	257.00
	10/04/89	--	--	--	--	--	--	31.48	0.00	256.47
	11/03/89	--	--	--	--	--	--	31.32	0.00	256.63
	12/04/89	ND	ND	ND	ND	ND	--	31.70	0.00	256.25
	03/07/90	--	--	--	--	--	--	30.28	0.00	257.67
	03/09/90	ND	ND	ND	ND	ND	--	30.28	0.00	257.67
	06/12/90	ND	ND	ND	ND	90	--	30.48	0.00	257.47
	09/24/90	ND	ND	ND	ND	ND	--	31.78	0.00	256.17
	12/20/90	ND	ND	1.0	0.7	170	--	33.29	0.00	254.66
	03/27/91	--	--	--	--	--	--	27.98	0.00	259.97
06/18/91	--	--	--	--	--	--	32.52	0.00	255.43	
09/12/91	--	--	--	--	--	--	33.37	0.00	254.58	
01/23/92	--	--	--	--	--	--	32.67	0.00	255.28	
04/13/92	ND	ND	0.7	ND	140	--	28.48	0.00	259.47	
08/03/92	ND	ND	ND	ND	ND	ND	32.50	0.00	255.45	
C-6 275.28	03/26/85	--	--	--	--	--	--	16.74	--	--
	07/03/86	--	--	--	--	--	--	17.46	0.00	257.82
	03/26/87	--	--	--	--	--	--	18.37	0.00	256.91
	03/28/88	--	--	--	--	--	--	29.84	0.00	245.44
	03/10/89	--	--	--	--	--	--	14.44	0.00	260.84
	04/03/89	--	--	--	--	--	--	14.44	0.00	260.84
	05/08/89	--	--	--	--	--	--	17.16	0.00	258.12
	06/05/89	--	--	--	--	--	--	18.51	0.00	256.77
	07/12/90	--	--	--	--	--	--	18.71	0.00	256.57
	08/10/90	--	--	--	--	--	--	19.32	0.00	255.96
	09/13/89	5,600	3,000	2,400	10,000	47	--	19.95	0.00	255.33
	10/04/89	--	--	--	--	--	--	19.87	0.00	255.41
	11/03/89	--	--	--	--	--	--	19.35	0.00	255.93
	12/04/89	8,100	1,800	1,700	7,500	40,000	--	19.59	0.00	255.69
	03/07/90	--	--	--	--	--	--	18.39	0.00	256.89
	03/09/90	23,000	5,900	3,400	17,000	73,000	--	18.39	0.00	256.89
	06/12/90	19,000	6,500	3,400	16,000	85,000	--	18.87	0.00	256.41
	09/24/90	15,000	3,200	2,600	11,000	72,000	--	19.99	0.00	255.29
	12/20/90	11,000	4,200	3,400	16,000	100,000	--	21.57	0.00	253.71
	03/27/91	11,000	4,400	2,300	11,000	100,000	--	16.32	0.00	258.96
06/18/91	--	--	--	--	--	--	23.33	0.00	251.95	
09/12/91	--	--	--	--	--	--	23.96	0.00	251.32	
01/23/92	--	--	--	--	--	--	12.08	0.00	263.20	
04/13/92	--	--	--	--	--	--	19.85	SHEEN	255.43	
08/03/92	16,000	1,100	2,300	15,000	120,000	ND	14.72	0.00	260.56	

Table 1 (continued)
HISTORICAL GROUNDWATER ANALYTICAL RESULTS AND MONITORING DATA

FORMER CHEVRON SERVICE STATION NO. 9-5607
 5269 CROW CANYON ROAD, CASTRO VALLEY, CALIFORNIA

WELL ID/ ELEVATION (TOC)	DATE	BENZENE (ppb)	TOLUENE (ppb)	ETHYL- BENZENE (ppb)	XYLENES (ppb)	TPH-G (ppb)	ORGANIC LEAD (ppb)	DTW (feet)	SPT (feet)	WTE (feet)
C-7 270.70	03/26/85	--	--	--	--	--	--	9.61	--	--
	07/03/86	--	--	--	--	--	--	10.74	0.00	259.96
	03/26/87	--	--	--	--	--	--	10.08	0.00	260.62
	03/28/88	--	--	--	--	--	--	13.79	0.00	256.91
	03/10/89	--	--	--	--	--	--	10.42	0.00	260.28
	04/03/89	--	--	--	--	--	--	9.14	0.00	261.56
	05/08/89	--	--	--	--	--	--	11.91	0.00	258.79
	06/05/89	--	--	--	--	--	--	11.54	0.00	259.16
	07/12/90	--	--	--	--	--	--	13.45	0.00	257.25
	08/10/90	--	--	--	--	--	--	13.37	0.00	257.33
	09/13/89	1.3	ND	10	ND	410	--	14.60	0.00	256.10
	10/04/89	--	--	--	--	--	--	15.17	0.00	255.53
	11/03/89	--	--	--	--	--	--	15.28	0.00	255.42
	12/04/89	1	ND	5	ND	1,000	--	15.70	0.00	255.00
	03/07/90	--	--	--	--	--	--	14.22	0.00	256.48
	03/09/90	2.8	2.4	3.5	2	590	--	14.22	0.00	256.48
	06/12/90	ND	5	8.2	3.2	1,200	--	14.18	0.00	256.52
	09/24/90	1.4	1.9	1.4	2.2	400	--	15.44	SHEEN	255.26
	09/24/90D	ND	2.4	1.4	1.5	580	--	15.44	SHEEN	255.26
	12/20/90	ND	6.5	4.7	9.3	2,300	--	17.08	0.00	253.62
03/27/91	ND	2.4	9.1	3	980	--	12.65	0.00	258.05	
06/18/91	--	--	--	--	--	--	16.44	0.00	254.26	
09/12/91	ND	3.1	6.5	2.7	1,200***	--	17.05	0.00	253.65	
01/23/92	--	--	--	--	--	--	16.92	0.00	253.78	
04/13/92	ND	1	7.8	1.2	830	--	13.00	0.00	257.70	
08/03/92	--	--	--	--	--	--	--	--	--	
C-8 288.40	03/26/85	--	--	--	--	--	--	8.68	--	--
	07/03/86	--	--	--	--	--	--	13.89	0.00	274.51
	03/26/87	--	--	--	--	--	--	6.01	0.00	282.39
	03/28/88	--	--	--	--	--	--	10.66	0.00	277.74
	03/10/89	--	--	--	--	--	--	6.61	0.00	281.79
	04/03/89	--	--	--	--	--	--	6.46	0.00	281.94
	05/08/89	--	--	--	--	--	--	8.97	0.00	279.43
	06/05/89	--	--	--	--	--	--	10.88	0.00	277.52
	07/12/90	--	--	--	--	--	--	12.15	0.00	276.25
	08/10/90	--	--	--	--	--	--	12.46	0.00	275.94
	09/13/89	ND	ND	ND	ND	ND	--	12.78	0.00	275.62
	10/04/89	--	--	--	--	--	--	12.51	0.00	275.89
	11/03/89	--	--	--	--	--	--	14.63	0.00	273.77
	12/04/89	0.6	0.6	ND	1	64	--	9.59	0.00	278.81
	03/07/90	--	--	--	--	--	--	8.80	0.00	279.60
	03/09/90	ND	ND	ND	ND	ND	--	8.80	0.00	279.60
	06/12/90	2.5	1.2	1	1.4	120	--	8.94	0.00	279.46
	09/24/90	--	--	--	--	--	--	13.54	0.00	274.86
	12/20/90	--	--	--	--	--	--	9.33	0.00	279.07
	03/27/91	0.7	ND	0.7	1.9	54	--	6.10	0.00	282.30
06/18/91	--	--	--	--	--	--	11.96	0.00	276.44	
09/12/91	ND	ND	ND	ND	ND	--	13.60	0.00	274.80	
09/12/91D	ND	ND	ND	ND	ND	--	13.60	0.00	274.80	
01/23/92	--	--	--	--	--	--	24.20	0.00	264.20	
04/13/92	ND	ND	ND	ND	ND	--	8.35	0.00	280.05	
08/03/92	ND	ND	ND	ND	ND	ND	12.58	0.00	275.82	

Table 1 (continued)
HISTORICAL GROUNDWATER ANALYTICAL RESULTS AND MONITORING DATA
 FORMER CHEVRON SERVICE STATION NO. 9-5607
 5269 CROW CANYON ROAD, CASTRO VALLEY, CALIFORNIA

WELL ID/ ELEVATION (TOC)	DATE	BENZENE (ppb)	TOLUENE (ppb)	ETHYL- BENZENE (ppb)	XYLENES (ppb)	TPH-G (ppb)	ORGANIC LEAD (ppb)	DTW (feet)	SPT (feet)	WTE (feet)
C-9 268.46	07/03/86	--	--	--	--	--	--	13.89	0.00	254.57
	03/26/87	--	--	--	--	--	--	13.74	0.00	254.72
	03/28/88	--	--	--	--	--	--	14.99	0.00	253.47
	03/10/89	--	--	--	--	--	--	13.39	0.00	255.07
	04/03/89	--	--	--	--	--	--	12.84	0.00	255.62
	05/08/89	--	--	--	--	--	--	14.38	0.00	254.08
	06/05/89	--	--	--	--	--	--	15.36	0.00	253.10
	07/12/90	--	--	--	--	--	--	15.65	0.00	252.81
	08/10/90	--	--	--	--	--	--	15.80	0.00	252.66
	09/13/89	14,000	1,100	2,800	4,200	42,000	--	16.53	0.00	251.93
	10/04/89	--	--	--	--	--	--	16.52	0.00	251.94
	11/03/89	--	--	--	--	--	--	16.51	0.00	251.95
	12/04/89	11,000	670	2,500	3,800	36,000	--	16.79	0.00	251.67
	03/07/90	--	--	--	--	--	--	16.22	0.00	252.24
	03/09/90	12,000	940	3,000	4,700	28,000	--	16.22	0.00	252.24
	06/12/90	11,000	1,600	2,300	4,800	39,000	--	14.88	0.00	253.58
	09/24/90	13,000	1,600	3,700	6,800	120,000	--	16.30	0.00	252.16
	12/20/90	9,300	560	2,800	3,300	51,000	--	17.23	0.00	251.23
	12/20/90D	12,000	580	2,800	3,500	44,000	--	17.23	0.00	251.23
	03/27/91	3,400	5,000	1,600	5,600	56,000	--	13.78	0.00	254.68
06/18/91	--	--	--	--	--	--	18.64	0.00	249.82	
09/12/91#	--	--	--	--	--	--	--	--	--	
01/23/92#	--	--	--	--	--	--	--	--	--	
04/13/92#	--	--	--	--	--	--	--	--	--	
08/03/92#	--	--	--	--	--	--	--	--	--	
C-10A 264.84	03/07/90	--	--	--	--	--	--	20.21	0.00	244.63
	03/09/90	1.6	0.7	0.8	3.5	ND	--	--	--	--
	06/12/90	ND	ND	ND	ND	ND	--	19.70	0.00	245.14
	09/24/90	ND	ND	ND	ND	ND	--	19.54	0.00	245.30
	12/20/90	ND	ND	ND	ND	ND	--	19.84	0.00	245.00
	03/27/91	--	--	--	--	--	--	18.01	0.00	246.83
	06/18/91	ND	ND	ND	ND	ND	--	20.16	0.00	244.68
	09/12/91	ND	ND	ND	ND	ND	--	20.57	0.00	244.27
	01/23/92	ND	ND	ND	ND	ND	--	20.67	0.00	244.17
04/13/92	0.9	1.3	ND	1	53.0	--	19.40	0.00	245.44	
08/03/92	ND	ND	ND	ND	ND	ND	19.81	0.00	245.03	
C-10B 264.85	03/07/90	--	--	--	--	--	--	21.44	0.00	243.41
	06/12/90	ND	ND	ND	ND	ND	--	19.94	0.00	244.91
	09/24/90	ND	ND	ND	ND	ND	--	19.77	0.00	245.08
	12/20/90	ND	ND	ND	ND	ND	--	20.00	0.00	244.85
	03/27/91	--	--	--	--	--	--	18.23	0.00	246.62
	06/18/91	--	--	--	--	--	--	20.44	0.00	244.41
	09/12/91	ND	ND	ND	ND	ND	--	20.82	0.00	244.03
	01/23/92	ND	ND	ND	ND	ND	--	20.92	0.00	243.93
	04/13/92	ND	ND	ND	ND	ND	--	19.68	0.00	245.17
08/03/92	ND	ND	ND	ND	ND	ND	20.07	0.00	244.78	
C-11 265.30	03/07/90	--	--	--	--	--	--	22.74	0.00	242.56
	03/09/90	1.2	0.7	ND	1.4	ND	--	--	--	--
	06/12/90	ND	ND	ND	ND	ND	--	21.98	0.00	243.32
	09/24/90	ND	ND	ND	ND	ND	--	21.88	0.00	243.42
	12/20/90	ND	ND	ND	ND	ND	--	23.18	0.00	242.12
	03/27/91	ND	ND	ND	1.5	ND	--	21.52	0.00	243.78
	06/18/91	--	--	--	--	--	--	21.90	0.00	243.40
	09/12/91	ND	ND	ND	ND	ND	--	22.70	0.00	242.60
	01/23/92	ND	ND	ND	ND	ND	--	23.46	0.00	241.84
	04/13/92	ND	ND	ND	ND	ND	--	21.57	0.00	243.73
08/03/92	ND	ND	ND	ND	ND	ND	22.67	0.00	242.63	

Table 1 (continued)
HISTORICAL GROUNDWATER ANALYTICAL RESULTS AND MONITORING DATA

FORMER CHEVRON SERVICE STATION NO. 9-5607
 5269 CROW CANYON ROAD, CASTRO VALLEY, CALIFORNIA

WELL ID/ ELEVATION (TOC)	DATE	BENZENE (ppb)	TOLUENE (ppb)	ETHYL- BENZENE (ppb)	XYLENES (ppb)	TPH-G (ppb)	ORGANIC LEAD (ppb)	DTW (feet)	SPT (feet)	WTE (feet)
C-12 269.66	03/07/90	--	--	--	--	--	--	14.92	0.00	254.74
	03/09/90	230	140	33	180	1,400	--	--	--	--
	06/12/90	190	71	18	73	720	--	14.79	0.00	254.87
	09/24/90	1.1	ND	ND	0.6	ND	--	15.72	0.00	253.94
	12/20/90	210	26	8.2	23	810	--	15.26	0.00	254.40
	03/27/91	350	220	52	210	2,900	--	12.11	0.00	257.55
	06/18/91	--	--	--	--	--	--	16.38	0.00	253.28
	09/12/91	59	12	4.5	8.5	350	--	17.55	0.00	252.11
	01/23/92	110	31	7.9	22	450	--	17.11	0.00	252.55
	04/13/92	1,100	76	100	200	5,000	--	14.40	0.00	255.26
	08/03/92	200	21	13	25	520	ND	15.83	0.00	253.83
C-13 284.32	03/07/90	--	--	--	--	--	--	11.18	0.00	273.14
	03/09/90	15	3.7	1	6.2	ND	--	--	--	--
	06/12/90	2.6	ND	ND	ND	ND	--	10.70	0.00	273.62
	09/24/90	2.4	ND	ND	ND	ND	--	11.60	0.00	272.72
	12/20/90	1.6	ND	ND	ND	ND	--	10.16	0.00	274.16
	03/27/91	--	--	--	--	--	--	7.64	0.00	276.68
	06/18/91	--	--	--	--	--	--	11.32	0.00	273.00
	09/12/91	ND	ND	ND	ND	ND	--	11.84	0.00	272.48
	01/23/92	--	--	--	--	--	--	10.55	0.00	273.77
	04/13/92	1	ND	ND	ND	ND	--	10.96	0.00	273.36
	08/03/92	ND	ND	ND	ND	ND	ND	10.90	0.00	273.42
C-14 270.74	03/07/90	--	--	--	--	--	--	15.18	0.00	255.56
	03/09/90	ND	ND	ND	ND	ND	--	--	--	--
	06/12/90	ND	ND	ND	ND	ND	--	13.42	0.00	257.32
	09/24/90	ND	ND	ND	ND	ND	--	12.84	0.00	257.90
	12/20/90	1.7	0.7	ND	0.7	ND	--	16.72	0.00	254.02
	03/27/91	ND	ND	ND	1.3	ND	--	8.00	0.00	262.74
	06/18/91	--	--	--	--	--	--	15.21	0.00	255.53
	09/12/91	ND	ND	ND	ND	ND	--	15.61	0.00	255.13
	01/23/92	--	--	--	--	--	--	24.64	0.00	246.10
	04/13/92	ND	ND	ND	ND	ND	--	12.21	0.00	258.53
	08/03/92	ND	ND	ND	ND	ND	ND	14.64	0.00	256.10
C-15 246.15	03/07/90	--	--	--	--	--	--	11.10	0.00	235.05
	03/09/90	ND	1.4	0.5	0.6	410	--	--	--	--
	06/12/90	11	ND	ND	ND	420	--	10.78	0.00	235.37
	09/24/90	ND	1.5	ND	ND	430	--	10.93	0.00	235.22
	12/20/90	1.3	1.1	0.6	1.5	300	--	11.08	0.00	235.07
	03/27/91	4.6	1.1	ND	1	520***	--	8.50	0.00	237.65
	06/18/91	ND	1.1	ND	ND	290	--	10.83	0.00	235.32
	06/18/91D	ND	1.3	ND	ND	320	--	10.83	0.00	235.32
	09/12/91	ND	0.9	ND	ND	330***	--	11.05	0.00	235.10
	01/23/92	ND	0.6	ND	ND	210	--	10.80	0.00	235.35
	01/23/92D	1.2	0.8	ND	ND	190	--	10.80	0.00	235.35
04/13/92	1.8	ND	ND	ND	430	--	9.58	0.00	236.57	
08/03/92	ND	2.1	0.7	1.3	640	ND	11.21	0.00	234.94	
C-16 246.69	03/07/90	--	--	--	--	--	--	18.50	0.00	228.19
	03/09/90	ND	ND	ND	ND	ND	--	--	--	--
	06/12/90	ND	ND	ND	ND	ND	--	11.42	0.00	235.27
	09/24/90	ND	ND	ND	ND	ND	--	11.39	0.00	235.30
	12/20/90	ND	ND	ND	0.7	ND	--	11.57	0.00	235.12
	03/27/91	ND	ND	ND	1.3	ND	--	8.76	0.00	237.93
	03/27/91D	ND	ND	ND	1.2	ND	--	8.76	0.00	237.93
	06/18/91	ND	ND	ND	ND	ND	--	11.18	0.00	235.51
	09/12/91	ND	ND	ND	ND	ND	--	11.95	0.00	234.74
	01/23/92	ND	ND	ND	ND	ND	--	12.41	0.00	234.28
	04/13/92	ND	ND	ND	ND	ND	--	10.69	0.00	236.00
08/03/92	ND	ND	ND	ND	ND	ND	12.20	0.00	234.49	

Table 1 (continued)
HISTORICAL GROUNDWATER ANALYTICAL RESULTS AND MONITORING DATA

FORMER CHEVRON SERVICE STATION NO. 9-5607
 5269 CROW CANYON ROAD, CASTRO VALLEY, CALIFORNIA

WELL ID/ ELEVATION (TOC)	DATE	BENZENE (ppb)	TOLUENE (ppb)	ETHYL- BENZENE (ppb)	XYLENES (ppb)	TPH-G (ppb)	ORGANIC LEAD (ppb)	DTW (feet)	SPT (feet)	WTE (feet)
RW 274.52	12/04/89	29,000	1,700	1,800	8,800	62,000	--	--	--	--
	03/07/90	--	--	--	--	--	--	18.50	0.00	256.02
	06/12/90	15,000	2,000	560	3,100	31,000	--	18.49	0.00	256.03
	09/24/90	--	--	--	--	--	--	--	--	--
	12/20/90	0.5	ND	ND	1.2	ND	--	--	--	--
	03/27/91	--	--	--	--	--	--	--	--	--
	06/18/91	--	--	--	--	--	--	--	--	--
	09/12/91#	--	--	--	--	--	--	--	--	--
	01/23/92#	--	--	--	--	--	--	--	--	--
	04/13/92#	--	--	--	--	--	--	--	--	--
	08/03/92#	--	--	--	--	--	--	--	--	--

Explanation

Top of casing and groundwater elevations are expressed as feet above mean sea level.

TPH-G = Total Petroleum Hydrocarbons as Gasoline (ppb)

SP = Separate-phase petroleum hydrocarbons

DTW = Depth to water

SPT = Separate-phase hydrocarbon thickness

WTE = Water table elevation

TOC = Top of casing

ppb = parts per billion

ND = Not detected at or above the minimum quantitation limit

-- = Not analyzed

D = Duplicate

* = Not sampled due to insufficient water in well

** = Well could not be located

*** = Typical gasoline chromatographic pattern not present

= Not sampled: Well adapted for onsite remediation system

= Groundwater elevation corrected assuming 0.8 specific gravity for gasoline

Sampling frequency:

Quarterly: C-1, C-3, C-4, C-6, C-8, C-10, C-10B,
C-11, C-12, C-15, and C-16.

Semi-annually: C-5, C-7, C-13, and C-14.

Annually: C-2.

NOTE: See laboratory reports for minimum quantitation limits.

ATTACHMENT A

**LABORATORY REPORTS
AND
CHAIN-OF-CUSTODY MANIFESTS**



Superior Precision Analytical, Inc.

P.O. Box 1545 • Martinez, California 94553 • (510) 229-1590 / fax (510) 229-0916

Groundwater Technology Inc.
Attn: James W. Grasty

Project 02020-2887
Reported 08/10/92

TOTAL PETROLEUM HYDROCARBONS

Lab #	Sample Identification	Sampled	Analyzed Matrix
86367- 1	TB-LB	08/03/92	08/06/92 Water
86367- 2	RINSATE	08/03/92	08/06/92 Water
86367- 3	C-16	08/03/92	08/06/92 Water
86367- 4	C-14	08/03/92	08/06/92 Water
86367- 5	C-13	08/03/92	08/06/92 Water
86367- 6	C-11	08/03/92	08/07/92 Water
86367- 7	C-10B	08/03/92	08/06/92 Water
86367- 8	C-8	08/03/92	08/06/92 Water
86367- 9	C-10A	08/03/92	08/06/92 Water
86367-10	C-5	08/03/92	08/06/92 Water

RESULTS OF ANALYSIS

Laboratory Number:	86367- 1	86367- 2	86367- 3	86367- 4	86367- 5
--------------------	----------	----------	----------	----------	----------

Gasoline:	ND<50	ND<50	ND<50	ND<50	ND<50
Benzene:	ND<0.5	ND<0.5	ND<0.5	ND<0.5	ND<0.5
Toluene:	ND<0.5	ND<0.5	ND<0.5	ND<0.5	ND<0.5
Ethyl Benzene:	ND<0.5	ND<0.5	ND<0.5	ND<0.5	ND<0.5
Xylenes:	ND<0.5	ND<0.5	ND<0.5	ND<0.5	ND<0.5
Concentration:	ug/L	ug/L	ug/L	ug/L	ug/L

Laboratory Number:	86367- 6	86367- 7	86367- 8	86367- 9	86367-10
--------------------	----------	----------	----------	----------	----------

Gasoline:	ND<50	ND<50	ND<50	ND<50	ND<50
Benzene:	ND<0.5	ND<0.5	ND<0.5	ND<0.5	ND<0.5
Toluene:	ND<0.5	ND<0.5	ND<0.5	ND<0.5	ND<0.5
Ethyl Benzene:	ND<0.5	ND<0.5	ND<0.5	ND<0.5	ND<0.5
Xylenes:	ND<0.5	ND<0.5	ND<0.5	ND<0.5	ND<0.5
Concentration:	ug/L	ug/L	ug/L	ug/L	ug/L



Superior Precision Analytical, Inc.

P.O. Box 1545 • Martinez, California 94553 • (510) 229-1590 / fax (510) 229-0916

Groundwater Technology Inc.
Attn: James W. Grasty

Project 02020-2887
Reported 08/10/92

TOTAL PETROLEUM HYDROCARBONS

Lab #	Sample Identification	Sampled	Analyzed Matrix
86367-11	C-15	08/03/92	08/06/92 Water
86367-12	C-12	08/03/92	08/06/92 Water
86367-13	C-1	08/03/92	08/07/92 Water
86367-14	C-3	08/03/92	08/06/92 Water
86367-15	C-6	08/03/92	08/07/92 Water

RESULTS OF ANALYSIS

Laboratory Number:	86367-11	86367-12	86367-13	86367-14	86367-15
--------------------	----------	----------	----------	----------	----------

Gasoline:	640	520	13000	220000	120000
Benzene:	ND<0.5	200	1300	1300	16000
Toluene:	2.1	21	470	2800	1100
Ethyl Benzene:	0.7	13	550	3100	2300
Xylenes:	1.3	25	1600	17000	15000
Concentration:	ug/L	ug/L	ug/L	ug/L	ug/L



Superior Precision Analytical, Inc.

835 Arnold Drive, Suite 106 • Martinez, California 94553 • (510) 229-0166 / fax (510) 229-0916

C E R T I F I C A T E O F A N A L Y S I S

ANALYSIS FOR TOTAL PETROLEUM HYDROCARBONS

Page 3 of 3
QA/QC INFORMATION
SET: 86367

NA = ANALYSIS NOT REQUESTED

ND = ANALYSIS NOT DETECTED ABOVE QUANTITATION LIMIT

ug/L = parts per billion (ppb)

OIL AND GREASE ANALYSIS By Standard Methods Method 5520F:
Minimum Detection Limit in Water: 5000ug/L

Modified EPA SW-846 Method 8015 for Extractable Hydrocarbons:
Minimum Quantitation Limit for Diesel in Water: 50ug/L

EPA SW-846 Method 8015/5030 Total Purgable Petroleum Hydrocarbons:
Minimum Quantitation Limit for Gasoline in Water: 50ug/L

EPA SW-846 Method 8020/BTXE
Minimum Quantitation Limit in Water: 0.5ug/L

ANALYTE	SPIKE LEVEL	MS/MSD RECOVERY	RPD	CONTROL LIMIT
Gasoline:	200 ng	86/86	0%	70-130
Benzene:	200 ng	87/86	1%	70-130
Toluene:	200 ng	92/91	1%	70-130
Ethyl Benzene:	200 ng	95/94	1%	70-130
Xylenes:	200 ng	99/98	1%	70-130

Richard Srna, Ph.D.
Nancy A. Nelson for
Laboratory Director



Superior Precision Analytical, Inc.

P.O. Box 1545 • Martinez, California 94553 • (510) 229-1590 / fax (510) 229-0916

C E R T I F I C A T E O F A N A L Y S I S

LABORATORY NO.: 86367
CLIENT: Groundwater Technology Inc.
CLIENT JOB NO.: 02020-2887

DATE RECEIVED: 08/03/92
DATE REPORTED: 08/11/92
DATE SAMPLED : 08/03/92

ANALYSIS FOR TOTAL ORGANIC LEAD by DHS METHOD (LUFT MANUAL)

LAB #	Sample Identification	Concentration (mg/L)
3	C-16	ND<4
4	C-14	ND<4
5	C-13	ND<4
6	C-11	ND<4
7	C-10B	ND<4
8	C-8	ND<4
9	C-10A	ND<4
10	C-5	ND<4
11	C-15	ND<4
12	C-12	ND<4
13	C-1	ND<4
14	C-3	ND<4
15	C-6	ND<4

mg/L - parts per million (ppm)

Method Detection Limit for Organic Lead in Water: 4 mg/L

QAQC Summary: MS/MSD Average Recovery : 96%
Duplicate RPD : 13

Richard Srna, Ph.D.
Nancy A. Nelson for
Laboratory Director

