

THRIFTY OIL CO.

R-248

April 27, 2006

O.66040

Mr. Amir Gholami
Alameda County Health Care Agency
Hazardous Material Specialist
1131 Harbor Bay Parkway, Suite 250
Alameda, CA 94502

Local #RO0000348
RWQCB #01-1476

2006 MAY -1 PM 2:47

RE: **Former Thrifty Oil Co. Station #054**
TOSCO Station #2602486
2504 Castro Valley Boulevard
Castro Valley, CA
1st Quarter 2006, Status Report

Dear Mr. Gholami:

Presented herein is the First Quarter 2006, Status Report prepared for Former Thrifty Oil Co. (Thrifty) Station #054 located at 2504 Castro Valley Boulevard, Castro Valley, California (**Figure 1**). This report presents the results of the groundwater monitoring activities conducted during the first quarter of 2006. Thrifty has again provided evidence of a recent release of hydrocarbons at the site.

Should you have any questions regarding this report, please contact Michael Bowery or myself at 562 921-3581.

Respectfully submitted,



Chris Panaitescu
General Manager
Environmental Affairs

- cc: - Erika Assadi, SRWQCB (USTCF)
- Liz Sewell, TOSCO Marketing Company
76 Broadway
Sacramento CA 95818
- File



Summary of Monitoring and Sampling Activities

Former Thrifty Oil Co. Station #054

First Quarter 2006

Reporting Period: 1/1/2006 to 3/31/2006

Site Information:

Site address:	TOC SS #054 (TOSCO #2602486) 2504 Castro Valley Boulevard Castro Valley, CA
Global ID No.:	T0600101363
EDF Confirmation No.:	7072239577
Lead Agency No.:	Local # RO0000348
Lead Agency:	Alameda County Health Care Services
Agency Contact:	Mr. Amir Gholami / 510 567-6735
Project Manager:	Michael Bowery / 562-921-3581 ext. 404

Field Activity:

Groundwater wells onsite:	9
Groundwater wells offsite:	4
Date(s) monitored:	3/15/2006
Date(s) sampled:	3/15/2006
Groundwater wells gauged:	13
Groundwater wells sampled:	8
Purging method:	Bailer / Pump
Treatment / disposal method during sampling event:	Drums – Safety-Kleen pickup
Groundwater wells with free product:	0
Free product thickness (feet):	NA
Free product bailouts other than sampling event:	NA
Treatment / disposal method/free product bailouts:	NA

Site Hydrogeology:

Depth to groundwater (feet bgs):	2.64 to 9.83
Groundwater elevation (feet above mean sea level):	154.20 to 164.34
Groundwater gradient and flow direction:	East-Northeast at approximately 0.0479 ft./ft.
Consistent with previous quarter:	Consistent with previous quarters

Groundwater Conditions:

TPHg concentration (ug/L):	ND<2.9 to 35,500
Benzene concentration (ug/L):	ND<0.32 to 73
Toluene concentration (ug/L):	ND<0.1 to <1
Ethyl benzene concentration (ug/L):	ND<0.24 to 143
Total Xylenes concentration (ug/L):	ND<0.3 to 862
MTBE concentration (ug/L)	ND<0.63 to 28,500

Remediation Activity:

System type:	GWPT
System start-up:	April 1990
System Shut Down	January 2000
Cumulative Operation (hrs.):	19,388
Total GW discharge (gal.):	27,992
Total hydrocarbons extracted (lbs.):	5,631

Groundwater Monitoring

Depth to groundwater is measured in each monitoring well quarterly. Historic groundwater gauging data obtained from April 11, 1988 through March 15, 2006, is presented in **Table 1**. A groundwater elevation contour map based on the March 15, 2006, data is presented in **Figure 1**. Groundwater elevation data indicates that the general direction of groundwater flow beneath the site is toward the east-northeast with a hydraulic gradient of approximately 0.0479 feet/foot.

Quarterly Groundwater Sampling

As part of the ongoing groundwater-monitoring program, groundwater samples were obtained from selected monitoring wells PW-1, RE-2, RE-3, RE-4, RE-6, RE-7, RS-9, and RS-11 on March 15, 2006. In a letter from the Alameda County Health Care Services (ACHCS) dated November 6, 2001, the ACHCS released Thrifty from collecting groundwater samples from wells PW-2, RE-1, RE-5, RS-8, and RS-10 until further notice.

Groundwater samples were obtained by EMC and delivered in a chilled state in an ice chest following strict Chain-of-Custody procedures to a state-certified laboratory. The samples were analyzed for total petroleum hydrocarbons as gasoline (TPHg) by EPA Method 8015M for gasoline and for benzene, toluene, ethylbenzene, xylenes (BTEX) and methyl tert-butyl ether (MTBE) by EPA Method 8260B. Copies of the EMC Field Status Reports are presented in **Appendix A**, and copies of the laboratory analytical reports are contained in **Appendix B**.

TPHg, BTEX, and MTBE concentrations appear in **Table 1** and laboratory reports are provided in **Appendix B**. TPHg, benzene, and MTBE isoconcentration maps are presented in **Figures 2, 3, and 4**, respectively. The highest laboratory analytical concentrations for TPHg and MTBE were found in well PW-1 (35,500 ug/L and 28,500 ug/L, respectively). The highest benzene concentration was found in well RE-7 (73 ug/L).

Well RS-9 is located upgradient of the Thrifty site, and any contamination found in this well appears to be originating from an upgradient off-site source. However, the recent elevated dissolved hydrocarbon concentrations at the former Thrifty site appear to be from an onsite unauthorized release, as discussed in detail later in this report. TOSCO (ConocoPhillips) Marketing Company is the current operator of the service station and acquired the lease in 1994 from BP Oil, who previously leased the property beginning on July 10, 1991.

Site Remediation Activities

In August 1989, Remediation Service, Int'l. (RSI) installed a Spray Aeration Vapor Extraction (SAVE) system at the site for soil and groundwater remediation. However, due to unanticipated delays in permits, the system was not started until April 1990. Due to noise complaints, the system was operated only during daylight hours recovering hydrocarbon vapors during the first three months of operation. The equipment was moved to another location onsite in late June 1990, and from that date on the equipment was in operation for 24 hours a day.

On January 31, 2000, Thrifty submitted a *Request for Shutdown and Removal of the Vapor Extraction System* to the ACHCS. The ACHCS authorized the vapor extraction system shut down and removal on February 16, 2000. By the end of the operation, the system had destroyed a total of 5,631 pounds of hydrocarbons (Table 2) and treated/discharged 27,992 gallons of groundwater.

Continued Evidence of New/Recent Release or Possible Presence of an Active Source

In a letter dated December 30, 2004, submitted jointly to TOSCO (ConocoPhillips) and the ACHCS, Thrifty provided evidence of a recent release of hydrocarbons as detected in groundwater samples collected during the 2nd, 3rd, and 4th Quarters 2004. Data collected during the 1st Quarter 2005 indicated that while TPHg, benzene, and MTBE concentrations appeared to be decreasing, they were still significantly elevated over March, June, and September 2004 levels in onsite wells RE-2, RE-4, RE-6, and RE-7 located near the underground storage tanks and pump islands. The decrease in concentrations may simply be the result that the dissolved plume is moving away from the source and/or that some of the plume is being sorbed onto the soil particles.

In a letter dated February 1, 2005, TOSCO (Conoco Phillips) responded to Thrifty's assertion that a recent release had occurred and indicated that the site is likely being impacted by an offsite source. TOSCO (ConocoPhillips) indicated in their letter that no pattern of fluctuation in dissolved hydrocarbon concentrations has been established to date that has not been seen before at the site. Thrifty's review of the data, however, indicates that over the past 14 years (since 1991), there have been no fluctuations in dissolved hydrocarbon concentrations even close to those seen between the 3rd and 4th Quarters of 2004. TOSCO (ConocoPhillips) stated in their letter that dissolved elevated concentrations of hydrocarbons were present in wells RE-6 and RE-7, but were not present in well PW-1 located between RE-6 and RE-7, therefore a recent release was unlikely. **Data collected during the 2nd Quarter 2005 and the current quarter indicated that well PW-1 contained the highest TPHg and MTBE concentrations.** Thus, it appears that the recent release did impact well PW-1. Data during the third quarter 2005 indicates that dissolved hydrocarbon concentrations were not detected in well PW-1. However, the dissolved concentrations in adjacent, upgradient well RE-6 continued to decline whereas in downgradient well RE-7 the concentrations remained high indicating that the contamination is simply migrating in the area of these three wells. During the 1st quarter 2006, elevated TPHg and MTBE concentrations were again detected in well PW-1 at concentrations of 35,500 and 28,200 ug/L, respectively. TPHg and MTBE remained high in RE-7 during the 1st quarter 2006 and benzene increased from ND<16 to 73 ug/L.

TOSCO (ConocoPhillips) has asserted that the dissolved hydrocarbon concentrations noted in wells RE-3 and RE-4 were the result of migration of the dissolved plume from well RE-1. However, the maximum TPHg concentrations detected in well RE-1 was 150,000 ug/L on January 8, 1991, 28,000 ug/L on March 8, 1995, then consistently decreased to <50 ug/L beginning on December 1, 1999, as a result of active remediation conducted by Thrifty at the site from April 1990 to January 2000, whereas the TPHg concentration in well RE-4 was 297,000 ug/L in December 2004. The December 2004 levels were almost double than the highest historical level recorded 13 years ago, when the active remediation was just initiated.

Thrifty has plotted TPHg, benzene, and MTBE concentrations over time versus groundwater elevations for wells RE-2 (Figure 5), RE-3 (Figure 6), RE-4 (Figure 7), RE-6 (Figure 8), RE-7 (Figure 9), and PW-1 (Figure 10). The increases in TPHg and MTBE in wells RE-2, RE-4, RE-6, and RE-7 for the 3rd and 4th quarters of 2004 and 1st quarter of 2005 are quite dramatic when compared to the TPHg and MTBE concentrations over time. There is also a significant increase in TPHg and MTBE concentrations in well PW-1 in the 1st quarter 2005 and the 1st quarter 2006 (Figure 10). There is a corresponding rise in groundwater elevation in each of these wells; however, there have been comparable rises in groundwater elevations in the past with no corresponding increase in dissolved hydrocarbon concentrations. Thus, it appears that a rise in groundwater elevation is not the reason for the significant increases in dissolved hydrocarbon concentrations at the site.

Further evidence of a recent release is provided by the use of BTEX ratios that are used as a means to compare the relative age of gasoline releases into the subsurface. The most common method is the cumulative BTEX ration that is described as B+T/E+X. Site investigations indicate that values between 1 and 6 are supportive of a recent release and that values less than 0.5 usually indicate a release older than about 8 to 10 years (Kaplan et. al. 1997, "Forensic Environmental Geochemistry: Differentiation of Fuel Types, Their Sources and Release Time," Robert D. Morrison: "Forensic Techniques for Establishing the Origin and Timing of Contaminant Release"). The table provided below provides B+T/E+X ratios based on the groundwater samples collected during sampling events beginning in September 2004.

Sampling Date	Well ID	B	T	B+T	E	X	E+X	B+T/E+X
9/2/04	RE-3	982	65	1,047	77	86	163	6.42
9/2/04	RE-4	587	50	637	34	65	99	6.43
12/8/04	RE-4	4,680	44,900	49,580	4,850	29,000	33,850	1.46
12/8/04	RE-7	4,380	34,800	39,180	5,370	25,000	30,370	1.29
3/16/05	RE-7	2,840	19,400	22,240	2,760	14,400	17,160	1.30
6/1/05	RE-4	1,530	6,890	8,420	39	6,880	6,919	1.22
6/1/05	RE-7	1,860	8,690	10,550	1,180	4,980	6,160	1.71

Based on the September 2, 2004, sampling results, the B+T/E+X for monitoring wells RE-4 and RE-3 were 6.43 and 6.42, respectively. Beginning in September 2004, the BTEX ratios ranged between 0.54 and 6.43 thus providing additional evidence of a recent release at former Thrifty Station #054. Wells RE-3 and RE-4 are located downgradient of the USTs/piping and well RE-7 is located downgradient of the dispensers. Although well RE-2 is not located downgradient of the dispensers, it is located very close to the dispensers which appear to be a source of the recent release along with the USTs and/or piping.

Thrifty has contended in the past that an offsite upgradient source contributed to the contamination previously detected in offsite, upgradient well RS-9. The concentrations in well RS-9, however, have never been detected at nearly as high of concentrations recently found in wells RE-2, RE-4, RE-6, and RE-7.

TOSCO (ConocoPhillips) also provided evidence of tank tightness testing and secondary containment testing. Unfortunately, the most recent tank tightness test report was dated May 5, 2004 and the most recent secondary containment test report was dated September 7, 2004, both of which could have predated the recent release that apparently occurred during the 4th Quarter 2004. The UST Monitor Certification

Summary Report dated May 5, 2004 also reported one gallon of water in the 89 turbine sump and about 8 ounces of fuel in the 91 turbine sump.

In addition, the presence of MTBE in groundwater indicates a post 1991 release since Thrifty did not dispense MTBE blended gasoline during its operation. Thrifty's refinery (Golden West Refining Co.) began using MTBE in gasoline manufacturing processes in October 1992 when this site was already operated by BP Oil and later by TOSCO.

Thrifty believes that the recent increase (June 2005 and March 2006) in TPHg and MTBE concentrations in well PW-1 provide further evidence of a recent release at the site and strongly support Thrifty's position that if further assessment and remediation becomes necessary, it should be the responsibility of TOSCO (ConocoPhillips) and that TOSCO (ConocoPhillips) should investigate to determine if an upgradient source is contributing to the dissolved hydrocarbon plume at the site. Thrifty respectfully repeats its request that the ACHCS acknowledge the evidence of a new release (s) that occurred after 1991 and to designate the current operator of the facility as the Primary Responsible Party for any corrective actions required in the future.

Planned Activities

In a letter received by Thrifty dated December 7, 2005, the ACHCS requested site information including depth to water, groundwater flow direction, dissolved constituents concentrations, well screen levels, plume stability, and if active remediation was occurring onsite. Thrifty forwarded the requested information on January 10, 2006. The ACHCS also requested that a site conceptual model (SCM) be prepared for the site. Thrifty will submit the SCM under separate cover by May 2, 2005.

Thrifty will continue the groundwater monitoring, gauging, and sampling events at this site on a quarterly basis. All interpretations expressed in this report are based solely upon the review of data collected by EMC and laboratory analyses by Associated Laboratories.

Sincerely,



Michael H. Bowery, P.G. 5027
Project Manager



TABLES

**TABLE 1
GROUNDWATER DATA
THRIFTY OIL STATION #054, CASTRO VALLEY, CA.**

DATE SAMPLED	ANALYTICAL PARAMETERS						DEPTH TO GROUNDWATER (feet)	DEPTH TO PRODUCT (feet)	PRODUCT THICKNESS (feet)	CASING ELEVATION (feet)	GROUNDWATER ELEVATION (feet)
	TPH (ug/L)	BENZENE (ug/L)	TOLUENE (ug/L)	EthylBenzene (ug/L)	XYLENE (ug/L)	MTBE (ug/L)					
MONITORING WELL #PW-1											
<i>Screen Interval - 5 to 15 feet (Est.)</i>											
04/11/88	-	-	-	-	-	-	-	-	-	-	-
04/09/90	230,000	600	2,700	1,000	16,000	-	5.10	NP	0.00	166.46	161.36
10/30/90	35,000	240	970	240	3,580	-	6.17	NP	0.00	166.46	160.29
01/18/91	37,000	43	140	42	1,600	-	6.28	NP	0.00	166.46	160.18
02/12/91	45,000	99	130	25	700	-	5.88	NP	0.00	166.46	160.58
03/20/91	1,900	0.43	ND	ND	2.8	-	4.75	NP	0.00	166.46	161.71
05/22/91	41,000	600	730	250	3,800	-	5.10	NP	0.00	166.46	161.36
06/19/91	-	-	-	-	-	-	5.61	NP	0.00	166.46	160.85
07/17/91	-	-	-	-	-	-	5.53	FILM	0.00	166.46	160.93
08/07/91	-	-	-	-	-	-	5.67	FILM	0.00	166.46	160.79
09/24/91	-	-	-	-	-	-	5.57	FILM	0.00	166.46	160.89
10/23/91	-	-	-	-	-	-	6.53	FILM	0.00	166.46	159.93
11/06/91	-	-	-	-	-	-	5.85	FILM	0.00	166.46	160.61
12/04/91	-	-	-	-	-	-	5.91	FILM	0.00	166.46	160.55
01/29/92	-	-	-	-	-	-	5.43	FILM	0.00	166.46	161.03
02/26/92	-	-	-	-	-	-	5.54	FILM	0.00	166.46	160.92
03/19/92	ND	ND	ND	ND	ND	-	5.47	NP	0.00	166.46	160.99
04/22/92	-	-	-	-	-	-	5.62	FILM	0.00	166.46	160.84
05/21/92	1,300	19	2.9	0.7	58	-	6.21	NP	0.00	166.46	160.25
06/25/92	-	-	-	-	-	-	6.94	NP	0.00	166.46	159.52
07/30/92	-	-	-	-	-	-	5.90	FILM	0.00	166.46	160.56
08/20/92	-	-	-	-	-	-	7.12	FILM	0.00	166.46	159.34
09/30/92	3,400	57	ND	26	240	-	6.42	NP	0.00	166.46	160.04
12/23/92	-	-	-	-	-	-	5.56	FILM	0.00	166.46	160.90
03/10/93	-	-	-	-	-	-	5.65	FILM	0.00	166.46	160.81
06/09/93	400	<0.5	1.1	<1.0	<1.0	-	5.30	NP	0.00	166.46	161.16
09/14/93	180	3.7	3.2	1.5	14	-	5.43	NP	0.00	166.46	161.03
12/14/93	<50	<0.3	<0.3	<0.3	<0.5	-	4.65	NP	0.00	166.46	161.81
03/02/94	<50	<0.3	<0.3	<0.3	<0.5	-	5.43	NP	0.00	166.46	161.03
06/06/94	330	1.3	<0.3	0.88	9.8	-	4.70	NP	0.00	166.46	161.76
09/06/94	1,100	67	<0.3	<0.3	24	-	6.48	NP	0.00	166.46	159.98
12/07/94	<50	<0.3	<0.3	<0.5	<0.5	-	5.22	NP	0.00	166.46	161.24
03/08/95	<100	<0.5	<0.5	<0.5	<1	-	6.94	NP	0.00	166.46	159.52

TABLE 1
GROUNDWATER DATA
THRIFTY OIL STATION #054, CASTRO VALLEY, CA.

DATE SAMPLED	ANALYTICAL PARAMETERS						DEPTH TO GROUNDWATER (feet)	DEPTH TO PRODUCT (feet)	PRODUCT THICKNESS (feet)	CASING ELEVATION (feet)	GROUNDWATER ELEVATION (feet)
	TPH (ug/L)	BENZENE (ug/L)	TOLUENE (ug/L)	EthylBenzene (ug/L)	XYLENE (ug/L)	MTBE (ug/L)					
06/15/95	260	0.8	0.6	<0.5	3.2	-	5.72	NP	0.00	166.46	160.74
09/05/95	330	2.1	<0.5	2.1	9.6	-	5.96	NP	0.00	166.46	160.50
11/21/95	660	13	1.3	<0.3	4.0	-	6.04	NP	0.00	166.46	160.42
03/11/96	660	0.94	0.77	<0.3	8.1	-	3.60	NP	0.00	166.46	162.86
06/19/96	120	0.53	<0.3	<0.3	2.3	-	4.80	NP	0.00	166.46	161.66
09/16/96	<50	<0.3	<0.3	<0.3	<0.5	<20	5.10	NP	0.00	166.46	161.36
12/10/96	<50	<0.3	<0.3	<0.3	<0.5	<20	4.92	NP	0.00	166.46	161.54
03/12/97	<50	<0.3	<0.3	<0.3	<0.5	<20	4.50	NP	0.00	166.46	161.96
06/12/97	<50	<0.3	<0.3	<0.3	<0.5	<20	-	-	-	-	-
09/16/97	690	0.97	<0.3	<0.3	<0.5	<20	4.55	NP	0.00	166.46	161.91
12/09/97	640	150	0.64	<0.3	5.2	1,300	5.60	NP	0.00	166.46	160.86
03/03/98	<50	<0.3	0.57	<0.3	<0.5	<20	4.13	NP	0.00	166.46	162.33
07/08/98	<50	<0.3	<0.3	<0.3	<0.5	<5	-	-	-	-	-
09/10/98	<50	<0.3	<0.3	<0.3	<0.5	<5	6.35	NP	0.00	166.46	160.11
12/30/98	<50	1.1	<0.3	<0.3	<0.5	<5	6.40	NP	0.00	166.46	160.06
03/15/99	<50	<0.3	<0.3	<0.3	<0.5	<5	6.35	NP	0.00	166.46	160.11
06/22/99	<50	<0.3	<0.3	<0.3	<0.5	53	4.95	NP	0.00	166.46	161.51
09/08/99	<50	<0.3	<0.3	<0.3	<0.5	<5	4.80	NP	0.00	166.46	161.66
12/01/99	<50	<0.3	<0.3	<0.3	<0.5	<5	3.64	NP	0.00	166.46	162.82
03/23/00	<50	0.5	0.5	1.1	<0.5	<5	4.03	NP	0.00	166.46	162.43
06/08/00	<50	<5	<5	<5	<5	<5	4.40	NP	0.00	166.46	162.06
09/27/00	<50	<0.18	<0.14	<0.18	<0.26	<0.24	4.73	NP	0.00	166.46	161.73
12/13/00	<50	<0.18	<0.14	<0.18	<0.26	<0.24	4.01	NP	0.00	166.46	162.45
03/22/01	600	<0.18	1.3	<0.18	<0.26	*1,010 / 1,970	6.32	NP	0.00	166.46	160.14
06/15/01	<50	<0.18	<0.14	<0.18	<0.26	<0.24	6.32	NP	0.00	166.46	160.14
08/30/01	<50	<0.18	<0.14	<0.18	<0.26	<0.24	6.32	NP	0.00	166.46	160.14
12/12/01	<50	<0.18	<0.14	<0.18	<0.26	<0.24	6.02	NP	0.00	166.46	160.44
03/13/02	<50	<0.18	<0.14	<0.18	<0.26	<0.24	6.30	NP	0.00	166.46	160.16
06/12/02	1,320	1	1	<0.18	2	2,060	6.30	NP	0.00	166.46	160.16
09/18/02	<50	<0.18	<0.14	<0.18	<0.26	<0.24	7.06	NP	0.00	166.46	159.40
12/18/02	113	<0.18	1.1	<0.18	<0.26	89	6.30	NP	0.00	166.46	160.16
03/19/03	<15	<0.04	2.2	<0.02	2.7	<0.03	6.35	NP	0.00	166.46	160.11
06/11/03	<15	<0.04	<0.02	<0.02	<0.06	<0.03	6.35	NP	0.00	166.46	160.11
09/04/03	<15	<0.22	<0.32	<0.31	<0.4	<0.18	5.90	NP	0.00	166.46	160.56

**TABLE 1
GROUNDWATER DATA
THRIFTY OIL STATION #054, CASTRO VALLEY, CA.**

DATE SAMPLED	ANALYTICAL PARAMETERS						DEPTH TO GROUNDWATER (feet)	DEPTH TO PRODUCT (feet)	PRODUCT THICKNESS (feet)	CASING ELEVATION (feet)	GROUNDWATER ELEVATION (feet)
	TPH (ug/L)	BENZENE (ug/L)	TOLUENE (ug/L)	EthylBenzene (ug/L)	XYLENE (ug/L)	MTBE (ug/L)					
12/04/03	<15	<0.04	<0.02	<0.02	<0.06	<0.03	3.38	NP	0.00	165.95	162.57
03/18/04	<15	<0.22	<0.32	<0.31	<0.4	<0.18	5.51	NP	0.00	165.95	160.44
06/09/04	<15	<0.14	<0.16	<0.18	<0.45	<0.22	5.35	NP	0.00	165.95	160.60
09/02/04	133	<0.14	2.4	<0.18	1.9	<0.22	6.33	NP	0.00	165.95	159.62
12/08/04	<15	<0.14	1.3	<0.18	<0.45	<0.22	4.59	NP	0.00	165.95	161.36
03/16/05	<15	<0.22	<0.32	<0.31	<0.4	<0.18	5.90	NP	0.00	165.95	160.05
06/01/05	49,300	1,540	3,990.0	154	6,190	69,000	4.81	NP	0.00	165.95	161.14
09/14/05	<2.9	<0.32	<0.10	<0.24	<0.30	<0.63	4.74	NP	0.00	165.95	161.21
12/06/05	272	6.6	1.5 J	5.1	9.6	217	4.35	NP	0.00	165.95	161.60
03/15/06	35,500	<3.2	<1.0	<2.4	862	28,500	4.79	NP	0.00	165.95	161.16
MONITORING WELL PW-2											
<i>Screen Interval = 5 to 15 feet (Est.)</i>											
04/11/88	-	-	-	-	-	-	-	-	-	-	-
04/09/90	600,000	1,300	11,000	4,600	4,300	-	5.81	NP	0.00	166.18	160.37
10/30/90	48,000	310	51	10	480	-	6.95	NP	0.00	166.18	159.23
01/18/91	86,000	230	1,400	350	8,300	-	6.92	NP	0.00	166.18	159.26
02/12/91	160,000	680	1,300	250	7,000	-	6.78	NP	0.00	166.18	159.40
03/20/91	17,000	34	50	ND	1,100	-	5.54	NP	0.00	166.18	160.64
05/22/91	14,000	57	2,100	500	8,200	-	6.07	NP	0.00	166.18	160.11
06/19/91	-	-	-	-	-	-	6.37	FILM	0.00	166.18	159.81
07/17/91	-	-	-	-	-	-	6.38	FILM	0.00	166.18	159.80
08/07/91	-	-	-	-	-	-	6.63	FILM	0.00	166.18	159.55
09/24/91	-	-	-	-	-	-	6.42	FILM	0.00	166.18	159.76
10/23/91	-	-	-	-	-	-	7.25	FILM	0.00	166.18	158.93
11/06/91	-	-	-	-	-	-	6.44	FILM	0.00	166.18	159.74
12/04/91	-	-	-	-	-	-	6.65	FILM	0.00	166.18	159.53
01/29/92	-	-	-	-	-	-	6.17	FILM	0.00	166.18	160.01
02/26/92	-	-	-	-	-	-	5.90	FILM	0.00	166.18	160.28
03/19/92	-	-	-	-	-	-	5.80	FILM	0.00	166.18	160.38
04/22/92	-	-	-	-	-	-	5.88	FILM	0.00	166.18	160.30
05/21/92	-	-	-	-	-	-	6.03	FILM	0.00	166.18	160.15
06/25/92	-	-	-	-	-	-	6.57	FILM	0.00	166.18	159.61
07/30/92	-	-	-	-	-	-	6.20	FILM	0.00	166.18	159.98

TABLE 1
GROUNDWATER DATA
THRIFTY OIL STATION #054, CASTRO VALLEY, CA.

DATE SAMPLED	ANALYTICAL PARAMETERS						DEPTH TO GROUNDWATER (feet)	DEPTH TO PRODUCT (feet)	PRODUCT THICKNESS (feet)	CASING ELEVATION (feet)	GROUNDWATER ELEVATION (feet)
	TPH (ug/L)	BENZENE (ug/L)	TOLUENE (ug/L)	EthylBenzene (ug/L)	XYLENE (ug/L)	MTBE (ug/L)					
08/20/92	-	-	-	-	-	-	6.64	FILM	0.00	166.18	159.54
09/30/92	-	-	-	-	-	-	6.88	FILM	0.00	166.18	159.30
12/23/92	-	-	-	-	-	-	6.08	FILM	0.00	166.18	160.10
03/10/93	-	-	-	-	-	-	5.95	FILM	0.00	166.18	160.23
06/09/93	3,400	24	22	<0.5	240	-	5.38	NP	0.00	166.18	160.80
09/14/93	4,900	190	15	6.8	480	-	6.26	NP	0.00	166.18	159.92
12/14/93	1,700	4.2	<0.3	<0.3	<0.5	-	5.22	NP	0.00	166.18	160.96
03/02/94	-	-	-	-	-	-	5.75	FILM	0.00	166.18	160.43
06/06/94	980	25	1.2	<0.3	42	-	5.25	NP	0.00	166.18	160.93
09/06/94	3,200	95	3.0	<1.7	76	-	6.80	NP	0.00	166.18	159.38
12/07/94	510	1.8	<0.3	<0.5	1.7	-	5.57	NP	0.00	166.18	160.61
03/08/95	1,900	<0.5	<0.5	1.4	35	-	4.10	NP	0.00	166.18	162.08
06/15/95	1,700	5.6	<0.5	<0.5	1.6	-	5.44	NP	0.00	166.18	160.74
09/05/95	2,500	33	1.0	0.86	18	-	6.13	NP	0.00	166.18	160.05
11/21/95	2,800	130	59	18	190	-	6.23	NP	0.00	166.18	159.95
03/11/96	13,000	330	460	<15	3,800	-	4.48	NP	0.00	166.18	161.70
06/19/96	1,400	<0.3	<0.3	<0.3	<0.5	-	5.38	NP	0.00	166.18	160.80
09/16/96	3,500	<0.3	<0.3	<0.3	<0.5	5,900	5.21	NP	0.00	166.18	160.97
12/10/96	2,100	<0.3	<0.3	<0.3	<0.5	4,700	4.87	NP	0.00	166.18	161.31
03/12/97	600	1.6	<0.3	<0.3	5.8	1,100	4.43	NP	0.00	166.18	161.75
06/12/97	270	<0.3	<0.3	<0.3	<0.5	630	-	-	-	-	-
09/10/97	220	<0.3	<0.3	<0.3	<0.5	320	4.07	NP	0.00	166.18	162.11
12/09/97	120	<0.3	0.73	<0.3	<0.5	420	5.20	NP	0.00	166.18	160.98
03/03/98	<50	0.43	0.48	<0.3	<0.5	47	3.30	NP	0.00	166.18	162.88
07/08/98	<50	<0.3	<0.3	<0.3	<0.5	<5	-	-	-	-	-
09/10/98	<50	<0.3	<0.3	<0.3	<0.5	<5	5.15	NP	0.00	166.18	161.03
12/30/98	<50	1.1	<0.3	<0.3	<0.5	<5	4.75	NP	0.00	166.18	161.43
03/15/99	<50	<0.3	<0.3	<0.3	<0.5	<5	4.40	NP	0.00	166.18	161.78
06/22/99	-	-	-	-	-	-	4.50	NP	0.00	166.18	161.68
09/08/99	100	<0.3	<0.3	<0.3	<0.5	230	3.99	NP	0.00	166.18	162.19
12/01/99	<50	<0.3	<0.3	<0.3	<0.5	<5	3.62	NP	0.00	166.18	162.56
03/23/00	<50	<0.25	<0.25	<0.25	<0.5	<5	2.93	NP	0.00	166.18	163.25
06/08/00	<50	<5	<5	<5	<5	<5	3.60	NP	0.00	166.18	162.58
09/27/00	<50	<0.18	<0.14	<0.18	<0.26	<0.24	3.61	NP	0.00	166.18	162.57

**TABLE 1
GROUNDWATER DATA
THRIFTY OIL STATION #054, CASTRO VALLEY, CA.**

DATE SAMPLED	ANALYTICAL PARAMETERS						DEPTH TO GROUNDWATER (feet)	DEPTH TO PRODUCT (feet)	PRODUCT THICKNESS (feet)	CASING ELEVATION (feet)	GROUNDWATER ELEVATION (feet)
	TPH (ug/L)	BENZENE (ug/L)	TOLUENE (ug/L)	EthylBenzene (ug/L)	XYLENE (ug/L)	MTBE (ug/L)					
12/13/00	<50	<0.18	<0.14	<0.18	<0.26	<0.24	3.60	NP	0.00	166.18	162.58
03/22/01	<50	<0.18	<0.14	<0.18	<0.26	<0.24	5.14	NP	0.00	166.18	161.04
06/15/01	<50	<0.18	<0.14	<0.18	<0.26	<0.24	5.13	NP	0.00	166.18	161.05
08/30/01	<50	<0.18	<0.14	<0.18	<0.26	<0.24	5.90	NP	0.00	166.18	160.28
12/12/01	<50	<0.18	<0.14	<0.18	<0.26	<0.24	6.20	NP	0.00	166.18	159.98
03/13/02	-	-	-	-	-	-	5.14	NP	0.00	166.18	161.04
06/12/02	-	-	-	-	-	-	-	-	-	-	-
09/18/02	-	-	-	-	-	-	-	-	-	-	-
12/18/02	-	-	-	-	-	-	-	-	-	-	-
03/19/03	-	-	-	-	-	-	-	-	-	-	-
06/11/03	-	-	-	-	-	-	-	-	-	-	-
09/04/03	-	-	-	-	-	-	-	-	-	-	-
12/04/03	-	-	-	-	-	-	3.20	NP	0.00	165.61	162.41
03/18/04	-	-	-	-	-	-	5.12	NP	0.00	165.61	160.49
06/09/04	-	-	-	-	-	-	4.72	NP	0.00	165.61	160.89
09/02/04	-	-	-	-	-	-	6.95	NP	0.00	165.61	158.66
12/08/04	-	-	-	-	-	-	3.63	NP	0.00	165.61	161.98
03/16/05	-	-	-	-	-	-	5.12	NP	0.00	165.61	160.49
06/01/05	-	-	-	-	-	-	4.00	NP	0.00	165.61	161.61
09/14/05	-	-	-	-	-	-	3.97	NP	0.00	165.61	161.64
12/06/05	-	-	-	-	-	-	3.97	NP	0.00	165.61	161.64
03/15/06	-	-	-	-	-	-	4.00	NP	0.00	165.61	161.61
MONITORING WELL #RE-1 <i>Screen Interval = 5 to 17 feet</i>											
04/11/88	37,000	1,900	8,400	1,200	15,000	-	-	-	-	-	-
04/09/90	45,000	6,100	7,000	2,000	8,800	-	4.99	NP	0.00	166.82	161.83
10/30/90	72,000	7,700	5,300	1,800	8,900	-	5.95	NP	0.00	166.82	160.87
01/18/91	150,000	11,000	14,000	1,800	4,300	-	5.17	NP	0.00	166.82	161.65
02/12/91	140,000	11,000	12,000	1,600	13,000	-	4.16	NP	0.00	166.82	162.66
03/20/91	53,000	3,100	4,200	400	5,500	-	4.75	NP	0.00	166.82	162.07
05/22/91	85,000	8,700	10,000	1,800	12,000	-	4.42	NP	0.00	166.82	162.40
06/19/91	110,000	8,500	9,600	2,600	16,000	-	4.93	NP	0.00	166.82	161.89
07/17/91	5,500	950	ND	26	ND	-	5.19	NP	0.00	166.82	161.63

TABLE 1
GROUNDWATER DATA
THRIFTY OIL STATION #054, CASTRO VALLEY, CA.

DATE SAMPLED	ANALYTICAL PARAMETERS						DEPTH TO GROUNDWATER (feet)	DEPTH TO PRODUCT (feet)	PRODUCT THICKNESS (feet)	CASING ELEVATION (feet)	GROUNDWATER ELEVATION (feet)
	TPH (ug/L)	BENZENE (ug/L)	TOLUENE (ug/L)	EthylBenzene (ug/L)	XYLENE (ug/L)	MTBE (ug/L)					
08/07/91	-	6,700	5,000	ND	7,100	-	5.12	NP	0.00	166.82	161.70
09/24/91	60,000	6,800	4,300	640	6,900	-	5.87	NP	0.00	166.82	160.95
10/23/91	79,000	7,900	8,300	450	7,100	-	5.81	NP	0.00	166.82	161.01
11/06/91	130,000	14,000	15,000	1,100	8,800	-	5.56	NP	0.00	166.82	161.26
12/04/91	50,000	8,000	4,700	520	4,100	-	5.35	NP	0.00	166.82	161.47
01/29/92	21,000	10,300	11,000	780	6,000	-	4.50	NP	0.00	166.82	162.32
02/26/92	38000	8,400	10,500	720	7,100	-	5.27	NP	0.00	166.82	161.55
03/19/92	48,000	6,200	9,700	780	7,200	-	4.47	NP	0.00	166.82	162.35
04/22/92	-	-	-	-	-	-	4.62	NP	0.00	166.82	162.20
05/21/92	20,000	7,600	10,100	830	6,900	-	4.98	NP	0.00	166.82	161.84
06/25/92	-	-	-	-	-	-	5.14	FILM	0.00	166.82	161.68
07/30/92	-	-	-	-	-	-	5.30	FILM	0.00	166.82	161.52
08/20/92	-	-	-	-	-	-	5.28	FILM	0.00	166.82	161.54
09/30/92	-	-	-	-	-	-	5.66	FILM	0.00	166.82	161.16
12/23/92	-	-	-	-	-	-	4.81	FILM	0.00	166.82	162.01
03/10/93	-	-	-	-	-	-	4.13	FILM	0.00	166.82	162.69
06/09/93	-	-	-	-	-	-	4.48	FILM	0.00	166.82	162.34
09/14/93	19,000	3,600	1,100	740	4,300	-	5.35	NP	0.00	166.82	161.47
12/14/93	38,000	4,300	1,300	<6.6	11	-	4.38	NP	0.00	166.82	162.44
03/02/94	-	-	-	-	-	-	4.22	FILM	0.00	166.82	162.60
06/06/94	-	-	-	-	-	-	2.16	FILM	0.00	166.82	164.66
09/06/94	74,000	3,300	3,900	1,200	6,100	-	5.00	NP	0.00	166.82	161.82
12/07/94	30,000	3,200	2,900	1,200	4,600	-	4.10	NP	0.00	166.82	162.72
03/08/95	28,000	4,200	2,300	810	7,800	-	3.92	NP	0.00	166.82	162.90
06/15/95	-	-	-	-	-	-	-	-	-	-	-
09/05/95	-	-	-	-	-	-	4.78	FILM	0.00	166.82	162.04
11/21/95	-	-	-	-	-	-	4.82	NP	0.00	166.82	162.00
03/11/96	270	2.4	6.0	4.5	19	-	3.32	NP	0.00	166.82	163.50
06/19/96	3,000	570	63	<1.5	400	-	4.20	NP	0.00	166.82	162.62
09/16/96	7,700	440	69	<1.5	680	230	4.68	NP	0.00	166.82	162.14
12/10/96	52	<0.3	<0.3	<0.3	<0.5	120	4.93	NP	0.00	166.82	161.89
03/12/97	8,700	180	5.4	40	1,100	130	4.10	NP	0.00	166.82	162.72
06/12/97	<50	<0.3	<0.3	<0.3	<0.5	36	-	-	-	-	-
09/16/97	<50	<0.3	<0.3	<0.3	<0.5	<20	4.55	NP	0.00	166.82	162.27

TABLE 1
GROUNDWATER DATA
THRIFTY OIL STATION #054, CASTRO VALLEY, CA.

DATE SAMPLED	ANALYTICAL PARAMETERS						DEPTH TO GROUNDWATER (feet)	DEPTH TO PRODUCT (feet)	PRODUCT THICKNESS (feet)	CASING ELEVATION (feet)	GROUNDWATER ELEVATION (feet)
	TPH (ug/L)	BENZENE (ug/L)	TOLUENE (ug/L)	EthylBenzene (ug/L)	XYLENE (ug/L)	MTBE (ug/L)					
12/09/97	<50	<0.3	0.44	<0.3	<0.5	<20	5.30	NP	0.00	166.82	161.52
03/03/98	1,100	13	0.51	<0.3	<0.5	220	4.55	NP	0.00	166.82	162.27
07/08/98	<50	<0.3	<0.3	<0.3	<0.5	<5	-	-	-	-	-
09/10/98	60	<0.3	<0.3	<0.3	<0.5	180	6.05	NP	0.00	166.82	160.77
12/30/98	<50	1.1	<0.3	<0.3	<0.5	<5	5.65	NP	0.00	166.82	161.17
03/15/99	<50	<0.3	<0.3	<0.3	<0.5	<5	5.68	NP	0.00	166.82	161.14
06/22/99	880	14	0.98	<0.3	8.1	260	4.95	NP	0.00	166.82	161.87
09/08/99	72	<0.3	<0.3	<0.3	<0.5	120	4.46	NP	0.00	166.82	162.36
12/01/99	<50	<0.3	<0.3	<0.3	<0.5	<5	4.08	NP	0.00	166.82	162.74
03/23/00	<50	<0.25	<0.25	<0.25	<0.5	<5	3.68	NP	0.00	166.82	163.14
06/08/00	<50	<5	<5	<5	<5	<5	4.07	NP	0.00	166.82	162.75
09/27/00	<50	<0.18	<0.14	<0.18	<0.26	<0.24	4.07	NP	0.00	166.82	162.75
12/13/00	<50	<0.18	<0.14	<0.18	<0.26	<0.24	4.06	NP	0.00	166.82	162.76
03/22/01	<50	<0.18	<0.14	<0.18	<0.26	<0.24	5.22	NP	0.00	166.82	161.60
06/15/01	<50	<0.18	<0.14	<0.18	<0.26	<0.24	5.99	NP	0.00	166.82	160.83
08/30/01	<50	<0.18	<0.14	<0.18	<0.26	<0.24	4.84	NP	0.00	166.82	161.98
12/12/01	<50	<0.18	<0.14	<0.18	<0.26	<0.24	4.80	NP	0.00	166.82	162.02
03/13/02	-	-	-	-	-	-	5.18	NP	0.00	166.82	161.64
06/12/02	-	-	-	-	-	-	-	-	-	-	-
09/18/02	-	-	-	-	-	-	-	-	-	-	-
12/18/02	-	-	-	-	-	-	-	-	-	-	-
03/19/03	-	-	-	-	-	-	-	-	-	-	-
06/11/03	-	-	-	-	-	-	-	-	-	-	-
09/04/03	-	-	-	-	-	-	-	-	-	-	-
12/04/03	-	-	-	-	-	-	4.50	NP	0.00	166.46	161.96
03/18/04	-	-	-	-	-	-	5.64	NP	0.00	166.46	160.82
06/09/04	-	-	-	-	-	-	5.65	NP	0.00	166.46	160.81
09/02/04	-	-	-	-	-	-	5.45	NP	0.00	166.46	161.01
12/08/04	-	-	-	-	-	-	4.64	NP	0.00	166.46	161.82
03/16/05	-	-	-	-	-	-	6.79	NP	0.00	166.46	159.67
06/01/05	-	-	-	-	-	-	4.43	NP	0.00	166.46	162.03
09/14/05	-	-	-	-	-	-	5.64	NP	0.00	166.46	160.82
12/06/05	-	-	-	-	-	-	5.64	NP	0.00	166.46	160.82
03/15/06	-	-	-	-	-	-	4.44	NP	0.00	166.46	162.02

TABLE 1
GROUNDWATER DATA
THRIFTY OIL STATION #054, CASTRO VALLEY, CA.

DATE SAMPLED	ANALYTICAL PARAMETERS						DEPTH TO GROUNDWATER (feet)	DEPTH TO PRODUCT (feet)	PRODUCT THICKNESS (feet)	CASING ELEVATION (feet)	GROUNDWATER ELEVATION (feet)
	TPH (ug/L)	BENZENE (ug/L)	TOLUENE (ug/L)	EthylBenzene (ug/L)	XYLENE (ug/L)	MTBE (ug/L)					
MONITORING WELL #RE-2											
<i>Screen Interval = 5 to 17 feet</i>											
04/11/88	-	-	-	-	-	-	-	-	-	-	-
04/09/90	850	5.8	0.5	4.8	1.1	-	4.90	NP	0.00	167.19	162.29
10/30/90	440	2.8	0.91	13	3.14	-	5.34	NP	0.00	167.19	161.85
01/18/91	1,100	8.4	3.1	ND	10	-	4.90	NP	0.00	167.19	162.29
02/12/91	1,100	5.9	ND	1.77	ND	-	4.94	NP	0.00	167.19	162.25
03/20/91	550	4.3	ND	ND	ND	-	4.32	NP	0.00	167.19	162.87
05/22/91	1,000	5.3	3.6	4.4	8.9	-	4.43	NP	0.00	167.19	162.76
06/19/91	700	2.1	1.4	3.8	3.5	-	6.43	NP	0.00	167.19	160.76
07/17/91	880	12	8.0	4.3	28	-	4.75	NP	0.00	167.19	162.44
08/07/91	-	3.8	1.6	ND	ND	-	4.87	NP	0.00	167.19	162.32
09/24/91	670	7.2	7.1	ND	23	-	5.50	NP	0.00	167.19	161.69
10/23/91	2,700	52	60	22	130	-	5.63	NP	0.00	167.19	161.56
11/06/91	1,900	18	61	9.1	83	-	5.14	NP	0.00	167.19	162.05
12/04/91	1,100	26	47	4.3	42	-	5.26	NP	0.00	167.19	161.93
01/29/92	900	14	24	5.3	19	-	5.11	NP	0.00	167.19	162.08
02/26/92	500	3.4	3.5	2.7	2.7	-	4.31	NP	0.00	167.19	162.88
03/19/92	1,200	14	20	15	18	-	4.45	NP	0.00	167.19	162.74
04/22/92	200	ND	ND	ND	ND	-	4.78	NP	0.00	167.19	162.41
05/21/92	500	7.5	6.8	3.9	7.4	-	5.02	NP	0.00	167.19	162.17
06/25/92	ND	ND	0.9	0.7	ND	-	5.13	NP	0.00	167.19	162.06
07/30/92	500	7.7	8.6	3.2	1.7	-	5.19	NP	0.00	167.19	162.00
08/20/92	1,100	6.6	4.5	2.7	2.0	-	5.27	NP	0.00	167.19	161.92
09/30/92	500	5.4	2.4	1.8	4.5	-	5.45	NP	0.00	167.19	161.74
12/23/92	800	1.9	ND	ND	2.3	-	4.60	NP	0.00	167.19	162.59
03/10/93	1,200	ND	1.4	ND	2.1	-	4.18	NP	0.00	167.19	163.01
06/09/93	200	ND	ND	ND	ND	-	4.53	NP	0.00	167.19	162.66
09/17/93	360	1.6	1.1	3.2	8.9	-	5.26	NP	0.00	167.19	161.93
12/14/93	260	5.6	3.9	<0.3	21.0	-	2.75	NP	0.00	167.19	164.44
03/02/94	410	<0.3	<0.3	<0.3	<0.5	-	4.27	NP	0.00	167.19	162.92
06/06/94	760	4.6	<0.3	0.32	1.3	-	4.88	NP	0.00	167.19	162.31
09/06/94	1,300	43	45	8.9	69	-	5.16	NP	0.00	167.19	162.03
12/07/94	-	-	-	-	-	-	4.16	NP	0.00	167.19	163.03
03/08/95	<100	<0.5	<0.5	<0.5	<1	-	3.96	NP	0.00	167.19	163.23

TABLE 1
GROUNDWATER DATA
THRIFTY OIL STATION #054, CASTRO VALLEY, CA.

DATE SAMPLED	ANALYTICAL PARAMETERS						DEPTH TO GROUNDWATER (feet)	DEPTH TO PRODUCT (feet)	PRODUCT THICKNESS (feet)	CASING ELEVATION (feet)	GROUNDWATER ELEVATION (feet)
	TPH (ug/L)	BENZENE (ug/L)	TOLUENE (ug/L)	EthylBenzene (ug/L)	XYLENE (ug/L)	MTBE (ug/L)					
06/15/95	130	<0.5	<0.5	<0.5	<1	-	4.52	NP	0.00	167.19	162.67
09/05/95	210	<0.5	<0.5	<0.5	<1	-	4.76	NP	0.00	167.19	162.43
11/21/95	160	0.65	<0.3	0.35	0.95	-	4.83	NP	0.00	167.19	162.36
03/11/96	<50	<0.3	<0.3	<0.3	<0.5	-	3.36	NP	0.00	167.19	163.83
06/19/96	<50	<0.3	<0.3	<0.3	<0.5	-	4.68	NP	0.00	167.19	162.51
09/16/96	<50	<0.3	<0.3	<0.3	<0.5	<20	5.10	NP	0.00	167.19	162.09
12/10/96	<50	<0.3	<0.3	<0.3	<0.5	<20	4.47	NP	0.00	167.19	162.72
03/12/97	<50	<0.3	<0.3	<0.3	<0.5	<20	4.05	NP	0.00	167.19	163.14
06/12/97	<50	<0.3	<0.3	<0.3	<0.5	<20	-	-	-	-	-
09/10/97	<50	<0.3	<0.3	<0.3	<0.5	<20	4.08	NP	0.00	167.19	163.11
12/09/97	<50	<0.3	<0.3	<0.3	<0.5	<20	4.40	NP	0.00	167.19	162.79
03/03/98	<50	<0.3	<0.3	<0.3	<0.5	<20	3.30	NP	0.00	167.19	163.89
07/08/98	<50	<0.3	<0.3	<0.3	<0.5	15	-	-	-	-	-
09/10/98	<50	<0.3	<0.3	<0.3	<0.5	<5	4.93	NP	0.00	167.19	162.26
12/30/98	460	0.92	<0.3	<0.3	<0.5	1,400	4.20	NP	0.00	167.19	162.99
03/15/99	<50	<0.3	<0.3	<0.3	<0.5	<5	4.20	NP	0.00	167.19	162.99
06/22/99	2,900	7.4	<0.3	0.43	4.1	4,500	3.70	NP	0.00	167.19	163.49
09/08/99	1,400	<3	<3	<3	<5	3,200	3.96	NP	0.00	167.19	163.23
12/01/99	<50	<0.3	<0.3	<0.3	<0.5	<5	3.58	NP	0.00	167.19	163.61
03/23/00	<50	<0.25	<0.25	<0.25	<0.5	<5	3.19	NP	0.00	167.19	164.00
06/08/00	<50	<5	<5	<5	<5	<5	3.18	NP	0.00	167.19	164.01
09/27/00	<50	<0.18	<0.14	<0.18	<0.26	<0.24	3.58	NP	0.00	167.19	163.61
12/13/00	<50	<0.18	<0.14	<0.18	<0.26	<0.24	3.58	NP	0.00	167.19	163.61
03/22/01	575	<0.18	1.3	<0.18	<0.26	*950 / 2,070	4.33	NP	0.00	167.19	162.86
06/15/01	<50	<0.18	<0.14	<0.18	<0.26	<0.24	5.10	NP	0.00	167.19	162.09
08/30/01	<50	<0.18	<0.14	<0.18	<0.26	<0.24	5.86	NP	0.00	167.19	161.33
12/12/01	<50	<0.18	<0.14	<0.18	<0.26	<0.24	4.81	NP	0.00	167.19	162.38
03/13/02	-	-	-	-	-	-	4.33	NP	0.00	167.19	162.86
06/12/02	<50	<0.18	<0.14	<0.18	<0.26	<0.24	5.86	NP	0.00	167.19	161.33
09/18/02	<50	<0.18	<0.14	<0.18	<0.26	<0.24	5.86	NP	0.00	167.19	161.33
12/18/02	<50	<0.18	<0.14	<0.18	<0.26	<0.24	5.48	NP	0.00	167.19	161.71
03/19/03	<15	<0.04	<0.02	<0.02	<0.06	<0.03	5.86	NP	0.00	167.19	161.33
06/11/03	<15	<0.04	<0.02	<0.02	<0.06	<0.03	5.86	NP	0.00	167.19	161.33
09/04/03	<15	<0.22	<0.32	<0.31	<0.4	<0.18	5.48	NP	0.00	167.19	161.71

**TABLE 1
GROUNDWATER DATA
THRIFTY OIL STATION #054, CASTRO VALLEY, CA.**

DATE SAMPLED	ANALYTICAL PARAMETERS						DEPTH TO GROUNDWATER (feet)	DEPTH TO PRODUCT (feet)	PRODUCT THICKNESS (feet)	CASING ELEVATION (feet)	GROUNDWATER ELEVATION (feet)
	TPH (ug/L)	BENZENE (ug/L)	TOLUENE (ug/L)	EthylBenzene (ug/L)	XYLENE (ug/L)	MIBE (ug/L)					
12/04/03	<15	<0.04	<0.02	<0.02	<0.06	<0.03	3.20	NP	0.00	166.61	163.41
03/18/04	<15	<0.22	<0.32	<0.31	<0.4	8.4	4.33	NP	0.00	166.61	162.28
06/09/04	<15	<0.14	<0.16	<0.18	<0.45	8.4	4.32	NP	0.00	166.61	162.29
09/02/04	877	2.3	2.2	5.8	4.0	*743 / 516	5.12	NP	0.00	166.61	161.49
12/08/04	194,000	1,960	26,900	4,660	23,200	*10,700 / 13,000	3.65	NP	0.00	166.61	162.96
03/16/05	50,600	901	10,100	130 J	12,100	4,040	5.47	NP	0.00	166.61	161.14
06/01/05	23,300	519	3,370	<7	7,180	3,800	3.95	NP	0.00	166.61	162.66
09/14/05	14,000	22	15 J	<2.4	3,930	2,420	4.32	NP	0.00	166.61	162.29
12/06/05	140	<0.32	<0.10	<0.24	<0.3	34	3.55	NP	0.00	166.61	163.06
03/15/06	57	<0.32	<0.10	<0.24	<0.30	31	3.95	NP	0.00	166.61	162.66
MONITORING WELL #RE-3 <i>Screen Interval = 5 to 18 feet</i>											
04/11/88	70,000	6,600	5,300	800	13,000	-	-	-	-	-	-
04/09/90	370,000	2,300	4,900	3,200	31,000	-	7.15	NP	0.00	167.39	160.24
10/30/90	13,000	860	660	220	2,210	-	7.84	NP	0.00	167.39	159.55
01/18/91	42,000	4,700	4,500	21	7,700	-	6.90	NP	0.00	167.39	160.49
02/12/91	72,000	3,600	4,500	ND	7,600	-	6.62	NP	0.00	167.39	160.77
03/20/91	65,000	2,400	9,400	50	9,800	-	5.87	NP	0.00	167.39	161.52
05/22/91	-	-	-	-	-	-	5.98	FILM	0.00	167.39	161.41
06/19/91	-	-	-	-	-	-	6.84	FILM	0.00	167.39	160.55
07/17/91	-	-	-	-	-	-	7.10	FILM	0.00	167.39	160.29
08/07/91	-	-	-	-	-	-	7.30	FILM	0.00	167.39	160.09
09/24/91	-	-	-	-	-	-	7.84	FILM	0.00	167.39	159.55
10/23/91	-	-	-	-	-	-	8.07	FILM	0.00	167.39	159.32
11/06/91	-	-	-	-	-	-	7.63	FILM	0.00	167.39	159.76
12/04/91	-	-	-	-	-	-	7.83	FILM	0.00	167.39	159.56
01/29/92	-	-	-	-	-	-	7.17	FILM	0.00	167.39	160.22
02/26/92	-	-	-	-	-	-	5.56	FILM	0.00	167.39	161.83
03/19/92	-	-	-	-	-	-	5.44	FILM	0.00	167.39	161.95
04/22/92	-	-	-	-	-	-	6.56	FILM	0.00	167.39	160.83
05/21/92	-	-	-	-	-	-	6.90	FILM	0.00	167.39	160.49
06/25/92	-	-	-	-	-	-	7.18	FILM	0.00	167.39	160.21
07/30/92	-	-	-	-	-	-	6.80	FILM	0.00	167.39	160.59

**TABLE 1
GROUNDWATER DATA
THRIFTY OIL STATION #054, CASTRO VALLEY, CA.**

DATE SAMPLED	ANALYTICAL PARAMETERS						DEPTH TO GROUNDWATER (feet)	DEPTH TO PRODUCT (feet)	PRODUCT THICKNESS (feet)	CASING ELEVATION (feet)	GROUNDWATER ELEVATION (feet)
	TPH (ug/L)	BENZENE (ug/L)	TOLUENE (ug/L)	EthylBenzene (ug/L)	XYLENE (ug/L)	MTBE (ug/L)					
08/20/92	-	-	-	-	-	-	7.25	FILM	0.00	167.39	160.14
09/30/92	-	-	-	-	-	-	7.68	FILM	0.00	167.39	159.71
12/23/92	-	-	-	-	-	-	6.07	FILM	0.00	167.39	161.32
03/10/93	-	-	-	-	-	-	5.66	FILM	0.00	167.39	161.73
06/09/93	-	-	-	-	-	-	6.66	FILM	0.00	167.39	160.73
09/14/93	40,000	2,900	1,500	180	6,900	-	7.30	NP	0.00	167.39	160.09
12/14/93	-	-	-	-	-	-	5.95	NP	0.00	167.39	161.44
03/02/94	-	-	-	-	-	-	5.08	NP	0.00	167.39	162.31
06/06/94	-	-	-	-	-	-	6.35	FILM	0.00	167.39	161.04
09/06/94	11,000	260	26	<6.6	1,000	-	7.50	NP	0.00	167.39	159.89
12/07/94	-	-	-	-	-	-	5.48	FILM	0.00	167.39	161.91
03/08/95	-	-	-	-	-	-	5.18	FILM	0.00	167.39	162.21
06/15/95	-	-	-	-	-	-	-	-	-	-	-
09/05/95	-	-	-	-	-	-	6.84	FILM	0.00	167.39	160.55
11/21/95	10,000	210	<3	4.5	330	-	7.38	NP	0.00	167.39	160.01
03/11/96	1,600	640	15	10	46	-	4.85	NP	0.00	167.39	162.54
06/19/96	2,100	280	<3	<3	120	-	5.80	NP	0.00	167.39	161.59
09/16/96	140	<0.3	<0.3	<0.3	<0.5	110	4.50	NP	0.00	167.39	162.89
12/10/96	<50	<0.3	<0.3	<0.3	<0.5	<20	5.35	NP	0.00	167.39	162.04
03/12/97	<50	<0.3	<0.3	<0.3	<0.5	<20	3.48	NP	0.00	167.39	163.91
06/12/97	<50	<0.3	<0.3	<0.3	0.58	<20	-	-	-	-	-
09/10/97	<50	<0.3	<0.3	<0.3	<0.5	<20	3.10	NP	0.00	167.39	164.29
12/09/97	3,600	1,000	1,000	<6	570	260	4.55	NP	0.00	167.39	162.84
03/03/98	2,800	20	0.65	0.39	16	5,600	2.30	NP	0.00	167.39	165.09
07/08/98	<50	<0.3	<0.3	<0.3	<0.5	<5	-	-	-	-	-
09/10/98	<50	<0.3	<0.3	<0.3	<0.5	23	4.95	NP	0.00	167.39	162.44
12/30/98	<50	1.1	<0.3	<0.3	<0.5	<5	4.55	NP	0.00	167.39	162.84
03/15/99	<50	<0.3	<0.3	<0.3	<0.5	<5	4.15	NP	0.00	167.39	163.24
06/22/99	670	17	1.2	0.36	1.7	340	3.85	NP	0.00	167.39	163.54
09/08/99	140	0.72	<0.3	<0.3	<0.5	230	2.63	NP	0.00	167.39	164.76
12/01/99	95	<0.3	<0.3	<0.3	<0.5	200	2.63	NP	0.00	167.39	164.76
03/23/00	315	<0.25	<0.25	<0.25	<0.5	*293/422	2.25	NP	0.00	167.39	165.14
06/08/00	<100	<5	<5	<5	<5	201	3.02	NP	0.00	167.39	164.37
09/27/00	154	<0.18	<0.14	<0.18	<0.26	*254 / 160	3.01	NP	0.00	167.39	164.38

TABLE 1
GROUNDWATER DATA
THRIFTY OIL STATION #054, CASTRO VALLEY, CA.

DATE SAMPLED	ANALYTICAL PARAMETERS						DEPTH TO GROUNDWATER (feet)	DEPTH TO PRODUCT (feet)	PRODUCT THICKNESS (feet)	CASING ELEVATION (feet)	GROUNDWATER ELEVATION (feet)
	TPH (ug/L)	BENZENE (ug/L)	TOLUENE (ug/L)	EthylBenzene (ug/L)	XYLENE (ug/L)	MTBE (ug/L)					
08/17/91	-	-	-	-	-	-	8.15	FILM	0.00	166.94	158.79
09/24/91	-	-	-	-	-	-	10.40	FILM	0.00	166.94	156.54
10/23/91	-	-	-	-	-	-	11.20	FILM	0.00	166.94	155.74
11/06/91	-	-	-	-	-	-	6.62	FILM	0.00	166.94	160.32
12/04/91	-	-	-	-	-	-	11.20	FILM	0.00	166.94	155.74
01/29/92	-	-	-	-	-	-	7.72	FILM	0.00	166.94	159.22
02/26/92	-	-	-	-	-	-	5.13	FILM	0.00	166.94	161.81
03/19/92	-	-	-	-	-	-	5.00	FILM	0.00	166.94	161.94
04/22/92	-	-	-	-	-	-	5.94	FILM	0.00	166.94	161.00
05/21/92	-	-	-	-	-	-	5.40	FILM	0.00	166.94	161.54
06/25/92	-	-	-	-	-	-	5.71	FILM	0.00	166.94	161.23
07/30/92	-	-	-	-	-	-	6.33	FILM	0.00	166.94	160.61
08/20/92	-	-	-	-	-	-	5.80	FILM	0.00	166.94	161.14
09/30/92	-	-	-	-	-	-	6.34	FILM	0.00	166.94	160.60
12/23/92	-	-	-	-	-	-	5.50	FILM	0.00	166.94	161.44
03/10/93	-	-	-	-	-	-	4.67	FILM	0.00	166.94	162.27
06/09/93	-	-	-	-	-	-	5.12	FILM	0.00	166.94	161.82
09/14/93	-	-	-	-	-	-	10.44	NP	0.00	166.94	156.50
12/14/93	-	-	-	-	-	-	7.52	NP	0.00	166.94	159.42
03/02/94	-	-	-	-	-	-	4.85	NP	0.00	166.94	162.09
06/06/94	-	-	-	-	-	-	5.20	FILM	0.00	166.94	161.74
09/06/94	-	-	-	-	-	-	9.85	FILM	0.00	166.94	157.09
12/07/94	-	-	-	-	-	-	5.20	FILM	0.00	166.94	161.74
03/08/95	-	-	-	-	-	-	4.98	FILM	0.00	166.94	161.96
06/15/95	-	-	-	-	-	-	-	-	-	-	-
09/05/95	-	-	-	-	-	-	13.72	FILM	0.00	166.94	153.22
11/21/95	32,000	46	21	66	340	-	12.53	NP	0.00	166.94	154.41
03/11/96	1,700	130	15	2.0	120	-	4.72	NP	0.00	166.94	162.22
06/19/96	1,700	230	30	0.35	100	-	5.40	NP	0.00	166.94	161.54
09/16/96	510	<0.3	0.73	<0.3	<0.5	800	5.18	NP	0.00	166.94	161.76
12/10/96	520	<0.3	<0.3	<0.3	<0.5	1,000	4.65	NP	0.00	166.94	162.29
03/12/97	420	3.2	<0.3	<0.3	11	370	3.87	NP	0.00	166.94	163.07
06/12/97	510	0.66	<0.3	<0.3	<0.5	1,600	-	-	-	-	-
09/10/97	<50	<0.3	<0.3	<0.3	<0.5	<20	5.40	NP	0.00	166.94	161.54

**TABLE 1
GROUNDWATER DATA
THRIFTY OIL STATION #054, CASTRO VALLEY, CA.**

DATE SAMPLED	ANALYTICAL PARAMETERS						DEPTH TO GROUNDWATER (feet)	DEPTH TO PRODUCT (feet)	PRODUCT THICKNESS (feet)	CASING ELEVATION (feet)	GROUNDWATER ELEVATION (feet)
	TPH (ug/L)	BENZENE (ug/L)	TOLUENE (ug/L)	EthylBenzene (ug/L)	XYLENE (ug/L)	MIBE (ug/L)					
12/09/97	1,400	330	2.3	<0.3	1.5	2,500	4.60	NP	0.00	166.94	162.34
03/03/98	3,000	400	0.61	0.5	97	3,800	5.05	NP	0.00	166.94	161.89
07/08/98	650	<0.3	<0.3	<0.3	<0.5	1,800	-	-	-	-	-
09/10/98	2,700	<0.3	<0.3	<0.3	1.4	7,600	4.60	NP	0.00	166.94	162.34
12/30/98	530	<0.3	<0.3	<0.3	<0.5	1,500	4.20	NP	0.00	166.94	162.74
03/15/99	<50	<0.3	<0.3	<0.3	<0.5	<5	3.85	NP	0.00	166.94	163.09
06/22/99	1,200	23	1.5	<0.3	2.4	1,400	3.90	NP	0.00	166.94	163.04
09/08/99	590	1.5	<0.6	<0.6	<1	1,100	5.72	NP	0.00	166.94	161.22
12/01/99	540	<0.3	<0.3	<0.3	<0.5	880	5.34	NP	0.00	166.94	161.60
03/23/00	<50	<0.25	<0.25	<0.25	<0.5	<5	5.36	NP	0.00	166.94	161.58
06/08/00	67	<5	<5	<5	<5	<5	5.34	NP	0.00	166.94	161.60
09/27/00	<50	<0.18	<0.14	<0.18	<0.26	<0.24	5.35	NP	0.00	166.94	161.59
12/13/00	<50	<0.18	<0.14	<0.18	<0.26	<0.24	5.71	NP	0.00	166.94	161.23
03/22/01	<50	<0.18	<0.14	<0.18	<0.26	<0.24	4.19	NP	0.00	166.94	162.75
06/15/01	409	18	2	2	5	*1,060 / 1,480	4.57	NP	0.00	166.94	162.37
08/30/01	<50	<0.18	<0.14	<0.18	<0.26	<0.24	6.10	NP	0.00	166.94	160.84
12/12/01	<50	<0.18	<0.14	<0.18	3	*7 / 3.7	4.95	NP	0.00	166.94	161.99
03/13/02	511	3	3	<0.18	2	519	4.17	NP	0.00	166.94	162.77
06/12/02	380	2	2	1	2	479	4.93	NP	0.00	166.94	162.01
09/18/02	<50	<0.18	<0.14	<0.18	<0.26	<0.24	5.32	NP	0.00	166.94	161.62
12/18/02	<50	<0.18	<0.14	<0.18	<0.26	<0.24	4.93	NP	0.00	166.94	162.01
03/19/03	<15	<0.04	<0.02	<0.02	<0.06	<0.03	5.32	NP	0.00	166.94	161.62
06/11/03	<15	<0.04	<0.02	<0.02	<0.06	<0.03	5.32	NP	0.00	166.94	161.62
09/04/03	<15	<0.22	<0.32	<0.31	<0.4	<0.18	4.93	NP	0.00	166.94	162.01
12/04/03	<15	<0.04	<0.02	<0.02	<0.06	<0.03	4.93	NP	0.00	166.23	161.30
03/18/04	<15	<0.22	<0.32	<0.31	<0.4	1.1	4.93	NP	0.00	166.23	161.30
06/09/04	<15	<0.14	<0.16	<0.18	<0.45	<0.22	4.56	NP	0.00	166.23	161.67
09/02/04	6,390	587	50	34	65	*4,150 / 2,650	6.00	NP	0.00	166.23	160.23
12/08/04	278,000	4,680	44,900	4,850	29,000	*54,800 / 43,400	4.93	NP	0.00	166.23	161.30
03/16/05	110,000	2,360	18,900	1,780	17,800	24,400	5.32	NP	0.00	166.23	160.91
06/01/05	40,800	1,530	6,890	39	6,880	25,800	5.7	NP	0.00	166.23	160.53
09/14/05	23,600	190	73	<2.4	3,460	14,200	5.32	NP	0.00	166.23	160.91
12/06/05	16,000	<3.2	<1.0	<2.4	<3	13,200	4.55	NP	0.00	166.23	161.68
03/15/06	4,910	37	<1.0	65	15 J	4,940	5.70	NP	0.00	166.23	160.53

TABLE 1
GROUNDWATER DATA
THRIFTY OIL STATION #054, CASTRO VALLEY, CA.

DATE SAMPLED	ANALYTICAL PARAMETERS						DEPTH TO GROUNDWATER (feet)	DEPTH TO PRODUCT (feet)	PRODUCT THICKNESS (feet)	CASING ELEVATION (feet)	GROUNDWATER ELEVATION (feet)
	TPH (ug/L)	BENZENE (ug/L)	TOLUENE (ug/L)	EthylBenzene (ug/L)	XYLENE (ug/L)	MTBE (ug/L)					
MONITORING WELL #RE-5											
<i>Screen Interval = 5 to 20 feet</i>											
04/11/88	14,000	1,300	1,100	100	2,600	-	-	-	-	-	-
04/09/90	3,000	690	190	40	270	-	4.79	NP	0.00	166.51	161.72
10/30/90	3,400	910	48	87	249	-	5.86	NP	0.00	166.51	160.65
01/18/91	1,400	180	8.6	0.52	48	-	4.40	NP	0.00	166.51	162.11
02/12/91	1,000	ND	ND	0.65	ND	-	4.76	NP	0.00	166.51	161.75
03/20/91	3,000	250	53	ND	110	-	5.08	NP	0.00	166.51	161.43
05/22/91	2,500	330	7.8	5.6	200	-	4.52	NP	0.00	166.51	161.99
01/19/91	2,000	59	1.6	5.1	110	-	4.39	NP	0.00	166.51	162.12
07/17/91	-	-	-	-	-	-	5.05	FILM	0.00	166.51	161.46
08/07/91	-	-	-	-	-	-	5.02	FILM	0.00	166.51	161.49
09/24/91	-	-	-	-	-	-	5.86	FILM	0.00	166.51	160.65
10/23/91	-	-	-	-	-	-	5.84	FILM	0.00	166.51	160.67
11/06/91	9,900	2,300	37	260	160	-	5.48	NP	0.00	166.51	161.03
12/04/91	4,500	1,000	27	ND	180	-	5.43	NP	0.00	166.51	161.08
01/29/92	600	6.1	2.3	ND	47	-	5.12	NP	0.00	166.51	161.39
02/26/92	500	5.4	2.7	1.2	14	-	4.93	NP	0.00	166.51	161.58
03/19/92	ND	1.7	1.1	ND	5.5	-	4.45	NP	0.00	166.51	162.06
04/22/92	1,600	240	2.2	ND	160	-	4.63	NP	0.00	166.51	161.88
05/21/92	1,200	410	37	ND	118	-	4.90	NP	0.00	166.51	161.61
06/25/92	ND	1.0	0.8	0.8	0.4	-	5.15	NP	0.00	166.51	161.36
07/30/92	ND	2.0	1.8	1.9	6.4	-	5.30	NP	0.00	166.51	161.21
08/20/92	300	1.7	3.3	0.7	12	-	5.44	NP	0.00	166.51	161.07
09/30/92	1,900	140	ND	19	35	-	5.73	NP	0.00	166.51	160.78
12/23/92	400	8.0	ND	ND	ND	-	4.75	NP	0.00	166.51	161.76
03/10/93	1,100	290	9.7	ND	75	-	4.14	NP	0.00	166.51	162.37
06/09/93	400	1.5	0.5	ND	12	-	5.42	NP	0.00	166.51	161.09
09/14/93	240	6.9	8.8	1.4	67	-	5.53	NP	0.00	166.51	160.98
12/14/93	3,300	510	5.4	4.1	55	-	4.78	NP	0.00	166.51	-311.49
03/02/94	2,400	270	4.5	<0.3	13	-	4.20	NP	0.00	166.51	162.31
06/06/94	730	<0.3	<0.3	0.70	22	-	5.13	NP	0.00	166.51	161.38
09/06/94	2,400	180	28	2.3	76	-	5.45	NP	0.00	166.51	161.06
12/07/94	540	5.6	<0.3	<0.5	6.9	-	4.13	NP	0.00	166.51	162.38
03/08/95	1,500	220	5.5	<0.5	83	-	5.20	NP	0.00	166.51	161.31

TABLE 1
GROUNDWATER DATA
THRIFTY OIL STATION #054, CASTRO VALLEY, CA.

DATE SAMPLED	ANALYTICAL PARAMETERS						DEPTH TO GROUNDWATER (feet)	DEPTH TO PRODUCT (feet)	PRODUCT THICKNESS (feet)	CASING ELEVATION (feet)	GROUNDWATER ELEVATION (feet)
	TPH (ug/L)	BENZENE (ug/L)	TOLUENE (ug/L)	EthylBenzene (ug/L)	XYLENE (ug/L)	MIBE (ug/L)					
06/15/95	3,200	820	53	6.2	74	-	4.93	NP	0.00	166.51	161.58
09/05/95	4,400	440	22	<2.5	57	-	5.03	NP	0.00	166.51	161.48
11/21/95	660	3.4	<0.3	<0.3	0.6	-	5.23	NP	0.00	166.51	161.28
03/11/96	1,000	76	2.2	<0.3	130	-	4.16	NP	0.00	166.51	162.35
06/09/96	90	<0.3	<0.3	<0.3	<0.5	-	5.42	NP	0.00	166.51	161.09
09/16/96	1,900	5.8	<0.3	<0.3	5.9	1,100	5.20	NP	0.00	166.51	161.31
12/10/96	740	<0.3	<0.3	<0.3	<0.5	1,300	5.27	NP	0.00	166.51	161.24
03/12/97	2,000	600	59	5.1	54	1,300	3.85	NP	0.00	166.51	162.66
06/12/97	230	<0.3	<0.3	<0.3	<0.5	720	-	-	-	-	-
09/10/97	210	<0.3	<0.3	<0.3	<0.5	210	4.10	NP	0.00	166.51	162.41
12/09/97	11,000	2,500	2,700	<6	1,500	510	5.20	NP	0.00	166.51	161.31
03/03/98	<50	<0.3	<0.3	<0.3	<0.5	<20	3.70	NP	0.00	166.51	162.81
07/08/98	<50	<0.3	<0.3	<0.3	<0.5	<5	-	-	-	-	-
09/10/98	<50	<0.3	<0.3	<0.3	<0.5	<5	6.77	NP	0.00	166.51	159.74
12/30/98	<50	<0.3	<0.3	<0.3	<0.5	<5	5.95	NP	0.00	166.51	160.56
03/15/99	<50	<0.3	<0.3	<0.3	<0.5	<5	5.25	NP	0.00	166.51	161.26
06/22/99	110	<0.3	<0.3	<0.3	<0.5	200	4.50	NP	0.00	166.51	162.01
09/08/99	68	<0.3	<0.3	<0.3	<0.5	110	4.43	NP	0.00	166.51	162.08
12/01/99	<50	<0.3	<0.3	<0.3	<0.5	<5	3.66	NP	0.00	166.51	162.85
03/23/00	<50	<0.25	<0.25	<0.25	<0.5	<5	4.06	NP	0.00	166.51	162.45
06/08/00	<50	<5	<5	<5	<5	<5	4.43	NP	0.00	166.51	162.08
09/27/00	<50	<0.18	<0.14	<0.18	<0.26	<0.24	4.06	NP	0.00	166.51	162.45
12/13/00	<50	<0.18	<0.14	<0.18	<0.26	<0.24	4.80	NP	0.00	166.51	161.71
03/22/01	<50	<0.18	<0.14	<0.18	<0.26	<0.24	6.33	NP	0.00	166.51	160.18
06/15/01	<50	<0.18	<0.14	<0.18	<0.26	<0.24	4.79	NP	0.00	166.51	161.72
08/30/01	<50	<0.18	<0.14	<0.18	<0.26	<0.24	5.54	NP	0.00	166.51	160.97
12/12/01	<50	<0.18	<0.14	<0.18	<0.26	<0.24	5.21	NP	0.00	166.51	161.30
03/13/02	-	-	-	-	-	-	6.32	NP	0.00	166.51	160.19
06/12/02	-	-	-	-	-	-	-	-	-	-	-
09/18/02	-	-	-	-	-	-	-	-	-	-	-
12/18/02	-	-	-	-	-	-	-	-	-	-	-
03/19/03	-	-	-	-	-	-	-	-	-	-	-
06/11/03	-	-	-	-	-	-	-	-	-	-	-
09/04/03	-	-	-	-	-	-	-	-	-	-	-

TABLE 1
GROUNDWATER DATA
THRIFTY OIL STATION #054, CASTRO VALLEY, CA.

DATE SAMPLED	ANALYTICAL PARAMETERS						DEPTH TO GROUNDWATER (feet)	DEPTH TO PRODUCT (feet)	PRODUCT THICKNESS (feet)	CASING ELEVATION (feet)	GROUNDWATER ELEVATION (feet)
	TPH (ug/L)	BENZENE (ug/L)	TOLUENE (ug/L)	EthylBenzene (ug/L)	XYLENE (ug/L)	MTBE (ug/L)					
12/04/03	-	-	-	-	-	-	3.67	NP	0.00	166.56	162.89
03/18/04	-	-	-	-	-	-	5.20	NP	0.00	166.56	161.36
06/09/04	-	-	-	-	-	-	4.61	NP	0.00	166.56	161.95
09/02/04	-	-	-	-	-	-	4.93	NP	0.00	166.56	161.63
12/08/04	-	-	-	-	-	-	4.06	NP	0.00	166.56	162.50
03/16/05	-	-	-	-	-	-	5.56	NP	0.00	166.56	161.00
06/01/05	-	-	-	-	-	-	4.42	NP	0.00	166.56	162.14
09/14/05	-	-	-	-	-	-	4.41	NP	0.00	166.56	162.15
12/06/05	-	-	-	-	-	-	4.03	NP	0.00	166.56	162.53
03/15/06	-	-	-	-	-	-	4.42	NP	0.00	166.56	162.14
MONITORING WELL #RE-6 <i>Screen Interval = 5 to 15 feet</i>											
04/11/88	6,000	3,000	40	80	140	-	-	-	-	-	-
04/09/90	3,000	990	ND	70	ND	-	5.64	NP	0.00	166.51	160.87
10/30/90	3,400	1,000	28	ND	ND	-	6.68	NP	0.00	166.51	159.83
01/18/91	6,300	1,200	ND	3.0	15	-	6.61	NP	0.00	166.51	159.90
02/12/91	5,200	850	8.4	4.9	41	-	6.20	NP	0.00	166.51	160.31
03/20/91	5,800	680	12	8.0	16	-	5.62	NP	0.00	166.51	160.89
05/22/91	8,500	1,700	14	24	6.7	-	6.05	NP	0.00	166.51	160.46
06/19/91	-	-	-	-	-	-	6.12	FILM	0.00	166.51	160.39
07/17/91	120,000	9,300	13,000	2,400	16,000	-	6.20	NP	0.00	166.51	160.31
08/07/91	-	590	5.3	ND	14	-	6.27	NP	0.00	166.51	160.24
09/24/91	7,000	310	11	5.3	35	-	6.63	NP	0.00	166.51	159.88
10/23/91	-	-	-	-	-	-	6.36	FILM	0.00	166.51	160.15
11/06/91	4,000	710	18	29	49	-	6.15	NP	0.00	166.51	160.36
12/04/91	4,100	1,100	14	33	39	-	6.19	NP	0.00	166.51	160.32
01/29/92	2,600	790	14	ND	49	-	6.70	NP	0.00	166.51	159.81
02/26/92	3,100	950	21	30	33	-	5.44	NP	0.00	166.51	161.07
03/19/92	2,200	630	14	12	40	-	5.30	NP	0.00	166.51	161.21
04/22/92	-	730	2.2	ND	40	-	6.00	NP	0.00	166.51	160.51
05/21/92	1,500	840	7.8	7.1	34	-	6.25	NP	0.00	166.51	160.26
06/25/92	<2000	740	8.0	27	28	-	6.38	NP	0.00	166.51	160.13
07/30/92	-	-	-	-	-	-	6.42	FILM	0.00	166.51	160.09

**TABLE 1
GROUNDWATER DATA
THRIFTY OIL STATION #054, CASTRO VALLEY, CA.**

DATE SAMPLED	ANALYTICAL PARAMETERS						DEPTH TO GROUNDWATER (feet)	DEPTH TO PRODUCT (feet)	PRODUCT THICKNESS (feet)	CASING ELEVATION (feet)	GROUNDWATER ELEVATION (feet)
	TPH (ug/L)	BENZENE (ug/L)	TOLUENE (ug/L)	EthylBenzene (ug/L)	XYLENE (ug/L)	MTBE (ug/L)					
08/20/92	2,800	630	17	23	22	-	6.50	NP	0.00	166.51	160.01
09/30/92	7,800	540	ND	12	29	-	6.66	NP	0.00	166.51	159.85
12/23/92	1,800	350	ND	7.7	11	-	5.83	NP	0.00	166.51	160.68
03/10/93	3,000	830	5.6	19	16	-	5.63	NP	0.00	166.51	160.88
06/09/93	4,800	920	6.2	3.2	12	-	6.01	NP	0.00	166.51	160.50
09/14/93	3,600	660	7.5	11	27	-	6.53	NP	0.00	166.51	159.98
12/14/93	1,500	200	<0.3	<0.3	8.8	-	3.58	NP	0.00	166.51	162.93
03/02/94	-	-	-	-	-	-	5.12	NP	0.00	166.51	161.39
06/06/94	2,400	290	4.6	1.3	24	-	1.85	NP	0.00	166.51	164.66
09/06/94	4,300	230	21	<6.6	130	-	6.40	NP	0.00	166.51	160.11
12/07/94	1,500	17	2.5	3.2	22	-	5.68	NP	0.00	166.51	160.83
03/08/95	2,500	460	5.5	2.1	51	-	5.12	NP	0.00	166.51	161.39
06/15/95	2,300	91	1.1	0.7	97	-	5.72	NP	0.00	166.51	160.79
09/05/95	3,300	60	<10	<10	74	-	5.94	NP	0.00	166.51	160.57
11/21/95	2,000	7.3	<0.3	0.56	8.7	-	6.24	NP	0.00	166.51	160.27
03/11/96	840	43	0.96	5.7	14	-	5.16	NP	0.00	166.51	161.35
06/19/96	1,800	160	2.7	9.9	25	-	5.80	NP	0.00	166.51	160.71
09/16/96	<50	<0.3	<0.3	<0.3	<0.5	<20	5.38	NP	0.00	166.51	161.13
12/10/96	<50	<0.3	<0.3	<0.3	<0.5	<20	5.62	NP	0.00	166.51	160.89
03/12/97	<50	<0.3	<0.3	<0.3	<0.5	<20	5.20	NP	0.00	166.51	161.31
06/12/97	<50	<0.3	<0.3	<0.3	<0.5	<20	-	-	-	-	-
09/10/97	440	<0.3	<0.3	<0.3	<0.5	320	5.20	NP	0.00	166.51	161.31
12/09/97	<50	<0.3	<0.3	<0.3	<0.5	<20	5.97	NP	0.00	166.51	160.54
03/03/98	400	7.0	<0.3	<0.3	4.3	65	4.45	NP	0.00	166.51	162.06
07/08/98	300	<0.3	<0.3	<0.3	1.0	35	-	-	-	-	-
09/10/98	<50	<0.3	<0.3	<0.3	<0.5	<5	5.90	NP	0.00	166.51	160.61
12/30/98	<50	<0.3	<0.3	<0.3	<0.5	<5	5.20	NP	0.00	166.51	161.31
03/15/99	<50	<0.3	<0.3	<0.3	<0.5	8.4	4.82	NP	0.00	166.51	161.69
06/22/99	700	11	1.9	<0.3	3.9	140	6.00	NP	0.00	166.51	160.51
09/08/99	<50	<0.3	<0.3	<0.3	<0.5	<5	5.15	NP	0.00	166.51	161.36
12/01/99	<50	<0.3	<0.3	<0.3	<0.5	12	4.02	NP	0.00	166.51	162.49
03/23/00	<50	<0.25	<0.25	<0.25	<0.5	<5	4.41	NP	0.00	166.51	162.10
06/08/00	<50	<5	<5	<5	<5	<5	4.78	NP	0.00	166.51	161.73
09/27/00	<50	<0.18	<0.14	<0.18	<0.26	<0.24	4.78	NP	0.00	166.51	161.73

TABLE 1
GROUNDWATER DATA
THRIFTY OIL STATION #054, CASTRO VALLEY, CA.

DATE SAMPLED	ANALYTICAL PARAMETERS						DEPTH TO GROUNDWATER (feet)	DEPTH TO PRODUCT (feet)	PRODUCT THICKNESS (feet)	CASING ELEVATION (feet)	GROUNDWATER ELEVATION (feet)
	TPH (ug/L)	BENZENE (ug/L)	TOLUENE (ug/L)	EthylBenzene (ug/L)	XYLENE (ug/L)	MTBE (ug/L)					
08/07/91	-	-	-	-	-	-	9.88	0.03	9.85	166.04	163.60
09/24/91	-	-	-	-	-	-	9.85	0.03	9.82	166.04	163.60
10/23/91	-	-	-	-	-	-	9.96	FILM	0.00	166.04	156.08
11/06/91	-	-	-	-	-	-	6.77	FILM	0.00	166.04	159.27
12/04/91	-	-	-	-	-	-	10.80	FILM	0.00	166.04	155.24
01/29/92	-	-	-	-	-	-	8.64	FILM	0.00	166.04	157.40
02/26/92	-	-	-	-	-	-	6.00	FILM	0.00	166.04	160.04
03/19/92	-	-	-	-	-	-	5.55	FILM	0.00	166.04	160.49
04/22/92	-	-	-	-	-	-	6.12	FILM	0.00	166.04	159.92
05/21/92	-	-	-	-	-	-	6.40	FILM	0.00	166.04	159.64
06/25/92	-	-	-	-	-	-	6.73	0.02	6.71	166.04	164.38
07/30/92	-	-	-	-	-	-	6.73	FILM	0.00	166.04	159.31
08/20/92	-	-	-	-	-	-	6.82	FILM	0.00	166.04	159.22
09/30/92	-	-	-	-	-	-	7.26	FILM	0.00	166.04	158.78
12/23/92	-	-	-	-	-	-	6.22	FILM	0.00	166.04	159.82
03/10/93	-	-	-	-	-	-	5.82	FILM	0.00	166.04	160.22
06/09/93	-	-	-	-	-	-	6.17	FILM	0.00	166.04	159.87
09/14/93	-	-	-	-	-	-	11.33	NP	0.00	166.04	154.71
12/14/93	-	-	-	-	-	-	8.40	NP	0.00	166.04	157.64
03/02/94	-	-	-	-	-	-	6.82	NP	0.00	166.04	159.22
06/06/94	-	-	-	-	-	-	10.95	FILM	0.00	166.04	155.09
09/06/94	-	-	-	-	-	-	11.30	FILM	0.00	166.04	154.74
12/07/94	-	-	-	-	-	-	5.63	FILM	0.00	166.04	160.41
03/08/95	-	-	-	-	-	-	5.06	FILM	0.00	166.04	160.98
06/15/95	-	-	-	-	-	-	-	-	-	-	-
09/05/95	-	-	-	-	-	-	7.98	FILM	0.00	166.04	158.06
11/21/95	20,000	8,800	110	<30	310	-	7.32	NP	0.00	166.04	158.72
03/11/96	4,800	2,200	38	26	120	-	5.62	NP	0.00	166.04	160.42
06/19/96	4,400	3,300	49	5.8	70	-	6.40	NP	0.00	166.04	159.64
09/19/96	7,200	510	83	<0.3	710	130	6.20	NP	0.00	166.04	159.84
12/10/96	700	<0.3	<0.3	<0.3	<0.5	1,400	5.92	NP	0.00	166.04	160.12
03/12/97	660	0.31	<0.3	<0.3	<0.5	1,400	5.62	NP	0.00	166.04	160.42
06/12/97	320	<0.3	0.45	<0.3	<0.5	850	-	-	-	-	-
09/10/97	780	<0.3	<0.3	<0.3	<0.5	930	7.45	NP	0.00	166.04	158.59

**TABLE 1
GROUNDWATER DATA
THRIFTY OIL STATION #054, CASTRO VALLEY, CA.**

DATE SAMPLED	ANALYTICAL PARAMETERS						DEPTH TO GROUNDWATER (feet)	DEPTH TO PRODUCT (feet)	PRODUCT THICKNESS (feet)	CASING ELEVATION (feet)	GROUNDWATER ELEVATION (feet)
	TPH (ug/L)	BENZENE (ug/L)	TOLUENE (ug/L)	EthylBenzene (ug/L)	XYLENE (ug/L)	MTBE (ug/L)					
12/09/97	14,000	3,500	3,700	<15	2,100	1,100	7.10	NP	0.00	166.04	158.94
03/03/98	6,100	2,500	18	<6	110	270	6.70	NP	0.00	166.04	159.34
07/08/98	1,300	8.7	<0.3	<0.3	<0.5	350	-	-	-	-	-
09/10/98	690	2.2	<0.3	<0.3	<0.5	350	7.04	NP	0.00	166.04	159.00
12/30/98	600	2.0	0.55	<0.3	<0.5	350	6.25	NP	0.00	166.04	159.79
03/15/99	350	0.71	<0.3	<0.3	<0.5	140	6.02	NP	0.00	166.04	160.02
06/22/99	5,900	2,100	16	4.6	48	170	6.35	NP	0.00	166.04	159.69
09/08/99	1,700	380	<3	<3	13	160	7.03	NP	0.00	166.04	159.01
12/01/99	930	3.7	<0.3	<0.3	<0.5	390	6.25	NP	0.00	166.04	159.79
03/23/00	581	5.4	5.3	1.9	7.3	*168/183	6.24	NP	0.00	166.04	159.80
06/08/00	<100	<5	<5	<5	<5	74	6.64	NP	0.00	166.04	159.40
09/27/00	236	<0.18	<0.14	<0.18	<0.26	*21 / 28	7.03	NP	0.00	166.04	159.01
12/13/00	<50	<0.18	<0.14	<0.18	<0.26	*13 / 19.8	6.63	NP	0.00	166.04	159.41
03/22/01	504	<0.18	<0.14	<0.18	1	*666 / 1,420	7.02	NP	0.00	166.04	159.02
06/15/01	144	5.0	<0.14	0.5	2	*369 / 408	7.02	NP	0.00	166.04	159.02
08/30/01	<50	<0.18	<0.14	<0.18	<0.26	<0.24	7.79	NP	0.00	166.04	158.25
12/12/01	<50	<0.18	<0.14	<0.18	<0.26	<0.24	7.28	NP	0.00	166.04	158.76
03/13/02	<50	<0.18	<0.14	<0.18	<0.26	<0.24	6.02	NP	0.00	166.04	160.02
06/12/02	5,130	772	970	59	550	113	7.79	NP	0.00	166.04	158.25
09/18/02	<50	<0.18	<0.14	<0.18	<0.26	<0.24	7.40	NP	0.00	166.04	158.64
12/18/02	<50	<0.18	<0.14	<0.18	<0.26	<0.24	6.63	NP	0.00	166.04	159.41
03/19/03	<15	<0.04	<0.02	<0.02	<0.06	<0.03	7.40	NP	0.00	166.04	158.64
06/11/03	<15	<0.04	<0.02	<0.02	<0.06	8.3	7.40	NP	0.00	166.04	158.64
09/04/03	<15	<0.22	<0.32	<0.31	<0.4	<0.18	7.39	NP	0.00	166.04	158.65
12/04/03	<15	<0.04	<0.02	<0.02	<0.06	<0.03	6.63	NP	0.00	165.33	158.70
03/18/04	<15	<0.22	<0.32	<0.31	<0.4	<0.18	6.63	NP	0.00	165.33	158.70
06/10/04	14,500	348	1,460	306	3,070	207	6.20	NP	0.00	165.33	159.13
09/02/04	35,900	2,390	174	1,250	8,020	*419 / 274	7.05	NP	0.00	165.33	158.28
12/08/04	276,000	4,380	34,800	5,370	25,000	*59,600 / 70,500	3.80	NP	0.00	165.33	161.53
03/16/05	114,000	2,840	19,400	2,760	14,400	29,300	6.64	NP	0.00	165.33	158.69
06/01/05	45,200	1,860	8,690	1,180	4,980	38,000	7.06	NP	0.00	165.33	158.27
09/14/05	33,900	770	943	<12	3,160	24,500	7.02	NP	0.00	165.33	158.31
12/06/05	25,600	<16	<5	<12	<15	22,300	3.96	NP	0.00	165.33	161.37
03/15/06	11,700	73	<1.0	143	22 J	10,200	7.05	NP	0.00	165.33	158.28

TABLE 1
GROUNDWATER DATA
THRIFTY OIL STATION #054, CASTRO VALLEY, CA.

DATE SAMPLED	ANALYTICAL PARAMETERS						DEPTH TO GROUNDWATER (feet)	DEPTH TO PRODUCT (feet)	PRODUCT THICKNESS (feet)	CASING ELEVATION (feet)	GROUNDWATER ELEVATION (feet)
	TPH (ug/L)	BENZENE (ug/L)	TOLUENE (ug/L)	EthylBenzene (ug/L)	XYLENE (ug/L)	MIBE (ug/L)					
MONITORING WELL #RS-8											
<i>Screen Interval = 5 to 25 feet</i>											
08/07/91	ND	ND	ND	ND	ND	-	9.68	NP	0.00	164.32	154.64
09/27/91	ND	ND	ND	ND	ND	-	9.89	NP	0.00	164.32	154.43
10/23/91	ND	ND	ND	ND	ND	-	10.05	NP	0.00	164.32	154.27
11/06/91	ND	ND	ND	ND	ND	-	9.71	NP	0.00	164.32	154.61
12/04/91	ND	ND	ND	ND	ND	-	10.00	NP	0.00	164.32	154.32
01/29/92	ND	2.1	1.0	2.5	3.6	-	9.28	NP	0.00	164.32	155.04
02/26/92	ND	ND	0.7	ND	0.7	-	7.05	NP	0.00	164.32	157.27
03/19/92	ND	0.5	1.0	1.5	2.7	-	7.30	NP	0.00	164.32	157.02
04/22/92	ND	ND	ND	ND	ND	-	8.60	NP	0.00	164.32	155.72
05/21/92	ND	ND	ND	ND	ND	-	9.22	NP	0.00	164.32	155.10
06/25/92	ND	ND	ND	ND	ND	-	9.49	NP	0.00	164.32	154.83
07/30/92	ND	1.1	4.2	ND	3.0	-	9.55	NP	0.00	164.32	154.77
08/20/92	ND	2.0	4.7	ND	5.7	-	9.63	NP	0.00	164.32	154.69
09/30/92	ND	ND	ND	ND	ND	-	9.90	NP	0.00	164.32	154.42
12/23/92	ND	ND	ND	ND	ND	-	9.96	NP	0.00	164.32	154.36
05/10/93	ND	ND	ND	ND	ND	-	8.95	NP	0.00	164.32	155.37
06/09/93	ND	ND	ND	ND	ND	-	9.00	NP	0.00	164.32	155.32
09/14/93	200	0.3	ND	ND	ND	-	9.50	NP	0.00	164.32	154.82
12/14/93	ND	ND	ND	ND	ND	-	8.75	NP	0.00	164.32	155.57
03/02/94	<50	<0.3	<0.3	<0.3	<0.5	-	7.52	NP	0.00	164.32	156.80
06/06/94	54	<0.3	<0.3	<0.3	2.4	-	9.00	NP	0.00	164.32	155.32
09/06/94	<50	<0.3	<0.3	<0.3	<0.5	-	9.26	NP	0.00	164.32	155.06
12/07/94	130	2.5	1.9	1.3	3.6	-	8.67	NP	0.00	164.32	155.65
03/08/95	<100	<0.5	<0.5	<0.5	<1	-	8.34	NP	0.00	164.32	155.98
06/15/95	<100	1.0	<0.5	<0.5	<1	-	9.12	NP	0.00	164.32	155.20
09/05/95	<100	<0.5	<0.5	<0.5	<1	-	9.56	NP	0.00	164.32	154.76
11/21/95	<50	0.44	<0.3	<0.3	1.5	-	9.28	NP	0.00	164.32	155.04
03/11/96	<50	1.3	<0.3	<0.3	0.6	-	7.52	NP	0.00	164.32	156.80
06/19/96	640	72	20	34	150	-	7.80	NP	0.00	164.32	156.52
09/16/96	<50	<0.3	<0.3	<0.3	<0.5	20	9.18	NP	0.00	164.32	155.14
12/10/96	<50	<0.3	<0.3	<0.3	<0.5	<20	6.08	NP	0.00	164.32	158.24
03/12/97	53	0.45	<0.3	<0.3	<0.5	140	8.65	NP	0.00	164.32	155.67
06/12/97	<50	<0.3	<0.3	<0.3	<0.5	68	-	-	-	-	-

**TABLE 1
GROUNDWATER DATA
THRIFTY OIL STATION #054, CASTRO VALLEY, CA.**

DATE SAMPLED	ANALYTICAL PARAMETERS						DEPTH TO GROUNDWATER (feet)	DEPTH TO PRODUCT (feet)	PRODUCT THICKNESS (feet)	CASING ELEVATION (feet)	GROUNDWATER ELEVATION (feet)
	TPH (ug/L)	BENZENE (ug/L)	TOLUENE (ug/L)	EthylBenzene (ug/L)	XYLENE (ug/L)	MTBE (ug/L)					
09/10/97	<50	<0.3	<0.3	<0.3	<0.5	<20	8.30	NP	0.00	164.32	156.02
12/09/97	<50	1.7	2.1	<0.3	1.4	82	9.98	NP	0.00	164.32	154.34
03/03/98	<50	<0.3	<0.3	<0.3	<0.5	84	8.33	NP	0.00	164.32	155.99
07/08/98	<50	<0.3	<0.3	<0.3	<0.5	97	-	-	-	-	-
09/10/98	<50	<0.3	<0.3	<0.3	<0.5	97	12.95	NP	0.00	164.32	151.37
12/30/98	<50	1.3	1.5	<0.3	0.86	19	11.35	NP	0.00	164.32	152.97
03/15/99	<50	<0.3	<0.3	<0.3	<0.5	9.6	9.85	NP	0.00	164.32	154.47
06/22/99	66	0.39	<0.3	<0.3	<0.5	62	9.90	NP	0.00	164.32	154.42
09/08/99	<50	<0.3	<0.3	<0.3	<0.5	25	9.85	NP	0.00	164.32	154.47
12/01/99	<50	<0.3	<0.3	<0.3	<0.5	30	8.30	NP	0.00	164.32	156.02
03/23/00	<50	<0.25	<0.25	<0.25	<0.5	*13.6/18.2	6.76	NP	0.00	164.32	157.56
06/08/00	<50	<5	<5	<5	<5	10	8.30	NP	0.00	164.32	156.02
09/27/00	<50	<0.18	<0.14	<0.18	<0.26	*6/4.9	8.30	NP	0.00	164.32	156.02
12/13/00	<50	<0.18	<0.14	<0.18	<0.26	<0.24	8.28	NP	0.00	164.32	156.04
03/22/01	<50	<0.18	<0.14	<0.18	<0.26	<0.24	12.89	NP	0.00	164.32	151.43
06/15/01	<50	<0.18	<0.14	<0.18	<0.26	<0.24	12.89	NP	0.00	164.32	151.43
08/30/01	<50	<0.18	<0.14	<0.18	<0.26	<0.24	9.82	NP	0.00	164.32	154.50
12/12/01	<50	<0.18	<0.14	<0.18	<0.26	<0.24	9.25	NP	0.00	164.32	155.07
03/13/02	-	-	-	-	-	-	12.89	NP	0.00	164.32	151.43
06/12/02	-	-	-	-	-	-	-	-	-	-	-
09/18/02	-	-	-	-	-	-	-	-	-	-	-
12/18/02	-	-	-	-	-	-	-	-	-	-	-
03/19/03	-	-	-	-	-	-	-	-	-	-	-
06/11/03	-	-	-	-	-	-	-	-	-	-	-
09/04/03	-	-	-	-	-	-	-	-	-	-	-
12/04/03	-	-	-	-	-	-	6.78	NP	0.00	164.03	157.25
03/18/04	-	-	-	-	-	-	9.65	NP	0.00	164.03	154.38
06/09/04	-	-	-	-	-	-	6.86	NP	0.00	164.03	157.17
09/02/04	-	-	-	-	-	-	8.23	NP	0.00	164.03	155.80
12/08/04	-	-	-	-	-	-	6.76	NP	0.00	164.03	157.27
03/16/05	-	-	-	-	-	-	8.29	NP	0.00	164.03	155.74
06/01/05	-	-	-	-	-	-	9.83	NP	0.00	164.03	154.20
09/14/05	-	-	-	-	-	-	6.76	NP	0.00	164.03	157.27
12/06/05	-	-	-	-	-	-	6.76	NP	0.00	164.03	157.27

TABLE 1
GROUNDWATER DATA
THRIFTY OIL STATION #054, CASTRO VALLEY, CA.

DATE SAMPLED	ANALYTICAL PARAMETERS						DEPTH TO GROUNDWATER (feet)	DEPTH TO PRODUCT (feet)	PRODUCT THICKNESS (feet)	CASING ELEVATION (feet)	GROUNDWATER ELEVATION (feet)
	TPH (ug/L)	BENZENE (ug/L)	TOLUENE (ug/L)	EthylBenzene (ug/L)	XYLENE (ug/L)	MTBE (ug/L)					
03/15/06	-	-	-	-	-	-	9.83	NP	0.00	164.03	154.20
MONITORING WELL #RS-9 <i>Screen Interval = 5 to 15 feet</i>											
08/07/91	-	0.5	ND	330	1,200	-	2.28	NP	0.00	167.51	165.23
09/27/91	13,000	3.5	3.0	82	140	-	2.77	NP	0.00	167.51	164.74
10/23/91	11,000	ND	ND	39	340	-	3.53	NP	0.00	167.51	163.98
11/06/91	6,800	8.4	0.6	22	230	-	2.51	NP	0.00	167.51	165.00
12/04/91	6,500	6.5	0.7	87	200	-	3.20	NP	0.00	167.51	164.31
01/29/92	8,100	22	10	140	260	-	2.65	NP	0.00	167.51	164.86
02/26/92	13,000	40	16	220	600	-	3.42	NP	0.00	167.51	164.09
03/19/92	12,000	21	12	100	280	-	3.12	NP	0.00	167.51	164.39
04/22/92	8,600	ND	ND	20	37	-	3.24	NP	0.00	167.51	164.27
05/21/92	6,000	21	10	53	210	-	3.75	NP	0.00	167.51	163.76
06/25/92	370	2.3	1.5	0.7	4.3	-	2.65	NP	0.00	167.51	164.86
07/30/92	3,600	20	ND	39	80	-	2.70	NP	0.00	167.51	164.81
08/20/92	3,000	0.7	5.2	2.0	5.3	-	2.83	NP	0.00	167.51	164.68
09/30/92	9,200	4.8	6.5	12	91	-	2.80	NP	0.00	167.51	164.71
12/23/92	2,000	17	ND	8.2	18	-	2.45	NP	0.00	167.51	165.06
03/10/93	1,500	ND	2.6	21	12	-	2.40	NP	0.00	167.51	165.11
06/09/93	1,300	0.6	1.7	ND	7.5	-	3.55	NP	0.00	167.51	163.96
09/14/93	1,500	1.3	7.6	4.1	14	-	2.81	NP	0.00	167.51	164.70
12/14/93	560	ND	ND	ND	5.5	-	2.63	NP	0.00	167.51	164.88
03/02/94	1,100	<0.3	<0.3	<0.3	<0.5	-	2.60	NP	0.00	167.51	164.91
06/06/94	290	0.58	0.53	1.1	5.8	-	2.52	NP	0.00	167.51	164.99
09/06/94	890	<0.3	<0.3	<0.3	3.1	-	3.16	NP	0.00	167.51	164.35
12/07/94	940	22	23	10	32	-	5.18	NP	0.00	167.51	162.33
03/08/95	1,600	<0.5	<0.5	<0.5	2.3	-	4.57	NP	0.00	167.51	162.94
06/15/95	3,200	2.2	5.3	4.3	3.1	-	5.08	NP	0.00	167.51	162.43
09/05/95	1,100	<0.5	<0.5	<0.5	<1	-	5.72	NP	0.00	167.51	161.79
11/21/95	1,100	1.1	2.9	3.5	3.0	-	2.46	NP	0.00	167.51	165.05
03/11/96	440	0.7	0.34	<0.3	3.7	-	3.44	NP	0.00	167.51	164.07
06/19/96	580	3.8	0.49	1.2	<0.5	-	3.80	NP	0.00	167.51	163.71
09/16/96	490	<0.3	1.6	<0.3	<0.5	<20	3.80	NP	0.00	167.51	163.71

TABLE 1
GROUNDWATER DATA
THRIFTY OIL STATION #054, CASTRO VALLEY, CA.

DATE SAMPLED	ANALYTICAL PARAMETERS						DEPTH TO GROUNDWATER (feet)	DEPTH TO PRODUCT (feet)	PRODUCT THICKNESS (feet)	CASING ELEVATION (feet)	GROUNDWATER ELEVATION (feet)
	TPH (ug/L)	BENZENE (ug/L)	TOLUENE (ug/L)	EthylBenzene (ug/L)	XYLENE (ug/L)	MTBE (ug/L)					
12/10/96	<50	<0.3	<0.3	<0.3	<0.5	<20	2.76	NP	0.00	167.51	164.75
03/12/97	<50	<0.3	0.42	<0.3	1.5	<20	3.20	NP	0.00	167.51	164.31
06/12/97	<50	<0.3	<0.3	<0.3	0.51	<20	-	-	-	-	-
09/10/97	<50	<0.3	<0.3	<0.3	<0.5	<20	4.24	NP	0.00	167.51	163.27
12/09/97	<50	<0.3	0.48	<0.3	<0.5	<20	2.72	NP	0.00	167.51	164.79
03/03/98	190	<0.3	<0.3	0.38	<0.5	<20	1.90	NP	0.00	167.51	165.61
07/08/98	<50	<0.3	<0.3	<0.3	<0.5	<5	-	-	-	-	-
09/10/98	<50	<0.3	<0.3	<0.3	<0.5	<5	2.72	NP	0.00	167.51	164.79
12/30/98	<50	<0.3	<0.3	<0.3	<0.5	<5	1.20	NP	0.00	167.51	166.31
03/15/99	<50	<0.3	<0.3	<0.3	<0.5	<5	4.25	NP	0.00	167.51	163.26
06/22/99	1,300	4.2	1.2	0.69	0.74	<5	3.70	NP	0.00	167.51	163.81
09/08/99	<50	<0.3	<0.3	<0.3	<0.5	<5	2.71	NP	0.00	167.51	164.80
12/01/99	<50	<0.3	<0.3	<0.3	<0.5	<5	2.70	NP	0.00	167.51	164.81
03/23/00	<50	<0.25	<0.25	<0.25	<0.5	<5	2.70	NP	0.00	167.51	164.81
06/08/00	585	<5	<5	<5	<5	821	2.72	NP	0.00	167.51	164.79
09/27/00	592	<0.18	<0.14	<0.18	<0.26	*1,180 / 1,360	2.72	NP	0.00	167.51	164.79
12/13/00	<50	<0.18	<0.14	<0.18	<0.26	*403 / 444	2.70	NP	0.00	167.51	164.81
03/22/01	425	<0.18	<0.14	<0.18	<0.26	*738 / 1,640	2.69	NP	0.00	167.51	164.82
06/15/01	<50	<0.18	<0.14	<0.18	<0.26	<0.24	2.68	NP	0.00	167.51	164.83
08/30/01	164	<0.18	<0.14	<0.18	<0.26	*396 / 284	2.68	NP	0.00	167.51	164.83
12/12/01	1,540	<0.18	<0.14	<0.18	<0.26	*4,370 / 2,480	2.41	NP	0.00	167.51	165.10
03/13/02	1,540	<0.18	<0.14	<0.18	<0.26	3,360	2.68	NP	0.00	167.51	164.83
06/12/02	2,020	1	3	1	3	3,280	4.21	NP	0.00	167.51	163.30
09/18/02	915	<0.18	<0.14	<0.18	<0.26	768	4.21	NP	0.00	167.51	163.30
12/18/02	1,070	<0.18	<0.14	<0.18	<0.26	960	2.68	NP	0.00	167.51	164.83
03/19/03	1,600	<0.04	<0.02	<0.02	<0.06	836	4.21	NP	0.00	167.51	163.30
06/11/03	1,960	<0.04	<0.02	<0.02	<0.06	583	4.21	NP	0.00	167.51	163.30
09/04/03	117	<0.22	<0.32	<0.31	13	8.3	4.21	NP	0.00	167.51	163.30
12/04/03	19,200	5,270	6,550	144	2,540	217	1.16	NP	0.00	167.05	165.89
03/18/04	193	7.5	18	1.4 J	6.1	127	2.68	NP	0.00	167.05	164.37
06/10/04	159	<0.14	3.3	1.9	2.5	<0.22	3.74	NP	0.00	167.05	163.31
09/02/04	<15	<0.14	<0.16	<0.18	<0.45	<0.22	3.68	NP	0.00	167.05	163.37
12/09/04	<15	1.2	2.1	<0.18	0.99	<0.22	1.20	NP	0.00	167.05	165.85
03/16/05	<15	<0.22	1.1 J	<0.31	<0.4	2.1	4.21	NP	0.00	167.05	162.84

TABLE 1
GROUNDWATER DATA
THRIFTY OIL STATION #054, CASTRO VALLEY, CA.

DATE SAMPLED	ANALYTICAL PARAMETERS						DEPTH TO GROUNDWATER (feet)	DEPTH TO PRODUCT (feet)	PRODUCT THICKNESS (feet)	CASING ELEVATION (feet)	GROUNDWATER ELEVATION (feet)
	TPH (ug/L)	BENZENE (ug/L)	TOLUENE (ug/L)	EthylBenzene (ug/L)	XYLENE (ug/L)	MTBE (ug/L)					
06/01/05	<2.9	<0.17	<0.22	<0.14	0.94	2.97 J	2.71	NP	0.00	167.05	164.34
09/14/05	63	<0.32	<0.10	<0.24	<0.30	36	4.21	NP	0.00	167.05	162.84
12/06/05	<2.9	<0.32	<0.10	<0.24	<0.3	32	1.14	NP	0.00	167.05	165.91
03/15/06	<5.6	<0.32	<0.10	<0.24	1.6 J	17	2.71	NP	0.00	167.05	164.34
MONITORING WELL #RS-10 <i>Screen Interval = 5 to 25 feet</i>											
08/07/91	ND	ND	ND	ND	ND	-	6.16	NP	0.00	162.89	156.73
09/27/91	ND	ND	ND	ND	ND	-	6.48	NP	0.00	162.89	156.41
10/23/91	ND	ND	ND	ND	ND	-	7.37	NP	0.00	162.89	155.52
11/06/91	ND	ND	ND	ND	ND	-	6.44	NP	0.00	162.89	156.45
12/04/91	ND	ND	ND	ND	ND	-	7.02	NP	0.00	162.89	155.87
01/29/92	ND	ND	ND	ND	ND	-	6.78	NP	0.00	162.89	156.11
02/26/92	ND	ND	ND	ND	ND	-	8.33	NP	0.00	162.89	154.56
03/19/92	ND	ND	ND	ND	0.6	-	8.02	NP	0.00	162.89	154.87
04/22/92	ND	ND	ND	ND	ND	-	7.78	NP	0.00	162.89	155.11
05/21/92	ND	ND	0.6	ND	1.2	-	6.21	NP	0.00	162.89	156.68
06/25/92	ND	ND	ND	ND	ND	-	7.73	NP	0.00	162.89	155.16
07/30/92	ND	ND	0.5	ND	1.0	-	7.84	NP	0.00	162.89	155.05
08/20/92	ND	ND	ND	ND	ND	-	7.50	NP	0.00	162.89	155.39
09/30/92	ND	ND	ND	ND	ND	-	7.63	NP	0.00	162.89	155.26
12/23/92	ND	ND	ND	ND	ND	-	7.24	NP	0.00	162.89	155.65
03/10/93	ND	ND	ND	ND	ND	-	6.38	NP	0.00	162.89	156.51
06/09/93	ND	ND	ND	ND	ND	-	7.98	NP	0.00	162.89	154.91
09/14/93	ND	ND	ND	ND	ND	-	7.35	NP	0.00	162.89	155.54
03/02/94	<50	<0.3	<0.3	<0.3	<0.3	-	7.00	NP	0.00	162.89	155.89
06/06/94	<50	<0.3	<0.3	<0.3	<0.5	-	6.55	NP	0.00	162.89	156.34
09/06/94	<50	<0.3	<0.3	<0.3	<0.5	-	7.63	NP	0.00	162.89	155.26
12/07/94	56	<0.3	<0.3	<0.5	2.1	-	5.92	NP	0.00	162.89	156.97
03/08/95	<100	<0.5	<0.5	<0.5	<1	-	7.84	NP	0.00	162.89	155.05
06/15/95	<100	<0.5	<0.5	<0.5	<1	-	6.97	NP	0.00	162.89	155.92
09/05/95	<100	<0.5	<0.5	<0.5	<1	-	8.14	NP	0.00	162.89	154.75
11/21/95	<50	<0.3	<0.3	<0.3	<0.5	-	7.68	NP	0.00	162.89	155.21
03/11/96	<50	<0.3	<0.3	<0.3	<0.5	-	6.76	NP	0.00	162.89	156.13

TABLE 1
GROUNDWATER DATA
THRIFTY OIL STATION #054, CASTRO VALLEY, CA.

DATE SAMPLED	ANALYTICAL PARAMETERS						DEPTH TO GROUNDWATER (feet)	DEPTH TO PRODUCT (feet)	PRODUCT THICKNESS (feet)	CASING ELEVATION (feet)	GROUNDWATER ELEVATION (feet)
	TPH (ug/L)	BENZENE (ug/L)	TOLUENE (ug/L)	EthylBenzene (ug/L)	XYLENE (ug/L)	MTBE (ug/L)					
06/19/96	<50	<0.3	<0.3	<0.3	<0.5	-	7.20	NP	0.00	162.89	155.69
09/16/96	<50	<0.3	<0.3	<0.3	<0.5	<20	6.30	NP	0.00	162.89	156.59
12/10/96	<50	<0.3	<0.3	<0.3	<0.5	<20	6.05	NP	0.00	162.89	156.84
03/12/97	<50	<0.3	<0.3	<0.3	<0.5	<20	7.56	NP	0.00	162.89	155.33
06/12/97	<50	<0.3	<0.3	<0.3	<0.5	<20	-	-	-	-	-
09/10/97	<50	<0.3	<0.3	<0.3	<0.5	<20	7.55	NP	0.00	162.89	155.34
12/09/97	1,900	610	510	<6	290	<20	7.55	NP	0.00	162.89	155.34
03/03/98	<50	2.0	<0.3	<0.3	<0.5	27	6.03	NP	0.00	162.89	156.86
07/08/98	<50	<0.3	<0.3	<0.3	<0.5	<5	-	-	-	-	-
09/10/98	<50	<0.3	<0.3	<0.3	<0.5	72	7.55	NP	0.00	162.89	155.34
12/30/98	<50	1.1	<0.3	<0.3	<0.5	<5	4.45	NP	0.00	162.89	158.44
03/15/99	<50	<0.3	<0.3	<0.3	1.3	<5	4.50	NP	0.00	162.89	158.39
06/22/99	<50	<0.3	<0.3	<0.3	<0.5	<5	9.15	NP	0.00	162.89	153.74
09/08/99	<50	<0.3	<0.3	<0.3	<0.5	<5	7.51	NP	0.00	162.89	155.38
12/01/99	<50	<0.3	<0.3	<0.3	<0.5	<5	5.97	NP	0.00	162.89	156.92
03/23/00	<50	<0.25	<0.25	<0.25	<0.5	<5	4.47	NP	0.00	162.89	158.42
06/08/00	<50	<5	<5	<5	<5	<5	5.97	NP	0.00	162.89	156.92
09/27/00	<50	<0.18	<0.14	<0.18	<0.26	<0.24	7.50	NP	0.00	162.89	155.39
12/13/00	<50	<0.18	<0.14	<0.18	<0.26	<0.24	5.94	NP	0.00	162.89	156.95
03/22/01	<50	<0.18	<0.14	<0.18	<0.26	<0.24	7.51	NP	0.00	162.89	155.38
06/15/01	<50	<0.18	<0.14	<0.18	<0.26	<0.24	7.50	NP	0.00	162.89	155.39
08/30/01	<50	<0.18	<0.14	<0.18	<0.26	<0.24	9.05	NP	0.00	162.89	153.84
12/12/01	<50	<0.18	<0.14	<0.18	<0.26	<0.24	7.65	NP	0.00	162.89	155.24
03/13/02	-	-	-	-	-	-	9.05	NP	0.00	162.89	153.84
06/12/02	-	-	-	-	-	-	-	-	-	-	-
09/18/02	-	-	-	-	-	-	-	-	-	-	-
12/18/02	-	-	-	-	-	-	-	-	-	-	-
03/19/03	-	-	-	-	-	-	-	-	-	-	-
06/11/03	-	-	-	-	-	-	-	-	-	-	-
09/04/03	-	-	-	-	-	-	-	-	-	-	-
12/04/03	-	-	-	-	-	-	5.98	NP	0.00	162.43	156.45
03/18/04	-	-	-	-	-	-	8.85	NP	0.00	162.43	153.58
06/09/04	-	-	-	-	-	-	6.27	NP	0.00	162.43	156.16
09/02/04	-	-	-	-	-	-	6.17	NP	0.00	162.43	156.26

TABLE 1
GROUNDWATER DATA
THRIFTY OIL STATION #054, CASTRO VALLEY, CA.

DATE SAMPLED	ANALYTICAL PARAMETERS						DEPTH TO GROUNDWATER (feet)	DEPTH TO PRODUCT (feet)	PRODUCT THICKNESS (feet)	CASING ELEVATION (feet)	GROUNDWATER ELEVATION (feet)
	TPH (ug/L)	BENZENE (ug/L)	TOLUENE (ug/L)	EthylBenzene (ug/L)	XYLENE (ug/L)	MTBE (ug/L)					
12/08/04	-	-	-	-	-	-	6.00	NP	0.00	162.43	156.43
03/16/05	-	-	-	-	-	-	9.05	NP	0.00	162.43	153.38
06/01/05	-	-	-	-	-	-	7.49	NP	0.00	162.43	154.94
09/14/05	-	-	-	-	-	-	7.49	NP	0.00	162.43	154.94
12/06/05	-	-	-	-	-	-	5.96	NP	0.00	162.43	156.47
03/15/06	-	-	-	-	-	-	7.52	NP	0.00	162.43	154.91
MONITORING WELL #RS-11											
<i>Screen Interval = 5 to 25 feet</i>											
09/21/95	110	<0.5	<0.5	<0.5	<1	-	9.37	NP	0.00	163.28	153.91
11/21/95	-	-	-	-	-	-	-	-	-	-	-
03/11/96	-	-	-	-	-	-	-	-	-	-	-
06/19/96	-	-	-	-	-	-	-	-	-	-	-
09/16/96	-	-	-	-	-	-	-	-	-	-	-
03/12/97	74	9.5	<0.3	<0.3	0.57	<20	7.75	NP	0.00	163.28	155.53
06/12/97	<50	<0.3	<0.3	<0.3	<0.5	<20	-	-	-	-	-
09/10/97	<50	<0.3	<0.3	<0.3	<0.5	<20	9.50	NP	0.00	163.28	153.78
12/09/97	<50	0.79	1.2	<0.3	<0.5	<20	9.50	NP	0.00	163.28	153.78
03/03/98	140	22	0.63	<0.3	<0.5	<20	7.93	NP	0.00	163.28	155.35
07/08/98	<50	<0.3	<0.3	<0.3	<0.5	<5	-	-	-	-	-
09/10/98	<50	<0.3	<0.3	<0.3	<0.5	<5	9.48	NP	0.00	163.28	153.80
12/30/98	<50	1.3	0.87	<0.3	0.55	<5	7.95	NP	0.00	163.28	155.33
03/15/99	<50	<0.3	<0.3	<0.3	<0.5	<5	6.40	NP	0.00	163.28	156.88
06/22/99	350	89	2.9	3.3	0.91	6.8	11.00	NP	0.00	163.28	152.28
09/08/99	99	9.1	0.37	<0.3	<0.5	<5	7.90	NP	0.00	163.28	155.38
12/01/99	82	9.7	0.44	<0.3	<0.5	<5	7.90	NP	0.00	163.28	155.38
03/23/00	73	5.8	2.3	<0.25	<0.5	*11.2 / 7.9	4.85	NP	0.00	163.28	158.43
06/08/00	306	<5	<5	<5	<5	<5	7.90	NP	0.00	163.28	155.38
09/27/00	<50	1	<0.14	<0.18	<0.26	3 J / 3.6	9.44	NP	0.00	163.28	153.84
12/13/00	<50	<0.18	<0.14	<0.18	<0.26	<0.24	6.34	NP	0.00	163.28	156.94
03/22/01	408	<0.18	<0.14	<0.18	<0.26	*664 / 941	7.96	NP	0.00	163.28	155.32
06/15/01	<50	<0.18	<0.14	<0.18	<0.26	<0.24	7.87	NP	0.00	163.28	155.41
08/30/01	<50	<0.18	<0.14	<0.18	<0.26	<0.24	9.41	NP	0.00	163.28	153.87
12/12/01	<50	<0.18	<0.14	<0.18	<0.26	<0.24	7.86	NP	0.00	163.28	155.42

**TABLE 1
GROUNDWATER DATA
THRIFTY OIL STATION #054, CASTRO VALLEY, CA.**

DATE SAMPLED	ANALYTICAL PARAMETERS						DEPTH TO GROUNDWATER (feet)	DEPTH TO PRODUCT (feet)	PRODUCT THICKNESS (feet)	CASING ELEVATION (feet)	GROUNDWATER ELEVATION (feet)
	TPH (ug/L)	BENZENE (ug/L)	TOLUENE (ug/L)	EthylBenzene (ug/L)	XYLENE (ug/L)	MTBE (ug/L)					
03/13/02	<50	<0.18	<0.14	<0.18	<0.26	<0.24	7.85	NP	0.00	163.28	155.43
06/12/02	<50	<0.18	I	<0.18	<0.26	<0.24	9.39	NP	0.00	163.28	153.89
09/18/02	<50	<0.18	<0.14	<0.18	<0.26	<0.24	9.38	NP	0.00	163.28	153.90
12/18/02	110	<0.18	<0.14	<0.18	<0.26	101	6.32	NP	0.00	163.28	156.96
03/19/03	<15	<0.04	<0.02	<0.02	<0.06	<0.03	9.39	NP	0.00	163.28	153.89
06/11/03	<15	<0.04	<0.02	<0.02	<0.06	20	9.39	NP	0.00	163.28	153.89
09/04/03	<15	<0.22	<0.32	<0.31	<0.4	<0.18	7.85	NP	0.00	163.28	155.43
12/04/03	<15	<0.04	<0.02	<0.02	<0.06	<0.03	6.32	NP	0.00	162.71	156.39
03/18/04	<15	<0.22	<0.32	<0.31	<0.4	<0.18	9.39	NP	0.00	162.71	153.32
06/10/04	1,080	48	3.8	30	1.8	68	6.87	NP	0.00	162.71	155.84
09/02/04	1,600	94	5.9	4.3	3.8	*185 / 78	7.07	NP	0.00	162.71	155.64
12/09/04	<15	1.2	1.3	<0.18	<0.45	*22 / <0.18	6.34	NP	0.00	162.71	156.37
03/16/05	<15	<0.22	<0.32	<0.31	<0.4	16	7.85	NP	0.00	162.71	154.86
06/01/05	<2.9	0.97	1.4	<0.14	2	22	7.88	NP	0.00	162.71	154.83
09/14/05	133	<0.32	<0.10	<0.24	<0.30	79	7.84	NP	0.00	162.71	154.87
12/06/05	905	16.00	3.1 J	11.0	23	578	6.32	NP	0.00	162.71	156.39
03/15/06	426	<0.32	<0.10	<0.24	<0.30	336	7.89	NP	0.00	162.71	154.82

NOTE: ND = Nondetectable
 " - " = Not Analyzed / Not Available
 NP = No Free Product
 *MTBE 8020/8260

Benzene, toluene, ethylbenzene, and xylene analyzed by EPA method 8020.
 Total petroleum hydrocarbons (TPH) analyzed by EPA method 8015 modified for gasoline
 Methyl-tert Butyl Ether (MTBE) analyzed by EPA method 8020
 On 3/16/05, 3/18/04, 9/4/03 & 6/8/00, BTEX and MTBE analyzed by EPA Method 8260B

TABLE 2
Vapor Extraction Operating Data
Thrifty Oil Station # 054, CASTRO VALLEY, CA

Month	Representative Date	Hour Meter Reading (hrs)	Operation Duration (hrs)	Inlet		Hydrocarbons Removed		Remark
				Average Flow (cfm)	Average PID Conc (ppmV)	Period (lbs)	Cumulative (lbs)	
Jan-91	1/9/1991	929	0	30	est. 10,000	0.0	0	
Feb-91	2/6/1991	979	50	30	est. 10,000	38.0	38	
Mar-91	3/6/1991	1,028	49	5	est. 10,000	6.2	44	System off 4/91 - 9/91
Oct-91	10/23/1991	1,786	758	15	est. 10,000	288.0	332	
Nov-91	11/6/1991	1,789	3	14	est. 10,000	1.1	333	
Dec-91	12/4/1991	1,896	107	14	est. 10,000	37.9	371	
Jan-92	1/29/1992	2,025	129	14	est. 10,000	45.7	417	
Feb-92	2/26/1992	2,293	268	14	est. 10,000	95.0	512	System off 3/92 - 7/92
Aug-93	8/11/1993	2,293	0	18	est. 10,000	0.0	512	
Sep-93	9/8/1993	2,446	153	17	est. 10,000	65.9	578	
Oct-93	10/7/1993	2,960	514	18	est. 10,000	234.4	812	
Nov-93	11/3/1993	3,381	421	18	est. 10,000	191.9	1,004	
Dec-93	12/1/1993	3,705	324	18	est. 10,000	147.7	1,152	
Jan-94	1/3/1994	4,313	608	18	est. 10,000	277.2	1,429	
Feb-94	2/7/1994	4,849	536	17	est. 10,000	230.8	1,660	
Mar-94	3/7/1994	5,196	347	20	est. 10,000	175.8	1,836	
Apr-94	4/4/1994	5,597	401	16	est. 10,000	162.5	1,998	
May-94	5/2/1994	6,003	406	17	est. 10,000	174.8	2,173	
Jun-94	6/6/1994	6,514	511	16	est. 10,000	207.1	2,380	
Jul-94	7/18/1994	6,679	165	15	est. 10,000	62.7	2,443	
Aug-94	8/1/1994	6,735	56	16	est. 10,000	22.7	2,466	
Sep-94	9/20/1994	7,340	605	16	est. 10,000	245.2	2,711	
Oct-94	10/5/1994	7,554	214	15	est. 10,000	81.3	2,792	
Dec-94	12/13/1994	7,656	102	15	est. 10,000	38.8	2,831	
Jan-95	1/6/1995	7,742	86	12	est. 10,000	26.1	2,857	
Feb-95	2/14/1995	7,906	164	13	est. 10,000	54.0	2,911	
Mar-95	3/2/1995	7,976	70	15	est. 10,000	26.6	2,938	
Apr-95	4/7/1995	8,009	33	8	est. 10,000	6.7	2,944	
May-95	5/5/1995	8,405	396	16	est. 10,000	160.5	3,105	
Jun-95	6/1/1995	8,436	31	16	est. 10,000	12.6	3,117	
Jul-95	7/7/1995	8,834	398	16	est. 10,000	161.3	3,279	
Aug-95	8/3/1995	8,910	76	16	est. 10,000	30.8	3,309	
Sep-95	9/5/1995	9,068	158	16	est. 10,000	64.0	3,373	
Oct-95	10/24/1995	9,163	95	14	est. 10,000	33.7	3,407	
Nov-95	11/2/1995	9,194	31	16	est. 10,000	12.6	3,420	
Jan-96	1/4/1996	8,930	0	9	est. 10,000	0.0	3,420	Replaced hour meter (8630)
Feb-96	2/1/1996	8,991	61	8	est. 10,000	12.4	3,432	System off 2/96 - 4/96
Apr-96	4/25/1996	9,084	93	8	est. 210	0.4	3,432	
May-96	5/2/1996	9,124	40	12	est. 220	0.3	3,433	
Jun-96	6/3/1996	9,279	155	9	est. 1,000	3.5	3,436	
Jul-96	7/2/1996	9,370	91	17	est. 420	1.6	3,438	
Aug-96	8/1/1996	9,391	21	9	est. 340	0.2	3,438	
Sep-96	9/5/1996	9,721	330	17	est. 340	4.8	3,443	
Oct-96	10/24/1996	9,773	52	7	est. 340	0.3	3,443	
Dec-96	12/26/1996	9,776	3	8	est. 340	0.0	3,443	System off 10/96 - 12/96
Apr-97	4/3/1997	9,781	5	15	est. 10,000	1.9	3,445	System off 1/97 - 4/97
May-97	5/1/1997	10,032	251	15	est. 9,800	93.5	3,539	
Jun-97	6/12/1997	10,663	631	11	est. 9,000	158.2	3,697	
Jul-97	7/3/1997	10,712	49	12	est. 9,000	13.4	3,710	
Aug-97	8/7/1997	10,950	238	12	est. 9,000	65.1	3,775	
Sep-97	9/3/1997	11,136	186	16	est. 9,000	67.8	3,843	
Oct-97	10/9/1997	11,320	184	12	est. 9,000	50.3	3,893	
Nov-97	11/6/1997	11,452	132	17	est. 9,000	51.2	3,945	
Dec-97	12/4/1997	11,510	58	19	est. 9,000	25.1	3,970	
Jan-98	1/8/1998	11,784	274	17	est. 10,000	118.0	4,088	
Feb-98	2/3/1998	12,180	396	16	est. 10,000	160.5	4,248	
Mar-98	3/10/1998	13,011	831	17	est. 10,000	357.8	4,606	
Apr-98	4/15/1998	13,060	49	17	est. 10,000	21.1	4,627	

TABLE 2
Vapor Extraction Operating Data
Thrifty Oil Station # 054, CASTRO VALLEY, CA

Month	Representative Date	Hour Meter Reading (hrs)	Operation Duration (hrs)	Inlet		Hydrocarbons Removed		Remark
				Average Flow (cm)	Average FID Conc (ppmV)	Period (hrs)	Cumulative (lbs)	
May-98	5/7/1998	13,311	251	16	10,000	101.7	4,729	
Jun-98	6/2/1998	13,658	347	17	10,000	149.4	4,878	
Jul-98	7/6/1998	14,340	682	16	est. 10,000	276.4	5,155	
Sep-98	9/21/1998	14,542	202	12	est. 10,000	61.4	5,216	System shut down, 10/98
Nov-98	11/16/1998	14,730	188	12	est. 10,000	57.1	5,273	
Dec-98	12/7/1998	15,124	394	11	est. 10,000	109.8	5,383	
Feb-99	2/9/1999	16,115	991	10	2,800	70.3	5,453	
Mar-99	3/12/1999	16,698	583	13	210	4.0	5,457	
Apr-99	4/6/1999	17,009	311	13	est. 210	2.2	5,459	
May-99	5/3/1999	17,098	89	10	est. 210	0.5	5,460	
Jun-99	6/28/1999	18,130	1,032	10	4,100	107.2	5,567	
Jul-99	7/7/1999	18,163	33	10	est. 4,000	3.3	5,570	
Aug-99	8/2/1999	18,196	33	11	est. 4,000	3.7	5,574	
Sep-99	9/13/1999	18,318	122	12	est. 4,000	14.8	5,589	
Oct-99	10/18/1999	18,348	30	13	est. 4,000	4.0	5,593	
Nov-99	11/29/1999	18,617	269	12	est. 4,000	32.7	5,626	
Dec-99	12/27/1999	19,096	479	12	210	3.1	5,629	
Jan-00	1/24/2000	19,388	292	12	est. 210	1.9	5,631	System shut down, 1/24/00

- Note: 1. The "duration" is derived from subtracting the hour meter from a representative day of the month by the hour meter from a representative day of the previous month. Some months may have more than 30 days.
2. In January 2000, the "hydrocarbons removed" calculations were corrected to reflect the actual calibration gas (methane) of the instrument used. Therefore, the corrected cumulative total value is different than the previous versions of this table.

FIGURES

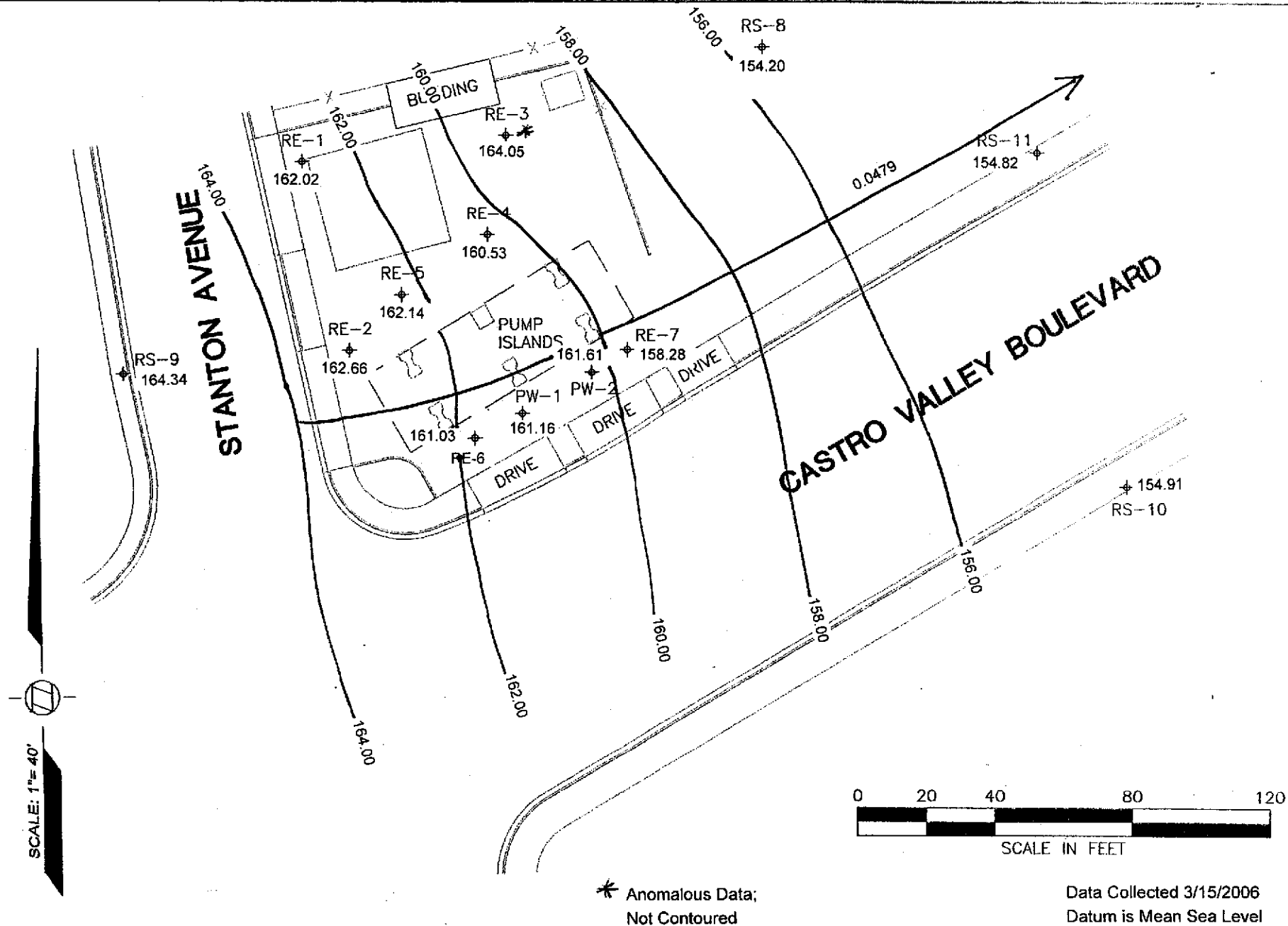

GROUNDWATER CONTOURS

THRIFTY STATION #054
2504 Castro Valley Boulevard
Castro Valley, CA

Figure
 1



Thrifty Oil Co.
 13116 Imperial Highway
 Santa Fe Springs, CA 90670

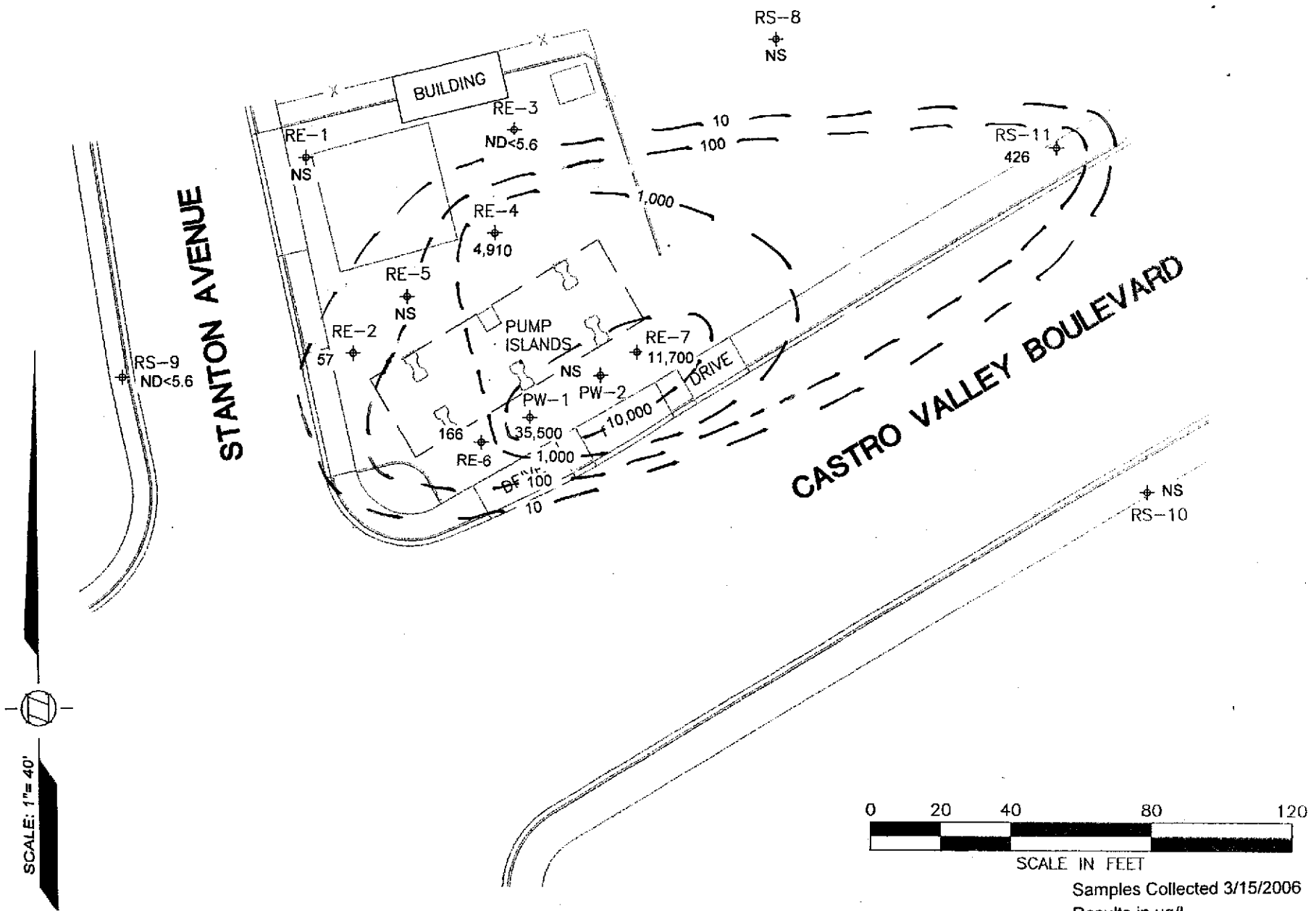

TPHg IN GROUNDWATER

THRIFTY STATION #054
 2504 Castro Valley Boulevard
 Castro Valley, CA

Figure

2



Thrifty Oil Co.
 13116 Imperial Highway
 Santa Fe Springs, CA 90670

Samples Collected 3/15/2006
 Results in ug/L
 NS = Not Sampled

SCALE: 1" = 40'

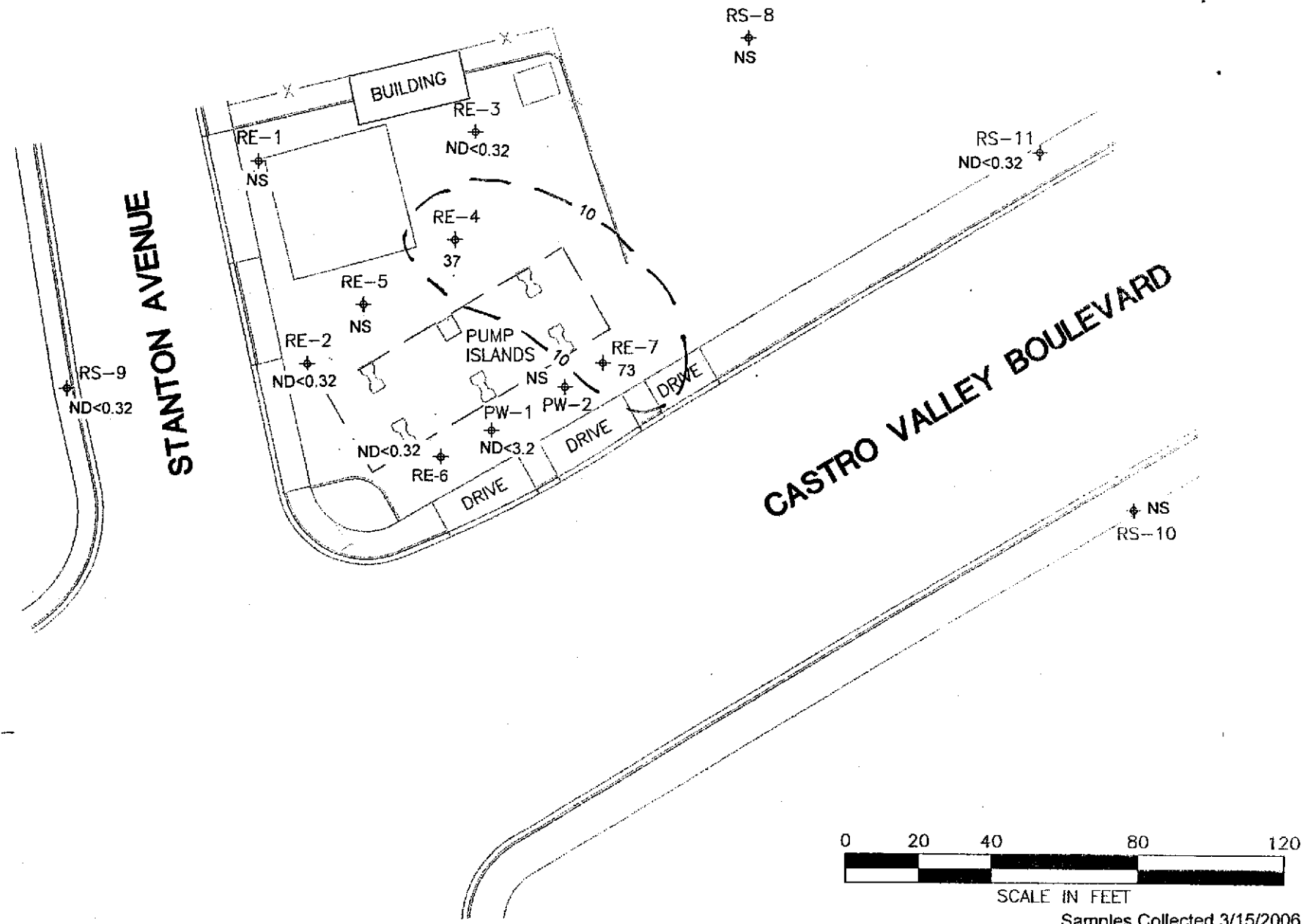

0 20 40 80 120
SCALE IN FEET

Samples Collected 3/15/2006
Results in ug/L
NS = Not Sampled



Thrifty Oil Co.
13116 Imperial Highway
Santa Fe Springs, CA 90670

BENZENE IN GROUNDWATER

THRIFTY STATION #054
2504 Castro Valley Boulevard
Castro Valley, CA

Figure
3

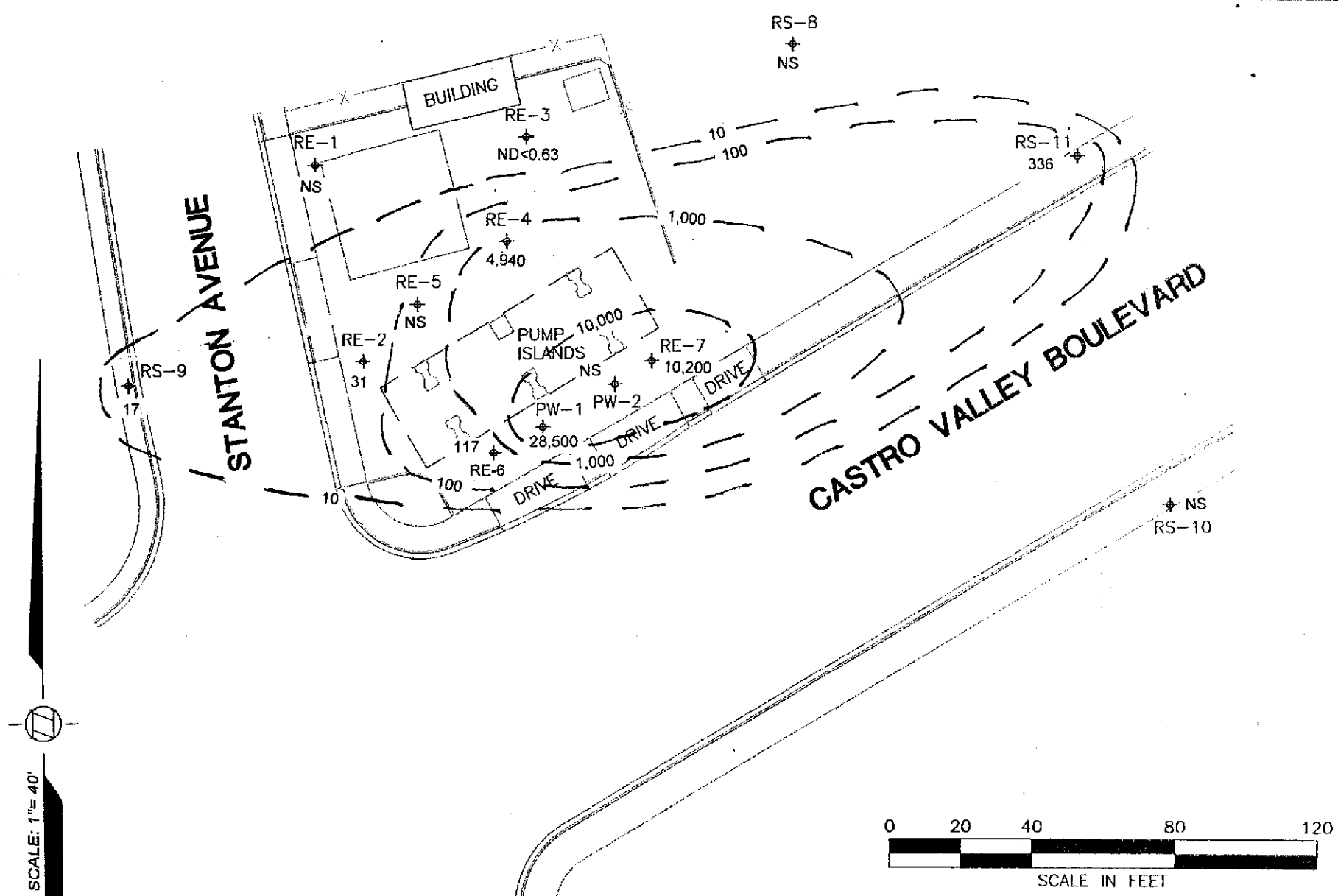

SCALE: 1" = 40'



Samples Collected 3/15/2006
Results in ug/L
NS = Not Sampled

MTBE IN GROUNDWATER

THRIFTY STATION #054
2504 Castro Valley Boulevard
Castro Valley, CA

Figure
4



Thrifty Oil Co.
13116 Imperial Highway
Santa Fe Springs, CA 90670

Figure 5
Groundwater Data - Monitoring Well RE-2
Thrifty Oil Co. SS#054 - Castro Valley, CA

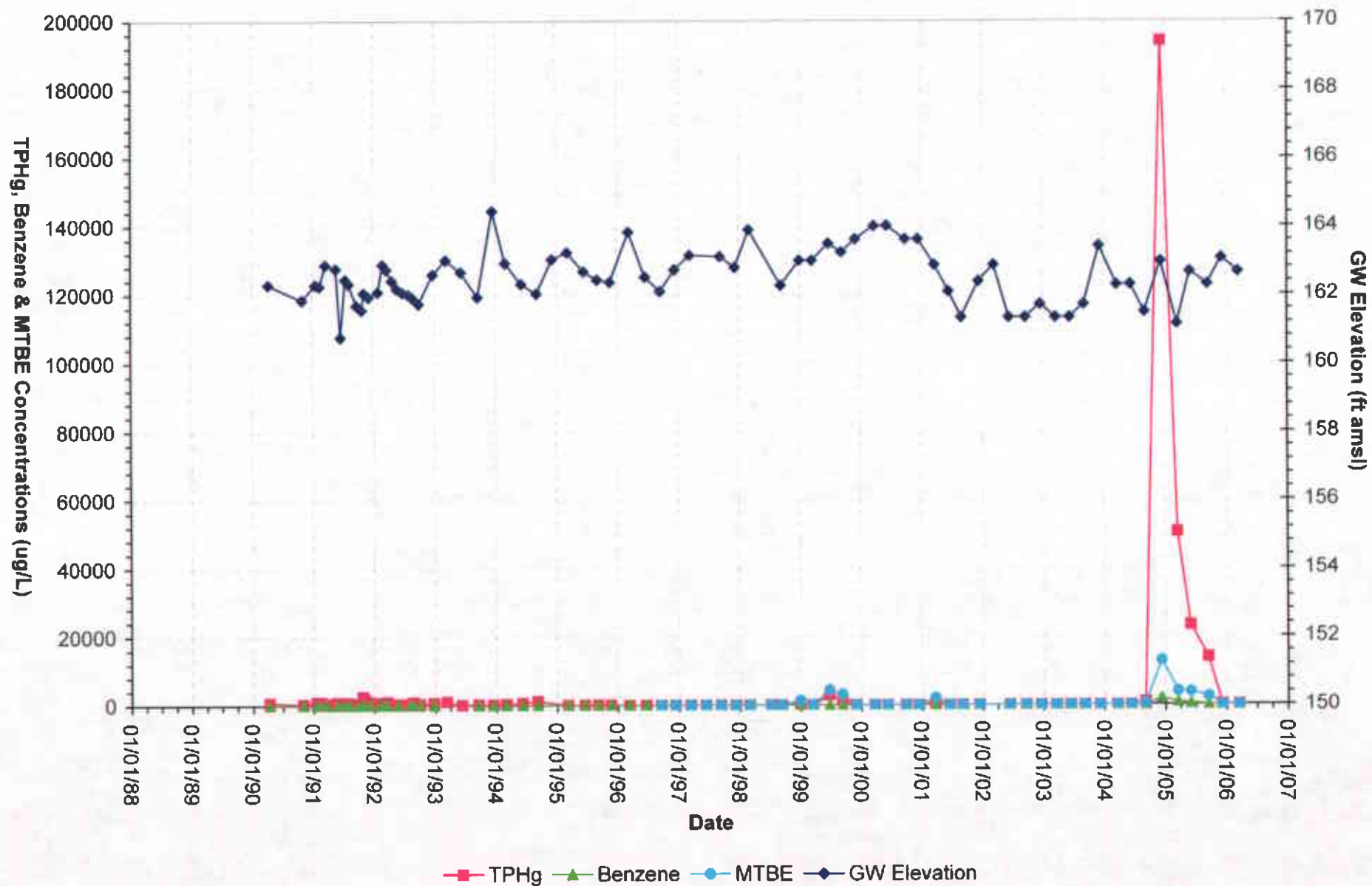

Figure 6
 Groundwater Data - Monitoring Well RE-3
 Thrifty Oil Co. SS#054 - Castro Valley, CA

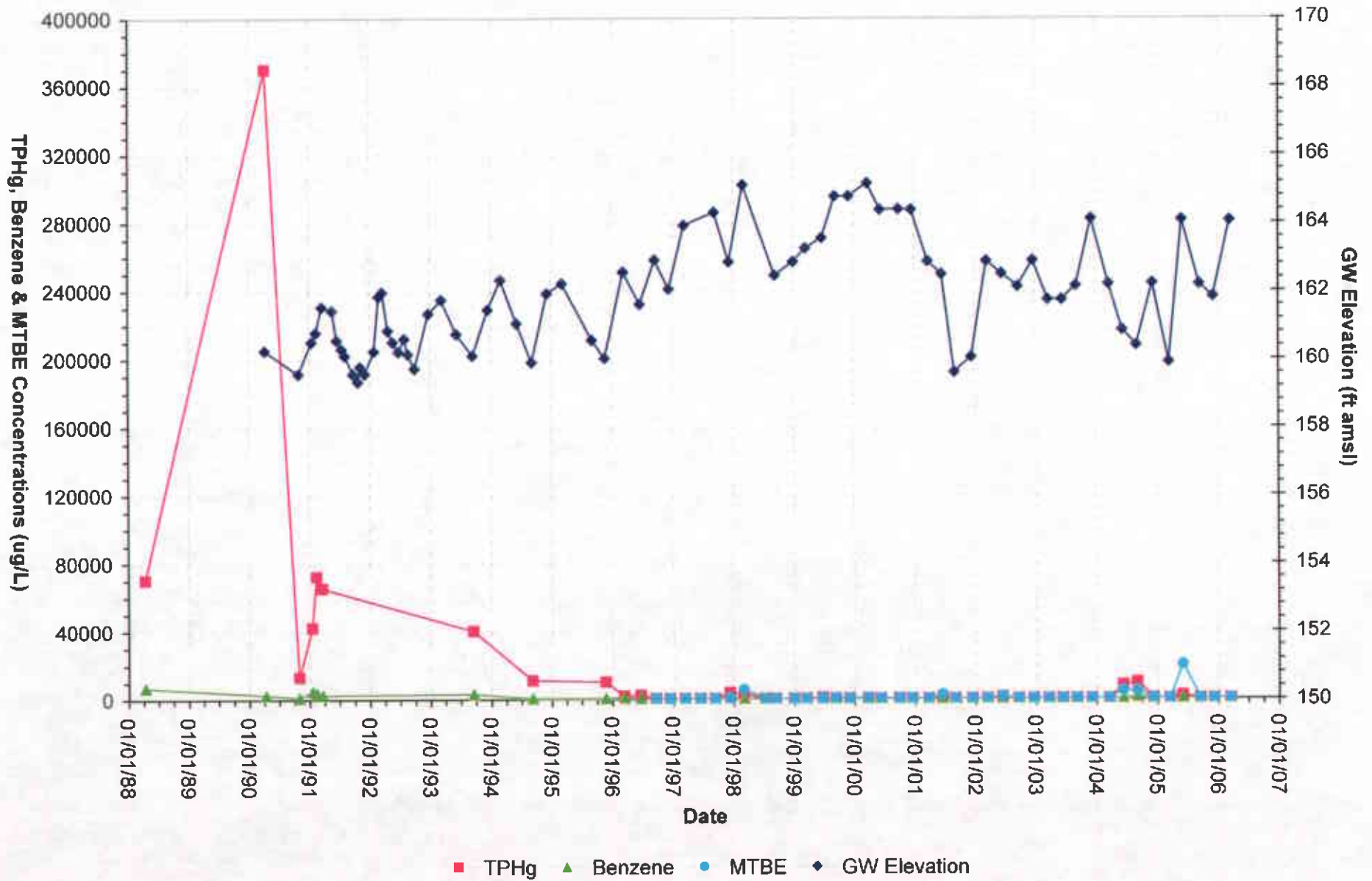

Figure 7
Groundwater Data - Monitoring Well RE-4
Thrifty Oil Co. SS#054 - Castro Valley, CA

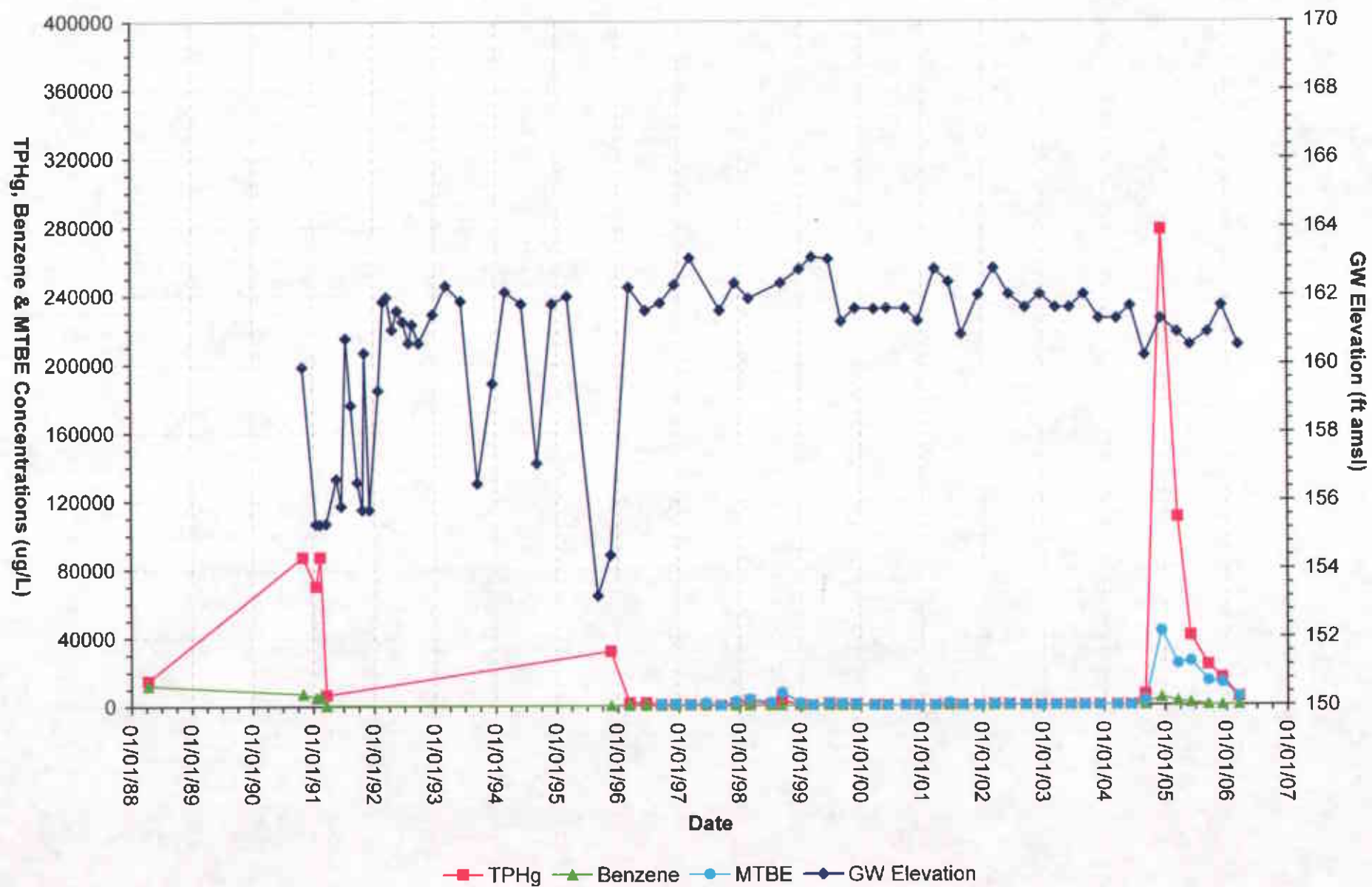

Figure 8
Groundwater Data - Monitoring Well RE-6
Thrifty Oil Co. SS#054 - Castro Valley, CA

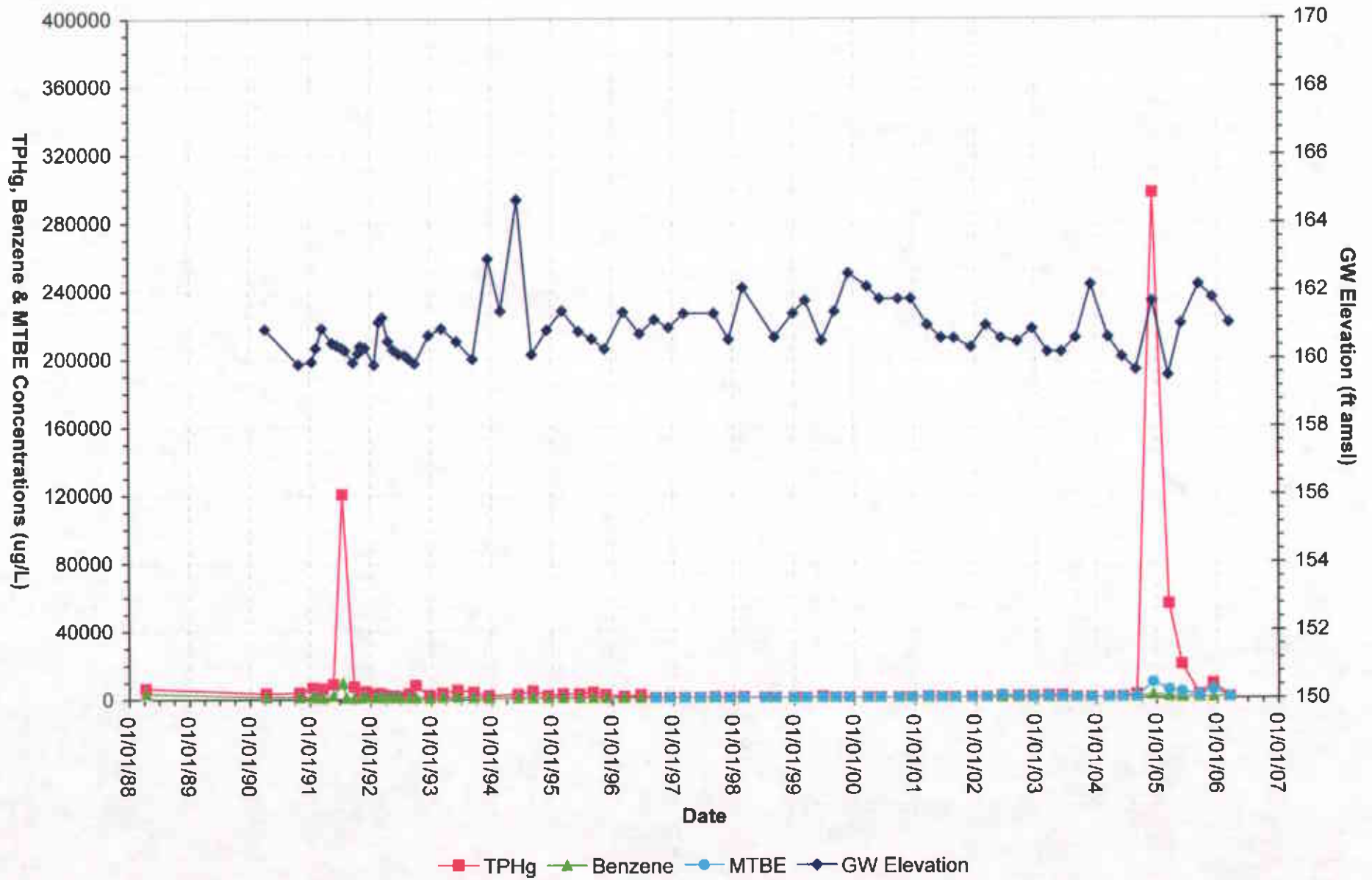

Figure 9
Groundwater Data - Monitoring Well RE-7
Thrifty Oil Co. SS#054 - Castro Valley, CA

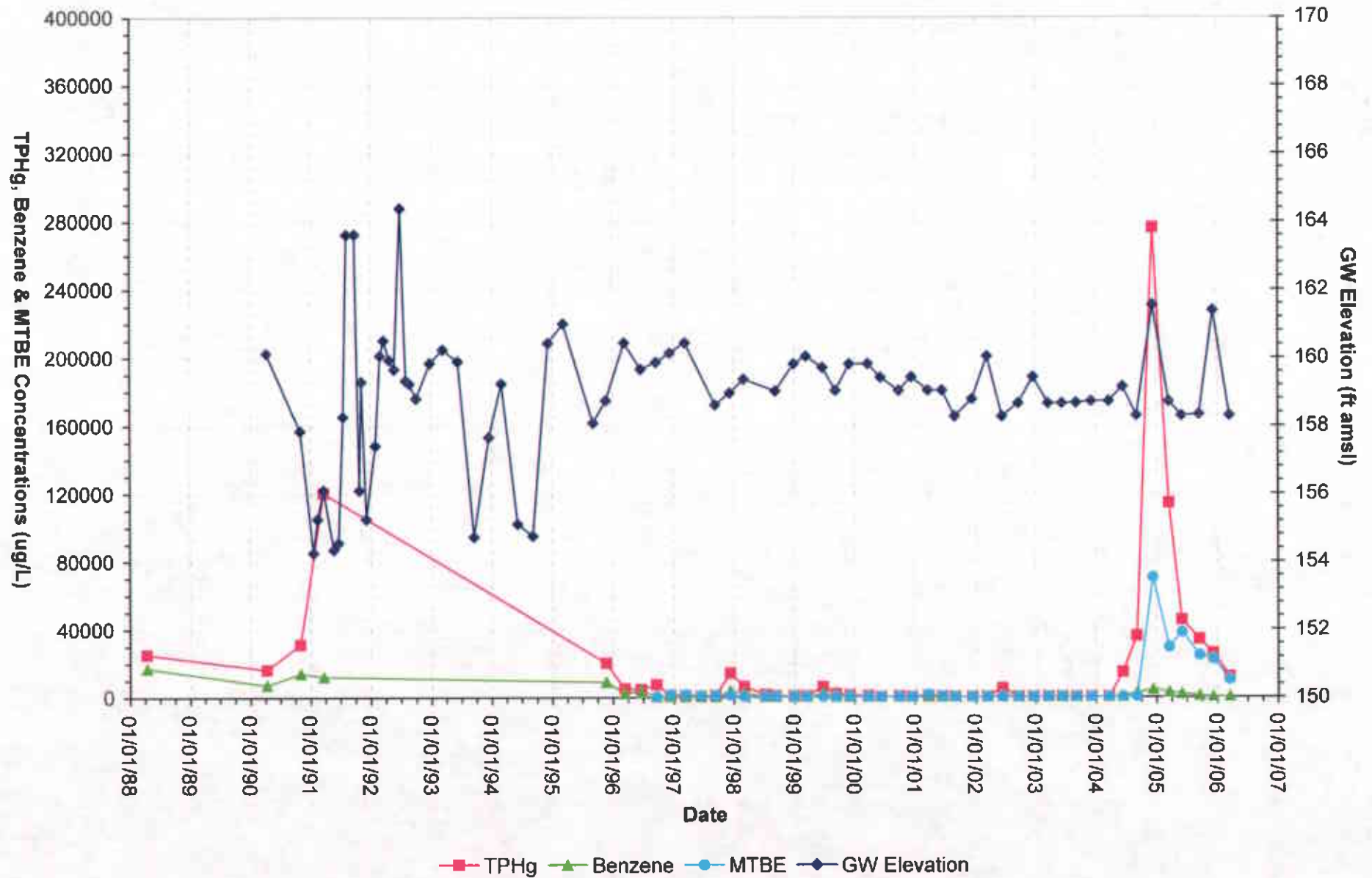
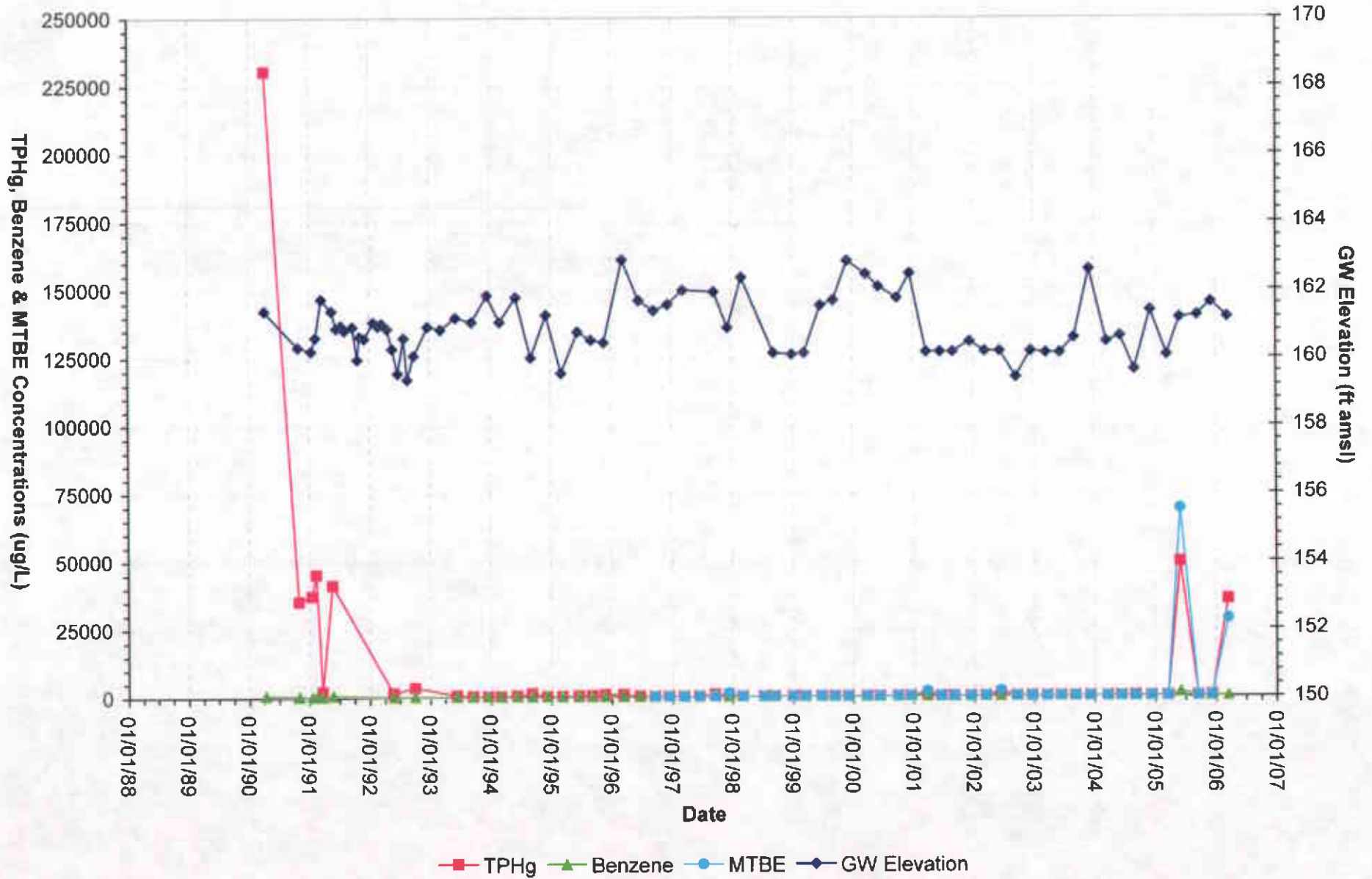

Figure 10
Groundwater Data - Monitoring Well PW-1
Thrifty Oil Co. SS#054 - Castro Valley, CA



APPENDIX A



PROJECT STATUS REPORT

SITE: THRIFTY OIL CO. # 054
 ADDRESS: 2504 CASTRO VALLEY BLVD.
CASTRO VALLEY, CA. 94546

DATE: 03-15-06

PERSONNEL: SERBATH

WELL ID	DTP (FT)	DTW (FT)	DTB (FT)	PT (FT)	WC (FT)	DIA (IN)	PURGE (GAL)		COMMENT
							EST.	ACT.	
QUARTERLY									
1 PW-1		4.79	13.92			4"	24	24	
2 RE-2		3.95	16.95			4"	34	34	
3 RE-3		2.64	17.51			4"	39	39	
4 RE-4		5.70	14.50			4"	23	23	
5 RE-6		5.12	13.56			4"	22	22	
6 RE-7		7.05	13.13			4"	16	16	
7 RS-9		2.71	14.94			2"	8	8	OFFSITE
8 RS-11		7.89	24.72			2"	11	11	OFFSITE
GAUGING ONLY									
9 PW-2		4.00	14.30			4"			
10 RE-1		4.44	14.80			4"			
11 RE-5		4.42	18.19			4"			
12 RS-8		9.83	25.16			2"			
13 RS-10		7.52	24.36			2"			OFFSITE

FREE PRODUCT REMOVED: APPROX. GALLONS

PURGE-WATER REMOVED: APPROX. 177 GALLONS

REMARKS: MONITORING WELLS AND TAKE WATER SAMPLE FROM EACH WELLS FOR Q.W.S

EXPLANATION:

DTP= DEPTH TO PRODUCT, DTW= DEPTH TO WATER, DTB= DEPTH TO BOTTOM, ALL MEASURED FROM TOP OF CASING.
 PT= PRODUCT THICKNESS, WC= WATER COLUMN, DIA= DIAMETER, EST=ESTIMATE, ACT= ACTUAL, FT= FEET, GAL= GALLONS

FIELD DATA - GROUNDWATER SAMPLING PROGRAM

Site: <u> # 054 </u>	Date: <u> 03-15-06 </u>
Address: _____	
Personnel: <u> SERBAH </u>	Weather: <u> SUNNY DAY </u>
Well No: <u> PW-1 </u>	Equip: <u> BAUER </u>

Before Purging:			
Total Well Depth: (ft.)	<u> 13.92 </u>	Well Diameter	<u> 4" </u>
Depth to Water (ft)	<u> 4.79 </u>	Est. Purge Volume:	<u> 24 </u>

Sampling Data:								
Initial Turbidity:			Final Turbidity:					
Time	8:36	8:42	8:48	8:54	9:00			
EC	1390	1370	1410	1420	1410			
pH	6.03	6.11	6.01	5.93	5.96			
Temp	71.3	71.5	71.4	71.6	71.6			
Gal.	4	9	14	19	24			
Time								
EC								
pH								
Temp								
Gal.								

After Purging/Before Sample Collection	
Depth to Water (ft.)	Total Well Depth(ft.)
<u> 8.11 </u>	<u> 13.92 </u>

FIELD DATA - GROUNDWATER SAMPLING PROGRAM

Site:	# 054	Date:	03-15-06
Address:			
Personnel:	SERBAN	Weather:	SUNNY DAY
Well No:	RE-3	Equip:	BAUER

Before Purging:			
Total Well Depth: (ft.)	17.52	Well Diameter	4"
Depth to Water (ft)	2.64	Est. Purge Volume:	39

Sampling Data:							
Initial Turbidity:				Final Turbidity:			
Time	9:04	9:13	9:22	9:31	9:40		
EC	1460	1470	1460	1460	1460		
pH	6.96	6.03	6.11	6.06	6.06		
Temp	71.3	71.4	71.6	71.1	71.7		
Gal.	7	15	23	31	39		
Time							
EC							
pH							
Temp							
Gal.							

After Purging/Before Sample Collection	
Depth to Water (ft.)	6.10
Total Well Depth(ft).	17.51

FIELD DATA - GROUNDWATER SAMPLING PROGRAM

Site:	H 054	Date:	03-15-06
Address:			
Personnel:	SERBAH	Weather:	SUNNY DAY
Well No:	RS-9	Equip:	BATLER

Before Purging:			
Total Well Depth: (ft.)	14.94	Well Diameter	2"
Depth to Water (ft)	2.71	Est. Purge Volume:	8

Sampling Data:						
Initial Turbidity:			Final Turbidity:			
Time	9:48	9:51	9:54	9:57	10:00	
EC	1490	1520	1520	1520	1530	
pH	5.93	5.93	6.06	6.11	6.06	
Temp	71.3	71.4	71.3	71.2	71.4	
Gal.	1	3	4	6	8	
Time						
EC						
pH						
Temp						
Gal.						

After Purging/Before Sample Collection	
Depth to Water (ft.)	7.11
Total Well Depth (ft.)	14.94

FIELD DATA -GROUNDWATER SAMPLING PROGRAM

Site: <u>H 054</u>	Date: <u>03-15-06</u>
Address: _____	
Personnel: <u>SERBAH</u>	Weather: <u>SUNNY DAY</u>
Well No: <u>RS-11</u>	Equip: <u>BATLER</u>

Before Purging:			
Total Well Depth: (ft.)	<u>24.72</u>	Well Diameter	<u>24</u>
Depth to Water (ft)	<u>7.89</u>	Est. Purge Volume:	<u>11</u>

Sampling Data:							
Initial Turbidity:				Final Turbidity:			
Time	<u>10:08</u>	<u>10:11</u>	<u>10:14</u>	<u>10:17</u>	<u>10:20</u>		
EC	<u>1690</u>	<u>1670</u>	<u>1670</u>	<u>1690</u>	<u>1690</u>		
pH	<u>6.03</u>	<u>6.04</u>	<u>6.03</u>	<u>5.96</u>	<u>5.93</u>		
Temp	<u>71.3</u>	<u>71.6</u>	<u>71.5</u>	<u>71.6</u>	<u>71.1</u>		
Gal.	<u>2</u>	<u>4</u>	<u>6</u>	<u>8</u>	<u>11</u>		
Time							
EC							
pH							
Temp							
Gal.							

After Purging/Before Sample Collection	
Depth to Water (ft.)	Total Well Depth(ft.)
<u>12.07</u>	<u>24.72</u>

FIELD DATA - GROUNDWATER SAMPLING PROGRAM

Site:	# 054	Date:	03-15-06
Address:			
Personnel:	SERBAM	Weather:	SUNNY DAY
Well No:	RE-6	Equip:	BAUER

Before Purging:			
Total Well Depth: (ft.)	13.56	Well Diameter	44
Depth to Water (ft)	5.12	Est. Purge Volume:	22

Sampling Data:						
Initial Turbidity:			Final Turbidity:			
Time	10:26	10:32	10:38	10:44	10:50	
EC	1580	1570	1560	1570	1570	
pH	5.96	6.06	6.11	6.03	6.04	
Temp	71.4	71.6	71.5	71.6	71.8	
Gal.	4	8	13	17	22	
Time						
EC						
pH						
Temp						
Gal.						

After Purging/Before Sample Collection			
Depth to Water (ft.)	8.06	Total Well Depth (ft.)	13.56

FIELD DATA - GROUNDWATER SAMPLING PROGRAM

Site:	# 054	Date:	03-15-06
Address:			
Personnel:	SERBAH	Weather:	SUNNY DAY
Well No:	RF-2	Equip:	BATLER

Before Purging:			
Total Well Depth: (ft.)	16.95	Well Diameter	4"
Depth to Water (ft)	3.95	Est. Purge Volume:	34

Sampling Data:							
Initial Turbidity:				Final Turbidity:			
Time	10:58	11:06	11:14	11:22	11:30		
EC	1640	170	1730	1720	1730		
pH	5.93	6.03	6.11	6.06	6.03		
Temp	71.3	71.4	71.6	71.3	71.5		
Gal.	6	13	20	27	34		
Time							
EC							
pH							
Temp							
Gal.							

After Purging/Before Sample Collection	
Depth to Water (ft.)	7.09
Total Well Depth (ft.)	16.95

FIELD DATA - GROUNDWATER SAMPLING PROGRAM

Site:	# 054	Date:	03-15-06
Address:			
Personnel:	SERBAN	Weather:	SUNNY DAY
Well No:	RE-4	Equip:	BATON

Before Purging:			
Total Well Depth: (ft.)	14.50	Well Diameter	4"
Depth to Water (ft)	5.70	Est. Purge Volume:	23

Sampling Data:							
Initial Turbidity:				Final Turbidity:			
Time	11:36	11:42	11:48	11:54	12:00		
EC	1530	1520	1490	1470	1470		
pH	6.03	6.09	5.96	5.93	5.91		
Temp	71.4	71.6	71.8	71.6	71.8		
Gal.	4	9	13	18	23		
Time							
EC							
pH							
Temp							
Gal.							

After Purging/Before Sample Collection	
Depth to Water (ft.)	9.06
Total Well Depth (ft.)	14.50

FIELD DATA -GROUNDWATER SAMPLING PROGRAM

Site:	# 054	Date:	03-15-06
Address:			
Personnel:	SERBAN	Weather:	SUNNY DAY
Well No:	RR-7	Equip:	BATLER

Before Purging:			
Total Well Depth: (ft.)	13.13	Well Diameter	4"
Depth to Water (ft)	7.06	Est. Purge Volume:	16

Sampling Data:							
Initial Turbidity:				Final Turbidity:			
Time	12:09	12:13	12:17	12:21	12:25		
EC	1540	1610	1620	1610	1620		
pH	5.96	5.96	6.04	6.07	6.11		
Temp	71.3	71.6	71.4	71.4	71.5		
Gal.	3	6	9	12	16		
Time							
EC							
pH							
Temp							
Gal.							

After Purging/Before Sample Collection	
Depth to Water (ft)	10.06
Total Well Depth(ft).	13.13

APPENDIX B



ASSOCIATED LABORATORIES

806 North Batavia - Orange, California 92868 - 714/771-6900

FAX 714/538-1209

CLIENT Thrifty Oil Company (8871)
ATTN: Jeff Suryakusuma
13116 Imperial Hwy.
P.O. Box 2128
Santa Fe Springs, CA 90670

LAB REQUEST 166382 ✓

REPORTED 03/28/2006

RECEIVED 03/16/2006

PROJECT Station #054 ✓
2504 Castro Valley Blvd., Castro Valley

SUBMITTER Client

COMMENTS Global ID #T0600101363

This laboratory request covers the following listed samples which were analyzed for the parameters indicated on the attached Analytical Result Report. All analyses were conducted using the appropriate methods as indicated on the report. This cover letter is an integral part of the final report.

<u>Order No.</u>	<u>Client Sample Identification</u>
695537	TOC #054 PW-1
695538	TOC #054 RE-3
695539	TOC #054 RS-9
695540	TOC #054 RS-11
695541	TOC #054 RE-6
695542	TOC #054 RE-2
695543	TOC #054 RE-4
695544	TOC #054 RE-7
695545	Trip Blank
695546	Laboratory Method Blank

Thank you for the opportunity to be of service to your company. Please feel free to call if there are any questions regarding this report or if we can be of further service.

ASSOCIATED LABORATORIES by,

Edward S. Behare, Ph.D.
Vice President

NOTE: Unless notified in writing, all samples will be discarded by appropriate disposal protocol 30 days from date reported.

The reports of the Associated Laboratories are confidential property of our clients and may not be reproduced or used for publication in part or in full without our written permission. This is for the mutual protection of the public, our clients, and ourselves.

TESTING & CONSULTING
Chemical
Microbiological
Environmental

Order #: 695537

Client Sample ID: TOC #054 PW-1

Matrix: WATER

Date Sampled: 03/15/2006 Time Sampled: 12:40

Analyte	Result	DF	PQL	MDL	Units	Date/Analyst
8260B BTEX/MTBE Only						
Benzene	ND	10	10.0	0.32	ug/L	03/21/06 LB
Ethyl benzene	ND	10	50.0	0.24	ug/L	03/21/06 LB
Methyl-tert-butylether (MTBE)	28500	250	250.0	0.63	ug/L	03/22/06 LB
Toluene	ND	10	50.0	0.10	ug/L	03/21/06 LB
Xylenes, total	862	10	50.0	0.3	ug/L	03/21/06 LB
Surrogates				Units	Control Limits	
Surr1 - Dibromofluoromethane	93			%	70 - 130	
Surr2 - 1,2-Dichloroethane-d4	100			%	70 - 130	
Surr3 - Toluene-d8	95			%	70 - 130	
Surr4 - p-Bromofluorobenzene	93			%	70 - 130	
8015B - Gasoline						
Gasoline	35500	20	1000.0	5.6	ug/L	03/21/06 SU
Surrogates				Units	Control Limits	
a,a,a-Trifluorotoluene	104			%	55 - 200	

PQL = Practical Quantitation Limit, MDL = Method detection limit, DF = Dilution Factor

ND = Not detected below indicated MDL, J=Trace



Order #: 695538

Client Sample ID: TOC #054 RE-3

Matrix: WATER

Date Sampled: 03/15/2006 Time Sampled: 12:50

Analyte	Result	DF	PQL	MDL	Units	Date/Analyst
8260B BTEX/MTBE Only						
Benzene	ND	1	1	0.32	ug/L	03/21/06 LB
Ethyl benzene	ND	1	5	0.24	ug/L	03/21/06 LB
Methyl-tert-butylether (MTBE)	ND	1	1	0.63	ug/L	03/21/06 LB
Toluene	ND	1	5	0.10	ug/L	03/21/06 LB
Xylenes, total	ND	1	5	0.3	ug/L	03/21/06 LB
Surrogates				Units	Control Limits	
Surr1 - Dibromofluoromethane	98			%	70 - 130	
Surr2 - 1,2-Dichloroethane-d4	99			%	70 - 130	
Surr3 - Toluene-d8	94			%	70 - 130	
Surr4 - p-Bromofluorobenzene	101			%	70 - 130	
8015B - Gasoline						
Gasoline	ND	1	50	5.6	ug/L	03/21/06 SU
Surrogates				Units	Control Limits	
a,a,a-Trifluorotoluene	79			%	55 - 200	

PQL = Practical Quantitation Limit, MDL = Method detection limit, DF = Dilution Factor
 ND = Not detected below indicated MDL, J=Trace



Order #: 695539

Client Sample ID: TOC #054 RS-9

Matrix: WATER

Date Sampled: 03/15/2006 Time Sampled: 13:00

Analyte	Result	DF	PQL	MDL	Units	Date/Analyst
8260B BTEX/MTBE Only						
Benzene	ND	1	1	0.32	ug/L	03/21/06 LB
Ethyl benzene	ND	1	5	0.24	ug/L	03/21/06 LB
Methyl-tert-butylether (MTBE)	17	1	1	0.63	ug/L	03/21/06 LB
Toluene	ND	1	5	0.10	ug/L	03/21/06 LB
Xylenes, total	1.6	J 1	5	0.3	ug/L	03/21/06 LB
Surrogates					Units	Control Limits
Surr1 - Dibromofluoromethane	104				%	70 - 130
Surr2 - 1,2-Dichloroethane-d4	109				%	70 - 130
Surr3 - Toluene-d8	93				%	70 - 130
Surr4 - p-Bromofluorobenzene	99				%	70 - 130
8015B - Gasoline						
Gasoline	ND	1	50	5.6	ug/L	03/21/06 SU
Surrogates					Units	Control Limits
a,a,a-Trifluorotoluene	78				%	55 - 200

PQL = Practical Quantitation Limit, MDL = Method detection limit, DF = Dilution Factor
 ND = Not detected below indicated MDL, J=Trace



Order #: 695540

Client Sample ID: TOC #054 RS-11

Matrix: WATER

Date Sampled: 03/15/2006 Time Sampled: 13:10

Analyte	Result	DF	PQL	MDL	Units	Date/Analyst
8260B BTEX/MTBE Only						
Benzene	ND	1	1	0.32	ug/L	03/22/06 LB
Ethyl benzene	ND	1	5	0.24	ug/L	03/22/06 LB
Methyl-tert-butylether (MTBE)	336	1	1	0.63	ug/L	03/22/06 LB
Toluene	ND	1	5	0.10	ug/L	03/22/06 LB
Xylenes, total	ND	1	5	0.3	ug/L	03/22/06 LB
Surrogates				Units	Control Limits	
Surr1 - Dibromofluoromethane	98			%	70 - 130	
Surr2 - 1,2-Dichloroethane-d4	100			%	70 - 130	
Surr3 - Toluene-d8	94			%	70 - 130	
Surr4 - p-Bromofluorobenzene	105			%	70 - 130	
8015B - Gasoline						
Gasoline	426	1	50	5.6	ug/L	03/21/06 SU
Surrogates				Units	Control Limits	
a,a,a-Trifluorotoluene	89			%	55 - 200	

PQL = Practical Quantitation Limit, MDL = Method detection limit, DF = Dilution Factor
 ND = Not detected below indicated MDL, J=Trace



Order #: 695541

Client Sample ID: TOC #054 RE-6

Matrix: WATER

Date Sampled: 03/15/2006 Time Sampled: 13:20

Analyte	Result	DF	PQL	MDL	Units	Date/Analyst	
8260B BTEX/MTBE Only							
Benzene	ND	1	1	0.32	ug/L	03/22/06 LB	
Ethyl benzene	ND	1	5	0.24	ug/L	03/22/06 LB	
Methyl-tert-butylether (MTBE)	117	1	1	0.63	ug/L	03/22/06 LB	
Toluene	ND	1	5	0.10	ug/L	03/22/06 LB	
Xylenes, total	ND	1	5	0.3	ug/L	03/22/06 LB	
Surrogates						Units	Control Limits
Surr1 - Dibromofluoromethane	95				%	70 - 130	
Surr2 - 1,2-Dichloroethane-d4	98				%	70 - 130	
Surr3 - Toluene-d8	91				%	70 - 130	
Surr4 - p-Bromofluorobenzene	101				%	70 - 130	
8015B - Gasoline							
Gasoline	166	1	50	5.6	ug/L	03/21/06 SU	
Surrogates						Units	Control Limits
a,a,a-Trifluorotoluene	80				%	55 - 200	

PQL = Practical Quantitation Limit, MDL = Method detection limit, DF = Dilution Factor
 ND = Not detected below indicated MDL, J=Trace



Order #: 695542

Client Sample ID: TOC #054 RE-2

Matrix: WATER

Date Sampled: 03/15/2006 Time Sampled: 13:35

Analyte	Result	DF	PQL	MDL	Units	Date/Analyst
8260B BTEX/MTBE Only						
Benzene	ND	1	1	0.32	ug/L	03/22/06 LB
Ethyl benzene	ND	1	5	0.24	ug/L	03/22/06 LB
Methyl-tert-butylether (MTBE)	31	1	1	0.63	ug/L	03/22/06 LB
Toluene	ND	1	5	0.10	ug/L	03/22/06 LB
Xylenes, total	ND	1	5	0.3	ug/L	03/22/06 LB
Surrogates				Units	Control Limits	
Surr1 - Dibromofluoromethane	96			%	70 - 130	
Surr2 - 1,2-Dichloroethane-d4	100			%	70 - 130	
Surr3 - Toluene-d8	94			%	70 - 130	
Surr4 - p-Bromofluorobenzene	103			%	70 - 130	
8015B - Gasoline						
Gasoline	57	1	50	5.6	ug/L	03/21/06 SU
Surrogates				Units	Control Limits	
a,a,a-Trifluorotoluene	76			%	55 - 200	

PQL = Practical Quantitation Limit, MDL = Method detection limit, DF = Dilution Factor
 ND = Not detected below indicated MDL, J=Trace



Order #: 695543

Client Sample ID: TOC #054 RE-4

Matrix: WATER

Date Sampled: 03/15/2006 Time Sampled: 14:05

Analyte	Result	DF	PQL	MDL	Units	Date/Analyst
8260B BTEX/MTBE Only						
Benzene	37	10	10.0	0.32	ug/L	03/22/06 LB
Ethyl benzene	65	10	50.0	0.24	ug/L	03/22/06 LB
Methyl-tert-butylether (MTBE)	4940	10	10.0	0.63	ug/L	03/22/06 LB
Toluene	ND	10	50.0	0.10	ug/L	03/22/06 LB
Xylenes, total	15	J 10	50.0	0.3	ug/L	03/22/06 LB
Surrogates					Units	Control Limits
Surr1 - Dibromofluoromethane	93				%	70 - 130
Surr2 - 1,2-Dichloroethane-d4	101				%	70 - 130
Surr3 - Toluene-d8	98				%	70 - 130
Surr4 - p-Bromofluorobenzene	93				%	70 - 130
8015B - Gasoline						
Gasoline	4910	1	50	5.6	ug/L	03/21/06 SU
Surrogates					Units	Control Limits
a,a,a-Trifluorotoluene	166				%	55 - 200

PQL = Practical Quantitation Limit, MDL = Method detection limit, DF = Dilution Factor
 ND = Not detected below indicated MDL, J=Trace



Order #: 695544

Client Sample ID: TOC #054 RE-7

Matrix: WATER

Date Sampled: 03/15/2006 Time Sampled: 14:30

Analyte	Result	DF	PQL	MDL	Units	Date/Analyst	
8260B BTEX/MTBE Only							
Benzene	73	10	10.0	0.32	ug/L	03/22/06 LB	
Ethyl benzene	143	10	50.0	0.24	ug/L	03/22/06 LB	
Methyl-tert-butylether (MTBE)	10200	50	50.0	0.63	ug/L	03/22/06 LB	
Toluene	ND	10	50.0	0.10	ug/L	03/22/06 LB	
Xylenes, total	22	J 10	50.0	0.3	ug/L	03/22/06 LB	
Surrogates						Units	Control Limits
Surr1 - Dibromofluoromethane	99				%	70 - 130	
Surr2 - 1,2-Dichloroethane-d4	107				%	70 - 130	
Surr3 - Toluene-d8	93				%	70 - 130	
Surr4 - p-Bromofluorobenzene	97				%	70 - 130	
8015B - Gasoline							
Gasoline	11700	10	500.0	5.6	ug/L	03/21/06 SU	
Surrogates						Units	Control Limits
a,a,a-Trifluorotoluene	106				%	55 - 200	

PQL = Practical Quantitation Limit, MDL = Method detection limit, DF = Dilution Factor
 ND = Not detected below indicated MDL, J=Trace



Order #: 695545

Client Sample ID: Trip Blank

Matrix: WATER

Date Sampled: 03/15/2006

Analyte	Result	DF	PQL	MDL	Units	Date/Analyst
8260B BTEX/MTBE Only						
Benzene	ND	1	1	0.32	ug/L	03/22/06 LB
Ethyl benzene	ND	1	5	0.24	ug/L	03/22/06 LB
Toluene	ND	1	5	0.10	ug/L	03/22/06 LB
Xylenes, total	ND	1	5	0.3	ug/L	03/22/06 LB

Surrogates		Units	Control Limits
Surr1 - Dibromofluoromethane	98	%	70 - 130
Surr2 - 1,2-Dichloroethane-d4	101	%	70 - 130
Surr3 - Toluene-d8	95	%	70 - 130
Surr4 - p-Bromofluorobenzene	93	%	70 - 130

8015B - Gasoline

Gasoline	ND	1	50	5.6	ug/L	03/21/06 SU
----------	----	---	----	-----	------	-------------

Surrogates		Units	Control Limits
a,a,a-Trifluorotoluene	77	%	55 - 200

PQL = Practical Quantitation Limit, MDL = Method detection limit, DF = Dilution Factor
 ND = Not detected below indicated MDL, J=Trace



Order #: 695546

Client Sample ID: Laboratory Method Blank

Matrix: WATER

Analyte	Result	DF	PQL	MDL	Units	Date/Analyst
8260B BTEX/MTBE Only						
Benzene	ND	1	1	0.32	ug/L	03/21/06 LB
Ethyl benzene	ND	1	5	0.24	ug/L	03/21/06 LB
Methyl-tert-butylether (MTBE)	ND	1	1	0.63	ug/L	03/21/06 LB
Toluene	ND	1	5	0.10	ug/L	03/21/06 LB
Xylenes, total	ND	1	5	0.3	ug/L	03/21/06 LB

Surrogates		Units	Control Limits
Surr1 - Dibromofluoromethane	99	%	70 - 130
Surr2 - 1,2-Dichloroethane-d4	102	%	70 - 130
Surr3 - Toluene-d8	93	%	70 - 130
Surr4 - p-Bromofluorobenzene	93	%	70 - 130

8015B - Gasoline

Gasoline	ND	1	50	5.6	ug/L	03/21/06 SU
----------	----	---	----	-----	------	-------------

Surrogates		Units	Control Limits
a,a,a-Trifluorotoluene	76	%	55 - 200

PQL = Practical Quantitation Limit, MDL = Method detection limit, DF = Dilution Factor
 ND = Not detected below indicated MDL, J=Trace



Associated Laboratories
QA / QC EPA Methods 8260, 624, & 524.2 - GCMS # 3

Sample ID: MS/MSD-water sample 166382-539
Date Analyzed: March 22, 2006 12:14am
Sample Matrix: water
Units: µg/L

Applies to LR: 166424, 166425, 166423, 166382, 166426

Compound	Sample Conc.	Spike Added	Spike Res	Dup Res	Spike % Rec	Dup % Rec	RPD	QC RPD	Limits % Rec
1,1-Dichloroethene	0.00	50.0	52.42	53.69	105	107	2	22	59 - 172
MTBE	0.00	50.0	51.64	50.63	103	101	2	24	62 - 137
Benzene	0.00	50.0	43.26	42.83	87	86	1	24	62 - 137
Trichloroethene	0.00	50.0	63.29	60.04	127	120	5	21	66 - 142
Toluene	0.00	50.0	56.67	55.82	113	112	2	21	59 - 139
Chlorobenzene	0.00	50.0	52.84	51.92	106	104	2	21	60 - 133

*=Outside QC limits due to high concentration in sample

Sample ID: LCS - water
Date Analyzed: March 21, 2006 2:35pm
Sample Matrix: water
Units: µg/L

Compound	Sample Conc.	Spike Added	Spike Res		Spike % Rec			QC RPD	Limits % Rec
1,1-Dichloroethene	0.00	50.0	56.41		113			22	59 - 172
MTBE	0.00	50.0	40.27		81			24	62 - 137
Benzene	0.00	50.0	44.17		88			24	62 - 137
Trichloroethene	0.00	50.0	58.81		118			21	66 - 142
Toluene	0.00	50.0	53.61		107			21	59 - 139
Chlorobenzene	0.00	50.0	51.75		104			21	60 - 133

If Sample Result > 4 times Spike Added, then "NC"

Surrogate Recovery GCMS # 3

Compound	MB1	MB2		MS	MSD	LCS			Limits % Rec
Dibromofluoromethane	99	102		95	99	103			70-135
1,2-Dichloroethane-d4	102	101		97	90	99			70-135
Toluene-d8	93	96		100	100	103			70-135
p-Bromofluorobenzene	93	104		112	117	110			70-135

Associated Laboratories
 QA / QC EPA Methods 8260, 624, & 524.2 - GCMS # 3

Sample ID: MS/MSD-water sample 166422-703
 Date Analyzed: March 23, 2006 7:45am
 Sample Matrix: water
 Units: µg/L

Applies to LR: 166423, 166382, 166422, 166427

Compound	Sample Conc.	Spike Added	Spike Res	Dup Res	Spike % Rec	Dup % Rec	RPD	QC RPD	Limits % Rec
1,1-Dichloroethene	0.00	50.0	48.88	51.02	98	102	4	22	59 - 172
MTBE	59.28	50.0	96.70	93.90	75	69	3	24	62 - 137
Benzene	0.00	50.0	37.97	38.88	76	78	2	24	62 - 137
Trichloroethene	0.00	50.0	56.19	58.88	112	118	5	21	66 - 142
Toluene	0.00	50.0	49.80	53.51	100	107	7	21	59 - 139
Chlorobenzene	0.00	50.0	48.33	50.77	97	102	5	21	60 - 133

* = Outside QC limits due to high concentration in sample

Sample ID: LCS - water
 Date Analyzed: March 22, 2006 5:22pm
 Sample Matrix: water
 Units: µg/L

Compound	Sample Conc.	Spike Added	Spike Res		Spike % Rec			QC RPD	Limits % Rec
1,1-Dichloroethene	0.00	50.0	54.03		108			22	59 - 172
MTBE	0.00	50.0	40.32		81			24	62 - 137
Benzene	0.00	50.0	42.65		85			24	62 - 137
Trichloroethene	0.00	50.0	55.84		112			21	66 - 142
Toluene	0.00	50.0	50.15		100			21	59 - 139
Chlorobenzene	0.00	50.0	50.00		100			21	60 - 133

If Sample Result > 4 times Spike Added, then "NC"

Surrogate Recovery GCMS # 3

Compound	MB1	MB2		MS	MSD	LCS		Limits % Rec
Dibromofluoromethane	100	94		107	91	103		70-135
1,2-Dichloroethane-d4	108	104		96	94	98		70-135
Toluene-d8	95	97		102	101	103		70-135
p-Bromofluorobenzene	95	98		111	112	112		70-135

**ASSOCIATED LABORATORIES
LCS REPORT FORM**

QC Sample: LCS/LCSD

Matrix: WATER

Prep. Date: March 20, 2006

Analysis Date 03/20/06-03/21/06

ID#'s in Batch: LR 166382

LAB CONTROLLED SPIKE / LAB CONTROLLED DUPLICATE RESULT

Reporting Units = ug/L

Test	Method	Method Blank	Spike Added	LCS Spike	LCSD Spk. Dup	%Rec LCS	%Rec LCSD	RPD
TPH	8015M-G	ND	500	435	435	87	87	0

ND = Not Detected

LCS Result = Lab Control Sample Result

%REC-LCS & LCSD = Percent Recovery of LCS Spike & LCS Spike Duplicate

RPD = Relative Percent Difference of LCS Spike and LCS Spike Duplicate

<i>%REC LIMITS = 70 - 130</i>
<i>RPD LIMITS = 30</i>

SURROGATE RECOVERY

Sample No.	AAA-TFT
QC Limit	55-200
Method Blank	76
LCS	145
LCSD	147

AAA-TFT = a,a,a-Trifluorotoluene

