

# THRIFTY OIL CO.

✓ 80249

April 20, 2005

O.56361

Mr. Amir Gholami  
Alameda County Health Care Agency  
Hazardous Material Specialist  
1131 Harbor Bay Parkway, Suite 250  
Alameda, CA 94502

Local #1252  
RWQCB #01-1476  
Global ID #T0600101363  
Confirmation #3026885807

RE: **Former Thrifty Oil Co. Station #054**  
**TOSCO Station #2602486**  
2504 Castro Valley Boulevard  
Castro Valley, CA  
*1st Quarter 2005, Status Report*

Alameda County  
APR 26 2005  
Environmental Health

Dear Mr. Gholami:

Presented herein is the First Quarter 2005, Status Report prepared for Former Thrifty Oil Co. (Thrifty) Station #054 located at 2504 Castro Valley Boulevard, Castro Valley, California (**Figure 1**). This report presents the results of the groundwater monitoring activities conducted during the first quarter of 2005. During the current quarter, Thrifty retained Earth Management Corporation (EMC) to conduct quarterly groundwater monitoring and sampling activities at this site.

## Groundwater Monitoring

Depth to groundwater is measured in each monitoring well quarterly. Historic groundwater gauging data obtained from April 11, 1988 through March 16, 2005, is presented in **Table 1**. In general, groundwater occurs beneath the station at depths ranging from 4.21 feet below top of casing (btc) in monitoring well RS-9 to 9.05 feet btc in monitoring well RS-10 (**Appendix A**). A groundwater elevation contour map based on the March 16, 2005, data is presented in **Figure 1**. Groundwater elevation data indicates that the general direction of groundwater flow beneath the site is toward the northeast with a hydraulic gradient of approximately 0.0376 feet/foot.

## Quarterly Groundwater Sampling

As part of the ongoing groundwater-monitoring program, groundwater samples were obtained from selected monitoring wells PW-1, RE-2, RE-3, RE-4, RE-6, RE-7, RS-9, and RS-11 on March 16, 2005. In a letter from the Alameda County Health Care Agency (ACHCA) dated November 6, 2001, the ACHCA released Thrifty from collecting groundwater samples from wells PW-2, RE-1, RE-5, RS-8, and RS-10 until further notice.

Groundwater samples were obtained by EMC and delivered in a chilled state in an ice chest following strict Chain-of-Custody procedures to a state-certified laboratory. The samples were analyzed for total petroleum hydrocarbons as gasoline (TPHg) by EPA Method 8015M for gasoline and for benzene, toluene, ethylbenzene, xylenes (BTEX) and methyl tert-butyl ether (MTBE) by EPA Method 8260B. Copies of the BTS Field Status Reports are presented in **Appendix A**, and copies of the laboratory analytical reports are contained in **Appendix B**.



TPHg, BTEX, and MTBE concentrations appear in **Table 1** and laboratory reports are provided in **Appendix B**. TPHg, benzene, and MTBE isoconcentration maps are presented in **Figures 2, 3, and 4**, respectively. The highest laboratory analytical concentrations for TPHg, benzene, and MTBE were found in well RE-7 (114,000 ug/L, 2,840 ug/L, and 29,300 ug/L, respectively).

Based on a survey of top of casing elevations performed by Morrow Surveying in October 2003, it was confirmed and Thrifty again reiterates that well RS-9 is located upgradient of the Thrifty site, and any contamination found in this well appears to be originating from an upgradient off-site source. TOSCO Marketing Company is the current operator of the service station and acquired the lease from BP Oil, who previously leased the property beginning on July 10, 1991.

### **Site Remediation Activities**

In August 1989, Remediation Service, Int'l. (RSI) installed a Spray Aeration Vapor Extraction (SAVE) system at the site. However, due to unanticipated delays in permits, the system was not started until April 1990. The system was operated only during daylight hours recovering hydrocarbon vapors during the first three months of operation. The equipment was relocated onsite in late June 1990, and from that date on the equipment was in operation for 24 hours a day.

On January 31, 2000, Thrifty submitted a *Request for Shutdown and Removal of the Vapor Extraction System* to the ACHCA. The ACHCA authorized the vapor extraction system shut down and removal on February 16, 2000. By the end of the operation, the system had destroyed a total of 5,631 pounds of hydrocarbons (**Table 2**).

### **Evidence of New/Recent Release or Possible Presence of an Active Source**

In a letter dated December 30, 2004, submitted jointly to ConocoPhillips and the ACHCA, Thrifty provided evidence of a recent release of hydrocarbons as detected in groundwater samples collected during the 2nd, 3rd, and 4th Quarters 2004. Data collected during the 1st Quarter 2005 indicated that while TPHg, benzene, and MTBE concentrations appear to be decreasing, they are still significantly elevated over March, June, and September 2004 levels in onsite wells RE-2, RE-4, RE-6, and RE-7 located near the underground storage tanks and pump islands. The decrease in concentrations may simply be the result that the dissolved plume is moving away from the source and/or that some of the plume is being sorbed onto the soil particles.

In a letter dated February 1, 2005, Conoco Phillips (TOSCO) responded to Thrifty's assertion that a recent release had occurred and indicated that the site is likely being impacted by an offsite source. ConocoPhillips indicated in their letter that no pattern of fluctuation in dissolved hydrocarbon concentrations has been established to date that has not been seen before at the site. Thrifty's review of the data, however, indicates that over the past 14 years (since 1991), there have been no fluctuations in dissolved hydrocarbon concentrations even close to those seen between the 3rd and 4th Quarters of 2004. ConocoPhillips states in their letter that dissolved elevated concentrations of hydrocarbons were present in wells RE-6 and RE-7, but were not present in well PW-1 located between RE-6 and RE-7. Interestingly, if an offsite source was the cause of the increased dissolved hydrocarbon concentrations in wells RE-6 and RE-7, why are the wells surrounding the plume not impacted? It is possible that the plume caused by the recent release simply migrated along a preferential soil pathway that directed the plume slightly to the north and thus around well PW-1. ConocoPhillips also asserted that the dissolved hydrocarbon concentrations noted in wells RE-3 and RE-4 were the result of migration of the dissolved plume from well RE-1. However, the maximum TPHg concentrations detected in well RE-1 was 150,000 ug/L on January

8, 1991, 28,000 ug/L on March 8, 1995, then consistently decreased to <50 ug/L beginning on December 1, 1999, as a result of active remediation conducted by Thrifty at the site from April 1990 to January 2000, whereas the TPHg concentration in well RE-4 was 297,000 ug/L in December 2004. The December 2004 levels were almost double than the highest historical level recorded 13 years ago, when the active remediation was just initiated.

Thrifty has plotted TPHg, benzene, and MTBE concentrations over time versus groundwater elevations for wells RE-1 (Figure 5), RE-2 (Figure 6), RE-3 (Figure 7), RE-4 (Figure 8), RE-6 (Figure 9), and RE-7 (Figure 10). The increases in TPHg and MTBE in wells RE-2, RE-4, RE-6, and RE-7 for the 3rd and 4th quarters of 2004 are quite dramatic when compared to the TPHg and MTBE concentrations over time. There is a corresponding rise in groundwater elevation in each of these wells; however, there have been comparable rises in groundwater elevations in the past with no corresponding increase in dissolved hydrocarbon concentrations. Thus, it appears that a rise in groundwater elevation is not the reason for the significant increases in dissolved hydrocarbon concentrations at the site.

Further evidence of a recent release is provided by the use of BTEX ratios that are used as a means to compare the relative age of gasoline releases into the subsurface. The most common method is the cumulative BTEX ration that is described as B+T/E+X. Site investigations indicate that values between 1 and 6 are supportive of a recent release and that values less than 0.5 usually indicate a release older than about 8 to 10 years (Kaplan et. al. 1997, "Forensic Environmental Geochemistry: Differentiation of Fuel Types, Their Sources and Release Time;" Robert D. Morrison: "Forensic Techniques for Establishing the Origin and Timing of Contaminant Release"). The table provided below provides B+T/E+X ratios based on the groundwater samples collected during the sampling event conducted on March 2005 sampling event.

Well ID	B	T	B+T	E	X	E+X	B+T/E+X
RE-2	901	10,100	11,001	130J	12,100	12,230	0.9
RE-4	2,360	18,900	21,260	1,780	17,800	19,580	1.09
RE-6	630	9,470	10,100	1,590	10,100	11,690	0.87
RE-7	2,840	19,400	22,240	2,760	14,400	17,160	1.30

Based on the September 2, 2004, sampling results, the B+T/E+X for monitoring wells RE-4 and RE-3 were 6.43 and 6.42, respectively. The BTEX ratios presented above are between 0.87 and 6.43 thus providing additional evidence of a recent release at former Thrifty Station #054. Wells RE-3 and RE-4 are located downgradient of the USTs/piping and well RE-7 is located downgradient of the dispensers. Although well RE-2 is not located downgradient of the dispensers, it is located very close to the dispensers which appear to be a source of the recent release along with the USTs and/or piping.

Thrifty has contended in the past that an offsite upgradient source contributed to the contamination previously detected in offsite, upgradient well RS-9. The concentrations in well RS-9, however, have never been detected at the concentrations recently found in wells RE-2, RE-4, RE-6, and RE-7.

ConocoPhillips also provided evidence of tank tightness testing and secondary containment testing. Unfortunately, the most recent tank tightness test report was dated May 5, 2004 and the most recent secondary containment test report was dated September 7, 2004, both of which could have predated the recent release that apparently occurred during the 4th Quarter 2004. The UST Monitor Certification Summary Report dated May 5, 2004 also reported one gallon of water in the 89 turbine sump and about 8 ounces of fuel in the 91 turbine sump.

In addition, the presence of MTBE in groundwater indicates a post 1991 release since Thrifty did not dispense MTBE blended gasoline during its operation. Thrifty's refinery (Golden West Refining Co.) began using MTBE in gasoline manufacturing processes in October 1992 when this site was already operated by BP Oil and later by TOSCO.

It is still Thrifty's position that if further assessment and remediation becomes necessary, it should be the responsibility of ConocoPhillips and that ConocoPhillips should investigate to determine if an upgradient source is contributing to the dissolved hydrocarbon plume at the site.

**Planned Activities**

Thrifty will continue the groundwater monitoring, gauging, and sampling events at this site on a quarterly basis. All interpretations expressed in this report are based solely upon the review of data collected by EMC and laboratory analyses by Associated Laboratories.

Respectfully submitted,



Michael H. Bowery, R.G.  
Project Manager



Chris Panaitescu  
General Manager  
Environmental Affairs

- cc: - Erika Assadi, SRWQCB (USTCF)  
- Liz Sewell, TOSCO Marketing Company  
76 Broadway  
Sacramento CA 95818  
- File

# ***TABLES***

Alameda County  
APR 25 2005  
Environmental Health

**TABLE 1  
GROUNDWATER DATA  
THRIFTY OIL STATION #054, CASTRO VALLEY, CA.**

DATE SAMPLED	ANALYTICAL PARAMETERS						DEPTH TO GROUNDWATER (feet)	DEPTH TO PRODUCT (feet)	PRODUCT THICKNESS (feet)	CASING ELEVATION (feet)	GROUNDWATER ELEVATION (feet)
	TPH (ug/L)	BENZENE (ug/L)	TOLUENE (ug/L)	EthylBenzene (ug/L)	XYLENE (ug/L)	MTBE (ug/L)					
<b>MONITORING WELL #PW-1</b>											
<i>Screen Interval = 5 to 15 feet (Est.)</i>											
04/11/88	-	-	-	-	-	-	-	-	-	-	-
04/09/90	230,000	600	2,700	1,000	16,000	-	5.10	NP	0.00	166.46	161.36
10/30/90	35,000	240	970	240	3,580	-	6.17	NP	0.00	166.46	160.29
01/18/91	37,000	43	140	42	1,600	-	6.28	NP	0.00	166.46	160.18
02/12/91	45,000	99	130	25	700	-	5.88	NP	0.00	166.46	160.58
03/20/91	1,900	0.43	ND	ND	2.8	-	4.75	NP	0.00	166.46	161.71
05/22/91	41,000	600	730	250	3,800	-	5.10	NP	0.00	166.46	161.36
06/19/91	-	-	-	-	-	-	5.61	NP	0.00	166.46	160.85
07/17/91	-	-	-	-	-	-	5.53	FILM	0.00	166.46	160.93
08/07/91	-	-	-	-	-	-	5.67	FILM	0.00	166.46	160.79
09/24/91	-	-	-	-	-	-	5.57	FILM	0.00	166.46	160.89
10/23/91	-	-	-	-	-	-	6.53	FILM	0.00	166.46	159.93
11/06/91	-	-	-	-	-	-	5.85	FILM	0.00	166.46	160.61
12/04/91	-	-	-	-	-	-	5.91	FILM	0.00	166.46	160.55
01/29/92	-	-	-	-	-	-	5.43	FILM	0.00	166.46	161.03
02/26/92	-	-	-	-	-	-	5.54	FILM	0.00	166.46	160.92
03/19/92	ND	ND	ND	ND	ND	-	5.47	NP	0.00	166.46	160.99
04/22/92	-	-	-	-	-	-	5.62	FILM	0.00	166.46	160.84
05/21/92	1,300	19	2.9	0.7	58	-	6.21	NP	0.00	166.46	160.25
06/25/92	-	-	-	-	-	-	6.94	NP	0.00	166.46	159.52
07/30/92	-	-	-	-	-	-	5.90	FILM	0.00	166.46	160.56
08/20/92	-	-	-	-	-	-	7.12	FILM	0.00	166.46	159.34
09/30/92	3,400	57	ND	26	240	-	6.42	NP	0.00	166.46	160.04
12/23/92	-	-	-	-	-	-	5.56	FILM	0.00	166.46	160.90
03/10/93	-	-	-	-	-	-	5.65	FILM	0.00	166.46	160.81
06/09/93	400	<0.5	1.1	<1.0	<1.0	-	5.30	NP	0.00	166.46	161.16
09/14/93	180	3.7	3.2	1.5	14	-	5.43	NP	0.00	166.46	161.03
12/14/93	<50	<0.3	<0.3	<0.3	<0.5	-	4.65	NP	0.00	166.46	161.81
03/02/94	<50	<0.3	<0.3	<0.3	<0.5	-	5.43	NP	0.00	166.46	161.03
06/06/94	330	1.3	<0.3	0.88	9.8	-	4.70	NP	0.00	166.46	161.76
09/06/94	1,100	67	<0.3	<0.3	24	-	6.48	NP	0.00	166.46	159.98
12/07/94	<50	<0.3	<0.3	<0.5	<0.5	-	5.22	NP	0.00	166.46	161.24
03/08/95	<100	<0.5	<0.5	<0.5	<1	-	6.94	NP	0.00	166.46	159.52
06/15/95	260	0.8	0.6	<0.5	3.2	-	5.72	NP	0.00	166.46	160.74
09/05/95	330	2.1	<0.5	2.1	9.6	-	5.96	NP	0.00	166.46	160.50
11/21/95	660	13	1.3	<0.3	4.0	-	6.04	NP	0.00	166.46	160.42
03/11/96	660	0.94	0.77	<0.3	8.1	-	3.60	NP	0.00	166.46	162.86

**TABLE 1**  
**GROUNDWATER DATA**  
**THRIFTY OIL STATION #054, CASTRO VALLEY, CA.**

DATE SAMPLED	ANALYTICAL PARAMETERS						DEPTH TO GROUNDWATER (feet)	DEPTH TO PRODUCT (feet)	PRODUCT THICKNESS (feet)	CASING ELEVATION (feet)	GROUNDWATER ELEVATION (feet)
	TPH (ug/L)	BENZENE (ug/L)	TOLUENE (ug/L)	EthylBenzene (ug/L)	XYLENE (ug/L)	MTBE (ug/L)					
06/19/96	120	0.53	<0.3	<0.3	2.3	-	4.80	NP	0.00	166.46	161.66
09/16/96	<50	<0.3	<0.3	<0.3	<0.5	<20	5.10	NP	0.00	166.46	161.36
12/10/96	<50	<0.3	<0.3	<0.3	<0.5	<20	4.92	NP	0.00	166.46	161.54
03/12/97	<50	<0.3	<0.3	<0.3	<0.5	<20	4.50	NP	0.00	166.46	161.96
06/12/97	<50	<0.3	<0.3	<0.3	<0.5	<20	-	-	-	-	-
09/16/97	690	0.97	<0.3	<0.3	<0.5	<20	4.55	NP	0.00	166.46	161.91
12/09/97	640	150	0.64	<0.3	5.2	1,300	5.60	NP	0.00	166.46	160.86
03/03/98	<50	<0.3	0.57	<0.3	<0.5	<20	4.13	NP	0.00	166.46	162.33
07/08/98	<50	<0.3	<0.3	<0.3	<0.5	<5	-	-	-	-	-
09/10/98	<50	<0.3	<0.3	<0.3	<0.5	<5	6.35	NP	0.00	166.46	160.11
12/30/98	<50	1.1	<0.3	<0.3	<0.5	<5	6.40	NP	0.00	166.46	160.06
03/15/99	<50	<0.3	<0.3	<0.3	<0.5	<5	6.35	NP	0.00	166.46	160.11
06/22/99	<50	<0.3	<0.3	<0.3	<0.5	53	4.95	NP	0.00	166.46	161.51
09/08/99	<50	<0.3	<0.3	<0.3	<0.5	<5	4.80	NP	0.00	166.46	161.66
12/01/99	<50	<0.3	<0.3	<0.3	<0.5	<5	3.64	NP	0.00	166.46	162.82
03/23/00	<50	0.5	0.5	1.1	<0.5	<5	4.03	NP	0.00	166.46	162.43
06/08/00	<50	<5	<5	<5	<5	<5	4.40	NP	0.00	166.46	162.06
09/27/00	<50	<0.18	<0.14	<0.18	<0.26	<0.24	4.73	NP	0.00	166.46	161.73
12/13/00	<50	<0.18	<0.14	<0.18	<0.26	<0.24	4.01	NP	0.00	166.46	162.45
03/22/01	600	<0.18	1.3	<0.18	<0.26	*1,010 / 1,970	6.32	NP	0.00	166.46	160.14
06/15/01	<50	<0.18	<0.14	<0.18	<0.26	<0.24	6.32	NP	0.00	166.46	160.14
08/30/01	<50	<0.18	<0.14	<0.18	<0.26	<0.24	6.32	NP	0.00	166.46	160.14
12/12/01	<50	<0.18	<0.14	<0.18	<0.26	<0.24	6.02	NP	0.00	166.46	160.44
03/13/02	<50	<0.18	<0.14	<0.18	<0.26	<0.24	6.30	NP	0.00	166.46	160.16
06/12/02	1,320	1	1	<0.18	2	2,060	6.30	NP	0.00	166.46	160.16
09/18/02	<50	<0.18	<0.14	<0.18	<0.26	<0.24	7.06	NP	0.00	166.46	159.40
12/18/02	113	<0.18	1.1	<0.18	<0.26	89	6.30	NP	0.00	166.46	160.16
03/19/03	<15	<0.04	2.2	<0.02	2.7	<0.03	6.35	NP	0.00	166.46	160.11
06/11/03	<15	<0.04	<0.02	<0.02	<0.06	<0.03	6.35	NP	0.00	166.46	160.11
09/04/03	<15	<0.22	<0.32	<0.31	<0.4	<0.18	5.90	NP	0.00	166.46	160.56
12/04/03	<15	<0.04	<0.02	<0.02	<0.06	<0.03	3.38	NP	0.00	165.95	162.57
03/18/04	<15	<0.22	<0.32	<0.31	<0.4	<0.18	5.51	NP	0.00	165.95	160.44
06/09/04	<15	<0.14	<0.16	<0.18	<0.45	<0.22	5.35	NP	0.00	165.95	160.60
09/02/04	133	<0.14	2.4	<0.18	1.9	<0.22	6.33	NP	0.00	165.95	159.62
12/08/04	<15	<0.14	1.3	<0.18	<0.45	<0.22	4.59	NP	0.00	165.95	161.36
03/16/05	<15	<0.22	<0.32	<0.31	<0.4	<0.18	5.90	NP	0.00	165.95	160.05

**TABLE 1  
GROUNDWATER DATA  
THRIFTY OIL STATION #054, CASTRO VALLEY, CA.**

DATE SAMPLED	ANALYTICAL PARAMETERS						DEPTH TO GROUNDWATER (feet)	DEPTH TO PRODUCT (feet)	PRODUCT THICKNESS (feet)	CASING ELEVATION (feet)	GROUNDWATER ELEVATION (feet)
	TPH (ug/L)	BENZENE (ug/L)	TOLUENE (ug/L)	EthylBenzene (ug/L)	XYLENE (ug/L)	MTBE (ug/L)					
<b>MONITORING WELL PW-2</b>											
<i>Screen Interval = 5 to 15 feet (Est.)</i>											
04/11/88	-	-	-	-	-	-	-	-	-	-	-
04/09/90	600,000	1,300	11,000	4,600	4,300	-	5.81	NP	0.00	166.18	160.37
10/30/90	48,000	310	51	10	480	-	6.95	NP	0.00	166.18	159.23
01/18/91	86,000	230	1,400	350	8,300	-	6.92	NP	0.00	166.18	159.26
02/12/91	160,000	680	1,300	250	7,000	-	6.78	NP	0.00	166.18	159.40
03/20/91	17,000	34	50	ND	1,100	-	5.54	NP	0.00	166.18	160.64
05/22/91	14,000	57	2,100	500	8,200	-	6.07	NP	0.00	166.18	160.11
06/19/91	-	-	-	-	-	-	6.37	FILM	0.00	166.18	159.81
07/17/91	-	-	-	-	-	-	6.38	FILM	0.00	166.18	159.80
08/07/91	-	-	-	-	-	-	6.63	FILM	0.00	166.18	159.55
09/24/91	-	-	-	-	-	-	6.42	FILM	0.00	166.18	159.76
10/23/91	-	-	-	-	-	-	7.25	FILM	0.00	166.18	158.93
11/06/91	-	-	-	-	-	-	6.44	FILM	0.00	166.18	159.74
12/04/91	-	-	-	-	-	-	6.65	FILM	0.00	166.18	159.53
01/29/92	-	-	-	-	-	-	6.17	FILM	0.00	166.18	160.01
02/26/92	-	-	-	-	-	-	5.90	FILM	0.00	166.18	160.28
03/19/92	-	-	-	-	-	-	5.80	FILM	0.00	166.18	160.38
04/22/92	-	-	-	-	-	-	5.88	FILM	0.00	166.18	160.30
05/21/92	-	-	-	-	-	-	6.03	FILM	0.00	166.18	160.15
06/25/92	-	-	-	-	-	-	6.57	FILM	0.00	166.18	159.61
07/30/92	-	-	-	-	-	-	6.20	FILM	0.00	166.18	159.98
08/20/92	-	-	-	-	-	-	6.64	FILM	0.00	166.18	159.54
09/30/92	-	-	-	-	-	-	6.88	FILM	0.00	166.18	159.30
12/23/92	-	-	-	-	-	-	6.08	FILM	0.00	166.18	160.10
03/10/93	-	-	-	-	-	-	5.95	FILM	0.00	166.18	160.23
06/09/93	3,400	24	22	<0.5	240	-	5.38	NP	0.00	166.18	160.80
09/14/93	4,900	190	15	6.8	480	-	6.26	NP	0.00	166.18	159.92
12/14/93	1,700	4.2	<0.3	<0.3	<0.5	-	5.22	NP	0.00	166.18	160.96
03/02/94	-	-	-	-	-	-	5.75	FILM	0.00	166.18	160.43
06/06/94	980	25	1.2	<0.3	42	-	5.25	NP	0.00	166.18	160.93
09/06/94	3,200	95	3.0	<1.7	76	-	6.80	NP	0.00	166.18	159.38
12/07/94	510	1.8	<0.3	<0.5	1.7	-	5.57	NP	0.00	166.18	160.61
03/08/95	1,900	<0.5	<0.5	1.4	35	-	4.10	NP	0.00	166.18	162.08
06/15/95	1,700	5.6	<0.5	<0.5	1.6	-	5.44	NP	0.00	166.18	160.74
09/05/95	2,500	33	1.0	0.86	18	-	6.13	NP	0.00	166.18	160.05
11/21/95	2,800	130	59	18	190	-	6.23	NP	0.00	166.18	159.95
03/11/96	13,000	330	460	<15	3,800	-	4.48	NP	0.00	166.18	161.70



**TABLE 1  
GROUNDWATER DATA  
THRIFTY OIL STATION #054, CASTRO VALLEY, CA.**

DATE SAMPLED	ANALYTICAL PARAMETERS						DEPTH TO GROUNDWATER (feet)	DEPTH TO PRODUCT (feet)	PRODUCT THICKNESS (feet)	CASING ELEVATION (feet)	GROUNDWATER ELEVATION (feet)
	TPH (ug/L)	BENZENE (ug/L)	TOLUENE (ug/L)	EthylBenzene (ug/L)	XYLENE (ug/L)	MTBE (ug/L)					
06/19/96	1,400	<0.3	<0.3	<0.3	<0.5	-	5.38	NP	0.00	166.18	160.80
09/16/96	3,500	<0.3	<0.3	<0.3	<0.5	5,900	5.21	NP	0.00	166.18	160.97
12/10/96	2,100	<0.3	<0.3	<0.3	<0.5	4,700	4.87	NP	0.00	166.18	161.31
03/12/97	600	1.6	<0.3	<0.3	5.8	1,100	4.43	NP	0.00	166.18	161.75
06/12/97	270	<0.3	<0.3	<0.3	<0.5	630	-	-	-	-	-
09/10/97	220	<0.3	<0.3	<0.3	<0.5	320	4.07	NP	0.00	166.18	162.11
12/09/97	120	<0.3	0.73	<0.3	<0.5	420	5.20	NP	0.00	166.18	160.98
03/03/98	<50	0.43	0.48	<0.3	<0.5	47	3.30	NP	0.00	166.18	162.88
07/08/98	<50	<0.3	<0.3	<0.3	<0.5	<5	-	-	-	-	-
09/10/98	<50	<0.3	<0.3	<0.3	<0.5	<5	5.15	NP	0.00	166.18	161.03
12/30/98	<50	1.1	<0.3	<0.3	<0.5	<5	4.75	NP	0.00	166.18	161.43
03/15/99	<50	<0.3	<0.3	<0.3	<0.5	<5	4.40	NP	0.00	166.18	161.78
06/22/99	-	-	-	-	-	-	4.50	NP	0.00	166.18	161.68
09/08/99	100	<0.3	<0.3	<0.3	<0.5	230	3.99	NP	0.00	166.18	162.19
12/01/99	<50	<0.3	<0.3	<0.3	<0.5	<5	3.62	NP	0.00	166.18	162.56
03/23/00	<50	<0.25	<0.25	<0.25	<0.5	<5	2.93	NP	0.00	166.18	163.25
06/08/00	<50	<5	<5	<5	<5	<5	3.60	NP	0.00	166.18	162.58
09/27/00	<50	<0.18	<0.14	<0.18	<0.26	<0.24	3.61	NP	0.00	166.18	162.57
12/13/00	<50	<0.18	<0.14	<0.18	<0.26	<0.24	3.60	NP	0.00	166.18	162.58
03/22/01	<50	<0.18	<0.14	<0.18	<0.26	<0.24	5.14	NP	0.00	166.18	161.04
06/15/01	<50	<0.18	<0.14	<0.18	<0.26	<0.24	5.13	NP	0.00	166.18	161.05
08/30/01	<50	<0.18	<0.14	<0.18	<0.26	<0.24	5.90	NP	0.00	166.18	160.28
12/12/01	<50	<0.18	<0.14	<0.18	<0.26	<0.24	6.20	NP	0.00	166.18	159.98
03/13/02	-	-	-	-	-	-	5.14	NP	0.00	166.18	161.04
06/12/02	-	-	-	-	-	-	-	-	-	-	-
09/18/02	-	-	-	-	-	-	-	-	-	-	-
12/18/02	-	-	-	-	-	-	-	-	-	-	-
03/19/03	-	-	-	-	-	-	-	-	-	-	-
06/11/03	-	-	-	-	-	-	-	-	-	-	-
09/04/03	-	-	-	-	-	-	-	-	-	-	-
12/04/03	-	-	-	-	-	-	3.20	NP	0.00	165.61	162.41
03/18/04	-	-	-	-	-	-	5.12	NP	0.00	165.61	160.49
06/09/04	-	-	-	-	-	-	4.72	NP	0.00	165.61	160.89
09/02/04	-	-	-	-	-	-	6.95	NP	0.00	165.61	158.66
12/08/04	-	-	-	-	-	-	3.63	NP	0.00	165.61	161.98
03/16/05	-	-	-	-	-	-	5.12	NP	0.00	165.61	160.49

**TABLE 1**  
**GROUNDWATER DATA**  
**THRIFTY OIL STATION #054, CASTRO VALLEY, CA.**

DATE SAMPLED	ANALYTICAL PARAMETERS						DEPTH TO GROUNDWATER (feet)	DEPTH TO PRODUCT (feet)	PRODUCT THICKNESS (feet)	CASING ELEVATION (feet)	GROUNDWATER ELEVATION (feet)
	TPH (ug/L)	BENZENE (ug/L)	TOLUENE (ug/L)	EthylBenzene (ug/L)	XYLENE (ug/L)	MTBE (ug/L)					
<b>MONITORING WELL #RE-1</b>											
<i>Screen Interval = 5 to 17 feet</i>											
04/11/88	37,000	1,900	8,400	1,200	15,000	-	-	-	-	-	-
04/09/90	45,000	6,100	7,000	2,000	8,800	-	4.99	NP	0.00	166.82	161.83
10/30/90	72,000	7,700	5,300	1,800	8,900	-	5.95	NP	0.00	166.82	160.87
01/18/91	150,000	11,000	14,000	1,800	4,300	-	5.17	NP	0.00	166.82	161.65
02/12/91	140,000	11,000	12,000	1,600	13,000	-	4.16	NP	0.00	166.82	162.66
03/20/91	53,000	3,100	4,200	400	5,500	-	4.75	NP	0.00	166.82	162.07
05/22/91	85,000	8,700	10,000	1,800	12,000	-	4.42	NP	0.00	166.82	162.40
06/19/91	110,000	8,500	9,600	2,600	16,000	-	4.93	NP	0.00	166.82	161.89
07/17/91	5,500	950	ND	26	ND	-	5.19	NP	0.00	166.82	161.63
08/07/91	-	6,700	5,000	ND	7,100	-	5.12	NP	0.00	166.82	161.70
09/24/91	60,000	6,800	4,300	640	6,900	-	5.87	NP	0.00	166.82	160.95
10/23/91	79,000	7,900	8,300	450	7,100	-	5.81	NP	0.00	166.82	161.01
11/06/91	130,000	14,000	15,000	1,100	8,800	-	5.56	NP	0.00	166.82	161.26
12/04/91	50,000	8,000	4,700	520	4,100	-	5.35	NP	0.00	166.82	161.47
01/29/92	21,000	10,300	11,000	780	6,000	-	4.50	NP	0.00	166.82	162.32
02/26/92	38,000	8,400	10,500	720	7,100	-	5.27	NP	0.00	166.82	161.55
03/19/92	48,000	6,200	9,700	780	7,200	-	4.47	NP	0.00	166.82	162.35
04/22/92	-	-	-	-	-	-	4.62	NP	0.00	166.82	162.20
05/21/92	20,000	7,600	10,100	830	6,900	-	4.98	NP	0.00	166.82	161.84
06/25/92	-	-	-	-	-	-	5.14	FILM	0.00	166.82	161.68
07/30/92	-	-	-	-	-	-	5.30	FILM	0.00	166.82	161.52
08/20/92	-	-	-	-	-	-	5.28	FILM	0.00	166.82	161.54
09/30/92	-	-	-	-	-	-	5.66	FILM	0.00	166.82	161.16
12/23/92	-	-	-	-	-	-	4.81	FILM	0.00	166.82	162.01
03/10/93	-	-	-	-	-	-	4.13	FILM	0.00	166.82	162.69
06/09/93	-	-	-	-	-	-	4.48	FILM	0.00	166.82	162.34
09/14/93	19,000	3,600	1,100	740	4,300	-	5.35	NP	0.00	166.82	161.47
12/14/93	38,000	4,300	1,300	<6.6	11	-	4.38	NP	0.00	166.82	162.44
03/02/94	-	-	-	-	-	-	4.22	FILM	0.00	166.82	162.60
06/06/94	-	-	-	-	-	-	2.16	FILM	0.00	166.82	164.66
09/06/94	74,000	3,300	3,900	1,200	6,100	-	5.00	NP	0.00	166.82	161.82
12/07/94	30,000	3,200	2,900	1,200	4,600	-	4.10	NP	0.00	166.82	162.72
03/08/95	28,000	4,200	2,300	810	7,800	-	3.92	NP	0.00	166.82	162.90
06/15/95	-	-	-	-	-	-	-	-	-	-	-
09/05/95	-	-	-	-	-	-	4.78	FILM	0.00	166.82	162.04
11/21/95	-	-	-	-	-	-	4.82	NP	0.00	166.82	162.00
03/11/96	270	2.4	6.0	4.5	19	-	3.32	NP	0.00	166.82	163.50

**TABLE 1**  
**GROUNDWATER DATA**  
**THRIFTY OIL STATION #054, CASTRO VALLEY, CA.**

DATE SAMPLED	ANALYTICAL PARAMETERS						DEPTH TO GROUNDWATER (feet)	DEPTH TO PRODUCT (feet)	PRODUCT THICKNESS (feet)	CASING ELEVATION (feet)	GROUNDWATER ELEVATION (feet)
	TPH (ug/L)	BENZENE (ug/L)	TOLUENE (ug/L)	EthylBenzene (ug/L)	XYLENE (ug/L)	MTBE (ug/L)					
06/19/96	3,000	570	63	<1.5	400	-	4.20	NP	0.00	166.82	162.62
09/16/96	7,700	440	69	<1.5	680	230	4.68	NP	0.00	166.82	162.14
12/10/96	52	<0.3	<0.3	<0.3	<0.5	120	4.93	NP	0.00	166.82	161.89
03/12/97	8,700	180	5.4	40	1,100	130	4.10	NP	0.00	166.82	162.72
06/12/97	<50	<0.3	<0.3	<0.3	<0.5	36	-	-	-	-	-
09/16/97	<50	<0.3	<0.3	<0.3	<0.5	<20	4.55	NP	0.00	166.82	162.27
12/09/97	<50	<0.3	0.44	<0.3	<0.5	<20	5.30	NP	0.00	166.82	161.52
03/03/98	1,100	13	0.51	<0.3	<0.5	220	4.55	NP	0.00	166.82	162.27
07/08/98	<50	<0.3	<0.3	<0.3	<0.5	<5	-	-	-	-	-
09/10/98	60	<0.3	<0.3	<0.3	<0.5	180	6.05	NP	0.00	166.82	160.77
12/30/98	<50	1.1	<0.3	<0.3	<0.5	<5	5.65	NP	0.00	166.82	161.17
03/15/99	<50	<0.3	<0.3	<0.3	<0.5	<5	5.68	NP	0.00	166.82	161.14
06/22/99	880	14	0.98	<0.3	8.1	260	4.95	NP	0.00	166.82	161.87
09/08/99	72	<0.3	<0.3	<0.3	<0.5	120	4.46	NP	0.00	166.82	162.36
12/01/99	<50	<0.3	<0.3	<0.3	<0.5	<5	4.08	NP	0.00	166.82	162.74
03/23/00	<50	<0.25	<0.25	<0.25	<0.5	<5	3.68	NP	0.00	166.82	163.14
06/08/00	<50	<5	<5	<5	<5	<5	4.07	NP	0.00	166.82	162.75
09/27/00	<50	<0.18	<0.14	<0.18	<0.26	<0.24	4.07	NP	0.00	166.82	162.75
12/13/00	<50	<0.18	<0.14	<0.18	<0.26	<0.24	4.06	NP	0.00	166.82	162.76
03/22/01	<50	<0.18	<0.14	<0.18	<0.26	<0.24	5.22	NP	0.00	166.82	161.60
06/15/01	<50	<0.18	<0.14	<0.18	<0.26	<0.24	5.99	NP	0.00	166.82	160.83
08/30/01	<50	<0.18	<0.14	<0.18	<0.26	<0.24	4.84	NP	0.00	166.82	161.98
12/12/01	<50	<0.18	<0.14	<0.18	<0.26	<0.24	4.80	NP	0.00	166.82	162.02
03/13/02	-	-	-	-	-	-	5.18	NP	0.00	166.82	161.64
06/12/02	-	-	-	-	-	-	-	-	-	-	-
09/18/02	-	-	-	-	-	-	-	-	-	-	-
12/18/02	-	-	-	-	-	-	-	-	-	-	-
03/19/03	-	-	-	-	-	-	-	-	-	-	-
06/11/03	-	-	-	-	-	-	-	-	-	-	-
09/04/03	-	-	-	-	-	-	-	-	-	-	-
12/04/03	-	-	-	-	-	-	4.50	NP	0.00	166.46	161.96
03/18/04	-	-	-	-	-	-	5.64	NP	0.00	166.46	160.82
06/09/04	-	-	-	-	-	-	5.65	NP	0.00	166.46	160.81
09/02/04	-	-	-	-	-	-	5.45	NP	0.00	166.46	161.01
12/08/04	-	-	-	-	-	-	4.64	NP	0.00	166.46	161.82
03/16/05	-	-	-	-	-	-	6.79	NP	0.00	166.46	159.67

**TABLE 1**  
**GROUNDWATER DATA**  
**THRIFTY OIL STATION #054, CASTRO VALLEY, CA.**

DATE SAMPLED	ANALYTICAL PARAMETERS						DEPTH TO GROUNDWATER (feet)	DEPTH TO PRODUCT (feet)	PRODUCT THICKNESS (feet)	CASING ELEVATION (feet)	GROUNDWATER ELEVATION (feet)
	TPH (ug/L)	BENZENE (ug/L)	TOLUENE (ug/L)	EthylBenzene (ug/L)	XYLENE (ug/L)	MIBE (ug/L)					
<b>MONITORING WELL #RE-2</b>											
<i>Screen Interval - 5 to 17 feet</i>											
04/11/88	-	-	-	-	-	-	-	-	-	-	-
04/09/90	850	5.8	0.5	4.8	1.1	-	4.90	NP	0.00	167.19	162.29
10/30/90	440	2.8	0.91	13	3.14	-	5.34	NP	0.00	167.19	161.85
01/18/91	1,100	8.4	3.1	ND	10	-	4.90	NP	0.00	167.19	162.29
02/12/91	1,100	5.9	ND	1.77	ND	-	4.94	NP	0.00	167.19	162.25
03/20/91	550	4.3	ND	ND	ND	-	4.32	NP	0.00	167.19	162.87
05/22/91	1,000	5.3	3.6	4.4	8.9	-	4.43	NP	0.00	167.19	162.76
06/19/91	700	2.1	1.4	3.8	3.5	-	6.43	NP	0.00	167.19	160.76
07/17/91	880	12	8.0	4.3	28	-	4.75	NP	0.00	167.19	162.44
08/07/91	-	3.8	1.6	ND	ND	-	4.87	NP	0.00	167.19	162.32
09/24/91	670	7.2	7.1	ND	23	-	5.50	NP	0.00	167.19	161.69
10/23/91	2,700	52	60	22	130	-	5.63	NP	0.00	167.19	161.56
11/06/91	1,900	18	61	9.1	83	-	5.14	NP	0.00	167.19	162.05
12/04/91	1,100	26	47	4.3	42	-	5.26	NP	0.00	167.19	161.93
01/29/92	900	14	24	5.3	19	-	5.11	NP	0.00	167.19	162.08
02/26/92	500	3.4	3.5	2.7	2.7	-	4.31	NP	0.00	167.19	162.88
03/19/92	1,200	14	20	15	18	-	4.45	NP	0.00	167.19	162.74
04/22/92	200	ND	ND	ND	ND	-	4.78	NP	0.00	167.19	162.41
05/21/92	500	7.5	6.8	3.9	7.4	-	5.02	NP	0.00	167.19	162.17
06/25/92	ND	ND	0.9	0.7	ND	-	5.13	NP	0.00	167.19	162.06
07/30/92	500	7.7	8.6	3.2	1.7	-	5.19	NP	0.00	167.19	162.00
08/20/92	1,100	6.6	4.5	2.7	2.0	-	5.27	NP	0.00	167.19	161.92
09/30/92	500	5.4	2.4	1.8	4.5	-	5.45	NP	0.00	167.19	161.74
12/23/92	800	1.9	ND	ND	2.3	-	4.60	NP	0.00	167.19	162.59
03/10/93	1,200	ND	1.4	ND	2.1	-	4.18	NP	0.00	167.19	163.01
06/09/93	200	ND	ND	ND	ND	-	4.53	NP	0.00	167.19	162.66
09/17/93	360	1.6	1.1	3.2	8.9	-	5.26	NP	0.00	167.19	161.93
12/14/93	260	5.6	3.9	<0.3	21.0	-	2.75	NP	0.00	167.19	164.44
03/02/94	410	<0.3	<0.3	<0.3	<0.5	-	4.27	NP	0.00	167.19	162.92
06/06/94	760	4.6	<0.3	0.32	1.3	-	4.88	NP	0.00	167.19	162.31
09/06/94	1,300	43	45	8.9	69	-	5.16	NP	0.00	167.19	162.03
12/07/94	-	-	-	-	-	-	4.16	NP	0.00	167.19	163.03
03/08/95	<100	<0.5	<0.5	<0.5	<1	-	3.96	NP	0.00	167.19	163.23
06/15/95	130	<0.5	<0.5	<0.5	<1	-	4.52	NP	0.00	167.19	162.67
09/05/95	210	<0.5	<0.5	<0.5	<1	-	4.76	NP	0.00	167.19	162.43
11/21/95	160	0.65	<0.3	0.35	0.95	-	4.83	NP	0.00	167.19	162.36
03/11/96	<50	<0.3	<0.3	<0.3	<0.5	-	3.36	NP	0.00	167.19	163.83

**TABLE 1**  
**GROUNDWATER DATA**  
**THRIFTY OIL STATION #054, CASTRO VALLEY, CA.**

DATE SAMPLED	ANALYTICAL PARAMETERS						DEPTH TO GROUNDWATER (feet)	DEPTH TO PRODUCT (feet)	PRODUCT THICKNESS (feet)	CASING ELEVATION (feet)	GROUNDWATER ELEVATION (feet)
	TPH (ug/L)	BENZENE (ug/L)	TOLUENE (ug/L)	EthylBenzene (ug/L)	XYLENE (ug/L)	MIBB (ug/L)					
06/19/96	<50	<0.3	<0.3	<0.3	<0.5	-	4.68	NP	0.00	167.19	162.51
09/16/96	<50	<0.3	<0.3	<0.3	<0.5	<20	5.10	NP	0.00	167.19	162.09
12/10/96	<50	<0.3	<0.3	<0.3	<0.5	<20	4.47	NP	0.00	167.19	162.72
03/12/97	<50	<0.3	<0.3	<0.3	<0.5	<20	4.05	NP	0.00	167.19	163.14
06/12/97	<50	<0.3	<0.3	<0.3	<0.5	<20	-	-	-	-	-
09/10/97	<50	<0.3	<0.3	<0.3	<0.5	<20	4.08	NP	0.00	167.19	163.11
12/09/97	<50	<0.3	<0.3	<0.3	<0.5	<20	4.40	NP	0.00	167.19	162.79
03/03/98	<50	<0.3	<0.3	<0.3	<0.5	<20	3.30	NP	0.00	167.19	163.89
07/08/98	<50	<0.3	<0.3	<0.3	<0.5	15	-	-	-	-	-
09/10/98	<50	<0.3	<0.3	<0.3	<0.5	<5	4.93	NP	0.00	167.19	162.26
12/30/98	460	0.92	<0.3	<0.3	<0.5	1,400	4.20	NP	0.00	167.19	162.99
03/15/99	<50	<0.3	<0.3	<0.3	<0.5	<5	4.20	NP	0.00	167.19	162.99
06/22/99	2,900	7.4	<0.3	0.43	4.1	4,500	3.70	NP	0.00	167.19	163.49
09/08/99	1,400	<3	<3	<3	<5	3,200	3.96	NP	0.00	167.19	163.23
12/01/99	<50	<0.3	<0.3	<0.3	<0.5	<5	3.58	NP	0.00	167.19	163.61
03/23/00	<50	<0.25	<0.25	<0.25	<0.5	<5	3.19	NP	0.00	167.19	164.00
06/08/00	<50	<5	<5	<5	<5	<5	3.18	NP	0.00	167.19	164.01
09/27/00	<50	<0.18	<0.14	<0.18	<0.26	<0.24	3.58	NP	0.00	167.19	163.61
12/13/00	<50	<0.18	<0.14	<0.18	<0.26	<0.24	3.58	NP	0.00	167.19	163.61
03/22/01	575	<0.18	1.3	<0.18	<0.26	*950 / 2,070	4.33	NP	0.00	167.19	162.86
06/15/01	<50	<0.18	<0.14	<0.18	<0.26	<0.24	5.10	NP	0.00	167.19	162.09
08/30/01	<50	<0.18	<0.14	<0.18	<0.26	<0.24	5.86	NP	0.00	167.19	161.33
12/12/01	<50	<0.18	<0.14	<0.18	<0.26	<0.24	4.81	NP	0.00	167.19	162.38
03/13/02	-	-	-	-	-	-	4.33	NP	0.00	167.19	162.86
06/12/02	<50	<0.18	<0.14	<0.18	<0.26	<0.24	5.86	NP	0.00	167.19	161.33
09/18/02	<50	<0.18	<0.14	<0.18	<0.26	<0.24	5.86	NP	0.00	167.19	161.33
12/18/02	<50	<0.18	<0.14	<0.18	<0.26	<0.24	5.48	NP	0.00	167.19	161.71
03/19/03	<15	<0.04	<0.02	<0.02	<0.06	<0.03	5.86	NP	0.00	167.19	161.33
06/11/03	<15	<0.04	<0.02	<0.02	<0.06	<0.03	5.86	NP	0.00	167.19	161.33
09/04/03	<15	<0.22	<0.32	<0.31	<0.4	<0.18	5.48	NP	0.00	167.19	161.71
12/04/03	<15	<0.04	<0.02	<0.02	<0.06	<0.03	3.20	NP	0.00	166.61	163.41
03/18/04	<15	<0.22	<0.32	<0.31	<0.4	8.4	4.33	NP	0.00	166.61	162.28
06/09/04	<15	<0.14	<0.16	<0.18	<0.45	8.4	4.32	NP	0.00	166.61	162.29
09/02/04	877	2.3	2.2	5.8	4.0	*743 / 516	5.12	NP	0.00	166.61	161.49
12/08/04	194,000	1,960	26,900	4,660	23,200	*10,700 / 13,000	3.65	NP	0.00	166.61	162.96
03/16/05	50,600	901	10,100	130 J	12,100	4,040	5.47	NP	0.00	166.61	161.14

**TABLE 1**  
**GROUNDWATER DATA**  
**THRIFTY OIL STATION #054, CASTRO VALLEY, CA.**

DATE SAMPLED	ANALYTICAL PARAMETERS						DEPTH TO GROUNDWATER (feet)	DEPTH TO PRODUCT (feet)	PRODUCT THICKNESS (feet)	CASING ELEVATION (feet)	GROUNDWATER ELEVATION (feet)
	TPH (ug/L)	BENZENE (ug/L)	TOLUENE (ug/L)	EthylBenzene (ug/L)	XYLENE (ug/L)	MTBE (ug/L)					
<b>MONITORING WELL #RE-3</b>											
<i>Screen Interval = 5 to 18 feet</i>											
04/11/88	70,000	6,600	5,300	800	13,000	-	-	-	-	-	-
04/09/90	370,000	2,300	4,900	3,200	31,000	-	7.15	NP	0.00	167.39	160.24
10/30/90	13,000	860	660	220	2,210	-	7.84	NP	0.00	167.39	159.55
01/18/91	42,000	4,700	4,500	21	7,700	-	6.90	NP	0.00	167.39	160.49
02/12/91	72,000	3,600	4,500	ND	7,600	-	6.62	NP	0.00	167.39	160.77
03/20/91	65,000	2,400	9,400	50	9,800	-	5.87	NP	0.00	167.39	161.52
05/22/91	-	-	-	-	-	-	5.98	FILM	0.00	167.39	161.41
06/19/91	-	-	-	-	-	-	6.84	FILM	0.00	167.39	160.55
07/17/91	-	-	-	-	-	-	7.10	FILM	0.00	167.39	160.29
08/07/91	-	-	-	-	-	-	7.30	FILM	0.00	167.39	160.09
09/24/91	-	-	-	-	-	-	7.84	FILM	0.00	167.39	159.55
10/23/91	-	-	-	-	-	-	8.07	FILM	0.00	167.39	159.32
11/06/91	-	-	-	-	-	-	7.63	FILM	0.00	167.39	159.76
12/04/91	-	-	-	-	-	-	7.83	FILM	0.00	167.39	159.56
01/29/92	-	-	-	-	-	-	7.17	FILM	0.00	167.39	160.22
02/26/92	-	-	-	-	-	-	5.56	FILM	0.00	167.39	161.83
03/19/92	-	-	-	-	-	-	5.44	FILM	0.00	167.39	161.95
04/22/92	-	-	-	-	-	-	6.56	FILM	0.00	167.39	160.83
05/21/92	-	-	-	-	-	-	6.90	FILM	0.00	167.39	160.49
06/25/92	-	-	-	-	-	-	7.18	FILM	0.00	167.39	160.21
07/30/92	-	-	-	-	-	-	6.80	FILM	0.00	167.39	160.59
08/20/92	-	-	-	-	-	-	7.25	FILM	0.00	167.39	160.14
09/30/92	-	-	-	-	-	-	7.68	FILM	0.00	167.39	159.71
12/23/92	-	-	-	-	-	-	6.07	FILM	0.00	167.39	161.32
03/10/93	-	-	-	-	-	-	5.66	FILM	0.00	167.39	161.73
06/09/93	-	-	-	-	-	-	6.66	FILM	0.00	167.39	160.73
09/14/93	40,000	2,900	1,500	180	6,900	-	7.30	NP	0.00	167.39	160.09
12/14/93	-	-	-	-	-	-	5.95	NP	0.00	167.39	161.44
03/02/94	-	-	-	-	-	-	5.08	NP	0.00	167.39	162.31
06/06/94	-	-	-	-	-	-	6.35	FILM	0.00	167.39	161.04
09/06/94	11,000	260	26	<6.6	1,000	-	7.50	NP	0.00	167.39	159.89
12/07/94	-	-	-	-	-	-	5.48	FILM	0.00	167.39	161.91
03/08/95	-	-	-	-	-	-	5.18	FILM	0.00	167.39	162.21
06/15/95	-	-	-	-	-	-	-	-	-	-	-
09/05/95	-	-	-	-	-	-	6.84	FILM	0.00	167.39	160.55
11/21/95	10,000	210	<3	4.5	330	-	7.38	NP	0.00	167.39	160.01
03/11/96	1,600	640	15	10	46	-	4.85	NP	0.00	167.39	162.54

**TABLE 1  
GROUNDWATER DATA  
THRIFTY OIL STATION #054, CASTRO VALLEY, CA.**

DATE SAMPLED	ANALYTICAL PARAMETERS						DEPTH TO GROUNDWATER (feet)	DEPTH TO PRODUCT (feet)	PRODUCT THICKNESS (feet)	CASING ELEVATION (feet)	GROUNDWATER ELEVATION (feet)
	TPH (ug/L)	BENZENE (ug/L)	TOLUENE (ug/L)	EthylBenzene (ug/L)	XYLENE (ug/L)	MTBE (ug/L)					
06/19/96	2,100	280	<3	<3	120	-	5.80	NP	0.00	167.39	161.59
09/16/96	140	<0.3	<0.3	<0.3	<0.5	110	4.50	NP	0.00	167.39	162.89
12/10/96	<50	<0.3	<0.3	<0.3	<0.5	<20	5.35	NP	0.00	167.39	162.04
03/12/97	<50	<0.3	<0.3	<0.3	<0.5	<20	3.48	NP	0.00	167.39	163.91
06/12/97	<50	<0.3	<0.3	<0.3	0.58	<20	-	-	-	-	-
09/10/97	<50	<0.3	<0.3	<0.3	<0.5	<20	3.10	NP	0.00	167.39	164.29
12/09/97	3,600	1,000	1,000	<6	570	260	4.55	NP	0.00	167.39	162.84
03/03/98	2,800	20	0.65	0.39	16	5,600	2.30	NP	0.00	167.39	165.09
07/08/98	<50	<0.3	<0.3	<0.3	<0.5	<5	-	-	-	-	-
09/10/98	<50	<0.3	<0.3	<0.3	<0.5	23	4.95	NP	0.00	167.39	162.44
12/30/98	<50	1.1	<0.3	<0.3	<0.5	<5	4.55	NP	0.00	167.39	162.84
03/15/99	<50	<0.3	<0.3	<0.3	<0.5	<5	4.15	NP	0.00	167.39	163.24
06/22/99	670	17	1.2	0.36	1.7	340	3.85	NP	0.00	167.39	163.54
09/08/99	140	0.72	<0.3	<0.3	<0.5	230	2.63	NP	0.00	167.39	164.76
12/01/99	95	<0.3	<0.3	<0.3	<0.5	200	2.63	NP	0.00	167.39	164.76
03/23/00	315	<0.25	<0.25	<0.25	<0.5	*293/422	2.25	NP	0.00	167.39	165.14
06/08/00	<100	<5	<5	<5	<5	201	3.02	NP	0.00	167.39	164.37
09/27/00	154	<0.18	<0.14	<0.18	<0.26	*254 / 160	3.01	NP	0.00	167.39	164.38
12/13/00	<50	<0.18	<0.14	<0.18	<0.26	*124 / 111	3.02	NP	0.00	167.39	164.37
03/22/01	<50	<0.18	<0.14	<0.18	<0.26	*90 / 57	4.54	NP	0.00	167.39	162.85
06/15/01	649	28	2.4	3.1	9	*1,790 / 2,560	4.92	NP	0.00	167.39	162.47
08/30/01	<50	<0.18	<0.14	<0.18	<0.26	<0.24	7.80	NP	0.00	167.39	159.59
12/12/01	<50	<0.18	<0.14	<0.18	<0.26	<0.24	7.35	NP	0.00	167.39	160.04
03/13/02	<50	<0.18	<0.14	<0.18	<0.26	<0.24	4.53	NP	0.00	167.39	162.86
06/12/02	969	<0.18	1.0	<0.18	<0.26	1,430	4.90	NP	0.00	167.39	162.49
09/18/02	<50	<0.18	<0.14	<0.18	<0.26	<0.24	5.28	NP	0.00	167.39	162.11
12/18/02	<50	<0.18	<0.14	<0.18	<0.26	<0.24	4.52	NP	0.00	167.39	162.87
03/19/03	<15	<0.04	<0.02	<0.02	<0.06	<0.03	5.67	NP	0.00	167.39	161.72
06/11/03	<15	<0.04	<0.02	<0.02	<0.06	<0.03	5.67	NP	0.00	167.39	161.72
09/04/03	<15	<0.22	<0.32	<0.31	<0.4	<0.18	5.26	NP	0.00	167.39	162.13
12/04/03	<15	<0.04	<0.02	<0.02	<0.06	<0.03	2.59	NP	0.00	166.69	164.10
03/18/04	57	<0.22	1.7	<0.31	<0.4	13	4.50	NP	0.00	166.69	162.19
06/09/04	7,950	39	21	<1.8	20	4,590	5.85	NP	0.00	166.69	160.84
09/02/04	9,560	982	65	77	86	*5,950 / 4,360	6.30	NP	0.00	166.69	160.39
12/08/04	233	1.3	3.9	1.7	2.6	*72 / 80	4.48	NP	0.00	166.69	162.21
03/16/05	<15	<0.22	<0.32	<0.31	<0.4	<0.18	6.80	NP	0.00	166.69	159.89

**TABLE 1  
GROUNDWATER DATA  
THRIFTY OIL STATION #054, CASTRO VALLEY, CA.**

DATE SAMPLED	ANALYTICAL PARAMETERS						DEPTH TO GROUNDWATER (feet)	DEPTH TO PRODUCT (feet)	PRODUCT THICKNESS (feet)	CASING ELEVATION (feet)	GROUNDWATER ELEVATION (feet)
	TPH (ug/L)	BENZENE (ug/L)	TOLUENE (ug/L)	EthylBenzene (ug/L)	XYLENE (ug/L)	MTBE (ug/L)					
<b>MONITORING WELL #RE-4</b>											
<i>Screen Interval = 5 to 15 feet</i>											
04/11/88	15,000	12,000	8,000	1,000	2,700	-	-	-	-	-	-
04/09/90	-	-	-	-	-	-	-	-	-	-	-
10/30/90	87,000	7,200	10,000	1,600	12,900	-	7.04	NP	0.00	166.94	159.90
01/18/91	70,000	5,000	5,400	790	9,900	-	11.62	NP	0.00	166.94	155.32
02/12/91	87,000	5,200	2,800	240	11,000	-	11.63	NP	0.00	166.94	155.31
03/20/91	6,500	370	230	17	670	-	11.61	NP	0.00	166.94	155.33
05/22/91	-	-	-	-	-	-	10.30	FILM	0.00	166.94	156.64
06/19/91	-	-	-	-	-	-	11.10	FILM	0.00	166.94	155.84
07/17/91	-	-	-	-	-	-	6.20	FILM	0.00	166.94	160.74
08/17/91	-	-	-	-	-	-	8.15	FILM	0.00	166.94	158.79
09/24/91	-	-	-	-	-	-	10.40	FILM	0.00	166.94	156.54
10/23/91	-	-	-	-	-	-	11.20	FILM	0.00	166.94	155.74
11/06/91	-	-	-	-	-	-	6.62	FILM	0.00	166.94	160.32
12/04/91	-	-	-	-	-	-	11.20	ILM	0.00	166.94	155.74
01/29/92	-	-	-	-	-	-	7.72	FILM	0.00	166.94	159.22
02/26/92	-	-	-	-	-	-	5.13	FILM	0.00	166.94	161.81
03/19/92	-	-	-	-	-	-	5.00	FILM	0.00	166.94	161.94
04/22/92	-	-	-	-	-	-	5.94	FILM	0.00	166.94	161.00
05/21/92	-	-	-	-	-	-	5.40	FILM	0.00	166.94	161.54
06/25/92	-	-	-	-	-	-	5.71	FILM	0.00	166.94	161.23
07/30/92	-	-	-	-	-	-	6.33	FILM	0.00	166.94	160.61
08/20/92	-	-	-	-	-	-	5.80	FILM	0.00	166.94	161.14
09/30/92	-	-	-	-	-	-	6.34	FILM	0.00	166.94	160.60
12/23/92	-	-	-	-	-	-	5.50	FILM	0.00	166.94	161.44
03/10/93	-	-	-	-	-	-	4.67	FILM	0.00	166.94	162.27
06/09/93	-	-	-	-	-	-	5.12	FILM	0.00	166.94	161.82
09/14/93	-	-	-	-	-	-	10.44	NP	0.00	166.94	156.50
12/14/93	-	-	-	-	-	-	7.52	NP	0.00	166.94	159.42
03/02/94	-	-	-	-	-	-	4.85	NP	0.00	166.94	162.09
06/06/94	-	-	-	-	-	-	5.20	FILM	0.00	166.94	161.74
09/06/94	-	-	-	-	-	-	9.85	FILM	0.00	166.94	157.09
12/07/94	-	-	-	-	-	-	5.20	FILM	0.00	166.94	161.74
03/08/95	-	-	-	-	-	-	4.98	FILM	0.00	166.94	161.96
06/15/95	-	-	-	-	-	-	-	-	-	-	-
09/05/95	-	-	-	-	-	-	13.72	FILM	0.00	166.94	153.22
11/21/95	32,000	46	21	66	340	-	12.53	NP	0.00	166.94	154.41
03/11/96	1,700	130	15	2.0	120	-	4.72	NP	0.00	166.94	162.22



**TABLE 1**  
**GROUNDWATER DATA**  
**THRIFTY OIL STATION #054, CASTRO VALLEY, CA.**

DATE SAMPLED	ANALYTICAL PARAMETERS						DEPTH TO GROUNDWATER (feet)	DEPTH TO PRODUCT (feet)	PRODUCT THICKNESS (feet)	CASING ELEVATION (feet)	GROUNDWATER ELEVATION (feet)
	TPH (ug/L)	BENZENE (ug/L)	TOLUENE (ug/L)	EthylBenzene (ug/L)	XYLENE (ug/L)	MTBE (ug/L)					
06/19/96	1,700	230	30	0.35	100	-	5.40	NP	0.00	166.94	161.54
09/16/96	510	<0.3	0.73	<0.3	<0.5	800	5.18	NP	0.00	166.94	161.76
12/10/96	520	<0.3	<0.3	<0.3	<0.5	1,000	4.65	NP	0.00	166.94	162.29
03/12/97	420	3.2	<0.3	<0.3	11	370	3.87	NP	0.00	166.94	163.07
06/12/97	510	0.66	<0.3	<0.3	<0.5	1,600	-	-	-	-	-
09/10/97	<50	<0.3	<0.3	<0.3	<0.5	<20	5.40	NP	0.00	166.94	161.54
12/09/97	1,400	330	2.3	<0.3	1.5	2,500	4.60	NP	0.00	166.94	162.34
03/03/98	3,000	400	0.61	0.5	97	3,800	5.05	NP	0.00	166.94	161.89
07/08/98	650	<0.3	<0.3	<0.3	<0.5	1,800	-	-	-	-	-
09/10/98	2,700	<0.3	<0.3	<0.3	1.4	7,600	4.60	NP	0.00	166.94	162.34
12/30/98	530	<0.3	<0.3	<0.3	<0.5	1,500	4.20	NP	0.00	166.94	162.74
03/15/99	<50	<0.3	<0.3	<0.3	<0.5	<5	3.85	NP	0.00	166.94	163.09
06/22/99	1,200	23	1.5	<0.3	2.4	1,400	3.90	NP	0.00	166.94	163.04
09/08/99	590	1.5	<0.6	<0.6	<1	1,100	5.72	NP	0.00	166.94	161.22
12/01/99	540	<0.3	<0.3	<0.3	<0.5	880	5.34	NP	0.00	166.94	161.60
03/23/00	<50	<0.25	<0.25	<0.25	<0.5	<5	5.36	NP	0.00	166.94	161.58
06/08/00	67	<5	<5	<5	<5	<5	5.34	NP	0.00	166.94	161.60
09/27/00	<50	<0.18	<0.14	<0.18	<0.26	<0.24	5.35	NP	0.00	166.94	161.59
12/13/00	<50	<0.18	<0.14	<0.18	<0.26	<0.24	5.71	NP	0.00	166.94	161.23
03/22/01	<50	<0.18	<0.14	<0.18	<0.26	<0.24	4.19	NP	0.00	166.94	162.75
06/15/01	409	18	2	2	5	*1,060 / 1,480	4.57	NP	0.00	166.94	162.37
08/30/01	<50	<0.18	<0.14	<0.18	<0.26	<0.24	6.10	NP	0.00	166.94	160.84
12/12/01	<50	<0.18	<0.14	<0.18	3	*7 / 3.7	4.95	NP	0.00	166.94	161.99
03/13/02	511	3	3	<0.18	2	519	4.17	NP	0.00	166.94	162.77
06/12/02	380	2	2	1	2	479	4.93	NP	0.00	166.94	162.01
09/18/02	<50	<0.18	<0.14	<0.18	<0.26	<0.24	5.32	NP	0.00	166.94	161.62
12/18/02	<50	<0.18	<0.14	<0.18	<0.26	<0.24	4.93	NP	0.00	166.94	162.01
03/19/03	<15	<0.04	<0.02	<0.02	<0.06	<0.03	5.32	NP	0.00	166.94	161.62
06/11/03	<15	<0.04	<0.02	<0.02	<0.06	<0.03	5.32	NP	0.00	166.94	161.62
09/04/03	<15	<0.22	<0.32	<0.31	<0.4	<0.18	4.93	NP	0.00	166.94	162.01
12/04/03	<15	<0.04	<0.02	<0.02	<0.06	<0.03	4.93	NP	0.00	166.23	161.30
03/18/04	<15	<0.22	<0.32	<0.31	<0.4	1.1	4.93	NP	0.00	166.23	161.30
06/09/04	<15	<0.14	<0.16	<0.18	<0.45	<0.22	4.56	NP	0.00	166.23	161.67
09/02/04	6,390	587	50	34	65	*4,150 / 2,650	6.00	NP	0.00	166.23	160.23
12/08/04	278,000	4,680	44,900	4,850	29,000	*54,800 / 43,400	4.93	NP	0.00	166.23	161.30
03/16/05	110,000	2,360	18,900	1,780	17,800	24,400	5.32	NP	0.00	166.23	160.91

**TABLE 1**  
**GROUNDWATER DATA**  
**THRIFTY OIL STATION #054, CASTRO VALLEY, CA.**

DATE SAMPLED	ANALYTICAL PARAMETERS						DEPTH TO GROUNDWATER (feet)	DEPTH TO PRODUCT (feet)	PRODUCT THICKNESS (feet)	CASING ELEVATION (feet)	GROUNDWATER ELEVATION (feet)
	TPH (ug/L)	BENZENE (ug/L)	TOLUENE (ug/L)	EthylBenzene (ug/L)	XYLENE (ug/L)	MTBE (ug/L)					
<b>MONITORING WELL BRE-5</b>											
<i>Screen Interval = 5 to 20 feet</i>											
04/11/88	14,000	1,300	1,100	100	2,600	-	-	-	-	-	-
04/09/90	3,000	690	190	40	270	-	4.79	NP	0.00	166.51	161.72
10/30/90	3,400	910	48	87	249	-	5.86	NP	0.00	166.51	160.65
01/18/91	1,400	180	8.6	0.52	48	-	4.40	NP	0.00	166.51	162.11
02/12/91	1,000	ND	ND	0.65	ND	-	4.76	NP	0.00	166.51	161.75
03/20/91	3,000	250	53	ND	110	-	5.08	NP	0.00	166.51	161.43
05/22/91	2,500	330	7.8	5.6	200	-	4.52	NP	0.00	166.51	161.99
01/19/91	2,000	59	1.6	5.1	110	-	4.39	NP	0.00	166.51	162.12
07/17/91	-	-	-	-	-	-	5.05	FILM	0.00	166.51	161.46
08/07/91	-	-	-	-	-	-	5.02	FILM	0.00	166.51	161.49
09/24/91	-	-	-	-	-	-	5.86	FILM	0.00	166.51	160.65
10/23/91	-	-	-	-	-	-	5.84	FILM	0.00	166.51	160.67
11/06/91	9,900	2,300	37	260	160	-	5.48	NP	0.00	166.51	161.03
12/04/91	4,500	1,000	27	ND	180	-	5.43	NP	0.00	166.51	161.08
01/29/92	600	6.1	2.3	ND	47	-	5.12	NP	0.00	166.51	161.39
02/26/92	500	5.4	2.7	1.2	14	-	4.93	NP	0.00	166.51	161.58
03/19/92	ND	1.7	1.1	ND	5.5	-	4.45	NP	0.00	166.51	162.06
04/22/92	1,600	240	2.2	ND	160	-	4.63	NP	0.00	166.51	161.88
05/21/92	1,200	410	37	ND	118	-	4.90	NP	0.00	166.51	161.61
06/25/92	ND	1.0	0.8	0.8	0.4	-	5.15	NP	0.00	166.51	161.36
07/30/92	ND	2.0	1.8	1.9	6.4	-	5.30	NP	0.00	166.51	161.21
08/20/92	300	1.7	3.3	0.7	12	-	5.44	NP	0.00	166.51	161.07
09/30/92	1,900	140	ND	19	35	-	5.73	NP	0.00	166.51	160.78
12/23/92	400	8.0	ND	ND	ND	-	4.75	NP	0.00	166.51	161.76
03/10/93	1,100	290	9.7	ND	75	-	4.14	NP	0.00	166.51	162.37
06/09/93	400	1.5	0.5	ND	12	-	5.42	NP	0.00	166.51	161.09
09/14/93	240	6.9	8.8	1.4	67	-	5.53	NP	0.00	166.51	160.98
12/14/93	3,300	510	5.4	4.1	55	-	4.78	NP	0.00	166.51	-311.49
03/02/94	2,400	270	4.5	<0.3	13	-	4.20	NP	0.00	166.51	162.31
06/06/94	730	<0.3	<0.3	0.70	22	-	5.13	NP	0.00	166.51	161.38
09/06/94	2,400	180	28	2.3	76	-	5.45	NP	0.00	166.51	161.06
12/07/94	540	5.6	<0.3	<0.5	6.9	-	4.13	NP	0.00	166.51	162.38
03/08/95	1,500	220	5.5	<0.5	83	-	5.20	NP	0.00	166.51	161.31
06/15/95	3,200	820	53	6.2	74	-	4.93	NP	0.00	166.51	161.58
09/05/95	4,400	440	22	<2.5	57	-	5.03	NP	0.00	166.51	161.48
11/21/95	660	3.4	<0.3	<0.3	0.6	-	5.23	NP	0.00	166.51	161.28
03/11/96	1,000	76	2.2	<0.3	130	-	4.16	NP	0.00	166.51	162.35

**TABLE 1  
GROUNDWATER DATA  
THRIFTY OIL STATION #054, CASTRO VALLEY, CA.**

DATE SAMPLED	ANALYTICAL PARAMETERS						DEPTH TO GROUNDWATER (feet)	DEPTH TO PRODUCT (feet)	PRODUCT THICKNESS (feet)	CASING ELEVATION (feet)	GROUNDWATER ELEVATION (feet)
	TPH (ug/L)	BENZENE (ug/L)	TOLUENE (ug/L)	EthylBenzene (ug/L)	XYLENE (ug/L)	MTBE (ug/L)					
06/09/96	90	<0.3	<0.3	<0.3	<0.5	-	5.42	NP	0.00	166.51	161.09
09/16/96	1,900	5.8	<0.3	<0.3	5.9	1,100	5.20	NP	0.00	166.51	161.31
12/10/96	740	<0.3	<0.3	<0.3	<0.5	1,300	5.27	NP	0.00	166.51	161.24
03/12/97	2,000	600	59	5.1	54	1,300	3.85	NP	0.00	166.51	162.66
06/12/97	230	<0.3	<0.3	<0.3	<0.5	720	-	-	-	-	-
09/10/97	210	<0.3	<0.3	<0.3	<0.5	210	4.10	NP	0.00	166.51	162.41
12/09/97	11,000	2,500	2,700	<6	1,500	510	5.20	NP	0.00	166.51	161.31
03/03/98	<50	<0.3	<0.3	<0.3	<0.5	<20	3.70	NP	0.00	166.51	162.81
07/08/98	<50	<0.3	<0.3	<0.3	<0.5	<5	-	-	-	-	-
09/10/98	<50	<0.3	<0.3	<0.3	<0.5	<5	6.77	NP	0.00	166.51	159.74
12/30/98	<50	<0.3	<0.3	<0.3	<0.5	<5	5.95	NP	0.00	166.51	160.56
03/15/99	<50	<0.3	<0.3	<0.3	<0.5	<5	5.25	NP	0.00	166.51	161.26
06/22/99	110	<0.3	<0.3	<0.3	<0.5	200	4.50	NP	0.00	166.51	162.01
09/08/99	68	<0.3	<0.3	<0.3	<0.5	110	4.43	NP	0.00	166.51	162.08
12/01/99	<50	<0.3	<0.3	<0.3	<0.5	<5	3.66	NP	0.00	166.51	162.85
03/23/00	<50	<0.25	<0.25	<0.25	<0.5	<5	4.06	NP	0.00	166.51	162.45
06/08/00	<50	<5	<5	<5	<5	<5	4.43	NP	0.00	166.51	162.08
09/27/00	<50	<0.18	<0.14	<0.18	<0.26	<0.24	4.06	NP	0.00	166.51	162.45
12/13/00	<50	<0.18	<0.14	<0.18	<0.26	<0.24	4.80	NP	0.00	166.51	161.71
03/22/01	<50	<0.18	<0.14	<0.18	<0.26	<0.24	6.33	NP	0.00	166.51	160.18
06/15/01	<50	<0.18	<0.14	<0.18	<0.26	<0.24	4.79	NP	0.00	166.51	161.72
08/30/01	<50	<0.18	<0.14	<0.18	<0.26	<0.24	5.54	NP	0.00	166.51	160.97
12/12/01	<50	<0.18	<0.14	<0.18	<0.26	<0.24	5.21	NP	0.00	166.51	161.30
03/13/02	-	-	-	-	-	-	6.32	NP	0.00	166.51	160.19
06/12/02	-	-	-	-	-	-	-	-	-	-	-
09/18/02	-	-	-	-	-	-	-	-	-	-	-
12/18/02	-	-	-	-	-	-	-	-	-	-	-
03/19/03	-	-	-	-	-	-	-	-	-	-	-
06/11/03	-	-	-	-	-	-	-	-	-	-	-
09/04/03	-	-	-	-	-	-	-	-	-	-	-
12/04/03	-	-	-	-	-	-	3.67	NP	0.00	166.56	162.89
03/18/04	-	-	-	-	-	-	5.20	NP	0.00	166.56	161.36
06/09/04	-	-	-	-	-	-	4.61	NP	0.00	166.56	161.95
09/02/04	-	-	-	-	-	-	4.93	NP	0.00	166.56	161.63
12/08/04	-	-	-	-	-	-	4.06	NP	0.00	166.56	162.50
03/16/05	-	-	-	-	-	-	5.56	NP	0.00	166.56	161.00

**TABLE 1  
GROUNDWATER DATA  
THRIFTY OIL STATION #054, CASTRO VALLEY, CA.**

DATE SAMPLED	ANALYTICAL PARAMETERS						DEPTH TO GROUNDWATER (feet)	DEPTH TO PRODUCT (feet)	PRODUCT THICKNESS (feet)	CASING ELEVATION (feet)	GROUNDWATER ELEVATION (feet)
	TPH (ug/L)	BENZENE (ug/L)	TOLUENE (ug/L)	EthylBenzene (ug/L)	XYLENE (ug/L)	MTBE (ug/L)					
<b>MONITORING WELL #RE-6</b>											
<i>Screen Interval = 5 to 15 feet</i>											
04/11/88	6,000	3,000	40	80	140	-	-	-	-	-	-
04/09/90	3,000	990	ND	70	ND	-	5.64	NP	0.00	166.51	160.87
10/30/90	3,400	1,000	28	ND	ND	-	6.68	NP	0.00	166.51	159.83
01/18/91	6,300	1,200	ND	3.0	15	-	6.61	NP	0.00	166.51	159.90
02/12/91	5,200	850	8.4	4.9	41	-	6.20	NP	0.00	166.51	160.31
03/20/91	5,800	680	12	8.0	16	-	5.62	NP	0.00	166.51	160.89
05/22/91	8,500	1,700	14	24	6.7	-	6.05	NP	0.00	166.51	160.46
06/19/91	-	-	-	-	-	-	6.12	FILM	0.00	166.51	160.39
07/17/91	120,000	9,300	13,000	2,400	16,000	-	6.20	NP	0.00	166.51	160.31
08/07/91	-	590	5.3	ND	14	-	6.27	NP	0.00	166.51	160.24
09/24/91	7,000	310	11	5.3	35	-	6.63	NP	0.00	166.51	159.88
10/23/91	-	-	-	-	-	-	6.36	FILM	0.00	166.51	160.15
11/06/91	4,000	710	18	29	49	-	6.15	NP	0.00	166.51	160.36
12/04/91	4,100	1,100	14	33	39	-	6.19	NP	0.00	166.51	160.32
01/29/92	2,600	790	14	ND	49	-	6.70	NP	0.00	166.51	159.81
02/26/92	3,100	950	21	30	33	-	5.44	NP	0.00	166.51	161.07
03/19/92	2,200	630	14	12	40	-	5.30	NP	0.00	166.51	161.21
04/22/92	-	730	2.2	ND	40	-	6.00	NP	0.00	166.51	160.51
05/21/92	1,500	840	7.8	7.1	34	-	6.25	NP	0.00	166.51	160.26
06/25/92	<2000	740	8.0	27	28	-	6.38	NP	0.00	166.51	160.13
07/30/92	-	-	-	-	-	-	6.42	FILM	0.00	166.51	160.09
08/20/92	2,800	630	17	23	22	-	6.50	NP	0.00	166.51	160.01
09/30/92	7,800	540	ND	12	29	-	6.66	NP	0.00	166.51	159.85
12/23/92	1,800	350	ND	7.7	11	-	5.83	NP	0.00	166.51	160.68
03/10/93	3,000	830	5.6	19	16	-	5.63	NP	0.00	166.51	160.88
06/09/93	4,800	920	6.2	3.2	12	-	6.01	NP	0.00	166.51	160.50
09/14/93	3,600	660	7.5	11	27	-	6.53	NP	0.00	166.51	159.98
12/14/93	1,500	200	<0.3	<0.3	8.8	-	3.58	NP	0.00	166.51	162.93
03/02/94	-	-	-	-	-	-	5.12	NP	0.00	166.51	161.39
06/06/94	2,400	290	4.6	1.3	24	-	1.85	NP	0.00	166.51	164.66
09/06/94	4,300	230	21	<6.6	130	-	6.40	NP	0.00	166.51	160.11
12/07/94	1,500	17	2.5	3.2	22	-	5.68	NP	0.00	166.51	160.83
03/08/95	2,500	460	5.5	2.1	51	-	5.12	NP	0.00	166.51	161.39
06/15/95	2,300	91	1.1	0.7	97	-	5.72	NP	0.00	166.51	160.79
09/05/95	3,300	60	<10	<10	74	-	5.94	NP	0.00	166.51	160.57
11/21/95	2,000	7.3	<0.3	0.56	8.7	-	6.24	NP	0.00	166.51	160.27
03/11/96	840	43	0.96	5.7	14	-	5.16	NP	0.00	166.51	161.35

**TABLE 1  
GROUNDWATER DATA  
THRIFTY OIL STATION #054, CASTRO VALLEY, CA.**

DATE SAMPLED	ANALYTICAL PARAMETERS						DEPTH TO GROUNDWATER (feet)	DEPTH TO PRODUCT (feet)	PRODUCT THICKNESS (feet)	CASING ELEVATION (feet)	GROUNDWATER ELEVATION (feet)
	TPH (ug/L)	BENZENE (ug/L)	TOLUENE (ug/L)	EthylBenzene (ug/L)	XYLENE (ug/L)	MTBE (ug/L)					
06/19/96	1,800	160	2.7	9.9	25	-	5.80	NP	0.00	166.51	160.71
09/16/96	<50	<0.3	<0.3	<0.3	<0.5	<20	5.38	NP	0.00	166.51	161.13
12/10/96	<50	<0.3	<0.3	<0.3	<0.5	<20	5.62	NP	0.00	166.51	160.89
03/12/97	<50	<0.3	<0.3	<0.3	<0.5	<20	5.20	NP	0.00	166.51	161.31
06/12/97	<50	<0.3	<0.3	<0.3	<0.5	<20	-	-	-	-	-
09/10/97	440	<0.3	<0.3	<0.3	<0.5	320	5.20	NP	0.00	166.51	161.31
12/09/97	<50	<0.3	<0.3	<0.3	<0.5	<20	5.97	NP	0.00	166.51	160.54
03/03/98	400	7.0	<0.3	<0.3	4.3	65	4.45	NP	0.00	166.51	162.06
07/08/98	300	<0.3	<0.3	<0.3	1.0	35	-	-	-	-	-
09/10/98	<50	<0.3	<0.3	<0.3	<0.5	<5	5.90	NP	0.00	166.51	160.61
12/30/98	<50	<0.3	<0.3	<0.3	<0.5	<5	5.20	NP	0.00	166.51	161.31
03/15/99	<50	<0.3	<0.3	<0.3	<0.5	8.4	4.82	NP	0.00	166.51	161.69
06/22/99	700	11	1.9	<0.3	3.9	140	6.00	NP	0.00	166.51	160.51
09/08/99	<50	<0.3	<0.3	<0.3	<0.5	<5	5.15	NP	0.00	166.51	161.36
12/01/99	<50	<0.3	<0.3	<0.3	<0.5	12	4.02	NP	0.00	166.51	162.49
03/23/00	<50	<0.25	<0.25	<0.25	<0.5	<5	4.41	NP	0.00	166.51	162.10
06/08/00	<50	<5	<5	<5	<5	<5	4.78	NP	0.00	166.51	161.73
09/27/00	<50	<0.18	<0.14	<0.18	<0.26	<0.24	4.78	NP	0.00	166.51	161.73
12/13/00	<50	<0.18	<0.14	<0.18	<0.26	<0.24	4.77	NP	0.00	166.51	161.74
03/22/01	367	<0.18	<0.14	<0.18	<0.26	*581 / 674	5.54	NP	0.00	166.51	160.97
06/15/01	<50	<0.18	<0.14	<0.18	<0.26	<0.24	5.92	NP	0.00	166.51	160.59
08/30/01	<50	<0.18	<0.14	<0.18	<0.26	<0.24	5.93	NP	0.00	166.51	160.58
12/12/01	138	<0.18	<0.14	<0.18	<0.26	*7 / <0.6	6.20	NP	0.00	166.51	160.31
03/13/02	<50	<0.18	<0.14	<0.18	<0.26	<0.24	5.55	NP	0.00	166.51	160.96
06/12/02	895	<0.18	1.0	<0.18	<0.26	1,360	5.93	NP	0.00	166.51	160.58
09/18/02	759	<0.18	<0.14	<0.18	<0.26	644	6.03	NP	0.00	166.51	160.48
12/18/02	531	<0.18	<0.14	<0.18	<0.26	441	5.65	NP	0.00	166.51	160.86
03/19/03	955	<0.04	<0.02	<0.02	<0.06	585	6.34	NP	0.00	166.51	160.17
06/11/03	945	<0.04	<0.02	<0.02	<0.06	328	6.34	NP	0.00	166.51	160.17
09/04/03	<15	<0.22	<0.32	<0.31	<0.4	<0.18	5.92	NP	0.00	166.51	160.59
12/04/03	<15	<0.04	<0.02	<0.02	<0.06	<0.03	4.00	NP	0.00	166.15	162.15
03/18/04	<15	<0.22	<0.32	<0.31	<0.4	<0.18	5.54	NP	0.00	166.15	160.61
06/10/04	340	2.6	1.5	<0.18	1.8	283	6.12	NP	0.00	166.15	160.03
09/02/04	1,720	4.9	8.2	8.7	7.7	*633 / 410	6.50	NP	0.00	166.15	159.65
12/09/04	297,000	1,620	38,500	9,470	56,000	*6,660 / 8,870	4.48	NP	0.00	166.15	161.67
03/16/05	55,000	630	9,470	1,590	10,100	4,480	6.67	NP	0.00	166.15	159.48

**TABLE 1  
GROUNDWATER DATA  
THRIFTY OIL STATION #054, CASTRO VALLEY, CA.**

DATE SAMPLED	ANALYTICAL PARAMETERS						DEPTH TO GROUNDWATER (feet)	DEPTH TO PRODUCT (feet)	PRODUCT THICKNESS (feet)	CASING ELEVATION (feet)	GROUNDWATER ELEVATION (feet)
	TPH (ug/L)	BENZENE (ug/L)	TOLUENE (ug/L)	EthylBenzene (ug/L)	XYLENE (ug/L)	MTBE (ug/L)					
<b>MONITORING WELL #RE-7</b>											
<i>Screen Interval - 5 to 15 feet</i>											
04/11/88	<50,000	17,000	4,400	600	8,400	-	-	-	-	-	-
04/09/90	16,000	7,000	1,200	640	1,600	-	5.93	NP	0.00	166.04	160.11
10/30/90	31,000	14,000	ND	ND	ND	-	8.21	NP	0.00	166.04	157.83
01/18/91	-	-	-	-	-	-	11.80	NP	0.00	166.04	154.24
02/12/91	-	-	-	-	-	-	10.80	FILM	0.00	166.04	155.24
03/20/91	120,000	12,000	2,800	490	6,600	-	9.96	NP	0.00	166.04	156.08
05/22/91	-	-	-	-	-	-	11.70	FILM	0.00	166.04	154.34
06/19/91	-	-	-	-	-	-	11.50	FILM	0.00	166.04	154.54
07/17/91	-	-	-	-	-	-	7.80	FILM	0.00	166.04	158.24
08/07/91	-	-	-	-	-	-	9.88	0.03	9.85	166.04	163.60
09/24/91	-	-	-	-	-	-	9.85	0.03	9.82	166.04	163.60
10/23/91	-	-	-	-	-	-	9.96	FILM	0.00	166.04	156.08
11/06/91	-	-	-	-	-	-	6.77	FILM	0.00	166.04	159.27
12/04/91	-	-	-	-	-	-	10.80	FILM	0.00	166.04	155.24
01/29/92	-	-	-	-	-	-	8.64	FILM	0.00	166.04	157.40
02/26/92	-	-	-	-	-	-	6.00	FILM	0.00	166.04	160.04
03/19/92	-	-	-	-	-	-	5.55	FILM	0.00	166.04	160.49
04/22/92	-	-	-	-	-	-	6.12	FILM	0.00	166.04	159.92
05/21/92	-	-	-	-	-	-	6.40	FILM	0.00	166.04	159.64
06/25/92	-	-	-	-	-	-	6.73	0.02	6.71	166.04	164.38
07/30/92	-	-	-	-	-	-	6.73	FILM	0.00	166.04	159.31
08/20/92	-	-	-	-	-	-	6.82	FILM	0.00	166.04	159.22
09/30/92	-	-	-	-	-	-	7.26	FILM	0.00	166.04	158.78
12/23/92	-	-	-	-	-	-	6.22	FILM	0.00	166.04	159.82
03/10/93	-	-	-	-	-	-	5.82	FILM	0.00	166.04	160.22
06/09/93	-	-	-	-	-	-	6.17	FILM	0.00	166.04	159.87
09/14/93	-	-	-	-	-	-	11.33	NP	0.00	166.04	154.71
12/14/93	-	-	-	-	-	-	8.40	NP	0.00	166.04	157.64
03/02/94	-	-	-	-	-	-	6.82	NP	0.00	166.04	159.22
06/06/94	-	-	-	-	-	-	10.95	FILM	0.00	166.04	155.09
09/06/94	-	-	-	-	-	-	11.30	FILM	0.00	166.04	154.74
12/07/94	-	-	-	-	-	-	5.63	FILM	0.00	166.04	160.41
03/08/95	-	-	-	-	-	-	5.06	FILM	0.00	166.04	160.98
06/15/95	-	-	-	-	-	-	-	-	-	-	-
09/05/95	-	-	-	-	-	-	7.98	FILM	0.00	166.04	158.06
11/21/95	20,000	8,800	110	<30	310	-	7.32	NP	0.00	166.04	158.72
03/11/96	4,800	2,200	38	26	120	-	5.62	NP	0.00	166.04	160.42

**TABLE 1  
GROUNDWATER DATA  
THRIFTY OIL STATION #054, CASTRO VALLEY, CA.**

DATE SAMPLED	ANALYTICAL PARAMETERS						DEPTH TO GROUNDWATER (feet)	DEPTH TO PRODUCT (feet)	PRODUCT THICKNESS (feet)	CASING ELEVATION (feet)	GROUNDWATER ELEVATION (feet)
	TPH (ug/L)	BENZENE (ug/L)	TOLUENE (ug/L)	EthylBenzene (ug/L)	XYLENE (ug/L)	MTBE (ug/L)					
06/19/96	4,400	3,300	49	5.8	70	-	6.40	NP	0.00	166.04	159.64
09/19/96	7,200	510	83	<0.3	710	130	6.20	NP	0.00	166.04	159.84
12/10/96	700	<0.3	<0.3	<0.3	<0.5	1,400	5.92	NP	0.00	166.04	160.12
03/12/97	660	0.31	<0.3	<0.3	<0.5	1,400	5.62	NP	0.00	166.04	160.42
06/12/97	320	<0.3	0.45	<0.3	<0.5	850	-	-	-	-	-
09/10/97	780	<0.3	<0.3	<0.3	<0.5	930	7.45	NP	0.00	166.04	158.59
12/09/97	14,000	3,500	3,700	<15	2,100	1,100	7.10	NP	0.00	166.04	158.94
03/03/98	6,100	2,500	18	<6	110	270	6.70	NP	0.00	166.04	159.34
07/08/98	1,300	8.7	<0.3	<0.3	<0.5	350	-	-	-	-	-
09/10/98	690	2.2	<0.3	<0.3	<0.5	350	7.04	NP	0.00	166.04	159.00
12/30/98	600	2.0	0.55	<0.3	<0.5	350	6.25	NP	0.00	166.04	159.79
03/15/99	350	0.71	<0.3	<0.3	<0.5	140	6.02	NP	0.00	166.04	160.02
06/22/99	5,900	2,100	16	4.6	48	170	6.35	NP	0.00	166.04	159.69
09/08/99	1,700	380	<3	<3	13	160	7.03	NP	0.00	166.04	159.01
12/01/99	930	3.7	<0.3	<0.3	<0.5	390	6.25	NP	0.00	166.04	159.79
03/23/00	581	5.4	5.3	1.9	7.3	*168/183	6.24	NP	0.00	166.04	159.80
06/08/00	<100	<5	<5	<5	<5	74	6.64	NP	0.00	166.04	159.40
09/27/00	236	<0.18	<0.14	<0.18	<0.26	*21 / 28	7.03	NP	0.00	166.04	159.01
12/13/00	<50	<0.18	<0.14	<0.18	<0.26	*13 / 19.8	6.63	NP	0.00	166.04	159.41
03/22/01	504	<0.18	<0.14	<0.18	1	*666 / 1,420	7.02	NP	0.00	166.04	159.02
06/15/01	144	5.0	<0.14	0.5	2	*369 / 408	7.02	NP	0.00	166.04	159.02
08/30/01	<50	<0.18	<0.14	<0.18	<0.26	<0.24	7.79	NP	0.00	166.04	158.25
12/12/01	<50	<0.18	<0.14	<0.18	<0.26	<0.24	7.28	NP	0.00	166.04	158.76
03/13/02	<50	<0.18	<0.14	<0.18	<0.26	<0.24	6.02	NP	0.00	166.04	160.02
06/12/02	5,130	772	970	59	550	113	7.79	NP	0.00	166.04	158.25
09/18/02	<50	<0.18	<0.14	<0.18	<0.26	<0.24	7.40	NP	0.00	166.04	158.64
12/18/02	<50	<0.18	<0.14	<0.18	<0.26	<0.24	6.63	NP	0.00	166.04	159.41
03/19/03	<15	<0.04	<0.02	<0.02	<0.06	<0.03	7.40	NP	0.00	166.04	158.64
06/11/03	<15	<0.04	<0.02	<0.02	<0.06	8.3	7.40	NP	0.00	166.04	158.64
09/04/03	<15	<0.22	<0.32	<0.31	<0.4	<0.18	7.39	NP	0.00	166.04	158.65
12/04/03	<15	<0.04	<0.02	<0.02	<0.06	<0.03	6.63	NP	0.00	165.33	158.70
03/18/04	<15	<0.22	<0.32	<0.31	<0.4	<0.18	6.63	NP	0.00	165.33	158.70
06/10/04	14,500	348	1,460	306	3,070	207	6.20	NP	0.00	165.33	159.13
09/02/04	35,900	2,390	174	1,250	8,020	*419 / 274	7.05	NP	0.00	165.33	158.28
12/08/04	276,000	4,380	34,800	5,370	25,000	*59,600 / 70,500	3.80	NP	0.00	165.33	161.53
03/16/05	114,000	2,840	19,400	2,760	14,400	29,300	6.64	NP	0.00	165.33	158.69

**TABLE 1  
GROUNDWATER DATA  
THRIFTY OIL STATION #054, CASTRO VALLEY, CA.**

DATE SAMPLED	ANALYTICAL PARAMETERS						DEPTH TO GROUNDWATER (feet)	DEPTH TO PRODUCT (feet)	PRODUCT THICKNESS (feet)	CASING ELEVATION (feet)	GROUNDWATER ELEVATION (feet)
	TPH (ug/L)	BENZENE (ug/L)	TOLUENE (ug/L)	EthylBenzene (ug/L)	XYLENE (ug/L)	MTBE (ug/L)					
<b>MONITORING WELL #RS-8</b>											
<i>Screen Interval = 5 to 25 feet</i>											
08/07/91	ND	ND	ND	ND	ND	-	9.68	NP	0.00	164.32	154.64
09/27/91	ND	ND	ND	ND	ND	-	9.89	NP	0.00	164.32	154.43
10/23/91	ND	ND	ND	ND	ND	-	10.05	NP	0.00	164.32	154.27
11/06/91	ND	ND	ND	ND	ND	-	9.71	NP	0.00	164.32	154.61
12/04/91	ND	ND	ND	ND	ND	-	10.00	NP	0.00	164.32	154.32
01/29/92	ND	2.1	1.0	2.5	3.6	-	9.28	NP	0.00	164.32	155.04
02/26/92	ND	ND	0.7	ND	0.7	-	7.05	NP	0.00	164.32	157.27
03/19/92	ND	0.5	1.0	1.5	2.7	-	7.30	NP	0.00	164.32	157.02
04/22/92	ND	ND	ND	ND	ND	-	8.60	NP	0.00	164.32	155.72
05/21/92	ND	ND	ND	ND	ND	-	9.22	NP	0.00	164.32	155.10
06/25/92	ND	ND	ND	ND	ND	-	9.49	NP	0.00	164.32	154.83
07/30/92	ND	1.1	4.2	ND	3.0	-	9.55	NP	0.00	164.32	154.77
08/20/92	ND	2.0	4.7	ND	5.7	-	9.63	NP	0.00	164.32	154.69
09/30/92	ND	ND	ND	ND	ND	-	9.90	NP	0.00	164.32	154.42
12/23/92	ND	ND	ND	ND	ND	-	9.96	NP	0.00	164.32	154.36
05/10/93	ND	ND	ND	ND	ND	-	8.95	NP	0.00	164.32	155.37
06/09/93	ND	ND	ND	ND	ND	-	9.00	NP	0.00	164.32	155.32
09/14/93	200	0.3	ND	ND	ND	-	9.50	NP	0.00	164.32	154.82
12/14/93	ND	ND	ND	ND	ND	-	8.75	NP	0.00	164.32	155.57
03/02/94	<50	<0.3	<0.3	<0.3	<0.5	-	7.52	NP	0.00	164.32	156.80
06/06/94	54	<0.3	<0.3	<0.3	2.4	-	9.00	NP	0.00	164.32	155.32
09/06/94	<50	<0.3	<0.3	<0.3	<0.5	-	9.26	NP	0.00	164.32	155.06
12/07/94	130	2.5	1.9	1.3	3.6	-	8.67	NP	0.00	164.32	155.65
03/08/95	<100	<0.5	<0.5	<0.5	<1	-	8.34	NP	0.00	164.32	155.98
06/15/95	<100	1.0	<0.5	<0.5	<1	-	9.12	NP	0.00	164.32	155.20
09/05/95	<100	<0.5	<0.5	<0.5	<1	-	9.56	NP	0.00	164.32	154.76
11/21/95	<50	0.44	<0.3	<0.3	1.5	-	9.28	NP	0.00	164.32	155.04
03/11/96	<50	1.3	<0.3	<0.3	0.6	-	7.52	NP	0.00	164.32	156.80
06/19/96	640	72	20	34	150	-	7.80	NP	0.00	164.32	156.52
09/16/96	<50	<0.3	<0.3	<0.3	<0.5	20	9.18	NP	0.00	164.32	155.14
12/10/96	<50	<0.3	<0.3	<0.3	<0.5	<20	6.08	NP	0.00	164.32	158.24
03/12/97	53	0.45	<0.3	<0.3	<0.5	140	8.65	NP	0.00	164.32	155.67
06/12/97	<50	<0.3	<0.3	<0.3	<0.5	68	-	-	-	-	-
09/10/97	<50	<0.3	<0.3	<0.3	<0.5	<20	8.30	NP	0.00	164.32	156.02
12/09/97	<50	1.7	2.1	<0.3	1.4	82	9.98	NP	0.00	164.32	154.34
03/03/98	<50	<0.3	<0.3	<0.3	<0.5	84	8.33	NP	0.00	164.32	155.99
07/08/98	<50	<0.3	<0.3	<0.3	<0.5	97	-	-	-	-	-



**TABLE 1**  
**GROUNDWATER DATA**  
**THRIFTY OIL STATION #054, CASTRO VALLEY, CA.**

DATE SAMPLED	ANALYTICAL PARAMETERS						DEPTH TO GROUNDWATER (feet)	DEPTH TO PRODUCT (feet)	PRODUCT THICKNESS (feet)	CASING ELEVATION (feet)	GROUNDWATER ELEVATION (feet)
	TPH (ug/L)	BENZENE (ug/L)	TOLUENE (ug/L)	EthylBenzene (ug/L)	XYLENE (ug/L)	MTBE (ug/L)					
09/10/98	<50	<0.3	<0.3	<0.3	<0.5	97	12.95	NP	0.00	164.32	151.37
12/30/98	<50	1.3	1.5	<0.3	0.86	19	11.35	NP	0.00	164.32	152.97
03/15/99	<50	<0.3	<0.3	<0.3	<0.5	9.6	9.85	NP	0.00	164.32	154.47
06/22/99	66	0.39	<0.3	<0.3	<0.5	62	9.90	NP	0.00	164.32	154.42
09/08/99	<50	<0.3	<0.3	<0.3	<0.5	25	9.85	NP	0.00	164.32	154.47
12/01/99	<50	<0.3	<0.3	<0.3	<0.5	30	8.30	NP	0.00	164.32	156.02
03/23/00	<50	<0.25	<0.25	<0.25	<0.5	*13.6/18.2	6.76	NP	0.00	164.32	157.56
06/08/00	<50	<5	<5	<5	<5	10	8.30	NP	0.00	164.32	156.02
09/27/00	<50	<0.18	<0.14	<0.18	<0.26	*6 / 4.9	8.30	NP	0.00	164.32	156.02
12/13/00	<50	<0.18	<0.14	<0.18	<0.26	<0.24	8.28	NP	0.00	164.32	156.04
03/22/01	<50	<0.18	<0.14	<0.18	<0.26	<0.24	12.89	NP	0.00	164.32	151.43
06/15/01	<50	<0.18	<0.14	<0.18	<0.26	<0.24	12.89	NP	0.00	164.32	151.43
08/30/01	<50	<0.18	<0.14	<0.18	<0.26	<0.24	9.82	NP	0.00	164.32	154.50
12/12/01	<50	<0.18	<0.14	<0.18	<0.26	<0.24	9.25	NP	0.00	164.32	155.07
03/13/02	-	-	-	-	-	-	12.89	NP	0.00	164.32	151.43
06/12/02	-	-	-	-	-	-	-	-	-	-	-
09/18/02	-	-	-	-	-	-	-	-	-	-	-
12/18/02	-	-	-	-	-	-	-	-	-	-	-
03/19/03	-	-	-	-	-	-	-	-	-	-	-
06/11/03	-	-	-	-	-	-	-	-	-	-	-
09/04/03	-	-	-	-	-	-	-	-	-	-	-
12/04/03	-	-	-	-	-	-	6.78	NP	0.00	164.03	157.25
03/18/04	-	-	-	-	-	-	9.65	NP	0.00	164.03	154.38
06/09/04	-	-	-	-	-	-	6.86	NP	0.00	164.03	157.17
09/02/04	-	-	-	-	-	-	8.23	NP	0.00	164.03	155.80
12/08/04	-	-	-	-	-	-	6.76	NP	0.00	164.03	157.27
03/16/05	-	-	-	-	-	-	8.29	NP	0.00	164.03	155.74
<b>MONITORING WELL HRS-9</b>											
<i>Screen Interval = 5 to 15 feet</i>											
08/07/91	-	0.5	ND	330	1,200	-	2.28	NP	0.00	167.51	165.23
09/27/91	13,000	3.5	3.0	82	140	-	2.77	NP	0.00	167.51	164.74
10/23/91	11,000	ND	ND	39	340	-	3.53	NP	0.00	167.51	163.98
11/06/91	6,800	8.4	0.6	22	230	-	2.51	NP	0.00	167.51	165.00
12/04/91	6,500	6.5	0.7	87	200	-	3.20	NP	0.00	167.51	164.31
01/29/92	8,100	22	10	140	260	-	2.65	NP	0.00	167.51	164.86
02/26/92	13,000	40	16	220	600	-	3.42	NP	0.00	167.51	164.09
03/19/92	12,000	21	12	100	280	-	3.12	NP	0.00	167.51	164.39

**TABLE 1  
GROUNDWATER DATA  
THRIFTY OIL STATION #054, CASTRO VALLEY, CA.**

DATE SAMPLED	ANALYTICAL PARAMETERS						DEPTH TO GROUNDWATER (feet)	DEPTH TO PRODUCT (feet)	PRODUCT THICKNESS (feet)	CASING ELEVATION (feet)	GROUNDWATER ELEVATION (feet)
	TPH (ug/L)	BENZENE (ug/L)	TOLUENE (ug/L)	EthylBenzene (ug/L)	XYLENE (ug/L)	MTBE (ug/L)					
04/22/92	8,600	ND	ND	20	37	-	3.24	NP	0.00	167.51	164.27
05/21/92	6,000	21	10	53	210	-	3.75	NP	0.00	167.51	163.76
06/25/92	370	2.3	1.5	0.7	4.3	-	2.65	NP	0.00	167.51	164.86
07/30/92	3,600	20	ND	39	80	-	2.70	NP	0.00	167.51	164.81
08/20/92	3,000	0.7	5.2	2.0	5.3	-	2.83	NP	0.00	167.51	164.68
09/30/92	9,200	4.8	6.5	12	91	-	2.80	NP	0.00	167.51	164.71
12/23/92	2,000	17	ND	8.2	18	-	2.45	NP	0.00	167.51	165.06
03/10/93	1,500	ND	2.6	21	12	-	2.40	NP	0.00	167.51	165.11
06/09/93	1,300	0.6	1.7	ND	7.5	-	3.55	NP	0.00	167.51	163.96
09/14/93	1,500	1.3	7.6	4.1	14	-	2.81	NP	0.00	167.51	164.70
12/14/93	560	ND	ND	ND	5.5	-	2.63	NP	0.00	167.51	164.88
03/02/94	1,100	<0.3	<0.3	<0.3	<0.5	-	2.60	NP	0.00	167.51	164.91
06/06/94	290	0.58	0.53	1.1	5.8	-	2.52	NP	0.00	167.51	164.99
09/06/94	890	<0.3	<0.3	<0.3	3.1	-	3.16	NP	0.00	167.51	164.35
12/07/94	940	22	23	10	32	-	5.18	NP	0.00	167.51	162.33
03/08/95	1,600	<0.5	<0.5	<0.5	2.3	-	4.57	NP	0.00	167.51	162.94
06/15/95	3,200	2.2	5.3	4.3	3.1	-	5.08	NP	0.00	167.51	162.43
09/05/95	1,100	<0.5	<0.5	<0.5	<1	-	5.72	NP	0.00	167.51	161.79
11/21/95	1,100	1.1	2.9	3.5	3.0	-	2.46	NP	0.00	167.51	165.05
03/11/96	440	0.7	0.34	<0.3	3.7	-	3.44	NP	0.00	167.51	164.07
06/19/96	580	3.8	0.49	1.2	<0.5	-	3.80	NP	0.00	167.51	163.71
09/16/96	490	<0.3	1.6	<0.3	<0.5	<20	3.80	NP	0.00	167.51	163.71
12/10/96	<50	<0.3	<0.3	<0.3	<0.5	<20	2.76	NP	0.00	167.51	164.75
03/12/97	<50	<0.3	0.42	<0.3	1.5	<20	3.20	NP	0.00	167.51	164.31
06/12/97	<50	<0.3	<0.3	<0.3	0.51	<20	-	-	-	-	-
09/10/97	<50	<0.3	<0.3	<0.3	<0.5	<20	4.24	NP	0.00	167.51	163.27
12/09/97	<50	<0.3	0.48	<0.3	<0.5	<20	2.72	NP	0.00	167.51	164.79
03/03/98	190	<0.3	<0.3	0.38	<0.5	<20	1.90	NP	0.00	167.51	165.61
07/08/98	<50	<0.3	<0.3	<0.3	<0.5	<5	-	-	-	-	-
09/10/98	<50	<0.3	<0.3	<0.3	<0.5	<5	2.72	NP	0.00	167.51	164.79
12/30/98	<50	<0.3	<0.3	<0.3	<0.5	<5	1.20	NP	0.00	167.51	166.31
03/15/99	<50	<0.3	<0.3	<0.3	<0.5	<5	4.25	NP	0.00	167.51	163.26
06/22/99	1,300	4.2	1.2	0.69	0.74	<5	3.70	NP	0.00	167.51	163.81
09/08/99	<50	<0.3	<0.3	<0.3	<0.5	<5	2.71	NP	0.00	167.51	164.80
12/01/99	<50	<0.3	<0.3	<0.3	<0.5	<5	2.70	NP	0.00	167.51	164.81
03/23/00	<50	<0.25	<0.25	<0.25	<0.5	<5	2.70	NP	0.00	167.51	164.81
06/08/00	585	<5	<5	<5	<5	821	2.72	NP	0.00	167.51	164.79
09/27/00	592	<0.18	<0.14	<0.18	<0.26	*1,180 / 1,360	2.72	NP	0.00	167.51	164.79



**TABLE 1  
GROUNDWATER DATA  
THRIFTY OIL STATION #054, CASTRO VALLEY, CA.**

DATE SAMPLED	ANALYTICAL PARAMETERS						DEPTH TO GROUNDWATER (feet)	DEPTH TO PRODUCT (feet)	PRODUCT THICKNESS (feet)	CASING ELEVATION (feet)	GROUNDWATER ELEVATION (feet)
	TPH (ug/L)	BENZENE (ug/L)	TOLUENE (ug/L)	EthylBenzene (ug/L)	XYLENE (ug/L)	MTBE (ug/L)					
09/14/93	ND	ND	ND	ND	ND	-	7.35	NP	0.00	162.89	155.54
03/02/94	<50	<0.3	<0.3	<0.3	<0.3	-	7.00	NP	0.00	162.89	155.89
06/06/94	<50	<0.3	<0.3	<0.3	<0.5	-	6.55	NP	0.00	162.89	156.34
09/06/94	<50	<0.3	<0.3	<0.3	<0.5	-	7.63	NP	0.00	162.89	155.26
12/07/94	56	<0.3	<0.3	<0.5	2.1	-	5.92	NP	0.00	162.89	156.97
03/08/95	<100	<0.5	<0.5	<0.5	<1	-	7.84	NP	0.00	162.89	155.05
06/15/95	<100	<0.5	<0.5	<0.5	<1	-	6.97	NP	0.00	162.89	155.92
09/05/95	<100	<0.5	<0.5	<0.5	<1	-	8.14	NP	0.00	162.89	154.75
11/21/95	<50	<0.3	<0.3	<0.3	<0.5	-	7.68	NP	0.00	162.89	155.21
03/11/96	<50	<0.3	<0.3	<0.3	<0.5	-	6.76	NP	0.00	162.89	156.13
06/19/96	<50	<0.3	<0.3	<0.3	<0.5	-	7.20	NP	0.00	162.89	155.69
09/16/96	<50	<0.3	<0.3	<0.3	<0.5	<20	6.30	NP	0.00	162.89	156.59
12/10/96	<50	<0.3	<0.3	<0.3	<0.5	<20	6.05	NP	0.00	162.89	156.84
03/12/97	<50	<0.3	<0.3	<0.3	<0.5	<20	7.56	NP	0.00	162.89	155.33
06/12/97	<50	<0.3	<0.3	<0.3	<0.5	<20	-	-	-	-	-
09/10/97	<50	<0.3	<0.3	<0.3	<0.5	<20	7.55	NP	0.00	162.89	155.34
12/09/97	1,900	610	510	<6	290	<20	7.55	NP	0.00	162.89	155.34
03/03/98	<50	2.0	<0.3	<0.3	<0.5	27	6.03	NP	0.00	162.89	156.86
07/08/98	<50	<0.3	<0.3	<0.3	<0.5	<5	-	-	-	-	-
09/10/98	<50	<0.3	<0.3	<0.3	<0.5	72	7.55	NP	0.00	162.89	155.34
12/30/98	<50	1.1	<0.3	<0.3	<0.5	<5	4.45	NP	0.00	162.89	158.44
03/15/99	<50	<0.3	<0.3	<0.3	1.3	<5	4.50	NP	0.00	162.89	158.39
06/22/99	<50	<0.3	<0.3	<0.3	<0.5	<5	9.15	NP	0.00	162.89	153.74
09/08/99	<50	<0.3	<0.3	<0.3	<0.5	<5	7.51	NP	0.00	162.89	155.38
12/01/99	<50	<0.3	<0.3	<0.3	<0.5	<5	5.97	NP	0.00	162.89	156.92
03/23/00	<50	<0.25	<0.25	<0.25	<0.5	<5	4.47	NP	0.00	162.89	158.42
06/08/00	<50	<5	<5	<5	<5	<5	5.97	NP	0.00	162.89	156.92
09/27/00	<50	<0.18	<0.14	<0.18	<0.26	<0.24	7.50	NP	0.00	162.89	155.39
12/13/00	<50	<0.18	<0.14	<0.18	<0.26	<0.24	5.94	NP	0.00	162.89	156.95
03/22/01	<50	<0.18	<0.14	<0.18	<0.26	<0.24	7.51	NP	0.00	162.89	155.38
06/15/01	<50	<0.18	<0.14	<0.18	<0.26	<0.24	7.50	NP	0.00	162.89	155.39
08/30/01	<50	<0.18	<0.14	<0.18	<0.26	<0.24	9.05	NP	0.00	162.89	153.84
12/12/01	<50	<0.18	<0.14	<0.18	<0.26	<0.24	7.65	NP	0.00	162.89	155.24
03/13/02	-	-	-	-	-	-	9.05	NP	0.00	162.89	153.84
06/12/02	-	-	-	-	-	-	-	-	-	-	-
09/18/02	-	-	-	-	-	-	-	-	-	-	-
12/18/02	-	-	-	-	-	-	-	-	-	-	-
03/19/03	-	-	-	-	-	-	-	-	-	-	-

**TABLE 1  
GROUNDWATER DATA  
THRIFTY OIL STATION #054, CASTRO VALLEY, CA.**

DATE SAMPLED	ANALYTICAL PARAMETERS						DEPTH TO GROUNDWATER (feet)	DEPTH TO PRODUCT (feet)	PRODUCT THICKNESS (feet)	CASING ELEVATION (feet)	GROUNDWATER ELEVATION (feet)
	TPH (ug/L)	BENZENE (ug/L)	TOLUENE (ug/L)	EthylBenzene (ug/L)	XYLENE (ug/L)	MTBE (ug/L)					
06/11/03	-	-	-	-	-	-	-	-	-	-	-
09/04/03	-	-	-	-	-	-	-	-	-	-	-
12/04/03	-	-	-	-	-	-	5.98	NP	0.00	162.43	156.45
03/18/04	-	-	-	-	-	-	8.85	NP	0.00	162.43	153.58
06/09/04	-	-	-	-	-	-	6.27	NP	0.00	162.43	156.16
09/02/04	-	-	-	-	-	-	6.17	NP	0.00	162.43	156.26
12/08/04	-	-	-	-	-	-	6.00	NP	0.00	162.43	156.43
03/16/05	-	-	-	-	-	-	9.05	NP	0.00	162.43	153.38
<b>MONITORING WELL #RS-11</b> <i>Screen Interval = 5 to 25 feet</i>											
09/21/95	110	<0.5	<0.5	<0.5	<1	-	9.37	NP	0.00	163.28	153.91
11/21/95	-	-	-	-	-	-	-	-	-	-	-
03/11/96	-	-	-	-	-	-	-	-	-	-	-
06/19/96	-	-	-	-	-	-	-	-	-	-	-
09/16/96	-	-	-	-	-	-	-	-	-	-	-
03/12/97	74	9.5	<0.3	<0.3	0.57	<20	7.75	NP	0.00	163.28	155.53
06/12/97	<50	<0.3	<0.3	<0.3	<0.5	<20	-	-	-	-	-
09/10/97	<50	<0.3	<0.3	<0.3	<0.5	<20	9.50	NP	0.00	163.28	153.78
12/09/97	<50	0.79	1.2	<0.3	<0.5	<20	9.50	NP	0.00	163.28	153.78
03/03/98	140	22	0.63	<0.3	<0.5	<20	7.93	NP	0.00	163.28	155.35
07/08/98	<50	<0.3	<0.3	<0.3	<0.5	<5	-	-	-	-	-
09/10/98	<50	<0.3	<0.3	<0.3	<0.5	<5	9.48	NP	0.00	163.28	153.80
12/30/98	<50	1.3	0.87	<0.3	0.55	<5	7.95	NP	0.00	163.28	155.33
03/15/99	<50	<0.3	<0.3	<0.3	<0.5	<5	6.40	NP	0.00	163.28	156.88
06/22/99	350	89	2.9	3.3	0.91	6.8	11.00	NP	0.00	163.28	152.28
09/08/99	99	9.1	0.37	<0.3	<0.5	<5	7.90	NP	0.00	163.28	155.38
12/01/99	82	9.7	0.44	<0.3	<0.5	<5	7.90	NP	0.00	163.28	155.38
03/23/00	73	5.8	2.3	<0.25	<0.5	*11.2 / 7.9	4.85	NP	0.00	163.28	158.43
06/08/00	306	<5	<5	<5	<5	<5	7.90	NP	0.00	163.28	155.38
09/27/00	<50	1	<0.14	<0.18	<0.26	3 J / 3.6	9.44	NP	0.00	163.28	153.84
12/13/00	<50	<0.18	<0.14	<0.18	<0.26	<0.24	6.34	NP	0.00	163.28	156.94
03/22/01	408	<0.18	<0.14	<0.18	<0.26	*664 / 941	7.96	NP	0.00	163.28	155.32
06/15/01	<50	<0.18	<0.14	<0.18	<0.26	<0.24	7.87	NP	0.00	163.28	155.41
08/30/01	<50	<0.18	<0.14	<0.18	<0.26	<0.24	9.41	NP	0.00	163.28	153.87
12/12/01	<50	<0.18	<0.14	<0.18	<0.26	<0.24	7.86	NP	0.00	163.28	155.42
03/13/02	<50	<0.18	<0.14	<0.18	<0.26	<0.24	7.85	NP	0.00	163.28	155.43
06/12/02	<50	<0.18	1	<0.18	<0.26	<0.24	9.39	NP	0.00	163.28	153.89

**TABLE 1**  
**GROUNDWATER DATA**  
**THRIFTY OIL STATION #054, CASTRO VALLEY, CA.**

DATE SAMPLED	ANALYTICAL PARAMETERS						DEPTH TO GROUNDWATER (feet)	DEPTH TO PRODUCT (feet)	PRODUCT THICKNESS (feet)	CASING ELEVATION (feet)	GROUNDWATER ELEVATION (feet)
	TPH (ug/L)	BENZENE (ug/L)	TOLUENE (ug/L)	EthylBenzene (ug/L)	XYLENE (ug/L)	MTBE (ug/L)					
09/18/02	<50	<0.18	<0.14	<0.18	<0.26	<0.24	9.38	NP	0.00	163.28	153.90
12/18/02	110	<0.18	<0.14	<0.18	<0.26	101	6.32	NP	0.00	163.28	156.96
03/19/03	<15	<0.04	<0.02	<0.02	<0.06	<0.03	9.39	NP	0.00	163.28	153.89
06/11/03	<15	<0.04	<0.02	<0.02	<0.06	20	9.39	NP	0.00	163.28	153.89
09/04/03	<15	<0.22	<0.32	<0.31	<0.4	<0.18	7.85	NP	0.00	163.28	155.43
12/04/03	<15	<0.04	<0.02	<0.02	<0.06	<0.03	6.32	NP	0.00	162.71	156.39
03/18/04	<15	<0.22	<0.32	<0.31	<0.4	<0.18	9.39	NP	0.00	162.71	153.32
06/10/04	1,080	48	3.8	30	1.8	68	6.87	NP	0.00	162.71	155.84
09/02/04	1,600	94	5.9	4.3	3.8	*185 / 78	7.07	NP	0.00	162.71	155.64
12/09/04	<15	1.2	1.3	<0.18	<0.45	*22 / <0.18	6.34	NP	0.00	162.71	156.37
03/16/05	<15	<0.22	<0.32	<0.31	<0.4	16	7.85	NP	0.00	162.71	154.86

**NOTE:** ND = Nondetectable  
 " - " = Not Analyzed / Not Available  
 NP = No Free Product  
 \*MTBE 8020/8260

Benzene, toluene, ethylbenzene, and xylene analyzed by EPA method 8020.  
 Total petroleum hydrocarbons (TPH) analyzed by EPA method 8015 modified for gasoline  
 Methyl-tert Butyl Ether (MTBE) analyzed by EPA method 8020  
 On 3/16/05, 3/18/04, 9/4/03 & 6/8/00, BTEX and MTBE analyzed by EPA Method 8260B

**TABLE 2**  
**Vapor Extraction Operating Data**  
**Thrifty Oil Station # 054, CASTRO VALLEY, CA**

Month	Representative Date	Hour Meter Reading (hrs)	Operation Duration (hrs)	Inlet		Hydrocarbons Removed		Remark
				Average Flow (cfm)	Average FID Conc. (ppmV)	Period (lbs)	Cumulative (lbs)	
Jan-91	1/9/1991	929	0	30	est. 10,000	0.0	0	
Feb-91	2/6/1991	979	50	30	est. 10,000	38.0	38	
Mar-91	3/6/1991	1,028	49	5	est. 10,000	6.2	44	System off 4/91 - 9/91
Oct-91	10/23/1991	1,786	758	15	est. 10,000	288.0	332	
Nov-91	11/6/1991	1,789	3	14	est. 10,000	1.1	333	
Dec-91	12/4/1991	1,896	107	14	est. 10,000	37.9	371	
Jan-92	1/29/1992	2,025	129	14	est. 10,000	45.7	417	
Feb-92	2/26/1999	2,293	268	14	est. 10,000	95.0	512	System off 3/92 - 7/92
Aug-93	8/11/1993	2,293	0	18	est. 10,000	0.0	512	
Sep-93	9/8/1993	2,446	153	17	est. 10,000	65.9	578	
Oct-93	10/7/1993	2,960	514	18	est. 10,000	234.4	812	
Nov-93	11/3/1993	3,381	421	18	est. 10,000	191.9	1,004	
Dec-93	12/1/1993	3,705	324	18	est. 10,000	147.7	1,152	
Jan-94	1/3/1994	4,313	608	18	est. 10,000	277.2	1,429	
Feb-94	2/7/1994	4,849	536	17	10,000	230.8	1,660	
Mar-94	3/7/1994	5,196	347	20	10,000	175.8	1,836	
Apr-94	4/4/1994	5,597	401	16	10,000	162.5	1,998	
May-94	5/2/1994	6,003	406	17	est. 10,000	174.8	2,173	
Jun-94	6/6/1994	6,514	511	16	10,000	207.1	2,380	
Jul-94	7/18/1994	6,679	165	15	10,000	62.7	2,443	
Aug-94	8/1/1994	6,735	56	16	est. 10,000	22.7	2,466	
Sep-94	9/20/1994	7,340	605	16	est. 10,000	245.2	2,711	
Oct-94	10/5/1994	7,554	214	15	est. 10,000	81.3	2,792	
Dec-94	12/13/1994	7,656	102	15	est. 10,000	38.8	2,831	
Jan-95	1/6/1995	7,742	86	12	est. 10,000	26.1	2,857	
Feb-95	2/14/1995	7,906	164	13	est. 10,000	54.0	2,911	
Mar-95	3/2/1995	7,976	70	15	est. 10,000	26.6	2,938	
Apr-95	4/7/1995	8,009	33	8	est. 10,000	6.7	2,944	
May-95	5/5/1995	8,405	396	16	est. 10,000	160.5	3,105	
Jun-95	6/1/1995	8,436	31	16	est. 10,000	12.6	3,117	
Jul-95	7/7/1993	8,834	398	16	est. 10,000	161.3	3,279	
Aug-95	8/3/1995	8,910	76	16	10,000	30.8	3,309	
Sep-95	9/5/1995	9,068	158	16	est. 10,000	64.0	3,373	
Oct-95	10/24/1995	9,163	95	14	10,000	33.7	3,407	
Nov-95	11/2/1995	9,194	31	16	est. 10,000	12.6	3,420	
Jan-96	1/4/1996	8,930	0	9	est. 10,000	0.0	3,420	Replaced hour meter (8930)
Feb-96	2/1/1996	8,991	61	8	est. 10,000	12.4	3,432	System off 2/96 - 4/96
Apr-96	4/25/1996	9,084	93	8	210	0.4	3,432	
May-96	5/2/1996	9,124	40	12	220	0.3	3,433	
Jun-96	6/3/1996	9,279	155	9	1,000	3.5	3,436	
Jul-96	7/2/1996	9,370	91	17	420	1.6	3,438	
Aug-96	8/1/1996	9,391	21	9	340	0.2	3,438	
Sep-96	9/5/1996	9,721	330	17	est. 340	4.8	3,443	
Oct-96	10/24/1996	9,773	52	7	est. 340	0.3	3,443	
Dec-96	12/26/1996	9,776	3	8	est. 340	0.0	3,443	System off 10/96 - 12/96
Apr-97	4/3/1997	9,781	5	15	10,000	1.9	3,445	System off 1/97 - 4/97
May-97	5/1/1997	10,032	251	15	9,800	93.5	3,539	
Jun-97	6/12/1997	10,663	631	11	est. 9,000	158.2	3,697	
Jul-97	7/3/1997	10,712	49	12	est. 9,000	13.4	3,710	
Aug-97	8/7/1997	10,950	238	12	est. 9,000	65.1	3,775	
Sep-97	9/3/1997	11,136	186	16	est. 9,000	67.8	3,843	
Oct-97	10/9/1997	11,320	184	12	est. 9,000	50.3	3,893	
Nov-97	11/6/1997	11,452	132	17	est. 9,000	51.2	3,945	
Dec-97	12/4/1997	11,510	58	19	9,000	25.1	3,970	
Jan-98	1/8/1998	11,784	274	17	10,000	118.0	4,088	
Feb-98	2/3/1998	12,180	396	16	10,000	160.5	4,248	
Mar-98	3/10/1998	13,011	831	17	10,000	357.8	4,606	
Apr-98	4/15/1998	13,060	49	17	est. 10,000	21.1	4,627	
May-98	5/7/1998	13,311	251	16	10,000	101.7	4,729	
Jun-98	6/2/1998	13,658	347	17	10,000	149.4	4,878	

**TABLE 2**  
**Vapor Extraction Operating Data**  
**Thrifty Oil Station # 054, CASTRO VALLEY, CA**

Month	Representative Date	Hour Meter Reading (hrs)	Operation Duration (hrs)	Inlet		Hydrocarbons Removed		Remark
				Average Flow (cfh)	Average FID Conc. (ppmV)	Period (lbs)	Cumulative (lbs)	
Jul-98	7/6/1998	14,340	682	16	est. 10,000	276.4	5,155	
Sep-98	9/21/1998	14,542	202	12	est. 10,000	61.4	5,216	System shut down, 10/98
Nov-98	11/16/1998	14,730	188	12	est. 10,000	57.1	5,273	
Dec-98	12/7/1998	15,124	394	11	est. 10,000	109.8	5,383	
Feb-99	2/9/1999	16,115	991	10	2,800	70.3	5,453	
Mar-99	3/12/1999	16,698	583	13	210	4.0	5,457	
Apr-99	4/6/1999	17,009	311	13	est. 210	2.2	5,459	
May-99	5/3/1999	17,098	89	10	est. 210	0.5	5,460	
Jun-99	6/28/1999	18,130	1,032	10	4,100	107.2	5,567	
Jul-99	7/7/1999	18,163	33	10	est. 4,000	3.3	5,570	
Aug-99	8/2/1999	18,196	33	11	est. 4,000	3.7	5,574	
Sep-99	9/13/1999	18,316	122	12	est. 4,000	14.8	5,589	
Oct-99	10/18/1999	18,348	30	13	est. 4,000	4.0	5,593	
Nov-99	11/29/1999	18,617	269	12	est. 4,000	32.7	5,626	
Dec-99	12/27/1999	19,096	479	12	210	3.1	5,629	
Jan-00	1/24/2000	19,388	292	12	est. 210	1.9	5,631	System shut down, 1/24/00

- Note: 1. The "duration" is derived from subtracting the hour meter from a representative day of the month by the hour meter from a representative day of the previous month. Some months may have more than 30 days.
2. In January 2000, the "hydrocarbons removed" calculations were corrected to reflect the actual calibration gas (methane) of the instrument used. Therefore, the corrected cumulative total value is different than the previous versions of this table.



# ***FIGURES***

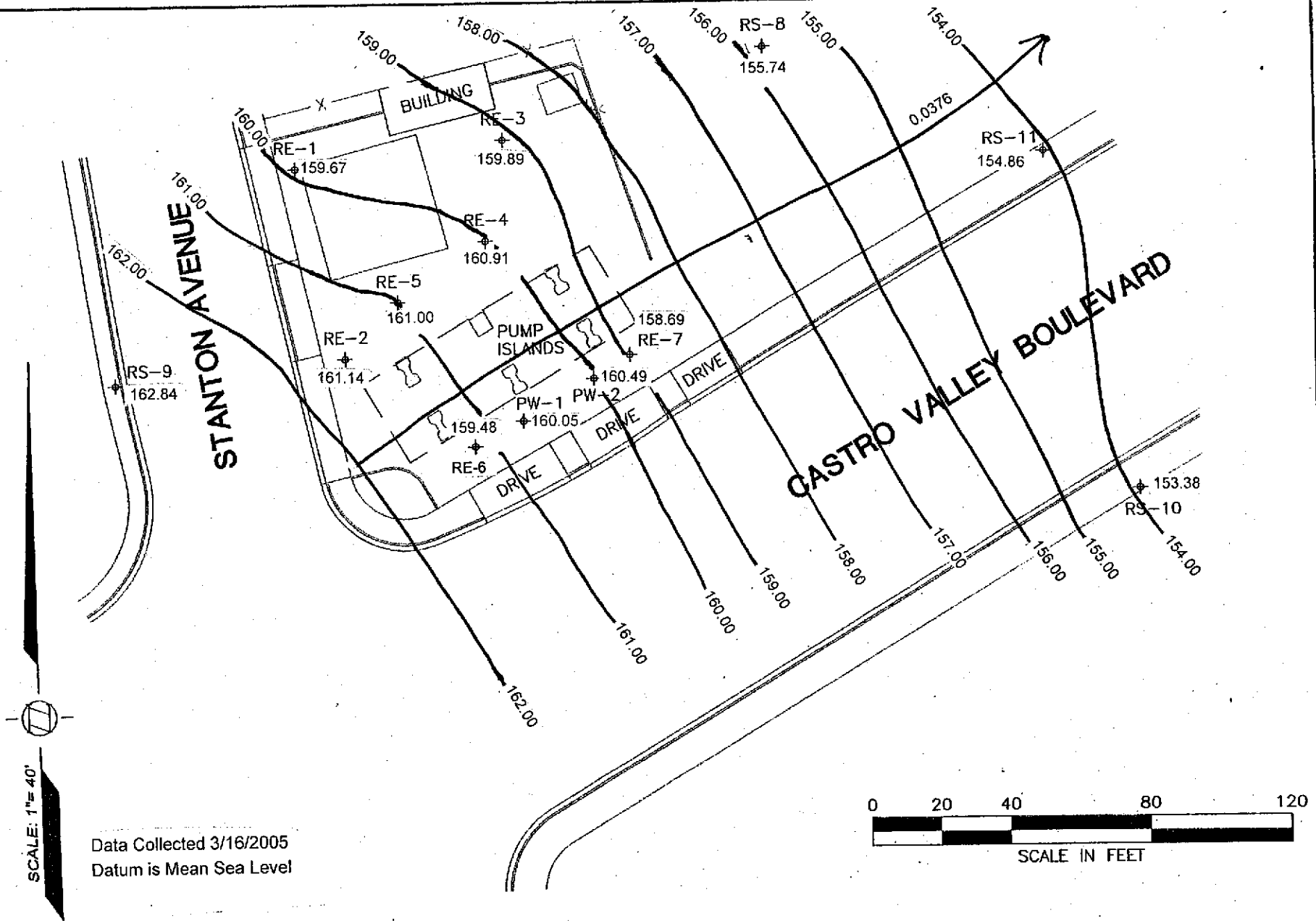

Thrifty Oil Co.  
13116 Imperial Highway  
Santa Fe Springs, CA 90670

## GROUNDWATER CONTOURS

THRIFTY STATION #054  
2504 Castro Valley Boulevard  
Castro Valley, CA

Figure

1

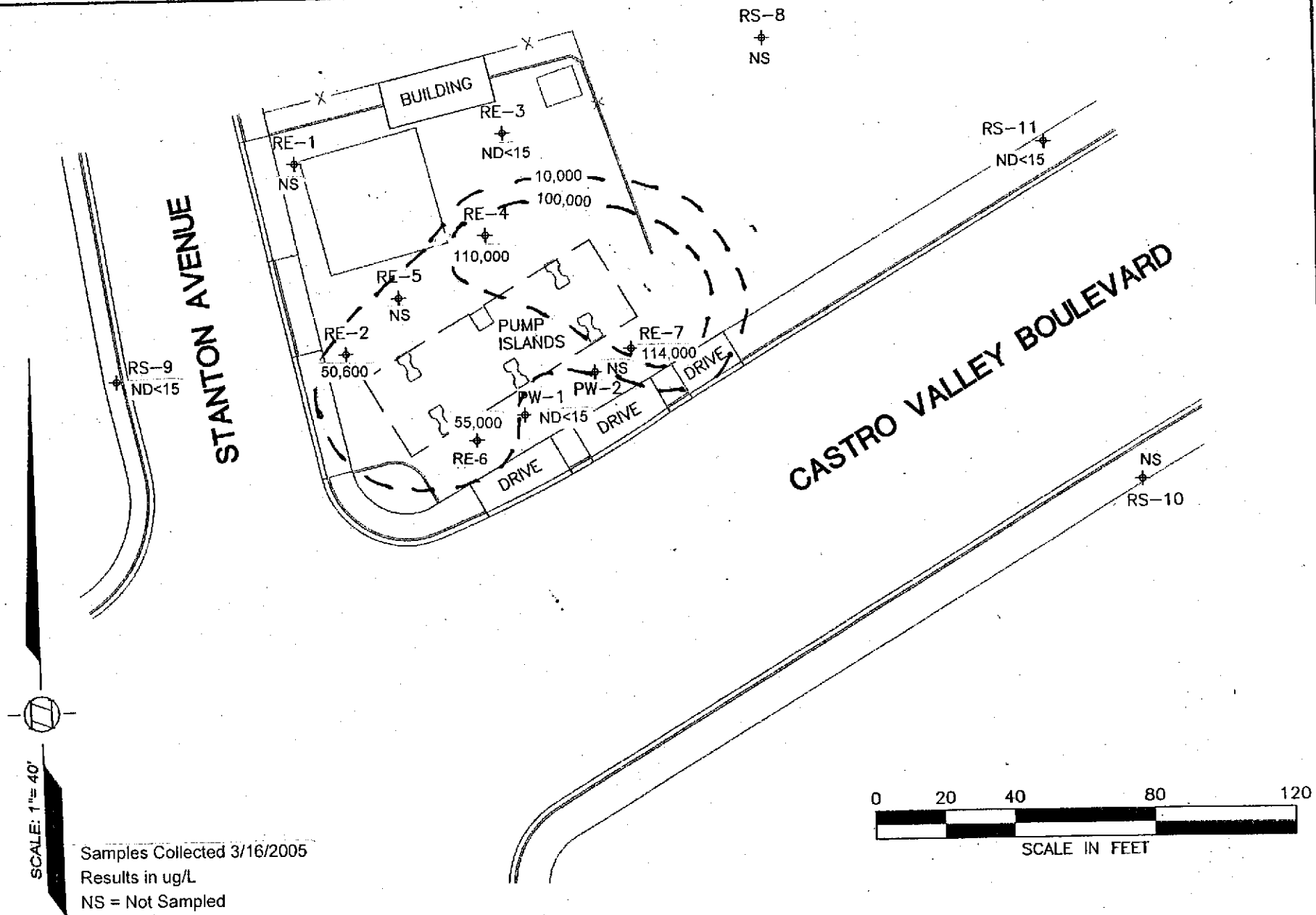

Thrifty Oil Co.  
 13116 Imperial Highway  
 Santa Fe Springs, CA 90670

### TPHg IN GROUNDWATER

THRIFTY STATION #054  
 2504 Castro Valley Boulevard  
 Castro Valley, CA

Figure

2

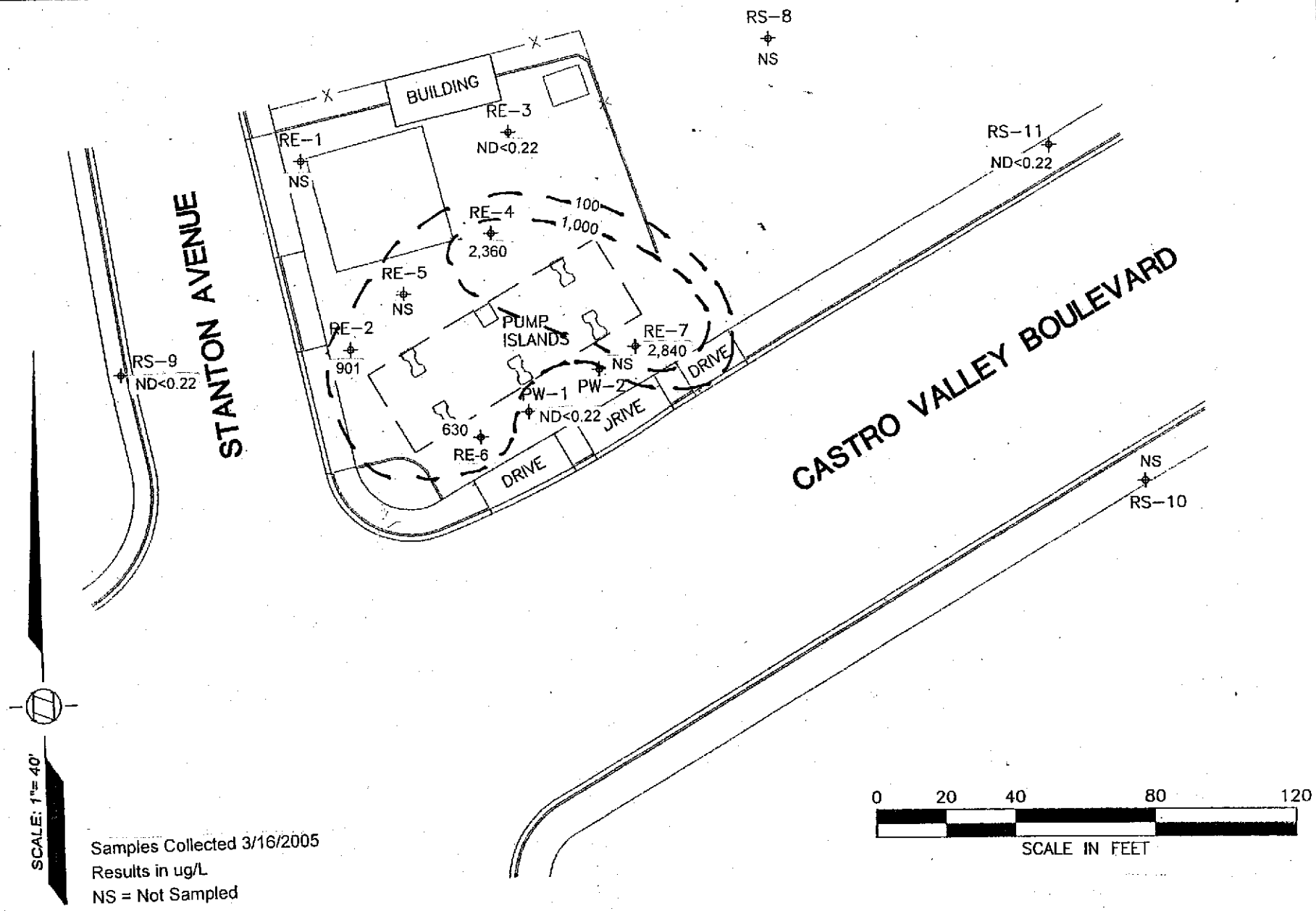

Thrifty Oil Co.  
13116 Imperial Highway  
Santa Fe Springs, CA 90670

## BENZENE IN GROUNDWATER

THRIFTY STATION #054  
2504 Castro Valley Boulevard  
Castro Valley, CA

Figure  
3

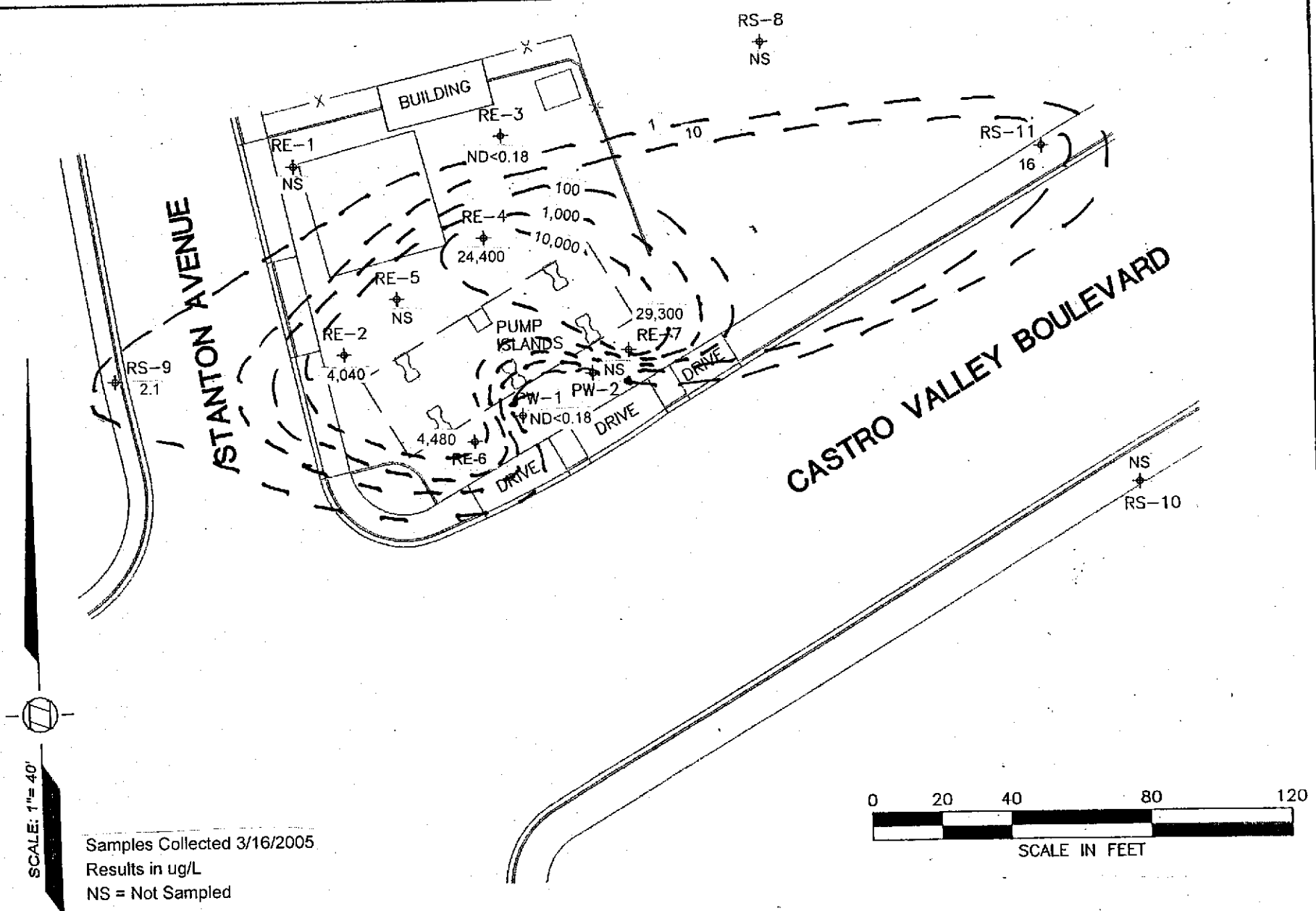

Thrifty Oil Co.  
 13116 Imperial Highway  
 Santa Fe Springs, CA 90670

### MTBE IN GROUNDWATER

**THRIFTY STATION #054**  
 2504 Castro Valley Boulevard  
 Castro Valley, CA

Figure  
 4

Figure 5  
**Groundwater Data - Monitoring Well RE-1**  
**Thrifty Oil Co. SS#054 - Castro Valley, CA**

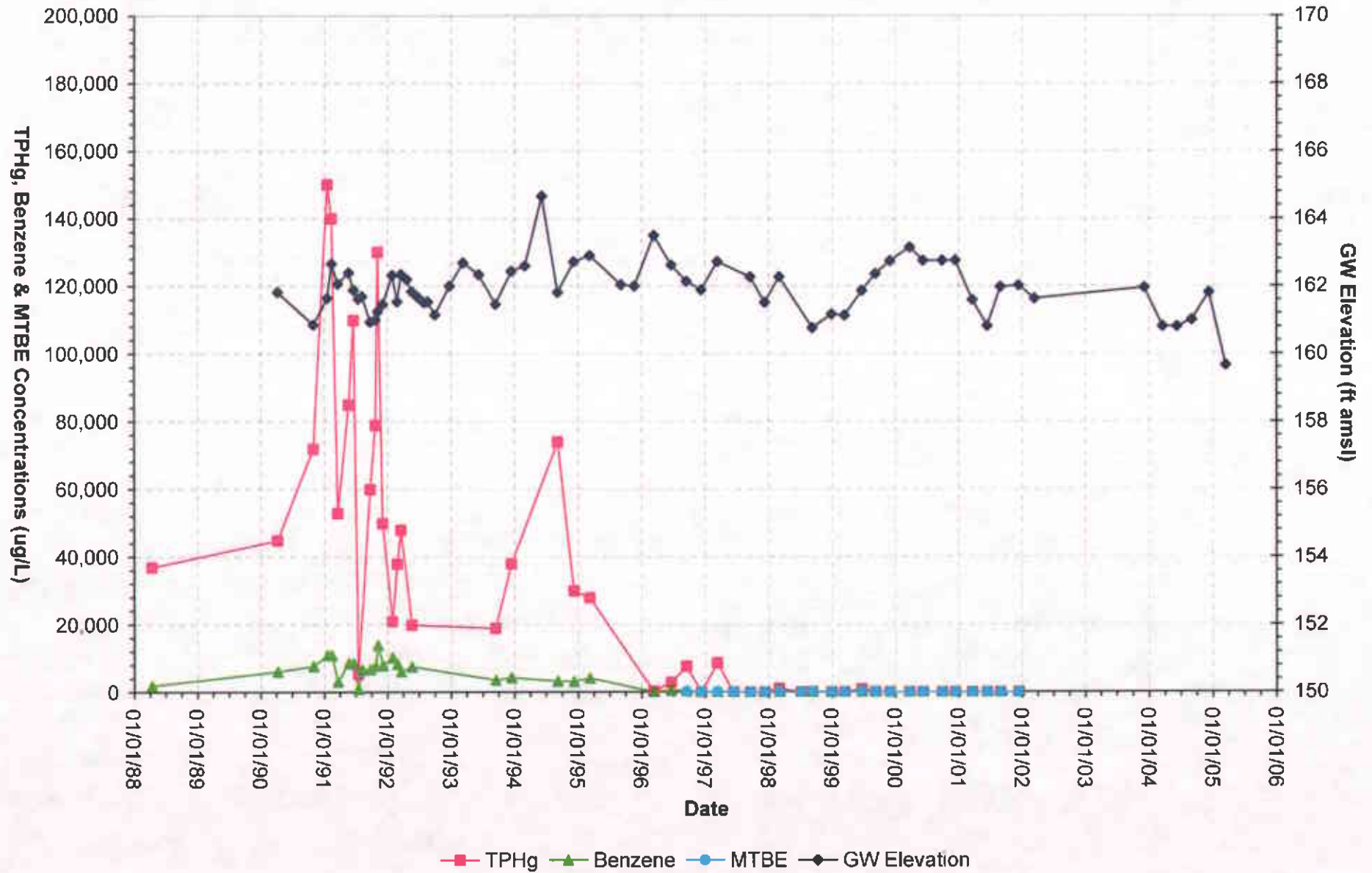

Figure 6  
 Groundwater Data - Monitoring Well RE-2  
 Thrifty Oil Co. SS#054 - Castro Valley, CA

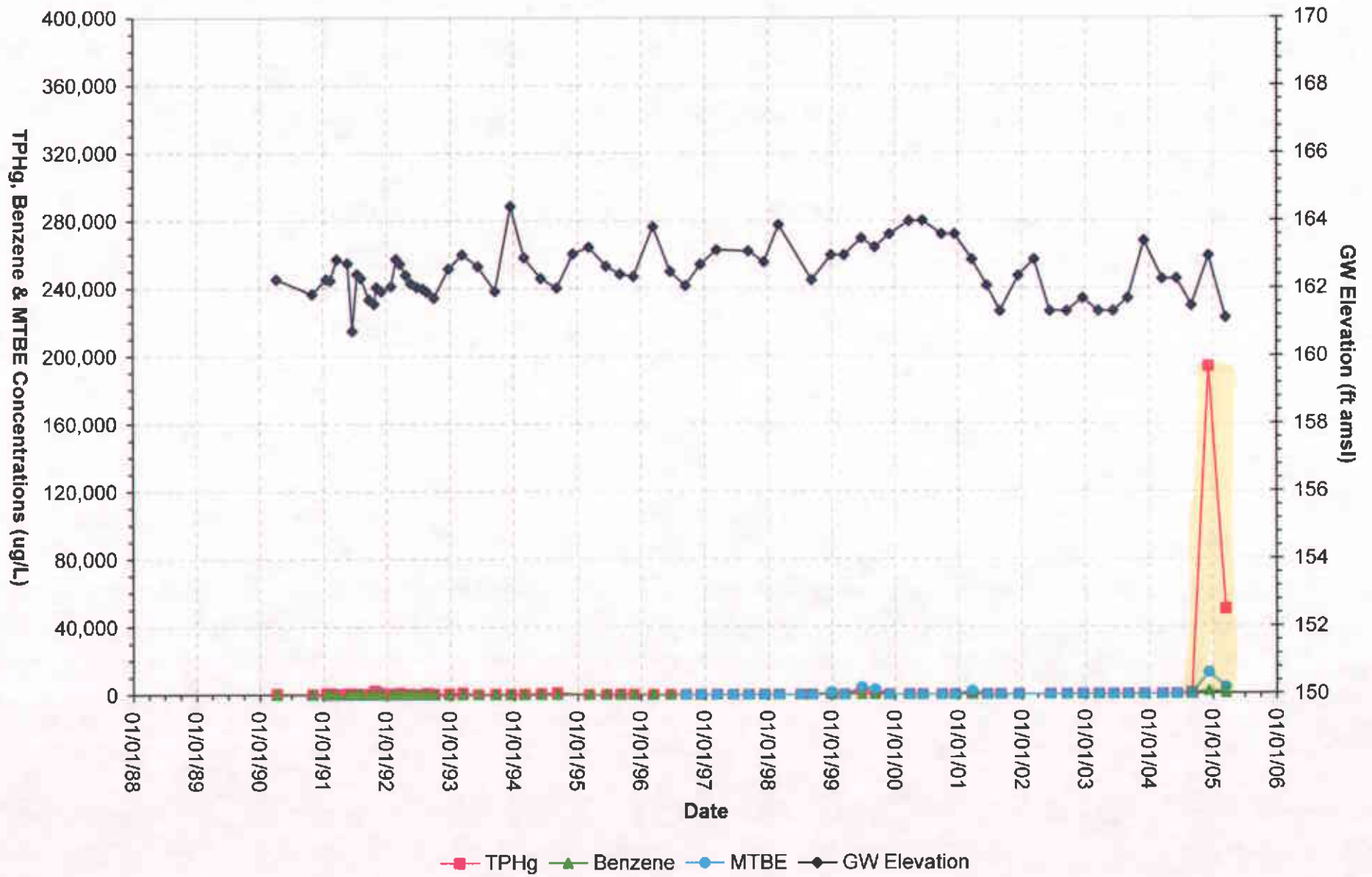

Figure 7  
**Groundwater Data - Monitoring Well RE-3**  
**Thrifty Oil Co. SS#054 - Castro Valley, CA**

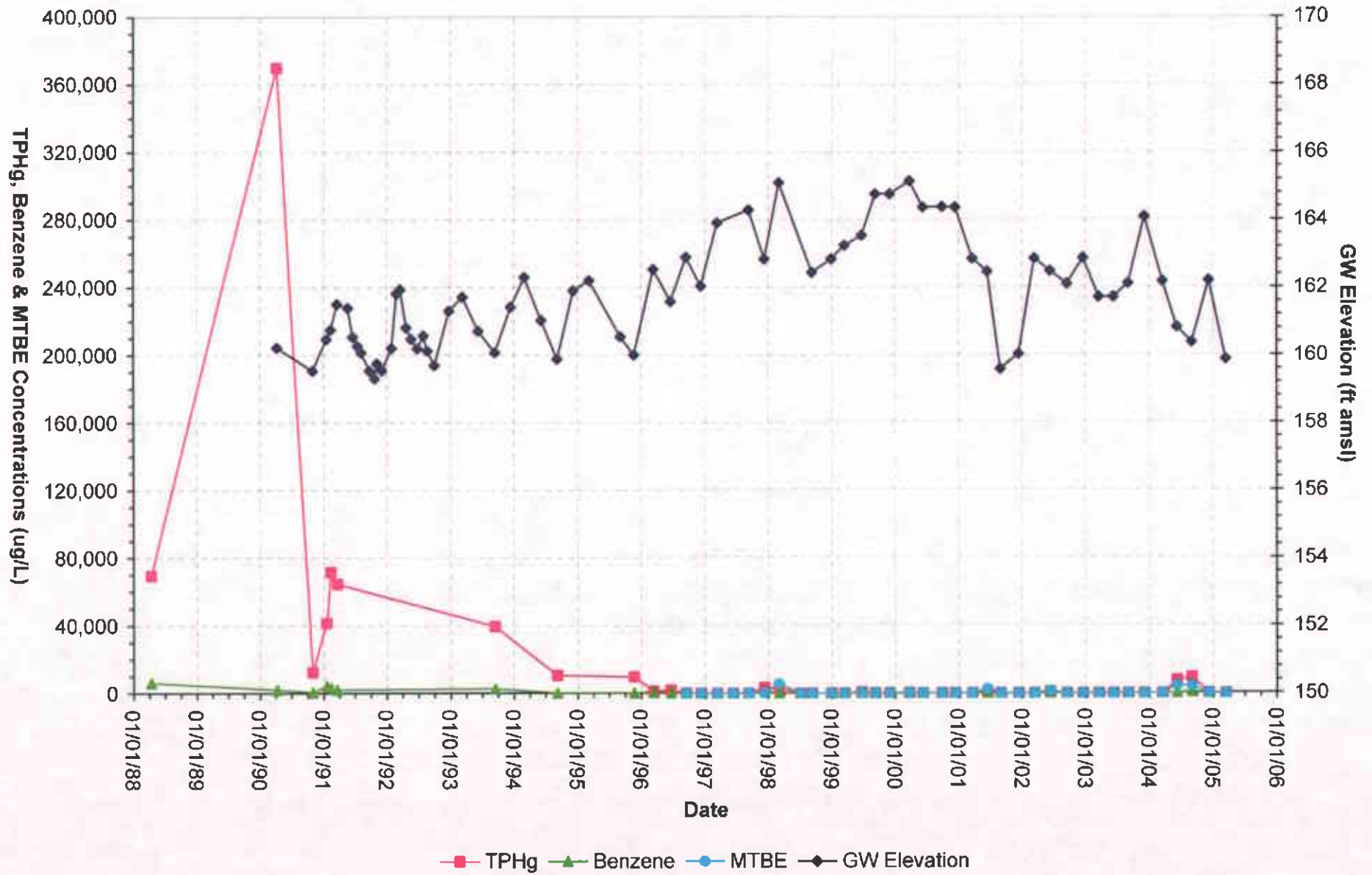



Figure 8  
 Groundwater Data - Monitoring Well RE-4  
 Thrifty Oil Co. SS#054 - Castro Valley, CA

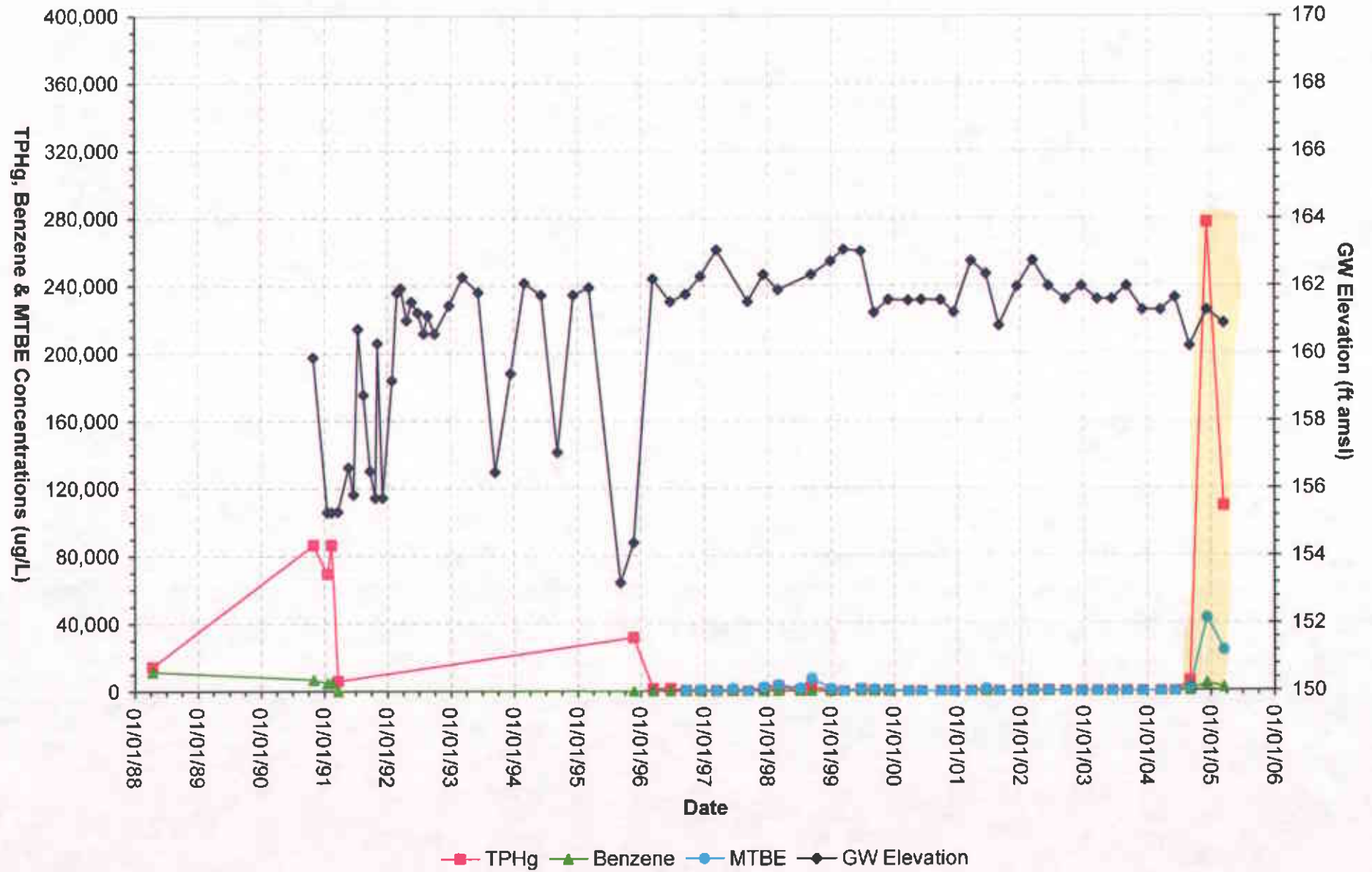

Figure 9  
 Groundwater Data - Monitoring Well RE-6  
 Thrifty Oil Co. SS#054 - Castro Valley, CA

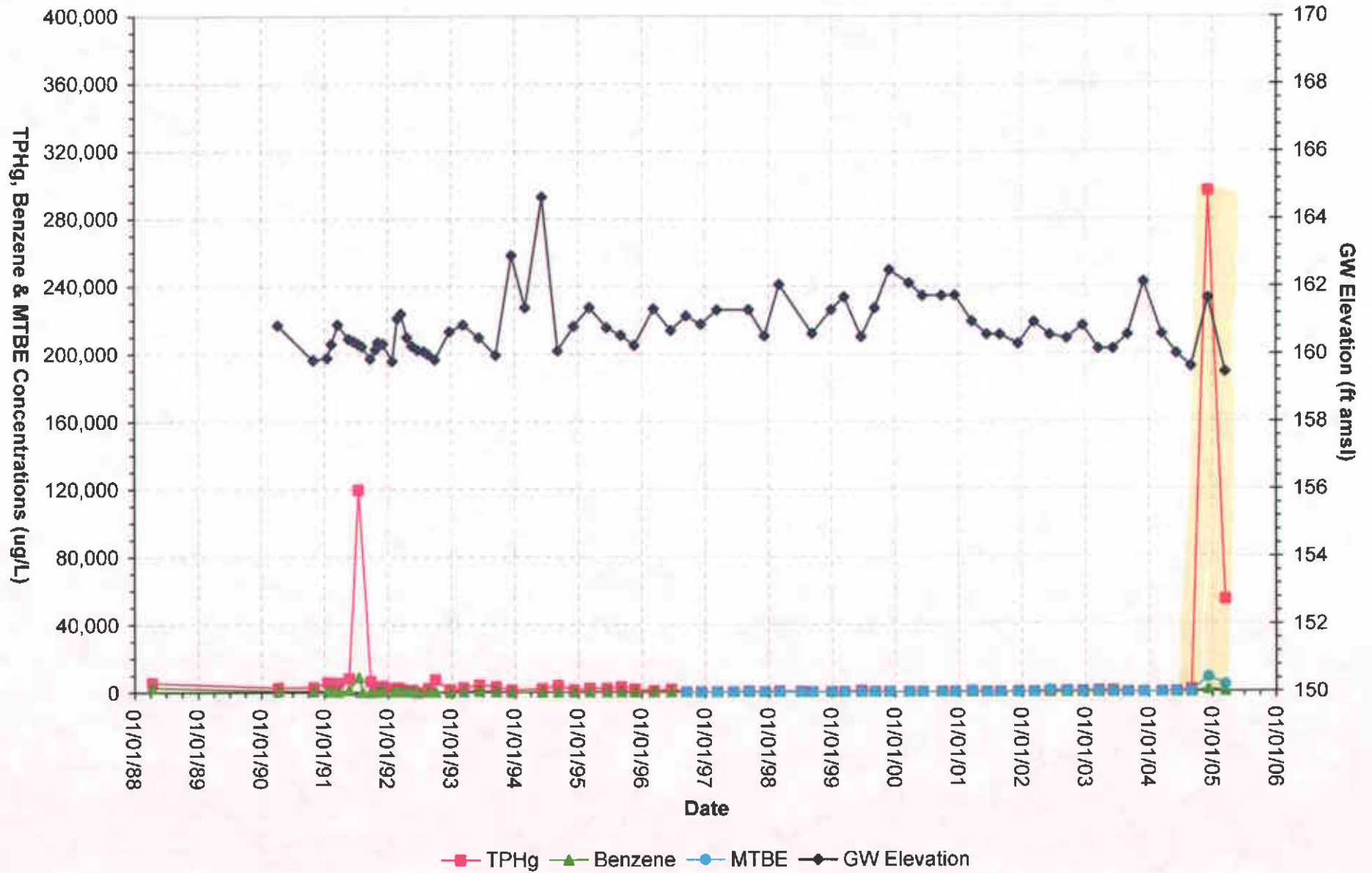
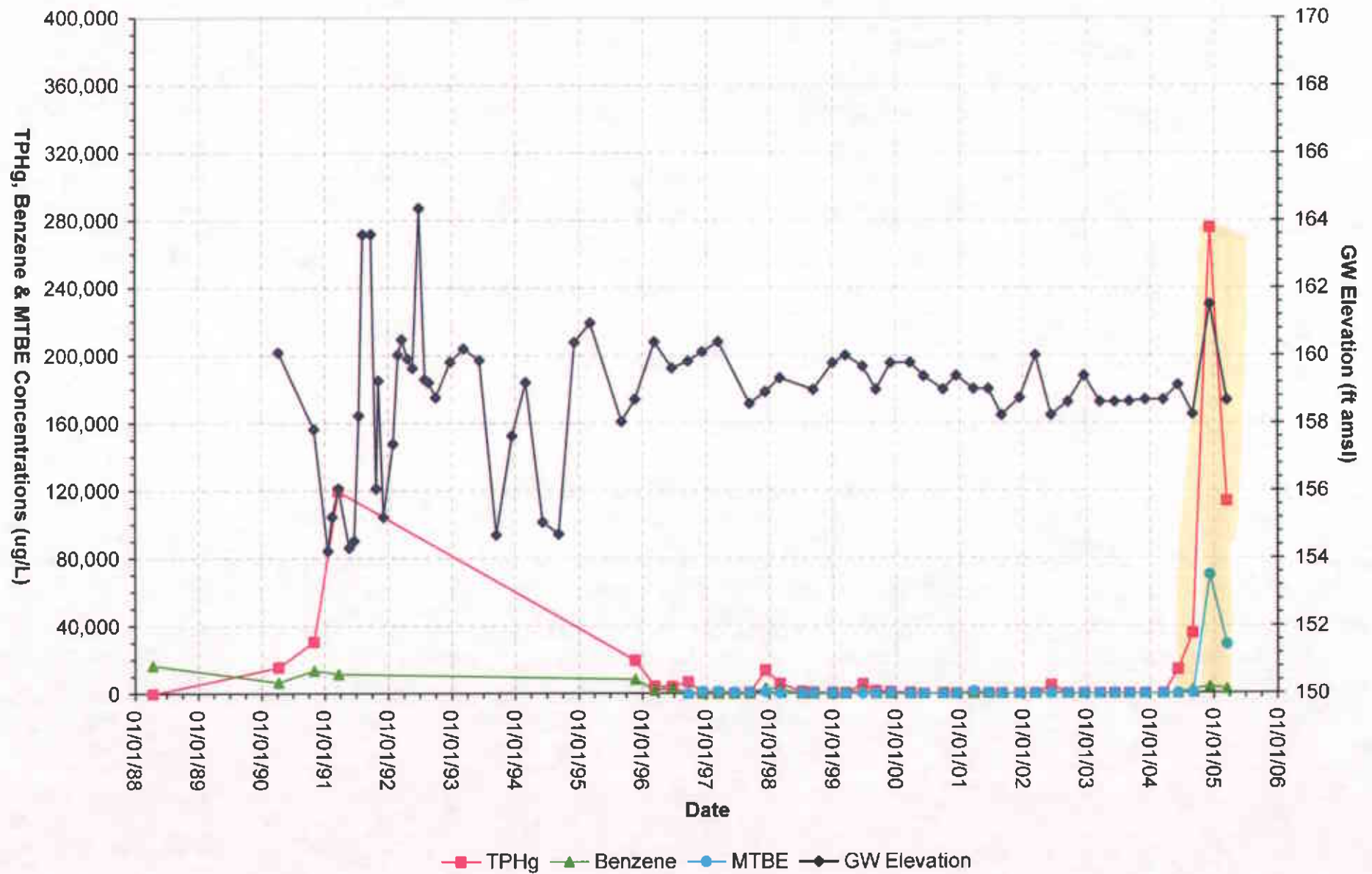

Figure 10  
 Groundwater Data - Monitoring Well RE-7  
 Thrifty Oil Co. SS#054 - Castro Valley, CA



# *APPENDIX A*



# PROJECT STATUS REPORT

SITE: THRIFTY OIL CO. # 054  
 ADDRESS: 2504 CASTRO VALLEY BLVD.  
CASTRO VALLEY, CA. 94546

DATE: 03-16-04

PERSONNEL: SEBBAN

WELL ID	DTP (FT)	DTW (FT)	DTB (FT)	PT (FT)	WC (FT)	DIA (IN)	PURGE (GAL)		COMMENT
							EST.	ACT.	
<b>QUARTERLY</b>									
1 PW-1		5.90	13.93			4"	21	21	
2 RE-2		5.47	16.95			4"	30	30	
3 RE-3		6.80	17.51			4"	28	28	
4 RE-4		5.32	14.50			4"	24	24	
5 RE-6		6.67	13.56			4"	18	18	
6 RE-7		6.64	13.14			4"	17	17	
7 RS-9		4.21	14.94			2"	7	7	OFFSITE
8 RS-11		7.85	24.72			2"	11	11	OFFSITE
<b>GAUGING ONLY</b>									
9 PW-2		5.12	14.30			4"			
10 RE-1		6.79	19.80			4"			
11 RE-5		5.56	18.19			4"			
12 RS-8		8.29	25.16			2"			OFFSITE
13 RS-10		9.05	24.38			2"			

FREE PRODUCT REMOVED: APPROX.      GALLONS | PURGE-WATER REMOVED: APPROX. 156 GALLONS

REMARKS: MONITORING WELLS, TAKE WATER SAMPLE FROM WELLS FOR Q.W.S. -

## FIELD DATA - GROUNDWATER SAMPLING PROGRAM

Site:	H 054	Date:	03-16-09
Address:			
Personnel:	SERBAN	Weather:	SUNNY DAY
Well No:	PW-1	Equip:	BAILER

<b>Before Purging:</b>			
Total Well Depth: (ft.)	13.93	Well Diameter	4"
Depth to Water (ft)	5.90	Est. Purge Volume:	21

<b>Sampling Data:</b>							
<b>Initial Turbidity:</b>				<b>Final Turbidity:</b>			
Time	8:36	8:42	8:48	8:54	9:00		
EC	1260	1230	1270	1280	1230		
pH	6.04	5.93	5.81	5.78	5.83		
Temp	72.4	72.1	71.9	72.1	71.8		
Gal.	4	8	12	16	21		
Time							
EC							
pH							
Temp							
Gal.							

<b>After Purging/Before Sample Collection</b>	
Depth to Water (ft.)	6.43
Total Well Depth (ft.)	13.93

## FIELD DATA - GROUNDWATER SAMPLING PROGRAM

Site:	# 054	Date:	03-16-04
Address:			
Personnel:	SARBAEL	Weather:	SUNNY DAY
Well No:	RR-2	Equip:	BAILER

<b>Before Purging:</b>			
Total Well Depth (ft.)	16.95	Well Diameter	44
Depth to Water (ft)	5.47	Est. Purge Volume:	30

<b>Sampling Data:</b>							
<b>Initial Turbidity:</b>				<b>Final Turbidity:</b>			
Time	9:12	9:19	9:26	9:33	9:40		
EC	1370	1350	1340	1320	1330		
pH	5.21	5.34	5.47	5.52	5.48		
Temp	72.1	71.8	72.2	72.3	72.1		
Gal.	6	12	18	24	30		
Time							
EC							
pH							
Temp							
Gal.							

<b>After Purging/Before Sample Collection</b>			
Depth to Water (ft.)	7.10	Total Well Depth (ft.)	16.95

## FIELD DATA - GROUNDWATER SAMPLING PROGRAM

Site:	H 054	Date:	03-16-04
Address:			
Personnel:	SERBAN	Weather:	SUNNY DAY
Well No:	RR-3	Equip:	BAILER

<b>Before Purging:</b>			
Total Well Depth: (ft.)	17.51	Well Diameter	44
Depth to Water (ft)	6.80	Est. Purge Volume:	29

<b>Sampling Data:</b>							
<b>Initial Turbidity:</b>				<b>Final Turbidity:</b>			
Time	9:52	9:59	10:06	10:13	10:20		
EC	1790	1810	1820	1910	1700		
pH	6.07	5.93	5.84	5.81	5.83		
Temp	71.6	71.3	71.1	71.2	71.1		
Gal.	5	11	17	23	29		
Time							
EC							
pH							
Temp							
Gal.							

<b>After Purging/Before Sample Collection</b>			
Depth to Water (ft)	8.04	Total Well Depth(ft).	17.51



## FIELD DATA - GROUNDWATER SAMPLING PROGRAM

Site:	H 054	Date:	03-16-04
Address:			
Personnel:	SERBAH	Weather:	SUNNY DAY
Well No:	RA-4	Equip:	BAUER

<b>Before Purging:</b>			
Total Well Depth: (ft.)	14.50	Well Diameter	44
Depth to Water (ft)	5.32	Est. Pore Volume:	24

Sampling Data:							
Initial Turbidity:				Final Turbidity:			
Time	10:26	10:32	10:38	10:44	10:50		
EC	1530	1560	1570	1560	1570		
pH	5.87	6.03	5.93	5.91	5.97		
Temp	71.8	72.1	72.3	72.4	72.2		
Gal.	4	9	14	19	24		
Time							
EC							
pH							
Temp							
Gal.							

<b>After Purging/Before Sample Collection</b>			
Depth to Water (ft.)	7.08	Total Well Depth (ft.)	14.50

## FIELD DATA - GROUNDWATER SAMPLING PROGRAM

Site:	# 054	Date:	03-16-05
Address:			
Personnel:	SERBANI,	Weather:	SUNNY DAY
Well No:	RR-6	Equip:	BAILER

<b>Before Purging:</b>			
Total Well Depth: (ft.)	13.56	Well Diameter	44
Depth to Water (ft)	6.67	Est. Purge Volume:	18

<b>Sampling Data:</b>							
<b>Initial Turbidity:</b>				<b>Final Turbidity:</b>			
Time	11:50	11:55	12:00	12:05	12:10		
EC	1620	1610	1580	1570	1580		
pH	5.93	6.03	5.97	5.93	5.91		
Temp	72.3	72.1	71.9	71.8	71.7		
Gal.	3	4	10	14	18		
Time							
EC							
pH							
Temp							
Gal.							

<b>After Purging/Before Sample Collection</b>	
Depth to Water (ft.)	9.09
Total Well Depth (ft.)	13.56

FIELD DATA - GROUNDWATER SAMPLING PROGRAM

Site:	H 054	Date:	03-16-09
Address:			
Personnel:	SERBACH,	Weather:	SUNNY DAY
Well No:	RE-7	Equip:	BAILER

<b>Before Purging:</b>			
Total Well Depth: (ft.)	13.14	Well Diameter	4"
Depth to Water (ft)	6.64	Est. Purge Volume:	17

<b>Sampling Data:</b>							
<b>Initial Turbidity:</b>				<b>Final Turbidity:</b>			
Time	11:04	11:08	11:12	11:16	11:20		
EC	1410	1380	1370	1360	1370		
pH	5.83	5.97	5.13	5.51	5.83		
Temp	72.4	72.1	71.9	71.6	71.4		
Gal.	3	6	10	13	17		
Time							
EC							
pH							
Temp							
Gal.							

<b>After Purging/Before Sample Collection</b>	
Depth to Water (ft.)	4.23
Total Well Depth (ft.)	13.14

## FIELD DATA - GROUNDWATER SAMPLING PROGRAM

Site:	# 054	Date:	03-16-09
Address:			
Personnel:	SERBAN	Weather:	SUNNY DAY
Well No:	RE-9	Equip:	BAUER

<b>Before Purging:</b>			
Total Well Depth (ft.)	14.94	Well Diameter	2"
Depth to Water (ft)	4.21	Est. Purge Volume:	7

<b>Sampling Data:</b>							
<b>Initial Turbidity:</b>				<b>Final Turbidity:</b>			
Time	12:18	12:21	12:24	12:27	12:30		
EC	1860	1790	1760	1780	1770		
pH	6.04	5.97	5.83	5.93	5.81		
Temp	71.2	71.1	70.9	70.7	70.6		
Gal.	1	2	4	5	7		
Time							
EC							
pH							
Temp							
Gal.							

<b>After Purging/Before Sample Collection</b>	
Depth to Water (ft.)	7.32
Total Well Depth (ft.)	14.94

## FIELD DATA - GROUNDWATER SAMPLING PROGRAM

Site:	H 054	Date:	03-16-06
Address:			
Personnel:	SERBAN	Weather:	SUNNY DAY
Well No:	RS-M	Equip:	BAILER

<b>Before Purging:</b>			
Total Well Depth: (ft.)	24.72	Well Diameter	2"
Depth to Water (ft)	7.85	Est. Purge Volume:	11

Sampling Data:							
Initial Turbidity:				Final Turbidity:			
Time	11:24	11:28	11:32	11:36	11:40		
EC	1210	1190	1210	1230	1220		
pH	5.87	5.83	5.81	5.97	5.93		
Temp	72.3	72.1	72.1	71.9	71.9		
Gal.	2	4	6	8	11		
Time							
EC							
pH							
Temp							
Gal.							

<b>After Purging/Before Sample Collection</b>			
Depth to Water (ft.)	10.04	Total Well Depth (ft.)	24.72

## ***APPENDIX B***



**ASSOCIATED LABORATORIES**

806 North Batavia - Orange, California 92868 - 714/771-6900

FAX 714/538-1209

CLIENT Thrifty Oil Company (8871)  
ATTN: Jeff Suryakusuma  
13116 Imperial Hwy.  
P.O. Box 2128  
Santa Fe Springs, CA 90670

LAB REQUEST 147153

REPORTED 03/25/2005

RECEIVED 03/17/2005

PROJECT Station #054  
2504 Castro Valley Blvd., Castro Valley

SUBMITTER Client

COMMENTS Global ID #T0600101363

This laboratory request covers the following listed samples which were analyzed for the parameters indicated on the attached Analytical Result Report. All analyses were conducted using the appropriate methods as indicated on the report. This cover letter is an integral part of the final report.

<u>Order No.</u>	<u>Client Sample Identification</u>
604988	TOC #054 PW-1
604989	TOC #054 RE-2
604990	TOC #054 RE-3
604991	TOC #054 RE-4
604992	TOC #054 RE-7
604993	TOC #054 RS-11
604994	TOC #054 RE-6
604995	TOC #054 RE-9
604996	Trip Blank
604997	Laboratory Method Blank

Thank you for the opportunity to be of service to your company. Please feel free to call if there are any questions regarding this report or if we can be of further service.

ASSOCIATED LABORATORIES by,

Edward S. Behare, Ph.D.  
Vice President

*NOTE: Unless notified in writing, all samples will be discarded by appropriate disposal protocol 30 days from date reported.*

The reports of the Associated Laboratories are confidential property of our clients and may not be reproduced or used for publication in part or in full without our written permission. This is for the mutual protection of the public, our clients, and ourselves.

TESTING & CONSULTING  
Chemical  
Microbiological  
Environmental

Order #: 604988

Client Sample ID: TOC #054 PW-1

Matrix: WATER

Date Sampled: 03/16/2005 Time Sampled: 12:40

Analyte	Result	DF	PQL	MDL	Units	Date/Analyst
---------	--------	----	-----	-----	-------	--------------

**8015M Ethanol / Methanol by GC-FID**

Ethanol	ND	1	50	20	mg/L	03/21/05 QN
Methanol	ND	1	50	20	mg/L	03/21/05 QN

**8260B BTEX/MTBE Only**

Benzene	ND	1	1	0.22	ug/L	03/20/05 LB
Ethyl benzene	ND	1	5	0.31	ug/L	03/20/05 LB
Ethyl-tertbutylether (ETBE)	ND	1	1	0.17	ug/L	03/20/05 LB
Isopropyl ether (DIPE)	ND	1	1	0.29	ug/L	03/20/05 LB
Methyl-tert-butylether (MTBE)	ND	1	1	0.18	ug/L	03/20/05 LB
Tert-amylmethylether (TAME)	ND	1	1	0.28	ug/L	03/20/05 LB
Tertiary butyl alcohol (TBA)	ND	1	10	10	ug/L	03/20/05 LB
Toluene	ND	1	5	0.32	ug/L	03/20/05 LB
Xylenes, total	ND	1	5	0.4	ug/L	03/20/05 LB

**Surrogates**

				Units	Control Limits
Surr1 - Dibromofluoromethane	92			%	70 - 130
Surr2 - 1,2-Dichloroethane-d4	98			%	70 - 130
Surr3 - Toluene-d8	97			%	70 - 130
Surr4 - p-Bromofluorobenzene	116			%	70 - 130

**8015M - Gasoline**

Gasoline	ND	1	50	15	ug/L	03/18/05 WL
----------	----	---	----	----	------	-------------

**Surrogates**

				Units	Control Limits
a,a,a-Trifluorotoluene	98			%	55 - 200

PQL = Practical Quantitation Limit, MDL = Method detection limit, DF = Dilution Factor  
 ND = Not detected below indicated MDL, J=Trace





Order #: 604989

Client Sample ID: TOC #054 RE-2

Matrix: WATER

Date Sampled: 03/16/2005 Time Sampled: 12:50

Analyte	Result	DF	PQL	MDL	Units	Date/Analyst
<b>8015M Ethanol / Methanol by GC-FID</b>						
Ethanol	ND	1	50	20	mg/L	03/21/05 QN
Methanol	ND	1	50	20	mg/L	03/21/05 QN
<b>8260B BTEX/MTBE Only</b>						
Benzene	901	100	100.0	0.22	ug/L	03/20/05 LB
Ethyl benzene	130 J	100	500.0	0.31	ug/L	03/20/05 LB
Ethyl-tertbutylether (ETBE)	ND	100	100.0	0.17	ug/L	03/20/05 LB
Isopropyl ether (DIPE)	ND	100	100.0	0.29	ug/L	03/20/05 LB
Methyl-tert-butylether (MTBE)	4040	100	100.0	0.18	ug/L	03/20/05 LB
Tert-amylmethylether (TAME)	116	100	100.0	0.28	ug/L	03/20/05 LB
Tertiary butyl alcohol (TBA)	ND	100	1000.0	10	ug/L	03/20/05 LB
Toluene	10100	100	500.0	0.32	ug/L	03/20/05 LB
Xylenes, total	12100	100	500.0	0.4	ug/L	03/20/05 LB
<b>Surrogates</b>				<b>Units</b>	<b>Control Limits</b>	
Surr1 - Dibromofluoromethane	88			%	70 - 130	
Surr2 - 1,2-Dichloroethane-d4	99			%	70 - 130	
Surr3 - Toluene-d8	98			%	70 - 130	
Surr4 - p-Bromofluorobenzene	114			%	70 - 130	
<b>8015M - Gasoline</b>						
Gasoline	50600	10	500.0	15	ug/L	03/18/05 WL
<b>Surrogates</b>				<b>Units</b>	<b>Control Limits</b>	
a,a,a-Trifluorotoluene	187			%	55 - 200	

PQL = Practical Quantitation Limit, MDL = Method detection limit, DF = Dilution Factor  
 ND = Not detected below indicated MDL, J=Trace



Order #: 604990

Client Sample ID: TOC #054 RE-3

Matrix: WATER

Date Sampled: 03/16/2005 Time Sampled: 13:00

Analyte	Result	DF	PQL	MDL	Units	Date/Analyst
---------	--------	----	-----	-----	-------	--------------

**8015M Ethanol / Methanol by GC-FID**

Ethanol	ND	1	50	20	mg/L	03/21/05 QN
Methanol	ND	1	50	20	mg/L	03/21/05 QN

**8260B BTEX/MTBE Only**

Benzene	ND	1	1	0.22	ug/L	03/20/05 LB
Ethyl benzene	ND	1	5	0.31	ug/L	03/20/05 LB
Ethyl-tertbutylether (ETBE)	ND	1	1	0.17	ug/L	03/20/05 LB
Isopropyl ether (DIPE)	ND	1	1	0.29	ug/L	03/20/05 LB
Methyl-tert-butylether (MTBE)	ND	1	1	0.18	ug/L	03/20/05 LB
Tert-amylmethylether (TAME)	ND	1	1	0.28	ug/L	03/20/05 LB
Tertiary butyl alcohol (TBA)	ND	1	10	10	ug/L	03/20/05 LB
Toluene	ND	1	5	0.32	ug/L	03/20/05 LB
Xylenes, total	ND	1	5	0.4	ug/L	03/20/05 LB

**Surrogates**

				Units	Control Limits
Surr1 - Dibromofluoromethane	89			%	70 - 130
Surr2 - 1,2-Dichloroethane-d4	93			%	70 - 130
Surr3 - Toluene-d8	98			%	70 - 130
Surr4 - p-Bromofluorobenzene	107			%	70 - 130

**8015M - Gasoline**

Gasoline	ND	1	50	15	ug/L	03/19/05 WL
----------	----	---	----	----	------	-------------

**Surrogates**

				Units	Control Limits
a,a,a-Trifluorotoluene	98			%	55 - 200

PQL = Practical Quantitation Limit, MDL = Method detection limit, DF = Dilution Factor  
 ND = Not detected below indicated MDL, J=Trace



Order #: 604991

Client Sample ID: TOC #054 RE-4

Matrix: WATER

Date Sampled: 03/16/2005 Time Sampled: 13:10

Analyte	Result	DF	PQL	MDL	Units	Date/Analyst
<b>8015M Ethanol / Methanol by GC-FID</b>						
Ethanol	ND	1	50	20	mg/L	03/21/05 QN
Methanol	ND	1	50	20	mg/L	03/21/05 QN
<b>8260B BTEX/MTBE Only</b>						
Benzene	2360	100	100.0	0.22	ug/L	03/20/05 LB
Ethyl benzene	1780	100	500.0	0.31	ug/L	03/20/05 LB
Ethyl-tertbutylether (ETBE)	ND	100	100.0	0.17	ug/L	03/20/05 LB
Isopropyl ether (DIPE)	ND	100	100.0	0.29	ug/L	03/20/05 LB
Methyl-tert-butylether (MTBE)	24400	100	100.0	0.18	ug/L	03/20/05 LB
Tert-amylmethylether (TAME)	354	100	100.0	0.28	ug/L	03/20/05 LB
Tertiary butyl alcohol (TBA)	ND	100	1000.0	10	ug/L	03/20/05 LB
Toluene	18900	100	500.0	0.32	ug/L	03/20/05 LB
Xylenes, total	17800	100	500.0	0.4	ug/L	03/20/05 LB
<b>Surrogates</b>				<b>Units</b>	<b>Control Limits</b>	
Surr1 - Dibromofluoromethane	87			%	70 - 130	
Surr2 - 1,2-Dichloroethane-d4	92			%	70 - 130	
Surr3 - Toluene-d8	99			%	70 - 130	
Surr4 - p-Bromofluorobenzene	112			%	70 - 130	
<b>8015M - Gasoline</b>						
Gasoline	110000	50	2500.0	15	ug/L	03/19/05 WL
<b>Surrogates</b>				<b>Units</b>	<b>Control Limits</b>	
a,a,a-Trifluorotoluene	143			%	55 - 200	

PQL = Practical Quantitation Limit, MDL = Method detection limit, DF = Dilution Factor  
 ND = Not detected below indicated MDL, J=Trace



Order #: 604992

Client Sample ID: TOC #054 RE-7

Matrix: WATER

Date Sampled: 03/16/2005 Time Sampled: 13:30

Analyte	Result	DF	PQL	MDL	Units	Date/Analyst
---------	--------	----	-----	-----	-------	--------------

**8015M Ethanol / Methanol by GC-FID**

Ethanol	ND	1	50	20	mg/L	03/21/05 QN
Methanol	ND	1	50	20	mg/L	03/21/05 QN

**8260B BTEX/MTBE Only**

Benzene	2840	100	100.0	0.22	ug/L	03/20/05 LB
Ethyl benzene	2760	100	500.0	0.31	ug/L	03/20/05 LB
Ethyl-tertbutylether (ETBE)	ND	100	100.0	0.17	ug/L	03/20/05 LB
Isopropyl ether (DIPE)	ND	100	100.0	0.29	ug/L	03/20/05 LB
Methyl-tert-butylether (MTBE)	29300	100	100.0	0.18	ug/L	03/20/05 LB
Tert-amylmethylether (TAME)	485	100	100.0	0.28	ug/L	03/20/05 LB
Tertiary butyl alcohol (TBA)	ND	100	1000.0	10	ug/L	03/20/05 LB
Toluene	19400	100	500.0	0.32	ug/L	03/20/05 LB
Xylenes, total	14400	100	500.0	0.4	ug/L	03/20/05 LB

**Surrogates**

				Units	Control Limits
Surr1 - Dibromofluoromethane	89			%	70 - 130
Surr2 - 1,2-Dichloroethane-d4	100			%	70 - 130
Surr3 - Toluene-d8	100			%	70 - 130
Surr4 - p-Bromofluorobenzene	105			%	70 - 130

**8015M - Gasoline**

Gasoline	114000	50	2500.0	15	ug/L	03/19/05 WL
----------	--------	----	--------	----	------	-------------

**Surrogates**

				Units	Control Limits
a,a,a-Trifluorotoluene	147			%	55 - 200

PQL = Practical Quantitation Limit, MDL = Method detection limit, DF = Dilution Factor  
 ND = Not detected below indicated MDL, J=Trace



Order #: 604993  
Matrix: WATER

Client Sample ID: TOC #054 RS-11  
Date Sampled: 03/16/2005 Time Sampled: 13:45

Analyte	Result	DF	PQL	MDL	Units	Date/Analyst
<b>8015M Ethanol / Methanol by GC-FID</b>						
Ethanol	ND	1	50	20	mg/L	03/21/05 QN
Methanol	ND	1	50	20	mg/L	03/21/05 QN
<b>8260B BTEX/MTBE Only</b>						
Benzene	ND	1	1	0.22	ug/L	03/21/05 LB
Ethyl benzene	ND	1	5	0.31	ug/L	03/21/05 LB
Ethyl-tertbutylether (ETBE)	ND	1	1	0.17	ug/L	03/21/05 LB
Isopropyl ether (DIPE)	1.2	1	1	0.29	ug/L	03/21/05 LB
Methyl-tert-butylether (MTBE)	16	1	1	0.18	ug/L	03/21/05 LB
Tert-amylmethylether (TAME)	ND	1	1	0.28	ug/L	03/21/05 LB
Tertiary butyl alcohol (TBA)	73	1	10	10	ug/L	03/21/05 LB
Toluene	ND	1	5	0.32	ug/L	03/21/05 LB
Xylenes, total	ND	1	5	0.4	ug/L	03/21/05 LB
<b>Surrogates</b>						<b>Units Control Limits</b>
Surr1 - Dibromofluoromethane	91				%	70 - 130
Surr2 - 1,2-Dichloroethane-d4	96				%	70 - 130
Surr3 - Toluene-d8	96				%	70 - 130
Surr4 - p-Bromofluorobenzene	109				%	70 - 130
<b>8015M - Gasoline</b>						
Gasoline	ND	1	50	15	ug/L	03/19/05 WL
<b>Surrogates</b>						<b>Units Control Limits</b>
a,a,a-Trifluorotoluene	103				%	55 - 200

PQL = Practical Quantitation Limit, MDL = Method detection limit, DF = Dilution Factor  
ND = Not detected below indicated MDL, J=Trace



Order #: 604994

Client Sample ID: TOC #054 RE-6

Matrix: WATER

Date Sampled: 03/16/2005 Time Sampled: 14:15

Analyte	Result	DF	PQL	MDL	Units	Date/Analyst
<b>8015M Ethanol / Methanol by GC-FID</b>						
Ethanol	ND	1	50	20	mg/L	03/21/05 QN
Methanol	ND	1	50	20	mg/L	03/21/05 QN
<b>8260B BTEX/MTBE Only</b>						
Benzene	630	10	10.0	0.22	ug/L	03/21/05 LB
Ethyl benzene	1590	10	50.0	0.31	ug/L	03/21/05 LB
Ethyl-tertbutylether (ETBE)	ND	10	10.0	0.17	ug/L	03/21/05 LB
Isopropyl ether (DIPE)	ND	10	10.0	0.29	ug/L	03/21/05 LB
Methyl-tert-butylether (MTBE)	4480	50	50.0	0.18	ug/L	03/21/05 LB
Tert-amylmethylether (TAME)	83	10	10.0	0.28	ug/L	03/21/05 LB
Tertiary butyl alcohol (TBA)	ND	10	100.0	10	ug/L	03/21/05 LB
Toluene	9470	50	250.0	0.32	ug/L	03/21/05 LB
Xylenes, total	10100	50	250.0	0.4	ug/L	03/21/05 LB
<b>Surrogates</b>					<b>Units</b>	<b>Control Limits</b>
Surr1 - Dibromofluoromethane	91				%	70 - 130
Surr2 - 1,2-Dichloroethane-d4	102				%	70 - 130
Surr3 - Toluene-d8	97				%	70 - 130
Surr4 - p-Bromofluorobenzene	109				%	70 - 130
<b>8015M - Gasoline</b>						
Gasoline	55000	20	1000.0	15	ug/L	03/19/05 WL
<b>Surrogates</b>					<b>Units</b>	<b>Control Limits</b>
a,a,a-Trifluorotoluene	122				%	55 - 200

PQL = Practical Quantitation Limit, MDL = Method detection limit, DF = Dilution Factor  
 ND = Not detected below indicated MDL, J=Trace



Order #: 604995

Client Sample ID: TOC #054 RE-9

Matrix: WATER

Date Sampled: 03/16/2005 Time Sampled: 14:40

Analyte	Result	DF	PQL	MDL	Units	Date/Analyst
<b>8015M Ethanol / Methanol by GC-FID</b>						
Ethanol	ND	1	50	20	mg/L	03/21/05 QN
Methanol	ND	1	50	20	mg/L	03/21/05 QN
<b>8260B BTEX/MTBE Only</b>						
Benzene	ND	1	1	0.22	ug/L	03/21/05 LB
Ethyl benzene	ND	1	5	0.31	ug/L	03/21/05 LB
Ethyl-tertbutylether (ETBE)	ND	1	1	0.17	ug/L	03/21/05 LB
Isopropyl ether (DIPE)	ND	1	1	0.29	ug/L	03/21/05 LB
Methyl-tert-butylether (MTBE)	2.1	1	1	0.18	ug/L	03/21/05 LB
Tert-amylmethylether (TAME)	ND	1	1	0.28	ug/L	03/21/05 LB
Tertiary butyl alcohol (TBA)	ND	1	10	10	ug/L	03/21/05 LB
Toluene	1.1 J	1	5	0.32	ug/L	03/21/05 LB
Xylenes, total	ND	1	5	0.4	ug/L	03/21/05 LB
<b>Surrogates</b>				<b>Units</b>	<b>Control Limits</b>	
Surr1 - Dibromofluoromethane	87			%	70 - 130	
Surr2 - 1,2-Dichloroethane-d4	97			%	70 - 130	
Surr3 - Toluene-d8	98			%	70 - 130	
Surr4 - p-Bromofluorobenzene	115			%	70 - 130	
<b>8015M - Gasoline</b>						
Gasoline	ND	1	50	15	ug/L	03/19/05 WL
<b>Surrogates</b>				<b>Units</b>	<b>Control Limits</b>	
a,a,a-Trifluorotoluene	84			%	55 - 200	

PQL = Practical Quantitation Limit, MDL = Method detection limit, DF = Dilution Factor  
 ND = Not detected below indicated MDL, J=Trace



Order #: 604996  
Matrix: WATER

Client Sample ID: Trip Blank  
Date Sampled: 03/16/2005

Analyte	Result	DF	PQL	MDL	Units	Date/Analyst
<b>8260B BTEX/MTBE Only</b>						
Benzene	ND	1	1	0.22	ug/L	03/21/05 LB
Ethyl benzene	ND	1	5	0.31	ug/L	03/21/05 LB
Toluene	ND	1	5	0.32	ug/L	03/21/05 LB
Xylenes, total	ND	1	5	0.4	ug/L	03/21/05 LB
<b>8015M - Gasoline</b>						
Gasoline	ND	1	50	15	ug/L	03/19/05 WL
<b>Surrogates</b>						
a,a,a-Trifluorotoluene	101				%	55 - 200

PQL = Practical Quantitation Limit, MDL = Method detection limit, DF = Dilution Factor  
ND = Not detected below indicated MDL, J=Trace





Order #: 604997

Client Sample ID: Laboratory Method Blank

Matrix: WATER

Analyte	Result	DF	PQL	MDL	Units	Date/Analyst
<b>8015M Ethanol / Methanol by GC-FID</b>						
Ethanol	ND	1	50	20	mg/L	03/21/05 QN
Methanol	ND	1	50	20	mg/L	03/21/05 QN
<b>8260B BTEX/MTBE Only</b>						
Benzene	ND	1	1	0.22	ug/L	03/20/05 LB
Ethyl benzene	ND	1	5	0.31	ug/L	03/20/05 LB
Ethyl-tertbutylether (ETBE)	ND	1	1	0.17	ug/L	03/20/05 LB
Isopropyl ether (DIPE)	ND	1	1	0.29	ug/L	03/20/05 LB
Methyl-tert-butylether (MTBE)	ND	1	1	0.18	ug/L	03/20/05 LB
Tert-amylmethylether (TAME)	ND	1	1	0.28	ug/L	03/20/05 LB
Tertiary butyl alcohol (TBA)	ND	1	10	10	ug/L	03/20/05 LB
Toluene	ND	1	5	0.32	ug/L	03/20/05 LB
Xylenes, total	ND	1	5	0.4	ug/L	03/20/05 LB
<b>Surrogates</b>				<b>Units</b>	<b>Control Limits</b>	
Surr1 - Dibromofluoromethane	86			%	70 - 130	
Surr2 - 1,2-Dichloroethane-d4	102			%	70 - 130	
Surr3 - Toluene-d8	97			%	70 - 130	
Surr4 - p-Bromofluorobenzene	110			%	70 - 130	
<b>8015M - Gasoline</b>						
Gasoline	ND	1	50	15	ug/L	03/19/05 WL
<b>Surrogates</b>				<b>Units</b>	<b>Control Limits</b>	
a,a,a-Trifluorotoluene	86			%	55 - 200	

PQL = Practical Quantitation Limit, MDL = Method detection limit, DF = Dilution Factor  
 ND = Not detected below indicated MDL, J=Trace



**ASSOCIATED LABORATORIES  
LCS REPORT FORM**

QC Sample: LCS/LCSD  
 Matrix: WATER  
 Prep. Date: March 18, 2005  
 Analysis Date: March 18 - 19, 2005  
 ID#'s in Batch: LR 147153, 147195, 147144, 147170, 147137

**LAB CONTROLLED SPIKE / LAB CONTROLLED DUPLICATE RESULT**

Reporting Units = mg/L

Test	Method	Method Blank	Spike Added	LCS Spike	LCSD Spk. Dup	%Rec LCS	%Rec LCSD	RPD
TPH	8015M-G	ND	500	510	504	102	101	1

ND = Not Detected

LCS Result = Lab Control Sample Result

%REC-LCS & LCSD = Percent Recovery of LCS Spike & LCS Spike Duplicate

RPD = Relative Percent Difference of LCS Spike and LCS Spike Duplicate

%REC LIMITS = 70 - 130
RPD LIMITS = 30

**SURROGATE RECOVERY**

Sample No.	AAA-TFT
QC Limit	55-200
Method Blank	110
LCS	155
LCSD	160

AAA-TFT = a,a,a-Trifluorotoluene

**ASSOCIATED LABORATORIES  
LCS REPORT FORM**

QC Sample: LCS/LCSD  
 Matrix: WATER  
 Prep. Date: March 18, 2005  
 Analysis Date: March 18 - 19, 2005  
 ID#'s in Batch: LR 147167, 147169, 147171, 147144, 147170, 147153

**LAB CONTROLLED SPIKE / LAB CONTROLLED DUPLICATE RESULT**

Reporting Units = mg/L

Test	Method	Method Blank	Spike Added	LCS Spike	LCSD Spk. Dup	%Rec LCS	%Rec LCSD	RPD
TPH	8015M-G	ND	500	529	501	106	100	5

*ND = Not Detected*

*LCS Result = Lab Control Sample Result*

*%REC-LCS & LCSD = Percent Recovery of LCS Spike & LCS Spike Duplicate*

*RPD = Relative Percent Difference of LCS Spike and LCS Spike Duplicate*

<i>%REC LIMITS = 70 - 130</i>
<i>RPD LIMITS = 30</i>

**SURROGATE RECOVERY**

Sample No.	AAA-TFT
QC Limit	55-200
Method Blank	86
LCS	180
LCSD	165

*AAA-TFT = a, a, a-Trifluorotoluene*

**ASSOCIATED LABORATORIES  
LCS REPORT FORM**

QC Sample: LCS / LCSD  
 Matrix: WATER  
 Prep. Date: 03/21/05  
 Analysis Date: 03/21/05  
 ID#'s in Batch: LR 147137; LR 147153

**LAB CONTROL SPIKE / LAB CONTROL SPIKE DUPLICATE RESULT**

Reporting Units = mg/L

Test	Method	Blank Result	Spike Added	LCS Spike	LCSD Spike Dup	%Rec LCS	%Rec LCSD	% RPD
Methanol	D285	ND	100	113.3	108.0	113	108	5
Ethanol	D285	ND	100	106.5	102.1	107	102	4

*RPD = Relative Percent Difference of LCS Spike and LCS Spike Duplicate*  
*%REC-LCS & LCSD = Percent Recovery of LCS Spike & LCS Spike Duplicate*

<p><i>% REC LIMITS = 70 - 130</i>  <i>RPD LIMITS = 25</i></p>
---

**Method Blank - All ND**

**ASSOCIATED LABORATORIES**  
**QA REPORT FORM - METHOD 8260 / 624 / 524.2**

QC Sample: MS / MSD - Water Samples 147195-102  
 Analysis Date: March 22, 2005 1:15 AM  
 Applies to: LR 146958, 147044, 146959, 147137, 147136, 147195, 147153

Reporting Units = ug/L

**Matrix Spike / Matrix Spike Duplicate**

Test	Sample Result	Spike Added	Matrix Spike	Matrix Spk Dup.	%Rec MS	%Rec MSD	RPD	QC Limits	
								RPD	%REC
1,1-Dichloroethene	ND	50	46.18	46.23	92	92	0	22	59-172
MTBE	ND	50	43.78	43.35	88	87	1	24	62-137
Benzene	ND	50	48.74	50.65	97	101	4	24	62-137
Trichloroethene	ND	50	42.80	41.13	86	82	4	21	66-142
Toluene	ND	50	52.02	50.67	104	101	3	21	59-139
Chlorobenzene	ND	50	51.15	49.68	102	99	3	21	60-133

QC Sample: LCS/LCSD 7:28 AM  
 Analysis Date: March 22, 2005

**Lab Controlled Spike / Lab Controlled Spike Duplicate**

Test	Sample Result	Spike Added	LCS Spike	LCS Spk Dup.	%Rec LCS	%Rec LCS D	RPD	QC Limits	
								RPD	%REC
1,1-Dichloroethene	ND	50	43.20	43.58	86	87	1	22	59-172
MTBE	ND	50	43.34	44.45	87	89	3	24	62-137
Benzene	ND	50	47.58	48.54	95	97	2	24	62-137
Trichloroethene	ND	50	40.47	41.57	81	83	3	21	66-142
Toluene	ND	50	48.15	50.23	96	100	4	21	59-139
Chlorobenzene	ND	50	45.74	50.66	91	101	10	21	60-133

Method Blank = All ND

**SURROGATE ( QC Limits : 70-135 )**

Compound	MB 1	MS	MS	MSD	LCS	LCSD
DBFM	91	93	91	94	87	91
1,2-DCA	93	97	97	99	87	82
Tol-d8	101	97	100	97	99	98
p-BFB	108	108	103	105	102	105



**ASSOCIATED LABORATORIES**

806 North Batavia - Orange, California 92868-1225 - 714/771-6900 FAX 714/538-1209

### Cooler Receipt Form

Client: Thripky Project: \_\_\_\_\_

Date Cooler Received: \_\_\_\_\_ Date Cooler Opened: \_\_\_\_\_

Was cooler scanned for presence of radioactivity? Yes/No  
If yes was radioactivity results above 25 cpm? Yes/No

Was a shipper's packing slip attached to the cooler? Yes/No

If the cooler had custody seal(s), were they signed and intact? Yes/No/Na

Was the cooler packed with: Ice X Ice Packs \_\_\_\_\_ Bubble wrap \_\_\_\_\_  
Styrofoam \_\_\_\_\_ Paper \_\_\_\_\_ None \_\_\_\_\_ Other \_\_\_\_\_

Cooler Temperature: 6.500 \*

\*cooler needs to be received @ 4°C with an acceptable range of 2°- 6 °C

If samples were hand delivered do they meet the temp. criteria, which should be @ 4°C with an acceptable range of 2°- 6 °C? Yes/No

If no explain: \_\_\_\_\_

Were all samples sealed in plastic bags? Yes/No

Did all samples arrive intact? If no, indicate below. Yes/No

Were all samples labeled correctly? (ID's Dates, Times) If no, indicate below. Yes/No

Can the tests required be ran with the provided containers, If no indicate below. Yes/No

Was sufficient sample volume sent for all containers? Yes/No

Were any VOA vials received with head space? Yes/No/Na

Was the correct preservatives used? Yes/No/Na  
If no, see the pH log for a list of samples containers regarding pH

Any other important information: \_\_\_\_\_

Receiving Department: \_\_\_\_\_ Date: 3/17/05

# Chain of Custody Record

**ASSOCIATED LABORATORIES**

806 North Batavia ■ Orange, CA 92868

Phone: (714) 771-6900 ■ Fax: (714) 538-1209



147153

Company <b>THRIFTY OIL CO.</b>		Phone <b>(562) 921-3581</b>		A.L. Job No.		Page _____ of _____	
Project Manager <b>JEFF SUPYAKUSUMA</b>		Fax <b>(562) 921-7510</b>		Project # <b>054</b>		Analysis Requested	
Project Name <b>Q. W. S.</b>		Site Name and Address <b>2504 CASTRO VALLEY BLVD. CASTRO VALLEY CA 94546</b>		TPWA (8015M) BYTEX (8260B) TOXICOLOGICAL		Test Instructions & Comments	
Sample ID	Lab ID	Date	Time	Matrix	Container Number/Size	Pres.	
1 PW-1		03-16-04	12:40	H <sub>2</sub> O	3-VOA	HCL	X X X
2 RE-2			12:50				X X X
3 RE-3			13:00				X X X
4 RE-4			13:10				X X X
5 RE-7			13:30				X X X
6 RS-11			13:45				X X X
7 RE-6			14:15				X X X
8 RE-9			14:40				X X X
9 TRIP BLANK			00:00		2-VOA		X X
10							
11							
12							
13							
14							
15							

T-0600/101363

ANALYSIS REQUIRED FOR COMPOUNDS USED IN CA. GASOLINE BY EPA METHOD 8260B

1-METHANOL  
2-ETHANOL  
3-TERTIARY BUTANOL  
4-MTBE  
5-D?PE  
6-ETBE  
7-TAME

<b>Sample Receipt - To Be Filled By Laboratory</b>				Relinquished by Sampler: <b>EMC</b> 1.	Relinquished by <b>GOLDEN STATE</b> 2.	Relinquished by 3.
Total Number of Containers	Properly Cooled Y/N/NA	Samples Intact Y/N/NA	Samples Accepted Y/N	Signature: <i>[Signature]</i>	Signature: <i>[Signature]</i>	Signature:
Custody Seals Y/N/NA				Printed Name: <b>SERRAN POPPICO</b>	Printed Name:	Printed Name:
Received in Good Condition Y/N				Date: <b>03-16-04</b> Time: <b>17:00</b>	Date: Time:	Date: Time:
<b>Turn Around Time</b>				Received By: <b>GOLDEN STATE</b> 1.	Received By: 2.	Received By: 3.
<input checked="" type="checkbox"/> Normal	<input type="checkbox"/> Rush	<input type="checkbox"/> Same Day	<input type="checkbox"/> 48 hrs.	Signature: <i>[Signature]</i>	Signature: <i>[Signature]</i>	Signature:
		<input type="checkbox"/> 24 hrs.	<input type="checkbox"/> 72 hrs.	Printed Name:	Printed Name:	Printed Name:
				Date: Time:	Date: <b>3/17/05</b> Time: <b>9:29</b>	Date: Time:

2-5770.1-1:40