

THRIFTY OIL CO.



O.51120

October 19, 2004

Mr. Amir Gholami
Alameda County Health Care Agency
Hazardous Material Specialist
1131 Harbor Bay Parkway, Suite 250
Alameda, CA 94502

Local #1252
RWQCB #01-1476
Global ID #T0600101363
Confirmation #7181681752

RE: **Former Thrifty Oil Co. Station #054**
TOSCO Station #2602486
2504 Castro Valley Boulevard
Castro Valley, CA
3rd Quarter 2004, Status Report

Alameda County Health Care Agency
OCT 22 2004

Dear Mr. Gholami:

Presented herein is the Third Quarter 2004, Status Report prepared for Former Thrifty Oil Co. (Thrifty) Station #054 located at 2504 Castro Valley Boulevard, Castro Valley, California (**Figure 1**). This report presents the results of the groundwater monitoring activities conducted during the third quarter of 2004. During the current quarter, Thrifty retained Blaine Tech Services (BTS) to conduct quarterly groundwater monitoring and sampling activities at this site.

Groundwater Monitoring

Depth to groundwater is measured in each monitoring well quarterly. Historic groundwater gauging data obtained from April 11, 1988 through September 2, 2004, is presented in **Table 1**. In general, groundwater occurs beneath the station at depths ranging from 3.68 feet below top of casing (btc) in monitoring well RS-9 to 8.23 feet btc in monitoring well RS-8 (**Appendix A**). A groundwater elevation contour map based on the September 2, 2004, data is presented in **Figure 1**. Groundwater elevation data indicates that the general direction of groundwater flow beneath the site is toward the east-northeast with a hydraulic gradient of approximately 0.0261 feet/foot.

Quarterly Groundwater Sampling

As part of the ongoing groundwater-monitoring program, groundwater samples were obtained from selected monitoring wells PW-1, RE-2, RE-3, RE-4, RE-6, RE-7, RS-9, and RS-11 on June 9 and 10, 2004. In a letter from the Alameda County Health Care Agency (ACHCA) dated November 6, 2001, the ACHCA released Thrifty from collecting groundwater samples from wells PW-2, RE-1, RE-5, RS-8, and RS-10 until further notice.

Groundwater samples were obtained by EMC and delivered in a chilled state in an ice chest following strict Chain-of-Custody procedures to a state-certified laboratory. The samples were analyzed for total petroleum hydrocarbons as gasoline (TPHg) by EPA Method 8015M for gasoline and for benzene, toluene, ethylbenzene, xylenes (BTEX) and methyl tert-butyl ether (MTBE) by EPA Method 8021B. Copies of the BTS Field Status Reports are presented in **Appendix A**, and copies of the laboratory analytical reports are contained in **Appendix B**.

TPHg, BTEX, and MTBE concentrations appear in **Table 1** and laboratory reports are provided in **Appendix B**. TPHg, benzene, and MTBE isoconcentration maps are presented in **Figures 2, 3, and 4**,



respectively. The highest laboratory analytical concentrations for TPHg and benzene concentrations were found in well RE-7 (35,700 ug/L and 2,390 ug/L, respectively). The highest MTBE concentration was found in monitoring well RE-3 (4,360 ug/L). MTBE was confirmed using EPA Method 8260B.

Based on a survey of top of casing elevations performed by Morrow Surveying in October 2003, it was confirmed and Thrifty again reiterates that well RS-9 is located upgradient of the Thrifty site, and contamination found in this well and onsite wells (RE-2 and RE-6) appears to be originating from an upgradient off-site source. TOSCO Marketing Company is the current operator of the service station and acquired the lease from BP Oil, who previously leased the property beginning on July 10, 1991.

The presence of MTBE in groundwater indicates a post 1991 release since Thrifty did not dispense MTBE blended gasoline during its operation. Thrifty's refinery (Golden West Refining Co.) began using MTBE in gasoline manufacturing processes in October 1992 when this site was already operated by BP Oil and later by TOSCO.

Evidence of New/Recent Release or Possible Presence of an Active Source

Contamination (TPHg, benzene, and MTBE) spikes initially found during the second quarter 2004 in onsite wells RE-3, RE-7 and offsite well RS-11 were confirmed during the current quarter with significant increases in TPHg in wells RE-6 and RE-7 and benzene in wells RE-3 and RE-7. In addition, during the current quarter, new TPHg, benzene, and MTBE spikes were detected in wells PW-1, RE-2, and RE-4 that further suggests that a recent release may have occurred. Wells RE-6 and RE-7 are located immediately downgradient of the pump islands, and wells RE-3 and RE-4 are located downgradient of the underground storage tanks (USTs). Offsite well RS-11 is located downgradient of both the pump islands and USTs. It is Thrifty's position that if further assessment becomes necessary, it should be the responsibility of the current station operator, who should also be required to provide the results of all UST system testing, maintenance, and repair records for the last two years of operation.

Planned Activities

Thrifty will continue the groundwater monitoring, gauging, and sampling events at this site on a quarterly basis. All interpretations expressed in this report are based solely upon the review of data collected by BTS and laboratory analyses by Associated Laboratories.

Respectfully submitted,

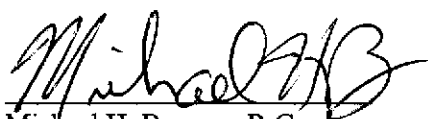

Michael H. Bowery, R.G.
Project Manager

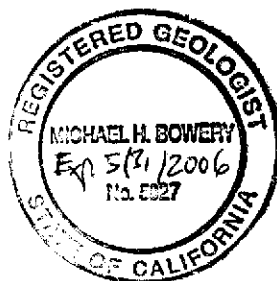

Chris Panaitescu
General Manager
Environmental Affairs

- cc:
- Erika Assadi, SRWQCB (USTCF)
 - Liz Sewell, TOSCO Marketing Company
76 Broadway
Sacramento CA 95818
 - File

TABLE

TABLE 1
GROUNDWATER DATA
THRIFTY OIL STATION #054, CASTRO VALLEY, CA.

DATE SAMPLED	ANALYTICAL PARAMETERS						DEPTH TO GROUNDWATER (feet)	DEPTH TO PRODUCT (feet)	PRODUCT THICKNESS (feet)	CASING ELEVATION (feet)	GROUNDWATER ELEVATION (feet)
	TPH (ug/L)	BENZENE (ug/L)	TOLUENE (ug/L)	Ethylbenzene (ug/L)	XYLENE (ug/L)	MTBE (ug/L)					
MONITORING WELL #PW-1											
<i>Screen Interval = 5 to 15 feet (Est.)</i>											
04/11/88	-	-	-	-	-	-	-	-	-	-	-
04/09/90	230,000	600	2,700	1,000	16,000	-	5.10	NP	0.00	166.46	161.36
10/30/90	35,000	240	970	240	3,580	-	6.17	NP	0.00	166.46	160.29
01/18/91	37,000	43	140	42	1,600	-	6.28	NP	0.00	166.46	160.18
02/12/91	45,000	99	130	25	700	-	5.88	NP	0.00	166.46	160.58
03/20/91	1,900	0.43	ND	ND	2.8	-	4.75	NP	0.00	166.46	161.71
05/22/91	41,000	600	730	250	3,800	-	5.10	NP	0.00	166.46	161.36
06/19/91	-	-	-	-	-	-	5.61	NP	0.00	166.46	160.85
07/17/91	-	-	-	-	-	-	5.53	FILM	0.00	166.46	160.93
08/07/91	-	-	-	-	-	-	5.67	FILM	0.00	166.46	160.79
09/24/91	-	-	-	-	-	-	5.57	FILM	0.00	166.46	160.89
10/23/91	-	-	-	-	-	-	6.53	FILM	0.00	166.46	159.93
11/06/91	-	-	-	-	-	-	5.85	FILM	0.00	166.46	160.61
12/04/91	-	-	-	-	-	-	5.91	FILM	0.00	166.46	160.55
01/29/92	-	-	-	-	-	-	5.43	FILM	0.00	166.46	161.03
02/26/92	-	-	-	-	-	-	5.54	FILM	0.00	166.46	160.92
03/19/92	ND	ND	ND	ND	ND	-	5.47	NP	0.00	166.46	160.99
04/22/92	-	-	-	-	-	-	5.62	FILM	0.00	166.46	160.84
05/21/92	1,300	19	2.9	0.7	58	-	6.21	NP	0.00	166.46	160.25
06/25/92	-	-	-	-	-	-	6.94	NP	0.00	166.46	159.52
07/30/92	-	-	-	-	-	-	5.90	FILM	0.00	166.46	160.56
08/20/92	-	-	-	-	-	-	7.12	FILM	0.00	166.46	159.34
09/30/92	3,400	57	ND	26	240	-	6.42	NP	0.00	166.46	160.04
12/23/92	-	-	-	-	-	-	5.56	FILM	0.00	166.46	160.90
03/10/93	-	-	-	-	-	-	5.65	FILM	0.00	166.46	160.81
06/09/93	400	<0.5	1.1	<1.0	<1.0	-	5.30	NP	0.00	166.46	161.16
09/14/93	180	3.7	3.2	1.5	14	-	5.43	NP	0.00	166.46	161.03
12/14/93	<50	<0.3	<0.3	<0.3	<0.5	-	4.65	NP	0.00	166.46	161.81
03/02/94	<50	<0.3	<0.3	<0.3	<0.5	-	5.43	NP	0.00	166.46	161.03
06/06/94	330	1.3	<0.3	0.88	9.8	-	4.70	NP	0.00	166.46	161.76
09/06/94	1,100	67	<0.3	<0.3	24	-	6.48	NP	0.00	166.46	159.98
12/07/94	<50	<0.3	<0.3	<0.5	<0.5	-	5.22	NP	0.00	166.46	161.24
03/08/95	<100	<0.5	<0.5	<0.5	<1	-	6.94	NP	0.00	166.46	159.52
06/15/95	260	0.8	0.6	<0.5	3.2	-	5.72	NP	0.00	166.46	160.74
09/05/95	330	2.1	<0.5	2.1	9.6	-	5.96	NP	0.00	166.46	160.50
11/21/95	660	13	1.3	<0.3	4.0	-	6.04	NP	0.00	166.46	160.42
03/11/96	660	0.94	0.77	<0.3	8.1	-	3.60	NP	0.00	166.46	162.86

TABLE 1
GROUNDWATER DATA
THRIFTY OIL STATION #054, CASTRO VALLEY, CA.

DATE SAMPLED	ANALYTICAL PARAMETERS						DEPTH TO GROUNDWATER (feet)	DEPTH TO PRODUCT (feet)	PRODUCT THICKNESS (feet)	CASING ELEVATION (feet)	GROUNDWATER ELEVATION (feet)
	TPH (ug/L)	BENZENE (ug/L)	TOLUENE (ug/L)	EthylBenzene (ug/L)	XYLENE (ug/L)	MTBE (ug/L)					
06/19/96	120	0.53	<0.3	<0.3	2.3	-	4.80	NP	0.00	166.46	161.66
09/16/96	<50	<0.3	<0.3	<0.3	<0.5	<20	5.10	NP	0.00	166.46	161.36
12/10/96	<50	<0.3	<0.3	<0.3	<0.5	<20	4.92	NP	0.00	166.46	161.54
03/12/97	<50	<0.3	<0.3	<0.3	<0.5	<20	4.50	NP	0.00	166.46	161.96
06/12/97	<50	<0.3	<0.3	<0.3	<0.5	<20	-	-	-	-	-
09/16/97	690	0.97	<0.3	<0.3	<0.5	<20	4.55	NP	0.00	166.46	161.91
12/09/97	640	150	0.64	<0.3	5.2	1,300	5.60	NP	0.00	166.46	160.86
03/03/98	<50	<0.3	0.57	<0.3	<0.5	<20	4.13	NP	0.00	166.46	162.33
07/08/98	<50	<0.3	<0.3	<0.3	<0.5	<5	-	-	-	-	-
09/10/98	<50	<0.3	<0.3	<0.3	<0.5	<5	6.35	NP	0.00	166.46	160.11
12/30/98	<50	1.1	<0.3	<0.3	<0.5	<5	6.40	NP	0.00	166.46	160.06
03/15/99	<50	<0.3	<0.3	<0.3	<0.5	<5	6.35	NP	0.00	166.46	160.11
06/22/99	<50	<0.3	<0.3	<0.3	<0.5	53	4.95	NP	0.00	166.46	161.51
09/08/99	<50	<0.3	<0.3	<0.3	<0.5	<5	4.80	NP	0.00	166.46	161.66
12/01/99	<50	<0.3	<0.3	<0.3	<0.5	<5	3.64	NP	0.00	166.46	162.82
03/23/00	<50	0.5	0.5	1.1	<0.5	<5	4.03	NP	0.00	166.46	162.43
06/08/00	<50	<5	<5	<5	<5	<5	4.40	NP	0.00	166.46	162.06
09/27/00	<50	<0.18	<0.14	<0.18	<0.26	<0.24	4.73	NP	0.00	166.46	161.73
12/13/00	<50	<0.18	<0.14	<0.18	<0.26	<0.24	4.01	NP	0.00	166.46	162.45
03/22/01	600	<0.18	1.3	<0.18	<0.26	*1,010 / 1,970	6.32	NP	0.00	166.46	160.14
06/15/01	<50	<0.18	<0.14	<0.18	<0.26	<0.24	6.32	NP	0.00	166.46	160.14
08/30/01	<50	<0.18	<0.14	<0.18	<0.26	<0.24	6.32	NP	0.00	166.46	160.14
12/12/01	<50	<0.18	<0.14	<0.18	<0.26	<0.24	6.02	NP	0.00	166.46	160.44
03/13/02	<50	<0.18	<0.14	<0.18	<0.26	<0.24	6.30	NP	0.00	166.46	160.16
06/12/02	1,320	1	1	<0.18	2	2,060	6.30	NP	0.00	166.46	159.40
09/18/02	<50	<0.18	<0.14	<0.18	<0.26	<0.24	7.06	NP	0.00	166.46	159.40
12/18/02	113	<0.18	1.1	<0.18	<0.26	89	6.30	NP	0.00	166.46	160.16
03/19/03	<15	<0.04	2.2	<0.02	2.7	<0.03	6.35	NP	0.00	166.46	160.11
06/11/03	<15	<0.04	<0.02	<0.02	<0.06	<0.03	6.35	NP	0.00	166.46	160.11
09/04/03	<15	<0.22	<0.32	<0.31	<0.4	<0.18	5.90	NP	0.00	166.46	160.56
12/04/03	<15	<0.04	<0.02	<0.02	<0.06	<0.03	3.38	NP	0.00	165.95	162.57
03/18/04	<15	<0.22	<0.32	<0.31	<0.4	<0.18	5.51	NP	0.00	165.95	160.44
06/09/04	<15	<0.14	<0.16	<0.18	<0.45	<0.22	5.35	NP	0.00	165.95	160.60
09/02/04	133	<0.14	2.4	<0.18	1.9	<0.22	6.33	NP	0.00	165.95	159.62

TABLE 1
GROUNDWATER DATA
THRIFTY OIL STATION #054, CASTRO VALLEY, CA.

DATE SAMPLED	ANALYTICAL PARAMETERS						DEPTH TO GROUNDWATER (feet)	DEPTH TO PRODUCT (feet)	PRODUCT THICKNESS (feet)	CASING ELEVATION (feet)	GROUNDWATER ELEVATION (feet)
	TPH (ug/L)	BENZENE (ug/L)	TOLUENE (ug/L)	EthylBenzene (ug/L)	XYLENE (ug/L)	MTBE (ug/L)					
MONITORING WELL PW-2											
<i>Screen Interval = 5 to 15 feet (Est)</i>											
04/11/88	-	-	-	-	-	-	-	-	-	-	-
04/09/90	600,000	1,300	11,000	4,600	4,300	-	5.81	NP	0.00	166.18	160.37
10/30/90	48,000	310	51	10	480	-	6.95	NP	0.00	166.18	159.23
01/18/91	86,000	230	1,400	350	8,300	-	6.92	NP	0.00	166.18	159.26
02/12/91	160,000	680	1,300	250	7,000	-	6.78	NP	0.00	166.18	159.40
03/20/91	17,000	34	50	ND	1,100	-	5.54	NP	0.00	166.18	160.64
05/22/91	14,000	57	2,100	500	8,200	-	6.07	NP	0.00	166.18	160.11
06/19/91	-	-	-	-	-	-	6.37	FILM	0.00	166.18	159.81
07/17/91	-	-	-	-	-	-	6.38	FILM	0.00	166.18	159.80
08/07/91	-	-	-	-	-	-	6.63	FILM	0.00	166.18	159.55
09/24/91	-	-	-	-	-	-	6.42	FILM	0.00	166.18	159.76
10/23/91	-	-	-	-	-	-	6.42	FILM	0.00	166.18	159.76
11/06/91	-	-	-	-	-	-	7.25	FILM	0.00	166.18	158.93
12/04/91	-	-	-	-	-	-	6.44	FILM	0.00	166.18	159.74
01/29/92	-	-	-	-	-	-	6.65	FILM	0.00	166.18	159.53
02/26/92	-	-	-	-	-	-	6.17	FILM	0.00	166.18	160.01
03/19/92	-	-	-	-	-	-	6.17	FILM	0.00	166.18	160.28
04/22/92	-	-	-	-	-	-	5.90	FILM	0.00	166.18	160.38
05/21/92	-	-	-	-	-	-	5.80	FILM	0.00	166.18	160.30
06/25/92	-	-	-	-	-	-	5.88	FILM	0.00	166.18	160.30
07/30/92	-	-	-	-	-	-	6.03	FILM	0.00	166.18	160.15
08/20/92	-	-	-	-	-	-	6.03	FILM	0.00	166.18	160.15
09/30/92	-	-	-	-	-	-	6.57	FILM	0.00	166.18	159.61
12/23/92	-	-	-	-	-	-	6.57	FILM	0.00	166.18	159.98
03/10/93	-	-	-	-	-	-	6.20	FILM	0.00	166.18	159.98
06/09/93	3,400	24	22	<0.5	240	-	6.20	FILM	0.00	166.18	159.54
09/14/93	4,900	190	15	6.8	480	-	6.64	FILM	0.00	166.18	159.30
12/14/93	1,700	4.2	<0.3	<0.3	<0.5	-	6.88	FILM	0.00	166.18	159.30
03/02/94	-	-	-	-	-	-	6.08	FILM	0.00	166.18	160.10
06/06/94	980	25	1.2	<0.3	42	-	6.08	FILM	0.00	166.18	160.23
09/06/94	3,200	95	3.0	<1.7	76	-	5.95	FILM	0.00	166.18	160.80
12/07/94	510	1.8	<0.3	<0.5	1.7	-	5.38	NP	0.00	166.18	160.80
03/08/95	1,900	<0.5	<0.5	1.4	35	-	6.26	NP	0.00	166.18	159.92
06/15/95	1,700	5.6	<0.5	<0.5	1.6	-	5.22	NP	0.00	166.18	160.96
09/05/95	2,500	33	1.0	0.86	18	-	5.75	FILM	0.00	166.18	160.43
11/21/95	2,800	130	59	18	190	-	5.25	NP	0.00	166.18	160.93
03/11/96	13,000	330	460	<15	3,800	-	5.25	NP	0.00	166.18	160.93
							5.25	NP	0.00	166.18	159.38
							6.80	NP	0.00	166.18	160.61
							5.57	NP	0.00	166.18	162.08
							4.10	NP	0.00	166.18	160.74
							5.44	NP	0.00	166.18	160.05
							6.13	NP	0.00	166.18	159.95
							6.23	NP	0.00	166.18	161.70
							4.48	NP	0.00	166.18	161.70

**TABLE 1
GROUNDWATER DATA
THRIFTY OIL STATION #054, CASTRO VALLEY, CA.**

DATE SAMPLED	ANALYTICAL PARAMETERS						DEPTH TO GROUNDWATER (feet)	DEPTH TO PRODUCT (feet)	PRODUCT THICKNESS (feet)	CASING ELEVATION (feet)	GROUNDWATER ELEVATION (feet)
	TPH (ug/L)	BENZENE (ug/L)	TOLUENE (ug/L)	EthylBenzene (ug/L)	XYLENE (ug/L)	MTBE (ug/L)					
06/19/96	1,400	<0.3	<0.3	<0.3	<0.5	-	5.38	NP	0.00	166.18	160.80
09/16/96	3,500	<0.3	<0.3	<0.3	<0.5	5,900	5.21	NP	0.00	166.18	160.97
12/10/96	2,100	<0.3	<0.3	<0.3	<0.5	4,700	4.87	NP	0.00	166.18	161.31
03/12/97	600	1.6	<0.3	<0.3	5.8	1,100	4.43	NP	0.00	166.18	161.75
06/12/97	270	<0.3	<0.3	<0.3	<0.5	630	-	-	-	-	-
09/10/97	220	<0.3	<0.3	<0.3	<0.5	320	4.07	NP	0.00	166.18	162.11
12/09/97	120	<0.3	0.73	<0.3	<0.5	420	5.20	NP	0.00	166.18	160.98
03/03/98	<50	0.43	0.48	<0.3	<0.5	47	3.30	NP	0.00	166.18	162.88
07/08/98	<50	<0.3	<0.3	<0.3	<0.5	<5	-	-	-	-	-
09/10/98	<50	<0.3	<0.3	<0.3	<0.5	<5	5.15	NP	0.00	166.18	161.03
12/30/98	<50	1.1	<0.3	<0.3	<0.5	<5	4.75	NP	0.00	166.18	161.43
03/15/99	<50	<0.3	<0.3	<0.3	<0.5	<5	4.40	NP	0.00	166.18	161.78
06/22/99	-	-	-	-	-	-	4.50	NP	0.00	166.18	161.68
09/08/99	100	<0.3	<0.3	<0.3	<0.5	230	3.99	NP	0.00	166.18	162.19
12/01/99	<50	<0.3	<0.3	<0.3	<0.5	<5	3.62	NP	0.00	166.18	162.56
03/23/00	<50	<0.25	<0.25	<0.25	<0.5	<5	2.93	NP	0.00	166.18	163.25
06/08/00	<50	<5	<5	<5	<5	<5	3.60	NP	0.00	166.18	162.58
09/27/00	<50	<0.18	<0.14	<0.18	<0.26	<0.24	3.61	NP	0.00	166.18	162.57
12/13/00	<50	<0.18	<0.14	<0.18	<0.26	<0.24	3.60	NP	0.00	166.18	162.58
03/22/01	<50	<0.18	<0.14	<0.18	<0.26	<0.24	5.14	NP	0.00	166.18	161.04
06/15/01	<50	<0.18	<0.14	<0.18	<0.26	<0.24	5.13	NP	0.00	166.18	160.28
08/30/01	<50	<0.18	<0.14	<0.18	<0.26	<0.24	5.90	NP	0.00	166.18	159.98
12/12/01	<50	<0.18	<0.14	<0.18	<0.26	<0.24	6.20	NP	0.00	166.18	159.98
03/13/02	-	-	-	-	-	-	5.14	NP	0.00	166.18	161.04
06/12/02	-	-	-	-	-	-	-	-	-	-	-
09/18/02	-	-	-	-	-	-	-	-	-	-	-
12/18/02	-	-	-	-	-	-	-	-	-	-	-
03/19/03	-	-	-	-	-	-	-	-	-	-	-
06/11/03	-	-	-	-	-	-	-	-	-	-	-
09/04/03	-	-	-	-	-	-	-	-	-	-	-
12/04/03	-	-	-	-	-	-	3.20	NP	0.00	165.61	162.41
03/18/04	-	-	-	-	-	-	5.12	NP	0.00	165.61	160.49
06/09/04	-	-	-	-	-	-	4.72	NP	0.00	165.61	160.89
09/02/04	-	-	-	-	-	-	6.95	NP	0.00	165.61	158.66

**TABLE 1
GROUNDWATER DATA
THRIFTY OIL STATION #054, CASTRO VALLEY, CA.**

DATE SAMPLED	ANALYTICAL PARAMETERS						DEPTH TO GROUNDWATER (feet)	DEPTH TO PRODUCT (feet)	PRODUCT THICKNESS (feet)	CASING ELEVATION (feet)	GROUNDWATER ELEVATION (feet)
	TPH (ug/L)	BENZENE (ug/L)	TOLUENE (ug/L)	EthylBenzene (ug/L)	XYLENE (ug/L)	MTBE (ug/L)					
MONITORING WELL #RE-1											
<i>Screen Interval = 5 to 17 feet</i>											
04/11/88	37,000	1,900	8,400	1,200	15,000	-	-	-	-	-	-
04/09/90	45,000	6,100	7,000	2,000	8,800	-	4.99	NP	0.00	166.82	161.83
10/30/90	72,000	7,700	5,300	1,800	8,900	-	5.95	NP	0.00	166.82	160.87
01/18/91	150,000	11,000	14,000	1,800	4,300	-	5.17	NP	0.00	166.82	161.65
02/12/91	140,000	11,000	12,000	1,600	13,000	-	4.16	NP	0.00	166.82	162.66
03/20/91	53,000	3,100	4,200	400	5,500	-	4.75	NP	0.00	166.82	162.07
05/22/91	85,000	8,700	10,000	1,800	12,000	-	4.42	NP	0.00	166.82	162.40
06/19/91	110,000	8,500	9,600	2,600	16,000	-	4.93	NP	0.00	166.82	161.89
07/17/91	5,500	950	ND	26	ND	-	5.19	NP	0.00	166.82	161.63
08/07/91	-	6,700	5,000	ND	7,100	-	5.12	NP	0.00	166.82	161.70
09/24/91	60,000	6,800	4,300	640	6,900	-	5.87	NP	0.00	166.82	160.95
10/23/91	79,000	7,900	8,300	450	7,100	-	5.81	NP	0.00	166.82	161.01
11/06/91	130,000	14,000	15,000	1,100	8,800	-	5.56	NP	0.00	166.82	161.26
12/04/91	50,000	8,000	4,700	520	4,100	-	5.35	NP	0.00	166.82	161.47
01/29/92	21,000	10,300	11,000	780	6,000	-	4.50	NP	0.00	166.82	162.32
02/26/92	38,000	8,400	10,500	720	7,100	-	5.27	NP	0.00	166.82	161.55
03/19/92	48,000	6,200	9,700	780	7,200	-	4.47	NP	0.00	166.82	162.35
04/22/92	-	-	-	-	-	-	4.62	NP	0.00	166.82	162.20
05/21/92	20,000	7,600	10,100	830	6,900	-	4.98	NP	0.00	166.82	161.84
06/25/92	-	-	-	-	-	-	5.14	FILM	0.00	166.82	161.68
07/30/92	-	-	-	-	-	-	5.30	FILM	0.00	166.82	161.52
08/20/92	-	-	-	-	-	-	5.28	FILM	0.00	166.82	161.54
09/30/92	-	-	-	-	-	-	5.66	FILM	0.00	166.82	161.16
12/23/92	-	-	-	-	-	-	4.81	FILM	0.00	166.82	162.01
03/10/93	-	-	-	-	-	-	4.13	FILM	0.00	166.82	162.69
06/09/93	-	-	-	-	-	-	4.48	FILM	0.00	166.82	162.34
09/14/93	19,000	3,600	1,100	740	4,300	-	5.35	NP	0.00	166.82	161.47
12/14/93	38,000	4,300	1,300	<6.6	11	-	4.38	NP	0.00	166.82	162.44
03/02/94	-	-	-	-	-	-	4.22	FILM	0.00	166.82	162.60
06/06/94	-	-	-	-	-	-	2.16	FILM	0.00	166.82	164.66
09/06/94	74,000	3,300	3,900	1,200	6,100	-	5.00	NP	0.00	166.82	161.82
12/07/94	30,000	3,200	2,900	1,200	4,600	-	4.10	NP	0.00	166.82	162.72
03/08/95	28,000	4,200	2,300	810	7,800	-	3.92	NP	0.00	166.82	162.90
06/15/95	-	-	-	-	-	-	-	-	-	-	-
09/05/95	-	-	-	-	-	-	4.78	FILM	0.00	166.82	162.04
11/21/95	-	-	-	-	-	-	4.82	NP	0.00	166.82	162.00
03/11/96	270	2.4	6.0	4.5	19	-	3.32	NP	0.00	166.82	163.50

**TABLE 1
GROUNDWATER DATA
THRIFTY OIL STATION #054, CASTRO VALLEY, CA.**

DATE SAMPLED	ANALYTICAL PARAMETERS						DEPTH TO GROUNDWATER (feet)	DEPTH TO PRODUCT (feet)	PRODUCT THICKNESS (feet)	CASING ELEVATION (feet)	GROUNDWATER ELEVATION (feet)
	TPH (ug/L)	BENZENE (ug/L)	TOLUENE (ug/L)	EthylBenzene (ug/L)	XYLENE (ug/L)	MTBE (ug/L)					
06/19/96	3,000	570	63	<1.5	400	-	4.20	NP	0.00	166.82	162.62
09/16/96	7,700	440	69	<1.5	680	230	4.68	NP	0.00	166.82	162.14
12/10/96	52	<0.3	<0.3	<0.3	<0.5	120	4.93	NP	0.00	166.82	161.89
03/12/97	8,700	180	5.4	40	1,100	130	4.10	NP	0.00	166.82	162.72
06/12/97	<50	<0.3	<0.3	<0.3	<0.5	36	-	-	-	-	-
09/16/97	<50	<0.3	<0.3	<0.3	<0.5	<20	4.55	NP	0.00	166.82	162.27
12/09/97	<50	<0.3	0.44	<0.3	<0.5	<20	5.30	NP	0.00	166.82	161.52
03/03/98	1,100	13	0.51	<0.3	<0.5	220	4.55	NP	0.00	166.82	162.27
07/08/98	<50	<0.3	<0.3	<0.3	<0.5	<5	-	-	-	-	-
09/10/98	60	<0.3	<0.3	<0.3	<0.5	180	6.05	NP	0.00	166.82	160.77
12/30/98	<50	1.1	<0.3	<0.3	<0.5	<5	5.65	NP	0.00	166.82	161.17
03/15/99	<50	<0.3	<0.3	<0.3	<0.5	<5	5.68	NP	0.00	166.82	161.14
06/22/99	880	14	0.98	<0.3	8.1	260	4.95	NP	0.00	166.82	161.87
09/08/99	72	<0.3	<0.3	<0.3	<0.5	120	4.46	NP	0.00	166.82	162.36
12/01/99	<50	<0.3	<0.3	<0.3	<0.5	<5	4.08	NP	0.00	166.82	162.74
03/23/00	<50	<0.25	<0.25	<0.25	<0.5	<5	3.68	NP	0.00	166.82	163.14
06/08/00	<50	<5	<5	<5	<5	<5	4.07	NP	0.00	166.82	162.75
09/27/00	<50	<0.18	<0.14	<0.18	<0.26	<0.24	4.07	NP	0.00	166.82	162.75
12/13/00	<50	<0.18	<0.14	<0.18	<0.26	<0.24	4.06	NP	0.00	166.82	162.76
03/22/01	<50	<0.18	<0.14	<0.18	<0.26	<0.24	5.22	NP	0.00	166.82	161.60
06/15/01	<50	<0.18	<0.14	<0.18	<0.26	<0.24	5.99	NP	0.00	166.82	160.83
08/30/01	<50	<0.18	<0.14	<0.18	<0.26	<0.24	4.84	NP	0.00	166.82	161.98
12/12/01	<50	<0.18	<0.14	<0.18	<0.26	<0.24	4.80	NP	0.00	166.82	162.02
03/13/02	-	-	-	-	-	-	5.18	NP	0.00	166.82	161.64
06/12/02	-	-	-	-	-	-	-	-	-	-	-
09/18/02	-	-	-	-	-	-	-	-	-	-	-
12/18/02	-	-	-	-	-	-	-	-	-	-	-
03/19/03	-	-	-	-	-	-	-	-	-	-	-
06/11/03	-	-	-	-	-	-	-	-	-	-	-
09/04/03	-	-	-	-	-	-	4.50	NP	0.00	166.46	161.96
12/04/03	-	-	-	-	-	-	5.64	NP	0.00	166.46	160.82
03/18/04	-	-	-	-	-	-	5.65	NP	0.00	166.46	160.81
06/09/04	-	-	-	-	-	-	5.45	NP	0.00	166.46	161.01
09/02/04	-	-	-	-	-	-	-	-	-	-	-

**TABLE 1
GROUNDWATER DATA
THRIFTY OIL STATION #054, CASTRO VALLEY, CA.**

DATE SAMPLED	ANALYTICAL PARAMETERS						DEPTH TO GROUNDWATER (feet)	DEPTH TO PRODUCT (feet)	PRODUCT THICKNESS (feet)	CASING ELEVATION (feet)	GROUNDWATER ELEVATION (feet)
	TPH (ug/L)	BENZENE (ug/L)	TOLUENE (ug/L)	EthylBenzene (ug/L)	XYLENE (ug/L)	MTBE (ug/L)					
MONITORING WELL #RE-2											
<i>Screen Interval = 5 to 17 feet</i>											
04/11/88	-	-	-	-	-	-	-	-	-	-	-
04/09/90	850	5.8	0.5	4.8	1.1	-	4.90	NP	0.00	167.19	162.29
10/30/90	440	2.8	0.91	13	3.14	-	5.34	NP	0.00	167.19	161.85
01/18/91	1,100	8.4	3.1	ND	10	-	4.90	NP	0.00	167.19	162.29
02/12/91	1,100	5.9	ND	1.77	ND	-	4.94	NP	0.00	167.19	162.25
03/20/91	550	4.3	ND	ND	ND	-	4.32	NP	0.00	167.19	162.87
05/22/91	1,000	5.3	3.6	4.4	8.9	-	4.43	NP	0.00	167.19	162.76
06/19/91	700	2.1	1.4	3.8	3.5	-	6.43	NP	0.00	167.19	160.76
07/17/91	880	12	8.0	4.3	28	-	4.75	NP	0.00	167.19	162.44
08/07/91	-	3.8	1.6	ND	ND	-	4.87	NP	0.00	167.19	162.32
09/24/91	670	7.2	7.1	ND	23	-	5.50	NP	0.00	167.19	161.69
10/23/91	2,700	52	60	22	130	-	5.63	NP	0.00	167.19	161.56
11/06/91	1,900	18	61	9.1	83	-	5.14	NP	0.00	167.19	162.05
12/04/91	1,100	26	47	4.3	42	-	5.26	NP	0.00	167.19	161.93
01/29/92	900	14	24	5.3	19	-	5.11	NP	0.00	167.19	162.08
02/26/92	500	3.4	3.5	2.7	2.7	-	4.31	NP	0.00	167.19	162.88
03/19/92	1,200	14	20	15	18	-	4.45	NP	0.00	167.19	162.74
04/22/92	200	ND	ND	ND	ND	-	4.78	NP	0.00	167.19	162.41
05/21/92	500	7.5	6.8	3.9	7.4	-	5.02	NP	0.00	167.19	162.17
06/25/92	ND	ND	0.9	0.7	ND	-	5.13	NP	0.00	167.19	162.06
07/30/92	500	7.7	8.6	3.2	1.7	-	5.19	NP	0.00	167.19	162.00
08/20/92	1,100	6.6	4.5	2.7	2.0	-	5.27	NP	0.00	167.19	161.92
09/30/92	500	5.4	2.4	1.8	4.5	-	5.45	NP	0.00	167.19	161.74
12/23/92	800	1.9	ND	ND	2.3	-	4.60	NP	0.00	167.19	162.59
03/10/93	1,200	ND	1.4	ND	2.1	-	4.18	NP	0.00	167.19	163.01
06/09/93	200	ND	ND	ND	ND	-	4.53	NP	0.00	167.19	162.66
09/17/93	360	1.6	1.1	3.2	8.9	-	5.26	NP	0.00	167.19	161.93
12/14/93	260	5.6	3.9	<0.3	21.0	-	2.75	NP	0.00	167.19	164.44
03/02/94	410	<0.3	<0.3	<0.3	<0.5	-	4.27	NP	0.00	167.19	162.92
06/06/94	760	4.6	<0.3	0.32	1.3	-	4.88	NP	0.00	167.19	162.31
09/06/94	1,300	43	45	8.9	69	-	5.16	NP	0.00	167.19	162.03
12/07/94	-	-	-	-	-	-	4.16	NP	0.00	167.19	163.03
03/08/95	<100	<0.5	<0.5	<0.5	<1	-	3.96	NP	0.00	167.19	163.23
06/15/95	130	<0.5	<0.5	<0.5	<1	-	4.52	NP	0.00	167.19	162.67
09/05/95	210	<0.5	<0.5	<0.5	<1	-	4.76	NP	0.00	167.19	162.43
11/21/95	160	0.65	<0.3	0.35	0.95	-	4.83	NP	0.00	167.19	162.36
03/11/96	<50	<0.3	<0.3	<0.3	<0.5	-	3.36	NP	0.00	167.19	163.83

**TABLE 1
GROUNDWATER DATA
THRIFTY OIL STATION #054, CASTRO VALLEY, CA.**

DATE SAMPLED	ANALYTICAL PARAMETERS						DEPTH TO GROUNDWATER (feet)	DEPTH TO PRODUCT (feet)	PRODUCT THICKNESS (feet)	CASING ELEVATION (feet)	GROUNDWATER ELEVATION (feet)
	TPH (ug/L)	BENZENE (ug/L)	TOLUENE (ug/L)	EthylBenzene (ug/L)	XYLENE (ug/L)	MTBE (ug/L)					
06/19/96	<50	<0.3	<0.3	<0.3	<0.5	-	4.68	NP	0.00	167.19	162.51
09/16/96	<50	<0.3	<0.3	<0.3	<0.5	<20	5.10	NP	0.00	167.19	162.09
12/10/96	<50	<0.3	<0.3	<0.3	<0.5	<20	4.47	NP	0.00	167.19	162.72
03/12/97	<50	<0.3	<0.3	<0.3	<0.5	<20	4.05	NP	0.00	167.19	163.14
06/12/97	<50	<0.3	<0.3	<0.3	<0.5	<20	-	-	-	-	-
09/10/97	<50	<0.3	<0.3	<0.3	<0.5	<20	4.08	NP	0.00	167.19	163.11
12/09/97	<50	<0.3	<0.3	<0.3	<0.5	<20	4.40	NP	0.00	167.19	162.79
03/03/98	<50	<0.3	<0.3	<0.3	<0.5	<20	3.30	NP	0.00	167.19	163.89
07/08/98	<50	<0.3	<0.3	<0.3	<0.5	15	-	-	-	-	-
09/10/98	<50	<0.3	<0.3	<0.3	<0.5	<5	4.93	NP	0.00	167.19	162.26
12/30/98	460	0.92	<0.3	<0.3	<0.5	1,400	4.20	NP	0.00	167.19	162.99
03/15/99	<50	<0.3	<0.3	<0.3	<0.5	<5	4.20	NP	0.00	167.19	162.99
06/22/99	2,900	7.4	<0.3	0.43	4.1	4,500	3.70	NP	0.00	167.19	163.49
09/08/99	1,400	<3	<3	<3	<5	3,200	3.96	NP	0.00	167.19	163.23
12/01/99	<50	<0.3	<0.3	<0.3	<0.5	<5	3.58	NP	0.00	167.19	163.61
03/23/00	<50	<0.25	<0.25	<0.25	<0.5	<5	3.19	NP	0.00	167.19	164.00
06/08/00	<50	<5	<5	<5	<5	<5	3.18	NP	0.00	167.19	164.01
09/27/00	<50	<0.18	<0.14	<0.18	<0.26	<0.24	3.58	NP	0.00	167.19	163.61
12/13/00	<50	<0.18	<0.14	<0.18	<0.26	<0.24	3.58	NP	0.00	167.19	163.61
03/22/01	575	<0.18	1.3	<0.18	<0.26	*950 / 2,070	4.33	NP	0.00	167.19	162.86
06/15/01	<50	<0.18	<0.14	<0.18	<0.26	<0.24	5.10	NP	0.00	167.19	162.09
08/30/01	<50	<0.18	<0.14	<0.18	<0.26	<0.24	5.86	NP	0.00	167.19	161.33
12/12/01	<50	<0.18	<0.14	<0.18	<0.26	<0.24	4.81	NP	0.00	167.19	162.38
03/13/02	-	-	-	-	-	-	4.33	NP	0.00	167.19	162.86
06/12/02	<50	<0.18	<0.14	<0.18	<0.26	<0.24	5.86	NP	0.00	167.19	161.33
09/18/02	<50	<0.18	<0.14	<0.18	<0.26	<0.24	5.86	NP	0.00	167.19	161.33
12/18/02	<50	<0.18	<0.14	<0.18	<0.26	<0.24	5.48	NP	0.00	167.19	161.71
03/19/03	<15	<0.04	<0.02	<0.02	<0.06	<0.03	5.86	NP	0.00	167.19	161.33
06/11/03	<15	<0.04	<0.02	<0.02	<0.06	<0.03	5.86	NP	0.00	167.19	161.33
09/04/03	<15	<0.22	<0.32	<0.31	<0.4	<0.18	5.48	NP	0.00	167.19	161.71
12/04/03	<15	<0.04	<0.02	<0.02	<0.06	<0.03	3.20	NP	0.00	166.61	163.41
03/18/04	<15	<0.22	<0.32	<0.31	<0.4	8.4	4.33	NP	0.00	166.61	162.28
06/09/04	<15	<0.14	<0.16	<0.18	<0.45	8.4	4.32	NP	0.00	166.61	162.29
09/02/04	877	2.3	2.2	5.8	4.0	*743 / 516	5.12	NP	0.00	166.61	161.49

**TABLE 1
GROUNDWATER DATA
THRIFTY OIL STATION #054, CASTRO VALLEY, CA.**

DATE SAMPLED	ANALYTICAL PARAMETERS						DEPTH TO GROUNDWATER (feet)	DEPTH TO PRODUCT (feet)	PRODUCT THICKNESS (feet)	CASING ELEVATION (feet)	GROUNDWATER ELEVATION (feet)
	TPH (ug/L)	BENZENE (ug/L)	TOLUENE (ug/L)	EthylBenzene (ug/L)	XYLENE (ug/L)	MTBE (ug/L)					
MONITORING WELL #RE-3											
<i>Screen Interval = 5 to 18 feet</i>											
04/11/88	70,000	6,600	5,300	800	13,000	-	-	-	-	-	-
04/09/90	370,000	2,300	4,900	3,200	31,000	-	7.15	NP	0.00	167.39	160.24
10/30/90	13,000	860	660	220	2,210	-	7.84	NP	0.00	167.39	159.55
01/18/91	42,000	4,700	4,500	21	7,700	-	6.90	NP	0.00	167.39	160.49
02/12/91	72,000	3,600	4,500	ND	7,600	-	6.62	NP	0.00	167.39	160.77
03/20/91	65,000	2,400	9,400	50	9,800	-	5.87	NP	0.00	167.39	161.52
05/22/91	-	-	-	-	-	-	5.98	FILM	0.00	167.39	161.41
06/19/91	-	-	-	-	-	-	6.84	FILM	0.00	167.39	160.55
07/17/91	-	-	-	-	-	-	7.10	FILM	0.00	167.39	160.29
08/07/91	-	-	-	-	-	-	7.30	FILM	0.00	167.39	160.09
09/24/91	-	-	-	-	-	-	7.84	FILM	0.00	167.39	159.55
09/24/91	-	-	-	-	-	-	8.07	FILM	0.00	167.39	159.32
10/23/91	-	-	-	-	-	-	7.63	FILM	0.00	167.39	159.76
11/06/91	-	-	-	-	-	-	7.83	FILM	0.00	167.39	159.56
12/04/91	-	-	-	-	-	-	7.17	FILM	0.00	167.39	160.22
01/29/92	-	-	-	-	-	-	5.56	FILM	0.00	167.39	161.83
02/26/92	-	-	-	-	-	-	5.44	FILM	0.00	167.39	161.95
03/19/92	-	-	-	-	-	-	6.56	FILM	0.00	167.39	160.83
04/22/92	-	-	-	-	-	-	6.90	FILM	0.00	167.39	160.49
05/21/92	-	-	-	-	-	-	7.18	FILM	0.00	167.39	160.21
06/25/92	-	-	-	-	-	-	6.80	FILM	0.00	167.39	160.59
07/30/92	-	-	-	-	-	-	7.25	FILM	0.00	167.39	160.14
08/20/92	-	-	-	-	-	-	7.68	FILM	0.00	167.39	159.71
09/30/92	-	-	-	-	-	-	6.07	FILM	0.00	167.39	161.32
12/23/92	-	-	-	-	-	-	5.66	FILM	0.00	167.39	161.73
03/10/93	-	-	-	-	-	-	6.66	FILM	0.00	167.39	160.73
06/09/93	-	-	-	-	-	-	7.30	NP	0.00	167.39	160.09
09/14/93	40,000	2,900	1,500	180	6,900	-	5.95	NP	0.00	167.39	161.44
12/14/93	-	-	-	-	-	-	5.08	NP	0.00	167.39	162.31
03/02/94	-	-	-	-	-	-	6.35	FILM	0.00	167.39	161.04
06/06/94	-	-	-	-	-	-	7.50	NP	0.00	167.39	159.89
09/06/94	11,000	260	26	<6.6	1,000	-	5.48	FILM	0.00	167.39	161.91
12/07/94	-	-	-	-	-	-	5.18	FILM	0.00	167.39	162.21
03/08/95	-	-	-	-	-	-	-	-	-	-	-
06/15/95	-	-	-	-	-	-	6.84	FILM	0.00	167.39	160.55
09/05/95	-	-	-	-	-	-	7.38	NP	0.00	167.39	160.01
11/21/95	10,000	210	<3	4.5	330	-	4.85	NP	0.00	167.39	162.54
03/11/96	1,600	640	15	10	46	-	-	-	-	-	-

**TABLE 1
GROUNDWATER DATA
THRIFTY OIL STATION #054, CASTRO VALLEY, CA.**

DATE SAMPLED	ANALYTICAL PARAMETERS						DEPTH TO GROUNDWATER (feet)	DEPTH TO PRODUCT (feet)	PRODUCT THICKNESS (feet)	CASING ELEVATION (feet)	GROUNDWATER ELEVATION (feet)
	TPH (ug/L)	BENZENE (ug/L)	TOLUENE (ug/L)	EthylBenzene (ug/L)	XYLENE (ug/L)	MTBE (ug/L)					
06/19/96	2,100	280	<3	<3	120	-	5.80	NP	0.00	167.39	161.59
09/16/96	140	<0.3	<0.3	<0.3	<0.5	110	4.50	NP	0.00	167.39	162.89
12/10/96	<50	<0.3	<0.3	<0.3	<0.5	<20	5.35	NP	0.00	167.39	162.04
03/12/97	<50	<0.3	<0.3	<0.3	<0.5	<20	3.48	NP	0.00	167.39	163.91
06/12/97	<50	<0.3	<0.3	<0.3	0.58	<20	-	-	-	-	-
09/10/97	<50	<0.3	<0.3	<0.3	<0.5	<20	3.10	NP	0.00	167.39	164.29
12/09/97	3,600	1,000	1,000	<6	570	260	4.55	NP	0.00	167.39	162.84
03/03/98	2,800	20	0.65	0.39	16	5,600	2.30	NP	0.00	167.39	165.09
07/08/98	<50	<0.3	<0.3	<0.3	<0.5	<5	-	-	-	-	-
09/10/98	<50	<0.3	<0.3	<0.3	<0.5	23	4.95	NP	0.00	167.39	162.44
12/30/98	<50	<0.3	<0.3	<0.3	<0.5	<5	4.55	NP	0.00	167.39	162.84
03/15/99	<50	<0.3	<0.3	<0.3	<0.5	<5	4.15	NP	0.00	167.39	163.24
06/22/99	670	17	1.2	0.36	1.7	340	3.85	NP	0.00	167.39	164.76
09/08/99	140	0.72	<0.3	<0.3	<0.5	230	2.63	NP	0.00	167.39	164.76
12/01/99	95	<0.3	<0.3	<0.3	<0.5	200	2.63	NP	0.00	167.39	165.14
03/23/00	315	<0.25	<0.25	<0.25	<0.5	*293/422	2.25	NP	0.00	167.39	164.37
06/08/00	<100	<5	<5	<5	<5	201	3.02	NP	0.00	167.39	164.37
09/27/00	154	<0.18	<0.14	<0.18	<0.26	*254 / 160	3.01	NP	0.00	167.39	164.38
12/13/00	<50	<0.18	<0.14	<0.18	<0.26	*124 / 111	3.02	NP	0.00	167.39	164.37
03/22/01	<50	<0.18	<0.14	<0.18	<0.26	*90 / 57	4.54	NP	0.00	167.39	162.85
06/15/01	649	28	2.4	3.1	9	*1,790 / 2,560	4.92	NP	0.00	167.39	162.47
08/30/01	<50	<0.18	<0.14	<0.18	<0.26	<0.24	7.80	NP	0.00	167.39	159.59
12/12/01	<50	<0.18	<0.14	<0.18	<0.26	<0.24	7.35	NP	0.00	167.39	160.04
03/13/02	<50	<0.18	<0.14	<0.18	<0.26	<0.24	4.53	NP	0.00	167.39	162.86
06/12/02	969	<0.18	1.0	<0.18	<0.26	1,430	4.90	NP	0.00	167.39	162.49
09/18/02	<50	<0.18	<0.14	<0.18	<0.26	<0.24	4.90	NP	0.00	167.39	162.11
12/18/02	<50	<0.18	<0.14	<0.18	<0.26	<0.24	5.28	NP	0.00	167.39	162.87
03/19/03	<15	<0.04	<0.02	<0.02	<0.06	<0.03	4.52	NP	0.00	167.39	161.72
06/11/03	<15	<0.04	<0.02	<0.02	<0.06	<0.03	5.67	NP	0.00	167.39	161.72
09/04/03	<15	<0.22	<0.32	<0.31	<0.4	<0.18	5.67	NP	0.00	167.39	162.13
12/04/03	<15	<0.04	<0.02	<0.02	<0.06	<0.03	5.26	NP	0.00	167.39	162.13
03/18/04	57	<0.22	1.7 J	<0.31	<0.4	13	2.59	NP	0.00	166.69	164.10
06/09/04	7,950	39	21	<1.8	20	4,590	2.59	NP	0.00	166.69	164.10
09/02/04	9,560	982	65	77	86	*5,950 / 4,360	4.50	NP	0.00	166.69	162.19
							5.85	NP	0.00	166.69	160.84
							6.30	NP	0.00	166.69	160.39

TABLE 1
GROUNDWATER DATA
THRIFTY OIL STATION #054, CASTRO VALLEY, CA.

DATE SAMPLED	ANALYTICAL PARAMETERS						DEPTH TO GROUNDWATER (feet)	DEPTH TO PRODUCT (feet)	PRODUCT THICKNESS (feet)	CASING ELEVATION (feet)	GROUNDWATER ELEVATION (feet)
	TPH (ug/L)	BENZENE (ug/L)	TOLUENE (ug/L)	EthylBenzene (ug/L)	XYLENE (ug/L)	MIBE (ug/L)					
MONITORING WELL #RE-1											
<i>Screen Interval = 5 to 15 feet</i>											
04/11/88	15,000	12,000	8,000	1,000	2,700	-	-	-	-	-	-
04/09/90	-	-	-	-	-	-	-	-	-	-	-
10/30/90	87,000	7,200	10,000	1,600	12,900	-	7.04	NP	0.00	166.94	159.90
01/18/91	70,000	5,000	5,400	790	9,900	-	11.62	NP	0.00	166.94	155.32
02/12/91	87,000	5,200	2,800	240	11,000	-	11.63	NP	0.00	166.94	155.31
03/20/91	6,500	370	230	17	670	-	11.61	NP	0.00	166.94	155.33
05/22/91	-	-	-	-	-	-	10.30	FILM	0.00	166.94	156.64
06/19/91	-	-	-	-	-	-	11.10	FILM	0.00	166.94	155.84
07/17/91	-	-	-	-	-	-	6.20	FILM	0.00	166.94	160.74
08/17/91	-	-	-	-	-	-	8.15	FILM	0.00	166.94	158.79
08/17/91	-	-	-	-	-	-	10.40	FILM	0.00	166.94	156.54
09/24/91	-	-	-	-	-	-	11.20	FILM	0.00	166.94	155.74
10/23/91	-	-	-	-	-	-	6.62	FILM	0.00	166.94	160.32
11/06/91	-	-	-	-	-	-	11.20	ILM	0.00	166.94	155.74
12/04/91	-	-	-	-	-	-	7.72	FILM	0.00	166.94	159.22
01/29/92	-	-	-	-	-	-	5.13	FILM	0.00	166.94	161.81
02/26/92	-	-	-	-	-	-	5.00	FILM	0.00	166.94	161.94
03/19/92	-	-	-	-	-	-	5.94	FILM	0.00	166.94	161.00
04/22/92	-	-	-	-	-	-	5.40	FILM	0.00	166.94	161.54
05/21/92	-	-	-	-	-	-	5.71	FILM	0.00	166.94	161.23
06/25/92	-	-	-	-	-	-	6.33	FILM	0.00	166.94	160.61
07/30/92	-	-	-	-	-	-	5.80	FILM	0.00	166.94	161.14
08/20/92	-	-	-	-	-	-	6.34	FILM	0.00	166.94	160.60
09/30/92	-	-	-	-	-	-	5.50	FILM	0.00	166.94	161.44
12/23/92	-	-	-	-	-	-	4.67	FILM	0.00	166.94	162.27
03/10/93	-	-	-	-	-	-	5.12	FILM	0.00	166.94	161.82
06/09/93	-	-	-	-	-	-	10.44	NP	0.00	166.94	156.50
09/14/93	-	-	-	-	-	-	7.52	NP	0.00	166.94	159.42
12/14/93	-	-	-	-	-	-	4.85	NP	0.00	166.94	162.09
03/02/94	-	-	-	-	-	-	5.20	FILM	0.00	166.94	161.74
06/06/94	-	-	-	-	-	-	9.85	FILM	0.00	166.94	157.09
09/06/94	-	-	-	-	-	-	5.20	FILM	0.00	166.94	161.74
12/07/94	-	-	-	-	-	-	4.98	FILM	0.00	166.94	161.96
03/08/95	-	-	-	-	-	-	-	-	-	-	-
06/15/95	-	-	-	-	-	-	13.72	FILM	0.00	166.94	153.22
09/05/95	-	-	-	-	-	-	12.53	NP	0.00	166.94	154.41
11/21/95	32,000	46	21	66	340	-	4.72	NP	0.00	166.94	162.22
03/11/96	1,700	130	15	2.0	120	-	-	-	-	-	-

**TABLE 1
GROUNDWATER DATA
THRIFTY OIL STATION #054, CASTRO VALLEY, CA.**

DATE SAMPLED	ANALYTICAL PARAMETERS						DEPTH TO GROUNDWATER (feet)	DEPTH TO PRODUCT (feet)	PRODUCT THICKNESS (feet)	CASING ELEVATION (feet)	GROUNDWATER ELEVATION (feet)
	TPH (ug/L)	BENZENE (ug/L)	TOLUENE (ug/L)	EthylBenzene (ug/L)	XYLENE (ug/L)	MTBE (ug/L)					
06/19/96	1,700	230	30	0.35	100	-	5.40	NP	0.00	166.94	161.54
09/16/96	510	<0.3	0.73	<0.3	<0.5	800	5.18	NP	0.00	166.94	161.76
12/10/96	520	<0.3	<0.3	<0.3	<0.5	1,000	4.65	NP	0.00	166.94	162.29
03/12/97	420	3.2	<0.3	<0.3	11	370	3.87	NP	0.00	166.94	163.07
06/12/97	510	0.66	<0.3	<0.3	<0.5	1,600	-	-	-	-	-
09/10/97	<50	<0.3	<0.3	<0.3	<0.5	<20	5.40	NP	0.00	166.94	161.54
12/09/97	1,400	330	2.3	<0.3	1.5	2,500	4.60	NP	0.00	166.94	162.34
03/03/98	3,000	400	0.61	0.5	97	3,800	5.05	NP	0.00	166.94	161.89
07/08/98	650	<0.3	<0.3	<0.3	<0.5	1,800	-	-	-	-	-
09/10/98	2,700	<0.3	<0.3	<0.3	1.4	7,600	4.60	NP	0.00	166.94	162.34
12/30/98	530	<0.3	<0.3	<0.3	<0.5	1,500	4.20	NP	0.00	166.94	162.74
03/15/99	<50	<0.3	<0.3	<0.3	<0.5	<5	3.85	NP	0.00	166.94	163.09
06/22/99	1,200	23	1.5	<0.3	2.4	1,400	3.90	NP	0.00	166.94	163.04
09/08/99	590	1.5	<0.6	<0.6	<1	1,100	5.72	NP	0.00	166.94	161.22
12/01/99	540	<0.3	<0.3	<0.3	<0.5	880	5.34	NP	0.00	166.94	161.60
03/23/00	<50	<0.25	<0.25	<0.25	<0.5	<5	5.36	NP	0.00	166.94	161.58
06/08/00	67	<5	<5	<5	<5	<5	5.34	NP	0.00	166.94	161.60
09/27/00	<50	<0.18	<0.14	<0.18	<0.26	<0.24	5.35	NP	0.00	166.94	161.59
12/13/00	<50	<0.18	<0.14	<0.18	<0.26	<0.24	5.71	NP	0.00	166.94	161.23
03/22/01	<50	<0.18	<0.14	<0.18	<0.26	<0.24	4.19	NP	0.00	166.94	162.75
06/15/01	409	18	2	2	5	*1,060 / 1,480	4.57	NP	0.00	166.94	162.37
08/30/01	<50	<0.18	<0.14	<0.18	<0.26	<0.24	6.10	NP	0.00	166.94	160.84
12/12/01	<50	<0.18	<0.14	<0.18	3	*7 / 3.7	4.95	NP	0.00	166.94	161.99
03/13/02	511	3	3	<0.18	2	519	4.17	NP	0.00	166.94	162.77
06/12/02	380	2	2	1	2	479	4.93	NP	0.00	166.94	162.01
09/18/02	<50	<0.18	<0.14	<0.18	<0.26	<0.24	5.32	NP	0.00	166.94	161.62
12/18/02	<50	<0.18	<0.14	<0.18	<0.26	<0.24	4.93	NP	0.00	166.94	162.01
03/19/03	<15	<0.04	<0.02	<0.02	<0.06	<0.03	5.32	NP	0.00	166.94	161.62
06/11/03	<15	<0.04	<0.02	<0.02	<0.06	<0.03	5.32	NP	0.00	166.94	161.62
09/04/03	<15	<0.22	<0.32	<0.31	<0.4	<0.18	4.93	NP	0.00	166.94	162.01
12/04/03	<15	<0.04	<0.02	<0.02	<0.06	<0.03	4.93	NP	0.00	166.23	161.30
03/18/04	<15	<0.22	<0.32	<0.31	<0.4	1.1	4.93	NP	0.00	166.23	161.30
06/09/04	<15	<0.14	<0.16	<0.18	<0.45	<0.22	4.56	NP	0.00	166.23	161.67
09/02/04	6,390	587	50	34	65	*4,150 / 2,650	6.00	NP	0.00	166.23	160.23

**TABLE 1
GROUNDWATER DATA
THRIFTY OIL STATION #054, CASTRO VALLEY, CA.**

DATE SAMPLED	ANALYTICAL PARAMETERS						DEPTH TO GROUNDWATER (feet)	DEPTH TO PRODUCT (feet)	PRODUCT THICKNESS (feet)	CASING ELEVATION (feet)	GROUNDWATER ELEVATION (feet)
	TPH (ug/L)	BENZENE (ug/L)	TOLUENE (ug/L)	EthylBenzene (ug/L)	XYLENE (ug/L)	MTBE (ug/L)					
MONITORING WELL ARE-5											
<i>Screen Interval = 5 to 20 feet</i>											
04/11/88	14,000	1,300	1,100	100	2,600	-	-	-	-	-	-
04/09/90	3,000	690	190	40	270	-	4.79	NP	0.00	166.51	161.72
10/30/90	3,400	910	48	87	249	-	5.86	NP	0.00	166.51	160.65
01/18/91	1,400	180	8.6	0.52	48	-	4.40	NP	0.00	166.51	162.11
02/12/91	1,000	ND	ND	0.65	ND	-	4.76	NP	0.00	166.51	161.75
03/20/91	3,000	250	53	ND	110	-	5.08	NP	0.00	166.51	161.43
05/22/91	2,500	330	7.8	5.6	200	-	4.52	NP	0.00	166.51	161.99
01/19/91	2,000	59	1.6	5.1	110	-	4.39	NP	0.00	166.51	162.12
07/17/91	-	-	-	-	-	-	5.05	FILM	0.00	166.51	161.46
08/07/91	-	-	-	-	-	-	5.02	FILM	0.00	166.51	161.49
09/24/91	-	-	-	-	-	-	5.86	FILM	0.00	166.51	160.65
10/23/91	-	-	-	-	-	-	5.84	FILM	0.00	166.51	160.67
11/06/91	9,900	2,300	37	260	160	-	5.48	NP	0.00	166.51	161.03
12/04/91	4,500	1,000	27	ND	180	-	5.43	NP	0.00	166.51	161.08
01/29/92	600	6.1	2.3	ND	47	-	5.12	NP	0.00	166.51	161.39
02/26/92	500	5.4	2.7	1.2	14	-	4.93	NP	0.00	166.51	161.58
03/19/92	ND	1.7	1.1	ND	5.5	-	4.45	NP	0.00	166.51	162.06
04/22/92	1,600	240	2.2	ND	160	-	4.63	NP	0.00	166.51	161.88
05/21/92	1,200	410	37	ND	118	-	4.90	NP	0.00	166.51	161.61
06/25/92	ND	1.0	0.8	0.8	0.4	-	5.15	NP	0.00	166.51	161.36
07/30/92	ND	2.0	1.8	1.9	6.4	-	5.30	NP	0.00	166.51	161.21
08/20/92	300	1.7	3.3	0.7	12	-	5.44	NP	0.00	166.51	161.07
09/30/92	1,900	140	ND	19	35	-	5.73	NP	0.00	166.51	160.78
12/23/92	400	8.0	ND	ND	ND	-	4.75	NP	0.00	166.51	161.76
03/10/93	1,100	290	9.7	ND	75	-	4.14	NP	0.00	166.51	162.37
06/09/93	400	1.5	0.5	ND	12	-	5.42	NP	0.00	166.51	161.09
09/14/93	240	6.9	8.8	1.4	67	-	5.53	NP	0.00	166.51	160.98
12/14/93	3,300	510	5.4	4.1	55	-	4.78	NP	0.00	166.51	-311.49
03/02/94	2,400	270	4.5	<0.3	13	-	4.20	NP	0.00	166.51	162.31
06/06/94	730	<0.3	<0.3	0.70	22	-	5.13	NP	0.00	166.51	161.38
09/06/94	2,400	180	28	2.3	76	-	5.45	NP	0.00	166.51	161.06
12/07/94	540	5.6	<0.3	<0.5	6.9	-	4.13	NP	0.00	166.51	162.38
03/08/95	1,500	220	5.5	<0.5	83	-	5.20	NP	0.00	166.51	161.31
06/15/95	3,200	820	53	6.2	74	-	4.93	NP	0.00	166.51	161.58
09/05/95	4,400	440	22	<2.5	57	-	5.03	NP	0.00	166.51	161.48
11/21/95	660	3.4	<0.3	<0.3	0.6	-	5.23	NP	0.00	166.51	161.28
03/11/96	1,000	76	2.2	<0.3	130	-	4.16	NP	0.00	166.51	162.35

**TABLE 1
GROUNDWATER DATA
THRIFTY OIL STATION #054, CASTRO VALLEY, CA.**

DATE SAMPLED	ANALYTICAL PARAMETERS						DEPTH TO GROUNDWATER (feet)	DEPTH TO PRODUCT (feet)	PRODUCT THICKNESS (feet)	CASING ELEVATION (feet)	GROUNDWATER ELEVATION (feet)
	TPH (ug/L)	BENZENE (ug/L)	TOLUENE (ug/L)	EthylBenzene (ug/L)	XYLENE (ug/L)	MTBE (ug/L)					
06/09/96	90	<0.3	<0.3	<0.3	<0.5	-	5.42	NP	0.00	166.51	161.09
09/16/96	1,900	5.8	<0.3	<0.3	<0.3	5.9	5.20	NP	0.00	166.51	161.31
12/10/96	740	<0.3	<0.3	<0.3	<0.3	<0.5	5.27	NP	0.00	166.51	161.24
03/12/97	2,000	600	59	5.1	54	1,300	3.85	NP	0.00	166.51	162.66
06/12/97	230	<0.3	<0.3	<0.3	<0.5	720	-	-	-	-	-
09/10/97	210	<0.3	<0.3	<0.3	<0.5	210	4.10	NP	0.00	166.51	162.41
12/09/97	11,000	2,500	2,700	<6	1,500	510	5.20	NP	0.00	166.51	161.31
03/03/98	<50	<0.3	<0.3	<0.3	<0.5	<20	3.70	NP	0.00	166.51	162.81
07/08/98	<50	<0.3	<0.3	<0.3	<0.5	<5	-	-	-	-	-
09/10/98	<50	<0.3	<0.3	<0.3	<0.5	<5	6.77	NP	0.00	166.51	159.74
12/30/98	<50	<0.3	<0.3	<0.3	<0.5	<5	5.95	NP	0.00	166.51	160.56
03/15/99	<50	<0.3	<0.3	<0.3	<0.5	<5	5.25	NP	0.00	166.51	161.26
06/22/99	110	<0.3	<0.3	<0.3	<0.5	200	4.50	NP	0.00	166.51	162.01
09/08/99	68	<0.3	<0.3	<0.3	<0.5	110	4.43	NP	0.00	166.51	162.08
12/01/99	<50	<0.3	<0.3	<0.3	<0.5	<5	3.66	NP	0.00	166.51	162.85
03/23/00	<50	<0.25	<0.25	<0.25	<0.5	<5	4.06	NP	0.00	166.51	162.45
06/08/00	<50	<5	<5	<5	<5	<5	4.43	NP	0.00	166.51	162.08
09/27/00	<50	<0.18	<0.14	<0.18	<0.26	<0.24	4.06	NP	0.00	166.51	162.45
12/13/00	<50	<0.18	<0.14	<0.18	<0.26	<0.24	4.80	NP	0.00	166.51	161.71
03/22/01	<50	<0.18	<0.14	<0.18	<0.26	<0.24	6.33	NP	0.00	166.51	160.18
06/15/01	<50	<0.18	<0.14	<0.18	<0.26	<0.24	4.79	NP	0.00	166.51	161.72
08/30/01	<50	<0.18	<0.14	<0.18	<0.26	<0.24	5.54	NP	0.00	166.51	160.97
12/12/01	<50	<0.18	<0.14	<0.18	<0.26	<0.24	5.21	NP	0.00	166.51	161.30
03/13/02	-	-	-	-	-	-	6.32	NP	0.00	166.51	160.19
06/12/02	-	-	-	-	-	-	-	-	-	-	-
09/18/02	-	-	-	-	-	-	-	-	-	-	-
12/18/02	-	-	-	-	-	-	-	-	-	-	-
03/19/03	-	-	-	-	-	-	-	-	-	-	-
06/11/03	-	-	-	-	-	-	-	-	-	-	-
09/04/03	-	-	-	-	-	-	-	-	-	-	-
12/04/03	-	-	-	-	-	-	3.67	NP	0.00	166.56	162.89
03/18/04	-	-	-	-	-	-	5.20	NP	0.00	166.56	161.36
06/09/04	-	-	-	-	-	-	4.61	NP	0.00	166.56	161.95
09/02/04	-	-	-	-	-	-	4.93	NP	0.00	166.56	161.63

**TABLE 1
GROUNDWATER DATA
THRIFTY OIL STATION #054, CASTRO VALLEY, CA.**

DATE SAMPLED	ANALYTICAL PARAMETERS						DEPTH TO GROUNDWATER (feet)	DEPTH TO PRODUCT (feet)	PRODUCT THICKNESS (feet)	CASING ELEVATION (feet)	GROUNDWATER ELEVATION (feet)
	TPH (ug/L)	BENZENE (ug/L)	TOLUENE (ug/L)	EthylBenzene (ug/L)	XYLENE (ug/L)	MTBE (ug/L)					
MONITORING WELL ARE-6											
<i>Screen Interval = 5 to 15 feet</i>											
04/11/88	6,000	3,000	40	80	140	-	-	-	-	-	-
04/09/90	3,000	990	ND	70	ND	-	5.64	NP	0.00	166.51	160.87
10/30/90	3,400	1,000	28	ND	ND	-	6.68	NP	0.00	166.51	159.83
01/18/91	6,300	1,200	ND	3.0	15	-	6.61	NP	0.00	166.51	159.90
02/12/91	5,200	850	8.4	4.9	41	-	6.20	NP	0.00	166.51	160.31
03/20/91	5,800	680	12	8.0	16	-	5.62	NP	0.00	166.51	160.89
05/22/91	8,500	1,700	14	24	6.7	-	6.05	NP	0.00	166.51	160.46
06/19/91	-	-	-	-	-	-	6.12	FILM	0.00	166.51	160.39
07/17/91	120,000	9,300	13,000	2,400	16,000	-	6.20	NP	0.00	166.51	160.31
08/07/91	-	590	5.3	ND	14	-	6.27	NP	0.00	166.51	160.24
09/24/91	7,000	310	11	5.3	35	-	6.63	NP	0.00	166.51	159.88
10/23/91	-	-	-	-	-	-	6.36	FILM	0.00	166.51	160.15
11/06/91	4,000	710	18	29	49	-	6.15	NP	0.00	166.51	160.36
12/04/91	4,100	1,100	14	33	39	-	6.19	NP	0.00	166.51	160.32
01/29/92	2,600	790	14	ND	49	-	6.70	NP	0.00	166.51	159.81
02/26/92	3,100	950	21	30	33	-	5.44	NP	0.00	166.51	161.07
03/19/92	2,200	630	14	12	40	-	5.30	NP	0.00	166.51	161.21
04/22/92	-	730	2.2	ND	40	-	6.00	NP	0.00	166.51	160.51
05/21/92	1,500	840	7.8	7.1	34	-	6.25	NP	0.00	166.51	160.26
06/25/92	<2000	740	8.0	27	28	-	6.38	NP	0.00	166.51	160.13
07/30/92	-	-	-	-	-	-	6.42	FILM	0.00	166.51	160.09
08/20/92	2,800	630	17	23	22	-	6.50	NP	0.00	166.51	160.01
09/30/92	7,800	540	ND	12	29	-	6.66	NP	0.00	166.51	159.85
12/23/92	1,800	350	ND	7.7	11	-	5.83	NP	0.00	166.51	160.68
03/10/93	3,000	830	5.6	19	16	-	5.63	NP	0.00	166.51	160.88
06/09/93	4,800	920	6.2	3.2	12	-	6.01	NP	0.00	166.51	160.50
09/14/93	3,600	660	7.5	11	27	-	6.53	NP	0.00	166.51	159.98
12/14/93	1,500	200	<0.3	<0.3	8.8	-	3.58	NP	0.00	166.51	162.93
03/02/94	-	-	-	-	-	-	5.12	NP	0.00	166.51	161.39
06/06/94	2,400	290	4.6	1.3	24	-	1.85	NP	0.00	166.51	164.66
09/06/94	4,300	230	21	<6.6	130	-	6.40	NP	0.00	166.51	160.11
12/07/94	1,500	17	2.5	3.2	22	-	5.68	NP	0.00	166.51	160.83
03/08/95	2,500	460	5.5	2.1	51	-	5.12	NP	0.00	166.51	161.39
06/15/95	2,300	91	1.1	0.7	97	-	5.72	NP	0.00	166.51	160.79
09/05/95	3,300	60	<10	<10	74	-	5.94	NP	0.00	166.51	160.57
11/21/95	2,000	7.3	<0.3	0.56	8.7	-	6.24	NP	0.00	166.51	160.27
03/11/96	840	43	0.96	5.7	14	-	5.16	NP	0.00	166.51	161.35

**TABLE 1
GROUNDWATER DATA
THRIFTY OIL STATION #054, CASTRO VALLEY, CA.**

DATE SAMPLED	ANALYTICAL PARAMETERS						DEPTH TO GROUNDWATER (feet)	DEPTH TO PRODUCT (feet)	PRODUCT THICKNESS (feet)	CASING ELEVATION (feet)	GROUNDWATER ELEVATION (feet)
	TPH (ug/L)	BENZENE (ug/L)	TOLUENE (ug/L)	EthylBenzene (ug/L)	XYLENE (ug/L)	MTBE (ug/L)					
06/19/96	1,800	160	2.7	9.9	25	-	5.80	NP	0.00	166.51	160.71
09/16/96	<50	<0.3	<0.3	<0.3	<0.5	<20	5.38	NP	0.00	166.51	161.13
12/10/96	<50	<0.3	<0.3	<0.3	<0.5	<20	5.62	NP	0.00	166.51	160.89
03/12/97	<50	<0.3	<0.3	<0.3	<0.5	<20	5.20	NP	0.00	166.51	161.31
06/12/97	<50	<0.3	<0.3	<0.3	<0.5	<20	-	-	-	-	-
09/10/97	440	<0.3	<0.3	<0.3	<0.5	320	5.20	NP	0.00	166.51	161.31
12/09/97	<50	<0.3	<0.3	<0.3	<0.5	<20	5.97	NP	0.00	166.51	160.54
03/03/98	400	7.0	<0.3	<0.3	4.3	65	4.45	NP	0.00	166.51	162.06
07/08/98	300	<0.3	<0.3	<0.3	1.0	35	-	-	-	-	-
09/10/98	<50	<0.3	<0.3	<0.3	<0.5	<5	5.90	NP	0.00	166.51	160.61
12/30/98	<50	<0.3	<0.3	<0.3	<0.5	<5	5.20	NP	0.00	166.51	161.31
03/15/99	<50	<0.3	<0.3	<0.3	<0.5	8.4	4.82	NP	0.00	166.51	161.69
06/22/99	700	11	1.9	<0.3	3.9	140	6.00	NP	0.00	166.51	160.51
09/08/99	<50	<0.3	<0.3	<0.3	<0.5	<5	5.15	NP	0.00	166.51	161.36
12/01/99	<50	<0.3	<0.3	<0.3	<0.5	12	4.02	NP	0.00	166.51	162.49
03/23/00	<50	<0.25	<0.25	<0.25	<0.5	<5	4.41	NP	0.00	166.51	162.10
06/08/00	<50	<5	<5	<5	<5	<5	4.78	NP	0.00	166.51	161.73
09/27/00	<50	<0.18	<0.14	<0.18	<0.26	<0.24	4.78	NP	0.00	166.51	161.73
12/13/00	<50	<0.18	<0.14	<0.18	<0.26	<0.24	4.77	NP	0.00	166.51	161.74
03/22/01	367	<0.18	<0.14	<0.18	<0.26	*581 / 674	5.54	NP	0.00	166.51	160.97
06/15/01	<50	<0.18	<0.14	<0.18	<0.26	<0.24	5.92	NP	0.00	166.51	160.59
08/30/01	<50	<0.18	<0.14	<0.18	<0.26	<0.24	5.93	NP	0.00	166.51	160.58
12/12/01	138	<0.18	<0.14	<0.18	<0.26	*7 / <0.6	6.20	NP	0.00	166.51	160.31
03/13/02	<50	<0.18	<0.14	<0.18	<0.26	<0.24	5.55	NP	0.00	166.51	160.96
06/12/02	895	<0.18	1.0	<0.18	<0.26	1,360	5.93	NP	0.00	166.51	160.58
09/18/02	759	<0.18	<0.14	<0.18	<0.26	644	6.03	NP	0.00	166.51	160.48
12/18/02	531	<0.18	<0.14	<0.18	<0.26	441	5.65	NP	0.00	166.51	160.86
03/19/03	955	<0.04	<0.02	<0.02	<0.06	585	6.34	NP	0.00	166.51	160.17
06/11/03	945	<0.04	<0.02	<0.02	<0.06	328	6.34	NP	0.00	166.51	160.17
09/04/03	<15	<0.22	<0.32	<0.31	<0.4	<0.18	5.92	NP	0.00	166.51	160.59
12/04/03	<15	<0.04	<0.02	<0.02	<0.06	<0.03	4.00	NP	0.00	166.15	162.15
03/18/04	<15	<0.22	<0.32	<0.31	<0.4	<0.18	5.54	NP	0.00	166.15	160.61
06/10/04	340	2.6	1.5	<0.18	1.8	283	6.12	NP	0.00	166.15	160.03
09/02/04	1,720	4.9	8.2	8.7	7.7	*633 / 410	6.50	NP	0.00	166.15	159.65

TABLE 1
GROUNDWATER DATA
THRIFTY OIL STATION #054, CASTRO VALLEY, CA.

DATE SAMPLED	ANALYTICAL PARAMETERS						DEPTH TO GROUNDWATER (feet)	DEPTH TO PRODUCT (feet)	PRODUCT THICKNESS (feet)	CASING ELEVATION (feet)	GROUNDWATER ELEVATION (feet)
	TPH (ug/L)	BENZENE (ug/L)	TOLUENE (ug/L)	EthylBenzene (ug/L)	XYLENE (ug/L)	MTBE (ug/L)					
<i>Screen Interval = 5 to 15 feet</i>											
04/11/88	<50,000	17,000	4,400	600	8,400	-	-	-	-	-	-
04/09/90	16,000	7,000	1,200	640	1,600	-	5.93	NP	0.00	166.04	160.11
10/30/90	31,000	14,000	ND	ND	ND	-	8.21	NP	0.00	166.04	157.83
01/18/91	-	-	-	-	-	-	11.80	NP	0.00	166.04	154.24
02/12/91	-	-	-	-	-	-	10.80	FILM	0.00	166.04	155.24
03/20/91	120,000	12,000	2,800	490	6,600	-	9.96	NP	0.00	166.04	156.08
05/22/91	-	-	-	-	-	-	11.70	FILM	0.00	166.04	154.34
06/19/91	-	-	-	-	-	-	11.50	FILM	0.00	166.04	154.54
07/17/91	-	-	-	-	-	-	7.80	FILM	0.00	166.04	158.24
08/07/91	-	-	-	-	-	-	9.88	0.03	9.85	166.04	163.60
09/24/91	-	-	-	-	-	-	9.85	0.03	9.82	166.04	163.60
10/23/91	-	-	-	-	-	-	9.96	FILM	0.00	166.04	156.08
11/06/91	-	-	-	-	-	-	6.77	FILM	0.00	166.04	159.27
12/04/91	-	-	-	-	-	-	10.80	FILM	0.00	166.04	155.24
01/29/92	-	-	-	-	-	-	8.64	FILM	0.00	166.04	157.40
02/26/92	-	-	-	-	-	-	6.00	FILM	0.00	166.04	160.04
03/19/92	-	-	-	-	-	-	5.55	FILM	0.00	166.04	160.49
04/22/92	-	-	-	-	-	-	6.12	FILM	0.00	166.04	159.92
05/21/92	-	-	-	-	-	-	6.40	FILM	0.00	166.04	159.64
06/25/92	-	-	-	-	-	-	6.73	0.02	6.71	166.04	164.38
07/30/92	-	-	-	-	-	-	6.73	FILM	0.00	166.04	159.31
08/20/92	-	-	-	-	-	-	6.82	FILM	0.00	166.04	159.22
09/30/92	-	-	-	-	-	-	7.26	FILM	0.00	166.04	158.78
12/23/92	-	-	-	-	-	-	6.22	FILM	0.00	166.04	159.82
03/10/93	-	-	-	-	-	-	5.82	FILM	0.00	166.04	160.22
06/09/93	-	-	-	-	-	-	6.17	FILM	0.00	166.04	159.87
09/14/93	-	-	-	-	-	-	11.33	NP	0.00	166.04	154.71
12/14/93	-	-	-	-	-	-	8.40	NP	0.00	166.04	157.64
03/02/94	-	-	-	-	-	-	6.82	NP	0.00	166.04	159.22
06/06/94	-	-	-	-	-	-	10.95	FILM	0.00	166.04	155.09
09/06/94	-	-	-	-	-	-	11.30	FILM	0.00	166.04	154.74
12/07/94	-	-	-	-	-	-	5.63	FILM	0.00	166.04	160.41
03/08/95	-	-	-	-	-	-	5.06	FILM	0.00	166.04	160.98
06/15/95	-	-	-	-	-	-	-	-	-	-	-
09/05/95	-	-	-	-	-	-	7.98	FILM	0.00	166.04	158.06
11/21/95	20,000	8,800	110	<30	310	-	7.32	NP	0.00	166.04	158.72
03/11/96	4,800	2,200	38	26	120	-	5.62	NP	0.00	166.04	160.42

TABLE 1
GROUNDWATER DATA
THRIFTY OIL STATION #054, CASTRO VALLEY, CA.

DATE SAMPLED	ANALYTICAL PARAMETERS						DEPTH TO GROUNDWATER (feet)	DEPTH TO PRODUCT (feet)	PRODUCT THICKNESS (feet)	CASING ELEVATION (feet)	GROUNDWATER ELEVATION (feet)
	TPH (ug/L)	BENZENE (ug/L)	TOLUENE (ug/L)	EthylBenzene (ug/L)	XYLENE (ug/L)	MTBE (ug/L)					
06/19/96	4,400	3,300	49	5.8	70	-	6.40	NP	0.00	166.04	159.64
09/19/96	7,200	510	83	<0.3	710	130	6.20	NP	0.00	166.04	159.84
12/10/96	700	<0.3	<0.3	<0.3	<0.5	1,400	5.92	NP	0.00	166.04	160.12
03/12/97	660	0.31	<0.3	<0.3	<0.5	1,400	5.62	NP	0.00	166.04	160.42
06/12/97	320	<0.3	0.45	<0.3	<0.5	850	-	-	-	-	-
09/10/97	780	<0.3	<0.3	<0.3	<0.5	930	7.45	NP	0.00	166.04	158.59
12/09/97	14,000	3,500	3,700	<15	2,100	1,100	7.10	NP	0.00	166.04	158.94
03/03/98	6,100	2,500	18	<6	110	270	6.70	NP	0.00	166.04	159.34
07/08/98	1,300	8.7	<0.3	<0.3	<0.5	350	-	-	-	-	-
09/10/98	690	2.2	<0.3	<0.3	<0.5	350	7.04	NP	0.00	166.04	159.00
12/30/98	600	2.0	0.55	<0.3	<0.5	350	6.25	NP	0.00	166.04	159.79
03/15/99	350	0.71	<0.3	<0.3	<0.5	140	6.02	NP	0.00	166.04	160.02
06/22/99	5,900	2,100	16	4.6	48	170	6.35	NP	0.00	166.04	159.69
09/08/99	1,700	380	<3	<3	13	160	7.03	NP	0.00	166.04	159.01
12/01/99	930	3.7	<0.3	<0.3	<0.5	390	6.25	NP	0.00	166.04	159.79
03/23/00	581	5.4	5.3	1.9	7.3	*168/183	6.24	NP	0.00	166.04	159.80
06/08/00	<100	<5	<5	<5	<5	74	6.64	NP	0.00	166.04	159.40
09/27/00	236	<0.18	<0.14	<0.18	<0.26	*21 / 28	7.03	NP	0.00	166.04	159.01
12/13/00	<50	<0.18	<0.14	<0.18	<0.26	*13 / 19.8	6.63	NP	0.00	166.04	159.41
03/22/01	504	<0.18	<0.14	<0.18	1	*666 / 1,420	7.02	NP	0.00	166.04	159.02
06/15/01	144	5.0	<0.14	0.5	2	*369 / 408	7.02	NP	0.00	166.04	159.02
08/30/01	<50	<0.18	<0.14	<0.18	<0.26	<0.24	7.79	NP	0.00	166.04	158.25
12/12/01	<50	<0.18	<0.14	<0.18	<0.26	<0.24	7.28	NP	0.00	166.04	158.76
03/13/02	<50	<0.18	<0.14	<0.18	<0.26	<0.24	6.02	NP	0.00	166.04	160.02
06/12/02	5,130	772	970	59	550	113	7.79	NP	0.00	166.04	158.25
09/18/02	<50	<0.18	<0.14	<0.18	<0.26	<0.24	7.40	NP	0.00	166.04	158.64
12/18/02	<50	<0.18	<0.14	<0.18	<0.26	<0.24	6.63	NP	0.00	166.04	159.41
03/19/03	<15	<0.04	<0.02	<0.02	<0.06	<0.03	7.40	NP	0.00	166.04	158.64
06/11/03	<15	<0.04	<0.02	<0.02	<0.06	8.3	7.40	NP	0.00	166.04	158.64
09/04/03	<15	<0.22	<0.32	<0.31	<0.4	<0.18	7.39	NP	0.00	166.04	158.65
12/04/03	<15	<0.04	<0.02	<0.02	<0.06	<0.03	6.63	NP	0.00	165.33	158.70
03/18/04	<15	<0.22	<0.32	<0.31	<0.4	<0.18	6.63	NP	0.00	165.33	158.70
06/10/04	14,500	348	1,460	306	3,070	207	6.20	NP	0.00	165.33	159.13
09/02/04	35,900	2,390	174	1,250	8,020	*419 / 274	7.05	NP	0.00	165.33	158.28

TABLE 1
GROUNDWATER DATA
THRIFTY OIL STATION #054, CASTRO VALLEY, CA.

DATE SAMPLED	ANALYTICAL PARAMETERS						DEPTH TO GROUNDWATER (feet)	DEPTH TO PRODUCT (feet)	PRODUCT THICKNESS (feet)	CASING ELEVATION (feet)	GROUNDWATER ELEVATION (feet)
	TPH (ug/L)	BENZENE (ug/L)	TOLUENE (ug/L)	EthylBenzene (ug/L)	XYLENE (ug/L)	MTBE (ug/L)					
MONITORING WELL ARS-8											
<i>Screen Interval - 5 to 25 feet</i>											
08/07/91	ND	ND	ND	ND	ND	-	9.68	NP	0.00	164.32	154.64
09/27/91	ND	ND	ND	ND	ND	-	9.89	NP	0.00	164.32	154.43
10/23/91	ND	ND	ND	ND	ND	-	10.05	NP	0.00	164.32	154.27
11/06/91	ND	ND	ND	ND	ND	-	9.71	NP	0.00	164.32	154.61
12/04/91	ND	ND	ND	ND	ND	-	10.00	NP	0.00	164.32	154.32
01/29/92	ND	2.1	1.0	2.5	3.6	-	9.28	NP	0.00	164.32	155.04
02/26/92	ND	ND	0.7	ND	0.7	-	7.05	NP	0.00	164.32	157.27
03/19/92	ND	0.5	1.0	1.5	2.7	-	7.30	NP	0.00	164.32	157.02
04/22/92	ND	ND	ND	ND	ND	-	8.60	NP	0.00	164.32	155.72
05/21/92	ND	ND	ND	ND	ND	-	9.22	NP	0.00	164.32	155.10
06/25/92	ND	ND	ND	ND	ND	-	9.49	NP	0.00	164.32	154.83
07/30/92	ND	ND	ND	ND	ND	-	9.55	NP	0.00	164.32	154.77
08/20/92	ND	1.1	4.2	ND	3.0	-	9.63	NP	0.00	164.32	154.69
08/20/92	ND	2.0	4.7	ND	5.7	-	9.90	NP	0.00	164.32	154.42
09/30/92	ND	ND	ND	ND	ND	-	9.96	NP	0.00	164.32	154.36
12/23/92	ND	ND	ND	ND	ND	-	8.95	NP	0.00	164.32	155.37
05/10/93	ND	ND	ND	ND	ND	-	9.00	NP	0.00	164.32	155.32
06/09/93	ND	ND	ND	ND	ND	-	9.50	NP	0.00	164.32	154.82
09/14/93	200	0.3	ND	ND	ND	-	8.75	NP	0.00	164.32	155.57
12/14/93	ND	ND	ND	ND	ND	-	8.75	NP	0.00	164.32	156.80
03/02/94	<50	<0.3	<0.3	<0.3	<0.5	-	7.52	NP	0.00	164.32	155.32
06/06/94	54	<0.3	<0.3	<0.3	2.4	-	9.00	NP	0.00	164.32	155.06
09/06/94	<50	<0.3	<0.3	<0.3	<0.5	-	9.26	NP	0.00	164.32	155.65
12/07/94	130	2.5	1.9	1.3	3.6	-	8.67	NP	0.00	164.32	155.98
03/08/95	<100	<0.5	<0.5	<0.5	<1	-	8.34	NP	0.00	164.32	155.20
06/15/95	<100	1.0	<0.5	<0.5	<1	-	9.12	NP	0.00	164.32	155.20
09/05/95	<100	<0.5	<0.5	<0.5	<1	-	9.56	NP	0.00	164.32	154.76
11/21/95	<50	0.44	<0.3	<0.3	1.5	-	9.28	NP	0.00	164.32	155.04
03/11/96	<50	1.3	<0.3	<0.3	0.6	-	7.52	NP	0.00	164.32	156.80
06/19/96	640	72	20	34	150	-	7.80	NP	0.00	164.32	156.52
09/16/96	<50	<0.3	<0.3	<0.3	<0.5	20	9.18	NP	0.00	164.32	155.14
12/10/96	<50	<0.3	<0.3	<0.3	<0.5	<20	6.08	NP	0.00	164.32	158.24
03/12/97	53	0.45	<0.3	<0.3	<0.5	140	8.65	NP	0.00	164.32	155.67
06/12/97	<50	<0.3	<0.3	<0.3	<0.5	68	-	-	-	-	-
09/10/97	<50	<0.3	<0.3	<0.3	<0.5	<20	8.30	NP	0.00	164.32	156.02
12/09/97	<50	1.7	2.1	<0.3	1.4	82	9.98	NP	0.00	164.32	154.34
03/03/98	<50	<0.3	<0.3	<0.3	<0.5	84	8.33	NP	0.00	164.32	155.99
07/08/98	<50	<0.3	<0.3	<0.3	<0.5	97	-	-	-	-	-

**TABLE 1
GROUNDWATER DATA
THRIFTY OIL STATION #054, CASTRO VALLEY, CA.**

DATE SAMPLED	ANALYTICAL PARAMETERS						DEPTH TO GROUNDWATER (feet)	DEPTH TO PRODUCT (feet)	PRODUCT THICKNESS (feet)	CASING ELEVATION (feet)	GROUNDWATER ELEVATION (feet)
	TPH (ug/L)	BENZENE (ug/L)	TOLUENE (ug/L)	EthylBenzene (ug/L)	XYLENE (ug/L)	MIBE (ug/L)					
09/10/98	<50	<0.3	<0.3	<0.3	<0.5	97	12.95	NP	0.00	164.32	151.37
12/30/98	<50	1.3	1.5	<0.3	0.86	19	11.35	NP	0.00	164.32	152.97
03/15/99	<50	<0.3	<0.3	<0.3	<0.5	9.6	9.85	NP	0.00	164.32	154.47
06/22/99	66	0.39	<0.3	<0.3	<0.5	62	9.90	NP	0.00	164.32	154.47
09/08/99	<50	<0.3	<0.3	<0.3	<0.5	25	9.85	NP	0.00	164.32	154.47
12/01/99	<50	<0.3	<0.3	<0.3	<0.5	30	8.30	NP	0.00	164.32	156.02
03/23/00	<50	<0.25	<0.25	<0.25	<0.5	*13.6/18.2	6.76	NP	0.00	164.32	157.56
06/08/00	<50	<5	<5	<5	<5	10	8.30	NP	0.00	164.32	156.02
09/27/00	<50	<0.18	<0.14	<0.18	<0.26	*6 / 4.9	8.30	NP	0.00	164.32	156.04
12/13/00	<50	<0.18	<0.14	<0.18	<0.26	<0.24	8.28	NP	0.00	164.32	156.04
03/22/01	<50	<0.18	<0.14	<0.18	<0.26	<0.24	12.89	NP	0.00	164.32	151.43
06/15/01	<50	<0.18	<0.14	<0.18	<0.26	<0.24	12.89	NP	0.00	164.32	151.43
08/30/01	<50	<0.18	<0.14	<0.18	<0.26	<0.24	9.82	NP	0.00	164.32	154.50
12/12/01	<50	<0.18	<0.14	<0.18	<0.26	<0.24	9.25	NP	0.00	164.32	155.07
03/13/02	-	-	-	-	-	-	12.89	NP	0.00	164.32	151.43
06/12/02	-	-	-	-	-	-	-	-	-	-	-
09/18/02	-	-	-	-	-	-	-	-	-	-	-
12/18/02	-	-	-	-	-	-	-	-	-	-	-
03/19/03	-	-	-	-	-	-	-	-	-	-	-
06/11/03	-	-	-	-	-	-	-	-	-	-	-
09/04/03	-	-	-	-	-	-	6.78	NP	0.00	164.03	157.25
12/04/03	-	-	-	-	-	-	9.65	NP	0.00	164.03	154.38
03/18/04	-	-	-	-	-	-	6.86	NP	0.00	164.03	157.17
06/09/04	-	-	-	-	-	-	8.23	NP	0.00	164.03	155.80
09/02/04	-	-	-	-	-	-	-	-	-	-	-
MONITORING WELL ARS-9 <i>Screen Interval = 5 to 15 feet</i>											
08/07/91	-	0.5	ND	330	1,200	-	2.28	NP	0.00	167.51	165.23
09/27/91	13,000	3.5	3.0	82	140	-	2.77	NP	0.00	167.51	164.74
10/23/91	11,000	ND	ND	39	340	-	3.53	NP	0.00	167.51	163.98
11/06/91	6,800	8.4	0.6	22	230	-	2.51	NP	0.00	167.51	165.00
12/04/91	6,500	6.5	0.7	87	200	-	3.20	NP	0.00	167.51	164.31
01/29/92	8,100	22	10	140	260	-	2.65	NP	0.00	167.51	164.86
02/26/92	13,000	40	16	220	600	-	3.42	NP	0.00	167.51	164.09
03/19/92	12,000	21	12	100	280	-	3.12	NP	0.00	167.51	164.39
04/22/92	8,600	ND	ND	20	37	-	3.24	NP	0.00	167.51	164.27
05/21/92	6,000	21	10	53	210	-	3.75	NP	0.00	167.51	163.76

TABLE 1
GROUNDWATER DATA
THRIFTY OIL STATION #054, CASTRO VALLEY, CA.

DATE SAMPLED	ANALYTICAL PARAMETERS						DEPTH TO GROUNDWATER (feet)	DEPTH TO PRODUCT (feet)	PRODUCT THICKNESS (feet)	CASING ELEVATION (feet)	GROUNDWATER ELEVATION (feet)
	TPH (ug/L)	BENZENE (ug/L)	TOLUENE (ug/L)	EthylBenzene (ug/L)	XYLENE (ug/L)	MTBE (ug/L)					
06/25/92	370	2.3	1.5	0.7	4.3	-	2.65	NP	0.00	167.51	164.86
07/30/92	3,600	20	ND	39	80	-	2.70	NP	0.00	167.51	164.81
08/20/92	3,000	0.7	5.2	2.0	5.3	-	2.83	NP	0.00	167.51	164.68
09/30/92	9,200	4.8	6.5	12	91	-	2.80	NP	0.00	167.51	164.71
12/23/92	2,000	17	ND	8.2	18	-	2.45	NP	0.00	167.51	165.06
03/10/93	1,500	ND	2.6	21	12	-	2.40	NP	0.00	167.51	165.11
06/09/93	1,300	0.6	1.7	ND	7.5	-	3.55	NP	0.00	167.51	163.96
09/14/93	1,500	1.3	7.6	4.1	14	-	2.81	NP	0.00	167.51	164.70
12/14/93	560	ND	ND	ND	5.5	-	2.63	NP	0.00	167.51	164.88
03/02/94	1,100	<0.3	<0.3	<0.3	<0.5	-	2.60	NP	0.00	167.51	164.91
06/06/94	290	0.58	0.53	1.1	5.8	-	2.52	NP	0.00	167.51	164.99
09/06/94	890	<0.3	<0.3	<0.3	3.1	-	3.16	NP	0.00	167.51	164.35
12/07/94	940	22	23	10	32	-	5.18	NP	0.00	167.51	162.33
03/08/95	1,600	<0.5	<0.5	<0.5	2.3	-	4.57	NP	0.00	167.51	162.94
06/15/95	3,200	2.2	5.3	4.3	3.1	-	5.08	NP	0.00	167.51	162.43
09/05/95	1,100	<0.5	<0.5	<0.5	<1	-	5.72	NP	0.00	167.51	161.79
11/21/95	1,100	1.1	2.9	3.5	3.0	-	2.46	NP	0.00	167.51	165.05
03/11/96	440	0.7	0.34	<0.3	3.7	-	3.44	NP	0.00	167.51	164.07
06/19/96	580	3.8	0.49	1.2	<0.5	-	3.80	NP	0.00	167.51	163.71
09/16/96	490	<0.3	1.6	<0.3	<0.5	<20	3.80	NP	0.00	167.51	163.71
12/10/96	<50	<0.3	<0.3	<0.3	<0.5	<20	2.76	NP	0.00	167.51	164.75
03/12/97	<50	<0.3	0.42	<0.3	1.5	<20	3.20	NP	0.00	167.51	164.31
06/12/97	<50	<0.3	<0.3	<0.3	0.51	<20	-	-	-	-	-
09/10/97	<50	<0.3	<0.3	<0.3	<0.5	<20	4.24	NP	0.00	167.51	163.27
12/09/97	<50	<0.3	0.48	<0.3	<0.5	<20	2.72	NP	0.00	167.51	164.79
03/03/98	190	<0.3	<0.3	0.38	<0.5	<20	1.90	NP	0.00	167.51	165.61
07/08/98	<50	<0.3	<0.3	<0.3	<0.5	<5	-	-	-	-	-
09/10/98	<50	<0.3	<0.3	<0.3	<0.5	<5	2.72	NP	0.00	167.51	164.79
12/30/98	<50	<0.3	<0.3	<0.3	<0.5	<5	1.20	NP	0.00	167.51	166.31
03/15/99	<50	<0.3	<0.3	<0.3	<0.5	<5	4.25	NP	0.00	167.51	163.26
06/22/99	1,300	4.2	1.2	0.69	0.74	<5	3.70	NP	0.00	167.51	163.81
09/08/99	<50	<0.3	<0.3	<0.3	<0.5	<5	2.71	NP	0.00	167.51	164.80
12/01/99	<50	<0.3	<0.3	<0.3	<0.5	<5	2.70	NP	0.00	167.51	164.81
03/23/00	<50	<0.25	<0.25	<0.25	<0.5	<5	2.70	NP	0.00	167.51	164.81
06/08/00	585	<5	<5	<5	<5	821	2.72	NP	0.00	167.51	164.79
09/27/00	592	<0.18	<0.14	<0.18	<0.26	*1,180 / 1,360	2.72	NP	0.00	167.51	164.79
12/13/00	<50	<0.18	<0.14	<0.18	<0.26	*403 / 444	2.70	NP	0.00	167.51	164.81
03/22/01	425	<0.18	<0.14	<0.18	<0.26	*738 / 1,640	2.69	NP	0.00	167.51	164.82

**TABLE 1
GROUNDWATER DATA
THRIFTY OIL STATION #054, CASTRO VALLEY, CA.**

DATE SAMPLED	ANALYTICAL PARAMETERS						DEPTH TO GROUNDWATER (feet)	DEPTH TO PRODUCT (feet)	PRODUCT THICKNESS (feet)	CASING ELEVATION (feet)	GROUNDWATER ELEVATION (feet)
	TPH (ug/L)	BENZENE (ug/L)	TOLUENE (ug/L)	EthylBenzene (ug/L)	XYLENE (ug/L)	MTBE (ug/L)					
06/15/01	<50	<0.18	<0.14	<0.18	<0.26	<0.24	2.68	NP	0.00	167.51	164.83
08/30/01	164	<0.18	<0.14	<0.18	<0.26	*396 / 284	2.68	NP	0.00	167.51	164.83
12/12/01	1,540	<0.18	<0.14	<0.18	<0.26	*4,370 / 2,480	2.41	NP	0.00	167.51	165.10
03/13/02	1,540	<0.18	<0.14	<0.18	<0.26	3,360	2.68	NP	0.00	167.51	164.83
06/12/02	2,020	1	3	1	3	3,280	4.21	NP	0.00	167.51	163.30
09/18/02	915	<0.18	<0.14	<0.18	<0.26	768	4.21	NP	0.00	167.51	163.30
12/18/02	1,070	<0.18	<0.14	<0.18	<0.26	960	2.68	NP	0.00	167.51	164.83
03/19/03	1,600	<0.04	<0.02	<0.02	<0.06	836	4.21	NP	0.00	167.51	163.30
06/11/03	1,960	<0.04	<0.02	<0.02	<0.06	583	4.21	NP	0.00	167.51	163.30
09/04/03	117	<0.22	<0.32	<0.31	13	8.3	4.21	NP	0.00	167.51	163.30
12/04/03	19,200	5,270	6,550	144	2,540	217	1.16	NP	0.00	167.05	165.89
03/18/04	193	7.5	18	1.4 J	6.1	127	2.68	NP	0.00	167.05	164.37
06/10/04	159	<0.14	3.3	1.9	2.5	<0.22	3.74	NP	0.00	167.05	163.31
09/02/04	<15	<0.14	<0.16	<0.18	<0.45	<0.22	3.68	NP	0.00	167.05	163.37
MONITORING WELL #RS-10											
<i>Screen Interval = 5 to 25 feet</i>											
08/07/91	ND	ND	ND	ND	ND	-	6.16	NP	0.00	162.89	156.73
09/27/91	ND	ND	ND	ND	ND	-	6.48	NP	0.00	162.89	156.41
10/23/91	ND	ND	ND	ND	ND	-	7.37	NP	0.00	162.89	155.52
11/06/91	ND	ND	ND	ND	ND	-	6.44	NP	0.00	162.89	156.45
12/04/91	ND	ND	ND	ND	ND	-	7.02	NP	0.00	162.89	155.87
01/29/92	ND	ND	ND	ND	ND	-	6.78	NP	0.00	162.89	156.11
02/26/92	ND	ND	ND	ND	ND	-	8.33	NP	0.00	162.89	154.56
03/19/92	ND	ND	ND	ND	0.6	-	8.02	NP	0.00	162.89	154.87
04/22/92	ND	ND	ND	ND	ND	-	7.78	NP	0.00	162.89	155.11
05/21/92	ND	ND	0.6	ND	1.2	-	6.21	NP	0.00	162.89	156.68
06/25/92	ND	ND	ND	ND	ND	-	7.73	NP	0.00	162.89	155.16
07/30/92	ND	ND	0.5	ND	1.0	-	7.84	NP	0.00	162.89	155.05
08/20/92	ND	ND	ND	ND	ND	-	7.50	NP	0.00	162.89	155.39
09/30/92	ND	ND	ND	ND	ND	-	7.63	NP	0.00	162.89	155.26
12/23/92	ND	ND	ND	ND	ND	-	7.24	NP	0.00	162.89	155.65
03/10/93	ND	ND	ND	ND	ND	-	7.24	NP	0.00	162.89	156.51
06/09/93	ND	ND	ND	ND	ND	-	6.38	NP	0.00	162.89	156.51
09/14/93	ND	ND	ND	ND	ND	-	7.98	NP	0.00	162.89	154.91
03/02/94	<50	<0.3	<0.3	<0.3	<0.3	-	7.35	NP	0.00	162.89	155.54
06/06/94	<50	<0.3	<0.3	<0.3	<0.5	-	7.00	NP	0.00	162.89	155.89
09/06/94	<50	<0.3	<0.3	<0.3	<0.5	-	6.55	NP	0.00	162.89	156.34
							7.63	NP	0.00	162.89	155.26

**TABLE 1
GROUNDWATER DATA
THRIFTY OIL STATION #054, CASTRO VALLEY, CA.**

DATE SAMPLED	ANALYTICAL PARAMETERS						DEPTH TO GROUNDWATER (feet)	DEPTH TO PRODUCT (feet)	PRODUCT THICKNESS (feet)	CASING ELEVATION (feet)	GROUNDWATER ELEVATION (feet)
	TPH (ug/L)	BENZENE (ug/L)	TOLUENE (ug/L)	EthylBenzene (ug/L)	XYLENE (ug/L)	MTBE (ug/L)					
12/07/94	56	<0.3	<0.3	<0.5	2.1	-	5.92	NP	0.00	162.89	156.97
03/08/95	<100	<0.5	<0.5	<0.5	<1	-	7.84	NP	0.00	162.89	155.05
06/15/95	<100	<0.5	<0.5	<0.5	<1	-	6.97	NP	0.00	162.89	155.92
09/05/95	<100	<0.5	<0.5	<0.5	<1	-	8.14	NP	0.00	162.89	154.75
11/21/95	<50	<0.3	<0.3	<0.3	<0.5	-	7.68	NP	0.00	162.89	155.21
03/11/96	<50	<0.3	<0.3	<0.3	<0.5	-	6.76	NP	0.00	162.89	156.13
06/19/96	<50	<0.3	<0.3	<0.3	<0.5	-	7.20	NP	0.00	162.89	155.69
09/16/96	<50	<0.3	<0.3	<0.3	<0.5	<20	6.30	NP	0.00	162.89	156.59
12/10/96	<50	<0.3	<0.3	<0.3	<0.5	<20	6.05	NP	0.00	162.89	156.84
03/12/97	<50	<0.3	<0.3	<0.3	<0.5	<20	7.56	NP	0.00	162.89	155.33
06/12/97	<50	<0.3	<0.3	<0.3	<0.5	<20	-	-	-	-	-
09/10/97	<50	<0.3	<0.3	<0.3	<0.5	<20	7.55	NP	0.00	162.89	155.34
12/09/97	1,900	610	510	<6	290	<20	7.55	NP	0.00	162.89	155.34
03/03/98	<50	2.0	<0.3	<0.3	<0.5	27	6.03	NP	0.00	162.89	156.86
07/08/98	<50	<0.3	<0.3	<0.3	<0.5	<5	-	-	-	-	-
09/10/98	<50	<0.3	<0.3	<0.3	<0.5	72	7.55	NP	0.00	162.89	155.34
12/30/98	<50	1.1	<0.3	<0.3	<0.5	<5	4.45	NP	0.00	162.89	158.44
03/15/99	<50	<0.3	<0.3	<0.3	1.3	<5	4.50	NP	0.00	162.89	158.39
06/22/99	<50	<0.3	<0.3	<0.3	<0.5	<5	9.15	NP	0.00	162.89	153.74
09/08/99	<50	<0.3	<0.3	<0.3	<0.5	<5	7.51	NP	0.00	162.89	155.38
12/01/99	<50	<0.3	<0.3	<0.3	<0.5	<5	5.97	NP	0.00	162.89	156.92
03/23/00	<50	<0.25	<0.25	<0.25	<0.5	<5	4.47	NP	0.00	162.89	158.42
06/08/00	<50	<5	<5	<5	<5	<5	5.97	NP	0.00	162.89	156.92
09/27/00	<50	<0.18	<0.14	<0.18	<0.26	<0.24	7.50	NP	0.00	162.89	155.39
12/13/00	<50	<0.18	<0.14	<0.18	<0.26	<0.24	5.94	NP	0.00	162.89	156.95
03/22/01	<50	<0.18	<0.14	<0.18	<0.26	<0.24	7.51	NP	0.00	162.89	155.38
06/15/01	<50	<0.18	<0.14	<0.18	<0.26	<0.24	7.50	NP	0.00	162.89	155.39
08/30/01	<50	<0.18	<0.14	<0.18	<0.26	<0.24	9.05	NP	0.00	162.89	153.84
12/12/01	<50	<0.18	<0.14	<0.18	<0.26	<0.24	7.65	NP	0.00	162.89	155.24
03/13/02	-	-	-	-	-	-	9.05	NP	0.00	162.89	153.84
06/12/02	-	-	-	-	-	-	-	-	-	-	-
09/18/02	-	-	-	-	-	-	-	-	-	-	-
12/18/02	-	-	-	-	-	-	-	-	-	-	-
03/19/03	-	-	-	-	-	-	-	-	-	-	-
06/11/03	-	-	-	-	-	-	-	-	-	-	-
09/04/03	-	-	-	-	-	-	5.98	NP	0.00	162.43	156.45
12/04/03	-	-	-	-	-	-	8.85	NP	0.00	162.43	153.58
03/18/04	-	-	-	-	-	-	-	-	-	-	-

**TABLE 1
GROUNDWATER DATA
THRIFTY OIL STATION #054, CASTRO VALLEY, CA.**

DATE SAMPLED	ANALYTICAL PARAMETERS						DEPTH TO GROUNDWATER (feet)	DEPTH TO PRODUCT (feet)	PRODUCT THICKNESS (feet)	CASING ELEVATION (feet)	GROUNDWATER ELEVATION (feet)
	TPH (ug/L)	BENZENE (ug/L)	TOLUENE (ug/L)	EthylBenzene (ug/L)	XYLENE (ug/L)	MTBE (ug/L)					
06/09/04	-	-	-	-	-	-	6.27	NP	0.00	162.43	156.16
09/02/04	-	-	-	-	-	-	6.17	NP	0.00	162.43	156.26
MONITORING WELL #RS-11											
<i>Screen Interval = 5 to 25 feet</i>											
09/21/95	110	<0.5	<0.5	<0.5	<1	-	9.37	NP	0.00	163.28	153.91
11/21/95	-	-	-	-	-	-	-	-	-	-	-
03/11/96	-	-	-	-	-	-	-	-	-	-	-
06/19/96	-	-	-	-	-	-	-	-	-	-	-
09/16/96	-	-	-	-	-	-	-	-	-	-	-
03/12/97	74	9.5	<0.3	<0.3	0.57	<20	7.75	NP	0.00	163.28	155.53
06/12/97	<50	<0.3	<0.3	<0.3	<0.5	<20	-	-	-	-	-
09/10/97	<50	<0.3	<0.3	<0.3	<0.5	<20	9.50	NP	0.00	163.28	153.78
12/09/97	<50	0.79	1.2	<0.3	<0.5	<20	9.50	NP	0.00	163.28	153.78
03/03/98	140	22	0.63	<0.3	<0.5	<20	7.93	NP	0.00	163.28	155.35
07/08/98	<50	<0.3	<0.3	<0.3	<0.5	<5	-	-	-	-	-
09/10/98	<50	<0.3	<0.3	<0.3	<0.5	<5	9.48	NP	0.00	163.28	153.80
12/30/98	<50	1.3	0.87	<0.3	0.55	<5	7.95	NP	0.00	163.28	155.33
03/15/99	<50	<0.3	<0.3	<0.3	<0.5	<5	6.40	NP	0.00	163.28	156.88
06/22/99	350	89	2.9	3.3	0.91	6.8	11.00	NP	0.00	163.28	152.28
09/08/99	99	9.1	0.37	<0.3	<0.5	<5	7.90	NP	0.00	163.28	155.38
12/01/99	82	9.7	0.44	<0.3	<0.5	<5	7.90	NP	0.00	163.28	155.38
03/23/00	73	5.8	2.3	<0.25	<0.5	*11.2 / 7.9	4.85	NP	0.00	163.28	158.43
06/08/00	306	<5	<5	<5	<5	<5	7.90	NP	0.00	163.28	155.38
09/27/00	<50	1	<0.14	<0.18	<0.26	3 J / 3.6	9.44	NP	0.00	163.28	153.84
12/13/00	<50	<0.18	<0.14	<0.18	<0.26	<0.24	6.34	NP	0.00	163.28	156.94
03/22/01	408	<0.18	<0.14	<0.18	<0.26	*664 / 941	7.96	NP	0.00	163.28	155.32
06/15/01	<50	<0.18	<0.14	<0.18	<0.26	<0.24	7.87	NP	0.00	163.28	155.41
08/30/01	<50	<0.18	<0.14	<0.18	<0.26	<0.24	9.41	NP	0.00	163.28	153.87
12/12/01	<50	<0.18	<0.14	<0.18	<0.26	<0.24	7.86	NP	0.00	163.28	155.42
03/13/02	<50	<0.18	<0.14	<0.18	<0.26	<0.24	7.85	NP	0.00	163.28	155.43
06/12/02	<50	<0.18	1	<0.18	<0.26	<0.24	9.39	NP	0.00	163.28	153.89
09/18/02	<50	<0.18	<0.14	<0.18	<0.26	<0.24	9.38	NP	0.00	163.28	156.96
12/18/02	110	<0.18	<0.14	<0.18	<0.26	101	6.32	NP	0.00	163.28	153.89
03/19/03	<15	<0.04	<0.02	<0.02	<0.06	<0.03	9.39	NP	0.00	163.28	153.89
06/11/03	<15	<0.04	<0.02	<0.02	<0.06	20	9.39	NP	0.00	163.28	155.43
09/04/03	<15	<0.22	<0.32	<0.31	<0.4	<0.18	7.85	NP	0.00	163.28	155.43
12/04/03	<15	<0.04	<0.02	<0.02	<0.06	<0.03	6.32	NP	0.00	162.71	156.39

**TABLE 1
GROUNDWATER DATA
THRIFTY OIL STATION #054, CASTRO VALLEY, CA.**

DATE SAMPLED	ANALYTICAL PARAMETERS						DEPTH TO GROUNDWATER (feet)	DEPTH TO PRODUCT (feet)	PRODUCT THICKNESS (feet)	CASING ELEVATION (feet)	GROUNDWATER ELEVATION (feet)
	TPH (ug/L)	BENZENE (ug/L)	TOLUENE (ug/L)	EthylBenzene (ug/L)	XYLENE (ug/L)	MTBE (ug/L)					
09/18/02	<50	<0.18	<0.14	<0.18	<0.26	<0.24	9.38	NP	0.00	163.28	153.90
12/18/02	110	<0.18	<0.14	<0.18	<0.26	101	6.32	NP	0.00	163.28	156.96
03/19/03	<15	<0.04	<0.02	<0.02	<0.06	<0.03	9.39	NP	0.00	163.28	153.89
06/11/03	<15	<0.04	<0.02	<0.02	<0.06	20	9.39	NP	0.00	163.28	153.89
09/04/03	<15	<0.22	<0.32	<0.31	<0.4	<0.18	7.85	NP	0.00	163.28	155.43
12/04/03	<15	<0.04	<0.02	<0.02	<0.06	<0.03	6.32	NP	0.00	162.71	156.39
03/18/04	<15	<0.22	<0.32	<0.31	<0.4	<0.18	9.39	NP	0.00	162.71	153.32
06/10/04	1,080	48	3.8	30	1.8	68	6.87	NP	0.00	162.71	155.84
09/02/04	1,600	94	5.9	4.3	3.8	*185 / 78	7.07	NP	0.00	162.71	155.64

NOTE: ND = Nondetectable
 " - " = Not Analyzed / Not Available
 NP = No Free Product
 *MTBE 8020/8260

Benzene, toluene, ethylbenzene, and xylene analyzed by EPA method 8020.
 Total petroleum hydrocarbons (TPH) analyzed by EPA method 8015 modified for gasoline
 Methyl-tert Butyl Ether (MTBE) analyzed by EPA method 8020
 On 3/18/04, 9/4/03 & 6/8/00, BTEX and MTBE analyzed by EPA Method 8260B

FIGURES

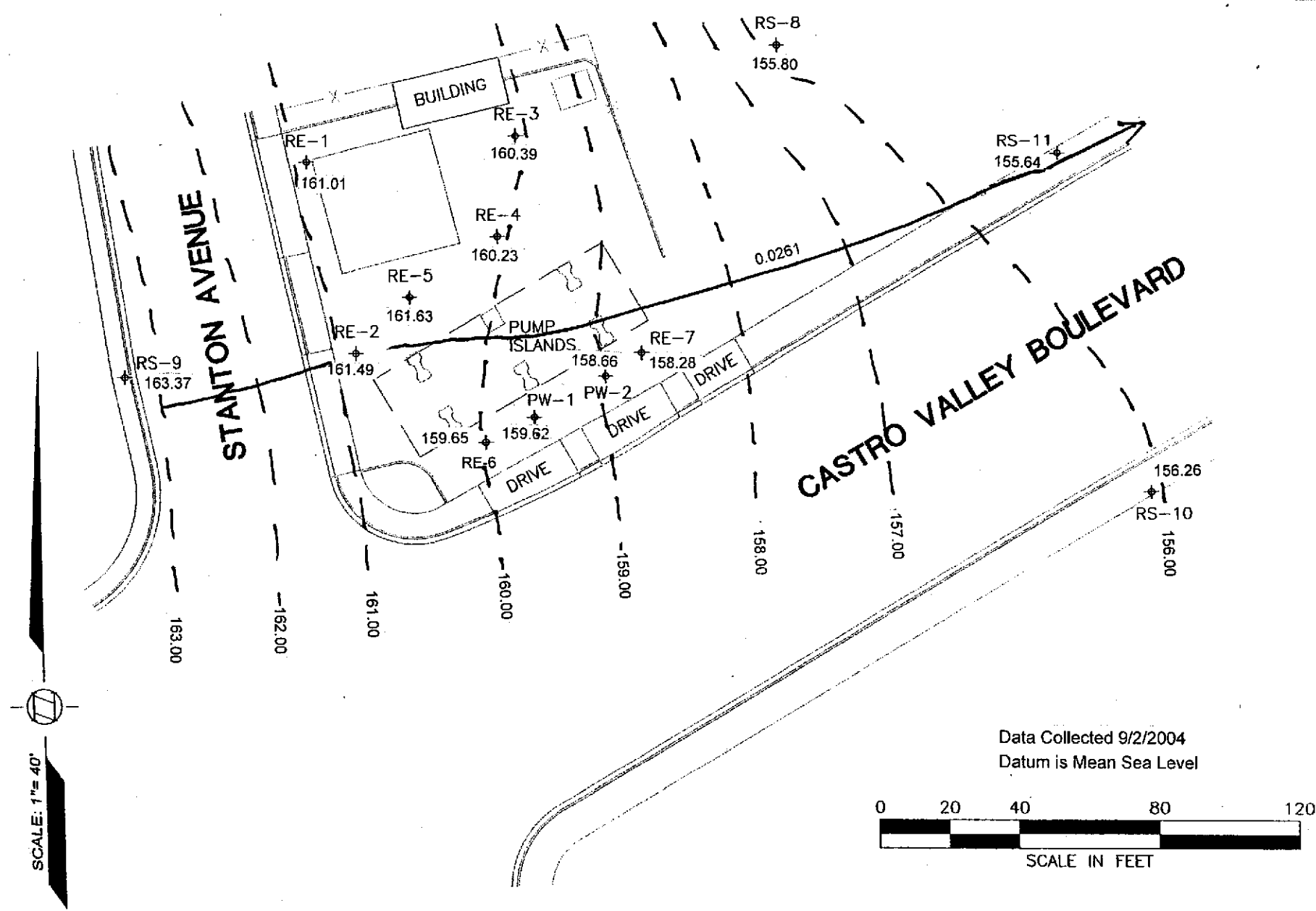

Thrifty Oil Co.
 13116 Imperial Highway
 Santa Fe Springs, CA 90670

GROUNDWATER CONTOURS

THRIFTY STATION #054
 2504 Castro Valley Boulevard
 Castro Valley, CA

Figure
 1

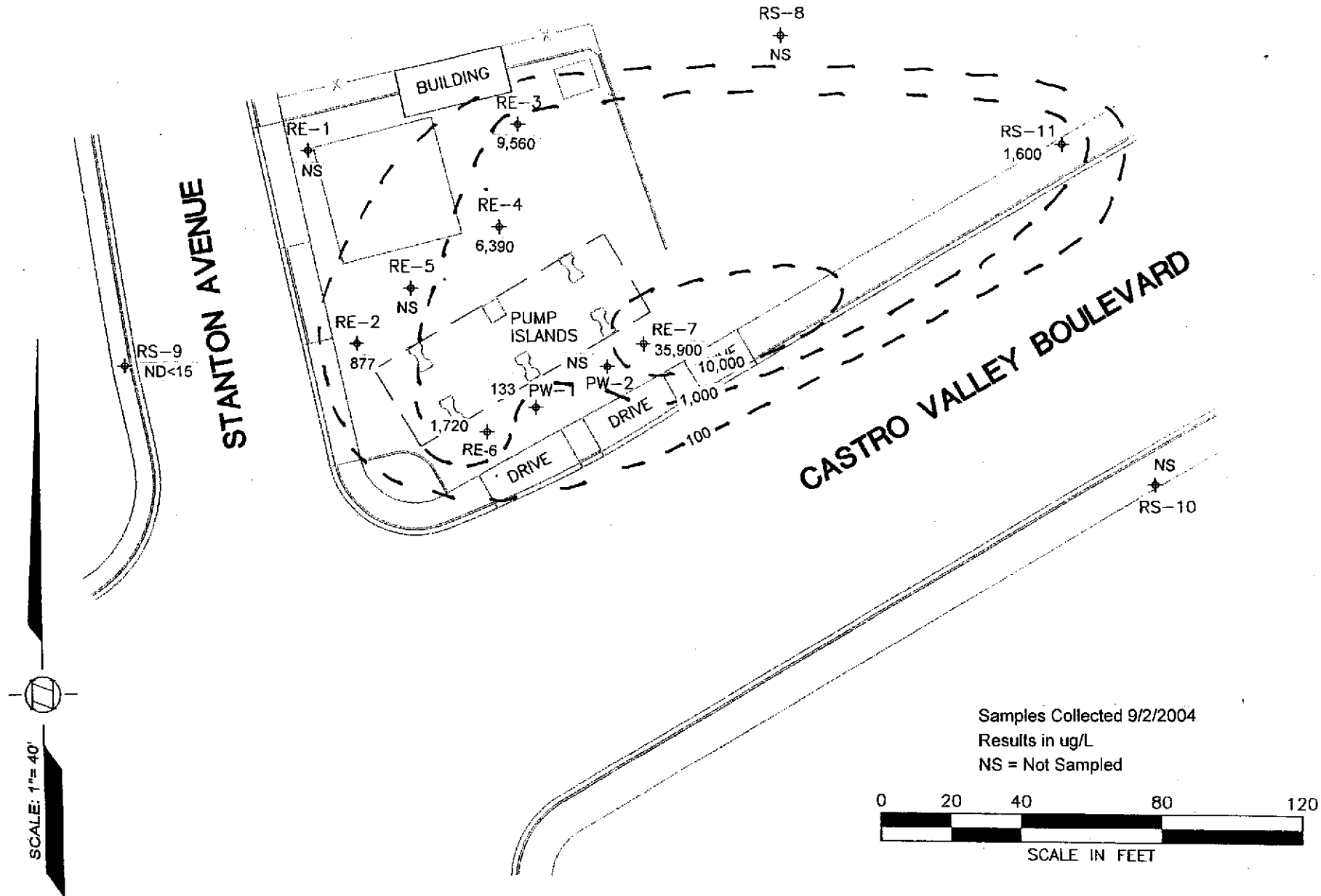

Thrifty Oil Co.
13116 Imperial Highway
Santa Fe Springs, CA 90670

TPHg IN GROUNDWATER

THRIFTY STATION #054
2504 Castro Valley Boulevard
Castro Valley, CA

Figure

2

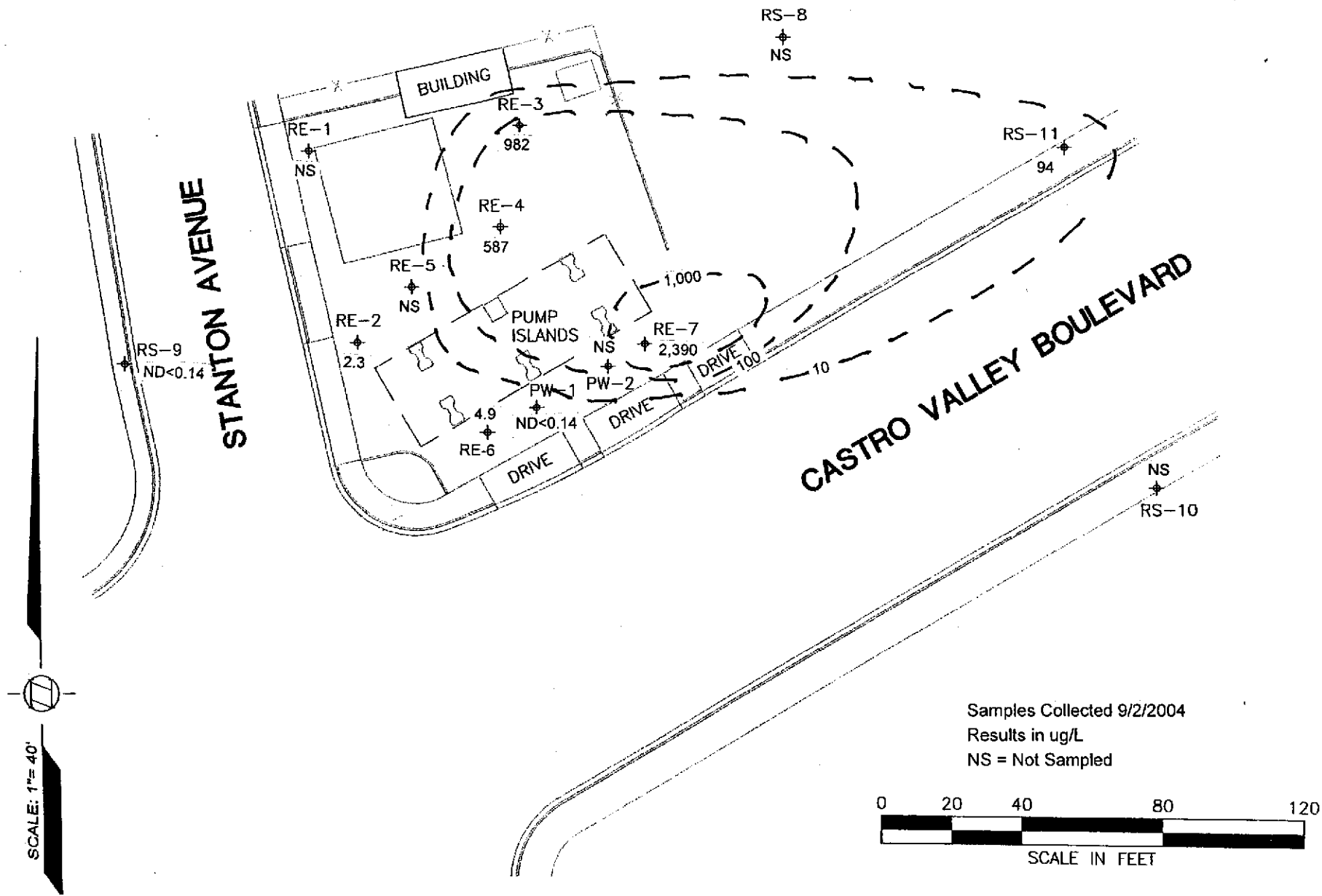

Samples Collected 9/2/2004
 Results in ug/L
 NS = Not Sampled

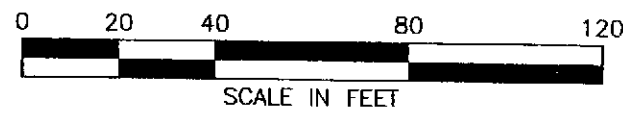

Thrifty Oil Co.
 13116 Imperial Highway
 Santa Fe Springs, CA 90670

BENZENE IN GROUNDWATER

THRIFTY STATION #054
 2504 Castro Valley Boulevard
 Castro Valley, CA

Figure

3

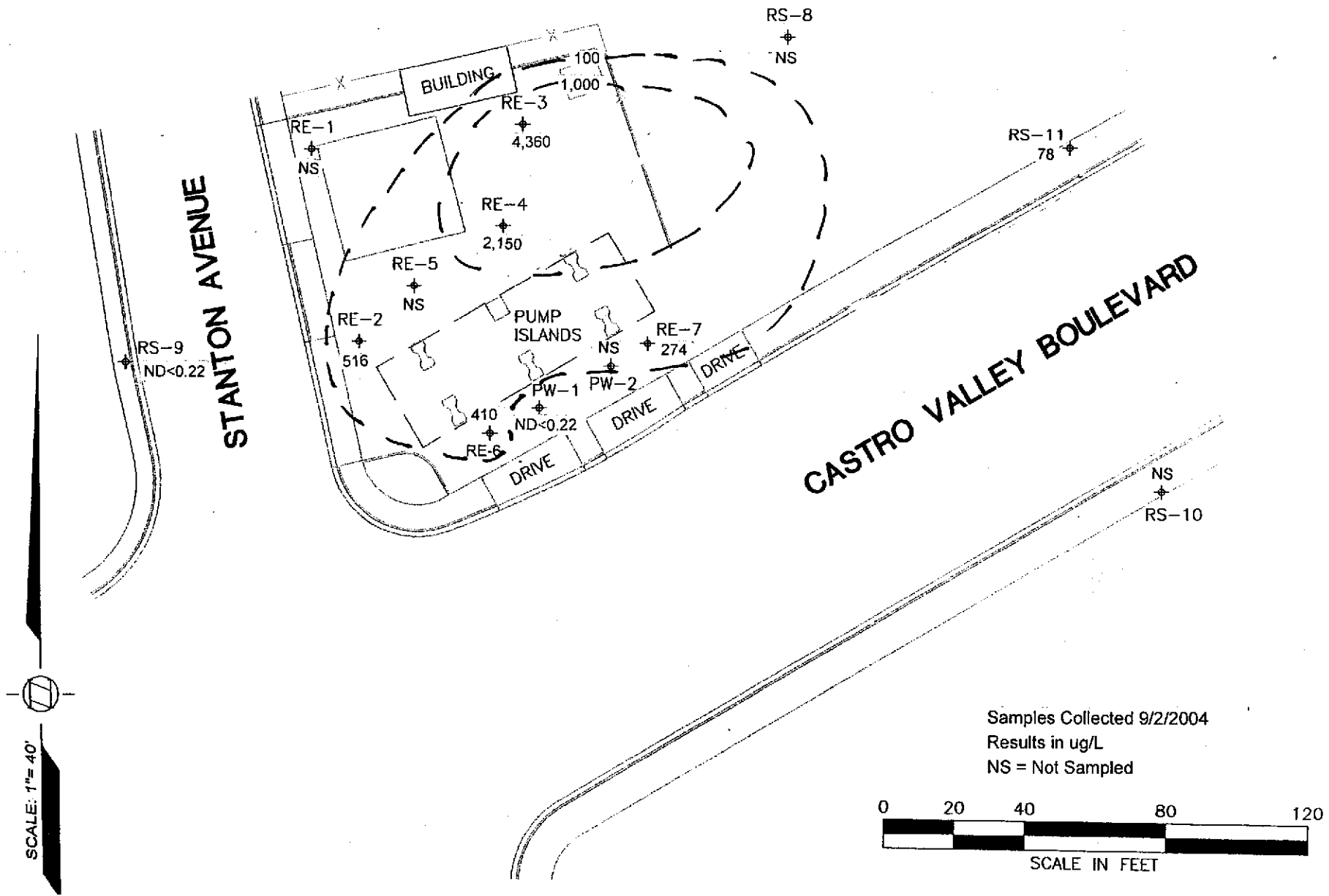

Thrifty Oil Co.
 13116 Imperial Highway
 Santa Fe Springs, CA 90670

MTBE IN GROUNDWATER

THRIFTY STATION #054
 2504 Castro Valley Boulevard
 Castro Valley, CA

Figure
 4

APPENDIX A

WELL GAUGING DATA

Project # 02-0912-SS1 Date 9/2/04 Client Thrifty Oil Co.

Site 2504 Castro Valley Blvd. Castro Valley

Well ID	Well Size (in.)	Sheen / Odor	Depth to Immiscible Liquid (ft.)	Thickness of Immiscible Liquid (ft.)	Volume of Immiscibles Removed (ml)	Depth to water (ft.)	Depth to well bottom (ft.)	Survey Point: TOB or TOC	
* PW-1	4					6.33	14.20	S	
* PW-2	4					6.95	14.32		Broken bolt
+ PE-1	4					5.45	19.75		overhead 1 bolt no bolts
* PE-2	4					5.12	17.33	S	
PE-3	4					6.30	17.25	S	
* PE-4	4					6.00	14.30	S	Missing 1 bolt
PE-5	4					4.93	17.77		
* PE-6	4					6.50	13.55	S	No bolts
* PE-7	4					7.05	13.20	S	
RS-8	2					8.23	25.20		stripped tabs no locks
RS-9	2					3.68	14.90	S	
RS-10	2					6.17	24.39		no bolts broken cap no locks
RS-11	2					7.07	25.15	S	
* pulled ded. pump device from well prior to gauging									

WELL MONITORING DATA SHEET

Project #: <u>0A0902-551</u>	Client: <u>Thrifty Oil Co.</u>
Sampler: <u>S000H</u>	Date: <u>9/2/04</u>
Well I.D.: <u>PE-7</u>	Well Diameter: 2 3 <u>4</u> 6 8 <u> </u>
Total Well Depth (TD): <u>13.20</u>	Depth to Water (DTW): <u>7.05</u>
Depth to Free Product: <u> </u>	Thickness of Free Product (feet): <u> </u>
Referenced to: <u>PVC</u> Grade	D.O. Meter (if req'd): <u>YSI</u> <u>HACH</u>
DTW with 80% Recharge [(Height of Water Column x 0.20) + DTW]: <u>8.28</u>	

Purge Method: Bailer Waterm Sampling Method: Bailer
 Disposable Bailer Peristaltic Disposable Bailer
 Positive Air Displacement Extraction Pump Extraction Port
 Electric Submersible Other Dedicated Tubing

Other:

$\frac{1 \text{ Case Volume}}{1} \times \frac{3 \text{ Specified Volumes}}{1} = \frac{12 \text{ Calculated Volume}}{1} \text{ Gals.}$	<table border="1" style="width: 100%; border-collapse: collapse;"> <thead> <tr> <th>Well Diameter</th> <th>Multiplier</th> <th>Well Diameter</th> <th>Multiplier</th> </tr> </thead> <tbody> <tr> <td>1"</td> <td>0.04</td> <td>4"</td> <td>0.65</td> </tr> <tr> <td>2"</td> <td>0.16</td> <td>6"</td> <td>1.47</td> </tr> <tr> <td>3"</td> <td>0.37</td> <td>Other</td> <td>radius² * 0.163</td> </tr> </tbody> </table>	Well Diameter	Multiplier	Well Diameter	Multiplier	1"	0.04	4"	0.65	2"	0.16	6"	1.47	3"	0.37	Other	radius ² * 0.163
Well Diameter	Multiplier	Well Diameter	Multiplier														
1"	0.04	4"	0.65														
2"	0.16	6"	1.47														
3"	0.37	Other	radius ² * 0.163														

Time	Temp (F or °C)	pH	Cond. (mS or µS)	Turbidity (NTUs)	Gals. Removed	Observations
1339	78.2	7.0	756	>200	4	TUB 10
VAL DEWATER @			4 gal.			DTW = 11.54
						10.20 @ 1425
1545	75.0	7.2	785	>200	—	LIGHT STAIN

Did well dewater? Yes No Gallons actually evacuated: 4

Sampling Date: 9/2/04 Sampling Time: 1545 Depth to Water: 10.20

Sample I.D.: PE-7 Laboratory: Kiff CalScience Other: Assisted

Analyzed for: TPH-G BTEX MTBE TPH-D Oxygenates (5) Other: confirm MBE detects by 8260E

EB I.D. (if applicable): @ Time Duplicate I.D. (if applicable):

Analyzed for: TPH-G BTEX MTBE TPH-D Oxygenates (5) Other:

D.O. (if req'd):	Pre-purge:	mg/L	Post-purge:	mg/L
O.R.P. (if req'd):	Pre-purge:	mV	Post-purge:	mV

WELL MONITORING DATA SHEET

Project #: <u>040907-551</u>	Client: <u>Thrifty Oil Co.</u>
Sampler: <u>SMOOTH</u>	Date: <u>9/2/04</u>
Well I.D.: <u>RS-11</u>	Well Diameter: <u>2</u> 3 4 6 8
Total Well Depth (TD): <u>25.15</u>	Depth to Water (DTW): <u>7.07</u>
Depth to Free Product:	Thickness of Free Product (feet):
Referenced to: <u>PVC</u> Grade	D.O. Meter (if req'd): YSI HACH
DTW with 80% Recharge [(Height of Water Column x 0.20) + DTW]: <u>10.69</u>	

Purge Method: Bailer Disposable Bailer Positive Air Displacement Electric Submersible
 Water: Peristaltic Extraction Pump Other: _____
 Sampling Method: Bailer Disposable Bailer Extraction Port Dedicated Tubing
 Other: _____

<u>3</u> (Gals.) X	<u>3</u>	=	<u>9</u> Gals.
1 Case Volume	Specified Volumes		Calculated Volume

Well Diameter	Multiplier	Well Diameter	Multiplier
1"	0.04	4"	0.65
2"	0.16	6"	1.47
3"	0.37	Other	radius ² * 0.163

Time	Temp (F or °C)	pH	Cond. (mS or µS)	Turbidity (NTUs)	Gals. Removed	Observations
1058	74.7	7.2	1129	>2000	3	two 10
1101	73.8	7.2	1142	132	6	clearing
1104	73.8	7.2	1161	145	9	"

Did well dewater? Yes No Gallons actually evacuated: 9

Sampling Date: 9/2/04 Sampling Time: 1112 Depth to Water: 10.67

Sample I.D.: RS-11 Laboratory: Kiff CalScience Other: Associated

Analyzed for: TPH-G BTEX MTBE TPH-D Oxygenates (5) Other: confirm MBE detects by 8260E

EB I.D. (if applicable): _____ @ _____ Time Duplicate I.D. (if applicable): _____

Analyzed for: TPH-G BTEX MTBE TPH-D Oxygenates (5) Other: _____

D.O. (if req'd):	Pre-purge:	mg/L	Post-purge:	mg/L
O.R.P. (if req'd):	Pre-purge:	mV	Post-purge:	mV

SPH or Purge Water Drum Log

Client: Thruway Oil Co.
 Site Address: 2504 Castro Valley Blvd. Castro Valley

STATUS OF DRUM(S) UPON ARRIVAL							
Date	9/2/04						
Number of drum(s) empty:	19						
Number of drum(s) 1/4 full:							
Number of drum(s) 1/2 full:							
Number of drum(s) 3/4 full:							
Number of drum(s) full:							
Total drum(s) on site:	19						
Are the drum(s) properly labeled?							
Drum ID & Contents:							
If any drum(s) are partially or totally filled, what is the first use date:	6 black 13 blue						

- If you add any SPH to an empty or partially filled drum, drum must have at least 20 gals. of Purgewater or DI Water.
- If drum contains SPH, the drum MUST be steel AND labeled with the appropriate label.
- All BTS drums MUST be labeled appropriately.

STATUS OF DRUM(S) UPON DEPARTURE							
Date	9/2/04						
Number of drums empty:							
Number of drum(s) 1/4 full:							
Number of drum(s) 1/2 full:							
Number of drum(s) 3/4 full:	1						
Number of drum(s) full:	1						
Total drum(s) on site:	19						
Are the drum(s) properly labeled?							
Drum ID & Contents:							

LOCATION OF DRUM(S)

Describe location of drum(s): Drum compound next to RE-3

FINAL STATUS							
Number of new drum(s) left on site this event	0						
Date of inspection:	9/2/04						
Drum(s) labelled properly:	yes						
Logged by BTS Field Tech:	JS						
Office reviewed by:	NI						

APPENDIX B



ASSOCIATED LABORATORIES

806 North Batavia - Orange, California 92868 - 714/771-6900

FAX 714/538-1209

CLIENT Thrifty Oil Company (8871)
ATTN: Mike Bowery
13116 Imperial Hwy.
P.O. Box 2128
Santa Fe Springs, CA 90670

LAB REQUEST 135778

REPORTED 09/13/2004

RECEIVED 09/03/2004

PROJECT Station #054
2504 Castro Valley Blvd., Castro Valley

SUBMITTER Client

COMMENTS

This laboratory request covers the following listed samples which were analyzed for the parameters indicated on the attached Analytical Result Report. All analyses were conducted using the appropriate methods as indicated on the report. This cover letter is an integral part of the final report.

<u>Order No.</u>	<u>Client Sample Identification</u>
552051	TOC #054 RE-2
552052	TOC #054 RE-3
552053	TOC #054 RE-4
552054	TOC #054 RE-6
552055	TOC #054 RE-7
552056	TOC #054 RS-9
552057	TOC #054 RS-11
552058	TOC #054 PW-1
552059	TOC #054 TB
552060	Laboratory Method Blank

Thank you for the opportunity to be of service to your company. Please feel free to call if there are any questions regarding this report or if we can be of further service.

ASSOCIATED LABORATORIES by,

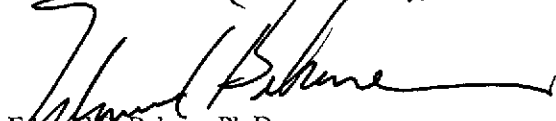
Edward S. Behare, Ph.D.
Vice President

NOTE: Unless notified in writing, all samples will be discarded by appropriate disposal protocol 30 days from date reported.

The reports of the Associated Laboratories are confidential property of our clients and may not be reproduced or used for publication in part or in full without our written permission. This is for the mutual protection of the public, our clients, and ourselves.

TESTING & CONSULTING
Chemical
Microbiological
Environmental

Order #: 552051

Client Sample ID: TOC #054 RE-2

Matrix: WATER

Date Sampled: 09/02/2004 Time Sampled: 15:15

Analyte	Result	DF	PQL	MDL	Units	Date/Analyst
8021B BTEX + MTBE						
Benzene	2.3	1	0.3	0.14	ug/L	09/03/04 LZ
Ethyl benzene	5.8	1	0.3	0.18	ug/L	09/03/04 LZ
Methyl t - butyl ether	743	20	100.0	0.22	ug/L	09/03/04 LZ
Toluene	2.2	1	0.3	0.16	ug/L	09/03/04 LZ
Xylene (total)	4.0	1	0.6	0.45	ug/L	09/03/04 LZ
Surrogates					Units	Control Limits
a,a,a-Trifluorotoluene	100				%	70 - 130
8260B BTEX/MTBE Only						
Methyl-tert-butylether (MTBE)	516	10	10.0	0.18	ug/L	09/10/04 LB
8015M - Gasoline						
Gasoline	877	1	50	15	ug/L	09/03/04 LZ
Surrogates					Units	Control Limits
a,a,a-Trifluorotoluene	112				%	55 - 200

PQL = Practical Quantitation Limit, MDL = Method detection limit, DF = Dilution Factor
 ND = Not detected below indicated MDL, J=Trace



Order #: 552052

Client Sample ID: TOC #054 RE-3

Matrix: WATER

Date Sampled: 09/02/2004 Time Sampled: 14:30

Analyte	Result	DF	PQL	MDL	Units	Date/Analyst
8021B BTEX + MTBE						
Benzene	982	20	6.0	0.14	ug/L	09/03/04 LZ
Ethyl benzene	77	20	6.0	0.18	ug/L	09/03/04 LZ
Methyl t - butyl ether	5950	200	1000.0	0.22	ug/L	09/03/04 LZ
Toluene	65	20	6.0	0.16	ug/L	09/03/04 LZ
Xylene (total)	86	20	12.0	0.45	ug/L	09/03/04 LZ
Surrogates					Units	Control Limits
a,a,a-Trifluorotoluene	100				%	70 - 130
8260B BTEX/MTBE Only						
Methyl-tert-butylether (MTBE)	4360	50	50.0	0.18	ug/L	09/10/04 LB
8015M - Gasoline						
Gasoline	9560	20	1000.0	15	ug/L	09/03/04 LZ
Surrogates					Units	Control Limits
a,a,a-Trifluorotoluene	143				%	55 - 200

PQL = Practical Quantitation Limit, MDL = Method detection limit, DF = Dilution Factor
 ND = Not detected below indicated MDL, J=Trace



Order #: 552053

Client Sample ID: TOC #054 RE-4

Matrix: WATER

Date Sampled: 09/02/2004 Time Sampled: 13:09

Analyte	Result	DF	PQL	MDL	Units	Date/Analyst
8021B BTEX + MTBE						
Benzene	587	20	6.0	0.14	ug/L	09/03/04 LZ
Ethyl benzene	34	20	6.0	0.18	ug/L	09/03/04 LZ
Methyl t - butyl ether	4150	100	500.0	0.22	ug/L	09/03/04 LZ
Toluene	50	20	6.0	0.16	ug/L	09/03/04 LZ
Xylene (total)	65	20	12.0	0.45	ug/L	09/03/04 LZ
Surrogates					Units	Control Limits
a,a,a-Trifluorotoluene	97				%	70 - 130
8260B BTEX/MTBE Only						
Methyl-tert-butylether (MTBE)	2650	25	25.0	0.18	ug/L	09/10/04 LB
8015M - Gasoline						
Gasoline	6390	20	1000.0	15	ug/L	09/03/04 LZ
Surrogates					Units	Control Limits
a,a,a-Trifluorotoluene	123				%	55 - 200

PQL = Practical Quantitation Limit, MDL = Method detection limit, DF = Dilution Factor
 ND = Not detected below indicated MDL, J=Trace



Order #: 552054

Client Sample ID: TOC #054 RE-6

Matrix: WATER

Date Sampled: 09/02/2004 Time Sampled: 15:29

Analyte	Result	DF	PQL	MDL	Units	Date/Analyst
8021B BTEX + MTBE						
Benzene	4.9	1	0.3	0.14	ug/L	09/07/04 LZ
Ethyl benzene	8.7	1	0.3	0.18	ug/L	09/07/04 LZ
Methyl t - butyl ether	633	50	250.0	0.22	ug/L	09/07/04 LZ
Toluene	8.2	1	0.3	0.16	ug/L	09/07/04 LZ
Xylene (total)	7.7	1	0.6	0.45	ug/L	09/07/04 LZ
Surrogates				Units	Control Limits	
a,a,a-Trifluorotoluene	104			%	70 - 130	
8260B BTEX/MTBE Only						
Methyl-tert-butylether (MTBE)	410	1	1	0.18	ug/L	09/10/04 LB
8015M - Gasoline						
Gasoline	1720	1	50	15	ug/L	09/07/04 LZ
Surrogates				Units	Control Limits	
a,a,a-Trifluorotoluene	151			%	55 - 200	

PQL = Practical Quantitation Limit, MDL = Method detection limit, DF = Dilution Factor
 ND = Not detected below indicated MDL, J=Trace



Order #: 552055

Client Sample ID: TOC #054 RE-7

Matrix: WATER

Date Sampled: 09/02/2004 Time Sampled: 15:45

Analyte	Result	DF	PQL	MDL	Units	Date/Analyst
8021B BTEX + MTBE						
Benzene	2390	50	15.0	0.14	ug/L	09/04/04 LZ
Ethyl benzene	1250	50	15.0	0.18	ug/L	09/04/04 LZ
Methyl t - butyl ether	419	50	250.0	0.22	ug/L	09/04/04 LZ
Toluene	174	50	15.0	0.16	ug/L	09/04/04 LZ
Xylene (total)	8020	200	120.0	0.45	ug/L	09/04/04 LZ
Surrogates					Units	Control Limits
a,a,a-Trifluorotoluene	95				%	70 - 130
8260B BTEX/MTBE Only						
Methyl-tert-butylether (MTBE)	274	1	1	0.18	ug/L	09/10/04 LB
8015M - Gasoline						
Gasoline	35900	50	2500.0	15	ug/L	09/04/04 LZ
Surrogates					Units	Control Limits
a,a,a-Trifluorotoluene	124				%	55 - 200

PQL = Practical Quantitation Limit, MDL = Method detection limit, DF = Dilution Factor
 ND = Not detected below indicated MDL, J=Trace



Order #: 552056

Client Sample ID: TOC #054 RS-9

Matrix: WATER

Date Sampled: 09/02/2004 Time Sampled: 10:50

Analyte	Result	DF	PQL	MDL	Units	Date/Analyst
8021B BTEX + MTBE						
Benzene	ND	1	0.3	0.14	ug/L	09/07/04 LZ
Ethyl benzene	ND	1	0.3	0.18	ug/L	09/07/04 LZ
Methyl t - butyl ether	ND	1	5	0.22	ug/L	09/07/04 LZ
Toluene	ND	1	0.3	0.16	ug/L	09/07/04 LZ
Xylene (total)	ND	1	0.6	0.45	ug/L	09/07/04 LZ
Surrogates				Units	Control Limits	
a,a,a-Trifluorotoluene	93			%	70 - 130	
8015M - Gasoline						
Gasoline	ND	1	50	15	ug/L	09/07/04 LZ
Surrogates				Units	Control Limits	
a,a,a-Trifluorotoluene	93			%	55 - 200	

PQL = Practical Quantitation Limit, MDL = Method detection limit, DF = Dilution Factor
 ND = Not detected below indicated MDL, J=Trace



Order #: 552057

Client Sample ID: TOC #054 RS-11

Matrix: WATER

Date Sampled: 09/02/2004 Time Sampled: 11:12

Analyte	Result	DF	PQL	MDL	Units	Date/Analyst
8021B BTEX + MTBE						
Benzene	94	10	3.0	0.14	ug/L	09/04/04 LZ
Ethyl benzene	4.3	1	0.3	0.18	ug/L	09/04/04 LZ
Methyl t - butyl ether	185	10	50.0	0.22	ug/L	09/04/04 LZ
Toluene	5.9	1	0.3	0.16	ug/L	09/04/04 LZ
Xylene (total)	3.8	1	0.6	0.45	ug/L	09/04/04 LZ
Surrogates				Units		Control Limits
a,a,a-Trifluorotoluene	102				%	70 - 130
8260B BTEX/MTBE Only						
Methyl-tert-butylether (MTBE)	78	1	1	0.18	ug/L	09/10/04 LB
8015M - Gasoline						
Gasoline	1600	1	50	15	ug/L	09/04/04 LZ
Surrogates				Units		Control Limits
a,a,a-Trifluorotoluene	170				%	55 - 200

PQL = Practical Quantitation Limit, MDL = Method detection limit, DF = Dilution Factor
 ND = Not detected below indicated MDL, J=Trace



Order #: 552058

Client Sample ID: TOC #054 PW-1

Matrix: WATER

Date Sampled: 09/02/2004 Time Sampled: 15:23

Analyte	Result	DF	PQL	MDL	Units	Date/Analyst
8021B BTEX + MTBE						
Benzene	ND	1	0.3	0.14	ug/L	09/08/04 LZ
Ethyl benzene	ND	1	0.3	0.18	ug/L	09/08/04 LZ
Methyl t - butyl ether	ND	1	5	0.22	ug/L	09/08/04 LZ
Toluene	2.4	1	0.3	0.16	ug/L	09/08/04 LZ
Xylene (total)	1.9	1	0.6	0.45	ug/L	09/08/04 LZ

Surrogates					Units	Control Limits
a,a,a-Trifluorotoluene	104				%	70 - 130

8015M - Gasoline

Gasoline	133	1	50	15	ug/L	09/08/04 LZ
----------	-----	---	----	----	------	-------------

Surrogates					Units	Control Limits
a,a,a-Trifluorotoluene	104				%	55 - 200

PQL = Practical Quantitation Limit, MDL = Method detection limit, DF = Dilution Factor
 ND = Not detected below indicated MDL, J=Trace



Order #: 552059

Client Sample ID: TOC #054 TB

Matrix: WATER

Analyte	Result	DF	PQL	MDL	Units	Date/Analyst
8021B BTEX + MTBE						
Benzene	ND	1	0.3	0.14	ug/L	09/03/04 LZ
Ethyl benzene	ND	1	0.3	0.18	ug/L	09/03/04 LZ
Methyl t - butyl ether	ND	1	5	0.22	ug/L	09/03/04 LZ
Toluene	ND	1	0.3	0.16	ug/L	09/03/04 LZ
Xylene (total)	ND	1	0.6	0.45	ug/L	09/03/04 LZ
					Units	Control Limits
Surrogates					%	70 - 130
a,a,a-Trifluorotoluene	93					
8015M - Gasoline						
Gasoline	ND	1	50	15	ug/L	09/03/04 LZ
					Units	Control Limits
Surrogates					%	55 - 200
a,a,a-Trifluorotoluene	93					

PQL = Practical Quantitation Limit, MDL = Method detection limit, DF = Dilution Factor
 ND = Not detected below indicated MDL, J=Trace



Order #: 552060

Client Sample ID: Laboratory Method Blank

Matrix: WATER

Analyte	Result	DF	PQL	MDL	Units	Date/Analyst
8021B BTEX + MTBE						
Benzene	ND	1	0.3	0.14	ug/L	09/03/04 LZ
Ethyl benzene	ND	1	0.3	0.18	ug/L	09/03/04 LZ
Methyl t - butyl ether	ND	1	5	0.22	ug/L	09/03/04 LZ
Toluene	ND	1	0.3	0.16	ug/L	09/03/04 LZ
Xylene (total)	ND	1	0.6	0.45	ug/L	09/03/04 LZ
Surrogates				Units		Control Limits
a,a,a-Trifluorotoluene	94				%	70 - 130
8015M - Gasoline						
Gasoline	ND	1	50	15	ug/L	09/03/04 LZ
Surrogates				Units		Control Limits
a,a,a-Trifluorotoluene	94				%	55 - 200

PQL = Practical Quantitation Limit, MDL = Method detection limit, DF = Dilution Factor
 ND = Not detected below indicated MDL, J=Trace



BLAINE

TECH SERVICES, INC.

1680 ROGERS AVENUE
 SAN JOSE, CALIFORNIA 95112-1105
 FAX (408) 573-7771
 PHONE (408) 573-0555

CONDUCT ANALYSIS TO DETECT

LAB Associated Lab DHS #

ALL ANALYSES MUST MEET SPECIFICATIONS AND DETECTION LIMITS SET BY CALIFORNIA DHS AND

- EPA
 LIA
 OTHER
- RWQCB REGION
135778

CHAIN OF CUSTODY

BTS # 010902-551

CLIENT Thrifty Oil Company

SITE Station #054

2504 Castro Valley Blvd.

Castro Valley, CA

C = COMPOSITE ALL CONTAINERS

TPH-G (8015M)

BTEX / MTBE (8021B) *

SPECIAL INSTRUCTIONS

Invoice and Report to : Thrifty Oil Company

Attn: Michael Bowery

* Confirm any MTBE detects by EPA 8260B.

SAMPLE I.D.	DATE	TIME	MATRIX		CONTAINERS	C	TPH-G (8015M)	BTEX / MTBE (8021B) *							ADD'L INFORMATION	STATUS	CONDITION	LAB SAMPLE #	
			S= SOIL	W=H ₂ O															
PE-2	9/2/04	1515	W		4		X	X											
PE-3		1430					X	X											
PE-4		1309					X	X											
PE-6		1529					X	X											
PE-7		1545					X	X											
PS-9		1050					X	X											
PS-11		1112					X	X											
PW-1		1523			4		X	X											
TB	1				2		X	X											

SAMPLING COMPLETED DATE 9/2/04 TIME 1600 SAMPLING PERFORMED BY *Suchan Sung* RESULTS NEEDED NO LATER THAN Standard TAT

RELEASED BY *[Signature]* DATE 9/2/04 TIME 1700 RECEIVED BY *[Signature]* DATE 9-3 TIME 10:30

RELEASED BY *[Signature]* DATE 9/2/04 TIME 1700 RECEIVED BY *[Signature]* DATE 9/2/04 TIME 1:50

RELEASED BY _____ DATE _____ TIME _____ RECEIVED BY _____ DATE _____ TIME _____

SHIPPED VIA *GOLOW STATE OVERNIGHT* DATE SENT 9/2/04 TIME SENT 1700 COOLER # 1