

THRIFTY OIL CO.

R0348

April 14, 2004

O.45300

Mr. Amer Gholami
Alameda County Health Care Agency
Hazardous Material Specialist
1131 Harbor Bay Parkway, Suite 250
Alameda, CA 94502

Alameda County
APR 20 2004
Environmental Health

Local #1252
RWQCB #01-1476
Global ID #T0600101363

RE: **Former Thrifty Oil Co. Station #054**
TOSCO Station #2602486
2504 Castro Valley Boulevard
Castro Valley, CA
1st Quarter 2004, Status Report and 2nd Request for Closure

Dear Mr. Gholami:

Presented herein is the First Quarter 2004, Status Report prepared for Former Thrifty Oil Co. (Thrifty) Station #054 located at 2504 Castro Valley Boulevard, Castro Valley, California (**Figure 1**). This report presents the results of the groundwater monitoring activities conducted during the first quarter of 2004. Thrifty has retained the services of Earth Management Company (EMC) to conduct quarterly groundwater monitoring and sampling activities at this site.

Groundwater Monitoring

Depth to groundwater is measured in each monitoring well quarterly. Historic groundwater gauging data obtained from April 11, 1988 through March 18, 2004, is presented in **Table 1**. In general, groundwater occurs beneath the station at depths ranging from 2.68 feet below top of casing (btc) in monitoring well RS-9 to 9.65 feet btc in monitoring well RS-8 (**Appendix A**). A groundwater elevation contour map based on the March 18, 2004, data is presented in **Figure 1**. Groundwater elevation data indicates that the general direction of groundwater flow beneath the site is toward the east-southeast with a hydraulic gradient of approximately 0.0588 feet/foot.

Quarterly Groundwater Sampling

As part of the ongoing groundwater-monitoring program, groundwater samples were obtained from selected monitoring wells PW-1, RE-2, RE-3, RE-4, RE-6, RE-7, RS-9, and RS-11 on March 18, 2004. In a letter from the Alameda County Health Care Agency (ACHCA) dated November 6, 2001, the ACHCA released Thrifty from collecting groundwater samples from wells PW-2, RE-1, RE-5, RS-8, and RS-10 until further notice.

Groundwater samples were obtained by EMC and delivered in a chilled state in an ice chest following strict Chain-of-Custody procedures to a state-certified laboratory. The samples were analyzed for total petroleum hydrocarbons as gasoline (TPHg) by EPA Method 8015M for gasoline and for benzene, toluene, ethylbenzene, xylenes (BTEX) and methyl tert-butyl ether (MTBE) by EPA Method 8021B. Copies of the EMC Field Status Reports are presented in **Appendix A**, and copies of the laboratory analytical reports are contained in **Appendix B**.



TPHg, BTEX, and MTBE concentrations appear in **Table 1** and laboratory reports are provided in **Appendix B**. TPHg, benzene, and MTBE isoconcentration maps are presented in **Figures 2, 3, and 4**, respectively. The highest laboratory analytical concentrations for TPHg, benzene, and MTBE were found in monitoring offsite well RS-9 (193 ug/L, 7.5 ug/L, and 127 ug/L, respectively).

Based on a new survey of top of casing elevations performed by Morrow Surveying in October 2003, it was confirmed and Thrifty again reiterates that well RS-9 is located up gradient of the Thrifty site, and contamination found in this well appears to be originating from an up gradient off-site source. TOSCO Marketing Company is the current operator of the service station, acquired the lease from BP Oil, who previously leased the property beginning on July 10, 1991. **Due to the low TPHg, benzene, and MTBE concentrations in all onsite monitoring wells, Thrifty respectfully repeats its request for closure of Thrifty Station #054 located at 2504 Castro Valley Boulevard, Castro Valley, California.** Thrifty will contact the ACHCA in the near future to discuss site closure.

Planned Activities

Thrifty will continue the groundwater monitoring, gauging, and sampling events at this site on a quarterly basis. All interpretations expressed in this report are based solely upon the review of data collected by EMC and laboratory analyses by Associated Laboratories.

Respectfully submitted,

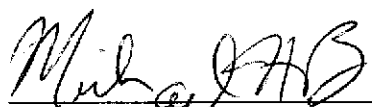

Michael H. Bowery, R.G.
Project Manager

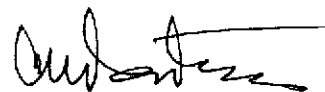
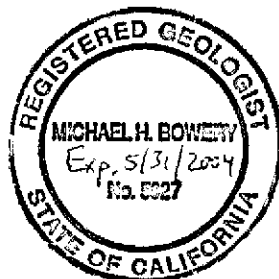

Chris Panaitescu
General Manager
Environmental Affairs

cc: - Erika Assadi, SRWQCB (USTCF)

- Liz Sewell, Tosco Marketing Company
76 Broadway
Sacramento CA 95818

File

TABLES

TABLE 1
GROUNDWATER DATA
THRIFTY OIL STATION #054, CASTRO VALLEY, CA.

DATE SAMPLED	ANALYTICAL PARAMETERS						DEPTH TO GROUNDWATER (feet)	DEPTH TO PRODUCT (feet)	PRODUCT THICKNESS (feet)	CASING ELEVATION (feet)	GROUNDWATER ELEVATION (feet)
	TPH (ug/L)	BENZENE (ug/L)	TOLUENE (ug/L)	EthylBenzene (ug/L)	XYLENE (ug/L)	MTBE (ug/L)					
MONITORING WELL HPW-1											
<i>Screen Interval = 5 to 15 feet (Est.)</i>											
04/11/88	-	-	-	-	-	-	-	-	-	-	-
04/09/90	230,000	600	2,700	1,000	16,000	-	5.10	NP	0.00	166.46	161.36
10/30/90	35,000	240	970	240	3,580	-	6.17	NP	0.00	166.46	160.29
01/18/91	37,000	43	140	42	1,600	-	6.28	NP	0.00	166.46	160.18
02/12/91	45,000	99	130	25	700	-	5.88	NP	0.00	166.46	160.58
03/20/91	1,900	0.43	ND	ND	2.8	-	4.75	NP	0.00	166.46	161.71
05/22/91	41,000	600	730	250	3,800	-	5.10	NP	0.00	166.46	161.36
06/19/91	-	-	-	-	-	-	5.61	NP	0.00	166.46	160.85
07/17/91	-	-	-	-	-	-	5.53	FILM	0.00	166.46	160.93
08/07/91	-	-	-	-	-	-	5.67	FILM	0.00	166.46	160.79
09/24/91	-	-	-	-	-	-	5.57	FILM	0.00	166.46	160.89
10/23/91	-	-	-	-	-	-	6.53	FILM	0.00	166.46	159.93
11/06/91	-	-	-	-	-	-	5.85	FILM	0.00	166.46	160.61
12/04/91	-	-	-	-	-	-	5.91	FILM	0.00	166.46	160.55
01/29/92	-	-	-	-	-	-	5.43	FILM	0.00	166.46	161.03
02/26/92	-	-	-	-	-	-	5.54	FILM	0.00	166.46	160.92
03/19/92	ND	ND	ND	ND	ND	-	5.47	NP	0.00	166.46	160.99
04/22/92	-	-	-	-	-	-	5.62	FILM	0.00	166.46	160.84
05/21/92	1,300	19	2.9	0.7	58	-	6.21	NP	0.00	166.46	160.25
06/25/92	-	-	-	-	-	-	6.94	NP	0.00	166.46	159.52
07/30/92	-	-	-	-	-	-	5.90	FILM	0.00	166.46	160.56
08/20/92	-	-	-	-	-	-	7.12	FILM	0.00	166.46	159.34
09/30/92	3,400	57	ND	26	240	-	6.42	NP	0.00	166.46	160.04
12/23/92	-	-	-	-	-	-	5.56	FILM	0.00	166.46	160.90
03/10/93	-	-	-	-	-	-	5.65	FILM	0.00	166.46	160.81
06/09/93	400	<0.5	1.1	<1.0	<1.0	-	5.30	NP	0.00	166.46	161.16
09/14/93	180	3.7	3.2	1.5	14	-	5.43	NP	0.00	166.46	161.03
12/14/93	<50	<0.3	<0.3	<0.3	<0.5	-	4.65	NP	0.00	166.46	161.81
03/02/94	<50	<0.3	<0.3	<0.3	<0.5	-	5.43	NP	0.00	166.46	161.03
06/06/94	330	1.3	<0.3	0.88	9.8	-	4.70	NP	0.00	166.46	161.76
09/06/94	1,100	67	<0.3	<0.3	24	-	6.48	NP	0.00	166.46	159.98
12/07/94	<50	<0.3	<0.3	<0.5	<0.5	-	5.22	NP	0.00	166.46	161.24
03/08/95	<100	<0.5	<0.5	<0.5	<1	-	6.94	NP	0.00	166.46	159.52
06/15/95	260	0.8	0.6	<0.5	3.2	-	5.72	NP	0.00	166.46	160.74

TABLE 1
GROUNDWATER DATA
THRIFTY OIL STATION #054, CASTRO VALLEY, CA.

DATE SAMPLED	ANALYTICAL PARAMETERS						DEPTH TO GROUNDWATER (feet)	DEPTH TO PRODUCT (feet)	PRODUCT THICKNESS (feet)	CASING ELEVATION (feet)	GROUNDWATER ELEVATION (feet)
	TPH (ug/L)	BENZENE (ug/L)	TOLUENE (ug/L)	EthylBenzene (ug/L)	XYLENE (ug/L)	MTBE (ug/L)					
09/05/95	330	2.1	<0.5	2.1	9.6	-	5.96	NP	0.00	166.46	160.50
11/21/95	660	13	1.3	<0.3	4.0	-	6.04	NP	0.00	166.46	160.42
03/11/96	660	0.94	0.77	<0.3	8.1	-	3.60	NP	0.00	166.46	162.86
06/19/96	120	0.53	<0.3	<0.3	2.3	-	4.80	NP	0.00	166.46	161.66
09/16/96	<50	<0.3	<0.3	<0.3	<0.5	<20	5.10	NP	0.00	166.46	161.36
12/10/96	<50	<0.3	<0.3	<0.3	<0.5	<20	4.92	NP	0.00	166.46	161.54
03/12/97	<50	<0.3	<0.3	<0.3	<0.5	<20	4.50	NP	0.00	166.46	161.96
06/12/97	<50	<0.3	<0.3	<0.3	<0.5	<20	-	-	-	-	-
09/16/97	690	0.97	<0.3	<0.3	<0.5	<20	4.55	NP	0.00	166.46	161.91
12/09/97	640	150	0.64	<0.3	5.2	1,300	5.60	NP	0.00	166.46	160.86
03/03/98	<50	<0.3	0.57	<0.3	<0.5	<20	4.13	NP	0.00	166.46	162.33
07/08/98	<50	<0.3	<0.3	<0.3	<0.5	<5	-	-	-	-	-
09/10/98	<50	<0.3	<0.3	<0.3	<0.5	<5	6.35	NP	0.00	166.46	160.11
12/30/98	<50	1.1	<0.3	<0.3	<0.5	<5	6.40	NP	0.00	166.46	160.06
03/15/99	<50	<0.3	<0.3	<0.3	<0.5	<5	6.35	NP	0.00	166.46	160.11
06/22/99	<50	<0.3	<0.3	<0.3	<0.5	53	4.95	NP	0.00	166.46	161.51
09/08/99	<50	<0.3	<0.3	<0.3	<0.5	<5	4.80	NP	0.00	166.46	161.66
12/01/99	<50	<0.3	<0.3	<0.3	<0.5	<5	3.64	NP	0.00	166.46	162.82
03/23/00	<50	0.5	0.5	1.1	<0.5	<5	4.03	NP	0.00	166.46	162.43
06/08/00	<50	<5	<5	<5	<5	<5	4.40	NP	0.00	166.46	162.06
09/27/00	<50	<0.18	<0.14	<0.18	<0.26	<0.24	4.73	NP	0.00	166.46	161.73
12/13/00	<50	<0.18	<0.14	<0.18	<0.26	<0.24	4.01	NP	0.00	166.46	162.45
03/22/01	600	<0.18	1.3	<0.18	<0.26	*1,010 / 1,970	6.32	NP	0.00	166.46	160.14
06/15/01	<50	<0.18	<0.14	<0.18	<0.26	<0.24	6.32	NP	0.00	166.46	160.14
08/30/01	<50	<0.18	<0.14	<0.18	<0.26	<0.24	6.32	NP	0.00	166.46	160.14
12/12/01	<50	<0.18	<0.14	<0.18	<0.26	<0.24	6.02	NP	0.00	166.46	160.44
03/13/02	<50	<0.18	<0.14	<0.18	<0.26	<0.24	6.30	NP	0.00	166.46	160.16
06/12/02	1,320	1	1	<0.18	2	2,060	6.30	NP	0.00	166.46	160.16
09/18/02	<50	<0.18	<0.14	<0.18	<0.26	<0.24	7.06	NP	0.00	166.46	159.40
12/18/02	113	<0.18	1.1	<0.18	<0.26	89	6.30	NP	0.00	166.46	160.16
03/19/03	<15	<0.04	2.2	<0.02	2.7	<0.03	6.35	NP	0.00	166.46	160.11
06/11/03	<15	<0.04	<0.02	<0.02	<0.06	<0.03	6.35	NP	0.00	166.46	160.11
09/04/03	<15	<0.22	<0.32	<0.31	<0.4	<0.18	5.90	NP	0.00	166.46	160.56
12/04/03	<15	<0.04	<0.02	<0.02	<0.06	<0.03	3.38	NP	0.00	165.95	162.57
03/18/04	<15	<0.22	<0.32	<0.31	<0.4	<0.18	5.51	NP	0.00	165.95	160.44

**TABLE 1
GROUNDWATER DATA
THRIFTY OIL STATION #054, CASTRO VALLEY, CA.**

DATE SAMPLED	ANALYTICAL PARAMETERS						DEPTH TO GROUNDWATER (feet)	DEPTH TO PRODUCT (feet)	PRODUCT THICKNESS (feet)	CASING ELEVATION (feet)	GROUNDWATER ELEVATION (feet)
	TPH (ug/L)	BENZENE (ug/L)	TOLUENE (ug/L)	EthylBenzene (ug/L)	KYLENE (ug/L)	MTBE (ug/L)					
MONITORING WELL PW-2											
<i>Screen Interval = 5 to 15 feet (Est.)</i>											
04/11/88	-	-	-	-	-	-	-	-	-	-	-
04/09/90	600,000	1,300	11,000	4,600	4,300	-	5.81	NP	0.00	166.18	160.37
10/30/90	48,000	310	51	10	480	-	6.95	NP	0.00	166.18	159.23
01/18/91	86,000	230	1,400	350	8,300	-	6.92	NP	0.00	166.18	159.26
02/12/91	160,000	680	1,300	250	7,000	-	6.78	NP	0.00	166.18	159.40
03/20/91	17,000	34	50	ND	1,100	-	5.54	NP	0.00	166.18	160.64
05/22/91	14,000	57	2,100	500	8,200	-	6.07	NP	0.00	166.18	160.11
06/19/91	-	-	-	-	-	-	6.37	FILM	0.00	166.18	159.81
07/17/91	-	-	-	-	-	-	6.38	FILM	0.00	166.18	159.80
08/07/91	-	-	-	-	-	-	6.63	FILM	0.00	166.18	159.55
09/24/91	-	-	-	-	-	-	6.42	FILM	0.00	166.18	159.76
10/23/91	-	-	-	-	-	-	7.25	FILM	0.00	166.18	158.93
11/06/91	-	-	-	-	-	-	6.44	FILM	0.00	166.18	159.74
12/04/91	-	-	-	-	-	-	6.65	FILM	0.00	166.18	159.53
01/29/92	-	-	-	-	-	-	6.17	FILM	0.00	166.18	160.01
02/26/92	-	-	-	-	-	-	5.90	FILM	0.00	166.18	160.28
03/19/92	-	-	-	-	-	-	5.80	FILM	0.00	166.18	160.38
04/22/92	-	-	-	-	-	-	5.88	FILM	0.00	166.18	160.30
05/21/92	-	-	-	-	-	-	6.03	FILM	0.00	166.18	160.15
06/25/92	-	-	-	-	-	-	6.57	FILM	0.00	166.18	159.61
07/30/92	-	-	-	-	-	-	6.20	FILM	0.00	166.18	159.98
08/20/92	-	-	-	-	-	-	6.64	FILM	0.00	166.18	159.54
09/30/92	-	-	-	-	-	-	6.88	FILM	0.00	166.18	159.30
12/23/92	-	-	-	-	-	-	6.08	FILM	0.00	166.18	160.10
03/10/93	-	-	-	-	-	-	5.95	FILM	0.00	166.18	160.23
06/09/93	3,400	24	22	<0.5	240	-	5.38	NP	0.00	166.18	160.80
09/14/93	4,900	190	15	6.8	480	-	6.26	NP	0.00	166.18	159.92
12/14/93	1,700	4.2	<0.3	<0.3	<0.5	-	5.22	NP	0.00	166.18	160.96
03/02/94	-	-	-	-	-	-	5.75	FILM	0.00	166.18	160.43
06/06/94	980	25	1.2	<0.3	42	-	5.25	NP	0.00	166.18	160.93
09/06/94	3,200	95	3.0	<1.7	76	-	6.80	NP	0.00	166.18	159.38
12/07/94	510	1.8	<0.3	<0.5	1.7	-	5.57	NP	0.00	166.18	160.61
03/08/95	1,900	<0.5	<0.5	1.4	35	-	4.10	NP	0.00	166.18	162.08
06/15/95	1,700	5.6	<0.5	<0.5	1.6	-	5.44	NP	0.00	166.18	160.74

TABLE 1
GROUNDWATER DATA
THRIFTY OIL STATION #054, CASTRO VALLEY, CA.

DATE SAMPLED	ANALYTICAL PARAMETERS						DEPTH TO GROUNDWATER (feet)	DEPTH TO PRODUCT (feet)	PRODUCT THICKNESS (feet)	CASING ELEVATION (feet)	GROUNDWATER ELEVATION (feet)
	TPH (ug/L)	BENZENE (ug/L)	TOLUENE (ug/L)	EthylBenzene (ug/L)	XYLENE (ug/L)	MTBE (ug/L)					
09/05/95	2,500	33	1.0	0.86	18	-	6.13	NP	0.00	166.18	160.05
11/21/95	2,800	130	59	18	190	-	6.23	NP	0.00	166.18	159.95
03/11/96	13,000	330	460	<15	3,800	-	4.48	NP	0.00	166.18	161.70
06/19/96	1,400	<0.3	<0.3	<0.3	<0.5	-	5.38	NP	0.00	166.18	160.80
09/16/96	3,500	<0.3	<0.3	<0.3	<0.5	5,900	5.21	NP	0.00	166.18	160.97
12/10/96	2,100	<0.3	<0.3	<0.3	<0.5	4,700	4.87	NP	0.00	166.18	161.31
03/12/97	600	1.6	<0.3	<0.3	5.8	1,100	4.43	NP	0.00	166.18	161.75
06/12/97	270	<0.3	<0.3	<0.3	<0.5	630	-	-	-	-	-
09/10/97	220	<0.3	<0.3	<0.3	<0.5	320	4.07	NP	0.00	166.18	162.11
12/09/97	120	<0.3	0.73	<0.3	<0.5	420	5.20	NP	0.00	166.18	160.98
03/03/98	<50	0.43	0.48	<0.3	<0.5	47	3.30	NP	0.00	166.18	162.88
07/08/98	<50	<0.3	<0.3	<0.3	<0.5	<5	-	-	-	-	-
09/10/98	<50	<0.3	<0.3	<0.3	<0.5	<5	5.15	NP	0.00	166.18	161.03
12/30/98	<50	1.1	<0.3	<0.3	<0.5	<5	4.75	NP	0.00	166.18	161.43
03/15/99	<50	<0.3	<0.3	<0.3	<0.5	<5	4.40	NP	0.00	166.18	161.78
06/22/99	-	-	-	-	-	-	4.50	NP	0.00	166.18	161.68
09/08/99	100	<0.3	<0.3	<0.3	<0.5	230	3.99	NP	0.00	166.18	162.19
12/01/99	<50	<0.3	<0.3	<0.3	<0.5	<5	3.62	NP	0.00	166.18	162.56
03/23/00	<50	<0.25	<0.25	<0.25	<0.5	<5	2.93	NP	0.00	166.18	163.25
06/08/00	<50	<5	<5	<5	<5	<5	3.60	NP	0.00	166.18	162.58
09/27/00	<50	<0.18	<0.14	<0.18	<0.26	<0.24	3.61	NP	0.00	166.18	162.57
12/13/00	<50	<0.18	<0.14	<0.18	<0.26	<0.24	3.60	NP	0.00	166.18	162.58
03/22/01	<50	<0.18	<0.14	<0.18	<0.26	<0.24	5.14	NP	0.00	166.18	161.04
06/15/01	<50	<0.18	<0.14	<0.18	<0.26	<0.24	5.13	NP	0.00	166.18	161.05
08/30/01	<50	<0.18	<0.14	<0.18	<0.26	<0.24	5.90	NP	0.00	166.18	160.28
12/12/01	<50	<0.18	<0.14	<0.18	<0.26	<0.24	6.20	NP	0.00	166.18	159.98
03/13/02	-	-	-	-	-	-	5.14	NP	0.00	166.18	161.04
06/12/02	-	-	-	-	-	-	-	-	-	-	-
09/18/02	-	-	-	-	-	-	-	-	-	-	-
12/18/02	-	-	-	-	-	-	-	-	-	-	-
03/19/03	-	-	-	-	-	-	-	-	-	-	-
06/11/03	-	-	-	-	-	-	-	-	-	-	-
09/04/03	-	-	-	-	-	-	-	-	-	-	-
12/04/03	-	-	-	-	-	-	3.20	NP	0.00	165.61	162.41
03/18/04	-	-	-	-	-	-	5.12	NP	0.00	165.61	160.49

TABLE 1
GROUNDWATER DATA
THRIFTY OIL STATION #054, CASTRO VALLEY, CA.

DATE SAMPLED	ANALYTICAL PARAMETERS						DEPTH TO GROUNDWATER (feet)	DEPTH TO PRODUCT (feet)	PRODUCT THICKNESS (feet)	CASING ELEVATION (feet)	GROUNDWATER ELEVATION (feet)
	TPH (ug/L)	BENZENE (ug/L)	TOLUENE (ug/L)	EthylBenzene (ug/L)	XYLENE (ug/L)	MTBE (ug/L)					
MONITORING WELL #RE-1											
<i>Screen Interval = 5 to 17 feet</i>											
04/11/88	37,000	1,900	8,400	1,200	15,000	-	-	-	-	-	-
04/09/90	45,000	6,100	7,000	2,000	8,800	-	4.99	NP	0.00	166.82	161.83
10/30/90	72,000	7,700	5,300	1,800	8,900	-	5.95	NP	0.00	166.82	160.87
01/18/91	150,000	11,000	14,000	1,800	4,300	-	5.17	NP	0.00	166.82	161.65
02/12/91	140,000	11,000	12,000	1,600	13,000	-	4.16	NP	0.00	166.82	162.66
03/20/91	53,000	3,100	4,200	400	5,500	-	4.75	NP	0.00	166.82	162.07
05/22/91	85,000	8,700	10,000	1,800	12,000	-	4.42	NP	0.00	166.82	162.40
06/19/91	110,000	8,500	9,600	2,600	16,000	-	4.93	NP	0.00	166.82	161.89
07/17/91	5,500	950	ND	26	ND	-	5.19	NP	0.00	166.82	161.63
08/07/91	-	6,700	5,000	ND	7,100	-	5.12	NP	0.00	166.82	161.70
09/24/91	60,000	6,800	4,300	640	6,900	-	5.87	NP	0.00	166.82	160.95
10/23/91	79,000	7,900	8,300	450	7,100	-	5.81	NP	0.00	166.82	161.01
11/06/91	130,000	14,000	15,000	1,100	8,800	-	5.56	NP	0.00	166.82	161.26
12/04/91	50,000	8,000	4,700	520	4,100	-	5.35	NP	0.00	166.82	161.47
01/29/92	21,000	10,300	11,000	780	6,000	-	4.50	NP	0.00	166.82	162.32
02/26/92	38,000	8,400	10,500	720	7,100	-	5.27	NP	0.00	166.82	161.55
03/19/92	48,000	6,200	9,700	780	7,200	-	4.47	NP	0.00	166.82	162.35
04/22/92	-	-	-	-	-	-	4.62	NP	0.00	166.82	162.20
05/21/92	20,000	7,600	10,100	830	6,900	-	4.98	NP	0.00	166.82	161.84
06/25/92	-	-	-	-	-	-	5.14	FILM	0.00	166.82	161.68
07/30/92	-	-	-	-	-	-	5.30	FILM	0.00	166.82	161.52
08/20/92	-	-	-	-	-	-	5.28	FILM	0.00	166.82	161.54
09/30/92	-	-	-	-	-	-	5.66	FILM	0.00	166.82	161.16
12/23/92	-	-	-	-	-	-	4.81	FILM	0.00	166.82	162.01
03/10/93	-	-	-	-	-	-	4.13	FILM	0.00	166.82	162.69
06/09/93	-	-	-	-	-	-	4.48	FILM	0.00	166.82	162.34
09/14/93	19,000	3,600	1,100	740	4,300	-	5.35	NP	0.00	166.82	161.47
12/14/93	38,000	4,300	1,300	<6.6	11	-	4.38	NP	0.00	166.82	162.44
03/02/94	-	-	-	-	-	-	4.22	FILM	0.00	166.82	162.60
06/06/94	-	-	-	-	-	-	2.16	FILM	0.00	166.82	164.66
09/06/94	74,000	3,300	3,900	1,200	6,100	-	5.00	NP	0.00	166.82	161.82
12/07/94	30,000	3,200	2,900	1,200	4,600	-	4.10	NP	0.00	166.82	162.72
03/08/95	28,000	4,200	2,300	810	7,800	-	3.92	NP	0.00	166.82	162.90
06/15/95	-	-	-	-	-	-	-	-	-	-	-

TABLE 1
GROUNDWATER DATA
THRIFTY OIL STATION #054, CASTRO VALLEY, CA.

DATE SAMPLED	ANALYTICAL PARAMETERS						DEPTH TO GROUNDWATER (feet)	DEPTH TO PRODUCT (feet)	PRODUCT THICKNESS (feet)	CASING ELEVATION (feet)	GROUNDWATER ELEVATION (feet)
	TPH (ug/L)	BENZENE (ug/L)	TOLUENE (ug/L)	EthylBenzene (ug/L)	XYLENE (ug/L)	MTBE (ug/L)					
09/05/95	-	-	-	-	-	-	4.78	FILM	0.00	166.82	162.04
11/21/95	-	-	-	-	-	-	4.82	NP	0.00	166.82	162.00
03/11/96	270	2.4	6.0	4.5	19	-	3.32	NP	0.00	166.82	163.50
06/19/96	3,000	570	63	<1.5	400	-	4.20	NP	0.00	166.82	162.62
09/16/96	7,700	440	69	<1.5	680	230	4.68	NP	0.00	166.82	162.14
12/10/96	52	<0.3	<0.3	<0.3	<0.5	120	4.93	NP	0.00	166.82	161.89
03/12/97	8,700	180	5.4	40	1,100	130	4.10	NP	0.00	166.82	162.72
06/12/97	<50	<0.3	<0.3	<0.3	<0.5	36	-	-	-	-	-
09/16/97	<50	<0.3	<0.3	<0.3	<0.5	<20	4.55	NP	0.00	166.82	162.27
12/09/97	<50	<0.3	0.44	<0.3	<0.5	<20	5.30	NP	0.00	166.82	161.52
03/03/98	1,100	13	0.51	<0.3	<0.5	220	4.55	NP	0.00	166.82	162.27
07/08/98	<50	<0.3	<0.3	<0.3	<0.5	<5	-	-	-	-	-
09/10/98	60	<0.3	<0.3	<0.3	<0.5	180	6.05	NP	0.00	166.82	160.77
12/30/98	<50	1.1	<0.3	<0.3	<0.5	<5	5.65	NP	0.00	166.82	161.17
03/15/99	<50	<0.3	<0.3	<0.3	<0.5	<5	5.68	NP	0.00	166.82	161.14
06/22/99	880	14	0.98	<0.3	8.1	260	4.95	NP	0.00	166.82	161.87
09/08/99	72	<0.3	<0.3	<0.3	<0.5	120	4.46	NP	0.00	166.82	162.36
12/01/99	<50	<0.3	<0.3	<0.3	<0.5	<5	4.08	NP	0.00	166.82	162.74
03/23/00	<50	<0.25	<0.25	<0.25	<0.5	<5	3.68	NP	0.00	166.82	163.14
06/08/00	<50	<5	<5	<5	<5	<5	4.07	NP	0.00	166.82	162.75
09/27/00	<50	<0.18	<0.14	<0.18	<0.26	<0.24	4.07	NP	0.00	166.82	162.75
12/13/00	<50	<0.18	<0.14	<0.18	<0.26	<0.24	4.06	NP	0.00	166.82	162.76
03/22/01	<50	<0.18	<0.14	<0.18	<0.26	<0.24	5.22	NP	0.00	166.82	161.60
06/15/01	<50	<0.18	<0.14	<0.18	<0.26	<0.24	5.99	NP	0.00	166.82	160.83
08/30/01	<50	<0.18	<0.14	<0.18	<0.26	<0.24	4.84	NP	0.00	166.82	161.98
12/12/01	<50	<0.18	<0.14	<0.18	<0.26	<0.24	4.80	NP	0.00	166.82	162.02
03/13/02	-	-	-	-	-	-	5.18	NP	0.00	166.82	161.64
06/12/02	-	-	-	-	-	-	-	-	-	-	-
09/18/02	-	-	-	-	-	-	-	-	-	-	-
12/18/02	-	-	-	-	-	-	-	-	-	-	-
03/19/03	-	-	-	-	-	-	-	-	-	-	-
06/11/03	-	-	-	-	-	-	-	-	-	-	-
09/04/03	-	-	-	-	-	-	-	-	-	-	-
12/04/03	-	-	-	-	-	-	4.50	NP	0.00	166.46	161.96
03/18/04	-	-	-	-	-	-	5.64	NP	0.00	166.46	160.82

TABLE 1
GROUNDWATER DATA
THRIFTY OIL STATION #054, CASTRO VALLEY, CA.

DATE SAMPLED	ANALYTICAL PARAMETERS						DEPTH TO GROUNDWATER (feet)	DEPTH TO PRODUCT (feet)	PRODUCT THICKNESS (feet)	CASING ELEVATION (feet)	GROUNDWATER ELEVATION (feet)
	TPH (ug/L)	BENZENE (ug/L)	TOLUENE (ug/L)	EthylBenzene (ug/L)	XYLENE (ug/L)	MTBE (ug/L)					
MONITORING WELL #RE-2											
<i>Screen Interval = 5 to 17 feet</i>											
04/11/88	-	-	-	-	-	-	-	-	-	-	-
04/09/90	850	5.8	0.5	4.8	1.1	-	4.90	NP	0.00	167.19	162.29
10/30/90	440	2.8	0.91	13	3.14	-	5.34	NP	0.00	167.19	161.85
01/18/91	1,100	8.4	3.1	ND	10	-	4.90	NP	0.00	167.19	162.29
02/12/91	1,100	5.9	ND	1.77	ND	-	4.94	NP	0.00	167.19	162.25
03/20/91	550	4.3	ND	ND	ND	-	4.32	NP	0.00	167.19	162.87
05/22/91	1,000	5.3	3.6	4.4	8.9	-	4.43	NP	0.00	167.19	162.76
06/19/91	700	2.1	1.4	3.8	3.5	-	6.43	NP	0.00	167.19	160.76
07/17/91	880	12	8.0	4.3	28	-	4.75	NP	0.00	167.19	162.44
08/07/91	-	3.8	1.6	ND	ND	-	4.87	NP	0.00	167.19	162.32
09/24/91	670	7.2	7.1	ND	23	-	5.50	NP	0.00	167.19	161.69
10/23/91	2,700	52	60	22	130	-	5.63	NP	0.00	167.19	161.56
11/06/91	1,900	18	61	9.1	83	-	5.14	NP	0.00	167.19	162.05
12/04/91	1,100	26	47	4.3	42	-	5.26	NP	0.00	167.19	161.93
01/29/92	900	14	24	5.3	19	-	5.11	NP	0.00	167.19	162.08
02/26/92	500	3.4	3.5	2.7	2.7	-	4.31	NP	0.00	167.19	162.88
03/19/92	1,200	14	20	15	18	-	4.45	NP	0.00	167.19	162.74
04/22/92	200	ND	ND	ND	ND	-	4.78	NP	0.00	167.19	162.41
05/21/92	500	7.5	6.8	3.9	7.4	-	5.02	NP	0.00	167.19	162.17
06/25/92	ND	ND	0.9	0.7	ND	-	5.13	NP	0.00	167.19	162.06
07/30/92	500	7.7	8.6	3.2	1.7	-	5.19	NP	0.00	167.19	162.00
08/20/92	1,100	6.6	4.5	2.7	2.0	-	5.27	NP	0.00	167.19	161.92
09/30/92	500	5.4	2.4	1.8	4.5	-	5.45	NP	0.00	167.19	161.74
12/23/92	800	1.9	ND	ND	2.3	-	4.60	NP	0.00	167.19	162.59
03/10/93	1,200	ND	1.4	ND	2.1	-	4.18	NP	0.00	167.19	163.01
06/09/93	200	ND	ND	ND	ND	-	4.53	NP	0.00	167.19	162.66
09/17/93	360	1.6	1.1	3.2	8.9	-	5.26	NP	0.00	167.19	161.93
12/14/93	260	5.6	3.9	<0.3	21.0	-	2.75	NP	0.00	167.19	164.44
03/02/94	410	<0.3	<0.3	<0.3	<0.5	-	4.27	NP	0.00	167.19	162.92
06/06/94	760	4.6	<0.3	0.32	1.3	-	4.88	NP	0.00	167.19	162.31
09/06/94	1,300	43	45	8.9	69	-	5.16	NP	0.00	167.19	162.03
12/07/94	-	-	-	-	-	-	4.16	NP	0.00	167.19	163.03
03/08/95	<100	<0.5	<0.5	<0.5	<1	-	3.96	NP	0.00	167.19	163.23
06/15/95	130	<0.5	<0.5	<0.5	<1	-	4.52	NP	0.00	167.19	162.67

**TABLE 1
GROUNDWATER DATA
THRIFTY OIL STATION #054, CASTRO VALLEY, CA.**

DATE SAMPLED	ANALYTICAL PARAMETERS						DEPTH TO GROUNDWATER (feet)	DEPTH TO PRODUCT (feet)	PRODUCT THICKNESS (feet)	CASING ELEVATION (feet)	GROUNDWATER ELEVATION (feet)
	TPH (ug/L)	BENZENE (ug/L)	TOLUENE (ug/L)	EthylBenzene (ug/L)	XYLENE (ug/L)	MIBE (ug/L)					
09/05/95	210	<0.5	<0.5	<0.5	<1	-	4.76	NP	0.00	167.19	162.43
11/21/95	160	0.65	<0.3	0.35	0.95	-	4.83	NP	0.00	167.19	162.36
03/11/96	<50	<0.3	<0.3	<0.3	<0.5	-	3.36	NP	0.00	167.19	163.83
06/19/96	<50	<0.3	<0.3	<0.3	<0.5	-	4.68	NP	0.00	167.19	162.51
09/16/96	<50	<0.3	<0.3	<0.3	<0.5	<20	5.10	NP	0.00	167.19	162.09
12/10/96	<50	<0.3	<0.3	<0.3	<0.5	<20	4.47	NP	0.00	167.19	162.72
03/12/97	<50	<0.3	<0.3	<0.3	<0.5	<20	4.05	NP	0.00	167.19	163.14
06/12/97	<50	<0.3	<0.3	<0.3	<0.5	<20	-	-	-	-	-
09/10/97	<50	<0.3	<0.3	<0.3	<0.5	<20	4.08	NP	0.00	167.19	163.11
12/09/97	<50	<0.3	<0.3	<0.3	<0.5	<20	4.40	NP	0.00	167.19	162.79
03/03/98	<50	<0.3	<0.3	<0.3	<0.5	<20	3.30	NP	0.00	167.19	163.89
07/08/98	<50	<0.3	<0.3	<0.3	<0.5	15	-	-	-	-	-
09/10/98	<50	<0.3	<0.3	<0.3	<0.5	<5	4.93	NP	0.00	167.19	162.26
12/30/98	460	0.92	<0.3	<0.3	<0.5	1,400	4.20	NP	0.00	167.19	162.99
03/15/99	<50	<0.3	<0.3	<0.3	<0.5	<5	4.20	NP	0.00	167.19	162.99
06/22/99	2,900	7.4	<0.3	0.43	4.1	4,500	3.70	NP	0.00	167.19	163.49
09/08/99	1,400	<3	<3	<3	<5	3,200	3.96	NP	0.00	167.19	163.23
12/01/99	<50	<0.3	<0.3	<0.3	<0.5	<5	3.58	NP	0.00	167.19	163.61
03/23/00	<50	<0.25	<0.25	<0.25	<0.5	<5	3.19	NP	0.00	167.19	164.00
06/08/00	<50	<5	<5	<5	<5	<5	3.18	NP	0.00	167.19	164.01
09/27/00	<50	<0.18	<0.14	<0.18	<0.26	<0.24	3.58	NP	0.00	167.19	163.61
12/13/00	<50	<0.18	<0.14	<0.18	<0.26	<0.24	3.58	NP	0.00	167.19	163.61
03/22/01	575	<0.18	1.3	<0.18	<0.26	*950 / 2,070	4.33	NP	0.00	167.19	162.86
06/15/01	<50	<0.18	<0.14	<0.18	<0.26	<0.24	5.10	NP	0.00	167.19	162.09
08/30/01	<50	<0.18	<0.14	<0.18	<0.26	<0.24	5.86	NP	0.00	167.19	161.33
12/12/01	<50	<0.18	<0.14	<0.18	<0.26	<0.24	4.81	NP	0.00	167.19	162.38
03/13/02	-	-	-	-	-	-	4.33	NP	0.00	167.19	162.86
06/12/02	<50	<0.18	<0.14	<0.18	<0.26	<0.24	5.86	NP	0.00	167.19	161.33
09/18/02	<50	<0.18	<0.14	<0.18	<0.26	<0.24	5.86	NP	0.00	167.19	161.33
12/18/02	<50	<0.18	<0.14	<0.18	<0.26	<0.24	5.48	NP	0.00	167.19	161.71
03/19/03	<15	<0.04	<0.02	<0.02	<0.06	<0.03	5.86	NP	0.00	167.19	161.33
06/11/03	<15	<0.04	<0.02	<0.02	<0.06	<0.03	5.86	NP	0.00	167.19	161.33
09/04/03	<15	<0.22	<0.32	<0.31	<0.4	<0.18	5.48	NP	0.00	167.19	161.71
12/04/03	<15	<0.04	<0.02	<0.02	<0.06	<0.03	3.20	NP	0.00	166.61	163.41
03/18/04	<15	<0.22	<0.32	<0.31	<0.4	8.4	4.33	NP	0.00	166.61	162.28

TABLE 1
GROUNDWATER DATA
THRIFTY OIL STATION #054, CASTRO VALLEY, CA.

DATE SAMPLED	ANALYTICAL PARAMETERS						DEPTH TO GROUNDWATER (feet)	DEPTH TO PRODUCT (feet)	PRODUCT THICKNESS (feet)	CASING ELEVATION (feet)	GROUNDWATER ELEVATION (feet)
	TPH (ug/L)	BENZENE (ug/L)	TOLUENE (ug/L)	EthylBenzene (ug/L)	XYLENE (ug/L)	MTBE (ug/L)					
MONITORING WELL #RE-3											
<i>Screen Interval = 5 to 18 feet</i>											
04/11/88	70,000	6,600	5,300	800	13,000	-	-	-	-	-	-
04/09/90	370,000	2,300	4,900	3,200	31,000	-	7.15	NP	0.00	167.39	160.24
10/30/90	13,000	860	660	220	2,210	-	7.84	NP	0.00	167.39	159.55
01/18/91	42,000	4,700	4,500	21	7,700	-	6.90	NP	0.00	167.39	160.49
02/12/91	72,000	3,600	4,500	ND	7,600	-	6.62	NP	0.00	167.39	160.77
03/20/91	65,000	2,400	9,400	50	9,800	-	5.87	NP	0.00	167.39	161.52
05/22/91	-	-	-	-	-	-	5.98	FILM	0.00	167.39	161.41
06/19/91	-	-	-	-	-	-	6.84	FILM	0.00	167.39	160.55
07/17/91	-	-	-	-	-	-	7.10	FILM	0.00	167.39	160.29
08/07/91	-	-	-	-	-	-	7.30	FILM	0.00	167.39	160.09
09/24/91	-	-	-	-	-	-	7.84	FILM	0.00	167.39	159.55
10/23/91	-	-	-	-	-	-	8.07	FILM	0.00	167.39	159.32
11/06/91	-	-	-	-	-	-	7.63	FILM	0.00	167.39	159.76
12/04/91	-	-	-	-	-	-	7.83	FILM	0.00	167.39	159.56
01/29/92	-	-	-	-	-	-	7.17	FILM	0.00	167.39	160.22
02/26/92	-	-	-	-	-	-	5.56	FILM	0.00	167.39	161.83
03/19/92	-	-	-	-	-	-	5.44	FILM	0.00	167.39	161.95
04/22/92	-	-	-	-	-	-	6.56	FILM	0.00	167.39	160.83
05/21/92	-	-	-	-	-	-	6.90	FILM	0.00	167.39	160.49
06/25/92	-	-	-	-	-	-	7.18	FILM	0.00	167.39	160.21
07/30/92	-	-	-	-	-	-	6.80	FILM	0.00	167.39	160.59
08/20/92	-	-	-	-	-	-	7.25	FILM	0.00	167.39	160.14
09/30/92	-	-	-	-	-	-	7.68	FILM	0.00	167.39	159.71
12/23/92	-	-	-	-	-	-	6.07	FILM	0.00	167.39	161.32
03/10/93	-	-	-	-	-	-	5.66	FILM	0.00	167.39	161.73
06/09/93	-	-	-	-	-	-	6.66	FILM	0.00	167.39	160.73
09/14/93	40,000	2,900	1,500	180	6,900	-	7.30	NP	0.00	167.39	160.09
12/14/93	-	-	-	-	-	-	5.95	NP	0.00	167.39	161.44
03/02/94	-	-	-	-	-	-	5.08	NP	0.00	167.39	162.31
06/06/94	-	-	-	-	-	-	6.35	FILM	0.00	167.39	161.04
09/06/94	11,000	260	26	<6.6	1,000	-	7.50	NP	0.00	167.39	159.89
12/07/94	-	-	-	-	-	-	5.48	FILM	0.00	167.39	161.91
03/08/95	-	-	-	-	-	-	5.18	FILM	0.00	167.39	162.21
06/15/95	-	-	-	-	-	-	-	-	-	-	-

TABLE 1
GROUNDWATER DATA
THRIFTY OIL STATION #054, CASTRO VALLEY, CA.

DATE SAMPLED	ANALYTICAL PARAMETERS						DEPTH TO GROUNDWATER (feet)	DEPTH TO PRODUCT (feet)	PRODUCT THICKNESS (feet)	CASING ELEVATION (feet)	GROUNDWATER ELEVATION (feet)
	TPH (ug/L)	BENZENE (ug/L)	TOLUENE (ug/L)	EthylBenzene (ug/L)	XYLENE (ug/L)	MTBE (ug/L)					
09/05/95	-	-	-	-	-	-	6.84	FILM	0.00	167.39	160.55
11/21/95	10,000	210	<3	4.5	330	-	7.38	NP	0.00	167.39	160.01
03/11/96	1,600	640	15	10	46	-	4.85	NP	0.00	167.39	162.54
06/19/96	2,100	280	<3	<3	120	-	5.80	NP	0.00	167.39	161.59
09/16/96	140	<0.3	<0.3	<0.3	<0.5	110	4.50	NP	0.00	167.39	162.89
12/10/96	<50	<0.3	<0.3	<0.3	<0.5	<20	5.35	NP	0.00	167.39	162.04
03/12/97	<50	<0.3	<0.3	<0.3	<0.5	<20	3.48	NP	0.00	167.39	163.91
06/12/97	<50	<0.3	<0.3	<0.3	0.58	<20	-	-	-	-	-
09/10/97	<50	<0.3	<0.3	<0.3	<0.5	<20	3.10	NP	0.00	167.39	164.29
12/09/97	3,600	1,000	1,000	<6	570	260	4.55	NP	0.00	167.39	162.84
03/03/98	2,800	20	0.65	0.39	16	5,600	2.30	NP	0.00	167.39	165.09
07/08/98	<50	<0.3	<0.3	<0.3	<0.5	<5	-	-	-	-	-
09/10/98	<50	<0.3	<0.3	<0.3	<0.5	23	4.95	NP	0.00	167.39	162.44
12/30/98	<50	1.1	<0.3	<0.3	<0.5	<5	4.55	NP	0.00	167.39	162.84
03/15/99	<50	<0.3	<0.3	<0.3	<0.5	<5	4.15	NP	0.00	167.39	163.24
06/22/99	670	17	1.2	0.36	1.7	340	3.85	NP	0.00	167.39	163.54
09/08/99	140	0.72	<0.3	<0.3	<0.5	230	2.63	NP	0.00	167.39	164.76
12/01/99	95	<0.3	<0.3	<0.3	<0.5	200	2.63	NP	0.00	167.39	164.76
03/23/00	315	<0.25	<0.25	<0.25	<0.5	*293/422	2.25	NP	0.00	167.39	165.14
06/08/00	<100	<5	<5	<5	<5	201	3.02	NP	0.00	167.39	164.37
09/27/00	154	<0.18	<0.14	<0.18	<0.26	*254 / 160	3.01	NP	0.00	167.39	164.38
12/13/00	<50	<0.18	<0.14	<0.18	<0.26	*124 / 111	3.02	NP	0.00	167.39	164.37
03/22/01	<50	<0.18	<0.14	<0.18	<0.26	*90 / 57	4.54	NP	0.00	167.39	162.85
06/15/01	649	28	2.4	3.1	9	*1,790 / 2,560	4.92	NP	0.00	167.39	162.47
08/30/01	<50	<0.18	<0.14	<0.18	<0.26	<0.24	7.80	NP	0.00	167.39	159.59
12/12/01	<50	<0.18	<0.14	<0.18	<0.26	<0.24	7.35	NP	0.00	167.39	160.04
03/13/02	<50	<0.18	<0.14	<0.18	<0.26	<0.24	4.53	NP	0.00	167.39	162.86
06/12/02	969	<0.18	1.0	<0.18	<0.26	1,430	4.90	NP	0.00	167.39	162.49
09/18/02	<50	<0.18	<0.14	<0.18	<0.26	<0.24	5.28	NP	0.00	167.39	162.11
12/18/02	<50	<0.18	<0.14	<0.18	<0.26	<0.24	4.52	NP	0.00	167.39	162.87
03/19/03	<15	<0.04	<0.02	<0.02	<0.06	<0.03	5.67	NP	0.00	167.39	161.72
06/11/03	<15	<0.04	<0.02	<0.02	<0.06	<0.03	5.67	NP	0.00	167.39	161.72
09/04/03	<15	<0.22	<0.32	<0.31	<0.4	<0.18	5.26	NP	0.00	167.39	162.13
12/04/03	<15	<0.04	<0.02	<0.02	<0.06	<0.03	2.59	NP	0.00	166.69	164.10
03/18/04	57	<0.22	1.7 J	<0.31	<0.4	13	4.50	NP	0.00	166.69	162.19

TABLE 1
GROUNDWATER DATA
THRIFTY OIL STATION #054, CASTRO VALLEY, CA.

DATE SAMPLED	ANALYTICAL PARAMETERS						DEPTH TO GROUNDWATER (feet)	DEPTH TO PRODUCT (feet)	PRODUCT THICKNESS (feet)	CASING ELEVATION (feet)	GROUNDWATER ELEVATION (feet)
	TPH (ug/L)	BENZENE (ug/L)	TOLUENE (ng/L)	EthylBenzene (ng/L)	XYLENE (ng/L)	MTBE (ug/L)					
MONITORING WELL ARE-4											
<i>Screen Interval = 5 to 15 feet</i>											
04/11/88	15,000	12,000	8,000	1,000	2,700	-	-	-	-	-	-
04/09/90	-	-	-	-	-	-	-	-	-	-	-
10/30/90	87,000	7,200	10,000	1,600	12,900	-	7.04	NP	0.00	166.94	159.90
01/18/91	70,000	5,000	5,400	790	9,900	-	11.62	NP	0.00	166.94	155.32
02/12/91	87,000	5,200	2,800	240	11,000	-	11.63	NP	0.00	166.94	155.31
03/20/91	6,500	370	230	17	670	-	11.61	NP	0.00	166.94	155.33
05/22/91	-	-	-	-	-	-	10.30	FILM	0.00	166.94	156.64
06/19/91	-	-	-	-	-	-	11.10	FILM	0.00	166.94	155.84
07/17/91	-	-	-	-	-	-	6.20	FILM	0.00	166.94	160.74
08/17/91	-	-	-	-	-	-	8.15	FILM	0.00	166.94	158.79
09/24/91	-	-	-	-	-	-	10.40	FILM	0.00	166.94	156.54
10/23/91	-	-	-	-	-	-	11.20	FILM	0.00	166.94	155.74
11/06/91	-	-	-	-	-	-	6.62	FILM	0.00	166.94	160.32
12/04/91	-	-	-	-	-	-	11.20	FILM	0.00	166.94	155.74
01/29/92	-	-	-	-	-	-	7.72	FILM	0.00	166.94	159.22
02/26/92	-	-	-	-	-	-	5.13	FILM	0.00	166.94	161.81
03/19/92	-	-	-	-	-	-	5.00	FILM	0.00	166.94	161.94
04/22/92	-	-	-	-	-	-	5.94	FILM	0.00	166.94	161.00
05/21/92	-	-	-	-	-	-	5.40	FILM	0.00	166.94	161.54
06/25/92	-	-	-	-	-	-	5.71	FILM	0.00	166.94	161.23
07/30/92	-	-	-	-	-	-	6.33	FILM	0.00	166.94	160.61
08/20/92	-	-	-	-	-	-	5.80	FILM	0.00	166.94	161.14
09/30/92	-	-	-	-	-	-	6.34	FILM	0.00	166.94	160.60
12/23/92	-	-	-	-	-	-	5.50	FILM	0.00	166.94	161.44
03/10/93	-	-	-	-	-	-	4.67	FILM	0.00	166.94	162.27
06/09/93	-	-	-	-	-	-	5.12	FILM	0.00	166.94	161.82
09/14/93	-	-	-	-	-	-	10.44	NP	0.00	166.94	156.50
12/14/93	-	-	-	-	-	-	7.52	NP	0.00	166.94	159.42
03/02/94	-	-	-	-	-	-	4.85	NP	0.00	166.94	162.09
06/06/94	-	-	-	-	-	-	5.20	FILM	0.00	166.94	161.74
09/06/94	-	-	-	-	-	-	9.85	FILM	0.00	166.94	157.09
12/07/94	-	-	-	-	-	-	5.20	FILM	0.00	166.94	161.74
03/08/95	-	-	-	-	-	-	4.98	FILM	0.00	166.94	161.96
06/15/95	-	-	-	-	-	-	-	-	-	-	-

TABLE 1
GROUNDWATER DATA
THRIFTY OIL STATION #054, CASTRO VALLEY, CA.

DATE SAMPLED	ANALYTICAL PARAMETERS						DEPTH TO GROUNDWATER (feet)	DEPTH TO PRODUCT (feet)	PRODUCT THICKNESS (feet)	CASING ELEVATION (feet)	GROUNDWATER ELEVATION (feet)
	TPH (ug/L)	BENZENE (ug/L)	TOLUENE (ug/L)	EthylBenzene (ug/L)	KYLENE (ug/L)	MIBE (ug/L)					
09/05/95	-	-	-	-	-	-	13.72	FILM	0.00	166.94	153.22
11/21/95	32,000	46	21	66	340	-	12.53	NP	0.00	166.94	154.41
03/11/96	1,700	130	15	2.0	120	-	4.72	NP	0.00	166.94	162.22
06/19/96	1,700	230	30	0.35	100	-	5.40	NP	0.00	166.94	161.54
09/16/96	510	<0.3	0.73	<0.3	<0.5	800	5.18	NP	0.00	166.94	161.76
12/10/96	520	<0.3	<0.3	<0.3	<0.5	1,000	4.65	NP	0.00	166.94	162.29
03/12/97	420	3.2	<0.3	<0.3	11	370	3.87	NP	0.00	166.94	163.07
06/12/97	510	0.66	<0.3	<0.3	<0.5	1,600	-	-	-	-	-
09/10/97	<50	<0.3	<0.3	<0.3	<0.5	<20	5.40	NP	0.00	166.94	161.54
12/09/97	1,400	330	2.3	<0.3	1.5	2,500	4.60	NP	0.00	166.94	162.34
03/03/98	3,000	400	0.61	0.5	97	3,800	5.05	NP	0.00	166.94	161.89
07/08/98	650	<0.3	<0.3	<0.3	<0.5	1,800	-	-	-	-	-
09/10/98	2,700	<0.3	<0.3	<0.3	1.4	7,600	4.60	NP	0.00	166.94	162.34
12/30/98	530	<0.3	<0.3	<0.3	<0.5	1,500	4.20	NP	0.00	166.94	162.74
03/15/99	<50	<0.3	<0.3	<0.3	<0.5	<5	3.85	NP	0.00	166.94	163.09
06/22/99	1,200	23	1.5	<0.3	2.4	1,400	3.90	NP	0.00	166.94	163.04
09/08/99	590	1.5	<0.6	<0.6	<1	1,100	5.72	NP	0.00	166.94	161.22
12/01/99	540	<0.3	<0.3	<0.3	<0.5	880	5.34	NP	0.00	166.94	161.60
03/23/00	<50	<0.25	<0.25	<0.25	<0.5	<5	5.36	NP	0.00	166.94	161.58
06/08/00	67	<5	<5	<5	<5	<5	5.34	NP	0.00	166.94	161.60
09/27/00	<50	<0.18	<0.14	<0.18	<0.26	<0.24	5.35	NP	0.00	166.94	161.59
12/13/00	<50	<0.18	<0.14	<0.18	<0.26	<0.24	5.71	NP	0.00	166.94	161.23
03/22/01	<50	<0.18	<0.14	<0.18	<0.26	<0.24	4.19	NP	0.00	166.94	162.75
06/15/01	409	18	2	2	5	*1,060 / 1,480	4.57	NP	0.00	166.94	162.37
08/30/01	<50	<0.18	<0.14	<0.18	<0.26	<0.24	6.10	NP	0.00	166.94	160.84
12/12/01	<50	<0.18	<0.14	<0.18	3	*7 / 3.7	4.95	NP	0.00	166.94	161.99
03/13/02	511	3	3	<0.18	2	519	4.17	NP	0.00	166.94	162.77
06/12/02	380	2	2	1	2	479	4.93	NP	0.00	166.94	162.01
09/18/02	<50	<0.18	<0.14	<0.18	<0.26	<0.24	5.32	NP	0.00	166.94	161.62
12/18/02	<50	<0.18	<0.14	<0.18	<0.26	<0.24	4.93	NP	0.00	166.94	162.01
03/19/03	<15	<0.04	<0.02	<0.02	<0.06	<0.03	5.32	NP	0.00	166.94	161.62
06/11/03	<15	<0.04	<0.02	<0.02	<0.06	<0.03	5.32	NP	0.00	166.94	161.62
09/04/03	<15	<0.22	<0.32	<0.31	<0.4	<0.18	4.93	NP	0.00	166.94	162.01
12/04/03	<15	<0.04	<0.02	<0.02	<0.06	<0.03	4.93	NP	0.00	166.23	161.30
03/18/04	<15	<0.22	<0.32	<0.31	<0.4	1.1	4.93	NP	0.00	166.23	161.30

TABLE 1
GROUNDWATER DATA
THRIFTY OIL STATION #054, CASTRO VALLEY, CA.

DATE SAMPLED	ANALYTICAL PARAMETERS						DEPTH TO GROUNDWATER (feet)	DEPTH TO PRODUCT (feet)	PRODUCT THICKNESS (feet)	CASING ELEVATION (feet)	GROUNDWATER ELEVATION (feet)
	TPH (ug/L)	BENZENE (ug/L)	TOLUENE (ug/L)	EthylBenzene (ug/L)	XYLENE (ug/L)	MTBE (ug/L)					
MONITORING WELL #RE-5											
<i>Screen Interval = 5 to 20 feet</i>											
04/11/88	14,000	1,300	1,100	100	2,600	-	-	-	-	-	-
04/09/90	3,000	690	190	40	270	-	4.79	NP	0.00	166.51	161.72
10/30/90	3,400	910	48	87	249	-	5.86	NP	0.00	166.51	160.65
01/18/91	1,400	180	8.6	0.52	48	-	4.40	NP	0.00	166.51	162.11
02/12/91	1,000	ND	ND	0.65	ND	-	4.76	NP	0.00	166.51	161.75
03/20/91	3,000	250	53	ND	110	-	5.08	NP	0.00	166.51	161.43
05/22/91	2,500	330	7.8	5.6	200	-	4.52	NP	0.00	166.51	161.99
01/19/91	2,000	59	1.6	5.1	110	-	4.39	NP	0.00	166.51	162.12
07/17/91	-	-	-	-	-	-	5.05	FILM	0.00	166.51	161.46
08/07/91	-	-	-	-	-	-	5.02	FILM	0.00	166.51	161.49
09/24/91	-	-	-	-	-	-	5.86	FILM	0.00	166.51	160.65
10/23/91	-	-	-	-	-	-	5.84	FILM	0.00	166.51	160.67
11/06/91	9,900	2,300	37	260	160	-	5.48	NP	0.00	166.51	161.03
12/04/91	4,500	1,000	27	ND	180	-	5.43	NP	0.00	166.51	161.08
01/29/92	600	6.1	2.3	ND	47	-	5.12	NP	0.00	166.51	161.39
02/26/92	500	5.4	2.7	1.2	14	-	4.93	NP	0.00	166.51	161.58
03/19/92	ND	1.7	1.1	ND	5.5	-	4.45	NP	0.00	166.51	162.06
04/22/92	1,600	240	2.2	ND	160	-	4.63	NP	0.00	166.51	161.88
05/21/92	1,200	410	37	ND	118	-	4.90	NP	0.00	166.51	161.61
06/25/92	ND	1.0	0.8	0.8	0.4	-	5.15	NP	0.00	166.51	161.36
07/30/92	ND	2.0	1.8	1.9	6.4	-	5.30	NP	0.00	166.51	161.21
08/20/92	300	1.7	3.3	0.7	12	-	5.44	NP	0.00	166.51	161.07
09/30/92	1,900	140	ND	19	35	-	5.73	NP	0.00	166.51	160.78
12/23/92	400	8.0	ND	ND	ND	-	4.75	NP	0.00	166.51	161.76
03/10/93	1,100	290	9.7	ND	75	-	4.14	NP	0.00	166.51	162.37
06/09/93	400	1.5	0.5	ND	12	-	5.42	NP	0.00	166.51	161.09
09/14/93	240	6.9	8.8	1.4	67	-	5.53	NP	0.00	166.51	160.98
12/14/93	3,300	510	5.4	4.1	55	-	478	NP	0.00	166.51	-311.49
03/02/94	2,400	270	4.5	<0.3	13	-	4.20	NP	0.00	166.51	162.31
06/06/94	730	<0.3	<0.3	0.70	22	-	5.13	NP	0.00	166.51	161.38
09/06/94	2,400	180	28	2.3	76	-	5.45	NP	0.00	166.51	161.06
12/07/94	540	5.6	<0.3	<0.5	6.9	-	4.13	NP	0.00	166.51	162.38
03/08/95	1,500	220	5.5	<0.5	83	-	5.20	NP	0.00	166.51	161.31
06/15/95	3,200	820	53	6.2	74	-	4.93	NP	0.00	166.51	161.58

TABLE 1
GROUNDWATER DATA
THRIFTY OIL STATION #054, CASTRO VALLEY, CA.

DATE SAMPLED	ANALYTICAL PARAMETERS						DEPTH TO GROUNDWATER (feet)	DEPTH TO PRODUCT (feet)	PRODUCT THICKNESS (feet)	CASING ELEVATION (feet)	GROUNDWATER ELEVATION (feet)
	TPH (ug/L)	BENZENE (ug/L)	TOLUENE (ug/L)	EthylBenzene (ug/L)	XYLENE (ug/L)	MIBE (ug/L)					
09/05/95	4,400	440	22	<2.5	57	-	5.03	NP	0.00	166.51	161.48
11/21/95	660	3.4	<0.3	<0.3	0.6	-	5.23	NP	0.00	166.51	161.28
03/11/96	1,000	76	2.2	<0.3	130	-	4.16	NP	0.00	166.51	162.35
06/09/96	90	<0.3	<0.3	<0.3	<0.5	-	5.42	NP	0.00	166.51	161.09
09/16/96	1,900	5.8	<0.3	<0.3	5.9	1,100	5.20	NP	0.00	166.51	161.31
12/10/96	740	<0.3	<0.3	<0.3	<0.5	1,300	5.27	NP	0.00	166.51	161.24
03/12/97	2,000	600	59	5.1	54	1,300	3.85	NP	0.00	166.51	162.66
06/12/97	230	<0.3	<0.3	<0.3	<0.5	720	-	-	-	-	-
09/10/97	210	<0.3	<0.3	<0.3	<0.5	210	4.10	NP	0.00	166.51	162.41
12/09/97	11,000	2,500	2,700	<6	1,500	510	5.20	NP	0.00	166.51	161.31
03/03/98	<50	<0.3	<0.3	<0.3	<0.5	<20	3.70	NP	0.00	166.51	162.81
07/08/98	<50	<0.3	<0.3	<0.3	<0.5	<5	-	-	-	-	-
09/10/98	<50	<0.3	<0.3	<0.3	<0.5	<5	6.77	NP	0.00	166.51	159.74
12/30/98	<50	<0.3	<0.3	<0.3	<0.5	<5	5.95	NP	0.00	166.51	160.56
03/15/99	<50	<0.3	<0.3	<0.3	<0.5	<5	5.25	NP	0.00	166.51	161.26
06/22/99	110	<0.3	<0.3	<0.3	<0.5	200	4.50	NP	0.00	166.51	162.01
09/08/99	68	<0.3	<0.3	<0.3	<0.5	110	4.43	NP	0.00	166.51	162.08
12/01/99	<50	<0.3	<0.3	<0.3	<0.5	<5	3.66	NP	0.00	166.51	162.85
03/23/00	<50	<0.25	<0.25	<0.25	<0.5	<5	4.06	NP	0.00	166.51	162.45
06/08/00	<50	<5	<5	<5	<5	<5	4.43	NP	0.00	166.51	162.08
09/27/00	<50	<0.18	<0.14	<0.18	<0.26	<0.24	4.06	NP	0.00	166.51	162.45
12/13/00	<50	<0.18	<0.14	<0.18	<0.26	<0.24	4.80	NP	0.00	166.51	161.71
03/22/01	<50	<0.18	<0.14	<0.18	<0.26	<0.24	6.33	NP	0.00	166.51	160.18
06/15/01	<50	<0.18	<0.14	<0.18	<0.26	<0.24	4.79	NP	0.00	166.51	161.72
08/30/01	<50	<0.18	<0.14	<0.18	<0.26	<0.24	5.54	NP	0.00	166.51	160.97
12/12/01	<50	<0.18	<0.14	<0.18	<0.26	<0.24	5.21	NP	0.00	166.51	161.30
03/13/02	-	-	-	-	-	-	6.32	NP	0.00	166.51	160.19
06/12/02	-	-	-	-	-	-	-	-	-	-	-
09/18/02	-	-	-	-	-	-	-	-	-	-	-
12/18/02	-	-	-	-	-	-	-	-	-	-	-
03/19/03	-	-	-	-	-	-	-	-	-	-	-
06/11/03	-	-	-	-	-	-	-	-	-	-	-
09/04/03	-	-	-	-	-	-	-	-	-	-	-
12/04/03	-	-	-	-	-	-	3.67	NP	0.00	166.56	162.89
03/18/04	-	-	-	-	-	-	5.20	NP	0.00	166.56	161.36

TABLE 1
GROUNDWATER DATA
THRIFTY OIL STATION #054, CASTRO VALLEY, CA.

DATE SAMPLED	ANALYTICAL PARAMETERS						DEPTH TO GROUNDWATER (feet)	DEPTH TO PRODUCT (feet)	PRODUCT THICKNESS (feet)	CASING ELEVATION (feet)	GROUNDWATER ELEVATION (feet)
	TPH (ug/L)	BENZENE (ug/L)	TOLUENE (ug/L)	EthylBenzene (ug/L)	XYLENE (ug/L)	MTBE (ug/L)					
MONITORING WELL #RE-6											
<i>Screen Interval = 5 to 15 feet</i>											
04/11/88	6,000	3,000	40	80	140	-	-	-	-	-	-
04/09/90	3,000	990	ND	70	ND	-	5.64	NP	0.00	166.51	160.87
10/30/90	3,400	1,000	28	ND	ND	-	6.68	NP	0.00	166.51	159.83
01/18/91	6,300	1,200	ND	3.0	15	-	6.61	NP	0.00	166.51	159.90
02/12/91	5,200	850	8.4	4.9	41	-	6.20	NP	0.00	166.51	160.31
03/20/91	5,800	680	12	8.0	16	-	5.62	NP	0.00	166.51	160.89
05/22/91	8,500	1,700	14	24	6.7	-	6.05	NP	0.00	166.51	160.46
06/19/91	-	-	-	-	-	-	6.12	FILM	0.00	166.51	160.39
07/17/91	120,000	9,300	13,000	2,400	16,000	-	6.20	NP	0.00	166.51	160.31
08/07/91	-	590	5.3	ND	14	-	6.27	NP	0.00	166.51	160.24
09/24/91	7,000	310	11	5.3	35	-	6.63	NP	0.00	166.51	159.88
10/23/91	-	-	-	-	-	-	6.36	FILM	0.00	166.51	160.15
11/06/91	4,000	710	18	29	49	-	6.15	NP	0.00	166.51	160.36
12/04/91	4,100	1,100	14	33	39	-	6.19	NP	0.00	166.51	160.32
01/29/92	2,600	790	14	ND	49	-	6.70	NP	0.00	166.51	159.81
02/26/92	3,100	950	21	30	33	-	5.44	NP	0.00	166.51	161.07
03/19/92	2,200	630	14	12	40	-	5.30	NP	0.00	166.51	161.21
04/22/92	-	730	2.2	ND	40	-	6.00	NP	0.00	166.51	160.51
05/21/92	1,500	840	7.8	7.1	34	-	6.25	NP	0.00	166.51	160.26
06/25/92	<2000	740	8.0	27	28	-	6.38	NP	0.00	166.51	160.13
07/30/92	-	-	-	-	-	-	6.42	FILM	0.00	166.51	160.09
08/20/92	2,800	630	17	23	22	-	6.50	NP	0.00	166.51	160.01
09/30/92	7,800	540	ND	12	29	-	6.66	NP	0.00	166.51	159.85
12/23/92	1,800	350	ND	7.7	11	-	5.83	NP	0.00	166.51	160.68
03/10/93	3,000	830	5.6	19	16	-	5.63	NP	0.00	166.51	160.88
06/09/93	4,800	920	6.2	3.2	12	-	6.01	NP	0.00	166.51	160.50
09/14/93	3,600	660	7.5	11	27	-	6.53	NP	0.00	166.51	159.98
12/14/93	1,500	200	<0.3	<0.3	8.8	-	3.58	NP	0.00	166.51	162.93
03/02/94	-	-	-	-	-	-	5.12	NP	0.00	166.51	161.39
06/06/94	2,400	290	4.6	1.3	24	-	1.85	NP	0.00	166.51	164.66
09/06/94	4,300	230	21	<6.6	130	-	6.40	NP	0.00	166.51	160.11
12/07/94	1,500	17	2.5	3.2	22	-	5.68	NP	0.00	166.51	160.83
03/08/95	2,500	460	5.5	2.1	51	-	5.12	NP	0.00	166.51	161.39
06/15/95	2,300	91	1.1	0.7	97	-	5.72	NP	0.00	166.51	160.79

TABLE 1
GROUNDWATER DATA
THRIFTY OIL STATION #054, CASTRO VALLEY, CA.

DATE SAMPLED	ANALYTICAL PARAMETERS						DEPTH TO GROUNDWATER (feet)	DEPTH TO PRODUCT (feet)	PRODUCT THICKNESS (feet)	CASING ELEVATION (feet)	GROUNDWATER ELEVATION (feet)
	TPH (ug/L)	BENZENE (ug/L)	TOLUENE (ug/L)	EthylBenzene (ug/L)	XYLENE (ug/L)	MTBE (ug/L)					
09/05/95	3,300	60	<10	<10	74	-	5.94	NP	0.00	166.51	160.57
11/21/95	2,000	7.3	<0.3	0.56	8.7	-	6.24	NP	0.00	166.51	160.27
03/11/96	840	43	0.96	5.7	14	-	5.16	NP	0.00	166.51	161.35
06/19/96	1,800	160	2.7	9.9	25	-	5.80	NP	0.00	166.51	160.71
09/16/96	<50	<0.3	<0.3	<0.3	<0.5	<20	5.38	NP	0.00	166.51	161.13
12/10/96	<50	<0.3	<0.3	<0.3	<0.5	<20	5.62	NP	0.00	166.51	160.89
03/12/97	<50	<0.3	<0.3	<0.3	<0.5	<20	5.20	NP	0.00	166.51	161.31
06/12/97	<50	<0.3	<0.3	<0.3	<0.5	<20	-	-	-	-	-
09/10/97	440	<0.3	<0.3	<0.3	<0.5	320	5.20	NP	0.00	166.51	161.31
12/09/97	<50	<0.3	<0.3	<0.3	<0.5	<20	5.97	NP	0.00	166.51	160.54
03/03/98	400	7.0	<0.3	<0.3	4.3	65	4.45	NP	0.00	166.51	162.06
07/08/98	300	<0.3	<0.3	<0.3	1.0	35	-	-	-	-	-
09/10/98	<50	<0.3	<0.3	<0.3	<0.5	<5	5.90	NP	0.00	166.51	160.61
12/30/98	<50	<0.3	<0.3	<0.3	<0.5	<5	5.20	NP	0.00	166.51	161.31
03/15/99	<50	<0.3	<0.3	<0.3	<0.5	8.4	4.82	NP	0.00	166.51	161.69
06/22/99	700	11	1.9	<0.3	3.9	140	6.00	NP	0.00	166.51	160.51
09/08/99	<50	<0.3	<0.3	<0.3	<0.5	<5	5.15	NP	0.00	166.51	161.36
12/01/99	<50	<0.3	<0.3	<0.3	<0.5	12	4.02	NP	0.00	166.51	162.49
03/23/00	<50	<0.25	<0.25	<0.25	<0.5	<5	4.41	NP	0.00	166.51	162.10
06/08/00	<50	<5	<5	<5	<5	<5	4.78	NP	0.00	166.51	161.73
09/27/00	<50	<0.18	<0.14	<0.18	<0.26	<0.24	4.78	NP	0.00	166.51	161.73
12/13/00	<50	<0.18	<0.14	<0.18	<0.26	<0.24	4.77	NP	0.00	166.51	161.74
03/22/01	367	<0.18	<0.14	<0.18	<0.26	*581 / 674	5.54	NP	0.00	166.51	160.97
06/15/01	<50	<0.18	<0.14	<0.18	<0.26	<0.24	5.92	NP	0.00	166.51	160.59
08/30/01	<50	<0.18	<0.14	<0.18	<0.26	<0.24	5.93	NP	0.00	166.51	160.58
12/12/01	138	<0.18	<0.14	<0.18	<0.26	*7 / <0.6	6.20	NP	0.00	166.51	160.31
03/13/02	<50	<0.18	<0.14	<0.18	<0.26	<0.24	5.55	NP	0.00	166.51	160.96
06/12/02	895	<0.18	1.0	<0.18	<0.26	1,360	5.93	NP	0.00	166.51	160.58
09/18/02	759	<0.18	<0.14	<0.18	<0.26	644	6.03	NP	0.00	166.51	160.48
12/18/02	531	<0.18	<0.14	<0.18	<0.26	441	5.65	NP	0.00	166.51	160.86
03/19/03	955	<0.04	<0.02	<0.02	<0.06	585	6.34	NP	0.00	166.51	160.17
06/11/03	945	<0.04	<0.02	<0.02	<0.06	328	6.34	NP	0.00	166.51	160.17
09/04/03	<15	<0.22	<0.32	<0.31	<0.4	<0.18	5.92	NP	0.00	166.51	160.59
12/04/03	<15	<0.04	<0.02	<0.02	<0.06	<0.03	4.00	NP	0.00	166.15	162.15
03/18/04	<15	<0.22	<0.32	<0.31	<0.4	<0.18	5.54	NP	0.00	166.15	160.61

**TABLE 1
GROUNDWATER DATA
THRIFTY OIL STATION #054, CASTRO VALLEY, CA.**

DATE SAMPLED	ANALYTICAL PARAMETERS						DEPTH TO GROUNDWATER (feet)	DEPTH TO PRODUCT (feet)	PRODUCT THICKNESS (feet)	CASING ELEVATION (feet)	GROUNDWATER ELEVATION (feet)
	TPH (ug/L)	BENZENE (ug/L)	TOLUENE (ug/L)	EthylBenzene (ug/L)	XYLENE (ug/L)	MTBE (ug/L)					
MONITORING WELL #RE-7											
<i>Screen Interval = 5 to 15 feet</i>											
04/11/88	< 50,000	17,000	4,400	600	8,400	-	-	-	-	-	-
04/09/90	16,000	7,000	1,200	640	1,600	-	5.93	NP	0.00	166.04	160.11
10/30/90	31,000	14,000	ND	ND	ND	-	8.21	NP	0.00	166.04	157.83
01/18/91	-	-	-	-	-	-	11.80	NP	0.00	166.04	154.24
02/12/91	-	-	-	-	-	-	10.80	FILM	0.00	166.04	155.24
03/20/91	120,000	12,000	2,800	490	6,600	-	9.96	NP	0.00	166.04	156.08
05/22/91	-	-	-	-	-	-	11.70	FILM	0.00	166.04	154.34
06/19/91	-	-	-	-	-	-	11.50	FILM	0.00	166.04	154.54
07/17/91	-	-	-	-	-	-	7.80	FILM	0.00	166.04	158.24
08/07/91	-	-	-	-	-	-	9.88	0.03	9.85	166.04	163.60
09/24/91	-	-	-	-	-	-	9.85	0.03	9.82	166.04	163.60
10/23/91	-	-	-	-	-	-	9.96	FILM	0.00	166.04	156.08
11/06/91	-	-	-	-	-	-	6.77	FILM	0.00	166.04	159.27
12/04/91	-	-	-	-	-	-	10.80	FILM	0.00	166.04	155.24
01/29/92	-	-	-	-	-	-	8.64	FILM	0.00	166.04	157.40
02/26/92	-	-	-	-	-	-	6.00	FILM	0.00	166.04	160.04
03/19/92	-	-	-	-	-	-	5.55	FILM	0.00	166.04	160.49
04/22/92	-	-	-	-	-	-	6.12	FILM	0.00	166.04	159.92
05/21/92	-	-	-	-	-	-	6.40	FILM	0.00	166.04	159.64
06/25/92	-	-	-	-	-	-	6.73	0.02	6.71	166.04	164.38
07/30/92	-	-	-	-	-	-	6.73	FILM	0.00	166.04	159.31
08/20/92	-	-	-	-	-	-	6.82	FILM	0.00	166.04	159.22
09/30/92	-	-	-	-	-	-	7.26	FILM	0.00	166.04	158.78
12/23/92	-	-	-	-	-	-	6.22	FILM	0.00	166.04	159.82
03/10/93	-	-	-	-	-	-	5.82	FILM	0.00	166.04	160.22
06/09/93	-	-	-	-	-	-	6.17	FILM	0.00	166.04	159.87
09/14/93	-	-	-	-	-	-	11.33	NP	0.00	166.04	154.71
12/14/93	-	-	-	-	-	-	8.40	NP	0.00	166.04	157.64
03/02/94	-	-	-	-	-	-	6.82	NP	0.00	166.04	159.22
06/06/94	-	-	-	-	-	-	10.95	FILM	0.00	166.04	155.09
09/06/94	-	-	-	-	-	-	11.30	FILM	0.00	166.04	154.74
12/07/94	-	-	-	-	-	-	5.63	FILM	0.00	166.04	160.41
03/08/95	-	-	-	-	-	-	5.06	FILM	0.00	166.04	160.98
06/15/95	-	-	-	-	-	-	-	-	-	-	-

TABLE 1
GROUNDWATER DATA
THRIFTY OIL STATION #054, CASTRO VALLEY, CA.

DATE SAMPLED	ANALYTICAL PARAMETERS						DEPTH TO GROUNDWATER (feet)	DEPTH TO PRODUCT (feet)	PRODUCT THICKNESS (feet)	CASING ELEVATION (feet)	GROUNDWATER ELEVATION (feet)
	TPH (ug/L)	BENZENE (ug/L)	TOLUENE (ug/L)	EthylBenzene (ug/L)	XYLENE (ug/L)	MIBE (ug/L)					
09/05/95	-	-	-	-	-	-	7.98	FILM	0.00	166.04	158.06
11/21/95	20,000	8,800	110	<30	310	-	7.32	NP	0.00	166.04	158.72
03/11/96	4,800	2,200	38	26	120	-	5.62	NP	0.00	166.04	160.42
06/19/96	4,400	3,300	49	5.8	70	-	6.40	NP	0.00	166.04	159.64
09/19/96	7,200	510	83	<0.3	710	130	6.20	NP	0.00	166.04	159.84
12/10/96	700	<0.3	<0.3	<0.3	<0.5	1,400	5.92	NP	0.00	166.04	160.12
03/12/97	660	0.31	<0.3	<0.3	<0.5	1,400	5.62	NP	0.00	166.04	160.42
06/12/97	320	<0.3	0.45	<0.3	<0.5	850	-	-	-	-	-
09/10/97	780	<0.3	<0.3	<0.3	<0.5	930	7.45	NP	0.00	166.04	158.59
12/09/97	14,000	3,500	3,700	<15	2,100	1,100	7.10	NP	0.00	166.04	158.94
03/03/98	6,100	2,500	18	<6	110	270	6.70	NP	0.00	166.04	159.34
07/08/98	1,300	8.7	<0.3	<0.3	<0.5	350	-	-	-	-	-
09/10/98	690	2.2	<0.3	<0.3	<0.5	350	7.04	NP	0.00	166.04	159.00
12/30/98	600	2.0	0.55	<0.3	<0.5	350	6.25	NP	0.00	166.04	159.79
03/15/99	350	0.71	<0.3	<0.3	<0.5	140	6.02	NP	0.00	166.04	160.02
06/22/99	5,900	2,100	16	4.6	48	170	6.35	NP	0.00	166.04	159.69
09/08/99	1,700	380	<3	<3	13	160	7.03	NP	0.00	166.04	159.01
12/01/99	930	3.7	<0.3	<0.3	<0.5	390	6.25	NP	0.00	166.04	159.79
03/23/00	581	5.4	5.3	1.9	7.3	*168/183	6.24	NP	0.00	166.04	159.80
06/08/00	<100	<5	<5	<5	<5	74	6.64	NP	0.00	166.04	159.40
09/27/00	236	<0.18	<0.14	<0.18	<0.26	*21 / 28	7.03	NP	0.00	166.04	159.01
12/13/00	<50	<0.18	<0.14	<0.18	<0.26	*13 / 19.8	6.63	NP	0.00	166.04	159.41
03/22/01	504	<0.18	<0.14	<0.18	1	*666 / 1,420	7.02	NP	0.00	166.04	159.02
06/15/01	144	5.0	<0.14	0.5	2	*369 / 408	7.02	NP	0.00	166.04	159.02
08/30/01	<50	<0.18	<0.14	<0.18	<0.26	<0.24	7.79	NP	0.00	166.04	158.25
12/12/01	<50	<0.18	<0.14	<0.18	<0.26	<0.24	7.28	NP	0.00	166.04	158.76
03/13/02	<50	<0.18	<0.14	<0.18	<0.26	<0.24	6.02	NP	0.00	166.04	160.02
06/12/02	5,130	772	970	59	550	113	7.79	NP	0.00	166.04	158.25
09/18/02	<50	<0.18	<0.14	<0.18	<0.26	<0.24	7.40	NP	0.00	166.04	158.64
12/18/02	<50	<0.18	<0.14	<0.18	<0.26	<0.24	6.63	NP	0.00	166.04	159.41
03/19/03	<15	<0.04	<0.02	<0.02	<0.06	<0.03	7.40	NP	0.00	166.04	158.64
06/11/03	<15	<0.04	<0.02	<0.02	<0.06	8.3	7.40	NP	0.00	166.04	158.64
09/04/03	<15	<0.22	<0.32	<0.31	<0.4	<0.18	7.39	NP	0.00	166.04	158.65
12/04/03	<15	<0.04	<0.02	<0.02	<0.06	<0.03	6.63	NP	0.00	165.33	158.70
03/18/04	<15	<0.22	<0.32	<0.31	<0.4	<0.18	6.63	NP	0.00	165.33	158.70

TABLE 1
GROUNDWATER DATA
THRIFTY OIL STATION #054, CASTRO VALLEY, CA.

DATE SAMPLED	ANALYTICAL PARAMETERS						DEPTH TO GROUNDWATER (feet)	DEPTH TO PRODUCT (feet)	PRODUCT THICKNESS (feet)	CASING ELEVATION (feet)	GROUNDWATER ELEVATION (feet)
	TPH (ug/L)	BENZENE (ug/L)	TOLUENE (ug/L)	EthylBenzene (ug/L)	XYLENE (ug/L)	MIBE (ug/L)					
MONITORING WELL #RS-8											
<i>Screen Interval = 5 to 25 feet</i>											
08/07/91	ND	ND	ND	ND	ND	-	9.68	NP	0.00	164.32	154.64
09/27/91	ND	ND	ND	ND	ND	-	9.89	NP	0.00	164.32	154.43
10/23/91	ND	ND	ND	ND	ND	-	10.05	NP	0.00	164.32	154.27
11/06/91	ND	ND	ND	ND	ND	-	9.71	NP	0.00	164.32	154.61
12/04/91	ND	ND	ND	ND	ND	-	10.00	NP	0.00	164.32	154.32
01/29/92	ND	2.1	1.0	2.5	3.6	-	9.28	NP	0.00	164.32	155.04
02/26/92	ND	ND	0.7	ND	0.7	-	7.05	NP	0.00	164.32	157.27
03/19/92	ND	0.5	1.0	1.5	2.7	-	7.30	NP	0.00	164.32	157.02
04/22/92	ND	ND	ND	ND	ND	-	8.60	NP	0.00	164.32	155.72
05/21/92	ND	ND	ND	ND	ND	-	9.22	NP	0.00	164.32	155.10
06/25/92	ND	ND	ND	ND	ND	-	9.49	NP	0.00	164.32	154.83
07/30/92	ND	1.1	4.2	ND	3.0	-	9.55	NP	0.00	164.32	154.77
08/20/92	ND	2.0	4.7	ND	5.7	-	9.63	NP	0.00	164.32	154.69
09/30/92	ND	ND	ND	ND	ND	-	9.90	NP	0.00	164.32	154.42
12/23/92	ND	ND	ND	ND	ND	-	9.96	NP	0.00	164.32	154.36
05/10/93	ND	ND	ND	ND	ND	-	8.95	NP	0.00	164.32	155.37
06/09/93	ND	ND	ND	ND	ND	-	9.00	NP	0.00	164.32	155.32
09/14/93	200	0.3	ND	ND	ND	-	9.50	NP	0.00	164.32	154.82
12/14/93	ND	ND	ND	ND	ND	-	8.75	NP	0.00	164.32	155.57
03/02/94	< 50	< 0.3	< 0.3	< 0.3	< 0.5	-	7.52	NP	0.00	164.32	156.80
06/06/94	54	< 0.3	< 0.3	< 0.3	2.4	-	9.00	NP	0.00	164.32	155.32
09/06/94	< 50	< 0.3	< 0.3	< 0.3	< 0.5	-	9.26	NP	0.00	164.32	155.06
12/07/94	130	2.5	1.9	1.3	3.6	-	8.67	NP	0.00	164.32	155.65
03/08/95	< 100	< 0.5	< 0.5	< 0.5	< 1	-	8.34	NP	0.00	164.32	155.98
06/15/95	< 100	1.0	< 0.5	< 0.5	< 1	-	9.12	NP	0.00	164.32	155.20
09/05/95	< 100	< 0.5	< 0.5	< 0.5	< 1	-	9.56	NP	0.00	164.32	154.76
11/21/95	< 50	0.44	< 0.3	< 0.3	1.5	-	9.28	NP	0.00	164.32	155.04
03/11/96	< 50	1.3	< 0.3	< 0.3	0.6	-	7.52	NP	0.00	164.32	156.80
06/19/96	640	72	20	34	150	-	7.80	NP	0.00	164.32	156.52
09/16/96	< 50	< 0.3	< 0.3	< 0.3	< 0.5	20	9.18	NP	0.00	164.32	155.14
12/10/96	< 50	< 0.3	< 0.3	< 0.3	< 0.5	< 20	6.08	NP	0.00	164.32	158.24
03/12/97	53	0.45	< 0.3	< 0.3	< 0.5	140	8.65	NP	0.00	164.32	155.67
06/12/97	< 50	< 0.3	< 0.3	< 0.3	< 0.5	68	-	-	-	-	-
09/10/97	< 50	< 0.3	< 0.3	< 0.3	< 0.5	< 20	8.30	NP	0.00	164.32	156.02

TABLE 1
GROUNDWATER DATA
THRIFTY OIL STATION #054, CASTRO VALLEY, CA.

DATE SAMPLED	ANALYTICAL PARAMETERS						DEPTH TO GROUNDWATER (feet)	DEPTH TO PRODUCT (feet)	PRODUCT THICKNESS (feet)	CASING ELEVATION (feet)	GROUNDWATER ELEVATION (feet)
	TPH (ug/L)	BENZENE (ug/L)	TOLUENE (ug/L)	EthylBenzene (ug/L)	XYLENE (ug/L)	MTBE (ug/L)					
12/09/97	<50	1.7	2.1	<0.3	1.4	82	9.98	NP	0.00	164.32	154.34
03/03/98	<50	<0.3	<0.3	<0.3	<0.5	84	8.33	NP	0.00	164.32	155.99
07/08/98	<50	<0.3	<0.3	<0.3	<0.5	97	-	-	-	-	-
09/10/98	<50	<0.3	<0.3	<0.3	<0.5	97	12.95	NP	0.00	164.32	151.37
12/30/98	<50	1.3	1.5	<0.3	0.86	19	11.35	NP	0.00	164.32	152.97
03/15/99	<50	<0.3	<0.3	<0.3	<0.5	9.6	9.85	NP	0.00	164.32	154.47
06/22/99	66	0.39	<0.3	<0.3	<0.5	62	9.90	NP	0.00	164.32	154.42
09/08/99	<50	<0.3	<0.3	<0.3	<0.5	25	9.85	NP	0.00	164.32	154.47
12/01/99	<50	<0.3	<0.3	<0.3	<0.5	30	8.30	NP	0.00	164.32	156.02
03/23/00	<50	<0.25	<0.25	<0.25	<0.5	*13.6/18.2	6.76	NP	0.00	164.32	157.56
06/08/00	<50	<5	<5	<5	<5	10	8.30	NP	0.00	164.32	156.02
09/27/00	<50	<0.18	<0.14	<0.18	<0.26	*6 / 4.9	8.30	NP	0.00	164.32	156.02
12/13/00	<50	<0.18	<0.14	<0.18	<0.26	<0.24	8.28	NP	0.00	164.32	156.04
03/22/01	<50	<0.18	<0.14	<0.18	<0.26	<0.24	12.89	NP	0.00	164.32	151.43
06/15/01	<50	<0.18	<0.14	<0.18	<0.26	<0.24	12.89	NP	0.00	164.32	151.43
08/30/01	<50	<0.18	<0.14	<0.18	<0.26	<0.24	9.82	NP	0.00	164.32	154.50
12/12/01	<50	<0.18	<0.14	<0.18	<0.26	<0.24	9.25	NP	0.00	164.32	155.07
03/13/02	-	-	-	-	-	-	12.89	NP	0.00	164.32	151.43
06/12/02	-	-	-	-	-	-	-	-	-	-	-
09/18/02	-	-	-	-	-	-	-	-	-	-	-
12/18/02	-	-	-	-	-	-	-	-	-	-	-
03/19/03	-	-	-	-	-	-	-	-	-	-	-
06/11/03	-	-	-	-	-	-	-	-	-	-	-
09/04/03	-	-	-	-	-	-	-	-	-	-	-
12/04/03	-	-	-	-	-	-	6.78	NP	0.00	164.03	157.25
03/18/04	-	-	-	-	-	-	9.65	NP	0.00	164.03	154.38
MONITORING WELL #RS-9											
<i>Screen Interval = 5 to 15 feet</i>											
08/07/91	-	0.5	ND	330	1,200	-	2.28	NP	0.00	167.51	165.23
09/27/91	13,000	3.5	3.0	82	140	-	2.77	NP	0.00	167.51	164.74
10/23/91	11,000	ND	ND	39	340	-	3.53	NP	0.00	167.51	163.98
11/06/91	6,800	8.4	0.6	22	230	-	2.51	NP	0.00	167.51	165.00
12/04/91	6,500	6.5	0.7	87	200	-	3.20	NP	0.00	167.51	164.31
01/29/92	8,100	22	10	140	260	-	2.65	NP	0.00	167.51	164.86

TABLE 1
GROUNDWATER DATA
THRIFTY OIL STATION #054, CASTRO VALLEY, CA.

DATE SAMPLED	ANALYTICAL PARAMETERS						DEPTH TO GROUNDWATER (feet)	DEPTH TO PRODUCT (feet)	PRODUCT THICKNESS (feet)	CASING ELEVATION (feet)	GROUNDWATER ELEVATION (feet)
	TPH (ug/L)	BENZENE (ug/L)	TOLUENE (ug/L)	EthylBenzene (ug/L)	XYLENE (ug/L)	MTBE (ug/L)					
02/26/92	13,000	40	16	220	600	-	3.42	NP	0.00	167.51	164.09
03/19/92	12,000	21	12	100	280	-	3.12	NP	0.00	167.51	164.39
04/22/92	8,600	ND	ND	20	37	-	3.24	NP	0.00	167.51	164.27
05/21/92	6,000	21	10	53	210	-	3.75	NP	0.00	167.51	163.76
06/25/92	370	2.3	1.5	0.7	4.3	-	2.65	NP	0.00	167.51	164.86
07/30/92	3,600	20	ND	39	80	-	2.70	NP	0.00	167.51	164.81
08/20/92	3,000	0.7	5.2	2.0	5.3	-	2.83	NP	0.00	167.51	164.68
09/30/92	9,200	4.8	6.5	12	91	-	2.80	NP	0.00	167.51	164.71
12/23/92	2,000	17	ND	8.2	18	-	2.45	NP	0.00	167.51	165.06
03/10/93	1,500	ND	2.6	21	12	-	2.40	NP	0.00	167.51	165.11
06/09/93	1,300	0.6	1.7	ND	7.5	-	3.55	NP	0.00	167.51	163.96
09/14/93	1,500	1.3	7.6	4.1	14	-	2.81	NP	0.00	167.51	164.70
12/14/93	560	ND	ND	ND	5.5	-	2.63	NP	0.00	167.51	164.88
03/02/94	1,100	<0.3	<0.3	<0.3	<0.5	-	2.60	NP	0.00	167.51	164.91
06/06/94	290	0.58	0.53	1.1	5.8	-	2.52	NP	0.00	167.51	164.99
09/06/94	890	<0.3	<0.3	<0.3	3.1	-	3.16	NP	0.00	167.51	164.35
12/07/94	940	22	23	10	32	-	5.18	NP	0.00	167.51	162.33
03/08/95	1,600	<0.5	<0.5	<0.5	2.3	-	4.57	NP	0.00	167.51	162.94
06/15/95	3,200	2.2	5.3	4.3	3.1	-	5.08	NP	0.00	167.51	162.43
09/05/95	1,100	<0.5	<0.5	<0.5	<1	-	5.72	NP	0.00	167.51	161.79
11/21/95	1,100	1.1	2.9	3.5	3.0	-	2.46	NP	0.00	167.51	165.05
03/11/96	440	0.7	0.34	<0.3	3.7	-	3.44	NP	0.00	167.51	164.07
06/19/96	580	3.8	0.49	1.2	<0.5	-	3.80	NP	0.00	167.51	163.71
09/16/96	490	<0.3	1.6	<0.3	<0.5	<20	3.80	NP	0.00	167.51	163.71
12/10/96	<50	<0.3	<0.3	<0.3	<0.5	<20	2.76	NP	0.00	167.51	164.75
03/12/97	<50	<0.3	0.42	<0.3	1.5	<20	3.20	NP	0.00	167.51	164.31
06/12/97	<50	<0.3	<0.3	<0.3	0.51	<20	-	-	-	-	-
09/10/97	<50	<0.3	<0.3	<0.3	<0.5	<20	4.24	NP	0.00	167.51	163.27
12/09/97	<50	<0.3	0.48	<0.3	<0.5	<20	2.72	NP	0.00	167.51	164.79
03/03/98	190	<0.3	<0.3	0.38	<0.5	<20	1.90	NP	0.00	167.51	165.61
07/08/98	<50	<0.3	<0.3	<0.3	<0.5	<5	-	-	-	-	-
09/10/98	<50	<0.3	<0.3	<0.3	<0.5	<5	2.72	NP	0.00	167.51	164.79
12/30/98	<50	<0.3	<0.3	<0.3	<0.5	<5	1.20	NP	0.00	167.51	166.31
03/15/99	<50	<0.3	<0.3	<0.3	<0.5	<5	4.25	NP	0.00	167.51	163.26
06/22/99	1,300	4.2	1.2	0.69	0.74	<5	3.70	NP	0.00	167.51	163.81

TABLE 1
GROUNDWATER DATA
THRIFTY OIL STATION #054, CASTRO VALLEY, CA.

DATE SAMPLED	ANALYTICAL PARAMETERS						DEPTH TO GROUNDWATER (feet)	DEPTH TO PRODUCT (feet)	PRODUCT THICKNESS (feet)	CASING ELEVATION (feet)	GROUNDWATER ELEVATION (feet)
	TPH (ug/L)	BENZENE (ug/L)	TOLUENE (ug/L)	EthylBenzene (ug/L)	XYLENE (ug/L)	MTBE (ug/L)					
09/08/99	<50	<0.3	<0.3	<0.3	<0.5	<5	2.71	NP	0.00	167.51	164.80
12/01/99	<50	<0.3	<0.3	<0.3	<0.5	<5	2.70	NP	0.00	167.51	164.81
03/23/00	<50	<0.25	<0.25	<0.25	<0.5	<5	2.70	NP	0.00	167.51	164.81
06/08/00	585	<5	<5	<5	<5	821	2.72	NP	0.00	167.51	164.79
09/27/00	592	<0.18	<0.14	<0.18	<0.26	*1,180 / 1,360	2.72	NP	0.00	167.51	164.79
12/13/00	<50	<0.18	<0.14	<0.18	<0.26	*403 / 444	2.70	NP	0.00	167.51	164.81
03/22/01	425	<0.18	<0.14	<0.18	<0.26	*738 / 1,640	2.69	NP	0.00	167.51	164.82
06/15/01	<50	<0.18	<0.14	<0.18	<0.26	<0.24	2.68	NP	0.00	167.51	164.83
08/30/01	164	<0.18	<0.14	<0.18	<0.26	*396 / 284	2.68	NP	0.00	167.51	164.83
12/12/01	1,540	<0.18	<0.14	<0.18	<0.26	*4,370 / 2,480	2.41	NP	0.00	167.51	165.10
03/13/02	1,540	<0.18	<0.14	<0.18	<0.26	3,360	2.68	NP	0.00	167.51	164.83
06/12/02	2,020	1	3	1	3	3,280	4.21	NP	0.00	167.51	163.30
09/18/02	915	<0.18	<0.14	<0.18	<0.26	768	4.21	NP	0.00	167.51	163.30
12/18/02	1,070	<0.18	<0.14	<0.18	<0.26	960	2.68	NP	0.00	167.51	164.83
03/19/03	1,600	<0.04	<0.02	<0.02	<0.06	836	4.21	NP	0.00	167.51	163.30
06/11/03	1,960	<0.04	<0.02	<0.02	<0.06	583	4.21	NP	0.00	167.51	163.30
09/04/03	117	<0.22	<0.32	<0.31	13	8.3	4.21	NP	0.00	167.51	163.30
12/04/03	19,200	5,270	6,550	144	2,540	217	1.16	NP	0.00	167.05	165.89
03/18/04	193	7.5	18	1.4 J	6.1	127	2.68	NP	0.00	167.05	164.37
MONITORING WELL #RS-10 Screen Interval = 5 to 25 feet											
08/07/91	ND	ND	ND	ND	ND	-	6.16	NP	0.00	162.89	156.73
09/27/91	ND	ND	ND	ND	ND	-	6.48	NP	0.00	162.89	156.41
10/23/91	ND	ND	ND	ND	ND	-	7.37	NP	0.00	162.89	155.52
11/06/91	ND	ND	ND	ND	ND	-	6.44	NP	0.00	162.89	156.45
12/04/91	ND	ND	ND	ND	ND	-	7.02	NP	0.00	162.89	155.87
01/29/92	ND	ND	ND	ND	ND	-	6.78	NP	0.00	162.89	156.11
02/26/92	ND	ND	ND	ND	ND	-	8.33	NP	0.00	162.89	154.56
03/19/92	ND	ND	ND	ND	0.6	-	8.02	NP	0.00	162.89	154.87
04/22/92	ND	ND	ND	ND	ND	-	7.78	NP	0.00	162.89	155.11
05/21/92	ND	ND	0.6	ND	1.2	-	6.21	NP	0.00	162.89	156.68
06/25/92	ND	ND	ND	ND	ND	-	7.73	NP	0.00	162.89	155.16
07/30/92	ND	ND	0.5	ND	1.0	-	7.84	NP	0.00	162.89	155.05
08/20/92	ND	ND	ND	ND	ND	-	7.50	NP	0.00	162.89	155.39

TABLE 1
GROUNDWATER DATA
THRIFTY OIL STATION #054, CASTRO VALLEY, CA.

DATE SAMPLED	ANALYTICAL PARAMETERS						DEPTH TO GROUNDWATER (feet)	DEPTH TO PRODUCT (feet)	PRODUCT THICKNESS (feet)	CASING ELEVATION (feet)	GROUNDWATER ELEVATION (feet)
	FPH (ug/L)	BENZENE (ug/L)	TOLUENE (ug/L)	EthylBenzene (ug/L)	XYLENE (ug/L)	MTBE (ug/L)					
09/30/92	ND	ND	ND	ND	ND	-	7.63	NP	0.00	162.89	155.26
12/23/92	ND	ND	ND	ND	ND	-	7.24	NP	0.00	162.89	155.65
03/10/93	ND	ND	ND	ND	ND	-	6.38	NP	0.00	162.89	156.51
06/09/93	ND	ND	ND	ND	ND	-	7.98	NP	0.00	162.89	154.91
09/14/93	ND	ND	ND	ND	ND	-	7.35	NP	0.00	162.89	155.54
03/02/94	<50	<0.3	<0.3	<0.3	<0.3	-	7.00	NP	0.00	162.89	155.89
06/06/94	<50	<0.3	<0.3	<0.3	<0.5	-	6.55	NP	0.00	162.89	156.34
09/06/94	<50	<0.3	<0.3	<0.3	<0.5	-	7.63	NP	0.00	162.89	155.26
12/07/94	56	<0.3	<0.3	<0.5	2.1	-	5.92	NP	0.00	162.89	156.97
03/08/95	<100	<0.5	<0.5	<0.5	<1	-	7.84	NP	0.00	162.89	155.05
06/15/95	<100	<0.5	<0.5	<0.5	<1	-	6.97	NP	0.00	162.89	155.92
09/05/95	<100	<0.5	<0.5	<0.5	<1	-	8.14	NP	0.00	162.89	154.75
11/21/95	<50	<0.3	<0.3	<0.3	<0.5	-	7.68	NP	0.00	162.89	155.21
03/11/96	<50	<0.3	<0.3	<0.3	<0.5	-	6.76	NP	0.00	162.89	156.13
06/19/96	<50	<0.3	<0.3	<0.3	<0.5	-	7.20	NP	0.00	162.89	155.69
09/16/96	<50	<0.3	<0.3	<0.3	<0.5	<20	6.30	NP	0.00	162.89	156.59
12/10/96	<50	<0.3	<0.3	<0.3	<0.5	<20	6.05	NP	0.00	162.89	156.84
03/12/97	<50	<0.3	<0.3	<0.3	<0.5	<20	7.56	NP	0.00	162.89	155.33
06/12/97	<50	<0.3	<0.3	<0.3	<0.5	<20	-	-	-	-	-
09/10/97	<50	<0.3	<0.3	<0.3	<0.5	<20	7.55	NP	0.00	162.89	155.34
12/09/97	1,900	610	510	<6	290	<20	7.55	NP	0.00	162.89	155.34
03/03/98	<50	2.0	<0.3	<0.3	<0.5	27	6.03	NP	0.00	162.89	156.86
07/08/98	<50	<0.3	<0.3	<0.3	<0.5	<5	-	-	-	-	-
09/10/98	<50	<0.3	<0.3	<0.3	<0.5	72	7.55	NP	0.00	162.89	155.34
12/30/98	<50	1.1	<0.3	<0.3	<0.5	<5	4.45	NP	0.00	162.89	158.44
03/15/99	<50	<0.3	<0.3	<0.3	1.3	<5	4.50	NP	0.00	162.89	158.39
06/22/99	<50	<0.3	<0.3	<0.3	<0.5	<5	9.15	NP	0.00	162.89	153.74
09/08/99	<50	<0.3	<0.3	<0.3	<0.5	<5	7.51	NP	0.00	162.89	155.38
12/01/99	<50	<0.3	<0.3	<0.3	<0.5	<5	5.97	NP	0.00	162.89	156.92
03/23/00	<50	<0.25	<0.25	<0.25	<0.5	<5	4.47	NP	0.00	162.89	158.42
06/08/00	<50	<5	<5	<5	<5	<5	5.97	NP	0.00	162.89	156.92
09/27/00	<50	<0.18	<0.14	<0.18	<0.26	<0.24	7.50	NP	0.00	162.89	155.39
12/13/00	<50	<0.18	<0.14	<0.18	<0.26	<0.24	5.94	NP	0.00	162.89	156.95
03/22/01	<50	<0.18	<0.14	<0.18	<0.26	<0.24	7.51	NP	0.00	162.89	155.38
06/15/01	<50	<0.18	<0.14	<0.18	<0.26	<0.24	7.50	NP	0.00	162.89	155.39

TABLE 1
GROUNDWATER DATA
THRIFTY OIL STATION #054, CASTRO VALLEY, CA.

DATE SAMPLED	ANALYTICAL PARAMETERS						DEPTH TO GROUNDWATER (feet)	DEPTH TO PRODUCT (feet)	PRODUCT THICKNESS (feet)	CASING ELEVATION (feet)	GROUNDWATER ELEVATION (feet)
	TPH (ug/L)	BENZENE (ug/L)	TOLUENE (ug/L)	EthylBenzene (ug/L)	XYLENE (ug/L)	MTBE (ug/L)					
08/30/01	<50	<0.18	<0.14	<0.18	<0.26	<0.24	9.05	NP	0.00	162.89	153.84
12/12/01	<50	<0.18	<0.14	<0.18	<0.26	<0.24	7.65	NP	0.00	162.89	155.24
03/13/02	-	-	-	-	-	-	9.05	NP	0.00	162.89	153.84
06/12/02	-	-	-	-	-	-	-	-	-	-	-
09/18/02	-	-	-	-	-	-	-	-	-	-	-
12/18/02	-	-	-	-	-	-	-	-	-	-	-
03/19/03	-	-	-	-	-	-	-	-	-	-	-
06/11/03	-	-	-	-	-	-	-	-	-	-	-
09/04/03	-	-	-	-	-	-	-	-	-	-	-
12/04/03	-	-	-	-	-	-	5.98	NP	0.00	162.43	156.45
03/18/04	-	-	-	-	-	-	8.85	NP	0.00	162.43	153.58
MONITORING WELL #RS-11											
<i>Screen Interval = 5 to 25 feet</i>											
09/21/95	110	<0.5	<0.5	<0.5	<1	-	9.37	NP	0.00	163.28	153.91
11/21/95	-	-	-	-	-	-	-	-	-	-	-
03/11/96	-	-	-	-	-	-	-	-	-	-	-
06/19/96	-	-	-	-	-	-	-	-	-	-	-
09/16/96	-	-	-	-	-	-	-	-	-	-	-
03/12/97	74	9.5	<0.3	<0.3	0.57	<20	7.75	NP	0.00	163.28	155.53
06/12/97	<50	<0.3	<0.3	<0.3	<0.5	<20	-	-	-	-	-
09/10/97	<50	<0.3	<0.3	<0.3	<0.5	<20	9.50	NP	0.00	163.28	153.78
12/09/97	<50	0.79	1.2	<0.3	<0.5	<20	9.50	NP	0.00	163.28	153.78
03/03/98	140	22	0.63	<0.3	<0.5	<20	7.93	NP	0.00	163.28	155.35
07/08/98	<50	<0.3	<0.3	<0.3	<0.5	<5	-	-	-	-	-
09/10/98	<50	<0.3	<0.3	<0.3	<0.5	<5	9.48	NP	0.00	163.28	153.80
12/30/98	<50	1.3	0.87	<0.3	0.55	<5	7.95	NP	0.00	163.28	155.33
03/15/99	<50	<0.3	<0.3	<0.3	<0.5	<5	6.40	NP	0.00	163.28	156.88
06/22/99	350	89	2.9	3.3	0.91	6.8	11.00	NP	0.00	163.28	152.28
09/08/99	99	9.1	0.37	<0.3	<0.5	<5	7.90	NP	0.00	163.28	155.38
12/01/99	82	9.7	0.44	<0.3	<0.5	<5	7.90	NP	0.00	163.28	155.38
03/23/00	73	5.8	2.3	<0.25	<0.5	*11.2 / 7.9	4.85	NP	0.00	163.28	158.43
06/08/00	306	<5	<5	<5	<5	<5	7.90	NP	0.00	163.28	155.38
09/27/00	<50	1	<0.14	<0.18	<0.26	3 J / 3.6	9.44	NP	0.00	163.28	153.84
12/13/00	<50	<0.18	<0.14	<0.18	<0.26	<0.24	6.34	NP	0.00	163.28	156.94

TABLE 1
GROUNDWATER DATA
THRIFTY OIL STATION #054, CASTRO VALLEY, CA.

DATE SAMPLED	ANALYTICAL PARAMETERS						DEPTH TO GROUNDWATER (feet)	DEPTH TO PRODUCT (feet)	PRODUCT THICKNESS (feet)	CASING ELEVATION (feet)	GROUNDWATER ELEVATION (feet)
	TPH (ug/L)	BENZENE (ug/L)	TOLUENE (ug/L)	EthylBenzene (ug/L)	XYLENE (ug/L)	MTBE (ug/L)					
03/22/01	408	<0.18	<0.14	<0.18	<0.26	*664 / 941	7.96	NP	0.00	163.28	155.32
06/15/01	<50	<0.18	<0.14	<0.18	<0.26	<0.24	7.87	NP	0.00	163.28	155.41
08/30/01	<50	<0.18	<0.14	<0.18	<0.26	<0.24	9.41	NP	0.00	163.28	153.87
12/12/01	<50	<0.18	<0.14	<0.18	<0.26	<0.24	7.86	NP	0.00	163.28	155.42
03/13/02	<50	<0.18	<0.14	<0.18	<0.26	<0.24	7.85	NP	0.00	163.28	155.43
06/12/02	<50	<0.18	1	<0.18	<0.26	<0.24	9.39	NP	0.00	163.28	153.89
09/18/02	<50	<0.18	<0.14	<0.18	<0.26	<0.24	9.38	NP	0.00	163.28	153.90
12/18/02	110	<0.18	<0.14	<0.18	<0.26	101	6.32	NP	0.00	163.28	156.96
03/19/03	<15	<0.04	<0.02	<0.02	<0.06	<0.03	9.39	NP	0.00	163.28	153.89
06/11/03	<15	<0.04	<0.02	<0.02	<0.06	20	9.39	NP	0.00	163.28	153.89
09/04/03	<15	<0.22	<0.32	<0.31	<0.4	<0.18	7.85	NP	0.00	163.28	155.43
12/04/03	<15	<0.04	<0.02	<0.02	<0.06	<0.03	6.32	NP	0.00	162.71	156.39
03/18/04	<15	<0.22	<0.32	<0.31	<0.4	<0.18	9.39	NP	0.00	162.71	153.32

NOTE: ND = Nondetectable
 " - " = Not Analyzed / Not Available
 NP = No Free Product
 *MTBE 8020/8260

Benzene, toluene, ethylbenzene, and xylene analyzed by EPA method 8020.
 Total petroleum hydrocarbons (TPH) analyzed by EPA method 8015 modified for gasoline
 Methyl-tert Butyl Ether (MTBE) analyzed by EPA method 8020
 On 3/18/04, 9/4/03 & 6/8/00, BTEX and MTBE analyzed by EPA Method 8260B

FIGURES

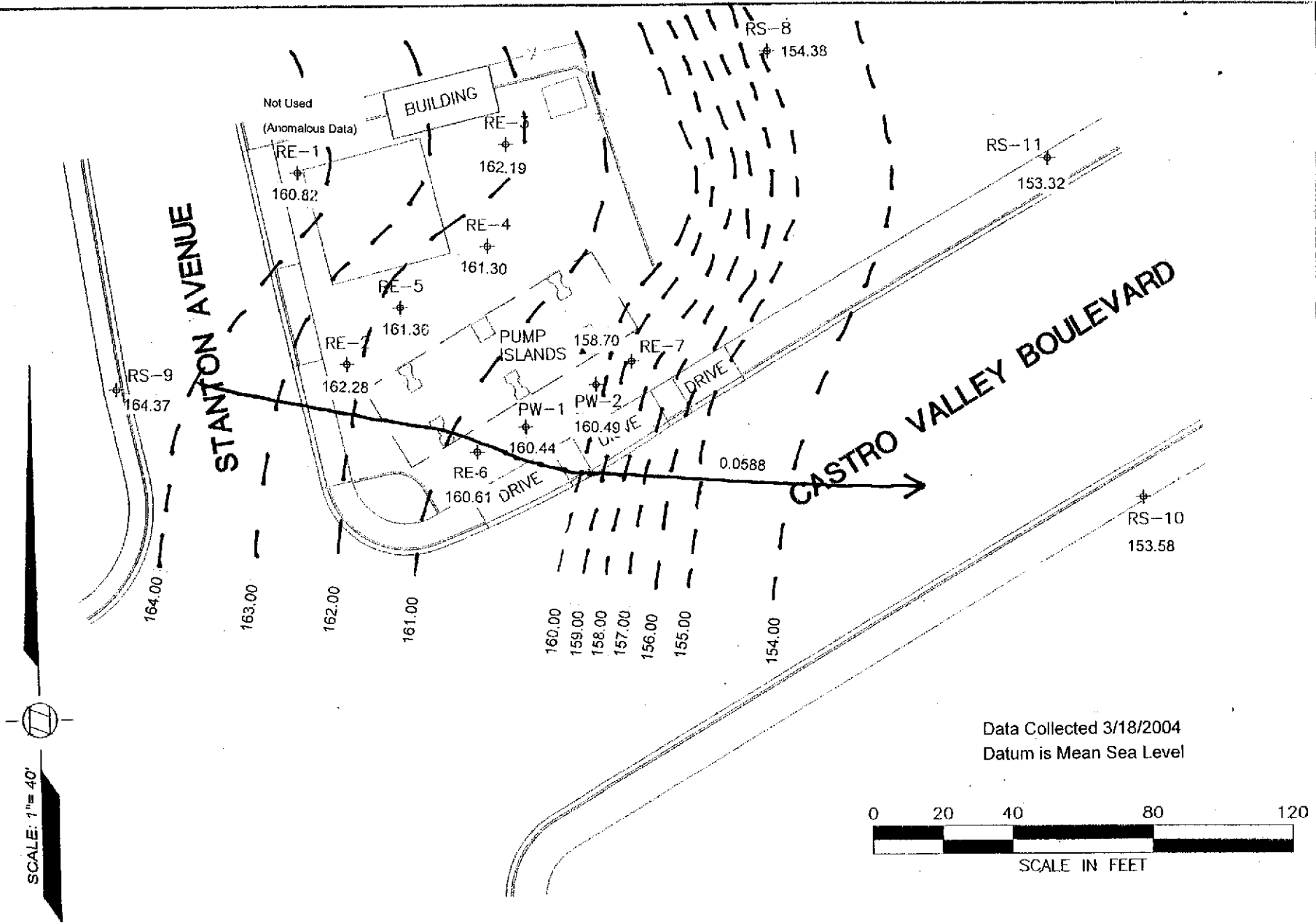

Thrifty Oil Co.
13116 Imperial Highway
Santa Fe Springs, CA 90670

GROUNDWATER CONTOURS

THRIFTY STATION #054
2504 Castro Valley Boulevard
Castro Valley, CA

Figure

1

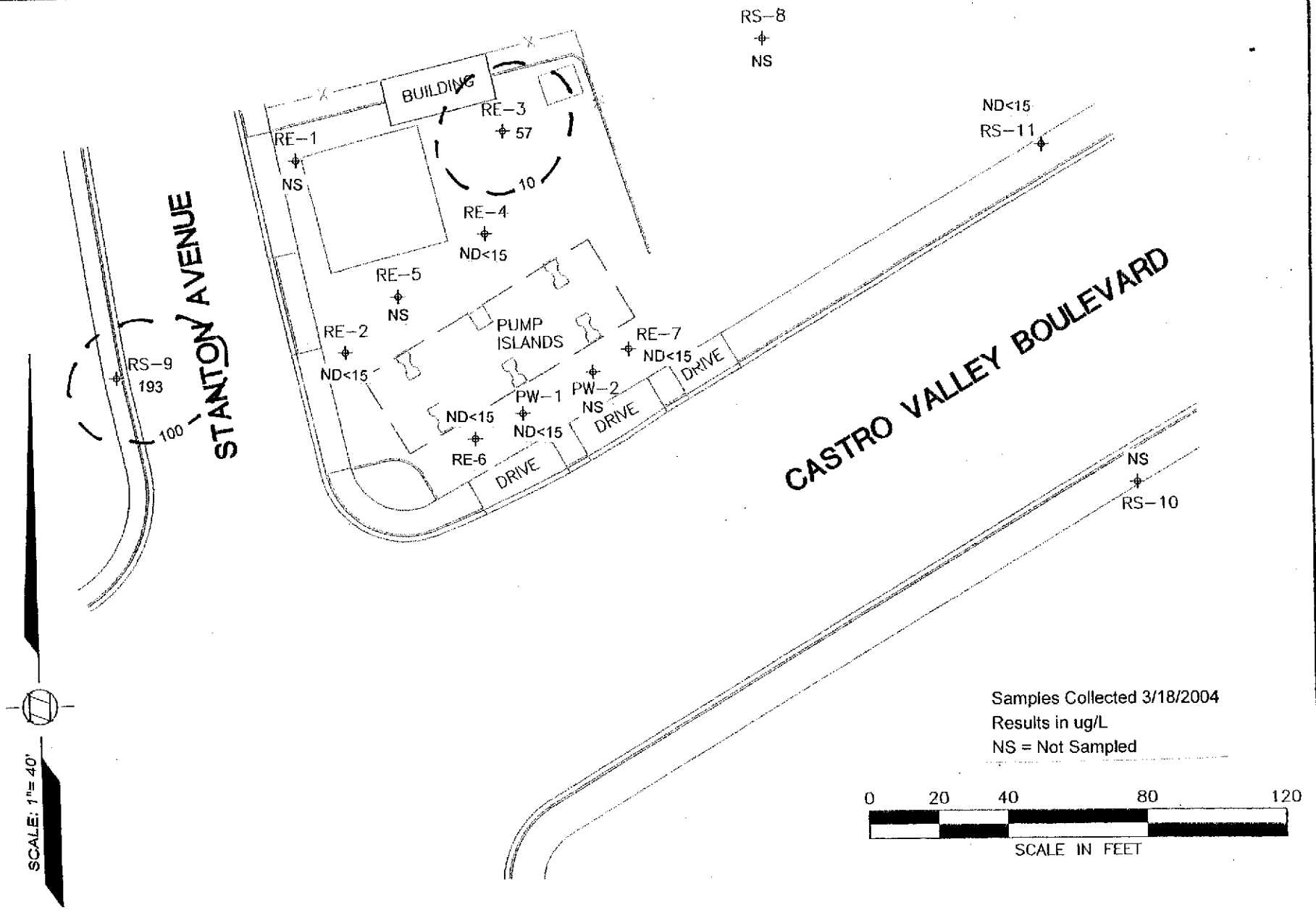

Samples Collected 3/18/2004
 Results in ug/L
 NS = Not Sampled

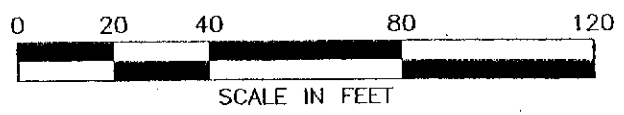

Thrifty Oil Co.
 13116 Imperial Highway
 Santa Fe Springs, CA 90670

TPHg IN GROUNDWATER

THRIFTY STATION #054
2504 Castro Valley Boulevard
Castro Valley, CA

Figure
 2

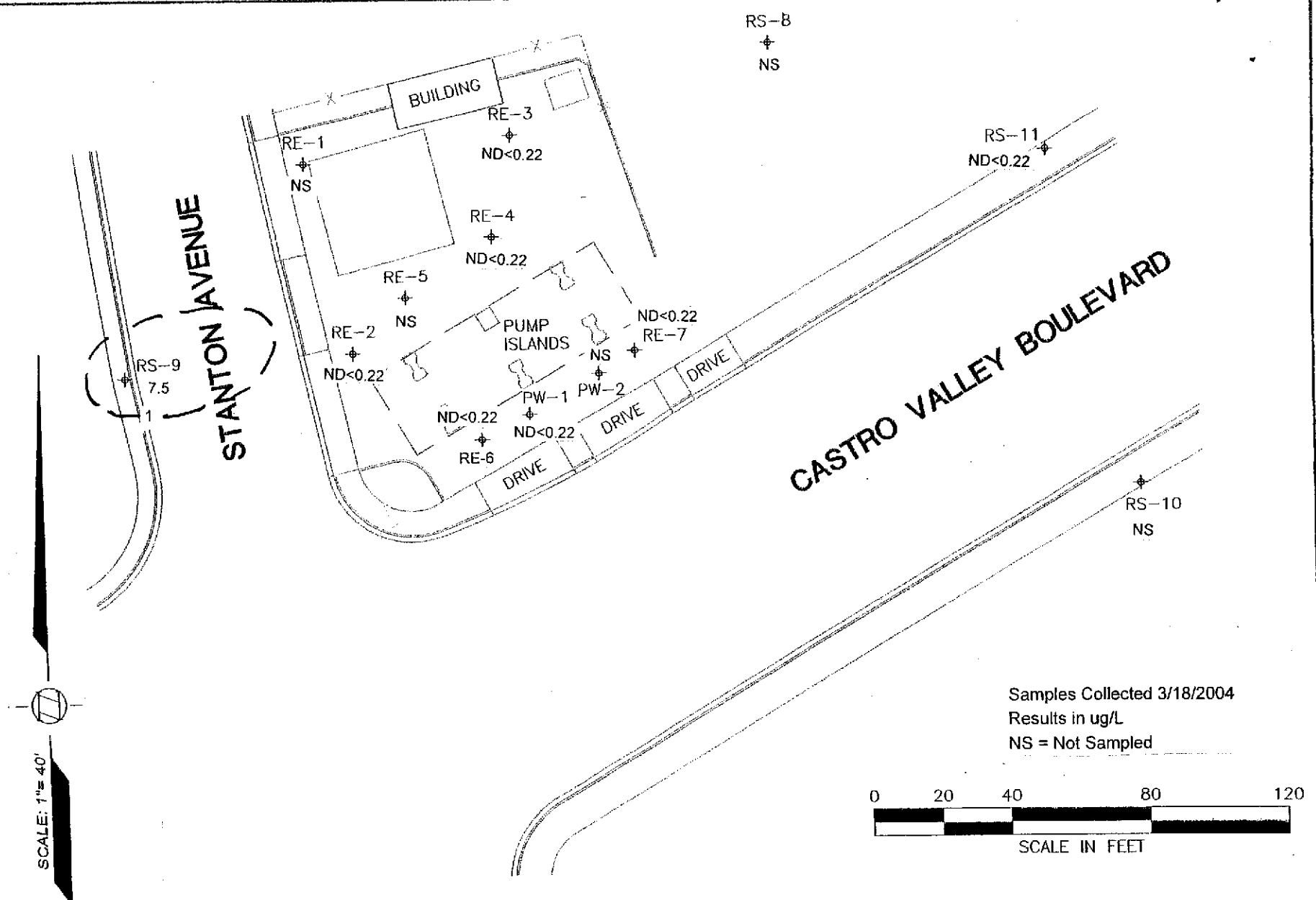

Samples Collected 3/18/2004
 Results in ug/L
 NS = Not Sampled



SCALE: 1" = 40'

BENZENE IN GROUNDWATER

THRIFTY STATION #054
2504 Castro Valley Boulevard
Castro Valley, CA

Figure

3



Thrifty Oil Co.
 13116 Imperial Highway
 Santa Fe Springs, CA 90670

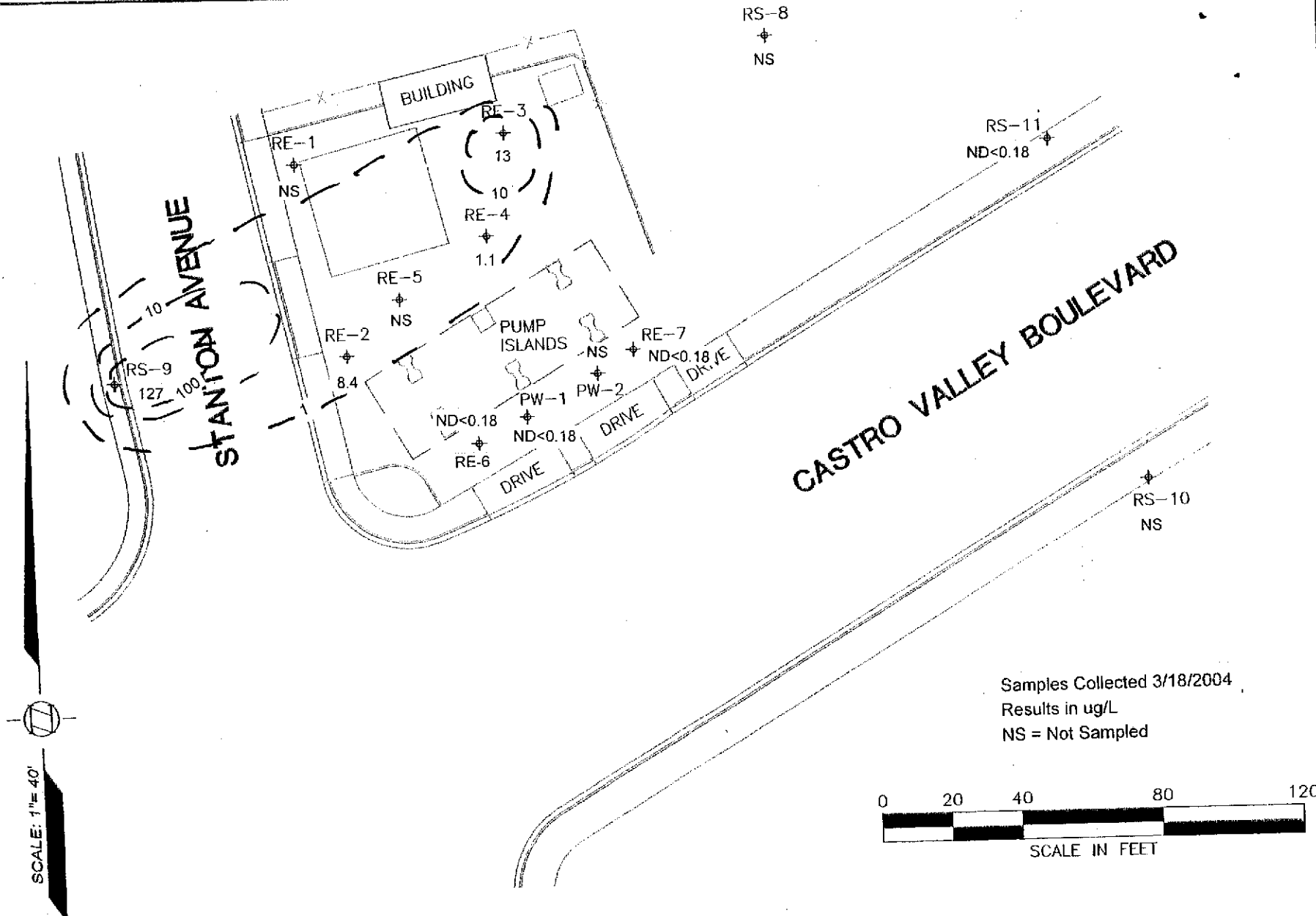

SCALE: 1"= 40'

Samples Collected 3/18/2004
 Results in ug/L
 NS = Not Sampled

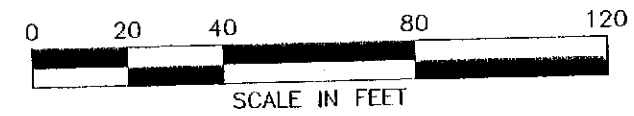

MTBE IN GROUNDWATER

THRIFTY STATION #054
 2504 Castro Valley Boulevard
 Castro Valley, CA

Figure

4



Thrifty Oil Co.
 13116 Imperial Highway
 Santa Fe Springs, CA 90670

APPENDIX A



PROJECT STATUS REPORT

SITE: THRIFTY OIL CO. # 054
 ADDRESS: 2504 CASTRO VALLEY BLVD.
CASTRO VALLEY, CA. 94546
 DATE: 03-18-04
 PERSONNEL: SERBAH

WELL ID	DTP (FT)	DTW (FT)	DTB (FT)	PT (FT)	WC (FT)	DIA (IN)	PURGE (GAL)		COMMENT
							EST.	ACT.	
QUARTERLY									
1 PW-1		5.51	13.93			4"	22	22	
2 RE-2		4.33	16.96			4"	33	33	
3 RE-3		4.50	17.51			4"	34	34	
4 RE-4		4.93	14.50			4"	25	25	
5 RE-6		5.54	13.57			4"	21	21	
6 RE-7		6.63	13.13			4"	17	17	
7 RS-9		2.68	14.94			2"	8	8	OFFSITE
8 RS-11		9.34	24.70			2"	10	10	OFFSITE
GAUGING ONLY									
9 PW-2		5.12	14.30			4"			
10 RE-1		5.64	19.80			4"			
11 RE-5		6.20	18.21			4"			
12 RS-8		9.65	25.18			2"			OFFSITE
13 RS-10		8.85	24.38			2"			
FREE PRODUCT REMOVED:						PURGE-WATER REMOVED:			
APPROX. <u> </u> GALLONS						APPROX. <u>170</u> GALLONS			
REMARKS: <u>Monitoring wells and purge water</u>									

EXPLANATION: DTP= DEPTH TO PRODUCT, DTW= DEPTH TO WATER, DTB= DEPTH TO BOTTOM; ALL MEASURED FROM TOP OF CASING
 PT= PRODUCT THICKNESS, WC= WATER COLUMN, DIA= DIAMETER, EST=ESTIMATE, ACT= ACTUAL, FT= FEET, GAL= GALLONS
 REV: 9/23/2003

FIELD DATA - GROUNDWATER SAMPLING PROGRAM

Site:	# 054	Date:	03-18-04
Address:			
Personnel:	SEBBAN	Weather:	SUNNY DAY
Well No:	PW-1	Equip:	BAUER

Before Purging:			
Total Well Depth: (ft.)	13.93	Well Diameter	4"
Depth to Water (ft)	5.51	Est. Purge Volume:	22

Sampling Data:						
Initial Turbidity:			Final Turbidity:			
Time	8:40	8:45	8:50	8:55	9:00	
EC	1460	1480	1450	1420	1440	
pH	5.73	5.71	5.74	5.74	5.74	
Temp	71.4	71.6	71.7	71.7	71.6	
Gal.	4	8	13	18	22	

After Purging/Before Sample Collection	
Depth to Water (ft.)	8.09
Total Well Depth (ft.)	13.93

FIELD DATA - GROUNDWATER SAMPLING PROGRAM

Site:	# 054	Date:	03-18-04
Address:		Weather:	SUNNY DAY
Personnel:	SEEBAN	Equip:	BAYER
Well No:	RA-2		

Before Purging:			
Total Well Depth: (ft.)	16.96	Well Diameter	4"
Depth to Water (ft)	4.33	Est. Purge Volume:	33

Sampling Data:						
Initial Turbidity:			Final Turbidity:			
Time	9:11	9:18	9:25	9:32	9:40	
EC	1550	1570	1590	1570	1560	
pH	6.19	6.16	6.15	6.13	6.11	
Temp	71.3	71.1	70.9	70.8	70.7	
Gal.	6	13	19	26	33	
Time						
EC						
pH						
Temp						
Gal.						

After Purging/Before Sample Collection	
Depth to Water (ft.)	7.14
Total Well Depth (ft.)	16.96

FIELD DATA - GROUNDWATER SAMPLING PROGRAM

Site: # 054	Date: 03-18-04
Address:	
Personnel: SEBBAN	Weather: SUNNY DAY
Well No: RE-3	Equip: BAUER

Before Purging:			
Total Well Depth: (ft.)	17.51	Well Diameter	4"
Depth to Water (ft)	4.50	Est. Purge Volume:	34

Sampling Data:						
Initial Turbidity:			Final Turbidity:			
Time	9:48	9:56	10:04	10:12	10:20	
EC	1320	1350	1370	1340	1330	
pH	5.72	5.75	5.64	5.61	5.63	
Temp	71.3	71.1	70.8	70.7	70.7	
Gal.	6	13	20	27	34	
Time						
EC						
pH						
Temp						
Gal.						

After Purging/Before Sample Collection	
Depth to Water (ft.)	8.03
Total Well Depth (ft.)	17.61

FIELD DATA - GROUNDWATER SAMPLING PROGRAM

Site:	# 054	Date:	03-18-04
Address:			
Personnel:	SRBBM	Weather:	SUNNY DAY
Well No:	RE-4	Equip:	BAILER

Before Purging:			
Total Well Depth: (ft.)	14.50	Well Diameter	4"
Depth to Water (ft)	4.93	Est. Purge Volume:	25

Sampling Data:							
Initial Turbidity:				Final Turbidity:			
Time	10:35	10:40	10:45	10:50	10:55		
EC	1600	1560	1530	1520	1510		
pH	5.44	5.46	5.43	5.44	5.46		
Temp	71.3	71.1	70.9	70.8	70.6		
Gal.	5	10	15	20	25		
Time							
EC							
pH							
Temp							
Gal.							

After Purging/Before Sample Collection	
Depth to Water (ft.)	Total Well Depth(ft). 14.50
7.11	

FIELD DATA - GROUNDWATER SAMPLING PROGRAM

Site:	#1 054	Date:	03-18-04
Address:			
Personnel:	SERBAH,	Weather:	SUNNY DAY
Well No:	RE-6	Equip:	BAUER

Before Purging:			
Total Well Depth: (ft.)	13.57	Well Diameter	4"
Depth to Water (ft)	5.54	Est. Purge Volume:	21

Sampling Data:							
Initial Turbidity:				Final Turbidity:			
Time	11:23	11:28	11:33	11:39	11:45		
EC	850	870	840	820	810		
pH	6.13	6.12	6.14	6.11	6.13		
Temp	70.4	70.6	70.7	70.7	70.6		
Gal.	4	8	12	16	21		
Time							
EC							
pH							
Temp							
Gal.							

After Purging/Before Sample Collection			
Depth to Water (ft.)	8.11	Total Well Depth(ft).	13.57

FIELD DATA - GROUNDWATER SAMPLING PROGRAM

Site: #054	Date: 03-18-04
Address:	
Personnel: JEBBAM	Weather: SUNNY DAY
Well No: RE-7	Equip: BAUER

Before Purging:			
Total Well Depth: (ft.)	13.13	Well Diameter	4"
Depth to Water (ft)	6.63	Est. Purge Volume:	17

Sampling Data:						
Initial Turbidity:			Final Turbidity:			
Time	11:00	11:03	11:06	11:10	11:15	
EC	1370	1360	1380	1360	1370	
pH	5.64	5.71	5.74	5.72	5.74	
Temp	71.4	71.7	71.6	71.5	71.4	
Gal.	3	6	10	13	17	
Time						
EC						
pH						
Temp						
Gal.						

After Purging/Before Sample Collection	
Depth to Water (ft.)	9.13
Total Well Depth(ft.)	13.13

FIELD DATA - GROUNDWATER SAMPLING PROGRAM

Site: #054	Date: 03.18.04
Address:	
Personnel: SERBAN	Weather: SUNNY DAY
Well No: RS-9	Equip: BAILER

Before Purging:			
Total Well Depth (ft.)	14.94	Well Diameter	2.4
Depth to Water (ft)	2.68	Est. Purge Volume:	8

Sampling Data:							
Initial Turbidity:				Final Turbidity:			
Time	12:03	12:06	12:09	12:12	12:15		
EC	890	910	920	910	910		
pH	6.07	6.03	6.01	6.03	6.01		
Temp	21.4	21.2	21.1	21.2	21.1		
Gal.	1	3	4	6	8		
Time							
EC							
pH							
Temp							
Gal.							

After Purging/Before Sample Collection			
Depth to Water (ft.)	6.04	Total Well Depth(ft.)	14.94

FIELD DATA - GROUNDWATER SAMPLING PROGRAM

Site: #054	Date: 03-18-04
Address:	
Personnel: SERBAN	Weather: SUNNY DAY
Well No: RS-11	Equip: BAUER

Before Purging:			
Total Well Depth (ft.)	24.70	Well Diameter	2"
Depth to Water (ft)	9.39	Est. Purge Volume:	10

Sampling Data:							
Initial Turbidity:				Final Turbidity:			
Time	11:48	11:51	11:54	11:57	12:00		
EC	1860	1840	1820	1830	1820		
pH	8.14	8.18	8.16	8.16	8.18		
Temp	72.3	72.1	72.9	72.8	72.7		
Gal.	2	4	6	8	10		
Time							
EC							
pH							
Temp							
Gal.							

After Purging/Before Sample Collection			
Depth to Water (ft.)	12.03	Total Well Depth(ft).	24.70

APPENDIX B



ASSOCIATED LABORATORIES
806 North Batavia - Orange, California 92868 - 714/771-6900

FAX 714/538-1209

CLIENT Thrifty Oil Company (8871)
ATTN: Jeff Suryakusuma
13116 Imperial Hwy.
P.O. Box 2128
Santa Fe Springs, CA 90670

LAB REQUEST 126575

REPORTED 03/30/2004

RECEIVED 03/23/2004

PROJECT Station #54
2504 Castro Valley Blvd., Castro Valley

SUBMITTER Client

COMMENTS Global ID: T0600101363

This laboratory request covers the following listed samples which were analyzed for the parameters indicated on the attached Analytical Result Report. All analyses were conducted using the appropriate methods as indicated on the report. This cover letter is an integral part of the final report.

<u>Order No.</u>	<u>Client Sample Identification</u>
507585	TOC #54, PW-1
507586	TOC #54, RE-2
507587	TOC #54, RE-3
507588	TOC #54, RE-4
507589	TOC #54, RE-7
507590	TOC #54, RE-6
507591	TOC #54, RS-11
507592	TOC #54, RS-9
507593	TOC #54, Trip Blank
507594	Laboratory Method Blank

Thank you for the opportunity to be of service to your company. Please feel free to call if there are any questions regarding this report or if we can be of further service.

ASSOCIATED LABORATORIES by,

Edward S. Behare, Ph.D.
Vice President

NOTE: Unless notified in writing, all samples will be discarded by appropriate disposal protocol 30 days from date reported.

The reports of the Associated Laboratories are confidential property of our clients and may not be reproduced or used for publication in part or in full without our written permission. This is for the mutual protection of the public, our clients, and ourselves.

TESTING & CONSULTING
Chemical
Microbiological
Environmental

Order #: 507585

Client Sample ID: TOC #54, PW-1

Matrix: WATER

Date Sampled: 03/18/2004 Time Sampled: 14:20

Analyte	Result	DF	PQL	MDL	Units	Date/Analyst
8260B BTEX/MTBE Only						
Benzene	ND	1	1	0.22	ug/L	03/26/04 LB
Ethyl benzene	ND	1	5	0.31	ug/L	03/26/04 LB
Methyl-tert-butylether (MTBE)	ND	1	1	0.18	ug/L	03/26/04 LB
Toluene	ND	1	5	0.32	ug/L	03/26/04 LB
Xylenes, total	ND	1	5	0.4	ug/L	03/26/04 LB
Surrogates				Units	Control Limits	
Surr1 - Dibromofluoromethane	113			%	70 - 130	
Surr2 - 1,2-Dichloroethane-d4	123			%	70 - 130	
Surr3 - Toluene-d8	99			%	70 - 130	
Surr4 - p-Bromofluorobenzene	123			%	70 - 130	
8015M - Gasoline						
Gasoline	ND	1	50	15	ug/L	03/25/04 LZ
Surrogates				Units	Control Limits	
a,a,a-Trifluorotoluene	92			%	55 - 200	

PQL = Practical Quantitation Limit, MDL = Method detection limit, DF = Dilution Factor
 ND = Not detected below indicated MDL, J=Trace



Order #: 507586

Client Sample ID: TOC #54, RE-2

Matrix: WATER

Date Sampled: 03/18/2004 Time Sampled: 14:25

Analyte	Result	DF	PQL	MDL	Units	Date/Analyst
8260B BTEX/MTBE Only						
Benzene	ND	1	1	0.22	ug/L	03/26/04 LB
Ethyl benzene	ND	1	5	0.31	ug/L	03/26/04 LB
Methyl-tert-butylether (MTBE)	8.4	1	1	0.18	ug/L	03/26/04 LB
Toluene	ND	1	5	0.32	ug/L	03/26/04 LB
Xylenes, total	ND	1	5	0.4	ug/L	03/26/04 LB
Surrogates					Units	Control Limits
Surr1 - Dibromofluoromethane	111				%	70 - 130
Surr2 - 1,2-Dichloroethane-d4	120				%	70 - 130
Surr3 - Toluene-d8	94				%	70 - 130
Surr4 - p-Bromofluorobenzene	124				%	70 - 130
8015M - Gasoline						
Gasoline	ND	1	50	15	ug/L	03/25/04 LZ
Surrogates					Units	Control Limits
a,a,a-Trifluorotoluene	93				%	55 - 200

PQL = Practical Quantitation Limit, MDL = Method detection limit, DF = Dilution Factor
 ND = Not detected below indicated MDL, J=Trace



Order #: 507587

Client Sample ID: TOC #54, RE-3

Matrix: WATER

Date Sampled: 03/18/2004 Time Sampled: 14:30

Analyte	Result	DF	PQL	MDL	Units	Date/Analyst
---------	--------	----	-----	-----	-------	--------------

8260B BTEX/MTBE Only

Benzene	ND	1	1	0.22	ug/L	03/26/04 LB
Ethyl benzene	ND	1	5	0.31	ug/L	03/26/04 LB
Methyl-tert-butylether (MTBE)	13	1	1	0.18	ug/L	03/26/04 LB
Toluene	1.7 J	1	5	0.32	ug/L	03/26/04 LB
Xylenes, total	ND	1	5	0.4	ug/L	03/26/04 LB

Surrogates				Units	Control Limits
Surr1 - Dibromofluoromethane	110			%	70 - 130
Surr2 - 1,2-Dichloroethane-d4	120			%	70 - 130
Surr3 - Toluene-d8	94			%	70 - 130
Surr4 - p-Bromofluorobenzene	122			%	70 - 130

8015M - Gasoline

Gasoline	57	1	50	15	ug/L	03/25/04 LZ
----------	----	---	----	----	------	-------------

Surrogates				Units	Control Limits
a,a,a-Trifluorotoluene	95			%	55 - 200

PQL = Practical Quantitation Limit, MDL = Method detection limit, DF = Dilution Factor
ND = Not detected below indicated MDL, J=Trace



Order #: 507588

Client Sample ID: TOC #54, RE-4

Matrix: WATER

Date Sampled: 03/18/2004 Time Sampled: 14:35

Analyte	Result	DF	PQL	MDL	Units	Date/Analyst
---------	--------	----	-----	-----	-------	--------------

8260B BTEX/MTBE Only

Benzene	ND	1	1	0.22	ug/L	03/26/04 LB
Ethyl benzene	ND	1	5	0.31	ug/L	03/26/04 LB
Methyl-tert-butylether (MTBE)	1.1	1	1	0.18	ug/L	03/26/04 LB
Toluene	ND	1	5	0.32	ug/L	03/26/04 LB
Xylenes, total	ND	1	5	0.4	ug/L	03/26/04 LB

Surrogates

				Units	Control Limits
Surr1 - Dibromofluoromethane	112			%	70 - 130
Surr2 - 1,2-Dichloroethane-d4	119			%	70 - 130
Surr3 - Toluene-d8	96			%	70 - 130
Surr4 - p-Bromofluorobenzene	122			%	70 - 130

8015M - Gasoline

Gasoline	ND	1	50	15	ug/L	03/25/04 LZ
----------	----	---	----	----	------	-------------

Surrogates

				Units	Control Limits
a,a,a-Trifluorotoluene	96			%	55 - 200

PQL = Practical Quantitation Limit, MDL = Method detection limit, DF = Dilution Factor
 ND = Not detected below indicated MDL, J=Trace



Order #: 507589

Client Sample ID: TOC #54, RE-7

Matrix: WATER

Date Sampled: 03/18/2004 Time Sampled: 14:40

Analyte	Result	DF	PQL	MDL	Units	Date/Analyst
8260B BTEX/MTBE Only						
Benzene	ND	1	1	0.22	ug/L	03/26/04 LB
Ethyl benzene	ND	1	5	0.31	ug/L	03/26/04 LB
Methyl-tert-butylether (MTBE)	ND	1	1	0.18	ug/L	03/26/04 LB
Toluene	ND	1	5	0.32	ug/L	03/26/04 LB
Xylenes, total	ND	1	5	0.4	ug/L	03/26/04 LB
				Units	Control Limits	
Surrogates						
Surr1 - Dibromofluoromethane	111				%	70 - 130
Surr2 - 1,2-Dichloroethane-d4	122				%	70 - 130
Surr3 - Toluene-d8	98				%	70 - 130
Surr4 - p-Bromofluorobenzene	126				%	70 - 130
8015M - Gasoline						
Gasoline	ND	1	50	15	ug/L	03/25/04 LZ
				Units	Control Limits	
Surrogates						
a,a,a-Trifluorotoluene	93				%	55 - 200

PQL = Practical Quantitation Limit, MDL = Method detection limit, DF = Dilution Factor
 ND = Not detected below indicated MDL, J=Trace



Order #: 507590

Client Sample ID: TOC #54, RE-6

Matrix: WATER

Date Sampled: 03/18/2004 Time Sampled: 14:45

Analyte	Result	DF	PQL	MDL	Units	Date/Analyst
---------	--------	----	-----	-----	-------	--------------

8260B BTEX/MTBE Only

Benzene	ND	1	1	0.22 ug/L	03/26/04 LB
Ethyl benzene	ND	1	5	0.31 ug/L	03/26/04 LB
Methyl-tert-butylether (MTBE)	ND	1	1	0.18 ug/L	03/26/04 LB
Toluene	ND	1	5	0.32 ug/L	03/26/04 LB
Xylenes, total	ND	1	5	0.4 ug/L	03/26/04 LB

Surrogates

				Units	Control Limits
Surr1 - Dibromofluoromethane	112			%	70 - 130
Surr2 - 1,2-Dichloroethane-d4	120			%	70 - 130
Surr3 - Toluene-d8	98			%	70 - 130
Surr4 - p-Bromofluorobenzene	121			%	70 - 130

8015M - Gasoline

Gasoline	ND	1	50	15 ug/L	03/25/04 LZ
----------	----	---	----	---------	-------------

Surrogates

				Units	Control Limits
a,a,a-Trifluorotoluene	93			%	55 - 200

PQL = Practical Quantitation Limit, MDL = Method detection limit, DF = Dilution Factor
 ND = Not detected below indicated MDL, J=Trace



Order #: 507591

Matrix: WATER

Client Sample ID: TOC #54, RS-11

Date Sampled: 03/18/2004 Time Sampled: 14:50

Analyte	Result	DF	PQL	MDL	Units	Date/Analyst
8260B BTEX/MTBE Only						
Benzene	ND	1	1	0.22	ug/L	03/26/04 LB
Ethyl benzene	ND	1	5	0.31	ug/L	03/26/04 LB
Methyl-tert-butylether (MTBE)	ND	1	1	0.18	ug/L	03/26/04 LB
Toluene	ND	1	5	0.32	ug/L	03/26/04 LB
Xylenes, total	ND	1	5	0.4	ug/L	03/26/04 LB
					Units	Control Limits
Surrogates					%	70 - 130
Surr1 - Dibromofluoromethane	113				%	70 - 130
Surr2 - 1,2-Dichloroethane-d4	121				%	70 - 130
Surr3 - Toluene-d8	94				%	70 - 130
Surr4 - p-Bromofluorobenzene	123				%	70 - 130
8015M - Gasoline						
Gasoline	ND	1	50	15	ug/L	03/25/04 LZ
					Units	Control Limits
Surrogates					%	55 - 200
a,a,a-Trifluorotoluene	93					

PQL = Practical Quantitation Limit, MDL = Method detection limit, DF = Dilution Factor
 ND = Not detected below indicated MDL, J=Trace



Order #: 507592

Client Sample ID: TOC #54, RS-9

Matrix: WATER

Date Sampled: 03/18/2004 Time Sampled: 15:00

Analyte	Result	DF	PQL	MDL	Units	Date/Analyst
8260B BTEX/MTBE Only						
Benzene	7.5	1	1	0.22	ug/L	03/26/04 LB
Ethyl benzene	1.4 J	1	5	0.31	ug/L	03/26/04 LB
Methyl-tert-butylether (MTBE)	127	1	1	0.18	ug/L	03/26/04 LB
Toluene	18	1	5	0.32	ug/L	03/26/04 LB
Xylenes, total	6.1	1	5	0.4	ug/L	03/26/04 LB
Surrogates				Units	Control Limits	
Surr1 - Dibromofluoromethane	113			%	70 - 130	
Surr2 - 1,2-Dichloroethane-d4	114			%	70 - 130	
Surr3 - Toluene-d8	99			%	70 - 130	
Surr4 - p-Bromofluorobenzene	121			%	70 - 130	
8015M - Gasoline						
Gasoline	193	1	50	15	ug/L	03/25/04 LZ
Surrogates				Units	Control Limits	
a,a,a-Trifluorotoluene	102			%	55 - 200	

PQL = Practical Quantitation Limit, MDL = Method detection limit, DF = Dilution Factor
 ND = Not detected below indicated MDL, J=Trace



Order #: 507593

Client Sample ID: TOC #54, Trip Blank

Matrix: WATER

Date Sampled: 03/18/2004 Time Sampled: 00:00

Analyte	Result	DF	PQL	MDL	Units	Date/Analyst
---------	--------	----	-----	-----	-------	--------------

8260B BTEX/MTBE Only

Benzene	ND	1	1	0.22	ug/L	03/26/04 LB
Ethyl benzene	ND	1	5	0.31	ug/L	03/26/04 LB
Toluene	5.1	1	5	0.32	ug/L	03/26/04 LB
Xylenes, total	5.0	1	5	0.4	ug/L	03/26/04 LB

Surrogates

					Units	Control Limits
Surr1 - Dibromofluoromethane	111				%	70 - 130
Surr2 - 1,2-Dichloroethane-d4	112				%	70 - 130
Surr3 - Toluene-d8	101				%	70 - 130
Surr4 - p-Bromofluorobenzene	120				%	70 - 130

8015M - Gasoline

Gasoline	ND	1	50	15	ug/L	03/25/04 LZ
----------	----	---	----	----	------	-------------

Surrogates

					Units	Control Limits
a,a,a-Trifluorotoluene	84				%	55 - 200

PQL = Practical Quantitation Limit, MDL = Method detection limit, DF = Dilution Factor
 ND = Not detected below indicated MDL, J=Trace



Order #: 507594

Client Sample ID: Laboratory Method Blank

Matrix: WATER

Analyte	Result	DF	PQL	MDL	Units	Date/Analyst
8260B BTEX/MTBE Only						
Benzene	ND	1	1	0.22	ug/L	03/25/04 LB
Ethyl benzene	ND	1	5	0.31	ug/L	03/25/04 LB
Methyl-tert-butylether (MTBE)	ND	1	1	0.18	ug/L	03/25/04 LB
Toluene	ND	1	5	0.32	ug/L	03/25/04 LB
Xylenes, total	ND	1	5	0.4	ug/L	03/25/04 LB

Surrogates

				Units	Control Limits
Surr1 - Dibromofluoromethane	123			%	70 - 130
Surr2 - 1,2-Dichloroethane-d4	122			%	70 - 130
Surr3 - Toluene-d8	102			%	70 - 130
Surr4 - p-Bromofluorobenzene	116			%	70 - 130

8015M - Gasoline

Gasoline	ND	1	50	15	ug/L	03/25/04 LZ
----------	----	---	----	----	------	-------------

Surrogates

				Units	Control Limits
a,a,a-Trifluorotoluene	96			%	55 - 200

PQL = Practical Quantitation Limit, MDL = Method detection limit, DF = Dilution Factor
 ND = Not detected below indicated MDL, J=Trace



ASSOCIATED LABORATORIES
LCS REPORT FORM - METHOD 8260 / 624 / 524.2

QC Sample: LCS/LCSD - Water Samples
 Analysis Date: 03/26/04
 Applies to: LR 126784, 126552, 126575, 126660, 126630

Reporting Units = ug/L

Lab Controlled Spike / Lab Controlled Spike Duplicate

Test	Sample Result	Spike Added	LCS Spike	LCS Spk. Dup	%Rec LCS	%Rec LCS D	RPD	QC Limits	
								RPD	%REC
1,1-Dichloroethene	ND	50	58.67	58.30	117	117	1	22	59-172
MTBE	ND	50	49.12	47.99	98	96	2	24	62-137
Benzene	ND	50	52.65	52.35	105	105	1	24	62-137
Trichloroethene	ND	50	59.43	59.72	119	119	0	21	66-142
Toluene	ND	50	55.67	56.37	111	113	1	21	59-139
Chlorobenzene	ND	50	53.65	55.33	107	111	3	21	60-133

Method Blank = All ND

SURROGATE (QC Limits : 70-135)

Compounds	DBFM	1,2-DCA	Tol-d8	p-BFB
LCS	110	104	106	100
LCSD	109	100	106	103
BLANK # 1	108	112	103	117
BLANK # 2	110	118	101	118

ASSOCIATED LABORATORIES
LCS REPORT FORM - METHOD 8260 / 624 / 524.2

QC Sample: LCS/LCSD - Water Samples
 Analysis Date: 03/25/04
 Applies to: LR 126552, 126448, 126554, 126575
 Reporting Units = ug/L

Lab Controlled Spike / Lab Controlled Spike Duplicate

Test	Sample Result	Spike Added	LCS Spike	LCS Spk. Dup	%Rec LCS	%Rec LCS D	RPD	QC Limits	
								RPD	%REC
1,1-Dichloroethene	ND	50	60.00	57.14	120	114	5	22	59-172
MTBE	ND	50	52.13	50.32	104	101	4	24	62-137
Benzene	ND	50	54.65	52.65	109	105	4	24	62-137
Trichloroethene	ND	50	55.75	53.68	112	107	4	21	66-142
Toluene	ND	50	52.33	49.68	105	99	5	21	59-139
Chlorobenzene	ND	50	50.64	48.70	101	97	4	21	60-133

Method Blank = All ND

SURROGATE (QC Limits : 70-135)

Compounds	DBFM	1,2-DCA	Tol-d8	p-BFB
LCS	115	108	99	102
LCSD	112	104	101	101
BLANK # 1	123	122	102	116
BLANK # 2	112	121	94	121

**ASSOCIATED LABORATORIES
QA REPORT FORM**

QC Sample: LCS / LCSD
 Matrix: WATER
 Prep. Date: 03/24/04
 Analysis Date: 03/24/04-03/25/04
 ID#'s in Batch: LR 126629, 126575

Reporting Units = ug/L

PREPARATION BLANK / LAB CONTROL SAMPLE RESULTS

			PREP BLK					
			Value	Result	True	%Rec	L.Limit	H.Limit
Test	Method	LCS	ND	522	500	104	80%	120%
TPH	8015M-G	LCSD	ND	463	500	93	80%	120%

LCS Result = Lab Control Sample Result

True = True Value of LCS

L.Limit / H.Limit = LCS Control Limits

SURROGATE RECOVERY

Sample No.	AAA-TFT
QC Limit	55-200
Method Blank	96
LCS	172
LCSD	163

AAA-TFT = a,a,a-Trifluorotoluene



ASSOCIATED LABORATORIES

806 North Batavia - Orange, California 92868-1225 - 714/771-6900 FAX 714/538-1209

Cooler Receipt Form

Client: Therby Project: TOC TO600/01363

Date Cooler Received: 3/23 Date Cooler Opened: 3/23

Was cooler scanned for presence of radioactivity?
If yes was radioactivity results above 25 cpm? Yes/No
Yes/No

Was a shipper's packing slip attached to the cooler? Yes/No

If the cooler had custody seal(s), were they signed and intact? Yes/No/Na

Was the cooler packed with: Ice X Ice Packs _____ Bubble wrap _____
Styrofoam _____ Paper _____ None _____ Other _____

Cooler Temperature: 2.7°C *
*cooler needs to be received @ 4°C with an acceptable range of 2°- 6 °C

If samples were hand delivered do they meet the temp. criteria, which should be @ 4°C with an acceptable range of 2°- 6 °C? Yes/No

If no explain: _____

Were all samples sealed in plastic bags? Yes/No

Did all samples arrive intact? If no, indicate below. Yes/No

Were all samples labeled correctly? (ID's Dates, Times) If no, indicate below. Yes/No

Can the tests required be ran with the provided containers, If no indicate below. Yes/No

Was sufficient sample volume sent for all containers? Yes/No

Were any VOA vials received with head space? Yes/No/Na

Was the correct preservatives used?
If no, see the pH log for a list of samples containers regarding pH Yes/No/Na

Any other important information: _____

Receiving Department: W Date: 3/23

Chain of Custody Record



Company THRIFTY OIL CO.		Phone (562) 921-3581		A.L. Job No. 126575		Page _____ of _____			
Project Manager JEFF JURYAKUSUMA		Fax (562) 921-7510		Analysis Requested				Test Instructions & Comments	
Project Name Q.W.S.		Project # T0600101363							
Site Name and Address 2504 CASTRO VALLEY BLVD. T060054 CASTRO VALLEY, CA. 94546									
Sample ID	Lab ID	Date	Time	Matrix	Container Number/Size	Pres.	TPH (2015M)	BTEX (8260B)	MTBE (8260B)
1 PW-1 ✓		03-18-04	14:20	H ₂ O	3-VOA	HCL	X	X	X
2 RE-2 ✓		↑	14:25	↑	↑	↑	X	X	X
3 RE-3 ✓		↑	14:30	↑	↑	↑	X	X	X
4 RE-4 ✓		↑	14:35	↑	↑	↑	X	X	X
5 RE-7 ✓		↑	14:40	↑	↑	↑	X	X	X
6 RE-6 ✓		↑	14:45	↑	↑	↑	X	X	X
7 RS-11 ✓		↑	14:50	↑	↓	↓	X	X	X
8 RS-9 ✓		↑	15:00	↑	↓	↓	X	X	X
9 TRIP BLANK ✓		↑	00:00	↑	2-VOA	↓	X	X	
10									
11									
12									
13									
14									
15									

Sample Receipt - To Be Filled By Laboratory				Relinquished by Sampler: EMC 1.		Relinquished by GOLDEN STATE 2.		Relinquished by _____ 3.	
Total Number of Containers	26	Property Cooled	Y/N/NA	Signature:	SC	Signature:	OVERNIGHT	Signature:	
Custody Seals	Y/N/NA	Samples Intact	Y/N/NA	Printed Name:	SERRA PAPER	Printed Name:		Printed Name:	
Received in Good Condition	Y/N	Samples Accepted	Y/N	Date:	03-22-04	Time:	17:30	Date:	
Turn Around Time				Received By: GOLDEN STATE 1.		Received By: _____ 2.		Received By: _____ 3.	
<input checked="" type="checkbox"/> Normal	<input type="checkbox"/> Rush	<input type="checkbox"/> Same Day	<input type="checkbox"/> 48 hrs.	Signature:	OVERNIGHT	Signature:	[Signature]	Signature:	[Signature]
		<input type="checkbox"/> 24 hrs.	<input type="checkbox"/> 72 hrs.	Printed Name:		Printed Name:	ROVANO	Printed Name:	
				Date:		Date:	3/23 12:15	Date:	7-2004 - 2:50