

# THRIFTY OIL CO.

O.39512

October 15, 2003

Local #1252  
 RWQCB #01-1476  
 Global ID #T0600101363  
 Confirmation #4175032198

Mr. Amer Gholami  
 Alameda County Health Care Agency  
 Hazardous Material Specialist  
 1131 Harbor Bay Parkway, Suite 250  
 Alameda, CA 94502

Alameda County

OCT 21 2003

Environmental Health

RE: **Former Thrifty Oil Co. Station #054**  
**TOSCO Station #2602486**  
 2504 Castro Valley Boulevard  
 Castro Valley, CA  
**3rd Quarter 2003, Status Report**

Dear Mr. Gholami:

Presented herein is the Third Quarter 2003, Status Report prepared for Former Thrifty Oil Co. (Thrifty) Station #054 located at 2504 Castro Valley Boulevard, Castro Valley, California (**Figure 1**). This report presents the results of the groundwater monitoring activities conducted during the third quarter of 2003. Thrifty has retained the services of Earth Management Company (EMC) to conduct quarterly groundwater monitoring and sampling activities at this site.

### Groundwater Monitoring

Depth to groundwater is measured in each monitoring well quarterly. Historic groundwater gauging data obtained from April 11, 1988 through September 4, 2003, is presented in **Table 1**. In general, groundwater occurs beneath the station at depths ranging from 4.21 feet below ground surface (bgs) in monitoring well RS-9 to 7.85 feet bgs in monitoring well RS-11 (**Appendix A**). A groundwater elevation contour map based on the September 4, 2003 data is presented in **Figure 1**. Groundwater elevation data indicates that the general direction of groundwater flow beneath the site is toward the southeast with a hydraulic gradient of approximately 0.0636 feet/foot.

### Quarterly Groundwater Sampling

As part of the ongoing groundwater-monitoring program, groundwater samples were obtained from selected monitoring wells PW-1, RE-2, RE-3, RE-4, RE-6, RE-7, RS-9, and RS-11 on September 4, 2003. In a letter from the Alameda County Health Care Services (ACHCS) dated November 6, 2001, the ACHCS released Thrifty from collecting groundwater samples from wells PW-2, RE-1, RE-5, RS-8, and RS-10 until further notice.

Groundwater samples were obtained by EMC and delivered in a chilled state in an ice chest following strict Chain-of-Custody procedures to a state-certified laboratory. The samples were analyzed for total petroleum hydrocarbons as gasoline (TPHg) by EPA Method 8015M for gasoline and for benzene, toluene, ethylbenzene, xylenes (BTEX) and methyl tert-butyl ether (MTBE) by EPA Method 8021B. Copies of the EMC Field Status Reports are presented in **Appendix A**, and copies of the laboratory analytical reports are contained in **Appendix B**.



TPHg, BTEX, and MTBE concentrations appear in **Table 1**, and **Appendix B**. TPHg, benzene, and MTBE isoconcentration maps are presented in **Figures 2, 3, and 4**, respectively. The highest laboratory analytical concentrations for TPHg and MTBE were found in monitoring well RS-9 (117 ug/L and 8.3 ug/L, respectively). Benzene concentrations were below the laboratory detection limit in all groundwater wells sampled. Thrifty again reiterates that well RS-9 is located up gradient of the Thrifty site, and contamination found in this well probably originated from an up gradient off-site source. TOSCO Marketing Company is the current operator of the service station, acquiring the lease from BP Oil, who previously leased the property beginning on July 10, 1991. **Due to the low TPHg, benzene, and MTBE concentrations in all monitoring wells, Thrifty respectfully requests your consideration for closure of Thrifty Station #054 located at 2504 Castro Valley Boulevard, Castro Valley, California.**

#### Other Activities

Thrifty has retained Morrow Surveying of West Sacramento, California, to resurvey the groundwater monitoring wells located on- and offsite. The results of the survey will be provided in the 4th Quarter 2003 report.

Thrifty will continue the groundwater monitoring, gauging, and sampling events at this site on a quarterly basis. All interpretations expressed in this report are based solely upon the review of data collected by EMC and laboratory analyses by Associated Laboratories.

Respectfully submitted,

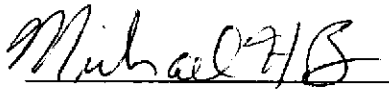

Michael H. Bowery, R.G.  
Project Manager



Chris Panaitescu  
General Manager  
Environmental Affairs

***TABLE***

**TABLE 1  
GROUNDWATER DATA  
THRIFTY OIL STATION #054, CASTRO VALLEY, CA.**

DATE SAMPLED	ANALYTICAL PARAMETERS						DEPTH TO GROUNDWATER (feet)	DEPTH TO PRODUCT (feet)	PRODUCT THICKNESS (feet)	CASING ELEVATION (feet)	GROUNDWATER ELEVATION (feet)
	TPH (ug/L)	BENZENE (ug/L)	TOLUENE (ug/L)	EthylBenzene (ug/L)	XYLENE (ug/L)	MTBE (ug/L)					
<b>MONITORING WELL #PW-1</b>											
<i>Screen Interval = 5 to 15 feet (Est.)</i>											
04/11/88	-	-	-	-	-	-	-	-	-	-	-
04/09/90	230,000	600	2,700	1,000	16,000	-	5.10	NP	0.00	166.46	161.36
10/30/90	35,000	240	970	240	3,580	-	6.17	NP	0.00	166.46	160.29
01/18/91	37,000	43	140	42	1,600	-	6.28	NP	0.00	166.46	160.18
02/12/91	45,000	99	130	25	700	-	5.88	NP	0.00	166.46	160.58
03/20/91	1,900	0.43	ND	ND	2.8	-	4.75	NP	0.00	166.46	161.71
05/22/91	41,000	600	730	250	3,800	-	5.10	NP	0.00	166.46	161.36
06/19/91	-	-	-	-	-	-	5.61	NP	0.00	166.46	160.85
07/17/91	-	-	-	-	-	-	5.53	FILM	0.00	166.46	160.93
08/07/91	-	-	-	-	-	-	5.67	FILM	0.00	166.46	160.79
09/24/91	-	-	-	-	-	-	5.57	FILM	0.00	166.46	160.89
10/23/91	-	-	-	-	-	-	6.53	FILM	0.00	166.46	159.93
11/06/91	-	-	-	-	-	-	5.85	FILM	0.00	166.46	160.61
12/04/91	-	-	-	-	-	-	5.91	FILM	0.00	166.46	160.55
01/29/92	-	-	-	-	-	-	5.43	FILM	0.00	166.46	161.03
02/26/92	-	-	-	-	-	-	5.54	FILM	0.00	166.46	160.92
03/19/92	ND	ND	ND	ND	ND	-	5.47	NP	0.00	166.46	160.99
04/22/92	-	-	-	-	-	-	5.62	FILM	0.00	166.46	160.84
05/21/92	1,300	19	2.9	0.7	58	-	6.21	NP	0.00	166.46	160.25
06/25/92	-	-	-	-	-	-	6.94	NP	0.00	166.46	159.52
07/30/92	-	-	-	-	-	-	5.90	FILM	0.00	166.46	160.56
08/20/92	-	-	-	-	-	-	7.12	FILM	0.00	166.46	159.34
09/30/92	3,400	57	ND	26	240	-	6.42	NP	0.00	166.46	160.04
12/23/92	-	-	-	-	-	-	5.56	FILM	0.00	166.46	160.90
03/10/93	-	-	-	-	-	-	5.65	FILM	0.00	166.46	160.81
06/09/93	400	<0.5	1.1	<1.0	<1.0	-	5.30	NP	0.00	166.46	161.16
09/14/93	180	3.7	3.2	1.5	14	-	5.43	NP	0.00	166.46	161.03
12/14/93	<50	<0.3	<0.3	<0.3	<0.5	-	4.65	NP	0.00	166.46	161.81
03/02/94	<50	<0.3	<0.3	<0.3	<0.5	-	5.43	NP	0.00	166.46	161.03
06/06/94	330	1.3	<0.3	0.88	9.8	-	4.70	NP	0.00	166.46	161.76
09/06/94	1,100	67	<0.3	<0.3	24	-	6.48	NP	0.00	166.46	159.98
12/07/94	<50	<0.3	<0.3	<0.5	<0.5	-	5.22	NP	0.00	166.46	161.24
03/08/95	<100	<0.5	<0.5	<0.5	<1	-	6.94	NP	0.00	166.46	159.52
06/15/95	260	0.8	0.6	<0.5	3.2	-	5.72	NP	0.00	166.46	160.74

**TABLE 1  
GROUNDWATER DATA  
THRIFTY OIL STATION #054, CASTRO VALLEY, CA.**

DATE SAMPLED	ANALYTICAL PARAMETERS						DEPTH TO GROUNDWATER (feet)	DEPTH TO PRODUCT (feet)	PRODUCT THICKNESS (feet)	CASING ELEVATION (feet)	GROUNDWATER ELEVATION (feet)
	TPH (ug/L)	BENZENE (ug/L)	TOLUENE (ug/L)	EthylBenzene (ug/L)	XYLENE (ug/L)	MTBE (ug/L)					
09/05/95	330	2.1	<0.5	2.1	9.6	-	5.96	NP	0.00	166.46	160.50
11/21/95	660	13	1.3	<0.3	4.0	-	6.04	NP	0.00	166.46	160.42
03/11/96	660	0.94	0.77	<0.3	8.1	-	3.60	NP	0.00	166.46	162.86
06/19/96	120	0.53	<0.3	<0.3	2.3	-	4.80	NP	0.00	166.46	161.66
09/16/96	<50	<0.3	<0.3	<0.3	<0.5	<20	5.10	NP	0.00	166.46	161.36
12/10/96	<50	<0.3	<0.3	<0.3	<0.5	<20	4.92	NP	0.00	166.46	161.54
03/12/97	<50	<0.3	<0.3	<0.3	<0.5	<20	4.50	NP	0.00	166.46	161.96
06/12/97	<50	<0.3	<0.3	<0.3	<0.5	<20	-	-	-	-	-
09/16/97	690	0.97	<0.3	<0.3	<0.5	<20	4.55	NP	0.00	166.46	161.91
12/09/97	640	150	0.64	<0.3	5.2	1,300	5.60	NP	0.00	166.46	160.86
03/03/98	<50	<0.3	0.57	<0.3	<0.5	<20	4.13	NP	0.00	166.46	162.33
07/08/98	<50	<0.3	<0.3	<0.3	<0.5	<5	-	-	-	-	-
09/10/98	<50	<0.3	<0.3	<0.3	<0.5	<5	6.35	NP	0.00	166.46	160.11
12/30/98	<50	1.1	<0.3	<0.3	<0.5	<5	6.40	NP	0.00	166.46	160.06
03/15/99	<50	<0.3	<0.3	<0.3	<0.5	<5	6.35	NP	0.00	166.46	160.11
06/22/99	<50	<0.3	<0.3	<0.3	<0.5	53	4.95	NP	0.00	166.46	161.51
09/08/99	<50	<0.3	<0.3	<0.3	<0.5	<5	4.80	NP	0.00	166.46	161.66
12/01/99	<50	<0.3	<0.3	<0.3	<0.5	<5	3.64	NP	0.00	166.46	162.82
03/23/00	<50	0.5	0.5	1.1	<0.5	<5	4.03	NP	0.00	166.46	162.43
06/08/00	<50	<5	<5	<5	<5	<5	4.40	NP	0.00	166.46	162.06
09/27/00	<50	<0.18	<0.14	<0.18	<0.26	<0.24	4.73	NP	0.00	166.46	161.73
12/13/00	<50	<0.18	<0.14	<0.18	<0.26	<0.24	4.01	NP	0.00	166.46	162.45
03/22/01	600	<0.18	1.3	<0.18	<0.26	*1,010 / 1,970	6.32	NP	0.00	166.46	160.14
06/15/01	<50	<0.18	<0.14	<0.18	<0.26	<0.24	6.32	NP	0.00	166.46	160.14
08/30/01	<50	<0.18	<0.14	<0.18	<0.26	<0.24	6.32	NP	0.00	166.46	160.14
12/12/01	<50	<0.18	<0.14	<0.18	<0.26	<0.24	6.02	NP	0.00	166.46	160.44
03/13/02	<50	<0.18	<0.14	<0.18	<0.26	<0.24	6.30	NP	0.00	166.46	160.16
06/12/02	1,320	1	1	<0.18	2	2,060	6.30	NP	0.00	166.46	160.16
09/18/02	<50	<0.18	<0.14	<0.18	<0.26	<0.24	7.06	NP	0.00	166.46	159.40
12/18/02	113	<0.18	1.1	<0.18	<0.26	89	6.30	NP	0.00	166.46	160.16
03/19/03	<15	<0.04	2.2	<0.02	2.7	<0.03	6.35	NP	0.00	166.46	160.11
06/11/03	<15	<0.04	<0.02	<0.02	<0.06	<0.03	6.35	NP	0.00	166.46	160.11
09/04/03	<15	<0.22	<0.32	<0.31	<0.4	<0.18	5.90	NP	0.00	166.46	160.56

**TABLE 1  
GROUNDWATER DATA  
THRIFTY OIL STATION #054, CASTRO VALLEY, CA.**

DATE SAMPLED	ANALYTICAL PARAMETERS						DEPTH TO GROUNDWATER (feet)	DEPTH TO PRODUCT (feet)	PRODUCT THICKNESS (feet)	CASING ELEVATION (feet)	GROUNDWATER ELEVATION (feet)
	TPIH (ug/L)	BENZENE (ug/L)	TOLUENE (ug/L)	EthylBenzene (ug/L)	XYLENE (ug/L)	MTBE (ug/L)					
<b>MONITORING WELL PW-2</b>											
<i>Screen Interval = 5 to 15 feet (Est.)</i>											
04/11/88	-	-	-	-	-	-	-	-	-	-	-
04/09/90	600,000	1,300	11,000	4,600	4,300	-	5.81	NP	0.00	166.18	160.37
10/30/90	48,000	310	51	10	480	-	6.95	NP	0.00	166.18	159.23
01/18/91	86,000	230	1,400	350	8,300	-	6.92	NP	0.00	166.18	159.26
02/12/91	160,000	680	1,300	250	7,000	-	6.78	NP	0.00	166.18	159.40
03/20/91	17,000	34	50	ND	1,100	-	5.54	NP	0.00	166.18	160.64
05/22/91	14,000	57	2,100	500	8,200	-	6.07	NP	0.00	166.18	160.11
06/19/91	-	-	-	-	-	-	6.37	FILM	0.00	166.18	159.81
07/17/91	-	-	-	-	-	-	6.38	FILM	0.00	166.18	159.80
08/07/91	-	-	-	-	-	-	6.63	FILM	0.00	166.18	159.55
09/24/91	-	-	-	-	-	-	6.42	FILM	0.00	166.18	159.76
10/23/91	-	-	-	-	-	-	7.25	FILM	0.00	166.18	158.93
11/06/91	-	-	-	-	-	-	6.44	FILM	0.00	166.18	159.74
12/04/91	-	-	-	-	-	-	6.65	FILM	0.00	166.18	159.53
01/29/92	-	-	-	-	-	-	6.17	FILM	0.00	166.18	160.01
02/26/92	-	-	-	-	-	-	5.90	FILM	0.00	166.18	160.28
03/19/92	-	-	-	-	-	-	5.80	FILM	0.00	166.18	160.38
04/22/92	-	-	-	-	-	-	5.88	FILM	0.00	166.18	160.30
05/21/92	-	-	-	-	-	-	6.03	FILM	0.00	166.18	160.15
06/25/92	-	-	-	-	-	-	6.57	FILM	0.00	166.18	159.61
07/30/92	-	-	-	-	-	-	6.20	FILM	0.00	166.18	159.98
08/20/92	-	-	-	-	-	-	6.64	FILM	0.00	166.18	159.54
09/30/92	-	-	-	-	-	-	6.88	FILM	0.00	166.18	159.30
12/23/92	-	-	-	-	-	-	6.08	FILM	0.00	166.18	160.10
03/10/93	-	-	-	-	-	-	5.95	FILM	0.00	166.18	160.23
06/09/93	3,400	24	22	<0.5	240	-	5.38	NP	0.00	166.18	160.80
09/14/93	4,900	190	15	6.8	480	-	6.26	NP	0.00	166.18	159.92
12/14/93	1,700	4.2	<0.3	<0.3	<0.5	-	5.22	NP	0.00	166.18	160.96
03/02/94	-	-	-	-	-	-	5.75	FILM	0.00	166.18	160.43
06/06/94	980	25	1.2	<0.3	42	-	5.25	NP	0.00	166.18	160.93
09/06/94	3,200	95	3.0	<1.7	76	-	6.80	NP	0.00	166.18	159.38
12/07/94	510	1.8	<0.3	<0.5	1.7	-	5.57	NP	0.00	166.18	160.61
03/08/95	1,900	<0.5	<0.5	1.4	35	-	4.10	NP	0.00	166.18	162.08
06/15/95	1,700	5.6	<0.5	<0.5	1.6	-	5.44	NP	0.00	166.18	160.74

**TABLE 1**  
**GROUNDWATER DATA**  
**THRIFTY OIL STATION #054, CASTRO VALLEY, CA.**

DATE SAMPLED	ANALYTICAL PARAMETERS						DEPTH TO GROUNDWATER (feet)	DEPTH TO PRODUCT (feet)	PRODUCT THICKNESS (feet)	CASING ELEVATION (feet)	GROUNDWATER ELEVATION (feet)
	TPH (ug/L)	BENZENE (ug/L)	TOLUENE (ug/L)	EthylBenzene (ug/L)	XYLENE (ug/L)	MTBE (ug/L)					
09/05/95	2,500	33	1.0	0.86	18	-	6.13	NP	0.00	166.18	160.05
11/21/95	2,800	130	59	18	190	-	6.23	NP	0.00	166.18	159.95
03/11/96	13,000	330	460	<15	3,800	-	4.48	NP	0.00	166.18	161.70
06/19/96	1,400	<0.3	<0.3	<0.3	<0.5	-	5.38	NP	0.00	166.18	160.80
09/16/96	3,500	<0.3	<0.3	<0.3	<0.5	5,900	5.21	NP	0.00	166.18	160.97
12/10/96	2,100	<0.3	<0.3	<0.3	<0.5	4,700	4.87	NP	0.00	166.18	161.31
03/12/97	600	1.6	<0.3	<0.3	5.8	1,100	4.43	NP	0.00	166.18	161.75
06/12/97	270	<0.3	<0.3	<0.3	<0.5	630	-	-	-	-	-
09/10/97	220	<0.3	<0.3	<0.3	<0.5	320	4.07	NP	0.00	166.18	162.11
12/09/97	120	<0.3	0.73	<0.3	<0.5	420	5.20	NP	0.00	166.18	160.98
03/03/98	<50	0.43	0.48	<0.3	<0.5	47	3.30	NP	0.00	166.18	162.88
07/08/98	<50	<0.3	<0.3	<0.3	<0.5	<5	-	-	-	-	-
09/10/98	<50	<0.3	<0.3	<0.3	<0.5	<5	5.15	NP	0.00	166.18	161.03
12/30/98	<50	1.1	<0.3	<0.3	<0.5	<5	4.75	NP	0.00	166.18	161.43
03/15/99	<50	<0.3	<0.3	<0.3	<0.5	<5	4.40	NP	0.00	166.18	161.78
06/22/99	-	-	-	-	-	-	4.50	NP	0.00	166.18	161.68
09/08/99	100	<0.3	<0.3	<0.3	<0.5	230	3.99	NP	0.00	166.18	162.19
12/01/99	<50	<0.3	<0.3	<0.3	<0.5	<5	3.62	NP	0.00	166.18	162.56
03/23/00	<50	<0.25	<0.25	<0.25	<0.5	<5	2.93	NP	0.00	166.18	163.25
06/08/00	<50	<5	<5	<5	<5	<5	3.60	NP	0.00	166.18	162.58
09/27/00	<50	<0.18	<0.14	<0.18	<0.26	<0.24	3.61	NP	0.00	166.18	162.57
12/13/00	<50	<0.18	<0.14	<0.18	<0.26	<0.24	3.60	NP	0.00	166.18	162.58
03/22/01	<50	<0.18	<0.14	<0.18	<0.26	<0.24	5.14	NP	0.00	166.18	161.04
06/15/01	<50	<0.18	<0.14	<0.18	<0.26	<0.24	5.13	NP	0.00	166.18	161.05
08/30/01	<50	<0.18	<0.14	<0.18	<0.26	<0.24	5.90	NP	0.00	166.18	160.28
12/12/01	<50	<0.18	<0.14	<0.18	<0.26	<0.24	6.20	NP	0.00	166.18	159.98
03/13/02	-	-	-	-	-	-	5.14	NP	0.00	166.18	161.04
06/12/02	-	-	-	-	-	-	-	-	-	-	-
09/18/02	-	-	-	-	-	-	-	-	-	-	-
12/18/02	-	-	-	-	-	-	-	-	-	-	-
03/19/03	-	-	-	-	-	-	-	-	-	-	-
06/11/03	-	-	-	-	-	-	-	-	-	-	-
09/04/03	-	-	-	-	-	-	-	-	-	-	-

**TABLE 1  
GROUNDWATER DATA  
THRIFTY OIL STATION #054, CASTRO VALLEY, CA.**

DATE SAMPLED	ANALYTICAL PARAMETERS						DEPTH TO GROUNDWATER (feet)	DEPTH TO PRODUCT (feet)	PRODUCT THICKNESS (feet)	CASING ELEVATION (feet)	GROUNDWATER ELEVATION (feet)
	TPH (ug/L)	BENZENE (ug/L)	TOLUENE (ug/L)	EthylBenzene (ug/L)	XYLENE (ug/L)	MTBE (ug/L)					
<b>MONITORING WELL #RE-1</b>											
<i>Screen Interval = 5 to 17 feet</i>											
04/11/88	37,000	1,900	8,400	1,200	15,000	-	-	-	-	-	-
04/09/90	45,000	6,100	7,000	2,000	8,800	-	4.99	NP	0.00	166.82	161.83
10/30/90	72,000	7,700	5,300	1,800	8,900	-	5.95	NP	0.00	166.82	160.87
01/18/91	150,000	11,000	14,000	1,800	4,300	-	5.17	NP	0.00	166.82	161.65
02/12/91	140,000	11,000	12,000	1,600	13,000	-	4.16	NP	0.00	166.82	162.66
03/20/91	53,000	3,100	4,200	400	5,500	-	4.75	NP	0.00	166.82	162.07
05/22/91	85,000	8,700	10,000	1,800	12,000	-	4.42	NP	0.00	166.82	162.40
06/19/91	110,000	8,500	9,600	2,600	16,000	-	4.93	NP	0.00	166.82	161.89
07/17/91	5,500	950	ND	26	ND	-	5.19	NP	0.00	166.82	161.63
08/07/91	-	6,700	5,000	ND	7,100	-	5.12	NP	0.00	166.82	161.70
09/24/91	60,000	6,800	4,300	640	6,900	-	5.87	NP	0.00	166.82	160.95
10/23/91	79,000	7,900	8,300	450	7,100	-	5.81	NP	0.00	166.82	161.01
11/06/91	130,000	14,000	15,000	1,100	8,800	-	5.56	NP	0.00	166.82	161.26
12/04/91	50,000	8,000	4,700	520	4,100	-	5.35	NP	0.00	166.82	161.47
01/29/92	21,000	10,300	11,000	780	6,000	-	4.50	NP	0.00	166.82	162.32
02/26/92	38,000	8,400	10,500	720	7,100	-	5.27	NP	0.00	166.82	161.55
03/19/92	48,000	6,200	9,700	780	7,200	-	4.47	NP	0.00	166.82	162.35
04/22/92	-	-	-	-	-	-	4.62	NP	0.00	166.82	162.20
05/21/92	20,000	7,600	10,100	830	6,900	-	4.98	NP	0.00	166.82	161.84
06/25/92	-	-	-	-	-	-	5.14	FILM	0.00	166.82	161.68
07/30/92	-	-	-	-	-	-	5.30	FILM	0.00	166.82	161.52
08/20/92	-	-	-	-	-	-	5.28	FILM	0.00	166.82	161.54
09/30/92	-	-	-	-	-	-	5.66	FILM	0.00	166.82	161.16
12/23/92	-	-	-	-	-	-	4.81	FILM	0.00	166.82	162.01
03/10/93	-	-	-	-	-	-	4.13	FILM	0.00	166.82	162.69
06/09/93	-	-	-	-	-	-	4.48	FILM	0.00	166.82	162.34
09/14/93	19,000	3,600	1,100	740	4,300	-	5.35	NP	0.00	166.82	161.47
12/14/93	38,000	4,300	1,300	<6.6	11	-	4.38	NP	0.00	166.82	162.44
03/02/94	-	-	-	-	-	-	4.22	FILM	0.00	166.82	162.60
06/06/94	-	-	-	-	-	-	2.16	FILM	0.00	166.82	164.66
09/06/94	74,000	3,300	3,900	1,200	6,100	-	5.00	NP	0.00	166.82	161.82
12/07/94	30,000	3,200	2,900	1,200	4,600	-	4.10	NP	0.00	166.82	162.72
03/08/95	28,000	4,200	2,300	810	7,800	-	3.92	NP	0.00	166.82	162.90
06/15/95	-	-	-	-	-	-	-	-	-	-	-



**TABLE 1  
GROUNDWATER DATA  
THRIFTY OIL STATION #054, CASTRO VALLEY, CA.**

DATE SAMPLED	ANALYTICAL PARAMETERS						DEPTH TO GROUNDWATER (feet)	DEPTH TO PRODUCT (feet)	PRODUCT THICKNESS (feet)	CASING ELEVATION (feet)	GROUNDWATER ELEVATION (feet)
	TPH (ug/L)	BENZENE (ug/L)	TOLUENE (ug/L)	EthylBenzene (ug/L)	XYLENE (ug/L)	MTBE (ug/L)					
09/05/95	-	-	-	-	-	-	4.78	FILM	0.00	166.82	162.04
11/21/95	-	-	-	-	-	-	4.82	NP	0.00	166.82	162.00
03/11/96	270	2.4	6.0	4.5	19	-	3.32	NP	0.00	166.82	163.50
06/19/96	3,000	570	63	<1.5	400	-	4.20	NP	0.00	166.82	162.62
09/16/96	7,700	440	69	<1.5	680	230	4.68	NP	0.00	166.82	162.14
12/10/96	52	<0.3	<0.3	<0.3	<0.5	120	4.93	NP	0.00	166.82	161.89
03/12/97	8,700	180	5.4	40	1,100	130	4.10	NP	0.00	166.82	162.72
06/12/97	<50	<0.3	<0.3	<0.3	<0.5	36	-	-	-	-	-
09/16/97	<50	<0.3	<0.3	<0.3	<0.5	<20	4.55	NP	0.00	166.82	162.27
12/09/97	<50	<0.3	0.44	<0.3	<0.5	<20	5.30	NP	0.00	166.82	161.52
03/03/98	1,100	13	0.51	<0.3	<0.5	220	4.55	NP	0.00	166.82	162.27
07/08/98	<50	<0.3	<0.3	<0.3	<0.5	<5	-	-	-	-	-
09/10/98	60	<0.3	<0.3	<0.3	<0.5	180	6.05	NP	0.00	166.82	160.77
12/30/98	<50	1.1	<0.3	<0.3	<0.5	<5	5.65	NP	0.00	166.82	161.17
03/15/99	<50	<0.3	<0.3	<0.3	<0.5	<5	5.68	NP	0.00	166.82	161.14
06/22/99	880	14	0.98	<0.3	8.1	260	4.95	NP	0.00	166.82	161.87
09/08/99	72	<0.3	<0.3	<0.3	<0.5	120	4.46	NP	0.00	166.82	162.36
12/01/99	<50	<0.3	<0.3	<0.3	<0.5	<5	4.08	NP	0.00	166.82	162.74
03/23/00	<50	<0.25	<0.25	<0.25	<0.5	<5	3.68	NP	0.00	166.82	163.14
06/08/00	<50	<5	<5	<5	<5	<5	4.07	NP	0.00	166.82	162.75
09/27/00	<50	<0.18	<0.14	<0.18	<0.26	<0.24	4.07	NP	0.00	166.82	162.75
12/13/00	<50	<0.18	<0.14	<0.18	<0.26	<0.24	4.06	NP	0.00	166.82	162.76
03/22/01	<50	<0.18	<0.14	<0.18	<0.26	<0.24	5.22	NP	0.00	166.82	161.60
06/15/01	<50	<0.18	<0.14	<0.18	<0.26	<0.24	5.99	NP	0.00	166.82	160.83
08/30/01	<50	<0.18	<0.14	<0.18	<0.26	<0.24	4.84	NP	0.00	166.82	161.98
12/12/01	<50	<0.18	<0.14	<0.18	<0.26	<0.24	4.80	NP	0.00	166.82	162.02
03/13/02	-	-	-	-	-	-	5.18	NP	0.00	166.82	161.64
06/12/02	-	-	-	-	-	-	-	-	-	-	-
09/18/02	-	-	-	-	-	-	-	-	-	-	-
12/18/02	-	-	-	-	-	-	-	-	-	-	-
03/19/03	-	-	-	-	-	-	-	-	-	-	-
06/11/03	-	-	-	-	-	-	-	-	-	-	-
09/04/03	-	-	-	-	-	-	-	-	-	-	-

**TABLE 1  
GROUNDWATER DATA  
THRIFTY OIL STATION #054, CASTRO VALLEY, CA.**

DATE SAMPLED	ANALYTICAL PARAMETERS						DEPTH TO GROUNDWATER (feet)	DEPTH TO PRODUCT (feet)	PRODUCT THICKNESS (feet)	CASING ELEVATION (feet)	GROUNDWATER ELEVATION (feet)
	TPH (ug/L)	BENZENE (ug/L)	TOLUENE (ug/L)	EthylBenzene (ug/L)	XYLENE (ug/L)	MIBE (ug/L)					
<b>MONITORING WELL #RE-2</b>											
<i>Screen Interval = 5 to 17 feet</i>											
04/11/88	-	-	-	-	-	-	-	-	-	-	-
04/09/90	850	5.8	0.5	4.8	1.1	-	4.90	NP	0.00	167.19	162.29
10/30/90	440	2.8	0.91	13	3.14	-	5.34	NP	0.00	167.19	161.85
01/18/91	1,100	8.4	3.1	ND	10	-	4.90	NP	0.00	167.19	162.29
02/12/91	1,100	5.9	ND	1.77	ND	-	4.94	NP	0.00	167.19	162.25
03/20/91	550	4.3	ND	ND	ND	-	4.32	NP	0.00	167.19	162.87
05/22/91	1,000	5.3	3.6	4.4	8.9	-	4.43	NP	0.00	167.19	162.76
06/19/91	700	2.1	1.4	3.8	3.5	-	6.43	NP	0.00	167.19	160.76
07/17/91	880	12	8.0	4.3	28	-	4.75	NP	0.00	167.19	162.44
08/07/91	-	3.8	1.6	ND	ND	-	4.87	NP	0.00	167.19	162.32
09/24/91	670	7.2	7.1	ND	23	-	5.50	NP	0.00	167.19	161.69
10/23/91	2,700	52	60	22	130	-	5.63	NP	0.00	167.19	161.56
11/06/91	1,900	18	61	9.1	83	-	5.14	NP	0.00	167.19	162.05
12/04/91	1,100	26	47	4.3	42	-	5.26	NP	0.00	167.19	161.93
01/29/92	900	14	24	5.3	19	-	5.11	NP	0.00	167.19	162.08
02/26/92	500	3.4	3.5	2.7	2.7	-	4.31	NP	0.00	167.19	162.88
03/19/92	1,200	14	20	15	18	-	4.45	NP	0.00	167.19	162.74
04/22/92	200	ND	ND	ND	ND	-	4.78	NP	0.00	167.19	162.41
05/21/92	500	7.5	6.8	3.9	7.4	-	5.02	NP	0.00	167.19	162.17
06/25/92	ND	ND	0.9	0.7	ND	-	5.13	NP	0.00	167.19	162.06
07/30/92	500	7.7	8.6	3.2	1.7	-	5.19	NP	0.00	167.19	162.00
08/20/92	1,100	6.6	4.5	2.7	2.0	-	5.27	NP	0.00	167.19	161.92
09/30/92	500	5.4	2.4	1.8	4.5	-	5.45	NP	0.00	167.19	161.74
12/23/92	800	1.9	ND	ND	2.3	-	4.60	NP	0.00	167.19	162.59
03/10/93	1,200	ND	1.4	ND	2.1	-	4.18	NP	0.00	167.19	163.01
06/09/93	200	ND	ND	ND	ND	-	4.53	NP	0.00	167.19	162.66
09/17/93	360	1.6	1.1	3.2	8.9	-	5.26	NP	0.00	167.19	161.93
12/14/93	260	5.6	3.9	<0.3	21.0	-	2.75	NP	0.00	167.19	164.44
03/02/94	410	<0.3	<0.3	<0.3	<0.5	-	4.27	NP	0.00	167.19	162.92
06/06/94	760	4.6	<0.3	0.32	1.3	-	4.88	NP	0.00	167.19	162.31
09/06/94	1,300	43	45	8.9	69	-	5.16	NP	0.00	167.19	162.03
12/07/94	-	-	-	-	-	-	4.16	NP	0.00	167.19	163.03
03/08/95	<100	<0.5	<0.5	<0.5	<1	-	3.96	NP	0.00	167.19	163.23
06/15/95	130	<0.5	<0.5	<0.5	<1	-	4.52	NP	0.00	167.19	162.67

**TABLE 1**  
**GROUNDWATER DATA**  
**THRIFTY OIL STATION #054, CASTRO VALLEY, CA.**

DATE SAMPLED	ANALYTICAL PARAMETERS						DEPTH TO GROUNDWATER (feet)	DEPTH TO PRODUCT (feet)	PRODUCT THICKNESS (feet)	CASING ELEVATION (feet)	GROUNDWATER ELEVATION (feet)
	TPH (ug/L)	BENZENE (ug/L)	TOLUENE (ug/L)	EthylBenzene (ug/L)	XYLENE (ug/L)	MTBE (ug/L)					
09/05/95	210	<0.5	<0.5	<0.5	<1	-	4.76	NP	0.00	167.19	162.43
11/21/95	160	0.65	<0.3	0.35	0.95	-	4.83	NP	0.00	167.19	162.36
03/11/96	<50	<0.3	<0.3	<0.3	<0.5	-	3.36	NP	0.00	167.19	163.83
06/19/96	<50	<0.3	<0.3	<0.3	<0.5	-	4.68	NP	0.00	167.19	162.51
09/16/96	<50	<0.3	<0.3	<0.3	<0.5	<20	5.10	NP	0.00	167.19	162.09
12/10/96	<50	<0.3	<0.3	<0.3	<0.5	<20	4.47	NP	0.00	167.19	162.72
03/12/97	<50	<0.3	<0.3	<0.3	<0.5	<20	4.05	NP	0.00	167.19	163.14
06/12/97	<50	<0.3	<0.3	<0.3	<0.5	<20	-	-	-	-	-
09/10/97	<50	<0.3	<0.3	<0.3	<0.5	<20	4.08	NP	0.00	167.19	163.11
12/09/97	<50	<0.3	<0.3	<0.3	<0.5	<20	4.40	NP	0.00	167.19	162.79
03/03/98	<50	<0.3	<0.3	<0.3	<0.5	<20	3.30	NP	0.00	167.19	163.89
07/08/98	<50	<0.3	<0.3	<0.3	<0.5	15	-	-	-	-	-
09/10/98	<50	<0.3	<0.3	<0.3	<0.5	<5	4.93	NP	0.00	167.19	162.26
12/30/98	460	0.92	<0.3	<0.3	<0.5	1,400	4.20	NP	0.00	167.19	162.99
03/15/99	<50	<0.3	<0.3	<0.3	<0.5	<5	4.20	NP	0.00	167.19	162.99
06/22/99	2,900	7.4	<0.3	0.43	4.1	4,500	3.70	NP	0.00	167.19	163.49
09/08/99	1,400	<3	<3	<3	<5	3,200	3.96	NP	0.00	167.19	163.23
12/01/99	<50	<0.3	<0.3	<0.3	<0.5	<5	3.58	NP	0.00	167.19	163.61
03/23/00	<50	<0.25	<0.25	<0.25	<0.5	<5	3.19	NP	0.00	167.19	164.00
06/08/00	<50	<5	<5	<5	<5	<5	3.18	NP	0.00	167.19	164.01
09/27/00	<50	<0.18	<0.14	<0.18	<0.26	<0.24	3.58	NP	0.00	167.19	163.61
12/13/00	<50	<0.18	<0.14	<0.18	<0.26	<0.24	3.58	NP	0.00	167.19	163.61
03/22/01	575	<0.18	1.3	<0.18	<0.26	*950 / 2,070	4.33	NP	0.00	167.19	162.86
06/15/01	<50	<0.18	<0.14	<0.18	<0.26	<0.24	5.10	NP	0.00	167.19	162.09
08/30/01	<50	<0.18	<0.14	<0.18	<0.26	<0.24	5.86	NP	0.00	167.19	161.33
12/12/01	<50	<0.18	<0.14	<0.18	<0.26	<0.24	4.81	NP	0.00	167.19	162.38
03/13/02	-	-	-	-	-	-	4.33	NP	0.00	167.19	162.86
06/12/02	<50	<0.18	<0.14	<0.18	<0.26	<0.24	5.86	NP	0.00	167.19	161.33
09/18/02	<50	<0.18	<0.14	<0.18	<0.26	<0.24	5.86	NP	0.00	167.19	161.33
12/18/02	<50	<0.18	<0.14	<0.18	<0.26	<0.24	5.48	NP	0.00	167.19	161.71
03/19/03	<15	<0.04	<0.02	<0.02	<0.06	<0.03	5.86	NP	0.00	167.19	161.33
06/11/03	<15	<0.04	<0.02	<0.02	<0.06	<0.03	5.86	NP	0.00	167.19	161.33
09/04/03	<15	<0.22	<0.32	<0.31	<0.4	<0.18	5.48	NP	0.00	167.19	161.71

**TABLE 1**  
**GROUNDWATER DATA**  
**THRIFTY OIL STATION #054, CASTRO VALLEY, CA.**

DATE SAMPLED	ANALYTICAL PARAMETERS						DEPTH TO GROUNDWATER (feet)	DEPTH TO PRODUCT (feet)	PRODUCT THICKNESS (feet)	CASING ELEVATION (feet)	GROUNDWATER ELEVATION (feet)
	TPH (ug/L)	BENZENE (ug/L)	TOLUENE (ug/L)	EthylBenzene (ug/L)	XYLENE (ug/L)	MTBE (ug/L)					
<b>MONITORING WELL #RE-3</b>											
<i>Screen Interval = 5 to 13 feet</i>											
04/11/88	70,000	6,600	5,300	800	13,000	-	-	-	-	-	-
04/09/90	370,000	2,300	4,900	3,200	31,000	-	7.15	NP	0.00	167.39	160.24
10/30/90	13,000	860	660	220	2,210	-	7.84	NP	0.00	167.39	159.55
01/18/91	42,000	4,700	4,500	21	7,700	-	6.90	NP	0.00	167.39	160.49
02/12/91	72,000	3,600	4,500	ND	7,600	-	6.62	NP	0.00	167.39	160.77
03/20/91	65,000	2,400	9,400	50	9,800	-	5.87	NP	0.00	167.39	161.52
05/22/91	-	-	-	-	-	-	5.98	FILM	0.00	167.39	161.41
06/19/91	-	-	-	-	-	-	6.84	FILM	0.00	167.39	160.55
07/17/91	-	-	-	-	-	-	7.10	FILM	0.00	167.39	160.29
08/07/91	-	-	-	-	-	-	7.30	FILM	0.00	167.39	160.09
09/24/91	-	-	-	-	-	-	7.84	FILM	0.00	167.39	159.55
10/23/91	-	-	-	-	-	-	8.07	FILM	0.00	167.39	159.32
11/06/91	-	-	-	-	-	-	7.63	FILM	0.00	167.39	159.76
12/04/91	-	-	-	-	-	-	7.83	FILM	0.00	167.39	159.56
01/29/92	-	-	-	-	-	-	7.17	FILM	0.00	167.39	160.22
02/26/92	-	-	-	-	-	-	5.56	FILM	0.00	167.39	161.83
03/19/92	-	-	-	-	-	-	5.44	FILM	0.00	167.39	161.95
04/22/92	-	-	-	-	-	-	6.56	FILM	0.00	167.39	160.83
05/21/92	-	-	-	-	-	-	6.90	FILM	0.00	167.39	160.49
06/25/92	-	-	-	-	-	-	7.18	FILM	0.00	167.39	160.21
07/30/92	-	-	-	-	-	-	6.80	FILM	0.00	167.39	160.59
08/20/92	-	-	-	-	-	-	7.25	FILM	0.00	167.39	160.14
09/30/92	-	-	-	-	-	-	7.68	FILM	0.00	167.39	159.71
12/23/92	-	-	-	-	-	-	6.07	FILM	0.00	167.39	161.32
03/10/93	-	-	-	-	-	-	5.66	FILM	0.00	167.39	161.73
06/09/93	-	-	-	-	-	-	6.66	FILM	0.00	167.39	160.73
09/14/93	40,000	2,900	1,500	180	6,900	-	7.30	NP	0.00	167.39	160.09
12/14/93	-	-	-	-	-	-	5.95	NP	0.00	167.39	161.44
03/02/94	-	-	-	-	-	-	5.08	NP	0.00	167.39	162.31
06/06/94	-	-	-	-	-	-	6.35	FILM	0.00	167.39	161.04
09/06/94	11,000	260	26	<6.6	1,000	-	7.50	NP	0.00	167.39	159.89
12/07/94	-	-	-	-	-	-	5.48	FILM	0.00	167.39	161.91
03/08/95	-	-	-	-	-	-	5.18	FILM	0.00	167.39	162.21
06/15/95	-	-	-	-	-	-	-	-	-	-	-

**TABLE 1**  
**GROUNDWATER DATA**  
**THRIFTY OIL STATION #054, CASTRO VALLEY, CA.**

DATE SAMPLED	ANALYTICAL PARAMETERS						DEPTH TO GROUNDWATER (feet)	DEPTH TO PRODUCT (feet)	PRODUCT THICKNESS (feet)	CASING ELEVATION (feet)	GROUNDWATER ELEVATION (feet)
	TPH (ug/L)	BENZENE (ug/L)	TOLUENE (ug/L)	EthylBenzene (ug/L)	XYLENE (ug/L)	MTBE (ug/L)					
09/05/95	-	-	-	-	-	-	6.84	FILM	0.00	167.39	160.55
11/21/95	10,000	210	<3	4.5	330	-	7.38	NP	0.00	167.39	160.01
03/11/96	1,600	640	15	10	46	-	4.85	NP	0.00	167.39	162.54
06/19/96	2,100	280	<3	<3	120	-	5.80	NP	0.00	167.39	161.59
09/16/96	140	<0.3	<0.3	<0.3	<0.5	110	4.50	NP	0.00	167.39	162.89
12/10/96	<50	<0.3	<0.3	<0.3	<0.5	<20	5.35	NP	0.00	167.39	162.04
03/12/97	<50	<0.3	<0.3	<0.3	<0.5	<20	3.48	NP	0.00	167.39	163.91
06/12/97	<50	<0.3	<0.3	<0.3	0.58	<20	-	-	-	-	-
09/10/97	<50	<0.3	<0.3	<0.3	<0.5	<20	3.10	NP	0.00	167.39	164.29
12/09/97	3,600	1,000	1,000	<6	570	260	4.55	NP	0.00	167.39	162.84
03/03/98	2,800	20	0.65	0.39	16	5,600	2.30	NP	0.00	167.39	165.09
07/08/98	<50	<0.3	<0.3	<0.3	<0.5	<5	-	-	-	-	-
09/10/98	<50	<0.3	<0.3	<0.3	<0.5	23	4.95	NP	0.00	167.39	162.44
12/30/98	<50	1.1	<0.3	<0.3	<0.5	<5	4.55	NP	0.00	167.39	162.84
03/15/99	<50	<0.3	<0.3	<0.3	<0.5	<5	4.15	NP	0.00	167.39	163.24
06/22/99	670	17	1.2	0.36	1.7	340	3.85	NP	0.00	167.39	163.54
09/08/99	140	0.72	<0.3	<0.3	<0.5	230	2.63	NP	0.00	167.39	164.76
12/01/99	95	<0.3	<0.3	<0.3	<0.5	200	2.63	NP	0.00	167.39	164.76
03/23/00	315	<0.25	<0.25	<0.25	<0.5	*293/422	2.25	NP	0.00	167.39	165.14
06/08/00	<100	<5	<5	<5	<5	201	3.02	NP	0.00	167.39	164.37
09/27/00	154	<0.18	<0.14	<0.18	<0.26	*254 / 160	3.01	NP	0.00	167.39	164.38
12/13/00	<50	<0.18	<0.14	<0.18	<0.26	*124 / 111	3.02	NP	0.00	167.39	164.37
03/22/01	<50	<0.18	<0.14	<0.18	<0.26	*90 / 57	4.54	NP	0.00	167.39	162.85
06/15/01	649	28	2.4	3.1	9	*1,790 / 2,560	4.92	NP	0.00	167.39	162.47
08/30/01	<50	<0.18	<0.14	<0.18	<0.26	<0.24	7.80	NP	0.00	167.39	159.59
12/12/01	<50	<0.18	<0.14	<0.18	<0.26	<0.24	7.35	NP	0.00	167.39	160.04
03/13/02	<50	<0.18	<0.14	<0.18	<0.26	<0.24	4.53	NP	0.00	167.39	162.86
06/12/02	969	<0.18	1.0	<0.18	<0.26	1,430	4.90	NP	0.00	167.39	162.49
09/18/02	<50	<0.18	<0.14	<0.18	<0.26	<0.24	5.28	NP	0.00	167.39	162.11
12/18/02	<50	<0.18	<0.14	<0.18	<0.26	<0.24	4.52	NP	0.00	167.39	162.87
03/19/03	<15	<0.04	<0.02	<0.02	<0.06	<0.03	5.67	NP	0.00	167.39	161.72
06/11/03	<15	<0.04	<0.02	<0.02	<0.06	<0.03	5.67	NP	0.00	167.39	161.72
09/04/03	<15	<0.22	<0.32	<0.31	<0.4	<0.18	5.26	NP	0.00	167.39	162.13

**TABLE 1  
GROUNDWATER DATA  
THRIFTY OIL STATION #054, CASTRO VALLEY, CA.**

DATE SAMPLED	ANALYTICAL PARAMETERS						DEPTH TO GROUNDWATER (feet)	DEPTH TO PRODUCT (feet)	PRODUCT THICKNESS (feet)	CASING ELEVATION (feet)	GROUNDWATER ELEVATION (feet)
	TPH (ug/L)	BENZENE (ug/L)	TOLUENE (ug/L)	EthylBenzene (ug/L)	XYLENE (ug/L)	MTBE (ug/L)					
<b>MONITORING WELL #RE-4</b>											
<i>Screen Interval = 5 to 15 feet</i>											
04/11/88	15,000	12,000	8,000	1,000	2,700	-	-	-	-	-	-
04/09/90	-	-	-	-	-	-	-	-	-	-	-
10/30/90	87,000	7,200	10,000	1,600	12,900	-	7.04	NP	0.00	166.94	159.90
01/18/91	70,000	5,000	5,400	790	9,900	-	11.62	NP	0.00	166.94	155.32
02/12/91	87,000	5,200	2,800	240	11,000	-	11.63	NP	0.00	166.94	155.31
03/20/91	6,500	370	230	17	670	-	11.61	NP	0.00	166.94	155.33
05/22/91	-	-	-	-	-	-	10.30	FILM	0.00	166.94	156.64
06/19/91	-	-	-	-	-	-	11.10	FILM	0.00	166.94	155.84
07/17/91	-	-	-	-	-	-	6.20	FILM	0.00	166.94	160.74
08/17/91	-	-	-	-	-	-	8.15	FILM	0.00	166.94	158.79
09/24/91	-	-	-	-	-	-	10.40	FILM	0.00	166.94	156.54
10/23/91	-	-	-	-	-	-	11.20	FILM	0.00	166.94	155.74
11/06/91	-	-	-	-	-	-	6.62	FILM	0.00	166.94	160.32
12/04/91	-	-	-	-	-	-	11.20	FILM	0.00	166.94	155.74
01/29/92	-	-	-	-	-	-	7.72	FILM	0.00	166.94	159.22
02/26/92	-	-	-	-	-	-	5.13	FILM	0.00	166.94	161.81
03/19/92	-	-	-	-	-	-	5.00	FILM	0.00	166.94	161.94
04/22/92	-	-	-	-	-	-	5.94	FILM	0.00	166.94	161.00
05/21/92	-	-	-	-	-	-	5.40	FILM	0.00	166.94	161.54
06/25/92	-	-	-	-	-	-	5.71	FILM	0.00	166.94	161.23
07/30/92	-	-	-	-	-	-	6.33	FILM	0.00	166.94	160.61
08/20/92	-	-	-	-	-	-	5.80	FILM	0.00	166.94	161.14
09/30/92	-	-	-	-	-	-	6.34	FILM	0.00	166.94	160.60
12/23/92	-	-	-	-	-	-	5.50	FILM	0.00	166.94	161.44
03/10/93	-	-	-	-	-	-	4.67	FILM	0.00	166.94	162.27
06/09/93	-	-	-	-	-	-	5.12	FILM	0.00	166.94	161.82
09/14/93	-	-	-	-	-	-	10.44	NP	0.00	166.94	156.50
12/14/93	-	-	-	-	-	-	7.52	NP	0.00	166.94	159.42
03/02/94	-	-	-	-	-	-	4.85	NP	0.00	166.94	162.09
06/06/94	-	-	-	-	-	-	5.20	FILM	0.00	166.94	161.74
09/06/94	-	-	-	-	-	-	9.85	FILM	0.00	166.94	157.09
12/07/94	-	-	-	-	-	-	5.20	FILM	0.00	166.94	161.74
03/08/95	-	-	-	-	-	-	4.98	FILM	0.00	166.94	161.96
06/15/95	-	-	-	-	-	-	-	-	-	-	-

**TABLE 1**  
**GROUNDWATER DATA**  
**THRIFTY OIL STATION #054, CASTRO VALLEY, CA.**

DATE SAMPLED	ANALYTICAL PARAMETERS						DEPTH TO GROUNDWATER (feet)	DEPTH TO PRODUCT (feet)	PRODUCT THICKNESS (feet)	CASING ELEVATION (feet)	GROUNDWATER ELEVATION (feet)
	TPH (ug/L)	BENZENE (ug/L)	TOLUENE (ug/L)	EthylBenzene (ug/L)	XYLENE (ug/L)	MTBE (ug/L)					
09/05/95	-	-	-	-	-	-	13.72	FILM	0.00	166.94	153.22
11/21/95	32,000	46	21	66	340	-	12.53	NP	0.00	166.94	154.41
03/11/96	1,700	130	15	2.0	120	-	4.72	NP	0.00	166.94	162.22
06/19/96	1,700	230	30	0.35	100	-	5.40	NP	0.00	166.94	161.54
09/16/96	510	<0.3	0.73	<0.3	<0.5	800	5.18	NP	0.00	166.94	161.76
12/10/96	520	<0.3	<0.3	<0.3	<0.5	1,000	4.65	NP	0.00	166.94	162.29
03/12/97	420	3.2	<0.3	<0.3	11	370	3.87	NP	0.00	166.94	163.07
06/12/97	510	0.66	<0.3	<0.3	<0.5	1,600	-	-	-	-	-
09/10/97	<50	<0.3	<0.3	<0.3	<0.5	<20	5.40	NP	0.00	166.94	161.54
12/09/97	1,400	330	2.3	<0.3	1.5	2,500	4.60	NP	0.00	166.94	162.34
03/03/98	3,000	400	0.61	0.5	97	3,800	5.05	NP	0.00	166.94	161.89
07/08/98	650	<0.3	<0.3	<0.3	<0.5	1,800	-	-	-	-	-
09/10/98	2,700	<0.3	<0.3	<0.3	1.4	7,600	4.60	NP	0.00	166.94	162.34
12/30/98	530	<0.3	<0.3	<0.3	<0.5	1,500	4.20	NP	0.00	166.94	162.74
03/15/99	<50	<0.3	<0.3	<0.3	<0.5	<5	3.85	NP	0.00	166.94	163.09
06/22/99	1,200	23	1.5	<0.3	2.4	1,400	3.90	NP	0.00	166.94	163.04
09/08/99	590	1.5	<0.6	<0.6	<1	1,100	5.72	NP	0.00	166.94	161.22
12/01/99	540	<0.3	<0.3	<0.3	<0.5	880	5.34	NP	0.00	166.94	161.60
03/23/00	<50	<0.25	<0.25	<0.25	<0.5	<5	5.36	NP	0.00	166.94	161.58
06/08/00	67	<5	<5	<5	<5	<5	5.34	NP	0.00	166.94	161.60
09/27/00	<50	<0.18	<0.14	<0.18	<0.26	<0.24	5.35	NP	0.00	166.94	161.59
12/13/00	<50	<0.18	<0.14	<0.18	<0.26	<0.24	5.71	NP	0.00	166.94	161.23
03/22/01	<50	<0.18	<0.14	<0.18	<0.26	<0.24	4.19	NP	0.00	166.94	162.75
06/15/01	409	18	2	2	5	*1,060 / 1,480	4.57	NP	0.00	166.94	162.37
08/30/01	<50	<0.18	<0.14	<0.18	<0.26	<0.24	6.10	NP	0.00	166.94	160.84
12/12/01	<50	<0.18	<0.14	<0.18	3	*7 / 3.7	4.95	NP	0.00	166.94	161.99
03/13/02	511	3	3	<0.18	2	519	4.17	NP	0.00	166.94	162.77
06/12/02	380	2	2	1	2	479	4.93	NP	0.00	166.94	162.01
09/18/02	<50	<0.18	<0.14	<0.18	<0.26	<0.24	5.32	NP	0.00	166.94	161.62
12/18/02	<50	<0.18	<0.14	<0.18	<0.26	<0.24	4.93	NP	0.00	166.94	162.01
03/19/03	<15	<0.04	<0.02	<0.02	<0.06	<0.03	5.32	NP	0.00	166.94	161.62
06/11/03	<15	<0.04	<0.02	<0.02	<0.06	<0.03	5.32	NP	0.00	166.94	161.62
09/04/03	<15	<0.22	<0.32	<0.31	<0.4	<0.18	4.93	NP	0.00	166.94	162.01

**TABLE 1**  
**GROUNDWATER DATA**  
**THRIFTY OIL STATION #054, CASTRO VALLEY, CA.**

DATE SAMPLED	ANALYTICAL PARAMETERS						DEPTH TO GROUNDWATER (feet)	DEPTH TO PRODUCT (feet)	PRODUCT THICKNESS (feet)	CASING ELEVATION (feet)	GROUNDWATER ELEVATION (feet)
	TPH (ug/L)	BENZENE (ug/L)	TOLUENE (ug/L)	EthylBenzene (ug/L)	XYLENE (ug/L)	MTBE (ug/L)					
<b>MONITORING WELL #RE-5</b>											
<i>Screen Interval = 5 to 20 feet</i>											
04/11/88	14,000	1,300	1,100	100	2,600	-	-	-	-	-	-
04/09/90	3,000	690	190	40	270	-	4.79	NP	0.00	166.51	161.72
10/30/90	3,400	910	48	87	249	-	5.86	NP	0.00	166.51	160.65
01/18/91	1,400	180	8.6	0.52	48	-	4.40	NP	0.00	166.51	162.11
02/12/91	1,000	ND	ND	0.65	ND	-	4.76	NP	0.00	166.51	161.75
03/20/91	3,000	250	53	ND	110	-	5.08	NP	0.00	166.51	161.43
05/22/91	2,500	330	7.8	5.6	200	-	4.52	NP	0.00	166.51	161.99
01/19/91	2,000	59	1.6	5.1	110	-	4.39	NP	0.00	166.51	162.12
07/17/91	-	-	-	-	-	-	5.05	FILM	0.00	166.51	161.46
08/07/91	-	-	-	-	-	-	5.02	FILM	0.00	166.51	161.49
09/24/91	-	-	-	-	-	-	5.86	FILM	0.00	166.51	160.65
10/23/91	-	-	-	-	-	-	5.84	FILM	0.00	166.51	160.67
11/06/91	9,900	2,300	37	260	160	-	5.48	NP	0.00	166.51	161.03
12/04/91	4,500	1,000	27	ND	180	-	5.43	NP	0.00	166.51	161.08
01/29/92	600	6.1	2.3	ND	47	-	5.12	NP	0.00	166.51	161.39
02/26/92	500	5.4	2.7	1.2	14	-	4.93	NP	0.00	166.51	161.58
03/19/92	ND	1.7	1.1	ND	5.5	-	4.45	NP	0.00	166.51	162.06
04/22/92	1,600	240	2.2	ND	160	-	4.63	NP	0.00	166.51	161.88
05/21/92	1,200	410	37	ND	118	-	4.90	NP	0.00	166.51	161.61
06/25/92	ND	1.0	0.8	0.8	0.4	-	5.15	NP	0.00	166.51	161.36
07/30/92	ND	2.0	1.8	1.9	6.4	-	5.30	NP	0.00	166.51	161.21
08/20/92	300	1.7	3.3	0.7	12	-	5.44	NP	0.00	166.51	161.07
09/30/92	1,900	140	ND	19	35	-	5.73	NP	0.00	166.51	160.78
12/23/92	400	8.0	ND	ND	ND	-	4.75	NP	0.00	166.51	161.76
03/10/93	1,100	290	9.7	ND	75	-	4.14	NP	0.00	166.51	162.37
06/09/93	400	1.5	0.5	ND	12	-	5.42	NP	0.00	166.51	161.09
09/14/93	240	6.9	8.8	1.4	67	-	5.53	NP	0.00	166.51	160.98
12/14/93	3,300	510	5.4	4.1	55	-	478	NP	0.00	166.51	-311.49
03/02/94	2,400	270	4.5	<0.3	13	-	4.20	NP	0.00	166.51	162.31
06/06/94	730	<0.3	<0.3	0.70	22	-	5.13	NP	0.00	166.51	161.38
09/06/94	2,400	180	28	2.3	76	-	5.45	NP	0.00	166.51	161.06
12/07/94	540	5.6	<0.3	<0.5	6.9	-	4.13	NP	0.00	166.51	162.38
03/08/95	1,500	220	5.5	<0.5	83	-	5.20	NP	0.00	166.51	161.31
06/15/95	3,200	820	53	6.2	74	-	4.93	NP	0.00	166.51	161.58



**TABLE 1  
GROUNDWATER DATA  
THRIFTY OIL STATION #054, CASTRO VALLEY, CA.**

DATE SAMPLED	ANALYTICAL PARAMETERS						DEPTH TO GROUNDWATER (feet)	DEPTH TO PRODUCT (feet)	PRODUCT THICKNESS (feet)	CASING ELEVATION (feet)	GROUNDWATER ELEVATION (feet)
	TPH (ug/L)	BENZENE (ug/L)	TOLUENE (ug/L)	EthylBenzene (ug/L)	XYLENE (ug/L)	MTBE (ug/L)					
09/05/95	4,400	440	22	<2.5	57	-	5.03	NP	0.00	166.51	161.48
11/21/95	660	3.4	<0.3	<0.3	0.6	-	5.23	NP	0.00	166.51	161.28
03/11/96	1,000	76	2.2	<0.3	130	-	4.16	NP	0.00	166.51	162.35
06/09/96	90	<0.3	<0.3	<0.3	<0.5	-	5.42	NP	0.00	166.51	161.09
09/16/96	1,900	5.8	<0.3	<0.3	5.9	1,100	5.20	NP	0.00	166.51	161.31
12/10/96	740	<0.3	<0.3	<0.3	<0.5	1,300	5.27	NP	0.00	166.51	161.24
03/12/97	2,000	600	59	5.1	54	1,300	3.85	NP	0.00	166.51	162.66
06/12/97	230	<0.3	<0.3	<0.3	<0.5	720	-	-	-	-	-
09/10/97	210	<0.3	<0.3	<0.3	<0.5	210	4.10	NP	0.00	166.51	162.41
12/09/97	11,000	2,500	2,700	<6	1,500	510	5.20	NP	0.00	166.51	161.31
03/03/98	<50	<0.3	<0.3	<0.3	<0.5	<20	3.70	NP	0.00	166.51	162.81
07/08/98	<50	<0.3	<0.3	<0.3	<0.5	<5	-	-	-	-	-
09/10/98	<50	<0.3	<0.3	<0.3	<0.5	<5	6.77	NP	0.00	166.51	159.74
12/30/98	<50	<0.3	<0.3	<0.3	<0.5	<5	5.95	NP	0.00	166.51	160.56
03/15/99	<50	<0.3	<0.3	<0.3	<0.5	<5	5.25	NP	0.00	166.51	161.26
06/22/99	110	<0.3	<0.3	<0.3	<0.5	200	4.50	NP	0.00	166.51	162.01
09/08/99	68	<0.3	<0.3	<0.3	<0.5	110	4.43	NP	0.00	166.51	162.08
12/01/99	<50	<0.3	<0.3	<0.3	<0.5	<5	3.66	NP	0.00	166.51	162.85
03/23/00	<50	<0.25	<0.25	<0.25	<0.5	<5	4.06	NP	0.00	166.51	162.45
06/08/00	<50	<5	<5	<5	<5	<5	4.43	NP	0.00	166.51	162.08
09/27/00	<50	<0.18	<0.14	<0.18	<0.26	<0.24	4.06	NP	0.00	166.51	162.45
12/13/00	<50	<0.18	<0.14	<0.18	<0.26	<0.24	4.80	NP	0.00	166.51	161.71
03/22/01	<50	<0.18	<0.14	<0.18	<0.26	<0.24	6.33	NP	0.00	166.51	160.18
06/15/01	<50	<0.18	<0.14	<0.18	<0.26	<0.24	4.79	NP	0.00	166.51	161.72
08/30/01	<50	<0.18	<0.14	<0.18	<0.26	<0.24	5.54	NP	0.00	166.51	160.97
12/12/01	<50	<0.18	<0.14	<0.18	<0.26	<0.24	5.21	NP	0.00	166.51	161.30
03/13/02	-	-	-	-	-	-	6.32	NP	0.00	166.51	160.19
06/12/02	-	-	-	-	-	-	-	-	-	-	-
09/18/02	-	-	-	-	-	-	-	-	-	-	-
12/18/02	-	-	-	-	-	-	-	-	-	-	-
03/19/03	-	-	-	-	-	-	-	-	-	-	-
06/11/03	-	-	-	-	-	-	-	-	-	-	-
09/04/03	-	-	-	-	-	-	-	-	-	-	-

**TABLE 1**  
**GROUNDWATER DATA**  
**THRIFTY OIL STATION #054, CASTRO VALLEY, CA.**

DATE SAMPLED	ANALYTICAL PARAMETERS						DEPTH TO GROUNDWATER (feet)	DEPTH TO PRODUCT (feet)	PRODUCT THICKNESS (feet)	CASING ELEVATION (feet)	GROUNDWATER ELEVATION (feet)
	TPH (ug/L)	BENZENE (ug/L)	TOLUENE (ug/L)	EthylBenzene (ug/L)	XYLENE (ug/L)	MTBE (ug/L)					
<b>MONITORING WELL #RE-6</b>											
<i>Screen Interval = 5 to 15 feet</i>											
04/11/88	6,000	3,000	40	80	140	-	-	-	-	-	-
04/09/90	3,000	990	ND	70	ND	-	5.64	NP	0.00	166.51	160.87
10/30/90	3,400	1,000	28	ND	ND	-	6.68	NP	0.00	166.51	159.83
01/18/91	6,300	1,200	ND	3.0	15	-	6.61	NP	0.00	166.51	159.90
02/12/91	5,200	850	8.4	4.9	41	-	6.20	NP	0.00	166.51	160.31
03/20/91	5,800	680	12	8.0	16	-	5.62	NP	0.00	166.51	160.89
05/22/91	8,500	1,700	14	24	6.7	-	6.05	NP	0.00	166.51	160.46
06/19/91	-	-	-	-	-	-	6.12	FILM	0.00	166.51	160.39
07/17/91	120,000	9,300	13,000	2,400	16,000	-	6.20	NP	0.00	166.51	160.31
08/07/91	-	590	5.3	ND	14	-	6.27	NP	0.00	166.51	160.24
09/24/91	7,000	310	11	5.3	35	-	6.63	NP	0.00	166.51	159.88
10/23/91	-	-	-	-	-	-	6.36	FILM	0.00	166.51	160.15
11/06/91	4,000	710	18	29	49	-	6.15	NP	0.00	166.51	160.36
12/04/91	4,100	1,100	14	33	39	-	6.19	NP	0.00	166.51	160.32
01/29/92	2,600	790	14	ND	49	-	6.70	NP	0.00	166.51	159.81
02/26/92	3,100	950	21	30	33	-	5.44	NP	0.00	166.51	161.07
03/19/92	2,200	630	14	12	40	-	5.30	NP	0.00	166.51	161.21
04/22/92	-	730	2.2	ND	40	-	6.00	NP	0.00	166.51	160.51
05/21/92	1,500	840	7.8	7.1	34	-	6.25	NP	0.00	166.51	160.26
06/25/92	<2000	740	8.0	27	28	-	6.38	NP	0.00	166.51	160.13
07/30/92	-	-	-	-	-	-	6.42	FILM	0.00	166.51	160.09
08/20/92	2,800	630	17	23	22	-	6.50	NP	0.00	166.51	160.01
09/30/92	7,800	540	ND	12	29	-	6.66	NP	0.00	166.51	159.85
12/23/92	1,800	350	ND	7.7	11	-	5.83	NP	0.00	166.51	160.68
03/10/93	3,000	830	5.6	19	16	-	5.63	NP	0.00	166.51	160.88
06/09/93	4,800	920	6.2	3.2	12	-	6.01	NP	0.00	166.51	160.50
09/14/93	3,600	660	7.5	11	27	-	6.53	NP	0.00	166.51	159.98
12/14/93	1,500	200	<0.3	<0.3	8.8	-	3.58	NP	0.00	166.51	162.93
03/02/94	-	-	-	-	-	-	5.12	NP	0.00	166.51	161.39
06/06/94	2,400	290	4.6	1.3	24	-	1.85	NP	0.00	166.51	164.66
09/06/94	4,300	230	21	<6.6	130	-	6.40	NP	0.00	166.51	160.11
12/07/94	1,500	17	2.5	3.2	22	-	5.68	NP	0.00	166.51	160.83
03/08/95	2,500	460	5.5	2.1	51	-	5.12	NP	0.00	166.51	161.39
06/15/95	2,300	91	1.1	0.7	97	-	5.72	NP	0.00	166.51	160.79

**TABLE 1**  
**GROUNDWATER DATA**  
**THRIFTY OIL STATION #054, CASTRO VALLEY, CA.**

DATE SAMPLED	ANALYTICAL PARAMETERS						DEPTH TO GROUNDWATER (feet)	DEPTH TO PRODUCT (feet)	PRODUCT THICKNESS (feet)	CASING ELEVATION (feet)	GROUNDWATER ELEVATION (feet)
	IPH (ug/L)	BENZENE (ug/L)	TOLUENE (ug/L)	EthylBenzene (ug/L)	XYLENE (ug/L)	MTBE (ug/L)					
09/05/95	3,300	60	<10	<10	74	-	5.94	NP	0.00	166.51	160.57
11/21/95	2,000	7.3	<0.3	0.56	8.7	-	6.24	NP	0.00	166.51	160.27
03/11/96	840	43	0.96	5.7	14	-	5.16	NP	0.00	166.51	161.35
06/19/96	1,800	160	2.7	9.9	25	-	5.80	NP	0.00	166.51	160.71
09/16/96	<50	<0.3	<0.3	<0.3	<0.5	<20	5.38	NP	0.00	166.51	161.13
12/10/96	<50	<0.3	<0.3	<0.3	<0.5	<20	5.62	NP	0.00	166.51	160.89
03/12/97	<50	<0.3	<0.3	<0.3	<0.5	<20	5.20	NP	0.00	166.51	161.31
06/12/97	<50	<0.3	<0.3	<0.3	<0.5	<20	-	-	-	-	-
09/10/97	440	<0.3	<0.3	<0.3	<0.5	320	5.20	NP	0.00	166.51	161.31
12/09/97	<50	<0.3	<0.3	<0.3	<0.5	<20	5.97	NP	0.00	166.51	160.54
03/03/98	400	7.0	<0.3	<0.3	4.3	65	4.45	NP	0.00	166.51	162.06
07/08/98	300	<0.3	<0.3	<0.3	1.0	35	-	-	-	-	-
09/10/98	<50	<0.3	<0.3	<0.3	<0.5	<5	5.90	NP	0.00	166.51	160.61
12/30/98	<50	<0.3	<0.3	<0.3	<0.5	<5	5.20	NP	0.00	166.51	161.31
03/15/99	<50	<0.3	<0.3	<0.3	<0.5	8.4	4.82	NP	0.00	166.51	161.69
06/22/99	700	11	1.9	<0.3	3.9	140	6.00	NP	0.00	166.51	160.51
09/08/99	<50	<0.3	<0.3	<0.3	<0.5	<5	5.15	NP	0.00	166.51	161.36
12/01/99	<50	<0.3	<0.3	<0.3	<0.5	12	4.02	NP	0.00	166.51	162.49
03/23/00	<50	<0.25	<0.25	<0.25	<0.5	<5	4.41	NP	0.00	166.51	162.10
06/08/00	<50	<5	<5	<5	<5	<5	4.78	NP	0.00	166.51	161.73
09/27/00	<50	<0.18	<0.14	<0.18	<0.26	<0.24	4.78	NP	0.00	166.51	161.73
12/13/00	<50	<0.18	<0.14	<0.18	<0.26	<0.24	4.77	NP	0.00	166.51	161.74
03/22/01	367	<0.18	<0.14	<0.18	<0.26	*581 / 674	5.54	NP	0.00	166.51	160.97
06/15/01	<50	<0.18	<0.14	<0.18	<0.26	<0.24	5.92	NP	0.00	166.51	160.59
08/30/01	<50	<0.18	<0.14	<0.18	<0.26	<0.24	5.93	NP	0.00	166.51	160.58
12/12/01	138	<0.18	<0.14	<0.18	<0.26	*7 / <0.6	6.20	NP	0.00	166.51	160.31
03/13/02	<50	<0.18	<0.14	<0.18	<0.26	<0.24	5.55	NP	0.00	166.51	160.96
06/12/02	895	<0.18	1.0	<0.18	<0.26	1,360	5.93	NP	0.00	166.51	160.58
09/18/02	759	<0.18	<0.14	<0.18	<0.26	644	6.03	NP	0.00	166.51	160.48
12/18/02	531	<0.18	<0.14	<0.18	<0.26	441	5.65	NP	0.00	166.51	160.86
03/19/03	955	<0.04	<0.02	<0.02	<0.06	585	6.34	NP	0.00	166.51	160.17
06/11/03	945	<0.04	<0.02	<0.02	<0.06	328	6.34	NP	0.00	166.51	160.17
09/04/03	<15	<0.22	<0.32	<0.31	<0.4	<0.18	5.92	NP	0.00	166.51	160.59

**TABLE 1**  
**GROUNDWATER DATA**  
**THRIFTY OIL STATION #054, CASTRO VALLEY, CA.**

DATE SAMPLED	ANALYTICAL PARAMETERS						DEPTH TO GROUNDWATER (feet)	DEPTH TO PRODUCT (feet)	PRODUCT THICKNESS (feet)	CASING ELEVATION (feet)	GROUNDWATER ELEVATION (feet)
	TPH (ug/L)	BENZENE (ug/L)	TOLUENE (ug/L)	EthylBenzene (ug/L)	XYLENE (ug/L)	MTBE (ug/L)					
<b>MONITORING WELL #RE-7</b>											
<i>Screen Interval = 5 to 15 feet</i>											
04/11/88	< 50,000	17,000	4,400	600	8,400	-	-	-	-	-	-
04/09/90	16,000	7,000	1,200	640	1,600	-	5.93	NP	0.00	166.04	160.11
10/30/90	31,000	14,000	ND	ND	ND	-	8.21	NP	0.00	166.04	157.83
01/18/91	-	-	-	-	-	-	11.80	NP	0.00	166.04	154.24
02/12/91	-	-	-	-	-	-	10.80	FILM	0.00	166.04	155.24
03/20/91	120,000	12,000	2,800	490	6,600	-	9.96	NP	0.00	166.04	156.08
05/22/91	-	-	-	-	-	-	11.70	FILM	0.00	166.04	154.34
06/19/91	-	-	-	-	-	-	11.50	FILM	0.00	166.04	154.54
07/17/91	-	-	-	-	-	-	7.80	FILM	0.00	166.04	158.24
08/07/91	-	-	-	-	-	-	9.88	0.03	9.85	166.04	163.60
09/24/91	-	-	-	-	-	-	9.85	0.03	9.82	166.04	163.60
10/23/91	-	-	-	-	-	-	9.96	FILM	0.00	166.04	156.08
11/06/91	-	-	-	-	-	-	6.77	FILM	0.00	166.04	159.27
12/04/91	-	-	-	-	-	-	10.80	FILM	0.00	166.04	155.24
01/29/92	-	-	-	-	-	-	8.64	FILM	0.00	166.04	157.40
02/26/92	-	-	-	-	-	-	6.00	FILM	0.00	166.04	160.04
03/19/92	-	-	-	-	-	-	5.55	FILM	0.00	166.04	160.49
04/22/92	-	-	-	-	-	-	6.12	FILM	0.00	166.04	159.92
05/21/92	-	-	-	-	-	-	6.40	FILM	0.00	166.04	159.64
06/25/92	-	-	-	-	-	-	6.73	0.02	6.71	166.04	164.38
07/30/92	-	-	-	-	-	-	6.73	FILM	0.00	166.04	159.31
08/20/92	-	-	-	-	-	-	6.82	FILM	0.00	166.04	159.22
09/30/92	-	-	-	-	-	-	7.26	FILM	0.00	166.04	158.78
12/23/92	-	-	-	-	-	-	6.22	FILM	0.00	166.04	159.82
03/10/93	-	-	-	-	-	-	5.82	FILM	0.00	166.04	160.22
06/09/93	-	-	-	-	-	-	6.17	FILM	0.00	166.04	159.87
09/14/93	-	-	-	-	-	-	11.33	NP	0.00	166.04	154.71
12/14/93	-	-	-	-	-	-	8.40	NP	0.00	166.04	157.64
03/02/94	-	-	-	-	-	-	6.82	NP	0.00	166.04	159.22
06/06/94	-	-	-	-	-	-	10.95	FILM	0.00	166.04	155.09
09/06/94	-	-	-	-	-	-	11.30	FILM	0.00	166.04	154.74
12/07/94	-	-	-	-	-	-	5.63	FILM	0.00	166.04	160.41
03/08/95	-	-	-	-	-	-	5.06	FILM	0.00	166.04	160.98
06/15/95	-	-	-	-	-	-	-	-	-	-	-

**TABLE 1**  
**GROUNDWATER DATA**  
**THRIFTY OIL STATION #054, CASTRO VALLEY, CA.**

DATE SAMPLED	ANALYTICAL PARAMETERS						DEPTH TO GROUNDWATER (feet)	DEPTH TO PRODUCT (feet)	PRODUCT THICKNESS (feet)	CASING ELEVATION (feet)	GROUNDWATER ELEVATION (feet)
	TPH (ug/L)	BENZENE (ug/L)	TOLUENE (ug/L)	EthylBenzene (ug/L)	XYLENE (ug/L)	MTBE (ug/L)					
09/05/95	-	-	-	-	-	-	7.98	FILM	0.00	166.04	158.06
11/21/95	20,000	8,800	110	<30	310	-	7.32	NP	0.00	166.04	158.72
03/11/96	4,800	2,200	38	26	120	-	5.62	NP	0.00	166.04	160.42
06/19/96	4,400	3,300	49	5.8	70	-	6.40	NP	0.00	166.04	159.64
09/19/96	7,200	510	83	<0.3	710	130	6.20	NP	0.00	166.04	159.84
12/10/96	700	<0.3	<0.3	<0.3	<0.5	1,400	5.92	NP	0.00	166.04	160.12
03/12/97	660	0.31	<0.3	<0.3	<0.5	1,400	5.62	NP	0.00	166.04	160.42
06/12/97	320	<0.3	0.45	<0.3	<0.5	850	-	-	-	-	-
09/10/97	780	<0.3	<0.3	<0.3	<0.5	930	7.45	NP	0.00	166.04	158.59
12/09/97	14,000	3,500	3,700	<15	2,100	1,100	7.10	NP	0.00	166.04	158.94
03/03/98	6,100	2,500	18	<6	110	270	6.70	NP	0.00	166.04	159.34
07/08/98	1,300	8.7	<0.3	<0.3	<0.5	350	-	-	-	-	-
09/10/98	690	2.2	<0.3	<0.3	<0.5	350	7.04	NP	0.00	166.04	159.00
12/30/98	600	2.0	0.55	<0.3	<0.5	350	6.25	NP	0.00	166.04	159.79
03/15/99	350	0.71	<0.3	<0.3	<0.5	140	6.02	NP	0.00	166.04	160.02
06/22/99	5,900	2,100	16	4.6	48	170	6.35	NP	0.00	166.04	159.69
09/08/99	1,700	380	<3	<3	13	160	7.03	NP	0.00	166.04	159.01
12/01/99	930	3.7	<0.3	<0.3	<0.5	390	6.25	NP	0.00	166.04	159.79
03/23/00	581	5.4	5.3	1.9	7.3	*168/183	6.24	NP	0.00	166.04	159.80
06/08/00	<100	<5	<5	<5	<5	74	6.64	NP	0.00	166.04	159.40
09/27/00	236	<0.18	<0.14	<0.18	<0.26	*21 / 28	7.03	NP	0.00	166.04	159.01
12/13/00	<50	<0.18	<0.14	<0.18	<0.26	*13 / 19.8	6.63	NP	0.00	166.04	159.41
03/22/01	504	<0.18	<0.14	<0.18	1	*666 / 1,420	7.02	NP	0.00	166.04	159.02
06/15/01	144	5.0	<0.14	0.5	2	*369 / 408	7.02	NP	0.00	166.04	159.02
08/30/01	<50	<0.18	<0.14	<0.18	<0.26	<0.24	7.79	NP	0.00	166.04	158.25
12/12/01	<50	<0.18	<0.14	<0.18	<0.26	<0.24	7.28	NP	0.00	166.04	158.76
03/13/02	<50	<0.18	<0.14	<0.18	<0.26	<0.24	6.02	NP	0.00	166.04	160.02
06/12/02	5,130	772	970	59	550	113	7.79	NP	0.00	166.04	158.25
09/18/02	<50	<0.18	<0.14	<0.18	<0.26	<0.24	7.40	NP	0.00	166.04	158.64
12/18/02	<50	<0.18	<0.14	<0.18	<0.26	<0.24	6.63	NP	0.00	166.04	159.41
03/19/03	<15	<0.04	<0.02	<0.02	<0.06	<0.03	7.40	NP	0.00	166.04	158.64
06/11/03	<15	<0.04	<0.02	<0.02	<0.06	8.3	7.40	NP	0.00	166.04	158.64
09/04/03	<15	<0.22	<0.32	<0.31	<0.4	<0.18	7.39	NP	0.00	166.04	158.65

**TABLE 1**  
**GROUNDWATER DATA**  
**THRIFTY OIL STATION #054, CASTRO VALLEY, CA.**

DATE SAMPLED	ANALYTICAL PARAMETERS						DEPTH TO GROUNDWATER (feet)	DEPTH TO PRODUCT (feet)	PRODUCT THICKNESS (feet)	CASING ELEVATION (feet)	GROUNDWATER ELEVATION (feet)
	TPH (ug/L)	BENZENE (ug/L)	TOLUENE (ug/L)	EthylBenzene (ug/L)	XYLENE (ug/L)	MTBE (ug/L)					
<b>MONITORING WELL #RS-8</b> <i>Screen Interval = 5 to 25 feet</i>											
08/07/91	ND	ND	ND	ND	ND	-	9.68	NP	0.00	164.32	154.64
09/27/91	ND	ND	ND	ND	ND	-	9.89	NP	0.00	164.32	154.43
10/23/91	ND	ND	ND	ND	ND	-	10.05	NP	0.00	164.32	154.27
11/06/91	ND	ND	ND	ND	ND	-	9.71	NP	0.00	164.32	154.61
12/04/91	ND	ND	ND	ND	ND	-	10.00	NP	0.00	164.32	154.32
01/29/92	ND	2.1	1.0	2.5	3.6	-	9.28	NP	0.00	164.32	155.04
02/26/92	ND	ND	0.7	ND	0.7	-	7.05	NP	0.00	164.32	157.27
03/19/92	ND	0.5	1.0	1.5	2.7	-	7.30	NP	0.00	164.32	157.02
04/22/92	ND	ND	ND	ND	ND	-	8.60	NP	0.00	164.32	155.72
05/21/92	ND	ND	ND	ND	ND	-	9.22	NP	0.00	164.32	155.10
06/25/92	ND	ND	ND	ND	ND	-	9.49	NP	0.00	164.32	154.83
07/30/92	ND	1.1	4.2	ND	3.0	-	9.55	NP	0.00	164.32	154.77
08/20/92	ND	2.0	4.7	ND	5.7	-	9.63	NP	0.00	164.32	154.69
09/30/92	ND	ND	ND	ND	ND	-	9.90	NP	0.00	164.32	154.42
12/23/92	ND	ND	ND	ND	ND	-	9.96	NP	0.00	164.32	154.36
05/10/93	ND	ND	ND	ND	ND	-	8.95	NP	0.00	164.32	155.37
06/09/93	ND	ND	ND	ND	ND	-	9.00	NP	0.00	164.32	155.32
09/14/93	200	0.3	ND	ND	ND	-	9.50	NP	0.00	164.32	154.82
12/14/93	ND	ND	ND	ND	ND	-	8.75	NP	0.00	164.32	155.57
03/02/94	<50	<0.3	<0.3	<0.3	<0.5	-	7.52	NP	0.00	164.32	156.80
06/06/94	54	<0.3	<0.3	<0.3	2.4	-	9.00	NP	0.00	164.32	155.32
09/06/94	<50	<0.3	<0.3	<0.3	<0.5	-	9.26	NP	0.00	164.32	155.06
12/07/94	130	2.5	1.9	1.3	3.6	-	8.67	NP	0.00	164.32	155.65
03/08/95	<100	<0.5	<0.5	<0.5	<1	-	8.34	NP	0.00	164.32	155.98
06/15/95	<100	1.0	<0.5	<0.5	<1	-	9.12	NP	0.00	164.32	155.20
09/05/95	<100	<0.5	<0.5	<0.5	<1	-	9.56	NP	0.00	164.32	154.76
11/21/95	<50	0.44	<0.3	<0.3	1.5	-	9.28	NP	0.00	164.32	155.04
03/11/96	<50	1.3	<0.3	<0.3	0.6	-	7.52	NP	0.00	164.32	156.80
06/19/96	640	72	20	34	150	-	7.80	NP	0.00	164.32	156.52
09/16/96	<50	<0.3	<0.3	<0.3	<0.5	20	9.18	NP	0.00	164.32	155.14
12/10/96	<50	<0.3	<0.3	<0.3	<0.5	<20	6.08	NP	0.00	164.32	158.24
03/12/97	53	0.45	<0.3	<0.3	<0.5	140	8.65	NP	0.00	164.32	155.67
06/12/97	<50	<0.3	<0.3	<0.3	<0.5	68	-	-	-	-	-
09/10/97	<50	<0.3	<0.3	<0.3	<0.5	<20	8.30	NP	0.00	164.32	156.02

**TABLE 1  
GROUNDWATER DATA  
THRIFTY OIL STATION #054, CASTRO VALLEY, CA.**

DATE SAMPLED	ANALYTICAL PARAMETERS						DEPTH TO GROUNDWATER (feet)	DEPTH TO PRODUCT (feet)	PRODUCT THICKNESS (feet)	CASING ELEVATION (feet)	GROUNDWATER ELEVATION (feet)
	TPH (ug/L)	BENZENE (ug/L)	TOLUENE (ug/L)	EthylBenzene (ug/L)	XYLENE (ug/L)	MTBE (ug/L)					
12/09/97	< 50	1.7	2.1	<0.3	1.4	82	9.98	NP	0.00	164.32	154.34
03/03/98	< 50	<0.3	<0.3	<0.3	<0.5	84	8.33	NP	0.00	164.32	155.99
07/08/98	< 50	<0.3	<0.3	<0.3	<0.5	97	-	-	-	-	-
09/10/98	< 50	<0.3	<0.3	<0.3	<0.5	97	12.95	NP	0.00	164.32	151.37
12/30/98	< 50	1.3	1.5	<0.3	0.86	19	11.35	NP	0.00	164.32	152.97
03/15/99	< 50	<0.3	<0.3	<0.3	<0.5	9.6	9.85	NP	0.00	164.32	154.47
06/22/99	66	0.39	<0.3	<0.3	<0.5	62	9.90	NP	0.00	164.32	154.42
09/08/99	< 50	<0.3	<0.3	<0.3	<0.5	25	9.85	NP	0.00	164.32	154.47
12/01/99	< 50	<0.3	<0.3	<0.3	<0.5	30	8.30	NP	0.00	164.32	156.02
03/23/00	< 50	<0.25	<0.25	<0.25	<0.5	*13.6/18.2	6.76	NP	0.00	164.32	157.56
06/08/00	< 50	<5	<5	<5	<5	10	8.30	NP	0.00	164.32	156.02
09/27/00	< 50	<0.18	<0.14	<0.18	<0.26	*6 / 4.9	8.30	NP	0.00	164.32	156.02
12/13/00	< 50	<0.18	<0.14	<0.18	<0.26	<0.24	8.28	NP	0.00	164.32	156.04
03/22/01	< 50	<0.18	<0.14	<0.18	<0.26	<0.24	12.89	NP	0.00	164.32	151.43
06/15/01	< 50	<0.18	<0.14	<0.18	<0.26	<0.24	12.89	NP	0.00	164.32	151.43
08/30/01	< 50	<0.18	<0.14	<0.18	<0.26	<0.24	9.82	NP	0.00	164.32	154.50
12/12/01	< 50	<0.18	<0.14	<0.18	<0.26	<0.24	9.25	NP	0.00	164.32	155.07
03/13/02	-	-	-	-	-	-	12.89	NP	0.00	164.32	151.43
06/12/02	-	-	-	-	-	-	-	-	-	-	-
09/18/02	-	-	-	-	-	-	-	-	-	-	-
12/18/02	-	-	-	-	-	-	-	-	-	-	-
03/19/03	-	-	-	-	-	-	-	-	-	-	-
06/11/03	-	-	-	-	-	-	-	-	-	-	-
09/04/03	-	-	-	-	-	-	-	-	-	-	-
<b>MONITORING WELL #RS-9      Screen Interval = 5 to 15 feet</b>											
08/07/91	-	0.5	ND	330	1,200	-	2.28	NP	0.00	167.51	165.23
09/27/91	13,000	3.5	3.0	82	140	-	2.77	NP	0.00	167.51	164.74
10/23/91	11,000	ND	ND	39	340	-	3.53	NP	0.00	167.51	163.98
11/06/91	6,800	8.4	0.6	22	230	-	2.51	NP	0.00	167.51	165.00
12/04/91	6,500	6.5	0.7	87	200	-	3.20	NP	0.00	167.51	164.31
01/29/92	8,100	22	10	140	260	-	2.65	NP	0.00	167.51	164.86
02/26/92	13,000	40	16	220	600	-	3.42	NP	0.00	167.51	164.09
03/19/92	12,000	21	12	100	280	-	3.12	NP	0.00	167.51	164.39

**TABLE 1  
GROUNDWATER DATA  
THRIFTY OIL STATION #054, CASTRO VALLEY, CA.**

DATE SAMPLED	ANALYTICAL PARAMETERS						DEPTH TO GROUNDWATER (feet)	DEPTH TO PRODUCT (feet)	PRODUCT THICKNESS (feet)	CASING ELEVATION (feet)	GROUNDWATER ELEVATION (feet)
	TPH (ug/L)	BENZENE (ug/L)	TOLUENE (ug/L)	EthylBenzene (ug/L)	XYLENE (ug/L)	MTBE (ug/L)					
04/22/92	8,600	ND	ND	20	37	-	3.24	NP	0.00	167.51	164.27
05/21/92	6,000	21	10	53	210	-	3.75	NP	0.00	167.51	163.76
06/25/92	370	2.3	1.5	0.7	4.3	-	2.65	NP	0.00	167.51	164.86
07/30/92	3,600	20	ND	39	80	-	2.70	NP	0.00	167.51	164.81
08/20/92	3,000	0.7	5.2	2.0	5.3	-	2.83	NP	0.00	167.51	164.68
09/30/92	9,200	4.8	6.5	12	91	-	2.80	NP	0.00	167.51	164.71
12/23/92	2,000	17	ND	8.2	18	-	2.45	NP	0.00	167.51	165.06
03/10/93	1,500	ND	2.6	21	12	-	2.40	NP	0.00	167.51	165.11
06/09/93	1,300	0.6	1.7	ND	7.5	-	3.55	NP	0.00	167.51	163.96
09/14/93	1,500	1.3	7.6	4.1	14	-	2.81	NP	0.00	167.51	164.70
12/14/93	560	ND	ND	ND	5.5	-	2.63	NP	0.00	167.51	164.88
03/02/94	1,100	<0.3	<0.3	<0.3	<0.5	-	2.60	NP	0.00	167.51	164.91
06/06/94	290	0.58	0.53	1.1	5.8	-	2.52	NP	0.00	167.51	164.99
09/06/94	890	<0.3	<0.3	<0.3	3.1	-	3.16	NP	0.00	167.51	164.35
12/07/94	940	22	23	10	32	-	5.18	NP	0.00	167.51	162.33
03/08/95	1,600	<0.5	<0.5	<0.5	2.3	-	4.57	NP	0.00	167.51	162.94
06/15/95	3,200	2.2	5.3	4.3	3.1	-	5.08	NP	0.00	167.51	162.43
09/05/95	1,100	<0.5	<0.5	<0.5	<1	-	5.72	NP	0.00	167.51	161.79
11/21/95	1,100	1.1	2.9	3.5	3.0	-	2.46	NP	0.00	167.51	165.05
03/11/96	440	0.7	0.34	<0.3	3.7	-	3.44	NP	0.00	167.51	164.07
06/19/96	580	3.8	0.49	1.2	<0.5	-	3.80	NP	0.00	167.51	163.71
09/16/96	490	<0.3	1.6	<0.3	<0.5	<20	3.80	NP	0.00	167.51	163.71
12/10/96	<50	<0.3	<0.3	<0.3	<0.5	<20	2.76	NP	0.00	167.51	164.75
03/12/97	<50	<0.3	0.42	<0.3	1.5	<20	3.20	NP	0.00	167.51	164.31
06/12/97	<50	<0.3	<0.3	<0.3	0.51	<20	-	-	-	-	-
09/10/97	<50	<0.3	<0.3	<0.3	<0.5	<20	4.24	NP	0.00	167.51	163.27
12/09/97	<50	<0.3	0.48	<0.3	<0.5	<20	2.72	NP	0.00	167.51	164.79
03/03/98	190	<0.3	<0.3	0.38	<0.5	<20	1.90	NP	0.00	167.51	165.61
07/08/98	<50	<0.3	<0.3	<0.3	<0.5	<5	-	-	-	-	-
09/10/98	<50	<0.3	<0.3	<0.3	<0.5	<5	2.72	NP	0.00	167.51	164.79
12/30/98	<50	<0.3	<0.3	<0.3	<0.5	<5	1.20	NP	0.00	167.51	166.31
03/15/99	<50	<0.3	<0.3	<0.3	<0.5	<5	4.25	NP	0.00	167.51	163.26
06/22/99	1,300	4.2	1.2	0.69	0.74	<5	3.70	NP	0.00	167.51	163.81
09/08/99	<50	<0.3	<0.3	<0.3	<0.5	<5	2.71	NP	0.00	167.51	164.80
12/01/99	<50	<0.3	<0.3	<0.3	<0.5	<5	2.70	NP	0.00	167.51	164.81





**TABLE 1  
GROUNDWATER DATA  
THRIFTY OIL STATION #054, CASTRO VALLEY, CA.**

DATE SAMPLED	ANALYTICAL PARAMETERS						DEPTH TO GROUNDWATER (feet)	DEPTH TO PRODUCT (feet)	PRODUCT THICKNESS (feet)	CASING ELEVATION (feet)	GROUNDWATER ELEVATION (feet)
	TPH (ug/L)	BENZENE (ug/L)	TOLUENE (ug/L)	EthylBenzene (ug/L)	XYLENE (ug/L)	MTBE (ug/L)					
09/14/93	ND	ND	ND	ND	ND	-	7.35	NP	0.00	162.89	155.54
03/02/94	< 50	<0.3	<0.3	<0.3	<0.3	-	7.00	NP	0.00	162.89	155.89
06/06/94	< 50	<0.3	<0.3	<0.3	<0.5	-	6.55	NP	0.00	162.89	156.34
09/06/94	< 50	<0.3	<0.3	<0.3	<0.5	-	7.63	NP	0.00	162.89	155.26
12/07/94	56	<0.3	<0.3	<0.5	2.1	-	5.92	NP	0.00	162.89	156.97
03/08/95	<100	<0.5	<0.5	<0.5	<1	-	7.84	NP	0.00	162.89	155.05
06/15/95	<100	<0.5	<0.5	<0.5	<1	-	6.97	NP	0.00	162.89	155.92
09/05/95	<100	<0.5	<0.5	<0.5	<1	-	8.14	NP	0.00	162.89	154.75
11/21/95	< 50	<0.3	<0.3	<0.3	<0.5	-	7.68	NP	0.00	162.89	155.21
03/11/96	< 50	<0.3	<0.3	<0.3	<0.5	-	6.76	NP	0.00	162.89	156.13
06/19/96	< 50	<0.3	<0.3	<0.3	<0.5	-	7.20	NP	0.00	162.89	155.69
09/16/96	< 50	<0.3	<0.3	<0.3	<0.5	<20	6.30	NP	0.00	162.89	156.59
12/10/96	< 50	<0.3	<0.3	<0.3	<0.5	<20	6.05	NP	0.00	162.89	156.84
03/12/97	< 50	<0.3	<0.3	<0.3	<0.5	<20	7.56	NP	0.00	162.89	155.33
06/12/97	< 50	<0.3	<0.3	<0.3	<0.5	<20	-	-	-	-	-
09/10/97	< 50	<0.3	<0.3	<0.3	<0.5	<20	7.55	NP	0.00	162.89	155.34
12/09/97	1,900	610	510	<6	290	<20	7.55	NP	0.00	162.89	155.34
03/03/98	< 50	2.0	<0.3	<0.3	<0.5	27	6.03	NP	0.00	162.89	156.86
07/08/98	< 50	<0.3	<0.3	<0.3	<0.5	<5	-	-	-	-	-
09/10/98	< 50	<0.3	<0.3	<0.3	<0.5	72	7.55	NP	0.00	162.89	155.34
12/30/98	< 50	1.1	<0.3	<0.3	<0.5	<5	4.45	NP	0.00	162.89	158.44
03/15/99	< 50	<0.3	<0.3	<0.3	1.3	<5	4.50	NP	0.00	162.89	158.39
06/22/99	< 50	<0.3	<0.3	<0.3	<0.5	<5	9.15	NP	0.00	162.89	153.74
09/08/99	< 50	<0.3	<0.3	<0.3	<0.5	<5	7.51	NP	0.00	162.89	155.38
12/01/99	< 50	<0.3	<0.3	<0.3	<0.5	<5	5.97	NP	0.00	162.89	156.92
03/23/00	< 50	<0.25	<0.25	<0.25	<0.5	<5	4.47	NP	0.00	162.89	158.42
06/08/00	< 50	<5	<5	<5	<5	<5	5.97	NP	0.00	162.89	156.92
09/27/00	< 50	<0.18	<0.14	<0.18	<0.26	<0.24	7.50	NP	0.00	162.89	155.39
12/13/00	< 50	<0.18	<0.14	<0.18	<0.26	<0.24	5.94	NP	0.00	162.89	156.95
03/22/01	< 50	<0.18	<0.14	<0.18	<0.26	<0.24	7.51	NP	0.00	162.89	155.38
06/15/01	< 50	<0.18	<0.14	<0.18	<0.26	<0.24	7.50	NP	0.00	162.89	155.39
08/30/01	< 50	<0.18	<0.14	<0.18	<0.26	<0.24	9.05	NP	0.00	162.89	153.84
12/12/01	< 50	<0.18	<0.14	<0.18	<0.26	<0.24	7.65	NP	0.00	162.89	155.24
03/13/02	-	-	-	-	-	-	9.05	NP	0.00	162.89	153.84
06/12/02	-	-	-	-	-	-	-	-	-	-	-

**TABLE 1**  
**GROUNDWATER DATA**  
**THRIFTY OIL STATION #054, CASTRO VALLEY, CA.**

DATE SAMPLED	ANALYTICAL PARAMETERS						DEPTH TO GROUNDWATER (feet)	DEPTH TO PRODUCT (feet)	PRODUCT THICKNESS (feet)	CASING ELEVATION (feet)	GROUNDWATER ELEVATION (feet)
	TPH (ug/L)	BENZENE (ug/L)	TOLUENE (ug/L)	EthylBenzene (ug/L)	XYLENE (ug/L)	MTBE (ug/L)					
09/18/02	-	-	-	-	-	-	-	-	-	-	-
12/18/02	-	-	-	-	-	-	-	-	-	-	-
03/19/03	-	-	-	-	-	-	-	-	-	-	-
06/11/03	-	-	-	-	-	-	-	-	-	-	-
09/04/03	-	-	-	-	-	-	-	-	-	-	-
<b>MONITORING WELL #RS-11</b> <i>Screen Interval = 5 to 25 feet</i>											
09/21/95	110	<0.5	<0.5	<0.5	<1	-	9.37	NP	0.00	163.28	153.91
11/21/95	-	-	-	-	-	-	-	-	-	-	-
03/11/96	-	-	-	-	-	-	-	-	-	-	-
06/19/96	-	-	-	-	-	-	-	-	-	-	-
09/16/96	-	-	-	-	-	-	-	-	-	-	-
03/12/97	74	9.5	<0.3	<0.3	0.57	<20	7.75	NP	0.00	163.28	155.53
06/12/97	<50	<0.3	<0.3	<0.3	<0.5	<20	-	-	-	-	-
09/10/97	<50	<0.3	<0.3	<0.3	<0.5	<20	9.50	NP	0.00	163.28	153.78
12/09/97	<50	0.79	1.2	<0.3	<0.5	<20	9.50	NP	0.00	163.28	153.78
03/03/98	140	22	0.63	<0.3	<0.5	<20	7.93	NP	0.00	163.28	155.35
07/08/98	<50	<0.3	<0.3	<0.3	<0.5	<5	-	-	-	-	-
09/10/98	<50	<0.3	<0.3	<0.3	<0.5	<5	9.48	NP	0.00	163.28	153.80
12/30/98	<50	1.3	0.87	<0.3	0.55	<5	7.95	NP	0.00	163.28	155.33
03/15/99	<50	<0.3	<0.3	<0.3	<0.5	<5	6.40	NP	0.00	163.28	156.88
06/22/99	350	89	2.9	3.3	0.91	6.8	11.00	NP	0.00	163.28	152.28
09/08/99	99	9.1	0.37	<0.3	<0.5	<5	7.90	NP	0.00	163.28	155.38
12/01/99	82	9.7	0.44	<0.3	<0.5	<5	7.90	NP	0.00	163.28	155.38
03/23/00	73	5.8	2.3	<0.25	<0.5	*11.2 / 7.9	4.85	NP	0.00	163.28	158.43
06/08/00	306	<5	<5	<5	<5	<5	7.90	NP	0.00	163.28	155.38
09/27/00	<50	1	<0.14	<0.18	<0.26	3.1 / 3.6	9.44	NP	0.00	163.28	153.84
12/13/00	<50	<0.18	<0.14	<0.18	<0.26	<0.24	6.34	NP	0.00	163.28	156.94
03/22/01	408	<0.18	<0.14	<0.18	<0.26	*664 / 941	7.96	NP	0.00	163.28	155.32
06/15/01	<50	<0.18	<0.14	<0.18	<0.26	<0.24	7.87	NP	0.00	163.28	155.41
08/30/01	<50	<0.18	<0.14	<0.18	<0.26	<0.24	9.41	NP	0.00	163.28	153.87
12/12/01	<50	<0.18	<0.14	<0.18	<0.26	<0.24	7.86	NP	0.00	163.28	155.42
03/13/02	<50	<0.18	<0.14	<0.18	<0.26	<0.24	7.85	NP	0.00	163.28	155.43
06/12/02	<50	<0.18	1	<0.18	<0.26	<0.24	9.39	NP	0.00	163.28	153.89
09/18/02	<50	<0.18	<0.14	<0.18	<0.26	<0.24	9.38	NP	0.00	163.28	153.90

**TABLE 1  
GROUNDWATER DATA  
THRIFTY OIL STATION #054, CASTRO VALLEY, CA.**

DATE SAMPLED	ANALYTICAL PARAMETERS						DEPTH TO GROUNDWATER (feet)	DEPTH TO PRODUCT (feet)	PRODUCT THICKNESS (feet)	CASING ELEVATION (feet)	GROUNDWATER ELEVATION (feet)
	TPH (ug/L)	BENZENE (ug/L)	TOLUENE (ug/L)	EthylBenzene (ug/L)	XYLENE (ug/L)	MTBE (ug/L)					
12/18/02	110	<0.18	<0.14	<0.18	<0.26	101	6.32	NP	0.00	163.28	156.96
03/19/03	<15	<0.04	<0.02	<0.02	<0.06	<0.03	9.39	NP	0.00	163.28	153.89
06/11/03	<15	<0.04	<0.02	<0.02	<0.06	20	9.39	NP	0.00	163.28	153.89
09/04/03	<15	<0.22	<0.32	<0.31	<0.4	<0.18	7.85	NP	0.00	163.28	155.43

**NOTE:** ND = Nondetectable  
 " - " = Not Analyzed / Not Available  
 NP = No Free Product  
 \*MTBE 8020/8260

Benzene, toluene, ethylbenzene, and xylene analyzed by EPA method 8020.  
 Total petroleum hydrocarbons (TPH) analyzed by EPA method 8015 modified for gasoline  
 Methyl-tert Butyl Ether (MTBE) analyzed by EPA method 8020  
 On June 8, 2000, BTEX and MTBE analyzed by EPA Method 8260B

# ***FIGURES***

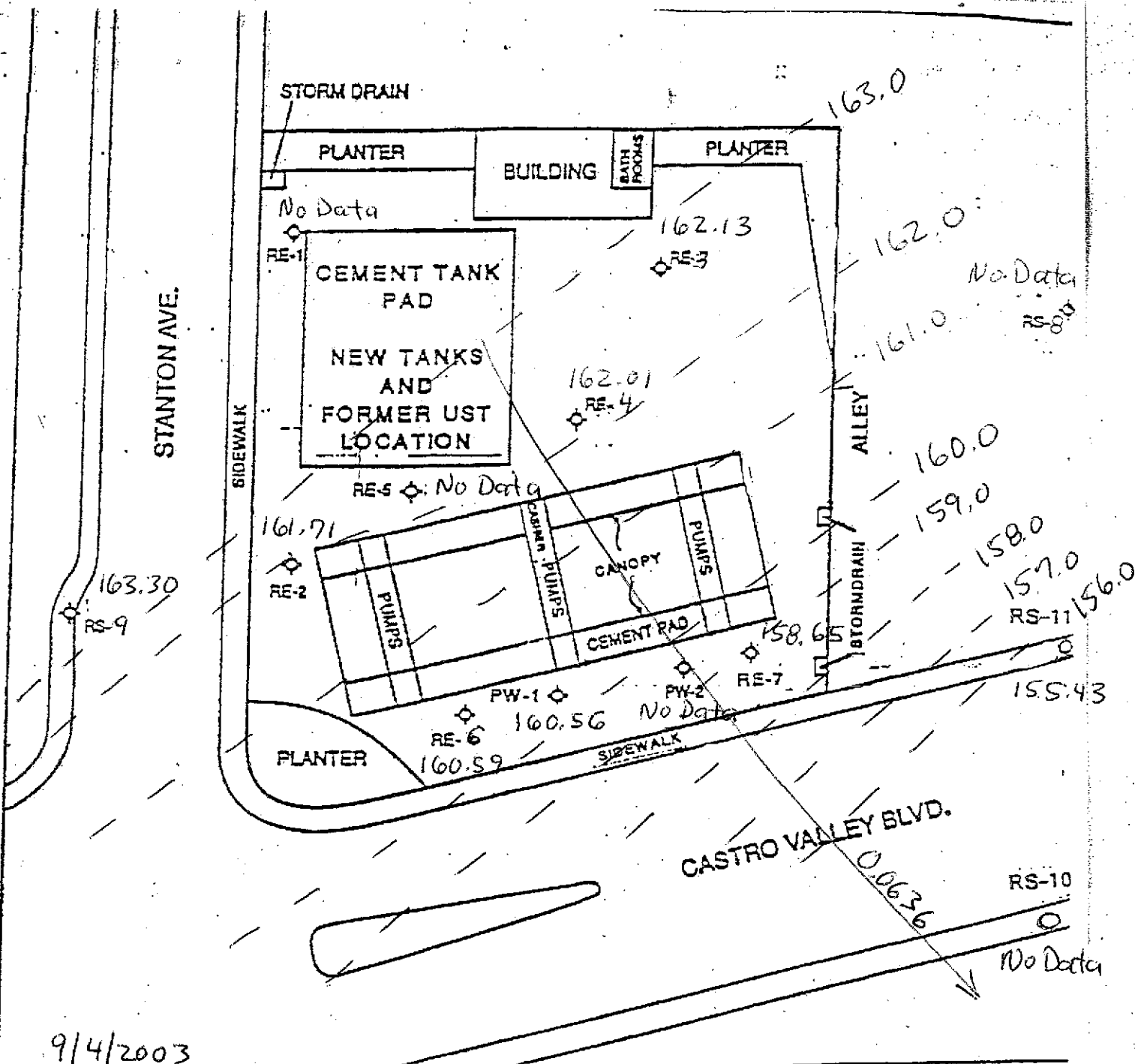

Datum is Mean Sea Level

GROUNDWATER CONTOUR MAP  
 THRIFTY OIL CO. #054  
 CASTRO VALLEY, CALIFORNIA  
 Prepared for  
 THRIFTY OIL CO.  
 SANTA FE, SPRINGS  
 CALIFORNIA

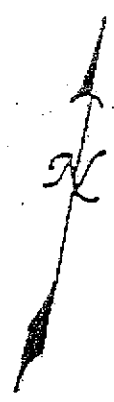

◊ EXISTING MONITORING WELL

FIGURE 1

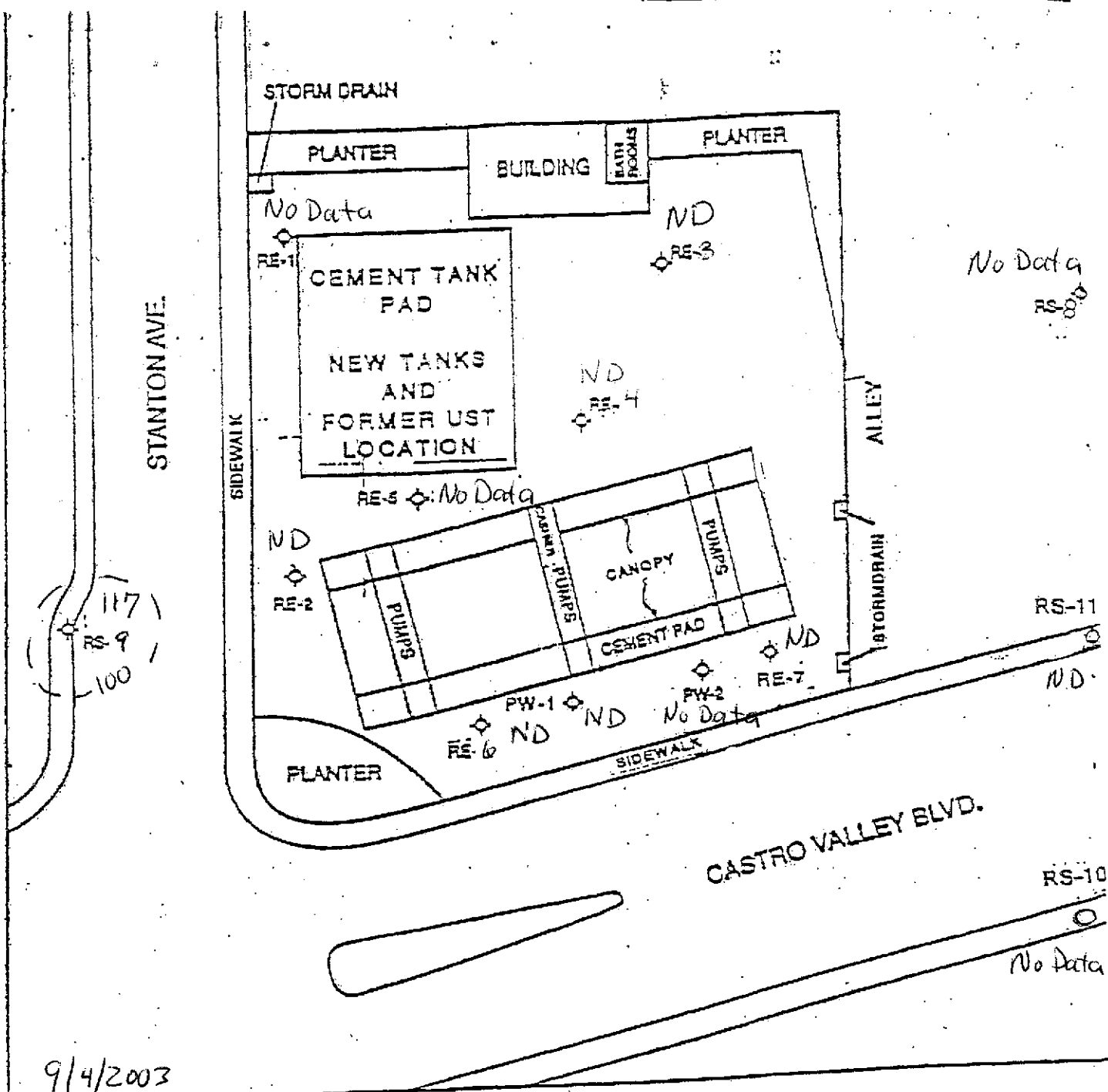

9/4/2003

ug/L  
 ND = Not Detected

TPH-g Isoconcentration Map  
 THRIFTY OIL CO. #054  
 CASTRO VALLEY, CALIFORNIA  
 Prepared for  
 THRIFTY OIL CO.  
 SANTA FE, SPRINGS  
 CALIFORNIA

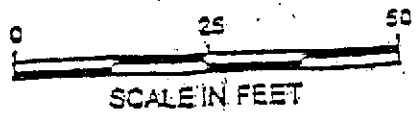

◊ EXISTING MONITORING WELL

FIGURE 2

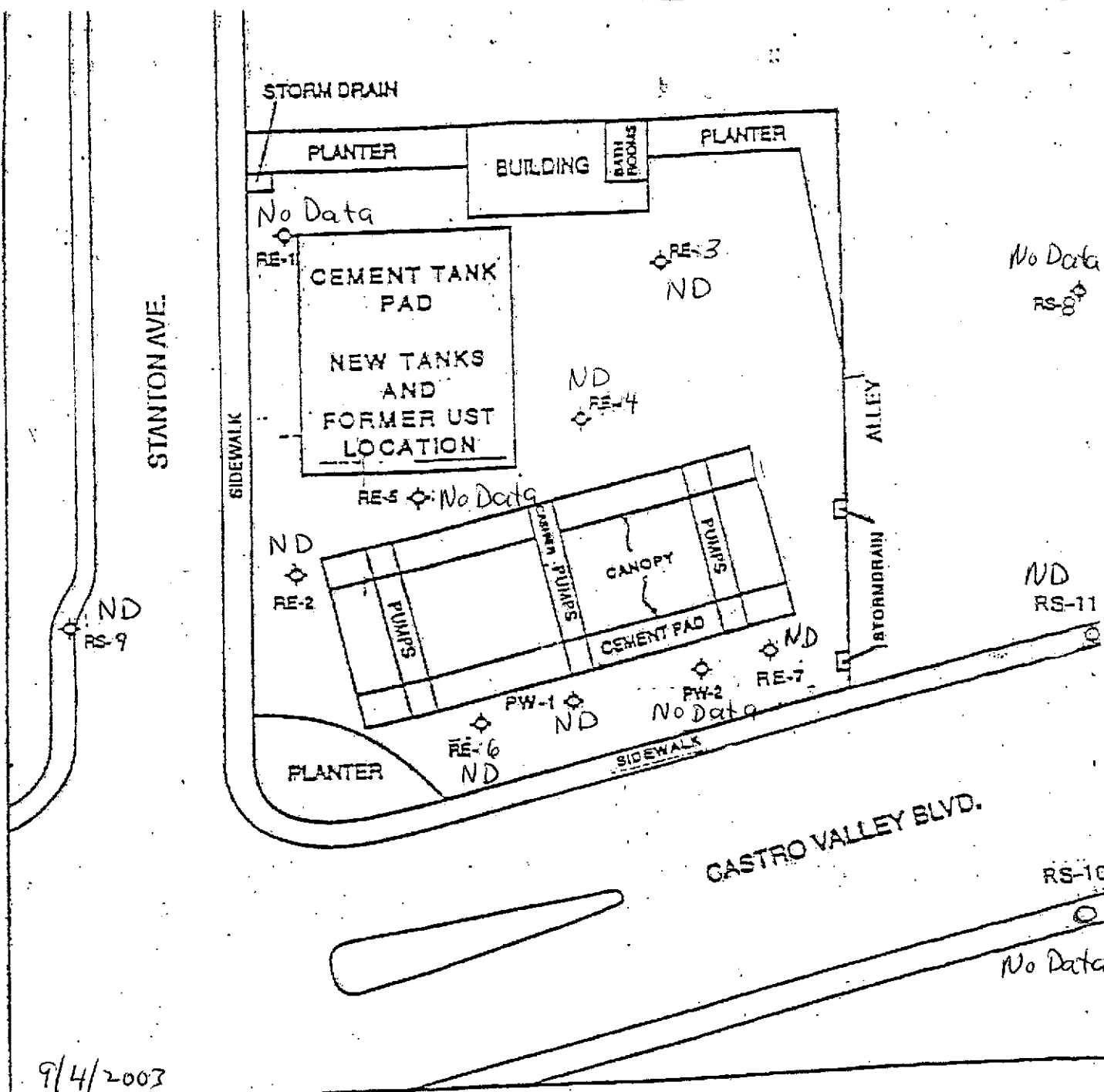

9/4/2003

ug/L  
 ND = Not Detected

Benzene Isoconcentration Map  
 THRIFTY OIL CO. #054  
 CASTRO VALLEY, CALIFORNIA  
 Prepared for  
 THRIFTY OIL CO.  
 SANTA FE, SPRINGS  
 CALIFORNIA

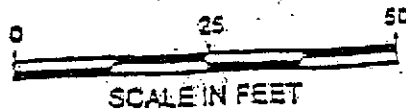

◉ EXISTING MONITORING WELL

FIGURE 3



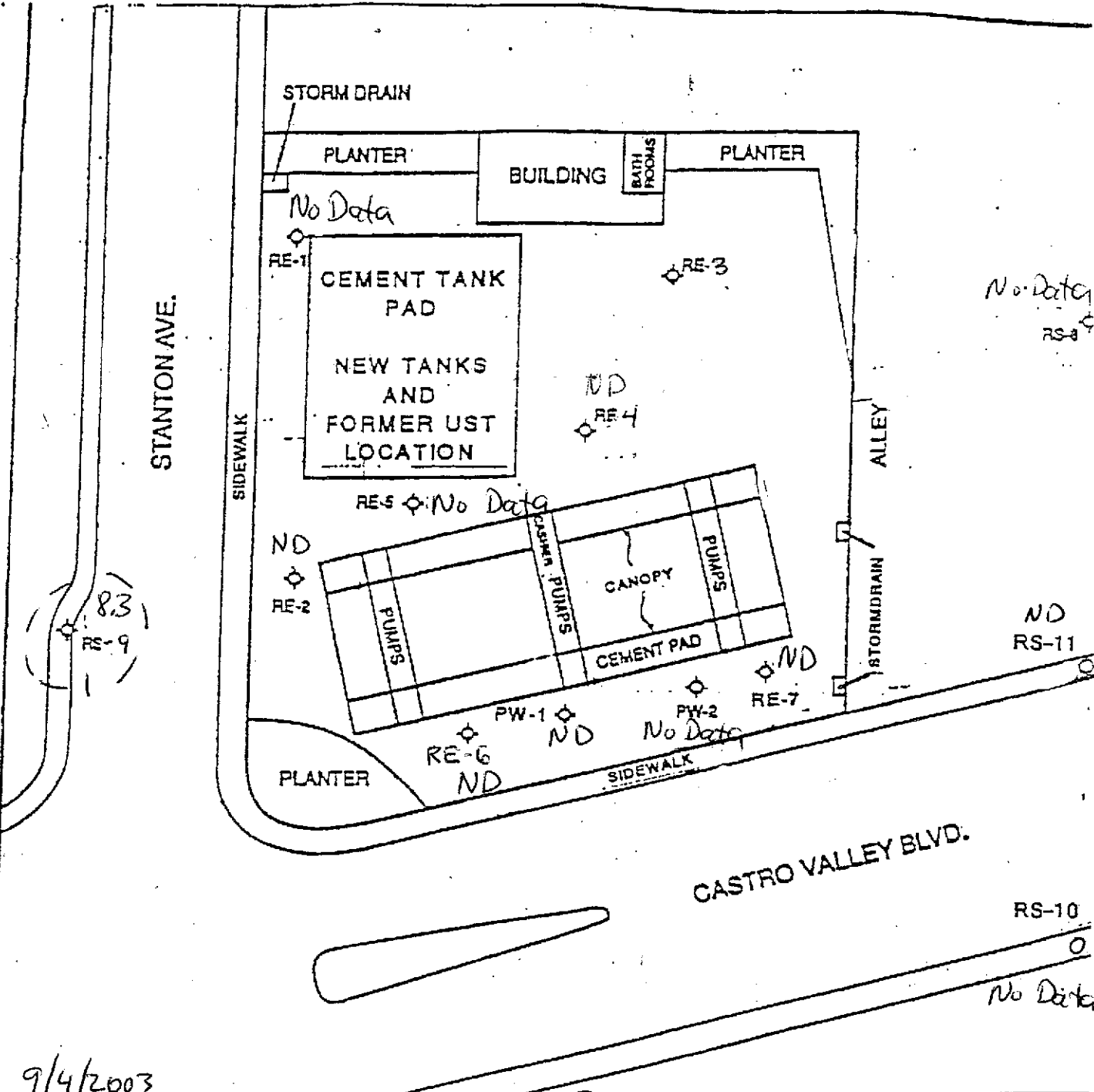

9/4/2003

ug/L  
 ND = Not Detected

MTBE ISOCONCENTRATION MAP ug/L  
 THRIFTY OIL CO. #054  
 CASTRO VALLEY, CALIFORNIA  
 Prepared for  
 THRIFTY OIL CO.  
 SANTA FE, SPRINGS  
 CALIFORNIA



◊ EXISTING MONITORING WELL

FIGURE 4

# ***APPENDIX A***





FIELD DATA - GROUNDWATER SAMPLING PROGRAM

Site: # 054	Date: 09-04-03
Address:	
Personnel: SERBAX	Weather: SUNNY DAY
Well No: RE-2	Equip: BAUER

Before Purging:			
Total Well Depth: (ft.)	16.96	Well Diameter	4"
Depth to Water (ft)	5.48	Est. Purge Volume:	30

Sampling Data:							
Initial Turbidity:				Final Turbidity:			
Time	9:10	9:15	9:20	9:25	9:30	9:35	9:40
EC	1700	1750	1770	1760	1730	1720	1720
pH	6.19	6.11	6.13	6.14	6.14	6.16	6.14
Temp	71.3	71.1	70.8	70.9	70.7	70.6	70.5
Gal.	4	8	12	17	21	25	30
Time							
EC							
pH							
Temp							
Gal.							

After Purging/Before Sample Collection	
Depth to Water (ft.)	9.03
Total Well Depth (ft.)	16.96

FIELD DATA - GROUNDWATER SAMPLING PROGRAM

Site: <u>W 054</u>	Date: <u>09-04-03</u>
Address: _____	
Personnel: <u>SEBBAN</u>	Weather: <u>SUNNY DAY</u>
Well No: <u>RE-3</u>	Equip: <u>BAILER</u>

<u>Before Purging:</u>			
Total Well Depth: (ft.)	<u>17.51</u>	Well Diameter	<u>4"</u>
Depth to Water (ft)	<u>5.26</u>	Est. Purge Volume:	<u>32</u>

<u>Sampling Data:</u>							
<u>Initial Turbidity:</u>				<u>Final Turbidity:</u>			
Time	<u>9:20</u>	<u>9:55</u>	<u>10:00</u>	<u>10:05</u>	<u>10:10</u>	<u>10:15</u>	<u>10:20</u>
C	<u>1610</u>	<u>1630</u>	<u>1620</u>	<u>1610</u>	<u>1600</u>	<u>1590</u>	<u>1610</u>
H	<u>6.13</u>	<u>6.16</u>	<u>6.15</u>	<u>6.16</u>	<u>6.13</u>	<u>6.11</u>	<u>6.13</u>
Temp	<u>71.5</u>	<u>71.2</u>	<u>71.1</u>	<u>70.8</u>	<u>70.7</u>	<u>70.6</u>	<u>70.4</u>
Sal.	<u>4</u>	<u>9</u>	<u>13</u>	<u>18</u>	<u>22</u>	<u>27</u>	<u>32</u>
Time							
C							
H							
Temp							
Sal.							

<u>After Purging/Before Sample Collection</u>	
Depth to Water (ft.)	<u>8.11</u>
Total Well Depth(ft).	<u>14.51</u>

FIELD DATA -GROUNDWATER SAMPLING PROGRAM

Site:	H 054	Date:	09-04-03
Address:			
Personnel:	SERBAH	Weather:	SUNNY DAY
Well No:	RE-4	Equip:	BAUER

<b>Before Purging:</b>			
Total Well Depth: (ft.)	14.50	Well Diameter	4"
Depth to Water (ft)	4.93	Est. Purge Volume:	25

<b>Sampling Data:</b>							
Initial Turbidity:				Final Turbidity:			
Time	10:34	10:38	10:42	10:47	10:51	10:55	11:00
EC	1210	1190	1170	1140	1130	1140	1130
pH	6.11	6.14	6.13	6.11	6.10	6.13	6.11
Temp	71.2	71.4	71.2	71.8	71.7	71.8	71.6
Gal.	3	7	10	14	17	21	25
Time							
EC							
pH							
Temp							
Gal.							

<b>After Purging/Before Sample Collection</b>	
Depth to Water (ft.)	7.06
Total Well Depth (ft.)	14.50

FIELD DATA - GROUNDWATER SAMPLING PROGRAM

Site: <u>H 054</u>	Date: <u>09-04-03</u>
Address: _____	
Personnel: <u>SERBAU</u>	Weather: <u>SUNNY DAY</u>
Well No: <u>RE-6</u>	Equip: <u>BAUER</u>

Before Purging:	
Total Well Depth: (ft.) <u>13.57</u>	Well Diameter <u>4"</u>
Depth to Water (ft) <u>5.92</u>	Est. Purge Volume: <u>20</u>

Sampling Data:							
Initial Turbidity:				Final Turbidity:			
Time	<u>11:51</u>	<u>11:54</u>	<u>11:58</u>	<u>12:01</u>	<u>12:04</u>	<u>12:07</u>	<u>12:10</u>
EC	<u>1300</u>	<u>1340</u>	<u>1320</u>	<u>1310</u>	<u>1320</u>	<u>1310</u>	<u>1320</u>
pH	<u>6.30</u>	<u>6.28</u>	<u>6.31</u>	<u>6.30</u>	<u>6.29</u>	<u>6.28</u>	<u>6.30</u>
Temp	<u>71.4</u>	<u>71.3</u>	<u>71.3</u>	<u>71.1</u>	<u>70.9</u>	<u>70.8</u>	<u>70.9</u>
Gal.	<u>2</u>	<u>5</u>	<u>8</u>	<u>11</u>	<u>14</u>	<u>17</u>	<u>20</u>
Time							
EC							
pH							
Temp							
Gal.							

After Purging/Before Sample Collection	TIME: <u>11:51</u> <u>AM/PM</u>
Depth to Water (ft.) <u>8.11</u>	Total Well Depth (ft.) <u>13.57</u>



FIELD DATA - GROUNDWATER SAMPLING PROGRAM

Site:	# 054	Date:	09-04-03
Address:			
Personnel:	SERBATA	Weather:	SUNNY DAY
Well No:	RE-7	Equip:	BAUER

Before Purging:			
Total Well Depth: (ft.)	13.13	Well Diameter	4"
Depth to Water (ft)	7.34	Est. Purge Volume:	15

Sampling Data:									
Initial Turbidity:				Final Turbidity:					
Time	11:07	11:09	11:11	11:13	11:15	11:17	11:20		
EC	1660	1660	1630	1620	1630	1610	1630		
pH	6.09	6.01	5.92	5.88	5.87	5.88	5.87		
Temp	71.4	71.6	71.4	71.1	70.9	70.7	70.6		
Gal.	2	4	6	8	10	12	15		
Time									
EC									
pH									
Temp									
Gal.									

After Purging/Before Sample Collection	TIME: 11:07	AM/PM
Depth to Water (ft.)	9.11	Total Well Depth(ft.) 13.13

FIELD DATA - GROUNDWATER SAMPLING PROGRAM

Site:	# 054	Date:	09-04-03
Address:			
Personnel:	SERBAH	Weather:	SUNNY DAY
Well No:	RS-9	Equip:	BAILER

<b>Before Purging:</b>			
Total Well Depth: (ft.)	14.94	Well Diameter	2"
Depth to Water (ft)	4.21	Est. Purge Volume:	7

Sampling Data:							
Initial Turbidity:				Final Turbidity:			
Time	12:12	12:14	12:15	12:16	12:17	12:18	12:20
EC	1920	1940	1920	1930	1910	1930	1910
pH	6.11	6.18	6.19	6.21	6.18	6.19	6.18
Temp	72.1	72.3	72.1	71.8	71.7	71.6	71.6
Gal.	1	2	3	4	5	6	7
Time							
EC							
pH							
Temp							
Gal.							

After Purging/Before Sample Collection	TIME:	12:12	AM/PM
Depth to Water (ft.)	1.06	Total Well Depth(ft).	14.94

FIELD DATA - GROUNDWATER SAMPLING PROGRAM

Site:	# 054	Date:	09-04-03
Address:			
Personnel:	SERBATH,	Weather:	SUNNY DAY
Well No:	RS-11	Equip:	BAILER

<b>Before Purging:</b>			
Total Well Depth: (ft.)	24.72	Well Diameter	2'
Depth to Water (ft)	7.85	Est. Purge Volume:	11

Sampling Data:							
Initial Turbidity:				Final Turbidity:			
Time	11:23	11:25	11:28	11:31	11:34	11:37	11:40
EC	1310	1340	1320	1320	1310	1330	1320
pH	6.19	6.16	6.18	6.23	6.16	6.19	6.16
Temp	71.0	71.3	71.2	71.1	71.2	70.9	70.8
Gal.	1	3	4	6	7	9	11
Time							
EC							
pH							
Temp							
Gal.							

After Purging/Before Sample Collection	TIME: 12:25	AM/PM
Depth to Water (ft.)	12.03	Total Well Depth(ft). 24.72

***APPENDIX B***



**ASSOCIATED LABORATORIES**

806 North Batavia - Orange, California 92868 - 714/771-6900

FAX 714/538-1209

CLIENT Thrifty Oil Co. (8871)  
ATTN: Jeff Suryakusuma  
13116 Imperial Hwy.  
P.O. Box 2128  
Santa Fe Springs, CA 90670

LAB REQUEST 116488  
REPORTED 09/15/2003  
RECEIVED 09/05/2003

PROJECT Station #054  
2504 Castro Valley, Castro Valley

SUBMITTER Client

COMMENTS

This laboratory request covers the following listed samples which were analyzed for the parameters indicated on the attached Analytical Result Report. All analyses were conducted using the appropriate methods as indicated on the report. This cover letter is an integral part of the final report.

<u>Order No.</u>	<u>Client Sample Identification</u>
461166	TOC #054, PW-1
461167	TOC #054, RE-2
461168	TOC #054, RE-3
461169	TOC #054, RE-4
461170	TOC #054, RE-7
461171	TOC #054, RS-11
461172	TOC #054, RE-6
461173	TOC #054, RE-9
461174	TOC #054, Trip Blank
461175	Laboratory Method Blank

I thank you for the opportunity to be of service to your company. Please feel free to call if there are any questions regarding this report or if we can be of further service.

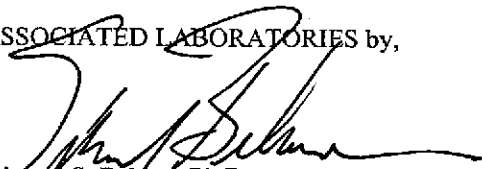
ASSOCIATED LABORATORIES by,  
  
Edward S. Behare, Ph.D.  
Vice President

NOTE: Unless notified in writing, all samples will be discarded by appropriate disposal protocol 30 days from date reported.

The reports of the Associated Laboratories are confidential property of our clients and may not be reproduced or used for publication in part or in full without our written permission. This is for the mutual protection of the public, our clients, and ourselves.

TESTING & CONSULTING  
Chemical  
Microbiological  
Environmental

Order #: 461166

Client Sample ID: TOC #054, PW-1

Matrix: WATER

Date Sampled: 09/04/2003 Time Sampled: 14:00

Analyte	Result	DF	PQL	MDL	Units	Date/Analyst
<b>8260B BTEX/MTBE Only</b>						
Benzene	ND	1	1	0.22	ug/L	09/11/03 LB
Ethyl benzene	ND	1	5	0.31	ug/L	09/11/03 LB
Ethyl-tertbutylether (ETBE)	ND	1	1	0.17	ug/L	09/11/03 LB
Isopropyl ether (DIPE)	ND	1	1	0.29	ug/L	09/11/03 LB
Methyl-tert-butylether (MTBE)	ND	1	1	0.18	ug/L	09/11/03 LB
Tert-amylmethylether (TAME)	ND	1	1	0.28	ug/L	09/11/03 LB
Tertiary butyl alcohol (TBA)	ND	1	10	10	ug/L	09/11/03 LB
Toluene	ND	1	5	0.32	ug/L	09/11/03 LB
Xylenes, total	ND	1	5	0.4	ug/L	09/11/03 LB
<b>Surrogates</b>						
					<b>Units</b>	<b>Control Limits</b>
Surr1 - Dibromofluoromethane	101				%	70 - 130
Surr2 - 1,2-Dichloroethane-d4	114				%	70 - 130
Surr3 - Toluene-d8	99				%	70 - 130
Surr4 - p-Bromofluorobenzene	102				%	70 - 130
<b>D285 Ethanol / Methanol by GC-FID</b>						
Ethanol	ND	1	50	20	mg/L	09/09/03 QN
Methanol	ND	1	50	20	mg/L	09/09/03 QN
<b>8015M - Gasoline</b>						
Gasoline	ND	1	50	15	ug/L	09/09/03 LZ
<b>Surrogates</b>						
					<b>Units</b>	<b>Control Limits</b>
a,a,a-Trifluorotoluene	85				%	55 - 200

PQL = Practical Quantitation Limit, MDL = Method detection limit, DF = Dilution Factor  
 ND = Not detected below indicated MDL, J=Trace



Order #: 461167

Client Sample ID: TOC #054, RE-2

Matrix: WATER

Date Sampled: 09/04/2003 Time Sampled: 14:10

Analyte	Result	DF	PQL	MDL	Units	Date/Analyst
<b>8260B BTEX/MTBE Only</b>						
Benzene	ND	1	1	0.22	ug/L	09/11/03 LB
Ethyl benzene	ND	1	5	0.31	ug/L	09/11/03 LB
Ethyl-tertbuylether (ETBE)	ND	1	1	0.17	ug/L	09/11/03 LB
Isopropyl ether (DIPE)	ND	1	1	0.29	ug/L	09/11/03 LB
Methyl-tert-butylether (MTBE)	ND	1	1	0.18	ug/L	09/11/03 LB
Tert-amylmethylether (TAME)	ND	1	1	0.28	ug/L	09/11/03 LB
Tertiary butyl alcohol (TBA)	ND	1	10	10	ug/L	09/11/03 LB
Toluene	ND	1	5	0.32	ug/L	09/11/03 LB
Xylenes, total	ND	1	5	0.4	ug/L	09/11/03 LB
<b>Surrogates</b>						
					<b>Units</b>	<b>Control Limits</b>
Surr1 - Dibromofluoromethane	100				%	70 - 130
Surr2 - 1,2-Dichloroethane-d4	114				%	70 - 130
Surr3 - Toluene-d8	100				%	70 - 130
Surr4 - p-Bromofluorobenzene	100				%	70 - 130
<b>D285 Ethanol / Methanol by GC-FID</b>						
Ethanol	ND	1	50	20	mg/L	09/09/03 QN
Methanol	ND	1	50	20	mg/L	09/09/03 QN
<b>8015M - Gasoline</b>						
Gasoline	ND	1	50	15	ug/L	09/09/03 LZ
<b>Surrogates</b>						
					<b>Units</b>	<b>Control Limits</b>
a,a,a-Trifluorotoluene	85				%	55 - 200

PQL = Practical Quantitation Limit, MDL = Method detection limit, DF = Dilution Factor  
 ND = Not detected below indicated MDL, J=Trace



Order #: 461168

Client Sample ID: TOC #054, RE-3

Matrix: WATER

Date Sampled: 09/04/2003 Time Sampled: 14:20

Analyte	Result	DF	PQL	MDL	Units	Date/Analyst
<b>8260B BTEX/MTBE Only</b>						
Benzene	ND	1	1	0.22	ug/L	09/11/03 LB
Ethyl benzene	ND	1	5	0.31	ug/L	09/11/03 LB
Ethyl-tertbutylether (ETBE)	ND	1	1	0.17	ug/L	09/11/03 LB
Isopropyl ether (DIPE)	ND	1	1	0.29	ug/L	09/11/03 LB
Methyl-tert-butylether (MTBE)	ND	1	1	0.18	ug/L	09/11/03 LB
Tert-amylmethylether (TAME)	ND	1	1	0.28	ug/L	09/11/03 LB
Tertiary butyl alcohol (TBA)	ND	1	10	10	ug/L	09/11/03 LB
Toluene	ND	1	5	0.32	ug/L	09/11/03 LB
Xylenes, total	ND	1	5	0.4	ug/L	09/11/03 LB
<b>Surrogates</b>				<b>Units</b>	<b>Control Limits</b>	
Surr1 - Dibromofluoromethane	103			%	70 - 130	
Surr2 - 1,2-Dichloroethane-d4	116			%	70 - 130	
Surr3 - Toluene-d8	100			%	70 - 130	
Surr4 - p-Bromofluorobenzene	102			%	70 - 130	
<b>D285 Ethanol / Methanol by GC-FID</b>						
Ethanol	ND	1	50	20	mg/L	09/09/03 QN
Methanol	ND	1	50	20	mg/L	09/09/03 QN
<b>8015M - Gasoline</b>						
Gasoline	ND	1	50	15	ug/L	09/09/03 LZ
<b>Surrogates</b>				<b>Units</b>	<b>Control Limits</b>	
a,a,a-Trifluorotoluene	85			%	55 - 200	

PQL = Practical Quantitation Limit, MDL = Method detection limit, DF = Dilution Factor  
 ND = Not detected below indicated MDL, J=Trace





Order #: 461169

Client Sample ID: TOC #054, RE-4

Matrix: WATER

Date Sampled: 09/04/2003 Time Sampled: 14:25

Analyte	Result	DF	PQL	MDL	Units	Date/Analyst
---------	--------	----	-----	-----	-------	--------------

**8260B BTEX/MTBE Only**

Benzene	ND	1	1	0.22 ug/L	09/11/03 LB
Ethyl benzene	ND	1	5	0.31 ug/L	09/11/03 LB
Ethyl-tertbutylether (ETBE)	ND	1	1	0.17 ug/L	09/11/03 LB
Isopropyl ether (DIPE)	ND	1	1	0.29 ug/L	09/11/03 LB
Methyl-tert-butylether (MTBE)	ND	1	1	0.18 ug/L	09/11/03 LB
Tert-amylmethylether (TAME)	ND	1	1	0.28 ug/L	09/11/03 LB
Tertiary butyl alcohol (TBA)	ND	1	10	10 ug/L	09/11/03 LB
Toluene	ND	1	5	0.32 ug/L	09/11/03 LB
Xylenes, total	ND	1	5	0.4 ug/L	09/11/03 LB

**Surrogates**

				Units	Control Limits
Surr1 - Dibromofluoromethane	109			%	70 - 130
Surr2 - 1,2-Dichloroethane-d4	110			%	70 - 130
Surr3 - Toluene-d8	100			%	70 - 130
Surr4 - p-Bromofluorobenzene	101			%	70 - 130

**D285 Ethanol / Methanol by GC-FID**

Ethanol	ND	1	50	20 mg/L	09/09/03 QN
Methanol	ND	1	50	20 mg/L	09/09/03 QN

**8015M - Gasoline**

Gasoline	ND	1	50	15 ug/L	09/09/03 LZ
----------	----	---	----	---------	-------------

**Surrogates**

				Units	Control Limits
a,a,a-Trifluorotoluene	85			%	55 - 200

PQL = Practical Quantitation Limit, MDL = Method detection limit, DF = Dilution Factor  
 ND = Not detected below indicated MDL, J=Trace



Order #: 461170

Client Sample ID: TOC #054, RE-7

Matrix: WATER

Date Sampled: 09/04/2003 Time Sampled: 14:30

Analyte	Result	DF	PQL	MDL	Units	Date/Analyst
<b>8260B BTEX/MTBE Only</b>						
Benzene	ND	1	1	0.22	ug/L	09/11/03 LB
Ethyl benzene	ND	1	5	0.31	ug/L	09/11/03 LB
Ethyl-tertbutylether (ETBE)	ND	1	1	0.17	ug/L	09/11/03 LB
Isopropyl ether (DIPE)	ND	1	1	0.29	ug/L	09/11/03 LB
Methyl-tert-butylether (MTBE)	ND	1	1	0.18	ug/L	09/11/03 LB
Tert-amylmethylether (TAME)	ND	1	1	0.28	ug/L	09/11/03 LB
Tertiary butyl alcohol (TBA)	ND	1	10	10	ug/L	09/11/03 LB
Toluene	ND	1	5	0.32	ug/L	09/11/03 LB
Xylenes, total	ND	1	5	0.4	ug/L	09/11/03 LB
<b>Surrogates</b>						
					<b>Units</b>	<b>Control Limits</b>
Surr1 - Dibromofluoromethane	108				%	70 - 130
Surr2 - 1,2-Dichloroethane-d4	113				%	70 - 130
Surr3 - Toluene-d8	100				%	70 - 130
Surr4 - p-Bromofluorobenzene	100				%	70 - 130
<b>D285 Ethanol / Methanol by GC-FID</b>						
Ethanol	ND	1	50	20	mg/L	09/09/03 QN
Methanol	ND	1	50	20	mg/L	09/09/03 QN
<b>8015M - Gasoline</b>						
Gasoline	ND	1	50	15	ug/L	09/09/03 LZ
<b>Surrogates</b>						
					<b>Units</b>	<b>Control Limits</b>
a,a,a-Trifluorotoluene	87				%	55 - 200

PQL = Practical Quantitation Limit, MDL = Method detection limit, DF = Dilution Factor  
 ND = Not detected below indicated MDL, J=Trace



Order #: 461171

Client Sample ID: TOC #054, RS-11

Matrix: WATER

Date Sampled: 09/04/2003 Time Sampled: 14:40

Analyte	Result	DF	PQL	MDL	Units	Date/Analyst
---------	--------	----	-----	-----	-------	--------------

**8260B BTEX/MTBE Only**

Benzene	ND	1	1	0.22 ug/L	09/13/03 LB
Ethyl benzene	ND	1	5	0.31 ug/L	09/13/03 LB
Ethyl-tertbutylether (ETBE)	ND	1	1	0.17 ug/L	09/13/03 LB
Isopropyl ether (DIPE)	ND	1	1	0.29 ug/L	09/13/03 LB
Methyl-tert-butylether (MTBE)	ND	1	1	0.18 ug/L	09/13/03 LB
Tert-amylmethylether (TAME)	ND	1	1	0.28 ug/L	09/13/03 LB
Tertiary butyl alcohol (TBA)	ND	1	10	10 ug/L	09/13/03 LB
Toluene	ND	1	5	0.32 ug/L	09/13/03 LB
Xylenes, total	ND	1	5	0.4 ug/L	09/13/03 LB

**Surrogates**

				Units	Control Limits
Surr1 - Dibromofluoromethane	97			%	70 - 130
Surr2 - 1,2-Dichloroethane-d4	108			%	70 - 130
Surr3 - Toluene-d8	104			%	70 - 130
Surr4 - p-Bromofluorobenzene	93			%	70 - 130

**D285 Ethanol / Methanol by GC-FID**

Ethanol	ND	1	50	20 mg/L	09/09/03 QN
Methanol	ND	1	50	20 mg/L	09/09/03 QN

**8015M - Gasoline**

Gasoline	ND	1	50	15 ug/L	09/09/03 LZ
----------	----	---	----	---------	-------------

**Surrogates**

				Units	Control Limits
a,a,a-Trifluorotoluene	96			%	55 - 200

PQL = Practical Quantitation Limit, MDL = Method detection limit, DF = Dilution Factor  
 ND = Not detected below indicated MDL, J=Trace



Order #: 461172

Client Sample ID: TOC #054, RE-6

Matrix: WATER

Date Sampled: 09/04/2003 Time Sampled: 14:50

Analyte	Result	DF	PQL	MDL	Units	Date/Analyst
---------	--------	----	-----	-----	-------	--------------

**8260B BTEX/MTBE Only**

Benzene	ND	1	1	0.22	ug/L	09/13/03 LB
Ethyl benzene	ND	1	5	0.31	ug/L	09/13/03 LB
Ethyl-tertbutylether (ETBE)	ND	1	1	0.17	ug/L	09/13/03 LB
Isopropyl ether (DIPE)	ND	1	1	0.29	ug/L	09/13/03 LB
Methyl-tert-butylether (MTBE)	ND	1	1	0.18	ug/L	09/13/03 LB
Tert-amylmethylether (TAME)	ND	1	1	0.28	ug/L	09/13/03 LB
Tertiary butyl alcohol (TBA)	ND	1	10	10	ug/L	09/13/03 LB
Toluene	ND	1	5	0.32	ug/L	09/13/03 LB
Xylenes, total	ND	1	5	0.4	ug/L	09/13/03 LB

**Surrogates**

				Units	Control Limits
Surr1 - Dibromofluoromethane	97			%	70 - 130
Surr2 - 1,2-Dichloroethane-d4	104			%	70 - 130
Surr3 - Toluene-d8	104			%	70 - 130
Surr4 - p-Bromofluorobenzene	97			%	70 - 130

**D285 Ethanol / Methanol by GC-FID**

Ethanol	ND	1	50	20	mg/L	09/09/03 QN
Methanol	ND	1	50	20	mg/L	09/09/03 QN

**8015M - Gasoline**

Gasoline	ND	1	50	15	ug/L	09/09/03 LZ
----------	----	---	----	----	------	-------------

**Surrogates**

				Units	Control Limits
a,a,a-Trifluorotoluene	ND			%	55 - 200

PQL = Practical Quantitation Limit, MDL = Method detection limit, DF = Dilution Factor  
 ND = Not detected below indicated MDL, J=Trace



Order #: 461173

Client Sample ID: TOC #054, RE-9

Matrix: WATER

Date Sampled: 09/04/2003 Time Sampled: 15:00

Analyte	Result	DF	PQL	MDL	Units	Date/Analyst
---------	--------	----	-----	-----	-------	--------------

**8260B BTEX/MTBE Only**

Benzene	ND	1	1	0.22	ug/L	09/14/03 LB
Ethyl benzene	ND	1	5	0.31	ug/L	09/14/03 LB
Ethyl-tertbutylether (ETBE)	ND	1	1	0.17	ug/L	09/14/03 LB
Isopropyl ether (DIPE)	ND	1	1	0.29	ug/L	09/14/03 LB
Methyl-tert-butylether (MTBE)	8.3	1	1	0.18	ug/L	09/14/03 LB
Tert-amylmethylether (TAME)	ND	1	1	0.28	ug/L	09/14/03 LB
Tertiary butyl alcohol (TBA)	ND	1	10	10	ug/L	09/14/03 LB
Toluene	ND	1	5	0.32	ug/L	09/14/03 LB
Xylenes, total	13	1	5	0.4	ug/L	09/14/03 LB

**Surrogates**

				Units	Control Limits
Surr1 - Dibromofluoromethane	102			%	70 - 130
Surr2 - 1,2-Dichloroethane-d4	110			%	70 - 130
Surr3 - Toluene-d8	102			%	70 - 130
Surr4 - p-Bromofluorobenzene	99			%	70 - 130

**D285 Ethanol / Methanol by GC-FID**

Ethanol	ND	1	50	20	mg/L	09/09/03 QN
Methanol	ND	1	50	20	mg/L	09/09/03 QN

**8015M - Gasoline**

Gasoline	117	1	50	15	ug/L	09/10/03 LZ
----------	-----	---	----	----	------	-------------

**Surrogates**

				Units	Control Limits
a,a,a-Trifluorotoluene	90			%	55 - 200

PQL = Practical Quantitation Limit, MDL = Method detection limit, DF = Dilution Factor  
 ND = Not detected below indicated MDL, J=Trace



Order #: 461174

Client Sample ID: TOC #054, Trip Blank

Matrix: WATER

Date Sampled: 09/04/2003 Time Sampled: 14:00

Analyte	Result	DF	PQL	MDL	Units	Date/Analyst
<b>8260B BTEX/MTBE Only</b>						
Benzene	ND	1	1	0.22	ug/L	09/13/03 LB
Ethyl benzene	ND	1	5	0.31	ug/L	09/13/03 LB
Toluene	ND	1	5	0.32	ug/L	09/13/03 LB
Xylenes, total	ND	1	5	0.4	ug/L	09/13/03 LB
<b>8015M - Gasoline</b>						
Gasoline	ND	1	50	15	ug/L	09/10/03 LZ
<b>Surrogates</b>						
a,a,a-Trifluorotoluene	87				%	55 - 200

PQL = Practical Quantitation Limit, MDL = Method detection limit, DF = Dilution Factor  
ND = Not detected below indicated MDL, J=Trace



Order #: 461175

Client Sample ID: Laboratory Method Blank

Matrix: WATER

Analyte	Result	DF	PQL	MDL	Units	Date/Analyst
---------	--------	----	-----	-----	-------	--------------

**8260B BTEX/MTBE Only**

Benzene	ND	1	1	0.22 ug/L	09/10/03 LB
Ethyl benzene	ND	1	5	0.31 ug/L	09/10/03 LB
Ethyl-tertbuylether (ETBE)	ND	1	1	0.17 ug/L	09/10/03 LB
Isopropyl ether (DIPE)	ND	1	1	0.29 ug/L	09/10/03 LB
Methyl-tert-butylether (MTBE)	ND	1	1	0.18 ug/L	09/10/03 LB
Tert-amylmethylether (TAME)	ND	1	1	0.28 ug/L	09/10/03 LB
Tertiary-butyl alcohol (TBA)	ND	1	10	10 ug/L	09/10/03 LB
Toluene	ND	1	5	0.32 ug/L	09/10/03 LB
Xylenes, total	ND	1	5	0.4 ug/L	09/10/03 LB

**Surrogates**

				Units	Control Limits
Surr1 - Dibromofluoromethane	101			%	70 - 130
Surr2 - 1,2-Dichloroethane-d4	112			%	70 - 130
Surr3 - Toluene-d8	101			%	70 - 130
Surr4 - p-Bromofluorobenzene	102			%	70 - 130

**D285 Ethanol / Methanol by GC-FID**

Ethanol	ND	1	50	20 mg/L	09/09/03 QN
Methanol	ND	1	50	20 mg/L	09/09/03 QN

**8015M - Gasoline**

Gasoline	ND	1	50	15 ug/L	09/09/03 LZ
----------	----	---	----	---------	-------------

**Surrogates**

				Units	Control Limits
a,a,a-Trifluorotoluene	97			%	55 - 200

PQL = Practical Quantitation Limit, MDL = Method detection limit, DF = Dilution Factor

ND = Not detected below indicated MDL, J=Trace



**ASSOCIATED LABORATORIES  
QA REPORT FORM**

QC Sample: LCS / LCSD  
 Matrix: WATER  
 Prep. Date: 09/09/03  
 Analysis Date: 09/09/03-09/10/03  
 ID#'s in Batch: LR 116488, 116551, 116568, 116484

Reporting Units = mg/L

**PREPARATION BLANK / LAB CONTROL SAMPLE RESULTS**

			PREP BLK					
			Value	Result	True	%Rec	L.Limit	H.Limit
Test	Method	LCS	ND	510	500	102	80%	120%
TPH	8015M-G	LCSD	ND	554	500	111	80%	120%

*LCS Result = Lab Control Sample Result*

*True = True Value of LCS*

*L.Limit / H.Limit = LCS Control Limits*

**SURROGATE RECOVERY**

Sample No.	AAA-TFT
QC Limit	55-200
Method Blank	97
LCS	146
LCSD	186

*AAA-TFT = a,a,a-Trifluorotoluene*



ASSOCIATED LABORATORIES  
LCS REPORT FORM

QC Sample: LCS / LCSD  
 Matrix: WATER  
 Prep. Date: 09/09/03  
 Analysis Date: 09/09/03  
 ID#'s in Batch: LR 116484;LR 116488

**LAB CONTROL SPIKE / LAB CONTROL SPIKE DUPLICATE RESULT**

Reporting Units = mg/L

Test	Method	Blank Result	Spike Added	LCS Spike	LCSD Spike Dup	%Rec LCS	%Rec LCSD	% RPD
Methanol	D285	ND	100	104.7	96.8	105	97	8
Ethanol	D285	ND	100	101.8	100.0	102	100	2

*RPD = Relative Percent Difference of LCS Spike and LCS Spike Duplicate*  
*%REC-LCS & LCSD = Percent Recovery of LCS Spike & LCS Spike Duplicate*

<p><i>% REC LIMITS = 70 - 130</i>  <i>RPD LIMITS = 25</i></p>
-------------------------------------------------------------------

**Method Blank - All ND**

ASSOCIATED LABORATORIES  
LCS REPORT FORM - METHOD 8260 / 624 / 524.2

QC Sample: LCS/LCSD - Water Samples

Analysis Date: 09/10/03

Applies to: LR 116363, 116362, 116488

Reporting Units = ug/L

**Lab Controlled Spike / Lab Controlled Spike Duplicate**

Test	Sample Result	Spike Added	LCS Spike	LCS Spk. Dup	%Rec LCS	%Rec LCS D	RPD	QC Limits	
								RPD	%REC
1,1-Dichloroethene	ND	50	58.40	58.92	117	118	1	22	59-172
MTBE	ND	50	59.40	59.25	119	119	0	24	62-137
Benzene	ND	50	60.61	60.03	121	120	1	24	62-137
Trichloroethene	ND	50	59.85	59.31	120	119	1	21	66-142
Toluene	ND	50	59.28	57.26	119	115	3	21	59-139
Chlorobenzene	ND	50	59.35	56.60	119	113	5	21	60-133

Method Blank = All ND

**SURROGATE ( QC Limits : 70-130 )**

Compounds	DBFM	1,2-DCA	Tol-d8	p-BFB
LCS	104	108	98	100
LCSD	103	105	98	95
BLANK # 1	101	112	101	102

ASSOCIATED LABORATORIES  
LCS REPORT FORM - METHOD 8260 / 624 / 524.2

QC Sample: LCS/LCSD - Water Samples

Analysis Date: 09/13/03

Applies to: LR 116462, 116362, 116488

Reporting Units = ug/L

**Lab Controlled Spike / Lab Controlled Spike Duplicate**

Test	Sample Result	Spike Added	LCS Spike	LCS Spk. Dup	%Rec LCS	%Rec LCS D	RPD	QC Limits	
								RPD	%REC
1,1-Dichloroethene	ND	50	52.35	55.13	105	110	5	22	59-172
MTBE	ND	50	52.35	55.69	105	111	6	24	62-137
Benzene	ND	50	53.78	55.95	108	112	4	24	62-137
Trichloroethene	ND	50	57.45	60.89	115	122	6	21	66-142
Toluene	ND	50	55.11	59.27	110	119	7	21	59-139
Chlorobenzene	ND	50	54.32	57.25	109	115	5	21	60-133

Method Blank = All ND

**SURROGATE ( QC Limits : 70-130 )**

Compounds	DBFM	1,2-DCA	Tol-d8	p-BFB
LCS	101	102	101	95
LCSD	100	104	102	97
BLANK # 3	99	110	104	99

ASSOCIATED LABORATORIES  
LCS REPORT FORM - METHOD 8260 / 624 / 524.2

QC Sample: LCS/LCSD - Water Samples

Analysis Date: 09/14/03-09/15/03-09/20/03

Applies to: LR 116663, 116488

Reporting Units = ug/L

**Lab Controlled Spike / Lab Controlled Spike Duplicate**

Test	Sample Result	Spike Added	LCS Spike	LCS Spk. Dup	%Rec LCS	%Rec LCS D	RPD	QC Limits	
								RPD	%REC
1,1-Dichloroethene	ND	50	58.61	57.21	117	114	2	22	59-172
MTBE	ND	50	58.97	58.23	118	116	1	24	62-137
Benzene	ND	50	58.94	57.74	118	115	2	24	62-137
Trichloroethene	ND	50	62.87	61.03	126	122	3	21	66-142
Toluene	ND	50	62.64	59.16	125	118	6	21	59-139
Chlorobenzene	ND	50	60.72	57.38	121	115	6	21	60-133

Method Blank = All ND

**SURROGATE ( QC Limits : 70-130 )**

Compounds	DBFM	1,2-DCA	Tol-d8	p-BFB
LCS	102	105	102	101
LCSD	102	104	102	98
BLANK # 1	100	111	103	99

# Chain of Custody Record

**ASSOCIATED LABORATORIES**

806 North Batavia • Orange, CA 92868

Phone: (714) 771-6900 • Fax: (714) 538-1209



Company <b>THRIFTY OIL CO.</b>		Phone <b>(562) 921-3581</b>		A.L. Job No. <b>116488</b>		Page <b>1</b> of <b>1</b>			
Project Manager <b>JEFF JURYANUSUMU</b>		Fax <b>(562) 921-7510</b>		Analysis Requested				Test Instructions & Comments	
Project Name <b>Q. W. S.</b>		Project # <b>054</b>							
Site Name and Address <b>2504 CASTRO VALLEY BLVD. CASTRO VALLEY, CA. 94546</b>				TPH (8015) BTEX (8020) OXYGENATE				<b>TO600101363</b>	
Sample ID	Lab ID	Date	Time	Matrix	Container Number/Size	Pres.			
1 - PW-1		09-04-03	14:00	H <sub>2</sub> O	3VOA	HCL	X	X	X
2 - RE-2		↑	14:10	↑	↑	↑	X	X	X
3 - RE-3		↑	14:20	↑	↑	↑	X	X	X
4 - RE-4		↑	14:25	↑	↑	↑	X	X	X
5 - RE-7		↑	14:30	↑	↑	↑	X	X	X
6 - RS-M		↑	14:40	↑	↑	↑	X	X	X
7 - RE-6		↑	14:50	↑	↓	↓	X	X	X
8 - RE-9		↓	15:00	↓	↓	↓	X	X	X
9 - TRIP BLANK		↓	14:00	↓	2VOA	HCL	X	X	
10									
11									
12									
13									
14									
15									

Sample Receipt - To Be Filled By Laboratory				Relinquished by Sampler: <b>THRIFTY</b>	Relinquished by <b>GOLDEN STATE</b>	Relinquished by
Total Number of Containers	<b>26</b>	Properly Cooled Y / N / NA	<b>Y</b>	Signature: <i>[Signature]</i>	Signature: <b>OVERNIGHT</b>	Signature:
Custody Seals Y / N / NA	<b>N</b>	Samples Intact Y / N / NA	<b>Y</b>	Printed Name: <b>SERBAPOPICU</b>	Printed Name:	Printed Name:
Received in Good Condition Y / N	<b>Y</b>	Samples Accepted Y / N	<b>Y</b>	Date: <b>09-04-03</b> Time: <b>17:30</b>	Date: Time:	Date: Time:
Turn Around Time				Received By: <b>GOLDEN STATE</b>	Received By: <b>2</b>	Received By: <b>3</b>
<input checked="" type="checkbox"/> Normal <input type="checkbox"/> Rush <input type="checkbox"/> Same Day <input type="checkbox"/> 48 hrs. <input type="checkbox"/> 24 hrs. <input type="checkbox"/> 72 hrs.				Signature: <b>OVERNIGHT</b>	Signature: <i>[Signature]</i>	Signature:
				Printed Name:	Printed Name: <b>Copeland Okune</b>	Printed Name:
				Date: Time:	Date: <b>9/05/03</b> Time: <b>10:00am</b>	Date: <b>9-8-03</b> Time: <b>9:57</b>