

THRIFTY OIL CO.

July 31, 2002

Mr. Amer Gholami
Alameda County Health Care Agency
Hazardous Material Specialist
1131 Harbor Bay Parkway, Suite 250
Alameda, CA 94502

O.29939

Local #1252
Global ID #T0600101363
Confirmation #4372052788

STW
1252 ✓

RE: **Former Thrifty Oil Co. #054**
Tosco Marketing Company Station #2602486
2504 Castro Valley Boulevard
Castro Valley, CA 94541
2nd Quarter 2002, Status Report

Attn: ACHCA
AUG 06 2002
AG

Dear Mr. Gholami:

Presented herewith is the Second Quarter 2002, Status Report for Thrifty Oil Co. (Thrifty) Station #054 located at 2504 Castro Valley Boulevard, Castro Valley, California.

A response to the Alameda County Health Care Agency (ACHCA) letter dated June 24, 2002 will soon be submitted by Thrifty under a separate cover letter.

If you have any questions or comments, please contact Raymond C. Friedrichsen or me at (562) 921-3581.

Sincerely,



Chris Panaitescu
General Manager
Environmental Affairs

c: Mr. David J. Camille
Tosco Marketing Company
2000 Crow Canyon Place, Suite 400
San Ramon, CA 94583

File



THRIFTY OIL CO.

July 31, 2002

Mr. Amer Gholami
Alameda County Health Care Agency
Hazardous Material Specialist
1131 Harbor Bay Parkway, Suite 250
Alameda, CA 94502

Local #1252
RWQCB #01-1476
Global ID #T0600101363
Confirmation #4372052788

RE: **Former Thrifty Oil Co. Station #054**
TOSCO Station #2602486
2504 Castro Valley Boulevard
Castro Valley, CA
2nd Quarter 2002, Status Report

Dear Mr. Gholami:

Presented herein is the Second Quarter 2002, Status Report prepared for Former Thrifty Oil Co. (Thrifty) Station #054 located at 2504 Castro Valley Boulevard, Castro Valley, California (**Figure 1**). Presented in this report are the results of the groundwater monitoring efforts conducted during the second quarter of 2002. Thrifty has retained the services of Earth Management Company (EMC) to conduct quarterly monitoring and sampling activities at this site.

Groundwater Monitoring

Depth to groundwater is measured in each monitoring well quarterly. Historic groundwater gauging data obtained from April 11, 1988 through June 12, 2002 is presented in **Table 1**. In general, groundwater occurs beneath the station at depths ranging from 4.21 feet below ground surface (bgs) in monitoring well RS-9 to 9.39 feet bgs in monitoring well RS-11 (**Appendix A**). A groundwater elevation contour map based on the June 12, 2002 data is presented in **Figure 1**. Groundwater elevation data indicates that the general direction of groundwater flow beneath the site is toward the east, with a hydraulic gradient of 0.09 feet/foot.

Quarterly Groundwater Sampling

As part of the ongoing groundwater monitoring program, groundwater samples were obtained from selected monitoring wells PW-1, RE-2, RE-3, RE-4, RE-6, RE-7, RS-9, and RS-11 on June 12, 2002. In a letter from the Alameda County Health Care Services (ACHCS) dated November 6, 2001, the ACHCS released Thrifty from the sampling of wells PW-2, RE-1, RE-2, RE-5, RS-8, and RS-10 until further notice.

Groundwater samples were obtained by EMC and delivered in a chilled state in an ice chest following strict Chain-of-Custody procedures to a state-certified laboratory. Total petroleum hydrocarbons as gasoline (TPH-g) were analyzed by EPA method 8015M modified for gasoline, with benzene, toluene, ethylbenzene, xylenes (BTEX) and methyl tert-butyl ether (MTBE) analyzed by EPA method 8021B. Copies of the EMC Field Status Reports are presented in **Appendix A**, and copies of the laboratory analytical reports are contained in **Appendix B**.



TPH-g, BTEX, and MTBE concentrations appear in **Table 1**, and **Appendix B**. TPH-g, benzene, and MTBE isoconcentration maps are presented in **Figures 2, 3, and 4**, respectively. The highest laboratory analytical concentrations for TPH-g and benzene, were from monitoring well RE-7: 5130 ug/L and 772 ug/L, respectively. The highest laboratory analytical concentrations for MTBE was found in well RS-9: 3280 ug/L. The laboratory analytical results are located in **Table 2**. TOSCO Marketing Company is the current operator of the service station, acquiring the lease from BP Oil, who previously leased the property since July 10, 1991.

The concentration of total petroleum hydrocarbons in off-site monitoring well RS-9 has increased over the last several quarters (**Table 1**). Groundwater levels in this well have historically ranged between two to five feet bgs. Groundwater well RE-2 located on the western edge of the property, historically had TPH-g concentrations below the laboratory detection limits for nine of the last eleven quarters sampled.

Other Activities

Thrifty will continue the groundwater monitoring, gauging, and sampling events at this site on a quarterly basis. All interpretations expressed in this report are based solely upon the review of data collected by EMC, and analyzed by Associated Laboratories.

Written by:

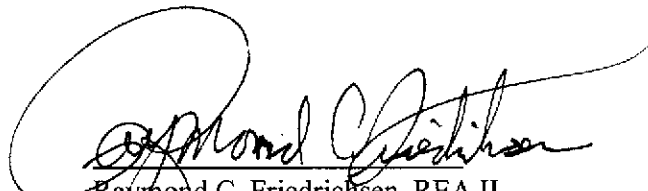

Raymond C. Friedrichsen, REA II
Project Manager, MBA
Senior Environmental Hydrogeologist

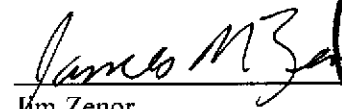
Reviewed by:

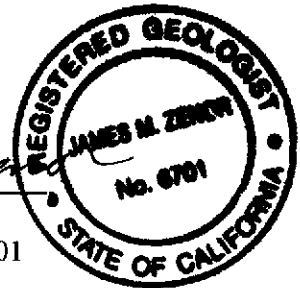

Jim Zenor
Registered Geologist #6701

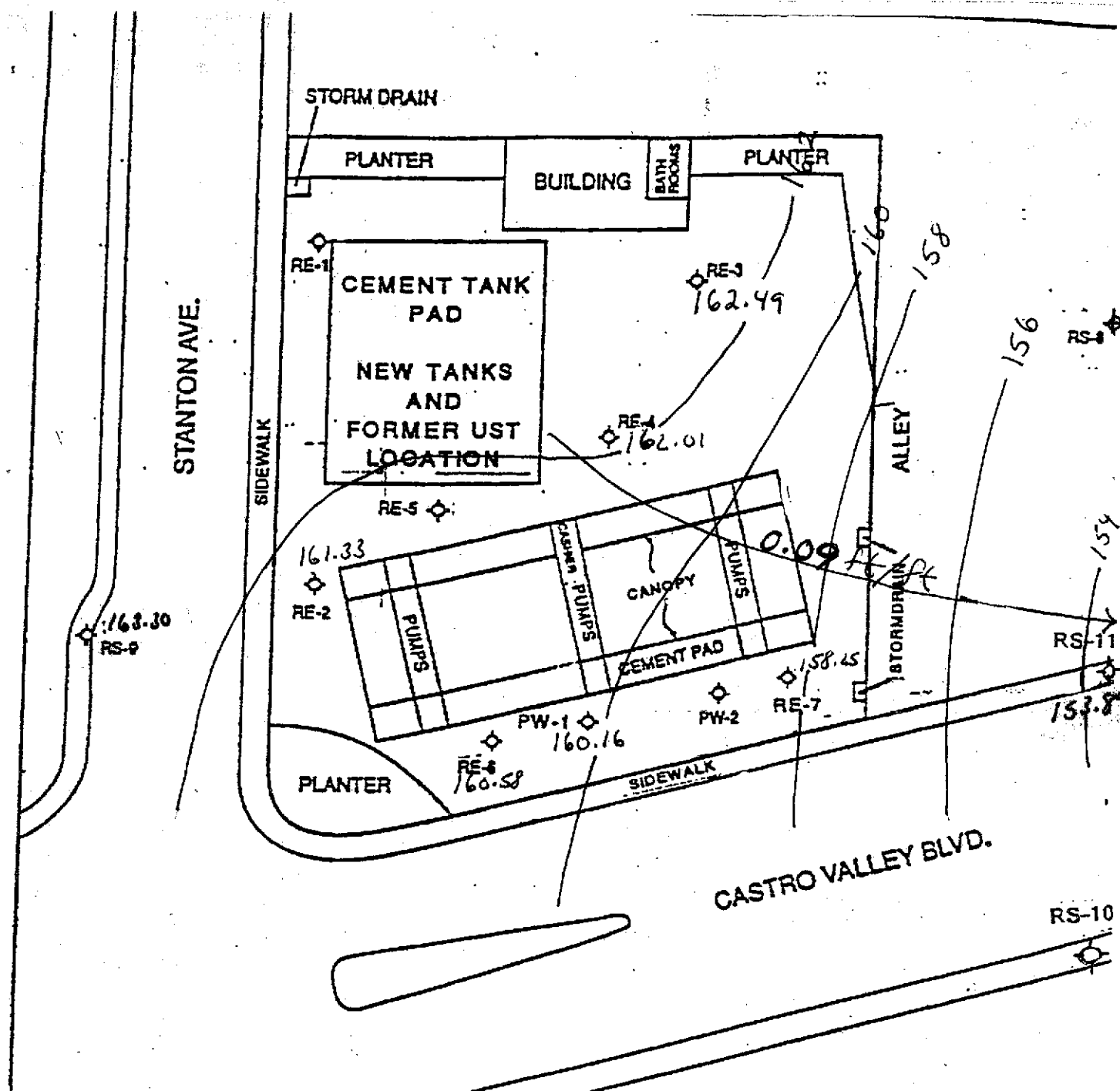

FIGURES

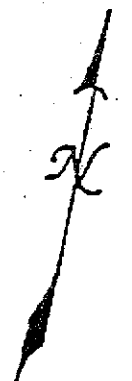

GROUNDWATER CONTOUR MAP
THRIFTY OIL CO. #054
CASTRO VALLEY, CALIFORNIA
 Prepared for
THRIFTY OIL CO.
SANTA FE, SPRINGS
CALIFORNIA



◊ EXISTING MONITORING WELL

6/12/02 **FIGURE 1**

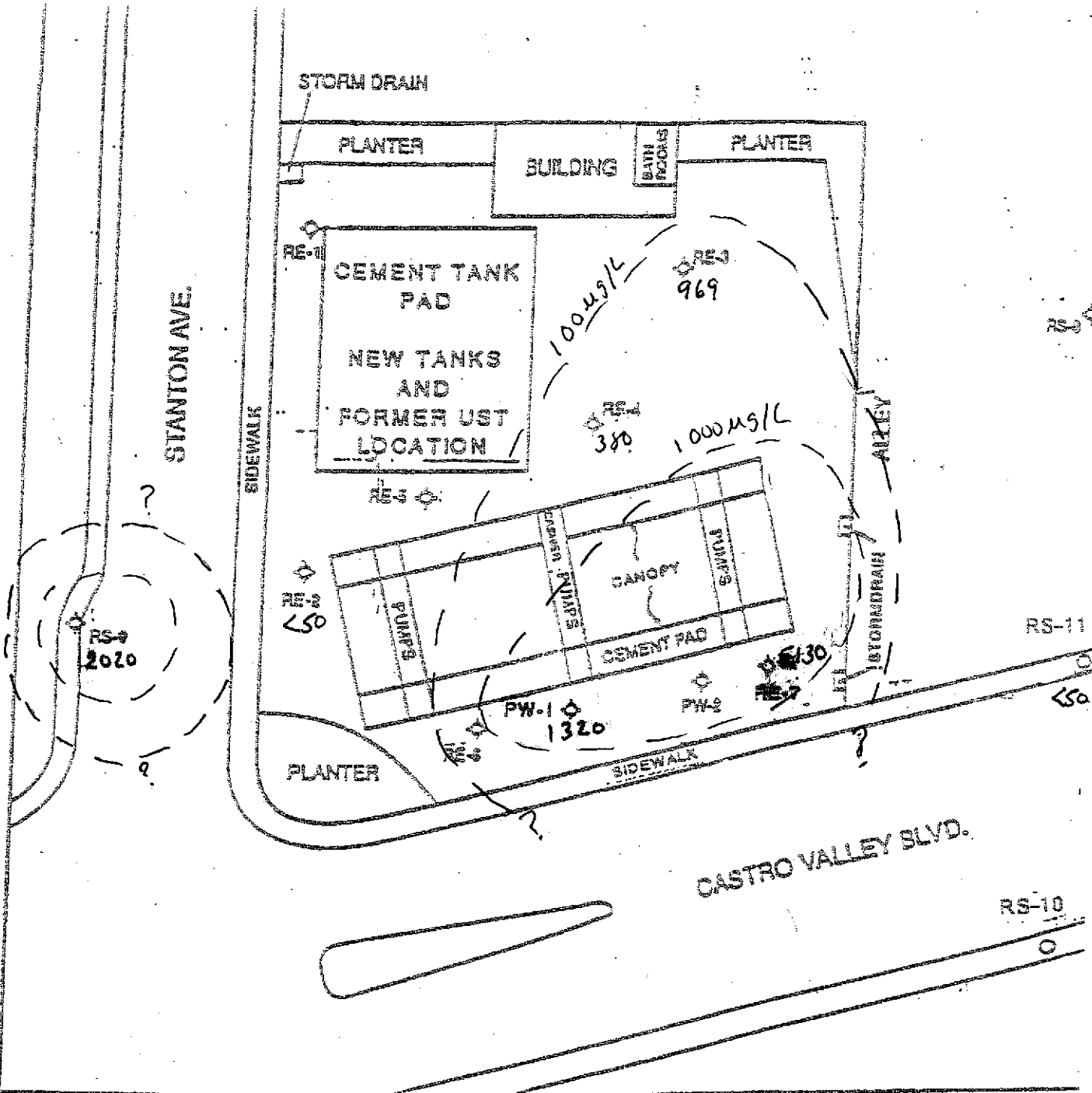

TPH GROUNDWATER ISOCONCENTRATION MAP PPB

THRIFTY OIL CO. #054
 CASTRO VALLEY, CALIFORNIA
 Prepared for
 THRIFTY OIL CO.
 SANTA FE, SPRINGS
 CALIFORNIA



○ EXISTING MONITORING WELL

6/12/02 FIGURE 2

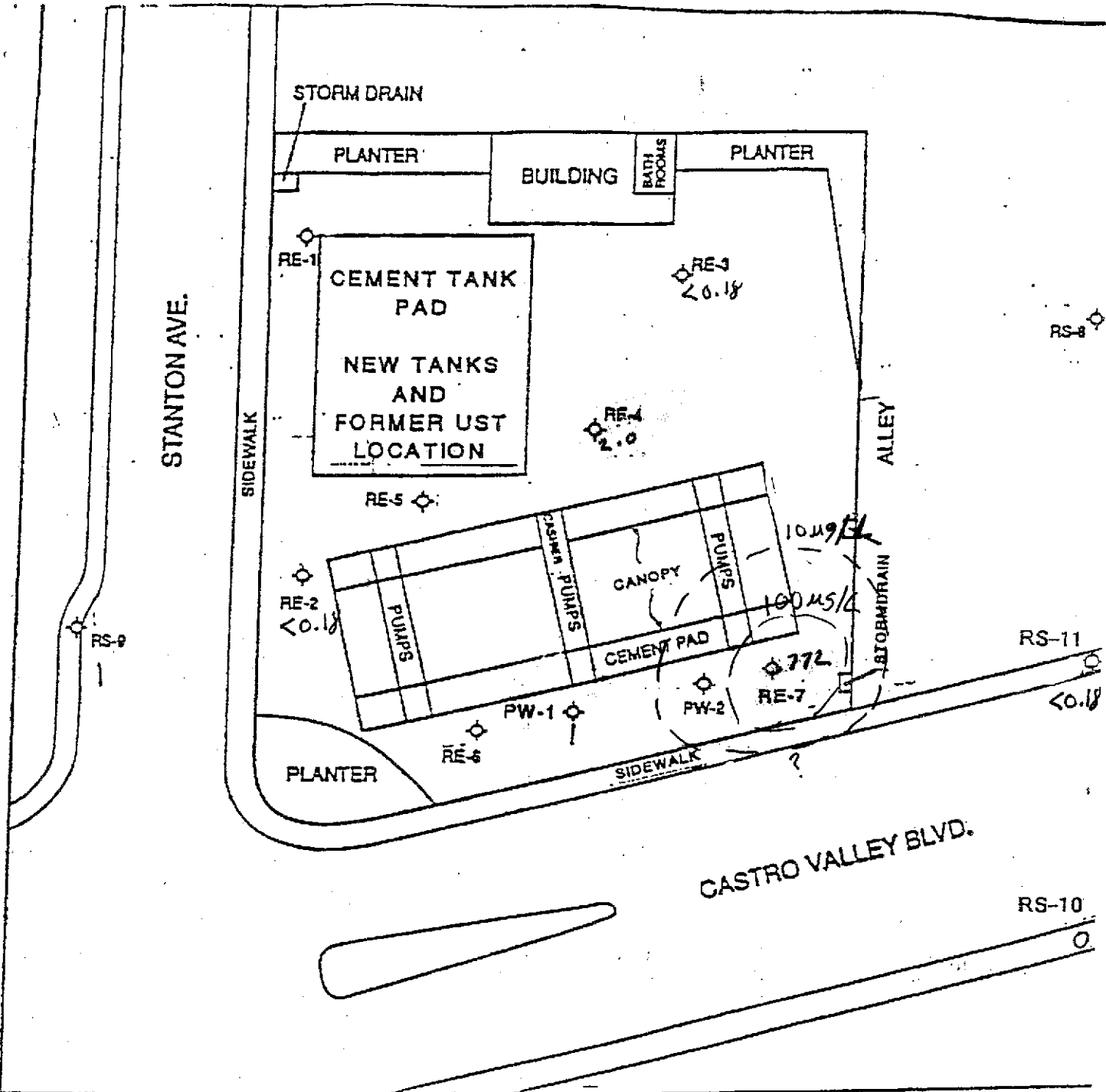

~~Ben zone~~ ISOCONCENTRATION MAP
 THRIFTY OIL CO. #054
 CASTRO VALLEY, CALIFORNIA
 Prepared for
 THRIFTY OIL CO.
 SANTA FE, SPRINGS
 CALIFORNIA

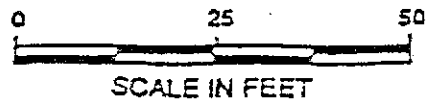

◊ EXISTING MONITORING WELL

-6/12/82

FIGURE 3

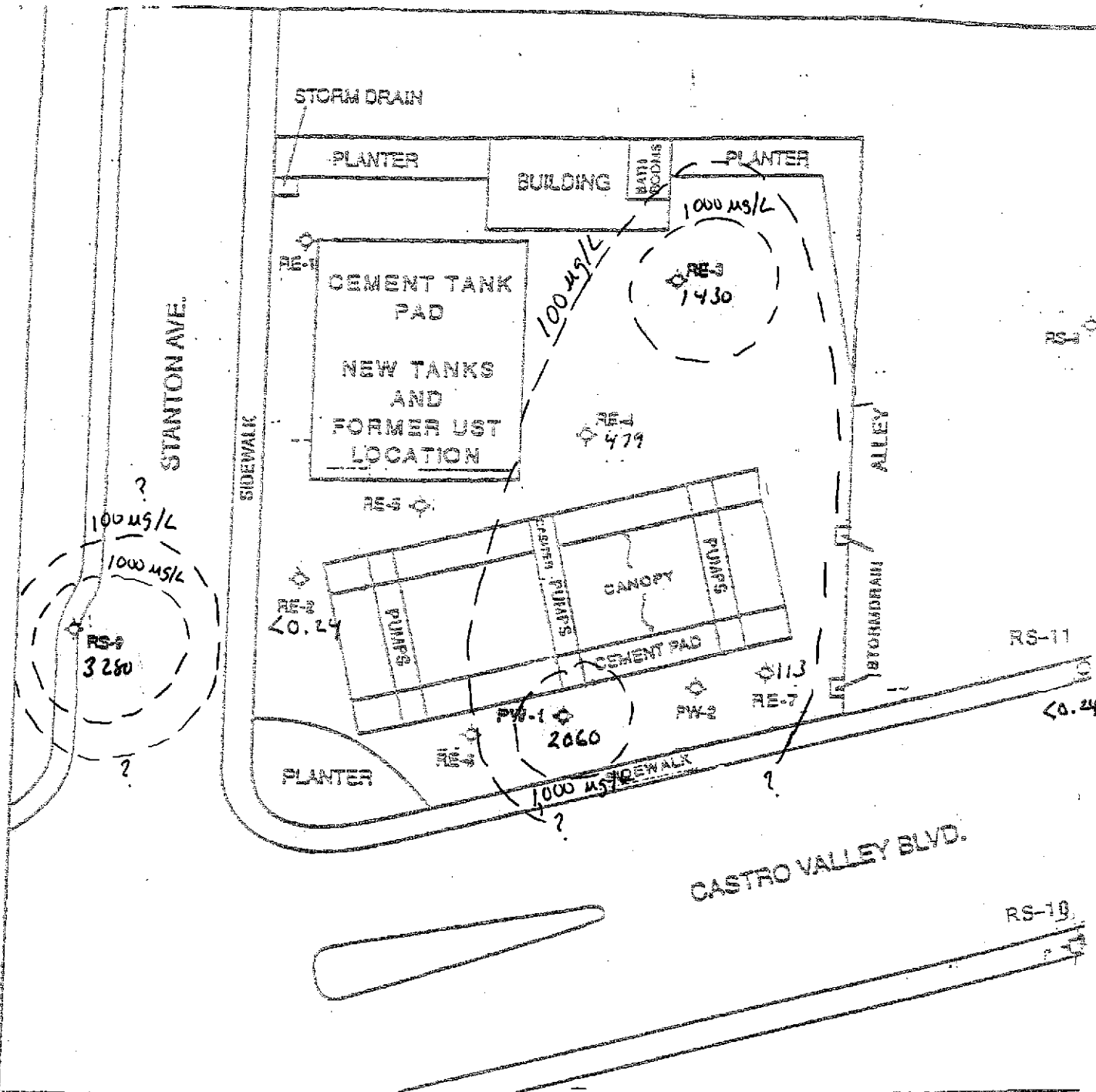

MTBE ISOCONCENTRATION MAP

THRIFTY OIL CO. #054
 CASTRO VALLEY, CALIFORNIA
 Prepared for
 THRIFTY OIL CO.
 SANTA FE, SPRINGS
 CALIFORNIA

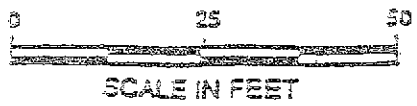

EXISTING MONITORING WELL

6/12/02 FIGURE 4

TABLES

**TABLE 1
GROUNDWATER DATA
THRIFTY OIL STATION #054, CASTRO VALLEY, CA.**

DATE SAMPLED	ANALYTICAL PARAMETERS						DEPTH TO GROUNDWATER (feet)	DEPTH TO PRODUCT (feet)	PRODUCT THICKNESS (feet)	CASING ELEVATION (feet)	GROUNDWATER ELEVATION (feet)
	TPH (ug/L)	BENZENE (ug/L)	TOLUENE (ug/L)	Ethylbenzene (ug/L)	XYLENE (ug/L)	MTBE (ug/L)					
MONITORING WELL #PW-1											
04/11/88	-	-	-	-	-	-	-	-	-	-	-
04/09/90	230,000	600	2,700	1,000	16,000	-	5.10	NP	0.00	166.46	161.36
10/30/90	35,000	240	970	240	3,580	-	6.17	NP	0.00	166.46	160.29
01/18/91	37,000	43	140	42	1,600	-	6.28	NP	0.00	166.46	160.18
02/12/91	45,000	99	130	25	700	-	5.88	NP	0.00	166.46	160.58
03/20/91	1,900	0.43	ND	ND	2.8	-	4.75	NP	0.00	166.46	161.71
05/22/91	41,000	600	730	250	3,800	-	5.10	NP	0.00	166.46	161.36
06/19/91	-	-	-	-	-	-	5.61	NP	0.00	166.46	160.85
07/17/91	-	-	-	-	-	-	5.53	FILM	0.00	166.46	160.93
08/07/91	-	-	-	-	-	-	5.67	FILM	0.00	166.46	160.79
09/24/91	-	-	-	-	-	-	5.57	FILM	0.00	166.46	160.89
10/23/91	-	-	-	-	-	-	6.53	FILM	0.00	166.46	159.93
11/06/91	-	-	-	-	-	-	5.85	FILM	0.00	166.46	160.61
12/04/91	-	-	-	-	-	-	5.91	FILM	0.00	166.46	160.55
01/29/92	-	-	-	-	-	-	5.43	FILM	0.00	166.46	161.03
02/26/92	-	-	-	-	-	-	5.54	FILM	0.00	166.46	160.92
03/19/92	ND	ND	ND	ND	ND	-	5.47	NP	0.00	166.46	160.99
04/22/92	-	-	-	-	-	-	5.62	FILM	0.00	166.46	160.84
05/21/92	1,300	19	2.9	0.7	58	-	6.21	NP	0.00	166.46	160.25
06/25/92	-	-	-	-	-	-	6.94	NP	0.00	166.46	159.52
07/30/92	-	-	-	-	-	-	5.90	FILM	0.00	166.46	160.56
08/20/92	-	-	-	-	-	-	7.12	FILM	0.00	166.46	159.34
09/30/92	3,400	57	ND	26	240	-	6.42	NP	0.00	166.46	160.04
12/23/92	-	-	-	-	-	-	5.56	FILM	0.00	166.46	160.90
03/10/93	-	-	-	-	-	-	5.65	FILM	0.00	166.46	160.81
06/09/93	400	<0.5	1.1	<1.0	<1.0	-	5.30	NP	0.00	166.46	161.16
09/14/93	180	3.7	3.2	1.5	14	-	5.43	NP	0.00	166.46	161.03
12/14/93	<50	<0.3	<0.3	<0.3	<0.5	-	4.65	NP	0.00	166.46	161.81
03/02/94	<50	<0.3	<0.3	<0.3	<0.5	-	5.43	NP	0.00	166.46	161.03
06/06/94	330	1.3	<0.3	0.88	9.8	-	4.70	NP	0.00	166.46	161.76
09/06/94	1,100	67	<0.3	<0.3	24	-	6.48	NP	0.00	166.46	159.98
12/07/94	<50	<0.3	<0.3	<0.5	<0.5	-	5.22	NP	0.00	166.46	161.24
03/08/95	<100	<0.5	<0.5	<0.5	<1	-	6.94	NP	0.00	166.46	159.52
06/15/95	260	0.8	0.6	<0.5	3.2	-	5.72	NP	0.00	166.46	160.74
09/05/95	330	2.1	<0.5	2.1	9.6	-	5.96	NP	0.00	166.46	160.50
11/21/95	660	13	1.3	<0.3	4.0	-	6.04	NP	0.00	166.46	160.42

**TABLE 1
GROUNDWATER DATA
THRIFTY OIL STATION #054, CASTRO VALLEY, CA.**

DATE SAMPLED	ANALYTICAL PARAMETERS						DEPTH TO GROUNDWATER (feet)	DEPTH TO PRODUCT (feet)	PRODUCT THICKNESS (feet)	CASING ELEVATION (feet)	GROUNDWATER ELEVATION (feet)
	FFH (ug/L)	BENZENE (ug/L)	TOLUENE (ug/L)	EthylBenzene (ug/L)	XYLENE (ug/L)	MIBT (ug/L)					
03/11/96	660	0.94	0.77	<0.3	8.1	-	3.60	NP	0.00	166.46	162.86
06/19/96	120	0.53	<0.3	<0.3	2.3	-	4.80	NP	0.00	166.46	161.66
09/16/96	<50	<0.3	<0.3	<0.3	<0.5	<20	5.10	NP	0.00	166.46	161.36
12/10/96	<50	<0.3	<0.3	<0.3	<0.5	<20	4.92	NP	0.00	166.46	161.54
03/12/97	<50	<0.3	<0.3	<0.3	<0.5	<20	4.50	NP	0.00	166.46	161.96
06/12/97	<50	<0.3	<0.3	<0.3	<0.5	<20	-	-	-	-	-
09/16/97	690	0.97	<0.3	<0.3	<0.5	<20	4.55	NP	0.00	166.46	161.91
12/09/97	640	150	0.64	<0.3	5.2	1,300	5.60	NP	0.00	166.46	160.86
03/03/98	<50	<0.3	0.57	<0.3	<0.5	<20	4.13	NP	0.00	166.46	162.33
07/08/98	<50	<0.3	<0.3	<0.3	<0.5	<5	-	-	-	-	-
09/10/98	<50	<0.3	<0.3	<0.3	<0.5	<5	6.35	NP	0.00	166.46	160.11
12/30/98	<50	1.1	<0.3	<0.3	<0.5	<5	6.40	NP	0.00	166.46	160.06
03/15/99	<50	<0.3	<0.3	<0.3	<0.5	<5	6.35	NP	0.00	166.46	160.11
06/22/99	<50	<0.3	<0.3	<0.3	<0.5	53	4.95	NP	0.00	166.46	161.51
09/08/99	<50	<0.3	<0.3	<0.3	<0.5	<5	4.80	NP	0.00	166.46	161.66
12/01/99	<50	<0.3	<0.3	<0.3	<0.5	<5	3.64	NP	0.00	166.46	162.82
03/23/00	<50	0.5	0.5	1.1	<0.5	<5	4.03	NP	0.00	166.46	162.43
06/08/00	<50	<5	<5	<5	<5	<5	4.40	NP	0.00	166.46	162.06
09/27/00	<50	<0.18	<0.14	<0.18	<0.26	<0.24	4.73	NP	0.00	166.46	161.73
12/13/00	<50	<0.18	<0.14	<0.18	<0.26	<0.24	4.01	NP	0.00	166.46	162.45
03/22/01	600	<0.18	1.3	<0.18	<0.26	*1,010 / 1,970	6.32	NP	0.00	166.46	160.14
06/15/01	<50	<0.18	<0.14	<0.18	<0.26	<0.24	6.32	NP	0.00	166.46	160.14
08/30/01	<50	<0.18	<0.14	<0.18	<0.26	<0.24	6.32	NP	0.00	166.46	160.14
12/12/01	<50	<0.18	<0.14	<0.18	<0.26	<0.24	6.02	NP	0.00	166.46	160.44
03/13/02	<50	<0.18	<0.14	<0.18	<0.26	<0.24	6.30	NP	0.00	166.46	160.16
06/12/02	1,320	1	1	<0.18	2	2,060	6.30	NP	0.00	166.46	160.16
MONITORING WELL PW-2											
04/11/88	-	-	-	-	-	-	-	-	-	-	-
04/09/90	600,000	1,300	11,000	4,600	4,300	-	5.81	NP	0.00	166.18	160.37
10/30/90	48,000	310	51	10	480	-	6.95	NP	0.00	166.18	159.23
01/18/91	86,000	230	1,400	350	8,300	-	6.92	NP	0.00	166.18	159.26
02/12/91	160,000	680	1,300	250	7,000	-	6.78	NP	0.00	166.18	159.40
03/20/91	17,000	34	50	ND	1,100	-	5.54	NP	0.00	166.18	160.64
05/22/91	14,000	57	2,100	500	8,200	-	6.07	NP	0.00	166.18	160.11
06/19/91	-	-	-	-	-	-	6.37	FILM	0.00	166.18	159.81

**TABLE 1
GROUNDWATER DATA
THRIFTY OIL STATION #054, CASTRO VALLEY, CA.**

DATE SAMPLED	ANALYTICAL PARAMETERS						DEPTH TO GROUNDWATER (feet)	DEPTH TO PRODUCT (feet)	PRODUCT THICKNESS (feet)	CASING ELEVATION (feet)	GROUNDWATER ELEVATION (feet)
	TPH (ug/L)	BENZENE (ug/L)	TOLUENE (ug/L)	EthylBenzene (ug/L)	XYLENE (ug/L)	MTBE (ug/L)					
07/17/91	-	-	-	-	-	-	6.38	FILM	0.00	166.18	159.80
08/07/91	-	-	-	-	-	-	6.63	FILM	0.00	166.18	159.55
09/24/91	-	-	-	-	-	-	6.42	FILM	0.00	166.18	159.76
10/23/91	-	-	-	-	-	-	7.25	FILM	0.00	166.18	158.93
11/06/91	-	-	-	-	-	-	6.44	FILM	0.00	166.18	159.74
12/04/91	-	-	-	-	-	-	6.65	FILM	0.00	166.18	159.53
01/29/92	-	-	-	-	-	-	6.17	FILM	0.00	166.18	160.01
02/26/92	-	-	-	-	-	-	5.90	FILM	0.00	166.18	160.28
03/19/92	-	-	-	-	-	-	5.80	FILM	0.00	166.18	160.38
04/22/92	-	-	-	-	-	-	5.88	FILM	0.00	166.18	160.30
05/21/92	-	-	-	-	-	-	6.03	FILM	0.00	166.18	160.15
06/25/92	-	-	-	-	-	-	6.57	FILM	0.00	166.18	159.61
07/30/92	-	-	-	-	-	-	6.20	FILM	0.00	166.18	159.98
08/20/92	-	-	-	-	-	-	6.64	FILM	0.00	166.18	159.54
09/30/92	-	-	-	-	-	-	6.88	FILM	0.00	166.18	159.30
12/23/92	-	-	-	-	-	-	6.08	FILM	0.00	166.18	160.10
03/10/93	-	-	-	-	-	-	5.95	FILM	0.00	166.18	160.23
06/09/93	3,400	24	22	<0.5	240	-	5.38	NP	0.00	166.18	160.80
09/14/93	4,900	190	15	6.8	480	-	6.26	NP	0.00	166.18	159.92
12/14/93	1,700	4.2	<0.3	<0.3	<0.5	-	5.22	NP	0.00	166.18	160.96
03/02/94	-	-	-	-	-	-	5.75	FILM	0.00	166.18	160.43
06/06/94	980	25	1.2	<0.3	42	-	5.25	NP	0.00	166.18	160.93
09/06/94	3,200	95	3.0	<1.7	76	-	6.80	NP	0.00	166.18	159.38
12/07/94	510	1.8	<0.3	<0.5	1.7	-	5.57	NP	0.00	166.18	160.61
03/08/95	1,900	<0.5	<0.5	1.4	35	-	4.10	NP	0.00	166.18	162.08
06/15/95	1,700	5.6	<0.5	<0.5	1.6	-	5.44	NP	0.00	166.18	160.74
09/05/95	2,500	33	1.0	0.86	18	-	6.13	NP	0.00	166.18	160.05
11/21/95	2,800	130	59	18	190	-	6.23	NP	0.00	166.18	159.95
03/11/96	13,000	330	460	<15	3,800	-	4.48	NP	0.00	166.18	161.70
06/19/96	1,400	<0.3	<0.3	<0.3	<0.5	-	5.38	NP	0.00	166.18	160.80
09/16/96	3,500	<0.3	<0.3	<0.3	<0.5	5,900	5.21	NP	0.00	166.18	160.97
12/10/96	2,100	<0.3	<0.3	<0.3	<0.5	4,700	4.87	NP	0.00	166.18	161.31
03/12/97	600	1.6	<0.3	<0.3	5.8	1,100	4.43	NP	0.00	166.18	161.75
06/12/97	270	<0.3	<0.3	<0.3	<0.5	630	-	-	-	-	-
09/10/97	220	<0.3	<0.3	<0.3	<0.5	320	4.07	NP	0.00	166.18	162.11
12/09/97	120	<0.3	0.73	<0.3	<0.5	420	5.20	NP	0.00	166.18	160.98
03/03/98	<50	0.43	0.48	<0.3	<0.5	47	3.30	NP	0.00	166.18	162.88

**TABLE 1
GROUNDWATER DATA
THRIFTY OIL STATION #054, CASTRO VALLEY, CA.**

DATE SAMPLED	ANALYTICAL PARAMETERS						DEPTH TO GROUNDWATER (feet)	DEPTH TO PRODUCT (feet)	PRODUCT THICKNESS (feet)	CASING ELEVATION (feet)	GROUNDWATER ELEVATION (feet)
	TPH (ug/L)	BENZENE (ug/L)	TOLUENE (ug/L)	EthylBenzene (ug/L)	XYLENE (ug/L)	MTHC (ug/L)					
04/22/92	-	-	-	-	-	-	4.62	NP	0.00	166.82	162.20
05/21/92	20,000	7,600	10,100	830	6,900	-	4.98	NP	0.00	166.82	161.84
06/25/92	-	-	-	-	-	-	5.14	FILM	0.00	166.82	161.68
07/30/92	-	-	-	-	-	-	5.30	FILM	0.00	166.82	161.52
08/20/92	-	-	-	-	-	-	5.28	FILM	0.00	166.82	161.54
09/30/92	-	-	-	-	-	-	5.66	FILM	0.00	166.82	161.16
12/23/92	-	-	-	-	-	-	4.81	FILM	0.00	166.82	162.01
03/10/93	-	-	-	-	-	-	4.13	FILM	0.00	166.82	162.69
06/09/93	-	-	-	-	-	-	4.48	FILM	0.00	166.82	162.34
09/14/93	19,000	3,600	1,100	740	4,300	-	5.35	NP	0.00	166.82	161.47
12/14/93	38,000	4,300	1,300	<6.6	11	-	4.38	NP	0.00	166.82	162.44
03/02/94	-	-	-	-	-	-	4.22	FILM	0.00	166.82	162.60
06/06/94	-	-	-	-	-	-	2.16	FILM	0.00	166.82	164.66
09/06/94	74,000	3,300	3,900	1,200	6,100	-	5.00	NP	0.00	166.82	161.82
12/07/94	30,000	3,200	2,900	1,200	4,600	-	4.10	NP	0.00	166.82	162.72
03/08/95	28,000	4,200	2,300	810	7,800	-	3.92	NP	0.00	166.82	162.90
06/15/95	-	-	-	-	-	-	-	-	-	-	-
09/05/95	-	-	-	-	-	-	4.78	FILM	0.00	166.82	162.04
11/21/95	-	-	-	-	-	-	4.82	NP	0.00	166.82	162.00
03/11/96	270	2.4	6.0	4.5	19	-	3.32	NP	0.00	166.82	163.50
06/19/96	3,000	570	63	<1.5	400	-	4.20	NP	0.00	166.82	162.62
09/16/96	7,700	440	69	<1.5	680	230	4.68	NP	0.00	166.82	162.14
12/10/96	52	<0.3	<0.3	<0.3	<0.5	120	4.93	NP	0.00	166.82	161.89
03/12/97	8,700	180	5.4	40	1,100	130	4.10	NP	0.00	166.82	162.72
06/12/97	<50	<0.3	<0.3	<0.3	<0.5	36	-	-	-	-	-
09/16/97	<50	<0.3	<0.3	<0.3	<0.5	<20	4.55	NP	0.00	166.82	162.27
12/09/97	<50	<0.3	0.44	<0.3	<0.5	<20	5.30	NP	0.00	166.82	161.52
03/03/98	1,100	13	0.51	<0.3	<0.5	220	4.55	NP	0.00	166.82	162.27
07/08/98	<50	<0.3	<0.3	<0.3	<0.5	<5	-	-	-	-	-
09/10/98	60	<0.3	<0.3	<0.3	<0.5	180	6.05	NP	0.00	166.82	160.77
12/30/98	<50	1.1	<0.3	<0.3	<0.5	<5	5.65	NP	0.00	166.82	161.17
03/15/99	<50	<0.3	<0.3	<0.3	<0.5	<5	5.68	NP	0.00	166.82	161.14
06/22/99	880	14	0.98	<0.3	8.1	260	4.95	NP	0.00	166.82	161.87
09/08/99	72	<0.3	<0.3	<0.3	<0.5	120	4.46	NP	0.00	166.82	162.36
12/01/99	<50	<0.3	<0.3	<0.3	<0.5	<5	4.08	NP	0.00	166.82	162.74
03/23/00	<50	<0.25	<0.25	<0.25	<0.5	<5	3.68	NP	0.00	166.82	163.14
06/08/00	<50	<5	<5	<5	<5	<5	4.07	NP	0.00	166.82	162.75

**TABLE 1
GROUNDWATER DATA
THRIFTY OIL STATION #054, CASTRO VALLEY, CA.**

DATE SAMPLED	ANALYTICAL PARAMETERS						DEPTH TO GROUNDWATER (feet)	DEPTH TO PRODUCT (feet)	PRODUCT THICKNESS (feet)	CASING ELEVATION (feet)	GROUNDWATER ELEVATION (feet)
	TPH (ug/L)	Benzene (ug/L)	TOLUENE (ug/L)	EthylBenzene (ug/L)	XYLENE (ug/L)	METHANE (ug/L)					
09/27/00	<50	<0.18	<0.14	<0.18	<0.26	<0.24	4.07	NP	0.00	166.82	162.75
12/13/00	<50	<0.18	<0.14	<0.18	<0.26	<0.24	4.06	NP	0.00	166.82	162.76
03/22/01	<50	<0.18	<0.14	<0.18	<0.26	<0.24	5.22	NP	0.00	166.82	161.60
06/15/01	<50	<0.18	<0.14	<0.18	<0.26	<0.24	5.99	NP	0.00	166.82	160.83
08/30/01	<50	<0.18	<0.14	<0.18	<0.26	<0.24	4.84	NP	0.00	166.82	161.98
12/12/01	<50	<0.18	<0.14	<0.18	<0.26	<0.24	4.80	NP	0.00	166.82	162.02
03/13/02	-	-	-	-	-	-	5.18	NP	0.00	166.82	161.64
06/12/02	-	-	-	-	-	-	-	-	-	-	-
MONITORING HISTORY											
04/11/88	-	-	-	-	-	-	-	-	-	-	-
04/09/90	850	5.8	0.5	4.8	1.1	-	4.90	NP	0.00	167.19	162.29
10/30/90	440	2.8	0.91	13	3.14	-	5.34	NP	0.00	167.19	161.85
01/18/91	1,100	8.4	3.1	ND	10	-	4.90	NP	0.00	167.19	162.29
02/12/91	1,100	5.9	ND	1.77	ND	-	4.94	NP	0.00	167.19	162.25
03/20/91	550	4.3	ND	ND	ND	-	4.32	NP	0.00	167.19	162.87
05/22/91	1,000	5.3	3.6	4.4	8.9	-	4.43	NP	0.00	167.19	162.76
06/19/91	700	2.1	1.4	3.8	3.5	-	6.43	NP	0.00	167.19	160.76
07/17/91	880	12	8.0	4.3	28	-	4.75	NP	0.00	167.19	162.44
08/07/91	-	3.8	1.6	ND	ND	-	4.87	NP	0.00	167.19	162.32
09/24/91	670	7.2	7.1	ND	23	-	5.50	NP	0.00	167.19	161.69
10/23/91	2,700	52	60	22	130	-	5.63	NP	0.00	167.19	161.56
11/06/91	1,900	18	61	9.1	83	-	5.14	NP	0.00	167.19	162.05
12/04/91	1,100	26	47	4.3	42	-	5.26	NP	0.00	167.19	161.93
01/29/92	900	14	24	5.3	19	-	5.11	NP	0.00	167.19	162.08
02/26/92	500	3.4	3.5	2.7	2.7	-	4.31	NP	0.00	167.19	162.88
03/19/92	1,200	14	20	15	18	-	4.45	NP	0.00	167.19	162.74
04/22/92	200	ND	ND	ND	ND	-	4.78	NP	0.00	167.19	162.41
05/21/92	500	7.5	6.8	3.9	7.4	-	5.02	NP	0.00	167.19	162.17
06/25/92	ND	ND	0.9	0.7	ND	-	5.13	NP	0.00	167.19	162.06
07/30/92	500	7.7	8.6	3.2	1.7	-	5.19	NP	0.00	167.19	162.00
08/20/92	1,100	6.6	4.5	2.7	2.0	-	5.27	NP	0.00	167.19	161.92
09/30/92	500	5.4	2.4	1.8	4.5	-	5.45	NP	0.00	167.19	161.74
12/23/92	800	1.9	ND	ND	2.3	-	4.60	NP	0.00	167.19	162.59
03/10/93	1,200	ND	1.4	ND	2.1	-	4.18	NP	0.00	167.19	163.01
06/09/93	200	ND	ND	ND	ND	-	4.53	NP	0.00	167.19	162.66

TABLE 1
GROUNDWATER DATA
THRIFTY OIL STATION #054, CASTRO VALLEY, CA.

DATE SAMPLED	ANALYTICAL PARAMETERS						DEPTH TO GROUNDWATER (feet)	DEPTH TO PRODUCT (feet)	PRODUCT THICKNESS (feet)	CASING ELEVATION (feet)	GROUNDWATER ELEVATION (feet)
	TPH (ug/L)	BENZENE (ug/L)	TOLUENE (ug/L)	EthylBenzene (ug/L)	XYLENE (ug/L)	MTBE (ug/L)					
09/17/93	360	1.6	1.1	3.2	8.9	-	5.26	NP	0.00	167.19	161.93
12/14/93	260	5.6	3.9	<0.3	21.0	-	2.75	NP	0.00	167.19	164.44
03/02/94	410	<0.3	<0.3	<0.3	<0.5	-	4.27	NP	0.00	167.19	162.92
06/06/94	760	4.6	<0.3	0.32	1.3	-	4.88	NP	0.00	167.19	162.31
09/06/94	1,300	43	45	8.9	69	-	5.16	NP	0.00	167.19	162.03
12/07/94	-	-	-	-	-	-	4.16	NP	0.00	167.19	163.03
03/08/95	<100	<0.5	<0.5	<0.5	<1	-	3.96	NP	0.00	167.19	163.23
06/15/95	130	<0.5	<0.5	<0.5	<1	-	4.52	NP	0.00	167.19	162.67
09/05/95	210	<0.5	<0.5	<0.5	<1	-	4.76	NP	0.00	167.19	162.43
11/21/95	160	0.65	<0.3	0.35	0.95	-	4.83	NP	0.00	167.19	162.36
03/11/96	<50	<0.3	<0.3	<0.3	<0.5	-	3.36	NP	0.00	167.19	163.83
06/19/96	<50	<0.3	<0.3	<0.3	<0.5	-	4.68	NP	0.00	167.19	162.51
09/16/96	<50	<0.3	<0.3	<0.3	<0.5	<20	5.10	NP	0.00	167.19	162.09
12/10/96	<50	<0.3	<0.3	<0.3	<0.5	<20	4.47	NP	0.00	167.19	162.72
03/12/97	<50	<0.3	<0.3	<0.3	<0.5	<20	4.05	NP	0.00	167.19	163.14
06/12/97	<50	<0.3	<0.3	<0.3	<0.5	<20	-	-	-	-	-
09/10/97	<50	<0.3	<0.3	<0.3	<0.5	<20	4.08	NP	0.00	167.19	163.11
12/09/97	<50	<0.3	<0.3	<0.3	<0.5	<20	4.40	NP	0.00	167.19	162.79
03/03/98	<50	<0.3	<0.3	<0.3	<0.5	<20	3.30	NP	0.00	167.19	163.89
07/08/98	<50	<0.3	<0.3	<0.3	<0.5	15	-	-	-	-	-
09/10/98	<50	<0.3	<0.3	<0.3	<0.5	<5	4.93	NP	0.00	167.19	162.26
12/30/98	460	0.92	<0.3	<0.3	<0.5	1,400	4.20	NP	0.00	167.19	162.99
03/15/99	<50	<0.3	<0.3	<0.3	<0.5	<5	4.20	NP	0.00	167.19	162.99
06/22/99	2,900	7.4	<0.3	0.43	4.1	4,500	3.70	NP	0.00	167.19	163.49
09/08/99	1,400	<3	<3	<3	<5	3,200	3.96	NP	0.00	167.19	163.23
12/01/99	<50	<0.3	<0.3	<0.3	<0.5	<5	3.58	NP	0.00	167.19	163.61
03/23/00	<50	<0.25	<0.25	<0.25	<0.5	<5	3.19	NP	0.00	167.19	164.00
06/08/00	<50	<5	<5	<5	<5	<5	3.18	NP	0.00	167.19	164.01
09/27/00	<50	<0.18	<0.14	<0.18	<0.26	<0.24	3.58	NP	0.00	167.19	163.61
12/13/00	<50	<0.18	<0.14	<0.18	<0.26	<0.24	3.58	NP	0.00	167.19	163.61
03/22/01	575	<0.18	1.3	<0.18	<0.26	*950 / 2,070	4.33	NP	0.00	167.19	162.86
06/15/01	<50	<0.18	<0.14	<0.18	<0.26	<0.24	5.10	NP	0.00	167.19	162.09
08/30/01	<50	<0.18	<0.14	<0.18	<0.26	<0.24	5.86	NP	0.00	167.19	161.33
12/12/01	<50	<0.18	<0.14	<0.18	<0.26	<0.24	4.81	NP	0.00	167.19	162.38
03/13/02	-	-	-	-	-	-	4.33	NP	0.00	167.19	162.86
06/12/02	<50	<0.18	<0.14	<0.18	<0.26	<0.24	5.86	NP	0.00	167.19	161.33

**TABLE 1
GROUNDWATER DATA
THRIFTY OIL STATION #054, CASTRO VALLEY, CA.**

DATE SAMPLED	ANALYTICAL PARAMETERS						DEPTH TO GROUNDWATER (feet)	DEPTH TO PRODUCT (feet)	PRODUCT THICKNESS (feet)	CASING ELEVATION (feet)	GROUNDWATER ELEVATION (feet)
	TPH (ug/L)	BENZENE (ug/L)	TOLUENE (ug/L)	EthylBenzene (ug/L)	XYLENE (ug/L)	MTBE (ug/L)					
MONITORING WELL ARE-1											
04/11/88	70,000	6,600	5,300	800	13,000	-	-	-	-	-	-
04/09/90	370,000	2,300	4,900	3,200	31,000	-	7.15	NP	0.00	167.39	160.24
10/30/90	13,000	860	660	220	2,210	-	7.84	NP	0.00	167.39	159.55
01/18/91	42,000	4,700	4,500	21	7,700	-	6.90	NP	0.00	167.39	160.49
02/12/91	72,000	3,600	4,500	ND	7,600	-	6.62	NP	0.00	167.39	160.77
03/20/91	65,000	2,400	9,400	50	9,800	-	5.87	NP	0.00	167.39	161.52
05/22/91	-	-	-	-	-	-	5.98	FILM	0.00	167.39	161.41
06/19/91	-	-	-	-	-	-	6.84	FILM	0.00	167.39	160.55
07/17/91	-	-	-	-	-	-	7.10	FILM	0.00	167.39	160.29
08/07/91	-	-	-	-	-	-	7.30	FILM	0.00	167.39	160.09
09/24/91	-	-	-	-	-	-	7.84	FILM	0.00	167.39	159.55
10/23/91	-	-	-	-	-	-	8.07	FILM	0.00	167.39	159.32
11/06/91	-	-	-	-	-	-	7.63	FILM	0.00	167.39	159.76
12/04/91	-	-	-	-	-	-	7.83	FILM	0.00	167.39	159.56
01/29/92	-	-	-	-	-	-	7.17	FILM	0.00	167.39	160.22
02/26/92	-	-	-	-	-	-	5.56	FILM	0.00	167.39	161.83
03/19/92	-	-	-	-	-	-	5.44	FILM	0.00	167.39	161.95
04/22/92	-	-	-	-	-	-	6.36	FILM	0.00	167.39	160.83
05/21/92	-	-	-	-	-	-	6.90	FILM	0.00	167.39	160.49
06/25/92	-	-	-	-	-	-	7.18	FILM	0.00	167.39	160.21
07/30/92	-	-	-	-	-	-	6.80	FILM	0.00	167.39	160.59
08/20/92	-	-	-	-	-	-	7.25	FILM	0.00	167.39	160.14
09/30/92	-	-	-	-	-	-	7.68	FILM	0.00	167.39	159.71
12/23/92	-	-	-	-	-	-	6.07	FILM	0.00	167.39	161.32
03/10/93	-	-	-	-	-	-	5.66	FILM	0.00	167.39	161.73
06/09/93	-	-	-	-	-	-	6.66	FILM	0.00	167.39	160.73
09/14/93	40,000	2,900	1,500	180	6,900	-	7.30	NP	0.00	167.39	160.09
12/14/93	-	-	-	-	-	-	5.95	NP	0.00	167.39	161.44
03/02/94	-	-	-	-	-	-	5.08	NP	0.00	167.39	162.31
06/06/94	-	-	-	-	-	-	6.35	FILM	0.00	167.39	161.04
09/06/94	11,000	260	26	<6.6	1,000	-	7.50	NP	0.00	167.39	159.89
12/07/94	-	-	-	-	-	-	5.48	FILM	0.00	167.39	161.91
03/08/95	-	-	-	-	-	-	5.18	FILM	0.00	167.39	162.21
06/15/95	-	-	-	-	-	-	-	-	-	-	-
09/05/95	-	-	-	-	-	-	6.84	FILM	0.00	167.39	160.55
11/21/95	10,000	210	<3	4.5	330	-	7.38	NP	0.00	167.39	160.01

**TABLE 1
GROUNDWATER DATA
THRIFTY OIL STATION #054, CASTRO VALLEY, CA.**

DATE SAMPLED	ANALYTICAL PARAMETERS						DEPTH TO GROUNDWATER (feet)	DEPTH TO PRODUCT (feet)	PRODUCT THICKNESS (feet)	CASING ELEVATION (feet)	GROUNDWATER ELEVATION (feet)
	TPH (ug/L)	BENZENE (ug/L)	TOLUENE (ug/L)	EthylBenzene (ug/L)	XYLENE (ug/L)	NIPEL (ug/L)					
03/11/96	1,600	640	15	10	46	-	4.85	NP	0.00	167.39	162.54
06/19/96	2,100	280	<3	<3	120	-	5.80	NP	0.00	167.39	161.59
09/16/96	140	<0.3	<0.3	<0.3	<0.5	110	4.50	NP	0.00	167.39	162.89
12/10/96	<50	<0.3	<0.3	<0.3	<0.5	<20	5.35	NP	0.00	167.39	162.04
03/12/97	<50	<0.3	<0.3	<0.3	<0.5	<20	3.48	NP	0.00	167.39	163.91
06/12/97	<50	<0.3	<0.3	<0.3	0.58	<20	-	-	-	-	-
09/10/97	<50	<0.3	<0.3	<0.3	<0.5	<20	3.10	NP	0.00	167.39	164.29
12/09/97	3,600	1,000	1,000	<6	570	260	4.55	NP	0.00	167.39	162.84
03/03/98	2,800	20	0.65	0.39	16	5,600	2.30	NP	0.00	167.39	165.09
07/08/98	<50	<0.3	<0.3	<0.3	<0.5	<5	-	-	-	-	-
09/10/98	<50	<0.3	<0.3	<0.3	<0.5	23	4.95	NP	0.00	167.39	162.44
12/30/98	<50	1.1	<0.3	<0.3	<0.5	<5	4.55	NP	0.00	167.39	162.84
03/15/99	<50	<0.3	<0.3	<0.3	<0.5	<5	4.15	NP	0.00	167.39	163.24
06/22/99	670	17	1.2	0.36	1.7	340	3.85	NP	0.00	167.39	163.54
09/08/99	140	0.72	<0.3	<0.3	<0.5	230	2.63	NP	0.00	167.39	164.76
12/01/99	95	<0.3	<0.3	<0.3	<0.5	200	2.63	NP	0.00	167.39	164.76
03/23/00	315	<0.25	<0.25	<0.25	<0.5	*293/422	2.25	NP	0.00	167.39	165.14
06/08/00	<100	<5	<5	<5	<5	201	3.02	NP	0.00	167.39	164.37
09/27/00	154	<0.18	<0.14	<0.18	<0.26	*254 / 160	3.01	NP	0.00	167.39	164.38
12/13/00	<50	<0.18	<0.14	<0.18	<0.26	*124 / 111	3.02	NP	0.00	167.39	164.37
03/22/01	<50	<0.18	<0.14	<0.18	<0.26	*90 / 57	4.54	NP	0.00	167.39	162.85
06/15/01	649	28	2.4	3.1	9	*1,790 / 2,560	4.92	NP	0.00	167.39	162.47
08/30/01	<50	<0.18	<0.14	<0.18	<0.26	<0.24	7.80	NP	0.00	167.39	159.59
12/12/01	<50	<0.18	<0.14	<0.18	<0.26	<0.24	7.35	NP	0.00	167.39	160.04
03/13/02	<50	<0.18	<0.14	<0.18	<0.26	<0.24	4.53	NP	0.00	167.39	162.86
06/12/02	969	<0.18	1.0	<0.18	<0.26	1,430	4.90	NP	0.00	167.39	162.49
MONITORING WELL #RE-1											
04/11/88	15,000	12,000	8,000	1,000	2,700	-	-	-	-	-	-
04/09/90	-	-	-	-	-	-	-	-	-	-	-
10/30/90	87,000	7,200	10,000	1,600	12,900	-	7.04	NP	0.00	166.94	159.90
01/18/91	70,000	5,000	5,400	790	9,900	-	11.62	NP	0.00	166.94	155.32
02/12/91	87,000	5,200	2,800	240	11,000	-	11.63	NP	0.00	166.94	155.31
03/20/91	6,500	370	230	17	670	-	11.61	NP	0.00	166.94	155.33
05/22/91	-	-	-	-	-	-	10.30	FILM	0.00	166.94	156.64
06/19/91	-	-	-	-	-	-	11.10	FILM	0.00	166.94	155.84

TABLE 1
GROUNDWATER DATA
THRIFTY OIL STATION #054, CASTRO VALLEY, CA.

DATE SAMPLED	ANALYTICAL PARAMETERS						DEPTH TO GROUNDWATER (feet)	DEPTH TO PRODUCT (feet)	PRODUCT THICKNESS (feet)	CASING ELEVATION (feet)	GROUNDWATER ELEVATION (feet)
	TPH (ug/L)	BENZENE (ug/L)	TOLUENE (ug/L)	EthylBenzene (ug/L)	XYLENE (ug/L)	MIBK (ug/L)					
07/17/91	-	-	-	-	-	-	6.20	FILM	0.00	166.94	160.74
08/17/91	-	-	-	-	-	-	8.15	FILM	0.00	166.94	158.79
09/24/91	-	-	-	-	-	-	10.40	FILM	0.00	166.94	156.54
10/23/91	-	-	-	-	-	-	11.20	FILM	0.00	166.94	155.74
11/06/91	-	-	-	-	-	-	6.62	FILM	0.00	166.94	160.32
12/04/91	-	-	-	-	-	-	11.20	ILM	0.00	166.94	155.74
01/29/92	-	-	-	-	-	-	7.72	FILM	0.00	166.94	159.22
02/26/92	-	-	-	-	-	-	5.13	FILM	0.00	166.94	161.81
03/19/92	-	-	-	-	-	-	5.00	FILM	0.00	166.94	161.94
04/22/92	-	-	-	-	-	-	5.94	FILM	0.00	166.94	161.00
05/21/92	-	-	-	-	-	-	5.40	FILM	0.00	166.94	161.54
06/25/92	-	-	-	-	-	-	5.71	FILM	0.00	166.94	161.23
07/30/92	-	-	-	-	-	-	6.33	FILM	0.00	166.94	160.61
08/20/92	-	-	-	-	-	-	5.80	FILM	0.00	166.94	161.14
09/30/92	-	-	-	-	-	-	6.34	FILM	0.00	166.94	160.60
12/23/92	-	-	-	-	-	-	5.50	FILM	0.00	166.94	161.44
03/10/93	-	-	-	-	-	-	4.67	FILM	0.00	166.94	162.27
06/09/93	-	-	-	-	-	-	5.12	FILM	0.00	166.94	161.82
09/14/93	-	-	-	-	-	-	10.44	NP	0.00	166.94	156.50
12/14/93	-	-	-	-	-	-	7.52	NP	0.00	166.94	159.42
03/02/94	-	-	-	-	-	-	4.85	NP	0.00	166.94	162.09
06/06/94	-	-	-	-	-	-	5.20	FILM	0.00	166.94	161.74
09/06/94	-	-	-	-	-	-	9.85	FILM	0.00	166.94	157.09
12/07/94	-	-	-	-	-	-	5.20	FILM	0.00	166.94	161.74
03/08/95	-	-	-	-	-	-	4.98	FILM	0.00	166.94	161.96
06/15/95	-	-	-	-	-	-	-	-	-	-	-
09/05/95	-	-	-	-	-	-	13.72	FILM	0.00	166.94	153.22
11/21/95	32,000	46	21	66	340	-	12.53	NP	0.00	166.94	154.41
03/11/96	1,700	130	15	2.0	120	-	4.72	NP	0.00	166.94	162.22
06/19/96	1,700	230	30	0.35	100	-	5.40	NP	0.00	166.94	161.54
09/16/96	510	<0.3	0.73	<0.3	<0.5	800	5.18	NP	0.00	166.94	161.76
12/10/96	520	<0.3	<0.3	<0.3	<0.5	1,000	4.65	NP	0.00	166.94	162.29
03/12/97	420	3.2	<0.3	<0.3	11	370	3.87	NP	0.00	166.94	163.07
06/12/97	510	0.66	<0.3	<0.3	<0.5	1,600	-	-	-	-	-
09/10/97	<50	<0.3	<0.3	<0.3	<0.5	<20	5.40	NP	0.00	166.94	161.54
12/09/97	1,400	330	2.3	<0.3	1.5	2,500	4.60	NP	0.00	166.94	162.34
03/03/98	3,000	400	0.61	0.5	97	3,800	5.05	NP	0.00	166.94	161.89

**TABLE 1
GROUNDWATER DATA
THRIFTY OIL STATION #054, CASTRO VALLEY, CA.**

DATE SAMPLED	ANALYTICAL PARAMETERS						DEPTH TO GROUNDWATER (feet)	DEPTH TO PRODUCT (feet)	PRODUCT THICKNESS (feet)	CASING ELEVATION (feet)	GROUNDWATER ELEVATION (feet)
	TPH (ug/L)	BENZENE (ug/L)	TOLUENE (ug/L)	EthylBenzene (ug/L)	XYLENE (ug/L)	MTBE (ug/L)					
07/08/98	650	<0.3	<0.3	<0.3	<0.5	1,800	-	-	-	-	-
09/10/98	2,700	<0.3	<0.3	<0.3	1.4	7,600	4.60	NP	0.00	166.94	162.34
12/30/98	530	<0.3	<0.3	<0.3	<0.5	1,500	4.20	NP	0.00	166.94	162.74
03/15/99	<50	<0.3	<0.3	<0.3	<0.5	<5	3.85	NP	0.00	166.94	163.09
06/22/99	1,200	23	1.5	<0.3	2.4	1,400	3.90	NP	0.00	166.94	163.04
09/08/99	590	1.5	<0.6	<0.6	<1	1,100	5.72	NP	0.00	166.94	161.22
12/01/99	540	<0.3	<0.3	<0.3	<0.5	880	5.34	NP	0.00	166.94	161.60
03/23/00	<50	<0.25	<0.25	<0.25	<0.5	<5	5.36	NP	0.00	166.94	161.58
06/08/00	67	<5	<5	<5	<5	<5	5.34	NP	0.00	166.94	161.60
09/27/00	<50	<0.18	<0.14	<0.18	<0.26	<0.24	5.35	NP	0.00	166.94	161.59
12/13/00	<50	<0.18	<0.14	<0.18	<0.26	<0.24	5.71	NP	0.00	166.94	161.23
03/22/01	<50	<0.18	<0.14	<0.18	<0.26	<0.24	4.19	NP	0.00	166.94	162.75
06/15/01	409	18	2	2	5	*1,060 / 1,480	4.57	NP	0.00	166.94	162.37
08/30/01	<50	<0.18	<0.14	<0.18	<0.26	<0.24	6.10	NP	0.00	166.94	160.84
12/12/01	<50	<0.18	<0.14	<0.18	3	*7 / 3.7	4.95	NP	0.00	166.94	161.99
03/13/02	511	3	3	<0.18	2	519	4.17	NP	0.00	166.94	162.77
06/12/02	380	2.0	2.0	1.0	2	479	4.93	NP	0.00	166.94	162.01
MONITORING WELL ARE-5											
04/11/88	14,000	1,300	1,100	100	2,600	-	-	-	-	-	-
04/09/90	3,000	690	190	40	270	-	4.79	NP	0.00	166.51	161.72
10/30/90	3,400	910	48	87	249	-	5.86	NP	0.00	166.51	160.65
01/18/91	1,400	180	8.6	0.52	48	-	4.40	NP	0.00	166.51	162.11
02/12/91	1,000	ND	ND	0.65	ND	-	4.76	NP	0.00	166.51	161.75
03/20/91	3,000	250	53	ND	110	-	5.08	NP	0.00	166.51	161.43
05/22/91	2,500	330	7.8	5.6	200	-	4.52	NP	0.00	166.51	161.99
01/19/91	2,000	59	1.6	5.1	110	-	4.39	NP	0.00	166.51	162.12
07/17/91	-	-	-	-	-	-	5.05	FILM	0.00	166.51	161.46
08/07/91	-	-	-	-	-	-	5.02	FILM	0.00	166.51	161.49
09/24/91	-	-	-	-	-	-	5.86	FILM	0.00	166.51	160.65
10/23/91	-	-	-	-	-	-	5.84	FILM	0.00	166.51	160.67
11/06/91	9,900	2,300	37	260	160	-	5.48	NP	0.00	166.51	161.03
12/04/91	4,500	1,000	27	ND	180	-	5.43	NP	0.00	166.51	161.08
01/29/92	600	6.1	2.3	ND	47	-	5.12	NP	0.00	166.51	161.39
02/26/92	500	5.4	2.7	1.2	14	-	4.93	NP	0.00	166.51	161.58
03/19/92	ND	1.7	1.1	ND	5.5	-	4.45	NP	0.00	166.51	162.06

**TABLE 1
GROUNDWATER DATA
THRIFTY OIL STATION #054, CASTRO VALLEY, CA.**

DATE SAMPLED	ANALYTICAL PARAMETERS						DEPTH TO GROUNDWATER (feet)	DEPTH TO PRODUCT (feet)	PRODUCT THICKNESS (feet)	CASING ELEVATION (feet)	GROUNDWATER ELEVATION (feet)
	TPH (ug/L)	BENZENE (ug/L)	TOLUENE (ug/L)	EthylBenzene (ug/L)	XYLENE (ug/L)	MTBE (ug/L)					
04/22/92	1,600	240	2.2	ND	160	-	4.63	NP	0.00	166.51	161.88
05/21/92	1,200	410	37	ND	118	-	4.90	NP	0.00	166.51	161.61
06/25/92	ND	1.0	0.8	0.8	0.4	-	5.15	NP	0.00	166.51	161.36
07/30/92	ND	2.0	1.8	1.9	6.4	-	5.30	NP	0.00	166.51	161.21
08/20/92	300	1.7	3.3	0.7	12	-	5.44	NP	0.00	166.51	161.07
09/30/92	1,900	140	ND	19	35	-	5.73	NP	0.00	166.51	160.78
12/23/92	400	8.0	ND	ND	ND	-	4.75	NP	0.00	166.51	161.76
03/10/93	1,100	290	9.7	ND	75	-	4.14	NP	0.00	166.51	162.37
06/09/93	400	1.5	0.5	ND	12	-	5.42	NP	0.00	166.51	161.09
09/14/93	240	6.9	8.8	1.4	67	-	5.53	NP	0.00	166.51	160.98
12/14/93	3,300	510	5.4	4.1	55	-	478	NP	0.00	166.51	-311.49
03/02/94	2,400	270	4.5	<0.3	13	-	4.20	NP	0.00	166.51	162.31
06/06/94	730	<0.3	<0.3	0.70	22	-	5.13	NP	0.00	166.51	161.38
09/06/94	2,400	180	28	2.3	76	-	5.45	NP	0.00	166.51	161.06
12/07/94	540	5.6	<0.3	<0.5	6.9	-	4.13	NP	0.00	166.51	162.38
03/08/95	1,500	220	5.5	<0.5	83	-	5.20	NP	0.00	166.51	161.31
06/15/95	3,200	820	53	6.2	74	-	4.93	NP	0.00	166.51	161.58
09/05/95	4,400	440	22	<2.5	57	-	5.03	NP	0.00	166.51	161.48
11/21/95	660	3.4	<0.3	<0.3	0.6	-	5.23	NP	0.00	166.51	161.28
03/11/96	1,000	76	2.2	<0.3	130	-	4.16	NP	0.00	166.51	162.35
06/09/96	90	<0.3	<0.3	<0.3	<0.5	-	5.42	NP	0.00	166.51	161.09
09/16/96	1,900	5.8	<0.3	<0.3	5.9	1,100	5.20	NP	0.00	166.51	161.31
12/10/96	740	<0.3	<0.3	<0.3	<0.5	1,300	5.27	NP	0.00	166.51	161.24
03/12/97	2,000	600	59	5.1	54	1,300	3.85	NP	0.00	166.51	162.66
06/12/97	230	<0.3	<0.3	<0.3	<0.5	720	-	-	-	-	-
09/10/97	210	<0.3	<0.3	<0.3	<0.5	210	4.10	NP	0.00	166.51	162.41
12/09/97	11,000	2,500	2,700	<6	1,500	510	5.20	NP	0.00	166.51	161.31
03/03/98	<50	<0.3	<0.3	<0.3	<0.5	<20	3.70	NP	0.00	166.51	162.81
07/08/98	<50	<0.3	<0.3	<0.3	<0.5	<5	-	-	-	-	-
09/10/98	<50	<0.3	<0.3	<0.3	<0.5	<5	6.77	NP	0.00	166.51	159.74
12/30/98	<50	<0.3	<0.3	<0.3	<0.5	<5	5.95	NP	0.00	166.51	160.56
03/15/99	<50	<0.3	<0.3	<0.3	<0.5	<5	5.25	NP	0.00	166.51	161.26
06/22/99	110	<0.3	<0.3	<0.3	<0.5	200	4.50	NP	0.00	166.51	162.01
09/08/99	68	<0.3	<0.3	<0.3	<0.5	110	4.43	NP	0.00	166.51	162.08
12/01/99	<50	<0.3	<0.3	<0.3	<0.5	<5	3.66	NP	0.00	166.51	162.85
03/23/00	<50	<0.25	<0.25	<0.25	<0.5	<5	4.06	NP	0.00	166.51	162.45
06/08/00	<50	<5	<5	<5	<5	<5	4.43	NP	0.00	166.51	162.08

**TABLE 1
GROUNDWATER DATA
THRIFTY OIL STATION #054, CASTRO VALLEY, CA.**

DATE SAMPLED	ANALYTICAL PARAMETERS						DEPTH TO GROUNDWATER (feet)	DEPTH TO PRODUCT (feet)	PRODUCT THICKNESS (feet)	CASING ELEVATION (feet)	GROUNDWATER ELEVATION (feet)
	TPH (ug/L)	BENZENE (ug/L)	TOLUENE (ng/L)	EthylBenzene (ng/L)	XYLENE (ug/L)	MIBH (ug/L)					
09/27/00	<50	<0.18	<0.14	<0.18	<0.26	<0.24	4.06	NP	0.00	166.51	162.45
12/13/00	<50	<0.18	<0.14	<0.18	<0.26	<0.24	4.80	NP	0.00	166.51	161.71
03/22/01	<50	<0.18	<0.14	<0.18	<0.26	<0.24	6.33	NP	0.00	166.51	160.18
06/15/01	<50	<0.18	<0.14	<0.18	<0.26	<0.24	4.79	NP	0.00	166.51	161.72
08/30/01	<50	<0.18	<0.14	<0.18	<0.26	<0.24	5.54	NP	0.00	166.51	160.97
12/12/01	<50	<0.18	<0.14	<0.18	<0.26	<0.24	5.21	NP	0.00	166.51	161.30
03/13/02	-	-	-	-	-	-	6.32	NP	0.00	166.51	160.19
06/12/02	-	-	-	-	-	-	-	-	-	-	-
MONITORING WELL #RE-5											
04/11/88	6,000	3,000	40	80	140	-	-	-	-	-	-
04/09/90	3,000	990	ND	70	ND	-	5.64	NP	0.00	166.51	160.87
10/30/90	3,400	1,000	28	ND	ND	-	6.68	NP	0.00	166.51	159.83
01/18/91	6,300	1,200	ND	3.0	15	-	6.61	NP	0.00	166.51	159.90
02/12/91	5,200	850	8.4	4.9	41	-	6.20	NP	0.00	166.51	160.31
03/20/91	5,800	680	12	8.0	16	-	5.62	NP	0.00	166.51	160.89
05/22/91	8,500	1,700	14	24	6.7	-	6.05	NP	0.00	166.51	160.46
06/19/91	-	-	-	-	-	-	6.12	FILM	0.00	166.51	160.39
07/17/91	120,000	9,300	13,000	2,400	16,000	-	6.20	NP	0.00	166.51	160.31
08/07/91	-	590	5.3	ND	14	-	6.27	NP	0.00	166.51	160.24
09/24/91	7,000	310	11	5.3	35	-	6.63	NP	0.00	166.51	159.88
10/23/91	-	-	-	-	-	-	6.36	FILM	0.00	166.51	160.15
11/06/91	4,000	710	18	29	49	-	6.15	NP	0.00	166.51	160.36
12/04/91	4,100	1,100	14	33	39	-	6.19	NP	0.00	166.51	160.32
01/29/92	2,600	790	14	ND	49	-	6.70	NP	0.00	166.51	159.81
02/26/92	3,100	950	21	30	33	-	5.44	NP	0.00	166.51	161.07
03/19/92	2,200	630	14	12	40	-	5.30	NP	0.00	166.51	161.21
04/22/92	-	730	2.2	ND	40	-	6.00	NP	0.00	166.51	160.51
05/21/92	1,500	840	7.8	7.1	34	-	6.25	NP	0.00	166.51	160.26
06/25/92	<2000	740	8.0	27	28	-	6.38	NP	0.00	166.51	160.13
07/30/92	-	-	-	-	-	-	6.42	FILM	0.00	166.51	160.09
08/20/92	2,800	630	17	23	22	-	6.50	NP	0.00	166.51	160.01
09/30/92	7,800	540	ND	12	29	-	6.66	NP	0.00	166.51	159.85
12/23/92	1,800	350	ND	7.7	11	-	5.83	NP	0.00	166.51	160.68
03/10/93	3,000	830	5.6	19	16	-	5.63	NP	0.00	166.51	160.88
06/09/93	4,800	920	6.2	3.2	12	-	6.01	NP	0.00	166.51	160.50

TABLE 1
GROUNDWATER DATA
THRIFTY OIL STATION #054, CASTRO VALLEY, CA.

DATE SAMPLED	ANALYTICAL PARAMETERS						DEPTH TO GROUNDWATER (feet)	DEPTH TO PRODUCT (feet)	PRODUCT THICKNESS (feet)	CASING ELEVATION (feet)	GROUNDWATER ELEVATION (feet)
	TPH (ug/L)	BENZENE (ug/L)	TOLUENE (ug/L)	EthylBenzene (ug/L)	XYLENE (ug/L)	MTBE (ug/L)					
09/14/93	3,600	660	7.5	11	27	-	6.53	NP	0.00	166.51	159.98
12/14/93	1,500	200	<0.3	<0.3	8.8	-	3.58	NP	0.00	166.51	162.93
03/02/94	-	-	-	-	-	-	5.12	NP	0.00	166.51	161.39
06/06/94	2,400	290	4.6	1.3	24	-	1.85	NP	0.00	166.51	164.66
09/06/94	4,300	230	21	<6.6	130	-	6.40	NP	0.00	166.51	160.11
12/07/94	1,500	17	2.5	3.2	22	-	5.68	NP	0.00	166.51	160.83
03/08/95	2,500	460	5.5	2.1	51	-	5.12	NP	0.00	166.51	161.39
06/15/95	2,300	91	1.1	0.7	97	-	5.72	NP	0.00	166.51	160.79
09/05/95	3,300	60	<10	<10	74	-	5.94	NP	0.00	166.51	160.57
11/21/95	2,000	7.3	<0.3	0.56	8.7	-	6.24	NP	0.00	166.51	160.27
03/11/96	840	43	0.96	5.7	14	-	5.16	NP	0.00	166.51	161.35
06/19/96	1,800	160	2.7	9.9	25	-	5.80	NP	0.00	166.51	160.71
09/16/96	<50	<0.3	<0.3	<0.3	<0.5	<20	5.38	NP	0.00	166.51	161.13
12/10/96	<50	<0.3	<0.3	<0.3	<0.5	<20	5.62	NP	0.00	166.51	160.89
03/12/97	<50	<0.3	<0.3	<0.3	<0.5	<20	5.20	NP	0.00	166.51	161.31
06/12/97	<50	<0.3	<0.3	<0.3	<0.5	<20	-	-	-	-	-
09/10/97	440	<0.3	<0.3	<0.3	<0.5	320	5.20	NP	0.00	166.51	161.31
12/09/97	<50	<0.3	<0.3	<0.3	<0.5	<20	5.97	NP	0.00	166.51	160.54
03/03/98	400	7.0	<0.3	<0.3	4.3	65	4.45	NP	0.00	166.51	162.06
07/08/98	300	<0.3	<0.3	<0.3	1.0	35	-	-	-	-	-
09/10/98	<50	<0.3	<0.3	<0.3	<0.5	<5	5.90	NP	0.00	166.51	160.61
12/30/98	<50	<0.3	<0.3	<0.3	<0.5	<5	5.20	NP	0.00	166.51	161.31
03/15/99	<50	<0.3	<0.3	<0.3	<0.5	8.4	4.82	NP	0.00	166.51	161.69
06/22/99	700	11	1.9	<0.3	3.9	140	6.00	NP	0.00	166.51	160.51
09/08/99	<50	<0.3	<0.3	<0.3	<0.5	<5	5.15	NP	0.00	166.51	161.36
12/01/99	<50	<0.3	<0.3	<0.3	<0.5	12	4.02	NP	0.00	166.51	162.49
03/23/00	<50	<0.25	<0.25	<0.25	<0.5	<5	4.41	NP	0.00	166.51	162.10
06/08/00	<50	<5	<5	<5	<5	<5	4.78	NP	0.00	166.51	161.73
09/27/00	<50	<0.18	<0.14	<0.18	<0.26	<0.24	4.78	NP	0.00	166.51	161.73
12/13/00	<50	<0.18	<0.14	<0.18	<0.26	<0.24	4.77	NP	0.00	166.51	161.74
03/22/01	367	<0.18	<0.14	<0.18	<0.26	*581 / 674	5.54	NP	0.00	166.51	160.97
06/15/01	<50	<0.18	<0.14	<0.18	<0.26	<0.24	5.92	NP	0.00	166.51	160.59
08/30/01	<50	<0.18	<0.14	<0.18	<0.26	<0.24	5.93	NP	0.00	166.51	160.58
12/12/01	138	<0.18	<0.14	<0.18	<0.26	*7 / <0.6	6.20	NP	0.00	166.51	160.31
03/13/02	<50	<0.18	<0.14	<0.18	<0.26	<0.24	5.55	NP	0.00	166.51	160.96
06/12/02		<0.18	1.0	<0.18	<0.26		5.93	NP	0.00	166.51	160.58

**TABLE 1
GROUNDWATER DATA
THRIFTY OIL STATION #054, CASTRO VALLEY, CA.**

DATE SAMPLED	ANALYTICAL PARAMETERS						DEPTH TO GROUNDWATER (feet)	DEPTH TO PRODUCT (feet)	PRODUCT THICKNESS (feet)	CASING ELEVATION (feet)	GROUNDWATER ELEVATION (feet)
	TPH (ug/L)	BENZENE (ug/L)	TOLUENE (ug/L)	Ethylbenzene (ug/L)	XYLENE (ug/L)	MIBK (ug/L)					
MONITORING WELL #RE-7											
04/11/88	<50,000	17,000	4,400	600	8,400	-	-	-	-	-	-
04/09/90	16,000	7,000	1,200	640	1,600	-	5.93	NP	0.00	166.04	160.11
10/30/90	31,000	14,000	ND	ND	ND	-	8.21	NP	0.00	166.04	157.83
01/18/91	-	-	-	-	-	-	11.80	NP	0.00	166.04	154.24
02/12/91	-	-	-	-	-	-	10.80	FILM	0.00	166.04	155.24
03/20/91	120,000	12,000	2,800	490	6,600	-	9.96	NP	0.00	166.04	156.08
05/22/91	-	-	-	-	-	-	11.70	FILM	0.00	166.04	154.34
06/19/91	-	-	-	-	-	-	11.50	FILM	0.00	166.04	154.54
07/17/91	-	-	-	-	-	-	7.80	FILM	0.00	166.04	158.24
08/07/91	-	-	-	-	-	-	9.88	0.03	9.85	166.04	163.60
09/24/91	-	-	-	-	-	-	9.85	0.03	9.82	166.04	163.60
10/23/91	-	-	-	-	-	-	9.96	FILM	0.00	166.04	156.08
11/06/91	-	-	-	-	-	-	6.77	FILM	0.00	166.04	159.27
12/04/91	-	-	-	-	-	-	10.80	FILM	0.00	166.04	155.24
01/29/92	-	-	-	-	-	-	8.64	FILM	0.00	166.04	157.40
02/26/92	-	-	-	-	-	-	6.00	FILM	0.00	166.04	160.04
03/19/92	-	-	-	-	-	-	5.55	FILM	0.00	166.04	160.49
04/22/92	-	-	-	-	-	-	6.12	FILM	0.00	166.04	159.92
05/21/92	-	-	-	-	-	-	6.40	FILM	0.00	166.04	159.64
06/25/92	-	-	-	-	-	-	6.73	0.02	6.71	166.04	164.38
07/30/92	-	-	-	-	-	-	6.73	FILM	0.00	166.04	159.31
08/20/92	-	-	-	-	-	-	6.82	FILM	0.00	166.04	159.22
09/30/92	-	-	-	-	-	-	7.26	FILM	0.00	166.04	158.78
12/23/92	-	-	-	-	-	-	6.22	FILM	0.00	166.04	159.82
03/10/93	-	-	-	-	-	-	5.82	FILM	0.00	166.04	160.22
06/09/93	-	-	-	-	-	-	6.17	FILM	0.00	166.04	159.87
09/14/93	-	-	-	-	-	-	11.33	NP	0.00	166.04	154.71
12/14/93	-	-	-	-	-	-	8.40	NP	0.00	166.04	157.64
03/02/94	-	-	-	-	-	-	6.82	NP	0.00	166.04	159.22
06/06/94	-	-	-	-	-	-	10.95	FILM	0.00	166.04	155.09
09/06/94	-	-	-	-	-	-	11.30	FILM	0.00	166.04	154.74
12/07/94	-	-	-	-	-	-	5.63	FILM	0.00	166.04	160.41
03/08/95	-	-	-	-	-	-	5.06	FILM	0.00	166.04	160.98
06/15/95	-	-	-	-	-	-	-	-	-	-	-
09/05/95	-	-	-	-	-	-	7.98	FILM	0.00	166.04	158.06
11/21/95	20,000	8,800	110	<30	310	-	7.32	NP	0.00	166.04	158.72

**TABLE 1
GROUNDWATER DATA
THRIFTY OIL STATION #054, CASTRO VALLEY, CA.**

DATE SAMPLED	ANALYTICAL PARAMETERS						DEPTH TO GROUNDWATER (feet)	DEPTH TO PRODUCT (feet)	PRODUCT THICKNESS (feet)	CASING ELEVATION (feet)	GROUNDWATER ELEVATION (feet)
	TPH (ug/L)	BENZENE (ug/L)	TOLUENE (ug/L)	EthylBenzene (ug/L)	XYLENE (ug/L)	MTBE (ug/L)					
03/11/96	4,800	2,200	38	26	120	-	5.62	NP	0.00	166.04	160.42
06/19/96	4,400	3,300	49	5.8	70	-	6.40	NP	0.00	166.04	159.64
09/19/96	7,200	510	83	<0.3	710	130	6.20	NP	0.00	166.04	159.84
12/10/96	700	<0.3	<0.3	<0.3	<0.5	1,400	5.92	NP	0.00	166.04	160.12
03/12/97	660	0.31	<0.3	<0.3	<0.5	1,400	5.62	NP	0.00	166.04	160.42
06/12/97	320	<0.3	0.45	<0.3	<0.5	850	-	-	-	-	-
09/10/97	780	<0.3	<0.3	<0.3	<0.5	930	7.45	NP	0.00	166.04	158.59
12/09/97	14,000	3,500	3,700	<15	2,100	1,100	7.10	NP	0.00	166.04	158.94
03/03/98	6,100	2,500	18	<6	110	270	6.70	NP	0.00	166.04	159.34
07/08/98	1,300	8.7	<0.3	<0.3	<0.5	350	-	-	-	-	-
09/10/98	690	2.2	<0.3	<0.3	<0.5	350	7.04	NP	0.00	166.04	159.00
12/30/98	600	2.0	0.55	<0.3	<0.5	350	6.25	NP	0.00	166.04	159.79
03/15/99	350	0.71	<0.3	<0.3	<0.5	140	6.02	NP	0.00	166.04	160.02
06/22/99	5,900	2,100	16	4.6	48	170	6.35	NP	0.00	166.04	159.69
09/08/99	1,700	380	<3	<3	13	160	7.03	NP	0.00	166.04	159.01
12/01/99	930	3.7	<0.3	<0.3	<0.5	390	6.25	NP	0.00	166.04	159.79
03/23/00	581	5.4	5.3	1.9	7.3	*168/183	6.24	NP	0.00	166.04	159.80
06/08/00	<100	<5	<5	<5	<5	74	6.64	NP	0.00	166.04	159.40
09/27/00	236	<0.18	<0.14	<0.18	<0.26	*21 / 28	7.03	NP	0.00	166.04	159.01
12/13/00	<50	<0.18	<0.14	<0.18	<0.26	*13 / 19.8	6.63	NP	0.00	166.04	159.41
03/22/01	504	<0.18	<0.14	<0.18	1	*666 / 1,420	7.02	NP	0.00	166.04	159.02
06/15/01	144	5.0	<0.14	0.5	2	*369 / 408	7.02	NP	0.00	166.04	159.02
08/30/01	<50	<0.18	<0.14	<0.18	<0.26	<0.24	7.79	NP	0.00	166.04	158.25
12/12/01	<50	<0.18	<0.14	<0.18	<0.26	<0.24	7.28	NP	0.00	166.04	158.76
03/13/02	<50	<0.18	<0.14	<0.18	<0.26	<0.24	6.02	NP	0.00	166.04	160.02
06/12/02	5,130	772	970	59	550	113	7.79	NP	0.00	166.04	158.25
MONITORING WELL #RS-3											
08/07/91	ND	ND	ND	ND	ND	-	9.68	NP	0.00	164.32	154.64
09/27/91	ND	ND	ND	ND	ND	-	9.89	NP	0.00	164.32	154.43
10/23/91	ND	ND	ND	ND	ND	-	10.05	NP	0.00	164.32	154.27
11/06/91	ND	ND	ND	ND	ND	-	9.71	NP	0.00	164.32	154.61
12/04/91	ND	ND	ND	ND	ND	-	10.00	NP	0.00	164.32	154.32
01/29/92	ND	2.1	1.0	2.5	3.6	-	9.28	NP	0.00	164.32	155.04
02/26/92	ND	ND	0.7	ND	0.7	-	7.05	NP	0.00	164.32	157.27
03/19/92	ND	0.5	1.0	1.5	2.7	-	7.30	NP	0.00	164.32	157.02

**TABLE 1
GROUNDWATER DATA
THRIFTY OIL STATION #054, CASTRO VALLEY, CA.**

DATE SAMPLED	ANALYTICAL PARAMETERS						DEPTH TO GROUNDWATER (feet)	DEPTH TO PRODUCT (feet)	PRODUCT THICKNESS (feet)	CASING ELEVATION (feet)	GROUNDWATER ELEVATION (feet)
	TPH (ug/L)	BENZENE (ug/L)	TOLUENE (ug/L)	EthylBenzene (ug/L)	XYLENE (ug/L)	MTBE (ug/L)					
04/22/92	ND	ND	ND	ND	ND	-	8.60	NP	0.00	164.32	155.72
05/21/92	ND	ND	ND	ND	ND	-	9.22	NP	0.00	164.32	155.10
06/25/92	ND	ND	ND	ND	ND	-	9.49	NP	0.00	164.32	154.83
07/30/92	ND	1.1	4.2	ND	3.0	-	9.55	NP	0.00	164.32	154.77
08/20/92	ND	2.0	4.7	ND	5.7	-	9.63	NP	0.00	164.32	154.69
09/30/92	ND	ND	ND	ND	ND	-	9.90	NP	0.00	164.32	154.42
12/23/92	ND	ND	ND	ND	ND	-	9.96	NP	0.00	164.32	154.36
05/10/93	ND	ND	ND	ND	ND	-	8.95	NP	0.00	164.32	155.37
06/09/93	ND	ND	ND	ND	ND	-	9.00	NP	0.00	164.32	155.32
09/14/93	200	0.3	ND	ND	ND	-	9.50	NP	0.00	164.32	154.82
12/14/93	ND	ND	ND	ND	ND	-	8.75	NP	0.00	164.32	155.57
03/02/94	<50	<0.3	<0.3	<0.3	<0.5	-	7.52	NP	0.00	164.32	156.80
06/06/94	54	<0.3	<0.3	<0.3	2.4	-	9.00	NP	0.00	164.32	155.32
09/06/94	<50	<0.3	<0.3	<0.3	<0.5	-	9.26	NP	0.00	164.32	155.06
12/07/94	130	2.5	1.9	1.3	3.6	-	8.67	NP	0.00	164.32	155.65
03/08/95	<100	<0.5	<0.5	<0.5	<1	-	8.34	NP	0.00	164.32	155.98
06/15/95	<100	1.0	<0.5	<0.5	<1	-	9.12	NP	0.00	164.32	155.20
09/05/95	<100	<0.5	<0.5	<0.5	<1	-	9.56	NP	0.00	164.32	154.76
11/21/95	<50	0.44	<0.3	<0.3	1.5	-	9.28	NP	0.00	164.32	155.04
03/11/96	<50	1.3	<0.3	<0.3	0.6	-	7.52	NP	0.00	164.32	156.80
06/19/96	640	72	20	34	150	-	7.80	NP	0.00	164.32	156.52
09/16/96	<50	<0.3	<0.3	<0.3	<0.5	20	9.18	NP	0.00	164.32	155.14
12/10/96	<50	<0.3	<0.3	<0.3	<0.5	<20	6.08	NP	0.00	164.32	158.24
03/12/97	53	0.45	<0.3	<0.3	<0.5	140	8.65	NP	0.00	164.32	155.67
06/12/97	<50	<0.3	<0.3	<0.3	<0.5	68	-	-	-	-	-
09/10/97	<50	<0.3	<0.3	<0.3	<0.5	<20	8.30	NP	0.00	164.32	156.02
12/09/97	<50	1.7	2.1	<0.3	1.4	82	9.98	NP	0.00	164.32	154.34
03/03/98	<50	<0.3	<0.3	<0.3	<0.5	84	8.33	NP	0.00	164.32	155.99
07/08/98	<50	<0.3	<0.3	<0.3	<0.5	97	-	-	-	-	-
09/10/98	<50	<0.3	<0.3	<0.3	<0.5	97	12.95	NP	0.00	164.32	151.37
12/30/98	<50	1.3	1.5	<0.3	0.86	19	11.35	NP	0.00	164.32	152.97
03/15/99	<50	<0.3	<0.3	<0.3	<0.5	9.6	9.85	NP	0.00	164.32	154.47
06/22/99	66	0.39	<0.3	<0.3	<0.5	62	9.90	NP	0.00	164.32	154.42
09/08/99	<50	<0.3	<0.3	<0.3	<0.5	25	9.85	NP	0.00	164.32	154.47
12/01/99	<50	<0.3	<0.3	<0.3	<0.5	30	8.30	NP	0.00	164.32	156.02
03/23/00	<50	<0.25	<0.25	<0.25	<0.5	*13.6/18.2	6.76	NP	0.00	164.32	157.56
06/08/00	<50	<5	<5	<5	<5	10	8.30	NP	0.00	164.32	156.02

**TABLE 1
GROUNDWATER DATA
THRIFTY OIL STATION #054, CASTRO VALLEY, CA.**

DATE SAMPLED	ANALYTICAL PARAMETERS						DEPTH TO GROUNDWATER (feet)	DEPTH TO PRODUCT (feet)	PRODUCT THICKNESS (feet)	CASING ELEVATION (feet)	GROUNDWATER ELEVATION (feet)
	IPH (ng/L)	BENZENE (ng/L)	TOLUENE (ng/L)	EthylBenzene (ng/L)	XYLENE (ng/L)	MTHB (ng/L)					
09/27/00	<50	<0.18	<0.14	<0.18	<0.26	*6 / 4.9	8.30	NP	0.00	164.32	156.02
12/13/00	<50	<0.18	<0.14	<0.18	<0.26	<0.24	8.28	NP	0.00	164.32	156.04
03/22/01	<50	<0.18	<0.14	<0.18	<0.26	<0.24	12.89	NP	0.00	164.32	151.43
06/15/01	<50	<0.18	<0.14	<0.18	<0.26	<0.24	12.89	NP	0.00	164.32	151.43
08/30/01	<50	<0.18	<0.14	<0.18	<0.26	<0.24	9.82	NP	0.00	164.32	154.50
12/12/01	<50	<0.18	<0.14	<0.18	<0.26	<0.24	9.25	NP	0.00	164.32	155.07
03/13/02	-	-	-	-	-	-	12.89	NP	0.00	164.32	151.43
06/12/02	-	-	-	-	-	-	-	-	-	-	-
MONITORING WELL #RS-9											
08/07/91	-	0.5	ND	330	1,200	-	2.28	NP	0.00	167.51	165.23
09/27/91	13,000	3.5	3.0	82	140	-	2.77	NP	0.00	167.51	164.74
10/23/91	11,000	ND	ND	39	340	-	3.53	NP	0.00	167.51	163.98
11/06/91	6,800	8.4	0.6	22	230	-	2.51	NP	0.00	167.51	165.00
12/04/91	6,500	6.5	0.7	87	200	-	3.20	NP	0.00	167.51	164.31
01/29/92	8,100	22	10	140	260	-	2.65	NP	0.00	167.51	164.86
02/26/92	13,000	40	16	220	600	-	3.42	NP	0.00	167.51	164.09
03/19/92	12,000	21	12	100	280	-	3.12	NP	0.00	167.51	164.39
04/22/92	8,600	ND	ND	20	37	-	3.24	NP	0.00	167.51	164.27
05/21/92	6,000	21	10	53	210	-	3.75	NP	0.00	167.51	163.76
06/25/92	370	2.3	1.5	0.7	4.3	-	2.65	NP	0.00	167.51	164.86
07/30/92	3,600	20	ND	39	80	-	2.70	NP	0.00	167.51	164.81
08/20/92	3,000	0.7	5.2	2.0	5.3	-	2.83	NP	0.00	167.51	164.68
09/30/92	9,200	4.8	6.5	12	91	-	2.80	NP	0.00	167.51	164.71
12/23/92	2,000	17	ND	8.2	18	-	2.45	NP	0.00	167.51	165.06
03/10/93	1,500	ND	2.6	21	12	-	2.40	NP	0.00	167.51	165.11
06/09/93	1,300	0.6	1.7	ND	7.5	-	3.55	NP	0.00	167.51	163.96
09/14/93	1,500	1.3	7.6	4.1	14	-	2.81	NP	0.00	167.51	164.70
12/14/93	560	ND	ND	ND	5.5	-	2.63	NP	0.00	167.51	164.88
03/02/94	1,100	<0.3	<0.3	<0.3	<0.5	-	2.60	NP	0.00	167.51	164.91
06/06/94	290	0.58	0.53	1.1	5.8	-	2.52	NP	0.00	167.51	164.99
09/06/94	890	<0.3	<0.3	<0.3	3.1	-	3.16	NP	0.00	167.51	164.35
12/07/94	940	22	23	10	32	-	5.18	NP	0.00	167.51	162.33
03/08/95	1,600	<0.5	<0.5	<0.5	2.3	-	4.57	NP	0.00	167.51	162.94
06/15/95	3,200	2.2	5.3	4.3	3.1	-	5.08	NP	0.00	167.51	162.43
09/05/95	1,100	<0.5	<0.5	<0.5	<1	-	5.72	NP	0.00	167.51	161.79

**TABLE 1
GROUNDWATER DATA
THRIFTY OIL STATION #054, CASTRO VALLEY, CA.**

DATE SAMPLED	ANALYTICAL PARAMETERS						DEPTH TO GROUNDWATER (feet)	DEPTH TO PRODUCT (feet)	PRODUCT THICKNESS (feet)	CASING ELEVATION (feet)	GROUNDWATER ELEVATION (feet)
	TPH (ug/L)	BENZENE (ug/L)	TOLUENE (ug/L)	EthylBenzene (ug/L)	XYLENE (ug/L)	MTHB (ug/L)					
11/21/95	1,100	1.1	2.9	3.5	3.0	-	2.46	NP	0.00	167.51	165.05
03/11/96	440	0.7	0.34	<0.3	3.7	-	3.44	NP	0.00	167.51	164.07
06/19/96	580	3.8	0.49	1.2	<0.5	-	3.80	NP	0.00	167.51	163.71
09/16/96	490	<0.3	1.6	<0.3	<0.5	<20	3.80	NP	0.00	167.51	163.71
12/10/96	<50	<0.3	<0.3	<0.3	<0.5	<20	2.76	NP	0.00	167.51	164.75
03/12/97	<50	<0.3	0.42	<0.3	1.5	<20	3.20	NP	0.00	167.51	164.31
06/12/97	<50	<0.3	<0.3	<0.3	0.51	<20	-	-	-	-	-
09/10/97	<50	<0.3	<0.3	<0.3	<0.5	<20	4.24	NP	0.00	167.51	163.27
12/09/97	<50	<0.3	0.48	<0.3	<0.5	<20	2.72	NP	0.00	167.51	164.79
03/03/98	190	<0.3	<0.3	0.38	<0.5	<20	1.90	NP	0.00	167.51	165.61
07/08/98	<50	<0.3	<0.3	<0.3	<0.5	<5	-	-	-	-	-
09/10/98	<50	<0.3	<0.3	<0.3	<0.5	<5	2.72	NP	0.00	167.51	164.79
12/30/98	<50	<0.3	<0.3	<0.3	<0.5	<5	1.20	NP	0.00	167.51	166.31
03/15/99	<50	<0.3	<0.3	<0.3	<0.5	<5	4.25	NP	0.00	167.51	163.26
06/22/99	1,300	4.2	1.2	0.69	0.74	<5	3.70	NP	0.00	167.51	163.81
09/08/99	<50	<0.3	<0.3	<0.3	<0.5	<5	2.71	NP	0.00	167.51	164.80
12/01/99	<50	<0.3	<0.3	<0.3	<0.5	<5	2.70	NP	0.00	167.51	164.81
03/23/00	<50	<0.25	<0.25	<0.25	<0.5	<5	2.70	NP	0.00	167.51	164.81
06/08/00	585	<5	<5	<5	<5	821	2.72	NP	0.00	167.51	164.79
09/27/00	592	<0.18	<0.14	<0.18	<0.26	*1,180 / 1,360	2.72	NP	0.00	167.51	164.79
12/13/00	<50	<0.18	<0.14	<0.18	<0.26	*403 / 444	2.70	NP	0.00	167.51	164.81
03/22/01	425	<0.18	<0.14	<0.18	<0.26	*738 / 1,640	2.69	NP	0.00	167.51	164.82
06/15/01	<50	<0.18	<0.14	<0.18	<0.26	<0.24	2.68	NP	0.00	167.51	164.83
08/30/01	164	<0.18	<0.14	<0.18	<0.26	*396 / 284	2.68	NP	0.00	167.51	164.83
12/12/01	1,540	<0.18	<0.14	<0.18	<0.26	*4,370 / 2,480	2.41	NP	0.00	167.51	165.10
03/13/02	1,540	<0.18	<0.14	<0.18	<0.26	3,360	2.68	NP	0.00	167.51	164.83
06/12/02	2,020	1	3	1	3	3,280	4.21	NP	0.00	167.51	163.30
MONITORING WELL #RS-10											
08/07/91	ND	ND	ND	ND	ND	-	6.16	NP	0.00	162.89	156.73
09/27/91	ND	ND	ND	ND	ND	-	6.48	NP	0.00	162.89	156.41
10/23/91	ND	ND	ND	ND	ND	-	7.37	NP	0.00	162.89	155.52
11/06/91	ND	ND	ND	ND	ND	-	6.44	NP	0.00	162.89	156.45
12/04/91	ND	ND	ND	ND	ND	-	7.02	NP	0.00	162.89	155.87
01/29/92	ND	ND	ND	ND	ND	-	6.78	NP	0.00	162.89	156.11
02/26/92	ND	ND	ND	ND	ND	-	8.33	NP	0.00	162.89	154.56

**TABLE 1
GROUNDWATER DATA
THRIFTY OIL STATION #054, CASTRO VALLEY, CA.**

DATE SAMPLED	ANALYTICAL PARAMETERS						DEPTH TO GROUNDWATER (feet)	DEPTH TO PRODUCT (feet)	PRODUCT THICKNESS (feet)	CASING ELEVATION (feet)	GROUNDWATER ELEVATION (feet)
	TPH (ug/L)	BENZENE (ug/L)	TOLUENE (ug/L)	EthylBenzene (ug/L)	XYLENE (ug/L)	MTBE (ug/L)					
03/19/92	ND	ND	ND	ND	0.6	-	8.02	NP	0.00	162.89	154.87
04/22/92	ND	ND	ND	ND	ND	-	7.78	NP	0.00	162.89	155.11
05/21/92	ND	ND	0.6	ND	1.2	-	6.21	NP	0.00	162.89	156.68
06/25/92	ND	ND	ND	ND	ND	-	7.73	NP	0.00	162.89	155.16
07/30/92	ND	ND	0.5	ND	1.0	-	7.84	NP	0.00	162.89	155.05
08/20/92	ND	ND	ND	ND	ND	-	7.50	NP	0.00	162.89	155.39
09/30/92	ND	ND	ND	ND	ND	-	7.63	NP	0.00	162.89	155.26
12/23/92	ND	ND	ND	ND	ND	-	7.24	NP	0.00	162.89	155.65
03/10/93	ND	ND	ND	ND	ND	-	6.38	NP	0.00	162.89	156.51
06/09/93	ND	ND	ND	ND	ND	-	7.98	NP	0.00	162.89	154.91
09/14/93	ND	ND	ND	ND	ND	-	7.35	NP	0.00	162.89	155.54
03/02/94	<50	<0.3	<0.3	<0.3	<0.3	-	7.00	NP	0.00	162.89	155.89
06/06/94	<50	<0.3	<0.3	<0.3	<0.5	-	6.55	NP	0.00	162.89	156.34
09/06/94	<50	<0.3	<0.3	<0.3	<0.5	-	7.63	NP	0.00	162.89	155.26
12/07/94	56	<0.3	<0.3	<0.5	2.1	-	5.92	NP	0.00	162.89	156.97
03/08/95	<100	<0.5	<0.5	<0.5	<1	-	7.84	NP	0.00	162.89	155.05
06/15/95	<100	<0.5	<0.5	<0.5	<1	-	6.97	NP	0.00	162.89	155.92
09/05/95	<100	<0.5	<0.5	<0.5	<1	-	8.14	NP	0.00	162.89	154.75
11/21/95	<50	<0.3	<0.3	<0.3	<0.5	-	7.68	NP	0.00	162.89	155.21
03/11/96	<50	<0.3	<0.3	<0.3	<0.5	-	6.76	NP	0.00	162.89	156.13
06/19/96	<50	<0.3	<0.3	<0.3	<0.5	-	7.20	NP	0.00	162.89	155.69
09/16/96	<50	<0.3	<0.3	<0.3	<0.5	<20	6.30	NP	0.00	162.89	156.59
12/10/96	<50	<0.3	<0.3	<0.3	<0.5	<20	6.05	NP	0.00	162.89	156.84
03/12/97	<50	<0.3	<0.3	<0.3	<0.5	<20	7.56	NP	0.00	162.89	155.33
06/12/97	<50	<0.3	<0.3	<0.3	<0.5	<20	-	-	-	-	-
09/10/97	<50	<0.3	<0.3	<0.3	<0.5	<20	7.55	NP	0.00	162.89	155.34
12/09/97	1,900	610	510	<6	290	<20	7.55	NP	0.00	162.89	155.34
03/03/98	<50	2.0	<0.3	<0.3	<0.5	27	6.03	NP	0.00	162.89	156.86
07/08/98	<50	<0.3	<0.3	<0.3	<0.5	<5	-	-	-	-	-
09/10/98	<50	<0.3	<0.3	<0.3	<0.5	72	7.55	NP	0.00	162.89	155.34
12/30/98	<50	1.1	<0.3	<0.3	<0.5	<5	4.45	NP	0.00	162.89	158.44
03/15/99	<50	<0.3	<0.3	<0.3	1.3	<5	4.50	NP	0.00	162.89	158.39
06/22/99	<50	<0.3	<0.3	<0.3	<0.5	<5	9.15	NP	0.00	162.89	153.74
09/08/99	<50	<0.3	<0.3	<0.3	<0.5	<5	7.51	NP	0.00	162.89	155.38
12/01/99	<50	<0.3	<0.3	<0.3	<0.5	<5	5.97	NP	0.00	162.89	156.92
03/23/00	<50	<0.25	<0.25	<0.25	<0.5	<5	4.47	NP	0.00	162.89	158.42
06/08/00	<50	<5	<5	<5	<5	<5	5.97	NP	0.00	162.89	156.92

**TABLE 1
GROUNDWATER DATA
THRIFTY OIL STATION #054, CASTRO VALLEY, CA.**

DATE SAMPLED	ANALYTICAL PARAMETERS						DEPTH TO GROUNDWATER (feet)	DEPTH TO PRODUCT (feet)	PRODUCT THICKNESS (feet)	CASING ELEVATION (feet)	GROUNDWATER ELEVATION (feet)
	TPH (ug/L)	BENZENE (ug/L)	TOLUENE (ug/L)	EthylBenzene (ug/L)	XYLENE (ug/L)	MIBK (ug/L)					
09/27/00	<50	<0.18	<0.14	<0.18	<0.26	<0.24	7.50	NP	0.00	162.89	155.39
12/13/00	<50	<0.18	<0.14	<0.18	<0.26	<0.24	5.94	NP	0.00	162.89	156.95
03/22/01	<50	<0.18	<0.14	<0.18	<0.26	<0.24	7.51	NP	0.00	162.89	155.38
06/15/01	<50	<0.18	<0.14	<0.18	<0.26	<0.24	7.50	NP	0.00	162.89	155.39
08/30/01	<50	<0.18	<0.14	<0.18	<0.26	<0.24	9.05	NP	0.00	162.89	153.84
12/12/01	<50	<0.18	<0.14	<0.18	<0.26	<0.24	7.65	NP	0.00	162.89	155.24
03/13/02	-	-	-	-	-	-	9.05	NP	0.00	162.89	153.84
06/12/02	-	-	-	-	-	-	-	-	-	-	-
MONITORING WELLS - II											
09/21/95	110	<0.5	<0.5	<0.5	<1	-	9.37	NP	0.00	163.28	153.91
11/21/95	-	-	-	-	-	-	-	-	-	-	-
03/11/96	-	-	-	-	-	-	-	-	-	-	-
06/19/96	-	-	-	-	-	-	-	-	-	-	-
09/16/96	-	-	-	-	-	-	-	-	-	-	-
03/12/97	74	9.5	<0.3	<0.3	0.57	<20	7.75	NP	0.00	163.28	155.53
06/12/97	<50	<0.3	<0.3	<0.3	<0.5	<20	-	-	-	-	-
09/10/97	<50	<0.3	<0.3	<0.3	<0.5	<20	9.50	NP	0.00	163.28	153.78
12/09/97	<50	0.79	1.2	<0.3	<0.5	<20	9.50	NP	0.00	163.28	153.78
03/03/98	140	22	0.63	<0.3	<0.5	<20	7.93	NP	0.00	163.28	155.35
07/08/98	<50	<0.3	<0.3	<0.3	<0.5	<5	-	-	-	-	-
09/10/98	<50	<0.3	<0.3	<0.3	<0.5	<5	9.48	NP	0.00	163.28	153.80
12/30/98	<50	1.3	0.87	<0.3	0.55	<5	7.95	NP	0.00	163.28	155.33
03/15/99	<50	<0.3	<0.3	<0.3	<0.5	<5	6.40	NP	0.00	163.28	156.88
06/22/99	350	89	2.9	3.3	0.91	6.8	11.00	NP	0.00	163.28	152.28
09/08/99	99	9.1	0.37	<0.3	<0.5	<5	7.90	NP	0.00	163.28	155.38
12/01/99	82	9.7	0.44	<0.3	<0.5	<5	7.90	NP	0.00	163.28	155.38
03/23/00	73	5.8	2.3	<0.25	<0.5	*11.2 / 7.9	4.85	NP	0.00	163.28	158.43
06/08/00	306	<5	<5	<5	<5	<5	7.90	NP	0.00	163.28	155.38
09/27/00	<50	1	<0.14	<0.18	<0.26	3 J / 3.6	9.44	NP	0.00	163.28	153.84
12/13/00	<50	<0.18	<0.14	<0.18	<0.26	<0.24	6.34	NP	0.00	163.28	156.94
03/22/01	408	<0.18	<0.14	<0.18	<0.26	*664 / 941	7.96	NP	0.00	163.28	155.32
06/15/01	<50	<0.18	<0.14	<0.18	<0.26	<0.24	7.87	NP	0.00	163.28	155.41
08/30/01	<50	<0.18	<0.14	<0.18	<0.26	<0.24	9.41	NP	0.00	163.28	153.87
12/12/01	<50	<0.18	<0.14	<0.18	<0.26	<0.24	7.86	NP	0.00	163.28	155.42

**TABLE 1
GROUNDWATER DATA
THRIFTY OIL STATION #054, CASTRO VALLEY, CA.**

DATE SAMPLED	ANALYTICAL PARAMETERS						DEPTH TO GROUNDWATER (feet)	DEPTH TO PRODUCT (feet)	PRODUCT THICKNESS (feet)	CASING ELEVATION (feet)	GROUNDWATER ELEVATION (feet)
	TPH (ug/L)	BENZENE (ug/L)	TOLUENE (ug/L)	EthylBenzene (ug/L)	XYLENE (ug/L)	MTBE (ug/L)					
03/13/02	<50	<0.18	<0.14	<0.18	<0.26	<0.24	7.85	NP	0.00	163.28	155.43
06/12/02	<50	<0.18	1	<0.18	<0.26	<0.24	9.39	NP	0.00	163.28	153.89

NOTE: ND = Nondetectable
 " - " = Not Analyzed / Not Available
 NP = No Free Product
 *MTBE 8020/8260

Benzene, toluene, ethylbenzene, and xylene analyzed by EPA method 8020.
 Total petroleum hydrocarbons (TPH) analyzed by EPA method 8015 modified for gasoline
 Methyl-tert Butyl Ether (MTBE) analyzed by EPA method 8020
 On June 8, 2000, BTEX and MTBE analyzed by EPA Method 8260B



THRIFTY OIL CO. SS #054
 2504 CASTRO VALLEY BLVD.
 CASTRO VALLEY, CA 94546
 DATE: 06.12.02

PROJECT STATUS REPORT

F R E E Q .	M O N I T O R I N G				O D O R S			F R E E		W E L L S C O N N E C T E D T O S Y S T E M (W)							
	O B S E R V A T I O N W E L L S				(S = S L I G H T)			P R O D U C T		C O N N E C T		I N T E G R I T Y		V A P O R		W A T E R	
	NO.	DTW	DTB	PT	YES	NO	S	YES	NO	YES	NO	OK	NO	ON	OFF	ON	OFF
M	PW-1	6.80	13.95								X	-					
M	PW-2										X	-					
M	RE-1										X	-					
M	RE-2	5.86	16.46								X	-					
M	RE-3	4.90	17.53								X	-					
M	RE-4	4.93	14.50								X	-					
M	RE-5										X	-					
M	RE-6	5.93	13.58								X	-					
M	RE-7	7.79	13.14								X	-					
M	RS-8										-	X					
M	RS-9	4.21	14.94								-	X					
M	RS-10											X					
M	RS-11	9.39	24.72									X					

S A V E S Y S T E M W E E K L Y

PARAMETER	U/M	DATA	PARAMETER	U/M	DATA
TIME	AM/PM		AIR FLOW	C F M	
WORKING	YES/NO		VAPOR FLOW	C F M	
RESTARTED	YES/NO		FUEL FLOW	C F M/H	
HOURS	#		WELL VACUUM	IN H2O	
ENGINE ROT.	RPM		L P G TANKS	%	#1:
ENGINE VACUUM	IN HG		GAS METER READING	-	N/A
TANK VACUUM	IN HG		WATER FLOWMETER	GALL.	

EXHAUST (By others) _____

INLET TO ENGINE _____

MAINTENANCE ES/100/400/800 _____ FOR SPECIFIC OPERATIONS SEE FIELD RECORD

W A T E R S A M P L I N G - C H E C K () W H E N D O N E

EFFLUENT	INFLUENT	WELLS
() _____	() _____	() Q.-SEE C.CUST.

REMARKS: _____

FREE PRODUCT REMOVED: APPROX. _____ GALLONS WATER REMOVED: APPROX. 158 GALLONS

DATA RECORDED BY: _____ INPUT BY: AJB 02/05/97

FIELD DATA - GROUNDWATER SAMPLING PROGRAM

Site: <u>054</u>	Date: <u>06.12.02</u>
Address: _____	
Personnel: <u>BERBAH</u>	Weather: <u>SUNNY DAY</u>
Well No: <u>PW-1</u>	Equip: <u>BAPLER</u>

Before Purging:			
Total Well Depth: (ft.)	<u>13.95</u>	Well Diameter	<u>44</u>
Depth to Water (ft)	<u>6.30</u>	Est. Purge Volume:	<u>20</u>

Sampling Data:							
Initial Turbidity:				Final Turbidity:			
Time	<u>8:41</u>	<u>8:44</u>	<u>8:47</u>	<u>8:51</u>	<u>8:54</u>	<u>8:57</u>	<u>9:00</u>
EC	<u>1760</u>	<u>1800</u>	<u>1830</u>	<u>1840</u>	<u>1850</u>	<u>1740</u>	<u>1830</u>
pH	<u>5.50</u>	<u>5.51</u>	<u>5.52</u>	<u>5.53</u>	<u>5.51</u>	<u>5.51</u>	<u>5.51</u>
Temp	<u>74.3</u>	<u>74.2</u>	<u>74.2</u>	<u>73.9</u>	<u>73.8</u>	<u>73.6</u>	<u>73.6</u>
Gal.	<u>2</u>	<u>5</u>	<u>8</u>	<u>11</u>	<u>14</u>	<u>17</u>	<u>20</u>
Time							
EC							
pH							
Temp							
Gal.							

After Purging/Before Sample Collection	
Depth to Water (ft.)	<u>8.20</u>
Total Well Depth(ft.)	<u>13.95</u>

FIELD DATA - GROUNDWATER SAMPLING PROGRAM

Site:	054	Date:	06-12-02
Address:			
Personnel:	SERBOY	Weather:	SUNNY DAY
Well No:	RE-2	Equip:	BAUER

Before Purging:			
Total Well Depth: (ft.)	16.96	Well Diameter	4.4
Depth to Water (ft)	5.86	Est. Purge Volume:	29

Sampling Data:							
Initial Turbidity:				Final Turbidity:			
Time	9:06	9:09	9:13	9:17	9:21	9:25	9:30
EC	1680	1690	1670	1680	1670	1680	1690
pH	5.49	5.47	5.43	5.49	5.47	5.46	5.47
Temp	73.3	73.1	72.9	72.8	72.7	72.6	72.6
Gal.	4	8	12	16	20	24	29
Time							
EC							
pH							
Temp							
Gal.							

After Purging/Before Sample Collection			
Depth to Water (ft.)	6.40	Total Well Depth(ft).	16.96

FIELD DATA - GROUNDWATER SAMPLING PROGRAM

Site: <u>054</u>	Date: <u>06.12.02</u>
Address: _____	
Personnel: <u>8ERBATA</u>	Weather: <u>SUNNY DAY</u>
Well No: <u>RE-3</u>	Equip: <u>BALUED</u>

Before Purging:			
Total Well Depth: (ft.)	<u>17.53</u>	Well Diameter	<u>4.5</u>
Depth to Water (ft)	<u>4.90</u>	Est. Purge Volume:	<u>33</u>

Sampling Data:							
Initial Turbidity:				Final Turbidity:			
Time	<u>9:41</u>	<u>9:46</u>	<u>9:51</u>	<u>9:55</u>	<u>10:00</u>	<u>10:05</u>	<u>10:10</u>
EC	<u>1450</u>	<u>1430</u>	<u>1410</u>	<u>1400</u>	<u>1410</u>	<u>1440</u>	<u>1430</u>
pH	<u>5.52</u>	<u>5.50</u>	<u>5.59</u>	<u>6.01</u>	<u>5.59</u>	<u>5.58</u>	<u>6.01</u>
Temp	<u>73.4</u>	<u>73.4</u>	<u>73.2</u>	<u>73.1</u>	<u>73.1</u>	<u>72.9</u>	<u>72.8</u>
Gal.	<u>4</u>	<u>9</u>	<u>14</u>	<u>18</u>	<u>23</u>	<u>28</u>	<u>33</u>
Time							
EC							
pH							
Temp							
Gal.							

After Purging/Before Sample Collection	
Depth to Water (ft.)	<u>6.20</u>
Total Well Depth (ft.)	<u>17.53</u>

FIELD DATA -GROUNDWATER SAMPLING PROGRAM

Site: <u>054</u>	Date: <u>06.12.02</u>
Address: _____	
Personnel: <u>SERBAN</u>	Weather: <u>SUNNY DAY</u>
Well No: <u>RE 4</u>	Equip: <u>BATLER</u>

Before Purging:			
Total Well Depth: (ft.)	<u>14.50</u>	Well Diameter	<u>44</u>
Depth to Water (ft)	<u>4.93</u>	Est. Purge Volume:	<u>25</u>

Sampling Data:							
Initial Turbidity:				Final Turbidity:			
Time	<u>10:19</u>	<u>10:22</u>	<u>10:25</u>	<u>10:29</u>	<u>10:32</u>	<u>10:36</u>	<u>10:40</u>
EC	<u>1300</u>	<u>1360</u>	<u>1380</u>	<u>1370</u>	<u>1360</u>	<u>1350</u>	<u>1370</u>
pH	<u>5.60</u>	<u>5.65</u>	<u>5.67</u>	<u>5.66</u>	<u>5.67</u>	<u>5.65</u>	<u>5.67</u>
Temp	<u>72.4</u>	<u>72.3</u>	<u>72.2</u>	<u>72.2</u>	<u>71.9</u>	<u>71.9</u>	<u>71.8</u>
Gal.	<u>3</u>	<u>7</u>	<u>10</u>	<u>14</u>	<u>17</u>	<u>21</u>	<u>25</u>
Time							
EC							
pH							
Temp							
Gal.							

After Purging/Before Sample Collection	
Depth to Water (ft.)	<u>6.32</u>
Total Well Depth(ft.)	<u>14.50</u>

FIELD DATA - GROUNDWATER SAMPLING PROGRAM

Site: <u>054</u>	Date: <u>06.12.02</u>
Address: _____	
Personnel: <u>BERBAW</u>	Weather: <u>SUNNY DAY</u>
Well No: <u>REG</u>	Equip: <u>BAPLER</u>

Before Purging:			
Total Well Depth: (ft.)	<u>13.58</u>	Well Diameter	<u>4"</u>
Depth to Water (ft)	<u>5.93</u>	Est. Purge Volume:	<u>20</u>

Sampling Data:							
Initial Turbidity:				Final Turbidity:			
Time	<u>10:52</u>	<u>10:55</u>	<u>10:58</u>	<u>11:01</u>	<u>11:04</u>	<u>11:07</u>	<u>11:10</u>
EC	<u>1020</u>	<u>1010</u>	<u>1020</u>	<u>1020</u>	<u>1020</u>	<u>1020</u>	<u>1020</u>
pH	<u>5.68</u>	<u>5.70</u>	<u>5.73</u>	<u>5.74</u>	<u>5.72</u>	<u>5.73</u>	<u>5.72</u>
Temp	<u>73.4</u>	<u>73.2</u>	<u>73.2</u>	<u>72.9</u>	<u>72.8</u>	<u>72.7</u>	<u>72.7</u>
Gal.	<u>2</u>	<u>5</u>	<u>8</u>	<u>11</u>	<u>14</u>	<u>17</u>	<u>20</u>
Time							
EC							
pH							
Temp							
Gal.							

After Purging/Before Sample Collection	
Depth to Water (ft.)	<u>7.30</u>
Total Well Depth(ft).	<u>13.58</u>

FIELD DATA - GROUNDWATER SAMPLING PROGRAM

Site:	054	Date:	06.12.02
Address:			
Personnel:	SERBARI	Weather:	SUNNY DAY
Well No:	RE 7	Equip:	ROSTER

Before Purging:			
Total Well Depth: (ft.)	13.14	Well Diameter	4.4
Depth to Water (ft)	7.79	Est. Purge Volume:	14

Sampling Data:							
Initial Turbidity:				Final Turbidity:			
Time	11:18	11:20	11:22	11:24	11:26	11:28	11:30
EC	1430	1400	1460	1470	1450	1460	1450
pH	5.57	5.54	5.58	5.54	5.58	5.54	5.58
Temp	73.4	73.2	73.2	72.9	72.4	72.7	72.7
Gal.	2	4	6	8	10	12	14
Time							
EC							
pH							
Temp							
Gal.							

After Purging/Before Sample Collection			
Depth to Water (ft.)	9.20	Total Well Depth(ft).	13.14

FIELD DATA - GROUNDWATER SAMPLING PROGRAM

Site:	054	Date:	06.12.02
Address:			
Personnel:	ZERBAY	Weather:	SUNNY DAY
Well No:	RS-9	Equip:	BAILER

Before Purging:			
Total Well Depth: (ft.)	14.94	Well Diameter	2.4
Depth to Water (ft)	4.21	Est. Purge Volume:	7

Sampling Data:							
Initial Turbidity:				Final Turbidity:			
Time	11:34	11:35	11:36	11:37	11:38	11:39	11:40
EC	1770	1750	1740	1760	1780	1740	1750
pH	5.53	5.50	5.52	5.53	5.51	5.50	5.52
Temp	73.3	73.1	72.9	72.8	72.7	72.7	72.6
Gal.	1	2	3	4	5	6	7
Time							
EC							
pH							
Temp							
Gal.							

After Purging/Before Sample Collection	
Depth to Water (ft.)	6.30
Total Well Depth (ft.)	14.94

FIELD DATA -GROUNDWATER SAMPLING PROGRAM

Site: <u>054</u>	Date: <u>06.12.02</u>
Address: _____	
Personnel: <u>SERBAN</u>	Weather: <u>SUNNY DAY</u>
Well No: <u>RS-11</u>	Equip: <u>BATUER</u>

Before Purging:			
Total Well Depth: (ft.)	<u>24.72</u>	Well Diameter	<u>24</u>
Depth to Water (ft)	<u>9.39</u>	Est. Purge Volume:	<u>10</u>

Sampling Data:							
Initial Turbidity:				Final Turbidity:			
Time	<u>11:51</u>	<u>11:52</u>	<u>11:54</u>	<u>11:55</u>	<u>11:57</u>	<u>11:58</u>	<u>12:00</u>
EC	<u>1860</u>	<u>1870</u>	<u>1850</u>	<u>1940</u>	<u>1930</u>	<u>1930</u>	<u>1840</u>
pH	<u>5.50</u>	<u>5.51</u>	<u>5.53</u>	<u>5.51</u>	<u>5.51</u>	<u>5.50</u>	<u>5.50</u>
Temp	<u>73.4</u>	<u>73.2</u>	<u>73.1</u>	<u>72.9</u>	<u>72.8</u>	<u>72.8</u>	<u>72.7</u>
Gal.	<u>1</u>	<u>2</u>	<u>4</u>	<u>5</u>	<u>7</u>	<u>8</u>	<u>10</u>
Time							
EC							
pH							
Temp							
Gal.							

After Purging/Before Sample Collection	
Depth to Water (ft.) <u>11.20</u>	Total Well Depth(ft.) <u>24.72</u>

APPENDIX A

APPENDIX B



ASSOCIATED LABORATORIES

806 North Batavia - Orange, California 92868 - 714/771-6900

FAX 714/538-1209

CLIENT Thrifty Oil (8871)
ATTN: Jeff Suryakusuma
13116 Imperial Hwy.
P.O. Box 2128
Santa Fe Springs, CA 90670

LAB REQUEST 94613

REPORTED 06/24/2002

RECEIVED 06/14/2002

PROJECT Station #054 ✓
2504 Castro Valley Bldg., Castro Valley

SUBMITTER Client

COMMENTS

This laboratory request covers the following listed samples which were analyzed for the parameters indicated on the attached Analytical Result Report. All analyses were conducted using the appropriate methods as indicated on the report. This cover letter is an integral part of the final report.

<u>Order No.</u>	<u>Client Sample Identification</u> ✓
358707	TOC #054, PW1
358708	TOC #054, RE2
358709	TOC #054, RE3
358710	TOC #054, RE4
358711	TOC #054, RE6
358712	TOC #054, RE7
358713	TOC #054, RS9
358714	TOC #054, RS11
358715	TOC #054, Trip Blank
358716	Laboratory Method Blank

Thank you for the opportunity to be of service to your company. Please feel free to call if there are any questions regarding this report or if we can be of further service.

ASSOCIATED LABORATORIES by,

Edward S. Behare, Ph.D.
Vice President

NOTE: Unless notified in writing, all samples will be discarded by appropriate disposal protocol 30 days from date reported.

The reports of the Associated Laboratories are confidential property of our clients and may not be reproduced or used for publication in part or in full without our written permission. This is for the mutual protection of the public, our clients, and ourselves.

TESTING & CONSULTING
Chemical
Microbiological
Environmental

Order #: 358707

Client Sample ID: TOC #054, PW1

Matrix: WATER

Date Sampled: 06/12/2002 Time Sampled: 14:00

Analyte	Result	DF	PQL	MDL	Units	Date/Analyst
---------	--------	----	-----	-----	-------	--------------

8021B BTEX

Benzene	1.0	1	0.3	0.18	ug/L	06/18/02 HP
Ethyl benzene	ND	1	0.3	0.18	ug/L	06/18/02 HP
Methyl t - butyl ether	2,060	100	500.0	0.24	ug/L	06/18/02 HP
Toluene	1.0	1	0.3	0.14	ug/L	06/18/02 HP
Xylene (total)	2.0	1	0.6	0.26	ug/L	06/18/02 HP

8015M - Total Petroleum Hydrocarbons

Gasoline	1,320	1	50	50	ug/L	06/18/02 HP
----------	-------	---	----	----	------	-------------

Surrogates

				Units	Control Limits
a,a,a-Trifluorotoluene	116			%	70 - 130

Order #: 358708

Client Sample ID: TOC #054, RE2

Matrix: WATER

Date Sampled: 06/12/2002 Time Sampled: 14:05

Analyte	Result	DF	PQL	MDL	Units	Date/Analyst
---------	--------	----	-----	-----	-------	--------------

8021B BTEX

Benzene	ND	1	0.3	0.18	ug/L	06/18/02 HP
Ethyl benzene	ND	1	0.3	0.18	ug/L	06/18/02 HP
Methyl t - butyl ether	ND	1	5	0.24	ug/L	06/18/02 HP
Toluene	ND	1	0.3	0.14	ug/L	06/18/02 HP
Xylene (total)	ND	1	0.6	0.26	ug/L	06/18/02 HP

8015M - Total Petroleum Hydrocarbons

Gasoline	ND	1	50	50	ug/L	06/18/02 HP
----------	----	---	----	----	------	-------------

Surrogates

				Units	Control Limits
a,a,a-Trifluorotoluene	102			%	70 - 130

Order #: 358709

Client Sample ID: TOC #054, RE3

Matrix: WATER

Date Sampled: 06/12/2002 Time Sampled: 14:10

Analyte	Result	DF	PQL	MDL	Units	Date/Analyst
---------	--------	----	-----	-----	-------	--------------

PQL = Practical Quantitation Limit, MDL = Method detection limit, DF = Dilution Factor
 ND = Not detected below indicated MDL, J=Trace



8021B BTEX

Benzene	ND	1	0.3	0.18 ug/L	06/18/02 HP
Ethyl benzene	ND	1	0.3	0.18 ug/L	06/18/02 HP
Methyl t - butyl ether	1,430	50	250.0	0.24 ug/L	06/18/02 HP
Toluene	1.0	1	0.3	0.14 ug/L	06/18/02 HP
Xylene (total)	ND	1	0.6	0.26 ug/L	06/18/02 HP

8015M - Total Petroleum Hydrocarbons

Gasoline	969	1	50	50 ug/L	06/18/02 HP
Surrogates				Units	Control Limits
a,a,a-Trifluorotoluene	108			%	70 - 130

Order #: 358710

Client Sample ID: TOC #054, RE4

Matrix: WATER

Date Sampled: 06/12/2002 Time Sampled: 14:15

Analyte	Result	DF	PQL	MDL	Units	Date/Analyst
---------	--------	----	-----	-----	-------	--------------

8021B BTEX

Benzene	2.0	1	0.3	0.18 ug/L	06/18/02 HP
Ethyl benzene	1.0	1	0.3	0.18 ug/L	06/18/02 HP
Methyl t - butyl ether	479	20	100.0	0.24 ug/L	06/18/02 HP
Toluene	2.0	1	0.3	0.14 ug/L	06/18/02 HP
Xylene (total)	2.0	1	0.6	0.26 ug/L	06/18/02 HP

8015M - Total Petroleum Hydrocarbons

Gasoline	380	1	50	50 ug/L	06/18/02 HP
Surrogates				Units	Control Limits
a,a,a-Trifluorotoluene	111			%	70 - 130

Order #: 358711

Client Sample ID: TOC #054, RE6

Matrix: WATER

Date Sampled: 06/12/2002 Time Sampled: 14:20

Analyte	Result	DF	PQL	MDL	Units	Date/Analyst
---------	--------	----	-----	-----	-------	--------------

PQL = Practical Quantitation Limit, MDL = Method detection limit, DF = Dilution Factor
 ND = Not detected below indicated MDL, J=Trace



8021B BTEX

Benzene	ND	1	0.3	0.18 ug/L	06/18/02 HP
Ethyl benzene	ND	1	0.3	0.18 ug/L	06/18/02 HP
Methyl t - butyl ether	1,360	50	250.0	0.24 ug/L	06/18/02 HP
Toluene	1.0	1	0.3	0.14 ug/L	06/18/02 HP
Xylene (total)	ND	1	0.6	0.26 ug/L	06/18/02 HP

8015M - Total Petroleum Hydrocarbons

Gasoline	895	1	50	50 ug/L	06/18/02 HP
Surrogates				Units	Control Limits
a,a,a-Trifluorotoluene	108			%	70 - 130

Order #: 358712

Client Sample ID: TOC #054, RE7

Matrix: WATER

Date Sampled: 06/12/2002 Time Sampled: 14:25

Analyte	Result	DF	PQL	MDL Units	Date/Analyst
---------	--------	----	-----	-----------	--------------

8021B BTEX

Benzene	772	100	30.0	0.18 ug/L	06/18/02 HP
Ethyl benzene	59	2	0.6	0.18 ug/L	06/18/02 HP
Methyl t - butyl ether	113	2	10.0	0.24 ug/L	06/18/02 HP
Toluene	970	100	30.0	0.14 ug/L	06/18/02 HP
Xylene (total)	550	100	60.0	0.26 ug/L	06/18/02 HP

8015M - Total Petroleum Hydrocarbons

Gasoline	5,130	2	100.0	50 ug/L	06/18/02 HP
Surrogates				Units	Control Limits
a,a,a-Trifluorotoluene	130			%	70 - 130

Order #: 358713

Client Sample ID: TOC #054, RS9

Matrix: WATER

Date Sampled: 06/12/2002 Time Sampled: 14:35

Analyte	Result	DF	PQL	MDL Units	Date/Analyst
---------	--------	----	-----	-----------	--------------

PQL = Practical Quantitation Limit, MDL = Method detection limit, DF = Dilution Factor
 ND = Not detected below indicated MDL, J=Trace



8021B BTEX

Benzene	1.0	1	0.3	0.18 ug/L	06/18/02 HP
Ethyl benzene	1.0	1	0.3	0.18 ug/L	06/18/02 HP
Methyl t - butyl ether	3,280	100	500.0	0.24 ug/L	06/18/02 HP
Toluene	3.0	1	0.3	0.14 ug/L	06/18/02 HP
Xylene (total)	3.0	1	0.6	0.26 ug/L	06/18/02 HP

8015M - Total Petroleum Hydrocarbons

Gasoline	2,020	1	50	50 ug/L	06/18/02 HP
Surrogates				Units	Control Limits
a,a,a-Trifluorotoluene	121			%	70 - 130

Order #: 358714	Client Sample ID: TOC #054, RS11
Matrix: WATER	Date Sampled: 06/12/2002 Time Sampled: 14:45

Analyte	Result	DF	PQL	MDL	Units	Date/Analyst
---------	--------	----	-----	-----	-------	--------------

8021B BTEX

Benzene	ND	1	0.3	0.18 ug/L	06/18/02 HP
Ethyl benzene	ND	1	0.3	0.18 ug/L	06/18/02 HP
Methyl t - butyl ether	ND	1	5	0.24 ug/L	06/18/02 HP
Toluene	1.0	1	0.3	0.14 ug/L	06/18/02 HP
Xylene (total)	ND	1	0.6	0.26 ug/L	06/18/02 HP

8015M - Total Petroleum Hydrocarbons

Gasoline	ND	1	50	50 ug/L	06/18/02 HP
Surrogates				Units	Control Limits
a,a,a-Trifluorotoluene	101			%	70 - 130

Order #: 358715	Client Sample ID: TOC #054, Trip Blank
Matrix: WATER	Date Sampled: 06/12/2002 Time Sampled: 14:00

Analyte	Result	DF	PQL	MDL	Units	Date/Analyst
---------	--------	----	-----	-----	-------	--------------

PQL = Practical Quantitation Limit, MDL = Method detection limit, DF = Dilution Factor
 ND = Not detected below indicated MDL, J=Trace



8021B BTEX

Benzene	ND	1	0.3	0.18 ug/L	06/18/02 HP
Ethyl benzene	ND	1	0.3	0.18 ug/L	06/18/02 HP
Methyl t - butyl ether	ND	1	5	0.24 ug/L	06/18/02 HP
Toluene	ND	1	0.3	0.14 ug/L	06/18/02 HP
Xylene (total)	ND	1	0.6	0.26 ug/L	06/18/02 HP

8015M - Total Petroleum Hydrocarbons

Gasoline	ND	1	50	50 ug/L	06/18/02 HP
Surrogates				Units	Control Limits
a,a,a-Trifluorotoluene	103			%	70 - 130

Order #: 358716 Client Sample ID: Laboratory Method Blank
 Matrix: WATER

Analyte	Result	DF	PQL	MDL	Units	Date/Analyst
---------	--------	----	-----	-----	-------	--------------

8021B BTEX

Benzene	ND	1	0.3	0.18 ug/L	06/18/02 HP
Ethyl benzene	ND	1	0.3	0.18 ug/L	06/18/02 HP
Toluene	ND	1	0.3	0.14 ug/L	06/18/02 HP
Xylene (total)	ND	1	0.6	0.26 ug/L	06/18/02 HP

8015M - Total Petroleum Hydrocarbons

Gasoline	ND	1	50	50 ug/L	06/18/02 HP
Surrogates				Units	Control Limits
a,a,a-Trifluorotoluene	101			%	70 - 130

PQL = Practical Quantitation Limit, MDL = Method detection limit, DF = Dilution Factor
 ND = Not detected below indicated MDL, J=Trace



ASSOCIATED LABORATORIES
QA REPORT FORM

QC Sample: LR 94620-740
 Matrix: WATER
 Prep. Date: 06/18/02
 Analysis Date: 06/18/02-06/19/02
 LAB ID#'s in Batch: LR 94606, 94613

MATRIX SPIKE / MATRIX SPIKE DUPLICATE RESULT

REPORTING UNITS = ug/L

Test	Method	Sample Result	Spike Added	Matrix Spike	Matrix Spk. Dup	%Rec MS	%Rec MSD	RPD
Benzene	8021	ND	10	9.6	9.4	96	94	2
Toluene	8021	ND	10	9.7	9.6	97	96	1
Ethylbenzene	8021	ND	10	10.6	10.4	106	104	2
Xylenes	8021	ND	20	20.6	20.2	103	101	2

ND = Not Detected

RPD = Relative Percent Difference of Matrix Spike and Matrix Spike Dup

%REC-MS & MSD = Percent Recovery of Matrix Spike & Matrix Spike Duplicate

%REC LIMITS = 70 - 130

RPD LIMITS = 30

PREPARATION BLANK / LAB CONTROL SAMPLE RESULTS

Test	Method	PREP. BLK	LCS				
		Value	Result	True	%Rec	L.Limit	H.Limit
Benzene	8021	ND	9.4	10	94	80%	120%
Toluene	8021	ND	9.3	10	93	80%	120%
Ethylbenzene	8021	ND	10.2	10	102	80%	120%
Xylenes	8021	ND	19.4	20	97	80%	120%

LCS = Lab Control Sample Result

TRUE = True Value of LCS

L.LIMIT / H.LIMIT = LCS Control Limits

SURROGATE RECOVERY

Sample No.	AAA-TFT
QC Limit	70-130
QA Sample	113
MS	108
MSD	108
Method Blank	101
LCS	109

AAA-TFT = a.a.a-Trifluorotoluene

ASSOCIATED LABORATORIES
QA REPORT FORM

QC Sample: LR 94620-740
 Matrix: WATER
 Prep. Date: 06/19/02
 Analysis Date: 06/19/02-06/20/02
 ID#'s in Batch: LR 94613

MATRIX SPIKE / MATRIX SPIKE DUPLICATE RESULT

Reporting Units = ug/L

Test	Method	Sample Result	Spike Added	Matrix Spike	Matrix Spike Dup	%Rec MS	%Rec MSD	RPD
TPH	8015M-G	ND	200	234	235	117	118	0

ND = Not Detected

RPD = Relative Percent Difference of Matrix Spike and Matrix Spike Duplicate

%REC-MS & MSD = Percent Recovery of Matrix Spike & Matrix Spike Duplicate

%REC LIMITS = 70 - 130

RPD LIMITS = 30

PREPARATION BLANK / LAB CONTROL SAMPLE RESULTS

	PREP BLK					
	Value	Result	True	%Rec	L.Limit	H.Limit
LCS	ND	242	300	81	80%	120%

LCS Result = Lab Control Sample Result

True = True Value of LCS

L.Limit / H.Limit = LCS Control Limits

SURROGATE RECOVERY

Sample No.	AAA-TFT
QC Limit	70-130
QA Sample	113
MS	90
MSD	89
Method Blank	108
LCS	91

AAA-TFT = a, a, a-Trifluorotoluene

ASSOCIATED LABORATORIES
QA REPORT FORM

QC Sample: LR 94593-646
 Matrix: WATER
 Prep. Date: 06/18/02
 Analysis Date: 06/18/02-06/19/02
 ID#'s in Batch: LR 94620, 94626, 94604, 94613

MATRIX SPIKE / MATRIX SPIKE DUPLICATE RESULT

Reporting Units = **ug/L**

Test	Method	Sample Result	Spike Added	Matrix Spike	Matrix Spike Dup	%Rec MS	%Rec MSD	RPD
TPH	8015M-G	ND	300	264	253	88	84	4

ND = Not Detected

RPD = Relative Percent Difference of Matrix Spike and Matrix Spike Duplicate

%REC-MS & MSD = Percent Recovery of Matrix Spike & Matrix Spike Duplicate

%REC LIMITS = 70 - 130

RPD LIMITS = 30

PREPARATION BLANK / LAB CONTROL SAMPLE RESULTS

	PREP BLK					
	Value	Result	True	%Rec	L.Limit	H.Limit
LCS	ND	243	300	81	80%	120%

LCS Result = Lab Control Sample Result

True = True Value of LCS

L.Limit / H.Limit = LCS Control Limits

SURROGATE RECOVERY

Sample No.	AAA-TFT
QC Limit	70-130
QA Sample	105
MS	92
MSD	92
Method Blank	101
LCS	92

AAA-TFT = a.a.a-Trifluorotoluene

Chain of Custody Record



Company THRIFTY OIL CO.		Phone (562) 921-3581		A.L. Job No. 94613 V		Page _____ of _____								
Project Manager JEFF SURYARUSUMA		Fax (562) 921-7510		Analysis Requested				Test Instructions & Comments						
Project Name Q. W. S.		Project # 054 ✓												
Site Name and Address 2504 CASTRO VALLEY Blvd. CASTRO VALLEY, CA 94546				T B M P T T H E B X E										
Sample ID	Lab ID	Date	Time	Matrix	Container Number/Size	Pres.								
1 PW 1		06.12.02	14:00	H ₂ O	300A	HCL	X	X	X					
2 RE 2		↑ ↓	14:05	↑ ↓	↑ ↓	↑ ↓	X	X	X					
3 RE 3			14:10				X	X	X					
4 RE 4			14:15				X	X	X					
5 RE 6			14:20				X	X	X					
6 RE 7			14:25				X	X	X					
7 RS 9			14:35				X	X	X					
8 RS 11			14:45				X	X	X					
9 TRIP BLANK			14:00					2 VOLS			X	X		
10														
11														
12														
13														
14														
15														

Sample Receipt - To Be Filled By Laboratory				Relinquished by Sampler: SERBAM ^{1.}		Relinquished by GOLAFK STAFF ^{2.}		Relinquished by ^{3.}	
Total Number of Containers	26	Properly Cooled Y/N/NA		Signature:	<i>[Signature]</i>	Signature:		Signature:	
Custody Seals Y/N/NA	NA	Samples Intact Y/N/NA		Printed Name:	SERBAM SURYARUSUMA	Printed Name:		Printed Name:	
Received in Good Condition Y/N		Samples Accepted Y/N		Date:		Date:		Date:	
Turn Around Time				Received By: GOLAFK STAFF ^{1.}		Received By: ^{2.}		Received By: ^{3.}	
<input checked="" type="checkbox"/> Normal	<input type="checkbox"/> Rush	<input type="checkbox"/> Same Day	<input type="checkbox"/> 48 hrs.	Signature:	<i>[Signature]</i>	Signature:	<i>[Signature]</i>	Signature:	<i>[Signature]</i>
		<input type="checkbox"/> 24 hrs.	<input type="checkbox"/> 72 hrs.	Printed Name:	Danalo	Printed Name:	Danalo	Printed Name:	
				Date:	06/14/02	Date:	06/17	Date:	06/17
				Time:	12:00	Time:	12:00	Time:	05:35