

THRIFTY OIL CO.

January 31, 2002

O.23666

Mr. Amer Gholami
Alameda County Health Care Agency
Hazardous Material Specialist
1131 Harbor Bay Parkway, Suite 250
Alameda, CA 94502

FEB 05 2002

ST10 1252 ✓

RE: **Former Thrifty Oil Co. #054**
Tosco Marketing Company Station #2602486
2504 Castro Valley Boulevard
Castro Valley, CA 94541
4th Quarter 2001, Status Report

Dear Mr. Gholami:

Presented herewith is the Fourth Quarter 2001, Status Report for Thrifty Oil Co. Station #054 located at 2504 Castro Valley Boulevard, Castro Valley, California.

If you have any questions or comments, please contact Raymond C. Friedrichsen or me at (562) 921-3581.

Sincerely,

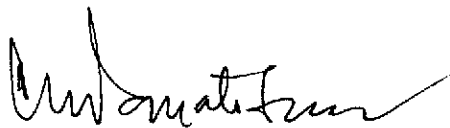

Chris Panaitescu
General Manager
Environmental Affairs

c: Mr. David J. Camille
Tosco Marketing Company
2000 Crow Canyon Place, Suite 400
San Ramon, CA 94583



File

constituent concentrations to be below the laboratory detection limits, except for TPH-g in up gradient well RS-9 and well RE-6 (1,540 ug/L and 138 ug/L, respectively), and MTBE in up gradient well RS-9 and well RE-4 (2,480 ug/L and 3.7 ug/L, respectively). The MTBE samples were confirmed by EPA method 8260B. TOSCO Marketing Company is the current operator at the service station property, acquiring the lease from BP Oil, who has leased the property since July 10, 1991.

The concentration of total petroleum hydrocarbons in off-site monitoring well RS-9 has increased over the last several quarters to the highest level this quarter (Table 1). The groundwater gradient has historically been to the east, which places monitoring well RS-9 up gradient of the former Thrifty Station. Groundwater levels in this well have historically ranged between two to five feet bgs. The off-site well is located in the sidewalk at the bottom of a steep driveway and planter area of a quick oil change business. Due to the shallow groundwater level, any washdown of the site could result in surface runoff entering cracks in the concrete and/or penetrating the soil in the planter area and infiltrating to the groundwater. Thrifty's has a well on the western property boundary (RE-2) down gradient of off-site well RS-9. The well RE-2 has exhibited TPH-g concentrations below the laboratory detection limits for the last three quarters and eight of the last nine quarters. Therefore, Thrifty contends that the rise in hydrocarbon concentrations in well RS-9 is from an off-site source.

Other Activities

On September 19, 2001, the Alameda County Health Care Services requested that an additional site assessment be conducted, because of the elevated levels of hydrocarbons in wells RE-3, RE-4, and RE-7 during the second quarter 2001 sampling event. In our third quarter report Thrifty requested that this additional site assessment be deferred for at least three quarterly sampling events. Thrifty requested the additional site assessment postponement because all analyzed constituents in samples from wells RE-3, RE-4, and RE-7 were below the laboratory detection limits (non-detect) during the third and fourth quarters 2001, except for a minor detection of MTBE in well RE-4 of 3.4 ug/L.

Thrifty will continue the groundwater monitoring, gauging, and sampling events at this site on a quarterly basis. All interpretations expressed in this report are based solely upon the review of data collected by EMC, and analyzed by Associated Laboratories.

Written by:

Reviewed by:

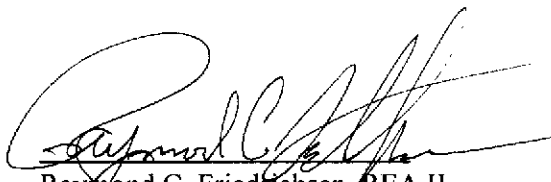

Raymond C. Friedrichsen, REA II
Project Manager, MBA
Senior Environmental Hydrogeologist

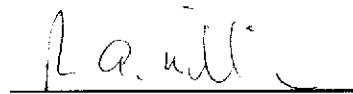

Ross A. Williams
Registered Geologist #6327

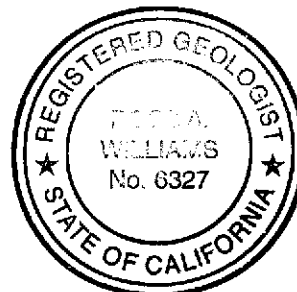

FIGURES

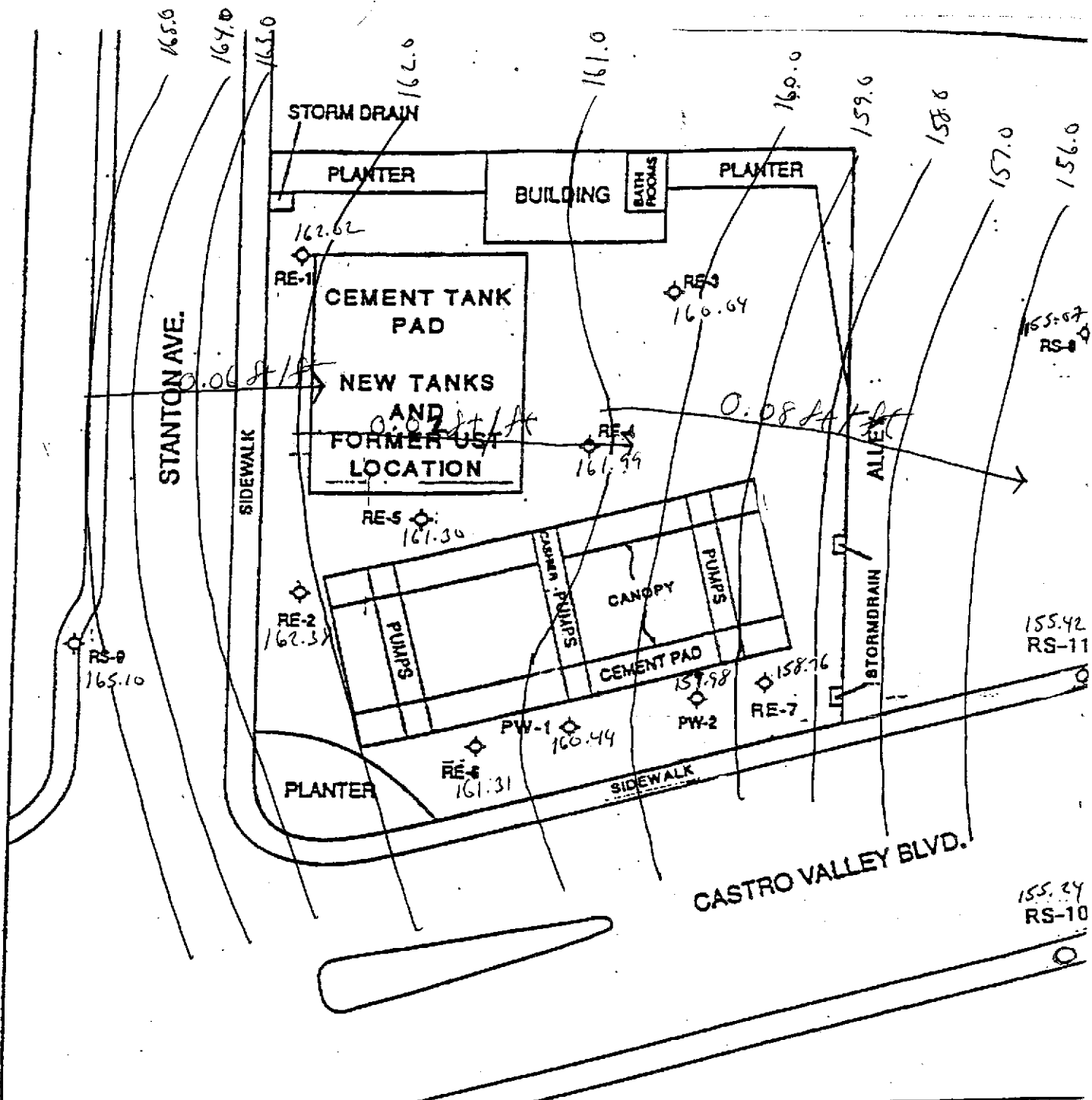

GROUNDWATER CONTOUR MAP
 THRIFTY OIL CO. #054
 CASTRO VALLEY, CALIFORNIA
 Prepared for
 THRIFTY OIL CO.
 SANTA FE, SPRINGS
 CALIFORNIA

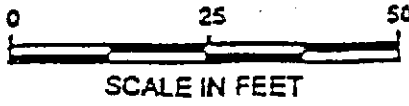

◊ EXISTING MONITORING WELL

FIGURE 1

12/12/01

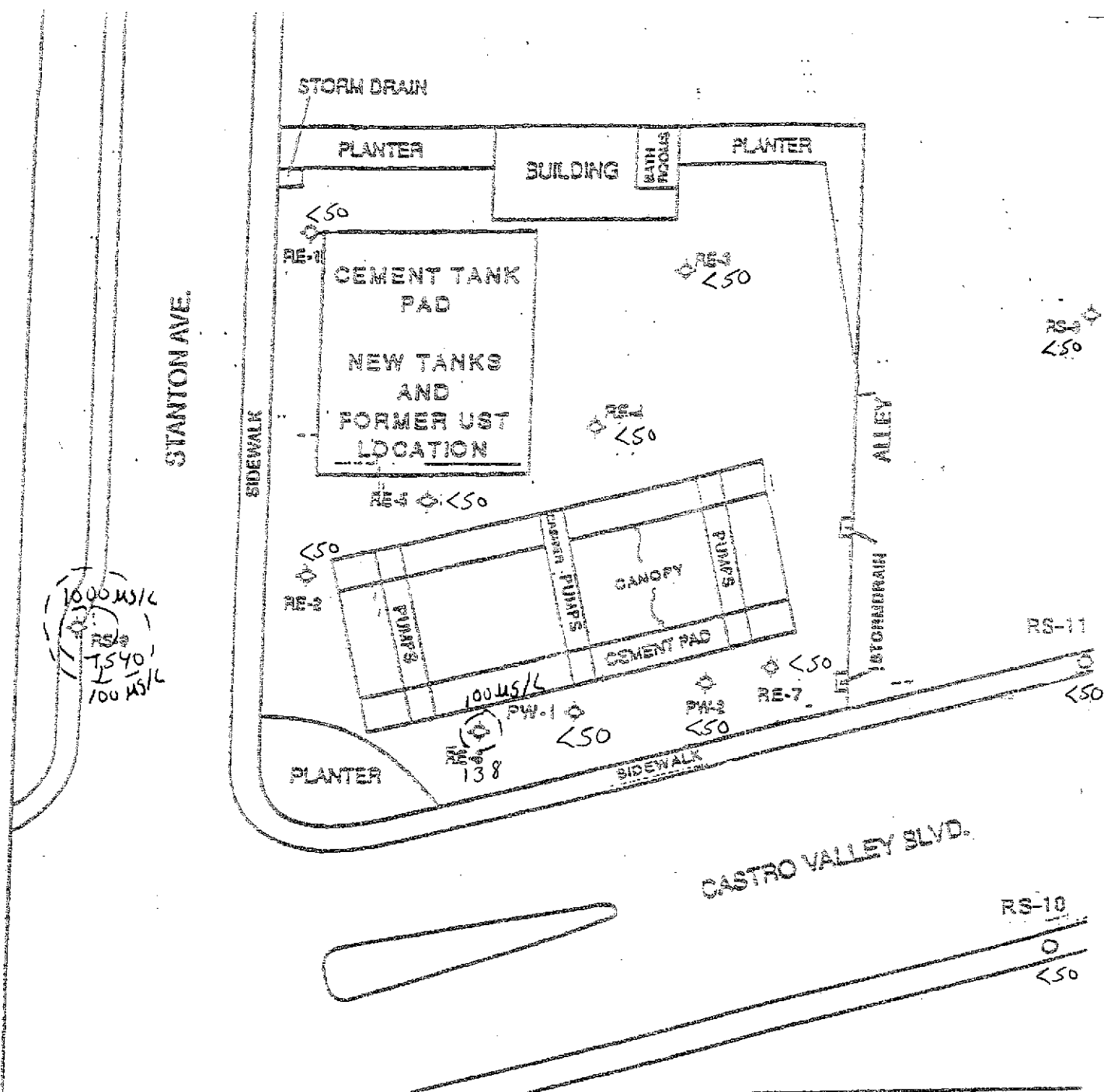

TPH GROUNDWATER ISOCONCENTRATION MAP PPB

THRIFTY OIL CO. #054
 CASTRO VALLEY, CALIFORNIA
 Prepared for
 THRIFTY OIL CO.
 SANTA FE, SPRINGS
 CALIFORNIA



◊ EXISTING MONITORING WELL

FIGURE 2

12/12/01

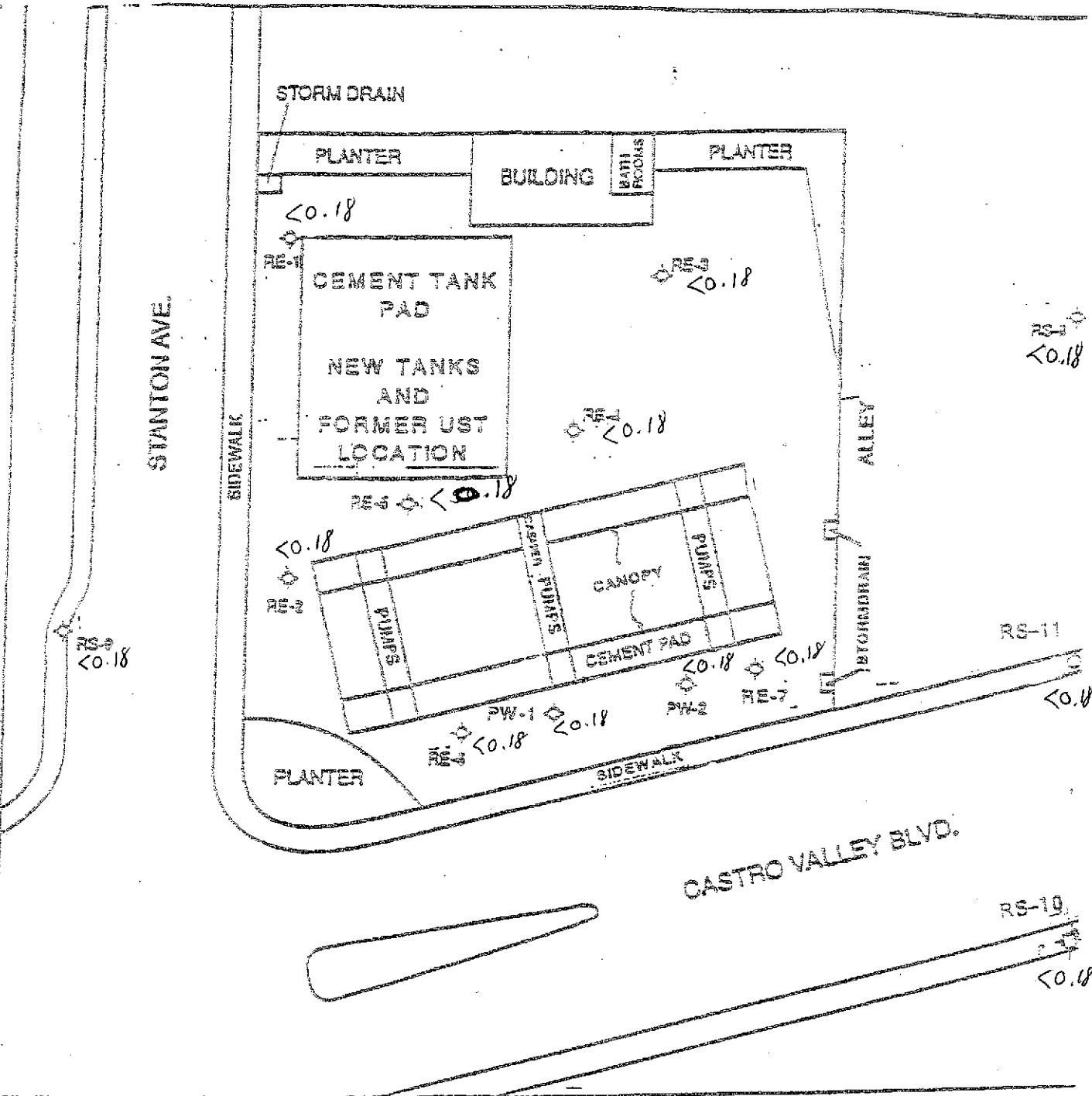

BENZENE ISOCONCENTRATION MAP PPB

THRIFTY OIL CO. #054
 CASTRO VALLEY, CALIFORNIA
 Prepared for
 THRIFTY OIL CO.
 SANTA FE, SPRINGS
 CALIFORNIA



⊙ EXISTING MONITORING WELL

FIGURE 3

12/12/81

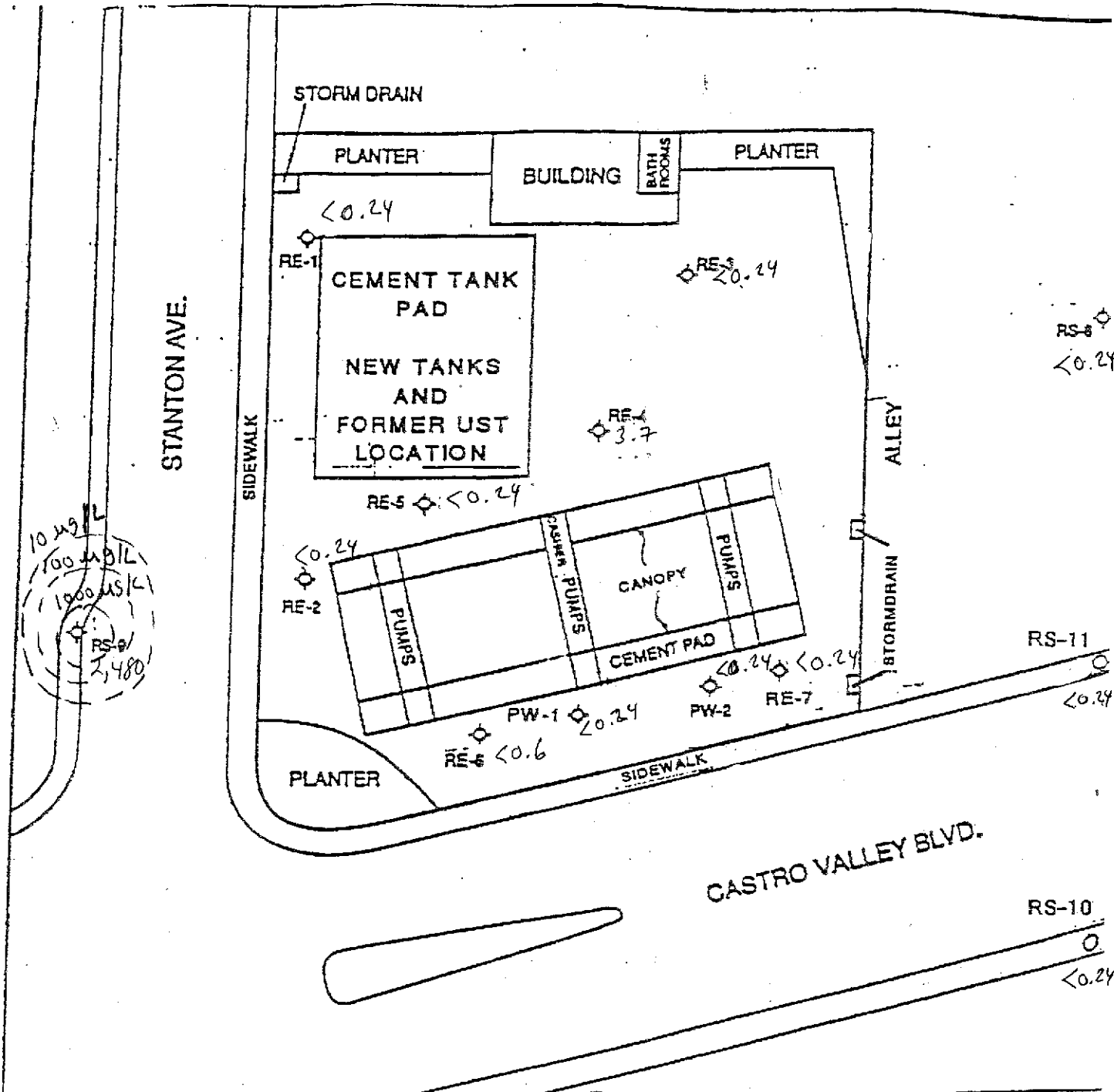

MTBE ISOCONCENTRATION MAP ug/L
 THRIFTY OIL CO. #054
 CASTRO VALLEY, CALIFORNIA
 Prepared for
 THRIFTY OIL CO.
 SANTA FE, SPRINGS
 CALIFORNIA



◊ EXISTING MONITORING WELL

FIGURE 4

12/12/01

TABLES

**TABLE 1
GROUNDWATER DATA
THRIFTY OIL STATION #054, CASTRO VALLEY, CA.**

DATE SAMPLED	ANALYTICAL PARAMETERS						DEPTH TO GROUNDWATER (feet)	DEPTH TO PRODUCT (feet)	PRODUCT THICKNESS (feet)	CASING ELEVATION (feet)	GROUNDWATER ELEVATION (feet)
	TPH (ug/L)	BENZENE (ug/L)	TOLUENE (ug/L)	Ethyl Benzene (ug/L)	XYLENE (ug/L)	MIBE (ug/L)					
MONITORING WELL #PW-1											
04/11/88	-	-	-	-	-	-	-	-	-	-	-
04/09/90	230,000	600	2,700	1,000	16,000	-	5.10	NP	0.00	166.46	161.36
10/30/90	35,000	240	970	240	3,580	-	6.17	NP	0.00	166.46	160.29
01/18/91	37,000	43	140	42	1,600	-	6.28	NP	0.00	166.46	160.18
02/12/91	45,000	99	130	25	700	-	5.88	NP	0.00	166.46	160.58
03/20/91	1,900	0.43	ND	ND	2.8	-	4.75	NP	0.00	166.46	161.71
05/22/91	41,000	600	730	250	3,800	-	5.10	NP	0.00	166.46	161.36
06/19/91	-	-	-	-	-	-	5.61	NP	0.00	166.46	160.85
07/17/91	-	-	-	-	-	-	5.53	FILM	0.00	166.46	160.93
08/07/91	-	-	-	-	-	-	5.67	FILM	0.00	166.46	160.79
09/24/91	-	-	-	-	-	-	5.57	FILM	0.00	166.46	160.89
10/23/91	-	-	-	-	-	-	6.53	FILM	0.00	166.46	159.93
11/06/91	-	-	-	-	-	-	5.85	FILM	0.00	166.46	160.61
12/04/91	-	-	-	-	-	-	5.91	FILM	0.00	166.46	160.55
01/29/92	-	-	-	-	-	-	5.43	FILM	0.00	166.46	161.03
02/26/92	-	-	-	-	-	-	5.54	FILM	0.00	166.46	160.92
03/19/92	ND	ND	ND	ND	ND	-	5.47	NP	0.00	166.46	160.99
04/22/92	-	-	-	-	-	-	5.62	FILM	0.00	166.46	160.84
05/21/92	1,300	19	2.9	0.7	58	-	6.21	NP	0.00	166.46	160.25
06/25/92	-	-	-	-	-	-	6.94	NP	0.00	166.46	159.52
07/30/92	-	-	-	-	-	-	5.90	FILM	0.00	166.46	160.56
08/20/92	-	-	-	-	-	-	7.12	FILM	0.00	166.46	159.34
09/30/92	3,400	57	ND	26	240	-	6.42	NP	0.00	166.46	160.04
12/23/92	-	-	-	-	-	-	5.56	FILM	0.00	166.46	160.90
03/10/93	-	-	-	-	-	-	5.65	FILM	0.00	166.46	160.81
06/09/93	400	<0.5	1.1	<1.0	<1.0	-	5.30	NP	0.00	166.46	161.16
09/14/93	180	3.7	3.2	1.5	14	-	5.43	NP	0.00	166.46	161.03
12/14/93	<50	<0.3	<0.3	<0.3	<0.5	-	4.65	NP	0.00	166.46	161.81
03/02/94	<50	<0.3	<0.3	<0.3	<0.5	-	5.43	NP	0.00	166.46	161.03
06/06/94	330	1.3	<0.3	0.88	9.8	-	4.70	NP	0.00	166.46	161.76
09/06/94	1,100	67	<0.3	<0.3	24	-	6.48	NP	0.00	166.46	159.98
12/07/94	<50	<0.3	<0.3	<0.5	<0.5	-	5.22	NP	0.00	166.46	161.24
03/08/95	<100	<0.5	<0.5	<0.5	<1	-	6.94	NP	0.00	166.46	159.52
06/15/95	260	0.8	0.6	<0.5	3.2	-	5.72	NP	0.00	166.46	160.74

**TABLE 1
GROUNDWATER DATA
THRIFTY OIL STATION #054, CASTRO VALLEY, CA.**

DATE SAMPLED	ANALYTICAL PARAMETERS						DEPTH TO GROUNDWATER (feet)	DEPTH TO PRODUCT (feet)	PRODUCT THICKNESS (feet)	CASING ELEVATION (feet)	GROUNDWATER ELEVATION (feet)
	TPH (ug/L)	BENZENE (ug/L)	TOLUENE (ug/L)	EthylBenzene (ug/L)	XYLENE (ug/L)	MTBE (ug/L)					
09/05/95	330	2.1	<0.5	2.1	9.6	-	5.96	NP	0.00	166.46	160.50
11/21/95	660	13	1.3	<0.3	4.0	-	6.04	NP	0.00	166.46	160.42
03/11/96	660	0.94	0.77	<0.3	8.1	-	3.60	NP	0.00	166.46	162.86
06/19/96	120	0.53	<0.3	<0.3	2.3	-	4.80	NP	0.00	166.46	161.66
09/16/96	<50	<0.3	<0.3	<0.3	<0.5	<20	5.10	NP	0.00	166.46	161.36
12/10/96	<50	<0.3	<0.3	<0.3	<0.5	<20	4.92	NP	0.00	166.46	161.54
03/12/97	<50	<0.3	<0.3	<0.3	<0.5	<20	4.50	NP	0.00	166.46	161.96
06/12/97	<50	<0.3	<0.3	<0.3	<0.5	<20	-	-	-	-	-
09/16/97	690	0.97	<0.3	<0.3	<0.5	<20	4.55	NP	0.00	166.46	161.91
12/09/97	640	150	0.64	<0.3	5.2	1,300	5.60	NP	0.00	166.46	160.86
03/03/98	<50	<0.3	0.57	<0.3	<0.5	<20	4.13	NP	0.00	166.46	162.33
07/08/98	<50	<0.3	<0.3	<0.3	<0.5	<5	-	-	-	-	-
09/10/98	<50	<0.3	<0.3	<0.3	<0.5	<5	6.35	NP	0.00	166.46	160.11
12/30/98	<50	1.1	<0.3	<0.3	<0.5	<5	6.40	NP	0.00	166.46	160.06
03/15/99	<50	<0.3	<0.3	<0.3	<0.5	<5	6.35	NP	0.00	166.46	160.11
06/22/99	<50	<0.3	<0.3	<0.3	<0.5	53	4.95	NP	0.00	166.46	161.51
09/08/99	<50	<0.3	<0.3	<0.3	<0.5	<5	4.80	NP	0.00	166.46	161.66
12/01/99	<50	<0.3	<0.3	<0.3	<0.5	<5	3.64	NP	0.00	166.46	162.82
03/23/00	<50	0.5	0.5	1.1	<0.5	<5	4.03	NP	0.00	166.46	162.43
06/08/00	<50	<5	<5	<5	<5	<5	4.40	NP	0.00	166.46	162.06
09/27/00	<50	<0.18	<0.14	<0.18	<0.26	<0.24	4.73	NP	0.00	166.46	161.73
12/13/00	<50	<0.18	<0.14	<0.18	<0.26	<0.24	4.01	NP	0.00	166.46	162.45
03/22/01	600	<0.18	1.3	<0.18	<0.26	*1,010 / 1,970	6.32	NP	0.00	166.46	160.14
06/15/01	<50	<0.18	<0.14	<0.18	<0.26	<0.24	6.32	NP	0.00	166.46	160.14
08/30/01	<50	<0.18	<0.14	<0.18	<0.26	<0.24	6.32	NP	0.00	166.46	160.14
12/12/01	<50	<0.18	<0.14	<0.18	<0.26	<0.24	6.02	NP	0.00	166.46	160.44
MONITORING WELL PW-2											
04/11/88	-	-	-	-	-	-	-	-	-	-	-
04/09/90	600,000	1,300	11,000	4,600	4,300	-	5.81	NP	0.00	166.18	160.37
10/30/90	48,000	310	51	10	480	-	6.95	NP	0.00	166.18	159.23
01/18/91	86,000	230	1,400	350	8,300	-	6.92	NP	0.00	166.18	159.26
02/12/91	160,000	680	1,300	250	7,000	-	6.78	NP	0.00	166.18	159.40
03/20/91	17,000	34	50	ND	1,100	-	5.54	NP	0.00	166.18	160.64

**TABLE 1
GROUNDWATER DATA
THRIFTY OIL STATION #054, CASTRO VALLEY, CA.**

DATE SAMPLED	ANALYTICAL PARAMETERS						DEPTH TO GROUNDWATER (feet)	DEPTH TO PRODUCT (feet)	PRODUCT THICKNESS (feet)	CASING ELEVATION (feet)	GROUNDWATER ELEVATION (feet)
	TPH (ug/L)	BENZENE (ug/L)	TOLUENE (ug/L)	EthylBenzene (ug/L)	XYLENE (ug/L)	MIBK (ug/L)					
05/22/91	14,000	57	2,100	500	8,200	-	6.07	NP	0.00	166.18	160.11
06/19/91	-	-	-	-	-	-	6.37	FILM	0.00	166.18	159.81
07/17/91	-	-	-	-	-	-	6.38	FILM	0.00	166.18	159.80
08/07/91	-	-	-	-	-	-	6.63	FILM	0.00	166.18	159.55
09/24/91	-	-	-	-	-	-	6.42	FILM	0.00	166.18	159.76
10/23/91	-	-	-	-	-	-	7.25	FILM	0.00	166.18	158.93
11/06/91	-	-	-	-	-	-	6.44	FILM	0.00	166.18	159.74
12/04/91	-	-	-	-	-	-	6.65	FILM	0.00	166.18	159.53
01/29/92	-	-	-	-	-	-	6.17	FILM	0.00	166.18	160.01
02/26/92	-	-	-	-	-	-	5.90	FILM	0.00	166.18	160.28
03/19/92	-	-	-	-	-	-	5.80	FILM	0.00	166.18	160.38
04/22/92	-	-	-	-	-	-	5.88	FILM	0.00	166.18	160.30
05/21/92	-	-	-	-	-	-	6.03	FILM	0.00	166.18	160.15
06/25/92	-	-	-	-	-	-	6.57	FILM	0.00	166.18	159.61
07/30/92	-	-	-	-	-	-	6.20	FILM	0.00	166.18	159.98
08/20/92	-	-	-	-	-	-	6.64	FILM	0.00	166.18	159.54
09/30/92	-	-	-	-	-	-	6.88	FILM	0.00	166.18	159.30
12/23/92	-	-	-	-	-	-	6.08	FILM	0.00	166.18	160.10
03/10/93	-	-	-	-	-	-	5.95	FILM	0.00	166.18	160.23
06/09/93	3,400	24	22	<0.5	240	-	5.38	NP	0.00	166.18	160.80
09/14/93	4,900	190	15	6.8	480	-	6.26	NP	0.00	166.18	159.92
12/14/93	1,700	4.2	<0.3	<0.3	<0.5	-	5.22	NP	0.00	166.18	160.96
03/02/94	-	-	-	-	-	-	5.75	FILM	0.00	166.18	160.43
06/06/94	980	25	1.2	<0.3	42	-	5.25	NP	0.00	166.18	160.93
09/06/94	3,200	95	3.0	<1.7	76	-	6.80	NP	0.00	166.18	159.38
12/07/94	510	1.8	<0.3	<0.5	1.7	-	5.57	NP	0.00	166.18	160.61
03/08/95	1,900	<0.5	<0.5	1.4	35	-	4.10	NP	0.00	166.18	162.08
06/15/95	1,700	5.6	<0.5	<0.5	1.6	-	5.44	NP	0.00	166.18	160.74
09/05/95	2,500	33	1.0	0.86	18	-	6.13	NP	0.00	166.18	160.05
11/21/95	2,800	130	59	18	190	-	6.23	NP	0.00	166.18	159.95
03/11/96	13,000	330	460	<15	3,800	-	4.48	NP	0.00	166.18	161.70
06/19/96	1,400	<0.3	<0.3	<0.3	<0.5	-	5.38	NP	0.00	166.18	160.80
09/16/96	3,500	<0.3	<0.3	<0.3	<0.5	5,900	5.21	NP	0.00	166.18	160.97
12/10/96	2,100	<0.3	<0.3	<0.3	<0.5	4,700	4.87	NP	0.00	166.18	161.31
03/12/97	600	1.6	<0.3	<0.3	5.8	1,100	4.43	NP	0.00	166.18	161.75

**TABLE 1
GROUNDWATER DATA
THRIFTY OIL STATION #054, CASTRO VALLEY, CA.**

DATE SAMPLED	ANALYTICAL PARAMETERS						DEPTH TO GROUNDWATER (feet)	DEPTH TO PRODUCT (feet)	PRODUCT THICKNESS (feet)	CASING ELEVATION (feet)	GROUNDWATER ELEVATION (feet)
	TPH (ug/L)	BENZENE (ug/L)	TOLUENE (ug/L)	EthylBenzene (ug/L)	XYLENE (ug/L)	MtBE (ug/L)					
06/12/97	270	<0.3	<0.3	<0.3	<0.5	630	-	-	-	-	-
09/10/97	220	<0.3	<0.3	<0.3	<0.5	320	4.07	NP	0.00	166.18	162.11
12/09/97	120	<0.3	0.73	<0.3	<0.5	420	5.20	NP	0.00	166.18	160.98
03/03/98	<50	0.43	0.48	<0.3	<0.5	47	3.30	NP	0.00	166.18	162.88
07/08/98	<50	<0.3	<0.3	<0.3	<0.5	<5	-	-	-	-	-
09/10/98	<50	<0.3	<0.3	<0.3	<0.5	<5	5.15	NP	0.00	166.18	161.03
12/30/98	<50	1.1	<0.3	<0.3	<0.5	<5	4.75	NP	0.00	166.18	161.43
03/15/99	<50	<0.3	<0.3	<0.3	<0.5	<5	4.40	NP	0.00	166.18	161.78
06/22/99	-	-	-	-	-	-	4.50	NP	0.00	166.18	161.68
09/08/99	100	<0.3	<0.3	<0.3	<0.5	230	3.99	NP	0.00	166.18	162.19
12/01/99	<50	<0.3	<0.3	<0.3	<0.5	<5	3.62	NP	0.00	166.18	162.56
03/23/00	<50	<0.25	<0.25	<0.25	<0.5	<5	2.93	NP	0.00	166.18	163.25
06/08/00	<50	<5	<5	<5	<5	<5	3.60	NP	0.00	166.18	162.58
09/27/00	<50	<0.18	<0.14	<0.18	<0.26	<0.24	3.61	NP	0.00	166.18	162.57
12/13/00	<50	<0.18	<0.14	<0.18	<0.26	<0.24	3.60	NP	0.00	166.18	162.58
03/22/01	<50	<0.18	<0.14	<0.18	<0.26	<0.24	5.14	NP	0.00	166.18	161.04
06/15/01	<50	<0.18	<0.14	<0.18	<0.26	<0.24	5.13	NP	0.00	166.18	161.05
08/30/01	<50	<0.18	<0.14	<0.18	<0.26	<0.24	5.90	NP	0.00	166.18	160.28
12/12/01	<50	<0.18	<0.14	<0.18	<0.26	<0.24	6.20	NP	0.00	166.18	159.98
MONITORING WELL #RE-1											
04/11/88	37,000	1,900	8,400	1,200	15,000	-	-	-	-	-	-
04/09/90	45,000	6,100	7,000	2,000	8,800	-	4.99	NP	0.00	166.82	161.83
10/30/90	72,000	7,700	5,300	1,800	8,900	-	5.95	NP	0.00	166.82	160.87
01/18/91	150,000	11,000	14,000	1,800	4,300	-	5.17	NP	0.00	166.82	161.65
02/12/91	140,000	11,000	12,000	1,600	13,000	-	4.16	NP	0.00	166.82	162.66
03/20/91	53,000	3,100	4,200	400	5,500	-	4.75	NP	0.00	166.82	162.07
05/22/91	85,000	8,700	10,000	1,800	12,000	-	4.42	NP	0.00	166.82	162.40
06/19/91	110,000	8,500	9,600	2,600	16,000	-	4.93	NP	0.00	166.82	161.89
07/17/91	5,500	950	ND	26	ND	-	5.19	NP	0.00	166.82	161.63
08/07/91	-	6,700	5,000	ND	7,100	-	5.12	NP	0.00	166.82	161.70
09/24/91	60,000	6,800	4,300	640	6,900	-	5.87	NP	0.00	166.82	160.95
10/23/91	79,000	7,900	8,300	450	7,100	-	5.81	NP	0.00	166.82	161.01
11/06/91	130,000	14,000	15,000	1,100	8,800	-	5.56	NP	0.00	166.82	161.26

**TABLE 1
GROUNDWATER DATA
THRIFTY OIL STATION #054, CASTRO VALLEY, CA.**

DATE SAMPLED	ANALYTICAL PARAMETERS						DEPTH TO GROUNDWATER (feet)	DEPTH TO PRODUCT (feet)	PRODUCT THICKNESS (feet)	CASING ELEVATION (feet)	GROUNDWATER ELEVATION (feet)
	TPH (ug/L)	BENZENE (ug/L)	TOLUENE (ug/L)	EthylBenzene (ug/L)	XYLENE (ug/L)	MTBE (ug/L)					
12/04/91	50,000	8,000	4,700	520	4,100	-	5.35	NP	0.00	166.82	161.47
01/29/92	21,000	10,300	11,000	780	6,000	-	4.50	NP	0.00	166.82	162.32
02/26/92	38000	8,400	10,500	720	7,100	-	5.27	NP	0.00	166.82	161.55
03/19/92	48,000	6,200	9,700	780	7,200	-	4.47	NP	0.00	166.82	162.35
04/22/92	-	-	-	-	-	-	4.62	NP	0.00	166.82	162.20
05/21/92	20,000	7,600	10,100	830	6,900	-	4.98	NP	0.00	166.82	161.84
06/25/92	-	-	-	-	-	-	5.14	FILM	0.00	166.82	161.68
07/30/92	-	-	-	-	-	-	5.30	FILM	0.00	166.82	161.52
08/20/92	-	-	-	-	-	-	5.28	FILM	0.00	166.82	161.54
09/30/92	-	-	-	-	-	-	5.66	FILM	0.00	166.82	161.16
12/23/92	-	-	-	-	-	-	4.81	FILM	0.00	166.82	162.01
03/10/93	-	-	-	-	-	-	4.13	FILM	0.00	166.82	162.69
06/09/93	-	-	-	-	-	-	4.48	FILM	0.00	166.82	162.34
09/14/93	19,000	3,600	1,100	740	4,300	-	5.35	NP	0.00	166.82	161.47
12/14/93	38,000	4,300	1,300	<6.6	11	-	4.38	NP	0.00	166.82	162.44
03/02/94	-	-	-	-	-	-	4.22	FILM	0.00	166.82	162.60
06/06/94	-	-	-	-	-	-	2.16	FILM	0.00	166.82	164.66
09/06/94	74,000	3,300	3,900	1,200	6,100	-	5.00	NP	0.00	166.82	161.82
12/07/94	30,000	3,200	2,900	1,200	4,600	-	4.10	NP	0.00	166.82	162.72
03/08/95	28,000	4,200	2,300	810	7,800	-	3.92	NP	0.00	166.82	162.90
06/15/95	-	-	-	-	-	-	-	-	-	-	-
09/05/95	-	-	-	-	-	-	4.78	FILM	0.00	166.82	162.04
11/21/95	-	-	-	-	-	-	4.82	NP	0.00	166.82	162.00
03/11/96	270	2.4	6.0	4.5	19	-	3.32	NP	0.00	166.82	163.50
06/19/96	3,000	570	63	<1.5	400	-	4.20	NP	0.00	166.82	162.62
09/16/96	7,700	440	69	<1.5	680	230	4.68	NP	0.00	166.82	162.14
12/10/96	52	<0.3	<0.3	<0.3	<0.5	120	4.93	NP	0.00	166.82	161.89
03/12/97	8,700	180	5.4	40	1,100	130	4.10	NP	0.00	166.82	162.72
06/12/97	<50	<0.3	<0.3	<0.3	<0.5	36	-	-	-	-	-
09/16/97	<50	<0.3	<0.3	<0.3	<0.5	<20	4.55	NP	0.00	166.82	162.27
12/09/97	<50	<0.3	0.44	<0.3	<0.5	<20	5.30	NP	0.00	166.82	161.52
03/03/98	1,100	13	0.51	<0.3	<0.5	220	4.55	NP	0.00	166.82	162.27
07/08/98	<50	<0.3	<0.3	<0.3	<0.5	<5	-	-	-	-	-
09/10/98	60	<0.3	<0.3	<0.3	<0.5	180	6.05	NP	0.00	166.82	160.77
12/30/98	<50	1.1	<0.3	<0.3	<0.5	<5	5.65	NP	0.00	166.82	161.17

**TABLE 1
GROUNDWATER DATA
THRIFTY OIL STATION #054, CASTRO VALLEY, CA.**

DATE SAMPLED	ANALYTICAL PARAMETERS						DEPTH TO GROUNDWATER (feet)	DEPTH TO PRODUCT (feet)	PRODUCT THICKNESS (feet)	CASING ELEVATION (feet)	GROUNDWATER ELEVATION (feet)
	TPH (ug/L)	BENZENE (ug/L)	TOLUENE (ug/L)	EthylBenzene (ug/L)	XYLENE (ug/L)	MTBE (ug/L)					
03/15/99	< 50	<0.3	<0.3	<0.3	<0.5	<5	5.68	NP	0.00	166.82	161.14
06/22/99	880	14	0.98	<0.3	8.1	260	4.95	NP	0.00	166.82	161.87
09/08/99	72	<0.3	<0.3	<0.3	<0.5	120	4.46	NP	0.00	166.82	162.36
12/01/99	< 50	<0.3	<0.3	<0.3	<0.5	<5	4.08	NP	0.00	166.82	162.74
03/23/00	< 50	<0.25	<0.25	<0.25	<0.5	<5	3.68	NP	0.00	166.82	163.14
06/08/00	< 50	<5	<5	<5	<5	<5	4.07	NP	0.00	166.82	162.75
09/27/00	< 50	<0.18	<0.14	<0.18	<0.26	<0.24	4.07	NP	0.00	166.82	162.75
12/13/00	< 50	<0.18	<0.14	<0.18	<0.26	<0.24	4.06	NP	0.00	166.82	162.76
03/22/01	< 50	<0.18	<0.14	<0.18	<0.26	<0.24	5.22	NP	0.00	166.82	161.60
06/15/01	< 50	<0.18	<0.14	<0.18	<0.26	<0.24	5.99	NP	0.00	166.82	160.83
08/30/01	< 50	<0.18	<0.14	<0.18	<0.26	<0.24	4.84	NP	0.00	166.82	161.98
12/12/01	< 50	<0.18	<0.14	<0.18	<0.26	<0.24	4.80	NP	0.00	166.82	162.02
MONITORING WELL #RE-2											
04/11/88	-	-	-	-	-	-	-	-	-	-	-
04/09/90	850	5.8	0.5	4.8	1.1	-	4.90	NP	0.00	167.19	162.29
10/30/90	440	2.8	0.91	13	3.14	-	5.34	NP	0.00	167.19	161.85
01/18/91	1,100	8.4	3.1	ND	10	-	4.90	NP	0.00	167.19	162.29
02/12/91	1,100	5.9	ND	1.77	ND	-	4.94	NP	0.00	167.19	162.25
03/20/91	550	4.3	ND	ND	ND	-	4.32	NP	0.00	167.19	162.87
05/22/91	1,000	5.3	3.6	4.4	8.9	-	4.43	NP	0.00	167.19	162.76
06/19/91	700	2.1	1.4	3.8	3.5	-	6.43	NP	0.00	167.19	160.76
07/17/91	880	12	8.0	4.3	28	-	4.75	NP	0.00	167.19	162.44
08/07/91	-	3.8	1.6	ND	ND	-	4.87	NP	0.00	167.19	162.32
09/24/91	670	7.2	7.1	ND	23	-	5.50	NP	0.00	167.19	161.69
10/23/91	2,700	52	60	22	130	-	5.63	NP	0.00	167.19	161.56
11/06/91	1,900	18	61	9.1	83	-	5.14	NP	0.00	167.19	162.05
12/04/91	1,100	26	47	4.3	42	-	5.26	NP	0.00	167.19	161.93
01/29/92	900	14	24	5.3	19	-	5.11	NP	0.00	167.19	162.08
02/26/92	500	3.4	3.5	2.7	2.7	-	4.31	NP	0.00	167.19	162.88
03/19/92	1,200	14	20	15	18	-	4.45	NP	0.00	167.19	162.74
04/22/92	200	ND	ND	ND	ND	-	4.78	NP	0.00	167.19	162.41
05/21/92	500	7.5	6.8	3.9	7.4	-	5.02	NP	0.00	167.19	162.17
06/25/92	ND	ND	0.9	0.7	ND	-	5.13	NP	0.00	167.19	162.06

**TABLE 1
GROUNDWATER DATA
THRIFTY OIL STATION #054, CASTRO VALLEY, CA.**

DATE SAMPLED	ANALYTICAL PARAMETERS						DEPTH TO GROUNDWATER (feet)	DEPTH TO PRODUCT (feet)	PRODUCT THICKNESS (feet)	CASING ELEVATION (feet)	GROUNDWATER ELEVATION (feet)
	TPH (ug/L)	BENZENE (ug/L)	TOLUENE (ug/L)	EthylBenzene (ug/L)	XYLENE (ng/L)	MTBE (ug/L)					
07/30/92	500	7.7	8.6	3.2	1.7	-	5.19	NP	0.00	167.19	162.00
08/20/92	1,100	6.6	4.5	2.7	2.0	-	5.27	NP	0.00	167.19	161.92
09/30/92	500	5.4	2.4	1.8	4.5	-	5.45	NP	0.00	167.19	161.74
12/23/92	800	1.9	ND	ND	2.3	-	4.60	NP	0.00	167.19	162.59
03/10/93	1,200	ND	1.4	ND	2.1	-	4.18	NP	0.00	167.19	163.01
06/09/93	200	ND	ND	ND	ND	-	4.53	NP	0.00	167.19	162.66
09/17/93	360	1.6	1.1	3.2	8.9	-	5.26	NP	0.00	167.19	161.93
12/14/93	260	5.6	3.9	<0.3	21.0	-	2.75	NP	0.00	167.19	164.44
03/02/94	410	<0.3	<0.3	<0.3	<0.5	-	4.27	NP	0.00	167.19	162.92
06/06/94	760	4.6	<0.3	0.32	1.3	-	4.88	NP	0.00	167.19	162.31
09/06/94	1,300	43	45	8.9	69	-	5.16	NP	0.00	167.19	162.03
12/07/94	-	-	-	-	-	-	4.16	NP	0.00	167.19	163.03
03/08/95	<100	<0.5	<0.5	<0.5	<1	-	3.96	NP	0.00	167.19	163.23
06/15/95	130	<0.5	<0.5	<0.5	<1	-	4.52	NP	0.00	167.19	162.67
09/05/95	210	<0.5	<0.5	<0.5	<1	-	4.76	NP	0.00	167.19	162.43
11/21/95	160	0.65	<0.3	0.35	0.95	-	4.83	NP	0.00	167.19	162.36
03/11/96	<50	<0.3	<0.3	<0.3	<0.5	-	3.36	NP	0.00	167.19	163.83
06/19/96	<50	<0.3	<0.3	<0.3	<0.5	-	4.68	NP	0.00	167.19	162.51
09/16/96	<50	<0.3	<0.3	<0.3	<0.5	<20	5.10	NP	0.00	167.19	162.09
12/10/96	<50	<0.3	<0.3	<0.3	<0.5	<20	4.47	NP	0.00	167.19	162.72
03/12/97	<50	<0.3	<0.3	<0.3	<0.5	<20	4.05	NP	0.00	167.19	163.14
06/12/97	<50	<0.3	<0.3	<0.3	<0.5	<20	-	-	-	-	-
09/10/97	<50	<0.3	<0.3	<0.3	<0.5	<20	4.08	NP	0.00	167.19	163.11
12/09/97	<50	<0.3	<0.3	<0.3	<0.5	<20	4.40	NP	0.00	167.19	162.79
03/03/98	<50	<0.3	<0.3	<0.3	<0.5	<20	3.30	NP	0.00	167.19	163.89
07/08/98	<50	<0.3	<0.3	<0.3	<0.5	15	-	-	-	-	-
09/10/98	<50	<0.3	<0.3	<0.3	<0.5	<5	4.93	NP	0.00	167.19	162.26
12/30/98	460	0.92	<0.3	<0.3	<0.5	1,400	4.20	NP	0.00	167.19	162.99
03/15/99	<50	<0.3	<0.3	<0.3	<0.5	<5	4.20	NP	0.00	167.19	162.99
06/22/99	2,900	7.4	<0.3	0.43	4.1	4,500	3.70	NP	0.00	167.19	163.49
09/08/99	1,400	<3	<3	<3	<5	3,200	3.96	NP	0.00	167.19	163.23
12/01/99	<50	<0.3	<0.3	<0.3	<0.5	<5	3.58	NP	0.00	167.19	163.61
03/23/00	<50	<0.25	<0.25	<0.25	<0.5	<5	3.19	NP	0.00	167.19	164.00
06/08/00	<50	<5	<5	<5	<5	<5	3.18	NP	0.00	167.19	164.01
09/27/00	<50	<0.18	<0.14	<0.18	<0.26	<0.24	3.58	NP	0.00	167.19	163.61

TABLE 1
GROUNDWATER DATA
THRIFTY OIL STATION #054, CASTRO VALLEY, CA.

DATE SAMPLED	ANALYTICAL PARAMETERS						DEPTH TO GROUNDWATER (feet)	DEPTH TO PRODUCT (feet)	PRODUCT THICKNESS (feet)	CASING ELEVATION (feet)	GROUNDWATER ELEVATION (feet)
	TPH (ug/L)	BENZENE (ug/L)	TOLUENE (ug/L)	EthylBenzene (ug/L)	XYLENE (ug/L)	MTBE (ug/L)					
12/13/00	<50	<0.18	<0.14	<0.18	<0.26	<0.24	3.58	NP	0.00	167.19	163.61
03/22/01	575	<0.18	1.3	<0.18	<0.26	*950 / 2,070	4.33	NP	0.00	167.19	162.86
06/15/01	<50	<0.18	<0.14	<0.18	<0.26	<0.24	5.10	NP	0.00	167.19	162.09
08/30/01	<50	<0.18	<0.14	<0.18	<0.26	<0.24	5.86	NP	0.00	167.19	161.33
12/12/01	<50	<0.18	<0.14	<0.18	<0.26	<0.24	4.81	NP	0.00	167.19	162.38
MONITORING WELL #RE-3											
04/11/88	70,000	6,600	5,300	800	13,000	-	-	-	-	-	-
04/09/90	370,000	2,300	4,900	3,200	31,000	-	7.15	NP	0.00	167.39	160.24
10/30/90	13,000	860	660	220	2,210	-	7.84	NP	0.00	167.39	159.55
01/18/91	42,000	4,700	4,500	21	7,700	-	6.90	NP	0.00	167.39	160.49
02/12/91	72,000	3,600	4,500	ND	7,600	-	6.62	NP	0.00	167.39	160.77
03/20/91	65,000	2,400	9,400	50	9,800	-	5.87	NP	0.00	167.39	161.52
05/22/91	-	-	-	-	-	-	5.98	FILM	0.00	167.39	161.41
06/19/91	-	-	-	-	-	-	6.84	FILM	0.00	167.39	160.55
07/17/91	-	-	-	-	-	-	7.10	FILM	0.00	167.39	160.29
08/07/91	-	-	-	-	-	-	7.30	FILM	0.00	167.39	160.09
09/24/91	-	-	-	-	-	-	7.84	FILM	0.00	167.39	159.55
10/23/91	-	-	-	-	-	-	8.07	FILM	0.00	167.39	159.32
11/06/91	-	-	-	-	-	-	7.63	FILM	0.00	167.39	159.76
12/04/91	-	-	-	-	-	-	7.83	FILM	0.00	167.39	159.56
01/29/92	-	-	-	-	-	-	7.17	FILM	0.00	167.39	160.22
02/26/92	-	-	-	-	-	-	5.56	FILM	0.00	167.39	161.83
03/19/92	-	-	-	-	-	-	5.44	FILM	0.00	167.39	161.95
04/22/92	-	-	-	-	-	-	6.56	FILM	0.00	167.39	160.83
05/21/92	-	-	-	-	-	-	6.90	FILM	0.00	167.39	160.49
06/25/92	-	-	-	-	-	-	7.18	FILM	0.00	167.39	160.21
07/30/92	-	-	-	-	-	-	6.80	FILM	0.00	167.39	160.59
08/20/92	-	-	-	-	-	-	7.25	FILM	0.00	167.39	160.14
09/30/92	-	-	-	-	-	-	7.68	FILM	0.00	167.39	159.71
12/23/92	-	-	-	-	-	-	6.07	FILM	0.00	167.39	161.32
03/10/93	-	-	-	-	-	-	5.66	FILM	0.00	167.39	161.73
06/09/93	-	-	-	-	-	-	6.66	FILM	0.00	167.39	160.73
09/14/93	40,000	2,900	1,500	180	6,900	-	7.30	NP	0.00	167.39	160.09

TABLE 1
GROUNDWATER DATA
THRIFTY OIL STATION #054, CASTRO VALLEY, CA.

DATE SAMPLED	ANALYTICAL PARAMETERS						DEPTH TO GROUNDWATER (feet)	DEPTH TO PRODUCT (feet)	PRODUCT THICKNESS (feet)	CASING ELEVATION (feet)	GROUNDWATER ELEVATION (feet)
	TPH (ug/L)	BENZENE (ug/L)	TOLUENE (ug/L)	EthylBenzene (ug/L)	XYLENE (ug/L)	MIBE (ug/L)					
12/14/93	-	-	-	-	-	-	5.95	NP	0.00	167.39	161.44
03/02/94	-	-	-	-	-	-	5.08	NP	0.00	167.39	162.31
06/06/94	-	-	-	-	-	-	6.35	FILM	0.00	167.39	161.04
09/06/94	11,000	260	26	<6.6	1,000	-	7.50	NP	0.00	167.39	159.89
12/07/94	-	-	-	-	-	-	5.48	FILM	0.00	167.39	161.91
03/08/95	-	-	-	-	-	-	5.18	FILM	0.00	167.39	162.21
06/15/95	-	-	-	-	-	-	-	-	-	-	-
09/05/95	-	-	-	-	-	-	6.84	FILM	0.00	167.39	160.55
11/21/95	10,000	210	<3	4.5	330	-	7.38	NP	0.00	167.39	160.01
03/11/96	1,600	640	15	10	46	-	4.85	NP	0.00	167.39	162.54
06/19/96	2,100	280	<3	<3	120	-	5.80	NP	0.00	167.39	161.59
09/16/96	140	<0.3	<0.3	<0.3	<0.5	110	4.50	NP	0.00	167.39	162.89
12/10/96	<50	<0.3	<0.3	<0.3	<0.5	<20	5.35	NP	0.00	167.39	162.04
03/12/97	<50	<0.3	<0.3	<0.3	<0.5	<20	3.48	NP	0.00	167.39	163.91
06/12/97	<50	<0.3	<0.3	<0.3	0.58	<20	-	-	-	-	-
09/10/97	<50	<0.3	<0.3	<0.3	<0.5	<20	3.10	NP	0.00	167.39	164.29
12/09/97	3,600	1,000	1,000	<6	570	260	4.55	NP	0.00	167.39	162.84
03/03/98	2,800	20	0.65	0.39	16	5,600	2.30	NP	0.00	167.39	165.09
07/08/98	<50	<0.3	<0.3	<0.3	<0.5	<5	-	-	-	-	-
09/10/98	<50	<0.3	<0.3	<0.3	<0.5	23	4.95	NP	0.00	167.39	162.44
12/30/98	<50	1.1	<0.3	<0.3	<0.5	<5	4.55	NP	0.00	167.39	162.84
03/15/99	<50	<0.3	<0.3	<0.3	<0.5	<5	4.15	NP	0.00	167.39	163.24
06/22/99	670	17	1.2	0.36	1.7	340	3.85	NP	0.00	167.39	163.54
09/08/99	140	0.72	<0.3	<0.3	<0.5	230	2.63	NP	0.00	167.39	164.76
12/01/99	95	<0.3	<0.3	<0.3	<0.5	200	2.63	NP	0.00	167.39	164.76
03/23/00	315	<0.25	<0.25	<0.25	<0.5	*293/422	2.25	NP	0.00	167.39	165.14
06/08/00	<100	<5	<5	<5	<5	201	3.02	NP	0.00	167.39	164.37
09/27/00	154	<0.18	<0.14	<0.18	<0.26	*254 / 160	3.01	NP	0.00	167.39	164.38
12/13/00	<50	<0.18	<0.14	<0.18	<0.26	*124 / 111	3.02	NP	0.00	167.39	164.37
03/22/01	<50	<0.18	<0.14	<0.18	<0.26	*90 / 57	4.54	NP	0.00	167.39	162.85
06/15/01	649	28	2.4	3.1	9	*1,790 / 2,560	4.92	NP	0.00	167.39	162.47
08/30/01	<50	<0.18	<0.14	<0.18	<0.26	<0.24	7.80	NP	0.00	167.39	159.59
12/12/01	<50	<0.18	<0.14	<0.18	<0.26	<0.24	7.35	NP	0.00	167.39	160.04

TABLE 1
GROUNDWATER DATA
THRIFTY OIL STATION #054, CASTRO VALLEY, CA.

DATE SAMPLED	ANALYTICAL PARAMETERS						DEPTH TO GROUNDWATER (feet)	DEPTH TO PRODUCT (feet)	PRODUCT THICKNESS (feet)	CASING ELEVATION (feet)	GROUNDWATER ELEVATION (feet)
	TPH (ug/L)	BENZENE (ug/L)	TOLUENE (ug/L)	EthylBenzene (ug/L)	XYLENE (ug/L)	MIBK (ug/L)					
MONITORING WELL #RE-4											
04/11/88	15,000	12,000	8,000	1,000	2,700	-	-	-	-	-	-
04/09/90	-	-	-	-	-	-	-	-	-	-	-
10/30/90	87,000	7,200	10,000	1,600	12,900	-	7.04	NP	0.00	166.94	159.90
01/18/91	70,000	5,000	5,400	790	9,900	-	11.62	NP	0.00	166.94	155.32
02/12/91	87,000	5,200	2,800	240	11,000	-	11.63	NP	0.00	166.94	155.31
03/20/91	6,500	370	230	17	670	-	11.61	NP	0.00	166.94	155.33
05/22/91	-	-	-	-	-	-	10.30	FILM	0.00	166.94	156.64
06/19/91	-	-	-	-	-	-	11.10	FILM	0.00	166.94	155.84
07/17/91	-	-	-	-	-	-	6.20	FILM	0.00	166.94	160.74
08/17/91	-	-	-	-	-	-	8.15	FILM	0.00	166.94	158.79
09/24/91	-	-	-	-	-	-	10.40	FILM	0.00	166.94	156.54
10/23/91	-	-	-	-	-	-	11.20	FILM	0.00	166.94	155.74
11/06/91	-	-	-	-	-	-	6.62	FILM	0.00	166.94	160.32
12/04/91	-	-	-	-	-	-	11.20	FILM	0.00	166.94	155.74
01/29/92	-	-	-	-	-	-	7.72	FILM	0.00	166.94	159.22
02/26/92	-	-	-	-	-	-	5.13	FILM	0.00	166.94	161.81
03/19/92	-	-	-	-	-	-	5.00	FILM	0.00	166.94	161.94
04/22/92	-	-	-	-	-	-	5.94	FILM	0.00	166.94	161.00
05/21/92	-	-	-	-	-	-	5.40	FILM	0.00	166.94	161.54
06/25/92	-	-	-	-	-	-	5.71	FILM	0.00	166.94	161.23
07/30/92	-	-	-	-	-	-	6.33	FILM	0.00	166.94	160.61
08/20/92	-	-	-	-	-	-	5.80	FILM	0.00	166.94	161.14
09/30/92	-	-	-	-	-	-	6.34	FILM	0.00	166.94	160.60
12/23/92	-	-	-	-	-	-	5.50	FILM	0.00	166.94	161.44
03/10/93	-	-	-	-	-	-	4.67	FILM	0.00	166.94	162.27
06/09/93	-	-	-	-	-	-	5.12	FILM	0.00	166.94	161.82
09/14/93	-	-	-	-	-	-	10.44	NP	0.00	166.94	156.50
12/14/93	-	-	-	-	-	-	7.52	NP	0.00	166.94	159.42
03/02/94	-	-	-	-	-	-	4.85	NP	0.00	166.94	162.09
06/06/94	-	-	-	-	-	-	5.20	FILM	0.00	166.94	161.74
09/06/94	-	-	-	-	-	-	9.85	FILM	0.00	166.94	157.09
12/07/94	-	-	-	-	-	-	5.20	FILM	0.00	166.94	161.74
03/08/95	-	-	-	-	-	-	4.98	FILM	0.00	166.94	161.96
06/15/95	-	-	-	-	-	-	-	-	-	-	-

**TABLE 1
GROUNDWATER DATA
THRIFTY OIL STATION #054, CASTRO VALLEY, CA.**

DATE SAMPLED	ANALYTICAL PARAMETERS						DEPTH TO GROUNDWATER (feet)	DEPTH TO PRODUCT (feet)	PRODUCT THICKNESS (feet)	CASING ELEVATION (feet)	GROUNDWATER ELEVATION (feet)
	TPH (ug/L)	BENZENE (ug/L)	TOLUENE (ug/L)	EthylBenzene (ug/L)	XYLENE (ug/L)	MTBE (ug/L)					
09/05/95	-	-	-	-	-	-	13.72	FILM	0.00	166.94	153.22
11/21/95	32,000	46	21	66	340	-	12.53	NP	0.00	166.94	154.41
03/11/96	1,700	130	15	2.0	120	-	4.72	NP	0.00	166.94	162.22
06/19/96	1,700	230	30	0.35	100	-	5.40	NP	0.00	166.94	161.54
09/16/96	510	<0.3	0.73	<0.3	<0.5	800	5.18	NP	0.00	166.94	161.76
12/10/96	520	<0.3	<0.3	<0.3	<0.5	1,000	4.65	NP	0.00	166.94	162.29
03/12/97	420	3.2	<0.3	<0.3	11	370	3.87	NP	0.00	166.94	163.07
06/12/97	510	0.66	<0.3	<0.3	<0.5	1,600	-	-	-	-	-
09/10/97	<50	<0.3	<0.3	<0.3	<0.5	<20	5.40	NP	0.00	166.94	161.54
12/09/97	1,400	330	2.3	<0.3	1.5	2,500	4.60	NP	0.00	166.94	162.34
03/03/98	3,000	400	0.61	0.5	97	3,800	5.05	NP	0.00	166.94	161.89
07/08/98	650	<0.3	<0.3	<0.3	<0.5	1,800	-	-	-	-	-
09/10/98	2,700	<0.3	<0.3	<0.3	1.4	7,600	4.60	NP	0.00	166.94	162.34
12/30/98	530	<0.3	<0.3	<0.3	<0.5	1,500	4.20	NP	0.00	166.94	162.74
03/15/99	<50	<0.3	<0.3	<0.3	<0.5	<5	3.85	NP	0.00	166.94	163.09
06/22/99	1,200	23	1.5	<0.3	2.4	1,400	3.90	NP	0.00	166.94	163.04
09/08/99	590	1.5	<0.6	<0.6	<1	1,100	5.72	NP	0.00	166.94	161.22
12/01/99	540	<0.3	<0.3	<0.3	<0.5	880	5.34	NP	0.00	166.94	161.60
03/23/00	<50	<0.25	<0.25	<0.25	<0.5	<5	5.36	NP	0.00	166.94	161.58
06/08/00	67	<5	<5	<5	<5	<5	5.34	NP	0.00	166.94	161.60
09/27/00	<50	<0.18	<0.14	<0.18	<0.26	<0.24	5.35	NP	0.00	166.94	161.59
12/13/00	<50	<0.18	<0.14	<0.18	<0.26	<0.24	5.71	NP	0.00	166.94	161.23
03/22/01	<50	<0.18	<0.14	<0.18	<0.26	<0.24	4.19	NP	0.00	166.94	162.75
06/15/01	409	18	2	2	5	*1,060 / 1,480	4.57	NP	0.00	166.94	162.37
08/30/01	<50	<0.18	<0.14	<0.18	<0.26	<0.24	6.10	NP	0.00	166.94	160.84
12/12/01	<50	<0.18	<0.14	<0.18	3	*7 / 3.7	4.95	NP	0.00	166.94	161.99
MONITORING WELL #RE-5											
04/11/88	14,000	1,300	1,100	100	2,600	-	-	-	-	-	-
04/09/90	3,000	690	190	40	270	-	4.79	NP	0.00	166.51	161.72
10/30/90	3,400	910	48	87	249	-	5.86	NP	0.00	166.51	160.65
01/18/91	1,400	180	8.6	0.52	48	-	4.40	NP	0.00	166.51	162.11
02/12/91	1,000	ND	ND	0.65	ND	-	4.76	NP	0.00	166.51	161.75
03/20/91	3,000	250	53	ND	110	-	5.08	NP	0.00	166.51	161.43

TABLE 1
GROUNDWATER DATA
THRIFTY OIL STATION #054, CASTRO VALLEY, CA.

DATE SAMPLED	ANALYTICAL PARAMETERS						DEPTH TO GROUNDWATER (feet)	DEPTH TO PRODUCT (feet)	PRODUCT THICKNESS (feet)	CASING ELEVATION (feet)	GROUNDWATER ELEVATION (feet)
	TPH (ug/L)	BENZENE (ug/L)	TOLUENE (ug/L)	EthylBenzene (ug/L)	XYLENE (ug/L)	MTBE (ug/L)					
05/22/91	2,500	330	7.8	5.6	200	-	4.52	NP	0.00	166.51	161.99
01/19/91	2,000	59	1.6	5.1	110	-	4.39	NP	0.00	166.51	162.12
07/17/91	-	-	-	-	-	-	5.05	FILM	0.00	166.51	161.46
08/07/91	-	-	-	-	-	-	5.02	FILM	0.00	166.51	161.49
09/24/91	-	-	-	-	-	-	5.86	FILM	0.00	166.51	160.65
10/23/91	-	-	-	-	-	-	5.84	FILM	0.00	166.51	160.67
11/06/91	9,900	2,300	37	260	160	-	5.48	NP	0.00	166.51	161.03
12/04/91	4,500	1,000	27	ND	180	-	5.43	NP	0.00	166.51	161.08
01/29/92	600	6.1	2.3	ND	47	-	5.12	NP	0.00	166.51	161.39
02/26/92	500	5.4	2.7	1.2	14	-	4.93	NP	0.00	166.51	161.58
03/19/92	ND	1.7	1.1	ND	5.5	-	4.45	NP	0.00	166.51	162.06
04/22/92	1,600	240	2.2	ND	160	-	4.63	NP	0.00	166.51	161.88
05/21/92	1,200	410	37	ND	118	-	4.90	NP	0.00	166.51	161.61
06/25/92	ND	1.0	0.8	0.8	0.4	-	5.15	NP	0.00	166.51	161.36
07/30/92	ND	2.0	1.8	1.9	6.4	-	5.30	NP	0.00	166.51	161.21
08/20/92	300	1.7	3.3	0.7	12	-	5.44	NP	0.00	166.51	161.07
09/30/92	1,900	140	ND	19	35	-	5.73	NP	0.00	166.51	160.78
12/23/92	400	8.0	ND	ND	ND	-	4.75	NP	0.00	166.51	161.76
03/10/93	1,100	290	9.7	ND	75	-	4.14	NP	0.00	166.51	162.37
06/09/93	400	1.5	0.5	ND	12	-	5.42	NP	0.00	166.51	161.09
09/14/93	240	6.9	8.8	1.4	67	-	5.53	NP	0.00	166.51	160.98
12/14/93	3,300	510	5.4	4.1	55	-	478	NP	0.00	166.51	-311.49
03/02/94	2,400	270	4.5	<0.3	13	-	4.20	NP	0.00	166.51	162.31
06/06/94	730	<0.3	<0.3	0.70	22	-	5.13	NP	0.00	166.51	161.38
09/06/94	2,400	180	28	2.3	76	-	5.45	NP	0.00	166.51	161.06
12/07/94	540	5.6	<0.3	<0.5	6.9	-	4.13	NP	0.00	166.51	162.38
03/08/95	1,500	220	5.5	<0.5	83	-	5.20	NP	0.00	166.51	161.31
06/15/95	3,200	820	53	6.2	74	-	4.93	NP	0.00	166.51	161.58
09/05/95	4,400	440	22	<2.5	57	-	5.03	NP	0.00	166.51	161.48
11/21/95	660	3.4	<0.3	<0.3	0.6	-	5.23	NP	0.00	166.51	161.28
03/11/96	1,000	76	2.2	<0.3	130	-	4.16	NP	0.00	166.51	162.35
06/09/96	90	<0.3	<0.3	<0.3	<0.5	-	5.42	NP	0.00	166.51	161.09
09/16/96	1,900	5.8	<0.3	<0.3	5.9	1,100	5.20	NP	0.00	166.51	161.31
12/10/96	740	<0.3	<0.3	<0.3	<0.5	1,300	5.27	NP	0.00	166.51	161.24
03/12/97	2,000	600	59	5.1	54	1,300	3.85	NP	0.00	166.51	162.66

**TABLE 1
GROUNDWATER DATA
THRIFTY OIL STATION #054, CASTRO VALLEY, CA.**

DATE SAMPLED	ANALYTICAL PARAMETERS						DEPTH TO GROUNDWATER (feet)	DEPTH TO PRODUCT (feet)	PRODUCT THICKNESS (feet)	CASING ELEVATION (feet)	GROUNDWATER ELEVATION (feet)
	TPH (ug/L)	BENZENE (ug/L)	TOLUENE (ug/L)	EthylBenzene (ug/L)	XYLENE (ug/L)	MTBE (ug/L)					
06/12/97	230	<0.3	<0.3	<0.3	<0.5	720	-	-	-	-	-
09/10/97	210	<0.3	<0.3	<0.3	<0.5	210	4.10	NP	0.00	166.51	162.41
12/09/97	11,000	2,500	2,700	<6	1,500	510	5.20	NP	0.00	166.51	161.31
03/03/98	<50	<0.3	<0.3	<0.3	<0.5	<20	3.70	NP	0.00	166.51	162.81
07/08/98	<50	<0.3	<0.3	<0.3	<0.5	<5	-	-	-	-	-
09/10/98	<50	<0.3	<0.3	<0.3	<0.5	<5	6.77	NP	0.00	166.51	159.74
12/30/98	<50	<0.3	<0.3	<0.3	<0.5	<5	5.95	NP	0.00	166.51	160.56
03/15/99	<50	<0.3	<0.3	<0.3	<0.5	<5	5.25	NP	0.00	166.51	161.26
06/22/99	110	<0.3	<0.3	<0.3	<0.5	200	4.50	NP	0.00	166.51	162.01
09/08/99	68	<0.3	<0.3	<0.3	<0.5	110	4.43	NP	0.00	166.51	162.08
12/01/99	<50	<0.3	<0.3	<0.3	<0.5	<5	3.66	NP	0.00	166.51	162.85
03/23/00	<50	<0.25	<0.25	<0.25	<0.5	<5	4.06	NP	0.00	166.51	162.45
06/08/00	<50	<5	<5	<5	<5	<5	4.43	NP	0.00	166.51	162.08
09/27/00	<50	<0.18	<0.14	<0.18	<0.26	<0.24	4.06	NP	0.00	166.51	162.45
12/13/00	<50	<0.18	<0.14	<0.18	<0.26	<0.24	4.80	NP	0.00	166.51	161.71
03/22/01	<50	<0.18	<0.14	<0.18	<0.26	<0.24	6.33	NP	0.00	166.51	160.18
06/15/01	<50	<0.18	<0.14	<0.18	<0.26	<0.24	4.79	NP	0.00	166.51	161.72
08/30/01	<50	<0.18	<0.14	<0.18	<0.26	<0.24	5.54	NP	0.00	166.51	160.97
12/12/01	<50	<0.18	<0.14	<0.18	<0.26	<0.24	5.21	NP	0.00	166.51	161.30
MONITORING WELL #RE-6											
04/11/88	6,000	3,000	40	80	140	-	-	-	-	-	-
04/09/90	3,000	990	ND	70	ND	-	5.64	NP	0.00	166.51	160.87
10/30/90	3,400	1,000	28	ND	ND	-	6.68	NP	0.00	166.51	159.83
01/18/91	6,300	1,200	ND	3.0	15	-	6.61	NP	0.00	166.51	159.90
02/12/91	5,200	850	8.4	4.9	41	-	6.20	NP	0.00	166.51	160.31
03/20/91	5,800	680	12	8.0	16	-	5.62	NP	0.00	166.51	160.89
05/22/91	8,500	1,700	14	24	6.7	-	6.05	NP	0.00	166.51	160.46
06/19/91	-	-	-	-	-	-	6.12	FILM	0.00	166.51	160.39
07/17/91	120,000	9,300	13,000	2,400	16,000	-	6.20	NP	0.00	166.51	160.31
08/07/91	-	590	5.3	ND	14	-	6.27	NP	0.00	166.51	160.24
09/24/91	7,000	310	11	5.3	35	-	6.63	NP	0.00	166.51	159.88
10/23/91	-	-	-	-	-	-	6.36	FILM	0.00	166.51	160.15
11/06/91	4,000	710	18	29	49	-	6.15	NP	0.00	166.51	160.36

TABLE 1
GROUNDWATER DATA
THRIFTY OIL STATION #054, CASTRO VALLEY, CA.

DATE SAMPLED	ANALYTICAL PARAMETERS						DEPTH TO GROUNDWATER (feet)	DEPTH TO PRODUCT (feet)	PRODUCT THICKNESS (feet)	CASING ELEVATION (feet)	GROUNDWATER ELEVATION (feet)
	TPH (ug/L)	BENZENE (ug/L)	TOLUENE (ug/L)	EthylBenzene (ug/L)	XYLENE (ug/L)	MTBE (ug/L)					
12/04/91	4,100	1,100	14	33	39	-	6.19	NP	0.00	166.51	160.32
01/29/92	2,600	790	14	ND	49	-	6.70	NP	0.00	166.51	159.81
02/26/92	3,100	950	21	30	33	-	5.44	NP	0.00	166.51	161.07
03/19/92	2,200	630	14	12	40	-	5.30	NP	0.00	166.51	161.21
04/22/92	-	730	2.2	ND	40	-	6.00	NP	0.00	166.51	160.51
05/21/92	1,500	840	7.8	7.1	34	-	6.25	NP	0.00	166.51	160.26
06/25/92	<2000	740	8.0	27	28	-	6.38	NP	0.00	166.51	160.13
07/30/92	-	-	-	-	-	-	6.42	FILM	0.00	166.51	160.09
08/20/92	2,800	630	17	23	22	-	6.50	NP	0.00	166.51	160.01
09/30/92	7,800	540	ND	12	29	-	6.66	NP	0.00	166.51	159.85
12/23/92	1,800	350	ND	7.7	11	-	5.83	NP	0.00	166.51	160.68
03/10/93	3,000	830	5.6	19	16	-	5.63	NP	0.00	166.51	160.88
06/09/93	4,800	920	6.2	3.2	12	-	6.01	NP	0.00	166.51	160.50
09/14/93	3,600	660	7.5	11	27	-	6.53	NP	0.00	166.51	159.98
12/14/93	1,500	200	<0.3	<0.3	8.8	-	3.58	NP	0.00	166.51	162.93
03/02/94	-	-	-	-	-	-	5.12	NP	0.00	166.51	161.39
06/06/94	2,400	290	4.6	1.3	24	-	1.85	NP	0.00	166.51	164.66
09/06/94	4,300	230	21	<6.6	130	-	6.40	NP	0.00	166.51	160.11
12/07/94	1,500	17	2.5	3.2	22	-	5.68	NP	0.00	166.51	160.83
03/08/95	2,500	460	5.5	2.1	51	-	5.12	NP	0.00	166.51	161.39
06/15/95	2,300	91	1.1	0.7	97	-	5.72	NP	0.00	166.51	160.79
09/05/95	3,300	60	<10	<10	74	-	5.94	NP	0.00	166.51	160.57
11/21/95	2,000	7.3	<0.3	0.56	8.7	-	6.24	NP	0.00	166.51	160.27
03/11/96	840	43	0.96	5.7	14	-	5.16	NP	0.00	166.51	161.35
06/19/96	1,800	160	2.7	9.9	25	-	5.80	NP	0.00	166.51	160.71
09/16/96	<50	<0.3	<0.3	<0.3	<0.5	<20	5.38	NP	0.00	166.51	161.13
12/10/96	<50	<0.3	<0.3	<0.3	<0.5	<20	5.62	NP	0.00	166.51	160.89
03/12/97	<50	<0.3	<0.3	<0.3	<0.5	<20	5.20	NP	0.00	166.51	161.31
06/12/97	<50	<0.3	<0.3	<0.3	<0.5	<20	-	-	-	-	-
09/10/97	440	<0.3	<0.3	<0.3	<0.5	320	5.20	NP	0.00	166.51	161.31
12/09/97	<50	<0.3	<0.3	<0.3	<0.5	<20	5.97	NP	0.00	166.51	160.54
03/03/98	400	7.0	<0.3	<0.3	4.3	65	4.45	NP	0.00	166.51	162.06
07/08/98	300	<0.3	<0.3	<0.3	1.0	35	-	-	-	-	-
09/10/98	<50	<0.3	<0.3	<0.3	<0.5	<5	5.90	NP	0.00	166.51	160.61
12/30/98	<50	<0.3	<0.3	<0.3	<0.5	<5	5.20	NP	0.00	166.51	161.31

TABLE 1
GROUNDWATER DATA
THRIFTY OIL STATION #054, CASTRO VALLEY, CA.

DATE SAMPLED	ANALYTICAL PARAMETERS						DEPTH TO GROUNDWATER (feet)	DEPTH TO PRODUCT (feet)	PRODUCT THICKNESS (feet)	CASING ELEVATION (feet)	GROUNDWATER ELEVATION (feet)
	TPH (ug/L)	BENZENE (ug/L)	TOLUENE (ug/L)	EthylBenzene (ug/L)	XYLENE (ug/L)	MTBE (ug/L)					
07/30/92	-	-	-	-	-	-	6.73	FILM	0.00	166.04	159.31
08/20/92	-	-	-	-	-	-	6.82	FILM	0.00	166.04	159.22
09/30/92	-	-	-	-	-	-	7.26	FILM	0.00	166.04	158.78
12/23/92	-	-	-	-	-	-	6.22	FILM	0.00	166.04	159.82
03/10/93	-	-	-	-	-	-	5.82	FILM	0.00	166.04	160.22
06/09/93	-	-	-	-	-	-	6.17	FILM	0.00	166.04	159.87
09/14/93	-	-	-	-	-	-	11.33	NP	0.00	166.04	154.71
12/14/93	-	-	-	-	-	-	8.40	NP	0.00	166.04	157.64
03/02/94	-	-	-	-	-	-	6.82	NP	0.00	166.04	159.22
06/06/94	-	-	-	-	-	-	10.95	FILM	0.00	166.04	155.09
09/06/94	-	-	-	-	-	-	11.30	FILM	0.00	166.04	154.74
12/07/94	-	-	-	-	-	-	5.63	FILM	0.00	166.04	160.41
03/08/95	-	-	-	-	-	-	5.06	FILM	0.00	166.04	160.98
06/15/95	-	-	-	-	-	-	-	-	-	-	-
09/05/95	-	-	-	-	-	-	7.98	FILM	0.00	166.04	158.06
11/21/95	20,000	8,800	110	<30	310	-	7.32	NP	0.00	166.04	158.72
03/11/96	4,800	2,200	38	26	120	-	5.62	NP	0.00	166.04	160.42
06/19/96	4,400	3,300	49	5.8	70	-	6.40	NP	0.00	166.04	159.64
09/19/96	7,200	510	83	<0.3	710	130	6.20	NP	0.00	166.04	159.84
12/10/96	700	<0.3	<0.3	<0.3	<0.5	1,400	5.92	NP	0.00	166.04	160.12
03/12/97	660	0.31	<0.3	<0.3	<0.5	1,400	5.62	NP	0.00	166.04	160.42
06/12/97	320	<0.3	0.45	<0.3	<0.5	850	-	-	-	-	-
09/10/97	780	<0.3	<0.3	<0.3	<0.5	930	7.45	NP	0.00	166.04	158.59
12/09/97	14,000	3,500	3,700	<15	2,100	1,100	7.10	NP	0.00	166.04	158.94
03/03/98	6,100	2,500	18	<6	110	270	6.70	NP	0.00	166.04	159.34
07/08/98	1,300	8.7	<0.3	<0.3	<0.5	350	-	-	-	-	-
09/10/98	690	2.2	<0.3	<0.3	<0.5	350	7.04	NP	0.00	166.04	159.00
12/30/98	600	2.0	0.55	<0.3	<0.5	350	6.25	NP	0.00	166.04	159.79
03/15/99	350	0.71	<0.3	<0.3	<0.5	140	6.02	NP	0.00	166.04	160.02
06/22/99	5,900	2,100	16	4.6	48	170	6.35	NP	0.00	166.04	159.69
09/08/99	1,700	380	<3	<3	13	160	7.03	NP	0.00	166.04	159.01
12/01/99	930	3.7	<0.3	<0.3	<0.5	390	6.25	NP	0.00	166.04	159.79
03/23/00	581	5.4	5.3	1.9	7.3	*168/183	6.24	NP	0.00	166.04	159.80
06/08/00	<100	<5	<5	<5	<5	74	6.64	NP	0.00	166.04	159.40
09/27/00	236	<0.18	<0.14	<0.18	<0.26	*21 / 28	7.03	NP	0.00	166.04	159.01

TABLE 1
GROUNDWATER DATA
THRIFTY OIL STATION #054, CASTRO VALLEY, CA.

DATE SAMPLED	ANALYTICAL PARAMETERS						DEPTH TO GROUNDWATER (feet)	DEPTH TO PRODUCT (feet)	PRODUCT THICKNESS (feet)	CASING ELEVATION (feet)	GROUNDWATER ELEVATION (feet)
	TPH (ug/L)	BENZENE (ug/L)	TOLUENE (ug/L)	EthylBenzene (ug/L)	XYLENE (ug/L)	MTBE (ug/L)					
12/13/00	<50	<0.18	<0.14	<0.18	<0.26	*13 / 19.8	6.63	NP	0.00	166.04	159.41
03/22/01	504	<0.18	<0.14	<0.18	1	*666 / 1,420	7.02	NP	0.00	166.04	159.02
06/15/01	144	5.0	<0.14	0.5	2	*369 / 408	7.02	NP	0.00	166.04	159.02
08/30/01	<50	<0.18	<0.14	<0.18	<0.26	<0.24	7.79	NP	0.00	166.04	158.25
12/12/01	<50	<0.18	<0.14	<0.18	<0.26	<0.24	7.28	NP	0.00	166.04	158.76
MONITORING WELL #RS-8											
08/07/91	ND	ND	ND	ND	ND	-	9.68	NP	0.00	164.32	154.64
09/27/91	ND	ND	ND	ND	ND	-	9.89	NP	0.00	164.32	154.43
10/23/91	ND	ND	ND	ND	ND	-	10.05	NP	0.00	164.32	154.27
11/06/91	ND	ND	ND	ND	ND	-	9.71	NP	0.00	164.32	154.61
12/04/91	ND	ND	ND	ND	ND	-	10.00	NP	0.00	164.32	154.32
01/29/92	ND	2.1	1.0	2.5	3.6	-	9.28	NP	0.00	164.32	155.04
02/26/92	ND	ND	0.7	ND	0.7	-	7.05	NP	0.00	164.32	157.27
03/19/92	ND	0.5	1.0	1.5	2.7	-	7.30	NP	0.00	164.32	157.02
04/22/92	ND	ND	ND	ND	ND	-	8.60	NP	0.00	164.32	155.72
05/21/92	ND	ND	ND	ND	ND	-	9.22	NP	0.00	164.32	155.10
06/25/92	ND	ND	ND	ND	ND	-	9.49	NP	0.00	164.32	154.83
07/30/92	ND	1.1	4.2	ND	3.0	-	9.55	NP	0.00	164.32	154.77
08/20/92	ND	2.0	4.7	ND	5.7	-	9.63	NP	0.00	164.32	154.69
09/30/92	ND	ND	ND	ND	ND	-	9.90	NP	0.00	164.32	154.42
12/23/92	ND	ND	ND	ND	ND	-	9.96	NP	0.00	164.32	154.36
05/10/93	ND	ND	ND	ND	ND	-	8.95	NP	0.00	164.32	155.37
06/09/93	ND	ND	ND	ND	ND	-	9.00	NP	0.00	164.32	155.32
09/14/93	200	0.3	ND	ND	ND	-	9.50	NP	0.00	164.32	154.82
12/14/93	ND	ND	ND	ND	ND	-	8.75	NP	0.00	164.32	155.57
03/02/94	<50	<0.3	<0.3	<0.3	<0.5	-	7.52	NP	0.00	164.32	156.80
06/06/94	54	<0.3	<0.3	<0.3	2.4	-	9.00	NP	0.00	164.32	155.32
09/06/94	<50	<0.3	<0.3	<0.3	<0.5	-	9.26	NP	0.00	164.32	155.06
12/07/94	130	2.5	1.9	1.3	3.6	-	8.67	NP	0.00	164.32	155.65
03/08/95	<100	<0.5	<0.5	<0.5	<1	-	8.34	NP	0.00	164.32	155.98
06/15/95	<100	1.0	<0.5	<0.5	<1	-	9.12	NP	0.00	164.32	155.20
09/05/95	<100	<0.5	<0.5	<0.5	<1	-	9.56	NP	0.00	164.32	154.76
11/21/95	<50	0.44	<0.3	<0.3	1.5	-	9.28	NP	0.00	164.32	155.04

TABLE 1
GROUNDWATER DATA
THRIFTY OIL STATION #054, CASTRO VALLEY, CA.

DATE SAMPLED	ANALYTICAL PARAMETERS						DEPTH TO GROUNDWATER (feet)	DEPTH TO PRODUCT (feet)	PRODUCT THICKNESS (feet)	GASING ELEVATION (feet)	GROUNDWATER ELEVATION (feet)
	TPH (ug/L)	BENZENE (ug/L)	TOLUENE (ug/L)	Ethyl Benzene (ug/L)	XYLENE (ug/L)	MTBE (ug/L)					
03/11/96	<50	1.3	<0.3	<0.3	0.6	-	7.52	NP	0.00	164.32	156.80
06/19/96	640	72	20	34	150	-	7.80	NP	0.00	164.32	156.52
09/16/96	<50	<0.3	<0.3	<0.3	<0.5	20	9.18	NP	0.00	164.32	155.14
12/10/96	<50	<0.3	<0.3	<0.3	<0.5	<20	6.08	NP	0.00	164.32	158.24
03/12/97	53	0.45	<0.3	<0.3	<0.5	140	8.65	NP	0.00	164.32	155.67
06/12/97	<50	<0.3	<0.3	<0.3	<0.5	68	-	-	-	-	-
09/10/97	<50	<0.3	<0.3	<0.3	<0.5	<20	8.30	NP	0.00	164.32	156.02
12/09/97	<50	1.7	2.1	<0.3	1.4	82	9.98	NP	0.00	164.32	154.34
03/03/98	<50	<0.3	<0.3	<0.3	<0.5	84	8.33	NP	0.00	164.32	155.99
07/08/98	<50	<0.3	<0.3	<0.3	<0.5	97	-	-	-	-	-
09/10/98	<50	<0.3	<0.3	<0.3	<0.5	97	12.95	NP	0.00	164.32	151.37
12/30/98	<50	1.3	1.5	<0.3	0.86	19	11.35	NP	0.00	164.32	152.97
03/15/99	<50	<0.3	<0.3	<0.3	<0.5	9.6	9.85	NP	0.00	164.32	154.47
06/22/99	66	0.39	<0.3	<0.3	<0.5	62	9.90	NP	0.00	164.32	154.42
09/08/99	<50	<0.3	<0.3	<0.3	<0.5	25	9.85	NP	0.00	164.32	154.47
12/01/99	<50	<0.3	<0.3	<0.3	<0.5	30	8.30	NP	0.00	164.32	156.02
03/23/00	<50	<0.25	<0.25	<0.25	<0.5	*13.6/18.2	6.76	NP	0.00	164.32	157.56
06/08/00	<50	<5	<5	<5	<5	10	8.30	NP	0.00	164.32	156.02
09/27/00	<50	<0.18	<0.14	<0.18	<0.26	*6 / 4.9	8.30	NP	0.00	164.32	156.02
12/13/00	<50	<0.18	<0.14	<0.18	<0.26	<0.24	8.28	NP	0.00	164.32	156.04
03/22/01	<50	<0.18	<0.14	<0.18	<0.26	<0.24	12.89	NP	0.00	164.32	151.43
06/15/01	<50	<0.18	<0.14	<0.18	<0.26	<0.24	12.89	NP	0.00	164.32	151.43
08/30/01	<50	<0.18	<0.14	<0.18	<0.26	<0.24	9.82	NP	0.00	164.32	154.50
12/12/01	<50	<0.18	<0.14	<0.18	<0.26	<0.24	9.25	NP	0.00	164.32	155.07
MONITORING WELL #RS-9											
08/07/91	-	0.5	ND	330	1,200	-	2.28	NP	0.00	167.51	165.23
09/27/91	13,000	3.5	3.0	82	140	-	2.77	NP	0.00	167.51	164.74
10/23/91	11,000	ND	ND	39	340	-	3.53	NP	0.00	167.51	163.98
11/06/91	6,800	8.4	0.6	22	230	-	2.51	NP	0.00	167.51	165.00
12/04/91	6,500	6.5	0.7	87	200	-	3.20	NP	0.00	167.51	164.31
01/29/92	8,100	22	10	140	260	-	2.65	NP	0.00	167.51	164.86
02/26/92	13,000	40	16	220	600	-	3.42	NP	0.00	167.51	164.09
03/19/92	12,000	21	12	100	280	-	3.12	NP	0.00	167.51	164.39

TABLE 1
GROUNDWATER DATA
THRIFTY OIL STATION #054, CASTRO VALLEY, CA.

DATE SAMPLED	ANALYTICAL PARAMETERS						DEPTH TO GROUNDWATER (feet)	DEPTH TO PRODUCT (feet)	PRODUCT THICKNESS (feet)	CASING ELEVATION (feet)	GROUNDWATER ELEVATION (feet)
	TPH (ug/L)	BENZENE (ug/L)	TOLUENE (ug/L)	EthylBenzene (ug/L)	XYLENE (ug/L)	MTBE (ug/L)					
04/22/92	8,600	ND	ND	20	37	-	3.24	NP	0.00	167.51	164.27
05/21/92	6,000	21	10	53	210	-	3.75	NP	0.00	167.51	163.76
06/25/92	370	2.3	1.5	0.7	4.3	-	2.65	NP	0.00	167.51	164.86
07/30/92	3,600	20	ND	39	80	-	2.70	NP	0.00	167.51	164.81
08/20/92	3,000	0.7	5.2	2.0	5.3	-	2.83	NP	0.00	167.51	164.68
09/30/92	9,200	4.8	6.5	12	91	-	2.80	NP	0.00	167.51	164.71
12/23/92	2,000	17	ND	8.2	18	-	2.45	NP	0.00	167.51	165.06
03/10/93	1,500	ND	2.6	21	12	-	2.40	NP	0.00	167.51	165.11
06/09/93	1,300	0.6	1.7	ND	7.5	-	3.55	NP	0.00	167.51	163.96
09/14/93	1,500	1.3	7.6	4.1	14	-	2.81	NP	0.00	167.51	164.70
12/14/93	560	ND	ND	ND	5.5	-	2.63	NP	0.00	167.51	164.88
03/02/94	1,100	<0.3	<0.3	<0.3	<0.5	-	2.60	NP	0.00	167.51	164.91
06/06/94	290	0.58	0.53	1.1	5.8	-	2.52	NP	0.00	167.51	164.99
09/06/94	890	<0.3	<0.3	<0.3	3.1	-	3.16	NP	0.00	167.51	164.35
12/07/94	940	22	23	10	32	-	5.18	NP	0.00	167.51	162.33
03/08/95	1,600	<0.5	<0.5	<0.5	2.3	-	4.57	NP	0.00	167.51	162.94
06/15/95	3,200	2.2	5.3	4.3	3.1	-	5.08	NP	0.00	167.51	162.43
09/05/95	1,100	<0.5	<0.5	<0.5	<1	-	5.72	NP	0.00	167.51	161.79
11/21/95	1,100	1.1	2.9	3.5	3.0	-	2.46	NP	0.00	167.51	165.05
03/11/96	440	0.7	0.34	<0.3	3.7	-	3.44	NP	0.00	167.51	164.07
06/19/96	580	3.8	0.49	1.2	<0.5	-	3.80	NP	0.00	167.51	163.71
09/16/96	490	<0.3	1.6	<0.3	<0.5	<20	3.80	NP	0.00	167.51	163.71
12/10/96	<50	<0.3	<0.3	<0.3	<0.5	<20	2.76	NP	0.00	167.51	164.75
03/12/97	<50	<0.3	0.42	<0.3	1.5	<20	3.20	NP	0.00	167.51	164.31
06/12/97	<50	<0.3	<0.3	<0.3	0.51	<20	-	-	-	-	-
09/10/97	<50	<0.3	<0.3	<0.3	<0.5	<20	4.24	NP	0.00	167.51	163.27
12/09/97	<50	<0.3	0.48	<0.3	<0.5	<20	2.72	NP	0.00	167.51	164.79
03/03/98	190	<0.3	<0.3	0.38	<0.5	<20	1.90	NP	0.00	167.51	165.61
07/08/98	<50	<0.3	<0.3	<0.3	<0.5	<5	-	-	-	-	-
09/10/98	<50	<0.3	<0.3	<0.3	<0.5	<5	2.72	NP	0.00	167.51	164.79
12/30/98	<50	<0.3	<0.3	<0.3	<0.5	<5	1.20	NP	0.00	167.51	166.31
03/15/99	<50	<0.3	<0.3	<0.3	<0.5	<5	4.25	NP	0.00	167.51	163.26
06/22/99	1,300	4.2	1.2	0.69	0.74	<5	3.70	NP	0.00	167.51	163.81
09/08/99	<50	<0.3	<0.3	<0.3	<0.5	<5	2.71	NP	0.00	167.51	164.80
12/01/99	<50	<0.3	<0.3	<0.3	<0.5	<5	2.70	NP	0.00	167.51	164.81

**TABLE 1
GROUNDWATER DATA
THRIFTY OIL STATION #054, CASTRO VALLEY, CA.**

DATE SAMPLED	ANALYTICAL PARAMETERS						DEPTH TO GROUNDWATER (feet)	DEPTH TO PRODUCT (feet)	PRODUCT THICKNESS (feet)	CASING ELEVATION (feet)	GROUNDWATER ELEVATION (feet)
	TPH (ug/L)	BENZENE (ug/L)	TOLUENE (ug/L)	EthylBenzene (ug/L)	XYLENE (ug/L)	MIBL (ug/L)					
03/23/00	< 50	<0.25	<0.25	<0.25	<0.5	<5	2.70	NP	0.00	167.51	164.81
06/08/00	585	<5	<5	<5	<5	821	2.72	NP	0.00	167.51	164.79
09/27/00	592	<0.18	<0.14	<0.18	<0.26	*1,180 / 1,360	2.72	NP	0.00	167.51	164.79
12/13/00	< 50	<0.18	<0.14	<0.18	<0.26	*403 / 444	2.70	NP	0.00	167.51	164.81
03/22/01	425	<0.18	<0.14	<0.18	<0.26	*738 / 1,640	2.69	NP	0.00	167.51	164.82
06/15/01	< 50	<0.18	<0.14	<0.18	<0.26	<0.24	2.68	NP	0.00	167.51	164.83
08/30/01	164	<0.18	<0.14	<0.18	<0.26	*396 / 284	2.68	NP	0.00	167.51	164.83
12/12/01	1,540	<0.18	<0.14	<0.18	<0.26	*4,370 / 2,480	2.41	NP	0.00	167.51	165.10
MONITORING WELL #RS-10											
08/07/91	ND	ND	ND	ND	ND	-	6.16	NP	0.00	162.89	156.73
09/27/91	ND	ND	ND	ND	ND	-	6.48	NP	0.00	162.89	156.41
10/23/91	ND	ND	ND	ND	ND	-	7.37	NP	0.00	162.89	155.52
11/06/91	ND	ND	ND	ND	ND	-	6.44	NP	0.00	162.89	156.45
12/04/91	ND	ND	ND	ND	ND	-	7.02	NP	0.00	162.89	155.87
01/29/92	ND	ND	ND	ND	ND	-	6.78	NP	0.00	162.89	156.11
02/26/92	ND	ND	ND	ND	ND	-	8.33	NP	0.00	162.89	154.56
03/19/92	ND	ND	ND	ND	0.6	-	8.02	NP	0.00	162.89	154.87
04/22/92	ND	ND	ND	ND	ND	-	7.78	NP	0.00	162.89	155.11
05/21/92	ND	ND	0.6	ND	1.2	-	6.21	NP	0.00	162.89	156.68
06/25/92	ND	ND	ND	ND	ND	-	7.73	NP	0.00	162.89	155.16
07/30/92	ND	ND	0.5	ND	1.0	-	7.84	NP	0.00	162.89	155.05
08/20/92	ND	ND	ND	ND	ND	-	7.50	NP	0.00	162.89	155.39
09/30/92	ND	ND	ND	ND	ND	-	7.63	NP	0.00	162.89	155.26
12/23/92	ND	ND	ND	ND	ND	-	7.24	NP	0.00	162.89	155.65
03/10/93	ND	ND	ND	ND	ND	-	6.38	NP	0.00	162.89	156.51
06/09/93	ND	ND	ND	ND	ND	-	7.98	NP	0.00	162.89	154.91
09/14/93	ND	ND	ND	ND	ND	-	7.35	NP	0.00	162.89	155.54
03/02/94	< 50	<0.3	<0.3	<0.3	<0.3	-	7.00	NP	0.00	162.89	155.89
06/06/94	< 50	<0.3	<0.3	<0.3	<0.5	-	6.55	NP	0.00	162.89	156.34
09/06/94	< 50	<0.3	<0.3	<0.3	<0.5	-	7.63	NP	0.00	162.89	155.26
12/07/94	56	<0.3	<0.3	<0.5	2.1	-	5.92	NP	0.00	162.89	156.97
03/08/95	< 100	<0.5	<0.5	<0.5	<1	-	7.84	NP	0.00	162.89	155.05
06/15/95	< 100	<0.5	<0.5	<0.5	<1	-	6.97	NP	0.00	162.89	155.92

**TABLE 1
GROUNDWATER DATA
THRIFTY OIL STATION #054, CASTRO VALLEY, CA.**

DATE SAMPLED	ANALYTICAL PARAMETERS						DEPTH TO GROUNDWATER (feet)	DEPTH TO PRODUCT (feet)	PRODUCT THICKNESS (feet)	CASING ELEVATION (feet)	GROUNDWATER ELEVATION (feet)
	TPH (ug/L)	BENZENE (ug/L)	TOLUENE (ug/L)	EthylBenzene (ug/L)	XYLENE (ug/L)	MtBE (ug/L)					
09/05/95	<100	<0.5	<0.5	<0.5	<1	-	8.14	NP	0.00	162.89	154.75
11/21/95	<50	<0.3	<0.3	<0.3	<0.5	-	7.68	NP	0.00	162.89	155.21
03/11/96	<50	<0.3	<0.3	<0.3	<0.5	-	6.76	NP	0.00	162.89	156.13
06/19/96	<50	<0.3	<0.3	<0.3	<0.5	-	7.20	NP	0.00	162.89	155.69
09/16/96	<50	<0.3	<0.3	<0.3	<0.5	<20	6.30	NP	0.00	162.89	156.59
12/10/96	<50	<0.3	<0.3	<0.3	<0.5	<20	6.05	NP	0.00	162.89	156.84
03/12/97	<50	<0.3	<0.3	<0.3	<0.5	<20	7.56	NP	0.00	162.89	155.33
06/12/97	<50	<0.3	<0.3	<0.3	<0.5	<20	-	-	-	-	-
09/10/97	<50	<0.3	<0.3	<0.3	<0.5	<20	7.55	NP	0.00	162.89	155.34
12/09/97	1,900	610	510	<6	290	<20	7.55	NP	0.00	162.89	155.34
03/03/98	<50	2.0	<0.3	<0.3	<0.5	27	6.03	NP	0.00	162.89	156.86
07/08/98	<50	<0.3	<0.3	<0.3	<0.5	<5	-	-	-	-	-
09/10/98	<50	<0.3	<0.3	<0.3	<0.5	72	7.55	NP	0.00	162.89	155.34
12/30/98	<50	1.1	<0.3	<0.3	<0.5	<5	4.45	NP	0.00	162.89	158.44
03/15/99	<50	<0.3	<0.3	<0.3	1.3	<5	4.50	NP	0.00	162.89	158.39
06/22/99	<50	<0.3	<0.3	<0.3	<0.5	<5	9.15	NP	0.00	162.89	153.74
09/08/99	<50	<0.3	<0.3	<0.3	<0.5	<5	7.51	NP	0.00	162.89	155.38
12/01/99	<50	<0.3	<0.3	<0.3	<0.5	<5	5.97	NP	0.00	162.89	156.92
03/23/00	<50	<0.25	<0.25	<0.25	<0.5	<5	4.47	NP	0.00	162.89	158.42
06/08/00	<50	<5	<5	<5	<5	<5	5.97	NP	0.00	162.89	156.92
09/27/00	<50	<0.18	<0.14	<0.18	<0.26	<0.24	7.50	NP	0.00	162.89	155.39
12/13/00	<50	<0.18	<0.14	<0.18	<0.26	<0.24	5.94	NP	0.00	162.89	156.95
03/22/01	<50	<0.18	<0.14	<0.18	<0.26	<0.24	7.51	NP	0.00	162.89	155.38
06/15/01	<50	<0.18	<0.14	<0.18	<0.26	<0.24	7.50	NP	0.00	162.89	155.39
08/30/01	<50	<0.18	<0.14	<0.18	<0.26	<0.24	9.05	NP	0.00	162.89	153.84
12/12/01	<50	<0.18	<0.14	<0.18	<0.26	<0.24	7.65	NP	0.00	162.89	155.24
MONITORING WELL #RS-11											
09/21/95	110	<0.5	<0.5	<0.5	<1	-	9.37	NP	0.00	163.28	153.91
11/21/95	-	-	-	-	-	-	-	-	-	-	-
03/11/96	-	-	-	-	-	-	-	-	-	-	-
06/19/96	-	-	-	-	-	-	-	-	-	-	-
09/16/96	-	-	-	-	-	-	-	-	-	-	-
03/12/97	74	9.5	<0.3	<0.3	0.57	<20	7.75	NP	0.00	163.28	155.53

**TABLE 1
GROUNDWATER DATA
THRIFTY OIL STATION #054, CASTRO VALLEY, CA.**

DATE SAMPLED	ANALYTICAL PARAMETERS						DEPTH TO GROUNDWATER (feet)	DEPTH TO PRODUCT (feet)	PRODUCT THICKNESS (feet)	CASING ELEVATION (feet)	GROUNDWATER ELEVATION (feet)
	TPH (ug/L)	BENZENE (ug/L)	TOLUENE (ug/L)	EthylBenzene (ug/L)	XYLENE (ug/L)	MTBE (ug/L)					
06/12/97	<50	<0.3	<0.3	<0.3	<0.5	<20	-	-	-	-	-
09/10/97	<50	<0.3	<0.3	<0.3	<0.5	<20	9.50	NP	0.00	163.28	153.78
12/09/97	<50	0.79	1.2	<0.3	<0.5	<20	9.50	NP	0.00	163.28	153.78
03/03/98	140	22	0.63	<0.3	<0.5	<20	7.93	NP	0.00	163.28	155.35
07/08/98	<50	<0.3	<0.3	<0.3	<0.5	<5	-	-	-	-	-
09/10/98	<50	<0.3	<0.3	<0.3	<0.5	<5	9.48	NP	0.00	163.28	153.80
12/30/98	<50	1.3	0.87	<0.3	0.55	<5	7.95	NP	0.00	163.28	155.33
03/15/99	<50	<0.3	<0.3	<0.3	<0.5	<5	6.40	NP	0.00	163.28	156.88
06/22/99	350	89	2.9	3.3	0.91	6.8	11.00	NP	0.00	163.28	152.28
09/08/99	99	9.1	0.37	<0.3	<0.5	<5	7.90	NP	0.00	163.28	155.38
12/01/99	82	9.7	0.44	<0.3	<0.5	<5	7.90	NP	0.00	163.28	155.38
03/23/00	73	5.8	2.3	<0.25	<0.5	*11.2 / 7.9	4.85	NP	0.00	163.28	158.43
06/08/00	306	<5	<5	<5	<5	<5	7.90	NP	0.00	163.28	155.38
09/27/00	<50	1	<0.14	<0.18	<0.26	3 J / 3.6	9.44	NP	0.00	163.28	153.84
12/13/00	<50	<0.18	<0.14	<0.18	<0.26	<0.24	6.34	NP	0.00	163.28	156.94
03/22/01	408	<0.18	<0.14	<0.18	<0.26	*664 / 941	7.96	NP	0.00	163.28	155.32
06/15/01	<50	<0.18	<0.14	<0.18	<0.26	<0.24	7.87	NP	0.00	163.28	155.41
08/30/01	<50	<0.18	<0.14	<0.18	<0.26	<0.24	9.41	NP	0.00	163.28	153.87
12/12/01	<50	<0.18	<0.14	<0.18	<0.26	<0.24	7.86	NP	0.00	163.28	155.42

NOTE: ND = Nondetectable
 " - " = Not Analyzed / Not Available
 NP = No Free Product
 *MTBE 8020/8260

Benzene, toluene, ethylbenzene, and xylene analyzed by EPA method 8020.
 Total petroleum hydrocarbons (TPH) analyzed by EPA method 8015 modified for gasoline
 Methyl-tert Butyl Ether (MTBE) analyzed by EPA method 8020
 On June 8, 2000, BTEX and MTBE analyzed by EPA Method 8260B

APPENDIX A



THRIFTY OIL CO. SS #054
 2504 CASTRO VALLEY BLVD.
 CASTRO VALLEY, CA 94546
 DATE: 12.12.01

PROJECT STATUS REPORT

F R E E Q .	M O N I T O R I N G				O D O R S			F R E E		W E L L S C O N N E C T E D T O S Y S T E M (W)							
	O B S E R V A T I O N W E L L S				(S = S L I G H T)			P R O D U C T		C O N N E C T		I N T E G R I T Y		V A P O R		W A T E R	
	NO.	DTW	DTP	PT	YES	NO	S	YES	NO	YES	NO	OK	NO	ON	OFF	ON	OFF
M	PW-1	6.02				X			X		X	-					
M	PW-2	6.20				X			X		X	-					
M	RE-1	4.80				X			X		X	-					
M	RE-2	4.81				X			X		X	-					
M	RE-3	7.35				X			X		X	-					
M	RE-4	4.95				X			X		X	-					
M	RE-5	5.21				X			X		X	-					
M	RE-6	6.20				X			X		X	-					
M	RE-7	7.28				X			X		X	-					
M	RS-8	9.25				X			X		-	X					
M	RS-9	2.41				X			X		-	X					
M	RS-10	7.65				X			X		X						
M	RS-11	2.86				X			X		X						

S A V E S Y S T E M W E E K L Y

PARAMETER	U/M	DATA	PARAMETER	U/M	DATA
TIME	AM/PM		AIR FLOW	C F M	
WORKING	YES/NO		VAPOR FLOW	C F M	
RESTARTED	YES/NO		FUEL FLOW	C F M/H	
HOURS	#		WELL VACUUM	IN H2O	
ENGINE ROT.	RPM		L P G TANKS	%	#1:
ENGINE VACUUM	IN HG		GAS METER READING	-	N/A
TANK VACUUM	IN HG		WATER FLOWMETER	GALL.	

EXHAUST (By others) _____

INLET TO ENGINE _____

MAINTENANCE ES/100/400/800 _____ FOR SPECIFIC OPERATIONS SEE FIELD RECORD

W A T E R S A M P L I N G - C H E C K () W H E N D O N E

EFFLUENT	INFLUENT	WELLS
() _____	() _____	() Q. - SEE C. CUST.

REMARKS: _____

FREE PRODUCT REMOVED: APPROX. _____ GALLONS WATER REMOVED: APPROX. 256 GALLONS

DATA RECORDED BY: GERARD INPUT BY: AJB 02/05/97

FIELD DATA - GROUNDWATER SAMPLING PROGRAM

Site:	H 054	Date:	12.12.01
Address:			
Personnel:	SERBAN,	Weather:	RAIN,
Well No:	RS-9	Equip:	BAPLER,

Before Purging:			
Total Well Depth: (ft.)	14.94	Well Diameter	2"
Depth to Water (ft)	2.41	Est. Purge Volume:	8

Sampling Data:							
Initial Turbidity:				Final Turbidity:			
Time	14:03	14:04	14:05	14:06	14:07	14:08	14:10
EC	830	820	820	830	840	830	840
pH	5.73	5.69	5.70	5.73	5.75	5.73	5.75
Temp	73.1	73.1	72.8	72.7	72.7	72.5	72.4
Gal.	1	2	3	4	5	6	8
Time							
EC							
pH							
Temp							
Gal.							

After Purging/Before Sample Collection			
Depth to Water (ft.)	8.35	Total Well Depth(ft.)	14.94

FIELD DATA - GROUNDWATER SAMPLING PROGRAM

Site:	# 054	Date:	12.12.01
Address:			
Personnel:	SERBAN,	Weather:	RAIN,
Well No:	RE-2	Equip:	BAILER,

Before Purging:			
Total Well Depth: (ft.)	16.96	Well Diameter	4"
Depth to Water (ft)	4.81	Est. Purge Volume:	31

Sampling Data:							
	Initial Turbidity:			Final Turbidity:			
Time	13:33	13:37	13:42	13:46	13:51	13:55	14:00
EC	710	740	730	720	730	240	720
pH	6.19	6.16	6.18	6.16	6.16	6.16	6.16
Temp	72.1	72.4	72.3	72.2	72.1	71.9	71.8
Gal.	4	8	13	17	22	26	31
Time							
EC							
pH							
Temp							
Gal.							

After Purging/Before Sample Collection			
Depth to Water (ft.)	9.35	Total Well Depth(ft).	16.96

FIELD DATA - GROUNDWATER SAMPLING PROGRAM

Site:	# 054	Date:	12.12.01
Address:			
Personnel:	JERBAH,	Weather:	RAIN,
Well No:	RE-6,	Equip:	BAILER,

Before Purging:			
Total Well Depth: (ft.)	13.58	Well Diameter	4"
Depth to Water (ft)	6.20	Est. Purge Volume:	19

Sampling Data:							
Initial Turbidity:				Final Turbidity:			
Time	13:08	13:11	13:14	13:16	13:19	13:22	13:25
EC	860	830	820	820	810	810	820
pH	6.30	6.27	6.24	6.22	6.22	6.22	6.22
Temp	72.3	72.2	72.1	72.1	71.8	71.6	71.6
Gal.	2	5	8	10	13	16	19
Time							
EC							
pH							
Temp							
Gal.							

After Purging/Before Sample Collection			
Depth to Water (ft.)	9.30	Total Well Depth(ft).	13.58

FIELD DATA - GROUNDWATER SAMPLING PROGRAM

Site:	HL 054	Date:	12.12.01
Address:			
Personnel:	SERBAN,	Weather:	RAIN,
Well No:	PW-1	Equip:	BAILER,

Before Purging:			
Total Well Depth: (ft.)	13.97	Well Diameter	4"
Depth to Water (ft)	6.02	Est. Purge Volume:	20

Sampling Data:							
Initial Turbidity:				Final Turbidity:			
Time	12:42	12:45	12:48	12:51	12:54	12:57	13:00
EC	800	860	860	860	870	860	860
pH	6.03	6.07	6.03	6.08	6.09	6.08	6.09
Temp	72.1	71.8	71.6	71.1	71.4	71.3	71.2
Gal.	2	5	8	11	14	17	20
Time							
EC							
pH							
Temp							
Gal.							

After Purging/Before Sample Collection			
Depth to Water (ft.)	10.32	Total Well Depth(ft).	13.97

FIELD DATA - GROUNDWATER SAMPLING PROGRAM

Site:	# 054	Date:	12.12.01
Address:			
Personnel:	SERBAN,	Weather:	RAIN
Well No:	RS-11	Equip:	BATLER

Before Purging:			
Total Well Depth: (ft.)	24.74	Well Diameter	2"
Depth to Water (ft)	7.86	Est. Purge Volume:	11

Sampling Data:							
Initial Turbidity:				Final Turbidity:			
Time	12:05	12:06	12:08	12:10	12:11	12:13	12:15
EC	900	930	960	940	910	900	910
pH	6.05	6.07	6.03	5.99	5.97	5.98	5.98
Temp	71.1	71.3	71.2	71.1	70.9	70.8	70.6
Gal.	1	2	4	6	7	9	11
Time							
EC							
pH							
Temp							
Gal.							

After Purging/Before Sample Collection			
Depth to Water (ft.)	10.40	Total Well Depth(ft.)	24.74

FIELD DATA - GROUNDWATER SAMPLING PROGRAM

Site:	<u># 054</u>	Date:	<u>12.12.01</u>
Address:			
Personnel:	<u>SERBAN,</u>	Weather:	<u>RAIN</u>
Well No:	<u>RE-7</u>	Equip:	<u>BAPLER</u>

Before Purging:			
Total Well Depth: (ft.)	<u>13.14</u>	Well Diameter	<u>4"</u>
Depth to Water (ft)	<u>7.28</u>	Est. Purge Volume:	<u>15</u>

Sampling Data:							
Initial Turbidity:				Final Turbidity:			
Time	<u>12:27</u>	<u>12:29</u>	<u>12:31</u>	<u>12:33</u>	<u>12:35</u>	<u>12:37</u>	<u>12:40</u>
EC	<u>870</u>	<u>890</u>	<u>890</u>	<u>860</u>	<u>870</u>	<u>860</u>	<u>860</u>
pH	<u>6.13</u>	<u>6.09</u>	<u>6.07</u>	<u>6.06</u>	<u>6.06</u>	<u>6.07</u>	<u>6.08</u>
Temp	<u>21.3</u>	<u>21.1</u>	<u>21.1</u>	<u>20.9</u>	<u>20.7</u>	<u>20.6</u>	<u>20.5</u>
Gal.	<u>2</u>	<u>4</u>	<u>6</u>	<u>8</u>	<u>10</u>	<u>12</u>	<u>15</u>
Time							
EC							
pH							
Temp							
Gal.							

After Purging/Before Sample Collection	
Depth to Water (ft.)	<u>11.30</u>
Total Well Depth (ft.)	<u>13.14</u>

FIELD DATA -GROUNDWATER SAMPLING PROGRAM

Site: # 054	Date: 12.12.01
Address:	
Personnel: SERBAN,	Weather: RAIN,
Well No: RE-3	Equip: BAPLER,

Before Purging:			
Total Well Depth: (ft.)	17.55	Well Diameter	4"
Depth to Water (ft)	7.35	Est. Purge Volume:	26

Sampling Data:							
Initial Turbidity:				Final Turbidity:			
Time	11:37	11:41	11:45	11:48	11:52	11:56	12:00
EC	700	730	720	700	730	730	720
pH	6.02	5.98	5.97	5.97	5.98	5.98	5.97
Temp	71.3	71.1	71.1	70.8	70.7	70.6	70.6
Gal.	3	7	11	14	18	22	26
Time							
EC							
pH							
Temp							
Gal.							

After Purging/Before Sample Collection	
Depth to Water (ft.)	10.10
Total Well Depth(ft.)	17.55

FIELD DATA -GROUNDWATER SAMPLING PROGRAM

Site:	# 054	Date:	12.12.01
Address:			
Personnel:	JERBAN,	Weather:	RAI,
Well No:	PW 2	Equip:	BAILER,

Before Purging:			
Total Well Depth: (ft.)	14.32	Well Diameter	4"
Depth to Water (ft)	6.20	Est. Purge Volume:	21

Sampling Data:							
Initial Turbidity:	Final Turbidity:						
Time	11:12	11:15	11:18	11:21	11:24	11:27	11:30
EC	950	940	960	970	970	950	970
pH	6.07	6.03	6.01	6.04	6.01	6.03	6.03
Temp	71.4	71.4	71.2	71.1	70.8	70.9	70.8
Gal.	3	6	9	12	15	18	21
Time							
EC							
pH							
Temp							
Gal.							

After Purging/Before Sample Collection	
Depth to Water (ft.)	9.30
Total Well Depth (ft.)	14.32

FIELD DATA - GROUNDWATER SAMPLING PROGRAM

Site: #054	Date: 12-12-01
Address:	
Personnel: FERBAN,	Weather: RAIN,
Well No: RE-1	Equip: BAYLER

Before Purging:			
Total Well Depth: (ft.)	19.00	Well Diameter	4"
Depth to Water (ft)	4.80	Est. Purge Volume:	37

Sampling Data:							
Initial Turbidity:				Final Turbidity:			
Time	10:28	10:33	10:38	10:44	10:49	10:54	11:00
EC	980	980	980	960	940	960	960
pH	6.04	6.01	5.98	5.97	5.93	5.91	5.91
Temp	72.1	72.1	71.8	71.8	71.6	71.7	71.6
Gal.	5	10	15	21	26	31	37
Time							
EC							
pH							
Temp							
Gal.							

After Purging/Before Sample Collection	
Depth to Water (ft.)	9.20
Total Well Depth(ft.)	19.00

FIELD DATA - GROUNDWATER SAMPLING PROGRAM

Site:	# 054	Date:	12-12-01
Address:			
Personnel:	SERBAN,	Weather:	RAIN,
Well No:	RE-5	Equip:	BATLER

Before Purging:			
Total Well Depth: (ft.)	18.17	Well Diameter	4"
Depth to Water (ft)	5.21	Est. Purge Volume:	33

Sampling Data:							
Initial Turbidity:				Final Turbidity:			
Time	9:51	9:56	10:01	10:05	10:10	10:15	10:20
EC	870	890	910	930	960	940	960
pH	5.98	6.01	6.03	6.06	6.03	6.03	6.06
Temp	71.4	71.3	71.2	71.1	71.1	70.9	70.8
Gal.	4	9	14	18	23	28	33
Time							
EC							
pH							
Temp							
Gal.							

After Purging/Before Sample Collection			
Depth to Water (ft.)	8.70	Total Well Depth(ft).	18.17

FIELD DATA - GROUNDWATER SAMPLING PROGRAM

Site:	# 054	Date:	12-12-01
Address:			
Personnel:	SERBAN,	Weather:	RAIN,
Well No:	RE4	Equip:	BAPLER

Before Purging:			
Total Well Depth: (ft.)	14.52	Well Diameter	4"
Depth to Water (ft)	4.95	Est. Purge Volume:	25

Sampling Data:							
Initial Turbidity:				Final Turbidity:			
Time	9:23	9:27	9:30	9:34	9:37	9:41	9:45
EC	260	270	280	260	270	260	260
pH	6.21	6.19	6.17	6.20	6.17	6.20	6.20
Temp	73.1	73.1	72.9	72.8	72.7	72.6	72.4
Gal.	3	7	10	14	17	21	25
Time							
EC							
pH							
Temp							
Gal.							

After Purging/Before Sample Collection	
Depth to Water (ft.)	9.30
Total Well Depth(ft.)	14.52

FIELD DATA - GROUNDWATER SAMPLING PROGRAM

Site:	# 054	Date:	12.12.01
Address:			
Personnel:	SERBONI,	Weather:	RAIN,
Well No:	RS 8	Equip:	BAILER

Before Purging:			
Total Well Depth: (ft.)	21.15	Well Diameter	2"
Depth to Water (ft)	9.25	Est. Purge Volume:	10

Sampling Data:							
Initial Turbidity:				Final Turbidity:			
Time	9:06	9:07	9:09	9:10	9:12	9:13	9:15
EC	970	980	990	970	970	970	980
pH	6.03	6.07	6.07	6.08	6.09	6.08	6.09
Temp	71.3	71.1	70.9	70.7	70.6	70.4	70.2
Gal.	1	2	4	5	7	8	10
Time							
EC							
pH							
Temp							
Gal.							

After Purging/Before Sample Collection			
Depth to Water (ft.)	11.32	Total Well Depth(ft.)	21.15

FIELD DATA - GROUNDWATER SAMPLING PROGRAM

Site: <u># 054</u>	Date: <u>12. 12. 01</u>
Address: _____	
Personnel: <u>SERBAN,</u>	Weather: <u>RAIN,</u>
Well No: <u>RS 10</u>	Equip: <u>BAILER</u>

Before Purging:			
Total Well Depth: (ft.)	<u>24.38</u>	Well Diameter	<u>2⁴</u>
Depth to Water (ft)	<u>7.65</u>	Est. Purge Volume:	<u>11</u>

Sampling Data:							
Initial Turbidity:	Final Turbidity:						
Time	8:50	8:51	8:53	8:55	8:56	8:58	9:00
EC	730	720	720	730	740	740	740
pH	6.12	6.07	6.07	6.03	6.07	6.01	6.01
Temp	71.4	71.2	71.2	70.9	70.8	70.7	70.6
Gal.	1	2	4	6	7	9	11
Time							
EC							
pH							
Temp							
Gal.							

After Purging/Before Sample Collection	
Depth to Water (ft.)	Total Well Depth(ft.)
<u>11.20</u>	<u>24.38</u>

APPENDIX B



ASSOCIATED LABORATORIES

806 North Batavia - Orange, California 92868 - 714/771-6900

FAX 714/538-1209

CLIENT Thrifty Oil (8871)
ATTN: Jeff Suryakusuma
13539 E. Foster Rd.
Santa Fe Springs, CA 90670

LAB REQUEST 85039

REPORTED 01/07/2002
RECEIVED 12/14/2001

PROJECT Station #054
2504 Castro Valley Blvd., Castro Valley

SUBMITTER Client

COMMENTS Global ID: T0600101363

This laboratory request covers the following listed samples which were analyzed for the parameters indicated on the attached Analytical Result Report. All analyses were conducted using the appropriate methods as indicated on the report. This cover letter is an integral part of the final report.

<u>Order No.</u>	<u>Client Sample Identification</u>
314079	TOC 054 RS10
314080	TOC 054 RS8
314081	TOC 054 RE4
314082	TOC 054 RE5
314083	TOC 054 RE1
314084	TOC 054 PW2
314085	TOC 054 RE3
314086	TOC 054 RS11
314087	TOC 054 RE7
314088	TOC 054 PW1
314089	TOC 054 RE6
314090	TOC 054 RE2

Thank you for the opportunity to be of service to your company. Please feel free to call if there are any questions regarding this report or if we can be of further service.

ASSOCIATED LABORATORIES by,

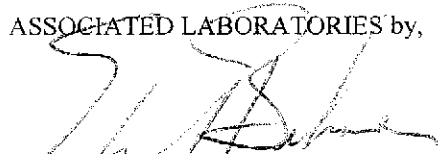
Edward S. Behare, Ph.D.
Vice President

NOTE: Unless notified in writing, all samples will be discarded by appropriate disposal protocol 30 days from date reported.

The reports of the Associated Laboratories are confidential property of our clients and may not be reproduced or used for publication in part or in full without our written permission. This is for the mutual protection of the public, our clients, and ourselves.

TESTING & CONSULTING
Chemical
Microbiological
Environmental

CLIENT Thrifty Oil (8871)
ATTN: Jeff Suryakusuma
13539 E. Foster Rd.
Santa Fe Springs, CA 90670

LAB REQUEST 85039

REPORTED 01/07/2002

RECEIVED 12/14/2001

PROJECT Station #054
2504 Castro Valley Blvd., Castro Valley

SUBMITTER Client

COMMENTS Global ID: T0600101363

This laboratory request covers the following listed samples which were analyzed for the parameters indicated on the attached Analytical Result Report. All analyses were conducted using the appropriate methods as indicated on the report. This cover letter is an integral part of the final report.

Order No.

314091

314092

Client Sample Identification

TOC 054 RS9

TOC 054 Trip Blank

Thank you for the opportunity to be of service to your company. Please feel free to call if there are any questions regarding this report or if we can be of further service.

ASSOCIATED LABORATORIES by,



Edward S. Behare, Ph.D.
Vice President

NOTE: Unless notified in writing, all samples will be discarded by appropriate disposal protocol 30 days from date reported.

The reports of the Associated Laboratories are confidential property of our clients and may not be reproduced or used for publication in part or in full without our written permission. This is for the mutual protection of the public, our clients, and ourselves.

TESTING & CONSULTING

Chemical
Microbiological

Environmental

Order #: 314079

Client Sample ID TOC 054 RS10

Matrix: WATER

Date Sampled: 12/12/2001 Time Sampled: 16:15

Analyte	Result	DF	PQL	MDL	Units	Date/Analyst
---------	--------	----	-----	-----	-------	--------------

8021B BTEX

Benzene	ND	1	0.3	0.18	ug/L	12/17/01 HP
Ethyl benzene	ND	1	0.3	0.18	ug/L	12/17/01 HP
Methyl t - butyl ether	ND	1	5	0.24	ug/L	12/17/01 HP
Toluene	ND	1	0.3	0.14	ug/L	12/17/01 HP
Xylene (total)	ND	1	0.6	0.26	ug/L	12/17/01 HP

8015M - Total Petroleum Hydrocarbons

Gasoline	ND	1	50	50	ug/L	12/17/01 HP
----------	----	---	----	----	------	-------------

Order #: 314080

Client Sample ID TOC 054 RS8

Matrix: WATER

Date Sampled: 12/12/2001 Time Sampled: 16:20

Analyte	Result	DF	PQL	MDL	Units	Date/Analyst
---------	--------	----	-----	-----	-------	--------------

8021B BTEX

Benzene	ND	1	0.3	0.18	ug/L	12/17/01 HP
Ethyl benzene	ND	1	0.3	0.18	ug/L	12/17/01 HP
Methyl t - butyl ether	ND	1	5	0.24	ug/L	12/17/01 HP
Toluene	ND	1	0.3	0.14	ug/L	12/17/01 HP
Xylene (total)	ND	1	0.6	0.26	ug/L	12/17/01 HP

8015M - Total Petroleum Hydrocarbons

Gasoline	ND	1	50	50	ug/L	12/17/01 HP
----------	----	---	----	----	------	-------------

Order #: 314081

Client Sample ID TOC 054 RE4

Matrix: WATER

Date Sampled: 12/12/2001 Time Sampled: 16:30

Analyte	Result	DF	PQL	MDL	Units	Date/Analyst
---------	--------	----	-----	-----	-------	--------------

8021B BTEX

Benzene	ND	1	0.3	0.18	ug/L	12/17/01 HP
Ethyl benzene	ND	1	0.3	0.18	ug/L	12/17/01 HP
Methyl t - butyl ether	7.0	1	5	0.24	ug/L	12/17/01 HP
Toluene	ND	1	0.3	0.14	ug/L	12/17/01 HP
Xylene (total)	3.0	1	0.6	0.26	ug/L	12/17/01 HP

8260B BTEX/MTBE Only

Methyl-tert-butylether (MTBE)	3.7	1	1	0.6	ug/L	12/22/01 LB
-------------------------------	-----	---	---	-----	------	-------------

PQL = Practical Quantitation Limit, MDL = Method detection limit, DF = Dilution Factor

ND = Not detected below indicated MDL, J=Trace



8015M - Total Petroleum Hydrocarbons

Gasoline	ND	1	50	50	ug/L	12/17/01	HP
----------	----	---	----	----	------	----------	----

Order #: 314082

Client Sample ID TOC 054 RE5

Matrix: WATER

Date Sampled: 12/12/2001 Time Sampled: 16:35

Analyte	Result	DF	PQL	MDL	Units	Date/Analyst
---------	--------	----	-----	-----	-------	--------------

8021B BTEX

Benzene	ND	1	0.3	0.18	ug/L	12/17/01	HP
Ethyl benzene	ND	1	0.3	0.18	ug/L	12/17/01	HP
Methyl t - butyl ether	ND	1	5	0.24	ug/L	12/17/01	HP
Toluene	ND	1	0.3	0.14	ug/L	12/17/01	HP
Xylene (total)	ND	1	0.6	0.26	ug/L	12/17/01	HP

8015M - Total Petroleum Hydrocarbons

Gasoline	ND	1	50	50	ug/L	12/17/01	HP
----------	----	---	----	----	------	----------	----

Order #: 314083

Client Sample ID TOC 054 RE1

Matrix: WATER

Date Sampled: 12/12/2001 Time Sampled: 16:40

Analyte	Result	DF	PQL	MDL	Units	Date/Analyst
---------	--------	----	-----	-----	-------	--------------

8021B BTEX

Benzene	ND	1	0.3	0.18	ug/L	12/17/01	HP
Ethyl benzene	ND	1	0.3	0.18	ug/L	12/17/01	HP
Methyl t - butyl ether	ND	1	5	0.24	ug/L	12/17/01	HP
Toluene	ND	1	0.3	0.14	ug/L	12/17/01	HP
Xylene (total)	ND	1	0.6	0.26	ug/L	12/17/01	HP

8015M - Total Petroleum Hydrocarbons

Gasoline	ND	1	50	50	ug/L	12/17/01	HP
----------	----	---	----	----	------	----------	----

Order #: 314084

Client Sample ID TOC 054 PW2

Matrix: WATER

Date Sampled: 12/12/2001 Time Sampled: 16:45

Analyte	Result	DF	PQL	MDL	Units	Date/Analyst
---------	--------	----	-----	-----	-------	--------------

PQL = Practical Quantitation Limit, MDL = Method detection limit, DF = Dilution Factor
 ND = Not detected below indicated MDL, J=Trace



8021B BTEX

Benzene	ND	1	0.3	0.18	ug/L	12/17/01	HP
Ethyl benzene	ND	1	0.3	0.18	ug/L	12/17/01	HP
Methyl t - butyl ether	ND	1	5	0.24	ug/L	12/17/01	HP
Toluene	ND	1	0.3	0.14	ug/L	12/17/01	HP
Xylene (total)	ND	1	0.6	0.26	ug/L	12/17/01	HP

8015M - Total Petroleum Hydrocarbons

Gasoline	ND	1	50	50	ug/L	12/17/01	HP
----------	----	---	----	----	------	----------	----

Order #: 314085

Client Sample ID TOC 054 RE3

Matrix: WATER

Date Sampled: 12/12/2001 Time Sampled: 16:50

Analyte	Result	DF	PQL	MDL	Units	Date/Analyst
---------	--------	----	-----	-----	-------	--------------

8021B BTEX

Benzene	ND	1	0.3	0.18	ug/L	12/17/01	HP
Ethyl benzene	ND	1	0.3	0.18	ug/L	12/17/01	HP
Methyl t - butyl ether	ND	1	5	0.24	ug/L	12/17/01	HP
Toluene	ND	1	0.3	0.14	ug/L	12/17/01	HP
Xylene (total)	ND	1	0.6	0.26	ug/L	12/17/01	HP

8015M - Total Petroleum Hydrocarbons

Gasoline	ND	1	50	50	ug/L	12/17/01	HP
----------	----	---	----	----	------	----------	----

Order #: 314086

Client Sample ID TOC 054 RS11

Matrix: WATER

Date Sampled: 12/12/2001 Time Sampled: 17:00

Analyte	Result	DF	PQL	MDL	Units	Date/Analyst
---------	--------	----	-----	-----	-------	--------------

8021B BTEX

Benzene	ND	1	0.3	0.18	ug/L	12/17/01	HP
Ethyl benzene	ND	1	0.3	0.18	ug/L	12/17/01	HP
Methyl t - butyl ether	ND	1	5	0.24	ug/L	12/17/01	HP
Toluene	ND	1	0.3	0.14	ug/L	12/17/01	HP
Xylene (total)	ND	1	0.6	0.26	ug/L	12/17/01	HP

8015M - Total Petroleum Hydrocarbons

Gasoline	ND	1	50	50	ug/L	12/17/01	HP
----------	----	---	----	----	------	----------	----

Order #: 314087

Client Sample ID TOC 054 RE7

Matrix: WATER

Date Sampled: 12/12/2001 Time Sampled: 17:05

PQL = Practical Quantitation Limit, MDL = Method detection limit, DF = Dilution Factor
 ND = Not detected below indicated MDL, J=Trace



Order #: 314090**Client Sample ID** TOC 054 RE2**Matrix:** WATER**Date Sampled:** 12/12/2001 **Time Sampled:** 17:20

Analyte	Result	DF	PQL	MDL	Units	Date/Analyst
8021B BTEX						
Benzene	ND	1	0.3	0.18	ug/L	12/17/01 HP
Ethyl benzene	ND	1	0.3	0.18	ug/L	12/17/01 HP
Methyl t - butyl ether	ND	1	5	0.24	ug/L	12/17/01 HP
Toluene	ND	1	0.3	0.14	ug/L	12/17/01 HP
Xylene (total)	ND	1	0.6	0.26	ug/L	12/17/01 HP
8015M - Total Petroleum Hydrocarbons						
Gasoline	ND	1	50	50	ug/L	12/17/01 HP

Order #: 314091**Client Sample ID** TOC 054 RS9**Matrix:** WATER**Date Sampled:** 12/12/2001 **Time Sampled:** 17:30

Analyte	Result	DF	PQL	MDL	Units	Date/Analyst
8021B BTEX						
Benzene	ND	1	0.3	0.18	ug/L	12/17/01 HP
Ethyl benzene	ND	1	0.3	0.18	ug/L	12/17/01 HP
Methyl t - butyl ether	4,370	100	500.0	0.24	ug/L	12/17/01 HP
Toluene	ND	1	0.3	0.14	ug/L	12/17/01 HP
Xylene (total)	ND	1	0.6	0.26	ug/L	12/17/01 HP
8260B BTEX/MTBE Only						
Methyl-tert-butylether (MTBE)	2,480	10	10.0	0.6	ug/L	01/04/02 LB
8015M - Total Petroleum Hydrocarbons						
Gasoline	1,540	1	50	50	ug/L	12/17/01 HP

Order #: 314092**Client Sample ID** TOC 054 Trip Blank**Matrix:** WATER**Date Sampled:** 12/12/2001 **Time Sampled:** 16:15

Analyte	Result	DF	PQL	MDL	Units	Date/Analyst
8021B BTEX						
Benzene	ND	1	0.3	0.18	ug/L	12/17/01 HP
Ethyl benzene	ND	1	0.3	0.18	ug/L	12/17/01 HP
Toluene	ND	1	0.3	0.14	ug/L	12/17/01 HP
Xylene (total)	ND	1	0.6	0.26	ug/L	12/17/01 HP

PQL = Practical Quantitation Limit, MDL = Method detection limit, DF = Dilution Factor
 ND = Not detected below indicated MDL, J=Trace



Analyte	Result	DF	PQL	MDL	Units	Date/Analyst
---------	--------	----	-----	-----	-------	--------------

8021B BTEX

Benzene	ND	1	0.3	0.18	ug/L	12/17/01 HP
Ethyl benzene	ND	1	0.3	0.18	ug/L	12/17/01 HP
Methyl t - butyl ether	ND	1	5	0.24	ug/L	12/17/01 HP
Toluene	ND	1	0.3	0.14	ug/L	12/17/01 HP
Xylene (total)	ND	1	0.6	0.26	ug/L	12/17/01 HP

8015M - Total Petroleum Hydrocarbons

Gasoline	ND	1	50	50	ug/L	12/17/01 HP
----------	----	---	----	----	------	-------------

Order #: 314088	Client Sample ID TOC 054 PW1
Matrix: WATER	Date Sampled: 12/12/2001 Time Sampled: 17:10

Analyte	Result	DF	PQL	MDL	Units	Date/Analyst
---------	--------	----	-----	-----	-------	--------------

8021B BTEX

Benzene	ND	1	0.3	0.18	ug/L	12/17/01 HP
Ethyl benzene	ND	1	0.3	0.18	ug/L	12/17/01 HP
Methyl t - butyl ether	ND	1	5	0.24	ug/L	12/17/01 HP
Toluene	ND	1	0.3	0.14	ug/L	12/17/01 HP
Xylene (total)	ND	1	0.6	0.26	ug/L	12/17/01 HP

8015M - Total Petroleum Hydrocarbons

Gasoline	ND	1	50	50	ug/L	12/17/01 HP
----------	----	---	----	----	------	-------------

Order #: 314089	Client Sample ID TOC 054 RE6
Matrix: WATER	Date Sampled: 12/12/2001 Time Sampled: 17:15

Analyte	Result	DF	PQL	MDL	Units	Date/Analyst
---------	--------	----	-----	-----	-------	--------------

8021B BTEX

Benzene	ND	1	0.3	0.18	ug/L	12/17/01 HP
Ethyl benzene	ND	1	0.3	0.18	ug/L	12/17/01 HP
Methyl t - butyl ether	7.0	1	5	0.24	ug/L	12/17/01 HP
Toluene	ND	1	0.3	0.14	ug/L	12/17/01 HP
Xylene (total)	ND	1	0.6	0.26	ug/L	12/17/01 HP

8260B BTEX/MTBE Only

Methyl-tert-butylether (MTBE)	ND	1	1	0.6	ug/L	12/25/01 LB
-------------------------------	----	---	---	-----	------	-------------

8015M - Total Petroleum Hydrocarbons

Gasoline	138	1	50	50	ug/L	12/17/01 HP
----------	-----	---	----	----	------	-------------

PQL = Practical Quantitation Limit, MDL = Method detection limit, DF = Dilution Factor
 ND = Not detected below indicated MDL, J=Trace



ASSOCIATED LABORATORIES
QA REPORT FORM

QC Sample: LR 85020-041
 Matrix: WATER
 Prep. Date: 12/17/01
 Analysis Date: 12/17/01 - 12/18/01
 ID#'s in Batch: LR 85039, 85100

MATRIX SPIKE / MATRIX SPIKE DUPLICATE RESULT

Reporting Units = ug/L

Test	Method	Sample Result	Spike Added	Matrix Spike	Matrix Spike Dup	%Rec MS	%Rec MSD	RPD
TPH	8015M-G	ND	200	185	184	93	92	0.5

ND = Not Detected

RPD = Relative Percent Difference of Matrix Spike and Matrix Spike Duplicate

%REC-MS & MSD = Percent Recovery of Matrix Spike & Matrix Spike Duplicate

%REC LIMITS = 70 - 130
RPD LIMITS = 30

PREPARATION BLANK / LAB CONTROL SAMPLE RESULTS

	PREP BLK					
	Value	Result	True	%Rec	L.Limit	H.Limit
LCS	ND	191	200	96	80%	120%

LCS Result = Lab Control Sample Result

True = True Value of LCS

L.Limit / H.Limit = LCS Control Limits

SURROGATE RECOVERY

Sample No.	AAA-TFT
QC Limit	70-130
QA Sample	107
MS	108
MSD	108
Method Blank	86
LCS	108

AAA-TFT = *a,a,a*-Trifluorotoluene

ASSOCIATED LABORATORIES LAB REQUEST RESULTS SUMMARY

Client: Thrifty Oil
 Jeff Suryakusuma
 13539 E. Foster Rd.
 Santa Fe Springs, CA 90670

Lab Request: 85039
 Date Received: 12/14/2001
 Print Date: 01/07/2002

Project: Station #054
 2504 Castro Valley Blvd., Castro Valley

Sample ID.	Gasoline	MTBE	MTBE by EPA8260	a,a,a-Trifluorotoluene
TOC 054 PW1	ND	ND		84 %
TOC 054 PW2	ND	ND		85 %
TOC 054 RE1	ND	ND		84 %
TOC 054 RE2	ND	ND		84 %
TOC 054 RE3	ND	ND		83 %
TOC 054 RE4	ND	7.0 ug/L	3.7 ug/L	87 %
TOC 054 RE5	ND	ND		84 %
TOC 054 RE6	138 ug/L	7.0 ug/L	ND	89 %
TOC 054 RE7	ND	ND		84 %
TOC 054 RS10	ND	ND		84 %
TOC 054 RS11	ND	ND		84 %
TOC 054 RS8	ND	ND		84 %
TOC 054 RS9	1,540 ug/L	4,370 ug/L	2,480 ug/L	147 %
TOC 054 Trip Blank	ND			86 %

ND = Not Detected
 Blank Field = Component not analyzed by this method.

ASSOCIATED LABORATORIES
QA REPORT FORM

QC Sample: LR 85020-041
 Matrix: WATER
 Prep. Date: 12/18/02
 Analysis Date: 12/18/01 - 12/19/01
 LAB ID#'s in Batch: LR 85039

MATRIX SPIKE / MATRIX SPIKE DUPLICATE RESULT

REPORTING UNITS = ug/L

Test	Method	Sample Result	Spike Added	Matrix Spike	Matrix Spk. Dup	%Rec MS	%Rec MSD	RPD
Benzene	8021	ND	10.0	9.9	9.7	99	97	2
Toluene	8021	ND	10.0	9.9	9.7	99	97	2
Ethylbenzene	8021	ND	10.0	11.8	11.6	118	116	2
Xylenes	8021	ND	20.0	20.0	19.3	100	97	4

ND = Not Detected

RPD = Relative Percent Difference of Matrix Spike and Matrix Spike Dup

%REC-MS & MSD = Percent Recovery of Matrix Spike & Matrix Spike Duplicate

%REC LIMITS = 70 - 130
RPD LIMITS = 30

PREPARATION BLANK / LAB CONTROL SAMPLE RESULTS

Test	Method	PREP. BLK	LCS	True	%Rec	L.Limit	H.Limit
		Value	Result				
Benzene	8021	ND	9.6	10.0	96	80%	120%
Toluene	8021	ND	9.8	10.0	98	80%	120%
Ethylbenzene	8021	ND	11.6	10.0	116	80%	120%
Xylenes	8021	ND	20.0	20.0	100	80%	120%

LCS = Lab Control Sample Result

TRUE = True Value of LCS

L.LIMIT / H.LIMIT = LCS Control Limits

SURROGATE RECOVERY

Sample No.	AAA-TFT
QC Limit	70-130
QA Sample	107
MS	89
MSD	88
Method Blank	83
LCS	88

AAA-TFT = a,a,a-Trifluorotoluene

ASSOCIATED LABORATORIES
LCS REPORT FORM

QC Sample: LCS/LCSD - Water Samples

Matrix: WATER

Method : 8260 / 624

Analysis Date: 12/23/01

Applies to: LR 85283, 85173, 85039

Reporting Units = ug/L

Lab Controlled Spike / Lab Controlled Spike Duplicate

Test	Sample Result	Spike Added	LCS Spike	LCS Spk. Dup	%Rec LCS	%Rec LCS D	RPD	QC Limits	
								RPD	%REC
I,1-Dichloroethene*	ND	50	37.97	49.46	76	99	26	22	59-172
MTBE	ND	50	38.25	41.93	77	84	9	24	62-137
Benzene	ND	50	55.51	54.67	111	109	2	24	62-137
Trichloroethene	ND	50	52.78	50.99	106	102	3	21	66-142
Toluene	ND	50	46.64	47.25	93	95	1	21	59-139
Chlorobenzene	ND	50	47.73	48.02	95	96	1	21	60-133

QC Sample: LCS # 5

Analysis Date: 12/22/01

LCS RECOVERY / METHOD BLANK

Test	Sample Result	Spike Added	LCS Spike	%Rec LCS	QC Limits %REC
I,1-Dichloroethene	ND	50	68.00	136	59-172
MTBE	ND	50	47.23	94	62-137
Benzene	ND	50	58.27	117	62-137
Trichloroethene	ND	50	55.55	111	66-142
Toluene	ND	50	45.86	92	59-139
Chlorobenzene	ND	50	47.27	95	60-133

Method Blank = All ND

*Outside QC limits

ASSOCIATED LABORATORIES
LCS REPORT FORM - METHOD 8260 / 624 / 524.2

QC Sample: LCS # 1

Matrix: WATER

Analysis Date: 01/04/02

Applies to: LR 85039

Reporting Units = ug/L

LCS RECOVERY / METHOD BLANK

Test	Sample Result	Spike Added	LCS Spike	%Rec LCS	QC Limits %REC
1,1-Dichloroethene	ND	50	35.25	71	59-172
MTBE	ND	50	38.37	77	62-137
Benzene	ND	50	43.53	87	62-137
Trichloroethene	ND	50	48.65	97	66-142
Toluene	ND	50	45.99	92	59-139
Chlorobenzene	ND	50	48.92	98	60-133

QC Sample: LCS/LCSD - Water Samples

Analysis Date: 01/04/02

Lab Controlled Spike / Lab Controlled Spike Duplicate

Test	Sample Result	Spike Added	LCS Spike	LCS Spk. Dup	%Rec LCS	%Rec LCS D	RPD	QC Limits	
								RPD	%REC
1,1-Dichloroethene	ND	50	43.23	49.29	86	99	13	22	59-172
MTBE	ND	50	42.19	46.70	84	93	10	24	62-137
Benzene	ND	50	43.36	45.85	87	92	6	24	62-137
Trichloroethene	ND	50	50.64	49.19	101	98	3	21	66-142
Toluene	ND	50	45.80	44.78	92	90	2	21	59-139
Chlorobenzene	ND	50	48.72	49.61	97	99	2	21	60-133

Method Blank = All ND

ASSOCIATED LABORATORIES
EPA 8021 / 8015G - SURROGATE RECOVERY

Lab Request: 85039

Analysis Date: 12/17/01

Matrix : WATER

Sample No.(Order)	AAA-TFT
QC Limit	70-130
314079	84
314080	84
314081	87
314082	84
314083	84
314084	85
314085	83
314086	84
314087	84
314088	84
314089	89
314090	84
314091	147 *
314092	86

AAA-TFT = a,a,a-Trifluorotoluene

* Outside QC Limits

ASSOCIATED LABORATORIES
EPA 8260 / 624 - SURROGATE RECOVERY

Lab Request: 85039

Analysis Date: 12/22/01, 12/25/01, 1/4/02

Matrix : WATER

Sample No.(Order)	(DCA)	(DBF)	(TOL)	(BFB)
314081	126	75	112	69 *
314089	124	77	120	66 *
314091	136 *	94	104	102

***Outside QC limits**

(DBF) = Dibromofluoromethane

(DCA) = 1,2-Dichloroethane-d4

(TOL) = Toluene-d8

(BFB) = p-Bromofluorobenzene

QC Limits: 70-135

Chain of Custody Record

ASSOCIATED LABORATORIES

806 North Batavia ■ Orange, CA 92868

Phone: (714) 771-6900 ■ Fax: (714) 538-1209



Company THRIFTY OIL CO.		Phone (562) 921-3581		A.L. Job No. 55071		Page _____ of _____							
Project Manager JEFF SURYAKUSUMA		Fax (562) 921-7510		Analysis Requested				Test Instructions & Comments					
Project Name R. W. S.		Project # 054											
Site Name and Address 2504 CASTRO VALLEY Blvd. CASTRO VALLEY CA. 94546				T B M P T T H E B X X X									
Sample ID	Lab ID	Date	Time	Matrix	Container Number/Size	Pres.							
1 RS 10		12.12.01	16:15	H ₂ O	3VOA	HCL	X	X	X				
2 RS 8		↑	16:20	↑	↑	↑	X	X	X				
3 RE 4			16:30				X	X	X				
4 RE 5			16:35				X	X	X				
5 RE 1			16:40				X	X	X				
6 PW 2			16:45				X	X	X				
7 RE 3			16:50				X	X	X				
8 RS 11			17:00				X	X	X				
9 RE 7			17:05				X	X	X				
10 PW 1			17:10				X	X	X				
11 RE 6			17:15				X	X	X				
12 RE 2			17:20				X	X	X				
13 RS 9			17:30				X	X	X				
14 TRIP BLANK			16:15						2VOA		X	X	
15													

Sample Receipt - To Be Filled By Laboratory				Relinquished by 1. Jebr		Relinquished by 2. FEDEX		Relinquished by 3.	
Total Number of Containers	41	Properly Cooled Y/N/NA	Y	Signature:	[Signature]	Signature:	[Signature]	Signature:	
Custody Seals Y/N/NA	Y	Samples Intact Y/N/NA	Y	Printed Name:	JEFF SURYAKUSUMA	Printed Name:		Printed Name:	
Received in Good Condition Y/N	Y	Samples Accepted Y/N	Y	Date:	12.13.01	Time:	16:30	Date:	
Turn Around Time				Received By: 1. FEDEX		Received By: 2.		Received By: 3.	
<input checked="" type="checkbox"/> Normal <input type="checkbox"/> Rush <input type="checkbox"/> Same Day <input type="checkbox"/> 48 hrs. <input type="checkbox"/> 24 hrs. <input type="checkbox"/> 72 hrs.				Signature:	[Signature]	Signature:		Signature:	[Signature]
				Printed Name:		Printed Name:		Printed Name:	[Signature]
				Date:		Time:		Date:	

12-14-215