

# THRIFTY OIL CO.

October 29, 2001

O.20669

SHD 1252 ✓

Mr. Amer Gholami  
Alameda County Health Agency  
Hazardous Material Specialist  
1131 Harbor Bay Parkway, Suite 250  
Alameda, CA 94502

NOV 05 2001

RE: **Former Thrifty Oil Co. #054**  
**Tosco Marketing Company Station #02486**  
2504 Castro Valley Boulevard  
Castro Valley, CA 94541  
**3rd Quarter 2001, Status Report**

Dear Mr. Gholami:

Presented herewith is the Third Quarter 2001, Status Report for Thrifty Oil Co. Station #054 located at 2504 Castro Valley Boulevard, Castro Valley, California.

If you have any questions or comments, please contact Raymond C. Friedrichsen or me at (562) 921-3581.

Sincerely,



Chris Panaitescu  
General Manager  
Environmental Affairs

c: Mr. David J. Camille  
Tosco Marketing Company  
2000 Crow Canyon Place, Suite 400  
San Ramon, CA 94583

File



# THRIFTY OIL CO.

October 29, 2001

Mr. Amer Gholami  
Alameda County Health Care Agency  
Hazardous Material Specialist  
1131 Harbor Bay Parkway, Suite 250  
Alameda, CA 94502

RE: **Former Thrifty Oil Co. Station #054**  
2504 Castro Valley Boulevard  
Castro Valley, CA  
*3rd Quarter 2001, Status Report*

Dear Mr. Gholami:

Presented herein is the Third Quarter 2001, Status Report prepared for Former Thrifty Oil Co. (Thrifty) Station #054 located at 2504 Castro Valley Boulevard, Castro Valley, California (**Figure 1**). Presented in this report are the results of the groundwater monitoring efforts conducted during the Third Quarter 2001. Thrifty has retained the services of Earth Management Company (EMC) to conduct quarterly monitoring and sampling activities at this site.

## **Groundwater Monitoring**

Depth to groundwater is measured in each monitoring well quarterly. Historic groundwater gauging data obtained from April 11, 1988 through August 30, 2001 is presented in **Table 1**. In general, groundwater occurs under water table conditions beneath the station at depths ranging from 2.68 feet below ground surface (bgs) in monitoring well RS-9 to 9.82 feet bgs in monitoring well RS-8 (**Appendix A**). A groundwater elevation contour map based on the August 30, 2001 data is presented in **Figure 1**. Groundwater elevation data indicates that the general direction of groundwater flow beneath the site is toward the east, with a hydraulic gradient ranging from 0.02 to 0.09 feet/foot.

## **Quarterly Groundwater Sampling**

As part of the ongoing groundwater monitoring program, groundwater samples were obtained from monitoring wells PW-1, PW-2, RE-1 through RE-7, and RS-8 through RS-11 on August 30, 2001. Groundwater samples were obtained by EMC and delivered in a chilled state in an ice chest following strict Chain-of-Custody procedures to a state-certified laboratory. Total petroleum hydrocarbons as gasoline (TPH-g) was analyzed by EPA method 8015M modified for gasoline, and benzene, toluene, ethylbenzene, xylenes (BTEX) and methyl tert-butyl ether (MTBE) were analyzed



by EPA method 8021B. Detected MTBE concentrations were confirmed by EPA method 8260B. Copies of the EMC Field Status Reports are presented in **Appendix A**, and copies of the laboratory analytical reports are contained in **Appendix B**.

TPH-g, BTEX, and MTBE concentrations appear in **Table 1**, and **Appendix B**. TPH-g, benzene, and MTBE isoconcentration maps are presented in **Figure 2, 3, and 4**, respectively. **Analytical results indicate all constituent concentrations to be below the laboratory detection limits, except for TPH-g and MTBE in well RS-9 at 164 ug/L and 284 ug/L (by EPA method 8260B), respectively.** TOSCO Marketing Company is the current operator at the service station property, acquiring the lease from BP Oil, who has leased the property since July 10, 1991.

### Other Activities

On September 19, 2001 the Alameda County Health Care Services requested that an additional site be conducted, because of the elevated levels of hydrocarbons in wells RE-3, RE-4, and RE-7 during the second quarter 2001 sampling event. Thrifty requests that this additional site assessment be deferred for at least three quarterly sampling events. The reason Thrifty requests the additional site assessment postponement is because all analyzed constituents for these wells (RE-3, RE-4, and RE-7) were below the laboratory detection limits (non-detect) during the third quarter 2001.

Thrifty will continue the groundwater monitoring, gauging, and sampling events at this site on a quarterly basis. All interpretations expressed in this report are based solely upon the review of data collected by EMC, and analyzed by Associated Laboratories.

Written by:



Raymond C. Friedrichsen, REA II  
Project Manager, MBA  
Senior Environmental Hydrogeologist

Reviewed by:



Larry Higinbotham  
Registered Geologist #5497

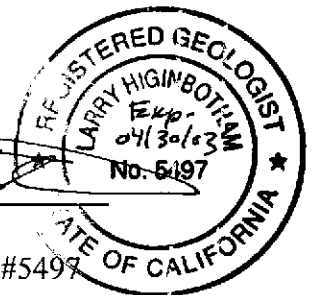

# FIGURES

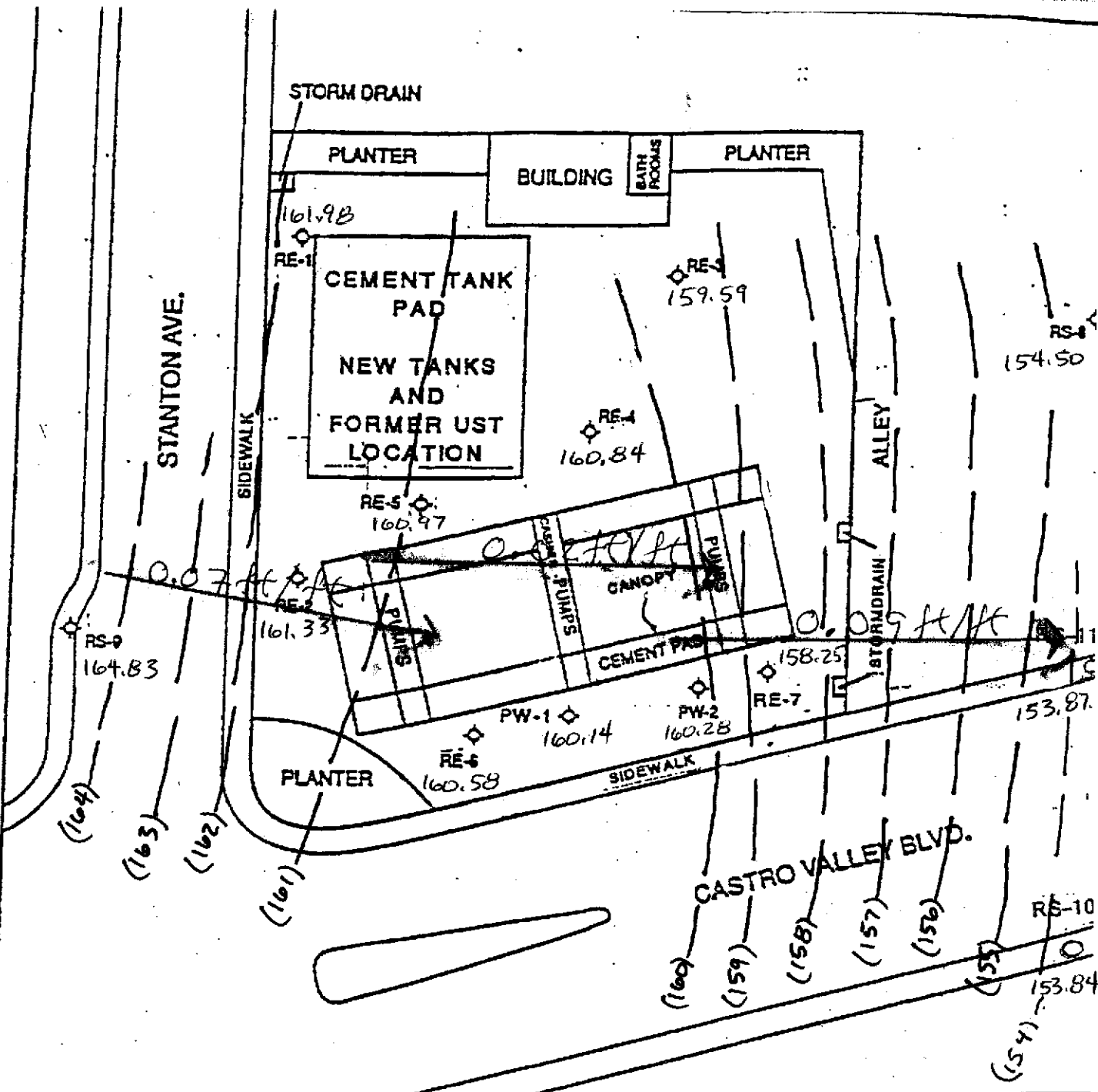

GROUNDWATER CONTOUR MAP  
 THRIFTY OIL CO. #054  
 CASTRO VALLEY, CALIFORNIA  
 Prepared for  
 THRIFTY OIL CO.  
 SANTA FE, SPRINGS  
 CALIFORNIA



8/30/01

◊ EXISTING MONITORING WELL

FIGURE 1

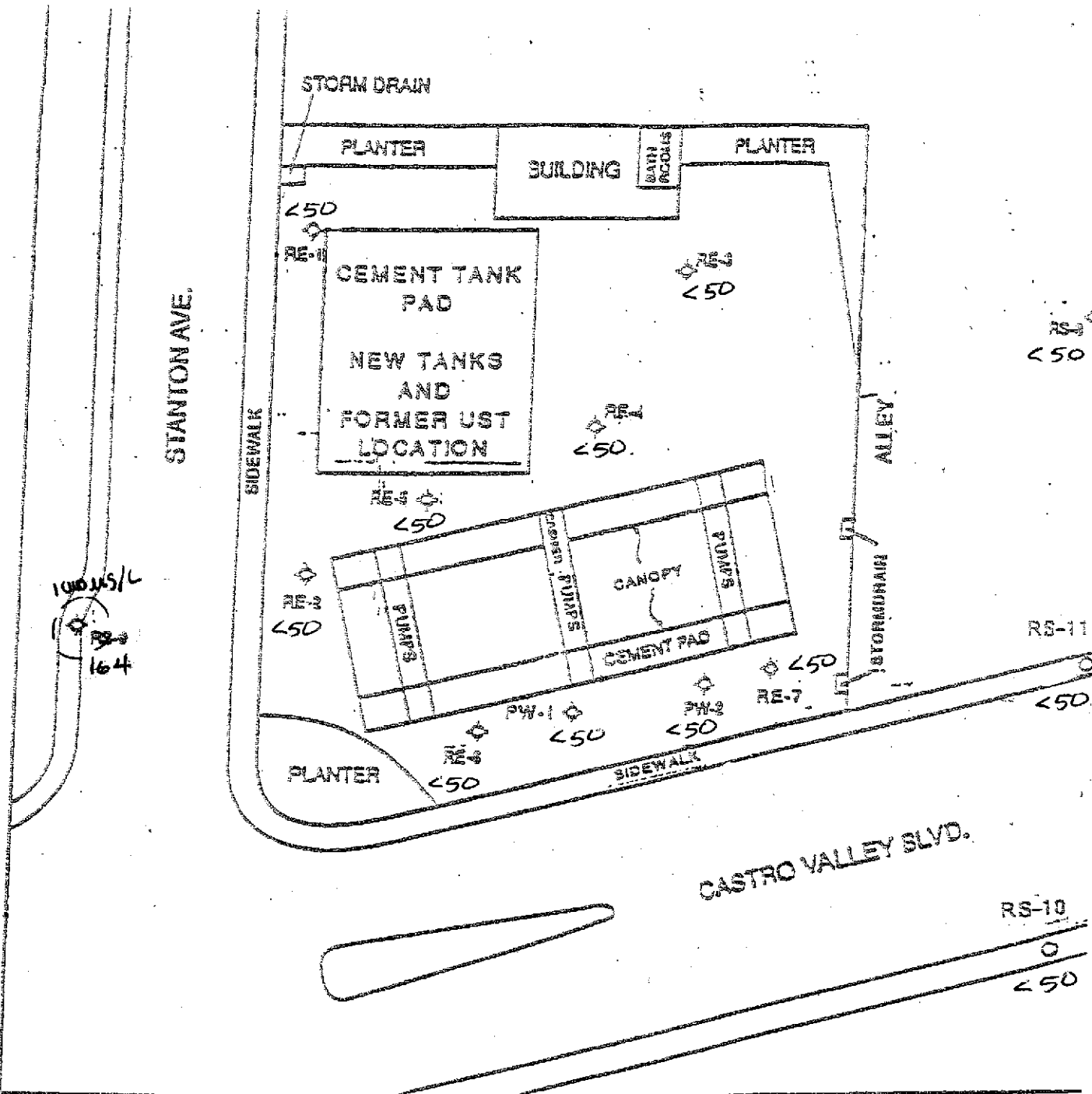

TPH GROUNDWATER ISOCONCENTRATION MAP PPB

THRIFTY OIL CO. #054  
 CASTRO VALLEY, CALIFORNIA  
 Prepared for  
 THRIFTY OIL CO.  
 SANTA FE, SPRINGS  
 CALIFORNIA

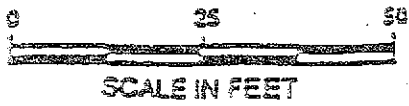

8/30/01

⊕ EXISTING MONITORING WELL

FIGURE 2

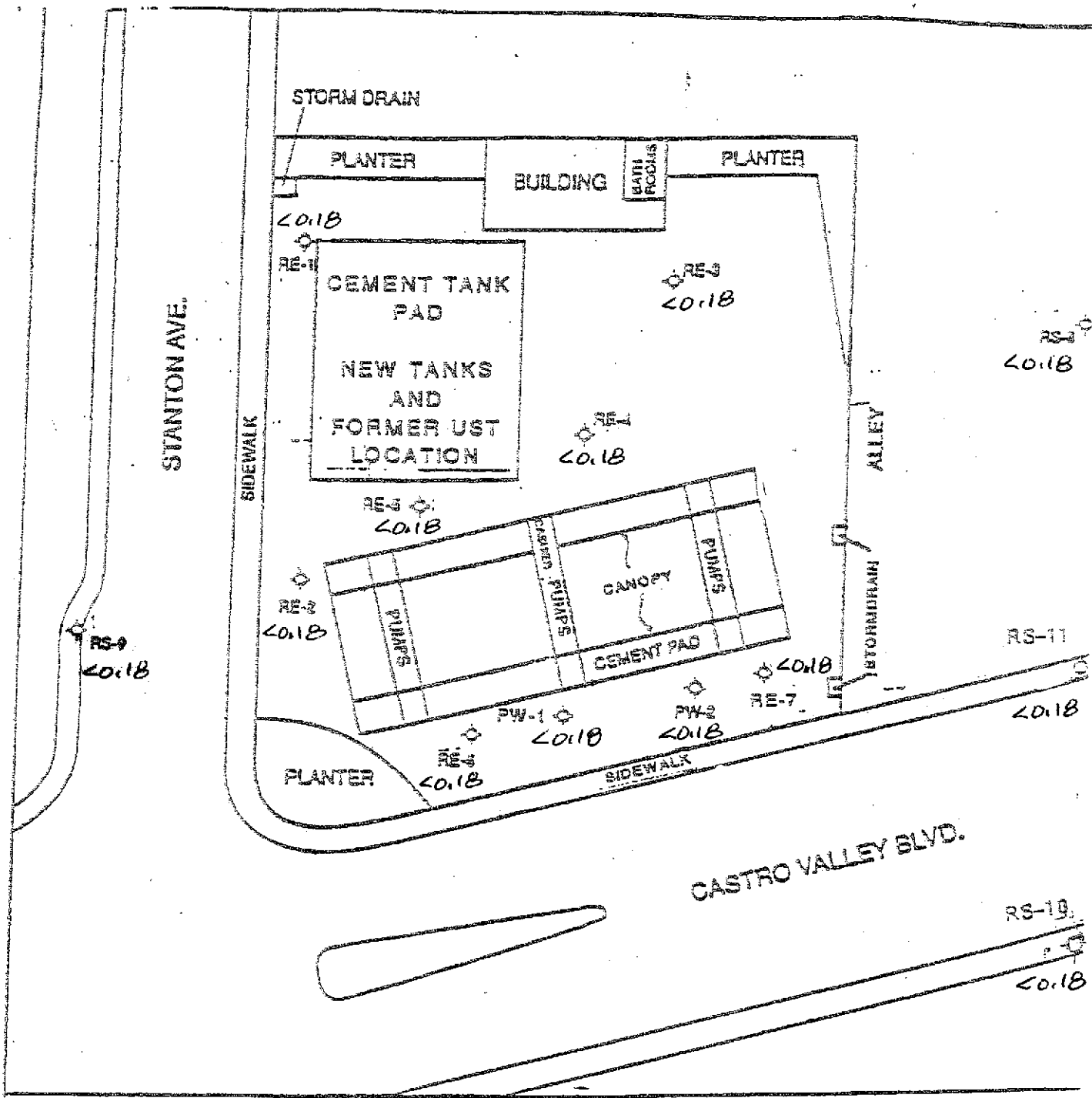

**BENZENE ISOCONCENTRATION MAP PPB**

THRIFTY OIL CO. #054  
 CASTRO VALLEY, CALIFORNIA  
 Prepared for  
 THRIFTY OIL CO.  
 SANTA FE, SPRINGS  
 CALIFORNIA

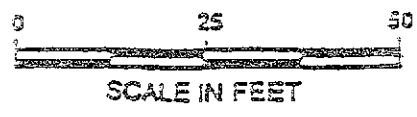

B/30/01

◊ EXISTING MONITORING WELL

FIGURE 3

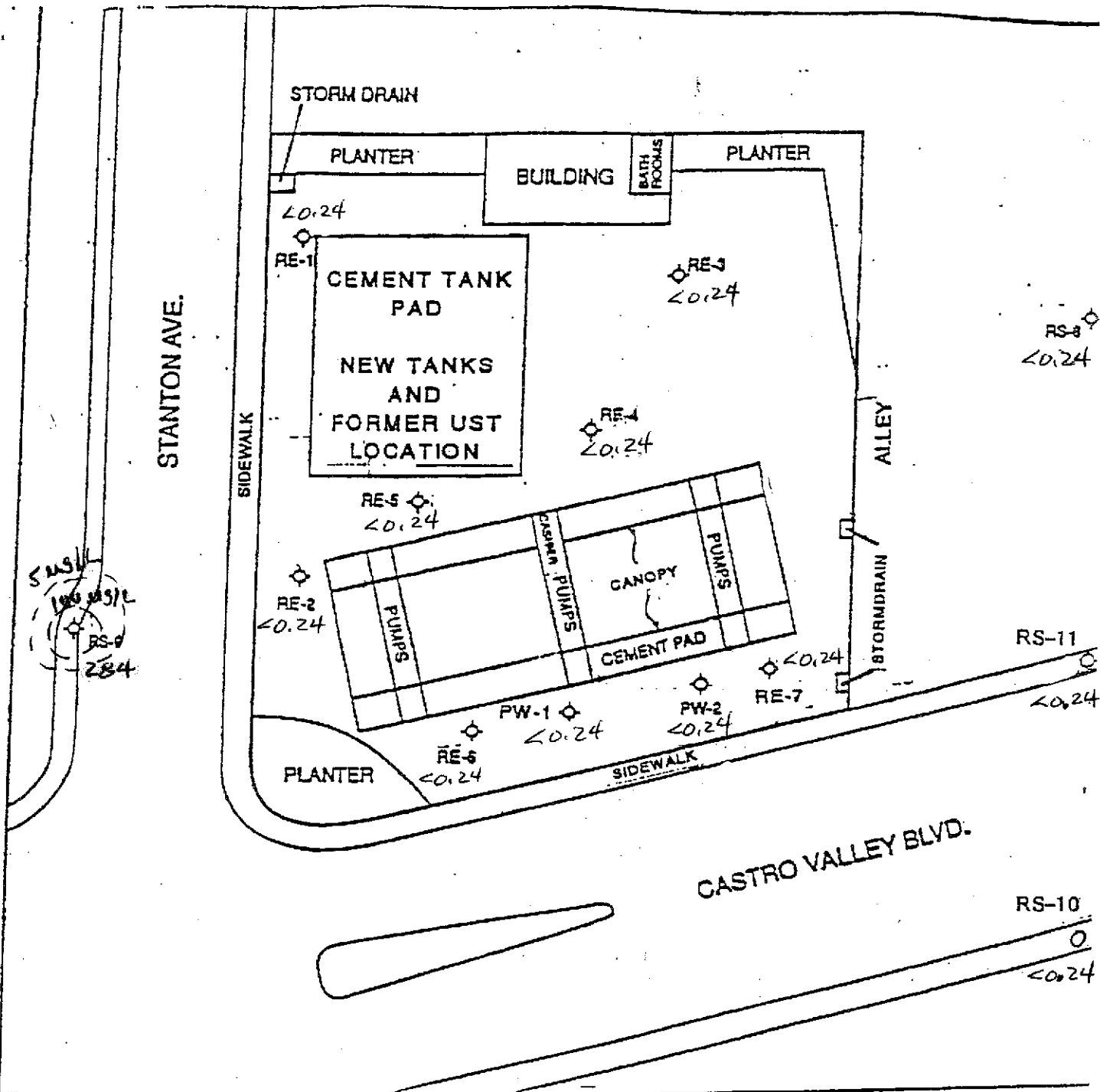

MTBE ISOCONCENTRATION MAP ug/L  
 THRIFTY OIL CO. #054  
 CASTRO VALLEY, CALIFORNIA  
 Prepared for  
 THRIFTY OIL CO.  
 SANTA FE, SPRINGS  
 CALIFORNIA

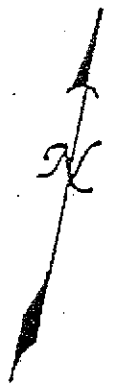
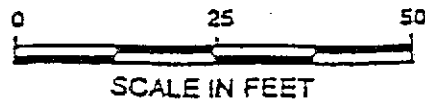

B/30/01

◊ EXISTING MONITORING WELL

FIGURE 4



# **TABLES**

**TABLE 1  
GROUNDWATER DATA  
THRIFTY OIL STATION #054, CASTRO VALLEY, CA.**

DATE SAMPLED	ANALYTICAL PARAMETERS						DEPTH TO GROUNDWATER (feet)	DEPTH TO PRODUCT (feet)	PRODUCT THICKNESS (feet)	CASING ELEVATION (feet)	GROUNDWATER ELEVATION (feet)
	TPH (ug/L)	BENZENE (ug/L)	TOLUENE (ug/L)	EthylBenzene (ug/L)	XYLENE (ug/L)	MTBE (ug/L)					
<b>MONITORING WELL #PW-1</b>											
04/11/88	-	-	-	-	-	-	-	-	-	-	-
04/09/90	230,000	600	2,700	1,000	16,000	-	5.10	NP	0.00	166.46	161.36
10/30/90	35,000	240	970	240	3,580	-	6.17	NP	0.00	166.46	160.29
01/18/91	37,000	43	140	42	1,600	-	6.28	NP	0.00	166.46	160.18
02/12/91	45,000	99	130	25	700	-	5.88	NP	0.00	166.46	160.58
03/20/91	1,900	0.43	ND	ND	2.8	-	4.75	NP	0.00	166.46	161.71
05/22/91	41,000	600	730	250	3,800	-	5.10	NP	0.00	166.46	161.36
06/19/91	-	-	-	-	-	-	5.61	NP	0.00	166.46	160.85
07/17/91	-	-	-	-	-	-	5.53	FILM	0.00	166.46	160.93
08/07/91	-	-	-	-	-	-	5.67	FILM	0.00	166.46	160.79
09/24/91	-	-	-	-	-	-	5.57	FILM	0.00	166.46	160.89
10/23/91	-	-	-	-	-	-	6.53	FILM	0.00	166.46	159.93
11/06/91	-	-	-	-	-	-	5.85	FILM	0.00	166.46	160.61
12/04/91	-	-	-	-	-	-	5.91	FILM	0.00	166.46	160.55
01/29/92	-	-	-	-	-	-	5.43	FILM	0.00	166.46	161.03
02/26/92	-	-	-	-	-	-	5.54	FILM	0.00	166.46	160.92
03/19/92	ND	ND	ND	ND	ND	-	5.47	NP	0.00	166.46	160.99
04/22/92	-	-	-	-	-	-	5.62	FILM	0.00	166.46	160.84
05/21/92	1,300	19	2.9	0.7	58	-	6.21	NP	0.00	166.46	160.25
06/25/92	-	-	-	-	-	-	6.94	NP	0.00	166.46	159.52
07/30/92	-	-	-	-	-	-	5.90	FILM	0.00	166.46	160.56
08/20/92	-	-	-	-	-	-	7.12	FILM	0.00	166.46	159.34
09/30/92	3,400	57	ND	26	240	-	6.42	NP	0.00	166.46	160.04
12/23/92	-	-	-	-	-	-	5.56	FILM	0.00	166.46	160.90
03/10/93	-	-	-	-	-	-	5.65	FILM	0.00	166.46	160.81
06/09/93	400	<0.5	1.1	<1.0	<1.0	-	5.30	NP	0.00	166.46	161.16
09/14/93	180	3.7	3.2	1.5	14	-	5.43	NP	0.00	166.46	161.03
12/14/93	<50	<0.3	<0.3	<0.3	<0.5	-	4.65	NP	0.00	166.46	161.81
03/02/94	<50	<0.3	<0.3	<0.3	<0.5	-	5.43	NP	0.00	166.46	161.03
06/06/94	330	1.3	<0.3	0.88	9.8	-	4.70	NP	0.00	166.46	161.76
09/06/94	1,100	67	<0.3	<0.3	24	-	6.48	NP	0.00	166.46	159.98
12/07/94	<50	<0.3	<0.3	<0.5	<0.5	-	5.22	NP	0.00	166.46	161.24
03/08/95	<100	<0.5	<0.5	<0.5	<1	-	6.94	NP	0.00	166.46	159.52
06/15/95	260	0.8	0.6	<0.5	3.2	-	5.72	NP	0.00	166.46	160.74

**TABLE 1  
GROUNDWATER DATA  
THRIFTY OIL STATION #054, CASTRO VALLEY, CA.**

DATE SAMPLED	ANALYTICAL PARAMETERS						DEPTH TO GROUNDWATER (feet)	DEPTH TO PRODUCT (feet)	PRODUCT THICKNESS (feet)	CASING ELEVATION (feet)	GROUNDWATER ELEVATION (feet)
	TPH (ug/L)	BENZENE (ug/L)	TOLUENE (ug/L)	EthylBenzene (ug/L)	XYLENE (ug/L)	MTBE (ug/L)					
09/05/95	330	2.1	<0.5	2.1	9.6	-	5.96	NP	0.00	166.46	160.50
11/21/95	660	13	1.3	<0.3	4.0	-	6.04	NP	0.00	166.46	160.42
03/11/96	660	0.94	0.77	<0.3	8.1	-	3.60	NP	0.00	166.46	162.86
06/19/96	120	0.53	<0.3	<0.3	2.3	-	4.80	NP	0.00	166.46	161.66
09/16/96	<50	<0.3	<0.3	<0.3	<0.5	<20	5.10	NP	0.00	166.46	161.36
12/10/96	<50	<0.3	<0.3	<0.3	<0.5	<20	4.92	NP	0.00	166.46	161.54
03/12/97	<50	<0.3	<0.3	<0.3	<0.5	<20	4.50	NP	0.00	166.46	161.96
06/12/97	<50	<0.3	<0.3	<0.3	<0.5	<20	-	-	-	-	-
09/16/97	690	0.97	<0.3	<0.3	<0.5	<20	4.55	NP	0.00	166.46	161.91
12/09/97	640	150	0.64	<0.3	5.2	1,300	5.60	NP	0.00	166.46	160.86
03/03/98	<50	<0.3	0.57	<0.3	<0.5	<20	4.13	NP	0.00	166.46	162.33
07/08/98	<50	<0.3	<0.3	<0.3	<0.5	<5	-	-	-	-	-
09/10/98	<50	<0.3	<0.3	<0.3	<0.5	<5	6.35	NP	0.00	166.46	160.11
12/30/98	<50	1.1	<0.3	<0.3	<0.5	<5	6.40	NP	0.00	166.46	160.06
03/15/99	<50	<0.3	<0.3	<0.3	<0.5	<5	6.35	NP	0.00	166.46	160.11
06/22/99	<50	<0.3	<0.3	<0.3	<0.5	53	4.95	NP	0.00	166.46	161.51
09/08/99	<50	<0.3	<0.3	<0.3	<0.5	<5	4.80	NP	0.00	166.46	161.66
12/01/99	<50	<0.3	<0.3	<0.3	<0.5	<5	3.64	NP	0.00	166.46	162.82
03/23/00	<50	0.5	0.5	1.1	<0.5	<5	4.03	NP	0.00	166.46	162.43
06/08/00	<50	<5	<5	<5	<5	<5	4.40	NP	0.00	166.46	162.06
09/27/00	<50	<0.18	<0.14	<0.18	<0.26	<0.24	4.73	NP	0.00	166.46	161.73
12/13/00	<50	<0.18	<0.14	<0.18	<0.26	<0.24	4.01	NP	0.00	166.46	162.45
03/22/01	600	<0.18	1.3	<0.18	<0.26	*1,010 / 1,970	6.32	NP	0.00	166.46	160.14
06/15/01	<50	<0.18	<0.14	<0.18	<0.26	<0.24	6.32	NP	0.00	166.46	160.14
08/30/01	<50	<0.18	<0.14	<0.18	<0.26	<0.24	6.32	NP	0.00	166.46	160.14
<b>MONITORING WELL PW-2</b>											
04/11/88	-	-	-	-	-	-	-	-	-	-	-
04/09/90	600,000	1,300	11,000	4,600	4,300	-	5.81	NP	0.00	166.18	160.37
10/30/90	48,000	310	51	10	480	-	6.95	NP	0.00	166.18	159.23
01/18/91	86,000	230	1,400	350	8,300	-	6.92	NP	0.00	166.18	159.26
02/12/91	160,000	680	1,300	250	7,000	-	6.78	NP	0.00	166.18	159.40
03/20/91	17,000	34	50	ND	1,100	-	5.54	NP	0.00	166.18	160.64
05/22/91	14,000	57	2,100	500	8,200	-	6.07	NP	0.00	166.18	160.11

**TABLE 1  
GROUNDWATER DATA  
THRIFTY OIL STATION #054, CASTRO VALLEY, CA.**

DATE SAMPLED	ANALYTICAL PARAMETERS						DEPTH TO GROUNDWATER (feet)	DEPTH TO PRODUCT (feet)	PRODUCT THICKNESS (feet)	CASING ELEVATION (feet)	GROUNDWATER ELEVATION (feet)
	TPH (ug/L)	BENZENE (ug/L)	TOLUENE (ug/L)	EthylBenzene (ug/L)	XYLENE (ug/L)	MTBE (ug/L)					
06/19/91	-	-	-	-	-	-	6.37	FILM	0.00	166.18	159.81
07/17/91	-	-	-	-	-	-	6.38	FILM	0.00	166.18	159.80
08/07/91	-	-	-	-	-	-	6.63	FILM	0.00	166.18	159.55
09/24/91	-	-	-	-	-	-	6.42	FILM	0.00	166.18	159.76
10/23/91	-	-	-	-	-	-	7.25	FILM	0.00	166.18	158.93
11/06/91	-	-	-	-	-	-	6.44	FILM	0.00	166.18	159.74
12/04/91	-	-	-	-	-	-	6.65	FILM	0.00	166.18	159.53
01/29/92	-	-	-	-	-	-	6.17	FILM	0.00	166.18	160.01
02/26/92	-	-	-	-	-	-	5.90	FILM	0.00	166.18	160.28
03/19/92	-	-	-	-	-	-	5.80	FILM	0.00	166.18	160.38
04/22/92	-	-	-	-	-	-	5.88	FILM	0.00	166.18	160.30
05/21/92	-	-	-	-	-	-	6.03	FILM	0.00	166.18	160.15
06/25/92	-	-	-	-	-	-	6.57	FILM	0.00	166.18	159.61
07/30/92	-	-	-	-	-	-	6.20	FILM	0.00	166.18	159.98
08/20/92	-	-	-	-	-	-	6.64	FILM	0.00	166.18	159.54
09/30/92	-	-	-	-	-	-	6.88	FILM	0.00	166.18	159.30
12/23/92	-	-	-	-	-	-	6.08	FILM	0.00	166.18	160.10
03/10/93	-	-	-	-	-	-	5.95	FILM	0.00	166.18	160.23
06/09/93	3,400	24	22	<0.5	240	-	5.38	NP	0.00	166.18	160.80
09/14/93	4,900	190	15	6.8	480	-	6.26	NP	0.00	166.18	159.92
12/14/93	1,700	4.2	<0.3	<0.3	<0.5	-	5.22	NP	0.00	166.18	160.96
03/02/94	-	-	-	-	-	-	5.75	FILM	0.00	166.18	160.43
06/06/94	980	25	1.2	<0.3	42	-	5.25	NP	0.00	166.18	160.93
09/06/94	3,200	95	3.0	<1.7	76	-	6.80	NP	0.00	166.18	159.38
12/07/94	510	1.8	<0.3	<0.5	1.7	-	5.57	NP	0.00	166.18	160.61
03/08/95	1,900	<0.5	<0.5	1.4	35	-	4.10	NP	0.00	166.18	162.08
06/15/95	1,700	5.6	<0.5	<0.5	1.6	-	5.44	NP	0.00	166.18	160.74
09/05/95	2,500	33	1.0	0.86	18	-	6.13	NP	0.00	166.18	160.05
11/21/95	2,800	130	59	18	190	-	6.23	NP	0.00	166.18	159.95
03/11/96	13,000	330	460	<15	3,800	-	4.48	NP	0.00	166.18	161.70
06/19/96	1,400	<0.3	<0.3	<0.3	<0.5	-	5.38	NP	0.00	166.18	160.80
09/16/96	3,500	<0.3	<0.3	<0.3	<0.5	5,900	5.21	NP	0.00	166.18	160.97
12/10/96	2,100	<0.3	<0.3	<0.3	<0.5	4,700	4.87	NP	0.00	166.18	161.31
03/12/97	600	1.6	<0.3	<0.3	5.8	1,100	4.43	NP	0.00	166.18	161.75
06/12/97	270	<0.3	<0.3	<0.3	<0.5	630	-	-	-	-	-

**TABLE 1  
GROUNDWATER DATA  
THRIFTY OIL STATION #054, CASTRO VALLEY, CA.**

DATE SAMPLED	ANALYTICAL PARAMETERS						DEPTH TO GROUNDWATER (feet)	DEPTH TO PRODUCT (feet)	PRODUCT THICKNESS (feet)	CASING ELEVATION (feet)	GROUNDWATER ELEVATION (feet)
	TPH (ug/L)	BENZENE (ug/L)	TOLUENE (ug/L)	EthylBenzene (ug/L)	XYLENE (ug/L)	MTBE (ug/L)					
09/10/97	220	<0.3	<0.3	<0.3	<0.5	320	4.07	NP	0.00	166.18	162.11
12/09/97	120	<0.3	0.73	<0.3	<0.5	420	5.20	NP	0.00	166.18	160.98
03/03/98	<50	0.43	0.48	<0.3	<0.5	47	3.30	NP	0.00	166.18	162.88
07/08/98	<50	<0.3	<0.3	<0.3	<0.5	<5	-	-	-	-	-
09/10/98	<50	<0.3	<0.3	<0.3	<0.5	<5	5.15	NP	0.00	166.18	161.03
12/30/98	<50	1.1	<0.3	<0.3	<0.5	<5	4.75	NP	0.00	166.18	161.43
03/15/99	<50	<0.3	<0.3	<0.3	<0.5	<5	4.40	NP	0.00	166.18	161.78
06/22/99	-	-	-	-	-	-	4.50	NP	0.00	166.18	161.68
09/08/99	100	<0.3	<0.3	<0.3	<0.5	230	3.99	NP	0.00	166.18	162.19
12/01/99	<50	<0.3	<0.3	<0.3	<0.5	<5	3.62	NP	0.00	166.18	162.56
03/23/00	<50	<0.25	<0.25	<0.25	<0.5	<5	2.93	NP	0.00	166.18	163.25
06/08/00	<50	<5	<5	<5	<5	<5	3.60	NP	0.00	166.18	162.58
09/27/00	<50	<0.18	<0.14	<0.18	<0.26	<0.24	3.61	NP	0.00	166.18	162.57
12/13/00	<50	<0.18	<0.14	<0.18	<0.26	<0.24	3.60	NP	0.00	166.18	162.58
03/22/01	<50	<0.18	<0.14	<0.18	<0.26	<0.24	5.14	NP	0.00	166.18	161.04
06/15/01	<50	<0.18	<0.14	<0.18	<0.26	<0.24	5.13	NP	0.00	166.18	161.05
08/30/01	<50	<0.18	<0.14	<0.18	<0.26	<0.24	5.90	NP	0.00	166.18	160.28
<b>MONITORING WELL #RE-1</b>											
04/11/88	37,000	1,900	8,400	1,200	15,000	-	-	-	-	-	-
04/09/90	45,000	6,100	7,000	2,000	8,800	-	4.99	NP	0.00	166.82	161.83
10/30/90	72,000	7,700	5,300	1,800	8,900	-	5.95	NP	0.00	166.82	160.87
01/18/91	150,000	11,000	14,000	1,800	4,300	-	5.17	NP	0.00	166.82	161.65
02/12/91	140,000	11,000	12,000	1,600	13,000	-	4.16	NP	0.00	166.82	162.66
03/20/91	53,000	3,100	4,200	400	5,500	-	4.75	NP	0.00	166.82	162.07
05/22/91	85,000	8,700	10,000	1,800	12,000	-	4.42	NP	0.00	166.82	162.40
06/19/91	110,000	8,500	9,600	2,600	16,000	-	4.93	NP	0.00	166.82	161.89
07/17/91	5,500	950	ND	26	ND	-	5.19	NP	0.00	166.82	161.63
08/07/91	-	6,700	5,000	ND	7,100	-	5.12	NP	0.00	166.82	161.70
09/24/91	60,000	6,800	4,300	640	6,900	-	5.87	NP	0.00	166.82	160.95
10/23/91	79,000	7,900	8,300	450	7,100	-	5.81	NP	0.00	166.82	161.01
11/06/91	130,000	14,000	15,000	1,100	8,800	-	5.56	NP	0.00	166.82	161.26
12/04/91	50,000	8,000	4,700	520	4,100	-	5.35	NP	0.00	166.82	161.47
01/29/92	21,000	10,300	11,000	780	6,000	-	4.50	NP	0.00	166.82	162.32

**TABLE 1  
GROUNDWATER DATA  
THRIFTY OIL STATION #054, CASTRO VALLEY, CA.**

DATE SAMPLED	ANALYTICAL PARAMETERS						DEPTH TO GROUNDWATER (feet)	DEPTH TO PRODUCT (feet)	PRODUCT THICKNESS (feet)	CASING ELEVATION (feet)	GROUNDWATER ELEVATION (feet)
	TPH (ug/L)	BENZENE (ug/L)	TOLUENE (ug/L)	EthylBenzene (ug/L)	XYLENE (ug/L)	MTBE (ug/L)					
02/26/92	38000	8,400	10,500	720	7,100	-	5.27	NP	0.00	166.82	161.55
03/19/92	48,000	6,200	9,700	780	7,200	-	4.47	NP	0.00	166.82	162.35
04/22/92	-	-	-	-	-	-	4.62	NP	0.00	166.82	162.20
05/21/92	20,000	7,600	10,100	830	6,900	-	4.98	NP	0.00	166.82	161.84
06/25/92	-	-	-	-	-	-	5.14	FILM	0.00	166.82	161.68
07/30/92	-	-	-	-	-	-	5.30	FILM	0.00	166.82	161.52
08/20/92	-	-	-	-	-	-	5.28	FILM	0.00	166.82	161.54
09/30/92	-	-	-	-	-	-	5.66	FILM	0.00	166.82	161.16
12/23/92	-	-	-	-	-	-	4.81	FILM	0.00	166.82	162.01
03/10/93	-	-	-	-	-	-	4.13	FILM	0.00	166.82	162.69
06/09/93	-	-	-	-	-	-	4.48	FILM	0.00	166.82	162.34
09/14/93	19,000	3,600	1,100	740	4,300	-	5.35	NP	0.00	166.82	161.47
12/14/93	38,000	4,300	1,300	<6.6	11	-	4.38	NP	0.00	166.82	162.44
03/02/94	-	-	-	-	-	-	4.22	FILM	0.00	166.82	162.60
06/06/94	-	-	-	-	-	-	2.16	FILM	0.00	166.82	164.66
09/06/94	74,000	3,300	3,900	1,200	6,100	-	5.00	NP	0.00	166.82	161.82
12/07/94	30,000	3,200	2,900	1,200	4,600	-	4.10	NP	0.00	166.82	162.72
03/08/95	28,000	4,200	2,300	810	7,800	-	3.92	NP	0.00	166.82	162.90
06/15/95	-	-	-	-	-	-	-	-	-	-	-
09/05/95	-	-	-	-	-	-	4.78	FILM	0.00	166.82	162.04
11/21/95	-	-	-	-	-	-	4.82	NP	0.00	166.82	162.00
03/11/96	270	2.4	6.0	4.5	19	-	3.32	NP	0.00	166.82	163.50
06/19/96	3,000	570	63	<1.5	400	-	4.20	NP	0.00	166.82	162.62
09/16/96	7,700	440	69	<1.5	680	230	4.68	NP	0.00	166.82	162.14
12/10/96	52	<0.3	<0.3	<0.3	<0.5	120	4.93	NP	0.00	166.82	161.89
03/12/97	8,700	180	5.4	40	1,100	130	4.10	NP	0.00	166.82	162.72
06/12/97	<50	<0.3	<0.3	<0.3	<0.5	36	-	-	-	-	-
09/16/97	<50	<0.3	<0.3	<0.3	<0.5	<20	4.55	NP	0.00	166.82	162.27
12/09/97	<50	<0.3	0.44	<0.3	<0.5	<20	5.30	NP	0.00	166.82	161.52
03/03/98	1,100	13	0.51	<0.3	<0.5	220	4.55	NP	0.00	166.82	162.27
07/08/98	<50	<0.3	<0.3	<0.3	<0.5	<5	-	-	-	-	-
09/10/98	60	<0.3	<0.3	<0.3	<0.5	180	6.05	NP	0.00	166.82	160.77
12/30/98	<50	1.1	<0.3	<0.3	<0.5	<5	5.65	NP	0.00	166.82	161.17
03/15/99	<50	<0.3	<0.3	<0.3	<0.5	<5	5.68	NP	0.00	166.82	161.14
06/22/99	880	14	0.98	<0.3	8.1	260	4.95	NP	0.00	166.82	161.87

**TABLE 1**  
**GROUNDWATER DATA**  
**THRIFTY OIL STATION #054, CASTRO VALLEY, CA.**

DATE SAMPLED	ANALYTICAL PARAMETERS						DEPTH TO GROUNDWATER (feet)	DEPTH TO PRODUCT (feet)	PRODUCT THICKNESS (feet)	CASING ELEVATION (feet)	GROUNDWATER ELEVATION (feet)
	TPH (ug/L)	BENZENE (ug/L)	TOLUENE (ug/L)	EthylBenzene (ug/L)	XYLENE (ug/L)	MTBE (ug/L)					
09/08/99	72	<0.3	<0.3	<0.3	<0.5	120	4.46	NP	0.00	166.82	162.36
12/01/99	<50	<0.3	<0.3	<0.3	<0.5	<5	4.08	NP	0.00	166.82	162.74
03/23/00	<50	<0.25	<0.25	<0.25	<0.5	<5	3.68	NP	0.00	166.82	163.14
06/08/00	<50	<5	<5	<5	<5	<5	4.07	NP	0.00	166.82	162.75
09/27/00	<50	<0.18	<0.14	<0.18	<0.26	<0.24	4.07	NP	0.00	166.82	162.75
12/13/00	<50	<0.18	<0.14	<0.18	<0.26	<0.24	4.06	NP	0.00	166.82	162.76
03/22/01	<50	<0.18	<0.14	<0.18	<0.26	<0.24	5.22	NP	0.00	166.82	161.60
06/15/01	<50	<0.18	<0.14	<0.18	<0.26	<0.24	5.99	NP	0.00	166.82	160.83
08/30/01	<50	<0.18	<0.14	<0.18	<0.26	<0.24	4.84	NP	0.00	166.82	161.98
<b>MONITORING WELL #RE-2</b>											
04/11/88	-	-	-	-	-	-	-	-	-	-	-
04/09/90	850	5.8	0.5	4.8	1.1	-	4.90	NP	0.00	167.19	162.29
10/30/90	440	2.8	0.91	13	3.14	-	5.34	NP	0.00	167.19	161.85
01/18/91	1,100	8.4	3.1	ND	10	-	4.90	NP	0.00	167.19	162.29
02/12/91	1,100	5.9	ND	1.77	ND	-	4.94	NP	0.00	167.19	162.25
03/20/91	550	4.3	ND	ND	ND	-	4.32	NP	0.00	167.19	162.87
05/22/91	1,000	5.3	3.6	4.4	8.9	-	4.43	NP	0.00	167.19	162.76
06/19/91	700	2.1	1.4	3.8	3.5	-	6.43	NP	0.00	167.19	160.76
07/17/91	880	12	8.0	4.3	28	-	4.75	NP	0.00	167.19	162.44
08/07/91	-	3.8	1.6	ND	ND	-	4.87	NP	0.00	167.19	162.32
09/24/91	670	7.2	7.1	ND	23	-	5.50	NP	0.00	167.19	161.69
10/23/91	2,700	52	60	22	130	-	5.63	NP	0.00	167.19	161.56
11/06/91	1,900	18	61	9.1	83	-	5.14	NP	0.00	167.19	162.05
12/04/91	1,100	26	47	4.3	42	-	5.26	NP	0.00	167.19	161.93
01/29/92	900	14	24	5.3	19	-	5.11	NP	0.00	167.19	162.08
02/26/92	500	3.4	3.5	2.7	2.7	-	4.31	NP	0.00	167.19	162.88
03/19/92	1,200	14	20	15	18	-	4.45	NP	0.00	167.19	162.74
04/22/92	200	ND	ND	ND	ND	-	4.78	NP	0.00	167.19	162.41
05/21/92	500	7.5	6.8	3.9	7.4	-	5.02	NP	0.00	167.19	162.17
06/25/92	ND	ND	0.9	0.7	ND	-	5.13	NP	0.00	167.19	162.06
07/30/92	500	7.7	8.6	3.2	1.7	-	5.19	NP	0.00	167.19	162.00
08/20/92	1,100	6.6	4.5	2.7	2.0	-	5.27	NP	0.00	167.19	161.92
09/30/92	500	5.4	2.4	1.8	4.5	-	5.45	NP	0.00	167.19	161.74

**TABLE 1  
GROUNDWATER DATA  
THRIFTY OIL STATION #054, CASTRO VALLEY, CA.**

DATE SAMPLED	ANALYTICAL PARAMETERS						DEPTH TO GROUNDWATER (feet)	DEPTH TO PRODUCT (feet)	PRODUCT THICKNESS (feet)	CASING ELEVATION (feet)	GROUNDWATER ELEVATION (feet)
	TPH (ug/L)	BENZENE (ug/L)	TOLUENE (ug/L)	EthylBenzene (ug/L)	XYLENE (ug/L)	MTBE (ug/L)					
12/23/92	800	1.9	ND	ND	2.3	-	4.60	NP	0.00	167.19	162.59
03/10/93	1,200	ND	1.4	ND	2.1	-	4.18	NP	0.00	167.19	163.01
06/09/93	200	ND	ND	ND	ND	-	4.53	NP	0.00	167.19	162.66
09/17/93	360	1.6	1.1	3.2	8.9	-	5.26	NP	0.00	167.19	161.93
12/14/93	260	5.6	3.9	<0.3	21.0	-	2.75	NP	0.00	167.19	164.44
03/02/94	410	<0.3	<0.3	<0.3	<0.5	-	4.27	NP	0.00	167.19	162.92
06/06/94	760	4.6	<0.3	0.32	1.3	-	4.88	NP	0.00	167.19	162.31
09/06/94	1,300	43	45	8.9	69	-	5.16	NP	0.00	167.19	162.03
12/07/94	-	-	-	-	-	-	4.16	NP	0.00	167.19	163.03
03/08/95	<100	<0.5	<0.5	<0.5	<1	-	3.96	NP	0.00	167.19	163.23
06/15/95	130	<0.5	<0.5	<0.5	<1	-	4.52	NP	0.00	167.19	162.67
09/05/95	210	<0.5	<0.5	<0.5	<1	-	4.76	NP	0.00	167.19	162.43
11/21/95	160	0.65	<0.3	0.35	0.95	-	4.83	NP	0.00	167.19	162.36
03/11/96	<50	<0.3	<0.3	<0.3	<0.5	-	3.36	NP	0.00	167.19	163.83
06/19/96	<50	<0.3	<0.3	<0.3	<0.5	-	4.68	NP	0.00	167.19	162.51
09/16/96	<50	<0.3	<0.3	<0.3	<0.5	<20	5.10	NP	0.00	167.19	162.09
12/10/96	<50	<0.3	<0.3	<0.3	<0.5	<20	4.47	NP	0.00	167.19	162.72
03/12/97	<50	<0.3	<0.3	<0.3	<0.5	<20	4.05	NP	0.00	167.19	163.14
06/12/97	<50	<0.3	<0.3	<0.3	<0.5	<20	-	-	-	-	-
09/10/97	<50	<0.3	<0.3	<0.3	<0.5	<20	4.08	NP	0.00	167.19	163.11
12/09/97	<50	<0.3	<0.3	<0.3	<0.5	<20	4.40	NP	0.00	167.19	162.79
03/03/98	<50	<0.3	<0.3	<0.3	<0.5	<20	3.30	NP	0.00	167.19	163.89
07/08/98	<50	<0.3	<0.3	<0.3	<0.5	15	-	-	-	-	-
09/10/98	<50	<0.3	<0.3	<0.3	<0.5	<5	4.93	NP	0.00	167.19	162.26
12/30/98	460	0.92	<0.3	<0.3	<0.5	1,400	4.20	NP	0.00	167.19	162.99
03/15/99	<50	<0.3	<0.3	<0.3	<0.5	<5	4.20	NP	0.00	167.19	162.99
06/22/99	2,900	7.4	<0.3	0.43	4.1	4,500	3.70	NP	0.00	167.19	163.49
09/08/99	1,400	<3	<3	<3	<5	3,200	3.96	NP	0.00	167.19	163.23
12/01/99	<50	<0.3	<0.3	<0.3	<0.5	<5	3.58	NP	0.00	167.19	163.61
03/23/00	<50	<0.25	<0.25	<0.25	<0.5	<5	3.19	NP	0.00	167.19	164.00
06/08/00	<50	<5	<5	<5	<5	<5	3.18	NP	0.00	167.19	164.01
09/27/00	<50	<0.18	<0.14	<0.18	<0.26	<0.24	3.58	NP	0.00	167.19	163.61
12/13/00	<50	<0.18	<0.14	<0.18	<0.26	<0.24	3.58	NP	0.00	167.19	163.61
03/22/01	575	<0.18	1.3	<0.18	<0.26	*950 / 2,070	4.33	NP	0.00	167.19	162.86



**TABLE 1  
GROUNDWATER DATA  
THRIFTY OIL STATION #054, CASTRO VALLEY, CA.**

DATE SAMPLED	ANALYTICAL PARAMETERS						DEPTH TO GROUNDWATER (feet)	DEPTH TO PRODUCT (feet)	PRODUCT THICKNESS (feet)	CASING ELEVATION (feet)	GROUNDWATER ELEVATION (feet)
	TPH (ug/L)	BENZENE (ug/L)	TOLUENE (ug/L)	EthylBenzene (ug/L)	XYLENE (ug/L)	MTBE (ug/L)					
06/15/01	<50	<0.18	<0.14	<0.18	<0.26	<0.24	5.10	NP	0.00	167.19	162.09
08/30/01	<50	<0.18	<0.14	<0.18	<0.26	<0.24	5.86	NP	0.00	167.19	161.33
<b>MONITORING WELL #RE-3</b>											
04/11/88	70,000	6,600	5,300	800	13,000	-	-	-	-	-	-
04/09/90	370,000	2,300	4,900	3,200	31,000	-	7.15	NP	0.00	167.39	160.24
10/30/90	13,000	860	660	220	2,210	-	7.84	NP	0.00	167.39	159.55
01/18/91	42,000	4,700	4,500	21	7,700	-	6.90	NP	0.00	167.39	160.49
02/12/91	72,000	3,600	4,500	ND	7,600	-	6.62	NP	0.00	167.39	160.77
03/20/91	65,000	2,400	9,400	50	9,800	-	5.87	NP	0.00	167.39	161.52
05/22/91	-	-	-	-	-	-	5.98	FILM	0.00	167.39	161.41
06/19/91	-	-	-	-	-	-	6.84	FILM	0.00	167.39	160.55
07/17/91	-	-	-	-	-	-	7.10	FILM	0.00	167.39	160.29
08/07/91	-	-	-	-	-	-	7.30	FILM	0.00	167.39	160.09
09/24/91	-	-	-	-	-	-	7.84	FILM	0.00	167.39	159.55
10/23/91	-	-	-	-	-	-	8.07	FILM	0.00	167.39	159.32
11/06/91	-	-	-	-	-	-	7.63	FILM	0.00	167.39	159.76
12/04/91	-	-	-	-	-	-	7.83	FILM	0.00	167.39	159.56
01/29/92	-	-	-	-	-	-	7.17	FILM	0.00	167.39	160.22
02/26/92	-	-	-	-	-	-	5.56	FILM	0.00	167.39	161.83
03/19/92	-	-	-	-	-	-	5.44	FILM	0.00	167.39	161.95
04/22/92	-	-	-	-	-	-	6.56	FILM	0.00	167.39	160.83
05/21/92	-	-	-	-	-	-	6.90	FILM	0.00	167.39	160.49
06/25/92	-	-	-	-	-	-	7.18	FILM	0.00	167.39	160.21
07/30/92	-	-	-	-	-	-	6.80	FILM	0.00	167.39	160.59
08/20/92	-	-	-	-	-	-	7.25	FILM	0.00	167.39	160.14
09/30/92	-	-	-	-	-	-	7.68	FILM	0.00	167.39	159.71
12/23/92	-	-	-	-	-	-	6.07	FILM	0.00	167.39	161.32
03/10/93	-	-	-	-	-	-	5.66	FILM	0.00	167.39	161.73
06/09/93	-	-	-	-	-	-	6.66	FILM	0.00	167.39	160.73
09/14/93	40,000	2,900	1,500	180	6,900	-	7.30	NP	0.00	167.39	160.09
12/14/93	-	-	-	-	-	-	5.95	NP	0.00	167.39	161.44
03/02/94	-	-	-	-	-	-	5.08	NP	0.00	167.39	162.31
06/06/94	-	-	-	-	-	-	6.35	FILM	0.00	167.39	161.04

**TABLE 1**  
**GROUNDWATER DATA**  
**THRIFTY OIL STATION #054, CASTRO VALLEY, CA.**

DATE SAMPLED	ANALYTICAL PARAMETERS						DEPTH TO GROUNDWATER (feet)	DEPTH TO PRODUCT (feet)	PRODUCT THICKNESS (feet)	CASING ELEVATION (feet)	GROUNDWATER ELEVATION (feet)
	BENZENE (ug/L)	BROMOBENZENE (ug/L)	TOLUENE (ug/L)	EthylBenzene (ug/L)	XYLENE (ug/L)	CHLOROBENZENE (ug/L)					
09/06/94	11,000	260	26	<6.6	1,000	-	7.50	NP	0.00	167.39	159.89
12/07/94	-	-	-	-	-	-	5.48	FILM	0.00	167.39	161.91
03/08/95	-	-	-	-	-	-	5.18	FILM	0.00	167.39	162.21
06/15/95	-	-	-	-	-	-	-	-	-	-	-
09/05/95	-	-	-	-	-	-	6.84	FILM	0.00	167.39	160.55
11/21/95	10,000	210	<3	4.5	330	-	7.38	NP	0.00	167.39	160.01
03/11/96	1,600	640	15	10	46	-	4.85	NP	0.00	167.39	162.54
06/19/96	2,100	280	<3	<3	120	-	5.80	NP	0.00	167.39	161.59
09/16/96	140	<0.3	<0.3	<0.3	<0.5	110	4.50	NP	0.00	167.39	162.89
12/10/96	<50	<0.3	<0.3	<0.3	<0.5	<20	5.35	NP	0.00	167.39	162.04
03/12/97	<50	<0.3	<0.3	<0.3	<0.5	<20	3.48	NP	0.00	167.39	163.91
06/12/97	<50	<0.3	<0.3	<0.3	0.58	<20	-	-	-	-	-
09/10/97	<50	<0.3	<0.3	<0.3	<0.5	<20	3.10	NP	0.00	167.39	164.29
12/09/97	3,600	1,000	1,000	<6	570	260	4.55	NP	0.00	167.39	162.84
03/03/98	2,800	20	0.65	0.39	16	5,600	2.30	NP	0.00	167.39	165.09
07/08/98	<50	<0.3	<0.3	<0.3	<0.5	<5	-	-	-	-	-
09/10/98	<50	<0.3	<0.3	<0.3	<0.5	23	4.95	NP	0.00	167.39	162.44
12/30/98	<50	1.1	<0.3	<0.3	<0.5	<5	4.55	NP	0.00	167.39	162.84
03/15/99	<50	<0.3	<0.3	<0.3	<0.5	<5	4.15	NP	0.00	167.39	163.24
06/22/99	670	17	1.2	0.36	1.7	340	3.85	NP	0.00	167.39	163.54
09/08/99	140	0.72	<0.3	<0.3	<0.5	230	2.63	NP	0.00	167.39	164.76
12/01/99	95	<0.3	<0.3	<0.3	<0.5	200	2.63	NP	0.00	167.39	164.76
03/23/00	315	<0.25	<0.25	<0.25	<0.5	*293/422	2.25	NP	0.00	167.39	165.14
06/08/00	<100	<5	<5	<5	<5	201	3.02	NP	0.00	167.39	164.37
09/27/00	154	<0.18	<0.14	<0.18	<0.26	*254 / 160	3.01	NP	0.00	167.39	164.38
12/13/00	<50	<0.18	<0.14	<0.18	<0.26	*124 / 111	3.02	NP	0.00	167.39	164.37
03/22/01	<50	<0.18	<0.14	<0.18	<0.26	*90 / 57	4.54	NP	0.00	167.39	162.85
06/15/01	649	28	2.4	3.1	9	*1,790 / 2,560	4.92	NP	0.00	167.39	162.47
08/30/01	<50	<0.18	<0.14	<0.18	<0.26	<0.24	7.80	NP	0.00	167.39	159.59
<b>MONITORING WELL #RE-4</b>											
04/11/88	15,000	12,000	8,000	1,000	2,700	-	-	-	-	-	-
04/09/90	-	-	-	-	-	-	-	-	-	-	-
10/30/90	87,000	7,200	10,000	1,600	12,900	-	7.04	NP	0.00	166.94	159.90

**TABLE 1  
GROUNDWATER DATA  
THRIFTY OIL STATION #054, CASTRO VALLEY, CA.**

DATE SAMPLED	ANALYTICAL PARAMETERS						DEPTH TO GROUNDWATER (feet)	DEPTH TO PRODUCT (feet)	PRODUCT THICKNESS (feet)	CASING ELEVATION (feet)	GROUNDWATER ELEVATION (feet)
	TPH (ug/L)	BENZENE (ug/L)	TOLUENE (ug/L)	EthylBenzene (ug/L)	XYLENE (ug/L)	MTBE (ug/L)					
01/18/91	70,000	5,000	5,400	790	9,900	-	11.62	NP	0.00	166.94	155.32
02/12/91	87,000	5,200	2,800	240	11,000	-	11.63	NP	0.00	166.94	155.31
03/20/91	6,500	370	230	17	670	-	11.61	NP	0.00	166.94	155.33
05/22/91	-	-	-	-	-	-	10.30	FILM	0.00	166.94	156.64
06/19/91	-	-	-	-	-	-	11.10	FILM	0.00	166.94	155.84
07/17/91	-	-	-	-	-	-	6.20	FILM	0.00	166.94	160.74
08/17/91	-	-	-	-	-	-	8.15	FILM	0.00	166.94	158.79
09/24/91	-	-	-	-	-	-	10.40	FILM	0.00	166.94	156.54
10/23/91	-	-	-	-	-	-	11.20	FILM	0.00	166.94	155.74
11/06/91	-	-	-	-	-	-	6.62	FILM	0.00	166.94	160.32
12/04/91	-	-	-	-	-	-	11.20	ILM	0.00	166.94	155.74
01/29/92	-	-	-	-	-	-	7.72	FILM	0.00	166.94	159.22
02/26/92	-	-	-	-	-	-	5.13	FILM	0.00	166.94	161.81
03/19/92	-	-	-	-	-	-	5.00	FILM	0.00	166.94	161.94
04/22/92	-	-	-	-	-	-	5.94	FILM	0.00	166.94	161.00
05/21/92	-	-	-	-	-	-	5.40	FILM	0.00	166.94	161.54
06/25/92	-	-	-	-	-	-	5.71	FILM	0.00	166.94	161.23
07/30/92	-	-	-	-	-	-	6.33	FILM	0.00	166.94	160.61
08/20/92	-	-	-	-	-	-	5.80	FILM	0.00	166.94	161.14
09/30/92	-	-	-	-	-	-	6.34	FILM	0.00	166.94	160.60
12/23/92	-	-	-	-	-	-	5.50	FILM	0.00	166.94	161.44
03/10/93	-	-	-	-	-	-	4.67	FILM	0.00	166.94	162.27
06/09/93	-	-	-	-	-	-	5.12	FILM	0.00	166.94	161.82
09/14/93	-	-	-	-	-	-	10.44	NP	0.00	166.94	156.50
12/14/93	-	-	-	-	-	-	7.52	NP	0.00	166.94	159.42
03/02/94	-	-	-	-	-	-	4.85	NP	0.00	166.94	162.09
06/06/94	-	-	-	-	-	-	5.20	FILM	0.00	166.94	161.74
09/06/94	-	-	-	-	-	-	9.85	FILM	0.00	166.94	157.09
12/07/94	-	-	-	-	-	-	5.20	FILM	0.00	166.94	161.74
03/08/95	-	-	-	-	-	-	4.98	FILM	0.00	166.94	161.96
06/15/95	-	-	-	-	-	-	-	-	-	-	-
09/05/95	-	-	-	-	-	-	13.72	FILM	0.00	166.94	153.22
11/21/95	32,000	46	21	66	340	-	12.53	NP	0.00	166.94	154.41
03/11/96	1,700	130	15	2.0	120	-	4.72	NP	0.00	166.94	162.22
06/19/96	1,700	230	30	0.35	100	-	5.40	NP	0.00	166.94	161.54

**TABLE 1  
GROUNDWATER DATA  
THRIFTY OIL STATION #054, CASTRO VALLEY, CA.**

DATE SAMPLED	ANALYTICAL PARAMETERS						DEPTH TO GROUNDWATER (feet)	DEPTH TO PRODUCT (feet)	PRODUCT THICKNESS (feet)	CASING ELEVATION (feet)	GROUNDWATER ELEVATION (feet)
	TPH (ug/L)	BENZENE (ug/L)	TOLUENE (ug/L)	EthylBenzene (ug/L)	XYLENE (ug/L)	MTBE (ug/L)					
09/16/96	510	<0.3	0.73	<0.3	<0.5	800	5.18	NP	0.00	166.94	161.76
12/10/96	520	<0.3	<0.3	<0.3	<0.5	1,000	4.65	NP	0.00	166.94	162.29
03/12/97	420	3.2	<0.3	<0.3	11	370	3.87	NP	0.00	166.94	163.07
06/12/97	510	0.66	<0.3	<0.3	<0.5	1,600	-	-	-	-	-
09/10/97	<50	<0.3	<0.3	<0.3	<0.5	<20	5.40	NP	0.00	166.94	161.54
12/09/97	1,400	330	2.3	<0.3	1.5	2,500	4.60	NP	0.00	166.94	162.34
03/03/98	3,000	400	0.61	0.5	97	3,800	5.05	NP	0.00	166.94	161.89
07/08/98	650	<0.3	<0.3	<0.3	<0.5	1,800	-	-	-	-	-
09/10/98	2,700	<0.3	<0.3	<0.3	1.4	7,600	4.60	NP	0.00	166.94	162.34
12/30/98	530	<0.3	<0.3	<0.3	<0.5	1,500	4.20	NP	0.00	166.94	162.74
03/15/99	<50	<0.3	<0.3	<0.3	<0.5	<5	3.85	NP	0.00	166.94	163.09
06/22/99	1,200	23	1.5	<0.3	2.4	1,400	3.90	NP	0.00	166.94	163.04
09/08/99	590	1.5	<0.6	<0.6	<1	1,100	5.72	NP	0.00	166.94	161.22
12/01/99	540	<0.3	<0.3	<0.3	<0.5	880	5.34	NP	0.00	166.94	161.60
03/23/00	<50	<0.25	<0.25	<0.25	<0.5	<5	5.36	NP	0.00	166.94	161.58
06/08/00	67	<5	<5	<5	<5	<5	5.34	NP	0.00	166.94	161.60
09/27/00	<50	<0.18	<0.14	<0.18	<0.26	<0.24	5.35	NP	0.00	166.94	161.59
12/13/00	<50	<0.18	<0.14	<0.18	<0.26	<0.24	5.71	NP	0.00	166.94	161.23
03/22/01	<50	<0.18	<0.14	<0.18	<0.26	<0.24	4.19	NP	0.00	166.94	162.75
06/15/01	409	18	2	2	5	*1,000 / 1,480	4.57	NP	0.00	166.94	162.37
08/30/01	<50	<0.18	<0.14	<0.18	<0.26	<0.24	6.10	NP	0.00	166.94	160.84
<b>MONITORING WELL #RE-5</b>											
04/11/88	14,000	1,300	1,100	100	2,600	-	-	-	-	-	-
04/09/90	3,000	690	190	40	270	-	4.79	NP	0.00	166.51	161.72
10/30/90	3,400	910	48	87	249	-	5.86	NP	0.00	166.51	160.65
01/18/91	1,400	180	8.6	0.52	48	-	4.40	NP	0.00	166.51	162.11
02/12/91	1,000	ND	ND	0.65	ND	-	4.76	NP	0.00	166.51	161.75
03/20/91	3,000	250	53	ND	110	-	5.08	NP	0.00	166.51	161.43
05/22/91	2,500	330	7.8	5.6	200	-	4.52	NP	0.00	166.51	161.99
01/19/91	2,000	59	1.6	5.1	110	-	4.39	NP	0.00	166.51	162.12
07/17/91	-	-	-	-	-	-	5.05	FILM	0.00	166.51	161.46
08/07/91	-	-	-	-	-	-	5.02	FILM	0.00	166.51	161.49
09/24/91	-	-	-	-	-	-	5.86	FILM	0.00	166.51	160.65

**TABLE 1  
GROUNDWATER DATA  
THRIFTY OIL STATION #054, CASTRO VALLEY, CA.**

DATE SAMPLED	ANALYTICAL PARAMETERS						DEPTH TO GROUNDWATER (feet)	DEPTH TO PRODUCT (feet)	PRODUCT THICKNESS (feet)	CASING ELEVATION (feet)	GROUNDWATER ELEVATION (feet)
	TPH (ug/L)	BENZENE (ug/L)	TOLUENE (ug/L)	EthylBenzene (ug/L)	XYLENE (ug/L)	MTBE (ug/L)					
10/23/91	-	-	-	-	-	-	5.84	FILM	0.00	166.51	160.67
11/06/91	9,900	2,300	37	260	160	-	5.48	NP	0.00	166.51	161.03
12/04/91	4,500	1,000	27	ND	180	-	5.43	NP	0.00	166.51	161.08
01/29/92	600	6.1	2.3	ND	47	-	5.12	NP	0.00	166.51	161.39
02/26/92	500	5.4	2.7	1.2	14	-	4.93	NP	0.00	166.51	161.58
03/19/92	ND	1.7	1.1	ND	5.5	-	4.45	NP	0.00	166.51	162.06
04/22/92	1,600	240	2.2	ND	160	-	4.63	NP	0.00	166.51	161.88
05/21/92	1,200	410	37	ND	118	-	4.90	NP	0.00	166.51	161.61
06/25/92	ND	1.0	0.8	0.8	0.4	-	5.15	NP	0.00	166.51	161.36
07/30/92	ND	2.0	1.8	1.9	6.4	-	5.30	NP	0.00	166.51	161.21
08/20/92	300	1.7	3.3	0.7	12	-	5.44	NP	0.00	166.51	161.07
09/30/92	1,900	140	ND	19	35	-	5.73	NP	0.00	166.51	160.78
12/23/92	400	8.0	ND	ND	ND	-	4.75	NP	0.00	166.51	161.76
03/10/93	1,100	290	9.7	ND	75	-	4.14	NP	0.00	166.51	162.37
06/09/93	400	1.5	0.5	ND	12	-	5.42	NP	0.00	166.51	161.09
09/14/93	240	6.9	8.8	1.4	67	-	5.53	NP	0.00	166.51	160.98
12/14/93	3,300	510	5.4	4.1	55	-	4.78	NP	0.00	166.51	-311.49
03/02/94	2,400	270	4.5	<0.3	13	-	4.20	NP	0.00	166.51	162.31
06/06/94	730	<0.3	<0.3	0.70	22	-	5.13	NP	0.00	166.51	161.38
09/06/94	2,400	180	28	2.3	76	-	5.45	NP	0.00	166.51	161.06
12/07/94	540	5.6	<0.3	<0.5	6.9	-	4.13	NP	0.00	166.51	162.38
03/08/95	1,500	220	5.5	<0.5	83	-	5.20	NP	0.00	166.51	161.31
06/15/95	3,200	820	53	6.2	74	-	4.93	NP	0.00	166.51	161.58
09/05/95	4,400	440	22	<2.5	57	-	5.03	NP	0.00	166.51	161.48
11/21/95	660	3.4	<0.3	<0.3	0.6	-	5.23	NP	0.00	166.51	161.28
03/11/96	1,000	76	2.2	<0.3	130	-	4.16	NP	0.00	166.51	162.35
06/09/96	90	<0.3	<0.3	<0.3	<0.5	-	5.42	NP	0.00	166.51	161.09
09/16/96	1,900	5.8	<0.3	<0.3	5.9	1,100	5.20	NP	0.00	166.51	161.31
12/10/96	740	<0.3	<0.3	<0.3	<0.5	1,300	5.27	NP	0.00	166.51	161.24
03/12/97	2,000	600	59	5.1	54	1,300	3.85	NP	0.00	166.51	162.66
06/12/97	230	<0.3	<0.3	<0.3	<0.5	720	-	-	-	-	-
09/10/97	210	<0.3	<0.3	<0.3	<0.5	210	4.10	NP	0.00	166.51	162.41
12/09/97	11,000	2,500	2,700	<6	1,500	510	5.20	NP	0.00	166.51	161.31
03/03/98	<50	<0.3	<0.3	<0.3	<0.5	<20	3.70	NP	0.00	166.51	162.81
07/08/98	<50	<0.3	<0.3	<0.3	<0.5	<5	-	-	-	-	-



**TABLE 1**  
**GROUNDWATER DATA**  
**THRIFTY OIL STATION #054, CASTRO VALLEY, CA.**

DATE SAMPLED	ANALYTICAL PARAMETERS						DEPTH TO GROUNDWATER (feet)	DEPTH TO PRODUCT (feet)	PRODUCT THICKNESS (feet)	CASING ELEVATION (feet)	GROUNDWATER ELEVATION (feet)
	TPH (ug/L)	BENZENE (ug/L)	TOLUENE (ug/L)	EthylBenzene (ug/L)	XYLENE (ug/L)	MTBE (ug/L)					
06/25/92	<2000	740	8.0	27	28	-	6.38	NP	0.00	166.51	160.13
07/30/92	-	-	-	-	-	-	6.42	FILM	0.00	166.51	160.09
08/20/92	2,800	630	17	23	22	-	6.50	NP	0.00	166.51	160.01
09/30/92	7,800	540	ND	12	29	-	6.66	NP	0.00	166.51	159.85
12/23/92	1,800	350	ND	7.7	11	-	5.83	NP	0.00	166.51	160.68
03/10/93	3,000	830	5.6	19	16	-	5.63	NP	0.00	166.51	160.88
06/09/93	4,800	920	6.2	3.2	12	-	6.01	NP	0.00	166.51	160.50
09/14/93	3,600	660	7.5	11	27	-	6.53	NP	0.00	166.51	159.98
12/14/93	1,500	200	<0.3	<0.3	8.8	-	3.58	NP	0.00	166.51	162.93
03/02/94	-	-	-	-	-	-	5.12	NP	0.00	166.51	161.39
06/06/94	2,400	290	4.6	1.3	24	-	1.85	NP	0.00	166.51	164.66
09/06/94	4,300	230	21	<6.6	130	-	6.40	NP	0.00	166.51	160.11
12/07/94	1,500	17	2.5	3.2	22	-	5.68	NP	0.00	166.51	160.83
03/08/95	2,500	460	5.5	2.1	51	-	5.12	NP	0.00	166.51	161.39
06/15/95	2,300	91	1.1	0.7	97	-	5.72	NP	0.00	166.51	160.79
09/05/95	3,300	60	<10	<10	74	-	5.94	NP	0.00	166.51	160.57
11/21/95	2,000	7.3	<0.3	0.56	8.7	-	6.24	NP	0.00	166.51	160.27
03/11/96	840	43	0.96	5.7	14	-	5.16	NP	0.00	166.51	161.35
06/19/96	1,800	160	2.7	9.9	25	-	5.80	NP	0.00	166.51	160.71
09/16/96	<50	<0.3	<0.3	<0.3	<0.5	<20	5.38	NP	0.00	166.51	161.13
12/10/96	<50	<0.3	<0.3	<0.3	<0.5	<20	5.62	NP	0.00	166.51	160.89
03/12/97	<50	<0.3	<0.3	<0.3	<0.5	<20	5.20	NP	0.00	166.51	161.31
06/12/97	<50	<0.3	<0.3	<0.3	<0.5	<20	-	-	-	-	-
09/10/97	440	<0.3	<0.3	<0.3	<0.5	320	5.20	NP	0.00	166.51	161.31
12/09/97	<50	<0.3	<0.3	<0.3	<0.5	<20	5.97	NP	0.00	166.51	160.54
03/03/98	400	7.0	<0.3	<0.3	4.3	65	4.45	NP	0.00	166.51	162.06
07/08/98	300	<0.3	<0.3	<0.3	1.0	35	-	-	-	-	-
09/10/98	<50	<0.3	<0.3	<0.3	<0.5	<5	5.90	NP	0.00	166.51	160.61
12/30/98	<50	<0.3	<0.3	<0.3	<0.5	<5	5.20	NP	0.00	166.51	161.31
03/15/99	<50	<0.3	<0.3	<0.3	<0.5	8.4	4.82	NP	0.00	166.51	161.69
06/22/99	700	11	1.9	<0.3	3.9	140	6.00	NP	0.00	166.51	160.51
09/08/99	<50	<0.3	<0.3	<0.3	<0.5	<5	5.15	NP	0.00	166.51	161.36
12/01/99	<50	<0.3	<0.3	<0.3	<0.5	12	4.02	NP	0.00	166.51	162.49
03/23/00	<50	<0.25	<0.25	<0.25	<0.5	<5	4.41	NP	0.00	166.51	162.10
06/08/00	<50	<5	<5	<5	<5	<5	4.78	NP	0.00	166.51	161.73

**TABLE 1  
GROUNDWATER DATA  
THRIFTY OIL STATION #054, CASTRO VALLEY, CA.**

DATE SAMPLED	ANALYTICAL PARAMETERS						DEPTH TO GROUNDWATER (feet)	DEPTH TO PRODUCT (feet)	PRODUCT THICKNESS (feet)	CASING ELEVATION (feet)	GROUNDWATER ELEVATION (feet)
	TPH (ug/L)	BENZENE (ug/L)	TOLUENE (ug/L)	EthylBenzene (ug/L)	XYLENE (ug/L)	MTBE (ug/L)					
09/27/00	<50	<0.18	<0.14	<0.18	<0.26	<0.24	4.78	NP	0.00	166.51	161.73
12/13/00	<50	<0.18	<0.14	<0.18	<0.26	<0.24	4.77	NP	0.00	166.51	161.74
03/22/01	367	<0.18	<0.14	<0.18	<0.26	*581 / 674	5.54	NP	0.00	166.51	160.97
06/15/01	<50	<0.18	<0.14	<0.18	<0.26	<0.24	5.92	NP	0.00	166.51	160.59
08/30/01	<50	<0.18	<0.14	<0.18	<0.26	<0.24	5.93	NP	0.00	166.51	160.58
<b>MONITORING WELL #RE-7</b>											
04/11/88	<50,000	17,000	4,400	600	8,400	-	-	-	-	-	-
04/09/90	16,000	7,000	1,200	640	1,600	-	5.93	NP	0.00	166.04	160.11
10/30/90	31,000	14,000	ND	ND	ND	-	8.21	NP	0.00	166.04	157.83
01/18/91	-	-	-	-	-	-	11.80	NP	0.00	166.04	154.24
02/12/91	-	-	-	-	-	-	10.80	FILM	0.00	166.04	155.24
03/20/91	120,000	12,000	2,800	490	6,600	-	9.96	NP	0.00	166.04	156.08
05/22/91	-	-	-	-	-	-	11.70	FILM	0.00	166.04	154.34
06/19/91	-	-	-	-	-	-	11.50	FILM	0.00	166.04	154.54
07/17/91	-	-	-	-	-	-	7.80	FILM	0.00	166.04	158.24
08/07/91	-	-	-	-	-	-	9.88	0.03	9.85	166.04	163.60
09/24/91	-	-	-	-	-	-	9.85	0.03	9.82	166.04	163.60
10/23/91	-	-	-	-	-	-	9.96	FILM	0.00	166.04	156.08
11/06/91	-	-	-	-	-	-	6.77	FILM	0.00	166.04	159.27
12/04/91	-	-	-	-	-	-	10.80	FILM	0.00	166.04	155.24
01/29/92	-	-	-	-	-	-	8.64	FILM	0.00	166.04	157.40
02/26/92	-	-	-	-	-	-	6.00	FILM	0.00	166.04	160.04
03/19/92	-	-	-	-	-	-	5.55	FILM	0.00	166.04	160.49
04/22/92	-	-	-	-	-	-	6.12	FILM	0.00	166.04	159.92
05/21/92	-	-	-	-	-	-	6.40	FILM	0.00	166.04	159.64
06/25/92	-	-	-	-	-	-	6.73	0.02	6.71	166.04	164.38
07/30/92	-	-	-	-	-	-	6.73	FILM	0.00	166.04	159.31
08/20/92	-	-	-	-	-	-	6.82	FILM	0.00	166.04	159.22
09/30/92	-	-	-	-	-	-	7.26	FILM	0.00	166.04	158.78
12/23/92	-	-	-	-	-	-	6.22	FILM	0.00	166.04	159.82
03/10/93	-	-	-	-	-	-	5.82	FILM	0.00	166.04	160.22
06/09/93	-	-	-	-	-	-	6.17	FILM	0.00	166.04	159.87
09/14/93	-	-	-	-	-	-	11.33	NP	0.00	166.04	154.71



**TABLE 1  
GROUNDWATER DATA  
THRIFTY OIL STATION #054, CASTRO VALLEY, CA.**

DATE SAMPLED	ANALYTICAL PARAMETERS						DEPTH TO GROUNDWATER (feet)	DEPTH TO PRODUCT (feet)	PRODUCT THICKNESS (feet)	CASING ELEVATION (feet)	GROUNDWATER ELEVATION (feet)
	TPH (ug/L)	BENZENE (ug/L)	TOLUENE (ug/L)	EthylBenzene (ug/L)	XYLENE (ug/L)	MTBE (ug/L)					
12/14/93	-	-	-	-	-	-	8.40	NP	0.00	166.04	157.64
03/02/94	-	-	-	-	-	-	6.82	NP	0.00	166.04	159.22
06/06/94	-	-	-	-	-	-	10.95	FILM	0.00	166.04	155.09
09/06/94	-	-	-	-	-	-	11.30	FILM	0.00	166.04	154.74
12/07/94	-	-	-	-	-	-	5.63	FILM	0.00	166.04	160.41
03/08/95	-	-	-	-	-	-	5.06	FILM	0.00	166.04	160.98
06/15/95	-	-	-	-	-	-	-	-	-	-	-
09/05/95	-	-	-	-	-	-	7.98	FILM	0.00	166.04	158.06
11/21/95	20,000	8,800	110	<30	310	-	7.32	NP	0.00	166.04	158.72
03/11/96	4,800	2,200	38	26	120	-	5.62	NP	0.00	166.04	160.42
06/19/96	4,400	3,300	49	5.8	70	-	6.40	NP	0.00	166.04	159.64
09/19/96	7,200	510	83	<0.3	710	130	6.20	NP	0.00	166.04	159.84
12/10/96	700	<0.3	<0.3	<0.3	<0.5	1,400	5.92	NP	0.00	166.04	160.12
03/12/97	660	0.31	<0.3	<0.3	<0.5	1,400	5.62	NP	0.00	166.04	160.42
06/12/97	320	<0.3	0.45	<0.3	<0.5	850	-	-	-	-	-
09/10/97	780	<0.3	<0.3	<0.3	<0.5	930	7.45	NP	0.00	166.04	158.59
12/09/97	14,000	3,500	3,700	<15	2,100	1,100	7.10	NP	0.00	166.04	158.94
03/03/98	6,100	2,500	18	<6	110	270	6.70	NP	0.00	166.04	159.34
07/08/98	1,300	8.7	<0.3	<0.3	<0.5	350	-	-	-	-	-
09/10/98	690	2.2	<0.3	<0.3	<0.5	350	7.04	NP	0.00	166.04	159.00
12/30/98	600	2.0	0.55	<0.3	<0.5	350	6.25	NP	0.00	166.04	159.79
03/15/99	350	0.71	<0.3	<0.3	<0.5	140	6.02	NP	0.00	166.04	160.02
06/22/99	5,900	2,100	16	4.6	48	170	6.35	NP	0.00	166.04	159.69
09/08/99	1,700	380	<3	<3	13	160	7.03	NP	0.00	166.04	159.01
12/01/99	930	3.7	<0.3	<0.3	<0.5	390	6.25	NP	0.00	166.04	159.79
03/23/00	581	5.4	5.3	1.9	7.3	*168/183	6.24	NP	0.00	166.04	159.80
06/08/00	<100	<5	<5	<5	<5	74	6.64	NP	0.00	166.04	159.40
09/27/00	236	<0.18	<0.14	<0.18	<0.26	*21 / 28	7.03	NP	0.00	166.04	159.01
12/13/00	<50	<0.18	<0.14	<0.18	<0.26	*13 / 19.8	6.63	NP	0.00	166.04	159.41
03/22/01	504	<0.18	<0.14	<0.18	1	*666 / 1,420	7.02	NP	0.00	166.04	159.02
06/15/01	144	5.0	<0.14	0.5	2	*269 / 408	7.02	NP	0.00	166.04	159.02
08/30/01	<50	<0.18	<0.14	<0.18	<0.26	<0.24	7.79	NP	0.00	166.04	158.25

**TABLE 1  
GROUNDWATER DATA  
THRIFTY OIL STATION #054, CASTRO VALLEY, CA.**

DATE SAMPLED	ANALYTICAL PARAMETERS						DEPTH TO GROUNDWATER (feet)	DEPTH TO PRODUCT (feet)	PRODUCT THICKNESS (feet)	CASING ELEVATION (feet)	GROUNDWATER ELEVATION (feet)
	HPH (ug/L)	BENZENE (ug/L)	TOLUENE (ug/L)	EthylBenzene (ug/L)	XYLENE (ug/L)	MTBE (ug/L)					
<b>MONITORING WELL #RS-8</b>											
08/07/91	ND	ND	ND	ND	ND	-	9.68	NP	0.00	164.32	154.64
09/27/91	ND	ND	ND	ND	ND	-	9.89	NP	0.00	164.32	154.43
10/23/91	ND	ND	ND	ND	ND	-	10.05	NP	0.00	164.32	154.27
11/06/91	ND	ND	ND	ND	ND	-	9.71	NP	0.00	164.32	154.61
12/04/91	ND	ND	ND	ND	ND	-	10.00	NP	0.00	164.32	154.32
01/29/92	ND	2.1	1.0	2.5	3.6	-	9.28	NP	0.00	164.32	155.04
02/26/92	ND	ND	0.7	ND	0.7	-	7.05	NP	0.00	164.32	157.27
03/19/92	ND	0.5	1.0	1.5	2.7	-	7.30	NP	0.00	164.32	157.02
04/22/92	ND	ND	ND	ND	ND	-	8.60	NP	0.00	164.32	155.72
05/21/92	ND	ND	ND	ND	ND	-	9.22	NP	0.00	164.32	155.10
06/25/92	ND	ND	ND	ND	ND	-	9.49	NP	0.00	164.32	154.83
07/30/92	ND	1.1	4.2	ND	3.0	-	9.55	NP	0.00	164.32	154.77
08/20/92	ND	2.0	4.7	ND	5.7	-	9.63	NP	0.00	164.32	154.69
09/30/92	ND	ND	ND	ND	ND	-	9.90	NP	0.00	164.32	154.42
12/23/92	ND	ND	ND	ND	ND	-	9.96	NP	0.00	164.32	154.36
05/10/93	ND	ND	ND	ND	ND	-	8.95	NP	0.00	164.32	155.37
06/09/93	ND	ND	ND	ND	ND	-	9.00	NP	0.00	164.32	155.32
09/14/93	200	0.3	ND	ND	ND	-	9.50	NP	0.00	164.32	154.82
12/14/93	ND	ND	ND	ND	ND	-	8.75	NP	0.00	164.32	155.57
03/02/94	<50	<0.3	<0.3	<0.3	<0.5	-	7.52	NP	0.00	164.32	156.80
06/06/94	54	<0.3	<0.3	<0.3	2.4	-	9.00	NP	0.00	164.32	155.32
09/06/94	<50	<0.3	<0.3	<0.3	<0.5	-	9.26	NP	0.00	164.32	155.06
12/07/94	130	2.5	1.9	1.3	3.6	-	8.67	NP	0.00	164.32	155.65
03/08/95	<100	<0.5	<0.5	<0.5	<1	-	8.34	NP	0.00	164.32	155.98
06/15/95	<100	1.0	<0.5	<0.5	<1	-	9.12	NP	0.00	164.32	155.20
09/05/95	<100	<0.5	<0.5	<0.5	<1	-	9.56	NP	0.00	164.32	154.76
11/21/95	<50	0.44	<0.3	<0.3	1.5	-	9.28	NP	0.00	164.32	155.04
03/11/96	<50	1.3	<0.3	<0.3	0.6	-	7.52	NP	0.00	164.32	156.80
06/19/96	640	72	20	34	150	-	7.80	NP	0.00	164.32	156.52
09/16/96	<50	<0.3	<0.3	<0.3	<0.5	20	9.18	NP	0.00	164.32	155.14
12/10/96	<50	<0.3	<0.3	<0.3	<0.5	<20	6.08	NP	0.00	164.32	158.24
03/12/97	53	0.45	<0.3	<0.3	<0.5	140	8.65	NP	0.00	164.32	155.67
06/12/97	<50	<0.3	<0.3	<0.3	<0.5	68	-	-	-	-	-
09/10/97	<50	<0.3	<0.3	<0.3	<0.5	<20	8.30	NP	0.00	164.32	156.02



**TABLE 1**  
**GROUNDWATER DATA**  
**THRIFTY OIL STATION #054, CASTRO VALLEY, CA.**

DATE SAMPLED	ANALYTICAL PARAMETERS						DEPTH TO GROUNDWATER (feet)	DEPTH TO PRODUCT (feet)	PRODUCT THICKNESS (feet)	CASING ELEVATION (feet)	GROUNDWATER ELEVATION (feet)
	TPH (ug/L)	BENZENE (ug/L)	TOLUENE (ug/L)	EthylBenzene (ug/L)	XYLENE (ug/L)	MTBE (ug/L)					
06/09/93	1,300	0.6	1.7	ND	7.5	-	3.55	NP	0.00	167.51	163.96
09/14/93	1,500	1.3	7.6	4.1	14	-	2.81	NP	0.00	167.51	164.70
12/14/93	560	ND	ND	ND	5.5	-	2.63	NP	0.00	167.51	164.88
03/02/94	1,100	<0.3	<0.3	<0.3	<0.5	-	2.60	NP	0.00	167.51	164.91
06/06/94	290	0.58	0.53	1.1	5.8	-	2.52	NP	0.00	167.51	164.99
09/06/94	890	<0.3	<0.3	<0.3	3.1	-	3.16	NP	0.00	167.51	164.35
12/07/94	940	22	23	10	32	-	5.18	NP	0.00	167.51	162.33
03/08/95	1,600	<0.5	<0.5	<0.5	2.3	-	4.57	NP	0.00	167.51	162.94
06/15/95	3,200	2.2	5.3	4.3	3.1	-	5.08	NP	0.00	167.51	162.43
09/05/95	1,100	<0.5	<0.5	<0.5	<1	-	5.72	NP	0.00	167.51	161.79
11/21/95	1,100	1.1	2.9	3.5	3.0	-	2.46	NP	0.00	167.51	165.05
03/11/96	440	0.7	0.34	<0.3	3.7	-	3.44	NP	0.00	167.51	164.07
06/19/96	580	3.8	0.49	1.2	<0.5	-	3.80	NP	0.00	167.51	163.71
09/16/96	490	<0.3	1.6	<0.3	<0.5	<20	3.80	NP	0.00	167.51	163.71
12/10/96	<50	<0.3	<0.3	<0.3	<0.5	<20	2.76	NP	0.00	167.51	164.75
03/12/97	<50	<0.3	0.42	<0.3	1.5	<20	3.20	NP	0.00	167.51	164.31
06/12/97	<50	<0.3	<0.3	<0.3	0.51	<20	-	-	-	-	-
09/10/97	<50	<0.3	<0.3	<0.3	<0.5	<20	4.24	NP	0.00	167.51	163.27
12/09/97	<50	<0.3	0.48	<0.3	<0.5	<20	2.72	NP	0.00	167.51	164.79
03/03/98	190	<0.3	<0.3	0.38	<0.5	<20	1.90	NP	0.00	167.51	165.61
07/08/98	<50	<0.3	<0.3	<0.3	<0.5	<5	-	-	-	-	-
09/10/98	<50	<0.3	<0.3	<0.3	<0.5	<5	2.72	NP	0.00	167.51	164.79
12/30/98	<50	<0.3	<0.3	<0.3	<0.5	<5	1.20	NP	0.00	167.51	166.31
03/15/99	<50	<0.3	<0.3	<0.3	<0.5	<5	4.25	NP	0.00	167.51	163.26
06/22/99	1,300	4.2	1.2	0.69	0.74	<5	3.70	NP	0.00	167.51	163.81
09/08/99	<50	<0.3	<0.3	<0.3	<0.5	<5	2.71	NP	0.00	167.51	164.80
12/01/99	<50	<0.3	<0.3	<0.3	<0.5	<5	2.70	NP	0.00	167.51	164.81
03/23/00	<50	<0.25	<0.25	<0.25	<0.5	<5	2.70	NP	0.00	167.51	164.81
06/08/00	585	<5	<5	<5	<5	821	2.72	NP	0.00	167.51	164.79
09/27/00	592	<0.18	<0.14	<0.18	<0.26	*1,180 / 1,360	2.72	NP	0.00	167.51	164.79
12/13/00	<50	<0.18	<0.14	<0.18	<0.26	*403 / 444	2.70	NP	0.00	167.51	164.81
03/22/01	425	<0.18	<0.14	<0.18	<0.26	*738 / 1,640	2.69	NP	0.00	167.51	164.82
06/15/01	<50	<0.18	<0.14	<0.18	<0.26	<0.24	2.68	NP	0.00	167.51	164.83
08/30/01	164	<0.18	<0.14	<0.18	<0.26	*396 / 284	2.68	NP	0.00	167.51	164.83

**TABLE 1  
GROUNDWATER DATA  
THRIFTY OIL STATION #054, CASTRO VALLEY, CA.**

DATE SAMPLED	ANALYTICAL PARAMETERS						DEPTH TO GROUNDWATER (feet)	DEPTH TO PRODUCT (feet)	PRODUCT THICKNESS (feet)	CASING ELEVATION (feet)	GROUNDWATER ELEVATION (feet)
	TPH (ug/L)	BENZENE (ug/L)	TOLUENE (ug/L)	EthylBenzene (ug/L)	XYLENE (ug/L)	MTBE (ug/L)					
<b>MONITORING WELL ARS-10</b>											
08/07/91	ND	ND	ND	ND	ND	-	6.16	NP	0.00	162.89	156.73
09/27/91	ND	ND	ND	ND	ND	-	6.48	NP	0.00	162.89	156.41
10/23/91	ND	ND	ND	ND	ND	-	7.37	NP	0.00	162.89	155.52
11/06/91	ND	ND	ND	ND	ND	-	6.44	NP	0.00	162.89	156.45
12/04/91	ND	ND	ND	ND	ND	-	7.02	NP	0.00	162.89	155.87
01/29/92	ND	ND	ND	ND	ND	-	6.78	NP	0.00	162.89	156.11
02/26/92	ND	ND	ND	ND	ND	-	8.33	NP	0.00	162.89	154.56
03/19/92	ND	ND	ND	ND	0.6	-	8.02	NP	0.00	162.89	154.87
04/22/92	ND	ND	ND	ND	ND	-	7.78	NP	0.00	162.89	155.11
05/21/92	ND	ND	0.6	ND	1.2	-	6.21	NP	0.00	162.89	156.68
06/25/92	ND	ND	ND	ND	ND	-	7.73	NP	0.00	162.89	155.16
07/30/92	ND	ND	0.5	ND	1.0	-	7.84	NP	0.00	162.89	155.05
08/20/92	ND	ND	ND	ND	ND	-	7.50	NP	0.00	162.89	155.39
09/30/92	ND	ND	ND	ND	ND	-	7.63	NP	0.00	162.89	155.26
12/23/92	ND	ND	ND	ND	ND	-	7.24	NP	0.00	162.89	155.65
03/10/93	ND	ND	ND	ND	ND	-	6.38	NP	0.00	162.89	156.51
06/09/93	ND	ND	ND	ND	ND	-	7.98	NP	0.00	162.89	154.91
09/14/93	ND	ND	ND	ND	ND	-	7.35	NP	0.00	162.89	155.54
03/02/94	< 50	<0.3	<0.3	<0.3	<0.3	-	7.00	NP	0.00	162.89	155.89
06/06/94	< 50	<0.3	<0.3	<0.3	<0.5	-	6.55	NP	0.00	162.89	156.34
09/06/94	< 50	<0.3	<0.3	<0.3	<0.5	-	7.63	NP	0.00	162.89	155.26
12/07/94	56	<0.3	<0.3	<0.5	2.1	-	5.92	NP	0.00	162.89	156.97
03/08/95	<100	<0.5	<0.5	<0.5	<1	-	7.84	NP	0.00	162.89	155.05
06/15/95	<100	<0.5	<0.5	<0.5	<1	-	6.97	NP	0.00	162.89	155.92
09/05/95	<100	<0.5	<0.5	<0.5	<1	-	8.14	NP	0.00	162.89	154.75
11/21/95	< 50	<0.3	<0.3	<0.3	<0.5	-	7.68	NP	0.00	162.89	155.21
03/11/96	< 50	<0.3	<0.3	<0.3	<0.5	-	6.76	NP	0.00	162.89	156.13
06/19/96	< 50	<0.3	<0.3	<0.3	<0.5	-	7.20	NP	0.00	162.89	155.69
09/16/96	< 50	<0.3	<0.3	<0.3	<0.5	<20	6.30	NP	0.00	162.89	156.59
12/10/96	< 50	<0.3	<0.3	<0.3	<0.5	<20	6.05	NP	0.00	162.89	156.84
03/12/97	< 50	<0.3	<0.3	<0.3	<0.5	<20	7.56	NP	0.00	162.89	155.33
06/12/97	< 50	<0.3	<0.3	<0.3	<0.5	<20	-	-	-	-	-
09/10/97	< 50	<0.3	<0.3	<0.3	<0.5	<20	7.55	NP	0.00	162.89	155.34
12/09/97	1,900	610	510	< 6	290	< 20	7.55	NP	0.00	162.89	155.34



**TABLE 1  
GROUNDWATER DATA  
THRIFTY OIL STATION #054, CASTRO VALLEY, CA.**

DATE SAMPLED	ANALYTICAL PARAMETERS						DEPTH TO	DEPTH TO	PRODUCT	CASING	GROUNDWATER
	TPH (ug/L)	BENZENE (ug/L)	TOLUENE (ug/L)	EthylBenzene (ug/L)	XYLENE (ug/L)	MTBE (ug/L)	GROUNDWATER (feet)	PRODUCT (feet)	THICKNESS (feet)	ELEVATION (feet)	ELEVATION (feet)
03/23/00	73	5.8	2.3	<0.25	<0.5	*11.2 / 7.9	4.85	NP	0.00	163.28	158.43
06/08/00	306	<5	<5	<5	<5	<5	7.90	NP	0.00	163.28	155.38
09/27/00	<50	1	<0.14	<0.18	<0.26	3 J / 3.6	9.44	NP	0.00	163.28	153.84
12/13/00	<50	<0.18	<0.14	<0.18	<0.26	<0.24	6.34	NP	0.00	163.28	156.94
03/22/01	408	<0.18	<0.14	<0.18	<0.26	*664 / 941	7.96	NP	0.00	163.28	155.32
06/15/01	<50	<0.18	<0.14	<0.18	<0.26	<0.24	7.87	NP	0.00	163.28	155.41
08/30/01	<50	<0.18	<0.14	<0.18	<0.26	<0.24	9.41	NP	0.00	163.28	153.87

**NOTE:** ND = Nondetectable  
 " - " = Not Analyzed / Not Available  
 NP = No Free Product  
 \*MTBE 8020/8260

Benzene, toluene, ethlybenzene, and xylene analyzed by EPA method 8020.  
 Total petroleum hydrocarbons (TPH) analyzed by EPA method 8015 modified for gasoline  
 Methyl-tert Butyl Ether (MTBE) analyzed by EPA method 8020  
 On June 8, 2000, BTEX and MTBE analyzed by EPA Method 8260B

# APPENDIX A





THRIFTY OIL CO. SS #054  
 2504 CASTRO VALLEY BLVD.  
 CASTRO VALLEY, CA 94546  
 DATE: 08.30.01

PROJECT STATUS REPORT

F R E E Q .	MONITORING				ODORS			FREE		WELLS CONNECTED TO SYSTEM (W)							
	OBSERVATION WELLS				(S=SLIGHT)			PRODUCT		CONNECT		INTEGRITY		VAPOR		WATER	
	NO.	DTW	DTR	PT	YES	NO	S	YES	NO	YES	NO	OK	NO	ON	OFF	ON	OFF
	M	PW-1	6.32	13.97			X			X		X	-		X		
M	PW-2	5.90	14.32			X			X		X	-		X			
M	RE-1	4.84	19.00			X			X		X	-		X			
M	RE-2	5.86	16.96			X			X		X	-		X			
M	RE-3	7.30	17.55			X			X		X	-		X			
M	RE-4	6.10	14.62			X			X		X	-		X			
M	RE-5	5.54	18.17			X			X		X	-		X			
M	RE-6	5.93	13.58			X			X		X	-		X			
M	RE-7	7.74	13.14			X			X		X	-		X			
M	RS-8	4.82	25.15			X			X		-	X		X			
M	RS-9	2.68	14.94			X			X		-	X		X			
M	RS-10	9.05	24.38			X			X		X			X			
M	RS-11	9.41	24.74			X			X		X			X			

SAVE SYSTEM WEEKLY

PARAMETER	U/M	DATA	PARAMETER	U/M	DATA
TIME	AM/PM		AIR FLOW	C F M	
WORKING	YES/NO		VAPOR FLOW	C F M	
RESTARTED	YES/NO		FUEL FLOW	C F M/H	
HOURS	#		WELL VACUUM	IN H2O	
ENGINE ROT.	RPM		L P G TANKS	%	#1:
ENGINE VACUUM	IN HG		GAS METER READING	-	N/A
TANK VACUUM	IN HG		WATER FLOWMETER	GALL.	

EXHAUST (By others) \_\_\_\_\_

INLET TO ENGINE \_\_\_\_\_

MAINTENANCE ES/100/400/800 \_\_\_\_\_ FOR SPECIFIC OPERATIONS SEE FIELD RECORD

WATER SAMPLING - CHECK ( ) WHEN DONE

EFFLUENT ( ) \_\_\_\_\_ INFLUENT ( ) \_\_\_\_\_ WELLS ( ) Q.-SEE C.CUST.

REMARKS: Q.W.S.

FREE PRODUCT REMOVED: APPROX. \_\_\_\_\_ GALLONS WATER REMOVED: APPROX. 261 GALLONS

DATA RECORDED BY: [Signature] INPUT BY: AJB 02/05/97

FIELD DATA -GROUNDWATER SAMPLING PROGRAM

Site: <u>2054</u>	Date: <u>08.30.01</u>
Address: _____	
Personnel: <u>SERBAN,</u>	Weather: <u>SUNNY DAY</u>
Well No: <u>PW1</u>	Equip: <u>BUTLER</u>

Before Purging:			
Total Well Depth: (ft.)	<u>13.97</u>	Well Diameter	<u>4"</u>
Depth to Water (ft)	<u>6.32</u>	Est. Purge Volume:	<u>20</u>

Sampling Data:							
Initial Turbidity:				Final Turbidity:			
Time	<u>12:06</u>	<u>12:09</u>	<u>12:12</u>	<u>12:16</u>	<u>12:19</u>	<u>12:22</u>	<u>12:25</u>
EC	<u>1600</u>	<u>1660</u>	<u>1650</u>	<u>1670</u>	<u>1670</u>	<u>1680</u>	<u>1680</u>
pH	<u>6.03</u>	<u>5.98</u>	<u>5.97</u>	<u>5.87</u>	<u>5.88</u>	<u>5.97</u>	<u>5.88</u>
Temp	<u>21.3</u>	<u>21.3</u>	<u>21.1</u>	<u>20.8</u>	<u>20.6</u>	<u>20.4</u>	<u>20.4</u>
Gal.	<u>2</u>	<u>5</u>	<u>8</u>	<u>11</u>	<u>14</u>	<u>17</u>	<u>20</u>
Time							
EC							
pH							
Temp							
Gal.							

After Purging/Before Sample Collection	
Depth to Water (ft.)	<u>10.20</u>
Total Well Depth(ft.)	<u>13.97</u>

## FIELD DATA - GROUNDWATER SAMPLING PROGRAM

Site:	# 054	Date:	08.30.01
Address:			
Personnel:	SERBAN	Weather:	SUNNY DAY
Well No:	PW-2	Equip:	BAILER

<b>Before Purging:</b>			
Total Well Depth: (ft.)	14.32	Well Diameter	4"
Depth to Water (ft)	5.90	Est. Purge Volume:	22

<b>Sampling Data:</b>							
<b>Initial Turbidity:</b>				<b>Final Turbidity:</b>			
Time	10:56	10:59	11:02	11:05	11:08	11:11	11:15
EC	1650	1670	1640	1670	1630	1640	1620
pH	6.09	6.16	6.20	6.16	6.16	6.20	6.18
Temp	21.3	21.1	20.9	20.7	20.6	20.6	20.5
Gal.	3	6	9	12	15	18	22
Time							
EC							
pH							
Temp							
Gal.							

<b>After Purging/Before Sample Collection</b>	
Depth to Water (ft.)	9.20
Total Well Depth (ft.)	14.32

FIELD DATA - GROUNDWATER SAMPLING PROGRAM

Site:	# 054	Date:	08.30.01
Address:			
Personnel:	BERBAH	Weather:	SUNNY DAY
Well No:	RE-1	Equip:	BAUER

Before Purging:			
Total Well Depth: (ft.)	19.00	Well Diameter	4.4
Depth to Water (ft)	4.84	Est. Purge Volume:	37

Sampling Data:							
Initial Turbidity:				Final Turbidity:			
Time	10:18	10:23	10:28	10:34	10:39	10:44	10:50
EC	710	730	740	710	730	740	760
pH	6.20	6.26	6.24	6.30	6.24	6.30	6.30
Temp	21.3	21.1	20.4	20.7	20.7	20.6	20.4
Gal.	5	10	15	21	26	31	37
Time							
EC							
pH							
Temp							
Gal.							

After Purging/Before Sample Collection	
Depth to Water (ft.)	9.14
Total Well Depth(ft.)	19.00

## FIELD DATA - GROUNDWATER SAMPLING PROGRAM

Site:	<u># 054</u>	Date:	<u>08.30.01</u>
Address:			
Personnel:	<u>SERBAK</u>	Weather:	<u>SUNNY DAY</u>
Well No:	<u>RE-2</u>	Equip:	<u>BAUER</u>

<b>Before Purging:</b>			
Total Well Depth: (ft.)	<u>16.96</u>	Well Diameter	<u>44</u>
Depth to Water (ft)	<u>5.86</u>	Est. Purge Volume:	<u>29</u>

<b>Sampling Data:</b>							
<b>Initial Turbidity:</b>				<b>Final Turbidity:</b>			
Time	<u>13:00</u>	<u>13:04</u>	<u>13:08</u>	<u>13:12</u>	<u>13:16</u>	<u>13:20</u>	<u>13:25</u>
EC	<u>660</u>	<u>640</u>	<u>660</u>	<u>670</u>	<u>690</u>	<u>210</u>	<u>210</u>
pH	<u>6.20</u>	<u>6.18</u>	<u>6.13</u>	<u>6.11</u>	<u>6.03</u>	<u>6.11</u>	<u>6.11</u>
Temp	<u>71.3</u>	<u>21.2</u>	<u>21.2</u>	<u>20.9</u>	<u>20.6</u>	<u>20.6</u>	<u>20.6</u>
Gal.	<u>4</u>	<u>8</u>	<u>12</u>	<u>16</u>	<u>20</u>	<u>24</u>	<u>29</u>
Time							
EC							
pH							
Temp							
Gal.							

<b>After Purging/Before Sample Collection</b>	
Depth to Water (ft.)	<u>9.30</u> Total Well Depth(ft.) <u>16.96</u>

## FIELD DATA - GROUNDWATER SAMPLING PROGRAM

Site:	# 054	Date:	08.30.01
Address:			
Personnel:	SERBAN	Weather:	SUNNY DAY
Well No:	RE-3	Equip:	BILFAR

<b>Before Purging:</b>			
Total Well Depth: (ft.)	17.55	Well Diameter	44
Depth to Water (ft)	7.60	Est. Purge Volume:	26

<b>Sampling Data:</b>							
<b>Initial Turbidity:</b>				<b>Final Turbidity:</b>			
Time	11:17	11:21	11:25	11:28	11:32	11:36	11:40
EC	1600	1590	1560	1230	1240	1220	1220
pH	6.20	6.18	6.13	6.18	6.20	6.18	6.20
Temp	21.3	21.1	20.9	20.9	20.7	20.6	20.6
Gal.	3	7	11	14	18	22	26
Time							
EC							
pH							
Temp							
Gal.							

<b>After Purging/Before Sample Collection</b>	
Depth to Water (ft.)	10.30
Total Well Depth (ft.)	17.55

## FIELD DATA - GROUNDWATER SAMPLING PROGRAM

Site:	# 054	Date:	08.30.01
Address:			
Personnel:	STERRON	Weather:	SUNNY DAY
Well No:	RE-4	Equip:	BILFER

Before Purging:			
Total Well Depth: (ft.)	14.52	Well Diameter	4"
Depth to Water (ft)	6.10	Est. Purge Volume:	22

Sampling Data:							
Initial Turbidity:				Final Turbidity:			
Time	9:21	9:24	9:27	9:30	9:33	9:36	9:40
EC	1460	1470	1470	1460	1450	1440	1420
pH	6.21	6.27	6.27	6.26	6.26	6.27	6.27
Temp	21.1	20.9	20.8	20.8	20.6	20.6	20.0
Gal.	3	6	9	12	15	18	22
Time							
EC							
pH							
Temp							
Gal.							

After Purging/Before Sample Collection	
Depth to Water (ft.)	10.10
Total Well Depth (ft.)	14.52

## FIELD DATA - GROUNDWATER SAMPLING PROGRAM

Site:	H 054	Date:	08.30.01
Address:			
Personnel:	SERBAY	Weather:	SUNNY DAY
Well No:	RE-5	Equip:	BAUER

<b>Before Purging:</b>			
Total Well Depth: (ft.)	18.17	Well Diameter	4"
Depth to Water (ft.)	5.54	Est. Purge Volume:	33

<b>Sampling Data:</b>							
Initial Turbidity:				Final Turbidity:			
Time	9:41	9:46	9:51	9:55	10:00	10:05	10:10
EC	1670	1690	1680	1690	1690	1680	1680
pH	6.03	5.91	5.90	5.91	5.90	5.90	5.91
Temp	21.3	21.1	21.1	20.9	20.8	20.7	20.7
Gal.	4	9	14	18	25	28	33
Time							
EC							
pH							
Temp							
Gal.							

<b>After Purging/Before Sample Collection</b>	
Depth to Water (ft.)	9.40
Total Well Depth (ft.)	18.17



FIELD DATA -GROUNDWATER SAMPLING PROGRAM

Site:	# 054	Date:	08.30.01
Address:			
Personnel:	SERBAN,	Weather:	SUNNY DAY
Well No:	RE-6	Equip:	BAUER

Before Purging:			
Total Well Depth: (ft.)	13.58	Well Diameter	4"
Depth to Water (ft)	5.93	Est. Purge Volume:	20

Sampling Data:							
Initial Turbidity:				Final Turbidity:			
Time	12:32	12:35	12:38	12:41	12:44	12:47	12:50
EC	670	680	690	680	640	630	620
pH	6.03	5.98	5.97	5.88	5.97	5.96	5.96
Temp	21.3	21.1	21.1	20.8	20.6	20.6	20.4
Gal.	2	5	8	11	14	17	20
Time							
EC							
pH							
Temp							
Gal.							

After Purging/Before Sample Collection	
Depth to Water (ft.)	9.42
Total Well Depth(ft).	13.58

## FIELD DATA - GROUNDWATER SAMPLING PROGRAM

Site:	# 054	Date:	08.30.01
Address:			
Personnel:	SERBAN P.	Weather:	SUNNY DAY
Well No:	RE-7	Equip:	BAUER

<b>Before Purging:</b>			
Total Well Depth: (ft.)	13.14	Well Diameter	4"
Depth to Water (ft.)	7.74	Est. Purge Volume:	14

<b>Sampling Data:</b>							
<b>Initial Turbidity:</b>				<b>Final Turbidity:</b>			
Time	11:48	11:50	11:52	11:54	11:56	11:58	12:00
EC	930	950	970	1120	1110	1130	1170
pH	5.84	5.79	5.74	5.72	5.76	5.76	5.72
Temp	21.3	21.2	21.2	20.9	20.7	20.7	20.6
Gal.	2	4	6	8	10	12	14
Time							
EC							
pH							
Temp							
Gal.							

<b>After Purging/Before Sample Collection</b>	
Depth to Water (ft.)	11.20
Total Well Depth (ft.)	13.14

FIELD DATA -GROUNDWATER SAMPLING PROGRAM

Site:	# 054	Date:	08.30.01
Address:			
Personnel:	SERBAM	Weather:	SUNNY DAY
Well No:	RS-8	Equip:	BAUER

Before Purging:			
Total Well Depth: (ft.)	25.15	Well Diameter	24
Depth to Water (ft)	9.82	Est. Purge Volume:	10

Sampling Data:							
Initial Turbidity:				Final Turbidity:			
Time	9:06	9:07	9:09	9:10	9:12	9:13	9:15
EC	1690	1670	1630	1620	1630	1620	1620
pH	6.20	6.18	6.11	6.09	6.03	6.01	6.03
Temp	21.3	21.1	20.9	20.7	20.6	20.6	20.5
Gal.	1	2	4	5	7	8	10
Time							
EC							
pH							
Temp							
Gal.							

After Purging/Before Sample Collection			
Depth to Water (ft.)	11.30	Total Well Depth(ft.)	25.15

## FIELD DATA - GROUNDWATER SAMPLING PROGRAM

Site:	d 054	Date:	08.30.01
Address:			
Personnel:	SEARBAW,	Weather:	SUNNY DAY
Well No:	RS-9	Equip:	BAICER

<b>Before Purging:</b>			
Total Well Depth: (ft.)	14.94	Well Diameter	2 <sup>4</sup>
Depth to Water (ft)	2.68	Est. Purge Volume:	8

Sampling Data:							
Initial Turbidity:				Final Turbidity:			
Time	13:33	13:34	13:35	13:36	13:37	13:38	13:40
EC	670	680	690	680	690	680	680
pH	6.08	6.06	6.08	6.07	6.06	6.07	6.07
Temp	70.1	69.8	69.7	69.8	69.5	69.4	69.4
Gal.	1	2	3	4	5	6	8
Time							
EC							
pH							
Temp							
Gal.							

<b>After Purging/Before Sample Collection</b>	
Depth to Water (ft.)	6.30
Total Well Depth (ft.)	14.94

FIELD DATA - GROUNDWATER SAMPLING PROGRAM

Site: <u>      # 054      </u>	Date: <u>      08.30.01      </u>
Address: _____	
Personnel: <u>      SERBAN      </u>	Weather: <u>      SUNNY DAY      </u>
Well No: <u>      RS 10      </u>	Equip: <u>      BAILER      </u>

Before Purging:	
Total Well Depth: (ft.) <u>      24.38      </u>	Well Diameter <u>      2'      </u>
Depth to Water (ft.) <u>      9.05      </u>	Est. Purge Volume: <u>      10      </u>

Sampling Data:							
Initial Turbidity:				Final Turbidity:			
Time	8:51	8:52	8:54	8:55	8:57	8:58	9:00
EC	1640	1710	1730	1710	1740	1730	1740
pH	6.09	6.03	6.01	5.90	5.93	5.91	5.90
Temp	21.7	21.3	21.1	20.9	20.7	20.6	20.4
Gal.	1	2	4	5	7	8	10
Time							
EC							
pH							
Temp							
Gal.							

After Purging/Before Sample Collection	
Depth to Water (ft.) <u>      12.43      </u>	Total Well Depth(ft.) <u>      24.38      </u>

## FIELD DATA - GROUNDWATER SAMPLING PROGRAM

Site: <u>12054</u>	Date: <u>08-30-01</u>
Address: _____	
Personnel: <u>SERBOM</u>	Weather: <u>SUNNY DAY</u>
Well No: <u>RS-11</u>	Equip: <u>BAILER</u>

<b>Before Purging:</b>	
Total Well Depth: (ft.) <u>24.74</u>	Well Diameter <u>24</u>
Depth to Water (ft) <u>9.41</u>	Est. Purge Volume: <u>10</u>

<b>Sampling Data:</b>							
<b>Initial Turbidity:</b>				<b>Final Turbidity:</b>			
Time	11:36	11:37	11:39	11:40	11:42	11:43	11:45
EC	600	640	660	680	720	730	740
pH	6.13	6.09	6.11	6.04	6.03	6.01	6.03
Temp	71.4	71.2	71.1	70.9	70.9	70.7	70.7
Gal.	1	2	4	5	7	8	10
Time							
EC							
pH							
Temp							
Gal.							

<b>After Purging/Before Sample Collection</b>	
Depth to Water (ft.) <u>12.32</u>	Total Well Depth(ft) <u>24.74</u>

# APPENDIX B



**ASSOCIATED LABORATORIES**

806 North Batavia - Orange, California 92868 - 714/771-6900

FAX 714/538-1209

CLIENT Thrifty Oil (8871)  
ATTN: Jeff Suryakusuma  
13539 E. Foster Rd.  
Santa Fe Springs, CA 90670

LAB REQUEST 79080

REPORTED 09/24/2001

RECEIVED 08/31/2001

PROJECT Station #054  
2504 Castro Valley Blvd., Castro Valley

SUBMITTER Client

COMMENTS

This laboratory request covers the following listed samples which were analyzed for the parameters indicated on the attached Analytical Result Report. All analyses were conducted using the appropriate methods as indicated on the report. This cover letter is an integral part of the final report.

<u>Order No.</u>	<u>Client Sample Identification</u>
290063	TOC 054 RS10
290064	TOC 054 RS 8
290065	TOC 054 RE 4
290066	TOC 054 RE 5
290067	TOC 054 RE 1
290068	TOC 054 PW 2
290069	TOC 054 RE 3
290070	TOC 054 RS11
290071	TOC 054 RE 7
290072	TOC 054 PW 1
290073	TOC 054 RE 6
290074	TOC 054 RE 2

Thank you for the opportunity to be of service to your company. Please feel free to call if there are any questions regarding this report or if we can be of further service.

ASSOCIATED LABORATORIES by,

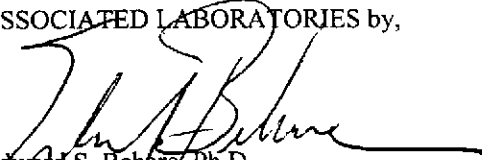
  
Edward S. Behare, Ph.D.  
Vice President

NOTE: Unless notified in writing, all samples will be discarded by appropriate disposal protocol 30 days from date reported.

The reports of the Associated Laboratories are confidential property of our clients and may not be reproduced or used for publication in part or in full without our written permission. This is for the mutual protection of the public, our clients, and ourselves.

TESTING & CONSULTING  
Chemical  
Microbiological  
Environmental



CLIENT Thrifty Oil (8871)  
ATTN: Jeff Suryakusuma  
13539 E. Foster Rd.  
Santa Fe Springs, CA 90670

LAB REQUEST 79080

REPORTED 09/24/2001

RECEIVED 08/31/2001

PROJECT Station #054  
2504 Castro Valley Blvd., Castro Valley

SUBMITTER Client

### COMMENTS

This laboratory request covers the following listed samples which were analyzed for the parameters indicated on the attached Analytical Result Report. All analyses were conducted using the appropriate methods as indicated on the report. This cover letter is an integral part of the final report.

Order No.

290075

290076

Client Sample Identification

TOC 054 RS 9

TOC 054 Trip Blank

Thank you for the opportunity to be of service to your company. Please feel free to call if there are any questions regarding this report or if we can be of further service.

ASSOCIATED LABORATORIES by,

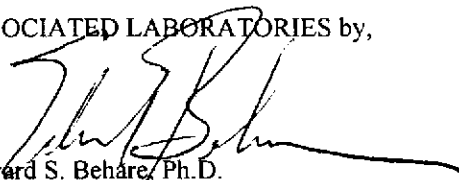
  
Edward S. Behare, Ph.D.  
Vice President

*NOTE: Unless notified in writing, all samples will be discarded by appropriate disposal protocol 30 days from date reported.*

The reports of the Associated Laboratories are confidential property of our clients and may not be reproduced or used for publication in part or in full without our written permission. This is for the mutual protection of the public, our clients, and ourselves.

TESTING & CONSULTING  
Chemical  
Microbiological  
Environmental

Order #: 290063

Client Sample ID TOC 054 RS10

Matrix: WATER

Date Sampled: 08/30/2001 Time Sampled: 15:50

Analyte	Result	DF	PQL	MDL	Units	Date/Analyst
---------	--------	----	-----	-----	-------	--------------

## 8021B BTEX + MTBE

Benzene	ND	1	0.3	0.18	ug/L	09/05/01 HP
Ethyl benzene	ND	1	0.3	0.18	ug/L	09/05/01 HP
Methyl t - butyl ether	ND	1	5	0.24	ug/L	09/05/01 HP
Toluene	ND	1	0.3	0.14	ug/L	09/05/01 HP
Xylene (total)	ND	1	0.6	0.26	ug/L	09/05/01 HP

## 8015M - Total Petroleum Hydrocarbons

Gasoline	ND	1	50	50	ug/L	09/05/01 HP
----------	----	---	----	----	------	-------------

Order #: 290064

Client Sample ID TOC 054 RS 8

Matrix: WATER

Date Sampled: 08/30/2001 Time Sampled: 16:00

Analyte	Result	DF	PQL	MDL	Units	Date/Analyst
---------	--------	----	-----	-----	-------	--------------

## 8021B BTEX + MTBE

Benzene	ND	1	0.3	0.18	ug/L	09/05/01 HP
Ethyl benzene	ND	1	0.3	0.18	ug/L	09/05/01 HP
Methyl t - butyl ether	ND	1	5	0.24	ug/L	09/05/01 HP
Toluene	ND	1	0.3	0.14	ug/L	09/05/01 HP
Xylene (total)	ND	1	0.6	0.26	ug/L	09/05/01 HP

## 8015M - Total Petroleum Hydrocarbons

Gasoline	ND	1	50	50	ug/L	09/05/01 HP
----------	----	---	----	----	------	-------------

Order #: 290065

Client Sample ID TOC 054 RE 4

Matrix: WATER

Date Sampled: 08/30/2001 Time Sampled: 16:05

Analyte	Result	DF	PQL	MDL	Units	Date/Analyst
---------	--------	----	-----	-----	-------	--------------

## 8021B BTEX + MTBE

Benzene	ND	1	0.3	0.18	ug/L	09/05/01 HP
Ethyl benzene	ND	1	0.3	0.18	ug/L	09/05/01 HP
Methyl t - butyl ether	ND	1	5	0.24	ug/L	09/05/01 HP
Toluene	ND	1	0.3	0.14	ug/L	09/05/01 HP
Xylene (total)	ND	1	0.6	0.26	ug/L	09/05/01 HP

## 8015M - Total Petroleum Hydrocarbons

Gasoline	ND	1	50	50	ug/L	09/05/01 HP
----------	----	---	----	----	------	-------------

PQL = Practical Quantitation Limit, MDL = Method detection limit, DF = Dilution Factor  
 ND = Not detected below indicated MDL, J=Trace



Order #: 290066

Client Sample ID TOC 054 RE 5

Matrix: WATER

Date Sampled: 08/30/2001 Time Sampled: 16:10

Analyte	Result	DF	PQL	MDL	Units	Date/Analyst
---------	--------	----	-----	-----	-------	--------------

## 8021B BTEX + MTBE

Benzene	ND	1	0.3	0.18	ug/L	09/05/01 HP
Ethyl benzene	ND	1	0.3	0.18	ug/L	09/05/01 HP
Methyl t - butyl ether	ND	1	5	0.24	ug/L	09/05/01 HP
Toluene	ND	1	0.3	0.14	ug/L	09/05/01 HP
Xylene (total)	ND	1	0.6	0.26	ug/L	09/05/01 HP

## 8015M - Total Petroleum Hydrocarbons

Gasoline	ND	1	50	50	ug/L	09/05/01 HP
----------	----	---	----	----	------	-------------

Order #: 290067

Client Sample ID TOC 054 RE 1

Matrix: WATER

Date Sampled: 08/30/2001 Time Sampled: 16:15

Analyte	Result	DF	PQL	MDL	Units	Date/Analyst
---------	--------	----	-----	-----	-------	--------------

## 8021B BTEX + MTBE

Benzene	ND	1	0.3	0.18	ug/L	09/05/01 HP
Ethyl benzene	ND	1	0.3	0.18	ug/L	09/05/01 HP
Methyl t - butyl ether	ND	1	5	0.24	ug/L	09/05/01 HP
Toluene	ND	1	0.3	0.14	ug/L	09/05/01 HP
Xylene (total)	ND	1	0.6	0.26	ug/L	09/05/01 HP

## 8015M - Total Petroleum Hydrocarbons

Gasoline	ND	1	50	50	ug/L	09/05/01 HP
----------	----	---	----	----	------	-------------

Order #: 290068

Client Sample ID TOC 054 PW 2

Matrix: WATER

Date Sampled: 08/30/2001 Time Sampled: 16:20

Analyte	Result	DF	PQL	MDL	Units	Date/Analyst
---------	--------	----	-----	-----	-------	--------------

## 8021B BTEX + MTBE

Benzene	ND	1	0.3	0.18	ug/L	09/05/01 HP
Ethyl benzene	ND	1	0.3	0.18	ug/L	09/05/01 HP
Methyl t - butyl ether	ND	1	5	0.24	ug/L	09/05/01 HP
Toluene	ND	1	0.3	0.14	ug/L	09/05/01 HP
Xylene (total)	ND	1	0.6	0.26	ug/L	09/05/01 HP

PQL = Practical Quantitation Limit, MDL = Method detection limit, DF = Dilution Factor  
 ND = Not detected below indicated MDL, J=Trace



**8015M - Total Petroleum Hydrocarbons**

Gasoline	ND	1	50	50	ug/L	09/05/01	HP
----------	----	---	----	----	------	----------	----

**Order #:** 290069

**Client Sample ID** TOC 054 RE 3

**Matrix:** WATER

**Date Sampled:** 08/30/2001 **Time Sampled:** 16:25

Analyte	Result	DF	PQL	MDL	Units	Date/Analyst
---------	--------	----	-----	-----	-------	--------------

**8021B BTEX + MTBE**

Benzene	ND	1	0.3	0.18	ug/L	09/05/01	HP
Ethyl benzene	ND	1	0.3	0.18	ug/L	09/05/01	HP
Methyl t - butyl ether	ND	1	5	0.24	ug/L	09/05/01	HP
Toluene	ND	1	0.3	0.14	ug/L	09/05/01	HP
Xylene (total)	ND	1	0.6	0.26	ug/L	09/05/01	HP

**8015M - Total Petroleum Hydrocarbons**

Gasoline	ND	1	50	50	ug/L	09/05/01	HP
----------	----	---	----	----	------	----------	----

**Order #:** 290070

**Client Sample ID** TOC 054 RS11

**Matrix:** WATER

**Date Sampled:** 08/30/2001 **Time Sampled:** 16:30

Analyte	Result	DF	PQL	MDL	Units	Date/Analyst
---------	--------	----	-----	-----	-------	--------------

**8021B BTEX + MTBE**

Benzene	ND	1	0.3	0.18	ug/L	09/05/01	HP
Ethyl benzene	ND	1	0.3	0.18	ug/L	09/05/01	HP
Methyl t - butyl ether	ND	1	5	0.24	ug/L	09/05/01	HP
Toluene	ND	1	0.3	0.14	ug/L	09/05/01	HP
Xylene (total)	ND	1	0.6	0.26	ug/L	09/05/01	HP

**8015M - Total Petroleum Hydrocarbons**

Gasoline	ND	1	50	50	ug/L	09/05/01	HP
----------	----	---	----	----	------	----------	----

**Order #:** 290071

**Client Sample ID** TOC 054 RE 7

**Matrix:** WATER

**Date Sampled:** 08/30/2001 **Time Sampled:** 16:35

Analyte	Result	DF	PQL	MDL	Units	Date/Analyst
---------	--------	----	-----	-----	-------	--------------

PQL = Practical Quantitation Limit, MDL = Method detection limit, DF = Dilution Factor  
 ND = Not detected below indicated MDL, J=Trace



**8021B BTEX + MTBE**

Benzene	ND	1	0.3	0.18	ug/L	09/05/01	HP
Ethyl benzene	ND	1	0.3	0.18	ug/L	09/05/01	HP
Methyl t - butyl ether	ND	1	5	0.24	ug/L	09/05/01	HP
Toluene	ND	1	0.3	0.14	ug/L	09/05/01	HP
Xylene (total)	ND	1	0.6	0.26	ug/L	09/05/01	HP

**8015M - Total Petroleum Hydrocarbons**

Gasoline	ND	1	50	50	ug/L	09/05/01	HP
----------	----	---	----	----	------	----------	----

**Order #:** 290072**Client Sample ID** TOC 054 PW 1

Matrix: WATER

Date Sampled: 08/30/2001 Time Sampled: 16:45

Analyte	Result	DF	PQL	MDL	Units	Date/Analyst
---------	--------	----	-----	-----	-------	--------------

**8021B BTEX + MTBE**

Benzene	ND	1	0.3	0.18	ug/L	09/05/01	HP
Ethyl benzene	ND	1	0.3	0.18	ug/L	09/05/01	HP
Methyl t - butyl ether	ND	1	5	0.24	ug/L	09/05/01	HP
Toluene	ND	1	0.3	0.14	ug/L	09/05/01	HP
Xylene (total)	ND	1	0.6	0.26	ug/L	09/05/01	HP

**8015M - Total Petroleum Hydrocarbons**

Gasoline	ND	1	50	50	ug/L	09/05/01	HP
----------	----	---	----	----	------	----------	----

**Order #:** 290073**Client Sample ID** TOC 054 RE 6

Matrix: WATER

Date Sampled: 08/30/2001 Time Sampled: 16:50

Analyte	Result	DF	PQL	MDL	Units	Date/Analyst
---------	--------	----	-----	-----	-------	--------------

**8021B BTEX + MTBE**

Benzene	ND	1	0.3	0.18	ug/L	09/05/01	HP
Ethyl benzene	ND	1	0.3	0.18	ug/L	09/05/01	HP
Methyl t - butyl ether	ND	1	5	0.24	ug/L	09/05/01	HP
Toluene	ND	1	0.3	0.14	ug/L	09/05/01	HP
Xylene (total)	ND	1	0.6	0.26	ug/L	09/05/01	HP

**8015M - Total Petroleum Hydrocarbons**

Gasoline	ND	1	50	50	ug/L	09/05/01	HP
----------	----	---	----	----	------	----------	----

**Order #:** 290074**Client Sample ID** TOC 054 RE 2

Matrix: WATER

Date Sampled: 08/30/2001 Time Sampled: 16:55

PQL = Practical Quantitation Limit, MDL = Method detection limit, DF = Dilution Factor  
 ND = Not detected below indicated MDL, J=Trace



Analyte	Result	DF	PQL	MDL	Units	Date/Analyst
---------	--------	----	-----	-----	-------	--------------

**8021B BTEX + MTBE**

Benzene	ND	1	0.3	0.18	ug/L	09/05/01 HP
Ethyl benzene	ND	1	0.3	0.18	ug/L	09/05/01 HP
Methyl t - butyl ether	ND	1	5	0.24	ug/L	09/05/01 HP
Toluene	ND	1	0.3	0.14	ug/L	09/05/01 HP
Xylene (total)	ND	1	0.6	0.26	ug/L	09/05/01 HP

**8015M - Total Petroleum Hydrocarbons**

Gasoline	ND	1	50	50	ug/L	09/05/01 HP
----------	----	---	----	----	------	-------------

<b>Order #:</b> 290075	<b>Client Sample ID</b> TOC 054 RS 9
<b>Matrix:</b> WATER	<b>Date Sampled:</b> 08/30/2001 <b>Time Sampled:</b> 17:00

**8021B BTEX + MTBE**

Analyte	Result	DF	PQL	MDL	Units	Date/Analyst
Benzene	ND	1	0.3	0.18	ug/L	09/05/01 HP
Ethyl benzene	ND	1	0.3	0.18	ug/L	09/05/01 HP
Methyl t - butyl ether	396	10	50.0	0.24	ug/L	09/05/01 HP
Toluene	ND	1	0.3	0.14	ug/L	09/05/01 HP
Xylene (total)	ND	1	0.6	0.26	ug/L	09/05/01 HP

**8260B BTEX/MTBE Only**

Methyl-tert-butylether (MTBE)	284	10	10.0	0.6	ug/L	09/21/01 DP
-------------------------------	-----	----	------	-----	------	-------------

**8015M - Total Petroleum Hydrocarbons**

Gasoline	164	1	50	50	ug/L	09/05/01 HP
----------	-----	---	----	----	------	-------------

<b>Order #:</b> 290076	<b>Client Sample ID</b> TOC 054 Trip Blank
<b>Matrix:</b> WATER	<b>Date Sampled:</b> 08/30/2001 <b>Time Sampled:</b> 15:50

**8021B BTEX + MTBE**

Benzene	ND	1	0.3	0.18	ug/L	09/05/01 HP
Ethyl benzene	ND	1	0.3	0.18	ug/L	09/05/01 HP
Toluene	ND	1	0.3	0.14	ug/L	09/05/01 HP
Xylene (total)	ND	1	0.6	0.26	ug/L	09/05/01 HP

**8015M - Total Petroleum Hydrocarbons**

Gasoline	ND	1	50	50	ug/L	09/05/01 HP
----------	----	---	----	----	------	-------------

PQL = Practical Quantitation Limit, MDL = Method detection limit, DF = Dilution Factor  
 ND = Not detected below indicated MDL, J=Trace

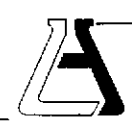

**ASSOCIATED LABORATORIES LAB REQUEST RESULTS SUMMARY**

Client: Thrifty Oil  
 Jeff Suryakusuma  
 13539 E. Foster Rd.  
 Santa Fe Springs, CA 90670

Lab Request: 79080  
 Date Received: 8/31/2001  
 Print Date: 09/24/2001

Project: Station #054  
 2504 Castro Valley Blvd., Castro Valley

Sample ID.	Gasoline	Benzene	Toluene	Ethyl benzene	Xylene (total)	MTBE	MTBE by EPA8260
TOC 054 PW 1	ND	ND	ND	ND	ND	ND	
TOC 054 PW 2	ND	ND	ND	ND	ND	ND	
TOC 054 RE 1	ND	ND	ND	ND	ND	ND	
TOC 054 RE 2	ND	ND	ND	ND	ND	ND	
TOC 054 RE 3	ND	ND	ND	ND	ND	ND	
TOC 054 RE 4	ND	ND	ND	ND	ND	ND	
TOC 054 RE 5	ND	ND	ND	ND	ND	ND	
TOC 054 RE 6	ND	ND	ND	ND	ND	ND	
TOC 054 RE 7	ND	ND	ND	ND	ND	ND	
TOC 054 RS 8	ND	ND	ND	ND	ND	ND	
TOC 054 RS 9	164 ug/L	ND	ND	ND	ND	396 ug/L	284 ug/L
TOC 054 RS10	ND	ND	ND	ND	ND	ND	
TOC 054 RS11	ND	ND	ND	ND	ND	ND	
TOC 054 Trip Blank	ND	ND	ND	ND	ND		

ND = Not Detected  
 Blank Field = Component not analyzed by this method.

**ASSOCIATED LABORATORIES**  
LCS REPORT FORM

QC Sample: LCS / LCSD water samples

Method : 8260 / 624

Analysis Date: 09/21/01

Applies to: LR 79996, 79828, 79080

REPORTING UNITS = ug/L

**Lab Controlled Spike / Lab Controlled Spike Duplicate**

Test	Sample Result	Spike Added	LCS Spike	LCS Spk. Dup	%Rec LCS	%Rec LCS D	% RPD	QC Limits	
								RPD	%REC
1,1-Dichloroethene	ND	50.0	55.76	56.34	112	113	1	22	59-172
MTBE	ND	50.0	55.32	54.94	111	110	1	24	62-137
Benzene	ND	50.0	55.07	55.82	110	112	1	24	62-137
Trichloroethene	ND	50.0	56.07	56.77	112	114	1	21	66-142
Toluene	ND	50.0	55.60	55.52	111	111	0	21	59-139
Chlorobenzene	ND	50.0	54.49	56.50	109	113	4	21	60-133

*ND = Not Detected*

*RPD = Relative Percent Difference of LCS and LCS Dup.*

*%REC-MS & MSD = Percent Recovery of LCS & LCS Dup.*

**Method Blank = All ND**



**ASSOCIATED LABORATORIES**  
QA REPORT FORM

QC Sample: LR 79094-156

Matrix: WATER

Prep. Date: 09/05/01

Analysis Date: 09/05/01 - 09/06/01

ID#'s in Batch: LR 79094, 79146, 79133, 79079, 79080

**MATRIX SPIKE / MATRIX SPIKE DUPLICATE RESULT**

Reporting Units = ug/L

Test	Method	Sample Result	Spike Added	Matrix Spike	Matrix Spike Dup	%Rec MS	%Rec MSD	RPD
TPH	8015M-G	ND	200	173	174	86.5	87.0	0.6

ND = Not Detected

RPD = Relative Percent Difference of Matrix Spike and Matrix Spike Duplicate

%REC-MS & MSD = Percent Recovery of Matrix Spike & Matrix Spike Duplicate

**%REC LIMITS = 70 - 130**

**RPD LIMITS = 30**

**PREPARATION BLANK / LAB CONTROL SAMPLE RESULTS**

Test	Method	PREP BLK	LCS				
		Value	Result	True	%Rec	L.Limit	H.Limit
TPH	8015M-G	ND	170	200	85.0	80%	120%

LCS Result = Lab Control Sample Result

True = True Value of LCS

L.Limit / H.Limit = LCS Control Limits

**SURROGATE RECOVERY**

Sample No.	AAA-TFT
QC Limit	70-130
QA Sample	89
MS	94
MSD	95
Method Blank	86
LCS	108

AAA-TFT = a.a.a-Trifluorotoluene

**ASSOCIATED LABORATORIES**  
QA REPORT FORM

QC Sample: LR 79052-917

Matrix: WATER

Prep. Date: 09/04/01

Analysis Date: 09/04/01 - 09/05/01

LAB ID#'s in Batch: LR 79080, 79079

**MATRIX SPIKE / MATRIX SPIKE DUPLICATE RESULT**

REPORTING UNITS = ug/L

Test	Method	Sample Result	Spike Added	Matrix Spike	Matrix Spk. Dup	%Rec MS	%Rec MSD	RPD
Benzene	8021	ND	10.0	9.2	9.7	92	97	5
Toluene	8021	ND	10.0	8.9	9.6	89	96	8
Ethylbenzene	8021	ND	10.0	10.2	10.5	102	105	3
Xylenes	8021	ND	20.0	15.9	17.7	80	89	11

ND = Not Detected

RPD = Relative Percent Difference of Matrix Spike and Matrix Spike Dup

%REC-MS & MSD = Percent Recovery of Matrix Spike & Matrix Spike Duplicate

%REC LIMITS = 70 - 130
RPD LIMITS = 30

**PREPARATION BLANK / LAB CONTROL SAMPLE RESULTS**

Test	Method	PREP. BLK	LCS				
		Value	Result	True	%Rec	L.Limit	H.Limit
Benzene	8021	ND	9.8	10.0	98	80%	120%
Toluene	8021	ND	9.7	10.0	97	80%	120%
Ethylbenzene	8021	ND	10.8	10.0	108	80%	120%
Xylenes	8021	ND	17.6	20.0	88	80%	120%

LCS = Lab Control Sample Result

TRUE = True Value of LCS

L.LIMIT / H.LIMIT = LCS Control Limits

**SURROGATE RECOVERY**

Sample No.	AAA-TFT
QC Limit	70-130
QA Sample	89
MS	90
MSD	91
Method Blank	89
LCS	92

AAA-TFT = a,a,a-Trifluorotoluene

# Chain of Custody Record

**ASSOCIATED LABORATORIES**

806 North Batavia • Orange, CA 92868  
Phone: (714) 771-6900 • Fax: (714) 538-1209



Company: <b>THRIFTY OIL CO.</b>	Phone: <b>(562) 921-3581</b>	A.L. Job No. <b>79080 ✓</b>	Page _____ of _____																																
Project Manager: <b>JEFF JURYAKUSUMA</b>	Fax: <b>(562) 921-7510</b>	<table border="1" style="width:100%; border-collapse: collapse;"> <tr> <th colspan="10">Analysis Requested</th> <th rowspan="2">Test Instructions &amp; Comments</th> </tr> <tr> <td style="width:10%;">T</td><td style="width:10%;">P</td><td style="width:10%;">B</td><td style="width:10%;">T</td><td style="width:10%;">M</td><td style="width:10%;">T</td><td style="width:10%;">B</td><td style="width:10%;">E</td><td style="width:10%;">T</td><td style="width:10%;">B</td> </tr> <tr> <td>H</td><td>X</td><td>X</td><td>X</td><td>X</td><td>X</td><td>X</td><td>X</td><td>X</td><td>X</td> <td rowspan="15" style="vertical-align: top; padding: 5px;"> <p><b>*CONFIRMED BY EPA METHOD 8260 B, if detected.</b></p> </td> </tr> </table>		Analysis Requested										Test Instructions & Comments	T	P	B	T	M	T	B	E	T	B	H	X	X	X	X	X	X	X	X	X	<p><b>*CONFIRMED BY EPA METHOD 8260 B, if detected.</b></p>
Analysis Requested										Test Instructions & Comments																									
T	P	B	T	M	T	B	E	T	B																										
H	X	X	X	X	X	X	X	X	X	<p><b>*CONFIRMED BY EPA METHOD 8260 B, if detected.</b></p>																									
Project Name: <b>Q. W. S.</b>	Project #: <b>054V</b>																																		
Site Name and Address: <b>2504 CASTRO VALLEY BLVD. CASTRO VALLEY, CA. 94546</b>																																			

Sample ID	Lab ID	Date	Time	Matrix	Container Number/Size	Pres.	T	P	B	T	M	T	B	E	T	B
1	RS 10	08.30.01	15:50	H <sub>2</sub> O	3VOA	HCL	X	X	X	X	X	X	X	X	X	X
2	RS 8	↑	16:00	↑	↑	↑	X	X	X	X	X	X	X	X	X	X
3	RE 4	↑	16:05	↑	↑	↑	X	X	X	X	X	X	X	X	X	X
4	RE 5	↑	16:10	↑	↑	↑	X	X	X	X	X	X	X	X	X	X
5	RE 1	↑	16:15	↑	↑	↑	X	X	X	X	X	X	X	X	X	X
6	PW 2	↑	16:20	↑	↑	↑	X	X	X	X	X	X	X	X	X	X
7	RE 3	↑	16:25	↑	↑	↑	X	X	X	X	X	X	X	X	X	X
8	RS 11	↑	16:55	↑	↑	↑	X	X	X	X	X	X	X	X	X	X
9	RE 7	↑	16:45	↑	↑	↑	X	X	X	X	X	X	X	X	X	X
10	PW 1	↑	16:50	↑	↑	↑	X	X	X	X	X	X	X	X	X	X
11	RE 6	↑	16:55	↑	↑	↑	X	X	X	X	X	X	X	X	X	X
12	RE 2	↑	17:00	↑	↑	↑	X	X	X	X	X	X	X	X	X	X
13	RS 9	↑	17:10	↑	↑	↑	X	X	X	X	X	X	X	X	X	X
14	TRIP BLANK	↓	15:50	↓	2VOA	↓	X	X	X	X	X	X	X	X	X	X
15																

Sample Receipt - To Be Filled By Laboratory				Relinquished by Sampler: 1.		Relinquished by: 2.		Relinquished by: 3.			
Total Number of Containers	41	Properly Cooled Y/N/NA	Y	Signature:	<i>[Signature]</i>	Signature:	<i>[Signature]</i>	Signature:			
Custody Seals Y/N/NA	7	Samples Intact Y/N/NA	7	Printed Name:	<b>SERRANO PAPERELLI</b>	Printed Name:		Printed Name:			
Received in Good Condition Y/N	7	Samples Accepted Y/N	7	Date:	08.30.01	Time:	16:20	Date:			
Turn Around Time				Received By: 1.	Received By: 2.	Received By: 3.					
<input checked="" type="checkbox"/> Normal <input type="checkbox"/> Rush <input type="checkbox"/> Same Day <input type="checkbox"/> 24 hrs. <input type="checkbox"/> 48 hrs. <input type="checkbox"/> 72 hrs.				Signature:	<i>[Signature]</i>	Signature:	<i>[Signature]</i>	Signature: <i>[Signature]</i>			
				Printed Name:		Printed Name:	<b>DUONG SU</b>	Printed Name:		Printed Name:	
				Date:		Time:		Date:	8/31	Time:	9:50