

THRIFTY OIL CO.

April 18, 2001

STID 1252

O.13898

Mr. Amer Gholami
Alameda County Health Agency
Hazardous Material Specialist
1131 Harbor Bay Parkway, Suite 250
Alameda, CA 94502

RE: **Thrifty Oil Co. #054**
2504 Castro Valley Boulevard
Castro Valley, CA 94541
1st Quarter 2001, Status Report

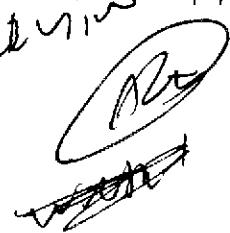
Review 4/24/01

Dear Mr. Gholami:

Presented herewith is the First Quarter 2001, Status Report for Thrifty Oil Co. Station #054 located at 2504 Castro Valley Boulevard, Castro Valley, California. If you have any questions or comments, regarding this report please contact Raymond C. Friedrichsen or me at (562) 921-3581.

Sincerely,



Chris Panaitescu
General Manager
Environmental Affairs

c: File



THRIFTY OIL CO.

April 17, 2001

Mr. Amer Gholami
Alameda County Health Care Agency
Hazardous Material Specialist
1131 Harbor Bay Parkway, Suite 250
Alameda, CA 94502

RE: **Thrifty Oil Co. Station #054**
2504 Castro Valley Boulevard
Castro Valley, CA
1st Quarter 2001, Status Report

Dear Mr. Gholami:

Presented herein is the First Quarter 2001, Status Report prepared for Thrifty Oil Co. (Thrifty) Station #054 located at 2504 Castro Valley Boulevard, Castro Valley, California (**Figure 1**). Presented in this report are the results of the groundwater monitoring efforts conducted during the First Quarter 2001. Thrifty has retained the services of Earth Management Company (EMC) to conduct quarterly monitoring and sampling activities at this site.

Groundwater Monitoring

Depth to groundwater is measured in each monitoring well quarterly. Historic groundwater gauging data obtained from April 11, 1988 through March 22, 2001 is presented in **Table 1**. In general, groundwater occurs under water table conditions beneath the station at depths ranging from 2.69 feet below ground surface (bgs) in monitoring well RS-9 to 12.84 feet bgs in monitoring well RS-8 (**Appendix A**). A groundwater elevation contour map based on the March 22, 2001 data is presented in **Figure 1**. Groundwater elevation data indicates that the general direction of groundwater flow beneath the site is toward the east, with a hydraulic gradient ranging from 0.03 to 0.07 feet/foot. A local groundwater depression appears to be present in the western portion of the site in the area of well RE-5.

Quarterly Groundwater Sampling

As part of the ongoing groundwater monitoring program, groundwater samples were obtained from monitoring wells PW-1, PW-2, RE-1 through RE-7, and RS-8 through RS-11 on March 22, 2001. Groundwater samples were obtained by EMC and delivered in a chilled state in an ice chest following strict Chain-of-Custody procedures to a state-certified laboratory. Total petroleum hydrocarbons as gasoline (TPH-g) was analyzed by EPA method 8015M modified for gasoline, and



benzene, toluene, ethylbenzene, xylenes (BTEX) and methyl tert-butyl ether (MTBE) were analyzed by EPA method 8021B. Detected MTBE concentrations were confirmed by EPA method 8260B.

Copies of the EMC Field Status Reports are presented in **Appendix A**, and copies of the laboratory analytical reports are contained in **Appendix B**.

TPH-g, BTEX, and MTBE concentrations appear in **Table 1** and **Appendix B**. TPH-g, benzene, and MTBE isoconcentration maps are presented in **Figure 2, 3, and 4**, respectively. Benzene was below laboratory method detection limits in all samples analyzed. The highest concentration levels of TPH-g and MTBE were detected in wells PW-1 and RE-2 at 600 ug/L and 2,070 ug/L (by EPA method 8260B), respectively.

Thrifty believes that the elevated MTBE concentration in upgradient monitoring well RS-9 is from an off-site source across Stanton Avenue. The source could be the quick change oil business; well RS-9 is located at the base of their drive way, which is at the bottom of an incline. It is probable that any surface hydrocarbon contamination would be transported (by water from either site wash-down or by rainfall) down the incline and infiltrate through any cracks in the concrete around or near the well. Thrifty has taken preventive measures and tried to reinforce the well surface by repairing any cracks around the well, but the water could still infiltrate the ground by seeping into the ground through the planter. As shown in **Table 1**, MTBE concentrations have increased in this well, and this well is located a significant distance up gradient from the Thrifty site.

Therefore; if ACHCS will not close this site at this time, Thrifty requests the immediate abandonment of well RS-9, to reduce the potential pathway for migration of hydrocarbons from the surface to the shallow groundwater.

Other Activities

Thrifty will continue the groundwater monitoring, gauging, and sampling events at this site on a quarterly basis.

Written by:

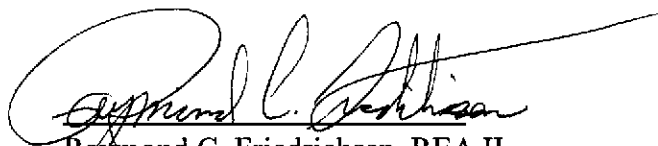

Raymond C. Friedrichsen, REA II
Project Manager, MBA
Senior Environmental Hydrogeologist

Reviewed by:

Larry Higinbotham
Registered Geologist #5497

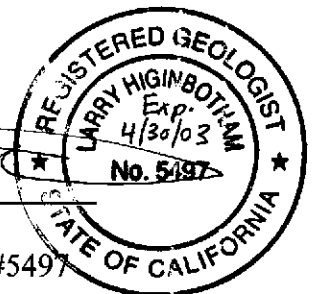

FIGURES

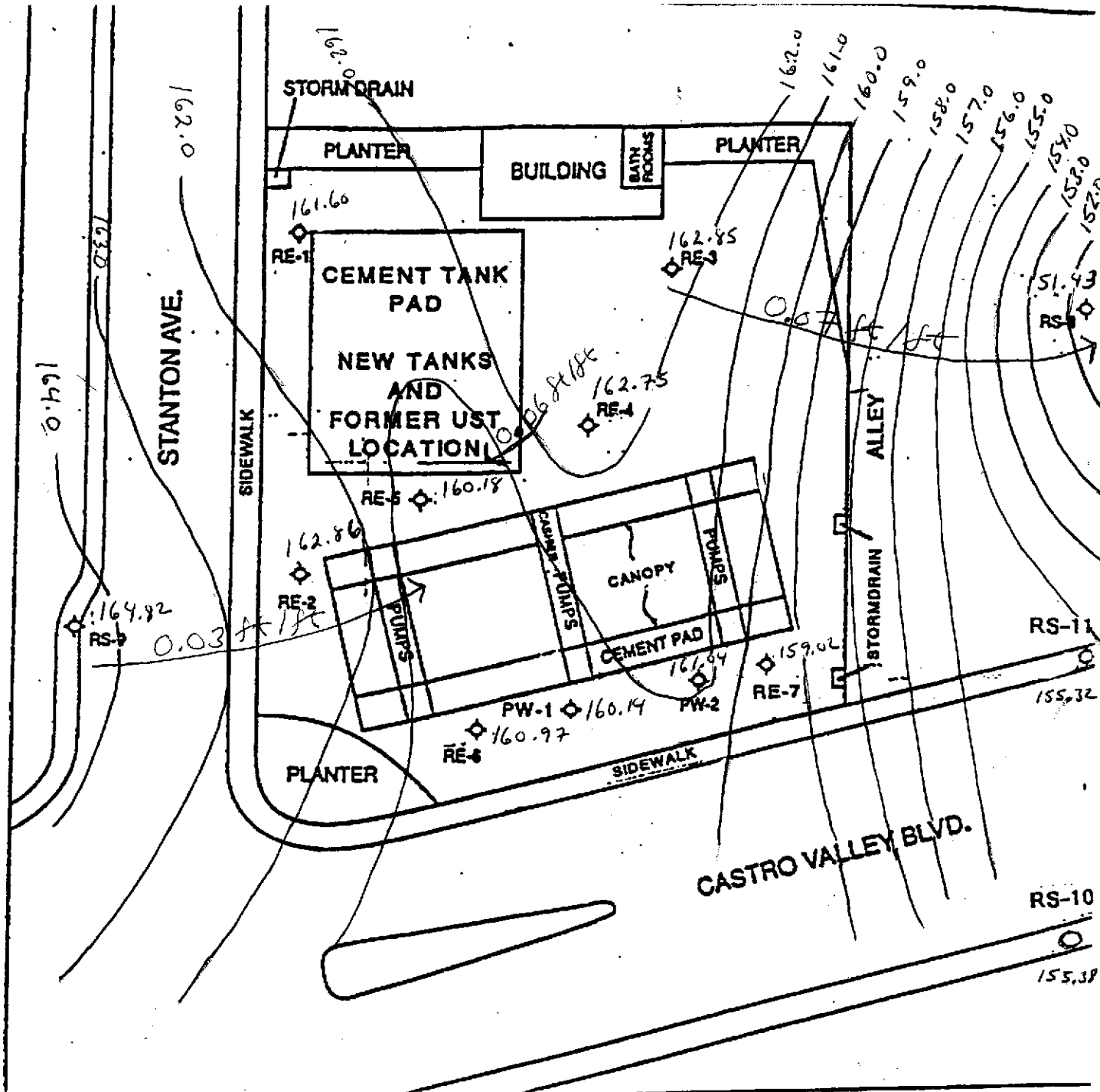

GROUNDWATER CONTOUR MAP
 THRIFTY OIL CO. #054
 CASTRO VALLEY, CALIFORNIA
 Prepared for
 THRIFTY OIL CO.
 SANTA FE, SPRINGS
 CALIFORNIA



◊ EXISTING MONITORING WELL

3/22/01

FIGURE 1

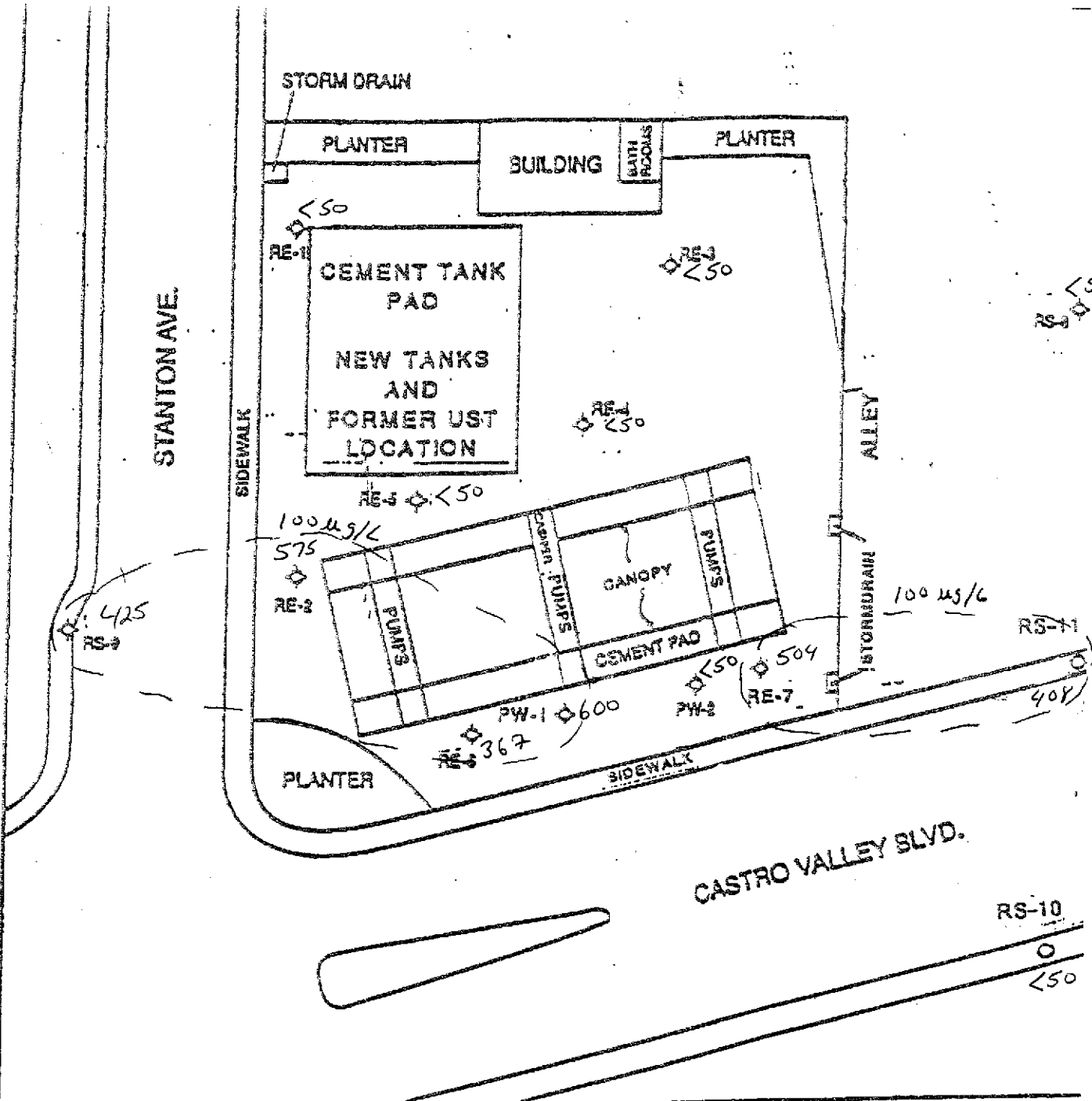

TPH GROUNDWATER ISOCONCENTRATION MAP PPB

THRIFTY OIL CO. #054
 CASTRO VALLEY, CALIFORNIA
 Prepared for
 THRIFTY OIL CO.
 SANTA FE, SPRINGS
 CALIFORNIA



◊ EXISTING MONITORING WELL

3/22/81 FIGURE 2

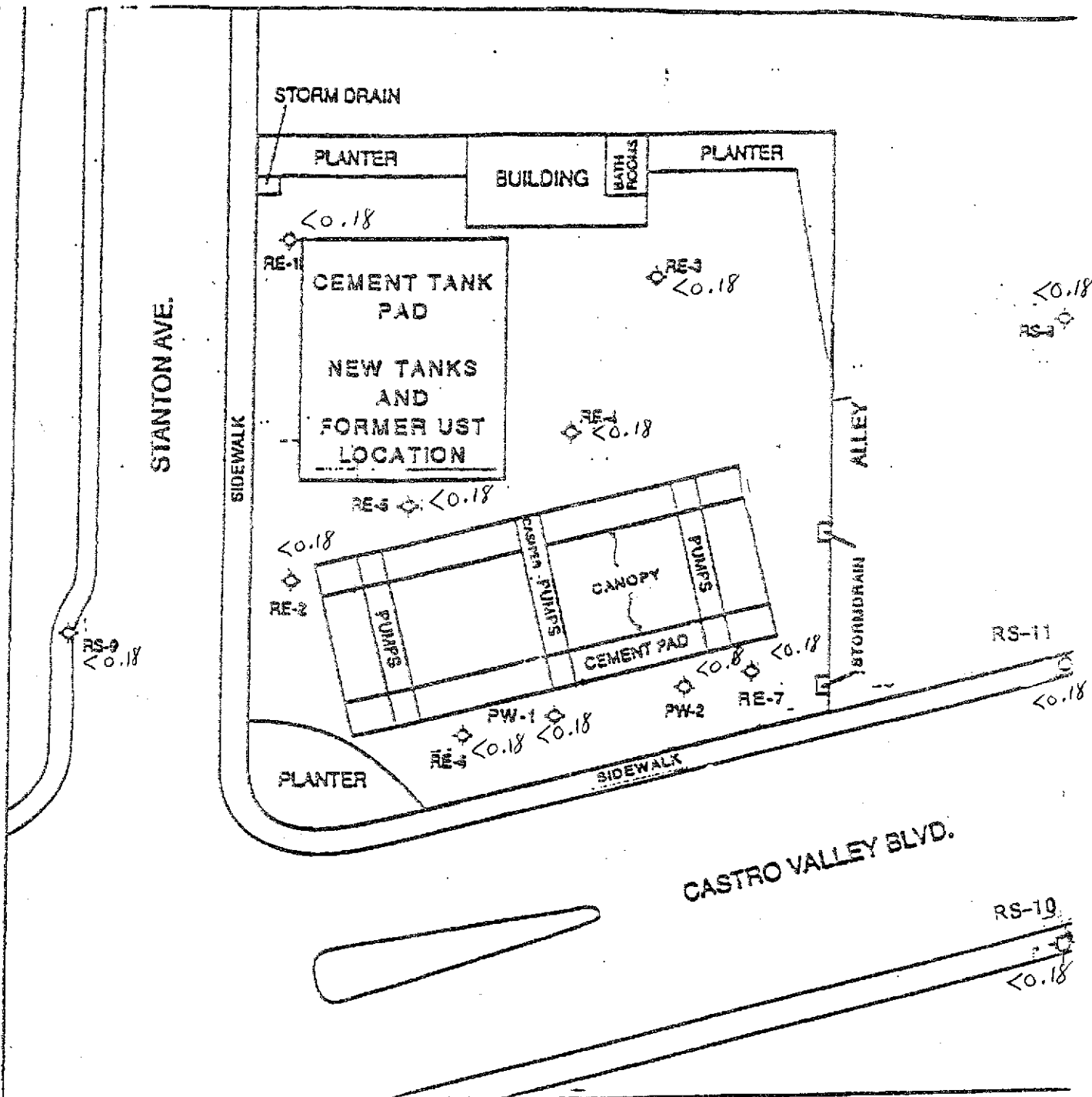

BENZENE ISOCONCENTRATION MAP PPB

THRIFTY OIL CO. #054
 CASTRO VALLEY, CALIFORNIA
 Prepared for
 THRIFTY OIL CO.
 SANTA FE, SPRINGS
 CALIFORNIA

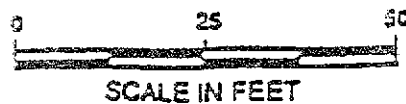

◊ EXISTING MONITORING WELL

3/22/01

FIGURE 3

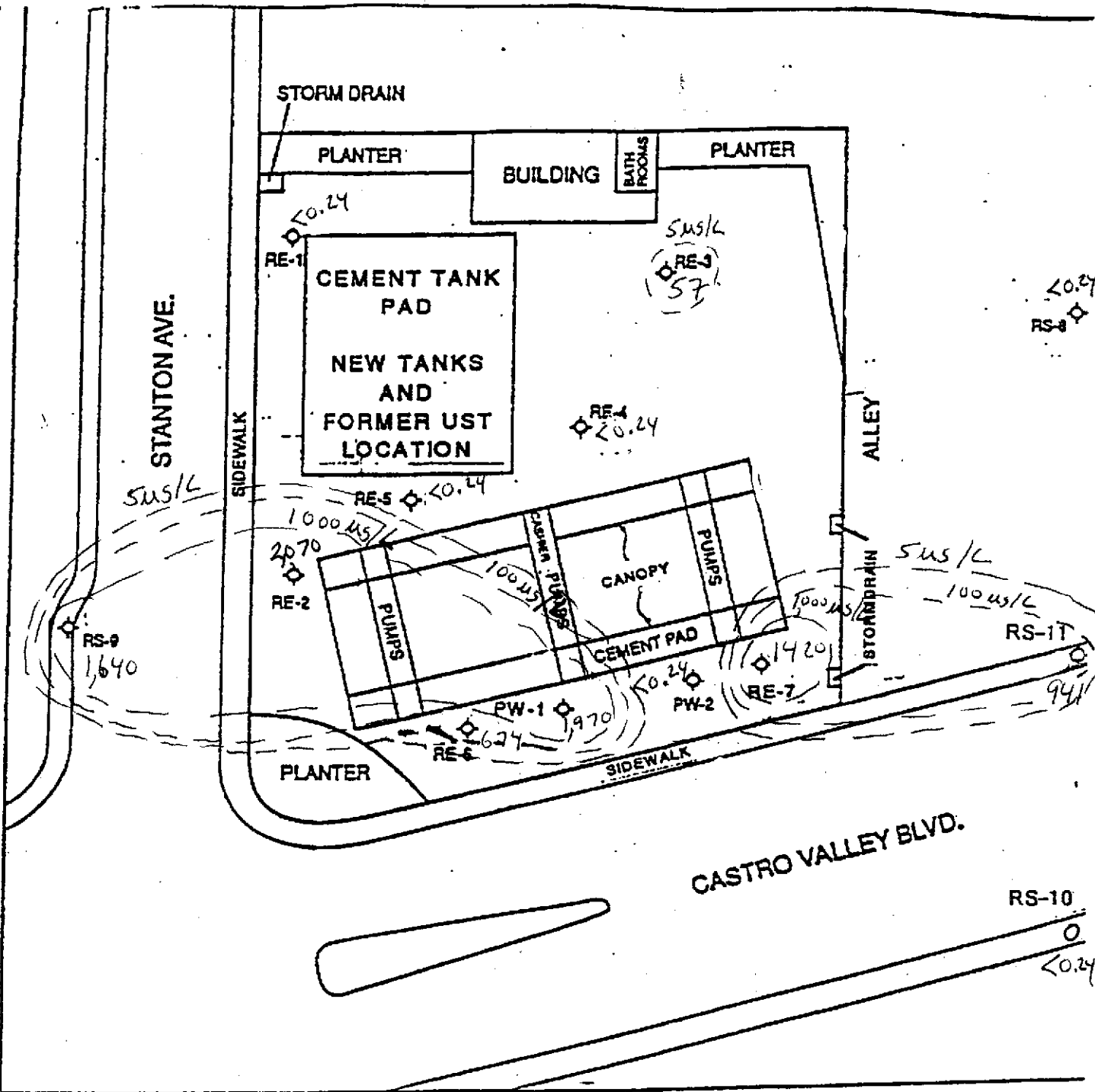

MTBE ISOCONCENTRATION MAP $\mu\text{g/L}$
 THRIFTY OIL CO. #054
 CASTRO VALLEY, CALIFORNIA
 Prepared for
 THRIFTY OIL CO.
 SANTA FE, SPRINGS
 CALIFORNIA



EXISTING MONITORING WELL

3/22/81 FIGURE 4

TABLES

**TABLE 1
GROUNDWATER DATA
THRIFTY OIL STATION #054, CASTRO VALLEY, CA.**

DATE SAMPLED	ANALYTICAL PARAMETERS						DEPTH TO GROUNDWATER (feet)	DEPTH TO PRODUCT (feet)	PRODUCT THICKNESS (feet)	CASING ELEVATION (feet)	GROUNDWATER ELEVATION (feet)
	TPH (ug/L)	BENZENE (ug/L)	TOLUENE (ug/L)	EthylBenzene (ug/L)	XYLENE (ug/L)	MTBE (ug/L)					
MONITORING WELL EPW-1											
04/11/88	-	-	-	-	-	-	-	-	-	-	-
04/09/90	230,000	600	2,700	1,000	16,000	-	5.10	NP	0.00	166.46	161.36
10/30/90	35,000	240	970	240	3,580	-	6.17	NP	0.00	166.46	160.29
01/18/91	37,000	43	140	42	1,600	-	6.28	NP	0.00	166.46	160.18
02/12/91	45,000	99	130	25	700	-	5.88	NP	0.00	166.46	160.58
03/20/91	1,900	0.43	ND	ND	2.8	-	4.75	NP	0.00	166.46	161.71
05/22/91	41,000	600	730	250	3,800	-	5.10	NP	0.00	166.46	161.36
06/19/91	-	-	-	-	-	-	5.61	NP	0.00	166.46	160.85
07/17/91	-	-	-	-	-	-	5.53	FILM	0.00	166.46	160.93
08/07/91	-	-	-	-	-	-	5.67	FILM	0.00	166.46	160.79
09/24/91	-	-	-	-	-	-	5.57	FILM	0.00	166.46	160.89
10/23/91	-	-	-	-	-	-	6.53	FILM	0.00	166.46	159.93
11/06/91	-	-	-	-	-	-	5.85	FILM	0.00	166.46	160.61
12/04/91	-	-	-	-	-	-	5.91	FILM	0.00	166.46	160.55
01/29/92	-	-	-	-	-	-	5.43	FILM	0.00	166.46	161.03
02/26/92	-	-	-	-	-	-	5.54	FILM	0.00	166.46	160.92
03/19/92	ND	ND	ND	ND	ND	-	5.47	NP	0.00	166.46	160.99
04/22/92	-	-	-	-	-	-	5.62	FILM	0.00	166.46	160.84
05/21/92	1,300	19	2.9	0.7	58	-	6.21	NP	0.00	166.46	160.25
06/25/92	-	-	-	-	-	-	6.94	NP	0.00	166.46	159.52
07/30/92	-	-	-	-	-	-	5.90	FILM	0.00	166.46	160.56
08/20/92	-	-	-	-	-	-	7.12	FILM	0.00	166.46	159.34
09/30/92	3,400	57	ND	26	240	-	6.42	NP	0.00	166.46	160.04
12/23/92	-	-	-	-	-	-	5.56	FILM	0.00	166.46	160.90
03/10/93	-	-	-	-	-	-	5.65	FILM	0.00	166.46	160.81
06/09/93	400	<0.5	1.1	<1.0	<1.0	-	5.30	NP	0.00	166.46	161.16
09/14/93	180	3.7	3.2	1.5	14	-	5.43	NP	0.00	166.46	161.03
12/14/93	<50	<0.3	<0.3	<0.3	<0.5	-	4.65	NP	0.00	166.46	161.81
03/02/94	<50	<0.3	<0.3	<0.3	<0.5	-	5.43	NP	0.00	166.46	161.03
06/06/94	330	1.3	<0.3	0.88	9.8	-	4.70	NP	0.00	166.46	161.76
09/06/94	1,100	67	<0.3	<0.3	24	-	6.48	NP	0.00	166.46	159.98
12/07/94	<50	<0.3	<0.3	<0.5	<0.5	-	5.22	NP	0.00	166.46	161.24
03/08/95	<100	<0.5	<0.5	<0.5	<1	-	6.94	NP	0.00	166.46	159.52
06/15/95	260	0.8	0.6	<0.5	3.2	-	5.72	NP	0.00	166.46	160.74

**TABLE 1
GROUNDWATER DATA
THRIFTY OIL STATION #054, CASTRO VALLEY, CA.**

DATE SAMPLED	ANALYTICAL PARAMETERS						DEPTH TO GROUNDWATER (feet)	DEPTH TO PRODUCT (feet)	PRODUCT THICKNESS (feet)	CASING ELEVATION (feet)	GROUNDWATER ELEVATION (feet)
	TRP (PPM)	BENZENE (UG/L)	TOLUENE (UG/L)	ETHYLBENZENE (UG/L)	XYLENE (UG/L)	METH (UG/L)					
09/05/95	330	2.1	<0.5	2.1	9.6	-	5.96	NP	0.00	166.46	160.50
11/21/95	660	13	1.3	<0.3	4.0	-	6.04	NP	0.00	166.46	160.42
03/11/96	660	0.94	0.77	<0.3	8.1	-	3.60	NP	0.00	166.46	162.86
06/19/96	120	0.53	<0.3	<0.3	2.3	-	4.80	NP	0.00	166.46	161.66
09/16/96	<50	<0.3	<0.3	<0.3	<0.5	<20	5.10	NP	0.00	166.46	161.36
12/10/96	<50	<0.3	<0.3	<0.3	<0.5	<20	4.92	NP	0.00	166.46	161.54
03/12/97	<50	<0.3	<0.3	<0.3	<0.5	<20	4.50	NP	0.00	166.46	161.96
06/12/97	<50	<0.3	<0.3	<0.3	<0.5	<20	-	-	-	-	-
09/16/97	690	0.97	<0.3	<0.3	<0.5	<20	4.55	NP	0.00	166.46	161.91
12/09/97	640	150	0.64	<0.3	5.2	1,300	5.60	NP	0.00	166.46	160.86
03/03/98	<50	<0.3	0.57	<0.3	<0.5	<20	4.13	NP	0.00	166.46	162.33
07/08/98	<50	<0.3	<0.3	<0.3	<0.5	<5	-	-	-	-	-
09/10/98	<50	<0.3	<0.3	<0.3	<0.5	<5	6.35	NP	0.00	166.46	160.11
12/30/98	<50	1.1	<0.3	<0.3	<0.5	<5	6.40	NP	0.00	166.46	160.06
03/15/99	<50	<0.3	<0.3	<0.3	<0.5	<5	6.35	NP	0.00	166.46	160.11
06/22/99	<50	<0.3	<0.3	<0.3	<0.5	53	4.95	NP	0.00	166.46	161.51
09/08/99	<50	<0.3	<0.3	<0.3	<0.5	<5	4.80	NP	0.00	166.46	161.66
12/01/99	<50	<0.3	<0.3	<0.3	<0.5	<5	3.64	NP	0.00	166.46	162.82
03/23/00	<50	0.5	0.5	1.1	<0.5	<5	4.03	NP	0.00	166.46	162.43
06/08/00	<50	<5	<5	<5	<5	<5	4.40	NP	0.00	166.46	162.06
09/27/00	<50	<0.18	<0.14	<0.18	<0.26	<0.24	4.73	NP	0.00	166.46	161.73
12/13/00	<50	<0.18	<0.14	<0.18	<0.26	<0.24	4.01	NP	0.00	166.46	162.45
03/22/01	600	<0.18	1.3	<0.18	<0.26	*1,010 / 1,970	6.32	NP	0.00	166.46	160.14
MONITORING WELL DATA											
04/11/88	-	-	-	-	-	-	-	-	-	-	-
04/09/90	600,000	1,300	11,000	4,600	4,300	-	5.81	NP	0.00	166.18	160.37
10/30/90	48,000	310	51	10	480	-	6.95	NP	0.00	166.18	159.23
01/18/91	86,000	230	1,400	350	8,300	-	6.92	NP	0.00	166.18	159.26
02/12/91	160,000	680	1,300	250	7,000	-	6.78	NP	0.00	166.18	159.40
03/20/91	17,000	34	50	ND	1,100	-	5.54	NP	0.00	166.18	160.64
05/22/91	14,000	57	2,100	500	8,200	-	6.07	NP	0.00	166.18	160.11
06/19/91	-	-	-	-	-	-	6.37	FILM	0.00	166.18	159.81
07/17/91	-	-	-	-	-	-	6.38	FILM	0.00	166.18	159.80

**TABLE 1
GROUNDWATER DATA
THRIFTY OIL STATION #054, CASTRO VALLEY, CA.**

DATE SAMPLED	ANALYTICAL PARAMETERS						DEPTH TO GROUNDWATER (feet)	DEPTH TO PRODUCT (feet)	PRODUCT THICKNESS (feet)	CASING ELEVATION (feet)	GROUNDWATER ELEVATION (feet)
	TPH (ug/L)	BENZENE (ug/L)	TOLUENE (ug/L)	EthylBenzene (ug/L)	XYLENE (ug/L)	MTBE (ug/L)					
08/07/91	-	-	-	-	-	-	6.63	FILM	0.00	166.18	159.55
09/24/91	-	-	-	-	-	-	6.42	FILM	0.00	166.18	159.76
10/23/91	-	-	-	-	-	-	7.25	FILM	0.00	166.18	158.93
11/06/91	-	-	-	-	-	-	6.44	FILM	0.00	166.18	159.74
12/04/91	-	-	-	-	-	-	6.65	FILM	0.00	166.18	159.53
01/29/92	-	-	-	-	-	-	6.17	FILM	0.00	166.18	160.01
02/26/92	-	-	-	-	-	-	5.90	FILM	0.00	166.18	160.28
03/19/92	-	-	-	-	-	-	5.80	FILM	0.00	166.18	160.38
04/22/92	-	-	-	-	-	-	5.88	FILM	0.00	166.18	160.30
05/21/92	-	-	-	-	-	-	6.03	FILM	0.00	166.18	160.15
06/25/92	-	-	-	-	-	-	6.57	FILM	0.00	166.18	159.61
07/30/92	-	-	-	-	-	-	6.20	FILM	0.00	166.18	159.98
08/20/92	-	-	-	-	-	-	6.64	FILM	0.00	166.18	159.54
09/30/92	-	-	-	-	-	-	6.88	FILM	0.00	166.18	159.30
12/23/92	-	-	-	-	-	-	6.08	FILM	0.00	166.18	160.10
03/10/93	-	-	-	-	-	-	5.95	FILM	0.00	166.18	160.23
06/09/93	3,400	24	22	<0.5	240	-	5.38	NP	0.00	166.18	160.80
09/14/93	4,900	190	15	6.8	480	-	6.26	NP	0.00	166.18	159.92
12/14/93	1,700	4.2	<0.3	<0.3	<0.5	-	5.22	NP	0.00	166.18	160.96
03/02/94	-	-	-	-	-	-	5.75	FILM	0.00	166.18	160.43
06/06/94	980	25	1.2	<0.3	42	-	5.25	NP	0.00	166.18	160.93
09/06/94	3,200	95	3.0	<1.7	76	-	6.80	NP	0.00	166.18	159.38
12/07/94	510	1.8	<0.3	<0.5	1.7	-	5.57	NP	0.00	166.18	160.61
03/08/95	1,900	<0.5	<0.5	1.4	35	-	4.10	NP	0.00	166.18	162.08
06/15/95	1,700	5.6	<0.5	<0.5	1.6	-	5.44	NP	0.00	166.18	160.74
09/05/95	2,500	33	1.0	0.86	18	-	6.13	NP	0.00	166.18	160.05
11/21/95	2,800	130	59	18	190	-	6.23	NP	0.00	166.18	159.95
03/11/96	13,000	330	460	<15	3,800	-	4.48	NP	0.00	166.18	161.70
06/19/96	1,400	<0.3	<0.3	<0.3	<0.5	-	5.38	NP	0.00	166.18	160.80
09/16/96	3,500	<0.3	<0.3	<0.3	<0.5	5,900	5.21	NP	0.00	166.18	160.97
12/10/96	2,100	<0.3	<0.3	<0.3	<0.5	4,700	4.87	NP	0.00	166.18	161.31
03/12/97	600	1.6	<0.3	<0.3	5.8	1,100	4.43	NP	0.00	166.18	161.75
06/12/97	270	<0.3	<0.3	<0.3	<0.5	630	-	-	-	-	-
09/10/97	220	<0.3	<0.3	<0.3	<0.5	320	4.07	NP	0.00	166.18	162.11
12/09/97	120	<0.3	0.73	<0.3	<0.5	420	5.20	NP	0.00	166.18	160.98

TABLE 1
GROUNDWATER DATA
THRIFTY OIL STATION #054, CASTRO VALLEY, CA.

DATE SAMPLED	ANALYTICAL PARAMETERS						DEPTH TO GROUNDWATER (feet)	DEPTH TO PRODUCT (feet)	PRODUCT THICKNESS (feet)	CASING ELEVATION (feet)	GROUNDWATER ELEVATION (feet)
	TPH (ug/L)	BENZENE (ug/L)	TOLUENE (ug/L)	ETHYLBENZENE (ug/L)	XYLENE (ug/L)	MTBE (ug/L)					
03/03/98	<50	0.43	0.48	<0.3	<0.5	47	3.30	NP	0.00	166.18	162.88
07/08/98	<50	<0.3	<0.3	<0.3	<0.5	<5	-	-	-	-	-
09/10/98	<50	<0.3	<0.3	<0.3	<0.5	<5	5.15	NP	0.00	166.18	161.03
12/30/98	<50	1.1	<0.3	<0.3	<0.5	<5	4.75	NP	0.00	166.18	161.43
03/15/99	<50	<0.3	<0.3	<0.3	<0.5	<5	4.40	NP	0.00	166.18	161.78
06/22/99	-	-	-	-	-	-	4.50	NP	0.00	166.18	161.68
09/08/99	100	<0.3	<0.3	<0.3	<0.5	230	3.99	NP	0.00	166.18	162.19
12/01/99	<50	<0.3	<0.3	<0.3	<0.5	<5	3.62	NP	0.00	166.18	162.56
03/23/00	<50	<0.25	<0.25	<0.25	<0.5	<5	2.93	NP	0.00	166.18	163.25
06/08/00	<50	<5	<5	<5	<5	<5	3.60	NP	0.00	166.18	162.58
09/27/00	<50	<0.18	<0.14	<0.18	<0.26	<0.24	3.61	NP	0.00	166.18	162.57
12/13/00	<50	<0.18	<0.14	<0.18	<0.26	<0.24	3.60	NP	0.00	166.18	162.58
03/22/01	<50	<0.18	<0.14	<0.18	<0.26	<0.24	5.14	NP	0.00	166.18	161.04

MONITORING WELL #RE-1											
04/11/88	37,000	1,900	8,400	1,200	15,000	-	-	-	-	-	-
04/09/90	45,000	6,100	7,000	2,000	8,800	-	4.99	NP	0.00	166.82	161.83
10/30/90	72,000	7,700	5,300	1,800	8,900	-	5.95	NP	0.00	166.82	160.87
01/18/91	150,000	11,000	14,000	1,800	4,300	-	5.17	NP	0.00	166.82	161.65
02/12/91	140,000	11,000	12,000	1,600	13,000	-	4.16	NP	0.00	166.82	162.66
03/20/91	53,000	3,100	4,200	400	5,500	-	4.75	NP	0.00	166.82	162.07
05/22/91	85,000	8,700	10,000	1,800	12,000	-	4.42	NP	0.00	166.82	162.40
06/19/91	110,000	8,500	9,600	2,600	16,000	-	4.93	NP	0.00	166.82	161.89
07/17/91	5,500	950	ND	26	ND	-	5.19	NP	0.00	166.82	161.63
08/07/91	-	6,700	5,000	ND	7,100	-	5.12	NP	0.00	166.82	161.70
09/24/91	60,000	6,800	4,300	640	6,900	-	5.87	NP	0.00	166.82	160.95
10/23/91	79,000	7,900	8,300	450	7,100	-	5.81	NP	0.00	166.82	161.01
11/06/91	130,000	14,000	15,000	1,100	8,800	-	5.56	NP	0.00	166.82	161.26
12/04/91	50,000	8,000	4,700	520	4,100	-	5.35	NP	0.00	166.82	161.47
01/29/92	21,000	10,300	11,000	780	6,000	-	4.50	NP	0.00	166.82	162.32
02/26/92	38,000	8,400	10,500	720	7,100	-	5.27	NP	0.00	166.82	161.55
03/19/92	48,000	6,200	9,700	780	7,200	-	4.47	NP	0.00	166.82	162.35
04/22/92	-	-	-	-	-	-	4.62	NP	0.00	166.82	162.20
05/21/92	20,000	7,600	10,100	830	6,900	-	4.98	NP	0.00	166.82	161.84

**TABLE 1
GROUNDWATER DATA
THRIFTY OIL STATION #054, CASTRO VALLEY, CA.**

DATE SAMPLED	ANALYTICAL PARAMETERS						DEPTH TO GROUNDWATER (feet)	DEPTH TO PRODUCT (feet)	PRODUCT THICKNESS (feet)	CASING ELEVATION (feet)	GROUNDWATER ELEVATION (feet)
	TPI (ug/L)	BENZENE (ug/L)	TOLUENE (ug/L)	ETHYL BENE (ug/L)	XYLENE (ug/L)	MIBE (ug/L)					
06/25/92	-	-	-	-	-	-	5.14	FILM	0.00	166.82	161.68
07/30/92	-	-	-	-	-	-	5.30	FILM	0.00	166.82	161.52
08/20/92	-	-	-	-	-	-	5.28	FILM	0.00	166.82	161.54
09/30/92	-	-	-	-	-	-	5.66	FILM	0.00	166.82	161.16
12/23/92	-	-	-	-	-	-	4.81	FILM	0.00	166.82	162.01
03/10/93	-	-	-	-	-	-	4.13	FILM	0.00	166.82	162.69
06/09/93	-	-	-	-	-	-	4.48	FILM	0.00	166.82	162.34
09/14/93	19,000	3,600	1,100	740	4,300	-	5.35	NP	0.00	166.82	161.47
12/14/93	38,000	4,300	1,300	<6.6	11	-	4.38	NP	0.00	166.82	162.44
03/02/94	-	-	-	-	-	-	4.22	FILM	0.00	166.82	162.60
06/06/94	-	-	-	-	-	-	2.16	FILM	0.00	166.82	164.66
09/06/94	74,000	3,300	3,900	1,200	6,100	-	5.00	NP	0.00	166.82	161.82
12/07/94	30,000	3,200	2,900	1,200	4,600	-	4.10	NP	0.00	166.82	162.72
03/08/95	28,000	4,200	2,300	810	7,800	-	3.92	NP	0.00	166.82	162.90
06/15/95	-	-	-	-	-	-	-	-	-	-	-
09/05/95	-	-	-	-	-	-	4.78	FILM	0.00	166.82	162.04
11/21/95	-	-	-	-	-	-	4.82	NP	0.00	166.82	162.00
03/11/96	270	2.4	6.0	4.5	19	-	3.32	NP	0.00	166.82	163.50
06/19/96	3,000	570	63	<1.5	400	-	4.20	NP	0.00	166.82	162.62
09/16/96	7,700	440	69	<1.5	680	230	4.68	NP	0.00	166.82	162.14
12/10/96	52	<0.3	<0.3	<0.3	<0.5	120	4.93	NP	0.00	166.82	161.89
03/12/97	8,700	180	5.4	40	1,100	130	4.10	NP	0.00	166.82	162.72
06/12/97	<50	<0.3	<0.3	<0.3	<0.5	36	-	-	-	-	-
09/16/97	<50	<0.3	<0.3	<0.3	<0.5	<20	4.55	NP	0.00	166.82	162.27
12/09/97	<50	<0.3	0.44	<0.3	<0.5	<20	5.30	NP	0.00	166.82	161.52
03/03/98	1,100	13	0.51	<0.3	<0.5	220	4.55	NP	0.00	166.82	162.27
07/08/98	<50	<0.3	<0.3	<0.3	<0.5	<5	-	-	-	-	-
09/10/98	60	<0.3	<0.3	<0.3	<0.5	180	6.05	NP	0.00	166.82	160.77
12/30/98	<50	1.1	<0.3	<0.3	<0.5	<5	5.65	NP	0.00	166.82	161.17
03/15/99	<50	<0.3	<0.3	<0.3	<0.5	<5	5.68	NP	0.00	166.82	161.14
06/22/99	880	14	0.98	<0.3	8.1	260	4.95	NP	0.00	166.82	161.87
09/08/99	72	<0.3	<0.3	<0.3	<0.5	120	4.46	NP	0.00	166.82	162.36
12/01/99	<50	<0.3	<0.3	<0.3	<0.5	<5	4.08	NP	0.00	166.82	162.74
03/23/00	<50	<0.25	<0.25	<0.25	<0.5	<5	3.68	NP	0.00	166.82	163.14
06/08/00	<50	<5	<5	<5	<5	<5	4.07	NP	0.00	166.82	162.75

**TABLE 1
GROUNDWATER DATA
THRIFTY OIL STATION #054, CASTRO VALLEY, CA.**

DATE SAMPLED	ANALYTICAL PARAMETERS						DEPTH TO GROUNDWATER (feet)	DEPTH TO PRODUCT (feet)	PRODUCT THICKNESS (feet)	CASING ELEVATION (feet)	GROUNDWATER ELEVATION (feet)
	TPH (ug/L)	BENZENE (ug/L)	TOLUENE (ug/L)	ETHYL Benzene (ug/L)	XYLENE (ug/L)	MULE (ug/L)					
09/27/00	<50	<0.18	<0.14	<0.18	<0.26	<0.24	4.07	NP	0.00	166.82	162.75
12/13/00	<50	<0.18	<0.14	<0.18	<0.26	<0.24	4.06	NP	0.00	166.82	162.76
03/22/01	<50	<0.18	<0.14	<0.18	<0.26	<0.24	5.22	NP	0.00	166.82	161.60
MONITORING WELL #RE-2											
04/11/88	-	-	-	-	-	-	-	-	-	-	-
04/09/90	850	5.8	0.5	4.8	1.1	-	4.90	NP	0.00	167.19	162.29
10/30/90	440	2.8	0.91	13	3.14	-	5.34	NP	0.00	167.19	161.85
01/18/91	1,100	8.4	3.1	ND	10	-	4.90	NP	0.00	167.19	162.29
02/12/91	1,100	5.9	ND	1.77	ND	-	4.94	NP	0.00	167.19	162.25
03/20/91	550	4.3	ND	ND	ND	-	4.32	NP	0.00	167.19	162.87
05/22/91	1,000	5.3	3.6	4.4	8.9	-	4.43	NP	0.00	167.19	162.76
06/19/91	700	2.1	1.4	3.8	3.5	-	6.43	NP	0.00	167.19	160.76
07/17/91	880	12	8.0	4.3	28	-	4.75	NP	0.00	167.19	162.44
08/07/91	-	3.8	1.6	ND	ND	-	4.87	NP	0.00	167.19	162.32
09/24/91	670	7.2	7.1	ND	23	-	5.50	NP	0.00	167.19	161.69
10/23/91	2,700	52	60	22	130	-	5.63	NP	0.00	167.19	161.56
11/06/91	1,900	18	61	9.1	83	-	5.14	NP	0.00	167.19	162.05
12/04/91	1,100	26	47	4.3	42	-	5.26	NP	0.00	167.19	161.93
01/29/92	900	14	24	5.3	19	-	5.11	NP	0.00	167.19	162.08
02/26/92	500	3.4	3.5	2.7	2.7	-	4.31	NP	0.00	167.19	162.88
03/19/92	1,200	14	20	15	18	-	4.45	NP	0.00	167.19	162.74
04/22/92	200	ND	ND	ND	ND	-	4.78	NP	0.00	167.19	162.41
05/21/92	500	7.5	6.8	3.9	7.4	-	5.02	NP	0.00	167.19	162.17
06/25/92	ND	ND	0.9	0.7	ND	-	5.13	NP	0.00	167.19	162.06
07/30/92	500	7.7	8.6	3.2	1.7	-	5.19	NP	0.00	167.19	162.00
08/20/92	1,100	6.6	4.5	2.7	2.0	-	5.27	NP	0.00	167.19	161.92
09/30/92	500	5.4	2.4	1.8	4.5	-	5.45	NP	0.00	167.19	161.74
12/23/92	800	1.9	ND	ND	2.3	-	4.60	NP	0.00	167.19	162.59
03/10/93	1,200	ND	1.4	ND	2.1	-	4.18	NP	0.00	167.19	163.01
06/09/93	200	ND	ND	ND	ND	-	4.53	NP	0.00	167.19	162.66
09/17/93	360	1.6	1.1	3.2	8.9	-	5.26	NP	0.00	167.19	161.93
12/14/93	260	5.6	3.9	<0.3	21.0	-	2.75	NP	0.00	167.19	164.44
03/02/94	410	<0.3	<0.3	<0.3	<0.5	-	4.27	NP	0.00	167.19	162.92

**TABLE 1
GROUNDWATER DATA
THRIFTY OIL STATION #054, CASTRO VALLEY, CA.**

DATE SAMPLED	ANALYTICAL PARAMETERS						DEPTH TO GROUNDWATER (feet)	DEPTH TO PRODUCT (feet)	PRODUCT THICKNESS (feet)	CASING ELEVATION (feet)	GROUNDWATER ELEVATION (feet)
	TPH (ug/L)	BENZENE (ug/L)	TOLUENE (ug/L)	EthylBenzene (ug/L)	XYLENE (ug/L)	MTBE (ug/L)					
06/06/94	760	4.6	<0.3	0.32	1.3	-	4.88	NP	0.00	167.19	162.31
09/06/94	1,300	43	45	8.9	69	-	5.16	NP	0.00	167.19	162.03
12/07/94	-	-	-	-	-	-	4.16	NP	0.00	167.19	163.03
03/08/95	<100	<0.5	<0.5	<0.5	<1	-	3.96	NP	0.00	167.19	163.23
06/15/95	130	<0.5	<0.5	<0.5	<1	-	4.52	NP	0.00	167.19	162.67
09/05/95	210	<0.5	<0.5	<0.5	<1	-	4.76	NP	0.00	167.19	162.43
11/21/95	160	0.65	<0.3	0.35	0.95	-	4.83	NP	0.00	167.19	162.36
03/11/96	<50	<0.3	<0.3	<0.3	<0.5	-	3.36	NP	0.00	167.19	163.83
06/19/96	<50	<0.3	<0.3	<0.3	<0.5	-	4.68	NP	0.00	167.19	162.51
09/16/96	<50	<0.3	<0.3	<0.3	<0.5	<20	5.10	NP	0.00	167.19	162.09
12/10/96	<50	<0.3	<0.3	<0.3	<0.5	<20	4.47	NP	0.00	167.19	162.72
03/12/97	<50	<0.3	<0.3	<0.3	<0.5	<20	4.05	NP	0.00	167.19	163.14
06/12/97	<50	<0.3	<0.3	<0.3	<0.5	<20	-	-	-	-	-
09/10/97	<50	<0.3	<0.3	<0.3	<0.5	<20	4.08	NP	0.00	167.19	163.11
12/09/97	<50	<0.3	<0.3	<0.3	<0.5	<20	4.40	NP	0.00	167.19	162.79
03/03/98	<50	<0.3	<0.3	<0.3	<0.5	<20	3.30	NP	0.00	167.19	163.89
07/08/98	<50	<0.3	<0.3	<0.3	<0.5	15	-	-	-	-	-
09/10/98	<50	<0.3	<0.3	<0.3	<0.5	<5	4.93	NP	0.00	167.19	162.26
12/30/98	460	0.92	<0.3	<0.3	<0.5	1,400	4.20	NP	0.00	167.19	162.99
03/15/99	<50	<0.3	<0.3	<0.3	<0.5	<5	4.20	NP	0.00	167.19	162.99
06/22/99	2,900	7.4	<0.3	0.43	4.1	4,500	3.70	NP	0.00	167.19	163.49
09/08/99	1,400	<3	<3	<3	<5	3,200	3.96	NP	0.00	167.19	163.23
12/01/99	<50	<0.3	<0.3	<0.3	<0.5	<5	3.58	NP	0.00	167.19	163.61
03/23/00	<50	<0.25	<0.25	<0.25	<0.5	<5	3.19	NP	0.00	167.19	164.00
06/08/00	<50	<5	<5	<5	<5	<5	3.18	NP	0.00	167.19	164.01
09/27/00	<50	<0.18	<0.14	<0.18	<0.26	<0.24	3.58	NP	0.00	167.19	163.61
12/13/00	<50	<0.18	<0.14	<0.18	<0.26	<0.24	3.58	NP	0.00	167.19	163.61
03/22/01	575	<0.18	1.3	<0.18	<0.26	*950 / 2,070	4.33	NP	0.00	167.19	162.86
MONITORING WELLS											
04/11/88	70,000	6,600	5,300	800	13,000	-	-	-	-	-	-
04/09/90	370,000	2,300	4,900	3,200	31,000	-	7.15	NP	0.00	167.39	160.24
10/30/90	13,000	860	660	220	2,210	-	7.84	NP	0.00	167.39	159.55
01/18/91	42,000	4,700	4,500	21	7,700	-	6.90	NP	0.00	167.39	160.49

TABLE 1
GROUNDWATER DATA
THRIFTY OIL STATION #054, CASTRO VALLEY, CA.

DATE SAMPLED	ANALYTICAL PARAMETERS						DEPTH TO GROUNDWATER (feet)	DEPTH TO PRODUCT (feet)	PRODUCT THICKNESS (feet)	CASING ELEVATION (feet)	GROUNDWATER ELEVATION (feet)
	TPH (ug/L)	BENZENE (ug/L)	TOLUENE (ug/L)	EthylBenzene (ug/L)	XYLENE (ug/L)	MIBP (ug/L)					
02/12/91	72,000	3,600	4,500	ND	7,600	-	6.62	NP	0.00	167.39	160.77
03/20/91	65,000	2,400	9,400	50	9,800	-	5.87	NP	0.00	167.39	161.52
05/22/91	-	-	-	-	-	-	5.98	FILM	0.00	167.39	161.41
06/19/91	-	-	-	-	-	-	6.84	FILM	0.00	167.39	160.55
07/17/91	-	-	-	-	-	-	7.10	FILM	0.00	167.39	160.29
08/07/91	-	-	-	-	-	-	7.30	FILM	0.00	167.39	160.09
09/24/91	-	-	-	-	-	-	7.84	FILM	0.00	167.39	159.55
10/23/91	-	-	-	-	-	-	8.07	FILM	0.00	167.39	159.32
11/06/91	-	-	-	-	-	-	7.63	FILM	0.00	167.39	159.76
12/04/91	-	-	-	-	-	-	7.83	FILM	0.00	167.39	159.56
01/29/92	-	-	-	-	-	-	7.17	FILM	0.00	167.39	160.22
02/26/92	-	-	-	-	-	-	5.56	FILM	0.00	167.39	161.83
03/19/92	-	-	-	-	-	-	5.44	FILM	0.00	167.39	161.95
04/22/92	-	-	-	-	-	-	6.56	FILM	0.00	167.39	160.83
05/21/92	-	-	-	-	-	-	6.90	FILM	0.00	167.39	160.49
06/25/92	-	-	-	-	-	-	7.18	FILM	0.00	167.39	160.21
07/30/92	-	-	-	-	-	-	6.80	FILM	0.00	167.39	160.59
08/20/92	-	-	-	-	-	-	7.25	FILM	0.00	167.39	160.14
09/30/92	-	-	-	-	-	-	7.68	FILM	0.00	167.39	159.71
12/23/92	-	-	-	-	-	-	6.07	FILM	0.00	167.39	161.32
03/10/93	-	-	-	-	-	-	5.66	FILM	0.00	167.39	161.73
06/09/93	-	-	-	-	-	-	6.66	FILM	0.00	167.39	160.73
09/14/93	40,000	2,900	1,500	180	6,900	-	7.30	NP	0.00	167.39	160.09
12/14/93	-	-	-	-	-	-	5.95	NP	0.00	167.39	161.44
03/02/94	-	-	-	-	-	-	5.08	NP	0.00	167.39	162.31
06/06/94	-	-	-	-	-	-	6.35	FILM	0.00	167.39	161.04
09/06/94	11,000	260	26	<6.6	1,000	-	7.50	NP	0.00	167.39	159.89
12/07/94	-	-	-	-	-	-	5.48	FILM	0.00	167.39	161.91
03/08/95	-	-	-	-	-	-	5.18	FILM	0.00	167.39	162.21
06/15/95	-	-	-	-	-	-	-	-	-	-	-
09/05/95	-	-	-	-	-	-	6.84	FILM	0.00	167.39	160.55
11/21/95	10,000	210	<3	4.5	330	-	7.38	NP	0.00	167.39	160.01
03/11/96	1,600	640	15	10	46	-	4.85	NP	0.00	167.39	162.54
06/19/96	2,100	280	<3	<3	120	-	5.80	NP	0.00	167.39	161.59
09/16/96	140	<0.3	<0.3	<0.3	<0.5	110	4.50	NP	0.00	167.39	162.89

**TABLE 1
GROUNDWATER DATA
THRIFTY OIL STATION #054, CASTRO VALLEY, CA.**

DATE SAMPLED	ANALYTICAL PARAMETERS						DEPTH TO GROUNDWATER (feet)	DEPTH TO PRODUCT (feet)	PRODUCT THICKNESS (feet)	CASING ELEVATION (feet)	GROUNDWATER ELEVATION (feet)
	TPH (ug/L)	BENZENE (ug/L)	TOLUENE (ug/L)	Ethyl Benzene (ug/L)	XYLENE (ug/L)	MIBK (ug/L)					
12/10/96	<50	<0.3	<0.3	<0.3	<0.5	<20	5.35	NP	0.00	167.39	162.04
03/12/97	<50	<0.3	<0.3	<0.3	<0.5	<20	3.48	NP	0.00	167.39	163.91
06/12/97	<50	<0.3	<0.3	<0.3	0.58	<20	-	-	-	-	-
09/10/97	<50	<0.3	<0.3	<0.3	<0.5	<20	3.10	NP	0.00	167.39	164.29
12/09/97	3,600	1,000	1,000	<6	570	260	4.55	NP	0.00	167.39	162.84
03/03/98	2,800	20	0.65	0.39	16	5,600	2.30	NP	0.00	167.39	165.09
07/08/98	<50	<0.3	<0.3	<0.3	<0.5	<5	-	-	-	-	-
09/10/98	<50	<0.3	<0.3	<0.3	<0.5	23	4.95	NP	0.00	167.39	162.44
12/30/98	<50	1.1	<0.3	<0.3	<0.5	<5	4.55	NP	0.00	167.39	162.84
03/15/99	<50	<0.3	<0.3	<0.3	<0.5	<5	4.15	NP	0.00	167.39	163.24
06/22/99	670	17	1.2	0.36	1.7	340	3.85	NP	0.00	167.39	163.54
09/08/99	140	0.72	<0.3	<0.3	<0.5	230	2.63	NP	0.00	167.39	164.76
12/01/99	95	<0.3	<0.3	<0.3	<0.5	200	2.63	NP	0.00	167.39	164.76
03/23/00	315	<0.25	<0.25	<0.25	<0.5	*293/422	2.25	NP	0.00	167.39	165.14
06/08/00	<100	<5	<5	<5	<5	201	3.02	NP	0.00	167.39	164.37
09/27/00	154	<0.18	<0.14	<0.18	<0.26	*254 / 160	3.01	NP	0.00	167.39	164.38
12/13/00	<50	<0.18	<0.14	<0.18	<0.26	*124 / 111	3.02	NP	0.00	167.39	164.37
03/22/01	<50	<0.18	<0.14	<0.18	<0.26	*90 / 57	4.54	NP	0.00	167.39	162.85
MONITORING WELLS											
04/11/88	15,000	12,000	8,000	1,000	2,700	-	-	-	-	-	-
04/09/90	-	-	-	-	-	-	-	-	-	-	-
10/30/90	87,000	7,200	10,000	1,600	12,900	-	7.04	NP	0.00	166.94	159.90
01/18/91	70,000	5,000	5,400	790	9,900	-	11.62	NP	0.00	166.94	155.32
02/12/91	87,000	5,200	2,800	240	11,000	-	11.63	NP	0.00	166.94	155.31
03/20/91	6,500	370	230	17	670	-	11.61	NP	0.00	166.94	155.33
05/22/91	-	-	-	-	-	-	10.30	FILM	0.00	166.94	156.64
06/19/91	-	-	-	-	-	-	11.10	FILM	0.00	166.94	155.84
07/17/91	-	-	-	-	-	-	6.20	FILM	0.00	166.94	160.74
08/17/91	-	-	-	-	-	-	8.15	FILM	0.00	166.94	158.79
09/24/91	-	-	-	-	-	-	10.40	FILM	0.00	166.94	156.54
10/23/91	-	-	-	-	-	-	11.20	FILM	0.00	166.94	155.74
11/06/91	-	-	-	-	-	-	6.62	FILM	0.00	166.94	160.32
12/04/91	-	-	-	-	-	-	11.20	ILM	0.00	166.94	155.74

**TABLE 1
GROUNDWATER DATA
THRIFTY OIL STATION #054, CASTRO VALLEY, CA.**

DATE SAMPLED	ANALYTICAL PARAMETERS						DEPTH TO GROUNDWATER (feet)	DEPTH TO PRODUCT (feet)	PRODUCT THICKNESS (feet)	CASING ELEVATION (feet)	GROUNDWATER ELEVATION (feet)
	TPH (ug/L)	BENZENE (ug/L)	TOLUENE (ug/L)	EthylBenzene (ug/L)	XYLENE (ug/L)	MTBE (ug/L)					
01/29/92	-	-	-	-	-	-	7.72	FILM	0.00	166.94	159.22
02/26/92	-	-	-	-	-	-	5.13	FILM	0.00	166.94	161.81
03/19/92	-	-	-	-	-	-	5.00	FILM	0.00	166.94	161.94
04/22/92	-	-	-	-	-	-	5.94	FILM	0.00	166.94	161.00
05/21/92	-	-	-	-	-	-	5.40	FILM	0.00	166.94	161.54
06/25/92	-	-	-	-	-	-	5.71	FILM	0.00	166.94	161.23
07/30/92	-	-	-	-	-	-	6.33	FILM	0.00	166.94	160.61
08/20/92	-	-	-	-	-	-	5.80	FILM	0.00	166.94	161.14
09/30/92	-	-	-	-	-	-	6.34	FILM	0.00	166.94	160.60
12/23/92	-	-	-	-	-	-	5.50	FILM	0.00	166.94	161.44
03/10/93	-	-	-	-	-	-	4.67	FILM	0.00	166.94	162.27
06/09/93	-	-	-	-	-	-	5.12	FILM	0.00	166.94	161.82
09/14/93	-	-	-	-	-	-	10.44	NP	0.00	166.94	156.50
12/14/93	-	-	-	-	-	-	7.52	NP	0.00	166.94	159.42
03/02/94	-	-	-	-	-	-	4.85	NP	0.00	166.94	162.09
06/06/94	-	-	-	-	-	-	5.20	FILM	0.00	166.94	161.74
09/06/94	-	-	-	-	-	-	9.85	FILM	0.00	166.94	157.09
12/07/94	-	-	-	-	-	-	5.20	FILM	0.00	166.94	161.74
03/08/95	-	-	-	-	-	-	4.98	FILM	0.00	166.94	161.96
06/15/95	-	-	-	-	-	-	-	-	-	-	-
09/05/95	-	-	-	-	-	-	13.72	FILM	0.00	166.94	153.22
11/21/95	32,000	46	21	66	340	-	12.53	NP	0.00	166.94	154.41
03/11/96	1,700	130	15	2.0	120	-	4.72	NP	0.00	166.94	162.22
06/19/96	1,700	230	30	0.35	100	-	5.40	NP	0.00	166.94	161.54
09/16/96	510	<0.3	0.73	<0.3	<0.5	800	5.18	NP	0.00	166.94	161.76
12/10/96	520	<0.3	<0.3	<0.3	<0.5	1,000	4.65	NP	0.00	166.94	162.29
03/12/97	420	3.2	<0.3	<0.3	11	370	3.87	NP	0.00	166.94	163.07
06/12/97	510	0.66	<0.3	<0.3	<0.5	1,600	-	-	-	-	-
09/10/97	<50	<0.3	<0.3	<0.3	<0.5	<20	5.40	NP	0.00	166.94	161.54
12/09/97	1,400	330	2.3	<0.3	1.5	2,500	4.60	NP	0.00	166.94	162.34
03/03/98	3,000	400	0.61	0.5	97	3,800	5.05	NP	0.00	166.94	161.89
07/08/98	650	<0.3	<0.3	<0.3	<0.5	1,800	-	-	-	-	-
09/10/98	2,700	<0.3	<0.3	<0.3	1.4	7,600	4.60	NP	0.00	166.94	162.34
12/30/98	530	<0.3	<0.3	<0.3	<0.5	1,500	4.20	NP	0.00	166.94	162.74
03/15/99	<50	<0.3	<0.3	<0.3	<0.5	<5	3.85	NP	0.00	166.94	163.09

**TABLE 1
GROUNDWATER DATA
THRIFTY OIL STATION #054, CASTRO VALLEY, CA.**

DATE SAMPLED	ANALYTICAL PARAMETERS						DEPTH TO GROUNDWATER (feet)	DEPTH TO PRODUCT (feet)	PRODUCT THICKNESS (feet)	CASING ELEVATION (feet)	GROUNDWATER ELEVATION (feet)
	TPH (ug/L)	BENZENE (ug/L)	TOLUENE (ug/L)	EthylBenzene (ug/L)	XYLENE (ug/L)	MTBE (ug/L)					
06/22/99	1,200	23	1.5	<0.3	2.4	1,400	3.90	NP	0.00	166.94	163.04
09/08/99	590	1.5	<0.6	<0.6	<1	1,100	5.72	NP	0.00	166.94	161.22
12/01/99	540	<0.3	<0.3	<0.3	<0.5	880	5.34	NP	0.00	166.94	161.60
03/23/00	<50	<0.25	<0.25	<0.25	<0.5	<5	5.36	NP	0.00	166.94	161.58
06/08/00	67	<5	<5	<5	<5	<5	5.34	NP	0.00	166.94	161.60
09/27/00	<50	<0.18	<0.14	<0.18	<0.26	<0.24	5.35	NP	0.00	166.94	161.59
12/13/00	<50	<0.18	<0.14	<0.18	<0.26	<0.24	5.71	NP	0.00	166.94	161.23
03/22/01	<50	<0.18	<0.14	<0.18	<0.26	<0.24	4.19	NP	0.00	166.94	162.75
MONITORING WELLS											
04/11/88	14,000	1,300	1,100	100	2,600	-	-	-	-	-	-
04/09/90	3,000	690	190	40	270	-	4.79	NP	0.00	166.51	161.72
10/30/90	3,400	910	48	87	249	-	5.86	NP	0.00	166.51	160.65
01/18/91	1,400	180	8.6	0.52	48	-	4.40	NP	0.00	166.51	162.11
02/12/91	1,000	ND	ND	0.65	ND	-	4.76	NP	0.00	166.51	161.75
03/20/91	3,000	250	53	ND	110	-	5.08	NP	0.00	166.51	161.43
05/22/91	2,500	330	7.8	5.6	200	-	4.52	NP	0.00	166.51	161.99
01/19/91	2,000	59	1.6	5.1	110	-	4.39	NP	0.00	166.51	162.12
07/17/91	-	-	-	-	-	-	5.05	FILM	0.00	166.51	161.46
08/07/91	-	-	-	-	-	-	5.02	FILM	0.00	166.51	161.49
09/24/91	-	-	-	-	-	-	5.86	FILM	0.00	166.51	160.65
10/23/91	-	-	-	-	-	-	5.84	FILM	0.00	166.51	160.67
11/06/91	9,900	2,300	37	260	160	-	5.48	NP	0.00	166.51	161.03
12/04/91	4,500	1,000	27	ND	180	-	5.43	NP	0.00	166.51	161.08
01/29/92	600	6.1	2.3	ND	47	-	5.12	NP	0.00	166.51	161.39
02/26/92	500	5.4	2.7	1.2	14	-	4.93	NP	0.00	166.51	161.58
03/19/92	ND	1.7	1.1	ND	5.5	-	4.45	NP	0.00	166.51	162.06
04/22/92	1,600	240	2.2	ND	160	-	4.63	NP	0.00	166.51	161.88
05/21/92	1,200	410	37	ND	118	-	4.90	NP	0.00	166.51	161.61
06/25/92	ND	1.0	0.8	0.8	0.4	-	5.15	NP	0.00	166.51	161.36
07/30/92	ND	2.0	1.8	1.9	6.4	-	5.30	NP	0.00	166.51	161.21
08/20/92	300	1.7	3.3	0.7	12	-	5.44	NP	0.00	166.51	161.07
09/30/92	1,900	140	ND	19	35	-	5.73	NP	0.00	166.51	160.78
12/23/92	400	8.0	ND	ND	ND	-	4.75	NP	0.00	166.51	161.76

**TABLE 1
GROUNDWATER DATA
THRIFTY OIL STATION #054, CASTRO VALLEY, CA.**

DATE SAMPLED	ANALYTICAL PARAMETERS						DEPTH TO GROUNDWATER (feet)	DEPTH TO PRODUCT (feet)	PRODUCT THICKNESS (feet)	CASING ELEVATION (feet)	GROUNDWATER ELEVATION (feet)
	TUO (ppb)	BENZENE (ug/L)	TOLUENE (ug/L)	EthylBenzene (ug/L)	XYLENE (ug/L)	MIBB (ug/L)					
03/10/93	1,100	290	9.7	ND	75	-	4.14	NP	0.00	166.51	162.37
06/09/93	400	1.5	0.5	ND	12	-	5.42	NP	0.00	166.51	161.09
09/14/93	240	6.9	8.8	1.4	67	-	5.53	NP	0.00	166.51	160.98
12/14/93	3,300	510	5.4	4.1	55	-	478	NP	0.00	166.51	-311.49
03/02/94	2,400	270	4.5	<0.3	13	-	4.20	NP	0.00	166.51	162.31
06/06/94	730	<0.3	<0.3	0.70	22	-	5.13	NP	0.00	166.51	161.38
09/06/94	2,400	180	28	2.3	76	-	5.45	NP	0.00	166.51	161.06
12/07/94	540	5.6	<0.3	<0.5	6.9	-	4.13	NP	0.00	166.51	162.38
03/08/95	1,500	220	5.5	<0.5	83	-	5.20	NP	0.00	166.51	161.31
06/15/95	3,200	820	53	6.2	74	-	4.93	NP	0.00	166.51	161.58
09/05/95	4,400	440	22	<2.5	57	-	5.03	NP	0.00	166.51	161.48
11/21/95	660	3.4	<0.3	<0.3	0.6	-	5.23	NP	0.00	166.51	161.28
03/11/96	1,000	76	2.2	<0.3	130	-	4.16	NP	0.00	166.51	162.35
06/09/96	90	<0.3	<0.3	<0.3	<0.5	-	5.42	NP	0.00	166.51	161.09
09/16/96	1,900	5.8	<0.3	<0.3	5.9	1,100	5.20	NP	0.00	166.51	161.31
12/10/96	740	<0.3	<0.3	<0.3	<0.5	1,300	5.27	NP	0.00	166.51	161.24
03/12/97	2,000	600	59	5.1	54	1,300	3.85	NP	0.00	166.51	162.66
06/12/97	230	<0.3	<0.3	<0.3	<0.5	720	-	-	-	-	-
09/10/97	210	<0.3	<0.3	<0.3	<0.5	210	4.10	NP	0.00	166.51	162.41
12/09/97	11,000	2,500	2,700	<6	1,500	510	5.20	NP	0.00	166.51	161.31
03/03/98	<50	<0.3	<0.3	<0.3	<0.5	<20	3.70	NP	0.00	166.51	162.81
07/08/98	<50	<0.3	<0.3	<0.3	<0.5	<5	-	-	-	-	-
09/10/98	<50	<0.3	<0.3	<0.3	<0.5	<5	6.77	NP	0.00	166.51	159.74
12/30/98	<50	<0.3	<0.3	<0.3	<0.5	<5	5.95	NP	0.00	166.51	160.56
03/15/99	<50	<0.3	<0.3	<0.3	<0.5	<5	5.25	NP	0.00	166.51	161.26
06/22/99	110	<0.3	<0.3	<0.3	<0.5	200	4.50	NP	0.00	166.51	162.01
09/08/99	68	<0.3	<0.3	<0.3	<0.5	110	4.43	NP	0.00	166.51	162.08
12/01/99	<50	<0.3	<0.3	<0.3	<0.5	<5	3.66	NP	0.00	166.51	162.85
03/23/00	<50	<0.25	<0.25	<0.25	<0.5	<5	4.06	NP	0.00	166.51	162.45
06/08/00	<50	<5	<5	<5	<5	<5	4.43	NP	0.00	166.51	162.08
09/27/00	<50	<0.18	<0.14	<0.18	<0.26	<0.24	4.06	NP	0.00	166.51	162.45
12/13/00	<50	<0.18	<0.14	<0.18	<0.26	<0.24	4.80	NP	0.00	166.51	161.71
03/22/01	<50	<0.18	<0.14	<0.18	<0.26	<0.24	6.33	NP	0.00	166.51	160.18

**TABLE 1
GROUNDWATER DATA
THRIFTY OIL STATION #054, CASTRO VALLEY, CA.**

DATE SAMPLED	ANALYTICAL PARAMETERS						DEPTH TO GROUNDWATER (feet)	DEPTH TO PRODUCT (feet)	PRODUCT THICKNESS (in)	CASING ELEVATION (feet)	GROUNDWATER ELEVATION (feet)
	TPH (ug/L)	BENZENE (ug/L)	TOLUENE (ug/L)	EthylBenzene (ug/L)	XYLENE (ug/L)	MTBE (ug/L)					
MONITORING WELL #RE-6											
04/11/88	6,000	3,000	40	80	140	-	-	-	-	-	-
04/09/90	3,000	990	ND	70	ND	-	5.64	NP	0.00	166.51	160.87
10/30/90	3,400	1,000	28	ND	ND	-	6.68	NP	0.00	166.51	159.83
01/18/91	6,300	1,200	ND	3.0	15	-	6.61	NP	0.00	166.51	159.90
02/12/91	5,200	850	8.4	4.9	41	-	6.20	NP	0.00	166.51	160.31
03/20/91	5,800	680	12	8.0	16	-	5.62	NP	0.00	166.51	160.89
05/22/91	8,500	1,700	14	24	6.7	-	6.05	NP	0.00	166.51	160.46
06/19/91	-	-	-	-	-	-	6.12	FILM	0.00	166.51	160.39
07/17/91	120,000	9,300	13,000	2,400	16,000	-	6.20	NP	0.00	166.51	160.31
08/07/91	-	590	5.3	ND	14	-	6.27	NP	0.00	166.51	160.24
09/24/91	7,000	310	11	5.3	35	-	6.63	NP	0.00	166.51	159.88
10/23/91	-	-	-	-	-	-	6.36	FILM	0.00	166.51	160.15
11/06/91	4,000	710	18	29	49	-	6.15	NP	0.00	166.51	160.36
12/04/91	4,100	1,100	14	33	39	-	6.19	NP	0.00	166.51	160.32
01/29/92	2,600	790	14	ND	49	-	6.70	NP	0.00	166.51	159.81
02/26/92	3,100	950	21	30	33	-	5.44	NP	0.00	166.51	161.07
03/19/92	2,200	630	14	12	40	-	5.30	NP	0.00	166.51	161.21
04/22/92	-	730	2.2	ND	40	-	6.00	NP	0.00	166.51	160.51
05/21/92	1,500	840	7.8	7.1	34	-	6.25	NP	0.00	166.51	160.26
06/25/92	<2000	740	8.0	27	28	-	6.38	NP	0.00	166.51	160.13
07/30/92	-	-	-	-	-	-	6.42	FILM	0.00	166.51	160.09
08/20/92	2,800	630	17	23	22	-	6.50	NP	0.00	166.51	160.01
09/30/92	7,800	540	ND	12	29	-	6.66	NP	0.00	166.51	159.85
12/23/92	1,800	350	ND	7.7	11	-	5.83	NP	0.00	166.51	160.68
03/10/93	3,000	830	5.6	19	16	-	5.63	NP	0.00	166.51	160.88
06/09/93	4,800	920	6.2	3.2	12	-	6.01	NP	0.00	166.51	160.50
09/14/93	3,600	660	7.5	11	27	-	6.53	NP	0.00	166.51	159.98
12/14/93	1,500	200	<0.3	<0.3	8.8	-	3.58	NP	0.00	166.51	162.93
03/02/94	-	-	-	-	-	-	5.12	NP	0.00	166.51	161.39
06/06/94	2,400	290	4.6	1.3	24	-	1.85	NP	0.00	166.51	164.66
09/06/94	4,300	230	21	<6.6	130	-	6.40	NP	0.00	166.51	160.11
12/07/94	1,500	17	2.5	3.2	22	-	5.68	NP	0.00	166.51	160.83
03/08/95	2,500	460	5.5	2.1	51	-	5.12	NP	0.00	166.51	161.39
06/15/95	2,300	91	1.1	0.7	97	-	5.72	NP	0.00	166.51	160.79

**TABLE 1
GROUNDWATER DATA
THRIFTY OIL STATION #054, CASTRO VALLEY, CA.**

DATE SAMPLED	ANALYTICAL PARAMETERS						DEPTH TO GROUNDWATER (feet)	DEPTH TO PRODUCT (feet)	PRODUCT THICKNESS (feet)	CASING ELEVATION (feet)	GROUNDWATER ELEVATION (feet)
	TBP (ug/L)	BENZENE (ug/L)	TOLUENE (ug/L)	TriBenzene (ug/L)	XYLENE (ug/L)	MIBK (ug/L)					
09/05/95	3,300	60	<10	<10	74	-	5.94	NP	0.00	166.51	160.57
11/21/95	2,000	7.3	<0.3	0.56	8.7	-	6.24	NP	0.00	166.51	160.27
03/11/96	840	43	0.96	5.7	14	-	5.16	NP	0.00	166.51	161.35
06/19/96	1,800	160	2.7	9.9	25	-	5.80	NP	0.00	166.51	160.71
09/16/96	<50	<0.3	<0.3	<0.3	<0.5	<20	5.38	NP	0.00	166.51	161.13
12/10/96	<50	<0.3	<0.3	<0.3	<0.5	<20	5.62	NP	0.00	166.51	160.89
03/12/97	<50	<0.3	<0.3	<0.3	<0.5	<20	5.20	NP	0.00	166.51	161.31
06/12/97	<50	<0.3	<0.3	<0.3	<0.5	<20	-	-	-	-	-
09/10/97	440	<0.3	<0.3	<0.3	<0.5	320	5.20	NP	0.00	166.51	161.31
12/09/97	<50	<0.3	<0.3	<0.3	<0.5	<20	5.97	NP	0.00	166.51	160.54
03/03/98	400	7.0	<0.3	<0.3	4.3	65	4.45	NP	0.00	166.51	162.06
07/08/98	300	<0.3	<0.3	<0.3	1.0	35	-	-	-	-	-
09/10/98	<50	<0.3	<0.3	<0.3	<0.5	<5	5.90	NP	0.00	166.51	160.61
12/30/98	<50	<0.3	<0.3	<0.3	<0.5	<5	5.20	NP	0.00	166.51	161.31
03/15/99	<50	<0.3	<0.3	<0.3	<0.5	8.4	4.82	NP	0.00	166.51	161.69
06/22/99	700	11	1.9	<0.3	3.9	140	6.00	NP	0.00	166.51	160.51
09/08/99	<50	<0.3	<0.3	<0.3	<0.5	<5	5.15	NP	0.00	166.51	161.36
12/01/99	<50	<0.3	<0.3	<0.3	<0.5	12	4.02	NP	0.00	166.51	162.49
03/23/00	<50	<0.25	<0.25	<0.25	<0.5	<5	4.41	NP	0.00	166.51	162.10
06/08/00	<50	<5	<5	<5	<5	<5	4.78	NP	0.00	166.51	161.73
09/27/00	<50	<0.18	<0.14	<0.18	<0.26	<0.24	4.78	NP	0.00	166.51	161.73
12/13/00	<50	<0.18	<0.14	<0.18	<0.26	<0.24	4.77	NP	0.00	166.51	161.74
03/22/01	367	<0.18	<0.14	<0.18	<0.26	*581 / 674	5.54	NP	0.00	166.51	160.97
MONITORING WELL #RD-7											
04/11/88	<50,000	17,000	4,400	600	8,400	-	-	-	-	-	-
04/09/90	16,000	7,000	1,200	640	1,600	-	5.93	NP	0.00	166.04	160.11
10/30/90	31,000	14,000	ND	ND	ND	-	8.21	NP	0.00	166.04	157.83
01/18/91	-	-	-	-	-	-	11.80	NP	0.00	166.04	154.24
02/12/91	-	-	-	-	-	-	10.80	FILM	0.00	166.04	155.24
03/20/91	120,000	12,000	2,800	490	6,600	-	9.96	NP	0.00	166.04	156.08
05/22/91	-	-	-	-	-	-	11.70	FILM	0.00	166.04	154.34
06/19/91	-	-	-	-	-	-	11.50	FILM	0.00	166.04	154.54
07/17/91	-	-	-	-	-	-	7.80	FILM	0.00	166.04	158.24

**TABLE 1
GROUNDWATER DATA
THRIFTY OIL STATION #054, CASTRO VALLEY, CA.**

DATE SAMPLED	ANALYTICAL PARAMETERS						DEPTH TO GROUNDWATER (feet)	DEPTH TO PRODUCT (feet)	PRODUCT THICKNESS (feet)	CASING ELEVATION (feet)	GROUNDWATER ELEVATION (feet)
	TPH (ug/L)	BENZENE (ug/L)	TOLUENE (ug/L)	Ethyl Benzene (ug/L)	XYLENE (ug/L)	MIBK (ug/L)					
08/07/91	-	-	-	-	-	-	9.88	0.03	9.85	166.04	163.60
09/24/91	-	-	-	-	-	-	9.85	0.03	9.82	166.04	163.60
10/23/91	-	-	-	-	-	-	9.96	FILM	0.00	166.04	156.08
11/06/91	-	-	-	-	-	-	6.77	FILM	0.00	166.04	159.27
12/04/91	-	-	-	-	-	-	10.80	FILM	0.00	166.04	155.24
01/29/92	-	-	-	-	-	-	8.64	FILM	0.00	166.04	157.40
02/26/92	-	-	-	-	-	-	6.00	FILM	0.00	166.04	160.04
03/19/92	-	-	-	-	-	-	5.55	FILM	0.00	166.04	160.49
04/22/92	-	-	-	-	-	-	6.12	FILM	0.00	166.04	159.92
05/21/92	-	-	-	-	-	-	6.40	FILM	0.00	166.04	159.64
06/25/92	-	-	-	-	-	-	6.73	0.02	6.71	166.04	164.38
07/30/92	-	-	-	-	-	-	6.73	FILM	0.00	166.04	159.31
08/20/92	-	-	-	-	-	-	6.82	FILM	0.00	166.04	159.22
09/30/92	-	-	-	-	-	-	7.26	FILM	0.00	166.04	158.78
12/23/92	-	-	-	-	-	-	6.22	FILM	0.00	166.04	159.82
03/10/93	-	-	-	-	-	-	5.82	FILM	0.00	166.04	160.22
06/09/93	-	-	-	-	-	-	6.17	FILM	0.00	166.04	159.87
09/14/93	-	-	-	-	-	-	11.33	NP	0.00	166.04	154.71
12/14/93	-	-	-	-	-	-	8.40	NP	0.00	166.04	157.64
03/02/94	-	-	-	-	-	-	6.82	NP	0.00	166.04	159.22
06/06/94	-	-	-	-	-	-	10.95	FILM	0.00	166.04	155.09
09/06/94	-	-	-	-	-	-	11.30	FILM	0.00	166.04	154.74
12/07/94	-	-	-	-	-	-	5.63	FILM	0.00	166.04	160.41
03/08/95	-	-	-	-	-	-	5.06	FILM	0.00	166.04	160.98
06/15/95	-	-	-	-	-	-	-	-	-	-	-
09/05/95	-	-	-	-	-	-	7.98	FILM	0.00	166.04	158.06
11/21/95	20,000	8,800	110	<30	310	-	7.32	NP	0.00	166.04	158.72
03/11/96	4,800	2,200	38	26	120	-	5.62	NP	0.00	166.04	160.42
06/19/96	4,400	3,300	49	5.8	70	-	6.40	NP	0.00	166.04	159.64
09/19/96	7,200	510	83	<0.3	710	130	6.20	NP	0.00	166.04	159.84
12/10/96	700	<0.3	<0.3	<0.3	<0.5	1,400	5.92	NP	0.00	166.04	160.12
03/12/97	660	0.31	<0.3	<0.3	<0.5	1,400	5.62	NP	0.00	166.04	160.42
06/12/97	320	<0.3	0.45	<0.3	<0.5	850	-	-	-	-	-
09/10/97	780	<0.3	<0.3	<0.3	<0.5	930	7.45	NP	0.00	166.04	158.59
12/09/97	14,000	3,500	3,700	<15	2,100	1,100	7.10	NP	0.00	166.04	158.94

**TABLE 1
GROUNDWATER DATA
THRIFTY OIL STATION #054, CASTRO VALLEY, CA.**

DATE SAMPLED	ANALYTICAL PARAMETERS						DEPTH TO GROUNDWATER (feet)	DEPTH TO PRODUCT (feet)	PRODUCT THICKNESS (feet)	CASING ELEVATION (feet)	GROUNDWATER ELEVATION (feet)
	TPH (ug/L)	BENZENE (ug/L)	TOLUENE (ug/L)	EthylBenzene (ug/L)	XYLENE (ug/L)	MIBK (ug/L)					
03/03/98	6,100	2,500	18	<6	110	270	6.70	NP	0.00	166.04	159.34
07/08/98	1,300	8.7	<0.3	<0.3	<0.5	350	-	-	-	-	-
09/10/98	690	2.2	<0.3	<0.3	<0.5	350	7.04	NP	0.00	166.04	159.00
12/30/98	600	2.0	0.55	<0.3	<0.5	350	6.25	NP	0.00	166.04	159.79
03/15/99	350	0.71	<0.3	<0.3	<0.5	140	6.02	NP	0.00	166.04	160.02
06/22/99	5,900	2,100	16	4.6	48	170	6.35	NP	0.00	166.04	159.69
09/08/99	1,700	380	<3	<3	13	160	7.03	NP	0.00	166.04	159.01
12/01/99	930	3.7	<0.3	<0.3	<0.5	390	6.25	NP	0.00	166.04	159.79
03/23/00	581	5.4	5.3	1.9	7.3	*168/183	6.24	NP	0.00	166.04	159.80
06/08/00	<100	<5	<5	<5	<5	74	6.64	NP	0.00	166.04	159.40
09/27/00	236	<0.18	<0.14	<0.18	<0.26	*21 / 28	7.03	NP	0.00	166.04	159.01
12/13/00	<50	<0.18	<0.14	<0.18	<0.26	*13 / 19.8	6.63	NP	0.00	166.04	159.41
03/22/01	504	<0.18	<0.14	<0.18	1	*666 / 1,420	7.02	NP	0.00	166.04	159.02
MONITORING WELL #15-3											
08/07/91	ND	ND	ND	ND	ND	-	9.68	NP	0.00	164.32	154.64
09/27/91	ND	ND	ND	ND	ND	-	9.89	NP	0.00	164.32	154.43
10/23/91	ND	ND	ND	ND	ND	-	10.05	NP	0.00	164.32	154.27
11/06/91	ND	ND	ND	ND	ND	-	9.71	NP	0.00	164.32	154.61
12/04/91	ND	ND	ND	ND	ND	-	10.00	NP	0.00	164.32	154.32
01/29/92	ND	2.1	1.0	2.5	3.6	-	9.28	NP	0.00	164.32	155.04
02/26/92	ND	ND	0.7	ND	0.7	-	7.05	NP	0.00	164.32	157.27
03/19/92	ND	0.5	1.0	1.5	2.7	-	7.30	NP	0.00	164.32	157.02
04/22/92	ND	ND	ND	ND	ND	-	8.60	NP	0.00	164.32	155.72
05/21/92	ND	ND	ND	ND	ND	-	9.22	NP	0.00	164.32	155.10
06/25/92	ND	ND	ND	ND	ND	-	9.49	NP	0.00	164.32	154.83
07/30/92	ND	1.1	4.2	ND	3.0	-	9.55	NP	0.00	164.32	154.77
08/20/92	ND	2.0	4.7	ND	5.7	-	9.63	NP	0.00	164.32	154.69
09/30/92	ND	ND	ND	ND	ND	-	9.90	NP	0.00	164.32	154.42
12/23/92	ND	ND	ND	ND	ND	-	9.96	NP	0.00	164.32	154.36
05/10/93	ND	ND	ND	ND	ND	-	8.95	NP	0.00	164.32	155.37
06/09/93	ND	ND	ND	ND	ND	-	9.00	NP	0.00	164.32	155.32
09/14/93	200	0.3	ND	ND	ND	-	9.50	NP	0.00	164.32	154.82
12/14/93	ND	ND	ND	ND	ND	-	8.75	NP	0.00	164.32	155.57

**TABLE 1
GROUNDWATER DATA
THRIFTY OIL STATION #054, CASTRO VALLEY, CA.**

DATE SAMPLED	ANALYTICAL PARAMETERS						DEPTH TO GROUNDWATER (feet)	DEPTH TO PRODUCT (feet)	PRODUCT THICKNESS (feet)	CASING ELEVATION (feet)	GROUNDWATER ELEVATION (feet)
	TPH (ug/L)	BENZENE (ug/L)	TOLUENE (ug/L)	EthylBenzene (ug/L)	XYLENE (ug/L)	MUIBE (ug/L)					
03/02/94	<50	<0.3	<0.3	<0.3	<0.5	-	7.52	NP	0.00	164.32	156.80
06/06/94	54	<0.3	<0.3	<0.3	2.4	-	9.00	NP	0.00	164.32	155.32
09/06/94	<50	<0.3	<0.3	<0.3	<0.5	-	9.26	NP	0.00	164.32	155.06
12/07/94	130	2.5	1.9	1.3	3.6	-	8.67	NP	0.00	164.32	155.65
03/08/95	<100	<0.5	<0.5	<0.5	<1	-	8.34	NP	0.00	164.32	155.98
06/15/95	<100	1.0	<0.5	<0.5	<1	-	9.12	NP	0.00	164.32	155.20
09/05/95	<100	<0.5	<0.5	<0.5	<1	-	9.56	NP	0.00	164.32	154.76
11/21/95	<50	0.44	<0.3	<0.3	1.5	-	9.28	NP	0.00	164.32	155.04
03/11/96	<50	1.3	<0.3	<0.3	0.6	-	7.52	NP	0.00	164.32	156.80
06/19/96	640	72	20	34	150	-	7.80	NP	0.00	164.32	156.52
09/16/96	<50	<0.3	<0.3	<0.3	<0.5	20	9.18	NP	0.00	164.32	155.14
12/10/96	<50	<0.3	<0.3	<0.3	<0.5	<20	6.08	NP	0.00	164.32	158.24
03/12/97	53	0.45	<0.3	<0.3	<0.5	140	8.65	NP	0.00	164.32	155.67
06/12/97	<50	<0.3	<0.3	<0.3	<0.5	68	-	-	-	-	-
09/10/97	<50	<0.3	<0.3	<0.3	<0.5	<20	8.30	NP	0.00	164.32	156.02
12/09/97	<50	1.7	2.1	<0.3	1.4	82	9.98	NP	0.00	164.32	154.34
03/03/98	<50	<0.3	<0.3	<0.3	<0.5	84	8.33	NP	0.00	164.32	155.99
07/08/98	<50	<0.3	<0.3	<0.3	<0.5	97	-	-	-	-	-
09/10/98	<50	<0.3	<0.3	<0.3	<0.5	97	12.95	NP	0.00	164.32	151.37
12/30/98	<50	1.3	1.5	<0.3	0.86	19	11.35	NP	0.00	164.32	152.97
03/15/99	<50	<0.3	<0.3	<0.3	<0.5	9.6	9.85	NP	0.00	164.32	154.47
06/22/99	66	0.39	<0.3	<0.3	<0.5	62	9.90	NP	0.00	164.32	154.42
09/08/99	<50	<0.3	<0.3	<0.3	<0.5	25	9.85	NP	0.00	164.32	154.47
12/01/99	<50	<0.3	<0.3	<0.3	<0.5	30	8.30	NP	0.00	164.32	156.02
03/23/00	<50	<0.25	<0.25	<0.25	<0.5	*13.6/18.2	6.76	NP	0.00	164.32	157.56
06/08/00	<50	<5	<5	<5	<5	10	8.30	NP	0.00	164.32	156.02
09/27/00	<50	<0.18	<0.14	<0.18	<0.26	*6 / 4.9	8.30	NP	0.00	164.32	156.02
12/13/00	<50	<0.18	<0.14	<0.18	<0.26	<0.24	8.28	NP	0.00	164.32	156.04
03/22/01	<50	<0.18	<0.14	<0.18	<0.26	<0.24	12.89	NP	0.00	164.32	151.43
MONITORING WELL #6											
08/07/91	-	0.5	ND	330	1,200	-	2.28	NP	0.00	167.51	165.23
09/27/91	13,000	3.5	3.0	82	140	-	2.77	NP	0.00	167.51	164.74
10/23/91	11,000	ND	ND	39	340	-	3.53	NP	0.00	167.51	163.98

TABLE 1
GROUNDWATER DATA
THRIFTY OIL STATION #054, CASTRO VALLEY, CA.

DATE SAMPLED	ANALYTICAL PARAMETERS						DEPTH TO GROUNDWATER (feet)	DEPTH TO PRODUCT (feet)	PRODUCT THICKNESS (feet)	CASE NO. ELEVATION (feet)	GROUNDWATER ELEVATION (feet)
	TPH (ug/L)	BENZENE (ug/L)	TOLUENE (ug/L)	Ethyl Benzene (ug/L)	XYLENE (ug/L)	MIBK (ug/L)					
11/06/91	6,800	8.4	0.6	22	230	-	2.51	NP	0.00	167.51	165.00
12/04/91	6,500	6.5	0.7	87	200	-	3.20	NP	0.00	167.51	164.31
01/29/92	8,100	22	10	140	260	-	2.65	NP	0.00	167.51	164.86
02/26/92	13,000	40	16	220	600	-	3.42	NP	0.00	167.51	164.09
03/19/92	12,000	21	12	100	280	-	3.12	NP	0.00	167.51	164.39
04/22/92	8,600	ND	ND	20	37	-	3.24	NP	0.00	167.51	164.27
05/21/92	6,000	21	10	53	210	-	3.75	NP	0.00	167.51	163.76
06/25/92	370	2.3	1.5	0.7	4.3	-	2.65	NP	0.00	167.51	164.86
07/30/92	3,600	20	ND	39	80	-	2.70	NP	0.00	167.51	164.81
08/20/92	3,000	0.7	5.2	2.0	5.3	-	2.83	NP	0.00	167.51	164.68
09/30/92	9,200	4.8	6.5	12	91	-	2.80	NP	0.00	167.51	164.71
12/23/92	2,000	17	ND	8.2	18	-	2.45	NP	0.00	167.51	165.06
03/10/93	1,500	ND	2.6	21	12	-	2.40	NP	0.00	167.51	165.11
06/09/93	1,300	0.6	1.7	ND	7.5	-	3.55	NP	0.00	167.51	163.96
09/14/93	1,500	1.3	7.6	4.1	14	-	2.81	NP	0.00	167.51	164.70
12/14/93	560	ND	ND	ND	5.5	-	2.63	NP	0.00	167.51	164.88
03/02/94	1,100	<0.3	<0.3	<0.3	<0.5	-	2.60	NP	0.00	167.51	164.91
06/06/94	290	0.58	0.53	1.1	5.8	-	2.52	NP	0.00	167.51	164.99
09/06/94	890	<0.3	<0.3	<0.3	3.1	-	3.16	NP	0.00	167.51	164.35
12/07/94	940	22	23	10	32	-	5.18	NP	0.00	167.51	162.33
03/08/95	1,600	<0.5	<0.5	<0.5	2.3	-	4.57	NP	0.00	167.51	162.94
06/15/95	3,200	2.2	5.3	4.3	3.1	-	5.08	NP	0.00	167.51	162.43
09/05/95	1,100	<0.5	<0.5	<0.5	<1	-	5.72	NP	0.00	167.51	161.79
11/21/95	1,100	1.1	2.9	3.5	3.0	-	2.46	NP	0.00	167.51	165.05
03/11/96	440	0.7	0.34	<0.3	3.7	-	3.44	NP	0.00	167.51	164.07
06/19/96	580	3.8	0.49	1.2	<0.5	-	3.80	NP	0.00	167.51	163.71
09/16/96	490	<0.3	1.6	<0.3	<0.5	<20	3.80	NP	0.00	167.51	163.71
12/10/96	<50	<0.3	<0.3	<0.3	<0.5	<20	2.76	NP	0.00	167.51	164.75
03/12/97	<50	<0.3	0.42	<0.3	1.5	<20	3.20	NP	0.00	167.51	164.31
06/12/97	<50	<0.3	<0.3	<0.3	0.51	<20	-	-	-	-	-
09/10/97	<50	<0.3	<0.3	<0.3	<0.5	<20	4.24	NP	0.00	167.51	163.27
12/09/97	<50	<0.3	0.48	<0.3	<0.5	<20	2.72	NP	0.00	167.51	164.79
03/03/98	190	<0.3	<0.3	0.38	<0.5	<20	1.90	NP	0.00	167.51	165.61
07/08/98	<50	<0.3	<0.3	<0.3	<0.5	<5	-	-	-	-	-
09/10/98	<50	<0.3	<0.3	<0.3	<0.5	<5	2.72	NP	0.00	167.51	164.79

**TABLE 1
GROUNDWATER DATA
THRIFTY OIL STATION #054, CASTRO VALLEY, CA.**

DATE SAMPLED	ANALYTICAL PARAMETERS						DEPTH TO GROUNDWATER (feet)	DEPTH TO PRODUCT (feet)	PRODUCT THICKNESS (feet)	CASING ELEVATION (feet)	GROUNDWATER ELEVATION (feet)
	EPI (ug/L)	BENZENE (ug/L)	TOLUENE (ug/L)	Ethyl Benzene (ug/L)	XYLENE (ug/L)	MIBK (ug/L)					
12/30/98	<50	<0.3	<0.3	<0.3	<0.5	<5	1.20	NP	0.00	167.51	166.31
03/15/99	<50	<0.3	<0.3	<0.3	<0.5	<5	4.25	NP	0.00	167.51	163.26
06/22/99	1,300	4.2	1.2	0.69	0.74	<5	3.70	NP	0.00	167.51	163.81
09/08/99	<50	<0.3	<0.3	<0.3	<0.5	<5	2.71	NP	0.00	167.51	164.80
12/01/99	<50	<0.3	<0.3	<0.3	<0.5	<5	2.70	NP	0.00	167.51	164.81
03/23/00	<50	<0.25	<0.25	<0.25	<0.5	<5	2.70	NP	0.00	167.51	164.81
06/08/00	585	<5	<5	<5	<5	821	2.72	NP	0.00	167.51	164.79
09/27/00	592	<0.18	<0.14	<0.18	<0.26	*1,180 / 1,360	2.72	NP	0.00	167.51	164.79
12/13/00	<50	<0.18	<0.14	<0.18	<0.26	*403 / 444	2.70	NP	0.00	167.51	164.81
03/22/01	425	<0.18	<0.14	<0.18	<0.26	*738 / 1,640	2.69	NP	0.00	167.51	164.82
MONITORING WELLS 10											
08/07/91	ND	ND	ND	ND	ND	-	6.16	NP	0.00	162.89	156.73
09/27/91	ND	ND	ND	ND	ND	-	6.48	NP	0.00	162.89	156.41
10/23/91	ND	ND	ND	ND	ND	-	7.37	NP	0.00	162.89	155.52
11/06/91	ND	ND	ND	ND	ND	-	6.44	NP	0.00	162.89	156.45
12/04/91	ND	ND	ND	ND	ND	-	7.02	NP	0.00	162.89	155.87
01/29/92	ND	ND	ND	ND	ND	-	6.78	NP	0.00	162.89	156.11
02/26/92	ND	ND	ND	ND	ND	-	8.33	NP	0.00	162.89	154.56
03/19/92	ND	ND	ND	ND	0.6	-	8.02	NP	0.00	162.89	154.87
04/22/92	ND	ND	ND	ND	ND	-	7.78	NP	0.00	162.89	155.11
05/21/92	ND	ND	0.6	ND	1.2	-	6.21	NP	0.00	162.89	156.68
06/25/92	ND	ND	ND	ND	ND	-	7.73	NP	0.00	162.89	155.16
07/30/92	ND	ND	0.5	ND	1.0	-	7.84	NP	0.00	162.89	155.05
08/20/92	ND	ND	ND	ND	ND	-	7.50	NP	0.00	162.89	155.39
09/30/92	ND	ND	ND	ND	ND	-	7.63	NP	0.00	162.89	155.26
12/23/92	ND	ND	ND	ND	ND	-	7.24	NP	0.00	162.89	155.65
03/10/93	ND	ND	ND	ND	ND	-	6.38	NP	0.00	162.89	156.51
06/09/93	ND	ND	ND	ND	ND	-	7.98	NP	0.00	162.89	154.91
09/14/93	ND	ND	ND	ND	ND	-	7.35	NP	0.00	162.89	155.54
03/02/94	<50	<0.3	<0.3	<0.3	<0.3	-	7.00	NP	0.00	162.89	155.89
06/06/94	<50	<0.3	<0.3	<0.3	<0.5	-	6.55	NP	0.00	162.89	156.34
09/06/94	<50	<0.3	<0.3	<0.3	<0.5	-	7.63	NP	0.00	162.89	155.26
12/07/94	56	<0.3	<0.3	<0.5	2.1	-	5.92	NP	0.00	162.89	156.97

**TABLE 1
GROUNDWATER DATA
THRIFTY OIL STATION #054, CASTRO VALLEY, CA.**

DATE SAMPLED	ANALYTICAL PARAMETERS						DEPTH TO GROUNDWATER (feet)	DEPTH TO PRODUCT (feet)	PRODUCT THICKNESS (feet)	CASING ELEVATION (feet)	GROUNDWATER ELEVATION (feet)
	TPH (ug/L)	BENZENE (ug/L)	TOLUENE (ug/L)	EthylBenzene (ug/L)	XYLENE (ug/L)	MIBK (ug/L)					
03/08/95	<100	<0.5	<0.5	<0.5	<1	-	7.84	NP	0.00	162.89	155.05
06/15/95	<100	<0.5	<0.5	<0.5	<1	-	6.97	NP	0.00	162.89	155.92
09/05/95	<100	<0.5	<0.5	<0.5	<1	-	8.14	NP	0.00	162.89	154.75
11/21/95	<50	<0.3	<0.3	<0.3	<0.5	-	7.68	NP	0.00	162.89	155.21
03/11/96	<50	<0.3	<0.3	<0.3	<0.5	-	6.76	NP	0.00	162.89	156.13
06/19/96	<50	<0.3	<0.3	<0.3	<0.5	-	7.20	NP	0.00	162.89	155.69
09/16/96	<50	<0.3	<0.3	<0.3	<0.5	<20	6.30	NP	0.00	162.89	156.59
12/10/96	<50	<0.3	<0.3	<0.3	<0.5	<20	6.05	NP	0.00	162.89	156.84
03/12/97	<50	<0.3	<0.3	<0.3	<0.5	<20	7.56	NP	0.00	162.89	155.33
06/12/97	<50	<0.3	<0.3	<0.3	<0.5	<20	-	-	-	-	-
09/10/97	<50	<0.3	<0.3	<0.3	<0.5	<20	7.55	NP	0.00	162.89	155.34
12/09/97	1,900	610	510	<6	290	<20	7.55	NP	0.00	162.89	155.34
03/03/98	<50	2.0	<0.3	<0.3	<0.5	27	6.03	NP	0.00	162.89	156.86
07/08/98	<50	<0.3	<0.3	<0.3	<0.5	<5	-	-	-	-	-
09/10/98	<50	<0.3	<0.3	<0.3	<0.5	72	7.55	NP	0.00	162.89	155.34
12/30/98	<50	1.1	<0.3	<0.3	<0.5	<5	4.45	NP	0.00	162.89	158.44
03/15/99	<50	<0.3	<0.3	<0.3	1.3	<5	4.50	NP	0.00	162.89	158.39
06/22/99	<50	<0.3	<0.3	<0.3	<0.5	<5	9.15	NP	0.00	162.89	153.74
09/08/99	<50	<0.3	<0.3	<0.3	<0.5	<5	7.51	NP	0.00	162.89	155.38
12/01/99	<50	<0.3	<0.3	<0.3	<0.5	<5	5.97	NP	0.00	162.89	156.92
03/23/00	<50	<0.25	<0.25	<0.25	<0.5	<5	4.47	NP	0.00	162.89	158.42
06/08/00	<50	<5	<5	<5	<5	<5	5.97	NP	0.00	162.89	156.92
09/27/00	<50	<0.18	<0.14	<0.18	<0.26	<0.24	7.50	NP	0.00	162.89	155.39
12/13/00	<50	<0.18	<0.14	<0.18	<0.26	<0.24	5.94	NP	0.00	162.89	156.95
03/22/01	<50	<0.18	<0.14	<0.18	<0.26	<0.24	7.51	NP	0.00	162.89	155.38
MONITORING WELLS-11											
09/21/95	110	<0.5	<0.5	<0.5	<1	-	9.37	NP	0.00	163.28	153.91
11/21/95	-	-	-	-	-	-	-	-	-	-	-
03/11/96	-	-	-	-	-	-	-	-	-	-	-
06/19/96	-	-	-	-	-	-	-	-	-	-	-
09/16/96	-	-	-	-	-	-	-	-	-	-	-
03/12/97	74	9.5	<0.3	<0.3	0.57	<20	7.75	NP	0.00	163.28	155.53
06/12/97	<50	<0.3	<0.3	<0.3	<0.5	<20	-	-	-	-	-

**TABLE 1
GROUNDWATER DATA
THRIFTY OIL STATION #054, CASTRO VALLEY, CA.**

DATE SAMPLED	ANALYTICAL PARAMETERS						DEPTH TO GROUNDWATER (ft)	DEPTH TO PRODUCT (ft)	PRODUCT THICKNESS (ft)	CASING ELEVATION (ft)	GROUNDWATER ELEVATION (ft)
	TPH (ug/L)	BENZENE (ug/L)	TOLUENE (ug/L)	EthylBenzene (ug/L)	XYLENE (ug/L)	MTBE (ug/L)					
09/10/97	<50	<0.3	<0.3	<0.3	<0.5	<20	9.50	NP	0.00	163.28	153.78
12/09/97	<50	0.79	1.2	<0.3	<0.5	<20	9.50	NP	0.00	163.28	153.78
03/03/98	140	22	0.63	<0.3	<0.5	<20	7.93	NP	0.00	163.28	155.35
07/08/98	<50	<0.3	<0.3	<0.3	<0.5	<5	-	-	-	-	-
09/10/98	<50	<0.3	<0.3	<0.3	<0.5	<5	9.48	NP	0.00	163.28	153.80
12/30/98	<50	1.3	0.87	<0.3	0.55	<5	7.95	NP	0.00	163.28	155.33
03/15/99	<50	<0.3	<0.3	<0.3	<0.5	<5	6.40	NP	0.00	163.28	156.88
06/22/99	350	89	2.9	3.3	0.91	6.8	11.00	NP	0.00	163.28	152.28
09/08/99	99	9.1	0.37	<0.3	<0.5	<5	7.90	NP	0.00	163.28	155.38
12/01/99	82	9.7	0.44	<0.3	<0.5	<5	7.90	NP	0.00	163.28	155.38
03/23/00	73	5.8	2.3	<0.25	<0.5	*11.2 / 7.9	4.85	NP	0.00	163.28	158.43
06/08/00	306	<5	<5	<5	<5	<5	7.90	NP	0.00	163.28	155.38
09/27/00	<50	1	<0.14	<0.18	<0.26	3 J / 3.6	9.44	NP	0.00	163.28	153.84
12/13/00	<50	<0.18	<0.14	<0.18	<0.26	<0.24	6.34	NP	0.00	163.28	156.94
03/22/01	408	<0.18	<0.14	<0.18	<0.26	*664 / 941	7.96	NP	0.00	163.28	155.32

NOTE: ND = Nondetectable
 " - " = Not Analyzed / Not Available
 NP = No Free Product
 *MTBE 8020/8260

Benzene, toluene, ethylbenzene, and xylene analyzed by EPA method 8020.
 Total petroleum hydrocarbons (TPH) analyzed by EPA method 8015 modified for gasoline
 Methyl-tert Butyl Ether (MTBE) analyzed by EPA method 8020
 On June 8, 2000, BTEX and MTBE analyzed by EPA Method 8260B

APPENDIX A



PROJECT STATUS REPORT

SITE: THRIFTY OIL CO. # 054
 ADDR: 2504 CASTRO VALLEY BLVD.
CASTRO VALLEY, CA. 94546

DATE: 03.22.01

PERSON: SERBATA P.

OBSERVATION WELLS

WELL ID	DTP (FT)	DTW (FT)	DTB (FT)	PT (FT)	DIA (IN)	PURGE (GAL)	ODORS			FP		COMMENT
							Y	N	S	Y	N	
MONTHLY/QUARTERLY												
PW-1		6.32'	19.97		4"	20		X			X	
PW-2		5.14'	14.32		4"	24		X			X	
RE-1		5.22'	19.00		4"	36		X			X	
RE-2		4.33'	16.96		4"	33		X			X	
RE-3		4.54'	17.55		4"	34		X			X	
RE-4		4.19'	14.52		4"	27		X			X	
RE-5		6.33'	18.19		4"	31		X			X	
RE-6		5.54'	13.58		4"	20		X			X	
RE-7		7.02'	13.14		4"	16		X			X	
RS-8		12.84'	23.15		2"	8		X			X	
RS-9		2.69'	14.95		2"	8		X			X	
RS-10		7.51'	24.38		2"	11		X			X	
RS-11		7.96'	24.74		2"	11		X			X	

FREE PRODUCT REMOVED: APPROX GALLONS

WATER REMOVED: APPROX 280 GALLONS

REMARKS:

R.W.S.

EXPLANATION:

DTP= DEPTH TO PRODUCT FROM TOP OF CASING, DTW= DEPTH TO WATER FROM TOP OF CASING
 DTB= DEPTH TO BOTTOM FROM TOP OF CASING, PT= PRODUCT THICKNESS, S= SLIGHT

FIELD DATA -GROUNDWATER SAMPLING PROGRAM

Site:	# 054	Date:	03.22.01
Address:			
Personnel:	SERBAP	Weather:	SUNNY DAY
Well No:	PW-1	Equip:	BAUER

Before Purging:			
Total Well Depth: (ft.)	13.97	Well Diameter	4"
Depth to Water (ft)	6.32	Est. Purge Volume:	20

Sampling Data:							
Initial Turbidity:				Final Turbidity:			
Time	11:02	11:06	11:08	11:11	11:14	11:17	11:20
EC	1640	1700	1730	1730	1740	1720	1720
pH	6.41	6.42	6.43	6.41	6.42	6.42	6.43
Temp	73.4	73.2	73.2	72.9	72.8	72.8	72.6
Gal.	2	5	8	11	14	17	20
Time							
EC							
pH							
Temp							
Gal.							

After Purging/Before Sample Collection	
Depth to Water (ft.)	7.23
Total Well Depth(ft).	13.97

FIELD DATA - GROUNDWATER SAMPLING PROGRAM

Site:	#054	Date:	03.22.01
Address:			
Personnel:	BERBA P.	Weather:	SUNNY DAY
Well No:	PW-2	Equip:	BUDER

Before Purging:			
Total Well Depth: (ft.)	14.32	Well Diameter	4"
Depth to Water (ft)	5.14	Est. Purge Volume:	24

Sampling Data:							
Initial Turbidity:				Final Turbidity:			
Time	11:29	11:32	11:36	11:39	11:43	11:46	11:50
EC	1730	1760	1680	1670	1680	1690	1680
pH	6.49	6.49	6.49	6.50	6.49	6.49	6.49
Temp	73.3	73.1	72.9	72.8	72.8	72.6	72.5
Gal.	3	6	10	13	17	20	24
Time							
EC							
pH							
Temp							
Gal.							

After Purging/Before Sample Collection	
Depth to Water (ft.)	6.30
Total Well Depth (ft.)	14.32

FIELD DATA - GROUNDWATER SAMPLING PROGRAM

Site:	#054	Date:	03.22.01
Address:			
Personnel:	DERBASP	Weather:	SUNNY DAY
Well No:	REA	Equip:	BAUER

Before Purging:			
Total Well Depth: (ft.)	19.00	Well Diameter	4"
Depth to Water (ft)	5.22	Est. Purge Volume:	36

Sampling Data:							
Initial Turbidity:				Final Turbidity:			
Time	9:09	9:14	9:19	9:24	9:29	9:34	9:40
EC	1400	1400	1380	1370	1390	1380	1370
pH	6.50	6.51	6.50	6.52	6.52	6.50	6.52
Temp	72.8	72.7	72.7	72.6	72.6	72.4	72.3
Gal.	5	10	15	20	25	30	36
Time							
EC							
pH							
Temp							
Gal.							

After Purging/Before Sample Collection	
Depth to Water (ft.)	6.21
Total Well Depth (ft.)	19.00

FIELD DATA - GROUNDWATER SAMPLING PROGRAM

Site:	# 054	Date:	03.22.01
Address:			
Personnel:	SERBON	Weather:	SUNNY DAY
Well No:	RE 2	Equip:	BAUER

Before Purging:			
Total Well Depth: (ft.)	16.96	Well Diameter	4"
Depth to Water (ft)	4.33	Est. Purge Volume:	33

Sampling Data:							
Initial Turbidity:				Final Turbidity:			
Time	9:51	9:56	10:01	10:05	10:10	10:15	10:20
EC	1430	1420	14300	1420	1420	1420	1430
pH	6.48	6.47	6.49	6.48	6.49	6.47	6.49
Temp	73.2	73.1	73.1	72.9	72.8	72.7	72.7
Gal.	4	9	14	18	23	28	33
Time							
EC							
pH							
Temp							
Gal.							

After Purging/Before Sample Collection			
Depth to Water (ft.)	5.30	Total Well Depth(ft.)	16.96

FIELD DATA - GROUNDWATER SAMPLING PROGRAM

Site: #054	Date: 03.22.01
Address:	
Personnel: STEBBINS P-	Weather: SUNNY DAY
Well No: RE3	Equip: BAUER

Before Purging:			
Total Well Depth: (ft.)	17.55	Well Diameter	44
Depth to Water (ft)	4.54	Est. Purge Volume:	39

Sampling Data:							
Initial Turbidity:				Final Turbidity:			
Time	13:30	13:35	13:40	13:45	13:50	13:55	14:00
EC	1270	1260	1230	1220	1220	1220	1220
pH	4.47	4.48	4.47	4.48	4.48	4.49	4.48
Temp	73.4	73.3	73.2	73.2	72.8	72.8	72.6
Gal.	4	9	14	19	24	29	34
Time							
EC							
pH							
Temp							
Gal.							

After Purging/Before Sample Collection	TIME: 14:00 AM/PM
Depth to Water (ft.) 6.12	Total Well Depth(ft.) 17.55

FIELD DATA - GROUNDWATER SAMPLING PROGRAM

Site: # 054 Date: 03-22-01
 Address: _____
 Personnel: SERBATA Weather: SUNNY DAY
 Well No: PE4 Equip: BAILER

Before Purging:
 Total Well Depth: (ft.) 14.52 Well Diameter 44
 Depth to Water (ft) 4.19 Est. Purge Volume: 27

Sampling Data:

Initial Turbidity:		Final Turbidity:					
Time	12:56	13:00	13:04	13:08	13:12	13:16	13:20
EC	1300	1340	1320	1340	1360	1360	1340
pH	4.65	4.67	4.66	4.65	4.66	4.64	4.67
Temp	24.2	23.9	23.8	23.6	23.4	23.4	23.3
Gal.	3	7	11	15	19	23	27
Time							
EC							
pH							
Temp							
Gal.							

After Purging/Before Sample Collection TIME: 13:20 AM/PM
 Depth to Water (ft.) 6.30 Total Well Depth(ft) 14.52

FIELD DATA -GROUNDWATER SAMPLING PROGRAM

Site:	<u>H 054</u>	Date:	<u>03.22.01</u>
Address:			
Personnel:	<u>GERBOTA P.</u>	Weather:	<u>SUNNY DAY</u>
Well No:	<u>RE 5</u>	Equip:	<u>BATLER</u>

Before Purging:			
Total Well Depth: (ft.)	<u>18.19</u>	Well Diameter	<u>44</u>
Depth to Water (ft)	<u>6.33</u>	Est. Purge Volume:	<u>31</u>

Sampling Data:							
Initial Turbidity:				Final Turbidity:			
Time	<u>12:23</u>	<u>12:27</u>	<u>12:32</u>	<u>12:36</u>	<u>12:41</u>	<u>12:45</u>	<u>12:50</u>
EC	<u>1100</u>	<u>1150</u>	<u>1120</u>	<u>1140</u>	<u>1120</u>	<u>1120</u>	<u>1110</u>
pH	<u>4.21</u>	<u>4.22</u>	<u>4.20</u>	<u>4.21</u>	<u>4.21</u>	<u>4.50</u>	<u>4.50</u>
Temp	<u>73.3</u>	<u>73.2</u>	<u>73.2</u>	<u>73.1</u>	<u>72.9</u>	<u>72.8</u>	<u>72.8</u>
Gal.	<u>4</u>	<u>8</u>	<u>13</u>	<u>17</u>	<u>22</u>	<u>26</u>	<u>31</u>
Time							
EC							
pH							
Temp							
Gal.							

After Purging/Before Sample Collection	
Depth to Water (ft.)	<u>7.10</u> Total Well Depth(ft.) <u>18.19</u>

FIELD DATA -GROUNDWATER SAMPLING PROGRAM

Site:	#054	Date:	03.22.01
Address:			
Personnel:	SERBON P.	Weather:	SUNNY DAY
Well No:	R26	Equip:	BAUER

Before Purging:			
Total Well Depth: (ft.)	13.38	Well Diameter	4"
Depth to Water (ft)	6.54	Est. Purge Volume:	21

Sampling Data:							
Initial Turbidity:				Final Turbidity:			
Time	10:32	10:35	10:38	10:41	10:44	10:47	10:50
EC	1020	1010	1020	1030	1040	1020	1020
pH	4.65	4.67	4.66	4.65	4.65	4.66	4.65
Temp	73.4	73.4	73.3	73.2	73.1	73.1	72.9
Gal.	5	6	9	12	15	18	21
Time							
EC							
pH							
Temp							
Gal.							

After Purging/Before Sample Collection	
Depth to Water (ft.)	6.14
Total Well Depth(ft.)	13.58

FIELD DATA -GROUNDWATER SAMPLING PROGRAM

Site:	# 054	Date:	03.22.01
Address:			
Personnel:	SERBA	Weather:	SUNNY DAY
Well No:	REF	Equip:	BAIFR

Before Purging:			
Total Well Depth: (ft.)	13.14	Well Diameter	4.4
Depth to Water (ft)	2.02	Est. Purge Volume:	16

Sampling Data:							
Initial Turbidity:				Final Turbidity:			
Time	11:56	11:58	12:00	12:03	12:05	12:07	12:10
EC	1360	1350	1370	1360	1370	1360	1360
pH	4.65	4.67	4.66	4.65	4.66	4.65	4.65
Temp	74.3	74.2	74.1	74.1	73.9	73.8	73.7
Gal.	2	4	6	9	11	13	16
Time							
EC							
pH							
Temp							
Gal.							

After Purging/Before Sample Collection	
Depth to Water (ft.)	2.80
Total Well Depth(ft).	13.14

FIELD DATA - GROUNDWATER SAMPLING PROGRAM

Site: # 054	Date: 03.22.01
Address:	
Personnel: SERBATA P	Weather: SUNNY DAY
Well No: RS 8	Equip: BRICER

Before Purging:			
Total Well Depth: (ft.)	25.15	Well Diameter	2"
Depth to Water (ft)	12.89	Est. Purge Volume:	8

Sampling Data:							
Initial Turbidity:				Final Turbidity:			
Time	14:03	14:04	14:05	14:06	14:07	14:08	14:10
EC	1970	1890	1870	1960	1930	1960	1860
pH	4.48	4.50	4.52	4.50	4.48	4.50	4.48
Temp	72.8	72.6	72.6	72.4	72.3	72.3	72.1
Gal.	1	2	3	4	5	6	8
Time							
EC							
pH							
Temp							
Gal.							

After Purging/Before Sample Collection	TIME: 14:10 AM/PM
Depth to Water (ft.) 14.14	Total Well Depth(ft). 25.15

FIELD DATA -GROUNDWATER SAMPLING PROGRAM

Site: # 054	Date: 03.22.01
Address:	
Personnel: JERBA + P	Weather: SUNNY DAY
Well No: R39	Equip: BAILER

Before Purging:			
Total Well Depth: (ft.)	14.95	Well Diameter	2"
Depth to Water (ft)	2.69	Est. Purge Volume:	8

Sampling Data:							
Initial Turbidity:				Final Turbidity:			
Time	8:53	8:54	8:55	8:56	8:57	8:58	9:00
EC	1430	1420	1430	1440	1460	1450	1470
pH	4.82	4.83	4.82	4.83	4.82	4.82	4.83
Temp	72.6	72.4	72.4	72.3	72.3	72.1	72.1
Gal.	1	2	3	4	5	6	8
Time							
EC							
pH							
Temp							
Gal.							

After Purging/Before Sample Collection	
Depth to Water (ft.) 4.30	Total Well Depth(ft.) 14.95

FIELD DATA - GROUNDWATER SAMPLING PROGRAM

Site: # 054 Date: 03.22.01
 Address:
 Personnel: SERBAND Weather: SUNNY DAY
 Well No: R310 Equip: BAUER

Before Purging:
 Total Well Depth (ft.) 24.38 Well Diameter 24
 Depth to Water (ft) 7.51 Est. Purge Volume: 11

Sampling Data:

Initial Turbidity:		Final Turbidity:					
Time	14:30	14:32	14:33	14:35	14:36	14:38	14:40
EC	1890	1860	1860	1880	1860	1880	1860
pH	4.52	4.51	4.50	4.50	4.51	4.50	4.51
Temp	73.4	73.2	73.1	72.9	72.8	72.7	72.7
Gal.	1	3	4	6	7	9	11
Time							
EC							
pH							
Temp							
Gal.							

After Purging/Before Sample Collection TIME: 14:40 AM/PM
 Depth to Water (ft.) 8.20 Total Well Depth(ft) 24.38

FIELD DATA - GROUNDWATER SAMPLING PROGRAM

Site: # 054 Date: 03.22.01
 Address: _____
 Personnel: JERBA P Weather: SUNNY DAY
 Well No: RSM Equip: BAUER

Before Purging:
 Total Well Depth: (ft.) 24.74 Well Diameter 27
 Depth to Water (ft) 2.96 Est. Purge Volume: 11

Sampling Data:

Time	Initial Turbidity:			Final Turbidity:			
	14:15	14:17	14:18	14:20	14:21	14:23	14:25
EC	1770	1720	1720	1740	1740	1720	1720
pH	4.60	4.62	4.60	4.61	4.62	4.60	4.60
Temp	73.3	73.3	73.1	72.9	72.9	72.7	72.6
Gal.	1	3	4	6	7	9	11
Time							
EC							
pH							
Temp							
Gal.							

After Purging/Before Sample Collection TIME: 14:25 AM/PM
 Depth to Water (ft.) 8.15 Total Well Depth(ft) 24.74

APPENDIX B



ASSOCIATED LABORATORIES

806 North Batavia - Orange, California 92868 - 714/771-6900

FAX 714/538-1209

CLIENT Thrifty Oil (8871)
ATTN: Jeff Suryakusuma
13539 E. Foster Rd.
Santa Fe Springs, CA 90670

LAB REQUEST 69958

REPORTED 04/02/2001

RECEIVED 03/27/2001

PROJECT Station #054
2504 Castro Valley Blvd., Castro Valley.

SUBMITTER Client

COMMENTS Added MTBE by EPA 8260 to order #254384, 386, 387, 388,
390, 393 & 395 on 04/12/2001.

This laboratory request covers the following listed samples which were analyzed for the parameters indicated on the attached Analytical Result Report. All analyses were conducted using the appropriate methods as indicated on the report. This cover letter is an integral part of the final report.

<u>Order No.</u>	<u>Client Sample Identification</u>
254384	T.O.C. #054, RS-9
254385	T.O.C. #054, RE-1
254386	T.O.C. #054, RE-2
254387	T.O.C. #054, RE-6
254388	T.O.C. #054, PW-1
254389	T.O.C. #054, PW-2
254390	T.O.C. #054, RE-7
254391	T.O.C. #054, RE-5
254392	T.O.C. #054, RE-4
254393	T.O.C. #054, RE-3
254394	T.O.C. #054, RS-8

Thank you for the opportunity to be of service to your company. Please feel free to call if there are any questions regarding this report or if we can be of further service.

ASSOCIATED LABORATORIES by,

Edward S. Behare, Ph.D.
Vice President

NOTE: Unless notified in writing, all samples will be discarded by appropriate disposal protocol 30 days from date reported.

The reports of the Associated Laboratories are confidential property of our clients and may not be reproduced or used for publication in part or in full without our written permission. This is for the mutual protection of the public, our clients, and ourselves.

TESTING & CONSULTING
Chemical
Microbiological
Environmental

CLIENT Thrifty Oil (8871)
ATTN: Jeff Suryakusuma
13539 E. Foster Rd.
Santa Fe Springs, CA 90670

LAB REQUEST 69958

REPORTED 04/02/2001

RECEIVED 03/27/2001

PROJECT Station #054
2504 Castro Valley Blvd., Castro Valley

SUBMITTER Client

COMMENTS Added MTBE by EPA 8260 to order #254384, 386, 387, 388,
390, 393 & 395 on 04/12/2001.

This laboratory request covers the following listed samples which were analyzed for the parameters indicated on the attached Analytical Result Report. All analyses were conducted using the appropriate methods as indicated on the report. This cover letter is an integral part of the final report.

Order No.

254395

254396

254397

Client Sample Identification

T.O.C. #054, RS-11

T.O.C. #054, RS-10

T.O.C. #054, Trip Blank

Thank you for the opportunity to be of service to your company. Please feel free to call if there are any questions regarding this report or if we can be of further service.

ASSOCIATED LABORATORIES by,

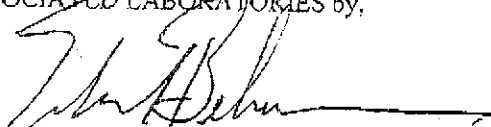
Edward S. Behare, Ph.D.
Vice President

NOTE: Unless notified in writing, all samples will be discarded by appropriate disposal protocol 30 days from date reported.

The reports of the Associated Laboratories are confidential property of our clients and may not be reproduced or used for publication in part or in full without our written permission. This is for the mutual protection of the public, our clients, and ourselves.

TESTING & CONSULTING
Chemical
Microbiological
Environmental

Order #: 254384

Client Sample ID T.O.C. #054, RS-9

Matrix: WATER

Date Sampled: 03/22/2001 Time Sampled: 12:00

Analyte	Result	DF	PQL	MDL	Units	Date/Analyst
8021B BTEX + MTBE						
Benzene	ND	1	0.3	0.18	ug/L	03/28/01 HP
Ethyl benzene	ND	1	0.3	0.18	ug/L	03/28/01 HP
Methyl t - butyl ether	738	33	165.0	0.24	ug/L	03/28/01 HP
Toluene	ND	1	0.3	0.14	ug/L	03/28/01 HP
Xylene (total)	ND	1	0.6	0.26	ug/L	03/28/01 HP

8260B BTEX/MTBE Only

Methyl-tert-butyl ether (MTBE)	1,640	1	1	0.6	ug/L	04/13/01 MB
--------------------------------	-------	---	---	-----	------	-------------

8015M - Total Petroleum Hydrocarbons

Gasoline	425	1	50	50	ug/L	03/28/01 HP
----------	-----	---	----	----	------	-------------

Order #: 254385

Client Sample ID T.O.C. #054, RE-1

Matrix: WATER

Date Sampled: 03/22/2001 Time Sampled: 12:05

Analyte	Result	DF	PQL	MDL	Units	Date/Analyst
3021B BTEX + MTBE						
Benzene	ND	1	0.3	0.18	ug/L	03/28/01 HP
Ethyl benzene	ND	1	0.3	0.18	ug/L	03/28/01 HP
Methyl t - butyl ether	ND	1	5	0.24	ug/L	03/28/01 HP
Toluene	ND	1	0.3	0.14	ug/L	03/28/01 HP
Xylene (total)	ND	1	0.6	0.26	ug/L	03/28/01 HP

3015M - Total Petroleum Hydrocarbons

Gasoline	ND	1	50	50	ug/L	03/28/01 HP
----------	----	---	----	----	------	-------------

Order #: 254386

Client Sample ID T.O.C. #054, RE-2

Matrix: WATER

Date Sampled: 03/22/2001 Time Sampled: 12:10

Analyte	Result	DF	PQL	MDL	Units	Date/Analyst
3021B BTEX + MTBE						
Benzene	ND	1	0.3	0.18	ug/L	03/28/01 HP
Ethyl benzene	ND	1	0.3	0.18	ug/L	03/28/01 HP
Methyl t - butyl ether	950	33	165.0	0.24	ug/L	03/28/01 HP
Toluene	1.3	1	0.3	0.14	ug/L	03/28/01 HP
Xylene (total)	ND	1	0.6	0.26	ug/L	03/28/01 HP

FQL = Practical Quantitation Limit, MDL = Method detection limit, DF = Dilution Factor
 ND = Not detected below indicated MDL, I=Trace



3260B BTEX/MTBE Only

Methyl-tert-butylether (MTBE)	2.070	1	1	0.6	ug/L	04/13/01	MB
-------------------------------	-------	---	---	-----	------	----------	----

3015M - Total Petroleum Hydrocarbons

Gasoline	575	1	50	50	ug/L	03/28/01	HP
----------	-----	---	----	----	------	----------	----

Order #: 254387

Client Sample ID T.O.C. #054, RE-6

Matrix: WATER

Date Sampled: 03/22/2001 Time Sampled: 12:15

Analyte	Result	DF	PQL	MDL	Units	Date/Analyst
---------	--------	----	-----	-----	-------	--------------

3021B BTEX + MTBE

Benzene	ND	1	0.3	0.18	ug/L	03/28/01	HP
Ethyl benzene	ND	1	0.3	0.18	ug/L	03/28/01	HP
Methyl t - butyl ether	581	25	125.0	0.24	ug/L	03/28/01	HP
Toluene	ND	1	0.3	0.14	ug/L	03/28/01	HP
Xylene (total)	ND	1	0.6	0.26	ug/L	03/28/01	HP

3260B BTEX/MTBE Only

Methyl-tert-butylether (MTBE)	674	1	1	0.6	ug/L	04/13/01	MB
-------------------------------	-----	---	---	-----	------	----------	----

3015M - Total Petroleum Hydrocarbons

Gasoline	367	1	50	50	ug/L	03/28/01	HP
----------	-----	---	----	----	------	----------	----

Order #: 254388

Client Sample ID T.O.C. #054, PW-1

Matrix: WATER

Date Sampled: 03/22/2001 Time Sampled: 12:20

Analyte	Result	DF	PQL	MDL	Units	Date/Analyst
---------	--------	----	-----	-----	-------	--------------

3021B BTEX + MTBE

Benzene	ND	1	0.3	0.18	ug/L	03/28/01	HP
Ethyl benzene	ND	1	0.3	0.18	ug/L	03/28/01	HP
Methyl t - butyl ether	1,010	33	165.0	0.24	ug/L	03/28/01	HP
Toluene	1.3	1	0.3	0.14	ug/L	03/28/01	HP
Xylene (total)	ND	1	0.6	0.26	ug/L	03/28/01	HP

3260B BTEX/MTBE Only

Methyl-tert-butylether (MTBE)	1,970	1	1	0.6	ug/L	04/13/01	MB
-------------------------------	-------	---	---	-----	------	----------	----

3015M - Total Petroleum Hydrocarbons

Gasoline	600	1	50	50	ug/L	03/28/01	HP
----------	-----	---	----	----	------	----------	----

Order #: 254389

Client Sample ID T.O.C. #054, PW-2

Matrix: WATER

Date Sampled: 03/22/2001 Time Sampled: 12:25

PQL = Practical Quantitation Limit, MDL = Method detection limit, DF = Dilution Factor

ND = Not detected below indicated MDL, J=Trace



Analyte	Result	DF	PQL	MDL	Units	Date/Analyst
---------	--------	----	-----	-----	-------	--------------

8021B BTEX + MTBE

Benzene	ND	1	0.3	0.18	ug/L	03/28/01 HP
Ethyl benzene	ND	1	0.3	0.18	ug/L	03/28/01 HP
Methyl t - butyl ether	ND	1	5	0.24	ug/L	03/28/01 HP
Toluene	ND	1	0.3	0.14	ug/L	03/28/01 HP
Xylene (total)	ND	1	0.6	0.26	ug/L	03/28/01 HP

8015M - Total Petroleum Hydrocarbons

Gasoline	ND	1	50	50	ug/L	03/28/01 HP
----------	----	---	----	----	------	-------------

Order #: 254390	Client Sample ID T.O.C. #054, RE-7
Matrix: WATER	Date Sampled: 03/22/2001 Time Sampled: 12:30

Analyte	Result	DF	PQL	MDL	Units	Date/Analyst
---------	--------	----	-----	-----	-------	--------------

8021B BTEX + MTBE

Benzene	ND	1	0.3	0.18	ug/L	03/28/01 HP
Ethyl benzene	ND	1	0.3	0.18	ug/L	03/28/01 HP
Methyl t - butyl ether	666	25	125.0	0.24	ug/L	03/28/01 HP
Toluene	ND	1	0.3	0.14	ug/L	03/28/01 HP
Xylene (total)	1.0	1	0.6	0.26	ug/L	03/28/01 HP

8260B BTEX/MTBE Only

Methyl-tert-butylether (MTBE)	1,420	1	1	0.6	ug/L	04/13/01 MB
-------------------------------	-------	---	---	-----	------	-------------

8015M - Total Petroleum Hydrocarbons

Gasoline	504	1	50	50	ug/L	03/28/01 HP
----------	-----	---	----	----	------	-------------

Order #: 254391	Client Sample ID T.O.C. #054, RE-5
Matrix: WATER	Date Sampled: 03/22/2001 Time Sampled: 12:35

Analyte	Result	DF	PQL	MDL	Units	Date/Analyst
---------	--------	----	-----	-----	-------	--------------

8021B BTEX + MTBE

Benzene	ND	1	0.3	0.18	ug/L	03/28/01 HP
Ethyl benzene	ND	1	0.3	0.18	ug/L	03/28/01 HP
Methyl t - butyl ether	ND	1	5	0.24	ug/L	03/28/01 HP
Toluene	ND	1	0.3	0.14	ug/L	03/28/01 HP
Xylene (total)	ND	1	0.6	0.26	ug/L	03/28/01 HP

PQL = Practical Quantitation Limit, MDL = Method detection limit, DF = Dilution Factor
 ND = Not detected below indicated MDL, J=Trace



8015M - Total Petroleum Hydrocarbons

Gasoline	ND	1	50	50	ug/L	03/28/01	HP
----------	----	---	----	----	------	----------	----

Order #: 254392	Client Sample ID T.O.C. #054, RE-4
Matrix: WATER	Date Sampled: 03/22/2001 Time Sampled: 12:40

Analyte	Result	DF	PQL	MDL	Units	Date/Analyst
8021B BTEX + MTBE						
Benzene	ND	1	0.3	0.18	ug/L	03/28/01 HP
Ethyl benzene	ND	1	0.3	0.18	ug/L	03/28/01 HP
Methyl t - butyl ether	ND	1	5	0.24	ug/L	03/28/01 HP
Toluene	ND	1	0.3	0.14	ug/L	03/28/01 HP
Xylene (total)	ND	1	0.6	0.26	ug/L	03/28/01 HP

8015M - Total Petroleum Hydrocarbons

Gasoline	ND	1	50	50	ug/L	03/28/01	HP
----------	----	---	----	----	------	----------	----

Order #: 254393	Client Sample ID T.O.C. #054, RE-3
Matrix: WATER	Date Sampled: 03/22/2001 Time Sampled: 12:45

Analyte	Result	DF	PQL	MDL	Units	Date/Analyst
8021B BTEX + MTBE						
Benzene	ND	1	0.3	0.18	ug/L	03/28/01 HP
Ethyl benzene	ND	1	0.3	0.18	ug/L	03/28/01 HP
Methyl t - butyl ether	90	2	10.0	0.24	ug/L	03/28/01 HP
Toluene	ND	1	0.3	0.14	ug/L	03/28/01 HP
Xylene (total)	ND	1	0.6	0.26	ug/L	03/28/01 HP

8260B BTEX/MTBE Only

Methyl-tert-butylether (MTBE)	57	1	1	0.6	ug/L	04/13/01	MB
-------------------------------	----	---	---	-----	------	----------	----

8015M - Total Petroleum Hydrocarbons

Gasoline	ND	1	50	50	ug/L	03/28/01	HP
----------	----	---	----	----	------	----------	----

Order #: 254394	Client Sample ID T.O.C. #054, RS-8
Matrix: WATER	Date Sampled: 03/22/2001 Time Sampled: 12:55

Analyte	Result	DF	PQL	MDL	Units	Date/Analyst
---------	--------	----	-----	-----	-------	--------------

PQL = Practical Quantitation Limit, MDL = Method detection limit, DF = Dilution Factor
 ND = Not detected below indicated MDL, J=Trace

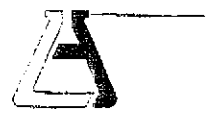

3021B BTEX + MTBE

Benzene	ND	1	0.3	0.18	ug/L	03/28/01	HP
Ethyl benzene	ND	1	0.3	0.18	ug/L	03/28/01	HP
Methyl t - butyl ether	ND	1	5	0.24	ug/L	03/28/01	HP
Toluene	ND	1	0.3	0.14	ug/L	03/28/01	HP
Xylene (total)	ND	1	0.6	0.26	ug/L	03/28/01	HP

3015M - Total Petroleum Hydrocarbons

Gasoline	ND	1	50	50	ug/L	03/28/01	HP
----------	----	---	----	----	------	----------	----

Order #: 254395

Client Sample ID T.O.C. #054, RS-11

Matrix: WATER

Date Sampled: 03/22/2001 Time Sampled: 18:05

Analyte	Result	DF	PQL	MDL	Units	Date/Analyst
---------	--------	----	-----	-----	-------	--------------

3021B BTEX + MTBE

Benzene	ND	1	0.3	0.18	ug/L	03/28/01	HP
Ethyl benzene	ND	1	0.3	0.18	ug/L	03/28/01	HP
Methyl t - butyl ether	664	25	125.0	0.24	ug/L	03/28/01	HP
Toluene	ND	1	0.3	0.14	ug/L	03/28/01	HP
Xylene (total)	ND	1	0.6	0.26	ug/L	03/28/01	HP

3260B BTEX/MTBE Only

Methyl-tert-butylether (MTBE)	941	10	10.0	0.6	ug/L	04/13/01	MB
-------------------------------	-----	----	------	-----	------	----------	----

3015M - Total Petroleum Hydrocarbons

Gasoline	408	1	50	50	ug/L	03/28/01	HP
----------	-----	---	----	----	------	----------	----

Order #: 254396

Client Sample ID T.O.C. #054, RS-10

Matrix: WATER

Date Sampled: 03/22/2001 Time Sampled: 18:15

Analyte	Result	DF	PQL	MDL	Units	Date/Analyst
---------	--------	----	-----	-----	-------	--------------

3021B BTEX + MTBE

Benzene	ND	1	0.3	0.18	ug/L	03/28/01	HP
Ethyl benzene	ND	1	0.3	0.18	ug/L	03/28/01	HP
Methyl t - butyl ether	ND	1	5	0.24	ug/L	03/28/01	HP
Toluene	ND	1	0.3	0.14	ug/L	03/28/01	HP
Xylene (total)	ND	1	0.6	0.26	ug/L	03/28/01	HP

3015M - Total Petroleum Hydrocarbons

Gasoline	ND	1	50	50	ug/L	03/28/01	HP
----------	----	---	----	----	------	----------	----

PQL = Practical Quantitation Limit, MDL = Method detection limit, DF = Dilution Factor
 ND = Not detected below indicated MDL, J=Trace



Order #: 254397

Client Sample ID T.O.C. #054, Trip Blank

Matrix: WATER

Date Sampled: 03/22/2001 Time Sampled: 17:00

Analyte	Result	DF	PQL	MDL	Units	Date/Analyst
---------	--------	----	-----	-----	-------	--------------

8021B BTEX

Benzene	ND	1	0.3	0.18	ug/L	03/28/01 HP
Ethyl benzene	ND	1	0.3	0.18	ug/L	03/28/01 HP
Toluene	ND	1	0.3	0.14	ug/L	03/28/01 HP
Xylene (total)	ND	1	0.6	0.26	ug/L	03/28/01 HP

8015M - Total Petroleum Hydrocarbons

Gasoline	ND	1	50	50	ug/L	03/28/01 HP
----------	----	---	----	----	------	-------------

PQL = Practical Quantitation Limit, MDL = Method detection limit, DF = Dilution Factor
ND = Not detected below indicated MDL, J=Trace



Chain of Custody Record

109958

ASSOCIATED LABORATORIES

806 North Batavia • Orange, CA 92868
Phone: (714) 771-6900 • Fax: (714) 538-1209



Company THRIFTY OIL CO		Phone (562) 921-3580		AL Job No.		Page _____ of _____			
Project Manager JEFF JURYARUSUMA		Fax		Analysis Requested				Test Instructions & Comments	
Project Name Q. W. S.		Project # 054							
Site Name and Address 2504 CASTRO VALLEY BLVD CASTRO VALLEY CA. 94546				T P H B T E X M T B E					
Sample ID	Lab ID	Date	Time	Matrix	Container Number/Size	Pres.			
1 RS 9		03.22.01	17:00	WATER	3 VIALS	HCL	X	X	X
2 RE 1			17:05				X	X	X
3 RE 2			17:10				X	X	X
4 RE C			17:15				X	X	X
5 PW 1			17:20				X	X	X
6 PW 2			17:25				X	X	X
7 RE F			17:30				X	X	X
8 RE 5			17:35				X	X	X
9 RE 4			17:40				X	X	X
10 RE 3			17:45				X	X	X
11 RS 8			17:55				X	X	X
12 RS 11			18:05				X	X	X
13 RS 10			18:15				X	X	X
14 TRIP BLANK			17:00		2 VIALS		X	X	
15									

Sample Receipt - To Be Filled By Laboratory				Relinquished by		Relinquished by		Relinquished by	
Total Number of Containers	41	Properly Cooled	Y/N/NA	Signature:	[Signature]	Signature:	[Signature]	Signature:	[Signature]
Custody Seals	Y/N/NA	Samples Intact	Y/N/NA	Printed Name:	SERENA P.	Printed Name:	[Signature]	Printed Name:	[Signature]
Received in Good Condition	Y/N	Samples Accepted	Y/N	Date:	03.22.01	Date:	[Signature]	Date:	[Signature]
Turn Around Time				Received By:	1. [Signature]	Received By:	2. [Signature]	Received By:	3. [Signature]
<input checked="" type="checkbox"/> Normal	<input type="checkbox"/> Rush	<input type="checkbox"/> Same Day	<input type="checkbox"/> 48 hrs.	Signature:	[Signature]	Signature:	[Signature]	Signature:	[Signature]
		<input type="checkbox"/> 24 hrs.	<input type="checkbox"/> 72 hrs.	Printed Name:	U. GARON	Printed Name:	[Signature]	Printed Name:	[Signature]
				Date:	3-27	Date:	3-27	Date:	[Signature]