

THRIFTY OIL CO.

January 12, 2001

O.10634

Mr. Amer Gholami
Alameda County Health Agency
Hazardous Material Specialist
1131 Harbor Bay Parkway, Suite 250
Alameda, CA 94502

RE: **Thrifty Oil Co. #054**
2504 Castro Valley Boulevard
Castro Valley, CA 94541
4th Quarter 2000, Status Report

SHD
1252
RECEIVED FEB 8, 2001
AC

Dear Mr. Gholami:

Presented herewith is the Fourth Quarter 2000, Status Report for Thrifty Oil Co. Station #054 located at 2504 Castro Valley Boulevard, Castro Valley, California.

Due to continued low to non-detectable hydrocarbons constituents concentrations in groundwater, Thrifty respectfully requests that the Alameda County Health Care Agency (ACHCA) grant environmental closure for this site.

If you have any questions or comments, regarding this report please contact Raymond C. Friedrichsen or me at (562) 921-3581.

Sincerely,

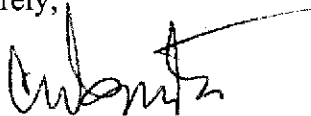

Chris Panaitescu
General Manager
Environmental Affairs

c: File



THRIFTY OIL CO.

January 8, 2001

Mr. Amer Gholami
Alameda County Health Care Agency
Hazardous Material Specialist
1131 Harbor Bay Parkway, Suite 250
Alameda, CA 94502

RE: Thrifty Oil Co. Station #054
2504 Castro Valley Boulevard
Castro Valley, CA
4th Quarter 2000, Status Report

Dear Mr. Gholami:

Presented herein is the Fourth Quarter 2000, Status Report prepared for Thrifty Oil Co. (Thrifty) Station #054 located at 2504 Castro Valley Boulevard, Castro Valley, California (**Figure 1**). Presented in this report are the results of the groundwater monitoring efforts conducted during the Fourth Quarter 2000. Thrifty has retained the services of Earth Management Company (EMC) to conduct quarterly monitoring and sampling activities at this site.

Groundwater Monitoring

Depth to groundwater is measured in each monitoring well quarterly. Historic groundwater gauging data obtained from April 11, 1988 through December 13, 2000 is presented in **Table 1**. In general, groundwater occurs under water table conditions beneath the station at depths ranging from 2.70 feet below ground surface (bgs) in monitoring well RS-9 to 8.28 feet bgs in monitoring well RS-8 (**Appendix A**). A groundwater elevation contour map based on the December 13, 2000 data is presented in **Figure 1**. The **general direction of groundwater flow beneath the site is toward the south and east with a hydraulic gradient ranging from 0.07 to 0.13 feet/foot.**

Quarterly Groundwater Sampling

As part of the ongoing groundwater monitoring program, groundwater samples were obtained from



monitoring wells PW-1, PW-2, RE-1 through RE-7, and RS-8 through RS-11 on December 13, 2000. Groundwater samples were obtained by EMC and delivered in a chilled state in an ice chest following strict Chain-of-Custody procedures to a state-certified laboratory. Total petroleum hydrocarbons as gasoline (TPH-g) was analyzed by EPA method 8015M modified for gasoline, and benzene, toluene, ethylbenzene, xylenes (BTEX) and methyl tert-butyl ether (MTBE) were analyzed by EPA method 8021B. Detected MTBE concentrations were confirmed by EPA method 8260B. Copies of the EMC Field Status Reports are presented in **Appendix A**, and copies of the laboratory analytical reports are contained in **Appendix B**.

TPH-g, BTEX, and MTBE concentrations appear in **Table 1** and **Appendix B**. TPH-g, benzene, and MTBE isoconcentration maps are presented in **Figure 2, 3, and 4, respectively**. TPH-g and benzene were below laboratory method detection limits in all samples analyzed. MTBE was detected in three groundwater wells (RE-3, RE-7, and RS-9) with concentrations ranging from 19.8 ug/L to 444 ug/L (by EPA method 8260B).

Thrifty believes that the elevated MTBE concentration in up gradient monitoring well RS-9 is from an off-site source across Stanton Avenue. The source could be the quick change oil business; well RS-9 is located at the base of their drive way, which is at the bottom of an incline. It is probable that any surface hydrocarbon contamination would be transported (by water from either site wash down or by rainfall) down the incline and infiltrate through any cracks in the concrete around or near the well. Thrifty has taken preventive measures and tried to reinforce the well surface by repairing any cracks around the well, but the water could still infiltrate the ground by seeping into the ground through the planter. As shown in **Table 1**, MTBE concentrations have increased in this well, and this well is located a significant distance up gradient from the Thrifty site. Also, the concentration of MTBE in well RS-9 (444 ug/L) being greater than any other MTBE concentrations found on-site (RE-3; 111 ug/L) indicates that it must be generated from an off site source. Three groundwater monitoring wells (RE-2, RE-5, and RE-4) between well RS-9 (off-site) and well RE-3 (on-site) were all below the laboratory detection limit for MTBE (**Figure 4**).

Therefore, if ACHCS will not close this site at this time, Thrifty requests the immediate abandonment of well RS-9, to reduce the potential pathway for migration of hydrocarbons from the surface to the shallow groundwater. Thrifty position is that once this well is abandoned, the petroleum hydrocarbon concentration (MTBE) will be reduced. Furthermore, it is recommended that the off site wells RS-8, RS-10, and RS-11 be abandoned due to the shrinking of the impacted groundwater hydrocarbon plume over the last year (see **Table 1**).

Other Activities

The soil vapor extraction and the groundwater treatment systems were authorized by the ACHCS (in a letter dated February 16, 2000) to be shut down and removed from the site. This is because of the low to non-detect concentrations of petroleum hydrocarbons. Historical vapor extraction operational data is summarized in **Table 2**. Due to continued low to non-detectable hydrocarbon constituent concentrations in groundwater, Thrifty respectfully requests that the ACHCS grant closure for this site.

Groundwater monitoring, gauging, and sampling at this site will continue quarterly.

Written by:

Reviewed by:



Raymond C. Friedrichsen, REA II
Project Manager, MBA
Senior Environmental Hydrogeologist

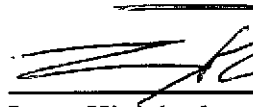

Larry Higinbotham
Registered Geologist #5497

FIGURES

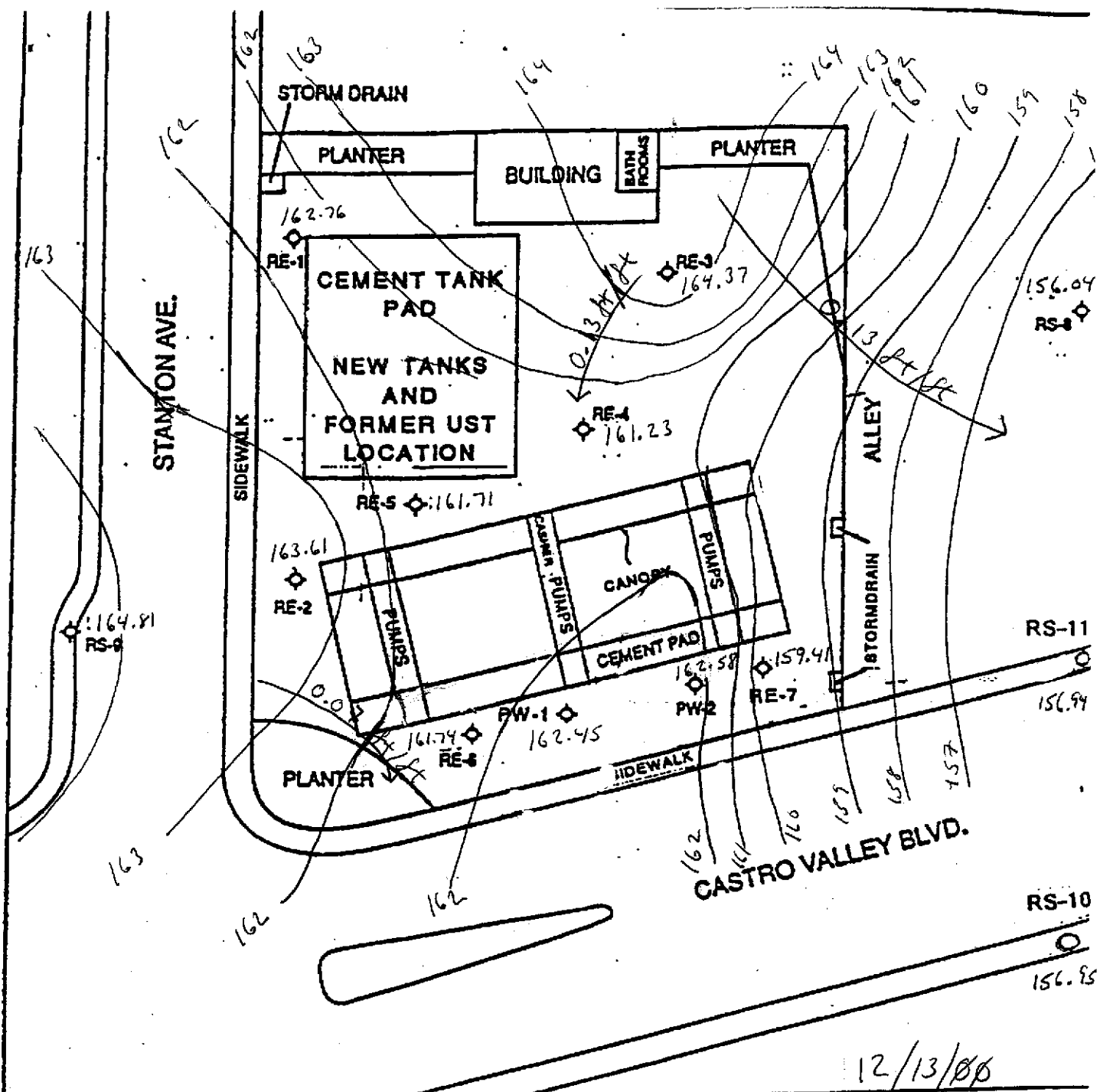

GROUNDWATER CONTOUR MAP
 THRIFTY OIL CO. #054
 CASTRO VALLEY, CALIFORNIA
 Prepared for
 THRIFTY OIL CO.
 SANTA FE, SPRINGS
 CALIFORNIA



◊ EXISTING MONITORING WELL

FIGURE 1

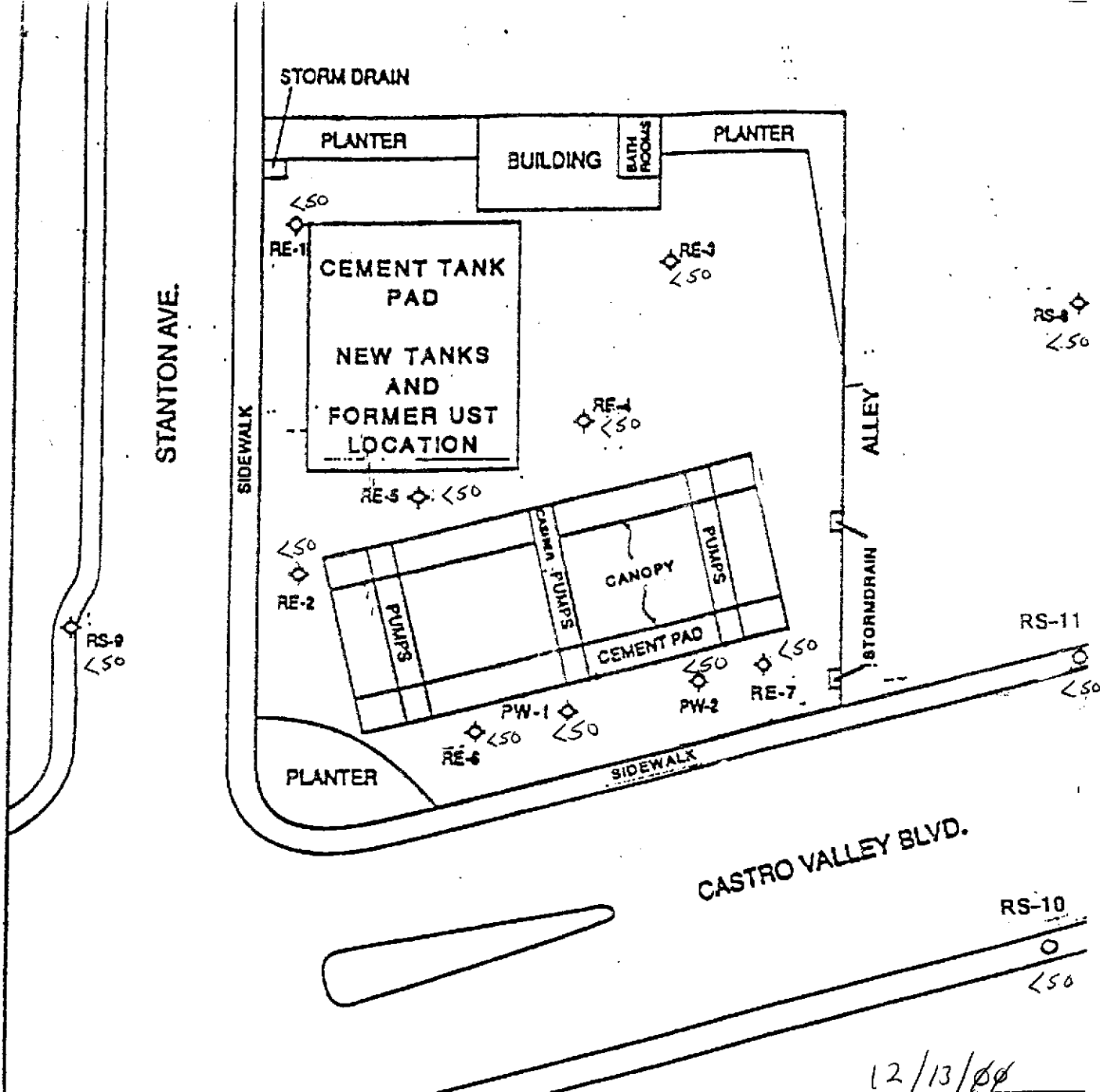

12/13/00

TPH GROUNDWATER ISOCONCENTRATION MAP PPB

**THRIFTY OIL CO. #054
 CASTRO VALLEY, CALIFORNIA
 Prepared for
 THRIFTY OIL CO.
 SANTA FE, SPRINGS
 CALIFORNIA**

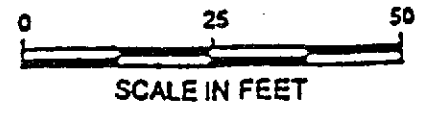

◊ EXISTING MONITORING WELL

FIGURE 2

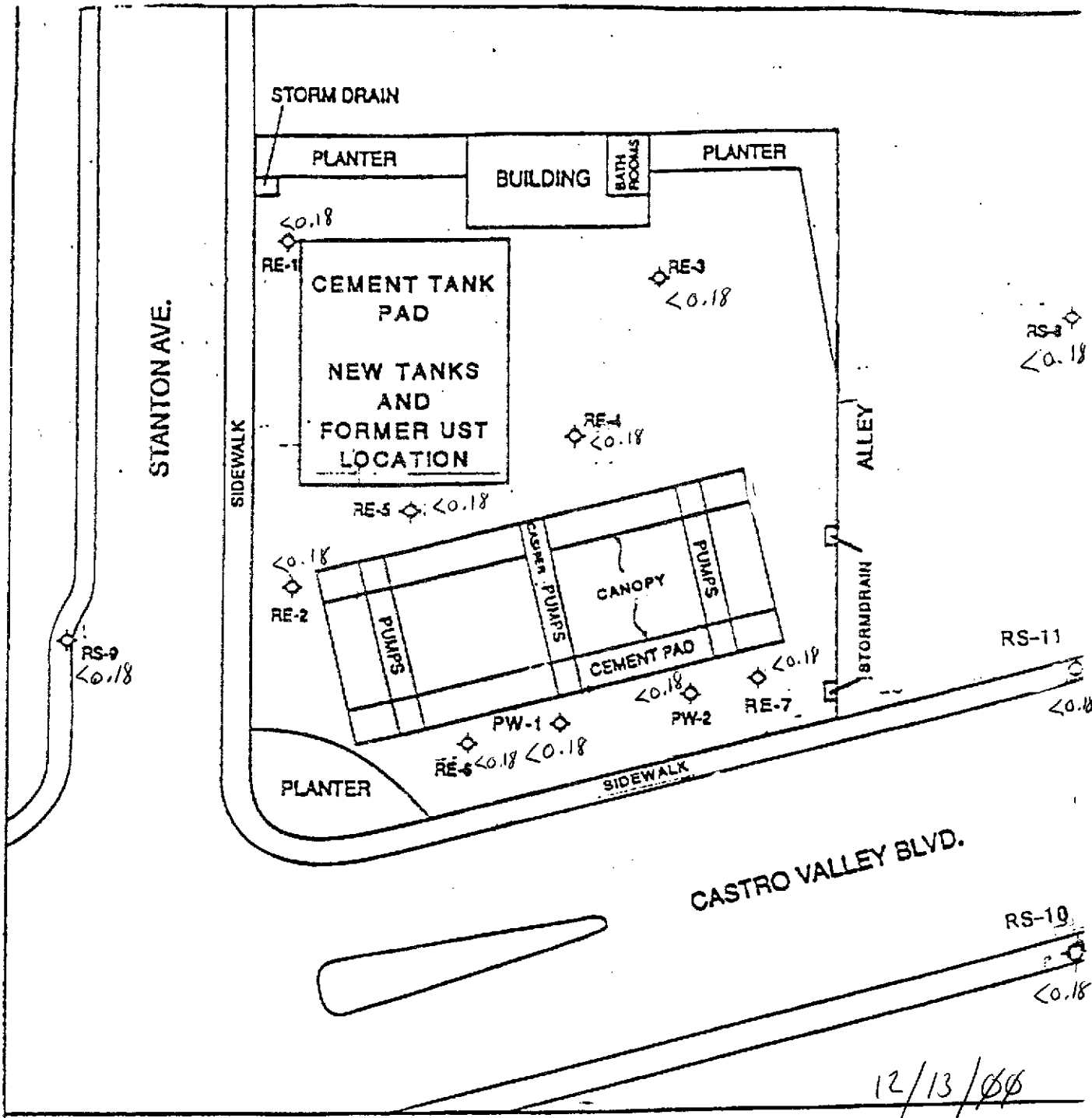

BENZENE ISOCONCENTRATION MAP PPB

**THRIFTY OIL CO. #054
 CASTRO VALLEY, CALIFORNIA
 Prepared for
 THRIFTY OIL CO.
 SANTA FE, SPRINGS
 CALIFORNIA**



◇ EXISTING MONITORING WELL

FIGURE 3

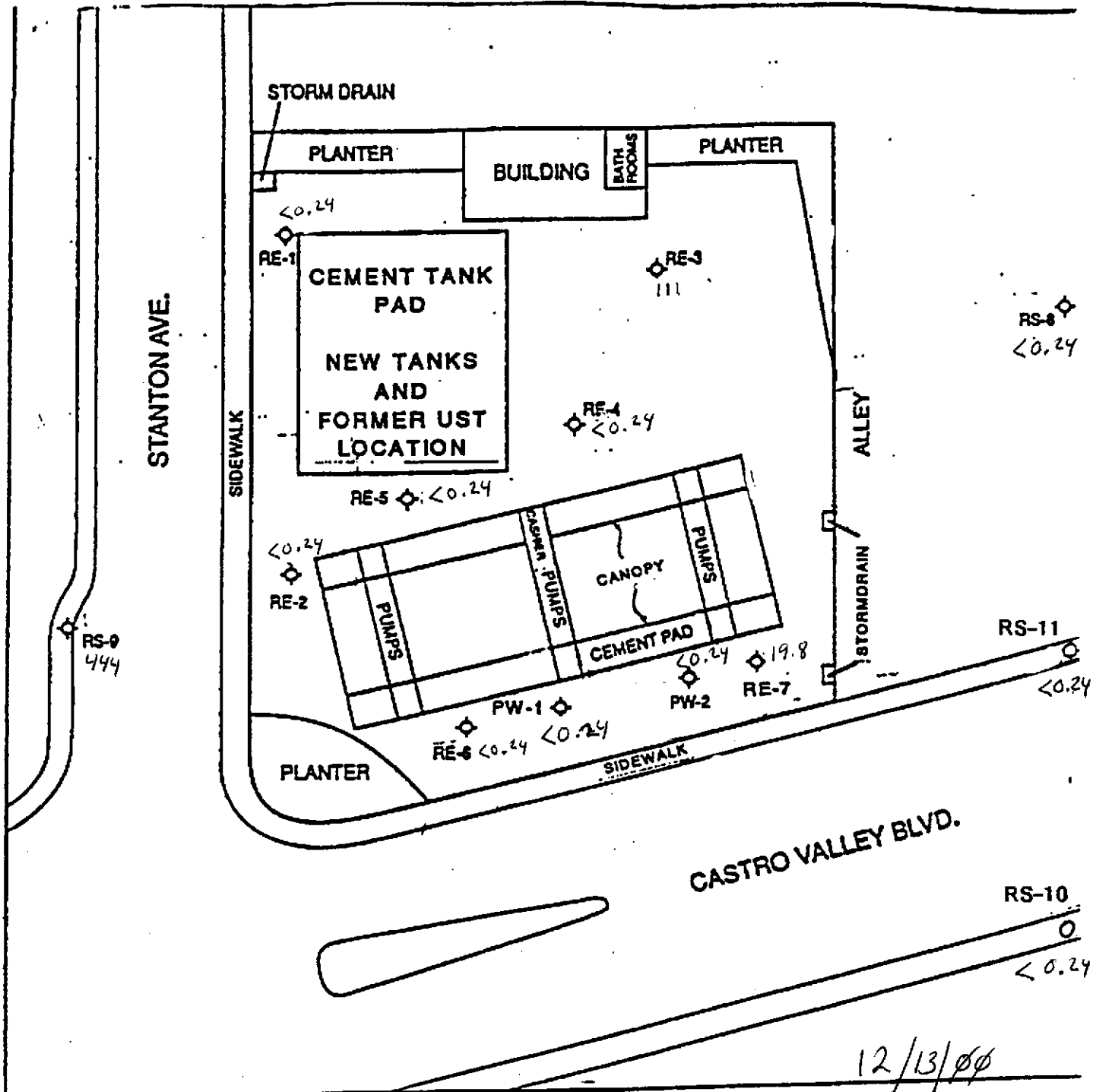

MTBE ISOCONCENTRATION MAP ug/L
 THRIFTY OIL CO. #054
 CASTRO VALLEY, CALIFORNIA
 Prepared for
 THRIFTY OIL CO.
 SANTA FE, SPRINGS
 CALIFORNIA

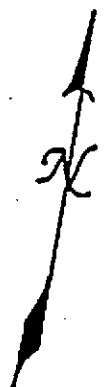

EXISTING MONITORING WELL

FIGURE 4

TABLES

**TABLE 1
GROUNDWATER DATA
THRIFTY OIL STATION #054, CASTRO VALLEY, CA.**

DATE SAMPLED	ANALYTICAL PARAMETERS						DEPTH TO GROUNDWATER (feet)	DEPTH TO PRODUCT (feet)	PRODUCT THICKNESS (feet)	CASING ELEVATION (feet)	GROUNDWATER ELEVATION (feet)
	TPH (ug/L)	BENZENE (ug/L)	TOLUENE (ug/L)	EthylBenzene (ug/L)	XYLENE (ug/L)	MIBK (ug/L)					
MONITORING WELL #PW-1											
04/11/88	-	-	-	-	-	-	-	-	-	-	-
04/09/90	230,000	600	2,700	1,000	16,000	-	5.10	NP	0.00	166.46	161.36
10/30/90	35,000	240	970	240	3,580	-	6.17	NP	0.00	166.46	160.29
01/18/91	37,000	43	140	42	1,600	-	6.28	NP	0.00	166.46	160.18
02/12/91	45,000	99	130	25	700	-	5.88	NP	0.00	166.46	160.58
03/20/91	1,900	0.43	ND	ND	2.8	-	4.75	NP	0.00	166.46	161.71
05/22/91	41,000	600	730	250	3,800	-	5.10	NP	0.00	166.46	161.36
06/19/91	-	-	-	-	-	-	5.61	NP	0.00	166.46	160.85
07/17/91	-	-	-	-	-	-	5.53	FILM	0.00	166.46	160.93
08/07/91	-	-	-	-	-	-	5.67	FILM	0.00	166.46	160.79
09/24/91	-	-	-	-	-	-	5.57	FILM	0.00	166.46	160.89
10/23/91	-	-	-	-	-	-	6.53	FILM	0.00	166.46	159.93
11/06/91	-	-	-	-	-	-	5.85	FILM	0.00	166.46	160.61
12/04/91	-	-	-	-	-	-	5.91	FILM	0.00	166.46	160.55
01/29/92	-	-	-	-	-	-	5.43	FILM	0.00	166.46	161.03
02/26/92	-	-	-	-	-	-	5.54	FILM	0.00	166.46	160.92
03/19/92	ND	ND	ND	ND	ND	-	5.47	NP	0.00	166.46	160.99
04/22/92	-	-	-	-	-	-	5.62	FILM	0.00	166.46	160.84
05/21/92	1,300	19	2.9	0.7	58	-	6.21	NP	0.00	166.46	160.25
06/25/92	-	-	-	-	-	-	6.94	NP	0.00	166.46	159.52
07/30/92	-	-	-	-	-	-	5.90	FILM	0.00	166.46	160.56
08/20/92	-	-	-	-	-	-	7.12	FILM	0.00	166.46	159.34
09/30/92	3,400	57	ND	26	240	-	6.42	NP	0.00	166.46	160.04
12/23/92	-	-	-	-	-	-	5.56	FILM	0.00	166.46	160.90
03/10/93	-	-	-	-	-	-	5.65	FILM	0.00	166.46	160.81
06/09/93	400	<0.5	1.1	<1.0	<1.0	-	5.30	NP	0.00	166.46	161.16
09/14/93	180	3.7	3.2	1.5	14	-	5.43	NP	0.00	166.46	161.03
12/14/93	<50	<0.3	<0.3	<0.3	<0.5	-	4.65	NP	0.00	166.46	161.81
03/02/94	<50	<0.3	<0.3	<0.3	<0.5	-	5.43	NP	0.00	166.46	161.03
06/06/94	330	1.3	<0.3	0.88	9.8	-	4.70	NP	0.00	166.46	161.76
09/06/94	1,100	67	<0.3	<0.3	24	-	6.48	NP	0.00	166.46	159.98
12/07/94	<50	<0.3	<0.3	<0.5	<0.5	-	5.22	NP	0.00	166.46	161.24
03/08/95	<100	<0.5	<0.5	<0.5	<1	-	6.94	NP	0.00	166.46	159.52
06/15/95	260	0.8	0.6	<0.5	3.2	-	5.72	NP	0.00	166.46	160.74

**TABLE 1
GROUNDWATER DATA
THRIFTY OIL STATION #054, CASTRO VALLEY, CA.**

DATE SAMPLED	ANALYTICAL PARAMETERS						DEPTH TO GROUNDWATER (feet)	DEPTH TO PRODUCT (feet)	PRODUCT THICKNESS (feet)	CASING ELEVATION (feet)	GROUNDWATER ELEVATION (feet)
	TPH (ug/L)	BENZENE (ug/L)	TOLUENE (ug/L)	EthylBenzene (ug/L)	XYLENE (ug/L)	MTBE (ug/L)					
09/05/95	330	2.1	<0.5	2.1	9.6	-	5.96	NP	0.00	166.46	160.50
11/21/95	660	13	1.3	<0.3	4.0	-	6.04	NP	0.00	166.46	160.42
03/11/96	660	0.94	0.77	<0.3	8.1	-	3.60	NP	0.00	166.46	162.86
06/19/96	120	0.53	<0.3	<0.3	2.3	-	4.80	NP	0.00	166.46	161.66
09/16/96	<50	<0.3	<0.3	<0.3	<0.5	<20	5.10	NP	0.00	166.46	161.36
12/10/96	<50	<0.3	<0.3	<0.3	<0.5	<20	4.92	NP	0.00	166.46	161.54
03/12/97	<50	<0.3	<0.3	<0.3	<0.5	<20	4.50	NP	0.00	166.46	161.96
06/12/97	<50	<0.3	<0.3	<0.3	<0.5	<20	-	-	-	-	-
09/16/97	690	0.97	<0.3	<0.3	<0.5	<20	4.55	NP	0.00	166.46	161.91
12/09/97	640	150	0.64	<0.3	5.2	1,300	5.60	NP	0.00	166.46	160.86
03/03/98	<50	<0.3	0.57	<0.3	<0.5	<20	4.13	NP	0.00	166.46	162.33
07/08/98	<50	<0.3	<0.3	<0.3	<0.5	<5	-	-	-	-	-
09/10/98	<50	<0.3	<0.3	<0.3	<0.5	<5	6.35	NP	0.00	166.46	160.11
12/30/98	<50	1.1	<0.3	<0.3	<0.5	<5	6.40	NP	0.00	166.46	160.06
03/15/99	<50	<0.3	<0.3	<0.3	<0.5	<5	6.35	NP	0.00	166.46	160.11
06/22/99	<50	<0.3	<0.3	<0.3	<0.5	53	4.95	NP	0.00	166.46	161.51
09/08/99	<50	<0.3	<0.3	<0.3	<0.5	<5	4.80	NP	0.00	166.46	161.66
12/01/99	<50	<0.3	<0.3	<0.3	<0.5	<5	3.64	NP	0.00	166.46	162.82
03/23/00	<50	0.5	0.5	1.1	<0.5	<5	4.03	NP	0.00	166.46	162.43
06/08/00	<50	<5	<5	<5	<5	<5	4.40	NP	0.00	166.46	162.06
09/27/00	<50	<0.18	<0.14	<0.18	<0.26	<0.24	4.73	NP	0.00	166.46	161.73
12/13/00	<50	<0.18	<0.14	<0.18	<0.26	<0.24	4.01	NP	0.00	166.46	162.45
MONITORING WELL PW-2											
04/11/88	-	-	-	-	-	-	-	-	-	-	-
04/09/90	600,000	1,300	11,000	4,600	4,300	-	5.81	NP	0.00	166.18	160.37
10/30/90	48,000	310	51	10	480	-	6.95	NP	0.00	166.18	159.23
01/18/91	86,000	230	1,400	350	8,300	-	6.92	NP	0.00	166.18	159.26
02/12/91	160,000	680	1,300	250	7,000	-	6.78	NP	0.00	166.18	159.40
03/20/91	17,000	34	50	ND	1,100	-	5.54	NP	0.00	166.18	160.64
05/22/91	14,000	57	2,100	500	8,200	-	6.07	NP	0.00	166.18	160.11
06/19/91	-	-	-	-	-	-	6.37	FILM	0.00	166.18	159.81
07/17/91	-	-	-	-	-	-	6.38	FILM	0.00	166.18	159.80
08/07/91	-	-	-	-	-	-	6.63	FILM	0.00	166.18	159.55

**TABLE 1
GROUNDWATER DATA
THRIFTY OIL STATION #054, CASTRO VALLEY, CA.**

DATE SAMPLED	ANALYTICAL PARAMETERS						DEPTH TO GROUNDWATER (feet)	DEPTH TO PRODUCT (feet)	PRODUCT THICKNESS (feet)	CASING ELEVATION (feet)	GROUNDWATER ELEVATION (feet)
	THC (ug/L)	BENZENE (ug/L)	TOLUENE (ug/L)	EthylBenzene (ug/L)	XYLENE (ug/L)	MTBE (ug/L)					
09/24/91	-	-	-	-	-	-	6.42	FILM	0.00	166.18	159.76
10/23/91	-	-	-	-	-	-	7.25	FILM	0.00	166.18	158.93
11/06/91	-	-	-	-	-	-	6.44	FILM	0.00	166.18	159.74
12/04/91	-	-	-	-	-	-	6.65	FILM	0.00	166.18	159.53
01/29/92	-	-	-	-	-	-	6.17	FILM	0.00	166.18	160.01
02/26/92	-	-	-	-	-	-	5.90	FILM	0.00	166.18	160.28
03/19/92	-	-	-	-	-	-	5.80	FILM	0.00	166.18	160.38
04/22/92	-	-	-	-	-	-	5.88	FILM	0.00	166.18	160.30
05/21/92	-	-	-	-	-	-	6.03	FILM	0.00	166.18	160.15
06/25/92	-	-	-	-	-	-	6.57	FILM	0.00	166.18	159.61
07/30/92	-	-	-	-	-	-	6.20	FILM	0.00	166.18	159.98
08/20/92	-	-	-	-	-	-	6.64	FILM	0.00	166.18	159.54
09/30/92	-	-	-	-	-	-	6.88	FILM	0.00	166.18	159.30
12/23/92	-	-	-	-	-	-	6.08	FILM	0.00	166.18	160.10
03/10/93	-	-	-	-	-	-	5.95	FILM	0.00	166.18	160.23
06/09/93	3,400	24	22	<0.5	240	-	5.38	NP	0.00	166.18	160.80
09/14/93	4,900	190	15	6.8	480	-	6.26	NP	0.00	166.18	159.92
12/14/93	1,700	4.2	<0.3	<0.3	<0.5	-	5.22	NP	0.00	166.18	160.96
03/02/94	-	-	-	-	-	-	5.75	FILM	0.00	166.18	160.43
06/06/94	980	25	1.2	<0.3	42	-	5.25	NP	0.00	166.18	160.93
09/06/94	3,200	95	3.0	<1.7	76	-	6.80	NP	0.00	166.18	159.38
12/07/94	510	1.8	<0.3	<0.5	1.7	-	5.57	NP	0.00	166.18	160.61
03/08/95	1,900	<0.5	<0.5	1.4	35	-	4.10	NP	0.00	166.18	162.08
06/15/95	1,700	5.6	<0.5	<0.5	1.6	-	5.44	NP	0.00	166.18	160.74
09/05/95	2,500	33	1.0	0.86	18	-	6.13	NP	0.00	166.18	160.05
11/21/95	2,800	130	59	18	190	-	6.23	NP	0.00	166.18	159.95
03/11/96	13,000	330	460	<15	3,800	-	4.48	NP	0.00	166.18	161.70
06/19/96	1,400	<0.3	<0.3	<0.3	<0.5	-	5.38	NP	0.00	166.18	160.80
09/16/96	3,500	<0.3	<0.3	<0.3	<0.5	5,900	5.21	NP	0.00	166.18	160.97
12/10/96	2,100	<0.3	<0.3	<0.3	<0.5	4,700	4.87	NP	0.00	166.18	161.31
03/12/97	600	1.6	<0.3	<0.3	5.8	1,100	4.43	NP	0.00	166.18	161.75
06/12/97	270	<0.3	<0.3	<0.3	<0.5	630	-	-	-	-	-
09/10/97	220	<0.3	<0.3	<0.3	<0.5	320	4.07	NP	0.00	166.18	162.11
12/09/97	120	<0.3	0.73	<0.3	<0.5	420	5.20	NP	0.00	166.18	160.98
03/03/98	<50	0.43	0.48	<0.3	<0.5	47	3.30	NP	0.00	166.18	162.88

**TABLE 1
GROUNDWATER DATA
THRIFTY OIL STATION #054, CASTRO VALLEY, CA.**

DATE SAMPLED	ANALYTICAL PARAMETERS						DEPTH TO GROUNDWATER (feet)	DEPTH TO PRODUCT (feet)	PRODUCT THICKNESS (feet)	CASING ELEVATION (feet)	GROUNDWATER ELEVATION (feet)
	TPH (ug/L)	BENZENE (ug/L)	TOLUENE (ug/L)	EthylBenzene (ug/L)	XYLENE (ug/L)	MIBE (ug/L)					
08/20/92	-	-	-	-	-	-	5.28	FILM	0.00	166.82	161.54
09/30/92	-	-	-	-	-	-	5.66	FILM	0.00	166.82	161.16
12/23/92	-	-	-	-	-	-	4.81	FILM	0.00	166.82	162.01
03/10/93	-	-	-	-	-	-	4.13	FILM	0.00	166.82	162.69
06/09/93	-	-	-	-	-	-	4.48	FILM	0.00	166.82	162.34
09/14/93	19,000	3,600	1,100	740	4,300	-	5.35	NP	0.00	166.82	161.47
12/14/93	38,000	4,300	1,300	<6.6	11	-	4.38	NP	0.00	166.82	162.44
03/02/94	-	-	-	-	-	-	4.22	FILM	0.00	166.82	162.60
06/06/94	-	-	-	-	-	-	2.16	FILM	0.00	166.82	164.66
09/06/94	74,000	3,300	3,900	1,200	6,100	-	5.00	NP	0.00	166.82	161.82
12/07/94	30,000	3,200	2,900	1,200	4,600	-	4.10	NP	0.00	166.82	162.72
03/08/95	28,000	4,200	2,300	810	7,800	-	3.92	NP	0.00	166.82	162.90
06/15/95	-	-	-	-	-	-	-	-	-	-	-
09/05/95	-	-	-	-	-	-	4.78	FILM	0.00	166.82	162.04
11/21/95	-	-	-	-	-	-	4.82	NP	0.00	166.82	162.00
03/11/96	270	2.4	6.0	4.5	19	-	3.32	NP	0.00	166.82	163.50
06/19/96	3,000	570	63	<1.5	400	-	4.20	NP	0.00	166.82	162.62
09/16/96	7,700	440	69	<1.5	680	230	4.68	NP	0.00	166.82	162.14
12/10/96	52	<0.3	<0.3	<0.3	<0.5	120	4.93	NP	0.00	166.82	161.89
03/12/97	8,700	180	5.4	40	1,100	130	4.10	NP	0.00	166.82	162.72
06/12/97	<50	<0.3	<0.3	<0.3	<0.5	36	-	-	-	-	-
09/16/97	<50	<0.3	<0.3	<0.3	<0.5	<20	4.55	NP	0.00	166.82	162.27
12/09/97	<50	<0.3	0.44	<0.3	<0.5	<20	5.30	NP	0.00	166.82	161.52
03/03/98	1,100	13	0.51	<0.3	<0.5	220	4.55	NP	0.00	166.82	162.27
07/08/98	<50	<0.3	<0.3	<0.3	<0.5	<5	-	-	-	-	-
09/10/98	60	<0.3	<0.3	<0.3	<0.5	180	6.05	NP	0.00	166.82	160.77
12/30/98	<50	1.1	<0.3	<0.3	<0.5	<5	5.65	NP	0.00	166.82	161.17
03/15/99	<50	<0.3	<0.3	<0.3	<0.5	<5	5.68	NP	0.00	166.82	161.14
06/22/99	880	14	0.98	<0.3	8.1	260	4.95	NP	0.00	166.82	161.87
09/08/99	72	<0.3	<0.3	<0.3	<0.5	120	4.46	NP	0.00	166.82	162.36
12/01/99	<50	<0.3	<0.3	<0.3	<0.5	<5	4.08	NP	0.00	166.82	162.74
03/23/00	<50	<0.25	<0.25	<0.25	<0.5	<5	3.68	NP	0.00	166.82	163.14
06/08/00	<50	<5	<5	<5	<5	<5	4.07	NP	0.00	166.82	162.75
09/27/00	<50	<0.18	<0.14	<0.18	<0.26	<0.24	4.07	NP	0.00	166.82	162.75
12/13/00	<50	<0.18	<0.14	<0.18	<0.26	<0.24	4.06	NP	0.00	166.82	162.76

**TABLE 1
GROUNDWATER DATA
THRIFTY OIL STATION #054, CASTRO VALLEY, CA.**

DATE SAMPLED	ANALYTICAL PARAMETERS						DEPTH TO GROUNDWATER (feet)	DEPTH TO PRODUCT (feet)	PRODUCT THICKNESS (feet)	CASING ELEVATION (feet)	GROUNDWATER ELEVATION (feet)
	TRIP (ug/L)	BENZENE (ug/L)	TOLUENE (ug/L)	Ethyl Benzene (ug/L)	XYLENE (ug/L)	MIBB (ug/L)					
MONITORING WELL #RE-2											
04/11/88	-	-	-	-	-	-	-	-	-	-	-
04/09/90	850	5.8	0.5	4.8	1.1	-	4.90	NP	0.00	167.19	162.29
10/30/90	440	2.8	0.91	13	3.14	-	5.34	NP	0.00	167.19	161.85
01/18/91	1,100	8.4	3.1	ND	10	-	4.90	NP	0.00	167.19	162.29
02/12/91	1,100	5.9	ND	1.77	ND	-	4.94	NP	0.00	167.19	162.25
03/20/91	550	4.3	ND	ND	ND	-	4.32	NP	0.00	167.19	162.87
05/22/91	1,000	5.3	3.6	4.4	8.9	-	4.43	NP	0.00	167.19	162.76
06/19/91	700	2.1	1.4	3.8	3.5	-	6.43	NP	0.00	167.19	160.76
07/17/91	880	12	8.0	4.3	28	-	4.75	NP	0.00	167.19	162.44
08/07/91	-	3.8	1.6	ND	ND	-	4.87	NP	0.00	167.19	162.32
09/24/91	670	7.2	7.1	ND	23	-	5.50	NP	0.00	167.19	161.69
10/23/91	2,700	52	60	22	130	-	5.63	NP	0.00	167.19	161.56
11/06/91	1,900	18	61	9.1	83	-	5.14	NP	0.00	167.19	162.05
12/04/91	1,100	26	47	4.3	42	-	5.26	NP	0.00	167.19	161.93
01/29/92	900	14	24	5.3	19	-	5.11	NP	0.00	167.19	162.08
02/26/92	500	3.4	3.5	2.7	2.7	-	4.31	NP	0.00	167.19	162.88
03/19/92	1,200	14	20	15	18	-	4.45	NP	0.00	167.19	162.74
04/22/92	200	ND	ND	ND	ND	-	4.78	NP	0.00	167.19	162.41
05/21/92	500	7.5	6.8	3.9	7.4	-	5.02	NP	0.00	167.19	162.17
06/25/92	ND	ND	0.9	0.7	ND	-	5.13	NP	0.00	167.19	162.06
07/30/92	500	7.7	8.6	3.2	1.7	-	5.19	NP	0.00	167.19	162.00
08/20/92	1,100	6.6	4.5	2.7	2.0	-	5.27	NP	0.00	167.19	161.92
09/30/92	500	5.4	2.4	1.8	4.5	-	5.45	NP	0.00	167.19	161.74
12/23/92	800	1.9	ND	ND	2.3	-	4.60	NP	0.00	167.19	162.59
03/10/93	1,200	ND	1.4	ND	2.1	-	4.18	NP	0.00	167.19	163.01
06/09/93	200	ND	ND	ND	ND	-	4.53	NP	0.00	167.19	162.66
09/17/93	360	1.6	1.1	3.2	8.9	-	5.26	NP	0.00	167.19	161.93
12/14/93	260	5.6	3.9	<0.3	21.0	-	2.75	NP	0.00	167.19	164.44
03/02/94	410	<0.3	<0.3	<0.3	<0.5	-	4.27	NP	0.00	167.19	162.92
06/06/94	760	4.6	<0.3	0.32	1.3	-	4.88	NP	0.00	167.19	162.31
09/06/94	1,300	43	45	8.9	69	-	5.16	NP	0.00	167.19	162.03
12/07/94	-	-	-	-	-	-	4.16	NP	0.00	167.19	163.03
03/08/95	<100	<0.5	<0.5	<0.5	<1	-	3.96	NP	0.00	167.19	163.23
06/15/95	130	<0.5	<0.5	<0.5	<1	-	4.52	NP	0.00	167.19	162.67

**TABLE 1
GROUNDWATER DATA
THRIFTY OIL STATION #054, CASTRO VALLEY, CA.**

DATE SAMPLED	ANALYTICAL PARAMETERS						DEPTH TO GROUNDWATER (feet)	DEPTH TO PRODUCT (feet)	PRODUCT THICKNESS (feet)	CASING ELEVATION (feet)	GROUNDWATER ELEVATION (feet)
	TPH (ug/L)	BENZENE (ug/L)	TOLUENE (ug/L)	EthylBenzene (ug/L)	XYLENE (ug/L)	MTBE (ug/L)					
09/05/95	210	<0.5	<0.5	<0.5	<1	-	4.76	NP	0.00	167.19	162.43
11/21/95	160	0.65	<0.3	0.35	0.95	-	4.83	NP	0.00	167.19	162.36
03/11/96	<50	<0.3	<0.3	<0.3	<0.5	-	3.36	NP	0.00	167.19	163.83
06/19/96	<50	<0.3	<0.3	<0.3	<0.5	-	4.68	NP	0.00	167.19	162.51
09/16/96	<50	<0.3	<0.3	<0.3	<0.5	<20	5.10	NP	0.00	167.19	162.09
12/10/96	<50	<0.3	<0.3	<0.3	<0.5	<20	4.47	NP	0.00	167.19	162.72
03/12/97	<50	<0.3	<0.3	<0.3	<0.5	<20	4.05	NP	0.00	167.19	163.14
06/12/97	<50	<0.3	<0.3	<0.3	<0.5	<20	-	-	-	-	-
09/10/97	<50	<0.3	<0.3	<0.3	<0.5	<20	4.08	NP	0.00	167.19	163.11
12/09/97	<50	<0.3	<0.3	<0.3	<0.5	<20	4.40	NP	0.00	167.19	162.79
03/03/98	<50	<0.3	<0.3	<0.3	<0.5	<20	3.30	NP	0.00	167.19	163.89
07/08/98	<50	<0.3	<0.3	<0.3	<0.5	15	-	-	-	-	-
09/10/98	<50	<0.3	<0.3	<0.3	<0.5	<5	4.93	NP	0.00	167.19	162.26
12/30/98	460	0.92	<0.3	<0.3	<0.5	1,400	4.20	NP	0.00	167.19	162.99
03/15/99	<50	<0.3	<0.3	<0.3	<0.5	<5	4.20	NP	0.00	167.19	162.99
06/22/99	2,900	7.4	<0.3	0.43	4.1	4,500	3.70	NP	0.00	167.19	163.49
09/08/99	1,400	<3	<3	<3	<5	3,200	3.96	NP	0.00	167.19	163.23
12/01/99	<50	<0.3	<0.3	<0.3	<0.5	<5	3.58	NP	0.00	167.19	163.61
03/23/00	<50	<0.25	<0.25	<0.25	<0.5	<5	3.19	NP	0.00	167.19	164.00
06/08/00	<50	<5	<5	<5	<5	<5	3.18	NP	0.00	167.19	164.01
09/27/00	<50	<0.18	<0.14	<0.18	<0.26	<0.24	3.58	NP	0.00	167.19	163.61
12/13/00	<50	<0.18	<0.14	<0.18	<0.26	<0.24	3.58	NP	0.00	167.19	163.61
MONITORING WELL #RE-3											
04/11/88	70,000	6,600	5,300	800	13,000	-	-	-	-	-	-
04/09/90	370,000	2,300	4,900	3,200	31,000	-	7.15	NP	0.00	167.39	160.24
10/30/90	13,000	860	660	220	2,210	-	7.84	NP	0.00	167.39	159.55
01/18/91	42,000	4,700	4,500	21	7,700	-	6.90	NP	0.00	167.39	160.49
02/12/91	72,000	3,600	4,500	ND	7,600	-	6.62	NP	0.00	167.39	160.77
03/20/91	65,000	2,400	9,400	50	9,800	-	5.87	NP	0.00	167.39	161.52
05/22/91	-	-	-	-	-	-	5.98	FILM	0.00	167.39	161.41
06/19/91	-	-	-	-	-	-	6.84	FILM	0.00	167.39	160.55
07/17/91	-	-	-	-	-	-	7.10	FILM	0.00	167.39	160.29
08/07/91	-	-	-	-	-	-	7.30	FILM	0.00	167.39	160.09

**TABLE 1
GROUNDWATER DATA
THRIFTY OIL STATION #054, CASTRO VALLEY, CA.**

DATE SAMPLED	ANALYTICAL PARAMETERS						DEPTH TO GROUNDWATER (feet)	DEPTH TO PRODUCT II (feet)	PRODUCT THICKNESS (feet)	CASING ELEVATION (feet)	GROUNDWATER ELEVATION (feet)
	TPH (ug/L)	BENZENE (ug/L)	TOLUENE (ug/L)	EthylBenzene (ug/L)	XYLENE (ug/L)	MIBE (ug/L)					
09/24/91	-	-	-	-	-	-	7.84	FILM	0.00	167.39	159.55
10/23/91	-	-	-	-	-	-	8.07	FILM	0.00	167.39	159.32
11/06/91	-	-	-	-	-	-	7.63	FILM	0.00	167.39	159.76
12/04/91	-	-	-	-	-	-	7.83	FILM	0.00	167.39	159.56
01/29/92	-	-	-	-	-	-	7.17	FILM	0.00	167.39	160.22
02/26/92	-	-	-	-	-	-	5.56	FILM	0.00	167.39	161.83
03/19/92	-	-	-	-	-	-	5.44	FILM	0.00	167.39	161.95
04/22/92	-	-	-	-	-	-	6.56	FILM	0.00	167.39	160.83
05/21/92	-	-	-	-	-	-	6.90	FILM	0.00	167.39	160.49
06/25/92	-	-	-	-	-	-	7.18	FILM	0.00	167.39	160.21
07/30/92	-	-	-	-	-	-	6.80	FILM	0.00	167.39	160.59
08/20/92	-	-	-	-	-	-	7.25	FILM	0.00	167.39	160.14
09/30/92	-	-	-	-	-	-	7.68	FILM	0.00	167.39	159.71
12/23/92	-	-	-	-	-	-	6.07	FILM	0.00	167.39	161.32
03/10/93	-	-	-	-	-	-	5.66	FILM	0.00	167.39	161.73
06/09/93	-	-	-	-	-	-	6.66	FILM	0.00	167.39	160.73
09/14/93	40,000	2,900	1,500	180	6,900	-	7.30	NP	0.00	167.39	160.09
12/14/93	-	-	-	-	-	-	5.95	NP	0.00	167.39	161.44
03/02/94	-	-	-	-	-	-	5.08	NP	0.00	167.39	162.31
06/06/94	-	-	-	-	-	-	6.35	FILM	0.00	167.39	161.04
09/06/94	11,000	260	26	<6.6	1,000	-	7.50	NP	0.00	167.39	159.89
12/07/94	-	-	-	-	-	-	5.48	FILM	0.00	167.39	161.91
03/08/95	-	-	-	-	-	-	5.18	FILM	0.00	167.39	162.21
06/15/95	-	-	-	-	-	-	-	-	-	-	-
09/05/95	-	-	-	-	-	-	6.84	FILM	0.00	167.39	160.55
11/21/95	10,000	210	<3	4.5	330	-	7.38	NP	0.00	167.39	160.01
03/11/96	1,600	640	15	10	46	-	4.85	NP	0.00	167.39	162.54
06/19/96	2,100	280	<3	<3	120	-	5.80	NP	0.00	167.39	161.59
09/16/96	140	<0.3	<0.3	<0.3	<0.5	110	4.50	NP	0.00	167.39	162.89
12/10/96	<50	<0.3	<0.3	<0.3	<0.5	<20	5.35	NP	0.00	167.39	162.04
03/12/97	<50	<0.3	<0.3	<0.3	<0.5	<20	3.48	NP	0.00	167.39	163.91
06/12/97	<50	<0.3	<0.3	<0.3	0.58	<20	-	-	-	-	-
09/10/97	<50	<0.3	<0.3	<0.3	<0.5	<20	3.10	NP	0.00	167.39	164.29
12/09/97	3,600	1,000	1,000	<6	570	260	4.55	NP	0.00	167.39	162.84
03/03/98	2,800	20	0.65	0.39	16	5,600	2.30	NP	0.00	167.39	165.09

TABLE 1
GROUNDWATER DATA
THRIFTY OIL STATION #054, CASTRO VALLEY, CA.

DATE SAMPLED	ANALYTICAL PARAMETERS						DEPTH TO GROUNDWATER (feet)	DEPTH TO PRODUCT (feet)	PRODUCT THICKNESS (feet)	CASING ELEVATION (feet)	GROUNDWATER ELEVATION (feet)
	TPH (ug/L)	BENZENE (ug/L)	TOLUENE (ug/L)	EthylBenzene (ug/L)	XYLENE (ug/L)	MTBE (ug/L)					
07/08/98	<50	<0.3	<0.3	<0.3	<0.5	<5	-	-	-	-	-
09/10/98	<50	<0.3	<0.3	<0.3	<0.5	23	4.95	NP	0.00	167.39	162.44
12/30/98	<50	1.1	<0.3	<0.3	<0.5	<5	4.55	NP	0.00	167.39	162.84
03/15/99	<50	<0.3	<0.3	<0.3	<0.5	<5	4.15	NP	0.00	167.39	163.24
06/22/99	670	17	1.2	0.36	1.7	340	3.85	NP	0.00	167.39	163.54
09/08/99	140	0.72	<0.3	<0.3	<0.5	230	2.63	NP	0.00	167.39	164.76
12/01/99	95	<0.3	<0.3	<0.3	<0.5	200	2.63	NP	0.00	167.39	164.76
03/23/00	315	<0.25	<0.25	<0.25	<0.5	*293/422	2.25	NP	0.00	167.39	165.14
06/08/00	<100	<5	<5	<5	<5	201	3.02	NP	0.00	167.39	164.37
09/27/00	154	<0.18	<0.14	<0.18	<0.26	*254 / 160	3.01	NP	0.00	167.39	164.38
12/13/00	<50	<0.18	<0.14	<0.18	<0.26	*124 / 111	3.02	NP	0.00	167.39	164.37
MONITORING WELL #RE-1											
04/11/88	15,000	12,000	8,000	1,000	2,700	-	-	-	-	-	-
04/09/90	-	-	-	-	-	-	-	-	-	-	-
10/30/90	87,000	7,200	10,000	1,600	12,900	-	7.04	NP	0.00	166.94	159.90
01/18/91	70,000	5,000	5,400	790	9,900	-	11.62	NP	0.00	166.94	155.32
02/12/91	87,000	5,200	2,800	240	11,000	-	11.63	NP	0.00	166.94	155.31
03/20/91	6,500	370	230	17	670	-	11.61	NP	0.00	166.94	155.33
05/22/91	-	-	-	-	-	-	10.30	FILM	0.00	166.94	156.64
06/19/91	-	-	-	-	-	-	11.10	FILM	0.00	166.94	155.84
07/17/91	-	-	-	-	-	-	6.20	FILM	0.00	166.94	160.74
08/17/91	-	-	-	-	-	-	8.15	FILM	0.00	166.94	158.79
09/24/91	-	-	-	-	-	-	10.40	FILM	0.00	166.94	156.54
10/23/91	-	-	-	-	-	-	11.20	FILM	0.00	166.94	155.74
11/06/91	-	-	-	-	-	-	6.62	FILM	0.00	166.94	160.32
12/04/91	-	-	-	-	-	-	11.20	FILM	0.00	166.94	155.74
01/29/92	-	-	-	-	-	-	7.72	FILM	0.00	166.94	159.22
02/26/92	-	-	-	-	-	-	5.13	FILM	0.00	166.94	161.81
03/19/92	-	-	-	-	-	-	5.00	FILM	0.00	166.94	161.94
04/22/92	-	-	-	-	-	-	5.94	FILM	0.00	166.94	161.00
05/21/92	-	-	-	-	-	-	5.40	FILM	0.00	166.94	161.54
06/25/92	-	-	-	-	-	-	5.71	FILM	0.00	166.94	161.23
07/30/92	-	-	-	-	-	-	6.33	FILM	0.00	166.94	160.61

**TABLE 1
GROUNDWATER DATA
THRIFTY OIL STATION #054, CASTRO VALLEY, CA.**

DATE SAMPLED	ANALYTICAL PARAMETERS						DEPTH TO GROUNDWATER (feet)	DEPTH TO PRODUCT (feet)	PRODUCT THICKNESS (feet)	CASING ELEVATION (feet)	GROUNDWATER ELEVATION (feet)
	TPH (ug/L)	BENZENE (ug/L)	TOLUENE (ug/L)	Ethyl Benzene (ug/L)	XYLENE (ug/L)	MIBK (ug/L)					
08/20/92	-	-	-	-	-	-	5.80	FILM	0.00	166.94	161.14
09/30/92	-	-	-	-	-	-	6.34	FILM	0.00	166.94	160.60
12/23/92	-	-	-	-	-	-	5.50	FILM	0.00	166.94	161.44
03/10/93	-	-	-	-	-	-	4.67	FILM	0.00	166.94	162.27
06/09/93	-	-	-	-	-	-	5.12	FILM	0.00	166.94	161.82
09/14/93	-	-	-	-	-	-	10.44	NP	0.00	166.94	156.50
12/14/93	-	-	-	-	-	-	7.52	NP	0.00	166.94	159.42
03/02/94	-	-	-	-	-	-	4.85	NP	0.00	166.94	162.09
06/06/94	-	-	-	-	-	-	5.20	FILM	0.00	166.94	161.74
09/06/94	-	-	-	-	-	-	9.85	FILM	0.00	166.94	157.09
12/07/94	-	-	-	-	-	-	5.20	FILM	0.00	166.94	161.74
03/08/95	-	-	-	-	-	-	4.98	FILM	0.00	166.94	161.96
06/15/95	-	-	-	-	-	-	-	-	-	-	-
09/05/95	-	-	-	-	-	-	13.72	FILM	0.00	166.94	153.22
11/21/95	32,000	46	21	66	340	-	12.53	NP	0.00	166.94	154.41
03/11/96	1,700	130	15	2.0	120	-	4.72	NP	0.00	166.94	162.22
06/19/96	1,700	230	30	0.35	100	-	5.40	NP	0.00	166.94	161.54
09/16/96	510	<0.3	0.73	<0.3	<0.5	800	5.18	NP	0.00	166.94	161.76
12/10/96	520	<0.3	<0.3	<0.3	<0.5	1,000	4.65	NP	0.00	166.94	162.29
03/12/97	420	3.2	<0.3	<0.3	11	370	3.87	NP	0.00	166.94	163.07
06/12/97	510	0.66	<0.3	<0.3	<0.5	1,600	-	-	-	-	-
09/10/97	<50	<0.3	<0.3	<0.3	<0.5	<20	5.40	NP	0.00	166.94	161.54
12/09/97	1,400	330	2.3	<0.3	1.5	2,500	4.60	NP	0.00	166.94	162.34
03/03/98	3,000	400	0.61	0.5	97	3,800	5.05	NP	0.00	166.94	161.89
07/08/98	650	<0.3	<0.3	<0.3	<0.5	1,800	-	-	-	-	-
09/10/98	2,700	<0.3	<0.3	<0.3	1.4	7,600	4.60	NP	0.00	166.94	162.34
12/30/98	530	<0.3	<0.3	<0.3	<0.5	1,500	4.20	NP	0.00	166.94	162.74
03/15/99	<50	<0.3	<0.3	<0.3	<0.5	<5	3.85	NP	0.00	166.94	163.09
06/22/99	1,200	23	1.5	<0.3	2.4	1,400	3.90	NP	0.00	166.94	163.04
09/08/99	590	1.5	<0.6	<0.6	<1	1,100	5.72	NP	0.00	166.94	161.22
12/01/99	540	<0.3	<0.3	<0.3	<0.5	880	5.34	NP	0.00	166.94	161.60
03/23/00	<50	<0.25	<0.25	<0.25	<0.5	<5	5.36	NP	0.00	166.94	161.58
06/08/00	67	<5	<5	<5	<5	<5	5.34	NP	0.00	166.94	161.60
09/27/00	<50	<0.18	<0.14	<0.18	<0.26	<0.24	5.35	NP	0.00	166.94	161.59
12/13/00	<50	<0.18	<0.14	<0.18	<0.26	<0.24	5.71	NP	0.00	166.94	161.23

**TABLE 1
GROUNDWATER DATA
THRIFTY OIL STATION #054, CASTRO VALLEY, CA.**

DATE SAMPLED	ANALYTICAL PARAMETERS						DEPTH TO GROUNDWATER (feet)	DEPTH TO PRODUCT (feet)	PRODUCT THICKNESS (feet)	CASING ELEVATION (feet)	GROUNDWATER ELEVATION (feet)
	TPH (ug/L)	BENZENE (ug/L)	TOLUENE (ug/L)	ETHYLENEGLYCOL (ug/L)	XYLENE (ug/L)	MIBK (ug/L)					
MONITORING WELL #RE-5											
04/11/88	14,000	1,300	1,100	100	2,600	-	-	-	-	-	-
04/09/90	3,000	690	190	40	270	-	4.79	NP	0.00	166.51	161.72
10/30/90	3,400	910	48	87	249	-	5.86	NP	0.00	166.51	160.65
01/18/91	1,400	180	8.6	0.52	48	-	4.40	NP	0.00	166.51	162.11
02/12/91	1,000	ND	ND	0.65	ND	-	4.76	NP	0.00	166.51	161.75
03/20/91	3,000	250	53	ND	110	-	5.08	NP	0.00	166.51	161.43
05/22/91	2,500	330	7.8	5.6	200	-	4.52	NP	0.00	166.51	161.99
01/19/91	2,000	59	1.6	5.1	110	-	4.39	NP	0.00	166.51	162.12
07/17/91	-	-	-	-	-	-	5.05	FILM	0.00	166.51	161.46
08/07/91	-	-	-	-	-	-	5.02	FILM	0.00	166.51	161.49
09/24/91	-	-	-	-	-	-	5.86	FILM	0.00	166.51	160.65
10/23/91	-	-	-	-	-	-	5.84	FILM	0.00	166.51	160.67
11/06/91	9,900	2,300	37	260	160	-	5.48	NP	0.00	166.51	161.03
12/04/91	4,500	1,000	27	ND	180	-	5.43	NP	0.00	166.51	161.08
01/29/92	600	6.1	2.3	ND	47	-	5.12	NP	0.00	166.51	161.39
02/26/92	500	5.4	2.7	1.2	14	-	4.93	NP	0.00	166.51	161.58
03/19/92	ND	1.7	1.1	ND	5.5	-	4.45	NP	0.00	166.51	162.06
04/22/92	1,600	240	2.2	ND	160	-	4.63	NP	0.00	166.51	161.88
05/21/92	1,200	410	37	ND	118	-	4.90	NP	0.00	166.51	161.61
06/25/92	ND	1.0	0.8	0.8	0.4	-	5.15	NP	0.00	166.51	161.36
07/30/92	ND	2.0	1.8	1.9	6.4	-	5.30	NP	0.00	166.51	161.21
08/20/92	300	1.7	3.3	0.7	12	-	5.44	NP	0.00	166.51	161.07
09/30/92	1,900	140	ND	19	35	-	5.73	NP	0.00	166.51	160.78
12/23/92	400	8.0	ND	ND	ND	-	4.75	NP	0.00	166.51	161.76
03/10/93	1,100	290	9.7	ND	75	-	4.14	NP	0.00	166.51	162.37
06/09/93	400	1.5	0.5	ND	12	-	5.42	NP	0.00	166.51	161.09
09/14/93	240	6.9	8.8	1.4	67	-	5.53	NP	0.00	166.51	160.98
12/14/93	3,300	510	5.4	4.1	55	-	478	NP	0.00	166.51	-311.49
03/02/94	2,400	270	4.5	<0.3	13	-	4.20	NP	0.00	166.51	162.31
06/06/94	730	<0.3	<0.3	0.70	22	-	5.13	NP	0.00	166.51	161.38
09/06/94	2,400	180	28	2.3	76	-	5.45	NP	0.00	166.51	161.06
12/07/94	540	5.6	<0.3	<0.5	6.9	-	4.13	NP	0.00	166.51	162.38
03/08/95	1,500	220	5.5	<0.5	83	-	5.20	NP	0.00	166.51	161.31
06/15/95	3,200	820	53	6.2	74	-	4.93	NP	0.00	166.51	161.58

**TABLE 1
GROUNDWATER DATA
THRIFTY OIL STATION #054, CASTRO VALLEY, CA.**

DATE SAMPLED	ANALYTICAL PARAMETERS						DEPTH TO GROUNDWATER (feet)	DEPTH TO PRODUCT (feet)	PRODUCT THICKNESS (feet)	CASING ELEVATION (feet)	GROUNDWATER ELEVATION (feet)
	ETH (ug/L)	BENZENE (ug/L)	TOLUENE (ug/L)	EthylBenzene (ug/L)	XYLENE (ug/L)	MTBE (ug/L)					
09/05/95	4,400	440	22	<2.5	57	-	5.03	NP	0.00	166.51	161.48
11/21/95	660	3.4	<0.3	<0.3	0.6	-	5.23	NP	0.00	166.51	161.28
03/11/96	1,000	76	2.2	<0.3	130	-	4.16	NP	0.00	166.51	162.35
06/09/96	90	<0.3	<0.3	<0.3	<0.5	-	5.42	NP	0.00	166.51	161.09
09/16/96	1,900	5.8	<0.3	<0.3	5.9	1,100	5.20	NP	0.00	166.51	161.31
12/10/96	740	<0.3	<0.3	<0.3	<0.5	1,300	5.27	NP	0.00	166.51	161.24
03/12/97	2,000	600	59	5.1	54	1,300	3.85	NP	0.00	166.51	162.66
06/12/97	230	<0.3	<0.3	<0.3	<0.5	720	-	-	-	-	-
09/10/97	210	<0.3	<0.3	<0.3	<0.5	210	4.10	NP	0.00	166.51	162.41
12/09/97	11,000	2,500	2,700	<6	1,500	510	5.20	NP	0.00	166.51	161.31
03/03/98	<50	<0.3	<0.3	<0.3	<0.5	<20	3.70	NP	0.00	166.51	162.81
07/08/98	<50	<0.3	<0.3	<0.3	<0.5	<5	-	-	-	-	-
09/10/98	<50	<0.3	<0.3	<0.3	<0.5	<5	6.77	NP	0.00	166.51	159.74
12/30/98	<50	<0.3	<0.3	<0.3	<0.5	<5	5.95	NP	0.00	166.51	160.56
03/15/99	<50	<0.3	<0.3	<0.3	<0.5	<5	5.25	NP	0.00	166.51	161.26
06/22/99	110	<0.3	<0.3	<0.3	<0.5	200	4.50	NP	0.00	166.51	162.01
09/08/99	68	<0.3	<0.3	<0.3	<0.5	110	4.43	NP	0.00	166.51	162.08
12/01/99	<50	<0.3	<0.3	<0.3	<0.5	<5	3.66	NP	0.00	166.51	162.85
03/23/00	<50	<0.25	<0.25	<0.25	<0.5	<5	4.06	NP	0.00	166.51	162.45
06/08/00	<50	<5	<5	<5	<5	<5	4.43	NP	0.00	166.51	162.08
09/27/00	<50	<0.18	<0.14	<0.18	<0.26	<0.24	4.06	NP	0.00	166.51	162.45
12/13/00	<50	<0.18	<0.14	<0.18	<0.26	<0.24	4.80	NP	0.00	166.51	161.71
MONITORING WELL #RE-6											
04/11/88	6,000	3,000	40	80	140	-	-	-	-	-	-
04/09/90	3,000	990	ND	70	ND	-	5.64	NP	0.00	166.51	160.87
10/30/90	3,400	1,000	28	ND	ND	-	6.68	NP	0.00	166.51	159.83
01/18/91	6,300	1,200	ND	3.0	15	-	6.61	NP	0.00	166.51	159.90
02/12/91	5,200	850	8.4	4.9	41	-	6.20	NP	0.00	166.51	160.31
03/20/91	5,800	680	12	8.0	16	-	5.62	NP	0.00	166.51	160.89
05/22/91	8,500	1,700	14	24	6.7	-	6.05	NP	0.00	166.51	160.46
06/19/91	-	-	-	-	-	-	6.12	FILM	0.00	166.51	160.39
07/17/91	120,000	9,300	13,000	2,400	16,000	-	6.20	NP	0.00	166.51	160.31
08/07/91	-	590	5.3	ND	14	-	6.27	NP	0.00	166.51	160.24

**TABLE 1
GROUNDWATER DATA
THRIFTY OIL STATION #054, CASTRO VALLEY, CA.**

DATE SAMPLED	ANALYTICAL PARAMETERS						DEPTH TO GROUNDWATER (feet)	DEPTH TO PRODUCT (feet)	PRODUCT THICKNESS (feet)	CASING ELEVATION (feet)	GROUNDWATER ELEVATION (feet)
	TPH (ug/L)	BENZENE (ug/L)	TOLUENE (ug/L)	EthylBenzene (ug/L)	XYLENE (ug/L)	MIBK (ug/L)					
09/24/91	7,000	310	11	5.3	35	-	6.63	NP	0.00	166.51	159.88
10/23/91	-	-	-	-	-	-	6.36	FILM	0.00	166.51	160.15
11/06/91	4,000	710	18	29	49	-	6.15	NP	0.00	166.51	160.36
12/04/91	4,100	1,100	14	33	39	-	6.19	NP	0.00	166.51	160.32
01/29/92	2,600	790	14	ND	49	-	6.70	NP	0.00	166.51	159.81
02/26/92	3,100	950	21	30	33	-	5.44	NP	0.00	166.51	161.07
03/19/92	2,200	630	14	12	40	-	5.30	NP	0.00	166.51	161.21
04/22/92	-	730	2.2	ND	40	-	6.00	NP	0.00	166.51	160.51
05/21/92	1,500	840	7.8	7.1	34	-	6.25	NP	0.00	166.51	160.26
06/25/92	<2000	740	8.0	27	28	-	6.38	NP	0.00	166.51	160.13
07/30/92	-	-	-	-	-	-	6.42	FILM	0.00	166.51	160.09
08/20/92	2,800	630	17	23	22	-	6.50	NP	0.00	166.51	160.01
09/30/92	7,800	540	ND	12	29	-	6.66	NP	0.00	166.51	159.85
12/23/92	1,800	350	ND	7.7	11	-	5.83	NP	0.00	166.51	160.68
03/10/93	3,000	830	5.6	19	16	-	5.63	NP	0.00	166.51	160.88
06/09/93	4,800	920	6.2	3.2	12	-	6.01	NP	0.00	166.51	160.50
09/14/93	3,600	660	7.5	11	27	-	6.53	NP	0.00	166.51	159.98
12/14/93	1,500	200	<0.3	<0.3	8.8	-	3.58	NP	0.00	166.51	162.93
03/02/94	-	-	-	-	-	-	5.12	NP	0.00	166.51	161.39
06/06/94	2,400	290	4.6	1.3	24	-	1.85	NP	0.00	166.51	164.66
09/06/94	4,300	230	21	<6.6	130	-	6.40	NP	0.00	166.51	160.11
12/07/94	1,500	17	2.5	3.2	22	-	5.68	NP	0.00	166.51	160.83
03/08/95	2,500	460	5.5	2.1	51	-	5.12	NP	0.00	166.51	161.39
06/15/95	2,300	91	1.1	0.7	97	-	5.72	NP	0.00	166.51	160.79
09/05/95	3,300	60	<10	<10	74	-	5.94	NP	0.00	166.51	160.57
11/21/95	2,000	7.3	<0.3	0.56	8.7	-	6.24	NP	0.00	166.51	160.27
03/11/96	840	43	0.96	5.7	14	-	5.16	NP	0.00	166.51	161.35
06/19/96	1,800	160	2.7	9.9	25	-	5.80	NP	0.00	166.51	160.71
09/16/96	<50	<0.3	<0.3	<0.3	<0.5	<20	5.38	NP	0.00	166.51	161.13
12/10/96	<50	<0.3	<0.3	<0.3	<0.5	<20	5.62	NP	0.00	166.51	160.89
03/12/97	<50	<0.3	<0.3	<0.3	<0.5	<20	5.20	NP	0.00	166.51	161.31
06/12/97	<50	<0.3	<0.3	<0.3	<0.5	<20	-	-	-	-	-
09/10/97	440	<0.3	<0.3	<0.3	<0.5	320	5.20	NP	0.00	166.51	161.31
12/09/97	<50	<0.3	<0.3	<0.3	<0.5	<20	5.97	NP	0.00	166.51	160.54
03/03/98	400	7.0	<0.3	<0.3	4.3	65	4.45	NP	0.00	166.51	162.06

**TABLE 1
GROUNDWATER DATA
THRIFTY OIL STATION #054, CASTRO VALLEY, CA.**

DATE SAMPLED	ANALYTICAL PARAMETERS						DEPTH TO GROUNDWATER (feet)	DEPTH TO PRODUCT (feet)	PRODUCT THICKNESS (feet)	CASING ELEVATION (feet)	GROUNDWATER ELEVATION (feet)
	TPH (ug/L)	BENZENE (ug/L)	TOLUENE (ug/L)	Ethyl Benzene (ug/L)	XYLENE (ug/L)	MTBE (ug/L)					
07/08/98	300	<0.3	<0.3	<0.3	1.0	35	-	-	-	-	-
09/10/98	<50	<0.3	<0.3	<0.3	<0.5	<5	5.90	NP	0.00	166.51	160.61
12/30/98	<50	<0.3	<0.3	<0.3	<0.5	<5	5.20	NP	0.00	166.51	161.31
03/15/99	<50	<0.3	<0.3	<0.3	<0.5	8.4	4.82	NP	0.00	166.51	161.69
06/22/99	700	11	1.9	<0.3	3.9	140	6.00	NP	0.00	166.51	160.51
09/08/99	<50	<0.3	<0.3	<0.3	<0.5	<5	5.15	NP	0.00	166.51	161.36
12/01/99	<50	<0.3	<0.3	<0.3	<0.5	12	4.02	NP	0.00	166.51	162.49
03/23/00	<50	<0.25	<0.25	<0.25	<0.5	<5	4.41	NP	0.00	166.51	162.10
06/08/00	<50	<5	<5	<5	<5	<5	4.78	NP	0.00	166.51	161.73
09/27/00	<50	<0.18	<0.14	<0.18	<0.26	<0.24	4.78	NP	0.00	166.51	161.73
12/13/00	<50	<0.18	<0.14	<0.18	<0.26	<0.24	4.77	NP	0.00	166.51	161.74
MONITORING WELL #RC-7											
04/11/88	<50,000	17,000	4,400	600	8,400	-	-	-	-	-	-
04/09/90	16,000	7,000	1,200	640	1,600	-	5.93	NP	0.00	166.04	160.11
10/30/90	31,000	14,000	ND	ND	ND	-	8.21	NP	0.00	166.04	157.83
01/18/91	-	-	-	-	-	-	11.80	NP	0.00	166.04	154.24
02/12/91	-	-	-	-	-	-	10.80	FILM	0.00	166.04	155.24
03/20/91	120,000	12,000	2,800	490	6,600	-	9.96	NP	0.00	166.04	156.08
05/22/91	-	-	-	-	-	-	11.70	FILM	0.00	166.04	154.34
06/19/91	-	-	-	-	-	-	11.50	FILM	0.00	166.04	154.54
07/17/91	-	-	-	-	-	-	7.80	FILM	0.00	166.04	158.24
08/07/91	-	-	-	-	-	-	9.88	0.03	9.85	166.04	163.60
09/24/91	-	-	-	-	-	-	9.85	0.03	9.82	166.04	163.60
10/23/91	-	-	-	-	-	-	9.96	FILM	0.00	166.04	156.08
11/06/91	-	-	-	-	-	-	6.77	FILM	0.00	166.04	159.27
12/04/91	-	-	-	-	-	-	10.80	FILM	0.00	166.04	155.24
01/29/92	-	-	-	-	-	-	8.64	FILM	0.00	166.04	157.40
02/26/92	-	-	-	-	-	-	6.00	FILM	0.00	166.04	160.04
03/19/92	-	-	-	-	-	-	5.55	FILM	0.00	166.04	160.49
04/22/92	-	-	-	-	-	-	6.12	FILM	0.00	166.04	159.92
05/21/92	-	-	-	-	-	-	6.40	FILM	0.00	166.04	159.64
06/25/92	-	-	-	-	-	-	6.73	0.02	6.71	166.04	164.38
07/30/92	-	-	-	-	-	-	6.73	FILM	0.00	166.04	159.31

**TABLE 1
GROUNDWATER DATA
THRIFTY OIL STATION #054, CASTRO VALLEY, CA.**

DATE SAMPLED	ANALYTICAL PARAMETERS						DEPTH TO GROUNDWATER (feet)	DEPTH TO PRODUCT (feet)	PRODUCT THICKNESS (feet)	CASING ELEVATION (feet)	GROUNDWATER ELEVATION (feet)
	TPH (ug/L)	BENZENE (ug/L)	TOLUENE (ug/L)	EthylBenzene (ug/L)	XYLENE (ug/L)	MIBK (ug/L)					
08/20/92	-	-	-	-	-	-	6.82	FILM	0.00	166.04	159.22
09/30/92	-	-	-	-	-	-	7.26	FILM	0.00	166.04	158.78
12/23/92	-	-	-	-	-	-	6.22	FILM	0.00	166.04	159.82
03/10/93	-	-	-	-	-	-	5.82	FILM	0.00	166.04	160.22
06/09/93	-	-	-	-	-	-	6.17	FILM	0.00	166.04	159.87
09/14/93	-	-	-	-	-	-	11.33	NP	0.00	166.04	154.71
12/14/93	-	-	-	-	-	-	8.40	NP	0.00	166.04	157.64
03/02/94	-	-	-	-	-	-	6.82	NP	0.00	166.04	159.22
06/06/94	-	-	-	-	-	-	10.95	FILM	0.00	166.04	155.09
09/06/94	-	-	-	-	-	-	11.30	FILM	0.00	166.04	154.74
12/07/94	-	-	-	-	-	-	5.63	FILM	0.00	166.04	160.41
03/08/95	-	-	-	-	-	-	5.06	FILM	0.00	166.04	160.98
06/15/95	-	-	-	-	-	-	-	-	-	-	-
09/05/95	-	-	-	-	-	-	7.98	FILM	0.00	166.04	158.06
11/21/95	20,000	8,800	110	<30	310	-	7.32	NP	0.00	166.04	158.72
03/11/96	4,800	2,200	38	26	120	-	5.62	NP	0.00	166.04	160.42
06/19/96	4,400	3,300	49	5.8	70	-	6.40	NP	0.00	166.04	159.64
09/19/96	7,200	510	83	<0.3	710	130	6.20	NP	0.00	166.04	159.84
12/10/96	700	<0.3	<0.3	<0.3	<0.5	1,400	5.92	NP	0.00	166.04	160.12
03/12/97	660	0.31	<0.3	<0.3	<0.5	1,400	5.62	NP	0.00	166.04	160.42
06/12/97	320	<0.3	0.45	<0.3	<0.5	850	-	-	-	-	-
09/10/97	780	<0.3	<0.3	<0.3	<0.5	930	7.45	NP	0.00	166.04	158.59
12/09/97	14,000	3,500	3,700	<15	2,100	1,100	7.10	NP	0.00	166.04	158.94
03/03/98	6,100	2,500	18	<6	110	270	6.70	NP	0.00	166.04	159.34
07/08/98	1,300	8.7	<0.3	<0.3	<0.5	350	-	-	-	-	-
09/10/98	690	2.2	<0.3	<0.3	<0.5	350	7.04	NP	0.00	166.04	159.00
12/30/98	600	2.0	0.55	<0.3	<0.5	350	6.25	NP	0.00	166.04	159.79
03/15/99	350	0.71	<0.3	<0.3	<0.5	140	6.02	NP	0.00	166.04	160.02
06/22/99	5,900	2,100	16	4.6	48	170	6.35	NP	0.00	166.04	159.69
09/08/99	1,700	380	<3	<3	13	160	7.03	NP	0.00	166.04	159.01
12/01/99	930	3.7	<0.3	<0.3	<0.5	390	6.25	NP	0.00	166.04	159.79
03/23/00	581	5.4	5.3	1.9	7.3	*168/183	6.24	NP	0.00	166.04	159.80
06/08/00	<100	<5	<5	<5	<5	74	6.64	NP	0.00	166.04	159.40
09/27/00	236	<0.18	<0.14	<0.18	<0.26	*21 / 28	7.03	NP	0.00	166.04	159.01
12/13/00	<50	<0.18	<0.14	<0.18	<0.26	*13 / 19.8	6.63	NP	0.00	166.04	159.41

TABLE 1
GROUNDWATER DATA
THRIFTY OIL STATION #054, CASTRO VALLEY, CA.

DATE SAMPLED	ANALYTICAL PARAMETERS						DEPTH TO GROUNDWATER (feet)	DEPTH TO PRODUCT (feet)	PRODUCT THICKNESS (feet)	CASING ELEVATION (feet)	GROUNDWATER ELEVATION (feet)
	TPH (ug/L)	BENZENE (ug/L)	TOLUENE (ug/L)	EthylBenzene (ug/L)	XYLENE (ug/L)	MTBE (ug/L)					
MONITORING WELL #RS-8											
08/07/91	ND	ND	ND	ND	ND	-	9.68	NP	0.00	164.32	154.64
09/27/91	ND	ND	ND	ND	ND	-	9.89	NP	0.00	164.32	154.43
10/23/91	ND	ND	ND	ND	ND	-	10.05	NP	0.00	164.32	154.27
11/06/91	ND	ND	ND	ND	ND	-	9.71	NP	0.00	164.32	154.61
12/04/91	ND	ND	ND	ND	ND	-	10.00	NP	0.00	164.32	154.32
01/29/92	ND	2.1	1.0	2.5	3.6	-	9.28	NP	0.00	164.32	155.04
02/26/92	ND	ND	0.7	ND	0.7	-	7.05	NP	0.00	164.32	157.27
03/19/92	ND	0.5	1.0	1.5	2.7	-	7.30	NP	0.00	164.32	157.02
04/22/92	ND	ND	ND	ND	ND	-	8.60	NP	0.00	164.32	155.72
05/21/92	ND	ND	ND	ND	ND	-	9.22	NP	0.00	164.32	155.10
06/25/92	ND	ND	ND	ND	ND	-	9.49	NP	0.00	164.32	154.83
07/30/92	ND	1.1	4.2	ND	3.0	-	9.55	NP	0.00	164.32	154.77
08/20/92	ND	2.0	4.7	ND	5.7	-	9.63	NP	0.00	164.32	154.69
09/30/92	ND	ND	ND	ND	ND	-	9.90	NP	0.00	164.32	154.42
12/23/92	ND	ND	ND	ND	ND	-	9.96	NP	0.00	164.32	154.36
05/10/93	ND	ND	ND	ND	ND	-	8.95	NP	0.00	164.32	155.37
06/09/93	ND	ND	ND	ND	ND	-	9.00	NP	0.00	164.32	155.32
09/14/93	200	0.3	ND	ND	ND	-	9.50	NP	0.00	164.32	154.82
12/14/93	ND	ND	ND	ND	ND	-	8.75	NP	0.00	164.32	155.57
03/02/94	<50	<0.3	<0.3	<0.3	<0.5	-	7.52	NP	0.00	164.32	156.80
06/06/94	54	<0.3	<0.3	<0.3	2.4	-	9.00	NP	0.00	164.32	155.32
09/06/94	<50	<0.3	<0.3	<0.3	<0.5	-	9.26	NP	0.00	164.32	155.06
12/07/94	130	2.5	1.9	1.3	3.6	-	8.67	NP	0.00	164.32	155.65
03/08/95	<100	<0.5	<0.5	<0.5	<1	-	8.34	NP	0.00	164.32	155.98
06/15/95	<100	1.0	<0.5	<0.5	<1	-	9.12	NP	0.00	164.32	155.20
09/05/95	<100	<0.5	<0.5	<0.5	<1	-	9.56	NP	0.00	164.32	154.76
11/21/95	<50	0.44	<0.3	<0.3	1.5	-	9.28	NP	0.00	164.32	155.04
03/11/96	<50	1.3	<0.3	<0.3	0.6	-	7.52	NP	0.00	164.32	156.80
06/19/96	640	72	20	34	150	-	7.80	NP	0.00	164.32	156.52
09/16/96	<50	<0.3	<0.3	<0.3	<0.5	20	9.18	NP	0.00	164.32	155.14
12/10/96	<50	<0.3	<0.3	<0.3	<0.5	<20	6.08	NP	0.00	164.32	158.24
03/12/97	53	0.45	<0.3	<0.3	<0.5	140	8.65	NP	0.00	164.32	155.67
06/12/97	<50	<0.3	<0.3	<0.3	<0.5	68	-	-	-	-	-
09/10/97	<50	<0.3	<0.3	<0.3	<0.5	<20	8.30	NP	0.00	164.32	156.02

**TABLE 1
GROUNDWATER DATA
THRIFTY OIL STATION #054, CASTRO VALLEY, CA.**

DATE SAMPLED	ANALYTICAL PARAMETERS						DEPTH TO GROUNDWATER (feet)	DEPTH TO PRODUCT (feet)	PRODUCT THICKNESS (feet)	CASING ELEVATION (feet)	GROUNDWATER ELEVATION (feet)
	TPH (ug/L)	BENZENE (ug/L)	TOLUENE (ug/L)	Ethyl Benzene (ug/L)	XYLENE (ug/L)	MIBE (ug/L)					
12/09/97	<50	1.7	2.1	<0.3	1.4	82	9.98	NP	0.00	164.32	154.34
03/03/98	<50	<0.3	<0.3	<0.3	<0.5	84	8.33	NP	0.00	164.32	155.99
07/08/98	<50	<0.3	<0.3	<0.3	<0.5	97	-	-	-	-	-
09/10/98	<50	<0.3	<0.3	<0.3	<0.5	97	12.95	NP	0.00	164.32	151.37
12/30/98	<50	1.3	1.5	<0.3	0.86	19	11.35	NP	0.00	164.32	152.97
03/15/99	<50	<0.3	<0.3	<0.3	<0.5	9.6	9.85	NP	0.00	164.32	154.47
06/22/99	66	0.39	<0.3	<0.3	<0.5	62	9.90	NP	0.00	164.32	154.42
09/08/99	<50	<0.3	<0.3	<0.3	<0.5	25	9.85	NP	0.00	164.32	154.47
12/01/99	<50	<0.3	<0.3	<0.3	<0.5	30	8.30	NP	0.00	164.32	156.02
03/23/00	<50	<0.25	<0.25	<0.25	<0.5	*13.6/18.2	6.76	NP	0.00	164.32	157.56
06/08/00	<50	<5	<5	<5	<5	10	8.30	NP	0.00	164.32	156.02
09/27/00	<50	<0.18	<0.14	<0.18	<0.26	*6 / 4.9	8.30	NP	0.00	164.32	156.02
12/13/00	<50	<0.18	<0.14	<0.18	<0.26	<0.24	8.28	NP	0.00	164.32	156.04
MONITORING WELL IRS-9											
08/07/91	-	0.5	ND	330	1,200	-	2.28	NP	0.00	167.51	165.23
09/27/91	13,000	3.5	3.0	82	140	-	2.77	NP	0.00	167.51	164.74
10/23/91	11,000	ND	ND	39	340	-	3.53	NP	0.00	167.51	163.98
11/06/91	6,800	8.4	0.6	22	230	-	2.51	NP	0.00	167.51	165.00
12/04/91	6,500	6.5	0.7	87	200	-	3.20	NP	0.00	167.51	164.31
01/29/92	8,100	22	10	140	260	-	2.65	NP	0.00	167.51	164.86
02/26/92	13,000	40	16	220	600	-	3.42	NP	0.00	167.51	164.09
03/19/92	12,000	21	12	100	280	-	3.12	NP	0.00	167.51	164.39
04/22/92	8,600	ND	ND	20	37	-	3.24	NP	0.00	167.51	164.27
05/21/92	6,000	21	10	53	210	-	3.75	NP	0.00	167.51	163.76
06/25/92	370	2.3	1.5	0.7	4.3	-	2.65	NP	0.00	167.51	164.86
07/30/92	3,600	20	ND	39	80	-	2.70	NP	0.00	167.51	164.81
08/20/92	3,000	0.7	5.2	2.0	5.3	-	2.83	NP	0.00	167.51	164.68
09/30/92	9,200	4.8	6.5	12	91	-	2.80	NP	0.00	167.51	164.71
12/23/92	2,000	17	ND	8.2	18	-	2.45	NP	0.00	167.51	165.06
03/10/93	1,500	ND	2.6	21	12	-	2.40	NP	0.00	167.51	165.11
06/09/93	1,300	0.6	1.7	ND	7.5	-	3.55	NP	0.00	167.51	163.96
09/14/93	1,500	1.3	7.6	4.1	14	-	2.81	NP	0.00	167.51	164.70
12/14/93	560	ND	ND	ND	5.5	-	2.63	NP	0.00	167.51	164.88

**TABLE 1
GROUNDWATER DATA
THRIFTY OIL STATION #054, CASTRO VALLEY, CA.**

DATE SAMPLED	ANALYTICAL PARAMETERS						DEPTH TO GROUNDWATER (feet)	DEPTH TO PRODUCT (feet)	PRODUCT THICKNESS (feet)	CASING ELEVATION (feet)	GROUNDWATER ELEVATION (feet)
	TPH (ug/L)	BENZENE (ug/L)	TOLUENE (ug/L)	EthylBenzene (ug/L)	XYLENE (ug/L)	MTBF (ug/L)					
03/02/94	1,100	<0.3	<0.3	<0.3	<0.5	-	2.60	NP	0.00	167.51	164.91
06/06/94	290	0.58	0.53	1.1	5.8	-	2.52	NP	0.00	167.51	164.99
09/06/94	890	<0.3	<0.3	<0.3	3.1	-	3.16	NP	0.00	167.51	164.35
12/07/94	940	22	23	10	32	-	5.18	NP	0.00	167.51	162.33
03/08/95	1,600	<0.5	<0.5	<0.5	2.3	-	4.57	NP	0.00	167.51	162.94
06/15/95	3,200	2.2	5.3	4.3	3.1	-	5.08	NP	0.00	167.51	162.43
09/05/95	1,100	<0.5	<0.5	<0.5	<1	-	5.72	NP	0.00	167.51	161.79
11/21/95	1,100	1.1	2.9	3.5	3.0	-	2.46	NP	0.00	167.51	165.05
03/11/96	440	0.7	0.34	<0.3	3.7	-	3.44	NP	0.00	167.51	164.07
06/19/96	580	3.8	0.49	1.2	<0.5	-	3.80	NP	0.00	167.51	163.71
09/16/96	490	<0.3	1.6	<0.3	<0.5	<20	3.80	NP	0.00	167.51	163.71
12/10/96	<50	<0.3	<0.3	<0.3	<0.5	<20	2.76	NP	0.00	167.51	164.75
03/12/97	<50	<0.3	0.42	<0.3	1.5	<20	3.20	NP	0.00	167.51	164.31
06/12/97	<50	<0.3	<0.3	<0.3	0.51	<20	-	-	-	-	-
09/10/97	<50	<0.3	<0.3	<0.3	<0.5	<20	4.24	NP	0.00	167.51	163.27
12/09/97	<50	<0.3	0.48	<0.3	<0.5	<20	2.72	NP	0.00	167.51	164.79
03/03/98	190	<0.3	<0.3	0.38	<0.5	<20	1.90	NP	0.00	167.51	165.61
07/08/98	<50	<0.3	<0.3	<0.3	<0.5	<5	-	-	-	-	-
09/10/98	<50	<0.3	<0.3	<0.3	<0.5	<5	2.72	NP	0.00	167.51	164.79
12/30/98	<50	<0.3	<0.3	<0.3	<0.5	<5	1.20	NP	0.00	167.51	166.31
03/15/99	<50	<0.3	<0.3	<0.3	<0.5	<5	4.25	NP	0.00	167.51	163.26
06/22/99	1,300	4.2	1.2	0.69	0.74	<5	3.70	NP	0.00	167.51	163.81
09/08/99	<50	<0.3	<0.3	<0.3	<0.5	<5	2.71	NP	0.00	167.51	164.80
12/01/99	<50	<0.3	<0.3	<0.3	<0.5	<5	2.70	NP	0.00	167.51	164.81
03/23/00	<50	<0.25	<0.25	<0.25	<0.5	<5	2.70	NP	0.00	167.51	164.81
06/08/00	585	<5	<5	<5	<5	821	2.72	NP	0.00	167.51	164.79
09/27/00	592	<0.18	<0.14	<0.18	<0.26	*1,180 / 1,360	2.72	NP	0.00	167.51	164.79
12/13/00	<50	<0.18	<0.14	<0.18	<0.26	*403 / 444	2.70	NP	0.00	167.51	164.81
MONITORING WELL #RS-10											
08/07/91	ND	ND	ND	ND	ND	-	6.16	NP	0.00	162.89	156.73
09/27/91	ND	ND	ND	ND	ND	-	6.48	NP	0.00	162.89	156.41
10/23/91	ND	ND	ND	ND	ND	-	7.37	NP	0.00	162.89	155.52
11/06/91	ND	ND	ND	ND	ND	-	6.44	NP	0.00	162.89	156.45

**TABLE 1
GROUNDWATER DATA
THRIFTY OIL STATION #054, CASTRO VALLEY, CA.**

DATE SAMPLED	ANALYTICAL PARAMETERS						DEPTH TO GROUNDWATER (feet)	DEPTH TO PRODUCT (feet)	PRODUCT THICKNESS (feet)	CASING ELEVATION (feet)	GROUNDWATER ELEVATION (feet)
	TEH (ug/L)	BENZENE (ug/L)	TOLUENE (ug/L)	EthylBenzene (ug/L)	XYLENE (ug/L)	MIBE (ug/L)					
12/04/91	ND	ND	ND	ND	ND	-	7.02	NP	0.00	162.89	155.87
01/29/92	ND	ND	ND	ND	ND	-	6.78	NP	0.00	162.89	156.11
02/26/92	ND	ND	ND	ND	ND	-	8.33	NP	0.00	162.89	154.56
03/19/92	ND	ND	ND	ND	0.6	-	8.02	NP	0.00	162.89	154.87
04/22/92	ND	ND	ND	ND	ND	-	7.78	NP	0.00	162.89	155.11
05/21/92	ND	ND	0.6	ND	1.2	-	6.21	NP	0.00	162.89	156.68
06/25/92	ND	ND	ND	ND	ND	-	7.73	NP	0.00	162.89	155.16
07/30/92	ND	ND	0.5	ND	1.0	-	7.84	NP	0.00	162.89	155.05
08/20/92	ND	ND	ND	ND	ND	-	7.50	NP	0.00	162.89	155.39
09/30/92	ND	ND	ND	ND	ND	-	7.63	NP	0.00	162.89	155.26
12/23/92	ND	ND	ND	ND	ND	-	7.24	NP	0.00	162.89	155.65
03/10/93	ND	ND	ND	ND	ND	-	6.38	NP	0.00	162.89	156.51
06/09/93	ND	ND	ND	ND	ND	-	7.98	NP	0.00	162.89	154.91
09/14/93	ND	ND	ND	ND	ND	-	7.35	NP	0.00	162.89	155.54
03/02/94	<50	<0.3	<0.3	<0.3	<0.3	-	7.00	NP	0.00	162.89	155.89
06/06/94	<50	<0.3	<0.3	<0.3	<0.5	-	6.55	NP	0.00	162.89	156.34
09/06/94	<50	<0.3	<0.3	<0.3	<0.5	-	7.63	NP	0.00	162.89	155.26
12/07/94	56	<0.3	<0.3	<0.5	2.1	-	5.92	NP	0.00	162.89	156.97
03/08/95	<100	<0.5	<0.5	<0.5	<1	-	7.84	NP	0.00	162.89	155.05
06/15/95	<100	<0.5	<0.5	<0.5	<1	-	6.97	NP	0.00	162.89	155.92
09/05/95	<100	<0.5	<0.5	<0.5	<1	-	8.14	NP	0.00	162.89	154.75
11/21/95	<50	<0.3	<0.3	<0.3	<0.5	-	7.68	NP	0.00	162.89	155.21
03/11/96	<50	<0.3	<0.3	<0.3	<0.5	-	6.76	NP	0.00	162.89	156.13
06/19/96	<50	<0.3	<0.3	<0.3	<0.5	-	7.20	NP	0.00	162.89	155.69
09/16/96	<50	<0.3	<0.3	<0.3	<0.5	<20	6.30	NP	0.00	162.89	156.59
12/10/96	<50	<0.3	<0.3	<0.3	<0.5	<20	6.05	NP	0.00	162.89	156.84
03/12/97	<50	<0.3	<0.3	<0.3	<0.5	<20	7.56	NP	0.00	162.89	155.33
06/12/97	<50	<0.3	<0.3	<0.3	<0.5	<20	-	-	-	-	-
09/10/97	<50	<0.3	<0.3	<0.3	<0.5	<20	7.55	NP	0.00	162.89	155.34
12/09/97	1,900	610	510	<6	290	<20	7.55	NP	0.00	162.89	155.34
03/03/98	<50	2.0	<0.3	<0.3	<0.5	27	6.03	NP	0.00	162.89	156.86
07/08/98	<50	<0.3	<0.3	<0.3	<0.5	<5	-	-	-	-	-
09/10/98	<50	<0.3	<0.3	<0.3	<0.5	72	7.55	NP	0.00	162.89	155.34
12/30/98	<50	1.1	<0.3	<0.3	<0.5	<5	4.45	NP	0.00	162.89	158.44
03/15/99	<50	<0.3	<0.3	<0.3	1.3	<5	4.50	NP	0.00	162.89	158.39

**TABLE 1
GROUNDWATER DATA
THRIFTY OIL STATION #054, CASTRO VALLEY, CA.**

DATE SAMPLED	ANALYTICAL PARAMETERS						DEPTH TO GROUNDWATER (feet)	DEPTH TO PRODUCT (feet)	PRODUCT THICKNESS (feet)	CASING ELEVATION (feet)	GROUNDWATER ELEVATION (feet)
	TPH (ug/L)	BENZENE (ug/L)	TOLUENE (ug/l)	Ethylbenzene (ug/L)	XYLENE (ug/L)	MTBE (ug/L)					
06/22/99	<50	<0.3	<0.3	<0.3	<0.5	<5	9.15	NP	0.00	162.89	153.74
09/08/99	<50	<0.3	<0.3	<0.3	<0.5	<5	7.51	NP	0.00	162.89	155.38
12/01/99	<50	<0.3	<0.3	<0.3	<0.5	<5	5.97	NP	0.00	162.89	156.92
03/23/00	<50	<0.25	<0.25	<0.25	<0.5	<5	4.47	NP	0.00	162.89	158.42
06/08/00	<50	<5	<5	<5	<5	<5	5.97	NP	0.00	162.89	156.92
09/27/00	<50	<0.18	<0.14	<0.18	<0.26	<0.24	7.50	NP	0.00	162.89	155.39
12/13/00	<50	<0.18	<0.14	<0.18	<0.26	<0.24	5.94	NP	0.00	162.89	156.95
MONITORING WELL #RS-11											
09/21/95	110	<0.5	<0.5	<0.5	<1	-	9.37	NP	0.00	163.28	153.91
11/21/95	-	-	-	-	-	-	-	-	-	-	-
03/11/96	-	-	-	-	-	-	-	-	-	-	-
06/19/96	-	-	-	-	-	-	-	-	-	-	-
09/16/96	-	-	-	-	-	-	-	-	-	-	-
03/12/97	74	9.5	<0.3	<0.3	0.57	<20	7.75	NP	0.00	163.28	155.53
06/12/97	<50	<0.3	<0.3	<0.3	<0.5	<20	-	-	-	-	-
09/10/97	<50	<0.3	<0.3	<0.3	<0.5	<20	9.50	NP	0.00	163.28	153.78
12/09/97	<50	0.79	1.2	<0.3	<0.5	<20	9.50	NP	0.00	163.28	153.78
03/03/98	140	22	0.63	<0.3	<0.5	<20	7.93	NP	0.00	163.28	155.35
07/08/98	<50	<0.3	<0.3	<0.3	<0.5	<5	-	-	-	-	-
09/10/98	<50	<0.3	<0.3	<0.3	<0.5	<5	9.48	NP	0.00	163.28	153.80
12/30/98	<50	1.3	0.87	<0.3	0.55	<5	7.95	NP	0.00	163.28	155.33
03/15/99	<50	<0.3	<0.3	<0.3	<0.5	<5	6.40	NP	0.00	163.28	156.88
06/22/99	350	89	2.9	3.3	0.91	6.8	11.00	NP	0.00	163.28	152.28
09/08/99	99	9.1	0.37	<0.3	<0.5	<5	7.90	NP	0.00	163.28	155.38
12/01/99	82	9.7	0.44	<0.3	<0.5	<5	7.90	NP	0.00	163.28	155.38
03/23/00	73	5.8	2.3	<0.25	<0.5	*11.2 / 7.9	4.85	NP	0.00	163.28	158.43
06/08/00	306	<5	<5	<5	<5	<5	7.90	NP	0.00	163.28	155.38
09/27/00	<50	1	<0.14	<0.18	<0.26	3 J / 3.6	9.44	NP	0.00	163.28	153.84
12/13/00	<50	<0.18	<0.14	<0.18	<0.26	<0.24	6.34	NP	0.00	163.28	156.94

NOTE: ND = Nondetectable
 " - " = Not Analyzed / Not Available
 NP = No Free Product
 *MTBE 8020/8260

Benzene, toluene, ethylbenzene, and xylene analyzed by EPA method 8020.
 Total petroleum hydrocarbons (TPH) analyzed by EPA method 8015 modified for gasoline
 Methyl-tert Butyl Ether (MTBE) analyzed by EPA method 8020
 On June 8, 2000, BTEX and MTBE analyzed by EPA Method 8260B

TABLE 2
Vapor Extraction Operating Data
Thrifty Oil Station # 054, CASTRO VALLEY, CA

Month	Representative Date	Hour Meter Reading (hrs)	Operation Duration (hrs)	Inlet		Hydrocarbons Removed		Remarks
				Average Flow (cfm)	Average FID Conc. (ppmv)	Period (lbs)	Cumulative (lbs)	
Jan-91	1/9/91	929	0	30	est. 10,000	0.0	0	
Feb-91	2/6/91	979	50	30	est. 10,000	38.0	38	
Mar-91	3/6/91	1,028	49	5	est. 10,000	6.2	44	System off 4/91 - 9/91
Oct-91	10/23/91	1,786	758	15	est. 10,000	288.0	332	
Nov-91	11/6/91	1,789	3	14	est. 10,000	1.1	333	
Dec-91	12/4/91	1,896	107	14	est. 10,000	37.9	371	
Jan-92	1/29/92	2,025	129	14	est. 10,000	45.7	417	
Feb-92	2/26/92	2,293	268	14	est. 10,000	95.0	512	System off 3/92 - 7/92
Aug-93	8/11/93	2,293	0	18	est. 10,000	0.0	512	
Sep-93	9/8/93	2,446	153	17	est. 10,000	65.9	578	
Oct-93	10/7/93	2,960	514	18	est. 10,000	234.4	812	
Nov-93	11/3/93	3,381	421	18	est. 10,000	191.9	1,004	
Dec-93	12/1/93	3,705	324	18	est. 10,000	147.7	1,152	
Jan-94	1/3/94	4,313	608	18	est. 10,000	277.2	1,429	
Feb-94	2/7/94	4,849	536	17	10,000	230.8	1,660	
Mar-94	3/7/94	5,196	347	20	10,000	175.8	1,836	
Apr-94	4/4/94	5,597	401	16	10,000	162.5	1,998	
May-94	5/2/94	6,003	406	17	est. 10,000	174.8	2,173	
Jun-94	6/6/94	6,514	511	16	10,000	207.1	2,380	
Jul-94	7/18/94	6,679	165	15	10,000	62.7	2,443	
Aug-94	8/1/94	6,735	56	16	est. 10,000	22.7	2,466	
Sep-94	9/20/94	7,340	805	16	est. 10,000	245.2	2,711	
Oct-94	10/5/94	7,554	214	15	est. 10,000	81.3	2,792	
Dec-94	12/13/94	7,656	102	15	est. 10,000	38.8	2,831	
Jan-95	1/6/95	7,742	86	12	est. 10,000	26.1	2,857	
Feb-95	2/14/95	7,906	164	13	est. 10,000	54.0	2,911	
Mar-95	3/2/95	7,976	70	15	est. 10,000	26.6	2,938	
Apr-95	4/7/95	8,009	33	8	est. 10,000	6.7	2,944	
May-95	5/5/95	8,405	396	16	est. 10,000	160.5	3,105	
Jun-95	6/1/95	8,436	31	16	est. 10,000	12.6	3,117	
Jul-95	7/7/95	8,834	398	16	est. 10,000	161.3	3,279	
Aug-95	8/3/95	8,910	76	16	10,000	30.8	3,309	
Sep-95	9/5/95	9,068	158	16	est. 10,000	64.0	3,373	
Oct-95	10/24/95	9,163	95	14	10,000	33.7	3,407	
Nov-95	11/2/95	9,194	31	16	est. 10,000	12.6	3,420	
Jan-96	1/4/96	8,930	0	9	est. 10,000	0.0	3,420	Replaced hour meter (8930)
Feb-96	2/1/96	8,991	61	8	est. 10,000	12.4	3,432	System off 2/96 - 4/96
Apr-96	4/25/96	9,084	93	8	210	0.4	3,432	
May-96	5/2/96	9,124	40	12	220	0.3	3,433	
Jun-96	6/3/96	9,279	155	9	1,000	3.5	3,436	
Jul-96	7/2/96	9,370	91	17	420	1.6	3,438	
Aug-96	8/1/96	9,391	21	9	340	0.2	3,438	
Sep-96	9/5/96	9,721	330	17	est. 340	4.8	3,443	
Oct-96	10/24/96	9,773	52	7	est. 340	0.3	3,443	
Dec-96	12/26/96	9,776	3	8	est. 340	0.0	3,443	System off 10/96 - 12/96
Apr-97	4/3/97	9,781	5	15	10,000	1.9	3,445	System off 1/97 - 4/97
May-97	5/1/97	10,032	251	15	9,800	93.5	3,539	
Jun-97	6/12/97	10,663	631	11	est. 9,000	158.2	3,697	
Jul-97	7/3/97	10,712	49	12	est. 9,000	13.4	3,710	
Aug-97	8/7/97	10,950	238	12	est. 9,000	65.1	3,775	
Sep-97	9/3/97	11,136	186	16	est. 9,000	67.8	3,843	
Oct-97	10/9/97	11,320	184	12	est. 9,000	50.3	3,893	
Nov-97	11/6/97	11,452	132	17	est. 9,000	51.2	3,945	
Dec-97	12/4/97	11,510	58	19	9,000	25.1	3,970	
Jan-98	1/8/98	11,784	274	17	10,000	118.0	4,088	
Feb-98	2/3/98	12,180	396	16	10,000	160.5	4,248	

TABLE 2
Vapor Extraction Operating Data
Thrifty Oil Station # 054, CASTRO VALLEY, CA

Month	Representative Date	Hour Meter Reading (hrs)	Operation Duration (hrs)	Inlet		Hydrocarbons Removed		Remark
				Average Flow (cfm)	Average FID Conc. (ppmV)	Period (hrs)	Cumulative (lbs)	
Mar-98	3/10/98	13,011	831	17	10,000	357.8	4,606	
Apr-98	4/15/98	13,060	49	17	est. 10,000	21.1	4,627	
May-98	5/7/98	13,311	251	16	10,000	101.7	4,729	
Jun-98	6/2/98	13,658	347	17	10,000	149.4	4,878	
Jul-98	7/6/98	14,340	682	16	est. 10,000	276.4	5,155	
Sep-98	9/21/98	14,542	202	12	est. 10,000	61.4	5,216	System shut down, 10/98
Nov-98	11/16/98	14,730	188	12	est. 10,000	57.1	5,273	
Dec-98	12/7/98	15,124	394	11	est. 10,000	109.8	5,383	
Feb-99	2/9/99	16,115	991	10	2,800	70.3	5,453	
Mar-99	3/12/99	16,698	583	13	210	4.0	5,457	
Apr-99	4/6/99	17,009	311	13	est. 210	2.2	5,459	
May-99	5/3/99	17,098	89	10	est. 210	0.5	5,460	
Jun-99	6/28/99	18,130	1,032	10	4,100	107.2	5,567	
Jul-99	7/7/99	18,163	33	10	est. 4,000	3.3	5,570	
Aug-99	8/2/99	18,196	33	11	est. 4,000	3.7	5,574	
Sep-99	9/13/99	18,318	122	12	est. 4,000	14.8	5,589	
Oct-99	10/18/99	18,348	30	13	est. 4,000	4.0	5,593	
Nov-99	11/29/99	18,617	269	12	est. 4,000	32.7	5,626	
Dec-99	12/27/99	19,096	479	12	210	3.1	5,629	
Jan-00	1/24/00	19,388	292	12	est. 210	1.9	5,631	System shut down, 1/24/00 to 12/00

- Note: 1. The "duration" is derived from subtracting the hour meter from a representative day of the month by the hour meter from a representative day of the previous month. Some months may have more than 30 days.
2. In January 2000, the "hydrocarbons removed" calculations were corrected to reflect the actual calibration gas (methane) of the instrument used. Therefore, the corrected cumulative total value is different than the previous versions of this table.

TABLE 3
Laboratory Analytical Results of Inlet Vapor Samples
Thrifty Oil Co. Station # 054, CASTRO VALLEY, CA

Date	Analyses Results of Inlet Vapor Concentrations					
	TPH (ppmv)	Benzene (ppmv)	Toluene (ppmv)	Ethylbenzene (ppmv)	Total Xylenes (ppmv)	MTBE (ppmv)
5/15/97	-	0.36*	-	-	-	-
7/17/97	-	<0.1*	-	-	-	-
5/5/99	<5	<0.1	0.13	<0.1	<0.1	<1
8/24/99	53	1.4	8.1	2.5	14	<1
8/30/99	<5	<0.1	0.23	0.12	0.77	1.6
9/14/99	2,200	11	36	11	55	9.9
10/25/99	<5	<0.1	0.11	<0.1	0.44	<1
12/21/99	190	5.7	0.64	0.15	1.8	39

NOTE: *Unit of measure = ug, by NIOSH 1501 (Benzene)
 "- " = not analyzed

APPENDIX A



PROJECT STATUS REPORT

SITE: THRIFFY OIL CO. # 054
 ADDR: 2504 CASTRO VALLEY BLVD.
 CASTRO VALLEY, CA. 94546

DATE: 12-13-00

PERSON: SERBATA P.

OBSERVATION WELLS

WELL ID	DTP (FT)	DTW (FT)	DTB (FT)	PT (FT)	DIA (IN)	PURGE (GAL)	ODORS			FP		COMMENT
							Y	N	S	Y	N	
MONTHLY/QUARTERLY												
PW-1		4.01	13.97		4"	26	X			X		
PW-2		3.60	14.32		4"	28	X			X		
RE-1		4.06	19.00		4"	39	X			X		
RE-2		3.58	16.96		4"	35	X			X		
RE-3		3.02	17.55		4"	38	X			X		
RE-4		5.71	14.52		4"	23	X			X		
RE-5		4.80	18.14		4"	35	X			X		
RE-6		4.77	13.58		4"	23	X			X		
RE-7		6.63	13.14		4"	17	X			X		
RE-8		8.28	25.15		2"	11	X			X		
RE-9		2.70	14.97		2"	8	X			X		
RE-10		5.94	24.38		2"	12	X			X		
RE-11		6.34	24.74		2"	12	X			X		

PRODUCT REMOVED: APPROX GALLONS

WATER REMOVED: APPROX 307. GALLONS

AS:

Q. W. S -

NOTATION:

DEPTH T... FROM TOP OF CASING, DTW- DEPTH TO WATER FROM TOP OF CASING

DEPTH T... FROM TOP OF CASING, DTB- EXPOSED THICKNESS, D- FLIGHT

FIELD DATA - GROUNDWATER SAMPLING PROGRAM

Site:	#1054	Date:	12-13-00
Address:			
Personnel:	SERBATA	Weather:	RAIN
Well No:	PW-1	Equip:	BAICER

Before Purging:			
Total Well Depth: (ft.)	13.97	Well Diameter	4"
Depth to Water (ft)	4.01	Est. Purge Volume:	26

Sampling Data:							
Initial Turbidity:				Final Turbidity:			
Time	13:37	13:41	13:45	13:48	13:52	13:56	14:00
EC	1170	1140	1150	1140	1130	1120	1110
pH	5.51	5.52	5.50	5.51	5.50	5.51	5.50
Temp	73.1	72.8	72.8	72.6	72.4	72.3	72.1
Gal.	3	7	11	14	18	22	26
Time							
EC							
pH							
Temp							
Gal.							

After Purging/Before Sample Collection	
Depth to Water (ft.)	6.21
Total Well Depth (ft.)	13.97

FIELD DATA -GROUNDWATER SAMPLING PROGRAM

Site: # 054	Date: 12-13-00
Address:	
Personnel: JERBON	Weather: Rain
Well No: PW-2	Equip: BAUER

Before Purging:			
Total Well Depth: (ft.)	14.32	Well Diameter	4"
Depth to Water (ft)	3.60	Est. Purge Volume:	28

Sampling Data:							
Initial Turbidity:				Final Turbidity:			
Time	14:06	14:10	14:14	14:18	14:22	14:26	14:30
EC	1860	1830	1840	1860	1830	1830	1840
pH	5.65	5.67	5.66	5.64	5.65	5.66	5.64
Temp	73.1	72.9	72.7	72.6	72.4	72.3	72.1
Gal.	4	8	12	16	20	24	28
Time							
EC							
pH							
Temp							
Gal.							

After Purging/Before Sample Collection	
Depth to Water (ft.)	5.62
Total Well Depth (ft.)	14.32

FIELD DATA -GROUNDWATER SAMPLING PROGRAM

Site:	#059	Date:	12-13-00
Address:			
Personnel:	JERBOY P.	Weather:	RAIN
Well No:	RF2-1	Equip:	BAILER

Before Purging:			
Total Well Depth: (ft.)	19.00	Well Diameter	4"
Depth to Water (ft)	4.06	Est. Purge Volume:	39

Sampling Data:							
Initial Turbidity:				Final Turbidity:			
Time	9:47	9:52	9:57	10:03	10:07	10:14	10:20
EC	1660	1670	1680	1650	1630	1620	1630
pH	5.51	5.50	5.51	5.50	5.52	5.52	5.52
Temp	73.4	73.3	73.2	73.2	72.9	72.7	72.7
Turb	5	11	16	22	26	33	39

After Purging/Before Sample Collection	
Depth to Water (ft.)	6.21
Total Well Depth(ft.)	19.00

FIELD DATA - GROUNDWATER SAMPLING PROGRAM

Site:	#059	Date:	12-13-00
Address:			
Personnel:	ZERBAH	Weather:	Rainy Day
Well No:	RE-2	Equip:	BAILER

Before Purging:			
Total Well Depth: (ft.)	16.96	Well Diameter	4"
Depth to Water (ft)	3.58	Est. Purge Volume:	35

Sampling Data:							
Initial Turbidity:				Final Turbidity:			
Time	11:10	11:15	11:20	11:25	11:30	11:35	11:40
EC	1870	1860	1870	1840	1830	1940	1830
pH	5.46	5.47	5.44	5.46	5.44	5.47	5.46
Temp	72.9	72.8	72.7	72.5	72.5	72.6	72.4
Gal.	5	10	15	20	25	30	35
Time							
EC							
pH							
Temp							
Gal.							

After Purging/Before Sample Collection	
Depth to Water (ft.)	6.24
Total Well Depth (ft.)	16.96

FIELD DATA -GROUNDWATER SAMPLING PROGRAM

Site:	#054	Date:	12-13-00
Address:			
Personnel:	JERBAU,	Weather:	RAIN
Well No:	RE-3	Equip:	BAILER

Before Purging:			
Total Well Depth: (ft.)	17.55	Well Diameter	4"
Depth to Water (ft)	3.02	Est. Purge Volume:	38

Sampling Data:							
Initial Turbidity:				Final Turbidity:			
Time							13:30
EC							
pH							
Temp							
Gal.							38
Time							
EC							
pH							
Temp							
Gal.							

After Purging/Before Sample Collection			
Depth to Water (ft.)	6.13	Total Well Depth(ft.)	17.55

FIELD DATA -GROUNDWATER SAMPLING PROGRAM

Site:	# 054	Date:	12-13-00
Address:			
Personnel:	JERBATA P.	Weather:	RAIN
Well No:	RE-4	Equip:	BAYER

Before Purging:

Total Well Depth: (ft.)	14.52	Well Diameter	4"
Depth to Water (ft)	5.71	Est. Purge Volume:	23

Sampling Data:

Initial Turbidity:

Final Turbidity:

Time	12:20	12:23	12:26	12:30	12:33	12:36	12:40
EC	1400	1380	1390	1400	1420	1410	1420
pH	5.63	5.65	5.63	5.65	5.63	5.65	5.63
Temp	73.1	72.9	72.8	72.7	72.7	72.5	72.3
Gal.	3	6	9	13	16	19	23

Time							
EC							
pH							
Temp							
Gal.							

After Purging/Before Sample Collection

Depth to Water (ft.)	7.34	Total Well Depth(ft.)	14.52
----------------------	------	-----------------------	-------

FIELD DATA -GROUNDWATER SAMPLING PROGRAM

Site:	#054	Date:	12-13-00
Address:			
Personnel:	SERBAN,	Weather:	RAINY DAY
Well No:	RE-5	Equip:	BAUER

Before Purging:			
Total Well Depth: (ft.)	18.19	Well Diameter	44
Depth to Water (ft)	4.80	Est. Purge Volume:	35

Sampling Data:							
Initial Turbidity:				Final Turbidity:			
Time	10:30	10:35	10:40	10:45	10:50	10:55	11:00
EC	1360	1350	1380	1360	1340	1360	1340
pH	5.47	5.48	5.48	5.49	5.50	5.48	5.50
Temp	72.7	72.5	72.3	72.4	72.4	72.2	72.1
Gal.	5	10	15	20	25	30	35
Time							
EC							
pH							
Temp							
Gal.							

After Purging/Before Sample Collection			
Depth to Water (ft.)	6.15	Total Well Depth(ft.)	18.19

FIELD DATA - GROUNDWATER SAMPLING PROGRAM

Site:	# 054	Date:	12-13-00
Address:			
Personnel:	JERBAK	Weather:	RAIN
Well No:	RE-C	Equip:	BAUER

Before Purging:			
Total Well Depth: (ft.)	13.58	Well Diameter	4"
Depth to Water (ft)	4.77	Est. Purge Volume:	23

Sampling Data:							
Initial Turbidity:				Final Turbidity:			
Time	11:50	11:53	11:56	12:00	12:03	12:06	12:10
EC	1110	1020	1010	1010	1040	1030	1020
pH	5.80	5.81	5.80	5.82	5.82	5.80	5.82
Temp	73.4	73.2	73.1	72.9	72.8	72.7	72.6
Gal.	3	6	9	13	16	19	23
Time							
EC							
pH							
Temp							
Gal.							

After Purging/Before Sample Collection	
Depth to Water (ft.)	5.44
Total Well Depth (ft.)	13.58

FIELD DATA - GROUNDWATER SAMPLING PROGRAM

Site:	# 054	Date:	12-13-00
Address:			
Personnel:	SERBAN,	Weather:	RAIN
Well No:	RE-7	Equip:	BAUER

Before Purging:			
Total Well Depth: (ft.)	13.14	Well Diameter	4"
Depth to Water (ft)	6.63	Est. Purge Volume:	17

Sampling Data:							
Initial Turbidity:				Final Turbidity:			
Time	14:35	14:37	14:40	14:42	14:45	14:47	14:50
EC	1480	1420	1480	1420	1420	1480	1420
pH	5.52	5.51	5.50	5.51	5.50	5.51	5.51
Temp	73.3	73.1	73.2	72.9	72.8	72.8	72.6
Gal.	2	4	7	9	12	14	17
Time							
EC							
pH							
Temp							
Gal.							

After Purging/Before Sample Collection			
Depth to Water (ft.)	9.26	Total Well Depth(ft.)	13.14

FIELD DATA -GROUNDWATER SAMPLING PROGRAM

Site: <u> # 054 </u>	Date: <u> 12-13-00 </u>
Address: _____	
Personnel: <u> SERBAN, </u>	Weather: <u> RAIN, </u>
Well No: <u> R3-8 </u>	Equip: <u> BAUER </u>

Before Purging:			
Total Well Depth: (ft.)	<u> 25.15 </u>	Well Diameter	<u> 2" </u>
Depth to Water (ft)	<u> 8.28 </u>	Est. Purge Volume:	<u> 11 </u>

Sampling Data:							
Initial Turbidity:							Final Turbidity:
Time	15:01	15:03	15:04	15:06	15:07	15:08	15:10
EC	1890	1860	1850	1830	1840	1860	1840
pH	5.55	5.53	5.52	5.51	5.50	5.51	5.50
Temp	73.2	71.9	71.7	71.6	71.4	71.2	71.1
Gal.	1	3	4	6	7	9	11
Time							
EC							
pH							
Temp							
Gal.							

After Purging/Before Sample Collection	
Depth to Water (ft.)	<u> 12.20 </u>
Total Well Depth(ft).	<u> 25.15 </u>

FIELD DATA -GROUNDWATER SAMPLING PROGRAM

Site:	# 054	Date:	12-13-00
Address:			
Personnel:	ZERBON	Weather:	RAINY DAY
Well No:	RS-9	Equip:	BAILER

Before Purging:			
Total Well Depth: (ft.)	14.95	Well Diameter	2 ⁴
Depth to Water (ft)	2.70	Est. Purge Volume:	8

Sampling Data:							
Initial Turbidity:				Final Turbidity:			
Time	9:23	9:24	9:25	9:26	9:27	9:28	9:30
EC	1450	1480	1440	1470	1460	1430	1450
pH	5.52	5.52	5.49	5.47	5.49	5.20	6.00
Temp	73.6	73.4	73.4	73.2	73.1	72.9	72.8
Gal.	1	2	3	4	5	6	8
Time							
EC							
pH							
Temp							
Gal.							

After Purging/Before Sample Collection			
Depth to Water (ft.)	3.60	Total Well Depth(ft.)	14.95

FIELD DATA - GROUNDWATER SAMPLING PROGRAM

Site:	#054	Date:	12-13-00
Address:			
Personnel:	SERBAN,	Weather:	RAIN,
Well No:	RS-10	Equip:	BAUER

Before Purging:			
Total Well Depth: (ft.)	24.38	Well Diameter	2'
Depth to Water (ft)	5.94	Est. Purge Volume:	12

Sampling Data:							
Initial Turbidity:				Final Turbidity:			
Time	15:29	15:31	15:33	15:34	15:36	15:38	15:40
EC	1750	1760	1780	1790	1760	1760	1760
pH	5.43	5.45	5.47	5.48	5.47	5.49	5.49
Temp	73.2	72.9	72.8	72.7	72.6	72.4	72.2
Gal.	1	3	5	6	8	10	12
Time							
EC							
pH							
Temp							
Gal.							

After Purging/Before Sample Collection	
Depth to Water (ft.)	9.14
Total Well Depth (ft.)	24.38

FIELD DATA -GROUNDWATER SAMPLING PROGRAM

Site:	# 054	Date:	12-13-00
Address:			
Personnel:	SERBON	Weather:	RAIN
Well No:	RS-11	Equip:	BAILER

Before Purging:			
Total Well Depth: (ft.)	24.74	Well Diameter	2"
Depth to Water (ft)	6.34	Est. Purge Volume:	12

Sampling Data:							
Initial Turbidity:				Final Turbidity:			
Time	15:14	15:16	15:18	15:19	15:21	15:23	15:26
EC	1150	1140	1120	1120	1120	1140	1120
pH	5.42	5.43	5.40	5.42	5.42	5.40	5.38
Temp	73.1	72.8	72.6	72.6	72.4	72.1	72.1
Gal.	1	3	5	6	8	10	12
Time							
EC							
pH							
Temp							
Gal.							

After Purging/Before Sample Collection	
Depth to Water (ft.)	9.35
Total Well Depth(ft.)	24.74

APPENDIX B



ASSOCIATED LABORATORIES

806 North Batavia - Orange, California 92868 - 714/771-6900

FAX 714/538-1209

CLIENT Thrifty Oil (8871)
ATTN: Jeff Suryakusuma
13539 E. Foster Rd.
Santa Fe Springs, CA 90670

LAB REQUEST 64333

REPORTED 12/28/2000
RECEIVED 12/19/2000

PROJECT Station #054
2504 Castro Valley Blvd., Castro Valley

SUBMITTER Client

COMMENTS Added 8260 MTBE to 233431, 437, and 440 per DR 12-26-00
AV

This laboratory request covers the following listed samples which were analyzed for the parameters indicated on the attached Analytical Result Report. All analyses were conducted using the appropriate methods as indicated on the report. This cover letter is an integral part of the final report.

<u>Order No.</u>	<u>Client Sample Identification</u>
233431	TOC #054, RS9
233432	TOC #054, RE-1
233433	TOC #054, RE5
233434	TOC #054, RE2
233435	TOC #054, RE6
233436	TOC #054, RE4
233437	TOC #054, RE3
233438	TOC #054, PW1
233439	TOC #054, PW2
233440	TOC #054, RE7
233441	TOC #054, RS8

Thank you for the opportunity to be of service to your company. Please feel free to call if there are any questions regarding this report or if we can be of further service.

ASSOCIATED LABORATORIES by,

Edward S. Behare, Ph.D.
Vice President

NOTE: Unless notified in writing, all samples will be discarded by appropriate disposal protocol 30 days from date reported.

The reports of the Associated Laboratories are confidential property of our clients and may not be reproduced or used for publication in part or in full without our written permission. This is for the mutual protection of the public, our clients, and ourselves.

TESTING & CONSULTING
Chemical
Microbiological
Environmental

CLIENT Thrifty Oil
ATTN: Jeff Suryakusuma
13539 E. Foster Rd.
Santa Fe Springs, CA 90670

(8871)

LAB REQUEST 64333

REPORTED 12/28/2000

RECEIVED 12/19/2000

PROJECT Station #054
2504 Castro Valley Blvd., Castro Valley

SUBMITTER Client

COMMENTS Added 8260 MTBE to 233431, 437, and 440 per DR 12-26-00
AV

This laboratory request covers the following listed samples which were analyzed for the parameters indicated on the attached Analytical Result Report. All analyses were conducted using the appropriate methods as indicated on the report. This cover letter is an integral part of the final report.

Order No.

233442

233443

233444

Client Sample Identification

TOC #054, RS11

TOC #054, RS10

TOC #054, Trip Blank

Thank you for the opportunity to be of service to your company. Please feel free to call if there are any questions regarding this report or if we can be of further service.

ASSOCIATED LABORATORIES by

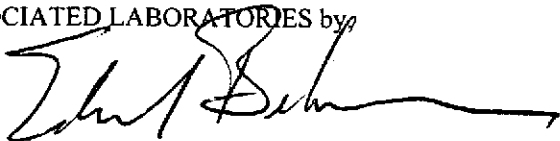

Edward S. Behare, Ph.D.
Vice President

NOTE: Unless notified in writing, all samples will be discarded by appropriate disposal protocol 30 days from date reported.

The reports of the Associated Laboratories are confidential property of our clients and may not be reproduced or used for publication in part or in full without our written permission. This is for the mutual protection of the public, our clients, and ourselves.

TESTING & CONSULTING
Chemical
Microbiological
Environmental

Order #: 233431**Matrix:** WATER**Client Sample ID:** TOC #054, RS9**Date Sampled:** 12/13/2000 **Time Sampled:** 18:00

Analyte	Result	DF	PQL	MDL	Units	Date/Analyst
---------	--------	----	-----	-----	-------	--------------

8021B BTEX + MTBE

Benzene	ND	1	0.3	0.18	ug/L	12/21/00 HP
Ethyl benzene	ND	1	0.3	0.18	ug/L	12/21/00 HP
Methyl t - butyl ether	403	14	70.0	0.24	ug/L	12/21/00 HP
Toluene	ND	1	0.3	0.14	ug/L	12/21/00 HP
Xylene (total)	ND	1	0.6	0.26	ug/L	12/21/00 HP

8260B BTEX/MTBE Only

Methyl-tert-butylether (MTBE)	444	10	10.0	0.6	ug/L	12/26/00 MB
-------------------------------	-----	----	------	-----	------	-------------

8015M - Total Petroleum Hydrocarbons

Gasoline	ND	1	50	50	ug/L	12/21/00 HP
----------	----	---	----	----	------	-------------

Order #: 233432**Matrix:** WATER**Client Sample ID:** TOC #054, RE-1**Date Sampled:** 12/13/2000 **Time Sampled:** 18:10

Analyte	Result	DF	PQL	MDL	Units	Date/Analyst
---------	--------	----	-----	-----	-------	--------------

8021B BTEX + MTBE

Benzene	ND	1	0.3	0.18	ug/L	12/21/00 HP
Ethyl benzene	ND	1	0.3	0.18	ug/L	12/21/00 HP
Methyl t - butyl ether	ND	1	5	0.24	ug/L	12/21/00 HP
Toluene	ND	1	0.3	0.14	ug/L	12/21/00 HP
Xylene (total)	ND	1	0.6	0.26	ug/L	12/21/00 HP

8015M - Total Petroleum Hydrocarbons

Gasoline	ND	1	50	50	ug/L	12/21/00 HP
----------	----	---	----	----	------	-------------

Order #: 233433**Matrix:** WATER**Client Sample ID:** TOC #054, RE5**Date Sampled:** 12/13/2000 **Time Sampled:** 18:15

Analyte	Result	DF	PQL	MDL	Units	Date/Analyst
---------	--------	----	-----	-----	-------	--------------

8021B BTEX + MTBE

Benzene	ND	1	0.3	0.18	ug/L	12/21/00 HP
Ethyl benzene	ND	1	0.3	0.18	ug/L	12/21/00 HP
Methyl t - butyl ether	ND	1	5	0.24	ug/L	12/21/00 HP
Toluene	ND	1	0.3	0.14	ug/L	12/21/00 HP
Xylene (total)	ND	1	0.6	0.26	ug/L	12/21/00 HP

PQL = Practical Quantitation Limit, MDL = Method detection limit, DF = Dilution Factor

ND = Not detected below indicated MDL, J=Trace



8015M - Total Petroleum Hydrocarbons

Gasoline	ND	1	50	50	ug/L	12/21/00	HP
----------	----	---	----	----	------	----------	----

Order #: 233434

Client Sample ID TOC #054, RE2

Matrix: WATER

Date Sampled: 12/13/2000 Time Sampled: 18:20

Analyte	Result	DF	PQL	MDL	Units	Date/Analyst
---------	--------	----	-----	-----	-------	--------------

8021B BTEX + MTBE

Benzene	ND	1	0.3	0.18	ug/L	12/21/00	HP
Ethyl benzene	ND	1	0.3	0.18	ug/L	12/21/00	HP
Methyl t - butyl ether	ND	1	5	0.24	ug/L	12/21/00	HP
Toluene	ND	1	0.3	0.14	ug/L	12/21/00	HP
Xylene (total)	ND	1	0.6	0.26	ug/L	12/21/00	HP

8015M - Total Petroleum Hydrocarbons

Gasoline	ND	1	50	50	ug/L	12/21/00	HP
----------	----	---	----	----	------	----------	----

Order #: 233435

Client Sample ID TOC #054, RE6

Matrix: WATER

Date Sampled: 12/13/2000 Time Sampled: 18:25

Analyte	Result	DF	PQL	MDL	Units	Date/Analyst
---------	--------	----	-----	-----	-------	--------------

8021B BTEX + MTBE

Benzene	ND	1	0.3	0.18	ug/L	12/21/00	HP
Ethyl benzene	ND	1	0.3	0.18	ug/L	12/21/00	HP
Methyl t - butyl ether	ND	1	5	0.24	ug/L	12/21/00	HP
Toluene	ND	1	0.3	0.14	ug/L	12/21/00	HP
Xylene (total)	ND	1	0.6	0.26	ug/L	12/21/00	HP

8015M - Total Petroleum Hydrocarbons

Gasoline	ND	1	50	50	ug/L	12/21/00	HP
----------	----	---	----	----	------	----------	----

Order #: 233436

Client Sample ID TOC #054, RE4

Matrix: WATER

Date Sampled: 12/13/2000 Time Sampled: 18:30

Analyte	Result	DF	PQL	MDL	Units	Date/Analyst
---------	--------	----	-----	-----	-------	--------------

PQL = Practical Quantitation Limit, MDL = Method detection limit, DF = Dilution Factor
 ND = Not detected below indicated MDL, J=Trace



8021B BTEX + MTBE

Benzene	ND	1	0.3	0.18	ug/L	12/21/00	HP
Ethyl benzene	ND	1	0.3	0.18	ug/L	12/21/00	HP
Methyl t - butyl ether	ND	1	5	0.24	ug/L	12/21/00	HP
Toluene	ND	1	0.3	0.14	ug/L	12/21/00	HP
Xylene (total)	ND	1	0.6	0.26	ug/L	12/21/00	HP

8015M - Total Petroleum Hydrocarbons

Gasoline	ND	1	50	50	ug/L	12/21/00	HP
----------	----	---	----	----	------	----------	----

Order #: 233437

Client Sample ID TOC #054, RE3

Matrix: WATER

Date Sampled: 12/13/2000 Time Sampled: 18:40

Analyte	Result	DF	PQL	MDL	Units	Date/Analyst
---------	--------	----	-----	-----	-------	--------------

8021B BTEX + MTBE

Benzene	ND	1	0.3	0.18	ug/L	12/21/00	HP
Ethyl benzene	ND	1	0.3	0.18	ug/L	12/21/00	HP
Methyl t - butyl ether	124	5	25.0	0.24	ug/L	12/21/00	HP
Toluene	ND	1	0.3	0.14	ug/L	12/21/00	HP
Xylene (total)	ND	1	0.6	0.26	ug/L	12/21/00	HP

8260B BTEX/MTBE Only

Methyl-tert-butylether (MTBE)	111	1	1	0.6	ug/L	12/26/00	MB
-------------------------------	-----	---	---	-----	------	----------	----

8015M - Total Petroleum Hydrocarbons

Gasoline	ND	1	50	50	ug/L	12/21/00	HP
----------	----	---	----	----	------	----------	----

Order #: 233438

Client Sample ID TOC #054, PW1

Matrix: WATER

Date Sampled: 12/13/2000 Time Sampled: 18:45

Analyte	Result	DF	PQL	MDL	Units	Date/Analyst
---------	--------	----	-----	-----	-------	--------------

8021B BTEX + MTBE

Benzene	ND	1	0.3	0.18	ug/L	12/21/00	HP
Ethyl benzene	ND	1	0.3	0.18	ug/L	12/21/00	HP
Methyl t - butyl ether	ND	1	5	0.24	ug/L	12/21/00	HP
Toluene	ND	1	0.3	0.14	ug/L	12/21/00	HP
Xylene (total)	ND	1	0.6	0.26	ug/L	12/21/00	HP

8015M - Total Petroleum Hydrocarbons

Gasoline	ND	1	50	50	ug/L	12/21/00	HP
----------	----	---	----	----	------	----------	----

PQL = Practical Quantitation Limit, MDL = Method detection limit, DF = Dilution Factor

ND = Not detected below indicated MDL, J=Trace



Order #: 233439
Matrix: WATER

Client Sample ID TOC #054, PW2
Date Sampled: 12/13/2000 Time Sampled: 18:50

Analyte	Result	DF	PQL	MDL	Units	Date/Analyst
8021B BTEX + MTBE						
Benzene	ND	1	0.3	0.18	ug/L	12/21/00 HP
Ethyl benzene	ND	1	0.3	0.18	ug/L	12/21/00 HP
Methyl t - butyl ether	ND	1	5	0.24	ug/L	12/21/00 HP
Toluene	ND	1	0.3	0.14	ug/L	12/21/00 HP
Xylene (total)	ND	1	0.6	0.26	ug/L	12/21/00 HP

8015M - Total Petroleum Hydrocarbons

Gasoline	ND	1	50	50	ug/L	12/21/00 HP
----------	----	---	----	----	------	-------------

Order #: 233440
Matrix: WATER

Client Sample ID TOC #054, RE7
Date Sampled: 12/13/2000 Time Sampled: 18:55

Analyte	Result	DF	PQL	MDL	Units	Date/Analyst
8021B BTEX + MTBE						
Benzene	ND	1	0.3	0.18	ug/L	12/21/00 HP
Ethyl benzene	ND	1	0.3	0.18	ug/L	12/21/00 HP
Methyl t - butyl ether	13	1	5	0.24	ug/L	12/21/00 HP
Toluene	ND	1	0.3	0.14	ug/L	12/21/00 HP
Xylene (total)	ND	1	0.6	0.26	ug/L	12/21/00 HP

8260B BTEX/MTBE Only

Methyl-tert-butylether (MTBE)	19.8	1	1	0.6	ug/L	12/26/00 MB
-------------------------------	------	---	---	-----	------	-------------

8015M - Total Petroleum Hydrocarbons

Gasoline	ND	1	50	50	ug/L	12/21/00 HP
----------	----	---	----	----	------	-------------

Order #: 233441
Matrix: WATER

Client Sample ID TOC #054, RS8
Date Sampled: 12/13/2000 Time Sampled: 19:00

Analyte	Result	DF	PQL	MDL	Units	Date/Analyst
8021B BTEX + MTBE						
Benzene	ND	1	0.3	0.18	ug/L	12/21/00 HP
Ethyl benzene	ND	1	0.3	0.18	ug/L	12/21/00 HP
Methyl t - butyl ether	ND	1	5	0.24	ug/L	12/21/00 HP
Toluene	ND	1	0.3	0.14	ug/L	12/21/00 HP
Xylene (total)	ND	1	0.6	0.26	ug/L	12/21/00 HP

PQL = Practical Quantitation Limit, MDL = Method detection limit, DF = Dilution Factor
ND = Not detected below indicated MDL, J=Trace



8015M - Total Petroleum Hydrocarbons

Gasoline	ND	1	50	50	ug/L	12/21/00	HP
----------	----	---	----	----	------	----------	----

Order #: 233442**Client Sample ID** TOC #054, RS11

Matrix: WATER

Date Sampled: 12/13/2000 **Time Sampled:** 19:10

Analyte	Result	DF	PQL	MDL	Units	Date/Analyst
---------	--------	----	-----	-----	-------	--------------

8021B BTEX + MTBE

Benzene	ND	1	0.3	0.18	ug/L	12/21/00	HP
Ethyl benzene	ND	1	0.3	0.18	ug/L	12/21/00	HP
Methyl t - butyl ether	ND	1	5	0.24	ug/L	12/21/00	HP
Toluene	ND	1	0.3	0.14	ug/L	12/21/00	HP
Xylene (total)	ND	1	0.6	0.26	ug/L	12/21/00	HP

8015M - Total Petroleum Hydrocarbons

Gasoline	ND	1	50	50	ug/L	12/21/00	HP
----------	----	---	----	----	------	----------	----

Order #: 233443**Client Sample ID** TOC #054, RS10

Matrix: WATER

Date Sampled: 12/13/2000 **Time Sampled:** 19:20

Analyte	Result	DF	PQL	MDL	Units	Date/Analyst
---------	--------	----	-----	-----	-------	--------------

8021B BTEX + MTBE

Benzene	ND	1	0.3	0.18	ug/L	12/21/00	HP
Ethyl benzene	ND	1	0.3	0.18	ug/L	12/21/00	HP
Methyl t - butyl ether	ND	1	5	0.24	ug/L	12/21/00	HP
Toluene	ND	1	0.3	0.14	ug/L	12/21/00	HP
Xylene (total)	ND	1	0.6	0.26	ug/L	12/21/00	HP

8015M - Total Petroleum Hydrocarbons

Gasoline	ND	1	50	50	ug/L	12/21/00	HP
----------	----	---	----	----	------	----------	----

Order #: 233444**Client Sample ID** TOC #054, Trip Blank

Matrix: WATER

Date Sampled: 12/13/2000 **Time Sampled:** 18:00

Analyte	Result	DF	PQL	MDL	Units	Date/Analyst
---------	--------	----	-----	-----	-------	--------------

PQL = Practical Quantitation Limit, MDL = Method detection limit, DF = Dilution Factor
 ND = Not detected below indicated MDL, J=Trace



8021B BTEX + MTBE

Benzene	ND	1	0.3	0.18	ug/L	12/21/00	HP
Ethyl benzene	ND	1	0.3	0.18	ug/L	12/21/00	HP
Methyl t - butyl ether	ND	1	5	0.24	ug/L	12/21/00	HP
Toluene	ND	1	0.3	0.14	ug/L	12/21/00	HP
Xylene (total)	ND	1	0.6	0.26	ug/L	12/21/00	HP

8015M - Total Petroleum Hydrocarbons

Gasoline	ND	1	50	50	ug/L	12/21/00	HP
----------	----	---	----	----	------	----------	----

PQL = Practical Quantitation Limit, MDL = Method detection limit, DF = Dilution Factor

ND = Not detected below indicated MDL, J=Trace



ASSOCIATED LABORATORIES LAB REQUEST RESULTS SUMMARY

Client: Thrifty Oil
 Jeff Suryakusuma
 13539 E. Foster Rd.
 Santa Fe Springs, CA 90670

Lab Request: 64333
 Date Received: 12/19/2000
 Print Date: 12/28/2000

Project: Station #054
 2504 Castro Valley Blvd., Castro Valley

Objectives: Confirm MTBE by 8260.

Sample ID.	Gasoline	Benzene	Toluene	Ethyl benzene	Xylene (total)	MTBE	MTBE by EPA8260
TOC #054, PW1	ND	ND	ND	ND	ND	ND	
TOC #054, PW2	ND	ND	ND	ND	ND	ND	
TOC #054, RE-1	ND	ND	ND	ND	ND	ND	
TOC #054, RE2	ND	ND	ND	ND	ND	ND	
TOC #054, RE3	ND	ND	ND	ND	ND	124 ug/L	111 ug/L
TOC #054, RE4	ND	ND	ND	ND	ND	ND	
TOC #054, RE5	ND	ND	ND	ND	ND	ND	
TOC #054, RE6	ND	ND	ND	ND	ND	ND	
TOC #054, RE7	ND	ND	ND	ND	ND	13 ug/L	19.8 ug/L
TOC #054, RS10	ND	ND	ND	ND	ND	ND	
TOC #054, RS11	ND	ND	ND	ND	ND	ND	
TOC #054, RS8	ND	ND	ND	ND	ND	ND	
TOC #054, RS9	ND	ND	ND	ND	ND	403 ug/L	444 ug/L
TOC #054, Trip Blank	ND	ND	ND	ND	ND	ND	

ND = Not Detected
 Blank Field = Component not analyzed by this method.

ASSOCIATED LABORATORIES
QA REPORT FORM

QC Sample: LR 64333 - 439

Matrix: WATER

Prep. Date: 12/20/00

Analysis Date: 12/20/00 - 12/21/00

LAB ID#'s in Batch: LR 64333, 64334

MATRIX SPIKE / MATRIX SPIKE DUPLICATE RESULT

REPORTING UNITS = ug/L

Test	Method	Sample Result	Spike Added	Matrix Spike	Matrix Spk. Dup	%Rec MS	%Rec MSD	RPD
Benzene	8021	ND	8.0	6.9	6.8	86	85	1
Toluene	8021	ND	8.0	6.9	6.9	86	86	0
Ethylbenzene	8021	ND	8.0	7.1	7.1	89	89	0
Xylenes	8021	ND	24.0	22.1	22.3	92	93	1

* = Matrix Interference. LCS OK. Data Reported.

ND = Not Detected

RPD = Relative Percent Difference of Matrix Spike and Matrix Spike Dup

%REC-MS & MSD = Percent Recovery of Matrix Spike & Matrix Spike Duplicate

%REC LIMITS = 70 - 130

RPD LIMITS = 30

PREPARATION BLANK / LAB CONTROL SAMPLE RESULTS

Test	Method	PREP. BLK	LCS				
		Value	Result	True	%Rec	L.Limit	H.Limit
Benzene	8021	ND	7.6	8.0	95	80%	120%
Toluene	8021	ND	7.7	8.0	96	80%	120%
Ethylbenzene	8021	ND	7.8	8.0	98	80%	120%
Xylenes	8021	ND	24.9	24.0	104	80%	120%

LCS = Lab Control Sample Result

TRUE = True Value of LCS

L.LIMIT / H.LIMIT = LCS Control Limits

ASSOCIATED LABORATORIES
QA REPORT FORM

QC Sample: LR 64333 - 439

Matrix: WATER

Prep. Date: 12/20/00

Analysis Date: 12/20/00 - 12/21/00

ID#'s in Batch: LR 64333, 64334

MATRIX SPIKE / MATRIX SPIKE DUPLICATE RESULT

Reporting Units = ug/L

Test	Method	Sample Result	Spike Added	Matrix Spike	Matrix Spike Dup	%Rec MS	%Rec MSD	RPD
TPH	8015M-G	ND	500	454	455	90.8	91.0	0.2

ND = Not Detected

RPD = Relative Percent Difference of Matrix Spike and Matrix Spike Duplicate

%REC-MS & MSD = Percent Recovery of Matrix Spike & Matrix Spike Duplicate

<i>%REC LIMITS = 70 - 130</i>

<i>RPD LIMITS = 30</i>

PREPARATION BLANK / LAB CONTROL SAMPLE RESULTS

PREP BLK	LCS				
Value	Result	True	%Rec	L.Limit	H.Limit
ND	305	300	101.7	80%	120%

LCS Result = Lab Control Sample Result

True = True Value of LCS

L.Limit / H.Limit = LCS Control Limits

ASSOCIATED LABORATORIES
LCS REPORT FORM

QC Sample: LCS/LCSD Water Samples

Method : 8260

Analysis Date: 12/26/00

Applies to: LR 64334, 64333

REPORTING UNITS = ug/L

Test	Sample Result	Spike Added	LCS Spike	LCS Spk. Dup	%Rec LCS	%Rec LCS D	RPD	QC Limits	
								RPD	%REC
1,1-Dichloroethene	ND	50.0	74.73	78.89	149	158	5	22	59-172
MTBE	ND	50.0	61.67	51.62	123	103	18	24	62-137
Benzene	ND	50.0	68.05	73.28	136	147#	7	24	62-137
Trichloroethene	ND	50.0	54.66	63.62	109	127	15	21	66-142
Toluene	ND	50.0	67.45	69.15	135	138	2	21	59-139
Chlorobenzene	ND	50.0	57.84	66.74	116	133	14	21	60-133

= Outside QC limits.

ND = Not Detected

RPD = Relative Percent Difference of LCS and LCS Dup.

%REC-MS & MSD = Percent Recovery of LCS & LCS Dup.

Method Blank = All ND

Chain of Custody Record

64333

ASSOCIATED LABORATORIES

806 North Batavia • Orange, CA 92868

Phone: (714) 771-6900 • Fax: (714) 538-1209



Company T. O. C.	Phone (562) 921-3581	A.L. Job No.	Page _____ of _____
Project Manager JEFF JURYAKUSUMA	Fax	Analysis Requested	
Project Name Q. W. S.	Project # #054		
Site Name and Address 2504 CASTRO VALLEY Blvd - CASTRO VALLEY, 94546		Test Instructions & Comments	

Sample ID	Lab ID	Date	Time	Matrix	Container Number/Size	Pres.	T	B	M
							H	E	B
✓ 1 R59		12-13-00	18:00	WATER	3VIALS	HCL	X	X	X
✓ 2 RE-1		↑	18:10	↑	↑	↑	X	X	X
✓ 3 RE5		↑	18:15	↑	↑	↑	X	X	X
✓ 4 RE2		↑	18:20	↑	↑	↑	X	X	X
✓ 5 RE6		↑	18:25	↑	↑	↑	X	X	X
✓ 6 RE4		↑	18:30	↑	↑	↑	X	X	X
✓ 7 RE3		↑	18:40	↑	↑	↑	X	X	X
✓ 8 PW1		↑	18:45	↑	↑	↑	X	X	X
✓ 9 PW2		↑	18:50	↑	↑	↑	X	X	X
✓ 10 RE7		↑	18:55	↑	↑	↑	X	X	X
✓ 11 R58		↑	19:00	↑	↑	↑	X	X	X
✓ 12 RS11		↑	19:10	↑	↓	↓	X	X	X
✓ 13 RS10		↑	19:20	↓	↓	↓	X	X	X
✓ 14 TRIP BLANK		↑	18:00	↓	2VIALS	↓	X	X	
15									

* CONFIRM BY 8260 IF DETECTABLE

Sample Receipt - To Be Filled By Laboratory				Relinquished by 1.		Relinquished by 2.		Relinquished by 3.	
Total Number of Containers	41	Properly Cooled Y/N/NA	Y	Signature:	<i>[Signature]</i>	Signature:		Signature:	
Custody Seals Y/N/NA	✓	Samples Intact Y/N/NA	Y	Printed Name:	SERBIA P.	Printed Name:		Printed Name:	
Received in Good Condition Y/N	✓	Samples Accepted Y/N	X	Date:		Date:		Date:	
Turn Around Time				Received By: 1.		Received By: 2.		Received By: 3.	
<input checked="" type="checkbox"/> Normal <input type="checkbox"/> Rush <input type="checkbox"/> Same Day <input type="checkbox"/> 48 hrs. <input type="checkbox"/> 24 hrs. <input type="checkbox"/> 72 hrs.				Signature:	<i>[Signature]</i>	Signature:		Signature:	
				Printed Name:	Greg S. 4th	Printed Name:		Printed Name:	
				Date:	12/19/00	Date:		Date:	
				Time:	0900	Time:		Time:	