

# THRIFTY OIL CO.

July 27, 2000

O.05375

Mr. Scott O. Seery, CHMM  
Alameda County Health Agency  
Hazardous Material Specialist  
1131 Harbor Bay Parkway, Suite 250  
Alameda, CA 94502

1252

ENVIRONMENTAL  
PROTECTION  
00 JUL 33 PM 3:54

RE: **Thrifty Oil Co. #054**  
2504 Castro Valley Boulevard  
Castro Valley, CA 94541  
*2nd Quarter 2000, Status Report*

Dear Mr. Seery:

Presented herewith is the Second Quarter 2000, Status Report for Thrifty Oil Co. Station #054 located at 2504 Castro Valley Boulevard, Castro Valley, California.

**Due to continued low to non-detectable hydrocarbons constituents concentrations in groundwater, Thrifty respectfully requests that the Alameda County Health Care Agency (ACHCA) grant environmental closure for this site.**

If you have any questions or comments, regarding this report please contact Raymond C. Friedrichsen or me at (562) 921-3581.

Sincerely,



Chris Panaitescu  
General Manager  
Environmental Affairs

c: File



# THRIFTY OIL CO.

July 27, 2000

Mr. Scott O. Seery, CHMM  
Alameda County Health Agency  
Hazardous Material Specialist  
1131 Harbor Bay Parkway, Suite 250  
Alameda, CA 94502

RE: **Thrifty Oil Co. Station #054**  
2504 Castro Valley Boulevard  
Castro Valley, CA  
*2nd Quarter 2000, Status Report*

Dear Mr. Seery:

Presented herein is the Second Quarter 2000, Status Report prepared for Thrifty Oil Co. (Thrifty) Station #054 located at 2504 Castro Valley Boulevard, Castro Valley, California (**Figure 1**). Presented in this report are the results of the quarterly groundwater monitoring program conducted on June 8, 2000, and the status of the groundwater and vapor extraction operations. Thrifty has retained the services of Earth Management Company (EMC) to conduct quarterly monitoring and sampling activities at this site.

## **Groundwater Monitoring**

Depth to groundwater is measured in each monitoring well on a quarterly basis. Historic gauging groundwater data obtained from April 11, 1988 through June 8, 2000 is presented in **Table 1**. In general, groundwater occurs under water table conditions beneath the station at depths ranging from 2.72 feet below ground surface (bgs) in monitoring well RS-9 to 8.30 feet bgs in monitoring well RS-8 (**Appendix A**). Groundwater elevation contour map based on the June 8, 2000 data is presented in **Figure 1**. The general direction of groundwater flow beneath the site is toward the south and east with a hydraulic gradient ranging from 0.07 to 0.13 feet/foot.

## **Quarterly Groundwater Sampling**

As part of the on-going groundwater monitoring program, groundwater samples were obtained from



monitoring wells PW-1, PW-2, RE-1 through RE-7, and RS-8 through RS-11 on June 8, 2000. Groundwater samples were obtained by EMC and delivered in a chilled state in an ice chest following strict Chain-of-Custody procedures to a state-certified laboratory. Total petroleum hydrocarbons (TPH-g) were analyzed by EPA method 8015 modified for gasoline, and benzene, toluene, ethylbenzene, xylenes (BTEX) and oxygenates including methyl tert-butyl ether (MTBE) were analyzed by EPA method 8260B. Copies of the EMC Field Status Reports are presented in **Appendix A**, and copies of the laboratory analytical reports are contained in **Appendix B**.

TPH-g, BTEX, and MTBE concentrations appear in **Table 1** and **Appendix B**. TPH-g, benzene, and MTBE isoconcentration maps are presented in **Figure 2, 3, and 4**, respectively. The highest concentrations of TPH-g (585 ug/L) and MTBE (821 ug/L) were found in monitoring well RS-9. Benzene concentration were not detected above laboratory limits in any of the monitoring wells. All other oxygenates were non-detect except for isopropyl ether (DIPE) in monitoring well RE-7 (365 ug/L).

### Other Activities

The soil vapor extraction and the groundwater treatment was authorized by the Alameda County Health Care Services (ACHCS) to be shut down and removed because of the low to non-detect concentrations of petroleum hydrocarbons, in a letter dated February 16, 2000. **Due to continued low to non-detectable hydrocarbon constituent concentrations in groundwater, Thrifty respectfully requests that the ACHCS grant closure for this site.**

Groundwater monitoring, gauging, and sampling at this site will continue on a quarterly basis.

Written by:

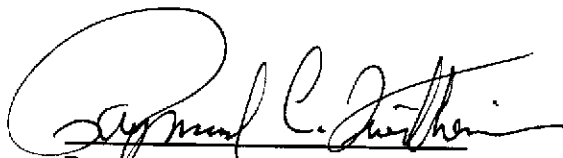

Raymond C. Friedrichsen, REA II  
Project Manager, MBA  
Senior Hydrogeologist

Reviewed by:



Larry Higinbotham  
Registered Geologist #5497

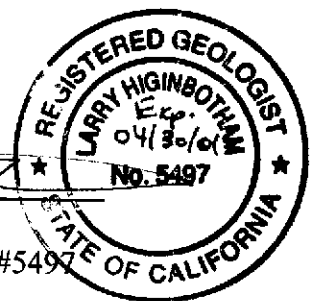

# FIGURES

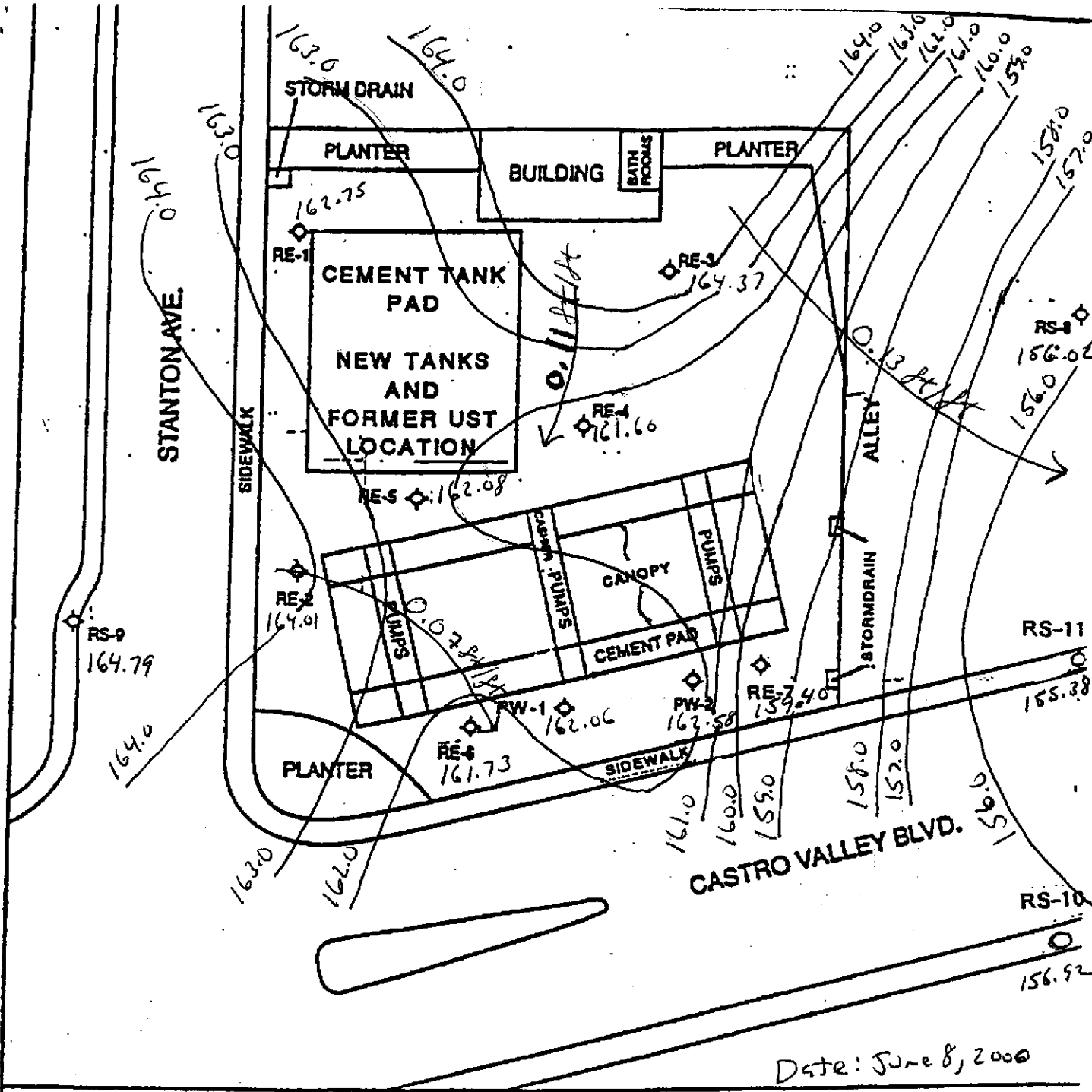

Date: June 8, 2000

**GROUNDWATER CONTOUR MAP**  
**THRIFTY OIL CO. #054**  
**CASTRO VALLEY, CALIFORNIA**  
 Prepared for  
**THRIFTY OIL CO.**  
**SANTA FE, SPRINGS**  
**CALIFORNIA**

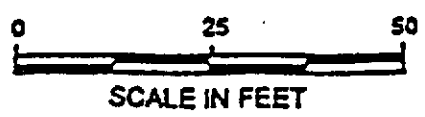

◊ EXISTING MONITORING WELL

**FIGURE 1**

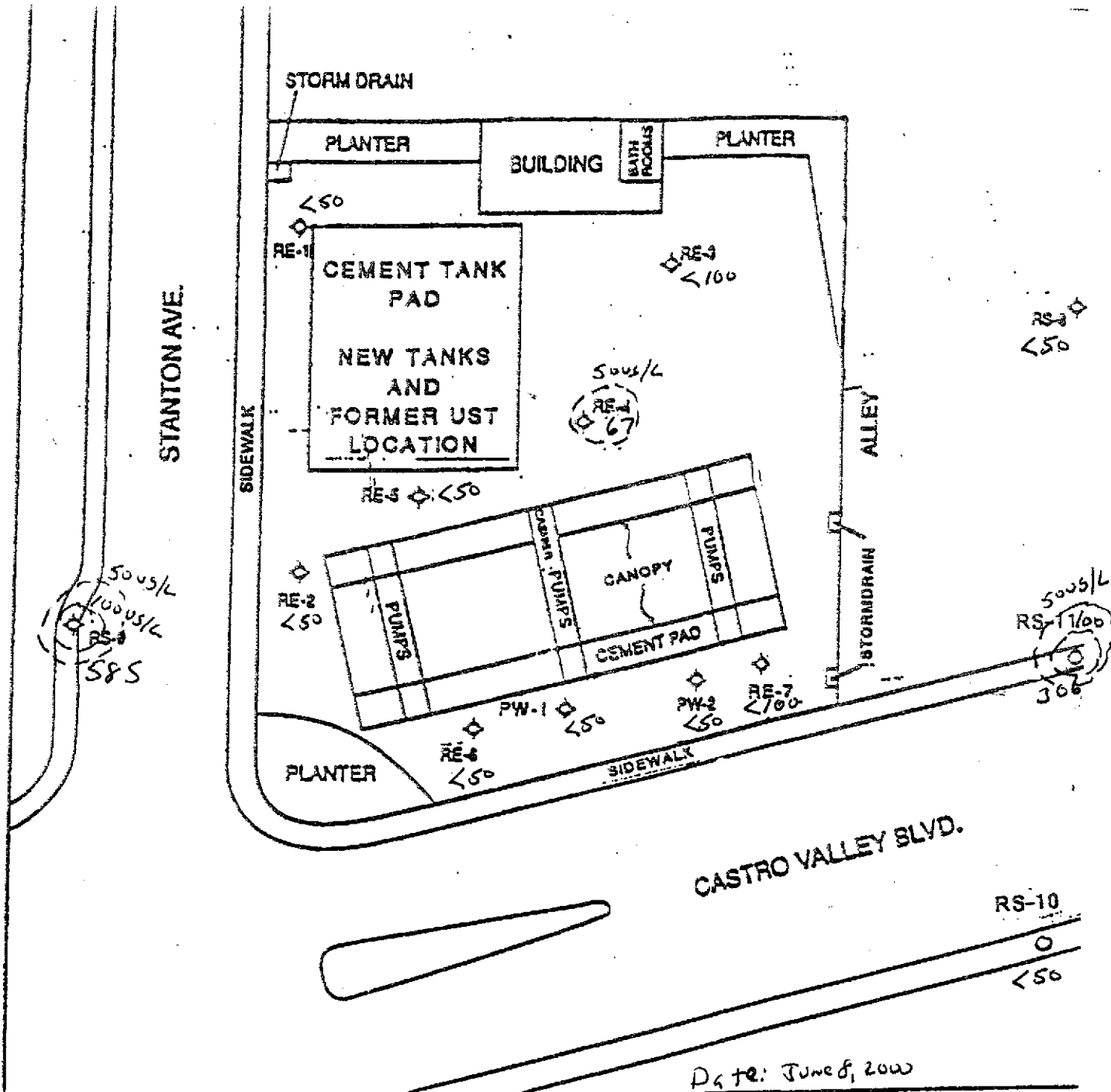

TPH GROUNDWATER ISOCONCENTRATION MAP PPB

THRIFTY OIL CO. #054  
 CASTRO VALLEY, CALIFORNIA  
 Prepared for  
 THRIFTY OIL CO.  
 SANTA FE, SPRINGS  
 CALIFORNIA



◊ EXISTING MONITORING WELL

FIGURE 2

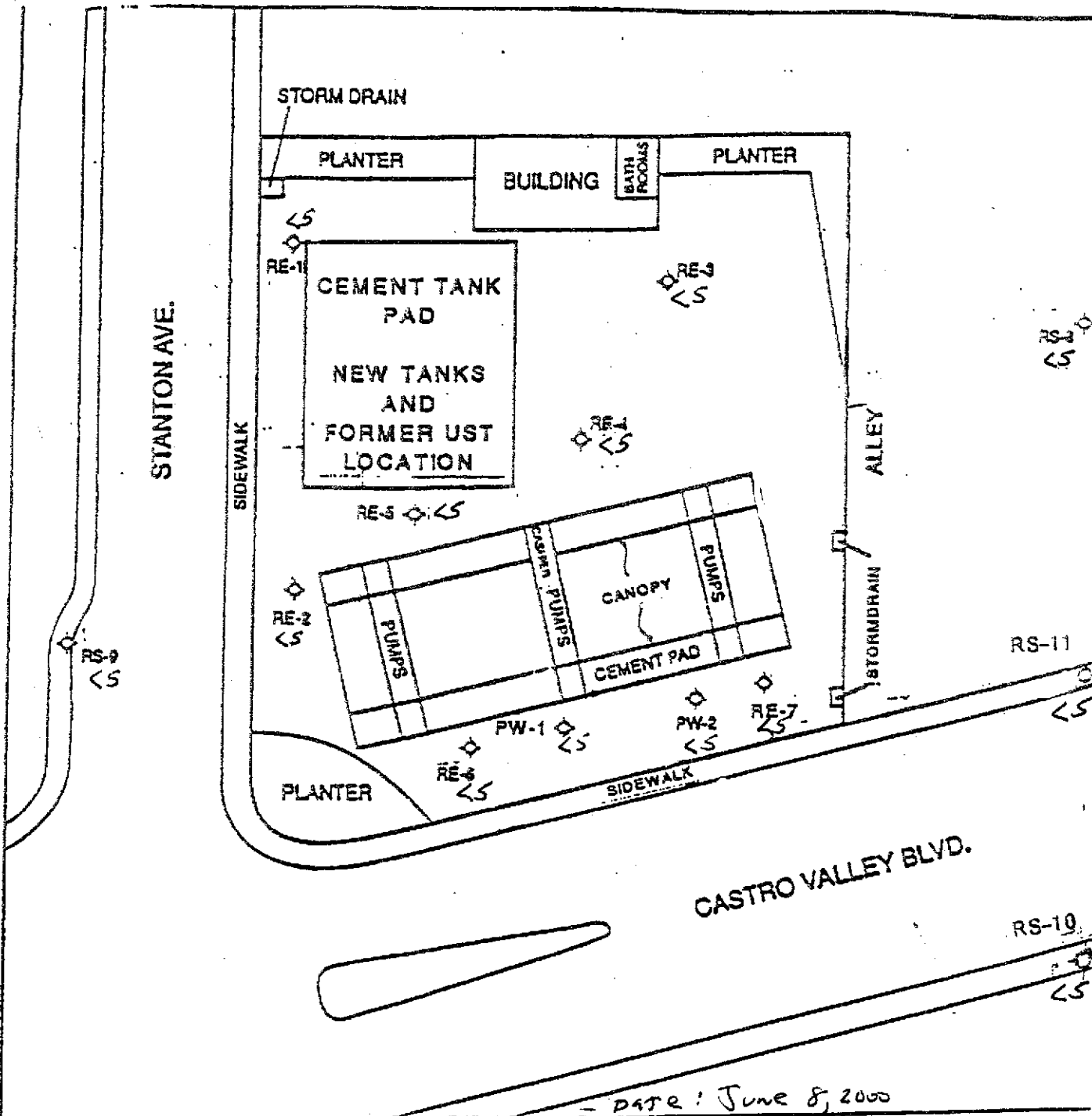

DATE: June 8, 2000

**BENZENE ISOCONCENTRATION MAP PPB**

**THRIFTY OIL CO. #054  
 CASTRO VALLEY, CALIFORNIA  
 Prepared for  
 THRIFTY OIL CO.  
 SANTA FE, SPRINGS  
 CALIFORNIA**

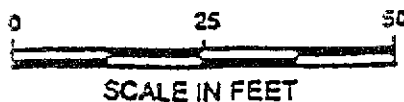

◊ EXISTING MONITORING WELL

**FIGURE 3**

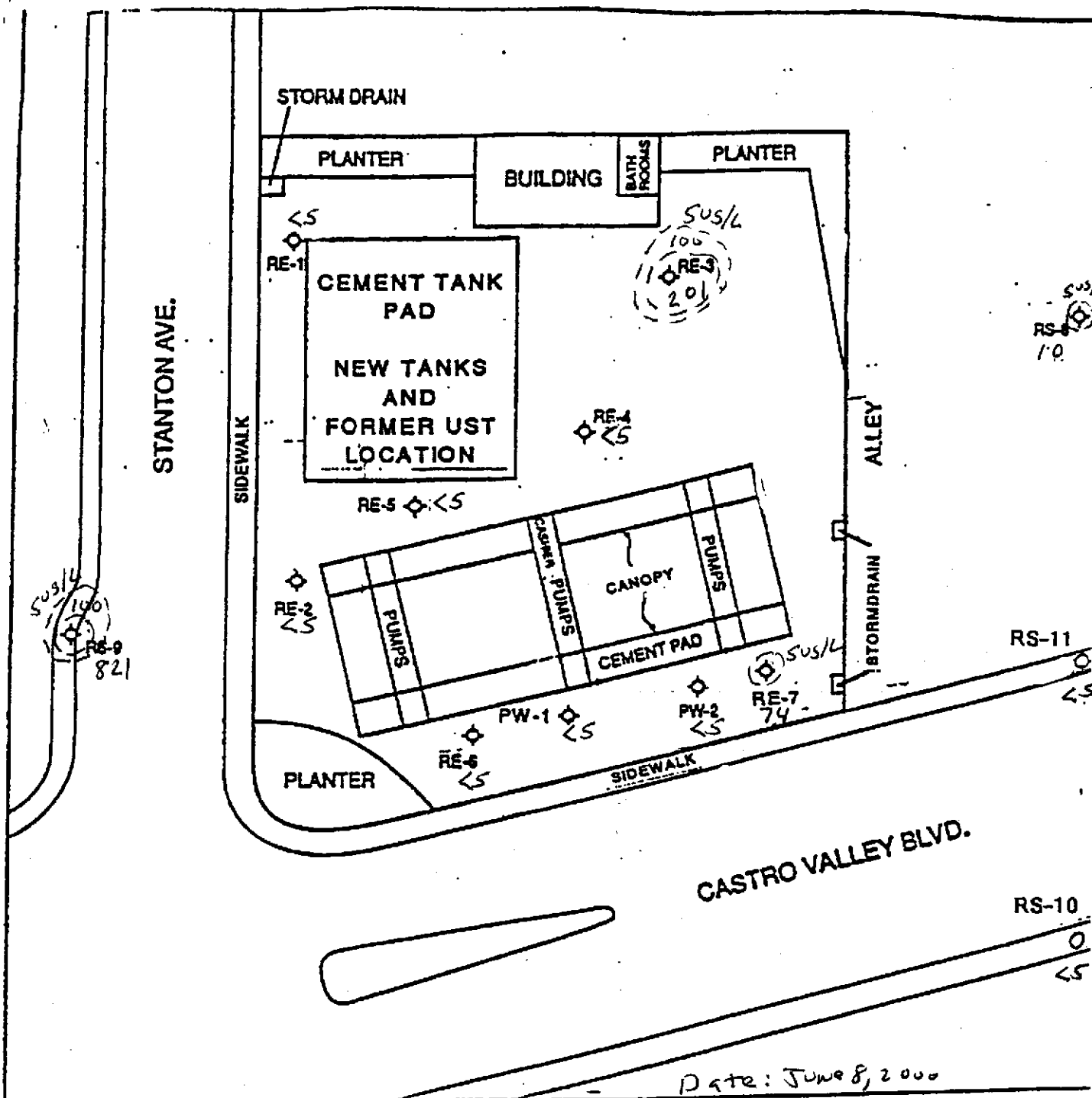

Date: June 8, 2000

MTBE ISOCONCENTRATION MAP ug/L  
 THRIFTY OIL CO. #054  
 CASTRO VALLEY, CALIFORNIA  
 Prepared for  
 THRIFTY OIL CO.  
 SANTA FE, SPRINGS  
 CALIFORNIA



◊ EXISTING MONITORING WELL

FIGURE 4



# TABLE(S)

**TABLE 1  
GROUNDWATER DATA  
THRIFTY OIL STATION #054, CASTRO VALLEY, CA.**

DATE SAMPLED	ANALYTICAL PARAMETERS						DEPTH TO GROUNDWATER (feet)	DEPTH TO PRODUCT (feet)	PRODUCT THICKNESS (feet)	CASING ELEVATION (feet)	GROUNDWATER ELEVATION (feet)
	TPH (ug/L)	BENZENE (ug/L)	TOLUENE (ug/L)	EthylBenzene (ug/L)	XYLENE (ug/L)	MIBK (ug/L)					
<b>MONITORING WELL #PW-1</b>											
04/11/88	-	-	-	-	-	-	-	-	-	-	-
04/09/90	230,000	600	2,700	1,000	16,000	-	5.10	NP	0.00	166.46	161.36
10/30/90	35,000	240	970	240	3,580	-	6.17	NP	0.00	166.46	160.29
01/18/91	37,000	43	140	42	1,600	-	6.28	NP	0.00	166.46	160.18
02/12/91	45,000	99	130	25	700	-	5.88	NP	0.00	166.46	160.58
03/20/91	1,900	0.43	ND	ND	2.8	-	4.75	NP	0.00	166.46	161.71
05/22/91	41,000	600	730	250	3,800	-	5.10	NP	0.00	166.46	161.36
06/19/91	-	-	-	-	-	-	5.61	NP	0.00	166.46	160.85
07/17/91	-	-	-	-	-	-	5.53	FILM	0.00	166.46	160.93
08/07/91	-	-	-	-	-	-	5.67	FILM	0.00	166.46	160.79
09/24/91	-	-	-	-	-	-	5.57	FILM	0.00	166.46	160.89
10/23/91	-	-	-	-	-	-	6.53	FILM	0.00	166.46	159.93
11/06/91	-	-	-	-	-	-	5.85	FILM	0.00	166.46	160.61
12/04/91	-	-	-	-	-	-	5.91	FILM	0.00	166.46	160.55
01/29/92	-	-	-	-	-	-	5.43	FILM	0.00	166.46	161.03
02/26/92	-	-	-	-	-	-	5.54	FILM	0.00	166.46	160.92
03/19/92	ND	ND	ND	ND	ND	-	5.47	NP	0.00	166.46	160.99
04/22/92	-	-	-	-	-	-	5.62	FILM	0.00	166.46	160.84
05/21/92	1,300	19	2.9	0.7	58	-	6.21	NP	0.00	166.46	160.25
06/25/92	-	-	-	-	-	-	6.94	NP	0.00	166.46	159.52
07/30/92	-	-	-	-	-	-	5.90	FILM	0.00	166.46	160.56
08/20/92	-	-	-	-	-	-	7.12	FILM	0.00	166.46	159.34
09/30/92	3,400	57	ND	26	240	-	6.42	NP	0.00	166.46	160.04
12/23/92	-	-	-	-	-	-	5.56	FILM	0.00	166.46	160.90
03/10/93	-	-	-	-	-	-	5.65	FILM	0.00	166.46	160.81
06/09/93	400	<0.5	1.1	<1.0	<1.0	-	5.30	NP	0.00	166.46	161.16
09/14/93	180	3.7	3.2	1.5	14	-	5.43	NP	0.00	166.46	161.03
12/14/93	<50	<0.3	<0.3	<0.3	<0.5	-	4.65	NP	0.00	166.46	161.81
03/02/94	<50	<0.3	<0.3	<0.3	<0.5	-	5.43	NP	0.00	166.46	161.03
06/06/94	330	1.3	<0.3	0.88	9.8	-	4.70	NP	0.00	166.46	161.76
09/06/94	1,100	67	<0.3	<0.3	24	-	6.48	NP	0.00	166.46	159.98
12/07/94	<50	<0.3	<0.3	<0.5	<0.5	-	5.22	NP	0.00	166.46	161.24
03/08/95	<100	<0.5	<0.5	<0.5	<1	-	6.94	NP	0.00	166.46	159.52
06/15/95	260	0.8	0.6	<0.5	3.2	-	5.72	NP	0.00	166.46	160.74

**TABLE 1  
GROUNDWATER DATA  
THRIFTY OIL STATION #054, CASTRO VALLEY, CA.**

DATE SAMPLED	ANALYTICAL PARAMETERS						DEPTH TO GROUNDWATER (feet)	DEPTH TO PRODUCT (feet)	PRODUCT THICKNESS (feet)	CASING ELEVATION (feet)	GROUNDWATER ELEVATION (feet)
	TPH (ug/L)	BENZENE (ug/L)	TOLUENE (ug/L)	EthylBenzene (ug/L)	XYLENE (ug/L)	MTBE (ug/L)					
09/05/95	330	2.1	<0.5	2.1	9.6	-	5.96	NP	0.00	166.46	160.50
11/21/95	660	13	1.3	<0.3	4.0	-	6.04	NP	0.00	166.46	160.42
03/11/96	660	0.94	0.77	<0.3	8.1	-	3.60	NP	0.00	166.46	162.86
06/19/96	120	0.53	<0.3	<0.3	2.3	-	4.80	NP	0.00	166.46	161.66
09/16/96	<50	<0.3	<0.3	<0.3	<0.5	<20	5.10	NP	0.00	166.46	161.36
12/10/96	<50	<0.3	<0.3	<0.3	<0.5	<20	4.92	NP	0.00	166.46	161.54
03/12/97	<50	<0.3	<0.3	<0.3	<0.5	<20	4.50	NP	0.00	166.46	161.96
06/12/97	<50	<0.3	<0.3	<0.3	<0.5	<20	-	-	-	-	-
09/16/97	690	0.97	<0.3	<0.3	<0.5	<20	4.55	NP	0.00	166.46	161.91
12/09/97	640	150	0.64	<0.3	5.2	1,300	5.60	NP	0.00	166.46	160.86
03/03/98	<50	<0.3	0.57	<0.3	<0.5	<20	4.13	NP	0.00	166.46	162.33
07/08/98	<50	<0.3	<0.3	<0.3	<0.5	<5	-	-	-	-	-
09/10/98	<50	<0.3	<0.3	<0.3	<0.5	<5	6.35	NP	0.00	166.46	160.11
12/30/98	<50	1.1	<0.3	<0.3	<0.5	<5	6.40	NP	0.00	166.46	160.06
03/15/99	<50	<0.3	<0.3	<0.3	<0.5	<5	6.35	NP	0.00	166.46	160.11
06/22/99	<50	<0.3	<0.3	<0.3	<0.5	53	4.95	NP	0.00	166.46	161.51
09/08/99	<50	<0.3	<0.3	<0.3	<0.5	<5	4.80	NP	0.00	166.46	161.66
12/01/99	<50	<0.3	<0.3	<0.3	<0.5	<5	3.64	NP	0.00	166.46	162.82
03/23/00	<50	0.5	0.5	1.1	<0.5	<5	4.03	NP	0.00	166.46	162.43
06/08/00	<50	<5	<5	<5	<5	<5	4.40	NP	0.00	166.46	162.06
<b>MONITORING WELL PW-2</b>											
04/11/88	-	-	-	-	-	-	-	-	-	-	-
04/09/90	600,000	1,300	11,000	4,600	4,300	-	5.81	NP	0.00	166.18	160.37
10/30/90	48,000	310	51	10	480	-	6.95	NP	0.00	166.18	159.23
01/18/91	86,000	230	1,400	350	8,300	-	6.92	NP	0.00	166.18	159.26
02/12/91	160,000	680	1,300	250	7,000	-	6.78	NP	0.00	166.18	159.40
03/20/91	17,000	34	50	ND	1,100	-	5.54	NP	0.00	166.18	160.64
05/22/91	14,000	57	2,100	500	8,200	-	6.07	NP	0.00	166.18	160.11
06/19/91	-	-	-	-	-	-	6.37	FILM	0.00	166.18	159.81
07/17/91	-	-	-	-	-	-	6.38	FILM	0.00	166.18	159.80
08/07/91	-	-	-	-	-	-	6.63	FILM	0.00	166.18	159.55
09/24/91	-	-	-	-	-	-	6.42	FILM	0.00	166.18	159.76
10/23/91	-	-	-	-	-	-	7.25	FILM	0.00	166.18	158.93

**TABLE 1  
GROUNDWATER DATA  
THRIFTY OIL STATION #054, CASTRO VALLEY, CA.**

DATE SAMPLED	ANALYTICAL PARAMETERS						DEPTH TO GROUNDWATER (feet)	DEPTH TO PRODUCT (feet)	PRODUCT THICKNESS (feet)	LEASING ELEVATION (feet)	GROUNDWATER ELEVATION (feet)
	TPH (ug/L)	BENZENE (ug/L)	TOLUENE (ug/L)	EthylBenzene (ug/L)	XYLENE (ug/L)	MTBE (ug/L)					
11/06/91	-	-	-	-	-	-	6.44	FILM	0.00	166.18	159.74
12/04/91	-	-	-	-	-	-	6.65	FILM	0.00	166.18	159.53
01/29/92	-	-	-	-	-	-	6.17	FILM	0.00	166.18	160.01
02/26/92	-	-	-	-	-	-	5.90	FILM	0.00	166.18	160.28
03/19/92	-	-	-	-	-	-	5.80	FILM	0.00	166.18	160.38
04/22/92	-	-	-	-	-	-	5.88	FILM	0.00	166.18	160.30
05/21/92	-	-	-	-	-	-	6.03	FILM	0.00	166.18	160.15
06/25/92	-	-	-	-	-	-	6.57	FILM	0.00	166.18	159.61
07/30/92	-	-	-	-	-	-	6.20	FILM	0.00	166.18	159.98
08/20/92	-	-	-	-	-	-	6.64	FILM	0.00	166.18	159.54
09/30/92	-	-	-	-	-	-	6.88	FILM	0.00	166.18	159.30
12/23/92	-	-	-	-	-	-	6.08	FILM	0.00	166.18	160.10
03/10/93	-	-	-	-	-	-	5.95	FILM	0.00	166.18	160.23
06/09/93	3,400	24	22	<0.5	240	-	5.38	NP	0.00	166.18	160.80
09/14/93	4,900	190	15	6.8	480	-	6.26	NP	0.00	166.18	159.92
12/14/93	1,700	4.2	<0.3	<0.3	<0.5	-	5.22	NP	0.00	166.18	160.96
03/02/94	-	-	-	-	-	-	5.75	FILM	0.00	166.18	160.43
06/06/94	980	25	1.2	<0.3	42	-	5.25	NP	0.00	166.18	160.93
09/06/94	3,200	95	3.0	<1.7	76	-	6.80	NP	0.00	166.18	159.38
12/07/94	510	1.8	<0.3	<0.5	1.7	-	5.57	NP	0.00	166.18	160.61
03/08/95	1,900	<0.5	<0.5	1.4	35	-	4.10	NP	0.00	166.18	162.08
06/15/95	1,700	5.6	<0.5	<0.5	1.6	-	5.44	NP	0.00	166.18	160.74
09/05/95	2,500	33	1.0	0.86	18	-	6.13	NP	0.00	166.18	160.05
11/21/95	2,800	130	59	18	190	-	6.23	NP	0.00	166.18	159.95
03/11/96	13,000	330	460	<15	3,800	-	4.48	NP	0.00	166.18	161.70
06/19/96	1,400	<0.3	<0.3	<0.3	<0.5	-	5.38	NP	0.00	166.18	160.80
09/16/96	3,500	<0.3	<0.3	<0.3	<0.5	5,900	5.21	NP	0.00	166.18	160.97
12/10/96	2,100	<0.3	<0.3	<0.3	<0.5	4,700	4.87	NP	0.00	166.18	161.31
03/12/97	600	1.6	<0.3	<0.3	5.8	1,100	4.43	NP	0.00	166.18	161.75
06/12/97	270	<0.3	<0.3	<0.3	<0.5	630	-	-	-	-	-
09/10/97	220	<0.3	<0.3	<0.3	<0.5	320	4.07	NP	0.00	166.18	162.11
12/09/97	120	<0.3	0.73	<0.3	<0.5	420	5.20	NP	0.00	166.18	160.98
03/03/98	<50	0.43	0.48	<0.3	<0.5	47	3.30	NP	0.00	166.18	162.88
07/08/98	<50	<0.3	<0.3	<0.3	<0.5	<5	-	-	-	-	-
09/10/98	<50	<0.3	<0.3	<0.3	<0.5	<5	5.15	NP	0.00	166.18	161.03

**TABLE 1  
GROUNDWATER DATA  
THRIFTY OIL STATION #054, CASTRO VALLEY, CA.**

DATE SAMPLED	ANALYTICAL PARAMETERS						DEPTH TO GROUNDWATER (feet)	DEPTH TO PRODUCT (feet)	PRODUCT THICKNESS (feet)	CASING ELEVATION (feet)	GROUNDWATER ELEVATION (feet)
	TPH (ug/L)	BENZENE (ug/L)	TOLUENE (ug/L)	Ethyl Benzene (ug/L)	XYLENE (ug/L)	MTBE (ug/L)					
12/30/98	<50	1.1	<0.3	<0.3	<0.5	<5	4.75	NP	0.00	166.18	161.43
03/15/99	<50	<0.3	<0.3	<0.3	<0.5	<5	4.40	NP	0.00	166.18	161.78
06/22/99	-	-	-	-	-	-	4.50	NP	0.00	166.18	161.68
09/08/99	100	<0.3	<0.3	<0.3	<0.5	230	3.99	NP	0.00	166.18	162.19
12/01/99	<50	<0.3	<0.3	<0.3	<0.5	<5	3.62	NP	0.00	166.18	162.56
03/23/00	<50	<0.25	<0.25	<0.25	<0.5	<5	2.93	NP	0.00	166.18	163.25
06/08/00	<50	<5	<5	<5	<5	<5	3.60	NP	0.00	166.18	162.58
<b>MONITORING WELL #RE-1</b>											
04/11/88	37,000	1,900	8,400	1,200	15,000	-	-	-	-	-	-
04/09/90	45,000	6,100	7,000	2,000	8,800	-	4.99	NP	0.00	166.82	161.83
10/30/90	72,000	7,700	5,300	1,800	8,900	-	5.95	NP	0.00	166.82	160.87
01/18/91	150,000	11,000	14,000	1,800	4,300	-	5.17	NP	0.00	166.82	161.65
02/12/91	140,000	11,000	12,000	1,600	13,000	-	4.16	NP	0.00	166.82	162.66
03/20/91	53,000	3,100	4,200	400	5,500	-	4.75	NP	0.00	166.82	162.07
05/22/91	85,000	8,700	10,000	1,800	12,000	-	4.42	NP	0.00	166.82	162.40
06/19/91	110,000	8,500	9,600	2,600	16,000	-	4.93	NP	0.00	166.82	161.89
07/17/91	5,500	950	ND	26	ND	-	5.19	NP	0.00	166.82	161.63
08/07/91	-	6,700	5,000	ND	7,100	-	5.12	NP	0.00	166.82	161.70
09/24/91	60,000	6,800	4,300	640	6,900	-	5.87	NP	0.00	166.82	160.95
10/23/91	79,000	7,900	8,300	450	7,100	-	5.81	NP	0.00	166.82	161.01
11/06/91	130,000	14,000	15,000	1,100	8,800	-	5.56	NP	0.00	166.82	161.26
12/04/91	50,000	8,000	4,700	520	4,100	-	5.35	NP	0.00	166.82	161.47
01/29/92	21,000	10,300	11,000	780	6,000	-	4.50	NP	0.00	166.82	162.32
02/26/92	38000	8,400	10,500	720	7,100	-	5.27	NP	0.00	166.82	161.55
03/19/92	48,000	6,200	9,700	780	7,200	-	4.47	NP	0.00	166.82	162.35
04/22/92	-	-	-	-	-	-	4.62	NP	0.00	166.82	162.20
05/21/92	20,000	7,600	10,100	830	6,900	-	4.98	NP	0.00	166.82	161.84
06/25/92	-	-	-	-	-	-	5.14	FILM	0.00	166.82	161.68
07/30/92	-	-	-	-	-	-	5.30	FILM	0.00	166.82	161.52
08/20/92	-	-	-	-	-	-	5.28	FILM	0.00	166.82	161.54
09/30/92	-	-	-	-	-	-	5.66	FILM	0.00	166.82	161.16
12/23/92	-	-	-	-	-	-	4.81	FILM	0.00	166.82	162.01
03/10/93	-	-	-	-	-	-	4.13	FILM	0.00	166.82	162.69

**TABLE 1  
GROUNDWATER DATA  
THRIFTY OIL STATION #054, CASTRO VALLEY, CA.**

DATE SAMPLED	ANALYTICAL PARAMETERS						DEPTH TO GROUNDWATER (feet)	DEPTH TO PRODUCT (feet)	PRODUCT THICKNESS (feet)	CASING ELEVATION (feet)	GROUNDWATER ELEVATION (feet)
	TPH (ug/l)	BENZENE (ug/L)	TOLUENE (ug/L)	EthylBenzene (ug/L)	XYLENE (ug/L)	MTBE (ug/L)					
06/09/93	-	-	-	-	-	-	4.48	FILM	0.00	166.82	162.34
09/14/93	19,000	3,600	1,100	740	4,300	-	5.35	NP	0.00	166.82	161.47
12/14/93	38,000	4,300	1,300	<6.6	11	-	4.38	NP	0.00	166.82	162.44
03/02/94	-	-	-	-	-	-	4.22	FILM	0.00	166.82	162.60
06/06/94	-	-	-	-	-	-	2.16	FILM	0.00	166.82	164.66
09/06/94	74,000	3,300	3,900	1,200	6,100	-	5.00	NP	0.00	166.82	161.82
12/07/94	30,000	3,200	2,900	1,200	4,600	-	4.10	NP	0.00	166.82	162.72
03/08/95	28,000	4,200	2,300	810	7,800	-	3.92	NP	0.00	166.82	162.90
06/15/95	-	-	-	-	-	-	-	-	-	-	-
09/05/95	-	-	-	-	-	-	4.78	FILM	0.00	166.82	162.04
11/21/95	-	-	-	-	-	-	4.82	NP	0.00	166.82	162.00
03/11/96	270	2.4	6.0	4.5	19	-	3.32	NP	0.00	166.82	163.50
06/19/96	3,000	570	63	<1.5	400	-	4.20	NP	0.00	166.82	162.62
09/16/96	7,700	440	69	<1.5	680	230	4.68	NP	0.00	166.82	162.14
12/10/96	52	<0.3	<0.3	<0.3	<0.5	120	4.93	NP	0.00	166.82	161.89
03/12/97	8,700	180	5.4	40	1,100	130	4.10	NP	0.00	166.82	162.72
06/12/97	<50	<0.3	<0.3	<0.3	<0.5	36	-	-	-	-	-
09/16/97	<50	<0.3	<0.3	<0.3	<0.5	<20	4.55	NP	0.00	166.82	162.27
12/09/97	<50	<0.3	0.44	<0.3	<0.5	<20	5.30	NP	0.00	166.82	161.52
03/03/98	1,100	13	0.51	<0.3	<0.5	220	4.55	NP	0.00	166.82	162.27
07/08/98	<50	<0.3	<0.3	<0.3	<0.5	<5	-	-	-	-	-
09/10/98	60	<0.3	<0.3	<0.3	<0.5	180	6.05	NP	0.00	166.82	160.77
12/30/98	<50	1.1	<0.3	<0.3	<0.5	<5	5.65	NP	0.00	166.82	161.17
03/15/99	<50	<0.3	<0.3	<0.3	<0.5	<5	5.68	NP	0.00	166.82	161.14
06/22/99	880	14	0.98	<0.3	8.1	260	4.95	NP	0.00	166.82	161.87
09/08/99	72	<0.3	<0.3	<0.3	<0.5	120	4.46	NP	0.00	166.82	162.36
12/01/99	<50	<0.3	<0.3	<0.3	<0.5	<5	4.08	NP	0.00	166.82	162.74
03/23/00	<50	<0.25	<0.25	<0.25	<0.5	<5	3.68	NP	0.00	166.82	163.14
06/08/00	<50	<5	<5	<5	<5	<5	4.07	NP	0.00	166.82	162.75
<b>MONITORING WELL #RE-2</b>											
04/11/88	-	-	-	-	-	-	-	-	-	-	-
04/09/90	850	5.8	0.5	4.8	1.1	-	4.90	NP	0.00	167.19	162.29
10/30/90	440	2.8	0.91	13	3.14	-	5.34	NP	0.00	167.19	161.85

**TABLE 1  
GROUNDWATER DATA  
THRIFTY OIL STATION #054, CASTRO VALLEY, CA.**

DATE SAMPLED	ANALYTICAL PARAMETERS						DEPTH TO GROUNDWATER (feet)	DEPTH TO PRODUCT (feet)	PRODUCT THICKNESS (feet)	CASING ELEVATION (feet)	GROUNDWATER ELEVATION (feet)
	TPH (ppm)	BENZENE (ug/L)	TOLUENE (ug/L)	ETHYL Benzene (ug/L)	XYLENE (ug/L)	MIBK (ug/L)					
01/18/91	1,100	8.4	3.1	ND	10	-	4.90	NP	0.00	167.19	162.29
02/12/91	1,100	5.9	ND	1.77	ND	-	4.94	NP	0.00	167.19	162.25
03/20/91	550	4.3	ND	ND	ND	-	4.32	NP	0.00	167.19	162.87
05/22/91	1,000	5.3	3.6	4.4	8.9	-	4.43	NP	0.00	167.19	162.76
06/19/91	700	2.1	1.4	3.8	3.5	-	6.43	NP	0.00	167.19	160.76
07/17/91	880	12	8.0	4.3	28	-	4.75	NP	0.00	167.19	162.44
08/07/91	-	3.8	1.6	ND	ND	-	4.87	NP	0.00	167.19	162.32
09/24/91	670	7.2	7.1	ND	23	-	5.50	NP	0.00	167.19	161.69
10/23/91	2,700	52	60	22	130	-	5.63	NP	0.00	167.19	161.56
11/06/91	1,900	18	61	9.1	83	-	5.14	NP	0.00	167.19	162.05
12/04/91	1,100	26	47	4.3	42	-	5.26	NP	0.00	167.19	161.93
01/29/92	900	14	24	5.3	19	-	5.11	NP	0.00	167.19	162.08
02/26/92	500	3.4	3.5	2.7	2.7	-	4.31	NP	0.00	167.19	162.88
03/19/92	1,200	14	20	15	18	-	4.45	NP	0.00	167.19	162.74
04/22/92	200	ND	ND	ND	ND	-	4.78	NP	0.00	167.19	162.41
05/21/92	500	7.5	6.8	3.9	7.4	-	5.02	NP	0.00	167.19	162.17
06/25/92	ND	ND	0.9	0.7	ND	-	5.13	NP	0.00	167.19	162.06
07/30/92	500	7.7	8.6	3.2	1.7	-	5.19	NP	0.00	167.19	162.00
08/20/92	1,100	6.6	4.5	2.7	2.0	-	5.27	NP	0.00	167.19	161.92
09/30/92	500	5.4	2.4	1.8	4.5	-	5.45	NP	0.00	167.19	161.74
12/23/92	800	1.9	ND	ND	2.3	-	4.60	NP	0.00	167.19	162.59
03/10/93	1,200	ND	1.4	ND	2.1	-	4.18	NP	0.00	167.19	163.01
06/09/93	200	ND	ND	ND	ND	-	4.53	NP	0.00	167.19	162.66
09/17/93	360	1.6	1.1	3.2	8.9	-	5.26	NP	0.00	167.19	161.93
12/14/93	260	5.6	3.9	<0.3	21.0	-	2.75	NP	0.00	167.19	164.44
03/02/94	410	<0.3	<0.3	<0.3	<0.5	-	4.27	NP	0.00	167.19	162.92
06/06/94	760	4.6	<0.3	0.32	1.3	-	4.88	NP	0.00	167.19	162.31
09/06/94	1,300	43	45	8.9	69	-	5.16	NP	0.00	167.19	162.03
12/07/94	-	-	-	-	-	-	4.16	NP	0.00	167.19	163.03
03/08/95	<100	<0.5	<0.5	<0.5	<1	-	3.96	NP	0.00	167.19	163.23
06/15/95	130	<0.5	<0.5	<0.5	<1	-	4.52	NP	0.00	167.19	162.67
09/05/95	210	<0.5	<0.5	<0.5	<1	-	4.76	NP	0.00	167.19	162.43
11/21/95	160	0.65	<0.3	0.35	0.95	-	4.83	NP	0.00	167.19	162.36
03/11/96	<50	<0.3	<0.3	<0.3	<0.5	-	3.36	NP	0.00	167.19	163.83
06/19/96	<50	<0.3	<0.3	<0.3	<0.5	-	4.68	NP	0.00	167.19	162.51

**TABLE 1  
GROUNDWATER DATA  
THRIFTY OIL STATION #054, CASTRO VALLEY, CA.**

DATE SAMPLED	ANALYTICAL PARAMETERS						DEPTH TO	DEPTH TO	PRODUCT	CASING	GROUNDWATER
	TPH (ug/L)	BENZENE (ug/L)	TOLUENE (ug/L)	1,1-DIBENZENE (ug/L)	XYLENE (ug/L)	MIBL (ug/L)	GROUNDWATER (feet)	PRODUCT (feet)	THICKNESS (feet)	ELEVATION (feet)	ELEVATION (feet)
09/16/96	<50	<0.3	<0.3	<0.3	<0.5	<20	5.10	NP	0.00	167.19	162.09
12/10/96	<50	<0.3	<0.3	<0.3	<0.5	<20	4.47	NP	0.00	167.19	162.72
03/12/97	<50	<0.3	<0.3	<0.3	<0.5	<20	4.05	NP	0.00	167.19	163.14
06/12/97	<50	<0.3	<0.3	<0.3	<0.5	<20	-	-	-	-	-
09/10/97	<50	<0.3	<0.3	<0.3	<0.5	<20	4.08	NP	0.00	167.19	163.11
12/09/97	<50	<0.3	<0.3	<0.3	<0.5	<20	4.40	NP	0.00	167.19	162.79
03/03/98	<50	<0.3	<0.3	<0.3	<0.5	<20	3.30	NP	0.00	167.19	163.89
07/08/98	<50	<0.3	<0.3	<0.3	<0.5	15	-	-	-	-	-
09/10/98	<50	<0.3	<0.3	<0.3	<0.5	<5	4.93	NP	0.00	167.19	162.26
12/30/98	460	0.92	<0.3	<0.3	<0.5	1,400	4.20	NP	0.00	167.19	162.99
03/15/99	<50	<0.3	<0.3	<0.3	<0.5	<5	4.20	NP	0.00	167.19	162.99
06/22/99	2,900	7.4	<0.3	0.43	4.1	4,500	3.70	NP	0.00	167.19	163.49
09/08/99	1,400	<3	<3	<3	<5	3,200	3.96	NP	0.00	167.19	163.23
12/01/99	<50	<0.3	<0.3	<0.3	<0.5	<5	3.58	NP	0.00	167.19	163.61
03/23/00	<50	<0.25	<0.25	<0.25	<0.5	<5	3.19	NP	0.00	167.19	164.00
06/08/00	<50	<5	<5	<5	<5	<5	3.18	NP	0.00	167.19	164.01
<b>MONITORING WELL MW-3</b>											
04/11/88	70,000	6,600	5,300	800	13,000	-	-	-	-	-	-
04/09/90	370,000	2,300	4,900	3,200	31,000	-	7.15	NP	0.00	167.39	160.24
10/30/90	13,000	860	660	220	2,210	-	7.84	NP	0.00	167.39	159.55
01/18/91	42,000	4,700	4,500	21	7,700	-	6.90	NP	0.00	167.39	160.49
02/12/91	72,000	3,600	4,500	ND	7,600	-	6.62	NP	0.00	167.39	160.77
03/20/91	65,000	2,400	9,400	50	9,800	-	5.87	NP	0.00	167.39	161.52
05/22/91	-	-	-	-	-	-	5.98	FILM	0.00	167.39	161.41
06/19/91	-	-	-	-	-	-	6.84	FILM	0.00	167.39	160.55
07/17/91	-	-	-	-	-	-	7.10	FILM	0.00	167.39	160.29
08/07/91	-	-	-	-	-	-	7.30	FILM	0.00	167.39	160.09
09/24/91	-	-	-	-	-	-	7.84	FILM	0.00	167.39	159.55
10/23/91	-	-	-	-	-	-	8.07	FILM	0.00	167.39	159.32
11/06/91	-	-	-	-	-	-	7.63	FILM	0.00	167.39	159.76
12/04/91	-	-	-	-	-	-	7.83	FILM	0.00	167.39	159.56
01/29/92	-	-	-	-	-	-	7.17	FILM	0.00	167.39	160.22
02/26/92	-	-	-	-	-	-	5.56	FILM	0.00	167.39	161.83



**TABLE 1  
GROUNDWATER DATA  
THRIFTY OIL STATION #054, CASTRO VALLEY, CA.**

DATE SAMPLED	ANALYTICAL PARAMETERS						DEPTH TO GROUNDWATER (ft)	DEPTH TO PRODUCT (ft)	PRODUCT THICKNESS (ft)	CASING ELEVATION (ft)	GROUNDWATER ELEVATION (ft)
	TPH (ug/L)	BENZENE (ug/L)	TOLUENE (ug/L)	ETHYLBENZENE (ug/L)	XYLENE (ug/L)	MIBK (ug/L)					
03/19/92	-	-	-	-	-	-	5.44	FILM	0.00	167.39	161.95
04/22/92	-	-	-	-	-	-	6.56	FILM	0.00	167.39	160.83
05/21/92	-	-	-	-	-	-	6.90	FILM	0.00	167.39	160.49
06/25/92	-	-	-	-	-	-	7.18	FILM	0.00	167.39	160.21
07/30/92	-	-	-	-	-	-	6.80	FILM	0.00	167.39	160.59
08/20/92	-	-	-	-	-	-	7.25	FILM	0.00	167.39	160.14
09/30/92	-	-	-	-	-	-	7.68	FILM	0.00	167.39	159.71
12/23/92	-	-	-	-	-	-	6.07	FILM	0.00	167.39	161.32
03/10/93	-	-	-	-	-	-	5.66	FILM	0.00	167.39	161.73
06/09/93	-	-	-	-	-	-	6.66	FILM	0.00	167.39	160.73
09/14/93	40,000	2,900	1,500	180	6,900	-	7.30	NP	0.00	167.39	160.09
12/14/93	-	-	-	-	-	-	5.95	NP	0.00	167.39	161.44
03/02/94	-	-	-	-	-	-	5.08	NP	0.00	167.39	162.31
06/06/94	-	-	-	-	-	-	6.35	FILM	0.00	167.39	161.04
09/06/94	11,000	260	26	<6.6	1,000	-	7.50	NP	0.00	167.39	159.89
12/07/94	-	-	-	-	-	-	5.48	FILM	0.00	167.39	161.91
03/08/95	-	-	-	-	-	-	5.18	FILM	0.00	167.39	162.21
06/15/95	-	-	-	-	-	-	-	-	-	-	-
09/05/95	-	-	-	-	-	-	6.84	FILM	0.00	167.39	160.55
11/21/95	10,000	210	<3	4.5	330	-	7.38	NP	0.00	167.39	160.01
03/11/96	1,600	640	15	10	46	-	4.85	NP	0.00	167.39	162.54
06/19/96	2,100	280	<3	<3	120	-	5.80	NP	0.00	167.39	161.59
09/16/96	140	<0.3	<0.3	<0.3	<0.5	110	4.50	NP	0.00	167.39	162.89
12/10/96	<50	<0.3	<0.3	<0.3	<0.5	<20	5.35	NP	0.00	167.39	162.04
03/12/97	<50	<0.3	<0.3	<0.3	<0.5	<20	3.48	NP	0.00	167.39	163.91
06/12/97	<50	<0.3	<0.3	<0.3	0.58	<20	-	-	-	-	-
09/10/97	<50	<0.3	<0.3	<0.3	<0.5	<20	3.10	NP	0.00	167.39	164.29
12/09/97	3,600	1,000	1,000	<6	570	260	4.55	NP	0.00	167.39	162.84
03/03/98	2,800	20	0.65	0.39	16	5,600	2.30	NP	0.00	167.39	165.09
07/08/98	<50	<0.3	<0.3	<0.3	<0.5	<5	-	-	-	-	-
09/10/98	<50	<0.3	<0.3	<0.3	<0.5	23	4.95	NP	0.00	167.39	162.44
12/30/98	<50	1.1	<0.3	<0.3	<0.5	<5	4.55	NP	0.00	167.39	162.84
03/15/99	<50	<0.3	<0.3	<0.3	<0.5	<5	4.15	NP	0.00	167.39	163.24
06/22/99	670	17	1.2	0.36	1.7	340	3.85	NP	0.00	167.39	163.54
09/08/99	140	0.72	<0.3	<0.3	<0.5	230	2.63	NP	0.00	167.39	164.76

**TABLE 1  
GROUNDWATER DATA  
THRIFTY OIL STATION #054, CASTRO VALLEY, CA.**

DATE SAMPLED	ANALYTICAL PARAMETERS						DEPTH TO GROUNDWATER (feet)	DEPTH TO PRODUCT (feet)	PRODUCT THICKNESS (feet)	CASING ELEVATION (feet)	GROUNDWATER ELEVATION (feet)
	TPH (ug/L)	BENZENE (ug/L)	TOLUENE (ug/L)	EthylBenzene (ug/L)	XYLENE (ug/L)	MIBK (ug/L)					
12/01/99	95	<0.3	<0.3	<0.3	<0.5	200	2.63	NP	0.00	167.39	164.76
03/23/00	315	<0.25	<0.25	<0.25	<0.5	*293/422	2.25	NP	0.00	167.39	165.14
06/08/00	<100	<5	<5	<5	<5	201	3.02	NP	0.00	167.39	164.37
<b>MONITORING WELL #RE-4</b>											
04/11/88	15,000	12,000	8,000	1,000	2,700	-	-	-	-	-	-
04/09/90	-	-	-	-	-	-	-	-	-	-	-
10/30/90	87,000	7,200	10,000	1,600	12,900	-	7.04	NP	0.00	166.94	159.90
01/18/91	70,000	5,000	5,400	790	9,900	-	11.62	NP	0.00	166.94	155.32
02/12/91	87,000	5,200	2,800	240	11,000	-	11.63	NP	0.00	166.94	155.31
03/20/91	6,500	370	230	17	670	-	11.61	NP	0.00	166.94	155.33
05/22/91	-	-	-	-	-	-	10.30	FILM	0.00	166.94	156.64
06/19/91	-	-	-	-	-	-	11.10	FILM	0.00	166.94	155.84
07/17/91	-	-	-	-	-	-	6.20	FILM	0.00	166.94	160.74
08/17/91	-	-	-	-	-	-	8.15	FILM	0.00	166.94	158.79
09/24/91	-	-	-	-	-	-	10.40	FILM	0.00	166.94	156.54
10/23/91	-	-	-	-	-	-	11.20	FILM	0.00	166.94	155.74
11/06/91	-	-	-	-	-	-	6.62	FILM	0.00	166.94	160.32
12/04/91	-	-	-	-	-	-	11.20	ILM	0.00	166.94	155.74
01/29/92	-	-	-	-	-	-	7.72	FILM	0.00	166.94	159.22
02/26/92	-	-	-	-	-	-	5.13	FILM	0.00	166.94	161.81
03/19/92	-	-	-	-	-	-	5.00	FILM	0.00	166.94	161.94
04/22/92	-	-	-	-	-	-	5.94	FILM	0.00	166.94	161.00
05/21/92	-	-	-	-	-	-	5.40	FILM	0.00	166.94	161.54
06/25/92	-	-	-	-	-	-	5.71	FILM	0.00	166.94	161.23
07/30/92	-	-	-	-	-	-	6.33	FILM	0.00	166.94	160.61
08/20/92	-	-	-	-	-	-	5.80	FILM	0.00	166.94	161.14
09/30/92	-	-	-	-	-	-	6.34	FILM	0.00	166.94	160.60
12/23/92	-	-	-	-	-	-	5.50	FILM	0.00	166.94	161.44
03/10/93	-	-	-	-	-	-	4.67	FILM	0.00	166.94	162.27
06/09/93	-	-	-	-	-	-	5.12	FILM	0.00	166.94	161.82
09/14/93	-	-	-	-	-	-	10.44	NP	0.00	166.94	156.50
12/14/93	-	-	-	-	-	-	7.52	NP	0.00	166.94	159.42
03/02/94	-	-	-	-	-	-	4.85	NP	0.00	166.94	162.09

**TABLE 1  
GROUNDWATER DATA  
THRIFTY OIL STATION #054, CASTRO VALLEY, CA.**

DATE SAMPLED	ANALYTICAL PARAMETERS						DEPTH TO GROUNDWATER (feet)	DEPTH TO PRODUCT (feet)	PRODUCT THICKNESS (feet)	CASING ELEVATION (feet)	GROUNDWATER ELEVATION (feet)
	TPH (ppb/L)	BENZENE (ug/L)	TOLUENE (ug/L)	EthylBenzene (ug/L)	XYLENE (ug/L)	MIBK (ug/L)					
06/06/94	-	-	-	-	-	-	5.20	FILM	0.00	166.94	161.74
09/06/94	-	-	-	-	-	-	9.85	FILM	0.00	166.94	157.09
12/07/94	-	-	-	-	-	-	5.20	FILM	0.00	166.94	161.74
03/08/95	-	-	-	-	-	-	4.98	FILM	0.00	166.94	161.96
06/15/95	-	-	-	-	-	-	-	-	-	-	-
09/05/95	-	-	-	-	-	-	13.72	FILM	0.00	166.94	153.22
11/21/95	32,000	46	21	66	340	-	12.53	NP	0.00	166.94	154.41
03/11/96	1,700	130	15	2.0	120	-	4.72	NP	0.00	166.94	162.22
06/19/96	1,700	230	30	0.35	100	-	5.40	NP	0.00	166.94	161.54
09/16/96	510	<0.3	0.73	<0.3	<0.5	800	5.18	NP	0.00	166.94	161.76
12/10/96	520	<0.3	<0.3	<0.3	<0.5	1,000	4.65	NP	0.00	166.94	162.29
03/12/97	420	3.2	<0.3	<0.3	11	370	3.87	NP	0.00	166.94	163.07
06/12/97	510	0.66	<0.3	<0.3	<0.5	1,600	-	-	-	-	-
09/10/97	<50	<0.3	<0.3	<0.3	<0.5	<20	5.40	NP	0.00	166.94	161.54
12/09/97	1,400	330	2.3	<0.3	1.5	2,500	4.60	NP	0.00	166.94	162.34
03/03/98	3,000	400	0.61	0.5	97	3,800	5.05	NP	0.00	166.94	161.89
07/08/98	650	<0.3	<0.3	<0.3	<0.5	1,800	-	-	-	-	-
09/10/98	2,700	<0.3	<0.3	<0.3	1.4	7,600	4.60	NP	0.00	166.94	162.34
12/30/98	530	<0.3	<0.3	<0.3	<0.5	1,500	4.20	NP	0.00	166.94	162.74
03/15/99	<50	<0.3	<0.3	<0.3	<0.5	<5	3.85	NP	0.00	166.94	163.09
06/22/99	1,200	23	1.5	<0.3	2.4	1,400	3.90	NP	0.00	166.94	163.04
09/08/99	590	1.5	<0.6	<0.6	<1	1,100	5.72	NP	0.00	166.94	161.22
12/01/99	540	<0.3	<0.3	<0.3	<0.5	880	5.34	NP	0.00	166.94	161.60
03/23/00	<50	<0.25	<0.25	<0.25	<0.5	<5	5.36	NP	0.00	166.94	161.58
06/08/00	67	<5	<5	<5	<5	<5	5.34	NP	0.00	166.94	161.60
<b>MONITORING WELL #RE-5</b>											
04/11/88	14,000	1,300	1,100	100	2,600	-	-	-	-	-	-
04/09/90	3,000	690	190	40	270	-	4.79	NP	0.00	166.51	161.72
10/30/90	3,400	910	48	87	249	-	5.86	NP	0.00	166.51	160.65
01/18/91	1,400	180	8.6	0.52	48	-	4.40	NP	0.00	166.51	162.11
02/12/91	1,000	ND	ND	0.65	ND	-	4.76	NP	0.00	166.51	161.75
03/20/91	3,000	250	53	ND	110	-	5.08	NP	0.00	166.51	161.43
05/22/91	2,500	330	7.8	5.6	200	-	4.52	NP	0.00	166.51	161.99

**TABLE 1  
GROUNDWATER DATA  
THRIFTY OIL STATION #054, CASTRO VALLEY, CA.**

DATE SAMPLED	ANALYTICAL PARAMETERS						DEPTH TO GROUNDWATER (feet)	DEPTH TO PRODUCT (feet)	PRODUCT THICKNESS (feet)	CASING ELEVATION (feet)	GROUNDWATER ELEVATION (feet)
	TUH (ug/L)	BENZENE (ug/L)	TOLUENE (ug/L)	Ethylbenzene (ug/L)	XYLENE (ug/L)	MIBK (ug/L)					
01/19/91	2,000	59	1.6	5.1	110	-	4.39	NP	0.00	166.51	162.12
07/17/91	-	-	-	-	-	-	5.05	FILM	0.00	166.51	161.46
08/07/91	-	-	-	-	-	-	5.02	FILM	0.00	166.51	161.49
09/24/91	-	-	-	-	-	-	5.86	FILM	0.00	166.51	160.65
10/23/91	-	-	-	-	-	-	5.84	FILM	0.00	166.51	160.67
11/06/91	9,900	2,300	37	260	160	-	5.48	NP	0.00	166.51	161.03
12/04/91	4,500	1,000	27	ND	180	-	5.43	NP	0.00	166.51	161.08
01/29/92	600	6.1	2.3	ND	47	-	5.12	NP	0.00	166.51	161.39
02/26/92	500	5.4	2.7	1.2	14	-	4.93	NP	0.00	166.51	161.58
03/19/92	ND	1.7	1.1	ND	5.5	-	4.45	NP	0.00	166.51	162.06
04/22/92	1,600	240	2.2	ND	160	-	4.63	NP	0.00	166.51	161.88
05/21/92	1,200	410	37	ND	118	-	4.90	NP	0.00	166.51	161.61
06/25/92	ND	1.0	0.8	0.8	0.4	-	5.15	NP	0.00	166.51	161.36
07/30/92	ND	2.0	1.8	1.9	6.4	-	5.30	NP	0.00	166.51	161.21
08/20/92	300	1.7	3.3	0.7	12	-	5.44	NP	0.00	166.51	161.07
09/30/92	1,900	140	ND	19	35	-	5.73	NP	0.00	166.51	160.78
12/23/92	400	8.0	ND	ND	ND	-	4.75	NP	0.00	166.51	161.76
03/10/93	1,100	290	9.7	ND	75	-	4.14	NP	0.00	166.51	162.37
06/09/93	400	1.5	0.5	ND	12	-	5.42	NP	0.00	166.51	161.09
09/14/93	240	6.9	8.8	1.4	67	-	5.53	NP	0.00	166.51	160.98
12/14/93	3,300	510	5.4	4.1	55	-	478	NP	0.00	166.51	-311.49
03/02/94	2,400	270	4.5	<0.3	13	-	4.20	NP	0.00	166.51	162.31
06/06/94	730	<0.3	<0.3	0.70	22	-	5.13	NP	0.00	166.51	161.38
09/06/94	2,400	180	28	2.3	76	-	5.45	NP	0.00	166.51	161.06
12/07/94	540	5.6	<0.3	<0.5	6.9	-	4.13	NP	0.00	166.51	162.38
03/08/95	1,500	220	5.5	<0.5	83	-	5.20	NP	0.00	166.51	161.31
06/15/95	3,200	820	53	6.2	74	-	4.93	NP	0.00	166.51	161.58
09/05/95	4,400	440	22	<2.5	57	-	5.03	NP	0.00	166.51	161.48
11/21/95	660	3.4	<0.3	<0.3	0.6	-	5.23	NP	0.00	166.51	161.28
03/11/96	1,000	76	2.2	<0.3	130	-	4.16	NP	0.00	166.51	162.35
06/09/96	90	<0.3	<0.3	<0.3	<0.5	-	5.42	NP	0.00	166.51	161.09
09/16/96	1,900	5.8	<0.3	<0.3	5.9	1,100	5.20	NP	0.00	166.51	161.31
12/10/96	740	<0.3	<0.3	<0.3	<0.5	1,300	5.27	NP	0.00	166.51	161.24
03/12/97	2,000	600	59	5.1	54	1,300	3.85	NP	0.00	166.51	162.66
06/12/97	230	<0.3	<0.3	<0.3	<0.5	720	-	-	-	-	-

**TABLE 1**  
**GROUNDWATER DATA**  
**THRIFTY OIL STATION #054, CASTRO VALLEY, CA.**

DATE SAMPLED	ANALYTICAL PARAMETERS						DEPTH TO GROUNDWATER (feet)	DEPTH TO PRODUCT (feet)	PRODUCT THICKNESS (feet)	CASING ELEVATION (feet)	GROUNDWATER ELEVATION (feet)
	THH (ug/L)	BENZENE (ug/L)	TOLENE (ug/L)	EthylBenzene (ug/L)	XYLENE (ug/L)	MTBE (ug/L)					
09/10/97	210	<0.3	<0.3	<0.3	<0.5	210	4.10	NP	0.00	166.51	162.41
12/09/97	11,000	2,500	2,700	<6	1,500	510	5.20	NP	0.00	166.51	161.31
03/03/98	<50	<0.3	<0.3	<0.3	<0.5	<20	3.70	NP	0.00	166.51	162.81
07/08/98	<50	<0.3	<0.3	<0.3	<0.5	<5	-	-	-	-	-
09/10/98	<50	<0.3	<0.3	<0.3	<0.5	<5	6.77	NP	0.00	166.51	159.74
12/30/98	<50	<0.3	<0.3	<0.3	<0.5	<5	5.95	NP	0.00	166.51	160.56
03/15/99	<50	<0.3	<0.3	<0.3	<0.5	<5	5.25	NP	0.00	166.51	161.26
06/22/99	110	<0.3	<0.3	<0.3	<0.5	200	4.50	NP	0.00	166.51	162.01
09/08/99	68	<0.3	<0.3	<0.3	<0.5	110	4.43	NP	0.00	166.51	162.08
12/01/99	<50	<0.3	<0.3	<0.3	<0.5	<5	3.66	NP	0.00	166.51	162.85
03/23/00	<50	<0.25	<0.25	<0.25	<0.5	<5	4.06	NP	0.00	166.51	162.45
06/08/00	<50	<5	<5	<5	<5	<5	4.43	NP	0.00	166.51	162.08
<b>MONITORING WELL #RE-6</b>											
04/11/88	6,000	3,000	40	80	140	-	-	-	-	-	-
04/09/90	3,000	990	ND	70	ND	-	5.64	NP	0.00	166.51	160.87
10/30/90	3,400	1,000	28	ND	ND	-	6.68	NP	0.00	166.51	159.83
01/18/91	6,300	1,200	ND	3.0	15	-	6.61	NP	0.00	166.51	159.90
02/12/91	5,200	850	8.4	4.9	41	-	6.20	NP	0.00	166.51	160.31
03/20/91	5,800	680	12	8.0	16	-	5.62	NP	0.00	166.51	160.89
05/22/91	8,500	1,700	14	24	6.7	-	6.05	NP	0.00	166.51	160.46
06/19/91	-	-	-	-	-	-	6.12	FILM	0.00	166.51	160.39
07/17/91	120,000	9,300	13,000	2,400	16,000	-	6.20	NP	0.00	166.51	160.31
08/07/91	-	590	5.3	ND	14	-	6.27	NP	0.00	166.51	160.24
09/24/91	7,000	310	11	5.3	35	-	6.63	NP	0.00	166.51	159.88
10/23/91	-	-	-	-	-	-	6.36	FILM	0.00	166.51	160.15
11/06/91	4,000	710	18	29	49	-	6.15	NP	0.00	166.51	160.36
12/04/91	4,100	1,100	14	33	39	-	6.19	NP	0.00	166.51	160.32
01/29/92	2,600	790	14	ND	49	-	6.70	NP	0.00	166.51	159.81
02/26/92	3,100	950	21	30	33	-	5.44	NP	0.00	166.51	161.07
03/19/92	2,200	630	14	12	40	-	5.30	NP	0.00	166.51	161.21
04/22/92	-	730	2.2	ND	40	-	6.00	NP	0.00	166.51	160.51
05/21/92	1,500	840	7.8	7.1	34	-	6.25	NP	0.00	166.51	160.26
06/25/92	<2000	740	8.0	27	28	-	6.38	NP	0.00	166.51	160.13

**TABLE 1  
GROUNDWATER DATA  
THRIFTY OIL STATION #054, CASTRO VALLEY, CA.**

DATE SAMPLED	ANALYTICAL PARAMETERS						DEPTH TO GROUNDWATER (feet)	DEPTH TO PRODUCT (feet)	PRODUCT THICKNESS (feet)	CASING ELEVATION (feet)	GROUNDWATER ELEVATION (feet)
	TPH (µg/L)	BENZENE (µg/L)	TOLUENE (µg/L)	EthylBenzene (µg/L)	XYLENE (µg/L)	MIBC (µg/L)					
07/30/92	-	-	-	-	-	-	6.42	FILM	0.00	166.51	160.09
08/20/92	2,800	630	17	23	22	-	6.50	NP	0.00	166.51	160.01
09/30/92	7,800	540	ND	12	29	-	6.66	NP	0.00	166.51	159.85
12/23/92	1,800	350	ND	7.7	11	-	5.83	NP	0.00	166.51	160.68
03/10/93	3,000	830	5.6	19	16	-	5.63	NP	0.00	166.51	160.88
06/09/93	4,800	920	6.2	3.2	12	-	6.01	NP	0.00	166.51	160.50
09/14/93	3,600	660	7.5	11	27	-	6.53	NP	0.00	166.51	159.98
12/14/93	1,500	200	<0.3	<0.3	8.8	-	3.58	NP	0.00	166.51	162.93
03/02/94	-	-	-	-	-	-	5.12	NP	0.00	166.51	161.39
06/06/94	2,400	290	4.6	1.3	24	-	1.85	NP	0.00	166.51	164.66
09/06/94	4,300	230	21	<6.6	130	-	6.40	NP	0.00	166.51	160.11
12/07/94	1,500	17	2.5	3.2	22	-	5.68	NP	0.00	166.51	160.83
03/08/95	2,500	460	5.5	2.1	51	-	5.12	NP	0.00	166.51	161.39
06/15/95	2,300	91	1.1	0.7	97	-	5.72	NP	0.00	166.51	160.79
09/05/95	3,300	60	<10	<10	74	-	5.94	NP	0.00	166.51	160.57
11/21/95	2,000	7.3	<0.3	0.56	8.7	-	6.24	NP	0.00	166.51	160.27
03/11/96	840	43	0.96	5.7	14	-	5.16	NP	0.00	166.51	161.35
06/19/96	1,800	160	2.7	9.9	25	-	5.80	NP	0.00	166.51	160.71
09/16/96	<50	<0.3	<0.3	<0.3	<0.5	<20	5.38	NP	0.00	166.51	161.13
12/10/96	<50	<0.3	<0.3	<0.3	<0.5	<20	5.62	NP	0.00	166.51	160.89
03/12/97	<50	<0.3	<0.3	<0.3	<0.5	<20	5.20	NP	0.00	166.51	161.31
06/12/97	<50	<0.3	<0.3	<0.3	<0.5	<20	-	-	-	-	-
09/10/97	440	<0.3	<0.3	<0.3	<0.5	320	5.20	NP	0.00	166.51	161.31
12/09/97	<50	<0.3	<0.3	<0.3	<0.5	<20	5.97	NP	0.00	166.51	160.54
03/03/98	400	7.0	<0.3	<0.3	4.3	65	4.45	NP	0.00	166.51	162.06
07/08/98	300	<0.3	<0.3	<0.3	1.0	35	-	-	-	-	-
09/10/98	<50	<0.3	<0.3	<0.3	<0.5	<5	5.90	NP	0.00	166.51	160.61
12/30/98	<50	<0.3	<0.3	<0.3	<0.5	<5	5.20	NP	0.00	166.51	161.31
03/15/99	<50	<0.3	<0.3	<0.3	<0.5	8.4	4.82	NP	0.00	166.51	161.69
06/22/99	700	11	1.9	<0.3	3.9	140	6.00	NP	0.00	166.51	160.51
09/08/99	<50	<0.3	<0.3	<0.3	<0.5	<5	5.15	NP	0.00	166.51	161.36
12/01/99	<50	<0.3	<0.3	<0.3	<0.5	12	4.02	NP	0.00	166.51	162.49
03/23/00	<50	<0.25	<0.25	<0.25	<0.5	<5	4.41	NP	0.00	166.51	162.10
06/08/00	<50	<5	<5	<5	<5	<5	4.78	NP	0.00	166.51	161.73

**TABLE 1**  
**GROUNDWATER DATA**  
**THRIFTY OIL STATION #054, CASTRO VALLEY, CA.**

DATE SAMPLED	ANALYTICAL PARAMETERS						DEPTH TO GROUNDWATER (feet)	DEPTH TO PRODUCT (feet)	PRODUCT THICKNESS (feet)	CASING ELEVATION (feet)	GROUNDWATER ELEVATION (feet)
	TPH (ug/L)	BENZENE (ug/L)	TOLUENE (ug/L)	EthylBenzene (ug/L)	XYLENE (ug/L)	MTBE (ug/L)					
<b>MONITORING WELL #RE-7</b>											
04/11/88	<50,000	17,000	4,400	600	8,400	-	-	-	-	-	-
04/09/90	16,000	7,000	1,200	640	1,600	-	5.93	NP	0.00	166.04	160.11
10/30/90	31,000	14,000	ND	ND	ND	-	8.21	NP	0.00	166.04	157.83
01/18/91	-	-	-	-	-	-	11.80	NP	0.00	166.04	154.24
02/12/91	-	-	-	-	-	-	10.80	FILM	0.00	166.04	155.24
03/20/91	120,000	12,000	2,800	490	6,600	-	9.96	NP	0.00	166.04	156.08
05/22/91	-	-	-	-	-	-	11.70	FILM	0.00	166.04	154.34
06/19/91	-	-	-	-	-	-	11.50	FILM	0.00	166.04	154.54
07/17/91	-	-	-	-	-	-	7.80	FILM	0.00	166.04	158.24
08/07/91	-	-	-	-	-	-	9.88	0.03	9.85	166.04	163.60
09/24/91	-	-	-	-	-	-	9.85	0.03	9.82	166.04	163.60
10/23/91	-	-	-	-	-	-	9.96	FILM	0.00	166.04	156.08
11/06/91	-	-	-	-	-	-	6.77	FILM	0.00	166.04	159.27
12/04/91	-	-	-	-	-	-	10.80	FILM	0.00	166.04	155.24
01/29/92	-	-	-	-	-	-	8.64	FILM	0.00	166.04	157.40
02/26/92	-	-	-	-	-	-	6.00	FILM	0.00	166.04	160.04
03/19/92	-	-	-	-	-	-	5.55	FILM	0.00	166.04	160.49
04/22/92	-	-	-	-	-	-	6.12	FILM	0.00	166.04	159.92
05/21/92	-	-	-	-	-	-	6.40	FILM	0.00	166.04	159.64
06/25/92	-	-	-	-	-	-	6.73	0.02	6.71	166.04	164.38
07/30/92	-	-	-	-	-	-	6.73	FILM	0.00	166.04	159.31
08/20/92	-	-	-	-	-	-	6.82	FILM	0.00	166.04	159.22
09/30/92	-	-	-	-	-	-	7.26	FILM	0.00	166.04	158.78
12/23/92	-	-	-	-	-	-	6.22	FILM	0.00	166.04	159.82
03/10/93	-	-	-	-	-	-	5.82	FILM	0.00	166.04	160.22
06/09/93	-	-	-	-	-	-	6.17	FILM	0.00	166.04	159.87
09/14/93	-	-	-	-	-	-	11.33	NP	0.00	166.04	154.71
12/14/93	-	-	-	-	-	-	8.40	NP	0.00	166.04	157.64
03/02/94	-	-	-	-	-	-	6.82	NP	0.00	166.04	159.22
06/06/94	-	-	-	-	-	-	10.95	FILM	0.00	166.04	155.09
09/06/94	-	-	-	-	-	-	11.30	FILM	0.00	166.04	154.74
12/07/94	-	-	-	-	-	-	5.63	FILM	0.00	166.04	160.41
03/08/95	-	-	-	-	-	-	5.06	FILM	0.00	166.04	160.98
06/15/95	-	-	-	-	-	-	-	-	-	-	-

**TABLE 1  
GROUNDWATER DATA  
THRIFTY OIL STATION #054, CASTRO VALLEY, CA.**

DATE SAMPLED	ANALYTICAL PARAMETERS						DEPTH TO GROUNDWATER (feet)	DEPTH TO PRODUCT (feet)	PRODUCT THICKNESS (feet)	CASING ELEVATION (feet)	GROUNDWATER ELEVATION (feet)
	UPH (µg/L)	BENZENE (µg/L)	TOLUENE (µg/L)	EthylBenzene (µg/L)	XYLENE (µg/L)	MIBK (µg/L)					
09/05/95	-	-	-	-	-	-	7.98	FILM	0.00	166.04	158.06
11/21/95	20,000	8,800	110	<30	310	-	7.32	NP	0.00	166.04	158.72
03/11/96	4,800	2,200	38	26	120	-	5.62	NP	0.00	166.04	160.42
06/19/96	4,400	3,300	49	5.8	70	-	6.40	NP	0.00	166.04	159.64
09/19/96	7,200	510	83	<0.3	710	130	6.20	NP	0.00	166.04	159.84
12/10/96	700	<0.3	<0.3	<0.3	<0.5	1,400	5.92	NP	0.00	166.04	160.12
03/12/97	660	0.31	<0.3	<0.3	<0.5	1,400	5.62	NP	0.00	166.04	160.42
06/12/97	320	<0.3	0.45	<0.3	<0.5	850	-	-	-	-	-
09/10/97	780	<0.3	<0.3	<0.3	<0.5	930	7.45	NP	0.00	166.04	158.59
12/09/97	14,000	3,500	3,700	<15	2,100	1,100	7.10	NP	0.00	166.04	158.94
03/03/98	6,100	2,500	18	<6	110	270	6.70	NP	0.00	166.04	159.34
07/08/98	1,300	8.7	<0.3	<0.3	<0.5	350	-	-	-	-	-
09/10/98	690	2.2	<0.3	<0.3	<0.5	350	7.04	NP	0.00	166.04	159.00
12/30/98	600	2.0	0.55	<0.3	<0.5	350	6.25	NP	0.00	166.04	159.79
03/15/99	350	0.71	<0.3	<0.3	<0.5	140	6.02	NP	0.00	166.04	160.02
06/22/99	5,900	2,100	16	4.6	48	170	6.35	NP	0.00	166.04	159.69
09/08/99	1,700	380	<3	<3	13	160	7.03	NP	0.00	166.04	159.01
12/01/99	930	3.7	<0.3	<0.3	<0.5	390	6.25	NP	0.00	166.04	159.79
03/23/00	581	5.4	5.3	1.9	7.3	*168/183	6.24	NP	0.00	166.04	159.80
06/08/00	<100	<5	<5	<5	<5	74	6.64	NP	0.00	166.04	159.40
<b>MONITORING WELL #RS-2</b>											
08/07/91	ND	ND	ND	ND	ND	-	9.68	NP	0.00	164.32	154.64
09/27/91	ND	ND	ND	ND	ND	-	9.89	NP	0.00	164.32	154.43
10/23/91	ND	ND	ND	ND	ND	-	10.05	NP	0.00	164.32	154.27
11/06/91	ND	ND	ND	ND	ND	-	9.71	NP	0.00	164.32	154.61
12/04/91	ND	ND	ND	ND	ND	-	10.00	NP	0.00	164.32	154.32
01/29/92	ND	2.1	1.0	2.5	3.6	-	9.28	NP	0.00	164.32	155.04
02/26/92	ND	ND	0.7	ND	0.7	-	7.05	NP	0.00	164.32	157.27
03/19/92	ND	0.5	1.0	1.5	2.7	-	7.30	NP	0.00	164.32	157.02
04/22/92	ND	ND	ND	ND	ND	-	8.60	NP	0.00	164.32	155.72
05/21/92	ND	ND	ND	ND	ND	-	9.22	NP	0.00	164.32	155.10
06/25/92	ND	ND	ND	ND	ND	-	9.49	NP	0.00	164.32	154.83
07/30/92	ND	1.1	4.2	ND	3.0	-	9.55	NP	0.00	164.32	154.77



**TABLE 1**  
**GROUNDWATER DATA**  
**THRIFTY OIL STATION #054, CASTRO VALLEY, CA.**

DATE SAMPLED	ANALYTICAL PARAMETERS						DEPTH TO GROUNDWATER (feet)	DEPTH TO PRODUCT (feet)	PRODUCT THICKNESS (feet)	CASING ELEVATION (feet)	GROUNDWATER ELEVATION (feet)
	TPH (ug/L)	BENZENE (ug/L)	TOLUENE (ug/L)	EthylBenzene (ug/L)	XYLENE (ug/L)	MIBK (ug/L)					
08/20/92	ND	2.0	4.7	ND	5.7	-	9.63	NP	0.00	164.32	154.69
09/30/92	ND	ND	ND	ND	ND	-	9.90	NP	0.00	164.32	154.42
12/23/92	ND	ND	ND	ND	ND	-	9.96	NP	0.00	164.32	154.36
05/10/93	ND	ND	ND	ND	ND	-	8.95	NP	0.00	164.32	155.37
06/09/93	ND	ND	ND	ND	ND	-	9.00	NP	0.00	164.32	155.32
09/14/93	200	0.3	ND	ND	ND	-	9.50	NP	0.00	164.32	154.82
12/14/93	ND	ND	ND	ND	ND	-	8.75	NP	0.00	164.32	155.57
03/02/94	<50	<0.3	<0.3	<0.3	<0.5	-	7.52	NP	0.00	164.32	156.80
06/06/94	54	<0.3	<0.3	<0.3	2.4	-	9.00	NP	0.00	164.32	155.32
09/06/94	<50	<0.3	<0.3	<0.3	<0.5	-	9.26	NP	0.00	164.32	155.06
12/07/94	130	2.5	1.9	1.3	3.6	-	8.67	NP	0.00	164.32	155.65
03/08/95	<100	<0.5	<0.5	<0.5	<1	-	8.34	NP	0.00	164.32	155.98
06/15/95	<100	1.0	<0.5	<0.5	<1	-	9.12	NP	0.00	164.32	155.20
09/05/95	<100	<0.5	<0.5	<0.5	<1	-	9.56	NP	0.00	164.32	154.76
11/21/95	<50	0.44	<0.3	<0.3	1.5	-	9.28	NP	0.00	164.32	155.04
03/11/96	<50	1.3	<0.3	<0.3	0.6	-	7.52	NP	0.00	164.32	156.80
06/19/96	640	72	20	34	150	-	7.80	NP	0.00	164.32	156.52
09/16/96	<50	<0.3	<0.3	<0.3	<0.5	20	9.18	NP	0.00	164.32	155.14
12/10/96	<50	<0.3	<0.3	<0.3	<0.5	<20	6.08	NP	0.00	164.32	158.24
03/12/97	53	0.45	<0.3	<0.3	<0.5	140	8.65	NP	0.00	164.32	155.67
06/12/97	<50	<0.3	<0.3	<0.3	<0.5	68	-	-	-	-	-
09/10/97	<50	<0.3	<0.3	<0.3	<0.5	<20	8.30	NP	0.00	164.32	156.02
12/09/97	<50	1.7	2.1	<0.3	1.4	82	9.98	NP	0.00	164.32	154.34
03/03/98	<50	<0.3	<0.3	<0.3	<0.5	84	8.33	NP	0.00	164.32	155.99
07/08/98	<50	<0.3	<0.3	<0.3	<0.5	97	-	-	-	-	-
09/10/98	<50	<0.3	<0.3	<0.3	<0.5	97	12.95	NP	0.00	164.32	151.37
12/30/98	<50	1.3	1.5	<0.3	0.86	19	11.35	NP	0.00	164.32	152.97
03/15/99	<50	<0.3	<0.3	<0.3	<0.5	9.6	9.85	NP	0.00	164.32	154.47
06/22/99	66	0.39	<0.3	<0.3	<0.5	62	9.90	NP	0.00	164.32	154.42
09/08/99	<50	<0.3	<0.3	<0.3	<0.5	25	9.85	NP	0.00	164.32	154.47
12/01/99	<50	<0.3	<0.3	<0.3	<0.5	30	8.30	NP	0.00	164.32	156.02
03/23/00	<50	<0.25	<0.25	<0.25	<0.5	*13.6/18.2	6.76	NP	0.00	164.32	157.56
06/08/00	<50	<5	<5	<5	<5	10	8.30	NP	0.00	164.32	156.02

**TABLE 1**  
**GROUNDWATER DATA**  
**THRIFTY OIL STATION #054, CASTRO VALLEY, CA.**

DATE SAMPLED	ANALYTICAL PARAMETERS						DEPTH TO GROUNDWATER (feet)	DEPTH TO PRODUCT (feet)	PRODUCT THICKNESS (feet)	CASING ELEVATION (feet)	GROUNDWATER ELEVATION (feet)
	TPE (ug/l)	BENZENE (ug/l)	TOLUENE (ug/l)	ETHYLBENZENE (ug/l)	XYLENE (ug/l)	MIBK (ug/l)					
<b>MONITORING WELLS 2</b>											
08/07/91	-	0.5	ND	330	1,200	-	2.28	NP	0.00	167.51	165.23
09/27/91	13,000	3.5	3.0	82	140	-	2.77	NP	0.00	167.51	164.74
10/23/91	11,000	ND	ND	39	340	-	3.53	NP	0.00	167.51	163.98
11/06/91	6,800	8.4	0.6	22	230	-	2.51	NP	0.00	167.51	165.00
12/04/91	6,500	6.5	0.7	87	200	-	3.20	NP	0.00	167.51	164.31
01/29/92	8,100	22	10	140	260	-	2.65	NP	0.00	167.51	164.86
02/26/92	13,000	40	16	220	600	-	3.42	NP	0.00	167.51	164.09
03/19/92	12,000	21	12	100	280	-	3.12	NP	0.00	167.51	164.39
04/22/92	8,600	ND	ND	20	37	-	3.24	NP	0.00	167.51	164.27
05/21/92	6,000	21	10	53	210	-	3.75	NP	0.00	167.51	163.76
06/25/92	370	2.3	1.5	0.7	4.3	-	2.65	NP	0.00	167.51	164.86
07/30/92	3,600	20	ND	39	80	-	2.70	NP	0.00	167.51	164.81
08/20/92	3,000	0.7	5.2	2.0	5.3	-	2.83	NP	0.00	167.51	164.68
09/30/92	9,200	4.8	6.5	12	91	-	2.80	NP	0.00	167.51	164.71
12/23/92	2,000	17	ND	8.2	18	-	2.45	NP	0.00	167.51	165.06
03/10/93	1,500	ND	2.6	21	12	-	2.40	NP	0.00	167.51	165.11
06/09/93	1,300	0.6	1.7	ND	7.5	-	3.55	NP	0.00	167.51	163.96
09/14/93	1,500	1.3	7.6	4.1	14	-	2.81	NP	0.00	167.51	164.70
12/14/93	560	ND	ND	ND	5.5	-	2.63	NP	0.00	167.51	164.88
03/02/94	1,100	<0.3	<0.3	<0.3	<0.5	-	2.60	NP	0.00	167.51	164.91
06/06/94	290	0.58	0.53	1.1	5.8	-	2.52	NP	0.00	167.51	164.99
09/06/94	890	<0.3	<0.3	<0.3	3.1	-	3.16	NP	0.00	167.51	164.35
12/07/94	940	22	23	10	32	-	5.18	NP	0.00	167.51	162.33
03/08/95	1,600	<0.5	<0.5	<0.5	2.3	-	4.57	NP	0.00	167.51	162.94
06/15/95	3,200	2.2	5.3	4.3	3.1	-	5.08	NP	0.00	167.51	162.43
09/05/95	1,100	<0.5	<0.5	<0.5	<1	-	5.72	NP	0.00	167.51	161.79
11/21/95	1,100	1.1	2.9	3.5	3.0	-	2.46	NP	0.00	167.51	165.05
03/11/96	440	0.7	0.34	<0.3	3.7	-	3.44	NP	0.00	167.51	164.07
06/19/96	580	3.8	0.49	1.2	<0.5	-	3.80	NP	0.00	167.51	163.71
09/16/96	490	<0.3	1.6	<0.3	<0.5	<20	3.80	NP	0.00	167.51	163.71
12/10/96	<50	<0.3	<0.3	<0.3	<0.5	<20	2.76	NP	0.00	167.51	164.75
03/12/97	<50	<0.3	0.42	<0.3	1.5	<20	3.20	NP	0.00	167.51	164.31
06/12/97	<50	<0.3	<0.3	<0.3	0.51	<20	-	-	-	-	-
09/10/97	<50	<0.3	<0.3	<0.3	<0.5	<20	4.24	NP	0.00	167.51	163.27

**TABLE 1  
GROUNDWATER DATA  
THRIFTY OIL STATION #054, CASTRO VALLEY, CA.**

DATE SAMPLED	ANALYTICAL PARAMETERS						DEPTH TO GROUNDWATER (feet)	DEPTH TO PRODUCT (feet)	PRODUCT THICKNESS (feet)	CASING ELEVATION (feet)	GROUNDWATER ELEVATION (feet)
	TPH (ppm)	BENZENE (ppm)	TOLUENE (ppm)	o,m,p-Xylene (ppm)	o,p-Xylene (ppm)	ETHB (ppm)					
12/09/97	<50	<0.3	0.48	<0.3	<0.5	<20	2.72	NP	0.00	167.51	164.79
03/03/98	190	<0.3	<0.3	0.38	<0.5	<20	1.90	NP	0.00	167.51	165.61
07/08/98	<50	<0.3	<0.3	<0.3	<0.5	<5	-	-	-	-	-
09/10/98	<50	<0.3	<0.3	<0.3	<0.5	<5	2.72	NP	0.00	167.51	164.79
12/30/98	<50	<0.3	<0.3	<0.3	<0.5	<5	1.20	NP	0.00	167.51	166.31
03/15/99	<50	<0.3	<0.3	<0.3	<0.5	<5	4.25	NP	0.00	167.51	163.26
06/22/99	1,300	4.2	1.2	0.69	0.74	<5	3.70	NP	0.00	167.51	163.81
09/08/99	<50	<0.3	<0.3	<0.3	<0.5	<5	2.71	NP	0.00	167.51	164.80
12/01/99	<50	<0.3	<0.3	<0.3	<0.5	<5	2.70	NP	0.00	167.51	164.81
03/23/00	<50	<0.25	<0.25	<0.25	<0.5	<5	2.70	NP	0.00	167.51	164.81
06/08/00	585	<5	<5	<5	<5	821	2.72	NP	0.00	167.51	164.79
<b>MONITORING WELLS 0RS-10</b>											
08/07/91	ND	ND	ND	ND	ND	-	6.16	NP	0.00	162.89	156.73
09/27/91	ND	ND	ND	ND	ND	-	6.48	NP	0.00	162.89	156.41
10/23/91	ND	ND	ND	ND	ND	-	7.37	NP	0.00	162.89	155.52
11/06/91	ND	ND	ND	ND	ND	-	6.44	NP	0.00	162.89	156.45
12/04/91	ND	ND	ND	ND	ND	-	7.02	NP	0.00	162.89	155.87
01/29/92	ND	ND	ND	ND	ND	-	6.78	NP	0.00	162.89	156.11
02/26/92	ND	ND	ND	ND	ND	-	8.33	NP	0.00	162.89	154.56
03/19/92	ND	ND	ND	ND	0.6	-	8.02	NP	0.00	162.89	154.87
04/22/92	ND	ND	ND	ND	ND	-	7.78	NP	0.00	162.89	155.11
05/21/92	ND	ND	0.6	ND	1.2	-	6.21	NP	0.00	162.89	156.68
06/25/92	ND	ND	ND	ND	ND	-	7.73	NP	0.00	162.89	155.16
07/30/92	ND	ND	0.5	ND	1.0	-	7.84	NP	0.00	162.89	155.05
08/20/92	ND	ND	ND	ND	ND	-	7.50	NP	0.00	162.89	155.39
09/30/92	ND	ND	ND	ND	ND	-	7.63	NP	0.00	162.89	155.26
12/23/92	ND	ND	ND	ND	ND	-	7.24	NP	0.00	162.89	155.65
03/10/93	ND	ND	ND	ND	ND	-	6.38	NP	0.00	162.89	156.51
06/09/93	ND	ND	ND	ND	ND	-	7.98	NP	0.00	162.89	154.91
09/14/93	ND	ND	ND	ND	ND	-	7.35	NP	0.00	162.89	155.54
03/02/94	<50	<0.3	<0.3	<0.3	<0.3	-	7.00	NP	0.00	162.89	155.89
06/06/94	<50	<0.3	<0.3	<0.3	<0.5	-	6.55	NP	0.00	162.89	156.34
09/06/94	<50	<0.3	<0.3	<0.3	<0.5	-	7.63	NP	0.00	162.89	155.26

**TABLE 1  
GROUNDWATER DATA  
THRIFTY OIL STATION #054, CASTRO VALLEY, CA.**

DATE SAMPLED	ANALYTICAL PARAMETERS						DEPTH TO GROUNDWATER (feet)	DEPTH TO PRODUCT (feet)	PRODUCT THICKNESS (feet)	CASING ELEVATION (feet)	GROUNDWATER ELEVATION (feet)
	TPH (ug/L)	BENZ/NI (ug/L)	TOLUENE (ug/L)	EthylBenzene (ug/L)	XYLENE (ug/L)	MTBE (ug/L)					
12/07/94	56	<0.3	<0.3	<0.5	2.1	-	5.92	NP	0.00	162.89	156.97
03/08/95	<100	<0.5	<0.5	<0.5	<1	-	7.84	NP	0.00	162.89	155.05
06/15/95	<100	<0.5	<0.5	<0.5	<1	-	6.97	NP	0.00	162.89	155.92
09/05/95	<100	<0.5	<0.5	<0.5	<1	-	8.14	NP	0.00	162.89	154.75
11/21/95	<50	<0.3	<0.3	<0.3	<0.5	-	7.68	NP	0.00	162.89	155.21
03/11/96	<50	<0.3	<0.3	<0.3	<0.5	-	6.76	NP	0.00	162.89	156.13
06/19/96	<50	<0.3	<0.3	<0.3	<0.5	-	7.20	NP	0.00	162.89	155.69
09/16/96	<50	<0.3	<0.3	<0.3	<0.5	<20	6.30	NP	0.00	162.89	156.59
12/10/96	<50	<0.3	<0.3	<0.3	<0.5	<20	6.05	NP	0.00	162.89	156.84
03/12/97	<50	<0.3	<0.3	<0.3	<0.5	<20	7.56	NP	0.00	162.89	155.33
06/12/97	<50	<0.3	<0.3	<0.3	<0.5	<20	-	-	-	-	-
09/10/97	<50	<0.3	<0.3	<0.3	<0.5	<20	7.55	NP	0.00	162.89	155.34
12/09/97	1,900	610	510	<6	290	<20	7.55	NP	0.00	162.89	155.34
03/03/98	<50	2.0	<0.3	<0.3	<0.5	27	6.03	NP	0.00	162.89	156.86
07/08/98	<50	<0.3	<0.3	<0.3	<0.5	<5	-	-	-	-	-
09/10/98	<50	<0.3	<0.3	<0.3	<0.5	72	7.55	NP	0.00	162.89	155.34
12/30/98	<50	1.1	<0.3	<0.3	<0.5	<5	4.45	NP	0.00	162.89	158.44
03/15/99	<50	<0.3	<0.3	<0.3	1.3	<5	4.50	NP	0.00	162.89	158.39
06/22/99	<50	<0.3	<0.3	<0.3	<0.5	<5	9.15	NP	0.00	162.89	153.74
09/08/99	<50	<0.3	<0.3	<0.3	<0.5	<5	7.51	NP	0.00	162.89	155.38
12/01/99	<50	<0.3	<0.3	<0.3	<0.5	<5	5.97	NP	0.00	162.89	156.92
03/23/00	<50	<0.25	<0.25	<0.25	<0.5	<5	4.47	NP	0.00	162.89	158.42
06/08/00	<50	<5	<5	<5	<5	<5	5.97	NP	0.00	162.89	156.92
<b>MONITORING WELL #S II</b>											
09/21/95	110	<0.5	<0.5	<0.5	<1	-	9.37	NP	0.00	163.28	153.91
11/21/95	-	-	-	-	-	-	-	-	-	-	-
03/11/96	-	-	-	-	-	-	-	-	-	-	-
06/19/96	-	-	-	-	-	-	-	-	-	-	-
09/16/96	-	-	-	-	-	-	-	-	-	-	-
03/12/97	74	9.5	<0.3	<0.3	0.57	<20	7.75	NP	0.00	163.28	155.53
06/12/97	<50	<0.3	<0.3	<0.3	<0.5	<20	-	-	-	-	-
09/10/97	<50	<0.3	<0.3	<0.3	<0.5	<20	9.50	NP	0.00	163.28	153.78
12/09/97	<50	0.79	1.2	<0.3	<0.5	<20	9.50	NP	0.00	163.28	153.78

**TABLE 1  
GROUNDWATER DATA  
THRIFTY OIL STATION #054, CASTRO VALLEY, CA.**

DATE SAMPLED	ANALYTICAL PARAMETERS						DEPTH TO GROUNDWATER (feet)	DEPTH TO PRODUCT (feet)	PRODUCT THICKNESS (feet)	CASING ELEVATION (feet)	GROUNDWATER ELEVATION (feet)
	TPH (ug/L)	BENZENE (ug/L)	TOLUENE (ug/L)	EthylBenzene (ug/L)	XYLENE (ug/L)	MTBE (ug/L)					
03/03/98	140	22	0.63	<0.3	<0.5	<20	7.93	NP	0.00	163.28	155.35
07/08/98	<50	<0.3	<0.3	<0.3	<0.5	<5	-	-	-	-	-
09/10/98	<50	<0.3	<0.3	<0.3	<0.5	<5	9.48	NP	0.00	163.28	153.80
12/30/98	<50	1.3	0.87	<0.3	0.55	<5	7.95	NP	0.00	163.28	155.33
03/15/99	<50	<0.3	<0.3	<0.3	<0.5	<5	6.40	NP	0.00	163.28	156.88
06/22/99	350	89	2.9	3.3	0.91	6.8	11.00	NP	0.00	163.28	152.28
09/08/99	99	9.1	0.37	<0.3	<0.5	<5	7.90	NP	0.00	163.28	155.38
12/01/99	82	9.7	0.44	<0.3	<0.5	<5	7.90	NP	0.00	163.28	155.38
03/23/00	73	5.8	2.3	<0.25	<0.5	*11.2 / 7.9	4.85	NP	0.00	163.28	158.43
06/08/00	306	<5	<5	<5	<5	<5	7.90	NP	0.00	163.28	155.38

**NOTE:** ND = Nondetectable  
 " - " = Not Analyzed / Not Available  
 NP = No Free Product  
 \*MTBE 8020/8260

Benzene, toluene, ethylbenzene, and xylene analyzed by EPA method 8020.  
 Total petroleum hydrocarbons (TPH) analyzed by EPA method 8015 modified for gasoline  
 Methyl-tert Butyl Ether (MTBE) analyzed by EPA method 8020  
 On June 8, 2000, BTEX and MTBE analyzed by EPA Method 8260B

**TABLE 2**  
**Vapor Extraction Operating Data**  
**Thrifty Oil Station # 054, CASTRO VALLEY, CA**

Month	Representative Date	Hour Meter Reading (hrs)	Operation Duration (hrs)	Inlet		Hydrocarbons Removed		Remark
				Average Flow (cm)	Average FID Conc. (ppmv)	Period (lbs/mo)	Cumulative (lbs)	
Jan-91	1/9/91	929	0	30	est. 10,000	0.0	0	
Feb-91	2/6/91	979	50	30	est. 10,000	38.0	38	
Mar-91	3/6/91	1,028	49	5	est. 10,000	6.2	44	System off 4/91 - 9/91
Oct-91	10/23/91	1,786	758	15	est. 10,000	288.0	332	
Nov-91	11/6/91	1,789	3	14	est. 10,000	1.1	333	
Dec-91	12/4/91	1,896	107	14	est. 10,000	37.9	371	
Jan-92	1/29/92	2,025	129	14	est. 10,000	45.7	417	
Feb-92	2/26/92	2,293	268	14	est. 10,000	95.0	512	System off 3/92 - 7/92
Aug-93	8/11/93	2,293	0	18	est. 10,000	0.0	512	
Sep-93	9/8/93	2,448	153	17	est. 10,000	65.9	578	
Oct-93	10/7/93	2,960	514	18	est. 10,000	234.4	812	
Nov-93	11/3/93	3,381	421	18	est. 10,000	191.9	1,004	
Dec-93	12/1/93	3,705	324	18	est. 10,000	147.7	1,152	
Jan-94	1/3/94	4,313	608	18	est. 10,000	277.2	1,429	
Feb-94	2/7/94	4,849	536	17	10,000	230.8	1,660	
Mar-94	3/7/94	5,196	347	20	10,000	175.8	1,836	
Apr-94	4/4/94	5,597	401	16	10,000	162.5	1,998	
May-94	5/2/94	6,003	406	17	est. 10,000	174.8	2,173	
Jun-94	6/6/94	6,514	511	16	10,000	207.1	2,380	
Jul-94	7/18/94	6,879	165	15	10,000	62.7	2,443	
Aug-94	8/1/94	6,735	56	16	est. 10,000	22.7	2,466	
Sep-94	9/20/94	7,340	605	16	est. 10,000	245.2	2,711	
Oct-94	10/5/94	7,554	214	15	est. 10,000	81.3	2,792	
Dec-94	12/13/94	7,656	102	15	est. 10,000	38.8	2,831	
Jan-95	1/6/95	7,742	86	12	est. 10,000	26.1	2,857	
Feb-95	2/14/95	7,906	164	13	est. 10,000	54.0	2,911	
Mar-95	3/2/95	7,976	70	15	est. 10,000	26.6	2,938	
Apr-95	4/7/95	8,009	33	8	est. 10,000	6.7	2,944	
May-95	5/5/95	8,405	396	16	est. 10,000	160.5	3,105	
Jun-95	6/1/95	8,436	31	16	est. 10,000	12.6	3,117	
Jul-95	7/7/95	8,834	398	16	est. 10,000	161.3	3,279	
Aug-95	8/3/95	8,910	76	16	10,000	30.8	3,309	
Sep-95	9/5/95	9,068	158	16	est. 10,000	64.0	3,373	
Oct-95	10/24/95	9,163	95	14	10,000	33.7	3,407	
Nov-95	11/2/95	9,194	31	16	est. 10,000	12.6	3,420	
Jan-96	1/4/96	8,930	0	9	est. 10,000	0.0	3,420	Replaced hour meter (8830)
Feb-96	2/1/96	8,991	61	8	est. 10,000	12.4	3,432	System off 2/96 - 4/96
Apr-96	4/25/96	9,084	93	8	210	0.4	3,432	
May-96	5/2/96	9,124	40	12	220	0.3	3,433	
Jun-96	6/3/96	9,279	155	9	1,000	3.5	3,436	
Jul-96	7/2/96	9,370	91	17	420	1.6	3,438	
Aug-96	8/1/96	9,391	21	9	340	0.2	3,438	
Sep-96	9/5/96	9,721	330	17	est. 340	4.8	3,443	
Oct-96	10/24/96	9,773	52	7	est. 340	0.3	3,443	
Dec-96	12/26/96	9,776	3	8	est. 340	0.0	3,443	System off 10/96 - 12/96
Apr-97	4/3/97	9,781	5	15	10,000	1.9	3,445	System off 1/97 - 4/97
May-97	5/1/97	10,032	251	15	9,800	93.5	3,539	
Jun-97	6/12/97	10,663	631	11	est. 9,000	158.2	3,697	
Jul-97	7/3/97	10,712	49	12	est. 9,000	13.4	3,710	
Aug-97	8/7/97	10,950	238	12	est. 9,000	65.1	3,775	
Sep-97	9/3/97	11,136	186	16	est. 9,000	67.8	3,843	
Oct-97	10/9/97	11,320	184	12	est. 9,000	50.3	3,893	
Nov-97	11/6/97	11,452	132	17	est. 9,000	51.2	3,945	
Dec-97	12/4/97	11,510	58	19	9,000	25.1	3,970	
Jan-98	1/8/98	11,784	274	17	10,000	118.0	4,088	
Feb-98	2/3/98	12,180	396	16	10,000	160.5	4,248	

**TABLE 2**  
**Vapor Extraction Operating Data**  
**Thrifty Oil Station # 054, CASTRO VALLEY, CA**

Month	Representative Date	Hour Meter Reading (hrs)	Operation Duration (hrs)	Inlet		Hydrocarbons Removed		Remarks
				Average Flow (cm)	Average FID Conc. (ppmV)	Period (lbs)	Cumulative (lbs)	
Mar-98	3/10/98	13,011	831	17	10,000	357.8	4,606	
Apr-98	4/15/98	13,060	49	17	est. 10,000	21.1	4,627	
May-98	5/7/98	13,311	251	16	10,000	101.7	4,729	
Jun-98	6/2/98	13,658	347	17	10,000	149.4	4,878	
Jul-98	7/6/98	14,340	682	16	est. 10,000	276.4	5,155	
Sep-98	9/21/98	14,542	202	12	est. 10,000	61.4	5,216	System shut down, 10/98
Nov-98	11/16/98	14,730	188	12	est. 10,000	57.1	5,273	
Dec-98	12/7/98	15,124	394	11	est. 10,000	109.8	5,383	
Feb-99	2/9/99	16,115	991	10	2,800	70.3	5,453	
Mar-99	3/12/99	16,698	583	13	210	4.0	5,457	
Apr-99	4/8/99	17,009	311	13	est. 210	2.2	5,459	
May-99	5/3/99	17,098	89	10	est. 210	0.5	5,460	
Jun-99	6/28/99	18,130	1,032	10	4,100	107.2	5,567	
Jul-99	7/7/99	18,163	33	10	est. 4,000	3.3	5,570	
Aug-99	8/2/99	18,196	33	11	est. 4,000	3.7	5,574	
Sep-99	9/13/99	18,318	122	12	est. 4,000	14.8	5,589	
Oct-99	10/18/99	18,348	30	13	est. 4,000	4.0	5,593	
Nov-99	11/29/99	18,617	269	12	est. 4,000	32.7	5,626	
Dec-99	12/27/99	19,096	479	12	210	3.1	5,629	
Jan-00	1/24/00	19,388	292	12	est. 210	1.9	5,631	System off for repairs, 1/24/00 to 6/00

- Note: 1. The "duration" is derived from subtracting the hour meter from a representative day of the month by the hour meter from a representative day of the previous month. Some months may have more than 30 days.
2. In January 2000, the "hydrocarbons removed" calculations were corrected to reflect the actual calibration gas (methane) of the instrument used. Therefore, the corrected cumulative total value is different than the previous versions of this table.

**TABLE 3**  
**Laboratory Analytical Results of Inlet Vapor Samples**  
**Thrifty Oil Co. Station # 054, CASTRO VALLEY, CA**

Date	Analyses Results of Inlet Vapor Concentrations					
	TPH (ppmv)	Benzene (ppmv)	Toluene (ppmv)	Ethylbenzene (ppmv)	Total Xylenes (ppmv)	MIBK (ppmv)
5/15/97	-	0.36*	-	-	-	-
7/17/97	-	<0.1*	-	-	-	-
5/5/99	<5	<0.1	0.13	<0.1	<0.1	<1
8/24/99	53	1.4	8.1	2.5	14	<1
8/30/99	<5	<0.1	0.23	0.12	0.77	1.6
9/14/99	2,200	11	36	11	55	9.9
10/25/99	<5	<0.1	0.11	<0.1	0.44	<1
12/21/99	190	5.7	0.64	0.15	1.8	39

NOTE:           \*Unit of measure = ug, by NIOSH 1501 (Benzene)  
                  "- " = not analyzed



# **APPENDIX A**



**PROJECT STATUS REPORT**

SITE: THRIFTY OIL CO. # 054  
 ADDR: 2504 CASTRO VALLEY BLVD.  
 CASTRO VALLEY, CA. 94546

DATE: 06-08-00

PERSON: SERBY P-

**OBSERVATION WELLS**

WELL ID	DTP (FT)	DTW (FT)	DTB (FT)	PT (FT)	DIA (IN)	PURGE (GAL)	ODORS			FP		COMMENT
							Y	N	S	Y	N	
MONTHLY/QUARTERLY												
PW-1		4.40	13.97		4"	25	X				X	
PW-2		3.60	14.32		4"	28	X				X	
RE-1		4.07	19.00		4"	39	X				X	
RE-2		3.18	16.96		4"	36	X				X	
RE-3		3.02	17.55		4"	38	X				X	
RE-4		5.34	14.52		4"	24	X				X	
RE-5		4.43	18.21		4"	36	X				X	
RE-6		4.78	13.58		4"	23	X				X	
RE-7		6.64	13.14		4"	17	X				X	
RS-8		8.80	25.17		2"	11	X				X	
RS-9		2.72	14.97		2"	8	X				X	
RS-10		5.97	24.38		2"	12	X				X	
RS-11		7.90	24.77		2"	11	X				X	

FREE PRODUCT REMOVED: APPROX      GALLONS

WATER REMOVED: APPROX 300 GALLONS

**REMARKS:**

*R.W.S-*

**EXPLANATION:**

DTP= DEPTH TO PRODUCT FROM TOP OF CASING, DTW= DEPTH TO WATER FROM TOP OF CASING  
 DTB= DEPTH TO BOTTOM FROM TOP OF CASING, PT= PRODUCT THICKNESS, S= SLIGHT

FIELD DATA - GROUNDWATER SAMPLING PROGRAM

Site:	054	Date:	06.08.00
Address:			
Personnel:	BERARDI	Weather:	SUNNY AM
Well No:	PW-1	Equip:	BOWSER

Before Purging:			
Total Well Depth: (ft.)	13.97	Well Diameter	4"
Depth to Water (ft)	4.60	Est. Purge Volume:	25

Sampling Data:							
Initial Turbidity:			Final Turbidity:				
Time	12:48	12:52	12:55	12:59	13:02	13:06	13:10
EC	1690	1700	1730	1730	1710	1720	1710
pH	5.50	5.21	5.22	5.50	5.53	5.51	5.31
Temp	21.1	20.8	20.8	20.6	20.4	20.1	20.1
Gal.	3	7	10	14	18	21	25
Time							
EC							
pH							
Temp							
Gal.							

After Purging/Before Sample Collection	
Depth to Water (ft.)	3.82
Total Well Depth(ft.)	13.97

**FIELD DATA - GROUNDWATER SAMPLING PROGRAM**

Site: <u># 054</u>	Date: <u>06.08.00</u>
Address: _____	
Personnel: <u>BERBAK</u>	Weather: <u>JUN 14 AM</u>
Well No: <u>PW-2</u>	Equip: <u>BTI VPR</u>

Before Purging:			
Total Well Depth (ft.)	<u>14.32</u>	Well Diameter	<u>4"</u>
Depth to Water (ft)	<u>3.60</u>	Est. Purge Volume:	<u>28</u>

Sampling Data:		Initial Turbidity:				Final Turbidity:		
Time		13:14	13:18	13:22	13:28	13:32	13:36	13:40
EC		1680	1670	1660	1670	1640	1660	1640
pH		5.49	5.47	5.42	5.46	5.46	5.43	5.43
Temp		71.1	70.9	70.7	70.6	70.4	70.4	70.1
Gal.		4	8	12	16	20	24	28
Time								
EC								
pH								
Temp								
Gal.								

After Purging/Before Sample Collection	
Depth to Water (ft.)	Total Well Depth(ft.)
<u>2.89</u>	<u>14.32</u>

# FIELD DATA - GROUNDWATER SAMPLING PROGRAM

Site: <u>28 054</u>	Date: <u>06.08.00</u>
Address: _____	
Personnel: <u>8FRANK</u>	Weather: <u>JUNNY SUN</u>
Well No: <u>RE-1</u>	Equip: <u>AWI CER</u>

<b>Before Purging:</b>			
Total Well Depth: (ft.)	<u>19.00</u>	Well Diameter	<u>4"</u>
Depth to Water (ft)	<u>4.07</u>	Est. Purge Volume:	<u>39</u>

Sampling Data:							
Initial Turbidity:				Final Turbidity:			
Time	<u>8:58</u>	<u>9:04</u>	<u>9:09</u>	<u>9:15</u>	<u>9:20</u>	<u>9:26</u>	<u>9:30</u>
EC	<u>1420</u>	<u>1430</u>	<u>1410</u>	<u>1420</u>	<u>1430</u>	<u>1410</u>	<u>1410</u>
pH	<u>5.48</u>	<u>5.46</u>	<u>5.44</u>	<u>5.46</u>	<u>5.42</u>	<u>5.42</u>	<u>5.44</u>
Temp	<u>21.3</u>	<u>21.1</u>	<u>20.9</u>	<u>20.7</u>	<u>20.1</u>	<u>20.5</u>	<u>20.1</u>
Gal.	<u>5</u>	<u>11</u>	<u>16</u>	<u>22</u>	<u>27</u>	<u>33</u>	<u>39</u>
Time							
EC							
pH							
Temp							
Gal.							

<b>After Purging/Before Sample Collection</b>	
Depth to Water (ft.)	Total Well Depth (ft.)
<u>3.10</u>	<u>19.00</u>

FIELD DATA - GROUNDWATER SAMPLING PROGRAM

Site:	83054	Date:	06.08.00
Address:			
Personnel:	SERBAM	Weather:	JUNNY DAY
Well No:	RE 2	Equip:	BAI VET

<b>Before Purging:</b>			
Total Well Depth: (ft.)	16.96	Well Diameter	44
Depth to Water (ft)	3.18	Est. Purge Volume:	36

Sampling Data:									
Initial Turbidity:				Final Turbidity:					
Time	9:40	9:45	9:49	9:54	9:59	10:04	10:10		
EC	1380	1360	1360	1360	1360	1320	1340		
pH	5.60	5.56	5.58	5.54	5.54	5.56	5.52		
Temp	20.1	20.3	20.6	20.4	20.3	20.6	20.8		
Gal.	5	10	15	20	25	30	36		
Time									
EC									
pH									
Temp									
Gal.									

<b>After Purging/Before Sample Collection</b>	
Depth to Water (ft.)	2.82
Total Well Depth(ft.)	16.96

FIELD DATA - GROUNDWATER SAMPLING PROGRAM

Site: # 054	Date: 06.08.00
Address:	
Personnel: SERBAM	Weather: SUNNY DAY
Well No: RE3	Equip: BRIFER

Before Purging:	
Total Well Depth: (ft.) 17.55	Well Diameter 4"
Depth to Water (ft) 3.02	Est. Purge Volume: 38

Sampling Data:							
Initial Turbidity:				Final Turbidity:			
Time	12:24	12:34	12:40	12:45	12:31	12:36	12:40
EC	1450	1410	1430	1420	1400	1420	1400
pH	8.52	8.56	8.54	8.50	8.52	8.52	8.52
Temp	21.3	21.3	21.1	20.8	20.6	20.4	20.4
Gal.	5	10	16	21	27	32	38
Time							
EC							
pH							
Temp							
Gal.							

After Purging/Before Sample Collection	
Depth to Water (ft.) 2.86	Total Well Depth(ft.) 17.55

# FIELD DATA - GROUNDWATER SAMPLING PROGRAM

Site:	33054	Date:	06.08.00
Address:			
Personnel:	SERAPHIM	Weather:	SUNNY DAY
Well No:	RE 4	Equip:	ROVER

Before Purging:			
Total Well Depth: (ft.)	14.52	Well Diameter	44
Depth to Water (ft)	5.34	Est. Purge Volume:	24

Sampling Data:							
Initial Turbidity:	Final Turbidity:						
Time	11:34	11:42	11:46	11:49	11:53	11:56	12:00
EC	1300	1360	1320	1320	1360	1340	1360
pH	5.45	5.47	5.46	5.42	5.43	5.41	5.43
Temp	21.4	21.3	21.1	20.8	20.7	20.5	20.3
Gal.	3	6	10	13	17	20	24
Time							
EC							
pH							
Temp							
Gal.							

After Purging/Before Sample Collection	
Depth to Water (ft.)	3.62
Total Well Depth (ft.)	14.52



**FIELD DATA -GROUNDWATER SAMPLING PROGRAM**

Site:	# 054	Date:	06.08.00
Address:			
Personnel:	BERBAH,	Weather:	SUNNY DAY
Well No:	RE 5	Equip:	BAUER

<b>Before Purging:</b>			
Total Well Depth: (ft.)	18.21	Well Diameter	4"
Depth to Water (ft)	4.43	Est. Purge Volume:	36

<b>Sampling Data:</b>									
Initial Turbidity:				Final Turbidity:					
Time	10:54	11:04	11:09	11:14	11:20	11:24	11:30		
EC	1730	1730	1720	1730	1720	1710	1710		
pH	5.40	5.41	5.42	5.40	5.41	5.41	5.40		
Temp	21.3	21.1	20.8	20.9	20.8	20.6	20.1		
Gal.	5	10	15	20	26	30	36		
Time									
EC									
pH									
Temp									
Gal.									

<b>After Purging/Before Sample Collection</b>	
Depth to Water (ft.)	3.32
Total Well Depth(ft.)	18.21

**FIELD DATA - GROUNDWATER SAMPLING PROGRAM**

Site: <u>33 054</u>	Date: <u>06.08.00</u>
Address: _____	
Personnel: <u>BERBAY</u>	Weather: <u>JUNNY DAY</u>
Well No: <u>RE 6</u>	Equip: <u>BOILER</u>

<b>Before Purging:</b>			
Total Well Depth: (ft.)	<u>13.58</u>	Well Diameter	<u>4"</u>
Depth to Water (ft)	<u>4.78</u>	Est. Purge Volume:	<u>23</u>

Sampling Data:							
Initial Turbidity:			Final Turbidity:				
Time	<u>10:20</u>	<u>10:23</u>	<u>10:26</u>	<u>10:30</u>	<u>10:33</u>	<u>10:36</u>	<u>10:40</u>
EC	<u>1110</u>	<u>1080</u>	<u>1060</u>	<u>1070</u>	<u>1040</u>	<u>1060</u>	<u>1040</u>
pH	<u>5.32</u>	<u>5.34</u>	<u>5.32</u>	<u>5.36</u>	<u>5.34</u>	<u>5.32</u>	<u>5.32</u>
Temp	<u>21.1</u>	<u>20.8</u>	<u>20.9</u>	<u>20.7</u>	<u>20.4</u>	<u>20.1</u>	<u>20.1</u>
Gal.	<u>3</u>	<u>6</u>	<u>9</u>	<u>13</u>	<u>16</u>	<u>19</u>	<u>23</u>
Time							
EC							
pH							
Temp							
Gal.							

<b>After Purging/Before Sample Collection</b>	
Depth to Water (ft.) <u>2.26</u>	Total Well Depth(ft.) <u>13.58</u>

FIELD DATA -GROUNDWATER SAMPLING PROGRAM

Site:	20 054	Date:	06.08.00
Address:			
Personnel:	SERBOM,	Weather:	JUNNY DRY
Well No:	RE 7	Equip:	RODIFAR

Before Purging:			
Total Well Depth: (ft.)	13.14	Well Diameter	4"
Depth to Water (ft)	6.64	Est. Purge Volume:	17

Sampling Data:		Initial Turbidity:		Final Turbidity:				
Time		13:45	13:47	13:50	13:52	13:55	13:57	14:00
EC		1230	1250	1260	1190	1160	1170	1150
pH		5.48	5.49	5.42	5.46	5.42	5.40	5.42
Temp		21.3	21.1	20.9	20.7	20.7	20.7	20.3
Gal.		2	4	7	9	12	14	17
Time								
EC								
pH								
Temp								
Gal.								

After Purging/Before Sample Collection	
Depth to Water (ft.)	3.79
Total Well Depth(ft.)	13.14

# FIELD DATA - GROUNDWATER SAMPLING PROGRAM

Site:	# 054	Date:	06.08.00
Address:			
Personnel:	SERBOM	Weather:	SUNNY DM
Well No:	R3-8	Equip:	BOWER

Before Purging:			
Total Well Depth: (ft.)	25.17	Well Diameter	24
Depth to Water (ft)	8.80	Est. Purge Volume:	11

Sampling Data:								
Initial Turbidity:				Final Turbidity:				
Time	8:20	8:22	8:23	8:25	8:26	8:28	8:30	
EC	1890	1860	1800	1820	1950	1810	1840	
pH	5.52	5.51	5.53	5.50	5.50	5.52	5.50	
Temp	21.1	20.8	20.9	20.7	20.5	20.6	20.6	
Gal.	1	3	4	6	7	9	11	
Time								
EC								
pH								
Temp								
Gal.								

After Purging/Before Sample Collection	
Depth to Water (ft.)	6.20
Total Well Depth (ft.)	25.17

# FIELD DATA - GROUNDWATER SAMPLING PROGRAM

Site:	# 054	Date:	06-08-00
Address:			
Personnel:	SERRA	Weather:	SUNNY Day
Well No:	RS-10	Equip:	BRICER

Before Purging:			
Total Well Depth: (ft.)	24.38	Well Diameter	2"
Depth to Water (ft)	5.97	Est. Purge Volume:	12

Sampling Data:							
Initial Turbidity:				Final Turbidity:			
Time	2:44	2:51	2:53	2:54	2:56	2:58	3:00
EC	1670	1660	1680	1670	1680	1660	1640
pH	5.44	5.45	5.43	5.45	5.48	5.48	5.46
Temp	21.1	20.8	20.7	20.5	20.3	20.4	20.3
Gal.	1	3	5	6	8	10	12
Time							
EC							
pH							
Temp							
Gal.							

After Purging/Before Sample Collection	
Depth to Water (ft.)	4.10
Total Well Depth (ft.)	24.38

# FIELD DATA - GROUNDWATER SAMPLING PROGRAM

Site:	# 054	Date:	06.08.00
Address:			
Personnel:	SEPRAY	Weather:	SUNNY DAY
Well No:	RS 11	Equip:	BAIFIR

Before Purging:			
Total Well Depth: (ft.)	24.77	Well Diameter	2.4
Depth to Water (ft)	7.90	Est. Purge Volume:	11

Sampling Data:								
Initial Turbidity:			Final Turbidity:					
Time	8:05	8:07	8:08	8:10	8:11	8:13	8:15	
EC	1360	1300	1380	1360	1340	1330	1330	
pH	5.51	5.20	5.24	5.51	5.21	5.20	5.20	
Temp	21.3	21.1	20.8	20.5	20.6	20.4	20.1	
Gal.	1	3	4	6	7	9	11	
Time								
EC								
pH								
Temp								
Gal.								

After Purging/Before Sample Collection	
Depth to Water (ft.)	5.32
Total Well Depth (ft.)	24.77



# EARTH MANAGEMENT CO.

Environmental Remediation

THRIFTY OIL CO. SS #054  
 2504 CASTRO VALLEY BLVD.  
 CASTRO VALLEY, CA 94546

## PROJECT STATUS REPORT

DATE: 04-10-00

F R E Q	MONITORING				ODORS			FREE		WELLS CONNECTED TO SYSTEM (W)							
	OBSERVATION WELLS				(S=SLIGHT)			PRODUCT		CONNECT		INTEGRITY		VAPOR		WATER	
	NO.	DTW	DTP	PT	YES	NO	S	YES	NO	YES	NO	OK	NO	ON	OFF	ON	OFF
M	PW-1	6.37				X			X		X	-			X		X
M	PW-2	4.21				X			X		X	-			X		X
M	RE-1	5.67				X			X		X	-			X		X
M	RE-2	4.21				X			X		X	-			X		X
M	RE-3	4.17				X			X		X	-			X		X
M	RE-4	3.87				X			X		X	-			X		X
M	RE-5	5.27				X			X		X	-			X		X
M	RE-6	4.83				X			X		X	-			X		X
M	RE-7	6.04				X			X		X	-			X		X
M	RS-8	9.86				X			X		-	X			X		X
M	RS-9	4.26				X			X		-	X			X		X
M	RS-10	4.52				X			X			X			X		X
M	RS-11	6.43				X			X			X			X		X

### SAVE SYSTEM WEEKLY

PARAMETER	U/M	DATA	PARAMETER	U/M	DATA
TIME	AM/PM		AIR FLOW	C F M	
WORKING	YES/NO		VAPOR FLOW	C F M	
RESTARTED	YES/NO		FUEL FLOW	C F M/H	
HOURS	#		WELL VACUUM	IN H2O	
ENGINE ROT.	RPM		L P G TANKS	%	#1:
ENGINE VACUUM	IN HG		GAS METER READING	-	N/A
TANK VACUUM	IN HG		WATER FLOWMETER	GALL.	

EXHAUST (By others) \_\_\_\_\_

INLET TO ENGINE \_\_\_\_\_

MAINTENANCE ES/100/400/800 \_\_\_\_\_ FOR SPECIFIC OPERATIONS SEE FIELD RECORD

WATER SAMPLING - CHECK ( ) WHEN DONE

EFFLUENT	INFLUENT	WELLS
( ) _____	( ) _____	( ) Q.-SEE C.CUST.

REMARKS: \_\_\_\_\_

FREE PRODUCT REMOVED: APPROX. \_\_\_\_\_ GALLONS WATER REMOVED: APPROX. \_\_\_\_\_ GALLONS

DATA RECORDED BY: [Signature] INPUT BY: AJB 02/05/97

# **APPENDIX B**





**ASSOCIATED LABORATORIES**

806 North Batavia - Orange, California 92868 - 714/771-6900

FAX 714/538-1209

CLIENT Thrifty Oil (8871)  
ATTN: Jeff Suryakusuma  
13539 E. Foster Rd.  
Santa Fe Springs, CA 90670

LAB REQUEST 54615

REPORTED 06/29/2000

RECEIVED 06/10/2000

PROJECT Station #054  
2504 Castro Valley Blvd., Castro Valley

SUBMITTER Client

COMMENTS

This laboratory request covers the following listed samples which were analyzed for the parameters indicated on the attached Analytical Result Report. All analyses were conducted using the appropriate methods as indicated on the report. This cover letter is an integral part of the final report.

<u>Order No.</u>	<u>Client Sample Identification</u>
190841	TOC #054 RS-10
190842	TOC #054 RS-11
190843	TOC #054 RS-8
190844	TOC #054 RS-9
190845	TOC #054 RE-1
190846	TOC #054 RE-2
190847	TOC #054 RE-6
190848	TOC #054 RE-5
190849	TOC #054 RE-4
190850	TOC #054 RE-3
190851	TOC #054 PW-1
190852	TOC #054 PW-2

Thank you for the opportunity to be of service to your company. Please feel free to call if there are any questions regarding this report or if we can be of further service.

ASSOCIATED LABORATORIES by,

Edward S. Behare, Ph.D.  
Vice President

NOTE: Unless notified in writing, all samples will be discarded by appropriate disposal protocol 30 days from date reported.

The reports of the Associated Laboratories are confidential property of our clients and may not be reproduced or used for publication in part or in full without our written permission. This is for the mutual protection of the public, our clients, and ourselves.

TESTING & CONSULTING  
Chemical  
Microbiological  
Environmental

CLIENT Thrifty Oil (8871)  
ATTN: Jeff Suryakusuma  
13539 E. Foster Rd.  
Santa Fe Springs, CA 90670

LAB REQUEST 54615

REPORTED 06/29/2000  
RECEIVED 06/10/2000

PROJECT Station #054  
2504 Castro Valley Blvd., Castro Valley

SUBMITTER Client

### COMMENTS

This laboratory request covers the following listed samples which were analyzed for the parameters indicated on the attached Analytical Result Report. All analyses were conducted using the appropriate methods as indicated on the report. This cover letter is an integral part of the final report.

Order No.

190853

190854

Client Sample Identification

TOC #054 RE-7

TOC #054 Trip Blank

Thank you for the opportunity to be of service to your company. Please feel free to call if there are any questions regarding this report or if we can be of further service.

ASSOCIATED LABORATORIES by,

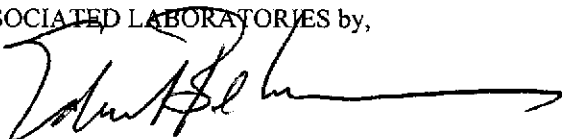

Edward S. Behare, Ph.D.  
Vice President

*NOTE: Unless notified in writing, all samples will be discarded by appropriate disposal protocol 30 days from date reported.*

The reports of the Associated Laboratories are confidential property of our clients and may not be reproduced or used for publication in part or in full without our written permission. This is for the mutual protection of the public, our clients, and ourselves.

TESTING & CONSULTING  
Chemical  
Microbiological  
Environmental

Order #: 190841

Client Sample ID: TOC #054 RS-10

Log Date: 06/12/20

Matrix: WATER

Date Sampled: 06/08/2000

Time Sampled: 16:00

Analyte	Result	DLR	Units	Date/Analyst
<b>8260B BTEX/MTBE Only</b>				
Benzene	ND	5	ug/L	06/19/00 DP
Ethyl benzene	ND	5	ug/L	06/19/00 DP
Ethyl-tertbutylether (ETBE)	ND	2	ug/L	06/19/00 DP
Isopropyl ether (DIPE)	ND	2	ug/L	06/19/00 DP
Methyl-tertbutylether (MTBE)	ND	5	ug/L	06/19/00 DP
Tert-amylmethylether (TAME)	ND	2	ug/L	06/19/00 DP
Tertiary butyl alcohol (TBA)	ND	50	ug/L	06/19/00 DP
Toluene	ND	5	ug/L	06/19/00 DP
Xylenes, total	ND	5	ug/L	06/19/00 DP

**D285 Glycols-Alcohols by GC-FID**

Ethanol	ND	50	mg/L	07/01/00 DO
Methanol	ND	50	mg/L	07/01/00 DO

**8015M - Total Petroleum Hydrocarbons**

Gasoline	ND	50	ug/L	06/27/00 HP
----------	----	----	------	-------------

Order #: 190842

Client Sample ID: TOC #054 RS-11

Log Date: 06/12/20

Matrix: WATER

Date Sampled: 06/08/2000

Time Sampled: 16:10

Analyte	Result	DLR	Units	Date/Analyst
<b>8260B BTEX/MTBE Only</b>				
Benzene	ND	5	ug/L	06/19/00 DP
Ethyl benzene	ND	5	ug/L	06/19/00 DP
Ethyl-tertbutylether (ETBE)	ND	2	ug/L	06/19/00 DP
Isopropyl ether (DIPE)	ND	2	ug/L	06/19/00 DP
Methyl-tertbutylether (MTBE)	ND	5	ug/L	06/19/00 DP
Tert-amylmethylether (TAME)	ND	2	ug/L	06/19/00 DP
Tertiary butyl alcohol (TBA)	ND	50	ug/L	06/19/00 DP
Toluene	ND	5	ug/L	06/19/00 DP
Xylenes, total	ND	5	ug/L	06/19/00 DP

**D285 Glycols-Alcohols by GC-FID**

DLR = Detection limit for reporting purposes, ND = Not Detected below indicated detection limit



Ethanol	ND	50	mg/L	07/01/00	DO
Methanol	ND	50	mg/L	07/01/00	DO

**8015M - Total Petroleum Hydrocarbons**

Gasoline	306	250	ug/L	06/27/00	HP
----------	-----	-----	------	----------	----

Order #: 190843

Client Sample ID: TOC #054 RS-8

Log Date: 06/12/20

Matrix: WATER

Date Sampled: 06/08/2000

Time Sampled: 16:20

Analyte	Result	DLR	Units	Date/Analyst
---------	--------	-----	-------	--------------

**8260B BTEX/MTBE Only**

Benzene	ND	5	ug/L	06/19/00	DP
Ethyl benzene	ND	5	ug/L	06/19/00	DP
Ethyl-tertbutylether (ETBE)	ND	2	ug/L	06/19/00	DP
Isopropyl ether (DIPE)	ND	2	ug/L	06/19/00	DP
Methyl-tertbutylether (MTBE)	10	5	ug/L	06/19/00	DP
Tert-amylmethylether (TAME)	ND	2	ug/L	06/19/00	DP
Tertiary butyl alcohol (TBA)	ND	50	ug/L	06/19/00	DP
Toluene	ND	5	ug/L	06/19/00	DP
Xylenes, total	ND	5	ug/L	06/19/00	DP

**D285 Glycols-Alcohols by GC-FID**

Ethanol	ND	50	mg/L	07/01/00	DO
Methanol	ND	50	mg/L	07/01/00	DO

**8015M - Total Petroleum Hydrocarbons**

Gasoline	ND	50	ug/L	06/27/00	HP
----------	----	----	------	----------	----

Order #: 190844

Client Sample ID: TOC #054 RS-9

Log Date: 06/12/20

Matrix: WATER

Date Sampled: 06/08/2000

Time Sampled: 16:30

Analyte	Result	DLR	Units	Date/Analyst
---------	--------	-----	-------	--------------

**8260B BTEX/MTBE Only**

Benzene	ND	5	ug/L	06/19/00	DP
Ethyl benzene	ND	5	ug/L	06/19/00	DP
Ethyl-tertbutylether (ETBE)	ND	2	ug/L	06/19/00	DP
Isopropyl ether (DIPE)	ND	2	ug/L	06/19/00	DP
Methyl-tertbutylether (MTBE)	821	5	ug/L	06/19/00	DP

DLR = Detection limit for reporting purposes, ND = Not Detected below indicated detection limit



Tert-amylmethylether (TAME)	ND	2	ug/L	06/19/00	DP
Tertiary butyl alcohol (TBA)	ND	50	ug/L	06/19/00	DP
Toluene	ND	5	ug/L	06/19/00	DP
Xylenes, total	ND	5	ug/L	06/19/00	DP

**D285 Glycols-Alcohols by GC-FID**

Ethanol	ND	50	mg/L	07/01/00	DO
Methanol	ND	50	mg/L	07/01/00	DO

**8015M - Total Petroleum Hydrocarbons**

Gasoline	585	500	ug/L	06/27/00	HP
----------	-----	-----	------	----------	----

Order #:

Client Sample ID: TOC #054 RE-1

Log Date: 06/12/20

Matrix: WATER

Date Sampled: 06/08/2000

Time Sampled: 16:40

Analyte	Result	DLR	Units	Date/Analyst
---------	--------	-----	-------	--------------

**8260B BTEX/MTBE Only**

Benzene	ND	5	ug/L	06/19/00	DP
Ethyl benzene	ND	5	ug/L	06/19/00	DP
Ethyl-tertbutylether (ETBE)	ND	2	ug/L	06/19/00	DP
Isopropyl ether (DIPE)	ND	2	ug/L	06/19/00	DP
Methyl-tertbutylether (MTBE)	ND	5	ug/L	06/19/00	DP
Tert-amylmethylether (TAME)	ND	2	ug/L	06/19/00	DP
Tertiary butyl alcohol (TBA)	ND	50	ug/L	06/19/00	DP
Toluene	ND	5	ug/L	06/19/00	DP
Xylenes, total	ND	5	ug/L	06/19/00	DP

**D285 Glycols-Alcohols by GC-FID**

Ethanol	ND	50	mg/L	07/01/00	DO
Methanol	ND	50	mg/L	07/01/00	DO

**8015M - Total Petroleum Hydrocarbons**

Gasoline	ND	50	ug/L	06/27/00	HP
----------	----	----	------	----------	----

Order #:

Client Sample ID: TOC #054 RE-2

Log Date: 06/12/20

Matrix: WATER

Date Sampled: 06/08/2000

Time Sampled: 16:45

Analyte	Result	DLR	Units	Date/Analyst
---------	--------	-----	-------	--------------

DLR = Detection limit for reporting purposes, ND = Not Detected below indicated detection limit



**8260B BTEX/MTBE Only**

Benzene	ND	5	ug/L	06/20/00	DP
Ethyl benzene	ND	5	ug/L	06/20/00	DP
Ethyl-tertbutylether (ETBE)	ND	2	ug/L	06/20/00	DP
Isopropyl ether (DIPE)	ND	2	ug/L	06/20/00	DP
Methyl-tertbutylether (MTBE)	ND	5	ug/L	06/20/00	DP
Tert-amylmethylether (TAME)	ND	2	ug/L	06/20/00	DP
Tertiary butyl alcohol (TBA)	ND	50	ug/L	06/20/00	DP
Toluene	ND	5	ug/L	06/20/00	DP
Xylenes, total	ND	5	ug/L	06/20/00	DP

**D285 Glycols-Alcohols by GC-FID**

Ethanol	ND	50	mg/L	07/01/00	DO
Methanol	ND	50	mg/L	07/01/00	DO

**8015M - Total Petroleum Hydrocarbons**

Gasoline	ND	50	ug/L	06/27/00	HP
----------	----	----	------	----------	----

Order #: 

Client Sample ID: TOC #054 RE-6

Log Date: 06/12/20

Matrix: WATER

Date Sampled: 06/08/2000

Time Sampled: 16:50

Analyte	Result	DLR	Units	Date/Analyst
---------	--------	-----	-------	--------------

**8260B BTEX/MTBE Only**

Benzene	ND	5	ug/L	06/20/00	DP
Ethyl benzene	ND	5	ug/L	06/20/00	DP
Ethyl-tertbutylether (ETBE)	ND	2	ug/L	06/20/00	DP
Isopropyl ether (DIPE)	ND	2	ug/L	06/20/00	DP
Methyl-tertbutylether (MTBE)	ND	5	ug/L	06/20/00	DP
Tert-amylmethylether (TAME)	ND	2	ug/L	06/20/00	DP
Tertiary butyl alcohol (TBA)	ND	50	ug/L	06/20/00	DP
Toluene	ND	5	ug/L	06/20/00	DP
Xylenes, total	ND	5	ug/L	06/20/00	DP

**D285 Glycols-Alcohols by GC-FID**

Ethanol	ND	50	mg/L	07/01/00	DO
Methanol	ND	50	mg/L	07/01/00	DO

**8015M - Total Petroleum Hydrocarbons**

Gasoline	ND	50	ug/L	06/27/00	HP
----------	----	----	------	----------	----

DLR = Detection limit for reporting purposes, ND = Not Detected below indicated detection limit



Order #: 190848

Client Sample ID: TOC #054 RE-5

Log Date: 06/12/20

Matrix: WATER

Date Sampled: 06/08/2000

Time Sampled: 16:55

Analyte	Result	DLR	Units	Date/Analyst
<b>8260B BTEX/MTBE Only</b>				
Benzene	ND	5	ug/L	06/20/00 DP
Ethyl benzene	ND	5	ug/L	06/20/00 DP
Ethyl-tertbutylether (ETBE)	ND	2	ug/L	06/20/00 DP
Isopropyl ether (DIPE)	ND	2	ug/L	06/20/00 DP
Methyl-tertbutylether (MTBE)	ND	5	ug/L	06/20/00 DP
Tert-amylmethylether (TAME)	ND	2	ug/L	06/20/00 DP
Tertiary butyl alcohol (TBA)	ND	50	ug/L	06/20/00 DP
Toluene	ND	5	ug/L	06/20/00 DP
Xylenes, total	ND	5	ug/L	06/20/00 DP

**D285 Glycols-Alcohols by GC-FID**

Ethanol	ND	50	mg/L	07/01/00 DO
Methanol	ND	50	mg/L	07/01/00 DO

**8015M - Total Petroleum Hydrocarbons**

Gasoline	ND	50	ug/L	06/27/00 HP
----------	----	----	------	-------------

Order #: 190849

Client Sample ID: TOC #054 RE-4

Log Date: 06/12/20

Matrix: WATER

Date Sampled: 06/08/2000

Time Sampled: 17:00

Analyte	Result	DLR	Units	Date/Analyst
<b>8260B BTEX/MTBE Only</b>				
Benzene	ND	5	ug/L	06/20/00 DP
Ethyl benzene	ND	5	ug/L	06/20/00 DP
Ethyl-tertbutylether (ETBE)	ND	2	ug/L	06/20/00 DP
Isopropyl ether (DIPE)	ND	2	ug/L	06/20/00 DP
Methyl-tertbutylether (MTBE)	ND	5	ug/L	06/20/00 DP
Tert-amylmethylether (TAME)	ND	2	ug/L	06/20/00 DP
Tertiary butyl alcohol (TBA)	ND	50	ug/L	06/20/00 DP
Toluene	ND	5	ug/L	06/20/00 DP
Xylenes, total	ND	5	ug/L	06/20/00 DP

**D285 Glycols-Alcohols by GC-FID**

DLR = Detection limit for reporting purposes, ND = Not Detected below indicated detection limit



Ethanol	ND	50	mg/L	07/01/00	DO
Methanol	ND	50	mg/L	07/01/00	DO

**8015M - Total Petroleum Hydrocarbons**

Gasoline	67	50	ug/L	06/27/00	HP
----------	----	----	------	----------	----

Order #: 190850

Client Sample ID: TOC #054 RE-3

Log Date: 06/12/20

Matrix: WATER

Date Sampled: 06/08/2000

Time Sampled: 17:05

Analyte	Result	DLR	Units	Date/Analyst
---------	--------	-----	-------	--------------

**8260B BTEX/MTBE Only**

Benzene	ND	5	ug/L	06/20/00	DP
Ethyl benzene	ND	5	ug/L	06/20/00	DP
Ethyl-tertbutylether (ETBE)	ND	2	ug/L	06/20/00	DP
Isopropyl ether (DIPE)	ND	2	ug/L	06/20/00	DP
Methyl-tertbutylether (MTBE)	201	5	ug/L	06/20/00	DP
Tert-amylmethylether (TAME)	ND	2	ug/L	06/20/00	DP
Tertiary butyl alcohol (TBA)	ND	50	ug/L	06/20/00	DP
Toluene	ND	5	ug/L	06/20/00	DP
Xylenes, total	ND	5	ug/L	06/20/00	DP

**D285 Glycols-Alcohols by GC-FID**

Ethanol	ND	50	mg/L	07/01/00	DO
Methanol	ND	50	mg/L	07/01/00	DO

**8015M - Total Petroleum Hydrocarbons**

Gasoline	ND	100	ug/L	06/27/00	HP
----------	----	-----	------	----------	----

Order #: 190851

Client Sample ID: TOC #054 PW-1

Log Date: 06/12/20

Matrix: WATER

Date Sampled: 06/08/2000

Time Sampled: 17:15

Analyte	Result	DLR	Units	Date/Analyst
---------	--------	-----	-------	--------------

**8260B BTEX/MTBE Only**

Benzene	ND	5	ug/L	06/20/00	DP
Ethyl benzene	ND	5	ug/L	06/20/00	DP
Ethyl-tertbutylether (ETBE)	ND	2	ug/L	06/20/00	DP
Isopropyl ether (DIPE)	ND	2	ug/L	06/20/00	DP
Methyl-tertbutylether (MTBE)	ND	5	ug/L	06/20/00	DP

DLR = Detection limit for reporting purposes, ND = Not Detected below indicated detection limit





Tert-amylmethylether (TAME)	ND	2	ug/L	06/20/00	DP
Tertiary butyl alcohol (TBA)	ND	50	ug/L	06/20/00	DP
Toluene	ND	5	ug/L	06/20/00	DP
Xylenes, total	ND	5	ug/L	06/20/00	DP

**D285 Glycols-Alcohols by GC-FID**

Ethanol	ND	50	mg/L	07/01/00	DO
Methanol	ND	50	mg/L	07/01/00	DO

**8015M - Total Petroleum Hydrocarbons**

Gasoline	ND	50	ug/L	06/27/00	HP
----------	----	----	------	----------	----

Order #:

Client Sample ID: TOC #054 PW-2

Log Date: 06/12/20

Matrix: WATER

Date Sampled: 06/08/2000

Time Sampled: 17:20

Analyte	Result	DLR	Units	Date/Analyst
---------	--------	-----	-------	--------------

**8260B BTEX/MTBE Only**

Benzene	ND	5	ug/L	06/20/00	DP
Ethyl benzene	ND	5	ug/L	06/20/00	DP
Ethyl-tertbutylether (ETBE)	ND	2	ug/L	06/20/00	DP
Isopropyl ether (DIPE)	ND	2	ug/L	06/20/00	DP
Methyl-tertbutylether (MTBE)	ND	5	ug/L	06/20/00	DP
Tert-amylmethylether (TAME)	ND	2	ug/L	06/20/00	DP
Tertiary butyl alcohol (TBA)	ND	50	ug/L	06/20/00	DP
Toluene	ND	5	ug/L	06/20/00	DP
Xylenes, total	ND	5	ug/L	06/20/00	DP

**D285 Glycols-Alcohols by GC-FID**

Ethanol	ND	50	mg/L	07/01/00	DO
Methanol	ND	50	mg/L	07/01/00	DO

**8015M - Total Petroleum Hydrocarbons**

Gasoline	ND	50	ug/L	06/27/00	HP
----------	----	----	------	----------	----

Order #:

Client Sample ID: TOC #054 RE-7

Log Date: 06/12/20

Matrix: WATER

Date Sampled: 06/08/2000

Time Sampled: 17:25

Analyte	Result	DLR	Units	Date/Analyst
---------	--------	-----	-------	--------------

DLR = Detection limit for reporting purposes, ND = Not Detected below indicated detection limit



**8260B BTEX/MTBE Only**

Benzene	ND	5	ug/L	06/20/00	DP
Ethyl benzene	ND	5	ug/L	06/20/00	DP
Ethyl-tertbutylether (ETBE)	ND	2	ug/L	06/20/00	DP
Isopropyl ether (DIPE)	365	2	ug/L	06/20/00	DP
Methyl-tertbutylether (MTBE)	74	5	ug/L	06/20/00	DP
Tert-amylmethylether (TAME)	ND	2	ug/L	06/20/00	DP
Tertiary butyl alcohol (TBA)	ND	50	ug/L	06/20/00	DP
Toluene	ND	5	ug/L	06/20/00	DP
Xylenes, total	ND	5	ug/L	06/20/00	DP

**D285 Glycols-Alcohols by GC-FID**

Ethanol	ND	50	mg/L	07/01/00	DO
Methanol	ND	50	mg/L	07/01/00	DO

**8015M - Total Petroleum Hydrocarbons**

Gasoline	ND	100	ug/L	06/27/00	HP
----------	----	-----	------	----------	----

Order #: 

Client Sample ID: TOC #054 Trip Blank

Log Date: 06/12/20

Matrix: WATER

Date Sampled: 06/08/2000

Time Sampled: 16:00

Analyte	Result	DLR	Units	Date/Analyst
---------	--------	-----	-------	--------------

**8260B BTEX/MTBE Only**

Benzene	ND	5	ug/L	06/20/00	DP
Ethyl benzene	ND	5	ug/L	06/20/00	DP
Ethyl-tertbutylether (ETBE)	ND	2	ug/L	06/20/00	DP
Isopropyl ether (DIPE)	ND	2	ug/L	06/20/00	DP
Methyl-tertbutylether (MTBE)	ND	5	ug/L	06/20/00	DP
Tert-amylmethylether (TAME)	ND	2	ug/L	06/20/00	DP
Tertiary butyl alcohol (TBA)	ND	50	ug/L	06/20/00	DP
Toluene	ND	5	ug/L	06/20/00	DP
Xylenes, total	ND	5	ug/L	06/20/00	DP

**D285 Glycols-Alcohols by GC-FID**

Ethanol	ND	50	mg/L	07/01/00	DO
Methanol	ND	50	mg/L	07/01/00	DO

**8015M - Total Petroleum Hydrocarbons**

Gasoline	ND	50	ug/L	06/27/00	HP
----------	----	----	------	----------	----

DLR = Detection limit for reporting purposes, ND = Not Detected below indicated detection limit



**ASSOCIATED LABORATORIES**  
QA REPORT FORM

QC Sample: LR 54732 - 488

Matrix: WATER

Prep. Date: 06/27/00

Analysis Date: 06/27/00 - 06/28/00

ID#'s in Batch: LR 54732, 55324, 55353, 54839, 54594, 54615, 54611, 54610

**MATRIX SPIKE / MATRIX SPIKE DUPLICATE RESULT**

Reporting Units = ug/L

Test	Method	Sample Result	Spike Added	Matrix Spike	Matrix Spike Dup	%Rec MS	%Rec MSD	RPD
TPH	8015M-G	ND	500	480	588	96.0	117.6	20.2

ND = Not Detected

RPD = Relative Percent Difference of Matrix Spike and Matrix Spike Duplicate

%REC-MS & MSD = Percent Recovery of Matrix Spike & Matrix Spike Duplicate

%REC LIMITS = 70 - 130
RPD LIMITS = 30

**PREPARATION BLANK / LAB CONTROL SAMPLE RESULTS**

PREP BLK	LCS				
Value	Result	True	%Rec	L.Limit	H.Limit
ND	4213	4000	105.3	80%	120%

LCS Result = Lab Control Sample Result

True = True Value of LCS

L.Limit / H.Limit = LCS Control Limits

**ASSOCIATED LABORATORIES**  
*LCS REPORT FORM*

QC Sample: LCS / LCSD 063000

Matrix: WATER

Prep. Date: 07/01/00

Analysis Date: 07/01/00

ID#'s in Batch: LR 54615

**MATRIX SPIKE / MATRIX SPIKE DUPLICATE RESULT**

Reporting Units = mg/L

Test	Method	Sample Result	Spike Added	LCS Spike	LCSD Spike Dup	%Rec MS	%Rec MSD	RPD
Ethanol	D285	ND	100	101.8	101.8	101.8	101.8	0.0

*RPD = Relative Percent Difference of LCS Spike and LCS Spike Duplicate*  
*%REC-LCS & LCSD = Percent Recovery of LCS Spike & LCS Spike Duplicate*

<i>%REC LIMITS = 65 - 135</i> <i>RPD LIMITS = 25</i>
---

**ASSOCIATED LABORATORIES**  
LCS REPORT FORM

QC Sample: LCS/LCSD Water Samples

Matrix: WATER

Method : 8260

Analysis Date: 06/17/00

Applies to: LR 54615

REPORTING UNITS = ug/L

Test	Sample Result	Spike Added	LCS Spike	LCS Spk. Dup	%Rec LCS	%Rec LCS D	RPD	QC Limits	
								RPD	%REC
1,1-Dichloroethene	ND	50.0	51.57	51.97	103.1	103.9	0.8	22	59-172
Benzene	ND	50.0	47.39	48.00	94.8	96.0	1.3	24	62-137
Trichloroethene	ND	50.0	48.48	48.99	97.0	98.0	1.0	21	66-142
Toluene	ND	50.0	50.39	52.37	100.8	104.7	3.9	21	59-139
Chlorobenzene	ND	50.0	49.53	48.72	99.1	97.4	1.6	21	60-133

ND = Not Detected

RPD = Relative Percent Difference of LCS and LCS Dup.

%REC-MS & MSD = Percent Recovery of LCS & LCS Dup.

Method Blank = All ND



# ASSOCIATED LABORATORIES

~~CONFIDENTIAL~~  
NO. 10181  
NO. 10181  
NO. 10181

## 54615 CHAIN OF CUSTODY RECORD

806 N. BATAVIA, ORANGE, CA. 92868

COMPANY **THRIFTY OIL CO.** PHONE **(662) 921-3581**

AETL JOB No.

Page 1 of 1

PROJECT MANAGER **JEFF SUPYAROSUMA** FAX

### ANALYSIS REQUESTED

### TEST INSTRUCTIONS & COMMENTS

PROJECT NAME **Q.W.S.** PROJECT # **054**

SITE NAME AND ADDRESS **2504 CASTRO VALLEY Blvd - CASTRO VALLEY 94546.**

SAMPLE ID	LAB ID	DATE	TIME	MATRIX	CONTAINER NUMBER/SIZE	PRES.
RS-10		06.08.00	16:00	WATER	3 VIALS	HCL
RS-11			16:10			
RS-8			16:20			
RS-9			16:30			
RE-1			16:40			
RE-2			16:45			
RE-6			16:50			
RE-5			16:55			
RE-4			17:00			
RE-3			17:05			
PW-1			17:15			
PW-2			17:20			
RE-7			17:25			
TRIP BLANK			16:00		2 VIALS	

T	P	B	O	X														
X	X	X	X															

ANALYSIS REQUIRED FOR OXYGENATE COMPOUNDS USED IN CA. GASOLINE EPA METHOD 8260-1 METHANOL 2. ETHANOL 3. TERTIARY BUTANOL 4. MTBE 5. DIPB 6. ETBE 7. TAME

### SAMPLE RECEIPT - TO BE FILLED BY LABORATORY

TOTAL NUMBER OF CONTAINERS	PROPERLY COOLED Y/N/NA
CUSTODY SEALS Y/N/NA	SAMPLES INTACT Y/N/NA
RECEIVED IN GOOD COND. Y/N	SAMPLES ACCEPTED Y/N

RELINQUISHED BY SAMPLER: 1.

Signature: *[Signature]*  
Printed Name: **SFRBY P -**  
Date: **06-08-00** Time:

RELINQUISHED BY: 2.

Signature:  
Printed Name:  
Date: Time:

RELINQUISHED BY: 3.

Signature:  
Printed Name:  
Date: Time:

### TURN AROUND TIME

NORMAL  RUSH  SAME DAY  48 HRS.  24 HRS.  72 HRS.

RECEIVED BY: 1.

Signature: *Albert V...*  
Printed Name: **Albert V...**  
Date: **6-10-00** Time:

RECEIVED BY: 2.

Signature:  
Printed Name:  
Date: Time:

RECEIVED BY LABORATORY: 3.

Signature:  
Printed Name:  
Date: Time: