

STID 1202
SOS

THRIFTY OIL CO.

ENVIRONMENTAL
PROTECTION

99 JAN 19 PM 3:42
O.7722

January 14, 1999

Mr. Brian P. Oliva, REHS, REA
Hazardous Material Specialist
1131 Harbor Bay Parkway, Suite 250
Alameda, CA 94502

RE: **Thrifty Oil Co. #054**
2504 Castro Valley Boulevard
Castro Valley, CA 94541
4th Quarter 1998, Status Report

Dear Mr. Oliva:

Presented herewith is the 4th Quarter 1998, Status Report for Thrifty Oil Co. Station #054 located at 2504 Castro Valley Boulevard, Castro Valley, California.

If you have any questions or comments, please contact the undersign in this report at (562) 921-3581.

Sincerely,



Chris Panaitescu
General Manager
Environmental Affairs

c: File



THRIFTY OIL CO.

January 14, 1999

Mr. Brian P. Oliva, REHS, REA
Hazardous Material Specialist
1131 Harbor Bay Parkway, Suite 250
Alameda, CA 94502

RE: **Thrifty Oil Co. Station #054**
2504 Castro Valley Boulevard
Castro Valley, CA
4th Quarter 1998, Status Report

Dear Mr. Oliva:

Presented herein is the 4th Quarter 1998, Status Report prepared for Thrifty Oil Co. (TOC) Station #054 located at 2504 Castro Valley Boulevard, Castro Valley, California (**Figure 1**). Presented in this report are the results of the quarterly groundwater monitoring program conducted on December 30, 1998. TOC has retained the services of Earth Management Company (EMC) to conduct quarterly monitoring and sampling activities at this site. The data is reported by Thrifty's in-house environmental staff.

Groundwater Monitoring

?? incorrect

Depth to groundwater is measured in each monitoring well on a quarterly basis. Historic gauging groundwater data obtained from April 11, 1988 through December 30, 1998 is presented in **Table 1**. In general, groundwater ~~occurs under water table conditions~~ beneath the station at depths ranging from 1.20 feet below ground surface (bgs) in monitoring well RS-9 to 11.35 feet bgs in monitoring well RS-8, as measured on December 30, 1998. Groundwater elevation contour map based on the December 30, 1998 data is presented in **Figure 1**. The general direction of groundwater flow beneath the site is to the east at a gradient ranging from 0.04 to 0.08 feet/foot.

Quarterly Groundwater Sampling

As part of the on-going groundwater monitoring program, groundwater samples were obtained from monitoring wells PW-1, PW-2, RE-1, RE-2, RE-3, RE-4, RE-5, RE-6, RE-7, RS-8, RS-9, RS-10, and RS-11 on December 30, 1998. Groundwater samples were obtained by EMC and delivered in a chilled state in an ice chest following strict Chain-of-Custody procedures to state-certified American Analytics laboratory, Chatsworth, California. Water samples were analyzed for benzene, toluene, ethylbenzene, xylenes (BTEX) and methyl tert-butyl ether (MTBE) by EPA method 8020, and total petroleum hydrocarbons (TPH) by EPA method 8015 modified.



Analytical Results

During this reporting period, dissolved total petroleum hydrocarbons (TPH) concentrations above 50 micrograms per liter (ug/L) were recorded in samples RE-2, RE-4, and RE-7 at concentrations of 460 ug/L, 530 ug/L, and 600 ug/L, respectively.

Dissolved benzene concentrations at or above 1.0 ug/L were recorded in samples PW-1, PW-2, RE-1, RE-3, RE-7, RS-8, RS-10, and RS-11 at concentrations of 1.0 ug/L, 1.1 ug/L, 1.1 ug/L, 2 ug/L, 1.0 ug/L, 1.0 ug/L, and 1.0 ug/L, respectively.

Similarly, MTBE concentrations above 20 ug/L were recorded in samples RE-2, RE-4, and RE-7 at concentrations of 1400 ug/L, 1500 ug/L, and 350 ug/L, respectively. All other samples collected did not contain TPH, benzene nor MTBE above the method detection limits. A summary of historical analytical sampling results are provided in **Table 1**, and copies of the analytical laboratory reports are contained in **Appendix A**. TPH, benzene, and MTBE distribution in groundwater during the reporting period are presented in **Figures 2, 3, and 4**, respectively.

Remediation System Operation Status

The soil and groundwater remediation system was designed and installed by Remediation Services Int'l (RSI) and has been in operation at the site since November 1989. The treatment compound consists of a Ford internal combustion engine, spray aeration tower, two activated carbon canisters and gauging instruments. The hydrocarbon laden vapors from the extraction wells are burned as fuel by the engine, and extracted water is being treated by carbon. The engine is equipped with a catalytic converter for exhaust emission reduction.

Water

As of December 1998, a total of about 27,922 gallons of water (current meter reading 11,832) had been processed by the unit and discharged to the local sanitary sewer. **During the 4th Quarter 1998 the water system was shut down because the system's compressor needed to be replaced.** Also during this period, the product lines were updated to meet 1998 underground storage tank regulations. A report should be generated by TOSCO cooperation. The remediation system was non-operation during this tank upgrade construction period. **The water system was restarted on December 11, 1998 to check the system repairs and collected a water sample;** the system was then shut down again due to site construction.

Effluent samples of the groundwater portion of the treatment unit were collected once during this quarter due to system maintenance, and the results are located in **Table 2**. Laboratory analysis of effluent water samples collected on December 11, 1998 indicated concentrations of TPH, benzene, and MTBE of 410 ug/L, <0.3 ug/L, and 860 ug/L. The high TPH concentrations maybe due to the high MTBE concentrations. Copies of analytical reports are located in **Appendix B**.

Vapor

The system was operational from November 16, 1998 through December 14, 1998 and non-operational the from October 1 through November 14, and December 15 through December 31, 1998. The system shut down due to maintenance problems and site construction. The site was maintained by EMC and, the RSI-SAVE unit operated 394 hours and 20,303 total hours (current meter reading 14,612). Treatment unit effluent vapor samples were collected during the operational period. Copies of laboratory analytical reports are located in **Appendix C**. Fields status reports for the vapor monitoring system are located in **Appendix D**.

Closing

All interpretations expressed in this report are based upon the review of data collected by Earth Management Company. If you have any questions please contact the undersigned at (562) 921-3581 X376.

Written by:

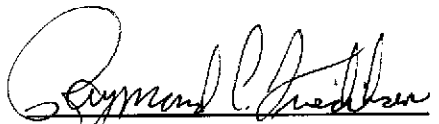
Raymond C. Friedrichsen, REA
Project Manager
Hydrogeologist

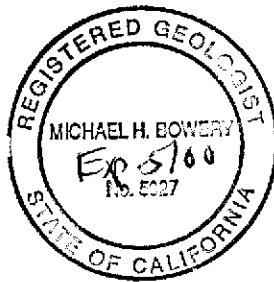

Reviewed by:

Michael H. Bowery, RG, REA
CA Registration #5027
Consulting Geologist

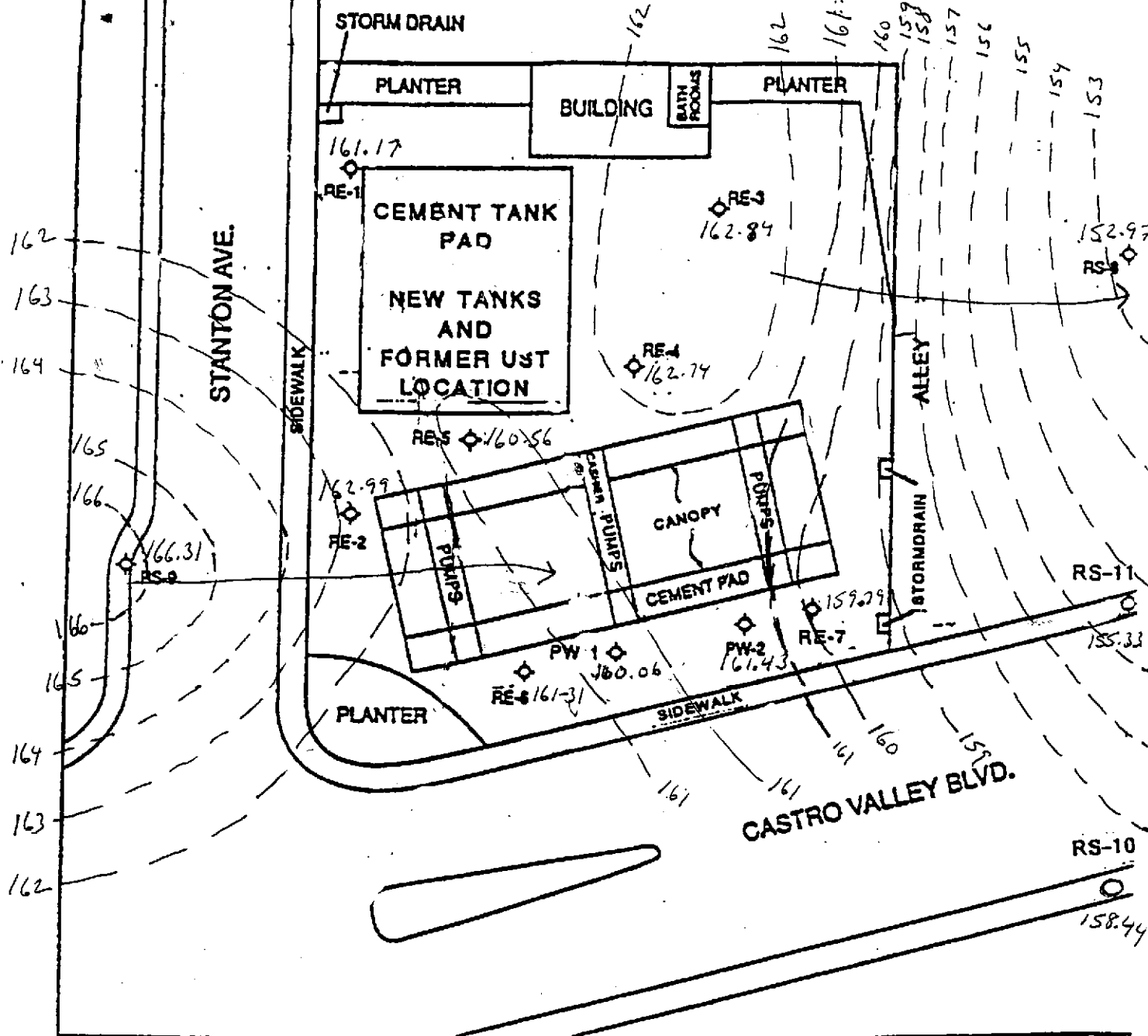

GROUNDWATER CONTOUR MAP
 THRIFTY OIL CO. #054
 CASTRO VALLEY, CALIFORNIA
 Prepared for
 THRIFTY OIL CO.
 SANTA FE, SPRINGS
 CALIFORNIA



◊ EXISTING MONITORING WELL

12/30/98

FIGURE 1

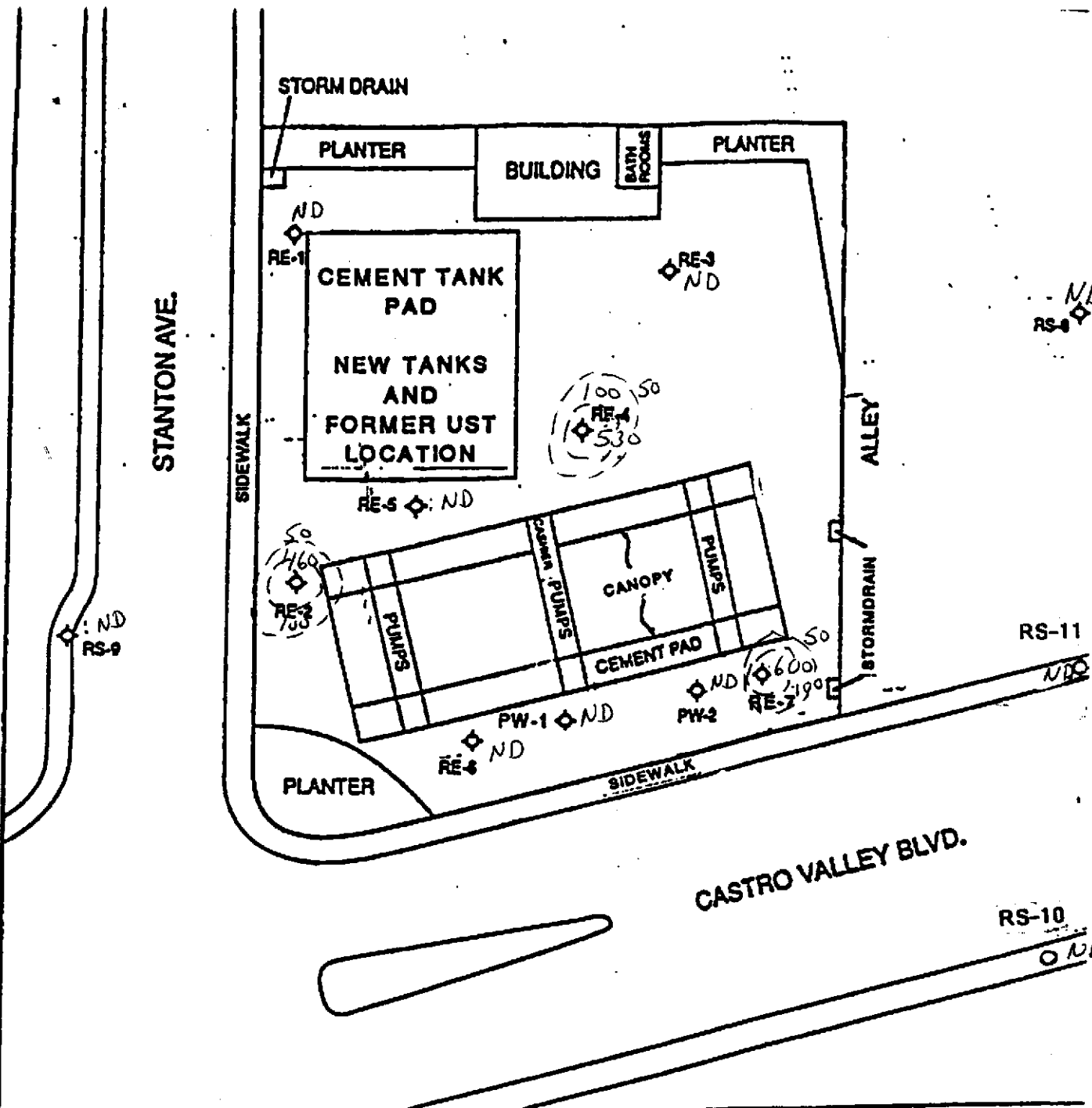

TPH GROUNDWATER ISOCONCENTRATION MAP PPB

**THRIFTY OIL CO. #054
 CASTRO VALLEY, CALIFORNIA
 Prepared for
 THRIFTY OIL CO.
 SANTA FE, SPRINGS
 CALIFORNIA**

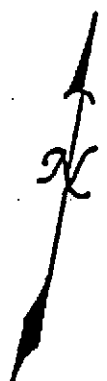
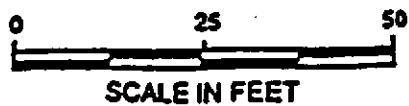

◊ EXISTING MONITORING WELL

FIGURE 2

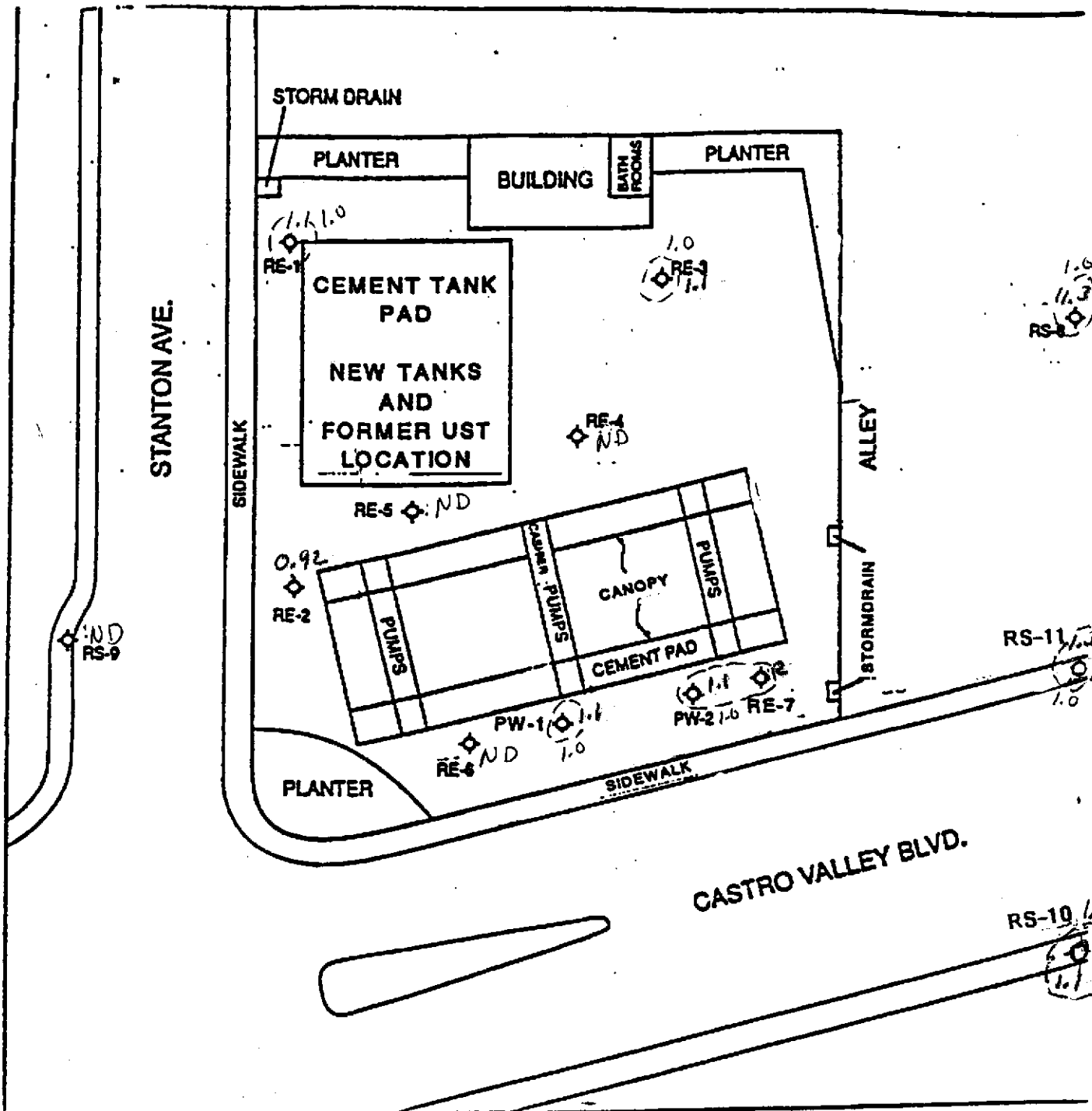

BENZENE ISOCONCENTRATION MAP PPB

THRIFTY OIL CO. #054
 CASTRO VALLEY, CALIFORNIA
 Prepared for
 THRIFTY OIL CO.
 SANTA FE, SPRINGS
 CALIFORNIA



SCALE IN FEET

◇ EXISTING MONITORING WELL

FIGURE 3

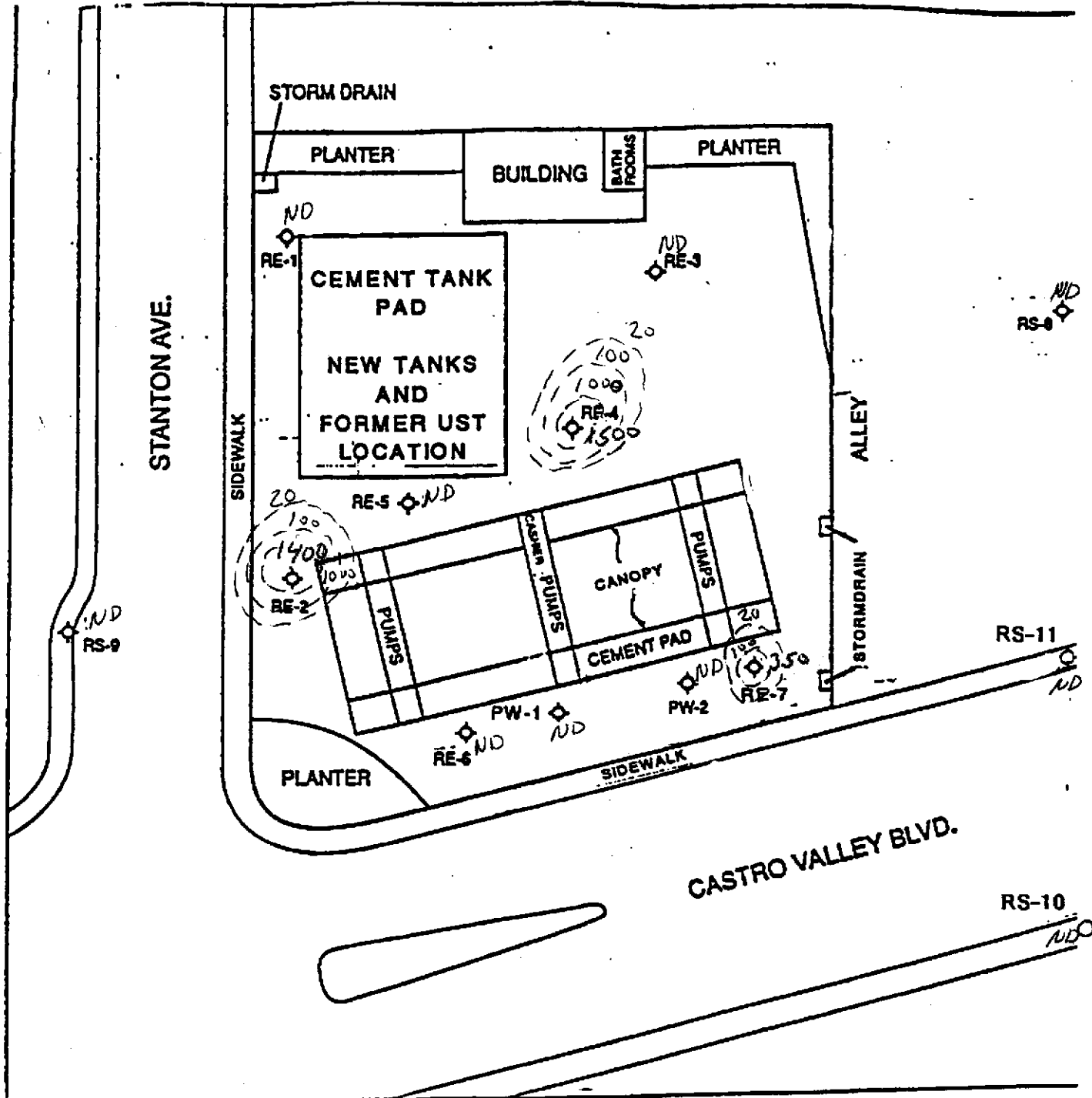

MTBE ISOCONCENTRATION MAP ug/L
 THRIFTY OIL CO. #054
 CASTRO VALLEY, CALIFORNIA
 Prepared for
 THRIFTY OIL CO.
 SANTA FE, SPRINGS
 CALIFORNIA

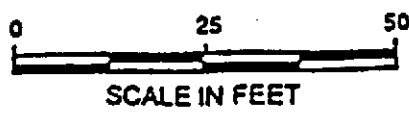

◇ EXISTING MONITORING WELL

FIGURE 4

TABLE(S)

**TABLE 1
GROUNDWATER DATA
THRIFTY OIL STATION #054, CASTRO VALLEY, CA.**

| DATE SAMPLED | ANALYTICAL PARAMETERS | | | | | | DEPTH TO GROUNDWATER (feet) | DEPTH TO PRODUCT (feet) | PRODUCT THICKNESS (feet) | CASING ELEVATION (feet) | GROUNDWATER ELEVATION (feet) |
|------------------------------|-----------------------|-------------------|-------------------|------------------------|------------------|----------------|-----------------------------------|-------------------------------|--------------------------------|-------------------------------|------------------------------------|
| | TPH (ug/L) | BENZENE (ug/L) | TOLUENE (ug/L) | EthylBenzene (ug/L) | XYLENE (ug/L) | MIRE (ug/L) | | | | | |
| MONITORING WELL #PW-1 | | | | | | | | | | | |
| 04/11/88 | - | - | - | - | - | - | - | - | - | - | - |
| 04/09/90 | 230,000 | 600 | 2,700 | 1,000 | 16,000 | - | 5.10 | NP | 0.00 | 166.46 | 161.36 |
| 10/30/90 | 35,000 | 240 | 970 | 240 | 3,580 | - | 6.17 | NP | 0.00 | 166.46 | 160.29 |
| 01/18/91 | 37,000 | 43 | 140 | 42 | 1,600 | - | 6.28 | NP | 0.00 | 166.46 | 160.18 |
| 02/12/91 | 45,000 | 99 | 130 | 25 | 700 | - | 5.88 | NP | 0.00 | 166.46 | 160.58 |
| 03/20/91 | 1,900 | 0.43 | ND | ND | 2.8 | - | 4.75 | NP | 0.00 | 166.46 | 161.71 |
| 05/22/91 | 41,000 | 600 | 730 | 250 | 3800 | - | 5.10 | NP | 0.00 | 166.46 | 161.36 |
| 06/19/91 | - | - | - | - | - | - | 5.61 | NP | 0.00 | 166.46 | 160.85 |
| 07/17/91 | - | - | - | - | - | - | 5.53 | FILM | 0.00 | 166.46 | 160.93 |
| 08/07/91 | - | - | - | - | - | - | 5.67 | FILM | 0.00 | 166.46 | 160.79 |
| 09/24/91 | - | - | - | - | - | - | 5.57 | FILM | 0.00 | 166.46 | 160.89 |
| 10/23/91 | - | - | - | - | - | - | 6.53 | FILM | 0.00 | 166.46 | 159.93 |
| 11/06/91 | - | - | - | - | - | - | 5.85 | FILM | 0.00 | 166.46 | 160.61 |
| 12/04/91 | - | - | - | - | - | - | 5.91 | FILM | 0.00 | 166.46 | 160.55 |
| 01/29/92 | - | - | - | - | - | - | 5.43 | FILM | 0.00 | 166.46 | 161.03 |
| 02/26/92 | - | - | - | - | - | - | 5.54 | FILM | 0.00 | 166.46 | 160.92 |
| 03/19/92 | ND | ND | ND | ND | ND | - | 5.47 | NP | 0.00 | 166.46 | 160.99 |
| 04/22/92 | - | - | - | - | - | - | 5.62 | FILM | 0.00 | 166.46 | 160.84 |
| 05/21/92 | 1,300 | 19 | 2.9 | 0.7 | 58 | - | 6.21 | NP | 0.00 | 166.46 | 160.25 |
| 06/25/92 | - | - | - | - | - | - | 6.94 | NP | 0.00 | 166.46 | 159.52 |
| 07/30/92 | - | - | - | - | - | - | 5.90 | FILM | 0.00 | 166.46 | 160.56 |
| 08/20/92 | - | - | - | - | - | - | 7.12 | FILM | 0.00 | 166.46 | 159.34 |
| 09/30/92 | 3,400 | 57 | ND | 26 | 240 | - | 6.42 | NP | 0.00 | 166.46 | 160.04 |
| 12/23/92 | - | - | - | - | - | - | 5.56 | FILM | 0.00 | 166.46 | 160.90 |
| 03/10/93 | - | - | - | - | - | - | 5.65 | FILM | 0.00 | 166.46 | 160.81 |
| 06/09/93 | 400 | <0.5 | 1.1 | <1.0 | <1.0 | - | 5.30 | NP | 0.00 | 166.46 | 161.16 |
| 09/14/93 | 180 | 3.7 | 3.2 | 1.5 | 14 | - | 5.43 | NP | 0.00 | 166.46 | 161.03 |
| 12/14/93 | <50 | <0.3 | <0.3 | <0.3 | <0.5 | - | 4.65 | NP | 0.00 | 166.46 | 161.81 |
| 03/02/94 | <50 | <0.3 | <0.3 | <0.3 | <0.5 | - | 5.43 | NP | 0.00 | 166.46 | 161.03 |
| 06/06/94 | 330 | 1.3 | <0.3 | 0.88 | 9.8 | - | 4.70 | NP | 0.00 | 166.46 | 161.76 |
| 09/06/94 | 1,100 | 67 | <0.3 | <0.3 | 24 | - | 6.48 | NP | 0.00 | 166.46 | 159.98 |
| 12/07/94 | <50 | <0.3 | <0.3 | <0.5 | <0.5 | - | 5.22 | NP | 0.00 | 166.46 | 161.24 |
| 03/08/95 | <100 | <0.5 | <0.5 | <0.5 | <1 | - | 6.94 | NP | 0.00 | 166.46 | 159.52 |
| 06/15/95 | 260 | 0.8 | 0.6 | <0.5 | 3.2 | - | 5.72 | NP | 0.00 | 166.46 | 160.74 |

**TABLE 1
GROUNDWATER DATA
THRIFTY OIL STATION #054, CASTRO VALLEY, CA.**

| DATE SAMPLED | ANALYTICAL PARAMETERS | | | | | | DEPTH TO GROUNDWATER (feet) | DEPTH TO PRODUCT (feet) | PRODUCT THICKNESS (feet) | CASING ELEVATION (feet) | GROUNDWATER ELEVATION (feet) |
|-----------------------------|-----------------------|----------------|----------------|---------------------|---------------|-------------|-----------------------------|-------------------------|--------------------------|-------------------------|------------------------------|
| | TPH (ug/L) | BENZENE (ug/L) | TOLUENE (ug/L) | EthylBenzene (ug/L) | XYLENE (ug/L) | MTHH (ug/L) | | | | | |
| 09/05/95 | 330 | 2.1 | <0.5 | 2.1 | 9.6 | - | 5.96 | NP | 0.00 | 166.46 | 160.50 |
| 11/21/95 | 660 | 13 | 1.3 | <0.3 | 4.0 | - | 6.04 | NP | 0.00 | 166.46 | 160.42 |
| 03/11/96 | 660 | 0.94 | 0.77 | <0.3 | 8.1 | - | 3.60 | NP | 0.00 | 166.46 | 162.86 |
| 06/19/96 | 120 | 0.53 | <0.3 | <0.3 | 2.3 | - | 4.80 | NP | 0.00 | 166.46 | 161.66 |
| 09/16/96 | <50 | <0.3 | <0.3 | <0.3 | <0.5 | <20 | 5.10 | NP | 0.00 | 166.46 | 161.36 |
| 12/10/96 | <50 | <0.3 | <0.3 | <0.3 | <0.5 | <20 | 4.92 | NP | 0.00 | 166.46 | 161.54 |
| 03/12/97 | <50 | <0.3 | <0.3 | <0.3 | <0.5 | <20 | 4.50 | NP | 0.00 | 166.46 | 161.96 |
| 06/12/97 | <50 | <0.3 | <0.3 | <0.3 | <0.5 | <20 | - | - | - | - | - |
| 09/16/97 | 690 | 0.97 | <0.3 | <0.3 | <0.5 | <20 | 4.55 | NP | 0.00 | 166.46 | 161.91 |
| 12/09/97 | 640 | 150 | 0.64 | <0.3 | 5.2 | 1,300 | 5.60 | NP | 0.00 | 166.46 | 160.86 |
| 03/03/98 | <50 | <0.3 | 0.57 | <0.3 | <0.5 | <20 | 4.13 | NP | 0.00 | 166.46 | 162.33 |
| 07/08/98 | <50 | <0.3 | <0.3 | <0.3 | <0.5 | <5 | - | - | - | - | - |
| 09/10/98 | <50 | <0.3 | <0.3 | <0.3 | <0.5 | <5 | 6.35 | NP | 0.00 | 166.46 | 160.11 |
| 12/30/98 | <50 | 1.1 | <0.3 | <0.3 | <0.5 | <5 | 6.40 | NP | 0.00 | 166.46 | 160.06 |
| MONITORING WELL PW-2 | | | | | | | | | | | |
| 04/11/88 | - | - | - | - | - | - | - | - | - | - | - |
| 04/09/90 | 600,000 | 1,300 | 11,000 | 4,600 | 4,300 | - | 5.81 | NP | 0.00 | 166.18 | 160.37 |
| 10/30/90 | 48,000 | 310 | 51 | 10 | 480 | - | 6.95 | NP | 0.00 | 166.18 | 159.23 |
| 01/18/91 | 86,000 | 230 | 1,400 | 350 | 8,300 | - | 6.92 | NP | 0.00 | 166.18 | 159.26 |
| 02/12/91 | 160,000 | 680 | 1,300 | 250 | 7,000 | - | 6.78 | NP | 0.00 | 166.18 | 159.40 |
| 03/20/91 | 17,000 | 34 | 50 | ND | 1,100 | - | 5.54 | NP | 0.00 | 166.18 | 160.64 |
| 05/22/91 | 14,000 | 57 | 2,100 | 500 | 8,200 | - | 6.07 | NP | 0.00 | 166.18 | 160.11 |
| 06/19/91 | - | - | - | - | - | - | 6.37 | FILM | 0.00 | 166.18 | 159.81 |
| 07/17/91 | - | - | - | - | - | - | 6.38 | FILM | 0.00 | 166.18 | 159.80 |
| 08/07/91 | - | - | - | - | - | - | 6.63 | FILM | 0.00 | 166.18 | 159.55 |
| 09/24/91 | - | - | - | - | - | - | 6.42 | FILM | 0.00 | 166.18 | 159.76 |
| 10/23/91 | - | - | - | - | - | - | 7.25 | FILM | 0.00 | 166.18 | 158.93 |
| 11/06/91 | - | - | - | - | - | - | 6.44 | FILM | 0.00 | 166.18 | 159.74 |
| 12/04/91 | - | - | - | - | - | - | 6.65 | FILM | 0.00 | 166.18 | 159.53 |
| 01/29/92 | - | - | - | - | - | - | 6.17 | FILM | 0.00 | 166.18 | 160.01 |
| 02/26/92 | - | - | - | - | - | - | 5.90 | FILM | 0.00 | 166.18 | 160.28 |
| 03/19/92 | - | - | - | - | - | - | 5.80 | FILM | 0.00 | 166.18 | 160.38 |
| 04/22/92 | - | - | - | - | - | - | 5.88 | FILM | 0.00 | 166.18 | 160.30 |

TABLE 1
GROUNDWATER DATA
THRIFTY OIL STATION #054, CASTRO VALLEY, CA.

| DATE SAMPLED | ANALYTICAL PARAMETERS | | | | | | DEPTH TO GROUNDWATER (feet) | DEPTH TO PRODUCT (feet) | PRODUCT THICKNESS (feet) | CASING ELEVATION (feet) | GROUNDWATER ELEVATION (feet) |
|--------------|-----------------------|----------------|----------------|---------------------|---------------|-------------|-----------------------------|-------------------------|--------------------------|-------------------------|------------------------------|
| | TPH (ug/L) | BENZENE (ug/L) | TOLUENE (ug/L) | EthylBenzene (ug/L) | XYLENE (ug/L) | MIBE (ug/L) | | | | | |
| 10/30/90 | 72,000 | 7,700 | 5,300 | 1,800 | 8,900 | - | 5.95 | NP | 0.00 | 166.82 | 160.87 |
| 01/18/91 | 150,000 | 11,000 | 14,000 | 1,800 | 4,300 | - | 5.17 | NP | 0.00 | 166.82 | 161.65 |
| 02/12/91 | 140,000 | 11,000 | 12,000 | 1,600 | 13,000 | - | 4.16 | NP | 0.00 | 166.82 | 162.66 |
| 03/20/91 | 53,000 | 3,100 | 4,200 | 400 | 5,500 | - | 4.75 | NP | 0.00 | 166.82 | 162.07 |
| 05/22/91 | 85,000 | 8,700 | 10,000 | 1,800 | 12,000 | - | 4.42 | NP | 0.00 | 166.82 | 162.40 |
| 06/19/91 | 110,000 | 8,500 | 9,600 | 2,600 | 16,000 | - | 4.93 | NP | 0.00 | 166.82 | 161.89 |
| 07/17/91 | 5,500 | 950 | ND | 26 | ND | - | 5.19 | NP | 0.00 | 166.82 | 161.63 |
| 08/07/91 | - | 6,700 | 5,000 | ND | 7,100 | - | 5.12 | NP | 0.00 | 166.82 | 161.70 |
| 09/24/91 | 60,000 | 6,800 | 4,300 | 640 | 6,900 | - | 5.87 | NP | 0.00 | 166.82 | 160.95 |
| 10/23/91 | 79,000 | 7,900 | 8,300 | 450 | 7,100 | - | 5.81 | NP | 0.00 | 166.82 | 161.01 |
| 11/06/91 | 130,000 | 14,000 | 15,000 | 1,100 | 8,800 | - | 5.56 | NP | 0.00 | 166.82 | 161.26 |
| 12/04/91 | 50,000 | 8,000 | 4,700 | 520 | 4,100 | - | 5.35 | NP | 0.00 | 166.82 | 161.47 |
| 01/29/92 | 21,000 | 10,300 | 11,000 | 780 | 6,000 | - | 4.50 | NP | 0.00 | 166.82 | 162.32 |
| 02/26/92 | 38000 | 8,400 | 10,500 | 720 | 7,100 | - | 5.27 | NP | 0.00 | 166.82 | 161.55 |
| 03/19/92 | 48,000 | 6,200 | 9,700 | 780 | 7,200 | - | 4.47 | NP | 0.00 | 166.82 | 162.35 |
| 04/22/92 | - | - | - | - | - | - | 4.62 | NP | 0.00 | 166.82 | 162.20 |
| 05/21/92 | 20,000 | 7,600 | 10,100 | 830 | 6,900 | - | 4.98 | NP | 0.00 | 166.82 | 161.84 |
| 06/25/92 | - | - | - | - | - | - | 5.14 | FILM | 0.00 | 166.82 | 161.68 |
| 07/30/92 | - | - | - | - | - | - | 5.30 | FILM | 0.00 | 166.82 | 161.52 |
| 08/20/92 | - | - | - | - | - | - | 5.28 | FILM | 0.00 | 166.82 | 161.54 |
| 09/30/92 | - | - | - | - | - | - | 5.66 | FILM | 0.00 | 166.82 | 161.16 |
| 12/23/92 | - | - | - | - | - | - | 4.81 | FILM | 0.00 | 166.82 | 162.01 |
| 03/10/93 | - | - | - | - | - | - | 4.13 | FILM | 0.00 | 166.82 | 162.69 |
| 06/09/93 | - | - | - | - | - | - | 4.48 | FILM | 0.00 | 166.82 | 162.34 |
| 09/14/93 | 19,000 | 3,600 | 1,100 | 740 | 4,300 | - | 5.35 | NP | 0.00 | 166.82 | 161.47 |
| 12/14/93 | 38,000 | 4,300 | 1,300 | <6.6 | 11 | - | 4.38 | NP | 0.00 | 166.82 | 162.44 |
| 03/02/94 | - | - | - | - | - | - | 4.22 | FILM | 0.00 | 166.82 | 162.60 |
| 06/06/94 | - | - | - | - | - | - | 2.16 | FILM | 0.00 | 166.82 | 164.66 |
| 09/06/94 | 74,000 | 3,300 | 3,900 | 1,200 | 6,100 | - | 5.00 | NP | 0.00 | 166.82 | 161.82 |
| 12/07/94 | 30,000 | 3,200 | 2,900 | 1,200 | 4,600 | - | 4.10 | NP | 0.00 | 166.82 | 162.72 |
| 03/08/95 | 28,000 | 4,200 | 2,300 | 810 | 7,800 | - | 3.92 | NP | 0.00 | 166.82 | 162.90 |
| 06/15/95 | - | - | - | - | - | - | - | - | - | - | - |
| 09/05/95 | - | - | - | - | - | - | 4.78 | FILM | 0.00 | 166.82 | 162.04 |
| 11/21/95 | - | - | - | - | - | - | 4.82 | NP | 0.00 | 166.82 | 162.00 |
| 03/11/96 | 270 | 2.4 | 6.0 | 4.5 | 19 | - | 3.32 | NP | 0.00 | 166.82 | 163.50 |

**TABLE 1
GROUNDWATER DATA
THRIFTY OIL STATION #054, CASTRO VALLEY, CA.**

| DATE SAMPLED | ANALYTICAL PARAMETERS | | | | | | DEPTH TO GROUNDWATER (feet) | DEPTH TO PRODUCT (feet) | PRODUCT THICKNESS (feet) | CASING ELEVATION (feet) | GROUNDWATER ELEVATION (feet) |
|------------------------------|-----------------------|-------------------|-------------------|------------------------|------------------|----------------|-----------------------------------|-------------------------------|--------------------------------|-------------------------------|------------------------------------|
| | TPH (ug/L) | BENZENE (ug/L) | TOLUENE (ug/L) | EthylBenzene (ug/L) | XYLENE (ug/L) | MIBK (ug/L) | | | | | |
| 06/19/96 | 3,000 | 570 | 63 | <1.5 | 400 | - | 4.20 | NP | 0.00 | 166.82 | 162.62 |
| 09/16/96 | 7,700 | 440 | 69 | <1.5 | 680 | 230 | 4.68 | NP | 0.00 | 166.82 | 162.14 |
| 12/10/96 | 52 | <0.3 | <0.3 | <0.3 | <0.5 | 120 | 4.93 | NP | 0.00 | 166.82 | 161.89 |
| 03/12/97 | 8,700 | 180 | 5.4 | 40 | 1,100 | 130 | 4.10 | NP | 0.00 | 166.82 | 162.72 |
| 06/12/97 | <50 | <0.3 | <0.3 | <0.3 | <0.5 | 36 | - | - | - | - | - |
| 09/16/97 | <50 | <0.3 | <0.3 | <0.3 | <0.5 | <20 | 4.55 | NP | 0.00 | 166.82 | 162.27 |
| 12/09/97 | <50 | <0.3 | 0.44 | <0.3 | <0.5 | <20 | 5.30 | NP | 0.00 | 166.82 | 161.52 |
| 03/03/98 | 1,100 | 13 | 0.51 | <0.3 | <0.5 | 220 | 4.55 | NP | 0.00 | 166.82 | 162.27 |
| 07/08/98 | <50 | <0.3 | <0.3 | <0.3 | <0.5 | <5 | - | - | - | - | - |
| 09/10/98 | 60 | <0.3 | <0.3 | <0.3 | <0.5 | 180 | 6.05 | NP | 0.00 | 166.82 | 160.77 |
| 12/30/98 | <50 | 1.1 | <0.3 | <0.3 | <0.5 | <5 | 5.65 | NP | 0.00 | 166.82 | 161.17 |
| MONITORING WELL #RE-2 | | | | | | | | | | | |
| 04/11/88 | - | - | - | - | - | - | - | - | - | - | - |
| 04/09/90 | 850 | 5.8 | 0.5 | 4.8 | 1.1 | - | 4.90 | NP | 0.00 | 167.19 | 162.29 |
| 10/30/90 | 440 | 2.8 | 0.91 | 13 | 3.14 | - | 5.34 | NP | 0.00 | 167.19 | 161.85 |
| 01/18/91 | 1,100 | 8.4 | 3.1 | ND | 10 | - | 4.90 | NP | 0.00 | 167.19 | 162.29 |
| 02/12/91 | 1,100 | 5.9 | ND | 1.77 | ND | - | 4.94 | NP | 0.00 | 167.19 | 162.25 |
| 03/20/91 | 550 | 4.3 | ND | ND | ND | - | 4.32 | NP | 0.00 | 167.19 | 162.87 |
| 05/22/91 | 1,000 | 5.3 | 3.6 | 4.4 | 8.9 | - | 4.43 | NP | 0.00 | 167.19 | 162.76 |
| 06/19/91 | 700 | 2.1 | 1.4 | 3.8 | 3.5 | - | 6.43 | NP | 0.00 | 167.19 | 160.76 |
| 07/17/91 | 880 | 12 | 8.0 | 4.3 | 28 | - | 4.75 | NP | 0.00 | 167.19 | 162.44 |
| 08/07/91 | - | 3.8 | 1.6 | ND | ND | - | 4.87 | NP | 0.00 | 167.19 | 162.32 |
| 09/24/91 | 670 | 7.2 | 7.1 | ND | 23 | - | 5.50 | NP | 0.00 | 167.19 | 161.69 |
| 10/23/91 | 2,700 | 52 | 60 | 22 | 130 | - | 5.63 | NP | 0.00 | 167.19 | 161.56 |
| 11/06/91 | 1,900 | 18 | 61 | 9.1 | 83 | - | 5.14 | NP | 0.00 | 167.19 | 162.05 |
| 12/04/91 | 1,100 | 26 | 47 | 4.3 | 42 | - | 5.26 | NP | 0.00 | 167.19 | 161.93 |
| 01/29/92 | 900 | 14 | 24 | 5.3 | 19 | - | 5.11 | NP | 0.00 | 167.19 | 162.08 |
| 02/26/92 | 500 | 3.4 | 3.5 | 2.7 | 2.7 | - | 4.31 | NP | 0.00 | 167.19 | 162.88 |
| 03/19/92 | 1,200 | 14 | 20 | 15 | 18 | - | 4.45 | NP | 0.00 | 167.19 | 162.74 |
| 04/22/92 | 200 | ND | ND | ND | ND | - | 4.78 | NP | 0.00 | 167.19 | 162.41 |
| 05/21/92 | 500 | 7.5 | 6.8 | 3.9 | 7.4 | - | 5.02 | NP | 0.00 | 167.19 | 162.17 |
| 06/25/92 | ND | ND | 0.9 | 0.7 | ND | - | 5.13 | NP | 0.00 | 167.19 | 162.06 |
| 07/30/92 | 500 | 7.7 | 8.6 | 3.2 | 1.7 | - | 5.19 | NP | 0.00 | 167.19 | 162.00 |

TABLE 1
GROUNDWATER DATA
THRIFTY OIL STATION #054, CASTRO VALLEY, CA.

| DATE SAMPLED | ANALYTICAL PARAMETERS | | | | | | DEPTH TO GROUNDWATER (feet) | DEPTH TO PRODUCT (feet) | PRODUCT THICKNESS (feet) | CASING ELEVATION (feet) | GROUNDWATER ELEVATION (feet) |
|------------------------------|-----------------------|-------------------|-------------------|------------------------|------------------|----------------|-----------------------------------|-------------------------------|--------------------------------|-------------------------------|------------------------------------|
| | TPH (ug/L) | BENZENE (ug/L) | TOLUENE (ug/L) | EthylBenzene (ug/L) | XYLENE (ug/L) | MTHP (ug/L) | | | | | |
| 08/20/92 | 1,100 | 6.6 | 4.5 | 2.7 | 2.0 | - | 5.27 | NP | 0.00 | 167.19 | 161.92 |
| 09/30/92 | 500 | 5.4 | 2.4 | 1.8 | 4.5 | - | 5.45 | NP | 0.00 | 167.19 | 161.74 |
| 12/23/92 | 800 | 1.9 | ND | ND | 2.3 | - | 4.60 | NP | 0.00 | 167.19 | 162.59 |
| 03/10/93 | 1,200 | ND | 1.4 | ND | 2.1 | - | 4.18 | NP | 0.00 | 167.19 | 163.01 |
| 06/09/93 | 200 | ND | ND | ND | ND | - | 4.53 | NP | 0.00 | 167.19 | 162.66 |
| 09/17/93 | 360 | 1.6 | 1.1 | 3.2 | 8.9 | - | 5.26 | NP | 0.00 | 167.19 | 161.93 |
| 12/14/93 | 260 | 5.6 | 3.9 | <0.3 | 21.0 | - | 2.75 | NP | 0.00 | 167.19 | 164.44 |
| 03/02/94 | 410 | <0.3 | <0.3 | <0.3 | <0.5 | - | 4.27 | NP | 0.00 | 167.19 | 162.92 |
| 06/06/94 | 760 | 4.6 | <0.3 | 0.32 | 1.3 | - | 4.88 | NP | 0.00 | 167.19 | 162.31 |
| 09/06/94 | 1,300 | 43 | 45 | 8.9 | 69 | - | 5.16 | NP | 0.00 | 167.19 | 162.03 |
| 12/07/94 | - | - | - | - | - | - | 4.16 | NP | 0.00 | 167.19 | 163.03 |
| 03/08/95 | <100 | <0.5 | <0.5 | <0.5 | <1 | - | 3.96 | NP | 0.00 | 167.19 | 163.23 |
| 06/15/95 | 130 | <0.5 | <0.5 | <0.5 | <1 | - | 4.52 | NP | 0.00 | 167.19 | 162.67 |
| 09/05/95 | 210 | <0.5 | <0.5 | <0.5 | <1 | - | 4.76 | NP | 0.00 | 167.19 | 162.43 |
| 11/21/95 | 160 | 0.65 | <0.3 | 0.35 | 0.95 | - | 4.83 | NP | 0.00 | 167.19 | 162.36 |
| 03/11/96 | <50 | <0.3 | <0.3 | <0.3 | <0.5 | - | 3.36 | NP | 0.00 | 167.19 | 163.83 |
| 06/19/96 | <50 | <0.3 | <0.3 | <0.3 | <0.5 | - | 4.68 | NP | 0.00 | 167.19 | 162.51 |
| 09/16/96 | <50 | <0.3 | <0.3 | <0.3 | <0.5 | <20 | 5.10 | NP | 0.00 | 167.19 | 162.09 |
| 12/10/96 | <50 | <0.3 | <0.3 | <0.3 | <0.5 | <20 | 4.47 | NP | 0.00 | 167.19 | 162.72 |
| 03/12/97 | <50 | <0.3 | <0.3 | <0.3 | <0.5 | <20 | 4.05 | NP | 0.00 | 167.19 | 163.14 |
| 06/12/97 | <50 | <0.3 | <0.3 | <0.3 | <0.5 | <20 | - | - | - | - | - |
| 09/10/97 | <50 | <0.3 | <0.3 | <0.3 | <0.5 | <20 | 4.08 | NP | 0.00 | 167.19 | 163.11 |
| 12/09/97 | <50 | <0.3 | <0.3 | <0.3 | <0.5 | <20 | 4.40 | NP | 0.00 | 167.19 | 162.79 |
| 03/03/98 | <50 | <0.3 | <0.3 | <0.3 | <0.5 | <20 | 3.30 | NP | 0.00 | 167.19 | 163.89 |
| 07/08/98 | <50 | <0.3 | <0.3 | <0.3 | <0.5 | 15 | - | - | - | - | - |
| 09/10/98 | <50 | <0.3 | <0.3 | <0.3 | <0.5 | <5 | 4.93 | NP | 0.00 | 167.19 | 162.26 |
| 12/30/98 | 460 | 0.92 | <0.3 | <0.3 | <0.5 | 4.20 | 4.20 | NP | 0.00 | 167.19 | 162.99 |
| MONITORING WELL #RE-3 | | | | | | | | | | | |
| 04/11/88 | 70,000 | 6,600 | 5,300 | 800 | 13,000 | - | - | - | - | - | - |
| 04/09/90 | 370,000 | 2,300 | 4,900 | 3,200 | 31,000 | - | 7.15 | NP | 0.00 | 167.39 | 160.24 |
| 10/30/90 | 13,000 | 860 | 660 | 220 | 2,210 | - | 7.84 | NP | 0.00 | 167.39 | 159.55 |
| 01/18/91 | 42,000 | 4,700 | 4,500 | 21 | 7,700 | - | 6.90 | NP | 0.00 | 167.39 | 160.49 |
| 02/12/91 | 72,000 | 3,600 | 4,500 | ND | 7,600 | - | 6.62 | NP | 0.00 | 167.39 | 160.77 |

TABLE 1
GROUNDWATER DATA
THRIFTY OIL STATION #054, CASTRO VALLEY, CA.

| DATE SAMPLED | ANALYTICAL PARAMETERS | | | | | | DEPTH TO GROUNDWATER (feet) | DEPTH TO PRODUCT (feet) | PRODUCT THICKNESS (feet) | CASING ELEVATION (feet) | GROUNDWATER ELEVATION (feet) |
|-----------------|-----------------------|-------------------|-------------------|------------------------|------------------|----------------|-----------------------------------|-------------------------------|--------------------------------|-------------------------------|------------------------------------|
| | TPH (ug/L) | BENZENE (ug/L) | TOLUENE (ug/L) | EthylBenzene (ug/L) | XYLENE (ug/L) | MTBE (ug/L) | | | | | |
| 03/20/91 | 65,000 | 2,400 | 9,400 | 50 | 9,800 | - | 5.87 | NP | 0.00 | 167.39 | 161.52 |
| 05/22/91 | - | - | - | - | - | - | 5.98 | FILM | 0.00 | 167.39 | 161.41 |
| 06/19/91 | - | - | - | - | - | - | 6.84 | FILM | 0.00 | 167.39 | 160.55 |
| 07/17/91 | - | - | - | - | - | - | 7.10 | FILM | 0.00 | 167.39 | 160.29 |
| 08/07/91 | - | - | - | - | - | - | 7.30 | FILM | 0.00 | 167.39 | 160.09 |
| 09/24/91 | - | - | - | - | - | - | 7.84 | FILM | 0.00 | 167.39 | 159.55 |
| 10/23/91 | - | - | - | - | - | - | 8.07 | FILM | 0.00 | 167.39 | 159.32 |
| 11/06/91 | - | - | - | - | - | - | 7.63 | FILM | 0.00 | 167.39 | 159.76 |
| 12/04/91 | - | - | - | - | - | - | 7.83 | FILM | 0.00 | 167.39 | 159.56 |
| 01/29/92 | - | - | - | - | - | - | 7.17 | FILM | 0.00 | 167.39 | 160.22 |
| 02/26/92 | - | - | - | - | - | - | 5.56 | FILM | 0.00 | 167.39 | 161.83 |
| 03/19/92 | - | - | - | - | - | - | 5.44 | FILM | 0.00 | 167.39 | 161.95 |
| 04/22/92 | - | - | - | - | - | - | 6.56 | FILM | 0.00 | 167.39 | 160.83 |
| 05/21/92 | - | - | - | - | - | - | 6.90 | FILM | 0.00 | 167.39 | 160.49 |
| 06/25/92 | - | - | - | - | - | - | 7.18 | FILM | 0.00 | 167.39 | 160.21 |
| 07/30/92 | - | - | - | - | - | - | 6.80 | FILM | 0.00 | 167.39 | 160.59 |
| 08/20/92 | - | - | - | - | - | - | 7.25 | FILM | 0.00 | 167.39 | 160.14 |
| 09/30/92 | - | - | - | - | - | - | 7.68 | FILM | 0.00 | 167.39 | 159.71 |
| 12/23/92 | - | - | - | - | - | - | 6.07 | FILM | 0.00 | 167.39 | 161.32 |
| 03/10/93 | - | - | - | - | - | - | 5.66 | FILM | 0.00 | 167.39 | 161.73 |
| 06/09/93 | - | - | - | - | - | - | 6.66 | FILM | 0.00 | 167.39 | 160.73 |
| 09/14/93 | 40,000 | 2,900 | 1,500 | 180 | 6,900 | - | 7.30 | NP | 0.00 | 167.39 | 160.09 |
| 12/14/93 | - | - | - | - | - | - | 5.95 | NP | 0.00 | 167.39 | 161.44 |
| 03/02/94 | - | - | - | - | - | - | 5.08 | NP | 0.00 | 167.39 | 162.31 |
| 06/06/94 | - | - | - | - | - | - | 6.35 | FILM | 0.00 | 167.39 | 161.04 |
| 09/06/94 | 11,000 | 260 | 26 | <6.6 | 1,000 | - | 7.50 | NP | 0.00 | 167.39 | 159.89 |
| 12/07/94 | - | - | - | - | - | - | 5.48 | FILM | 0.00 | 167.39 | 161.91 |
| 03/08/95 | - | - | - | - | - | - | 5.18 | FILM | 0.00 | 167.39 | 162.21 |
| 06/15/95 | - | - | - | - | - | - | - | - | - | - | - |
| 09/05/95 | - | - | - | - | - | - | 6.84 | FILM | 0.00 | 167.39 | 160.55 |
| 11/21/95 | 10,000 | 210 | <3 | 4.5 | 330 | - | 7.38 | NP | 0.00 | 167.39 | 160.01 |
| 03/11/96 | 1,600 | 640 | 15 | 10 | 46 | - | 4.85 | NP | 0.00 | 167.39 | 162.54 |
| 06/19/96 | 2,100 | 280 | <3 | <3 | 120 | - | 5.80 | NP | 0.00 | 167.39 | 161.59 |
| 09/16/96 | 140 | <0.3 | <0.3 | <0.3 | <0.5 | 110 | 4.50 | NP | 0.00 | 167.39 | 162.89 |
| 12/10/96 | <50 | <0.3 | <0.3 | <0.3 | <0.5 | <20 | 5.35 | NP | 0.00 | 167.39 | 162.04 |

TABLE 1
GROUNDWATER DATA
THRIFTY OIL STATION #054, CASTRO VALLEY, CA.

| DATE SAMPLED | ANALYTICAL PARAMETERS | | | | | | DEPTH TO GROUNDWATER (feet) | DEPTH TO PRODUCT (feet) | PRODUCT THICKNESS (feet) | CASING ELEVATION (feet) | GROUNDWATER ELEVATION (feet) |
|------------------------------|-----------------------|----------------|----------------|---------------------|---------------|-------------|-----------------------------|-------------------------|--------------------------|-------------------------|------------------------------|
| | TPH (ug/L) | BENZENE (ug/L) | TOLUENE (ug/L) | EthylBenzene (ug/L) | XYLENE (ug/L) | MTBE (ug/L) | | | | | |
| 03/12/97 | <50 | <0.3 | <0.3 | <0.3 | <0.5 | <20 | 3.48 | NP | 0.00 | 167.39 | 163.91 |
| 06/12/97 | <50 | <0.3 | <0.3 | <0.3 | 0.58 | <20 | - | - | - | - | - |
| 09/10/97 | <50 | <0.3 | <0.3 | <0.3 | <0.5 | <20 | 3.10 | NP | 0.00 | 167.39 | 164.29 |
| 12/09/97 | 3,600 | 1,000 | 1,000 | <6 | 570 | 260 | 4.55 | NP | 0.00 | 167.39 | 162.84 |
| 03/03/98 | 2,800 | 20 | 0.65 | 0.39 | 16 | 5,000 | 2.30 | NP | 0.00 | 167.39 | 165.09 |
| 07/08/98 | <50 | <0.3 | <0.3 | <0.3 | <0.5 | <5 | - | - | - | - | - |
| 09/10/98 | <50 | <0.3 | <0.3 | <0.3 | <0.5 | 23 | 4.95 | NP | 0.00 | 167.39 | 162.44 |
| 12/30/98 | <50 | 1.1 | <0.3 | <0.3 | <0.5 | <5 | 4.55 | NP | 0.00 | 167.39 | 162.84 |
| MONITORING WELL #RE-4 | | | | | | | | | | | |
| 04/11/88 | 15,000 | 12,000 | 8,000 | 1,000 | 2,700 | - | - | - | - | - | - |
| 04/09/90 | NSC | | | | | | - | - | - | - | - |
| 10/30/90 | 87,000 | 7,200 | 10,000 | 1,600 | 12,900 | - | 7.04 | NP | 0.00 | 166.94 | 159.90 |
| 01/18/91 | 70,000 | 5,000 | 5,400 | 790 | 9,900 | - | 11.62 | NP | 0.00 | 166.94 | 155.32 |
| 02/12/91 | 87,000 | 5,200 | 2,800 | 240 | 11,000 | - | 11.63 | NP | 0.00 | 166.94 | 155.31 |
| 03/20/91 | 6,500 | 370 | 230 | 17 | 670 | - | 11.61 | NP | 0.00 | 166.94 | 155.33 |
| 05/22/91 | - | - | - | - | - | - | 10.30 | FILM | 0.00 | 166.94 | 156.64 |
| 06/19/91 | - | - | - | - | - | - | 11.10 | FILM | 0.00 | 166.94 | 155.84 |
| 07/17/91 | - | - | - | - | - | - | 6.20 | FILM | 0.00 | 166.94 | 160.74 |
| 08/17/91 | - | - | - | - | - | - | 8.15 | FILM | 0.00 | 166.94 | 158.79 |
| 09/24/91 | - | - | - | - | - | - | 10.40 | FILM | 0.00 | 166.94 | 156.54 |
| 10/23/91 | - | - | - | - | - | - | 11.20 | FILM | 0.00 | 166.94 | 155.74 |
| 11/06/91 | - | - | - | - | - | - | 6.62 | FILM | 0.00 | 166.94 | 160.32 |
| 12/04/91 | - | - | - | - | - | - | 11.20 | FILM | 0.00 | 166.94 | 155.74 |
| 01/29/92 | - | - | - | - | - | - | 7.72 | FILM | 0.00 | 166.94 | 159.22 |
| 02/26/92 | - | - | - | - | - | - | 5.13 | FILM | 0.00 | 166.94 | 161.81 |
| 03/19/92 | - | - | - | - | - | - | 5.00 | FILM | 0.00 | 166.94 | 161.94 |
| 04/22/92 | - | - | - | - | - | - | 5.94 | FILM | 0.00 | 166.94 | 161.00 |
| 05/21/92 | - | - | - | - | - | - | 5.40 | FILM | 0.00 | 166.94 | 161.54 |
| 06/25/92 | - | - | - | - | - | - | 5.71 | FILM | 0.00 | 166.94 | 161.23 |
| 07/30/92 | - | - | - | - | - | - | 6.33 | FILM | 0.00 | 166.94 | 160.61 |
| 08/20/92 | - | - | - | - | - | - | 5.80 | FILM | 0.00 | 166.94 | 161.14 |
| 09/30/92 | - | - | - | - | - | - | 6.34 | FILM | 0.00 | 166.94 | 160.60 |
| 12/23/92 | - | - | - | - | - | - | 5.50 | FILM | 0.00 | 166.94 | 161.44 |

TABLE 1
GROUNDWATER DATA
THRIFTY OIL STATION #054, CASTRO VALLEY, CA.

| DATE SAMPLED | ANALYTICAL PARAMETERS | | | | | | DEPTH TO GROUNDWATER (feet) | DEPTH TO PRODUCT (feet) | PRODUCT THICKNESS (feet) | CASING ELEVATION (feet) | GROUNDWATER ELEVATION (feet) |
|------------------------------|-----------------------|----------------|----------------|---------------------|---------------|-------------|-----------------------------|-------------------------|--------------------------|-------------------------|------------------------------|
| | TPE (ug/L) | BENZENE (ug/L) | TOLUENE (ug/L) | EthylBenzene (ug/L) | XYLENE (ug/L) | MIBE (ug/L) | | | | | |
| 03/10/93 | - | - | - | - | - | - | 4.67 | FILM | 0.00 | 166.94 | 162.27 |
| 06/09/93 | - | - | - | - | - | - | 5.12 | FILM | 0.00 | 166.94 | 161.82 |
| 09/14/93 | - | - | - | - | - | - | 10.44 | NP | 0.00 | 166.94 | 156.50 |
| 12/14/93 | - | - | - | - | - | - | 7.52 | NP | 0.00 | 166.94 | 159.42 |
| 03/02/94 | - | - | - | - | - | - | 4.85 | NP | 0.00 | 166.94 | 162.09 |
| 06/06/94 | - | - | - | - | - | - | 5.20 | FILM | 0.00 | 166.94 | 161.74 |
| 09/06/94 | - | - | - | - | - | - | 9.85 | FILM | 0.00 | 166.94 | 157.09 |
| 12/07/94 | - | - | - | - | - | - | 5.20 | FILM | 0.00 | 166.94 | 161.74 |
| 03/08/95 | - | - | - | - | - | - | 4.98 | FILM | 0.00 | 166.94 | 161.96 |
| 06/15/95 | - | - | - | - | - | - | - | - | - | - | - |
| 09/05/95 | - | - | - | - | - | - | 13.72 | FILM | 0.00 | 166.94 | 153.22 |
| 11/21/95 | 32,000 | 46 | 21 | 66 | 340 | - | 12.53 | NP | 0.00 | 166.94 | 154.41 |
| 03/11/96 | 1,700 | 130 | 15 | 2.0 | 120 | - | 4.72 | NP | 0.00 | 166.94 | 162.22 |
| 06/19/96 | 1,700 | 230 | 30 | 0.35 | 100 | - | 5.40 | NP | 0.00 | 166.94 | 161.54 |
| 09/16/96 | 510 | <0.3 | 0.73 | <0.3 | <0.5 | 800 | 5.18 | NP | 0.00 | 166.94 | 161.76 |
| 12/10/96 | 520 | <0.3 | <0.3 | <0.3 | <0.5 | 1,000 | 4.65 | NP | 0.00 | 166.94 | 162.29 |
| 03/12/97 | 420 | 3.2 | <0.3 | <0.3 | 11 | 370 | 3.87 | NP | 0.00 | 166.94 | 163.07 |
| 06/12/97 | 510 | 0.66 | <0.3 | <0.3 | <0.5 | 1,600 | - | - | - | - | - |
| * 09/10/97 | <50 | <0.3 | <0.3 | <0.3 | <0.5 | <20 | 5.40 | NP | 0.00 | 166.94 | 161.54 |
| 12/09/97 | 1,400 | 330 | 2.3 | <0.3 | 1.5 | 2,500 | 4.60 | NP | 0.00 | 166.94 | 162.34 |
| 03/03/98 | 3,000 | 400 | 0.61 | 0.5 | 97 | 3,300 | 5.05 | NP | 0.00 | 166.94 | 161.89 |
| 07/08/98 | 650 | <0.3 | <0.3 | <0.3 | <0.5 | 1,300 | - | - | - | - | - |
| * 09/10/98 | 2,700 | <0.3 | <0.3 | <0.3 | 1.4 | 7,000 | 4.60 | NP | 0.00 | 166.94 | 162.34 |
| 12/30/98 | 530 | <0.3 | <0.3 | <0.3 | <0.5 | 1,500 | 4.20 | NP | 0.00 | 166.94 | 162.74 |
| MONITORING WELL #RE-5 | | | | | | | | | | | |
| 04/11/88 | 14,000 | 1,300 | 1,100 | 100 | 2,600 | - | - | - | - | - | - |
| 04/09/90 | 3,000 | 690 | 190 | 40 | 270 | - | 4.79 | NP | 0.00 | 166.51 | 161.72 |
| 10/30/90 | 3,400 | 910 | 48 | 87 | 249 | - | 5.86 | NP | 0.00 | 166.51 | 160.65 |
| 01/18/91 | 1,400 | 180 | 8.6 | 0.52 | 48 | - | 4.40 | NP | 0.00 | 166.51 | 162.11 |
| 02/12/91 | 1,000 | ND | ND | 0.65 | ND | - | 4.76 | NP | 0.00 | 166.51 | 161.75 |
| 03/20/91 | 3,000 | 250 | 53 | ND | 110 | - | 5.08 | NP | 0.00 | 166.51 | 161.43 |
| 05/22/91 | 2,500 | 330 | 7.8 | 5.6 | 200 | - | 4.52 | NP | 0.00 | 166.51 | 161.99 |
| 01/19/91 | 2,000 | 59 | 1.6 | 5.1 | 110 | - | 4.39 | NP | 0.00 | 166.51 | 162.12 |

TABLE 1
GROUNDWATER DATA
THRIFTY OIL STATION #054, CASTRO VALLEY, CA.

| DATE SAMPLED | ANALYTICAL PARAMETERS | | | | | | DEPTH TO GROUNDWATER (feet) | DEPTH TO PRODUCT (feet) | PRODUCT THICKNESS (feet) | CASING ELEVATION (feet) | GROUNDWATER ELEVATION (feet) |
|-----------------|-----------------------|-------------------|-------------------|------------------------|------------------|----------------|-----------------------------------|-------------------------------|--------------------------------|-------------------------------|------------------------------------|
| | TPH (ug/L) | BENZENE (ug/L) | TOLUENE (ug/L) | EthylBenzene (ug/L) | XYLENE (ug/L) | MTBE (ug/L) | | | | | |
| 07/17/91 | - | - | - | - | - | - | 5.05 | FILM | 0.00 | 166.51 | 161.46 |
| 08/07/91 | - | - | - | - | - | - | 5.02 | FILM | 0.00 | 166.51 | 161.49 |
| 09/24/91 | - | - | - | - | - | - | 5.86 | FILM | 0.00 | 166.51 | 160.65 |
| 10/23/91 | - | - | - | - | - | - | 5.84 | FILM | 0.00 | 166.51 | 160.67 |
| 11/06/91 | 9,900 | 2,300 | 37 | 260 | 160 | - | 5.48 | NP | 0.00 | 166.51 | 161.03 |
| 12/04/91 | 4,500 | 1,000 | 27 | ND | 180 | - | 5.43 | NP | 0.00 | 166.51 | 161.08 |
| 01/29/92 | 600 | 6.1 | 2.3 | ND | 47 | - | 5.12 | NP | 0.00 | 166.51 | 161.39 |
| 02/26/92 | 500 | 5.4 | 2.7 | 1.2 | 14 | - | 4.93 | NP | 0.00 | 166.51 | 161.58 |
| 03/19/92 | ND | 1.7 | 1.1 | ND | 5.5 | - | 4.45 | NP | 0.00 | 166.51 | 162.06 |
| 04/22/92 | 1,600 | 240 | 2.2 | ND | 160 | - | 4.63 | NP | 0.00 | 166.51 | 161.88 |
| 05/21/92 | 1,200 | 410 | 37 | ND | 118 | - | 4.90 | NP | 0.00 | 166.51 | 161.61 |
| 06/25/92 | ND | 1.0 | 0.8 | 0.8 | 0.4 | - | 5.15 | NP | 0.00 | 166.51 | 161.36 |
| 07/30/92 | ND | 2.0 | 1.8 | 1.9 | 6.4 | - | 5.30 | NP | 0.00 | 166.51 | 161.21 |
| 08/20/92 | 300 | 1.7 | 3.3 | 0.7 | 12 | - | 5.44 | NP | 0.00 | 166.51 | 161.07 |
| 09/30/92 | 1,900 | 140 | ND | 19 | 35 | - | 5.73 | NP | 0.00 | 166.51 | 160.78 |
| 12/23/92 | 400 | 8.0 | ND | ND | ND | - | 4.75 | NP | 0.00 | 166.51 | 161.76 |
| 03/10/93 | 1,100 | 290 | 9.7 | ND | 75 | - | 4.14 | NP | 0.00 | 166.51 | 162.37 |
| 06/09/93 | 400 | 1.5 | 0.5 | ND | 12 | - | 5.42 | NP | 0.00 | 166.51 | 161.09 |
| 09/14/93 | 240 | 6.9 | 8.8 | 1.4 | 67 | - | 5.53 | NP | 0.00 | 166.51 | 160.98 |
| 12/14/93 | 3,300 | 510 | 5.4 | 4.1 | 55 | - | 478 | NP | 0.00 | 166.51 | -311.49 |
| 03/02/94 | 2,400 | 270 | 4.5 | <0.3 | 13 | - | 4.20 | NP | 0.00 | 166.51 | 162.31 |
| 06/06/94 | 730 | <0.3 | <0.3 | 0.70 | 22 | - | 5.13 | NP | 0.00 | 166.51 | 161.38 |
| 09/06/94 | 2,400 | 180 | 28 | 2.3 | 76 | - | 5.45 | NP | 0.00 | 166.51 | 161.06 |
| 12/07/94 | 540 | 5.6 | <0.3 | <0.5 | 6.9 | - | 4.13 | NP | 0.00 | 166.51 | 162.38 |
| 03/08/95 | 1,500 | 220 | 5.5 | <0.5 | 83 | - | 5.20 | NP | 0.00 | 166.51 | 161.31 |
| 06/15/95 | 3,200 | 820 | 53 | 6.2 | 74 | - | 4.93 | NP | 0.00 | 166.51 | 161.58 |
| 09/05/95 | 4,400 | 440 | 22 | <2.5 | 57 | - | 5.03 | NP | 0.00 | 166.51 | 161.48 |
| 11/21/95 | 660 | 3.4 | <0.3 | <0.3 | 0.6 | - | 5.23 | NP | 0.00 | 166.51 | 161.28 |
| 03/11/96 | 1,000 | 76 | 2.2 | <0.3 | 130 | - | 4.16 | NP | 0.00 | 166.51 | 162.35 |
| 06/09/96 | 90 | <0.3 | <0.3 | <0.3 | <0.5 | - | 5.42 | NP | 0.00 | 166.51 | 161.09 |
| 09/16/96 | 1,900 | 5.8 | <0.3 | <0.3 | 5.9 | 1,100 | 5.20 | NP | 0.00 | 166.51 | 161.31 |
| 12/10/96 | 740 | <0.3 | <0.3 | <0.3 | <0.5 | 1,300 | 5.27 | NP | 0.00 | 166.51 | 161.24 |
| 03/12/97 | 2,000 | 600 | 59 | 5.1 | 54 | 1,200 | 3.85 | NP | 0.00 | 166.51 | 162.66 |
| 06/12/97 | 230 | <0.3 | <0.3 | <0.3 | <0.5 | 720 | - | - | - | - | - |
| 09/10/97 | 210 | <0.3 | <0.3 | <0.3 | <0.5 | 210 | 4.10 | NP | 0.00 | 166.51 | 162.41 |

**TABLE 1
GROUNDWATER DATA
THRIFTY OIL STATION #054, CASTRO VALLEY, CA.**

| DATE SAMPLED | ANALYTICAL PARAMETERS | | | | | | DEPTH TO GROUNDWATER (feet) | DEPTH TO PRODUCT (feet) | PRODUCT THICKNESS (feet) | CASING ELEVATION (feet) | GROUNDWATER ELEVATION (feet) |
|------------------------------|-----------------------|----------------|----------------|---------------------|---------------|-------------|-----------------------------|-------------------------|--------------------------|-------------------------|------------------------------|
| | TPH (ug/L) | BENZENE (ug/L) | TOLUENE (ug/L) | EthylBenzene (ug/L) | XYLENE (ug/L) | MIBP (ug/L) | | | | | |
| * 12/09/97 | 11,000 | 2,500 | 2,700 | <6 | 1,500 | 510 | 5.20 | NP | 0.00 | 166.51 | 161.31 |
| 03/03/98 | <50 | <0.3 | <0.3 | <0.3 | <0.5 | <20 | 3.70 | NP | 0.00 | 166.51 | 162.81 |
| 07/08/98 | <50 | <0.3 | <0.3 | <0.3 | <0.5 | <5 | - | - | - | - | - |
| 09/10/98 | <50 | <0.3 | <0.3 | <0.3 | <0.5 | <5 | 6.77 | NP | 0.00 | 166.51 | 159.74 |
| 12/30/98 | <50 | <0.3 | <0.3 | <0.3 | <0.5 | <5 | 5.95 | NP | 0.00 | 166.51 | 160.56 |
| MONITORING WELL #RE-6 | | | | | | | | | | | |
| 04/11/88 | 6,000 | 3,000 | 40 | 80 | 140 | - | - | - | - | - | - |
| 04/09/90 | 3,000 | 990 | ND | 70 | ND | - | 5.64 | NP | 0.00 | 166.51 | 160.87 |
| 10/30/90 | 3,400 | 1,000 | 28 | ND | ND | - | 6.68 | NP | 0.00 | 166.51 | 159.83 |
| 01/18/91 | 6,300 | 1,200 | ND | 3.0 | 15 | - | 6.61 | NP | 0.00 | 166.51 | 159.90 |
| 02/12/91 | 5,200 | 850 | 8.4 | 4.9 | 41 | - | 6.20 | NP | 0.00 | 166.51 | 160.31 |
| 03/20/91 | 5,800 | 680 | 12 | 8.0 | 16 | - | 5.62 | NP | 0.00 | 166.51 | 160.89 |
| 05/22/91 | 8,500 | 1,700 | 14 | 24 | 6.7 | - | 6.05 | NP | 0.00 | 166.51 | 160.46 |
| 06/19/91 | - | - | - | - | - | - | 6.12 | FILM | 0.00 | 166.51 | 160.39 |
| 07/17/91 | 120,000 | 9,300 | 13,000 | 2,400 | 16,000 | - | 6.20 | NP | 0.00 | 166.51 | 160.31 |
| 08/07/91 | - | 590 | 5.3 | ND | 14 | - | 6.27 | NP | 0.00 | 166.51 | 160.24 |
| 09/24/91 | 7,000 | 310 | 11 | 5.3 | 35 | - | 6.63 | NP | 0.00 | 166.51 | 159.88 |
| 10/23/91 | - | - | - | - | - | - | 6.36 | FILM | 0.00 | 166.51 | 160.15 |
| 11/06/91 | 4,000 | 710 | 18 | 29 | 49 | - | 6.15 | NP | 0.00 | 166.51 | 160.36 |
| 12/04/91 | 4,100 | 1,100 | 14 | 33 | 39 | - | 6.19 | NP | 0.00 | 166.51 | 160.32 |
| 01/29/92 | 2,600 | 790 | 14 | ND | 49 | - | 6.70 | NP | 0.00 | 166.51 | 159.81 |
| 02/26/92 | 3,100 | 950 | 21 | 30 | 33 | - | 5.44 | NP | 0.00 | 166.51 | 161.07 |
| 03/19/92 | 2,200 | 630 | 14 | 12 | 40 | - | 5.30 | NP | 0.00 | 166.51 | 161.21 |
| 04/22/92 | - | 730 | 2.2 | ND | 40 | - | 6.00 | NP | 0.00 | 166.51 | 160.51 |
| 05/21/92 | 1,500 | 840 | 7.8 | 7.1 | 34 | - | 6.25 | NP | 0.00 | 166.51 | 160.26 |
| 06/25/92 | <2000 | 740 | 8.0 | 27 | 28 | - | 6.38 | NP | 0.00 | 166.51 | 160.13 |
| 07/30/92 | - | - | - | - | - | - | 6.42 | FILM | 0.00 | 166.51 | 160.09 |
| 08/20/92 | 2,800 | 630 | 17 | 23 | 22 | - | 6.50 | NP | 0.00 | 166.51 | 160.01 |
| 09/30/92 | 7,800 | 540 | ND | 12 | 29 | - | 6.66 | NP | 0.00 | 166.51 | 159.85 |
| 12/23/92 | 1,800 | 350 | ND | 7.7 | 11 | - | 5.83 | NP | 0.00 | 166.51 | 160.68 |
| 03/10/93 | 3,000 | 830 | 5.6 | 19 | 16 | - | 5.63 | NP | 0.00 | 166.51 | 160.88 |
| 06/09/93 | 4,800 | 920 | 6.2 | 3.2 | 12 | - | 6.01 | NP | 0.00 | 166.51 | 160.50 |
| 09/14/93 | 3,600 | 660 | 7.5 | 11 | 27 | - | 6.53 | NP | 0.00 | 166.51 | 159.98 |

**TABLE 1
GROUNDWATER DATA
THRIFTY OIL STATION #054, CASTRO VALLEY, CA.**

| DATE SAMPLED | ANALYTICAL PARAMETERS | | | | | | DEPTH TO GROUNDWATER (feet) | DEPTH TO PRODUCT (feet) | PRODUCT THICKNESS (feet) | CASING ELEVATION (feet) | GROUNDWATER ELEVATION (feet) |
|------------------------------|-----------------------|----------------|----------------|---------------------|---------------|-------------|-----------------------------|-------------------------|--------------------------|-------------------------|------------------------------|
| | TPH (ug/L) | BENZENE (ug/L) | TOLUENE (ug/L) | EthylBenzene (ug/L) | XYLENE (ug/L) | MTBE (ug/L) | | | | | |
| 12/14/93 | 1,500 | 200 | <0.3 | <0.3 | 8.8 | - | 3.58 | NP | 0.00 | 166.51 | 162.93 |
| 03/02/94 | - | - | - | - | - | - | 5.12 | NP | 0.00 | 166.51 | 161.39 |
| 06/06/94 | 2,400 | 290 | 4.6 | 1.3 | 24 | - | 1.85 | NP | 0.00 | 166.51 | 164.66 |
| 09/06/94 | 4,300 | 230 | 21 | <6.6 | 130 | - | 6.40 | NP | 0.00 | 166.51 | 160.11 |
| 12/07/94 | 1,500 | 17 | 2.5 | 3.2 | 22 | - | 5.68 | NP | 0.00 | 166.51 | 160.83 |
| 03/08/95 | 2,500 | 460 | 5.5 | 2.1 | 51 | - | 5.12 | NP | 0.00 | 166.51 | 161.39 |
| 06/15/95 | 2,300 | 91 | 1.1 | 0.7 | 97 | - | 5.72 | NP | 0.00 | 166.51 | 160.79 |
| 09/05/95 | 3,300 | 60 | <10 | <10 | 74 | - | 5.94 | NP | 0.00 | 166.51 | 160.57 |
| 11/21/95 | 2,000 | 7.3 | <0.3 | 0.56 | 8.7 | - | 6.24 | NP | 0.00 | 166.51 | 160.27 |
| 03/11/96 | 840 | 43 | 0.96 | 5.7 | 14 | - | 5.16 | NP | 0.00 | 166.51 | 161.35 |
| 06/19/96 | 1,800 | 160 | 2.7 | 9.9 | 25 | - | 5.80 | NP | 0.00 | 166.51 | 160.71 |
| 09/16/96 | <50 | <0.3 | <0.3 | <0.3 | <0.5 | <20 | 5.38 | NP | 0.00 | 166.51 | 161.13 |
| 12/10/96 | <50 | <0.3 | <0.3 | <0.3 | <0.5 | <20 | 5.62 | NP | 0.00 | 166.51 | 160.89 |
| 03/12/97 | <50 | <0.3 | <0.3 | <0.3 | <0.5 | <20 | 5.20 | NP | 0.00 | 166.51 | 161.31 |
| 06/12/97 | <50 | <0.3 | <0.3 | <0.3 | <0.5 | <20 | - | - | - | - | - |
| 09/10/97 | 440 | <0.3 | <0.3 | <0.3 | <0.5 | 320 | 5.20 | NP | 0.00 | 166.51 | 161.31 |
| 12/09/97 | <50 | <0.3 | <0.3 | <0.3 | <0.5 | <20 | 5.97 | NP | 0.00 | 166.51 | 160.54 |
| 03/03/98 | 400 | 7.0 | <0.3 | <0.3 | 4.3 | 65 | 4.45 | NP | 0.00 | 166.51 | 162.06 |
| 07/08/98 | 300 | <0.3 | <0.3 | <0.3 | 1.0 | 35 | - | - | - | - | - |
| 09/10/98 | <50 | <0.3 | <0.3 | <0.3 | <0.5 | <5 | 5.90 | NP | 0.00 | 166.51 | 160.61 |
| 12/30/98 | <50 | <0.3 | <0.3 | <0.3 | <0.5 | <5 | 5.20 | NP | 0.00 | 166.51 | 161.31 |
| MONITORING WELL #RR-7 | | | | | | | | | | | |
| 04/11/88 | <50000 | 17,000 | 4,400 | 600 | 8,400 | - | - | - | - | - | - |
| 04/09/90 | 16,000 | 7,000 | 1,200 | 640 | 1,600 | - | 5.93 | NP | 0.00 | 166.04 | 160.11 |
| 10/30/90 | 31,000 | 14,000 | ND | ND | ND | - | 8.21 | NP | 0.00 | 166.04 | 157.83 |
| 01/18/91 | - | - | - | - | - | - | 11.80 | NP | 0.00 | 166.04 | 154.24 |
| 02/12/91 | - | - | - | - | - | - | 10.80 | FILM | 0.00 | 166.04 | 155.24 |
| 03/20/91 | 120,000 | 12,000 | 2,800 | 490 | 6,600 | - | 9.96 | NP | 0.00 | 166.04 | 156.08 |
| 05/22/91 | - | - | - | - | - | - | 11.70 | FILM | 0.00 | 166.04 | 154.34 |
| 06/19/91 | - | - | - | - | - | - | 11.50 | FILM | 0.00 | 166.04 | 154.54 |
| 07/17/91 | - | - | - | - | - | - | 7.80 | FILM | 0.00 | 166.04 | 158.24 |
| 08/07/91 | - | - | - | - | - | - | 9.88 | 0.03 | 9.85 | 166.04 | 163.60 |
| 09/24/91 | - | - | - | - | - | - | 9.85 | 0.03 | 9.82 | 166.04 | 163.60 |

TABLE 1
GROUNDWATER DATA
THRIFTY OIL STATION #054, CASTRO VALLEY, CA.

| DATE SAMPLED | ANALYTICAL PARAMETERS | | | | | | DEPTH TO GROUNDWATER (feet) | DEPTH TO PRODUCT (feet) | PRODUCT THICKNESS (feet) | CASING ELEVATION (feet) | GROUNDWATER ELEVATION (feet) |
|--------------|-----------------------|----------------|----------------|---------------------|---------------|-------------|-----------------------------|-------------------------|--------------------------|-------------------------|------------------------------|
| | TPH (ug/L) | BENZENE (ug/L) | TOLUENE (ug/L) | EthylBenzene (ug/L) | XYLENE (ug/L) | MIBE (ug/L) | | | | | |
| 10/23/91 | - | - | - | - | - | - | 9.96 | FILM | 0.00 | 166.04 | 156.08 |
| 11/06/91 | - | - | - | - | - | - | 6.77 | FILM | 0.00 | 166.04 | 159.27 |
| 12/04/91 | - | - | - | - | - | - | 10.80 | FILM | 0.00 | 166.04 | 155.24 |
| 01/29/92 | - | - | - | - | - | - | 8.64 | FILM | 0.00 | 166.04 | 157.40 |
| 02/26/92 | - | - | - | - | - | - | 6.00 | FILM | 0.00 | 166.04 | 160.04 |
| 03/19/92 | - | - | - | - | - | - | 5.55 | FILM | 0.00 | 166.04 | 160.49 |
| 04/22/92 | - | - | - | - | - | - | 6.12 | FILM | 0.00 | 166.04 | 159.92 |
| 05/21/92 | - | - | - | - | - | - | 6.40 | FILM | 0.00 | 166.04 | 159.64 |
| 06/25/92 | - | - | - | - | - | - | 6.73 | 0.02 | 6.71 | 166.04 | 164.38 |
| 07/30/92 | - | - | - | - | - | - | 6.73 | FILM | 0.00 | 166.04 | 159.31 |
| 08/20/92 | - | - | - | - | - | - | 6.82 | FILM | 0.00 | 166.04 | 159.22 |
| 09/30/92 | - | - | - | - | - | - | 7.26 | FILM | 0.00 | 166.04 | 158.78 |
| 12/23/92 | - | - | - | - | - | - | 6.22 | FILM | 0.00 | 166.04 | 159.82 |
| 03/10/93 | - | - | - | - | - | - | 5.82 | FILM | 0.00 | 166.04 | 160.22 |
| 06/09/93 | - | - | - | - | - | - | 6.17 | FILM | 0.00 | 166.04 | 159.87 |
| 09/14/93 | - | - | - | - | - | - | 11.33 | NP | 0.00 | 166.04 | 154.71 |
| 12/14/93 | - | - | - | - | - | - | 8.40 | NP | 0.00 | 166.04 | 157.64 |
| 03/02/94 | - | - | - | - | - | - | 6.82 | NP | 0.00 | 166.04 | 159.22 |
| 06/06/94 | - | - | - | - | - | - | 10.95 | FILM | 0.00 | 166.04 | 155.09 |
| 09/06/94 | - | - | - | - | - | - | 11.30 | FILM | 0.00 | 166.04 | 154.74 |
| 12/07/94 | - | - | - | - | - | - | 5.63 | FILM | 0.00 | 166.04 | 160.41 |
| 03/08/95 | - | - | - | - | - | - | 5.06 | FILM | 0.00 | 166.04 | 160.98 |
| 06/15/95 | - | - | - | - | - | - | - | - | - | - | - |
| 09/05/95 | - | - | - | - | - | - | 7.98 | FILM | 0.00 | 166.04 | 158.06 |
| 11/21/95 | 20,000 | 8,800 | 110 | <30 | 310 | - | 7.32 | NP | 0.00 | 166.04 | 158.72 |
| 03/11/96 | 4,800 | 2,200 | 38 | 26 | 120 | - | 5.62 | NP | 0.00 | 166.04 | 160.42 |
| 06/19/96 | 4,400 | 3,300 | 49 | 5.8 | 70 | - | 6.40 | NP | 0.00 | 166.04 | 159.64 |
| 09/19/96 | 7,200 | 510 | 83 | <0.3 | 710 | 130 | 6.20 | NP | 0.00 | 166.04 | 159.84 |
| 12/10/96 | 700 | <0.3 | <0.3 | <0.3 | <0.5 | 1,400 | 5.92 | NP | 0.00 | 166.04 | 160.12 |
| 03/12/97 | 660 | 0.31 | <0.3 | <0.3 | <0.5 | 1,400 | 5.62 | NP | 0.00 | 166.04 | 160.42 |
| 06/12/97 | 320 | <0.3 | 0.45 | <0.3 | <0.5 | 850 | - | - | - | - | - |
| 09/10/97 | 780 | <0.3 | <0.3 | <0.3 | <0.5 | 930 | 7.45 | NP | 0.00 | 166.04 | 158.59 |
| 12/09/97 | 14,000 | 3,500 | 3,700 | <15 | 2,100 | 1,100 | 7.10 | NP | 0.00 | 166.04 | 158.94 |
| 03/03/98 | 6,100 | 2,500 | 18 | <6 | 110 | 270 | 6.70 | NP | 0.00 | 166.04 | 159.34 |
| 07/08/98 | 1,300 | 8.7 | <0.3 | <0.3 | <0.5 | 350 | - | - | - | - | - |

TABLE 1
GROUNDWATER DATA
THRIFTY OIL STATION #054, CASTRO VALLEY, CA.

| DATE SAMPLED | ANALYTICAL PARAMETERS | | | | | | DEPTH TO GROUNDWATER (feet) | DEPTH TO PRODUCT (feet) | PRODUCT THICKNESS (feet) | CASING ELEVATION (feet) | GROUNDWATER ELEVATION (feet) |
|------------------------------|-----------------------|-------------------|-------------------|------------------------|------------------|----------------|-----------------------------------|-------------------------------|--------------------------------|-------------------------------|------------------------------------|
| | TPH (ug/L) | BENZENE (ug/L) | TOLUENE (ug/L) | EthylBenzene (ug/L) | XYLENE (ug/L) | MTBE (ug/L) | | | | | |
| 09/10/98 | 690 | 2.2 | <0.3 | <0.3 | <0.5 | 350 | 7.04 | NP | 0.00 | 166.04 | 159.00 |
| 12/30/98 | 600 | 2.0 | 0.55 | <0.3 | <0.5 | 350 | 6.25 | NP | 0.00 | 166.04 | 159.79 |
| MONITORING WELL IRS-3 | | | | | | | | | | | |
| 08/07/91 | ND | ND | ND | ND | ND | - | 9.68 | NP | 0.00 | 164.32 | 154.64 |
| 09/27/91 | ND | ND | ND | ND | ND | - | 9.89 | NP | 0.00 | 164.32 | 154.43 |
| 10/23/91 | ND | ND | ND | ND | ND | - | 10.05 | NP | 0.00 | 164.32 | 154.27 |
| 11/06/91 | ND | ND | ND | ND | ND | - | 9.71 | NP | 0.00 | 164.32 | 154.61 |
| 12/04/91 | ND | ND | ND | ND | ND | - | 10.00 | NP | 0.00 | 164.32 | 154.32 |
| 01/29/92 | ND | 2.1 | 1.0 | 2.5 | 3.6 | - | 9.28 | NP | 0.00 | 164.32 | 155.04 |
| 02/26/92 | ND | ND | 0.7 | ND | 0.7 | - | 7.05 | NP | 0.00 | 164.32 | 157.27 |
| 03/19/92 | ND | 0.5 | 1.0 | 1.5 | 2.7 | - | 7.30 | NP | 0.00 | 164.32 | 157.02 |
| 04/22/92 | ND | ND | ND | ND | ND | - | 8.60 | NP | 0.00 | 164.32 | 155.72 |
| 05/21/92 | ND | ND | ND | ND | ND | - | 9.22 | NP | 0.00 | 164.32 | 155.10 |
| 06/25/92 | ND | ND | ND | ND | ND | - | 9.49 | NP | 0.00 | 164.32 | 154.83 |
| 07/30/92 | ND | 1.1 | 4.2 | ND | 3.0 | - | 9.55 | NP | 0.00 | 164.32 | 154.77 |
| 08/20/92 | ND | 2.0 | 4.7 | ND | 5.7 | - | 9.63 | NP | 0.00 | 164.32 | 154.69 |
| 09/30/92 | ND | ND | ND | ND | ND | - | 9.90 | NP | 0.00 | 164.32 | 154.42 |
| 12/23/92 | ND | ND | ND | ND | ND | - | 9.96 | NP | 0.00 | 164.32 | 154.36 |
| 05/10/93 | ND | ND | ND | ND | ND | - | 8.95 | NP | 0.00 | 164.32 | 155.37 |
| 06/09/93 | ND | ND | ND | ND | ND | - | 9.00 | NP | 0.00 | 164.32 | 155.32 |
| 09/14/93 | 200 | 0.3 | ND | ND | ND | - | 9.50 | NP | 0.00 | 164.32 | 154.82 |
| 12/14/93 | ND | ND | ND | ND | ND | - | 8.75 | NP | 0.00 | 164.32 | 155.57 |
| 03/02/94 | <50 | <0.3 | <0.3 | <0.3 | <0.5 | - | 7.52 | NP | 0.00 | 164.32 | 156.80 |
| 06/06/94 | 54 | <0.3 | <0.3 | <0.3 | 2.4 | - | 9.00 | NP | 0.00 | 164.32 | 155.32 |
| 09/06/94 | <50 | <0.3 | <0.3 | <0.3 | <0.5 | - | 9.26 | NP | 0.00 | 164.32 | 155.06 |
| 12/07/94 | 130 | 2.5 | 1.9 | 1.3 | 3.6 | - | 8.67 | NP | 0.00 | 164.32 | 155.65 |
| 03/08/95 | <100 | <0.5 | <0.5 | <0.5 | <1 | - | 8.34 | NP | 0.00 | 164.32 | 155.98 |
| 06/15/95 | <100 | 1.0 | <0.5 | <0.5 | <1 | - | 9.12 | NP | 0.00 | 164.32 | 155.20 |
| 09/05/95 | <100 | <0.5 | <0.5 | <0.5 | <1 | - | 9.56 | NP | 0.00 | 164.32 | 154.76 |
| 11/21/95 | <50 | 0.44 | <0.3 | <0.3 | 1.5 | - | 9.28 | NP | 0.00 | 164.32 | 155.04 |
| 03/11/96 | <50 | 1.3 | <0.3 | <0.3 | 0.6 | - | 7.52 | NP | 0.00 | 164.32 | 156.80 |
| 06/19/96 | 640 | 72 | 20 | 34 | 150 | - | 7.80 | NP | 0.00 | 164.32 | 156.52 |
| 09/16/96 | <50 | <0.3 | <0.3 | <0.3 | <0.5 | 20 | 9.18 | NP | 0.00 | 164.32 | 155.14 |

**TABLE 1
GROUNDWATER DATA
THRIFTY OIL STATION #054, CASTRO VALLEY, CA.**

| DATE SAMPLED | ANALYTICAL PARAMETERS | | | | | | DEPTH TO GROUNDWATER (feet) | DEPTH TO PRODUCT (feet) | PRODUCT THICKNESS (feet) | CASING ELEVATION (feet) | GROUNDWATER ELEVATION (feet) |
|------------------------------|-----------------------|-------------------|-------------------|------------------------|------------------|----------------|-----------------------------------|-------------------------------|--------------------------------|-------------------------------|------------------------------------|
| | TPH (ug/L) | BENZENE (ug/L) | TOLUENE (ug/L) | EthylBenzene (ug/L) | XYLENE (ug/L) | MTBE (ug/L) | | | | | |
| 12/10/96 | <50 | <0.3 | <0.3 | <0.3 | <0.5 | <20 | 6.08 | NP | 0.00 | 164.32 | 158.24 |
| 03/12/97 | 53 | 0.45 | <0.3 | <0.3 | <0.5 | 140 | 8.65 | NP | 0.00 | 164.32 | 155.67 |
| 06/12/97 | <50 | <0.3 | <0.3 | <0.3 | <0.5 | 68 | - | - | - | - | - |
| 09/10/97 | <50 | <0.3 | <0.3 | <0.3 | <0.5 | <20 | 8.30 | NP | 0.00 | 164.32 | 156.02 |
| 12/09/97 | <50 | 1.7 | 2.1 | <0.3 | 1.4 | 82 | 9.98 | NP | 0.00 | 164.32 | 154.34 |
| 03/03/98 | <50 | <0.3 | <0.3 | <0.3 | <0.5 | 84 | 8.33 | NP | 0.00 | 164.32 | 155.99 |
| 07/08/98 | <50 | <0.3 | <0.3 | <0.3 | <0.5 | 97 | - | - | - | - | - |
| 09/10/98 | <50 | <0.3 | <0.3 | <0.3 | <0.5 | 97 | 12.95 | NP | 0.00 | 164.32 | 151.37 |
| 12/30/98 | <50 | 1.3 | 1.5 | <0.3 | 0.86 | 19 | 11.35 | NP | 0.00 | 164.32 | 152.97 |
| MONITORING WELL #RS-9 | | | | | | | | | | | |
| 08/07/91 | - | 0.5 | ND | 330 | 1,200 | - | 2.28 | NP | 0.00 | 167.51 | 165.23 |
| 09/27/91 | 13,000 | 3.5 | 3.0 | 82 | 140 | - | 2.77 | NP | 0.00 | 167.51 | 164.74 |
| 10/23/91 | 11,000 | ND | ND | 39 | 340 | - | 3.53 | NP | 0.00 | 167.51 | 163.98 |
| 11/06/91 | 6,800 | 8.4 | 0.6 | 22 | 230 | - | 2.51 | NP | 0.00 | 167.51 | 165.00 |
| 12/04/91 | 6,500 | 6.5 | 0.7 | 87 | 200 | - | 3.20 | NP | 0.00 | 167.51 | 164.31 |
| 01/29/92 | 8,100 | 22 | 10 | 140 | 260 | - | 2.65 | NP | 0.00 | 167.51 | 164.86 |
| 02/26/92 | 13,000 | 40 | 16 | 220 | 600 | - | 3.42 | NP | 0.00 | 167.51 | 164.09 |
| 03/19/92 | 12,000 | 21 | 12 | 100 | 280 | - | 3.12 | NP | 0.00 | 167.51 | 164.39 |
| 04/22/92 | 8,600 | ND | ND | 20 | 37 | - | 3.24 | NP | 0.00 | 167.51 | 164.27 |
| 05/21/92 | 6,000 | 21 | 10 | 53 | 210 | - | 3.75 | NP | 0.00 | 167.51 | 163.76 |
| 06/25/92 | 370 | 2.3 | 1.5 | 0.7 | 4.3 | - | 2.65 | NP | 0.00 | 167.51 | 164.86 |
| 07/30/92 | 3,600 | 20 | ND | 39 | 80 | - | 2.70 | NP | 0.00 | 167.51 | 164.81 |
| 08/20/92 | 3,000 | 0.7 | 5.2 | 2.0 | 5.3 | - | 2.83 | NP | 0.00 | 167.51 | 164.68 |
| 09/30/92 | 9,200 | 4.8 | 6.5 | 12 | 91 | - | 2.80 | NP | 0.00 | 167.51 | 164.71 |
| 12/23/92 | 2,000 | 17 | ND | 8.2 | 18 | - | 2.45 | NP | 0.00 | 167.51 | 165.06 |
| 03/10/93 | 1,500 | ND | 2.6 | 21 | 12 | - | 2.40 | NP | 0.00 | 167.51 | 165.11 |
| 06/09/93 | 1,300 | 0.6 | 1.7 | ND | 7.5 | - | 3.55 | NP | 0.00 | 167.51 | 163.96 |
| 09/14/93 | 1,500 | 1.3 | 7.6 | 4.1 | 14 | - | 2.81 | NP | 0.00 | 167.51 | 164.70 |
| 12/14/93 | 560 | ND | ND | ND | 5.5 | - | 2.63 | NP | 0.00 | 167.51 | 164.88 |
| 03/02/94 | 1,100 | <0.3 | <0.3 | <0.3 | <0.5 | - | 2.60 | NP | 0.00 | 167.51 | 164.91 |
| 06/06/94 | 290 | 0.58 | 0.53 | 1.1 | 5.8 | - | 2.52 | NP | 0.00 | 167.51 | 164.99 |
| 09/06/94 | 890 | <0.3 | <0.3 | <0.3 | 3.1 | - | 3.16 | NP | 0.00 | 167.51 | 164.35 |
| 12/07/94 | 940 | 22 | 23 | 10 | 32 | - | 5.18 | NP | 0.00 | 167.51 | 162.33 |

TABLE 1
GROUNDWATER DATA
THRIFTY OIL STATION #054, CASTRO VALLEY, CA.

| DATE SAMPLED | ANALYTICAL PARAMETERS | | | | | | DEPTH TO GROUNDWATER (feet) | DEPTH TO PRODUCT (feet) | PRODUCT THICKNESS (feet) | CASING ELEVATION (feet) | GROUNDWATER ELEVATION (feet) |
|-------------------------------|-----------------------|----------------|----------------|---------------------|---------------|-------------|-----------------------------|-------------------------|--------------------------|-------------------------|------------------------------|
| | TPH (ug/L) | BENZENE (ug/L) | TOLUENE (ug/L) | EthylBenzene (ug/L) | XYLENE (ug/L) | MTHB (ug/L) | | | | | |
| 06/09/93 | ND | ND | ND | ND | ND | - | 7.98 | NP | 0.00 | 162.89 | 154.91 |
| 09/14/93 | ND | ND | ND | ND | ND | - | 7.35 | NP | 0.00 | 162.89 | 155.54 |
| 03/02/94 | <50 | <0.3 | <0.3 | <0.3 | <0.3 | - | 7.00 | NP | 0.00 | 162.89 | 155.89 |
| 06/06/94 | <50 | <0.3 | <0.3 | <0.3 | <0.5 | - | 6.55 | NP | 0.00 | 162.89 | 156.34 |
| 09/06/94 | <50 | <0.3 | <0.3 | <0.3 | <0.5 | - | 7.63 | NP | 0.00 | 162.89 | 155.26 |
| 12/07/94 | 56 | <0.3 | <0.3 | <0.5 | 2.1 | - | 5.92 | NP | 0.00 | 162.89 | 156.97 |
| 03/08/95 | <100 | <0.5 | <0.5 | <0.5 | <1 | - | 7.84 | NP | 0.00 | 162.89 | 155.05 |
| 06/15/95 | <100 | <0.5 | <0.5 | <0.5 | <1 | - | 6.97 | NP | 0.00 | 162.89 | 155.92 |
| 09/05/95 | <100 | <0.5 | <0.5 | <0.5 | <1 | - | 8.14 | NP | 0.00 | 162.89 | 154.75 |
| 11/21/95 | <50 | <0.3 | <0.3 | <0.3 | <0.5 | - | 7.68 | NP | 0.00 | 162.89 | 155.21 |
| 03/11/96 | <50 | <0.3 | <0.3 | <0.3 | <0.5 | - | 6.76 | NP | 0.00 | 162.89 | 156.13 |
| 06/19/96 | <50 | <0.3 | <0.3 | <0.3 | <0.5 | - | 7.20 | NP | 0.00 | 162.89 | 155.69 |
| 09/16/96 | <50 | <0.3 | <0.3 | <0.3 | <0.5 | <20 | 6.30 | NP | 0.00 | 162.89 | 156.59 |
| 12/10/96 | <50 | <0.3 | <0.3 | <0.3 | <0.5 | <20 | 6.05 | NP | 0.00 | 162.89 | 156.84 |
| 03/12/97 | <50 | <0.3 | <0.3 | <0.3 | <0.5 | <20 | 7.56 | NP | 0.00 | 162.89 | 155.33 |
| 06/12/97 | <50 | <0.3 | <0.3 | <0.3 | <0.5 | <20 | - | - | - | - | - |
| 09/10/97 | <50 | <0.3 | <0.3 | <0.3 | <0.5 | <20 | 7.55 | NP | 0.00 | 162.89 | 155.34 |
| 12/09/97 | 1,900 | 610 | 510 | <6 | 290 | <20 | 7.55 | NP | 0.00 | 162.89 | 155.34 |
| 03/03/98 | <50 | 2.0 | <0.3 | <0.3 | <0.5 | 27 | 6.03 | NP | 0.00 | 162.89 | 156.86 |
| 07/08/98 | <50 | <0.3 | <0.3 | <0.3 | <0.5 | <5 | - | - | - | - | - |
| 09/10/98 | <50 | <0.3 | <0.3 | <0.3 | <0.5 | 72 | 7.55 | NP | 0.00 | 162.89 | 155.34 |
| 12/30/98 | <50 | 1.1 | <0.3 | <0.3 | <0.5 | <5 | 4.45 | NP | 0.00 | 162.89 | 158.44 |
| MONITORING WELL #RS-17 | | | | | | | | | | | |
| 09/21/95 | 110 | <0.5 | <0.5 | <0.5 | <1 | - | 9.37 | NP | 0.00 | 163.28 | 153.91 |
| 11/21/95 | - | - | - | - | - | - | - | - | - | - | - |
| 03/11/96 | - | - | - | - | - | - | - | - | - | - | - |
| 06/19/96 | - | - | - | - | - | - | - | - | - | - | - |
| 09/16/96 | - | - | - | - | - | - | - | - | - | - | - |
| 03/12/97 | 74 | 9.5 | <0.3 | <0.3 | 0.57 | <20 | 7.75 | NP | 0.00 | 163.28 | 155.53 |
| 06/12/97 | <50 | <0.3 | <0.3 | <0.3 | <0.5 | <20 | - | - | - | - | - |
| 09/10/97 | <50 | <0.3 | <0.3 | <0.3 | <0.5 | <20 | 9.50 | NP | 0.00 | 163.28 | 153.78 |
| 12/09/97 | <50 | 0.79 | 1.2 | <0.3 | <0.5 | <20 | 9.50 | NP | 0.00 | 163.28 | 153.78 |
| 03/03/98 | 140 | 22 | 0.63 | <0.3 | <0.5 | <20 | 7.93 | NP | 0.00 | 163.28 | 155.35 |

TABLE 1
GROUNDWATER DATA
THRIFTY OIL STATION #054, CASTRO VALLEY, CA.

| DATE SAMPLED | ANALYTICAL PARAMETERS | | | | | | DEPTH TO GROUNDWATER (feet) | DEPTH TO PRODUCT (feet) | PRODUCT THICKNESS (feet) | CASING ELEVATION (feet) | GROUNDWATER ELEVATION (feet) |
|-----------------|-----------------------|-------------------|-------------------|------------------------|------------------|----------------|-----------------------------------|-------------------------------|--------------------------------|-------------------------------|------------------------------------|
| | TPH (ug/L) | BENZENE (ug/L) | TOLUENE (ug/L) | EthylBenzene (ug/L) | XYLENE (ug/L) | MTBE (ug/L) | | | | | |
| 07/08/98 | <50 | <0.3 | <0.3 | <0.3 | <0.5 | <5 | - | - | - | - | - |
| 09/10/98 | <50 | <0.3 | <0.3 | <0.3 | <0.5 | <5 | 9.48 | NP | 0.00 | 163.28 | 153.80 |
| 12/30/98 | <50 | 1.3 | 0.87 | <0.3 | 0.55 | <5 | 7.95 | NP | 0.00 | 163.28 | 155.33 |
| | | | | | | | | | | | |

NOTE: ND = Nondetectable
 * - " = Not Analyzed / Not Available
 NP = No Free Product

Benzene, toluene, ethylbenzene, and xylene analyzed by EPA method 8020.
 Total petroleum hydrocarbons (TPH) analyzed by EPA method 8015 modified for gasoline
 Methyl-tert Butyl Ether (MTBE) analyzed by EPA method 8020 or 8260

APPENDIX A



LABORATORY ANALYSIS RESULTS

Client: Thrifty Oil Company
Project No.: N/A
Project Name: SS #054
Sample Matrix: Water
Method: EPA 8015M (Gasoline)

AA Project No.: A135054-90
Date Received: 12/31/98
Date Reported: 01/05/99
Units: ug/L

| AA I.D. No. | Client I.D. No. | Date Sampled | Date Analyzed | Results | MRL |
|-------------|-----------------|--------------|---------------|---------|-----|
| 80853 | RS-9 | 12/30/98 | 12/31/98 | <50 | 50 |
| 80854 | RE-1 | 12/30/98 | 12/31/98 | <50 | 50 |
| 80855 | RE-2 | 12/30/98 | 12/31/98 | 460 | 50 |
| 80856 | RE-6 | 12/30/98 | 12/31/98 | <50 | 50 |
| 80857 | PW-1 | 12/30/98 | 12/31/98 | <50 | 50 |
| 80858 | PW-2 | 12/30/98 | 12/31/98 | <50 | 50 |
| 80859 | RE-7 | 12/30/98 | 12/31/98 | 600 | 50 |
| 80860 | RE-5 | 12/30/98 | 12/31/98 | <50 | 50 |
| 80861 | RE-4 | 12/30/98 | 12/31/98 | 530 | 50 |
| 80862 | RE-3 | 12/30/98 | 12/31/98 | <50 | 50 |
| 80863 | RS-8 | 12/30/98 | 12/31/98 | <50 | 50 |
| 80864 | RS-11 | 12/30/98 | 12/31/98 | <50 | 50 |
| 80865 | RS-10 | 12/30/98 | 12/31/98 | <50 | 50 |
| 80866 | Trip Blank | 12/30/98 | 12/31/98 | <50 | 50 |

MRL: Method Reporting Limit
<: Not detected at or above the value of the concentration indicated.

George Havalas
Laboratory Director



LABORATORY ANALYSIS RESULTS

Client: Thrifty Oil Company
Project No.: N/A
Project Name: SS #054
Sample Matrix: Water
Method: EPA 8020 (BTEX)

AA Project No.: A135054-90
Date Received: 12/31/98
Date Reported: 01/05/99
Units: ug/L

| Date Sampled: | 12/30/98 | 12/30/98 | 12/30/98 | 12/30/98 | |
|-------------------|----------|----------|----------|----------|-----|
| Date Analyzed: | 12/31/98 | 12/31/98 | 12/31/98 | 12/31/98 | |
| AA ID No.: | 80853 | 80854 | 80855 | 80856 | |
| Client ID No.: | RS-9 | RE-1 | RE-2 | RE-6 | MRL |
| <u>Compounds:</u> | | | | | |
| Benzene | <0.3 | 1.1 | 0.92 | <0.3 | 0.3 |
| Ethylbenzene | <0.3 | <0.3 | <0.3 | <0.3 | 0.3 |
| Toluene | <0.3 | <0.3 | <0.3 | <0.3 | 0.3 |
| Xylenes | <0.5 | <0.5 | <0.5 | <0.5 | 0.5 |

George Havalias
Laboratory Director



LABORATORY ANALYSIS RESULTS

Page 2

Client: Thrifty Oil Company
Project No.: N/A
Project Name: SS #054
Sample Matrix: Water
Method: EPA 8020 (BTEX)

AA Project No.: A135054-90
Date Received: 12/31/98
Date Reported: 01/05/99
Units: ug/L

| Date Sampled: | 12/30/98 | 12/30/98 | 12/30/98 | 12/30/98 | |
|-------------------|----------|----------|----------|----------|-----|
| Date Analyzed: | 12/31/98 | 12/31/98 | 12/31/98 | 12/31/98 | |
| AA ID No.: | 80857 | 80858 | 80859 | 80860 | |
| Client ID No.: | PW-1 | PW-2 | RE-7 | RE-5 | MRL |
| Compounds: | | | | | |
| Benzene | 1.1 | 1.1 | 2.0 | <0.3 | 0.3 |
| Ethylbenzene | <0.3 | <0.3 | <0.3 | <0.3 | 0.3 |
| Toluene | <0.3 | <0.3 | 0.55 | <0.3 | 0.3 |
| Xylenes | <0.5 | <0.5 | <0.5 | <0.5 | 0.5 |

George Havallas
Laboratory Director



LABORATORY ANALYSIS RESULTS

Client: Thrifty Oil Company
Project No.: N/A
Project Name: SS #054
Sample Matrix: Water
Method: EPA 8020 (BTEX)

AA Project No.: A135054-90
Date Received: 12/31/98
Date Reported: 01/05/99
Units: ug/L

| | 12/30/98 | 12/30/98 | 12/30/98 | 12/30/98 | |
|-------------------|----------|----------|----------|----------|-----|
| Date Sampled: | 12/30/98 | 12/30/98 | 12/30/98 | 12/30/98 | |
| Date Analyzed: | 12/31/98 | 12/31/98 | 12/31/98 | 12/31/98 | |
| AA ID No.: | 80861 | 80862 | 80863 | 80864 | |
| Client ID No.: | RE-4 | RE-3 | RS-8 | RS-11 | MRL |
| <u>Compounds:</u> | | | | | |
| Benzene | <0.3 | 1.1 | 1.3 | 1.3 | 0.3 |
| Ethylbenzene | <0.3 | <0.3 | <0.3 | <0.3 | 0.3 |
| Toluene | <0.3 | <0.3 | 1.5 | 0.87 | 0.3 |
| Xylenes | <0.5 | <0.5 | 0.86 | 0.55 | 0.5 |

George Havalias
Laboratory Director



LABORATORY ANALYSIS RESULTS

Client: Thrifty Oil Company
Project No.: N/A
Project Name: SS #054
Sample Matrix: Water
Method: EPA 8020 (BTEX)

AA Project No.: A135054-90
Date Received: 12/31/98
Date Reported: 01/05/99
Units: ug/L

| Date Sampled: | 12/30/98 | 12/30/98 | |
|-------------------|----------|------------|-----|
| Date Analyzed: | 12/31/98 | 12/31/98 | |
| AA ID No.: | 80865 | 80866 | |
| Client ID No.: | RS-10 | Trip Blank | MRL |
| <u>Compounds:</u> | | | |
| Benzene | 1.1 | <0.3 | 0.3 |
| Ethylbenzene | <0.3 | <0.3 | 0.3 |
| Toluene | <0.3 | 0.89 | 0.3 |
| Xylenes | <0.5 | <0.5 | 0.5 |

MRL: Method Reporting Limit

<: Not detected at or above the value of the concentration indicated.

George Havalias
Laboratory Director



LABORATORY ANALYSIS RESULTS

Client: Thrifty Oil Company
Project No.: N/A
Project Name: SS #054
Sample Matrix: Water
Method: MTBE (EPA 8020)

AA Project No.: A135054-90
Date Received: 12/31/98
Date Reported: 01/05/99
Units: ug/L

| AA I.D. No. | Client I.D. No. | Date Sampled | Date Analyzed | Results | MRL |
|-------------|-----------------|--------------|---------------|---------|-----|
| 80853 | RS-9 | 12/30/98 | 12/31/98 | <5 | 5 |
| 80854 | RE-1 | 12/30/98 | 12/31/98 | <5 | 5 |
| 80855 | RE-2 | 12/30/98 | 12/31/98 | 1400 | 5 |
| 80856 | RE-6 | 12/30/98 | 12/31/98 | <5 | 5 |
| 80857 | PW-1 | 12/30/98 | 12/31/98 | <5 | 5 |
| 80858 | PW-2 | 12/30/98 | 12/31/98 | <5 | 5 |
| 80859 | RE-7 | 12/30/98 | 12/31/98 | 350 | 5 |
| 80860 | RE-5 | 12/30/98 | 12/31/98 | <5 | 5 |
| 80861 | RE-4 | 12/30/98 | 12/31/98 | 1500 | 5 |
| 80862 | RE-3 | 12/30/98 | 12/31/98 | <5 | 5 |
| 80863 | RS-8 | 12/30/98 | 12/31/98 | 19 | 5 |
| 80864 | RS-11 | 12/30/98 | 12/31/98 | <5 | 5 |
| 80865 | RS-10 | 12/30/98 | 12/31/98 | <5 | 5 |

MRL: Method Reporting Limit

<: Not detected at or above the value of the concentration indicated.

George Havallas
Laboratory Director



AMERICAN ANALYTICS CHAIN-OF-CUSTODY RECORD

9765 ETON AVE., CHATSWORTH, CA 91311

(818) 998-5547 (818) 998-5548 1-800-533-TEST 1-800-533-8378 FAX (818) 998-7258

DATE: 12-30-98

PAGE 1 OF 4

| | | | | | | | | | | | | |
|---|--------------|----------|-------|-------------|----------------------|---------------------------------------|------|--|-------------------|-----------------------------------|--|--|
| AA Client <u>THRIFTY OIL CO.</u> | | | | | | Phone <u>(562) 921-3581</u> | | Sampler's Name <u>SERBATH A</u> | | | | |
| Project Manager <u>JEFF SURYAKUSUMIT</u> | | | | | | P.O. No. | | Sampler's Signature <u>[Signature]</u> | | | | |
| Project Name <u>Q.W.S.</u> | | | | | | Project No. | | Project Manager's Signature | | | | |
| Job Name and Address <u># 054</u> <u>2504 CASTRO VALLEY BLVD.</u> <u>CASTRO VALLEY, CA 94546</u> | | | | | | ANALYSIS REQUIRED | | | | Test Requirements | | |
| | | | | | | Detection Limits | | | | | | |
| | | | | | | Test Name | | | | | | |
| AA ID.# | Client's ID. | Date | Time | Sample Type | Number of Containers | TPH | BTEX | MTBE | | | | |
| 80853 | RS-9 | 12.30.98 | 15:35 | WATER | 3 | X | X | X | | | | |
| 80854 | RE-1 | ↓ | 15:40 | ↓ | 3 | X | X | X | | | | |
| 80855 | RE-2 | | 15:45 | | 3 | X | X | X | | | | |
| 80856 | RE-6 | | 15:50 | | 3 | X | X | X | | | | |
| 80857 | PK-1 | | 15:55 | | 3 | X | X | X | | | | |
| 80858 | PK-2 | | 16:00 | | 3 | X | X | X | | | | |
| 80859 | RE-7 | | 16:05 | | 3 | X | X | X | | | | |
| 80860 | RE-5 | | 16:10 | | 3 | X | X | X | | | | |
| 80861 | RE-4 | | 16:15 | | 3 | X | X | X | | | | |
| 80862 | RE-3 | | 16:20 | | 3 | X | X | X | | | | |
| 80863 | RS-8 | | 16:30 | | 3 | X | X | X | | | | |
| 80864 | RS-11 | | 16:35 | | 3 | X | X | X | | | | |
| 80865 | RS-10 | | 16:40 | | 3 | X | X | X | | | | |
| 80866 | TRIP BLANK | | 7:30 | | 2 | X | X | | | | | |
| SAMPLE INTEGRITY-TO BE FILLED IN BY RECEIVING LAB | | | | | | Relinquished by: <u>[Signature]</u> | | Date <u>12.30.98</u> | Time <u>17:00</u> | Received by: <u>CA. OVERTHIRE</u> | | |
| Samples Intact Yes <input checked="" type="checkbox"/> No <input type="checkbox"/> | | | | | | Relinquished by: <u>CA. OVERTHIRE</u> | | Date <u>12.30.98</u> | Time <u>17:30</u> | Received by: _____ | | |
| Samples Properly Cooled Yes <input checked="" type="checkbox"/> No <input type="checkbox"/> | | | | | | Relinquished by: _____ | | Date <u>12.30.98</u> | Time <u>7:30</u> | Received by: <u>[Signature]</u> | | |
| Samples Accepted Yes <input checked="" type="checkbox"/> No <input type="checkbox"/> | | | | | | Relinquished by: _____ | | Date _____ | Time _____ | Received by: _____ | | |
| If Not Why: _____ | | | | | | | | | | | | |
| AA Project No. <u>A135054-90</u> | | | | | | | | | | | | |

APPENDIX B



054

LABORATORY ANALYSIS RESULTS

Client: Thrifty Oil Company
Project No.: N/A
Project Name: SS# 054
Sample Matrix: Water
Method: EPA 8015M (Gasoline)

AA Project No.: A135054-89
Date Received: 12/15/98
Date Reported: 12/18/98
Units: ug/L

| AA I.D. No. | Client I.D. No. | Date Sampled | Date Analyzed | Results | MRL |
|-------------|-----------------|--------------|---------------|---------|-----|
| 80195 | Effluent | 12/11/98 | 12/15/98 | 410 | 50 |
| 80196 | Influent | 12/11/98 | 12/15/98 | 3400 | 50 |
| 80197 | Trip Blank | 12/11/98 | 12/15/98 | <50 | 50 |

MRL: Method Reporting Limit
<: Not detected at or above the value of the concentration indicated.

George Havallas
Laboratory Director



LABORATORY ANALYSIS RESULTS

Page 1

Client: Thrifty Oil Company
Project No.: N/A
Project Name: SS# 054
Sample Matrix: Water
Method: EPA 8020 (BTEX)

AA Project No.: A135054-89
Date Received: 12/15/98
Date Reported: 12/18/98
Units: ug/L

| Date Sampled: | 12/11/98 | 12/11/98 | 12/11/98 | |
|--------------------------|-----------------|-----------------|-------------------|------------|
| Date Analyzed: | 12/15/98 | 12/15/98 | 12/15/98 | |
| AA ID No.: | 80195 | 80196 | 80197 | |
| Client ID No.: | Effluent | Influent | Trip Blank | MRL |
| <u>Compounds:</u> | | | | |
| Benzene | <0.3 | 0.98 | <0.3 | 0.3 |
| Ethylbenzene | <0.3 | <0.3 | <0.3 | 0.3 |
| Toluene | <0.3 | <0.3 | <0.3 | 0.3 |
| Xylenes | <0.5 | 3.7 | <0.5 | 0.5 |

MRL: Method Reporting Limit

<: Not detected at or above the value of the concentration indicated.



George Havallas
Laboratory Director



LABORATORY ANALYSIS RESULTS

Client: Thrifty Oil Company
Project No.: N/A
Project Name: SS# 054
Sample Matrix: Water
Method: MTBE (EPA 8020)

AA Project No.: A135054-89
Date Received: 12/15/98
Date Reported: 12/18/98
Units: ug/L

| AA I.D. No. | Client I.D. No. | Date Sampled | Date Analyzed | Results | MRL |
|-------------|-----------------|--------------|---------------|---------|-----|
| 80195 | Effluent | 12/11/98 | 12/15/98 | 860 | 5 |
| 80196 | Influent | 12/11/98 | 12/15/98 | 6600 | 5 |

MRL: Method Reporting Limit
<: Not detected at or above the value of the concentration indicated.

George Havalias
Laboratory Director



LABORATORY QA/QC REPORT

Client: Thrifty Oil Company
Project Name: SS# 054
Method: EPA 8015M (Gasoline)
Sample ID: Matrix Spike
Concentration: 500 ug/L

AA ID No.: 80187
Project No.: N/A
AA Project No.: A135054-89
Date Analyzed: 12/15/98
Date Reported: 12/18/98

| Compounds | Result (ug/L) | Spike Recovery (%) | Dup. Result (ug/L) | Spike/Dup. Recovery (%) | RPD (%) | Accept. Rec. Range (%) |
|-------------------------|---------------|--------------------|--------------------|-------------------------|---------|------------------------|
| Gasoline Range Organics | 490 | 98 | 470 | 94 | 4 | 59 - 149 |

George Havalis
Laboratory Director



LABORATORY QA/QC REPORT

Client: Thrifty Oil Company
Project Name: SS# 054
Method: EPA 8020 (BTEX)
Sample ID: Matrix Spike
Concentration: 20 ug/L

AA ID No.: 80187
Project No.: N/A
AA Project No.: A135054-89
Date Analyzed: 12/15/98
Date Reported: 12/18/98

| Compounds | Result (ug/L) | Spike Recovery (%) | Dup. Result (ug/L) | Spike/Dup. Recovery (%) | RPD (%) | Accept.Rec. Range (%) |
|--------------|---------------|--------------------|--------------------|-------------------------|---------|-----------------------|
| Benzene | 22.60 | 113 | 19.84 | 99 | 13 | 65 - 135 |
| Ethylbenzene | 18.94 | 95 | 20.44 | 102 | 7 | 77 - 123 |
| Toluene | 19.00 | 95 | 20.02 | 100 | 5 | 66 - 134 |
| Xylenes | 18.92 | 95 | 20.08 | 100 | 5 | 73 - 127 |

George Havalas
Laboratory Director

APPENDIX C



LABORATORY ANALYSIS RESULTS

Client: Thrifty Oil Company
Project No.: N/A
Project Name: SS# 054
Sample Matrix: Vapor
Method: NIOSH 1501 (Benzene)

AA Project No.: A135054-88
Date Received: 11/24/98
Date Reported: 12/02/98
Units: ug

| AA I.D. No. | Client I.D. No. | Date Sampled | Date Extracted | Date Analyzed | Results | MRL |
|-------------|-----------------|--------------|----------------|---------------|---------|-----|
| 79359 | Effluent | 11/23/98 | 12/01/98 | 12/01/98 | <0.1 | 0.1 |
| 79360 | Trip Blank | 11/23/98 | 12/01/98 | 12/01/98 | <0.1 | 0.1 |

MRL: Method Reporting Limit

<: Not detected at or above the value of the concentration indicated.

George Havallas
Laboratory Director



LABORATORY ANALYSIS RESULTS

Client: Thrifty Oil Company
Project No.: N/A
Project Name: SS# 054
Sample Matrix: Vapor
Method: NIOSH 1501 (Benzene)

AA Project No.: A135054-87
Date Received: 09/30/98
Date Reported: 12/03/98
Units: ug

| AA I.D. No. | Client I.D. No. | Date Sampled | Date Extracted | Date Analyzed | Results | MRL |
|-------------|-----------------|--------------|----------------|---------------|---------|-----|
| 76935 | Effluent | 09/28/98 | 12/02/98 | 12/02/98 | <0.1 | 0.1 |
| 76936 | Trip Blank | 09/28/98 | 12/01/98 | 12/01/98 | <0.1 | 0.1 |

MRL: Method Reporting Limit

<: Not detected at or above the value of the concentration indicated.

George Havallas
Laboratory Director

APPENDIX D



EARTH MANAGEMENT CO.

Environmental Remediation

THRIFTY OIL CO. SS #054

2504 CASTRO VALLEY BLVD.

CASTRO VALLEY, CA 94546

DATE: 12-30-1998

PROJECT STATUS REPORT

| F R E Q . | MONITORING | | | | ODORS | | | FREE | | WELLS CONNECTED TO SYSTEM (W) | | | | | | | | | |
|-----------------------|-------------------|-------|-----|----|------------|----|---|---------|----|-------------------------------|----|-----------|----|-------|----|-------|-----|----|-----|
| | OBSERVATION WELLS | | | | (S-SLIGHT) | | | PRODUCT | | CONNECT | | INTEGRITY | | VAPOR | | WATER | | | |
| | NO. | DTW | DTP | PT | YES | NO | S | YES | NO | YES | NO | YES | NO | OK | NO | ON | OFF | ON | OFF |
| M | PW-1 | 6.40 | | | | X | | | X | | X | - | | | | | | | |
| M | PW-2 | 4.75 | | | | X | | | X | | X | - | | | | | | | |
| M | RE-1 | 5.65 | | | | X | | | X | | X | - | | | X | | | | |
| M | RE-2 | 4.20 | | | | X | | | X | | X | - | | | | | | | |
| M | RE-3 | 4.55 | | | | X | | | X | | X | - | | | X | | | | |
| M | RE-4 | 4.20 | | | | X | | | X | | X | - | | | | | | X | |
| M | RE-5 | 5.95 | | | | X | | | X | | X | - | | | | | | | |
| M | RE-6 | 5.20 | | | | X | | | X | | X | - | | | X | | | | |
| M | RE-7 | 6.25 | | | | X | | | X | | X | - | | | X | | | X | |
| M | RS-8 | 11.35 | | | | X | | | X | | - | X | | | | | | | |
| M | RS-9 | 1.20 | | | | X | | | X | | - | X | | | | | | | |
| M | RS-10 | 4.45 | | | | X | | | X | | | X | | | | | | | |
| M | RS-11 | 7.95 | | | | X | | | X | | | X | | | | | | | |

SAVE SYSTEM WEEKLY

| PARAMETER | U/M | DATA | PARAMETER | U/M | DATA |
|---------------|--------|------|-------------------|---------|------|
| TIME | AM/PM | | AIR FLOW | C F M | |
| WORKING | YES/NO | | VAPOR FLOW | C F M | |
| RESTARTED | YES/NO | | FUEL FLOW | C F M/H | |
| HOURS | # | | WELL VACUUM | IN H2O | |
| ENGINE ROT. | RPM | | L P G TANKS | † | #1: |
| ENGINE VACUUM | IN HG | | GAS METER READING | - | N/A |
| TANK VACUUM | IN HG | | WATER FLOWMETER | GALL. | |

EXHAUST (By others) _____

INLET TO ENGINE _____

MAINTENANCE ES/100/400/800 _____ FOR SPECIFIC OPERATIONS SEE FIELD RECORD

WATER SAMPLING - CHECK () WHEN DONE

| EFFLUENT | INFLUENT | WELLS |
|-----------|-----------|--------------------|
| () _____ | () _____ | () Q.-SEE C.CUST. |

REMARKS: _____

FREE PRODUCT REMOVED: APPROX. _____ GALLONS WATER REMOVED: APPROX. 250 GALLONS

DATA RECORDED BY: [Signature] INPUT BY: AJB 02/05/97

FIELD DATA - GROUNDWATER SAMPLING PROGRAM

| | | | |
|------------|----------|----------|------------|
| Site: | 35 # 054 | Date: | 12-30-98 |
| Address: | | | |
| Personnel: | SERBINA | Weather: | CLOUDY DAY |
| Well No: | RS-9 | Equip: | BAILER |

| | | | |
|-------------------------|-------|--------------------|----|
| Before Purging: | | | |
| Total Well Depth: (ft.) | 14.98 | Well Diameter | 2" |
| Depth to Water (ft) | 1.20 | Est. Purge Volume: | 9 |

| | | | | | | | |
|-----------------------|------|------|------|------------------|------|------|------|
| Sampling Data: | | | | | | | |
| Initial Turbidity: | | | | Final Turbidity: | | | |
| Time | 7:52 | 7:53 | 7:54 | 7:56 | 7:57 | 7:58 | 8:00 |
| EC | 1870 | 1850 | 1900 | 1920 | 1800 | 1800 | 1780 |
| pH | 6.09 | 6.00 | 6.01 | 5.93 | 5.91 | 5.89 | 5.83 |
| Temp | 70.1 | 69.9 | 69.7 | 69.5 | 69.4 | 69.5 | 69.3 |
| Gal. | 1 | 2 | 3 | 5 | 6 | 7 | 9 |
| | | | | | | | |
| Time | | | | | | | |
| EC | | | | | | | |
| pH | | | | | | | |
| Temp | | | | | | | |
| Gal. | | | | | | | |

| | |
|---|-------|
| After Purging/Before Sample Collection | |
| Depth to Water (ft.) | 1.00 |
| Total Well Depth (ft.) | 14.98 |

FIELD DATA - GROUNDWATER SAMPLING PROGRAM

| | |
|---------------------------|-----------------------------|
| Site: <u>054</u> | Date: <u>12-30-98</u> |
| Address: _____ | |
| Personnel: <u>BERNARD</u> | Weather: <u>CLOUDY RAIN</u> |
| Well No: <u>RE-1</u> | Equip: <u>BAILER</u> |

| | | | |
|-------------------------|--------------|--------------------|-----------|
| Before Purging: | | | |
| Total Well Depth: (ft.) | <u>19.83</u> | Well Diameter | <u>4"</u> |
| Depth to Water (ft) | <u>5.65</u> | Est. Purge Volume: | <u>37</u> |

| | | | | | | | |
|---------------------------|-------------|-------------|-------------|-------------------------|-------------|-------------|-------------|
| Sampling Data: | | | | | | | |
| Initial Turbidity: | | | | Final Turbidity: | | | |
| Time | <u>8:08</u> | <u>8:13</u> | <u>8:18</u> | <u>8:24</u> | <u>8:29</u> | <u>8:30</u> | <u>8:40</u> |
| EC | <u>1730</u> | <u>1710</u> | <u>1690</u> | <u>1660</u> | <u>1640</u> | <u>1620</u> | <u>1600</u> |
| pH | <u>6.13</u> | <u>6.09</u> | <u>6.02</u> | <u>6.01</u> | <u>5.94</u> | <u>5.91</u> | <u>5.89</u> |
| Temp | <u>71.3</u> | <u>71.1</u> | <u>70.9</u> | <u>70.7</u> | <u>70.0</u> | <u>70.3</u> | <u>70.1</u> |
| Gal. | <u>5</u> | <u>10</u> | <u>15</u> | <u>21</u> | <u>26</u> | <u>27</u> | <u>37</u> |
| Time | | | | | | | |
| EC | | | | | | | |
| pH | | | | | | | |
| Temp | | | | | | | |
| Gal. | | | | | | | |

| | | | |
|---|-------------|-----------------------|--------------|
| After Purging/Before Sample Collection | | | |
| Depth to Water (ft.) | <u>3.80</u> | Total Well Depth(ft.) | <u>19.83</u> |

FIELD DATA -GROUNDWATER SAMPLING PROGRAM

| | |
|---------------------------|----------------------------|
| Site: <u>33 054</u> | Date: <u>12-30-98</u> |
| Address: _____ | |
| Personnel: <u>SPERBOW</u> | Weather: <u>CLOUDY DAY</u> |
| Well No: <u>RE-2</u> | Equip: <u>BAILER</u> |

| | | | |
|-------------------------|--------------|--------------------|-----------|
| Before Purging: | | | |
| Total Well Depth: (ft.) | <u>17.20</u> | Well Diameter | <u>4"</u> |
| Depth to Water (ft) | <u>4.20</u> | Est. Purge Volume: | <u>34</u> |

| | | | | | | | |
|---------------------------|-------------|-------------|-------------|-------------------------|-------------|-------------|-------------|
| Sampling Data: | | | | | | | |
| Initial Turbidity: | | | | Final Turbidity: | | | |
| Time | <u>8:50</u> | <u>8:55</u> | <u>9:00</u> | <u>9:05</u> | <u>9:09</u> | <u>9:15</u> | <u>9:20</u> |
| EC | <u>1830</u> | <u>1820</u> | <u>1800</u> | <u>1770</u> | <u>1760</u> | <u>1750</u> | <u>1730</u> |
| pH | <u>6.18</u> | <u>6.13</u> | <u>6.09</u> | <u>6.07</u> | <u>6.03</u> | <u>5.98</u> | <u>5.94</u> |
| Temp | <u>70.3</u> | <u>70.1</u> | <u>69.7</u> | <u>69.5</u> | <u>69.3</u> | <u>69.1</u> | <u>68.9</u> |
| Gal. | <u>4</u> | <u>9</u> | <u>14</u> | <u>19</u> | <u>23</u> | <u>29</u> | <u>34</u> |
| | | | | | | | |
| Time | | | | | | | |
| EC | | | | | | | |
| pH | | | | | | | |
| Temp | | | | | | | |
| Gal. | | | | | | | |

| | |
|---|--------------|
| After Purging/Before Sample Collection | |
| Depth to Water (ft.) | <u>3.60</u> |
| Total Well Depth(ft). | <u>17.20</u> |

FIELD DATA - GROUNDWATER SAMPLING PROGRAM

| | |
|-------------------------|----------------------------|
| Site: <u>→ 054</u> | Date: <u>12-30-98</u> |
| Address: _____ | |
| Personnel: <u>SEBIM</u> | Weather: <u>CLOUDY DAY</u> |
| Well No: <u>DE-6</u> | Equip: <u>BAILER</u> |

| | | | |
|-------------------------|--------------|--------------------|-----------|
| Before Purging: | | | |
| Total Well Depth: (ft.) | <u>13.60</u> | Well Diameter | <u>4"</u> |
| Depth to Water (ft) | <u>5.20</u> | Est. Purge Volume: | <u>22</u> |

| | | | | | | | |
|---------------------------|-------------|-------------|-------------|-------------------------|-------------|-------------|-------------|
| Sampling Data: | | | | | | | |
| Initial Turbidity: | | | | Final Turbidity: | | | |
| Time | <u>9:31</u> | <u>9:34</u> | <u>9:37</u> | <u>9:40</u> | <u>9:43</u> | <u>9:46</u> | <u>9:50</u> |
| EC | <u>1810</u> | <u>1790</u> | <u>1780</u> | <u>1760</u> | <u>1740</u> | <u>1730</u> | <u>1710</u> |
| pH | <u>6.13</u> | <u>6.09</u> | <u>6.07</u> | <u>6.05</u> | <u>6.01</u> | <u>5.89</u> | <u>5.83</u> |
| Temp | <u>70.1</u> | <u>69.9</u> | <u>69.7</u> | <u>69.5</u> | <u>69.3</u> | <u>69.1</u> | <u>68.9</u> |
| Gal. | <u>3</u> | <u>6</u> | <u>9</u> | <u>12</u> | <u>15</u> | <u>18</u> | <u>22</u> |
| Time | | | | | | | |
| EC | | | | | | | |
| pH | | | | | | | |
| Temp | | | | | | | |
| Gal. | | | | | | | |

| | |
|---|--------------|
| After Purging/Before Sample Collection | |
| Depth to Water (ft.) | <u>4.70</u> |
| Total Well Depth (ft.) | <u>13.60</u> |

FIELD DATA - GROUNDWATER SAMPLING PROGRAM

| | |
|------------------------|----------------------------|
| Site: <u>23 054</u> | Date: <u>12-30-98</u> |
| Address: _____ | |
| Personnel: <u>BERN</u> | Weather: <u>CLOUDY DAY</u> |
| Well No: <u>PW-1</u> | Equip: <u>BAILER</u> |

| | | | |
|-------------------------|--------------|--------------------|-----------|
| Before Purging: | | | |
| Total Well Depth: (ft.) | <u>14.00</u> | Well Diameter | <u>4"</u> |
| Depth to Water (ft) | <u>6.40</u> | Est. Purge Volume: | <u>20</u> |

| | | | | | | | |
|--------------------|------|-------|-------|------------------|-------|-------|-------|
| Sampling Data: | | | | | | | |
| Initial Turbidity: | | | | Final Turbidity: | | | |
| Time | 9:57 | 10:00 | 10:03 | 10:06 | 10:09 | 10:12 | 10:15 |
| EC | 1910 | 1880 | 1870 | 1820 | 1830 | 1810 | 1790 |
| pH | 6.09 | 6.03 | 6.01 | 5.98 | 5.93 | 5.89 | 5.84 |
| Temp | 71.1 | 70.9 | 70.7 | 70.5 | 70.4 | 70.1 | 69.9 |
| Gal. | 2 | 5 | 8 | 11 | 14 | 17 | 20 |
| Time | | | | | | | |
| EC | | | | | | | |
| pH | | | | | | | |
| Temp | | | | | | | |
| Gal. | | | | | | | |

| | |
|--|-----------------------|
| After Purging/Before Sample Collection | |
| Depth to Water (ft.) | Total Well Depth(ft.) |
| <u>4.90</u> | <u>14.00</u> |

FIELD DATA - GROUNDWATER SAMPLING PROGRAM

| | | | |
|------------|--------|----------|------------|
| Site: | 82054 | Date: | 12-30-98 |
| Address: | | | |
| Personnel: | SERBOW | Weather: | CLOUDY DAY |
| Well No: | PW-2 | Equip: | BAILER |

| | | | |
|-------------------------|-------|--------------------|----|
| Before Purging: | | | |
| Total Well Depth: (ft.) | 14.35 | Well Diameter | 4" |
| Depth to Water (ft) | 4.75 | Est. Purge Volume: | 25 |

| | | | | | | | |
|---------------------------|-------|-------|-------|-------------------------|-------|-------|-------|
| Sampling Data: | | | | | | | |
| Initial Turbidity: | | | | Final Turbidity: | | | |
| Time | 10:23 | 10:27 | 10:30 | 10:34 | 10:37 | 10:41 | 10:45 |
| EC | 1840 | 1810 | 1790 | 1770 | 1740 | 1730 | 1710 |
| pH | 6.14 | 6.11 | 6.09 | 6.09 | 6.09 | 6.01 | 5.98 |
| Temp | 71.3 | 71.1 | 70.9 | 70.9 | 70.7 | 70.5 | 70.3 |
| Gal. | 3 | 7 | 10 | 14 | 17 | 21 | 25 |
| Time | | | | | | | |
| EC | | | | | | | |
| pH | | | | | | | |
| Temp | | | | | | | |
| Gal. | | | | | | | |

| | |
|---|-------|
| After Purging/Before Sample Collection | |
| Depth to Water (ft.) | 3.85 |
| Total Well Depth (ft.) | 14.35 |

FIELD DATA - GROUNDWATER SAMPLING PROGRAM

| | | | |
|------------|--------|----------|------------|
| Site: | 20 054 | Date: | 12-30-98 |
| Address: | | | |
| Personnel: | SEBDM | Weather: | CLOUDY DAY |
| Well No: | RE-7 | Equip: | BAILER |

| | | | |
|-------------------------|-------|--------------------|----|
| Before Purging: | | | |
| Total Well Depth: (ft.) | 13.16 | Well Diameter | 4" |
| Depth to Water (ft) | 6.25 | Est. Purge Volume: | 18 |

| Sampling Data: | | | | | | | |
|--------------------|-------|-------|-------|------------------|-------|-------|-------|
| Initial Turbidity: | | | | Final Turbidity: | | | |
| Time | 10:54 | 10:57 | 10:59 | 11:02 | 11:04 | 11:07 | 11:10 |
| EC | 1740 | 1730 | 1710 | 1690 | 1670 | 1640 | 1620 |
| pH | 6.13 | 6.11 | 6.09 | 6.07 | 6.09 | 6.03 | 6.01 |
| Temp | 71.1 | 70.9 | 70.7 | 70.5 | 70.3 | 70.1 | 70.1 |
| Gal. | 2 | 5 | 7 | 10 | 12 | 15 | 18 |
| | | | | | | | |
| Time | | | | | | | |
| EC | | | | | | | |
| pH | | | | | | | |
| Temp | | | | | | | |
| Gal. | | | | | | | |

| | |
|---|-------|
| After Purging/Before Sample Collection | |
| Depth to Water (ft.) | 5.60 |
| Total Well Depth (ft.) | 13.16 |

FIELD DATA - GROUNDWATER SAMPLING PROGRAM

| | |
|--------------------------|----------------------------|
| Site: <u>00054</u> | Date: <u>12-30-98</u> |
| Address: _____ | |
| Personnel: <u>BERSON</u> | Weather: <u>CLOUDY DAY</u> |
| Well No: <u>RE-5</u> | Equip: <u>BAUER</u> |

| | | | |
|-------------------------|--------------|--------------------|-----------|
| Before Purging: | | | |
| Total Well Depth: (ft.) | <u>18.23</u> | Well Diameter | <u>4"</u> |
| Depth to Water (ft) | <u>5.95</u> | Est. Purge Volume: | <u>32</u> |

| | | | | | | | |
|---------------------------|--------------|--------------|--------------|-------------------------|--------------|--------------|--------------|
| Sampling Data: | | | | | | | |
| Initial Turbidity: | | | | Final Turbidity: | | | |
| Time | <u>11:17</u> | <u>11:22</u> | <u>11:26</u> | <u>11:31</u> | <u>11:35</u> | <u>11:40</u> | <u>11:45</u> |
| EC | <u>1740</u> | <u>1730</u> | <u>1710</u> | <u>1690</u> | <u>1670</u> | <u>1640</u> | <u>1630</u> |
| pH | <u>6.13</u> | <u>6.09</u> | <u>6.04</u> | <u>6.01</u> | <u>5.98</u> | <u>5.97</u> | <u>6.03</u> |
| Temp | <u>71.1</u> | <u>70.9</u> | <u>70.7</u> | <u>70.5</u> | <u>70.3</u> | <u>70.1</u> | <u>69.9</u> |
| Gal. | <u>4</u> | <u>9</u> | <u>13</u> | <u>18</u> | <u>22</u> | <u>27</u> | <u>32</u> |
| Time | | | | | | | |
| EC | | | | | | | |
| pH | | | | | | | |
| Temp | | | | | | | |
| Gal. | | | | | | | |

| | |
|---|--------------|
| After Purging/Before Sample Collection | |
| Depth to Water (ft.) | <u>4.30</u> |
| Total Well Depth (ft.) | <u>18.23</u> |

FIELD DATA -GROUNDWATER SAMPLING PROGRAM

| | |
|--|--|
| Site: <u> 57.054 </u> | Date: <u> 12-30-92 </u> |
| Address: _____ | |
| Personnel: <u> SP2 RBDM </u> | Weather: <u> CLOUDY DAY </u> |
| Well No: <u> RB-4 </u> | Equip: <u> API LAR </u> |

| | | | |
|-------------------------|--------------------------|--------------------|-----------------------|
| Before Purging: | | | |
| Total Well Depth: (ft.) | <u> 14.54 </u> | Well Diameter | <u> 4" </u> |
| Depth to Water (ft) | <u> 4.20 </u> | Est. Purge Volume: | <u> 27 </u> |

| | | | | | | | |
|-----------------------|--------------------|-------|-------|------------------|-------|-------|-------|
| Sampling Data: | | | | | | | |
| | Initial Turbidity: | | | Final Turbidity: | | | |
| Time | 11:51 | 11:55 | 11:59 | 12:03 | 12:07 | 12:11 | 12:15 |
| EC | 1780 | 1760 | 1740 | 1730 | 1710 | 1690 | 1670 |
| pH | 6.11 | 6.09 | 6.08 | 6.03 | 6.01 | 5.98 | 5.93 |
| Temp | 71.3 | 71.1 | 70.9 | 70.8 | 70.6 | 70.4 | 70.3 |
| Gal. | 3 | 7 | 11 | 15 | 19 | 23 | 27 |
| | | | | | | | |
| Time | | | | | | | |
| EC | | | | | | | |
| pH | | | | | | | |
| Temp | | | | | | | |
| Gal. | | | | | | | |

| | |
|---|--------------------------|
| After Purging/Before Sample Collection | |
| Depth to Water (ft.) | <u> 3.95 </u> |
| Total Well Depth(ft.) | <u> 14.54 </u> |

FIELD DATA -GROUNDWATER SAMPLING PROGRAM

| | |
|--------------------------|----------------------------|
| Site: <u>07 054</u> | Date: <u>12-30-98</u> |
| Address: _____ | |
| Personnel: <u>JERRAM</u> | Weather: <u>CLOUDY DAY</u> |
| Well No: <u>RE-3</u> | Equip: <u>BAILER</u> |

| | | | |
|-------------------------|--------------|--------------------|-----------|
| Before Purging: | | | |
| Total Well Depth: (ft.) | <u>17.55</u> | Well Diameter | <u>4"</u> |
| Depth to Water (ft) | <u>4.55</u> | Est. Purge Volume: | <u>34</u> |

| | | | | | | | |
|---------------------------|-------|-------|-------|-------------------------|-------|-------|-------|
| Sampling Data: | | | | | | | |
| Initial Turbidity: | | | | Final Turbidity: | | | |
| Time | 12:20 | 12:25 | 12:30 | 12:35 | 12:40 | 12:45 | 12:50 |
| EC | 1690 | 1670 | 1640 | 1620 | 1630 | 1610 | 1610 |
| pH | 6.13 | 6.09 | 6.08 | 6.04 | 6.01 | 5.98 | 5.93 |
| Temp | 71.1 | 70.9 | 70.7 | 70.5 | 70.3 | 70.1 | 70.1 |
| Gal. | 4 | 9 | 14 | 19 | 24 | 29 | 34 |
| Time | | | | | | | |
| EC | | | | | | | |
| pH | | | | | | | |
| Temp | | | | | | | |
| Gal. | | | | | | | |

| | |
|---|--------------|
| After Purging/Before Sample Collection | |
| Depth to Water (ft.) | <u>3.80</u> |
| Total Well Depth(ft.) | <u>17.55</u> |

FIELD DATA - GROUNDWATER SAMPLING PROGRAM

| | |
|--------------------------|----------------------------|
| Site: <u>→ 054</u> | Date: <u>12-20-98</u> |
| Address: _____ | |
| Personnel: <u>SERBIM</u> | Weather: <u>CLOUDY DAY</u> |
| Well No: <u>RS-8</u> | Equip: <u>BAILER</u> |

| | | | |
|-------------------------|--------------|--------------------|-----------|
| Before Purging: | | | |
| Total Well Depth: (ft.) | <u>25.18</u> | Well Diameter | <u>2"</u> |
| Depth to Water (ft.) | <u>11.35</u> | Est. Purge Volume: | <u>9</u> |

| Sampling Data: | | | | | | | |
|--------------------|-------------|-------------|-------------|------------------|-------------|-------------|-------------|
| Initial Turbidity: | | | | Final Turbidity: | | | |
| Time | 12:52 | 12:53 | 12:54 | 12:56 | 12:57 | 12:58 | 13:00 |
| EC | <u>1280</u> | <u>1260</u> | <u>1240</u> | <u>1230</u> | <u>1210</u> | <u>1200</u> | <u>1670</u> |
| pH | <u>6.16</u> | <u>6.16</u> | <u>6.13</u> | <u>6.09</u> | <u>6.06</u> | <u>6.04</u> | <u>6.02</u> |
| Temp | <u>21.3</u> | <u>21.1</u> | <u>20.9</u> | <u>20.8</u> | <u>20.7</u> | <u>20.6</u> | <u>20.4</u> |
| Gal. | <u>1</u> | <u>2</u> | <u>3</u> | <u>5</u> | <u>6</u> | <u>7</u> | <u>9</u> |
| | | | | | | | |
| Time | | | | | | | |
| EC | | | | | | | |
| pH | | | | | | | |
| Temp | | | | | | | |
| Gal. | | | | | | | |

| | |
|--|--------------|
| After Purging/Before Sample Collection | |
| Depth to Water (ft.) | <u>10.10</u> |
| Total Well Depth (ft.) | <u>25.18</u> |

FIELD DATA - GROUNDWATER SAMPLING PROGRAM

| | |
|--------------------------|----------------------------|
| Site: <u>72054</u> | Date: <u>12.30-98</u> |
| Address: _____ | |
| Personnel: <u>SRB/14</u> | Weather: <u>CLOUDY DAY</u> |
| Well No: <u>RS-11</u> | Equip: <u>RAILOR</u> |

| | | | |
|-------------------------|--------------|--------------------|-----------|
| Before Purging: | | | |
| Total Well Depth: (ft.) | <u>24.80</u> | Well Diameter | <u>2"</u> |
| Depth to Water (ft) | <u>2.95</u> | Est. Purge Volume: | <u>11</u> |

| | | | | | | | |
|---------------------------|--------------|--------------|--------------|-------------------------|--------------|--------------|--------------|
| Sampling Data: | | | | | | | |
| Initial Turbidity: | | | | Final Turbidity: | | | |
| Time | <u>13:05</u> | <u>13:07</u> | <u>13:08</u> | <u>13:10</u> | <u>13:11</u> | <u>13:13</u> | <u>13:15</u> |
| EC | <u>1830</u> | <u>1810</u> | <u>1800</u> | <u>1770</u> | <u>1750</u> | <u>1730</u> | <u>1710</u> |
| pH | <u>6.18</u> | <u>6.16</u> | <u>6.14</u> | <u>6.11</u> | <u>6.09</u> | <u>6.07</u> | <u>6.04</u> |
| Temp | <u>71.1</u> | <u>70.9</u> | <u>70.8</u> | <u>70.6</u> | <u>70.4</u> | <u>70.3</u> | <u>70.1</u> |
| Gal. | <u>1</u> | <u>3</u> | <u>4</u> | <u>6</u> | <u>7</u> | <u>9</u> | <u>11</u> |
| | | | | | | | |
| Time | | | | | | | |
| EC | | | | | | | |
| pH | | | | | | | |
| Temp | | | | | | | |
| Gal. | | | | | | | |

| | | | |
|---|-------------|-----------------------|--------------|
| After Purging/Before Sample Collection | | | |
| Depth to Water (ft.) | <u>6.70</u> | Total Well Depth(ft.) | <u>24.80</u> |



EARTH MANAGEMENT CO.

Environmental Remediation

054
MAINTENANCE & REPAIR REPORT

A) SS #: 054 SYSTEM TYPE: R.S.I
B) DEFICIENCY DESCRIPTION :

C) NAME OF REPORTING PARTY AND DATE:
D) DATE SCHEDULED : 12-28-91

1) NAME: DATE/TIME
2) FINDINGS:

3) HAS THE JOB BEEN COMPLETED? YES/NO
IF "NO", PLEASE DESCRIBE WHY AND WHAT YOU NEED
TO FINISH:

4) POST REPAIR TEST RESULTS:

5) THE CAUSE OF THE DEFICIENCY:

BRIEF INSTRUCTIONS FOR PREVENTIVE MAINTENANCE
TO THE TECHNICIAN:

6) OTHER:
BRING DRUMS FOR D.U.S. AND CLEAN AROUND
WELLS FOR DO THE JOB -



054

DATE: 12-26-98

START UP / SHUT DOWN REPORT
STATION # 054
SYSTEM TYPE : RSI

START UP REPORT:

SHUT DOWN REPORT:

System is shut down because construction at this side.

SIGNATURE: _____

[Handwritten Signature]

DAILY CONSTRUCTION REPORT

054 DATE 12-21-1998
 DAY

| | | | | | | |
|---|---|---|---|----|---|---|
| S | M | T | W | TH | F | S |
| | X | | | | | |

PROJECT _____
 JOB NO. 33 054
 CLIENT TASCOCO INC.
 CONTRACTOR K.E. CURTIS INC.
 PROJECT MANAGER _____

| | | | | |
|----------|---|--|--------|------------|
| WEATHER | Clear <input checked="" type="checkbox"/> | Overcast <input type="checkbox"/> | Partly | Other |
| TEMP. | 75-82 | 57-60 | 52-76 | 70-85 |
| WIND | Swift | Steady <input checked="" type="checkbox"/> | Light | Report No. |
| HUMIDITY | Dry | Moist <input checked="" type="checkbox"/> | Humid | |

| AVERAGE FIELD FORCE | | | |
|---------------------|------------|--------|---------|
| Name of Contractor | Non-manual | Manual | Remarks |
| N/A | | | |

| VISITORS | | | |
|----------|--------------|--------------|---------|
| Time | Representing | Representing | Remarks |
| | | | |

EQUIPMENT AT THE SITE TRUCKS, BULLDOZER, CRANE, SMALL TOOLS FOR HANDS, COMPRESSOR,

CONSTRUCTION ACTIVITIES THEY ARE IN FINAL STAGE. AFTER CLEAN UP THE STATION CAN BEGIN AGAIN SELL GASOLINE -

- DISTRIBUTION:
1. Proj. Mgr
 2. Field Office
 3. File
 4. Client

BY R. Curtis TITLE _____



DATE: 12-14-88

START UP / SHUT DOWN REPORT
STATION # 054
SYSTEM TYPE :

START UP REPORT:

SHUT DOWN REPORT:

Shut down system because construction (pull out
tanks).

SIGNATURE: _____

[Handwritten Signature]

054

FIELD STATUS REPORT

GROUND WATER AND SOIL CLEAN-UP SYSTEM

| MAINFOLD | | | | | | | | | | | | | | | |
|----------|-------|--|--|-----|--|--|-----|-------|--------|--|-----|--|-----|-----|--|
| WELLS | WATER | | | | | | | WELLS | VAPORS | | | | | | |
| | | | | | | | | | | | | | | | |
| ON | | | | RE4 | | | RE7 | ON | RE1 | | RE3 | | RE6 | RE7 | |
| OFF | | | | | | | | OFF | | | | | | | |

| WELL MONITORING | | | | | RSI SYSTEM | | | |
|-----------------|-----|-----|----|-----|---------------|--------|-------|-----|
| WELL NO | DTW | DTP | PT | DTB | PARAMETER | U/M | DATA | OBS |
| | | | | | TIME | AM/PM | 10 | |
| | | | | | HOURS | # | 15124 | |
| | | | | | ENGINE RPM | RPM | 1300 | |
| | | | | | ENGINE VACUUM | IN HG | 13 | |
| | | | | | TK REC TEMP | F | 95 | |
| | | | | | AIR TEMP | F | 48 | |
| | | | | | AIR FLOW | CFM | 14 | |
| | | | | | VAPOR FLOW | CFM | 11 | |
| | | | | | FUEL FLOW | CFM/H | 30 | |
| | | | | | WELL VACUUM | IN H2O | 13 | |
| | | | | | GAS METER | | %40 | |

| HYDROCARBON STRIPPER & VAPOR EXTRACTION SYSTEM W/ACU OR CAT | | | |
|---|---------|-------|-------|
| PARAMETER | U/M | LIMIT | DATA |
| FLOWMETER | GALLONS | | 11832 |
| ROTAMETER | | | |
| VPI FLOW | | | |
| VPI VACUUM | | | |
| AIR COMPRES | | | |
| VAPOR | | | |
| INLET VAPOR | | | |
| TEMPERATURE | | | |
| LEL | | | |

COMMENTS: RESTART WATER SYSTEM MAKE SAMPLING

SERVICE TECHNICAN HTC DATE 12-07-99 THRIFTY OIL CO # 054

057

FIELD STATUS REPORT

GROUND WATER AND SOIL CLEAN-UP SYSTEM

| MAINFOLD | | | | | | | | | | | | | | | |
|----------|-------|--|--|--|--|--|--|-------|--------|--|------|--|--|------|------|
| WELLS | WATER | | | | | | | WELLS | VAPORS | | | | | | |
| | | | | | | | | | | | | | | | |
| ON | | | | | | | | ON | RE 1 | | RE 3 | | | RE 6 | RE 7 |
| OFF | | | | | | | | OFF | | | | | | | |

| WELL MONITORING | | | | | RSI SYSTEM | | | |
|-----------------|-----|-----|----|-----|----------------------|--------|-------|-----|
| WELL NO | DTW | DTP | PT | DTB | PARAMETER | U/M | DATA | OBS |
| | | | | | TIME | AM/PM | AM | |
| | | | | | HOURS | # | 14963 | |
| | | | | | ENGINE RPM | RPM | 1800 | |
| | | | | | ENGINE VACUUM | IN HG | 13 | |
| | | | | | TK REC TEMP | F | 90 | |
| | | | | | AIR TEMP | F | 48 | |
| | | | | | AIR FLOW | CFM | 13 | |
| | | | | | VAPOR FLOW | CFM | 11 | |
| | | | | | FUEL FLOW | CFM/H | 70 | |
| | | | | | WELL VACUUM | IN H2O | 13 | |
| | | | | | GAS METER | | % 48 | |
| | | | | | CATALIST IN | F | | |
| | | | | | CATALIST OUT | F | | |
| | | | | | EXHAUST HC | PPM/% | | |
| | | | | | EXHAUST CO | %PPM | | |
| | | | | | EXHAUST CO2 | % | | |
| | | | | | EXHAUST NOX | %PPM | | |
| | | | | | CATALYST REPLACEMENT | | | |
| | | | | | EXHAUST O2 | % | | |
| | | | | | INLET | PPM | | |
| | | | | | OUTLET | PPM | | |

| HYDROCARBON STRIPPER & VAPOR EXTRACTION SYSTEM W/ACU OR CAT | | | |
|---|-----|-------|------|
| PARAMETER | U/M | LIMIT | DATA |
| FLOWMETER | | | |
| ROTAMETER | | | |
| VPI FLOW | | | |
| VPI VACUUM | | | |
| AIR COMPRES | | | |
| VAPOR | | | |
| INLET VAPOR | | | |
| TEMPERATURE | | | |
| LEL | | | |

COMMENTS: *System was shut down. I restart again.*

SERVICE TECHNICAN *J. M. ...* DATE *12-30-96* THRIFTY OIL CO # *057*

GROUND WATER AND SOIL CLEAN-UP SYSTEM

| MAINFOLD | | | | | | | | | | | | | | | |
|----------|-------|--|--|--|--|--|--|-------|--------|--|------|--|------|------|--|
| WELLS | WATER | | | | | | | WELLS | VAPORS | | | | | | |
| | | | | | | | | | | | | | | | |
| ON | | | | | | | | ON | RE 1 | | RE 3 | | RE 6 | RE 7 | |
| OFF | | | | | | | | OFF | | | | | | | |

| WELL MONITORING | | | | | RSI SYSTEM | | | |
|-----------------|-----|-----|----|-----|---------------|--------|--------|-----|
| WELL NO | DTW | DTP | PT | DTB | PARAMETER | U/M | DATA | OBS |
| | | | | | TIME | AM/PM | AM | |
| | | | | | HOURS | # | 147.60 | |
| | | | | | ENGINE RPM | RPM | 1300 | |
| | | | | | ENGINE VACUUM | IN HG | 13 | |
| | | | | | TK REC TEMP | F | 100 | |
| | | | | | AIR TEMP | F | 68 | |
| | | | | | AIR FLOW | CFM | 14 | |
| | | | | | VAPOR FLOW | CFM | 11 | |
| | | | | | FUEL FLOW | CFM/H | 70 | |
| | | | | | WELL VACUUM | IN H2O | 13 | |
| | | | | | GAS METER | | 4.60 | |

| HYDROCARBON STRIPPER & VAPOR EXTRACTION SYSTEM W/ACU OR CAT | | | |
|---|-----|-------|------|
| PARAMETER | U/M | LIMIT | DATA |
| FLOWMETER | | | |
| ROTAMETER | | | |
| VPI FLOW | | | |
| VPI VACUUM | | | |
| AIR COMPRES | | | |
| VAPOR | | | |
| INLET VAPOR | | | |
| TEMPERATURE | | | |
| LEL | | | |

COMMENTS: NO SAMPLING

SERVICE TECHNICAN SFRAN DATE 11-23-95 THRIFTY OIL CO # 054



EARTH MANAGEMENT CO.

Environmental Remediation

(054)

FIELD STATUS REPORT

GROUND WATER AND SOIL CLEAN-UP SYSTEM

| MAINFOLD | | | | | | | | | | | | | | | |
|----------|-------|--|--|--|--|--|--|-------|--------|--|------|--|--|------|------|
| WELLS | WATER | | | | | | | WELLS | VAPORS | | | | | | |
| | | | | | | | | | | | | | | | |
| ON | | | | | | | | ON | REF1 | | REF2 | | | REF6 | REF7 |
| OFF | | | | | | | | OFF | | | | | | | |

| WELL MONITORING | | | | | RSI SYSTEM | | | |
|-----------------|-----|-----|----|-----|---------------|--------|-------|-----|
| WELL NO | DTW | DTP | PT | DTB | PARAMETER | U/M | DATA | OBS |
| | | | | | TIME | AM/PM | AM | |
| | | | | | HOURS | # | 14130 | |
| | | | | | ENGINE RPM | RPM | 1780 | |
| | | | | | ENGINE VACUUM | IN HG | 13 | |
| | | | | | TK REC TEMP | F | 90 | |
| | | | | | AIR TEMP | F | 70 | |
| | | | | | AIR FLOW | CFM | 14 | |
| | | | | | VAPOR FLOW | CFM | 13 | |
| | | | | | FUEL FLOW | CFM/H | 80 | |
| | | | | | WELL VACUUM | IN H2O | 13 | |

| HYDROCARBON STRIPPER & VAPOR EXTRACTION SYSTEM W/ACU OR CAT | | | |
|---|-----|-------|------|
| PARAMETER | U/M | LIMIT | DATA |
| FLOWMETER | | | |
| ROTAMETER | | | |
| VPI FLOW | | | |
| VPI VACUUM | | | |
| AIR COMPRES | | | |
| VAPOR | | | |
| INLET VAPOR | | | |
| TEMPERATURE | | | |
| LEL | | | |

| | | | |
|----------------------|-------|-----|--|
| GAS METER | | %50 | |
| CATALIST IN | F | | |
| CATALIST OUT | F | | |
| EXHAUST HC | PPM/% | | |
| EXHAUST CO | %PPM | | |
| EXHAUST CO2 | % | | |
| EXHAUST NOX | %PPM | | |
| CATALYST REPLACEMENT | | | |
| EXHAUST O2 | % | | |
| INLET | PPM | | |
| OUTLET | PPM | | |

COMMENTS: WATER IS SHUT DOWN, ONLY VAPOR FROM 13 ON -

SERVICE TECHNICAN DNA DATE 11-26-94 THRIFTY OIL CO # 054



EARTH MANAGEMENT CO.

Environmental Remediation

MAINTENANCE : REPAIR REPORT

- A) SS #: 054 SYSTEM TYPE: RSI
B) DEFICIENCY DESCRIPTION :
TRY TO KEEP VAPOR SIDE OF THE SYSTEM IN THE
PROPER WAY
C) NAME OF REPORTING PARTY AND DATE:
D) DATE SCHEDULED :

- | 1) NAME: | DATE/TIME |
|--------------|-----------|
| 2) FINDINGS: | |

- 3) HAS THE JOB BEEN COMPLETED? YES/NO
IF "NO", PLEASE DESCRIBE WHY AND WHAT YOU NEED
TO FINISH:

- 4) POST REPAIR TEST RESULTS:

- 5) THE CAUSE OF THE DEFICIENCY:

BRIEF INSTRUCTIONS FOR PREVENTIVE MAINTENANCE
TO THE TECHNICIAN:

- 6) OTHER:
WATER IS OFF, ONLY VAPOR ARE ON -



DATE: 11-02-98

START UP / SHUT DOWN REPORT
STATION # 054
SYSTEM TYPE : RSI

START UP REPORT:

SHUT DOWN REPORT:

System shut down for replace compressor -

SIGNATURE: *[Signature]*



DATE: 10-27-98

START UP / SHUT DOWN REPORT
STATION # 054
SYSTEM TYPE : RS.I.

START UP REPORT:

SHUT DOWN REPORT:

System shut down for maintenance

SIGNATURE: _____

[Handwritten Signature]



DATE: 10-14-98

START UP / SHUT DOWN REPORT
STATION # 054
SYSTEM TYPE : RS.1

START UP REPORT:

SHUT DOWN REPORT:

System shut down for maintenance

SIGNATURE: _____

[Handwritten Signature]



DATE: 10-13-98

START UP / SHUT DOWN REPORT
STATION # 054
SYSTEM TYPE : RS.1

START UP REPORT:

SHUT DOWN REPORT:

System shut down for compressor replacement,
and result from LAB →

SIGNATURE: _____

[Handwritten signature]