

THRIFTY OIL CO.

February 15, 1994

Mr. Scott O. Seary
Alameda County
Department of Environmental Health
Hazardous Materials Program
80 Swan Way, Room 200
Oakland, California 94621

ALCO
HAZMAT
94 FEB 22 PM 2:25

RE: Thrifty Oil Co. Station #054
2504 Castro Valley Boulevard
Castro Valley, California
4th. QUARTER REPORT, 1993

Dear Mr. Seary,

This letter report presents the results of soil/groundwater treatment and site monitoring during the 4th. quarter of 1993 at the subject site. The approximate location of the on- and off-site monitoring wells are shown on **Figure 1**. The engine of the RSI unit was replaced and was operational the first week in May, 1993. All monitoring is conducted by Earth Management Co. (EMC).

Site Monitoring and Sample Collection

The site was visited on December 14, 1993, by an EMC technician in order to gauge the wells and collect groundwater samples. Water levels were measured in each well from the rim of well cover using a Marine Moisture Tape (nearest 0.01 feet) capable of also measuring the presence of free floating hydrocarbons. *Depth to water* ranged from about 2.75 to 8.75 feet below grade which is consistent with previous data collected, indicating a slight rise. **As of December 14, 1993, only three of wells, RE-3, RE-4 and RE-7, exhibited floating product visible as a sheen or film.** The depth to water data was used in conjunction with the recent survey data to determine groundwater elevations across the site. The interpretation of groundwater flow across the site is depicted on **Figure 1**. In general, **the groundwater flow was to the east at a calculated gradient of about 6.7 feet per 100 feet.**

Prior to collecting groundwater samples from the wells, about 4 well volumes of groundwater was removed using a PVC bailer. **No samples were collected from the recovery wells RE-4 and RE-7.** During the purging process, the pH, conductivity and temperature were checked and recorded to insure formation water was entering the well to be sampled. About 8 to 40 gallons of water were removed from each well and stored in 55 gallon D.O.T approved drums pending



disposal or discharge through the treatment unit. Groundwater samples were collected with a Teflon bailer. Samples were maintained and transported in 40 milliliter vials placed on ice pending delivery to Smith-Emery, a state certified analytical laboratory headquartered in Los Angeles, California. Field monitoring sheets prepared by EMC personnel are included in Appendix A.

Analytical Results

Groundwater Monitoring Wells. Groundwater samples were analyzed for total hydrocarbons (TPH) and volatile aromatic compounds (BETX) using EPA methods 8015 and 8020, respectively. Copies of the laboratory analysis reports are attached in Appendix B. A summary of the results are presented in Table 1. **The two down-gradient wells, RS-8 and RS-10 continue to indicate less than detectable or acceptable levels of volatile aromatic compounds.** Iso-concentration maps of TPH and benzene based on the December sampling event are presented as Figures 2 and 3.

Treatment Unit Discharge. In addition, the inlet and outlet to the groundwater treatment unit was sampled monthly. ~~TPH in the inlet and BETX in the inlet were 5 mg/L to 7500 mg/L. TPH and BETX was not detected in the outlet.~~

Air Sample Collection. In order to monitor the emissions of the engine, bi-weekly samples of the outlet vapors were collected and analyzed for benzene. Based on the analysis of samples by D&M Laboratories, no detectable concentrations of benzene were noted in the outlet vapor sampled. Copies of complete laboratory reports are included in Appendix B.

Treatment Unit Operation Status

Based on the data obtained by EMC, the RSI-SAVE unit operated 1440 hours during the reporting period and 7280 hours total. ~~total of 1424 gallons of water has been processed by the unit and discharged to the local sanitary sewer to date, December 29, 1993. During this reporting period, a total of 117 gallons of water was processed.~~

Closing

Thrifty will continue to conduct quarterly groundwater monitoring at the site. If you have any questions please contact me at (310) 923-9876.

Very truly yours,



Peter D'Amico
Manager
Environmental Affairs

Table 1 - Summary of Analytical Results

I.D	Date	D-Wat	TPH	Benzene	Toluene	E-Benzene	Xylenes
PW-1 (166.48)	4/11/88	--	NSC				
	4/09/90	5.10	230000	600	2700	1000	16000
	10/30/90	6.17	35000	240	970	240	3580
	1/18/91	6.28	37000	43	140	42	1600
	2/12/91	5.88	45000	99	130	25	700
	3/20/91	4.75	1900	0.43	ND	ND	2.8
	5/22/91	5.10	41000	600	730	250	3800
	6/19/91	5.61	NSC				
	7/17/91	5.53(Film)	NSC				
	8/07/91	5.67(Film)	NSC				
	9/24/91	5.57(Film)	NSC				
	10/23/91	6.53(Film)	NSC				
	11/06/91	5.85(Film)	NSC				
	12/04/91	5.91(Film)	NSC				
	1/29/92	5.43(Film)	NSC				
	2/26/92	5.54(Film)	NSC				
	3/19/92	5.47	ND	ND	ND	ND	ND
	4/22/92	5.62(Film)	NSC				
	5/21/92	6.21	1300	19	2.9	0.7	58
	6/25/92	6.94	NSC				
	7/30/92	5.90(Film)	NSC				
	8/20/92	7.12(Film)	NSC				
	9/30/92	6.42	3400	57	ND	26	240
	12/23/92	5.56(Film)	NSC				
	3/10/93	5.65(Film)	NSC				
	6/09/93	5.30	400	<0.5	1.1	<1.0	<1.0
	09/14/93	5.43	180	3.7	3.2	1.5	14.0
12/14/93	4.65	<50	<0.3	<0.3	<0.3	<0.5	
PW-2 (166.18)	4/11/88	--	NSC				
	4/09/90	5.81	600000	1300	11000	4600	43000
	10/30/90	6.95	48000	310	51	10	480
	1/18/91	6.92	86000	230	1400	350	8300
	2/12/91	6.78	160000	680	1300	250	7000
	3/20/91	5.54	17000	34	50	ND	1100
	5/22/91	6.07	14000	57	2100	500	8200
	6/19/91	6.37(Film)	NSC				
	7/17/91	6.38(Film)	NSC				
	8/07/91	6.63(Film)	NSC				
	9/24/91	6.42(Film)	NSC				
	10/23/91	7.25(Film)	NSC				
	11/06/91	6.44(Film)	NSC				
	12/04/91	6.65(Film)	NSC				
	1/29/92	6.17(Film)	NSC				
	2/26/92	5.90(Film)	NSC				
	3/19/92	5.80(Film)	NSC				
	4/22/92	5.88(Film)	NSC				
	5/21/92	6.03(Film)	NSC				
	6/25/92	6.57(Film)	NSC				
	7/30/92	6.20(Film)	NSC				
	8/20/92	6.64(Film)	NSC				
	9/30/92	6.88(Film)	NSC				
	12/23/92	6.08(Film)	NSC				
	3/10/93	5.95(Film)	NSC				
	6/09/93	5.38	3400	24	2.2	<0.5	240
	09/14/93	6.26	4900	190	15.0	6.8	480
12/14/93	5.22	1700	4.2	<0.3	<0.3	<0.5	

Results reported in micrograms per liter (ug/L)

NA - Not Analyzed.
 ND - Not Detected.
 TPH - Total Petroleum Hydrocarbons as gasoline.
 D-Wat - Depth to Water.
 NSC - No sample collected due to film or sheen of liquid phase hydrocarbons.

Table 1 (CONT.) - Summary of Analytical Results

I.D	Date	D-Wat	TPH	Benzene	Toluene	E-Benzene	Xylenes	
RE-1 (166.82)	4/11/88	--	37000	1900	8400	1200	15000	
	4/09/90	4.99	45000	6100	7000	2000	8800	
	10/30/90	5.95	72000	7700	5300	1800	8900	
	1/18/91	5.17	150000	11000	14000	1800	4300	
	2/12/91	4.16	140000	11000	12000	1600	13000	
	3/20/91	4.75	53000	3100	4200	400	5500	
	5/22/91	4.42	85000	8700	10000	1800	12000	
	6/19/91	4.93	110000	8500	9600	2600	16000	
	7/17/91	5.19	5500	950	ND	26	ND	
	8/07/91	5.12	NA	6700	5000	ND	7100	
	9/24/91	5.87	60000	6800	4300	640	6900	
	10/23/91	5.81	79000	7900	8300	450	7100	
	11/06/91	5.56	130000	14000	15000	1100	8800	
	12/04/91	5.35	50000	8000	4700	520	4100	
	1/29/92	4.50	21000	10300	11000	780	6000	
	2/26/92	5.27	38000	8400	10500	720	7100	
	3/19/92	4.47	48000	6200	9700	780	7200	
	4/22/92	4.62	NSC					
	5/21/92	4.98	20000	7600	10100	830	6900	
	6/25/92	5.14(Film)	NSC					
	7/30/92	5.30(Film)	NSC					
	8/20/92	5.28(Film)	NSC					
	9/30/92	5.66(Film)	NSC					
	12/23/92	4.81(Film)	NSC					
	3/10/93	4.13(Film)	NSC					
	6/09/93	4.48(Film)	NSC					
	09/14/93	5.35	19000	3600	1100	740	4300	
12/14/93	4.38	39000	4300	4300	<6.6	7100		
RE-2 (167.19)	4/11/88	--	NSC					
	4/09/90	4.90	850	5.8	0.5	4.8	1.1	
	10/30/90	5.34	440	2.8	0.91	13	3.14	
	1/18/91	4.90	1100	8.4	3.1	ND	10	
	2/12/91	4.94	1100	5.9	ND	0.77	ND	
	3/20/91	4.32	550	4.3	ND	ND	ND	
	5/22/91	4.43	1000	5.3	3.6	4.4	8.9	
	6/19/91	6.43	700	2.1	1.4	3.8	3.5	
	7/17/91	4.75	880	12.0	8.0	4.3	28.0	
	8/07/91	4.87	NA	3.8	1.6	ND	ND	
	9/24/91	5.50	670	7.2	7.1	ND	23	
	10/23/91	5.63	2700	52	60	22	130	
	11/06/91	5.14	1900	18	61	9.1	83	
	12/04/91	5.26	1100	26	47	4.3	42	
	1/29/92	5.11	900	14	24	5.3	19	
	2/26/92	4.31	500	3.4	3.5	2.7	2.7	
	3/19/92	4.45	1200	14	20	15	18	
	4/22/92	4.78	200	ND	ND	ND	ND	
	5/21/92	5.02	500	7.5	6.8	3.9	7.4	
	6/25/92	5.13	ND	ND	0.9	0.7	ND	
	7/30/92	5.19	500	7.7	8.6	3.2	1.7	
	8/20/92	5.27	1100	6.6	4.5	2.7	2.0	
	9/30/92	5.45	500	5.4	2.4	1.8	4.5	
	12/23/92	4.60	800	1.9	ND	ND	2.3	
	3/10/93	4.18	1200	ND	1.4	ND	2.1	
	6/09/93	4.53	200	ND	ND	ND	ND	
	09/14/93	5.26	360	1.6	1.1	3.2	8.9	
12/16/93	2.75	260	5.8	3.9	<0.3	21.0		

Results reported in micrograms per liter (ug/L)

NA - Not Analyzed.
 ND - Not Detected.
 TPH - Total Petroleum Hydrocarbons as gasoline.
 D-Wat - Depth to Water.
 NSC - No sample collected due to film or sheen of liquid phase hydrocarbons.

Table 1 (CONT.) - Summary of Analytical Results

I.D	Date	D-Wat	TPH	Benzene	Toluene	Ethyl-Benzene	Xylenes
RE-3 (167.39)	4/11/88	-	70000	6600	5300	800	13000
	4/09/90	7.15	370000	2300	4900	3200	31000
	10/30/90	7.84	13000	860	660	220	2210
	1/18/91	6.90	42000	4700	4500	21	7700
	2/12/91	6.62	72000	3600	4500	ND	7600
	3/20/91	5.87	65000	2400	9400	50	9800
	5/22/91	5.98(Film)	NSC				
	6/19/91	6.84(Film)	NSC				
	7/17/91	7.10(Film)	NSC				
	8/07/91	7.30(Film)	NSC				
	9/24/91	7.84(Film)	NSC				
	10/23/91	8.07(Film)	NSC				
	11/06/91	7.63(Film)	NSC				
	12/04/91	7.83(Film)	NSC				
	1/29/92	7.17(Film)	NSC				
	2/26/92	5.56(Film)	NSC				
	3/19/92	5.44(Film)	NSC				
	4/22/92	6.56(Film)	NSC				
	5/21/92	6.90(Film)	NSC				
	6/25/92	7.18(Film)	NSC				
7/30/92	6.80(Film)	NSC					
8/20/92	7.25(Film)	NSC					
9/30/92	7.68(Film)	NSC					
12/23/92	6.07(Film)	NSC					
3/10/93	5.66(Film)	NSC					
6/10/93	6.66(Film)	NSC					
09/14/93	7.30	40000	2900	1500	180	6900	
12/14/93	5.95	NSC					
RE-4 (166.94)	4/11/88	-	150000	12000	8000	1000	27000
	4/09/90	-	NSC				
	10/30/90	7.04	87000	7200	10000	1600	12900
	1/18/91	11.62	70000	5000	5400	790	9900
	2/12/91	11.63	87000	5200	2800	240	11000
	3/20/91	11.61	6500	370	230	17	670
	5/22/91	10.3(Film)	NSC				
	6/19/91	11.1(Film)	NSC				
	7/17/91	6.20(Film)	NSC				
	8/07/91	8.15(Film)	NSC				
	9/24/91	10.4(Film)	NSC				
	10/23/91	11.2(Film)	NSC				
	11/06/91	6.62(Film)	NSC				
	12/04/91	11.2(Film)	NSC				
	1/29/92	7.72(Film)	NSC				
	2/26/92	5.13(Film)	NSC				
	3/19/92	5.00(Film)	NSC				
	4/22/92	5.94(Film)	NSC				
	5/21/92	5.40(Film)	NSC				
	6/25/92	5.71(0.02)	NSC				
7/30/92	6.33(Film)	NSC					
8/20/92	5.80(Film)	NSC					
9/30/92	6.34(Film)	NSC					
12/23/92	5.50(Film)	NSC					
3/10/93	4.67(Film)	NSC					
6/09/93	5.12(Film)	NSC					
09/14/93	10.44	NSC					
12/14/93	7.52	NSC					

Results reported in micrograms per liter (ug/L)

- NA - Not Analyzed.
- ND - Not Detected.
- TPH - Total Petroleum Hydrocarbons as gasoline.
- D-Wat - Depth to Water.
- NSC - No sample collected due to film or sheen of liquid phase hydrocarbons.

Table 1 (CONT.) - Summary of Analytical Results

I.D	Date	D-Wat	TPH	Benzene	Toluene	Ethyl-Benzene	Xylenes	
RE-5 (166.51)	4/11/88	-	14000	1300	1100	100	2600	
	4/09/90	4.79	3000	690	190	40	270	
	10/30/90	5.86	3400	910	48	87	249	
	1/18/91	4.40	1400	180	8.6	0.52	48	
	2/12/91	4.76	1000	ND	ND	0.65	ND	
	3/20/91	5.08	3000	250	53	ND	110	
	5/22/91	4.52	2500	330	7.8	5.6	200	
	6/19/91	4.39	2000	59	1.6	5.1	110	
	7/17/91	5.05(Film)	NSC					
	8/07/91	5.02(Film)	NSC					
	9/24/91	5.86(Film)	NSC					
	10/23/91	5.84(Film)	NSC					
	11/06/91	5.48	9900	2300	37	260	160	
	12/04/91	5.43	4500	1000	27	ND	180	
	1/29/92	5.12	600	6.1	2.3	ND	47	
	2/26/92	4.93	500	5.4	2.7	1.2	14	
	3/19/92	4.45	ND	1.7	1.1	ND	5.5	
	4/22/92	4.63	1600	240	2.2	ND	160	
	5/21/92	4.90	1200	410	37	ND	118	
	6/25/92	5.15	ND	1.0	0.8	0.8	0.4	
	7/30/92	5.30	ND	2.0	1.8	1.9	6.4	
	8/20/92	5.44	300	1.7	3.3	0.7	12	
	9/30/92	5.73	1900	140	ND	19	35	
	12/23/92	4.75	400	8.0	ND	ND	ND	
	3/10/93	4.14	1100	290	9.7	ND	75	
	6/09/93	5.42	400	1.5	0.5	ND	12	
	09/14/93	5.53	240	6.9	8.8	1.4	67	
	12/14/93	4.78	1400	510	5.4	4.1	55	
RE-5 (166.51)	4/11/88	-	6000	3000	40	80	140	
	4/09/90	5.64	3000	990	ND	70	ND	
	10/30/90	6.68	3400	1000	28	ND	ND	
	1/18/91	6.61	6300	1200	ND	3	15	
	2/12/91	6.20	5200	850	8.4	4.9	41	
	3/20/91	5.62	5800	680	12	8	16	
	5/22/91	6.05	8500	1700	14	24	6.7	
	6/19/91	6.12(Film)	NSC					
	7/17/91	6.20	12000	9300	13000	2400	16000	
	8/07/91	6.27	NA	590	5.3	ND	14	
	9/24/91	6.63	7000	310	11	5.3	35	
	10/23/91	6.36(Film)	NSC					
	11/06/91	6.15	4000	710	18	28	49	
	12/04/91	6.19	4100	1100	14	33	39	
	1/29/92	6.70	2600	790	14	ND	49	
	2/26/92	5.44	3100	950	21	30	33	
	3/19/92	5.30	2200	630	14	12	40	
	4/22/92	6.00	NA	730	2.2	ND	40	
	5/21/92	6.25	1500	840	7.8	7.1	34	
	6/25/92	6.38	<2000	740	8	27	28	
	7/30/92	6.42(Film)	NSC					
	8/20/92	6.50	2800	630	17	23	22	
	9/30/92	6.66	7800	540	ND	12	29	
	12/23/92	5.83	1800	350	ND	7.7	11	
	3/10/93	5.83	3000	830	5.6	19	16	
	6/09/93	6.01	4800	920	6.2	3.2	12	
	09/14/93	6.53	3600	660	7.5	11	27	
	12/14/93	3.58	1500	350	<0.3	<0.3	5.3	

Results reported in micrograms per liter (ug/L)

- NA - Not Analyzed.
- ND - Not Detected.
- TPH - Total Petroleum Hydrocarbons as gasoline.
- D-Wat - Depth to Water.
- NSC - No sample collected due to film or sheen of liquid phase hydrocarbons.

Table 1 (CONT.) - Summary of Analytical Results

I.D	Date	E-Wat	TPH	Benzene	Toluene	Ethyl-Benzene	Xylenes
RE-7 (166.04)	4/11/88	--	<50000	17000	4400	600	8400
	4/05/90	5.93	18000	7000	1200	640	1600
	10/30/90	8.21	31000	14000	ND	ND	ND
	1/18/91	11.8(Film)	NSC				
	2/12/91	10.8(Film)	NSC				
	3/20/91	9.96	120000	12000	2800	490	6600
	5/22/91	11.7(Film)	NSC				
	6/19/91	11.5(Film)	NSC				
	7/17/91	7.80(Film)	NSC				
	8/07/91	9.88(0.03)	NSC				
	9/24/91	9.85(0.03)	NSC				
	10/23/91	9.96(Film)	NSC				
	11/06/91	6.77(Film)	NSC				
	12/04/91	10.8(Film)	NSC				
	1/29/92	8.64(Film)	NSC				
	2/26/92	6.00(Film)	NSC				
	3/19/92	5.55(Film)	NSC				
	4/22/92	6.12(Film)	NSC				
	5/21/92	6.40(Film)	NSC				
	6/25/92	6.73(0.02)	NSC				
	7/30/92	6.73(Film)	NSC				
	8/20/92	6.82(Film)	NSC				
	9/30/92	7.26(Film)	NSC				
12/23/92	6.22(Film)	NSC					
3/10/93	5.82(Film)	NSC					
6/09/93	6.17(Film)	NSC					
09/14/93	11.33	NSC					
12/14/93	8.40	NSC					
RE-8 (164.32)	8/07/91	9.68	ND	ND	ND	ND	ND
	9/27/91	9.89	ND	ND	ND	ND	ND
	10/23/91	10.05	ND	ND	ND	ND	ND
	11/06/91	9.71	ND	ND	ND	ND	ND
	12/04/91	10.00	ND	ND	ND	ND	ND
	1/29/92	9.28	ND	2.1	1.0	2.5	3.6
	2/26/92	7.05	ND	ND	0.7	ND	0.7
	3/19/92	7.30	ND	0.5	1.0	1.5	2.7
	4/22/92	8.60	ND	ND	ND	ND	ND
	5/21/92	9.22	ND	ND	ND	ND	ND
	6/25/92	9.49	ND	ND	ND	ND	ND
	7/30/92	9.55	ND	1.1	4.2	ND	3.0
	8/20/92	9.63	ND	2.0	4.7	ND	5.7
	9/30/92	9.90	ND	ND	ND	ND	ND
	12/23/92	9.98	ND	ND	ND	ND	ND
3/10/93	8.95	ND	ND	ND	ND	ND	
6/09/93	9.00	ND	ND	ND	ND	ND	
09/14/93	9.50	0.2	0.3	ND	ND	ND	
12/14/93	8.75	ND	ND	ND	ND	ND	

Results reported in micrograms per liter (ug/L)

- NA - Not Analyzed.
- ND - Not Detected.
- TPH - Total Petroleum Hydrocarbons as gasoline.
- D-Wat - Depth to Water.
- NSC - No sample collected due to film or sheen of liquid phase hydrocarbons.

Table 1 (CONT.) - Summary of Analytical Results

I.D	Date	E-Wat	TPH	Benzene	Toluene	Ethyl-Benzene	Xylenes
RS-9 (167.51)	8/07/91	2.28	NA	0.5	ND	330	1200
	9/27/91	2.77	13000	3.5	3.0	82	140
	10/23/91	3.53	11000	ND	ND	39	340
	11/06/91	2.51	6800	8.4	0.6	22	230
	12/04/91	3.20	6500	6.5	0.7	87	200
	1/29/92	2.65	8100	22	10	140	260
	2/26/92	3.42	13000	40	16	220	600
	3/19/92	3.12	12000	21	12	100	280
	4/22/92	3.24	8600	ND	ND	20	37
	5/21/92	3.75	6000	21	10	53	210
	6/25/92	2.65	370	2.3	1.5	0.7	4.3
	7/30/92	2.70	3600	20	ND	39	80
	8/20/92	2.83	3000	0.7	5.2	2.0	5.3
	9/30/92	2.80	9200	4.8	6.5	12	91
	12/23/92	2.45	2000	17	ND	8.2	18
	3/10/93	2.40	1500	ND	2.6	21	12
	6/09/93	3.55	1300	0.6	1.7	ND	7.5
09/14/93	2.81	1500	1.3	7.6	4.1	14.0	
12/14/93	2.63	580	ND	ND	ND	5.5	

Results reported in micrograms per liter (ug/L)

- NA - Not Analyzed.
- ND - Not Detected.
- TPH - Total Petroleum Hydrocarbons as gasoline.
- D-Wat - Depth to Water.
- NSC - No sample collected due to film or sheen of liquid phase hydrocarbons.

Table 1(CONT.) - Summary of Analytical Results

I.D.	Date	D-Wat	TPH	Benzene	Toluene	Ethyl-Benzene	Xylenes
RS10 (162.89)	8/07/91	6.16	ND	ND	ND	ND	ND
	9/27/01	6.48	ND	ND	ND	ND	ND
	10/23/91	7.37	ND	ND	ND	ND	ND
	11/06/91	6.44	ND	ND	ND	ND	ND
	12/04/91	7.02	ND	ND	ND	ND	ND
	1/29/92	6.78	ND	ND	ND	ND	ND
	2/26/92	8.33	ND	ND	ND	ND	ND
	3/19/92	8.02	ND	ND	ND	ND	0.8
	4/22/92	7.78	ND	ND	ND	ND	ND
	5/21/92	6.21	ND	ND	0.6	ND	1.2
	6/25/92	7.73	ND	ND	ND	ND	ND
	7/30/92	7.84	ND	ND	0.5	ND	1.0
	8/20/92	7.50	ND	ND	ND	ND	ND
	9/30/92	7.63	ND	ND	ND	ND	ND
	12/23/92	7.24	ND	ND	ND	ND	ND
	3/10/93	6.38	ND	ND	ND	ND	ND
	6/09/93	7.98	ND	ND	ND	ND	ND
09/14/93	7.35	ND	ND	ND	ND	ND	

Results reported in micrograms per liter (ug/L)

- NA - Not Analyzed.
- ND - Not Detected.
- TPH - Total Petroleum Hydrocarbons as gasoline.
- D-Wat - Depth to Water.
- NSC - No sample collected due to film or sheen of liquid phase hydrocarbons.

FIGURES

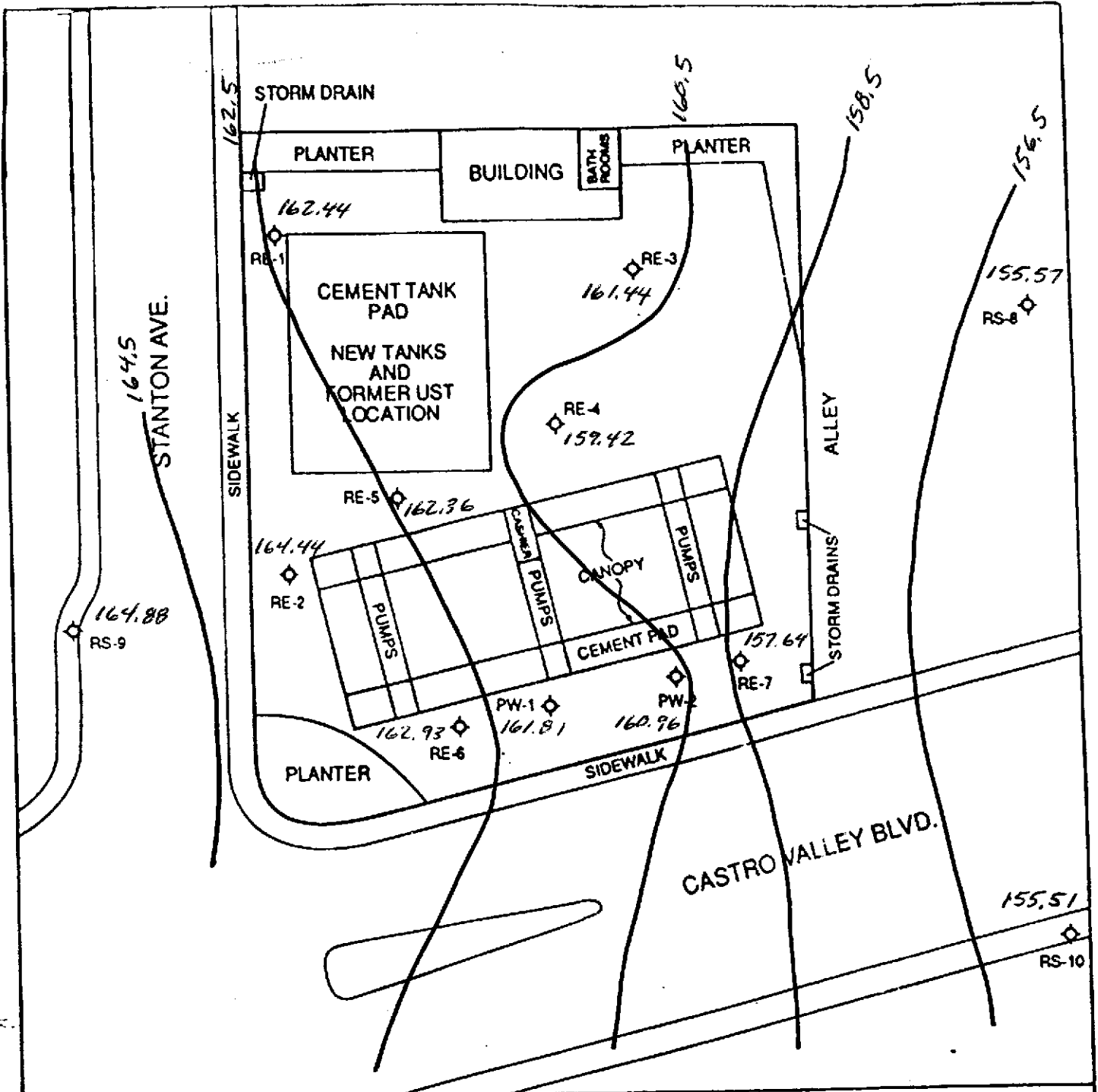

SITE PLAN II
THRIFTY OIL CO. #054
CASTRO VALLEY, CALIFORNIA
 *Prepared for
THRIFTY OIL CO.
DOWNEY, CALIFORNIA

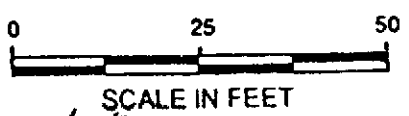

┌───┐ GROUNDWATER CONTOUR, 12/14/94

◊ EXISTING MONITORING WELL

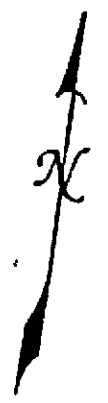

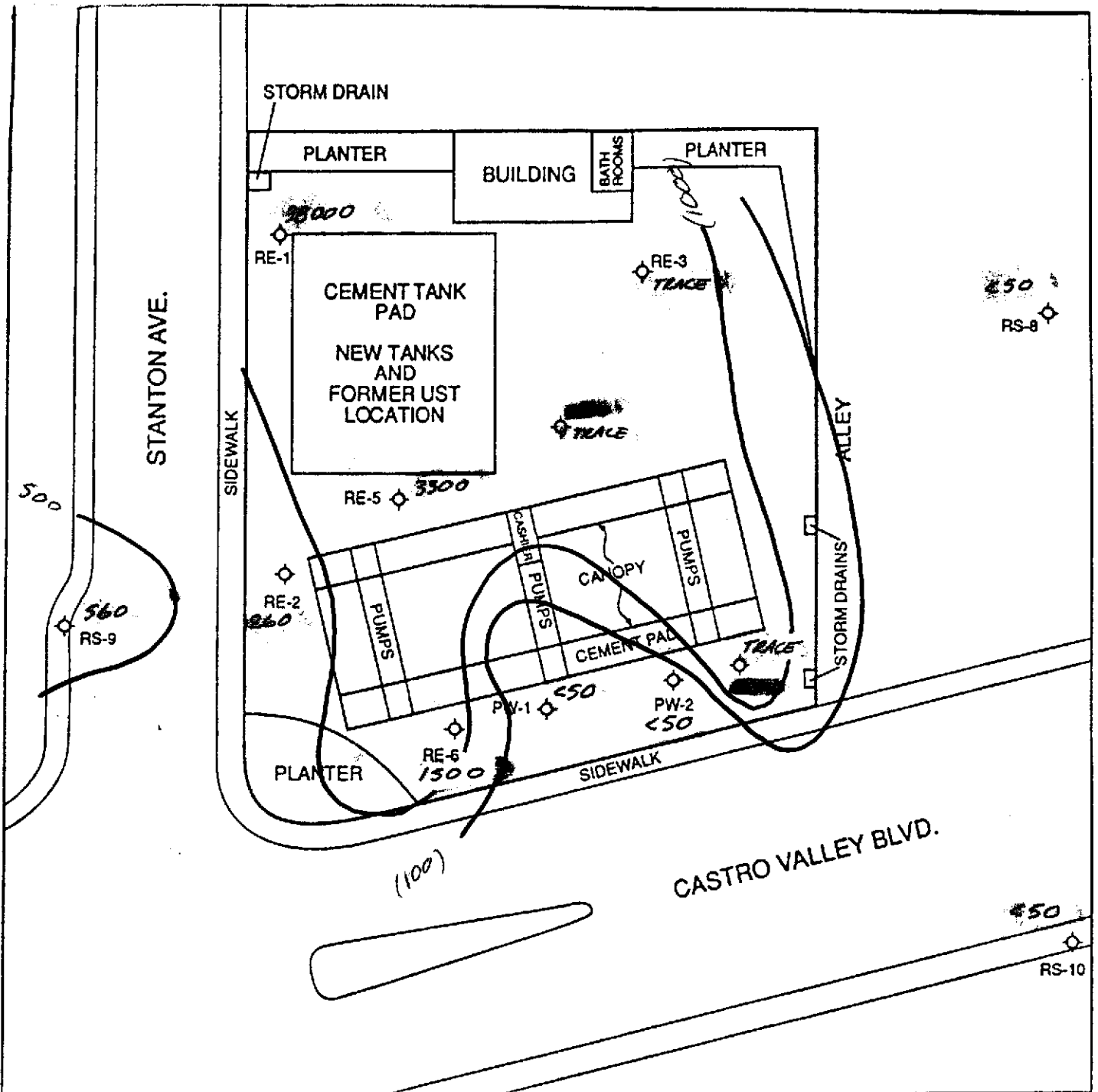

THRIFTY OIL CO. #054
 CASTRO VALLEY, CALIFORNIA
 Prepared for
 THRIFTY OIL CO.
 DOWNEY, CALIFORNIA



SCALE IN FEET

◊ EXISTING MONITORING WELL



FIGURE 2



(TPH 150-CON. 12/14/94, 1996)

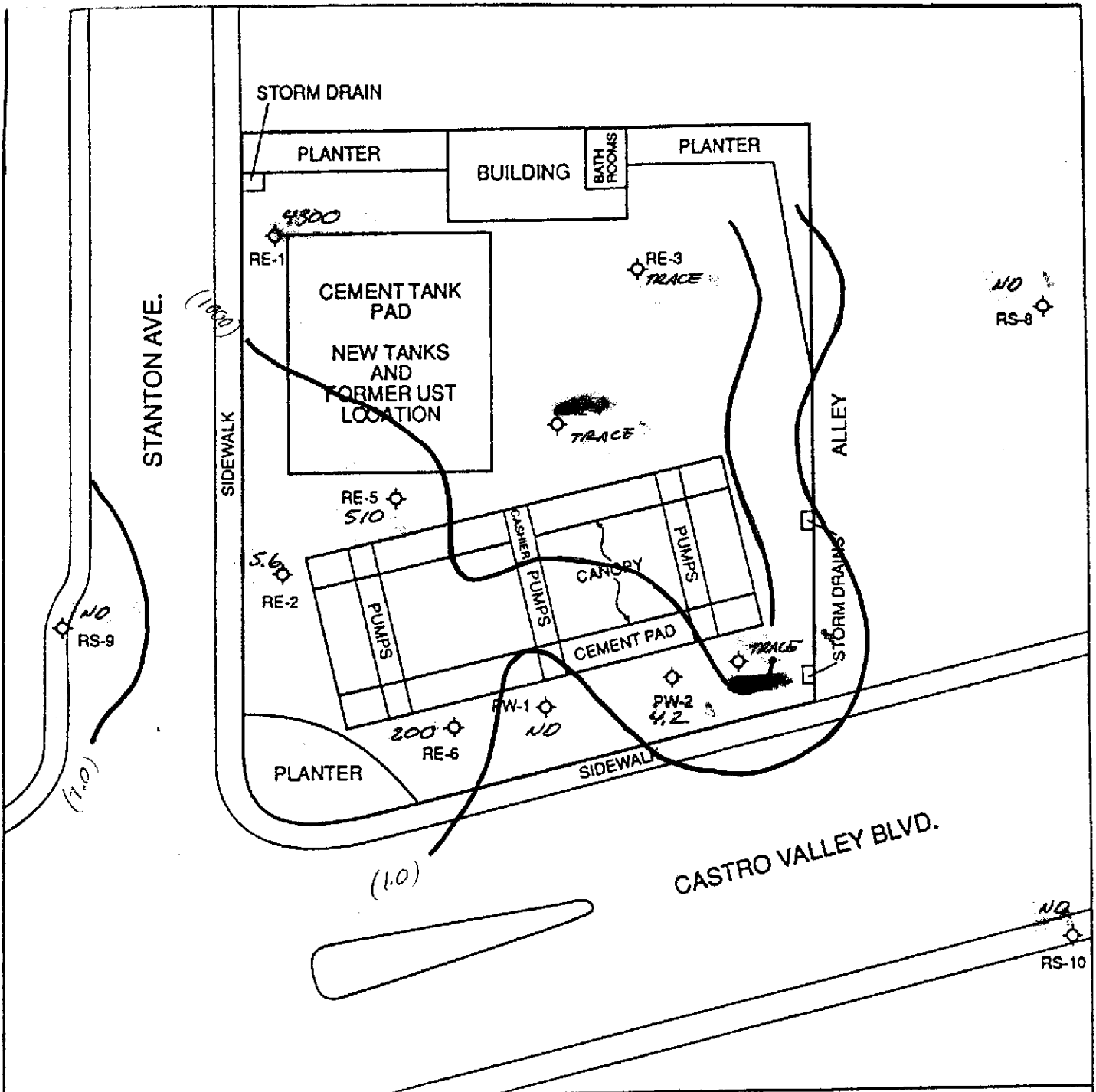

THRIFTY OIL CO. #054
 CASTRO VALLEY, CALIFORNIA
 Prepared for
 THRIFTY OIL CO.
 DOWNEY, CALIFORNIA



(BENZENE 150-CON. 12/14/94, pp 6

◊ EXISTING MONITORING WELL

FIGURE 3



APPENDIX A

SAVE SYSTEM

OPERATING DATA

FIELD STATUS REPORT

PARAMETER	U/M	
TIME	AM/PM	10:30
WORKING	YES/NO	YES
RESTARTED	YES/NO	NO
HOURS	#	2960
ENGINE ROT.	RPM	1800
ENGINE VACUUM	IN HG	10
ENG. OIL PRESS.	PSI	40
ENG. WATER TEMP.	°F	160
ENG. ELECTR. TENS.	VOLTS	13
TANK VACUUM	IN HG	12
TK. REC. PRES.	PSI	30
TK. REC. TEMP.	°F	100
AIR TEMPERATURE	°F	65
AIR FLOW	CFM	15
VAPOR FLOW	CFM	17
FUEL FLOW	CFM/H	80
WELL VACUUM	IN H2O	25
L P G TANKS	%	#1: 18 #2:
GAS METER READING		
WATER FLOWMETER	GALL.	3038
CATALYST IN TEMP.	°F	
CATALYST OUT TEMP.	°F	

MAINTENANCE RECORD				
Operation	Each Stop	100 Hours Week	400 Hours 2 Weeks	800 Hours Monthly
Oil, Engine, Check Level		✓		
Coolant, Check Level		✓		
Fuel, Oil, Coolant, Check for Leaks		✓		
Oil, Engine, Change		✓		
Oil, Filter, Change		✓		
Battery, Check Charge and Fluid		✓		
Battery Cables, Clean		✓		
P.T.O. Bearings, Lubricate		✓		
Fan, Alternator Belts, Check and Adjust		✓		
Idle Speed, Check		✓		
Idle Mixture, Check		✓		
Radiator, Inspect and Clean Exterior				✓
Distributor, Clean and Check Points				✓
Ignition Timing, Check and Adjust				✓
PCV Valve, Replace				✓
PCV Hoses and Fitting, Check				✓
Spark Plugs, Replace				✓
Points, Replace				
Oil, Vacuum Pump, Change				
Intake Manifold Bolts, Torque				✓
All Nuts and Bolts, Check				✓

EXHAUST (See permit and PSR for frequency and limits)	BY C.A.	H-C	ppm/%
		CO	%/ppm
		CO2	%
		O2	%
		NOX	%/ppm
	BY	O.V.	ppm
OUTLET FROM ENGINE	O.V.	ppm	
INLET TO ENGINE	O.V.	ppm	

Comments: _____

READJUST ENGINE PARAMETERS AT LEAST ONCE PER MONTH (IGNITION TIMING, AIR TO FUEL RATIO, EXHAUST O2 AND TEMP., NOX, HC & CO). CHECK HERE () WHEN DONE

INSPECT CATALYST (See permit and PSR for frequency). CHECK HERE (✓) O.K. () NO

CHANGE CATALYST (See permit and PSR for limits). CHECK HERE () WHEN REPLACED

VAPOR WELLS ON: ALL WATER WELLS ON: RE 4 + RE 7

SERVICE TECH: E GEMAN DATE: 10-7-93 THRIFTY OIL CO. ss #: 054

SAVE SYSTEM

OPERATING DATA

FIELD STATUS REPORT

PARAMETER	U/M		
TIME	AM/PM		
WORKING	YES/NO	N/O	
RESTARTED	YES/NO	YES	
HOURS	#	2972	
ENGINE ROT.	RPM	1800	
ENGINE VACUUM	IN HG	10	
ENG. OIL PRESS.	PSI	40	
ENG. WATER TEMP.	°F	160	
ENG. ELECTR. TENS.	VOLTS	13	
TANK VACUUM	IN HG	12	
TK. REC. PRES.	PSI	25	
TK. REC. TEMP.	°F	90	
AIR TEMPERATURE	°F	63	
AIR FLOW	CFM	15	
VAPOR FLOW	CFM	18	
FUEL FLOW	CFM/H	80	
WELL VACUUM	IN H2O	26	
L P G TANKS	%	#1: 90 #2:	
GAS METER READING			
WATER FLOWMETER	GALL.	3039	
CATALYST IN TEMP.	°F		
CATALYST OUT TEMP.	°F		
EXHAUST (See permit and PSR for frequency and limits)	BY C.A.	H-C	ppm/%
		CO	%/ppm
		CO2	%
		O2	%
		NOX	%/ppm
	BY	O.V.	ppm
OUTLET FROM ENGINE		O.V.	ppm
INLET TO ENGINE		O.V.	ppm

MAINTENANCE RECORD				
Operation	Each Stop	100 Hours Week	400 Hours 2 Weeks	800 Hours Monthly
Oil, Engine, Check Level	✓			
Coolant, Check Level	✓			
Fuel, Oil, Coolant, Check for Leaks	✓			
Oil, Engine, Change				
Oil, Filter, Change				
Battery, Check Charge and Fluid				
Battery Cables, Clean				
P.T.O. Bearings, Lubricate				
Fan, Alternator Belts, Check and Adjust				
Idle Speed, Check				
Idle Mixture, Check				
Radiator, Inspect and Clean Exterior				
Distributor, Clean and Check Points				
Ignition Timing, Check and Adjust				
PCV Valve, Replace				
PCV Hoses and Fitting, Check				
Spark Plugs, Replace				
Points, Replace				
Oil, Vacuum Pump, Change				
Intake Manifold Bolts, Torque				
All Nuts and Bolts, Check				

Comments: _____

READJUST ENGINE PARAMETERS AT LEAST ONCE PER MONTH (IGNITION TIMING, AIR TO FUEL RATIO, EXHAUST O2 AND TEMP., NOX, HC & CO). CHECK HERE () WHEN DONE

INSPECT CATALYST (See permit and PSR for frequency). CHECK HERE () O.K. () NO

CHANGE CATALYST (See permit and PSR for limits). CHECK HERE () WHEN REPLACED

VAPOR WELLS ON: ALL WATER WELLS ON: RS-4 ; RS-7

SERVICE TECH: E. GASMAN DATE: 10.14.93 THRIFTY OIL CO. ss #: 054

PARAMETER	U/M	
TIME	AM/PM	18.00
WORKING	YES/NO	No
RESTARTED	YES/NO	YES
HOURS	#	3089
ENGINE ROT.	R P M	1800
ENGINE VACUUM	IN HG	10
ENG. OIL PRESS.	P S I	40
ENG. WATER TEMP.	°F	160
ENG. ELECTR. TENS.	VOLTS	13
TANK VACUUM	IN HG	11
TK. REC. PRES.	PSI	25
TK. REC. TEMP.	°F	90
AIR TEMPERATURE	°F	62
AIR FLOW	C F M	16
VAPOR FLOW	C F M	18
FUEL FLOW	C F M/H	80
WELL VACUUM	IN H2O	24
L P G TANKS	%	#1: 88 #2:
GAS METER READING		
WATER FLOWMETER	GALL.	3039
CATALYST IN TEMP.	°F	
CATALYST OUT TEMP.	°F	

MAINTENANCE RECORD				
Operation	Each Stop	100 Hours Week	400 Hours 2 Weeks	800 Hours Monthly
Oil, Engine, Check Level	✓			
Coolant, Check Level	✓			
Fuel, Oil, Coolant, Check for Leaks	✓			
Oil, Engine, Change				
Oil, Filter, Change				
Battery, Check Charge and Fluid				
Battery Cables, Clean				
P.T.O. Bearings, Lubricate				
Fan, Alternator Belts, Check and Adjust				
Idle Speed, Check				
Idle Mixture, Check				
Radiator, Inspect and Clean Exterior				
Distributor, Clean and Check Points				
Ignition Timing, Check and Adjust				
PCV Valve, Replace				
PCV Hoses and Fitting, Check				
Spark Plugs, Replace				
Points, Replace				
Oil, Vacuum Pump, Change				
Intake Manifold Bolts, Torque				
All Nuts and Bolts, Check				

Comments: On arrival the engine was slow. For restart replaced the coil.

EXHAUST (See permit and PSR for frequency and limits)	BY C.A.	H-C	ppm/%
		CO	%/ppm
		CO2	%
		O2	%
		NOX	%/ppm
	BY	O.V.	ppm
OUTLET FROM ENGINE		O.V.	ppm
INLET TO ENGINE		O.V.	ppm

READJUST ENGINE PARAMETERS AT LEAST ONCE PER MONTH (IGNITION TIMING, AIR TO FUEL RATIO, EXHAUST O2 AND TEMP., NOX, HC & CO). CHECK HERE () WHEN DONE

INSPECT CATALYST (See permit and PSR for frequency). CHECK HERE () O.K. () NO

CHANGE CATALYST (See permit and PSR for limits). CHECK HERE () WHEN REPLACED

VAPOR WELLS ON: ALL WATER WELLS ON: RS-4, RS-7

SERVICE TECH: E. GASMAN DATE: 10/21/93 THRIFTY OIL CO. ss #: 054

PARAMETER	U/M	
TIME	AM/PM	
WORKING	YES/NO	YES
RESTARTED	YES/NO	YES
HOURS	#	
ENGINE ROT.	R P M	2000
ENGINE VACUUM	IN HG	10
ENG. OIL PRESS.	PSI	42
ENG. WATER TEMP.	°F	160
ENG. ELECTR. TENS.	VOLTS	13
TANK VACUUM	IN HG	12
TK. REC. PRES.	PSI	0
TK. REC. TEMP.	°F	120
AIR TEMPERATURE	°F	65
AIR FLOW	C F M	14
VAPOR FLOW	C F M	18
FUEL FLOW	C F M/H	80
WELL VACUUM	IN H2O	24
L P G TANKS	%	#1: 85 #2:
GAS METER READING		
WATER FLOWMETER	GALL.	3047
CATALYST IN TEMP.	°F	
CATALYST OUT TEMP.	°F	

EXHAUST (See permit and PSR for frequency and limits)	BY C.A.	H-C	ppm/%
		CO	%/ppm
		CO2	%
		O2	%
		NOX	%/ppm
	BY	O.V.	ppm
OUTLET FROM ENGINE	O.V.	ppm	
INLET TO ENGINE	O.V.	ppm	

MAINTENANCE RECORD				
Operation	Each Stop	100 Hours Week	400 Hours 2 Weeks	800 Hours Monthly
Oil, Engine, Check Level				
Coolant, Check Level				
Fuel, Oil, Coolant, Check for Leaks				
Oil, Engine, Change		✓		
Oil, Filter, Change		✓		
Battery, Check Charge and Fluid		✓		
Battery Cables, Clean		✓		
P.T.O. Bearings, Lubricate		✓		
Fan, Alternator Belts, Check and Adjust		✓		
Idle Speed, Check		✓		
Idle Mixture, Check		✓		
Radiator, Inspect and Clean Exterior				
Distributor, Clean and Check Points				
Ignition Timing, Check and Adjust				
PCV Valve, Replace				
PCV Hoses and Fitting, Check				
Spark Plugs, Replace				
Points, Replace				
Oil, Vacuum Pump, Change				
Intake Manifold Bolts, Torque				
All Nuts and Bolts, Check				

Comments: _____

READJUST ENGINE PARAMETERS AT LEAST ONCE PER MONTH (IGNITION TIMING, AIR TO FUEL RATIO, EXHAUST O2 AND TEMP., NOX, HC & CO). CHECK HERE () WHEN DONE

INSPECT CATALYST (See permit and PSR for frequency). CHECK HERE () O.K. () NO

CHANGE CATALYST (See permit and PSR for limits). CHECK HERE () WHEN REPLACED

VAPOR WELLS ON: ALL WATER WELLS ON: No

SERVICE TECH: E. GASMAN DATE: 10/28/93 THRIFTY OIL CO. ss #: SS # 054

PARAMETER	U/M	
TIME	AM/PM	15:40
WORKING	YES/NO	YES
RESTARTED	YES/NO	YES
HOURS	#	3381
ENGINE ROT.	RPM	1900
ENGINE VACUUM	IN HG	10
ENG. OIL PRESS.	PSI	45
ENG. WATER TEMP.	°F	160
ENG. ELECTR. TENS.	VOLTS	15
TANK VACUUM	IN HG	0
TK. REC. PRES.	PSI	40
TK. REC. TEMP.	°F	100
AIR TEMPERATURE	°F	70
AIR FLOW	CFM	14
VAPOR FLOW	CFM	18
FUEL FLOW	CFM/H	80
WELL VACUUM	IN H2O	25
L P G TANKS	%	#1: 25 #2:
GAS METER READING		
WATER FLOWMETER	GALL.	3047
CATALYST IN TEMP.	°F	
CATALYST OUT TEMP.	°F	

EXHAUST (See permit and PSR for frequency and limits)	BY C.A.	H-C	ppm/%
		CO	%/ppm
		CO2	%
		O2	%
	NOX	%/ppm	
	BY	O.V.	ppm
OUTLET FROM ENGINE		O.V.	ppm
INLET TO ENGINE		O.V.	ppm

MAINTENANCE RECORD				
Operation	Each Stop	100 Hours Week	400 Hours 2 Weeks	800 Hours Monthly
Oil, Engine, Check Level				
Coolant, Check Level				
Fuel, Oil, Coolant, Check for Leaks				
Oil, Engine, Change		✓		
Oil, Filter, Change		✓		
Battery, Check Charge and Fluid		✓		
Battery Cables, Clean		✓		
P.T.O. Bearings, Lubricate		✓		
Fan, Alternator Belts, Check and Adjust		✓		
Idle Speed, Check		✓		
Idle Mixture, Check		✓		
Radiator, Inspect and Clean Exterior				
Distributor, Clean and Check Points				
Ignition Timing, Check and Adjust				
PCV Valve, Replace				
PCV Hoses and Fitting, Check				
Spark Plugs, Replace				
Points, Replace				
Oil, Vacuum Pump, Change				
Intake Manifold Bolts, Torque				
All Nuts and Bolts, Check				

Comments: _____

READJUST ENGINE PARAMETERS AT LEAST ONCE PER MONTH (IGNITION TIMING, AIR TO FUEL RATIO, EXHAUST O2 AND TEMP., NOX, HC & CO). CHECK HERE () WHEN DONE

INSPECT CATALYST (See permit and PSR for frequency). CHECK HERE (✓) O.K. () NO

CHANGE CATALYST (See permit and PSR for limits). CHECK HERE () WHEN REPLACED

VAPOR WELLS ON: ALL WATER WELLS ON: No

SERVICE TECH: E. GASMAN DATE: 11/03/98 THRIFTY OIL CO. ss #: 054

PARAMETER	U/M	
TIME	AM/PM	11:00
WORKING	YES/NO	YES
RESTARTED	YES/NO	NO
HOURS	#	3526
ENGINE ROT.	RPM	1700
ENGINE VACUUM	IN HG	10
ENG. OIL PRESS.	PSI	45
ENG. WATER TEMP.	°F	160
ENG. ELECTR. TENS.	VOLTS	13
TANK VACUUM	IN HG	11
TK. REC. PRES.	PSI	20
TK. REC. TEMP.	°F	100
AIR TEMPERATURE	°F	65
AIR FLOW	CFM	14
VAPOR FLOW	CFM	17
FUEL FLOW	CFM/H	70
WELL VACUUM	IN H2O	25
LPG TANKS	%	#1: #2:
GAS METER READING		
WATER FLOWMETER	GALL.	3050
CATALYST IN TEMP.	°F	
CATALYST OUT TEMP.	°F	

EXHAUST (See permit and PSR for frequency and limits)	BY C.A.	H-C	ppm/%
		CO	%/ppm
		CO2	%
		O2	%
		NOX	%/ppm
	BY	O.V.	ppm
OUTLET FROM ENGINE		O.V.	ppm
INLET TO ENGINE		O.V.	ppm

MAINTENANCE RECORD				
Operation	Each Stop	100 Hours Week	400 Hours 2 Weeks	800 Hours Monthly
Oil, Engine, Check Level				
Coolant, Check Level				
Fuel, Oil, Coolant, Check for Leaks				
Oil, Engine, Change			✓	
Oil, Filter, Change			✓	
Battery, Check Charge and Fluid			✓	
Battery Cables, Clean			✓	
P.T.O. Bearings, Lubricate			✓	
Fan, Alternator Belts, Check and Adjust			✓	
Idle Speed, Check			✓	
Idle Mixture, Check			✓	
Radiator, Inspect and Clean Exterior			✓	
Distributor, Clean and Check Points			✓	
Ignition Timing, Check and Adjust			✓	
PCV Valve, Replace				
PCV Hoses and Fitting, Check			✓	
Spark Plugs, Replace				
Points, Replace				
Oil, Vacuum Pump, Change				
Intake Manifold Bolts, Torque			✓	
All Nuts and Bolts, Check			✓	

Comments: The recovery well is very slow in R5-4 and R5-7

READJUST ENGINE PARAMETERS AT LEAST ONCE PER MONTH (IGNITION TIMING, AIR TO FUEL RATIO, EXHAUST O2 AND TEMP., NOX, HC & CO). CHECK HERE () WHEN DONE

INSPECT CATALYST (See permit and PSR for frequency). CHECK HERE () O.K. () NO

CHANGE CATALYST (See permit and PSR for limits). CHECK HERE () WHEN REPLACED

VAPOR WELLS ON: ALL WATER WELLS ON: R5-4 + R5-7

SERVICE TECH: E. CABRADO DATE: 11/10/93 THRIFTY OIL CO. SS #: 054

PARAMETER	U/M	
TIME	AM/PM	15:00
WORKING	YES/NO	No
RESTARTED	YES/NO	YES
HOURS	#	3546
ENGINE ROT.	R P M	1900
ENGINE VACUUM	IN HG	10
ENG. OIL PRESS.	PSI	40
ENG. WATER TEMP.	°F	160
ENG. ELECTR. TENS.	VOLTS	13
TANK VACUUM	IN HG	12
TK. REC. PRES.	PSI	30
TK. REC. TEMP.	°F	90
AIR TEMPERATURE	°F	63
AIR FLOW	C F M	16
VAPOR FLOW	C F M	18
FUEL FLOW	C F M/H	80
WELL VACUUM	IN H2O	26
L P G TANKS	%	#1: 90 #2:
GAS METER READING		
WATER FLOWMETER	GALL.	3053
CATALYST IN TEMP.	°F	
CATALYST OUT TEMP.	°F	

EXHAUST (See permit and PSR for frequency and limits)	BY C.A.	H-C	ppm/%
		CO	%/ppm
		CO2	%
		O2	%
		NOX	%/ppm
	BY	O.V.	ppm
OUTLET FROM ENGINE	O.V.	ppm	
INLET TO ENGINE	O.V.	ppm	

MAINTENANCE RECORD				
Operation	Each Stop	100 Hours Week	400 Hours 2 Weeks	800 Hours Monthly
Oil, Engine, Check Level	✓			
Coolant, Check Level	✓			
Fuel, Oil, Coolant, Check for Leaks	✓			
Oil, Engine, Change				
Oil, Filter, Change				
Battery, Check Charge and Fluid				
Battery Cables, Clean				
P.T.O. Bearings, Lubricate				
Fan, Alternator Belts, Check and Adjust				
Idle Speed, Check				
Idle Mixture, Check				
Radiator, Inspect and Clean Exterior				
Distributor, Clean and Check Points				
Ignition Timing, Check and Adjust				
PCV Valve, Replace				
PCV Hoses and Fitting, Check				
Spark Plugs, Replace				
Points, Replace				
Oil, Vacuum Pump, Change				
Intake Manifold Bolts, Torque				
All Nuts and Bolts, Check				

Comments: D/W air system sampling
Monthly water system sampling

READJUST ENGINE PARAMETERS AT LEAST ONCE PER MONTH (IGNITION TIMING, AIR TO FUEL RATIO, EXHAUST O2 AND TEMP., NOX, HC & CO). CHECK HERE () WHEN DONE

INSPECT CATALYST (See permit and PSR for frequency). CHECK HERE () O.K. () NO

CHANGE CATALYST (See permit and PSR for limits). CHECK HERE () WHEN REPLACED

VAPOR WELLS ON: ALL WATER WELLS ON: RE-4 ; RE-7

SERVICE TECH: E. GAZMAN DATE: 11/17/93 THRIFTY OIL CO. ss #: 054



PROJECT STATUS REPORT
 THRIFTY OIL CO. S.S. #054
 2504 CASTRO VALLEY BLVD.
 CASTRO VALLEY, CA 94546
 DATE: 11/17/1993

F R E Q .	MONITORING				ODORS			FREE		WELLS CONNECTED TO SYSTEM (W)							
	OBSERVATION WELLS				(S=SLIGHT)			PRODUCT		CONNECT		INTEGRITY		VAPOR		WATER	
	NO.	DTW	DTP	PT	YES	NO	S	YES	NO	YES	NO	OK	NO	ON	OFF	ON	OFF
M	PW-1	6.56					Y		Y		X	-					
M	PW-2	6.40					Y		Y		X	-					
M	RE-1	5.25					Y		Y		X	-					
M	RE-2	5.12					Y		Y		X	-					
M	RE-3	7.65	Flu		Y				Y		X	-					
M	RE-4	6.15	Flu		Y				Y		X	-					
M	RE-5	5.43					Y		Y		X	-					
M	RE-6	6.32					Y		Y		X	-					
M	RE-7	7.57	Flu		Y				Y		X	-					
M	RS-8	9.68					Y		Y		-	X					
M	RS-9	3.20					Y		Y		-	X					
M	RS-10	7.82					Y		Y		-	X					

SAVE SYSTEM WEEKLY

PARAMETER	U/M	DATA	PARAMETER	U/M	DATA
TIME	AM/PM	15:00	AIR FLOW	C F M	16
WORKING	YES/NO	No	VAPOR FLOW	C F M	18
RESTARTED	YES/NO	YES	FUEL FLOW	C F M/H	80
HOURS	#	3546	WELL VACUUM	IN H2O	26
ENGINE ROT.	RPM	1900	L P G TANKS	#	#1: 90
ENGINE VACUUM	IN HG	10	GAS METER READING	-	N/A
TANK VACUUM	IN HG	12	WATER FLOWMETER	GALL.	3053

EXHAUST (By others) _____

INLET TO ENGINE _____

MAINTENANCE ES/100/400/800 _____ FOR SPECIFIC OPERATIONS SEE FIELD RECORD

WATER SAMPLING - CHECK (✓) WHEN DONE

EFFLUENT	INFLUENT	WELLS
(✓) _____	() _____	() Q.-SEE C.CUST.

REMARKS: _____

FREE PRODUCT REMOVED: APPROX. _____ GALLONS WATER REMOVED: APPROX. _____ GALLONS

DATA RECORDED BY: E-GASMAN INPUT BY: M.M. >|FF/054rsirt

PARAMETER	U/M			
TIME	AM/PM	10:30		
WORKING	YES/NO	YES		
RESTARTED	YES/NO			
HOURS	#	3692		
ENGINE ROT.	RPM	1900		
ENGINE VACUUM	IN HG	10		
ENG. OIL PRESS.	PSI	45		
ENG. WATER TEMP.	°F	150		
ENG. ELECTR. TENS.	VOLTS	13		
TANK VACUUM	IN HG	12		
TK. REC. PRES.	PSI	40		
TK. REC. TEMP.	°F	110		
AIR TEMPERATURE	°F	60		
AIR FLOW	CFM	15		
VAPOR FLOW	CFM	17		
FUEL FLOW	CFM/H	20		
WELL VACUUM	IN H2O	26		
LPG TANKS	%	#1: 10 #2:		
GAS METER READING				
WATER FLOWMETER	GALL.	3091		
CATALYST IN TEMP.	°F			
CATALYST OUT TEMP.	°F			
EXHAUST (See permit and PSR for frequency and limits)	BY C.A.	H-C	ppm/%	
		CO	%/ppm	
		CO2	%	
		O2	%	
		NOX	%/ppm	
	BY	O.V.	ppm	
OUTLET FROM ENGINE	O.V.	ppm		
INLET TO ENGINE	O.V.	ppm		

MAINTENANCE RECORD				
Operation	Each Stop	100 Hours Week	400 Hours 2 Weeks	800 Hours Monthly
Oil, Engine, Check Level	<input checked="" type="checkbox"/>			
Coolant, Check Level	<input checked="" type="checkbox"/>			
Fuel, Oil, Coolant, Check for Leaks	<input checked="" type="checkbox"/>			
Oil, Engine, Change		<input checked="" type="checkbox"/>		
Oil, Filter, Change		<input checked="" type="checkbox"/>		
Battery, Check Charge and Fluid		<input checked="" type="checkbox"/>		
Battery Cables, Clean		<input checked="" type="checkbox"/>		
P.T.O. Bearings, Lubricate		<input checked="" type="checkbox"/>		
Fan, Alternator Belts, Check and Adjust		<input checked="" type="checkbox"/>		
Idle Speed, Check		<input checked="" type="checkbox"/>		
Idle Mixture, Check		<input checked="" type="checkbox"/>		
Radiator, Inspect and Clean Exterior				
Distributor, Clean and Check Points				
Ignition Timing, Check and Adjust				
PCV Valve, Replace				
PCV Hoses and Fitting, Check				
Spark Plugs, Replace				
Points, Replace				
Oil, Vacuum Pump, Change				
Intake Manifold Bolts, Torque				
All Nuts and Bolts, Check				

Comments: _____

READJUST ENGINE PARAMETERS AT LEAST ONCE PER MONTH (IGNITION TIMING, AIR TO FUEL RATIO, EXHAUST O2 AND TEMP., NOX, HC & CO). CHECK HERE () WHEN DONE

INSPECT CATALYST (See permit and PSR for frequency). CHECK HERE () O.K. () NO

CHANGE CATALYST (See permit and PSR for limits). CHECK HERE () WHEN REPLACED

VAPOR WELLS ON: ALL WATER WELLS ON: RE-4; RE-7

SERVICE TECH: E. GASMAN DATE: 11/24/1993 THRIFTY OIL CO. ss #: 054

PARAMETER	U/M	
TIME	AM/PM	11
WORKING	YES/NO	No
RESTARTED	YES/NO	YES
HOURS	#	3705
ENGINE ROT.	R P M	1900
ENGINE VACUUM	IN HG	10
ENG. OIL PRESS.	P S I	45
ENG. WATER TEMP.	°F	160
ENG. ELECTR. TENS.	VOLTS	13
TANK VACUUM	IN HG	12
TK. REC. PRES.	PSI	25
TK. REC. TEMP.	°F	80
AIR TEMPERATURE	°F	53
AIR FLOW	C F M	15
VAPOR FLOW	C F M	18
FUEL FLOW	C F M/H	80
WELL VACUUM	IN H2O	25
L P G TANKS	%	#1: 87 #2:
GAS METER READING		
WATER FLOWMETER	GALL.	3093
CATALYST IN TEMP.	°F	
CATALYST OUT TEMP.	°F	

Operation	Each Stop	100 Hours Week	400 Hours 2 Weeks	800 Hours Monthly
Oil, Engine, Check Level	✓			
Coolant, Check Level	✓			
Fuel, Oil, Coolant, Check for Leaks	✓			
Oil, Engine, Change				
Oil, Filter, Change				
Battery, Check Charge and Fluid				
Battery Cables, Clean				
P.T.O. Bearings, Lubricate				
Fan, Alternator Belts, Check and Adjust				
Idle Speed, Check				
Idle Mixture, Check				
Radiator, Inspect and Clean Exterior				
Distributor, Clean and Check Points				
Ignition Timing, Check and Adjust				
PCV Valve, Replace				
PCV Hoses and Fitting, Check				
Spark Plugs, Replace				
Points, Replace				
Oil, Vacuum Pump, Change				
Intake Manifold Bolts, Torque				
All Nuts and Bolts, Check				

EXHAUST (See permit and PSR for frequency and limits)	BY C.A.	H-C	ppm/%
		CO	%/ppm
		CO2	%
		O2	%
		NOX	%/ppm
	BY	O.V.	ppm
OUTLET FROM ENGINE		O.V.	ppm
INLET TO ENGINE		O.V.	ppm

Comments: _____

READJUST ENGINE PARAMETERS AT LEAST ONCE PER MONTH (IGNITION TIMING, AIR TO FUEL RATIO, EXHAUST O2 AND TEMP., NOX, HC & CO). CHECK HERE () WHEN DONE

INSPECT CATALYST (See permit and PSR for frequency). CHECK HERE () O.K. () NO

CHANGE CATALYST (See permit and PSR for limits). CHECK HERE () WHEN REPLACED

VAPOR WELLS ON: ALL WATER WELLS ON: RE 4 + RE 7

SERVICE TECH: E. GASMAN DATE: 12.01.93 THRIFTY OIL CO. ss #: 054

PARAMETER	U/M	
TIME	AM/PM	11:45
WORKING	YES/NO	Y/N
RESTARTED	YES/NO	Y/N
HOURS	#	3850
ENGINE ROT.	RPM	1800
ENGINE VACUUM	IN HG	11
ENG. OIL PRESS.	PSI	45
ENG. WATER TEMP.	°F	150
ENG. ELECTR. TENS.	VOLTS	13
TANK VACUUM	IN HG	12
TK. REC. PRES.	PSI	25
TK. REC. TEMP.	°F	100
AIR TEMPERATURE	°F	50
AIR FLOW	CFM	15
VAPOR FLOW	CFM	17
FUEL FLOW	CFM/H	80
WELL VACUUM	IN H2O	27
L P G TANKS	%	#1: 35 #2:
GAS METER READING		37
WATER FLOWMETER	GALL.	3145
CATALYST IN TEMP.	°F	
CATALYST OUT TEMP.	°F	

EXHAUST (See permit and PSR for frequency and limits)	BY C.A.	H-C	ppm/%	
		CO	%/ppm	
		CO2	%	
		O2	%	
		NOX	%/ppm	
	BY	O.V.	ppm	
OUTLET FROM ENGINE	O.V.	ppm		
INLET TO ENGINE	O.V.	ppm		

MAINTENANCE RECORD				
Operation	Each Stop	100 Hours Week	400 Hours 2 Weeks	800 Hours Monthly
Oil, Engine, Check Level		✓		
Coolant, Check Level		✓		
Fuel, Oil, Coolant, Check for Leaks		✓		
Oil, Engine, Change		✓		
Oil, Filter, Change		✓		
Battery, Check Charge and Fluid		✓		
Battery Cables, Clean		✓		
P.T.O. Bearings, Lubricate		✓		
Fan, Alternator Belts, Check and Adjust		✓		
Idle Speed, Check		✓		
Idle Mixture, Check		✓		
Radiator, Inspect and Clean Exterior				
Distributor, Clean and Check Points				
Ignition Timing, Check and Adjust				
PCV Valve, Replace				
PCV Hoses and Fitting, Check				
Spark Plugs, Replace				
Points, Replace				
Oil, Vacuum Pump, Change				
Intake Manifold Bolts, Torque				
All Nuts and Bolts, Check				

Comments: _____

READJUST ENGINE PARAMETERS AT LEAST ONCE PER MONTH (IGNITION TIMING, AIR TO FUEL RATIO, EXHAUST O2 AND TEMP., NOX, HC & CO). CHECK HERE () WHEN DONE

INSPECT CATALYST (See permit and PSR for frequency). CHECK HERE () O.K. () NO

CHANGE CATALYST (See permit and PSR for limits). CHECK HERE () WHEN REPLACED

VAPOR WELLS ON: ALL WATER WELLS ON: RE-4, RE-7

SERVICE TECH: E. GASMAN DATE: 12/07/93 THRIFTY OIL CO. ss #: 054

PARAMETER	U/M			
TIME	AM/PM	12:10		
WORKING	YES/NO	YES		
RESTARTED	YES/NO	No		
HOURS	#	4022		
ENGINE ROT.	RPM	2000		
ENGINE VACUUM	IN HG	11		
ENG. OIL PRESS.	PSI	45		
ENG. WATER TEMP.	°F	150		
ENG. ELECTR. TENS.	VOLTS	13		
TANK VACUUM	IN HG	13		
TK. REC. PRES.	PSI	35		
TK. REC. TEMP.	°F	90		
AIR TEMPERATURE	°F	54		
AIR FLOW	CFM	16		
VAPOR FLOW	CFM	18		
FUEL FLOW	CFM/H	85		
WELL VACUUM	IN H2O	27		
L P G TANKS	%	#1: 25 #2:		
GAS METER READING				
WATER FLOWMETER	GALL.	3246		
CATALYST IN TEMP.	°F			
CATALYST OUT TEMP.	°F			
EXHAUST (See permit and PSR for frequency and limits)	BY C.A.	H-C	ppm/%	
		CO	%/ppm	
		CO2	%	
		O2	%	
		NOX	%/ppm	
	BY	O.V.	ppm	
OUTLET FROM ENGINE		O.V.	ppm	
INLET TO ENGINE		O.V.	ppm	

MAINTENANCE RECORD				
Operation	Each Stop	100 Hours Week	400 Hours 2 Weeks	800 Hours Monthly
Oil, Engine, Check Level				
Coolant, Check Level				
Fuel, Oil, Coolant, Check for Leaks				
Oil, Engine, Change		✓		
Oil, Filter, Change		✓		
Battery, Check Charge and Fluid		✓		
Battery Cables, Clean		✓		
P.T.O. Bearings, Lubricate		✓		
Fan, Alternator Belts, Check and Adjust		✓		
Idle Speed, Check		✓		
Idle Mixture, Check		✓		
Radiator, Inspect and Clean Exterior				
Distributor, Clean and Check Points				
Ignition Timing, Check and Adjust				
PCV Valve, Replace				
PCV Hoses and Fitting, Check				
Spark Plugs, Replace				
Points, Replace				
Oil, Vacuum Pump, Change				
Intake Manifold Bolts, Torque				
All Nuts and Bolts, Check				
Comments: _____				

READJUST ENGINE PARAMETERS AT LEAST ONCE PER MONTH (IGNITION TIMING, AIR TO FUEL RATIO, EXHAUST O2 AND TEMP., NOX, HC & CO). CHECK HERE () WHEN DONE

INSPECT CATALYST (See permit and PSR for frequency). CHECK HERE () O.K. () NO

CHANGE CATALYST (See permit and PSR for limits). CHECK HERE () WHEN REPLACED

VAPOR WELLS ON: ALL WATER WELLS ON: RE 7, RE 4

SERVICE TECH: F. GASMAN DATE: 12/15/1995 THRIFTY OIL CO. ss #: 059



PROJECT STATUS REPORT
 THRIFTY OIL CO. S.S. #054
 2504 CASTRO VALLEY BLVD.
 CASTRO VALLEY, CA 94546
 DATE: 12/14/1993

F R E Q .	MONITORING				ODORS			FREE		WELLS CONNECTED TO SYSTEM (W)							
	OBSERVATION WELLS				(S=SLIGHT)			PRODUCT		CONNECT		INTEGRITY		VAPOR		WATER	
	NO.	DTW	DTP	PT	YES	NO	S	YES	NO	YES	NO	OK	NO	ON	OFF	ON	OFF
M	PW-1	4.65				Y			Y		X	-	Y		Y		
M	PW-2	5.22				X			Y		X	-	Y		Y		
M	RE-1	4.38				Y			Y		X	-	Y		Y		
M	RE-2	2.75				Y			Y		X	-	Y		Y		
M	RE-3	5.95	Felny		Y				X		X	-	Y		Y		
M	RE-4	7.52	Felny		Y				X		X	-	Y		Y		X
M	RE-5	4.78				X			Y		X	-	Y		X		
M	RE-6	3.58				Y			Y		X	-	Y		Y		
M	RE-7	8.40	STEEN				X		Y		X	-	Y		X		X
M	RS-8	8.75				Y			Y		-	X					
M	RS-9	2.65				Y			Y		-	X					
M	RS-10	7.38				Y			Y		-	X					

SAVE SYSTEM WEEKLY

PARAMETER	U/M	DATA	PARAMETER	U/M	DATA
TIME	AM/PM	13:00	AIR FLOW	CFM	16
WORKING	YES/NO	YES	VAPOR FLOW	CFM	18
RESTARTED	YES/NO	No	FUEL FLOW	CFM/H	80
HOURS	#	4002	WELL VACUUM	IN H2O	27
ENGINE ROT.	RPM	1900	LPG TANKS	%	#1: 29
ENGINE VACUUM	IN HG	11	GAS METER READING	-	N/A
TANK VACUUM	IN HG	45	WATER FLOWMETER	GALL.	3146

EXHAUST (By others) _____

INLET TO ENGINE _____

MAINTENANCE ES/100/400/800 _____ FOR SPECIFIC OPERATIONS SEE FIELD RECORD

WATER SAMPLING - CHECK () WHEN DONE

EFFLUENT	INFLUENT	WELLS
() _____	() _____	() Q.-SEE C.CUST.

REMARKS: _____

FREE PRODUCT REMOVED: APPROX. _____ GALLONS WATER REMOVED: APPROX. 185 GALLONS

DATA RECORDED BY: E. GASPAN INPUT BY: M.M. >|FF\054rsirt



FIELD DATA - GROUNDWATER WELL SAMPLING PROGRAM

DATE 12/14/1993 STATION NO. 054
 PERSONNEL E. CASMAN, T. ROW
 WELL NO. RS 9 WEATHER SUNNY
 SAMPLE EQUIPMENT TEFLON BAILER

Before Sampling

Total Well Depth 15 Ft. Well Diameter 2"
 Depth to Water 2.63 Ft. Purge Volume 8 gallons

Sampling Data

Time	<u>8:02</u>	<u>8:03</u>	<u>8:04</u>	<u>8:05</u>	<u>8:06</u>	<u>8:07</u>	
EC	<u>794</u>	<u>798</u>	<u>812</u>	<u>814</u>	<u>820</u>	<u>819</u>	
pH	<u>7.20</u>	<u>7.40</u>	<u>7.40</u>	<u>7.40</u>	<u>7.40</u>	<u>7.41</u>	
Temp	<u>65.5</u>	<u>66.3</u>	<u>67</u>	<u>67.9</u>	<u>68</u>	<u>68</u>	
Gal.	<u>3</u>	<u>4</u>	<u>5</u>	<u>6</u>	<u>7</u>	<u>8</u>	
Time							
EC							
pH							
Temp							
Gal.							

After Sampling

Depth to Water 3.10 Ft. Total Well Depth 15 Ft.



FIELD DATA - GROUNDWATER WELL SAMPLING PROGRAM

DATE 12/14/1993 STATION NO. 054

PERSONNEL E. GARMAN, T. ROSE

WELL NO. RJ 8 WEATHER SUNNY

SAMPLE EQUIPMENT _____

Before Sampling

Total Well Depth 25.20 Ft. Well Diameter 2"

Depth to Water 8.75 Ft. Purge Volume 10 gallons

Sampling Data

Time	<u>8:09</u>	<u>8:10</u>	<u>8:11</u>	<u>8:12</u>	<u>8:13</u>	<u>8:14</u>	_____
EC	<u>1130</u>	<u>980</u>	<u>980</u>	<u>1020</u>	<u>1020</u>	<u>1020</u>	_____
pH	<u>7.50</u>	<u>7.47</u>	<u>7.40</u>	<u>7.33</u>	<u>7.35</u>	<u>7.35</u>	_____
Temp	<u>66.7</u>	<u>67.5</u>	<u>68.2</u>	<u>68.2</u>	<u>68.1</u>	<u>68.2</u>	_____
Gal.	<u>3</u>	<u>4</u>	<u>5</u>	<u>6</u>	<u>8</u>	<u>10</u>	_____
Time	_____	_____	_____	_____	_____	_____	_____
EC	_____	_____	_____	_____	_____	_____	_____
pH	_____	_____	_____	_____	_____	_____	_____
Temp	_____	_____	_____	_____	_____	_____	_____
Gal.	_____	_____	_____	_____	_____	_____	_____

After Sampling

Depth to Water 9.20 Ft. Total Well Depth 25.20 Ft.



FIELD DATA - GROUNDWATER WELL SAMPLING PROGRAM

DATE 12/14/1993 STATION NO. 057
 PERSONNEL E. CASMAN, T. ROBU
 WELL NO. RS-10 WEATHER SUNNY
 SAMPLE EQUIPMENT TEFLON BAITER

Before Sampling

Total Well Depth 24.45 Ft. Well Diameter 2"
 Depth to Water 7.38 Ft. Purge Volume 11 gallons

Sampling Data

Time	<u>8:16</u>	<u>8:15</u>	<u>8:16</u>	<u>8:17</u>	<u>8:18</u>	<u>8:19</u>	<u>8:20</u>
EC	<u>4530</u>	<u>4520</u>	<u>4560</u>	<u>4620</u>	<u>4620</u>	<u>4620</u>	<u>4620</u>
pH	<u>7.55</u>	<u>7.18</u>	<u>7.07</u>	<u>7.07</u>	<u>7.08</u>	<u>7.08</u>	<u>7.08</u>
Temp	<u>65.4</u>	<u>67.1</u>	<u>67.9</u>	<u>68.3</u>	<u>68.4</u>	<u>69</u>	<u>69</u>
Gal.	<u>1</u>	<u>3</u>	<u>5</u>	<u>7</u>	<u>9</u>	<u>10</u>	<u>11</u>
Time	_____	_____	_____	_____	_____	_____	_____
EC	_____	_____	_____	_____	_____	_____	_____
pH	_____	_____	_____	_____	_____	_____	_____
Temp	_____	_____	_____	_____	_____	_____	_____
Gal.	_____	_____	_____	_____	_____	_____	_____

After Sampling

Depth to Water 8.35 Ft. Total Well Depth 24.45 Ft.



FIELD DATA - GROUNDWATER WELL SAMPLING PROGRAM

DATE 12/14/1993 STATION NO. 054
 PERSONNEL E. GASMAN, T. ROJU
 WELL NO. RE2 WEATHER SUNNY
 SAMPLE EQUIPMENT TETLON BAITLER

Before Sampling

Total Well Depth 17.10 Ft. Well Diameter 4"
 Depth to Water 2.75 Ft. Purge Volume 37 gallons

Sampling Data

Time	<u>8:30</u>	<u>8:32</u>	<u>8:34</u>	<u>8:36</u>	<u>8:38</u>	<u>8:40</u>	<u>8:42</u>
EC	<u>650</u>	<u>400</u>	<u>400</u>	<u>398</u>	<u>397</u>	<u>400</u>	<u>400</u>
pH	<u>7.45</u>	<u>7.60</u>	<u>7.60</u>	<u>7.58</u>	<u>7.59</u>	<u>7.59</u>	<u>7.59</u>
Temp	<u>66.8</u>	<u>67.5</u>	<u>67.8</u>	<u>67.8</u>	<u>67.6</u>	<u>67.7</u>	<u>67.8</u>
Gal.	<u>10</u>	<u>15</u>	<u>20</u>	<u>25</u>	<u>30</u>	<u>33</u>	<u>37</u>
Time	_____	_____	_____	_____	_____	_____	_____
EC	_____	_____	_____	_____	_____	_____	_____
pH	_____	_____	_____	_____	_____	_____	_____
Temp	_____	_____	_____	_____	_____	_____	_____
Gal.	_____	_____	_____	_____	_____	_____	_____

After Sampling

Depth to Water 4.10 Ft. Total Well Depth 17.10 Ft.



FIELD DATA - GROUNDWATER WELL SAMPLING PROGRAM

DATE 12/14/1993 STATION NO. 057
 PERSONNEL E. GARMAN, T. ROSE
 WELL NO. RE5 WEATHER SUNNY
 SAMPLE EQUIPMENT TEFLON BAKER

Before Sampling

Total Well Depth 18.25 Ft. Well Diameter 4"
 Depth to Water 4.78 Ft. Purge Volume 35 gallons

Sampling Data

Time	<u>8:59</u>	<u>9:02</u>	<u>9:05</u>	<u>9:08</u>	<u>9:10</u>	_____	_____
EC	<u>950</u>	<u>990</u>	<u>1010</u>	<u>1010</u>	<u>1010</u>	_____	_____
pH	<u>7.30</u>	<u>7.26</u>	<u>7.27</u>	<u>7.26</u>	<u>7.28</u>	_____	_____
Temp	<u>64.5</u>	<u>66.3</u>	<u>67.5</u>	<u>67.5</u>	<u>67.5</u>	_____	_____
Gal.	<u>15</u>	<u>20</u>	<u>25</u>	<u>30</u>	<u>35</u>	_____	_____
Time	_____	_____	_____	_____	_____	_____	_____
EC	_____	_____	_____	_____	_____	_____	_____
pH	_____	_____	_____	_____	_____	_____	_____
Temp	_____	_____	_____	_____	_____	_____	_____
Gal.	_____	_____	_____	_____	_____	_____	_____

After Sampling

Depth to Water 6.10 Ft. Total Well Depth 18.25 Ft.



FIELD DATA - GROUNDWATER WELL SAMPLING PROGRAM

DATE 12/14/1993 STATION NO. 054
 PERSONNEL E-CASMAN, T. ROSE
 WELL NO. REG WEATHER SUNNY
 SAMPLE EQUIPMENT TEFLON BAILED

Before Sampling

Total Well Depth 13.25 Ft. Well Diameter 4"
 Depth to Water 3.58 Ft. Purge Volume 25 gallons

Sampling Data

Time	9:30	9:33	9:36	9:40	9:43	9:46
EC	1080	1120	1140	1130	1130	1130
pH	7.63	7.56	7.53	7.58	7.55	7.53
Temp	64.5	67.6	68.5	68.5	68.6	68.6
Gal.	5	8	10	15	20	25
Time						
EC						
pH						
Temp						
Gal.						

After Sampling

Depth to Water 4.27 Ft. Total Well Depth 13.25 Ft.



FIELD DATA - GROUNDWATER WELL SAMPLING PROGRAM

DATE 12/14/93 STATION NO. 054
 PERSONNEL E. GASMAN, T. ROFU
 WELL NO. RE 1 WEATHER SUNNY
 SAMPLE EQUIPMENT TEFLON BAILER

Before Sampling

Total Well Depth 19.85 Ft. Well Diameter 4"
 Depth to Water 4.38 Ft. Purge Volume 40 gallons

Sampling Data

Time	9:55	9:58	10:01	10:04	10:07	10:10	10:14
EC	1130	980	860	770	760	780	780
pH	7.26	7.14	7.21	7.24	7.25	7.25	7.26
Temp	68	69.3	69.4	69.3	69.2	69.3	69.3
Gal.	10	15	20	25	30	35	40
Time	_____	_____	_____	_____	_____	_____	_____
EC	_____	_____	_____	_____	_____	_____	_____
pH	_____	_____	_____	_____	_____	_____	_____
Temp	_____	_____	_____	_____	_____	_____	_____
Gal.	_____	_____	_____	_____	_____	_____	_____

After Sampling

Depth to Water _____ Ft. Total Well Depth _____ Ft.



FIELD DATA - GROUNDWATER WELL SAMPLING PROGRAM

DATE 12/14/1995 STATION NO. 054
 PERSONNEL E. GARMAN, T. ROFU
 WELL NO. RX 1 WEATHER SUNNY
 SAMPLE EQUIPMENT TEFLON BAILO

Before Sampling

Total Well Depth 14.10 Ft. Well Diameter 4"
 Depth to Water 4.65 Ft. Purge Volume 25 gallons

Sampling Data

Time	10:23	10:25	10:28	10:30	10:33		
EC	150	150	148	148	148		
pH	7.76	7.69	7.65	7.59	7.59		
Temp	66.9	67	67.2	67.3	67.3		
Gal.	5	10	15	20	25		
Time							
EC							
pH							
Temp							
Gal.							

After Sampling

Depth to Water 5.28 Ft. Total Well Depth 14.10 Ft.



FIELD DATA - GROUNDWATER WELL SAMPLING PROGRAM

DATE 12/14/1993 STATION NO. 054
 PERSONNEL E. CARMAN, T. ROJO
 WELL NO. PW 2 WEATHER SUNNY
 SAMPLE EQUIPMENT TEFLON BAKER

Before Sampling

Total Well Depth 14.40 Ft. Well Diameter 4"
 Depth to Water 5.22 Ft. Purge Volume 24 gallons

Sampling Data

Time	<u>10:47</u>	<u>10:50</u>	<u>10:53</u>	<u>10:57</u>	<u>11:00</u>	_____	_____
EC	<u>165</u>	<u>170</u>	<u>172</u>	<u>172</u>	<u>172</u>	_____	_____
pH	<u>7.55</u>	<u>7.46</u>	<u>7.45</u>	<u>7.43</u>	<u>7.43</u>	_____	_____
Temp	<u>66.9</u>	<u>68</u>	<u>69.6</u>	<u>69.6</u>	<u>69.7</u>	_____	_____
Gal.	<u>5</u>	<u>10</u>	<u>15</u>	<u>20</u>	<u>24</u>	_____	_____
Time	_____	_____	_____	_____	_____	_____	_____
EC	_____	_____	_____	_____	_____	_____	_____
pH	_____	_____	_____	_____	_____	_____	_____
Temp	_____	_____	_____	_____	_____	_____	_____
Gal.	_____	_____	_____	_____	_____	_____	_____

After Sampling

Depth to Water 6.40 Ft. Total Well Depth 14.40 Ft.

PARAMETER	U/M	
TIME	AM/PM	15:05
WORKING	YES/NO	No
RESTARTED	YES/NO	YES
HOURS	#	4028
ENGINE ROT.	R P M	1200
ENGINE VACUUM	IN HG	10
ENG. OIL PRESS.	P S I	45
ENG. WATER TEMP.	°F	150
ENG. ELECTR. TENS.	VOLTS	13
TANK VACUUM	IN HG	12
TK. REC. PRES.	PSI	40
TK. REC. TEMP.	°F	70
AIR TEMPERATURE	°F	45
AIR FLOW	C F M	15
VAPOR FLOW	C F M	19
FUEL FLOW	C F M/H	80
WELL VACUUM	IN H2O	26
L P G TANKS	%	#1: 87 #2:
GAS METER READING		
WATER FLOWMETER	GALL.	3250
CATALYST IN TEMP.	°F	
CATALYST OUT TEMP.	°F	

MAINTENANCE RECORD				
Operation	Each Stop	100 Hours Week	400 Hours 2 Weeks	800 Hours Monthly
Oil, Engine, Check Level	✓			
Coolant, Check Level	✓			
Fuel, Oil, Coolant, Check for Leaks	✓			
Oil, Engine, Change		✓ No		
Oil, Filter, Change		✓ No		
Battery, Check Charge and Fluid		✓		
Battery Cables, Clean		✓		
P.T.O. Bearings, Lubricate		✓		
Fan, Alternator Belts, Check and Adjust		✓		
Idle Speed, Check		✓		
Idle Mixture, Check		✓		
Radiator, Inspect and Clean Exterior				
Distributor, Clean and Check Points				
Ignition Timing, Check and Adjust				
PCV Valve, Replace				
PCV Hoses and Fitting, Check				
Spark Plugs, Replace				
Points, Replace				
Oil, Vacuum Pump, Change				
Intake Manifold Bolts, Torque				
All Nuts and Bolts, Check				

Comments: Upon arrival the RSI was shut off. (Restart) because no more propane Restart.

EXHAUST (See permit and PSR for frequency and limits)	BY C.A.	H-C	ppm/%
		CO	%/ppm
		CO2	%
		O2	%
		NOX	%/ppm
	BY	O.V.	ppm
OUTLET FROM ENGINE		O.V.	ppm
INLET TO ENGINE		O.V.	ppm

READJUST ENGINE PARAMETERS AT LEAST ONCE PER MONTH (IGNITION TIMING, AIR TO FUEL RATIO, EXHAUST O2 AND TEMP., NOX, HC & CO). CHECK HERE () WHEN DONE

INSPECT CATALYST (See permit and PSR for frequency). CHECK HERE () O.K. () NO

CHANGE CATALYST (See permit and PSR for limits). CHECK HERE () WHEN REPLACED

VAPOR WELLS ON: ALL WATER WELLS ON: RE-4 + RE-7

SERVICE TECH: E. GARMAN DATE: 12/22/93 THRIFTY OIL CO. ss #: 054

PARAMETER	U/M	
TIME	AM/PM	10:40
WORKING	YES/NO	YES
RESTARTED	YES/NO	NO
HOURS	#	4196
ENGINE ROT.	RPM	1800
ENGINE VACUUM	IN HG	10
ENG. OIL PRESS.	PSI	40
ENG. WATER TEMP.	°F	160
ENG. ELECTR. TENS.	VOLTS	13
TANK VACUUM	IN HG	11
TK. REC. PRES.	PSI	25
TK. REC. TEMP.	°F	100
AIR TEMPERATURE	°F	60
AIR FLOW	CFM	14
VAPOR FLOW	CFM	17
FUEL FLOW	CFM/H	80
WELL VACUUM	IN H2O	26
L P G TANKS	%	#1:23 #2:
GAS METER READING		
WATER FLOWMETER	GALL.	3421
CATALYST IN TEMP.	°F	
CATALYST OUT TEMP.	°F	

EXHAUST (See permit and PSR for frequency and limits)	BY C.A.	H-C	ppm/%
		CO	%/ppm
		CO2	%
		O2	%
		NOX	%/ppm
	BY	O.V.	ppm
OUTLET FROM ENGINE	O.V.	ppm	
INLET TO ENGINE	O.V.	ppm	

MAINTENANCE RECORD				
Operation	Each Stop	100 Hours Week	400 Hours 2 Weeks	800 Hours Monthly
Oil, Engine, Check Level				
Coolant, Check Level				
Fuel, Oil, Coolant, Check for Leaks				
Oil, Engine, Change		✓		
Oil, Filter, Change		✓		
Battery, Check Charge and Fluid		✓		
Battery Cables, Clean		✓		
P.T.O. Bearings, Lubricate		✓		
Fan, Alternator Belts, Check and Adjust		✓		
Idle Speed, Check		✓		
Idle Mixture, Check		✓		
Radiator, Inspect and Clean Exterior				
Distributor, Clean and Check Points				
Ignition Timing, Check and Adjust				
PCV Valve, Replace				
PCV Hoses and Fitting, Check				
Spark Plugs, Replace				
Points, Replace				
Oil, Vacuum Pump, Change				
Intake Manifold Bolts, Torque				
All Nuts and Bolts, Check				

Comments: B/W air sampling

READJUST ENGINE PARAMETERS AT LEAST ONCE PER MONTH (IGNITION TIMING, AIR TO FUEL RATIO, EXHAUST O2 AND TEMP., NOX, HC & CO). CHECK HERE () WHEN DONE

INSPECT CATALYST (See permit and PSR for frequency). CHECK HERE () O.K. () NO

CHANGE CATALYST (See permit and PSR for limits). CHECK HERE () WHEN REPLACED

VAPOR WELLS ON: ALL WATER WELLS ON: RE-5 - RE-7

SERVICE TECH: E. GASMAN DATE: 12.29.93 THRIFTY OIL CO. ss #: 054

APPENDIX B



SMITH-EMERY COMPANY

The Full Service Independent Testing Laboratory, Established 1904

781 East Washington Boulevard
P.O. Box 880550, Hunter's Point Shipyard Bldg. 114
5427 East La Palma Avenue

- Los Angeles, California 90021
- San Francisco, California 94188
- Anaheim, California 92807
- (213) 749-3411
- (415) 330-3000
- (714) 693-1026
- Fax: (213) 746-7228
- Fax: (415) 822-5864
- Fax: (714) 693-1034

Thrifty Oil Co.
File# 72546
10000 Lakewood Blvd.
Downey, CA 90240

10/29/93

Attn: Michael S. Cosby
310/923/9876

T.O.C.# 054
Chain of custody

Sample #: 3300105001
Received: 10/27/93
Type: Water

Collector: Client
Sampling Date & Time: 10/21/93, 1805
Method: Submitted By Client

I.D.: Effluent

T.O.C.# 054

CONSTITUENT	METHOD	RESULT	UNIT	MDL
Extraction Method/Date	EPA 5030	10/27/93		
Analysis Date		10/27/93		
EPA 8015M/602, Combination		*		
TPH-Gasoline	EPA 8015M	ND	ug/l	50 ug/l
Benzene	EPA 602	ND	ug/l	0.3 ug/l
Toluene	EPA 602	ND	ug/l	0.3 ug/l
Ethylbenzene	EPA 602	ND	ug/l	0.3 ug/l
Xylenes	EPA 602	ND	ug/l	0.5 ug/l
Surrogate		*		
Trifluorotoluene	EPA 602	99	Percent	



SMITH-EMERY COMPANY

The Full Service Independent Testing Laboratory, Established 1904

781 East Washington Boulevard
P.O. Box 880550, Hunter's Point Shipyard Bldg. 114
5427 East La Palma Avenue

- Los Angeles, California 90021
- San Francisco, California 94188
- Anaheim, California 92807
- (213) 749-3411
- (415) 330-3000
- (714) 693-1026
- Fax: (213) 746-7228
- Fax: (415) 822-5864
- Fax: (714) 693-1034

Thrifty Oil Co.
File# 72546
10000 Lakewood Blvd.
Downey, CA 90240

10/29/93

Attn: Michael S. Cosby
310/923/9876

T.O.C.# 054
Chain of custody

Sample #: 3300105002
Received: 10/27/93
Type: Water

Collector: Client
Sampling Date & Time: 10/21/93, 1820
Method: Submitted By Client

I.D.: Influent

T.O.C.# 054

CONSTITUENT	METHOD	RESULT	UNIT	MDL
Extraction Method/Date	EPA 5030	10/27/93		
Analysis Date		10/27/93		
EPA 8015M/602, Combination		*		
TPH-Gasoline	EPA 8015M	38000	ug/l	440 ug/l
Benzene	EPA 602	7900	ug/l	2.6 ug/l
Toluene	EPA 602	610	ug/l	2.6 ug/l
Ethylbenzene	EPA 602	110	ug/l	2.6 ug/l
Xylenes	EPA 602	2800	ug/l	4.4 ug/l
Surrogate		*		
Trifluorotoluene	EPA 602	84	Percent	



SMITH-EMERY COMPANY

The Full Service Independent Testing Laboratory, Established 1904

781 East Washington Boulevard
P.O. Box 880550, Hunter's Point Shipyard Bldg. 114
5427 East La Palma Avenue

- Los Angeles, California 90021
- San Francisco, California 94188
- Anaheim, California 92807
- (213) 749-3411
- (415) 330-3000
- (714) 693-1026
- Fax: (213) 746-7228
- Fax: (415) 822-5864
- Fax: (714) 693-1034

Thrifty Oil Co.
File# 72546
10000 Lakewood Blvd.
Downey, CA 90240

10/29/93

Attn: Michael S. Cosby
310/923/9876

T.O.C.# 054
Chain of custody

Sample #: 3300105003
Received: 10/27/93
Type: Water

Collector: Client
Sampling Date & Time: 10/21/93, 0700
Method: Submitted By Client

I.D.: Trip Blank

T.O.C.# 054

CONSTITUENT	METHOD	RESULT	UNIT	MDL
Extraction Method/Date	EPA 5030	10/27/93		
Analysis Date		10/27/93		
EPA 8015M/602, Combination		*		
TPH-Gasoline	EPA 8015M	ND	ug/l	50 ug/l
Benzene	EPA 602	ND	ug/l	0.3 ug/l
Toluene	EPA 602	ND	ug/l	0.3 ug/l
Ethylbenzene	EPA 602	ND	ug/l	0.3 ug/l
Xylenes	EPA 602	ND	ug/l	0.5 ug/l
Surrogate		*		
Trifluorotoluene	EPA 602	98	Percent	

Respectfully Submitted,

Shahid Noori, Manager Chemical Lab



SMITH-EMERY COMPANY

The Full Service Independent Testing Laboratory, Established 1904

781 East Washington Boulevard
P.O. Box 880550, Hunter's Point Shipyard Bldg. 114
5427 East La Palma Avenue

• Los Angeles, California 90021 • (213) 749-3411 • Fax: (213) 746-7228
• San Francisco, California 94188 • (415) 330-3000 • Fax: (415) 822-5864
• Anaheim, California 92807 • (714) 693-1026 • Fax: (714) 693-1034

December 3, 1993

Quality Control Report Matrix Spike and Duplicate Spike

Client: Thrifty Oil
File No: 72546
Report No: 33001050
Matrix: Water
Method: EPA 602
Lab No: 3298115901
Batch No: 3300602-1
Date Analyzed: 10/27/93

<u>PARAMETER</u>		<u>SAMPLE RESULTS</u> (ug/l)	<u>AMOUNT SPIKED</u> (ug/l)	<u>AMOUNT RECOVERED</u> (ug/l)	<u>% REC</u>	<u>SPIKE RECOVERY ACCEPTANCE RANGE(%)</u>	<u>R.P.D.</u>
Benzene	(S)	ND	22.7	22.3	98		
Benzene	(DS)	ND	13.6	14.9	109	77-120	10%
Toluene	(S)	ND	22.7	23.4	103		
Toluene	(DS)	ND	13.6	14.7	108	75-115	5%
Ethyl Benzene	(S)	ND	22.7	24.1	106		
Ethyl Benzene	(DS)	ND	13.6	14.8	109	60-130	2%
Xylene	(S)	ND	68.1	69.9	103		
Xylene	(DS)	ND	40.8	43.8	107	50-130	4%

S = Spike
DS = Duplicate Spike
R.P.D. = Relative Percent Difference
ND = None Detected



SMITH-EMERY COMPANY
The Full Service Independent Testing Laboratory, Established 1904

781 East Washington Boulevard
P.O. Box 880550, Hunter's Point Shipyard Bldg. 114
5427 East La Palma Avenue

• Los Angeles, California 90021 • (213) 749-3411 • Fax: (213) 745-6372
• San Francisco, California 94188 • (415) 330-3000 • Fax: (415) 822-5864
• Anaheim, California 92807 • (714) 693-1026 • Fax: (714) 693-1034

CHAIN OF CUSTODY AND ANALYSIS REQUEST

DATE: 10/21/93 PAGE 1 OF 1
FILE NO. 72546 LAB NO. 3300105701

CLIENT NAME: THRIFTY OIL CO

ANALYSES REQUESTED:

REMARKS:

PROJECT NAME: PROJECT NO. SS#054 P.O. NO.

ADDRESS:

PROJECT MANAGER: MICHAEL COSBY PHONE #: FAX #:

SAMPLER NAME: EUGENIU GASMAY (Printed) Eugeniu Gasmay (Signature)

TAT (Analytical Turn Around Time) 0 = Same Day, 1 = 24 Hour, 2 = 48 Hour, (Etc.)

CONTAINER TYPES: B = Brass, G = Glass, P = Plastic, V = Voa Vial, O = Other:

SAMPLE NO.	DATE SAMPLED	TIME SAMPLED	SAMPLE DESCRIPTION	MATRIX				TAT	CONTAINER		8015M GAS	DIESEL	602/8020 BTEX	418.1	SAMPLE CONDITION/ COMMENTS:
				WATER	SOIL	SLUDGE	OTHER		#	TYPE					
<u>EFFLUENT</u>	<u>10/21/93</u>	<u>18:05</u>		<u>X</u>					<u>2</u>	<u>V</u>	<u>X</u>	<u>X</u>			
<u>INFLUENT</u>	<u>10/21/93</u>	<u>18:20</u>		<u>X</u>					<u>2</u>	<u>V</u>	<u>X</u>	<u>X</u>			
<u>RIP BLANK</u>	<u>10/21/93</u>	<u>7:00</u>		<u>X</u>					<u>2</u>	<u>V</u>	<u>X</u>	<u>X</u>			

Relinquished By: (Signature and Printed Name) E. CASMAN Eugeniu Gasmay Received By: (Signature and Printed Name) _____ Date: _____ Time: _____

Relinquished By: (Signature and Printed Name) _____ Received By: (Signature and Printed Name) _____ Date: _____ Time: _____

Relinquished By: (Signature and Printed Name) _____ Received By: (Signature and Printed Name) _____ Date: _____ Time: _____

SAMPLE DISPOSITION:

1. Samples returned to client? YES NO

2. Samples will not be stored over 30 days, unless additional storage time is requested.

3. Storage time requested: _____ days

By _____ Date _____

SPECIAL INSTRUCTIONS:



SMITH-EMERY COMPANY

The Full Service Independent Testing Laboratory, Established 1904

781 East Washington Boulevard
P.O. Box 880550, Hunter's Point Shipyard Bldg. 114
5427 East La Palma Avenue

- Los Angeles, California 90021
- San Francisco, California 94188
- Anaheim, California 92807
- (213) 749-3411
- (415) 330-3000
- (714) 693-1026
- Fax: (213) 746-7228
- Fax: (415) 822-5864
- Fax: (714) 693-1034

Thrifty Oil Co.
File# 72546
10000 Lakewood Blvd.
Downey, CA 90240

11/29/93

Attn: Michael S. Cosby
310/923/9876

T.O.C.# 054
Chain of custody

Sample #: 3322150101
Received: 11/18/93
Type: Water

Collector: Client
Sampling Date & Time: 11/17/93, 1510
Method: Submitted By Client

I.D.: Effluent

T.O.C.# 054

CONSTITUENT	METHOD	RESULT	UNIT	MDL
Extraction Method/Date	EPA 5030	11/23/93		
Analysis Date		11/23/93		
EPA 8015M/602, Combination		*		
TPH-Gasoline	EPA 8015M	ND	ug/l	50 ug/l
Benzene	EPA 602	ND	ug/l	0.3 ug/l
Toluene	EPA 602	ND	ug/l	0.3 ug/l
Ethylbenzene	EPA 602	ND	ug/l	0.3 ug/l
Xylenes	EPA 602	ND	ug/l	0.5 ug/l
Surrogate		*		
Trifluorotoluene	EPA 602	91	Percent	



SMITH-EMERY COMPANY

The Full Service Independent Testing Laboratory, Established 1904

781 East Washington Boulevard
P. O. Box 880550, Hunter's Point Shipyard Bldg. 114
5427 East La Palma Avenue

- Los Angeles, California 90021
- San Francisco, California 94188
- Anaheim, California 92807
- (213) 749-3411
- (415) 330-3000
- (714) 693-1026
- Fax: (213) 746-7228
- Fax: (415) 822-5864
- Fax: (714) 693-1034

Thrifty Oil Co.
File# 72546
10000 Lakewood Blvd.
Downey, CA 90240

11/29/93

Attn: Michael S. Cosby
310/923/9876

T.O.C.# 054
Chain of custody

Sample #: 3322150102
Received: 11/18/93
Type: Water

Collector: Client
Sampling Date & Time: 11/17/93, 1525
Method: Submitted By Client

I.D.: Influent

T.O.C.# 054

CONSTITUENT	METHOD	RESULT	UNIT	MDL
Extraction Method/Date	EPA 5030	11/23/93		
Analysis Date		11/23/93		
EPA 8015M/602, Combination		*		
TPH-Gasoline	EPA 8015M	53000	ug/l	1100 ug/l
Benzene	EPA 602	6700	ug/l	6.6 ug/l
Toluene	EPA 602	250	ug/l	6.6 ug/l
Ethylbenzene	EPA 602	ND	ug/l	6.6 ug/l
Xylenes	EPA 602	3200	ug/l	11 ug/l
Surrogate		*		
Trifluorotoluene	EPA 602	91	Percent	



SMITH-EMERY COMPANY

The Full Service Independent Testing Laboratory, Established 1904

781 East Washington Boulevard
P.O. Box 880550, Hunter's Point Shipyard Bldg. 114
5427 East La Palma Avenue

- Los Angeles, California 90021
- San Francisco, California 94188
- Anaheim, California 92807
- (213) 749-3411
- (415) 330-3000
- (714) 693-1026
- Fax: (213) 746-7228
- Fax: (415) 822-5864
- Fax: (714) 693-1034

Thrifty Oil Co.
File# 72546
10000 Lakewood Blvd.
Downey, CA 90240

11/29/93

Attn: Michael S. Cosby
310/923/9876

T.O.C.# 054
Chain of custody

Sample #: 3322150103
Received: 11/18/93
Type: Water

Collector: Client
Sampling Date & Time: 11/17/93, 0630
Method: Submitted By Client

I.D.: Trip Blank

T.O.C.# 054

CONSTITUENT	METHOD	RESULT	UNIT	MDL
Extraction Method/Date	EPA 5030	11/23/93		
Analysis Date		11/23/93		
EPA 8015M/602, Combination		*		
TPH-Gasoline	EPA 8015M	ND	ug/l	50 ug/l
Benzene	EPA 602	ND	ug/l	0.3 ug/l
Toluene	EPA 602	ND	ug/l	0.3 ug/l
Ethylbenzene	EPA 602	ND	ug/l	0.3 ug/l
Xylenes	EPA 602	ND	ug/l	0.5 ug/l
Surrogate		*		
Trifluorotoluene	EPA 602	93	Percent	

Respectfully Submitted,

Shahid Noori

Shahid Noori, Manager Chemical Lab



SMITH-EMERY COMPANY

The Full Service Independent Testing Laboratory, Established 1904

781 East Washington Boulevard
P.O. Box 880550, Hunter's Point Shipyard Bldg. 114
5427 East La Palma Avenue

- Los Angeles, California 90021
- San Francisco, California 94188
- Anaheim, California 92807
- (213) 749-3411
- (415) 330-3000
- (714) 693-1026
- Fax: (213) 746-7228
- Fax: (415) 822-5864
- Fax: (714) 693-1034

December 3, 1993

Quality Control Report Matrix Spike and Duplicate Spike

Client: Thrifty Oil
 File No: 72546
 Report No: 33221501
 Matrix: Water
 Method: EPA 602/8015
 Lab No: 3320155107
 Batch No: 3327602/8015-1
 Date Analyzed: 11/23/93

<u>PARAMETER</u>		<u>SAMPLE RESULTS</u> (ug/l)	<u>AMOUNT SPIKED</u> (ug/l)	<u>AMOUNT RECOVERED</u> (ug/l)	<u>% REC</u>	<u>SPIKE RECOVERY ACCEPTANCE RANGE(%)</u>	<u>R. P. D.</u>
Benzene	(S)	ND	4.5	4.2	92		
Benzene	(DS)	ND	4.5	4.9	109	77-120	17%
Toluene	(S)	ND	4.5	4.4	97		
Toluene	(DS)	ND	4.5	5.0	112	75-115	14%
Ethyl Benzene	(S)	ND	4.5	4.3	96		
Ethyl Benzene	(DS)	ND	4.5	5.0	111	60-130	15%
Xylene	(S)	ND	13.5	14.1	104		
Xylene	(DS)	ND	13.5	15.7	117	50-130	11%

S = Spike
 DS = Duplicate Spike
 R.P.D. = Relative Percent Difference
 ND = None Detected



SMITH-EMERY COMPANY
The Full Service Independent Testing Laboratory, Established 1904

781 East Washington Boulevard
P.O. Box 880550, Hunter's Point Shipyard Bldg. 114
5427 East La Palma Avenue

• Los Angeles, California 90021
• San Francisco, California 94188
• Anaheim, California 92807

• (213) 749-3411
• (415) 330-3000
• (714) 693-1026

• Fax: (213) 745-6372
• Fax: (415) 822-5864
• Fax: (714) 693-1034

CHAIN OF CUSTODY AND ANALYSIS REQUEST

DATE: 11/17/93 PAGE 1 OF 1
FILE NO. 72546 LAB NO. 3322150101

CLIENT NAME: THRIFTY OIL CO

ANALYSES REQUESTED:

REMARKS:

PROJECT NAME: PROJECT NO. SS#057 P.O. NO.

ADDRESS:

PROJECT MANAGER: MICHAEL COSBY PHONE #: FAX #:

SAMPLER NAME: EUGENIU GASMAN
(Printed) (Signature)

TAT (Analytical Turn Around Time) 0 = Same Day; 1 = 24 Hour; 2 = 48 Hour; (Etc.)

CONTAINER TYPES: B = Brass, G = Glass, P = Plastic, V = Voa Vial, O = Other:

8015M GAS	DIESEL	602/8020 BTEX	418.1																

SAMPLE NO.	DATE SAMPLED	TIME SAMPLED	SAMPLE DESCRIPTION	MATRIX				TAT	CONTAINER		8015M GAS	DIESEL	602/8020 BTEX	418.1							SAMPLE CONDITION/ COMMENTS:	
				WATER	SOIL	SLUDGE	OTHER		#	TYPE												
EFFLUENT	11/17/93	3:10		X					2	V	X	X										
INTAKE	11/17/93	3:25		X					2	V	X	X										
TRIP BLANK	11/17/93	6:30		X					2	V	X	X										

Relinquished By: (Signature and Printed Name) E. Gasman Received By: (Signature and Printed Name) Fed-X Date: Time:
 Relinquished By: (Signature and Printed Name) Fed-X Received By: (Signature and Printed Name) Michael Gasman Date: 11/18/93 Time: 1419
 Relinquished By: (Signature and Printed Name) Received By: (Signature and Printed Name) Date: Time:

SAMPLE DISPOSITION:
 1. Samples returned to client? YES NO
 2. Samples will not be stored over 30 days, unless additional storage time is requested.
 3. Storage time requested: _____ days

SPECIAL INSTRUCTIONS:

By _____ Date _____



SMITH-EMERY COMPANY

The Full Service Independent Testing Laboratory, Established 1904

781 East Washington Boulevard
P.O. Box 880550, Hunter's Point Shipyard Bldg. 114
5427 East La Palma Avenue

- Los Angeles, California 90021
- San Francisco, California 94188
- Anaheim, California 92807
- (213) 749-3411
- (415) 330-3000
- (714) 693-1026
- Fax: (213) 746-7228
- Fax: (415) 822-5864
- Fax: (714) 693-1034

Thrifty Oil Co.
File# 72546
10000 Lakewood Blvd.
Downey, CA 90240

12/21/93

Attn: Michael S. Cosby
310/923/9876

T.O.C# 054
Chain of custody

Sample #: 3350104801
Received: 12/16/93
Type: Water

Collector: Client
Sampling Date & Time: 12/14/93, 1210
Method: Submitted By Client

I.D.: RE - 2

T.O.C# 054

CONSTITUENT	METHOD	RESULT	UNIT	MDL
Extraction Method/Date	EPA 5030	12/17/93		
Analysis Date		12/17/93		
EPA 8015M/602, Combination		*		
TPH-Gasoline	EPA 8015M	260 ug/l		50 ug/l
Benzene	EPA 602	5.6 ug/l		0.3 ug/l
Toluene	EPA 602	3.9 ug/l		0.3 ug/l
Ethylbenzene	EPA 602	ND ug/l		0.3 ug/l
Xylenes	EPA 602	21 ug/l		0.5 ug/l
Surrogate		*		
Trifluorotoluene	EPA 602	94 Percent		

RECEIVED

DEC 11 1994

EARTH MANAGEMENT CO.



SMITH-EMERY COMPANY

The Full Service Independent Testing Laboratory, Established 1904

781 East Washington Boulevard
P.O. Box 880550, Hunter's Point Shipyard Bldg. 114
5427 East La Palma Avenue

- Los Angeles, California 90021
- San Francisco, California 94188
- Anaheim, California 92807
- (213) 749-3411
- (415) 330-3000
- (714) 693-1026
- Fax: (213) 746-7228
- Fax: (415) 822-5864
- Fax: (714) 693-1034

Thrifty Oil Co.
File# 72546
10000 Lakewood Blvd.
Downey, CA 90240

12/21/93

Attn: Michael S. Cosby
310/923/9876

T.O.C# 054
Chain of custody

Sample #: 3350104802
Received: 12/16/93
Type: Water

Collector: Client
Sampling Date & Time: 12/14/93, 1135
Method: Submitted By Client

I.D.: RS - 9

T.O.C# 054

CONSTITUENT	METHOD	RESULT	UNIT	MDL
Extraction Method/Date	EPA 5030	12/17/93		
Analysis Date		12/17/93		
EPA 8015M/602, Combination		*		
TPH-Gasoline	EPA 8015M	560 ug/l		50 ug/l
Benzene	EPA 602	ND ug/l		0.3 ug/l
Toluene	EPA 602	ND ug/l		0.3 ug/l
Ethylbenzene	EPA 602	ND ug/l		0.3 ug/l
Xylenes	EPA 602	5.5 ug/l		0.5 ug/l
Surrogate		*		
Trifluorotoluene	EPA 602	93 Percent		



SMITH-EMERY COMPANY

The Full Service Independent Testing Laboratory, Established 1904

781 East Washington Boulevard
P.O. Box 880550, Hunter's Point Shipyard Bldg. 114
5427 East La Palma Avenue

- Los Angeles, California 90021
- San Francisco, California 94188
- Anaheim, California 92807
- (213) 749-3411
- (415) 330-3000
- (714) 693-1026
- Fax: (213) 746-7228
- Fax: (415) 822-5864
- Fax: (714) 693-1034

Thrifty Oil Co.
File# 72546
10000 Lakewood Blvd.
Downey, CA 90240

12/21/93

Attn: Michael S. Cosby
310/923/9876

T.O.C# 054
Chain of custody

Sample #: 3350104803
Received: 12/16/93
Type: Water

Collector: Client
Sampling Date & Time: 12/14/93, 1150
Method: Submitted By Client

I.D.: RS - 8

T.O.C# 054

CONSTITUENT	METHOD	RESULT	UNIT	MDL
Extraction Method/Date	EPA 5030	12/17/93		
Analysis Date		12/17/93		
EPA 8015M/602, Combination		*		
TPH-Gasoline	EPA 8015M	ND	ug/l	50 ug/l
Benzene	EPA 602	ND	ug/l	0.3 ug/l
Toluene	EPA 602	ND	ug/l	0.3 ug/l
Ethylbenzene	EPA 602	ND	ug/l	0.3 ug/l
Xylenes	EPA 602	ND	ug/l	0.5 ug/l
Surrogate		*		
Trifluorotoluene	EPA 602	98	Percent	



SMITH-EMERY COMPANY

The Full Service Independent Testing Laboratory, Established 1904

781 East Washington Boulevard
P.O. Box 880550, Hunter's Point Shipyard Bldg. 114
5427 East La Palma Avenue

- Los Angeles, California 90021
- San Francisco, California 94188
- Anaheim, California 92807
- (213) 749-3411
- (415) 330-3000
- (714) 693-1026
- Fax: (213) 746-7228
- Fax: (415) 822-5864
- Fax: (714) 693-1034

Thrifty Oil Co.
File# 72546
10000 Lakewood Blvd.
Downey, CA 90240

12/21/93

Attn: Michael S. Cosby
310/923/9876

T.O.C# 054
Chain of custody

Sample #: 3350104804
Received: 12/16/93
Type: Water

Collector: Client
Sampling Date & Time: 12/14/93, 1200
Method: Submitted By Client

I.D.: RS - 10

T.O.C# 054

CONSTITUENT	METHOD	RESULT	UNIT	MDL
Extraction Method/Date	EPA 5030	12/17/93		
Analysis Date		12/17/93		
EPA 8015M/602, Combination		*		
TPH-Gasoline	EPA 8015M	ND	ug/l	50 ug/l
Benzene	EPA 602	ND	ug/l	0.3 ug/l
Toluene	EPA 602	ND	ug/l	0.3 ug/l
Ethylbenzene	EPA 602	ND	ug/l	0.3 ug/l
Xylenes	EPA 602	ND	ug/l	0.5 ug/l
Surrogate		*		
Trifluorotoluene	EPA 602	96	Percent	



SMITH-EMERY COMPANY

The Full Service Independent Testing Laboratory, Established 1904

781 East Washington Boulevard
P.O. Box 880550, Hunter's Point Shipyard Bldg. 114
5427 East La Palma Avenue

- Los Angeles, California 90021
- San Francisco, California 94188
- Anaheim, California 92807
- (213) 749-3411
- (415) 330-3000
- (714) 693-1026
- Fax: (213) 746-7228
- Fax: (415) 822-5864
- Fax: (714) 693-1034

Thrifty Oil Co.
File# 72546
10000 Lakewood Blvd.
Downey, CA 90240

12/21/93

Attn: Michael S. Cosby
310/923/9876

T.O.C# 054
Chain of custody

Sample #: 3350104805
Received: 12/16/93
Type: Water

Collector: Client
Sampling Date & Time: 12/14/93, 1225
Method: Submitted By Client

I.D.: RE - 5

T.O.C# 054

CONSTITUENT	METHOD	RESULT	UNIT	MDL
Extraction Method/Date	EPA 5030	12/17/93		
Analysis Date		12/17/93		
EPA 8015M/602, Combination		*		
TPH-Gasoline	EPA 8015M	3300	ug/l	50 ug/l
Benzene	EPA 602	510	ug/l	0.3 ug/l
Toluene	EPA 602	5.4	ug/l	0.3 ug/l
Ethylbenzene	EPA 602	4.1	ug/l	0.3 ug/l
Xylenes	EPA 602	55	ug/l	0.5 ug/l
Surrogate		*		
Trifluorotoluene	EPA 602	105	Percent	



SMITH-EMERY COMPANY

The Full Service Independent Testing Laboratory, Established 1904

781 East Washington Boulevard
P.O. Box 880550, Hunter's Point Shipyard Bldg. 114
5427 East La Palma Avenue

- Los Angeles, California 90021
- San Francisco, California 94188
- Anaheim, California 92807
- (213) 749-3411
- (415) 330-3000
- (714) 693-1026
- Fax: (213) 746-7228
- Fax: (415) 822-5864
- Fax: (714) 693-1034

Thrifty Oil Co.
File# 72546
10000 Lakewood Blvd.
Downey, CA 90240

12/21/93

Attn: Michael S. Cosby
310/923/9876

T.O.C# 054
Chain of custody

Sample #: 3350104806
Received: 12/16/93
Type: Water

Collector: Client
Sampling Date & Time: 12/14/93, 1235
Method: Submitted By Client

I.D.: RE - 1

T.O.C# 054

CONSTITUENT	METHOD	RESULT	UNIT	MDL
Extraction Method/Date	EPA 5030	12/17/93		
Analysis Date		12/17/93		
EPA 8015M/602, Combination		*		
TPH-Gasoline	EPA 8015M	38000	ug/l	1100 ug/l
Benzene	EPA 602	4300	ug/l	6.6 ug/l
Toluene	EPA 602	1300	ug/l	6.6 ug/l
Ethylbenzene	EPA 602	ND	ug/l	6.6 ug/l
Xylenes	EPA 602	6500	ug/l	11 ug/l
Surrogate		*		
Trifluorotoluene	EPA 602	94	Percent	



SMITH-EMERY COMPANY

The Full Service Independent Testing Laboratory, Established 1904

781 East Washington Boulevard
P.O. Box 880550, Hunter's Point Shipyard Bldg. 114
5427 East La Palma Avenue

- Los Angeles, California 90021
- San Francisco, California 94188
- Anaheim, California 92807
- (213) 749-3411
- (415) 330-3000
- (714) 693-1026
- Fax: (213) 746-7228
- Fax: (415) 822-5864
- Fax: (714) 693-1034

Thrifty Oil Co.
File# 72546
10000 Lakewood Blvd.
Downey, CA 90240

12/21/93

Attn: Michael S. Cosby
310/923/9876

T.O.C# 054
Chain of custody

Sample #: 3350104807
Received: 12/16/93
Type: Water

Collector: Client
Sampling Date & Time: 12/14/93, 1245
Method: Submitted By Client

I.D.: RS - 6

T.O.C# 054

CONSTITUENT	METHOD	RESULT	UNIT	MDL
Extraction Method/Date	EPA 5030	12/17/93		
Analysis Date		12/17/93		
EPA 8015M/602, Combination		*		
TPH-Gasoline	EPA 8015M	1500 ug/l		50 ug/l
Benzene	EPA 602	200 ug/l		0.3 ug/l
Toluene	EPA 602	ND ug/l		0.3 ug/l
Ethylbenzene	EPA 602	ND ug/l		0.3 ug/l
Xylenes	EPA 602	8.8 ug/l		0.5 ug/l
Surrogate		*		
Trifluorotoluene	EPA 602	108 Percent		



SMITH-EMERY COMPANY

The Full Service Independent Testing Laboratory, Established 1904

781 East Washington Boulevard
P.O. Box 880550, Hunter's Point Shipyard Bldg. 114
5427 East La Palma Avenue

- Los Angeles, California 90021
- San Francisco, California 94188
- Anaheim, California 92807
- (213) 749-3411
- (415) 330-3000
- (714) 693-1026
- Fax: (213) 746-7228
- Fax: (415) 822-5864
- Fax: (714) 693-1034

Thrifty Oil Co.
File# 72546
10000 Lakewood Blvd.
Downey, CA 90240

12/21/93

Attn: Michael S. Cosby
310/923/9876

T.O.C# 054
Chain of custody

Sample #: 3350104808
Received: 12/16/93
Type: Water

Collector: Client
Sampling Date & Time: 12/14/93, 1255
Method: Submitted By Client

I.D.: PW - 1

T.O.C# 054

CONSTITUENT	METHOD	RESULT	UNIT	MDL
Extraction Method/Date	EPA 5030	12/17/93		
Analysis Date		12/17/93		
EPA 8015M/602, Combination		*		
TPH-Gasoline	EPA 8015M	ND	ug/l	50 ug/l
Benzene	EPA 602	ND	ug/l	0.3 ug/l
Toluene	EPA 602	ND	ug/l	0.3 ug/l
Ethylbenzene	EPA 602	ND	ug/l	0.3 ug/l
Xylenes	EPA 602	ND	ug/l	0.5 ug/l
Surrogate		*		
Trifluorotoluene	EPA 602	97	Percent	



SMITH-EMERY COMPANY

The Full Service Independent Testing Laboratory, Established 1904

781 East Washington Boulevard
P.O. Box 880550, Hunter's Point Shipyard Bldg. 114
5427 East La Palma Avenue

- Los Angeles, California 90021
- San Francisco, California 94188
- Anaheim, California 92807
- (213) 749-3411
- (415) 330-3000
- (714) 693-1026
- Fax: (213) 746-7228
- Fax: (415) 822-5864
- Fax: (714) 693-1034

Thrifty Oil Co.
File# 72546
10000 Lakewood Blvd.
Downey, CA 90240

12/21/93

Attn: Michael S. Cosby
310/923/9876

T.O.C# 054
Chain of custody

Sample #: 3350104809
Received: 12/16/93
Type: Water

Collector: Client
Sampling Date & Time: 12/14/93, 1255
Method: Submitted By Client

I.D.: PW - 2

T.O.C# 054

CONSTITUENT	METHOD	RESULT	UNIT	MDL
Extraction Method/Date	EPA 5030	12/17/93		
Analysis Date		12/17/93		
EPA 8015M/602, Combination		*		
TPH-Gasoline	EPA 8015M	1700 ug/l		50 ug/l
Benzene	EPA 602	4.2 ug/l		0.3 ug/l
Toluene	EPA 602	ND ug/l		0.3 ug/l
Ethylbenzene	EPA 602	ND ug/l		0.3 ug/l
Xylenes	EPA 602	49 ug/l		0.5 ug/l
Surrogate		*		
Trifluorotoluene	EPA 602	90 Percent		



SMITH-EMERY COMPANY

The Full Service Independent Testing Laboratory, Established 1904

781 East Washington Boulevard
P.O. Box 880550, Hunter's Point Shipyard Bldg. 114
5427 East La Palma Avenue

- Los Angeles, California 90021
- San Francisco, California 94188
- Anaheim, California 92807
- (213) 749-3411
- (415) 330-3000
- (714) 693-1026
- Fax: (213) 746-7228
- Fax: (415) 822-5864
- Fax: (714) 693-1034

Thrifty Oil Co.
File# 72546
10000 Lakewood Blvd.
Downey, CA 90240

12/21/93

Attn: Michael S. Cosby
310/923/9876

T.O.C# 054
Chain of custody

Sample #: 3350104810
Received: 12/16/93
Type: Water

Collector: Client
Sampling Date & Time: 12/15/93, 1230
Method: Submitted By Client

I.D.: Effluent

T.O.C# 054

CONSTITUENT	METHOD	RESULT	UNIT	MDL
Extraction Method/Date	EPA 5030	12/17/93		
Analysis Date		12/17/93		
EPA 8015M/602, Combination		*		
TPH-Gasoline	EPA 8015M	ND	ug/l	50 ug/l
Benzene	EPA 602	ND	ug/l	0.3 ug/l
Toluene	EPA 602	ND	ug/l	0.3 ug/l
Ethylbenzene	EPA 602	ND	ug/l	0.3 ug/l
Xylenes	EPA 602	ND	ug/l	0.5 ug/l
Surrogate		*		
Trifluorotoluene	EPA 602	95	Percent	



SMITH-EMERY COMPANY

The Full Service Independent Testing Laboratory, Established 1904

781 East Washington Boulevard
P.O. Box 880530, Hunter's Point Shipyard Bldg. 114
5427 East La Palma Avenue

- Los Angeles, California 90021
- San Francisco, California 94188
- Anaheim, California 92807
- (213) 749-3411
- (415) 330-3000
- (714) 693-1026
- Fax: (213) 746-7228
- Fax: (415) 822-5864
- Fax: (714) 693-1034

Thrifty Oil Co.
File# 72546
10000 Lakewood Blvd.
Downey, CA 90240

12/21/93

Attn: Michael S. Cosby
310/923/9876

T.O.C# 054
Chain of custody

Sample #: 3350104811
Received: 12/16/93
Type: Water

Collector: Client
Sampling Date & Time: 12/14/93, 1310
Method: Submitted By Client

I.D.: Influent

T.O.C# 054

CONSTITUENT	METHOD	RESULT	UNIT	MDL
Extraction Method/Date	EPA 5030	12/17/93		
Analysis Date		12/17/93		
EPA 8015M/602, Combination		*		
TPH-Gasoline	EPA 8015M	27000	ug/l	730 ug/l
Benzene	EPA 602	2300	ug/l	4.4 ug/l
Toluene	EPA 602	950	ug/l	4.4 ug/l
Ethylbenzene	EPA 602	42	ug/l	4.4 ug/l
Xylenes	EPA 602	4300	ug/l	7.3 ug/l
Surrogate		*		
Trifluorotoluene	EPA 602	95	Percent	



SMITH-EMERY COMPANY

The Full Service Independent Testing Laboratory, Established 1904

781 East Washington Boulevard
P.O. Box 880550, Hunter's Point Shipyard Bldg. 114
5427 East La Palma Avenue

- Los Angeles, California 90021
- San Francisco, California 94188
- Anaheim, California 92807
- (213) 749-3411
- (415) 330-3000
- (714) 693-1026
- Fax: (213) 746-7228
- Fax: (415) 822-5864
- Fax: (714) 693-1034

Thrifty Oil Co.
File# 72546
10000 Lakewood Blvd.
Downey, CA 90240

12/21/93

Attn: Michael S. Cosby
310/923/9876

T.O.C# 054
Chain of custody

Sample #: 3350104812
Received: 12/16/93
Type: Water

Collector: Client
Sampling Date & Time: 12/14/93, 1900
Method: Submitted By Client

I.D.: Trip Blank

T.O.C# 054

CONSTITUENT	METHOD	RESULT	UNIT	MDL
Extraction Method/Date	EPA 5030	12/17/93		
Analysis Date		12/17/93		
EPA 8015M/602, Combination		*		
TPH-Gasoline	EPA 8015M	ND	ug/l	50 ug/l
Benzene	EPA 602	ND	ug/l	0.3 ug/l
Toluene	EPA 602	ND	ug/l	0.3 ug/l
Ethylbenzene	EPA 602	ND	ug/l	0.3 ug/l
Xylenes	EPA 602	ND	ug/l	0.5 ug/l
Surrogate		*		
Trifluorotoluene	EPA 602	99	Percent	

Respectfully Submitted,

Shahid Noori

Shahid Noori, Manager Chemical Lab



SMITH-EMERY COMPANY

The Full Service Independent Testing Laboratory, Established 1904

781 East Washington Boulevard
P.O. Box 880550, Hunter's Point Shipyard Bldg. 114
5427 East La Palma Avenue

• Los Angeles, California 90021 • (213) 749-3411 • Fax: (213) 746-7228
• San Francisco, California 94188 • (415) 330-3000 • Fax: (415) 822-5864
• Anaheim, California 92807 • (714) 693-1026 • Fax: (714) 693-1034

December 28, 1993

Quality Control Report Matrix Spike and Duplicate Spike

Client: Thrifty Oil
File No: 72546
Report No: 33501048
Matrix: Water
Method: EPA 602/8015
Lab No: 3350081902
Batch No: 3351602/8015-1
Date Analyzed: 12/17/93

PARAMETER		SAMPLE RESULTS (ug/l)	AMOUNT SPIKED (ug/l)	AMOUNT RECOVERED (ug/l)	% REC	SPIKE RECOVERY ACCEPTANCE RANGE (%)	R.P.D.
Benzene	(S)	ND	22.7	24.8	109		
Benzene	(DS)	ND	22.7	24.0	106	77-120	3%
Toluene	(S)	ND	22.7	25.1	110		
Toluene	(DS)	ND	22.7	25.3	111	75-115	1%
Ethyl Benzene	(S)	ND	22.7	27.5	121		
Ethyl Benzene	(DS)	ND	22.7	26.8	118	60-130	3%
Xylene	(S)	ND	68.1	84.2	123		
Xylene	(DS)	ND	68.1	81.8	120	50-130	3%

S = Spike
DS = Duplicate Spike
R.P.D. = Relative Percent Difference
ND = None Detected



SMITH-EMERY COMPANY
The Full Service Independent Testing Laboratory, Established 1904

781 East Washington Boulevard
P.O. Box 880550, Hunter's Point Shipyard Bldg. 114
5427 East La Palma Avenue

• Los Angeles, California 90021 • (213) 749-3411 • Fax: (213) 745-6372
• San Francisco, California 94188 • (415) 330-3000 • Fax: (415) 822-5864
• Anaheim, California 92807 • (714) 693-1026 • Fax: (714) 693-1034

CHAIN OF CUSTODY AND ANALYSIS REQUEST

DATE: 12/15/93 PAGE 1 OF 2
FILE NO. 72546 LAB NO. 3350104801

CLIENT NAME: THRIFTY OIL CO

PROJECT NAME: _____ PROJECT NO. SS #059 P.O. NO. _____

ADDRESS: _____

PROJECT MANAGER: MICHAEL COSBY PHONE #: _____ FAX #: _____

SAMPLER NAME: EUGENIU GASMAN (Printed) *Eugeniu Gasman* (Signature)

TAT (Analytical Turn Around Time) 0 = Same Day; 1 = 24 Hour; 2 = 48 Hour; (Etc.)

CONTAINER TYPES: B = Brass, G = Glass, P = Plastic, V = Voa Vial, O = Other:

ANALYSES REQUESTED:

8015M GAS DIESEL

602/8020 BTEX

418.1

REMARKS:

SAMPLE CONDITION/ COMMENTS:

SAMPLE NO.	DATE SAMPLED	TIME SAMPLED	SAMPLE DESCRIPTION	MATRIX				TAT	CONTAINER		8015M GAS	602/8020 BTEX	418.1						
				WATER	SOL	SLUDGE	OTHER		#	TYPE									
RE 2	12/14/93	12:10		X					2	V	X	X							
RS-9	12/14/93	11:35		X					2	V	X	X							
RS-8	12/14/93	11:50		X					2	V	X	X							
RS-10	12/14/93	12:00		X					2	V	X	X							
RE 5	12/14/93	12:25		X					2	V	X	X							
RE 1	12/14/93	12:35		X					2	V	X	X							
RE 6	12/14/93	12:45		X					2	V	X	X							
PW 1	12/14/93	12:55		X					2	V	X	X							
PW 2	12/14/93	12:55		X					2	V	X	X							
EFFLUENT	12/15/93	12:30		X					2	V	X	X							

Relinquished By: (Signature and Printed Name) E. CASMAN Received By: (Signature and Printed Name) Fedex Date: 12/15/93 Time: _____

Relinquished By: (Signature and Printed Name) Fedex Received By: (Signature and Printed Name) M. J. Olen Date: 12/14/93 Time: 10:51

Relinquished By: (Signature and Printed Name) _____ Received By: (Signature and Printed Name) _____ Date: _____ Time: _____

SAMPLE DISPOSITION:

1. Samples returned to client? YES NO

2. Samples will not be stored over 30 days, unless additional storage time is requested.

3. Storage time requested: _____ days

SPECIAL INSTRUCTIONS:



SMITH-EMERY COMPANY
The Full Service Independent Testing Laboratory, Established 1904

781 East Washington Boulevard
P.O. Box 880550, Hunter's Point Shipyard Bldg. 114
5427 East La Palma Avenue

• Los Angeles, California 90021 • (213) 749-3411 • Fax: (213) 745-6372
• San Francisco, California 94188 • (415) 330-3000 • Fax: (415) 822-5864
• Anaheim, California 92807 • (714) 693-1026 • Fax: (714) 693-1034

CHAIN OF CUSTODY AND ANALYSIS REQUEST

DATE: 12/15/93 PAGE 2 OF 2
FILE NO. 72546 LAB NO. 3350104901

CLIENT NAME: THRIFTY OIL CO

PROJECT NAME: _____ PROJECT NO. SS #059 P.O. NO. _____

ADDRESS: _____

PROJECT MANAGER: MICHAEL COSBY PHONE #: _____ FAX #: _____

SAMPLER NAME: _____
(Printed) (Signature)

TAT (Analytical Turn Around Time) 0 = Same Day; 1 = 24 Hour; 2 = 48 Hour; (Etc.)

CONTAINER TYPES: B = Brass, G = Glass, P = Plastic, V = Voa Vial, O = Other:

ANALYSES REQUESTED:

8015M GAS <input checked="" type="checkbox"/> DIESEL <input type="checkbox"/>	602/8020 BTEX	418.1																			

REMARKS:

SAMPLE NO.	DATE SAMPLED	TIME SAMPLED	SAMPLE DESCRIPTION	MATRIX				TAT	CONTAINER		8015M GAS <input checked="" type="checkbox"/> DIESEL <input type="checkbox"/>	602/8020 BTEX	418.1								SAMPLE CONDITION/ COMMENTS:
				WATER	SOIL	SLUDGE	OTHER		#	TYPE											
INFLUENT	12/15/93	13:10		X					2	V	X	X									
TOP BLANK	12/14/93	7:00		X					2	V	X	X									

Relinquished By: (Signature and Printed Name) E. GARMAN Received By: (Signature and Printed Name) Suzanne Cosby Date: _____ Time: _____

Relinquished By: (Signature and Printed Name) Fed-A Received By: (Signature and Printed Name) Michelle Date: 12/14/93 Time: 10:52

Relinquished By: (Signature and Printed Name) _____ Received By: (Signature and Printed Name) _____ Date: _____ Time: _____

SAMPLE DISPOSITION:

1. Samples returned to client? YES NO

2. Samples will not be stored over 30 days, unless additional storage time is requested.

3. Storage time requested: _____ days

SPECIAL INSTRUCTIONS:

By _____ Date _____



3700 Lakeville Highway, Petaluma, CA 94954
P.O. Box 808024, Petaluma, CA 94975-8024
Telephone: (707) 763-8245
FAX (707) 763-4065

Karl Kerner
Thrifty Oil Company
10,000 Lakewood Blvd.
Downey, CA 90240

September 23, 1993

Customer Project: T.O.C. SS#054
Laboratory Job: L9309085

On September 10, 1993 we received 2 sample(s) for analysis.
Samples were analyzed by the following method(s):

Benzene by GC (Niosh 1501)

Project Manager

Laboratory Director
Robert Peak

D&M Laboratories

ANALYTICAL DATA REPORT

Prepared for: Thrifty Oil Company
 Project Id: T.O.C. SS#054
 Sample Id: EFFLUENT
 Lab Id: L9309085-1

Collected: 08-SEP-93
 Received: 10-SEP-93
 Reported: 22-SEP-93

Parameter	Value	Limit	Units	Dilution	Extracted	Analyzed
NIOSH 1501: BENZENE						
AIR VOLUME	1.00	-	L	1	17-SEP-93	20-SEP-93
Front	<	0.0075	mg	1	17-SEP-93	20-SEP-93
Back	<	0.0075	mg	1	17-SEP-93	20-SEP-93
Total	<	0.0075	mg	1	17-SEP-93	20-SEP-93
mg/m3	<	7.5	mg/m3	1	17-SEP-93	20-SEP-93
BENZENE	<	2.3	ppm	1	17-SEP-93	20-SEP-93

D&M Laboratories

ANALYTICAL DATA REPORT

Prepared for: Thrifty Oil Company
 Project Id: T.O.C. SS#054
 Sample Id: TRIP BLANK
 Lab Id: L9309085-2

Collected: 08-SEP-93
 Received: 10-SEP-93
 Reported: 22-SEP-93

Parameter	Value	Limit	Units	Dilution	Extracted	Analyzed
NIOSH 1501: BENZENE						
AIR VOLUME	BLANK	-	L	1	17-SEP-93	20-SEP-93
Front	<	0.0075	mg	1	17-SEP-93	20-SEP-93
Back	<	0.0075	mg	1	17-SEP-93	20-SEP-93
Total	<	0.0075	mg	1	17-SEP-93	20-SEP-93



3700 Lakeville Highway, Petaluma, CA 94954
 P.O. Box 808024, Petaluma, CA 94975-8024
 Telephone: (707) 763-8245 Fax: (707) 763-4065

L9309085

SAMPLE CHAIN OF CUSTODY / WORK ORDER

Client's Name THRIFTY OIL Co Phone (310) 422-9876
 Address 10000 LAKEWOOD
 City, State, Zip DOWNEY CA 90240
 Client's or Representative's Signature EUGENIU GARMAN *Eugeniu Garmann*
 (signature authorizes the work and terms listed below)

All samples remain the property of the client who is responsible for disposal. A disposal fee may be imposed if client fails to pick up samples.

PROJ. NO.		PROJECT NAME					NO. OF CONTAINERS	RECEIVED				REMARKS	LAB USE ONLY LAB NO.	
		70c ss # 054												
SAMPLERS (Signature)														
<i>Eugeniu Garmann</i>														
STA. NO.	DATE	TIME	COMP	GRAB	STATION LOCATION									
	9-8-93	9:30		X	EFFLUENT 1L		1	X						
	9-8-93	9:30			TRIP BLANK		1	X						
<p>SAMPLES RECEIVED IN GOOD CONDITION NO BROKEN OR LEAKING CONTAINERS</p> <p style="font-size: 2em; font-weight: bold;">Fed Ex. - 2ct</p>														
Relinquished by: (Signature)		DATE	TIME	Received by: (Signature)		General Remarks: <u>ANALYZE RESULT</u> <u>SEND BILL TO: KARL KERNER</u> <u>10000 LAKEWOOD BLVD DOWNEY</u> <u>CA 90240</u> <u>PLEASE SEND COOLER + COPY C</u> <u>ANALYZE RESULT TO</u> <u>1250 N WILSON WAY STOCKTON</u> <u>CA 95205</u>								
<i>Eugeniu Garmann</i>		9-9-93	9:30	<i>L. Larson</i>										
Relinquished by: (Signature)		DATE	TIME	Received by: (Signature)										
Relinquished by: (Signature)		DATE	TIME	Received by: (Signature)										

RECEIVED
 D&M LABORATORIES
 1993 SEP 10 AM 9:30



3700 Lakeville Highway, Petaluma, CA 94954
P.O. Box 808024, Petaluma, CA 94975-8024
Telephone: (707) 763-8245
FAX (707) 763-4065

Karl Kerner
Thrifty Oil Company
10,000 Lakewood Blvd.
Downey, CA 90240

October 1, 1993

Customer Project: TOS SS#054
Laboratory Job: L9309208

On September 23, 1993 we received 2 sample(s) for analysis.
Samples were analyzed by the following method(s):

Benzene by GC (Niosh 1501)

Project Manager

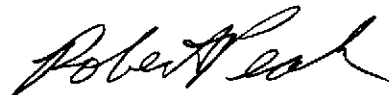
Laboratory Director
Robert Peak

D&M Laboratories

ANALYTICAL DATA REPORT

Prepared for: Thrifty Oil Company
 Project Id: TOS SS#054
 Sample Id: EFFLUENT
 Lab Id: L9309208-1

Collected: 21-SEP-93
 Received: 23-SEP-93
 Reported: 30-SEP-93

Parameter	Value	Limit	Units	Dilution	Extracted	Analyzed
NIOSH 1501: BENZENE						
AIR VOLUME	1.00	-	L	1	27-SEP-93	27-SEP-93
Front	<	0.0075	mg	1	27-SEP-93	27-SEP-93
Back	<	0.0075	mg	1	27-SEP-93	27-SEP-93
Total	<	0.0075	mg	1	27-SEP-93	27-SEP-93
mg/m ³	<	7.5	mg/m ³	1	27-SEP-93	27-SEP-93
BENZENE	<	2.3	ppm	1	27-SEP-93	27-SEP-93

D&M Laboratories

ANALYTICAL DATA REPORT

Prepared for: Thrifty Oil Company
 Project Id: TOS SS#054
 Sample Id: TRIP BLANK
 Lab Id: L9309208-2

Collected: 21-SEP-93
 Received: 23-SEP-93
 Reported: 30-SEP-93

Parameter	Value	Limit	Units	Dilution	Extracted	Analyzed
NIOSH 1501: BENZENE						
AIR VOLUME	BLANK	-	L	1	27-SEP-93	27-SEP-93
Front	<	0.0075	mg	1	27-SEP-93	27-SEP-93
Back	<	0.0075	mg	1	27-SEP-93	27-SEP-93
Total	<	0.0075	mg	1	27-SEP-93	27-SEP-93



L 9309208

3700 Lakeville Highway, Petaluma, CA 94954
P.O. Box 808024, Petaluma, CA 94975-8024
Telephone: (707) 763-8245 Fax: (707) 763-4065

SAMPLE CHAIN OF CUSTODY / WORK ORDER

Phone (310) 923-9876

Client's Name THRIFTY OIL CO

Address 10000 LAKEWOOD BLVD

City, State, Zip DOWNEY CA 90240

Client's or Representative's Signature EUGENIU GAMAN Eugeniu Gaman

(signature authorizes the work and terms listed below)

All samples remain the property of the client who is responsible for disposal. A disposal fee may be imposed if client fails to pick up samples.

PROJ. NO.		PROJECT NAME		NO. OF CONTAINERS		REMARKS	
		TOS SS #054					
SAMPLERS (Signature) <i>Eugeniu Gaman</i>							
STA. NO.	DATE	TIME	COMP	GRAB	STATION LOCATION	LAB USE ONLY LAB NO.	
	9-21-93	17:30		X	EFFLUENT / L	1	X
	9-21-93	17:30			TRIP BLANK	1	X
<p>SAMPLES RECEIVED IN GOOD CONDITION NO BROKEN OR LEAKING CONTAINERS</p> <p>Fed. Ex - 2ct</p>							
Relinquished by: (Signature) <i>Eugeniu Gaman</i>		DATE 9-22-93	TIME 9	Received by: (Signature) <i>J. Larson</i>		General Remarks: + ANALYZE RESULT SEND BILL TO: KARL KERNER 10000 LAKEWOOD BLVD DOWNEY CA 90240 PLEASE SEND COOLER + A COPY ANALYZE RESULT TO: 1250 N WILSON WAY STOCKTON CA 95205	
Relinquished by: (Signature)		DATE	TIME	Received by: (Signature)			
Relinquished by: (Signature)		DATE	TIME	Received by: (Signature)			

RECEIVED
DAM LABORATORIES
1333 SEP 23 AM 9:38



3700 Lakeville Highway, Petaluma, CA 94954
P.O. Box 808024, Petaluma, CA 94975-8024
Telephone: (707) 763-8245
FAX (707) 763-4065

Michael Cosby
Thrifty Oil Company
10,000 Lakewood Blvd.
Downey, CA 90240

October 18, 1993

Customer Project: SS #054
Laboratory Job: L9310071

On October 8, 1993 we received 2 sample(s) for analysis.
Samples were analyzed by the following method(s):

Benzene by GC (Niosh 1501)

Stella Harris
Project Manager

Laura Hull for
Laboratory Director
Robert Peak

D&M Laboratories

ANALYTICAL DATA REPORT

Prepared for: Thrifty Oil Company
 Project Id: SS #054
 Sample Id: EFFLUENT
 Lab Id: L9310071-1

Collected: 07-OCT-93
 Received: 08-OCT-93
 Reported: 18-OCT-93

Parameter	Value	Limit	Units	Dilution	Extracted	Analyzed
NIOSH 1501: BENZENE						
AIR VOLUME	1.00	-	L	1	13-OCT-93	13-OCT-93
Front	<	0.0075	mg	1	13-OCT-93	13-OCT-93
Back	<	0.0075	mg	1	13-OCT-93	13-OCT-93
Total	<	0.0075	mg	1	13-OCT-93	13-OCT-93
mg/m3	<	7.5	mg/m3	1	13-OCT-93	13-OCT-93
BENZENE	<	2.3	ppm	1	13-OCT-93	13-OCT-93

D&M Laboratories

ANALYTICAL DATA REPORT

Prepared for: Thrifty Oil Company
 Project Id: SS #054
 Sample Id: TRIP BLANK
 Lab Id: L9310071-2

Collected: 07-OCT-93
 Received: 08-OCT-93
 Reported: 18-OCT-93

Parameter	Value	Limit	Units	Dilution	Extracted	Analyzed
NIOSH 1501: BENZENE						
AIR VOLUME	BLANK	-	L	1	13-OCT-93	13-OCT-93
Front	<	0.0075	mg	1	13-OCT-93	13-OCT-93
Back	<	0.0075	mg	1	13-OCT-93	13-OCT-93
Total	<	0.0075	mg	1	13-OCT-93	13-OCT-93



L9310071

3700 Lakeville Highway, Petaluma, CA 94954
 P.O. Box 808024, Petaluma, CA 94975-8024
 Telephone: (707) 783-8245 Fax: (707) 783-4085

SAMPLE CHAIN OF CUSTODY / WORK ORDER

Client's Name THRIFTY OIL CO Phone (310) 923-9876
 Address 1000 LAKEWOOD BLVD
 City, State, Zip BOWNEY CA 90240
 Client's or Representative's Signature EUGENIU GARMAN *Eugeniu Gorman*

(signature authorizes the work and terms listed below)
 All samples remain the property of the client who is responsible for disposal. A disposal fee may be imposed if client fails to pick up samples.

PROJ. NO.		PROJECT NAME				NO. OF CONTAINERS	REMARKS				LAB USE ONLY LAB NO.	
SS # 054												
SAMPLERS (Signature)												
E. GASMAN <i>Eugeniu Gorman</i>												
STA. NO.	DATE	TIME	COMP	GRAB	STATION LOCATION							
	10.7.92	10:20			EFFLUENT IL	1	X					
	10.7.92	10:30			TRIP BLANK	1	X					
						COOLER CUSTODY SEALS INTACT <input type="checkbox"/> NOT INTACT <input checked="" type="checkbox"/> <i>NA</i>						
						COOLER TEMPERATURE <u>COLD</u> °C						
						SAMPLES RECEIVED IN GOOD CONDITION NO BROKEN OR LEAKING CONTAINERS						
						(2 CH. TU)						

RECEIVED
 DAM LABORATORIES
 1993 OCT - 8 AM 9:43

Relinquished by: (Signature) <i>Eugeniu Gorman</i>	DATE	TIME	Received by: (Signature) <i>K. Paul</i>
Relinquished by: (Signature)	DATE	TIME	Received by: (Signature)
Relinquished by: (Signature)	DATE	TIME	Received by: (Signature)

General Remarks:
 SEND RESULT OF ANALYZES TO
 KARL KERNER 1000 LAKEWOOD BL
 BOWNEY CA 90240
 PLEASE FEND COOLER + 1 COPY OF
 ANALYZES TO:
 1250 N WILSON WAY
 STOCKTON CA 95205
 THANK YOU



3700 Lakeville Highway, Petaluma, CA 94954
P.O. Box 808024, Petaluma, CA 94975-8024
Telephone: (707) 763-8245
FAX (707) 763-4065

Michael Cosby
Thrifty Oil Company
10,000 Lakewood Blvd.
Downey, CA 90240

October 29, 1993

Customer Project: SS #054
Laboratory Job: L9310209

On October 22, 1993 we received 2 sample(s) for analysis.
Samples were analyzed by the following method(s):

Benzene by GC (Niosh 1501)

Stella Wand
Project Manager

Robert Peak
Laboratory Director
Robert Peak

D&M Laboratories

ANALYTICAL DATA REPORT

Prepared for: Thrifty Oil Company
 Project Id: SS #054
 Sample Id: EFFLUENT
 Lab Id: L9310209-1

Collected: 21-OCT-93
 Received: 22-OCT-93
 Reported: 29-OCT-93

Parameter	Value	Limit	Units	Dilution	Extracted	Analyzed
NIOSH 1501: BENZENE						
AIR VOLUME	1.00	-	L	1	28-OCT-93	28-OCT-93
Front	<	0.0075	mg	1	28-OCT-93	28-OCT-93
Back	<	0.0075	mg	1	28-OCT-93	28-OCT-93
Total	<	0.0075	mg	1	28-OCT-93	28-OCT-93
mg/m3	<	7.5	mg/m3	1	28-OCT-93	28-OCT-93
BENZENE	<	2.3	ppm	1	28-OCT-93	28-OCT-93

D&M Laboratories

ANALYTICAL DATA REPORT

Prepared for: Thrifty Oil Company
Project id: SS #054
Sample id: TRIP BLANK
Lab id: L9310209-2

Collected: 21-OCT-93
Received: 22-OCT-93
Reported: 29-OCT-93

Parameter	Value	Limit	Units	Dilution	Extracted	Analyzed
NIOSH 1501: BENZENE						
AIR VOLUME	BLANK	-	L	1	28-OCT-93	28-OCT-93
Front	<	0.0075	mg	1	28-OCT-93	28-OCT-93
Back	<	0.0075	mg	1	28-OCT-93	28-OCT-93
Total	<	0.0075	mg	1	28-OCT-93	28-OCT-93



L9310209

3700 Lakeville Highway, Petaluma, CA 94954
 P.O. Box 808024, Petaluma, CA 94975-8024
 Telephone: (707) 763-8245 Fax: (707) 763-4065

SAMPLE CHAIN OF CUSTODY / WORK ORDER

Client's Name THRIFTY OIL CO Phone (310)923-9876
 Address 10000 LAKEWOOD BLVD
 City, State, Zip DOWNEY CA 90240
 Client's or Representative's Signature EUGEN GARMAN *Eugen Gorman*
 (signature authorizes the work and terms listed below)

All samples remain the property of the client who is responsible for disposal. A disposal fee may be imposed if client fails to pick up samples.

PROJ. NO.		PROJECT NAME						REMARKS		LAB USE ONLY LAB NO.	
STA. NO.	DATE	TIME	COMP	GRAB	STATION LOCATION	NO. OF CONTAINERS					
SS#054											
SAMPLERS (Signature) <i>Eugen Gorman</i>											
EFFLUENT	10/21	16:40		✓	1 L	1	✓	<div style="border: 1px solid black; padding: 5px; transform: rotate(-45deg); display: inline-block;">BENZENE</div>			
TRIT BLANK	10/21	16:41		✓		1	✓				
SAMPLES RECEIVED IN GOOD CONDITION NO CRACKS OR LEAKING CONT.											
COOLER CUSTODY SEALS INTACT <input type="checkbox"/> NOT INTACT <input checked="" type="checkbox"/>						COOLER TEMPERATURE <u>COLD</u> °C					
2 CHAR TUBES FEDEX AIR						<i>cooler not taped; Rec. opened. J.P.</i>					
Relinquished by: (Signature) <i>Eugen Gorman</i>		DATE	TIME	Received by: (Signature) <i>J. Powell</i>		General Remarks:					
Relinquished by: (Signature)		DATE	TIME	Received by: (Signature)							
Relinquished by: (Signature)		DATE	TIME	Received by: (Signature)							

RECEIVED
 D&M LABORATORIES
 1563 OCT 22 AM 9:35



3700 Lakeville Highway, Petaluma, CA 94954
P.O. Box 808024, Petaluma, CA 94975-8024
Telephone: (707) 763-8245
FAX (707) 763-4065

Michael Cosby
Thrifty Oil Company
10,000 Lakewood Blvd.
Downey, CA 90240

November 16, 1993

Customer Project: SS#054
Laboratory Job: L9311048

On November 4, 1993 we received 2 sample(s) for analysis.
Samples were analyzed by the following method(s):

Benzene - Niosh 1501 (Niosh 1501)

Project Manager

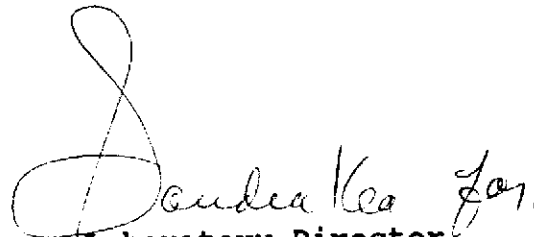
Laboratory Director
Robert Peak

RECEIVED

NOV 19 1993

EARTH MANAGEMENT CO.

D&M Laboratories

ANALYTICAL DATA REPORT

Prepared for: Thrifty Oil Company
 Project Id: SS#054
 Sample Id: EFFLUENT
 Lab Id: L9311048-1

Collected: 03-NOV-93
 Received: 04-NOV-93
 Reported: 16-NOV-93

Parameter	Value	Limit	Units	Extracted	Analyzed
NIOSH 1501-BENZENE					
AIR	1.00	-	L	08-NOV-93	10-NOV-93
FRONT	<	0.0040	mg	08-NOV-93	10-NOV-93
BACK	<	0.0040	mg	08-NOV-93	10-NOV-93
TOTAL	<	0.0040	mg	08-NOV-93	10-NOV-93
mg/M3	<	4.0	mg/m3	08-NOV-93	10-NOV-93
BENZENE	<	1.3	ppm	08-NOV-93	10-NOV-93

D&M Laboratories

ANALYTICAL DATA REPORT

Prepared for: Thrifty Oil Company
Project Id: SS#054
Sample Id: TRIP BLANK
Lab Id: L9311048-2

Collected: 03-NOV-93
Received: 04-NOV-93
Reported: 16-NOV-93

Parameter	Value	Limit	Units	Extracted	Analyzed
NIOSH 1501-BENZENE					
FRONT	<	0.0040	mg	08-NOV-93	10-NOV-93
BACK	<	0.0040	mg	08-NOV-93	10-NOV-93
TOTAL	<	0.0040	mg	08-NOV-93	10-NOV-93



3700 Lakeville Highway, Petaluma, CA 94954
P.O. Box 808024, Petaluma, CA 94975-8024
Telephone: (707) 763-8245
FAX (707) 763-4065

Michael Cosby
Thrifty Oil Company
10,000 Lakewood Blvd.
Downey, CA 90240

November 29, 1993

Customer Project: SS # 054
Laboratory Job: L9311174

On November 18, 1993 we received 2 sample(s) for analysis.
Samples were analyzed by the following method(s):

Benzene (Niosh 1501)

Project Manager

Laboratory Director
Robert Peak

D&M Laboratories

ANALYTICAL DATA REPORT

Prepared for: Thrifty Oil Company
 Project Id: SS # 054
 Sample Id: EFFLUENT
 Lab Id: L9311174-1

Collected: 22-NOV-93
 Received: 18-NOV-93
 Reported: 29-NOV-93

Parameter	Value	Limit	Units	Extracted	Analyzed
NIOSH 1501-BENZENE					
AIR	1.00	-	L	22-NOV-93	24-NOV-93
FRONT	<	0.0040	mg	22-NOV-93	24-NOV-93
BACK	<	0.0040	mg	22-NOV-93	24-NOV-93
TOTAL	<	0.0040	mg	22-NOV-93	24-NOV-93
mg/M3	<	4.0	mg/m3	22-NOV-93	24-NOV-93
BENZENE	<	1.3	ppm	22-NOV-93	24-NOV-93

D&M Laboratories

ANALYTICAL DATA REPORT

Prepared for: Thrifty Oil Company
Project Id: SS # 054
Sample Id: TRIP BLANK
Lab Id: L9311174-2

Collected: 22-NOV-93
Received: 18-NOV-93
Reported: 29-NOV-93

Parameter	Value	Limit	Units	Extracted	Analyzed
NIOSH 1501-BENZENE					
FRONT	<	0.0040	mg	22-NOV-93	24-NOV-93
BACK	<	0.0040	mg	22-NOV-93	24-NOV-93
TOTAL	<	0.0040	mg	22-NOV-93	24-NOV-93



L9311174

3700 Lakeville Highway, Petaluma, CA 94954
 P.O. Box 808024, Petaluma, CA 94975-8024
 Telephone: (707) 763-8245 Fax: (707) 763-4065

SAMPLE CHAIN OF CUSTODY / WORK ORDER

Client's Name THRIFTY OIL CO Phone (310) 922-9876
 Address 1000 LAKEWOOD BLVD
 City, State, Zip BOWNEY CA 90240
 Client's or Representative's Signature EUGENIU GARMAN *Eugeniu Gorman*

(signature authorizes the work and terms listed below)
 All samples remain the property of the client who is responsible for disposal. A disposal fee may be imposed if client fails to pick up samples.

PROJ. NO.		PROJECT NAME				NO. OF CONTAINERS	REMARKS			
		SS # 054								
SAMPLERS (Signature)						<div style="border: 1px solid black; padding: 5px; display: inline-block; transform: rotate(-45deg);">BENZENE</div> LAB USE ONLY LAB NO.				
STA. NO.	DATE	TIME	COMP	GRAB	STATION LOCATION					
	11/17/73	15:00			EFFLUENT IL	1	X			
	11/17/73	15:00			TRIP BLANK	1	X			
SAMPLERS (Signature)						SAMPLES RECEIVED IN GOOD CONDITION NO BROKEN OR LEAKING CONTAINERS				
<i>Eugeniu Gorman</i>										
2 CHAR. TUBES - Fed Ex.						RECEIVED 11/18/73 10:30 AM WASHINGTON FIELD				
Relinquished by: (Signature)	DATE	TIME	Received by: (Signature)			General Remarks:				
<i>Eugeniu Gorman</i>			<i>Christy Coker</i>			SEND BILL AND RESULT OF ANALYSIS				
Relinquished by: (Signature)	DATE	TIME	Received by: (Signature)			KARL KORTER 1000 LAKEWOOD BLVD				
						BOWNEY CA 90240				
Relinquished by: (Signature)	DATE	TIME	Received by: (Signature)			SEND COOLER + 1 COPY OF RECV				
						TO: 1250 N WILLIAMSON WAY				
						STOCKTON CA 95205				



3700 Lakeville Highway, Petaluma, CA 94954
P.O. Box 808024, Petaluma, CA 94975-8024
Telephone: (707) 763-8245
FAX (707) 763-4065

Michael Cosby
Thrifty Oil Company
10,000 Lakewood Blvd.
Downey, CA 90240

December 16, 1993

Customer Project: SS # 054
Laboratory Job: L9312025

On December 2, 1993 we received 2 sample(s) for analysis.
Samples were analyzed by the following method(s):

Benzene - Niosh 1501 (Niosh 1501)

Stella Hancock
Project Manager

Robert Peak
Laboratory Director
Robert Peak

D&M Laboratories

ANALYTICAL DATA REPORT

Prepared for: Thrifty Oil Company
Project Id: SS # 054
Sample Id: EFFLUENT
Lab Id: L9312025-1

Collected: 01-DEC-93
Received: 02-DEC-93
Reported: 14-DEC-93

Parameter	Value	Limit	Units	Extracted	Analyzed
NIOSH 1501: BENZENE					
AIR VOLUME	1.0	-	L	08-DEC-93	10-DEC-93
Front	<	0.0040	mg	08-DEC-93	10-DEC-93
Back	<	0.0040	mg	08-DEC-93	10-DEC-93
Total	<	0.0040	mg	08-DEC-93	10-DEC-93
mg/m3	<	4.0	mg/m3	08-DEC-93	10-DEC-93
BENZENE	<	1.3	ppm	08-DEC-93	10-DEC-93

D&M Laboratories

ANALYTICAL DATA REPORT

Prepared for: Thrifty Oil Company
Project Id: SS # 054
Sample Id: TRIP BLANK
Lab Id: L9312025-2

Collected: 01-DEC-93
Received: 02-DEC-93
Reported: 14-DEC-93

Parameter	Value	Limit	Units	Extracted	Analyzed
NIOSH 1501: BENZENE					
Front	<	0.0040	mg	08-DEC-93	10-DEC-93
Back	<	0.0040	mg	08-DEC-93	10-DEC-93
Total	<	0.0040	mg	08-DEC-93	10-DEC-93



3700 Lakeville Highway, Petaluma, CA 94954
 P.O. Box 80824, Petaluma, CA 94975-8024
 Telephone: (707) 763-8245 Fax: (707) 763-4065

L9312020

SAMPLE CHAIN OF CUSTODY / WORK ORDER

Phone: (310) 923-9876

Client's Name THRIFTY OIL CO.
 Address 10000 LAKEWOOD BLVD
 City, State, Zip DOWNEY CA 90240
 Client's or Representative's Signature EUGENIU GARMAN *Eugeniu Gorman*

(signature authorizes the work and terms listed below)
 All samples remain the property of the client who is responsible for disposal. A disposal fee may be imposed if client fails to pick up samples.

PROJ. NO.		PROJECT NAME					NO. OF CONTAINERS	BENZENE	REMARKS	
SAMPLERS (Signature)									LAB USE ONLY LAB NO.	
STA. NO.	DATE	TIME	COMP	GRAB	STATION LOCATION					
					SS # 054					
	12/1/93	11:30				EFFLUENT 12	1	X		
	12/1/93	11:30				TRIP BLANK	1	X		
SAMPLES RECEIVED IN GOOD CONDITION NO BROKEN OR LEAKING CONTAINERS										
								COOLER CUSTODY SEALS INTACT <input type="checkbox"/>	NOT INTACT <input type="checkbox"/>	
								COOLER TEMPERATURE <u>COLD</u> °C		
<u>2 CHAR. TUBES - Fed ex</u>										
Relinquished by: (Signature)		DATE	TIME	Received by: (Signature)			General Remarks: SEND RESULT OF ANALYZES TO: KARL KERNER 10000 LAKEWOOD BLVD DOWNEY CA 90240 PLEASE SEND COOLER + 1 COPY OF ANALYZES TO: 1250 N WILSON WAY STOCKTON CA 95205 TAXI JC			
Relinquished by: (Signature)		DATE	TIME	Received by: (Signature)						
Relinquished by: (Signature)		DATE	TIME	Received by: (Signature)						

RECEIVED
 D&L LABORATORIES
 1993 DEC -2 AM 9:32



3700 Lakeville Highway, Petaluma, CA 94954
P.O. Box 808024, Petaluma, CA 94975-8024
Telephone: (707) 763-8245
FAX (707) 763-4065

Michael Cosby
Thrifty Oil Company
10,000 Lakewood Blvd.
Downey, CA 90240

January 3, 1994

Customer Project: SS # 054
Laboratory Job: L9312165

On December 16, 1993 we received 2 sample(s) for analysis.
Samples were analyzed by the following method(s):

Benzene - Niosh 1501 (Niosh 1501)

Stella Hanes
Project Manager

Robert Peak
Laboratory Director
Robert Peak

RECEIVED
DEC 6 1994
EARTH MANAGEMENT CO

D&M Laboratories

ANALYTICAL DATA REPORT

Prepared for: Thrifty Oil Company
 Project Id: SS # 054
 Sample Id: EFFLUENT
 Lab Id: L9312165-1

Collected: 15-DEC-93
 Received: 16-DEC-93
 Reported: 30-DEC-93

Parameter	Value	Limit	Units	Extracted	Analyzed
-----------	-------	-------	-------	-----------	----------

NIOSH 1501-BENZENE

AIR	1.00	-	L	28-DEC-93	30-DEC-93
FRONT	<	0.0050	mg	28-DEC-93	30-DEC-93
BACK	<	0.0050	mg	28-DEC-93	30-DEC-93
TOTAL	<	0.0050	mg	28-DEC-93	30-DEC-93
mg/M3	<	5.0	mg/m3	28-DEC-93	30-DEC-93
BENZENE	<	1.6	ppm	28-DEC-93	30-DEC-93

D&M Laboratories

ANALYTICAL DATA REPORT

Prepared for: Thrifty Oil Company
Project Id: SS # 054
Sample Id: TRIP BLANK
Lab Id: L9312165-2

Collected: 15-DEC-93
Received: 16-DEC-93
Reported: 30-DEC-93

Parameter	Value	Limit	Units	Extracted	Analyzed
NIOSH 1501-BENZENE					
FRONT	<	0.0050	mg	28-DEC-93	30-DEC-93
BACK	<	0.0050	mg	28-DEC-93	30-DEC-93
TOTAL	<	0.0050	mg	28-DEC-93	30-DEC-93



3700 Lakeville Highway, Petaluma, CA 94954
P.O. Box 808024, Petaluma, CA 94975-8024
Telephone: (707) 763-8245
FAX (707) 763-4065

Michael Cosby
Thrifty Oil Company
10,000 Lakewood Blvd.
Downey, CA 90240

January 5, 1994

Customer Project: SS#054
Laboratory Job: L9312258

On December 30, 1993 we received 2 sample(s) for analysis.
Samples were analyzed by the following method(s):

Benzene - Niosh 1501 (Niosh 1501)

Project Manager

Laboratory Director
Robert Peak

RECEIVED

DEC 7 1994

EARTH MANAGEMENT CO.

D&M Laboratories

ANALYTICAL DATA REPORT

Prepared for: Thrifty Oil Company
 Project Id: SS#054
 Sample Id: EFFLUENT
 Lab Id: L9312258-1

Collected: 29-DEC-93
 Received: 30-DEC-93
 Reported: 05-JAN-94

Parameter	Value	Limit	Units	Extracted	Analyzed
NIOSH 1501-BENZENE					
AIR	1.00	-	L	03-JAN-94	03-JAN-94
FRONT	<	0.0050	mg	03-JAN-94	03-JAN-94
BACK	<	0.0050	mg	03-JAN-94	03-JAN-94
TOTAL	<	0.0050	mg	03-JAN-94	03-JAN-94
mg/M3	<	5.0	mg/m3	03-JAN-94	03-JAN-94
BENZENE	<	1.6	ppm	03-JAN-94	03-JAN-94

D&M Laboratories

ANALYTICAL DATA REPORT

Prepared for: Thrifty Oil Company
Project Id: SS#054
Sample Id: TRIP BLANK
Lab Id: L9312258-2

Collected: 29-DEC-93
Received: 30-DEC-93
Reported: 05-JAN-94

Parameter	Value	Unit	Extracted	Analyzed
NIOSH 1501-BENZENE				
FRONT	<	0.0050 mg	03-JAN-94	03-JAN-94
BACK	<	0.0050 mg	03-JAN-94	03-JAN-94
TOTAL	<	0.0050 mg	03-JAN-94	03-JAN-94



L9312258

3700 Lakeville Highway, Petaluma, CA 94954
 P.O. Box 808024, Petaluma, CA 94975-8024
 Telephone: (707) 763-8245 Fax: (707) 763-4065

SAMPLE CHAIN OF CUSTODY / WORK ORDER

Client's Name THRIFTY OIL CO Phone (310) 923-9876
 Address 10000 LAKEWOOD BLVD
 City, State, Zip BOWNEY CA 90240
 Client's or Representative's Signature E. GASMAN Eugenio Gasman
 (signature authorizes the work and terms listed below)

All samples remain the property of the client who is responsible for disposal. A disposal fee may be imposed if client fails to pick up samples.

PROJ. NO.		PROJECT NAME					NO. OF CONTAINERS	REMARKS				LAB USE ONLY LAB NO.
		SS # 054										
SAMPLERS (Signature)												
STA. NO.	DATE	TIME	COMP	GRAB	STATION LOCATION							
EFFLUENT	12/7/93	11:30		X	EFFLUENT 1R	1	X					
TRIP BLANK	12/7/93	11:30				1	X					
2 CH. TUBES - Fedex												

RECEIVED
 103 DEC 31 11:11:24

Relinquished by: (Signature)	DATE	TIME	Received by: (Signature)	General Remarks: COOLER CUSTODY SEALS INTACT <input type="checkbox"/> NOT INTACT <input checked="" type="checkbox"/> N/A COOLER TEMPERATURE <u>COLD</u> °C SAMPLES RECEIVED IN GOOD CONDITION NO BROKEN OR LEAKING CONTAINERS
<u>Eugenio Gasman</u>	12/7/93	12:30	<u>Christy Cokerham</u>	
Relinquished by: (Signature)	DATE	TIME	Received by: (Signature)	
Relinquished by: (Signature)	DATE	TIME	Received by: (Signature)	