

January 23, 1991²

THRIFTY OIL CO.

92-10000-1111-01

Mr. Scott O. Seary
Alameda County
Department of Environmental Health
Hazardous Materials Program
80 Swan Way, Room 200
Oakland, California 94621

RE: Thrifty Oil Co. Station #054
2504 Castro Valley Boulevard
Castro Valley, California
4th. QUARTER REPORT, 1991

Dear Mr. Seary,

This letter report presents the results of soil/groundwater treatment and site monitoring during the 4th. quarter of 1991 at the subject site. A vicinity map is presented as Figure 1. The approximate location of the on-site monitoring wells are shown on Figure 2. During the 4th. Quarter of 1991, Remediation Services Intl. (RSI) no longer operated and maintained the soil/groundwater treatment unit (RSI-SAVE system). All monitoring is to be conducted by Earth Management Co. (EMC). During the monthly site visits by EMC, a technician inspected the treatment unit and recorded any pertinent data.

treatment system operation, too?

Treatment Unit Operation

Based on the data obtained by EMC, the RSI-SAVE unit has operated a total of 5080 hours with about 172 hours of operation during the reporting period. This decrease in operational hours from last quarter is partially due to the transition of duties from RSI to EMC. A total of about 2516 gallons of water has been processed by the unit and discharged to the local sanitary sewer of this 355 gallons was processed during the quarter.

Site Monitoring and Sample Collection

The site was visited once a month by an EMC technician in order to gauge the wells and collect groundwater samples. Water levels were measured in each well from the rim of well cover using a Marine Moisture Tape (nearest 0.01 feet) capable of also measuring the presence of free floating hydrocarbons. Depth to water ranged from about 2.51 to 11.21 feet below grade. As of December, five of the twelve wells exhibited free floating product that was measurable only as a sheen or film. The depth to water data was used in conjunction with the recent survey data to determine groundwater elevations across the site. The interpretations of groundwater flow across the site during the reporting period are depicted on Figures 3, 4 and 5. In general the groundwater flow was to the east with pumping depressions noted in October and December near well RE-4, currently used for groundwater recovery.



Prior to collecting groundwater samples from the wells that did not exhibit free floating hydrocarbons, about 4 well volumes of groundwater was removed using a PVC bailer. During the purging process, the pH, conductivity and temperature were checked and recorded to insure formation water was entering the well to be sampled. About 7 to 37 gallons of water were removed from each well and stored in 55 gallon D.O.T approved drums pending disposal or discharge through the treatment unit. Groundwater samples were collected with a Teflon bailer. Samples were maintained and transported in 40 milliliter vials placed on ice pending delivery to Smith-Emery Laboratory, a state certified analytical laboratory headquartered in Los Angeles. Field monitoring sheets prepared by EMC personnel are included in Appendix A.

Analytical Results

Groundwater samples were analyzed for total hydrocarbons (TPH) and volatile aromatic compounds (BETX) using EPA methods 8015 and 8020, respectively. Copies of the laboratory analysis reports are attached in Appendix B. A summary of the results are presented in Table 1. The two down-gradient wells, RS-8 and RS-9¹⁰ indicate no detectable hydrocarbons. Iso-concentration maps of TPH and Benzene for the December sampling event are presented as Figures 6 and 7.

Closing

Thrifty will continue to monitor groundwater at the site on a monthly basis for the remainder of 1991 at which time the data will be evaluated and, if appropriate, sampling on a quarterly basis will be requested. If you have any questions please contact me or Mr. Karl Kerner at (213) 923-9876.

Very truly yours,



Peter D'Amico
Manager
Environmental Affairs

Table 1
Summary of Analytical Results
1991

Partial

I.D	Date	TPH	Benzene	Toluene	Ethyl-Benzene	Xylenes
PW-1	5/22/91	41000	600	730	250	3800
	6/19	NA	NA	NA	NA	NA
PW-2	5/22	14000	57	51	10	480
	6/19	NA	NA	NA	NA	NA
RE-1	5/22	85000	8700	10000	1800	12000
	6/19	110000	8500	9600	2600	16000
	7/17	5500	950	ND	26	ND
	8/07	NA	6700	5000	ND	7100
	9/27	60000	6800	4300	640	6900
	10/23	79000	7900	8300	450	7100
	11/06	130000	14000	15000	1100	8800
	12/04	50000	8000	4700	520	4100
RE-2	5/22	1000	5.3	3.6	4.4	8.9
	6/19	700	2.1	1.4	3.8	3.5
	7/17	880	12.0	8.0	4.3	28.0
	8/07	NA	3.8	1.6	ND	ND
	9/27	670	7.2	7.1	ND	23
	10/23	2700	52	60	22	130
	11/06	1900	18	61	9.1	83
	12/04	1100	26	47	4.3	42
RE-5	5/22	2500	330	7.8	5.6	200
	6/19	2000	59	1.6	5.1	110
	11/06	9900	2300	37	260	160
	12/04	4500	1000	27	ND	180
RE-6	5/22	8500	1700	14	24	6.7
	6/19	NA	NA	NA	NA	NA
	7/17	120000	9300	13000	2400	16000
	8/07	NA	590	5.3	ND	14
	9/27	7000	310	11	5.3	35
	11/06	4000	710	18	29	49
	12/04	4100	1100	14	33	39
	4/25/91	ND	ND	ND	ND	ND
RS-8	8/07	ND	ND	ND	ND	ND
	9/27	ND	ND	ND	ND	ND
	10/23	ND	ND	ND	ND	ND
	11/06	ND	ND	ND	ND	ND
	12/04	ND	ND	ND	ND	ND
RS9	8/07	NA	0.5	ND	330	1200
	9/27	13000	3.5	3.0	82	140
	10/23	11000	ND	ND	39	340
	11/06	6800	8.4	0.6	22	230
	12/04	6500	6.5	0.7	87	200
RS10	8/07	ND	ND	ND	ND	ND
	9/27	ND	ND	ND	ND	ND
	10/23	ND	ND	ND	ND	ND
	11/06	ND	ND	ND	ND	ND
	12/04	ND	ND	ND	ND	ND

Results reported in micrograms per liter (ug/L)

NA - Not Analyzed.

TPH - Total Petroleum Hydrocarbons as gasoline.



21161-002-044

**THRIFTY OIL
STORE #054**

DAMES & MOORE

2504 CASTRO VALLEY BLVD
CASTRO VALLEY, CA

VICINITY MAP

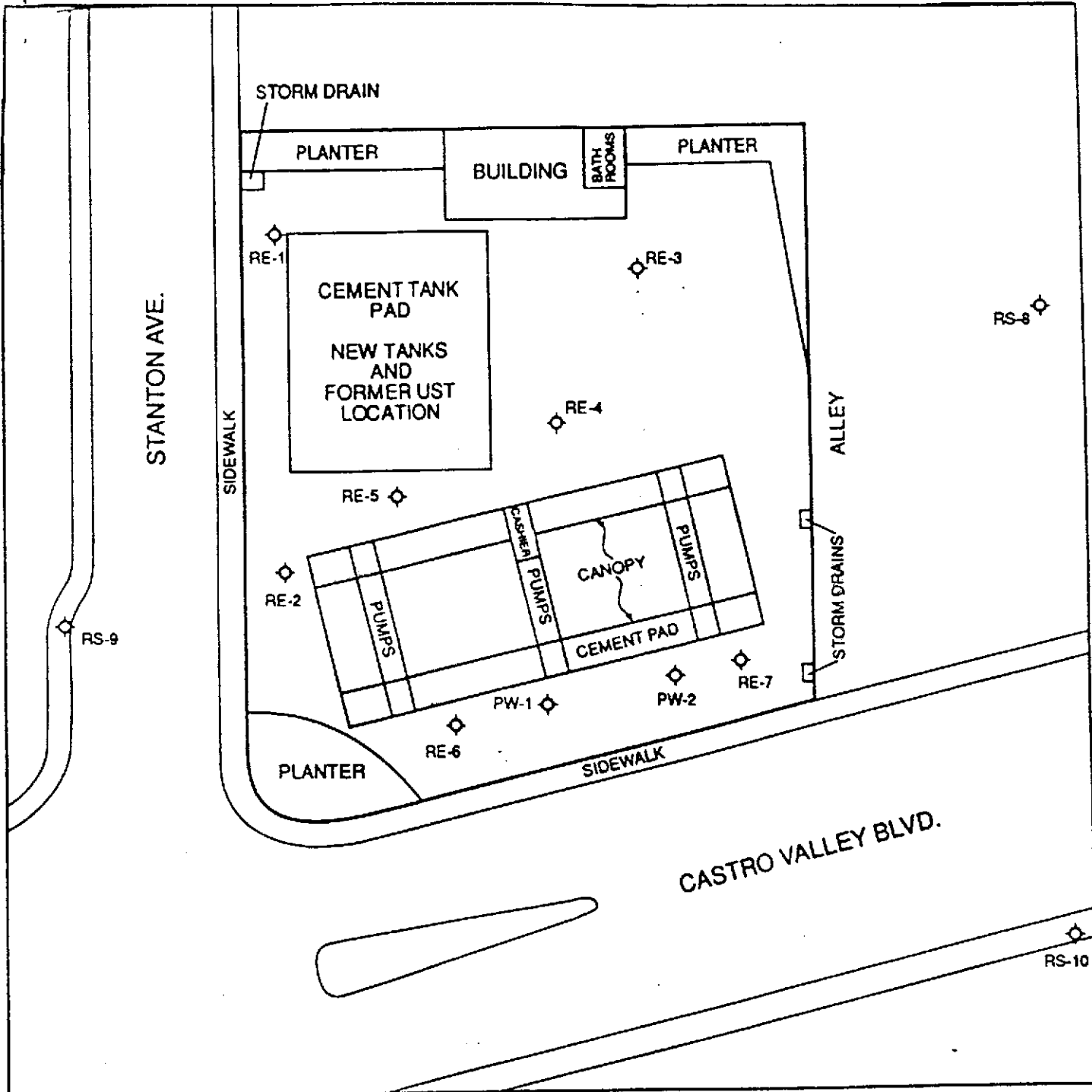

SITE PLAN II
THRIFTY OIL CO. #054
CASTRO VALLEY, CALIFORNIA
 Prepared for
THRIFTY OIL CO.
DOWNEY, CALIFORNIA

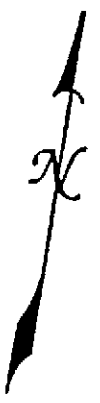

◊ EXISTING MONITORING WELL

Figure 2



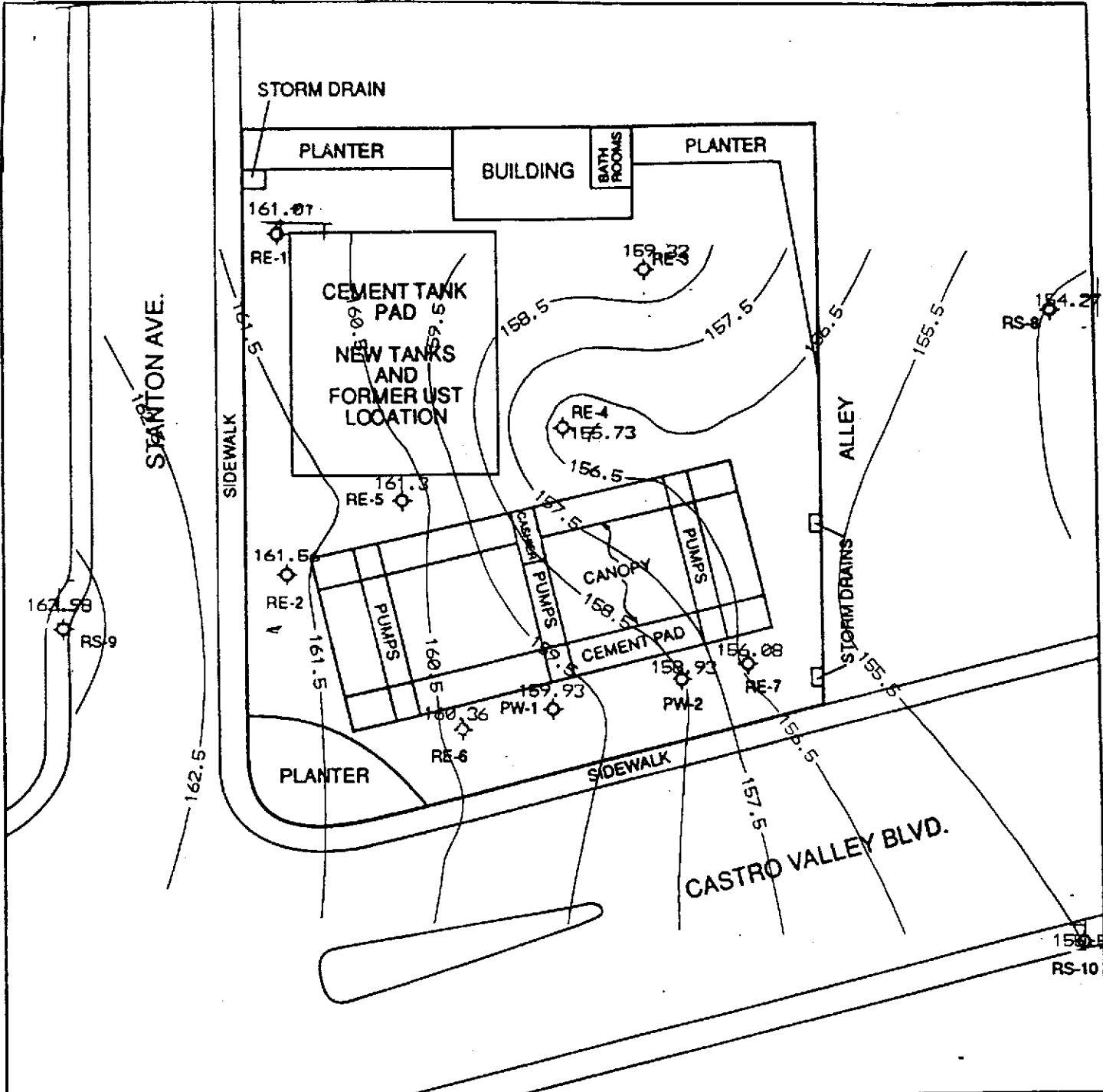

SITE PLAN II
THRIFTY OIL CO. #054
CASTRO VALLEY, CALIFORNIA
 Prepared for
THRIFTY OIL CO.
DOWNEY, CALIFORNIA

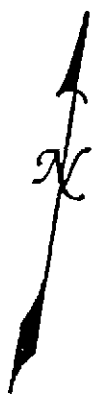

(GROUNDWATER CONTOUR
 (10-23-91)
 ◊ EXISTING MONITORING WELL

Figure 3



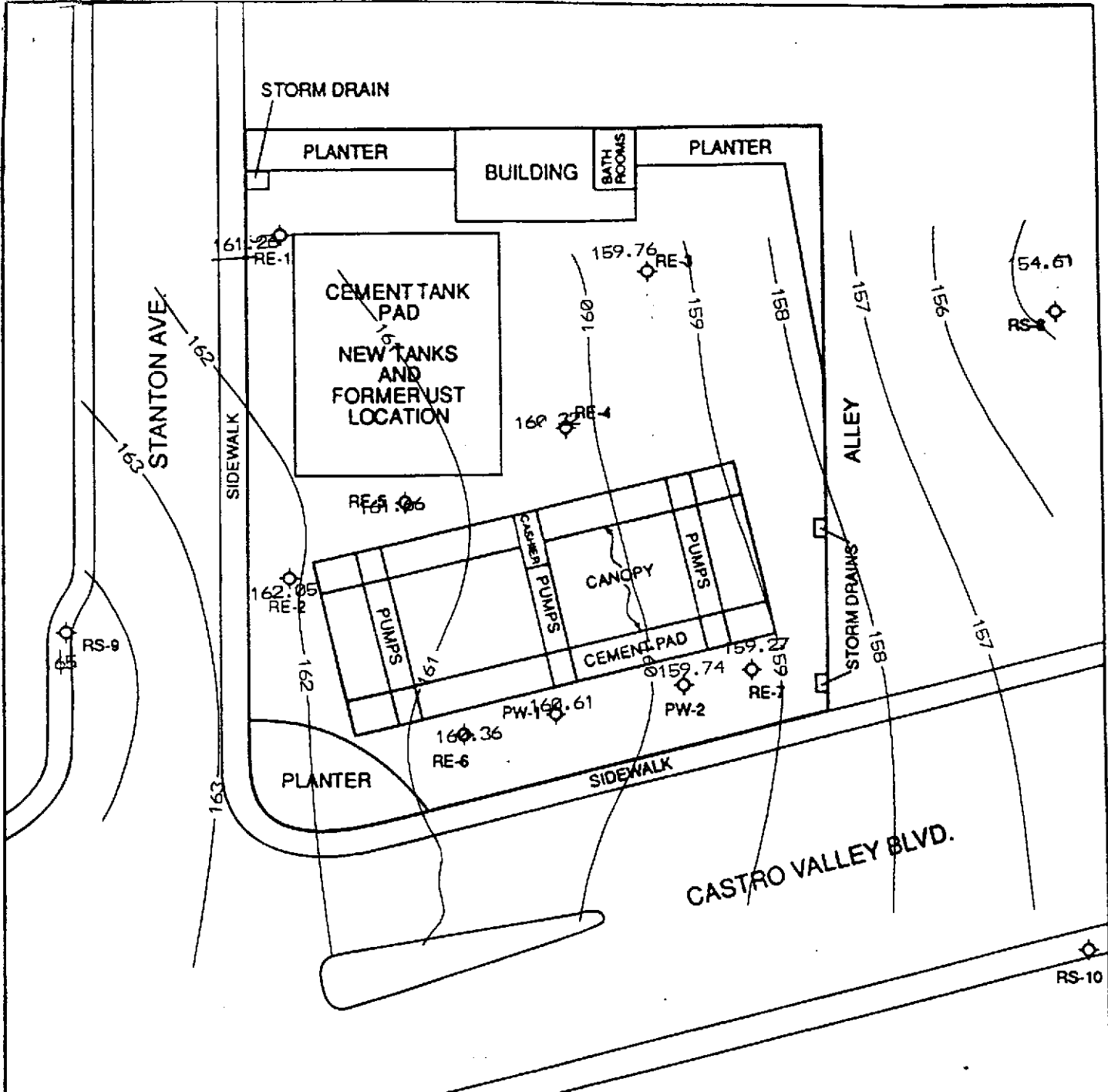

SITE PLAN II
THRIFTY OIL CO. #054
CASTRO VALLEY, CALIFORNIA
 Prepared for
THRIFTY OIL CO.
DOWNEY, CALIFORNIA



(GROUNDWATER CONTOUR
 (11/6/91)

◊ EXISTING MONITORING WELL

Figure 4



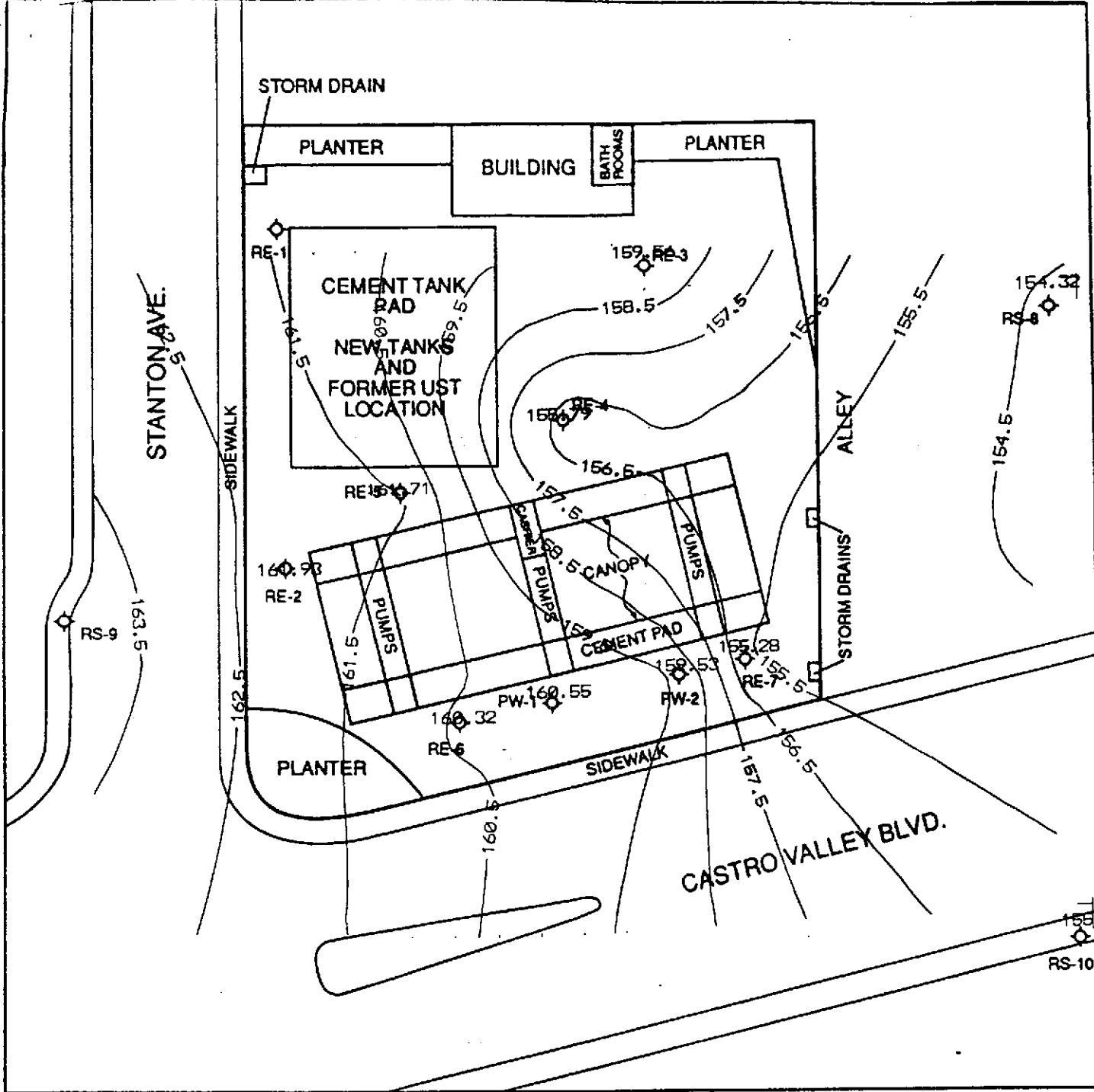

SITE PLAN II
THRIFTY OIL CO. #054
CASTRO VALLEY, CALIFORNIA
 Prepared for
THRIFTY OIL CO.
DOWNEY, CALIFORNIA



(GROUNDWATER CONTOUR
 (12-4-91)
 ◊ EXISTING MONITORING WELL

Figure 5



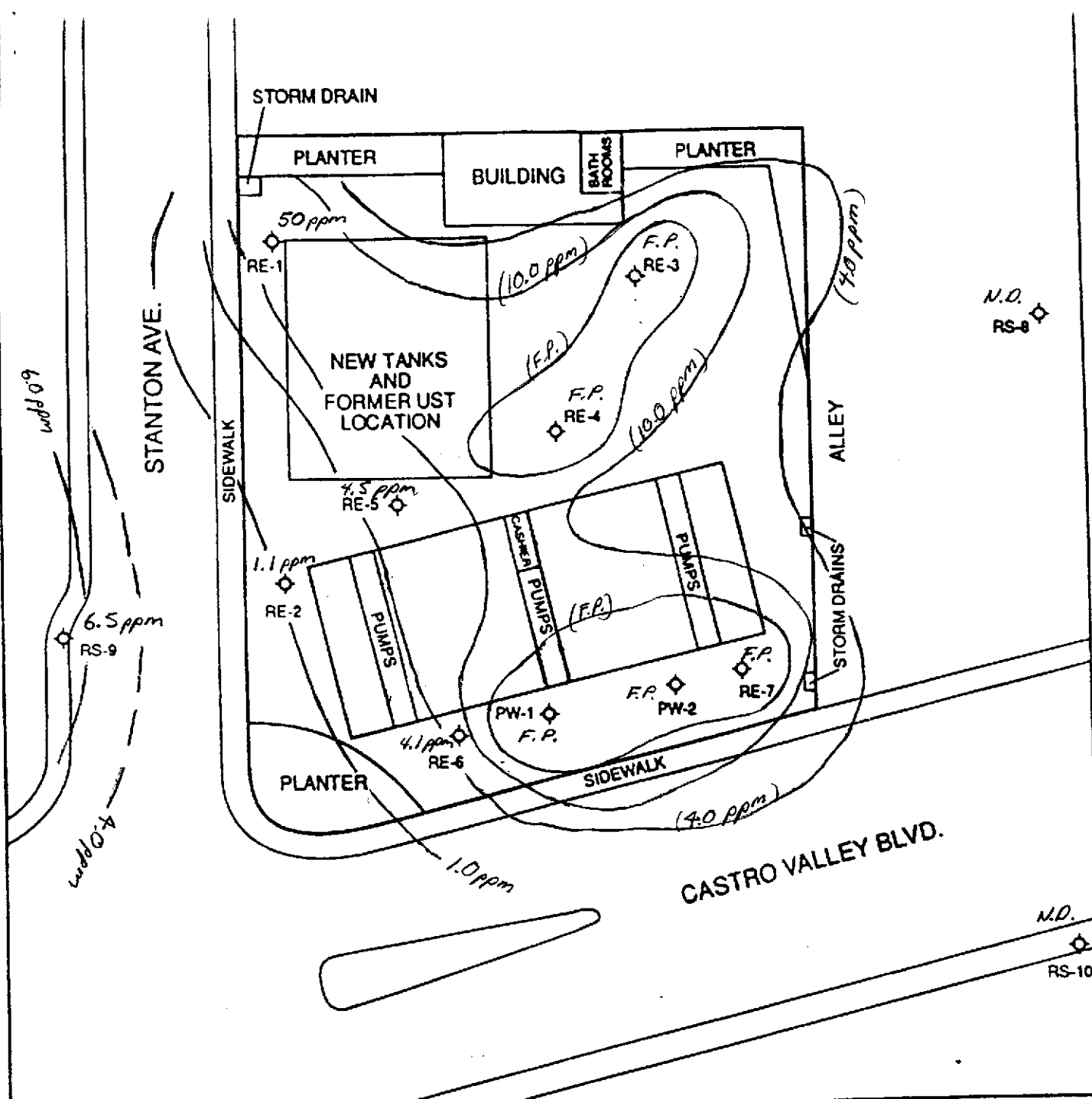

SITE PLAN II
THRIFTY OIL CO. #054
CASTRO VALLEY, CALIFORNIA
 *Prepared for
THRIFTY OIL CO.
DOWNEY, CALIFORNIA

N.D. NOT DETECTED
 F.P. - HYDROCARBON FILM
 (TPH CONTOUR, ppm
 (12-04-91)

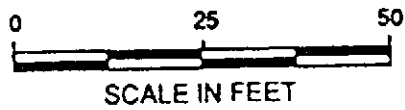

◇ EXISTING MONITORING WELL

Figure 6



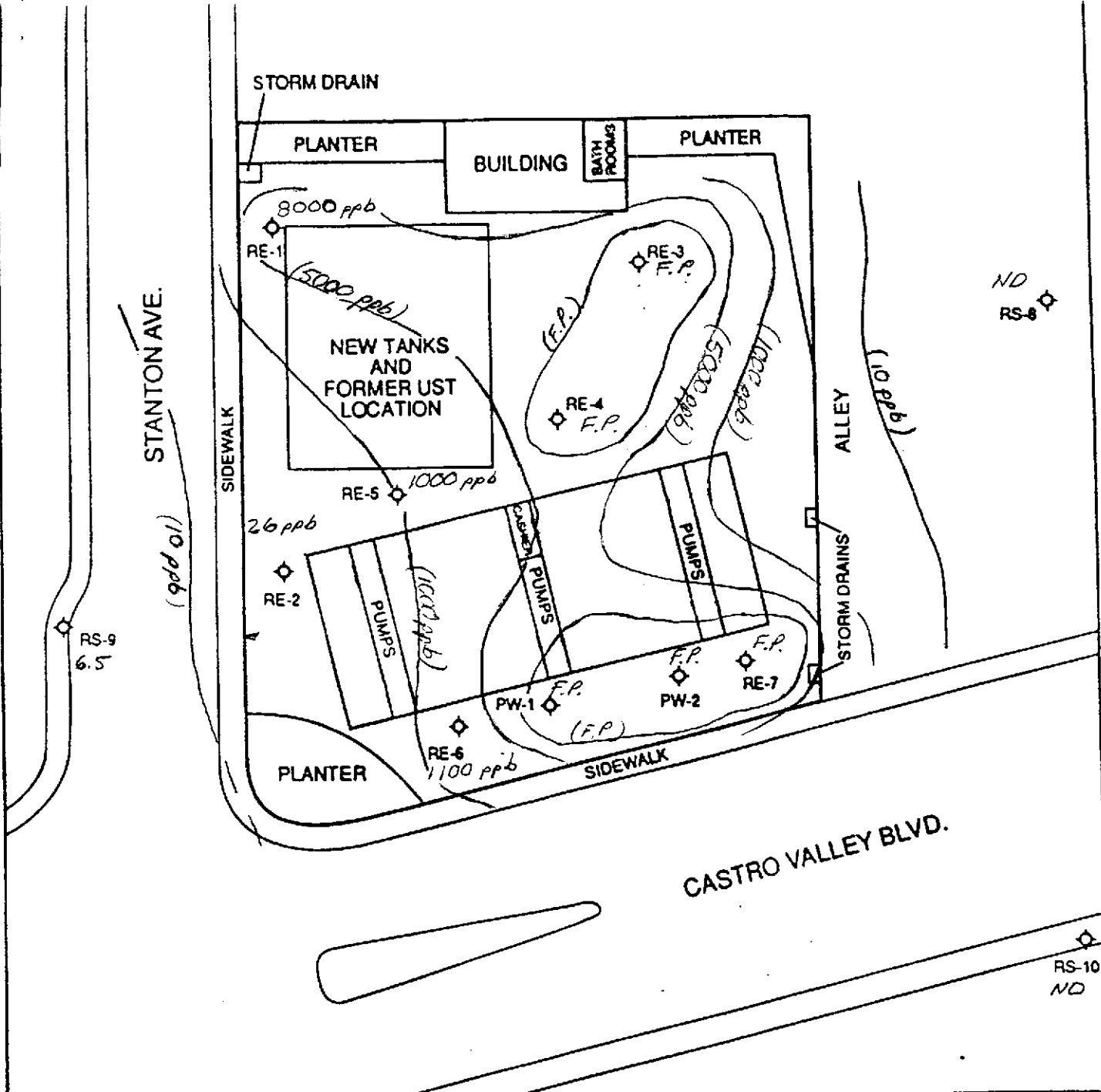

SITE PLAN II
THRIFTY OIL CO. #054
CASTRO VALLEY, CALIFORNIA
 *Prepared for
THRIFTY OIL CO.
DOWNEY, CALIFORNIA

N.D. NOT DETECTED

F.P. HYDROCARBON FILM

(BENZENE CONCENTRATION), ppb
 (12-04-91)

◇ EXISTING MONITORING WELL

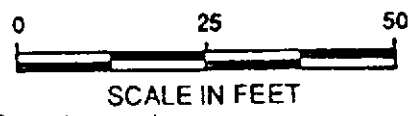

Figure 7





PROJECT STATUS REPORT
 THRIFTY OIL CO. S.S. #054
 2504 CASTRO VALLEY BLVD.
 CASTRO VALLEY, CA 94546
 DATE: 10-23-91

F R E Q .	M O N I T O R I N G				O D O R S			F R E E		W E L L S C O N N E C T E D T O S Y S T E M (W)									
	O B S E R V A T I O N W E L L S				(S = S L I G H T)			P R O D U C T		C O N N E C T		I N T E G R I T Y		V A P O R		W A T E R			
	NO.	DTW	DTP	PT	YES	NO	S	YES	NO	YES	NO	YES	NO	OK	NO	ON	OFF	ON	OFF
M	PW-1	6.53	SHEEN		-	-	X	-	X	X	-	X	-	X	-	X	-	-	-
M	PW-2	7.25	SHEEN		-	-	X	-	X	X	-	X	-	X	-	X	-	-	-
M	RE-1	5.81			-	X	-	-	X	X	-	X	-	X	-	X	-	-	-
M	RE-2	5.63			-	X	-	-	X	X	-	X	-	X	-	X	-	-	-
M	RE-3	8.07	SHEEN		-	-	X	-	X	X	-	X	-	X	-	X	-	-	-
M	RE-4	11.21	FILM		X	-	-	X	-	X	-	X	-	X	-	X	X	-	-
M	RE-5	5.84	SHEEN		-	-	X	-	X	X	-	X	-	X	-	X	-	-	-
M	RE-6	6.36	SHEEN		-	-	X	-	X	X	-	X	-	X	-	X	-	-	-
M	RE-7	9.96	FILM		X	-	-	X	-	X	-	X	-	X	-	X	-	X	-
M	RS-8	10.05			-	X	-	-	X	-	X	-	X	-	-	-	-	-	-
M	RS-9	3.53			-	X	-	-	X	-	X	-	X	-	-	-	-	-	-
M	RS-10	7.37			-	X	-	-	X	-	X	-	X	-	-	-	-	-	-

S A V E S Y S T E M W E E K L Y

PARAMETER	U/M	DATA	PARAMETER	U/M	DATA
TIME	AM/PM	11:30AM	AIR FLOW	C F M	12
WORKING	YES/NO	NO	VAPOR FLOW	C F M	15
RESTARTED	YES/NO	YES	FUEL FLOW	C F M/H	5.5
HOURS	#	1786	WELL VACUUM	IN H2O	24
ENGINE ROT.	RPM	1800	L P G TANKS	%	#1: 40
ENGINE VACUUM	IN HG	5	GAS METER READING	-	N/A
TANK VACUUM	IN HG	5	WATER FLOWMETER	GALL.	2345

EXHAUST (By others)					
INLET TO ENGINE					

MAINTENANCE ES/100/400/800 FOR SPECIFIC OPERATIONS SEE FIELD RECORD

W A T E R S A M P L I N G - C H E C K () W H E N D O N E

EFFLUENT	INFLUENT	WELLS
()	()	() Q.-SEE C.CUST.

REMARKS:
 FREE PRODUCT REMOVED: APPROX. GALLONS WATER REMOVED: APPROX. GALLONS
 DATA RECORDED BY : EUGENIU GASMAN INPUT BY: R.K. >\FF\054rsirt

FIELD DATA - GROUNDWATER WELL SAMPLING PROGRAM

DATE 10.23.1991 STATION NO. 054
 PERSONNEL E. GARMAN, T. ROFU
 WELL NO. RE. 2 WEATHER SUNNY
 SAMPLE EQUIPMENT TEFLON BAITER

Before Sampling

Total Well Depth 17.10 Ft. Well Diameter 4"
 Depth to Water 5.63 Ft. Purge Volume 30 gallons

Sampling Data

Time	<u>1:30</u>	<u>1:35</u>	<u>1:40</u>	<u>1:45</u>	<u>1:50</u>	<u>2:00</u>	_____
EC	<u>960</u>	<u>980</u>	<u>980</u>	<u>990</u>	<u>990</u>	<u>990</u>	_____
pH	<u>7.60</u>	<u>7.50</u>	<u>7.28</u>	<u>7.20</u>	<u>7.20</u>	<u>7.20</u>	_____
Temp	<u>71.5</u>	<u>71.5</u>	<u>71</u>	<u>70</u>	<u>70</u>	<u>69.5</u>	_____
Gal.	<u>5</u>	<u>10</u>	<u>15</u>	<u>20</u>	<u>25</u>	<u>30</u>	_____
Time	_____	_____	_____	_____	_____	_____	_____
EC	_____	_____	_____	_____	_____	_____	_____
pH	_____	_____	_____	_____	_____	_____	_____
Temp	_____	_____	_____	_____	_____	_____	_____
Gal.	_____	_____	_____	_____	_____	_____	_____

After Sampling

Depth to Water 6.31 Ft. Total Well Depth 17.10 Ft.

FIELD DATA - GROUNDWATER WELL SAMPLING PROGRAM

DATE 10.23.1991 STATION NO. 054
 PERSONNEL E. GARMAN, T. ROLO
 WELL NO. RE 1 WEATHER SUNNY
 SAMPLE EQUIPMENT TEFLON BAILER

Before Sampling

Total Well Depth 19.85 Ft. Well Diameter 4"
 Depth to Water 5.81 Ft. Purge Volume 36 gallons

Sampling Data

	<u>12:20</u>	<u>12:25</u>	<u>12:30</u>	<u>12:35</u>	<u>12:40</u>	<u>12:45</u>	<u>12:50</u>
Time	<u>12:20</u>	<u>12:25</u>	<u>12:30</u>	<u>12:35</u>	<u>12:40</u>	<u>12:45</u>	<u>12:50</u>
EC	<u>980</u>	<u>970</u>	<u>960</u>	<u>920</u>	<u>910</u>	<u>900</u>	<u>900</u>
pH	<u>7.3</u>	<u>7.2</u>	<u>7.15</u>	<u>7.06</u>	<u>7.07</u>	<u>7.06</u>	<u>7.06</u>
Temp	<u>71.9</u>	<u>71.5</u>	<u>71.5</u>	<u>71.5</u>	<u>71.5</u>	<u>71.5</u>	<u>71.5</u>
Gal.	<u>5</u>	<u>10</u>	<u>15</u>	<u>20</u>	<u>25</u>	<u>30</u>	<u>36</u>
Time	_____	_____	_____	_____	_____	_____	_____
EC	_____	_____	_____	_____	_____	_____	_____
pH	_____	_____	_____	_____	_____	_____	_____
Temp	_____	_____	_____	_____	_____	_____	_____
Gal.	_____	_____	_____	_____	_____	_____	_____

After Sampling

Depth to Water 6.10 Ft. Total Well Depth 19.85 Ft.

FIELD DATA - GROUNDWATER WELL SAMPLING PROGRAM

DATE 10.23.1991 STATION NO. 054
PERSONNEL E. GARMAN. T. ROFU
WELL NO. RS-8 WEATHER SUNNY
SAMPLE EQUIPMENT TEFLON BAILER

Before Sampling

Total Well Depth 25.20 Ft. Well Diameter 2"
Depth to Water 10.05 Ft. Purge Volume 10 gallons

Sampling Data

	<u>11:30</u>	<u>11:35</u>	<u>11:40</u>	<u>11:45</u>	<u>11:50</u>		
Time	<u>11:30</u>	<u>11:35</u>	<u>11:40</u>	<u>11:45</u>	<u>11:50</u>		
EC	<u>1020</u>	<u>1030</u>	<u>1040</u>	<u>1040</u>	<u>1040</u>		
pH	<u>7.50</u>	<u>7.40</u>	<u>7.37</u>	<u>7.34</u>	<u>7.34</u>		
Temp	<u>70.4</u>	<u>70.2</u>	<u>69.5</u>	<u>69</u>	<u>69</u>		
Gal.	<u>2</u>	<u>4</u>	<u>6</u>	<u>8</u>	<u>10</u>		
Time							
EC							
pH							
Temp							
Gal.							

After Sampling

Depth to Water 11.00 Ft. Total Well Depth 25.20 Ft.

FIELD DATA - GROUNDWATER WELL SAMPLING PROGRAM

DATE 10.23.1991 STATION NO. 054
 PERSONNEL F. GARMAN, T. ROJU
 WELL NO. RS. 9 WEATHER SUNNY
 SAMPLE EQUIPMENT BAILER TEFLOIN

Before Sampling

Total Well Depth 15 Ft. Well Diameter 2"
 Depth to Water 3.53 Ft. Purge Volume 7 gallons

Sampling Data

	<u>10:45</u>	<u>10:50</u>	<u>10:55</u>	<u>11:00</u>	<u>11:05</u>		
Time	<u>10:45</u>	<u>10:50</u>	<u>10:55</u>	<u>11:00</u>	<u>11:05</u>		
EC	<u>770</u>	<u>740</u>	<u>740</u>	<u>740</u>	<u>740</u>		
pH	<u>7.93</u>	<u>7.56</u>	<u>7.42</u>	<u>7.42</u>	<u>7.42</u>		
Temp	<u>70</u>	<u>69.6</u>	<u>69.5</u>	<u>69</u>	<u>69</u>		
Gal.	<u>3</u>	<u>4</u>	<u>5</u>	<u>6</u>	<u>7</u>		
Time							
EC							
pH							
Temp							
Gal.							

After Sampling

Depth to Water 4.05 Ft. Total Well Depth 15 Ft.

FIELD DATA - GROUNDWATER WELL SAMPLING PROGRAM

DATE 10.23.1991 STATION NO. 054
PERSONNEL E. GARMAN, T. ROE
WELL NO. RS-10 WEATHER SUNNY
SAMPLE EQUIPMENT TEFLON BAILER

Before Sampling

Total Well Depth 24.45 Ft. Well Diameter 2"
Depth to Water 7.37 Ft. Purge Volume 11 gallons

Sampling Data

Time	10:05	10:10	10:15	10:20	10:25		
EC	3600	3620	3680	3690	3690		
pH	7.17	7.22	7.33	7.33	7.33		
Temp	68	67.5	67	67	67		
Gal.	3	5	7	9	11		
Time							
EC							
pH							
Temp							
Gal.							

After Sampling

Depth to Water 8.05 Ft. Total Well Depth 24.45 Ft.



PROJECT STATUS REPORT
 THRIFTY OIL CO. S.S. #054
 2504 CASTRO VALLEY BLVD.
 CASTRO VALLEY, CA 94546
 DATE: _____

FREQUENCY	MONITORING				ODORS			FREE		WELLS CONNECTED TO SYSTEM (W)							
	OBSERVATION WELLS				(S=SLIGHT)			PRODUCT		CONNECT		INTEGRITY		VAPOR		WATER	
	NO.	DTW	DTP	PT	YES	NO	S	YES	NO	YES	NO	OK	NO	ON	OFF	ON	OFF
M	PW-1	5.85	SHEEN		-	-	X	-	X	X	-	X	-			-	-
M	PW-2	6.44	SHEEN		-	-	X	-	X	X	-	X	-			-	-
M	RE-1	5.56			-	X	-	-	X	X	-	X	-			-	-
M	RE-2	5.14			-	X	-	-	X	X	-	X	-			-	-
M	RE-3	7.63	FILM		X	-	-	X	-	X	-	X	-			-	-
M	RE-4	6.62	FILM		X	-	-	X	-	X	-	X	-			X	-
M	RE-5	5.48			-	X	-	-	X	X	-	X	-			-	-
M	RE-6	6.15			-	X	-	-	X	X	-	X	-			-	-
M	RE-7	6.77	FILM		X	-	-	X	-	X	-	X	-			X	-
M	RS-8	9.71			-	X	-	-	X	-	X	-			-	-	-
M	RS-9	2.51			-	X	-	-	X	-	X	-			-	-	-
M	RS-10	6.44			-	X	-	-	X	-	X	-			-	-	-

SAVE SYSTEM WEEKLY

PARAMETER	U/M	DATA	PARAMETER	U/M	DATA
TIME	AM/PM	11:00AM	AIR FLOW	C F M	12
	YES/NO		VAPOR FLOW	C F M	14
	YES/NO		FUEL FLOW	C F M/H	5.5
HOURS	#	1789	WELL VACUUM	IN H2O	20
ENGINE ROT.	RPM	1800	L P G TANKS	%	#1: 35
ENGINE VACUUM	IN HG	5	GAS METER READING	-	N/A
TANK VACUUM	IN HG	5	WATER FLOWMETER	GALL.	2346

EXHAUST (By others)					
INLET TO ENGINE					

MAINTENANCE ES/100/400/800 FOR SPECIFIC OPERATIONS SEE FIELD RECORD

WATER SAMPLING - CHECK () WHEN DONE

EFFLUENT	INFLUENT	WELLS
()	()	() Q.-SEE C.CUST.

REMARKS: _____

FREE PRODUCT REMOVED: APPROX. _____ GALLONS WATER REMOVED: APPROX. _____ GALLONS

DATA RECORDED BY : EUGENIU GASMAN INPUT BY: R.K. >\FF\054rsirt

FIELD DATA - GROUNDWATER WELL SAMPLING PROGRAM

DATE 11.06.91 STATION NO. 054
 PERSONNEL EUGENIO GASMAN, ROSU TIBERIUS
 WELL NO. RE1 WEATHER SUNNY
 SAMPLE EQUIPMENT TEFLON BAILER

Before Sampling

Total Well Depth 19.85 Ft. Well Diameter 4"
 Depth to Water 5.56 Ft. Purge Volume 37 gallons

Sampling Data

Time	<u>10:50</u>	<u>10:53</u>	<u>10:56</u>	<u>10:50</u>	<u>11:01</u>	<u>11:04</u>	<u>11:10</u>
EC	<u>770</u>	<u>750</u>	<u>750</u>	<u>750</u>	<u>750</u>	<u>750</u>	<u>750</u>
pH	<u>7.30</u>	<u>7.30</u>	<u>7.30</u>	<u>7.28</u>	<u>7.28</u>	<u>7.28</u>	<u>7.28</u>
Temp	<u>73</u>	<u>72</u>	<u>69</u>	<u>68</u>	<u>68</u>	<u>68</u>	<u>68</u>
Gal.	<u>5</u>	<u>10</u>	<u>15</u>	<u>20</u>	<u>25</u>	<u>30</u>	<u>37</u>
Time	_____	_____	_____	_____	_____	_____	_____
EC	_____	_____	_____	_____	_____	_____	_____
pH	_____	_____	_____	_____	_____	_____	_____
Temp	_____	_____	_____	_____	_____	_____	_____
Gal.	_____	_____	_____	_____	_____	_____	_____

After Sampling

Depth to Water 6.21 Ft. Total Well Depth 19.85 Ft.

FIELD DATA - GROUNDWATER WELL SAMPLING PROGRAM

DATE 11.06.91 STATION NO. 054
 PERSONNEL ROSU TIBERIUS, EUGENIU GASMAN
 WELL NO. RE2 WEATHER SUNNY
 SAMPLE EQUIPMENT TEFLON BAILER

Before Sampling

Total Well Depth 17.10 Ft. Well Diameter 4"
 Depth to Water 5.14 Ft. Purge Volume 31 gallons

Sampling Data

Time	<u>11:30</u>	<u>11:32</u>	<u>11:35</u>	<u>11:38</u>	<u>11:41</u>	<u>11:45</u>	_____
EC	<u>830</u>	<u>820</u>	<u>810</u>	<u>800</u>	<u>800</u>	<u>800</u>	_____
pH	<u>7.50</u>	<u>7.38</u>	<u>7.33</u>	<u>7.33</u>	<u>7.33</u>	<u>7.33</u>	_____
Temp	<u>73</u>	<u>72</u>	<u>72</u>	<u>72</u>	<u>72</u>	<u>72</u>	_____
Gal.	<u>5</u>	<u>10</u>	<u>15</u>	<u>20</u>	<u>25</u>	<u>31</u>	_____
Time	_____	_____	_____	_____	_____	_____	_____
EC	_____	_____	_____	_____	_____	_____	_____
pH	_____	_____	_____	_____	_____	_____	_____
Temp	_____	_____	_____	_____	_____	_____	_____
Gal.	_____	_____	_____	_____	_____	_____	_____

After Sampling

Depth to Water _____ Ft. Total Well Depth _____ Ft.

FIELD DATA - GROUNDWATER WELL SAMPLING PROGRAM

DATE 11.06.91 STATION NO. 054
 PERSONNEL ROSU TIBERIUS, EUGENIU GASMAN
 WELL NO. REG WEATHER SUNNY
 SAMPLE EQUIPMENT TEFLON BAILER

Before Sampling

Total Well Depth 13.65 Ft. Well Diameter 4"
 Depth to Water 6.15 Ft. Purge Volume 20 gallons

Sampling Data

Time	<u>10:30</u>	<u>10:33</u>	<u>10:36</u>	<u>10:39</u>	<u>10:42</u>	_____	_____
EC	<u>870</u>	<u>870</u>	<u>870</u>	<u>870</u>	<u>870</u>	_____	_____
pH	<u>7.70</u>	<u>7.30</u>	<u>7.13</u>	<u>7.13</u>	<u>7.13</u>	_____	_____
Temp	<u>73</u>	<u>72</u>	<u>71</u>	<u>71</u>	<u>71</u>	_____	_____
Gal.	<u>4</u>	<u>8</u>	<u>12</u>	<u>16</u>	<u>20</u>	_____	_____
Time	_____	_____	_____	_____	_____	_____	_____
EC	_____	_____	_____	_____	_____	_____	_____
pH	_____	_____	_____	_____	_____	_____	_____
Temp	_____	_____	_____	_____	_____	_____	_____
Gal.	_____	_____	_____	_____	_____	_____	_____

After Sampling

Depth to Water 6.90 Ft. Total Well Depth 13.65 Ft.

FIELD DATA - GROUNDWATER WELL SAMPLING PROGRAM

DATE 11.06.91 STATION NO. 054
PERSONNEL EUGENIU GASMAN, ROSU TIBERIUS
WELL NO. R58 WEATHER SUNNY
SAMPLE EQUIPMENT TEFLON BAILER

Before Sampling

Total Well Depth 25.20 Ft. Well Diameter 2"
Depth to Water 9.71 Ft. Purge Volume 10 gallons

Sampling Data

Time	9:25	9:30	9:35	9:40	9:45		
EC	1000	880	880	880	880		
pH	7.38	7.36	7.34	7.35	7.34		
Temp	72	71	69	69	69		
Gal.	2	4	6	8	10		
Time							
EC							
pH							
Temp							
Gal.							

After Sampling

Depth to Water 10.10 Ft. Total Well Depth 25.20 Ft.

FIELD DATA - GROUNDWATER WELL SAMPLING PROGRAM

DATE 11.06.91 STATION NO. 054
PERSONNEL EUGEN W. GARMAN, ROSU TIBERIUS
WELL NO. R59 WEATHER SUNNY
SAMPLE EQUIPMENT TEFLON BAIER

Before Sampling

Total Well Depth 15 Ft. Well Diameter 2"
Depth to Water 2.51 Ft. Purge Volume 8 gallons

Sampling Data

Time	9:00	9:05	9:10	9:15			
EC	<u>610</u>	<u>600</u>	<u>600</u>	<u>600</u>			
pH	<u>7.79</u>	<u>7.62</u>	<u>7.62</u>	<u>7.60</u>			
Temp	<u>71</u>	<u>70</u>	<u>70</u>	<u>70</u>			
Gal.	<u>2</u>	<u>4</u>	<u>6</u>	<u>8</u>			
Time							
EC							
pH							
Temp							
Gal.							

After Sampling

Depth to Water 3.17 Ft. Total Well Depth 15 Ft.

FIELD DATA - GROUNDWATER WELL SAMPLING PROGRAM

DATE 11.06.1991 STATION NO. 054
PERSONNEL E. GARMAN, T. ROJU
WELL NO. RS. 10 WEATHER SUNNY
SAMPLE EQUIPMENT TEFLON BAILER

Before Sampling

Total Well Depth 24.45 Ft. Well Diameter 2"
Depth to Water 6.44 Ft. Purge Volume 12 gallons

Sampling Data

Time	9:55	10:00	10:05	10:10	10:15	10:20	
EC	3080	3070	3080	3070	3070	3070	
pH	7.54	7.32	7.31	7.30	7.30	7.30	
Temp	71	70.5	70	69	69	69	
Gal.	2	4	6	8	10	12	
Time							
EC							
pH							
Temp							
Gal.							

After Sampling

Depth to Water 7.05 Ft. Total Well Depth 24.45 Ft.

FIELD DATA - GROUNDWATER WELL SAMPLING PROGRAM

DATE 11.06.91 STATION NO. 054
PERSONNEL ROSU TIBERIUS, EUGENIU GASMAN
WELL NO. REF WEATHER SUNNY
SAMPLE EQUIPMENT TEFLON BAILER

Before Sampling

Total Well Depth 18.25 Ft. Well Diameter 4"
Depth to Water 5.48 Ft. Purge Volume 33 gallons

Sampling Data

Time	<u>11:55</u>	<u>11:58</u>	<u>12:01</u>	<u>12:04</u>	<u>12:07</u>	<u>12:10</u>	<u>12:15</u>
EC	<u>720</u>	<u>720</u>	<u>720</u>	<u>720</u>	<u>720</u>	<u>720</u>	<u>720</u>
pH	<u>7.55</u>	<u>7.40</u>	<u>7.35</u>	<u>7.35</u>	<u>7.35</u>	<u>7.35</u>	<u>7.35</u>
Temp	<u>71</u>	<u>71</u>	<u>70</u>	<u>69.5</u>	<u>69</u>	<u>69</u>	<u>69</u>
Gal.	<u>5</u>	<u>10</u>	<u>15</u>	<u>20</u>	<u>25</u>	<u>30</u>	<u>33</u>
Time	_____	_____	_____	_____	_____	_____	_____
EC	_____	_____	_____	_____	_____	_____	_____
pH	_____	_____	_____	_____	_____	_____	_____
Temp	_____	_____	_____	_____	_____	_____	_____
Gal.	_____	_____	_____	_____	_____	_____	_____

After Sampling

Depth to Water 6.40 Ft. Total Well Depth 18.25 Ft.



PROJECT STATUS REPORT
 THRIFTY OIL CO. S.S. #054
 2504 CASTRO VALLEY BLVD.
 CASTRO VALLEY, CA 94546
 DATE: ~~XXXXXXXXXX~~

F R E E Q .	MONITORING				ODORS			FREE		WELLS CONNECTED TO SYSTEM (W)							
	OBSERVATION WELLS				(S=SLIGHT)			PRODUCT		CONNECT		INTEGRITY		VAPOR		WATER	
	NO.	DTW	DTP	PT	YES	NO	S	YES	NO	YES	NO	OK	NO	ON	OFF	ON	OFF
M	PW-1	5.91	SHEEN		-	-	X	-	X	X	-	X	-			-	-
M	PW-2	6.65	Filem		-	-	X	-	X	X	-	X	-			-	-
M	RE-1	5.35			-	X	-	-	X	X	-	X	-			-	-
M	RE-2	5.26			-	X	-	-	X	X	-	X	-			-	-
M	RE-3	7.83	SHEEN		-	-	X	-	X	X	-	X	-			-	-
M	RE-4	11.15	Filem		X	-	-	-	X	X	-	X	-			X	-
M	RE-5	5.43			-	X	-	-	X	X	-	X	-			-	-
M	RE-6	6.19			-	X	-	-	X	X	-	X	-			X	-
M	RE-7	10.76	Filem		X	-	-	-	X	X	-	X	-			-	-
M	RS-8	10.00			-	X	-	-	X	-	X	-	-	-	-	-	-
M	RS-9	3.20			-	X	-	-	X	-	X	-	-	-	-	-	-
M	RS-10	7.02			-	X	-	-	X	-	X	-	-	-	-	-	-

SAVE SYSTEM WEEKLY

PARAMETER	U/M	DATA	PARAMETER	U/M	DATA
TIME	AM/PM	10:30E	AIR FLOW	C F M	12
WATER	YES/NO	XXXXXX	VAPOR FLOW	C F M	14
REMOVED	YES/NO	XXXXXX	FUEL FLOW	C F M/H	5.5
HOURS	#	1896	WELL VACUUM	IN H2O	18
ENGINE ROT.	RPM	1800	L P G TANKS	%	#1: 65
ENGINE VACUUM	IN HG	6	GAS METER READING	-	N/A
TANK VACUUM	IN HG	5	WATER FLOWMETER	GALL.	251.65

EXHAUST (By others) _____

INLET TO ENGINE _____

MAINTENANCE ES/100/400/800 _____ FOR SPECIFIC OPERATIONS SEE FIELD RECORD

WATER SAMPLING - CHECK () WHEN DONE

EFFLUENT	INFLUENT	WELLS
() _____	() _____	() Q.-SEE C.CUST.

REMARKS: _____

FREE PRODUCT REMOVED: APPROX. _____ GALLONS WATER REMOVED: APPROX. 150 GALLONS

DATA RECORDED BY: E. GARMAN INPUT BY: M.M. >\FF\054rsirt

FIELD DATA - GROUNDWATER WELL SAMPLING PROGRAM

DATE 12.4.1991 STATION NO. 054
PERSONNEL E. GASMAN, T. ROSU
WELL NO. RS 3 WEATHER SUNNY
SAMPLE EQUIPMENT TEFLON BAILER

Before Sampling

Total Well Depth 25.20 Ft. Well Diameter 2"
Depth to Water 10 Ft. Purge Volume 10 gallons

Sampling Data

Time	9:20	9:25	9:30	9:35	9:40		
EC	1270	1270	1270	1270	1270		
pH	7.55	7.63	7.68	7.68	7.68		
Temp	64.5	64.2	64	64	64		
Gal.	2	4	6	8	10		
Time							
EC							
pH							
Temp							
Gal.							

After Sampling

Depth to Water 12 Ft. Total Well Depth 25.20 Ft.

FIELD DATA - GROUNDWATER WELL SAMPLING PROGRAM

DATE 12.4.1991 STATION NO. 054
PERSONNEL E. GARMANI, T. ROSU
WELL NO. RS.10 WEATHER SUNNY
SAMPLE EQUIPMENT TEFLON BAILER

Before Sampling

Total Well Depth 24.45 Ft. Well Diameter 2"
Depth to Water 7.02 Ft. Purge Volume 11 gallons

Sampling Data

Time	9.55	10.00	10.05	10.10	10.15		
EC	4620	4800	4800	4800	4800		
pH	7.72	7.33	7.26	7.26	7.26		
Temp	66	65.7	65.4	65.4	65.4		
Gal.	2	4	6	8	11		
Time							
EC							
pH							
Temp							
Gal.							

After Sampling

Depth to Water 8.27 Ft. Total Well Depth 24.45 Ft.

FIELD DATA - GROUNDWATER WELL SAMPLING PROGRAM

DATE 12.4.1991 STATION NO. 054
 PERSONNEL F. GARMAN, T. ROJU
 WELL NO. RS.9 WEATHER SUNNY
 SAMPLE EQUIPMENT TEFLON BAILER

Before Sampling

Total Well Depth 15 Ft. Well Diameter 2"
 Depth to Water 3.20 Ft. Purge Volume 8 gallons

Sampling Data

Time	<u>10:30</u>	<u>10:35</u>	<u>10:40</u>	<u>10:45</u>	_____	_____	_____
EC	<u>1030</u>	<u>900</u>	<u>900</u>	<u>900</u>	_____	_____	_____
pH	<u>7.69</u>	<u>7.69</u>	<u>7.69</u>	<u>7.69</u>	_____	_____	_____
Temp	<u>61.8</u>	<u>61.4</u>	<u>61.4</u>	<u>61.4</u>	_____	_____	_____
Gal.	<u>2</u>	<u>4</u>	<u>6</u>	<u>3</u>	_____	_____	_____
Time	_____	_____	_____	_____	_____	_____	_____
EC	_____	_____	_____	_____	_____	_____	_____
pH	_____	_____	_____	_____	_____	_____	_____
Temp	_____	_____	_____	_____	_____	_____	_____
Gal.	_____	_____	_____	_____	_____	_____	_____

After Sampling

Depth to Water 5.00 Ft. Total Well Depth 15 Ft.

FIELD DATA - GROUNDWATER WELL SAMPLING PROGRAM

DATE 12.4.1991 STATION NO. 054
 PERSONNEL F. GASMAN, T. ROSE
 WELL NO. RE 1 WEATHER SUNNY
 SAMPLE EQUIPMENT TEFLON BAILER

Before Sampling

Total Well Depth 19.85 Ft. Well Diameter 4"
 Depth to Water 5.35 Ft. Purge Volume 38 gallons

Sampling Data

Time	<u>10:58</u>	<u>11:10</u>	<u>11:20</u>	<u>11:30</u>	_____	_____	_____
EC	<u>1250</u>	<u>1250</u>	<u>1250</u>	<u>1250</u>	_____	_____	_____
pH	<u>7.61</u>	<u>7.45</u>	<u>7.45</u>	<u>7.45</u>	_____	_____	_____
Temp	<u>62.8</u>	<u>62.5</u>	<u>62</u>	<u>62</u>	_____	_____	_____
Gal.	<u>10</u>	<u>20</u>	<u>30</u>	<u>38</u>	_____	_____	_____
Time	_____	_____	_____	_____	_____	_____	_____
EC	_____	_____	_____	_____	_____	_____	_____
pH	_____	_____	_____	_____	_____	_____	_____
Temp	_____	_____	_____	_____	_____	_____	_____
Gal.	_____	_____	_____	_____	_____	_____	_____

After Sampling

Depth to Water 7.20 Ft. Total Well Depth 19.85 Ft.

FIELD DATA - GROUNDWATER WELL SAMPLING PROGRAM

DATE 12.4.1991 STATION NO. 054
PERSONNEL E. GASMAN, T. ROJU
WELL NO. RE 2 WEATHER SUNNY
SAMPLE EQUIPMENT TEFLON BAILER

Before Sampling

Total Well Depth 17.10 Ft. Well Diameter 4"
Depth to Water 5.26 Ft. Purge Volume 30 gallons

Sampling Data

Time	<u>11:45</u>	<u>11:50</u>	<u>11:55</u>	<u>12:00</u>	<u>12:05</u>		
EC	<u>1230</u>	<u>1240</u>	<u>1240</u>	<u>1240</u>	<u>1240</u>		
pH	<u>7.90</u>	<u>7.60</u>	<u>7.60</u>	<u>7.60</u>	<u>7.60</u>		
Temp	<u>69.5</u>	<u>68.9</u>	<u>68.9</u>	<u>68.8</u>	<u>68.9</u>		
Gal.	<u>10</u>	<u>15</u>	<u>20</u>	<u>25</u>	<u>30</u>		
Time							
EC							
pH							
Temp							
Gal.							

After Sampling

Depth to Water 8.00 Ft. Total Well Depth 17.10 Ft.

FIELD DATA - GROUNDWATER WELL SAMPLING PROGRAM

DATE 12.4.1991 STATION NO. 054
 PERSONNEL E. GARMAN, T. ROSU
 WELL NO. RE 5 WEATHER SUNNY
 SAMPLE EQUIPMENT TEFLON BAILER

Before Sampling

Total Well Depth 18.25 Ft. Well Diameter ~~4.3~~ 4"
 Depth to Water 5.43 Ft. Purge Volume 33 gallons

Sampling Data

Time	<u>12:20</u>	<u>12:25</u>	<u>12:30</u>	<u>12:35</u>	<u>12:40</u>	<u>12:45</u>	_____
EC	<u>1110</u>	<u>1130</u>	<u>1130</u>	<u>1130</u>	<u>1130</u>	<u>1130</u>	_____
pH	<u>7.70</u>	<u>7.65</u>	<u>7.55</u>	<u>7.41</u>	<u>7.41</u>	<u>7.41</u>	_____
Temp	<u>68</u>	<u>67.8</u>	<u>67</u>	<u>66.4</u>	<u>66.4</u>	<u>66.4</u>	_____
Gal.	<u>10</u>	<u>15</u>	<u>20</u>	<u>25</u>	<u>30</u>	<u>33</u>	_____
Time	_____	_____	_____	_____	_____	_____	_____
EC	_____	_____	_____	_____	_____	_____	_____
pH	_____	_____	_____	_____	_____	_____	_____
Temp	_____	_____	_____	_____	_____	_____	_____
Gal.	_____	_____	_____	_____	_____	_____	_____

After Sampling

Depth to Water 7.10 Ft. Total Well Depth 18.25 Ft.

FIELD DATA - GROUNDWATER WELL SAMPLING PROGRAM

DATE 12.4.1991 STATION NO. 054
PERSONNEL E. G. ALMAN, T. ROSU
WELL NO. RE 6 WEATHER SUNNY
SAMPLE EQUIPMENT TEFLON BAILER

Before Sampling

Total Well Depth 13.65 Ft. Well Diameter 4"
Depth to Water 6.19 Ft. Purge Volume 20 gallons

Sampling Data

Time	<u>1:00</u>	<u>1:05</u>	<u>1:10</u>	<u>1:20</u>	_____	_____	_____
EC	<u>1290</u>	<u>1290</u>	<u>1290</u>	<u>1290</u>	_____	_____	_____
pH	<u>6.30</u>	<u>6.30</u>	<u>6.30</u>	<u>6.30</u>	_____	_____	_____
Temp	<u>68</u>	<u>67</u>	<u>67</u>	<u>67</u>	_____	_____	_____
Gal.	<u>5</u>	<u>10</u>	<u>15</u>	<u>20</u>	_____	_____	_____
Time	_____	_____	_____	_____	_____	_____	_____
EC	_____	_____	_____	_____	_____	_____	_____
pH	_____	_____	_____	_____	_____	_____	_____
Temp	_____	_____	_____	_____	_____	_____	_____
Gal.	_____	_____	_____	_____	_____	_____	_____

After Sampling

Depth to Water 7.00 Ft. Total Well Depth 13.65 Ft.



SMITH-EMERY COMPANY

The Full Service Independent Testing Laboratory. Established 1904

781 East Washington Boulevard
P.O. Box 880550, Hunter's Point Shipyard Bldg. 114
5427 East La Palma Avenue

- Los Angeles, California 90021
- San Francisco, California 94188
- Anaheim, California 92807
- (213) 749-3411
- (415) 330-3000
- (714) 693-1026
- Fax: (213) 746-7228
- Fax: (415) 822-5864
- Fax: (714) 693-1034

THRIFTY OIL COMPANY
FILE# 7144
10000 LAKEWOOD BLVD.
DOWNEY, CA. 90240

10/30/91

Attn: NICK CIORTAN ✓
213/923/9876

P.O.# 36218, SS # 054
CHAIN OF CUSTODY

Sample #: 1297140201
Received: 10/24/91
Type: WATER

Collector: Client
Sampling Date & Time: 10/23/91, 1305
Method: GRAB

I.D.: WELL RE-1

=====CONSTITUENT=====	=====METHOD=====	==RESULT==	====UNIT====
EPA 8015M/602, COMBINATION		ANALYZED	10/28/91
GASOLINE	EPA 8015M	79,000	UG/L
BENZENE	EPA 602	7900	UG/L
TOLUENE	EPA 602	8300	UG/L
ETHYLBENZENE	EPA 602	450	UG/L
XYLENES	EPA 602	7100	UG/L

Sample #: 1297140202
Received: 10/24/91
Type: WATER

Collector: Client
Sampling Date & Time: 10/23/91, 1340
Method: GRAB

I.D.: WELL RE-2

EPA 8015M/602, COMBINATION		ANALYZED	10/28/91
GASOLINE	EPA 8015M	2700	UG/L
BENZENE	EPA 602	52	UG/L
TOLUENE	EPA 602	60	UG/L
ETHYLBENZENE	EPA 602	22	UG/L
XYLENES	EPA 602	130	UG/L



SMITH-EMERY COMPANY

The Full Service Independent Testing Laboratory. Established 1904

781 East Washington Boulevard
P.O. Box 880550, Hunter's Point Shipyard Bldg. 114
5427 East La Palma Avenue

• Los Angeles, California 90021 • (213) 749-3411 • Fax: (213) 746-7228
• San Francisco, California 94188 • (415) 330-3000 • Fax: (415) 822-5864
• Anaheim, California 92807 • (714) 693-1026 • Fax: (714) 693-1034

Sample #: 1297140203
Received: 10/24/91
Type: WATER

Collector: Client
Sampling Date & Time: 10/23/91, 1240
Method: GRAB

I.D.: WELL RS-8

===== CONSTITUENT =====	===== METHOD =====	===== RESULT ====	===== UNIT =====
EPA 8015M/602, COMBINATION		ANALYZED	10/28/91
GASOLINE	EPA 8015M	ND <50	UG/L
BENZENE	EPA 602	ND <0.5	UG/L
TOLUENE	EPA 602	ND <0.5	UG/L
ETHYLBENZENE	EPA 602	ND <1.0	UG/L
XYLENES	EPA 602	ND <1.0	UG/L

Sample #: 1297140204
Received: 10/24/91
Type: WATER

Collector: Client
Sampling Date & Time: 10/23/91, 1210
Method: GRAB

I.D.: WELL RS-9

EPA 8015M/602, COMBINATION		ANALYZED	10/28/91
GASOLINE	EPA 8015M	11,000	UG/L
BENZENE	EPA 602	ND <3.0	UG/L
TOLUENE	EPA 602	ND <3.0	UG/L
ETHYLBENZENE	EPA 602	39	UG/L
XYLENES	EPA 602	340	UG/L

Sample #: 1297140205
Received: 10/24/91
Type: WATER

Collector: Client
Sampling Date & Time: 10/23/91, 1225
Method: GRAB

I.D.: WELL RS-10

EPA 8015M/602, COMBINATION		ANALYZED	10/28/91
GASOLINE	EPA 8015M	ND <50	UG/L
BENZENE	EPA 602	ND <0.5	UG/L
TOLUENE	EPA 602	ND <0.5	UG/L
ETHYLBENZENE	EPA 602	ND <1.0	UG/L
XYLENES	EPA 602	ND <1.0	UG/L



SMITH-EMERY COMPANY

The Full Service Environmental Testing Laboratory, Established 1904

781 East Washington Boulevard
P O Box 880550, Hunter's Point Shipyard Bldg. 114
5427 East La Palma Avenue

- Los Angeles, California 90021
- San Francisco, California 94188
- Anaheim, California 92807
- (213) 749-3411
- (415) 330-3000
- (714) 693-1026
- Fax: (213) 746-7228
- Fax: (415) 822-5864
- Fax: (714) 693-1034

Sample #: 1297140206
Received: 10/24/91
Type: WATER

Collector: Client
Sampling Date & Time: 10/23/91, 0900
Method: GRAB

I.D.: TRIP BLANK

===== <u>CONSTITUENT</u> =====	===== <u>METHOD</u> =====	===== <u>RESULT</u> ====	===== <u>UNIT</u> =====
EPA 8015M/602, COMBINATION		ANALYZED	10/28/91
GASOLINE	EPA 8015M	ND <50	UG/L
BENZENE	EPA 602	ND <0.5	UG/L
TOLUENE	EPA 602	ND <0.5	UG/L
ETHYLBENZENE	EPA 602	ND <1.0	UG/L
XYLENES	EPA 602	ND <1.0	UG/L

Respectfully submitted,

Shahid Noori

Shahid Noori, Manager Chemical Lab

CHAIN OF CUSTODY FORM

P.O. #
36218

Client and Site Location:
THRIFTY OIL CO., SS # 054

MONTHLY SAMPLING

ANALYTICAL METHOD

Submit Results To:

**THRIFTY OIL CO.
10000 LAKEWOOD BLVD.
DOWNEY, CA 90240**

**Attn: CONSTANTIN TUCULESCU
Phone No. (213) 923 - 9876**

Samplers (Signature)

Juergen Goswami

Sample Number	Date	Time	Depth Below Grade (ft)	Sample Type	Suspect Contamination	No. of Containers (VIALS)	T P H / B T X E *												
WELL PW-1	*			GRAB	GASOLINE	4	X	-	-	-	-	-	-	-	-	-	-	-	-
WELL PW-2	*			GRAB	GASOLINE	4	X	-	-	-	-	-	-	-	-	-	-	-	-
WELL RE-1	10/23/91	1:05P	9	GRAB	GASOLINE	4	X	-	-	-	-	-	-	-	-	-	-	-	-
WELL RE-2	10/23/91	1:40P	9	GRAB	GASOLINE	4	X	-	-	-	-	-	-	-	-	-	-	-	-
WELL RE-3	*			GRAB	GASOLINE	4	X	-	-	-	-	-	-	-	-	-	-	-	-
WELL RE-4	*			GRAB	GASOLINE	4	X	-	-	-	-	-	-	-	-	-	-	-	-
WELL RE-5	*			GRAB	GASOLINE	4	X	-	-	-	-	-	-	-	-	-	-	-	-
WELL RE-6	*			GRAB	GASOLINE	4	X	-	-	-	-	-	-	-	-	-	-	-	-
WELL RE-7	*			GRAB	GASOLINE	4	X	-	-	-	-	-	-	-	-	-	-	-	-
WELL RS-8	10/23/91	12:40P	13	GRAB	GASOLINE	4	X	-	-	-	-	-	-	-	-	-	-	-	-
WELL RS-9	10/23/91	12:10P	7	GRAB	GASOLINE	4	X	-	-	-	-	-	-	-	-	-	-	-	-
WELL RS-10	10/23/91	12:25P	11	GRAB	GASOLINE	4	X	-	-	-	-	-	-	-	-	-	-	-	-
TRIP BLANK	10/23/91	9:00A		-	-	2	X	-	-	-	-	-	-	-	-	-	-	-	-

REMARKS

MONTHLY WATER SAMPLING
* COMBINED TEST

Sample Integrity: **NOT SAMPLED FREE PRODUCT FLOATED**

Samples Intact: Yes _____ No _____

Samples Properly Cooled: Yes _____ No _____

Samples Accepted: Yes _____ No _____

If not, why: _____

Samples Placed in Lab Refrigerator
Yes _____ No _____ Rep. Initials _____

Laboratory Name: **SMITH - EMERY COMPANY**

Relinquished by: *Juergen Goswami* Date / Time: 10/23 / 2:30P Received by: *Ralph [Signature]*

Relinquished by: _____ Date / Time: _____ Received by: _____

Relinquished by: _____ Date / Time: _____ Received for Lab by: _____

Certification No.: _____



SMITH-EMERY COMPANY

The Oil Service Independent Testing Laboratory, Established 1904

781 East Washington Boulevard
P.O. Box 880550, Hunter's Point Shipyard Bldg. 114
5427 East La Palma Avenue

- Los Angeles, California 90021
- San Francisco, California 94188
- Anaheim, California 92807
- (213) 749-3411
- (415) 330-3000
- (714) 693-1026
- Fax: (213) 746-7228
- Fax: (415) 822-5864
- Fax: (714) 693-1034

THRIFTY OIL COMPANY
FILE# 7144
10000 LAKEWOOD BLVD.
DOWNEY, CA. 90240

11/14/91

Attn: NICK CIORTAN
213/923/9876

P.O.# 35948, SS # 054
CHAIN OF CUSTODY

Sample #: 1312150901
Received: 11/08/91
Type: WATER

Collector: Client
Sampling Date & Time: 11/06/91, 1210
Method: GRAB

I.D.: WELL RE - 1

===== <u>CONSTITUENT</u> =====	===== <u>METHOD</u> =====	===== <u>RESULT</u> ====	===== <u>UNIT</u> =====
EPA 8015M/602, COMBINATION		ANALYZED	11-11-91
GASOLINE	EPA 8015M	130,000	UG/L
BENZENE	EPA 602	14,000	UG/L
TOLUENE	EPA 602	15,000	UG/L
ETHYLBENZENE	EPA 602	1,100	UG/L
XYLENES	EPA 602	8,800	UG/L

Sample #: 1312150902
Received: 11/08/91
Type: WATER

Collector: Client
Sampling Date & Time: 11/06/91, 1220
Method: GRAB

I.D.: WELL RE - 2

EPA 8015M/602, COMBINATION		ANALYZED	11-11-91
GASOLINE	EPA 8015M	1,900	UG/L
BENZENE	EPA 602	18	UG/L
TOLUENE	EPA 602	61	UG/L
ETHYLBENZENE	EPA 602	9.1	UG/L
XYLENES	EPA 602	83	UG/L

INV. # _____ DATE _____
 INVOICE AMT. _____
 ACCT. # _____
 CONT. # _____ GRP _____
 CHECK # _____ DATE _____

RECEIVED
NOV 18 1991
ACCOUNTS PAYABLE



SMITH-EMERY COMPANY

The Full Service Independent Testing Laboratory. Established 1904

781 East Washington Boulevard
P.O. Box 880550, Hunter's Point Shipyard Bldg. 114
5427 East La Palma Avenue

- Los Angeles, California 90021
- San Francisco, California 94188
- Anaheim, California 92807
- (213) 749-3411
- (415) 330-3000
- (714) 693-1026
- Fax: (213) 746-7228
- Fax: (415) 822-5864
- Fax: (714) 693-1034

Sample #: 1312150903
Received: 11/08/91
Type: WATER

Collector: Client
Sampling Date & Time: 11/06/91, 1310
Method: GRAB

I.D.: WELL RE - 5

===== CONSTITUENT =====	===== METHOD =====	===== RESULT =====	===== UNIT =====
EPA 8015M/602, COMBINATION		ANALYZED	11-11-91
GASOLINE	EPA 8015M	9,900	UG/L
BENZENE	EPA 602	2,300	UG/L
TOLUENE	EPA 602	37	UG/L
ETHYLBENZENE	EPA 602	260	UG/L
XYLENES	EPA 602	160	UG/L

Sample #: 1312150904
Received: 11/08/91
Type: WATER

Collector: Client
Sampling Date & Time: 11/06/91, 1250
Method: GRAB

I.D.: WELL RE - 6

EPA 8015M/602, COMBINATION		ANALYZED	11-11-91
GASOLINE	EPA 8015M	4,000	UG/L
BENZENE	EPA 602	710	UG/L
TOLUENE	EPA 602	18	UG/L
ETHYLBENZENE	EPA 602	29	UG/L
XYLENES	EPA 602	49	UG/L

Sample #: 1312150905
Received: 11/08/91
Type: WATER

Collector: Client
Sampling Date & Time: 11/06/91, 1120
Method: GRAB

I.D.: WELL RS - 8

EPA 8015M/602, COMBINATION		ANALYZED	11-11-91
GASOLINE	EPA 8015M	ND <50	UG/L
BENZENE	EPA 602	ND <0.5	UG/L
TOLUENE	EPA 602	ND <0.5	UG/L
ETHYLBENZENE	EPA 602	ND <1.0	UG/L
XYLENES	EPA 602	ND <1.0	UG/L



SMITH-EMERY COMPANY

The Full Service Independent Testing Laboratory. Established 1904

781 East Washington Boulevard
P. O. Box 880550, Hunter's Point Shipyard Bldg. 114
5427 East La Palma Avenue

• Los Angeles, California 90021 • (213) 749-3411 • Fax: (213) 746-7228
• San Francisco, California 94188 • (415) 330-3000 • Fax: (415) 822-5864
• Anaheim, California 92807 • (714) 693-1026 • Fax: (714) 693-1034

Sample #: 1312150906
Received: 11/08/91
Type: WATER

Collector: Client
Sampling Date & Time: 11/06/91, 1235
Method: GRAB

I.D.: WELL RS - 9

===== <u>CONSTITUENT</u> =====	===== <u>METHOD</u> =====	===== <u>RESULT</u> ====	===== <u>UNIT</u> =====
EPA 8015M/602, COMBINATION		ANALYZED	11-11-91
GASOLINE	EPA 8015M	6,800	UG/L
BENZENE	EPA 602	8.4	UG/L
TOLUENE	EPA 602	0.6	UG/L
ETHYLBENZENE	EPA 602	22	UG/L
XYLENES	EPA 602	230	UG/L

Sample #: 1312150907
Received: 11/08/91
Type: WATER

Collector: Client
Sampling Date & Time: 11/06/91, 1150
Method: GRAB

I.D.: WELL RS - 10

EPA 8015M/602, COMBINATION		ANALYZED	11-11-91
GASOLINE	EPA 8015M	ND <50	UG/L
BENZENE	EPA 602	ND <0.5	UG/L
TOLUENE	EPA 602	ND <0.5	UG/L
ETHYLBENZENE	EPA 602	ND <1.0	UG/L
XYLENES	EPA 602	ND <1.0	UG/L

Sample #: 1312150908
Received: 11/08/91
Type: WATER

Collector: Client
Sampling Date & Time: 11/06/91, 0830
Method: GRAB

I.D.: TRIP BLANK

EPA 8015M/602, COMBINATION		ANALYZED	11-11-91
GASOLINE	EPA 8015M	ND <50	UG/L
BENZENE	EPA 602	ND <0.5	UG/L
TOLUENE	EPA 602	ND <0.5	UG/L
ETHYLBENZENE	EPA 602	ND <1.0	UG/L
XYLENES	EPA 602	ND <1.0	UG/L

Respectfully submitted,

Shahid Noori, Manager Chemical Lab

CHAIN OF CUSTODY FORM

P.O. # 35948	Client and Site Location: THRIFTY OIL CO., SS # 054	MONTHLY SAMPLING	ANALYTICAL METHOD	Submit Results To:
--------------	--	------------------	-------------------	--------------------

Samplers (Signature)
Juzeni Gorman

THRIFTY OIL CO.
10000 LAKEWOOD BLVD.
DOWNEY, CA 90240

Attn: CONSTANTIN TUCULESCU
Phone No. (213) 923 - 9876

Sample Number	Date	Time	Depth Below Grade (ft)	Sample Type	Suspect Contamination	No. of Containers (VIALS)	ANALYTICAL METHOD												REMARKS						
							T	P	H	/	B	T	X	E	*										
WELL PW-1		*		GRAB	GASOLINE	4	X	-	-	-	-	-	-	-	-	-	-	-	-	-	-	-	-	-	MONTHLY WATER SAMPLING
WELL PW-2		*		GRAB	GASOLINE	4	X	-	-	-	-	-	-	-	-	-	-	-	-	-	-	-	-	-	* COMBINED TEST
WELL RE-1	11.6.91	12:10P	9	GRAB	GASOLINE	4	X	-	-	-	-	-	-	-	-	-	-	-	-	-	-	-	-		
WELL RE-2	11.6.91	12:20P	10	GRAB	GASOLINE	4	X	-	-	-	-	-	-	-	-	-	-	-	-	-	-	-	-		
WELL RE-3		*		GRAB	GASOLINE	4	X	-	-	-	-	-	-	-	-	-	-	-	-	-	-	-	-		
WELL RE-4		*		GRAB	GASOLINE	4	X	-	-	-	-	-	-	-	-	-	-	-	-	-	-	-	-		
WELL RE-5	11.6.91	1:10P	9	GRAB	GASOLINE	4	X	-	-	-	-	-	-	-	-	-	-	-	-	-	-	-	-		
WELL RE-6	11.6.91	12:50P	9	GRAB	GASOLINE	4	X	-	-	-	-	-	-	-	-	-	-	-	-	-	-	-	-		
WELL RE-7		*		GRAB	GASOLINE	4	X	-	-	-	-	-	-	-	-	-	-	-	-	-	-	-	-		
WELL RS-8	11.6.91	11:20P	12	GRAB	GASOLINE	4	X	-	-	-	-	-	-	-	-	-	-	-	-	-	-	-	-		
WELL RS-9	11.6.91	12:35P	6	GRAB	GASOLINE	4	X	-	-	-	-	-	-	-	-	-	-	-	-	-	-	-	-		
WELL RS-10	11.6.91	11:50P	10	GRAB	GASOLINE	4	X	-	-	-	-	-	-	-	-	-	-	-	-	-	-	-	-		
TRIP BLANK	11.6.91	8:30A		-	-	2	X	-	-	-	-	-	-	-	-	-	-	-	-	-	-	-	-		

Sample Integrity: **✓**

Samples Intact: Yes No

Samples Properly Cooled: Yes No

Samples Accepted: Yes No

If not, why: _____

Samples Placed in Lab Refrigerator
Yes _____ No _____ Rep. Initials _____

*** NOT SAMPLED FREE PRODUCT FLOATED**

Relinquished by:	Date / Time	Received by:
<i>Juzeni Gorman</i>	11/6 12:36	<i>Caro J.N.</i>
Relinquished by:	Date / Time	Received by:
Relinquished by:	Date / Time	Received for Lab by:

Laboratory Name: SMITH - EMERY COMPANY Certification No.: _____



SMITH-EMERY COMPANY

The Full Service Independent Testing Laboratory. Established 1904

781 East Washington Boulevard
P.O. Box 680550, Hunter's Point Shipyard Bldg. 114
5427 East La Palma Avenue

- Los Angeles, California 90021
- San Francisco, California 94188
- Anaheim, California 92807
- (213) 749-3411
- (415) 330-3000
- (714) 693-1026
- Fax: (213) 746-7228
- Fax: (415) 822-5864
- Fax: (714) 693-1034

THRIFTY OIL COMPANY
FILE# 7144
10000 LAKEWOOD BLVD.
DOWNEY, CA. 90240

12/17/91

Attn: NICK CIORTAN ✓
213/923/9876

SS# 054
CHAIN OF CUSTODY P.O.#

Sample #: 1343122801
Received: 12/09/91
Type: WATER

Collector: Client
Sampling Date & Time: 12/04/91, 1350
Method: GRAB

I.D.: WELL RE - 1

=====CONSTITUENT=====	=====METHOD=====	==RESULT==	===UNIT===
EPA 8015M/602, COMBINATION		ANALYZED	12/11/91
GASOLINE	EPA 8015M	50,000	UG/L
BENZENE	EPA 602	8000	UG/L
TOLUENE	EPA 602	4700	UG/L
ETHYLBENZENE	EPA 602	520	UG/L
XYLENES	EPA 602	4100	UG/L

Sample #: 1343122802
Received: 12/09/91
Type: WATER

Collector: Client
Sampling Date & Time: 12/04/91, 1405
Method: GRAB

I.D.: WELL RE - 2

EPA 8015M/602, COMBINATION		ANALYZED	12/11/91
GASOLINE	EPA 8015M	1100	UG/L
BENZENE	EPA 602	26	UG/L
TOLUENE	EPA 602	47	UG/L
ETHYLBENZENE	EPA 602	4.3	UG/L
XYLENES	EPA 602	42	UG/L



SMITH-EMERY COMPANY

The Full Service Independent Testing Laboratory, Established 1904

781 East Washington Boulevard
P.O. Box 880550, Hunter's Point Shipyard Bldg. 114
5427 East La Palma Avenue

- Los Angeles, California 90021
- San Francisco, California 94188
- Anaheim, California 92807
- (213) 749-3411
- (415) 330-3000
- (714) 693-1026
- Fax: (213) 746-7228
- Fax: (415) 822-5864
- Fax: (714) 693-1034

Sample #: 1343122803
Received: 12/09/91
Type: WATER

Collector: Client
Sampling Date & Time: 12/04/91, 1415
Method: GRAB

I.D.: WELL RE - 5

====CONSTITUENT=====	====METHOD=====	==RESULT==	==UNIT==
EPA 8015M/602, COMBINATION		ANALYZED	12/11/91
GASOLINE	EPA 8015M	4500	UG/L
BENZENE	EPA 602	1000	UG/L
TOLUENE	EPA 602	27	UG/L
ETHYLBENZENE	EPA 602	ND	<1.0 UG/L
XYLENES	EPA 602	180	UG/L

Sample #: 1343122804
Received: 12/09/91
Type: WATER

Collector: Client
Sampling Date & Time: 12/04/91, 1425
Method: GRAB

I.D.: WELL RE - 6

EPA 8015M/602, COMBINATION		ANALYZED	12/11/91
GASOLINE	EPA 8015M	4100	UG/L
BENZENE	EPA 602	1100	UG/L
TOLUENE	EPA 602	14	UG/L
ETHYLBENZENE	EPA 602	33	UG/L
XYLENES	EPA 602	39	UG/L

Sample #: 1343122805
Received: 12/09/91
Type: WATER

Collector: Client
Sampling Date & Time: 12/04/91, 1305
Method: GRAB

I.D.: WELL RS - 8

EPA 8015M/602, COMBINATION		ANALYZED	12/11/91
GASOLINE	EPA 8015M	ND	<50 UG/L
BENZENE	EPA 602	ND	<0.5 UG/L
TOLUENE	EPA 602	ND	<0.5 UG/L
ETHYLBENZENE	EPA 602	ND	<1.0 UG/L
XYLENES	EPA 602	ND	<1.0 UG/L



SMITH-EMERY COMPANY

The Full Service Independent Testing Laboratory Established 1904

781 East Washington Boulevard
P.O. Box 880550, Hunter's Point Shipyard Bldg. 114
5427 East La Palma Avenue

- Los Angeles, California 90021
- San Francisco, California 94188
- Anaheim, California 92807
- (213) 749-3411
- (415) 330-3000
- (714) 693-1026
- Fax: (213) 746-7228
- Fax: (415) 822-5864
- Fax: (714) 693-1034

Sample #: 1343122806
Received: 12/09/91
Type: WATER

Collector: Client
Sampling Date & Time: 12/04/91, 1320
Method: GRAB

I.D.: WELL RS - 9

===== <u>CONSTITUENT</u> =====	===== <u>METHOD</u> =====	===== <u>RESULT</u> ====	===== <u>UNIT</u> =====
EPA 8015M/602, COMBINATION		ANALYZED	12/11/91
GASOLINE	EPA 8015M	6500	UG/L
BENZENE	EPA 602	6.5	UG/L
TOLUENE	EPA 602	0.7	UG/L
ETHYLBENZENE	EPA 602	87	UG/L
XYLENES	EPA 602	200	UG/L

Sample #: 1343122807
Received: 12/09/91
Type: WATER

Collector: Client
Sampling Date & Time: 12/04/91, 1335
Method: GRAB

I.D.: WELL RS - 10

EPA 8015M/602, COMBINATION		ANALYZED	12/11/91
GASOLINE	EPA 8015M	ND	<50 UG/L
BENZENE	EPA 602	ND	<0.5 UG/L
TOLUENE	EPA 602	ND	<0.5 UG/L
ETHYLBENZENE	EPA 602	ND	<1.0 UG/L
XYLENES	EPA 602	ND	<1.0 UG/L

Sample #: 1343122808
Received: 12/09/91
Type: WATER

Collector: Client
Sampling Date & Time: 12/04/91, 0810
Method: GRAB

I.D.: TRIP BLANK

EPA 8015M/602, COMBINATION		ANALYZED	12/11/91
GASOLINE	EPA 8015M	ND	<50 UG/L
BENZENE	EPA 602	ND	<0.5 UG/L
TOLUENE	EPA 602	ND	<0.5 UG/L
ETHYLBENZENE	EPA 602	ND	<1.0 UG/L
XYLENES	EPA 602	ND	<1.0 UG/L

Respectfully submitted,

Shahid Noori, Manager Chemical Lab

FILE # 7144
LAB# 1343122801

CHAIN OF CUSTODY FORM

P.O. #	Client and Site Location: THRIFTY OIL CO., SS # 054	MONTHLY SAMPLING	ANALYTICAL METHOD	Submit Results To:
--------	--	------------------	-------------------	--------------------

Samplers (Signature) <i>Eugenie Gorman</i>							T P H / B T X E *											THRIFTY OIL CO. 10000 LAKEWOOD BLVD. DOWNEY, CA 90240				
Sample Number	Date	Time	Depth Below Grade (ft)	Sample Type	Suspect Contamination	No. of Containers (VIALS)													REMARKS			
WELL PW-1	*			GRAB	GASOLINE	4	X	-	-	-	-	-	-	-	-	-	-	-	-	-	-	MONTHLY WATER SAMPLING
WELL PW-2	*			GRAB	GASOLINE	4	X	-	-	-	-	-	-	-	-	-	-	-	-	-	-	* COMBINED TEST
WELL RE-1	12-4-91	1:50P	9	GRAB	GASOLINE	4	X	X	-	-	-	-	-	-	-	-	-	-	-	-	-	
WELL RE-2	11-4-91	2:05A	8	GRAB	GASOLINE	4	X	X	-	-	-	-	-	-	-	-	-	-	-	-	-	
WELL RE-3	*			GRAB	GASOLINE	4	X	-	-	-	-	-	-	-	-	-	-	-	-	-	-	
WELL RE-4	*			GRAB	GASOLINE	4	X	-	-	-	-	-	-	-	-	-	-	-	-	-	-	
WELL RE-5	12-4-91	2:15P	9	GRAB	GASOLINE	4	X	X	-	-	-	-	-	-	-	-	-	-	-	-	-	
WELL RE-6	12-4-91	2:25P	9	GRAB	GASOLINE	4	X	X	-	-	-	-	-	-	-	-	-	-	-	-	-	
WELL RE-7	*			GRAB	GASOLINE	4	X	-	-	-	-	-	-	-	-	-	-	-	-	-	-	
WELL RS-8	12-4-91	1:05P	13	GRAB	GASOLINE	4	X	X	-	-	-	-	-	-	-	-	-	-	-	-	-	
WELL RS-9	12-4-91	1:20P	6	GRAB	GASOLINE	4	X	X	-	-	-	-	-	-	-	-	-	-	-	-	-	
WELL RS-10	12-4-91	1:35P	10	GRAB	GASOLINE	4	X	X	-	-	-	-	-	-	-	-	-	-	-	-	-	
TRIP BLANK	12-4-91	8:10A		-	-	2	X	X	-	-	-	-	-	-	-	-	-	-	-	-	-	

Sample Integrity: * NOT SAMPLED, FREE PRODUCT FLOATED		Relinquished by: <i>Eugenie Gorman</i>		Date / Time: 12/4/91 13:30		Received by: <i>John C. Uranga</i>	
Samples Intact: Yes <input checked="" type="checkbox"/> No <input type="checkbox"/>		Relinquished by:		Date / Time:		Received by:	
Samples Properly Cooled: Yes <input checked="" type="checkbox"/> No <input type="checkbox"/>		Relinquished by:		Date / Time:		Received by:	
Samples Accepted: Yes <input checked="" type="checkbox"/> No <input type="checkbox"/>		Relinquished by:		Date / Time:		Received by:	
If not, why: _____		Relinquished by:		Date / Time:		Received for Lab by:	
Samples Placed in Lab Refrigerator Yes <input checked="" type="checkbox"/> No <input type="checkbox"/> Rep. Initials <i>JG</i>		Relinquished by:		Date / Time: 12/6/91 16:30		Received for Lab by: <i>John C. Uranga</i>	
Laboratory Name: SMITH - EMERY COMPANY				Certification No.:			