

Rose Diagram of Approximate Groundwater Flow Direction (3495 Castro Valley)

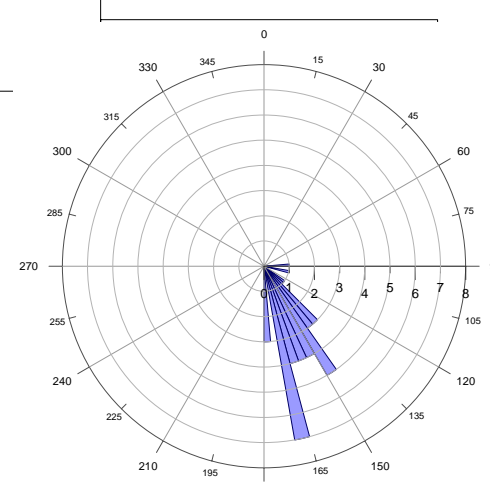
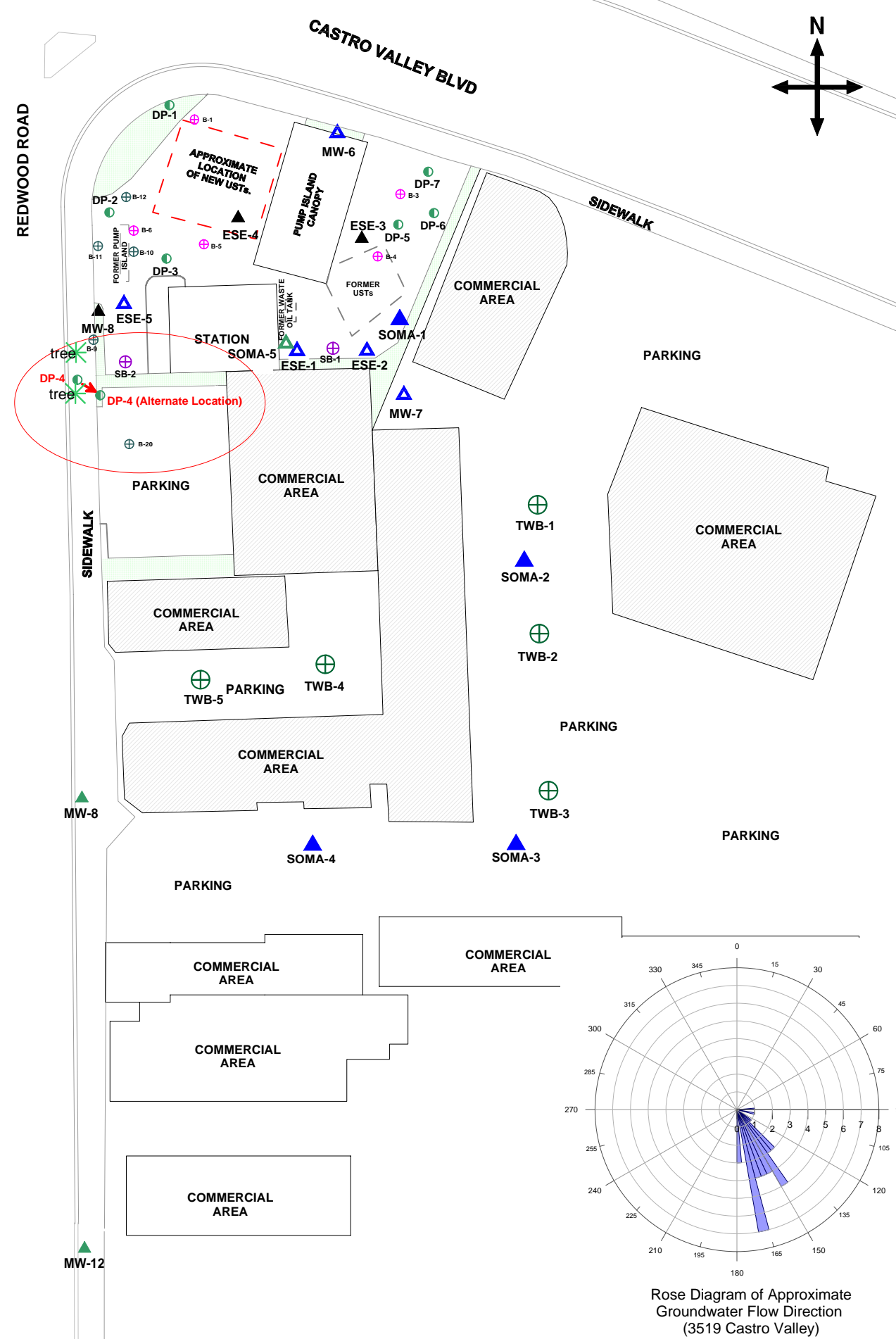
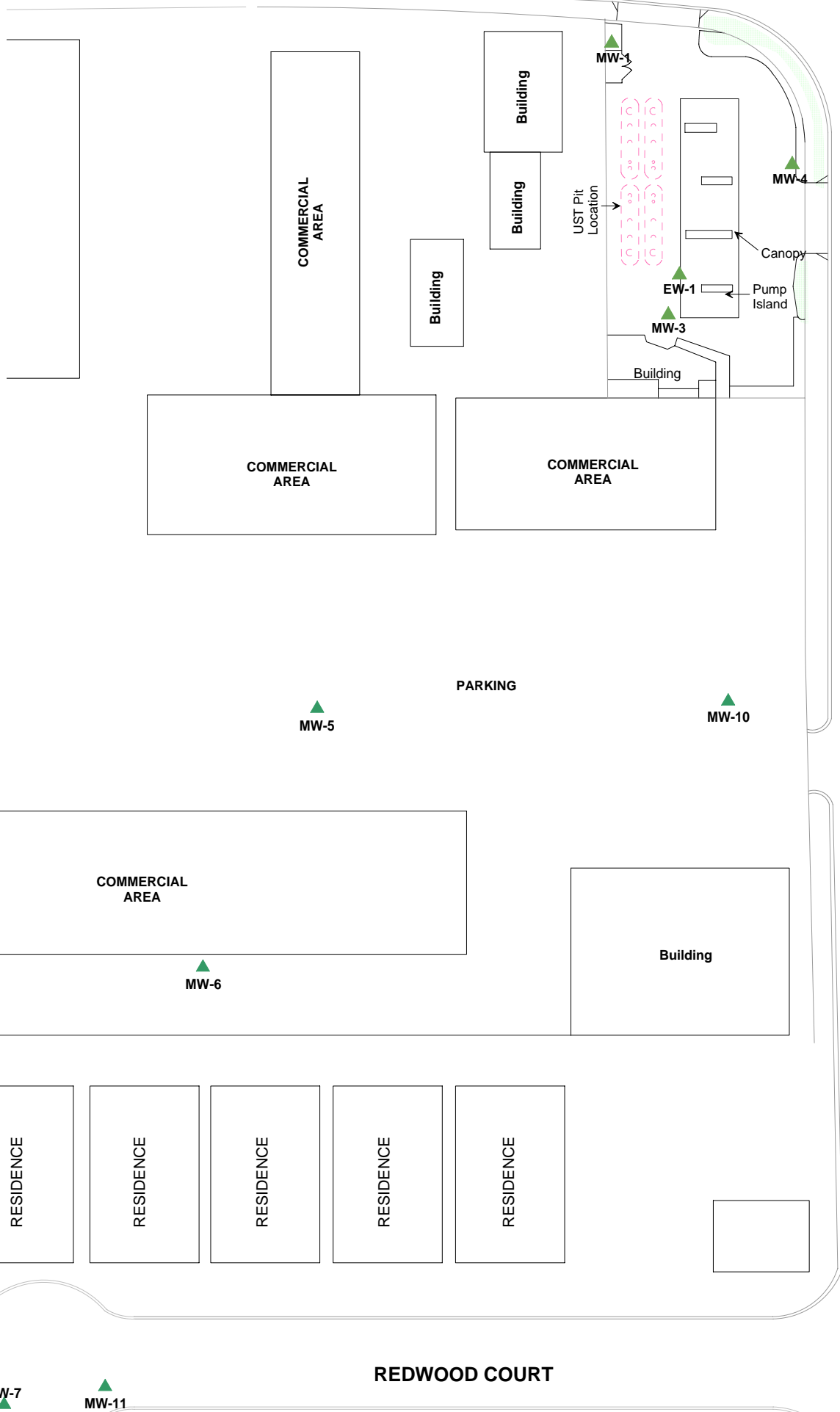

Rose Diagram of Approximate Groundwater Flow Direction (3519 Castro Valley)

- PROPOSED MONITORING WELL
- PROPOSED SOIL BORINGS
- SOIL BORINGS- DELTA CONS. SEPT. 2008
- SOIL BORINGS REDWOOD ROAD EXPANSION FEB 1995
- MONITORING WELL
- DECOMMISSIONED WELL
- COMPLETED OFFSITE TEMPORARY WELL BOREHOLE DRILLED DEC. 2003
- SOIL BORINGS DRILLED PRIOR TO UST REMOVAL AUG. 2003
- MONITORING WELL (Located at 3495 Castro Valley Blvd.)

NOTES:
 ESE-3 and ESE-4 were decommissioned during UST tank excavation activities.
 MW-8 was decommissioned by the previous consultant.

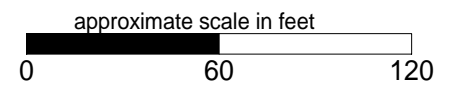

Site Map Showing Locations of Proposed Monitoring Well and Soil and Groundwater Borings

