



RECEIVED

9:29 am, Feb 15, 2012

Alameda County
Environmental Health

Dave Patten
Project Manager
Marketing Business Unit

**Chevron Environmental
Management Company**
6101 Bollinger Canyon Road
San Ramon, CA 94583
Tel (925)760-6491
drpatten@chevron.com

Alameda County Health Care Services
1131 Harbor Bay Parkway, Suite 250
Alameda, CA 94502-6577

Re: Chevron Service Station No. 9-4800
1700 Castro Street
Oakland, CA

I have reviewed the attached report dated February 7, 2012.

I agree with the conclusions and recommendations presented in the referenced report. The information in this report is accurate to the best of my knowledge and all local Agency/Regional Board guidelines have been followed. This report was prepared by Conestoga-Rovers & Associates, upon whose assistance and advice I have relied.

This letter is submitted pursuant to the requirements of California Water Code Section 13267(b)(1) and the regulating implementation entitled Appendix A pertaining thereto.

I declare under penalty of perjury that the foregoing is true and correct to the best of my knowledge.

Sincerely,

Dave Patten
Project Manager

Attachment: Report



**CONESTOGA-ROVERS
& ASSOCIATES**

5900 Hollis Street, Suite A
Emeryville, California 94608
Telephone: (510) 420-0700 Fax: (510) 420-9170
<http://www.craworld.com>

February 7, 2012

Reference No. 060061

Mr. Mark Detterman
Alameda County Environmental Health Services
1131 Harbor Bay Parkway, Suite 250
Alameda, California 94502-6577

Re: Second Semi-Annual 2011
Groundwater Monitoring and Sampling Report
Chevron Service Station 9-4800
1700 Castro Street
Oakland, California
Fuel Leak Case No. RO0000342

Dear Mr. Mark Detterman:

Conestoga-Rovers & Associates (CRA) is submitting this *Second Semi-Annual 2011 Groundwater Monitoring and Sampling Report* for the site referenced above (Figure 1) on behalf of Chevron Environmental Management Company (Chevron). Groundwater monitoring and sampling was performed by Blaine Tech Services (Blaine Tech) of San Jose, California. Blaine Tech's December 13, 2011 *Second Semi-Annual 2011 Monitoring* report is included as Attachment A. Groundwater monitoring and sampling data are presented in Table 1. Lancaster Laboratories' December 22, 2011 *Analytical Results* is included as Attachment B.

Equal
Employment Opportunity
Employer



**CONESTOGA-ROVERS
& ASSOCIATES**

February 7, 2012

Reference No. 060061

- 2 -

Please contact Nathan Lee at (510) 420-3333 if you have any questions or require additional information.

Sincerely,

CONESTOGA-ROVERS & ASSOCIATES



Brandon S. Wilken, PG 7564

BW/cw/8
Encl.

Figure 1	Vicinity Map
Figure 2	Groundwater Elevation Contour and Hydrocarbon Concentration Map
Table 1	Groundwater Monitoring and Sampling Data
Attachment A	Monitoring Data Package
Attachment B	Laboratory Analytical Report

cc: Mr. Dave Patten, Chevron (electronic only)
Mr. Mark Horne, Chevron (electronic only)

FIGURES

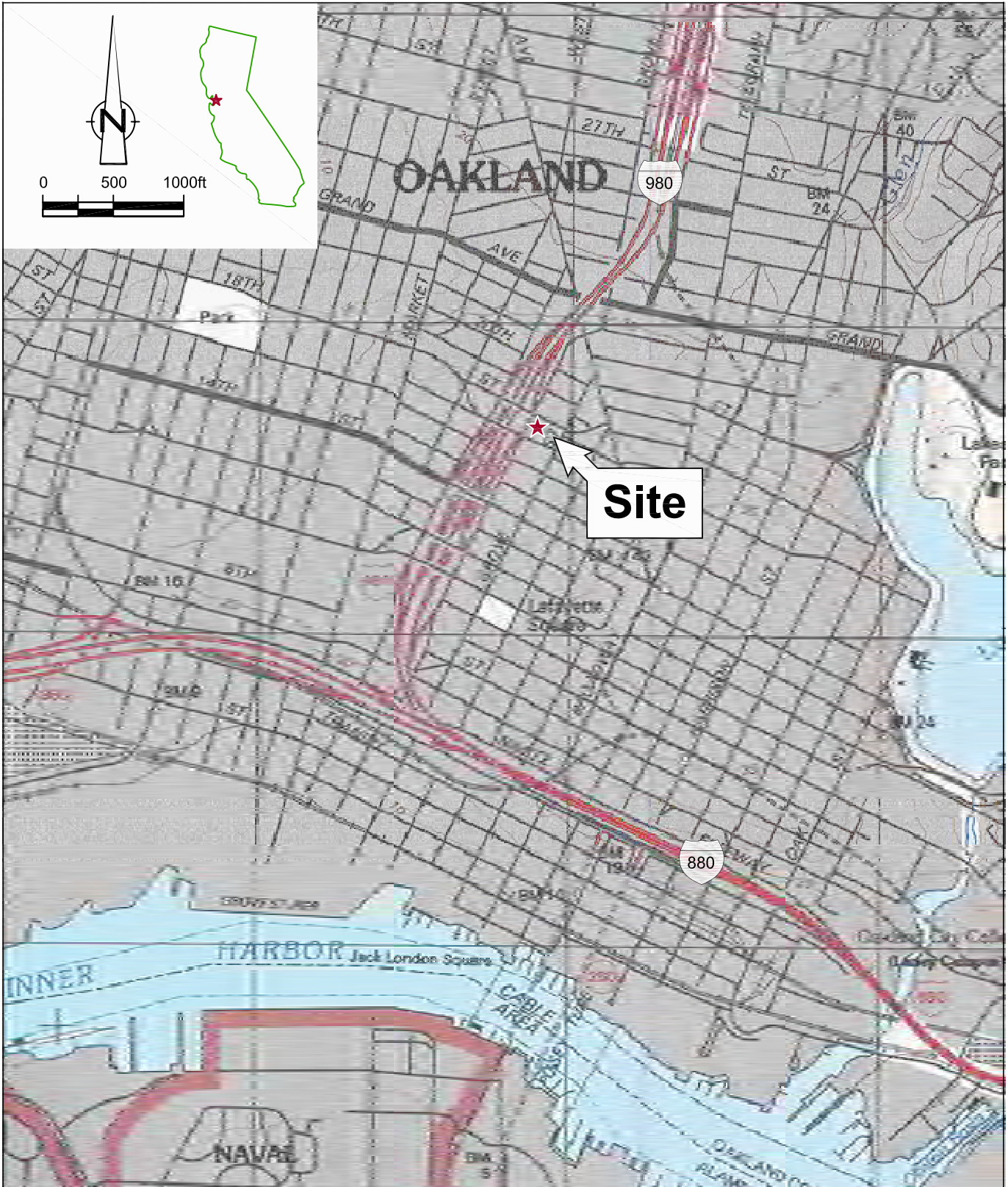
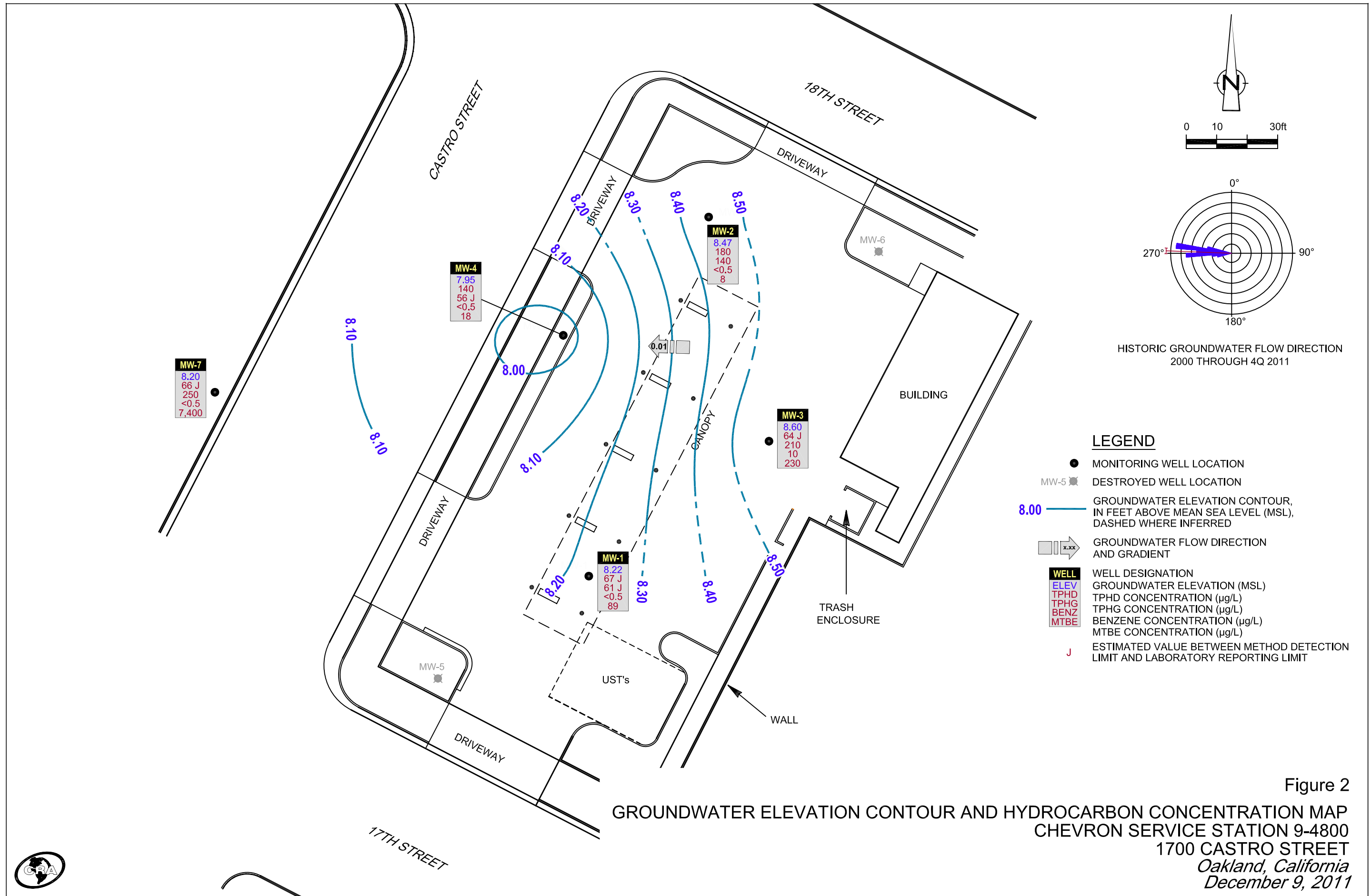

Figure 1
 VICINITY MAP
 CHEVRON SERVICE STATION 9-4800
 1700 CASTRO STREET
 Oakland, California





TABLE

TABLE 1

GROUNDWATER MONITORING AND SAMPLING DATA
 FORMER CHEVRON SERVICE STATION 9-4800
 1700 CASTRO ST.
 OAKLAND, CALIFORNIA

Location	Date	TOC	DTW	GWE	HYDROCARBONS			PRIMARY VOCS						ADDITIONAL VOCS						
					TPH-DRO	TPH-DRO w/ Si Gel	TPH-GRO	B	T	E	X	MTBE by VOC	MTBE by SW8240	MTBE by SW8260	ETHANOL	TBA	DIPE	ETBE	TAME	
	Units	ft	ft	ft-amsl	µg/L	µg/L	µg/L	µg/L	µg/L	µg/L	µg/L	µg/L	µg/L	µg/L	µg/L	µg/L	µg/L	µg/L	µg/L	µg/L
MW-1	06/04/1997	30.75	25.82	4.39	71 ¹	-	890	100	110	29	150	<10	-	-	-	-	-	-	-	-
MW-1	09/16/1997	30.75	25.90	4.85	75 ¹	-	1,600	210	210	60	250	<10	-	-	-	-	-	-	-	-
MW-1	12/17/1997	30.75	25.87	4.88	65 ¹	-	940	120	100	41	160	<25	-	-	-	-	-	-	-	-
MW-1	03/18/1998	30.75	24.85	5.90	77 ¹	-	530	91	39	22	65	6.8	-	-	-	-	-	-	-	-
MW-1	06/28/1998	30.75	24.83	5.92	140 ¹	-	1,100	220	140	37	120	-	14	-	-	-	-	-	-	-
MW-1	09/07/1998	30.75	25.19	5.56	280 ¹	-	1,700	530	86	84	240	49	-	-	-	-	-	-	-	-
MW-1	12/09/1998	30.75	25.65	5.10	240 ¹	-	1,700	240	130	100	270	32	-	-	-	-	-	-	-	-
MW-1	03/11/1999	30.75	25.45	5.30	98 ¹	-	353	53.9	28.6	20.5	56.1	14.1	-	-	-	-	-	-	-	-
MW-1	06/17/1999	30.75	25.36	5.39	217 ¹	-	810	270	150	95	340	15	-	-	-	-	-	-	-	-
MW-1	09/29/1999	30.75	25.62	5.13	153 ¹	-	659	76	49.7	35.1	118	12.6	-	-	-	-	-	-	-	-
MW-1	12/14/1999	30.75	25.68	5.07	188 ^{1,2}	-	2,760	287	199	139	502	<12.5	-	-	-	-	-	-	-	-
MW-1	03/09/2000 ³	30.75	25.21	5.54	166 ¹	-	1,590	238	94.9	72.2	247	22.3	-	-	-	-	-	-	-	-
MW-1	06/10/2000	30.75	25.02	5.73	-	-	1,460	242	47.8	83.8	151	97.3	-	-	-	-	-	-	-	-
MW-1	09/30/2000	30.75	25.45	5.30	240 ⁷	-	650 ⁶	130	49	69	190	21	-	-	-	-	-	-	-	-
MW-1	12/22/2000	30.75	25.70	5.05	200 ⁹	-	640 ⁶	110	33	58	160	68	-	-	-	-	-	-	-	-
MW-1	03/01/2001	30.75	25.50	5.25	211 ⁷	-	1,500 ⁶	210	67.9	109	320	87.3	-	-	-	-	-	-	-	-
MW-1	05/04/2001	30.75	25.34	5.41	130 ⁷	-	991	127	32.6	73.0	137	95.4	-	-	-	-	-	-	-	-
MW-1	09/05/2001	30.75	25.59	5.16	-	-	-	-	-	-	-	-	-	-	-	-	-	-	-	-
MW-1	12/21/2001	30.75	25.58	5.17	210	-	2,000	220	16	110	400	34	-	-	-	-	-	-	-	-
MW-1	03/15/2002	30.75	25.15	5.60	-	-	-	-	-	-	-	-	-	-	-	-	-	-	-	-
MW-1	06/15/2002	30.75	25.26	5.49	140	-	350	54	0.61	12	40	130	-	-	-	-	-	-	-	-
MW-1	09/06/2002	30.75	25.49	5.26	-	-	-	-	-	-	-	-	-	-	-	-	-	-	-	-
MW-1	12/06/2002	30.75	25.63	5.12	2,900	-	900	71	2.1	39	150	34	-	-	-	-	-	-	-	-
MW-1	03/03/2003	30.75	25.29	5.46	-	-	-	-	-	-	-	-	-	-	-	-	-	-	-	-
MW-1	06/17/2003 ¹⁴	30.75	25.11	5.64	180	-	290	34	0.6	23	90	-	-	92	-	-	-	-	-	-
MW-1	09/16/2003	30.75	25.38	5.37	-	-	-	-	-	-	-	-	-	-	-	-	-	-	-	-
MW-1	12/31/2003 ¹⁴	30.75	25.55	5.20	150	-	1,500	97	6	70	230	-	-	86	<50	-	-	-	-	-
MW-1	03/26/2004	30.75	25.01	5.74	-	-	-	-	-	-	-	-	-	-	-	-	-	-	-	-
MW-1	08/17/2004 ¹⁴	30.75	26.16	4.59	860	-	500	44	5	12	54	-	-	76	<50	-	-	-	-	-
MW-1	11/16/2004 ¹⁴	34.01	26.16	7.85	<26	-	570	33	<0.5	14	53	-	-	48	<50	-	-	-	-	-
MW-1	02/18/2005	34.01	25.76	8.25	-	-	-	-	-	-	-	-	-	-	-	-	-	-	-	-

TABLE 1

GROUNDWATER MONITORING AND SAMPLING DATA
 FORMER CHEVRON SERVICE STATION 9-4800
 1700 CASTRO ST.
 OAKLAND, CALIFORNIA

Location	Date	TOC	DTW	GWE	HYDROCARBONS			PRIMARY VOCS						ADDITIONAL VOCS						
					TPH-DRO	TPH-DRO w/ Si Gel	TPH-GRO	B	T	E	X	MTBE by VOC	MTBE by SW8240	MTBE by SW8260	ETHANOL	TBA	DIPE	ETBE	TAME	
	Units	ft	ft	ft-amsl	µg/L	µg/L	µg/L	µg/L	µg/L	µg/L	µg/L	µg/L	µg/L	µg/L	µg/L	µg/L	µg/L	µg/L	µg/L	µg/L
MW-1	05/06/2005 ¹⁴	34.01	25.39	8.62	110	-	170	13	<0.5	4	18	-	-	220	<50	-	-	-	-	-
MW-1	08/05/2005	34.01	25.70	8.31	-	-	-	-	-	-	-	-	-	-	-	-	-	-	-	-
MW-1	11/07/2005 ¹⁴	34.01	26.02	7.99	260 ²⁰	-	180	7	<0.5	3	24	-	-	260	<50	-	-	-	-	-
MW-1	02/06/2006	34.01	25.68	8.33	-	-	-	-	-	-	-	-	-	-	-	-	-	-	-	-
MW-1	05/08/2006 ¹⁴	34.01	24.98	9.03	730	-	270	23	<0.7	1	18	590	-	-	<50	-	-	-	-	-
MW-1	08/08/2006	34.01	25.52	8.49	-	-	-	-	-	-	-	-	-	-	-	-	-	-	-	-
MW-1	11/08/2006 ¹⁴	34.01	25.90	8.11	380	-	<50	0.6	<0.5	<0.5	2	140	-	-	<50	-	-	-	-	-
MW-1	02/06/2007	34.01	25.98	8.03	-	-	-	-	-	-	-	-	-	-	-	-	-	-	-	-
MW-1	05/01/2007 ¹⁴	34.01	25.78	8.23	750	-	58	0.8	<0.5	<0.5	1	-	-	280	<50	-	-	-	-	-
MW-1	07/31/2007	34.01	26.00	8.01	-	-	-	-	-	-	-	-	-	-	-	-	-	-	-	-
MW-1	11/08/2007 ¹⁴	34.01	26.16	7.85	330	-	<50	<0.5	<0.5	<0.5	0.9	-	-	270	<50	-	-	-	-	-
MW-1	02/04/2008	34.01	25.97	8.04	-	-	-	-	-	-	-	-	-	-	-	-	-	-	-	-
MW-1	05/01/2008 ¹⁴	34.01	25.95	8.06	86	-	<50	<0.5	<0.5	<0.5	<0.5	-	-	470	<50	-	-	-	-	-
MW-1	08/01/2008	34.01	26.04	7.97	-	-	-	-	-	-	-	-	-	-	-	-	-	-	-	-
MW-1	11/13/2008 ¹⁴	34.01	26.13	7.88	<50	-	170	1	<0.5	<0.5	2	-	-	190	<50	-	-	-	-	-
MW-1	02/23/2009	34.01	25.94	8.07	-	-	-	-	-	-	-	-	-	-	-	-	-	-	-	-
MW-1	05/20/2009	34.01	25.63	8.38	88 J	-	<50	0.6 J	<0.5	<0.5	2	-	-	190	<50	-	-	-	-	-
MW-1	08/25/2009	34.01	25.80	8.21	-	-	-	-	-	-	-	-	-	-	-	-	-	-	-	-
MW-1	11/18/2009	34.01	25.93	8.08	150	-	<50	<0.5	<0.5	0.6 J	<0.5	-	-	310	<50	-	-	-	-	-
MW-1	05/18/2010	34.01	25.54	8.47	110	-	<50	<0.5	<0.5	<0.5	<0.5	-	-	230	<50	9	-	-	-	-
MW-1	12/01/2010	34.01	25.92	8.09	52 J	-	<50	<0.5	<0.5	<0.5	<0.5	-	-	230	<50	-	-	-	-	-
MW-1	05/04/2011	34.01	25.26	8.75	-	75 J	<50	<0.5	<0.5	<0.5	<0.5	-	-	180	<50	-	-	-	-	-
MW-1	12/09/2011	34.01	25.79	8.22	67 J	-	61 J	<0.5	<0.5	<0.5	<0.5	-	-	89	<50	-	-	-	-	-
MW-2	06/04/1997	30.00	24.87	5.13	4,000 ¹	-	13,000	790	30	420	1,700	4,000	-	-	-	-	-	-	-	-
MW-2	09/16/1997	30.00	24.94	5.06	2,200 ¹	-	4,000	360	9.7	210	460	1,500	-	-	-	-	-	-	-	-
MW-2	12/17/1997	30.00	24.82	5.18	2,100 ¹	-	4,100	380	<10	200	460	2,100	-	-	-	-	-	-	-	-
MW-2	03/18/1998	30.00	23.57	6.43	3,700 ¹	-	8,400	1,800	<50	350	630	13,000	-	-	-	-	-	-	-	-
MW-2	06/28/1998 ⁴	30.00	23.79	6.21	4,400 ¹	-	9,300	740	340	710	2,300	-	3,800	-	-	-	-	-	-	-
MW-2	09/07/1998	30.00	24.22	5.78	3,100 ¹	-	9,900	1,000	150	640	1,800	4,500 / 4,100 ⁵	-	-	-	-	-	-	-	-
MW-2	12/09/1998	30.00	24.69	5.31	1,900 ¹	-	8,500	860	74	610	960	2,600 / 2,600 ⁵	-	-	-	-	-	-	-	-
MW-2	03/11/1999	30.00	24.21	5.79	2,700 ¹	-	12,500	1,520	42.2	645	2,250	5,050 / 3,400 ⁵	-	-	-	-	-	-	-	-

TABLE 1

GROUNDWATER MONITORING AND SAMPLING DATA
 FORMER CHEVRON SERVICE STATION 9-4800
 1700 CASTRO ST.
 OAKLAND, CALIFORNIA

Location	Date	TOC	DTW	GWE	HYDROCARBONS			PRIMARY VOCS						ADDITIONAL VOCS						
					TPH-DRO	TPH-DRO w/ Si Gel	TPH-GRO	B	T	E	X	MTBE by VOC	MTBE by SW8240	MTBE by SW8260	ETHANOL	TBA	DIPE	ETBE	TAME	
	Units	ft	ft	ft-amsl	µg/L	µg/L	µg/L	µg/L	µg/L	µg/L	µg/L	µg/L	µg/L	µg/L	µg/L	µg/L	µg/L	µg/L	µg/L	µg/L
MW-2	06/17/1999	30.00	24.31	5.69	7,150 ¹	-	27,000	2,200	260	1,500	5,900	4,700	-	-	-	-	-	-	-	-
MW-2	09/29/1999	30.00	24.55	5.45	3,030 ¹	-	6,910	582	11.1	491	1,170	1,970	-	-	-	-	-	-	-	-
MW-2	12/14/1999	30.00	24.61	5.39	615 ^{1,2}	-	4,230	282	12.3	284	690	631	-	-	-	-	-	-	-	-
MW-2	03/09/2000 ³	30.00	23.92	6.08	3,300 ¹	-	15,300	1,110	39.4	1,040	3,030	2,470	-	-	-	-	-	-	-	-
MW-2	06/10/2000	30.00	23.87	6.13	-	-	7,360	560	40.7	627	1,280	1,260	-	-	-	-	-	-	-	-
MW-2	09/30/2000	30.00	24.33	5.67	1,800 ⁷	-	3,600 ⁶	280	<10	420	430	290	-	-	-	-	-	-	-	-
MW-2	12/22/2000	30.00	24.61	5.39	870 ⁹	-	1,500 ⁶	100	<1.3	160	59	380	-	-	-	-	-	-	-	-
MW-2	03/01/2001	30.00	24.21	5.79	1,320 ⁷	-	2,340 ⁶	171	<5.00	238	157	864	-	-	-	-	-	-	-	-
MW-2	05/04/2001	30.00	24.17	5.83	3,100 ⁷	-	11,900	199	33.9	1,420	290	3,890	-	-	-	-	-	-	-	-
MW-2	09/05/2001	30.00	24.55	5.45	2,200	-	3,300	170	1.7	310	110	1,100	-	-	-	-	-	-	-	-
MW-2	12/21/2001	30.00	24.40	5.60	980	-	1,100	58	0.72	120	14	450	-	-	-	-	-	-	-	-
MW-2	03/15/2002	30.00	23.95	6.05	2,200	-	5,000	250	9.1	470	430	1,800	-	-	-	-	-	-	-	-
MW-2	06/15/2002	30.00	24.16	5.84	3,700	-	5,200	240	5.2	540	210	2,200	-	-	-	-	-	-	-	-
MW-2	09/06/2002	30.00	24.41	5.59	2,200	-	2,100	84	1.4	250	30	1,000	-	-	-	-	-	-	-	-
MW-2	12/06/2002	30.00	24.56	5.44	730	-	780	21	<0.50	58	3.4	480	-	-	-	-	-	-	-	-
MW-2	03/03/2003	30.00	24.21	5.79	3,500	-	4,800	220	1.9	650	46	4,400	-	-	-	-	-	-	-	-
MW-2	06/17/2003 ¹⁴	30.00	23.93	6.07	4,100	-	4,700	140	4	370	84	-	-	2,700	-	-	-	-	-	-
MW-2	09/16/2003 ¹⁴	30.00	24.31	5.69	1,800 ¹⁵	-	1,300	38	<1	110	3	-	-	1,300	<130	-	-	-	-	-
MW-2	12/31/2003 ¹⁴	30.00	24.36	5.64	330	-	990	11	<0.5	23	3	-	-	440	<50	-	-	-	-	-
MW-2	03/26/2004	30.00	23.75	6.25	-	-	-	-	-	-	-	-	-	-	-	-	-	-	-	-
MW-2	08/17/2004 ¹⁴	30.00	24.47	5.53	400	-	300	9	<0.5	18	1	-	-	340	<50	-	-	-	-	-
MW-2	11/16/2004 ¹⁴	32.59	24.45	8.14	4,300	-	10,000	91	7	830	1,300	-	-	1,100	<100	-	-	-	-	-
MW-2	02/18/2005	32.59	23.92	8.67	-	-	-	-	-	-	-	-	-	-	-	-	-	-	-	-
MW-2	05/06/2005 ¹⁴	32.59	23.53	9.06	1,300	-	4,900	62	4	290	320	-	-	400	<50	-	-	-	-	-
MW-2	08/05/2005	32.59	23.98	8.61	-	-	-	-	-	-	-	-	-	-	-	-	-	-	-	-
MW-2	11/07/2005 ¹⁴	32.59	24.32	8.27	300 ²⁰	-	800	2	<0.5	<0.5	<0.5	-	-	66	<50	-	-	-	-	-
MW-2	02/06/2006	32.59	23.83	8.76	-	-	-	-	-	-	-	-	-	-	-	-	-	-	-	-
MW-2	05/08/2006 ¹⁴	32.59	23.10	9.49	2,100	-	6,100	32	4	430	460	360	-	-	<50	-	-	-	-	-
MW-2	08/08/2006	32.59	23.80	8.79	-	-	-	-	-	-	-	-	-	-	-	-	-	-	-	-
MW-2	11/08/2006 ¹⁴	32.59	24.27	8.32	770	-	120	12	<0.5	0.7	8	840	-	-	<50	-	-	-	-	-
MW-2	02/06/2007	32.59	24.29	8.30	-	-	-	-	-	-	-	-	-	-	-	-	-	-	-	-
MW-2	05/01/2007 ¹⁴	32.59	24.05	8.54	160	-	850	<0.5	<0.5	16	36	-	-	100	<50	-	-	-	-	-

TABLE 1

GROUNDWATER MONITORING AND SAMPLING DATA
 FORMER CHEVRON SERVICE STATION 9-4800
 1700 CASTRO ST.
 OAKLAND, CALIFORNIA

Location	Date	TOC	DTW	GWE	HYDROCARBONS			PRIMARY VOCS						ADDITIONAL VOCS						
					TPH-DRO	TPH-DRO w/ Si Gel	TPH-GRO	B	T	E	X	MTBE by VOC	MTBE by SW8240	MTBE by SW8260	ETHANOL	TBA	DIPE	ETBE	TAME	
	Units	ft	ft	ft-amsl	µg/L	µg/L	µg/L	µg/L	µg/L	µg/L	µg/L	µg/L	µg/L	µg/L	µg/L	µg/L	µg/L	µg/L	µg/L	µg/L
MW-2	07/31/2007	32.59	24.31	8.28	-	-	-	-	-	-	-	-	-	-	-	-	-	-	-	-
MW-2	11/08/2007 ¹⁴	32.59	24.47	8.12	800	-	180	<0.5	<0.5	<0.5	<0.5	-	-	37	<50	-	-	-	-	-
MW-2	02/04/2008	32.59	24.21	8.38	-	-	-	-	-	-	-	-	-	-	-	-	-	-	-	-
MW-2	05/01/2008 ¹⁴	32.59	24.25	8.34	500	-	430	<0.5	<0.5	<0.5	5	-	-	120	<50	-	-	-	-	-
MW-2	08/01/2008	32.59	24.33	8.26	-	-	-	-	-	-	-	-	-	-	-	-	-	-	-	-
MW-2	11/13/2008 ¹⁴	32.59	24.42	8.17	2,600	-	2,500	3	1	190	83	-	-	240	<50	-	-	-	-	-
MW-2	02/23/2009	32.59	24.21	8.38	-	-	-	-	-	-	-	-	-	-	-	-	-	-	-	-
MW-2	05/20/2009	32.59	23.65	8.94	2,800 J	-	4,000	4	1	42	55	-	-	160	<50	-	-	-	-	-
MW-2	08/25/2009	32.59	24.00	8.59	-	-	-	-	-	-	-	-	-	-	-	-	-	-	-	-
MW-2	11/18/2009	32.59	24.51	8.08	2,800	-	5,400	4	1 J	69	34	-	-	79	<100	-	-	-	-	-
MW-2	05/18/2010	32.59	23.65	8.94	1,100	-	580	<0.5	<0.5	<0.5	<0.5	-	-	22	<50	6	-	-	-	-
MW-2	12/01/2010	32.59	24.20	8.39	930	-	230	<0.5	<0.5	<0.5	<0.5	-	-	20	<50	-	-	-	-	-
MW-2	05/04/2011	32.59	23.50	9.09	-	1,300	830	<0.5	<0.5	51	10	-	-	16	<50	-	-	-	-	-
MW-2	12/09/2011	32.59	24.12	8.47	180	-	140	<0.5	<0.5	<0.5	<0.5	-	-	8	<50	-	-	-	-	-
MW-3	06/04/1997	31.32	26.05	5.27	<50	-	190	26	20	1.5	16	8.2	-	-	-	-	-	-	-	-
MW-3	09/16/1997	31.32	26.15	5.17	<50	-	270	58	53	6.1	30	21	-	-	-	-	-	-	-	-
MW-3	12/17/1997	31.32	26.10	5.22	<50	-	290	50	54	8.1	37	21	-	-	-	-	-	-	-	-
MW-3	03/18/1998	31.32	24.90	6.42	<50	-	390	140	33	4.6	30	94	-	-	-	-	-	-	-	-
MW-3	06/28/1998	31.32	24.93	6.39	<50	-	290	90	11	1.6	13	-	150	-	-	-	-	-	-	-
MW-3	09/07/1998	31.32	25.35	5.97	<50	-	170	46	20	4.3	19	120	-	-	-	-	-	-	-	-
MW-3	12/09/1998	31.32	25.91	5.41	55 ¹	-	660	120	93	22	72	150	-	-	-	-	-	-	-	-
MW-3	03/11/1999	31.32	25.47	5.85	<50	-	653	136	69.5	13.7	63.8	144	-	-	-	-	-	-	-	-
MW-3	06/17/1999	31.32	25.42	5.90	103 ¹	-	530	190	110	24	88	210	-	-	-	-	-	-	-	-
MW-3	09/29/1999	31.32	25.71	5.61	232 ¹	-	433	97.8	61.4	16.9	56.6	156	-	-	-	-	-	-	-	-
MW-3	12/14/1999	31.32	25.77	5.55	<50 ²	-	8,650	1,040	795	212	800	995	-	-	-	-	-	-	-	-
MW-3	03/09/2000 ³	31.32	25.18	6.14	74.6 ¹	-	1,170	304	103	25.2	114	539	-	-	-	-	-	-	-	-
MW-3	06/10/2000	31.32	25.03	6.29	-	-	359	63.8	27.8	10.5	35.4	393	-	-	-	-	-	-	-	-
MW-3	09/30/2000	31.32	25.53	5.79	100 ⁸	-	220 ⁶	42	33	12	38	67	-	-	-	-	-	-	-	-
MW-3	12/22/2000	31.32	25.80	5.52	110 ⁹	-	370 ⁶	96	48	18	58	180	-	-	-	-	-	-	-	-
MW-3	03/01/2001	31.32	25.57	5.75	144 ⁷	-	912 ⁶	218	89.0	36.0	110	310	-	-	-	-	-	-	-	-
MW-3	05/04/2001	31.32	25.36	5.96	<50	-	1,260	146	79.6	38.2	101	1,070	-	-	-	-	-	-	-	-
MW-3	09/05/2001	31.32	25.71	5.61	-	-	-	-	-	-	-	-	-	-	-	-	-	-	-	-

TABLE 1

GROUNDWATER MONITORING AND SAMPLING DATA
 FORMER CHEVRON SERVICE STATION 9-4800
 1700 CASTRO ST.
 OAKLAND, CALIFORNIA

Location	Date	TOC	DTW	GWE	HYDROCARBONS			PRIMARY VOCS						ADDITIONAL VOCS						
					TPH-DRO	TPH-DRO w/ Si Gel	TPH-GRO	B	T	E	X	MTBE by VOC	MTBE by SW8240	MTBE by SW8260	ETHANOL	TBA	DIPE	ETBE	TAME	
	Units	ft	ft	ft-amsl	µg/L	µg/L	µg/L	µg/L	µg/L	µg/L	µg/L	µg/L	µg/L	µg/L	µg/L	µg/L	µg/L	µg/L	µg/L	µg/L
MW-3	12/21/2001	31.32	25.65	5.67	180	-	850	160	11	32	84	300	-	-	-	-	-	-	-	-
MW-3	03/15/2002	31.32	25.17	6.15	-	-	-	-	-	-	-	-	-	-	-	-	-	-	-	-
MW-3	06/15/2002	31.32	25.31	6.01	<50	-	550	110	3.0	23	58	590	-	-	-	-	-	-	-	-
MW-3	09/06/2002	31.32	25.58	5.74	-	-	-	-	-	-	-	-	-	-	-	-	-	-	-	-
MW-3	12/06/2002	31.32	25.76	5.56	160	-	350	60	1.3	11	32	530	-	-	-	-	-	-	-	-
MW-3	03/03/2003	31.32	25.40	5.92	-	-	-	-	-	-	-	-	-	-	-	-	-	-	-	-
MW-3	06/17/2003 ¹⁴	31.32	25.13	6.19	130	-	560	90	2	19	57	-	-	590	-	-	-	-	-	-
MW-3	09/16/2003	31.32	25.47	5.85	-	-	-	-	-	-	-	-	-	-	-	-	-	-	-	-
MW-3	12/31/2003 ¹⁴	31.32	25.65	5.67	120	-	840	140	24	25	87	-	-	670	66	-	-	-	-	-
MW-3	03/26/2004	31.32	24.99	6.33	-	-	-	-	-	-	-	-	-	-	-	-	-	-	-	-
MW-3	08/17/2004 ¹⁴	31.32	25.86	5.46	110	-	630	84	18	11	35	-	-	410	<50	-	-	-	-	-
MW-3	11/16/2004 ¹⁴	34.16	25.90	8.26	92	-	740	100	4	21	45	-	-	460	<50	-	-	-	-	-
MW-3	02/18/2005	34.16	25.37	8.79	-	-	-	-	-	-	-	-	-	-	-	-	-	-	-	-
MW-3	05/06/2005 ¹⁴	34.16	24.98	9.18	83	-	290	43	<1	6	11	-	-	740	<100	-	-	-	-	-
MW-3	08/05/2005	34.16	25.35	8.81	-	-	-	-	-	-	-	-	-	-	-	-	-	-	-	-
MW-3	11/07/2005 ¹⁴	34.16	25.69	8.47	66	-	220	29	0.7	3	26	-	-	440	<50	-	-	-	-	-
MW-3	02/06/2006	34.16	25.28	8.88	-	-	-	-	-	-	-	-	-	-	-	-	-	-	-	-
MW-3	05/08/2006 ¹⁴	34.16	24.49	9.67	310	-	560	70	<1	3	24	3,300	-	-	<100	-	-	-	-	-
MW-3	08/08/2006	34.16	25.16	9.00	-	-	-	-	-	-	-	-	-	-	-	-	-	-	-	-
MW-3	11/08/2006 ¹⁴	34.16	25.59	8.57	210	-	510	<0.5	<0.5	<0.5	<0.5	73	-	-	<50	-	-	-	-	-
MW-3	02/06/2007	34.16	25.68	8.48	-	-	-	-	-	-	-	-	-	-	-	-	-	-	-	-
MW-3	05/01/2007 ¹⁴	34.16	25.46	8.70	84	-	260	36	<0.5	0.8	18	-	-	1,200	<50	-	-	-	-	-
MW-3	07/31/2007	34.16	25.70	8.46	-	-	-	-	-	-	-	-	-	-	-	-	-	-	-	-
MW-3	11/08/2007 ¹⁴	34.16	25.87	8.29	260	-	270	32	0.9	3	29	-	-	440	<50	-	-	-	-	-
MW-3	02/04/2008	34.16	25.68	8.48	-	-	-	-	-	-	-	-	-	-	-	-	-	-	-	-
MW-3	05/01/2008 ¹⁴	34.16	25.66	8.50	82	-	240	30	<0.5	<0.5	20	-	-	690	<50	-	-	-	-	-
MW-3	08/01/2008	34.16	25.76	8.40	-	-	-	-	-	-	-	-	-	-	-	-	-	-	-	-
MW-3	11/13/2008 ¹⁴	34.16	25.80	8.36	<50	-	720	22	<0.5	<0.5	7	-	-	790	<50	-	-	-	-	-
MW-3	02/23/2009	34.16	25.72	8.44	-	-	-	-	-	-	-	-	-	-	-	-	-	-	-	-
MW-3	05/20/2009	34.16	25.30	8.86	210	-	460	42	<0.5	1	20	-	-	450	<50	-	-	-	-	-
MW-3	08/25/2009	34.16	25.56	8.60	-	-	-	-	-	-	-	-	-	-	-	-	-	-	-	-
MW-3	11/18/2009	34.16	25.71	8.45	240	-	280	25	<0.5	<0.5	9	-	-	170	<50	-	-	-	-	-
MW-3	05/18/2010	34.16	25.11	9.05	150	-	63 J	11	<0.5	<0.5	1	-	-	110	<50	470	-	-	-	-

TABLE 1

GROUNDWATER MONITORING AND SAMPLING DATA
 FORMER CHEVRON SERVICE STATION 9-4800
 1700 CASTRO ST.
 OAKLAND, CALIFORNIA

Location	Date	TOC	DTW	GWE	HYDROCARBONS			PRIMARY VOCS						ADDITIONAL VOCS						
					TPH-DRO	TPH-DRO w/ Si Gel	TPH-GRO	B	T	E	X	MTBE by VOC	MTBE by SW8240	MTBE by SW8260	ETHANOL	TBA	DIPE	ETBE	TAME	
	Units	ft	ft	ft-amsl	µg/L	µg/L	µg/L	µg/L	µg/L	µg/L	µg/L	µg/L	µg/L	µg/L	µg/L	µg/L	µg/L	µg/L	µg/L	µg/L
MW-3	12/01/2010	34.16	25.69	8.47	110	-	78 J	6	<0.5	<0.5	3	-	-	19	<50	-	-	-	-	-
MW-3	05/04/2011	34.16	24.90	9.26	-	250	-	30	<0.5	<0.5	8	-	-	200	<50	-	-	-	-	-
MW-3	12/09/2011	34.16	25.56	8.60	64 J	-	210	10	<0.5	<0.5	9	-	-	230	<50	-	-	-	-	-
MW-4	04/08/1999	30.13	-	-	-	-	130	3.1	<0.5	<0.5	7.7	4,700 / 5,400	-	-	<25,000	<5,000	<100	<100	<100	
MW-4	06/17/1999	30.13	24.94	5.19	3,780 ¹	-	590	58	<5.0	<5.0	160	6,200	-	-	-	-	-	-	-	
MW-4	09/29/1999	30.13	25.17	4.96	1,130 ¹	-	692	10.7	<2.5	5.51	236	7,840	-	-	-	-	-	-	-	
MW-4	12/14/1999	30.13	25.22	4.91	571 ^{1,2}	-	625	<10	3.83	<10	94.6	4,470	-	-	-	-	-	-	-	
MW-4	03/09/2000 ³	30.13	24.68	5.45	600 ¹	-	402	3.76	1.18	<0.5	71.4	3,140	-	-	-	-	-	-	-	
MW-4	06/10/2000	30.13	24.60	5.53	-	-	<1,000	13.2	<10.0	<10.0	97.8	3,080	-	-	-	-	-	-	-	
MW-4	09/30/2000	30.13	25.04	5.09	1,400 ⁷	-	280 ⁶	21	0.67	6.3	60	3,300	-	-	-	-	-	-	-	
MW-4	12/22/2000	30.13	25.23	4.90	740 ⁹	-	240 ⁶	2.2	<0.50	1.3	25	2,200	-	-	-	-	-	-	-	
MW-4	03/01/2001	30.13	24.98	5.15	661 ⁷	-	193	2.31	<0.500	1.34	12.1	1,220	-	-	-	-	-	-	-	
MW-4	05/04/2001	30.13	24.88	5.25	1,100 ⁷	-	722	12.0	<5.00	17.1	89.4	2,390	-	-	-	-	-	-	-	
MW-4	09/05/2001	30.13	25.17	4.96	2,500	-	1,400	23	2.2	19	260	2,300	-	-	-	-	-	-	-	
MW-4	12/21/2001	30.13	25.07	5.06	1,100	-	310	2.9	<0.50	2.6	32	860	-	-	-	-	-	-	-	
MW-4	03/15/2002	30.13	24.69	5.44	3,100	-	520	5.0	<0.50	15	6.8	2,700	-	-	-	-	-	-	-	
MW-4	06/15/2002	30.13	24.84	5.29	2,400	-	950	16	3.6	41	100	2,200	-	2,400 ¹²	-	840	<2.0	<2.0	110	
MW-4	09/06/2002	30.13	25.06	5.07	2,600	-	640	9.6	0.52	9.8	28	1,700	-	-	-	-	-	-	-	
MW-4	12/06/2002	30.13	25.20	4.93	1,400	-	280	3.6	<0.50	1.7	<1.5	730	-	-	-	-	-	-	-	
MW-4	03/03/2003	30.13	24.85	5.28	1,500	-	280	2.7	<0.50	7.3	2.3	910	-	-	-	-	-	-	-	
MW-4	06/17/2003 ¹⁴	30.13	24.69	5.44	2,000	-	660	8	1	38	16	-	-	1,100	-	520	<0.5	<0.5	110	
MW-4	09/16/2003 ¹⁴	30.13	24.98	5.15	2,100 ¹⁶	-	480	6	<1	11	3	-	-	710	<100	-	-	-	-	
MW-4	12/31/2003 ¹⁴	30.13	25.06	5.07	1,400	-	220	3	<0.5	2	<0.5	-	-	390	<50	-	-	-	-	
MW-4	03/26/2004	30.13	24.53	5.60	-	-	-	-	-	-	-	-	-	-	-	-	-	-	-	
MW-4	08/17/2004 ¹⁴	30.13	25.45	4.68	2,100	-	470	12	1	28	4	-	-	370	<50	66	<0.5	<0.5	50	
MW-4	11/16/2004 ¹⁴	33.07	25.44	7.63	960	-	270	7	<0.5	7	6	-	-	270	<50	-	-	-	-	
MW-4	02/18/2005	33.07	25.00	8.07	-	-	-	-	-	-	-	-	-	-	-	-	-	-	-	
MW-4	05/06/2005 ¹⁴	33.07	24.69	8.38	350	-	86	0.7	<0.5	<0.5	<0.5	-	-	110	<50	21	<0.5	<0.5	8	
MW-4	08/05/2005	33.07	25.02	8.05	-	-	-	-	-	-	-	-	-	-	-	-	-	-	-	
MW-4	11/07/2005 ¹⁴	33.07	25.33	7.74	150	-	54	0.6	<0.5	<0.5	<0.5	-	-	59	<50	-	-	-	-	
MW-4	02/06/2006	33.07	24.94	8.13	-	-	-	-	-	-	-	-	-	-	-	-	-	-	-	

TABLE 1

GROUNDWATER MONITORING AND SAMPLING DATA
 FORMER CHEVRON SERVICE STATION 9-4800
 1700 CASTRO ST.
 OAKLAND, CALIFORNIA

Location	Date	TOC	DTW	GWE	HYDROCARBONS			PRIMARY VOCS						ADDITIONAL VOCS						
					TPH-DRO	TPH-DRO w/ Si Gel	TPH-GRO	B	T	E	X	MTBE by VOC	MTBE by SW8240	MTBE by SW8260	ETHANOL	TBA	DIPE	ETBE	TAME	
	Units	ft	ft	ft-amsl	µg/L	µg/L	µg/L	µg/L	µg/L	µg/L	µg/L	µg/L	µg/L	µg/L	µg/L	µg/L	µg/L	µg/L	µg/L	µg/L
MW-4	05/08/2006 ¹⁴	33.07	24.27	8.80	200	-	66	0.5	<0.5	<0.5	<0.5	92	-	-	<50	-	-	-	-	
MW-4	08/08/2006	33.07	25.16	7.91	-	-	-	-	-	-	-	-	-	-	-	-	-	-	-	
MW-4	11/08/2006 ¹⁴	33.07	25.23	7.84	400	-	55	<0.5	<0.5	<0.5	<0.5	40	-	-	<50	-	-	-	-	
MW-4	02/06/2007	33.07	25.28	7.79	-	-	-	-	-	-	-	-	-	-	-	-	-	-	-	
MW-4	05/01/2007 ¹⁴	33.07	25.08	7.99	150	-	67	<0.5	<0.5	<0.5	<0.5	-	-	76	<50	10	<0.5	<0.5	6	
MW-4	07/31/2007	33.07	25.27	7.80	-	-	-	-	-	-	-	-	-	-	-	-	-	-	-	
MW-4	11/08/2007 ¹⁴	33.07	25.42	7.65	850	-	<50	<0.5	<0.5	<0.5	<0.5	-	-	44	<50	-	-	-	-	
MW-4	02/04/2008	33.07	25.23	7.84	-	-	-	-	-	-	-	-	-	-	-	-	-	-	-	
MW-4	05/01/2008 ¹⁴	33.07	25.21	7.86	110	-	<50	<0.5	<0.5	<0.5	<0.5	-	-	67	<50	12	<0.5	<0.5	4	
MW-4	08/01/2008	33.07	25.28	7.79	-	-	-	-	-	-	-	-	-	-	-	-	-	-	-	
MW-4	11/13/2008 ¹⁴	33.07	25.43	7.64	330	-	64	<0.5	<0.5	<0.5	1	-	-	220	<50	-	-	-	-	
MW-4	02/23/2009	33.07	25.06	8.01	-	-	-	-	-	-	-	-	-	-	-	-	-	-	-	
MW-4	05/20/2009	33.07	24.73	8.34	560	-	130	<0.5	<0.5	<0.5	<0.5	-	-	190	<50	58	<0.5	<0.5	6	
MW-4	08/25/2009	33.07	24.97	8.10	-	-	-	-	-	-	-	-	-	-	-	-	-	-	-	
MW-4	11/18/2009	33.07	25.27	7.80	860	-	120	<0.5	<0.5	<0.5	<0.5	-	-	150	<50	-	-	-	-	
MW-4	05/18/2010	33.07	24.73	8.34	340	-	56 J	<0.5	<0.5	<0.5	<0.5	-	-	70	<50	33	<0.5	<0.5	4	
MW-4	12/01/2010	33.07	25.13	7.94	570	-	64 J	<0.5	<0.5	<0.5	<0.5	-	-	110	<50	-	-	-	-	
MW-4	05/04/2011	33.07	24.50	8.57	-	60 J	<50	<0.5	<0.5	<0.5	<0.5	-	-	25	<50	49	<0.5	<0.5	<0.5	
MW-4	12/09/2011	33.07	25.12	7.95	140	-	56 J	<0.5	<0.5	<0.5	<0.5	-	-	18	<50	-	-	-	-	
MW-5	04/08/1999	30.93	-	-	<50	-	<50	<0.5	<0.5	<0.5	<0.5	<2.0 / <2.5	-	-	<500	<100	<2.0	<2.0	<2.0	
MW-5	06/17/1999	30.93	26.00	4.93	53.8 ¹	-	<50	<0.5	<0.5	<0.5	<0.5	<2.5	-	-	-	-	-	-	-	
MW-5	09/29/1999	30.93	26.20	4.73	<50	-	<50	<0.5	<0.5	<0.5	<0.5	<2.5	-	-	-	-	-	-	-	
MW-5	12/14/1999	30.93	26.32	4.61	<50 ²	-	<50	<0.5	<0.5	<0.5	<0.5	0.598	-	-	-	-	-	-	-	
MW-5	03/09/2000 ³	30.93	25.93	5.00	<50	-	<50	<0.5	<0.5	<0.5	<0.5	<2.5	-	-	-	-	-	-	-	
MW-5	06/10/2000	30.93	25.72	5.21	-	-	<50.0	<0.500	<0.500	<0.500	<0.500	<2.50	-	-	-	-	-	-	-	
MW-5	09/30/2000	30.93	26.14	4.79	130 ⁸	-	<50	<0.50	<0.50	<0.50	<0.50	<2.5	-	-	-	-	-	-	-	
MW-5	12/22/2000	30.93	26.33	4.60	250 ⁸	-	<50	<0.50	<0.50	<0.50	<0.50	9.1	-	-	-	-	-	-	-	
MW-5	03/01/2001	30.93	26.16	4.77	77.4 ⁷	-	<50.0	<0.500	<0.500	<0.500	<0.500	<2.50	-	-	-	-	-	-	-	
MW-5	05/04/2001	30.93	26.04	4.89	-	-	-	-	-	-	-	-	-	-	-	-	-	-	-	
MW-5	09/05/2001	30.93	26.21	4.72	-	-	-	-	-	-	-	-	-	-	-	-	-	-	-	
MW-5	12/21/2001	30.93	26.20	4.73	110	-	<50	<0.50	<0.50	<0.50	<1.5	<2.5	-	-	-	-	-	-	-	
MW-5	03/15/2002	30.93	25.87	5.06	-	-	-	-	-	-	-	-	-	-	-	-	-	-	-	

TABLE 1

GROUNDWATER MONITORING AND SAMPLING DATA
 FORMER CHEVRON SERVICE STATION 9-4800
 1700 CASTRO ST.
 OAKLAND, CALIFORNIA

Location	Date	TOC	DTW	GWE	HYDROCARBONS			PRIMARY VOCs						ADDITIONAL VOCs						
					TPH-DRO	TPH-DRO w/ Si Gel	TPH-GRO	B	T	E	X	MTBE by VOC	MTBE by SW8240	MTBE by SW8260	ETHANOL	TBA	DIPE	ETBE	TAME	
	Units	ft	ft	ft-amsl	µg/L	µg/L	µg/L	µg/L	µg/L	µg/L	µg/L	µg/L	µg/L	µg/L	µg/L	µg/L	µg/L	µg/L	µg/L	µg/L
MW-5	06/15/2002	30.93	25.98	4.95	<50	-	<50	<0.50	<0.50	<0.50	<1.5	<2.5	-	-	-	-	-	-	-	-
MW-5	09/06/2002	30.93	26.18	4.75	-	-	-	-	-	-	-	-	-	-	-	-	-	-	-	-
MW-5	12/06/2002	30.93	26.32	4.61	<50	-	<50	<0.50	<0.50	<0.50	<1.5	<2.5	-	-	-	-	-	-	-	-
MW-5	03/03/2003	30.93	25.99	4.94	-	-	-	-	-	-	-	-	-	-	-	-	-	-	-	-
MW-5	06/17/2003 ¹⁴	30.93	25.87	5.06	<50	-	<50	<0.5	<0.5	<0.5	<0.5	-	-	<0.5	-	-	-	-	-	-
MW-5	09/16/2003	30.93	26.09	4.84	-	-	-	-	-	-	-	-	-	-	-	-	-	-	-	-
MW-5	12/31/2003 ¹⁴	30.93	26.21	4.72	<50	-	<50	<0.5	<0.5	<0.5	<0.5	-	-	<0.5	<50	-	-	-	-	-
MW-5	03/26/2004	30.93	25.74	5.19	-	-	-	-	-	-	-	-	-	-	-	-	-	-	-	-
MW-5	08/17/2004	30.93	-	-	-	-	-	-	-	-	-	-	-	-	-	-	-	-	-	-
MW-6	04/08/1999	30.58	-	-	-	-	<50	<0.5	<0.5	<0.5	<0.5	5.6 / 4.5	-	-	<500	<100	<2.0	<2.0	<2.0	
MW-6	06/17/1999	30.58	24.59	5.99	<50	-	<50	<0.5	<0.5	<0.5	<0.5	<2.5	-	-	-	-	-	-	-	
MW-6	09/29/1999	30.58	24.77	5.81	<50	-	<50	<0.5	<0.5	<0.5	<0.5	4.46	-	-	-	-	-	-	-	
MW-6	12/14/1999	30.58	24.84	5.74	<50 ²	-	<50	<0.5	<0.5	<0.5	<0.5	4.13	-	-	-	-	-	-	-	
MW-6	03/09/2000 ³	30.58	24.09	6.49	<50	-	<50	<0.5	<0.5	<0.5	<0.5	2.82	-	-	-	-	-	-	-	
MW-6	06/10/2000	30.58	24.00	6.58	-	-	<50.0	<0.500	<0.500	<0.500	<0.500	<2.50	-	-	-	-	-	-	-	
MW-6	09/30/2000	30.58	24.58	6.00	110 ⁸	-	<50	<0.50	<0.50	<0.50	<0.50	7.3	-	-	-	-	-	-	-	
MW-6	12/22/2000	30.58	24.83	5.75	100 ⁸	-	<50	<0.50	<0.50	<0.50	<0.50	4.5	-	-	-	-	-	-	-	
MW-6	03/01/2001	30.58	24.51	6.07	141 ⁷	-	<50.0	<0.500	<0.500	<0.500	<0.500	7.52	-	-	-	-	-	-	-	
MW-6	05/04/2001	30.58	24.32	6.26	<50	-	<50.0	<0.500	<5.00	<5.00	<5.00	2.74	-	-	-	-	-	-	-	
MW-6	09/05/2001	30.58	24.59	5.99	-	-	-	-	-	-	-	-	-	-	-	-	-	-	-	
MW-6	12/21/2001	30.58	24.65	5.93	200	-	<50	<0.50	<0.50	<0.50	<1.5	8.5	-	-	-	-	-	-	-	
MW-6	03/15/2002	30.58	24.14	6.44	-	-	-	-	-	-	-	-	-	-	-	-	-	-	-	
MW-6	06/15/2002	30.58	24.33	6.25	<50	-	<50	<0.50	<0.50	<0.50	<1.5	4.3	-	-	-	-	-	-	-	
MW-6	09/06/2002	30.58	24.60	5.98	-	-	-	-	-	-	-	-	-	-	-	-	-	-	-	
MW-6	12/06/2002	30.58	24.79	5.79	64	-	<50	<0.50	<0.50	<0.50	<1.5	5.0	-	-	-	-	-	-	-	
MW-6	03/03/2003	30.58	24.44	6.14	-	-	-	-	-	-	-	-	-	-	-	-	-	-	-	
MW-6	06/17/2003 ¹⁴	30.58	24.11	6.47	<50	-	<50	<0.5	<0.5	<0.5	<0.5	-	-	13	-	-	-	-	-	
MW-6	09/16/2003	30.58	24.52	6.06	-	-	-	-	-	-	-	-	-	-	-	-	-	-	-	
MW-6	12/31/2003 ¹⁴	30.58	24.58	6.00	<50	-	<50	<0.5	<0.5	<0.5	0.5	-	-	14	<50	-	-	-	-	
MW-6	03/26/2004	30.58	23.89	6.69	-	-	-	-	-	-	-	-	-	-	-	-	-	-	-	
MW-6	08/17/2004	30.58	-	-	-	-	-	-	-	-	-	-	-	-	-	-	-	-	-	
MW-7	05/04/2001 ¹¹	31.90	27.87	4.03	<50	-	<50.0	<0.500	<5.00	<5.00	<5.00	567	-	470 ¹²	<500	57	<2.0	<2.0	11	

TABLE 1

GROUNDWATER MONITORING AND SAMPLING DATA
 FORMER CHEVRON SERVICE STATION 9-4800
 1700 CASTRO ST.
 OAKLAND, CALIFORNIA

Location	Date	TOC	DTW	GWE	HYDROCARBONS			PRIMARY VOCS						ADDITIONAL VOCS						
					TPH-DRO	TPH-DRO w/ Si Gel	TPH-GRO	B	T	E	X	MTBE by VOC	MTBE by SW8240	MTBE by SW8260	ETHANOL	TBA	DIPE	ETBE	TAME	
	Units	ft	ft	ft-amsl	µg/L	µg/L	µg/L	µg/L	µg/L	µg/L	µg/L	µg/L	µg/L	µg/L	µg/L	µg/L	µg/L	µg/L	µg/L	µg/L
MW-7	09/05/2001	31.90	28.04	3.86	<50	-	<50	<0.50	<0.50	<0.50	<1.5	1,400	-	1,300 ¹²	<500	<100	<2.0	<2.0	32	
MW-7	12/21/2001	31.90	28.86	3.04	210	-	<50	<0.50	<0.50	<0.50	<1.5	620	-	670 ¹²	<500	<100	<2.0	<2.0	15	
MW-7	03/15/2002	31.90	27.72	4.18	<50	-	<50	<0.50	<0.50	<0.50	<1.5	350 / 320	-	350 ¹²	<500	<100	<2.0	<2.0	8	
MW-7	06/15/2002	31.90	27.84	4.06	<50	-	<50	<0.50	<0.50	<0.50	<1.5	850	-	960 ¹²	-	<100	<2.0	<2.0	18	
MW-7	09/06/2002	31.90	27.97	3.93	<50	-	59	<0.50	<0.50	<0.50	<1.5	1,900	-	-	-	-	-	-	-	
MW-7	12/06/2002	31.90	28.03	3.87	<50	-	68	<0.50	<0.50	<0.50	<1.5	2,200	-	-	-	-	-	-	-	
MW-7	03/03/2003	31.90	27.69	4.21	<50	-	<50	<0.50	<0.50	<0.50	<1.5	1,300	-	-	-	-	-	-	-	
MW-7	06/17/2003 ¹⁴	31.90	27.76	4.14	<50	-	79	<0.5	<0.5	<0.5	<0.5	-	-	2,500	-	37	<0.5	<0.5	53	
MW-7	09/16/2003 ¹⁴	31.90	27.83	4.07	<50 ¹⁷	-	110	<5	<5	<5	<5	-	-	4,400	<500	-	-	-	-	
MW-7	12/31/2003 ¹⁴	31.90	27.86	4.04	<50	-	76	<2.0	<2.0	<2.0	<2.0	-	-	3,000	<200	-	-	-	-	
MW-7	03/26/2004 ¹⁴	31.90	27.65	4.25	<50	-	61	<1	<1	<1	<1	-	-	2,000	-	-	-	-	-	
MW-7	08/17/2004 ¹⁴	31.90	27.88	4.02	2,200	-	130	<5	<5	<5	<5	-	-	8,000	<500	<50	<5	<5	140	
MW-7	11/16/2004 ¹⁴	34.35	27.87	6.48	<50	-	200	<3	<3	<3	<3	-	-	7,300	<250	-	-	-	-	
MW-7	02/18/2005 ¹⁴	34.35	27.60	6.75	64	-	86	<10	<10	<10	<10	-	-	5,700	<1,000	-	-	-	-	
MW-7	05/06/2005 ¹⁴	34.35	27.43	6.92	60	-	160	<5	<5	<5	<5	-	-	8,400	<500	<50	<5	<5	140	
MW-7	08/05/2005 ¹⁴	34.35	27.65	6.70	81 ¹⁸	-	500	<5	<5	<5	<5	-	-	20,000 ¹⁹	<500	-	-	-	-	
MW-7	11/07/2005 ¹⁴	34.35	27.79	6.56	68	-	300	<10	<10	<10	<10	-	-	24,000	<1,000	-	-	-	-	
MW-7	02/06/2006 ¹⁴	34.35	27.54	6.81	72 ²¹	-	300	<0.5	<0.5	<0.5	<0.5	14,000	-	-	<50	-	-	-	-	
MW-7	05/08/2006 ¹⁴	34.35	27.15	7.20	94	-	80	<2.0	<2.0	3	7	6,500	-	-	<200	-	-	-	-	
MW-7	08/08/2006 ¹⁴	34.35	27.53	6.82	150	-	520	<10	<10	<10	<10	17,000	-	-	<1,000	-	-	-	-	
MW-7	11/08/2006 ¹⁴	34.35	27.75	6.60	440	-	900	<5	<5	<5	<5	41,000	-	-	<500	-	-	-	-	
MW-7	02/06/2007 ¹⁴	34.35	27.76	6.59	200	-	590	<5	<5	<5	<5	-	-	31,000	<500	-	-	-	-	
MW-7	05/01/2007 ¹⁴	34.35	27.65	6.70	190	-	380	<3	<3	<3	<3	-	-	14,000	<250	<10	<3	<3	260	
MW-7	07/31/2007 ¹⁴	34.35	27.75	6.60	270	-	570	<3	<3	<3	<3	-	-	15,000	<250	-	-	-	-	
MW-7	11/08/2007 ¹⁴	34.35	27.83	6.52	150	-	520	<5	<5	<5	<5	-	-	25,000	<500	-	-	-	-	
MW-7	02/04/2008 ¹⁴	34.35	27.69	6.66	87	-	540	<1	<1	<1	<1	-	-	17,000	<100	-	-	-	-	
MW-7	05/01/2008 ¹⁴	34.35	27.72	6.63	<50	-	230	<5	<5	<5	<5	-	-	10,000	<500	<20	<5	<5	170	
MW-7	08/01/2008 ¹⁴	34.35	27.84	6.51	<50	-	330	<3	<3	<3	<3	-	-	12,000	<250	-	-	-	-	
MW-7	11/13/2008 ¹⁴	34.35	28.01	6.34	64	-	390	<10	<10	<10	<10	-	-	16,000	<1,000	-	-	-	-	
MW-7	02/23/2009 ¹⁴	34.35	27.65	6.70	100	-	270	<3	<3	<3	<3	-	-	11,000	<250	-	-	-	-	

TABLE 1

GROUNDWATER MONITORING AND SAMPLING DATA
 FORMER CHEVRON SERVICE STATION 9-4800
 1700 CASTRO ST.
 OAKLAND, CALIFORNIA

Location	Date	TOC	DTW	GWE	HYDROCARBONS			PRIMARY VOCS						ADDITIONAL VOCS						
					TPH-DRO	TPH-DRO w/ Si Gel	TPH-GRO	B	T	E	X	MTBE by VOC	MTBE by SW8240	MTBE by SW8260	ETHANOL	TBA	DIPE	ETBE	TAME	
	Units	ft	ft	ft-amsl	µg/L	µg/L	µg/L	µg/L	µg/L	µg/L	µg/L	µg/L	µg/L	µg/L	µg/L	µg/L	µg/L	µg/L	µg/L	µg/L
MW-7	05/20/2009	34.35	27.55	6.80	48 J	-	210	<1	<1	<1	<1	-	-	6,300	<100	31	<1	<1	<1	120
MW-7	08/25/2009	34.35	27.70	6.65	<100 U	-	160	<3	<3	<3	<3	-	-	5,700	<250	-	-	-	-	-
MW-7	11/18/2009	34.35	27.77	6.58	250	-	100	<1	<1	<1	<1	-	-	2,800	<130	-	-	-	-	-
MW-7	05/18/2010	34.35	27.51	6.84	160	-	76 J	<1	<1	<1	<1	-	-	2,400	<100	<4	<1	2	52	-
MW-7	12/01/2010	34.35	27.71	6.64	120	-	230	<0.5	<0.5	<0.5	<0.5	-	-	7,000	<50	-	-	-	-	-
MW-7	05/04/2011	34.35	27.35	7.00	-	85 J	150	<0.5	<0.5	<0.5	<0.5	-	-	4,200	<50	<2	<0.5	1	100	-
MW-7	12/09/2011	34.35	26.15	8.20	66 J	-	250	<0.5	<0.5	<0.5	<0.5	-	-	7,400	<50	-	-	-	-	-
QA	12/21/2001	-	-	-	-	-	<50	<0.50	<0.50	<0.50	<1.5	<2.5	-	-	-	-	-	-	-	-
QA	03/15/2002	-	-	-	-	-	<50	<0.50	<0.50	<0.50	<1.5	<2.5	-	-	-	-	-	-	-	-
QA	06/15/2002	-	-	-	-	-	<50	<0.50	<0.50	<0.50	<1.5	<2.5	-	-	-	-	-	-	-	-
QA	09/06/2002	-	-	-	-	-	<50	<0.50	<0.50	<0.50	<1.5	<2.5	-	-	-	-	-	-	-	-
QA	12/06/2002	-	-	-	-	-	<50	<0.50	<0.50	<0.50	<1.5	<2.5	-	-	-	-	-	-	-	-
QA	06/17/2003 ¹⁴	-	-	-	-	-	<50	<0.5	<0.5	<0.5	<0.5	-	-	<0.5	-	-	-	-	-	-
QA	09/16/2003 ¹⁴	-	-	-	-	-	<50	<0.5	<0.5	<0.5	<0.5	-	-	<0.5	-	-	-	-	-	-
QA	12/31/2003 ¹⁴	-	-	-	-	-	<50	<0.5	<0.5	<0.5	<0.5	-	-	<0.5	-	-	-	-	-	-
QA	03/26/2004 ¹⁴	-	-	-	-	-	<50	<0.5	<0.5	<0.5	<0.5	-	-	<0.5	-	-	-	-	-	-
QA	08/17/2004 ¹⁴	-	-	-	-	-	<50	<0.5	<0.5	<0.5	<0.5	-	-	<0.5	-	-	-	-	-	-
QA	11/16/2004 ¹⁴	-	-	-	-	-	<50	<0.5	<0.5	<0.5	<0.5	-	-	<0.5	-	-	-	-	-	-
QA	02/18/2005 ¹⁴	-	-	-	-	-	<50	<0.5	<0.5	<0.5	<0.5	-	-	<0.5	-	-	-	-	-	-
QA	05/06/2005 ¹⁴	-	-	-	-	-	<50	<0.5	<0.5	<0.5	<0.5	-	-	<0.5	-	-	-	-	-	-
QA	08/05/2005 ¹⁴	-	-	-	-	-	<50	<0.5	<0.5	<0.5	<0.5	-	-	<0.5	-	-	-	-	-	-
QA	11/07/2005 ¹⁴	-	-	-	-	-	<50	0.6	<0.5	<0.5	<0.5	-	-	<0.5	-	-	-	-	-	-
QA	02/06/2006 ¹⁴	-	-	-	-	-	<50	<0.5	<0.5	<0.5	<0.5	<0.5	-	-	-	-	-	-	-	-
QA	05/08/2006 ¹⁴	-	-	-	-	-	<50	<0.5	<0.5	<0.5	<0.5	<0.5	-	-	-	-	-	-	-	-
QA	08/08/2006 ¹⁴	-	-	-	-	-	<50	<0.5	<0.5	<0.5	<0.5	<0.5	-	-	-	-	-	-	-	-
QA	11/08/2006 ¹⁴	-	-	-	-	-	<50	<0.5	<0.5	<0.5	<0.5	<0.5	-	-	-	-	-	-	-	-
QA	02/06/2007 ¹⁴	-	-	-	-	-	<50	<0.5	<0.5	<0.5	<0.5	-	-	<0.5	-	-	-	-	-	-
QA	05/01/2007 ¹⁴	-	-	-	-	-	<50	<0.5	<0.5	<0.5	<0.5	-	-	<0.5	-	-	-	-	-	-
QA	07/31/2007 ¹⁴	-	-	-	-	-	<50	<0.5	<0.5	<0.5	<0.5	-	-	<0.5	-	-	-	-	-	-
QA	11/08/2007 ¹⁴	-	-	-	-	-	<50	<0.5	<0.5	<0.5	<0.5	-	-	<0.5	-	-	-	-	-	-
QA	02/04/2008 ¹⁴	-	-	-	-	-	<50	<0.5	<0.5	<0.5	<0.5	-	-	<0.5	-	-	-	-	-	-

TABLE 1

GROUNDWATER MONITORING AND SAMPLING DATA
 FORMER CHEVRON SERVICE STATION 9-4800
 1700 CASTRO ST.
 OAKLAND, CALIFORNIA

Location	Date	TOC	DTW	GWE	HYDROCARBONS			PRIMARY VOCS						ADDITIONAL VOCS						
					TPH-DRO	TPH-DRO w/ Si Gel	TPH-GRO	B	T	E	X	MTBE by VOC	MTBE by SW8240	MTBE by SW8260	ETHANOL	TBA	DIPE	ETBE	TAME	
	Units	ft	ft	ft-amsl	µg/L	µg/L	µg/L	µg/L	µg/L	µg/L	µg/L	µg/L	µg/L	µg/L	µg/L	µg/L	µg/L	µg/L	µg/L	µg/L
QA	05/01/2008 ¹⁴	-	-	-	-	-	<50	<0.5	<0.5	<0.5	<0.5	-	-	<0.5	-	-	-	-	-	-
QA	08/01/2008 ¹⁴	-	-	-	-	-	<50	<0.5	<0.5	<0.5	<0.5	-	-	<0.5	-	-	-	-	-	-
QA	11/13/2008 ¹⁴	-	-	-	-	-	<50	<0.5	<0.5	<0.5	<0.5	-	-	<0.5	-	-	-	-	-	-
QA	02/23/2009 ¹⁴	-	-	-	-	-	<50	<0.5	<0.5	<0.5	<0.5	-	-	<0.5	-	-	-	-	-	-
QA	05/20/2009	-	-	-	-	-	<50	<0.5	<0.5	<0.5	<0.5	-	-	<0.5	-	-	-	-	-	-
QA	08/25/2009	-	-	-	-	-	<50	<0.5	<0.5	<0.5	<0.5	-	-	<0.5	-	-	-	-	-	-
QA	11/18/2009	-	-	-	-	-	<50	<0.5	0.5 J	<0.5	<0.5	-	-	<0.5	-	-	-	-	-	-
QA	05/18/2010	-	-	-	-	-	<50	<0.5	<0.5	<0.5	<0.5	-	-	<0.5	-	-	-	-	-	-
QA	12/01/2010	-	-	-	-	-	<50	<0.5	<0.5	<0.5	<0.5	-	-	<0.5	-	-	-	-	-	-
QA	05/04/2011	-	-	-	-	-	<50	<0.5	<0.5	<0.5	<0.5	-	-	<0.5	-	-	-	-	-	-
QA	12/09/2011	-	-	-	-	-	<50	<0.5	<0.5	<0.5	<0.5	-	-	<0.5	-	-	-	-	-	-
Trip Blank	06/04/1997	-	-	-	-	-	<50	<0.5	<0.5	<0.5	<0.5	<2.5	-	-	-	-	-	-	-	-
Trip Blank	09/16/1997	-	-	-	-	-	<50	<0.5	<0.5	<0.5	<0.5	<2.5	-	-	-	-	-	-	-	-
Trip Blank	12/17/1997	-	-	-	-	-	<50	<0.5	<0.5	<0.5	<0.5	<2.5	-	-	-	-	-	-	-	-
Trip Blank	03/18/1998	-	-	-	-	-	<50	<0.5	<0.5	<0.5	<0.5	<2.5	-	-	-	-	-	-	-	-
Trip Blank	06/28/1998	-	-	-	-	-	<50	<0.5	<0.5	<0.5	<0.5	-	<2.5	-	-	-	-	-	-	-
Trip Blank	09/07/1998	-	-	-	-	-	<50	<0.5	<0.5	<0.5	<0.5	<2.5	-	-	-	-	-	-	-	-
Trip Blank	12/09/1998	-	-	-	-	-	<50	<0.5	<0.5	<0.5	<0.5	<2.5	-	-	-	-	-	-	-	-
Trip Blank	03/11/1999	-	-	-	-	-	<50	<0.5	<0.5	<0.5	<0.5	<5.0	-	-	-	-	-	-	-	-
Trip Blank	06/17/1999	-	-	-	-	-	<50	<0.5	<0.5	<0.5	<0.5	<2.5	-	-	-	-	-	-	-	-
Trip Blank	12/14/1999	-	-	-	-	-	<50	<0.5	<0.5	<0.5	<0.5	<2.5	-	-	-	-	-	-	-	-
Trip Blank	03/09/2000 ³	-	-	-	-	-	<50	<0.5	<0.5	<0.5	<0.5	<2.5	-	-	-	-	-	-	-	-
Trip Blank	06/10/2000	-	-	-	-	-	<50.0	<0.500	<0.500	<0.500	<0.500	<2.50	-	-	-	-	-	-	-	-
Trip Blank	09/30/2000	-	-	-	-	-	<50	<0.50	<0.50	<0.50	<0.50	<2.5	-	-	-	-	-	-	-	-
Trip Blank	12/22/2000 ¹⁰	-	-	-	-	-	<50	<0.50	<0.50	<0.50	<0.50	<2.5	-	-	-	-	-	-	-	-
Trip Blank	03/01/2001	-	-	-	-	-	<50.0	<0.500	<0.500	<0.500	<0.500	<2.50	-	-	-	-	-	-	-	-
Trip Blank	05/04/2001	-	-	-	-	-	<50.0	<0.500	<5.00	<5.00	<5.00	<0.500	-	-	-	-	-	-	-	-
Trip Blank	09/05/2001	-	-	-	-	-	<50	<0.50	<0.50	<0.50	<1.5	<2.5	-	-	-	-	-	-	-	-

TABLE 1

GROUNDWATER MONITORING AND SAMPLING DATA
 FORMER CHEVRON SERVICE STATION 9-4800
 1700 CASTRO ST.
 OAKLAND, CALIFORNIA

Location	Date	TOC	DTW	GWE	HYDROCARBONS			PRIMARY VOCS						ADDITIONAL VOCS								
					TPH-DRO	TPH-DRO w/ Si Gel	TPH-GRO	B	T	E	X	MTBE by VOC	MTBE by SW8240	MTBE by SW8260	ETHANOL	TBA	DIPE	ETBE	TAME			
Units		ft	ft	ft-amsl	µg/L	µg/L	µg/L	µg/L	µg/L	µg/L	µg/L	µg/L	µg/L	µg/L	µg/L	µg/L	µg/L	µg/L	µg/L	µg/L	µg/L	

**GROUNDWATER MONITORING AND SAMPLING DATA
FORMER CHEVRON SERVICE STATION 9-4800
1700 CASTRO ST.
OAKLAND, CALIFORNIA**

Location	Date	TOC	DTW	GWE	HYDROCARBONS			PRIMARY VOCS						ADDITIONAL VOCS						
					TPH-DRO	TPH-DRO w/ Si Gel	TPH-GRO	B	T	E	X	MTBE by VOC	MTBE by SW8240	MTBE by SW8260	ETHANOL	TBA	DIPE	ETBE	TAME	
Units		ft	ft	ft-amsl	µg/L	µg/L	µg/L	µg/L	µg/L	µg/L	µg/L	µg/L	µg/L	µg/L	µg/L	µg/L	µg/L	µg/L	µg/L	µg/L

Abbreviations and Notes:

TOC = Top of Casing

DTW = Depth to Water

GWE = Groundwater elevation

(ft-amsl) = Feet Above Mean sea level

ft = Feet

µg/L = Micrograms per Liter

TPH-DRO = Total Petroleum Hydrocarbons - Diesel Range Organics

TPH-GRO = Total Petroleum Hydrocarbons - Gasoline Range Organics

VOCS = Volatile Organic Compounds

B = Benzene

T = Toluene

E = Ethylbenzene

X = Xylene

MTBE = Methyl tert butyl ether

TBA = Tert-Butyl alcohol

DIPE = Diisopropyl ether

ETBE = Tert-Butyl ethyl ether

TAME = Tert-Amyl methyl ether

-- = Not available / not applicable

<x = Not detected above laboratory method detection limit

J = Estimated concentration

- 1 Chromatogram pattern indicates an unidentified hydrocarbon.
- 2 Sample was extracted outside EPA recommended holding time.
- 3 TPH-G, BTEX and MTBE was analyzed outside EPA recommended holding time.
- 4 EPA Method 8240.
- 5 Confirmation run.
- 6 Laboratory report indicates gasoline C6-C12.
- 7 Laboratory report indicates unidentified hydrocarbons C9-C24.
- 8 Laboratory report indicates unidentified hydrocarbons >C16.
- 9 Laboratory report indicates unidentified hydrocarbons C9-C40.

**GROUNDWATER MONITORING AND SAMPLING DATA
FORMER CHEVRON SERVICE STATION 9-4800
1700 CASTRO ST.
OAKLAND, CALIFORNIA**

Location	Date	TOC	DTW	GWE	HYDROCARBONS			PRIMARY VOCS						ADDITIONAL VOCS							
					TPH-DRO	TPH-DRO w/ Si Gel	TPH-GRO	B	T	E	X	MTBE by VOC	MTBE by SW8240	MTBE by SW8260	ETHANOL	TBA	DIPE	ETBE	TAME		
Units		ft	ft	ft-amsl	µg/L	µg/L	µg/L	µg/L	µg/L	µg/L	µg/L	µg/L	µg/L	µg/L	µg/L	µg/L	µg/L	µg/L	µg/L	µg/L	µg/L

- 10 Laboratory report indicates this sample was analyzed outside of the EPA recommended holding time.
- 11 Well development performed.
- 12 MTBE by EPA Method 8260.
- 14 BTEX and MTBE by EPA Method 8260.
- 15 Laboratory report indicates the surrogate data for the method blank is outside QC limits. Results from the re-extraction are within the limits. The hold time had expired prior to re-extraction so all results are reported from the original extract. The TPH-D result from the re-extraction is 910 ppb.
- 16 Laboratory report indicates the surrogate data for the method blank is outside QC limits. Results from the re-extraction are within the limits. The hold time had expired prior to re-extraction so all results are reported from the original extract. The TPH-D result from the re-extraction is 1,700 ppb.
- 17 Laboratory report indicates the surrogate data for the method blank is outside QC limits. Results from the re-extraction are within the limits. The hold time had expired prior to re-extraction so all results are reported from the original extract. Similar results were obtained in both extracts.
- 18 Laboratory report indicates the observed sample pattern is not typical of #2 fuel/diesel. It elutes in the DRO range later than #2 fuel.
- 19 Analytical result confirmed.
- 20 Laboratory report indicates the observed sample pattern includes #2 fuel/diesel and an additional pattern which elutes later in the DRO range.
- 21 Laboratory report indicates the observed sample pattern is not typical of #2 fuel/diesel. The reported result is due to individual peak(s) eluting in the DRO range.

ATTACHMENT A

MONITORING DATA PACKAGE



December 13, 2011

Chevron Environmental Management Company
Dave Patten
6111 Bollinger Canyon Rd.
San Ramon, CA 94583

Fourth Quarter 2011 Monitoring at
Chevron Service Station 94800
1700 Castro St.
Oakland, CA

Monitoring performed on December 9, 2011

Blaine Tech Services, Inc. Groundwater Monitoring Event 111209-PC2

This submission covers the routine monitoring of groundwater wells conducted on December 9, 2011 at this location. Five monitoring wells were measured for depth to groundwater (DTW). Five monitoring wells were sampled. All sampling activities were performed in accordance with local, state and federal guidelines.

Water levels measurements were collected using an electronic slope indicator. All sampled wells were purged of three case volumes, depending on well recovery, or until water temperature, pH and conductivity stabilized. Purging was accomplished using electric submersible pumps, positive air-displacement pumps or stainless steel, Teflon or disposable bailers. Subsequent sample collection and sample handling was performed in accordance with EPA protocols using disposable bailers. Alternately, where applicable, wells were sampled utilizing no-purge methodology. All reused equipment was decontaminated in an integrated stainless steel sink with de-ionized water supplied Hotsy pressure washer and Liquinox or equivalent.

Fourth Quarter Groundwater Monitoring at Chevron 94800, 1700 Castro St., Oakland, CA

SAN JOSE

SACRAMENTO

LOS ANGELES

SAN DIEGO

1680 ROGERS AVENUE

SAN JOSE, CA 95112-1105

(408) 573-0555

FAX (408) 573-7771

LIC: 746684

www.blainetech.com

Samples were delivered under chain-of-custody to Lancaster Laboratories of Lancaster, Pennsylvania, for analysis. Monitoring well purgewater and equipment rinsate water was collected and transported under bill-of-lading to IWM facilities of San Jose, California.

Enclosed documentation from this event includes copies of the Well Gauging Sheet, Well Monitoring Data Sheets, and Chain-of-Custody.

Blaine Tech Services, Inc.'s activities at this site consisted of objective data and sample collection only. No interpretation of analytical results, defining of hydrogeologic conditions or formulation of recommendations was performed.

Please call if you have any questions.

Sincerely,



Dustin Becker
Blaine Tech Services, Inc.
Senior Project Manager

attachments: SOP
Well Gauging Sheet
Individual Well Monitoring Data Sheets
Chain of Custody
Wellhead Inspection Form
Bill of Lading
Calibration Log

cc: CRA
Attn: Nathan Lee
5900 Hollis St. Suite A
Emeryville, CA 94608

Fourth Quarter Groundwater Monitoring at Chevron 94800, 1700 Castro St., Oakland, CA

SAN JOSE

SACRAMENTO

LOS ANGELES

SAN DIEGO

1680 ROGERS AVENUE

SAN JOSE, CA 95112-1105

(408) 573-0555

FAX (408) 573-7771

LIC: 746684

www.blainetech.com

BLAINE TECH SERVICES, INC. METHODS AND PROCEDURES FOR THE ROUTINE MONITORING OF GROUNDWATER WELLS AT CHEVRON SITES

Blaine Tech Services, Inc. performs environmental sampling and documentation as an independent third party. We specialize in groundwater monitoring assignments and intentionally limit the scope of our services to those centered on the generation of objective information.

To avoid conflicts of interest, Blaine Tech Services, Inc. personnel do not evaluate or interpret the information we collect. As a state licensed contractor (C-57 well drilling –water – 746684) performing strictly technical services, we do not make any professional recommendations and perform no consulting of any kind.

SAMPLING PROCEDURES OVERVIEW

SAFETY

All groundwater monitoring assignments performed for Chevron comply with Chevron's safety guidelines, 29 CFR 1910.120 and SB-198 Injury and Illness Prevention Program (IIPP). All Field Technicians receive the full 40-hour 29CFR 1910.120 OSHA SARA HAZWOPER course, medical clearance and on-the-job training prior to commencing any work on any Chevron site.

INSPECTION AND GAUGING

Wells are inspected prior to evacuation and sampling. The condition of the wellhead is checked and noted according to a wellhead inspection checklist.

Standard measurements include the depth to water (DTW) and the total well depth (TD) obtained with industry standard electronic water level indicators that are graduated in increments of hundredths of a foot.

The water in each well is inspected for the presence of immiscibles. When free product is suspected, its presence is confirmed using an electronic interface probe (e.g. GeoTech). No samples are collected from a well containing over two-hundredths of a foot (0.02') of product.

EVACUATION

Depth to water measurements are collected by our personnel prior to purging and minimum purge volumes are calculated anew for each well based on the height of the water column and the diameter of the well. Expected purge volumes are never less than three case volumes and are set at no less than four case volumes in some jurisdictions.

Well purging devices are selected on the basis of the well diameter and the total volume to be

evacuated. In most cases the well will be purged using an electric submersible pump (i.e. Grundfos) suspended near (but not touching) the bottom of the well.

PARAMETER STABILIZATION

Well purging completion standards include minimum purge volumes, but additionally require stabilization of specific groundwater parameters prior to sample collection. Typical groundwater parameters used to measure stability are electrical conductivity, pH, and temperature. Instrument readings are obtained at regular intervals during the evacuation process (no less than once per case volume).

Stabilization standards for routine quarterly monitoring of fuel sites include the following: Temperature is considered to have stabilized when successive readings do not fluctuate more than +/- 1 degree Celsius. Electrical conductivity is considered stable when successive readings are within 10%. pH is considered to be stable when successive readings remain constant or vary no more than 0.2 of a pH unit.

DEWATERED WELLS

Normal evacuation removes no less than three case volumes of water from the well. However, less water may be removed in cases where the well dewateres and does not immediately recharge.

MEASURING RECHARGE

Upon completion of well purging, a depth to water measurement is collected and notated to ensure that the well has recharged to within 80% of its static, pre-purge level prior to sampling.

Wells that do not immediately show 80% recharge or dewatered wells will be allowed approximately 2 hours to recharge prior to sampling or will be sampled at site departure. All wells requiring off-site traffic control in the public right-of-way, the 80% recharge rule may be disregarded in the interests of Health and Safety. The sample may be collected as soon as there is sufficient water. The water level at time of sampling will be noted.

PURGEWATER CONTAINMENT

All non-hazardous purgewater evacuated from each groundwater monitoring well is captured and contained in on-board storage tanks on the Sampling Vehicle and/or special water hauling trailers. Effluent from the decontamination of reusable apparatus (sounders, electric pumps and hoses etc.), consisting of groundwater combined with deionized water and non-phosphate soap, is also captured and pumped into effluent tanks.

Non-hazardous purgewater is transported under standard Bill of Lading documentation to a Blaine Tech Services, Inc. facility before being transported to a Chevron approved disposal facility.

SAMPLE COLLECTION DEVICES

All samples are collected using disposable bailers.

SAMPLE CONTAINERS

Sample material is decanted directly from the sampling bailer into sample containers provided by the laboratory that will analyze the samples. The transfer of sample material from the bailer to the sample container conforms to specifications contained in the USEPA T.E.G.D. The type of sample container, material of construction, method of closure and filling requirements are specific to the intended analysis. Chemicals needed to preserve the sample material are commonly placed inside the sample containers by the laboratory or glassware vendor prior to delivery of the bottle to our personnel. The laboratory sets the number of replicate containers.

TRIP BLANKS

Trip Blanks, if requested, are taken to the site and kept inside the sample cooler for the duration of the event. They are turned over to the laboratory for analysis with the samples from that site.

DUPLICATES

Duplicates, if requested, may be collected at a site. The Duplicate sample is collected, typically from the well containing the most measurable contaminants. The Duplicate sample is labeled the same as the original.

SAMPLE STORAGE

All sample containers are promptly placed in food grade ice chests for storage in the field and transport (direct or via our facility) to the designated analytical laboratory. These ice chests contain quantities of restaurant grade ice as a refrigerant material. The samples are maintained in either an ice chest or a refrigerator until relinquished into the custody of the laboratory or laboratory courier.

DOCUMENTATION CONVENTIONS

A label must be affixed to all sample containers. In most cases these labels are generated by our office personnel and are partially preprinted. Labels can also be hand written by our field personnel. The site is identified with the store number and site address, as is the particular groundwater well from which the sample is drawn (e.g. MW-1, MW-2, S-1 etc.). The time and date of sample collection along with the initials of the person who collects the sample are handwritten onto the label.

Chain of Custody records are created using client specific preprinted forms following USEPA specifications.

Bill of Lading records are contemporaneous records created in the field at the site where the non-hazardous purgewater is generated. Field Technicians use preprinted Bill of Lading forms.

DECONTAMINATION

All equipment is brought to the site in clean and serviceable condition and is cleaned after use in each well and before subsequent use in any other well. Equipment is decontaminated before leaving the site.

The primary decontamination device is a commercial steam cleaner. The steam cleaner is de-tuned to function as a hot pressure washer that is then operated with high quality deionized water that is produced at our facility and stored onboard our sampling vehicle. Cleaning is facilitated by the use of proprietary fixtures and devices included in the patented workstation (U.S. Patent 5,535,775) that is incorporated in each sampling vehicle. The steam cleaner is used to decon reels, pumps and bailers.

Any sensitive equipment or parts (i.e. Dissolved Oxygen sensor membrane, water level indicator, etc.) that cannot be washed using the high pressure water, will be sprayed with a non-phosphate soap and deionized water solution and rinsed with deionized water.

DISSOLVED OXYGEN READINGS

Dissolved Oxygen readings are taken pre- and/or post-purge using YSI meters (e.g. YSI Model 550) or HACH field test kits.

The YSI meters are able to collect accurate in-situ readings. The probe allows downhole measurements to be taken from wells with diameters as small as two inches. The probe and reel is decontaminated between wells as described above. The meter is calibrated between wells as per the instructions in the operating manual. The probe is lowered into the water column and the reading is allowed to stabilize prior to collection.

OXYIDATON REDUCTION POTENTIAL READINGS

All readings are obtained with either Corning or Myron-L meters (e.g. Corning ORP-65 or a Myron-L Ultrameter GP). The meter is cleaned between wells as described above. The meter is calibrated at the start of each day according to the instruction manual.

FERROUS IRON MEASUREMENTS

All field measurements are collected at time of sampling with a HACH test kit.

WELL GAUGING DATA

Project # 11209-PCZ Date 12/9/10 Client Cherron

Site 1700 Castro St., Oakland

Well ID	Time	Well Size (in.)	Sheen / Odor	Depth to Immiscible Liquid (ft.)	Thickness of Immiscible Liquid (ft.)	Volume of Immiscibles Removed (ml)	Depth to water (ft.)	Depth to well bottom (ft.)	Survey Point: TOB or TOC	Notes
MW-1	1300	2 1.5					25.79	30.75	↓	
MW-2	1334	2				24.12	30.32			
MW-3	1309	2				25.56	30.30			
MW-4	1327	2				25.12	28.84			
MW-7	1320	2				26.15	30.21			

CHEVRON WELL MONITORING DATA SHEET

Project #: <u>111209-PC2</u>	Station #: <u>9-4800</u>
Sampler: <u>PC</u>	Date: <u>12/9/11</u>
Weather: <u>clear</u>	Ambient Air Temperature: <u>63 °F</u>
Well I.D.: <u>MW-1</u>	Well Diameter: <u>(2)</u> 3 4 6 8 _____
Total Well Depth: <u>30.75</u>	Depth to Water: <u>25.79</u>
Depth to Free Product:	Thickness of Free Product (feet):
Referenced to: <u>(PVC)</u> Grade	D.O. Meter (if req'd): YSI HACH
DTW with 80% Recharge [(Height of Water Column x 0.20) + DTW]: <u>26.75</u>	

Purge Method:

- Bailer
 Disposable Bailer
 Positive Air Displacement
 Electric Submersible
- Waterra
 Peristaltic
 Extraction Pump
 Other _____

Sampling Method:

- Bailer
 Disposable Bailer
 Extraction Port
 Dedicated Tubing
 Other: _____

<u>0.8</u> (Gals.) X	<u>3</u>	<u>=</u>	<u>2.4</u> Gals.
I Case Volume	Specified Volumes		Calculated Volume

Well Diameter	Multiplier	Well Diameter	Multiplier
1"	0.04	4"	0.65
2"	0.16	6"	1.47
3"	0.37	Other	radius ² * 0.163

Time	Temp (°F)	pH	Cond. (mS or μ S)	Turbidity (NTUs)	Gals. Removed	Observations
<u>1350</u>	<u>53.7</u>	<u>7.30</u>	<u>1003</u>	<u>185</u>	<u>0.8</u>	
<u>1356</u>	<u>54.6</u>	<u>7.22</u>	<u>986.1</u>	<u>450</u>	<u>1.6</u>	
<u>1402</u>	<u>54.9</u>	<u>7.20</u>	<u>974.4</u>	<u>21000</u>	<u>2.4</u>	

Did well dewater? Yes No Gallons actually evacuated: 2.4

Sampling Date: 12/9/11 Sampling Time: 1408 Depth to Water: 25.98

Sample I.D.: MW-1 Laboratory: (Lancaster) Other _____

Analyzed for: TPH-G BTEX MTBE OXYS Other: see Coc

Duplicate I.D.: Analyzed for: TPH-G BTEX MTBE OXYS Other:

D.O. (if req'd):	Pre-purge:	mg/L	Post-purge:	mg/L
O.R.P. (if req'd):	Pre-purge:	mV	Post-purge:	mV

CHECK ON WELL MONITORING DATA SHEET

Project #: <u>111209-PC2</u>	Station #: <u>9-4800</u>
Sampler: <u>PC</u>	Date: <u>12/9/11</u>
Weather: <u>clear</u>	Ambient Air Temperature: <u>66 °F</u>
Well I.D.: <u>MW-2</u>	Well Diameter: <u>(2)</u> 3 4 6 8 _____
Total Well Depth: <u>30.32</u>	Depth to Water: <u>24.12</u>
Depth to Free Product:	Thickness of Free Product (feet):
Referenced to: <u>(PVC)</u> Grade	D.O. Meter (if req'd): YSI HACH
DTW with 80% Recharge [(Height of Water Column x 0.20) + DTW]: <u>25.36</u>	

Purge Method: _____ Sampling Method: Bailer

Bailer
 Disposable Bailer
 Positive Air Displacement
 Electric Submersible

Waterra
 Peristaltic
 Extraction Pump
 Other _____

Disposable Bailer
 Extraction Port
 Dedicated Tubing
 Other: _____

1	(Gals.) X	<u>3</u>	=	<u>3</u>	Gals.
1 Case Volume		Specified Volumes		Calculated Volume	

Well Diameter	Multiplier	Well Diameter	Multiplier
1"	0.04	4"	0.65
2"	0.16	6"	1.47
3"	0.37	Other	radius ² * 0.163

Time	Temp (°F)	pH	Cond. (mS or µS)	Turbidity (NTUs)	Gals. Removed	Observations
<u>1525</u>	<u>67.5</u>	<u>6.81</u>	<u>686.8</u>	<u>35</u>	<u>1</u>	
<u>1529</u>	<u>67.5</u>	<u>6.81</u>	<u>687.6</u>	<u>52</u>	<u>2</u>	
<u>1532</u>	<u>67.1</u>	<u>6.80</u>	<u>689.9</u>	<u>113</u>	<u>3</u>	

Did well dewater? Yes No Gallons actually evacuated: 3

Sampling Date: 12/9/11 Sampling Time: 1535 Depth to Water: 25.11

Sample I.D.: MW-2 Laboratory: (Cancaster) Other _____

Analyzed for: TPH-G BTEX MTBE OXYS Other: see Coc

Duplicate I.D.: _____ Analyzed for: TPH-G BTEX MTBE OXYS Other: _____

D.O. (if req'd):	Pre-purge:	mg/L	Post-purge:	mg/L
	O.R.P. (if req'd):	Pre-purge:	mV	Post-purge:

CHEVRON WELL MONITORING DATA SHEET

Project #: <u>W1209-PC2</u>	Station #: <u>9-4800</u>
Sampler: <u>PC</u>	Date: <u>12/9/11</u>
Weather: <u>clear</u>	Ambient Air Temperature: <u>65 °F</u>
Well I.D.: <u>MW-3</u>	Well Diameter: <u>(2)</u> 3 4 6 8 _____
Total Well Depth: <u>30.30</u>	Depth to Water: <u>25.56</u>
Depth to Free Product:	Thickness of Free Product (feet):
Referenced to: <u>(PVC)</u> Grade	D.O. Meter (if req'd): YSI HACH
DTW with 80% Recharge [(Height of Water Column x 0.20) + DTW]: <u>26.51</u>	

Purge Method: Bailer Waterra Peristaltic Extraction Pump Other _____

Disposable Bailer Positive Air Displacement Electric Submersible

Sampling Method: Bailer Disposable Bailer Extraction Port Dedicated Tubing Other _____

0.8 (Gals.) X 3 = 2.4 Gals.

I Case Volume Specified Volumes Calculated Volume

Well Diameter	Multiplier	Well Diameter	Multiplier
1"	0.04	4"	0.65
2"	0.16	6"	1.47
3"	0.37	Other	radius ² * 0.163

Time	Temp (°F)	pH	Cond. (mS or <u>µS</u>)	Turbidity (NTUs)	Gals. Removed	Observations
<u>1419</u>	<u>66.9</u>	<u>6.73</u>	<u>1012</u>	<u>70</u>	<u>0.8</u>	
<u>1424</u>	<u>66.7</u>	<u>6.72</u>	<u>1001</u>	<u>112</u>	<u>1.6</u>	
<u>1429</u>	<u>66.7</u>	<u>6.71</u>	<u>989.6</u>	<u>310</u>	<u>2.4</u>	

Did well dewater? Yes No Gallons actually evacuated: 24

Sampling Date: 12/9/11 Sampling Time: 1435 Depth to Water: 26.04

Sample I.D.: MW-3 Laboratory: (Cancaster) Other _____

Analyzed for: TPH-G BTEX MTBE OXYS Other: see Cdc

Duplicate I.D.: Analyzed for: TPH-G BTEX MTBE OXYS Other:

D.O. (if req'd):	Pre-purge:	mg/L	Post-purge:	mg/L
	O.R.P. (if req'd):	mV	Post-purge:	mV

CHEVRON WELL MONITORING DATA SHEET

Project #: <u>111209-PC2</u>	Station #: <u>9-4800</u>
Sampler: <u>PC</u>	Date: <u>12/9/11</u>
Weather: <u>clear</u>	Ambient Air Temperature: <u>65°F</u>
Well I.D.: <u>MW-4</u>	Well Diameter: <u>(2)</u> 3 4 6 8
Total Well Depth: <u>28.84</u>	Depth to Water: <u>25.12</u>
Depth to Free Product:	Thickness of Free Product (feet):
Referenced to: <u>PVC</u> Grade	D.O. Meter (if req'd): YSI HACH
DTW with 80% Recharge [(Height of Water Column x 0.20) + DTW]: <u>25.86</u>	

Purge Method:

- Bailer
- Disposable Bailer
- Positive Air Displacement
- Electric Submersible
- Waterra
- Peristaltic
- Extraction Pump
- Other _____

Sampling Method:

- Bailer
- Disposable Bailer
- Extraction Port
- Dedicated Tubing
- Other: _____

<u>0.6</u>	(Gals.) X	<u>3</u>	=	<u>1.8</u>	Gals.
I Case Volume		Specified Volumes		Calculated Volume	

Well Diameter	Multiplier	Well Diameter	Multiplier
1"	0.04	4"	0.65
2"	0.16	6"	1.47
3"	0.37	Other	radius ² * 0.163

Time	Temp (°F)	pH	Cond. (mS or μ S)	Turbidity (NTUs)	Gals. Removed	Observations
1508	66.4	7.12	793.9	80	0.6	
1512	67.1	6.87	824.8	143	1.2	
1516	66.8	6.84	826.1	211	1.8	

Did well dewater? Yes No Gallons actually evacuated: 1.8

Sampling Date: 12/9/11 Sampling Time: 1520 Depth to Water: 25.21

Sample I.D.: MW-4 Laboratory: Cancaster Other _____

Analyzed for: TPH-G BTEX MTBE OXYS Other: see Coc

Duplicate I.D.: Analyzed for: TPH-G BTEX MTBE OXYS Other:

D.O. (if req'd):	Pre-purge:	mg/L	Post-purge:	mg/L
------------------	------------	------	-------------	------

O.R.P. (if req'd):	Pre-purge:	mV	Post-purge:	mV
--------------------	------------	----	-------------	----

CHEVRON WELL MONITORING DATA SHEET

Project #: 111209-PC2	Station #: 9-4800
Sampler: PC	Date: 12/9/11
Weather: clear	Ambient Air Temperature: 64 °F
Well I.D.: MW-7	Well Diameter: (2) 3 4 6 8 _____
Total Well Depth: 30.21	Depth to Water: 26.15
Depth to Free Product:	Thickness of Free Product (feet):
Referenced to: (PVC) Grade	D.O. Meter (if req'd): YSI HACH
DTW with 80% Recharge [(Height of Water Column x 0.20) + DTW]: 26.96	

Purge Method: Bailer Waterra Disposable Bailer Peristaltic Extraction Pump Other _____

Sampling Method: Bailer Disposable Bailer Extraction Port Dedicated Tubing Other _____

0.6 (Gals.) X 3 = _____ Gals.
 1 Case Volume Specified Volumes Calculated Volume

Well Diameter	Multiplier	Well Diameter	Multiplier
1"	0.04	4"	0.65
2"	0.16	6"	1.47
3"	0.37	Other	radius ² * 0.163

Time	Temp (°F)	pH	Cond. (mS or µS)	Turbidity (NTUs)	Gals. Removed	Observations
1449	65.4	7.12	989.4	222	0.0	
1453	66.4	6.88	952.4	288	1.2	
1457	66.5	6.85	946.1	319	1.8	

Did well dewater? Yes No Gallons actually evacuated: 1.8

Sampling Date: 12/9/11 Sampling Time: 1502 Depth to Water: 26.81

Sample I.D.: MW-7 Laboratory: (Cancaster) Other _____

Analyzed for: TPH-G BTEX MTBE OXYS Other: see Cdc

Duplicate I.D.: Analyzed for: TPH-G BTEX MTBE OXYS Other:

D.O. (if req'd): Pre-purge: _____ mg/L Post-purge: _____ mg/L

O.R.P. (if req'd): Pre-purge: _____ mV Post-purge: _____ mV

CHAIN OF CUSTODY FORM

Chevron Environmental Management Company ■ 6111 Bollinger Canyon Rd. ■ San Ramon, CA 94583

COC 1 of 1

Chevron Site Number: 94800
 Chevron Site Global ID: T0600102076
 Chevron Site Address: 1700 Casrto St.,
Oakland, CA
 Chevron PM: DAVE PATTEN
 Chevron PM Phone No.: (925)790-6491
 Retail and Terminal Business Unit (RTBU) Job
 Construction/Retail Job

Chevron Consultant: CRA
 Address: 5900 Hollis St. Suite A Emeryville,
 CA Consultant Contact: Nathan Lee
 Consultant Phone No. 510-420-3333
 Consultant Project No. 11209-PC1
 Sampling Company: Blaine Tech Services
 Sampled By (Print): Pete Cornish
 Sampler Signature: Dattui

ANALYSES REQUIRED												Preservation Codes					
<input checked="" type="checkbox"/>	<input checked="" type="checkbox"/>	<input type="checkbox"/>	<input type="checkbox"/>	<input type="checkbox"/>	<input type="checkbox"/>	<input type="checkbox"/>	<input type="checkbox"/>	<input type="checkbox"/>	<input type="checkbox"/>	<input type="checkbox"/>	<input type="checkbox"/>	<input type="checkbox"/>	<input type="checkbox"/>	<input type="checkbox"/>	<input type="checkbox"/>	<input type="checkbox"/>	H = HCL T = Thiosulfate N = HNO ₃ B = NaOH S = H ₂ SO ₄ O = Other acct # 10991 ap # 1280481 sample # 6496089-94
EPA 8260B/GC/MS	TPH-G	BTEX	MTBE	OXYGENATES	HVOC	HC SCREEN	ORO	DRO	GRO	MTBE	Ca, Fe, K, Mg, Mn, Na	TITLE 22 METALS	TLC	STLC	EPA 310.1 ALKALINITY	EPA 413.1 OIL & GREASE	Special Instructions Must meet lowest detection limits possible for 8260 Compounds, Run TPH-D with Silica Gel Clean Up
EPA 8015B	GRO	MTBE	EPA 6010	Ca, Fe, K, Mg, Mn, Na	EPA 6010/7000	TITLE 22 METALS	TLC	STLC	EPA 150.1	PH	SM 2510B	SPECIFIC CONDUCTIVITY	EPA 418.1	TRPH	EPA 8260	ETHANOL	TPH-D

Charge Code: **NWRTB-0094800-0-OML**
 NWRTB 00SITE NUMBER-0-WBS
(WBS ELEMENTS:
 SITE ASSESSMENT: A1L REMEDIATION IMPLEMENTATION: R5L
 SITE MONITORING: OML OPERATION MAINTENANCE & MONITORING: M1L
THIS IS A LEGAL DOCUMENT. ALL FIELDS MUST BE FILLED OUT CORRECTLY AND COMPLETELY.

Lancaster Laboratories
 Lancaster, PA
 Lab Contact: Jill Parker
 2425 New Holland Pike,
 Lancaster, PA 17601
 Phone No:
 (717)656-2300

Other Lab
 Temp. Blank Check Time Temp.
 1315 9 C
 1500 1 C

SAMPLE ID				Sample Time	# of Containers	Container Type	ANALYSES REQUIRED												Notes/Comments														
Field Point Name	Matrix	Top Depth	Date (yyymmdd)				EPA 8260B/GC/MS	TPH-G	BTEX	MTBE	OXYGENATES	HVOC	HC SCREEN	ORO	DRO	GRO	MTBE	Ca, Fe, K, Mg, Mn, Na		EPA 6010/7000	TITLE 22 METALS	TLC	STLC	EPA 150.1	PH	SM 2510B	SPECIFIC CONDUCTIVITY	EPA 418.1	TRPH	EPA 8260	ETHANOL	TPH-D	
MW-1	W		11209	1408	8	HCL 500ml VOAs/Amber	X																										
MW-2				1535	8		X																										
MW-3				1435	8		X																										
MW-4				1520	8		X																										
MW-7	↓			1502	8		X																										
QA	T			1315	2	VOAs	X	X																									

Relinquished By: <u>Dattui</u>	Company: <u>BTS</u>	Date/Time: <u>12/9/11/1540</u>	Relinquished To: <u>[Signature]</u>	Company: <u>LLI</u>	Date/Time: <u>12/9/11/1540</u>	Turnaround Time: Standard <input checked="" type="checkbox"/> 24 Hours <input type="checkbox"/> 48 hours <input type="checkbox"/> 72 Hours Other <input type="checkbox"/>
Relinquished By: <u>[Signature]</u>	Company: <u>LLI</u>	Date/Time: <u>12/15/11/1600</u>	Relinquished To: <u>(FE)</u>	Company: <u>[Signature]</u>	Date/Time: <u>[Signature]</u>	
Relinquished By: <u>[Signature]</u>	Company: <u>LLI</u>	Date/Time: <u>[Signature]</u>	Relinquished To: <u>[Signature]</u>	Company: <u>LLI</u>	Date/Time: <u>12/20/11</u>	Intact: <input checked="" type="checkbox"/> On Ice: <input checked="" type="checkbox"/> Temp: <u>[Signature]</u> COC # <u>17-28</u>

WELLHEAD INSPECTION CHECKLIST

Page 1 of 1

Client Cherron Date 12/9/11

Site Address 1700 Castro St., Oakland

Job Number 11209-PC2 Technician P. Cornish

Well ID	Well Inspected - No Corrective Action Required	WELL IS SECURABLE BY DESIGN (12" or less)	WELL IS CLEARLY MARKED WITH THE WORDS "MONITORING WELL" (12" or less)	Water Bailed From Wellbox	Wellbox Components Cleaned	Cap Replaced	Lock Replaced	Other Action Taken (explain below)	Well Not Inspected (explain below)	Repair Order Submitted
MW-1		X	X							X
MW-2				X						X
MW-3	X	X	X	X						
MW-4	X	X	X	X						
MW-7	X	X	X	X						

NOTES: MW-1 1/3 tabs stripped
MW-2 1/3 tabs broken, 3/8 bolts missing

CHEVRON-NORTHERN CALIFORNIA TYPE **A** BILL OF LADING

SOURCE RECORD **BILL OF LADING**

FOR NON-HAZARDOUS PURGEWATER RECOVERED FROM GROUNDWATER WELLS AT CHEVRON FACILITIES IN THE STATE OF CALIFORNIA. THE NON-HAZARDOUS PURGE- WATER WHICH HAS BEEN RECOVERED FROM GROUND- WATER WELLS IS COLLECTED BY THE CONTRACTOR, MADE UP INTO LOADS OF APPROPRIATE SIZE AND HAULED BY IWM TO THEIR FACILITY IN SAN JOSE, CALIFORNIA.

The contractor performing this work is BLAINE TECH SERVICES, INC. (BTS), 1680 Rogers Ave. San Jose CA (408)573-0555). Blaine Tech Services, Inc. is authorized by CHEVRON PRODUCTS COMPANY (CHEVRON) to recover, collect, apportion into loads, and haul the Non-Hazardous Well Purgewater that is drawn from wells at the CHEVRON facility indicated below and to deliver that purgewater to BTS. Transport routing of the Non-Hazardous Well Purgewater may be direct from one Chevron facility to BTS; from one Chevron facility to BTS via another Chevron facility; or any combination thereof. The Non-Hazardous Well Purgewater is and remains the property of CHEVRON.

This Source Record **BILL OF LADING** was initiated to cover the recovery of Non-Hazardous Well Purgewater from wells at the Chevron facility described below:

9-4800 Dave Patten
 CHEVRON # Chevron Engineer
 1700 Castro St. Oakland CA
 street number street name city state

WELL I.D.	GALS.	WELL I.D.	GALS.
MW-1	2.4	/	
MW-2	3	/	
MW-3	2.4	/	
MW-4	1.8	/	
MW-7	1.8	/	
/		/	
/		/	
/		/	
added equip.		any other	
rinse water	1 5	adjustments	/
TOTAL GALS.		loaded onto	
RECOVERED	16	BTS vehicle #	FS
BTS event #	11/20/09-PC2	time	1540
signature	Patten	date	12/7/11

REC'D AT	BTS	time	1630
unloaded by		date	12/9/11
signature	Patten		

ATTACHMENT B

LABORATORY ANALYTICAL REPORT

ANALYTICAL RESULTS

Prepared by:

Lancaster Laboratories
2425 New Holland Pike
Lancaster, PA 17605-2425

Prepared for:

Chevron
6001 Bollinger Canyon Rd L4310
San Ramon CA 94583

December 22, 2011

Project: 94800

Submittal Date: 12/10/2011
Group Number: 1280481
PO Number: 0015074399
Release Number: PATTEN
State of Sample Origin: CAClient Sample DescriptionMW-1-W-111209 NA Water
MW-2-W-111209 NA Water
MW-3-W-111209 NA Water
MW-4-W-111209 NA Water
MW-7-W-111209 NA Water
QA-T-111209 NA WaterLancaster Labs (LLI) #6496089
6496090
6496091
6496092
6496093
6496094

The specific methodologies used in obtaining the enclosed analytical results are indicated on the Laboratory Sample Analysis Record.

ELECTRONIC COPY TO	Chevron c/o CRA	Attn: Report Contact
ELECTRONIC COPY TO	Blaine Tech Services, Inc.	Attn: Dustin Becker
ELECTRONIC COPY TO	Chevron	Attn: Anna Avina
ELECTRONIC COPY TO	CRA	Attn: Nathan Lee
ELECTRONIC COPY TO	CRA	Attn: Ian Hull

Questions? Contact your Client Services Representative
Jill M Parker at (717) 656-2300 Ext. 1241

Respectfully Submitted,

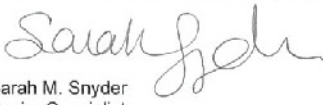

Sarah M. Snyder
Senior Specialist



Analysis Report

2425 New Holland Pike, PO Box 12425, Lancaster, PA 17605-2425 • 717-656-2300 Fax: 717-656-2681 • www.lancasterlabs.com

Sample Description: MW-1-W-111209 NA Water
Facility# 94800 BTST
1700 Castro St-Oakland T0600102076 MW-1

LLI Sample # WW 6496089
LLI Group # 1280481
Account # 10991

Project Name: 94800

Collected: 12/09/2011 14:08 by PC

Chevron

6001 Bollinger Canyon Rd L4310
San Ramon CA 94583

Submitted: 12/10/2011 09:30

Reported: 12/22/2011 09:58

CS001

CAT No.	Analysis Name	CAS Number	As Received Result	As Received Method Detection Limit*	As Received Limit of Quantitation	Dilution Factor
GC/MS Volatiles SW-846 8260B						
10943	Benzene	71-43-2	N.D.	0.5	1	1
10943	Ethanol	64-17-5	N.D.	50	250	1
10943	Ethylbenzene	100-41-4	N.D.	0.5	1	1
10943	Methyl Tertiary Butyl Ether	1634-04-4	89	0.5	1	1
10943	Toluene	108-88-3	N.D.	0.5	1	1
10943	Xylene (Total)	1330-20-7	N.D.	0.5	1	1
GC Volatiles SW-846 8015B						
01728	TPH-GRO N. CA water C6-C12	n.a.	61 J	50	100	1
GC Petroleum SW-846 8015B						
Hydrocarbons						
06609	TPH-DRO CA C10-C28	n.a.	67 J	50	100	1

General Sample Comments

State of California Lab Certification No. 2501

All QC is compliant unless otherwise noted. Please refer to the Quality Control Summary for overall QC performance data and associated samples.

Laboratory Sample Analysis Record

CAT No.	Analysis Name	Method	Trial#	Batch#	Analysis Date and Time	Analyst	Dilution Factor
10943	UST VOCs by 8260B - Water	SW-846 8260B	1	Z113531AA	12/19/2011 15:21	Daniel H Heller	1
01163	GC/MS VOA Water Prep	SW-846 5030B	1	Z113531AA	12/19/2011 15:21	Daniel H Heller	1
01728	TPH-GRO N. CA water C6-C12	SW-846 8015B	1	11353B07A	12/20/2011 20:26	Laura M Krieger	1
01146	GC VOA Water Prep	SW-846 5030B	1	11353B07A	12/20/2011 20:26	Laura M Krieger	1
06609	TPH-DRO CA C10-C28	SW-846 8015B	1	113460005A	12/16/2011 04:11	Nicholas R Rossi	1
02376	Extraction - Fuel/TPH (Waters)	SW-846 3510C	1	113460005A	12/12/2011 18:40	Bronson L Cole	1

*=This limit was used in the evaluation of the final result



Analysis Report

2425 New Holland Pike, PO Box 12425, Lancaster, PA 17605-2425 • 717-656-2300 Fax: 717-656-2681 • www.lancasterlabs.com

Sample Description: MW-2-W-111209 NA Water
Facility# 94800 BTST
 1700 Castro St-Oakland T0600102076 MW-2

LLI Sample # WW 6496090
LLI Group # 1280481
Account # 10991

Project Name: 94800

Collected: 12/09/2011 15:35 by PC

Chevron

6001 Bollinger Canyon Rd L4310
 San Ramon CA 94583

Submitted: 12/10/2011 09:30

Reported: 12/22/2011 09:58

CS002

CAT No.	Analysis Name	CAS Number	As Received Result	As Received Method Detection Limit*	As Received Limit of Quantitation	Dilution Factor
GC/MS Volatiles SW-846 8260B						
10943	Benzene	71-43-2	N.D.	0.5	1	1
10943	Ethanol	64-17-5	N.D.	50	250	1
10943	Ethylbenzene	100-41-4	N.D.	0.5	1	1
10943	Methyl Tertiary Butyl Ether	1634-04-4	8	0.5	1	1
10943	Toluene	108-88-3	N.D.	0.5	1	1
10943	Xylene (Total)	1330-20-7	N.D.	0.5	1	1
GC Volatiles SW-846 8015B						
01728	TPH-GRO N. CA water C6-C12	n.a.	140	50	100	1
GC Petroleum SW-846 8015B						
Hydrocarbons						
06609	TPH-DRO CA C10-C28	n.a.	180	50	100	1

General Sample Comments

State of California Lab Certification No. 2501

All QC is compliant unless otherwise noted. Please refer to the Quality Control Summary for overall QC performance data and associated samples.

Laboratory Sample Analysis Record

CAT No.	Analysis Name	Method	Trial#	Batch#	Analysis Date and Time	Analyst	Dilution Factor
10943	UST VOCs by 8260B - Water	SW-846 8260B	1	Z113531AA	12/19/2011 14:09	Daniel H Heller	1
01163	GC/MS VOA Water Prep	SW-846 5030B	1	Z113531AA	12/19/2011 14:09	Daniel H Heller	1
01728	TPH-GRO N. CA water C6-C12	SW-846 8015B	1	11353B07A	12/20/2011 13:58	Laura M Krieger	1
01146	GC VOA Water Prep	SW-846 5030B	1	11353B07A	12/20/2011 13:58	Laura M Krieger	1
06609	TPH-DRO CA C10-C28	SW-846 8015B	1	113460005A	12/16/2011 04:30	Nicholas R Rossi	1
02376	Extraction - Fuel/TPH (Waters)	SW-846 3510C	1	113460005A	12/12/2011 18:40	Bronson L Cole	1

*=This limit was used in the evaluation of the final result



Analysis Report

2425 New Holland Pike, PO Box 12425, Lancaster, PA 17605-2425 • 717-656-2300 Fax: 717-656-2681 • www.lancasterlabs.com

Sample Description: MW-3-W-111209 NA Water
Facility# 94800 BTST
1700 Castro St-Oakland T0600102076 MW-3

LLI Sample # WW 6496091
LLI Group # 1280481
Account # 10991

Project Name: 94800

Collected: 12/09/2011 14:35 by PC

Chevron

6001 Bollinger Canyon Rd L4310
San Ramon CA 94583

Submitted: 12/10/2011 09:30

Reported: 12/22/2011 09:58

CSO03

CAT No.	Analysis Name	CAS Number	As Received Result	As Received Method Detection Limit*	As Received Limit of Quantitation	Dilution Factor
GC/MS Volatiles SW-846 8260B						
10943	Benzene	71-43-2	10	ug/l 0.5	ug/l 1	1
10943	Ethanol	64-17-5	N.D.	50	250	1
10943	Ethylbenzene	100-41-4	N.D.	0.5	1	1
10943	Methyl Tertiary Butyl Ether	1634-04-4	230	0.5	1	1
10943	Toluene	108-88-3	N.D.	0.5	1	1
10943	Xylene (Total)	1330-20-7	9	0.5	1	1
GC Volatiles SW-846 8015B						
01728	TPH-GRO N. CA water C6-C12	n.a.	210	ug/l 50	ug/l 100	1
GC Petroleum SW-846 8015B						
Hydrocarbons						
06609	TPH-DRO CA C10-C28	n.a.	64 J	ug/l 50	ug/l 100	1

General Sample Comments

State of California Lab Certification No. 2501

All QC is compliant unless otherwise noted. Please refer to the Quality Control Summary for overall QC performance data and associated samples.

Laboratory Sample Analysis Record

CAT No.	Analysis Name	Method	Trial#	Batch#	Analysis Date and Time	Analyst	Dilution Factor
10943	UST VOCs by 8260B - Water	SW-846 8260B	1	Z113531AA	12/19/2011 16:08	Daniel H Heller	1
01163	GC/MS VOA Water Prep	SW-846 5030B	1	Z113531AA	12/19/2011 16:08	Daniel H Heller	1
01728	TPH-GRO N. CA water C6-C12	SW-846 8015B	1	11353B07A	12/20/2011 14:23	Laura M Krieger	1
01146	GC VOA Water Prep	SW-846 5030B	1	11353B07A	12/20/2011 14:23	Laura M Krieger	1
06609	TPH-DRO CA C10-C28	SW-846 8015B	1	113460005A	12/16/2011 04:49	Nicholas R Rossi	1
02376	Extraction - Fuel/TPH (Waters)	SW-846 3510C	1	113460005A	12/12/2011 18:40	Bronson L Cole	1

*=This limit was used in the evaluation of the final result



Analysis Report

2425 New Holland Pike, PO Box 12425, Lancaster, PA 17605-2425 • 717-656-2300 Fax: 717-656-2681 • www.lancasterlabs.com

Sample Description: MW-4-W-111209 NA Water
Facility# 94800 BTST
 1700 Castro St-Oakland T0600102076 MW-4

LLI Sample # WW 6496092
LLI Group # 1280481
Account # 10991

Project Name: 94800

Collected: 12/09/2011 15:20 by PC

Chevron

6001 Bollinger Canyon Rd L4310
 San Ramon CA 94583

Submitted: 12/10/2011 09:30

Reported: 12/22/2011 09:58

CSO04

CAT No.	Analysis Name	CAS Number	As Received Result	As Received Method Detection Limit*	As Received Limit of Quantitation	Dilution Factor
GC/MS Volatiles SW-846 8260B						
10943	Benzene	71-43-2	N.D.	0.5	1	1
10943	Ethanol	64-17-5	N.D.	50	250	1
10943	Ethylbenzene	100-41-4	N.D.	0.5	1	1
10943	Methyl Tertiary Butyl Ether	1634-04-4	18	0.5	1	1
10943	Toluene	108-88-3	N.D.	0.5	1	1
10943	Xylene (Total)	1330-20-7	N.D.	0.5	1	1
GC Volatiles SW-846 8015B						
01728	TPH-GRO N. CA water C6-C12	n.a.	56 J	50	100	1
GC Petroleum SW-846 8015B						
Hydrocarbons						
06609	TPH-DRO CA C10-C28	n.a.	140	50	100	1

General Sample Comments

State of California Lab Certification No. 2501

All QC is compliant unless otherwise noted. Please refer to the Quality Control Summary for overall QC performance data and associated samples.

Laboratory Sample Analysis Record

CAT No.	Analysis Name	Method	Trial#	Batch#	Analysis Date and Time	Analyst	Dilution Factor
10943	UST VOCs by 8260B - Water	SW-846 8260B	1	Z113531AA	12/19/2011 16:33	Daniel H Heller	1
01163	GC/MS VOA Water Prep	SW-846 5030B	1	Z113531AA	12/19/2011 16:33	Daniel H Heller	1
01728	TPH-GRO N. CA water C6-C12	SW-846 8015B	1	11353B07A	12/20/2011 14:48	Laura M Krieger	1
01146	GC VOA Water Prep	SW-846 5030B	1	11353B07A	12/20/2011 14:48	Laura M Krieger	1
06609	TPH-DRO CA C10-C28	SW-846 8015B	1	113460005A	12/16/2011 03:32	Nicholas R Rossi	1
02376	Extraction - Fuel/TPH (Waters)	SW-846 3510C	1	113460005A	12/12/2011 18:40	Bronson L Cole	1

*=This limit was used in the evaluation of the final result



Analysis Report

2425 New Holland Pike, PO Box 12425, Lancaster, PA 17605-2425 • 717-656-2300 Fax: 717-656-2681 • www.lancasterlabs.com

Sample Description: MW-7-W-111209 NA Water
Facility# 94800 BTST
 1700 Castro St-Oakland T0600102076 MW-7

LLI Sample # WW 6496093
LLI Group # 1280481
Account # 10991

Project Name: 94800

Collected: 12/09/2011 15:02 by PC

Chevron

6001 Bollinger Canyon Rd L4310
 San Ramon CA 94583

Submitted: 12/10/2011 09:30

Reported: 12/22/2011 09:58

CSO07

CAT No.	Analysis Name	CAS Number	As Received Result	As Received Method Detection Limit*	As Received Limit of Quantitation	Dilution Factor
GC/MS Volatiles SW-846 8260B						
10943	Benzene	71-43-2	N.D.	0.5	1	1
10943	Ethanol	64-17-5	N.D.	50	250	1
10943	Ethylbenzene	100-41-4	N.D.	0.5	1	1
10943	Methyl Tertiary Butyl Ether	1634-04-4	7,400	5	10	10
10943	Toluene	108-88-3	N.D.	0.5	1	1
10943	Xylene (Total)	1330-20-7	N.D.	0.5	1	1
GC Volatiles SW-846 8015B						
01728	TPH-GRO N. CA water C6-C12	n.a.	250	50	100	1
GC Petroleum SW-846 8015B						
Hydrocarbons						
06609	TPH-DRO CA C10-C28	n.a.	66	J 50	100	1

General Sample Comments

State of California Lab Certification No. 2501

All QC is compliant unless otherwise noted. Please refer to the Quality Control Summary for overall QC performance data and associated samples.

Laboratory Sample Analysis Record

CAT No.	Analysis Name	Method	Trial#	Batch#	Analysis Date and Time	Analyst	Dilution Factor
10943	UST VOCs by 8260B - Water	SW-846 8260B	1	Z113531AA	12/19/2011 16:57	Daniel H Heller	1
10943	UST VOCs by 8260B - Water	SW-846 8260B	1	D113544AA	12/20/2011 22:59	Kevin A Sposito	10
01163	GC/MS VOA Water Prep	SW-846 5030B	1	Z113531AA	12/19/2011 16:57	Daniel H Heller	1
01163	GC/MS VOA Water Prep	SW-846 5030B	2	D113544AA	12/20/2011 22:59	Kevin A Sposito	10
01728	TPH-GRO N. CA water C6-C12	SW-846 8015B	1	11353B07A	12/20/2011 20:51	Laura M Krieger	1
01146	GC VOA Water Prep	SW-846 5030B	1	11353B07A	12/20/2011 20:51	Laura M Krieger	1
06609	TPH-DRO CA C10-C28	SW-846 8015B	1	113460005A	12/16/2011 03:51	Nicholas R Rossi	1
02376	Extraction - Fuel/TPH (Waters)	SW-846 3510C	1	113460005A	12/12/2011 18:40	Bronson L Cole	1

*=This limit was used in the evaluation of the final result



Analysis Report

2425 New Holland Pike, PO Box 12425, Lancaster, PA 17605-2425 • 717-656-2300 Fax: 717-656-2681 • www.lancasterlabs.com

Sample Description: QA-T-111209 NA Water
Facility# 94800 BTST
1700 Castro St-Oakland T0600102076 QA

LLI Sample # WW 6496094
LLI Group # 1280481
Account # 10991

Project Name: 94800

Collected: 12/09/2011 13:15

Chevron

Submitted: 12/10/2011 09:30

6001 Bollinger Canyon Rd L4310

Reported: 12/22/2011 09:58

San Ramon CA 94583

CSOQA

CAT No.	Analysis Name	CAS Number	As Received Result	As Received Method Detection Limit*	As Received Limit of Quantitation	Dilution Factor
GC/MS Volatiles SW-846 8260B			ug/l	ug/l	ug/l	
10943	Benzene	71-43-2	N.D.	0.5	1	1
10943	Ethylbenzene	100-41-4	N.D.	0.5	1	1
10943	Methyl Tertiary Butyl Ether	1634-04-4	N.D.	0.5	1	1
10943	Toluene	108-88-3	N.D.	0.5	1	1
10943	Xylene (Total)	1330-20-7	N.D.	0.5	1	1
GC Volatiles SW-846 8015B			ug/l	ug/l	ug/l	
01728	TPH-GRO N. CA water C6-C12	n.a.	N.D.	50	100	1

General Sample Comments

State of California Lab Certification No. 2501

All QC is compliant unless otherwise noted. Please refer to the Quality Control Summary for overall QC performance data and associated samples.

Laboratory Sample Analysis Record

CAT No.	Analysis Name	Method	Trial#	Batch#	Analysis Date and Time	Analyst	Dilution Factor
10943	BTEX/MTBE 8260 Water	SW-846 8260B	1	Z113531AA	12/19/2011 13:45	Daniel H Heller	1
01163	GC/MS VOA Water Prep	SW-846 5030B	1	Z113531AA	12/19/2011 13:45	Daniel H Heller	1
01728	TPH-GRO N. CA water C6-C12	SW-846 8015B	1	11353B07A	12/20/2011 12:17	Laura M Krieger	1
01146	GC VOA Water Prep	SW-846 5030B	1	11353B07A	12/20/2011 12:17	Laura M Krieger	1

*=This limit was used in the evaluation of the final result

Quality Control Summary

 Client Name: Chevron
 Reported: 12/22/11 at 09:58 AM

Group Number: 1280481

Matrix QC may not be reported if insufficient sample or site-specific QC samples were not submitted. In these situations, to demonstrate precision and accuracy at a batch level, a LCS/LCSD was performed, unless otherwise specified in the method.

All Inorganic Initial Calibration and Continuing Calibration Blanks met acceptable method criteria unless otherwise noted on the Analysis Report.

Laboratory Compliance Quality Control

<u>Analysis Name</u>	<u>Blank Result</u>	<u>Blank MDL**</u>	<u>Blank LOQ</u>	<u>Report Units</u>	<u>LCS %REC</u>	<u>LCSD %REC</u>	<u>LCS/LCSD Limits</u>	<u>RPD</u>	<u>RPD Max</u>
Batch number: D113544AA	Sample number(s): 6496093								
Methyl Tertiary Butyl Ether	N.D.	0.5	1	ug/l	94		76-120		
Batch number: Z113531AA	Sample number(s): 6496089-6496094								
Benzene	N.D.	0.5	1	ug/l	115		79-120		
Ethanol	N.D.	50.	250	ug/l	85		54-149		
Ethylbenzene	N.D.	0.5	1	ug/l	120		79-120		
Methyl Tertiary Butyl Ether	N.D.	0.5	1	ug/l	118		76-120		
Toluene	N.D.	0.5	1	ug/l	118		79-120		
Xylene (Total)	N.D.	0.5	1	ug/l	119		80-120		
Batch number: 11353B07A	Sample number(s): 6496089-6496094								
TPH-GRO N. CA water C6-C12	N.D.	50.	100	ug/l	109	109	75-135	0	30
Batch number: 113460005A	Sample number(s): 6496089-6496093								
TPH-DRO CA C10-C28	N.D.	32.	100	ug/l	78	60	56-122	25*	20

Sample Matrix Quality Control

Unspiked (UNSPK) = the sample used in conjunction with the matrix spike
 Background (BKG) = the sample used in conjunction with the duplicate

<u>Analysis Name</u>	<u>MS %REC</u>	<u>MSD %REC</u>	<u>MS/MSD Limits</u>	<u>RPD</u>	<u>RPD MAX</u>	<u>BKG Conc</u>	<u>DUP Conc</u>	<u>DUP RPD</u>	<u>Dup RPD Max</u>
Batch number: D113544AA	Sample number(s): 6496093 UNSPK: P499306								
Methyl Tertiary Butyl Ether	88	102	72-126	11	30				
Batch number: Z113531AA	Sample number(s): 6496089-6496094 UNSPK: 6496090								
Benzene	105	105	80-126	0	30				
Ethanol	98	99	53-146	0	30				
Ethylbenzene	111	110	71-134	1	30				
Methyl Tertiary Butyl Ether	105	100	72-126	4	30				
Toluene	106	106	80-125	0	30				
Xylene (Total)	112	110	79-125	1	30				

Surrogate Quality Control

Surrogate recoveries which are outside of the QC window are confirmed unless attributed to dilution or otherwise noted on the Analysis Report.

*- Outside of specification

** - This limit was used in the evaluation of the final result for the blank

- (1) The result for one or both determinations was less than five times the LOQ.
- (2) The unspiked result was more than four times the spike added.

Quality Control Summary

Client Name: Chevron
Reported: 12/22/11 at 09:58 AM

Group Number: 1280481

Surrogate Quality Control

Analysis Name: UST VOCs by 8260B - Water
Batch number: D113544AA

	Dibromofluoromethane	1,2-Dichloroethane-d4	Toluene-d8	4-Bromofluorobenzene
Blank	102	99	99	90
LCS	103	99	99	98
MS	102	101	99	98
MSD	103	104	98	96
Limits:	80-116	77-113	80-113	78-113

Analysis Name: UST VOCs by 8260B - Water
Batch number: Z113531AA

	Dibromofluoromethane	1,2-Dichloroethane-d4	Toluene-d8	4-Bromofluorobenzene
6496089	102	98	99	91
6496090	103	98	101	96
6496091	100	98	101	94
6496092	101	98	100	93
6496093	95	91	102	92
6496094	104	99	100	91
Blank	103	100	101	92
LCS	101	99	101	97
MS	100	97	100	101
MSD	100	101	100	101
Limits:	80-116	77-113	80-113	78-113

Analysis Name: TPH-GRO N. CA water C6-C12
Batch number: 11353B07A
Trifluorotoluene-F

6496089	109
6496090	109
6496091	107
6496092	107
6496093	108
6496094	109
Blank	104
LCS	119
LCSD	117
Limits:	63-135

Analysis Name: TPH-DRO CA C10-C28
Batch number: 11346005A
Orthoterphenyl

6496089	87
6496090	105
6496091	86
6496092	78
6496093	84
Blank	62
LCS	89
LCSD	67

*- Outside of specification

** - This limit was used in the evaluation of the final result for the blank

- (1) The result for one or both determinations was less than five times the LOQ.
- (2) The unspiked result was more than four times the spike added.

Quality Control Summary

Client Name: Chevron
Reported: 12/22/11 at 09:58 AM

Group Number: 1280481

Surrogate Quality Control

Limits: 59-131

*- Outside of specification

** - This limit was used in the evaluation of the final result for the blank

- (1) The result for one or both determinations was less than five times the LOQ.
- (2) The unspiked result was more than four times the spike added.

Explanation of Symbols and Abbreviations

The following defines common symbols and abbreviations used in reporting technical data:

RL	Reporting Limit	BMQL	Below Minimum Quantitation Level
N.D.	none detected	MPN	Most Probable Number
TNTC	Too Numerous To Count	CP Units	cobalt-chloroplatinate units
IU	International Units	NTU	nephelometric turbidity units
umhos/cm	micromhos/cm	ng	nanogram(s)
C	degrees Celsius	F	degrees Fahrenheit
meq	milliequivalents	lb.	pound(s)
g	gram(s)	kg	kilogram(s)
ug	microgram(s)	mg	milligram(s)
ml	milliliter(s)	l	liter(s)
m3	cubic meter(s)	ul	microliter(s)
<	less than - The number following the sign is the <u>limit of quantitation</u> , the smallest amount of analyte which can be reliably determined using this specific test.		
>	greater than		
J	estimated value – The result is \geq the Method Detection Limit (MDL) and $<$ the Limit of Quantitation (LOQ).		
ppm	parts per million - One ppm is equivalent to one milligram per kilogram (mg/kg), or one gram per million grams. For aqueous liquids, ppm is usually taken to be equivalent to milligrams per liter (mg/l), because one liter of water has a weight very close to a kilogram. For gases or vapors, one ppm is equivalent to one microliter of gas per liter of gas.		
ppb	parts per billion		
Dry weight basis	Results printed under this heading have been adjusted for moisture content. This increases the analyte weight concentration to approximate the value present in a similar sample without moisture. All other results are reported on an as-received basis.		

U.S. EPA CLP Data Qualifiers:

Organic Qualifiers	Inorganic Qualifiers
A TIC is a possible aldol-condensation product	B Value is $<$ CRDL, but \geq IDL
B Analyte was also detected in the blank	E Estimated due to interference
C Pesticide result confirmed by GC/MS	M Duplicate injection precision not met
D Compound quantitated on a diluted sample	N Spike sample not within control limits
E Concentration exceeds the calibration range of the instrument	S Method of standard additions (MSA) used for calculation
N Presumptive evidence of a compound (TICs only)	U Compound was not detected
P Concentration difference between primary and confirmation columns $>$ 25%	W Post digestion spike out of control limits
U Compound was not detected	* Duplicate analysis not within control limits
X,Y,Z Defined in case narrative	+ Correlation coefficient for MSA $<$ 0.995

Analytical test results meet all requirements of NELAC unless otherwise noted under the individual analysis.

Measurement uncertainty values, as applicable, are available upon request.

Tests results relate only to the sample tested. Clients should be aware that a critical step in a chemical or microbiological analysis is the collection of the sample. Unless the sample analyzed is truly representative of the bulk of material involved, the test results will be meaningless. If you have questions regarding the proper techniques of collecting samples, please contact us. We cannot be held responsible for sample integrity, however, unless sampling has been performed by a member of our staff. This report shall not be reproduced except in full, without the written approval of the laboratory.

WARRANTY AND LIMITS OF LIABILITY - In accepting analytical work, we warrant the accuracy of test results for the sample as submitted. THE FOREGOING EXPRESS WARRANTY IS EXCLUSIVE AND IS GIVEN IN LIEU OF ALL OTHER WARRANTIES, EXPRESSED OR IMPLIED. WE DISCLAIM ANY OTHER WARRANTIES, EXPRESSED OR IMPLIED, INCLUDING A WARRANTY OF FITNESS FOR PARTICULAR PURPOSE AND WARRANTY OF MERCHANTABILITY. IN NO EVENT SHALL LANCASTER LABORATORIES BE LIABLE FOR INDIRECT, SPECIAL, CONSEQUENTIAL, OR INCIDENTAL DAMAGES INCLUDING, BUT NOT LIMITED TO, DAMAGES FOR LOSS OF PROFIT OR GOODWILL REGARDLESS OF (A) THE NEGLIGENCE (EITHER SOLE OR CONCURRENT) OF LANCASTER LABORATORIES AND (B) WHETHER LANCASTER LABORATORIES HAS BEEN INFORMED OF THE POSSIBILITY OF SUCH DAMAGES. We accept no legal responsibility for the purposes for which the client uses the test results. No purchase order or other order for work shall be accepted by Lancaster Laboratories which includes any conditions that vary from the Standard Terms and Conditions, and Lancaster hereby objects to any conflicting terms contained in any acceptance or order submitted by client.