

**Chevron**Date: 9/27/95To: JULIET SHINACHCS337-9335

Chevron U.S.A. Products Company  
6001 Bollinger Canyon Road  
Building L  
San Ramon, CA 94583  
P.O. Box 5004  
San Ramon, CA 94583-0804

Marketing - Northwest Region  
Voice 510 842-8134  
Fax 510 842-8252

From: Mark Miller  
Site Assessment and Remediation Engineer

Re: 9-1153 : 3126 FERNSIDE, ALAMEDAMessage: JULIET

I'M PULLING TOGETHER A RESPONSE TO  
YOUR 9/25/95 LETTER INCLUDING AN ADDENDUM  
TO THE WORK PLAN. BEFORE WE FINALIZE  
IT, I'D LIKE TO GET YOUR OPINION ON THE  
ADDITIONAL WELL LOCATION IN HIGH ST.  
THE HIGH ST. BRIDGE IS CLOSED UNTIL 10/20/95,  
SO WE'D LIKE TO MOVE ON THE WELL  
INSTALLATION A.S.A.P.

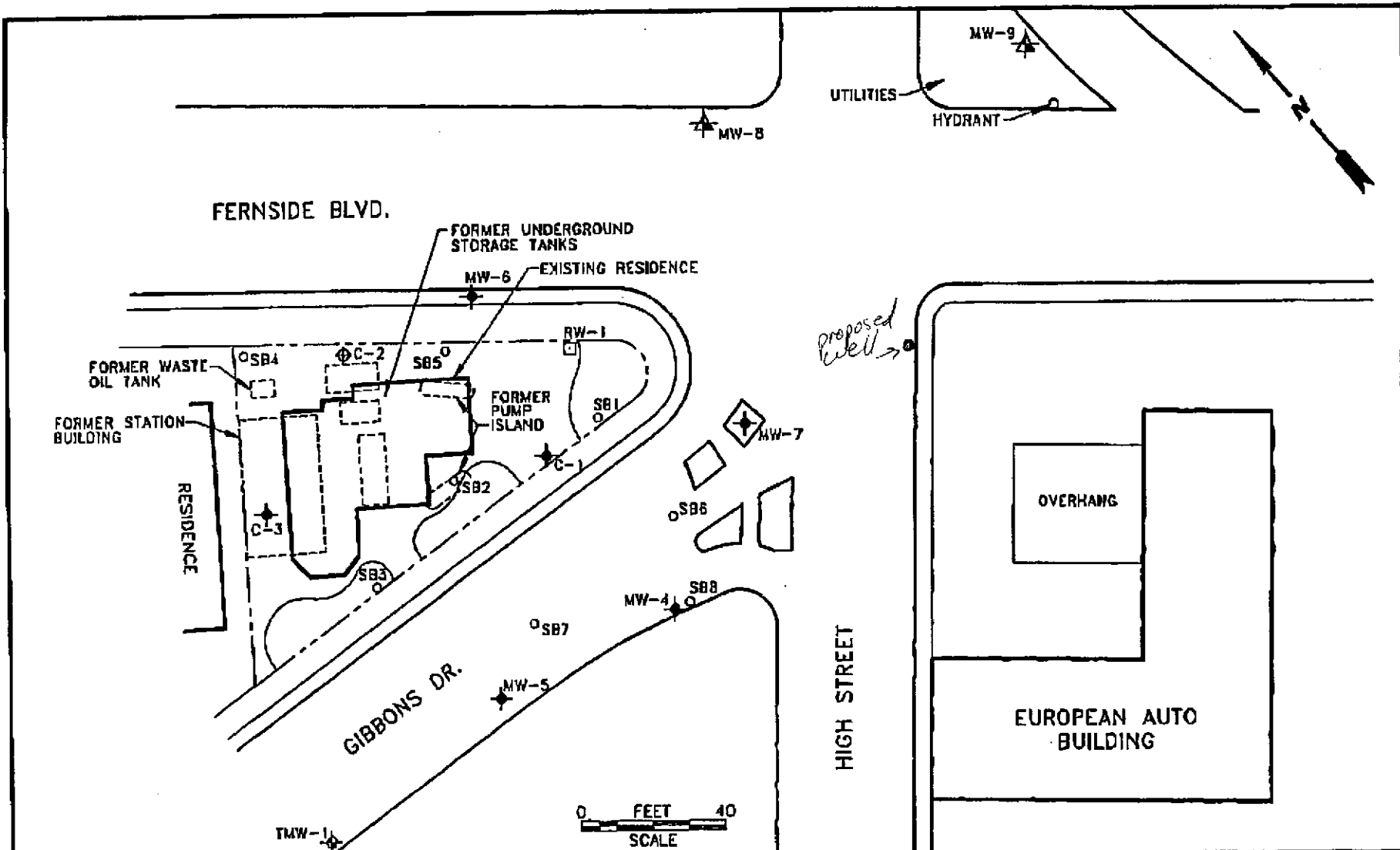

- LEGEND**
- ◆ MONITORING WELL
  - EXTRACTION WELL
  - ⊕ ABANDONED WELL
  - ⊙ TEMPORARY MONITORING WELL
  - SOIL BORING
  - ★ PROPOSED MONITORING WELL

 <b>GROUNDWATER TECHNOLOGY</b>		4057 PORT CHICAGO HWY CONCORD, CA 94520 (510) 671-2387		<b>SITE PLAN</b>		
<b>CLIENT:</b> CHEVRON U.S.A. PRODUCTS CO. SERVICE STATION No. 9-1153			<b>LOCATION:</b> 3126 FERNSIDE BLVD. ALAMEDA, CALIFORNIA		<b>REV. NO.:</b> 0	<b>DATE:</b> 1/7/94
<b>PM</b> <i>JAW</i>	<b>PE/TRG</b> <i>[Signature]</i>	<b>DESIGNED</b> TW	<b>DETAILED</b> ML	<b>ACAD FILE:</b> SP194	<b>PROJECT NO.:</b> 020204100	<b>FIGURE:</b> 2

85 09:48 510 842 8252 CHEVRON PRODUCTS 002/002