



RECEIVED

11:15 am, May 03, 2011

Alameda County
Environmental Health

Dave Patten
Project Manager
Marketing Business Unit

**Chevron Environmental
Management Company**
6111 Bollinger Canyon Road
San Ramon, CA 94583
Tel (925) 543-1740
Fax (925) 543-2324
drpattenchevron.com

Alameda County Health Care Services
1131 Harbor Bay Parkway, Suite 250
Alameda, CA 94502-6577

Re: Chevron Service Station No. 9-1153
3135 Gibbons Drive (3126 Fernside Blvd)
Alameda, CA

I have reviewed the attached report dated May 2, 2011.

The information in this report is accurate to the best of my knowledge and all local Agency/Regional Board guidelines have been followed. This report was prepared by Conestoga-Rovers & Associates, upon whose assistance and advice I have relied.

This letter is submitted pursuant to the requirements of California Water Code Section 13267(b)(1) and the regulating implementation entitled Appendix A pertaining thereto.

I declare under penalty of perjury that the foregoing is true and correct to the best of my knowledge.

Sincerely,

Dave Patten
Project Manager

Attachment: Report



**CONESTOGA-ROVERS
& ASSOCIATES**

5900 Hollis Street, Suite A
Emeryville, California 94608
Telephone: (510) 420-0700 Fax: (510) 420-9170
<http://www.craworld.com>

May 2, 2011

Reference No. 311642

Mr. Mark Detterman
Alameda County Environmental Health Services
1131 Harbor Bay Parkway, Suite 250
Alameda, California 94502-6577

Re: First Quarter 2011
Groundwater Monitoring and Sampling Report
Former Chevron Service Station 9-1153
3135 Gibbons Drive (3126 Fernside Boulevard)
Alameda, California
Agency Case No. RO0000341

Dear Mr. Mark Detterman:

Conestoga-Rovers & Associates (CRA) is submitting this *First Quarter 2011 Groundwater Monitoring and Sampling Report* for the site referenced above (Figure 1) on behalf of Chevron Environmental Management Company. Groundwater monitoring was performed by Blaine Tech Services (Blaine Tech) of San Jose, California. Blaine Tech's March 8, 2011 *First Quarter Monitoring* report is included as Attachment A. Current and historical groundwater monitoring and sampling data are presented in Table 1. Lancaster Laboratories' March 14, 2011 *Analytical Results* is included as Attachment B.

RESULTS OF FIRST QUARTER 2011 EVENT

On March 2, 2011, Blaine Tech monitored and sampled the site wells per the established schedule.

Results of the current monitoring event indicate the following:

- Groundwater Flow Direction East
- Hydraulic Gradient 0.03
- Depth to Water 0.75 to 3.33 feet below grade

Equal
Employment Opportunity
Employer



May 2, 2011

Reference No. 311642

- 2 -

Results of the current sampling event are presented in Table A:

TABLE A: GROUNDWATER ANALYTICAL DATA						
Well ID	TPHg ($\mu\text{g/L}$)	Benzene ($\mu\text{g/L}$)	Toluene ($\mu\text{g/L}$)	Ethylbenzene ($\mu\text{g/L}$)	Total Xylenes ($\mu\text{g/L}$)	MTBE ($\mu\text{g/L}$)
ESLs	100	1	40	30	20	5
C-1	LNAPL					
C-3	<50	<0.5	<0.5	<0.5	<0.5	<0.5
MW-4	<50	<0.5	<0.5	<0.5	<0.5	<0.5
MW-5	<50	<0.5	<0.5	<0.5	<0.5	<0.5
MW-6	<50	<0.5	<0.5	<0.5	<0.5	<0.5
MW-7	1,100	<0.5	<0.5	<0.5	<0.5	<0.5
MW-8	<50	<0.5	<0.5	<0.5	<0.5	<0.5
MW-9	<50	<0.5	<0.5	<0.5	<0.5	<0.5
MW-10	<50	<0.5	<0.5	<0.5	<0.5	<0.5
ESLs	Environmental Screening Levels from <i>Screening for Environmental Concerns at Sites with Contaminated Soil and Groundwater</i> , Regional Water Quality Control Board – San Francisco Bay Region, Interim Final November 2007, revised May 2008.					
Bold	Concentration exceeds applicable ESL.					

CONCLUSIONS AND RECOMMENDATIONS

The results of ongoing groundwater monitoring and sampling at the site indicate the following:

- Hydrocarbons were only detected in wells C-1 and MW-7.
- No benzene toluene, ethylbenzene, xylenes or MTBE are detected in any wells.
- The dissolved hydrocarbons in groundwater are delineated in all directions.
- Dissolved hydrocarbon concentrations are within historical ranges, seasonal fluctuations, and are stable or decreasing

ANTICIPATED FUTURE ACTIVITIES

Groundwater Monitoring

Blaine Tech will monitor and sample site wells per the established schedule. CRA will submit a groundwater monitoring and sampling report.



**CONESTOGA-ROVERS
& ASSOCIATES**

May 2, 2011

Reference No. 311642

- 3 -

Additional Activity

CRA is current working on addressing the items outlined in Alameda County Environmental Health letter dated March 3, 2011.

Please contact Nathan Lee at (510) 420-3333 if you have any questions or require additional information.

Sincerely,

CONESTOGA-ROVERS & ASSOCIATES

Nathan Lee, PG 8486



DG/aa/14
Encl.

Figure 1	Vicinity Map
Figure 2	Groundwater Elevation and Hydrocarbon Concentration Map
Table 1	Groundwater Monitoring and Sampling Data
Attachment A	Monitoring Data Package
Attachment B	Laboratory Analytical Report

cc: Mr. David Patten, Chevron
Mr. Mark Hom, Property Owner

FIGURES

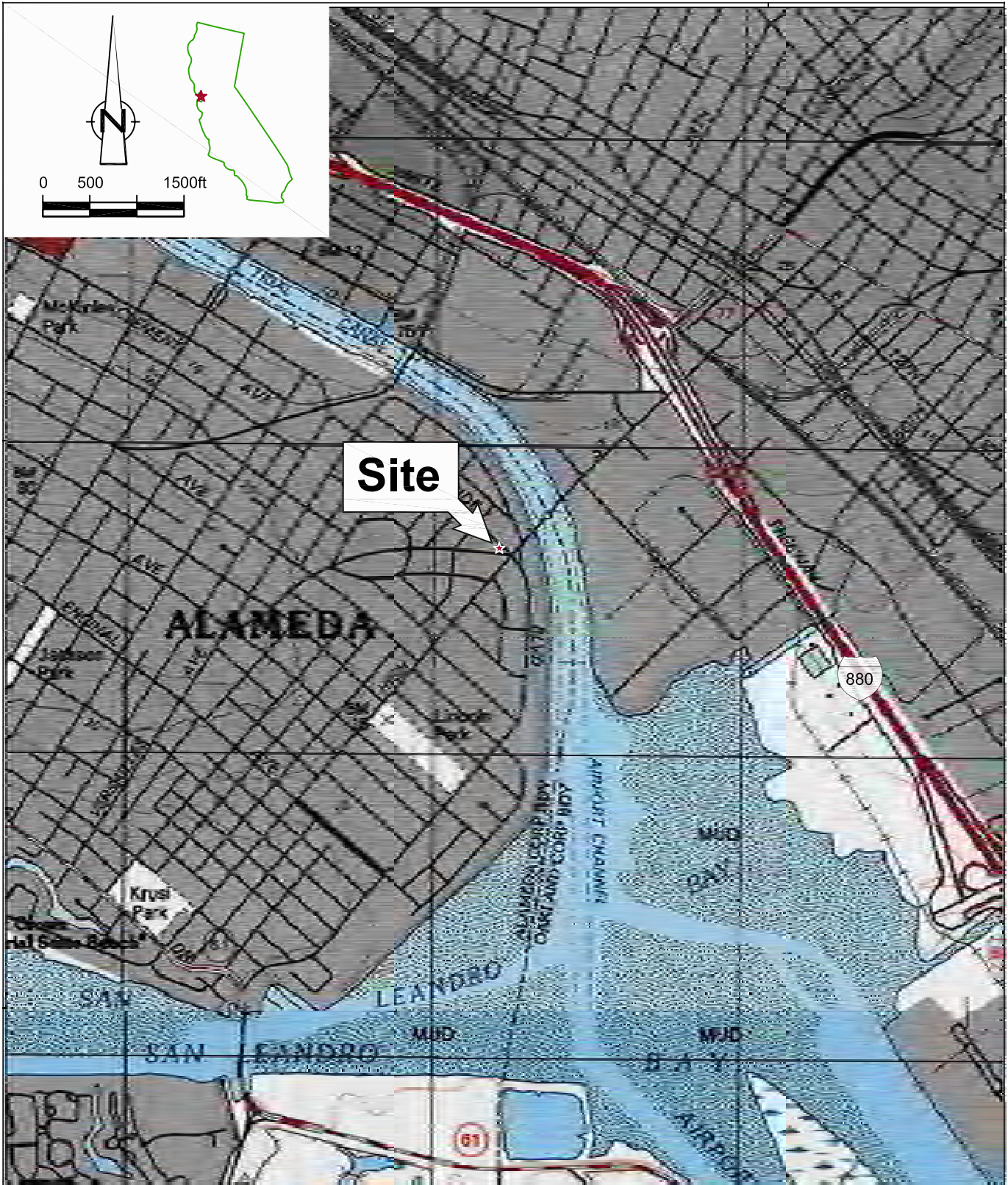
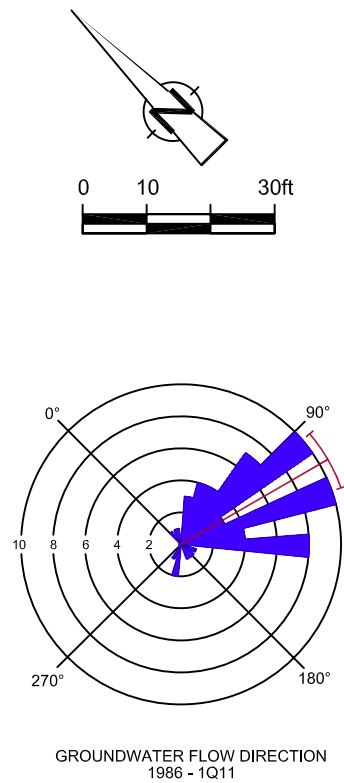

Figure 1
VICINITY MAP
FORMER CHEVRON SERVICE STATION 9-1153
3135 GIBBONS DRIVE (3126 FERNSIDE BLVD)
Alameda, California





- LEGEND**
- MW-1 ● MONITORING WELL LOCATION
 - TMW-1 ⊕ TEMPORARY MONITORING WELL LOCATION
 - RW-1 ⊕ EXTRACTION WELL LOCATION
 - C-2 ⊕ DESTROYED WELL LOCATION
 - 5.00 — GROUNDWATER ELEVATION CONTOUR, IN FEET ABOVE MEAN SEA LEVEL (MSL), DASHED WHERE INFERRED
 - GROUNDWATER FLOW DIRECTION AND GRADIENT
 - WELL**
ELEV GROUNDWATER ELEVATION (MSL)
TPHG TPHg CONCENTRATION (µg/L)
BENZ BENZENE CONCENTRATION (µg/L)
MTBE MTBE CONCENTRATION (µg/L)
 - SA SAMPLED ANNUALLY
 - SSA SAMPLED SEMI-ANNUALLY
 - LNAPL LIGHT NON-AQUEOUS PHASE LIQUID
 - ** CORRECTED FOR PRESENCE OF LNAPL

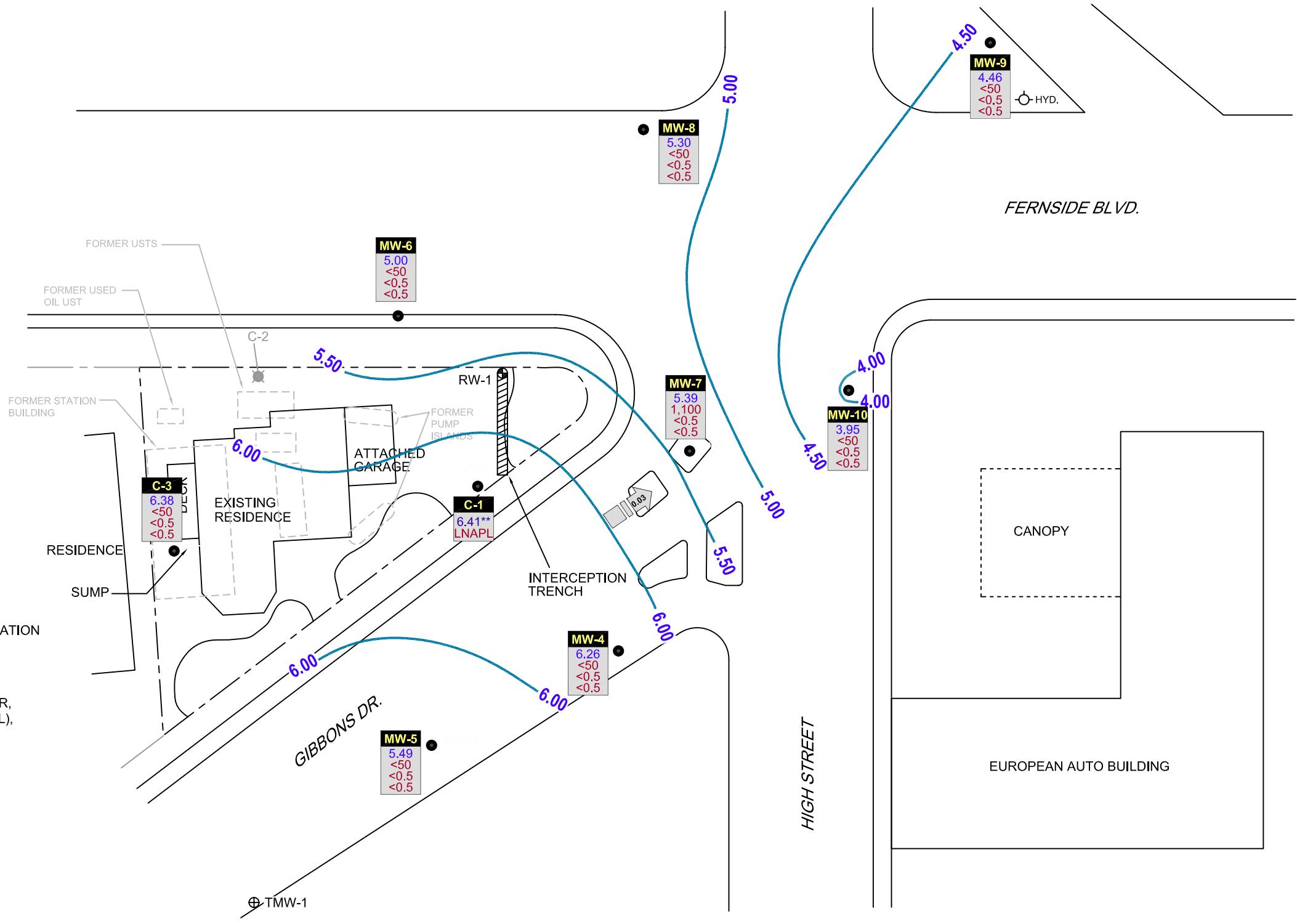

Figure 2
GROUNDWATER ELEVATION AND HYDROCARBON CONCENTRATION MAP
FORMER CHEVRON SERVICE STATION 9-1153
3135 GIBBONS DRIVE (3126 FERN SIDE BLVD)
Alameda, California
March 2, 2011



TABLE

TABLE 1

**GROUNDWATER MONITORING AND SAMPLING DATA
FORMER CHEVRON SERVICE STATION 9-1153
3135 GIBBONS DRIVE
ALAMEDA, CALIFORNIA**

Location	Date	TOC	DTW	GWE	LNAPLT	FIELD PARAMETERS	HYDROCARBONS	PRIMARY VOCS				
						Dissolved Oxygen	TPH-GRO	B	T	E	X	MTBE by SW8260
	Units	ft	ft	ft-amsl	ft	mg/L	µg/L	µg/L	µg/L	µg/L	µg/L	µg/L
C-1	08/18/1986	-	4.10	-	-	-	-	-	-	-	-	-
C-1	09/04/1986	-	-	-	-	-	15,000	760	820	1,500	-	-
C-1	07/22/1987	-	-	-	-	-	1,100	250	7.0	40	-	-
C-1	05/03/1989	-	4.46	-	-	-	6,900	3,800	190	229	-	-
C-1	12/04/1989	-	4.16	-	-	-	17,000	8,000	490	470	-	-
C-1	02/14/1990	-	3.64	-	-	-	19,000	12,000	990	1,050	-	-
C-1	03/07/1990	-	3.36	-	-	-	-	4,260	261	430	-	-
C-1	09/06/1991	-	4.43	-	-	-	21,000	10,000	100	240	560	-
C-1	12/15/1991	-	4.78	-	-	-	20,000	4,900	43	110	330	-
C-1	03/03/1992	-	2.39	-	-	-	13,000	5,800	730	340	1,200	-
C-1	06/04/1992	4.08	4.08	0.00	0.00	-	34,000	9,400	350	290	1,200	-
C-1	10/13/1992	4.08	4.75	-0.67	0.00	-	24,000	11,000	98	280	530	-
C-1	01/11/1993	4.08	2.26	1.82	Sheen	-	7,100	1,500	130	150	700	-
C-1	04/14/1993	4.08	2.90	1.18	Sheen	-	29,000	7,300	4,000	640	2,300	-
C-1	07/13/1993	4.08	3.97	0.11	Sheen	-	650,000	27,000	18,000	6,300	29,000	-
C-1	10/19/1993	4.08	4.50	-0.42	0.00	-	40,000	12,000	730	1,100	3,600	-
C-1	11/30/1993	7.50	4.27	3.23	0.00	-	-	-	-	-	-	-
C-1	01/27/1994	7.50	3.35	4.15	0.00	-	36,000	8,600	220	670	1,900	-
C-1	04/07/1994	7.50	3.42	4.08	0.00	-	53,000	12,000	3,500	480	3,300	-
C-1	07/01/1994	7.50	3.96	3.54	0.00	-	65,000	19,000	5,900	1,000	9,000	-
C-1	10/05/1994	7.50	4.39	3.11	0.00	-	160,000	23,000	12,000	2,200	11,000	-
C-1	01/12/1995	7.50	1.52	6.38	0.50	-	-	-	-	-	-	-
C-1	04/26/1995	7.50	4.40	4.86	2.20	-	-	-	-	-	-	-

TABLE 1

GROUNDWATER MONITORING AND SAMPLING DATA
 FORMER CHEVRON SERVICE STATION 9-1153
 3135 GIBBONS DRIVE
 ALAMEDA, CALIFORNIA

Location	Date	TOC	DTW	GWE	LNAPL	FIELD PARAMETERS	HYDROCARBONS	PRIMARY VOCS				
						Dissolved Oxygen	TPH-GRO	B	T	E	X	MTBE by SW8260
	Units	ft	ft	ft-amsl	ft	mg/L	µg/L	µg/L	µg/L	µg/L	µg/L	µg/L
C-1	07/12/1995	7.50	4.85	4.10	1.81	-	-	-	-	-	-	-
C-1	10/30/1995	7.50	5.67	3.13	1.63	-	-	-	-	-	-	-
C-1	01/04/1996	7.50	3.92	3.68	0.12	-	-	-	-	-	-	-
C-1	01/10/1996	7.50	3.48	4.12	0.13	-	-	-	-	-	-	-
C-1	01/17/1996	7.50	3.40	4.12	0.02	-	-	-	-	-	-	-
C-1	01/22/1996	7.50	2.90	4.60	0.00	-	82,000	18,000	4,400	1,400	5,200	<1,000
C-1	02/23/1996	7.50	4.10	4.89	1.86	-	-	-	-	-	-	-
C-1	02/28/1996	7.50	-	-	0.83 >	-	-	-	-	-	-	-
C-1	03/08/1996	7.50	2.86	6.10	1.83	-	-	-	-	-	-	-
C-1	03/26/1996	7.50	3.96	4.56	1.28	-	-	-	-	-	-	-
C-1	04/11/1996	7.50	5.61	3.29	1.75	-	-	-	-	-	-	-
C-1	04/19/1996	7.50	3.09	4.44	0.04	-	-	-	-	-	-	-
C-1	04/24/1996	7.50	3.04	4.48	0.03	-	-	-	-	-	-	-
C-1	05/03/1996	7.50	4.02	3.85	0.46	-	-	-	-	-	-	-
C-1	05/08/1996	7.50	4.25	3.53	0.35	-	-	-	-	-	-	-
C-1	05/17/1996	7.50	3.24	4.29	0.04	-	-	-	-	-	-	-
C-1	05/22/1996	7.50	3.10	4.46	0.07	-	-	-	-	-	-	-
C-1	06/18/1996	7.50	4.68	3.20	0.48	-	-	-	-	-	-	-
C-1	07/03/1996	7.50	5.03	2.57	0.13	-	-	-	-	-	-	-
C-1	07/09/1996	7.50	4.63	3.05	0.23	-	-	-	-	-	-	-
C-1	07/17/1996	7.50	4.73	2.89	0.15	-	-	-	-	-	-	-
C-1	07/29/1996	7.50	5.10	2.47	0.09	-	-	-	-	-	-	-
C-1	08/02/1996	7.50	5.68	1.84	0.03	-	-	-	-	-	-	-

TABLE 1

GROUNDWATER MONITORING AND SAMPLING DATA
 FORMER CHEVRON SERVICE STATION 9-1153
 3135 GIBBONS DRIVE
 ALAMEDA, CALIFORNIA

Location	Date	TOC	DTW	GWE	LNAPLT	FIELD PARAMETERS	HYDROCARBONS	PRIMARY VOCS				
						Dissolved Oxygen	TPH-GRO	B	T	E	X	MTBE by SW8260
	Units	ft	ft	ft-amsl	ft	mg/L	µg/L	µg/L	µg/L	µg/L	µg/L	µg/L
C-1	08/07/1996	7.50	5.16	2.35	0.01	-	-	-	-	-	-	-
C-1	08/23/1996	7.50	5.75	1.77	0.03	-	-	-	-	-	-	-
C-1	08/28/1996	7.50	5.53	1.99	0.03	-	-	-	-	-	-	-
C-1	09/06/1996	7.50	5.38	2.12	0.00	-	-	-	-	-	-	-
C-1	09/12/1996	7.50	5.48	2.04	0.03	-	-	-	-	-	-	-
C-1	09/19/1996	7.50	6.32	1.20	0.03	-	-	-	-	-	-	-
C-1	10/10/1996	7.50	4.58	3.00	0.10	-	-	-	-	-	-	-
C-1	10/17/1996	7.50	5.61	1.90	0.01	-	-	-	-	-	-	-
C-1	10/29/1996	7.50	6.01	1.49	0.00	-	-	-	-	-	-	-
C-1	11/07/1996	7.50	5.56	1.94	0.04	-	-	-	-	-	-	-
C-1	11/11/1996	7.50	5.32	2.18	0.04	-	-	-	-	-	-	-
C-1	12/17/1996	7.50	3.73	3.77	0.01	-	-	-	-	-	-	-
C-1	12/20/1996	7.50	3.33	4.17	0.03	-	-	-	-	-	-	-
C-1	01/15/1997	7.50	2.74	4.76	0.00	-	47,000	16,000	2,800	1,300	4,900	<1,000
C-1	01/22/1997	7.50	1.37	6.13	0.19	-	-	-	-	-	-	-
C-1	02/04/1997	7.50	2.98	4.52	0.51	-	-	-	-	-	-	-
C-1	02/20/1997	7.50	4.09	3.41	0.13	-	-	-	-	-	-	-
C-1	03/06/1997	7.50	3.75	3.75	0.56	-	-	-	-	-	-	-
C-1	03/14/1997	7.50	3.82	3.68	0.03	-	-	-	-	-	-	-
C-1	03/20/1997	7.50	3.73	3.77	0.03	-	-	-	-	-	-	-
C-1	03/25/1997	7.50	4.32	3.18	0.01	-	-	-	-	-	-	-
C-1	03/31/1997	7.50	3.71	3.79	0.03	-	-	-	-	-	-	-
C-1	04/03/1997	7.50	4.60	2.92	0.03	-	-	-	-	-	-	-

TABLE 1

**GROUNDWATER MONITORING AND SAMPLING DATA
FORMER CHEVRON SERVICE STATION 9-1153
3135 GIBBONS DRIVE
ALAMEDA, CALIFORNIA**

Location	Date	TOC	DTW	GWE	LNAPLT	FIELD PARAMETERS	HYDROCARBONS	PRIMARY VOCS				
						Dissolved Oxygen	TPH-GRO	B	T	E	X	MTBE by SW8260
	Units	ft	ft	ft-amsl	ft	mg/L	µg/L	µg/L	µg/L	µg/L	µg/L	µg/L
C-1	04/09/1997	7.50	4.25	3.27	0.02	-	-	-	-	-	-	-
C-1	04/24/1997	7.50	4.65	2.87	0.02	-	-	-	-	-	-	-
C-1	04/30/1997	7.50	3.50	4.02	0.02	-	-	-	-	-	-	-
C-1	05/22/1997	7.50	4.97	2.53	0.00	-	-	-	-	-	-	-
C-1	06/03/1997	7.50	3.62	3.93	0.06	-	-	-	-	-	-	-
C-1	07/09/1997	7.50	4.30	3.25	0.06	-	-	-	-	-	-	-
C-1	08/12/1997	7.50	5.18	2.32	0.00	-	-	-	-	-	-	-
C-1	09/30/1997	7.50	5.25	2.65	0.50	-	-	-	-	-	-	-
C-1	10/29/1997	7.50	5.33	2.19	0.03	-	-	-	-	-	-	-
C-1	11/13/1997	7.50	4.86	2.66	0.02	-	-	-	-	-	-	-
C-1	12/18/1997	7.50	2.34	5.16	0.00	-	-	-	-	-	-	-
C-1	01/14/1998	7.50	0.25	7.27	0.02	-	-	-	-	-	-	-
C-1	02/02/1998	7.50	2.35	5.19	0.05	-	-	-	-	-	-	-
C-1	03/16/1998	7.50	2.50	5.40	0.50	-	-	-	-	-	-	-
C-1	04/17/1998	7.50	2.65	5.17	0.40	-	-	-	-	-	-	-
C-1	05/01/1998	7.50	2.39	5.14	0.04	-	-	-	-	-	-	-
C-1	06/17/1998	7.50	3.26	4.30	0.08	-	-	-	-	-	-	-
C-1	07/15/1998	7.50	3.55	3.95	0.00	-	110,000	22,000	22,000	1,000	10,000	<250
C-1	09/01/1998	7.50	4.00	3.50	0.00	-	-	-	-	-	-	-
C-1	10/27/1998	7.50	4.48	3.02	0.00	-	45,000	12,000	5,400	590	4,300	<500
C-1	11/19/1998	7.50	3.89	3.61	0.00	-	-	-	-	-	-	-
C-1	12/19/1998	7.50	2.13	5.39	0.02	-	-	-	-	-	-	-
C-1	01/20/1999	7.50	3.98	3.52	0.00	-	50,300	7,050	5,030	244	6,090	<40

TABLE 1

GROUNDWATER MONITORING AND SAMPLING DATA
 FORMER CHEVRON SERVICE STATION 9-1153
 3135 GIBBONS DRIVE
 ALAMEDA, CALIFORNIA

Location	Date	TOC	DTW	GWE	LNAPL	FIELD PARAMETERS	HYDROCARBONS	PRIMARY VOCS				
						Dissolved Oxygen	TPH-GRO	B	T	E	X	MTBE by SW8260
	Units	ft	ft	ft-amsl	ft	mg/L	µg/L	µg/L	µg/L	µg/L	µg/L	µg/L
C-1	02/24/1999	7.50	2.55	4.95	0.00	-	-	-	-	-	-	-
C-1	03/26/1999	7.50	2.14	5.97	0.76	-	-	-	-	-	-	-
C-1	04/19/1999	7.50	1.04	6.46	0.00	-	150,000	21,000	20,000	3,000	18,000	49 ² / _{<2.5}
C-1	07/29/1999	7.50	3.76	3.76	0.02	-	-	-	-	-	-	-
C-1	08/30/1999	7.50	4.30	3.20	0.00	-	-	-	-	-	-	-
C-1	09/23/1999	7.50	3.84	3.68	0.02	-	-	-	-	-	-	-
C-1	10/13/1999	7.50	1.27	6.23	0.00	-	136,000	23,900	30,000	2,390	17,300	<500
C-1	11/17/1999	7.50	3.59	3.91	0.00	-	-	-	-	-	-	-
C-1	12/08/1999	7.50	3.79	3.71	0.00	-	-	-	-	-	-	-
C-1	01/25/2000	7.50	1.99	5.54	0.04	-	-	-	-	-	-	-
C-1	04/03/2000**	7.50	2.20	5.38	0.10	-	-	-	-	-	-	-
C-1	05/26/2000**	7.50	2.52	5.16	0.23	-	-	-	-	-	-	-
C-1	06/19/2000**	7.50	2.89	4.76	0.19	-	-	-	-	-	-	-
C-1	07/03/2000**	7.50	3.45	4.25	0.25	-	-	-	-	-	-	-
C-1	08/01/2000**	7.50	3.78	3.85	0.16	-	-	-	-	-	-	-
C-1	09/30/2000**	7.50	4.03	3.50	0.04	-	-	-	-	-	-	-
C-1	10/23/2000**	7.50	4.15	3.37	0.03	-	-	-	-	-	-	-
C-1	11/21/2000	7.50	3.42	4.08	0.00	-	-	-	-	-	-	-
C-1	12/22/2000	7.50	2.96	4.54	0.00	-	-	-	-	-	-	-
C-1	01/08/2001	7.50	2.94	4.56	0.00	-	-	-	-	-	-	-
C-1	02/17/2001**	7.50	2.09	5.88	0.59	-	-	-	-	-	-	-
C-1	03/13/2001**	7.50	2.20	5.91	0.76	-	-	-	-	-	-	-
C-1	04/09/2001 ^{18,**}	7.50	2.45	5.26	0.26	-	-	-	-	-	-	-

TABLE 1

GROUNDWATER MONITORING AND SAMPLING DATA
 FORMER CHEVRON SERVICE STATION 9-1153
 3135 GIBBONS DRIVE
 ALAMEDA, CALIFORNIA

Location	Date	TOC	DTW	GWE	LNAPL	FIELD PARAMETERS	HYDROCARBONS	PRIMARY VOCS				
						Dissolved Oxygen	TPH-GRO	B	T	E	X	MTBE by SW8260
	Units	ft	ft	ft-amsl	ft	mg/L	µg/L	µg/L	µg/L	µg/L	µg/L	µg/L
C-1	05/18/2001**	7.50	2.70	5.27	0.59	-	-	-	-	-	-	-
C-1	06/12/2001**	7.50	3.50	4.78	0.97	-	-	-	-	-	-	-
C-1	07/19/2001**	7.50	4.25	4.01	0.95	-	-	-	-	-	-	-
C-1	08/23/2001 ^{18,**}	7.50	4.34	3.22	0.07	-	-	-	-	-	-	-
C-1	09/17/2001**	7.50	4.39	3.17	0.08	-	-	-	-	-	-	-
C-1	10/08/2001**	7.50	4.45	3.08	0.04	-	-	-	-	-	-	-
C-1	11/27/2001	7.50	3.89	3.61	0.00	-	330,000	9,800	5,300	3,800	22,000	<50
C-1	12/17/2001	7.50	1.81	5.69	0.00	-	-	-	-	-	-	-
C-1	01/07/2002**	7.50	2.27	5.64	0.51	-	-	-	-	-	-	-
C-1	02/26/2002 ^{18,**}	7.50	2.70	5.22	0.52	-	-	-	-	-	-	-
C-1	03/27/2002**	7.50	2.87	5.47	1.05	-	-	-	-	-	-	-
C-1	04/08/2002**	7.50	2.45	6.03	1.23	-	-	-	-	-	-	-
C-1	05/23/2002 ^{18,**}	7.50	3.57	4.35	0.52	-	-	-	-	-	-	-
C-1	06/17/2002**	7.50	3.90	3.88	0.35	-	-	-	-	-	-	-
C-1	07/31/2002**	7.50	4.12	3.54	0.20	-	-	-	-	-	-	-
C-1	08/09/2002 ^{18,**}	7.50	4.15	3.48	0.16	-	-	-	-	-	-	-
C-1	09/17/2002**	7.50	4.33	3.27	0.12	-	-	-	-	-	-	-
C-1	10/15/2002**	7.50	4.51	3.11	0.15	-	-	-	-	-	-	-
C-1	11/08/2002	7.50	4.11	3.39	0.00	-	51,000	7,000	510	820	5,800	<3.0
C-1	12/19/2002	7.50	1.14	6.36	0.00	-	-	-	-	-	-	-
C-1	01/14/2003	7.50	1.80	5.70	0.00	-	-	-	-	-	-	-
C-1	02/07/2003 ^{18,**}	7.50	2.95	4.79	0.30	-	-	-	-	-	-	-
C-1	03/20/2003**	7.50	2.86	4.97	0.41	-	-	-	-	-	-	-

TABLE 1

GROUNDWATER MONITORING AND SAMPLING DATA
 FORMER CHEVRON SERVICE STATION 9-1153
 3135 GIBBONS DRIVE
 ALAMEDA, CALIFORNIA

Location	Date	TOC	DTW	GWE	LNAPLT	FIELD PARAMETERS	HYDROCARBONS	PRIMARY VOCS				
						Dissolved Oxygen	TPH-GRO	B	T	E	X	MTBE by SW8260
	Units	ft	ft	ft-amsl	ft	mg/L	µg/L	µg/L	µg/L	µg/L	µg/L	µg/L
C-1	04/15/2003**	7.50	2.12	5.46	0.10	-	-	-	-	-	-	-
C-1	05/09/2003 ^{18,**}	7.50	2.95	5.11	0.70	-	-	-	-	-	-	-
C-1	06/27/2003**	7.50	3.97	3.93	0.50	-	-	-	-	-	-	-
C-1	07/16/2003**	7.50	3.68	4.04	0.28	-	-	-	-	-	-	-
C-1	08/15/2003 ^{18,**}	7.50	4.29	3.39	0.22	-	-	-	-	-	-	-
C-1	09/26/2003**	7.50	4.60	3.05	0.19	-	-	-	-	-	-	-
C-1	10/18/2003**	7.50	4.72	2.90	0.15	-	-	-	-	-	-	-
C-1	11/14/2003 ^{18,**}	7.50	4.31	3.35	0.20	-	-	-	-	-	-	-
C-1	12/23/2003	7.50	1.81	5.69	0.00	-	-	-	-	-	-	-
C-1	01/22/2004**	7.50	4.19	3.32	0.01	-	-	-	-	-	-	-
C-1	02/13/2004 ^{18,**}	7.50	3.04	4.49	0.04	-	-	-	-	-	-	-
C-1	03/11/2004**	7.50	1.85	5.97	0.40	-	-	-	-	-	-	-
C-1	04/22/2004**	7.50	3.08	4.60	0.22	-	-	-	-	-	-	-
C-1	05/14/2004 ^{18,**}	7.50	3.49	4.03	0.03	-	-	-	-	-	-	-
C-1	06/18/2004**	7.50	3.41	4.19	0.13	-	-	-	-	-	-	-
C-1	07/23/2004**	7.50	3.28	4.31	0.11	-	-	-	-	-	-	-
C-1	08/13/2004 ^{18,**}	7.50	3.14	4.40	0.05	-	-	-	-	-	-	-
C-1	09/13/2004**	7.50	4.53	3.04	0.09	-	-	-	-	-	-	-
C-1	10/22/2004**	7.50	3.19	4.33	0.03	-	-	-	-	-	-	-
C-1	11/12/2004 ^{18,**}	7.50	3.22	4.30	0.03	-	-	-	-	-	-	-
C-1	12/02/2004**	7.50	3.28	4.24	0.02	-	-	-	-	-	-	-
C-1	01/28/2005**	7.50	3.19	4.32	0.01	-	-	-	-	-	-	-
C-1	02/11/2005 ^{18,**}	7.50	2.75	4.78	0.04	-	-	-	-	-	-	-

TABLE 1

**GROUNDWATER MONITORING AND SAMPLING DATA
FORMER CHEVRON SERVICE STATION 9-1153
3135 GIBBONS DRIVE
ALAMEDA, CALIFORNIA**

Location	Date	TOC	DTW	GWE	LNAPLT	FIELD PARAMETERS	HYDROCARBONS	PRIMARY VOCS				
						Dissolved Oxygen	TPH-GRO	B	T	E	X	MTBE by SW8260
	Units	ft	ft	ft-amsl	ft	mg/L	µg/L	µg/L	µg/L	µg/L	µg/L	µg/L
C-1	03/11/2005**	7.50	2.94	4.58	0.03	-	-	-	-	-	-	-
C-1	04/26/2005**	7.50	3.03	4.49	0.02	-	-	-	-	-	-	-
C-1	05/13/2005 ^{18,**}	7.50	3.18	4.34	0.02	-	-	-	-	-	-	-
C-1	06/01/2005**	7.50	3.22	4.30	0.02	-	-	-	-	-	-	-
C-1	07/15/2005**	7.50	3.09	4.43	0.02	-	-	-	-	-	-	-
C-1	08/19/2005 ^{18,**}	7.50	2.88	4.64	0.03	-	-	-	-	-	-	-
C-1	09/23/2005**	7.50	2.95	4.57	0.02	-	-	-	-	-	-	-
C-1	10/14/2005**	7.50	3.01	4.50	0.01	-	-	-	-	-	-	-
C-1	11/18/2005 ^{18,**}	7.50	3.21	4.31	0.02	-	-	-	-	-	-	-
C-1	12/09/2005**	7.50	3.61	3.90	0.01	-	-	-	-	-	-	-
C-1	01/12/2006**	7.50	2.98	4.53	0.01	-	-	-	-	-	-	-
C-1	02/10/2006 ^{15,**}	7.50	2.69	4.82	0.01	-	100,000	11,000	2,500	2,900	15,000	<10
C-1	03/13/2006**	7.50	2.81	4.70	0.01	-	-	-	-	-	-	-
C-1	04/13/2006**	7.50	2.75	4.76	0.01	-	-	-	-	-	-	-
C-1	05/12/2006 ^{18,**}	7.50	3.02	4.49	0.01	-	-	-	-	-	-	-
C-1	06/12/2006**	7.50	3.10	4.41	0.01	-	-	-	-	-	-	-
C-1	07/13/2006**	7.50	3.14	4.38	0.02	-	-	-	-	-	-	-
C-1	08/11/2006 ^{15,**}	7.50	3.70	3.81	0.01	-	200,000	8,600	470	1,700	8,800	<10
C-1	09/11/2006**	7.50	3.75	3.77	0.02	-	-	-	-	-	-	-
C-1	10/17/2006**	7.50	3.82	3.69	0.01	-	-	-	-	-	-	-
C-1	11/17/2006 ^{18,**}	7.50	3.11	4.41	0.03	-	-	-	-	-	-	-
C-1	12/15/2006**	7.50	2.95	4.57	0.02	-	-	-	-	-	-	-
C-1	01/16/2007**	7.50	2.98	4.54	0.02	-	-	-	-	-	-	-

TABLE 1

GROUNDWATER MONITORING AND SAMPLING DATA
 FORMER CHEVRON SERVICE STATION 9-1153
 3135 GIBBONS DRIVE
 ALAMEDA, CALIFORNIA

Location	Date	TOC	DTW	GWE	LNAPLT	FIELD PARAMETERS	HYDROCARBONS	PRIMARY VOCS				
						Dissolved Oxygen	TPH-GRO	B	T	E	X	MTBE by SW8260
	Units	ft	ft	ft-amsl	ft	mg/L	µg/L	µg/L	µg/L	µg/L	µg/L	µg/L
C-1	02/16/2007 ¹⁵	7.50	2.77	4.73	0.00	-	25,000	4,300	260	310	3,300	<5
C-1	03/16/2007 ^{**}	7.50	3.07	4.44	0.01	-	-	-	-	-	-	-
C-1	04/17/2007 ^{**}	7.50	2.98	4.53	0.01	-	-	-	-	-	-	-
C-1	05/17/2007 ^{15,**}	7.50	3.05	4.46	0.01	-	110,000 ¹⁶	12,000 ¹⁶	1,000 ¹⁶	2,000 ¹⁶	15,000 ¹⁶	<5
C-1	06/15/2007 ^{**}	7.50	3.08	4.43	0.01	-	-	-	-	-	-	-
C-1	07/17/2007 ^{**}	7.50	3.13	4.38	0.01	-	-	-	-	-	-	-
C-1	08/09/2007 ^{18,**}	7.50	3.24	4.28	0.02	-	-	-	-	-	-	-
C-1	09/14/2007 ^{**}	7.50	3.16	4.35	0.01	-	-	-	-	-	-	-
C-1	10/16/2007 ^{**}	7.50	3.04	4.47	0.01	-	-	-	-	-	-	-
C-1	11/08/2007 ^{15,**}	7.50	3.11	4.40	0.01	-	150,000	13,000	570	1,800	10,000	<13
C-1	12/07/2007 ^{**}	7.50	2.98	4.54	0.03	-	-	-	-	-	-	-
C-1	01/16/2008 ^{**}	7.50	2.95	4.57	0.02	-	-	-	-	-	-	-
C-1	02/06/2008 ^{15,**}	7.50	2.61	4.90	0.01	-	110,000	13,000	500	5,300	21,000	<10
C-1	03/07/2008 ^{**}	7.50	2.87	4.65	0.02	-	-	-	-	-	-	-
C-1	04/16/2008 ^{**}	7.50	3.06	4.46	0.02	-	-	-	-	-	-	-
C-1	05/07/2008 ^{18,**}	7.50	2.98	4.54	0.03	-	-	-	-	-	-	-
C-1	06/06/2008 ^{**}	7.50	3.02	4.50	0.02	-	-	-	-	-	-	-
C-1	07/16/2008 ^{**}	7.50	3.12	4.40	0.02	-	-	-	-	-	-	-
C-1	09/05/2008 ^{**}	7.50	3.97	3.75	0.28	-	-	-	-	-	-	-
C-1	09/11/2008 ^{18,**}	7.50	4.22	3.61	0.41	-	-	-	-	-	-	-
C-1	10/17/2008 ^{**}	7.50	4.16	3.60	0.33	-	-	-	-	-	-	-
C-1	11/10/2008 ^{18,**}	7.50	4.05	3.54	0.11	-	-	-	-	-	-	-
C-1	12/15/2008 ^{**}	7.50	3.85	3.69	0.05	-	-	-	-	-	-	-

TABLE 1

**GROUNDWATER MONITORING AND SAMPLING DATA
FORMER CHEVRON SERVICE STATION 9-1153
3135 GIBBONS DRIVE
ALAMEDA, CALIFORNIA**

Location	Date	TOC	DTW	GWE	LNAPL	FIELD PARAMETERS	HYDROCARBONS	PRIMARY VOCS				
						Dissolved Oxygen	TPH-GRO	B	T	E	X	MTBE by SW8260
	Units	ft	ft	ft-amsl	ft	mg/L	µg/L	µg/L	µg/L	µg/L	µg/L	µg/L
C-1	01/21/2009**	7.50	3.91	3.62	0.04	-	-	-	-	-	-	-
C-1	02/09/2009 ^{15,**}	7.50	3.72	3.79	0.01	-	53,000	3,100	66	660	3,700	<1
C-1	05/28/2009	7.50	3.48	4.02	0.02	-	-	-	-	-	-	-
C-1	08/18/2009	7.50	4.40	3.10	0.02	-	-	-	-	-	-	-
C-1	11/17/2009	7.50	4.21	3.29	0.03	-	-	-	-	-	-	-
C-1	03/31/2010	7.50	2.07	5.46	0.04	-	-	-	-	-	-	-
C-1	05/17/2010	7.50	2.87	4.83	0.25	-	-	-	-	-	-	-
C-1	08/26/2010 ¹⁸	7.50	4.03	3.50	0.04	-	-	-	-	-	-	-
C-1	11/11/2010 ^{18,**}	7.50	3.82	3.70	0.03	-	-	-	-	-	-	-
C-1	03/02/2011^{18,**}	7.50	1.12	6.41	0.04	-	-	-	-	-	-	-
C-3	08/18/1986	-	4.00	-	-	-	-	-	-	-	-	-
C-3	09/04/1986	-	-	-	-	-	50	3.2	5.4	5.8	-	-
C-3	07/22/1987	-	-	-	-	-	<50	<0.5	<1.0	<4.0	-	-
C-3	05/03/1989	-	4.15	-	-	-	<50	<0.5	<1.0	<2.0	-	-
C-3	12/04/1989	-	4.24	-	-	-	<250	<0.5	<0.5	<0.5	-	-
C-3	02/14/1990	-	3.57	-	-	-	<50	<0.5	<0.5	<0.5	-	-
C-3	03/07/1990	-	3.31	-	-	-	-	<5.0	<5.0	<5.0	-	-
C-3	09/06/1991	-	4.59	-	-	-	<50	<0.5	<0.5	<0.5	<0.5	-
C-3	12/15/1991	-	4.84	-	-	-	<50	<0.5	<0.5	<0.5	<0.5	-
C-3	03/03/1992	-	2.17	-	-	-	<50	<0.5	<0.5	<0.5	<0.5	-
C-3	06/04/1992	4.41	4.01	0.40	0.00	-	<50	<0.5	<0.5	<0.5	<0.5	-
C-3	10/13/1992	4.41	4.79	-0.38	0.00	-	<50	<0.5	<0.5	<0.5	<0.5	-

**GROUNDWATER MONITORING AND SAMPLING DATA
FORMER CHEVRON SERVICE STATION 9-1153
3135 GIBBONS DRIVE
ALAMEDA, CALIFORNIA**

Location	Date	TOC	DTW	GWE	LNAPL	FIELD PARAMETERS	HYDROCARBONS	PRIMARY VOCS				
						Dissolved Oxygen	TPH-GRO	B	T	E	X	MTBE by SW8260
	Units	ft	ft	ft-amsl	ft	mg/L	µg/L	µg/L	µg/L	µg/L	µg/L	µg/L
C-3	01/11/1993	4.41	2.01	2.40	0.00	-	<50	<0.5	<0.5	<0.5	<0.5	-
C-3	04/14/1993	4.41	2.76	1.65	0.00	-	<50	<0.5	<0.5	<0.5	<0.5	-
C-3	07/13/1993	4.41	3.96	0.45	0.00	-	<50	<0.5	<0.5	<0.5	<1.5	-
C-3	10/19/1993	4.41	4.53	-0.12	0.00	-	66	12	1.4	1.0	8.4	-
C-3	11/30/1993	7.83	4.04	3.79	0.00	-	-	-	-	-	-	-
C-3	01/27/1994	7.83	3.17	4.66	0.00	-	<50	<0.5	<0.5	<0.5	<0.5	-
C-3	04/07/1994	7.83	3.20	4.63	0.00	-	<50	<0.5	<0.5	<0.5	<0.5	-
C-3	07/01/1994	7.83	3.99	3.84	0.00	-	<50	<0.5	<0.5	<0.5	<0.5	-
C-3	10/05/1994	7.83	4.54	3.29	0.00	-	<50	<0.5	<0.5	<0.5	<0.5	-
C-3	01/12/1995	7.83	0.80	7.03	0.00	-	<50	<0.5	<0.5	<0.5	<0.5	-
C-3	05/02/1995	7.83	2.15	5.68	0.00	-	<50	<0.5	<0.5	<0.5	<0.5	-
C-3	07/12/1995	7.83	3.42	4.41	0.00	-	<50	<0.5	<0.5	<0.5	<0.5	-
C-3	10/30/1995	7.83	4.46	3.37	0.00	-	<50	<0.5	<0.5	<0.5	<0.5	<2.5
C-3	01/22/1996	7.83	1.73	6.10	0.00	-	<50	<0.5	<0.5	<0.5	<0.5	<2.5
C-3	04/24/1996	7.83	2.62	5.21	0.00	-	<50	<0.5	<0.5	<0.5	<0.5	<2.5
C-3	07/29/1996	7.83	3.94	3.89	0.00	-	<50	<0.5	<0.5	<0.5	<0.5	<2.5
C-3	10/10/1996	7.83	4.06	3.77	0.00	-	<50	<0.5	<0.5	<0.5	<0.5	<2.5
C-3	01/15/1997	7.83	1.54	6.29	0.00	-	<50	<0.5	<0.5	<0.5	<0.5	<2.5
C-3	04/03/1997	7.83	3.23	4.60	0.00	-	<50	<0.5	<0.5	<0.5	<0.5	<2.5
C-3	07/09/1997	7.83	4.36	3.47	0.00	-	<50	<0.5	<0.5	<0.5	<0.5	<2.5
C-3	10/29/1997	7.83	4.65	3.18	0.00	-	<50	<0.5	<0.5	<0.5	<0.5	<2.5
C-3	01/14/1998	7.83	0.77	7.06	0.00	-	<50	<0.5	<0.5	<0.5	<0.5	<2.5
C-3	07/15/1998	7.83	3.72	4.11	0.00	-	<50	<0.5	<0.5	<0.5	<0.5	<2.5

TABLE 1

**GROUNDWATER MONITORING AND SAMPLING DATA
FORMER CHEVRON SERVICE STATION 9-1153
3135 GIBBONS DRIVE
ALAMEDA, CALIFORNIA**

Location	Date	TOC	DTW	GWE	LNAPL	FIELD PARAMETERS	HYDROCARBONS	PRIMARY VOCS				
						Dissolved Oxygen	TPH-GRO	B	T	E	X	MTBE by SW8260
	Units	ft	ft	ft-amsl	ft	mg/L	µg/L	µg/L	µg/L	µg/L	µg/L	µg/L
C-3	01/20/1999	7.83	2.65	5.18	0.00	-	<50	<0.5	<0.5	<0.5	<0.5	<2.0
C-3	04/19/1999	7.83	1.78	6.05	0.00	-	-	-	-	-	-	-
C-3	04/03/2000 ¹⁹	7.83	-	-	-	-	-	-	-	-	-	-
C-3	07/03/2000	7.83	-	-	-	-	-	-	-	-	-	-
C-3	10/23/2000	7.83	-	-	-	-	-	-	-	-	-	-
C-3	01/08/2001 ¹¹	7.83	3.71	4.12	0.00	-	<50	<0.50	<0.50	<0.50	<0.50	<2.5
C-3	04/09/2001	7.83	-	-	-	-	-	-	-	-	-	-
C-3	08/23/2001 ¹⁹	7.83	-	-	-	-	-	-	-	-	-	-
C-3	11/27/2001 ¹⁹	7.83	-	-	-	-	-	-	-	-	-	-
C-3	02/26/2002	7.83	2.38	5.45	0.00	-	<50	<0.50	<0.50	<0.50	<1.5	<2.5
C-3	05/23/2002 ¹⁹	7.83	-	-	-	-	-	-	-	-	-	-
C-3	08/09/2002 ¹⁹	7.83	-	-	-	-	-	-	-	-	-	-
C-3	11/08/2002 ¹⁹	7.83	-	-	-	-	-	-	-	-	-	-
C-3	02/07/2003	7.83	2.73	5.10	0.00	-	<50	<0.50	<0.50	<0.50	<1.5	<2.5
C-3	05/09/2003 ¹⁹	7.83	-	-	-	-	-	-	-	-	-	-
C-3	08/15/2003 ¹⁹	7.83	-	-	-	-	-	-	-	-	-	-
C-3	11/14/2003 ¹⁹	7.83	-	-	-	-	-	-	-	-	-	-
C-3	02/13/2004 ¹⁵	7.83	2.81	5.02	0.00	-	<50	<0.5	<0.5	<0.5	<0.5	<0.5
C-3	05/14/2004 ¹⁹	7.83	-	-	-	-	-	-	-	-	-	-
C-3	11/12/2004 ¹⁹	7.83	-	-	-	-	-	-	-	-	-	-
C-3	02/11/2005 ¹⁵	7.83	2.58	5.25	0.00	-	<50	<0.5	<0.5	<0.5	<0.5	<0.5
C-3	05/13/2005 ¹⁹	7.83	-	-	-	-	-	-	-	-	-	-
C-3	08/19/2005 ¹⁹	7.83	-	-	-	-	-	-	-	-	-	-

TABLE 1

**GROUNDWATER MONITORING AND SAMPLING DATA
FORMER CHEVRON SERVICE STATION 9-1153
3135 GIBBONS DRIVE
ALAMEDA, CALIFORNIA**

Location	Date	TOC	DTW	GWE	LNAPLT	FIELD PARAMETERS	HYDROCARBONS	PRIMARY VOCS				
						Dissolved Oxygen	TPH-GRO	B	T	E	X	MTBE by SW8260
	Units	ft	ft	ft-amsl	ft	mg/L	µg/L	µg/L	µg/L	µg/L	µg/L	µg/L
C-3	11/18/2005 ¹⁹	7.83	-	-	-	-	-	-	-	-	-	-
C-3	02/10/2006 ¹⁵	7.83	2.52	5.31	0.00	-	<50	<0.5	<0.5	<0.5	<0.5	<0.5
C-3	05/12/2006 ¹⁹	7.83	-	-	-	-	-	-	-	-	-	-
C-3	08/11/2006 ¹⁹	7.83	-	-	-	-	-	-	-	-	-	-
C-3	11/17/2006 ¹⁹	7.83	-	-	-	-	-	-	-	-	-	-
C-3	02/16/2007 ¹⁵	7.83	2.63	5.20	0.00	-	<50	<0.5	<0.5	<0.5	<0.5	<0.5
C-3	05/17/2007 ¹⁹	7.83	-	-	-	-	-	-	-	-	-	-
C-3	08/09/2007 ¹⁹	7.83	-	-	-	-	-	-	-	-	-	-
C-3	11/08/2007 ¹⁹	7.83	-	-	-	-	-	-	-	-	-	-
C-3	02/06/2008 ¹⁵	7.83	2.91	4.92	0.00	-	<50	<0.5	<0.5	<0.5	<0.5	<0.5
C-3	05/07/2008 ¹⁹	7.83	-	-	-	-	-	-	-	-	-	-
C-3	09/11/2008 ¹⁹	7.83	-	-	-	-	-	-	-	-	-	-
C-3	11/10/2008 ¹⁹	7.83	-	-	-	-	-	-	-	-	-	-
C-3	02/09/2009 ¹⁵	7.83	2.95	4.88	0.00	-	<50	<0.5	<0.5	<0.5	<0.5	<0.5
C-3	03/31/2010	7.83	2.22	5.61	0.00	-	<50	<0.5	<0.5	<0.5	<0.5	<0.5
C-3	05/17/2010	7.83	3.07	4.76	0.00	-	-	-	-	-	-	-
C-3	08/26/2010 ¹⁹	7.83	4.29	3.54	0.00	-	-	-	-	-	-	-
C-3	11/11/2010 ¹⁹	7.83	4.48	3.35	0.00	-	-	-	-	-	-	-
C-3	03/02/2011 ¹⁹	7.83	1.45	6.38	0.00	-	<50	<0.5	<0.5	<0.5	<0.5	<0.5
MW-4	06/04/1992	3.58	3.63	-0.05	0.00	-	<50	0.8	<0.5	<0.5	<0.5	-
MW-4	10/13/1992	3.58	-	-	-	-	-	-	-	-	-	-
MW-4	01/11/1993	3.58	1.89	1.69	0.00	-	<50	<0.5	<0.5	<0.5	<0.5	-

TABLE 1

GROUNDWATER MONITORING AND SAMPLING DATA
 FORMER CHEVRON SERVICE STATION 9-1153
 3135 GIBBONS DRIVE
 ALAMEDA, CALIFORNIA

Location	Date	TOC	DTW	GWE	LNAPLT	FIELD PARAMETERS	HYDROCARBONS	PRIMARY VOCS				
						Dissolved Oxygen	TPH-GRO	B	T	E	X	MTBE by SW8260
	Units	ft	ft	ft-amsl	ft	mg/L	µg/L	µg/L	µg/L	µg/L	µg/L	µg/L
MW-4	04/14/1993	3.58	2.20	1.38	0.00	-	<50	<0.5	<0.5	<0.5	<1.5	-
MW-4	07/13/1993	3.58	3.51	0.07	0.00	-	54	2.6	1.6	<0.5	<1.5	-
MW-4	10/19/1993	3.58	4.22	-0.64	0.00	-	<50	<0.5	<0.5	<0.5	<0.5	-
MW-4	11/30/1993	7.01	4.01	3.00	0.00	-	-	-	-	-	-	-
MW-4	01/27/1994	7.01	2.89	4.12	0.00	-	<50	<0.5	<0.5	<0.5	<0.5	-
MW-4	04/07/1994	7.01	3.06	3.95	0.00	-	<50	<0.5	<0.5	<0.5	<0.5	-
MW-4	07/01/1994	7.01	3.59	3.42	0.00	-	<50	<0.5	<0.5	<0.5	<0.5	-
MW-4	10/05/1994	7.01	4.33	2.68	0.00	-	<50	<0.5	<0.5	<0.5	<0.5	-
MW-4	01/12/1995	7.01	1.20	5.81	0.00	-	<50	<0.5	<0.5	<0.5	<0.5	-
MW-4	04/26/1995	7.01	1.15	5.86	0.00	-	<50	<0.5	<0.5	<0.5	<0.5	-
MW-4	07/12/1995	7.01	2.72	4.29	0.00	-	<50	6.4	<0.5	0.63	0.72	-
MW-4	10/30/1995	7.01	4.08	2.93	0.00	-	<50	<0.5	<0.5	<0.5	<0.5	<2.5
MW-4	01/22/1996	7.01	1.76	5.25	0.00	-	<50	<0.5	<0.5	<0.5	<0.5	<2.5
MW-4	04/24/1996	7.01	1.95	5.06	0.00	-	<50	<0.5	<0.5	<0.5	<0.5	<2.5
MW-4	07/29/1996	7.01	3.37	3.64	0.00	-	<50	<0.5	<0.5	<0.5	<0.5	<2.5
MW-4	10/10/1996	7.01	3.96	3.05	0.00	-	<50	<0.5	<0.5	<0.5	<0.5	<2.5
MW-4	01/15/1997	7.01	1.27	5.74	0.00	-	<50	<0.5	<0.5	<0.5	<0.5	<2.5
MW-4	04/03/1997	7.01	2.11	4.90	0.00	-	<50	<0.5	<0.5	<0.5	<0.5	<2.5
MW-4	07/09/1997	7.01	4.04	2.97	0.00	-	<50	<0.5	<0.5	<0.5	<0.5	<2.5
MW-4	10/29/1997	7.01	4.56	2.45	0.00	-	<50	<0.5	<0.5	<0.5	<0.5	<2.5
MW-4	01/14/1998	7.01	0.39	6.62	0.00	-	<50	<0.5	<0.5	<0.5	<0.5	<2.5
MW-4	01/20/1999	7.01	2.83	4.18	0.00	-	<50	<0.5	<0.5	<0.5	<0.5	<2.0
MW-4	04/19/1999	7.01	2.91	4.10	0.00	-	-	-	-	-	-	-

TABLE 1

GROUNDWATER MONITORING AND SAMPLING DATA
 FORMER CHEVRON SERVICE STATION 9-1153
 3135 GIBBONS DRIVE
 ALAMEDA, CALIFORNIA

Location	Date	TOC	DTW	GWE	LNAPL	FIELD PARAMETERS	HYDROCARBONS	PRIMARY VOCS				
						Dissolved Oxygen	TPH-GRO	B	T	E	X	MTBE by SW8260
	Units	ft	ft	ft-amsl	ft	mg/L	µg/L	µg/L	µg/L	µg/L	µg/L	µg/L
MW-4	01/25/2000	7.01	1.92	5.09	0.00	-	<50	<0.5	<0.5	<0.5	<0.5	<2.5
MW-4	04/03/2000 ¹⁹	7.01	-	-	-	-	-	-	-	-	-	-
MW-4	07/03/2000	7.01	-	-	-	-	-	-	-	-	-	-
MW-4	10/23/2000	7.01	-	-	-	-	-	-	-	-	-	-
MW-4	01/08/2001 ¹¹	7.01	3.02	3.99	0.00	-	87 ¹²	<0.50	<0.50	0.55	2.9	<2.5
MW-4	04/09/2001	7.01	-	-	-	-	-	-	-	-	-	-
MW-4	08/23/2001 ¹⁹	7.01	-	-	-	-	-	-	-	-	-	-
MW-4	11/27/2001 ¹⁹	7.01	-	-	-	-	-	-	-	-	-	-
MW-4	02/26/2002	7.01	1.37	5.64	0.00	-	<50	<0.50	<0.50	<0.50	<1.5	<2.5
MW-4	05/23/2002 ¹⁹	7.01	-	-	-	-	-	-	-	-	-	-
MW-4	08/09/2002 ¹⁹	7.01	-	-	-	-	-	-	-	-	-	-
MW-4	11/08/2002 ¹⁹	7.01	-	-	-	-	-	-	-	-	-	-
MW-4	02/07/2003	7.01	1.72	5.29	0.00	-	<50	<0.50	<0.50	<0.50	<1.5	<2.5
MW-4	05/09/2003 ¹⁹	7.01	-	-	-	-	-	-	-	-	-	-
MW-4	08/15/2003 ¹⁹	7.01	-	-	-	-	-	-	-	-	-	-
MW-4	11/14/2003 ¹⁹	7.01	-	-	-	-	-	-	-	-	-	-
MW-4	02/13/2004 ¹⁵	7.01	1.82	5.19	0.00	-	<50	<0.5	<0.5	<0.5	<0.5	<0.5
MW-4	05/14/2004 ¹⁹	7.01	-	-	-	-	-	-	-	-	-	-
MW-4	11/12/2004 ¹⁹	7.01	-	-	-	-	-	-	-	-	-	-
MW-4	02/11/2005 ¹⁵	7.01	1.46	5.55	0.00	-	<50	<0.5	<0.5	<0.5	<0.5	<0.5
MW-4	05/13/2005 ¹⁹	7.01	-	-	-	-	-	-	-	-	-	-
MW-4	08/19/2005 ¹⁹	7.01	-	-	-	-	-	-	-	-	-	-
MW-4	11/18/2005 ¹⁹	7.01	-	-	-	-	-	-	-	-	-	-

TABLE 1

**GROUNDWATER MONITORING AND SAMPLING DATA
FORMER CHEVRON SERVICE STATION 9-1153
3135 GIBBONS DRIVE
ALAMEDA, CALIFORNIA**

Location	Date	TOC	DTW	GWE	LNAPL	FIELD PARAMETERS	HYDROCARBONS	PRIMARY VOCS				
						Dissolved Oxygen	TPH-GRO	B	T	E	X	MTBE by SW8260
	Units	ft	ft	ft-amsl	ft	mg/L	µg/L	µg/L	µg/L	µg/L	µg/L	µg/L
MW-4	02/10/2006 ¹⁵	7.01	1.35	5.66	0.00	-	<50	<0.5	<0.5	<0.5	<0.5	<0.5
MW-4	05/12/2006 ¹⁹	7.01	-	-	-	-	-	-	-	-	-	-
MW-4	08/11/2006 ¹⁹	7.01	-	-	-	-	-	-	-	-	-	-
MW-4	11/17/2006 ¹⁹	7.01	-	-	-	-	-	-	-	-	-	-
MW-4	02/16/2007 ¹⁵	7.01	1.48	5.53	0.00	-	<50	<0.5	<0.5	<0.5	<0.5	<0.5
MW-4	05/17/2007 ¹⁹	7.01	-	-	-	-	-	-	-	-	-	-
MW-4	08/09/2007 ¹⁹	7.01	-	-	-	-	-	-	-	-	-	-
MW-4	11/08/2007 ¹⁹	7.01	-	-	-	-	-	-	-	-	-	-
MW-4	02/06/2008 ¹⁵	7.01	1.27	5.74	0.00	-	<50	<0.5	<0.5	<0.5	<0.5	<0.5
MW-4	05/07/2008 ¹⁹	7.01	-	-	-	-	-	-	-	-	-	-
MW-4	09/11/2008 ¹⁹	7.01	-	-	-	-	-	-	-	-	-	-
MW-4	11/10/2008 ¹⁹	7.01	-	-	-	-	-	-	-	-	-	-
MW-4	02/09/2009 ¹⁵	7.01	2.33	4.68	0.00	-	<50	<0.5	<0.5	<0.5	<0.5	<0.5
MW-4	03/31/2010	7.01	2.13	4.88	0.00	-	<50	<0.5	<0.5	<0.5	<0.5	<0.5
MW-4	05/17/2010	7.01	2.05	4.96	0.00	-	-	-	-	-	-	-
MW-4	08/26/2010 ¹⁹	7.01	3.70	3.31	0.00	-	-	-	-	-	-	-
MW-4	11/11/2010 ¹⁹	7.01	3.98	3.03	0.00	-	-	-	-	-	-	-
MW-4	03/02/2011¹⁹	7.01	0.75	6.26	0.00	-	<50	<0.5	<0.5	<0.5	<0.5	<0.5
MW-5	06/04/1992	3.61	3.25	0.36	0.00	-	560	110	0.5	37	2.2	-
MW-5	10/13/1992	3.61	4.20	-0.59	0.00	-	1,200	150	<2.5	84	8.6	-
MW-5	01/11/1993	3.61	1.30	2.31	0.00	-	1,300	48	1.0	83	33	-
MW-5	04/14/1993	3.61	1.20	2.41	0.00	-	2,600	240	6.1	250	170	-

TABLE 1

**GROUNDWATER MONITORING AND SAMPLING DATA
FORMER CHEVRON SERVICE STATION 9-1153
3135 GIBBONS DRIVE
ALAMEDA, CALIFORNIA**

Location	Date	TOC	DTW	GWE	LNAPLT	FIELD PARAMETERS	HYDROCARBONS	PRIMARY VOCS				
						Dissolved Oxygen	TPH-GRO	B	T	E	X	MTBE by SW8260
	Units	ft	ft	ft-amsl	ft	mg/L	µg/L	µg/L	µg/L	µg/L	µg/L	µg/L
MW-5	07/13/1993	3.61	3.15	0.46	0.00	-	1,700	260	7.8	160	100	-
MW-5	10/19/1993	3.61	3.82	-0.21	0.00	-	1,900	190	3.3	200	93	-
MW-5	11/30/1993	7.04	3.56	3.48	0.00	-	-	-	-	-	-	-
MW-5	01/27/1994	7.04	2.42	4.62	0.00	-	4,000	100	12	210	110	-
MW-5	04/07/1994	7.04	2.33	4.71	0.00	-	2,600	170	10	150	88	-
MW-5	07/01/1994	7.04	3.18	3.86	0.00	-	2,300	350	9.1	110	76	-
MW-5	10/05/1994	7.04	3.98	3.06	0.00	-	11,000	840	150	130	340	-
MW-5	01/12/1995	7.04	0.40	6.64	0.00	-	2,300	82	<2.5	54	20	-
MW-5	04/26/1995	7.04	0.50	6.54	0.00	-	1,600	52	<5.0	36	61	-
MW-5	07/12/1995	7.04	2.41	4.63	0.00	-	2,800	150	<5.0	34	38	-
MW-5	10/30/1995	7.04	3.78	3.26	0.00	-	1,100	81	<5.0	<5.0	<5.0	35
MW-5	01/22/1996	7.04	0.78	6.26	0.00	-	880	7.3	<2.0	15	4.8	<10
MW-5	04/24/1996	7.04	1.65	5.39	0.00	-	1,600	51	3.8	14	5.6	56
MW-5	07/29/1996 ²¹	7.04	-	-	-	-	-	-	-	-	-	-
MW-5	10/10/1996	7.04	3.60	3.44	0.00	-	1,000	18	<1.2	1.5	<1.2	<6.2
MW-5	01/15/1997	7.04	0.45	6.59	0.00	-	520	0.84	<0.5	3.1	1.2	8.4
MW-5	04/03/1997	7.04	2.11	4.93	0.00	-	1,400	13	<2.0	4.3	8.4	32
MW-5	07/09/1997	7.04	3.71	3.33	0.00	-	810	3.6	0.97	<0.5	<0.5	9.7
MW-5	10/29/1997	7.04	4.20	2.84	0.00	-	<50	<0.5	<0.5	<0.5	<0.5	<2.5
MW-5	01/14/1998	7.04	0.00	7.04	0.00	-	430	5.8	2.4	<0.5	1.6	17
MW-5	04/17/1998 ²⁰	7.04	0.71	6.33	0.00	-	-	-	-	-	-	-
MW-5	07/15/1998	7.04	0.00	7.04	0.00	-	990	11	3.9	0.56	2.2	61
MW-5	10/27/1998	7.04	4.23	2.81	0.00	-	-	-	-	-	-	-

TABLE 1

**GROUNDWATER MONITORING AND SAMPLING DATA
FORMER CHEVRON SERVICE STATION 9-1153
3135 GIBBONS DRIVE
ALAMEDA, CALIFORNIA**

Location	Date	TOC	DTW	GWE	LNAPLT	FIELD PARAMETERS	HYDROCARBONS	PRIMARY VOCS				
						Dissolved Oxygen	TPH-GRO	B	T	E	X	MTBE by SW8260
	Units	ft	ft	ft-amsl	ft	mg/L	µg/L	µg/L	µg/L	µg/L	µg/L	µg/L
MW-5	01/20/1999	7.04	2.58	4.46	0.00	-	168	<0.5	<0.5	<0.5	0.692	<2.0
MW-5	04/19/1999	7.04	2.07	4.97	0.00	-	-	-	-	-	-	-
MW-5	07/29/1999	7.04	3.43	3.61	0.00	-	246	1.54	<0.5	<0.5	<0.5	<2.0 ² / ^{5.0}
MW-5	10/13/1999 ²¹	7.04	-	-	-	-	-	-	-	-	-	-
MW-5	01/25/2000	7.04	1.51	5.53	0.00	-	169	1.94	<0.5	<0.5	<0.5	201
MW-5	04/03/2000	7.04	1.20	5.84	0.00	-	-	-	-	-	-	-
MW-5	07/03/2000	7.04	2.98	4.06	0.00	-	320 ^{6,10}	5.3	1.1	<0.50	<0.50	5.0
MW-5	10/23/2000	7.04	4.18	2.86	0.00	-	-	-	-	-	-	-
MW-5	01/08/2001 ¹¹	7.04	2.92	4.12	0.00	-	220 ⁶	3.9	<0.50	<0.50	<0.50	7.7
MW-5	04/09/2001	7.04	1.01	6.03	0.00	-	-	-	-	-	-	-
MW-5	08/23/2001	7.04	3.48	3.56	0.00	-	630	40	3.5	<2.5	<2.5	43
MW-5	11/27/2001 ²⁰	7.04	3.05	3.99	0.00	-	-	-	-	-	-	-
MW-5	02/26/2002	7.04	1.00	6.04	0.00	-	410	4.3	<0.50	<0.50	<1.5	<2.5
MW-5	05/23/2002 ²⁰	7.04	2.21	4.83	0.00	-	-	-	-	-	-	-
MW-5	08/09/2002	7.04	3.38	3.66	0.00	-	240	1.3	<0.50	<0.50	<1.5	<2.5
MW-5	11/08/2002 ²⁰	7.04	4.56	2.48	0.00	-	-	-	-	-	-	-
MW-5	02/07/2003	7.04	1.42	5.62	0.00	-	380	3.2	<0.50	0.64	<1.5	<2.5
MW-5	05/09/2003 ²⁰	7.04	1.25	5.79	0.00	-	-	-	-	-	-	-
MW-5	08/15/2003 ¹⁵	7.04	3.61	3.43	0.00	-	<50	<0.5	<0.5	<0.5	<0.5	<0.5
MW-5	11/14/2003 ²⁰	7.04	3.57	3.47	0.00	-	-	-	-	-	-	-
MW-5	02/13/2004 ¹⁵	7.04	1.50	5.54	0.00	-	<50	<0.5	<0.5	<0.5	<0.5	<0.5
MW-5	05/14/2004 ²⁰	7.04	2.47	4.57	0.00	-	-	-	-	-	-	-
MW-5	08/13/2004 ¹⁵	7.04	5.46	1.58	0.00	-	<50	<0.5	<0.5	<0.5	<0.5	<0.5

TABLE 1

GROUNDWATER MONITORING AND SAMPLING DATA
 FORMER CHEVRON SERVICE STATION 9-1153
 3135 GIBBONS DRIVE
 ALAMEDA, CALIFORNIA

Location	Date	TOC	DTW	GWE	LNAPLT	FIELD PARAMETERS	HYDROCARBONS	PRIMARY VOCS				
						Dissolved Oxygen	TPH-GRO	B	T	E	X	MTBE by SW8260
	Units	ft	ft	ft-amsl	ft	mg/L	µg/L	µg/L	µg/L	µg/L	µg/L	µg/L
MW-5	11/12/2004 ²⁰	7.04	4.65	2.39	0.00	-	-	-	-	-	-	-
MW-5	02/11/2005 ¹⁵	7.04	1.20	5.84	0.00	-	130	<0.5	<0.5	<0.5	<0.5	<0.5
MW-5	05/13/2005 ²⁰	7.04	4.36	2.68	0.00	-	-	-	-	-	-	-
MW-5	08/19/2005 ¹⁵	7.04	2.78	4.26	0.00	-	96	<0.5	<0.5	<0.5	<0.5	<0.5
MW-5	11/18/2005 ²⁰	7.04	4.51	2.53	0.00	-	-	-	-	-	-	-
MW-5	02/10/2006 ¹⁵	7.04	1.12	5.92	0.00	-	<50	<0.5	<0.5	<0.5	<0.5	<0.5
MW-5	05/12/2006 ²⁰	7.04	2.23	4.81	0.00	-	-	-	-	-	-	-
MW-5	08/11/2006 ¹⁵	7.04	3.40	3.64	0.00	-	<50	<0.5	<0.5	<0.5	<0.5	<0.5
MW-5	11/17/2006 ²⁰	7.04	4.16	2.88	0.00	-	-	-	-	-	-	-
MW-5	02/16/2007 ¹⁵	7.04	1.22	5.82	0.00	-	<50	<0.5	<0.7	<0.8	<0.8	<0.5
MW-5	05/17/2007 ²⁰	7.04	4.06	2.98	0.00	-	-	-	-	-	-	-
MW-5	08/09/2007 ¹⁵	7.04	3.61	3.43	0.00	-	<50	<0.5	<0.5	<0.5	<0.5	<0.5
MW-5	11/08/2007 ²⁰	7.04	3.70	3.34	0.00	-	-	-	-	-	-	-
MW-5	02/06/2008 ¹⁵	7.04	1.06	5.98	0.00	-	<50	<0.5	<0.5	<0.5	<0.5	<0.5
MW-5	05/07/2008 ²⁰	7.04	3.57	3.47	0.00	-	-	-	-	-	-	-
MW-5	09/11/2008 ¹⁵	7.04	4.58	2.46	0.00	-	<50	<0.5	<0.5	<0.5	<0.5	<0.5
MW-5	11/10/2008 ²⁰	7.04	4.26	2.78	0.00	-	-	-	-	-	-	-
MW-5	02/09/2009 ¹⁵	7.04	2.15	4.89	0.00	-	<50	<0.5	<0.5	<0.5	<0.5	<0.5
MW-5	05/28/2009	7.04	2.76	4.28	0.00	-	-	-	-	-	-	-
MW-5	08/18/2009 ¹⁵	7.04	3.81	3.23	0.00	-	<50	<0.5	<0.5	<0.5	<0.5	<0.5
MW-5	11/17/2009	7.04	4.02	3.02	0.00	-	-	-	-	-	-	-
MW-5	03/31/2010	7.04	1.86	5.18	0.00	-	<50	<0.5	<0.5	<0.5	<0.5	<0.5
MW-5	05/17/2010	7.04	1.57	5.47	0.00	-	-	-	-	-	-	-

TABLE 1

**GROUNDWATER MONITORING AND SAMPLING DATA
FORMER CHEVRON SERVICE STATION 9-1153
3135 GIBBONS DRIVE
ALAMEDA, CALIFORNIA**

Location	Date	TOC	DTW	GWE	LNAPLT	FIELD PARAMETERS	HYDROCARBONS	PRIMARY VOCS				
						Dissolved Oxygen	TPH-GRO	B	T	E	X	MTBE by SW8260
	Units	ft	ft	ft-amsl	ft	mg/L	µg/L	µg/L	µg/L	µg/L	µg/L	µg/L
MW-5	08/26/2010	7.04	3.25	3.79	0.00	-	<50	<0.5	<0.5	<0.5	<0.5	<0.5
MW-5	11/11/2010 ²⁰	7.04	3.52	3.52	0.00	-	-	-	-	-	-	-
MW-5	03/02/2011²⁰	7.04	1.55	5.49	0.00	-	<50	<0.5	<0.5	<0.5	<0.5	<0.5
MW-6	06/04/1992	3.85	3.89	-0.04	0.00	-	210	54	<0.5	1.9	2.4	-
MW-6	10/13/1992	3.85	4.56	-0.71	0.00	-	10,000	5,300	<10	70	<10	-
MW-6	01/11/1993	3.85	2.36	1.49	0.00	-	100	50	<0.5	<0.5	<0.5	-
MW-6	04/14/1993	3.85	3.15	0.70	0.00	-	<50	<0.5	<0.5	<0.5	<0.5	-
MW-6	07/13/1993	3.85	3.94	-0.09	0.00	-	<50	1.8	<0.5	<0.5	<1.5	-
MW-6	10/19/1993	3.85	4.40	-0.55	0.00	-	320	150	<0.5	0.8	<0.5	-
MW-6	11/30/1993	7.27	4.16	3.11	0.00	-	-	-	-	-	-	-
MW-6	01/27/1994	7.27	3.33	3.94	0.00	-	120	45	<0.5	<0.5	<0.5	-
MW-6	04/07/1994	7.27	3.43	3.84	0.00	-	<50	<0.5	<0.5	<0.5	<0.5	-
MW-6	07/01/1994	7.27	3.94	3.33	0.00	-	<50	<0.5	<0.5	<0.5	<0.5	-
MW-6	10/05/1994	7.27	4.38	2.89	0.00	-	8,300	2,400	160	42	190	-
MW-6	01/12/1995 ¹	7.27	2.43	4.84	0.00	-	<50	12	<0.5	<0.5	<0.5	-
MW-6	04/26/1995	7.27	2.06	5.21	0.00	-	<50	5.5	0.67	<0.5	1.3	-
MW-6	07/12/1995	7.27	3.53	3.74	0.00	-	65	27	<0.5	<0.5	<0.5	-
MW-6	10/30/1995	7.27	4.34	2.93	0.00	-	<50	3.9	<0.5	<0.5	<0.5	<2.5
MW-6	01/22/1996	7.27	2.61	4.66	0.00	-	<50	0.93	<0.5	<0.5	<0.5	<2.5
MW-6	04/24/1996	7.27	2.50	4.77	0.00	-	260	110	<1.2	<1.2	<1.2	<6.2
MW-6	07/29/1996	7.27	3.85	3.42	0.00	-	<50	23	<0.5	<0.5	<0.5	<2.5
MW-6	10/10/1996	7.27	4.37	2.90	0.00	-	79	31	<0.5	<0.5	<0.5	<2.5

TABLE 1

**GROUNDWATER MONITORING AND SAMPLING DATA
FORMER CHEVRON SERVICE STATION 9-1153
3135 GIBBONS DRIVE
ALAMEDA, CALIFORNIA**

Location	Date	TOC	DTW	GWE	LNAPLT	FIELD PARAMETERS	HYDROCARBONS	PRIMARY VOCS				
						Dissolved Oxygen	TPH-GRO	B	T	E	X	MTBE by SW8260
	Units	ft	ft	ft-amsl	ft	mg/L	µg/L	µg/L	µg/L	µg/L	µg/L	µg/L
MW-6	01/15/1997	7.27	2.63	4.64	0.00	-	<50	<0.5	<0.5	<0.5	<0.5	<2.5
MW-6	04/03/1997	7.27	3.42	3.85	0.00	-	670	360	<5.0	<5.0	<5.0	<25
MW-6	07/09/1997	7.27	4.29	2.98	0.00	-	330	140	<2.0	<2.0	<2.0	<10
MW-6	10/29/1997	7.27	4.56	2.71	0.00	-	400	260	<2.0	<2.0	<2.0	5.8
MW-6	01/14/1998	7.27	1.01	6.26	0.00	-	<50	<0.5	<0.5	<0.5	<0.5	<2.5
MW-6	04/17/1998	7.27	2.94	4.33	0.00	-	<50	1.7	<0.5	<0.5	<0.5	<2.5
MW-6	07/15/1998	7.27	4.72	2.55	0.00	-	<50	<0.5	<0.5	<0.5	<0.5	<2.5
MW-6	10/27/1998 ²¹	7.27	-	-	-	-	-	-	-	-	-	-
MW-6	11/25/1998	7.27	4.16	3.11	0.00	-	110 ³	54	<0.5	<0.5	<0.5	<2.5
MW-6	01/20/1999	7.27	3.45	3.82	0.00	-	<50	10	<0.5	<0.5	<0.5	<2.0
MW-6	04/19/1999	7.27	3.39	3.88	0.00	-	<50	2.6	<0.5	<0.5	<0.5	<2.0/<2.5 ²
MW-6	07/29/1999 ⁴	7.27	4.34	2.93	0.00	-	<5,000	2,590	<50	<50	<50	<500
MW-6	10/13/1999	7.27	5.89	1.38	0.00	-	9,270	4,610	44.2	<25	<25	<125
MW-6	01/25/2000	7.27	4.11	3.16	0.00	-	529	289	<0.5	<0.5	<0.5	738
MW-6	04/03/2000 ^{7,8}	7.27	2.84	4.43	0.00	-	<50	<0.50	<0.50	<0.50	<0.50	<2.5
MW-6	07/03/2000 ⁷	7.27	3.77	3.50	0.00	-	91 ⁶	89	0.77	<0.50	<0.50	<2.5
MW-6	10/12/2000	7.27	6.32	0.95	0.00	-	<50	8.0	<0.50	<0.50	<0.50	<2.5
MW-6	01/08/2001 ^{7,11}	7.27	3.74	3.53	0.00	-	400 ⁶	640	8.2	8.0	5.0	10
MW-6	04/09/2001 ⁷	7.27	3.03	4.24	0.00	-	91.3	22.0	3.36	0.751	2.14	<0.500
MW-6	08/23/2001 ⁷	7.27	4.70	2.57	0.00	-	53 ¹³	23	0.50	<0.50	1.1	<2.5
MW-6	11/27/2001 ¹⁴	7.27	4.43	2.84	0.00	-	<50	4.1	<0.50	<0.50	<1.5	<2.5
MW-6	02/26/2002 ¹⁴	7.27	2.50	4.77	0.00	-	100	53	<0.50	<0.50	<1.5	<2.5
MW-6	05/23/2002	7.27	3.27	4.00	0.00	-	610	260	4.2	1.7	2.1	<2.5

**GROUNDWATER MONITORING AND SAMPLING DATA
FORMER CHEVRON SERVICE STATION 9-1153
3135 GIBBONS DRIVE
ALAMEDA, CALIFORNIA**

Location	Date	TOC	DTW	GWE	LNAPLT	FIELD PARAMETERS	HYDROCARBONS	PRIMARY VOCS				
						Dissolved Oxygen	TPH-GRO	B	T	E	X	MTBE by SW8260
	Units	ft	ft	ft-amsl	ft	mg/L	µg/L	µg/L	µg/L	µg/L	µg/L	µg/L
MW-6	08/09/2002	7.27	4.11	3.16	0.00	-	<50	1.1	<0.50	<0.50	<1.5	<2.5
MW-6	11/08/2002	7.27	4.12	3.15	0.00	2.10	<50	<0.50	<0.50	<0.50	<1.5	<2.5
MW-6	02/07/2003	7.27	2.60	4.67	0.00	2.60	<50	0.65	<0.50	<0.50	<1.5	<2.5
MW-6	05/09/2003	7.27	2.57	4.70	0.00	3.10	<50	1.9	<0.5	<0.5	<1.5	<2.5
MW-6	08/15/2003 ¹⁵	7.27	4.15	3.12	0.00	2.90	<50	<0.5	<0.5	<0.5	<0.5	<0.5
MW-6	11/14/2003 ¹⁵	7.27	4.10	3.17	0.00	3.41	<50	<0.5	0.6	<0.5	<0.5	1
MW-6	02/13/2004 ¹⁵	7.27	2.66	4.61	0.00	-	<50	<0.5	<0.5	<0.5	<0.5	<0.5
MW-6	05/14/2004 ¹⁵	7.27	3.55	3.72	0.00	-	<50	3	<0.5	<0.5	<0.5	<0.5
MW-6	08/13/2004 ¹⁵	7.27	4.32	2.95	0.00	-	<50	<0.5	<0.5	<0.5	<0.5	<0.5
MW-6	11/12/2004 ¹⁵	7.27	4.20	3.07	0.00	-	<50	<0.5	<0.5	<0.5	<0.5	<0.5
MW-6	02/11/2005 ¹⁵	7.27	2.18	5.09	0.00	-	<50	<0.5	<0.5	<0.5	<0.5	<0.5
MW-6	05/13/2005 ¹⁵	7.27	4.11	3.16	0.00	-	<50	<0.5	<0.5	<0.5	<0.5	<0.5
MW-6	08/19/2005 ¹⁵	7.27	3.70	3.57	0.00	1.90	<50	<0.5	<0.5	<0.5	<0.5	<0.5
MW-6	11/18/2005 ¹⁵	7.27	3.98	3.29	0.00	1.70	<50	<0.5	<0.5	<0.5	<0.5	<0.5
MW-6	02/10/2006 ¹⁵	7.27	2.11	5.16	0.00	2.20	<50	<0.5	<0.5	<0.5	<0.5	<0.5
MW-6	05/12/2006 ¹⁵	7.27	3.18	4.09	0.00	2.80	<50	<0.5	<0.5	<0.5	<0.5	<0.5
MW-6	08/11/2006 ¹⁵	7.27	3.80	3.47	0.00	2.50	<50	<0.5	<0.5	<0.5	<0.5	<0.5
MW-6	11/17/2006 ¹⁵	7.27	3.78	3.49	0.00	2.20	<50	<0.5	<0.5	<0.5	<0.5	<0.5
MW-6	02/16/2007 ¹⁵	7.27	2.08	5.19	0.00	1.80	<50	1	<0.5	<0.5	<0.5	<0.5
MW-6	05/17/2007 ¹⁵	7.27	3.61	3.66	0.00	2.0	<50	<0.5	<0.5	<0.5	<0.5	<0.5
MW-6	08/09/2007 ¹⁵	7.27	4.05	3.22	0.00	2.6	<50	<0.5	<0.5	<0.5	<0.5	<0.5
MW-6	11/08/2007 ¹⁵	7.27	4.12	3.15	0.00	2.2	<50	5	<0.5	<0.5	<0.5	<0.5
MW-6	02/06/2008 ¹⁵	7.27	1.85	5.42	0.00	2.4	<50	<0.5	<0.5	<0.5	<0.5	<0.5

TABLE 1

**GROUNDWATER MONITORING AND SAMPLING DATA
FORMER CHEVRON SERVICE STATION 9-1153
3135 GIBBONS DRIVE
ALAMEDA, CALIFORNIA**

Location	Date	TOC	DTW	GWE	LNAPL	FIELD PARAMETERS	HYDROCARBONS	PRIMARY VOCS				
						Dissolved Oxygen	TPH-GRO	B	T	E	X	MTBE by SW8260
	Units	ft	ft	ft-amsl	ft	mg/L	µg/L	µg/L	µg/L	µg/L	µg/L	µg/L
MW-6	05/07/2008 ¹⁵	7.27	3.91	3.36	0.00	2.3	63	18	<0.5	<0.5	<0.5	<0.5
MW-6	09/11/2008 ¹⁵	7.27	4.93	2.34	0.00	1.9	<50	<0.5	<0.5	<0.5	<0.5	<0.5
MW-6	11/10/2008 ¹⁵	7.27	4.30	2.97	0.00	2.2	<50	<0.5	<0.5	<0.5	<0.5	<0.5
MW-6	02/09/2009 ¹⁵	7.27	2.97	4.30	0.00	2.0	<50	2	<0.5	<0.5	<0.5	<0.5
MW-6	05/28/2009 ¹⁵	7.27	3.53	3.74	0.00	1.77	<50	4	<0.5	<0.5	<0.5	<0.5
MW-6	08/18/2009 ¹⁵	7.27	3.38	3.89	0.00	1.81	560	130	3	<0.5	0.7J	<0.5
MW-6	11/17/2009	7.27	4.00	3.27	0.00	-	-	-	-	-	-	-
MW-6	03/31/2010	7.27	2.44	4.83	0.00	-	<50	<0.5	<0.5	<0.5	<0.5	<0.5
MW-6	05/17/2010	7.27	3.30	3.97	0.00	-	-	-	-	-	-	-
MW-6	08/26/2010	7.27	4.15	3.12	0.00	-	<50	<0.5	<0.5	<0.5	<0.5	<0.5
MW-6	11/11/2010 ²⁰	7.27	4.16	3.11	0.00	-	-	-	-	-	-	-
MW-6	03/02/2011²⁰	7.27	2.27	5.00	0.00	-	<50	<0.5	<0.5	<0.5	<0.5	<0.5
MW-7	11/30/1993	8.22	5.33	2.89	0.00	-	480	110	41	4.4	38	-
MW-7	01/27/1994	8.22	4.50	3.72	0.00	-	120	21	1.1	2.2	4.8	-
MW-7	04/07/1994	8.22	4.62	3.60	0.00	-	2,600	630	39	56	94	-
MW-7	07/01/1994	8.22	5.13	3.09	0.00	-	2,200	770	42	<10	92	-
MW-7	10/05/1994	8.22	5.61	2.61	0.00	-	15,000	3,300	90	130	320	-
MW-7	01/12/1995	8.22	2.83	5.39	0.00	-	340	57	<1.3	18	6.4	-
MW-7	04/26/1995	8.22	2.35	5.87	0.00	-	15,000	3,700	210	520	800	-
MW-7	07/12/1995	8.22	4.66	3.56	0.00	-	7,700	1,800	59	130	370	-
MW-7	10/30/1995	8.22	5.48	2.74	0.00	-	770	260	<5.0	33	48	25
MW-7	01/22/1996	8.22	3.34	4.88	0.00	-	290	63	<1.0	6.4	5.7	<5.0

TABLE 1

**GROUNDWATER MONITORING AND SAMPLING DATA
FORMER CHEVRON SERVICE STATION 9-1153
3135 GIBBONS DRIVE
ALAMEDA, CALIFORNIA**

Location	Date	TOC	DTW	GWE	LNAPLT	FIELD PARAMETERS	HYDROCARBONS	PRIMARY VOCS				
						Dissolved Oxygen	TPH-GRO	B	T	E	X	MTBE by SW8260
	Units	ft	ft	ft-amsl	ft	mg/L	µg/L	µg/L	µg/L	µg/L	µg/L	µg/L
MW-7	04/24/1996	8.22	4.12	4.10	0.00	-	12,000	2,500	510	380	810	<125
MW-7	07/29/1996	8.22	5.03	3.19	0.00	-	2,600	650	<25	61	150	<125
MW-7	10/10/1996	8.22	5.52	2.70	0.00	-	5,800	1,700	28	170	210	<62
MW-7	01/15/1997	8.22	2.92	5.30	0.00	-	1,000	230	<2.5	28	11	63
MW-7	04/03/1997	8.22	4.65	3.57	0.00	-	6,000	1,800	100	140	170	<100
MW-7	07/09/1997	8.22	5.39	2.83	0.00	-	5,500	2,200	<20	41	30	<100
MW-7	10/29/1997	8.22	5.58	2.64	0.00	-	220	40	0.61	3.0	2.4	7.6
MW-7	01/14/1998	8.22	2.80	5.42	0.00	-	140	5.1	<0.5	<0.5	1.4	<2.5
MW-7	04/17/1998	8.22	3.00	5.22	0.00	-	13,000	4,200	98	250	240	250
MW-7	07/15/1998 ²¹	8.22	-	-	-	-	-	-	-	-	-	-
MW-7	08/17/1998 ⁵	7.92	5.52	2.40	0.00	-	1,600	380	51	68	280	22
MW-7	10/27/1998	7.92	7.51	0.41	0.00	-	190	2.3	0.53	<0.5	<0.5	33
MW-7	01/20/1999	7.92	3.45	4.47	0.00	-	<50	<0.5	<0.5	<0.5	<0.5	<2.0
MW-7	04/19/1999	7.92	4.61	3.31	0.00	-	6,500	3,000	<0.5	110	210	150 ² /310
MW-7	07/29/1999 ⁴	7.92	5.00	2.92	0.00	-	8,390	2,100	129	222	729	248
MW-7	10/13/1999	7.92	5.61	2.31	0.00	-	14,300	6,600	58.8	117	190	<125
MW-7	01/25/2000	7.92	3.32	4.60	0.00	-	1,100	184	<5.0	13.5	33.7	151
MW-7	04/03/2000 ^{7,9}	7.92	3.38	4.54	0.00	-	2,600 ⁶	780	12	<5.0	61	95
MW-7	07/03/2000 ⁷	7.92	4.34	3.58	0.00	-	4,100 ⁶	2,600	72	240	690	<50
MW-7	10/23/2000	7.92	6.11	1.81	0.00	-	12,000 ⁶	2,600	<50	150	290	<250
MW-7	01/08/2001 ^{7,11}	7.92	4.32	3.60	0.00	-	3,900 ⁶	2,200	61	140	350	<25
MW-7	04/09/2001 ⁷	7.92	3.63	4.29	0.00	-	25,100	4,590	1,200	843	1,920	48.1
MW-7	08/23/2001 ⁷	7.92	4.83	3.09	0.00	-	27,000	4,100	970	1,100	3,500	<500

TABLE 1

**GROUNDWATER MONITORING AND SAMPLING DATA
FORMER CHEVRON SERVICE STATION 9-1153
3135 GIBBONS DRIVE
ALAMEDA, CALIFORNIA**

Location	Date	TOC	DTW	GWE	LNAPLT	FIELD PARAMETERS	HYDROCARBONS	PRIMARY VOCS				
						Dissolved Oxygen	TPH-GRO	B	T	E	X	MTBE by SW8260
	Units	ft	ft	ft-amsl	ft	mg/L	µg/L	µg/L	µg/L	µg/L	µg/L	µg/L
MW-7	11/27/2001	7.92	4.30	3.62	0.00	-	12,000	1,800	50	450	830	91
MW-7	02/26/2002	7.92	3.00	4.92	0.00	-	15,000	3,100	260	380	860	<10
MW-7	05/23/2002	7.92	3.69	4.23	0.00	-	28,000	6,000	120	820	1,900	42
MW-7	08/09/2002	7.92	4.38	3.54	0.00	-	24,000	3,700	81	710	1,300	56
MW-7	11/08/2002	7.92	4.43	3.49	0.00	-98.00	18,000	2,300	150	660	1,400	<100
MW-7	02/07/2003	7.92	3.20	4.72	0.00	2.90	13,000	2,300	200	310	620	<25
MW-7	05/09/2003	7.92	3.18	4.74	0.00	2.60	17,000	4,200	36	350	360	<50
MW-7	08/15/2003 ¹⁵	7.92	4.75	3.17	0.00	2.30	29,000	7,300	140	780	1,900	<5
MW-7	11/14/2003 ¹⁵	7.92	4.95	2.97	0.00	1.87	7,200	950	3	45	20	7
MW-7	02/13/2004 ¹⁵	7.92	3.29	4.63	0.00	-	3,300	360	4	82	130	3
MW-7	05/14/2004 ¹⁵	7.92	3.98	3.94	0.00	-	17,000	3,100	480	510	1,300	3
MW-7	08/13/2004 ¹⁵	7.92	5.94	1.98	0.00	-	10,000	2,000	4	130	150	4
MW-7	11/12/2004 ¹⁵	7.92	4.50	3.42	0.00	-	680	4	<0.5	1	0.7	0.8
MW-7	02/11/2005 ¹⁵	7.92	3.07	4.85	0.00	-	4,600	680	6	80	44	4
MW-7	05/13/2005 ¹⁵	7.92	4.51	3.41	0.00	-	4,200	380	3	38	13	2
MW-7	08/19/2005 ¹⁵	7.92	4.03	3.89	0.00	0.80	7,900	1,300	3	190	310	<1
MW-7	11/18/2005 ¹⁵	7.92	4.62	3.30	0.00	0.90	3,900	4	1	16	8	2
MW-7	02/10/2006 ¹⁵	7.92	3.12	4.80	0.00	1.30	3,200	320	2	14	8	2
MW-7	05/12/2006 ¹⁵	7.92	4.25	3.67	0.00	1.40	3,600	1,000	2	65	27	<1
MW-7	08/11/2006 ¹⁵	7.92	4.45	3.47	0.00	1.10	6,700	1,900	6	280	300	<1
MW-7	11/17/2006 ¹⁵	7.92	4.71	3.21	0.00	0.70	1,200	0.6	<0.5	1	0.8	<0.5
MW-7	02/16/2007 ¹⁵	7.92	3.26	4.66	0.00	1.10	110	<0.5	<0.5	<0.5	<0.5	<0.5
MW-7	05/17/2007 ¹⁵	7.92	4.62	3.30	0.00	1.7	6,400	1,400	4	130	26	<1

TABLE 1

**GROUNDWATER MONITORING AND SAMPLING DATA
FORMER CHEVRON SERVICE STATION 9-1153
3135 GIBBONS DRIVE
ALAMEDA, CALIFORNIA**

Location	Date	TOC	DTW	GWE	LNAPLT	FIELD PARAMETERS	HYDROCARBONS	PRIMARY VOCS				
						Dissolved Oxygen	TPH-GRO	B	T	E	X	MTBE by SW8260
	Units	ft	ft	ft-amsl	ft	mg/L	µg/L	µg/L	µg/L	µg/L	µg/L	µg/L
MW-7	08/09/2007 ¹⁵	7.92	4.61	3.31	0.00	1.2	10,000	1,400	4	230	12	<3
MW-7	11/08/2007 ¹⁵	7.92	4.72	3.20	0.00	0.9	2,300	4	1	3	7	0.9
MW-7	02/06/2008 ¹⁵	7.92	2.98	4.94	0.00	0.5	190	<0.5	<0.5	<0.5	<0.5	<0.5
MW-7	05/07/2008 ¹⁵	7.92	4.48	3.44	0.00	1.2	8,000	1,500	15	380	260	<1
MW-7	09/11/2008 ¹⁵	7.92	5.95	1.97	0.00	1.0	5,100	530	4	47	12	0.7
MW-7	11/10/2008 ¹⁵	7.92	5.81	2.11	0.00	0.6	2,800	13	1	1	7	<0.5
MW-7	02/09/2009 ¹⁵	7.92	4.06	3.86	0.00	0.8	3,900	190	2	51	11	0.5
MW-7	05/28/2009 ^{15,17}	7.92	3.84	4.08	0.00	0.45	5,800	870	8	220	27	<0.5
MW-7	08/18/2009 ¹⁵	7.92	4.80	3.12	0.00	0.57	6,700	660	4	110	13	0.7 J
MW-7	11/17/2009	7.92	4.52	3.40	0.00	-	-	-	-	-	-	-
MW-7	03/31/2010	7.92	3.11	4.81	0.00	-	2,000	110	1	2	3	0.7 J
MW-7	05/17/2010	7.92	3.41	4.51	0.00	-	-	-	-	-	-	-
MW-7	08/26/2010	7.92	4.60	3.32	0.00	-	5,100	470	3	150	9	<0.5
MW-7	11/11/2010 ²⁰	7.92	4.68	3.24	0.00	-	-	-	-	-	-	-
MW-7	03/02/2011 ²⁰	7.92	2.53	5.39	0.00	-	1,100	<0.5	<0.5	<0.5	<0.5	<0.5
MW-8	10/17/1995	6.96	4.40	2.56	0.00	-	-	-	-	-	-	-
MW-8	10/30/1995	6.96	4.44	2.52	0.00	-	<50	<0.5	<0.5	<0.5	<0.5	<2.5
MW-8	01/22/1996	6.96	2.24	4.72	0.00	-	<50	<0.5	<0.5	<0.5	<0.5	<2.5
MW-8	04/24/1996	6.96	2.97	3.99	0.00	-	<50	<0.5	<0.5	<0.5	<0.5	<2.5
MW-8	07/29/1996	6.96	3.37	3.59	0.00	-	<50	<0.5	<0.5	<0.5	<0.5	<2.5
MW-8	10/10/1996	6.96	4.12	2.84	0.00	-	<50	<0.5	<0.5	<0.5	<0.5	<2.5
MW-8	01/15/1997	6.96	0.94	6.02	0.00	-	<50	<0.5	<0.5	<0.5	<0.5	<2.5

TABLE 1

**GROUNDWATER MONITORING AND SAMPLING DATA
FORMER CHEVRON SERVICE STATION 9-1153
3135 GIBBONS DRIVE
ALAMEDA, CALIFORNIA**

Location	Date	TOC	DTW	GWE	LNAPL	FIELD PARAMETERS	HYDROCARBONS	PRIMARY VOCS				
						Dissolved Oxygen	TPH-GRO	B	T	E	X	MTBE by SW8260
	Units	ft	ft	ft-amsl	ft	mg/L	µg/L	µg/L	µg/L	µg/L	µg/L	µg/L
MW-8	04/03/1997	6.96	2.20	4.76	0.00	-	<50	<0.5	<0.5	<0.5	<0.5	<2.5
MW-8	07/09/1997	6.96	4.30	2.66	0.00	-	<50	<0.5	<0.5	<0.5	<0.5	<2.5
MW-8	10/29/1997	6.96	4.57	2.39	0.00	-	<50	<0.5	<0.5	<0.5	<0.5	<2.5
MW-8	01/14/1998	6.96	0.83	6.13	0.00	-	<50	<0.5	<0.5	<0.5	<0.5	<2.5
MW-8	01/20/1999	6.96	2.69	4.27	0.00	-	<50	<0.5	<0.5	<0.5	<0.5	<2.0
MW-8	04/19/1999	6.96	3.76	3.20	0.00	-	-	-	-	-	-	-
MW-8	01/25/2000	6.96	1.41	5.55	0.00	-	<50	<0.5	<0.5	<0.5	<0.5	<2.5
MW-8	04/03/2000 ¹⁹	6.96	-	-	-	-	-	-	-	-	-	-
MW-8	07/03/2000	6.96	-	-	-	-	-	-	-	-	-	-
MW-8	10/23/2000	6.96	-	-	-	-	-	-	-	-	-	-
MW-8	01/08/2001 ¹¹	6.96	3.58	3.38	0.00	-	<50	<0.50	<0.50	<0.50	<0.50	<2.5
MW-8	04/09/2001	6.96	-	-	-	-	-	-	-	-	-	-
MW-8	08/23/2001 ¹⁹	6.96	-	-	-	-	-	-	-	-	-	-
MW-8	11/27/2001 ¹⁹	6.96	-	-	-	-	-	-	-	-	-	-
MW-8	02/26/2002	6.96	2.91	4.05	0.00	-	<50	<0.50	<0.50	<0.50	<1.5	<2.5
MW-8	05/23/2002 ¹⁹	6.96	-	-	-	-	-	-	-	-	-	-
MW-8	08/09/2002 ¹⁹	6.96	-	-	-	-	-	-	-	-	-	-
MW-8	11/08/2002 ¹⁹	6.96	-	-	-	-	-	-	-	-	-	-
MW-8	02/07/2003	6.96	3.13	3.83	0.00	-	<50	<0.50	<0.50	<0.50	<1.5	<2.5
MW-8	05/09/2003 ¹⁹	6.96	-	-	-	-	-	-	-	-	-	-
MW-8	08/15/2003 ¹⁹	6.96	-	-	-	-	-	-	-	-	-	-
MW-8	11/14/2003 ¹⁹	6.96	-	-	-	-	-	-	-	-	-	-
MW-8	02/13/2004 ¹⁵	6.96	3.20	3.76	0.00	-	<50	<0.5	<0.5	<0.5	<0.5	<0.5

TABLE 1

**GROUNDWATER MONITORING AND SAMPLING DATA
FORMER CHEVRON SERVICE STATION 9-1153
3135 GIBBONS DRIVE
ALAMEDA, CALIFORNIA**

Location	Date	TOC	DTW	GWE	LNAPLT	FIELD PARAMETERS	HYDROCARBONS	PRIMARY VOCS				
						Dissolved Oxygen	TPH-GRO	B	T	E	X	MTBE by SW8260
	Units	ft	ft	ft-amsl	ft	mg/L	µg/L	µg/L	µg/L	µg/L	µg/L	µg/L
MW-8	05/14/2004 ¹⁹	6.96	-	-	-	-	-	-	-	-	-	-
MW-8	11/12/2004 ¹⁹	6.96	-	-	-	-	-	-	-	-	-	-
MW-8	02/11/2005 ¹⁵	6.96	2.85	4.11	0.00	-	<50	<0.5	<0.5	<0.5	<0.5	<0.5
MW-8	05/13/2005 ¹⁹	6.96	-	-	-	-	-	-	-	-	-	-
MW-8	08/19/2005 ¹⁹	6.96	-	-	-	-	-	-	-	-	-	-
MW-8	11/18/2005 ¹⁹	6.96	-	-	-	-	-	-	-	-	-	-
MW-8	02/10/2006 ¹⁵	6.96	2.74	4.22	<50	-	<0.5	<0.5	<0.5	<0.5	<0.5	<0.5
MW-8	05/12/2006 ¹⁹	6.96	-	-	-	-	-	-	-	-	-	-
MW-8	08/11/2006 ¹⁹	6.96	-	-	-	-	-	-	-	-	-	-
MW-8	11/17/2006 ¹⁹	6.96	-	-	-	-	-	-	-	-	-	-
MW-8	02/16/2007 ¹⁵	6.96	2.69	4.27	0.00	-	<50	<0.5	<0.5	<0.5	<0.5	<0.5
MW-8	05/17/2007 ¹⁹	6.96	-	-	-	-	-	-	-	-	-	-
MW-8	08/09/2007 ¹⁹	6.96	-	-	-	-	-	-	-	-	-	-
MW-8	11/08/2007 ¹⁹	6.96	-	-	-	-	-	-	-	-	-	-
MW-8	02/06/2008 ¹⁵	6.96	2.57	4.39	0.00	-	<50	<0.5	<0.5	<0.5	<0.5	<0.5
MW-8	05/07/2008 ¹⁹	6.96	-	-	-	-	-	-	-	-	-	-
MW-8	09/11/2008 ¹⁹	6.96	-	-	-	-	-	-	-	-	-	-
MW-8	11/10/2008 ¹⁹	6.96	-	-	-	-	-	-	-	-	-	-
MW-8	02/09/2009 ¹⁵	6.96	3.28	3.68	0.00	-	<50	<0.5	<0.5	<0.5	<0.5	<0.5
MW-8	03/31/2010	6.96	2.85	4.11	0.00	-	<50	<0.5	<0.5	<0.5	<0.5	<0.5
MW-8	05/17/2010	6.96	3.33	3.63	0.00	-	-	-	-	-	-	-
MW-8	08/26/2010 ¹⁹	6.96	4.27	2.69	0.00	-	-	-	-	-	-	-
MW-8	11/11/2010 ¹⁹	6.96	3.82	3.14	0.00	-	-	-	-	-	-	-

TABLE 1

GROUNDWATER MONITORING AND SAMPLING DATA
 FORMER CHEVRON SERVICE STATION 9-1153
 3135 GIBBONS DRIVE
 ALAMEDA, CALIFORNIA

Location	Date	TOC	DTW	GWE	LNAPLT	FIELD PARAMETERS	HYDROCARBONS	PRIMARY VOCS				
						Dissolved Oxygen	TPH-GRO	B	T	E	X	MTBE by SW8260
	Units	ft	ft	ft-amsl	ft	mg/L	µg/L	µg/L	µg/L	µg/L	µg/L	µg/L
MW-8	03/02/2011 ¹⁹	6.96	1.66	5.30	0.00	-	<50	<0.5	<0.5	<0.5	<0.5	<0.5
MW-9	10/17/1995	7.21	4.80	2.41	0.00	-	-	-	-	-	-	-
MW-9	10/30/1995	7.21	4.97	2.24	0.00	-	<50	<0.5	<0.5	<0.5	<0.5	<2.5
MW-9	01/22/1996	7.21	3.40	3.81	0.00	-	<50	<0.5	<0.5	<0.5	<0.5	<2.5
MW-9	04/24/1996	7.21	4.18	3.03	0.00	-	<50	<0.5	<0.5	<0.5	<0.5	<2.5
MW-9	07/29/1996	7.21	4.69	2.52	0.00	-	<50	<0.5	<0.5	<0.5	<0.5	<2.5
MW-9	10/10/1996	7.21	5.20	2.01	0.00	-	<50	<0.5	<0.5	<0.5	<0.5	<2.5
MW-9	01/15/1997	7.21	3.31	3.90	0.00	-	<50	<0.5	<0.5	<0.5	<0.5	<2.5
MW-9	04/03/1997	7.21	4.57	2.64	0.00	-	<50	<0.5	<0.5	<0.5	<0.5	<2.5
MW-9	07/09/1997	7.21	5.04	2.17	0.00	-	<50	<0.5	<0.5	<0.5	<0.5	<2.5
MW-9	10/29/1997	7.21	4.96	2.25	0.00	-	<50	<0.5	<0.5	<0.5	<0.5	<2.5
MW-9	01/14/1998	7.21	2.40	4.81	0.00	-	<50	<0.5	<0.5	<0.5	<0.5	<2.5
MW-9	01/20/1999	7.21	4.31	2.90	0.00	-	<50	<0.5	<0.5	<0.5	<0.5	<2.0
MW-9	04/19/1999	7.21	3.92	3.29	0.00	-	-	-	-	-	-	-
MW-9	01/25/2000	7.21	2.95	4.26	0.00	-	<50	<0.5	<0.5	<0.5	<0.5	<2.5
MW-9	04/03/2000 ¹⁹	7.21	-	-	-	-	-	-	-	-	-	-
MW-9	07/03/2000	7.21	-	-	-	-	-	-	-	-	-	-
MW-9	10/23/2000	7.21	-	-	-	-	-	-	-	-	-	-
MW-9	01/08/2001 ¹¹	7.21	4.59	2.62	0.00	-	<50	<0.50	<0.50	<0.50	<0.50	<2.5
MW-9	04/09/2001	7.21	-	-	-	-	-	-	-	-	-	-
MW-9	08/23/2001 ¹⁹	7.21	-	-	-	-	-	-	-	-	-	-
MW-9	11/27/2001 ¹⁹	7.21	-	-	-	-	-	-	-	-	-	-

TABLE 1

GROUNDWATER MONITORING AND SAMPLING DATA
 FORMER CHEVRON SERVICE STATION 9-1153
 3135 GIBBONS DRIVE
 ALAMEDA, CALIFORNIA

Location	Date	TOC	DTW	GWE	LNAPL	FIELD PARAMETERS	HYDROCARBONS	PRIMARY VOCS				
						Dissolved Oxygen	TPH-GRO	B	T	E	X	MTBE by SW8260
	Units	ft	ft	ft-amsl	ft	mg/L	µg/L	µg/L	µg/L	µg/L	µg/L	µg/L
MW-9	02/26/2002	7.21	3.75	3.46	0.00	-	<50	<0.50	<0.50	<0.50	<1.5	<2.5
MW-9	05/23/2002 ¹⁹	7.21	-	-	-	-	-	-	-	-	-	-
MW-9	08/09/2002 ¹⁹	7.21	-	-	-	-	-	-	-	-	-	-
MW-9	11/08/2002 ¹⁹	7.21	-	-	-	-	-	-	-	-	-	-
MW-9	02/07/2003	7.21	3.97	3.24	0.00	-	<50	<0.50	<0.50	<0.50	<1.5	<2.5
MW-9	05/09/2003 ¹⁹	7.21	-	-	-	-	-	-	-	-	-	-
MW-9	08/15/2003 ¹⁹	7.21	-	-	-	-	-	-	-	-	-	-
MW-9	11/14/2003 ¹⁹	7.21	-	-	-	-	-	-	-	-	-	-
MW-9	02/13/2004 ¹⁵	7.21	3.94	3.27	0.00	-	<50	<0.5	<0.5	<0.5	<0.5	<0.5
MW-9	05/14/2004 ¹⁹	7.21	-	-	-	-	-	-	-	-	-	-
MW-9	11/12/2004 ¹⁹	7.21	-	-	-	-	-	-	-	-	-	-
MW-9	02/11/2005 ¹⁵	7.21	3.66	3.55	0.00	-	<50	<0.5	<0.5	<0.5	<0.5	<0.5
MW-9	05/13/2005 ¹⁹	7.21	-	-	-	-	-	-	-	-	-	-
MW-9	08/19/2005 ¹⁹	7.21	-	-	-	-	-	-	-	-	-	-
MW-9	11/18/2005 ¹⁹	7.21	-	-	-	-	-	-	-	-	-	-
MW-9	02/10/2006 ¹⁵	7.21	3.53	3.68	0.00	-	<0.5	<0.5	<0.5	<0.5	<0.5	<0.5
MW-9	05/12/2006 ¹⁹	7.21	-	-	-	-	-	-	-	-	-	-
MW-9	08/11/2006 ¹⁹	7.21	-	-	-	-	-	-	-	-	-	-
MW-9	11/17/2006 ¹⁹	7.21	-	-	-	-	-	-	-	-	-	-
MW-9	02/16/2007 ¹⁵	7.21	3.50	3.71	0.00	-	<50	<0.5	<0.5	<0.5	<0.5	<0.5
MW-9	05/17/2007 ¹⁹	7.21	-	-	-	-	-	-	-	-	-	-
MW-9	08/09/2007 ¹⁹	7.21	-	-	-	-	-	-	-	-	-	-
MW-9	11/08/2007 ¹⁹	7.21	-	-	-	-	-	-	-	-	-	-

TABLE 1

**GROUNDWATER MONITORING AND SAMPLING DATA
FORMER CHEVRON SERVICE STATION 9-1153
3135 GIBBONS DRIVE
ALAMEDA, CALIFORNIA**

Location	Date	TOC	DTW	GWE	LNAPL	FIELD PARAMETERS	HYDROCARBONS	PRIMARY VOCS				
						Dissolved Oxygen	TPH-GRO	B	T	E	X	MTBE by SW8260
	Units	ft	ft	ft-amsl	ft	mg/L	µg/L	µg/L	µg/L	µg/L	µg/L	µg/L
MW-9	02/06/2008 ¹⁵	7.21	3.14	4.07	0.00	-	<50	<0.5	<0.5	<0.5	<0.5	<0.5
MW-9	05/07/2008 ¹⁹	7.21	-	-	-	-	-	-	-	-	-	-
MW-9	09/11/2008 ¹⁹	7.21	-	-	-	-	-	-	-	-	-	-
MW-9	11/10/2008 ¹⁹	7.21	-	-	-	-	-	-	-	-	-	-
MW-9	02/09/2009 ¹⁵	7.21	3.91	3.30	0.00	-	<50	<0.5	<0.5	<0.5	<0.5	<0.5
MW-9	03/31/2010	7.21	3.16	4.05	0.00	-	<50	<0.5	<0.5	<0.5	<0.5	<0.5
MW-9	05/17/2010	7.21	3.44	3.77	0.00	-	-	-	-	-	-	-
MW-9	08/26/2010 ¹⁹	7.21	4.77	2.44	0.00	-	-	-	-	-	-	-
MW-9	11/11/2010 ¹⁹	7.21	4.29	2.92	0.00	-	-	-	-	-	-	-
MW-9	03/02/2011¹⁹	7.21	2.75	4.46	0.00	-	<50	<0.5	<0.5	<0.5	<0.5	<0.5
MW-10	10/17/1995	7.28	5.05	2.23	0.00	-	-	-	-	-	-	-
MW-10	10/30/1995	7.28	5.11	2.17	0.00	-	<50	<0.5	<0.5	<0.5	<0.5	5.1
MW-10	01/22/1996	7.28	4.03	3.25	0.00	-	<50	<0.5	<0.5	<0.5	0.70	17
MW-10	04/24/1996	7.28	4.30	2.98	0.00	-	<50	<0.5	<0.5	<0.5	<0.5	12
MW-10	07/29/1996	7.28	4.70	2.58	0.00	-	<50	<0.5	<0.5	<0.5	<0.5	14
MW-10	10/10/1996	7.28	5.24	2.04	0.00	-	<50	<0.5	<0.5	<0.5	<0.5	<2.5
MW-10	01/15/1997	7.28	3.35	3.93	0.00	-	<50	<0.5	<0.5	<0.5	<0.5	<2.5
MW-10	04/03/1997	7.28	4.64	2.64	0.00	-	<50	<0.5	<0.5	<0.5	<0.5	8.2
MW-10	07/09/1997	7.28	5.12	2.16	0.00	-	<50	<0.5	<0.5	<0.5	<0.5	<2.5
MW-10	10/29/1997	7.28	5.10	2.18	0.00	-	<50	<0.5	<0.5	<0.5	<0.5	5.3
MW-10	01/14/1998	7.28	3.08	4.20	0.00	-	<50	<0.5	<0.5	<0.5	<0.5	8.6
MW-10	04/17/1998 ²⁰	7.28	3.79	3.49	0.00	-	-	-	-	-	-	-

TABLE 1

**GROUNDWATER MONITORING AND SAMPLING DATA
FORMER CHEVRON SERVICE STATION 9-1153
3135 GIBBONS DRIVE
ALAMEDA, CALIFORNIA**

Location	Date	TOC	DTW	GWE	LNAPLT	FIELD PARAMETERS	HYDROCARBONS	PRIMARY VOCS				
						Dissolved Oxygen	TPH-GRO	B	T	E	X	MTBE by SW8260
	Units	ft	ft	ft-amsl	ft	mg/L	µg/L	µg/L	µg/L	µg/L	µg/L	µg/L
MW-10	07/15/1998	7.28	4.55	2.73	0.00	-	<50	<0.5	<0.5	<0.5	<0.5	7.5
MW-10	10/27/1998	7.28	5.32	1.96	0.00	-	-	-	-	-	-	-
MW-10	01/20/1999	7.28	4.24	3.04	0.00	-	<50	<0.5	<0.5	<0.5	<0.5	<2.0
MW-10	04/19/1999	7.28	4.07	3.21	0.00	-	-	-	-	-	-	-
MW-10	07/29/1999	7.28	4.82	2.46	0.00	-	<50	<0.5	<0.5	<0.5	<0.5	<5.0/2.4 ²
MW-10	10/13/1999	7.28	4.86	2.42	0.00	-	-	-	-	-	-	-
MW-10	01/25/2000	7.28	3.00	4.28	0.00	-	<50	<0.5	<0.5	<0.5	<0.5	4.33
MW-10	04/03/2000	7.28	3.04	4.24	0.00	-	-	-	-	-	-	-
MW-10	07/03/2000	7.28	4.00	3.28	0.00	-	<50	<0.50	<0.50	<0.50	<0.50	4.7
MW-10	10/23/2000	7.28	5.86	1.42	0.00	-	-	-	-	-	-	-
MW-10	01/08/2001 ¹¹	7.28	3.98	3.30	0.00	-	<50	<0.50	<0.50	<0.50	<0.50	<2.5
MW-10	04/09/2001	7.28	3.74	3.54	0.00	-	-	-	-	-	-	-
MW-10	08/23/2001 ²¹	7.28	-	-	-	-	-	-	-	-	-	-
MW-10	11/27/2001 ²⁰	7.28	4.13	3.15	0.00	-	-	-	-	-	-	-
MW-10	02/26/2002	7.28	3.54	3.74	0.00	-	<50	<0.50	<0.50	<0.50	<1.5	<2.5
MW-10	05/23/2002 ²⁰	7.28	3.82	3.46	0.00	-	-	-	-	-	-	-
MW-10	08/09/2002	7.28	4.18	3.10	0.00	-	<50	<0.50	<0.50	<0.50	<1.5	<2.5
MW-10	11/08/2002 ²⁰	7.28	3.91	3.37	0.00	-	-	-	-	-	-	-
MW-10	02/07/2003	7.28	3.61	3.67	0.00	-	<50	<0.50	<0.50	<0.50	<1.5	<2.5
MW-10	05/09/2003 ²⁰	7.28	3.25	4.03	0.00	-	-	-	-	-	-	-
MW-10	08/15/2003 ¹⁵	7.28	4.35	2.93	0.00	-	<50	<0.5	<0.5	<0.5	<0.5	<0.5
MW-10	11/14/2003 ²⁰	7.28	4.30	2.98	0.00	-	-	-	-	-	-	-
MW-10	02/13/2004 ¹⁵	7.28	4.27	3.01	0.00	-	<50	<0.5	<0.5	<0.5	<0.5	<0.5

TABLE 1

GROUNDWATER MONITORING AND SAMPLING DATA
 FORMER CHEVRON SERVICE STATION 9-1153
 3135 GIBBONS DRIVE
 ALAMEDA, CALIFORNIA

Location	Date	TOC	DTW	GWE	LNAPLT	FIELD PARAMETERS	HYDROCARBONS	PRIMARY VOCS				
						Dissolved Oxygen	TPH-GRO	B	T	E	X	MTBE by SW8260
	Units	ft	ft	ft-amsl	ft	mg/L	µg/L	µg/L	µg/L	µg/L	µg/L	µg/L
MW-10	05/14/2004 ²⁰	7.28	4.08	3.20	0.00	-	-	-	-	-	-	-
MW-10	08/13/2004 ¹⁵	7.28	3.92	3.36	0.00	-	<50	<0.5	<0.5	<0.5	<0.5	<0.5
MW-10	11/12/2004 ²⁰	7.28	3.98	3.30	0.00	-	-	-	-	-	-	-
MW-10	02/11/2005 ¹⁵	7.28	4.07	3.21	0.00	-	<50	<0.5	<0.5	<0.5	<0.5	<0.5
MW-10	05/13/2005 ²⁰	7.28	4.01	3.27	0.00	-	-	-	-	-	-	-
MW-10	08/19/2005 ¹⁵	7.28	3.69	3.59	0.00	-	<50	<0.5	<0.5	<0.5	<0.5	<0.5
MW-10	11/18/2005 ²⁰	7.28	3.86	3.42	0.00	-	-	-	-	-	-	-
MW-10	02/10/2006 ¹⁵	7.28	3.94	3.34	0.00	-	<0.5	<0.5	<0.5	<0.5	<0.5	<0.5
MW-10	05/12/2006 ²⁰	7.28	4.07	3.21	0.00	-	-	-	-	-	-	-
MW-10	08/11/2006 ¹⁵	7.28	4.21	3.07	0.00	-	<50	<0.5	<0.5	<0.5	<0.5	<0.5
MW-10	11/17/2006 ²⁰	7.28	3.83	3.45	0.00	-	-	-	-	-	-	-
MW-10	02/16/2007 ¹⁵	7.28	3.87	3.41	0.00	-	<50	<0.5	<0.5	<0.5	<0.5	<0.5
MW-10	05/17/2007 ²⁰	7.28	3.71	3.57	0.00	-	-	-	-	-	-	-
MW-10	08/09/2007 ²¹	7.28	-	-	-	-	-	-	-	-	-	-
MW-10	11/08/2007 ²¹	7.28	-	-	-	-	-	-	-	-	-	-
MW-10	02/06/2008 ²¹	7.28	-	-	-	-	-	-	-	-	-	-
MW-10	05/07/2008 ²¹	7.28	-	-	-	-	-	-	-	-	-	-
MW-10	09/11/2008 ¹⁵	7.28	4.63	2.65	0.00	-	<50	<0.5	<0.5	<0.5	<0.5	<0.5
MW-10	11/10/2008 ²⁰	7.28	4.28	3.00	0.00	-	-	-	-	-	-	-
MW-10	02/09/2009 ¹⁵	7.28	2.17	5.11	0.00	-	<50	<0.5	<0.5	<0.5	<0.5	<0.5
MW-10	05/28/2009	7.28	3.69	3.59	0.00	-	-	-	-	-	-	-
MW-10	08/18/2009 ¹⁵	7.28	4.07	3.21	0.00	-	<50	<0.5	<0.5	<0.5	<0.5	<0.5
MW-10	11/17/2009	7.28	4.12	3.16	0.00	-	-	-	-	-	-	-

TABLE 1

**GROUNDWATER MONITORING AND SAMPLING DATA
FORMER CHEVRON SERVICE STATION 9-1153
3135 GIBBONS DRIVE
ALAMEDA, CALIFORNIA**

Location	Date	TOC	DTW	GWE	LNAPL	FIELD PARAMETERS	HYDROCARBONS	PRIMARY VOCS				
						Dissolved Oxygen	TPH-GRO	B	T	E	X	MTBE by SW8260
	Units	ft	ft	ft-amsl	ft	mg/L	µg/L	µg/L	µg/L	µg/L	µg/L	µg/L
MW-10	03/31/2010	7.28	3.43	3.85	0.00	-	<50	<0.5	<0.5	<0.5	<0.5	<0.5
MW-10	05/17/2010	7.28	3.53	3.75	0.00	-	-	-	-	-	-	-
MW-10	08/26/2010	7.28	4.33	2.95	0.00	-	<50	<0.5	<0.5	<0.5	<0.5	<0.5
MW-10	11/11/2010 ²⁰	7.28	4.34	2.94	0.00	-	-	-	-	-	-	-
MW-10	03/02/2011 ²⁰	7.28	3.33	3.95	0.00	-	<50	<0.5	<0.5	<0.5	<0.5	<0.5
C-2	09/04/1986	-	-	-	-	-	1,100	49	18	84	-	-
C-2	07/22/1987	-	-	-	-	-	<50	1.8	<1.0	<4.0	-	-
TMW-1	11/11/1993	-	-	-	-	-	<1.0	<0.5	<0.5	<0.5	<0.5	-
3115A GIBBONS DR.	01/14/1998	-	-	-	-	-	<50	<0.5	<0.5	<0.5	<0.5	<2.5
QA	02/14/1990	-	-	-	-	-	<50	<0.5	1.1	<0.5	<0.5	-
QA	09/06/1991	-	-	-	-	-	<50	<0.5	<0.5	<0.5	<0.5	-
QA	12/15/1991	-	-	-	-	-	<50	<0.5	<0.5	<0.5	<0.5	-
QA	03/03/1992	-	-	-	-	-	<50	<0.5	<0.5	<0.5	<0.5	-
QA	06/04/1992	-	-	-	-	-	<50	<0.5	<0.5	<0.5	<0.5	-
QA	10/13/1992	-	-	-	-	-	<50	<0.5	<0.5	<0.5	<0.5	-
QA	01/11/1993	-	-	-	-	-	<50	<0.5	<0.5	<0.5	<0.5	-
QA	04/14/1993	-	-	-	-	-	<50	<0.5	<0.5	<0.5	<0.5	-
QA	07/13/1993	-	-	-	-	-	<50	<0.5	<0.5	<0.5	<0.5	-
QA	10/19/1993	-	-	-	-	-	<50	<0.5	<0.5	<0.5	<1.5	-

TABLE 1

**GROUNDWATER MONITORING AND SAMPLING DATA
FORMER CHEVRON SERVICE STATION 9-1153
3135 GIBBONS DRIVE
ALAMEDA, CALIFORNIA**

Location	Date	TOC	DTW	GWE	LNAPL	FIELD PARAMETERS	HYDROCARBONS	PRIMARY VOCS				
						Dissolved Oxygen	TPH-GRO	B	T	E	X	MTBE by SW8260
	Units	ft	ft	ft-amsl	ft	mg/L	µg/L	µg/L	µg/L	µg/L	µg/L	µg/L
QA	01/27/1994	-	-	-	-	-	<50	<0.5	<0.5	<0.5	<0.5	-
QA	04/07/1994	-	-	-	-	-	<50	<0.5	<0.5	<0.5	<0.5	-
QA	07/01/1994	-	-	-	-	-	<50	<0.5	<0.5	<0.5	<0.5	-
QA	10/05/1994	-	-	-	-	-	<50	<0.5	<0.5	<0.5	<0.5	-
QA	01/12/1995	-	-	-	-	-	<50	<0.5	<0.5	<0.5	<0.5	-
QA	04/26/1995	-	-	-	-	-	<50	<0.5	<0.5	<0.5	<0.5	-
QA	07/12/1995	-	-	-	-	-	<50	<0.5	<0.5	<0.5	<0.5	-
QA	10/30/1995	-	-	-	-	-	<50	<0.5	<0.5	<0.5	<0.5	-
QA	01/22/1996	-	-	-	-	-	<50	<0.5	<0.5	<0.5	<0.5	<2.5
QA	04/24/1996	-	-	-	-	-	<50	<0.5	<0.5	<0.5	<0.5	<2.5
QA	07/29/1996	-	-	-	-	-	<50	<0.5	<0.5	<0.5	<0.5	<2.5
QA	01/15/1997	-	-	-	-	-	<50	<0.5	<0.5	<0.5	<0.5	<2.5
QA	04/03/1997	-	-	-	-	-	<50	<0.5	<0.5	<0.5	<0.5	<2.5
QA	07/09/1997	-	-	-	-	-	<50	<0.5	<0.5	<0.5	<0.5	<2.5
QA	10/29/1997	-	-	-	-	-	<50	<0.5	<0.5	<0.5	<0.5	<2.5
QA	01/14/1998	-	-	-	-	-	<50	<0.5	<0.5	<0.5	<0.5	<2.5
QA	04/17/1998	-	-	-	-	-	<50	<0.5	<0.5	<0.5	<0.5	<2.5
QA	07/15/1998	-	-	-	-	-	<50	<0.5	<0.5	<0.5	<0.5	<2.5
QA	10/27/1998	-	-	-	-	-	<50	<0.5	<0.5	<0.5	<0.5	<2.5
QA	01/20/1999	-	-	-	-	-	<50	<0.5	<0.5	<0.5	<0.5	<2.0
QA	04/19/1999	-	-	-	-	-	<50	<0.5	<0.5	<0.5	<0.5	<2.5
QA	07/29/1999	-	-	-	-	-	<50	<0.5	<0.5	<0.5	<0.5	<5.0
QA	10/13/1999	-	-	-	-	-	<50	<0.5	<0.5	<0.5	<0.5	<2.5

TABLE 1

GROUNDWATER MONITORING AND SAMPLING DATA
 FORMER CHEVRON SERVICE STATION 9-1153
 3135 GIBBONS DRIVE
 ALAMEDA, CALIFORNIA

Location	Date	TOC	DTW	GWE	LNAPL	FIELD PARAMETERS	HYDROCARBONS	PRIMARY VOCS				
						Dissolved Oxygen	TPH-GRO	B	T	E	X	MTBE by SW8260
	Units	ft	ft	ft-amsl	ft	mg/L	µg/L	µg/L	µg/L	µg/L	µg/L	µg/L
QA	01/25/2000	-	-	-	-	-	<50	<0.5	<0.5	<0.5	<0.5	<2.5
QA	04/03/2000	-	-	-	-	-	<50	<0.50	<0.50	<0.50	<0.50	<2.5
QA	07/03/2000	-	-	-	-	-	<50	<0.50	<0.50	<0.50	<0.50	<2.5
QA	10/23/2000	-	-	-	-	-	<50	<0.50	<0.50	<0.50	<0.50	<2.5
QA	01/08/2001 ¹¹	-	-	-	-	-	<50	<0.50	<0.50	<0.50	<0.50	<2.5
QA	04/09/2001	-	-	-	-	-	<50.0	<0.500	<2.00	<0.500	<2.00	<0.500
QA	08/23/2001	-	-	-	-	-	<50	<0.50	<0.50	<0.50	<0.50	<2.5
QA	11/27/2001	-	-	-	-	-	<50	<0.50	<0.50	<0.50	<1.5	<2.5
QA	02/26/2002	-	-	-	-	-	<50	<0.50	<0.50	<0.50	<1.5	<2.5
QA	05/23/2002	-	-	-	-	-	<50	<0.50	<0.50	<0.50	<1.5	<2.5
QA	08/09/2002	-	-	-	-	-	<50	<0.50	<0.50	<0.50	<1.5	<2.5
QA	11/08/2002	-	-	-	-	-	<50	<0.50	<0.50	<0.50	<1.5	<2.5
QA	02/07/2003	-	-	-	-	-	<50	<0.50	<0.50	<0.50	<1.5	<2.5
QA	05/09/2003	-	-	-	-	-	<50	<0.5	<0.5	<0.5	<1.5	<2.5
QA	08/15/2003 ¹⁵	-	-	-	-	-	<50	<0.5	<0.5	<0.5	<0.5	<0.5
QA	11/14/2003	-	-	-	-	-	<50	<0.5	<0.5	<0.5	<0.5	<0.5
QA	02/13/2004 ¹⁵	-	-	-	-	-	<50	<0.5	<0.5	<0.5	<0.5	<0.5
QA	05/14/2004 ¹⁵	-	-	-	-	-	<50	<0.5	<0.5	<0.5	<0.5	<0.5
QA	08/13/2004 ¹⁵	-	-	-	-	-	<50	<0.5	<0.5	<0.5	<0.5	<0.5
QA	11/12/2004 ¹⁵	-	-	-	-	-	<50	<0.5	<0.5	<0.5	<0.5	<0.5
QA	02/11/2005 ¹⁵	-	-	-	-	-	<50	<0.5	<0.5	<0.5	<0.5	<0.5
QA	05/13/2005 ¹⁵	-	-	-	-	-	<50	<0.5	<0.5	<0.5	<0.5	<0.5
QA	08/19/2005 ¹⁵	-	-	-	-	-	<50	<0.5	<0.5	<0.5	<0.5	<0.5

**GROUNDWATER MONITORING AND SAMPLING DATA
FORMER CHEVRON SERVICE STATION 9-1153
3135 GIBBONS DRIVE
ALAMEDA, CALIFORNIA**

Location	Date	TOC	DTW	GWE	LNAPL	FIELD PARAMETERS	HYDROCARBONS	PRIMARY VOCS				
						Dissolved Oxygen	TPH-GRO	B	T	E	X	MTBE by SW8260
	Units	ft	ft	ft-amsl	ft	mg/L	µg/L	µg/L	µg/L	µg/L	µg/L	µg/L
QA	11/18/2005 ¹⁵	-	-	-	-	-	<50	<0.5	<0.5	<0.5	<0.5	<0.5
QA	02/10/2006 ¹⁵	-	-	-	-	-	<50	<0.5	<0.5	<0.5	<0.5	<0.5
QA	05/12/2006 ¹⁵	-	-	-	-	-	<50	<0.5	<0.5	<0.5	<0.5	<0.5
QA	08/11/2006 ¹⁵	-	-	-	-	-	<50	<0.5	<0.5	<0.5	<0.5	<0.5
QA	11/17/2006 ¹⁵	-	-	-	-	-	<50	<0.5	<0.5	<0.5	<0.5	<0.5
QA	02/16/2007 ¹⁵	-	-	-	-	-	<50	<0.5	<0.5	<0.5	<0.5	<0.5
QA	05/17/2007 ¹⁵	-	-	-	-	-	<50	<0.5	<0.5	<0.5	<0.5	<0.5
QA	08/09/2007 ¹⁵	-	-	-	-	-	<50	<0.5	<0.5	<0.5	<0.5	<0.5
QA	11/08/2007 ¹⁵	-	-	-	-	-	<50	<0.5	<0.5	<0.5	<0.5	<0.5
QA	02/06/2008 ¹⁵	-	-	-	-	-	<50	<0.5	<0.5	<0.5	<0.5	<0.5
QA	05/07/2008 ¹⁵	-	-	-	-	-	<50	<0.5	<0.5	<0.5	<0.5	<0.5
QA	09/11/2008 ¹⁵	-	-	-	-	-	<50	<0.5	<0.5	<0.5	<0.5	<0.5
QA	11/10/2008 ¹⁵	-	-	-	-	-	<50	<0.5	<0.5	<0.5	<0.5	<0.5
QA	02/09/2009 ¹⁵	-	-	-	-	-	<50	<0.5	<0.5	<0.5	<0.5	<0.5
QA	05/28/2009 ¹⁵	-	-	-	-	-	<50	<0.5	<0.5	<0.5	<0.5	<0.5
QA	08/18/2009 ¹⁵	-	-	-	-	-	<50	<0.5	<0.5	<0.5	<0.5	<0.5
QA	03/31/2010	-	-	-	-	-	<50	<0.5	<0.5	<0.5	<0.5	<0.5
QA	08/26/2010	-	-	-	-	-	<50	<0.5	<0.5	<0.5	<0.5	<0.5
QA	03/02/2011	-	-	-	-	-	<50	<0.5	<0.5	<0.5	<0.5	<0.5

Abbreviations and Notes:

TOC = Top of Casing

DTW = Depth to Water

**GROUNDWATER MONITORING AND SAMPLING DATA
FORMER CHEVRON SERVICE STATION 9-1153
3135 GIBBONS DRIVE
ALAMEDA, CALIFORNIA**

Location	Date	TOC	DTW	GWE	LNAPLT	FIELD PARAMETERS	HYDROCARBONS	PRIMARY VOCS				
						Dissolved Oxygen	TPH-GRO	B	T	E	X	MTBE by SW8260
Units		ft	ft	ft-amsl	ft	mg/L	µg/L	µg/L	µg/L	µg/L	µg/L	µg/L

GWE = Groundwater elevation

(ft-amsl) = Feet Above Mean sea level

ft = Feet

mg/L - Milligrams per Liter

µg/L = Micrograms per Liter

TPH-GRO = Total Petroleum Hydrocarbons - Gasoline Range Organics

VOCS = Volatile Organic Compounds

B = Benzene

T = Toluene

E = Ethylbenzene

X = Xylene

MTBE = Methyl tert butyl ether

J = Estimated concentration

-- = Not available / not applicable

<x = Not detected above laboratory method detection limit

** GWE has been corrected due to the presence of LNAPL; correction factor: [(TOC - DTW) + (LNAPLT x 0.80)].

1 Laboratory report indicates EPA 8010 were not detected (ND)

2 MTBE confirmed

3 Chromatogram report indicates an unidentified hydrocarbon

4 ORC installed

5 TOC elevation altered due to well head maintenance

6 Laboratory report indicates gasoline C6-C12

7 ORC in well

**GROUNDWATER MONITORING AND SAMPLING DATA
FORMER CHEVRON SERVICE STATION 9-1153
3135 GIBBONS DRIVE
ALAMEDA, CALIFORNIA**

Location	Date	TOC	DTW	GWE	LNAPL	FIELD PARAMETERS	HYDROCARBONS	PRIMARY VOCS				
						Dissolved Oxygen	TPH-GRO	B	T	E	X	MTBE by SW8260
Units		ft	ft	ft-amsl	ft	mg/L	µg/L	µg/L	µg/L	µg/L	µg/L	µg/L

- 8 Laboratory report indicates Dissolved Oxygen was 1.50 parts per million (ppm) by EPA Method 360.1
- 9 Laboratory report indicates Dissolved Oxygen was 0.300 ppm by EPA Method 360.1
- 10 Laboratory report indicates sample originally shot in hold time at a raise D.L. re-analyzed and reported past hold time
- 11 Laboratory report indicates this sample was analyzed outside of the EPA recommended holding time
- 12 Laboratory report indicates unidentified hydrocarbons C6-C12
- 13 Laboratory report indicates hydrocarbon pattern is present in the requested fuel quantitation range but does not resemble the pattern of the requested fuel
- 14 ORC removed
- 15 BTEX and MTBE by EPA Method 8260
- 16 Laboratory confirmed analytical result
- 17 The vial submitted did not have pH<2. The pH of this sample used for the undiluted analysis was pH = 3
- 18 Not sampled due to the presence of LNAPL in the well.
- 19 Sampled annually.
- 20 Sampled semi-annually
- 21 Inaccessible

ATTACHMENT A

MONITORING DATA PACKAGE



March 8, 2011

Chevron Environmental Management Company
Dave Patten
6111 Bollinger Canyon Rd.
San Ramon, CA 94583

First Quarter 2011 Monitoring at
Chevron Service Station 91153
3135 Gibbons Dr.
Alameda, CA

Monitoring performed on March 2, 2011

Blaine Tech Services, Inc. Groundwater Monitoring Event 110302-FS1

This submission covers the routine monitoring of groundwater wells conducted on March 2, 2011 at this location. Nine monitoring wells were measured for depth to groundwater (DTW). Eight monitoring wells were sampled. Well C-1 was not sampled due to presence of SPH. SPH was bailed from the well and placed into a drum that was removed by IWM the same day. An SPH absorbent sock was installed in well after the SPH was bailed. All sampling activities were performed in accordance with local, state and federal guidelines.

Water levels measurements were collected using an electronic slope indicator. All sampled wells were purged of three case volumes, depending on well recovery, or until water temperature, pH and conductivity stabilized. Purging was accomplished using electric submersible pumps, positive air-displacement pumps or stainless steel, Teflon or disposable bailers. Subsequent sample collection and sample handling was performed in accordance with EPA protocols using disposable bailers. Alternately, where applicable, wells were sampled utilizing no-purge methodology. All reused equipment was decontaminated in an integrated stainless steel sink with de-ionized water supplied Hotsy pressure washer and Liquinox or equivalent.

First Quarter Groundwater Monitoring at Chevron 91153, 3135 Gibbons Dr., Alameda, CA

SAN JOSE

SACRAMENTO

LOS ANGELES

SAN DIEGO

1680 ROGERS AVENUE

SAN JOSE, CA 95112-1105

(408) 573-0555

FAX (408) 573-7771

LIC: 746684

www.blainetech.com

Samples were delivered under chain-of-custody to Lancaster Laboratories of Lancaster, Pennsylvania, for analysis. Monitoring well purgewater and equipment rinsate water was collected and transported under bill-of-lading to IWM facilities of San Jose, California.

Enclosed documentation from this event includes copies of the Well Gauging Sheet, Well Monitoring Data Sheets, and Chain-of-Custody.

Blaine Tech Services, Inc.'s activities at this site consisted of objective data and sample collection only. No interpretation of analytical results, defining of hydrogeologic conditions or formulation of recommendations was performed.

Please call if you have any questions.

Sincerely,



Dustin Becker
Blaine Tech Services, Inc.
Senior Project Manager

attachments: SOP
Well Gauging Sheet
Individual Well Monitoring Data Sheets
Chain of Custody
Wellhead Inspection Form
Bill of Lading
Calibration Log

cc: CRA
Attn: Nathan Lee
5900 Hollis St. Suite A
Emeryville, CA 94608

First Quarter Groundwater Monitoring at Chevron 91153, 3135 Gibbons Dr., Alameda, CA

SAN JOSE

SACRAMENTO

LOS ANGELES

SAN DIEGO

1680 ROGERS AVENUE

SAN JOSE, CA 95112-1105

(408) 573-0555

FAX (408) 573-7771

LIC: 746684

www.blainetech.com

BLAINE TECH SERVICES, INC. METHODS AND PROCEDURES FOR THE ROUTINE MONITORING OF GROUNDWATER WELLS AT CHEVRON SITES

Blaine Tech Services, Inc. performs environmental sampling and documentation as an independent third party. We specialize in groundwater monitoring assignments and intentionally limit the scope of our services to those centered on the generation of objective information.

To avoid conflicts of interest, Blaine Tech Services, Inc. personnel do not evaluate or interpret the information we collect. As a state licensed contractor (C-57 well drilling –water – 746684) performing strictly technical services, we do not make any professional recommendations and perform no consulting of any kind.

SAMPLING PROCEDURES OVERVIEW

SAFETY

All groundwater monitoring assignments performed for Chevron comply with Chevron's safety guidelines, 29 CFR 1910.120 and SB-198 Injury and Illness Prevention Program (IIPP). All Field Technicians receive the full 40-hour 29CFR 1910.120 OSHA SARA HAZWOPER course, medical clearance and on-the-job training prior to commencing any work on any Chevron site.

INSPECTION AND GAUGING

Wells are inspected prior to evacuation and sampling. The condition of the wellhead is checked and noted according to a wellhead inspection checklist.

Standard measurements include the depth to water (DTW) and the total well depth (TD) obtained with industry standard electronic water level indicators that are graduated in increments of hundredths of a foot.

The water in each well is inspected for the presence of immiscibles. When free product is suspected, its presence is confirmed using an electronic interface probe (e.g. GeoTech). No samples are collected from a well containing over two-hundredths of a foot (0.02') of product.

EVACUATION

Depth to water measurements are collected by our personnel prior to purging and minimum purge volumes are calculated anew for each well based on the height of the water column and the diameter of the well. Expected purge volumes are never less than three case volumes and are set at no less than four case volumes in some jurisdictions.

Well purging devices are selected on the basis of the well diameter and the total volume to be

evacuated. In most cases the well will be purged using an electric submersible pump (i.e. Grundfos) suspended near (but not touching) the bottom of the well.

PARAMETER STABILIZATION

Well purging completion standards include minimum purge volumes, but additionally require stabilization of specific groundwater parameters prior to sample collection. Typical groundwater parameters used to measure stability are electrical conductivity, pH, and temperature. Instrument readings are obtained at regular intervals during the evacuation process (no less than once per case volume).

Stabilization standards for routine quarterly monitoring of fuel sites include the following: Temperature is considered to have stabilized when successive readings do not fluctuate more than +/- 1 degree Celsius. Electrical conductivity is considered stable when successive readings are within 10%. pH is considered to be stable when successive readings remain constant or vary no more than 0.2 of a pH unit.

DEWATERED WELLS

Normal evacuation removes no less than three case volumes of water from the well. However, less water may be removed in cases where the well dewateres and does not immediately recharge.

MEASURING RECHARGE

Upon completion of well purging, a depth to water measurement is collected and notated to ensure that the well has recharged to within 80% of its static, pre-purge level prior to sampling.

Wells that do not immediately show 80% recharge or dewatered wells will be allowed approximately 2 hours to recharge prior to sampling or will be sampled at site departure. All wells requiring off-site traffic control in the public right-of-way, the 80% recharge rule may be disregarded in the interests of Health and Safety. The sample may be collected as soon as there is sufficient water. The water level at time of sampling will be noted.

PURGEWATER CONTAINMENT

All non-hazardous purgewater evacuated from each groundwater monitoring well is captured and contained in on-board storage tanks on the Sampling Vehicle and/or special water hauling trailers. Effluent from the decontamination of reusable apparatus (sounders, electric pumps and hoses etc.), consisting of groundwater combined with deionized water and non-phosphate soap, is also captured and pumped into effluent tanks.

Non-hazardous purgewater is transported under standard Bill of Lading documentation to a Blaine Tech Services, Inc. facility before being transported to a Chevron approved disposal facility.

SAMPLE COLLECTION DEVICES

All samples are collected using disposable bailers.

SAMPLE CONTAINERS

Sample material is decanted directly from the sampling bailer into sample containers provided by the laboratory that will analyze the samples. The transfer of sample material from the bailer to the sample container conforms to specifications contained in the USEPA T.E.G.D. The type of sample container, material of construction, method of closure and filling requirements are specific to the intended analysis. Chemicals needed to preserve the sample material are commonly placed inside the sample containers by the laboratory or glassware vendor prior to delivery of the bottle to our personnel. The laboratory sets the number of replicate containers.

TRIP BLANKS

Trip Blanks, if requested, are taken to the site and kept inside the sample cooler for the duration of the event. They are turned over to the laboratory for analysis with the samples from that site.

DUPLICATES

Duplicates, if requested, may be collected at a site. The Duplicate sample is collected, typically from the well containing the most measurable contaminants. The Duplicate sample is labeled the same as the original.

SAMPLE STORAGE

All sample containers are promptly placed in food grade ice chests for storage in the field and transport (direct or via our facility) to the designated analytical laboratory. These ice chests contain quantities of restaurant grade ice as a refrigerant material. The samples are maintained in either an ice chest or a refrigerator until relinquished into the custody of the laboratory or laboratory courier.

DOCUMENTATION CONVENTIONS

A label must be affixed to all sample containers. In most cases these labels are generated by our office personnel and are partially preprinted. Labels can also be hand written by our field personnel. The site is identified with the store number and site address, as is the particular groundwater well from which the sample is drawn (e.g. MW-1, MW-2, S-1 etc.). The time and date of sample collection along with the initials of the person who collects the sample are handwritten onto the label.

Chain of Custody records are created using client specific preprinted forms following USEPA specifications.

Bill of Lading records are contemporaneous records created in the field at the site where the non-hazardous purgewater is generated. Field Technicians use preprinted Bill of Lading forms.

DECONTAMINATION

All equipment is brought to the site in clean and serviceable condition and is cleaned after use in each well and before subsequent use in any other well. Equipment is decontaminated before leaving the site.

The primary decontamination device is a commercial steam cleaner. The steam cleaner is de-tuned to function as a hot pressure washer that is then operated with high quality deionized water that is produced at our facility and stored onboard our sampling vehicle. Cleaning is facilitated by the use of proprietary fixtures and devices included in the patented workstation (U.S. Patent 5,535,775) that is incorporated in each sampling vehicle. The steam cleaner is used to decon reels, pumps and bailers.

Any sensitive equipment or parts (i.e. Dissolved Oxygen sensor membrane, water level indicator, etc.) that cannot be washed using the high pressure water, will be sprayed with a non-phosphate soap and deionized water solution and rinsed with deionized water.

DISSOLVED OXYGEN READINGS

Dissolved Oxygen readings are taken pre- and/or post-purge using YSI meters (e.g. YSI Model 550) or HACH field test kits.

The YSI meters are able to collect accurate in-situ readings. The probe allows downhole measurements to be taken from wells with diameters as small as two inches. The probe and reel is decontaminated between wells as described above. The meter is calibrated between wells as per the instructions in the operating manual. The probe is lowered into the water column and the reading is allowed to stabilize prior to collection.

OXYIDATON REDUCTION POTENTIAL READINGS

All readings are obtained with either Corning or Myron-L meters (e.g. Corning ORP-65 or a Myron-L Ultrameter GP). The meter is cleaned between wells as described above. The meter is calibrated at the start of each day according to the instruction manual.

FERROUS IRON MEASUREMENTS

All field measurements are collected at time of sampling with a HACH test kit.

WELL GAUGING DATA

Project # 110302-FS1 Date 3-2-11 Client CHEVRON

Site 3135 GIBBONS DR. ALAMEDA, CA

Well ID	Time	Well Size (in.)	Sheen / Odor	Depth to Immiscible Liquid (ft.)	Thickness of Immiscible Liquid (ft.)	Volume of Immiscibles Removed (ml)	Depth to water (ft.)	Depth to well bottom (ft.)	Survey Point: TOB or TOC	Notes	
C-1	803	3	ODOR	1.08	0.04	60	112	—	TOC		
C-3	810	3					1.45	18.32	↓		
MW-4	820	2					0.75	12.86			
MW-5	803	2					1.55	12.75			
MW-6	824	2					2.27	13.43			
MW-7	825	2	ODOR				2.53	5.98			
MW-8	828	2					1.66	9.20			
MW-9	820	2					2.75	8.60			
MW-10	950	2					3.33	8.95			

CHEVRON WELL MONITORING DATA SHEET

Project #: 110302-FS1	Station #: 9-1153
Sampler: PH	Date: 3-2-11
Weather: overcast	Ambient Air Temperature: 55°F
Well I.D.: C-1	Well Diameter: 2 3 4 6 8 <u> </u>
Total Well Depth: <u> </u>	Depth to Water: 1.12
Depth to Free Product: 1.08	Thickness of Free Product (feet): 0.04
Referenced to: PVC Grade	D.O. Meter (if req'd): YSI HACH
DTW with 80% Recharge [(Height of Water Column x 0.20) + DTW]:	

Purge Method:

Bailer
 Disposable Bailer
 Positive Air Displacement
 Electric Submersible
 Waterra
 Peristaltic
 Extraction Pump
 Other _____

Sampling Method:

Bailer
 Disposable Bailer
 Extraction Port
 Dedicated Tubing
 Other: _____

/ (Gals.) X	3	= / Gals.
1 Case Volume	Specified Volumes	Calculated Volume

Well Diameter	Multiplier	Well Diameter	Multiplier
1"	0.04	4"	0.65
2"	0.16	6"	1.47
3"	0.37	Other	radius ² * 0.163

Time	Temp (°F)	pH	Cond. (mS or µS)	Turbidity (NTUs)	Gals. Removed	Observations
						0.04 ft. of SPH detected w/ water force probe
						60 ml of SPH removed w/ disposable bailer
						— DEPLOYED SPH SOCK, DRY WEIGHT 0.24 lbs (0.5oz.) PLACED HALFWAY SUBMERGED.
						No SAMPLE TAKEN

Did well dewater? Yes No Gallons actually evacuated: _____

Sampling Date: **3-2-11** Sampling Time: _____ Depth to Water: _____

Sample I.D.: _____ Laboratory: **Lancaster** Other _____

Analyzed for: **TPH-G** **BTEX** **MTBE** OXYS Other: _____

Duplicate I.D.: _____ Analyzed for: TPH-G BTEX MTBE OXYS Other: _____

D.O. (if req'd): Pre-purge: _____ mg/L Post-purge: _____ mg/L

O.R.P. (if req'd): Pre-purge: _____ mV Post-purge: _____ mV

CHEVRON WELL MONITORING DATA SHEET

Project #: 110302-FS1	Station #: 9-1153
Sampler: R	Date: 3-2-11
Weather: DRIZZLE	Ambient Air Temperature: 58°F
Well I.D.: C-3	Well Diameter: (2) 3 4 6 8
Total Well Depth: 18.32	Depth to Water: 1.45
Depth to Free Product:	Thickness of Free Product (feet):
Referenced to: PVC Grade	D.O. Meter (if req'd): YSI HACH
DTW with 80% Recharge [(Height of Water Column x 0.20) + DTW]: 4.82	

Purge Method: Bailer Waterra Disposable Bailer
 Disposable Bailer Peristaltic Extraction Port
Positive Air Displacement Extraction Pump Dedicated Tubing
 Electric Submersible Other _____ Other: _____

6.3	(Gals.) X	3	=	18.9	Gals.
1 Case Volume		Specified Volumes		Calculated Volume	

Well Diameter	Multiplier	Well Diameter	Multiplier
1"	0.04	4"	0.65
2"	0.16	6"	1.47
3"	0.37	Other	radius ² * 0.163

Time	Temp (°F)	pH	Cond. (mS or µS)	Turbidity (NTUs)	Gals. Removed	Observations
855	55.3	6.84	827	204	6.3	
8902	55.2	7.22	688	205	12.6	
910	55.6	7.28	695	123	18.9	

Did well dewater? Yes No Gallons actually evacuated: 18.9

Sampling Date: 3-2-11 Sampling Time: 920 Depth to Water: 3.50

Sample I.D.: C-3 Laboratory: Lancaster Other _____

Analyzed for: TPH-G BTEX MTBE OXYS Other:

Duplicate I.D.: Analyzed for: TPH-G BTEX MTBE OXYS Other:

D.O. (if req'd): Pre-purge: _____ mg/L Post-purge: _____ mg/L

O.R.P. (if req'd): Pre-purge: _____ mV Post-purge: _____ mV

CHEVRON WELL MONITORING DATA SHEET

Project #: 110302-FS1	Station #: 9-1153
Sampler: PH	Date: 3-2-11
Weather: overcast	Ambient Air Temperature: 55°F
Well I.D.: MW-4	Well Diameter: <input checked="" type="radio"/> 3 <input type="radio"/> 4 <input type="radio"/> 6 <input type="radio"/> 8 <input type="checkbox"/> _____
Total Well Depth: 12.86	Depth to Water: 0.75
Depth to Free Product:	Thickness of Free Product (feet):
Referenced to: <input checked="" type="radio"/> PVC <input type="radio"/> Grade	D.O. Meter (if req'd): <input type="checkbox"/> YSI <input type="checkbox"/> HACH
DTW with 80% Recharge [(Height of Water Column x 0.20) + DTW]: 3.17	

Purge Method:

- Bailer
 Disposable Bailer
 Positive Air Displacement
 Electric Submersible
 Waterra
 Peristaltic
 Extraction Pump
 Other _____

Sampling Method:

Bailer

- Disposable Bailer
 Extraction Port
 Dedicated Tubing
 Other: _____

1.9 (Gals.) X	3 Specified Volumes	=	5.8 Gals. Calculated Volume
----------------------	----------------------------	----------	------------------------------------

Well Diameter	Multiplier	Well Diameter	Multiplier
1"	0.04	4"	0.65
2"	0.16	6"	1.47
3"	0.37	Other	radius ² * 0.163

Time	Temp (°F)	pH	Cond. (mS or μ S)	Turbidity (NTUs)	Gals. Removed	Observations
1055	57.7	6.8	974	>1000	2.0	
1058	58.3	6.8	981	>1000	4.0	
1101	58.4	6.8	988	>1000	6.0	

Did well dewater? Yes No Gallons actually evacuated: **6**

Sampling Date: **3-2-11** Sampling Time: **1105** Depth to Water: **1.56**

Sample I.D.: **MW-4** Laboratory: Lancaster Other _____

Analyzed for: TPH-G BTEX MTBE OXYS Other: _____

Duplicate I.D.: _____ Analyzed for: TPH-G BTEX MTBE OXYS Other: _____

D.O. (if req'd):	Pre-purge:	mg/L	Post-purge:	mg/L
O.R.P. (if req'd):	Pre-purge:	mV	Post-purge:	mV

CHEVRON WELL MONITORING DATA SHEET

Project #: 110302-FS1	Station #: 9-1153
Sampler: FH	Date: 3-2-11
Weather: overcast	Ambient Air Temperature: 55°F
Well I.D.: MW-5	Well Diameter: 3 3 4 6 8 _____
Total Well Depth: 12.75	Depth to Water: 1.55
Depth to Free Product:	Thickness of Free Product (feet):
Referenced to: PVC Grade	D.O. Meter (if req'd): YSI HACH
DTW with 80% Recharge [(Height of Water Column x 0.20) + DTW]: 3.79	

Purge Method:

- Bailer
- Disposable** Bailer
- Positive Air Displacement
- Electric Submersible
- Waterra
- Peristaltic
- Extraction Pump
- Other _____

Sampling Method:

Bailer

- Disposable** Bailer
- Extraction Port
- Dedicated Tubing
- Other: _____

1.8	(Gals.) X	3	=	5.3	Gals.
1 Case Volume		Specified Volumes		Calculated Volume	

Well Diameter	Multiplier	Well Diameter	Multiplier
1"	0.04	4"	0.65
2"	0.16	6"	1.47
3"	0.37	Other	radius ² * 0.163

Time	Temp (°F)	pH	Cond. (mS or μ S)	Turbidity (NTUs)	Gals. Removed	Observations
0923	58.2	6.4	528	>1000	2.0	
0926	58.1	6.4	506	>1000	3.7	
0930	58.1	6.5	511	>1000	5.5	

Did well dewater? Yes **No** Gallons actually evacuated: **5.5**

Sampling Date: **3-2-11** Sampling Time: **0935** Depth to Water: **1.55**

Sample I.D.: **MW-5** Laboratory: **Lancaster** Other _____

Analyzed for: **TPH-G** **BTEX** **MTBE** OXYS Other:

Duplicate I.D.: Analyzed for: TPH-G BTEX MTBE OXYS Other:

D.O. (if req'd): Pre-purge: _____ mg/L Post-purge: _____ mg/L

O.R.P. (if req'd): Pre-purge: _____ mV Post-purge: _____ mV

CHEVRON WELL MONITORING DATA SHEET

Project #: 110302-FS1	Station #: 9-1153
Sampler: PH	Date: 3-2-11
Weather: overcast	Ambient Air Temperature: 55°F
Well I.D.: MW-6	Well Diameter: ② 3 4 6 8 _____
Total Well Depth: 13.43	Depth to Water: 2.27
Depth to Free Product:	Thickness of Free Product (feet):
Referenced to: PVC Grade	D.O. Meter (if req'd): YSI HACH
DTW with 80% Recharge [(Height of Water Column x 0.20) + DTW]: 4.50	

Purge Method: Bailer Waterra **Disposable Bailer**
 Disposable Bailer Peristaltic Extraction Port
 Positive Air Displacement Extraction Pump Dedicated Tubing
 Electric Submersible Other _____ Other: _____

1.8	(Gals.) X	3	=	5.3	Gals.
1 Case Volume		Specified Volumes		Calculated Volume	

Well Diameter	Multiplier	Well Diameter	Multiplier
1"	0.04	4"	0.65
2"	0.16	6"	1.47
3"	0.37	Other	radius ² * 0.163

Time	Temp (°F)	pH	Cond. (mS or μ S)	Turbidity (NTUs)	Gals. Removed	Observations
0950	57.7	6.8	635	>1000	2.0	
0953	58.4	6.9	671	>1000	3.7	
0956	58.6	6.9	704	>1000	5.5	

Did well dewater? Yes **No** Gallons actually evacuated: **5.5**

Sampling Date: **3-2-11** Sampling Time: **1000** Depth to Water: **2.27**

Sample I.D.: **MW-6** Laboratory: **Lancaster** Other _____

Analyzed for: **TPH-G** **BTEX** **MTBE** OXYS Other:

Duplicate I.D.: Analyzed for: TPH-G BTEX MTBE OXYS Other:

D.O. (if req'd):	Pre-purge: 0.65 mg/L	Post-purge: _____ mg/L
O.R.P. (if req'd):	Pre-purge: _____ mV	Post-purge: _____ mV

CHEVRON WELL MONITORING DATA SHEET

Project #: 110302-FS1	Station #: 9-1153
Sampler: K	Date: 3-2-11
Weather: OVERCAST	Ambient Air Temperature: 60°F
Well I.D.: MW-7	Well Diameter: ② 3 4 6 8 _____
Total Well Depth: 5.98	Depth to Water: 2.53
Depth to Free Product:	Thickness of Free Product (feet):
Referenced to: PVC Grade	D.O. Meter (if req'd): YSI HACH
DTW with 80% Recharge [(Height of Water Column x 0.20) + DTW]: 3.22	

Purge Method:

- Bailer
 Disposable Bailer
 Positive Air Displacement
 Electric Submersible
- Waterra
 Peristaltic
 Extraction Pump
 Other _____

Sampling Method:

- Bailer
 Disposable Bailer
 Extraction Port
 Dedicated Tubing
 Other: _____

0.6	(Gals.) X	3	=	1.8	Gals.
1 Case Volume		Specified Volumes		Calculated Volume	

Well Diameter	Multiplier	Well Diameter	Multiplier
1"	0.04	4"	0.65
2"	0.16	6"	1.47
3"	0.37	Other	radius ² * 0.163

Time	Temp (°F)	pH	Cond. (mS or μ S)	Turbidity (NTUs)	Gals. Removed	Observations
1106	57.7	7.1	1040	71000	0.6	
1108	57.8	6.9	1022	71000	1.2	
1110	57.7	6.8	1050	71000	1.8	

Did well dewater? Yes **No** Gallons actually evacuated: **1.8**

Sampling Date: **3-2-11** Sampling Time: **11/5** Depth to Water: **4.29** (SITE DEPART)

Sample I.D.: **MW-7** Laboratory: **Lancaster** Other _____

Analyzed for: **TPH-G** **BTEX** **MTBE** OXYS Other:

Duplicate I.D.: Analyzed for: TPH-G BTEX MTBE OXYS Other:

D.O. (if req'd):	Pre-purge:	0.64 mg/L	Post-purge:	
O.R.P. (if req'd):	Pre-purge:	mV	Post-purge:	mV

CHEVRON WELL MONITORING DATA SHEET

Project #: <u>110302-FS1</u>	Station #: <u>9-1153</u>
Sampler: <u>PH</u>	Date: <u>3-2-11</u>
Weather: <u>overcast</u>	Ambient Air Temperature: <u>60°F</u>
Well I.D.: <u>NW-8</u>	Well Diameter: <input checked="" type="radio"/> 2 <input type="radio"/> 3 <input type="radio"/> 4 <input type="radio"/> 6 <input type="radio"/> 8 <input type="checkbox"/> _____
Total Well Depth: <u>9.20</u>	Depth to Water: <u>1.66</u>
Depth to Free Product:	Thickness of Free Product (feet):
Referenced to: <input checked="" type="radio"/> PVC <input type="radio"/> Grade	D.O. Meter (if req'd): YSI HACH
DTW with 80% Recharge [(Height of Water Column x 0.20) + DTW]: <u>3.16</u>	

Purge Method:

- Bailer
 Disposable Bailer
 Positive Air Displacement
 Electric Submersible
- Waterra
 Peristaltic
 Extraction Pump
 Other _____

Sampling Method:

- Bailer
 Disposable Bailer
 Extraction Port
 Dedicated Tubing

Other: _____

<u>1.2</u>	(Gals.) X	<u>3</u>	=	<u>3.6</u>	Gals.
1 Case Volume		Specified Volumes		Calculated Volume	

Well Diameter	Multiplier	Well Diameter	Multiplier
1"	0.04	4"	0.65
2"	0.16	6"	1.47
3"	0.37	Other	radius ² * 0.163

Time	Temp (°F)	pH	Cond. (mS or μ S)	Turbidity (NTUs)	Gals. Removed	Observations
<u>1028</u>	<u>57.0</u>	<u>7.5</u>	<u>246</u>	<u>>1000</u>	<u>1.2</u>	
<u>1030</u>	<u>57.4</u>	<u>7.5</u>	<u>238</u>	<u>>1000</u>	<u>2.5</u>	
<u>1033</u>	<u>57.3</u>	<u>7.4</u>	<u>237</u>	<u>>1000</u>	<u>3.7</u>	

Did well dewater? Yes No Gallons actually evacuated: 3.7

Sampling Date: 3-2-11 Sampling Time: 1030 Depth to Water: 1.72

Sample I.D.: NW-8 Laboratory: Lancaster Other _____

Analyzed for: TPH-G BTEX MTBE OXYS Other:

Duplicate I.D.: Analyzed for: TPH-G BTEX MTBE OXYS Other:

D.O. (if req'd):	Pre-purge:	mg/L	Post-purge:	mg/L
	Pre-purge:	mV	Post-purge:	mV

CHEVRON WELL MONITORING DATA SHEET

Project #: 110302-FS1	Station #: 9-1153
Sampler: PH	Date: 3-2-11
Weather: overcast	Ambient Air Temperature: 55°F
Well I.D.: MW-9	Well Diameter: 2 3 4 6 8 _____
Total Well Depth: 8.60	Depth to Water: 2.75
Depth to Free Product:	Thickness of Free Product (feet):
Referenced to: PVC Grade	D.O. Meter (if req'd): YSI HACH
DTW with 80% Recharge [(Height of Water Column x 0.20) + DTW]: 3.92	

Purge Method:

- Bailer
 Disposable Bailer
 Positive Air Displacement
 Electric Submersible
 Waterra
 Peristaltic
 Extraction Pump
 Other _____

Sampling Method:

- Bailer
 Disposable Bailer
 Extraction Port
 Dedicated Tubing
 Other: _____

0.9	(Gals.) X	3	=	2.8	Gals.
1 Case Volume		Specified Volumes		Calculated Volume	

Well Diameter	Multiplier	Well Diameter	Multiplier
1"	0.04	4"	0.65
2"	0.16	6"	1.47
3"	0.37	Other	radius ² * 0.163

Time	Temp (°F)	pH	Cond. (mS or μ S)	Turbidity (NTUs)	Gals. Removed	Observations
1010	57.0	7.1	816	>1000	1.0	
1012	57.8	7.0	847	>1000	2.0	
1014	58.2	7.0	804	>1000	3.0	
						waited for recharge

Did well dewater? Yes **No** Gallons actually evacuated: **3**

Sampling Date: **3-2-11** Sampling Time: **1020** Depth to Water: **3.43**

Sample I.D.: **MW-9** Laboratory: **Lancaster** Other _____

Analyzed for: **TPH-G** **BTEX** **MTBE** OXYS Other:

Duplicate I.D.: Analyzed for: TPH-G BTEX MTBE OXYS Other:

D.O. (if req'd):	Pre-purge:	mg/L	Post-purge:	mg/L
------------------	------------	------	-------------	------

O.R.P. (if req'd):	Pre-purge:	mV	Post-purge:	mV
--------------------	------------	----	-------------	----

CHEVRON WELL MONITORING DATA SHEET

Project #: 110302-FS1	Station #: 9-1153
Sampler: F	Date: 3-2-11
Weather: CLOUDY	Ambient Air Temperature: 60°F
Well I.D.: MW-10	Well Diameter: 2 3 4 6 8 _____
Total Well Depth: 895	Depth to Water: 3.33
Depth to Free Product:	Thickness of Free Product (feet):
Referenced to: <u>PVC</u> Grade	D.O. Meter (if req'd): YSI HACH
DTW with 80% Recharge [(Height of Water Column x 0.20) + DTW]: 4.45	

Purge Method:

- Bailer
 Disposable Bailer
 Positive Air Displacement
 Electric Submersible
- Waterra
 Peristaltic
 Extraction Pump
 Other _____

Sampling Method:

- Bailer
 Disposable Bailer
 Extraction Port
 Dedicated Tubing
 Other: _____

0.9	(Gals.) X	3	=	2.7	Gals.
1 Case Volume		Specified Volumes		Calculated Volume	

Well Diameter	Multiplier	Well Diameter	Multiplier
1"	0.04	4"	0.65
2"	0.16	6"	1.47
3"	0.37	Other	radius ² * 0.163

Time	Temp (°F)	pH	Cond. (mS or μ S)	Turbidity (NTUs)	Gals. Removed	Observations
1012	57.7	7.3	2550	128	0.9	
1015	58.3	7.2	2584	284	1.8	
1018	58.4	7.1	2624	71000	2.7	

Did well dewater? Yes No Gallons actually evacuated: 2.7

Sampling Date: 3-2-11 Sampling Time: 1030 Depth to Water: 4.40

Sample I.D.: MW-10 Laboratory: Lancaster Other _____

Analyzed for: TPH-G BTEX MTBE OXYS Other:

Duplicate I.D.: Analyzed for: TPH-G BTEX MTBE OXYS Other:

D.O. (if req'd):	Pre-purge:	mg/L	Post-purge:	mg/L
------------------	------------	------	-------------	------

O.R.P. (if req'd):	Pre-purge:	mV	Post-purge:	mV
--------------------	------------	----	-------------	----

U50211-01

CHAIN OF CUSTODY FORM

Chevron Environmental Management Company ■ 6111 Bollinger Canyon Rd. ■ San Ramon, CA 94583 COC _____ of _____

Chevron Site Number: 91153
 Chevron Site Global ID: T0600100330
 Chevron Site Address: 3135 Gibbons Dr., Alameda, CA
 Chevron PM: DAVE PATTEN
 Chevron PM Phone No.: (925)543-1740
 Retail and Terminal Business Unit (RTBU) Job
 Construction/Retail Job

Chevron Consultant: CRA
 Address: 5900 Hollis St. Suite A Emeryville, CA
 Consultant Contact: Nathan Lee
 Consultant Phone No. 510-420-3333
 Consultant Project No. 110302-F51
 Sampling Company: Blaine Tech Services
 Sampled By (Print): F. SRINIVASARAO
 Sampler Signature: 



Charge Code: NWRTB-0091153-0-OML
NWRTB 00SITE NUMBER-0- WBS
(WBS ELEMENTS:
 SITE ASSESSMENT: A1L REMEDIATION IMPLEMENTATION: R5L
 SITE MONITORING: OML OPERATION MAINTENANCE & MONITORING: M1L
THIS IS A LEGAL DOCUMENT. ALL FIELDS MUST BE FILLED OUT CORRECTLY AND COMPLETELY.

Lancaster Laboratories
 Lancaster, PA
 Lab Contact: Jill Parker
 2425 New Holland Pike, Lancaster, PA 17601
 Phone No: (717)656-2300

Other Lab	Temp. Blank	Check Time	Temp.
	900		0.2
	1030		0.2
	1200		0.2

ANALYSES REQUIRED												Preservation Codes	
<input checked="" type="checkbox"/> H	<input checked="" type="checkbox"/> A	<input type="checkbox"/> HVOCL	<input type="checkbox"/> OXYGENATES	<input type="checkbox"/> HC SCREEN	<input type="checkbox"/> DRO	<input type="checkbox"/> ORO	<input type="checkbox"/> MTBE	<input type="checkbox"/> GRO	<input type="checkbox"/> DRO	<input type="checkbox"/> ORO	<input type="checkbox"/> HC SCREEN		H = HCL T = Thiosulfate N = HNO ₃ B = NaOH S = H ₂ SO ₄ O = Other
<input type="checkbox"/> EPA 8260B/GC/MS	<input type="checkbox"/> EPA 8015B	<input type="checkbox"/> EPA 8021B	<input type="checkbox"/> EPA 6010	<input type="checkbox"/> EPA 6010/7000	<input type="checkbox"/> EPA 150.1	<input type="checkbox"/> SM2510B	<input type="checkbox"/> EPA 418.1	<input type="checkbox"/> EPA 8260	<input type="checkbox"/> EPA 8015	<input type="checkbox"/> ETHANOL	<input type="checkbox"/> TPH-D		
<input type="checkbox"/> TPH-G	<input type="checkbox"/> STX	<input type="checkbox"/> GRO	<input type="checkbox"/> MTBE	<input type="checkbox"/> Ca, Fe, K, Mg, Mn, Na	<input type="checkbox"/> ALKALINITY	<input type="checkbox"/> SPECIFIC CONDUCTIVITY	<input type="checkbox"/> TRPH	<input type="checkbox"/> ETHANOL	<input type="checkbox"/> TPH-D	<input type="checkbox"/> ALKALINITY	<input type="checkbox"/> OIL & GREASE		Notes/Comment 6

SAMPLE ID				Sample Time	# of Containers	Container Type
Field Point Name	Matrix	Top Depth	Date (yyymmdd)			
C-3	W		110302	920	6	
MW-4				1105		
MW-5				935		
MW-6				1000		
MW-7				1115		
MW-8				1040		
MW-9				1020		
MW-10				1030		
DA	T			900	2	

Relinquished By: 	Company: <u>RTU</u>	Date/Time: <u>3-2-11 1:200</u>	Relinquished To: 	Company: <u>LLI</u>	Date/Time: <u>3/2/11 1200</u>	Turnaround Time: Standard <input checked="" type="checkbox"/> 24 Hours <input type="checkbox"/> 48 hours <input type="checkbox"/> 72 Hours <input type="checkbox"/> Other <input type="checkbox"/>
Relinquished By:	Company:	Date/Time:	Relinquished To:	Company:	Date/Time:	
Relinquished By:	Company:	Date/Time:	Relinquished To:	Company:	Date/Time:	Intact: _____ On Ice: _____ Temp: _____ COC # _____

04/02/2007 07:24 15102324913 BASC PAGE 01/01

WELLHEAD INSPECTION CHECKLIST

Client CHEVRON Date 3-2-11
 Site Address 3135 GIBBONS DR. ALAMEDA, CA
 Job Number 110302-FSI Technician F

Well ID	Well Inspected - No Corrective Action Required	WELL IS SECURABLE BY DESIGN (12" or less)	WELL IS CLEARLY MARKED WITH THE WORDS "MONITORING WELL" (12" or less)	Water Bailed From Wellbox	Wellbox Components Cleaned	Cap Replaced	Lock Replaced	Other Action Taken (explain below)	Well Not Inspected (explain below)	Repair Order Submitted
C-1	✓									
C-3	✓									
MW-4		✓	✓	✓				✓		
MW-5		✓	✓	✓				✓		
MW-6	✓	✓	✓							
MW-7	✓	✓	✓	✓						
MW-8		✓	✓					✓		
MW-9		✓	✓					✓		
MW-10				✓				✓		

NOTES: C-1 (CHRISTY, SCREW CAP) C-3 (CHRISTY)
MW-4 (NO BOLTS 2/2) MW-8 (2/3 BOLTS MISSING)
MW-9 (NO BOLTS) MW-5 (NO BOLTS) MW-10 (NO SECURABLE, MONUMENT)

CHEVRON-NORTHERN CALIFORNIA TYPE **A** BILL OF LADING

SOURCE RECORD **BILL OF LADING**

FOR NON-HAZARDOUS PURGEWATER RECOVERED FROM GROUNDWATER WELLS AT CHEVRON FACILITIES IN THE STATE OF CALIFORNIA. THE NON-HAZARDOUS PURGE- WATER WHICH HAS BEEN RECOVERED FROM GROUND- WATER WELLS IS COLLECTED BY THE CONTRACTOR, MADE UP INTO LOADS OF APPROPRIATE SIZE AND HAULED BY IWM TO THEIR FACILITY IN SAN JOSE, CALIFORNIA.

The contractor performing this work is BLAINE TECH SERVICES, INC. (BTS), 1680 Rogers Ave. San Jose CA (408)573-0555). Blaine Tech Services, Inc. is authorized by CHEVRON PRODUCTS COMPANY (CHEVRON) to recover, collect, apportion into loads, and haul the Non-Hazardous Well Purgewater that is drawn from wells at the CHEVRON facility indicated below and to deliver that purgewater to BTS. Transport routing of the Non-Hazardous Well Purgewater may be direct from one Chevron facility to BTS; from one Chevron facility to BTS via another Chevron facility; or any combination thereof. The Non-Hazardous Well Purgewater is and remains the property of CHEVRON.

This Source Record **BILL OF LADING** was initiated to cover the recovery of Non-Hazardous Well Purgewater from wells at the Chevron facility described below:

9-1153		DAVE PATTEN	
CHEVRON #		Chevron Engineer	
3135	GIBBONS DR.	ALAMEDA	CA
street number	street name	city	state

WELL I.D.	GALS.	WELL I.D.	GALS.
C-3	18.9		
MW-4	6		
MW-5	5.5		
MW-6	5.5		
MW-7	1.8		
MW-8	3.7		
MW-9	3		
MW-10	2.7		
added equip.		any other	
rinse water	13	adjustments	
TOTAL GALS.		loaded onto	
RECOVERED	60	BTS vehicle #	87

BTS event # 110302-FS1 time 1200 date 3/2/11
signature _____

REC'D AT BTS time AREA date 3/2/11

unloaded by signature [Signature]

ATTACHMENT B

LABORATORY ANALYTICAL REPORT

ANALYTICAL RESULTS

Prepared by:

Lancaster Laboratories
2425 New Holland Pike
Lancaster, PA 17605-2425

Prepared for:

Chevron
6001 Bollinger Canyon Rd L4310
San Ramon CA 94583

March 14, 2011

Project: 91153

Submittal Date: 03/03/2011
Group Number: 1235581
PO Number: 0015074399
Release Number: PATTEN
State of Sample Origin: CA

<u>Client Sample Description</u>	<u>Lancaster Labs (LLI) #</u>
C-3-W-110302 NA Water	6220857
MW-4-W-110302 NA Water	6220858
MW-5-W-110302 NA Water	6220859
MW-6-W-110302 NA Water	6220860
MW-7-W-110302 NA Water	6220861
MW-8-W-110302 NA Water	6220862
MW-9-W-110302 NA Water	6220863
MW-10-W-110302 NA Water	6220864
QA-T-110302 NA Water	6220865

The specific methodologies used in obtaining the enclosed analytical results are indicated on the Laboratory Sample Analysis Record.

ELECTRONIC COPY TO	Chevron c/o CRA	Attn: Report Contact
ELECTRONIC COPY TO	Blaine Tech Services, Inc.	Attn: Dustin Becker
ELECTRONIC COPY TO	Chevron	Attn: Anna Avina
ELECTRONIC COPY TO	CRA	Attn: Nathan Lee
ELECTRONIC COPY TO	CRA	Attn: Ian Hull

Questions? Contact your Client Services Representative
Jill M Parker at (717) 656-2300 Ext. 1241

Respectfully Submitted,



Robin C. Runkle
Senior Specialist



Analysis Report

2425 New Holland Pike, PO Box 12425, Lancaster, PA 17605-2425 • 717-656-2300 Fax: 717-656-2681 • www.lancasterlabs.com

Sample Description: C-3-W-110302 NA Water
Facility #91153 BTST
3135 Gibbons-Alameda T0600100330 C-3

LLI Sample # WW 6220857
LLI Group # 1235581
Account # 10991

Project Name: 91153

Collected: 03/02/2011 09:20 by FS

Chevron

6001 Bollinger Canyon Rd L4310
San Ramon CA 94583

Submitted: 03/03/2011 09:15

Reported: 03/14/2011 14:19

GAC3-

CAT No.	Analysis Name	CAS Number	As Received Result	As Received Method Detection Limit*	As Received Limit of Quantitation	Dilution Factor
GC/MS Volatiles SW-846 8260B						
10943	Benzene	71-43-2	N.D.	0.5	1	1
10943	Ethylbenzene	100-41-4	N.D.	0.5	1	1
10943	Methyl Tertiary Butyl Ether	1634-04-4	N.D.	0.5	1	1
10943	Toluene	108-88-3	N.D.	0.5	1	1
10943	Xylene (Total)	1330-20-7	N.D.	0.5	1	1
GC Volatiles SW-846 8015B						
01728	TPH-GRO N. CA water C6-C12	n.a.	N.D.	50	100	1

General Sample Comments

State of California Lab Certification No. 2501

All QC is compliant unless otherwise noted. Please refer to the Quality Control Summary for overall QC performance data and associated samples.

Laboratory Sample Analysis Record

CAT No.	Analysis Name	Method	Trial#	Batch#	Analysis Date and Time	Analyst	Dilution Factor
10943	BTEX/MTBE 8260 Water	SW-846 8260B	1	P110662AA	03/07/2011 04:42	Holly Berry	1
01163	GC/MS VOA Water Prep	SW-846 5030B	1	P110662AA	03/07/2011 04:42	Holly Berry	1
01728	TPH-GRO N. CA water C6-C12	SW-846 8015B	1	11068A07A	03/10/2011 00:42	Marie D John	1
01146	GC VOA Water Prep	SW-846 5030B	1	11068A07A	03/10/2011 00:42	Marie D John	1

*=This limit was used in the evaluation of the final result



Analysis Report

2425 New Holland Pike, PO Box 12425, Lancaster, PA 17605-2425 • 717-656-2300 Fax: 717-656-2681 • www.lancasterlabs.com

Sample Description: MW-4-W-110302 NA Water
Facility #91153 BTST
3135 Gibbons-Alameda T0600100330 MW-4

LLI Sample # WW 6220858
LLI Group # 1235581
Account # 10991

Project Name: 91153

Collected: 03/02/2011 11:05 by FS

Chevron

6001 Bollinger Canyon Rd L4310
San Ramon CA 94583

Submitted: 03/03/2011 09:15

Reported: 03/14/2011 14:19

GAMW4

CAT No.	Analysis Name	CAS Number	As Received Result	As Received Method Detection Limit*	As Received Limit of Quantitation	Dilution Factor
GC/MS Volatiles SW-846 8260B						
10943	Benzene	71-43-2	N.D.	0.5	1	1
10943	Ethylbenzene	100-41-4	N.D.	0.5	1	1
10943	Methyl Tertiary Butyl Ether	1634-04-4	N.D.	0.5	1	1
10943	Toluene	108-88-3	N.D.	0.5	1	1
10943	Xylene (Total)	1330-20-7	N.D.	0.5	1	1
GC Volatiles SW-846 8015B						
01728	TPH-GRO N. CA water C6-C12	n.a.	N.D.	50	100	1

General Sample Comments

State of California Lab Certification No. 2501

All QC is compliant unless otherwise noted. Please refer to the Quality Control Summary for overall QC performance data and associated samples.

Laboratory Sample Analysis Record

CAT No.	Analysis Name	Method	Trial#	Batch#	Analysis Date and Time	Analyst	Dilution Factor
10943	BTEX/MTBE 8260 Water	SW-846 8260B	1	P110662AA	03/07/2011 06:05	Holly Berry	1
01163	GC/MS VOA Water Prep	SW-846 5030B	1	P110662AA	03/07/2011 06:05	Holly Berry	1
01728	TPH-GRO N. CA water C6-C12	SW-846 8015B	1	11068A07A	03/10/2011 01:07	Marie D John	1
01146	GC VOA Water Prep	SW-846 5030B	1	11068A07A	03/10/2011 01:07	Marie D John	1

*=This limit was used in the evaluation of the final result



Analysis Report

2425 New Holland Pike, PO Box 12425, Lancaster, PA 17605-2425 • 717-656-2300 Fax: 717-656-2681 • www.lancasterlabs.com

Sample Description: MW-5-W-110302 NA Water
Facility #91153 BTST
3135 Gibbons-Alameda T0600100330 MW-5

LLI Sample # WW 6220859
LLI Group # 1235581
Account # 10991

Project Name: 91153

Collected: 03/02/2011 09:35 by FS

Chevron

6001 Bollinger Canyon Rd L4310
San Ramon CA 94583

Submitted: 03/03/2011 09:15

Reported: 03/14/2011 14:19

GAMW5

CAT No.	Analysis Name	CAS Number	As Received Result	As Received Method Detection Limit*	As Received Limit of Quantitation	Dilution Factor
GC/MS Volatiles SW-846 8260B						
10943	Benzene	71-43-2	N.D.	0.5	1	1
10943	Ethylbenzene	100-41-4	N.D.	0.5	1	1
10943	Methyl Tertiary Butyl Ether	1634-04-4	N.D.	0.5	1	1
10943	Toluene	108-88-3	N.D.	0.5	1	1
10943	Xylene (Total)	1330-20-7	N.D.	0.5	1	1
GC Volatiles SW-846 8015B						
01728	TPH-GRO N. CA water C6-C12	n.a.	N.D.	50	100	1

General Sample Comments

State of California Lab Certification No. 2501

All QC is compliant unless otherwise noted. Please refer to the Quality Control Summary for overall QC performance data and associated samples.

Laboratory Sample Analysis Record

CAT No.	Analysis Name	Method	Trial#	Batch#	Analysis Date and Time	Analyst	Dilution Factor
10943	BTEX/MTBE 8260 Water	SW-846 8260B	1	P110662AA	03/07/2011 06:32	Holly Berry	1
01163	GC/MS VOA Water Prep	SW-846 5030B	1	P110662AA	03/07/2011 06:32	Holly Berry	1
01728	TPH-GRO N. CA water C6-C12	SW-846 8015B	1	11068A07A	03/10/2011 01:33	Marie D John	1
01146	GC VOA Water Prep	SW-846 5030B	1	11068A07A	03/10/2011 01:33	Marie D John	1

*=This limit was used in the evaluation of the final result



Analysis Report

2425 New Holland Pike, PO Box 12425, Lancaster, PA 17605-2425 • 717-656-2300 Fax: 717-656-2681 • www.lancasterlabs.com

Sample Description: MW-6-W-110302 NA Water
Facility #91153 BTST
3135 Gibbons-Alameda T0600100330 MW-6

LLI Sample # WW 6220860
LLI Group # 1235581
Account # 10991

Project Name: 91153

Collected: 03/02/2011 10:00 by FS

Chevron

6001 Bollinger Canyon Rd L4310
San Ramon CA 94583

Submitted: 03/03/2011 09:15

Reported: 03/14/2011 14:19

GAMW6

CAT No.	Analysis Name	CAS Number	As Received Result	As Received Method Detection Limit*	As Received Limit of Quantitation	Dilution Factor
GC/MS Volatiles SW-846 8260B						
10943	Benzene	71-43-2	N.D.	0.5	1	1
10943	Ethylbenzene	100-41-4	N.D.	0.5	1	1
10943	Methyl Tertiary Butyl Ether	1634-04-4	N.D.	0.5	1	1
10943	Toluene	108-88-3	N.D.	0.5	1	1
10943	Xylene (Total)	1330-20-7	N.D.	0.5	1	1
GC Volatiles SW-846 8015B						
01728	TPH-GRO N. CA water C6-C12	n.a.	N.D.	50	100	1

General Sample Comments

State of California Lab Certification No. 2501

All QC is compliant unless otherwise noted. Please refer to the Quality Control Summary for overall QC performance data and associated samples.

Laboratory Sample Analysis Record

CAT No.	Analysis Name	Method	Trial#	Batch#	Analysis Date and Time	Analyst	Dilution Factor
10943	BTEX/MTBE 8260 Water	SW-846 8260B	1	P110662AA	03/07/2011 07:00	Holly Berry	1
01163	GC/MS VOA Water Prep	SW-846 5030B	1	P110662AA	03/07/2011 07:00	Holly Berry	1
01728	TPH-GRO N. CA water C6-C12	SW-846 8015B	1	11068A07A	03/10/2011 01:58	Marie D John	1
01146	GC VOA Water Prep	SW-846 5030B	1	11068A07A	03/10/2011 01:58	Marie D John	1

*=This limit was used in the evaluation of the final result



Analysis Report

2425 New Holland Pike, PO Box 12425, Lancaster, PA 17605-2425 • 717-656-2300 Fax: 717-656-2681 • www.lancasterlabs.com

Sample Description: MW-7-W-110302 NA Water
Facility #91153 BTST
3135 Gibbons-Alameda T0600100330 MW-7

LLI Sample # WW 6220861
LLI Group # 1235581
Account # 10991

Project Name: 91153

Collected: 03/02/2011 11:15 by FS

Chevron

6001 Bollinger Canyon Rd L4310
San Ramon CA 94583

Submitted: 03/03/2011 09:15

Reported: 03/14/2011 14:19

GAMW7

CAT No.	Analysis Name	CAS Number	As Received Result	As Received Method Detection Limit*	As Received Limit of Quantitation	Dilution Factor
GC/MS Volatiles SW-846 8260B						
10943	Benzene	71-43-2	N.D.	0.5	1	1
10943	Ethylbenzene	100-41-4	N.D.	0.5	1	1
10943	Methyl Tertiary Butyl Ether	1634-04-4	N.D.	0.5	1	1
10943	Toluene	108-88-3	N.D.	0.5	1	1
10943	Xylene (Total)	1330-20-7	N.D.	0.5	1	1
GC Volatiles SW-846 8015B						
01728	TPH-GRO N. CA water C6-C12	n.a.	1,100	50	100	1

General Sample Comments

State of California Lab Certification No. 2501

All QC is compliant unless otherwise noted. Please refer to the Quality Control Summary for overall QC performance data and associated samples.

Laboratory Sample Analysis Record

CAT No.	Analysis Name	Method	Trial#	Batch#	Analysis Date and Time	Analyst	Dilution Factor
10943	BTEX/MTBE 8260 Water	SW-846 8260B	1	P110662AA	03/07/2011 07:28	Holly Berry	1
01163	GC/MS VOA Water Prep	SW-846 5030B	1	P110662AA	03/07/2011 07:28	Holly Berry	1
01728	TPH-GRO N. CA water C6-C12	SW-846 8015B	1	11068A07A	03/10/2011 02:24	Marie D John	1
01146	GC VOA Water Prep	SW-846 5030B	1	11068A07A	03/10/2011 02:24	Marie D John	1

*=This limit was used in the evaluation of the final result



Analysis Report

2425 New Holland Pike, PO Box 12425, Lancaster, PA 17605-2425 • 717-656-2300 Fax: 717-656-2681 • www.lancasterlabs.com

Sample Description: MW-8-W-110302 NA Water
Facility #91153 BTST
3135 Gibbons-Alameda T0600100330 MW-8

LLI Sample # WW 6220862
LLI Group # 1235581
Account # 10991

Project Name: 91153

Collected: 03/02/2011 10:40 by FS

Chevron

6001 Bollinger Canyon Rd L4310
San Ramon CA 94583

Submitted: 03/03/2011 09:15

Reported: 03/14/2011 14:19

GAMW8

CAT No.	Analysis Name	CAS Number	As Received Result	As Received Method Detection Limit*	As Received Limit of Quantitation	Dilution Factor
GC/MS Volatiles SW-846 8260B			ug/l	ug/l	ug/l	
10943	Benzene	71-43-2	N.D.	0.5	1	1
10943	Ethylbenzene	100-41-4	N.D.	0.5	1	1
10943	Methyl Tertiary Butyl Ether	1634-04-4	N.D.	0.5	1	1
10943	Toluene	108-88-3	N.D.	0.5	1	1
10943	Xylene (Total)	1330-20-7	N.D.	0.5	1	1
GC Volatiles SW-846 8015B			ug/l	ug/l	ug/l	
01728	TPH-GRO N. CA water C6-C12	n.a.	N.D.	50	100	1

General Sample Comments

State of California Lab Certification No. 2501

All QC is compliant unless otherwise noted. Please refer to the Quality Control Summary for overall QC performance data and associated samples.

Laboratory Sample Analysis Record

CAT No.	Analysis Name	Method	Trial#	Batch#	Analysis Date and Time	Analyst	Dilution Factor
10943	BTEX/MTBE 8260 Water	SW-846 8260B	1	P110662AA	03/07/2011 07:55	Holly Berry	1
01163	GC/MS VOA Water Prep	SW-846 5030B	1	P110662AA	03/07/2011 07:55	Holly Berry	1
01728	TPH-GRO N. CA water C6-C12	SW-846 8015B	1	11068A07A	03/10/2011 02:49	Marie D John	1
01146	GC VOA Water Prep	SW-846 5030B	1	11068A07A	03/10/2011 02:49	Marie D John	1

*=This limit was used in the evaluation of the final result



Analysis Report

2425 New Holland Pike, PO Box 12425, Lancaster, PA 17605-2425 • 717-656-2300 Fax: 717-656-2681 • www.lancasterlabs.com

Sample Description: MW-9-W-110302 NA Water
Facility #91153 BTST
3135 Gibbons-Alameda T0600100330 MW-9

LLI Sample # WW 6220863
LLI Group # 1235581
Account # 10991

Project Name: 91153

Collected: 03/02/2011 10:20 by FS

Chevron

6001 Bollinger Canyon Rd L4310
San Ramon CA 94583

Submitted: 03/03/2011 09:15

Reported: 03/14/2011 14:19

GAMW9

CAT No.	Analysis Name	CAS Number	As Received Result	As Received Method Detection Limit*	As Received Limit of Quantitation	Dilution Factor
GC/MS Volatiles SW-846 8260B						
10943	Benzene	71-43-2	N.D.	0.5	1	1
10943	Ethylbenzene	100-41-4	N.D.	0.5	1	1
10943	Methyl Tertiary Butyl Ether	1634-04-4	N.D.	0.5	1	1
10943	Toluene	108-88-3	N.D.	0.5	1	1
10943	Xylene (Total)	1330-20-7	N.D.	0.5	1	1
GC Volatiles SW-846 8015B						
01728	TPH-GRO N. CA water C6-C12	n.a.	N.D.	50	100	1

General Sample Comments

State of California Lab Certification No. 2501

All QC is compliant unless otherwise noted. Please refer to the Quality Control Summary for overall QC performance data and associated samples.

Laboratory Sample Analysis Record

CAT No.	Analysis Name	Method	Trial#	Batch#	Analysis Date and Time	Analyst	Dilution Factor
10943	BTEX/MTBE 8260 Water	SW-846 8260B	1	P110662AA	03/07/2011 08:23	Holly Berry	1
01163	GC/MS VOA Water Prep	SW-846 5030B	1	P110662AA	03/07/2011 08:23	Holly Berry	1
01728	TPH-GRO N. CA water C6-C12	SW-846 8015B	1	11068A07A	03/10/2011 03:15	Marie D John	1
01146	GC VOA Water Prep	SW-846 5030B	1	11068A07A	03/10/2011 03:15	Marie D John	1

*=This limit was used in the evaluation of the final result



Analysis Report

2425 New Holland Pike, PO Box 12425, Lancaster, PA 17605-2425 • 717-656-2300 Fax: 717-656-2681 • www.lancasterlabs.com

Sample Description: MW-10-W-110302 NA Water
Facility #91153 BTST
3135 Gibbons-Alameda T0600100330 MW-10

LLI Sample # WW 6220864
LLI Group # 1235581
Account # 10991

Project Name: 91153

Collected: 03/02/2011 10:30 by FS

Chevron

6001 Bollinger Canyon Rd L4310
San Ramon CA 94583

Submitted: 03/03/2011 09:15

Reported: 03/14/2011 14:19

GAM10

CAT No.	Analysis Name	CAS Number	As Received Result	As Received Method Detection Limit*	As Received Limit of Quantitation	Dilution Factor
GC/MS Volatiles SW-846 8260B						
10943	Benzene	71-43-2	N.D.	0.5	1	1
10943	Ethylbenzene	100-41-4	N.D.	0.5	1	1
10943	Methyl Tertiary Butyl Ether	1634-04-4	N.D.	0.5	1	1
10943	Toluene	108-88-3	N.D.	0.5	1	1
10943	Xylene (Total)	1330-20-7	N.D.	0.5	1	1
GC Volatiles SW-846 8015B						
01728	TPH-GRO N. CA water C6-C12	n.a.	N.D.	50	100	1

General Sample Comments

State of California Lab Certification No. 2501

All QC is compliant unless otherwise noted. Please refer to the Quality Control Summary for overall QC performance data and associated samples.

Laboratory Sample Analysis Record

CAT No.	Analysis Name	Method	Trial#	Batch#	Analysis Date and Time	Analyst	Dilution Factor
10943	BTEX/MTBE 8260 Water	SW-846 8260B	1	F110674AA	03/08/2011 20:32	Kelly E Keller	1
01163	GC/MS VOA Water Prep	SW-846 5030B	1	F110674AA	03/08/2011 20:32	Kelly E Keller	1
01728	TPH-GRO N. CA water C6-C12	SW-846 8015B	1	11068A20A	03/10/2011 00:46	Marie D John	1
01146	GC VOA Water Prep	SW-846 5030B	1	11068A20A	03/10/2011 00:46	Marie D John	1

*=This limit was used in the evaluation of the final result



Analysis Report

2425 New Holland Pike, PO Box 12425, Lancaster, PA 17605-2425 • 717-656-2300 Fax: 717-656-2681 • www.lancasterlabs.com

Sample Description: QA-T-110302 NA Water
 Facility #91153 BTST
 3135 Gibbons-Alameda T0600100330 QA

LLI Sample # WW 6220865
LLI Group # 1235581
Account # 10991

Project Name: 91153

Collected: 03/02/2011 09:00

Chevron

Submitted: 03/03/2011 09:15

6001 Bollinger Canyon Rd L4310

Reported: 03/14/2011 14:19

San Ramon CA 94583

GAQA-

CAT No.	Analysis Name	CAS Number	As Received Result	As Received Method Detection Limit*	As Received Limit of Quantitation	Dilution Factor
GC/MS Volatiles SW-846 8260B						
10943	Benzene	71-43-2	N.D.	0.5	1	1
10943	Ethylbenzene	100-41-4	N.D.	0.5	1	1
10943	Methyl Tertiary Butyl Ether	1634-04-4	N.D.	0.5	1	1
10943	Toluene	108-88-3	N.D.	0.5	1	1
10943	Xylene (Total)	1330-20-7	N.D.	0.5	1	1
GC Volatiles SW-846 8015B						
01728	TPH-GRO N. CA water C6-C12	n.a.	N.D.	50	100	1

General Sample Comments

State of California Lab Certification No. 2501

All QC is compliant unless otherwise noted. Please refer to the Quality Control Summary for overall QC performance data and associated samples.

Laboratory Sample Analysis Record

CAT No.	Analysis Name	Method	Trial#	Batch#	Analysis Date and Time	Analyst	Dilution Factor
10943	BTEX/MTBE 8260 Water	SW-846 8260B	1	P110662AA	03/07/2011 03:46	Holly Berry	1
01163	GC/MS VOA Water Prep	SW-846 5030B	1	P110662AA	03/07/2011 03:46	Holly Berry	1
01728	TPH-GRO N. CA water C6-C12	SW-846 8015B	1	11068A20A	03/09/2011 23:18	Marie D John	1
01146	GC VOA Water Prep	SW-846 5030B	1	11068A20A	03/09/2011 23:18	Marie D John	1

*=This limit was used in the evaluation of the final result

Quality Control Summary

 Client Name: Chevron
 Reported: 03/14/11 at 02:19 PM

Group Number: 1235581

Matrix QC may not be reported if site-specific QC samples were not submitted. In these situations, to demonstrate precision and accuracy at a batch level, a LCS/LCSD was performed, unless otherwise specified in the method.

Laboratory Compliance Quality Control

<u>Analysis Name</u>	<u>Blank Result</u>	<u>Blank MDL**</u>	<u>Blank LOQ</u>	<u>Report Units</u>	<u>LCS %REC</u>	<u>LCSD %REC</u>	<u>LCS/LCSD Limits</u>	<u>RPD</u>	<u>RPD Max</u>
Batch number: F110674AA	Sample number(s): 6220864								
Benzene	N.D.	0.5	1	ug/l	89	90	79-120	1	30
Ethylbenzene	N.D.	0.5	1	ug/l	89	90	79-120	1	30
Methyl Tertiary Butyl Ether	N.D.	0.5	1	ug/l	89	87	76-120	1	30
Toluene	N.D.	0.5	1	ug/l	89	91	79-120	2	30
Xylene (Total)	N.D.	0.5	1	ug/l	90	91	80-120	1	30
Batch number: P110662AA	Sample number(s): 6220857-6220863,6220865								
Benzene	N.D.	0.5	1	ug/l	98		79-120		
Ethylbenzene	N.D.	0.5	1	ug/l	97		79-120		
Methyl Tertiary Butyl Ether	N.D.	0.5	1	ug/l	92		76-120		
Toluene	N.D.	0.5	1	ug/l	98		79-120		
Xylene (Total)	N.D.	0.5	1	ug/l	97		80-120		
Batch number: 11068A07A	Sample number(s): 6220857-6220863								
TPH-GRO N. CA water C6-C12	N.D.	50.	100	ug/l	100	100	75-135	0	30
Batch number: 11068A20A	Sample number(s): 6220864-6220865								
TPH-GRO N. CA water C6-C12	N.D.	50.	100	ug/l	127	118	75-135	7	30

Sample Matrix Quality Control

Unspiked (UNSPK) = the sample used in conjunction with the matrix spike
 Background (BKG) = the sample used in conjunction with the duplicate

<u>Analysis Name</u>	<u>MS %REC</u>	<u>MSD %REC</u>	<u>MS/MSD Limits</u>	<u>RPD</u>	<u>RPD MAX</u>	<u>BKG Conc</u>	<u>DUP Conc</u>	<u>DUP RPD</u>	<u>Dup RPD Max</u>
Batch number: P110662AA	Sample number(s): 6220857-6220863,6220865 UNSPK: 6220857								
Benzene	107	105	80-126	1	30				
Ethylbenzene	102	100	71-134	1	30				
Methyl Tertiary Butyl Ether	99	100	72-126	2	30				
Toluene	104	101	80-125	3	30				
Xylene (Total)	101	99	79-125	2	30				

Surrogate Quality Control

Surrogate recoveries which are outside of the QC window are confirmed unless attributed to dilution or otherwise noted on the Analysis Report.

Analysis Name: UST VOCs by 8260B - Water
 Batch number: F110674AA

*- Outside of specification

** - This limit was used in the evaluation of the final result for the blank

- (1) The result for one or both determinations was less than five times the LOQ.
- (2) The unspiked result was more than four times the spike added.

Quality Control Summary

 Client Name: Chevron
 Reported: 03/14/11 at 02:19 PM

Group Number: 1235581

Surrogate Quality Control

	Dibromofluoromethane	1,2-Dichloroethane-d4	Toluene-d8	4-Bromofluorobenzene
6220864	96	98	99	93
Blank	97	99	99	93
LCS	97	100	98	96
LCSD	97	101	99	96
Limits:	80-116	77-113	80-113	78-113

 Analysis Name: UST VOCs by 8260B - Water
 Batch number: P110662AA

	Dibromofluoromethane	1,2-Dichloroethane-d4	Toluene-d8	4-Bromofluorobenzene
6220857	99	94	99	95
6220858	99	98	98	93
6220859	99	95	99	94
6220860	98	95	99	93
6220861	99	94	99	96
6220862	99	95	98	93
6220863	99	95	98	94
6220865	99	96	99	94
Blank	99	94	99	95
LCS	99	97	98	97
MS	98	97	98	97
MSD	100	98	97	97
Limits:	80-116	77-113	80-113	78-113

 Analysis Name: TPH-GRO N. CA water C6-C12
 Batch number: 11068A07A
 Trifluorotoluene-F

6220857	83
6220858	88
6220859	89
6220860	88
6220861	117
6220862	87
6220863	94
Blank	85
LCS	92
LCSD	93
Limits:	63-135

 Analysis Name: TPH-GRO N. CA water C6-C12
 Batch number: 11068A20A
 Trifluorotoluene-F

6220864	78
6220865	79
Blank	75
LCS	125
LCSD	118
Limits:	63-135

*- Outside of specification

**-This limit was used in the evaluation of the final result for the blank

- (1) The result for one or both determinations was less than five times the LOQ.
- (2) The unspiked result was more than four times the spike added.

Quality Control Summary

Client Name: Chevron
Reported: 03/14/11 at 02:19 PM

Group Number: 1235581

Surrogate Quality Control

*- Outside of specification

** - This limit was used in the evaluation of the final result for the blank

- (1) The result for one or both determinations was less than five times the LOQ.
- (2) The unspiked result was more than four times the spike added.

030211-07

CHAIN OF CUSTODY FORM

Chevron Environmental Management Company ■ 6111 Bollinger Canyon Rd. ■ San Ramon, CA 94583 COC of

Chevron Site Number: 91153
 Chevron Site Global ID: T0600100330
 Chevron Site Address: 3135 Gibbons Dr.
Alameda, CA
 Chevron PM: DAVE PATTEN
 Chevron PM Phone No.: (925)543-1740
 Retail and Terminal Business Unit (RTBU) Job
 Construction/Retail Job

Chevron Consultant: CRA
 Address: 5900 Hollis St. Suite A Emeryville.
 CA Consultant Contact: Nathan Lee
 Consultant Phone No. 510-420-3333
 Consultant Project No. 110302-FS1
 Sampling Company: Blaine Tech Services
 Sampled By (Print): F. SRINIVASARAO
 Sampler Signature: [Signature]

ANALYSES REQUIRED

<input checked="" type="checkbox"/> EPA 8260B/GC/MS TPH-G	<input checked="" type="checkbox"/> BTEX	<input checked="" type="checkbox"/> GRO	<input checked="" type="checkbox"/> DRO	<input type="checkbox"/> ORO	<input type="checkbox"/> HC SCREEN	<input type="checkbox"/> HVOC	<input type="checkbox"/> OXYGENATES	<input type="checkbox"/> DRO	<input type="checkbox"/> ORO	<input type="checkbox"/> HC SCREEN	<input type="checkbox"/> STLC	<input type="checkbox"/> EPA 310.1 ALKALINITY	<input type="checkbox"/> EPA 413.1 OIL & GREASE	<input type="checkbox"/> EPA 8260	<input type="checkbox"/> ETHANOL	<input type="checkbox"/> EPA 8015	<input type="checkbox"/> TPH-D
<input type="checkbox"/> EPA 8015B	<input type="checkbox"/> GRO	<input type="checkbox"/> DRO	<input type="checkbox"/> ORO	<input type="checkbox"/> HC SCREEN	<input type="checkbox"/> HVOC	<input type="checkbox"/> OXYGENATES	<input type="checkbox"/> DRO	<input type="checkbox"/> ORO	<input type="checkbox"/> HC SCREEN	<input type="checkbox"/> STLC	<input type="checkbox"/> EPA 310.1 ALKALINITY	<input type="checkbox"/> EPA 413.1 OIL & GREASE	<input type="checkbox"/> EPA 8260	<input type="checkbox"/> ETHANOL	<input type="checkbox"/> EPA 8015	<input type="checkbox"/> TPH-D	

Preservation Codes
 H = HCL T = Thiosulfate
 N = HNO₃ B = NaOH
 S = H₂SO₄ O = Other
 Acct# 10991
 Grp# 1235581
 Sample# 6220857-65
 Special Instructions
 Must meet lowest detection limits possible for 8260 Compounds

Charge Code: NWRTB-0091153-0-OML
NWRTB 00SITE NUMBER-0-WBS
 (WBS ELEMENTS:
 SITE ASSESSMENT: A1L REMEDIATION IMPLEMENTATION: R5L
 SITE MONITORING: OML OPERATION MAINTENANCE & MONITORING: M1L
 THIS IS A LEGAL DOCUMENT. ALL FIELDS MUST BE FILLED OUT CORRECTLY AND COMPLETELY.

Lancaster Laboratories
 Lancaster, PA
 Lab Contact: Jill Parker
 2425 New Holland Pike,
 Lancaster, PA 17601
 Phone No:
 (717)656-2300

Other Lab	Temp. Blank	Check Time	Temp.
	900		0.2
	1030		0.2
	1200		0.2

SAMPLE ID				Sample Time	# of Containers	Container Type	ANALYSES REQUIRED																Notes/Comments												
Field Point Name	Matrix	Top Depth	Date (yyymmdd)				EPA 8260B/GC/MS TPH-G	BTEX	GRO	DRO	ORO	HC SCREEN	HVOC	OXYGENATES	DRO	ORO	HC SCREEN	STLC	EPA 310.1 ALKALINITY	EPA 413.1 OIL & GREASE	EPA 8260	ETHANOL		EPA 8015	TPH-D										
C-3	W		110302	920	6																														
MW-4				1105																															
MW-5				935																															
MW-6				1000																															
MW-7				1115																															
MW-8				1040																															
MW-9				1020																															
MW-10				1030																															
QA	T			900	2																														

Relinquished By: <u>[Signature]</u>	Company: <u>BTI</u>	Date/Time: <u>3-2-11 1:200</u>	Relinquished To: <u>[Signature]</u>	Company: <u>LLI</u>	Date/Time: <u>3/2/11 1200</u>
Relinquished By: <u>[Signature]</u>	Company: <u>LLI</u>	Date/Time: <u>3/2/11 1500</u>	Relinquished To: <u>[Signature]</u>	Company: <u>FE</u>	Date/Time: <u></u>
Relinquished By: <u>[Signature]</u>	Company: <u>LLI</u>	Date/Time: <u></u>	Relinquished To: <u>[Signature]</u>	Company: <u>LLI</u>	Date/Time: <u>3/2/11 025</u>

Turnaround Time:
 Standard 24 Hours 48 hours 72 Hours Other
 Sample Integrity: (Check by lab on arrival)
 Intact: On Ice: Temp: 05-16.6
 COC #

Explanation of Symbols and Abbreviations

The following defines common symbols and abbreviations used in reporting technical data:

RL	Reporting Limit	BMQL	Below Minimum Quantitation Level
N.D.	none detected	MPN	Most Probable Number
TNTC	Too Numerous To Count	CP Units	cobalt-chloroplatinate units
IU	International Units	NTU	nephelometric turbidity units
umhos/cm	micromhos/cm	ng	nanogram(s)
C	degrees Celsius	F	degrees Fahrenheit
meq	milliequivalents	lb.	pound(s)
g	gram(s)	kg	kilogram(s)
ug	microgram(s)	mg	milligram(s)
ml	milliliter(s)	l	liter(s)
m3	cubic meter(s)	ul	microliter(s)
<	less than - The number following the sign is the <u>limit of quantitation</u> , the smallest amount of analyte which can be reliably determined using this specific test.		
>	greater than		
J	estimated value – The result is \geq the Method Detection Limit (MDL) and $<$ the Limit of Quantitation (LOQ).		
ppm	parts per million - One ppm is equivalent to one milligram per kilogram (mg/kg), or one gram per million grams. For aqueous liquids, ppm is usually taken to be equivalent to milligrams per liter (mg/l), because one liter of water has a weight very close to a kilogram. For gases or vapors, one ppm is equivalent to one microliter of gas per liter of gas.		
ppb	parts per billion		
Dry weight basis	Results printed under this heading have been adjusted for moisture content. This increases the analyte weight concentration to approximate the value present in a similar sample without moisture. All other results are reported on an as-received basis.		

U.S. EPA CLP Data Qualifiers:

Organic Qualifiers	Inorganic Qualifiers
A TIC is a possible aldol-condensation product	B Value is $<$ CRDL, but \geq IDL
B Analyte was also detected in the blank	E Estimated due to interference
C Pesticide result confirmed by GC/MS	M Duplicate injection precision not met
D Compound quantitated on a diluted sample	N Spike sample not within control limits
E Concentration exceeds the calibration range of the instrument	S Method of standard additions (MSA) used for calculation
N Presumptive evidence of a compound (TICs only)	U Compound was not detected
P Concentration difference between primary and confirmation columns $>$ 25%	W Post digestion spike out of control limits
U Compound was not detected	* Duplicate analysis not within control limits
X,Y,Z Defined in case narrative	+ Correlation coefficient for MSA $<$ 0.995

Analytical test results meet all requirements of NELAC unless otherwise noted under the individual analysis.

Measurement uncertainty values, as applicable, are available upon request.

Tests results relate only to the sample tested. Clients should be aware that a critical step in a chemical or microbiological analysis is the collection of the sample. Unless the sample analyzed is truly representative of the bulk of material involved, the test results will be meaningless. If you have questions regarding the proper techniques of collecting samples, please contact us. We cannot be held responsible for sample integrity, however, unless sampling has been performed by a member of our staff. This report shall not be reproduced except in full, without the written approval of the laboratory.

WARRANTY AND LIMITS OF LIABILITY - In accepting analytical work, we warrant the accuracy of test results for the sample as submitted. THE FOREGOING EXPRESS WARRANTY IS EXCLUSIVE AND IS GIVEN IN LIEU OF ALL OTHER WARRANTIES, EXPRESSED OR IMPLIED. WE DISCLAIM ANY OTHER WARRANTIES, EXPRESSED OR IMPLIED, INCLUDING A WARRANTY OF FITNESS FOR PARTICULAR PURPOSE AND WARRANTY OF MERCHANTABILITY. IN NO EVENT SHALL LANCASTER LABORATORIES BE LIABLE FOR INDIRECT, SPECIAL, CONSEQUENTIAL, OR INCIDENTAL DAMAGES INCLUDING, BUT NOT LIMITED TO, DAMAGES FOR LOSS OF PROFIT OR GOODWILL REGARDLESS OF (A) THE NEGLIGENCE (EITHER SOLE OR CONCURRENT) OF LANCASTER LABORATORIES AND (B) WHETHER LANCASTER LABORATORIES HAS BEEN INFORMED OF THE POSSIBILITY OF SUCH DAMAGES. We accept no legal responsibility for the purposes for which the client uses the test results. No purchase order or other order for work shall be accepted by Lancaster Laboratories which includes any conditions that vary from the Standard Terms and Conditions, and Lancaster hereby objects to any conflicting terms contained in any acceptance or order submitted by client.